

34
45
47E

F-1-A
County Powder River

STATE OF MONTANA
STATE ENGINEERS OFFICE
Water Resources Survey

T 4S R. 47E Plat No. 34

Farm Checked: Date 9-24-60

Photo No. 17-47

By Robert Peter

Legal Land Owner James R. & Bertha B. Mitchell

Address Broadus

Operator Lars Knudson

Address Sannette

Water is delivered by— 1. Private System; 2. Ditch Company; 3. State Project; 4. Federal Project; 5. Irrigation District

If under Ditch Company, Irrigation District, or Government Project, state the number of shares or inches, acre feet, as the case may be in said system

App. No. Decree No.	NAME OF APPROPRIATOR TO WHOM DECREED	NAME OF STREAM	Date App. Date Priority	Miner's Inches	In Use	NAME OF DITCH (Water Delivered By)	No.	R/F	P/G/S	Present Irr. Acres	Irrigable Acres
754	J. V. Fields	Skinner Gulch	5-22-03	300	Yes	Dam	1	F		73	0

NOTE: R—Denotes Regular Irrigation. F—Flood Irrigation. P—Water diverted by means of pumping. G—Water diverted by gravity. S—Stored Water.

Condition of System Fair Topography Bottom River Basin Yellowstone

Adequate Supply: Yes No Explain

Remarks

Also in: Plat No. 34 Twp. 4S Rge. 48E	Plat No. Twp. Rge.	Plat No. Twp. Rge.
Plat No. Twp. Rge.	Plat No. Twp. Rge.	Plat No. Twp. Rge.

Information From:
Lars Knudson

02
TNS
RTE

6	5	4	3	2	1
7	8	9	10	11	12
13	17	16	15	14	13
19	20	21	22	23	24
20	20	23	27	26	25
31	32	33	34	35	36

B

A

24-B, 25-A

F-1-A Powder River
 County _____
 Farm Checked: Date 9-26-60
 By Robert Peter

STATE OF MONTANA
 STATE ENGINEERS OFFICE
 Water Resources Survey

T. 45 R. 47E Plat No. 33
 Photo No. 17-20

Legal Land Owner Nellie & Geneve Peterson Address _____
 Operator Jack Ridenour Address _____
 Water is delivered by: 1. Private System; 2. Ditch Company; 3. State Project; 4. Federal Project; 5. Irrigation District.

If under Ditch Company, Irrigation District, or Government Project, state the number of shares or inches, acre feet, as the case may be in said system.

App. No. Decree No.	NAME OF APPROPRIATOR TO WHOM DECREED	NAME OF STREAM	Date App. Date - Priority	Minor's Inches	In Use	NAME OF DITCH (Water Delivered By)	No.	R/F	F/G/S	Present In. Acres	Irrigabl Acres
-252	Robert T. Peterson	Dunan (Duncan) Gulch	3-26-10	400	Yes	Ridenour Dam & Ditch	1	F		42	6
-253	Nellie Ridenour	Dunan (Duncan) Gulch	9-1-50	2000	Yes						

NOTE: R—Denotes Regular Irrigation. F—Flood Irrigation. P—Water diverted by means of pumping. G—Water diverted by gravity. S—Stored Water.

Condition of System Fair Topography Bottom River Basin Yellowstone
 Adequate Supply: Yes No. Explain

Remarks

Also in: Plat No. Twp. Rge. Plat No. Twp. Rge. Plat No. Twp. Rge.
 Plat No. Twp. Rge. Plat No. Twp. Rge. Plat No. Twp. Rge.
 Information From: Jack Ridenour

6	5	4	3	2	1	
7	8	9	10	11	12	8
13	14	15	16	17	18	
19	20	21	22	23	24	
29	28	27	26	25	24	
31	32	33	34	35	36	

12-B

F-1-A
County Powder River

Farm Checked: Date 9-26-60

By Robert Peter

Legal Land Owner Nellie Ridenour

Operator Jack Ridenour

Water is delivered by: 1. Private System; 2. Ditch Company; 3. State Project; 4. Federal Project; 5. Irrigation District

If under Ditch Company, Irrigation District, or Government Project, state the number of shares or inches and acre feet, as the case may be in said system.

STATE OF MONTANA
STATE ENGINEERS OFFICE
Water Resources Survey

T. 4S R. 47E Plat No. 33
Photo No. 17-20

App. No. / Decree No.	NAME OF APPROPRIATOR TO WHOM DECREED	NAME OF STREAM	Date App. / Date Priority	Miner's Inches	In Use	NAME OF DITCH (Water Delivered By)	No.	R/F	P/G/S	Present Irr. Acres	Irrigable Acres
A-253	Nellie Ridenour	Dunan (Duncan) Gulch	9-1-50	2000	Yes	Ridenour Dam & Ditch	1	E		2	16

NOTE: R—Denotes Regular Irrigation. F—Flood Irrigation. P—Water diverted by means of pumping. G—Water diverted by gravity. S—Stored Water.

Condition of System Fair Topography Bottom River Basin Yellowstone
 Adequate Supply: Yes No Explain _____

Remarks _____

Also in: Plat No. _____ Twp. _____ Rge. _____	Plat No. _____ Twp. _____ Rge. _____	Plat No. _____ Twp. _____ Rge. _____	Information From:
Plat No. _____ Twp. _____ Rge. _____	Plat No. _____ Twp. _____ Rge. _____	Plat No. _____ Twp. _____ Rge. _____	Jack Ridenour

6	7	8	9	10	11	12
13	14	15	16	17	18	19
20	21	22	23	24	25	26
27	28	29	30	31	32	33
34	35	36	37	38	39	40

A

12-A

F-1-A Powder River
 County
 Farm Checked: Date 10-8-60
 By Robert Peter

STATE OF MONTANA
 STATE ENGINEERS OFFICE
 Water Resources Survey

T. 4S R. 47E Plat No. 33
 Photo No. 17-46

Legal Land Owner United States of America Address
 Operator Address

Water is delivered by:— 1. Private System; 2. Ditch Company; 3. State Project; 4. Federal Project; 5. Irrigation District
 If under Ditch Company, Irrigation District or Government Project, state the number of shares or inches, acre feet, as the case may be in said system

App. No. Decree No.	NAME OF APPROPRIATOR TO WHOM DECREE	NAME OF STREAM	Date App. Date Priority	Miner's Inches	In Use	NAME OF DITCH (Water Delivered By)	No.	R/E	P/G/S	Present Irr. Acres	Irrigabl Acres
		STOCK WATER									
A-794	U. S. A.	Three Mile Spring - point of diversion	6-22-39	All	Stock						
A-795	U. S. A.	Well Spring - Point of diversion	6-22-39	All	Stock						

NOTE: R—Denotes Regular Irrigation. F—Flood Irrigation. P—Water diverted by means of pumping. G—Water diverted by gravity. S—Stored Water.

Condition of System Topography River Basin Yellowstone
 Adequate Supply: Yes..... No..... Explain
 Remarks

Also in: Plat No. Twp. Rge.	Plat No. Twp. Rge.	Plat No. Twp. Rge.	Information From: Don Shultz, Dist. Ranger
Plat No. Twp. Rge.	Plat No. Twp. Rge.	Plat No. Twp. Rge.	

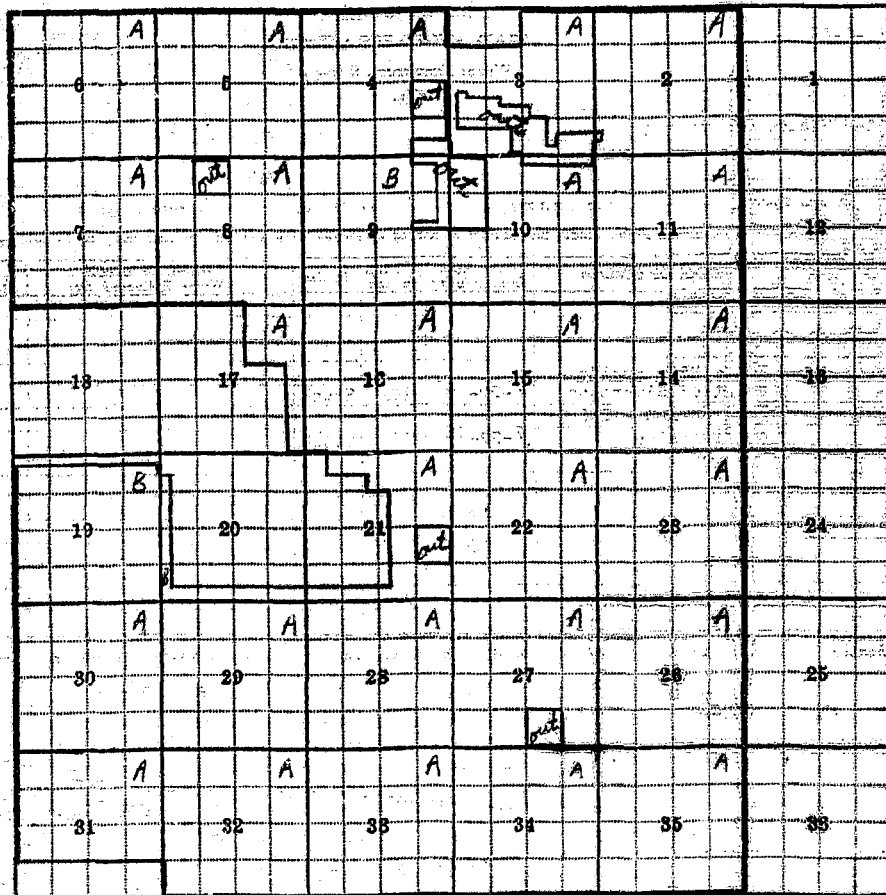

2-A, 3-A, 4-A, 5-A, 6-A, 7-A, 8-A, 9-B, 10-A, 11-A, 14-A, 15-A, 16-A, 17-A, 19-B, 20-B,
 21-A, 22-A, 23-A, 26-A, 27-A, 28-A, 29-A, 30-A, 31-A, 32-A, 33-A, 34-A, 35-A