



NOTICE
These forms and the
property of the State
of Montana and must
be returned.

STATE OF MONTANA
STATE ENGINEERS OFFICE

Water Resources Survey

Code No. 5A-6A

County Custer

T. 5N R. 48

Name of Land Owner Campbell Ranch Co. Address Miller City,

Name of Operator C. H. Trimbore Address "

Part A

TO BE FILED BY THOSE OBTAINING IRRIGATION WATER FROM
A DITCH COMPANY OR IRRIGATION DISTRICT

1. Water is delivered by: _____
Name of Ditch, Ditch Company or District Supplying Water
2. State the number of acres you irrigate under this system _____ Shares you hold _____
3. If you obtain water from more than one Company, give the number of shares, acres irrigated and the name of the Company under "Remarks." If you obtain water from a Ditch Company and also have a private system fill in both Part A and Part B.

Part B

TO BE FILED BY THOSE WHO HAVE A PRIVATE DITCH, PUMP OR IRRIGATION SYSTEM
or those who have a private water right under a Ditch Company

4. In what year was this land first irrigated? Date See attached filing
5. Give the name of the original appropriator (first user): None on Tongue
6. Give the date appropriated _____ Amount filed on: Miners Inches _____ C. F. S. _____
7. State the total number of acres irrigated under this system: See attached letter
8. Give the point of diversion: _____ $\frac{1}{4}$ _____ $\frac{1}{4}$ Section _____ Township _____ Range _____

Part C

TO BE FILED BY ALL WATER USERS IN ADDITION TO PART A OR PART B

9. Source of Water: Tongue River
Name of stream or lake from which water is originally diverted
10. Water is obtained by: (Check one) Gravity _____ Pumping ☒ Other _____
11. What is the greatest number of acres you have irrigated? 180.0 Date _____
12. How many acres did you irrigate in 1947? (Crop and pasture) 160.0
13. State the total number of additional acres that could be irrigated by increasing the water supply, land leveling, etc. 20.0 This land is under what ditch? 10 inch pump ditch
14. How many acres of reseeded land do you have which could be drained and put into production? _____
15. What is the condition of your irrigation system? Part in use part with
16. Is your water supply adequate? Yes ☒ No _____ Explain _____
17. REMARKS: Tongue River dry in 1934

NOTE: The foregoing questions apply only to irrigated land shown on this plat.

DESCRIPTION AND MAP OF FARM

18. Legal Description of this Farm

All in Section 5-6



IRRIGATED LAND



NON-IRRIGATED LAND



Potential Land

North

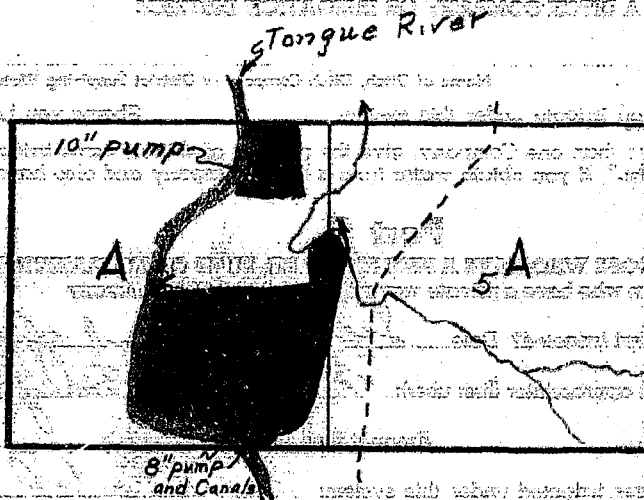

West

East

South

Ownership of crops
only irrigated land.
All ownership for
dry land not shown.

19. If the above land is irrigated from more than one ditch please give the acreage under each ditch in 19A and indicate the location of the land irrigated from each on the above map.

19A. Ditch: *Campbell 8 in pump Tongue R.* Acres: *1600*

Ditch: *Campbell 10 in " " " "* Acres: *0*

Information supplied by:

Name: *Johnson & J Paulant* Address: _____ Date: *6/12/47*

REMARKS: *see attached form*

If you cannot answer all of the questions on this form answer as many as you can and return the form to us as soon as possible.

STATE ENGINEER'S OFFICE
WATER RESOURCES SURVEY

COUNTY CusterFILE NO. 42-T.5N-R.48

Owner Campbell Ranch Co. Address Miles City, Montana
Private (pump)

AAA Owner Address

Operator Trimborn, C.H. Address " "

New Owner Address

New Operator Address

Assessment Record None - Pump (Private Ditch)

Assessed Acreage 0

Legal Description of This Farm all of Sections 5-6; T.5N-R.48E

Total Acres in Farm ✓

Code Number 5A-6A

Photo No. Ma-12-88

AAA Contract No.

AAA Total Cropland Acreage

Appl. No. 529

Decree No.

Land is located in

Twp. 5N Rge. 48E Twp. 6N Rge. 48E

Twp. Rge. Twp. Rge.

Filed in Twp. 5N Rge. 48E

Remarks

Tongue River Basin

Ownership covers
only irrigated land.
All ownership for
dry land not shown.

Farm Checked

STATE OF MONTANA

Code No. 5A, 6A.

By Collins & Joe

STATE ENGINEER'S OFFICE

County Custer

Area Tongue

WATER RESOURCES SURVEY

T. 5N R. 48E Sec. 5, 6
CN 48E 51

Date 6/12/47

check ownership

Photo No. MA 12-85

Legal Land Owner Campbell Ranch Co.

Address Miles City

Operator Trimborn, C. H.

Address Miles City

Water is delivered by:

Federal Project	Pres.	Pot.
Ditch Company	Pres.	Pot.
Irrigation District	Pres.	Pot.
Private System <u>pump</u>	Pres. <u>160.0</u>	Pot. <u>20</u>
	Pres. <u>475</u>	Pot. <u>about 100</u>
Totals		

Flood ☐ Pump ☒ Reservoir ☐ Gravity ☐

Size and Capacity, Pump, etc. 1-8" Cent. - 25' lift 75 H.P. Stationery: 1-10" Cent. - 14' lift
Tractor power

Original Appropriator, Company App. No.

Original Appropriator, Private (Show date of appropriation under Remarks) App. No.

Is the system an extension of another system? Yes ☐ No ☒

Is all land irrigated from one system? Yes ☐ No ☒

(If No, show break down on map)

Source of Water Tongue River

Acres Irrigated 1946, 175/160.0

Potential Acres 100, 20 Seeped

Explain potential under 10" pump

Condition of System good

Adequate Supply Yes ☒ No ☐

Explain

Topography bottom

Information From Trimborn

Remarks 100 acres by extending ditch system - 20 potential under present system,

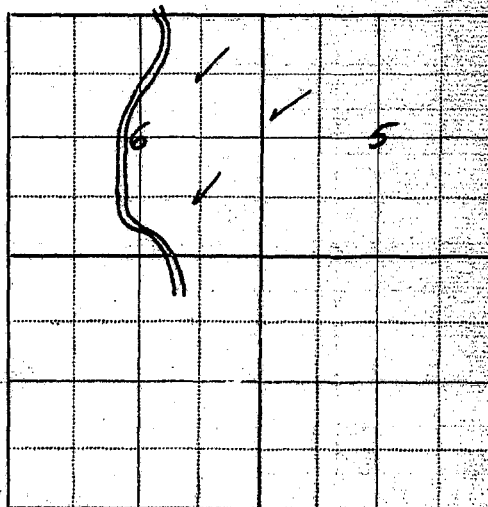



NOTICE
These forms are the
property of the State
of Montana and must
be returned.

STATE OF MONTANA
STATE ENGINEERS OFFICE

Water Resources Survey

Code No. 18A

County Custer

T. 5N R. 48E

Name of Land Owner Mrs Mary J. Morrison et Address Wilder City, Mont
Name of Operator To Edith Stanton Address _____

Part A

TO BE FILED BY THOSE OBTAINING IRRIGATION WATER FROM
A DITCH COMPANY OR IRRIGATION DISTRICT

1. Water is delivered by: _____ Name of Ditch, Ditch Company or District Supplying Water _____
2. State the number of acres you irrigate under this system _____ Shares you hold _____
3. If you obtain water from more than one Company, give the number of shares, acres irrigated and the name of the Company under "Remarks." If you obtain water from a Ditch Company and also have a private system fill in both Part A and Part B.

Part B

TO BE FILED BY THOSE WHO HAVE A PRIVATE DITCH, PUMP OR IRRIGATION SYSTEM
or those who have a private water right under a Ditch Company

4. In what year was this land first irrigated? Date No data
5. Give the name of the original appropriator (first user): _____
6. Give the date appropriated _____ Amount filed on: Miners Inches _____ C. F. S. _____
7. State the total number of acres irrigated under this system: _____
8. Give the point of diversion: _____ $\frac{1}{4}$ _____ $\frac{1}{4}$ Section _____ Township _____ Range _____

Part C

TO BE FILED BY ALL WATER USERS IN ADDITION TO PART A OR PART B

9. Source of Water: Longue River
Name of stream or lake from which water is originally diverted _____
10. Water is obtained by: (Check one) Gravity _____ Pumping ☒ Other _____
11. What is the greatest number of acres you have irrigated? 33.0 Date _____
12. How many acres did you irrigate in 1947? (Crop and pasture) 0
13. State the total number of additional acres that could be irrigated by increasing the water supply, land leveling, etc. 33.0 This land is under what ditch? Same
14. How many acres of seeped land do you have which could be drained and put into production? 0
15. What is the condition of your irrigation system? Out of use
16. Is your water supply adequate? Yes ☒ No _____ Explain _____
17. REMARKS: If stored water is purchased

NOTE: The foregoing questions apply only to irrigated land shown on this plat.

DESCRIPTION AND MAP OF FARM

18. Legal Description of this Farm W 1/2 Sec 18



None At Present
IRRIGATED LAND



NON-IRRIGATED LAND



Potential Land

North

A 18

NOTE: IF YOU HAVE ANY INFORMATION CONCERNING THE LOCATION OF THE FARM, PLEASE FURNISH IT TO THE BUREAU OF RECLAMATION, WASHINGTON, D. C.

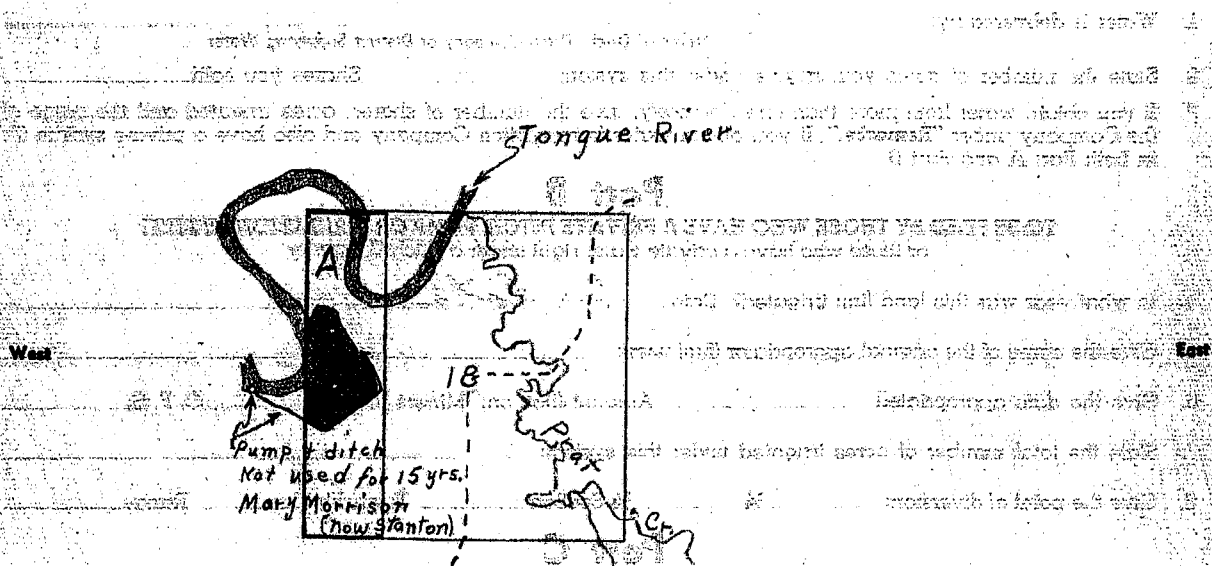

19. If the above land is irrigated from more than one ditch please give the acreage under each ditch in 19A and indicate the location of the land irrigated from each on the above map.

19A. Ditch: Private Pump ditch Tongue River Acres: 0

Ditch: _____ Acres: _____

Information supplied by:

Name Field Survey Address _____ Date 8/7/47

REMARKS: Clark & D. Paulist

If you cannot answer all of the questions on this form answer as many as you can and return the form to us as soon as possible.

STATE ENGINEER'S OFFICE
WATER RESOURCES SURVEYCOUNTY CusterFILE NO. 42-T.5N-R.48EOwner Marrison, Mrs. Mary J. (Est.) Address Tongue River Stage, Miles CityAAA Owner Y. Stanton, Edith Address _____

Operator _____ Address _____

New Owner _____ Address _____

New Operator _____ Address _____

Assessment Record None -Assessed Acreage 0Legal Description of This Farm W²W², Sec. 18; T.5N-R.48ETotal Acres in Farm ✓Code Number 18APhoto No. Ma 12-87

AAA Contract No. _____

AAA Total Cropland Acreage _____

App. No. No Record by Descript
2189?

Decree No. _____

Land is located in

Twp. 5N Rge. 48E Twp. _____ Rge. _____

Twp. _____ Rge. _____ Twp. _____ Rge. _____

Filed in Twp. 5N Rge. 48ERemarks Edith Stanton alsooperates some land inSec. 24; T.5N-R.47ETongue River BasinOwnership covers
only irrigated land.
All ownership for
dry land not shown.



NOTICE
These forms and the
property of the State
of Montana and must
be returned.

STATE OF MONTANA
STATE ENGINEERS OFFICE
Water Resources Survey

Code No. 1A

County Custer

T. 5N R. 48

Name of Land Owner N. P. R. R. Address _____

Name of Operator _____ Address _____

Part A

TO BE FILED BY THOSE OBTAINING IRRIGATION WATER FROM
A DITCH COMPANY OR IRRIGATION DISTRICT

1. Water is delivered by: _____
Name of Ditch, Ditch Company or District Supplying Water
2. State the number of acres you irrigate under this system _____ Shares you hold _____
3. If you obtain water from more than one Company, give the number of shares, acres irrigated and the name of the Company under "Remarks." If you obtain water from a Ditch Company and also have a private system fill in both Part A and Part B.

Part B

TO BE FILED BY THOSE WHO HAVE A PRIVATE DITCH, PUMP OR IRRIGATION SYSTEM
or those who have a private water right under a Ditch Company

4. In what year was this land first irrigated? Date No data
5. Give the name of the original appropriator (first user): _____
6. Give the date appropriated _____ Amount filed on: Miners Inches _____ C. F. S. _____
7. State the total number of acres irrigated under this system: _____
8. Give the point of diversion: _____ $\frac{1}{4}$ _____ $\frac{1}{4}$ Section _____ Township _____ Range _____

Part C

TO BE FILED BY ALL WATER USERS IN ADDITION TO PART A OR PART B

9. Source of Water: Tongue River + Wolf Creek
Name of stream or lake from which water is originally diverted
10. Water is obtained by: (Check one) Gravity ☒ Pumping ☒ Other _____
11. What is the greatest number of acres you have irrigated? 91.0 Date _____
12. How many acres did you irrigate in 1948 (Crop and pasture) 1.0
13. State the total number of additional acres that could be irrigated by increasing the water supply, land leveling, etc. 90. This land is under what ditch? Wolf Cr. Flood System
14. How many acres of seeped land do you have which could be drained and put into production? _____
15. What is the condition of your irrigation system? Wolf Creek and of river
16. Is your water supply adequate? Yes ☒ No ☒ Explain _____
17. REMARKS: No on Wolf Creek, yes on Tongue River

NOTE: The foregoing questions apply only to irrigated land shown on this plat.

DESCRIPTION AND MAP OF FARM

18. Legal Description of this Farm all sec 7

 IRRIGATED LAND

 NON-IRRIGATED LAND

 Potential Land

North

19. If the above land is irrigated from more than one ditch please give the acreage under each ditch in 19A and indicate the location of the land irrigated from each on the above map.

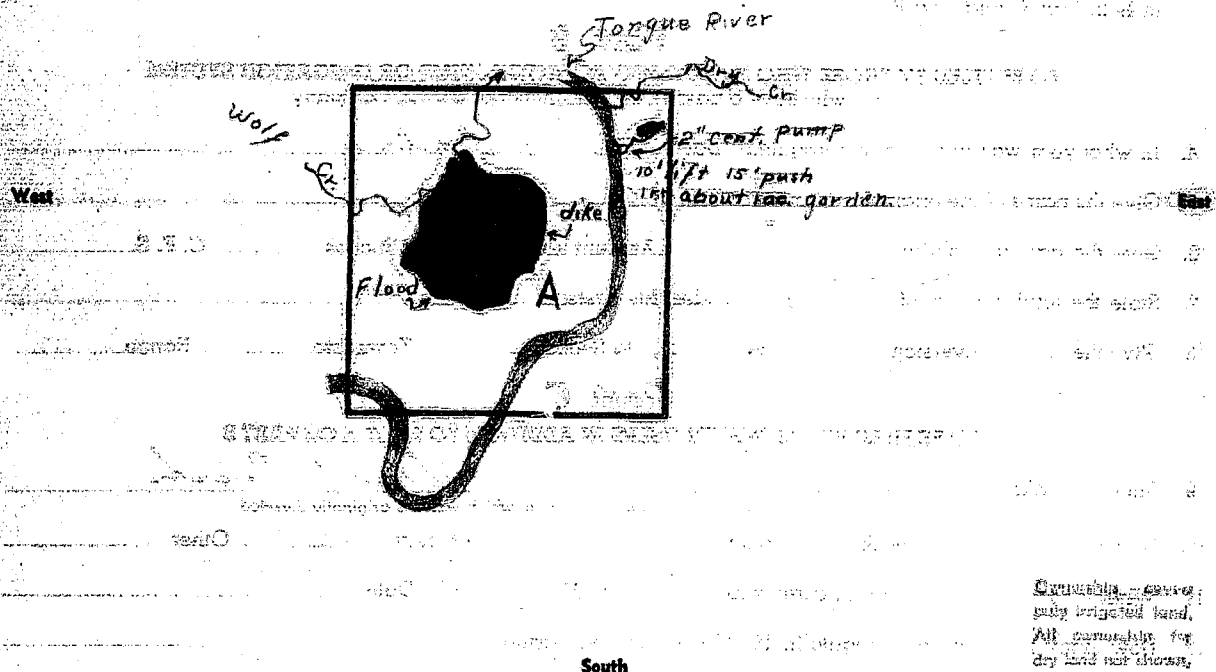

19. If the above land is irrigated from more than one ditch please give the acreage under each ditch in 19A and indicate the location of the land irrigated from each on the above map.

19A. Ditch: Tongue River Pump ditch Acres: 1.0
Ditch: Wolf Creek Flood dch Acres: 0

Information supplied by:

Name: Field Survey Address: _____ Date: 8/6/77

REMARKS: Gravel + R Paulist

If you cannot answer all of the questions on this form answer as many as you can and return the form to us as soon as possible.

STATE ENGINEER'S OFFICE
WATER RESOURCES SURVEYCOUNTY CusterFILE NO. 42-T.5N-R.48EOwner N.P.R.R.

Address

AAA Owner

Address

Operator PAddress P

New Owner

Address

New Operator

Address

Assessment Record None -Assessed Acreage 0Legal Description of This Farm all of Section 7; T.5N-R.48ETotal Acres in Farm ✓Code Number 7APhoto No. MA 12-87

AAA Contract No.

AAA Total Cropland Acreage

App. No. No Record by Descript.

Decree No.

Land is located in

Twp. 5N Rge. 48E Twp. Rge.

Twp. Rge. Twp. Rge.

Filed in Twp. 5N Rge. 48E

Remarks

Tongue River BasinOwnership covers
only irrigated land.
All ownership for
dry land not shown.