



NOTICE
These forms are the
property of the State
of Montana and must
be returned.

STATE OF MONTANA
STATE ENGINEERS OFFICE
Water Resources Survey

65

FORM WR-1-2M 12-47
18C, 19A, 29A, #
Code No. 30B, 31A, 32A,
28C, 20 B.
County Rosebud
T. 6S. R. 42E.

Name of Land Owner Brewster, Warren Address Birney, Mont.
Name of Operator _____ Address _____

Part A

TO BE FILED BY THOSE OBTAINING IRRIGATION WATER FROM
A DITCH COMPANY OR IRRIGATION DISTRICT

1. Water is delivered by: Butte Name of Ditch, Ditch Company or District Supplying Water _____
2. State the number of acres you irrigate under this system. _____ Shares you hold _____
3. If you obtain water from more than one Company, give the number of shares, acres irrigated and the name of the Company under "Remarks." If you obtain water from a Ditch Company and also have a private system fill in both Part A and Part B.

Part B

TO BE FILED BY THOSE WHO HAVE A PRIVATE DITCH, PUMP OR IRRIGATION SYSTEM
or those who have a private water right under a Ditch Company

4. In what year was this land first irrigated? Date See attached filings & decrees.
5. Give the name of the original appropriator (first user): _____
6. Give the date appropriated. _____ Amount filed on: Miners Inches _____ C. F. S. _____
7. State the total number of acres irrigated under this system: _____
8. Give the point of diversion: _____ $\frac{1}{4}$ _____ $\frac{1}{4}$ Section _____ Township _____ Range _____

Part C

TO BE FILED BY ALL WATER USERS IN ADDITION TO PART A OR PART B

9. Source of Water: Bull Cr., Tongue River and side coulees.
Name of stream or lake from which water is originally diverted _____
10. Water is obtained by: (Check one) Gravity Gravity Pumping _____ Other FLOOD
11. What is the greatest number of acres you have irrigated? 289 Date ?
12. How many acres did you irrigate in 1947? (Crop and pasture) 189
13. State the total number of additional acres that could be irrigated by increasing the water supply, land level-
ing, etc. 61 39 This land is under what ditch? Tongue R. E. & W. Gravity ditches.
Total 100 Flood - Bull Cr.
14. How many acres of seeped land do you have which could be drained and put into production? 0
15. What is the condition of your irrigation system? Good to poor
Tongue Dry 1934, adequate since, stored water
16. Is your water supply adequate? Yes X No X Explain available. Bull Cr. & Tongue side coulee
flood water only.
17. REMARKS _____

Over

T. 6S., R. 42E.

NOTE: The foregoing questions apply only to irrigated land shown on this plat.

DESCRIPTION AND MAP OF FARM

18. Legal Description of this Farm. See attached WR2 and map.



IRRIGATED LAND



NON-IRRIGATED LAND

North

West

East

South

Ownership covers
only irrigated land.
All ownership for
dry land not shown.

19. If the above land is irrigated from more than one ditch please give the acreage under each ditch in 19A and indicate the location of the land irrigated from each on the above map.

19A. Ditch: West Side ditch Acres: 72

Ditch: E. Side ditch Acres: 73



Information supplied by: Bull Cr. 0
Flood Side coulee 39

Name Warren Brawster Address Date Total 189

REMARKS: Field check & interview by Jim & Dave 8/7/47

If you cannot answer all of the questions on this form answer as many as you can and return the form to us as soon as possible.

(65) T6 S. - R. 42 E.

-  Irrigated land
-  potential land
-  ownership boundary

NOTE: These forms do not include your flood irrigation in T wnships 5 S. & 6 S. - R. 41 E. on Bull Cr.

These forms are the property of the State of Montana and must be returned.

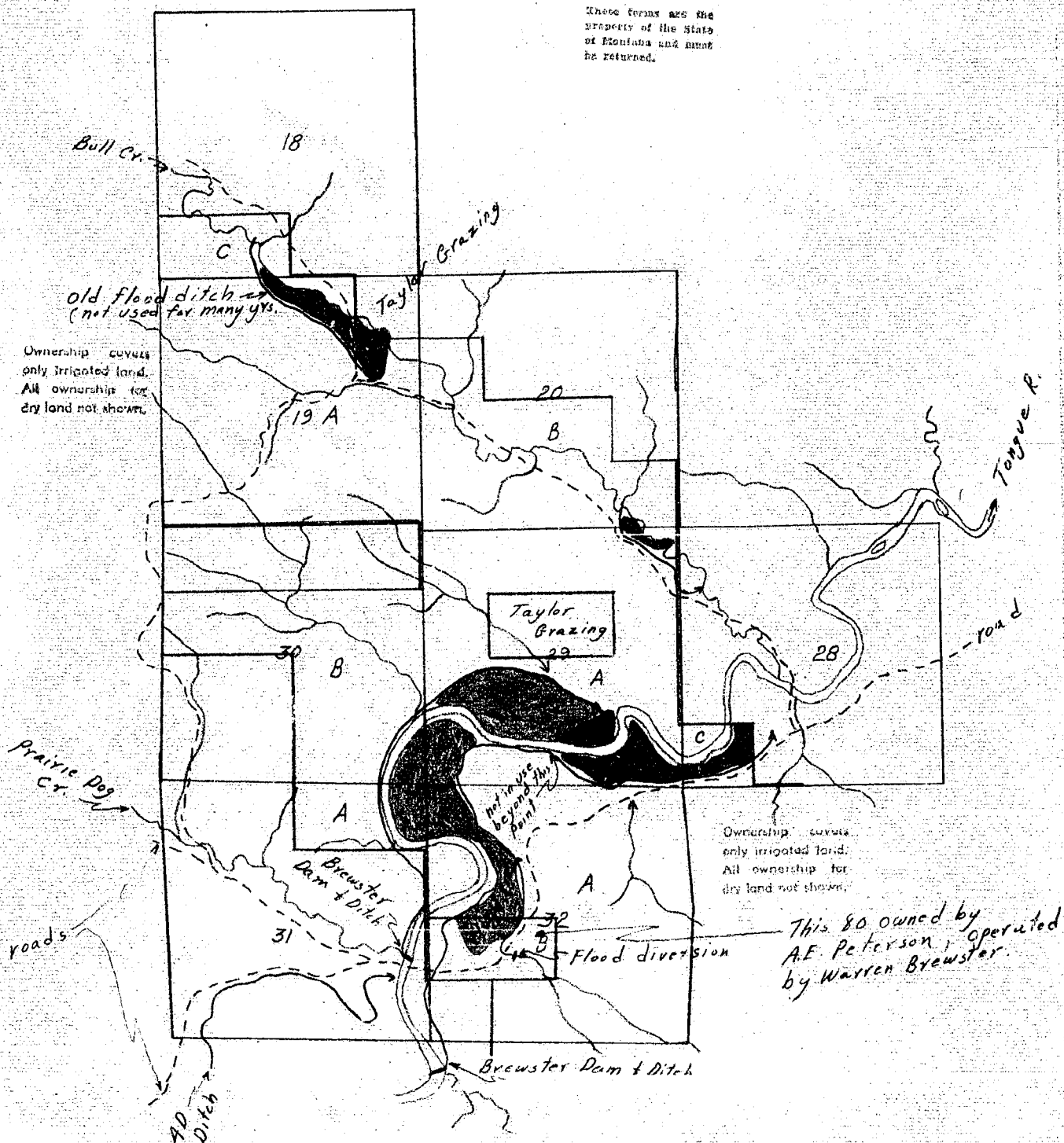



NOTE
These forms and the
property of the State
of Montana and must
be returned.

STATE OF MONTANA
STATE ENGINEERS OFFICE

(64) (64A) Code No. 4A, 13A 6S.

County Rosebud

Water Resources Survey

T. 5S. R. 41E.
6S. 41E.

Name of Land Owner Brewster, Warren

Address Birney

Name of Operator

Address

Complete Hold
R. C.

Part A

TO BE FILED BY THOSE OBTAINING IRRIGATION WATER FROM
A DITCH COMPANY OR IRRIGATION DISTRICT

1. Water is delivered by: _____
Name of Ditch, Ditch Company or District Supplying Water
2. State the number of acres you irrigate under this system _____ Shares you hold _____
3. If you obtain water from more than one Company, give the number of shares, acres irrigated and the name of the Company under "Remarks." If you obtain water from a Ditch Company and also have a private system "I" in both Part A and Part B.

Part B

TO BE FILED BY THOSE WHO HAVE A PRIVATE DITCH, PUMP OR IRRIGATION SYSTEM
or those who have a private water right under a Ditch Company

4. In what year was this land first irrigated? Date See attached filings.
5. Give the name of the original appropriator (first user): _____
6. Give the date appropriated _____ Amount filed on: Miners Inches _____ C. F. S. _____
7. State the total number of acres irrigated under this system: _____
8. Give the point of diversion: _____ $\frac{1}{4}$ _____ $\frac{1}{4}$ Section _____ Township _____ Range _____

Part C

TO BE FILED BY ALL WATER USERS IN ADDITION TO PART A OR PART B

9. Source of Water: Bull Cr.
Name of stream or lake from which water is originally diverted
10. Water is obtained by: (Check one) Gravity _____ Pumping _____ Other FLOOD
11. What is the greatest number of acres you have irrigated? 81 Date _____
12. How many acres did you irrigate in 1947? (Crop and pasture) 63
13. State the total number of additional acres that could be irrigated by increasing the water supply, land leveling, etc. 18 This land is under what ditch? lower
14. How many acres of seeped land do you have which could be drained and put into production? 0
15. What is the condition of your irrigation system? poor
16. Is your water supply adequate? Yes _____ No X Explain Flood waters only.
17. REMARKS: Field check & interview by Dave & Jim.

NOTE: The foregoing questions apply only to irrigated land shown on this plat.

DESCRIPTION AND MAP OF FARM

18. Legal Description of this Farm..... Lots 1 to 8 incl., N₂S₂, S₂SW₄, S₂SW₄, of Sec. 4; Lots 5, 6, 7, 8, S₂SW₄, W₂NE₄, E₂NW₄, NW₄NW₄ Sec. 13, T. 6S. - R. 41E. All Sec. 31, T. 5S. - R. 41E.



IRRIGATED LAND



NON-IRRIGATED LAND

North

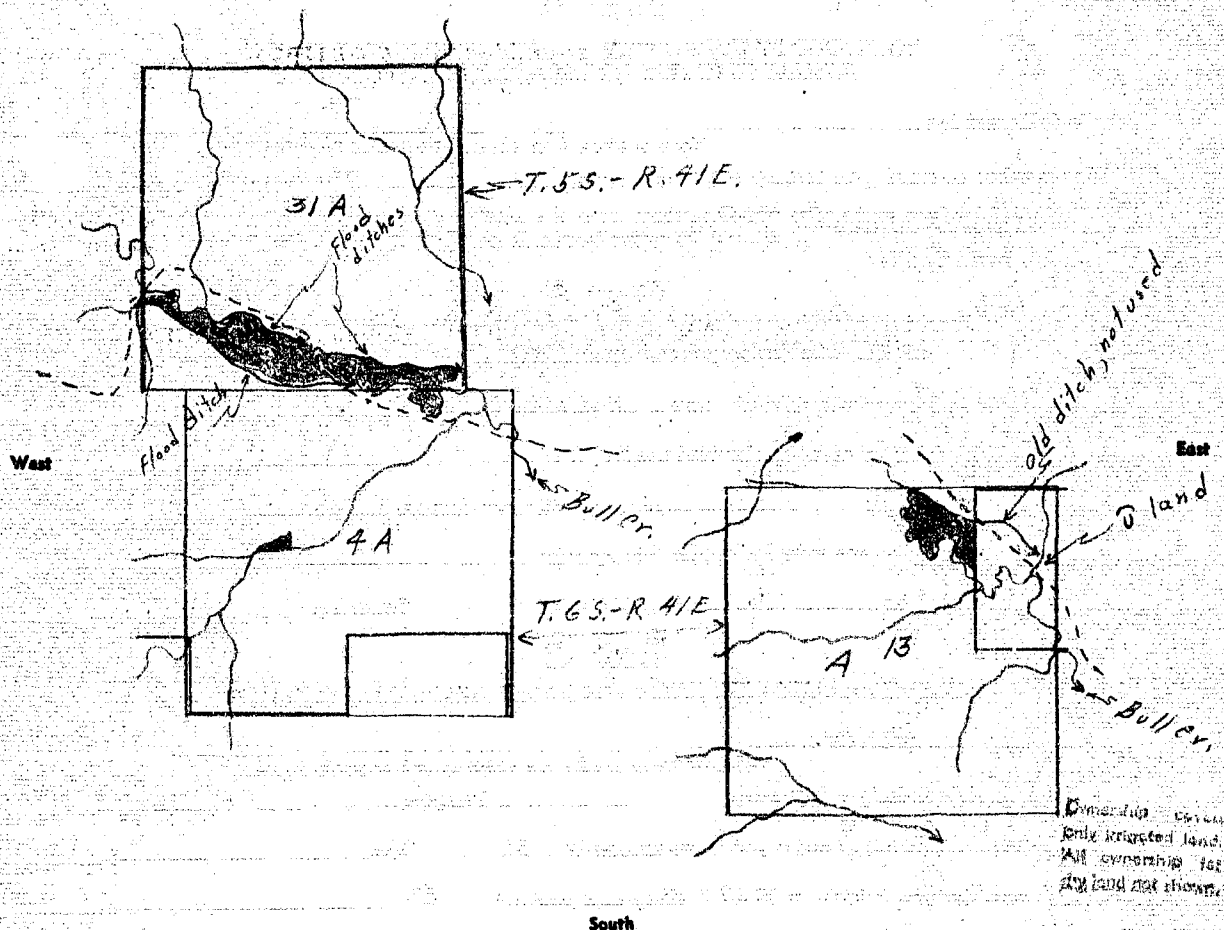

South

19. If the above land is irrigated from more than one ditch please give the acreage under each ditch in 19A and indicate the location of the land irrigated from each on the above map.

19A. Ditch: Flood ditches in Bull Cr. Acres: 63.0

Ditch: _____ Acres: _____

Information supplied by:

Name Warren Brewster Address _____ Date 8/7/47

REMARKS: Field check and interview by Dave & Jim

If you cannot answer all of the questions on this form answer as many as you can and return the form to us as soon as possible.

Farm Checked

STATE OF MONTANA

Code No. _____

By Dave, JimSTATE ENGINEER'S OFFICE
WATER RESOURCES SURVEYCounty Rosebud
✓ 63 42E 15, 19
63 41E 2, 3, 4, 11, 12, 13
T. 55 R. 41E Sec. 31
MA-5A 89
Photo No. WV-7A 91492Area BirneyDate 8/2/97

Legal Land Owner

Brewster, Warren

Address

Birney

Operator

Same

Address

Water is delivered by:

Federal Project

Pres.

Pot.

~~Bank Company~~Flood Tongue side Coulee

Pres.

39

Pot.

0~~Irrigation District~~Flood Bull Cr.

Pres.

0

Pot.

39

Private System

✓ Tongue R. Gravity

Pres.

150

Pot.

61

Totals

189100

Flood

☒

Pump

Reservoir

Gravity

☒

Size and Capacity, Pump, etc.

Original Appropriator, Company

App. No.

Original Appropriator, Private

(Show date of appropriation under Remarks)

App. No.

Is the system an extension of another system?

Yes

No

Is all land irrigated from one system?

Yes

No

(If No, show break down on map)

Source of Water

Flood water out of Bull Creek

COPY

Also filed in
T65 R41E
T55 R41EAcres Irrigated 1977

Potential Acres

Seeped 0Explain Poor (run down) some ditches are in working condition

Condition of System

Adequate Supply

Yes

No

☒Explain depends on rain & snow in Bull Creek

Topography

Bull Creek Valley bottom

Information From

Mr Brewster & field check

Remarks

Systems were old direct Claim Works

over

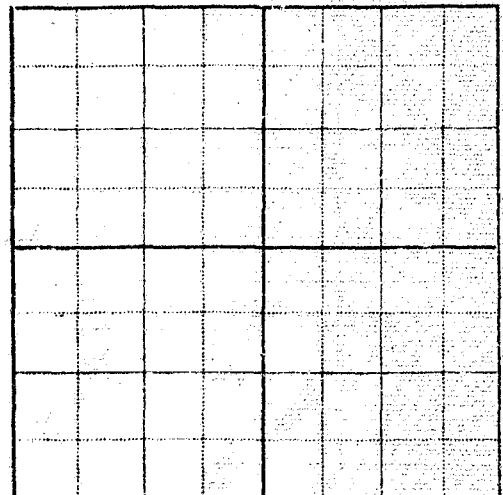

These flood systems were put in by the original homesteaders to prove on desert claims. They haven't been kept up as a whole, but Mr. Brewster has done some work on them to flood hay land. Most of the systems need cleaning and dams rebuilt to divert the water to the ditches.

**STATE ENGINEER'S OFFICE
WATER RESOURCES SURVEY**

COUNTY RosebudFILE NO. 65 - 18C, 19A, 29A, 30B, 31A, 32A,
28C, 200

Owner Brewster, Warren Address Birney, Montana
 AAA Owner Address
 Operator Address
 New Owner Same Address
 New Operator Address

Assessment Record YesCounty 150

Assessed Acreage

Legal Description of This Farm Lot 7, SE $\frac{1}{4}$ SW $\frac{1}{4}$ Sec. 18; Lots 1 to 7, incl., NE $\frac{1}{4}$ SW $\frac{1}{4}$, E $\frac{1}{2}$ NW $\frac{1}{4}$, N $\frac{1}{2}$ SE $\frac{1}{4}$,
 W $\frac{1}{2}$ NE $\frac{1}{4}$, SE $\frac{1}{4}$ NW $\frac{1}{4}$ Sec. 19; Lots 1,2,3, N $\frac{1}{2}$ NE $\frac{1}{4}$, SE $\frac{1}{4}$ NW $\frac{1}{4}$, S $\frac{1}{4}$ Sec. 29; Lots 7,8,9,10, SE $\frac{1}{4}$ Sec. 30;
 N $\frac{1}{2}$ NE $\frac{1}{4}$ Sec. 31; Lots 1,2,3,4, SE $\frac{1}{4}$ SW $\frac{1}{4}$, N $\frac{1}{2}$ Sec. 32, T. 6S., R. 42E., S $\frac{1}{4}$ SW $\frac{1}{4}$ Sec. 28, T.6S., R.42E.
 SW $\frac{1}{4}$, S $\frac{1}{4}$ SE, NWSE, SWNW Sec. 20 T. 6S. - R. 42E.
 Flood Bull Cr., Gravity Tongue, Flood Side Coulee Total Acres in Farm

Code Number 18C, 19A, 29A, 30B, 31A, 32A, 28CPhoto No. WY-7A-92, 7A-91, MA-9A-13

AAA Contract No.

AAA Total Cropland Acreage 674.8App. No. 128, 785, 779,13A 13BDecree No. D-33, D-35

Land is located in

Twp. 6S. Rge. 42E. Twp. 6S. Rge. 41E.Twp. 5S. Rge. 41E. Twp. Rge.Filed in Twp. 6S. Rge. 42E.

Remarks

T.R.B.

STATE ENGINEER'S OFFICE
WATER RESOURCES SURVEYCOUNTY RosebudFILE NO. 65 - 32BOwner Peterson, A. E. Address Birney, Montana

AAA Owner Address

Operator Brewster, Warren Address "

New Owner Address

New Operator Address

Assessment Record No

Assessed Acreage

Legal Description of This Farm N¹SW¹ Sec. 32, T. 6S., R. 42E.

Flood Side Coulee

Total Acres in Farm

Code Number 32BPhoto No. MA-9A-13

AAA Contract No.

AAA Total Cropland Acreage 0App. No. N.R.

Decree No.

Land is located in

Twp. 6S. Rge. 42E. Twp. Rge.

Twp. Rge. Twp. Rge.

Filed in Twp. 6S. Rge. 42E.

Remarks

T.R.B.



STATE OF MONTANA
STATE ENGINEERS OFFICE
Water Resources Survey

FORM WR-1-2M 12-47
1A-12B-13B-31B
Code No. _____
County Rosebud
T. 6S R. 42E

Name of Land Owner Brown Cattle Co. Address Beining Montana
Name of Operator _____ Address _____

Part A

TO BE FILED BY THOSE OBTAINING IRRIGATION WATER FROM
A DITCH COMPANY OR IRRIGATION DISTRICT

1. Water is delivered by: _____ Name of Ditch, Ditch Company or District Supplying Water _____
2. State the number of acres you irrigate under this system _____ Shares you hold _____
3. If you obtain water from more than one Company, give the number of shares, acres irrigated and the name of the Company under "Remarks." If you obtain water from a Ditch Company and also have a private system fill in both Part A and Part B.

Part B

TO BE FILED BY THOSE WHO HAVE A PRIVATE DITCH, PUMP OR IRRIGATION SYSTEM
or those who have a private water right under a Ditch Company

4. In what year was this land first irrigated? Date one attached decree & filings
5. Give the name of the original appropriator (first user): _____
6. Give the date appropriated _____ Amount filed on: Miners Inches _____ C. F. S. _____
7. State the total number of acres irrigated under this system: _____
8. Give the point of diversion: _____ $\frac{1}{4}$ _____ $\frac{1}{4}$ Section _____ Township _____ Range _____

Part C

TO BE FILED BY ALL WATER USERS IN ADDITION TO PART A OR PART B

9. Source of Water: Tongue River
Name of stream or lake from which water is originally diverted
10. Water is obtained by: (Check one) Gravity ☒ Pumping _____ Other _____
11. What is the greatest number of acres you have irrigated? _____ Date _____
12. How many acres did you irrigate in 1947? (Crop and pasture) 322.5
13. State the total number of additional acres that could be irrigated by increasing the water supply, land leveling, etc. Y This land is under what ditch? _____
14. How many acres of seeped land do you have which could be drained and put into production? Y
15. What is the condition of your irrigation system? Good
16. Is your water supply adequate? Yes ☒ No _____ Explain _____
17. REMARKS: in average years

Over

NOTE: The foregoing questions apply only to irrigated land shown on this plat.

DESCRIPTION AND MAP OF FARM

18. Legal Description of this Farm.

See attached form + map



IRRIGATED LAND



NON-IRRIGATED LAND

North

West

East

South

Ownership, cover only irrigated land. All ownership for dry land not shown.

19. If the above land is irrigated from more than one ditch please give the acreage under each ditch in 19A and indicate the location of the land irrigated from each on the above map.

19A. Ditch: *40-ditch* Acres: *100.2*
Ditch: *Brown ditch No 1* Acres: *192.3*
Ditch: *Brown ditch No 2* Acres: *30.0*

Information supplied by:

Name *Mr. Hance (Brown ditch Co.)* Address

Date *July 30-47*

REMARKS: *J. Cook & J. Paulist field survey*

If you cannot answer all of the questions on this form answer as many as you can and return the form to us as soon as possible.

(65) T. 6 S. - R. 4 E.

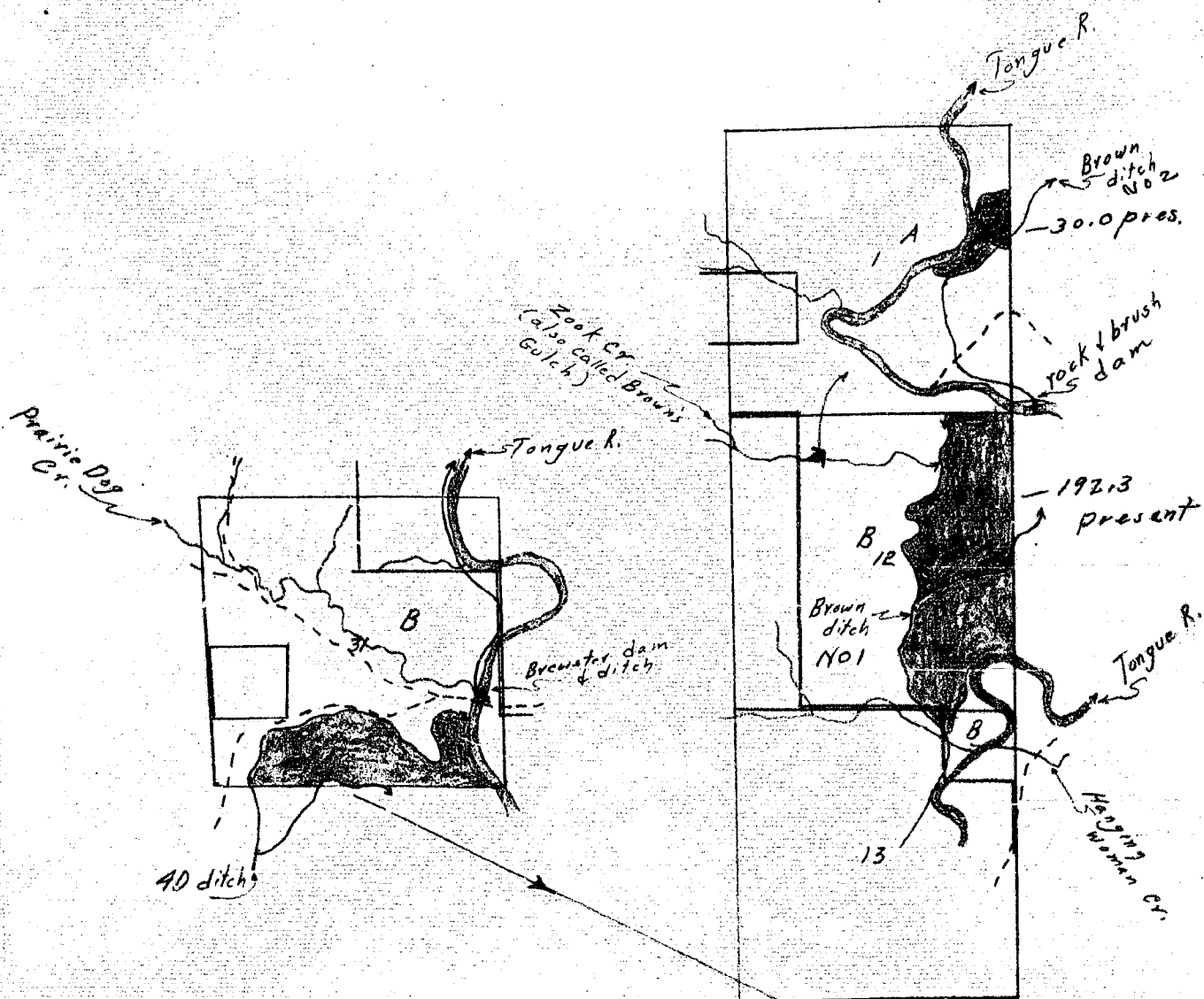

Acres
4D-Ditch - 65 R 42 E. 100.2

65-42L

ownership, covered
irrigated land,
ownership for
and not shown,

in 19A and

100.2

192.3

30.0

322.5

July 30-47

to us as soon

STATE ENGINEER'S OFFICE
WATER RESOURCES SURVEY

COUNTY Rosebud

FILE NO. 65 - 1A, 12B, 13B, 31B

Owner Brown Cattle Co. Address Birney, Montana

AAA Owner Address

Operator Same Address

ew Owner Address

New Operator Address

Assessment Record Yes

County 210

Assessed Acreage

Legal Description of This Farm All except lot 8 Sec. 1; E¹/₂, E¹/₂ Sec. 12; NE¹/₄ Sec. 13;

Lots 1, 2, 4, E¹/₂, SE¹/₄, S¹/₂NE¹/₄ Sec. 31, T. 6S., R. 42E.

Tongue River

Total Acres in Farm

Code Number 1A, 12B, 13B, 31B

Photo No. MA-9A-12, WY-7A-91

AAA Contract No.

AAA Total Cropland Acreage 0

App. No. 752, 508, 509, 514, 791, 901

Decree No. D-12, D-13, D-17

Land is located in 7S. 41E.

6S-43E 7S. 42E.

Twp. 6S. Rge. 42E. Twp. 4S. Rge. 43E.

p. 5S. Rge. 43E. Twp. 5S. Rge. 42E.

Filed in Twp. 4S. Rge. 43.

Remarks



NOTICE
These forms are the
property of the State
of Montana and must
be returned.

STATE OF MONTANA
STATE ENGINEERS OFFICE
Water Resources Survey

FORM WR-1-2M 12-47
13A, 14A, 22B, 22C
65 Code No. 23A, 27A, 28B
County Rosebud
T. 6S. R. 42E.

Name of Land Owner Quarter Circle U. Ranch Address Birney, Mont.
Name of Operator _____ Address _____

Part A

**TO BE FILED BY THOSE OBTAINING IRRIGATION WATER FROM
A DITCH COMPANY OR IRRIGATION DISTRICT**

1. Water is delivered by: _____ Name of Ditch, Ditch Company or District Supplying Water _____
2. State the number of acres you irrigate under this system _____ Shares you hold _____
3. If you obtain water from more than one Company, give the number of shares, acres irrigated and the name of the Company under "Remarks." If you obtain water from a Ditch Company and also have a private system fill in both Part A and Part B.

Part B

**TO BE FILED BY THOSE WHO HAVE A PRIVATE DITCH, PUMP OR IRRIGATION SYSTEM
or those who have a private water right under a Ditch Company**

4. In what year was this land first irrigated? Date See attached filings and decrees.
5. Give the name of the original appropriator (first user): _____
6. Give the date appropriated _____ Amount filed on: Miners Inches _____ C. F. S. _____
7. State the total number of acres irrigated under this system: _____
8. Give the point of diversion: $\frac{1}{4}$ $\frac{1}{4}$ Section _____ Township _____ Range _____

Part C

TO BE FILED BY ALL WATER USERS IN ADDITION TO PART A OR PART B

9. Source of Water: Bull Cr., Battle Butte Cr. & Tongue River.
Name of stream or lake from which water is originally diverted _____
10. Water is obtained by: (Check one) Gravity ☒ Pumping _____ Other FLOOD
11. What is the greatest number of acres you have irrigated? 441.60 Date ???
12. How many acres did you irrigate in 1947? (Crop and pasture) 326.6
13. State the total number of additional acres that could be irrigated by increasing the water supply, land leveling, etc. 5 23 This land is under what ditch? Bull Cr. Flood East side Ditch Brewster Ditch & pump site (Tongue) Battle Butte Cr. Flood
14. How many acres of seeped land do you have which could be drained and put into production? 42 0
15. What is the condition of your irrigation system? 45 - Total 115.0 Brown Ditch (Tongue) fair to poor. Tongue dry in 1934, stored water available.
16. Is your water supply adequate? Yes ☒ No ☒ Explain Seasonal flood only on creeks.
17. REMARKS: _____

Over

NOTE: The foregoing questions apply only to irrigated land shown on this plat.

DESCRIPTION AND MAP OF FARM

18. Legal Description of this Farm See attached WR2 and map.



IRRIGATED LAND



NON-IRRIGATED LAND

North

West

East

South

Ownership covers
only irrigated land.
All ownership for
dry land not shown.

19. If the above land is irrigated from more than one ditch please give the acreage under each ditch in 19A and indicate the location of the land irrigated from each on the above map.

Flood Battle Butte Cr.

41.8

19A. Ditch: Arnold Ditch (Tongue)

Acres: 284.8

Ditch: _____

Acres: _____

TOTAL 326.6

Information supplied by:

Name Burton Brewster

Address _____



Date 7/31/47

and interview

REMARKS: Field check by Jim and Dave.

If you cannot answer all of the questions on this form answer as many as you can and return the form to us as soon as possible.

(65) T. 6S. - R. 42E.

 irrigated land
 potential land
 ownership boundary

NOTE: Your flood irrigation in T. 6S. - R. 41 E. on Bull Creek is not included on these forms.

NOTE: These forms are the property of the State of California and must be returned.

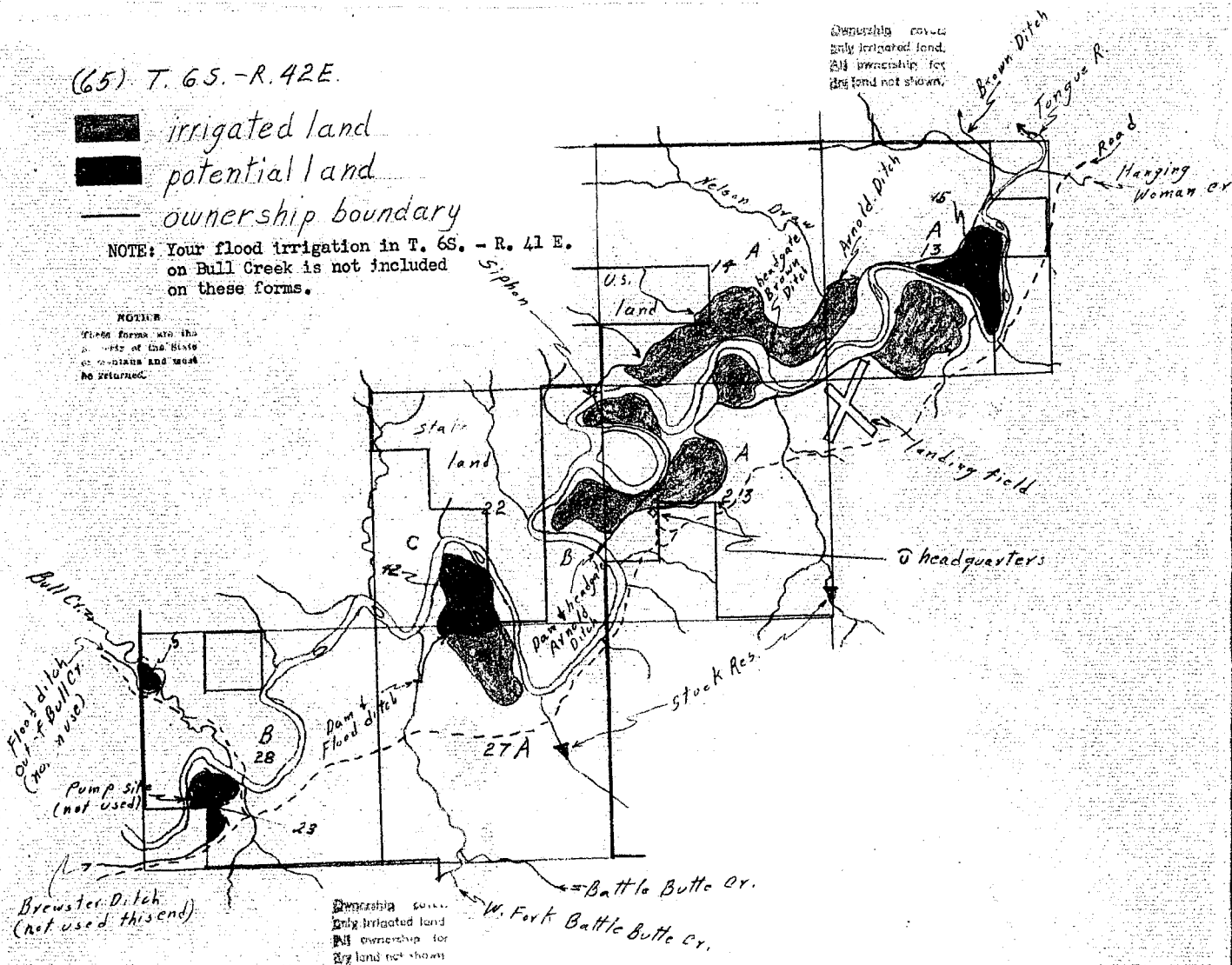



NOTICE
These forms are the
property of the State
of Montana and must
be returned.

STATE OF MONTANA
STATE ENGINEERS OFFICE
Water Resources Survey

FORM WR-1-2M 12-47

64 Code No. 2A, #B, 11A, 13B

County Rosebud

T. R.

Name of Land Owner Quarter Circle U Ranch Address 1/2 Lyman Brewster, Birney, Mont.
Name of Operator Lyman Brewster Address _____

Part A

**TO BE FILED BY THOSE OBTAINING IRRIGATION WATER FROM
A DITCH COMPANY OR IRRIGATION DISTRICT**

1. Water is delivered by: _____ Name of Ditch, Ditch Company or District Supplying Water _____
2. State the number of acres you irrigate under this system. _____ Shares you hold _____
3. If you obtain water from more than one Company, give the number of shares, acres irrigated and the name of the Company under "Remarks." If you obtain water from a Ditch Company and also have a private system fill in both Part A and Part B.

Part B

**TO BE FILED BY THOSE WHO HAVE A PRIVATE DITCH, PUMP OR IRRIGATION SYSTEM
or those who have a private water right under a Ditch Company**

4. In what year was this land first irrigated? Date No record.
5. Give the name of the original appropriator (first user): _____
6. Give the date appropriated _____ Amount filed on: Miners Inches _____ C. F. S. _____
7. State the total number of acres irrigated under this system: _____
8. Give the point of diversion: _____ 1/4 _____ 1/4 Section _____ Township _____ Range _____

Part C

TO BE FILED BY ALL WATER USERS IN ADDITION TO PART A OR PART B

9. Source of Water: Bull Cr.
Name of stream or lake from which water is originally diverted _____
10. Water is obtained by: (Check one) Gravity _____ Pumping _____ Other FLGOD
11. What is the greatest number of acres you have irrigated? 48 Date ?
12. How many acres did you irrigate in 1947? (Crop and pasture) 0
13. State the total number of additional acres that could be irrigated by increasing the water supply, land leveling, etc. 48. This land is under what ditch? _____
14. How many acres of seeped land do you have which could be drained and put into production? 0
15. What is the condition of your irrigation system? Very poor
16. Is your water supply adequate? Yes _____ No X Explain Seasonal flood only.
17. REMARKS: _____

Over

DESCRIPTION AND MAP OF FARM

IRRIGATED LAND *out* NON-IRRIGATED LAND

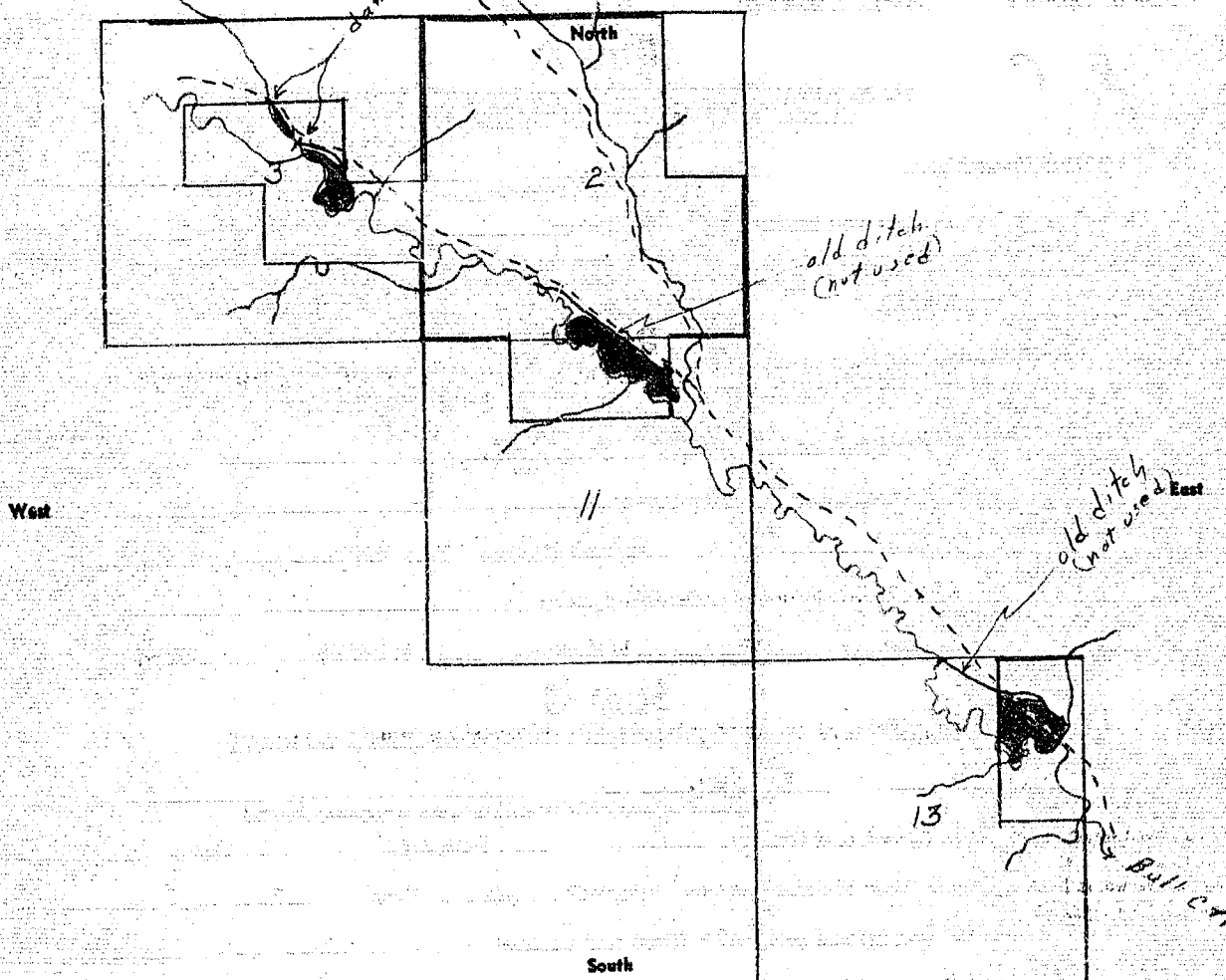

19A. Ditch: _____ Acres: 0

Ditch: _____ **Acres:** _____

Information supplied by: and interview with Burton Brewster 7/31/47
 Name Field check by Jim & Dave Address _____ Date 8/1/47

REMARKS:

If you cannot answer all of the questions on this form answer as many as you can and return the form to us as soon as possible.

STATE ENGINEER'S OFFICE
WATER RESOURCES SURVEYCOUNTY RosebudFILE NO. 65 - 13A, 14A, 22B, 22C, 23A, 27A,
28BOwner Quarter Circle ~~H~~ RanchAddress Birney, Montana

AAA Owner

Address

Operator

Same

Address

New Owner

Address

New Operator

Address

Assessment Record No(Assessed Arnold Brewster) County 277

Assessed Acreage

Legal Description of This Farm W $\frac{1}{2}$, W $\frac{1}{2}$ E $\frac{1}{2}$, SE $\frac{1}{4}$ NE $\frac{1}{4}$ Sec. 13; Lots 1, 2, 3, 4, E $\frac{1}{2}$, S $\frac{1}{2}$ SW $\frac{1}{4}$ Sec. 14;
SW $\frac{1}{4}$, SW $\frac{1}{4}$ NE $\frac{1}{4}$, E $\frac{1}{2}$ E $\frac{1}{2}$ Sec. 22; Lots 1, 2, 3, 4, N $\frac{1}{2}$, NW $\frac{1}{4}$ SW $\frac{1}{4}$ Sec. 23; Lots 1 to 8, incl., N $\frac{1}{2}$ Sec. 27;
E $\frac{1}{2}$, N $\frac{1}{2}$ SW $\frac{1}{4}$, SE $\frac{1}{4}$ SW $\frac{1}{4}$, SW $\frac{1}{4}$ NE $\frac{1}{4}$, NW $\frac{1}{4}$ NE $\frac{1}{4}$ Sec. 28, T. 6S., R. 42E.Flood Bull Cr., Flood Battle Butte Cr.,
Tongue River

Total Acres in Farm

Number 13A, 14A, 22B, 22C, 23A, 27A, 28BPhoto No. MA-9A-12, 9A-13,

AAA Contract No.

AAA Total Cropland Acreage 467.5App. No. 752, 769, 330, 334, 122Decree No. D-5, D-6, D-8, D-7

Land is located in

Twp. 6S. Rge. 42E. Twp. 6S. Rge. 41E.

Twp. Rge. Twp. Rge.

Filed in Twp. 6S. Rge. 42E.

Remarks