



These forms are the property of the State of Montana and must be returned.

STATE OF MONTANA  
STATE ENGINEERS OFFICE

66

Code No. 20A, 29A

County Rosebud

Water Resources Survey

T. 6 S. R. 43 E.

Name of Land Owner Bones Bros. Address Birney, Mont.  
Name of Operator \_\_\_\_\_ Address \_\_\_\_\_

Part A

TO BE FILED BY THOSE OBTAINING IRRIGATION WATER FROM A DITCH COMPANY OR IRRIGATION DISTRICT

- 1. Water is delivered by: \_\_\_\_\_ Name of Ditch, Ditch Company or District Supplying Water \_\_\_\_\_
- 2. State the number of acres you irrigate under this system \_\_\_\_\_ Shares you hold \_\_\_\_\_
- 3. If you obtain water from more than one Company, give the number of shares, acres irrigated and the name of the Company under "Remarks." If you obtain water from a Ditch Company and also have a private system fill in both Part A and Part B.

Part B

TO BE FILED BY THOSE WHO HAVE A PRIVATE DITCH, PUMP OR IRRIGATION SYSTEM or those who have a private water right under a Ditch Company

- 4. In what year was this land first irrigated? Date See attached filings
- 5. Give the name of the original appropriator (first user): \_\_\_\_\_
- 6. Give the date appropriated \_\_\_\_\_ Amount filed on: Miners Inches \_\_\_\_\_ C. F. S. \_\_\_\_\_
- 7. State the total number of acres irrigated under this system: \_\_\_\_\_
- 8. Give the point of diversion: \_\_\_\_\_ 1/4 \_\_\_\_\_ 1/4 Section \_\_\_\_\_ Township \_\_\_\_\_ Range \_\_\_\_\_

Part C

TO BE FILED BY ALL WATER USERS IN ADDITION TO PART A OR PART B

- 9. Source of Water: Hanging Woman Cr., E. Fork Hanging Woman Cr.,  
Name of stream or lake from which water is originally diverted \_\_\_\_\_
- 10. Water is obtained by: (Check one) Gravity \_\_\_\_\_ Pumping  Other FLOOD
- 11. What is the greatest number of acres you have irrigated? 113.8 Date \_\_\_\_\_
- 12. How many acres did you irrigate in 1947? (Crop and pasture) 113.8
- 13. State the total number of additional acres that could be irrigated by increasing the water supply, land leveling, etc. 0 This land is under what ditch? \_\_\_\_\_
- 14. How many acres of seeped land do you have which could be drained and put into production? 0
- 15. What is the condition of your irrigation system? Fair Flood only where indicated, water
- 16. Is your water supply adequate? Yes  No  Explain usually sufficient for garden pump.
- 17. REMARKS: \_\_\_\_\_

Over

T. 6 S., R. 43 E.

NOTE: The foregoing questions apply only to irrigated land shown on this plat.

### DESCRIPTION AND MAP OF FARM

18. Legal Description of this Farm All except SESE Sec. 20; All except SENE Sec. 29, T. 6N. R. 43E.

IRRIGATED LAND       NON-IRRIGATED LAND

North

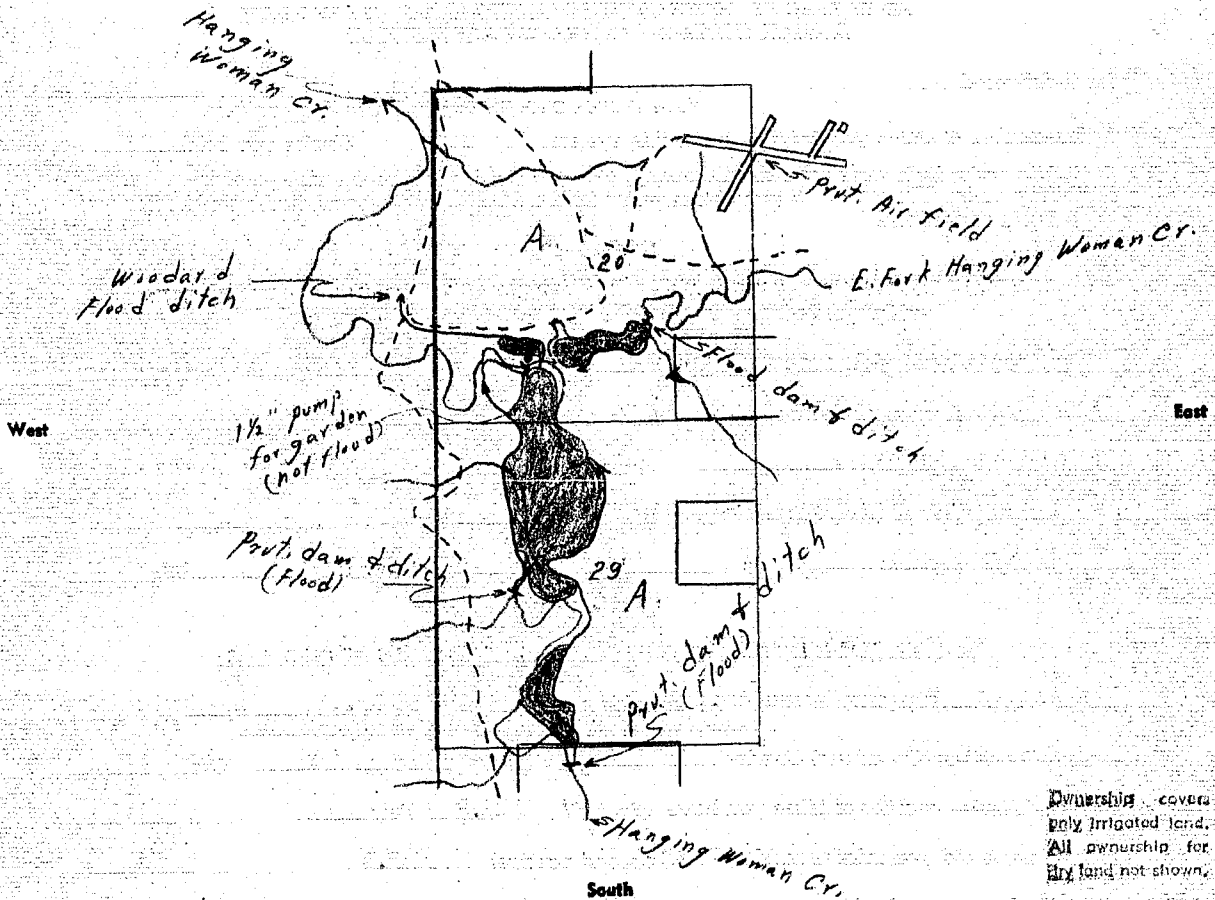

Ownership covers only irrigated land. All ownership for dry land not shown.

19. If the above land is irrigated from more than one ditch please give the acreage under each ditch in 19A and indicate the location of the land irrigated from each on the above map.

19A. Ditch: Flood Hanging Woman Cr. Acres: 101  
 Ditch: Flood E. Fork Hanging Woman Acres: 12  
Pump in E. Fork Hanging Woman Cr. Acres: 0.8  
 Information supplied by: \_\_\_\_\_ Total 113.8

Name Bones Address \_\_\_\_\_ Date 8/20/47

REMARKS: Field check & interview by Cook - Johnson

If you cannot answer all of the questions on this form answer as many as you can and return the form to us as soon as possible.

STATE ENGINEER'S OFFICE  
WATER RESOURCES SURVEY

COUNTY Rosebud

FILE NO. 66 - 20A, 29A

Owner Bones Bros. Address Birney, Montana

AAA Owner Address

Operator Same Address

New Owner Address

New Operator Address

Assessment Record No

Assessed Acreage

Legal Description of This Farm All except SE<sup>1</sup>/<sub>4</sub> SE<sup>1</sup>/<sub>4</sub> Sec. 20; All except SE<sup>1</sup>/<sub>4</sub> NE<sup>1</sup>/<sub>4</sub> Sec. 29, T. 6S., R. 43E.

Flood Hanging Woman and East Fork Hanging Woman Total Acres in Farm

Code Number 20A, 29A

Photo No. WY-7A-49

AAA Contract No.

AAA Total Cropland Acreage 0

App. No. 300, 301, (788 Custer)

Decree No.

Land is located in

Twp. 6S. Rge. 43E. Twp. Rge.

Twp. Rge. Twp. Rge.

Filed in Twp. 6S. Rge. 43E.

Remarks

T.R.B.



NO. 1002  
These forms are the property of the State of Montana and must be returned.

STATE OF MONTANA  
STATE ENGINEERS OFFICE  
Water Resources Survey

FORM WR-1-2M 12-47

Code No. 6A-7A  
County Rosebud  
T. 6S R. 43E

Name of Land Owner Brown Butte Co. Address Beiney, Mont.  
Name of Operator \_\_\_\_\_ Address \_\_\_\_\_

**Part A**

**TO BE FILED BY THOSE OBTAINING IRRIGATION WATER FROM DITCH COMPANY OR IRRIGATION DISTRICT**

1. Water is delivered by: \_\_\_\_\_ Name of Ditch, Ditch Company or District Supplying Water \_\_\_\_\_
2. State the number of acres you irrigate under this system \_\_\_\_\_ Shares you hold \_\_\_\_\_
3. If you obtain water from more than one Company, give the number of shares, acres irrigated and the name of the Company under "Remarks." If you obtain water from a Ditch Company and also have a private system fill in both Part A and Part B.

**Part B**

**TO BE FILED BY THOSE WHO HAVE A PRIVATE DITCH, PUMP OR IRRIGATION SYSTEM or those who have a private water right under a Ditch Company**

4. In what year was this land first irrigated? Date (See attached decree + filing)
5. Give the name of the original appropriator (first user): \_\_\_\_\_
6. Give the date appropriated \_\_\_\_\_ Amount filed on: Miners Inches \_\_\_\_\_ C. F. S. \_\_\_\_\_
7. State the total number of acres irrigated under this system: \_\_\_\_\_
8. Give the point of diversion: \_\_\_\_\_  $\frac{1}{4}$  \_\_\_\_\_  $\frac{1}{4}$  Section \_\_\_\_\_ Township \_\_\_\_\_ Range \_\_\_\_\_

**Part C**

**TO BE FILED BY ALL WATER USERS IN ADDITION TO PART A OR PART B**

9. Source of Water: Tongue River Name of stream or lake from which water is originally diverted \_\_\_\_\_
10. Water is obtained by: (Check one) Gravity  Pumping \_\_\_\_\_ Other \_\_\_\_\_
11. What is the greatest number of acres you have irrigated?  Date \_\_\_\_\_
12. How many acres did you irrigate in 1947 (Crop and pasture) 223, 0
13. State the total number of additional acres that could be irrigated by increasing the water supply, land leveling, etc. Y This land is under what ditch? Y
14. How many acres of seeped land do you have which could be drained and put into production? X
15. What is the condition of your irrigation system? Good
16. Is your water supply adequate? Yes  No \_\_\_\_\_ Explain \_\_\_\_\_
17. REMARKS: Could have ample water if stored water in Tongue River Res. were purchased, 0

Over

NOTE: The foregoing questions apply only to irrigated land shown on this plat.

DESCRIPTION AND MAP OF FARM

18. Legal Description of this Farm All Sec 6, N<sup>2</sup> Sec 7, NE<sup>4</sup> & E<sup>4</sup>,  
Sec 4, Sec 7, T 6 S R 43 E



IRRIGATED LAND



NON-IRRIGATED LAND

North

*see attached map*

West

East

South

Ownership covers only irrigated land. All ownership for dry land not shown.

19. If the above land is irrigated from more than one ditch please give the acreage under each ditch in 19A and indicate the location of the land irrigated from each on the above map.

19A. Ditch: Brown Cattle Co ditch Acres: 223.0

Ditch: \_\_\_\_\_ Acres: \_\_\_\_\_

Information supplied by:

Name Mrs. Vance (Brown Cattle Co) Address \_\_\_\_\_ Date July 30-47

REMARKS: to J. Cash & D. Paulist

If you cannot answer all of the questions on this form answer as many as you can and return the form to us as soon as possible.

STATE ENGINEER'S OFFICE  
WATER RESOURCES SURVEY

COUNTY Rosebud

FILE NO. 66 - 6A-7A

Owner Brown Cattle Co. Address Birney, Montana

AAA Owner \_\_\_\_\_ Address \_\_\_\_\_

Operator Same Address \_\_\_\_\_

New Owner \_\_\_\_\_ Address \_\_\_\_\_

New Operator \_\_\_\_\_ Address \_\_\_\_\_

Assessment Record \_\_\_\_\_ No. \_\_\_\_\_

Assessed Acreage \_\_\_\_\_

Legal Description of This Farm All Sec. 6, NE 1/4 Sec. 7, NW 1/4 Sec. 7, T. 6S., R. 43E.

Gravity Tongue

Total Acres in Farm \_\_\_\_\_

Code Number 6A, 7A

Photo No. Wy-7A-48

AAA Contract No. \_\_\_\_\_

AAA Total Cropland Acreage 399.8

App. No. 753, (1912 Custer)

Decree No. D-12-D-13

Land is located in

Twp. 6S. Rge. 43E. Twp. 4S. Rge. 43E.

Twp. 5S. Rge. 43E. Twp. 5S. Rge. 42E.

Filed in Twp. 4S. Rge. 43E.

Remarks \_\_\_\_\_

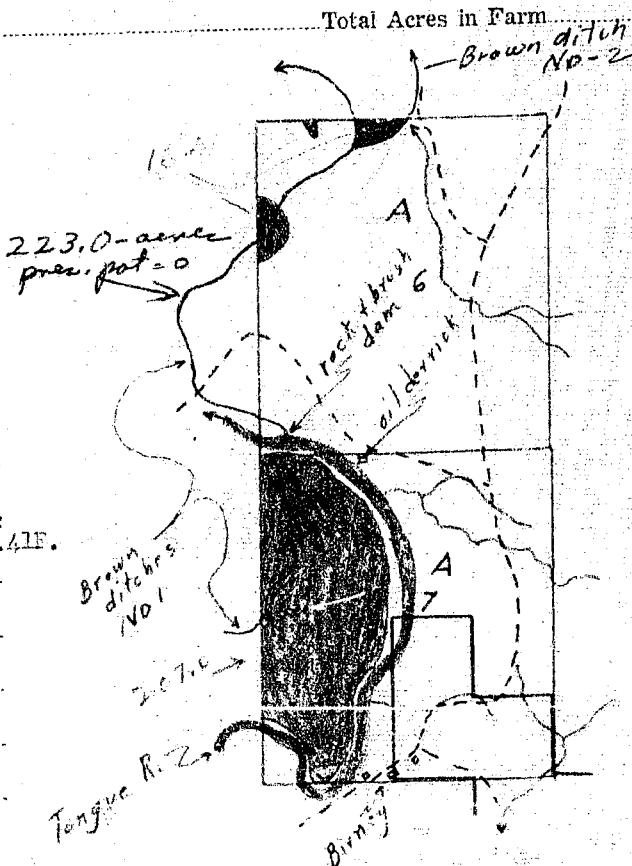



NOTICE  
These forms are the  
property of the State  
of Montana and must  
be returned.

STATE OF MONTANA  
STATE ENGINEERS OFFICE  
Water Resources Survey

66

FORM WR-1-2M 12-47  
Code No. 18B, 19A, 32E

County Rosebud

T. 6S. R. 43E.

Name of Land Owner Woodard, Gilbert Address Birney, Mont.

Name of Operator \_\_\_\_\_ Address \_\_\_\_\_

**Part A**

**TO BE FILED BY THOSE OBTAINING IRRIGATION WATER FROM  
A DITCH COMPANY OR IRRIGATION DISTRICT**

1. Water is delivered by: \_\_\_\_\_ Name of Ditch, Ditch Company or District Supplying Water \_\_\_\_\_
2. State the number of acres you irrigate under this system \_\_\_\_\_ Shares you hold \_\_\_\_\_
3. If you obtain water from more than one Company, give the number of shares, acres irrigated and the name of the Company under "Remarks." If you obtain water from a Ditch Company and also have a private system fill in both Part A and Part B.

**Part B**

**TO BE FILED BY THOSE WHO HAVE A PRIVATE DITCH, PUMP OR IRRIGATION SYSTEM  
or those who have a private water right under a Ditch Company**

4. In what year was this land first irrigated? Date See attached filings.
5. Give the name of the original appropriator (first user): \_\_\_\_\_
6. Give the date appropriated \_\_\_\_\_ Amount filed on: Miners Inches \_\_\_\_\_ C. F. S. \_\_\_\_\_
7. State the total number of acres irrigated under this system: \_\_\_\_\_
8. Give the point of diversion: \_\_\_\_\_  $\frac{1}{4}$  \_\_\_\_\_  $\frac{1}{2}$  Section \_\_\_\_\_ Township \_\_\_\_\_ Range \_\_\_\_\_

**Part C**

**TO BE FILED BY ALL WATER USERS IN ADDITION TO PART A OR PART B**

9. Source of Water: Hanging Woman Cr., Side coulees, & Lee Cr.  
Name of stream or lake from which water is originally diverted
10. Water is obtained by: (Check one) Gravity \_\_\_\_\_ Pumping  Other FLOOD
11. What is the greatest number of acres you have irrigated? 204.3 Date \_\_\_\_\_
12. How many acres did you irrigate in 1947? (Crop and pasture) 167.3
13. State the total number of additional acres that could be irrigated by increasing the water sur \_\_\_\_\_ land level-  
ing, etc. 37 This land is under what ditch? Old ditch on W. side Hanging Woman.
14. How many acres of seeped land do you have which could be drained and put into production? 10
15. What is the condition of your irrigation system? Good to poor  
Sufficient for pump but only seasonal
16. Is your water supply adequate? Yes  No  Explain high water on balance.
17. REMARKS: \_\_\_\_\_  
\_\_\_\_\_  
\_\_\_\_\_

NOTE: The foregoing questions apply only to irrigated land shown on this plat.

DESCRIPTION AND MAP OF FARM

18. Legal Description of this Farm Lots 3, 4, E $\frac{1}{2}$ SW, SWNW, SE $\frac{1}{4}$ , S $\frac{1}{2}$ NE, NENE, of Sec. 18; Lots 1 - 6 incl., NE $\frac{1}{4}$ , E $\frac{1}{2}$ NW, NESE, SESE Sec. 19; S $\frac{1}{2}$ SE, Sec. 32, T. 6S. - R. 43E.

IRRIGATED LAND       NON-IRRIGATED LAND

North

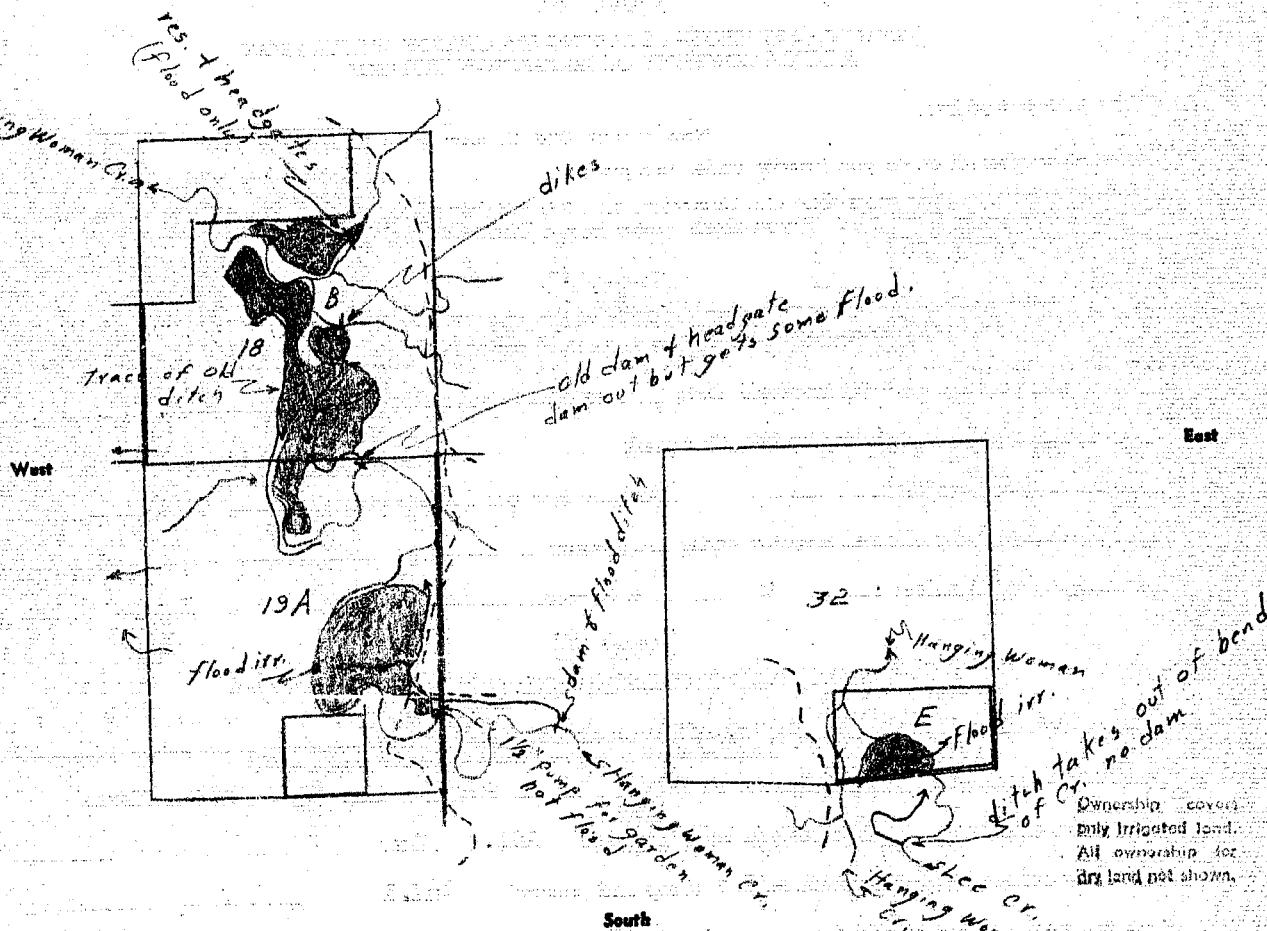

19. If the above land is irrigated from more than one ditch please give the acreage under each ditch in 19A and indicate the location of the land irrigated from each on the above map.

19A. Ditch: Hanging Woman Cr. & side coulee Acres: 167.6

Ditch: Lea Cr. Acres: 16.5

Information supplied by: Garden pump in Hanging Woman Total 3.2

Name Bones & field check by Cook - Johnson Address \_\_\_\_\_ Date 8/20/47

REMARKS: \_\_\_\_\_

If you cannot answer all of the questions on this form answer as many as you can and return the form to us as soon as possible.



