



NOTICE  
These forms are the  
property of the State  
of Montana and must  
be returned.

STATE OF MONTANA  
STATE ENGINEERS OFFICE  
Water Resources Survey

69

FORM WR 1-2M 12-47

Code No. 19B, 200

County Rosebud

T. 7 S. R. 43 E.

Name of Land Owner Cox, E.A. & Eliz.

Address Birney, Mont.

Name of Operator

Address

Part A

TO BE FILED BY THOSE OBTAINING IRRIGATION WATER FROM  
A DITCH COMPANY OR IRRIGATION DISTRICT

1. Water is delivered by: \_\_\_\_\_ Name of Ditch, Ditch Company or District Supplying Water \_\_\_\_\_
2. State the number of acres you irrigate under this system \_\_\_\_\_ Shares you hold \_\_\_\_\_
3. If you obtain water from more than one Company, give the number of shares, acres irrigated and the name of the Company under "Remarks." If you obtain water from a Ditch Company and also have a private system fill in both Part A and Part B.

Part B

TO BE FILED BY THOSE WHO HAVE A PRIVATE DITCH, PUMP OR IRRIGATION SYSTEM  
or those who have a private water right under a Ditch Company

4. In what year was this land first irrigated? Date See attached filings.
5. Give the name of the original appropriator (first user): \_\_\_\_\_
6. Give the date appropriated \_\_\_\_\_ Amount filed on: Miners Inches \_\_\_\_\_ C. F. S. \_\_\_\_\_
7. State the total number of acres irrigated under this system: \_\_\_\_\_
8. Give the point of diversion: \_\_\_\_\_  $\frac{1}{4}$  \_\_\_\_\_  $\frac{1}{4}$  Section \_\_\_\_\_ Township \_\_\_\_\_ Range \_\_\_\_\_

Part C

TO BE FILED BY ALL WATER USERS IN ADDITION TO PART A OR PART B

9. Source of Water: ~~Van Meter Cr.~~ <sup>Van \*</sup> Mete Gulch, & side coulees.  
Name of stream or lake from which water is originally diverted
10. Water is obtained by: (Check one) Gravity \_\_\_\_\_ Flood \_\_\_\_\_ Pumping \_\_\_\_\_ Other \_\_\_\_\_
11. What is the greatest number of acres you have irrigated? 98 Date 1947
12. How many acres did you irrigate in 1947? (Crop and pasture) 98
13. State the total number of additional acres that could be irrigated by increasing the water supply, land leveling, etc. 0 This land is under what ditch? \_\_\_\_\_
14. How many acres of seeped land do you have which could be drained and put into production? 0
15. What is the condition of your irrigation system? Fair
16. Is your water supply adequate? Yes \_\_\_\_\_ No ☒ Explain Flood Only
17. REMARKS:

Van Mete Gulch - 57.0  
Flood Side Coulees - 41.0

Over

T. 7S., R. 43E.

NOTE: The foregoing questions apply only to irrigated land shown on this plat.

### DESCRIPTION AND MAP OF FARM

18. Legal Description of this Farm:  $E\frac{1}{2}$ NW, NESW, NWSE,  $E\frac{1}{2}$ SE, NE $\frac{1}{4}$  Sec. 19: NW $\frac{1}{4}$ , NE $\frac{1}{4}$  SWSW, of Sec. 20, T. 7 S., R. 43 E.



IRRIGATED LAND



NON-IRRIGATED LAND

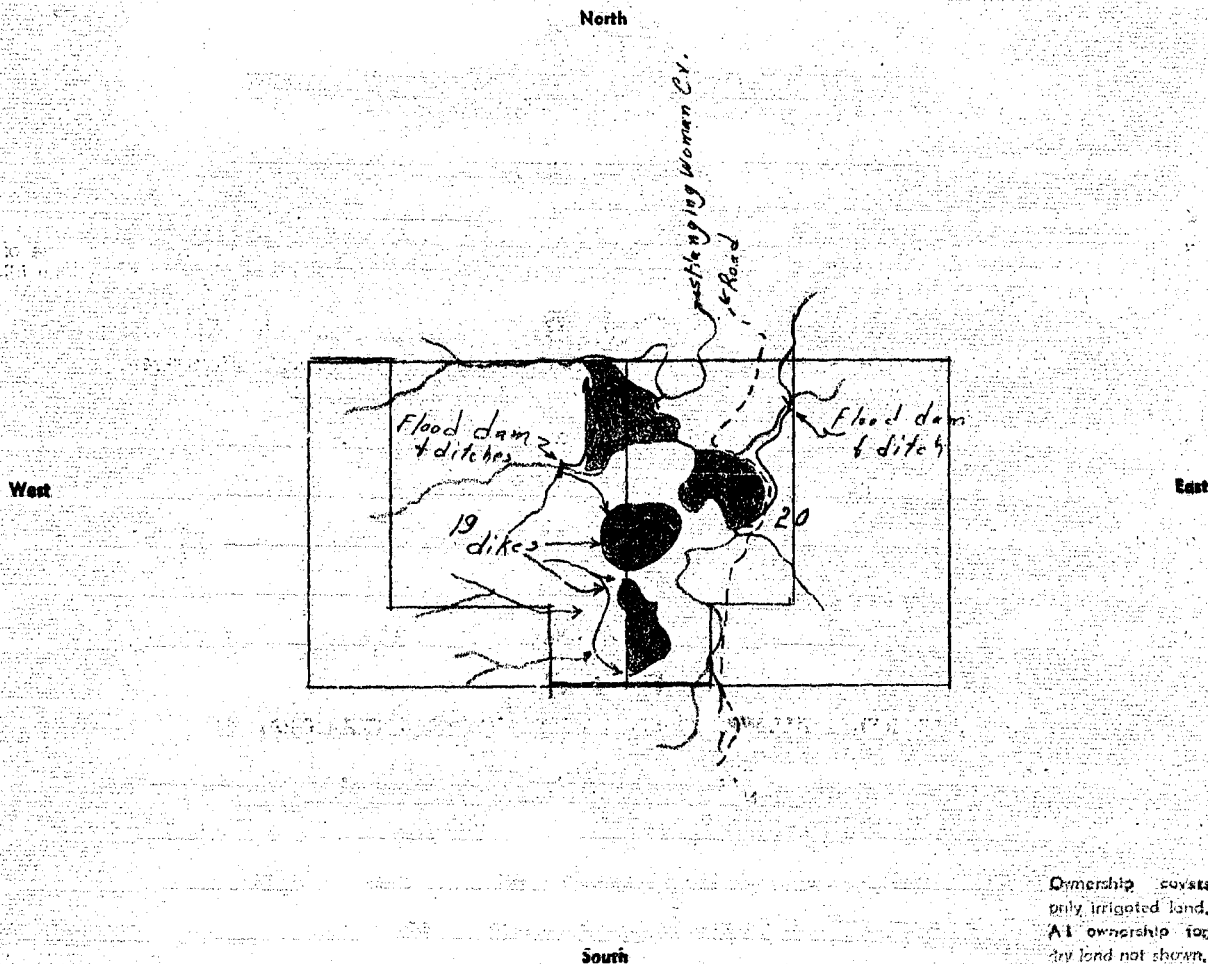

19. If the above land is irrigated from more than one ditch please give the acreage under each ditch in 19A and indicate the location of the land irrigated from each on the above map.

19A. Ditch: Private Flood Acres: 98

Ditch: \_\_\_\_\_ Acres: \_\_\_\_\_

Information supplied by:

Name E. A. Cox Address Birney, Mont. Date 8 / 20 / 47

REMARKS: Field check and interview by Cook - Johnson.

If you cannot answer all of the questions on this form answer as many as you can and return the form to us as soon as possible.

STATE ENGINEER'S OFFICE  
WATER RESOURCES SURVEYCOUNTY RosebudFILE NO. 69 - 19B, 20AOwner Cox, E. A. & ElizabethAddress Birney, Montana

AAA Owner

Address

Operator N.O.

Address

New Owner

Address

New Operator

Address

Assessment Record No

Assessed Acreage

Legal Description of This Farm E $\frac{1}{2}$ NW $\frac{1}{4}$ , NE $\frac{1}{4}$ SW $\frac{1}{4}$ , NW $\frac{1}{4}$ SE $\frac{1}{4}$ , E $\frac{1}{2}$ SE $\frac{1}{4}$ , NE $\frac{1}{4}$  Sec. 19; NW $\frac{1}{4}$ , N $\frac{1}{2}$ SW $\frac{1}{4}$ , SW $\frac{1}{4}$ SW $\frac{1}{4}$   
Sec. 20, T. 7S., R. 43E.Flood Hanging Woman and Mete Gulch & Side Coulees Total Acres in FarmCode Number 19B, 20APhoto No. Wy-7A-51, MA-9A-15

AAA Contract No.

AAA Total Cropland Acreage 0App. No. 658, 324

Decree No.

Land is located in

Twp. 7S. Rge. 43E. Twp. Rge.

Twp. Rge. Twp. Rge.

Filed in Twp. 7S. Rge. 43E.

Remarks

T.R.B.



NOT  
These forms are the  
property of the State  
of Montana and must  
be returned.

STATE OF MONTANA  
STATE ENGINEERS OFFICE  
Water Resources Survey

69

FORM WR-1-2M 12-47  
8A, 17B,  
Code No. 29A, 30B  
County Rosebud  
T. 7 S. R. 43 E.

Name of Land Owner Lacey, Frank Address \_\_\_\_\_  
Name of Operator c/o Cox, E. A. Address Birney, Mont.

**Part A**

**TO BE FILED BY THOSE OBTAINING IRRIGATION WATER FROM  
A DITCH COMPANY OR IRRIGATION DISTRICT**

1. Water is delivered by: \_\_\_\_\_ Name of Ditch, Ditch Company or District Supplying Water \_\_\_\_\_
2. State the number of acres you irrigate under this system \_\_\_\_\_ Shares you hold \_\_\_\_\_
3. If you obtain water from more than one Company, give the number of shares, acres irrigated and the name of the Company under "Remarks." If you obtain water from a Ditch Company and also have a private system fill in both Part A and Part B.

**Part B**

**TO BE FILED BY THOSE WHO HAVE A PRIVATE DITCH, PUMP OR IRRIGATION SYSTEM  
or those who have a private water right under a Ditch Company**

4. In what year was this land first irrigated? Date See attached filings.
5. Give the name of the original appropriator (first user): \_\_\_\_\_
6. Give the date appropriated \_\_\_\_\_ Amount filed on: Miners Inches \_\_\_\_\_ C. F. S. \_\_\_\_\_
7. State the total number of acres irrigated under this system: \_\_\_\_\_
8. Give the point of diversion:  $\frac{1}{4}$  \_\_\_\_\_  $\frac{1}{4}$  Section \_\_\_\_\_ Township \_\_\_\_\_ Range \_\_\_\_\_

**Part C**

**TO BE FILED BY ALL WATER USERS IN ADDITION TO PART A OR PART B**

9. Source of Water: Hanging Woman Cr. & side coulees.  
Name of stream or lake from which water is originally diverted \_\_\_\_\_
10. Water is obtained by: (Check one) Gravity \_\_\_\_\_ Flood \_\_\_\_\_ Pumping \_\_\_\_\_ Other \_\_\_\_\_
11. What is the greatest number of acres you have irrigated? 157 Date 1946
12. How many acres did you irrigate in 1946? (Crop and pasture) 157
13. State the total number of additional acres that could be irrigated by increasing the water supply, land leveling, etc. 0 This land is under what ditch? \_\_\_\_\_
14. How many acres of seeped land do you have which could be drained and put into production? 0
15. What is the condition of your irrigation system? Fair
16. Is your water supply adequate? Yes \_\_\_\_\_ No X Explain Flood waters only.
17. REMARKS: \_\_\_\_\_

Side Coulees 31.2  
Hanging Woman Cr. 125.8

Over

NOTE: The foregoing questions apply only to irrigated land shown on this plat.

### DESCRIPTION AND MAP OF FARM

18. Legal Description of this Farm NWNW, S $\frac{1}{2}$  NW, SW, W $\frac{1}{2}$ SE, SWNE, Sec. 8; W $\frac{1}{2}$ SE, NENW, S $\frac{1}{2}$ NW, N $\frac{1}{2}$ SW, Sec. 17; W $\frac{1}{2}$ SE, SWNE, Sec. 29; E $\frac{1}{2}$ SE, S $\frac{1}{2}$ NW, SWSW, N $\frac{1}{2}$ SW Sec. 29, T. 7S. - R. 43E.



IRRIGATED LAND



NON-IRRIGATED LAND

North

West

East

South

Ownership, survey,  
and acreage land  
not shown for  
this land not shown

19. If the above land is irrigated from more than one ditch please give the acreage under each ditch in 19A and indicate the location of the land irrigated from each on the above map.

19A. Ditch: Private Flood Acres: 157

Ditch: \_\_\_\_\_ Acres: \_\_\_\_\_

Information supplied by:

Name E. A. Cox Address \_\_\_\_\_ Date 8/20/47

REMARKS: Field check, interview by Johnson-Cook

If you cannot answer all of the questions on this form answer as many as you can and return the form to us as soon as possible.

69 75.- 43E

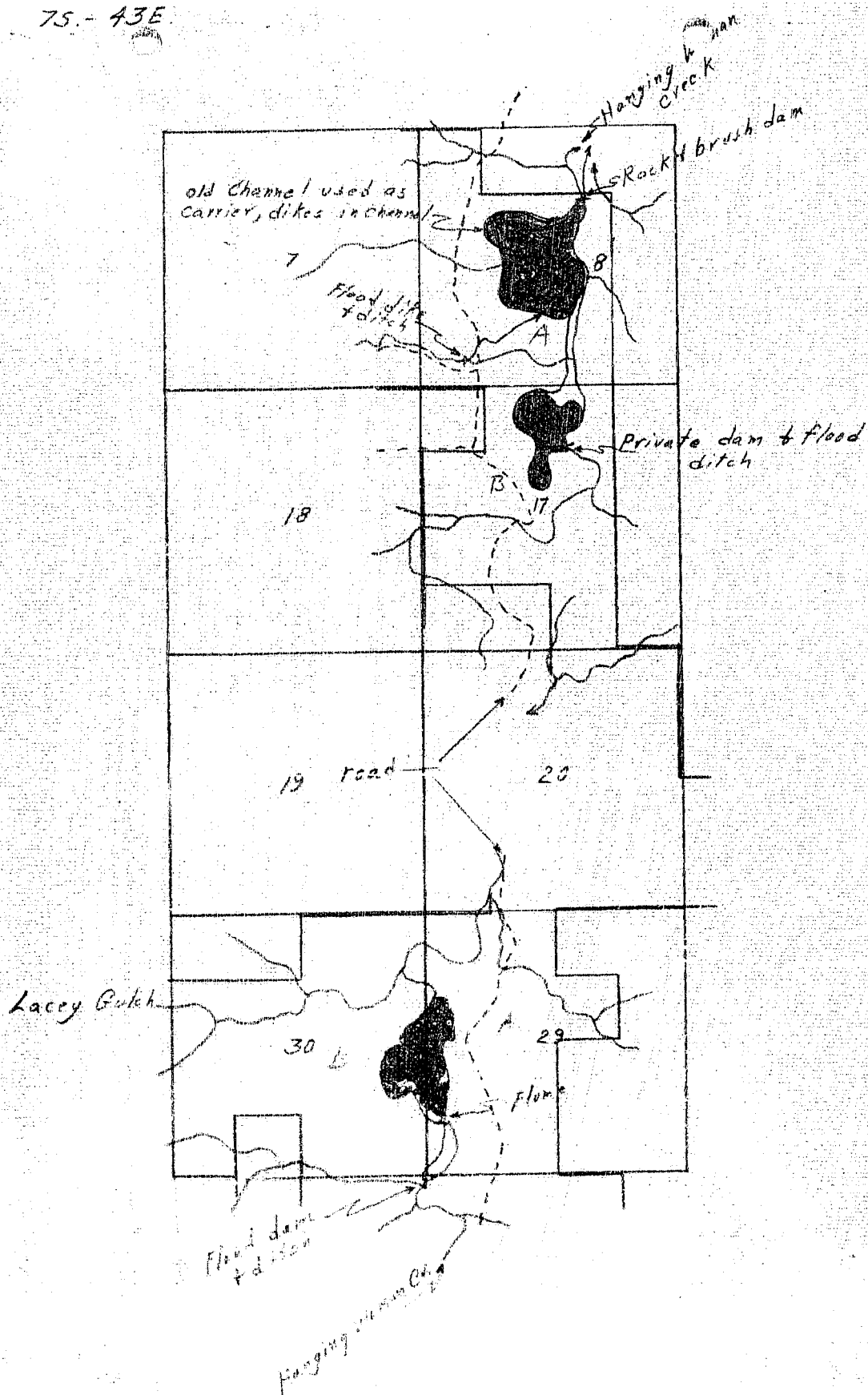

**STATE ENGINEER'S OFFICE  
WATER RESOURCES SURVEY**

COUNTY RosebudFILE NO. 69 - 8A, 17B, 29A, 30B

Owner Lacey, Frank Address Birney, Montana  
c/o Cox, E.A.  
 AAA Owner Address  
 Operator Address  
 New Owner Address  
 New Operator N.O. Address

Assessment Record

Assessed Acreage

Legal Description of This Farm N $\frac{1}{2}$ NE $\frac{1}{4}$ , S $\frac{1}{2}$ NE $\frac{1}{4}$ , SW $\frac{1}{4}$ , W $\frac{1}{2}$ SE $\frac{1}{4}$ , SW $\frac{1}{4}$ NE $\frac{1}{4}$  Sec. 8; W $\frac{1}{2}$ EA, NE $\frac{1}{4}$ NE $\frac{1}{4}$ , S $\frac{1}{2}$ NE $\frac{1}{4}$ ,  
 N $\frac{1}{2}$ SW $\frac{1}{4}$ , Sec. 17; W $\frac{1}{2}$ , SW $\frac{1}{4}$ NE $\frac{1}{4}$  Sec. 29; E $\frac{1}{2}$ , S $\frac{1}{2}$ NE $\frac{1}{4}$ , N $\frac{1}{2}$ SW $\frac{1}{4}$ , SW $\frac{1}{4}$ SW $\frac{1}{4}$  Sec. 30, T. 7S., R. 43E.

Flood Hanning Woman and Tide Coulees.

Total Acres in Farm

Code Number 8A, 17B, 29A, 30BPhoto No. WY-7A-50, 7A-51, 7A-52  
MA-9A-15

AAA Contract No.

AAA Total Cropland Acreage 163.3App. No. 305, 308

Decree No.

Land is located in

Twp. 7S. Rge. 43E. Twp. Rge.

Twp. Rge. Twp. Rge.

Filed in Twp. 7S. Rge. 43E.

Remarks



NOTICE  
These forms are the  
property of the State  
of Montana and must  
be returned.

STATE OF MONTANA  
STATE ENGINEERS OFFICE

Water Resources Survey

FORM WR-1-2M 12-47

69 Code No. 5A, 8B

County Rosebud

T. 7S. R. 43E.

Name of Land Owner Woodard, Henry Address Birney, Mont.

Name of Operator Address

Part A

TO BE FILED BY THOSE OBTAINING IRRIGATION WATER FROM  
A DITCH COMPANY OR IRRIGATION DISTRICT

1. Water is delivered by: Name of Ditch, Ditch Company or District Supplying Water
2. State the number of acres you irrigate under this system. Shares you hold
3. If you obtain water from more than one Company, give the number of shares, acres irrigated and the name of the Company under "Remarks." If you obtain water from a Ditch Company and also have a private system fill in both Part A and Part B.

Part B

TO BE FILED BY THOSE WHO HAVE A PRIVATE DITCH, PUMP OR IRRIGATION SYSTEM  
or those who have a private water right under a Ditch Company

4. In what year was this land first irrigated? Date See attached filings.
5. Give the name the original appropriator (first user):
6. Give the date appropriated. Amount filed on: Miners Inches C. F. S.
7. State the total number of acres irrigated under this system:
8. Give the point of diversion:  $\frac{1}{4}$   $\frac{1}{4}$  Section Township Range

Part C

TO BE FILED BY ALL WATER USERS IN ADDITION TO PART A OR PART B

9. Source of Water: Hanging Woman Cr. & Lee Cr.  
Name of stream or lake from which water is originally diverted
10. Water is obtained by: (Check one) Gravity Pumping Other Flood
11. What is the greatest number of acres you have irrigated? 89 Date
12. How many acres did you irrigate in 1947? (Crop and pasture) 89
13. State the total number of additional acres that could be irrigated by increasing the water supply, land leveling, etc. 0 This land is under what ditch?
14. How many acres of seeped land do you have which could be drained and put into production? 0
15. What is the condition of your irrigation system? Fair
16. Is your water supply adequate? Yes No X Explain Flood only
17. REMARKS:



NOTE: The foregoing questions apply only to irrigated land shown on this plat.

### DESCRIPTION AND MAP OF FARM

18. Legal Description of this Farm Lots 1, 2, 3, 4, S $\frac{1}{2}$ N $\frac{1}{2}$ , SE $\frac{1}{4}$ , E $\frac{1}{2}$ SW, NWSW Sec. 5; NENE, N $\frac{1}{2}$ NE, SENE, E $\frac{1}{2}$ SE Sec. 8, T. 7S - R. 43 E.



IRRIGATED LAND

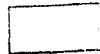

NON-IRRIGATED LAND

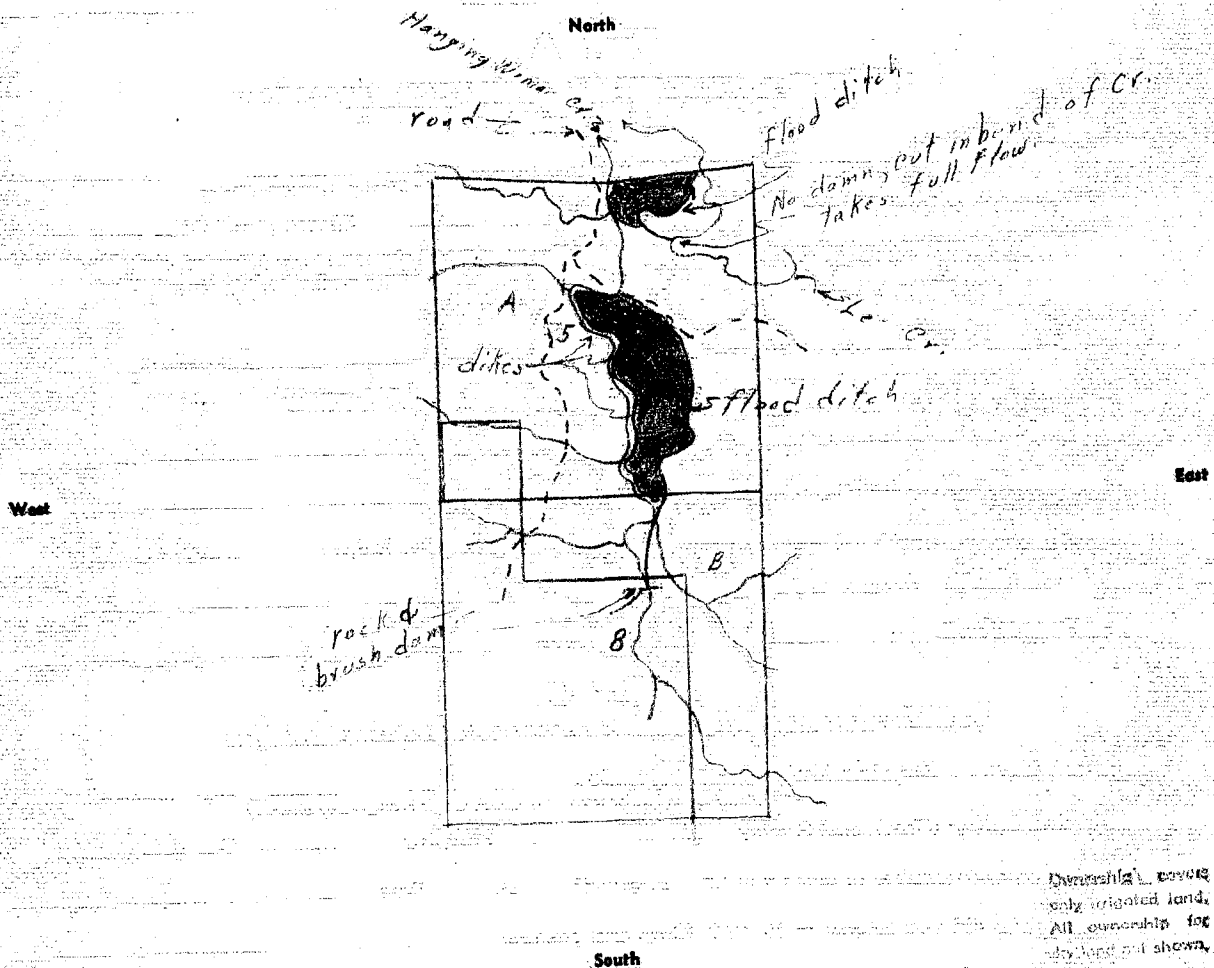

19. If the above land is irrigated from more than one ditch please give the acreage under each ditch in 19A and indicate the location of the land irrigated from each on the above map.

19A. Ditch: Flood Hanging Woman Cr. Acres: 72  
Ditch: Flood Lee Cr. Acres: 17  
Total 89

Information supplied by:

Name Henry Woodard

Address

Date 8/20/47

REMARKS: Field check & interview by Johnson - Cook.

If you cannot answer all of the questions on this form answer as many as you can and return the form to us as soon as possible

STATE ENGINEER'S OFFICE  
WATER RESOURCES SURVEYCOUNTY RosebudFILE NO. 69 - 5A, 8B

Owner Woodard, Henry Address Birney, Montana  
 AAA Owner Address  
 Operator N.O. Address  
 New Owner Address  
 New Operator Address  
 Assessment Record No

Assessed Acreage

Legal Description of This Farm Lots 1, 2, 3, 4, S $\frac{1}{2}$  E $\frac{1}{2}$ , SE $\frac{1}{4}$ , E $\frac{1}{2}$  SW $\frac{1}{4}$ , NW $\frac{1}{4}$  SW $\frac{1}{4}$  Sec. 5;  
 NE $\frac{1}{4}$  NW $\frac{1}{4}$ , N $\frac{1}{2}$  NE $\frac{1}{4}$ , SE $\frac{1}{4}$  NE $\frac{1}{4}$ , E $\frac{1}{2}$  SE $\frac{1}{4}$ , Sec. 8, T. 7S., R. 43E.

Flood Hanging Woman and Lee Creeks

Total Acres in Farm

Code Number 5A, 8BPhoto No. WY-7A-50

AAA Contract No.

AAA Total Cropland Acreage 217.9App. No. 304,307,384

Decree No.

Land is located in

Twp. 7S. Rge. 43E. Twp. Rge.

Twp. Rge. Twp. Rge.

Filed in Twp. 7S. Rge. 43E.

Remarks

T.R.B.

1NE

CC

East

ing, covers  
 gated land,  
 ownership for  
 and shown.

in 19A and

72

17

89

20/47

US GS 5000