

277 A



STATE OF MONTANA
STATE ENGINEERS OFFICE
Water Resources Survey

Form WR-1-10M 8-45

Code No. 1 HCounty Big HornT. 2 S R. 38 EName of Land Owner James T. Law Address Sheldon, Wyo.

Name of Operator _____ Address _____

Part A

**TO BE FILED BY THOSE OBTAINING IRRIGATION WATER FROM
 A DITCH COMPANY OR IRRIGATION DISTRICT**

1. Water is delivered by: _____
Name of Ditch, Ditch Company or District supplying water
2. State the number of acres you irrigate under this system _____ Shares you hold _____
3. If you obtain water from more than one Company, give the number of shares, acres irrigated and the name of the Company under "Remarks." If you obtain water from a Ditch Company and also have a private system fill in both Part A and Part B.

Part B

**TO BE FILED BY THOSE WHO HAVE A PRIVATE DITCH, PUMP OR IRRIGATION SYSTEM
 or those who have a private water right under a Ditch Company**

4. In what year was this land first irrigated? Date See attached water right
5. Give the name of the original appropriator (first user): Decreed right Case 676
6. Give the date appropriated _____ Amount filed on: Miners Inches 28 5/16 30 5/16 32 5/16 C. F. S.
7. State the total number of acres irrigated under this system: _____
8. Give the point of diversion: _____ $\frac{1}{4}$ _____ $\frac{1}{4}$ Section _____ Township _____ Range _____

Part C

TO BE FILED BY ALL WATER USERS IN ADDITION TO PART A OR PART B

9. Source of Water: Sagehen Creek
Name of stream or lake from which water is originally diverted
10. Water is obtained by: (Check one) Gravity ☒ Pumping _____ Other _____
11. What is the greatest number of acres you have irrigated? 35.7 Date 7
12. How many acres did you irrigate in 1945? (Crop and pasture) 35
13. State the total number of additional acres that could be irrigated by increasing the water supply, land leveling, etc. 0 This land is under what ditch? _____
14. How many acres of seeped land do you have which could be drained and put into production? None
15. What is the condition of your irrigation system? Good
16. Is your water supply adequate? Yes _____ No ☒ Explain Not enough water for 100 acres
17. REMARKS: _____

OVER

NOTE: The foregoing questions apply only to irrigated land shown on this plat.

DESCRIPTION AND MAP OF FARM

18. Legal Description of this Farm

lots 2, 3, 4, 5² NE⁴ Sec 1 Twp. 9^s Rge 8^{EE}



IRRIGATED LAND



NON-IRRIGATED LAND

NORTH

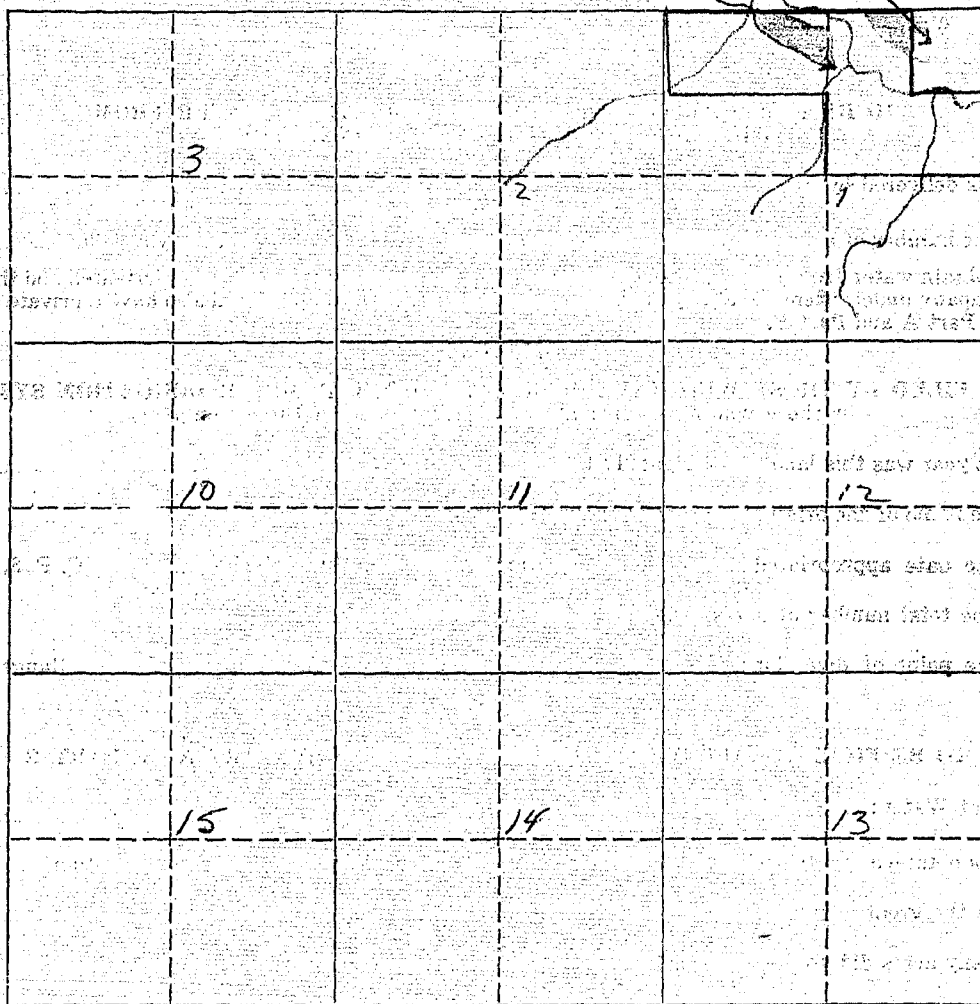

19. If the above land is irrigated from more than one ditch please give the acreage under each ditch in 19A and indicate the location of the land irrigated from each on the above map.

19A. Ditch: _____ Acres: 95

Ditch: _____ Acres: _____

Information supplied by:

Name P. G. Fraser

Address _____

Date 8-14-46

REMARKS: Interviewed with John & Bille

If you cannot answer all of the questions on this form answer as many as you can and return the form to us as soon as possible.

221 B - 271 - 271 A



STATE OF MONTANA
STATE ENGINEERS' OFFICE
Water Resources Survey

Form WB-1-1027, 8-45
 Code No. 8A, 9A, 16A, 17A, 18A, 19A, 20A, 21A

County Big Horn
 T. 9 S R. 38 E

Name of Land Owner Clark Morris & Indian Address Becket, Mont.

Name of Operator _____ Address _____

Part A

**TO BE FILED BY THOSE OBTAINING IRRIGATION WATER FROM
 A DITCH COMPANY OR IRRIGATION DISTRICT**

1. Water is delivered by: _____
 Name of Ditch, Ditch Company or District supplying water
2. State the number of acres you irrigate under this system _____ Shares you hold _____
3. If you obtain water from more than one Company, give the number of shares, acres irrigated and the name of the Company under "Remarks." If you obtain water from a Ditch Company and also have a private system fill in both Part A and Part B.

Part B

**TO BE FILED BY THOSE WHO HAVE A PRIVATE DITCH, PUMP OR IRRIGATION SYSTEM
 or those who have a private water right under a Ditch Company**

4. In what year was this land first irrigated? Date See Attached Water Rights
5. Give the name of the original appropriator (first user): ?
6. Give the date appropriated ? Amount filed on: Miners Inches * C. F. S. _____
7. State the total number of acres irrigated under this system: _____
8. Give the point of diversion: 1/4 Section _____ Township _____ Range _____

Part C

TO BE FILED BY ALL WATER USERS IN ADDITION TO PART A OR PART B

9. Source of Water: Young's Creek
 Name of stream or lake from which water is originally diverted
10. Water is obtained by: (Check one) Gravity _____ Pumping _____ Other _____
11. What is the greatest number of acres you have irrigated? _____ Date _____
12. How many acres did you irrigate in 1945? (Crop and pasture) 95
13. State the total number of additional acres that could be irrigated by increasing the water supply, land leveling, etc. 81 A This land is under what ditch? Private (Bar V)
14. How many acres of seeped land do you have which could be drained and put into production? None
15. What is the condition of your irrigation system? Fair
16. Is your water supply adequate? Yes _____ No No Explain Not sufficient water
17. REMARKS: All Canal Ditches in use in good condition
This plot is not in use in good condition
* Not included in Young's Creek Decree because they are leased Indian lands

OVER

NOTE: The foregoing questions apply only to irrigated land shown on this plat.

DESCRIPTION AND MAP OF FARM

18. Legal Description of this Farm all sec 17, 17 29 8, E² E² W² NW⁴ NW⁴
sec 7 E² SE⁴ sec 19 Twp 45 R 38 E



IRRIGATED LAND



NON-IRRIGATED LAND

NORTH

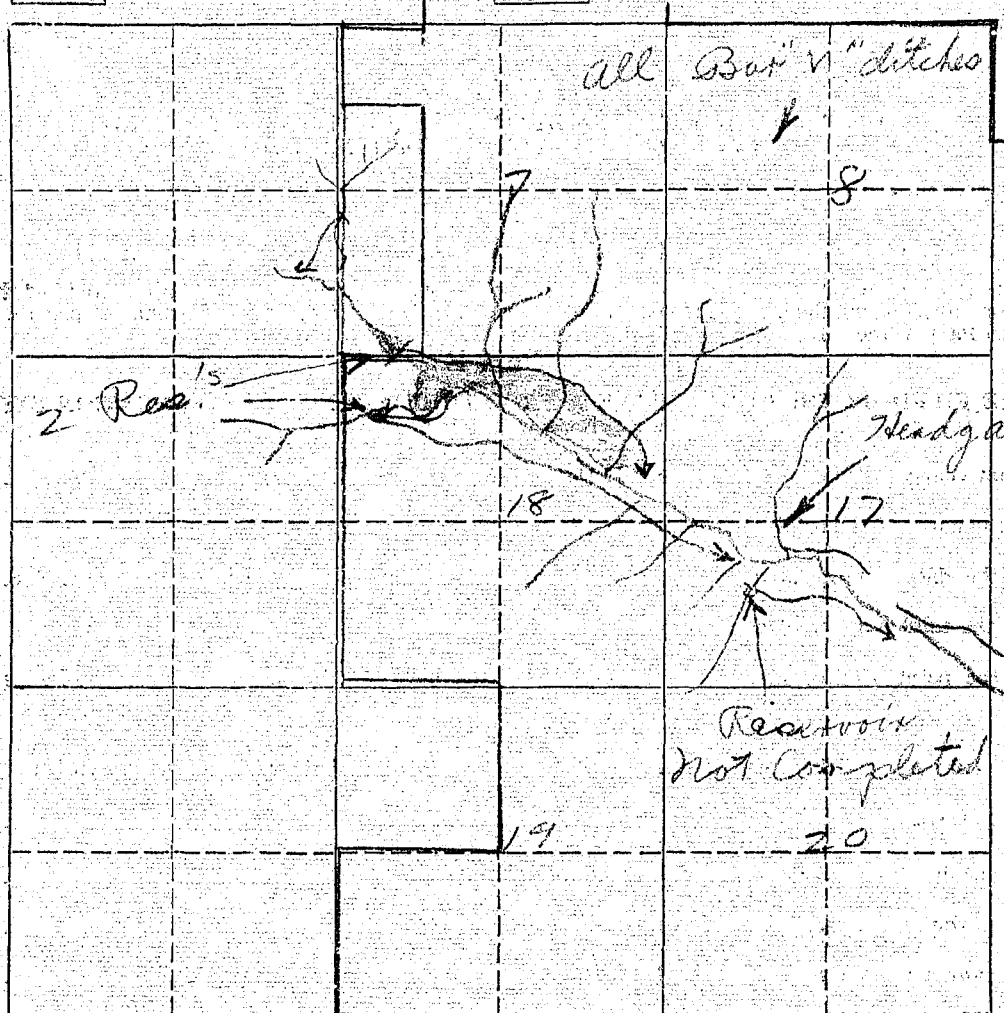

19. If the above land is irrigated from more than one ditch please give the acreage under each ditch in 19A and indicate the location of the land irrigated from each on the above map.

19A. Ditch: Private ditch (Bar V) Acres: 95 A

Ditch: _____ Acres: _____

Information supplied by:

Name Morris Clark Address Decker, Mont. Date 8-19-46

REMARKS: INTERVIEW & Field Check By John & Bille

If you cannot answer all of the questions on this form answer as many as you can and return the form to us as soon as possible.



STATE OF MONTANA
STATE ENGINEERS OFFICE
Water Resources Survey

Form WR-1-10M 8-45

Code No. 250

County Big Horn

T. 9 N. R. 38 E

Name of Land Owner Colt, H. W. Address La Jolla, Calif.

Name of Operator Address

Part A

TO BE FILED BY THOSE OBTAINING IRRIGATION WATER FROM
A DITCH COMPANY OR IRRIGATION DISTRICT

1. Water is delivered by: Name of Ditch, Ditch Company or District supplying water
2. State the number of acres you irrigate under this system Shares you hold
3. If you obtain water from more than one Company, give the number of shares, acres irrigated and the name of the Company under "Remarks." If you obtain water from a Ditch Company and also have a private system fill in both Part A and Part B.

Part B

TO BE FILED BY THOSE WHO HAVE A PRIVATE DITCH, PUMP OR IRRIGATION SYSTEM
or those who have a private water right under a Ditch Company

4. In what year was this land first irrigated? Date see attached water right
5. Give the name of the original appropriator (first user): see Young's Creek Decree Case 411-2470 118-2470
6. Give the date appropriated Amount filed on: Miners Inches C. F. S.
7. State the total number of acres irrigated under this system:
8. Give the point of diversion: 1/4 Section Township Range

Part C

TO BE FILED BY ALL WATER USERS IN ADDITION TO PART A OR PART B

9. Source of Water: Young's Creek Name of stream or lake from which water is originally diverted
10. Water is obtained by: (Check one) Gravity Pumping Other
11. What is the greatest number of acres you have irrigated? Date
12. How many acres did you irrigate in 19...? (Crop and pasture)
13. State the total number of additional acres that could be irrigated by increasing the water supply, land leveling, etc. 83 This land is under what ditch? Private (Colt) ditch
14. How many acres of seeped land do you have which could be drained and put into production?
15. What is the condition of your irrigation system?
16. Is your water supply adequate? Yes No Explain
17. REMARKS: did not appear when water was decreed therefore no right at present. Ditch has not been used for about 10 years.

OVER

NOTE: The foregoing questions apply only to irrigated land shown on this plat.

DESCRIPTION AND MAP OF FARM

18. Legal Description of this Farm

*E 2, lots 1, 4, 5, 8, Sec 25 SW 3E
Sec 24 Twp. 9S - R4E 38E*



IRRIGATED LAND



NON-IRRIGATED LAND

NORTH

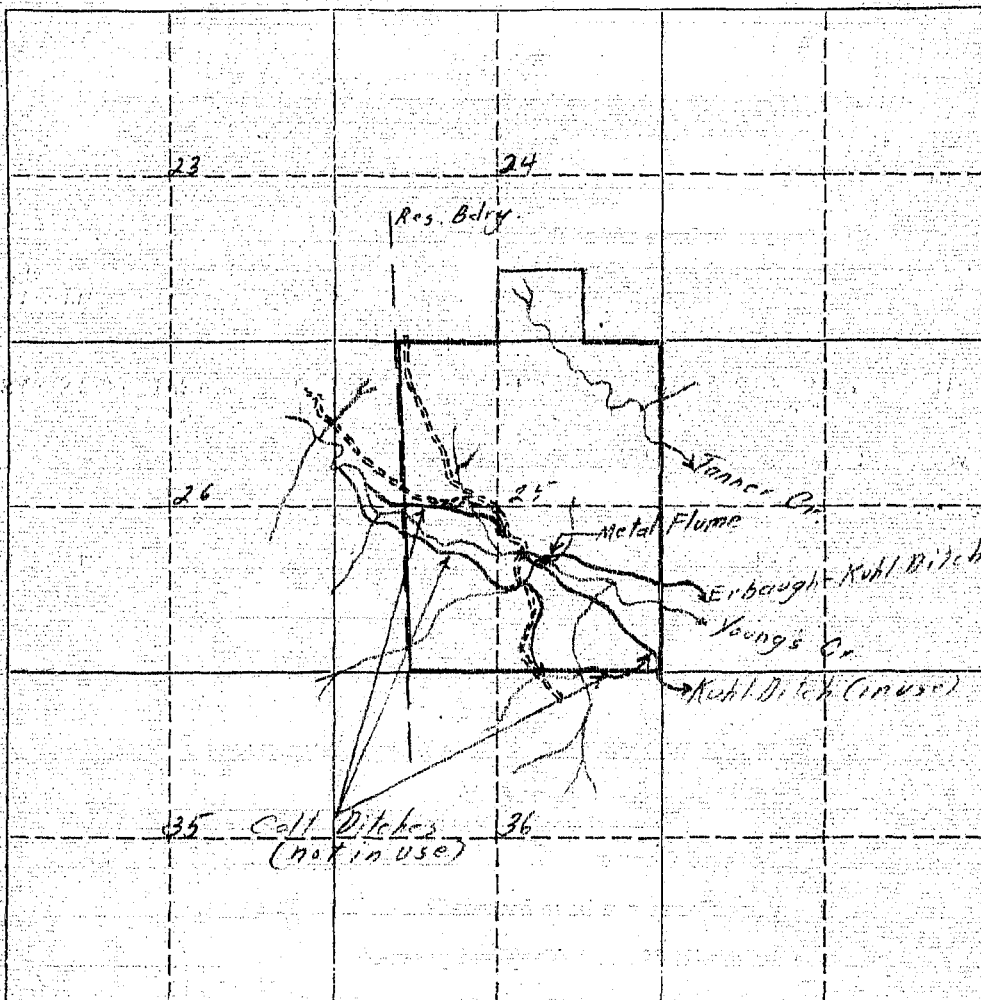

19. If the above land is irrigated from more than one ditch please give the acreage under each ditch in 19A and indicate the location of the land irrigated from each on the above map.

19A. Ditch: _____ Acres: _____

Ditch: _____ Acres: _____

Information supplied by:

Name _____ Address _____ Date *8-14-21*

REMARKS: *Interview & locate water rights on farm & fill*

If you cannot answer all of the questions on this form answer as many as you can and return the form to us as soon as possible.



STATE OF MONTANA
STATE ENGINEERS OFFICE
Water Resources Survey

Form WR-1-10M 8-45

Code No. 27722B

County Lincoln

T. 12 R. 2

Name of Land Owner Cook, Lloyd & Son Address Sheridan, Wyo

Name of Operator Address

Part A

TO BE FILED BY THOSE OBTAINING IRRIGATION WATER FROM
A DITCH COMPANY OR IRRIGATION DISTRICT

1. Water is delivered by: Name of Ditch, Ditch Company or District supplying water
2. State the number of acres you irrigate under this system Shares you hold
3. If you obtain water from more than one Company, give the number of shares, acres irrigated and the name of the Company under "Remarks." If you obtain water from a Ditch Company and also have a private system fill in both Part A and Part B.

Part B

TO BE FILED BY THOSE WHO HAVE A PRIVATE DITCH, PUMP OR IRRIGATION SYSTEM
or those who have a private water right under a Ditch Company

4. In what year was this land first irrigated? Date See attached water right
5. Give the name of the original appropriator (first user) Decreed Right Case 118-2470
6. Give the date appropriated Amount filed on: Miners Inches C. F. S.
7. State the total number of acres irrigated under this system:
8. Give the point of diversion: 1/4 1/4 Section Township Range

Part C

TO BE FILED BY ALL WATER USERS IN ADDITION TO PART A OR PART B

9. Source of Water: Youngs Creek 50A7 lead 9
Name of stream or lake from which water is originally diverted
10. Water is obtained by: (Check one) Gravity Pumping Other Spring 7A
11. What is the greatest number of acres you have irrigated? 579 Date ?
12. How many acres did you irrigate in 1945? (Crop and pasture) 57
13. State the total number of additional acres that could be irrigated by increasing the water supply, land leveling, etc. 0 This land is under what ditch?
14. How many acres of seeped land do you have which could be drained and put into production? 1200
15. What is the condition of your irrigation system?
16. Is your water supply adequate? Yes No Explain Private Spring only
17. REMARKS:

OVER

NOTE: The foregoing questions apply only to irrigated land shown on this plat.

DESCRIPTION AND MAP OF FARM

13. Legal Description of this Farm SE⁴, S²NE⁴, Sec 21, S²Sec 22, S⁴W⁴ Sec 23, Sec 24, 25, 26, 27, 28, Twp. 9S, R. 25E

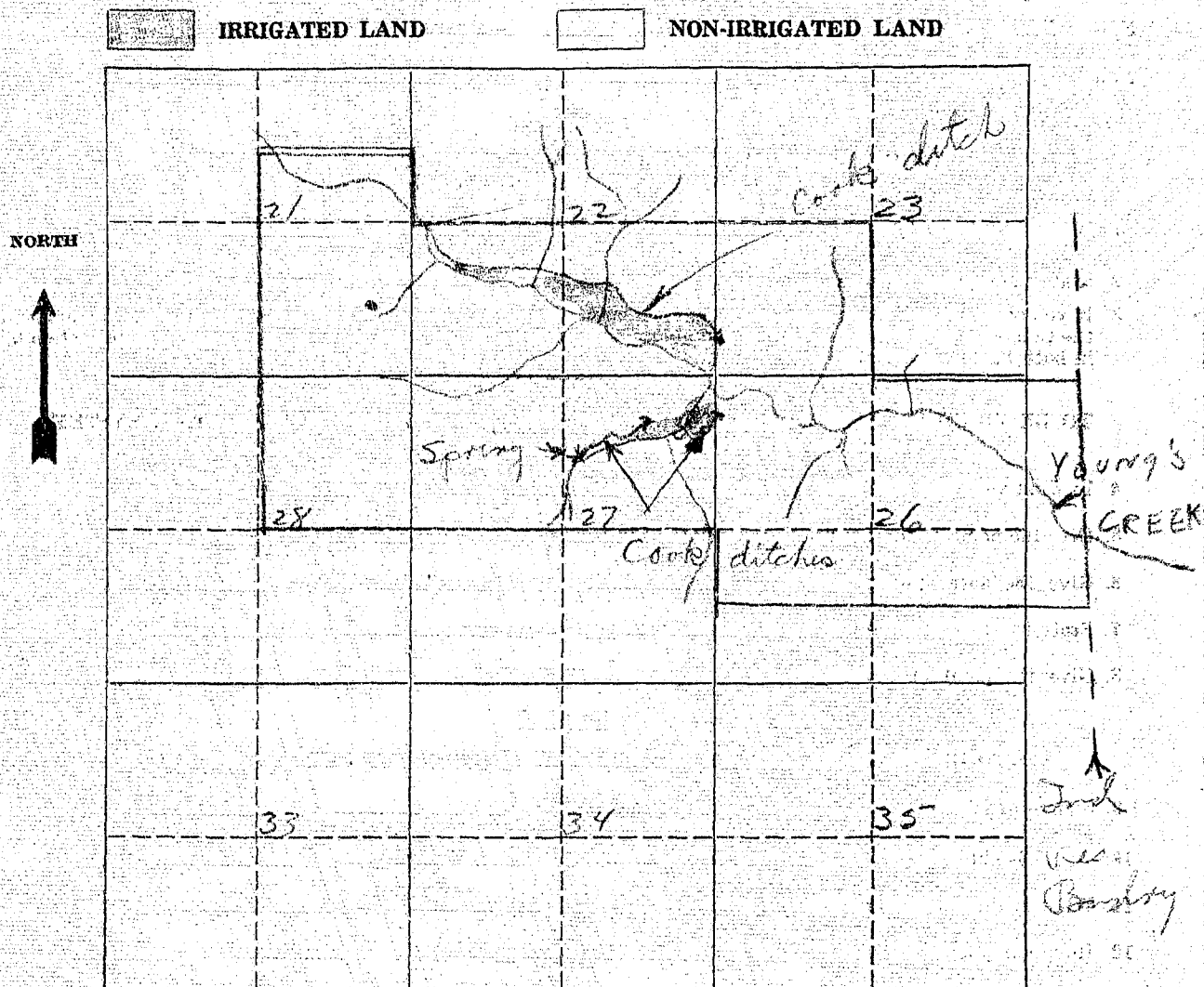

19. If the above land is irrigated from more than one ditch please give the acreage under each ditch in 19A and indicate the location of the land irrigated from each on the above map.

19A. Ditch: Cooks Ditch (Private) Flood Acres: 50.4

Ditch: " " Private Acres: 7.4

Information supplied by:

Name: _____ Address: _____ Date: 8-14-46

REMARKS: Interview + field check by Johnson + Bille

If you cannot answer all of the questions on this form answer as many as you can and return the form to us as soon as possible.



STATE OF MONTANA
STATE ENGINEERS OFFICE
Water Resources Survey

Form WR-1-10M 9-75

Code No. 12C, 13C, 23C, 24C

County Big Horn

T. R.

Name of Land Owner Kuhl, E. J. & Paul C Address Shidan, Wyo

Name of Operator Address

Part A

TO BE FILED BY THOSE OBTAINING IRRIGATION WATER FROM
A DITCH COMPANY OR IRRIGATION DISTRICT

1. Water is delivered by:
Name of Ditch, Ditch Company or District supplying water
2. State the number of acres you irrigate under this system Shares you hold
3. If you obtain water from more than one Company, give the number of shares, acres irrigated and the name of the Company under "Remarks." If you obtain water from a Ditch Company and also have a private system fill in both Part A and Part B.

Part B

TO BE FILED BY THOSE WHO HAVE A PRIVATE DITCH, PUMP OR IRRIGATION SYSTEM
or those who have a private water right under a Ditch Company

4. In what year was this land first irrigated? Date see attached water right
5. Give the name of the original appropriator (first user): Decree right - case 118-2470
as of decree
6. Give the date appropriated of 1935 Amount filed on: Miners Inches * C. F. S.
7. State the total number of acres irrigated under this system:
8. Give the point of diversion: 1/4 1/4 Section Township Range

Part C

TO BE FILED BY ALL WATER USERS IN ADDITION TO PART A OR PART B

9. Source of Water: Tanner Creek
Name of stream or lake from which water is originally diverted
10. Water is obtained by: (Check one) Gravity ✓ Pumping Other Flood
11. What is the greatest number of acres you have irrigated? 65A Date
12. How many acres did you irrigate in 1946? (Crop and pasture) 65A
13. State the total number of additional acres that could be irrigated by increasing the water supply, land leveling, etc. 0 This land is under what ditch?
14. How many acres of seeped land do you have which could be drained and put into production? none
15. What is the condition of your irrigation system? Part
16. Is your water supply adequate? Yes No No Explain spring of water
17. REMARKS: water is good but need
for spring water only
*live's right as of original appropriation

OVER

NOTE: The foregoing questions apply only to irrigated land shown on this plat.

DESCRIPTION AND MAP OF FARM

18. Legal Description of this Farm

*1/4 Sec 8 SE 1/4 SW 1/4 SE 1/4, T. 1 N. R. 1 E. W. 2, S. 1/2
1/4 Sec 13 W. 1/4 NE 1/4, N. 1/2 SE 1/4, S. 1/2 Sec 24 E. 2, S. 1/2
1/4 Sec 23*



IRRIGATED LAND



NON-IRRIGATED LAND

NORTH

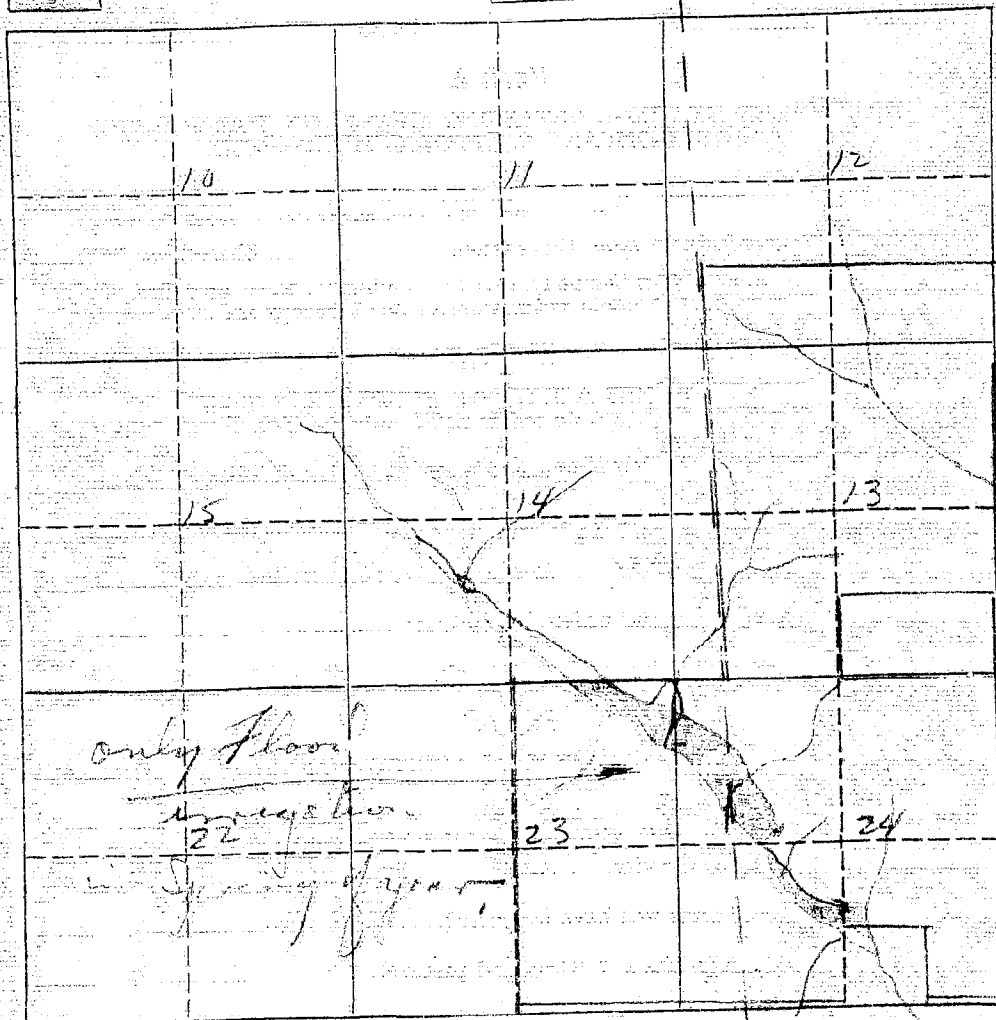

19. If the above land is irrigated from more than one ditch please give the acreage under each ditch in 19A and indicate the location of the land irrigated from each on the above map.

19A. Ditch: *Flood irrigation from Tanner Creek* Acres: *65A.*

Ditch: _____ Acres: _____

Information supplied by:

Name

Address

Date *8-14-46*

REMARKS:

If you cannot answer all of the questions on this form answer as many as you can and return the form to us as soon as possible