

Yellowstone

Township 4 North, Range 33 East

Water User

Beers, Wm.
Bott, John
California Lands, Inc.
Cross, James
Custer Lumber Co.
Gansale, Gilbert
Guhn, Wm.
Kuntz, Jerome
Kuntz, Adam
McVey, P. F.
Newkirk, C. T;
Parker, Joseph G.
Smith, George
Scott, Harry P.
Snelson, Mrs. Rebecca
VanDuzer, Mrs. Nellie E.
Wilson, Charles H.

STATE OF MONTANA

STATE ENGINEER'S OFFICE

WATER RESOURCES SURVEY

44N
71E

33 E

Yellowstone

			184 172	184 172			
6	5		172	184 172	184 182	3	2
					182		1
7	8			9		10	11
							12
13	17			16		15	14
							13
19	20			21		22	23
							24
30	29			28		27	26
							25
31	32			33		34	35
							36

.....
.....
.....
.....

Township..... Range.....

STATE OF MONTANA WATER RESOURCES SURVEY

County Yellowstone Date April 12, 1943

Name of Water User Robert J. Daem Address Custer

1. Do you own this land? Yes ___ No X If not give the owner's name below:

Owner's name Wm. V. Beers Address Billings

2. Source of Water Yellowstone River Water delivered by Waco Custer Ditch

3. Give point of Diversion 1/4 1/4 Section Township Range

4. Water is obtained by: (Check one) Gravity X Pumping Other

5. Who first used water on this land? I do not know Address

6. In what year was this land first irrigated? 1910 Approximate Acres 90 a

7. What is the greatest number of acres you have irrigated? 150 a Date 1925

8. Present Use: Year 1942 Acres Irrigated 163.1

9. If this land is not irrigated now give date of last use is irrigated now

10. State the total number of acres that could be irrigated 165 acres.

11. What is the condition of your irrigation system? good condition

12. Land Description: Lots 2,3,4, Sec. 7, Twp. 4 N. Range 33 E.

Remarks: Has 130 shares in the Waco Custer Ditch Co. The Company thru its main canal, distributes water to farms for irrigation. The water is taken out of Yellowstone River at 8 or 9 mi west of Custer, Mont

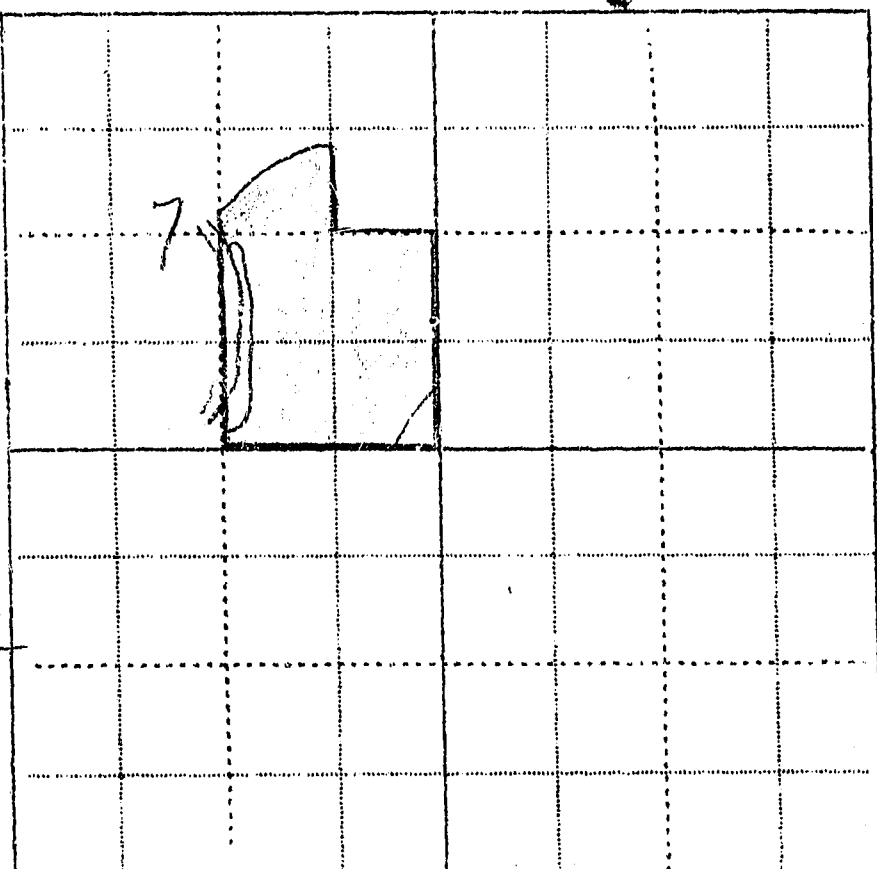

Information by Wm. V. Beers Place Billings, Mont Date May 1, 1943

STATE OF MONTANA WATER RESOURCES SURVEY

County Yellowstone Date April 12, 1943

Name of Water User John Bott Address Custer

1. Do you own this land? Yes No If not give the owner's name below:

Owner's name Calif. Lands, Inc. Address San Francisco, Calif.

2. Source of Water Yellowstone River Water delivered by Waco Custer Ditch

3. Give point of Diversion Same as ditch Co. Section 4 Township 4 Range 33

4. Water is obtained by: (Check one) Gravity Pumping Other

5. Who first used water on this land? Waco Custer Address Custer Mont.

6. In what year was this land first irrigated? 1911 Approximate Acres

7. What is the greatest number of acres you have irrigated? 99 Date 1940

8. Present Use: Year 1942 Acres Irrigated 96

9. If this land is not irrigated now give date of last use

10. State the total number of acres that could be irrigated 117 acres.

11. What is the condition of your irrigation system? Good

12. Land Description: Frac. NW¹, Sec. 18; Lot 5, Sec. 7, T. 4 N. Range 33 E.

Remarks: Have 196 shares in the Waco Custer Ditch. Do you know how many are used to irrigate this piece of land?

47 Shares from Waco Custer ditch Co.

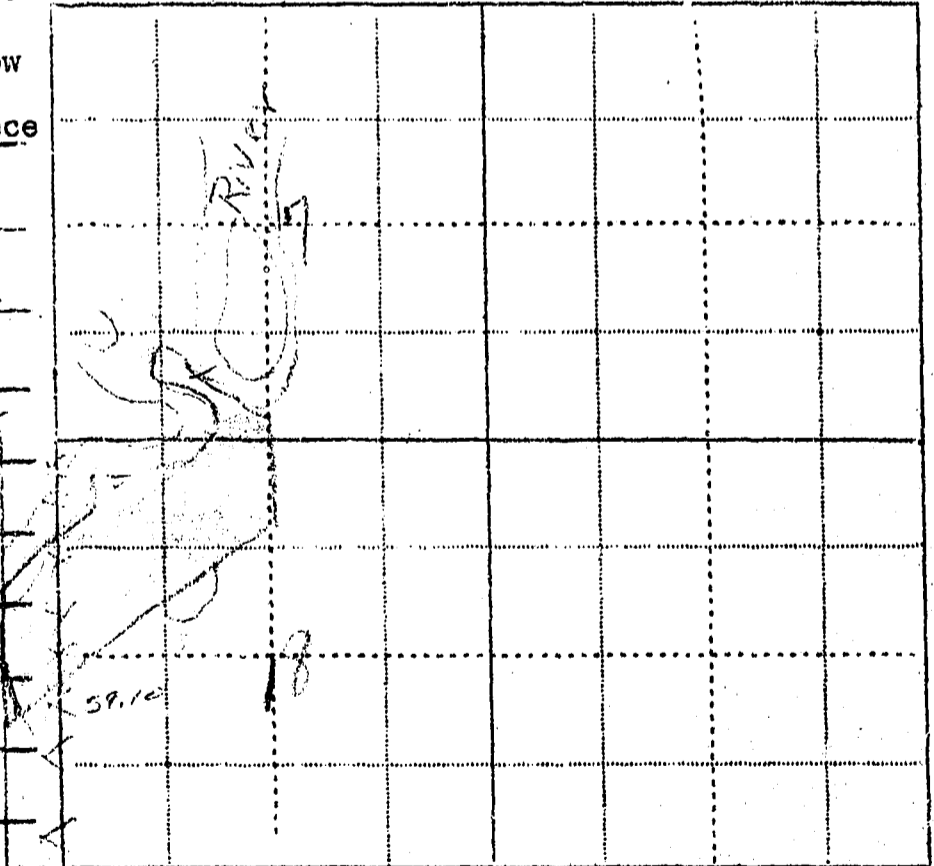

Information by John Bott Place Custer Date April 26, 1943

A STUDY OF MONTANA'S WATER RESOURCES

18C

County Yellowstone Source of Information RAA 746

1. Water User Calif. Lands Inc Address San Francisco Calif

2. Stream _____ Tributary to _____ Basin _____

3. Point of Diversion 1 Section _____ Township _____ Range _____

4. Description of System _____

5. Type of Irrigation _____

6. Original Appropriator _____ Address _____

7. First Use: Year _____ Acres Irrigated _____

8. Maximum Use: Year _____ Acres Irrigated _____

9. Present Use: Year _____ Acres Irrigated 162.2 117.2

10. Last Use: Year _____ Why Abandoned _____

11. Condition of System _____

12. Land Description Sec 7 NW 1/4 Sec 18 T 4 N R 33

Remarks: _____

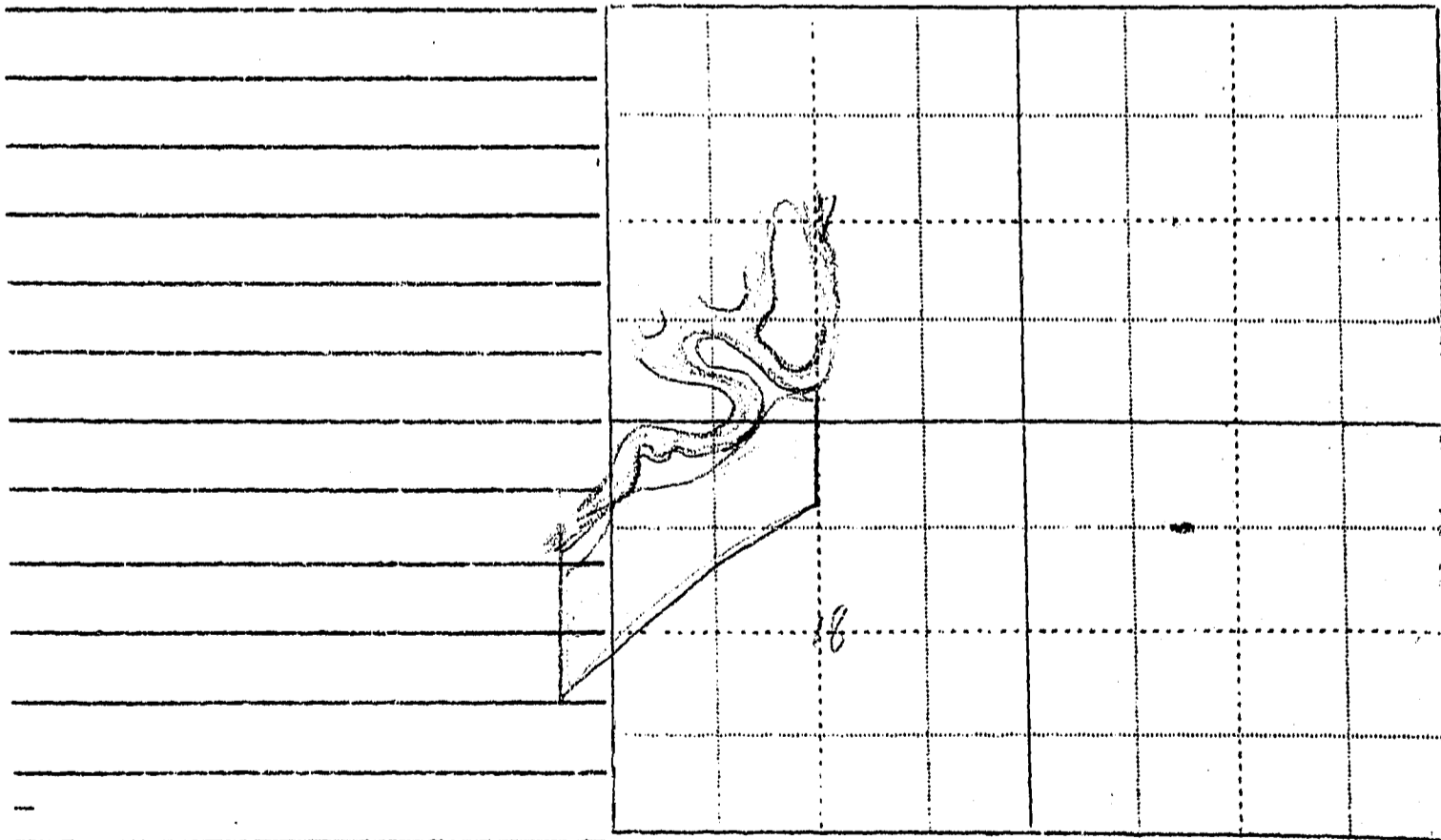

WITNESS _____ Information by _____

Place _____

*John Booth
Director, MWD*

15/5

Fire Insurance

Farms and Stock Ranches for Sale

Rental and Appraisal Service

F. C. KRIEG AGENCY

P. O. BOX 1084 - PHONE 7535
525 SECURITIES BUILDING

BILLINGS, MONTANA

May 11, 1943

Mr. G. J. Oravetz
Box 873
Billings, Montana

Dear Mr. Oravetz:

I am enclosing herewith two forms which Jake Bott brought into my office. I am now the owner of both tracts of land described in these two forms.

The land is under the Waco-Custer Ditch, and you no doubt have a history of it. Out of the land which I own, there are 120 acres irrigated at the present time. There are about 80 acres more which could be irrigated. About half of this would have to be drained before it could be irrigated, and the other half is above the ditch, and water would have to be pumped on it.

Perhaps with this additional information you can make up a new sheet.

I am

Very truly yours,

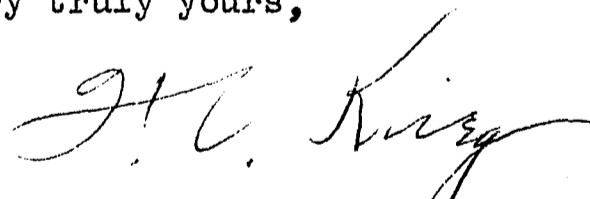

FCK/mef
Encl. 2

*As work sheet # 747 A.P.A. there are 143.5 acres irrigated with each
field measurement & map given
M.E.B. 5/12/43*

STATE OF MONTANA WATER RESOURCES SURVEY

County Yellowstone Date April 12, 1943

Name of Water User James Cross Address Custer Mont.

1. Do you own this land? Yes No If not give the owner's name below:

Owner's name James Cross Address Box 101, Custer

2. Source of Water Yellowstone River Water delivered by Waco Custer Ditch

3. Give point of Diversion 1/4 1/4 Section Township Range

4. Water is obtained by: (Check one) Gravity Pumping Other

5. Who first used water on this land? G. D. Parker Address Riverton Wyo.

6. In what year was this land first irrigated? Approximate Acres

7. What is the greatest number of acres you have irrigated? 110 Date

8. Present Use: Year 1942 Acres Irrigated 67.3

9. If this land is not irrigated now give date of last use

10. State the total number of acres that could be irrigated 100 acres.

11. What is the condition of your irrigation system? Good

12. Land Description: SE 1/4 SE 1/4, Sec. 8; 90 A. in SW 1/4, Sec. 9; E 1/2 NE 1/4, Sec. 17 Twp. 4 N. Range 33 E.

Remarks: has 36 shares in

the Waco Custer Ditch

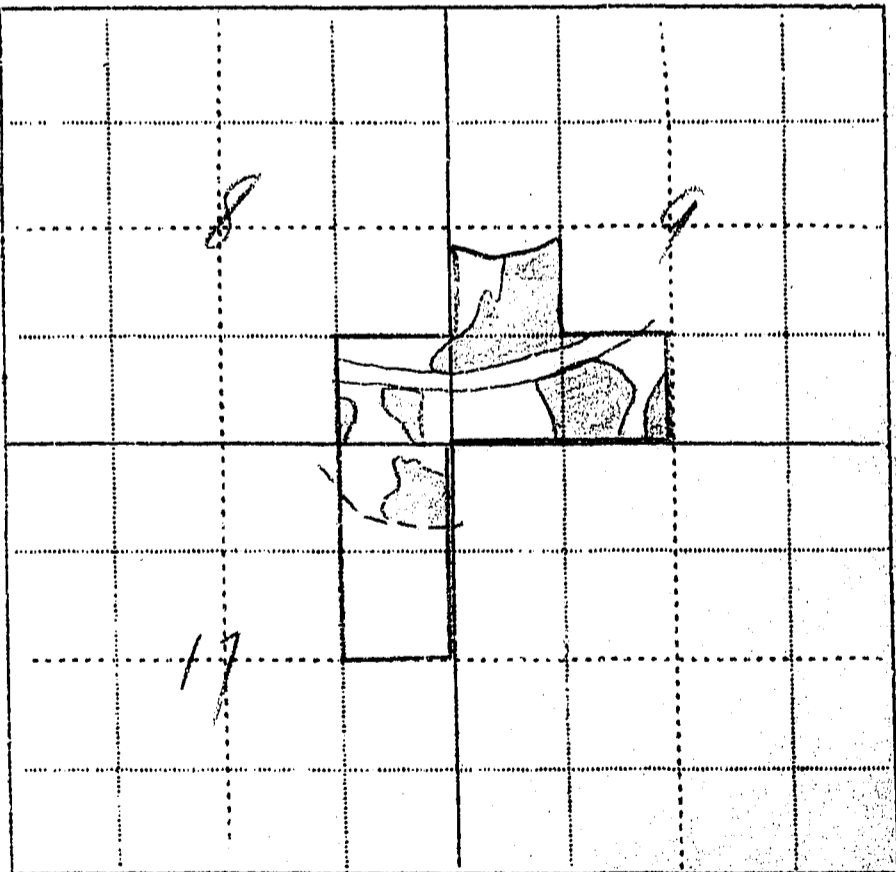

Information by James Cross Place Custer Date Apr. 23, '43
Letter

A STUDY OF MONTANA'S WATER RESOURCES

8-C
9-A
17-B

County Yellowstone Source of Information A. A. A #767-766

1. Water User James Cross Address Box 101 - Custer, Montana

2. Stream _____ Tributary to _____ Basin _____

3. Point of Diversion $\frac{1}{4}$ $\frac{1}{4}$ Section _____ Township _____ Range _____

4. Description of System _____

5. Type of Irrigation _____

6. Original Appropriator _____ Address _____

7. First Use: Year _____ Acres Irrigated _____

8. Maximum Use: Year _____ Acres Irrigated _____

231 9. Present Use: Year 1941 Acres Irrigated 55.3 + 12 = 67.3

10. Last Use: Year _____ Why Abandoned _____

11. Condition of System _____

12. Land Description 90 A in SW¹ Sec 9 SE SE¹ Sec 8 , T 4N , R 33E

Remarks: 36 shares

Waco Custer

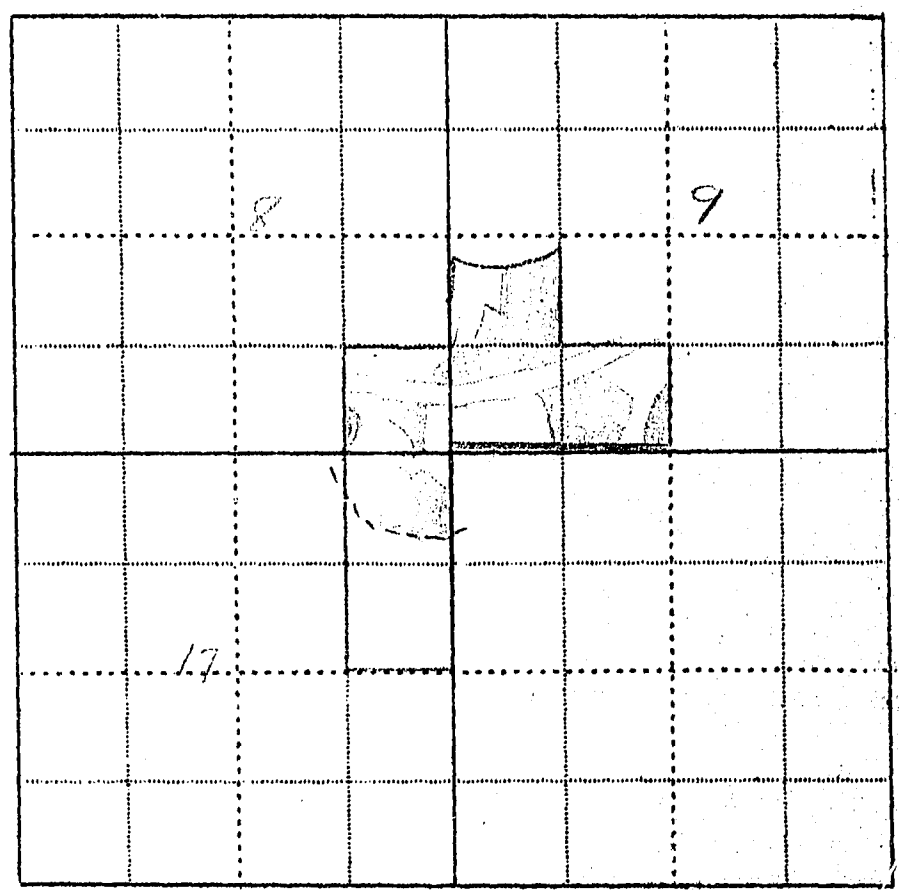

WITNESS: _____ Information by _____

Place _____

STATE OF MONTANA WATER RESOURCES SURVEY

County Yellowstone Date April 12, 1943

Name of Water User Wm. Gunn Address Custer

1. Do you own this land? Yes No If not give the owner's name below:
Owner's name Harry F. Scott Estate ^{% Florence Scott, Exec.} Address Casper Wyo.

2. Source of Water Yellowstone River Water delivered by Waco Custer Ditch

3. Give point of Diversion 1/2 1/2 Section Township Range

4. Water is obtained by: (Check one) Gravity Pumping Other

5. Who first used water on this land? Address

6. In what year was this land first irrigated? abt. 1914 Approximate Acres

7. What is the greatest number of acres you have irrigated? Date

8. Present Use: Year 1942 Acres Irrigated 126.6

9. If this land is not irrigated now give date of last use

10. State the total number of acres that could be irrigated 180 acres.

11. What is the condition of your irrigation system? good

12. Land Description: Lots 2 & 3, S1SE1, Sec. 9; Twp. 4 N. Range 33 E.

Remarks: Estate has 145 shares in

the Waco Custer Ditch. Do you know

how many shares are used on this land?

35 shares

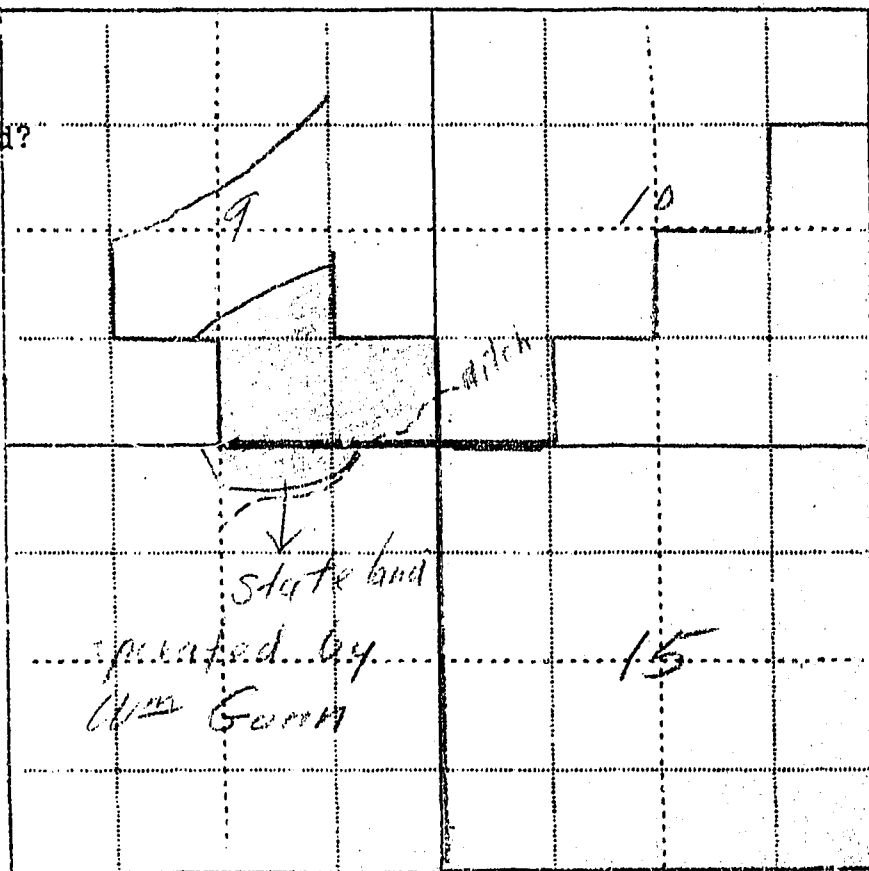

Information by Wm Gunn Place Custer Date 4/15/43

Florence Frank Scott
Box 2443, Casper

B
16-A

A STUDY OF MONTANA'S WATER RESOURCES

County Yellowstone Source of Information RAA-3111

1. Water User Harry Scott est. Florence Scott, etc. Address Casper Wyo

2. Stream _____ Tributary to _____ Basin _____

3. Point of Diversion 1/4 1/4 Section _____ Township _____ Range _____

4. Description of System _____

5. Type of Irrigation _____

6. Original Appropriator _____ Address _____

7. First Use: Year _____ Acres Irrigated _____

8. Maximum Use: Year _____ Acres Irrigated _____

9. Present Use: Year 1941 Acres Irrigated 126.6

10. Last Use: Year _____ Why Abandoned _____

11. Condition of System _____

12. Land Description Lot 2+3, S 38° Sec 9, T47N, R33E

Remarks: 145 acres State Land

Waco Custer

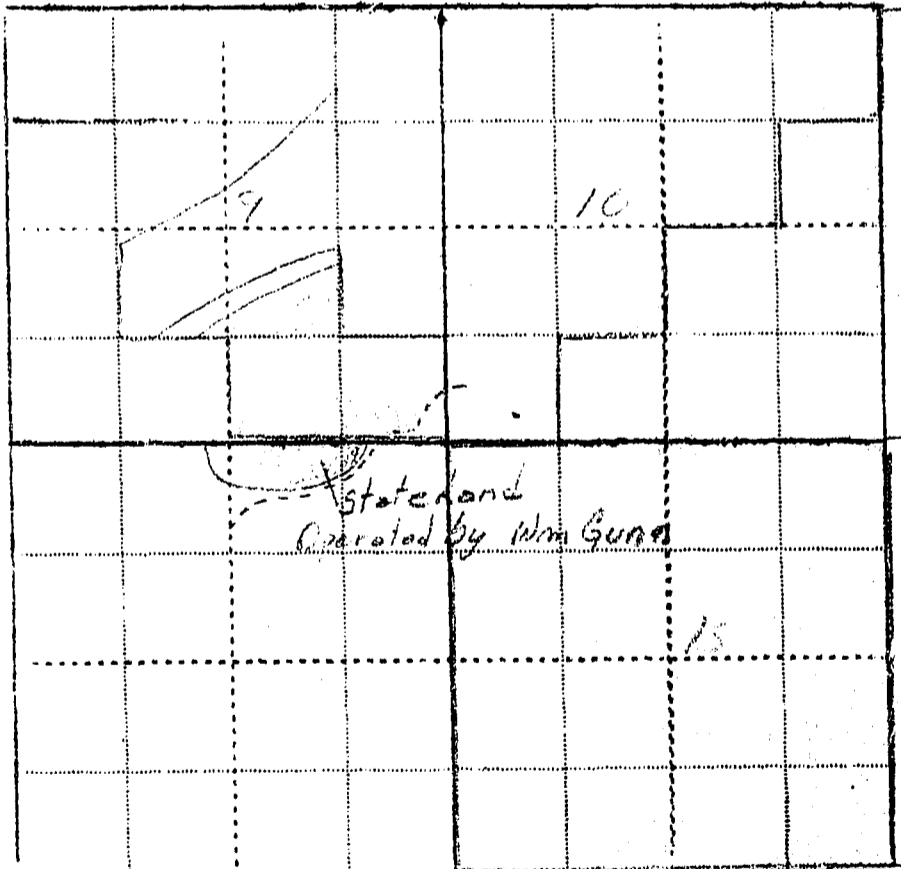

WITNESS: _____ Information by _____
Place _____

Casper Wyo, Wyo, Mont

485

1561

STATE OF MONTANA WATER RESOURCES SURVEY

County Yellowstone Date April 12, 1943

Name of Water User Jerome Kuntz Address Custer

1. Do you own this land? Yes No If not give the owner's name below:

Owner's name H. L. Hamlett Address Custer

2. Source of Water Yellowstone River Water delivered by Waco Custer Ditch

3. Give point of Diversion 1/4 Section 1 Township 14 N. Range 33 E.

4. Water is obtained by: (Check one) Gravity Pumping Other

5. Who first used water on this land? ✓ Address ✓

6. In what year was this land first irrigated? Approximate Acres 65 acres

7. What is the greatest number of acres you have irrigated? 961 Date 1934

8. Present Use: Year 1942 Acres Irrigated 96.1

9. If this land is not irrigated now give date of last use

10. State the total number of acres that could be irrigated 961 acres.

11. What is the condition of your irrigation system? Good

12. Land Description: Lots 5,6,9,10,11,12, Sec. 1, Twp. 14 N. Range 33 E.
Lot 9, Sec. 2

Remarks: Has 31 shares in the

Waco Custer Ditch

30 acres part made
water in 1934
with Pumping
Balance Gravity

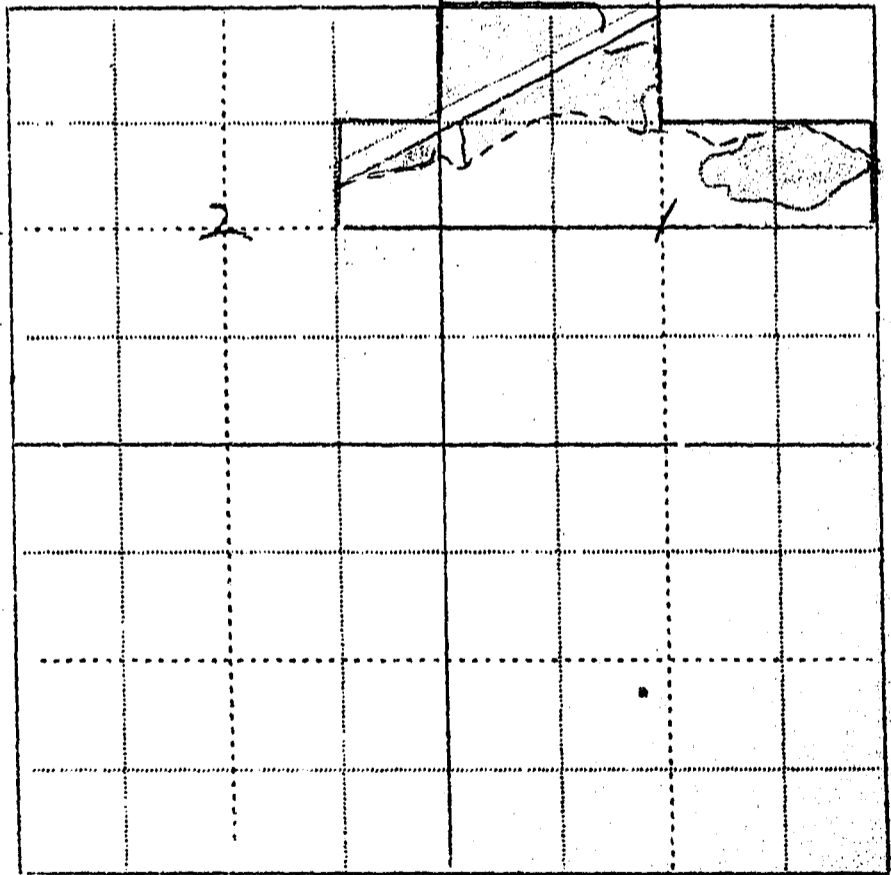

Information by H. L. Hamlett Place Custer Date 4/15-43

A STUDY OF MONTANA'S WATER RESOURCES

7B
2B

Jerome Kuntz - 43
Custer

County Yellowstone Source of Information AAA 2271

1. Water User H. L. Hamlett Address Custer, Mont.

2. Stream _____ Tributary to _____ Basin _____

3. Point of Diversion 1/4 Section _____ Township _____ Range _____

4. Description of System _____

5. Type of Irrigation _____

6. Original Appropriator _____ Address _____

7. First Use: Year _____ Acres Irrigated _____

8. Maximum Use: Year _____ Acres Irrigated _____

263 9. Present Use: Year 1941 Acres Irrigated 96.1

10. Last Use: Year _____ Why Abandoned _____

11. Condition of System _____

12. Land Description lots 5, 6, 9, 10, 11, 12 Sec 1 - lot 9 sec 2, T 47N, R 33E.

Remarks: Has 31 shares

Has Custer

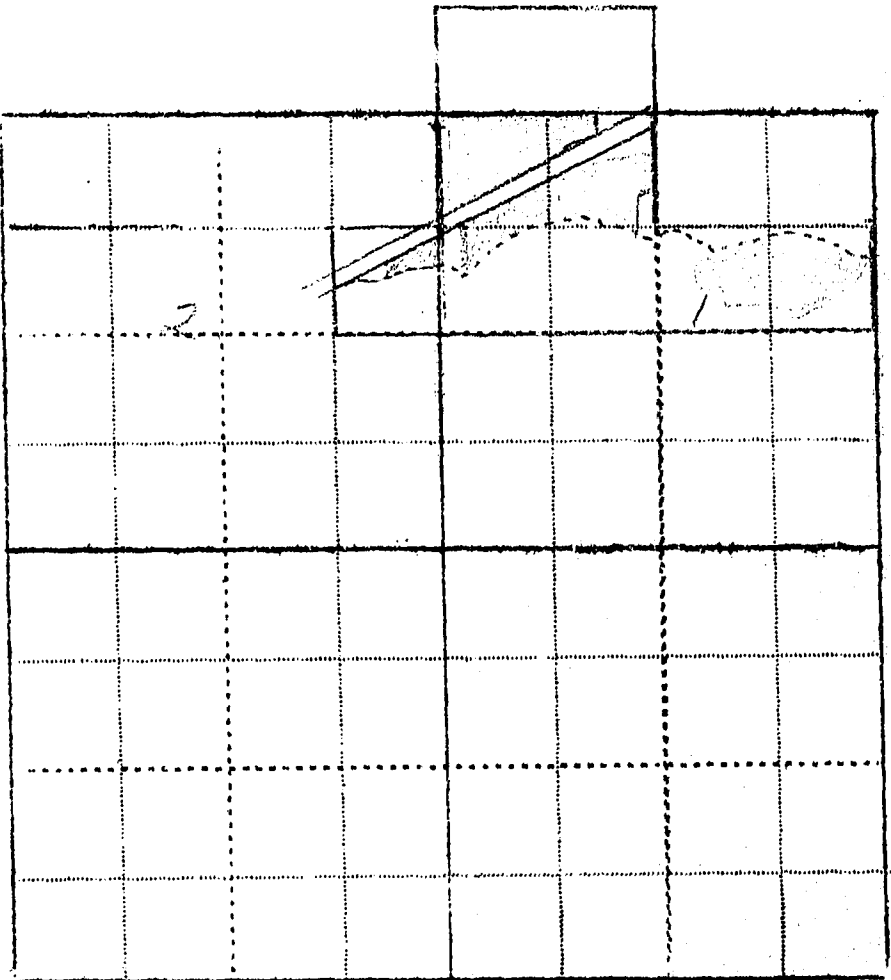

WITNESS: _____ Information by _____
Place _____

1614
1584

Please Do Not Fill in Any Items on This Page

Notice of Appropriation

1. County Yellowstone Book E Page 569 Record Misc.
2. Name of Appropriator Northern Pacific R. R. Address (A. Wisconsin Corporation)
3. Date Appropriated Sept. 21, 1907 Date Filed Sept. 21, 1907
Amount Appropriated, Miners Inches 16, Cubic Feet per second 2/5
4. Name of Stream Yellowstone River Tributary _____ Basin _____
5. Point of Diversion 2602 ft north 16° 34' west from SE corner of

Sec. 35 Twp. 5 N Rge. 33 E Bank of Stream right
6. Purpose Engines + railroad
7. Description of System 6 inch cast-iron pipe

8. Land Description of Intended Place of Use 2300 ft SW from where main line
crosses east line of sec. 1, 4 N, 33 E

9. Remarks (Pertaining to Use, etc.) In the NE SE⁴ sec. 35 5N, 33E

Decree

10. Case No. _____ Date _____ Amt. Decreed: M. I. _____ C. F. S. _____
11. To Whom Decreed _____ Address _____
12. Name of Ditch _____ Maximum Capacity (C. F. S.) _____
13. Date of Priority _____ Purpose _____
14. Land Description of Place of Use as Decreed _____

STATE OF MONTANA WATER RESOURCES SURVEY

County Yellowstone Date April 12, 1943

Name of Water User Adam Kuntz Address Custer

1. Do you own this land? Yes No X If not give the owner's name below:

Owner's name ^M Lillian Morton Address 122 S. 36" St., Billings

2. Source of Water Yellowstone River Water delivered by Waco Custer Ditch

3. Give point of Diversion Same as ditch co. Section Township Range

4. Water is obtained by: (Check one) Gravity X Pumping Other

5. Who first used water on this land? A. C. Van Houten Address ?

6. In what year was this land first irrigated? 1915 Approximate Acres 100

7. What is the greatest number of acres you have irrigated? 120 Date 1933

8. Present Use: Year 1942 Acres Irrigated 103

9. If this land is not irrigated now give date of last use ✓

10. State the total number of acres that could be irrigated 125 acres.

11. What is the condition of your irrigation system? Good

12. Land Description: Part S¹/₂S¹/₂, Sec. 8; N¹/₂NE¹/₄, Sec. 18; Twp. 4 N. Range 33 E.
NW¹/₄NW¹/₄, Sec. 17

Remarks:

Waco Custer ditch
60 shares
Sufficient Water
No seepage
down ditch +
natural slope.

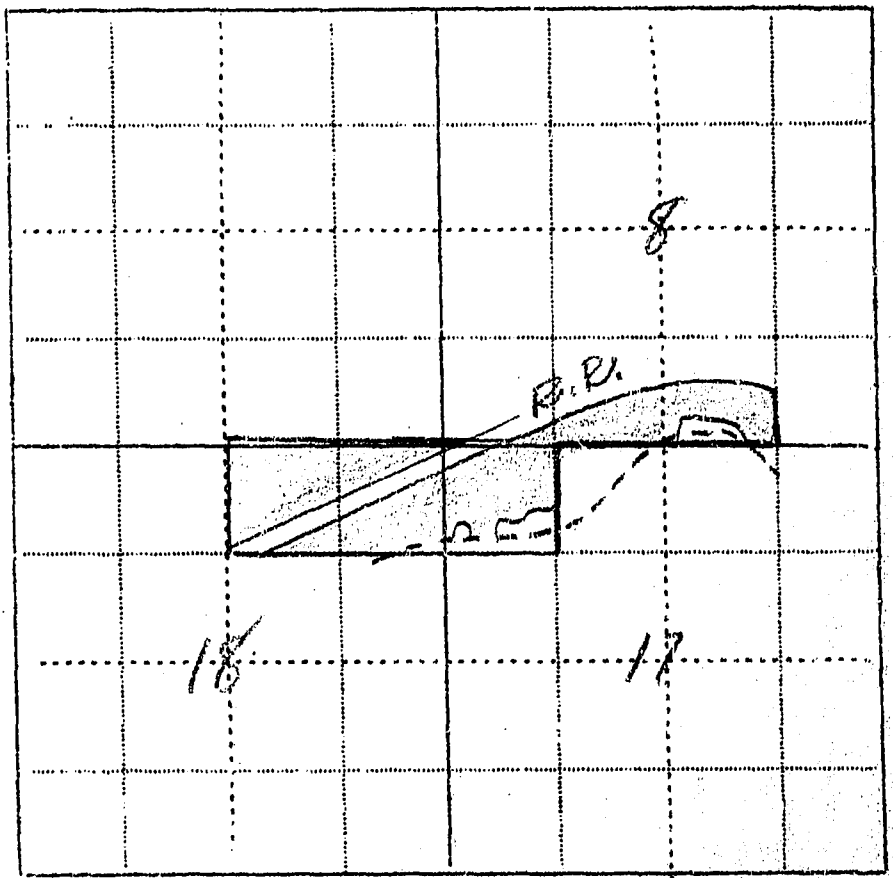

Information by Lillian M. Morton Billing Date April 24, 1943

A STUDY OF MONTANA'S WATER RESOURCES

8-B
17-A
18-A

County Ystone Source of Information ADA 815

1. Water User Lillian Norton Address 122 S. 36" Blga

2. Stream _____ Tributary to _____ Basin _____

3. Point of Diversion 1 1 Section _____ Township _____ Range _____

4. Description of System _____

5. Type of Irrigation _____

6. Original Appropriator _____ Address _____

7. First Use: Year _____ Acres Irrigated _____

8. Maximum Use: Year _____ Acres Irrigated _____

136 9. Present Use: Year 1941 Acres Irrigated 103.2

10. Last Use: Year _____ Why Abandoned _____

11. Condition of System _____

12. Land Description Part S²S² Sec 8, N²NE Sec 18, T 47, R 33 E

Remarks: M.S. NW NW Sec 17

Adams Kuris, Mont

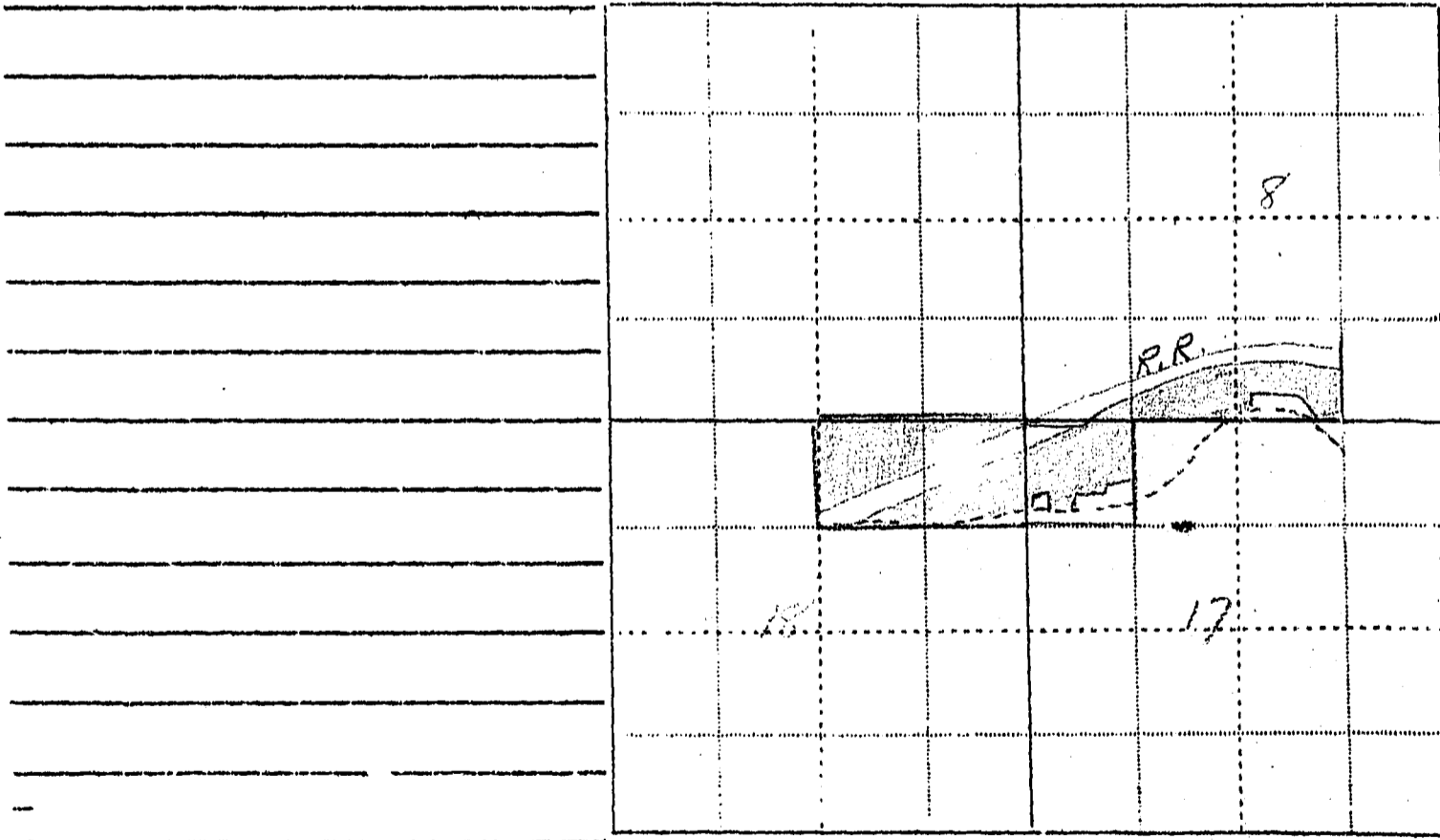

WITNESS _____ Information by _____

Place _____

1515

STATE OF MONTANA WATER RESOURCES SURVEY

County Yellowstone Date April 12, 1943

Name of Water User P. F. McVey Address Custer

1. Do you own this land? Yes No If not give the owner's name below:
owner's name _____ Address _____

2. Source of Water Yellowstone River Water delivered by Waco Custer Ditch

3. Give point of Diversion 1/4 1/4 Section _____ Township _____ Range _____

4. Water is obtained by: (Check one) Gravity Pumping _____ Other _____

5. Who first used water on this land? Mr. Holley Address Dissard

6. In what year was this land first irrigated? About 1910 Approximate Acres 100

7. What is the greatest number of acres you have irrigated? 100 Date 7/26-43

8. Present Use: Year 1942 Acres Irrigated 109.7 100.00

9. If this land is not irrigated now give date of last use _____

10. State the total number of acres that could be irrigated 100 acres.

11. What is the condition of your irrigation system? Good

12. Land Description: Part of SE 1/4 SE 1/4, Sec. 3; N 1/4 NE 1/4, Twp. 4 N, Range 33 E.

Remarks: Has 50 shares in the SW 1/4 NE 1/4, Sec. 10

Waco Custer Ditch

The measurement of 109.7
acres which you show to
be irrigated, is no doubt taken
from charts made from aerial survey
of the type A. In this neighborhood
these measurements showed
more acres than we had,
hence the difference of
109.7 acres, and 100 acres.

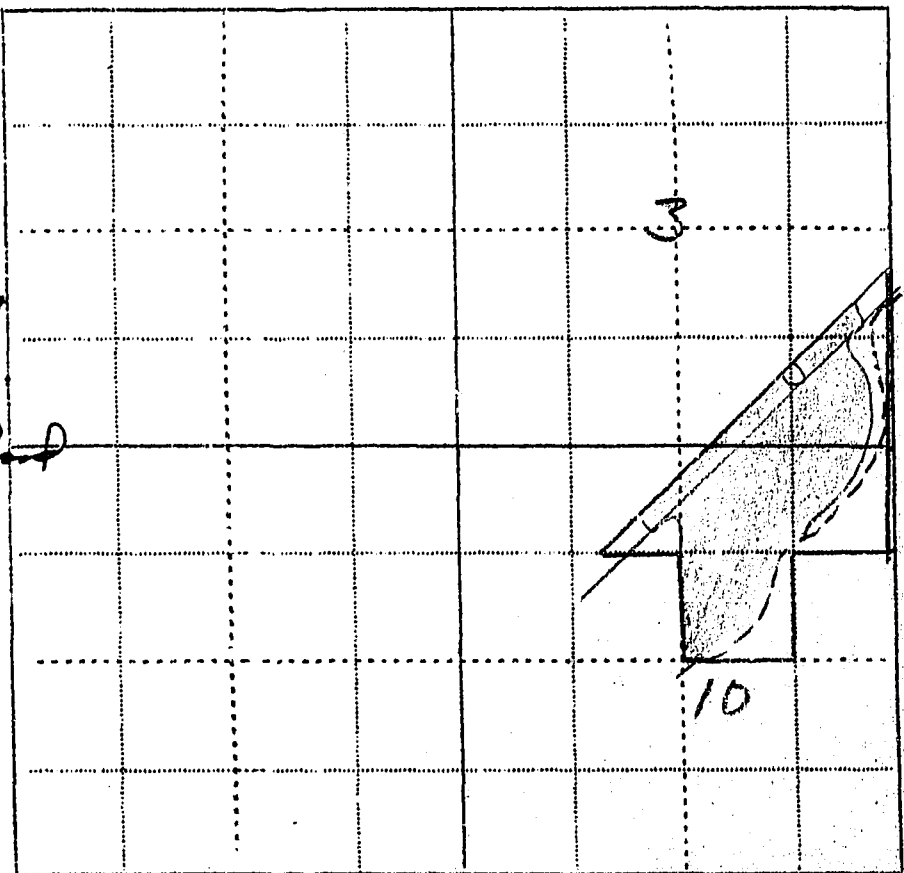

Information by P. F. McVey Place Custer Date 7/26-43

A STUDY OF MONTANA'S WATER RESOURCES

5-B
10-A

County Yellowstone Source of Information I.A.A. # 830-2275

1. Water User P.H. McVey Address Custer Mont.

2. Stream _____ Tributary to _____ Basin _____

3. Point of Diversion $\frac{1}{4}$ $\frac{1}{4}$ Section _____ Township _____ Range _____

4. Description of System _____

5. Type of Irrigation _____

6. Original Appropriator _____ Address _____

7. First Use: Year _____ Acres Irrigated _____

8. Maximum Use: Year _____ Acres Irrigated _____

791 9. Present Use: Year 1941 Acres Irrigated 103.1 + 6.6 = 109.7

10. Last Use: Year _____ Why Abandoned _____

11. Condition of System _____

12. Land Description part of SE SE¹ Sec 3, NE NE¹, SW NE¹, T 4N, R 33E

Remarks: Has part of NW NE¹ Sec 10

50 share Maco Custer

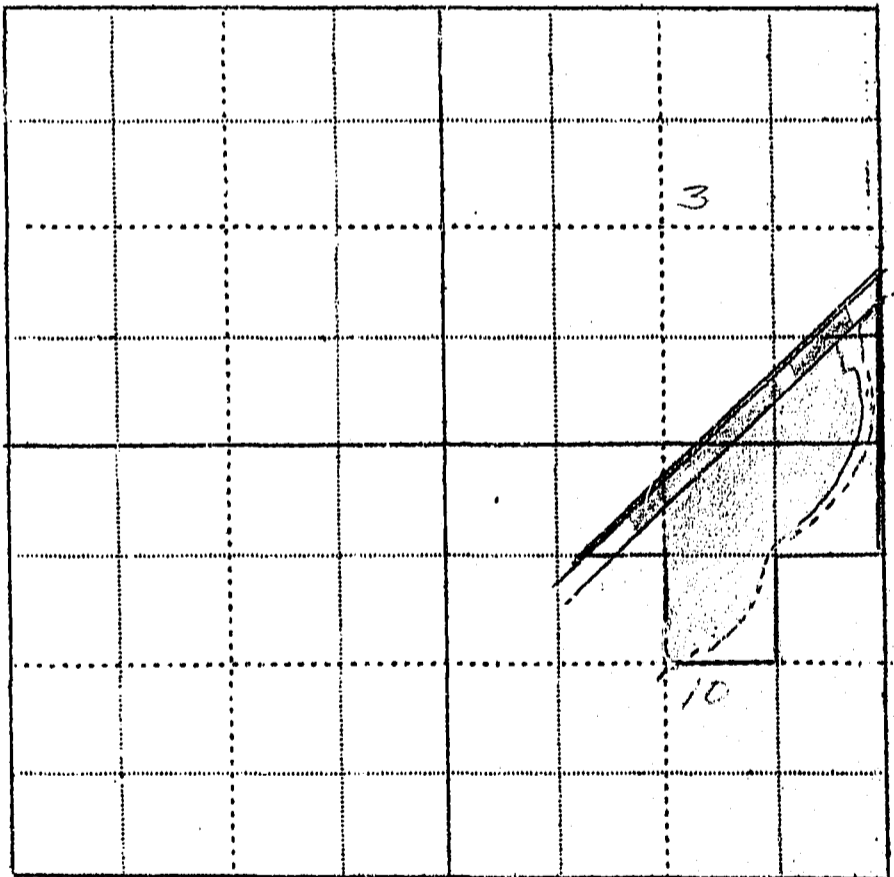

WITNESS: _____ Information by _____

Place _____

1852
1854

STATE OF MONTANA WATER RESOURCES SURVEY

County Yellowstone Date April 12, 1943

Name of Water User Clarence Newkirk Address Boyd Mont.

1. Do you own this land? Yes yes No If not give the owner's name below:

Owner's name Clarence Newkirk Address Boyd, Montana

2. Source of water Yellowstone River Water delivered by

3. Give point of Diversion 1/4 1/4 Section Township Range

4. Water is obtained by: (Check one) Gravity XX Pumping and pump Other

5. Who first used water on this land? Address

6. In what year was this land first irrigated? Approximate Acres 90

7. What is the greatest number of acres you have irrigated? Date

8. Present Use: Year 1942 Acres Irrigated 54 est.

9. If this land is not irrigated now give date of last use

10. State the total number of acres that could be irrigated 90 acres.

11. What is the condition of your irrigation system? fair

12. Land Description: Frac. SE 1/4, Sec. 8, T.4 N. Range 33 E.

Remarks:

There is 50 acres
unsurveyed land
along the river also
we will irrigate with
a pump if it all can be
irrigated with ditch

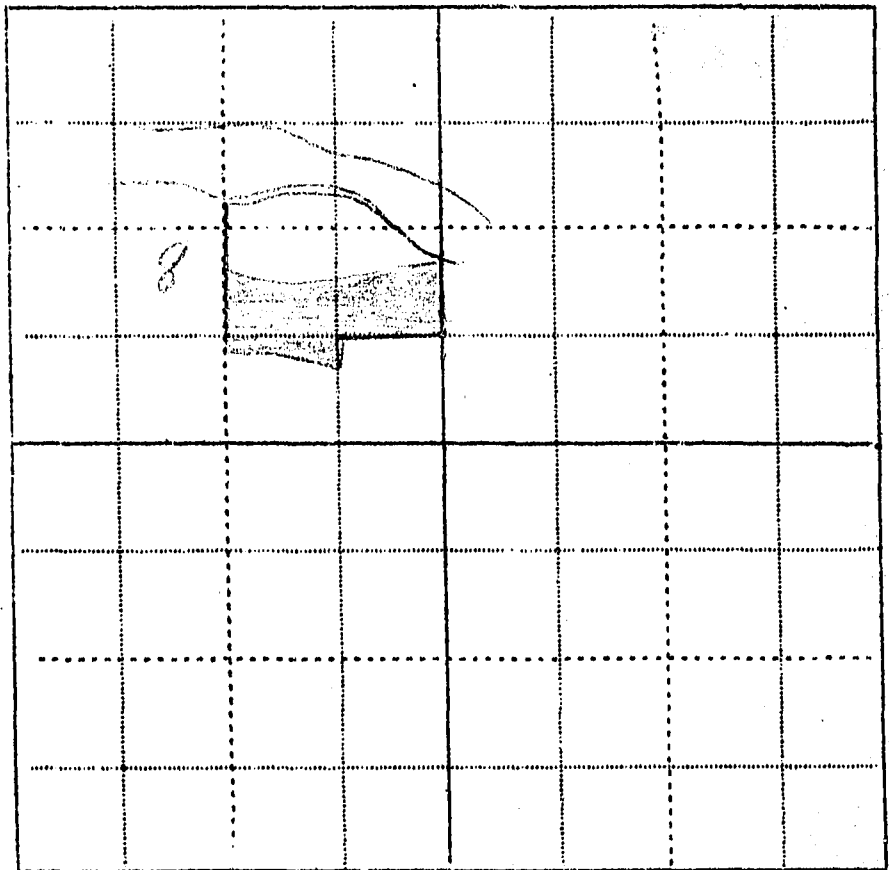

*and being abstracts
will see your work*

Information by Place Date

STATE OF MONTANA WATER RESOURCES SURVEY

County Yellowstone Date April 12, 1943

Name of Water User Joseph G. Parker Address Custer

1. Do you own this land? Yes No If not give the owner's name below:
Owner's name _____ Address _____

2. Source of Water Yellowstone River Water delivered by Waco Custer Ditch

3. Give point of Diversion 1/4 1/4 Section _____ Township _____ Range _____

4. Water is obtained by: (Check one) Gravity Pumping _____ Other _____

5. Who first used water on this land? J. Parker Address Custer

6. In what year was this land first irrigated? 1912 Approximate Acres 113

7. What is the greatest number of acres you have irrigated? 113 Date _____

8. Present Use: Year 1942 Acres Irrigated 113

9. If this land is not irrigated now give date of last use _____

10. State the total number of acres that could be irrigated 120 acres.

11. What is the condition of your irrigation system? good

12. Land Description: NE 1/4 SE 1/4, Sec. 9; SW 1/4 SW 1/4, N 1/2 SW 1/4, Part Twp. 4 N. Range 33 E.

Remarks: Has 52 shares in the S 1/2 NW 1/4, Sec. 10

Waco Custer Ditch.

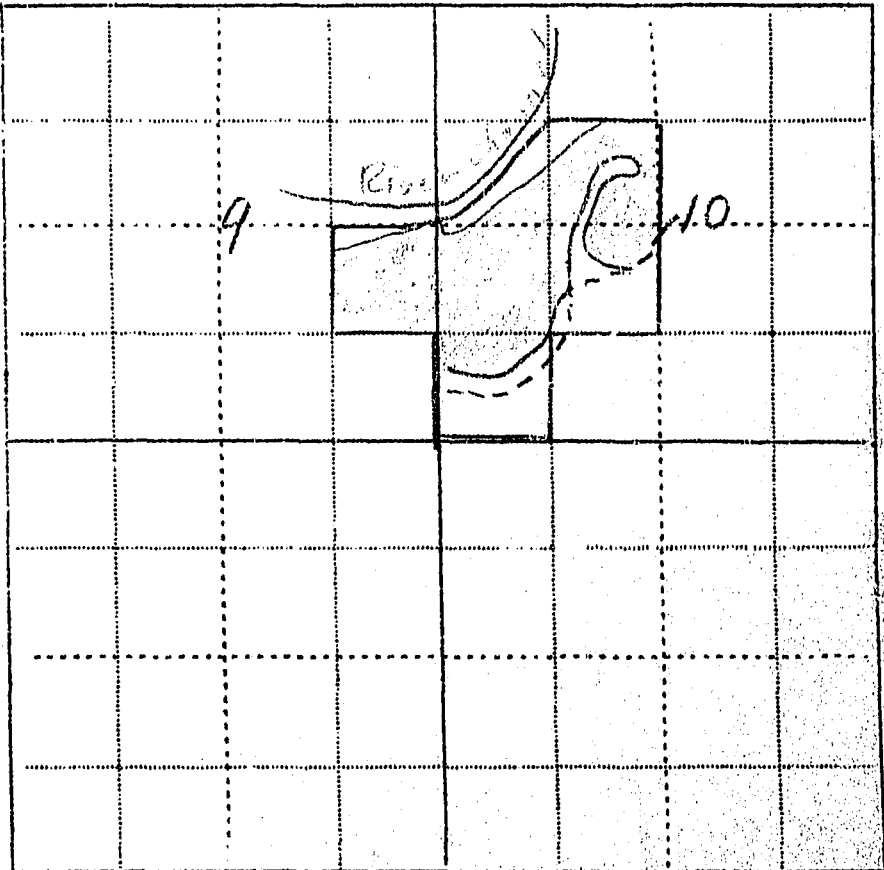

Information by J. G. Parker Place Custer Date 5-29-1943

A STUDY OF MONTANA'S WATER RESOURCES

92
100

County Yellowstone Source of Information A.A.A. # 851

1. Water User J. H. Parker Address Custer Mont.
Joseph

2. Stream _____ Tributary to _____ Basin _____

3. Point of Diversion $\frac{1}{4}$ $\frac{1}{4}$ Section _____ Township _____ Range _____

4. Description of System _____

5. Type of Irrigation _____

6. Original Appropriator _____ Address _____

7. First Use: Year _____ Acres Irrigated _____

8. Maximum Use: Year _____ Acres Irrigated _____

207 9. Present Use: Year 1941 Acres Irrigated 113.0

10. Last Use: Year _____ Why Abandoned _____

11. Condition of System _____

12. Land Description NE 1/4 Sec 9, part of NW 1/4, N 2 SW 1/4, T 4 N., R 33 E
SW 1/4 Sec 10

Remarks: None

52 shares Haco Custer

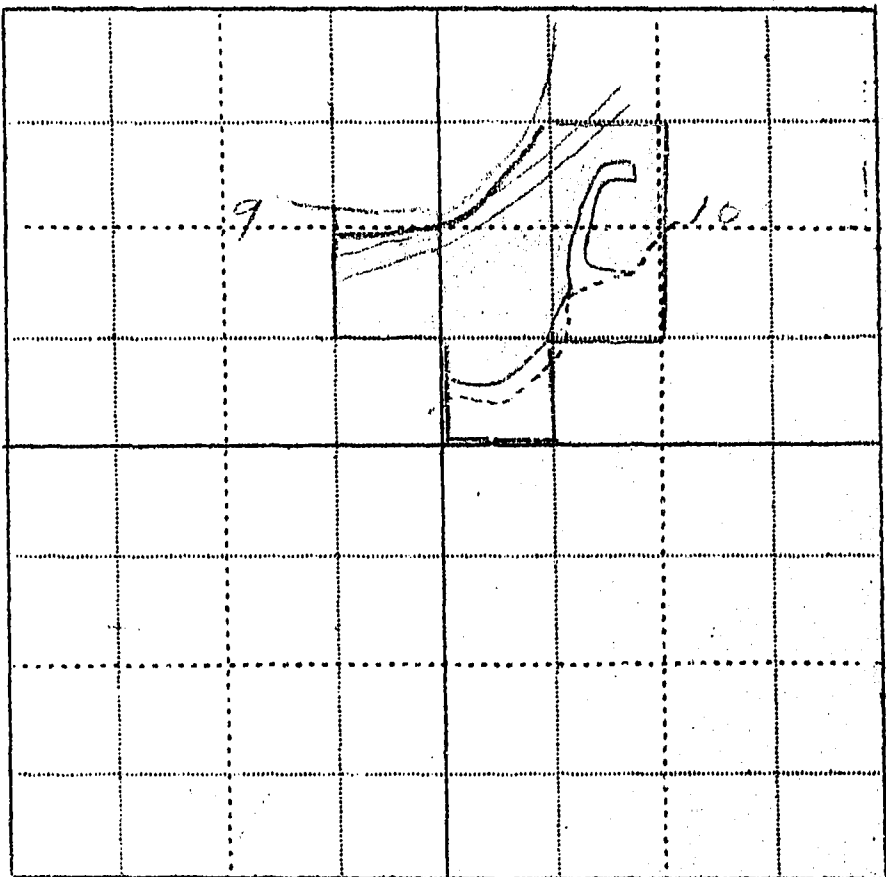

WITNESS: _____ Information by _____

Place _____

1551

STATE OF MONTANA WATER RESOURCES SURVEY

County Yellowstone Date April 12, 1943

Name of Water User George Smith Address Custer

1. Do you own this land? Yes No If not give the owner's name below:

Owner's name Rockwood Brown Address Billings

2. Source of Water Yellowstone River Water delivered by Waco Custer Ditch

3. Give point of Diversion 1/4 1/4 Section Township Range

4. Water is obtained by: (Check one) Gravity Pumping Other

5. Who first used water on this land? Address

6. In what year was this land first irrigated? Approximate Acres

7. What is the greatest number of acres you have irrigated? 450 Date 1942

8. Present Use: Year 1942 Acres Irrigated 186.31 450 a. (see remarks)

9. If this land is not irrigated now give date of last use

10. State the total number of acres that could be irrigated 490 acres.

11. What is the condition of your irrigation system? good

12. Land Description: E 1/2 E 1/2, N. of RR, Sec. 2; Lots 2, 3, 4, 5, 6, 7, 8, 9, 10, 11, 12, 13, 14, 15, 16, 17, 18, 19, 20, 21, 22, 23, 24, 25, 26, 27, 28, 29, 30, 31, 32, 33, 34, 35, 36, 37, 38, 39, 40, 41, 42, 43, 44, 45, 46, 47, 48, 49, 50, 51, 52, 53, 54, 55, 56, 57, 58, 59, 60, 61, 62, 63, 64, 65, 66, 67, 68, 69, 70, 71, 72, 73, 74, 75, 76, 77, 78, 79, 80, 81, 82, 83, 84, 85, 86, 87, 88, 89, 90, 91, 92, 93, 94, 95, 96, 97, 98, 99, 100, 101, 102, 103, 104, 105, 106, 107, 108, 109, 110, 111, 112, 113, 114, 115, 116, 117, 118, 119, 120, 121, 122, 123, 124, 125, 126, 127, 128, 129, 130, 131, 132, 133, 134, 135, 136, 137, 138, 139, 140, 141, 142, 143, 144, 145, 146, 147, 148, 149, 150, 151, 152, 153, 154, 155, 156, 157, 158, 159, 160, 161, 162, 163, 164, 165, 166, 167, 168, 169, 170, 171, 172, 173, 174, 175, 176, 177, 178, 179, 180, 181, 182, 183, 184, 185, 186, 187, 188, 189, 190, 191, 192, 193, 194, 195, 196, 197, 198, 199, 200, 201, 202, 203, 204, 205, 206, 207, 208, 209, 210, 211, 212, 213, 214, 215, 216, 217, 218, 219, 220, 221, 222, 223, 224, 225, 226, 227, 228, 229, 230, 231, 232, 233, 234, 235, 236, 237, 238, 239, 240, 241, 242, 243, 244, 245, 246, 247, 248, 249, 250, 251, 252, 253, 254, 255, 256, 257, 258, 259, 260, 261, 262, 263, 264, 265, 266, 267, 268, 269, 270, 271, 272, 273, 274, 275, 276, 277, 278, 279, 280, 281, 282, 283, 284, 285, 286, 287, 288, 289, 290, 291, 292, 293, 294, 295, 296, 297, 298, 299, 300, 301, 302, 303, 304, 305, 306, 307, 308, 309, 310, 311, 312, 313, 314, 315, 316, 317, 318, 319, 320, 321, 322, 323, 324, 325, 326, 327, 328, 329, 330, 331, 332, 333, 334, 335, 336, 337, 338, 339, 340, 341, 342, 343, 344, 345, 346, 347, 348, 349, 350, 351, 352, 353, 354, 355, 356, 357, 358, 359, 360, 361, 362, 363, 364, 365, 366, 367, 368, 369, 370, 371, 372, 373, 374, 375, 376, 377, 378, 379, 380, 381, 382, 383, 384, 385, 386, 387, 388, 389, 390, 391, 392, 393, 394, 395, 396, 397, 398, 399, 400, 401, 402, 403, 404, 405, 406, 407, 408, 409, 410, 411, 412, 413, 414, 415, 416, 417, 418, 419, 420, 421, 422, 423, 424, 425, 426, 427, 428, 429, 430, 431, 432, 433, 434, 435, 436, 437, 438, 439, 440, 441, 442, 443, 444, 445, 446, 447, 448, 449, 450, 451, 452, 453, 454, 455, 456, 457, 458, 459, 460, 461, 462, 463, 464, 465, 466, 467, 468, 469, 470, 471, 472, 473, 474, 475, 476, 477, 478, 479, 480, 481, 482, 483, 484, 485, 486, 487, 488, 489, 490, 491, 492, 493, 494, 495, 496, 497, 498, 499, 500, 501, 502, 503, 504, 505, 506, 507, 508, 509, 510, 511, 512, 513, 514, 515, 516, 517, 518, 519, 520, 521, 522, 523, 524, 525, 526, 527, 528, 529, 530, 531, 532, 533, 534, 535, 536, 537, 538, 539, 540, 541, 542, 543, 544, 545, 546, 547, 548, 549, 550, 551, 552, 553, 554, 555, 556, 557, 558, 559, 560, 561, 562, 563, 564, 565, 566, 567, 568, 569, 570, 571, 572, 573, 574, 575, 576, 577, 578, 579, 580, 581, 582, 583, 584, 585, 586, 587, 588, 589, 590, 591, 592, 593, 594, 595, 596, 597, 598, 599, 600, 601, 602, 603, 604, 605, 606, 607, 608, 609, 610, 611, 612, 613, 614, 615, 616, 617, 618, 619, 620, 621, 622, 623, 624, 625, 626, 627, 628, 629, 630, 631, 632, 633, 634, 635, 636, 637, 638, 639, 640, 641, 642, 643, 644, 645, 646, 647, 648, 649, 650, 651, 652, 653, 654, 655, 656, 657, 658, 659, 660, 661, 662, 663, 664, 665, 666, 667, 668, 669, 670, 671, 672, 673, 674, 675, 676, 677, 678, 679, 680, 681, 682, 683, 684, 685, 686, 687, 688, 689, 690, 691, 692, 693, 694, 695, 696, 697, 698, 699, 700, 701, 702, 703, 704, 705, 706, 707, 708, 709, 710, 711, 712, 713, 714, 715, 716, 717, 718, 719, 720, 721, 722, 723, 724, 725, 726, 727, 728, 729, 730, 731, 732, 733, 734, 735, 736, 737, 738, 739, 740, 741, 742, 743, 744, 745, 746, 747, 748, 749, 750, 751, 752, 753, 754, 755, 756, 757, 758, 759, 760, 761, 762, 763, 764, 765, 766, 767, 768, 769, 770, 771, 772, 773, 774, 775, 776, 777, 778, 779, 780, 781, 782, 783, 784, 785, 786, 787, 788, 789, 790, 791, 792, 793, 794, 795, 796, 797, 798, 799, 800, 801, 802, 803, 804, 805, 806, 807, 808, 809, 810, 811, 812, 813, 814, 815, 816, 817, 818, 819, 820, 821, 822, 823, 824, 825, 826, 827, 828, 829, 830, 831, 832, 833, 834, 835, 836, 837, 838, 839, 840, 841, 842, 843, 844, 845, 846, 847, 848, 849, 850, 851, 852, 853, 854, 855, 856, 857, 858, 859, 860, 861, 862, 863, 864, 865, 866, 867, 868, 869, 870, 871, 872, 873, 874, 875, 876, 877, 878, 879, 880, 881, 882, 883, 884, 885, 886, 887, 888, 889, 890, 891, 892, 893, 894, 895, 896, 897, 898, 899, 900, 901, 902, 903, 904, 905, 906, 907, 908, 909, 910, 911, 912, 913, 914, 915, 916, 917, 918, 919, 920, 921, 922, 923, 924, 925, 926, 927, 928, 929, 930, 931, 932, 933, 934, 935, 936, 937, 938, 939, 940, 941, 942, 943, 944, 945, 946, 947, 948, 949, 950, 951, 952, 953, 954, 955, 956, 957, 958, 959, 960, 961, 962, 963, 964, 965, 966, 967, 968, 969, 970, 971, 972, 973, 974, 975, 976, 977, 978, 979, 980, 981, 982, 983, 984, 985, 986, 987, 988, 989, 990, 991, 992, 993, 994, 995, 996, 997, 998, 999, 1000, 1001, 1002, 1003, 1004, 1005, 1006, 1007, 1008, 1009, 1010, 1011, 1012, 1013, 1014, 1015, 1016, 1017, 1018, 1019, 1020, 1021, 1022, 1023, 1024, 1025, 1026, 1027, 1028, 1029, 1030, 1031, 1032, 1033, 1034, 1035, 1036, 1037, 1038, 1039, 1040, 1041, 1042, 1043, 1044, 1045, 1046, 1047, 1048, 1049, 1050, 1051, 1052, 1053, 1054, 1055, 1056, 1057, 1058, 1059, 1060, 1061, 1062, 1063, 1064, 1065, 1066, 1067, 1068, 1069, 1070, 1071, 1072, 1073, 1074, 1075, 1076, 1077, 1078, 1079, 1080, 1081, 1082, 1083, 1084, 1085, 1086, 1087, 1088, 1089, 1090, 1091, 1092, 1093, 1094, 1095, 1096, 1097, 1098, 1099, 1100, 1101, 1102, 1103, 1104, 1105, 1106, 1107, 1108, 1109, 1110, 1111, 1112, 1113, 1114, 1115, 1116, 1117, 1118, 1119, 1120, 1121, 1122, 1123, 1124, 1125, 1126, 1127, 1128, 1129, 1130, 1131, 1132, 1133, 1134, 1135, 1136, 1137, 1138, 1139, 1140, 1141, 1142, 1143, 1144, 1145, 1146, 1147, 1148, 1149, 1150, 1151, 1152, 1153, 1154, 1155, 1156, 1157, 1158, 1159, 1160, 1161, 1162, 1163, 1164, 1165, 1166, 1167, 1168, 1169, 1170, 1171, 1172, 1173, 1174, 1175, 1176, 1177, 1178, 1179, 1180, 1181, 1182, 1183, 1184, 1185, 1186, 1187, 1188, 1189, 1190, 1191, 1192, 1193, 1194, 1195, 1196, 1197, 1198, 1199, 1200, 1201, 1202, 1203, 1204, 1205, 1206, 1207, 1208, 1209, 1210, 1211, 1212, 1213, 1214, 1215, 1216, 1217, 1218, 1219, 1220, 1221, 1222, 1223, 1224, 1225, 1226, 1227, 1228, 1229, 1230, 1231, 1232, 1233, 1234, 1235, 1236, 1237, 1238, 1239, 1240, 1241, 1242, 1243, 1244, 1245, 1246, 1247, 1248, 1249, 1250, 1251, 1252, 1253, 1254, 1255, 1256, 1257, 1258, 1259, 1260, 1261, 1262, 1263, 1264, 1265, 1266, 1267, 1268, 1269, 1270, 1271, 1272, 1273, 1274, 1275, 1276, 1277, 1278, 1279, 1280, 1281, 1282, 1283, 1284, 1285, 1286, 1287, 1288, 1289, 1290, 1291, 1292, 1293, 1294, 1295, 1296, 1297, 1298, 1299, 1300, 1301, 1302, 1303, 1304, 1305, 1306, 1307, 1308, 1309, 1310, 1311, 1312, 1313, 1314, 1315, 1316, 1317, 1318, 1319, 1320, 1321, 1322, 1323, 1324, 1325, 1326, 1327, 1328, 1329, 1330, 1331, 1332, 1333, 1334, 1335, 1336, 1337, 1338, 1339, 1340, 1341, 1342, 1343, 1344, 1345, 1346, 1347, 1348, 1349, 1350, 1351, 1352, 1353, 1354, 1355, 1356, 1357, 1358, 1359, 1360, 1361, 1362, 1363, 1364, 1365, 1366, 1367, 1368, 1369, 1370, 1371, 1372, 1373, 1374, 1375, 1376, 1377, 1378, 1379, 1380, 1381, 1382, 1383, 1384, 1385, 1386, 1387, 1388, 1389, 1390, 1391, 1392, 1393, 1394, 1395, 1396, 1397, 1398, 1399, 1400, 1401, 1402, 1403, 1404, 1405, 1406, 1407, 1408, 1409, 1410, 1411, 1412, 1413, 1414, 1415, 1416, 1417, 1418, 1419, 1420, 1421, 1422, 1423, 1424, 1425, 1426, 1427, 1428, 1429, 1430, 1431, 1432, 1433, 1434, 1435, 1436, 1437, 1438, 1439, 1440, 1441, 1442, 1443, 1444, 1445, 1446, 1447, 1448, 1449, 1450, 1451, 1452, 1453, 1454, 1455, 1456, 1457, 1458, 1459, 1460, 1461, 1462, 1463, 1464, 1465, 1466, 1467, 1468, 1469, 1470, 1471, 1472, 1473, 1474, 1475, 1476, 1477, 1478, 1479, 1480, 1481, 1482, 1483, 1484, 1485, 1486, 1487, 1488, 1489, 1490, 1491, 1492, 1493, 1494, 1495, 1496, 1497, 1498, 1499, 1500, 1501, 1502, 1503, 1504, 1505, 1506, 1507, 1508, 1509, 1510, 1511, 1512, 1513, 1514, 1515, 1516, 1517, 1518, 1519, 1520, 1521, 1522, 1523, 1524, 1525, 1526, 1527, 1528, 1529, 1530, 1531, 1532, 1533, 1534, 1535, 1536, 1537, 1538, 1539, 1540, 1541, 1542, 1543, 1544, 1545, 1546, 1547, 1548, 1549, 1550, 1551, 1552, 1553, 1554, 1555, 1556, 1557, 1558, 1559, 1560, 1561, 1562, 1563, 1564, 1565, 1566, 1567, 1568, 1569, 1570, 1571, 1572, 1573, 1574, 1575, 1576, 1577, 1578, 1579, 1580, 1581, 1582, 1583, 1584, 1585, 1586, 1587, 1588, 1589, 1590, 1591, 1592, 1593, 1594, 1595, 1596, 1597, 1598, 1599, 1600, 1601, 1602, 1603, 1604, 1605, 1606, 1607, 1608, 1609, 1610, 1611, 1612, 1613, 1614, 1615, 1616, 1617, 1618, 1619, 1620, 1621, 1622, 1623, 1624, 1625, 1626, 1627, 1628, 1629, 1630, 1631, 1632, 1633, 1634, 1635, 1636, 1637, 1638, 1639, 1640, 1641, 1642, 1643, 1644, 1645, 1646, 1647, 1648, 1649, 1650, 1651, 1652, 1653, 1654, 1655, 1656, 1657, 1658, 1659, 1660, 1661, 1662, 1663, 1664, 1665, 1666, 1667, 1668, 1669, 1670, 1671, 1672, 1673, 1674, 1675, 1676, 1677, 1678, 1679, 1680, 1681, 1682, 1683, 1684, 1685, 1686, 1687, 1688, 1689, 1690, 1691, 1692, 1693, 1694, 1695, 1696, 1697, 1698, 1699, 1700, 1701, 1702, 1703, 1704, 1705, 1706, 1707, 1708, 1709, 1710, 1711, 1712, 1713, 1714, 1715, 1716, 1717, 1718, 1719, 1720, 1721, 1722, 1723, 1724, 1725, 1726, 1727, 1728, 1729, 1730, 1731, 1732, 1733, 1734, 1735, 1736, 1737, 1738, 1739, 1740, 1741, 1742, 1743, 1744, 1745, 1746, 1747, 1748, 1749, 1750, 1751, 1752, 1753, 1754, 1755, 1756, 1757, 1758, 1759, 1760, 1761, 1762, 1763, 1764, 1765, 1766, 1767, 1768, 1769, 1770, 1771, 1772, 1773, 1774, 1775, 1776, 1777, 1778, 1779, 1780, 1781, 1782, 1783, 1784, 1785, 1786, 1787, 1788, 1789, 1790, 1791, 1792, 1793, 1794, 1795, 1796, 1797, 1798, 1799, 1800, 1801, 1802, 1803, 1804, 1805, 1806, 1807, 1808, 1809, 1810, 1811, 1812, 1813, 1814, 1815, 1816, 1817, 1818, 1819, 1820, 1821, 1822, 1823, 1824, 1825, 1826, 1827, 1828, 1829, 1830, 1831, 1832, 1833, 1834, 1835, 1836, 1837, 1838, 1839, 1840, 1841, 1842, 1843, 1844, 1845, 1846, 1847, 1848, 1849, 1850, 1851, 1852, 1853, 1854, 1855, 1856, 1857, 1858, 1859, 1860, 1861, 1862, 1863, 1864, 1865, 1866, 1867, 1868, 1869, 1870, 1871, 1872, 1873, 1874, 1875, 1876, 1877, 1878, 1879, 1880, 1881, 1882, 1883, 1884, 1885, 1886, 1887, 1888, 1889, 1890, 1891, 1892, 1893, 1894, 1895, 1896, 1897, 1898, 1899, 1900, 1901, 1902, 1903, 1904, 1905, 1906, 1907, 1908, 1909, 1910, 1911, 1912, 1913, 1914, 1915, 1916, 1917, 1918, 1919, 1920, 1921, 1922, 1923, 1924, 1925, 1926, 1927, 1928, 1929, 1930, 1931, 1932, 1933, 1934, 1935, 1936, 1937, 1938, 1939, 1940, 1941, 1942, 1943, 1944, 1945, 1946, 1947, 1948, 1949, 1950, 1951, 1952, 1953, 1954, 1955, 1956, 1957, 1958, 1959, 1960, 1961, 1962, 1963, 1964, 1965, 1966, 1967, 1968, 1969, 1970, 1971, 1972, 1973, 1974, 1975, 1976, 1977, 1978, 1979, 1980, 1981, 1982, 1983, 1984, 1985, 1986, 1987, 1988, 1989, 1990, 1991, 1992, 1993, 1994, 1995, 1996, 1997, 1998, 1999, 2000, 2001, 2002, 2003, 2004, 2005, 2006, 2007, 2008, 2009, 2010, 2011, 2012, 2013, 2014, 2015, 2016, 2017, 2018, 2019, 2020, 2021, 2022, 2023, 2024, 2025, 2026, 2027, 2028, 2029, 2030, 2031, 2032, 2033, 2034, 2035, 2036, 2037, 2038, 2039, 2040, 2041, 2042, 2043, 2044, 2045, 2046, 2047, 2048, 2049, 2050, 2051, 2052, 2053, 2054, 2055, 2056, 2057, 2058, 2059, 2060, 2061, 2062, 2063, 2064, 2065, 2066, 2067, 2068, 2069, 2070, 2071, 2072, 2073, 2074, 2075, 2076, 2077, 2

A STUDY OF MONTANA'S WATER RESOURCES

34 B
35 A

County Yellowstone Source of Information AAA 833A

1. Water User Rockwood Brown Address Bullings, Mont.

2. Stream Waco Custer Ditch Tributary to _____ Basin _____

3. Point of Diversion $\frac{1}{4}$ $\frac{1}{4}$ Section _____ Township _____ Range _____

4. Description of System _____

5. Type of Irrigation _____

6. Original Appropriator _____ Address _____

7. First Use: Year _____ Acres Irrigated _____

8. Maximum Use: Year _____ Acres Irrigated _____

9. Present Use: Year 1941 Acres Irrigated 153.4 ~~139~~ ~~131.0~~ ~~232.96~~

10. Last Use: Year _____ Why Abandoned See other sheet

11. Condition of System good or sheet A.

12. Land Description W 1/2 Sec 4 that part So. of River in SW 1/4 Sec 35, T 5 N, R 33 E.

that part No. 9 R.R. extending 128 Rods West of road Sec. 1
Remarks: see other sheets for L.D.

224 shares Waco Custer

150 shares

110 A. 15 shares

Sheet B.

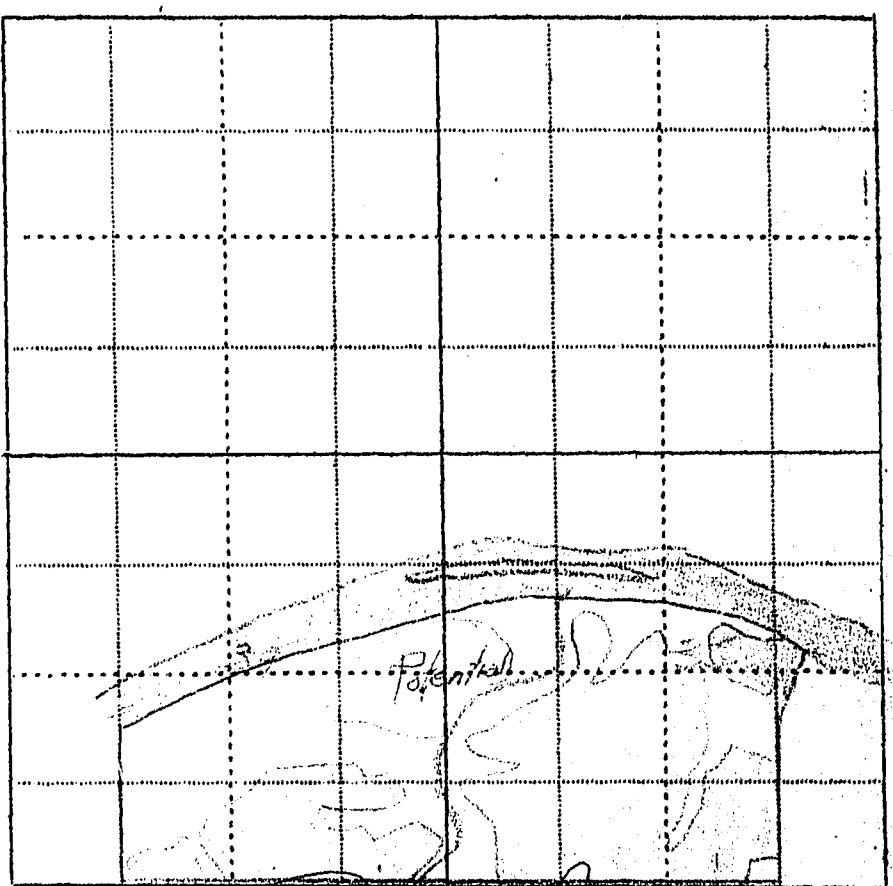

WITNESS: M.K.

Information by Rockwood Brown

Place Office - April 17 - 1943

1644
584

A STUDY OF MONTANA'S WATER RESOURCES

M. J. Moerkerke
Custer, Mont.

County Yellowstone Source of Information ARC-873

1. Water User Harry Polcott est. Florence Scott spec. Address Chaper Ways Box 2443

2. Stream To Wm Beers apt. Billings Tributary to _____ Basin _____

3. Point of Diversion 1/4 Section _____ Township _____ Range _____

4. Description of System _____

5. Type of Irrigation _____

6. Original Appropriator _____ Address _____

7. First Use: Year _____ Acres Irrigated _____

8. Maximum Use: Year _____ Acres Irrigated _____

9. Present Use: Year 1941 Acres Irrigated 184.8

10. Last Use: Year _____ Why Abandoned patented 1500

11. Condition of System good

12. Land Description lots 2, 3, 6, 7, 10, 11, 12, sec 2, T 47N, R 33E
Part of sec 4, sec 34 521 338

Remarks: _____

Operator: M. J. Moerkerke, Custer

145 acres in Union Custer

no steps

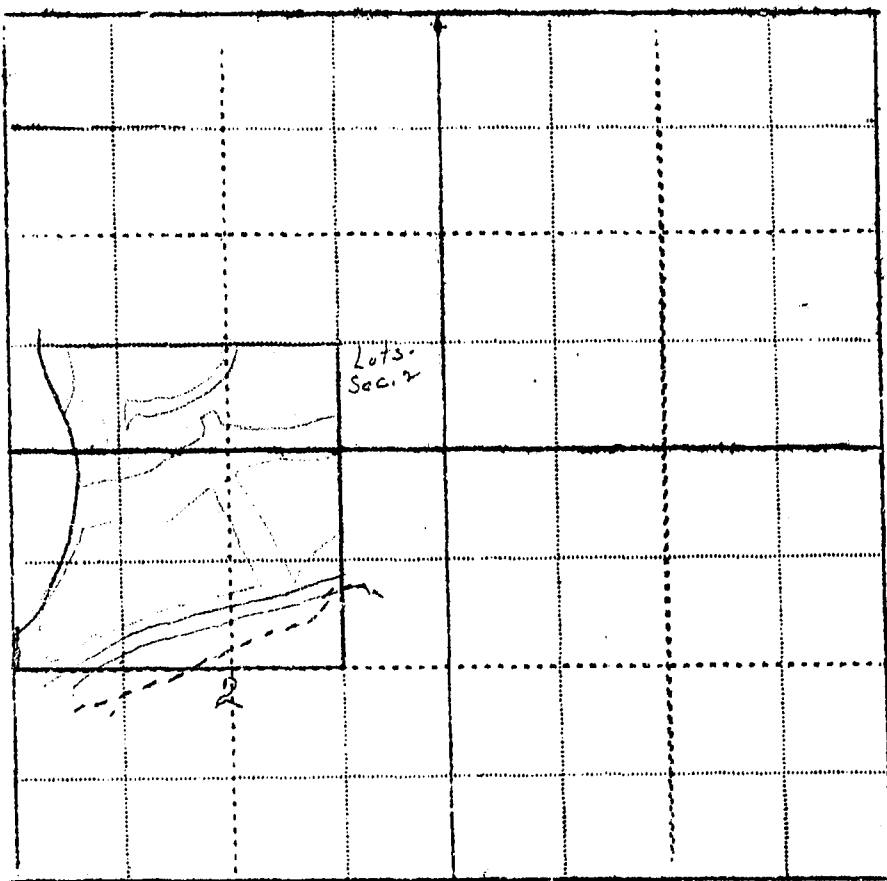

WITNESS: M. J.

Information by Wm Beers

Place Phone 6/15/43

A STUDY OF MONTANA'S WATER RESOURCES

7-B
8-A

County Yellowstone Source of Information A.A.A. # 798

1. Water User Mrs Rebecca Snelson Address 1608 3rd Ave. No Great Falls Mont.

2. Stream _____ Tributary to _____ Basin _____

3. Point of Diversion $\frac{1}{4}$ $\frac{1}{4}$ Section _____ Township _____ Range _____

4. Description of System _____

5. Type of Irrigation _____

6. Original Appropriator _____ Address _____

7. First Use: Year _____ Acres Irrigated _____

8. Maximum Use: Year _____ Acres Irrigated _____

168 9. Present Use: Year 1941 Acres Irrigated 101.9

10. Last Use: Year _____ Why Abandoned _____

11. Condition of System _____

12. Land Description No 9 Ry SE 1/4, lot 142, W 1/4 Sec 8, T 4N, R 33E
Lot 1, Sec 7.

Remarks: 40 acres

Thaco Custer

Evert Littler
Custer, Mont

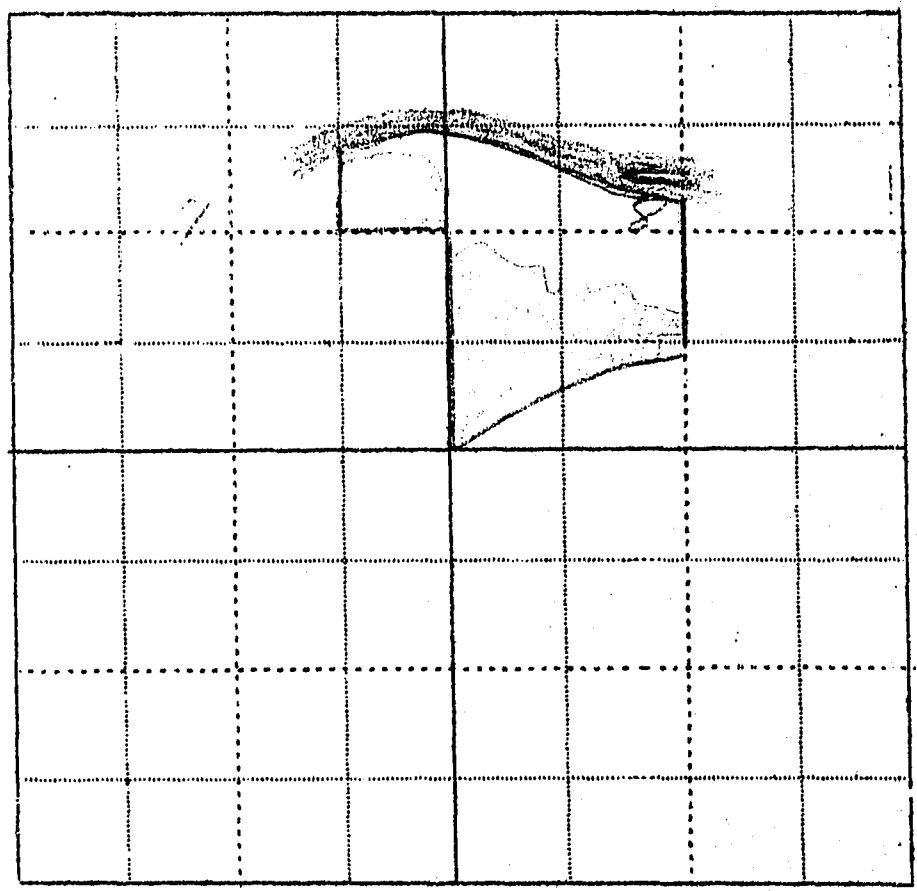

25

WITNESS: _____ Information by _____

Place _____

1575

STATE OF MONTANA WATER RESOURCES SURVEY

County Yellowstone Date May 7, 1943

Name of Water User Evert Littler Address Custer

1. Do you own this land? Yes No If not give the owner's name below:
 Owner's name Mrs. Rebecca Snelson Address 1609 Third Ave. N., Great Falls, Mont.
2. Source of Water Yellowstone River Water delivered by Waco Custer Ditch
3. Give point of Diversion 1/4 Section 1/4 Township Range
4. Water is obtained by: (Check one) Gravity Pumping Other
5. Who first used water on this land? Address
6. In what year was this land first irrigated? Approximate Acres
7. What is the greatest number of acres you have irrigated? Date
8. Present Use: Year 1942 Acres Irrigated 101.9
9. If this land is not irrigated now give date of last use
10. State the total number of acres that could be irrigated 101.9 acres.
11. What is the condition of your irrigation system?
12. Land Description: No. of RR SE 1/4 SW 1/4, Lots , Twp. 4 N. Range 33 E
1 & 2, W 1/2 SW 1/4, Sec. 8; Lot 1, Sec. 7
 Remarks:

Mrs. Snelson has 40 shares in the Waco Custer Ditch

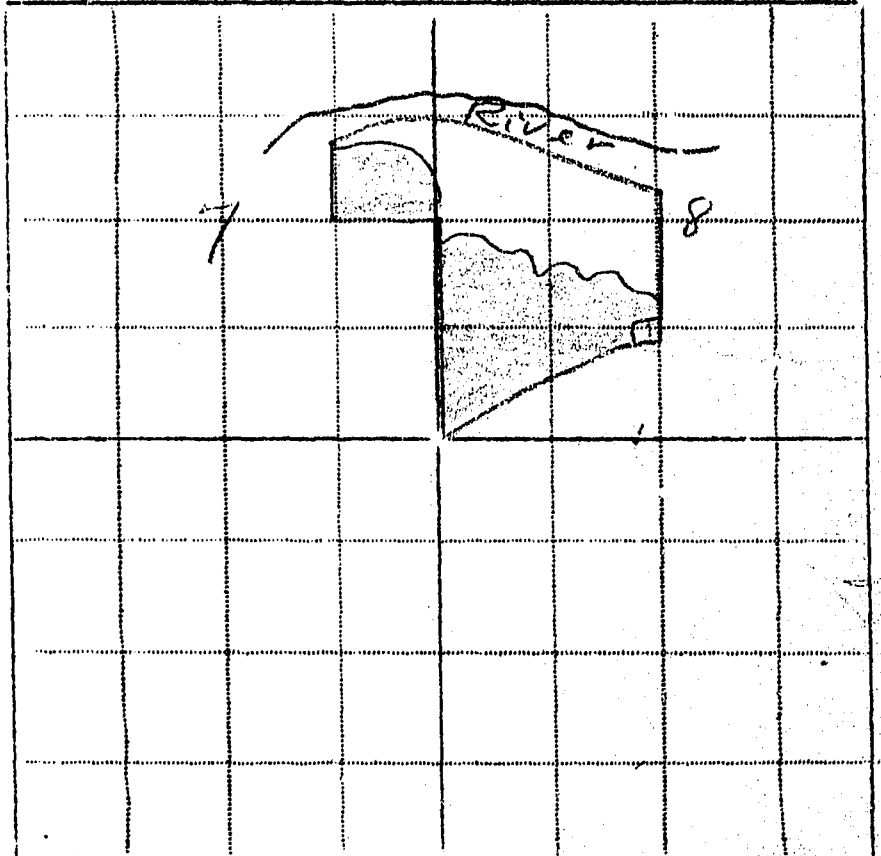

Information by Littler Place Billings Date May 15, 1943
(Evert Littler)

A STUDY OF MONTANA'S WATER RESOURCES

17-C
17-D
19-A
20-A

County Yellowstone Source of Information A.A.A. # 768

Operated by Adams County, Mont

- 1. Water User Mrs. Nellie E. Van Duzer Address Custer, Mont
- 2. Stream _____ Tributary to _____ Basin _____
- 3. Point of Diversion $\frac{1}{4}$ $\frac{1}{4}$ Section _____ Township _____ Range _____
- 4. Description of System _____
- 5. Type of Irrigation _____
- 6. Original Appropriator _____ Address _____
- 7. First Use: Year _____ Acres Irrigated _____
- 8. Maximum Use: Year _____ Acres Irrigated _____
- 9. Present Use: Year 1941 Acres Irrigated 13.7
- 10. Last Use: Year / _____ Why Abandoned _____
- 11. Condition of System _____
- 12. Land Description S² Sec 17, W² NE¹ E² NE¹ S² NW¹ Sec 17, T 41N, R 33E
Sec. 20, E² Sec 19 State Land

Remarks: 20 acres
Waco Custer

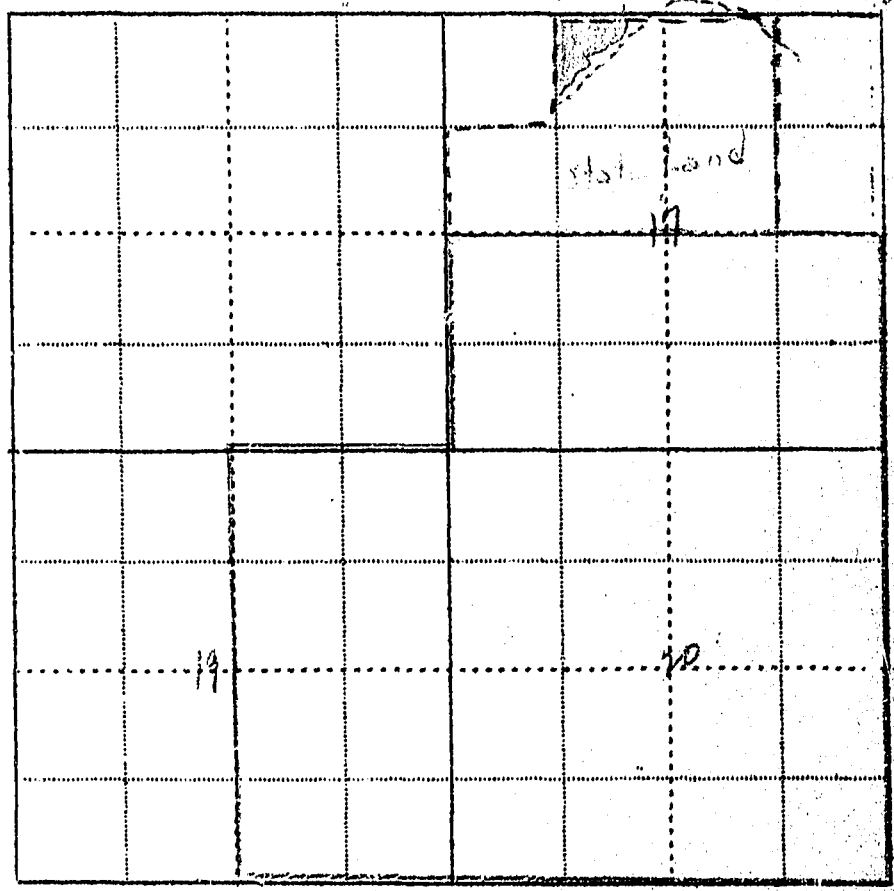

WITNESS: _____ Information by _____

Place _____

Letter sent Apr 12 with Lillian Norton

15-51

FORM SM-1

A STUDY OF MONTANA'S WATER RESOURCES

by Fred Thymann
801 Putnam (Edg)
Davenport Ia.
757

1 F
2 C
3 A
10 B

Op. Charles L. Cassidy
Luster, Mont.

County Yellowstone Source of Information A.A.C. # 757

1. Water User Charles H. Wilson Address James L. Humphrey, Box 1426
Great Falls, Mont.

2. Stream _____ Tributary to _____ Basin _____

3. Point of Diversion $\frac{1}{2}$ Section _____ Township _____ Range _____

4. Description of System _____

5. Type of Irrigation _____

6. Original Appropriator _____ Address _____

7. First Use: Year _____ Acres Irrigated _____

8. Maximum Use: Year _____ Acres Irrigated _____

10 44 9. Present Use: Year 1941 Acres Irrigated 97.0

10. Last Use: Year _____ Why Abandoned? _____

11. Condition of System _____

12. Land Description Trac. SE 4, Sec 3, T 47N, R 33E.

Remarks: n.p.

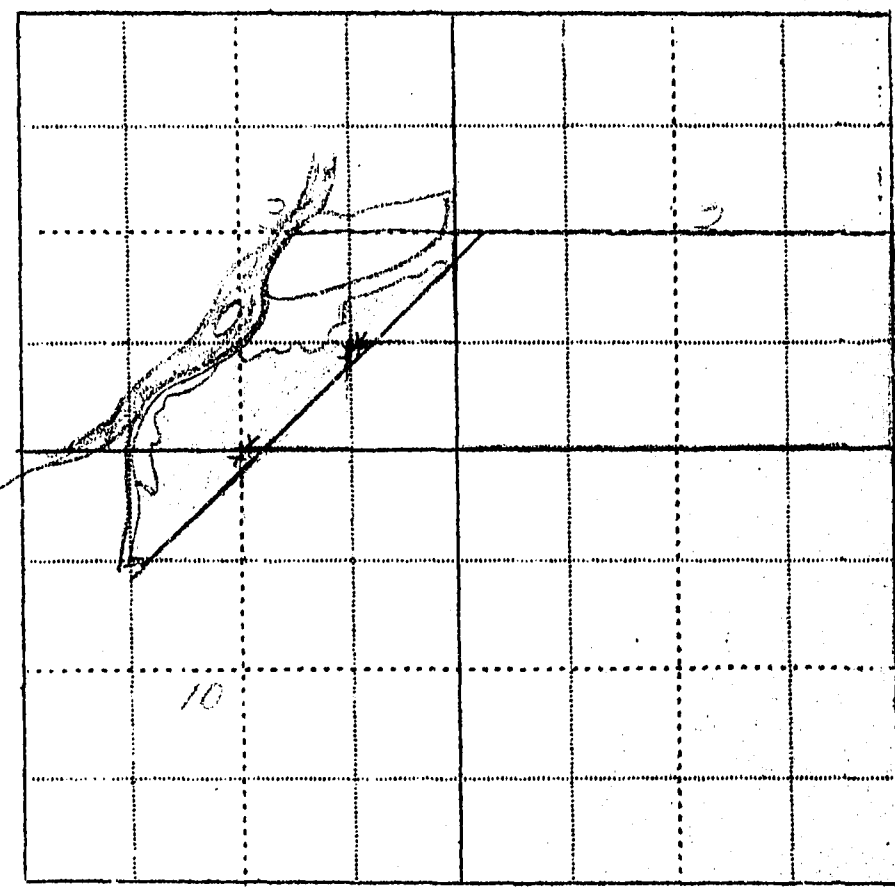

WITNESS: _____ Information by _____

Place _____

1584

STATE OF MONTANA WATER RESOURCES SURVEY

County Yellowstone Date April 12, 1943

Name of Water User Charles S. Cassidy Address Custer

1. Do you own this land? Yes No If not give the owner's name below:
Davenport, Iowa
Owner's name Charles H. Wilson Address % Fred Wynn, 801 Putnam Bldg.

2. Source of Water Yellowstone River Water delivered by _____

3. Give point of Diversion 1/4 1/4 Section _____ Township _____ Range _____

4. Water is obtained by: (Check one) Gravity Pumping _____ Other _____

5. Who first used water on this land? don't know Address _____

6. In what year was this land first irrigated? " Approximate Acres _____

7. What is the greatest number of acres you have irrigated? 97 Date _____

8. Present Use: Year 1942 Acres Irrigated 72

9. If this land is not irrigated now give date of last use _____

10. State the total number of acres that could be irrigated 97 acres.

11. What is the condition of your irrigation system? Headgates not too good.

12. Land Description: Frac. SE 1/4, Sec. 3, Twp. 4 N. Range 33 E.

Remarks: About 25 acres

has too much alkali so
it cuts down irrig.
area to 72 a.
42 shares Custer-Waco
Ditch.
no potential.

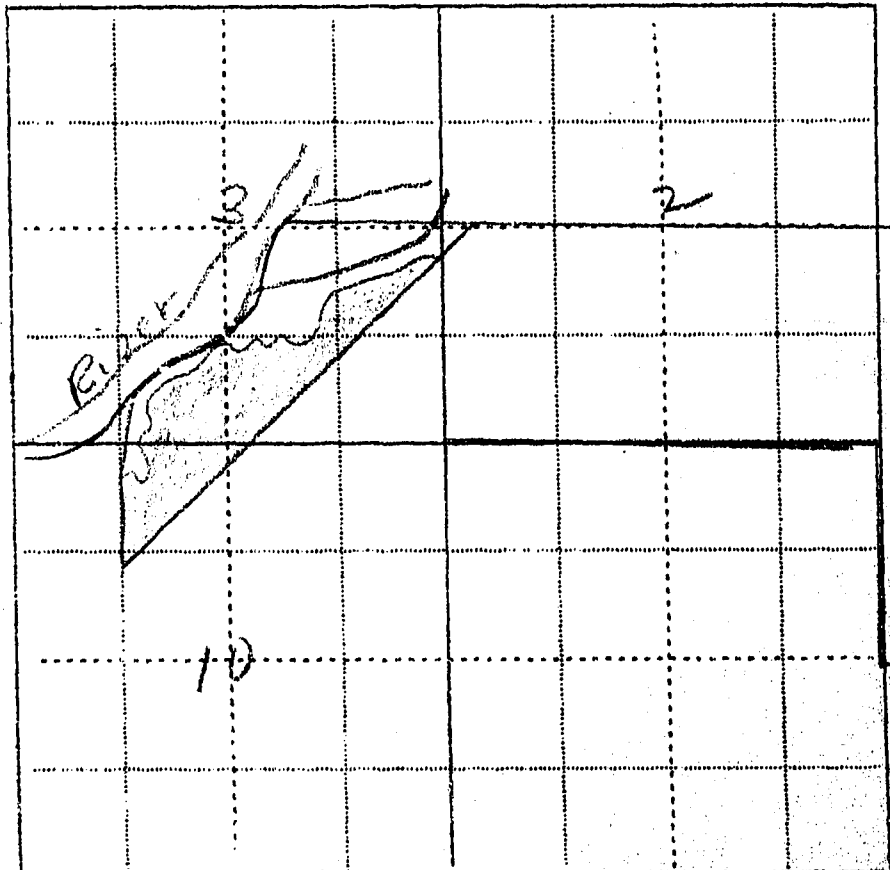

Information by Char S. Cassidy Place Custer Date Apr. 17

6	6	4	8	2	1
7	8	9	10	11	12
18	17	16	15	14	13
19	20	21	22	23	24
30	29	28	27	26	25
31	32	33	34	35	36

Land Ownership.....
.....
.....

Yellowstone

Township 4 North, Range 34 East

Water User

Belts, Geo. G. & Herman Dumler
Biggs, T. B.
Big Horn Farms Co.
Cox, J. A. Jr.
Cross, Bertha O. A.
DeCosse, A. B.
Dumler, George Jr.
Guptill, Lester
Gremmer, John
Jay, Ona M.
Korber, Albert
Koch, Math, Jr.
Kuntz, P. & Weinzetl, J.
Kuntz, P. & Weinzetl. J.
Letz, Arthur
Lingelback, A. L.
Lingelback, A. L.
Norstrom, Nels
Norstrom, Nels
Ray, Harry
St. John, W. E.
Thompson, H. J.
Weinzetl & Kuntz
Wright, D.

STATE OF MONTANA WATER RESOURCES SURVEY

County Yellowstone Date April 12, 1943

Name of Water User Geo. G. Belts & Herman Dunler Address Custer

1. Do you own this land? Yes No If not give the owner's name below:

Owner's name Pauline Cross Address Star Route, Shoshone, Wyo.

2. Source of Water Yellowstone River Water delivered by Victory Ditch

3. Give point of Diversion Section Township Range

4. Water is obtained by: (Check one) Gravity X Pumping Other

5. Who first used water on this land? P Address

6. In what year was this land first irrigated? Approximate Acres

7. What is the greatest number of acres you have irrigated? 65 Date

8. Present Use: Year 1942 Acres Irrigated 55 & 12 or 67

9. If this land is not irrigated now give date of last use

10. State the total number of acres that could be irrigated acres.

11. What is the condition of your irrigation system? Fair

12. Land Description: Lot 5, Sec. 3; Lot 1&8, Sec. 3, Twp. 4 N. Range 34 E.
SE 1/4, SE 1/4, Sec. 32 5 N. 34 E.

Remarks: Has 91.4 shares

in the Victory Ditch

about 8 acres of land on this place already.

All other information is correct to the best of my knowledge,

47.34 = 55 A 71.4 ac.

57.34 = 12 A - 20 ac.

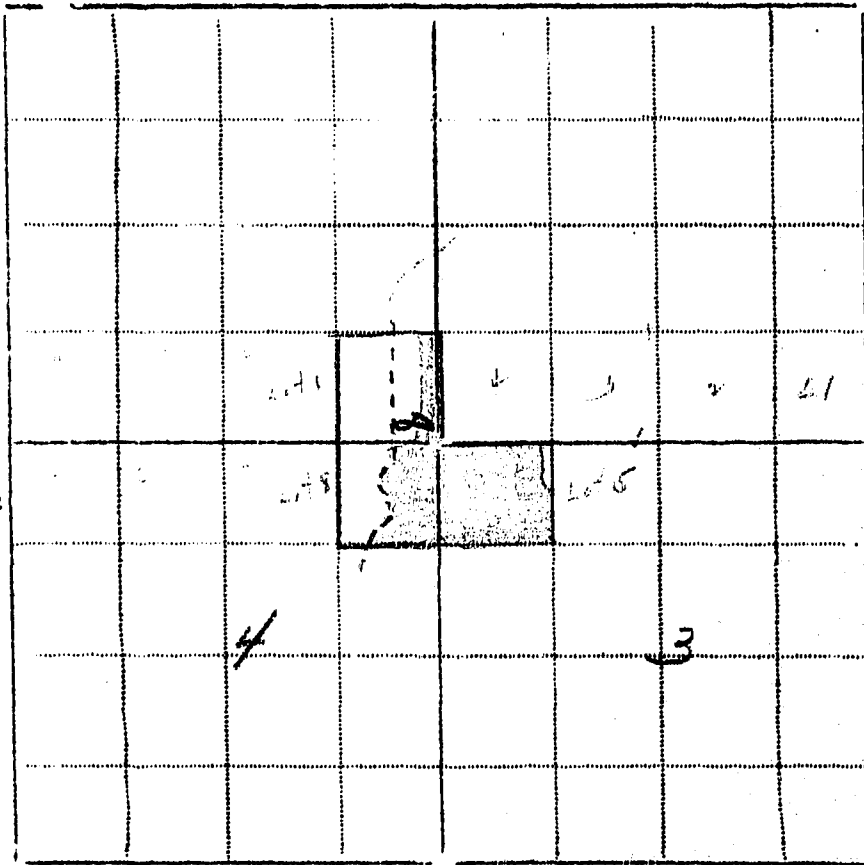

Information by George G. Belts Place Custer Date April 15, 1943

A STUDY OF MONTANA'S WATER RESOURCES

County Yellowstone Source of Information AAA-2245-

1. Water User J.B. Biggs Address Custer

2. Stream _____ Tributary to _____ Basin _____

3. Point of Diversion 1/2 Section _____ Township _____ Range _____

4. Description of System _____

5. Type of Irrigation _____

6. Original Appropriator _____ Address _____

7. First Use: Year _____ Acres Irrigated _____

8. Maximum Use: Year _____ Acres Irrigated _____

9. Present Use: Year 1941 Acres Irrigated 572

10. Last Use: Year _____ Why Abandoned _____

11. Condition of System _____

12. Land Description Sec 9 Sec 7 lot 7 Sec 10 T 47N R 34E

Remarks: _____

Wahara Victory

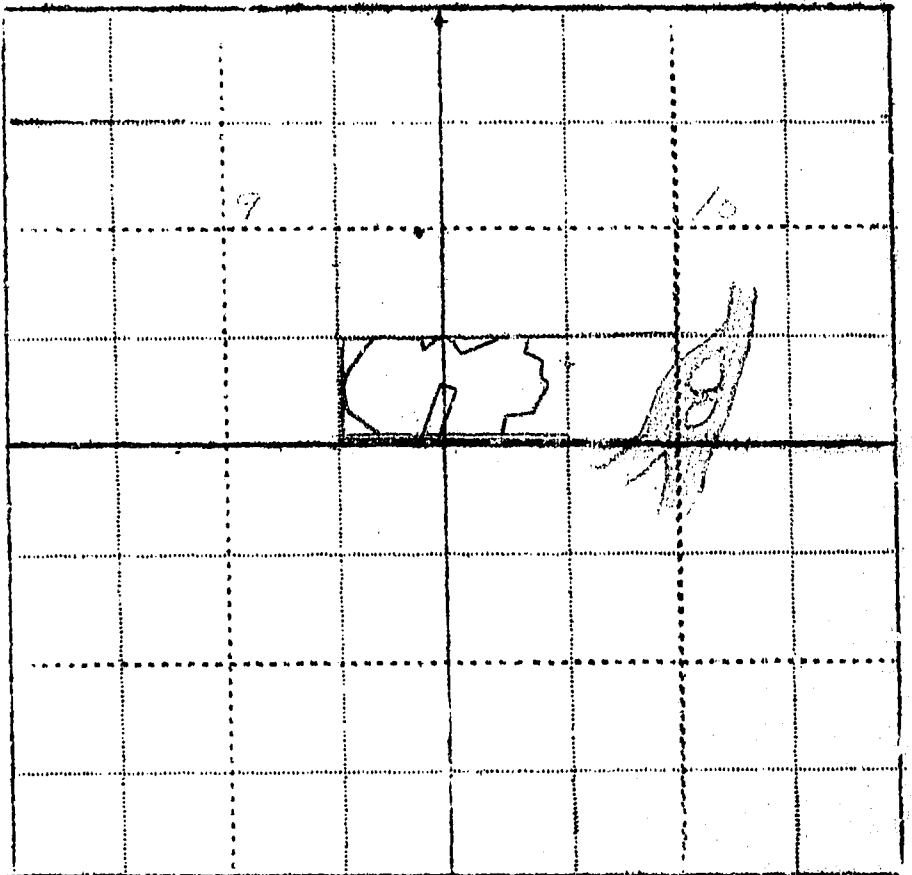

WITNESS: _____ Information by _____

Place _____

A STUDY OF MONTANA'S WATER RESOURCES

9C
10 B

Jack E. Faltin
Custer
J.B. Biggs
Custer

County Y. Stone Source of Information Ad. 2246

1. Water User Biggs, James, et al. A. J. Thompson Address 2815. 4 Ave No Billing

2. Stream Victory Tributary to _____ Basin _____

3. Point of Diversion _____ Section _____ Township _____ Range _____

4. Description of System _____

5. Type of Irrigation Gravity

6. Original Appropriator Biggs Address _____

7. First Use: Year _____ Acres Irrigated _____

8. Maximum Use: Year _____ Acres Irrigated _____

9. Present Use: Year 1941 Acres Irrigated 20.

10. Last Use: Year _____ Why Abandoned 30.00

11. Condition of System Bad

12. Land Description NE 1/4 Sec 9, NW 1/4 Sec 10, T 4 N, R 34 E.

Remarks: _____

90 shares Victory

20 acres crop-land

supplied 10 acres

total 100 acres

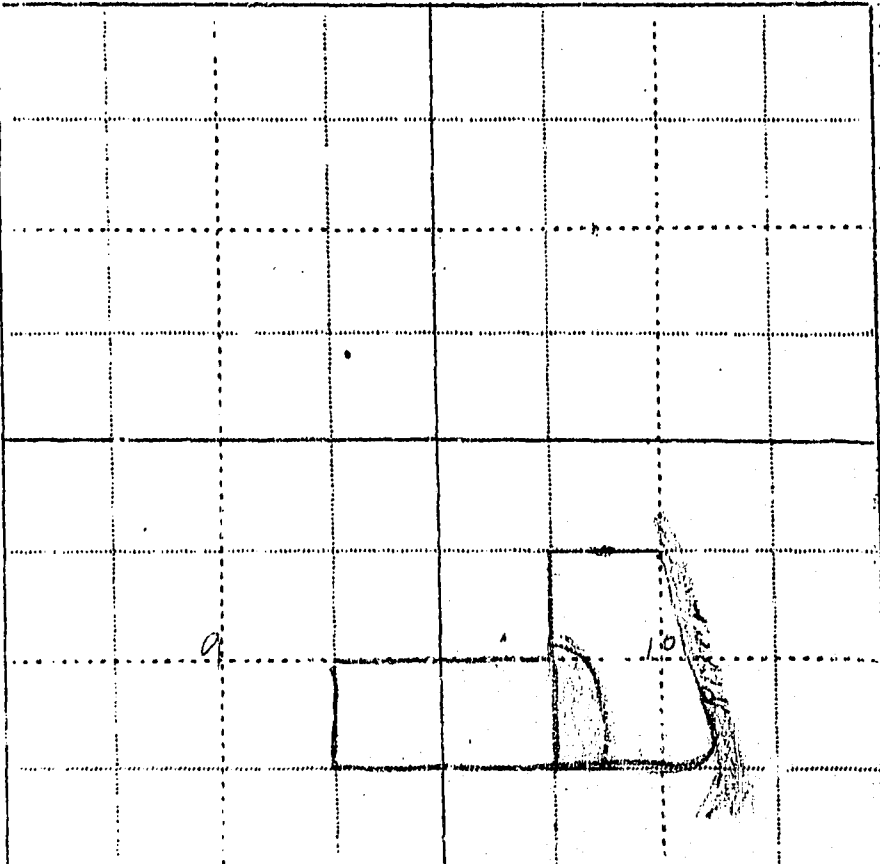

WITNESS _____ Information by Jack E. Faltin

Place May 1943

A STUDY OF MONTANA'S WATER RESOURCES

29 F
30 B
31 A
32 A

County Yellowstone Source of Information AAA 749

1. Water User Bert & O.A. Gross Mr. C. L. Anderson
Address Box 900 - Billings, Mont

2. Stream Big Horn River Tributary to _____ Basin _____

3. Point of Diversion 1/4 1/4 Section _____ Township _____ Range _____

4. Description of System Pump

5. Type of Irrigation canal, rows

6. Original Appropriator Carl Abarr 1942 first use on pump
Address _____

7. First Use: Year _____ Acres Irrigated _____

8. Maximum Use: Year 1942 Acres Irrigated 15.00

756 9. Present Use: Year 1942 Acres Irrigated 16.5 15.00

10. ~~Last Use: Year _____ Why Abandoned _____~~

11. Condition of System _____

12. Land Description Sec. 31 - E 1/4, Sec 30 - W 1/4, SE 1/4, part SW 1/4, 4 sec 29
NW 1/4, part SE 1/4, Sec. 32 - 47. 34E. T 47, R 34E

Remarks: _____ # 346

~~36 Acres Water Control~~
(not sure this is irrigated - M.K.)
Pumped from Big Horn
River - 6 in centrifugal pump
Pump 3-A potential.

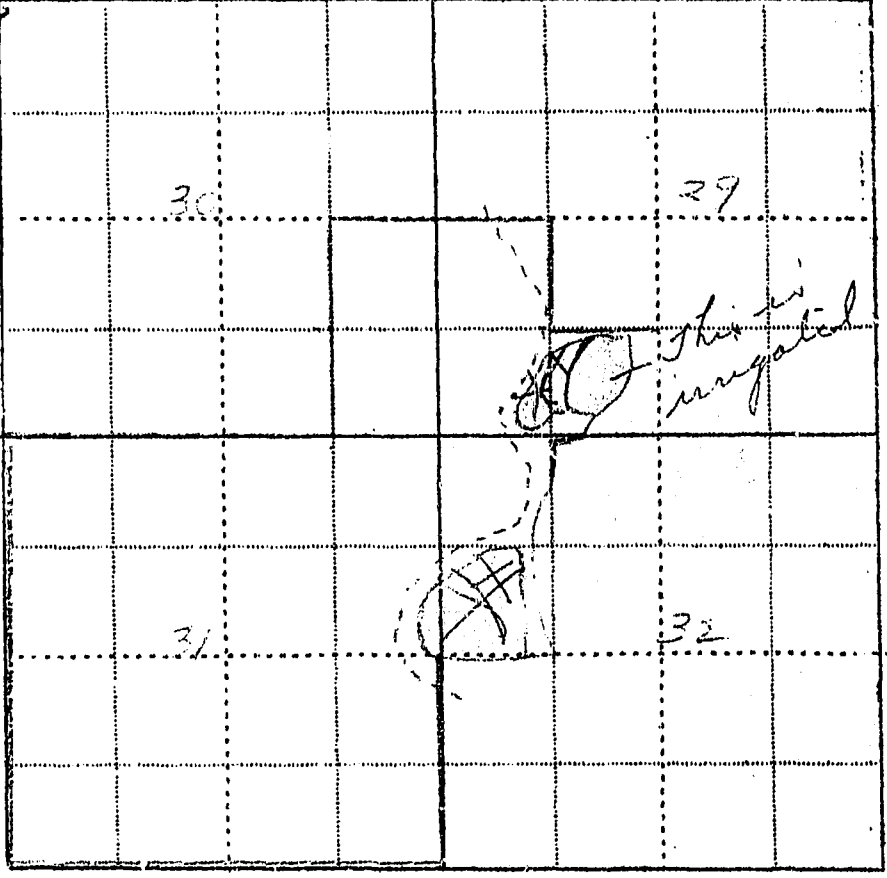

WITNESS: M.K.

Information by Carl Abarr

Place office 5/17-1943

Please Do Not Fill in Any Items on This Page

Notice of Appropriation

1. County Yellowstone Book P Page 378 Record Misc.
2. Name of Appropriator John Harvath Address Pompeys Pillar, Mont.
3. Date Appropriated Dec. 1, 1922 Date Filed Dec. 2, 1922
Amount Appropriated, Miners Inches 100, Cubic Feet per second _____
4. Name of Stream Harvath Coulee Tributary _____ Basin _____
5. Point of Diversion Near NE corner of land listed below

Sec. _____ Twp. _____ Rge. _____ Bank of Stream _____
6. Purpose Irrigation
7. Description of System Ditch 4 ft. wide on top, 1 ft. wide on bottom
1 1/2 to 2 ft. deep. Runs SW from coulee to land of use.
If necessary, claimant will build dam in coulee at
diversion point.
8. Land Description of Intended Place of Use
lots 3, 4, 9 and 10 sec. 31, 4N-34E
part of E²E² sec. 30, 4N-34E
9. Remarks (Pertaining to Use, etc.) Coulee which terminates near NE corner
of above listed land. Carries flood waters which collect
during rainy season of year. Coulee extends SW near
NE corner. Water appropriated Nov. 8, 1922

Decree

10. Case No. _____ Date _____ Amt. Decreed: M. I. _____ C. F. S. _____
11. To Whom Decreed _____ Address _____
12. Name of Ditch _____ Maximum Capacity (C. F. S.) _____
13. Date of Priority _____ Purpose _____
14. Land Description of Place of Use as Decreed _____



STATE OF MONTANA

STATE ENGINEER

HELENA, MONTANA
Billings
May 24, 1943

Mr. Manuel Zahn
Shepherd, Montana

Dear Mr. Zahn:

On April 12, 1943 we sent you a letter asking for certain information pertaining to your irrigated land in Township 4 North, Range 34 East. On May 1, 1943 we sent you another letter asking you to submit the information to us as soon as possible. To date we have not heard from you regarding this matter.

It is hereby declared to be a policy of the State and necessary for the welfare of the State and its citizens, that the waters of this State, and especially interstate streams arising out of the State, be investigated. The State Engineer shall, either before or after the bringing of such action (to adjudicate the waters of any stream and its tributaries in any county traversed by said stream), upon the direction of the State Water Conservation Board, or upon the direction of the court, do all things, make all surveys, and perform all services required by said board in the securing of all necessary information and make the same available to said board or others who may be interested therein, including the courts of this State.

In order to protect the water rights of the water users in this state it is mandatory that the State Engineer have the information that we have asked you to submit to this office.

We expect to hear from you in the very near future.

Very truly yours,

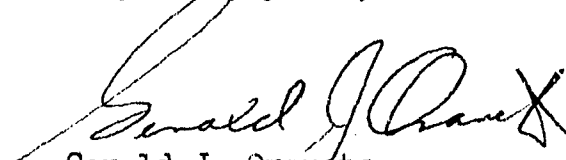
Gerald J. Oravetz
Assistant Engineer

GJO/ rh

STATE ENGINEER
~~REPORT BUILDING~~
Shepherd, Montana

Box 873 
Billings

BILLINGS
MAY 25
1 30 PM
MONT.

RETURN TO WRITER
REASON FOR RETURN CHECKED
 Unknown
 No return address
 No return address
 No return address
 No return address

Mr Manual Zahn
Shepherd, Montana

Thompson

Howard H. A.

STATE OF MONTANA WATER RESOURCES SURVEY

County Yellowstone Date April 12, 1943

Name of Water User Lester Guptill Address Custer

1. Do you own this land? Yes No If not give the owner's name below:

Owner's name H. J. Thompson Address 2815 4th Ave. N., Billings
Big Horn River

2. Source of Water Yellowstone River Water delivered by Victory Ditch

3. Give point of Diversion 1/4 1/4 Section Township Range

4. Water is obtained by: (Check one) Gravity Pumping Other

5. Who first used water on this land? Daving Address Custer Mont

6. In what year was this land first irrigated? X 0 Approximate Acres

7. What is the greatest number of acres you have irrigated? 60 Date

8. Present Use: Year 1942 Acres Irrigated ~~77.1~~ 60

9. If this land is not irrigated now give date of last use

10. State the total number of acres that could be irrigated 80 acres.

11. What is the condition of your irrigation system? Fair

12. Land Description: Lots 2,3,6 & 7, Sec. 3, Twp. 4 N. Range 34 E.

Remarks: Has 90 shares in the

Victory Ditch

*Some of the land is
rough*

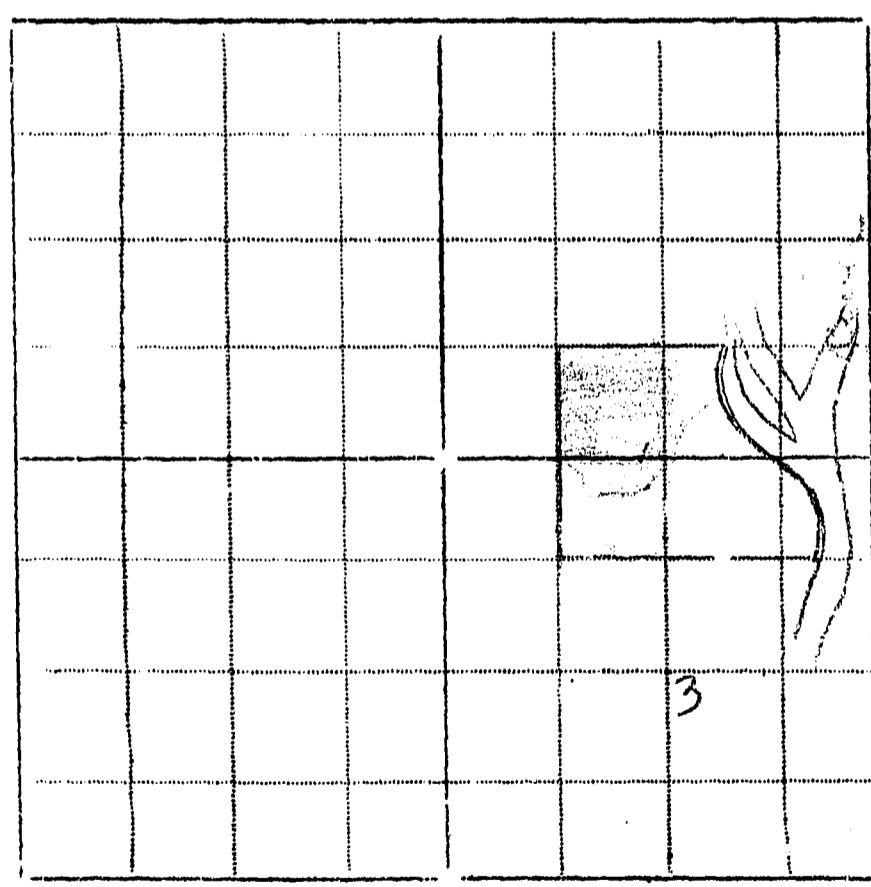

Information by Place Date