

File No. 3

MONTANA WATER RESOURCES BOARD

**RECEIVED**T. 1S R. 10W

DUPLICATE

OCT 10 1968

County Beaverhead

LOG

STATE OF MONTANA

ADMINISTRATOR OF GROUNDWATER CODE

OFFICE OF STATE ENGINEER

Top of Ground

(Elev. above sea level 5525)

Old hand dug well

clay, sand &amp; gravel

sand

sand & gravel  
(water)**Notice of Completion of Groundwater  
Appropriation by Means of Well**

DEVELOPED AFTER JANUARY 1, 1962

(Under Chapter 237, Montana Session Laws, 1961)

Owner Dexter Rexroad Address Dewey, MontanaDriller Barrus Drilling Pump Address Butte, MontanaDate of Notice of appropriation of groundwater July 19, 1968Date well started July 18, 1968 Date completed July 19, 1968Type of well Drilled Equipment used Churn  
(Dug, driven, bored or drilled) (Churn drill, rotary or other)Water use: Domestic ☒ Municipal ☐ Stock ☐ Irrigation ☐  
Industrial ☐ Drainage ☐ Other ☐

Indicate on the diagram the character and thickness of the different strata met with in drilling, such as soil, clay, shale, gravel, rock or sand, etc. Show depth at which water is encountered, thickness and character of water-bearing strata and height to which the water rises in the well.

Size of Drilled Hole	Size and Weight of Casing	From (Feet)	To (Feet)	PERFORATIONS		
				Kind Size	From (Feet)	To (Feet)
6 inch	6" ID 250" 16 lbs	6'	36'	None		

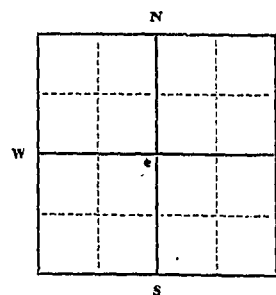
Static Water Level for non-flowing well  
12 feet.

Shut-in Pressure for Flowing Well.....

Pumping Water Level 18 feetat 15 gal. per minute.

Discharge in gal. per min. of flowing well

How Tested BallorLength of Test 1 Hr

Remarks: (Gravel packing, cementing, packers, type of shutoff).....

None

(Continue on reverse side)

USE—If used for irrigation, industrial, drainage or other. Explain, state number of acres and location or other data (i.e.: Lot, Block and Addition).

Show exact depth of bottom.

This form to be prepared by driller, and three copies to be filed by the owner with the County Clerk and Recorder in the county in which the well is located, tissue copy to be retained by driller.

Please answer all questions. If not applicable, so state, otherwise the form will be returned.

179  
Driller's License NumberMortier J. BarrusMortier J. Barrus  
Driller's Signature.

44,679

STATE OF MONTANA  
COUNTY OF BEAVERHEAD  
I hereby certify that the within instrument  
was filed in my office on the 9 day  
of October A. D. 1968 at 0 min.  
past 8 o'clock A. M. and recorded on  
page 675-6 of Book 194 of  
Records of Beaverhead  
County, Montana.

STATE OF MONTANA, ss. 121306  
County of Beaverhead.

I hereby certify that the within instrument  
was filed in my office on the 9 day  
of October A. D. 1968 at 0 min.  
past 8 o'clock A. M. and recorded on  
page 675-6 of Book 194 of  
Records of Beaverhead  
County, Montana.

Attest my hand and seal,

EVELYN J. SAGE

County Recorder

By

*Deane B. Richardson*  
Deputy

Fee \$ 4.00

File No. ....

DUPLICATE

T 1S R 10W

County Beaverhead

STATE OF MONTANA  
ADMINISTRATOR OF GROUNDWATER CODE  
OFFICE OF STATE ENGINEER

**Declaration of Vested Groundwater Rights**  
(Under Chapter 237, Montana Session Laws, 1961)

RECEIVED  
JUN 26 1962

STATE ENGINEER

1. The Montana Power Company, of 40 East Broadway Butte  
(Name of Appropriator) (Address) (Town)

County of Beaverhead State of Montana

have appropriated groundwater according to the Montana laws in effect prior to January 1, 1962, as follows:

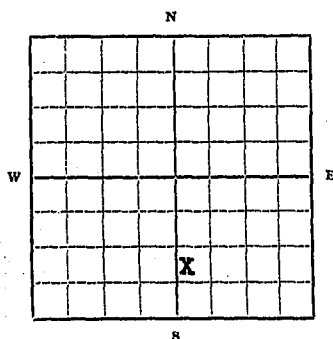

SW 1/4 Sec 11 T 1S R 10W

Indicate point of appropriation and place of use, if possible. Each small square represents 10 acres.

2. The beneficial use on which the claim is based Domestic consumption

3. Date or approximate date of earliest beneficial use; and how continuous the use has been Continuous since 1910

4. The amount of groundwater claimed (in miner's inches or gallons per minute) .8 Gallons per minute - 12 hours per day

5. If used for irrigation, give the acreage and description of the lands to which water has been applied and name of the owner thereof

6. The means of withdrawing such water from the ground and the location of each well or other means of withdrawal Well

7. The date of commencement and completion of the construction of the well, wells, or other works for withdrawal of groundwater 1910

8. The depth of water table 13'

9. So far as it may be available, the type, size and depth of each well or the general specifications of any other works for the withdrawal of groundwater 24" culvert steel pipe - 16' deep

10. The estimated amount of groundwater withdrawn each year 69,120 Gallons

11. The log of formations encountered in the drilling of each well if available Gravel

12. Such other information of a similar nature as may be useful in carrying out the policy of this act, including reference to book and page of any county record

(CORPORATE SEAL)

Attest:

Its Secretary

THE MONTANA POWER COMPANY

Signature of Owner By Vice President

Date February 1, 1962

Three copies to be filed by the owner with the County Clerk and Recorder of the county in which the well is located.

Please answer all questions. If not applicable, so state, otherwise the form will be returned.

Original to the County Clerk and Recorder; duplicate to the State Engineer; Triplicate to the School of Mines and Quadruplicate for the Appropriator.

...of the ...  
...of the ...

...of the ...  
...of the ...

...of the ...  
...of the ...

...of the ...  
...of the ...

...of the ...  
...of the ...

...of the ...  
...of the ...

...of the ...  
...of the ...

...of the ...  
...of the ...

...of the ...  
...of the ...

...of the ...  
...of the ...

...of the ...  
...of the ...

...of the ...  
...of the ...

...of the ...  
...of the ...

...of the ...  
...of the ...

...of the ...  
...of the ...

...of the ...  
...of the ...

...of the ...  
...of the ...

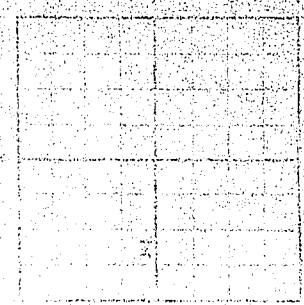

...of the ...  
...of the ...

...of the ...  
...of the ...

...of the ...  
...of the ...

...of the ...  
...of the ...

...of the ...  
...of the ...

...of the ...  
...of the ...

...of the ...  
...of the ...

...of the ...  
...of the ...

...of the ...  
...of the ...

...of the ...  
...of the ...

...of the ...  
...of the ...

...of the ...  
...of the ...

...of the ...  
...of the ...

...of the ...  
...of the ...

STATE OF MONTANA, ss. 104213  
County of Beaverhead.

I hereby certify that the within instrument  
was filed in my office on the 12 day  
of Apr A. D. 1962 at 31 min.  
past 9 o'clock, P. M. and recorded on  
page 237 of Book 151 of  
Water Well Records of Beaverhead  
County, Montana.

Attest my hand and seal,  
Dulyn J. Seger  
County Recorder

By \_\_\_\_\_ Deputy  
Rec 5

File No. ....

DUPLICATE

T 1S R 10W

County Beaverhead

STATE OF MONTANA  
ADMINISTRATOR OF GROUNDWATER CODE  
OFFICE OF STATE ENGINEER

RECEIVED  
JUN 26 1962

Declaration of Vested Groundwater Rights  
(Under Chapter 237, Montana Session Laws, 1961)

STATE ENGINEER

1. The Montana Power Company of 40 East Broadway Butte  
(Name of Appropriator) (Address) (Town)  
County of Beaverhead State of Montana  
have appropriated groundwater according to the Montana laws in effect prior to January 1, 1962, as follows:

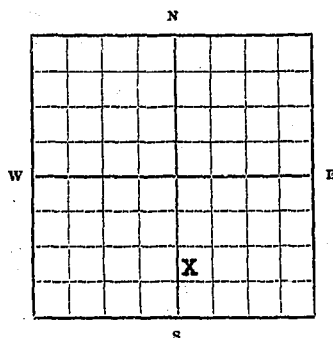

SW 1/4 SE 1/4 Sec. 11 T1S. R. 10W

Indicate point of appropriation  
and place of use, if possible.  
Each small square represents 10  
acres.

2. The beneficial use on which the claim is based Domestic consumption
3. Date or approximate date of earliest beneficial use; and how continuous the use has been Continuous since 1928
4. The amount of groundwater claimed (in miner's inches or gallons per minute) 1/2 Gallon per minute - 10 hours per day
5. If used for irrigation, give the acreage and description of the lands to which water has been applied and name of the owner thereof
6. The means of withdrawing such water from the ground and the location of each well or other means of withdrawal Well
7. The date of commencement and completion of the construction of the well, wells, or other works for withdrawal of groundwater 1928
8. The depth of water table 12"
9. So far as it may be available, the type, size and depth of each well or the general specifications of any other works for the withdrawal of groundwater 3' - Concrete 16' deep
10. The estimated amount of groundwater withdrawn each year 109,500 Gallons
11. The log of formations encountered in the drilling of each well if available Gravel
12. Such other information of a similar nature as may be useful in carrying out the policy of this act, including reference to book and page of any county record.

(CORPORATE SEAL)

Attest:

Tom Day  
Its Secretary

THE MONTANA POWER COMPANY

Signature of Owner By W. H. Kirk  
Vice President

Date February 1, 1962

Three copies to be filed by the owner with the County Clerk and Recorder of the county in which the well is located.

Please answer all questions. If not applicable, so state, otherwise the form will be returned.

Original to the County Clerk and Recorder; duplicate to the State Engineer; Triplicate to the School of Mines and Quaduplicate for the Appropriator.

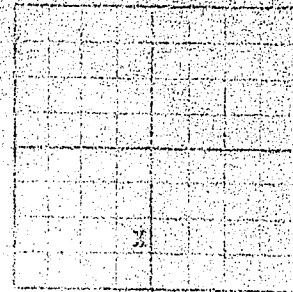

STATE OF MONTANA, ss. 104214  
County of Beaverhead.

I hereby certify that the within instrument  
was filed in my office on the 12 day  
of April A. D. 1967 at 32 min.  
past 9 o'clock P. M. and recorded on  
page 239 of Book 151 of  
Water Well Records of Beaverhead  
County, Montana.

Attest my hand and seal,

County Recorder

By

Deputy

Fee \$

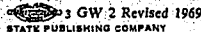

STATE OF MONTANA  
ADMINISTRATOR OF GROUNDWATER CODE  
MONTANA WATER RESOURCES BOARD

# NOTICE OF COMPLETION OF GROUNDWATER APPROPRIATION BY MEANS OF WELL.....

**Developed after January 1, 1962**

(Under Chapter 237 Montana Session Laws, 1961, as amended)

This form to be prepared by driller, and three copies to be filed by the owner with the County Clerk and Recorder in the county in which the well is located, last copy to be retained by driller.

Please answer all questions. If not applicable, so state, otherwise the form may be returned.

Owner Eugene Ardisson

Address Divide Mont

Date well started 3/2/73

completed 3/5/75

Type of well dripped

(Dug, driven, bored or drilled)

Equipment used Chain drill

(Churn drill, rotary or other)

Water Use: Domestic ☒ Municipal ☐ Stock ☐ Irrigation ☐

Industrial ☐ Drainage ☐ Other ☐\* Garden/Lawn ☒

**\*Describe**

**USE:** If used for irrigation, industrial, drainage or other. Explain, state number of acres and location or other data (i.e. Lot, Block and Addition). .....

## ESTIMATED ANNUAL WITHDRAWAL

Size of Drilled Hole	Size and Weight of Casing	From (Feet)	To (Feet)	PERFORATIONS		
				Kind Size	From (Feet)	To (Feet)
6 in	219	0	50	Cutting torch 2 - 6 Ft		

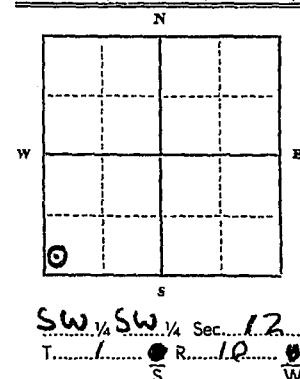

Static water level 32 ft.\*  
Pumping water level 70 ft.\*  
at 12 gallons per minute,  
measured 60 minutes after pumping  
began.

\*Measured from ground level.

Well developed by bailing  
for 2 hours.

Power..... Pump..... HP

Remarks: (Gravel packing, cementing,  
packers, type of shutoff) .....

INDICATE LOCATION OF WELL AND PLACE OF USE, IF POSSIBLE.  
EACH SMALL SQUARE REPRESENTS 40 ACRES.

Driller's Signature \_\_\_\_\_

Driller's Address:

Quacunda Mont

LICENSE NO. 209

County Beaverhead

**DRILLER'S LOG**

Indicate the character, color, thickness of strata such as soil, clay, sand, gravel, shale, sandstone, etc. Show depth at which water is found and height to which water rises in well.

RECEIVED Indicate

MAR 26 1951

MONTANA DEPARTMENT OF NATURAL  
RESOURCES AND CONSERVATION  
(ended) Top of Ground

Top of Ground

(Elev. above sea level)

[illegible]

50

Show exact depth of bottom

62,733

133372

133372

133372

STATE OF MONTANA, County of Beaverhead ss. I hereby certify that the within instrument was filed in my office on 22nd day of March A.D. 1913 at 01 min. past 8:00 o'clock P.M. and record page 29-30 of book 205, Records of Beaverhead County, Montana.

Attest my hand and seal  
By Charles A. Burrows Deputy  
Fee \$ 4.00

Margaret A. Thompson  
County Recorder

about 1913

18th of March

1913

1913



GW 2

Approved Stock Form—State Publishing Co., Helena, Montana—1964

File No. \_\_\_\_\_

DUPLICATE

MONTANA WATER RESOURCES BOARD  
LOG RECEIVEDSTATE OF MONTANA  
ADMINISTRATOR OF GROUNDWATER CODE  
OFFICE OF STATE ENGINEERCounty Beaverhead

Top of Ground \_\_\_\_\_

JUL 28 1969

(Elev. above sea level \_\_\_\_\_)

## Notice of Completion of Groundwater

## Appropriation by Means of Well

DEVELOPED AFTER JANUARY 1, 1962

(Under Chapter 287, Montana Session Laws, 1961)

0-6 heavy broken rock &  
dirtOwner Kendrick SmithAddress Butte, MontanaDriller Carl F. HollensteinerAddress Dillon, Mont.

6-25 clay &amp; gravel

Date of Notice of appropriation of groundwater. \*\*\*\*\*

Date well started Apr. 14, 1969Date completed Apr. 15, 1969

25- 37 semi solid rock

Type of well DrilledEquipment used Churn Drill

(Dug, driven, bored or drilled)

(Churn drill, rotary or other)

Water use:

Domestic ☒Municipal ☐Stock ☐Irrigation ☐Industrial ☐Drainage ☐Other ☐

37-42 rock ( solid)

Indicate on the diagram the character and thickness of the different strata met with in drilling, such as soil, clay, shale, gravel, rock or sand, etc. Show depth at which water is encountered, thickness and character of water-bearing strata and height to which the water rises in the well.

Finished @ 42 in coarse sand

Size of Drilled Hole	Size and Weight of Casing	From (Feet)	To (Feet)	PERFORATIONS		
				Kind Size	From (Feet)	To (Feet)
6"	6" I.D. 17 lb.	1'	up 37	None		

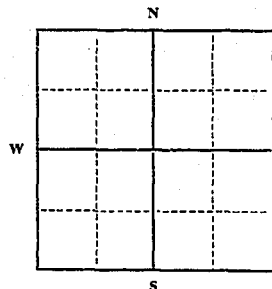

Static Water Level for non-flowing well \_\_\_\_\_ 18 feet.

Shut-in Pressure for Flowing Well. \*\*\*\*\*

Pumping Water Level \_\_\_\_\_ 28 feet

at \_\_\_\_\_ 20 gal. per minute.

Discharge in gal. per min. of flowing well \*\*\*\*\*

How Tested Bailer

Length of Test \_\_\_\_\_ 1 hr.

Remarks: (Gravel packing, cementing, packers, type of shutoff) XXXX

Indicate location of well and place of use, if possible. Each small square represents 40 acres.

Sec. 12 T. 15 S. R. 10 W.

(Continue on reverse side)

USE—If used for irrigation, industrial, drainage or other. Explain, state number of acres and location or other data (i.e.: Lot, Block and Addition).

\*\*\*\*\*

Show exact depth of bottom.

This form to be prepared by driller, and three copies to be filed by the owner with the County Clerk and Recorder in the county in which the well is located, tissue copy to be retained by driller.

Please answer all questions. If not applicable, so state, otherwise the form will be returned.

License No. 9

Driller's License Number \_\_\_\_\_

Driller's Signature \_\_\_\_\_

45482

STATE OF MONTANA, ss. 123449  
County of Beaverhead.

I hereby certify that the within instrument  
was filed in my office on the 24 day  
of July A. D. 1969 at 03 min.  
past 8 o'clock P. M. and recorded on  
page 120-1 of Book 197 of

Records of Beaverhead  
County, Montana.

Attest my hand and seal.

*Edgar J. Sager*

County Recorder

By *Edgar J. Sager*

Deputy

Fee \$ 4.00

File No. ....

DUPLICATE

T 1 S. R. 10 W. - 14

County Beaverhead

STATE OF MONTANA  
ADMINISTRATOR OF GROUNDWATER CODE  
OFFICE OF STATE ENGINEER

RECEIVED  
SEP 8 1964

**Notice of Completion of Groundwater Appropriation  
Without Well**

STATE ENGINEER

(Under Chapter 237 Montana Session Laws, 1961)

Date of Appropriation of Groundwater July 29, 1964  
Bureau of Box 191  
Owner Land Management Address Dillon, Montana 59725

Contractor (if any) Not Applicable

Address of Contractor N/A

Date Started 12-8-63 Date Completed 7-28-64

Describe means of obtaining groundwater without a well "as by sub-irrigation and other natural processes". Include depth to water when applicable. A covered collection system using tile to lead water to control point. Water is piped to stockwater tank approximately 6 feet to the water table.

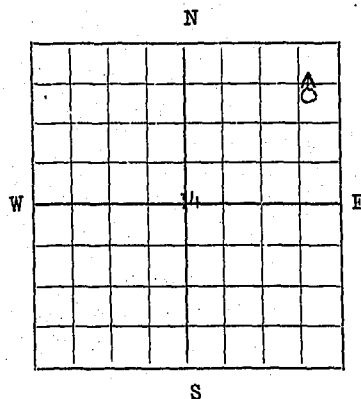

NE 1/4 NE 1/4 Sec. 14 T. 1 S. R. 10 W.

Indicate point of appropriation and place of use, if possible.

Quantity of water developed and used with explanation of method used to measure or estimate such amount. If use is intermittent estimate approximate lengths of periods of use. Approximately 3 gallons per minute measured by a container of known volume for a known period of time. Period of use from April 1 to November 30.

BUREAU OF LAND MANAGEMENT BY:

Signature of Owner

Date JUL 30 1964

This form to be prepared by contractor (if any), otherwise by the owner.

Three copies of this notice are to be filed with the County Clerk and Recorder of the county in which the works are located.

Please answer all questions. If not applicable, so state, otherwise the form will be returned.

Original to the County Clerk and Recorder; duplicate to the State Engineer; Triplicate to the Montana Bureau of Mines and Geology and Quadruplicate for the Appropriator.

38441

STATE OF MONTANA, ss.  
County of Beaverhead.

110725

I hereby certify that the within instrument  
was filed in my office on the 5 day  
of Aug A. D. 1964 at 05 min.  
past 2 o'clock P. M. and recorded on  
page 555 of Book 133 of  
Wain Records of Beaverhead  
County, Montana.

Attest my hand and seal,

Carlson J. Sage  
County Recorder

By \_\_\_\_\_

Deputy

Fee \$ 4.00

File No. STATE WATER CONSERVATION BOARD

T. 15 R. 10 W

DUPLICATE

JAN 4 1966

County Beaverhead

Bill LOG

Butzerin

Darlington

Top of Ground  
(Elev. above sea level)  
Surface to  
11' Open Hole

STATE OF MONTANA  
ADMINISTRATOR OF GROUNDWATER CODE  
OFFICE OF STATE ENGINEER

Notice of Completion of Groundwater  
Appropriation by Means of Well  
DEVELOPED AFTER JANUARY 1, 1962

(Under Chapter 237, Montana Session Laws, 1961)

19' Sand Gravel &  
Boulders

Owner John V. Fallon Address Dewey, Mont.

Driller C. F. Wroble Address R. Rte. 1 Milcreek  
Anaconda, Mont.

Date of Notice of appropriation of groundwater

Date well started Oct. 15, 1965 Date completed Oct. 16, 1965

Type of well Drilled Equipment used Churn Drill  
(Dug, Driven, bored or drilled) (Churn drill, rotary or other)Water use: Domestic ☒ Municipal ☐ Stock ☐ Irrigation ☐  
Industrial ☐ Drainage ☐ Other ☐

33' Intermitten layers  
of Sand Gravels and  
Clay mix

Indicate on the diagram the character and thickness of the different strata met with in drilling, such as soil, clay, shale, gravel, rock or sand, etc. Show depth at which water is encountered, thickness and character of water-bearing strata and height to which the water rises in the well.

38' Sand Gravel  
Water-Bearing

Size of Drilled Hole	Size and Weight of Casing	From (Feet)	To (Feet)	PERFORATIONS		
				Kind Size	From (Feet)	To (Feet)
6"	6" 20lb. per ft	11'	38'			

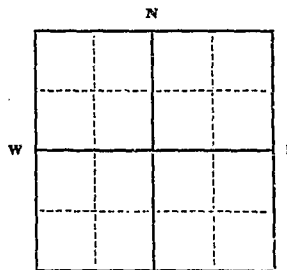
Static Water Level for non-flowing well  
9' feet.

Shut-in Pressure for Flowing Well

Pumping Water Level 25' feet  
at 25 gal. per minute.

Discharge in gal. per min. of flowing well

How Tested Failed

Length of Test 2 hr.

Lot 43-1N Dewey, Mont  
1/4 Sec. T. 15 R. 10 W  
Indicate location of well and  
place of use, if possible. Each  
small square represents 40  
acres.

Remarks: (Gravel packing, cementing, pack-  
ers, type of shutoff)

(Continue on reverse side)

USE—If used for irrigation, industrial, drainage or other. Explain, state  
number of acres and location or other data (i.e.: Lot, Block and Addi-  
tion).

Show exact depth of bottom.

This form to be prepared by driller, and three copies to be filed by the owner with the  
County Clerk and Recorder in the county in which the well is located, tissue copy to be  
retained by driller.

Please answer all questions. If not applicable, so state, otherwise the form will be  
returned.

62  
Driller's License Number

C. F. Wroble  
Driller's Signature

40449

STATE OF MONTANA,  
County of Beaverhead.

113827

I hereby certify that the within instrument  
was filed in my office on the 23rd day  
of Nov. A. D. 1945 at 30 min.

past 1 o'clock, P. M. and recorded on  
page 83 of 182 of

Water Well of Beaverhead  
County, Montana.

Attest my hand and seal,

Carolyn J. Sage  
County Recorder

By \_\_\_\_\_ Deputy

Fee 3.75

File No. ....

DUPLICATE

T. 15 R. 10 S. 30

County

Beaverhead

STATE OF MONTANA  
ADMINISTRATOR OF GROUNDWATER CODE  
OFFICE OF STATE ENGINEER

**Declaration of Vested Groundwater Rights**

(Under Chapter 237, Montana Session Laws, 1961)

1. JOE AND MARY HOLLY (PLEASE FORWARD TO 907 S. MAIN-BUTTE MONT) of DEWEY  
(Name of Appropriator) (Address) (Town)  
County of BEAVERHEAD State of MONTANA  
have appropriated groundwater according to the Montana laws in effect prior to January 1, 1962, as follows:

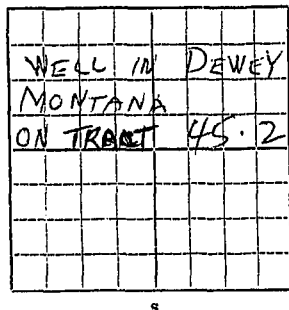

..... 1/4 Sec. T. 15 R. 10 S.

Indicate point of appropriation and place of use, if possible. Each small square represents 10 acres.

2. The beneficial use on which the claim is based USED FOR HUMAN CONSUMPTION
3. Date or approximate date of earliest beneficial use; and how continuous the use has been SPRING OF 1940  
AND HAS BEEN IN CONTINUOUS USE
4. The amount of groundwater claimed (in miner's inches or gallons per minute) NOMINAL AMOUNT
5. If used for irrigation, give the acreage and description of the lands to which water has been applied and name of the owner thereof ONLY IRRIGATION OF SMALL GARDEN PLOT BY JOE HOLLY  
1/4 ACRE
6. The means of withdrawing such water from the ground and the location of each well or other means of withdrawal WITHDRAWN BY HAND PUMP
7. The date of commencement and completion of the construction of the well, wells, or other works for withdrawal of groundwater SPRING OF 1940
8. The depth of water table 18 FEET
9. So far as it may be available, the type, size and depth of each well or the general specifications of any other works for the withdrawal of groundwater THE WELL IS APPROX 3 FEET IN DIAMETER  
AND 20 FEET DEEP
10. The estimated amount of groundwater withdrawn each year 2500 GALS
11. The log of formations encountered in the drilling of each well if available RIVER ROCK  
AND SAND
12. Such other information of a similar nature as may be useful in carrying out the policy of this act, including reference to book and page of any county record DONT KNOW OF ANY

Signature of Owner Joe Holly and Mary Holly

Date OCT 15 - 1963

Three copies to be filed by the owner with the County Clerk and Recorder of the county in which the well is located.

Please answer all questions. If not applicable, so state, otherwise the form will be returned.

Original to the County Clerk and Recorder; duplicate to the State Engineer; Triplicate to the School of Mines and Quadruplicate for the Appropriator.

6895

107885

INDEXED

STATE OF MONTANA, : ss.  
County of Beaverhead. :

I hereby certify that the within instrument  
was filed in my office on the 23rd day  
of October A. D. 1963 at 5 min.  
past 8:00 o'clock A. M. and recorded on  
page 477-8 of Book 151 of  
Private Records of Beaverhead  
County, Montana.

Attest my hand and seal,

[Signature]  
County Recorder

By \_\_\_\_\_ Deputy  
Per 400



File No. ....

DUPLICATE

LOG STATE WATER CONSERVATION BOARD

T. 15 R. 10 W

County Bakerhead

OCT 7 1966

STATE OF MONTANA

ADMINISTRATOR OF GROUNDWATER CODE

OFFICE OF STATE ENGINEER

Top of Ground

(Elev. above sea level)

By McDermott  
Witness McDermott  
Recorder McDermott  
Clerk McDermott

## Notice of Completion of Groundwater

## Appropriation by Means of Well

DEVELOPED AFTER JANUARY 1, 1962

(Under Chapter 237, Montana Session Laws, 1961)

0-4 surface dirt

Owner Joe Holly Address Butte, MontanaDriller Mr. L. F. Hollenstainer Address Dillon, MontanaDate of Notice of appropriation of groundwater \*\*\*

4-33 boulders, sand &amp; gravel

Date well started July 12, 1966 Date completed July 14, 1966Type of well Drilled Equipment used Churn Drill  
(Dug, Driven, bored or drilled) (Churn drill, rotary or other)Water use: Domestic ☒ Municipal ☐ Stock ☐ Irrigation ☐  
Industrial ☐ Drainage ☐ Other ☐

33-39 sand &amp; gravel

Indicate on the diagram the character and thickness of the different strata met with in drilling, such as soil, clay, shale, gravel, rock or sand, etc. Show depth at which water is encountered, thickness and character of water-bearing strata and height to which the water rises in the well.

finished at 39' coarse sand

Size of Drilled Hole	Size and Weight of Casing	From (Feet)	To (Feet)	PERFORATIONS		
				Kind Size	From (Feet)	To (Feet)
6"	6" blk 18.97 lb	1' up	39	None		

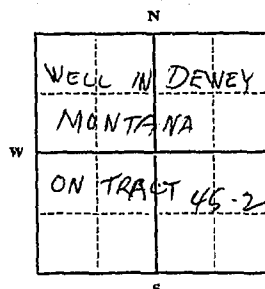
Static Water Level for non-flowing well 12 feet.Shut-in Pressure for Flowing Well \*\*\*Pumping Water Level 20 feet at 30 gal. per minute.Discharge in gal. per min. of flowing well \*\*\*How Tested BailerLength of Test 1 hr.Remarks: (Gravel packing, cementing, packers, type of shutoff) \*\*\*

1/4 Sec. T. 15 R. 10 W

Indicate location of well and place of use, if possible. Each small square represents 40 acres.

(Continue on reverse side)

USE—If used for irrigation, industrial, drainage or other. Explain, state number of acres and location or other data (i.e.: Lot, Block and Addition).

Show exact depth of bottom.

This form to be prepared by driller, and three copies to be filed by the owner with the County Clerk and Recorder in the county in which the well is located, tissue copy to be retained by driller.

Please answer all questions. If not applicable, so state, otherwise the form will be returned.

License No. 9

Driller's License Number

Driller's Signature

41, 481

STATE OF MONTANA ss.  
County of Beaverhead

115479

I hereby certify that the within instrument  
was filed in my office on the 22nd day  
of July A.D. 1966 at 0.6 min-  
past 9 o'clock A.M. and recorded on  
page 101 of Book 182 of  
Water Records of Beaverhead

County, Montana

Attest my hand and seal

Edlyn J. Sage  
County Recorder

By

Deputy

Fee \$ 4.00

GW 2

Approved Stock Form—State Publishing Co., Helena, Montana—4232

File No.

T. 15. R. 10 W. Sec. 36

DUPLICATE

County Beaverhead

STATE WATER CONSERVATION BOARD

STATE OF MONTANA

ADMINISTRATOR OF GROUNDWATER CODE  
OFFICE OF STATE ENGINEER

OCT 7 1966

Top of Ground

(Elev. above sea level)

McDevitt  
 Butcher  
 Coyne  
 Darlington  
 Dickert

# Notice of Completion of Groundwater Appropriation by Means of Well

DEVELOPED AFTER JANUARY 1, 1962

(Under Chapter 237, Montana Session Laws, 1961)

0-35 sand, gravel &amp; boulders

Owner Henry F. Kueks Address Butte, Montana

35-40 sand &amp; gravel

Driller Carl F. Hollensteiner Address Dillon, MontanaDate of Notice of appropriation of groundwater \*\*\*Date well started July 9, 1966 Date completed July 12, 1966pulled back & finished  
in coarse sand at 39½Type of well Drilled Equipment used Churn Drill  
(Dug, Driven, bored or drilled) (Churn drill, rotary or other)
 Water use: Domestic ☒ Municipal ☐ Stock ☐ Irrigation ☐  
 Industrial ☐ Drainage ☐ Other ☐

Indicate on the diagram the character and thickness of the different strata met with in drilling, such as soil, clay, shale, gravel, rock or sand, etc. Show depth at which water is encountered, thickness and character of water-bearing strata and height to which the water rises in the well.

Size of Drilled Hole	Size and Weight of Casing	From (Feet)	To (Feet)	PERFORATIONS		
				Kind Size	From (Feet)	To (Feet)
6"	6" I.D. Blk. 18.97 lb	1' up	40'	None		

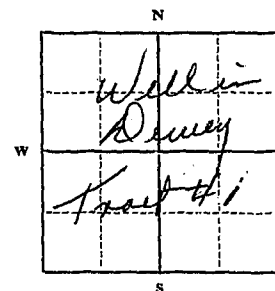
Static Water Level for non-flowing well 12 feet.Shut-in Pressure for Flowing Well \*\*\*Pumping Water Level 17 feet at 20 gal. per minute.Discharge in gal. per min. of flowing well \*\*\*How Tested BallcockLength of Test 1 hr.Remarks: (Gravel packing, cementing, packers, type of shutoff) \*\*\*

1/4 Sec. 15 R. 10 W  
 Indicate location of well and place of use, if possible. Each small square represents 40 acres.

(Continue on reverse side)

USE—If used for irrigation, industrial, drainage or other. Explain, state number of acres and location or other data (i.e.: Lot, Block and Addition).

\*\*\*

Show exact depth of bottom.

This form to be prepared by driller, and three copies to be filed by the owner with the County Clerk and Recorder in the county in which the well is located, tissue copy to be retained by driller.

Please answer all questions. If not applicable, so state, otherwise the form will be returned.

License No. 9

Driller's License Number

Driller's Signature

41, 482

STATE OF MONTANA  
County of Deerhead

115478

I, Walter, that the within instrument  
was filed in Deerhead on the 02 day  
of July A. D. 1966 at 05 min.  
past 9 o'clock, A. M. and recorded on  
page 99 of Book 187 of  
Walter Records of Deerhead  
County, Montana.

Attest my hand and seal.

Dorothy J. Sage  
County Recorder

By

Deputy

Fee \$ 4.00

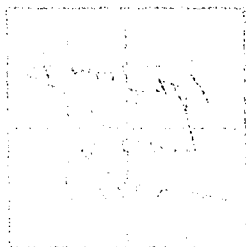

GW

Approved Stock Form—State Publishing Co., Helena, Montana—41338

File No. ....

T. 15 R. 10W

DUPLICATE

County Beaverhead

STATE OF MONTANA  
ADMINISTRATOR OF GROUNDWATER CODE  
OFFICE OF STATE ENGINEER

RECEIVED  
FEB 25 1964

## Declaration of Vested Groundwater Rights

(Under Chapter 237, Montana Session Laws, 1961)

STATE ENGINEER

1. Mrs. John W. Long, of Dewey Via Divide  
(Name of Appropriator) (Address) (Town)  
County of Beaverhead State of Montana  
have appropriated groundwater according to the Montana laws in effect prior to January 1, 1962, as follows:

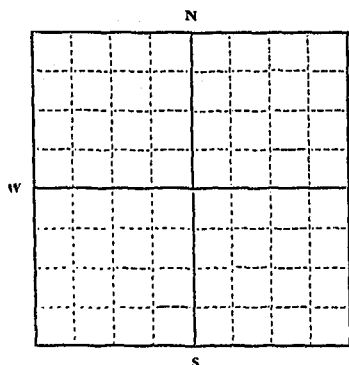

..... 1/4 Sec. T. R.

Indicate point of appropriation  
and place of use, if possible.  
Each small square represents 10  
acres.

Survey No. 4042 in  
Township 1 South Range  
10W formerly owned by Isaac  
Dodson

2. The beneficial use on which the claim is based house,  
yard, garden
3. Date or approximate date of earliest beneficial use; and how con-  
tinuous the use has been 1888 or before —  
use has been continuous.
4. The amount of groundwater claimed (in miner's inches or gallons  
per minute) 15 gallons per minute
5. If used for irrigation, give the acreage and description of the lands  
to which water has been applied and name of the owner thereof  
Owner is Mrs. John W. Long.
6. The means of withdrawing such water from the ground and the  
location of each well or other means of withdrawal electric  
pump from well in my yard  
near my house.
7. The date of commencement and completion of the construction of the well, wells, or other works for with-  
drawal of groundwater About 1888
8. The depth of water table About 18 or 20 feet
9. So far as it may be available, the type, size and depth of each well or the general specifications of any other  
works for the withdrawal of groundwater 1 well, dug, about 23 feet  
deep
10. The estimated amount of groundwater withdrawn each year about a million gallons
11. The log of formations encountered in the drilling of each well if available none
12. Such other information of a similar nature as may be useful in carrying out the policy of this act, including  
reference to book and page of any county record none

Signature of Owner

Date

Three copies to be filed by the owner with the County Clerk and Recorder of the county in which the well is located.

Please answer all questions. If not applicable, so state, otherwise the form will be returned.

Original to the County Clerk and Recorder; duplicate to the State Engineer; Triplicate to the Montana Bureau of Mines and Geology, and Quadruplicate for the Appropriator.

35013

STATE OF MONTANA,  
County of Beaverhead.

SA. 108944

I hereby certify that the within instrument  
was filed in my office on the 31 day  
of Dec., A. D. 19 63 at 57 min.  
past 11 o'clock, A. M. and recorded on  
page 583-4 of Book 174 of  
Records of Beaverhead

County, Montana

Attest my hand and seal,

*Lowell J. Sage*

County Recorder

By

Fee \$ 4.00

Deputy

File No. \_\_\_\_\_ STATE WATER CONSERVATION BOARD

T. 1S R. 10W

DUPLICATE

FEB 23 1967

County BEAVERHEAD

STATE OF MONTANA

 State \_\_\_\_\_  
 Butcher \_\_\_\_\_  
 Boyle \_\_\_\_\_  
 Barkin \_\_\_\_\_  
 Baker \_\_\_\_\_  
 McDermott, ADMINISTRATOR OF GROUNDWATER CODE  
 McNulty, OFFICE OF STATE ENGINEER  
 Norton \_\_\_\_\_  
 Smith \_\_\_\_\_

Top of Ground

(Elev. above sea level)

# Notice of Completion of Groundwater Appropriation by Means of Well

(Under Chapter 237, Montana Session Laws, 1961)

0-4½ pit.

Owner Richard H. Rose Address Divide, MontanaDriller C. Hollensteiner Address Dillon, MontanaDate of Notice of Appropriation of Groundwater. \*\*\*\*Date well started Sept. 17, 1965 Date Completed Sept. 18, 1965Type of well Drilled

(dug, driven, bored or drilled)

Equipment Used Churn Drill

(Churn, drill, rotary or other)

 finished sand & gravel  
 at 26½'

 Water Use: Domestic ☒ Municipal ☐ Other ☐ Irrigation ☐  
 Industrial ☐ Drainage ☐ Stock ☐

Indicate on the diagram the character and thickness of the different strata met with in drilling, such as soil, clay, shale, gravel, rock or sand, etc. Show depth at which water is encountered, thickness and character of water-bearing strata and height to which water rises in the well.

Size of Drilled Hole	Size and Weight of Casing	From (Feet)	To (Feet)	PERFORATIONS		
				Kind Size	From (Feet)	To (Feet)
6"	6" I.D. Blk. 18.97 foreign	4½' in pit	26½'	None		

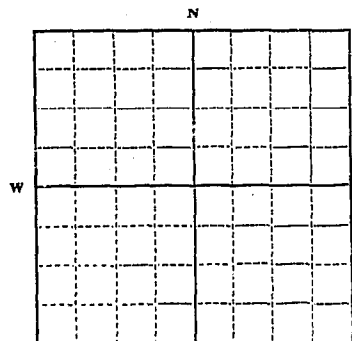

On LOT 39 in Town Of Dewey  
 ¼ Sec. T. 1S R. 10W  
 Indicate location of well and place of use, if possible. Each small square represents 10 acres.

Show exact depth of bottom.

Static Water Level for non-flowing Well..... 10 feet.

Shut-in Pressure for Flowing Well. \*\*\*\*

Pumping Water Level..... 12 feet at 20 gal. per minute.

Discharge in gal. per min. of flowing well. \*\*\*\*How Tested baler Length of Test 1½ hr.

Remarks: (Gravel packing, cementing, packers, type of shutoff, location of place of use of groundwater if not at well, and any other similar pertinent information, including number of acres irrigated, if used for irrigation) \*\*\*\*

License No. 9

Driller's License Number

Driller's Signature

This form to be prepared by driller, and three copies to be filed by the owner with the County Clerk and Recorder in the county in which the well is located.

Please answer all questions. If not applicable, so state, otherwise the form will be returned.

Original to the County Clerk and Recorder; duplicate to the State Engineer; Triplicate to the Montana Bureau of Mines and Geology and Quadruplicate for the Appropriator.

41744

STATE OF MONTANA, ss.  
County of Beaverhead.

116490

I hereby certify that the within instrument  
was filed in my office on the 10th day  
of Jan. A. D. 1967 at 41 min.  
past 9 o'clock A.M. and recorded on  
page 135 of Book 182 of  
Water Well Records of Beaverhead  
County, Montana.

Attest my hand and seal,

Evelyn J. Sege  
County Recorder

By

Deputy

Fee \$ 4.00



GROUNDWATER INDEX

Page \_\_\_\_\_ of \_\_\_\_\_

County Beaverhead Twp. 18 Rge. 9W

[illegible]

GW 2

File No. ....

DUPLICATE

RECEIVED  
Approved Stock Form—State Publishing Co., Helena, Montana—390b  
DEC 27 1962

T 1 S R 9 W

STATE ENGINEER County BeaverheadSTATE OF MONTANA  
ADMINISTRATOR OF GROUNDWATER CODE  
OFFICE OF STATE ENGINEER NOV 26 1962Notice of Completion of Groundwater  
Appropriation by Means of Well

(Under Chapter 237, Montana Session Laws, 1961)

Owner Ward A. Fanning Address Butte, MontanaDriller Carl F. Hollensteiner Address Dillon, Mont.Top of Ground  
(Elev. above sea level.....)

Date of Notice of Appropriation of Groundwater. \*\*\*

Date well started Nov. 14, 1962 Date Completed Nov. 16, 1962

sand &amp; gravel to 31'

Type of well Drilled  
(dug, driver, bored or  
drilled)Equipment Used Churn Drill  
(Churn, drill, rotary or  
other)

finished in coarse sand

Water Use: Domestic ☒ Municipal ☐ Other ☐ Irrigation ☐  
Industrial ☐ Drainage ☐ Stock ☐

Indicate on the diagram the character and thickness of the different strata met with in drilling, such as soil, clay, shale, gravel, rock or sand, etc. Show depth at which water is encountered, thickness and character of water-bearing strata and height to which water rises in the well.

Size of Drilled Hole	Size and Weight of Casing	From (Feet)	To (Feet)	PERFORATIONS		
				Kind Size	From (Feet)	To (Feet)
6"	6" O.D. 10.5 galv.	Surface	31	None		

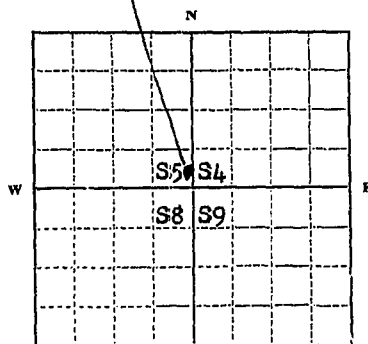
Schoolhouse  
Tarn of Blaney

SE 1/4 Sec 5 T. 15 R. 9 W

Indicate location of well and place of use, if possible. Each small square represents 10 acres.

Show exact depth of bottom.

Static Water Level for non-flowing Well..... 12 feet.

Shut-in Pressure for Flowing Well. \*\*\*

Pumping Water Level..... 15 feet at..... 20 gal. per minute.

Discharge in gal. per min. of flowing well..... \*\*\*

How Tested Bailer Length of Test..... 1 hr

Remarks: (Gravel packing, cementing, packers, type of shutoff, location of place of use of groundwater if not at well, and any other similar pertinent information, including number of acres irrigated, if used for irrigation)

License No. 9

Driller's License Number

Driller's Signature

This form to be prepared by driller, and three copies to be filed by the owner with the County Clerk and Recorder in the county in which the well is located.

Please answer all questions. If not applicable, so state, otherwise the form will be returned.

Original to the County Clerk and Recorder; duplicate to the State Engineer; Triplicate to the Montana Bureau of Mines and Geology and Quadruplicate for the Appropriator.

2559

STATE OF MONTANA, ss.  
County of Beaverhead

105713

I hereby certify that the within instrument  
was filed in my office on the 29 day  
of Nov A. D. 1962 at 31 min.  
past 11 o'clock, P. M. and recorded on  
page 507 of Book 151 of  
Water Well Records of Beaverhead  
County, Montana.

Attest my hand and seal,

Lloyd J. Sage  
County Recorder

By \_\_\_\_\_ Deputy

Fee \$ \_\_\_\_\_

105713  
105713

## GROUNDWATER INDEX

Page 1 of 1

County Beaverhead Twp. 2A Rge. 17W

[illegible]

File No. ....

FEB 23 1967

T. 2 S. R. 17 W.

DUPLICATE

Bills.....McDonnell.....

County.....Beaverhead.....

Butcher.....Montana.....

Coyle.....Montana.....

Darlington.....ADMINISTRATOR OF GROUNDWATER CODE

Pickert.....OFFICE OF STATE ENGINEER

**Declaration of Vested Groundwater Rights**

U.S. National Park Service Under Chapter 237, Montana Session Laws, 1961)

Big Hole National Battlefield

c/o Superintendent, Yellowstone National Park

1. Mammoth Hot Springs, Wyoming

(Name of Appropriator)

(Address)

Wisdom

(Town)

County of.....Beaverhead.....

State of.....Montana.....

have appropriated groundwater according to the Montana laws in effect prior to January 1, 1962, as follows:

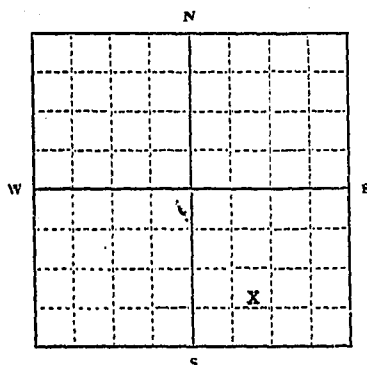

SW  $\frac{1}{4}$  SE Sec. 24 T. 2 S. R. 17 W  
 Indicate point of appropriation  
 and place of use, if possible. Each  
 small square represents 10 acres.

2. The beneficial use on which the claim is based.....

~~Domestic and irrigation~~

3. Date or approximate date of earliest beneficial use; and how continuous the use has been.....

~~June, 1965; continuous~~

4. The amount of groundwater claimed (in miner's inches or gallons per minute).....

~~10 gpm~~

5. If used for irrigation, give the acreage and description of the lands to which water has been applied and name of the owner thereof

~~Irrigation use not fully developed. All lands~~~~owned by the United States.~~

6. The means of withdrawing such water from the ground and the location of each well or other means of withdrawal.....

~~Submersible pump in a well adjacent to~~~~headquarters building~~

7. The date of commencement and completion of the construction of the well, wells, or other works for withdrawal of groundwater.....

~~Started May 26, 1965; completed June 25, 1965~~

8. The depth of water table.....

~~Static: 76-87 feet below surface; first water encountered in~~~~drilling between 100 and 300 feet.~~

9. So far as it may be available, the type, size and depth of each well or the general specifications of any other works for the withdrawal of groundwater.....

~~Drilled well with 6-5/8" casing to 250 feet;~~~~mill knife slotted between 200 and 245 feet.~~

10. The estimated amount of groundwater withdrawn each year.....

~~8 acre feet~~

11. The log of formations encountered in the drilling of each well if available.....

~~Attached~~

12. Such other information of a similar nature as may be useful in carrying out the policy of this act, including reference to book and page of any county record.....

~~Nothing herein shall constitute a waiver by the United States of any rights, title, priority or interest it may otherwise have~~~~to use of this or any other water in the State of Montana.~~

FOR THE UNITED STATES OF AMERICA:

Signature of Owner.....

(Sgd) MANUEL MORRIS  
Supervisory Hydraulic Engineer

Date.....

Three copies to be filed by the owner with the County Clerk and Recorder of the county in which the well is located.

Please answer all questions. If not applicable, so state, otherwise the form will be returned.

Original to the County Clerk and Recorder; Duplicate to the State Engineer; Triplicate to the Montana Bureau of Mines and Geology, and Quadruplicate for the Appropriator.

41750

STATE OF MONTANA, } ss.  
County of Beaverhead.

I hereby certify that the within instrument  
was filed in my office on the 7th day  
of Feb. A. D. 1967 at 34 min.  
past 10 o'clock, A. M. and recorded on  
page 143 of Book 187 of  
Vol. 11 Records of Beaverhead  
County, Montana.

116658

Attest my hand and seal.

Lowell J. J. J. County Recorder

By \_\_\_\_\_ Deputy

Fee \$ 1.00

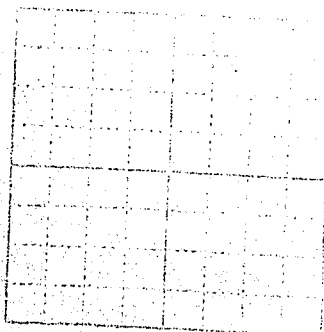

Sample log of Big Hole National Battlefield Monument Well No. 1,  
Beaverhead County, Montana

Drilled for the National Park Service by Paul Vollmer and Son, Aberdeen,  
Idaho, May 26 to June 23, 1965.

Located in NE $\frac{1}{4}$ SW $\frac{1}{4}$ SE $\frac{1}{4}$  sec. 24, T. 2 S., R. 17 W.

Sample study and log by R.L. Konizeski, U.S. Geological Survey, Missoula, Montana.

<u>Material</u>	<u>Depth</u>	
	<u>From</u>	<u>To</u>
Glaciofluvial mantle of unconsolidated poorly sorted, sub-to well-rounded, light colored, iron-stained sand, gravel, and cobbles. Mostly quartzite, some granite and much muscovite mica in minute books and flakes-----	0	40
Gravel and sand, semiconsolidated, sub-rangular to subround quartzite, some mica. Lenses of gray bentonitic clay	40	55
Conglomerate, lime-cemented; subrounded gray quartzite, some fine mica-----	55	60
Gravel, semiconsolidated; subround clear quartz and white quartzite with a few granite pebbles and some mica. Interbedded lenses of gray bentonitic clay-----	60	65
Gravel, semiconsolidated; subangular light-gray quartzite-----	65	75
Conglomerate, trace of limy cement; subangular white to gray quartzite and clear quartz sand and gravel; some iron stain. Thin beds of gray bentonitic clay	75	100
Conglomerate, poorly consolidated; 90 percent light-to dull-gray quartzite, 10 percent dark-gray to brown quartzite pebbles. Some water-----	100	130
Conglomerate, well-cemented; light-gray quartzite pebbles and some mica flakes. Interbedded lenses of dark-gray, bentonitic clay-----	130	170
Conglomerate, subangular light- to dark-gray quartzite pebbles. some mica and granitic pebbles-----	170	195
Clay, brown, iron-stained, bentonitic--	195	198
Sandstone, poorly consolidated; 85 percent subangular miky quartzite, 10 percent clear quartz. Some finely divided mica and a few thin lenses of gray bentonitic clay. Water bearing-----	198	215

STATE OF MONTANA  
ADMINISTRATOR OF GROUNDWATER CODE  
MONTANA WATER RESOURCES BOARD

JAN 18 1971

NOTICE OF COMPLETION OF GROUNDWATER  
APPROPRIATION BY MEANS OF WELL

Developed after January 1, 1962

(Under Chapter 237 Montana Session Laws, 1961, as amended)

This form to be prepared by driller, and three copies to be filed by the owner with the County Clerk and Recorder in the county in which the well is located, last copy to be retained by driller.

Please answer all questions. If not applicable, so state, otherwise the form may be returned.

Owner John T. Nelson

Address Wilson, Montana 57751

Date well started 11-16-69

completed 6-10-70

Type of well drilled

Equipment used cable tool

Water Use: Domestic ☒ Municipal ☐ Stock ☐ Irrigation ☐

Industrial ☐ Drainage ☐ Other ☐ Garden/Lawn ☐

\*Describe

USE: If used for irrigation, industrial, drainage or other. Explain, state number of acres and location or other data (i.e. Lot, Block and Addition).

ESTIMATED ANNUAL WITHDRAWAL 2,000,000 gal.

Size of Drilled Hole	Size and Weight of Casing	From (Feet)	To (Feet)	PERFORATIONS		
6"	6 5/8	1	170	Kind Size	From (Feet)	To (Feet)
	18.97			3 1/2"	164	170

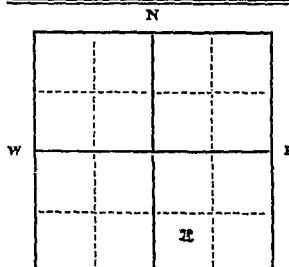

92 32  
1/2 S 1/4 Sec. 7  
T. N R. E  
S W

Static water level 35 ft.\*  
Pumping water level 20 ft.\*  
at 120 gallons per minute,  
measured 10 minutes after pumping  
began.

\*Measured from ground level.  
Well developed by 10 hours.  
for 20 hours.

Power 1 HP  
Remarks: (Gravel packing, cementing,  
packers, type of shutoff)

INDICATE LOCATION OF WELL AND PLACE OF USE, IF POSSIBLE.  
EACH SMALL SQUARE REPRESENTS 40 ACRES.

Briggs Drilling Contractor

Driller's Signature

P.O. Box 1083, Wilson, Montana 57755

Driller's Address

LICENSE NO.

DRILLER'S LOG

Indicate the character, color, thickness of strata such as soil, clay, sand, gravel, shale, sandstone, etc. Show depth at which water is found and height to which water rises in well.

Top of Ground		(Elev. above sea level)
From (Feet)	To (Feet)	
0	20	gravel & sandy clay
20	30	gray clay
30	35	brown clay
35	35	broken rock (water)
35	60	gray shale & clay
60	170	gray shale & clay with streaks of broken rock & gravels (water)
170	200	clay & gravel streaks with water

200

Show exact depth of bottom

418034



# GROUNDWATER INDEX

Page 1 of 1

County Beaverhead Twp. 24 Rge. 1 (all)

[illegible]

File No. ....

DUPLICATE

T. 25. R. 16 W.  
County. *Beaverhead*STATE OF MONTANA  
ADMINISTRATOR OF GROUNDWATER CODE  
OFFICE OF STATE ENGINEERRECEIVED  
FEB 20 1963Declaration of Vested Groundwater Rights  
(Under Chapter 237, Montana Session Laws, 1961)

STATE ENGINEER

1. *Lester J. Else* of *Madison* *Montana*  
(Name of Appropriator) (Address) (Town)  
County of *Beaverhead* State of *Montana*  
have appropriated groundwater according to the Montana laws in effect prior to January 1, 1962, as follows:

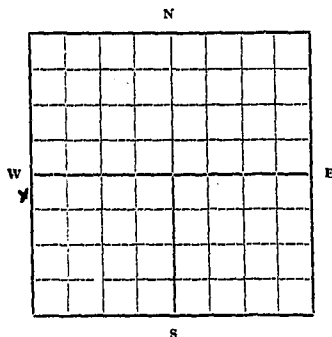

SW 1/4 Sec 25 16 W  
Indicate point of appropriation and place of use, if possible. Each small square represents 10 acres.

2. The beneficial use on which the claim is based *water for living quarters*
3. Date or approximate date of earliest beneficial use; and how continuous the use has been *1896 continuous since 1896*
4. The amount of groundwater claimed (in miner's inches or gallons per minute) *5 gal per minute*
5. If used for irrigation, give the acreage and description of the lands to which water has been applied and name of the owner thereof *land pump*
6. The means of withdrawing such water from the ground and the location of each well or other means of withdrawal *hand pump*
7. The date of commencement and completion of the construction of the well, wells, or other works for withdrawal of groundwater *1896*
8. The depth of water table *8 ft*
9. So far as it may be available, the type, size and depth of each well or the general specifications of any other works for the withdrawal of groundwater *5 ft diameter rocked up well*
10. The estimated amount of groundwater withdrawn each year *5000 gals*
11. The log of formations encountered in the drilling of each well if available
12. Such other information of a similar nature as may be useful in carrying out the policy of this act, including reference to book and page of any county record.

Signature of Owner

*Lester J. Else*

Date

*Oct 12, 1962*

Three copies to be filed by the owner with the County Clerk and Recorder of the county in which the well is located.

Please answer all questions. If not applicable, so state, otherwise the form will be returned.

Original to the County Clerk and Recorder; duplicate to the State Engineer; Triplicate to the School of Mines and Quadruplicate for the Appropriator.

3701

STATE OF MONTANA, ss.  
County of Beaverhead.

106072

I hereby certify that the within instrument  
was filed in my office on the 17 day  
of Jan. A. D. 1963 at 47 min.  
past 4 o'clock P. M. and recorded on  
page 361 of Book 151 of  
Native Well Records of Beaverhead  
County, Montana.

Attest my hand and seal.

Carolyn J. Sage  
County Recorder

By \_\_\_\_\_ Deputy

Fee \$ 4.00

GW 3

File No. ....

DUPLICATE

T. 2S R. 16W  
County BVD.

STATE OF MONTANA  
ADMINISTRATOR OF GROUNDWATER CODE  
OFFICE OF STATE ENGINEER

**Notice of Completion of Groundwater Appropriation Without Well**

(Under Chapter 237 Montana Session Laws, 1963) **STATE ENGINEER**

RECEIVED

Date of Appropriation of Groundwater 1

Owner Mark Clemon Ranch Address Wisdom

Contractor (if any) .....

Address of Contractor .....

Date Started..... Date Completed.....

Describe means of obtaining groundwater without a well "as by sub-irrigation and other natural processes". Include depth to water when applicable. SPRING at House  
FOR DOMESTIC & LIVESTOCK  
IRRIGATION

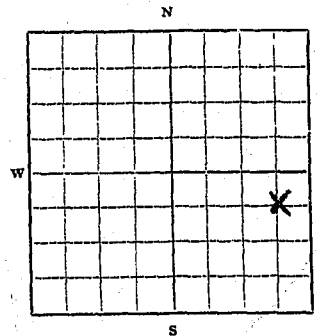

NE 1/4 Sec. 7 T2S R16W

Indicate point of appropriation and place of use, if possible.

Quantity of water developed and used with explanation of method used to measure or estimate such amount. If use is intermittent estimate approximate lengths of periods of use year

around

Signature of Owner Mark Clemon

Date Dec. 6 1963

This form to be prepared by contractor (if any), otherwise by the owner.

Three copies of this notice are to be filed with the County Clerk and Recorder of the county in which the works are located.

Please answer all questions. If not applicable, so state, otherwise the form will be returned.

Original to the County Clerk and Recorder; duplicate to the State Engineer; Triplicate to the Montana Bureau of Mines and Geology and Quadruplicate for the Appropriator.

108228  
108228

STATE OF MONTANA,  
County of Beaverhead. ss.

I hereby certify that the within instrument  
was filed in my office on the 6 day  
of Dec A. D. 1963 at 01 min.  
past 3 o'clock P M and recorded on  
page 199 of Book 133 of  
Water Right Records of Beaverhead  
County, Montana.

Attest my hand and seal.

Carolyn J. Sege  
County Recorder

By \_\_\_\_\_

Deputy

Fee \$ 4.00

## GROUNDWATER INDEX

Page 7 of 1

County Beaverhead Twp. 2S Rge. 15W

[illegible]

File No. ....

DUPLICATE

T. 2 R. 15 S. 3

County. Brown

STATE OF MONTANA  
ADMINISTRATOR OF GROUNDWATER CODE  
OFFICE OF STATE ENGINEER

Declaration of Vested Groundwater Rights  
(Under Chapter 237, Montana Session Laws, 1961)

RECEIVED  
DEC 30 1968  
STATE ENGINEER

1. Clarence L. & Jennie R. Smart, of Wilsdom  
(Name of Appropriator) (Address) (Town)

County of Brown State of Montana  
have appropriated groundwater according to the Montana laws in effect prior to January 1, 1962, as follows:

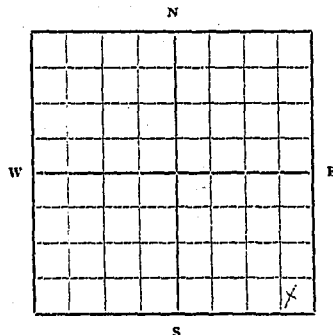

SW 1/4 NW 1/4 Sec. 3 T. 2. R. 15

Indicate point of appropriation and place of use, if possible. Each small square represents 10 acres.

2. The beneficial use on which the claim is based household
3. Date or approximate date of earliest beneficial use; and how continuous the use has been continuous  
Daily use
4. The amount of groundwater claimed (in miner's inches or gallons per minute) 300 gpm
5. If used for irrigation, give the acreage and description of the lands to which water has been applied and name of the owner thereof
6. The means of withdrawing such water from the ground and the location of each well or other means of withdrawal pump

7. The date of commencement and completion of the construction of the well, wells, or other works for withdrawal of groundwater continuous
8. The depth of water table 11.5 ft.
9. So far as it may be available, the type, size and depth of each well or the general specifications of any other works for the withdrawal of groundwater  
3 square foot - 11.5 foot deep
10. The estimated amount of groundwater withdrawn each year
11. The log of formations encountered in the drilling of each well if available  
not available
12. Such other information of a similar nature as may be useful in carrying out the policy of this act, including reference to book and page of any county record.

Signature of Owner Clarence L. & Jennie R. Smart

Date Dec. 2, 63

Three copies to be filed by the owner with the County Clerk and Recorder of the county in which the well is located.

Please answer all questions. If not applicable, so state, otherwise the form will be returned.

Original to the County Clerk and Recorder; duplicate to the State Engineer; Triplicate to the School of Mines and Quaduplicate for the Appropriator.

16342

STATE OF MONTANA,  
County of Beaverhead, ss.

108169

I hereby certify that the within instrument  
was filed in my office on the 1st day  
of Dec A. D. 1963 at 10 min.  
past 10 o'clock A. M. and recorded on  
page 513 of Book 151 of  
Natural Oil Records of Beaverhead  
County, Montana.

Attest my hand and seal

Carolyn J. Sage  
County Recorder

By

Deputy

Fee \$ 4.00



GW 2

File No. ....

DUPLICATE

RECEIVED  
NOV 12 1963

T 2 S R 15 W

County Beaverhead

STATE ENGINEER  
ADMINISTRATOR OF GROUNDWATER CODE  
OFFICE OF STATE ENGINEER  
NOV 15 1963

# Notice of Completion of Groundwater Appropriation by Means of Well

(Under Chapter 237, Montana Session Laws, 1961)

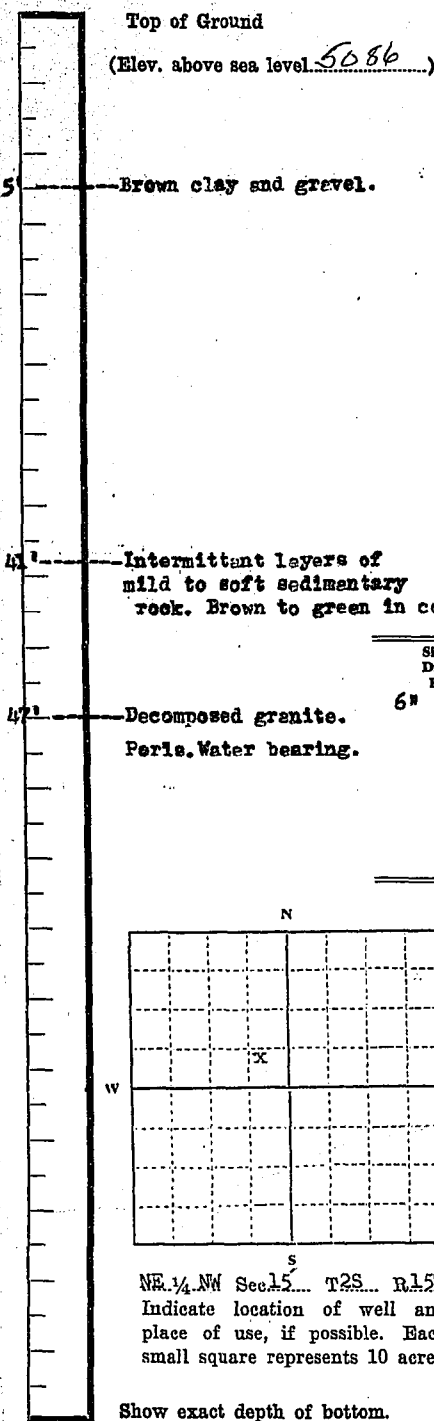

Owner Wisdom Cemetery Address Wisdom Montana  
Driller C.F. Wroble Address Millicreek RFD # 1  
Anaconda Montana  
Date of Notice of Appropriation of Groundwater.....  
Date well started Sept. 23 1962 Date Completed Sept. 24 1963  
Type of well Drilled Equipment Used Churn  
(dug, driven, bored or (Churn, drill, rotary or drilled) other)  
Water Use: Domestic ☐ Municipal ☐ Other ☐ Irrigation ☒  
Industrial ☐ Drainage ☐ Stock ☐

Indicate on the diagram the character and thickness of the different strata met with in drilling, such as soil, clay, shale, gravel, rock or sand, etc. Show depth at which water is encountered, thickness and character of water-bearing strata and height to which water rises in the well.

Size of Drilled Hole	Size and Weight of Casing	From (Feet)	To (Feet)	PERFORATIONS		
				Kind Size	From (Feet)	To (Feet)
6"	6" 15 lb. per ft.	Surface	46' 6"	<del>4 1/2"</del>	none	

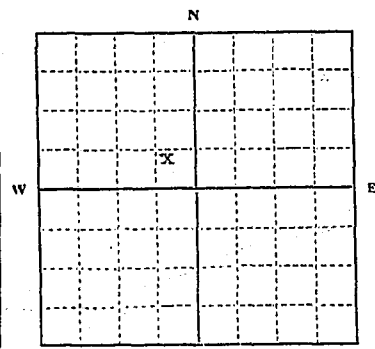

Show exact depth of bottom.  
Exact depth at bottom 47 ft.

Static Water Level for non-flowing Well 6' feet.  
Shut-in Pressure for Flowing Well.....  
Pumping Water Level 35' feet at 20 gal. per minute.  
Discharge in gal. per min. of flowing well.....  
How Tested Bailed Length of Test 2 hrs.  
Remarks: (Gravel packing, cementing, packers, type of shutoff, location of place of use of groundwater if not at well, and any other similar pertinent information, including number of acres irrigated, if used for irrigation) 20 acres.

Valve at Well  
Ditching from Well

Driller's License Number 62  
Driller's Signature C.F. Wroble

This form to be prepared by driller, and three copies to be filed by the owner with the County Clerk and Recorder in the county in which the well is located.  
Please answer all questions. If not applicable, so state, otherwise the form will be returned.  
Original to the County Clerk and Recorder; duplicate to the State Engineer; Triplicate to the Montana Bureau of Mines and Geology and Quadruplicate for the Appropriator.

6894



GW

Approved Stock Form—State Publishing Co., Helena, Montana—39089

File No. 33-62T 2S R 15W

DUPLICATE

County BeaverheadSTATE OF MONTANA  
ADMINISTRATOR OF GROUNDWATER CODE  
OFFICE OF STATE ENGINEERRECEIVED  
DEC 27 1962  
STATE ENGINEER

Top of Ground  
(Elev. above sea level 6000')

3' Top soil

Static level 3 ft.

# Notice of Completion of Groundwater Appropriation by Means of Well

(Under Chapter 237, Montana Session Laws, 1961)

Owner Harold Nelson Address Wisdom MontanaDriller C.F. Wroble Address Anaconda Montana

Date of Notice of Appropriation of Groundwater

Date well started Sept. 21 1962 Date Completed Sept. 21 1962Type of well Drilled Equipment Used Churn  
(dug, driven, bored or (Churn, drill, rotary or  
drilled) other)Water Use: Domestic ☐ Municipal ☐ Other ☐ Irrigation ☐  
Industrial ☐ Drainage ☐ Stock ☒

Indicate on the diagram the character and thickness of the different strata met with in drilling, such as soil, clay, shale, gravel, rock or sand, etc. Show depth at which water is encountered, thickness and character of water-bearing strata and height to which water rises in the well.

Pumping level 17 ft.

	Drilled Hole	Size and Weight of Casing	From (Feet)	To (Feet)	PERFORATIONS		
					Kind Size	From (Feet)	To (Feet)
18' Sand gravel and yellow clay mix.	6"	6"X15 lb.	Surface	24	3 7/16" X 5" slots	20'	23'
23' Sand and gravel .Water bearing.							
24' Clay							

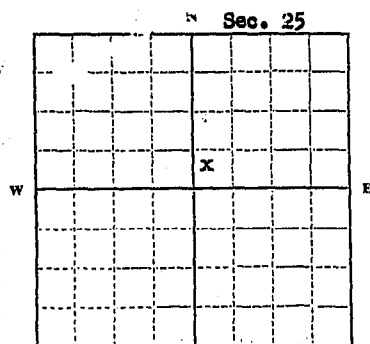

SW 1/4 NE Sec 25 T2S R. 15W  
Indicate location of well and place of use, if possible. Each small square represents 10 acres.

Show exact depth of bottom.  
24 ft. exact depth at bottom.

Static Water Level for non-flowing Well 3' feet.

Shut-in Pressure for Flowing Well

Pumping Water Level 17' feet at 15 gal. per minute.

Discharge in gal. per min. of flowing well

How Tested Pumped Length of Test 2 1/2 hrs.

Remarks: (Gravel packing, cementing, packers, type of shutoff, location of place of use of groundwater if not at well, and any other similar pertinent information, including number of acres irrigated, if used for irrigation)

62

Driller's License Number

C. F. Wroble  
Driller's Signature

This form to be prepared by driller, and three copies to be filed by the owner with the County Clerk and Recorder in the county in which the well is located.

Please answer all questions. If not applicable, so state, otherwise the form will be returned.

Original to the County Clerk and Recorder; duplicate to the State Engineer; Triplicate to the Montana Bureau of Mines and Geology and Quadruplicate for the Appropriator.

2855

STATE OF MONTANA, | sa. 105480  
County of Beaverhead.

I hereby certify that the within instrument  
was filed in my office on the 1st day  
of Nov A. D. 1962 at 3.0 min.  
past 9 o'clock A. M and recorded on  
page 293 of Book 151 of  
Water Well Records of Beaverhead  
County, Montana.

Attest my hand and seal,

Carolyn J. Sage  
County Recorder

By \_\_\_\_\_ Deputy

Fee \$ \_\_\_\_\_

GW

Approved Stock Form—State Publishing Co., Helena, Montana—3908

File No. 34-62

T. 2S R. 15W

DUPLICATE

County Beaverhead

STATE OF MONTANA  
ADMINISTRATOR OF GROUNDWATER  
OFFICE OF STATE ENGINEER

DEC 27 1962

# Notice of Completion of Groundwater Appropriation by Means of Well (Under Chapter 237, Montana Session Laws, 1961)

Owner Harold Nelson Address Wisdom Montana

Driller C.F. Wroble Address Anaconda Montana

Date of Notice of Appropriation of Groundwater

Date well started Sept. 21 1962 Date Completed Sept. 24 1962

Type of well Drilled Equipment Used Churn  
(dug, driven, bored or (Churn, drill, rotary or  
drilled) other)

Water Use: Domestic ☒ Municipal ☐ Other ☐ Irrigation ☐  
Industrial ☐ Drainage ☐ Stock ☐

Indicate on the diagram the character and thickness of the different strata met with in drilling, such as soil, clay, shale, gravel, rock or sand, etc. Show depth at which water is encountered, thickness and character of water-bearing strata and height to which water rises in the well.

Top of Ground  
(Elev. above sea level 6000)  
2 ft. Top soil

24' Sand gravel and clay mix.  
25' Sand and gravel Water 5 gpm. Not taken

32' Clay and gravel

61' Gray clay.

64' organic ash. Water bearing.

64 ft. exact depth to bottom.

SW 1/4 NE Sec. 25, T. 2S, R. 15W  
Indicate location of well and place of use, if possible. Each small square represents 10 acres.

Size of Drilled Hole	Size and Weight of Casing	From (Feet)	To (Feet)	PERFORATIONS		
				Kind Size	From (Feet)	To (Feet)
6"	6" 19.45	Surface	64	3/16" 5" X slots	61'	64'

Static Water Level for non-flowing Well 8' feet.

Shut-in Pressure for Flowing Well

Pumping Water Level 21' feet at 20 gal. per minute.

Discharge in gal. per min. of flowing well

How Tested Pumped Length of Test 1 1/2 hrs.

Remarks: (Gravel packing, cementing, packers, type of shutoff, location of place of use of groundwater if not at well, and any other similar pertinent information, including number of acres irrigated, if used for irrigation)

Gravel 20" in bottom.

62

Driller's License Number

C.F. Wroble  
Driller's Signature

This form to be prepared by driller, and three copies to be filed by the owner with the County Clerk and Recorder in the county in which the well is located.

Please answer all questions. If not applicable, so state, otherwise the form will be returned.

Original to the County Clerk and Recorder; duplicate to the State Engineer; Triplicate to the Montana Bureau of Mines and Geology and Quadruplicate for the Appropriator.

2856

STATE OF MONTANA  
County of Beaverhead

sa 105481

I hereby certify that the within instrument  
was filed in my office on the 1st day  
of Nov A. D. 19 62 at 31 min.  
past 9 o'clock, A M and recorded on  
page 295 of Book 151 of  
Water Use Records of Beaverhead  
County, Montana.

Attest my hand and seal,  
*Carolyn J. Sage*  
County Recorder

By \_\_\_\_\_ Deputy

Fee \$ \_\_\_\_\_

GW 2

Approved Stock Form—State Publishing Co., Helena, Montana—4231b

File No. ....

T. 28 N. 15 W. 28

DUPLICATE

LOG

Top of Ground  
(Elev. above sea level.....)  
2 ft. Top soil

### Static level 14 ft.

18 ft. Sand and gravel

Pumping level 22' at 20 gpm.

24 ft. Sand gravel and clay mix.

40 ft. Volcanic ash. Water bearing.

STATE OF MONTANA  
ADMINISTRATOR OF GROUNDWATER CODE  
OFFICE OF STATE ENGINEER

# Notice of Completion of Groundwater Appropriation by Means of Well DEVELOPED AFTER JANUARY 1, 1962.

(Under Chapter 237, Montana Session Laws, 1961)

Owner Sam McGee Address Wisdom, Montana

Driller C.F. Wroble Jr. Address Millcreek Box 1 Anaconda, Montana

Date of Notice of appropriation of groundwater.....

Date well started Nov. 9, 1964 Date completed Nov. 10, 1964

Type of well Drilled Equipment used Churn Drill  
(Dug, Driven, bored or drilled) (Churn drill, rotary or other)Water use: Domestic ☐ Municipal ☐ Stock ☒ Irrigation ☐  
Industrial ☐ Drainage ☐ Other ☐

Indicate on the diagram the character and thickness of the different strata met with in drilling, such as soil, clay, shale, gravel, rock or sand, etc. Show depth at which water is encountered, thickness and character of water-bearing strata and height to which the water rises in the well.

Size of Drilled Hole	Size and Weight of Casing	From (Feet)	To (Feet)	PERFORATIONS		
				Kind Size	From (Feet)	To (Feet)
8"	2" X 28 lb.	Surface	32'	Slots 3/16" X 6"	30'	32' 5"

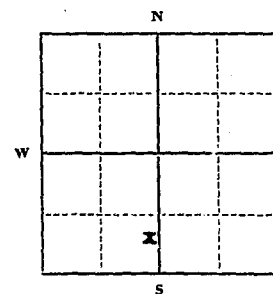

Static Water Level for non-flowing well 14 feet.

Shut-in Pressure for Flowing Well.....

Pumping Water Level 22 ft. feet

at 20 gal. per minute.

Discharge in gal. per min. of flowing well.....

How Tested Drilled

Length of Test 2 hrs.

Remarks: (Gravel packing, cementing, packers, type of shutoff).....

SE 1/4 Sec. 28 T. 28 N. R. 15 W.  
Indicate location of well and place of use, if possible. Each small square represents 40 acres.

(Continue on reverse side)

USE—If used for irrigation, industrial, drainage or other. Explain, state number of acres and location or other data (i.e.: Lot, Block and Addition).

Show exact depth of bottom.

Exact depth of finished well  
38 ft.

This form to be prepared by driller, and three copies to be filed by the owner with the County Clerk and Recorder in the county in which the well is located, tissue copy to be retained by driller.

Please answer all questions. If not applicable, so state, otherwise the form will be returned.

62  
Driller's License Number

C.F. Wroble  
Driller's Signature

39018

STATE OF MONTANA, 112041  
County of Beaverhead.

I hereby certify that the within instrument  
was filed in my office on the 18<sup>th</sup> day  
of January A. D. 1965 at 4<sup>5</sup> min.  
past 1:00 o'clock P. M. and recorded on  
page 5457 of Book 192 of  
Beaverhead County, Montana.

Attest my hand and seal,

*Evelyn J. Long*  
County Recorder

By

Deputy

Fee \$ 4.00



GW3

File No. ....

T2S R15W

DUPLICATE

County Beauregard

STATE OF MONTANA  
ADMINISTRATOR OF GROUNDWATER CODE  
OFFICE OF STATE ENGINEER

**Notice of Completion of Groundwater Appropriation Without Wells**

(Under Chapter 237 Montana Session Laws, 1961)

RECEIVED  
DEC 8 1963

STATE ENGINEER

Date of Appropriation of Groundwater .....

Owner Harold C. Nelson Address Wisdom, Montana

Contractor (if any) .....

Address of Contractor .....

Date Started ..... Date Completed .....

Describe means of obtaining groundwater without a well "as by sub-irrigation and other natural processes". Include depth to water when applicable. Flowing Spring

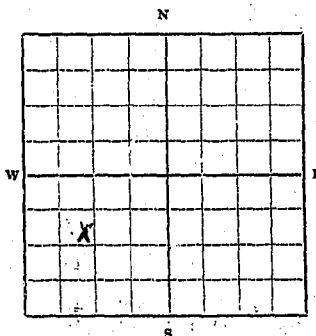

NW 1/4 Sec 29 T2S R15W  
Indicate point of appropriation and place of use, if possible.

Quantity of water developed and used with explanation of method used to measure or estimate such amount. If use is intermittent estimate approximate lengths of periods of use .....

Flow 5 (five) Gallons per minute

Signature of Owner Harold C. NelsonDate 12-18-63

This form to be prepared by contractor (if any), otherwise by the owner.

Three copies of this notice are to be filed with the County Clerk and Recorder of the county in which the works are located.

Please answer all questions. If not applicable, so state, otherwise the form will be returned.

Original to the County Clerk and Recorder; duplicate to the State Engineer; Triplicate to the Montana Bureau of Mines and Geology and Quadruplicate for the Appropriator.

16459

108448

STATE OF MONTANA, : sa  
County of Beaverhead.

I hereby certify that the within instrument  
was filed in my office on the 20 day  
of Dec A. D. 19 63 at 05 min.  
past 8 o'clock, A. M. and recorded on  
page 297 of Book 123 of  
Native Records of Beaverhead  
County, Montana.

Attest my hand and seal,

Conley J. Sage  
County Recorder

By

Deputy

Fee \$ 1.00

MA 34 51 52 12M

File No. ....

T. 2S R. 15W 33

DUPLICATE

County

BEAVERHEAD

STATE OF MONTANA  
ADMINISTRATOR OF GROUNDWATER CODE  
OFFICE OF STATE ENGINEER

SEP 8 1964

**Notice of Completion of Groundwater  
Appropriation by Means of Well**

(Under Chapter 237, Montana Session Laws, 1961)

Owner Beaverhead County Address Wisdom MontanaDriller C. F. Wroble, Jr. Address Mill Creek RFD # 1  
Anaconda Montana

Date of Notice of Appropriation of Groundwater .....

Date well started June 21, 1964 Date Completed June 22, 1964Type of well Drilled Equipment Used Churn drill  
(dug, driven, bored or (Churn, drill, rotary or  
drilled) other)Water Use: Domestic ☐ Municipal ☐ Other ☐ Irrigation ☐  
Industrial ☐ Drainage ☐ Stock ☐

Pumping level 40 ft.

Indicate on the diagram the character and thickness of the different strata met with in drilling, such as soil, clay, shale, gravel, rock or sand, etc. Show depth at which water is encountered, thickness and character of water-bearing strata and height to which water rises in the well.

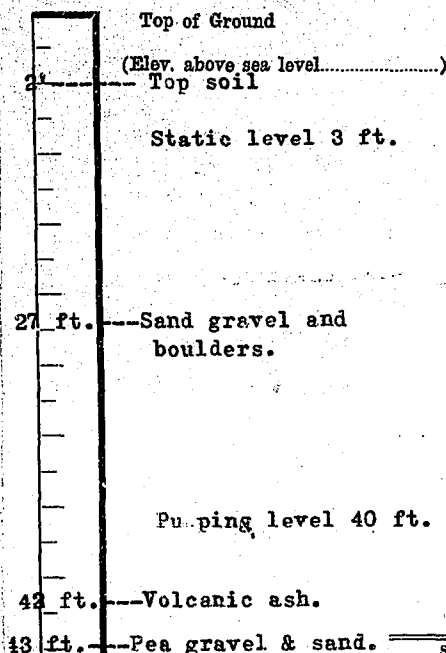

Size of Drilled Hole	Size and Weight of Casing	From (Feet)	To (Feet)	PERFORATIONS		
				Kind Size	From (Feet)	To (Feet)
6"	6" 28 lb. per ft.	Surface	43'	Slots 3/16" x 5"	40'	43'

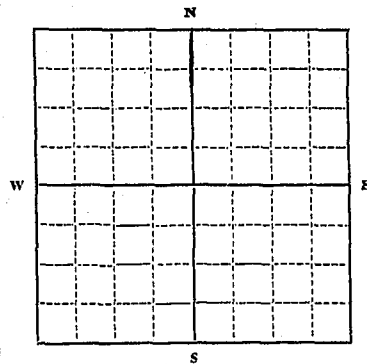

NE 1/4, SE Sec. 33 T. 2S R. 15W

Indicate location of well and place of use, if possible. Each small square represents 10 acres.

In Tract 21 & 22 in Town of Wisdom  
on the County Lands property - District #2.  
Show exact depth of bottom:  
43 ft.

Static Water Level for non-flowing Well 3 ft. feet.

Shut-in Pressure for Flowing Well .....

Pumping Water Level 40' feet at 15 gal. per minute.

Discharge in gal. per min. of flowing well .....

How Tested Surged & Bailed Length of Test 4 hrs.

Remarks: (Gravel packing, cementing, packers, type of shutoff, location of place of use of groundwater if not at well, and any other similar pertinent information, including number of acres irrigated, if used for irrigation) .....

62

Driller's License Number

C. F. Wroble  
Driller's Signature

This form to be prepared by driller, and three copies to be filed by the owner with the County Clerk and Recorder in the county in which the well is located.

Please answer all questions. If not applicable, so state, otherwise the form will be returned.

Original to the County Clerk and Recorder; duplicate to the State Engineer; Triplicate to the Montana Bureau of Mines and Geology and Quadruplicate for the Appropriator.

38440

STATE OF MONTANA  
County of Beaverhead

110724

I hereby certify that the within instrument  
was filed in my office on the 4 day  
of Aug A.D. 1964 at 45 min.  
past 12 o'clock P.M. and recorded on  
page 29 of Book 187 of  
Water Well Records of Beaverhead  
County, Montana.

Attest my hand and seal,

Lowell J. Sege  
County Recorder

By \_\_\_\_\_ Deputy

Fee \$ CH2

File No. ....

T. TWO S. R. Fifteen W. ....

DUPLICATE

County Beaverhead

STATE OF MONTANA  
ADMINISTRATOR OF GROUNDWATER CODE  
OFFICE OF STATE ENGINEER

RECEIVED  
JAN 15 1964

# Declaration of Vested Groundwater Rights

(Under Chapter 237, Montana Session Laws, 1961)

1. John W. and Barbara Harrer of Wisdom  
(Name of Appropriator) (Address) (Town)

County of Beaverhead State of Montana  
have appropriated groundwater according to the Montana laws in effect prior to January 1, 1962, as follows:

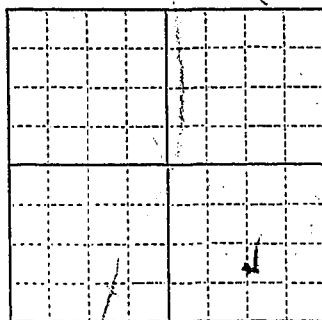

Drilled town.

1/4 Sec. 33 T. 2 S. R. 15 W.

Indicate point of appropriation and place of use, if possible. Each small square represents 10 acres.

Western original  
Lot-1- B1/4 8

2. The beneficial use on which the claim is based Domestic purposes - including lawn watering.

3. Date or approximate date of earliest beneficial use; and how continuous the use has been 1950

4. The amount of groundwater claimed (in miner's inches or gallons per minute) 50 gal per minute

5. If used for irrigation, give the acreage and description of the lands to which water has been applied and name of the owner thereof Used for lawn watering on Lot Number One, Block Number Eight, Original Townsite of Wisdom, Mont. Owned by above-named appropriator.

6. The means of withdrawing such water from the ground and the location of each well or other means of withdrawal Drilled well, located sixty feet from north boundary and six feet from east boundary of Lot 1, Block 8, Townsite of Wisdom

7. The date of commencement and completion of the construction of the well, wells, or other works for withdrawal of groundwater Drilled well - 43 feet deep - 6 inch casing

8. The depth of water table 25 feet

9. So far as it may be available, the type, size and depth of each well or the general specifications of any other works for the withdrawal of groundwater Drilled 43 feet deep - 6 inch casing

10. The estimated amount of groundwater withdrawn each year 3,500,000

11. The log of formations encountered in the drilling of each well if available

12. Such other information of a similar nature as may be useful in carrying out the policy of this act, including reference to book and page of any county record An indenture regarding use of water from this well is filed in the office of the Beaverhead County Recorder and recorded on pages 597-8 of Book 128 of Deeds Records of Beaverhead County.

Signature of Owner Barbara Harrer

Date Dec 31 - 1963

Three copies to be filed by the owner with the County Clerk and Recorder of the county in which the well is located.

Please answer all questions. If not applicable, so state, otherwise the form will be returned.

Original to the County Clerk and Recorder; Duplicate to the State Engineer; Triplicate to the Montana Bureau of Mines and Geology, and Quadruplicate for the Appropriator.

32267

STATE OF MONTANA  
County of Beaverhead

108666

I hereby certify that the within instrument  
was filed in my office on the 30 day  
of Dec A. D. 1963 at 51 min.  
past 4:00 o'clock P. M. and recorded on  
page 177 of Book 174 of  
Water Records of Beaverhead  
County, Montana.

Attest my hand and seal,

Emilyn J. Sage  
County Recorder

By \_\_\_\_\_ Deputy

Fee \$ \_\_\_\_\_

3295 000

401-1-127-3  
127-1-127-3

32 100 000

File No. ....

DUPLICATE

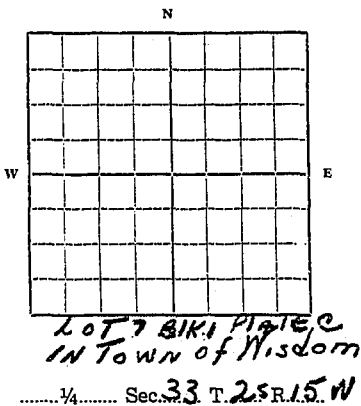
T. 2 R. 15 S. 33  
County BeauregardSTATE OF MONTANA  
ADMINISTRATOR OF GROUNDWATER CODE  
OFFICE OF STATE ENGINEERDeclaration of Vested Groundwater Rights  
(Under Chapter 237, Montana Session Laws, 1961)1. Floy Helming of Wisdom Montana  
(Name of Appropriator) (Address) (Town)  
County of Beauregard State of Montana  
have appropriated groundwater according to the Montana laws in effect prior to January 1, 1962, as follows:Indicate point of appropriation  
and place of use, if possible.  
Each small square represents 10  
acres.

2. The beneficial use on which the claim is based Domestic use
3. Date or approximate date of earliest beneficial use; and how continuous the use has been Dec 6 - 1958  
Daily use.
4. The amount of groundwater claimed (in miner's inches or gallons per minute) 20 gal Per Minute
5. If used for irrigation, give the acreage and description of the lands to which water has been applied and name of the owner thereof Domestic use only no  
irrigation
6. The means of withdrawing such water from the ground and the location of each well or other means of withdrawal Electric pump
7. The date of commencement and completion of the construction of the well, wells, or other works for withdrawal of groundwater Dec 6 - 1958
8. The depth of water table 18 ft
9. So far as it may be available, the type, size and depth of each well or the general specifications of any other works for the withdrawal of groundwater none
10. The estimated amount of groundwater withdrawn each year 73000
11. The log of formations encountered in the drilling of each well if available 12 ft gravel  
12' to 41' gray clay - 41' to 67' fine gray sand and  
wood chips 67' to 82' sand. white quartz. final dept
12. Such other information of a similar nature as may be useful in carrying out the policy of this act, including reference to book and page of any county record 6 inch casing.

Signature of Owner

Floy HelmingDate Nov 5, 1963

Three copies to be filed by the owner with the County Clerk and Recorder of the county in which the well is located.

Please answer all questions. If not applicable, so state, otherwise the form will be returned.

Original to the County Clerk and Recorder; duplicate to the State Engineer; Triplicate to the School of Mines and Quaduplicate for the Appropriator.

6902

STATE OF MONTANA, ss.  
County of Beaverhead.

107992

I hereby certify that the within instrument  
was filed in my office on the 7 day  
of Nov A. D. 1963 at 43 min.  
past 10 o'clock, A M and recorded on  
page 507 of Book 151 of  
Water Well Records of Beaverhead  
County, Montana.

Attest my hand and seal.

Arlyn J. Sage  
County Recorder

By \_\_\_\_\_ Deputy  
Fee \$ 4.00



File No. ....

DUPLICATE

T. 2-S R. 15-W 33

County Beaverhead

STATE OF MONTANA  
ADMINISTRATOR OF GROUNDWATER CODE  
OFFICE OF STATE ENGINEER

**Declaration of Vested Groundwater Rights**  
(Under Chapter 237, Montana Session Laws, 1961)

**R** JAN 15 1964

I, Marlow C. & Frances May Hyatt, of Wisdom, Montana (Name of Appropriator) (Address) (Town)

County of Beaverhead State of Montana  
have appropriated groundwater according to the Montana laws in effect prior to January 1, 1962, as follows:

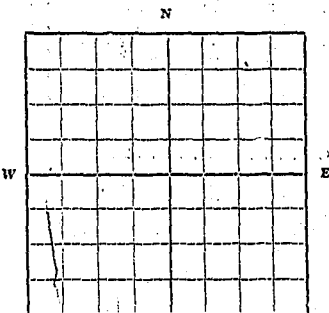

Plotted Town -

1/4 Sec. 33 T. 2-S R. 15-W

Indicate point of appropriation and place of use, if possible. Each small square represents 10 acres. Wisdom - Plat B

Lots 5, 6, 7 & 8 - Blk 3  
Lots 1, 2, 3, 4 - Blk 5

2. The beneficial use on which the claim is based household, lawn and shrubbery
3. Date or approximate date of earliest beneficial use; and how continuous the use has been 365 days per year
4. The amount of groundwater claimed (in miner's inches or gallons per minute) 25 gals per minute
5. If used for irrigation, give the acreage and description of the lands to which water has been applied and name of the owner thereof
6. The means of withdrawing such water from the ground and the location of each well or other means of withdrawal electric pump in basement of the house
7. The date of commencement and completion of the construction of the well, wells, or other works for withdrawal of groundwater October 1945
8. The depth of water table 9' from basement floor
9. So far as it may be available, the type, size and depth of each well or the general specifications of any other works for the withdrawal of groundwater 6" casing 71' deep
10. The estimated amount of groundwater withdrawn each year roughly 25,000 gallons per yr.
11. The log of formations encountered in the drilling of each well if available Hard pan yellow sand & clay with sand
12. Such other information of a similar nature as may be useful in carrying out the policy of this act, including reference to book and page of any county record

Signature of Owner Frances May Hyatt  
Marlow C. Hyatt  
Date December 30 63

Three copies to be filed by the owner with the County Clerk and Recorder of the county in which the well is located.

Please answer all questions. If not applicable, so state, otherwise the form will be returned.

Original to the County Clerk and Recorder; duplicate to the State Engineer; Triplicate to the School of Mines and Quadruplicate for the Appropriator.

32343

STATE OF MONTANA, ss. 108732  
County of Beaverhead.

I hereby certify that the within instrument  
was filed in my office on the 31 day  
of Dec A. D. 1943 at 5 min.  
part 2:00 o'clock P. M. and recorded on  
page 329-30 of Book 174 of  
Water Records of Beaverhead  
County, Montana.

Attest my hand and seal.

*Carolyn J. Sege*  
County Recorder

By \_\_\_\_\_ Deputy

Fee \$ \_\_\_\_\_

100 000

100 000 - 814 2  
100 000 - 814 3  
100 000 - 614 5

33 5-2 12-M

By \_\_\_\_\_

STATE OF MONTANA  
ADMINISTRATOR OF GROUNDWATER CODE  
MONTANA WATER RESOURCES BOARD

NOTICE OF COMPLETION OF GROUNDWATER  
APPROPRIATION BY MEANS OF WELL

Developed after January 1, 1962

(Under Chapter 237 Montana Session Laws, 1961, as amended)

This form to be prepared by driller, and three copies to be filed by the owner with the County Clerk and Recorder in the county in which the well is located, last copy to be retained by driller. Please answer all questions. If not applicable, so state, otherwise the form may be returned.

Owner John P. Paine

Address Madison, Montana

Date well started 11/15/72

completed 11/15/72

For Administrator's Use

File 132851

January 18, 1973

GW 1 10:30 A.M.

Type of well Drilled

(Dug, driven, bored, etc.)

Equipment 3" auger

(Chain drive, etc.)

Water Use: Domestic ☒ Municipal ☐ Stock ☐ Irrigation ☐

Industrial ☐ Drainage ☐ Other ☐ Garden/Lawn ☐

\*Describe

USE: If used for irrigation, industrial, drainage or other. Explain, state number of acres and location or other data (i.e. Lot, Block and Addition).

ESTIMATED ANNUAL WITHDRAWAL

Size of Drilled Hole	Size and Weight of Casing	From (Feet)	To (Feet)	PERFORATIONS		
				Kind Size	From (Feet)	To (Feet)
6"	13.50	415	51	4" (100)	20'	45'

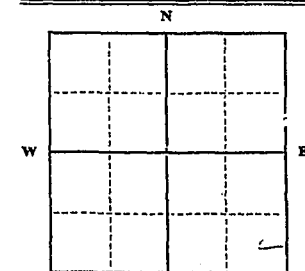

SE 1/4 Sec. 23

T. 2 N. R. 15 E. S. W.

Static water level 10 ft.\*  
Pumping water level 25 ft.\*  
at 15 gallons per minute,  
measured 15 minutes after pumping  
began.

\*Measured from ground level.

Well developed by 15 hours.

Power 1 HP

Remarks: (Gravel packing, cementing, packers, type of shutoff)

INDICATE LOCATION OF WELL AND PLACE OF USE, IF POSSIBLE. EACH SMALL SQUARE REPRESENTS 40 ACRES.

Driller's Signature John P. Paine

Driller's Address Box 1000, Madison, Montana 57105

John P. Paine LICENSE NO. 10

County Madison

DRILLER'S LOG

Indicate the character, color, thickness of strata such as soil, clay, sand, gravel, shale, sandstone, etc. Show depth at which water is found and height to which water rises in well.

Top of Ground

(Elev. above sea level)

From (Feet)	To (Feet)	
0	12	100% gravel
12	20	100% sand
20	45	100% sandstone
45	51	100% sandstone

Show exact depth of bottom

132851  
132851

STATE OF MONTANA, County of Beaverhead. I, the undersigned, hereby certify that the within instrument was filed in my office on the  
17<sup>th</sup> day of January A. D. 1913 at 30 min. past 10:00 o'clock A. M. and recorded on  
page 63-64 of book 305, Records of Beaverhead County, Montana.  
Attest my hand and seal  
By Charles D. Bennett Deputy  
Fee \$ 4.00  
Margaret L. Thompson  
County Recorder