

ATTENTION TO READER  
THIS INSTRUMENT IS A COPY OF THE ORIGINAL  
FILED IN THE PUBLIC RECORDS OFFICE

Montana Water Resource Board  
Division of Conservation  
1001 N. CENTRAL AVENUE, BOZEMAN, MONTANA

MONTANA WATER RESOURCE BOARD  
RECEIVED  
APR 27 1970

125244

STATE OF MONTANA, ss.  
County of Beaverhead.

I hereby certify that the within instrument  
was filed in my office on the 24th day  
of April, A. D. 1970, at 45 min.  
past 1:00 o'clock P. M. and recorded on  
page 945 of Book 198 of  
Water Well Records of Beaverhead  
County, Montana.

Attest my hand and seal.

*Evelyn J. Sage*  
County Recorder  
By *James P. Baller*  
Deputy

Fee \$ 4.00

File No. ....

T. 75 R. 10W

DUPLICATE

County Beaverhead

LOG

STATE OF MONTANA  
ADMINISTRATOR OF GROUNDWATER CODE

MONTANA WATER RESOURCES BOARD OFFICE OF STATE ENGINEER

RECEIVED

Notice of Completion of Groundwater

JUL 28 1969

Appropriation by Means of Well

DEVELOPED AFTER JANUARY 1, 1962

(Under Chapter 237, Montana Session Laws, 1961)



Top of Ground  
(Elev. above sea level.....)

31 boulders & overburden

78 sandy brown clay

84 Pea gravel & coarse sand with water

Owner Matt Vranish Address Dillon, Montana

Driller Briggs Drilling Address Dillon, Montana

Date of Notice of appropriation of groundwater.....

Date well started April 1, 1969 Date completed April 3, 1969

Type of well drilled Equipment used cable tool  
(Dug, driven, bored or drilled) (Churn drill, rotary or other)

Water use: Domestic  Municipal  Stock  Irrigation   
Industrial  Drainage  Other

Indicate on the diagram the character and thickness of the different strata met with in drilling, such as soil, clay, shale, gravel, rock or sand, etc. Show depth at which water is encountered, thickness and character of water-bearing strata and height to which the water rises in the well.

Size of Drilled Hole	Size and Weight of Casing	From (Feet)	To (Feet)	PERFORATIONS		
				Kind Size	From (Feet)	To (Feet)
6"	6 1/8 18.97	+1	80	4x5 4x12	77	80

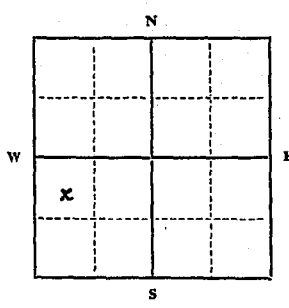

Static Water Level for non-flowing well ..... 5 feet.

Shut-in Pressure for Flowing Well.....

Pumping Water Level..... 70 feet at..... 6 gal. per minute.

Discharge in gal. per min. of flowing well .....

How Tested..... pump.....

Length of Test..... 2 hrs.

Remarks: (Gravel packing, cementing, packers, type of shutoff).....

NW 1/4, SW Sec. 14, T. 75, R. 10W

Indicate location of well and place of use, if possible. Each small square represents 40 acres.

(Continue on reverse side)

USE—If used for irrigation, industrial, drainage or other. Explain, state number of acres and location or other data (i.e.: Lot, Block and Addition).

Show exact depth of bottom.

This form to be prepared by driller, and three copies to be filed by the owner with the County Clerk and Recorder in the county in which the well is located, tissue copy to be retained by driller.

Please answer all questions. If not applicable, so state, otherwise the form will be returned.

148  
Driller's License Number  
Richard Briggs  
Driller's Signature

45481

STATE OF MONTANA, ca. 123455  
County of Beaverhead

I hereby certify that the within instrument  
was filed in my office on the 25 day  
of July A. D. 1919 at 30 min.  
past 9 o'clock A.M. and recorded on  
page 12-3 of Book 123 of

Records of Beaverhead  
County, Montana.

Attest my hand and seal

*George R. Long*  
County Recorder

By *Charles B. Richardson*  
Deputy

Fee \$ 40

ADMINISTRATOR OF GROUNDWATER CODE  
OFFICE OF STATE ENGINEER

County Beaverhead 7-10-15

DECLARATION OF VESTED GROUNDWATER RIGHTS  
(Under Ch. 237, Montana Session Laws, 1961)

JAN 15 1964

1. CIRCLE S RANCH, of STATE ENGINEER  
(Name of Appropriator) (Address) (Town)

County of Beaverhead State of Montana  
have appropriated groundwater according to the Montana Laws in effect  
prior to January 1, 1962, as follows:

2. The beneficial use on which the claim is based Irrigation
3. Date or approximate date of earliest beneficial use; and how continuous the use has been 1880 - continuous
4. The amount of groundwater claimed (in miner's inches or gallons per minute) 100 miner's inches
5. If used for irrigation, give the acreage and description of the lands to which water has been applied and name of the owner thereof 100 acres Sec. 15, T. 7 S., R. 10 W - Circle S Ranch
6. The means of withdrawing such water from the ground & the location of each well or other means of withdrawal Drilled well - 100 ft. deep 16 in. casing
7. The date of commencement & completion of the construction of the well, wells, or other works for withdrawal of groundwater 1880
8. The depth of water table 100 feet
9. So far as it may be available, the type, size & depth of each well or the general specifications of any other works for the withdrawal of groundwater Drilled well - 100 feet deep
10. The estimated amount of groundwater withdrawn each year 100 in. daily during irrigation season
11. The log of formations encountered in the drilling of each well if available \_\_\_\_\_
12. Such other information of a similar nature as may be useful in carrying out the policy of this act, including reference to book & page of any county record \_\_\_\_\_

Signature of Owner: CIRCLE S RANCH

By Ivan Remely  
Manager

Date: December 30, 1963

STATE OF MONTANA) ss  
County of Beaverhead)

Ivan Remely having first been duly sworn, deposes and says that he is of lawful age and manager of the appropriator and claimant of the order and water right mentioned in the foregoing declaration of vested groundwater rights and the person whose name is subscribed thereto, as the manager of the appropriator and claimant, that he knows the contents thereof and that the matters and things therein stated are true.

Subscribed and sworn to before me this 30th day of December, 1963.

Notary Public for State of Montana  
Residing at Dillon, Montana  
My commission expires Feb. 4, 1964

32483



ADMINISTRATOR OF GROUNDWATER CODE  
OFFICE OF STATE ENGINEER

7-10-15  
County, Beaverhead  
RECORDED  
JAN 15 1964

DECLARATION OF VESTED GROUNDWATER RIGHTS  
(Under Ch. 237, Montana Session Laws, 1961)

1. CIRCLE S RANCH, of STATE ENGINEER  
(Name of Appropriator) (Address) (Town)

County of Beaverhead State of Montana  
have appropriated groundwater according to the Montana Laws in effect  
prior to January 1, 1962, as follows:

2. The beneficial use on which the claim is based Irrigation
3. Date or approximate date of earliest beneficial use; and how continuous the use has been 1957
4. The amount of groundwater claimed (in miner's inches or gallons per minute) 100 inches
5. If used for irrigation, give the acreage and description of the lands to which water has been applied and name of the owner thereof 100 acres - Sec. 15, T. 7 S., R. 10 W.
6. The means of withdrawing such water from the ground & the location of each well or other means of withdrawal Drilled well
7. The date of commencement & completion of the construction of the well, wells, or other works for withdrawal of groundwater 1957
8. The depth of water table 100 feet
9. So far as it may be available, the type, size & depth of each well or the general specifications of any other works for the withdrawal of groundwater Drilled well - 16 in. casing - 100 feet deep
10. The estimated amount of groundwater withdrawn each year 100 in. daily
11. The log of formations encountered in the drilling of each well if available during irrigation season
12. Such other information of a similar nature as may be useful in carrying out the policy of this act, including reference to book & page of any county record \_\_\_\_\_

Signature of Owner: CIRCLE S RANCH

By Ivan Remely  
Manager

Date: December 30, 1963

STATE OF MONTANA)ss  
County of Beaverhead)

Ivan Remely having first been duly sworn, deposes and says that he is of lawful age and manager of the appropriator and claimant of the order and water right mentioned in the foregoing declaration of vested groundwater rights and the person whose name is subscribed thereto, as the manager of the appropriator and claimant, that he knows the contents thereof and that the matters and things therein stated are true.

Subscribed and sworn to before me this 30th day of December, 1963.

Notary Public for State of Montana  
Residing at Dillon, Montana  
My commission expires Feb. 4, 1964

32484

108873

32784

STATE OF MONTANA,  
County of Beaverhead.

I hereby certify that the within instrument  
was filed in my office on the 29th day  
of Dec A. D. 1923 at 26 min.  
of 10 o'clock P. M. and recorded on  
page 447-8 of Book 174 of  
Water Records of Beaverhead  
County, Montana.

Attest my hand and seal, this 30th day  
of Dec 1923 at Beaverhead, Montana.  
Carlton J. Sage  
County Recorder  
Deputy

RECORDED  
INDEXED

RECORDED  
INDEXED

1000  
5000

STATE OF MONTANA  
COUNTY OF BEAVERHEAD  
I, the undersigned, Clerk of the County of Beaverhead, do hereby certify that the within instrument was filed in my office on the 29th day of Dec A. D. 1923 at 26 min. of 10 o'clock P. M. and recorded on page 447-8 of Book 174 of Water Records of Beaverhead County, Montana.  
Attest my hand and seal, this 30th day of Dec 1923 at Beaverhead, Montana.  
Carlton J. Sage  
County Recorder  
Deputy

DEPARTMENT OF GEOLOGICAL SURVEY  
OFFICE OF STATE ENGINEER

DECLARATION OF VESTED GROUNDWATER RIGHTS  
(Under Ch. 237, Montana Session Laws, 1961)

7-10  
JAN 15 1964  
STATE ENGINEER

Walt Paddock

of R.T. I

(Address)

County of Beaverhead

State of

have appropriated groundwater according to the Montana Laws in effect prior to January 1, 1962, as follows:

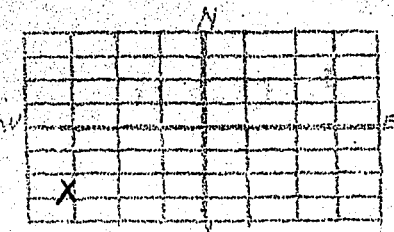

SW 1/4 SW Sec. 17 T. 75 S. R. 10 W

Indicate point of appropriation & place of use, if possible. Each small sq. represents 10 acres.

2. The beneficial use on which the claim is based  
Stock Water & Residence

3. Date or approximate date of earliest beneficial use; and how continuous the use has been  
1961

4. The amount of groundwater claimed in miner's inches or gallons per minute 50 gallons

5. If used for irrigation, give the acreage and description of the lands to which water has been applied and name of the owner thereof

6. The means of withdrawing such water from the ground & the location of each well or other means of withdrawal pump

7. The date of commencement & completion of the construction of the well, wells, or other works for withdrawal of groundwater 1961

8. The depth of water table 50'

9. So far as it may be available, the type, size & depth of each well or the general specifications of any other works for the withdrawal of groundwater  
4" casing

10. The estimated amount of groundwater withdrawn each year 60,000

11. The log of formations encountered in the drilling of each well if available  
unknown

12. Such other information of a similar nature as may be useful in carrying out the policy of this act, including reference to book & page of any county record  
unknown

STATE OF MONTANA, 108703  
County of Beaverhead, ss.

Signature of Owner Walt Paddock  
Date Dec 31, 1963

I hereby certify that the within instrument was filed in my office on the 30 day of Dec A. D. 1963 at 28 min. past 5 o'clock P.M and recorded on page 251-2 of Book 174 of Water Records of Beaverhead County, Montana.

Attest my hand and seal,  
Carolyn J. Sage  
County Recorder

By \_\_\_\_\_ Deputy

Fee \$ \_\_\_\_\_



GW3

File No. ....

DUPLICATE

T. 75 R. 10 W  
County Beaverhead

STATE OF MONTANA  
ADMINISTRATOR OF GROUNDWATER CODE  
OFFICE OF STATE ENGINEER

RECEIVED  
DEC 31 1963  
STATE ENGINEER

Notice of Completion of Groundwater Appropriation Without Well

(Under Chapter 237 Montana Session Laws, 1961)

Date of Appropriation of Groundwater *December 12, 1963*  
Owner *Berg Christensen Co* Address *Hellon, Montana*  
Contractor (if any) *Not applicable*  
Address of Contractor *Not applicable*  
Date Started *Not applicable* Date Completed *Not applicable*

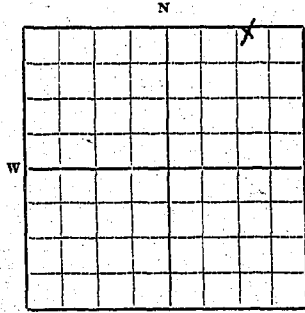

Describe means of obtaining groundwater without a well "as by sub-irrigation and other natural processes". Include depth to water when applicable.

*Natural spring*

Quantity of water developed and used with explanation of method used to measure or estimate such amount. If use is intermittent estimate approximate lengths of periods of use

*Natural spring, undeveloped  
cleaned as needed, flows less  
than 1" of water - Used for  
stock water 6 mo of year*

*NE 1/4 NE Sec 24 T. 75 R. 10 W*  
Indicate point of appropriation and place of use, if possible.

Signature of Owner *Berg Christensen Co*  
*by Loren Christensen - Pres*  
Date *12-12-63*

This form to be prepared by contractor (if any), otherwise by the owner.

Three copies of this notice are to be filed with the County Clerk and Recorder of the county in which the works are located.

Please answer all questions. If not applicable, so state, otherwise the form will be returned.

Original to the County Clerk and Recorder; duplicate to the State Engineer; Triplicate to the Montana Bureau of Mines and Geology and Quadruplicate for the Appropriator.

16427

108396

STATE OF MONTANA, ss.  
County of Beaverhead.

I hereby certify that the within instrument  
was filed in my office on the 18 day  
of Dec A. D. 1963 at 02 min.  
past 2 o'clock P. M. and recorded on  
page 233 of Book 133 of  
N. C. W. Records of Beaverhead  
County, Montana.

Attest my hand and seal.

*Dorothy J. Sage*  
County Recorder

By 450 Deputy

WE ME 34 and 2 1964

ADMINISTRATOR OF GROUNDWATER CODE  
OFFICE OF STATE ENGINEER

7-10  
RECEIVED  
JAN 15 1964  
24

DECLARATION OF VESTED GROUNDWATER RIGHTS  
(Under Ch. 237, Montana Session Laws, 1961)

1. CIRCLE S RANCH, of STATE ENGINEER  
(Name of Appropriator) (Address) (Town)

County of Beaverhead State of Montana  
have appropriated groundwater according to the Montana Laws in effect  
prior to January 1, 1962, as follows:

- 2. The beneficial use on which the claim is based Irrigation
- 3. Date or approximate date of earliest beneficial use; and how continuous the use has been 1880
- 4. The amount of groundwater claimed (in miner's inches or gallons per minute) 100 miner's inches
- 5. If used for irrigation, give the acreage and description of the lands to which water has been applied and name of the owner thereof  
Sec. 24, T. 7 S., R. 10 W. 100 acres Circle S Ranch
- 6. The means of withdrawing such water from the ground & the location of each well or other means of withdrawal Drilled well 16 in. casing
- 7. The date of commencement & completion of the construction of the well, wells, or other works for withdrawal of groundwater 1880
- 8. The depth of water table 100 ft. deep
- 9. So far as it may be available, the type, size & depth of each well or the general specifications of any other works for the withdrawal of groundwater 16 in. casing 100 ft. deep
- 10. The estimated amount of groundwater withdrawn each year 100 in. during irrigation season
- 11. The log of formations encountered in the drilling of each well if available \_\_\_\_\_
- 12. Such other information of a similar nature as may be useful in carrying out the policy of this act, including reference to book & page of any county record \_\_\_\_\_

Signature of Owner: CIRCLE S RANCH  
By Ivan Remely  
Manager  
Date: December 30, 1963

STATE OF MONTANA)  
County of Beaverhead) ss

Ivan Remely having first been duly sworn, deposes and says that he is of lawful age and manager of the appropriator and claimant of the order and water right mentioned in the foregoing declaration of vested groundwater rights and the person whose name is subscribed thereto, as the manager of the appropriator and claimant, that he knows the contents thereof and that the matters and things therein stated are true.

Subscribed and sworn to before me this 30th day of December, 1963.

Notary Public for State of Montana  
Residing at Dillon, Montana  
My commission expires Feb. 4, 1964



DECLARATION OF VESTED GROUNDWATER RIGHTS  
(Under Ch. 237, Montana Session Laws, 1951)

RECEIVED  
7-10  
JAN 15 1964  
Dillon  
STATE ENGINEER

Joseph F Carroll

(Name of Appropriator)

of Bx 8

(Address)

County of Beaverhead

State of Montana

have appropriated groundwater according to the Montana Laws in effect prior to January 1, 1982, as follows:

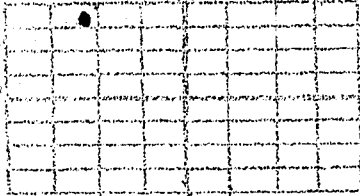

2. The beneficial use on which the claim is based

Stock Water

3. Date or approximate date of earliest beneficial use; and how continuous the use has been

4. The amount of groundwater claimed (in miner's inches or gallons per minute)

1/4 Sec. 26 T. 75 R. 10W

Indicate point of appropriation. If used for irrigation, give the acreage and location & place of use, if pump, description of the lands to which water has been applied and name of the owner thereof. Each small sq. represents 1/4 acre.

5. The means of withdrawing such water from the ground & the location of each well or other means of withdrawal:

Pump

6. The date of commencement & completion of the construction of the well, wells, or other works for withdrawal of groundwater

April 15 1942

7. The depth of water table

8. So far as it may be available, the type, size & depth of each well or the general specifications of any other works for the withdrawal of groundwater

200 FEET 6 INCH CASING

9. The estimated amount of groundwater withdrawn each year

10. The log of formation encountered in the drilling of each well if available

HILLIUSTINE DRILLER

11. Such other information of a similar nature as may be useful in carrying out the policy of this act, including reference to book & page of any county record

Signature of Owner J F Carroll

Date Dec 31, 1963

STATE OF MONTANA, ss. 108800  
County of Beaverhead.

I hereby certify that the within instrument was filed in my office on the 31 day of Dec A. D. 1963 at 33 min past 10 o'clock P. M. and recorded on page 46 of Book 174 of Water Records of Beaverhead County, Montana.

Attest my hand and seal,  
Coryn J. Sage  
County Recorder

By \_\_\_\_\_ Deputy

Fee \$ \_\_\_\_\_

GW 3

File No. ....

DUPLICATE

T. 7S R. 10W 34  
County Beaverhead

STATE OF MONTANA  
ADMINISTRATOR OF GROUNDWATER CODE  
OFFICE OF STATE ENGINEER

RECEIVED  
DEC 30 1963  
STATE ENGINEER

Notice of Completion of Groundwater Appropriation Without Well

(Under Chapter 237 Montana Session Laws, 1961)

Date of Appropriation of Groundwater December 12, 1963  
Owner Berg Christensen Co. Address Billon, Montana

Contractor (if any) Not applicable  
Address of Contractor Not applicable  
Date Started Not applicable Date Completed Not applicable

Describe means of obtaining groundwater without a well "as by sub-irrigation and other natural processes" include depth to water when applicable. Natural Spring

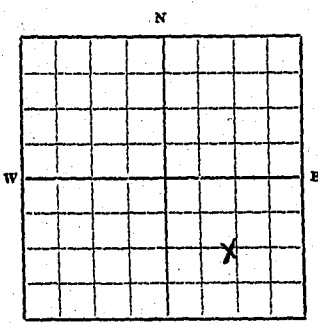

SW 1/4 SE 34 T. 7S R. 10W  
Indicate point of appropriation and place of use, if possible.

Quantity of water developed and used with explanation of method used to measure or estimate such amount. If use is intermittent estimate approximate lengths of periods of use  
Underdeveloped spring - Continuous flow of 5" water  
Used for stock water all year

Signature of Owner Berg Christensen Co.  
Erwin Christensen - Pres.  
Date 12-12-63

This form to be prepared by contractor (if any), otherwise by the owner.  
Three copies of this notice are to be filed with the County Clerk and Recorder of the county in which the works are located.  
Please answer all questions. If not applicable, so state, otherwise the form will be returned.  
Original to the County Clerk and Recorder; duplicate to the State Engineer; Triplicate to the Montana Bureau of Mines and Geology and Quadruplicate for the Appropriator.

STATE OF MONTANA  
County of Beaverhead

108403

I hereby certify that the within instrument  
was filed in my office on the 18 day  
of Dec A. D. 1963 at 09 min  
past 2 o'clock P. M. and recorded on  
page 247 of Book 133 of  
State Records of Beaverhead  
County Montana.

Attest my hand and seal

*Carlton J. Sage*  
County Recorder

By

Deputy

Fee \$ 1.00



RECEIVED  
7-10  
35  
Dillon  
MILNER

DECLARATION OF VESTED GROUNDWATER RIGHTS JAN 15 1964  
(Under Ch. 237, Montana Session Laws, 1961)

J F Carroll

of Box 8 STATE ENGINEER

(Name of Appropriator)

Montana

(Town)

County of Beaverhead State of Montana  
have appropriated groundwater according to the Montana Laws in effect prior to January 1, 1962, as follows:

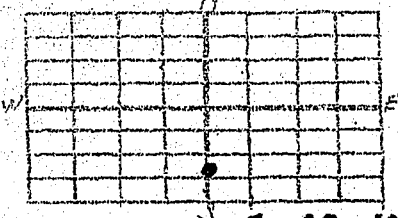

4 Sec. 35 T. 7S R. 10W

Indicate point of appropriation & place of use, if possible. Each small sq. represents 10 acres.

2. The beneficial use on which the claim is based  
Stock Water

3. Date or approximate date of earliest beneficial use; and how continuous the use has been  
1942 to date

4. The amount of groundwater claimed (in miner's inches or gallons per minute)

6. The means of withdrawing such water from the ground & the location of each well or other means of withdrawal  
Pump

7. The date of commencement & completion of the construction of the well, wells, or other works for withdrawal of groundwater  
April 1942

8. The depth of water table  
200 Feet

9. So far as it may be available, the type, size & depth of each well or the general specifications of any other works for the withdrawal of groundwater  
200-foot block casing

10. The estimated amount of groundwater withdrawn each year

11. The log of formations encountered in the drilling of each well if available

12. Such other information of a similar nature as may be useful in carrying out the policy of this act, including reference to book & page of any county record

Signature of Owner J. Carroll  
Date Dec 31, 1963

STATE OF MONTANA, ss. 108881  
County of Beaverhead.

I hereby certify that the within instrument was filed in my office on the 31 day of Dec A. D. 1963 at 34 min. past 10 o'clock A. M. and recorded on page 463-4 of Book 174 of Water Records of Beaverhead County, Montana.

Attest my hand and seal,  
Girlynd J. Long  
By \_\_\_\_\_ Deputy

Fee \$ \_\_\_\_\_

32492



County Beaverhead Twp. 75 Rge. 9w

Sec.	Name of Appropriator	Type of Form	County File No.	Remarks
1	Maki, John	GW2	128973	
1	Hungate, Marion	GW2	130446	
1	Heikkila, Ed	GW4	108742	
1	Heikkila, Ed	GW4	108743	
2	Heikkila, Ed	GW4	108744	
5	Whster, George A.	GW4	108762	
6	Carroll, Joe	GW2	108882	
7	Wheat, Edna L.	GW3	108830	
9	Feathers, Joseph J.S.	GW1	108952	
9	Feathers, Joseph J.S.	GW3	108821	
13	Stoddard, Vernon	GW2	130016	
13	Staudhauer, M.H.	GW2	117142	
13	Stathem, Vereau	GW2	119994	
13	Stathem, Chuck	GW2	130017	
13	Stathem, Chuck	GW2	119727	
13	Spehar, John A.	Water Well Log	94400	
13	Johnson, James + Hazel	GW4	107057	
13	Ingram, Ada	GW4	108659	
13	Garr, Glenn	GW4	108525	
13	Doyel, Betty H.	Water Well Log	95154	
13	Wheekly, Joe + Harry C.	GW4	108687	
13	Nithile, Walter B.	GW4	108709	
13	McClure, Mike + Elisabeth	GW4	108887	
13	Matzke, William H.	GW2	106776	
13	Martin, Marjorie	GW4	108895	
13	Mackenzie, Bob	GW2	128679	
13	Cote, Raymond L. +	GW2	106376	
"	Chisholm, Marty	"	"	
13	Collom, Jerry	GW2	128944	
17	Hayden, Archie	GW2	108289	
18	Christensen, Berg	GW3	108397	
*24	Arrish, Norbert + Norma	GW4	108902	
25	Peterson, Christian + Phoebe	GW4	108375	
25	Barnes, Carl + Willa	GW3	108811	
25	Hren, John J.	GW4	107504	
25	Hren, John J.	GW4	107503	
25	Hren, Beverly + John J. Jr	GW4	106401	
25	Madden, Frank	GW4	106605	
25	Madden, Frank	GW4	106604	
25	The Craig Cornell Co.	GW4	108511	
27	Dons, Hans	GW2	109441	
27	Benson, Arnold	GW3	108275	
29	Jurgens, Dr. A. L.	GW2	109890	
29	Beaverhead Stock farms	GW3	108852	

Some



MONTANA WATER RESOURCES BOARD  
**RECEIVED**

2-9-1  
County Beaverhead

STATE OF MONTANA  
ADMINISTRATOR OF GROUNDWATER CODE  
MONTANA WATER RESOURCES BOARD

SEP 27 1971

**NOTICE OF COMPLETION OF GROUNDWATER  
APPROPRIATION BY MEANS OF WELL**

Developed after January 1, 1962

(Under Chapter 237 Montana Session Laws, 1961, as amended)

This form to be prepared by driller, and three copies to be filed by the owner with the County Clerk and Recorder in the county in which the well is located, last copy to be retained by driller.

Please answer all questions. If not applicable, so state, otherwise the form may be returned.

Owner John Mold  
Address Dillon, Montana  
Date well started June 28, 1971  
completed June 29, 1971

For Administrator's Use
File <u>128973</u>
<u>September 23, 1971</u>
<u>10:10 AM</u>
G. 1

Type of well Drilled  
(Dug, driven, bored or drilled)

Equipment used Churn drill  
(Churn drill, rotary or other)

Water Use: Domestic  Municipal  Stock  Irrigation   
Industrial  Drainage  Other \* Garden/Lawn

\*Describe  
USE: If used for irrigation, industrial, drainage or other. Explain, state number of acres and location or other data (i.e. Lot, Block and Addition).

ESTIMATED ANNUAL WITHDRAWAL

Size of Drilled Hole	Size and Weight of Casing	From (Feet)	To (Feet)	PERFORATIONS		
				Kind Size	From (Feet)	To (Feet)
6"	6 5/8" O.D. 17 lb	1' up	56	None		

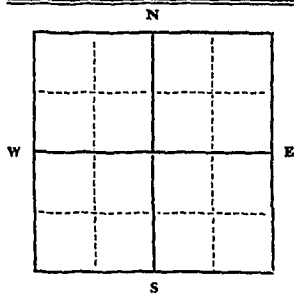

Static water level ..... 22 ft.\*  
Pumping water level ..... 27 ft.\*  
at ..... 30 gallons per minute,  
measured ..... 60 minutes after pumping  
began.  
\*Measured from ground level.  
Well developed by bailing  
for ..... 1 hours.  
Power..... Pump..... HP  
Remarks: (Gravel packing, cementing,  
packers, type of shutoff)

..... 1/4 Sec.  
T..... N R..... E  
S W

INDICATE LOCATION OF WELL AND PLACE OF USE, IF POSSIBLE.  
EACH SMALL SQUARE REPRESENTS 40 ACRES.

Driller's Signature Carl H. Neumann  
Driller's Address P.O. Box 5

LICENSE NO. 9

**DRILLER'S LOG**

Indicate the character, color, thickness of strata such as soil, clay, sand, gravel, shale, sandstone, etc. Show depth at which water is found and height to which water rises in well.

Top of Ground		(Elev. above sea level)
From (Feet)	To (Feet)	
0	6	Clay
6	24	Clay & gravel
	22	Static water level
24	40	Sand & gravel
40	50	Clay, sand, & fine gravel
50	57	Sandy clay
57	**	Finished in coarse sand & fine gravel

Show exact depth of bottom

49135

STATE OF MONTANA  
COUNTY OF BEAVERHEAD

BEFORE ME, the undersigned authority, on this day personally appeared \_\_\_\_\_, known to me to be the person whose name is subscribed to the foregoing instrument, and acknowledged to me that he executed the same for the purposes and consideration therein expressed.

My commission expires \_\_\_\_\_

128973

STATE OF MONTANA  
COUNTY OF BEAVERHEAD  
BEFORE ME, the undersigned authority, on this day personally appeared \_\_\_\_\_, known to me to be the person whose name is subscribed to the foregoing instrument, and acknowledged to me that he executed the same for the purposes and consideration therein expressed.

My commission expires \_\_\_\_\_

STATE OF MONTANA, County of Beaverhead ss. I hereby certify that the within instrument was filed in my office on the 23 day of Sept A. D. 1921 at 10 min. past 10:00 o'clock A. M. and recorded on page 705-6 of book 202, Records of Beaverhead County, Montana.

Attest my hand and seal  
By Paul S. Burwell  
Deputy  
Fee \$ 1.00

Margaret S. Thompson  
County Recorder

STATE OF MONTANA  
ADMINISTRATOR OF GROUNDWATER CODE  
MONTANA WATER RESOURCES BOARD

SEP 27 1971

DRILLER'S LOG

**NOTICE OF COMPLETION OF GROUNDWATER APPROPRIATION BY MEANS OF WELL**

MONTANA WATER RESOURCES BOARD

OCT 13 1971

Developed after January 1, 1962

Indicate the character, color, thickness of strata such as soil, clay, sand, gravel, shale, sandstone, etc. Show depth at which water is found and height to which water rises in well.

(Under Chapter 237 Montana Session Laws, 1961, as amended)

This form to be prepared by driller, and three copies to be filed by the owner with the County Clerk and Recorder in the county in which the well is located, last copy to be retained by driller. Please answer all questions. If not applicable, so state, otherwise the form may be returned.

Owner John Reid

Address Millon, Montana

Date well started June 20, 1971

completed June 24, 1971

Type of well Drilled

Equipment used Churn drill

Water Use: Domestic  Municipal  Stock  Irrigation

Industrial  Drainage  Other \* Garden/Lawn

\*Describe \_\_\_\_\_

USE: If used for irrigation, industrial, drainage or other. Explain, state number of acres and location or other data (i.e. Lot, Block and Addition). \_\_\_\_\_

ESTIMATED ANNUAL WITHDRAWAL \_\_\_\_\_

Size of Drilled Hole	Size and Weight of Casing	From (Feet)	To (Feet)	PERFORATIONS		
				Kind Size	From (Feet)	To (Feet)
6"	5 5/8" 17 lb	1'	50'	None		

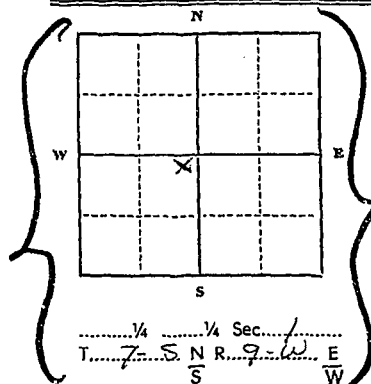

Static water level ..... 22 ft.\*  
Pumping water level ..... 27 ft.\*  
at ..... gallons per minute,  
measured ..... minutes after pumping  
began.

\*Measured from ground level.  
Well developed by .....  
for ..... hours.

Power..... Pump..... HP  
Remarks: (Gravel packing, cementing,  
packers, type of shutoff) .....

INDICATE LOCATION OF WELL AND PLACE OF USE, IF POSSIBLE.  
EACH SMALL SQUARE REPRESENTS 40 ACRES.

Driller's Signature Carl Hollenauer

Driller's Address 1. Dec. 5

Top of Ground		(Elev. above sea level)
From (Feet)	To (Feet)	
0	0	Clay
6	24	Clay, gravel
24	40	Clay, gravel
40	50	Clay, sand, gravel
50	57	Sandy clay
57	57	Finished in coarse sand & silt gravel

LICENSE NO. 9

Show exact depth of bottom

49135

RECEIVED

MAR 20 1972

County Beaverhead

STATE OF MONTANA  
ADMINISTRATOR OF GROUNDWATER CODE  
MONTANA WATER RESOURCES BOARD  
DEPARTMENT OF NATURAL RESOURCES AND CONSERVATION

NOTICE OF COMPLETION OF GROUNDWATER  
APPROPRIATION BY MEANS OF WELL

Developed after January 1, 1962

(Under Chapter 237 Montana Session Laws, 1961, as amended)

This form to be prepared by driller, and three copies to be filed by the owner with the County Clerk and Recorder in the county in which the well is located, last copy to be retained by driller. Please answer all questions. If not applicable, so state, otherwise the form may be returned.

Owner Marion Bmgate

Address Dillon, Montana 59725

Date well started 3-6-72

completed 3-9-72

Type of well drilled

Equipment used cable tool

Water Use: Domestic  Municipal  Stock  Irrigation

Industrial  Drainage  Other \* Garden/Lawn

\*Describe trailer court

USE: If used for irrigation, industrial, drainage or other. Explain, state number of acres and location or other data (i.e. Lot, Block and Addition).

ESTIMATED ANNUAL WITHDRAWAL 5,000,000 gallons

Size of Drilled Hole	Size and Weight of Casing	From (Feet)	To (Feet)	PERFORATIONS		
				Kind Size	From (Feet)	To (Feet)
8"	8 5/8 28.55#	42	69	2 1/2"	57	67

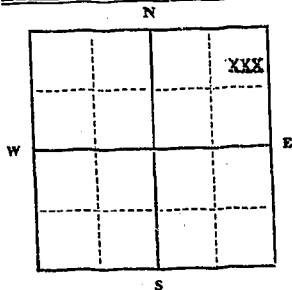

NE 1/4 NE 1/4 Sec. 1

T. 7 N. R. 9 E.

INDICATE LOCATION OF WELL AND PLACE OF USE, IF POSSIBLE. EACH SMALL SQUARE REPRESENTS 40 ACRES.

Driller's Signature Richard Briggs

Driller's Address Briggs Drilling Contractor

P.O. Box 1083 Dillon, Montana LICENSE NO. 148

DRILLER'S LOG  
Indicate the character, color, thickness of strata such as soil, clay, sand, gravel, shale, sandstone, etc. Show depth at which water is found and height to which water rises in well.

Top of Ground (Elev. above sea level)		
From (Feet)	To (Feet)	
0	2	topsoil
2	16	clay and rock
16	28	brown clay
28	30	gravel (1st water)
30	55	gravel and clay
55	67	gravel (water)
67	69	clay

Static water level 40 ft.\*  
Pumping water level 50 ft.\*  
at 25 gallons per minute,  
measured 180 minutes after pumping  
began.

\*Measured from ground level.  
Well developed by boiling & pump  
for 4 hours.

Power etc. Pump 1 HP  
Remarks: (Gravel packing, cementing,  
packers, type of shutoff)

Show exact depth of bottom

68 feet

50,062

STATE OF MONTANA, County of Beaverhead, I hereby certify that the within instrument was filed in my office on the

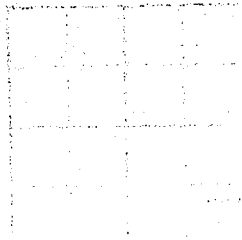

16th day of March A. D. 1973 at 10 min. past 2:00 o'clock P. M. and recorded on page 1230-31 of book 203 Records of Beaverhead County, Montana.

A large table with multiple rows and columns, mostly blank or containing illegible text, located on the right side of the document.

130146

STATE OF MONTANA, County of Beaverhead, I hereby certify that the within instrument was filed in my office on the 16th day of March A. D. 1973 at 10 min. past 2:00 o'clock P. M. and recorded on page 1230-31 of book 203 Records of Beaverhead County, Montana.

Attest my hand and seal  
By Theresa Sorenson  
Deputy  
Fee \$ 4.00

Margaret P. Thompson  
County Recorder



File No. ....

T. 7S. R. 9W.

DUPLICATE

County Beaverhead

STATE OF MONTANA  
ADMINISTRATOR OF GROUNDWATER CODE  
OFFICE OF STATE ENGINEER

RECEIVED  
JAN 15 1964

Declaration of Vested Groundwater Rights  
(Under Chapter 237, Montana Session Laws, 1961)

STATE ENGINEER

Ed. Heikkila of RFE Box 66 Dillon  
(Name of Appropriator) (Address) (Town)

County of Beaverhead State of Mont.  
have appropriated groundwater according to the Montana laws in effect prior to January 1, 1962, as follows:

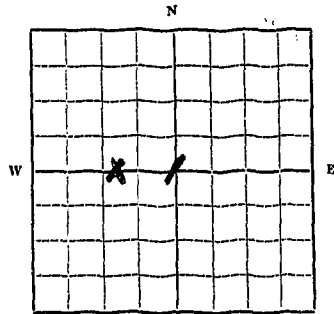

SE 1/4 of NW 1/4 of Sec. 1  
N. E. 1/4 of SW 1/4 of Sec. 1  
..... 1/4 Sec. 1 T. 7S R. 9W

Indicate point of appropriation and place of use, if possible. Each small square represents 10 acres.

2. The beneficial use on which the claim is based Stock-Well

3. Date or approximate date of earliest beneficial use; and how continuous the use has been 1913

4. The amount of groundwater claimed (in miner's inches or gallons per minute) 8 g.p.m. per minute

5. If used for irrigation, give the acreage and description of the lands to which water has been applied and name of the owner thereof Not used for irrigation

6. The means of withdrawing such water from the ground and the location of each well or other means of withdrawal Automatic Propane Gas Driven Pump

7. The date of commencement and completion of the construction of the well, wells, or other works for withdrawal of groundwater 1913

8. The depth of water table 170 ft

9. So far as it may be available, the type, size and depth of each well or the general specifications of any other works for the withdrawal of groundwater Hand dug about 45 ft in diameter cemented to bottom

10. The estimated amount of groundwater withdrawn each year 720,000 gal per year

11. The log of formations encountered in the drilling of each well if available Not available

12. Such other information of a similar nature as may be useful in carrying out the policy of this act, including reference to book and page of any county record

Signature of Owner Ed. Heikkila

Date Dec 28 1963

Three copies to be filed by the owner with the County Clerk and Recorder of the county in which the well is located.

Please answer all questions. If not applicable, so state, otherwise the form will be returned.

Original to the County Clerk and Recorder; duplicate to the State Engineer; Triplicate to the School of Mines and Quadruplicate for the Appropriator.



STATE OF MONTANA  
County of Beaverhead ss.

1087A2

I hereby certify that the within instrument  
was filed in my office on the 31 day  
of Dec A. D. 1963 at 15 min.  
past 8 o'clock, P. M. and recorded on  
page 349-50 of Book 174 of  
Water Records of Beaverhead  
County, Montana.

Attest my hand and seal,

*Corylyn J. Sage*  
County Recorder

By \_\_\_\_\_

Deputy

Fee \$ \_\_\_\_\_

File No. \_\_\_\_\_

T. 7 S. R. 9 West

DUPLICATE

County Beaver Head

STATE OF MONTANA  
ADMINISTRATOR OF GROUNDWATER CODE  
OFFICE OF STATE ENGINEER

RECEIVED  
JAN 15 1964

Declaration of Vested Groundwater Rights  
(Under Chapter 237, Montana Session Laws, 1961)

STATE ENGINEER

1. Ed. Heikkila of RHI Box 66 D17707  
(Name of Appropriator) (Address) (Town)

County of Beaver Head State of MONTANA  
have appropriated groundwater according to the Montana laws in effect prior to January 1, 1962, as follows:

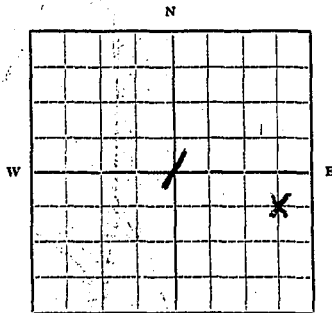

NE 1/4 Sec. 1 T. 7 S. R. 9 W.

Indicate point of appropriation and place of use, if possible. Each small square represents 10 acres.

2. The beneficial use on which the claim is based House Hold USE, STOCK WATER & GARDEN & LAWN.

3. Date or approximate date of earliest beneficial use; and how continuous the use has been 1882 HAS BEEN and CONTINUOUSLY.

4. The amount of groundwater claimed (in miner's inches or gallons per minute) 15 GALLONS PER MINUTE.

5. If used for irrigation, give the acreage and description of the lands to which water has been applied and name of the owner thereof Used For LAWN & Garden IRRIGATION OWNED BY E. H. & LOUISE HEIKKILA

6. The means of withdrawing such water from the ground and the location of each well, or other means of withdrawal PUMPED by ELECTRIC JET PUMP LOCATED IN GARD.

7. The date of commencement and completion of the construction of the well, wells, or other works for withdrawal of groundwater ORIGINALLY HAND DUG, DEEPEND IN 1949 by WELL DRILLER.

8. The depth of water table 80 ft.

9. So far as it may be available, the type, size and depth of each well or the general specifications of any other works for the withdrawal of groundwater

6" WELL CASE IN G. USED

10. The estimated amount of groundwater withdrawn each year 1,620,000 GALLONS.

11. The log of formations encountered in the drilling of each well if available

NOT AVAILABLE

12. Such other information of a similar nature as may be useful in carrying out the policy of this act, including reference to book and page of any county record.

Signature of Owner Ed Heikkila

Date Dec. 28. 1963

Three copies to be filed by the owner with the County Clerk and Recorder of the county in which the well is located.

Please answer all questions. If not applicable, so state, otherwise the form will be returned.

Original to the County Clerk and Recorder; duplicate to the State Engineer; Triplicate to the School of Mines and Quadruplicate for the Appropriator.

STATE OF MONTANA, ss.  
County of Beaverhead.

108743

I hereby certify that the within instrument

was filed in my office on the 31 day

of Dec A. D. 1963 at 1.6 min.

past 8 o'clock P. M. and recorded on

page 351-2 of Book 174 of

Water Records of Beaverhead

County, Montana.

Attest my hand and seal,

*Conroy J. Sage*

County Recorder

By \_\_\_\_\_ Deputy

Fee \$ \_\_\_\_\_

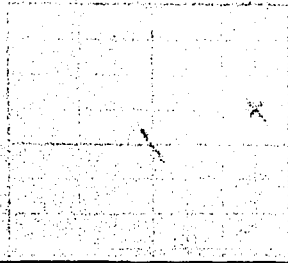

File No. ....

T. 7S. R. 9W.

DUPLICATE

County Beaverhead

STATE OF MONTANA  
ADMINISTRATOR OF GROUNDWATER CODE  
OFFICE OF STATE ENGINEER

RECEIVED  
JAN 15 1964

Declaration of Vested Groundwater Rights  
(Under Chapter 237, Montana Session Laws, 1961)

STATE ENGINEER

1. Ed. Milk Kila (Name of Appropriator), of Route 1, Poplar, Dillon (Address) (Town)

County of Beaverhead State of Montana  
have appropriated groundwater according to the Montana laws in effect prior to January 1, 1962, as follows:

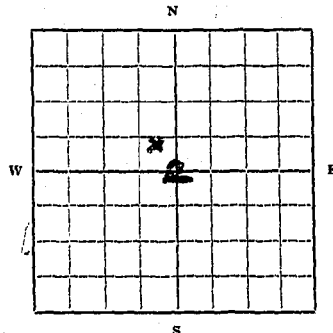

SE 1/4 NW 1/4 Sec. 2 T. 7S. R. 9W

Indicate point of appropriation and place of use, if possible. Each small square represents 10 acres.

2. The beneficial use on which the claim is based stock - wells

3. Date or approximate date of earliest beneficial use; and how continuous the use has been 1947 - during season

4. The amount of groundwater claimed (in miner's inches or gallons per minute) 8 gall per minute

5. If used for irrigation, give the acreage and description of the lands to which water has been applied and name of the owner thereof Not used for irrigation

6. The means of withdrawing such water from the ground and the location of each well or other means of withdrawal Automatic pressure gas driven pump

7. The date of commencement and completion of the construction of the well, wells, or other works for withdrawal of groundwater Drilled in 1947 to depth of 307ft. Reopened in 1963 to 300ft.

8. The depth of water table 290ft

9. So far as it may be available, the type, size and depth of each well or the general specifications of any other works for the withdrawal of groundwater 6 inch casing on Drilled well to 300ft.

10. The estimated amount of groundwater withdrawn each year 720,000 gall per year

11. The log of formations encountered in the drilling of each well if available Not available

12. Such other information of a similar nature as may be useful in carrying out the policy of this act, including reference to book and page of any county record.

Signature of Owner Ed. Milk Kila

Date Dec 28, 1963

Three copies to be filed by the owner with the County Clerk and Recorder of the county in which the well is located.

Please answer all questions. If not applicable, so state, otherwise the form will be returned.

Original to the County Clerk and Recorder; duplicate to the State Engineer; Triplicate to the School of Mines and Quadruplicate for the Appropriator.

STATE OF MONTANA, 108744  
County of Beaverhead. 58.

I hereby certify that the within instrument  
was filed in my office on the 31 day  
of Dec A. D. 1943 at 17 min.  
past 8 o'clock, P. M. and recorded on  
page 353-4 of Book 194  
Water Records of Beaverhead  
County, Montana.

Attest my hand and seal,

*Evelyn J. Sage*   
County Recorder

By \_\_\_\_\_ Deputy

Fee \$ \_\_\_\_\_

File No. ....

T. 7.5 R. 9.W

DUPLICATE

County Burns

STATE OF MONTANA  
ADMINISTRATOR OF GROUNDWATER CODE  
OFFICE OF STATE ENGINEER

RECEIVED  
JAN 15 1964

Declaration of Vested Groundwater Rights

(Under Chapter 237, Montana Session Laws, 1961)

STATE ENGINEER

1. Geo. A. Webster of Box 120 Dillon  
(Name of Appropriator) (Address) (Town)  
County of Burns State of Montana  
have appropriated groundwater according to the Montana laws in effect prior to January 1, 1962, as follows:

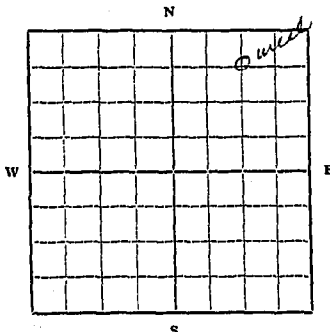

N. 1/4 E. Sec. 5. T. 7.5 R. 9.W

Indicate point of appropriation and place of use, if possible. Each small square represents 10 acres.

- The beneficial use on which the claim is based. stock water and irrigation
- Date or approximate date of earliest beneficial use; and how continuous the use has been. Prior to 1900 and continuous well since
- The amount of groundwater claimed (in miner's inches or gallons per minute) 1,000 gal per minute
- If used for irrigation, give the acreage and description of the lands to which water has been applied and name of the owner thereof. 20 acres of pasture and 30 acre farm ground
- The means of withdrawing such water from the ground and the location of each well or other means of withdrawal. Electric pump in well
- The date of commencement and completion of the construction of the well, wells, or other works for withdrawal of groundwater. Prior to 1900, do not know exact date
- The depth of water table. 8 to 25 ft
- So far as it may be available, the type, size and depth of each well or the general specifications of any other works for the withdrawal of groundwater. Well is 35 ft with 3 inch diameter casing
- The estimated amount of groundwater withdrawn each year. 8,000 gal
- The log of formations encountered in the drilling of each well if available. not known
- Such other information of a similar nature as may be useful in carrying out the policy of this act, including reference to book and page of any county record. None known

Signature of Owner Geo. A. Webster  
Date Dec. 30, 1963

Three copies to be filed by the owner with the County Clerk and Recorder of the county in which the well is located.

Please answer all questions. If not applicable, so state, otherwise the form will be returned.

Original to the County Clerk and Recorder; duplicate to the State Engineer; Triplicate to the School of Mines and Quadruplicate for the Appropriator.

STATE OF MONTANA, ss. 108762  
County of Beaverhead.

I hereby certify that the within instrument  
was filed in my office on the 31 day  
of Dec A. D. 1963 at 35 min.  
past 8 o'clock P. M. and recorded on  
page 389-90 of Book 174 of

Water Records of Beaverhead  
County, Montana.

Attest my hand and seal  
*Carolyn J. Sage*  
County Recorder

By \_\_\_\_\_ Deputy

Fee \$ \_\_\_\_\_

GW 2

File No. \_\_\_\_\_

QUADRUPPLICATE  
Duplicate

*Location 3*

RECEIVED  
MAY 20 1964

Approved Stock Form - State Publishing Co., Helena, Montana - 41933

T. M. R. 90 6

Beaverhead  
County

STATE OF MONTANA  
ADMINISTRATOR OF GROUNDWATER CODE  
OFFICE OF STATE ENGINEER

RECEIVED  
JAN 15 1964

### Notice of Completion of Groundwater Appropriation by Means of Well

(Under Chapter 237, Montana Session Laws, 1961)

Owner Joe Carroll Address Dillon, Mont.

Driller O'Keefe Drilling Co. Address Butte, Mont.

Date of Notice of Appropriation of Groundwater \_\_\_\_\_

Date well started 4-28-63 Date Completed 5-3-63

Type of well drilled Equipment Used churn  
(dug, driven, bored or drilled) (Churn, drill, rotary or other)

Water Use: Domestic  Municipal  Other  Irrigation   
Industrial  Drainage  Stock

Indicate on the diagram the character and thickness of the different strata met with in drilling, such as soil, clay, shale, gravel, rock or sand, etc. Show depth at which water is encountered, thickness and character of water-bearing strata and height to which water rises in the well.

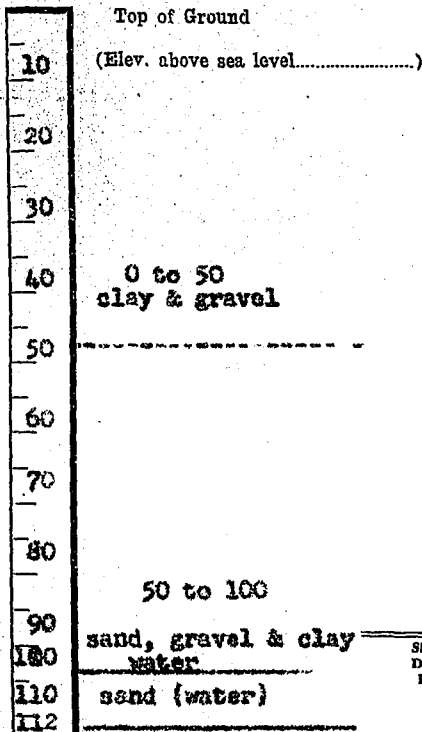

Size of Drilled Hole	Size and Weight of Casing	From (Feet)	To (Feet)	PERFORATIONS		
				Kind Size cutting torch	From (Feet)	To (Feet)
6"	6" 19#	0	112		106	112

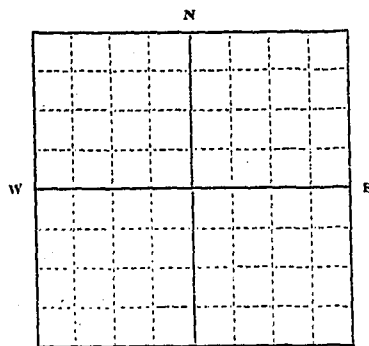

1/4 Sec. 6 T7.S. R9.W.  
Indicate location of well and place of use, if possible. Each small square represents 10 acres.

Show exact depth of bottom.

Static Water Level for non-flowing Well 85 feet.

Shut-in Pressure for Flowing Well \_\_\_\_\_

Pumping Water Level 90 feet at 15 gal. per minute.

Discharge in gal. per min. of flowing well \_\_\_\_\_

How Tested baller Length of Test 5 hrs.

Remarks: (Gravel packing, cementing, packers, type of shutoff, location of place of use of groundwater if not at well, and any other similar pertinent information, including number of acres irrigated, if used for irrigation) \_\_\_\_\_

Mont. License No. 8

Driller's License Number

*Edward A. O'Keefe*  
Driller's Signature

This form to be prepared by driller, and three copies to be filed by the owner with the County Clerk and Recorder in the county in which the well is located.

Please answer all questions. If not applicable, so state, otherwise the form will be returned.

Original to the County Clerk and Recorder; duplicate to the State Engineer; Triplicate to the Montana Bureau of Mines and Geology and Quadruplicate for the Appropriator.

32493



108882

STATE OF MONTANA, ss.  
County of Beaverhead.

I hereby certify that the within instrument was filed in my office on the 21 day of 10-10 A. D. 19 63 at 35 min. past 10 o'clock A. M. and recorded on page 4656 of Book 174 of Travis Steel Records of Beaverhead County, Montana.

Attest my hand and seal.

*Gwendolyn J. ...*  
County Registrar

By \_\_\_\_\_ Deputy

Fee \$ 4.00

File No.

ORIGINAL

T. 7S R. 9W

County Beaverhead

STATE OF MONTANA  
ADMINISTRATOR OF GROUNDWATER CODE  
OFFICE OF STATE ENGINEER

RECEIVED  
JAN 15 1964  
STATE ENGINEER

### Notice of Completion of Groundwater Appropriation Without Well

(Under Chapter 27 Montana Session Laws, 1961)

Date of Appropriation of Groundwater 1952  
Owner H. W. Wheat  
Edna L. Wheat Address Dillon, Mont.  
Contractor (if any) Ralph Davis  
Address of Contractor Dillon, Mont.  
Date Started 1952 Date Completed 1952

Describe means of obtaining groundwater without a well (as by  
subirrigation and other natural processes). Include depth of  
water when applicable. Excavation of drain ditch to a  
depth (average) of 5 ft.--ditch averages 25 ft.  
in width at top and 5 ft. wide at bottom. Ditch  
has course Northeasterly from point in Sec. 26,  
T. 7S, R. 9 W., M.E.M. through Section 23.

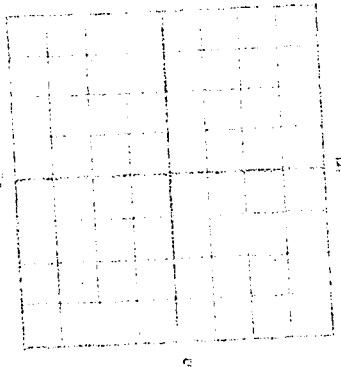

Quantity of water developed and used with explanation of method  
used to measure or estimate such amount. If use is intermittent  
estimate approximate months of period of use. 500 miner's  
inches developed--water measured by estimate  
at head gate.

T. 7S R. 9W  
Indicate date of appropriation and  
date of use, if possible

Edna L. Wheat  
Signature of Owner By *[Signature]*  
Agent.  
Date Dec. 31, 1963

This form to be prepared by contractor (if any) otherwise by the owner.  
These copies of this application to be filed with the county clerk and one copy of the copy of which this  
work is bonded.  
Please answer all questions. If not applicable, so state. Otherwise the form will be returned.  
Original to the County Clerk and Recorder, duplicate to the State Engineer, 1111 Lincoln Bldg., Helena, Mont.  
Bureau of Mines and Geology and quadruplicate to the Appropriator.

File No.  
ORIGINAL

T. 7S. R. 9W  
County: Beaverhead

STATE OF MONTANA  
ADMINISTRATOR OF GROUNDWATER CODE  
OFFICE OF STATE ENGINEER

RECEIVED  
JAN 15 1964  
STATE ENGINEER

Notice of Completion of Groundwater Appropriation  
Without Well

(Under Chapter 287 Montana Session Laws, 1961)

Date of Appropriation of Groundwater: 1952  
Owner: H. W. Wheat  
Edna L. Wheat Address: Dillon, Mont.  
Contractor (if any): Ralph Davis  
Address of Contractor: Dillon, Mont.  
Date Started: 1952 Date Completed: 1952

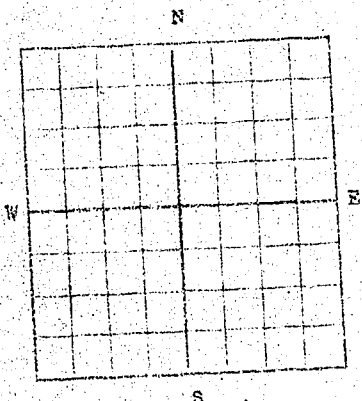

Describe means of obtaining groundwater without a well "as by sub-irrigation and other natural processes". Include depth to water when applicable. Excavation of drain ditch to a depth (average) of 5 ft.--ditch averages 25 ft. in width at top and 5 ft. wide at bottom. Ditch has course Northeasterly from point in Sec. 26, T. 7S., R. 9 W., M.F.M. through Section 23.

Quantity of water developed and used with explanation of method used to measure or estimate such amount. If use is intermittent estimate approximate lengths of periods of use. 500 miner's inches developed--water measured by estimate at head gate.

1/4 Sec. T. 7S. R. 9W.  
Indicate point of appropriation and place of use, if possible.

Signature of Owner: Edna L. Wheat  
By: [Signature] Agent

Date: Dec. 31, 1963

This form to be prepared by contractor (if any), otherwise by the owner.

Three copies of this notice are to be filed with the County Clerk and Recorder of the county in which the works are located.

Please answer all questions. If not applicable, so state. Otherwise the form will be returned.

Original to the County Clerk and Recorder; duplicate to the State Engineer; Triuplicate to the Montana Bureau of Mines and Geology and Quadruplicate for the Appropriator.

STATE OF MONTANA )  
County of Beaverhead )

H. W. WHEAT having first been duly sworn, deposes and says that he is of lawful age and is the agent for the appropriator and claimant of the order and water right mentioned in the foregoing ~~application for~~ notice of completion of groundwater appropriation without well and the person whose name is subscribed thereto, as agent for the appropriator and claimant; that he knows the contents of said foregoing notice and that the matters and things therein stated are true.

Subscribed and sworn to before me, this 31st day of December, 1963.

Notary Public for State of Montana;  
residing at Dillon, Montana. My commission  
expires \_\_\_\_\_.

108830

STATE OF MONTANA )  
County of Beaverhead ) ss.

I hereby certify that the within instrument  
was filed in my office on the 31 day  
of Dec A. D. 1963 at 43 min.  
past 9 o'clock A. M. and recorded on  
page 485-6 of Book 133 of  
Water Records of Beaverhead  
County, Montana.

Attest my hand and seal,

George J. [Signature]  
County Recorder

By \_\_\_\_\_ Deputy

Fee \$ \_\_\_\_\_

GW1

File No. ....

T. 7. S. R. 9. W. 9

DUPLICATE

County. Beaverhead

STATE OF MONTANA  
ADMINISTRATOR OF GROUNDWATER CODE  
OFFICE OF STATE ENGINEER

Notice of Appropriation of Groundwater  
(Under Chapter 237, Montana Session Laws, 1961)

RECEIVED  
JAN 15 1964

STATE ENGINEER

1. I, Joseph J. S. Feathers, of Bannack Star Route, Dillon  
(Name of Appropriator) (Address) (Town)  
County of Beaverhead, State of Montana, intend to appropriate groundwater in accordance with Chapter 237, Montana Session Laws of 1961.

2. The beneficial use to which water is to be applied is sub-irrigation and ranges  
well to be used for livestock and some irrigation.  
(describe lands to be benefited, if for irrigation)

3. The rate of use in gallons per minute or miner's inches of groundwater claimed  
20" casing - - - 150 to 200 miner's inches

4. The annual period (inclusive dates) of intended use May 1 to September 1.

5. The probable or intended date of first beneficial use June 1, 1964

6. The probable or intended date of commencement and completion of the well\* or wells\*  
May 1 to June 1.

7. The location, type, size and depth of well or wells contemplated  
SE 1/4 Sec. 9 T. 7S. R. 9W Depth 200 feet.

8. The probable or estimated depth of the water table or artesian aquifer 200 feet.

9. Name, address and license number of the driller engaged Carl Hollensteiner,  
Hillcrest Acres, Dillon, Montana, License no. 9.

10. Give such other similar information as may be useful in carrying out the policy of this act  
Not applicable.

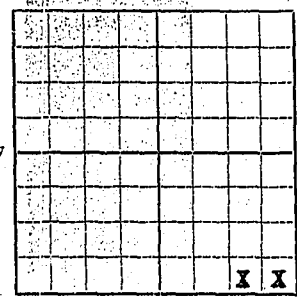

SE 1/4 Sec. 9 T. 7S. R. 9W.

Locate well or other means of development as accurately as possible on the plat.

Signature of Appropriator Joseph J. S. Feathers

Date December 30, 1963

\* As defined in the Code Sec. 1 (c) "Well" means any artificial opening or excavation in the ground, however made, by which groundwater can be obtained or through which it flows under natural pressures or is artificially withdrawn."

Three copies of this notice are to be filed with County Clerk and Recorder of the county in which the well is located.

Please answer all questions. If not applicable, so state, otherwise the form will be returned.

Original to the County Clerk and Recorder; duplicate to the State Engineer; Triplicate to the School of Mines and Quadruplicate for the Appropriator.

32558

108952

STATE OF MONTANA,  
County of Beaverhead, ss:

I hereby certify that the within instrument  
was filed in my office on the 31 day  
of Dec A. D. 1963 at 4.5 min.  
past 11:00 o'clock P. M. and recorded on  
page 599 of Book 174 of  
Watts Records of Beaverhead  
County, Montana.

Attest my hand and seal,

*Carolyn J. Snyder*  
By \_\_\_\_\_ Deputy

Fee \$ \_\_\_\_\_

Deputy

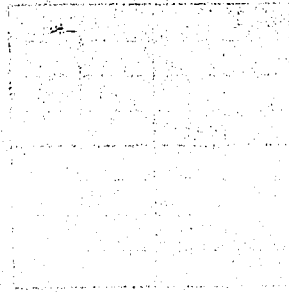

File No. ....

T. 7 S. R. 9 W.

DUPLICATE

County Beaverhead

STATE OF MONTANA  
ADMINISTRATOR OF GROUNDWATER CODE  
OFFICE OF STATE ENGINEER

RECEIVED  
JAN 15 1964

STATE ENGINEER

**Notice of Completion of Groundwater Appropriation  
Without Well**

(Under Chapter 237 Montana Session Laws, 1961)

Date of Appropriation of Groundwater December 30, 1963

Owner Joseph J. S. Feathers Address Bannack Star Route

Contractor (if any) Feathers Dillon, Montana

Address of Contractor .....

Date Started..... Date Completed.....

Describe means of obtaining groundwater without a well "as by sub-irrigation and other natural processes". Include depth to water when applicable. Sub-irrigation; sub-surface springs; and natural processes. Depth 4 to 6 feet.

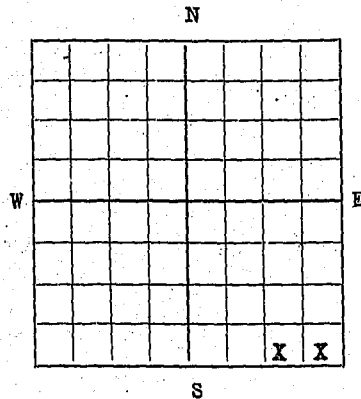

<sup>SE</sup>  
SE 1/4 Sec. 9 T7 S R9 W

Indicate point of appropriation and place of use, if possible.

Quantity of water developed and used with explanation of method used to measure or estimate such amount. If use is intermittent estimate approximate lengths of periods of use.....

Period of use, May 1 to September 1.

Signature of Owner Joseph J. S. Feathers

Date December 30, 1963

This form to be prepared by contractor (if any), otherwise by the owner.

Three copies of this notice are to be filed with the County Clerk and Recorder of the county in which the works are located.

Please answer all questions. If not applicable, so state, otherwise the form will be returned.

Original to the County Clerk and Recorder; duplicate to the State Engineer; Triplicate to the Montana Bureau of Mines and Geology and Quadruplicate for the Appropriator.



STATE OF MONTANA 108821  
County of Beaverhead

I hereby certify that the within instrument  
was filed in my office on the 31 day  
of Dec A. D. 1943 at 24 min.  
past 9 o'clock, P. M. and recorded on  
page 467-8 of Book 123 of  
Waters Records of Beaverhead  
County, Montana.

Attest my hand and seal,  
*Swilgn J. Sage*  
County Recorder

By \_\_\_\_\_ Deputy  
Fee \$ \_\_\_\_\_



RECEIVED

County Beaverhead

STATE OF MONTANA ADMINISTRATOR OF GROUNDWATER CODE MONTANA WATER RESOURCES BOARD

JAN 13 1972

DRILLER'S LOG

NOTICE OF COMPLETION OF GROUNDWATER APPROPRIATION BY MEANS OF WELL

Developed after January 1, 1962

(Under Chapter 237 Montana Session Laws, 1961, as amended)

This form to be prepared by driller, and three copies to be filed by the owner with the County Clerk and Recorder in the county in which the well is located, last copy to be retained by driller.

Please answer all questions. If not applicable, so state, otherwise the form may be returned.

Indicate the character, color, thickness of strata such as soil, clay, sand, gravel, shale, sandstone, etc. Show depth at which water is found and height to which water rises in well.

Top of Ground (Elev. above sea level)

Owner Vernon Stoddard

Address Dillon

Montana

Date well started 11-29-71

completed 12-2-71

Type of well Drilled

Equipment used Churn Drill

Water Use: Domestic [X] Municipal [ ] Stock [ ] Irrigation [ ]

Industrial [ ] Drainage [ ] Other [ ]\* Garden/Lawn [ ]

\*Describe

USE: If used for irrigation, industrial, drainage or other. Explain, state number of acres and location or other data (i.e. Lot, Block and Addition).

ESTIMATED ANNUAL WITHDRAWAL

Table with columns: Size of Drilled Hole, Size and Weight of Casing, From (Feet), To (Feet), PERFORATIONS (Kind Size, From (Feet), To (Feet)).

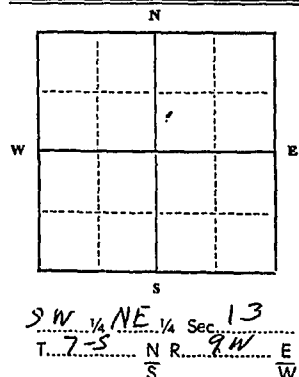

Static water level 45' ft.\* Pumping water level 5' ft.\* at 28 gallons per minute, measured ... minutes after pumping began. \*Measured from ground level. Well developed by bailing for 2 hours. Power Pump HP Remarks: (Gravel packing, cementing, packers, type of shutoff)

Large table for Driller's Log with columns: From (Feet), To (Feet), and strata description.

INDICATE LOCATION OF WELL AND PLACE OF USE, IF POSSIBLE. EACH SMALL SQUARE REPRESENTS 40 ACRES.

Driller's Signature O'Keefe Contracting Company

Driller's Address 2804 Harvard Ave.

Butte, Montana 59701

LICENSE NO. 8

57' = Show exact depth of bottom

STATE OF MONTANA  
COUNTY OF BEAVERHEAD

MONTANA WATER RECORDS BOARD  
MONTANA COMMISSION OF RECORDS  
COUNTY OF BEAVERHEAD

No.	Date	Name	Page	Book
130016	Jan 12 1904	Clark, Stephen	754	203

Beaverhead ss. I hereby certify that the within instrument was filed in my office on the 12th day of January, A. D. 1904, at 11:00 min. past 9 o'clock A. M. and recorded on page 754 of book 203, Records of Beaverhead County, Montana.

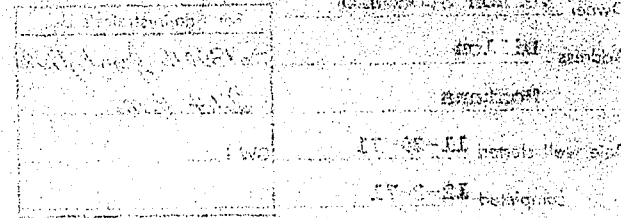

Witness my hand and the seal of said County Recorder, this 12th day of January, 1904, at the County Recorder's Office, Beaverhead County, Montana.

130016

STATE OF MONTANA, County of Beaverhead ss. I hereby certify that the within instrument was filed in my office on the 12th day of January, A. D. 1904, at 11:00 min. past 9 o'clock A. M. and recorded on page 754 of book 203, Records of Beaverhead County, Montana.

Attest my hand and seal  
By Stephen Clark  
Deputy

Margaret E. Thompson  
County Recorder

Clark, Stephen  
229 E. Ave., Billings

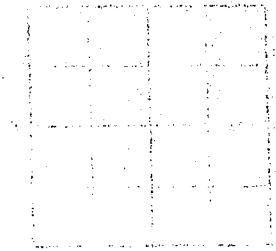

RECORDED JAN 14 1904

130016

File No. ....

STATE WATER CONSERVATION BOARD

T. 7S R. 9W

DUPLICATE

MAY 26 1967

County Beaverhead

LOG

Bill: \_\_\_\_\_ McDermott \_\_\_\_\_ STATE OF MONTANA  
 Butcher: \_\_\_\_\_ McNamee \_\_\_\_\_ ADMINISTRATOR OF GROUNDWATER CODE  
 Coyle: \_\_\_\_\_ Sullivan \_\_\_\_\_ OFFICE OF STATE ENGINEER  
 Dickert: \_\_\_\_\_



Top of Ground

(Elev. above sea level)

Loam

42 sandy clay

49 gravel (water)

54 clay

**Notice of Completion of Groundwater  
 Appropriation by Means of Well**  
 DEVELOPED AFTER JANUARY 1, 1962

(Under Chapter 237, Montana Session Laws, 1961)

*Staudhewer*

Owner H. H. Staudhewer Address Dillon, Montana

Driller Beiggs Drilling Co. Address Dillon, Montana

Date of Notice of appropriation of groundwater \_\_\_\_\_

Date well started 4-25-67 Date completed 4-25-67

Type of well drilled Equipment used cable tool  
(Dug, driven, bored or drilled) (Churn drill, rotary or other)

Water use: Domestic  Municipal  Stock  Irrigation   
 Industrial  Drainage  Other

Indicate on the diagram the character and thickness of the different strata met with in drilling, such as soil, clay, shale, gravel, rock or sand, etc. Show depth at which water is encountered, thickness and character of water-bearing strata and height to which the water rises in the well.

Size of Drilled Hole	Size and Weight of Casing	From (Feet)	To (Feet)	PERFORATIONS		
				Kind Size	From (Feet)	To (Feet)
6"	6/5/8 18.97	1	51	4x4	42	49

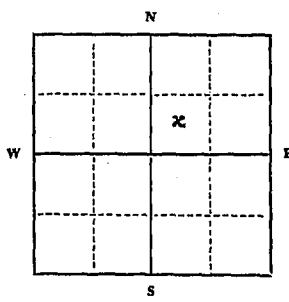

Static Water Level for non-flowing well \_\_\_\_\_ feet.  
 Shut-in Pressure for Flowing Well \_\_\_\_\_  
 Pumping Water Level \_\_\_\_\_ feet  
 at \_\_\_\_\_ gal. per minute.  
 Discharge in gal. per min. of flowing well \_\_\_\_\_

How Tested builer  
 Length of Test 2 hrs.  
 Remarks: (Gravel packing, cementing, packers, type of shutoff) \_\_\_\_\_

Sec. 13, T. 7S, R. 9W.  
 Indicate location of well and place of use, if possible. Each small square represents 40 acres.

(Continue on reverse side)

USE—If used for irrigation, industrial, drainage or other. Explain, state number of acres and location or other data (i.e.: Lot, Block and Addition).

This form to be prepared by driller, and three copies to be filed by the owner with the County Clerk and Recorder in the county in which the well is located, tissue copy to be retained by driller.

Please answer all questions. If not applicable, so state, otherwise the form will be returned.

148  
 Driller's License Number  
*Richard Beiggs*  
 Driller's Signature

42,022 #622

Show exact depth of bottom.

STATE OF MONTANA ss. 117142  
County of Beaverhead

I hereby certify that the within instrument  
was filed in my office on the 10 day  
of May A. D. 1927 at 9 min.  
past 9 o'clock A. M. and recorded on  
page 171 of Book 182 of  
W. A. B. C. Records of Beaverhead  
County, Montana.

Attest my hand and seal

*Erlynn J. Sage*  
County Recorder

By \_\_\_\_\_ Deputy

Fee \$ 4.00

File No. ....

T. 7S R. 9W

DUPLICATE

MONTANA WATER RESOURCES BOARD

County Beaverhead

LOG

RECEIVED  
MAY 15 1968

STATE OF MONTANA  
ADMINISTRATOR OF GROUNDWATER CODE  
STATE WATER CONSERVATION BOARD

### Notice of Completion of Groundwater Appropriation by Means of Well DEVELOPED AFTER JANUARY 1, 1962

(Under Chapter 237 Montana Session Laws, 1961, as amended)

Owner Vereau Stathem Address Dillon, Montana

Driller Briggs Dalg. Contractor Address Dillon, Montana

Date of Notice of appropriation of groundwater.....

Date well started 4-20-68 Date completed 4-24-68

Type of well drilled Equipment used cable tool  
(Dug, driven, bored or drilled) (Churn drill, rotary or other)

Water use: Domestic  Municipal  Stock  Irrigation   
Industrial  Drainage  Other

Indicate on the diagram the character and thickness of the different strata met with in drilling, such as soil, clay, shale, gravel, rock or sand, etc. Show depth at which water is encountered, thickness and character of water-bearing strata and height to which the water rises in the well.

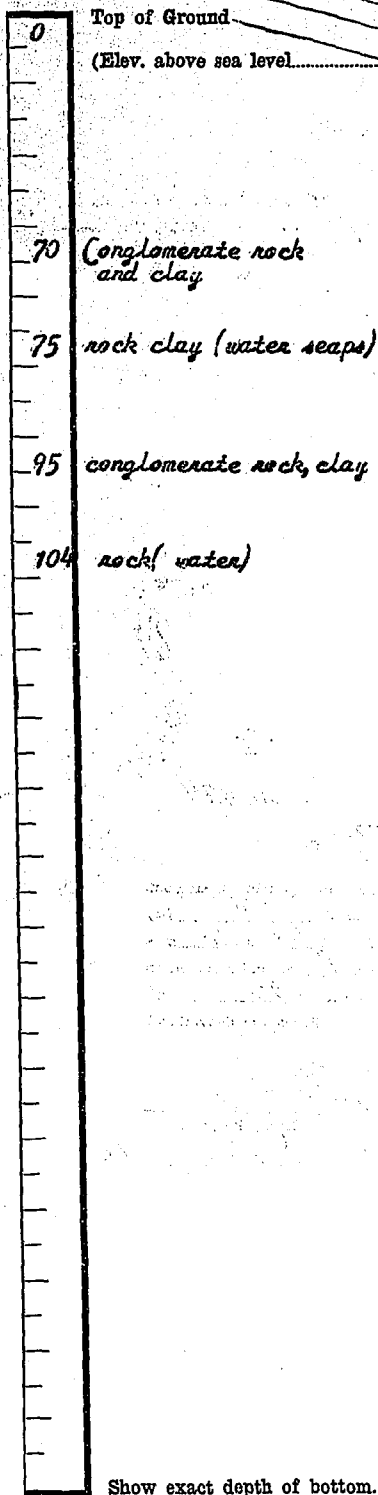

Size of Drilled Hole	Size and Weight of Casing	From (Feet)	To (Feet)	PERFORATIONS		
				Kind Size	From (Feet)	To (Feet)
6"	6 5/8	+1	104	7/8 x 6	96	104

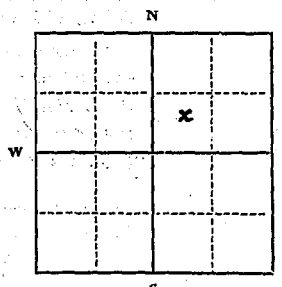

Static Water Level for non-flowing well ..... 60 feet.  
 Shut-in Pressure for Flowing Well.....  
 Pumping Water Level..... 65 feet  
 at..... 20 gal. per minute.  
 Discharge in gal. per min. of flowing well .....

How Tested..... bailer  
 Length of Test..... 1 hr.  
 Remarks: (Gravel packing, cementing, packers, type of shutoff).....

SW 1/4 NE Sec. 13 T. 7S R. 9W  
 Indicate location of well and place of use, if possible. Each small square represents 40 acres.

(Continue on reverse side)

USE—If used for irrigation, industrial, drainage or other. Explain, state number of acres and location or other data (i.e.: Lot, Block and Addition).

This form to be prepared by driller, and three copies to be filed by the owner with the County Clerk and Recorder in the county in which the well is located, tissue copy to be retained by driller.  
 Please answer all questions. If not applicable, so state, otherwise the form will be returned.

148  
 Driller's License Number  
Richard Briggs  
 Driller's Signature  
44,132

Show exact depth of bottom.

REPUBLICAN  
DIVISION TO STATE  
COUNTY RECORDERS  
OFFICE BEAVERHEAD MONTANA

Notice of Completion of Construction  
of Well

(Reference to 1991 local order or statute)

Agricultural  Domestic  Industrial  Municipal  Other

Attest my hand and seal this \_\_\_\_\_ day of \_\_\_\_\_ A. D. 19\_\_ at \_\_\_\_\_ Montana.

Area	Acres	Feet	Feet	Feet	Feet
1					
2					
3					
4					
5					

119994

STATE OF MONTANA, }  
County of Beaverhead, } ss

I hereby certify that the within instrument was filed in my office on the 10<sup>th</sup> day of May A. D. 1968 at 20 min. past 4:00 o'clock, P. M. and recorded on page 907-8 of Book 192 of Records of Beaverhead County, Montana.

Attest my hand and seal

*Gayle J. Sage*  
County Recorder  
By *Phyllis D. Bunnell*  
Deputy

Fee \$ 4.00

**RECEIVED**

County Beaverhead  
**DRILLER'S LOG**

**STATE OF MONTANA**  
**ADMINISTRATOR OF GROUNDWATER CODE**  
**MONTANA WATER RESOURCES BOARD**

**NOTICE OF COMPLETION OF GROUNDWATER APPROPRIATION BY MEANS OF WELL**

Developed after January 1, 1962

Indicate the character, color, thickness of strata such as soil, clay, sand, gravel, shale, sandstone, etc. Show depth at which water is found and height to which water rises in well.

(Under Chapter 237 Montana Session Laws, 1961, as amended)

This form to be prepared by driller, and three copies to be filed by the owner with the County Clerk and Recorder in the county in which the well is located, last copy to be retained by driller. Please answer all questions. If not applicable, so state, otherwise the form may be returned.

Owner Chuck Stathem  
Address 229 E. Orr  
Dillon, Montana 59722  
Date well started 11-22-71  
completed 11-23-71

For Administrator's Use  
File 130017 Jan. 10, 1972  
2:05 P.M.  
GW 1

Type of well Drilled  
(Dug, driven, bored or drilled)

Equipment used Churn Drill  
(Churn drill, rotary or other)

Water Use: Domestic  Municipal  Stock  Irrigation   
Industrial  Drainage  Other  Garden/Lawn

\*Describe

USE: If used for irrigation, industrial, drainage or other. Explain, state number of acres and location or other data (i.e. Lot, Block and Addition).

**ESTIMATED ANNUAL WITHDRAWAL**

Size of Drilled Hole	Size and Weight of Casing	From (Feet)	To (Feet)	PERFORATIONS		
				Kind Size	From (Feet)	To (Feet)
6"	6 5/8" x .230	od 1'7"	ag 50'	cutting torch	45'	50'

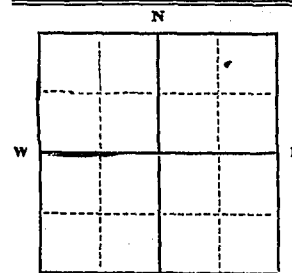

NW 1/4 NE 1/4 Sec 13  
T. 7 S N. R. 9 W

Static water level 39' ft.\*  
Pumping water level .....ft.\*  
at 23 gallons per minute,  
measured .....minutes after pumping began.  
\*Measured from ground level.  
Well developed by bailing  
for 1 1/2 hours.  
Power..... Pump..... HP  
Remarks: (Gravel packing, cementing, packers, type of shutoff) .....

INDICATE LOCATION OF WELL AND PLACE OF USE, IF POSSIBLE. EACH SMALL SQUARE REPRESENTS 40 ACRES.

Driller's Signature O'Keefe Contracting Company  
H. F. Kautfeld  
Driller's Address 2804 Harvard Ave.  
Dutte, Montana 59701

Top of Ground (Elev. above sea level)

From (Feet)	To (Feet)	Description
0'	8'	sandy soil w/ boulders
8'	37'	sand, gravel w/clay
37'	50'	sand & gravel water

50' Show exact depth of bottom

COUNTY OF BEAVERHEAD  
 BEAVERHEAD COUNTY, MONTANA  
 DEPARTMENT OF RECORDS  
 130017

BEAVERHEAD COUNTY, MONTANA  
 DEPARTMENT OF RECORDS  
 130017

130017  
 I hereby certify that the within instrument was filed in my office on the  
 10th day of January A. D. 1922 at 10:45 min. past 10 o'clock P. M. and recorded on  
 page 256-70 of book 263, Records of Beaverhead County, Montana.  
 Attest my hand and seal  
 By Theresa A. Buswell Deputy  
 Fee \$4.00  
 Chester Stathin  
 229 E. Arr - Dillon

130017  
 I hereby certify that the within instrument was filed in my office on the  
 10th day of January A. D. 1922 at 10:45 min. past 10 o'clock P. M. and recorded on  
 page 256-70 of book 263, Records of Beaverhead County, Montana.  
 Attest my hand and seal  
 By Marquet D. Thompson County Recorder



File No. \_\_\_\_\_

T. 7S R. 9W

DUPLICATE

County Beaverhead

LOG MONTANA WATER RESOURCES BOARD

STATE OF MONTANA

RECEIVED

ADMINISTRATOR OF GROUNDWATER CODE  
OFFICE OF STATE ENGINEER

Top of Ground \_\_\_\_\_

(Elev. above sea level \_\_\_\_\_)

APR 3 1968

### Notice of Completion of Groundwater Appropriation by Means of Well

DEVELOPED AFTER JANUARY 1, 1962

(Under Chapter 237, Montana Session Laws, 1961)



20 sand clay & gravel

43 gravel

56 sand gravel & water

Owner Chuck Stathen Address Dillon, Montana

Driller Briggs Dalg. Co. Address Dillon, Montana

Date of Notice of appropriation of groundwater \_\_\_\_\_

Date well started March 6, 1968 Date completed March 7, 1968

Type of well drilled Equipment used cable tool  
(Dug, driven, bored or drilled) (Churn drill, rotary or other)

Water use: Domestic  Municipal  Stock  Irrigation   
Industrial  Drainage  Other

Indicate on the diagram the character and thickness of the different strata met with in drilling, such as soil, clay, shale, gravel, rock or sand, etc. Show depth at which water is encountered, thickness and character of water-bearing strata and height to which the water rises in the well.

Size of Drilled Hole	Size and Weight of Casing	From (Feet)	To (Feet)	PERFORATIONS		
				Kind Size	From (Feet)	To (Feet)
6"	6 5/8 18.97	+18"	56	4x6	47	54

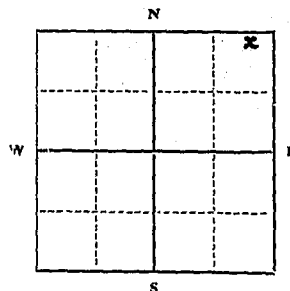

Static Water Level for non-flowing well \_\_\_\_\_ 22 feet.

Shut-in Pressure for Flowing Well \_\_\_\_\_

Pumping Water Level \_\_\_\_\_ 25 feet  
at \_\_\_\_\_ 25 gal. per minute.

Discharge in gal. per min. of flowing well \_\_\_\_\_

How Tested Bailer

Length of Test 1 hr.

Remarks: (Gravel packing, cementing, packers, type of shutoff) \_\_\_\_\_

NE 1/4 Sec. 13 T. 7S R. 9W

Indicate location of well and place of use, if possible. Each small square represents 40 acres.

(Continue on reverse side)

USE—If used for irrigation, industrial, drainage or other. Explain, state number of acres and location or other data (i.e.: Lot, Block and Addition).

Show exact depth of bottom.

This form to be prepared by driller, and three copies to be filed by the owner with the County Clerk and Recorder in the county in which the well is located, tissue copy to be retained by driller.

Please answer all questions; if not applicable, so state, otherwise the form will be returned.

148  
Driller's License Number

Richard Briggs  
Driller's Signature

44,021

STATE OF MONTANA, ss. 119727  
County of Beaverhead

I hereby certify that the within instrument  
was filed in my office on the 1 day  
of April A. D. 1968 at 15 min.  
past 9 o'clock A. M. and recorded on  
page 667-8 of Book 192 of  
Records of Beaverhead  
County, Montana.

Attest my hand and seal,

EVELYN J. SAGE

County Recorder

By *Lester W. Richardson*  
Deputy

Fee \$ 4.00

RECEIVED  
NOV 21 1957  
STATE ENGINEER

MONTANA BUREAU OF MINES AND GEOLOGY  
Butte, Montana

T. 7 R. 9 <sup>W</sup> 13  
County Beaverhead

WATER WELL LOG

Owner John D. Spehar Address Pellston, Mont  
Driller H. Beul Address Blount Mont  
Date Started Sept 12, 1928 Date Completed Sept 15, 1928  
Location: Sec. 13 T. 7 R. 9 1/4 sec. SE Corner

Type of well drilled Equipment used \_\_\_\_\_  
(Dug, driven, bored, or drilled) (Churn drill, rotary, other)

Water use: Domestic  Municipal  Stock  Irrigation   
Industrial  Drainage  Other: \_\_\_\_\_

Casing: 30 ft. to \_\_\_\_\_ ft. Type galvanized Size 4"  
Casing: \_\_\_\_\_ ft. to \_\_\_\_\_ ft. Type \_\_\_\_\_ Size \_\_\_\_\_  
Casing: \_\_\_\_\_ ft. to \_\_\_\_\_ ft. Type \_\_\_\_\_ Size \_\_\_\_\_

Perforated or Screened: Ft. \_\_\_\_\_ to ft. \_\_\_\_\_ Ft. \_\_\_\_\_ to ft. \_\_\_\_\_

Type of screen or perforations: \_\_\_\_\_

Static Water level, for non-flowing well: \_\_\_\_\_ feet.

Shut-in pressure, for flowing well: \_\_\_\_\_ lb./sq. in. on: \_\_\_\_\_ (date)

Pumping water level \_\_\_\_\_ feet at \_\_\_\_\_ gal. per min. \_\_\_\_\_

How tested: never tested

Length of test: \_\_\_\_\_

Remarks: (Gravel packing, cementing, packers, type of shut-off, depth of shut-off)

STATE OF MONTANA, 94400  
County of Beaverhead, ss.

I hereby certify that the within instrument was filed in my office on the 19 day of Nov, A. D. 1957 at 5 min. past 7.00 o'clock P.M. and recorded on page 15 of 151 of Water Well Records of Beaverhead County, Montana

Attest my hand and seal.  
Walter C. Schmitt  
COUNTY RECORDER.

(over)

By \_\_\_\_\_ DEPUTY.

Fee \$ 1.00

File No. ....

DUPLICATE

T. 7<sup>s</sup> R. 9<sup>w</sup> S. 13  
County BEAVERHEAD

STATE OF MONTANA  
ADMINISTRATOR OF GROUNDWATER CODE  
OFFICE OF STATE ENGINEER

RECEIVED  
AUG 5 1963

Declaration of Vested Groundwater Rights  
(Under Chapter 237, Montana Session Laws, 1961)

STATE ENGINEER

1. James + Hazel Johnson, of Sullivan  
(Name of Appropriator) (Address)  
County of Beaverhead State of Mont  
have appropriated groundwater according to the Montana laws in effect prior to January 1, 1962, as follows:

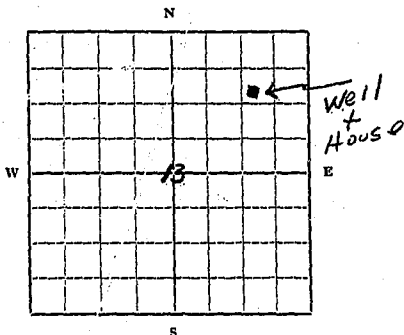

NE 1/4 Sec. 13, T. 7S, R. 9W

Indicate point of appropriation and place of use, if possible. Each small square represents 10 acres.

- 2. The beneficial use on which the claim is based used for Domestic Water - House & livestock Irrigate lawn & garden.
- 3. Date or approximate date of earliest beneficial use; and how continuous the use has been April 21, 1948  
use has been continuous  
ever since.
- 4. The amount of groundwater claimed (in miner's inches or gallons per minute) 10 G.P.M.
- 5. If used for irrigation, give the acreage and description of the lands to which water has been applied and name of the owner thereof lawn + Garden - 1/2 Acre  
see sketch for location  
Jim + Hazel Johnson
- 6. The means of withdrawing such water from the ground and the location of each well or other means of withdrawal PUMP

- 7. The date of commencement and completion of the construction of the well, wells, or other works for withdrawal of groundwater Well Completed April 21, 1948
- 8. The depth of water table within 22' of Ground surface
- 9. So far as it may be available, the type, size and depth of each well or the general specifications of any other works for the withdrawal of groundwater  
Dialed Well - 55' deep - 5 7/8" casing
- 10. The estimated amount of groundwater withdrawn each year 200,000 gal
- 11. The log of formations encountered in the drilling of each well if available No log
- 12. Such other information of a similar nature as may be useful in carrying out the policy of this act, including reference to book and page of any county record

Signature of Owner James + Hazel Johnson  
Date 6/25/63

Three copies to be filed by the owner with the County Clerk and Recorder of the county in which the well is located.

Please answer all questions. If not applicable, so state, otherwise the form will be returned.

Original to the County Clerk and Recorder; duplicate to the State Engineer; Triplicate to the School of Mines and Quadruplicate for the Appropriator.

STATE OF MONTANA,  
County of Beaverhead.

107057

I hereby certify that the within instrument  
was filed in my office on the 25 day  
of June A. D. 1963 at 30 min-  
utes past 11 o'clock A.M. and recorded on  
page 421 of Book 151 of  
Water Well Records of Beaverhead  
County, Montana.

Attest my hand and seal.

*Carolyn J. Sage*  
County Recorder

By \_\_\_\_\_  
Deputy

Fee \$ 1.00

*107057*

*107057*

*107057*

13

File No. ....

T. 7S R. 9W M.P.M.

DUPLICATE

County Beaverhead

STATE OF MONTANA  
ADMINISTRATOR OF GROUNDWATER CODE  
OFFICE OF STATE ENGINEER

RECEIVED  
JAN 15 1964

Declaration of Vested Groundwater Rights  
(Under Chapter 237, Montana Session Laws, 1961)

1. ADA INGRAM, of 643 West Park St., Dillon  
(Name of Appropriator) (Address) (Town)  
County of Beaverhead State of Montana  
have appropriated groundwater according to the Montana laws in effect prior to January 1, 1963, as follows:

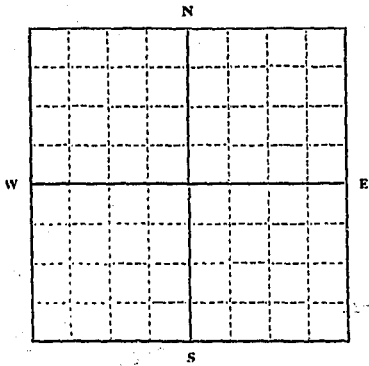

SE 1/4 Sec. 13 T. 7S R. 9W M.P.M.

Indicate point of appropriation and place of use, if possible. Each small square represents 10 acres.

- 2. The beneficial use on which the claim is based... Household, Domestic, irrigation and watering livestock.
- 3. Date or approximate date of earliest beneficial use; and how continuous the use has been... About spring of 1948 and continuous since.
- 4. The amount of groundwater claimed (in miner's inches or gallons per minute)... Sixty (60) gallon per minute.
- 5. If used for irrigation, give the acreage and description of the lands to which water has been applied and name of the owner thereof... 2/3 of an acre (Tract in SE 1/4 Sec. 13 T. 7 S. R. 9W) particularly described in deed appearing of record at page 240, Book 161 official records of Beaverhead County, Montana. Owned by Ada Ingram.
- 6. The means of withdrawing such water from the ground and the location of each well or other means of withdrawal... Electric Pump with pressure storage Tank

- 7. The date of commencement and completion of the construction of the well, wells, or other works for withdrawal of groundwater... 1948
- 8. The depth of water table... 5 feet
- 9. So far as it may be available, the type, size and depth of each well or the general specifications of any other works for the withdrawal of groundwater... 6" casing; depth 25 feet
- 10. The estimated amount of groundwater withdrawn each year... (5000 gallons per day) 1,500,000 gallons per annum
- 11. The log of formations encountered in the drilling of each well if available... Not available
- 12. Such other information of a similar nature as may be useful in carrying out the policy of this act, including reference to book and page of any county record... None

Signature of Owner *Ada Ingram*  
Date... December 30, 1963

Three copies to be filed by the owner with the County Clerk and Recorder of the county in which the well is located.  
Please answer all questions. If not applicable, so state, otherwise the form will be returned.  
Original to the County Clerk and Recorder; Duplicate to the State Engineer; Triplicate to the Montana Bureau of Mines and Geology, and Quadruplicate for the Appropriator.

32259

STATE OF MONTANA

County of Beaverhead

ss

ADA INGRAM having first been duly sworn, deposes and says that she is of lawful age and is the appropriator and claimant of the order and water right mentioned in the foregoing declaration of vested groundwater rights and the person whose name is subscribed thereto, as the appropriator and claimant, that she knows the contents of said foregoing notice and that the matter and things therein stated are true.

*Ada Ingram*

Subscribed and sworn to before me this 30th day of December, A.D. 1963.

*Glenn E. Jones*  
Notary Public for the State of Montana  
Residing at Dillon, Montana  
My Commission expires Jan. 4, 1965.

108659

STATE OF MONTANA  
County of Beaverhead ss

I hereby certify that the within instrument was filed in my office on the 30 day of Dec A. D. 1963 at 44 min. past 4:00 o'clock P. M. and recorded on page 163-4 of Book 174 of Water Records of Beaverhead County, Montana.

Attest my hand and seal,

*Carolyn J. Sage*  
County Recorder

By \_\_\_\_\_ Deputy

Fee \$ \_\_\_\_\_

79 94 13

File No. ....

T. 5 R. 14

DUPLICATE

County Beaverhead

STATE OF MONTANA  
ADMINISTRATOR OF GROUNDWATER CODE  
OFFICE OF STATE ENGINEER

RECEIVED  
DEC 30 1963

Declaration of Vested Groundwater Rights ENGINEER

(Under Chapter 237, Montana Session Laws, 1961)

1. Frank F. Dillon, of 127 Madison Ave (Town)  
(Name of Appropriator) (Address)  
County of Beaverhead State of Montana  
have appropriated groundwater according to the Montana laws in effect prior to January 1, 1962, as follows:

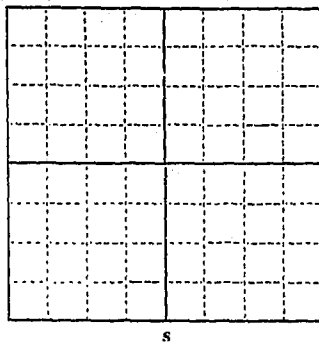

Sec. 1/4 Sec. T. R.

Indicate point of appropriation and place of use, if possible. Each small square represents 10 acres.

West Park addition  
Frank F. Dillon

- 2. The beneficial use on which the claim is based for irrigation
- 3. Date or approximate date of earliest beneficial use; and how continuous the use has been started 1953
- 4. The amount of groundwater claimed (in miner's inches or gallons per minute) 25
- 5. If used for irrigation, give the acreage and description of the lands to which water has been applied and name of the owner thereof 1.6 acres Frank F. Dillon
- 6. The means of withdrawing such water from the ground and the location of each well or other means of withdrawal Electric pump for withdrawing from
- 7. The date of commencement and completion of the construction of the well, wells, or other works for withdrawal of groundwater 7-1-1972
- 8. The depth of water table 56 ft
- 9. So far as it may be available, the type, size and depth of each well or the general specifications of any other works for the withdrawal of groundwater 2 inch diameter pipe 63 ft
- 10. The estimated amount of groundwater withdrawn each year 10000 gallons
- 11. The log of formations encountered in the drilling of each well if available see log attached
- 12. Such other information of a similar nature as may be useful in carrying out the policy of this act, including reference to book and page of any county record none

Signature of Owner Frank F. Dillon

Date 1972

Three copies to be filed by the owner with the County Clerk and Recorder of the county in which the well is located.

Please answer all questions. If not applicable, so state, otherwise the form will be returned.

Original to the County Clerk and Recorder; Duplicate to the State Engineer; Triplicate to the Montana Bureau of Mines and Geology, and Quadruplicate for the Appropriator.

16513



STATE OF MONTANA,  
County of Beaverhead.

108525

I hereby certify that the within instrument  
was filed in my office on the 23 day  
of Dec A. D. 1963 at 27 min.  
past 4 o'clock, P M and recorded on  
page 687 of Book 151 of  
Charles M. Bell Records of Beaverhead  
County, Montana.

Attest my hand and seal,

Forlynn J. Coody Register

By \_\_\_\_\_ Deputy

Fee \$ 4.00

**RECEIVED**  
APR 14 1958  
**STATE ENGINEER**

13

T. 7S R. 9W

County Beaverhead

**MONTANA BUREAU OF MINES AND GEOLOGY**  
Butte, Montana

**WATER WELL LOG**

Owner Betty H. Doyel Address Dillon, Montana

Driller Unknown Address \_\_\_\_\_

Date Started 1923 Date Completed 1923

Location: Sec. 13 T. 7S R. 9W ¼ sec. SE

Type of well Drilled Equipment used Churn  
(Dug, driven, bored, or drilled) (Churn drill, rotary, other)

Water use: Domestic  Municipal  Stock  Irrigation   
Industrial  Drainage  Other: \_\_\_\_\_

Casing: 21 0 ft. to 35 ft. Type CI Size 4"

Casing: \_\_\_\_\_ ft. to \_\_\_\_\_ ft. Type \_\_\_\_\_ Size \_\_\_\_\_

Casing: \_\_\_\_\_ ft. to \_\_\_\_\_ ft. Type \_\_\_\_\_ Size \_\_\_\_\_

perforated or Screened: Ft. \_\_\_\_\_ to ft. \_\_\_\_\_ Ft. \_\_\_\_\_ to ft. \_\_\_\_\_

Type of screen or perforations \_\_\_\_\_

Static Water level, for non-flowing well: 18 feet.

Shut-in pressure, for flowing well: \_\_\_\_\_ lb./sq. in. on: \_\_\_\_\_ (date)

Pumping water level 20 feet at 350 gal. per hour

How tested: Piston pump

Length of test 1 hour

Remarks: (Gravel packing, cementing, packers, type of shut-off, depth of shut-off)

Depth of well: Approximately 50'

Cased to hand-pan.

(over)

95154

STATE OF MONTANA  
County of Beaverhead

of Well

Depth, feet  
From To

Description

Material Drilled

I herewith certify that the within instrument  
was recorded on the \_\_\_\_\_ day  
of April 1958 at 10 min.  
past 9 o'clock A.M. and recorded on  
page \_\_\_\_\_ of  
Water Well Book 151  
County, Montana.

no record

Attest my hand and seal  
*Loyola Schmittz*  
COUNTY RECORDER.

By \_\_\_\_\_  
DEPUTY.

FEE \$ \_\_\_\_\_

OFFICE OF STATE ENGINEER

7294 13

DECLARATION OF VESTED GROUNDWATER RIGHTS JAN 15 1964  
(Under Ch. 237, Montana Session Laws, 1961)

Joe + Harry C. Weekly

639 West Park Dillon

(Name of Appropriator)

(Address)

(Town)

County of

Beaverhead

State of

Montana

have appropriated groundwater according to the Montana Laws in effect prior to January 1, 1962, as follows:

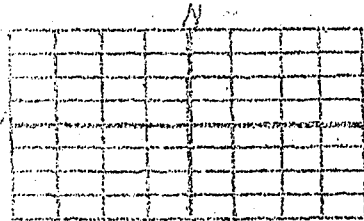

Sec. 13 T. 75 R. 9 W

Indicate point of appropriation & place of use, if possible. Each small sq. represents 10 acres.

4 wells -

1-A tract in the sec 1/4 sec. 13, T. 75 R. 9 W. sec. AS follows - begin at the SW cor. lot 4 ell to city of Dillon parallel to rd 155 - then S. 84° 01' W - then N. 5° 39' W

2. The beneficial use or uses to which the claim is used Household, stock, irrigation

3. Date or approximate date of earliest beneficial use Ten years (1953) full capacity

4. The amount of groundwater claimed (in miner's cubic feet or gallons per minute) 2500 gallons per minute

5. If used for irrigation, give the acreage and description of the lands to which water has been applied and name of the owner thereof

approximately 3 acres for pasture and garden Joe + Harry C. Weekly

The means of withdrawing such water from the ground & the location of pressure pumps from each of 2 dwellings in pasture area - 1/2 mi. yard

6. The date of commencement & completion of the construction of the well, wells. approximately from 0 to 15 years

7. The depth of water table 12 feet

8. So far as it may be available, the type, size & depth of each well or the means of withdrawal of groundwater  
- 2 inch depth 12 feet (pasture)  
- 2 inch depth 24 feet (dwelling)  
- 2 inch depth 24 feet (dwelling)  
- 2 inch depth 24 feet (yard)

9. The estimated amount of groundwater withdrawn each year 2 dwellings (73000) 2 irrigation wells - 1736000 (6 inches) gal.

10. The nature of strata encountered in the drilling of each well if available  
3 feet top soil  
2 feet sand  
Rest is gravel & rock

11. Such other information of a similar nature as may be useful in carrying out the policy of this act, including reference to book & page of any county record none that we know of.

Signature of Owner

Joe C. Weekly

Date Dec 31, 1963

STATE OF MONTANA, ss. County of Beaverhead.

108687

I hereby certify that the within instrument was filed in my office on the 30 day of Dec A. D. 1963 at 12 min. past 5:00 o'clock P. M. and recorded on page 219-20 of Book 174 of Water Records of Beaverhead County, Montana.

Attest my hand and seal Evelyn J. Sage County Recorder

By Deputy

Fee \$

32288