

File No. _____

DUPLICATE

T. _____

R. _____

County _____

STATE OF MONTANA
ADMINISTRATOR OF GROUNDWATER CODE
OFFICE OF STATE ENGINEER

RECEIVED
JAN 6 1964

Declaration of Vested Groundwater Rights

(Under Chapter 237, Montana Session Laws, 1961)

STATE ENGINEER

1. William C. Alderson of _____

(Name of Appropriator)

(Address)

Big Horn
(Town)

County of Shannon

State of Wyo

have appropriated groundwater according to the Montana laws in effect prior to January 1, 1962, as follows:

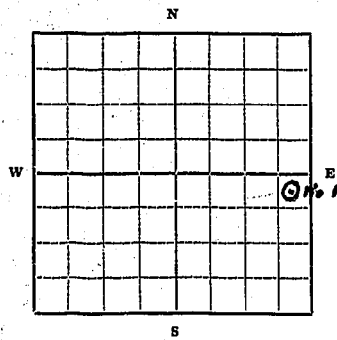

SE 1/4 Sec. 34 T. 14 N. R. 37 E

Indicate point of appropriation and place of use, if possible. Each small square represents 10 acres.

2. The beneficial use on which the claim is based _____

3. Date or approximate date of earliest beneficial use; and how continuous the use has been _____

4. The amount of groundwater claimed (in miner's inches or gallons per minute) _____

5. If used for irrigation, give the acreage and description of the lands to which water has been applied and name of the owner thereof _____

6. The means of withdrawing such water from the ground and the location of each well or other means of withdrawal _____

7. The date of commencement and completion of the construction of the well, wells, or other works for withdrawal of groundwater _____

8. The depth of water table _____

9. So far as it may be available, the type, size and depth of each well or the general specifications of any other works for the withdrawal of groundwater _____

10. The estimated amount of groundwater withdrawn each year _____

11. The log of formations encountered in the drilling of each well if available _____

12. Such other information of a similar nature as may be useful in carrying out the policy of this act, including reference to book and page of any county record _____

Signature of Owner _____

Date Dec 29 1963

Three copies to be filed by the owner with the County Clerk and Recorder of the county in which the well is located.

Please answer all questions. If not applicable, so state, otherwise the form will be returned.

Original to the County Clerk and Recorder; duplicate to the State Engineer; Triplicate to the School of Mines and Quadruplicate for the Appropriator.

21753

206422

STATE OF MONTANA }
County of Big Horn } ss.

The within instrument was filed
in my office at Hardin, Montana, this
DEC 30 1963 day of

A. D. 19

at 2:20 o'clock P.M.

Harry E. Carl
County Recorder

By Ruby Wemple Deputy

RECORDED
INDEXED

54554

240557

STATE OF MONTANA (ss.
County of Big Horn) ss.

The within instrument was file.
in my office at Hardin, Montana, this

23 day of

1913 A.D. 19

at 4:23 o'clock P.M.

James A. [Signature]
County Recorder
Alvin [Signature]

RECEIVED

GW-3 Revised 1969
2037-1500-1/71

JUL 2 1973

County Big Horn

STATE OF MONTANA
MONTANA DEPARTMENT OF
RESOURCES AND CONSERVATION
ADMINISTRATOR OF GROUNDWATER CODE
MONTANA WATER RESOURCES BOARD

AC20234

NOTICE OF COMPLETION OF GROUNDWATER APPROPRIATION WITHOUT WELL

Developed After January 1, 1962

(Under Chapter 237, Montana Session Laws, 1961, as amended)

This form to be prepared by contractor (if any), otherwise by the owner.

Three copies of this notice are to be filed with the County Clerk and Recorder of the county in which the works are located.

Please answer all questions. If not applicable, so state, otherwise the form may be returned.

For Administrator's Use

File 240534

June 28, 1973

GW 1 4:00 p.m.

Owner Westmoreland Resources

Address Box 449, Hardin, Montana 59034

Contractor (if any) _____

Address of Contractor _____

Date Started _____ Date Completed _____

1. Describe means of obtaining groundwater (as by sub-irrigation, developed spring, drains, etc.) natural spring and sub-irrigation

2. Means of withdrawing water (gravity, pump, canal, etc.) gravity

3. Depth of water table at surface

4. Use of the water stockwater, sub-irrigation

5. Amount of groundwater claimed (in miner's inches or gallons per minute) 5 gallons per minute

6. If used for irrigation, give number of acres and description of land sub-irrigation affects grazing land down to and along Middle Fork of Sappy Creek in SW of Sec. 3-1N-37E - 100 acres

7. Estimate amount of water used each year _____

2,628,000 gallons per year

8. Months of year spring flows 12

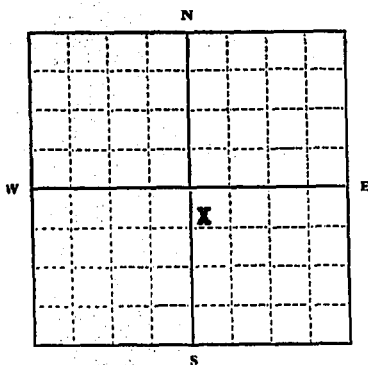

NW 1/4 SE 1/4 Sec. 35

T. 1 N. R. 37 E. 37

INDICATE POINT OF APPROPRIATION AND PLACE OF USE, IF POSSIBLE.
Elevation of spring, if known or estimated 3430

Signature of Owner

Matthew A. Taylor

Date

June 28, 1973

5-4531

1. _____
 2. _____
 3. _____
 4. _____
 5. _____
 6. _____
 7. _____
 8. _____
 9. _____
 10. _____
 11. _____
 12. _____
 13. _____
 14. _____
 15. _____
 16. _____
 17. _____
 18. _____
 19. _____
 20. _____
 21. _____
 22. _____
 23. _____
 24. _____
 25. _____
 26. _____
 27. _____
 28. _____
 29. _____
 30. _____
 31. _____
 32. _____
 33. _____
 34. _____
 35. _____
 36. _____
 37. _____
 38. _____
 39. _____
 40. _____
 41. _____
 42. _____
 43. _____
 44. _____
 45. _____
 46. _____
 47. _____
 48. _____
 49. _____
 50. _____
 51. _____
 52. _____
 53. _____
 54. _____
 55. _____
 56. _____
 57. _____
 58. _____
 59. _____
 60. _____
 61. _____
 62. _____
 63. _____
 64. _____
 65. _____
 66. _____
 67. _____
 68. _____
 69. _____
 70. _____
 71. _____
 72. _____
 73. _____
 74. _____
 75. _____
 76. _____
 77. _____
 78. _____
 79. _____
 80. _____
 81. _____
 82. _____
 83. _____
 84. _____
 85. _____
 86. _____
 87. _____
 88. _____
 89. _____
 90. _____
 91. _____
 92. _____
 93. _____
 94. _____
 95. _____
 96. _____
 97. _____
 98. _____
 99. _____
 100. _____

The within instrument was filed in my office at Hardin, Montana, this
 JUN 28 1973 day of
 A. D. 19
 at 4:00 o'clock P. M.
 Joseph L. Lippert
 County Recorder

NOTICE OF COMPLETION OF SURVEY
 HARDIN COUNTY, MONTANA
 240534
 THE WITHIN INSTRUMENT WAS FILED IN MY OFFICE AT HARDIN, MONTANA, THIS
 JUN 28 1973 DAY OF
 A. D. 19
 AT 4:00 O'CLOCK P. M.
 JOSEPH L. LIPPERT
 COUNTY RECORDER

GROUNDWATER INDEX

Page 1 of 1

County Big Horn

Twp. 17

Rge. 38 s

[illegible]

File No.

T. 10 R. 38E

DUPLICATE

County

STATE OF MONTANA
ADMINISTRATOR OF GROUNDWATER CODE
OFFICE OF STATE ENGINEER

JAN 6 1964

Notice of Completion of Groundwater Appropriation
Without Well

(Under Chapter 237 Montana Session Laws, 1961)

Date of Appropriation of Groundwater.....

Dec 29, 1963

Owner.....

William C. Olsen

Address.....

Big Horn Wyo

Contractor (if any)

Self

Address of Contractor

Date Started.....

June '54

Date Completed.....

1st July 1954

Describe means of obtaining groundwater without a well "as by sub-irrigation and other natural processes". Include depth to water when applicable.....

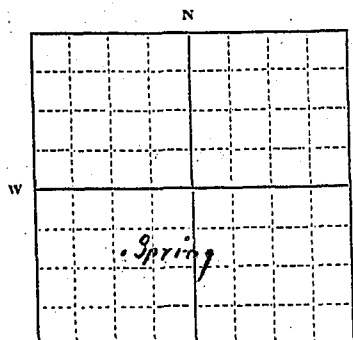

SW $\frac{1}{4}$ Sec. 5 T. 1N R. 38E

Indicate point of appropriation and place of use, if possible.

estimate approximate lengths of periods of use.....

year around stock water
1 1/2 gals per min - tiled
into stock tank

Signature of Owner.....

William C. Olsen

Date.....

Dec 29, 1963

This form to be prepared by contractor (if any), otherwise by the owner.

Three copies of this notice are to be filed with the County Clerk and Recorder of the county in which the works are located.

Please answer all questions. If not applicable, so state, otherwise the form will be returned.

Original to the County Clerk and Recorder; duplicate to the State Engineer; Triplicate to the Montana Bureau of Mines and Geology and Quadruplicate for the Appropriator.

21751

206420

STATE OF MONTANA }
County of Big Horn } ss.

The within instrument was filed
in my office at Hardin, Montana, this

DEC 30 1963 day of

A. D. 19

at 2:10 o'clock P.M.

Harry E. Cap
County Recorder

By Betty Temple Deputy

RECEIVED
COUNTY CLERK
HARDIN, MONTANA
DEC 31 1963

File No.

DUPLICATE

RECEIVED
MAY 19 1964

T. 14 N. R. 38
County. Big Horn

STATE OF MONTANA
ADMINISTRATOR OF GROUNDWATER CODE
OFFICE OF STATE ENGINEER

RECEIVED
JAN 8 1964

Declaration of Vested Groundwater Rights
(Under Chapter 237, Montana Session Laws, 1961)

STATE ENGINEER

1. William C. Alderson of Big Horn
(Name of Appropriator) (Address)
County of Big Horn State of Wyo.
have appropriated groundwater according to the Montana laws in effect prior to January 1, 1962, as follows:

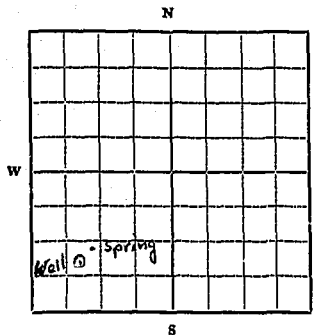

S.W. 1/4 Sec. 5 T. 14 N. R. 38 E.

Indicate point of appropriation
and place of use, if possible.
Each small square represents 10
acres.

2. The beneficial use on which the claim is based Stock Water
3. Date or approximate date of earliest beneficial use; and how continuous the use has been 1954 - continuous to date
4. The amount of groundwater claimed (in miner's inches or gallons per minute) 6 gals per min.
5. If used for irrigation, give the acreage and description of the lands to which water has been applied and name of the owner thereof none
6. The means of withdrawing such water from the ground and the location of each well or other means of withdrawal 200 ft. gas engine driven pump jack
7. The date of commencement and completion of the construction of the well, wells, or other works for withdrawal of groundwater July 1954
8. The depth of water table
9. So far as it may be available, the type, size and depth of each well or the general specifications of any other works for the withdrawal of groundwater 200 ft.
10. The estimated amount of groundwater withdrawn each year 200,000 gals
11. The log of formations encountered in the drilling of each well if available unknown
12. Such other information of a similar nature as may be useful in carrying out the policy of this act, including reference to book and page of any county record.

Signature of Owner William C. Alderson

Date

Three copies to be filed by the owner with the County Clerk and Recorder of the county in which the well is located.

Please answer all questions. If not applicable, so state, otherwise the form will be returned.

Original to the County Clerk and Recorder; duplicate to the State Engineer; Triplicate to the School of Mines and Quadruplicate for the Appropriator.

21752

206421

STATE OF MONTANA }
County of Big Horn } ss.

The within instrument was filed
In my office at Hardin, Montana, this

DEC 30 1963, day of

A. D. 19

at 2:15 o'clock P.M.

Harry E. Cox
County Recorder

By *Betty W. Sample* Deputy

RECEIVED

depth
ELL MONTANA DEPARTMENT OF NATURAL RESOURCES AND CONSERVATION

Indicate the character, color, thickness of strata such as soil, clay, sand, gravel, shale, sandstone, etc. Show depth at which water is found and height to which water rises in well.

Top of Ground (Elev. above sea level) **3463**

From (Feet)	To (Feet)	No Log Available
----------------	--------------	------------------

For Administrator's Use

File 240567

Dec 28, 1973

GW 1 1:22 p.m.

File 240567
Dec 28, 1973
 GW 1 1:22 p.m.

completed **1954**

(Dug, driven, bored or drilled)

.....
(Churn drill, rotary or other)

Industrial ☐ Drainage ☐ Other ☐* Garden/Lawn ☐

USE: If used for irrigation, industrial, drainage or other. Explain, state number of acres and location or other data (i.e. Lot, Block and Addition). _____

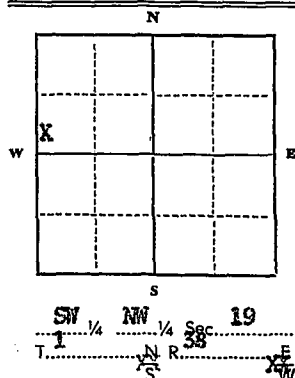
[illegible]

Static water level hand pumpft.*
Pumping water levelft.*
at fourgallons per minute,
measuredminutes after pumping
began.

*Measured from ground level.

Well developed by
forhours.

Power hand Pump..... HP

Remarks: (Gravel packing, cementing, packers, type of shutoff)

INDICATE LOCATION OF WELL AND PLACE OF USE, IF POSSIBLE.
EACH SMALL SQUARE REPRESENTS 40 ACRES.

Driller's Signature Henry Kray

Driller's Address Not known

..... LICENSE NO.

160' Show exact depth of bottom

54564

240567

STATE OF MONTANA } ss.
County of Big Horn }

The within instrument was filed
in my office at Hardin, Montana, this

JUN 28 1973 day of

 A. D. 19

at 4:33 o'clock P. M.

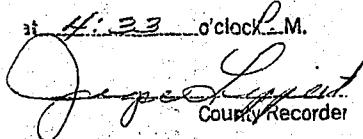
County Recorder

By Deputy

RECEIVED

JUL 2 1973

3 GW 3 Revised 1969 MONTANA DEPARTMENT OF NATURAL
2057-1500-1/71 RESOURCES AND CONSERVATION

County Big Horn

STATE OF MONTANA
ADMINISTRATOR OF GROUNDWATER CODE
MONTANA WATER RESOURCES BOARD

ACCORDS

NOTICE OF COMPLETION OF GROUNDWATER APPROPRIATION WITHOUT WELL

Developed After January 1, 1962

(Under Chapter 237, Montana Session Laws, 1961, as amended)

This form to be prepared by contractor (if any), otherwise by the owner.

Three copies of this notice are to be filed with the County Clerk and Recorder of the county in which the works are located.

Please answer all questions. If not applicable, so state, otherwise the form may be returned.

For Administrator's Use

File 240544

June 28, 1973

GW 1 4:10 p.m.

Owner Westmoreland Resources

Address Box 449, Hardin, Montana 59034

Contractor (if any) _____

Address of Contractor _____

Date Started _____ Date Completed _____

1. Describe means of obtaining groundwater (as by sub-irrigation, developed spring, drains, etc.) natural spring

2. Means of withdrawing water (gravity, pump, canal, etc.) gravity flow

3. Depth of water table at surface

4. Use of the water stockwater

5. Amount of groundwater claimed (in miner's inches or gallons per minute) two gallons per minute

6. If used for irrigation, give number of acres and description of land _____

7. Estimate amount of water used each year 150,000 gallons

8. Months of year spring flows 12

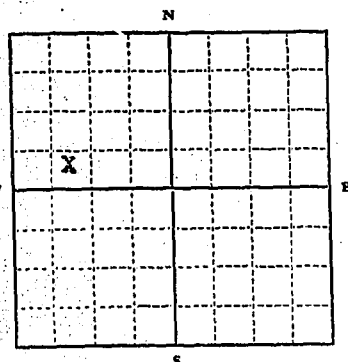

SW 1/4 NW 1/4 Sec. 19

T. 1 N R. 38 E
XI XIV

INDICATE POINT OF APPROPRIATION AND PLACE OF USE, IF POSSIBLE.

Elevation of spring, if known or estimated 3440

Signature of Owner Matthew S. Tudor

Date June 28, 1973

54541

JUN 28 1973

...o'clock PM

County Recorder

2 Dent

RECEIVED

JUL 2 1973

019

GW-3 Revised 1969
STATE PUBLISHING CO.-LITHO

MONTANA DEPARTMENT OF STATE OF MONTANA
RESOURCES AND INDUSTRIES
ADMINISTRATOR OF GROUNDWATER CODE
MONTANA WATER RESOURCES BOARD

County Big Horn

810248

NOTICE OF COMPLETION OF GROUNDWATER APPROPRIATION WITHOUT WELL

Developed After January 1, 1962

(Under Chapter 237, Montana Session Laws, 1961, as amended)

This form to be prepared by contractor (if any), otherwise by the owner.

Three copies of this notice are to be filed with the County Clerk and Recorder of the county in which the works are located.

Please answer all questions. If not applicable, so state, otherwise the form may be returned.

For Administrator's Use

File 240548

June 28, 1973

GW 1 7.14 p.m.

Owner Westmoreland Resources

Address Box 449, Hardin, Montana 59034

Contractor (if any) _____

Address of Contractor _____

Date Started _____ Date Completed _____

1. Describe means of obtaining groundwater (as by sub-irrigation, developed spring, drains, etc.) natural spring

2. Means of withdrawing water (gravity, pump, canal, etc.) _____

gravity flow

3. Depth of water table at surface

4. Use of the water stockwater

5. Amount of groundwater claimed (in miner's inches or gallons per minute) two gallons per minute

6. If used for irrigation, give number of acres and description of land _____

7. Estimate amount of water used each year 150,000
gallons

8. Months of year spring flows 12

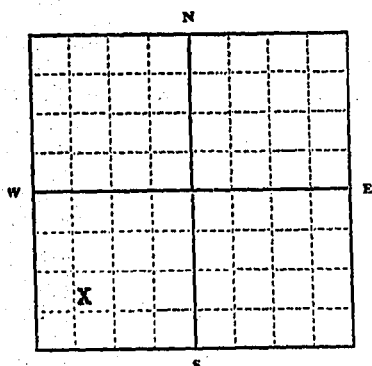

SW 1/4 SW 1/4 Sec. 19

T. 1 N. R. 38 E. 106 106

INDICATE POINT OF APPROPRIATION AND PLACE OF USE, IF POSSIBLE.

Elevation of spring, if known or estimated 3445

Signature of Owner

Mathew S. Judo

Date

June 28, 1973

54545

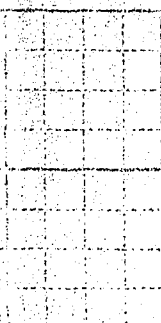

3. Book in which kept

Serial

4. Name of person or persons who executed same

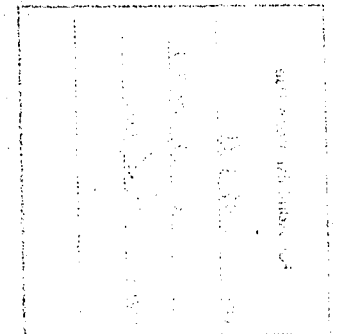

5. Name of person or persons who executed same

6. Name of person or persons who executed same

7. Name of person or persons who executed same

8. Name of person or persons who executed same

9. Name of person or persons who executed same

10. Name of person or persons who executed same

11. Name of person or persons who executed same

240548

STATE OF MONTANA } ss.
County of Big Horn

The within instrument was filed
in my office at Hardin, Montana

JUN 28 1973

at 4:14 o'clock P.M.

Joseph Lippert
County Recorder

Anthony Jones Deputy

File No.

T I N R 3 3 E

DUPLICATE

County Big Horn

STATE OF MONTANA
ADMINISTRATOR OF GROUNDWATER CODE
OFFICE OF STATE ENGINEER

RECEIVED
JAN 6 1964

Declaration of Vested Groundwater Rights STATE ENGINEER
(Under Chapter 237, Montana Session Laws, 1961)

1. J. T. and Villa B. Redding, of Larry Pt. Hysham
(Name of Appropriator) (Address) (Town)
County of Big Horn State of Montana
have appropriated groundwater according to the Montana laws in effect prior to January 1, 1962, as follows:

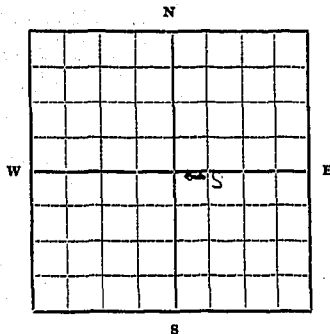

S.E. 1/4 Sec. 19 T.1 N. R.33 E

Indicate point of appropriation and place of use, if possible. Each small square represents 10 acres.

2. The beneficial use on which the claim is based livestock water
3. Date or approximate date of earliest beneficial use; and how continuous the use has been 1953
continuous use
4. The amount of groundwater claimed (in miner's inches or gallons per minute) 4 gallon
5. If used for irrigation, give the acreage and description of the lands to which water has been applied and name of the owner thereof not used for irrigation
6. The means of withdrawing such water from the ground and the location of each well or other means of withdrawal gravity
7. The date of commencement and completion of the construction of the well, wells, or other works for withdrawal of groundwater 1953
8. The depth of water table 2 feet
9. So far as it may be available, the type, size and depth of each well or the general specifications of any other works for the withdrawal of groundwater 3 feet deep
10. The estimated amount of groundwater withdrawn each year 132,400 gallons
11. The log of formations encountered in the drilling of each well if available not available
12. Such other information of a similar nature as may be useful in carrying out the policy of this act, including reference to book and page of any county record.

Signature of Owner

J. T. Redding
Villa B. Redding

Date Dec. 26, 1963

Three copies to be filed by the owner with the County Clerk and Recorder of the county in which the well is located.

Please answer all questions. If not applicable, so state, otherwise the form will be returned.

Original to the County Clerk and Recorder; duplicate to the State Engineer; Triplicate to the School of Mines and Quadruplicate for the Appropriator.

21656

206290

File No.

INDEXED

STATE OF MONTANA } ss:
County of Big Horn
The within instrument was filed
in my office at Hardin, Montana, this
DEC 26 1963 day of
_____ A.D. 19____
at 10:50 o'clock A.M.

Harvey E. Carl
County Recorder
By Ruby W. Sample Deputy

File No. _____

DUPLICATE

T. 1 N. R. 3 E.

County: Big Horn

STATE OF MONTANA
ADMINISTRATOR OF GROUNDWATER CODE
OFFICE OF STATE ENGINEER JAN 6 1964

Top of Ground
Brown Sandy Soil
(Elev. above sea level _____)

Notice of Completion of Groundwater Appropriation by Means of Well

Under Chapter 237, Montana Session Laws, 1961)

Owner: Vella B. Relling Address: High School, Mont.
Driller: C. S. Jones Address: Hardin, Mont.

Date of Notice of Appropriation of Groundwater: _____

Date well started: Oct. 25, 1963 Date Completed: Oct. 27, 1963

Type of well: drilled Equipment Used: Churn
(dug, driven, bored or drilled) (Churn, drill, rotary or other)

Water Use: Domestic ☐ Municipal ☐ Other ☐ Irrigation ☐
Industrial ☐ Drainage ☐ Stock ☒

Indicate on the diagram the character and thickness of the different strata met with in drilling, such as soil, clay, shale, gravel, rock or sand, etc. Show depth at which water is encountered, thickness and character of water-bearing strata and height to which water rises in the well.

Size of Drilled Hole	Size and Weight of Casing	From (Feet)	To (Feet)	PERFORATIONS		
				Kind Size	From (Feet)	To (Feet)
6"	9# 4"	0'	115'	slotted bottom		
				20' of 4" casing		

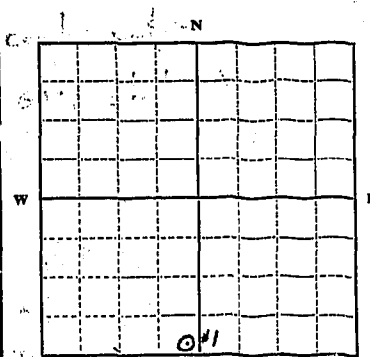

S.W. 1/4 Sec. 19 T. 1 N. R. 3 E.

Indicate location of well and place of use, if possible. Each small square represents 10 acres.

Show exact depth of bottom.

Static Water Level for non-flowing Well: 75 feet.

Shut-in Pressure for Flowing Well: _____

Pumping Water Level: 20 feet at 5 gal. per minute.

Discharge in gal. per min. of flowing well: _____

How Tested: Barler Length of Test: 1 day

Remarks: (Gravel packing, cementing, packers, type of shutoff, location of place of use of groundwater if not at well, and any other similar pertinent information, including number of acres irrigated, if used for irrigation)

noneDriller's License Number 81Driller's Signature C. S. Jones

This form to be prepared by driller, and three copies to be filed by the owner with the County Clerk and Recorder in the county in which the well is located.

Please answer all questions. If not applicable, so state, otherwise the form will be returned.

Original to the County Clerk and Recorder; duplicate to the State Engineer; Triplicate to the Montana Bureau of Mines and Geology and Quadruplicate for the Appropriator.

21663

206297

2007-08-27

STATE OF MONTANA } ss:
County of Big Horn }

The within instrument was filed
in my office at Hardin, Montana, this

26 day of

..... A.D. 1963

At 11:35 o'clock A.M.

James E. Cox
County Recorder

8v Ruby W. Sample Deputy

1. Organization in the Government
 2. Organization in the Private Sector
 3. Organization in the Non-Profit Sector
 4. Organization in the Public Sector
 5. Organization in the Health Sector
 6. Organization in the Education Sector
 7. Organization in the Environment Sector
 8. Organization in the Social Services Sector
 9. Organization in the Cultural Sector
 10. Organization in the Sports Sector
 11. Organization in the Media Sector
 12. Organization in the Arts Sector
 13. Organization in the Science Sector
 14. Organization in the Technology Sector
 15. Organization in the Agriculture Sector
 16. Organization in the Industry Sector
 17. Organization in the Construction Sector
 18. Organization in the Transportation Sector
 19. Organization in the Energy Sector
 20. Organization in the Water Sector
 21. Organization in the Telecommunications Sector
 22. Organization in the Information Sector
 23. Organization in the Security Sector
 24. Organization in the Defense Sector
 25. Organization in the Space Sector
 26. Organization in the Nuclear Sector
 27. Organization in the Environmental Protection Sector
 28. Organization in the Disaster Management Sector
 29. Organization in the Human Rights Sector
 30. Organization in the Gender Equality Sector
 31. Organization in the Youth Sector
 32. Organization in the Elderly Sector
 33. Organization in the Children Sector
 34. Organization in the Women Sector
 35. Organization in the Men Sector
 36. Organization in the LGBT Sector
 37. Organization in the Disability Sector
 38. Organization in the Mental Health Sector
 39. Organization in the Physical Health Sector
 40. Organization in the Nutrition Sector
 41. Organization in the Physical Activity Sector
 42. Organization in the Tobacco Sector
 43. Organization in the Alcohol Sector
 44. Organization in the Gambling Sector
 45. Organization in the Drugs Sector
 46. Organization in the Crime Sector
 47. Organization in the Terrorism Sector
 48. Organization in the Cyber Security Sector
 49. Organization in the Information Security Sector
 50. Organization in the Data Security Sector
 51. Organization in the Privacy Sector
 52. Organization in the Freedom of Information Sector
 53. Organization in the Access to Information Sector
 54. Organization in the Open Government Sector
 55. Organization in the Transparency Sector
 56. Organization in the Accountability Sector
 57. Organization in the Integrity Sector
 58. Organization in the Ethics Sector
 59. Organization in the Governance Sector
 60. Organization in the Rule of Law Sector
 61. Organization in the Justice Sector
 62. Organization in the Legal Sector
 63. Organization in the Judiciary Sector
 64. Organization in the Executive Sector
 65. Organization in the Legislative Sector
 66. Organization in the Judicial Sector
 67. Organization in the Administrative Sector
 68. Organization in the Regulatory Sector
 69. Organization in the Supervisory Sector
 70. Organization in the Oversight Sector
 71. Organization in the Inspection Sector
 72. Organization in the Audit Sector
 73. Organization in the Evaluation Sector
 74. Organization in the Research Sector
 75. Organization in the Innovation Sector
 76. Organization in the Entrepreneurship Sector
 77. Organization in the Small Business Sector
 78. Organization in the Medium Business Sector
 79. Organization in the Large Business Sector
 80. Organization in the Multinational Business Sector
 81. Organization in the International Business Sector
 82. Organization in the Global Business Sector
 83. Organization in the Cross-Border Business Sector
 84. Organization in the Transnational Business Sector
 85. Organization in the Transnational Business Sector
 86. Organization in the Transnational Business Sector
 87. Organization in the Transnational Business Sector
 88. Organization in the Transnational Business Sector
 89. Organization in the Transnational Business Sector
 90. Organization in the Transnational Business Sector
 91. Organization in the Transnational Business Sector
 92. Organization in the Transnational Business Sector
 93. Organization in the Transnational Business Sector
 94. Organization in the Transnational Business Sector
 95. Organization in the Transnational Business Sector
 96. Organization in the Transnational Business Sector
 97. Organization in the Transnational Business Sector
 98. Organization in the Transnational Business Sector
 99. Organization in the Transnational Business Sector
 100. Organization in the Transnational Business Sector

File No.

DUPLICATE

STATE OF MONTANA
ADMINISTRATOR OF GROUNDWATER CODE
OFFICE OF STATE ENGINEER

T. 1N. R. 38E
County Big Horn
JAN 8 1964

Declaration of Vested Groundwater Rights STATE ENGINEER
(Under Chapter 237, Montana Session Laws, 1961)

1. Jim Haynie of Hysham
(Name of Appropriator) (Address) (Town)
County of Big Horn State of Montana
have appropriated groundwater according to the Montana laws in effect prior to January 1, 1962, as follows:

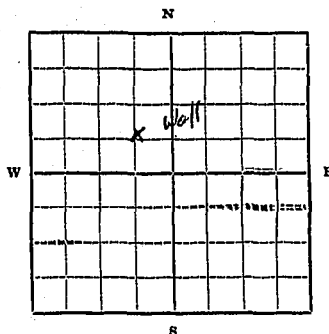

SE 1/4 NW 1/4 Sec. 20 T. 1N. R. 38E

Indicate point of appropriation and place of use, if possible. Each small square represents 10 acres.

2. The beneficial use on which the claim is based Ranch and stock water

3. Date or approximate date of earliest beneficial use; and how continuous the use has been used continuously for 18 yrs

4. The amount of groundwater claimed (in miner's inches or gallons per minute) 50 barrels for 3 months
2 barrels for 9 months

5. If used for irrigation, give the acreage and description of the lands to which water has been applied and name of the owner thereof none

6. The means of withdrawing such water from the ground and the location of each well or other means of withdrawal electric water

7. The date of commencement and completion of the construction of the well, wells, or other works for withdrawal of groundwater 1945

8. The depth of water table 40 ft.

9. So far as it may be available, the type, size and depth of each well or the general specifications of any other works for the withdrawal of groundwater 1/2 inch submersible pump

10. The estimated amount of groundwater withdrawn each year 8,100 barrels per yr.

11. The log of formations encountered in the drilling of each well if available not available

12. Such other information of a similar nature as may be useful in carrying out the policy of this act, including reference to book and page of any county record Log may be recorded in courthouse

Signature of Owner Jim Haynie

Date Dec 20, 1963

Three copies to be filed by the owner with the County Clerk and Recorder of the county in which the well is located.

Please answer all questions. If not applicable, so state, otherwise the form will be returned.

Original to the County Clerk and Recorder; duplicate to the State Engineer; Triplicate to the School of Mines and Quaduplicate for the Appropriator.

26803

206512

STATE OF MONTANA } ss.
County of Big Horn

The within instrument was filed
in my office at Hardin, Montana, this

DEC 31 1963 day of

A. D. 19

at 9²⁸ o'clock A.M.

James E. Carr
County Recorder

By *Goddard Smith* Deputy

DEC 31 1963

RECEIVED

1963

10/27

File No.

T. 1. N. R. 38. E

DUPLICATE

County Big Horn

STATE OF MONTANA
ADMINISTRATOR OF GROUNDWATER CODE
OFFICE OF STATE ENGINEER

Declaration of Vested Groundwater Rights
(Under Chapter 237, Montana Session Laws, 1961)

RECEIVED
JAN 6 1964
STATE ENGINEER

1. J. T. and Vella B. Redding, of Safety Pt. Hysham
(Name of Appropriator) (Address) (Town)
County of Big Horn State of Montana
have appropriated groundwater according to the Montana laws in effect prior to January 1, 1962, as follows:

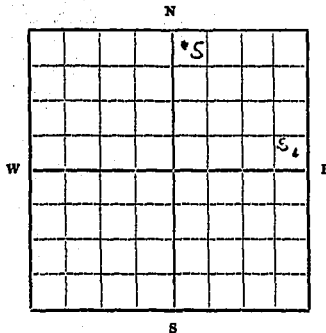

N. E. 1/4 Sec. 21, T. 1. N. R. 38. E

Indicate point of appropriation and place of use, if possible. Each small square represents 10 acres.

2. The beneficial use on which the claim is based live stock water
3. Date or approximate date of earliest beneficial use; and how continuous the use has been 1950
continuous use
4. The amount of groundwater claimed (in miner's inches or gallons per minute) 2 gallon each
5. If used for irrigation, give the acreage and description of the lands to which water has been applied and name of the owner thereof not used for irrigation
6. The means of withdrawing such water from the ground and the location of each well or other means of withdrawal gravity
7. The date of commencement and completion of the construction of the well, wells, or other works for withdrawal of groundwater undeveloped
8. The depth of water table 6 ft
9. So far as it may be available, the type, size and depth of each well or the general specifications of any other works for the withdrawal of groundwater 6 feet deep
10. The estimated amount of groundwater withdrawn each year 267,800 gallon for each
11. The log of formations encountered in the drilling of each well if available not available
12. Such other information of a similar nature as may be useful in carrying out the policy of this act, including reference to book and page of any county record.

Signature of Owner

J. T. Redding
Vella B. Redding
Date Dec. 26, 1963

Three copies to be filed by the owner with the County Clerk and Recorder of the county in which the well is located.

Please answer all questions. If not applicable, so state, otherwise the form will be returned.

Original to the County Clerk and Recorder; duplicate to the State Engineer; Triplicate to the School of Mines and Quadruplicate for the Appropriator.

21658

206292

STATE OF MONTANA } ss.
County of Big Horn }

The within instrument was filed
in my office at Hardin, Montana, this
DEC 26 1963 day of

A. D. 19

at 10:20 o'clock A.M.

Harvey E. Carl
County Recorder.
By *Ruby Wampler* Deputy

File No.

DUPLICATE

T. 1 N. R. 3 E

County Big Horn

STATE OF MONTANA
ADMINISTRATOR OF GROUNDWATER CODE
OFFICE OF STATE ENGINEER

Declaration of Vested Groundwater Rights

(Under Chapter 237, Montana Session Laws, 1961)

JAN 6 1964

STATE ENGINEER

1. J. T. and Villa B. Redding of Sage Pt.
(Name of Appropriator) (Address)
County of Big Horn State of Montana
have appropriated groundwater according to the Montana laws in effect prior to January 1, 1962, as follows:

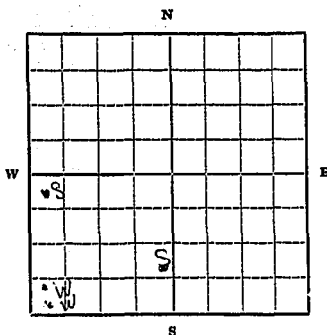

SW 1/4 Sec. 22 T. 1 N. R. 3 E

Indicate point of appropriation and place of use, if possible. Each small square represents 10 acres.

2. The beneficial use on which the claim is based livestock water
3. Date or approximate date of earliest beneficial use; and how continuous the use has been 1955
4. The amount of groundwater claimed (in miner's inches or gallons per minute) Wells 5 gallon for each
Spring 15 gallon for each
5. If used for irrigation, give the acreage and description of the lands to which water has been applied and name of the owner thereof not used for irrigation
6. The means of withdrawing such water from the ground and the location of each well or other means of withdrawal spring - gravity
pump for wells
7. The date of commencement and completion of the construction of the well, wells, or other works for withdrawal of groundwater 1955
8. The depth of water table Wells 16 ft. Springs 6 ft.
9. So far as it may be available, the type, size and depth of each well or the general specifications of any other works for the withdrawal of groundwater Well drilled, 16 ft. six inch casing
well drilled 35 ft. bunch casing
Springs undeveloped
10. The estimated amount of groundwater withdrawn each year 200,000 gallons for each
11. The log of formations encountered in the drilling of each well if available not available
12. Such other information of a similar nature as may be useful in carrying out the policy of this act, including reference to book and page of any county record

Signature of Owner

J. T. Redding
Villa B. Redding

Date Dec. 26, 1963

Three copies to be filed by the owner with the County Clerk and Recorder of the county in which the well is located.

Please answer all questions. If not applicable, so state, otherwise the form will be returned.

Original to the County Clerk and Recorder; duplicate to the State Engineer; Triplicate to the School of Mines and Quadruplicate for the Appropriator.

206289

STATE OF MONTANA } ss.
County of Big Horn

The within instrument was filed
in my office at Hardin, Montana, this
BIG HORN day of

A. D. 19

at 10:05 o'clock A.M.

Harry E. Cap
County Recorder

By Ruby W. Sample Deputy

GWS

File No.

DUPLICATE

T. 1 N R. 38E

County.

STATE OF MONTANA
ADMINISTRATOR OF GROUNDWATER CODE
OFFICE OF STATE ENGINEER

RECEIVED
JAN 8 1963

STATE ENGINEER

Notice of Completion of Groundwater Appropriation Without Well

(Under Chapter 237 Montana Session Laws, 1961)

Date of Appropriation of Groundwater July 30, 1955

Owner Cecil C. Nyckman Address Saxy area, Hysham, Mont.

Contractor (if any) Stephen Kenry

Address of Contractor Hardin, Montana

Date Started July 30 Date Completed Aug. 2, 1955

Describe means of obtaining groundwater without a well "as by sub-irrigation and other natural processes". Include depth to water when applicable. Cleaned out or dug by dragline four feet of earth removed from top of soapstone where a crack in the bottom let water come up to surface.

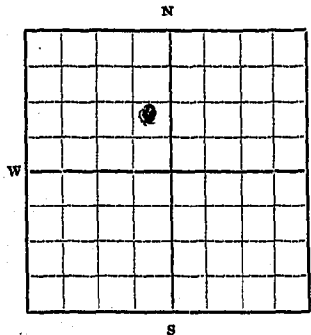

E 1/2 NW 1/4 Sec. 24 T1N R38E

Indicate point of appropriation and place of use, if possible.

Quantity of water developed and used with explanation of method used to measure or estimate such amount. If use is intermittent estimate approximate lengths of periods of use 400 gallons a day to water forty head of stock or cattle. More water can be produced by a well if drilled deeper.

Signature of Owner Cecil C. Nyckman

Date December 5th, 1962

This form to be prepared by contractor (if any), otherwise by the owner.

Three copies of this notice are to be filed with the County Clerk and Recorder of the county in which the works are located.

Please answer all questions. If not applicable, so state, otherwise the form will be returned.

Original to the County Clerk and Recorder; duplicate to the State Engineer; Triplicate to the School of Mines and Quadruplicate for the Appropriator.

201850

STATE OF MONTANA }
County of Big Horn }

The within instrument was filed
in my office at Hardin, Montana, this

JAN 7 1963 day of

A. D. 19

at 11:15 o'clock A.M.

Harry E. Carl
County Recorder

By Ruby Wemple Deputy

File No.

DUPLICATE

Tn. R38

County Big Horn

STATE OF MONTANA
ADMINISTRATOR OF GROUNDWATER CODE
OFFICE OF STATE ENGINEER

Declaration of Vested Groundwater Rights
(Under Chapter 237, Montana Session Laws, 1961)

RECEIVED
JAN 6 1964
STATE ENGINEER

I, Forrest L. Bass, of Hysham (Town)
(Name of Appropriator) (Address)

County of Big Horn State of Montana
have appropriated groundwater according to the Montana laws in effect prior to January 1, 1962, as follows:

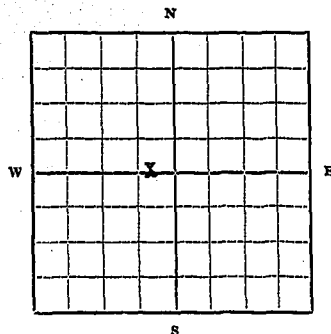

N W 1/4 S. 1 Sec. 25, T. 1 N. R. 38.

Indicate point of appropriation and place of use, if possible. Each small square represents 10 acres.

2. The beneficial use on which the claim is based

Stock water well

3. Date or approximate date of earliest beneficial use; and how continuous the use has been Aug 1957 and used eight

months per year since

4. The amount of groundwater claimed (in miner's inches or gallons per minute) 5 gallons per minute

5. If used for irrigation, give the acreage and description of the lands to which water has been applied and name of the owner thereof Not used for irrigation

6. The means of withdrawing such water from the ground and the location of each well or other means of withdrawal

Windmill and pump

7. The date of commencement and completion of the construction of the well, wells, or other works for withdrawal of groundwater Aug 1957

8. The depth of water table 225 feet

9. So far as it may be available, the type, size and depth of each well or the general specifications of any other works for the withdrawal of groundwater None other at this time

10. The estimated amount of groundwater withdrawn each year 218,000 gallons

11. The log of formations encountered in the drilling of each well if available None available

12. Such other information of a similar nature as may be useful in carrying out the policy of this act, including reference to book and page of any county record No other information available

Signature of Owner Forrest L. Bass

Date Dec 26 - 1963

Three copies to be filed by the owner with the County Clerk and Recorder of the county in which the well is located.

Please answer all questions. If not applicable, so state, otherwise the form will be returned.

Original to the County Clerk and Recorder; duplicate to the State Engineer; Triplicate to the School of Mines and Quadruplicate for the Appropriator.

21680

206319

STATE OF MONTANA }
County of Big Horn } ss.

The within instrument was filed
In my office at Hardin, Montana, this

DEC 27 1963 day of

at 11²⁰ A. D. 19
o'clock P. M.

Harry E. Cap
County Recorder

By Jack L. Smith Deputy

File No.

DUPLICATE

T.1N. R.38E

County Big Horn

STATE OF MONTANA
ADMINISTRATOR OF GROUNDWATER CODE
OFFICE OF STATE ENGINEER

RECEIVED
JAN 6 1964

Declaration of Vested Groundwater Rights
(Under Chapter 237, Montana Session Laws, 1961)

1. J. T. and Villa B. Redding, of Sandy Pt., Hysham
(Name of Appropriator) (Address) (Town)
County of Big Horn State of Montana
have appropriated groundwater according to the Montana laws in effect prior to January 1, 1962, as follows:

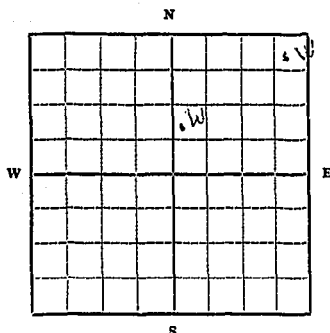

N.E. 1/4 Sec. 24 T.1N. R.38E

Indicate point of appropriation and place of use, if possible. Each small square represents 10 acres.

2. The beneficial use on which the claim is based livestock water

3. Date or approximate date of earliest beneficial use; and how continuous the use has been One well 1953
One well 1953
continuous use

4. The amount of groundwater claimed (in miner's inches or gallons per minute) One well - 7 gallons
One well - 10 gallons

5. If used for irrigation, give the acreage and description of the lands to which water has been applied and name of the owner thereof not used for irrigation

6. The means of withdrawing such water from the ground and the location of each well or other means of withdrawal pump

7. The date of commencement and completion of the construction of the well, wells, or other works for withdrawal of groundwater 1953

8. The depth of water table 20 ft. for each well

9. So far as it may be available, the type, size and depth of each well or the general specifications of any other works for the withdrawal of groundwater One well 5.4 feet deep, 6 inch casing
One well 20 feet deep, 6 inch casing

10. The estimated amount of groundwater withdrawn each year 100,000 gallons for each well

11. The log of formations encountered in the drilling of each well if available not available

12. Such other information of a similar nature as may be useful in carrying out the policy of this act, including reference to book and page of any county record.

Signature of Owner J. T. Redding
Villa B. Redding

Date Dec. 26, 1963

Three copies to be filed by the owner with the County Clerk and Recorder of the county in which the well is located.

Please answer all questions. If not applicable, so state, otherwise the form will be returned.

Original to the County Clerk and Recorder; duplicate to the State Engineer; Triplicate to the School of Mines and Quadruplicate for the Appropriator.

21661

206295

STATE OF MONTANA }
County of Big Horn } ss:

The within instrument was filed
in my office at Hardin, Montana, this
DEC 26 1965 day of

A. D. 19

at 10:30 o'clock A. M.

Harry E. Carl
County Recorder

By *Betty W. Wemple* Deputy

MONTANA DEPARTMENT OF STATE OF MONTANA
RESOURCES AND CONSERVATION
ADMINISTRATOR OF GROUNDWATER CODE
MONTANA WATER RESOURCES BOARD

County Big Horn

29

NOTICE OF COMPLETION OF GROUNDWATER APPROPRIATION WITHOUT WELL

Developed After January 1, 1962

(Under Chapter 237, Montana Session Laws, 1961, as amended)

This form to be prepared by contractor (if any), otherwise by the owner.

Three copies of this notice are to be filed with the County Clerk and Recorder of the county in which the works are located.

Please answer all questions. If not applicable, so state, otherwise the form may be returned.

For Administrator's Use

File 240546

June 28, 1973

GW 1 4:10 p.m.

Owner Westmoreland Resources

Address Box 449, Hardin, Montana 59024

Contractor (if any) _____

Address of Contractor _____

Date Started _____ Date Completed _____

1. Describe means of obtaining groundwater (as by sub-irrigation, developed spring, drains, etc.) developed spring with reservoir

2. Means of withdrawing water (gravity, pump, canal, etc.) gravity flow

3. Depth of water table at surface

4. Use of the water stockwater, sub-irrigation

5. Amount of groundwater claimed (in miner's inches or gallons per minute) one gallon per minute

6. If used for irrigation, give number of acres and description of land sub-irrigation affects 50 acres below reservoir

7. Estimate amount of water used each year 150,000

8. Months of year spring flows 12

INDICATE POINT OF APPROPRIATION AND PLACE OF USE, IF POSSIBLE.

Elevation of spring, if known or estimated

3465

SE 1/4 SW 1/4 Sec. 29

T. 1 N. R. 38 E. 10

INDICATE POINT OF APPROPRIATION AND PLACE OF USE, IF POSSIBLE.

Elevation of spring, if known or estimated

3465

Signature of Owner

Matthew A. Jador
Date June 28, 1973

540543

240546

STATE OF MONTANA
County of Big Horn

The within instrument was filed
in my office at Hardin, Montana, this
JUN 28 1973 day

A. D. 19

at 4:12 o'clock P. M.

James L. ...
Dorothy Jones
Deputy

RECEIVED

JUL 2 1973

29

STATE PUBLISHING CO. LITHO

DEPARTMENT OF NATURAL
RESOURCES AND CONSERVATION

County Big Horn

STATE OF MONTANA
ADMINISTRATOR OF GROUNDWATER CODE
MONTANA WATER RESOURCES BOARD

GAZON

NOTICE OF COMPLETION OF GROUNDWATER APPROPRIATION WITHOUT WELL

Developed After January 1, 1962

(Under Chapter 237, Montana Session Laws, 1961, as amended)

This form to be prepared by contractor (if any), otherwise by the owner.

Three copies of this notice are to be filed with the County Clerk and Recorder of the county in which the works are located.

Please answer all questions. If not applicable, so state, otherwise the form may be returned.

For Administrator's Use

File 240545

June 28, 1973

GW 1 411 p.m.

Owner Nestmoreland Resources

Address Box 449, Hardin, Montana 59034

Contractor (if any) _____

Address of Contractor _____

Date Started _____ Date Completed _____

1. Describe means of obtaining groundwater (as by sub-irrigation, developed spring, drains, etc.) natural spring with constructed reservoir

2. Means of withdrawing water (gravity, pump, canal, etc.) gravity flow

3. Depth of water table at surface

4. Use of the water stockwater and sub-irrigation

5. Amount of groundwater claimed (in miner's inches or gallons per minute) one gallon per minute

6. If used for irrigation, give number of acres and description of land sub-irrigation affects 10 acres below reservoir

7. Estimate amount of water used each year _____

150,000 gallons

8. Months of year spring flows 12

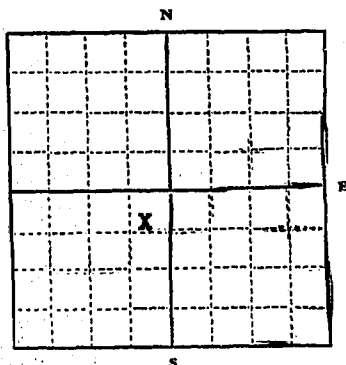

N 1/4 SW 1/4 Sec. 29

T. 1 N R. 38 E
X5 X6

INDICATE POINT OF APPROPRIATION
AND PLACE OF USE, IF POSSIBLE.
Elevation of spring, if known or esti-

mated 3470

Signature of Owner

Date

Matthew S. Tudor

June 28, 1973

54542

240545

STATE OF MONTANA } ss.
County of Big Horn

The within instrument was filed
in my office at Hardin, Montana, this

JUN 28 1913 day

A. D. 19

at 4:11 o'clock P. M.

Joseph P. Jones
County Recorder
Hardin, Montana

RECORDED

INDEXED

FILED

BOOK

PAGE

SECTION

TOWNSHIP

RANGE

COUNTY

STATE

DATE

TIME

BY

FILED

RECORDED

INDEXED

FILED

RECORDED

INDEXED

FILED

RECORDED

INDEXED

FILED

RECORDED

INDEXED

FILED

RECORDED

INDEXED

FILED

RECORDED

File No.

T. 1 N. R. 38 E. 29

DUPLICATE

STATE OF MONTANA
ADMINISTRATOR OF GROUNDWATER CODE
OFFICE OF STATE ENGINEER

County Big Horn

RECEIVED
JAN 6 1964

Declaration of Vested Groundwater Rights

(Under Chapter 237, Montana Session Laws, 1961)

STATE ENGINEER

1. J. T. and Vella B. Redding, of Larry Pt. Hysham
(Name of Appropriator) (Address) (Town)
County of Big Horn State of Montana
have appropriated groundwater according to the Montana laws in effect prior to January 1, 1962, as follows:

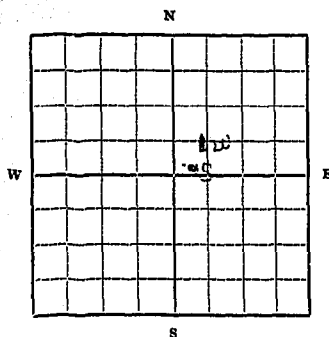

N.E. 1/4 Sec. 29 T. 1 N. R. 38 E

Indicate point of appropriation and place of use, if possible. Each small square represents 10 acres.

2. The beneficial use on which the claim is based livestock
3. Date or approximate date of earliest beneficial use; and how continuous the use has been 1950
continuous
4. The amount of groundwater claimed (in miner's inches or gallons per minute) Well 3 1/2 gallons
Spring 2 gallons
5. If used for irrigation, give the acreage and description of the lands to which water has been applied and name of the owner thereof not used for irrigation
6. The means of withdrawing such water from the ground and the location of each well or other means of withdrawal gravity for spring
pump for well
7. The date of commencement and completion of the construction of the well, wells, or other works for withdrawal of groundwater 1950
8. The depth of water table Well - 30 ft. Spring 6 ft.
9. So far as it may be available, the type, size and depth of each well or the general specifications of any other works for the withdrawal of groundwater Well - 6 1/2 ft. deep, 1 1/2 inch casing, drilled
Spring - 1 inch pipe
10. The estimated amount of groundwater withdrawn each year Well 73,000 gallon - Spring 263,000 gallon
11. The log of formations encountered in the drilling of each well if available not available
12. Such other information of a similar nature as may be useful in carrying out the policy of this act, including reference to book and page of any county record.

Signature of Owner J. T. Redding
Vella B. Redding

Date Dec. 26, 1963

Three copies to be filed by the owner with the County Clerk and Recorder of the county in which the well is located.

Please answer all questions. If not applicable, so state, otherwise the form will be returned.

Original to the County Clerk and Recorder; duplicate to the State Engineer; Triplicate to the School of Mines and Quadruplicate for the Appropriator.

21660

206294

STATE OF MONTANA }
County of Big Horn } ss.

The within instrument was filed
in my office at Hardin, Montana, this

DEC 26 1963

day of

A. D. 19

at 10:28 o'clock A.M.

Harry E. Carl
County Recorder

By *Ruby Temple* Deputy

File No.

DUPLICATE

MONTANA WATER RESOURCES BOARD

RECEIVED

OCT 25 1968

LOG

Top of Ground

(Elev. above sea level.....)

T. 1 North R. 38 E.

County.....Big Horn

STATE OF MONTANA
ADMINISTRATOR OF GROUNDWATER CODE
OFFICE OF STATE ENGINEERNotice of Completion of Groundwater
Appropriation by Means of Well

DEVELOPED AFTER JANUARY 1, 1962

(Under Chapter 237, Montana Session Laws, 1961)

Owner.....J. T. Redding.....Address.....Hysham, Montana

Driller.....S. J. / S. A. M.Address.....Hysham, Montana

Date of Notice of appropriation of groundwater.....

Date well started.....October 1.....Date completed.....October 2 68

Type of well.....bored.....Equipment used.....other
(Dug, driven, bored or drilled) (Churn drill, rotary or other)Water use: Domestic ☐ Municipal ☐ Stock ☒ Irrigation ☐
Industrial ☐ Drainage ☐ Other ☐

Indicate on the diagram the character and thickness of the different strata met with in drilling, such as soil, clay, shale, gravel, rock or sand, etc. Show depth at which water is encountered, thickness and character of water-bearing strata and height to which the water rises in the well.

Size of Drilled Hole	Size and Weight of Casing	From (Feet)	To (Feet)	PERFORATIONS		
				Kind Size	From (Feet)	To (Feet)
24"	24" x 1 1/2" gauge CMP	0	16'	1" x 2"	10'	2'

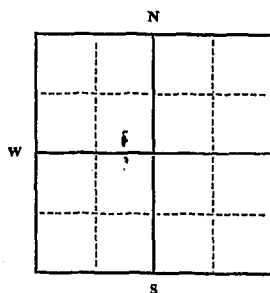

SW 1/4 NE 1/4 Sec. 7 N. T. 1 N. R. 38 E

Indicate location of well and place of use, if possible. Each small square represents 40 acres.

Static Water Level for non-flowing well.....feet.

Shut-in Pressure for Flowing Well.....feet

Pumping Water Level.....8.....feet
at.....10.....gal. per minute.

Discharge in gal. per min. of flowing well.....

How Tested.....

Length of Test.....

Remarks: (Gravel packing, cementing, packers, type of shutoff).....

(Continue on reverse side)

USE—If used for irrigation, industrial, drainage or other. Explain, state number of acres and location or other data (i.e.: Lot, Block and Addition).

Show exact depth of bottom.

This form to be prepared by driller, and three copies to be filed by the owner with the County Clerk and Recorder in the county in which the well is located, tissue copy to be retained by driller.

Please answer all questions. If not applicable, so state, otherwise the form will be returned.

Driller's License Number

Driller's Signature

44,718

224114

DIFFICULTY

五、

८५५

Test of Grouping

Glucose 6-phosphate

52

STATE OF MONTANA } ss.
County of Big Horn }

The within instrument was filed
in my office at Hardin, Montana, this
OCT 24 1968 day of

A. D. 19____

at 1:10 o'clock AM.

Joan Lippert
County Recorder

By Anthony A. Sample Deputy

REGION OF DOMINION

[illegible][illegible]

Q

29

54563

240566

STATE OF MONTANA }
County of Big Horn } ss.

The within instrument was filed
in my office at Hardin, Montana, this

JUN 28 1973 day of

A. D. 19

at 4:32 o'clock P. M.

James Lippert
County Recorder

W. _____ Denver

RECEIVED

30

GW 3 Revised 1969
STATE PUBLISHING CO.-LITHO

County Big Horn

STATE OF MONTANA
MONTANA DEPARTMENT OF NATURAL RESOURCES AND CONSERVATION
ADMINISTRATOR OF GROUNDWATER CODE
MONTANA WATER RESOURCES BOARD

142015

NOTICE OF COMPLETION OF GROUNDWATER APPROPRIATION WITHOUT WELL Developed After January 1, 1962

(Under Chapter 237, Montana Session Laws, 1961, as amended)

This form to be prepared by contractor (if any), otherwise by the owner.

Three copies of this notice are to be filed with the County Clerk and Recorder of the county in which the works are located.

Please answer all questions. If not applicable, so state, otherwise the form may be returned.

For Administrator's Use

File 240 541

June 28, 1973

GW 1 1:07 p.m.

Owner Westmoreland Resources

Address Box 449, Hardin, Montana 59034

Contractor (if any) _____

Address of Contractor _____

Date Started _____ Date Completed _____

1. Describe means of obtaining groundwater (as by sub-irrigation, developed spring, drains, etc.) natural spring

2. Means of withdrawing water (gravity, pump, canal, etc.) gravity

3. Depth of water table at surface

4. Use of the water stockwater

5. Amount of groundwater claimed (in miner's inches or gallons per minute) two gallons per minute

6. If used for ~~irrigation~~ on, give number of acres and description of land _____

7. Estimate amount of water used each year 200,000 gallons

8. Months of year spring flows 12

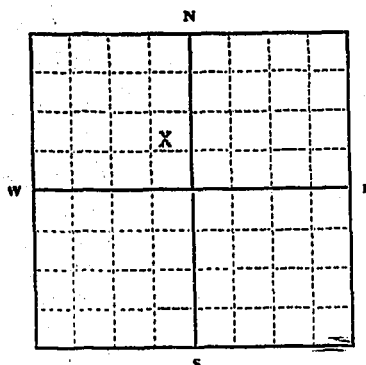

SE 1/4 NW 1/4 Sec. 30

T. 1 N R. 35 E
X5 X6

INDICATE POINT OF APPROPRIATION AND PLACE OF USE, IF POSSIBLE.

Elevation of spring, if known or estimated

3495

Signature of Owner Mathew A. Tudor

Date June 28, 1973

54538

240541

STATE OF MONTANA }
County of Big Horn } ss.

The within instrument was filed
in my office at Hardin, Montana, this

June 28, 1973

day of

A.D. 19

at 4:07 o'clock P.M.

Joyce Lippert
County Recorder

By Dorothy Jean Dan

RECEIVED

30

GW 3 Revised 1960
STATE PUBLISHING CO.-LITHO

MONTANA DEPARTMENT OF NATURAL
RESOURCES AND CONSERVATION

County Big Horn

STATE OF MONTANA
ADMINISTRATOR OF GROUNDWATER CODE
MONTANA WATER RESOURCES BOARD

NOTICE OF COMPLETION OF GROUNDWATER APPROPRIATION WITHOUT WELL

Developed After January 1, 1962

(Under Chapter 237, Montana Session Laws, 1961, as amended)

This form to be prepared by contractor (if any), otherwise by the owner.

Three copies of this notice are to be filed with the County Clerk and Recorder of the county in which the works are located.

Please answer all questions. If not applicable, so state, otherwise the form may be returned.

For Administrator's Use

File 240547

June 28, 1973

GW 1 4:13 P.M.

Owner Nestmoreland Resources

Address Box 449, Hardin, Montana 59034

Contractor (if any) _____

Address of Contractor _____

Date Started _____ Date Completed _____

1. Describe means of obtaining groundwater (as by sub-irrigation, developed spring, drains, etc.) natural spring

2. Means of withdrawing water (gravity, pump, canal, etc.) gravity flow

3. Depth of water table at surface

4. Use of the water stockwater

5. Amount of groundwater claimed (in miner's inches or gallons per minute) two gallons per minute

6. If used for irrigation, give number of acres and description of land _____

7. Estimate amount of water used each year 150,000 gallons
150,000 gallons

8. Months of year spring flows 12

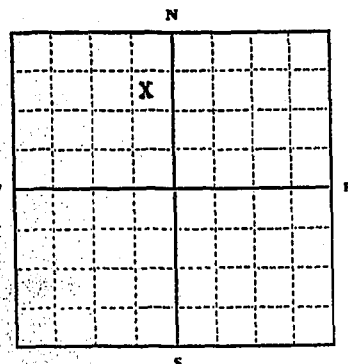

NW 1/4 Sec. 30
T. 1 N. R. 38 E
X X X X

INDICATE POINT OF APPROPRIATION
AND PLACE OF USE, IF POSSIBLE.

Elevation of spring, if known or estimated 3480

Signature of Owner

Matthew S. Tudor

Date

June 28, 1973

54544

240547

STATE OF MONTANA }
County of Big Horn } ss.

The within instrument was file
in my office at Hardin, Montana, thi

JUN 28 1973 day o

A. D. 19

at 4:13 o'clock P.M.

Joeye Lippert
County Recorder
Blair Jones Clerk

NOTARIAL PUBLIC
COUNTY OF BIG HORN
MONTANA

DEPT.

3. Order of Water Right

EXHIBIT 170A

4. Order of Water Right (Grand Jury Case)

5. Order of Water Right (Grand Jury Case)

6. Order of Water Right (Grand Jury Case)

7. Order of Water Right (Grand Jury Case)

8. Order of Water Right (Grand Jury Case)

9. Order of Water Right (Grand Jury Case)

10. Order of Water Right (Grand Jury Case)

11. Order of Water Right (Grand Jury Case)

12. Order of Water Right (Grand Jury Case)

13. Order of Water Right (Grand Jury Case)

14. Order of Water Right (Grand Jury Case)

15. Order of Water Right (Grand Jury Case)

16. Order of Water Right (Grand Jury Case)

17. Order of Water Right (Grand Jury Case)

18. Order of Water Right (Grand Jury Case)

19. Order of Water Right (Grand Jury Case)

20. Order of Water Right (Grand Jury Case)

21. Order of Water Right (Grand Jury Case)

22. Order of Water Right (Grand Jury Case)

23. Order of Water Right (Grand Jury Case)

24. Order of Water Right (Grand Jury Case)

25. Order of Water Right (Grand Jury Case)

26. Order of Water Right (Grand Jury Case)

27. Order of Water Right (Grand Jury Case)

28. Order of Water Right (Grand Jury Case)

29. Order of Water Right (Grand Jury Case)

30. Order of Water Right (Grand Jury Case)

31. Order of Water Right (Grand Jury Case)

32. Order of Water Right (Grand Jury Case)

33. Order of Water Right (Grand Jury Case)

34. Order of Water Right (Grand Jury Case)

35. Order of Water Right (Grand Jury Case)

36. Order of Water Right (Grand Jury Case)

37. Order of Water Right (Grand Jury Case)

38. Order of Water Right (Grand Jury Case)

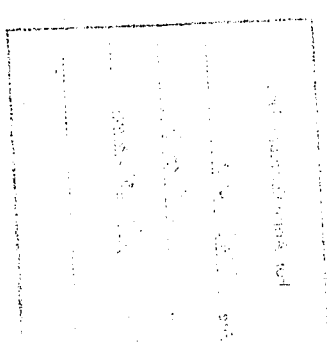

RECEIVED

JUL 6 1973

spring

30

2057-1500-1/71

DEPARTMENT OF NATURAL RESOURCES AND CONSERVATION

County Big Horn

STATE OF MONTANA
ADMINISTRATOR OF GROUNDWATER CODE
MONTANA WATER RESOURCES BOARD

NOTICE OF COMPLETION OF GROUNDWATER APPROPRIATION WITHOUT WELL

Developed After January 1, 1961

(Under Chapter 22, Montana Session Laws, 1961, as amended)

This form to be prepared by contractor (if any), otherwise by the owner.

Three copies of this notice are to be filed with the County Clerk and Recorder of the county in which the works are located.

Please answer all questions. If not applicable, so state, otherwise the form may be returned.

For Administrator's Use

File 240481

June 25, 1973

GW 1 2:20 p.m.

Owner Madge John

Address Highway 97 West, Laramie, WY

Contractor (if any) _____

Address of Contractor _____

Date Started _____ Date Completed _____

1. Describe means of obtaining groundwater (as by sub-irrigation, developed spring, drains, etc.) developed spring

2. Means of withdrawing water (gravity, pump, canal, etc.) gravity

3. Depth of water table six feet

4. Use of the water stock water

5. Amount of groundwater claimed (in miner's inches or gallons per minute) 20 gal per minute

6. If used for irrigation, give number of acres and description of land _____

7. Estimate amount of water used each year 200,000

8. Months of year spring flows all year

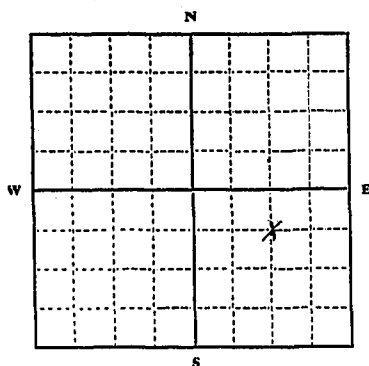

SE 1/4 1/4 Sec. 30

T. 11N N R. 38 E
S W

INDICATE POINT OF APPROPRIATION AND PLACE OF USE, IF POSSIBLE.
Elevation of spring, if known or estimated _____

Signature of Owner Madge John

Date June 25 - 1973

54072

240481

STATE OF MONTANA } ss.
County of Big Horn }

The within instrument was filed
in my office at Hardin, Montana, this

_____ day of
JUN 25 1973 A.D. 19__

at 220 o'clock P.M.

George Lippert

County Recorder

and *Dorothy Jones* Deputy

File No.

DUPLICATE

STATE OF MONTANA
ADMINISTRATOR OF GROUNDWATER CODE
OFFICE OF STATE ENGINEER

County

R

JAN 8 1964

Declaration of Vested Groundwater Rights
(Under Chapter 237, Montana Session Laws, 1961)

STATE ENGINEER

1. FINAR E. HEINANEN (Name of Appropriator) of SARDY ROUTE (Address) HYSHAM (Town)
County of BIG HORN State of MONTANA
have appropriated groundwater according to the Montana laws in effect prior to January 1, 1962, as follows:

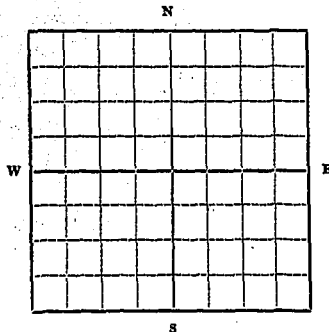

NW 1/4 Sec. 20 T. 1 N. R. 28 E.

Indicate point of appropriation and place of use, if possible. Each small square represents 10 acres.

2. The beneficial use on which the claim is based Domestic
or livestock
3. Date or approximate date of earliest beneficial use; and how continuous the use has been 1916
4. The amount of groundwater claimed (in miner's inches or gallons per minute) 30 gal minute
5. If used for irrigation, give the acreage and description of the lands to which water has been applied and name of the owner thereof
6. The means of withdrawing such water from the ground and the location of each well or other means of withdrawal gas pump
7. The date of commencement and completion of the construction of the well, wells, or other works for withdrawal of groundwater 1916
8. The depth of water table 180 ft.
9. So far as it may be available, the type, size and depth of each well or the general specifications of any other works for the withdrawal of groundwater 135 ft.
10. The estimated amount of groundwater withdrawn each year Varies.
11. The log of formations encountered in the drilling of each well if available Not available
12. Such other information of a similar nature as may be useful in carrying out the policy of this act, including reference to book and page of any county record Unknown

Signature of Owner

Finar Heinanen

Date Jan. 2, 1964

Three copies to be filed by the owner with the County Clerk and Recorder of the county in which the well is located.

Please answer all questions. If not applicable, so state, otherwise the form will be returned.

Original to the County Clerk and Recorder; duplicate to the State Engineer; Triplicate to the School of Mines and Quadruplicate for the Appropriator.

26967

206681

STATE OF MONTANA }
County of Big Horn } ss:

The within instrument was filed
In my office at Hardin, Montana, this

DEC 31 1963 day of

A.D. 19

at 3:55 o'clock P.M.

Harry E. Cap
County Recorder

By *Barthel Wemple* Deputy

County King Harris

STATE OF MONTANA
ADMINISTRATOR OF GROUNDWATER CODE
MONTANA WATER RESOURCES BOARD

NOTICE OF COMPLETION OF GROUNDWATER APPROPRIATION BY MEANS OF WELL

Developed after January 1, 1962

(Under Chapter 237 Montana Session Laws, 1961, as amended)

This form to be prepared by driller, and three copies to be filed by the **owner** with the County Clerk and Recorder in the county in which the well is located, last copy to be retained by driller.

Please answer all questions. If not applicable, so state, otherwise the form may be returned.

Owner	Madge John	For Administrator's Use
Address	21. [unclear]	File 24080
Date well started	June 25, 1973	GW 1 2:15 p.m.
completed		

Type of well drilled (Dug, driven, bored or drilled)

Equipment used
(Churn drill, rotary or other)

Water Use: Domestic ☒ Municipal ☐ Stock ☐ Irrigation ☐

Industrial ☐ Drainage ☐ Other ☐* Garden/Lawn ☒

*Describe

USE: If used for irrigation, industrial, drainage or other. Explain, state number of acres and location or other data (i.e. Lot, Block and Addition).

ESTIMATED ANNUAL WITHDRAWAL

Size of Drilled Hole	Size and Weight of Casing	From (Feet)	To (Feet)	PERFORATIONS		
				Kind Size	From (Feet)	To (Feet)
4"	4" Steel		40	—	—	—

Static water levelft.*
Pumping water levelft.*
atgallons per minute,
measuredminutes after pumping
began.

*Measured from ground level.

Well developed by
for 24 hours.

Power..... Pump..... HP

Remarks: (Gravel packing, cementing,
packers, type of shutoff)

SE $\frac{1}{4}$ $\frac{1}{4}$ Sec. 30
T. 1 N. N R. 38 E
S W

INDICATE LOCATION OF WELL AND PLACE OF USE, IF POSSIBLE.
EACH SMALL SQUARE REPRESENTS 40 ACRES.

Driller's Signature W. H. L. Wm

Driller's Address

LICENSE NO.

DRILLER'S LOG

Indicate the character, color, thickness of strata such as soil, clay, sand, gravel, shale, sandstone, etc. Show depth at which water is found and height to which water rises in well.

Top of Ground (Elev. above sea level) _____

[illegible]

Show exact depth of bottom

54671

240480

STATE OF MONTANA { ss.
County of Big Horn

The within instrument was filed
in my office at Hardin, Montana, this

day of

JUN 25 1973 A.D. 19

at 2:5 o'clock P.M.

Jaeger Lippert
County Recorder
Dorothy Jones Deputy

✓240479✓

STATE OF MONTANA } ss.
County of Big Horn }

The within instrument was filed
in my office at Hardin, Montana, this

_____ day of
JUN 25 1973 A.D. 19

at 2:10 o'clock P.M.

Joseph L. Lippert
County Recorder

By *Barbara Jones* Clerk

30

STATE OF MONTANA
ADMINISTRATOR OF GROUNDWATER CODE
MONTANA WATER RESOURCES BOARD

NOTICE OF COMPLETION OF GROUNDWATER APPROPRIATION BY MEANS OF WELL

Developed after January 1, 1962

(Under Chapter 237 Montana Session Laws, 1961, as amended)

This form to be prepared by driller, and three copies to be filed by the owner with the County Clerk and Recorder in the county in which the well is located, last copy to be retained by driller.

Please answer all questions. If not applicable, so state, otherwise the form may be returned.

Owner **Westmoreland Resources**

Address **Box 449**

Hardin, Montana 59034

Date well started

completeddrilled

Type of well Not known

.....
(Dug, driven, bored or drilled)

Equipment used

(Churn drill, rotary or other)

Water Use: Domestic ☐ Municipal ☐ Stock ☒ Irrigation ☐

Industrial ☒ Drainage ☐ Other ☐* Garden/Lawn ☐

***Describe**

USE: If used for irrigation, industrial, drainage or other. Explain, state number of acres and location or other data (i.e. Lot, Block

and Addition). NEW PUT IN GAS TANK

ESTIMATED ANNUAL WITHDRAWAL 200,000

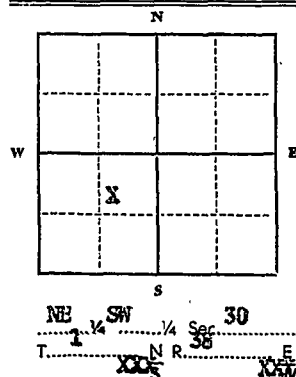
[illegible]

Static water level125.....ft.*

Pumping water levelft.*
 atgallons per minute,
 measuredminutes after pumping
 began.

*Measured from ground level.

Well developed by
forhours.

Power hand Pump..... HP

Remarks: (Gravel packing, cementing,
packers, type of shutoff)

INDICATE LOCATION OF WELL AND PLACE OF USE, IF POSSIBLE.
EACH SMALL SQUARE REPRESENTS 40 ACRES.

Driller's Signature

Not known

Driller's Address

LICENSE NO.

DRILLER'S LOG

Indicate the character, color, thickness of strata such as soil, clay, sand, gravel, shale, sandstone, etc. Show depth at which water is found and height to which water rises in well.

Top of Ground

(Elev. above sea level) 223

[illegible]

200 Show exact depth of bottom

54,566

240569

STATE OF MONTANA } ss.
County of Big Horn }

The within instrument was filed
in my office at Hardin, Montana, this
JUN 28 1973 day of

A. D. 19

at 4:35 o'clock P. M.

James L. Lippert
County Recorder

by _____ Deput

DUPLICATE

T/N R 38 E

County Big Horn

STATE OF MONTANA
ADMINISTRATOR OF GROUNDWATER CODE
OFFICE OF STATE ENGINEER

RECEIVED
JAN 6 1964

Declaration of Vested Groundwater Rights STATE ENGINEER
(Under Chapter 237, Montana Session Laws, 1961)

1. Myrtle C. Cox, of Glendora, Montana
(Name of Appropriator) (Address) (Town)
County of Big Horn State of Montana
have appropriated groundwater according to the Montana laws in effect prior to January 1, 1962, as follows:

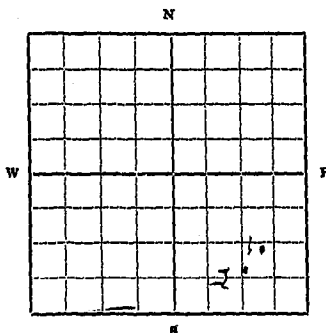

S.E. 1/4 ~~2~~ Sec. 32 T.1N R.38E

Indicate point of appropriation
and place of use, if possible.
Each small square represents 10
acres.

2. The beneficial use on which the claim is based stock water
3. Date or approximate date of earliest beneficial use; and how continuous the use has been
1. Oct. 1960 - drilled
2. July 1958 - in the water trough
4. The amount of groundwater claimed (in miner's inches or gallons per minute) 1. 8 gal per min
2. 2 in gal per min
5. If used for irrigation, give the acreage and description of the lands to which water has been applied and name of the owner thereof none used for irrigation
6. The means of withdrawing such water from the ground and the location of each well or other means of withdrawal
drilling & gas station
7. The date of commencement and completion of the construction of the well, wells, or other works for withdrawal of groundwater
1. Oct. 1960
2. July 1958
8. The depth of water table 1. 200 ft 2. 6 ft
9. So far as it may be available, the type, size and depth of each well or the general specifications of any other works for the withdrawal of groundwater
1. 22.5 ft deep 4 in casing drilled
2. 15 ft deep 6 in casing drilled by hand
10. The estimated amount of groundwater withdrawn each year 20,000
11. The log of formations encountered in the drilling of each well if available
05' to 22' sand, 22' to 28' coal, 28' to 47' gray shale, 47' to 84' coal, 84' to 170' sand & clay, 170' to 185' sand shale, 185' to 195' coal, 195' to 200' gray shale, 200' to 234' sand & clay
12. Such other information of a similar nature as may be useful in carrying out the policy of this act, including reference to book and page of any county record.

Signature of Owner _____

Date: 12-19-62

Three copies to be filed by the owner with the County Clerk and Recorder of the county in which the well is located.

Please answer all questions. If not applicable, so state, otherwise the form will be returned.

Original to the County Clerk and Recorder; duplicate to the State Engineer; Triplicate to the School of Mines and Quadruplicate for the Appropriator.

2161

206174

COMMERCIAL

STATE OF MONTANA
County of Big Horn

The within instrument was filed
in my office at Hardin, Montana, this
DEC 1 9 1963 day of

A. D. 19

at 2:25 o'clock P. M.

Harry E. Carl
County Recorder

By Richard W. Smith Deputy

JUL 2 1973

DRILLER'S LOG

Indicate the character, color, thickness of strata such as soil, clay, sand, gravel, shale, sandstone, etc. Show depth at which water is found and height to which water rises in well.

(Under Chapter 237 Montana Session Laws, 1961, as amended)

Please answer all questions. If not applicable, so state, otherwise the form may be returned.

For Administrator's Use

File 240559

June 28, 1971

GW 1 4:25 P.M.

.....
(Dug, driven, bored or drilled)

(Churn drill, rotary or other)

Industrial ☐ Drainage ☐ Other ☐* Garden/Lawn ☒

***Describe**

USE: If used for irrigation, industrial, drainage or other. Explain, state number of acres and location or other data (i.e. Lot, Block and Addition).

ESTIMATED ANNUAL WITHDRAWAL 300,000 gallons

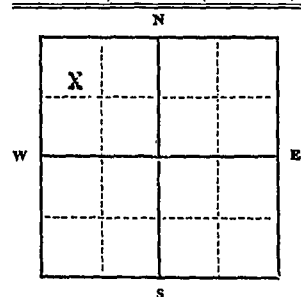
[illegible]

Static water level 93 ft.*

Pumping water levelft.*

atgallons per minute,

measuredminutes after pumping
home

*Measured from ground level.

Well developed by

for hours.

Power electric Pump..... HP

Remarks: (Gravel packing, cementing,
packers, type of shutoff)

IN 1/4 NW 1/4 Sec 32

..... 1/4 1/4 Sec. 38
T. N R.

INDICATE LOCATION OF WELL AND PLACE OF USE, IF POSSIBLE.
EACH SMALL SQUARE REPRESENTS 40 ACRES.

Driller's Signature Driller not known

Driller's Address

..... LICENSE NO.

Top of Ground

(Elev. above sea level) **3530**

From
(Feet)

**To
(Feet)**

Log Not Available

140

Show exact depth of bottom

54554