

235739

STATE OF MONTANA  
County of Big Horn

The within instrument was filed  
in my office at Hardin, Montana, this

MAY 15 1972 day of

A. D. 19

at 4:50 o'clock P.M.

*Joseph L. Lippert*  
County Recorder  
by *Debra Wemple* Deputy

ESTIMATED AVERAGE ANNUAL INCOME OBTAINED

Year	1969	1970	1971	1972	1973	1974	1975	1976	1977	1978	1979	1980	1981	1982	1983	1984	1985	1986	1987	1988	1989	1990	1991	1992	1993	1994	1995	1996	1997	1998	1999	2000	2001	2002	2003	2004	2005	2006	2007	2008	2009	2010	2011	2012	2013	2014	2015	2016	2017	2018	2019	2020	2021	2022	2023	2024	2025	2026	2027	2028	2029	2030	2031	2032	2033	2034	2035	2036	2037	2038	2039	2040	2041	2042	2043	2044	2045	2046	2047	2048	2049	2050	2051	2052	2053	2054	2055	2056	2057	2058	2059	2060	2061	2062	2063	2064	2065	2066	2067	2068	2069	2070	2071	2072	2073	2074	2075	2076	2077	2078	2079	2080	2081	2082	2083	2084	2085	2086	2087	2088	2089	2090	2091	2092	2093	2094	2095	2096	2097	2098	2099	2100	2101	2102	2103	2104	2105	2106	2107	2108	2109	2110	2111	2112	2113	2114	2115	2116	2117	2118	2119	2120	2121	2122	2123	2124	2125	2126	2127	2128	2129	2130	2131	2132	2133	2134	2135	2136	2137	2138	2139	2140	2141	2142	2143	2144	2145	2146	2147	2148	2149	2150	2151	2152	2153	2154	2155	2156	2157	2158	2159	2160	2161	2162	2163	2164	2165	2166	2167	2168	2169	2170	2171	2172	2173	2174	2175	2176	2177	2178	2179	2180	2181	2182	2183	2184	2185	2186	2187	2188	2189	2190	2191	2192	2193	2194	2195	2196	2197	2198	2199	2200	2201	2202	2203	2204	2205	2206	2207	2208	2209	2210	2211	2212	2213	2214	2215	2216	2217	2218	2219	2220	2221	2222	2223	2224	2225	2226	2227	2228	2229	2230	2231	2232	2233	2234	2235	2236	2237	2238	2239	2240	2241	2242	2243	2244	2245	2246	2247	2248	2249	2250	2251	2252	2253	2254	2255	2256	2257	2258	2259	2260	2261	2262	2263	2264	2265	2266	2267	2268	2269	2270	2271	2272	2273	2274	2275	2276	2277	2278	2279	2280	2281	2282	2283	2284	2285	2286	2287	2288	2289	2290	2291	2292	2293	2294	2295	2296	2297	2298	2299	2300	2301	2302	2303	2304	2305	2306	2307	2308	2309	2310	2311	2312	2313	2314	2315	2316	2317	2318	2319	2320	2321	2322	2323	2324	2325	2326	2327	2328	2329	2330	2331	2332	2333	2334	2335	2336	2337	2338	2339	2340	2341	2342	2343	2344	2345	2346	2347	2348	2349	2350	2351	2352	2353	2354	2355	2356	2357	2358	2359	2360	2361	2362	2363	2364	2365	2366	2367	2368	2369	2370	2371	2372	2373	2374	2375	2376	2377	2378	2379	2380	2381	2382	2383	2384	2385	2386	2387	2388	2389	2390	2391	2392	2393	2394	2395	2396	2397	2398	2399	2400	2401	2402	2403	2404	2405	2406	2407	2408	2409	2410	2411	2412	2413	2414	2415	2416	2417	2418	2419	2420	2421	2422	2423	2424	2425	2426	2427	2428	2429	2430	2431	2432	2433	2434	2435	2436	2437	2438	2439	2440	2441	2442	2443	2444	2445	2446	2447	2448	2449	2450	2451	2452	2453	2454	2455	2456	2457	2458	2459	2460	2461	2462	2463	2464	2465	2466	2467	2468	2469	2470	2471	2472	2473	2474	2475	2476	2477	2478	2479	2480	2481	2482	2483	2484	2485	2486	2487	2488	2489	2490	2491	2492	2493	2494	2495	2496	2497	2498	2499	2500	2501	2502	2503	2504	2505	2506	2507	2508	2509	2510	2511	2512	2513	2514	2515	2516	2517	2518	2519	2520	2521	2522	2523	2524	2525	2526	2527	2528	2529	2530	2531	2532	2533	2534	2535	2536	2537	2538	2539	2540	2541	2542	2543	2544	2545	2546	2547	2548	2549	2550	2551	2552	2553	2554	2555	2556	2557	2558	2559	2560	2561	2562	2563	2564	2565	2566	2567	2568	2569	2570	2571	2572	2573	2574	2575	2576	2577	2578	2579	2580	2581	2582	2583	2584	2585	2586	2587	2588	2589	2590	2591	2592	2593	2594	2595	2596	2597	2598	2599	2600	2601	2602	2603	2604	2605	2606	2607	2608	2609	2610	2611	2612	2613	2614	2615	2616	2617	2618	2619	2620	2621	2622	2623	2624	2625	2626	2627	2628	2629	2630	2631	2632	2633	2634	2635	2636	2637	2638	2639	2640	2641	2642	2643	2644	2645	2646	2647	2648	2649	2650	2651	2652	2653	2654	2655	2656	2657	2658	2659	2660	2661	2662	2663	2664	2665	2666	2667	2668	2669	2670	2671	2672	2673	2674	2675	2676	2677	2678	2679	2680	2681	2682	2683	2684	2685	2686	2687	2688	2689	2690	2691	2692	2693	2694	2695	2696	2697	2698	2699	2700	2701	2702	2703	2704	2705	2706	2707	2708	2709	2710	2711	2712	2713	2714	2715	2716	2717	2718	2719	2720	2721	2722	2723	2724	2725	2726	2727	2728	2729	2730	2731	2732	2733	2734	2735	2736	2737	2738	2739	2740	2741	2742	2743	2744	2745	2746	2747	2748	2749	2750	2751	2752	2753	2754	2755	2756	2757	2758	2759	2760	2761	2762	2763	2764	2765	2766	2767	2768	2769	2770	2771	2772	2773	2774	2775	2776	2777	2778	2779	2780	2781	2782	2783	2784	2785	2786	2787	2788	2789	2790	2791	2792	2793	2794	2795	2796	2797	2798	2799	2800	2801	2802	2803	2804	2805	2806	2807	2808	2809	2810	2811	2812	2813	2814	2815	2816	2817	2818	2819	2820	2821	2822	2823	2824	2825	2826	2827	2828	2829	2830	2831	2832	2833	2834	2835	2836	2837	2838	2839	2840	2841	2842	2843	2844	2845	2846	2847	2848	2849	2850	2851	2852	2853	2854	2855	2856	2857	2858	2859	2860	2861	2862	2863	2864	2865	2866	2867	2868	2869	2870	2871	2872	2873	2874	2875	2876	2877	2878	2879	2880	2881	2882	2883	2884	2885	2886	2887	2888	2889	2890	2891	2892	2893	2894	2895	2896	2897	2898	2899	2900	2901	2902	2903	2904	2905	2906	2907	2908	2909	2910	2911	2912	2913	2914	2915	2916	2917	2918	2919	2920	2921	2922	2923	2924	2925	2926	2927	2928	2929	2930	2931	2932	2933	2934	2935	2936	2937	2938	2939	2940	2941	2942	2943	2944	2945	2946	2947	2948	2949	2950	2951	2952	2953	2954	2955	2956	2957	2958	2959	2960	2961	2962	2963	2964	2965	2966	2967	2968	2969	2970	2971	2972	2973	2974	2975	2976	2977	2978	2979	2980	2981	2982	2983	2984	2985	2986	2987	2988	2989	2990	2991	2992	2993	2994	2995	2996	2997	2998	2999	3000	3001	3002	3003	3004	3005	3006	3007	3008	3009	3010	3011	3012	3013	3014	3015	3016	3017	3018	3019	3020	3021	3022	3023	3024	3025	3026	3027	3028	3029	3030	3031	3032	3033	3034	3035	3036	3037	3038	3039	3040	3041	3042	3043	3044	3045	3046	3047	3048	3049	3050	3051	3052	3053	3054	3055	3056	3057	3058	3059	3060	3061	3062	3063	3064	3065	3066	3067	3068	3069	3070	3071	3072	3073	3074	3075	3076	3077	3078	3079	3080	3081	3082	3083	3084	3085	3086	3087	3088	3089	3090	3091	3092	3093	3094	3095	3096	3097	3098	3099	3100	3101	3102	3103	3104	3105	3106	3107	3108	3109	3110	3111	3112	3113	3114	3115	3116	3117	3118	3119	3120	3121	3122	3123	3124	3125	3126	3127	3128	3129	3130	3131	3132	3133	3134	3135	3136	3137	3138	3139	3140	3141	3142	3143	3144	3145	3146	3147	3148	3149	3150	3151	3152	3153	3154	3155	3156	3157	3158	3159	3160	3161	3162	3163	3164	3165	3166	3167	3168	3169	3170	3171	3172	3173	3174	3175	3176	3177	3178	3179	3180	3181	3182	3183	3184	3185	3186	3187	3188	3189	3190	3191	3192	3193	3194	3195	3196	3197	3198	3199	3200	3201	3202	3203	3204	3205	3206	3207	3208	3209	3210	3211	3212	3213	3214	3215	3216	3217	3218	3219	3220	3221	3222	3223	3224	3225	3226	3227	3228	3229	3230	3231	3232	3233	3234	3235	3236	3237	3238	3239	3240	3241	3242	3243	3244	3245	3246	3247	3248	3249	3250	3251	3252	3253	3254	3255	3256	3257	3258	3259	3260	3261	3262	3263	3264	3265	3266	3267	3268	3269	3270	3271	3272	3273	3274	3275	3276	3277	3278	3279	3280	3281	3282	3283	3284	3285	3286	3287	3288	3289	3290	3291	3292	3293	3294	3295	3296	3297	3298	3299	3300	3301	3302	3303	3304	3305	3306	3307	3308	3309	3310	3311	3312	3313	3314	3315	3316	3317	3318	3319	3320	3321	3322	3323	3324	3325	3326	3327	3328	3329	3330	3331	3332	3333	3334	3335	3336	3337	3></
------	------	------	------	------	------	------	------	------	------	------	------	------	------	------	------	------	------	------	------	------	------	------	------	------	------	------	------	------	------	------	------	------	------	------	------	------	------	------	------	------	------	------	------	------	------	------	------	------	------	------	------	------	------	------	------	------	------	------	------	------	------	------	------	------	------	------	------	------	------	------	------	------	------	------	------	------	------	------	------	------	------	------	------	------	------	------	------	------	------	------	------	------	------	------	------	------	------	------	------	------	------	------	------	------	------	------	------	------	------	------	------	------	------	------	------	------	------	------	------	------	------	------	------	------	------	------	------	------	------	------	------	------	------	------	------	------	------	------	------	------	------	------	------	------	------	------	------	------	------	------	------	------	------	------	------	------	------	------	------	------	------	------	------	------	------	------	------	------	------	------	------	------	------	------	------	------	------	------	------	------	------	------	------	------	------	------	------	------	------	------	------	------	------	------	------	------	------	------	------	------	------	------	------	------	------	------	------	------	------	------	------	------	------	------	------	------	------	------	------	------	------	------	------	------	------	------	------	------	------	------	------	------	------	------	------	------	------	------	------	------	------	------	------	------	------	------	------	------	------	------	------	------	------	------	------	------	------	------	------	------	------	------	------	------	------	------	------	------	------	------	------	------	------	------	------	------	------	------	------	------	------	------	------	------	------	------	------	------	------	------	------	------	------	------	------	------	------	------	------	------	------	------	------	------	------	------	------	------	------	------	------	------	------	------	------	------	------	------	------	------	------	------	------	------	------	------	------	------	------	------	------	------	------	------	------	------	------	------	------	------	------	------	------	------	------	------	------	------	------	------	------	------	------	------	------	------	------	------	------	------	------	------	------	------	------	------	------	------	------	------	------	------	------	------	------	------	------	------	------	------	------	------	------	------	------	------	------	------	------	------	------	------	------	------	------	------	------	------	------	------	------	------	------	------	------	------	------	------	------	------	------	------	------	------	------	------	------	------	------	------	------	------	------	------	------	------	------	------	------	------	------	------	------	------	------	------	------	------	------	------	------	------	------	------	------	------	------	------	------	------	------	------	------	------	------	------	------	------	------	------	------	------	------	------	------	------	------	------	------	------	------	------	------	------	------	------	------	------	------	------	------	------	------	------	------	------	------	------	------	------	------	------	------	------	------	------	------	------	------	------	------	------	------	------	------	------	------	------	------	------	------	------	------	------	------	------	------	------	------	------	------	------	------	------	------	------	------	------	------	------	------	------	------	------	------	------	------	------	------	------	------	------	------	------	------	------	------	------	------	------	------	------	------	------	------	------	------	------	------	------	------	------	------	------	------	------	------	------	------	------	------	------	------	------	------	------	------	------	------	------	------	------	------	------	------	------	------	------	------	------	------	------	------	------	------	------	------	------	------	------	------	------	------	------	------	------	------	------	------	------	------	------	------	------	------	------	------	------	------	------	------	------	------	------	------	------	------	------	------	------	------	------	------	------	------	------	------	------	------	------	------	------	------	------	------	------	------	------	------	------	------	------	------	------	------	------	------	------	------	------	------	------	------	------	------	------	------	------	------	------	------	------	------	------	------	------	------	------	------	------	------	------	------	------	------	------	------	------	------	------	------	------	------	------	------	------	------	------	------	------	------	------	------	------	------	------	------	------	------	------	------	------	------	------	------	------	------	------	------	------	------	------	------	------	------	------	------	------	------	------	------	------	------	------	------	------	------	------	------	------	------	------	------	------	------	------	------	------	------	------	------	------	------	------	------	------	------	------	------	------	------	------	------	------	------	------	------	------	------	------	------	------	------	------	------	------	------	------	------	------	------	------	------	------	------	------	------	------	------	------	------	------	------	------	------	------	------	------	------	------	------	------	------	------	------	------	------	------	------	------	------	------	------	------	------	------	------	------	------	------	------	------	------	------	------	------	------	------	------	------	------	------	------	------	------	------	------	------	------	------	------	------	------	------	------	------	------	------	------	------	------	------	------	------	------	------	------	------	------	------	------	------	------	------	------	------	------	------	------	------	------	------	------	------	------	------	------	------	------	------	------	------	------	------	------	------	------	------	------	------	------	------	------	------	------	------	------	------	------	------	------	------	------	------	------	------	------	------	------	------	------	------	------	------	------	------	------	------	------	------	------	------	------	------	------	------	------	------	------	------	------	------	------	------	------	------	------	------	------	------	------	------	------	------	------	------	------	------	------	------	------	------	------	------	------	------	------	------	------	------	------	------	------	------	------	------	------	------	------	------	------	------	------	------	------	------	------	------	------	------	------	------	------	------	------	------	------	------	------	------	------	------	------	------	------	------	------	------	------	------	------	------	------	------	------	------	------	------	------	------	------	------	------	------	------	------	------	------	------	------	------	------	------	------	------	------	------	------	------	------	------	------	------	------	------	------	------	------	------	------	------	------	------	------	------	------	------	------	------	------	------	------	------	------	------	------	------	------	------	------	------	------	------	------	------	------	------	------	------	------	------	------	------	------	------	------	------	------	------	------	------	------	------	------	------	------	------	------	------	------	------	------	------	------	------	------	------	------	------	------	------	------	------	------	------	------	------	------	------	------	------	------	------	------	------	------	------	------	------	------	------	------	------	------	------	------	------	------	------	------	------	------	------	------	------	------	------	------	------	------	------	------	------	------	------	------	------	------	------	------	------	------	------	------	------	------	------	------	------	------	------	------	------	------	------	------	------	------	------	------	------	------	------	------	------	------	------	------	------	------	------	------	------	------	------	------	------	------	------	------	------	------	------	------	------	------	------	------	------	------	------	------	------	------	------	------	------	------	------	------	------	------	------	------	------	------	------	------	------	------	------	------	------	------	------	------	------	------	------	------	------	------	------	------	------	------	------	------	------	------	------	------	------	------	------	------	------	------	------	------	------	------	------	------	------	------	------	------	------	------	------	------	------	------	------	------	------	------	------	------	------	------	------	------	------	------	------	------	------	------	------	------	------	------	------	------	------	------	------	------	------	------	------	------	------	------	------	------	------	------	------	------	------	------	------	------	------	------	------	------	------	------	------	------	------	------	------	------	------	------	------	------	------	------	------	------	------	------	------	------	------	------	------	------	------	------	------	------	------	------	------	------	------	------	------	------	------	------	------	------	------	------	------	------	------	------	------	------	------	------	------	------	------	------	------	------	------	------	------	------

File No. ....

DUPLICATE

T. 8 R. 39  
County Big Horn

STATE OF MONTANA  
ADMINISTRATOR OF GROUNDWATER CODE  
OFFICE OF STATE ENGINEER

**Declaration of Vested Groundwater Rights**

(Under Chapter 237, Montana Session Laws, 1961)

RECEIVED  
JAN 6 1964

STATE ENGINEER

1. Chas L. Young, of Libby  
(Name of Appropriator) (Address) (Town)  
County of Big Horn State of Montana  
have appropriated groundwater according to the Montana laws in effect prior to January 1, 1962, as follows:

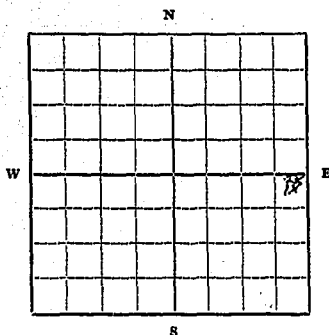

NE 1/4 Sec. 2 T. 8 R. 39

Indicate point of appropriation  
and place of use, if possible.  
Each small square represents 10  
acres.

2. The beneficial use on which the claim is based Domestic  
and Irrigation

3. Date or approximate date of earliest beneficial use; and how continuous the use has been 1910 daily  
1950 daily

4. The amount of groundwater claimed (in miner's inches or gallons per minute) 1.0 gpm Montana  
2.10 gpm Minnesota

5. If used for irrigation, give the acreage and description of the lands to which water has been applied and name of the owner thereof

6. The means of withdrawing such water from the ground and the location of each well or other means of withdrawal  
Windmill and electric pump

7. The date of commencement and completion of the construction of the well, wells, or other works for withdrawal of groundwater

8. The depth of water table 74' - 112 74' - 114

9. So far as it may be available, the type, size and depth of each well or the general specifications of any other works for the withdrawal of groundwater

74' 4 in Case 114 feet deep 2.10 gpm water  
74' 4 in Case 114 feet deep 2.10 gpm water

10. The estimated amount of groundwater withdrawn each year 200,000

11. The log of formations encountered in the drilling of each well if available Red shale  
all the way

12. Such other information of a similar nature as may be useful in carrying out the policy of this act, including reference to book and page of any county record.

Signature of Owner Chas L. Young

Date Dec 20 1963

Three copies to be filed by the owner with the County Clerk and Recorder of the county in which the well is located.

Please answer all questions. If not applicable, so state, otherwise the form will be returned.

Original to the County Clerk and Recorder; duplicate to the State Engineer; Triplicate to the School of Mines and Quadruplicate for the Appropriator.

21629

206234

STATE OF MONTANA } ss:  
County of Big Horn }

The within instrument was filed  
in my office at Hardin, Montana, this  
DEC 23 1963 day of

A. D. 19

at 11<sup>12</sup> o'clock A.M.

*Harry E. Carl*  
County Recorder  
By *Seldin L. Smith* Deputy

File No. ....

DUPLICATE

T. 8 R. 39E

County Big Horn

STATE OF MONTANA  
ADMINISTRATOR OF GROUNDWATER CODE  
OFFICE OF STATE ENGINEER

RECEIVED  
JAN 8 1964

Declaration of Vested Groundwater Rights  
(Under Chapter 237, Montana Session Laws, 1961) STATE ENGINEER

1. Charles T. Young, of Libby  
(Name of Appropriator) (Address)  
County of Big Horn State of Montana (Town)  
have appropriated groundwater according to the Montana laws in effect prior to January 1, 1962, as follows:

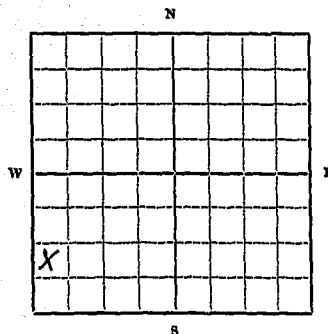

NE 1/4 Sec 4 T. 8 R. 39E

Indicate point of appropriation and place of use, if possible. Each small square represents 10 acres.

2. The beneficial use on which the claim is based Libby water
3. Date or approximate date of earliest beneficial use; and how continuous the use has been Continuous
4. The amount of groundwater claimed (in miner's inches or gallons per minute) 20 gpm
5. If used for irrigation, give the acreage and description of the lands to which water has been applied and name of the owner thereof None
6. The means of withdrawing such water from the ground and the location of each well or other means of withdrawal Flowing
7. The date of commencement and completion of the construction of the well, wells, or other works for withdrawal of groundwater Flowing water
8. The depth of water table 0
9. So far as it may be available, the type, size and depth of each well or the general specifications of any other works for the withdrawal of groundwater
10. The estimated amount of groundwater withdrawn each year 10,000,000
11. The log of formations encountered in the drilling of each well if available Flowing spring from gravel
12. Such other information of a similar nature as may be useful in carrying out the policy of this act, including reference to book and page of any county record

Signature of Owner Charles Young

Date Dec 30, 1963

Three copies to be filed by the owner with the County Clerk and Recorder of the county in which the well is located.

Please answer all questions. If not applicable, so state, otherwise the form will be returned.

Original to the County Clerk and Recorder; duplicate to the State Engineer; Triplicate to the School of Mines and Quadruplicate for the Appropriator.

21632

STATE OF MONTANA } ss:  
County of Big Horn

206237

The within instrument was filed  
in my office at Hardin, Montana, this  
DEC 23 1963 day of

A. D. 19

at 11:15 o'clock A.M.

*Harry E. Cap*

County Recorder

By *Charles P. Smith* Deputy

File No. ....

DUPLICATE

T. 8S R. 39E

County Big Horn

STATE OF MONTANA  
ADMINISTRATOR OF GROUNDWATER CODE  
OFFICE OF STATE ENGINEER

RECEIVED  
JAN 6 1964

Declaration of Vested Groundwater Rights

(Under Chapter 237, Montana Session Laws, 1961)

STATE ENGINEER

1. J.S. and/or Lois J. Hamilton, of Decker  
(Name of Appropriator) (Address) (Town)  
County of Big Horn State of Montana  
have appropriated groundwater according to the Montana laws in effect prior to January 1, 1962, as follows:

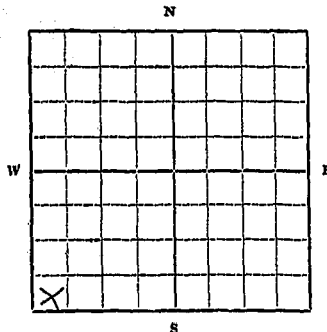

SW 1/4 Sec. 4 T. 8S. R. 39E

Indicate point of appropriation  
and place of use, if possible.  
Each small square represents 10  
acres.

2. The beneficial use on which the claim is based Stockwater
3. Date or approximate date of earliest beneficial use; and how continuous the use has been 1913, continuous
4. The amount of groundwater claimed (in miner's inches or gallons per minute) one quart per minute
5. If used for irrigation, give the acreage and description of the lands to which water has been applied and name of the owner thereof not applicable
6. The means of withdrawing such water from the ground and the location of each well or other means of withdrawal Natural spring
7. The date of commencement and completion of the construction of the well, wells, or other works for withdrawal of groundwater 1913
8. The depth of water table surface
9. So far as it may be available, the type, size and depth of each well or the general specifications of any other works for the withdrawal of groundwater Drained into a pool and piped from this pool into a stock tank
10. The estimated amount of groundwater withdrawn each year 131,400 gallons
11. The log of formations encountered in the drilling of each well if available not applicable
12. Such other information of a similar nature as may be useful in carrying out the policy of this act, including reference to book and page of any county record.

Signature of Owner

Lois J. Hamilton  
J. S. Hamilton  
Date Dec. 20, 1963

Three copies to be filed by the owner with the County Clerk and Recorder of the county in which the well is located.

Please answer all questions. If not applicable, so state, otherwise the form will be returned.

Original to the County Clerk and Recorder; duplicate to the State Engineer; Triplicate to the School of Mines and Quadruplicate for the Appropriator.

21649

206283

STATE OF MONTANA { ss.  
County of Big Horn

The within instrument was filed  
in my office at Hardin, Montana, this

DEC 26 1963 day of

                     A. D. 19

at 9:50 o'clock A.M.

Harvey E. Carl  
County Recorder

By Barry W. Wemple Deputy

File No. \_\_\_\_\_

DUPLICATE

T 85 R 39E

County Big Horn

STATE OF MONTANA  
ADMINISTRATOR OF GROUNDWATER CODE  
OFFICE OF STATE ENGINEER

RECEIVED  
DEC 3 1963

**Declaration of Vested Groundwater Rights**  
(Under Chapter 237, Montana Session Laws, 1961)

STATE ENGINEER

1. Louis Menegas, of Northport  
(Name of Appropriator) (Address) (Town)  
County of Stevens State of Washington  
have appropriated groundwater according to the Montana laws in effect prior to January 1, 1962, as follows:

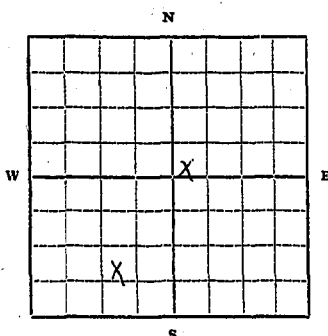

(1) SW 1/4 NE 1/4 Sec. 8 T 85 R 39 E

Indicate point of appropriation  
and place of use, if possible.  
Each small square represents 10  
acres.

(2) SE 1/4 SW 1/4

2. The beneficial use on which the claim is based (1) Stock water  
(2) Stock water

3. Date or approximate date of earliest beneficial use; and how continuous the use has been (1) 1914 - Continuous Use  
(2) 1914 - Continuous Use

4. The amount of groundwater claimed (in miner's inches or gallons per minute) (1) Two gallons per minute  
(2) one quart per minute

5. If used for irrigation, give the acreage and description of the lands to which water has been applied and name of the owner thereof not applicable

6. The means of withdrawing such water from the ground and the location of each well or other means of withdrawal (1) Natural Spring  
(2) Natural Spring

7. The date of commencement and completion of the construction of the well, wells, or other works for withdrawal of groundwater (1) 1914 (2) 1914

8. The depth of water table (1) Surface (2) Surface

9. So far as it may be available, the type, size and depth of each well or the general specifications of any other works for the withdrawal of groundwater (1) Two foot diameter hole dug and cased to a depth of three feet  
(2) Dug out and drained into reservoir

10. The estimated amount of groundwater withdrawn each year (1) 1,051,000 gallons (2) 131,400 gallons

11. The log of formations encountered in the drilling of each well if available not applicable

12. Such other information of a similar nature as may be useful in carrying out the policy of this act, including reference to book and page of any county record.

Signature of Owner Louis Menegas

Date November 29, 1963

Three copies to be filed by the owner with the County Clerk and Recorder of the county in which the well is located.

Please answer all questions. If not applicable, so state, otherwise the form will be returned.

Original to the County Clerk and Recorder; duplicate to the State Engineer; Triplicate to the School of Mines and Quadruplicate for the Appropriator.

7765



205780

STATE OF MONTANA } ss.  
County of Big Horn }

The within instrument was filed  
In my office at Hardin, Montana, this  
DEC 2 1963.

\_\_\_\_\_ day of

\_\_\_\_\_ A. D. 19

at 8:05 o'clock A.M.

*Harvey E. Cash*  
County Recorder

By *Deborah Wemple* Deputy

RECORDED  
INDEXED  
DEC 11 1963  
HARDIN, MONT.

RECEIVED

FEB 24 1971

8539E 12

County Big Horn

STATE OF MONTANA  
ADMINISTRATOR OF GROUNDWATER CODE  
MONTANA WATER RESOURCES BOARD

NOTICE OF APPROPRIATION OF GROUNDWATER

(Under Chapter 237, Montana Session Laws, 1961, as amended)

After filing a notice of appropriation, in order to acquire a right based thereon, the person must, within ninety (90) days, commence actual excavation and diligently prosecute construction of a well and, upon its completion, file a notice of completion with the County Clerk of the county in which the appropriation is located.

Three copies of this notice are to be filed with the County Clerk and Recorder of the county in which the well is located.

Please answer all questions. If not applicable, so state, otherwise the form may be returned.

1. I, Joseph M. Pierce, of Decker, Montana,  
(Name of Appropriator) (Address) (Town)

County of Big Horn, State of Montana, intend to appropriate groundwater in accordance with Chapter 237, Montana Session Laws of 1961.

2. The beneficial use to which water is to be applied is stock and irrigation  
of about 70 acres farmland in N.E. 1/4 NE 1/4 Sec. 12 T. 39 N. R. 39 E.  
(describe lands to be benefited, if for irrigation)

3. The rate of use in gallons per minute or miner's inches of groundwater claimed 200 gal. per  
Min.

The estimated amount of groundwater to be used annually 17,250,000

4. The annual period (inclusive dates) of intended use May 15 to July 31 irrigation. Year around  
stock water

5. The probable or intended date of first beneficial use May 15, 1971

6. The probable or intended date of commencement and completion of the well\* or wells\*  
April 1, 1971 to May 1, 1971

7. The location, type, size and depth of well or wells contemplated not less than 6" casing at  
bottom and not more than 300 ft. depth

8. The probable or estimated depth of the water-table or artesian aquifer 150 ft.

9. The name, address, and license number of the driller engaged Self  
Joseph M. Pierce, Business Address, Birney Star Route, Sheridan, Wyoming

10. Give such other similar information as may be useful in carrying out the policy of this act I plan to

drill a 6" hole and use a 5 3/4  
Submersible pump to test water for  
irrigation, if there appears to be  
available water, I desperately need  
stock water

For Administrator's Use

File 221694  
February 23, 1971  
8:10 A.M.

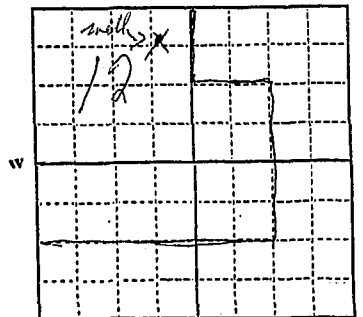

N.E. 1/4 N.E. 1/4 Sec. 12

T. 39 N. R. 39 E.

LOCATE WELL OR OTHER MEANS OF DEVELOPMENT AS ACCURATELY AS POSSIBLE ON THE PLAT.

Signature of Appropriator Joseph M. Pierce Date Feb 15 1971

\*As defined in the Code Sec. 11(c) "Well" means any artificial opening or excavation in the ground, however made, by which groundwater can be obtained or through which it flows under natural pressures or is artificially withdrawn.

48166

231694

STATE OF MONTANA }  
County of Big Horn } ss:

The within instrument was filed  
in my office at Hardin, Montana, this  
FEB 23 1971 day of

A. D. 19

at 8:10 o'clock A.M.

*Joseph Lippert*  
County Recorder

By *Ruby Wensple* Deputy

RECEIVED

STATE OF MONTANA  
ADMINISTRATOR OF GROUNDWATER CODE  
MONTANA WATER RESOURCES BOARD

DEC 13 1971

DRILLER'S LOG

Indicate the character, color, thickness of strata such as soil, clay, sand, gravel, shale, sandstone, etc. Show depth at which water is found and height to which water rises in well.

NOTICE OF COMPLETION OF GROUNDWATER  
APPROPRIATION BY MEANS OF WELL

Developed after January 1, 1962

(Under Chapter 237 Montana Session Laws, 1961, as amended)

This form to be prepared by driller, and three copies to be filed by the owner with the County Clerk and Recorder in the county in which the well is located, last copy to be retained by driller.

Please answer all questions. If not applicable, so state, otherwise the form may be returned.

Owner Joseph M. Pierce  
Address Barney St. W. Sheridan, Wyo.  
Date well started May 1, 1971  
completed Aug 15, 1971  
Type of well Drilled  
Equipment used Cable tool rig  
Water Use: Domestic ☒ Municipal ☐ Stock ☒ Irrigation ☐  
Industrial ☐ Drainage ☐ Other ☐ Garden/Lawn ☐

For Administrator's Use  
File 234308  
December 4, 1971  
8:35 AM  
GW 1

\*Describe for livestock water trough yard and household

USE: If used for irrigation, industrial, drainage or other. Explain, state number of acres and location or other data (i.e. Lot, Block and Addition). Will be used to water and trough

ESTIMATED ANNUAL WITHDRAWAL 600,000 gal

Size of Drilled Hole	Size and Weight of Casing	From (Feet)	To (Feet)	PERFORATIONS
7"	6" steel	0	118	Kind Size From (Feet) To (Feet)
6"	5" plastic	0	370	4x12" 225 370

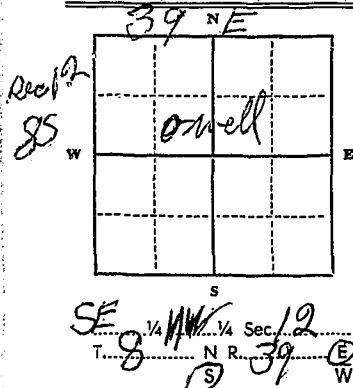

Static water level 165.5 ft.\*  
Pumping water level 20.5 ft.\*  
at 10.0 minutes after pumping began.  
\*Measured from ground level.  
Well developed by Bailing  
for 3 hours.  
Power 2 1/2 HP Pump 1 1/2 HP  
Remarks: (Gravel packing, cementing, packers, type of shutoff)  
6" pipe down solid into black S.S. at 11.8 ft

INDICATE LOCATION OF WELL AND PLACE OF USE, IF POSSIBLE. EACH SMALL SQUARE REPRESENTS 40 ACRES.

Driller's Signature Joseph M. Pierce  
Driller's Address Barney St. W. Sheridan, Wyo.  
Drilled by owner LICENSE NO. 3701

Top of Ground (Elev. above sea level) <u>3400</u>	
From (Feet)	To (Feet)
0	10
10	22
22	36
36	58
58	60
60	76
76	78
78	95
95	100
100	104
104	108
108	116
116	118
118	120
120	125
125	135
135	138
138	140
140	141
141	145
145	185
185	190
190	195
195	200
200	203
203	223
223	230
230	240
240	260
260	262
262	265
265	285
285	335
335	338
338	345
345	350
350	355
355	370
370	370

3701 Show exact depth of bottom

234308

STATE OF MONTANA }  
County of Big Horn }

The within instrument was filed  
in my office at Hardin, Montana, this

DEC 6 1971 day of

A. D. 19

at 8:35 o'clock A. M.

*Joeye L. Smith*  
County Recorder  
*Deputy* Deputy



237701

STATE OF MONTANA } ss.  
County of Big Horn }

The within instrument was filed  
in my office at Hardin, Montana, this

day of

OCT 25 1972 A. D. 19

at 8:10 o'clock A.M.

*James L. Linn*  
County Recorder  
by *Darby Wemple* Deputy

GW 2

RECEIVED

Approved Stock Form—State Publishing Co., Helena, Montana—45642

File No.

DUPLICATE

JAN 12 1973

T. 8 S. R. 39 E

County Big Horn Co.

LOG

MONTANA DEPARTMENT OF NATURAL  
RESOURCES AND CONSERVATION

STATE OF MONTANA

ADMINISTRATOR OF GROUNDWATER CODE  
OFFICE OF STATE ENGINEER

53835

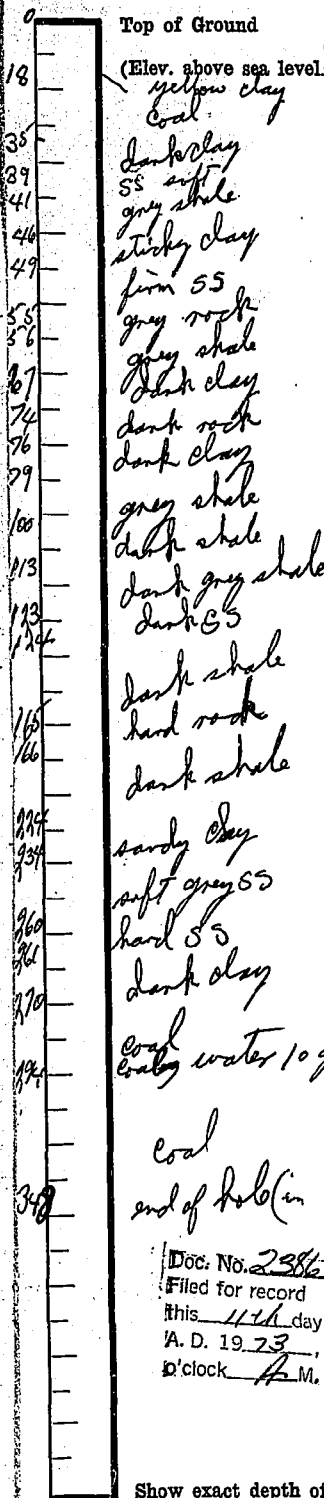

# Notice of Completion of Groundwater Appropriation by Means of Well

DEVELOPED AFTER JANUARY 1, 1962

(Under Chapter 237, Montana Session Laws, 1961)

Owner Joseph M. Pierce Address 3000 St. Rte. 1, Big Horn, Wyo. 82801Driller Joseph M. Pierce Address Big HornDate of Notice of appropriation of groundwater Oct 25 1972Date well started Oct 28 1972 Date completed Nov 1 1972Type of well drilled Equipment used Cable tools  
(Dug, driven, bored or drilled) (Churn drill, rotary or other)Water use: Domestic ☐ Municipal ☐ Stock ☒ Irrigation ☐  
Industrial ☐ Drainage ☐ Other ☐

Indicate on the diagram the character and thickness of the different strata met with in drilling, such as soil, clay, shale, gravel, rock or sand, etc. Show depth at which water is encountered, thickness and character of water-bearing strata and height to which the water rises in the well.

Size of Drilled Hole	Size and Weight of Casing	From (Feet)	To (Feet)	PERFORATIONS		
				Kind Size	From (Feet)	To (Feet)
7"	6" 19 lb.	0	12	none		
6"	4" 1/2 lb. (Plastic)	0	348	1/4 x 6"	990'	348'

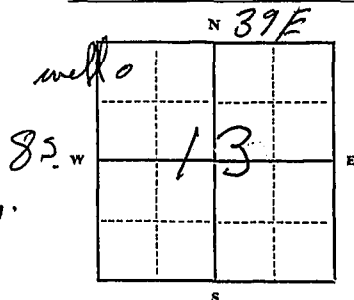
Static Water Level for non-flowing well 249' feet.

Shut-in Pressure for Flowing Well \_\_\_\_\_

Pumping Water Level 290' feet at 10 gal. per minute.

Discharge in gal. per min. of flowing well \_\_\_\_\_

How Tested by BailingLength of Test 1 hourRemarks: (Gravel packing, cementing, packers, type of shutoff) surface casing cemented to 12'plastic 4" casing gravel packed from 100' to 348'Doc. No. 238694

Filed for record

this 11th day of JanA. D. 19 73, at 8:30o'clock P. M.

USE If used for irrigation, industrial, drainage or other. Explain, state number of acres and location or other data (i.e.: Lot, Block and Addition).

Show exact depth of bottom.

This form to be prepared by driller, and three copies to be filed by the owner with the County Clerk and Recorder in the county in which the well is located, tissue copy to be retained by driller.

Please answer all questions. If not applicable, so state, otherwise the form will be returned.

Driller's License Number

Driller's Signature Joseph M. Pierce

52, 196



238694

STATE OF MONTANA  
County of Big Horn } ss.  
The within instrument was filed  
in my office at Hardin, Montana, this  
day of

JAN 11 1973 A.D. 19  
at 8:20 o'clock A.M.

*Joan Lippert*  
County Recorder  
by *Barth Jones* Dep't

DEPARTMENT OF REVENUE  
RECORDS SECTION  
JAN 11 1973

RECEIVED  
JAN 11 1973

DEB 10745

of	area	sq ft	sq ft	sq ft	sq ft	sq ft	sq ft	sq ft	sq ft
100	100	100	100	100	100	100	100	100	100
100	100	100	100	100	100	100	100	100	100
100	100	100	100	100	100	100	100	100	100
100	100	100	100	100	100	100	100	100	100
100	100	100	100	100	100	100	100	100	100
100	100	100	100	100	100	100	100	100	100
100	100	100	100	100	100	100	100	100	100
100	100	100	100	100	100	100	100	100	100
100	100	100	100	100	100	100	100	100	100

100 100 100 100 100 100 100 100 100 100

RECEIVED

MAR 29 1973

### DRILLER'S LOG

Indicate the character, color, thickness of strata such as soil, clay, sand, gravel, shale, sandstone, etc. Show depth at which water is found and height to which water rises in well.

# NOTICE OF COMPLETION OF GROUNDWATER APPROPRIATION BY MEANS OF WELL

**Developed after January 1, 1962**

(Under Chapter 237 Montana Session Laws, 1961, as amended)

This form to be prepared by driller, and three copies to be filed by the owner with the County Clerk and Recorder in the county in which the well is located, last copy to be retained by driller.

Please answer all questions. If not applicable, so state, otherwise the form may be returned.

Owner Corbano Rocco

## Address

Deck Key HT

Date well started

completed June 1916

Type of well

Drilled

### Equipment used

Horse Power Churn Drill  
(Dug, driven, bored or drilled)  
(Churn drill, rotary or other)

Water Use: Domestic ☐ Municipal ☐ Stock ☒ Irrigation ☐

Industrial ☐ Drainage ☐ Other ☐\* Garden/Lawn ☐

**\*Describe**

**USE:** If used for irrigation, industrial, drainage or other. Explain, state number of acres and location or other data (i.e. Lot, Block and Addition).

## ESTIMATED ANNUAL WITHDRAWAL

Size of Drilled Hole	Size and Weight of Casing	From (Feet)	To (Feet)	PERFORATIONS		
				Kind Size	From (Feet)	To (Feet)

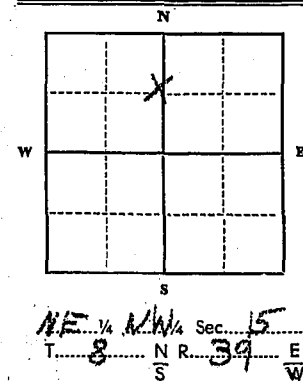

Static water level .....ft.\*  
Pumping water level .....ft.\*  
at .....gallons per minute,  
measured .....minutes after pumping  
began.

\*Measured from ground level.

Well developed by .....  
for ..... hours.

Power..... Pump..... HP

Remarks: (Gravel packing, cementing,

packers, type of shutoff) .....

INDICATE LOCATION OF WELL AND PLACE OF USE, IF POSSIBLE.  
EACH SMALL SQUARE REPRESENTS 40 ACRES.

Driller's Signature

Driller's Address

LICENSE NO

Top of Ground.

(Elev. above sea level)

[illegible]

1151

Show exact depth of bottom

52,767

239541

STATE OF MONTANA } ss.  
County of Big Horn }

The within instrument was filed  
in my office at Hardin, Montana, this

\_\_\_\_\_ day of

MAR 27 1973 A.D. 19

at 9:25 o'clock P.M.

*Joyce Lippert*

County Recorder

by *Dorothy Jones* Deputy

File No. ....

DUPLICATE

T. 8 R. 39E

County Big Horn

STATE OF MONTANA  
ADMINISTRATOR OF GROUNDWATER CODE  
OFFICE OF STATE ENGINEER

Declaration of Vested Groundwater Rights  
(Under Chapter 237, Montana Session Laws, 1961)

RECEIVED  
JAN 8 1964

STATE ENGINEER

1. Charles L. Young, of Libby  
(Name of Appropriator) (Address)  
County of Big Horn State of Montana (Town)  
have appropriated groundwater according to the Montana laws in effect prior to January 1, 1962, as follows:

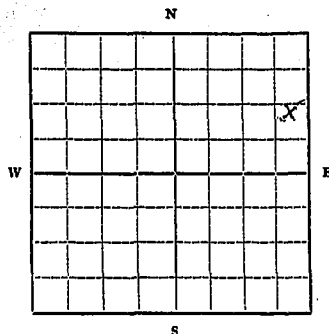

S.E. 1/4 Sec. 17, T. 8, R. 39E

Indicate point of appropriation  
and place of use, if possible.  
Each small square represents 10  
acres.

2. The beneficial use on which the claim is based forest water
3. Date or approximate date of earliest beneficial use; and how continuous the use has been Continuous Spring since 1953
4. The amount of groundwater claimed (in miner's inches or gallons per minute) 5 gal
5. If used for irrigation, give the acreage and description of the lands to which water has been applied and name of the owner thereof None
6. The means of withdrawing such water from the ground and the location of each well or other means of withdrawal Flowing spring through 15' cut in plate up into steel 100 gal tank
7. The date of commencement and completion of the construction of the well, wells, or other works for withdrawal of groundwater 1953
8. The depth of water table 0
9. So far as it may be available, the type, size and depth of each well or the general specifications of any other works for the withdrawal of groundwater could dry up in short time
10. The estimated amount of groundwater withdrawn each year 900,000
11. The log of formations encountered in the drilling of each well if available Water flowing off a coal base
12. Such other information of a similar nature as may be useful in carrying out the policy of this act, including reference to book and page of any county record

Signature of Owner Charles L. Young  
Date Dec 20, 1963

Three copies to be filed by the owner with the County Clerk and Recorder of the county in which the well is located.

Please answer all questions. If not applicable, so state, otherwise the form will be returned.

Original to the County Clerk and Recorder; duplicate to the State Engineer; Triplicate to the School of Mines and Quadruplicate for the Appropriator.

21633

206238

STATE OF MONTANA }  
County of Big Horn } ss:

The within instrument was filed  
in my office at Hardin, Montana, this

DEC 23 1963 day of

11<sup>20</sup> A. D. 19

at 11<sup>20</sup> o'clock A.M.

Harry E. Calk  
County Recorder

By Baldwin L. Smith Deputy

# GROUNDWATER INDEX

Page 1 of 1

County Big Horn Twp. 83 Rge. 42E

[illegible]

File No. ....

DUPLICATE

T 8 S R 42 E.

County BIG HORN

STATE OF MONTANA  
ADMINISTRATOR OF GROUNDWATER CODE  
OFFICE OF STATE ENGINEER

Declaration of Vested Groundwater Rights

(Under Chapter 237, Montana Session Laws, 1961)

RECEIVED  
JAN 8 1964

STATE ENGINEER

RALPH L. OR FRANCES C PARKER, of DECKER  
(Name of Appropriator) (Address) (Town)  
County of BIG HORN State of MONTANA  
have appropriated groundwater according to the Montana laws in effect prior to January 1, 1962, as follows:

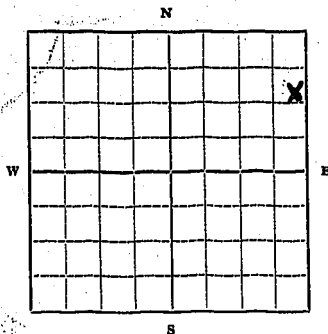

NE 1/4 NE Sec. 9 T8S R42E

Indicate point of appropriation and place of use, if possible. Each small square represents 10 acres.

2. The beneficial use on which the claim is based  
STOCK WATER WELL
3. Date or approximate date of earliest beneficial use; and how continuous the use has been  
1925 (APPROX)  
CONTINUOUS USE
4. The amount of groundwater claimed (in miner's inches or gallons per minute)  
1 1/2 GAL PER MIN.
5. If used for irrigation, give the acreage and description of the lands to which water has been applied and name of the owner thereof  
NONE
6. The means of withdrawing such water from the ground and the location of each well or other means of withdrawal  
PUMP + JACK
7. The date of commencement and completion of the construction of the well, wells, or other works for withdrawal of groundwater  
1925 (APPROX)
8. The depth of water table  
ABOUT 20-25'
9. So far as it may be available, the type, size and depth of each well or the general specifications of any other works for the withdrawal of groundwater  
HAND DUG  
DIA. 5'  
20-25' DEEP  
ROCKED 10'
10. The estimated amount of groundwater withdrawn each year  
65,000 GALS.
11. The log of formations encountered in the drilling of each well if available  
TOP SOIL 8'  
HARD SAND - BALANCE
12. Such other information of a similar nature as may be useful in carrying out the policy of this act, including reference to book and page of any county record  
UNKNOWN

Signature of Owner

Date

Three copies to be filed by the owner with the County Clerk and Recorder of the county in which the well is located.

Please answer all questions. If not applicable, so state, otherwise the form will be returned.

Original to the County Clerk and Recorder; duplicate to the State Engineer; Triplicate to the School of Mines and Quadruplicate for the Appropriator.

21709

206355

STATE OF MONTANA  
County of Big Horn ss.  
The within instrument was filed  
in my office at Hardin, Montana, this  
DEC 27 1969 day of

at 3:10 A.D. 19 o'clock P.M.

*Harry F. [Signature]*  
County Recorder  
By *Ruby W. [Signature]* Deputy

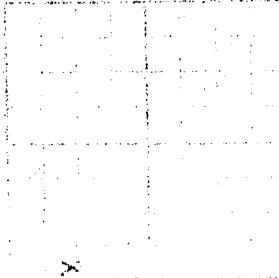

RECEIVED  
DEC 27 1969

RECEIVED  
DEC 27 1969

RECEIVED  
DEC 27 1969

RECEIVED  
DEC 27 1969



File No. ....

DUPLICATE

T. 8S. R. 42E.

County. BIG HORN

STATE OF MONTANA  
ADMINISTRATOR OF GROUNDWATER CODE  
OFFICE OF STATE ENGINEER

Declaration of Vested Groundwater Rights  
(Under Chapter 237, Montana Session Laws, 1961)

RECEIVED  
JAN 6 1964

STATE ENGINEER

RALPH L. or FRANCES C. PARKER of DECKER  
(Name of Appropriator) (Address) (Town)  
County of BIG HORN State of MONT.  
have appropriated groundwater according to the Montana laws in effect prior to January 1, 1962, as follows:

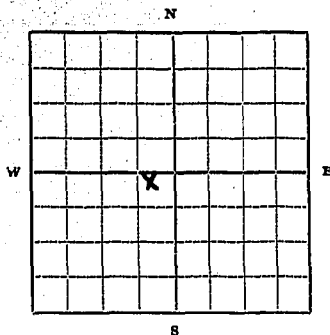

NE 1/4 SW Sec. 15 T. 8S R. 42E

Indicate point of appropriation and place of use, if possible. Each small square represents 10 acres.

2. The beneficial use on which the claim is based  
STOCK WATER WELL

3. Date or approximate date of earliest beneficial use; and how continuous the use has been  
1946  
CONTINUOUS

4. The amount of groundwater claimed (in miner's inches or gallons per minute)  
5 G.P.M.

5. If used for irrigation, give the acreage and description of the lands to which water has been applied and name of the owner thereof  
NONE

6. The means of withdrawing such water from the ground and the location of each well or other means of withdrawal  
PUMPJACK

7. The date of commencement and completion of the construction of the well, wells, or other works for withdrawal of groundwater  
1946

8. The depth of water table  
150'

9. So far as it may be available, the type, size and depth of each well or the general specifications of any other works for the withdrawal of groundwater  
DRILLED  
4" CASING  
157'

10. The estimated amount of groundwater withdrawn each year  
400000.00 GALS.

11. The log of formations encountered in the drilling of each well if available  
0-10 SOIL,  
10-31 SHALE, 31-35 Rock, 35-51 SAND, SHALE, 51-53 Rock,  
53-65 SAND, 65-114 SAND, SHALE, 114-120 COAL,  
120-122 SHALE, 122-128 COAL, 128-150 SAND SHALE  
ROCK, 150-157 SANDY SHALE.

12. Such other information of a similar nature as may be useful in carrying out the policy of this act, including reference to book and page of any county record.  
UNKNOWN

Signature of Owner

Date 12-27-63

Three copies to be filed by the owner with the County Clerk and Recorder of the county in which the well is located.

Please answer all questions. If not applicable, so state, otherwise the form will be returned.

Original to the County Clerk and Recorder; duplicate to the State Engineer; Triplicate to the School of Mines and Quadruplicate for the Appropriator.

21708

206354

STATE OF MONTANA }  
County of Big Horn } ss:

The within instrument was filed  
in my office at Hardin, Montana, this

DEC 27 1963 day of

A. D. 19

at 2:05 o'clock P.M.

[Signature] County Recorder  
By [Signature] Deputy

File No. ....

DUPLICATE

T. 8S R. 42E

County.....BIG HORN

STATE OF MONTANA  
ADMINISTRATOR OF GROUNDWATER CODE  
OFFICE OF STATE ENGINEER

RECEIVED  
JAN 6 1964

Declaration of Vested Groundwater Rights

(Under Chapter 237, Montana Session Laws, 1961)

STATE ENGINEER

RALPH L. FRANCES C. PARKER, of DECKER  
(Name of Appropriator) (Address) (Town)

County of BIG HORN State of MONT  
have appropriated groundwater according to the Montana laws in effect prior to January 1, 1962, as follows:

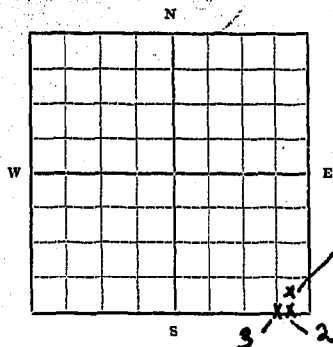

SE 1/4 SE Sec. 16 T8S R. 42E

Indicate point of appropriation  
and place of use, if possible.  
Each small square represents 10  
acres.

2. The beneficial use on which the claim is based NOS. 1-3  
STOCK WATER NO. 2 DOMESTIC  
USE
3. Date or approximate date of earliest beneficial use; and how continuous the use has been NOS. 1-2 1917  
CONTINUOUS NO. 3 1959  
CONTINUOUS
4. The amount of groundwater claimed (in miner's inches or gallons per minute) NOS. 1-2 1/2 GPM  
NO. 3 UNLIMITED
5. If used for irrigation, give the acreage and description of the lands to which water has been applied and name of the owner thereof NONE
6. The means of withdrawing such water from the ground and the location of each well or other means of withdrawal NO. 1 TILED  
SPRING NO. 2 GEAR PUMP NO. 3  
PUMP JACK

7. The date of commencement and completion of the construction of the well, wells, or other works for withdrawal of groundwater NOS. 1-2 1917  
NO. 3 1959

8. The depth of water table NO. 1 SPRING NO. 2 5' NO. 3 410'

9. So far as it may be available, the type, size and depth of each well or the general specifications of any other works for the withdrawal of groundwater NO. 1 SPRING NO. 2 HAND DUG  
3' DIA 8' DEEP NO. 3 DRILLED - 4" CASING -  
410' DEEP

10. The estimated amount of groundwater withdrawn each year NO. 2, 72,000 GALS NO. 1  
259,200 GALS NO. 3 600,000 GALS

11. The log of formations encountered in the drilling of each well if available NO. 1 TILED SPRING  
NO. 2 CLAY NO. 3 0-1 SOIL, 1-24 YELLOW CLAY, 24-29 ROCK,  
29-35 GRAY SHALE, 35-40 COAL, 40-109 BLUE SHALE, 109-111 ROCK,  
111-150 SANDSTONE, 150-168 SAND, 168-187 BLUE SHALE, 187-219 SAND, 219-244  
BLUESHALE, 244-256 SAND, 256-268 COAL, 268-285 BLUESHALE, 285-306 COAL

12. Such other information of a similar nature as may be useful in carrying out the policy of this act, including reference to book and page of any county record UNKNOWN  
306-337 BLUE SHALE, 337-343 ROCK, 343-347 SAND, 347-352 ROCK,  
352-356 SAND, 356-379 SANDSTONE, 379-404 SAND, 404-410 ROCK

Signature of Owner

Date 12-27-63

Three copies to be filed by the owner with the County Clerk and Recorder of the county in which the well is located.

Please answer all questions. If not applicable, so state, otherwise the form will be returned.

Original to the County Clerk and Recorder; duplicate to the State Engineer; Triplicate to the School of Mines and Quadruplicate for the Appropriator.

21710

206356

STATE OF MONTANA }  
County of Big Horn } ss:

The within instrument was filed  
in my office at Hardin, Montana, this  
DEC 27 1963 day of

A.D. 19

at 3:15 o'clock P.M.

*Harry E. Cook*  
County Recorder  
By *Ruby W. Temple* Deputy

File No. ....

T. 8<sup>S</sup> R. 42<sup>E</sup> 17

DUPLICATE

County .....

STATE OF MONTANA  
ADMINISTRATOR OF GROUNDWATER CODE  
OFFICE OF STATE ENGINEER

**Declaration of Vested Groundwater Rights**

(Under Chapter 237, Montana Session Laws, 1961)

Harry M. Mefford of Becker  
(Name of Appropriator) (Address) (Town)  
County of Big Horn State of Mont.  
have appropriated groundwater according to the Montana laws in effect prior to January 1, 1962, as follows:

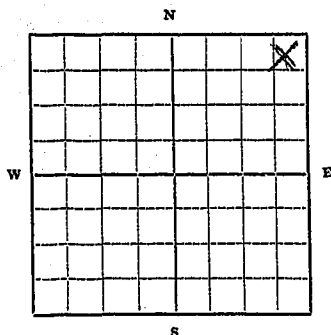

NE 1/4 Sec 17 T8S R42E

Indicate point of appropriation and place of use, if possible. Each small square represents 10 acres.

2. The beneficial use on which the claim is based stock water
3. Date or approximate date of earliest beneficial use; and how continuous the use has been 1946  
Continuous
4. The amount of groundwater claimed (in miner's inches or gallons per minute) 3 1/2 gal
5. If used for irrigation, give the acreage and description of the lands to which water has been applied and name of the owner thereof Not used for irrigation
6. The means of withdrawing such water from the ground and the location of each well or other means of withdrawal  
Working barrel electric motor
7. The date of commencement and completion of the construction of the well, wells, or other works for withdrawal of groundwater July 15 - 10 1946
8. The depth of water table 15 feet
9. So far as it may be available, the type, size and depth of each well or the general specifications of any other works for the withdrawal of groundwater 4 in casing 115 feet
10. The estimated amount of groundwater withdrawn each year 750,000 gal
11. The log of formations encountered in the drilling of each well if available  
top soil 5 feet clay 10 feet gravel 20 feet  
granite 170 feet silt shale 10 "  
Hard rock 5 ft
12. Such other information of a similar nature as may be useful in carrying out the policy of this act, including reference to book and page of any county record. None

Signature of Owner H. M. Mefford

Date Dec 27 - 63

Three copies to be filed by the owner with the County Clerk and Recorder of the county in which the well is located.

Please answer all questions. If not applicable, so state, otherwise the form will be returned.

Original to the County Clerk and Recorder; duplicate to the State Engineer; Triplicate to the School of Mines and Quadruplicate for the Appropriator.

21725

206389

STATE OF MONTANA } ss.  
County of Big Horn

The within instrument was filed  
in my office at Hardin, Montana, this

DEC 30 1963 day of

A.D. 19

at 8:46 o'clock A.M.

Harry E. Carr  
County Recorder

By Ruby Wemple Deputy

File No.

DUPLICATE

T. 8S R. 42E

County BIG HORN

STATE OF MONTANA  
ADMINISTRATOR OF GROUNDWATER CODE  
OFFICE OF STATE ENGINEER

RECEIVED  
JAN 6 1964

Declaration of Vested Groundwater Rights

(Under Chapter 237, Montana Session Laws, 1961)

ENGINEER

RALPH L. or FRANCES C. PARKER

of

DECKER

(Name of Appropriator)

(Address)

(Town)

County of BIG HORN

State of MONT.

have appropriated groundwater according to the Montana laws in effect prior to January 1, 1962, as follows:

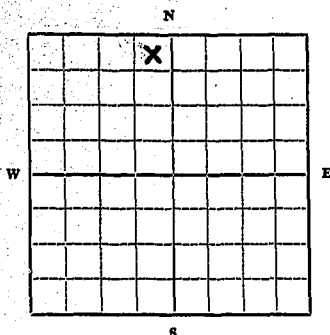

NE 1/4 NW Sec. 29 T8S R. 42E

Indicate point of appropriation and place of use, if possible. Each small square represents 10 acres.

2. The beneficial use on which the claim is based  
STOCK WATER WELL

3. Date or approximate date of earliest beneficial use; and how continuous the use has been  
APPROX. 1930  
CONTINUOUS USE

4. The amount of groundwater claimed (in miner's inches or gallons per minute)  
3 GPM

5. If used for irrigation, give the acreage and description of the lands to which water has been applied and name of the owner thereof  
NONE

6. The means of withdrawing such water from the ground and the location of each well or other means of withdrawal  
WINDMILL AND PUMP JACK

7. The date of commencement and completion of the construction of the well, wells, or other works for withdrawal of groundwater  
APPROX. 1930

8. The depth of water table  
20'

9. So far as it may be available, the type, size and depth of each well or the general specifications of any other works for the withdrawal of groundwater  
HAND DUG  
5' DIA.  
21' DEEP

10. The estimated amount of groundwater withdrawn each year  
500,000

11. The log of formations encountered in the drilling of each well if available  
17' CLAY  
17-21' HARD CLAY - SAND - ROCK.

12. Such other information of a similar nature as may be useful in carrying out the policy of this act, including reference to book and page of any county record  
UNKNOWN

Signature of Owner

*R. L. Parker*

Date 12-27-63

*Frances C. Parker*

Three copies to be filed by the owner with the County Clerk and Recorder of the county in which the well is located.

Please answer all questions. If not applicable, so state, otherwise the form will be returned.

Original to the County Clerk and Recorder; duplicate to the State Engineer; Triplicate to the School of Mines and Quadruplicate for the Appropriator.

21107

206353

STATE OF MONTANA }  
County of Big Horn } ss.

The within instrument was filed  
in my office at Hardin, Montana, this  
DEC 27 1963 day of

at 3:00 o'clock P.M. A.D. 19

By Harry E. Cox County Recorder  
By Ruby Wemple Deputy



GW 3

File No. \_\_\_\_\_

DUPLICATE

RECEIVED

MAY 19 1964

T. 8 R. 42

County Big Horn

STATE ENGINEER  
ADMINISTRATOR OF GROUNDWATER CODE  
OFFICE OF STATE ENGINEER

JAN 6 1964

# Notice of Completion of Groundwater Appropriation Without Well

(Under Chapter 237 Montana Session Laws, 1961)

Date of Appropriation of Groundwater 1920

Owner E. M. Weston Address Deckers

Contractor (if any) None

Address of Contractor

Date Started Date Completed 1920

Describe means of obtaining groundwater without a well "as by sub-irrigation and other natural processes". Include depth to water when applicable. by Spring

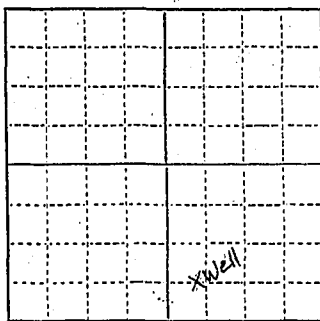

SE 1/4 Sec. 31 T. 8 R. 42  
Indicate point of appropriation and place of use, if possible.

Quantity of water developed and used with explanation of method used to measure or estimate such amount. If use is intermittent estimate approximate lengths of periods of use. 6 gal

Signature of Owner E. M. Weston

Date Dec. 30, 1963

This form to be prepared by contractor (if any), otherwise by the owner.

Three copies of this notice are to be filed with the County Clerk and Recorder of the county in which the works are located.

Please answer all questions. If not applicable, so state, otherwise the form will be returned.

Original to the County Clerk and Recorder; duplicate to the State Engineer; Triplicate to the Montana Bureau of Mines and Geology and Quadruplicate for the Appropriator.

2/764

206433

STATE OF MONTANA }  
County of Big Horn } ss:

The within instrument was filed  
in my office at Hardin, Montana, this

DEC 30 1963 day of

A. D. 19

at 3:15 o'clock P.M.

Harry E. Carl  
County Recorder

By Robert W. Temple Deputy

206433



File No.

DEC 15 1965

T. 85 R. 43E

DUPLICATE

Billie \_\_\_\_\_ McDermott \_\_\_\_\_  
 Butzer \_\_\_\_\_ McNulty \_\_\_\_\_  
 Coyne \_\_\_\_\_ Morton \_\_\_\_\_  
 Darlington \_\_\_\_\_ Sullivan \_\_\_\_\_

County Big Horn

STATE OF MONTANA  
 ADMINISTRATOR OF GROUNDWATER CODE  
 OFFICE OF STATE ENGINEER

Top of Ground

(Elev. above sea level)

52 ft Yellow clay  
 10 ft Blue Shale  
 35 ft Coal  
 7 ft Blue Shale  
 4 ft Sand Water Bearing  
 19 ft Blue Shale  
 10 ft Coal  
 14 ft Blue Shale  
 4 ft Rock  
 36 ft Blue Shale  
 8 ft Sand Rock Water Bearing

Notice of Completion of Groundwater  
 Appropriation by Means of Well

(Under Chapter 237, Montana Session Laws, 1961)

Owner Marena Stevens Address Otter MontanaDriller Carl Ritola Address Sheridan Wye

Date of Notice of Appropriation of Groundwater

Date well started 10/16/65 Date Completed 11/27/65

Type of well Drilled Equipment Used Cable Tool  
 (dug, driven, bored or drilled) (Churn, drill, rotary or other)

Water Use: Domestic ☐ Municipal ☐ Other ☐ Irrigation ☐  
 Industrial ☐ Drainage ☐ Stock ☒

Indicate on the diagram the character and thickness of the different strata met with in drilling, such as soil, clay, shale, gravel, rock or sand, etc. Show depth at which water is encountered, thickness and character of water-bearing strata and height to which water rises in the well.

Size of Drilled Hole	Size and Weight of Casing	From (Feet)	To (Feet)	PERFORATIONS		
				Kind Size	From (Feet)	To (Feet)
10"	4" 11#	0'	199'	1 1/4" Slots	100 ft	110
The well is Gravel packed all the way outside casing					190 ft	199

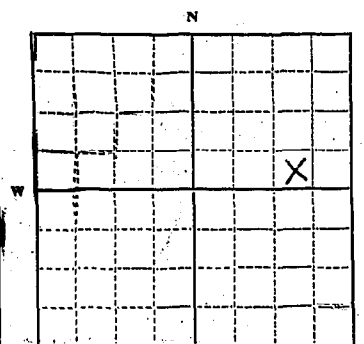

NE 1/4 Sec. 9 T. 85 R. 43E

Indicate location of well and place of use, if possible. Each small square represents 10 acres.

Show exact depth of bottom.

Static Water Level for non-flowing Well 83 ft feet.

Shut-in Pressure for Flowing Well

Pumping Water Level 190 ft feet at 4 gal. per minute.

Discharge in gal. per min. of flowing well

How Tested bailer Length of Test 8 hrs

Remarks: (Gravel packing, cementing, packers, type of shutoff, location of place of use of groundwater if not at well, and any other similar pertinent information, including number of acres irrigated, if used for irrigation)

No 133

Driller's License Number

Carl Ritola  
 Driller's Signature

This form to be prepared by driller, and three copies to be filed by the owner with the County Clerk and Recorder in the county in which the well is located.

Please answer all questions. If not applicable, so state, otherwise the form will be returned.

Original to the County Clerk and Recorder; duplicate to the State Engineer; Triplicate to the Montana Bureau of Mines and Geology and Quadruplicate for the Appropriator.

40005

214611

STATE OF MONTANA } ss.  
County of Big Horn

The within instrument was filed  
in my office at Hardin, Montana, this  
DEC 13 1965 day of

A. D. 19

at 3:55 o'clock P.M.

By James E. Cox County Recorder  
By Ruby Temple Deputy

Filed on the 13 day of December  
1965 at 11:45  
County of Big Horn  
STATE OF MONTANA

160081



Recorded in my office at Hardin, Montana  
this 13th day of December 1965  
at 11:45 A.M.  
James E. Cox, County Recorder  
Ruby Temple, Deputy

T 8S R 43E

County.....BIG HORN

RECEIVED  
DE JAN 6 1964

STATE ENGINEER

3301 J. Edgar Hoover

(Under Chapter 237 Montana Session Laws, 1961)

Owner... Marcus Stevens ..... Address... Otter, Montana .....

Contractor (if any) .....

Address of Contractor \_\_\_\_\_

Date Started..... Date Completed **June, 1961**

Describe means of obtaining groundwater without a well "as by sub-irrigation and other natural processes". Include depth to water when applicable.....

Tiled spring running into a tank

NE.... $\frac{1}{4}$ ..... Sec....**1078S**.... R**13E**

Indicate point of appropriation  
and place of use, if possible.

Quantity of water developed and used with explanation of method used to measure or estimate such amount. If use is intermittent

estimate approximate lengths of periods of use 2 Gal per minute

continuous

Signature of Owner Marcus Stevens

Owner Marcus Stevens  
by J.O. Stevens Date Dec 30<sup>th</sup> 1963

This form to be prepared by contractor (if any), otherwise by the owner.

Three copies of this notice are to be filed with the County Clerk and Recorder of the county in which the works are located.

Please answer all questions. If not applicable, so state, otherwise the form will be returned.

Original to the County Clerk and Recorder; duplicate to the State Engineer; Triplicate to the Montana Bureau of Mines and Geology and Quadruplicate for the Appropriator.

206395

STATE OF MONTANA } ss:  
County of Big Horn }

The within instrument was filed  
in my office at Hardin, Montana, this

DEC 20 1963 day of

A. D. 19

at 10<sup>30</sup> o'clock AM.

*Harry E. Capl*  
County Recorder

By *Goldie L. Smith* Deputy

... ..



239121

DRILLER'S LOG

Indicate the character, color, thickness to strata such as sand, gravel, shale, sandstone, etc. Show depth at which water is found, and height to which water rises in well.

Top of Ground

From (feet) To (feet)

Date started & completed?  
Driller?  
Casing?  
Log, etc?

NOTICE OF COMPLETION OF GEOWATER APPROPRIATION BY MEANS OF WELL

Developed after January 1, 1962

(Under Chapter 307, Montana Statutes, Laws 1961, as amended)

This form to be prepared by driller and three copies to be filed by the owner with the County Clerk and Recorder in the county in which the well is located, but only to be retained by driller. Please answer all questions. It will apply only to those other wells the form may be required.

Form with fields for well number, location, and other details. Well number 239121 is visible.

STATE OF MONTANA  
County of Big Horn

The within instrument was filed in my office at Hardin, Montana, this

FEB 13 1973

A.D. 19

at 4:40 o'clock P.M.  
Joseph Lippert  
County Recorder  
Dorothy Jones

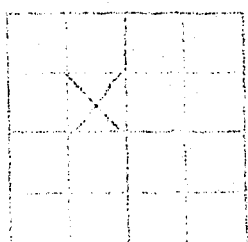

INDICATE LOCATION OF WELL AND PLANT OR USE IF POSSIBLE. EACH SQUARE REPRESENTS 1/4 SECTION.

Show flow depth of bottom

## GROUNDWATER INDEX

Page 1 of 1

County Big Horn Twp. 8 S Rge. 44 E

[illegible]

File No. \_\_\_\_\_

STATE OF MONTANA  
ADMINISTRATOR OF GROUNDWATER CODE  
OFFICE OF STATE ENGINEER

R 12 E 1 S, Rge E  
JAN 6 1964

DECLARATION OF VESTED GROUNDWATER RIGHTS  
(Under Chapter 237, Montana Session Laws, 1961)

1. J. O. Hedens, of Sheridan Wyoming,  
County of POWDER RIVER, State of MONTANA, have appropriated groundwater according to the  
Montana laws in effect prior to January 1, 1962, as follows:

	X	*	X	X	X	X
	Sec. 5	Sec. 1	Sec. 2	Sec. 2	Sec. 12	Sec. 2
WELLS	No. 1	No. 2	No. 3	No. 4	No. 5	No. 6
2. Beneficial Use	stock water	livestock water	livestock water	livestock water	livestock water	domestic livestock
3. Date of use	continuous	continuous	continuous	continuous	continuous	continuous
4. Amount claimed	5 gpm	1 gpm	1 gpm	1 gpm	3 gpm	6 gpm
Irrigated description						
5. Irrigation owner						
6. Location	T8S, R44E	T8S, R44E	T8S, R44E	T8S, R44E	T8S, R44E	T8S, R44E
7. Withdrawal means	pump	collection in creek channel	collection in creek channel	Till + Tank	spring box + Tank	pump
8. Completion date						
9. Water depth table	150 ft.	surface	surface	surface	surface	40 ft.
Type						
10. Size & depth	4" x 150 ft.					4" x 60'
11. Estimated annual						
12. Amount withdrawn	300,000 gals	500,000 gals	500,000 gals	500,000 gals	1,500,000 gals	100,000 gals
13. Other information						
14. Log, if available						

STATE OF MONTANA)

County of Big Horn) ss.J. O. HedensI, J. O. Hedens, being first duly sworn, deposes and says

that he is the appropriator and claimant of the order and water right

mentioned in the foregoing declaration of vested groundwater rights and the person whose

name is subscribed hereon as the appropriator and claimant, that he knows the contents

of said foregoing order and that the matters and things therein stated are true.

Subscribed and sworn to before me this

31<sup>st</sup> day of February, 1963.

Big Horn  
Montana

HARRY E. COX, County Clerk  
Deputy  
Sheridan, Montana

Date Dec 30th 1963

J. O. Hedens

21728

206396

STATE OF MONTANA }  
County of Big Horn } ss:

The within instrument was filed  
in my office at Hardin, Montana, this

DEC 30 1963 day of

                     A. D. 19        

at 10<sup>30</sup> o'clock P.M.

Harry E. Cap  
County Recorder

By Goldie Smith Deputy

File No.

DEC-15 1965

DUPLICATE

Billie \_\_\_\_\_ McDermott \_\_\_\_\_  
 Butzerin \_\_\_\_\_ McNulty \_\_\_\_\_  
 Coyle \_\_\_\_\_ Morton \_\_\_\_\_  
 Darlington \_\_\_\_\_ Sullivan \_\_\_\_\_

Top of Ground

(Elev. above sea level)

4 ft Yellow Clay

24 ft Yellow Clay

9 ft Blue Shale

7 ft Blue Shale

STATE OF MONTANA  
 ADMINISTRATOR OF GROUNDWATER CODE  
 OFFICE OF STATE ENGINEER

Notice of Completion of Groundwater  
 Appropriation by Means of Well

(Under Chapter 237, Montana Session Laws, 1961)

Owner J. O. Stevens Address Sheridan Wye

Driller Carl Ritola Address Sheridan Wye

Date of Notice of Appropriation of Groundwater

Date well started 11/12/65 Date Completed 12/4/65

Type of well Drilled Equipment Used Cable Tool  
 (dug, driven, bored or (Churn, drill, rotary or  
 drilled) other)

Water Use: Domestic ☐ Municipal ☐ Other ☐ Irrigation ☐  
 Industrial ☐ Drainage ☐ Stock ☒

Indicate on the diagram the character and thickness of the different strata met with in drilling, such as soil, clay, shale, gravel, rock or sand, etc. Show depth at which water is encountered, thickness and character of water-bearing strata and height to which water rises in the well.

Size of Drilled Hole	Size and Weight of Casing	From (Feet)	To (Feet)	PERFORATIONS		
12"	6" 18#	0 ft	44 ft	Kind Size	From (Feet)	To (Feet)
Gravel packed outside casing				1x6" Slots	28'	44'

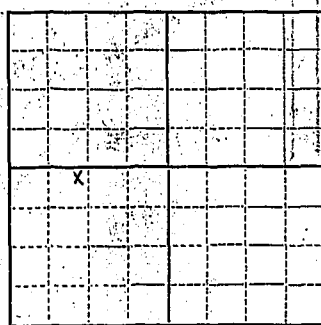

1/4 Sec 6 T.8S R.44E

Indicate location of well and place of use, if possible. Each small square represents 10 acres.

Show exact depth of bottom.

Static Water Level for non-flowing Well 30 ft feet.

Shut-in Pressure for Flowing Well

Pumping Water Level 37 ft feet at 5 gal per minute.

Discharge in gal. per min. of flowing well

How Tested Bailer Length of Test 6 hrs

Remarks: (Gravel packing, cementing, packers, type of shutoff, location of place of use of groundwater if not at well, and any other similar pertinent information, including number of acres irrigated, if used for irrigation)

No 133

Driller's License Number

Carl Ritola  
 Driller's Signature

This form to be prepared by driller, and three copies to be filed by the owner with the County Clerk and Recorder in the county in which the well is located.

Please answer all questions. If not applicable, so state, otherwise the form will be returned.

Original to the County Clerk and Recorder; duplicate to the State Engineer; Triplicate to the Montana Bureau of Mines and Geology and Quadruplicate for the Appropriator.

40006

214612

STATE OF MONTANA } ss.  
County of Big Horn }

The within instrument was filed  
in my office at Hardin, Montana, this  
DEC 13 1965 day of

A. D. 19

at 4:00 - o'clock P. M.

*James E. Carl*  
County Recorder

By *Deputy* Deputy

*200-2*  
~~FILED~~  
~~COUNTY CLERK'S OFFICE~~  
~~1965~~ at ~~11:46~~ o'clock ~~P.~~ M.  
~~FILED~~ on the ~~13th~~ day of ~~December~~  
STATE OF MONTANA } ss.  
COUNTY OF ROSSBURG }





DUPLICATE

STATE WATER CONSERVATION BOARD

MAR 8 1967

T. 2 S. R. 44 E.

County Big Horn

Billie \_\_\_\_\_  
 Butcher \_\_\_\_\_  
 Coyle \_\_\_\_\_  
 Darlington \_\_\_\_\_  
 Dickert \_\_\_\_\_

McDermott \_\_\_\_\_  
 Administrator \_\_\_\_\_  
 Morris \_\_\_\_\_  
 Sullivan \_\_\_\_\_

STATE OF MONTANA  
 OFFICE OF STATE ENGINEER  
 GROUNDWATER CODE

## Declaration of Vested Groundwater Rights

(Under Chapter 237, Montana Session Laws, 1961)

1. Harry J. Powell (Deceased), of formerly Ouster, Mont.  
 (Name of Appropriator) (Address) (Town)  
 County of Big Horn State of Montana  
 have appropriated groundwater according to the Montana laws in effect prior to January 1, 1962, as follows:

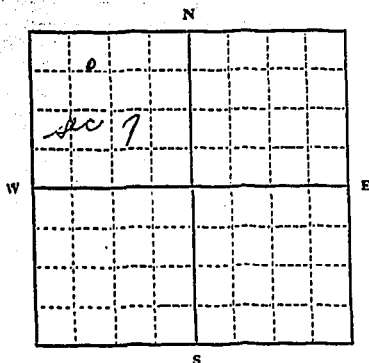

NE 1/4 Sec. 7 T. 2 R. 44  
 Indicate point of appropriation  
 and place of use, if possible. Each  
 small square represents 10 acres.

2. The beneficial use on which the claim is based Stocks  
Water
3. Date or approximate date of earliest beneficial use; and how continuous the use has been 1947 to 1967
4. The amount of groundwater claimed (in miner's inches or gallons per minute) 5 feet, shed water
5. If used for irrigation, give the acreage and description of the lands to which water has been applied and name of the owner thereof none
6. The means of withdrawing such water from the ground and the location of each well or other means of withdrawal Pump and engine
7. The date of commencement and completion of the construction of the well, wells, or other works for withdrawal of groundwater Mar. 1947 to Dec. 1947  
Hand dug, 4 foot calvert used for cribbing
8. The depth of water table 27 feet
9. So far as it may be available, the type, size and depth of each well or the general specifications of any other works for the withdrawal of groundwater Hand dug, 4 foot calvert used for cribbing, 32 feet deep
10. The estimated amount of groundwater withdrawn each year 10,000 gal
11. The log of formations encountered in the drilling of each well if available The water is coming out of red shale
12. Such other information of a similar nature as may be useful in carrying out the policy of this act, including reference to book and page of any county record I do not know

Signature of Owner

Ernest M. RudolphDate Feb. 17, 1967

Three copies to be filed by the owner with the County Clerk and Recorder of the county in which the well is located.

Please answer all questions. If not applicable, so state, otherwise the form will be returned.

Original to the County Clerk and Recorder; Duplicate to the State Engineer; Triplicate to the Montana Bureau of Mines and Geology, and Quadruplicate for the Appropriator.

41787

218480

Duplicate

File No.

STATE OF MONTANA }  
County of Big Horn }

The within instrument was filed  
in my office at Hardin, Montana, this  
MAR 7 1967 day of

A.D. 19

at 8:25 o'clock A.M.

County Recorder

By Deputy

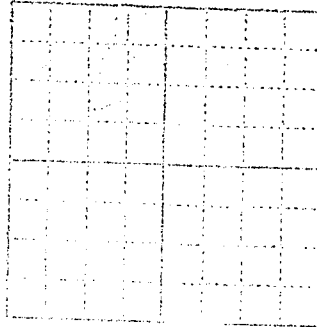

1. The date of commencement of the term of the instrument is the date of recording of the instrument.

2. The date of termination of the term of the instrument is the date of the expiration of the term of the instrument.

3. The date of commencement of the term of the instrument is the date of the expiration of the term of the instrument.

4. The date of termination of the term of the instrument is the date of the expiration of the term of the instrument.

5. The date of commencement of the term of the instrument is the date of the expiration of the term of the instrument.

6. The date of termination of the term of the instrument is the date of the expiration of the term of the instrument.

7. The date of commencement of the term of the instrument is the date of the expiration of the term of the instrument.

8. The date of termination of the term of the instrument is the date of the expiration of the term of the instrument.

9. The date of commencement of the term of the instrument is the date of the expiration of the term of the instrument.

10. The date of termination of the term of the instrument is the date of the expiration of the term of the instrument.



File No.

STATE WATER CONSERVATION BOARD

T. 8 S. R. 44 E.

DUPLICATE

MAR 8 1967

County Big Horn

Billie

McDermott

STATE OF MONTANA

Butcher

Mc

ADMINISTRATOR OF GROUNDWATER CODE

Coyle

Morton

OFFICE OF STATE ENGINEER

Darlington

Sullivan

Dickert

## Declaration of Vested Groundwater Rights

(Under Chapter 237, Montana Session Laws, 1961)

1. Howard Beyer (Name of Appropriator)of Deer Creek, Mont. (Address)

(Town)

County of Big HornState of Montana

have appropriated groundwater according to the Montana laws in effect prior to January 1, 1962, as follows:

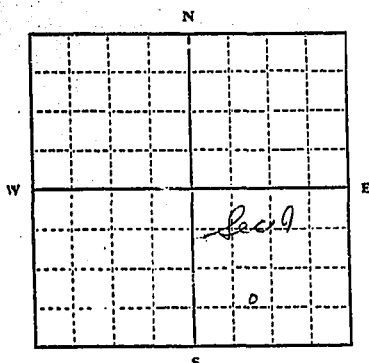

NE 1/4 Sec. 9 T. 8 R. 44

Indicate point of appropriation and place of use, if possible. Each small square represents 10 acres.

2. The beneficial use on which the claim is based Stock water3. Date or approximate date of earliest beneficial use; and how continuous the use has been 1942-1967  
by present owner used by Howard Beyer  
prior to 1942 exact time unknown4. The amount of groundwater claimed (in miner's inches or gallons per minute) 10 gal/min.5. If used for irrigation, give the acreage and description of the lands to which water has been applied and name of the owner thereof none6. The means of withdrawing such water from the ground and the location of each well or other means of withdrawal Pump7. The date of commencement and completion of the construction of the well, wells, or other works for withdrawal of groundwater July 1942  
July 1942 Date of Commencement and Completion by Howard Beyer unknown as it was prior to 1942.8. The depth of water table Water table comes to within three (3) feet of the surface of the ground9. So far as it may be available, the type, size and depth of each well or the general specifications of any other works for the withdrawal of groundwater Hand dug 30 feet deep  
6 feet across  
July 1942 date of commencement and completion by Howard Beyer  
is unknown but it was prior to 1942 water table comes to within three (3) feet of the surface of the ground10. The estimated amount of groundwater withdrawn each year 10,000 gal11. The log of formations encountered in the drilling of each well if available unavailable

12. Such other information of a similar nature as may be useful in carrying out the policy of this act, including reference to book and page of any county record.

Signature of Owner C. M. RandallDate February 17 1967

Three copies to be filed by the owner with the County Clerk and Recorder of the county in which the well is located.

Please answer all questions. If not applicable, so state. otherwise the form will be returned.

Original to the County Clerk and Recorder; Duplicate to the State Engineer; Triplicate to the Montana Bureau of Mines and Geology, and Quadruplicate for the Appropriator.

41788

218479

STATE OF MONTANA }  
County of Big Horn } ss.  
The within instrument was filed  
in my office at Hardin, Montana, this  
MAR 7 1967 day of

A. D. 19  
at 8:20 o'clock A.M.

Henry E. Cox  
County Recorder  
By Ruby L. Sample Deputy

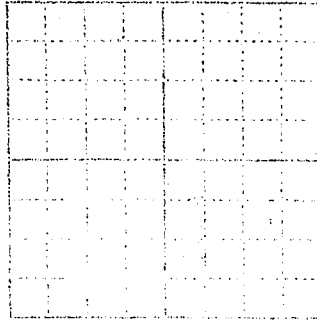

The undersigned hereby certifies that the foregoing is a true and correct copy of the original instrument as the same appears in the records of the County of Big Horn, Montana, this 7th day of March, 1967.

## STATE WATER CONSERVATION BOARD

File No. \_\_\_\_\_

T. \_\_\_\_\_ R. \_\_\_\_\_

13

DUPLICATE

SEP 29 1966

County Big Horn

Bill \_\_\_\_\_ McDermott \_\_\_\_\_

STATE OF MONTANA

Butzerin \_\_\_\_\_ McNulty \_\_\_\_\_

ADMINISTRATOR OF GROUNDWATER CODE

Coyle \_\_\_\_\_ Mcrton \_\_\_\_\_

OFFICE OF STATE ENGINEER

Darlington \_\_\_\_\_ Sullivan \_\_\_\_\_

Dickert \_\_\_\_\_

Top of Ground \_\_\_\_\_

(Elev. above sea level \_\_\_\_\_)

# Notice of Completion of Groundwater Appropriation by Means of Well

(Under Chapter 237, Montana Session Laws, 1961)

Owner J. O. Stevens Address Decker, MontanaDriller Carl Ritola Address Sheridan, Wyo.

Date of Notice of Appropriation of Groundwater \_\_\_\_\_

Date well started 8/12/66 Date Completed 8/17/66Type of well Drilled Equipment Used Cable Tool  
(dug, driven, bored or drilled) (Churn, drill, rotary or other)Water Use: Domestic ☐ Municipal ☐ Other ☐ Irrigation ☐  
Industrial ☐ Drainage ☐ Stock ☒

Indicate on the diagram the character and thickness of the different strata met with in drilling, such as soil, clay, shale, gravel, rock or sand, etc. Show depth at which water is encountered, thickness and character of water-bearing strata and height to which water rises in the well.

31 ft. Yellow Clay  
49 ft. Blue Shale  
32 ft. Coal water Bearing  
62 ft. Blue Shale  
22 ft. Coal  
14 ft. Blue Shale  
16 ft. Sand Rock Water bearing

Size of Drilled Hole	Size and Weight of Casing	From (Feet)	To (Feet)	PERFORATIONS		
				Kind	From (Feet)	To (Feet)
10"	4 1/2" OD 11#	0 ft.	226 ft.	1/2" x 3/4" Slots Staggered	30 ft.	110 ft.
					105 ft.	226 ft.

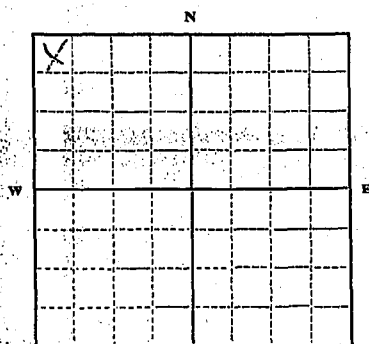

NW 1/4 NW Sec. 13, T. 85, R. 44E

Indicate location of well and place of use, if possible. Each small square represents 10 acres.

Show exact depth of bottom.

Static Water Level for non-flowing Well 145 feet.

Shut-in Pressure for Flowing Well \_\_\_\_\_

Pumping Water Level 120 feet at 5 gal. per minute

Discharge in gal. per min. of flowing well \_\_\_\_\_

How Tested Bailer Length of Test 3 Hrs.

Remarks: (Gravel packing, cementing, packers, type of shutoff, location of place of use of groundwater if not at well, and any other similar pertinent information, including number of

acres irrigated, if used for irrigation) \_\_\_\_\_

(Packed)

Gravel all the way outside casing

133

Driller's License Number

Carl Ritola  
Driller's Signature

This form to be prepared by driller, and three copies to be filed by the owner with the County Clerk and Recorder in the county in which the well is located.

Please answer all questions. If not applicable, so state, otherwise the form will be returned.

Original to the County Clerk and Recorder; duplicate to the State Engineer; Triplicate to the Montana Bureau of Mines and Geology and Quadruplicate for the Appropriator.

41, 446

RECORDED

217045

STATE OF MONTANA }  
County of Big Horn } ss.

The within instrument was filed  
in my office at Hardin, Montana, this  
SEP 26 1966 day of

at 2<sup>nd</sup> A.D. 19  
o'clock P.M.

By James E. Cox County Recorder  
Goldie D. Smith Deputy

STATE WATER CONSERVATION BOARD  
SEP 28 1966

File	McDermott
Butterlin	McCarthy
Coyle	McIntosh
Darlington	Sullivan
Dickert	

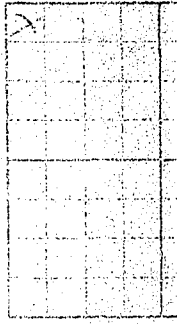

STATE OF MONTANA  
COUNTY OF BIG HORN  
RECORDED  
SEP 28 1966  
JAMES E. COX  
COUNTY RECORDER  
HARDIN, MONTANA

File No. \_\_\_\_\_

STATE OF MONTANA  
ADMINISTRATOR OF GROUNDWATER CODE  
OFFICE OF STATE ENGINEER

Twp \_\_\_\_\_ S, Rge \_\_\_\_\_ E

RECEIVED  
JAN 6 1964

DECLARATION OF VESTED GROUNDWATER RIGHTS  
(Under Chapter 237, Montana Session Laws, 1961)

1. J. C. Heiburn, of Montana STATE ENGINEER,  
County of POWDER RIVER, State of MONTANA, have appropriated groundwater according to the  
Montana laws in effect prior to January 1, 1962, as follows:

	Sec. 14	Sec. 15	Sec. 23	Sec. 33	Sec.	Sec.
WELLS	No. 1	No. 2	No. 3	No. 4	No. 5	No. 6
2. Beneficial Use	livestock water	livestock water	livestock water	livestock water		
3. Date of use	continuous	continuous	continuous	continuous		
4. Amount claimed	5 gpm	5 gpm	5 gpm	5 gpm		
Irrigated description						
5. Irrigation owner						
6. Location	T8S R44E	T8S R44E	T8S R44E	T8S R44E		
7. Withdrawal means	2 amp	2 amp	2 amp	2 amp		
8. Completion date						
9. Water depth table	135'	55'	surface	surface		
Type						
10. Size & depth	4" x 210'	4" x 86'				
Estimated annual						
11. Amount withdrawn	300,000 gal	300,000 gal	300,000 gal	300,000 gal		
12. Other information						
13. Log, if available						

STATE OF MONTANA  
County of POWDER RIVER ss.

Signature of Owner

J. C. Heiburn

J. C. Heiburn

having first been duly sworn, deposes and says  
that he is of lawful age and is the appropriator and claimant of the order and water right  
mentioned in the foregoing declaration of vested groundwater rights and the person whose  
name is subscribed thereto, as the appropriator and claimant, that he knows the contents  
of said foregoing notice and that the matters and things therein stated are true.

Subscribed and sworn to before me this  
30<sup>th</sup> day of December, 1963.

Big Horn  
Haden

Clerk and Recorder  
Powder River County  
Broadus, Montana

HARRY E. COX, County Clerk  
By W. L. Smith Deputy

Date Dec 30<sup>th</sup> 1963

J. C. Heiburn

21729

206397

STATE OF MONTANA { ss.  
County of Big Horn }

The within instrument was filed  
in my office at Hardin, Montana, this

DEC 30 1963 day of

                     A. D. 19

at 10<sup>42</sup> o'clock A. M.

Harry E. Carr  
County Recorder

By Leola L. Smith Deputy



File No.

RECEIVED

239122

Approved Stock Form—State Publishing Co., Helena, Montana—45642

T. P. S. R. H. H. F.

QUINTUPLICATE

FEB 14 1973

County Big Horn

LOG

STATE OF MONTANA  
MONTANA DEPARTMENT OF NATURAL RESOURCES AND CONSERVATION  
ADMINISTRATOR OF GROUNDWATER CODE  
OFFICE OF STATE ENGINEER

Top of Ground

(Elev. above sea level)

# Notice of Completion of Groundwater Appropriation by Means of Well

DEVELOPED AFTER JANUARY 1, 1962

(Under Chapter 237, Montana Session Laws, 1961)

Owner Powell Cattle Co Address Decker, MONT.

Driller \_\_\_\_\_ Address \_\_\_\_\_

Date of Notice of appropriation of groundwater \_\_\_\_\_

Date well started \_\_\_\_\_ Date completed \_\_\_\_\_

Type of well drilled Equipment used rotary  
(Dug, driven, bored or drilled) (Churn drill, rotary or other)

Water use: Domestic ☒ Municipal ☐ Stock ☒ Irrigation ☐  
Industrial ☐ Drainage ☐ Other ☐

Indicate on the diagram the character and thickness of the different strata met with in drilling, such as soil, clay, shale, gravel, rock or sand, etc. Show depth at which water is encountered, thickness and character of water-bearing strata and height to which the water rises in the well.

Size of Drilled Hole	Size and Weight of Casing	From (Feet)	To (Feet)	PERFORATIONS		
				Kind Size	From (Feet)	To (Feet)

Doc. No. 239122  
Filed for record  
this 13 day of Feb  
A. D. 1973 at 11:45  
o'clock p.m.

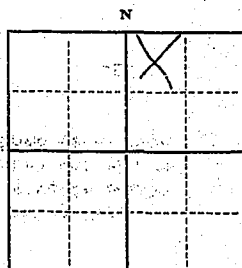

Static Water Level for non-flowing well 255 feet

Shut-in Pressure for Flowing Well \_\_\_\_\_

Pumping Water Level 240 feet  
at 12 gal. per minute.

Discharge in gal. per min. of flowing well \_\_\_\_\_

How Tested Baling

Length of Test 60 min

Remarks: (Gravel packing, cementing, pack-  
ers, type of shutoff) \_\_\_\_\_

Indicate location of well and place of use, if possible. Each small square represents 40 acres.

(Continue on reverse side)

USE—If used for irrigation, industrial, drainage or other. Explain, state number of acres and location or other data (i.e.: Lot, Block and Addition).

Show exact depth of bottom

This form to be prepared by driller, and three copies to be filed by the owner with the County Clerk and Recorder in the county in which the well is located, tissue copy to be retained by driller.

Please answer all questions. If not applicable, so state, otherwise the form will be returned.

Driller's License Number

Driller's Signature

521436

Date started &  
 completed?  
 Casing?  
 Log?  
 etc...  
 Driller?

STATE OF MONTANA  
 County of Big Horn  
 The within instrument was filed  
 in my office at Hardin, Montana, this

FEB 13 1973 A.D. 19

4:45 o'clock P.M.

*Joel Lippert*  
 County Recorder  
*Nancy Jones* Deputy

Notice  
 shall advise registrants to  
 place of use if by sample from  
 interest.

(for)  
 number of acres and location on other parts (i.e. 100) Block and 1000  
 used for industrial, agricultural, grazing or other. (Specify state)  
 (Continue on reverse side)

(NAME) (see page of sample)

Remarks: (General description of sample)  
 Location of use: (i.e. 100) Block and 1000  
 How tested: (i.e. 100) Block and 1000

Disposition: (i.e. 100) Block and 1000  
 of (i.e. 100) Block and 1000  
 Location: (i.e. 100) Block and 1000  
 Sample: (i.e. 100) Block and 1000

State: (i.e. 100) Block and 1000

Driller: (i.e. 100) Block and 1000

Driller: (i.e. 100) Block and 1000

239122



## MONTANA WATER RESOURCES BOARD

File No. 220596**RECEIVED**Filed: NOV 20 1967

NOV 21 1967

at NOV 20 1967 M.

GW 2

22

Notice of COMPLETION of Groundwater  
 Appropriation by Means of Well  
 Powder River County (Under Chapter 237, Montana Session Laws, 1961)

Twp. 85 Rge 44E

Top of Ground -

Elev. above sea level.

OWNER Milbra E LloydAddress 448 E. 1st. View DDRILLER C. T. ReidAddress Sheldon 440.

Date of Notice of Appropriation of Groundwater

Date well started SEP 17 Completed SEP - 20 - 67Type of Well \_\_\_\_\_ Equipment Used \_\_\_\_\_  
(dug, driven, bored, drilled) (churn, drill, rotary, etc)Water Use: Domestic \_\_\_\_\_; Municipal \_\_\_\_\_; Stock \_\_\_\_\_; Other \_\_\_\_\_;  
Industrial \_\_\_\_\_; Drainage \_\_\_\_\_; Irrigation \_\_\_\_\_;

Indicate on diagram character and thickness of different strata met in drilling - ei, soil, clay, shale, gravel, rock, sand. Show depth at which water is found, thickness and character of water-bearing strata and height to which water rises in well.

0-5 TOP SOIL

5-16 SANDY SOIL

16-34 CLAY

34-62 BLUE SHALE

62-67 SAND

67-175 B. SHALE

175-189 SAND

189-190 B. SAND

Size of Drilled Hole	Size and Weight of Casing	From (feet)	To (feet)	Perforations		
				Kind Size	From (feet)	To (feet)
6"	Black 10.87	0	190	4"	90	190

Static Water Level for non-flowing well 65 feet

Shut-in Pressure for Flowing Well \_\_\_\_\_

Pumping Water Level 80 feet at 10 gal. per minute.

Discharge in Gal. per min. of flowing well \_\_\_\_\_

How Tested Pumped & Bailed Length of Test 2 1/2 hrs

Remarks: (Gravel packing, cementing, packers, type of shut-off, location of use if not at well, other pertinent information, including number of acres irrigated, if any.)

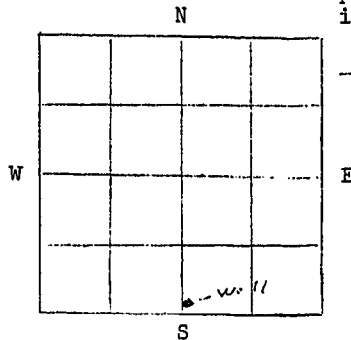
Driller's License NO. 90Driller's Signature C. T. ReidSec 22, Twp. 85, Rge 44 East.

STATE OF MONTANA)  
 County of Powder River) ss.  
B. C. Horn

Milbra E Lloyd having first been duly sworn, deposes and says that he is of lawful age and the appropriator and claimant of the order and water right mentioned in the foregoing notice of completion of groundwater appropriation by means of well and the person whose name is subscribed thereto, as the appropriator and claimant, that he knows the contents of said foregoing notice and that the matters and things therein stated are true.

Owner's Signature Milbra E LloydSubscribed and sworn to before me, this 20 day of Sept, 1967.Clerk and Recorder James E. Carr

42,549

220596

STATE OF MONTANA {  
County of Big Horn { ss.

The within instrument was filed  
in my office at Hardin, Montana, this

NOV 20 1967 day of

A. D. 19

at 8:10 o'clock A.M.

*Wm. E. Cap*  
County Recorder

By *Robert J. Temple* Deputy

File No. ....

DUPLICATE

T 8 S R 44 E

County BIGNON

STATE OF MONTANA  
ADMINISTRATOR OF GROUNDWATER CODE  
OFFICE OF STATE ENGINEER

Declaration of Vested Groundwater Rights  
(Under Chapter 237, Montana Session Laws, 1961)

RECEIVED  
MAY 1 1962

STATE ENGINEER

Mibra E Lloyd, of Otter (Name of Appropriator) (Address) (Town)  
County of BIGNON State of Montana  
have appropriated groundwater according to the Montana laws in effect prior to January 1, 1962, as follows:

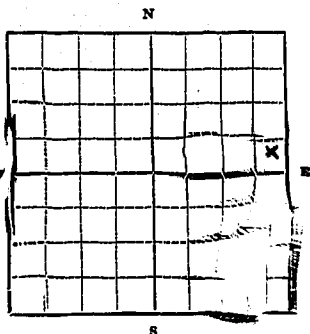

SE 1/4 Sec. 35 T23N R44E

Indicate point of appropriation and place of use, if possible. Each small square represents 10 acres.

2. The beneficial use on which this claim is based Stock & Household
3. Date or approximate date of ~~beneficial~~ use; and how continuous the use has been 1918  
Continuous
4. The amount of groundwater claimed (in miner's inches or gallons per minute) 3 Gal Per Min.
5. If used for irrigation, give the acreage and description of the lands to which water has been applied and name of the owner thereof None
6. The means of withdrawing such water from the ground and the location of each well or other means of withdrawal Pump & Wind Mill
7. The date of commencement and completion of the construction of the well, wells, or other works for withdrawal of groundwater 1918
8. The depth of water table 27 Ft
9. So far as it may be available, the type, size and depth of each well or the general specifications of any other works for the withdrawal of groundwater Dug Well. Roped up. About 4 ft deep. 32 ft deep. 4x16 cylinder. 2" drop pipe
10. The estimated amount of groundwater withdrawn each year 150000
11. The log of formations encountered in the drilling of each well if available No Log
12. Such other information of a similar nature as may be useful in carrying out the policy of this act, including reference to book and page of any county record None

Signature of Owner Mibra E Lloyd

Date May 7 1962

Three copies to be filed by the owner with the County Clerk and Recorder of the county in which the well is located.

Please answer all questions. If not applicable, so state, otherwise the form will be returned.

Original to the County Clerk and Recorder; duplicate to the State Engineer; Triplicate to the School of Mines and Quaduplicate for the Appropriator.

199063

STATE OF MONTANA } ss.  
County of Big Horn

The within instrument was filed  
In my office at Hardin, Montana, this

MAY 11 1962 day of

at 8:20 o'clock A. M.

Harry E. Cap  
County Recorder

By Robert W. Sample Deputy