

File No. 3w2

T. 37 R. 21

STATE WATER CONSERVATION BOARD

QUADRUPLICATE

NOV 10 1966

County Cleveland

Top of Ground  
(Elev. above sea level)

0 top soil  
8 gravel  
10 brown clay  
13 rock  
108 blue shale  
111 sandstone clay  
150 grey shale  
170 brown shale  
215 blue shale  
277 sandstone ~~grey~~ bed water  
278 grey shale  
300 sandstone water

300

Bill \_\_\_\_\_ Mr. DeWitt \_\_\_\_\_  
 Level \_\_\_\_\_ ADMINISTRATOR OF GROUNDWATER CODE  
 County \_\_\_\_\_ OFFICE OF STATE ENGINEER

### Notice of Completion of Groundwater Appropriation by Means of Well

(Under Chapter 237, Montana Session Laws, 1961)

Owner Mr EDWIN STARKS Address CLEVELAND MONTANA

Driller SEDFORD DRILLING CO. Address MALTA, MONTANA

Date of Notice of appropriation of ground water \_\_\_\_\_

Date well started Oct. 17 1966 Date Completed Oct. 26 1966

Type of well Drilled Equipment used Cable Tools  
 (dug, driven, bored or Churn, drill, rotary or drilled) other)

Water use: Domestic  Municipal  Stock  Irrigation   
 Industrial  Drainage  Other

Indicate on the diagram the character and thickness of the different strata met with in drilling, such as soil, clay, shale, gravel, rock or sand, etc. Show depth at which water is encountered, thickness and character of water-bearing strata and height to which the water rises in the well.

| Size of Drilled Hole | Size and Weight of Casing | From (Feet) | To (Feet) | PERFORATIONS |             |           |
|----------------------|---------------------------|-------------|-----------|--------------|-------------|-----------|
|                      |                           |             |           | Kind Size    | From (Feet) | To (Feet) |
| 6 3/4"               | 19 Lbs I. P.              | 2'          | 300'      | slots        | 276'        | 300'      |

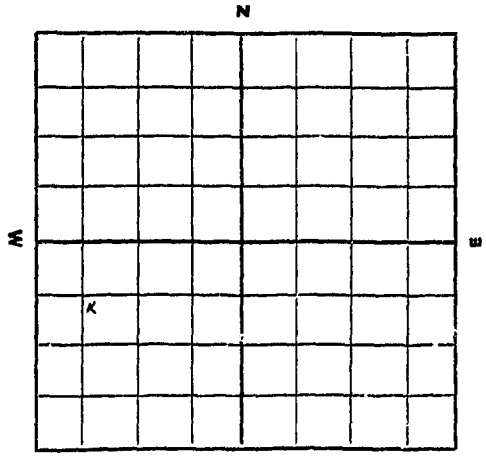

N 1/4 Sec 30 T. 2. R. 21  
 Indicate location of well and place of use, if possible. Each small square represents 10 acres.

Static Water Level for non-flowing well 19' feet.

Shut-in Pressure for Flowing Well \_\_\_\_\_

Pumping Water Level 18' feet at 9 gal. per minute.

Discharge in gal. per min. of flowing well \_\_\_\_\_

How Tested Bailer Length of Test 2 hours

Remarks: (Gravel packing, cementing, packers, type of shutoff, location of place of use of groundwater if not at well, and any other similar pertinent information, including number of acres irrigated, if used for irrigation)

15  
Driller's License Number

Driller's Signature

This form to be prepared by driller, and three copies to be filed by the owner with the County Clerk and Recorder in the county in which the well is located.

Please answer all questions. If not applicable, so state, otherwise the form will be returned.

Original to the County Clerk and Recorder; duplicate to the State Engineer; Triplicate to the School of Mines and Quadruplicate for Appropriator.

41,596

258853

STATE OF MONTANA  
County of Blaine  
Filed for record this  
of  
At  
County Clerk  
Deputy

Doc. No. 258853

State of Montana

STATE OF MONTANA  
County of Blaine  
Filed for record this  
of  
At  
County Clerk  
Deputy

Doc. No. 258853

Table with 10 columns and 10 rows, mostly empty.

STATE OF MONTANA  
County of Blaine  
Filed for record this  
of  
At  
County Clerk  
Deputy

Form No. 18  
8-60

T. 27 R. 21

County Flaine

MONTANA BUREAU OF MINES AND GEOLOGY  
Butte, Montana

Water Well Log

|  |  |   |
|--|--|---|
|  |  |   |
|  |  | x |
|  |  |   |

Owner Jim Spencer Address Dodson, Montana

Driller Simpson Drilling Co Address Malta, Montana

Date Started September 30 1961 Date Completed October 11, 1961

Location: Sec. 27 T. 27 R. 21  $\frac{1}{4}$  sec. NE SENECA

Type of well drilled Equipment used rotary  
(Dug, driven, bored, or drilled) (Churn, drill, rotary, other)

Water use: Domestic  Municipal  Stock  Irrigation   
Industrial  Drainage  Other \_\_\_\_\_

Casing: 0 ft. to 375 ft. Type screw joint Size 4 inch

Casing: 375 ft. to 485 ft. Type screw joint Size 3 inch

Casing: \_\_\_\_\_ ft. to \_\_\_\_\_ ft. Type \_\_\_\_\_ Size \_\_\_\_\_

Perforated or screened: Ft. 270 to ft. 375 . Ft. 380 to ft. 460

Type of screen or perforations drilled 1/4 inch holes

Static water level, for non-flowing well: 70 feet.

Shut-in pressure, for flowing well: \_\_\_\_\_ lb./sq. in. on: \_\_\_\_\_ (date)

Pumping water level 108 feet at 10 gal. per min.

How tested: bailer

Length of test 3 hours

Remarks: (Gravel packing, cementing, packers, type of shut-off, depth of shut-off)

rubber packers at 250 feet

(over)



STATE OF MONTANA  
ADMINISTRATOR OF GROUNDWATER CODE  
MONTANA WATER RESOURCES BOARD

NOTICE OF COMPLETION OF GROUNDWATER  
APPROPRIATION BY MEANS OF WELL

Developed after January 1, 1962

(Under Chapter 227 Montana Session Laws, 1961, as amended)

This form to be prepared by driller, and three copies to be filed by the owner with the County Clerk and Recorder in the county in which the well is located, last copy to be retained by driller. Please answer all questions. If not applicable, so state, otherwise the form may be returned.

Owner Edwyn Spinks

Address Chinook

Date well started 11/21/71

completed 11/27/71

Type of well drilled

Equipment used Churn drill

Water Use: Domestic  Municipal  Stock  Irrigation

Industrial  Drainage  Other \* Garden/Lawn

\*Describe \_\_\_\_\_  
USE: If used for irrigation, industrial, drainage or other. Explain, state number of acres and location or other data (i.e. Lot, Block and Addition).

ESTIMATED ANNUAL WITHDRAWAL

| Size of Drilled Hole | Size and Weight of Casing | From (Feet) | To (Feet) | PERFORATIONS |             |           |
|----------------------|---------------------------|-------------|-----------|--------------|-------------|-----------|
|                      |                           |             |           | Kind Size    | From (Feet) | To (Feet) |
| 6 3/4"               | 2 3/4" x 20'              | 0           | 20        |              |             |           |
| 7 1/2"               | 6 3/4"                    | 0           | 244       | 1/2" x 1/2"  | 200         | 244       |

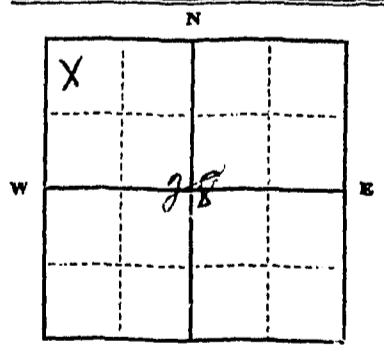

Static water level 0 ft.\*  
Pumping water level 24.0 ft.\*  
at 17 gallons per minute,  
measured 2 minutes after pumping began.

\*Measured from ground level.  
Well developed by soaking  
for \_\_\_\_\_ hours.

Power \_\_\_\_\_ Pump \_\_\_\_\_ HP  
Remarks: (Gravel packing, cementing, packers, type of shutoff) \_\_\_\_\_

N.W. 1/4 N.W. 1/4 Sec. 28  
T. 27 N.R. 27 E. 5 W. 21

INDICATE LOCATION OF WELL AND PLACE OF USE, IF POSSIBLE. EACH SMALL SQUARE REPRESENTS 40 ACRES.

Driller's Signature L. L. Winkler

Driller's Address Chinook, MT

LICENSE NO. 31

DRILLER'S LOG

Indicate the character, color, thickness of strata such as soil, clay, sand, gravel, shale, sandstone, etc. Show depth at which water is found and height to which water rises in well.

| Top of Ground (Elev. above sea level) |           |                        |
|---------------------------------------|-----------|------------------------|
| From (Feet)                           | To (Feet) |                        |
| 0                                     | 15        | soil                   |
| 15                                    | 30        | grey shale             |
| 30                                    | 37        | red bed                |
| 37                                    | 41        | grey shale             |
| 41                                    | 45        | grey sandstone & shale |
| 45                                    | 50        | grey shale             |
| 50                                    | 55        | yellow shale           |
| 55                                    | 60        | dark grey shale        |
| 60                                    | 70        | grey shale             |
| 70                                    | 85        | grey shale             |
| 85                                    | 110       | red shale              |
| 110                                   | 145       | dark grey shale        |
| 145                                   | 150       | sandstone & shale      |
| 150                                   | 165       | grey sandstone & shale |
| 165                                   | 175       | grey shale             |
| 175                                   | 180       | grey shale             |
| 180                                   | 195       | yellow shale           |
| 195                                   | 210       | grey sandstone & shale |
| 210                                   | 220       | yellow shale           |
| 220                                   | 225       | water & water          |
| 225                                   | 244       | bottom                 |

244 Show exact depth of bottom

267987

267987

STATE OF MISSISSIPPI  
County of \_\_\_\_\_

Filed \_\_\_\_\_ Day  
of November 1971  
at 9:34 A.M.

Quinn L. ...  
Deputy

Fee \_\_\_\_\_

T. 27 N. R. 21 E.

County **Blaine**

MONTANA BUREAU OF MINES AND GEOLOGY  
Butte, Montana

RECEIVED

WATER WELL LOG

STATE ENGINEER

|  |   |  |
|--|---|--|
|  |   |  |
|  | x |  |
|  |   |  |

Owner **Marguerite Dignan** Address **Glasgow, Montana**

Driller **Simpson Drilling Co.** Address **Malta, Montana**

Date Started **March 2, 1961** Date Completed **March 16, 1961**

Location: Sec. **35** T. **27 N.** R. **21 E.** 1/4 sec. **SW1/4**

Type of well **Drilled** Equipment used **Churn drill**  
(Dug, driven, bored, or drilled) (Churn drill, rotary, other)

Water use: Domestic  Municipal  Stock  Irrigation

Industrial  Drainage  Other: \_\_\_\_\_

Casing: **0** ft. to **257** ft. Type **Steel** Size **4"**

Casing: \_\_\_\_\_ ft. to \_\_\_\_\_ ft. Type \_\_\_\_\_ Size \_\_\_\_\_

Casing: \_\_\_\_\_ ft. to \_\_\_\_\_ ft. Type \_\_\_\_\_ Size \_\_\_\_\_

Perforated or Screened: Ft. **228** to ft. **257** Ft. \_\_\_\_\_ to ft. \_\_\_\_\_

Type of screen or perforations **3/16" holes drilled in casing**

Static Water level, for non-flowing well: **3 ft. above ground** feet.

Shut-in pressure, for flowing well: \_\_\_\_\_ lb./sq. in. on: \_\_\_\_\_ (date)

Pumping water level **126** feet at **6** gal. per min.

How tested: **bailer**

Length of test **1 hour**

Remarks: (Gravel packing, cementing, packers, type of shut-off, depth of shut-off)

**Packer at 226 ft.**

(over)







File No.....

DUPLICATE

T. 25 R. 21  
Twps. 27 & 28, R. 22  
County Blaine

STATE OF MONTANA  
ADMINISTRATOR OF GROUNDWATER CODE  
OFFICE OF STATE ENGINEER

JAN 1 1962

Declaration of Vested Groundwater Rights

(Under Chapter 237, Montana Session Laws, 1961)

1 James B. Spencer of Chinook,  
(Name of Appropriator) (Address) (Town)  
County of Blaine State of Montana  
have appropriated groundwater according to the Montana laws in effect prior to January 1, 1962, as follows:

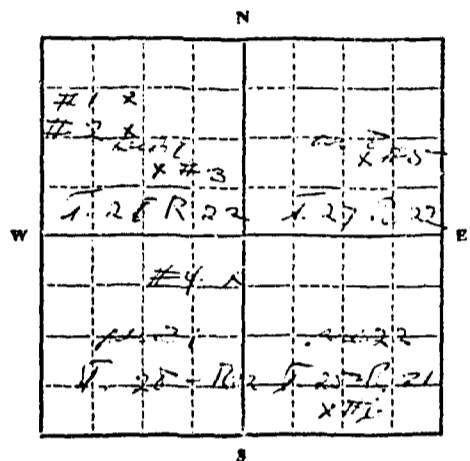

1/4 Sec. T. R.

Indicate point of appropriation and place of use, if possible. Each small square represents 10 acres.  
Sec. 30 & 31-28-22,  
Sec. 8-27-22,  
Sec. 22-25-21

- 2. The beneficial use on which the claim is based...Wells No. 1 and 2 household use; wells stock water.
- 3. Date or approximate date of earliest beneficial use; and how continuous the use has been...Wells 1, 3, 4, 5 & 6, October 15, 1948, continuous since then; Well No. 2, March 15, 1961, continuous since then;
- 4. The amount of groundwater claimed (in miner's inches or gallons per minute)...50 gal. per minute from Wells 1, 3, 4, & 5; 1 gal. and 6 gal. per minute from Wells 2 and 6.
- 5. If used for irrigation, give the acreage and description of the lands to which water has been applied and name of the owner thereof...None
- 6. The means of withdrawing such water from the ground and the location of each well or other means of withdrawal...Windmill as to Well 4; all other electric pump and motor excepting No. 6 which is a flowing well.
- 7. The date of commencement and completion of the construction of the well, wells, or other works for withdrawal of groundwater...Work commenced Well 1, Oct. 1, 1948; Well 2, March 1, 1961; Well 3, Oct. 1, 1948; Well 4, Oct. 1, 1948; Well 5, Oct. 1, 1948; Well 6, Sept. 1, 1948; All completed about Oct. 15, 1948, except No. 2, March 15, 1961. 1 inch pipe in all Well
- 8. The depth of water table...Well No. 1, 410 ft.; No. 2, 18 ft.; No. 3, 98 ft.; No. 4, 130 ft.; No. 5, 210 ft.; No. 6, 340 ft.;
- 9. So far as it may be available, the type, size and depth of each well or the general specifications of any other works for the withdrawal of groundwater...Depth of well same as water table give above.
- 10. The estimated amount of groundwater withdrawn each year...750,000 gal. per year, total, Well 1, 50,000; well 2, 200,000; well 3, 100,000; well 4, 100,000; well 5, 100,000; well 6, 200,000 gallons pump.
- 11. The log of formations encountered in the drilling of each well if available...None available.

12. Such other information of a similar nature as may be useful in carrying out the policy of this act, including reference to book and page of any county record

Signature of Owner James B. Spencer  
Date December 30, 1961

Three copies to be filed by the owner with the County Clerk and Recorder of the county in which the well is located.

Please answer all questions. If not applicable, so state, otherwise the form will be returned.  
Original to the County Clerk and Recorder; duplicate to the State Engineer; Triplicate to the Montana Bureau of Mines and Geology, and Quadruplicate for the Appropriator.

252136  
STATE OF MONTANA  
County of Blaine

FILED FOR RECORD THIS 71 DAY  
OF 11th A. D. 1915  
AT 3 O'CLOCK P. M.  
COUNTY CLERK  
DEPUTY

FEE

50

T 27 R 22

County Elaine

MONTANA BUREAU OF MINES AND GEOLOGY  
Butte, Montana

RECEIVED  
JUN 27 1961

WATER WELL LOG

STATE ENGINEER

|   |    |  |  |
|---|----|--|--|
|   |    |  |  |
| x |    |  |  |
|   | 30 |  |  |
|   |    |  |  |

Owner Jim Specher Address Chinook

Driller Simpson Drilling Co Address Malta

Date Started 22 June 1961 Date Completed 24 of June

Location: Sec. 30 T. 27 R. 22 1/4 sec. SW 1/4 NW 1/4

Type of well Drilled (Dug, driven, bored, or drilled) Equipment used Churn Drill (Churn drill, rotary, other)

Water use: Domestic  Municipal  Stock  Irrigation

Industrial  Drainage  Other:

Casing: 0 ft. to 223 ft. Type steel Size 4"

Casing: 223 ft. to 280 ft. Type steel Size 3"

Casing: ft. to ft. Type Size

Perforated or Screened: Ft. 240 to ft. 270 Ft. to ft.

Type of screen or perforations 1/4 holes drilled in liner

Static Water level, for non-flowing well: 8 feet.

Shut-in pressure, for flowing well: lb./sq. in. on: (date)

Pumping water level 120 feet at 6 gal. per min.

How tested: bailer

Length of test 1 1/2 hr

Remarks: (Gravel packing, cementing, packers, type of shut-off, depth of shut-off)

(over)

Log of Well

| Depth, feet |     | Description of Material Drilled       |
|-------------|-----|---------------------------------------|
| From        | To  |                                       |
| 0           | 20  | Brown sandy clay                      |
| 20          | 40  | Brown sandstone                       |
| 40          | 68  | Brown sandy clay                      |
| 69          | 123 | Grey shale                            |
| 123         | 125 | Brown shale coal                      |
| 125         | 135 | Grey brown shale coal                 |
| 135         | 141 | Hard shell                            |
| 141         | 143 | Grey shale                            |
| 143         | 157 | Grey brown shale                      |
| 157         | 160 | Grey green shale                      |
| 160         | 166 | Grey shale                            |
| 166         | 170 | Hard shell                            |
| 170         | 176 | Grey green shale                      |
| 176         | 179 | Grey green shale                      |
| 179         | 195 | Grey shale                            |
| 195         | 200 | Grey brown shale coal                 |
| 200         | 207 | Grey green shale                      |
| 207         | 210 | Grey brown shale                      |
| 210         | 214 | Grey sandy shale                      |
| 214         | 220 | Hard shell                            |
| 220         | 238 | Grey green shale                      |
| 238         | 255 | Grey shale                            |
| 255         | 270 | Grey sand stone water (69 P.M. 120ft) |
| 270         | 280 | Grey shale                            |
|             |     |                                       |
|             |     |                                       |

File No. ....

T 27 R 22

RECEIVED

DUPLICATE

STATE OF MONTANA AUG 13 1963  
ADMINISTRATOR OF GROUNDWATER CODE  
OFFICE OF STATE ENGINEER

### Notice of Completion of Groundwater Appropriation by Means of Well

(Under Chapter 237, Montana Session Laws, 1961)

Owner James J. Finner Address .....

Driller SIMPSON DRILLING CO Address MALTA, MONTANA

Date of Notice of appropriation of ground water .....

Date well started JULY 30, 1963 Date Completed AUG 1, 1963

Type of well drilled Equipment used rotary  
(dug, driven, bored or Churn, drill, rotary or drilled) other)

Water use: Domestic  Municipal  Stock  Irrigation   
Industrial  Drainage  Other

Indicate on the diagram the character and thickness of the different strata met with in drilling, such as soil, clay, shale, gravel, rock or sand, etc. Show depth at which water is encountered, thickness and character of water-bearing strata and height to which the water rises in the well.

Top of Ground  
(Elev. above sea level .....

|     |     |                  |
|-----|-----|------------------|
| 280 | 325 | green grey shale |
| 325 | 335 | sandstone        |
| 335 | 338 | rock layer       |
| 338 | 339 | sandstone        |
| 339 | 340 | rock layer       |
| 340 | 355 | sandstone        |
| 355 | 358 | rock layer       |
| 358 | 362 | sandstone        |
| 362 | 364 | rock layer       |
| 364 | 380 | sandstone        |
| 380 | 382 | rock layer       |
| 382 | 390 | sandstone        |

Show exact depth of bottom.

| Size of Drilled Hole | Size and Weight of Casing | From (Feet) | To (Feet) | PERFORATIONS |             |           |
|----------------------|---------------------------|-------------|-----------|--------------|-------------|-----------|
|                      |                           |             |           | Kind Size    | From (Feet) | To (Feet) |
| 4                    | 3 8 #                     | 280         | 390       | 1/4          | 327         | 390       |

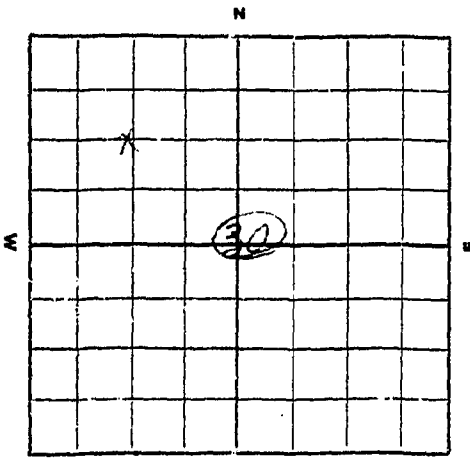

Sec 30 T 27 R 22  
Indicate location of well and place of use, if possible. Each small square represents 10 acres.

Static Water Level for non-flowing well  
ground level \_\_\_\_\_ feet.  
Shut-in Pressure for Flowing Well \_\_\_\_\_  
Pumping Water Level 55 \_\_\_\_\_ feet  
at 16 \_\_\_\_\_ gal. per minute.  
Discharge in gal. per min. of flowing well \_\_\_\_\_

How Tested bailer \_\_\_\_\_  
Length of Test one hour \_\_\_\_\_  
Remarks: (Gravel packing, cementing, packers, type of shutoff, location of place of use of groundwater if not at well, and any other similar pertinent information, including number of acres irrigated, if used for irrigation) \_\_\_\_\_

Driller's License Number \_\_\_\_\_  
Robert Simpson  
Driller's Signature

This form to be prepared by driller, and three copies to be filed by the owner with the County Clerk and Recorder in the county in which the well is located.

Please answer all questions. If not applicable, so state, otherwise the form will be returned.

Original to the County Clerk and Recorder; duplicate to the State Engineer; Triplicate to the School of Mines and Quadruplicate for Appropriator.

5371

James Spence

250137

STATE OF MONTANA  
County of Blaine

FILED FOR RECORD THIS 12 DAY

OF Aug A. D. 1963

AT 1:50 O'CLOCK P. M.

Carl L. Mungus

CLERK

Esther Sheets

DEPUTY

FEE





County Blaine

STATE OF MONTANA  
ADMINISTRATOR OF GROUNDWATER CODE  
MONTANA WATER RESOURCES BOARD

NOTICE OF COMPLETION OF GROUNDWATER  
APPROPRIATION BY MEANS OF WELL

Developed after January 1, 1962

(Under Chapter 237 Montana Session Laws, 1961, as amended)

This form to be prepared by driller, and three copies to be filed by the owner with the County Clerk and Recorder in the county in which the well is located, last copy to be retained by driller.

Please answer all questions. If not applicable, so state, otherwise the form may be returned.

DRILLER'S LOG

Indicate the character, color, thickness of strata such as soil, clay, sand, gravel, shale, sandstone, etc. Show depth at which water is found and height to which water rises in well.

Owner Al Thomas  
Address Harlem, Montana  
Date well started 6-7-70  
completed 6-10-70

For Administrator's Use  
File 265602  
July 23, 1970  
2:15 p.m.  
GW 1

Type of well drilled  
(Dug, driven, bored or drilled)  
Equipment used oil field  
(Churn drill, rotary or other)  
Water Use: Domestic  Municipal  Stock  Irrigation   
Industrial  Drainage  Other \* Garden/Lawn

\*Describe  
USE: If used for irrigation, industrial, drainage or other. Explain, state number of acres and location or other data (i.e. Lot, Block and Addition).

ESTIMATED ANNUAL WITHDRAWAL 1,000,000 gal.

| Size of Drilled Hole | Size and Weight of Casing | From (Feet) | To (Feet) | PERFORATIONS |             |           |
|----------------------|---------------------------|-------------|-----------|--------------|-------------|-----------|
|                      |                           |             |           | Kind Size    | From (Feet) | To (Feet) |
| 6"                   | 5 5/8<br>18.97            | 71          | 85        | 60x4         | 79          | 85        |

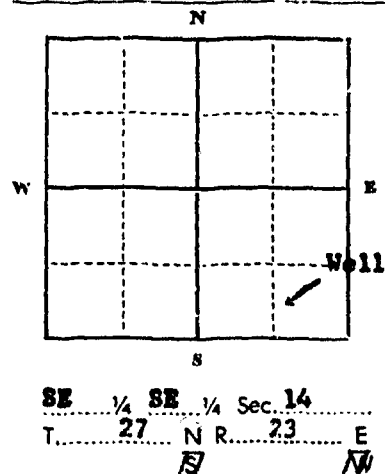

Static water level 25 ft.\*  
Pumping water level 30 ft.\*  
at 20 gallons per minute,  
measured 120 minutes after pumping  
began.  
\*Measured from ground level.  
Well developed by batler  
for 2 hours.  
Power 1/2 Pump 1/2 HP  
Remarks: (Gravel packing, cementing,  
packers, type of shutoff)

INDICATE LOCATION OF WELL AND PLACE OF USE, IF POSSIBLE.  
EACH SMALL SQUARE REPRESENTS 40 ACRES.

Driller's Signature Alvin Drilling Contractor  
Driller's Address P.O. Box 103, Dillon, Montana 59725  
LICENSE NO. 140

Top of Ground (Elev. above sea level)

| From (Feet) | To (Feet) |                |
|-------------|-----------|----------------|
| 0           | 5         | soil           |
| 5           | 71        | brown clay     |
| 71          | 85        | gravel (water) |

Show exact depth of bottom

467248



File No. ....

DUPLICATE

T. 26 R. 17

County Blaine

RECEIVED  
JAN 6 1964

STATE OF MONTANA  
ADMINISTRATOR OF GROUNDWATER CODE  
OFFICE OF STATE ENGINEER

STATE ENGINEER

Notice of Completion of Groundwater Appropriation  
Without Well

(Under Chapter 237 Montana Session Laws, 1961)

Date of Appropriation of Groundwater.....  
Owner *C. B. Mildred* Address *Blaine*

Contractor (if any) .....

Address of Contractor .....

Date Started *1934* Date Completed *1963*

Describe means of obtaining groundwater without a well "as by sub-irrigation and other natural processes". Include depth to water when applicable.

*Springs developed  
Spring Box - Water piped  
into 5 or 6 ft round  
pressure Tanks  
Legal description of locations att'd*

Quantity of water developed and used with explanation of method used to measure or estimate such amount. If use is intermittent

estimate approximate lengths of periods of use.....

*vary in flow from  
1/4 inch to one inch  
pipe full*

Signature of Owner *J. E. Beringer*

Date *12.26.63*

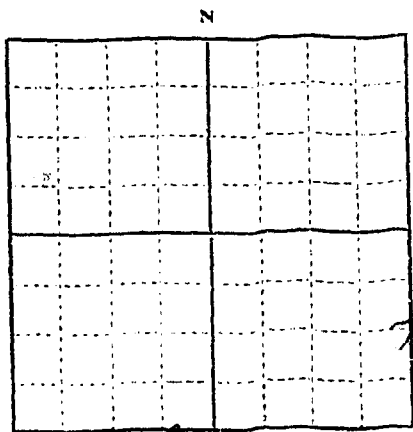

See Supplemental  
1/4 Sec. T. 17 R. 17  
Indicate point of appropriation  
and place of use, if possible.

This form to be prepared by contractor (if any), otherwise by the owner.

Three copies of this notice are to be filed with the County Clerk and Recorder of the county in which the works are located.

Please answer all questions. If not applicable, so state, otherwise the form will be returned.

Original to the County Clerk and Recorder; duplicate to the State Engineer; Triplicate to the Montana Bureau of Mines and Geology and Quadruplicate for the Appropriator.

*Arthur E. McLeish III*

NOTARY PUBLIC for the State of Montana  
Residing at Chinook, Montana  
My Commission Expires April 18, 1966

25195

STATE OF MONTANA  
County of Blaine

FILED FOR RECORD THIS 27 DAY  
OF December A. D. 1963  
AT 4:46 O'CLOCK P. M.

*Cora R. Mungro*  
COUNTY CLERK  
*Esther Sheets*  
DEPUTY

FEE 2.00

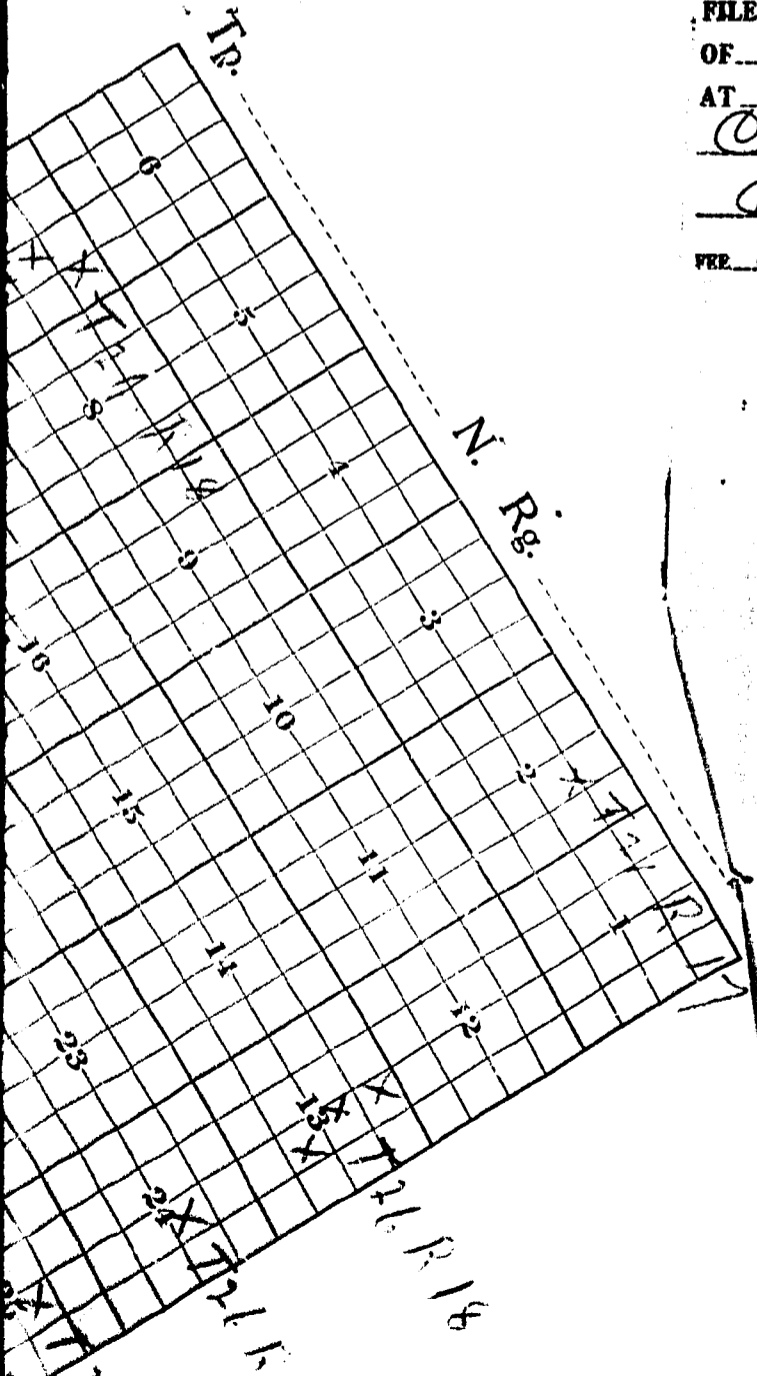

TP.

N. Rg.

|    |    |    |    |    |    |
|----|----|----|----|----|----|
| 6  | 5  | 4  | 3  | 2  | 1  |
| X  | X  |    |    |    |    |
| X  | 8  | 9  | 10 | 11 | 12 |
| 18 | 17 | 16 | 15 | 14 | 13 |
| 19 | 20 | 21 | 22 | 23 | 24 |
| 30 | 29 | 28 | 27 | 26 | 25 |
| 32 | 31 | 30 | 29 | 28 | 27 |
| 36 | 35 | 34 | 33 | 32 | 31 |

X T 21 R 17

X T 21 R 18

X T 26 R 18

X T 26 R 18

X T 26 R 17

X T 26 R 18

X T 26 R 18

X T 26 R 17

X T 26 R 18

MEMORANDUM

Locations of developed springs for  
 for the field of the ...

---



---



---

STATE OF MONTANA  
ADMINISTRATOR OF GROUNDWATER CODE  
MONTANA WATER RESOURCES BOARD

NOTICE OF COMPLETION OF GROUNDWATER  
APPROPRIATION BY MEANS OF WELL

Developed after January 1, 1962

(Under Chapter 237 Montana Session Laws, 1961, as amended)

This form to be prepared by driller, and three copies to be filed by the owner with the County Clerk and Recorder in the county in which the well is located, last copy to be retained by driller. Please answer all questions. If not applicable, so state, otherwise the form may be returned.

Owner GERALD KANE  
Address WARRICK RT  
BIG SANDY, MONTANA  
Date well started 7/29/71  
completed 8/3/71  
Type of well DRILLED + DUG  
(Dug, driven, bored or drilled)  
Equipment used CABLE TOOL RIG  
(Churn drill, rotary or other)  
Water Use: Domestic  Municipal  Stock  Irrigation   
Industrial  Drainage  Other \* Garden/Lawn

For Administrator's Use  
File 267887  
October 13, 1971  
8:17 AM  
GW 1

\*Describe  
USE: If used for irrigation, industrial, drainage or other. Explain, state number of acres and location or other data (i.e. Lot, Block and Addition).

ESTIMATED ANNUAL WITHDRAWAL 300,000 GALLONS

| Size of Drilled Hole | Size and Weight of Casing     | From (Feet) | To (Feet) | PERFORATIONS    |             |           |
|----------------------|-------------------------------|-------------|-----------|-----------------|-------------|-----------|
|                      |                               |             |           | Kind Size       | From (Feet) | To (Feet) |
| 38"                  | 30" GALVANIZED CULVERT 14 GA. | 0           | 16        | NO PERFORATIONS |             |           |
| 8"                   | 6 3/8" O.D. PVC PLASTIC       | 15 1/2      | 23        | 1/2" DRILLED    | 16          | 21        |

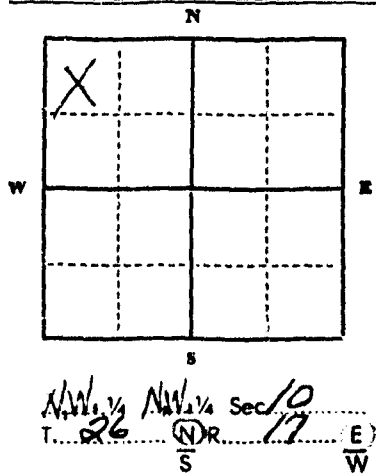

Static water level 102 ft.\*  
Pumping water level 22 ft.\*  
at 1 1/4 gallons per minute,  
measured 60 minutes after pumping began.  
\*Measured from ground level.  
Well developed by BAILING + PUMP  
for 2 hours.  
Power ELECTRIC Pump 1/3 HP  
Remarks: (Gravel packing, cementing, packers, type of shutoff) GRAVEL PLACED AROUND 30" CULVERT FROM 10 FT. BACK TO 10 FT. LEVEL CEMENT GROUT PLACED ABOVE GRAVEL TO SEAL OFF SURFACE CONTAMINATION.

INDICATE LOCATION OF WELL AND PLACE OF USE, IF POSSIBLE. EACH SMALL SQUARE REPRESENTS 40 ACRES.

Driller's signature Robert Dreier  
Dri. 1173 6th St. No.  
Haure, Montana LICENSE NO. 416

B. L. Zilio  
County CHOTEAU

DRILLER'S LOG

Indicate the character, color, thickness of strata such as soil, clay, sand, gravel, shale, sandstone, etc. Show depth at which water is found and height to which water rises in well.

| Top of Ground (Elev. above sea level) |           |   |
|---------------------------------------|-----------|---|
| From (Feet)                           | To (Feet) |   |
| 0                                     | 3         | GRAVELLY SOIL   |
| 6                                     |           | SANDY BROWN CLAY  |
| 8                                     |           | BROWN SAND & CLAY MIX   |
| 11                                    |           | GRAVELLY GREY CLAY  |
| 12                                    |           | SANDY GREY CLAY   |
| 15                                    |           | GREY CLAY - GRAVELLY - SOME SMALL BOULDERS                          |
| 16                                    |           | GRAVEL, SAND & CLAY MIX - SMALL BOULDERS - WATER - APPROX 1 1/2 GPM |
| 17                                    |           | GREY CLAY SAND SEAMS  |
| 23                                    |           | GREY SHALE  |

23 Show exact depth of bottom

49223

267887

STATE OF MISSISSIPPI  
County of Effaire  
Filed for record this 13 Day  
of October 1971  
At 8:17 P.M.  
Gene L. Musgrave  
Deputy Clerk

Fee 2.00 Deputy

County Blaine

*10/13/73*

STATE OF MONTANA  
ADMINISTRATOR OF GROUNDWATER CODE  
MONTANA WATER RESOURCES BOARD

NOTICE OF COMPLETION OF GROUNDWATER APPROPRIATION WITHOUT WELL

Developed After January 1, 1962

(Under Chapter 237, Montana Session Laws, 1961, as amended)

This form to be prepared by contractor (if any), otherwise by the owner.

Three copies of this notice are to be filed with the County Clerk and Recorder of the county in which the works are located.

Please answer all questions. If not applicable, so state, otherwise the form may be returned.

|                         |                      |
|-------------------------|----------------------|
| For Administrator's Use |                      |
| File                    | <u>272366</u>        |
|                         | <u>June 29, 1973</u> |
| GW 1                    | <u>329 p.m.</u>      |
|                         |                      |
|                         |                      |

Owner GERALD KANE

Address Lloyd, Montana

Contractor (if any) NA

Address of Contractor NA

Date Started ..... Date Completed early homestead days

1. Describe means of obtaining groundwater (as by sub-irrigation, developed spring, drains, etc.) developed springs

2. Means of withdrawing water (gravity, pump, canal, etc.) gravity

3. Depth of water table unknown

4. Use of the water stock water

5. Amount of groundwater claimed (in miner's inches or gallons per minute) Spring #1, 5 g/p/m; #2, 20 g/p/m; #3, 10 g/p/m; #4, 30 g/p/m

6. If used for irrigation, give number of acres and description of land NA

7. Estimate amount of water used each year unknown

8. Months of year spring flows entire year

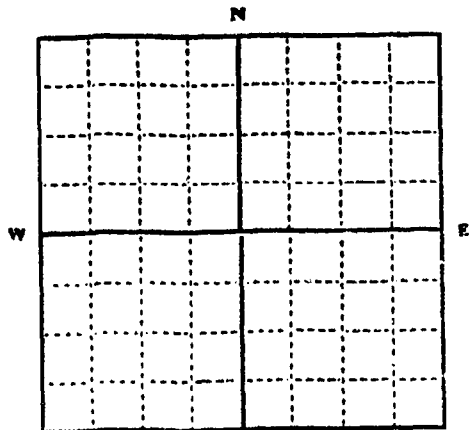

\* See Exhibit "A"

..... 1/4 ..... 1/4 Sec.....

T.....  $\frac{N}{S}$  R.....  $\frac{E}{W}$

INDICATE POINT OF APPROPRIATION AND PLACE OF USE, IF POSSIBLE. Elevation of spring, if known or estimated .....

.....

Signature of Owner Gerald Kane

Date June 29, 1973



ownship No. 26 North Range No. 17 East Merid

EXHIBIT "A"  
Rge. ....

Rge. ....

Rge. ....

|    |    |    |       |                |    |       |    |
|----|----|----|-------|----------------|----|-------|----|
| 36 | 31 | 32 | 33    | 34             | 35 | 36    | 31 |
| 1  | 6  | 5  | 4     | 3              | 2  | 1     | 6  |
| 12 | 7  | 8  | 9     | (1) •<br>(2) • | 10 | 11    | 12 |
| 13 | 18 | 17 | 16    | 15             | 14 | (3) • | 18 |
|    |    |    | (4) • |                |    |       |    |
| 24 | 19 | 20 | 21    | 22             | 23 | 24    | 19 |
| 25 | 30 | 29 | 28    | 27             | 26 | 25    | 30 |
| 36 | 31 | 32 | 33    | 34             | 35 | 36    | 31 |
| 1  | 6  | 5  | 4     | 3              | 2  | 1     | 6  |

OPINION PRINT. CHINGOOK, MONT.

MEMORANDUM

- Spring No. 1, located in NW $\frac{1}{4}$ SW $\frac{1}{4}$ , Section 10, Township 26N, Range 17E
- Spring No. 2, located in SW $\frac{1}{4}$ SW $\frac{1}{4}$ , Section 10, Township 26N, Range 17E
- Spring No. 3, located in NW $\frac{1}{4}$ SW $\frac{1}{4}$ , Section 13, Township 26N, Range 17E
- Spring No. 4, located in SW $\frac{1}{4}$ SW $\frac{1}{4}$ , Section 15, Township 26N, Range 17E

272366

STATE OF MONTANA )  
County of Blaine )

Filed for record this 29 Day  
of June A. D. 19 25  
At 3:29 O'Clock P M.

\_\_\_\_\_  
County Clerk

\_\_\_\_\_  
Deputy

Fee \_\_\_\_\_

File No.....

T. 26 R. 17  
County.....

DUPLICATE

JAN 6 1964  
STATE ENGINEER

STATE OF MONTANA  
ADMINISTRATOR OF GROUNDWATER CODE  
OFFICE OF STATE ENGINEER

Notice of Completion of Groundwater Appropriation  
Without Well

(Under Chapter 237 Montana Session Laws, 1961)

Date of Appropriation of Groundwater *stated on map*  
Owner *Arthur E. McLeish Co.* address *Lloyd, Mont*  
Contractor (if any) .....  
Address of Contractor .....

Date Started..... Date Completed.....

Describe means of obtaining groundwater without a well "as by sub-irrigation and other natural processes". Include depth to water when applicable.

*natural*

Quantity of water developed and used with explanation of method used to measure or estimate such amount. If use is intermittent estimate approximate lengths of periods of use.....

*continuous*

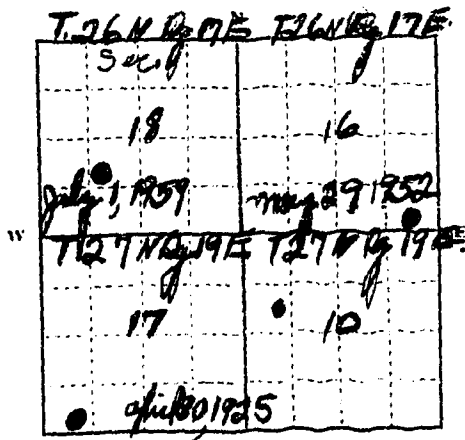

..... 1/4 ..... Sec. .... T. .... R. ....  
Indicate point of appropriation and place of use, if possible.

Signature of Owner *Arthur E. McLeish Co.*  
*A. E. McLeish*  
Date *Dec 31, 1963*

This form to be prepared by contractor (if any), otherwise by the owner.

Three copies of this notice are to be filed with the County Clerk and Recorder of the county in which the works are located.

Please answer all questions. If not applicable, so state, otherwise the form will be returned.

Original to the County Clerk and Recorder; duplicate to the State Engineer; Triplicate to the Montana Bureau of Mines and Geology and Quadruplicate for the Appropriator.

252125

STATE OF MONTANA  
County of Blaine

FILED FOR RECORD THIS 31 DAY  
OF December A. D. 1963  
AT 3:15 O'CLOCK P. M.

Cara L. Mueggen  
COUNTY CLERK

200  
FEB

DEPUTY

County Blaine

STATE OF MONTANA  
ADMINISTRATOR OF GROUNDWATER CODE  
MONTANA WATER RESOURCES BOARD

NOTICE OF COMPLETION OF GROUNDWATER APPROPRIATION WITHOUT WELL

Developed After January 1, 1962

(Under Chapter 237, Montana Session Laws, 1961, as amended)

This form to be prepared by contractor (if any), otherwise by the owner.

Three copies of this notice are to be filed with the County Clerk and Recorder of the county in which the works are located.

Please answer all questions. If not applicable, so state, otherwise the form may be returned.

For Administrator's Use

File 222379

June 29, 1973

GW 1 342 p.u.

Owner GERALD W. BREWER

Address Lloyd, Montana

Contractor (if any) NA

Address of Contractor NA

Spring No. 1: early homestead days

Date Started Spring No. 2: Dec, 1972 Date Completed Dec. 1972

1. Describe means of obtaining groundwater (as by sub-irrigation, developed spring, drains, etc.)

developed springs

2. Means of withdrawing water (gravity, pump, canal, etc.)

gravity

3. Depth of water table

unknown

4. Use of the water

stockwater

5. Amount of groundwater claimed (in miner's inches or gallons per minute)

Spring No. 1, 2 gallons per minute, Spring #2, 2 gallons per minute

6. If used for irrigation, give number of acres and description of land

NA

7. Estimate amount of water used each year

unknown

8. Months of year spring flows

both springs flow entire year

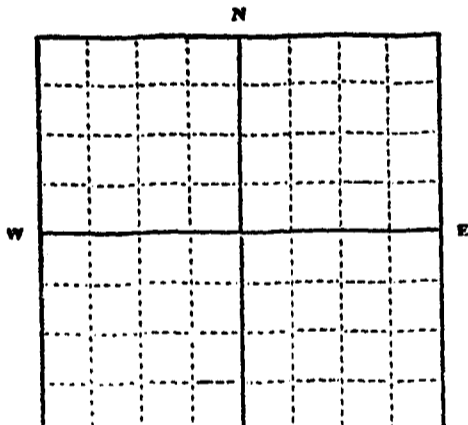

\* See Exhibit "A"

..... 1/4 ..... 1/4 Sec.....

T..... N R..... E  
S W

INDICATE POINT OF APPROPRIATION AND PLACE OF USE, IF POSSIBLE.

Elevation of spring, if known or estimated

Signature of Owner Gerald W. Brewer

June 29, 1973

Date

54862

Twp No. 26 North Range No. 17 East Meridian

EXHIBIT "A"

Rge. ....

Rge. ....

|    |    |    |    |       |    |    |    |
|----|----|----|----|-------|----|----|----|
| 36 | 31 | 32 | 33 | 34    | 35 | 36 | 31 |
| 1  | 6  | 5  | 4  | 3     | 2  | 1  | 6  |
| 12 | 7  | 8  | 9  | 10    | 11 | 12 | 7  |
| 13 | 18 | 17 | 16 | 15    | 14 | 13 | 18 |
| 24 | 19 | 20 | 21 | 22    | 23 | 24 | 19 |
|    |    |    |    | (2) • |    |    |    |
| 25 | 30 | 29 | 28 | 27    | 26 | 25 | 30 |
|    |    |    |    | (4) • |    |    |    |
| 35 | 31 | 32 | 33 | 34    | 35 | 36 | 31 |
| 1  | 6  | 5  | 4  | 3     | 2  | 1  | 6  |

OPINION PRINT. CHINGOOK, MONT.

MEMORANDUM

Spring No. 1 is located in the SW $\frac{1}{4}$ SE $\frac{1}{4}$  of Section 27, Township 26 North,  
Range 17 East

Spring No. 2 is located in the SE $\frac{1}{4}$ SW $\frac{1}{4}$  of Section 23, Township 26 North,  
Range 17 East.

272379

STATE OF ILLINOIS  
County of Blaine

Filed for record this 29 Day  
of June A. D. 1915  
At 3:45 O'Clock P.M.

\_\_\_\_\_  
County Clerk

\_\_\_\_\_  
Deputy

Fee \_\_\_\_\_

File No.....

T. 6 R. 17

DUPLICATE

County Blaine

STATE OF MONTANA  
ADMINISTRATOR OF GROUNDWATER CODE  
OFFICE OF STATE ENGINEER

JAN 6 1964  
STATE ENGINEER

**Notice of Completion of Groundwater Appropriation  
Without Well**

(Under Chapter 237 Montana Session Laws, 1961)

Date of Appropriation of Groundwater 1918  
Owner John Van Figher Mailing- 214 5th St. So. Great Fall  
Address Warrior, Mont. Mont.  
Contractor (if any) None  
Address of Contractor None  
Date Started None Date Completed None

Describe means of obtaining groundwater without a well "as by sub-irrigation and other natural processes". Include depth to water when applicable. spring water and rain and snow water in gullies and coulees

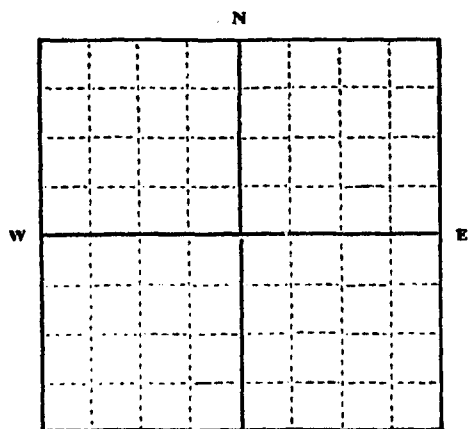

~~1/4~~ <sup>S</sup> 27 <sup>T</sup> 28 <sup>R</sup> 17

Indicate point of appropriation and place of use, if possible.

**Spring water all over the place-**

Quantity of water developed and used with explanation of method used to measure or estimate such amount. If use is intermittent

estimate approximate lengths of periods of use used for livestock

Signature of Owner John Van Figher

Date December 20, 1963

This form to be prepared by contractor (if any), otherwise by the owner.

Three copies of this notice are to be filed with the County Clerk and Recorder of the county in which the works are located.

Please answer all questions. If not applicable, so state, otherwise the form will be returned.

Original to the County Clerk and Recorder; duplicate to the State Engineer; Triplicate to the Montana Bureau of Mines and Geology and Quadruplicate for the Appropriator.



File No. ....

T. 26 R. 17

DUPLICATE

County Blaine

STATE OF MONTANA  
ADMINISTRATOR OF GROUNDWATER CODE  
OFFICE OF STATE ENGINEER

JAN 6 1964

STATE ENGINEER

**Notice of Completion of Groundwater Appropriation  
Without Well**

(Under Chapter 237 Montana Session Laws, 1961)

Date of Appropriation of Groundwater 1972  
Owner John Van Fighem Address Mailings- 214 5th St. So. Great Falls  
Mont.

Contractor (if any) None

Address of Contractor None

Date Started None Date Completed None

Describe means of obtaining groundwater without a well "as by sub-irrigation and other natural processes". Include depth to water when applicable. surface and spring water in gullies and coulees

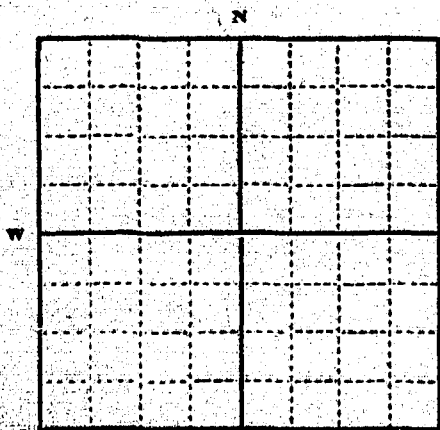

Quantity of water developed and used with explanation of method used to measure or estimate such amount. If use is intermittent

estimate approximate lengths of periods of use. used for livestock

1/4 Sec. 17 T. 26 R. 17

Indicate point of appropriation and place of use, if possible.

Spring water all over the place

Signature of Owner John Van Fighem

Date December 20, 1962

This form to be prepared by contractor (if any), otherwise by the owner.

Three copies of this notice are to be filed with the County Clerk and Recorder of the county in which the works are located.

Please answer all questions. If not applicable, so state, otherwise the form will be returned.

Original to the County Clerk and Recorder; duplicate to the State Engineer; Triplicate to the Montana Bureau of Mines and Geology and Quadruplicate for the Appropriator.

251964

STATE OF MONTANA  
County of Blaine

FILED FOR RECORD THIS 30 DAY

OF December A. D. 1963

AT 1:30 O'CLOCK P. M.

*Gene L. Morgan*

COUNTY CLERK

*Esther Sheet*

DEPUTY

FEB 2 1963

File No. \_\_\_\_\_

T. 24N R. 17E

TRIPPLICATE

County BLAINE

LOG

STATE OF MONTANA  
ADMINISTRATOR OF GROUNDWATER CODE  
STATE WATER CONSERVATION BOARD

Notice of Completion of Groundwater  
Appropriation by Means of Well  
DEVELOPED AFTER JANUARY 1, 1962

(Under Chapter 237 Montana Session Laws, 1961, as amended)

Owner MR. GERALD BREWER Address BIG SANDY, MONTANA

Driller HI-LINE DRILLING SERVICE Address HAURE, MONTANA

Date of Notice of appropriation of groundwater \_\_\_\_\_

Date well started 12/30/69 Date completed 1/19/70

Type of well DRILLED Equipment used CABLE TOOL RIG  
(Dug, driven, bored or drilled) (Churn drill, rotary or other)

Water use: Domestic  Municipal  Stock  Irrigation   
Industrial  Drainage  Other

Indicate on the diagram the character and thickness of the different strata met with in drilling, such as soil, clay, shale, gravel, rock or sand, etc. Show depth at which water is encountered, thickness and character of water-bearing strata and height to which the water rises in the well.

Top of Ground  
(Elev. above sea level.....)

0  
11 Volcanic GRAVEL + CLAY MIX  
15 YELLOW SHALE  
19 GREY SHALE  
27 BLUE SHALE  
37 BLUE-GREY SHALE  
40 FINE SANDY BLUE SHALE  
42 1/2 BROKE THROUGH ROOF OF ABANDONED COAL MINE TUNNEL OR ROOM. WATER ROSE TO 2 FT. LEVEL IMMEDIATELY. Baled well for 1 hour with no effect on water table.

270576  
JUL 24 1970  
3 37 ft.

Show exact depth of bottom.

| Size of Drilled Hole | Size of Well of Casing  | From (Feet) | To (Feet) | PERFORATIONS |             |           |
|----------------------|-------------------------|-------------|-----------|--------------|-------------|-----------|
|                      |                         |             |           | Rib Size     | From (Feet) | To (Feet) |
| 8 1/2"               |                         | 0           | 22        |              |             |           |
| 6 5/8"               |                         | 22          | 10        |              |             |           |
|                      | 6 7/8" O.D. 13 PER FOOT |             | 27        |              |             |           |

(NO PERFORATIONS) WATER COMES IN THROUGH BOTTOM OF CASING AT 39 FT.

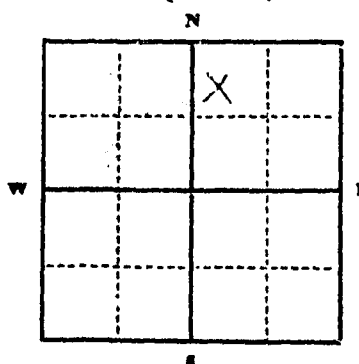

Static Water Level for non-flowing well 22 feet.

Shut-in Pressure for Flowing Well NOT APP.

Pumping Water Level 22 feet at 2 gal. per minute.

Discharge in gal. per min. of flowing well NOT APPLICABLE

How Tested QUALER

Length of Test 1 HOUR

Remarks: (Gravel packing, cementing, packers, type of shutoff) WELL DRILLED TO 8 1/2" DIAMETER TO 22 FOOT LEVEL. CASING INSTALLED IN 6 5/8" DIAMETER HOLE TO 27 FT. LEVEL. CEMENT GRANT PLACED AROUND CASING FROM 22 FT LEVEL DOWN TO APPROX 14 FT LEVEL. (Continue on reverse side)

USE—If used for irrigation, industrial, drainage or other. Explain, state number of acres and location or other data (i.e.: Lot, Block and Addition).

46  
Driller's License Number

Herbert Brewer  
Driller's Signature.

54561

This form to be prepared by driller, and three copies to be filed by the owner with the County Clerk and Recorder in the county in which the well is located, tissue copy to be retained by driller.

Please answer all questions. If not applicable, so state, otherwise the form will be returned.

File No. \_\_\_\_\_

T. 26N R 17E

TRIPPLICATE

County BLAINE

LOG

STATE OF MONTANA  
ADMINISTRATOR OF GROUNDWATER CODE  
STATE WATER CONSERVATION BOARD

Notice of Completion of Groundwater  
Appropriation by Means of Well

DEVELOPED AFTER JANUARY 1, 1962

(Under Chapter 237 Montana Session Laws, 1961, as amended)

Owner MR. GERALD BREWER Address BIG SANDY, MONTANA

Driller HI-LINE DRILLING SERVICE Address HAVER, MONTANA

Date of Notice of appropriation of groundwater \_\_\_\_\_

Date well started 12/30/69 Date completed 1/19/70

Type of well DRILLED Equipment used CABLE TOOL RIG  
(Dug, driven, bored or drilled) (Churn drill, rotary or other)

Water use: Domestic  Municipal  Stock  Irrigation   
Industrial  Drainage  Other

Indicate on the diagram the character and thickness of the different strata met with in drilling, such as soil, clay, shale, gravel, rock or sand, etc. Show depth at which water is encountered, thickness and character of water-bearing strata and height at which the water rises in the well.

Top of Ground  
(Elev. above sea level \_\_\_\_\_)

0  
11 Volcanic Gravel & Clay Mix  
15 Yellow Shale  
19 Grey Shale  
27 Blue Shale  
37 Blue-Grey Shale  
40 Fine Sandy Blue Shale  
42 1/2 Broke through roof of abandoned coal mine tunnel or room. Water rose to 22 foot level immediately.  
Baled well for 1 hour with no effect on water table  
272576  
June 29, 1975  
3:39 p.m.

42 1/2 Show exact depth of bottom.

| Size of Drilled Hole           | From (Foot) | To (Foot) | PERFORATIONS |             |           |
|--------------------------------|-------------|-----------|--------------|-------------|-----------|
|                                |             |           | Kind         | From (Foot) | To (Foot) |
| 8 1/2"                         | 0           | 22        |              |             |           |
| 6 7/8"                         | 22          | 10        |              |             |           |
| 6 7/8" O.D.<br>1 3/4" PER FOOT | 22          | 29        |              |             |           |

(NO PERFORATIONS)  
WATER COMING IN FROM BOTTOM OF CASING AT 39 FT.

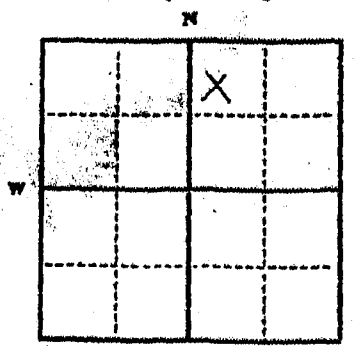

Static Water Level for non-flowing well 22 feet.

Shut-in Pressure for Flowing Well N/A

Pumping Water Level 22 feet at 8 gal. per minute.

Discharge in gal. per min. of flowing well NOT APPLICABLE

How Tested BALED

Length of Test 1 HOUR

Remarks: (Gravel packing, cementing, packers, type of shutoff) SOLE DRILLED TO 8 1/2" DIAMETER TO 22 FOOT LEVEL. CASING INSTALLED IN 6 7/8" DIAMETER HOLES TO 22 FT LEVEL. CEMENT GROUT PALED AROUND CASING FROM 22 FT LEVEL DOWN TO APPROX 14 FT LEVEL. (Continue on reverse side)

USE—If used for irrigation, industrial, drainage or other. Explain, state number of acres and location or other data (i.e.: Lot, Block and Addition).

46  
Driller's License Number

Herbert Brewer  
Driller's Signature.

54861

This form to be prepared by driller, and three copies to be filed by the owner with the County Clerk and Recorder in the county in which the well is located, tissue copy to be retained by driller.

Please answer all questions. If not applicable, so state, otherwise the form will be returned.

272376  
272376  
STATE OF MONTANA  
County of Blaine  
Filed for record this 29 Day  
of June A. D. 1955  
At 3:39 O'Clock P. M.  
\_\_\_\_\_  
County Clerk  
\_\_\_\_\_  
Deputy  
Fee \_\_\_\_\_

County BLAINE Twp. 26 NORTH Rge. 18 EAST

| Sec. | Name of Appropriator      | Type of Form | County File No. | Remarks      |
|------|---------------------------|--------------|-----------------|--------------|
| 1    | SIVERTSEN, WALTER         | GW-2         | 272372          |              |
| 1    | MAINARD, ALICE            |              | 252047          |              |
| 1    | SIVERTSEN, WALTER         | GW-3         | 272370          | } SAME FORM  |
| 1    | " "                       | GW-3         | 272370          |              |
| 1    | MAINARD, ALICE            | GW-3         | 252048          | } SAME FORM  |
| 1    | " "                       | GW-3         | 252048          |              |
| 2    | SIVERTSEN, WALTER         | GW-3         | 272370          | } SAME FORM  |
| 2    | " "                       | GW-3         | 272370          |              |
| 2    | MAINARD, ALICE            | GW-3         | 252048          | SEE SEC. 1   |
| 2    | SIVERTSEN, LEONARD T.     |              | 252112          | } SAME FORM  |
| 3    | " "                       |              | 252112          |              |
| 4    | " "                       |              | 252112          |              |
| 5    | MOORE, PAUL J.            | GW-3         | 252060          |              |
| 7    | BIEBINGER, J.E. & MILDRED | GW-3         | 251950          |              |
| 8    | SIVERTSEN, LEONARD T.     |              | 252112          | } SEE SEC. 2 |
| 9    | " "                       |              | 252112          |              |
| 10   | " "                       |              | 252112          |              |
| 10   | MOORE, PAUL J.            | GW-3         | 252060          | SEE SEC. 5   |
| 12   | SIVERTSEN, WALTER         | GW-3         | 272370          | SEE SEC. 1   |
| 12   | MAINARD, ALICE            | GW-3         | 252048          | SEE SEC. 1   |
| 12   | SIVERTSEN, WALTER         | GW-3         | 272370          | SEE SEC. 1   |
| 13   | BIEBINGER, J.E. & MILDRED | GW-3         | 251950          | } SEE SEC. 7 |
| 20   | " "                       | GW-3         | 251950          |              |
| 28   | ROBINSON, JOHN W.         |              | 252113          |              |
| 29   | BIEBINGER, J.E. & MILDRED | GW-3         | 251950          | } SEE SEC. 7 |
| 30   | " "                       | GW-3         | 251950          |              |
| 31   | " "                       | GW-3         | 251950          |              |
| 31   | BOGGES, BOYD              |              | 251989          |              |
| 33   | ROBINSON, JOHN W.         |              | 252113          | SEE SEC. 28  |



272372  
#272372

STATE OF MONTANA  
County of Blaine } 29  
Filed for record this \_\_\_\_\_ Day  
of June A. D. 19 73  
At 3:35 O'Clock P M.  
\_\_\_\_\_  
County Clerk  
\_\_\_\_\_  
Deputy  
Fee \_\_\_\_\_



File No.

T. 26 R. 18

*Duplicate*  
ORIGINAL

County

STATE OF MONTANA  
ADMINISTRATOR OF GROUNDWATER CODE  
OFFICE OF STATE ENGINEER

Declaration of Vested Groundwater Rights

(Under Chapter 237, Montana Session Laws, 1961)

1. *Alice Mainard*, of *Lloyd*  
(Name of Appropriator) (Address) (Town)  
County of *Blaine* State of *Montana*  
have appropriated groundwater according to the Montana laws in effect prior to January 1, 1962, as follows:

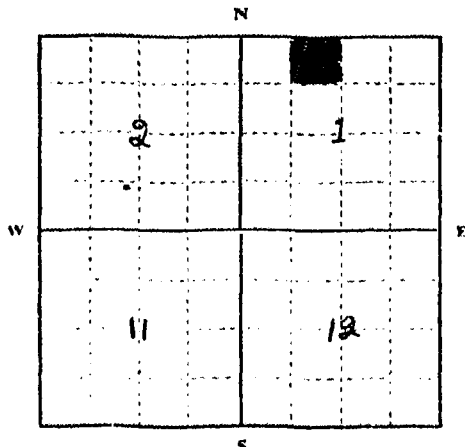

LOT 3  
1/4 Sec. 1 T. 26 R. 18

Indicate point of appropriation and place of use, if possible. Each small square represents 10 acres.

2. The beneficial use on which the claim is based *Household use*

3. Date or approximate date of earliest beneficial use; and how continuous the use has been *Nov. 5, 1956*

4. The amount of groundwater claimed (in miner's inches or gallons per minute) *5 Gal. Per Minute*

5. If used for irrigation, give the acreage and description of the lands to which water has been applied and name of the owner thereof

6. The means of withdrawing such water from the ground and the location of each well or other means of withdrawal *Hand and electric Pump*

7. The date of commencement and completion of the construction of the well, wells, or other works for withdrawal of groundwater *Started in April - 56 & Completed in Nov. 1956.*

8. The depth of water table *6 ft.*

9. So far as it may be available, the type, size and depth of each well or the general specifications of any other works for the withdrawal of groundwater *6 ft. x 15 ft.*

10. The estimated amount of groundwater withdrawn each year *unknown*

11. The log of formations encountered in the drilling of each well if available *Clay - sand - Rock*

12. Such other information of a similar nature as may be useful in carrying out the policy of this act, including reference to book and page of any county record

Signature of Owner *Alice Mainard*  
Date *Dec. 28, 1962*

Three copies to be filed by the owner with the County Clerk and Recorder of the county in which the well is located.

Please answer all questions. If not applicable, so state, otherwise the form will be returned.

Original to the County Clerk and Recorder; Duplicate to the State Engineer; Triplicate to the Montana Bureau of Mines and Geology, and Quadruplicate for the Appropriator. *21890*

252047

STATE OF MONTANA  
County of Blaine

FILED FOR RECORD THIS 30 DAY  
OF December A. D. 1963  
AT 3:40 O'CLOCK P. M.

Caro L. Musgrave  
COUNTY CLERK

DEPUTY

FILED 2<sup>010</sup>

14  
14  
20  
20  
12V  
13V

County Blaine

STATE OF MONTANA  
ADMINISTRATOR OF GROUNDWATER CODE  
MONTANA WATER RESOURCES BOARD

NOTICE OF COMPLETION OF GROUNDWATER APPROPRIATION WITHOUT WELL

Developed After January 1, 1962

(Under Chapter 237, Montana Session Laws, 1961, as amended)

This form to be prepared by contractor (if any), otherwise by the owner.

Three copies of this notice are to be filed with the County Clerk and Recorder of the county in which the works are located.

Please answer all questions. If not applicable, so state, otherwise the form may be returned.

For Administrator's Use

File 272370

June 29, 1973

GW 1 5.35 p.m.

Owner WALTER SIVERTSEN

Address Lloyd, Montana

Contractor (if any) NA

Address of Contractor NA

Date Started ..... Date Completed early homestead days

1. Describe means of obtaining groundwater (as by sub-irrigation, developed spring, drains, etc.)

developed springs

2. Means of withdrawing water (gravity, pump, canal, etc.)

gravity

3. Depth of water table

unknown

4. Use of the water

stock water

5. Amount of groundwater claimed (in miner's inches or gallons per minute)

Spring #1, 5 gal. per minute  
#2, 20 gal. per minute, #3, 15 gal. per minute, #4, 10 gal. per min, #5, 5 g/p/m

6. If used for irrigation, give number of acres and description of land

NA

7. Estimate amount of water used each year

unknown

8. Months of year spring flows

all springs flow entire year

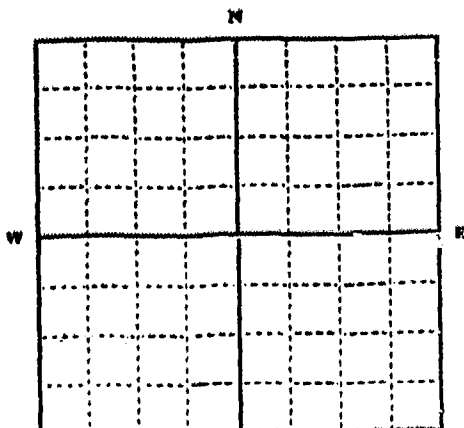

See Exhibit "A"

..... 1/4 ..... 1/4 Sec.

T..... N R..... E  
S W

INDICATE POINT OF APPROPRIATION AND PLACE OF USE, IF POSSIBLE.

Elevation of spring, if known or estimated

Signature of Owner Walter Sivertsen

Date June 29, 1973

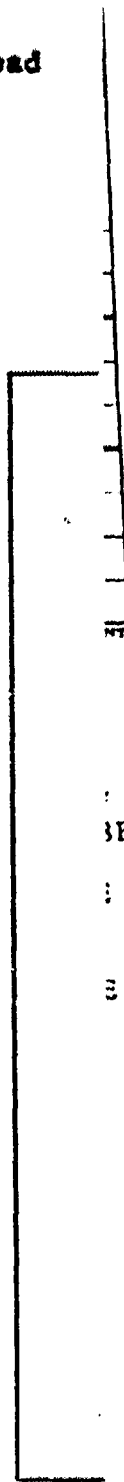

487

26 North Range No. 18 East Merid<sup>n</sup>

EXHIBIT "A"

Rge. ....

Rge. ....

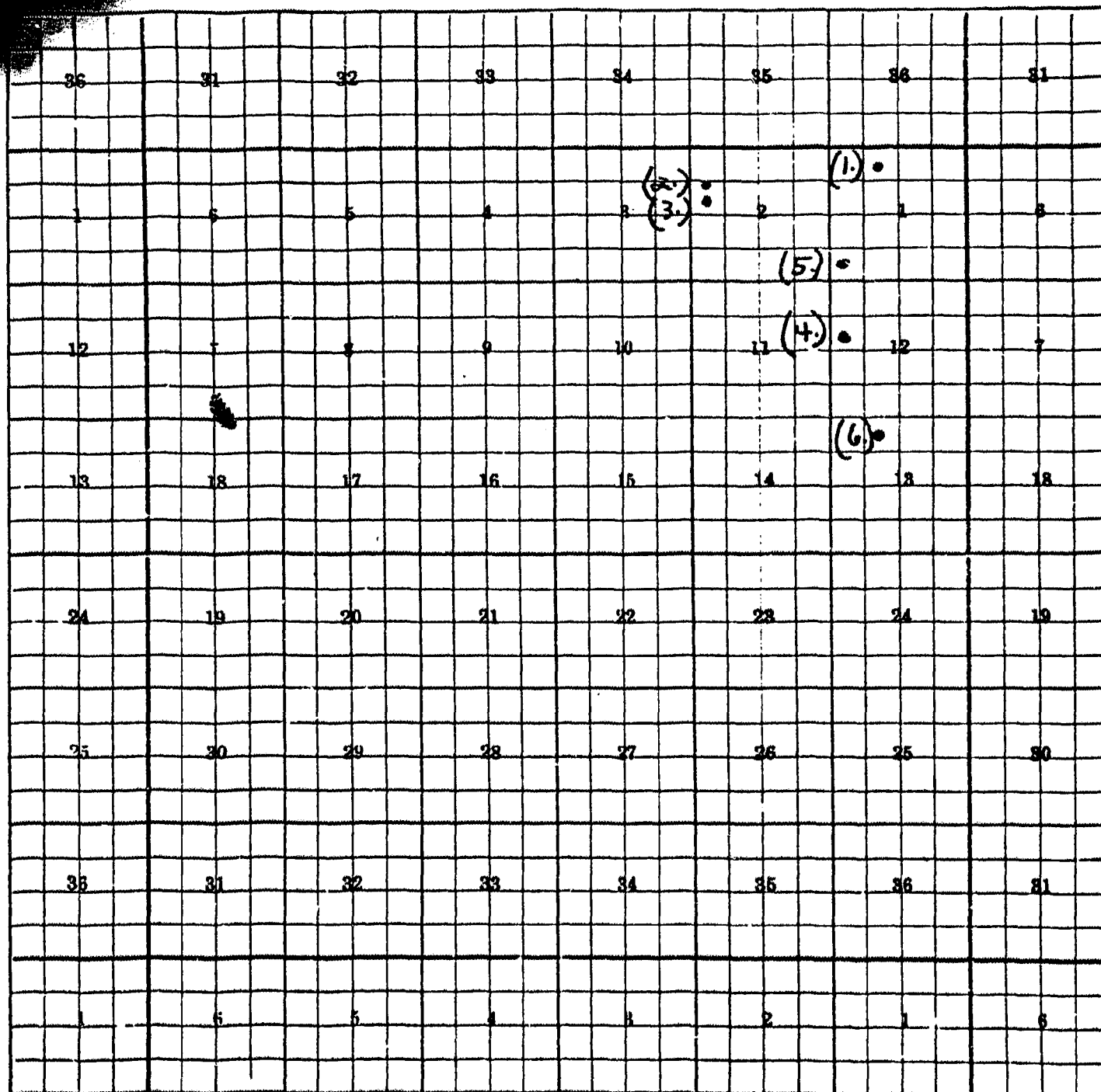

OPINION PRINT. CHINOOK, MONT.

### MEMORANDUM

- Spring No. 1. located in the NE $\frac{1}{4}$ NW $\frac{1}{4}$ , Section 1, Township 26 North, Range 18E
- Spring No. 2. located in the SW $\frac{1}{4}$ NW $\frac{1}{4}$ , Section 2, Township 26 North, Range 18E
- Spring No. 3. located in the SW $\frac{1}{4}$ NW $\frac{1}{4}$  of Section 2, Township 26N, Range 18E
- Spring No. 4. located in the SW $\frac{1}{4}$ NW $\frac{1}{4}$ , Section 12, Township 26N, Range 18E
- Spring No. 5. located in the SW $\frac{1}{4}$ SW $\frac{1}{4}$ , Section 1, Township 26N, Range 18E
- Spring No. 6. located in the NE $\frac{1}{4}$ NW $\frac{1}{4}$ , Section 13, Township 26N, Range 18E

272370

STATE OF MONTANA }  
County of Blaine }  
Filed for record this 29 Day  
of June A. D. 19 13  
At 3:53 O'Clock P.M.  
\_\_\_\_\_  
County Clerk  
\_\_\_\_\_  
Deputy  
Fee \_\_\_\_\_

C

JW 3

Approved Stock Form—State Publishing Co., Helena, Montana—2199

File No. ....

DUPLICATE

26 18  
 RECEIVED  
 JAN 8 1964  
 County

STATE OF MONTANA  
 ADMINISTRATOR OF GROUNDWATER CODE  
 OFFICE OF STATE ENGINEER

STATE ENGINEER

**Notice of Completion of Groundwater Appropriation  
 Without Well**

(Under Chapter 237 Montana Session Laws, 1961)

Date of Appropriation of Groundwater Dec 28, 1963

Owner Alice Mainard Address Lloyd, Mont.

Contractor (if any) .....

Address of Contractor .....

Date Started..... Date Completed.....

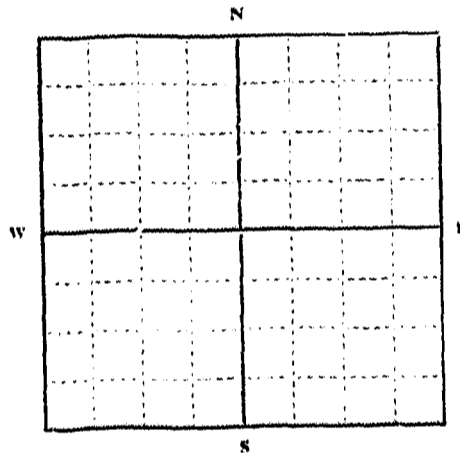

..... $\frac{1}{4}$ ..... Sec..... T..... R.....  
 Indicate point of appropriation  
 and place of use, if possible.

Describe means of obtaining groundwater without a well "as by  
 sub-irrigation and other natural processes". Include depth to  
 water when applicable. Springs by  
natural Process

Quantity of water developed and used with explanation of method  
 used to measure or estimate such amount. If use is intermittent  
 estimate approximate lengths of periods of use 12 months

Signature of Owner Alice Mainard  
 Date Dec 28, 1963

This form to be prepared by contractor (if any), otherwise by the owner.  
 Three copies of this notice are to be filed with the County Clerk and Recorder of the county in which the  
 works are located.  
 Please answer all questions. If not applicable, so state, otherwise the form will be returned.  
 Original to the County Clerk and Recorder; duplicate to the State Engineer; Triplicate to the Montana  
 Bureau of Mines and Geology and Quadruplicate for the Appropriator.

21891

252048

STATE OF MONTANA  
County of Blaine

FILED FOR RECORD THIS 30 DAY

OF December A. D. 1963

AT 3:40 O'CLOCK P. M.

Cara L. Musgrave  
COUNTY CLERK

FEZ 2<sup>nd</sup> DEPUTY

A vertical grid is positioned on the right side of the page. It consists of a single column of rectangular cells. The cells are separated by horizontal lines. The numbers 25, 26, 27, 28, 29, and 30 are printed vertically along the right edge of the grid, corresponding to the rows. The top cell is labeled '30', the second '25', the third '26', the fourth '27', the fifth '28', and the sixth '29'. The bottom cell is labeled '25'.

|  |    |
|--|----|
|  | 30 |
|  | 25 |
|  | 26 |
|  | 27 |
|  | 28 |
|  | 29 |
|  | 25 |

|    |    |    |    |    |       |             |
|----|----|----|----|----|-------|-------------|
| 36 | 31 | 30 | 34 | 35 | 36    | 31          |
| 1  | 6  | 5  | 4  | 3  | 26-18 | LOT 2-26-18 |
|    |    |    |    |    | 26-18 |             |
| 12 | 7  | 8  | 9  | 10 | 11    | 26-18       |
| 13 | 18 | 17 | 16 | 15 | 14    | 13          |
| 24 | 19 | 20 | 21 | 22 | 23    | 24          |
| 25 | 30 | 29 | 28 | 27 | 26    | 25          |
| 36 | 31 | 32 | 33 | 34 | 35    | 36          |
|    |    |    |    |    | 27-18 |             |
| 1  | 6  | 5  | 4  | 3  | 2     | 1           |



File No. ....

T 26, ~~22~~ R 18 E.

DUPLICATE

County Blaine

STATE OF MONTANA  
ADMINISTRATOR OF GROUNDWATER CODE  
OFFICE OF STATE ENGINEER

**Declaration of Vested Groundwater Rights**

(Under Chapter 237, Montana Session Laws, 1961)

2/24  
3/14  
4/17  
8/24  
9/24  
10/24

1. Leonard T. Sivertsen, of Lloyd  
(Name of Appropriator) (Address) (Town)  
County of Blaine State of Montana  
have appropriated groundwater according to the Montana laws in effect prior to January 1, 1962, as follows:

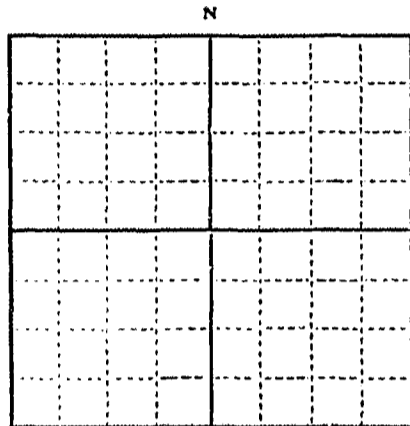

see plat attached

1/4 Sec. T. R.

Indicate point of appropriation and place of use, if possible. Each small square represents 10 acres.

2. The beneficial use on which the claim is based stockwater and irrigation
3. Date or approximate date of earliest beneficial use, and how continuous the use has been Well #1, 1920 and before; Well #2, 1948; 2 springs, 1920 and before; use continuous since commencement.
4. The amount of groundwater claimed (in miner's inches or gallons per minute) 2 wells, 5 gpm each; 1 gal. per min. on each spring, except spring no. 3, 5 gpm.
5. If used for irrigation, give the acreage and description of the lands to which water has been applied and name of the owner thereof 60 acres in W1SW1 Sec. 3-26-18; 15 acres in W1NW1, 3, E1SW1, 10 Ac. in W1SW1 2-26-18. Leonard T. Sivertsen, owner
6. The means of withdrawing such water from the ground and the location of each well or other means of withdrawal 2 wells, withdrawn by pump, with electric motor; springs by natural flow. See plat attached for location, also reverse side of form.
7. The date of commencement and completion of the construction of the well, wells, or other works for withdrawal of groundwater Well #1 completed prior to 1920; Well #2 completed in 1948; water from each spring withdrawn by natural flow.
8. The depth of water table Well #1 15'; Well #2, 12'
9. So far as it may be available, the type, size and depth of each well or the general specifications of any other works for the withdrawal of groundwater. Well #1, pump on 1" pipe, Well #2, pump on 3/4" pipe, operated by electric motors; six springs boxed in; water from all springs withdrawn by natural flow.
10. The estimated amount of groundwater withdrawn each year no fair estimate possible.
11. The log of formations encountered in the drilling of each well if available not available.
12. Such other information of a similar nature as may be useful in carrying out the policy of this act, including reference to book and page of any county record.

Signature of Owner Leonard T. Sivertsen Sr.

Date December 30, 1963

Three copies to be filed by the owner with the County Clerk and Recorder of the county in which the well is located.

Please answer all questions. If not applicable, so state, otherwise the form will be returned.

Original to the County Clerk and Recorder; Duplicate to the State Engineer; Triplicate to the Montana Bureau of Mines and Geology, and Quadruplicate for the Appropriator.

21951

STATE OF MONTANA  
County of Blaine

252114  
7-5-117

FILED FOR RECORD THIS 31 DAY

OF REGISTERED A. D. 1963

AT 3:30 O'CLOCK P. M.

By *John H. [Signature]*  
COUNTY CLERK

DEPUTY

6. Well No. 1, SW $\frac{1}{4}$ NW $\frac{1}{4}$  of Section 5, Township 26 N., Range 18 EMM  
Well No. 2, SE $\frac{1}{4}$ NE $\frac{1}{4}$  of Section 4,  
Spring #1, NE $\frac{1}{4}$ NW $\frac{1}{4}$  of Section 3, NE $\frac{1}{4}$ SE $\frac{1}{4}$ NE $\frac{1}{4}$  of Section 4-26-18  
Spring #2, S $\frac{1}{4}$ SW $\frac{1}{4}$ NW $\frac{1}{4}$  of Section 3, SE $\frac{1}{4}$ SE $\frac{1}{4}$ NE $\frac{1}{4}$  of Section 4-26-18  
Spring #3, W $\frac{1}{4}$ SW $\frac{1}{4}$  of Section 3, -26-18  
Spring #4, NE $\frac{1}{4}$ SE $\frac{1}{4}$  of Section 4-26-18  
Spring #5, SE $\frac{1}{4}$ SE $\frac{1}{4}$  of Section 4-26-18  
Spring #6, NW $\frac{1}{4}$ SW $\frac{1}{4}$  of Section 2, -26-18  
Spring #7, SW $\frac{1}{4}$ SW $\frac{1}{4}$  of Section 2-26-18  
Spring #8, NE $\frac{1}{4}$ SE $\frac{1}{4}$  of Section 3-26-18  
Spring #9, SE $\frac{1}{4}$ NE $\frac{1}{4}$  of Section 10-26-18  
Spring #10, NE $\frac{1}{4}$ SE $\frac{1}{4}$  of Section 10-26-18  
Spring #11, NE $\frac{1}{4}$ SE $\frac{1}{4}$  of Section 33-27-18  
Spring #12, SE $\frac{1}{4}$ SE $\frac{1}{4}$  of Section 33-27-18  
Spring #13, NW $\frac{1}{4}$ SE $\frac{1}{4}$  of Section 8-26-18

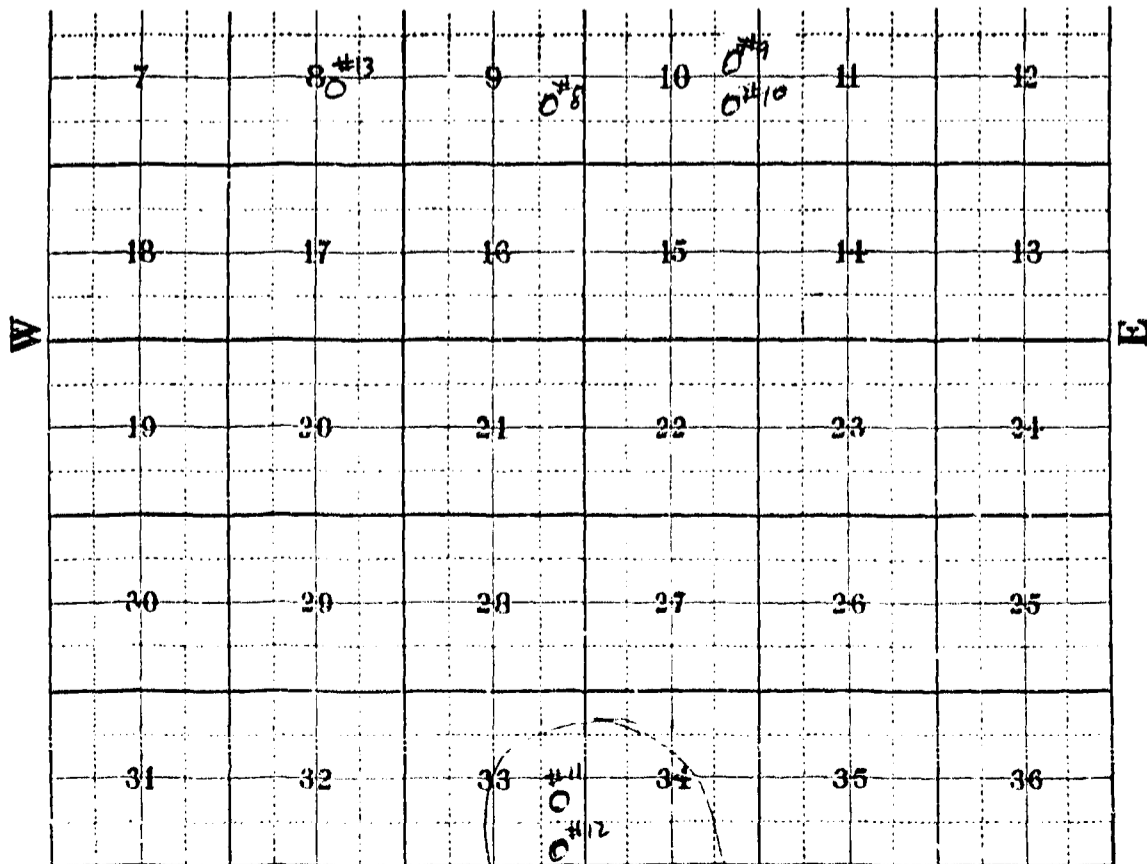

DIAGRAM

of  
Township No. 26 N Range No. 18 E

Blaine County, State of Montana

N

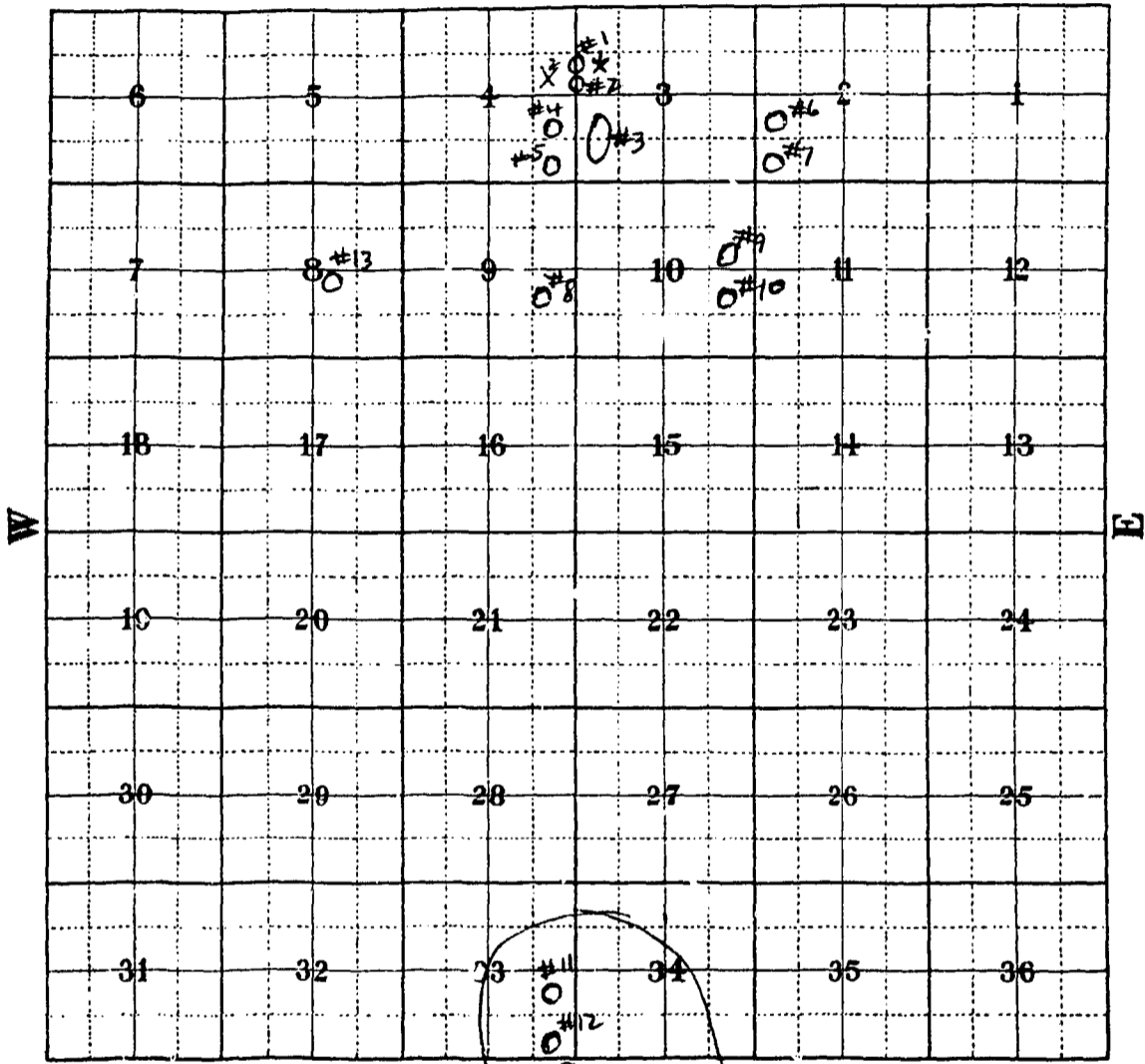

X 2 wells  
O 13 springs

File No.....

T. 26 R. 18 E

DUPLICATE

County Blaine

STATE OF MONTANA  
ADMINISTRATOR OF GROUNDWATER CODE  
OFFICE OF STATE ENGINEER

RECEIVED  
JAN 6 1964

Notice of Completion of Groundwater Appropriation  
Without Well

(Under Chapter 237, Montana Session Laws, 1961)

Date of Appropriation of Groundwater 1950

Owner Paul J. Moore Address Lloyd Mont

Contractor (if any) Self

Address of Contractor Same

Date Started 1950 Date Completed 1950

Describe means of obtaining groundwater without a well "as by sub-irrigation and other natural processes". Include depth to water when applicable. Natural flowing Springs were developed by excavating to a depth of 3 to 6 ft. Water was piped into tanks for livestock. Has been in continuous use since 1950.

Quantity of water developed and used with explanation of method used to measure or estimate such amount. If use is intermittent

estimate approximate lengths of periods of use. Each spring develops about 5 gal per min. Measured with one gal container. Have been in continuous use since 1950.

Signature of Owner Paul J. Moore

Date Dec 26<sup>th</sup> 1963

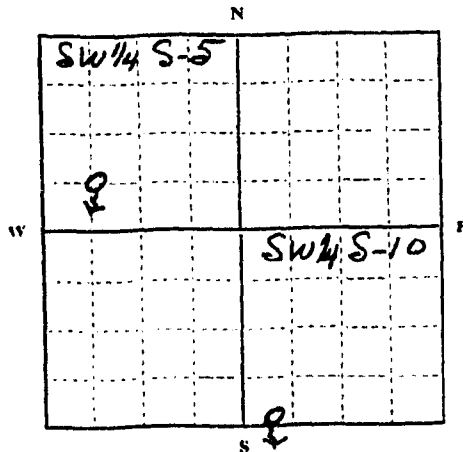

1/4 Sec 5-10 T. 26 R. 18 E

Indicate point of appropriation and place of use, if possible.

Spring  
Point of appropriation and place of use on the same

This form to be prepared by contractor (if any), otherwise by the owner.

Three copies of this notice are to be filed with the County Clerk and Recorder of the county in which the works are located.

Please answer all questions. If not applicable, so state, otherwise the form will be returned.

Original to the County Clerk and Recorder; duplicate to the State Engineer; Triplicate to the Montana Bureau of Mines and Geology and Quadruplicate for the Appropriator.

252060  
252060

STATE OF MONTANA  
County of Blaine

FILED FOR RECORD THIS 31 DAY  
OF December A. D. 1963  
AT 8:15 O'CLOCK A. M.  
Cora L. Maguire  
COUNTY CLERK  
Esther Shub  
DEPUTY  
MAR 2 1963

File No. ....

DUPLICATE

T. 26 R. 17

County *Blaine*

STATE OF MONTANA  
ADMINISTRATOR OF GROUNDWATER CODE  
OFFICE OF STATE ENGINEER

RECEIVED  
JAN 6 1963  
STATE ENGINEER

2/12  
1/11  
1/10  
1/9  
1/8  
1/7  
1/6  
1/5  
1/4  
1/3  
1/2  
1/1  
1V  
13V  
20V  
29V  
30V  
31V

Notice of Completion of Groundwater Appropriation  
Without Well

(Under Chapter 237 Montana Session Laws, 1961)

Date of Appropriation of Groundwater.....  
Owner *G. M. Milled* Address *FLYD Mont*  
Contractor (if any).....  
Address of Contractor.....  
Date Started *1930* Date Completed *1963*

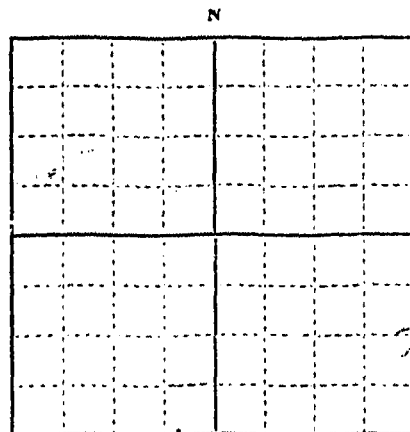

Describe means of obtaining groundwater without a well "as by sub-irrigation and other natural processes". Include depth to water when applicable. *Springs developed*  
*Spring Box - Water piped*  
*into 5 or 6 ft. diameter*  
*metal tanks*  
Legal description of locations attached

Quantity of water developed and used with explanation of method used to measure or estimate such amount. If use is intermittent

See Supplemental  
1/4 Sec. T. 26 R. 17  
Indicate point of appropriation and place of use, if possible.

estimate approximate lengths of periods of use.....  
*vary in flow from*  
*1/4 inch to 1 1/2 inch*  
*pipe full*

Signature of Owner *J. E. Beckinger*  
Date *12.26.63*

This form to be prepared by contractor (if any), otherwise by the owner.

Three copies of this notice are to be filed with the County Clerk and Recorder of the county in which the works are located.

Please answer all questions. If not applicable, so state, otherwise the form will be returned.

Original to the County Clerk and Recorder; duplicate to the State Engineer; Triplicate to the Montana Bureau of Mines and Geology and Quadra... the Appropriator.

*Arthur E. McLeish III*

|    |    |    |    |    |    |   |           |
|----|----|----|----|----|----|---|-----------|
|    |    |    |    |    |    |   |           |
| 6  | 5  | 4  | 3  | 2  | 1  |   |           |
| X  | X  |    |    |    |    |   |           |
|    | 8  | 9  | 10 | 11 | 12 |   |           |
|    |    |    |    |    |    |   |           |
| 18 | 17 | 16 | 15 | 14 | 13 | X | T 21 R 18 |
|    |    |    |    |    |    | X |           |
| 19 | 20 | 21 | 22 | 23 | 24 | X | T 21 R 17 |
|    |    |    |    |    |    |   |           |
| X  | X  | X  | X  | X  | X  | X | T 21 R 17 |
| 30 | 29 | 28 | 27 | 26 | 25 | X | T 21 R 17 |
|    |    |    |    |    |    |   |           |
| 31 | 32 | 33 | 34 | 35 | 36 |   |           |

MEMORANDUM

*Locations of developed springs for  
for the ... ..*

Signature of Owner *J. L. ...*  
Date *12.26.113*

This form to be prepared by contractor (if any), otherwise by the owner.  
Three copies of this notice are to be filed with the County Clerk and Recorder of the county in which the works are located.  
Please answer all questions. If not applicable, so state, otherwise the form will be returned.  
Original to the County Clerk and Recorder, Duplicate to the State Engineer, Triplicate to the Montana Bureau of Mines and Geology and Quadruplicate for the Appropriator.

*Arthur E. McLeish III*

|             |             |             |    |    |    |             |
|-------------|-------------|-------------|----|----|----|-------------|
| 6           | 5           | 4           | 3  | 2  | 1  | X T 21 R 17 |
| X           | X           | T 21 R 18   |    |    |    |             |
| X           | 8           | 9           | 10 | 11 | 12 |             |
| 15          | 17          | 16          | 15 | 14 | 13 | X T 21 R 18 |
| 19          | X T 21 R 18 | 21          | 22 | 23 | 24 | X T 21 R 17 |
| X T 21 R 18 | 29          | X T 21 R 18 | 27 | 26 | 25 | X T 21 R 17 |
| 31          | X T 21 R 18 | 32          | 33 | 34 | 35 | 36          |

**MEMORANDUM**

*Locations of developed springs in  
 J. H. ... ..  
 .....*

Signature of Owner *J. L. ... ..*  
 Date *12.26.1963*

This form to be prepared by contractor (if any), otherwise by the owner.  
 Three copies of this notice are to be filed with the County Clerk and Recorder of the county in which the  
 works are located.  
 Please answer all questions. If not applicable, so state, otherwise the form will be returned.  
 Original to the County Clerk and Recorder; duplicate to the State Engineer; Triplicate to the Montana  
 Bureau of Mines and Geology and Quadruplicate for the Appropriator.

*Arthur E. McLeish III*

NOTARY PUBLIC for the State of Montana  
 ... ..  
 My Comm. Expires on April 29, 1966



251950

F MONTANA  
y of Blaine

RECORD THIS 27 DAY  
December A. D. 1963  
46 O'CLOCK P. M.  
A. Thompson  
COUNTY CLERK  
Other Sheets  
DEPUTY

File No. ....

T. 26 N. P. 18 and 19 E. 33

DUPLICATE

County Blaine

STATE OF MONTANA  
ADMINISTRATOR OF GROUNDWATER CODE  
OFFICE OF STATE ENGINEER

JAN 6 1964

Declaration of Vested Groundwater Rights

(Under Chapter 237, Montana Session Laws, 1961)

1. John W. Robinson, of Lloyd  
(Name of Appropriator) (Address) (Town)

County of Blaine State of Montana

have appropriated groundwater according to the Montana laws in effect prior to January 1, 1962, as follows:

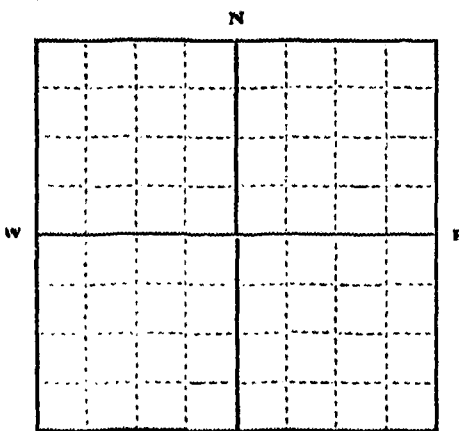

see plat attached

1/4 Sec. T. R.

Indicate point of appropriation and place of use, if possible. Each small square represents 10 acres.

- 2. The beneficial use on which the claim is based stockwater
- 3. Date or approximate date of earliest beneficial use; and how continuous the use has been around 1900; springs described in continuous use since early homestead days.
- 4. The amount of groundwater claimed (in miner's inches or gallons per minute) #1, 1gpm; #2, 1gpm; #3, 1gpm; #4, 2gpm; #5, 3/4gpm; #6, 3gpm; #7, 3/4gpm; #8, 1gpm; #9, 1gpm.
- 5. If used for irrigation, give the acreage and description of the lands to which water has been applied and name of the owner thereof
- 6. The means of withdrawing such water from the ground and the location of each well or other means of withdrawal natural flow; 9 springs located as shown on reverse side of this declaration.
- 7. The date of commencement and completion of the construction of the well, wells, or other works for withdrawal of groundwater springs used since early homestead days. In 1960 put in new curbing at springs, set 250 ft. deep, piped to watering tanks at each spring; tanks, 8' to 10' dia., 2 ft. deep. Replaced old curbing and tanks.
- 8. The depth of water table curbs at springs set from 2' to 6' deep.
- 9. So far as it may be available, the type, size and depth of each well or the general specifications of any other works for the withdrawal of groundwater withdrawal by natural flow; curbing and tanks installed at each spring as described in #7 above.
- 10. The estimated amount of groundwater withdrawn each year 5,000,000 gal., all springs.
- 11. The log of formations encountered in the drilling of each well if available not applicable
- 12. Such other information of a similar nature as may be useful in carrying out the policy of this act, including reference to book and page of any county record

Signature of Owner John W. Robinson  
Date December 26, 1963

Three copies to be filed by the owner with the County Clerk and Recorder of the county in which the well is located.

Please answer all questions. If not applicable, so state, otherwise the form will be returned.

Original to the County Clerk and Recorder; Duplicate to the State Engineer; Triplicate to the Montana Bureau of Mines and Geology, and Quadruplicate for the Appropriator. 21952

252-113  
252113

STATE OF MONTANA  
County of Blaine

FILED FOR RECORD THIS 31 DAY  
OF *December* A. D. 19 *63*  
AT *Bozeman* M.  
*Earl J. ...* COUNTY CLERK  
*...* DEPUTY  
PER *...*

- 6. Spring #1, NW-NE, Section 28, T. 26 N., R. 18 E.M.M.
- Spring #2, SE-SW, Section 33, T. 26 N., R. 18 E.M.M.
- Spring #3, SW-SW, Section 15, T. 26 N., R. 19 E. MN
- Spring #4, SW-SW, Section 15, T. 26 N., R. 19 E.M.M.
- Spring #5, NE-SE, Section 20, T. 26 N., R. 19 E.M.M.
- Spring #6, NE-NW, Section 31, T. 26 N., R. 19 E.M.M.
- Spring #7, SW-SW, Section 30, T. 26 N., R. 19 E.M.M.
- Spring #8, SW-NW, Section 30, T. 26 N., R. 19 E.M.M.
- Spring #9, SW-SE, Section 28, T. 26 N., R. 19 E.M.M.

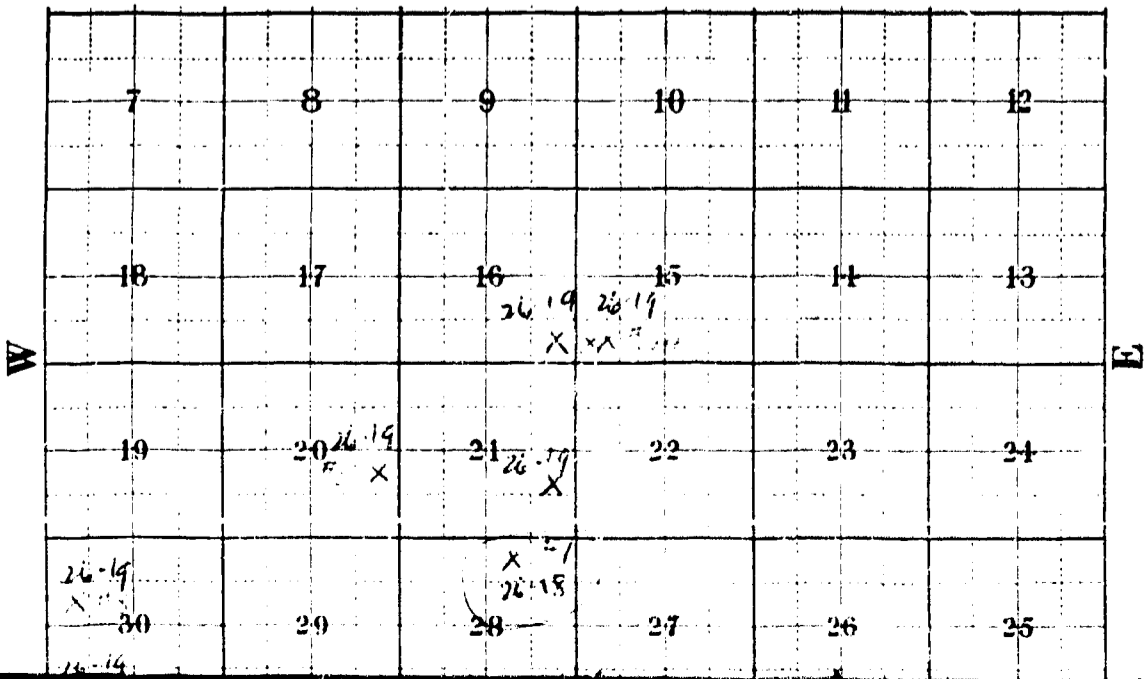

Township No. \_\_\_\_\_ Range No. \_\_\_\_\_

County, State of \_\_\_\_\_

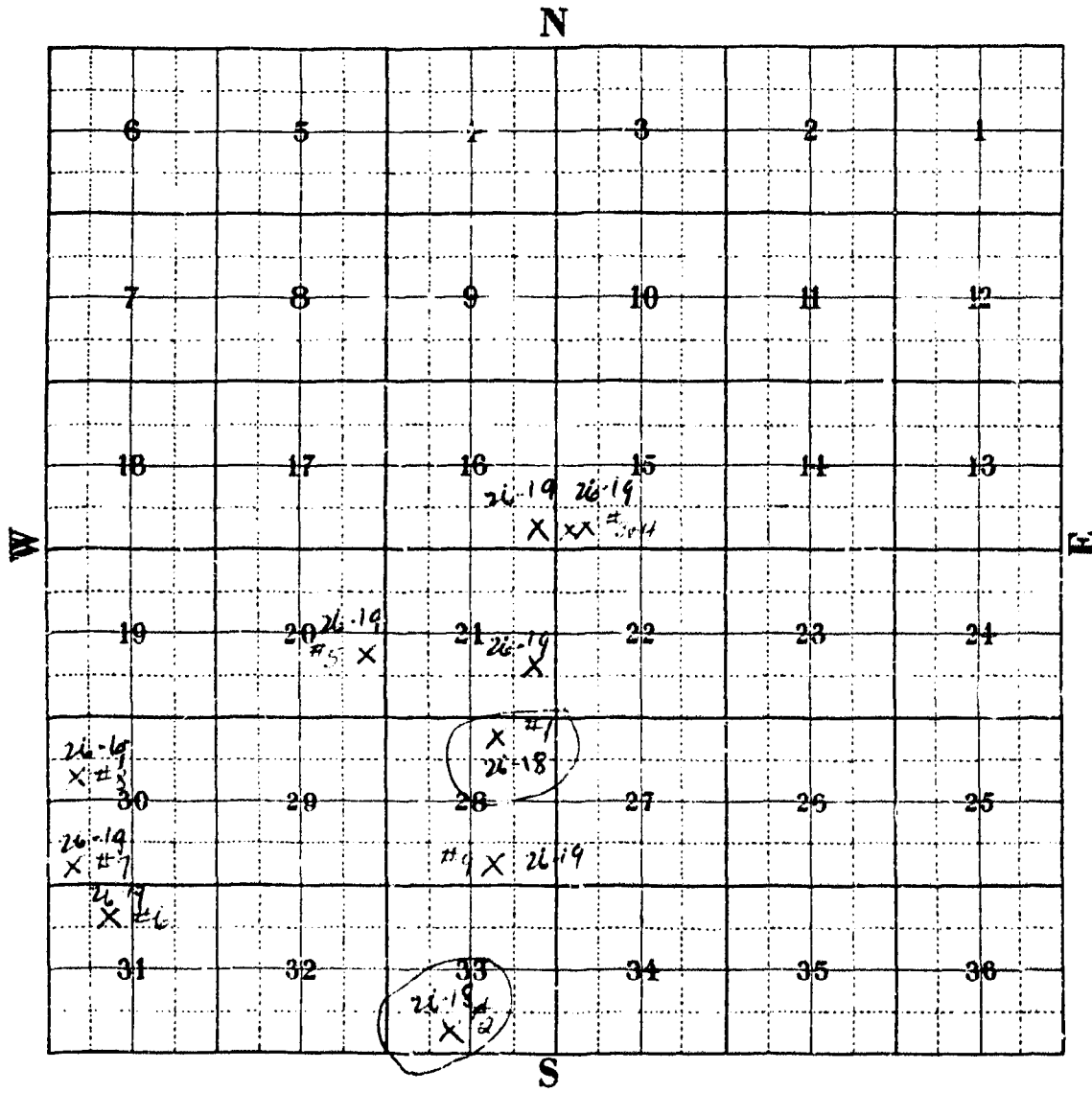

- X 7 springs T26 - R19
- X 2 wells T26 - R19
- X 2 springs T26 - R18