

252066

STATE OF MONTANA
County of Blaine

FILED FOR RECORD THIS 31 DAY

OF December A. D. 1963

AT 8:30 O'CLOCK A. M.

Carl L. Musgrave

COUNTY CLERK

Esther Sheet

DEPUTY

FEE 2⁰⁰

GW3

File No.

DUPLICATE

SW

T. 36 R. 24

County Blaine

RECEIVED
DEC 4 1963

STATE OF MONTANA
ADMINISTRATOR OF GROUNDWATER CODE
OFFICE OF STATE ENGINEER

STATE ENGINEER

Notice of Completion of Groundwater Appropriation Without Well

(Under Chapter 237 Montana Session Laws, 1961)

Date of Appropriation of Groundwater 4-19-43

Owner Clarence & Eddie Harmon Address Turner Court

Contractor (if any) None

Address of Contractor _____

Date Started _____ Date Completed _____

Describe means of obtaining groundwater without a well "as by sub-irrigation and other natural processes". Include depth to water when applicable.

Flowing Spring

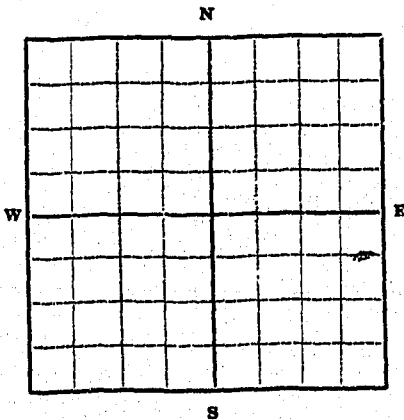

W 1/2 SW 1/4 Sec. 10. T36 R24
NE 1/4 SE 1/4
Indicate point of appropriation and place of use, if possible.

Quantity of water developed and used with explanation of method used to measure or estimate such amount. If use is intermittent estimate approximate lengths of periods of use

May 1 to Nov 1st

Signature of Owner Clarence J. Harmon

Signature of Owner Eddie J. Harmon

Date 12-3-63

This form to be prepared by contractor (if any), otherwise by the owner.

Three copies of this notice are to be filed with the County Clerk and Recorder of the county in which the works are located.

Please answer all questions. If not applicable, so state, otherwise the form will be returned.

Original to the County Clerk and Recorder; duplicate to the State Engineer; Triplicate to the School of Mines and Quadruplicate for the Appropriator.

STATE OF MONTANA
County of Blaine

FILED FOR RECORD THIS 3 DAY
OF December A. D. 1963
AT 11:45 O'CLOCK A. M.

Carl D. [unclear]
COUNTY CLERK
Arthur [unclear]
DEPUTY

FEE 2.00

File No.

T. 36 R. 24

DUPLICATE

County Blaine

STATE OF MONTANA
ADMINISTRATOR OF GROUNDWATER CODE
OFFICE OF STATE ENGINEER

RECEIVED
AUG 30 1963

Declaration of Vested Groundwater Rights

(Under Chapter 237, Montana Session Laws, 1961)

STATE ENGINEER

1. Clarence Harmon of Sumner
(Name of Appropriator) (Address) (Town)
County of Blaine State of Montana
have appropriated groundwater according to the Montana laws in effect prior to January 1, 1962, as follows:

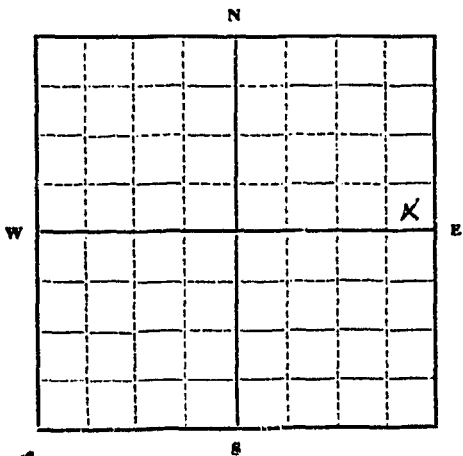

Sec 13 T. 36 R. 24

Indicate point of appropriation and place of use, if possible. Each small square represents 10 acres.

2. The beneficial use on which the claim is based.....

Stock + Domestic

3. Date or approximate date of earliest beneficial use; and how continuous the use has been.....

1950

4. The amount of groundwater claimed (in miner's inches or gallons per minute).....

4 gal per minute

5. If used for irrigation, give the acreage and description of the lands to which water has been applied and name of the owner thereof.....

70

6. The means of withdrawing such water from the ground and the location of each well or other means of withdrawal.....

jet pump

7. The date of commencement and completion of the construction of the well, wells, or other works for withdrawal of groundwater.....

1950

8. The depth of water table.....

36 feet

9. So far as it may be available, the type, size and depth of each well or the general specifications of any other works for the withdrawal of groundwater.....

6" steel casing 52' depth

10. The estimated amount of groundwater withdrawn each year.....

500,000

11. The log of formations encountered in the drilling of each well if available.....

Gravel, other formation not available

12. Such other information of a similar nature as may be useful in carrying out the policy of this act, including reference to book and page of any county record.....

Signature of Owner Clarence J. Harmon

Date Aug 29, 1963

Three copies to be filed by the owner with the County Clerk and Recorder of the county in which the well is located.

Please answer all questions. If not applicable, so state, otherwise the form will be returned.

Original to the County Clerk and Recorder; duplicate to the State Engineer; Triplicate to the Montana Bureau of Mines and Geology, and Quadruplicate for the Appropriator.

250270

STATE OF MONTANA
County of Blaine

FILED FOR RECORD THIS 29 DAY

OF Aug A. D. 1963

AT 2:00 O'CLOCK P. M.

Gene R. Magnus
COUNTY CLERK

Cather Sheets
DEPUTY

FEE 2.00

File No. _____

T. 36 N. R. 24 E.

DUPLICATE

County Blaine

STATE OF MONTANA
ADMINISTRATOR OF GROUNDWATER CODE
OFFICE OF STATE ENGINEER

RECEIVED
DEC 19 1963

STATE ENGINEER

Notice of Completion of Groundwater Appropriation Without Well

(Under Chapter 237 Montana Session Laws, 1961)

Date of Appropriation of Groundwater December 17, 1963

Owner Max Jenks Address Hogeland, Montana

Contractor (if any) _____

Address of Contractor _____

Date Started _____ Date Completed _____

Describe means of obtaining groundwater without a well "as by sub-irrigation and other natural processes". Include depth to water when applicable. flowing springs

* Known as Mosquito Springs
(4 Springs)

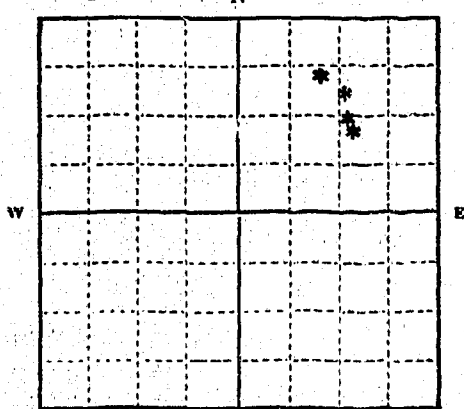

NE 1/4 Sec. 16 T. 36N R. 24E

Indicate point of appropriation and place of use, if possible.

Quantity of water developed and used with explanation of method used to measure or estimate such amount. If use is intermittent

estimate approximate lengths of periods of use _____

Year around.

Signature of Owner Max Jenks

Date December 17, 1963

This form to be prepared by contractor (if any), otherwise by the owner.

Three copies of this notice are to be filed with the County Clerk and Recorder of the county in which the works are located.

Please answer all questions. If not applicable, so state, otherwise the form will be returned.

Original to the County Clerk and Recorder; duplicate to the State Engineer; Triplicate to the Montana Bureau of Mines and Geology and Quadruplicate for the Appropriator.

251812

251812

STATE OF MONTANA
County of Blaine

FILED FOR RECORD THIS 15 DAY
OF December A. D. 1963
AT 3:40 O'CLOCK P. M.

C. L. Magnus
COUNTY CLERK

Cathleen Sheets
DEPUTY

FEE 2.00

16

File No.

T 36 N. R 24 E.

DUPLICATE

County BLAINE

STATE OF MONTANA
ADMINISTRATOR OF GROUNDWATER CODE
OFFICE OF STATE ENGINEER

RECEIVED
DEC 19 1963
STATE ENGINEER

Declaration of Vested Groundwater Rights
(Under Chapter 237, Montana Session Laws, 1961)

1. MAX JENKS, of Hogeland
(Name of Appropriator) (Address) (Town)
County of Blaine State of Montana
have appropriated groundwater according to the Montana laws in effect prior to January 1, 1962, as follows:

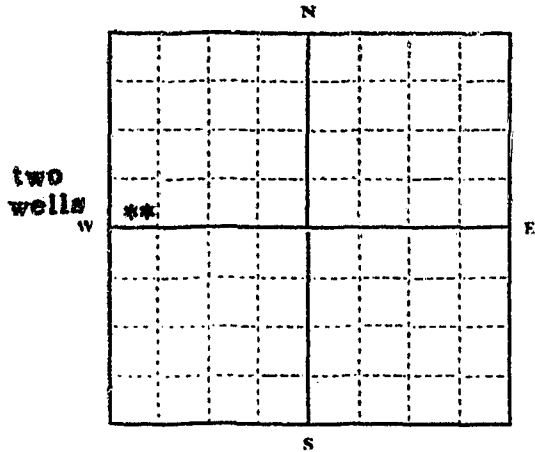

SW 1/4 NW 1/4 Sec. 16, T36N R24E.

Indicate point of appropriation and place of use, if possible. Each small square represents 10 acres.

- 2. The beneficial use on which the claim is based... Livestock water and household use.
- 3. Date or approximate date of earliest beneficial use; and how continuous the use has been... West well August 1932 and East well 1940. Continuous use since such dates.
- 4. The amount of groundwater claimed (in miner's inches or gallons per minute)... Seven (7) gallons per minute per well.
- 5. If used for irrigation, give the acreage and description of the lands to which water has been applied and name of the owner thereof... Garden and trees.
- 6. The means of withdrawing such water from the ground and the location of each well or other means of withdrawal... Jet pump in west well and cylinder pump in east well.

7. The date of commencement and completion of the construction of the well, wells, or other works for withdrawal of groundwater... West well dug in 1932 and east well drilled in 1940.

8. The depth of water table... 46 feet to water, Five feet of water in West well and 10 feet of water in east well.

9. So far as it may be available, the type, size and depth of each well or the general specifications of any other works for the withdrawal of groundwater... west well dug 46 feet, 4 ft curb. - east well drilled 4 in. casing.

10. The estimated amount of groundwater withdrawn each year... None

11. The log of formations encountered in the drilling of each well if available... Not available.

12. Such other information of a similar nature as may be useful in carrying out the policy of this act, including reference to book and page of any county record... None.

Signature of Owner Max Jenks

Date December 17, 1963

Three copies to be filed by the owner with the County Clerk and Recorder of the county in which the well is located.

Please answer all questions. If not applicable, so state, otherwise the form will be returned.

Original to the County Clerk and Recorder; Duplicate to the State Engineer; Triplicate to the Montana Bureau of Mines and Geology, and Quadruplicate for the Appropriator.

10206

251811

STATE OF MONTANA
County of Blaine

FILED FOR RECORD THIS 15 DAY
OF December A. D. 1963
AT 3:40 O'CLOCK P. M.

Cara L. Maguire
COUNTY CLERK
Cather Sheets
DEPUTY

FEE 2.00

FILED
DEC 15 1963
BLAINE

File No.

T. 36 R. 24

DUPLICATE

County. Blaine

STATE OF MONTANA
ADMINISTRATOR OF GROUNDWATER CODE
OFFICE OF STATE ENGINEER

RECEIVED
DEC 10 1963

Declaration of Vested Groundwater Rights

(Under Chapter 237, Montana Session Laws, 1961)

STATE ENGINEER

1. Frederick Nixon, of Hogeland
(Name of Appropriator) (Address) (Town)
County of Blaine State of Montana
have appropriated groundwater according to the Montana laws in effect prior to January 1, 1962, as follows:

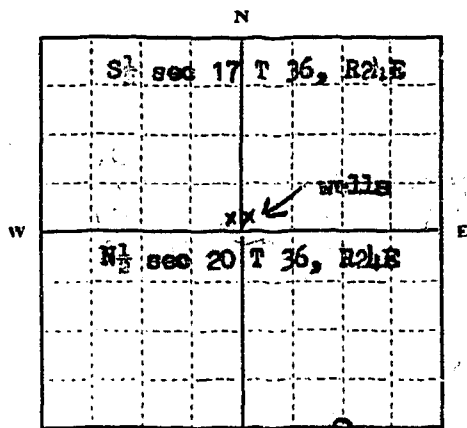

First
of Sec. 17 T. 36 R. 24
and 1/4 Sec. 20 T. 36 R. 24
pit

Indicate point of appropriation and place of use, if possible. Each small square represents 10 acres.

2. The beneficial use on which the claim is based for
livestock and domestic use

3. Date or approximate date of earliest beneficial use; and how continuous the use has been August 1931—used continually
ever since.

4. The amount of groundwater claimed (in miner's inches or gallons per minute) 10 gallons per minute from the three
structures

5. If used for irrigation, give the acreage and description of the lands to which water has been applied and name of the owner thereof

6. The means of withdrawing such water from the ground and the location of each well or other means of withdrawal a pump in
each well and the natural water table in the pit

7. The date of commencement and completion of the construction of the well, wells, or other works for withdrawal of groundwater one well in August 1931, one pit or dugout in June 1946, one
well in July 1947

8. The depth of water table In the wells about 38 feet, in the pit about 3 feet.

9. So far as it may be available, the type, size and depth of each well or the general specifications of any other works for the withdrawal of groundwater one well for stockwater 48 ft. depth, 36 feet to
water, 6 in. steel casing. One well 46 feet for domestic and stock use, 6 in.
steel casing. Both wells have pumps for drawing the water.
one pit opened with dragline, about 6 feet deep, about 3 feet to water during the
driest months

10. The estimated amount of groundwater withdrawn each year for 75 cattle, 50 hogs and domestic
use including irrigation of lawn and trees around farmstead.

11. The log of formations encountered in the drilling of each well if available no accurate record is
available at this time

12. Such other information of a similar nature as may be useful in carrying out the policy of this act, including reference to book and page of any county record these wells and the pit have never been
dry since they were put to use

Signature of Owner Frederick Nixon
Date Dec. 4, 1963

Three copies to be filed by the owner with the County Clerk and Recorder of the county in which the well is located.

Please answer all questions. If not applicable, so state, otherwise the form will be returned.

Original to the County Clerk and Recorder; Duplicate to the State Engineer; Triplicate to the Montana Bureau of Mines and Geology, and Quadruplicate for the Appropriator.

8296

251560

STATE OF MONTANA
County of Blaine

FILED FOR RECORD THIS 9 DAY
OF Dec A. D. 1963

AT 10:35 O'CLOCK A. M.
Cora L. Morgan
COUNTY CLERK

Catherine Sheets
DEPUTY
FEB 2 1963

STATE OF MONTANA
ADMINISTRATOR OF GROUNDWATER CODE
MONTANA WATER RESOURCES BOARD

NOTICE OF COMPLETION OF GROUNDWATER
APPROPRIATION BY MEANS OF WELL

Developed after January 1, 1962

(Under Chapter 237 Montana Session Laws, 1961, as amended)

This form to be prepared by driller, and three copies to be filed by the owner with the County Clerk and Recorder in the county in which the well is located, last copy to be retained by driller.

Please answer all questions. If not applicable, so state, otherwise the form may be returned.

Owner HARLAN KRASS

Address HOGLAND

MONT

Date well started 5-8-72

completed 5-11-72

Type of well drilled

(Dug, driven, bored or drilled)

Equipment used rotary

(Cable drill, rotary or other)

Water Use: Domestic Municipal Stock Irrigation

Industrial Drainage Other * Garden/Lawn

*Describe

USE: If used for irrigation, industrial, drainage or other. Explain, state number of acres and location or other data (i.e. Lot, Block and Addition). 320 A. Used w/ 2 other wells

ESTIMATED ANNUAL WITHDRAWAL 80 acre feet

Size of Drilled Hole	Size and Weight of Casing	From (Feet)	To (Feet)	PERFORATIONS		
				Kind Size	From (Feet)	To (Feet)
36"	16" .250	0	55	16"	55	70
				.100 Size		

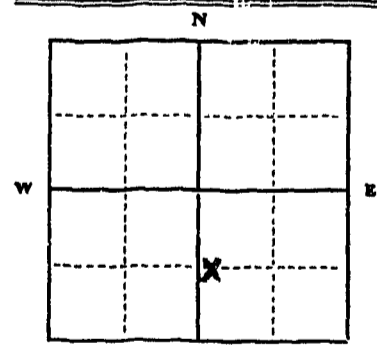

NW 1/4 SE 1/4 Sec. 34
T. 36 R. 24 E

Static water level 38 ft.*
Pumping water level 65 ft.*
at 300 gallons per minute,
measured 6 minutes after pumping began.

*Measured from ground level.
Well developed by pump
for 5 hours.

Power gas Pump 40 HP
Remarks: (Gravel packing, cementing, packers, type of shutoff)

70 GRAVEL PACKED
FROM TOP TO
BOTTOM WITH P.S.A.
GRAVEL

INDICATE LOCATION OF WELL AND PLACE OF USE, IF POSSIBLE. EACH SMALL SQUARE REPRESENTS 40 ACRES.

Driller's Signature Harlan Krass

Driller's Address Hogland Mont

Drilled for self
rig owned by self

LICENSE NO. —

DRILLER'S LOG

Indicate the character, color, thickness of strata such as soil, clay, sand, gravel, shale, sandstone, etc. Show depth at which water is found and height to which water rises in well.

Top of Ground (Elev. above sea level) 3000

From (Feet)	To (Feet)	
0	2	TOP
2	17	CLAY
17	21	SANDY CLAY
21	28	SAND + GRAVEL
28	47	GRAVEL (WATER)
47	55	CLAY
55	70	SAND + GRAVEL (WATER)

70 Show exact depth of bottom

RECEIVED
JUL 3 1973

County BLAINE 34

STATE OF MONTANA
ADMINISTRATOR OF GROUNDWATER CODE
MONTANA WATER RESOURCES BOARD

MONTANA DEPARTMENT OF NATURAL
RESOURCES AND CONSERVATION

DRILLER'S LOG

Indicate the character, color, thickness of strata such as soil, clay, sand, gravel, shale, sandstone, etc. Show depth at which water is found and height to which water rises in well.

NOTICE OF COMPLETION OF GROUNDWATER APPROPRIATION BY MEANS OF WELL

Developed after January 1, 1962

(Under Chapter 237 Montana Session Laws, 1961, as amended)

This form to be prepared by driller, and three copies to be filed by the owner with the County Clerk and Recorder in the county in which the well is located, last copy to be retained by driller. Please answer all questions. If not applicable, so state, otherwise the form may be returned.

Owner HARLAN KRASS

Address HOGEELAND

MONT

Date well started 5-8-72

completed 5-11-72

Type of well drilled

Equipment used Rotary

Water Use: Domestic Municipal Stock Irrigation
Industrial Drainage Other * Garden/Lawn

*Describe
USE: If used for irrigation, industrial, drainage or other. Explain, state number of acres and location or other data (i.e. Lot, Block and Addition). 320 A. Used w/2 other wells

ESTIMATED ANNUAL WITHDRAWAL 80 acre feet

Size of Drilled Hole	Size and Weight of Casing	From (Feet)	To (Feet)	PERFORATIONS		
				Kind Size	From (Feet)	To (Feet)
36"	16" .250	0	55	16"	55	70
				.100 Size		

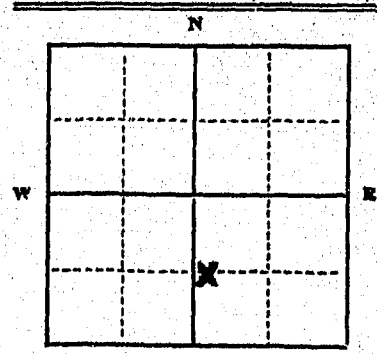

Static water level 38 ft.*
Pumping water level 65 ft.*
at 300 gallons per minute,
measured 60 minutes after pumping began.
*Measured from ground level.
Well developed by pump
for 2 hours.
Power gas Pump 40 HP
Remarks: (Gravel packing, cementing, packers, type of shutoff)
GRAVEL PACKED
FROM TOP TO
BOTTOM WITH PER
GRAVEL

INDICATE LOCATION OF WELL AND PLACE OF USE, IF POSSIBLE. EACH SMALL SQUARE REPRESENTS 40 ACRES.

Driller's Signature Harlan Krass

Driller's Address Hogeland Mont

Drilled for self
rig owned by self

LICENSE NO. —

Top of Ground (Elev. above sea level) 3000

From (Feet)	To (Feet)	
0	2	TOP
2	17	CLAY
17	29	SANDY CLAY
29	38	SAND + GRAVEL
38	47	GRAVEL (WATER)
47	52	CLAY
52	70	SAND + GRAVEL (WATER)

70 Show exact depth of bottom

34

ck-
nd,
ow
nd
all.

3000

TER

(WATER

272387
272387

STATE OF MONTANA }
County of Blaine }
Filed for record this 29 Day
of June A. D. 1923
At 3:50 O'Clock P M.

County Clerk

Deputy

Bottom

195

RECEIVED
County Blaine 34

STATE OF MONTANA
ADMINISTRATOR OF GROUNDWATER CODE
MONTANA WATER RESOURCES BOARD

DRILLER'S LOG

NOTICE OF COMPLETION OF GROUNDWATER
APPROPRIATION BY MEANS OF WELL

Developed after January 1, 1962

(Under Chapter 237 Montana Session Laws, 1961, as amended)

This form to be prepared by driller, and three copies to be filed by the owner with the County Clerk and Recorder in the county in which the well is located, last copy to be retained by driller.

Please answer all questions. If not applicable, so state, otherwise the form may be returned.

Indicate the character, color, thickness of strata such as soil, clay, sand, gravel, shale, sandstone, etc. Show depth at which water is found and height to which water rises in well.

Owner HARLAN KRASS

Address HIGHLAND

MONT

Date well started 5-30-72

completed 6-1-72

Type of well drilled

Equipment used ROTARY

Water Use: Domestic Municipal Stock Irrigation

Industrial Drainage Other * Garden/Lawn

*Describe

USE: If used for irrigation, industrial, drainage or other. Explain, state number of acres and location or other data (i.e. Lot, Block and Addition). 320 A used w/2 other wells

ESTIMATED ANNUAL WITHDRAWAL 160 acre feet

Size of Drilled Hole	Size and Weight of Casing	From (Feet)	To (Feet)	PERFORATIONS		
				Kind Size	From (Feet)	To (Feet)
36"	16" .250	Top	50	16"	50'	65'
				.100 Slot		

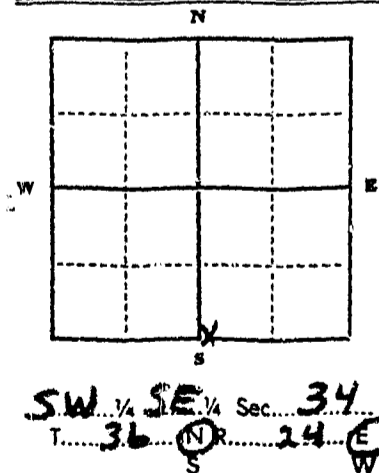

Static water level 38 ft.*
Pumping water level 65 ft.*
at 50 gallons per minute,
measured 60 minutes after pumping
began.
*Measured from ground level.
Well developed by PUMP
for 5 hours.
Power gas Pump 4HP
Remarks: (Gravel packing, cementing,
packers, type of shutoff)
gravel packed
14 ft. long
with pack gravel

INDICATE LOCATION OF WELL AND PLACE OF USE, IF POSSIBLE.
EACH SMALL SQUARE REPRESENTS 40 ACRES.

Driller's Signature Harlan Krass

Driller's Address Hogland Mont

Drilled for self use
owned by self. LICENSE NO. ---

Top of Ground (Elev. above sea level) 3000

From (Feet)	To (Feet)	
0	2	Top
2	17	Top
17	28	Gravel
28	65	Gravel

65 Show exact depth of bottom

54896

RECEIVED

County Blaine 34

STATE OF MONTANA
ADMINISTRATOR OF GROUNDWATER CODE
MONTANA WATER RESOURCES BOARD

MONTANA DEPARTMENT OF
RESOURCES AND CONSERVATION

DRILLER'S LOG

Indicate the character, color, thickness of strata such as soil, clay, sand, gravel, shale, sandstone, etc. Show depth at which water is found and height to which water rises in well.

NOTICE OF COMPLETION OF GROUNDWATER
APPROPRIATION BY MEANS OF WELL

Developed after January 1, 1962

(Under Chapter 237 Montana Session Laws, 1961, as amended)

This form to be prepared by driller, and three copies to be filed by the owner with the County Clerk and Recorder in the county in which the well is located, last copy to be retained by driller. Please answer all questions. If not applicable, so state, otherwise the form may be returned.

Owner HARLAN KRASS
Address HOGELAND
Mont
Date well started 5-30-73
completed 6-1-73
Type of well drilled
Equipment used rotary
Water Use: Domestic Municipal Stock Irrigation
Industrial Drainage Other Garden/Lawn

For Administrator's Use
File 272389
June 29, 1973
GW1 3:51 p.m.

*Describe
USE: If used for irrigation, industrial, drainage or other. Explain, state number of acres and location or other data (i.e. Lot, Block and Addition). 3.20 A used w/ 2 other wells
ESTIMATED ANNUAL WITHDRAWAL 160 acre feet

Size of Drilled Hole	Size and Weight of Casing	From (Feet)	To (Feet)	PERFORATIONS		
				Kind Size	From (Feet)	To (Feet)
36"	16" .250	Top	50	16"	50'	65'
				.100 SLOT		

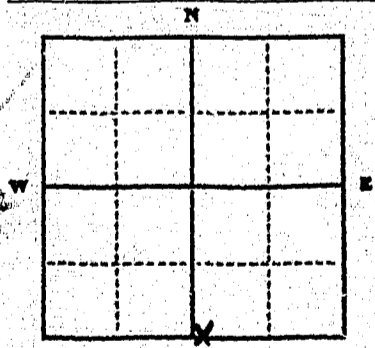

Static water level 38 ft.*
Pumping water level 55 ft.*
at 500 gallons per minute,
measured 60 minutes after pumping
began.
*Measured from ground level.
Well developed by pump
for 5 hours.
Power gas Pump 40 HP
Remarks: Gravel packing, cementing,
packers, type of shutoff)
gravel packed
9 ft. length
with pea gravel

SW 1/4 SE 1/4 Sec. 34
T. 36 N. 24 E.

INDICATE LOCATION OF WELL AND PLACE OF USE, IF POSSIBLE. EACH SMALL SQUARE REPRESENTS 40 ACRES.

Driller's Signature Harlan Krass
Driller's Address Hogeland Mont
drilled for self, rig
owned by self. LICENSE NO. 65

Top of Ground (Elev. above sea level) 3000

From (Feet)	To (Feet)	
0	2	Top
2	17	Clay
17	38	Gravel
38	65	Water in well

65 Show exact depth of bottom

54896

272388

STATE OF MONTANA
County of Blaine

Filed for record this 29 Day

of June A. D. 1973

At 3:51 O'Clock M.

County Clerk

Deputy

Fee _____

ALTA MATTER
115-4TH AVE
HAURLE 59501

T. 36 R. 24

County BLAINE

INTER CODE
ER

RECEIVED
DEC 19 1963

Water Rights
Laws, 1961)
STATE ENGINEER

70
11-1-A

Hogeland
(Town)

County of ~~Blaine~~ State of ~~Montana~~
have appropriated groundwater according to the Montana laws in effect prior to January 1, 1962, as follows:

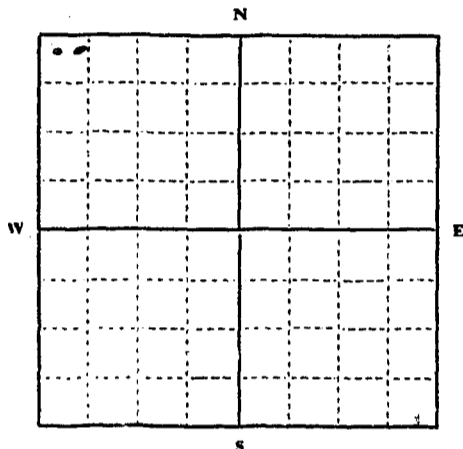

NW 1/4 Sec. 35 T. 36 R. 24

Indicate point of appropriation and place of use, if possible. Each small square represents 10 acres.

2. The beneficial use on which the claim is based. *For home use and water for stock*

3. Date or approximate date of earliest beneficial use; and how continuous the use has been. *1918 - continuously*

4. The amount of groundwater claimed (in miner's inches or gallons per minute). *5 gals*

5. If used for irrigation, give the acreage and description of the lands to which water has been applied and name of the owner thereof. *Garden use*

6. The means of withdrawing such water from the ground and the location of each well or other means of withdrawal. *pump, near the building*

7. The date of commencement and completion of the construction of the well, wells, or other works for withdrawal of groundwater. *First well in 1918 - second well in 1945*

8. The depth of water table. *Dug well has 4 ft. Drilled well 2 ft*

9. So far as it may be available, the type, size and depth of each well or the general specifications of any other works for the withdrawal of groundwater. *Dug well - 2 1/2' x 3 1/2' - 2.8 feet to water. Drilled well - 8 inch casing depth 50 feet - 2.8 feet to water.*

10. The estimated amount of groundwater withdrawn each year.

11. The log of formations encountered in the drilling of each well if available. *3 feet topsoil, 17 feet clay gravel to water level.*

12. Such other information of a similar nature as may be useful in carrying out the policy of this act, including reference to book and page of any county record.

Signature of Owner *Edward Matter*

Date *Dec - 18 - 63*

Three copies to be filed by the owner with the County Clerk and Recorder of the county in which the well is located.

Please answer all questions. If not applicable, so state, otherwise the form will be returned.

Original to the County Clerk and Recorder; Duplicate to the State Engineer; Triplicate to the Montana Bureau of Mines and Geology, and Quadruplicate for the Appropriator.

Helena

T 36 R 24
County BLAINE

STATE OF MONTANA
ADMINISTRATOR OF GROUNDWATER CODE
OFFICE OF STATE ENGINEER

RECEIVED
DEC 19 1963
STATE ENGINEER

Declaration of Vested Groundwater Rights
(Under Chapter 237, Montana Session Laws, 1961)

1. Edward Matter, of Hogeland
(Name of Appropriator) (Address) (Town)
County of Blaine State of Montana
have appropriated groundwater according to the Montana laws in effect prior to January 1, 1962, as follows:

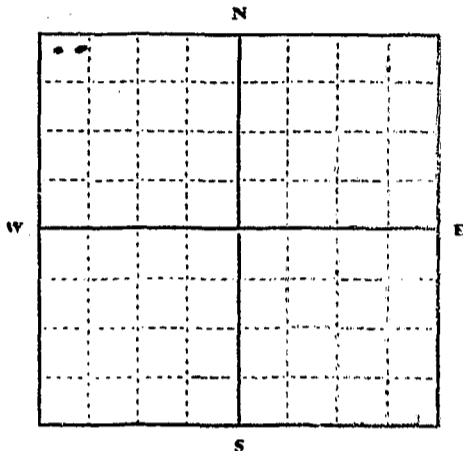

N.W. 1/4 Sec. 35 T. 36 R. 24
Indicate point of appropriation and place of use, if possible. Each small square represents 10 acres.

- The beneficial use on which the claim is based *For home use and water for stock*
- Date or approximate date of earliest beneficial use; and how continuous the use has been *1918 - continuously*
- The amount of groundwater claimed (in miner's inches or gallons per minute) *5 gals*
- If used for irrigation, give the acreage and description of the lands to which water has been applied and name of the owner thereof *Garden use*
- The means of withdrawing such water from the ground and the location of each well or other means of withdrawal *by pump near the buildings*
- The date of commencement and completion of the construction of the well, wells, or other works for withdrawal of groundwater *First well in 1918 - second well in 1945*
- The depth of water table *Dug well has 4 ft. Drilled well 28 ft*
- So far as it may be available, the type, size and depth of each well or the general specifications of any other works for the withdrawal of groundwater *Dug well - 2 1/2' x 3 1/2' - 28 feet to water casing depth 50 feet - Drilled well 8 inch casing depth 28 feet to water*
- The estimated amount of groundwater withdrawn each year
- The log of formations encountered in the drilling of each well if available *3 feet topsoil, 17 feet clay gravel to water level*
- Such other information of a similar nature as may be useful in carrying out the policy of this act, including reference to book and page of any county record

Signature of Owner *Edward Matter*
Date *Dec - 18 - 63*

Three copies to be filed by the owner with the County Clerk and Recorder of the county in which the well is located.

Please answer all questions. If not applicable, so state, otherwise the form will be returned.

Original to the County Clerk and Recorder; Duplicate to the State Engineer; Triplicate to the Montana Bureau of Mines and Geology, and Quadruplicate for the Appropriator.

Helena 10215

251737

STATE OF MONTANA
County of Blaine

FILED FOR RECORD THIS 18 DAY
OF December A. D. 1963
AT 12:05 O'CLOCK P. M.
Cara L. Musgrave
COUNTY CLERK

2⁰⁰ DEPUTY

GROUNDWATER INDEX

County BLAINE

Twp. 36 NORTH Rge. 25 EAST

Sec.	Name of Appropriator	Type of Form	County File No.	Remarks
1	PETRIE, LOUIE		251996	
1	PETRIE, LOUIE	GW-3	251995	
6	RASMUSSEN, HOWARD			
	WACE, RALPH		252004	
7	WARREN, GUY B.	WELL LOG		
9	WARREN, GUY B.	WELL LOG		
10	WARREN, GUY B.	WELL LOG		
13	CEDERBERG, GUST	GW-4	251121	
15	WARREN, GUY B.	WELL LOG		
18	STRUCK, GEORGE R.		251926	
21	JONES, ARTHUR A.		252119	
25	HALVERSON, VERNON		252057	
25	HUTTON, RALPH	WELL LOG		
25	SCHERLIE, ANNA	GW-4	251122	
26	M ^C CRACKEN, ALDEN		257433	
28	M ^C CRACKEN, ALDEN		257432	
29	EBBERT, ARTHUR	WELL LOG		
30	HINEBAUCH, WALTER	WELL LOG		
30	HINEBAUCH, WALTER, JR.	GW-2	272335	
31	HINEBAUCH, WALTER, JR.	GW-2	272334	
24	SIMONS, ROBERT M.		252049	
* 25	SKONES, SELMA		251894	
	ROSEBURG, SWAN A. M.		250434	
	NORTON, HENRY H.			
* 25	FOULS, ROY W.		25-2013	
* 25	EQUITY CO-OP	GW-2	251198	
	ASHCRAFT, HADLEY A. & AGNES		251817	
* 25	STAPLES, ERNEST & ERIS E.		25-2055	
* 25	Skones, Harold	GW-2-WL	272016	
* 25	Turner School #43	GW-2	256881	
* 25	Stenez, Oscar	1960	No #	
25	A. L. Simons	1960	No #	

File No.

T. 36 R. 25

DUPLICATE

County Blaine

STATE OF MONTANA
ADMINISTRATOR OF GROUNDWATER CODE
OFFICE OF STATE ENGINEER

RECEIVED
JAN 6 1964

Notice of Completion of Groundwater Appropriation
Without Well

(Under Chapter 237 Montana Session Laws, 1961)

Date of Appropriation of Groundwater 1964

Owner Louis Petris Address Turner, Montana

Contractor (if any) None

Address of Contractor --

Date Started -- Date Completed --

Describe means of obtaining groundwater without a well "as by sub-irrigation and other natural processes". Include depth to water when applicable. Natural spring

8' depth to water

Quantity of water developed and used with explanation of method used to measure or estimate such amount. If use is intermittent

estimate approximate lengths of periods of use

2,000 gallons per day.

Signature of Owner *Louis Petris*

Date 12/19/63

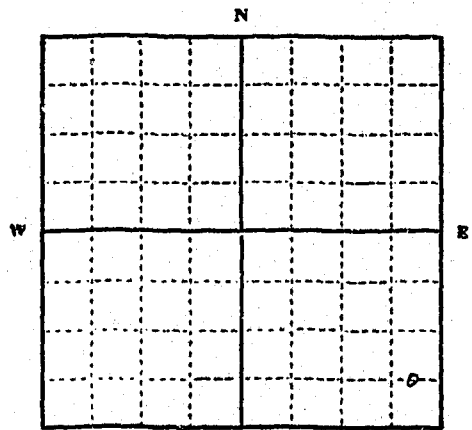

SE 1/4 Sec. 1 T. 36 R. 25

Indicate point of appropriation and place of use, if possible.

This form to be prepared by contractor (if any), otherwise by the owner.

Three copies of this notice are to be filed with the County Clerk and Recorder of the county in which the works are located.

Please answer all questions. If not applicable, so state, otherwise the form will be returned.

Original to the County Clerk and Recorder; duplicate to the State Engineer; Triplicate to the Montana Bureau of Mines and Geology and Quadruplicate for the Appropriator.

251995

STATE OF MONTANA
County of Blaine

FILED FOR RECORD THIS 30 DAY

OF December A. D. 1963

AT 1:15 O'CLOCK P. M.

Cara L. Musgrave
COUNTY CLERK

2 00 DEPUTY

File No.

T. 36 R. 25

DUPLICATE

County Blaine

STATE OF MONTANA
ADMINISTRATOR OF GROUNDWATER CODE
OFFICE OF STATE ENGINEER

RECEIVED
JAN 6 1964
REGISTER

Declaration of Vested Groundwater Rights

(Under Chapter 237, Montana Session Laws, 1961)

1. Louis Petrie, of Turner,
(Name of Appropriator) (Address) (Town)

County of Blaine State of Montana

have appropriated groundwater according to the Montana laws in effect prior to January 1, 1962, as follows:

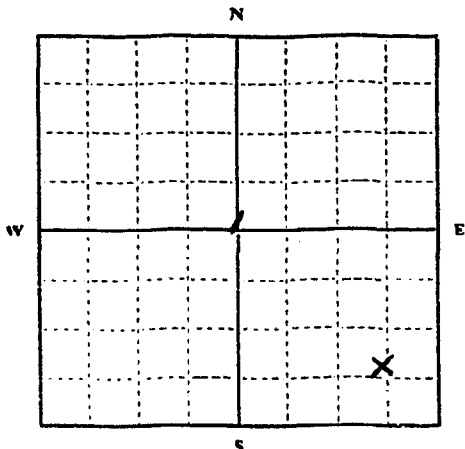

SE 1/4 Sec. 1 T. 36 R. 25

Indicate point of appropriation and place of use, if possible. Each small square represents 10 acres.

2. The beneficial use on which the claim is based Livestock water

3. Date or approximate date of earliest beneficial use; and how continuous the use has been 1945 - continuous

4. The amount of groundwater claimed (in miner's inches or gallons per minute)

5. If used for irrigation, give the acreage and description of the lands to which water has been applied and name of the owner thereof

6. The means of withdrawing such water from the ground and the location of each well or other means of withdrawal Electric pump

7. The date of commencement and completion of the construction of the well, wells, or other works for withdrawal of groundwater 1945

8. The depth of water table

9. So far as it may be available, the type, size and depth of each well or the general specifications of any other works for the withdrawal of groundwater 30' drilled

10. The estimated amount of groundwater withdrawn each year 730,000 gallons

11. The log of formations encountered in the drilling of each well if available

12. Such other information of a similar nature as may be useful in carrying out the policy of this act, including reference to book and page of any county record

Signature of Owner Louis Petrie
Date 12/19/63

Three copies to be filed by the owner with the County Clerk and Recorder of the county in which the well is located.

Please answer all questions. If not applicable, so state, otherwise the form will be returned.

Original to the County Clerk and Recorder; Duplicate to the State Engineer; Triplicate to the Montana Bureau of Mines and Geology, and Quadruplicate for the Appropriator.

21839

251996

STATE OF MONTANA
County of Blaine

FILED FOR RECORD THIS 30 DAY

OF December A. D. 1963

AT 1:20 O'CLOCK P M.

Caro L. Musgrove
COUNTY CLERK

200 DEPUTY

File No.

T. 36 R. 25

DUPLICATE

County Blaine

STATE OF MONTANA
ADMINISTRATOR OF GROUNDWATER CODE
OFFICE OF STATE ENGINEER

RECEIVED
JAN 5 1964
STATE ENGINEER

Declaration of Vested Groundwater Rights

(Under Chapter 237, Montana Session Laws, 1961)

1. Ralph Nace & Howard Rasmussen, of Turner,
(Name of Appropriator) (Address) (Town)

County of Blaine State of Montana
have appropriated groundwater according to the Montana laws in effect prior to January 1, 1962, as follows:

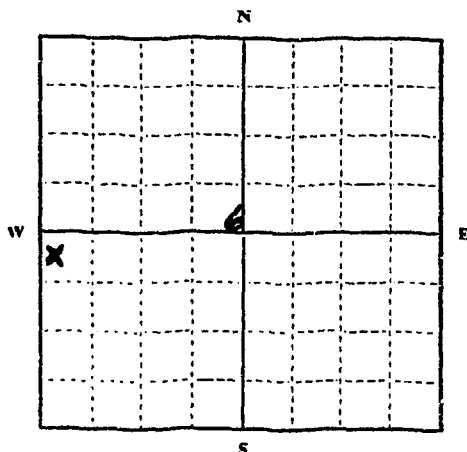

NW 1/4 Sec. 6 T. 36 R. 25

Indicate point of appropriation and place of use, if possible. Each small square represents 10 acres.

2. The beneficial use on which the claim is based.
Livestock water

3. Date or approximate date of earliest beneficial use; and how continuous the use has been. 1950

4. The amount of groundwater claimed (in miner's inches or gallons per minute)

5. If used for irrigation, give the acreage and description of the lands to which water has been applied and name of the owner thereof

6. The means of withdrawing such water from the ground and the location of each well or other means of withdrawal.
windmill

7. The date of commencement and completion of the construction of the well, wells, or other works for withdrawal of groundwater. 1971

8. The depth of water table

9. So far as it may be available, the type, size and depth of each well or the general specifications of any other works for the withdrawal of groundwater. dug well -- 70'

10. The estimated amount of groundwater withdrawn each year. 150,000 gallons

11. The log of formations encountered in the drilling of each well if available

12. Such other information of a similar nature as may be useful in carrying out the policy of this act, including reference to book and page of any county record

RALPH NACE & HOWARD RASMUSSEN

Signature of Owner By: Ralph Nace

Date 12/19/63

Three copies to be filed by the owner with the County Clerk and Recorder of the county in which the well is located.

Please answer all questions. If not applicable, so state, otherwise the form will be returned.

Original to the County Clerk and Recorder; Duplicate to the State Engineer; Triplicate to the Montana Bureau of Mines and Geology, and Quadruplicate for the Appropriator.

21848

252004

STATE OF MONTANA
County of Blaine

FILED FOR RECORD THIS 30 DAY

OF December A. D. 1963

AT 1:46 O'CLOCK P M.

Caro L. Musgrave
COUNTY CLERK

2.00 DEPUTY

S-7

T. 36 R. 25
County Blaine

MONTANA BUREAU OF MINES AND GEOLOGY
Butte, Montana

RECEIVED
JUL 19 1957

WATER WELL LOG

STATE ENGINEER

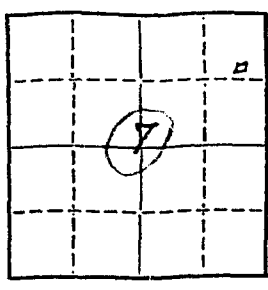

Owner Guy B. Warren Address Turner

Driller Unknown Address _____

Date Started Unknown Date Completed _____

Location: Sec. 7 T. 36 R. 25 1/4 sec. NE

Type of well Dug Equipment used Hand
(Dug, driven, bored, or drilled) (Churn drill, rotary, other)

Water use: Domestic Municipal Stock Irrigation
Industrial Drainage Other: _____

Casing: 0 ft. to 20 ft. Type Cement Size 24"

Casing: 20 ft. to 52 ft. Type Cement Tile Size 18"

Casing: _____ ft. to _____ ft. Type _____ Size _____

Perforated or Screened: Ft. _____ to ft. _____ Ft. _____ to ft. _____

Type of screen or perforations: _____

Static Water level, for non-flowing well: 50 feet.

Shut-in pressure, for flowing well: _____ lb./sq. in. on: _____ (date)

Pumping water level: 51 feet at 4 gal. per min.

How tested: Engine Jack & Pump

Length of test: 14 hrs

Remarks: (Gravel packing, cementing, packers, type of shut-off, depth of shut-off)

Gravel Pack

(over)

L-9

9

T. 36 R. 25
County Blaine

MONTANA BUREAU OF MINES AND GEOLOGY
Butte, Montana

STATE ENGINEER

WATER WELL LOG

	9	

Owner Guy B. Warren Address Turner
 Driller Andrew Anderson Address H. of James road
 Date Started Unknown Date Completed 1
 Location: Sec. 9 T. 36 R. 25 1/4 sec. NW 4

Type of well Drilled Equipment used Cable Rig
(Dug, driven, bored, or drilled) (Churn drill, rotary, other)

Water use: Domestic Municipal Stock Irrigation garden lawn
 Industrial Drainage Other: _____

Casing: 0 ft. to 53 ft. Type Pipe Size 6"
 Casing: _____ ft. to _____ ft. Type _____ Size _____
 Casing: _____ ft. to _____ ft. Type _____ Size _____

Perforated or Screened: Ft. 50 to ft. 53 Ft. _____ to ft. _____

Type of screen or perforations _____

Static Water level, for non-flowing well: 50' feet.

Shut-in pressure, for flowing well: _____ lb./sq. in. on: _____ (date)

Pumping water level 51 feet at 4 gal. per min.

How tested: Pump with Engine & face

Length of test: 18 hrs

Remarks: (Gravel packing, cementing, packers, type of shut-off, depth of shut-off)

Gravel pack some fine sand

(over)

S10

10

T. 36 R. 25
County Blaine
JUL 19 1957

MONTANA BUREAU OF MINES AND GEOLOGY
Butte, Montana

STATE ENGINEER

WATER WELL LOG

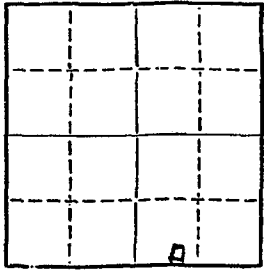

Owner L. B. Warren Address Furner

Driller Dug Address _____

Date Started June 13-1942 Date Completed Aug 17-1942

Location: Sec. 10 T. 36 R. 25 1/4 sec. SE 4

Type of well Dug Equipment used _____
(Dug, driven, bored, or drilled) (Churn drill, rotary, other)

Water use: Domestic Municipal Stock Irrigation Garden Lawn

Industrial Drainage Other: _____

Casing: 42 ft. to _____ ft. Type Cement Size 4-6"

Casing: 4 ft. to _____ ft. Type Steel Size 4"

Casing: _____ ft. to _____ ft. Type _____ Size _____

Perforated or Screened: Ft. 42' to ft. 46' Ft. _____ to ft. _____

Type of screen or perforations: _____

Static Water level, for non-flowing well: 42' feet.

Shut-in pressure, for flowing well: _____ lb./sq. in. on: _____ (date)

Pumping water level: 43'-44' feet at 5 gal. per min.

How tested: Air Pump

Length of test: 18 hrs

Remarks: (Gravel packing, cementing, packers, type of shut-off, depth of shut-off)

Gravel Packing

(over)

13

File No. _____

T. 36 R. 25

DUPLICATE

County Blaine

STATE OF MONTANA
ADMINISTRATOR OF GROUNDWATER CODE
OFFICE OF STATE ENGINEER

RECEIVED
NOV 18 1963

Declaration of Vested Groundwater Rights

(Under Chapter 237, Montana Session Laws, 1961)

STATE ENGINEER

1. Must Cederberg of Turner
(Name of Appropriator) (Address) (Town)
County of Blaine State of Montana
have appropriated groundwater according to the Montana laws in effect prior to January 1, 1962, as follows:

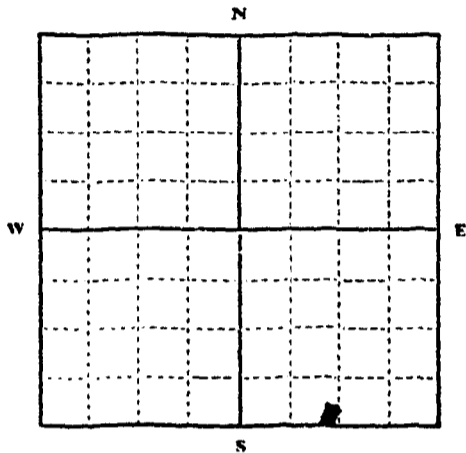

S. 1/4 E. Sec. 12, T. 36, R. 25

Indicate point of appropriation and place of use, if possible. Each small square represents 10 acres.

- 2. The beneficial use on which the claim is based this well is used for household & stock water
- 3. Date or approximate date of earliest beneficial use; and how continuous the use has been. This well has been in use continuously since 1934.
- 4. The amount of groundwater claimed (in miner's inches or gallons per minute) There is 19 ft of water in well.
- 5. If used for irrigation, give the acreage and description of the lands to which water has been applied and name of the owner thereof This well is used to irrigate on local garden next to farm household also yard
- 6. The means of withdrawing such water from the ground and the location of each well or other means of withdrawal It is pumped by a jet pump.
- 7. The date of commencement and completion of the construction of the well, wells, or other works for withdrawal of groundwater. This well was completed in 1934.
- 8. The depth of water table 40 ft
- 9. So far as it may be available, the type, size and depth of each well or the general specifications of any other works for the withdrawal of groundwater. This well has a six inch casing and is pumped by a jet - it is 59 ft deep
- 10. The estimated amount of groundwater withdrawn each year 365,000
- 11. The log of formations encountered in the drilling of each well if available. Not available
- 12. Such other information of a similar nature as may be useful in carrying out the policy of this act, including reference to book and page of any county record.

Signature of Owner Must Cederberg
Date Oct 30, 1963

Three copies to be filed by the owner with the County Clerk and Recorder of the county in which the well is located.

Please answer all questions. If not applicable, so state, otherwise the form will be returned.

Original to the County Clerk and Recorder; duplicate to the State Engineer; Triplicate to the Montana Bureau of Mines and Geology, and Quadruplicate for the Appropriator.

7136

251121
251121

STATE OF MONTANA
County of Blaine

FILED FOR RECORD THIS 15 DAY
OF Sept A. D. 1963
AT 11:20 O'CLOCK A. M.
Cora L. Morgan
COUNTY CLERK
Esther Sheets
DEPUTY
FEE 2.00

RECEIVED
STATE ENGINEER

T. 36 R. 25
County BLAINE

MONTANA BUREAU OF MINES AND GEOLOGY
Butte, Montana

WATER WELL LOG

		X	

Owner Guy B. Warren Address Turner
Driller Simpson Drilling Co Address Malta
Date Started 15 June 1959 Date Completed 16 June
Location: Sec. 15 T. 36 R. 25 NE 1/4 Sec. 15

Type of well Drilled Equipment used Churn drill
(Dig. driven, bored, or drilled) (Churn drill, rotary, other)

Water use: Domestic Municipal Stock Irrigation
Industrial Drainage Other: _____

Casing: 0 ft. to 60 ft. Type steel Size 4"

Casing: _____ ft. to _____ ft. Type _____ Size _____

Casing: _____ ft. to _____ ft. Type _____ Size _____

Perforated or Screened: Ft. 51 to ft. 53 Ft. _____ to ft. _____

Type of screen or perforations 3/16" holes drilled in pipe

Static Water level, for non-flowing well: 50- feet.

Shut-in pressure, for flowing well: _____ lb./sq. in. on: _____ (date)

Pumping water level: 50 feet at 9- gal. per min.

How tested: Bailor

Length of test: 1 hr-

Remarks: (Gravel packing, cementing, packers, type of shut-off, depth of shut-off)

(over)

File No.....

T 36 R 25

DUPLICATE

County BHAINE

STATE OF MONTANA
ADMINISTRATOR OF GROUNDWATER CODE
OFFICE OF STATE ENGINEER

RECEIVED
DEC 6 1963

Declaration of Vested Groundwater Rights

(Under Chapter 237, Montana Session Laws, 1961)

STATE ENGINEER

1. GEORGE R. STRUCK of TURNER
(Name of Appropriator) (Address)
County of BHAINE State of MONTANA (Town)
have appropriated groundwater according to the Montana laws in effect prior to January 1, 1962, as follows:

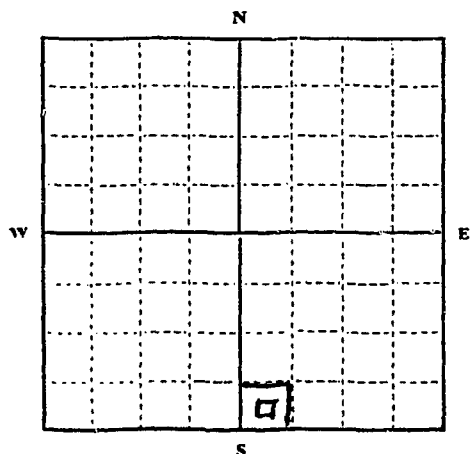

SE 1/4 Sec. 18 T36 R25

Indicate point of appropriation and place of use, if possible. Each small square represents 10 acres.

- The beneficial use on which the claim is based HOUSE HOLD LIVESTOCK, GARDEN, TREES
- Date or approximate date of earliest beneficial use; and how continuous the use has been 1st WELL DUG IN 1918 PROBABLY. 2ND WELL DUG IN 1955. USED CONTINUOUSLY
- The amount of groundwater claimed (in miner's inches or gallons per minute) 75 TO 100 GALLONS PER MINUTE
- If used for irrigation, give the acreage and description of the lands to which water has been applied and name of the owner thereof NOT APPLICABLE
- The means of withdrawing such water from the ground and the location of each well or other means of withdrawal NO. 1 IS BY JET PUMP NO. 2 IS BY SUBMERSIBLE. BOTH ARE NEAR HOUSE
- The date of commencement and completion of the construction of the well, wells, or other works for withdrawal of groundwater 1918 FOR NO. 1 1955 FOR NO. 2
- The depth of water table 25 TO 37 FEET
- So far as it may be available, the type, size and depth of each well or the general specifications of any other works for the withdrawal of groundwater NO. 1 HAND DUG TO 40 FEET IS A 4 FOOT BY 4 FOOT HOLE. NO. 2 A DRILLED WELL WITH 6 INCH CASING
- The estimated amount of groundwater withdrawn each year 100,000 GALLONS ON UP.
- The log of formations encountered in the drilling of each well if available NONE AVAILABLE
- Such other information of a similar nature as may be useful in carrying out the policy of this act, including reference to book and page of any county record NONE AVAILABLE TO MY KNOWLEDGE.

Signature of Owner

George R. Struck

Date DEC. 22. 1963

Three copies to be filed by the owner with the County Clerk and Recorder of the county in which the well is located.

Please answer all questions. If not applicable, so state, otherwise the form will be returned.

Original to the County Clerk and Recorder; duplicate to the State Engineer; Triplicate to the Montana Bureau of Mines and Geology, and Quadruplicate for the Appropriator.

251926

STATE OF MONTANA
County of Blaine

FILED FOR RECORD THIS 26 DAY

OF December A. D. 1963

AT 4:40 O'CLOCK P.M.

Cara L. Mesquero
COUNTY CLERK

FEE

200

DEPUTY

File No.
DUPLICATE

T. 36 25
27 25

County

STATE OF MONTANA
ADMINISTRATOR OF GROUNDWATER CODE
OFFICE OF STATE ENGINEER

RECEIVED
JAN 6 1964

DECLARATION OF VESTED GROUNDWATER RIGHTS
(Under Chapter 237, Montana Session Laws, 1951)

Arthur A. Jones of Turner
(Name of Appropriator) (Address) (Town)

County of Blaine State of Montana
have appropriated groundwater according to the Montana laws in effect prior to Jan. 1,
1952, as follows:

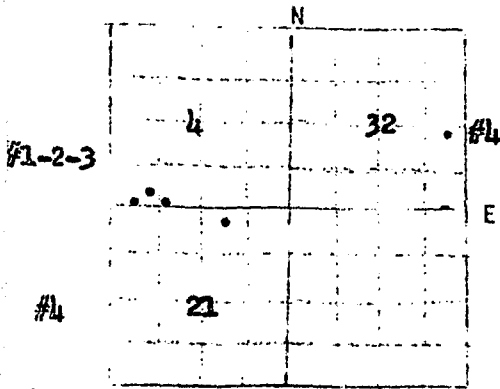

#1-2-3 in SW 1/4 of 4-26-25
#4 in NE 1/4 32-27-25
#5 in W 1/2 21-36-25
..... Sec. T. R.
Indicate point of appropriation
and place of use, if possible.
Each small square represents 64
acres.

2. The beneficial use on which the claim is based.....
~~#1 and #3 Domestic use--all others Stock water~~

3. Date or approximate date of earliest beneficial use;
and how continuous the use has been.....
~~Period from 1914 to 1956~~

4. The amount of groundwater claimed (in miner's inches
or gallons per minute).....
~~10 gallons per minute~~

5. If used for irrigation, give the acreage and description
of the lands to which water has been applied and name
of the owner thereof.....

6. The means of withdrawing such water from the ground and
the location of each well or other means of withdrawal.....
~~3 wells with plunger pump and 2 with electric jet pumps~~

7. The date of commencement and completion of the construction of the well, wells, or
other works for withdrawal of groundwater.....
~~Same as 3~~

8. The depth of water table..... ~~From 27 to 46 feet~~

9. So far as it may be available, the type, size and depth of each well or the general
specifications of any other works for the withdrawal of groundwater.....
~~@ 2 hand dug with concrete curbing--3 drilled with 6 inch steel casing~~

10. The estimated amount of groundwater withdrawn each year ~~#2 continuously--others during
grazing season~~

11. The log of formation encountered in the drilling of each well if available.....
~~clay, shale and gravel~~

12. Such other information of a similar nature as may be useful in carrying out the policy
of this act, including reference to book and page of any county record.....

Signature of Owner.....

STATE OF MONTANA)
County of Blaine) ss.

Date..... December 31, 1963.....

Arthur A. Jones having first been duly sworn, depose, swear, and say
that ..he, is of lawful age and.....the appropriator... and claimant... of the
order and water right mentioned in the foregoing declaration of vested groundwater
rights and the person... whose name, is subscribed thereto, as the appropriator... and
claimant..., that ..he ... know, the contents of said foregoing notice and that the
matters and things therein stated are true.

252119

STATE OF MONTANA
County of Blaine

FILED FOR RECORD THIS 31 DAY
OF Dec A. D. 1963
AT 2:47 O'CLOCK P M.
Chas. L. Musgrave
COUNTY CLERK

FEE 2.00

DEPUTY

New Turner Townsite
Lots 1 and 2 Block 16

SW corner Section 25

T. 36 R. 25 East

25

County Blaine

MONTANA BUREAU OF MINES AND GEOLOGY
Butte, Montana

RECEIVED
SEP 11 1960

WATER WELL LOG

STATE ENGINEER

x			

Owner Ralph Hutton Address Turner

Driller Simpson Drilling Co Address Malta

Date Started 5 Sept.-60 Date Completed 7 Sept.

Location: Sec. 25 T. 36 R. 25 1/4 sec. SW 1/4

Type of well Drilled (Dug, driven, bored, or drilled) Equipment used Chrundrill (Churn drill, rotary, other)

Water use: Domestic Municipal Stock Irrigation
Industrial Drainage Other: _____

Casing: 0 ft. to 44 ft. Type Steel Size 4'

Casing: _____ ft. to _____ ft. Type _____ Size _____

Casing: _____ ft. to _____ ft. Type _____ Size _____

Perforated or Screened: Ft. 36 to ft. 38 Ft. _____ to ft. _____

Type of screen or perforations 3/16 holes drilled in Cag

Static Water level, for non-flowing well: 26 feet.

Shut-in pressure, for flowing well: _____ lb./sq. in. on: _____ (date)

Pumping water level 26 feet at 20 gal. per min.

How tested: Miller

Length of test: 2 hrs

Remarks: (Gravel packing, cementing, packers, type of shut-off, depth of shut-off)

(over)

25

File No.

T. 36 R. 25

DUPLICATE

County Blaine

STATE OF MONTANA
ADMINISTRATOR OF GROUNDWATER CODE
OFFICE OF STATE ENGINEER

RECEIVED
NOV 18 1963

Declaration of Vested Groundwater Rights

(Under Chapter 237, Montana Session Laws, 1961)

STATE ENGINEER

1. Anna Scherlie of Turner
(Name of Appropriator) (Address) (Town)
County of Blaine State of Montana
have appropriated groundwater according to the Montana laws in effect prior to January 1, 1962, as follows:

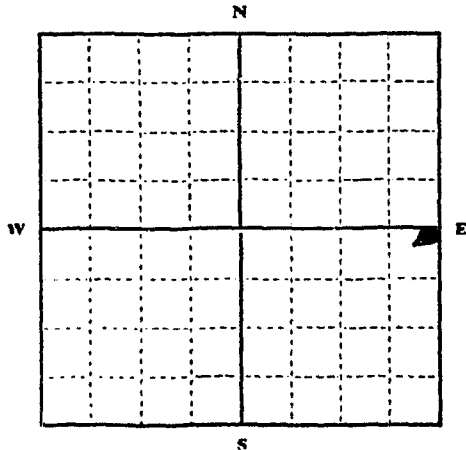

S 1/4 E Sec 25 T 36 R 25

Indicate point of appropriation and place of use, if possible. Each small square represents 10 acres.

- 2. The beneficial use on which the claim is based. This well has supplied household water since 1913.
- 3. Date or approximate date of earliest beneficial use; and how continuous the use has been. since 1913 for household use.
- 4. The amount of groundwater claimed (in miner's inches or gallons per minute). 5 ft of water
- 5. If used for irrigation, give the acreage and description of the lands to which water has been applied, and name of the owner thereof. This is used for household
- 6. The means of withdrawing such water from the ground and the location of each well or other means of withdrawal. This has a bucket & wheel type & draws from ground
- 7. The date of commencement and completion of the construction of the well, wells, or other works for withdrawal of groundwater. well completed in 1913
- 8. The depth of water table. 32 ft.
- 9. So far as it may be available, the type, size and depth of each well or the general specifications of any other works for the withdrawal of groundwater. This well is about 4 ft square cement curb. It is 37 ft. and has about 5 ft. of water.
- 10. The estimated amount of groundwater withdrawn each year. 7,500 gallons per year.
- 11. The log of formations encountered in the drilling of each well if available. Not available
- 12. Such other information of a similar nature as may be useful in carrying out the policy of this act, including reference to book and page of any county record.

Signature of Owner. Anna Scherlie
Date Oct 30, 1963

Three copies to be filed by the owner with the County Clerk and Recorder of the county in which the well is located.

Please answer all questions. If not applicable, so state, otherwise the form will be returned.

Original to the County Clerk and Recorder; duplicate to the State Engineer; Triplicate to the Montana Bureau of Mines and Geology, and Quadruplicate for the Appropriator.

251122
251122

STATE OF MONTANA
County of Blaine

FILED FOR RECORD THIS 15 DAY
OF Nov A. D. 1963

AT H. J. JOHNSON P. M.

Car L. Ferguson
COUNTY CLERK

Edith Hunt
DEPUTY

FILE 27

File No.
DUPLICATE

36-25
T... 35
County... Blaine
RECEIVED
JAN 6 1964
25

STATE OF MONTANA
ADMINISTRATOR OF GROUNDWATER CODE
OFFICE OF STATE ENGINEER

DECLARATION OF VESTED GROUNDWATER RIGHTS OF STATE ENGINEER
(Under Chapter 237, Montana Session Laws, 1951)

Vernon Halverson of Turner
(Name of Appropriator) (Address) (Town)

County of... Blaine State of... Montana
have appropriated groundwater according to the Montana laws in effect prior to Jan. 1, 1952, as follows:

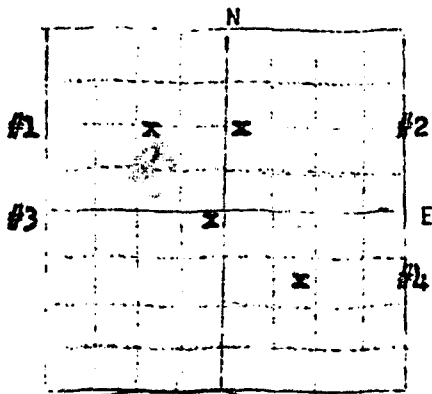

#1
#2
#3
#4

32-36-25
8-35-25
17-35-25
10-35-25
T...R...
indicate point of appropriation
place of use, if possible.
Each small square represents 5
acres.

- The beneficial use on which the claim is based.....
#1. for household and stock water, #1,2,3 stock water.
- Date or approximate date of earliest beneficial use;
and how continuous the use has been.....
#1,2,3 about 1915 and #3 1950
- The amount of groundwater claimed (in miner's inches
or gallons per minute).....
All about 10 gallons per minute.
- If used for irrigation, give the acreage and descriptive
of the lands to which water has been applied and name
of the owner thereof.....
- The means of withdrawing such water from the ground and
the location of each well or other means of withdrawal
#1 lift pump and jet pump. All others have lift pump.

The date of commencement and completion of the construction of the well, wells, or
other works for withdrawal of groundwater.....
Same as 3.

The depth of water table #1 30 feet #2 25 feet #3 16 feet and #4 20 feet

So far as it may be available, the type, size and depth of each well or the general
specifications of any other works for the withdrawal of groundwater.....
All cases concrete casing

The estimated amount of groundwater withdrawn each year #1 continuous use and others
during grazing season.

The log of formation encountered in the drilling of each well if available.....
clay, shale, sandstone and gravel

Such other information of a similar nature as may be useful in carrying out the policy
of this act, including reference to book and page of any county record.....

Signature of Owner Vernon Halverson

STATE OF MONTANA)
County of Blaine) ss.
Vernon Halverson

Date... December 30, 1963

..... having first been duly sworn, depose and say that ..he is.. of lawful age and..... the appropriator... and claimant... of the
order and water right mentioned in the foregoing declaration of vested groundwater
rights and the person... whose name is subscribed thereto, as the appropriator... and
claimant..., that ..he... know.g. the contents of said foregoing notice and that the
matters and things therein stated are true.

21700

252057

STATE OF MONTANA
County of Blaine

FILED FOR RECORD THIS 30 DAY

OF December A. D. 1963

AT 4:50 O'CLOCK P. M.

Carl L. Mueggen
COUNTY CLERK

FEES 2.00

DEPUTY

File No.

T. 36 N B 25 E

DUPLICATE

County BLAINE

STATE OF MONTANA
ADMINISTRATOR OF GROUNDWATER CODE
OFFICE OF STATE ENGINEER

RECEIVED

Declaration of Vested Groundwater Rights

(Under Chapter 237, Montana Session Laws, 1961)

STATE ENGINEER

1. S. ELMA SKONES, of TURNER, (Name of Appropriator) (Address) (Town)

County of BLAINE State of MONTANA
have appropriated groundwater according to the Montana laws in effect prior to January 1, 1962, as follows:

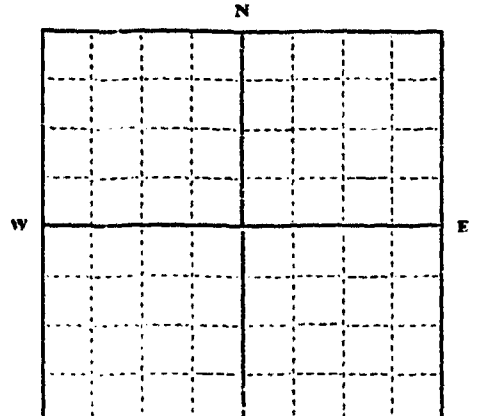

NEW TURNER TOWNSITE
LOTS 4, 5, 6 - BLOCK 1
1/4 Sec. T. R.

Indicate point of appropriation and place of use, if possible. Each small square represents 10 acres.

2. The beneficial use on which the claim is based
YARD & HOUSEHOLD

3. Date or approximate date of earliest beneficial use; and how continuous the use has been
1952
CONTINUOUS USE

4. The amount of groundwater claimed (in miner's inches or gallons per minute)
107.12 FT OR BEYOND

5. If used for irrigation, give the acreage and description of the lands to which water has been applied and name of the owner thereof
NOT APPLICABLE

6. The means of withdrawing such water from the ground and the location of each well or other means of withdrawal
JET PUMP

7. The date of commencement and completion of the construction of the well, wells, or other works for withdrawal of groundwater
NOT KNOWN

8. The depth of water table
NOT KNOWN

9. So far as it may be available, the type, size and depth of each well or the general specifications of any other works for the withdrawal of groundwater
CINDER DRILLED 50 FT DEEP

10. The estimated amount of groundwater withdrawn each year
NOT KNOWN

11. The log of formations encountered in the drilling of each well if available
NOT AVAILABLE

12. Such other information of a similar nature as may be useful in carrying out the policy of this act, including reference to book and page of any county record
NOT KNOWN

Signature of Owner Selma Skones
Date Dec 24 1969

Three copies to be filed by the owner with the County Clerk and Recorder of the county in which the well is located.

Please answer all questions. If not applicable, so state, otherwise the form will be returned.

Original to the County Clerk and Recorder; Duplicate to the State Engineer; Triplicate to the Montana Bureau of Mines and Geology, and Quadruplicate for the Appropriator.

251894

STATE OF MONTANA
County of Blaine

FILED FOR RECORD THIS 26 DAY

OF Dec. A. D. 1903

AT 9:45 O'CLOCK P.M.

Cora L. Mansfield
COUNTY CLERK

E. A. Sheet
DEPUTY

FEK 200

File No.
DUPLICATE

Lot 9 Block 7
Lot 3 and 4 Block 2 Turner Townsite

F

County... Blaine

STATE OF MONTANA
ADMINISTRATOR OF GROUNDWATER CODE
OFFICE OF STATE ENGINEER

JAN 6 1964

DECLARATION OF VESTED GROUNDWATER RIGHTS
(Under Chapter 237, Montana Session Laws, 1951)

Roy W. Fouts of Turner,
(Name of Appropriator) (Address) (Town)

County of... Blaine State of... Montana
have appropriated groundwater according to the Montana laws in effect prior to Jan. 1, 1952, as follows:

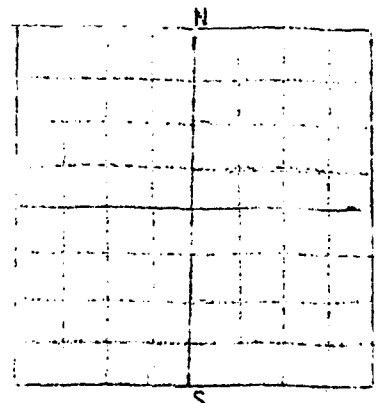

2. The beneficial use on which the claim is based.....
Household use, garden and lawn

3. Date or approximate date of earliest beneficial use;
and how continuous the use has been.....
1945 Approx. 1943, 1958

4. The amount of groundwater claimed (in miner's inches
or gallons per minute).....
Approx. 10 gallons per minute

5. If used for irrigation, give the acreage and descriptive
of the lands to which water has been applied and name
of the owner thereof.....
No

Lot 9 Block 7
Lot 3 and 4 Block 2 Turner Townsite
T36N R. 25E
Indicate point of appropriation
and place of use, if possible.
Each small square represents 5
acres.

The means of withdrawing such water from the ground and
the location of each well or other means of withdrawal
.....
Electric pump

The date of commencement and completion of the construction of the well, wells, or
other works for withdrawal of groundwater.....
Approx 1945 1943 and 1958

The depth of water table. Approx 10 feet

So far as it may be available, the type, size and depth of each well or the general
specifications of any other works for the withdrawal of groundwater.....
6" casing steel 7" wells, third well has cement casing.

The estimated amount of groundwater withdrawn each year.. Continuous use.

The log of formation encountered in the drilling of each well if available.....
rock, gravel, concrete sand

Such other information of a similar nature as may be useful in carrying out the policy
of this act, including reference to book and page of any county record.....

Signature of Owner. Roy W. Fouts.....

STATE OF MONTANA)
County of Blaine) ss.
Roy W. Fouts

Date..... December 30, 1963

..... having first been duly sworn, depose and say
that ..he.. of lawful age and ..18..... the appropriator... and claimant... of the
order and water right mentioned in the foregoing declaration of vested groundwater
rights and the person... whose name J. subscribed thereto, as the appropriator... and
claimant..., that ..he... knows the contents of said foregoing notice and that the
matters and things therein stated are true.

252013

STATE OF MONTANA
County of Blaine

FILED FOR RECORD THIS 3rd DAY
OF December A. D. 19 63
AT 2nd O'CLOCK P. M.

Cora L. Mungre
COUNTY CLERK
Catherine Shest
DEPUTY
3rd

File No. _____

STATE WATER CONSERVATION BOARD

R E C E I V E D
SEP 21 1965

T. 400 R. 25 E. S. 25

County Blaine

DUPLICATE

Top of Ground
(Elev. above sea level _____)

0 top soil
28 brown clay
42 hard pan
50 gravel and water

REFERRED TO _____

STATE OF MONTANA
ADMINISTRATOR OF GROUNDWATER CODE
OFFICE OF STATE ENGINEER

Notice of Completion of Groundwater Appropriation by Means of Well

(Under Chapter 237, Montana Session Laws, 1961)

Owner Turner School # 43 Address Turner Montana

Drillers Simpson Drilling Co. Address Malta, Montana

Date of Notice of appropriation of ground water _____

Date well started July 26 1965 Date Completed July 29 1965

Type of well Drilled Equipment used Cable Tools
(dug, driven, bored or Churn, drill, rotary or
drilled) other)

Water use: Domestic Municipal Stock Irrigation
Industrial Drainage Other

Indicate on the diagram the character and thickness of the different strata met with in drilling, such as soil, clay, shale, gravel, rock or sand, etc. Show depth at which water is encountered, thickness and character of water-bearing strata and height to which the water rises in the well.

Size of Drilled Hole	Size and Weight of Casing	From (Feet)	To (Feet)	PERFORATIONS		
				Kind Size	From (Feet)	To (Feet)
7"	6" 19 Lbs	A. G. L.	50	3/16	47'	50'

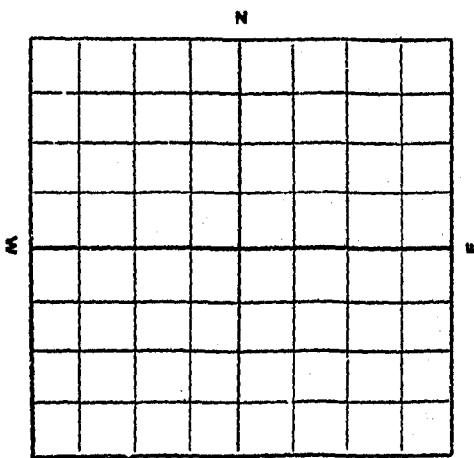

1/4 Sec. T. R.
Indicate location of well and place of use, if possible. Each small square represents 10 acres.

Static Water Level for non-flowing well

41 feet.

Shut-in Pressure for Flowing Well _____

Pumping Water Level 45 feet

at 10 gal. per minute.

Discharge in gal. per min. of flowing well _____

How Tested Ballar

Length of Test _____

Remarks: (Gravel packing, cementing, packers, type of shutoff, location of place of use of groundwater if not at well, and any other similar pertinent information, including number of acres irrigated, if used for irrigation)

Driller's License Number _____

[Signature]
Driller's Signature

This form to be prepared by driller, and three copies to be filed by the owner with the County Clerk and Recorder in the county in which the well is located.

Please answer all questions. If not applicable, so state, otherwise the form will be returned.

Original to the County Clerk and Recorder; duplicate to the State Engineer; Triplicate to the School of Mines and Quadruplicate for Appropriator.

39608

File No. _____

STATE WATER CONSERVATION BOARD
R E C E I V E D
SEP 21 1965

T320 R 35 E 3 Sec 25
County Blaine

DUPLICATE

REFERRED TO _____
STATE OF MONTANA
ADMINISTRATOR OF GROUNDWATER CODE
OFFICE OF STATE ENGINEER

Notice of Completion of Groundwater Appropriation by Means of Well

(Under Chapter 237, Montana Session Laws, 1961)



Top of Ground
(Elev. above sea level _____)
top soil
brown clay
hard pan
gravel and water

Owner Turner School # 43 Address Turner Montana
Driller Simpson Drilling Co. Address Malta, Montana
Date of Notice of appropriation of ground water _____
Date well started July 26 1965 Date Completed July 29 1965
Type of well drilled Equipment used same tools
(dug, driven, bored or drilled) Churn, drill, rotary or other)
Water use: Domestic Municipal Stock Irrigation
Industrial Drainage Other

Indicate on the diagram the character and thickness of the different strata met with in drilling, such as soil, clay, shale, gravel, rock or sand, etc. Show depth at which water is encountered, thickness and character of water-bearing strata and height to which the water rises in the well.

Size of Drilled Hole	Size and Weight of Casing	From (Feet)	To (Feet)	PERFORATIONS		
				Kind Size	Feet (Feet)	Feet (Feet)
7 1/2"	6" 19 lbs	1/2 A. G. L.	90	3/16"	27"	32"

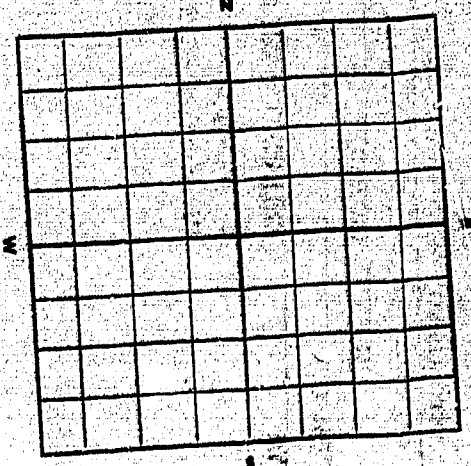

1/4 Sec T R
Indicate location of well and place of use, if possible. Each small square represents 10 acres.

Static Water Level for non-flowing well _____ feet
Shut-in Pressure for Flowing Well _____
Pumping Water Level _____
at _____ gal. per minute
Discharge in gal. per min. of flowing well _____
How Tested Refuse
Length of Test _____
Remarks: (Gravel packing, cementing packers, type of shutoff, location of place of use of groundwater if not at well, and any other similar pertinent information, including number of acres irrigated, if used for irrigation.)

Driller's License Number _____
Driller's Signature _____

This form to be prepared by driller, and three copies to be filed by the owner with the County Clerk and Recorder in the county in which the well is located.
Please answer all questions. If not applicable, so state, otherwise the form will be returned.
Original to the County Clerk and Recorder; duplicate to the State Engineer; Triplicate to the School of Mines and Quadruplicate for Appropriator.

39608

256881

256881

STATE OF MONTANA
County of Elaine

FILED FOR RECORD THIS 20 DAY

OF September A. D. 1965

AT 8:55 O'CLOCK A M.

Caro L. Musgrave
COUNTY CLERK

W.E. Galis

DEPUTY

25

File No.

T 36N R 25E

DUPLICATE

County Blaine

STATE OF MONTANA
ADMINISTRATOR OF GROUNDWATER CODE
OFFICE OF STATE ENGINEER

RECORDED
JAN 6 1964
STATE ENGINEER

Declaration of Vested Groundwater Rights

(Under Chapter 237, Montana Session Laws, 1961)

1. Ernest & Iris E. Staples, JT, of Turner
(Name of Appropriator) (Address) (Town)
Blaine Montana
County of Blaine State of Montana
have appropriated groundwater according to the Montana laws in effect prior to January 1, 1962, as follows:

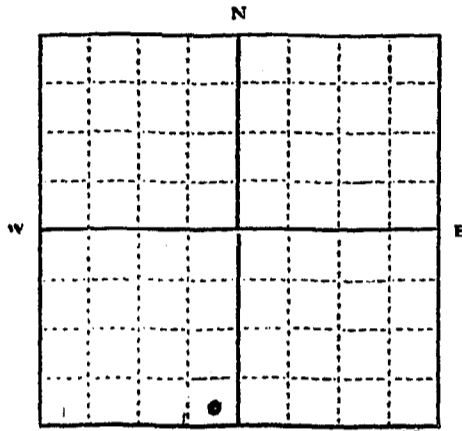

1/4 Sec. T. R.

Indicate point of appropriation and place of use, if possible. Each small square represents 10 acres.

Lots 9, 10, 11
East 17 feet of lot 8
New Turner Townsite
Block 15

2. The beneficial use on which the claim is based. Household and garden
3. Date or approximate date of earliest beneficial use; and how continuous the use has been. 1948. In daily use since that date.
4. The amount of groundwater claimed (in miner's inches or gallons per minute). 10 gallons per minute
5. If used for irrigation, give the acreage and description of the lands to which water has been applied and name of the owner thereof. garden plot owned by above
6. The means of withdrawing such water from the ground and the location of each well or other means of withdrawal. jet pump Block 15, Lot 9, Turner townsite
7. The date of commencement and completion of the construction of the well, wells, or other works for withdrawal of groundwater. June 15, 1948 and completed June 20, 1948.
8. The depth of water table. 45 feet
9. So far as it may be available, the type, size and depth of each well or the general specifications of any other works for the withdrawal of groundwater. drilled well with 6" casing. 49 feet deep
10. The estimated amount of groundwater withdrawn each year. 290,000 gallons
11. The log of formations encountered in the drilling of each well if available. No log available
12. Such other information of a similar nature as may be useful in carrying out the policy of this act, including reference to book and page of any county record. Not applicable

Signature of Owner

Date December 30, 1963

Three copies to be filed by the owner with the County Clerk and Recorder of the county in which the well is located.

Please answer all questions. If not applicable, so state, otherwise the form will be returned.

Original to the County Clerk and Recorder; Duplicate to the State Engineer; Triplicate to the Montana Bureau of Mines and Geology, and Quadruplicate for the Appropriator.

21898

252055

STATE OF MONTANA
County of Blaine

FILED FOR RECORD THIS 20 DAY
OF December A. D. 1963
AT 4:20 O'CLOCK P M.

Cara L. Mueggen
COUNTY CLERK

2.00
FEE

DEPUTY

File No.

T. 36 R. 25

TRIPLICATE

County Blaine

STATE OF MONTANA
ADMINISTRATOR OF GROUNDWATER CODE
OFFICE OF STATE ENGINEER
NOV 21 1963

Notice of Completion of Groundwater Appropriation by Means of Well

(Under Chapter 237, Montana Session Laws, 1961)

Owner Equity Co-op Address Turner, Mont.

Driller Billmeyer & Sons Address Hogeland, Mont.

Date of Notice of Appropriation of Groundwater

Date well started 9-10-63 Date Completed 9-11-63

Type of well drilled Equipment Used spudder
(dug, driven, bored or drilled) (Churn, drill, rotary or other)

Water Use: Domestic Municipal Other Irrigation
Industrial Drainage Stock

Indicate on the diagram the character and thickness of the different strata met with in drilling, such as soil, clay, shale, gravel, rock or sand, etc. Show depth at which water is encountered, thickness and character of water-bearing strata and height to which water rises in the well.

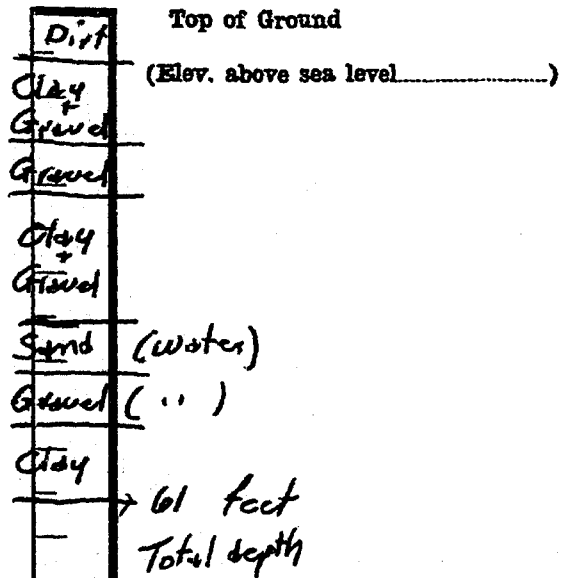

Size of Drilled Hole	Size and Weight of Casing	From (Feet)	To (Feet)	PERFORATIONS		
				Kind	From (Feet)	To (Feet)
7"	6 5/8" O.D. 19 lb.		61'	cut	51' - 56'	

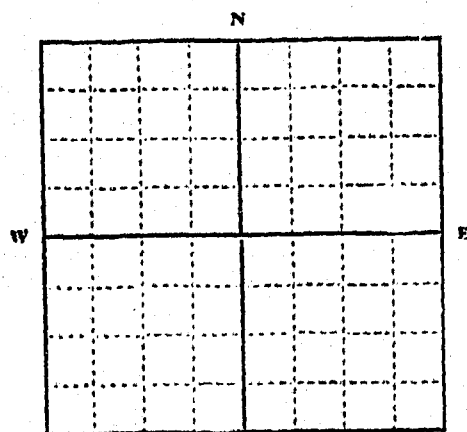

Lot 6-s Blk 2

1/4 Sec. T. R.

Indicate location of well and place of use, if possible. Each small square represents 10 acres.

First Add. Turner
Show exact depth of bottom. Gravel

Static Water Level for non-flowing Well..... 41 feet.

Shut-in Pressure for Flowing Well.....

Pumping Water Level.....feet at 25 gal. per minute.

Discharge in gal. per min. of flowing well.....

How Tested Bailer Length of Test One hour

Remarks: (Gravel packing, cementing, packers, type of shutoff, location of place of use of groundwater if not at well, and any other similar pertinent information, including number of acres irrigated, if used for irrigation).....

5
Driller's License Number

Ralph Wham
Driller's Signature

This form to be prepared by driller, and three copies to be filed by the owner with the County Clerk and Recorder in the county in which the well is located.

Please answer all questions. If not applicable, so state, otherwise the form will be returned.

Original to the County Clerk and Recorder; duplicate to the State Engineer; Triplicate to the Montana Bureau of Mines and Geology and Quadruplicate for the Appropriator.

251199

STATE OF MONTANA
County of Blaine

FILED FOR RECORD THIS 20 DAY

OF Nov A. D. 1963

AT 3:05 O'CLOCK P. M.

Carl L. Magnus
COUNTY CLERK

Esther Shuck
DEPUTY

VEN 2

RECEIVED

MAY 24 1973

Blaine County 25

MONTANA DEPARTMENT OF NATURAL RESOURCES AND CONSERVATION

Drilling Log

Driller - HICKEL & TOOKE DRILLING CO. - Turner, Montana
Montana Drilling License No. 196

Owner Gordon Skanes Address Turner, Mont

Date well started April 30, 1973 Date Completed May 2-1973

Water Use: Domestic Municipal Stock Irrigation
Industrial Drainage Other

DEPTH	DESCRIPTION
0-3 FT	Top Soil
3-9 FT	Gravel - Boulders
9-31 FT	Brown Clay - Sand
31-36 FT	Gravel - Sand
36-40 FT	Black Sand
40-48 FT	Sand - Gravel
48-60 FT	Gravel - Sand - Water
60 FT	Total Depth

Size of Drilled Hole	Size and Weight of Casing	From (Feet)	To (Feet)	PERFORATIONS		
				Kind Size	From (Feet)	To (Feet)
6 5/8"	6 5/8" 250 WALL	0'	60'	1/8"	49'	54'

Static Water Level for non-flowing Well 47 feet

Shut-in Pressure for Flowing Well _____

Pumping Water Level 54 feet at 15 gal. per minute.

Discharge in gal. per min. of flowing well _____

How Tested Bailed Length of Test 3 hrs.

Remarks: _____

File 378016

Date May 23, 1973

Time 10:35 A.M.

Township 36 Range 25 Sec 25
Blaine County

0	5	4	8	2	1
7	6	9	10	11	12
16	17	10	15	14	13
10	20	21	22	23	24
30	29	28	27	26	25
31	32	33	34	35	36

Hickel & Tooke Drilling
Driller's Signature

Gordon Skanes
53246

272016

STATE OF MONTANA }
County of Blaine }

Filed for record this 23 Day

of May A. D. 1978

At 10:35 O'Clock A M.

Carl S. Duquesne
County Clerk

Fee 200 Deputy