

GW-15 NO GW 2

GW1 152684
File No. 1 (one)

T 45 R 23E
County Carbon

DUPLICATE

STATE OF MONTANA
ADMINISTRATOR OF GROUNDWATER CODE
OFFICE OF STATE ENGINEER

RECEIVED
DEC 24 1961

Notice of Appropriation of Groundwater
(Under Chapter 237, Montana Session Laws, 1961)

STATE ENGINEER

1. I. Jerry B. and Helen H. Dean of P. O. Box 144, Billings, Montana.
(Name of Appropriator) (Address) (Town)
County of Yellowstone State of Montana intend to appropriate groundwater in accordance with Chapter 237, Montana Session Laws of 1961.
2. The beneficial use to which water is to be applied is in irrigation and domestic.
Southwest quarter southwest quarter PT SE 1/4 and SW 1/4 SECT 23
(describe lands to be benefited, if for irrigation)
3. The rate of use in gallons per minute or miner's inches of groundwater claimed 150
miner's inches.
4. The annual period (inclusive dates) of intended use Early May to late October
5. The probable or intended date of first beneficial use Probably 1963
6. The probable or intended date of commencement and completion of the well* or wells* Hope to complete during 1962 or early 1963.
7. The location, type, size and depth of well or wells contemplated 1 well 12" Dia. cased probably about 30' deep or much deeper is necessary to get proper flow.
8. The probable or estimated depth of the water table or artesian aquifer Artesian water probably 1300'.
9. Name, address and license number of the driller engaged Driller not yet engaged.

10. Give such other similar information as may be useful in carrying out the policy of this act. Have talked to Soil Conservation Engineers and plan to have their help in engineering location etc.

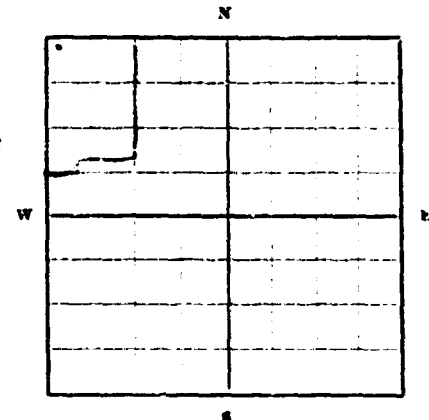

Recorded on the 12th day of January, A. D. 1962 at 3:05 o'clock P. M., in Book 1 of Wells, Page 1.

SW 1/4 Sec. 23 T45 R 23E
Locate well or other means of development as accurately as possible on the plat.

Signature of Appropriator Jerry B. Dean
Date December 28, 1961

* As defined in the Code Sec. 1 (c) "Well" means any artificial opening or excavation in the ground, however made, by which groundwater can be obtained or through which it flows under natural pressures or is artificially withdrawn.

Three copies of this notice are to be filed with County Clerk and Recorder of the county in which the well is located.

Please answer all questions. If not applicable, so state. otherwise the form will be returned.

Original to the County Clerk and Recorder; duplicate to the State Engineer; Triplicate to the School of Mines and Quadruplicate for the Appropriator.

1

152664

STATE OF MONTANA)
COUNTY OF CARBON) SS.

Office of the County Clerk & Recorder

well I hereby certify that the within
appropriate was filed in my office on
the 12th day of Jan A. D. 1962
at 3.05 o'clock P.M. and is recorded on
page 1 of book 1 of Wells,
records of Carbon County, Montana.

Attest my hand and the seal of

George W. Flashburn
Clerk and Recorder.

Tone 5 4 00

File No.

T. 53 R. 21E

DUPLICATE

County Carbon

STATE OF MONTANA
ADMINISTRATOR OF GROUNDWATER CODE
OFFICE OF STATE ENGINEER

Notice of Appropriation of Groundwater
(Under Chapter 237, Montana Session Laws, 1961)

- I. AMANDA DePRIES of Roberts,
(Name of Appropriator) (Address) (Town)
County of Carbon, State of Montana intend to appropriate groundwater in accordance with Chapter 237, Montana Session Laws of 1961.
- The beneficial use to which water is to be applied is stockwater.
(describe lands to be benefited, if for irrigation)
- The rate of use in gallons per minute or miner's inches of groundwater claimed 9 gallons per minute.
- The annual period (inclusive dates) of intended use year-round.
- The probable or intended date of first beneficial use 1934.
- The probable or intended date of commencement and completion of the well* or wells* None.
- The location, type, size and depth of well or wells contemplated None.
- The probable or estimated depth of the water table or artesian aquifer 15 feet.
- Name, address and license number of the driller engaged None.

10. Give such other similar information as may be useful in carrying out the policy of this act

the above is a spring which has been used for stockwater on the property for many years, although no notice of appropriation had been filed therefor.

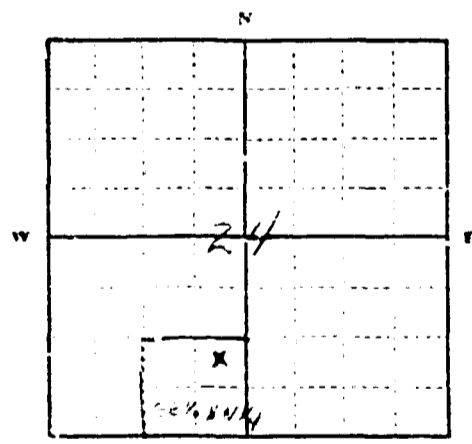

127723
February 3, 1970

Section 24 T. 53 R. 21E
Locate well or other means of development as accurately as possible on the plat.

Signature of Appropriator Amanda Depries
Date February 3, 1970.

* As defined in the Code Sec. 1-6-1 "Well" means any artificial opening or excavation in the ground, however made, by which groundwater can be obtained or through which it flows under natural pressures or is artificially withdrawn.

Three copies of this notice are to be filed with County Clerk and Recorder of the county in which the well is located.

Please answer all questions. If not applicable, so state, otherwise the form will be returned.

Original to the County Clerk and Recorder; duplicate to the State Engineer; Triplicate to the Montana Bureau of Mines and Geology and Quadruplicate for the Appropriator.

1234

#1263 177-278

COUNTY OF LARSEN, SS.

Office of the County Clerk & Recorder

I hereby certify that the within
appropriation was filed
in my office this 3 day
of Feb A. D. 19 70
at 10:45 o'clock A. M.

Attest my hand and the seal of
said County
Frank Brueck
Cl. & R. - Recorder

Fees \$ _____

File No.

T. 5S R. 22E

DUPLICATE

County Carbon

STATE OF MONTANA
ADMINISTRATOR OF GROUNDWATER CODE
OFFICE OF STATE ENGINEER

Notice of Appropriation of Groundwater
(Under Chapter 237, Montana Session Laws, 1961)

- I, AMANDA DEVRIES of Roberts,
(Name of Appropriator) (Address) (Town)
County of Carbon State of Montana, intend to appropriate groundwater in accordance with Chapter 237, Montana Session Laws of 1961.
- The beneficial use to which water is to be applied is stockwater.
(Describe lands to be benefited, if for irrigation)
- The rate of use in gallons per minute or miner's inches of groundwater claimed 12 gallons per minute.
- The annual period (inclusive dates) of intended use year-round.
- The probable or intended date of first beneficial use 1934.
- The probable or intended date of commencement and completion of the well* or wells* 1934.
- The location, type, size and depth of well or wells contemplated well is located in the SW 1/4 of Section 19, Township 5 South, Range 22 East, "..." is a dug well 12 feet in diameter and 100 feet deep.
- The probable or estimated depth of the water table or artesian aquifer 15 feet.
- Name, address and license number of the driller engaged None.

10. Give such other similar information as may be useful in carrying out the policy of this act.....
 the above is a well which has been used for stockwater on the property for many years, although no notice of appropriation had been filed therefor.

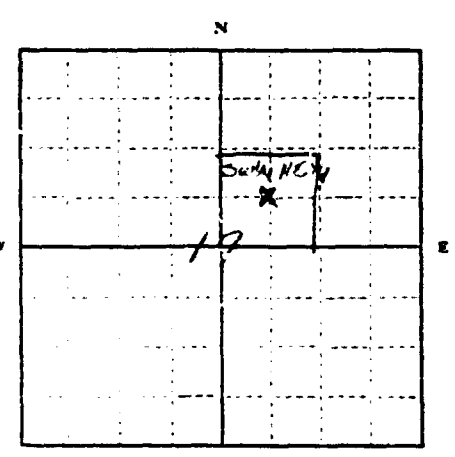

177429
 February 3, 1970

SW 1/4 Sec. 19 T. 5S R. 22E
 Locate well or other means of development as accurately as possible on the plat.

Signature of Appropriator Amanda Devries
 Date February 3, 1970.

* As defined in the Code Sec. 1-10) "Well" means any artificial opening or excavation in the ground, however made, by which groundwater can be obtained or through which it flows under natural pressures or is artificially withdrawn."

Three copies of this notice are to be filed with County Clerk and Recorder of the county in which the well is located.

Please answer all questions. If not applicable, so state, otherwise the form will be returned.

Original to the County Clerk and Recorder; duplicate to the State Engineer; Triplicate to the Montana Bureau of Mines and Geology and Quadruplicate for the Appropriator.

[Handwritten signature]

#1264 177109

CLERK OF THE COUNTY OF
SUNY OF CUBA
Clerk of the County Clerk & Recorder

I hereby certify that the within
Appropriation was paid
by the County Clerk on this 3
Feb A. D. 19 70
10:50 o'clock A. M.

Witness my hand and the seal
of the County Clerk
Frank Danick
Clerk of the County

File No.

T 55 R 22E

DUPLICATE

County Carbon

STATE OF MONTANA
ADMINISTRATOR OF GROUNDWATER CODE
OFFICE OF STATE ENGINEER

Notice of Appropriation of Groundwater
(Under Chapter 237, Montana Session Laws, 1961)

- I. AMANDA DEVRIES of Roberts,
(Name of Appropriator) (Address) (Town)
County of Carbon State of Montana intend to appropriate groundwater in accordance with Chapter 237, Montana Session Laws of 1961.
- The beneficial use to which water is to be applied is stockwater.
(describe lands to be benefited, if for irrigation)
- The rate of use in gallons per minute or miner's inches of groundwater is 11 gallons per minute.
- The annual period (inclusive dates) of intended use year-round.
- The probable or intended date of first beneficial use 1934.
- The probable or intended date of commencement and completion of the well* or wells*
None.
- The location, type, size and depth of well or wells contemplated
None.
- The probable or estimated depth of the water table or artesian aquifer 15 feet.
- Name, address and license number of the driller engaged None.

10. Give such other similar information as may be useful in carrying out the policy of this act.

The above are springs which have been used for stockwater on the property for many years although no notice of appropriation had been filed therefor.

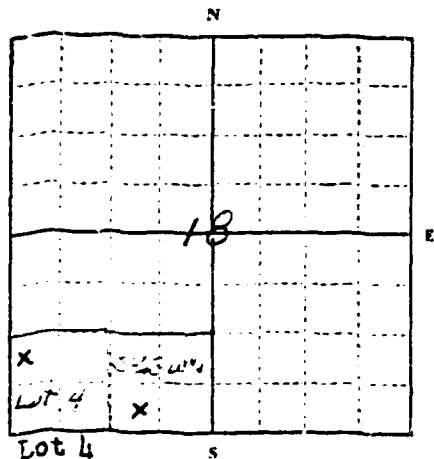

17730
Amanda Devries
70
10-55

SEAS 1/4 Sec. 18 T55 R 22E
Locate well or other means of development as accurately as possible on the plat.

Signature of Appropriator: Amanda Devries
Date: February 3, 1970.

* As defined in the Code Sec. 1 (c) "Well" means any artificial opening or excavation in the ground, however made, by which groundwater can be obtained or through which it flows under natural pressures or is artificially withdrawn"

Three copies of this notice are to be filed with County Clerk and Recorder of the county in which the well is located.
Please answer all questions. If not applicable, so state, otherwise the form will be returned.

Original to the County Clerk and Recorder; duplicate to the State Engineer; Triplicate to the Montana Bureau of Mines and Geology and Quadruplicate for the Appropriator.

10135

#1265 177230

STATE OF MICHIGAN,
County of the City and County of Detroit.
I do hereby certify that the within
Appropriation was paid
to the order of for this 3
of Feb A.D. 1970
at 10:55 o'clock A. M.
Attest my hand and the seal
of said County
Frank Sawicki
City and Recorder

By _____ Deput

Fees \$ _____

File No. _____

T 5S R 21E

DUPLICATE

County Carbon

STATE OF MONTANA
ADMINISTRATOR OF GROUNDWATER CODE
OFFICE OF STATE ENGINEER

Notice of Appropriation of Groundwater

(Under Chapter 237, Montana Session Laws, 1961)

1. I, AMANDA DEVRIES, of Roberts
(Name of Appropriator) (Address) (Town)
County of Carbon, State of Montana, intend to appropriate groundwater in accordance with Chapter 237, Montana Session Laws of 1961.

2. The beneficial use to which water is to be applied is stockwater
(describe lands to be benefited, if for irrigation)

3. The rate of use in gallons per minute or miner's inches of groundwater claimed 10 gallons per minute.

4. The annual period (inclusive dates) of intended use year-round.

5. The probable or intended date of first beneficial use 1934.

6. The probable or intended date of commencement and completion of the well* or wells*
None.

7. The location, type, size and depth of well or wells contemplated
None.

8. The probable or estimated depth of the water table or artesian aquifer 15 feet.

9. Name, address and license number of the driller engaged None

10. Give such other similar information as may be useful

in carrying out the policy of this act.
the above is a spring which has been used for stockwater on the property for many years, although no notice of appropriation had been filed therefor.

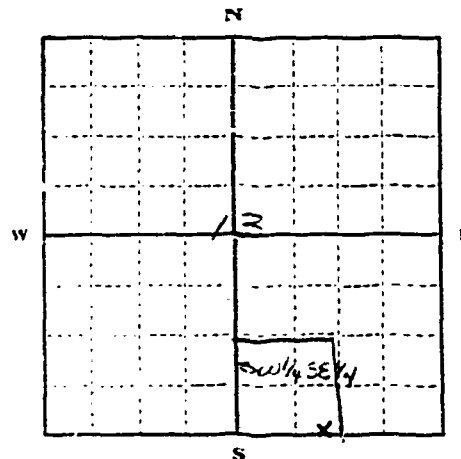

177431-
February
11:00

SW 1/4 Sec. 13 T. 5S. R. 21E
Locate well or other means of development as accurately as possible on the plat.

Signature of Appropriator Amanda Devries
Date February 3, 1970.

* As defined in the Code Sec. 1 (c) "Well" means any artificial opening or excavation in the ground, however made, by which groundwater can be obtained or through which it flows under natural pressures or is artificially withdrawn."

Three copies of this notice are to be filed with County Clerk and Recorder of the county in which the well is located.

Please answer all questions. If not applicable, so state. otherwise the form will be returned.

Original to the County Clerk and Recorder; duplicate to the State Engineer; Triplicate to the Montana Bureau of Mines and Geology and Quadruplicate for the Appropriator.

46136

#1266 874131

STATE OF CALIFORNIA
COUNTY OF SAN DIEGO

Deputy Clerk & Recorder

I hereby certify that the within

Appropriation was filed

on Wed. the 3 day

of Feb A.D. 19 70

at 11:00 o'clock A. M.

and the cost of

and Frank Dawick

Deputy

Page 5

GW 1

File No. 1523

T. 6 R. 21

DUPLICATE

County Carbon

STATE OF MONTANA
ADMINISTRATOR OF GROUNDWATER CODE
OFFICE OF STATE ENGINEER

JAN 26 1964

Notice of Appropriation of Groundwater

(Under Chapter 237, Montana Session Laws, 1961)

- I, Owen D. Rhoda E. Faust of Reberts
(Name of Appropriator) (Address) (Town)
County of Carbon, State of Montana, intend to appropriate groundwater in accordance with Chapter 237, Montana Session Laws of 1961.
- The beneficial use to which water is to be applied is livestock
(describe lands to be benefited, if for irrigation)
- The rate of use in gallons per minute or miner's inches of groundwater claimed 50 gallons per minute
- The annual period (inclusive dates) of intended use 7 months
- The probable or intended date of first beneficial use Spring of 1964
- The probable or intended date of commencement and completion of the well* or wells* Spring of 1964
- The location, type, size and depth of well or wells contemplated 6" casing - 150 - 200 feet deep
- The probable or estimated depth of the water table or artesian aquifer 50 feet
- Name, address and license number of the driller engaged unknown as yet
- Give such other similar information as may be useful in carrying out the policy of this act None

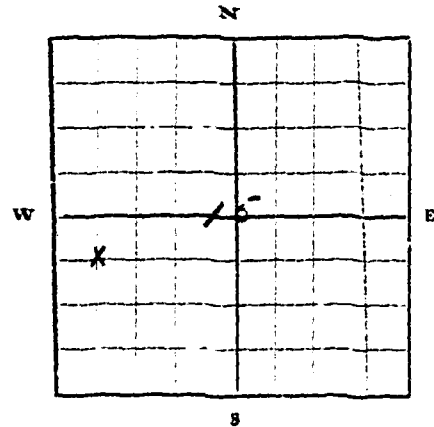

NW 1/4 Sec. 15 T. 6 R. 21
SW
Locate well or other means of development as accurately as possible on the plat.

Signature of Appropriator Owen D. Faust

Date 1/31/64

* As defined in the Code Sec. 1 (c) "Well" means any artificial opening or excavation in the ground, however made, by which groundwater can be obtained or through which it flows under natural pressures or is artificially withdrawn."

Three copies of this notice are to be filed with County Clerk and Recorder of the county in which the well is located.

Please answer all questions. If not applicable, so state, otherwise the form will be returned.

Original to the County Clerk and Recorder; duplicate to the State Engineer; Triplicate to the School of Mines and Quadruplicate for the Appropriator.

159982

1019

COUNTY OF CLATSOP

Office of the County Clerk & Recorder

I hereby certify that the within

Notice Appr. was file.

for record in my office this 31st day

of January A. D. 1964

at 3:10 o'clock P. M.

Attest my hand and the seal of
said County

EDMUND DANFORTH COUNTY CLERK

Clerk and Recorder

By Alicia E. New Deputy

Fees \$ 2.00

File No. 1056

LOTS 2 - 13 T. 6 R. 20 E

DUPLICATE

County of Carbon

STATE OF MONTANA
ADMINISTRATOR OF GROUNDWATER CODE
OFFICE OF STATE ENGINEER

Notice of Appropriation of Groundwater

(Under Chapter 237, Montana Session Laws, 1961)

1. I, Louis J. + June L. Hyem of Red Lodge
(Name of Appropriator) (Address) (Town)
County of Carbon, State of Montana, intend to appropriate groundwater in accordance with Chapter 237, Montana Session Laws of 1961.

2. The beneficial use to which water is to be applied is domestic + irrigation
LOTS 2 - 13 T. 6 R. 20 E
(describe lands to be benefited, if for irrigation)

3. The rate of use in gallons per minute or miner's inches of groundwater claimed 50 miner's inches

4. The annual period (inclusive dates) of intended use May 1 to about Sept 1 each year

5. The probable or intended date of first beneficial use 1966

6. The probable or intended date of commencement and completion of the well* or wells* 1966

7. The location, type, size and depth of well or wells contemplated pump size 8" depth unknown location Lots 2-13 T. 6. Sec 7 R. 20 E

8. The probable or estimated depth of the water table or artesian aquifer 60 feet

9. Name, address and license number of the driller engaged unknown at this time

10. Give such other similar information as may be useful

in carrying out the policy of this act.

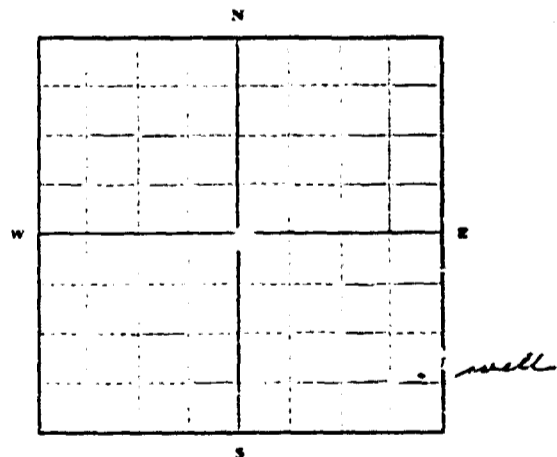

LOTS 2 - 13 Sec. 7 T. 6 R. 20 E
Locate well or other means of development as accurately as possible on the plat.

Signature of Appropriator Louis J. + June L. Hyem

Date May 29 1964

* As defined in the Code Sec. 1-1-1 "Well" means any artificial opening or excavation in the ground, however made, by which groundwater can be obtained or through which it flows under natural pressures or is artificially withdrawn."

Three copies of this notice are to be filed with County Clerk and Recorder of the county in which the well is located.

Please answer all questions. If not applicable, so state, otherwise the form will be returned.

Original to the County Clerk and Recorder; duplicate to the State Engineer; Triplicate to the Montana Bureau of Mines and Geology and Quadruplicate for the Appropriator.

#1056

161317

STATE OF MONTANA }
COUNTY OF CARBON } SS.

Office of the County Clerk & Recorder

I hereby certify that the within
Appropriation was filed
for record in my office this 29 day
of June A. D. 19 64
at 4:10 o'clock P. M.

Attest my hand and the seal of
said County
Frank Duvick
Clerk and Recorder

By _____ Deputy

Form 3 _____

GW 1

File No. 50

T 52 R 24E

DUPLICATE

County Carbon

STATE OF MONTANA
ADMINISTRATOR OF GROUNDWATER CODE
OFFICE OF STATE ENGINEER

Notice of Appropriation of Groundwater
(Under Chapter 237, Montana Session Laws, 1961)

1. I, James and Lucille Schumm of Edgar, Montana
(Name of Appropriator) (Address) (Town)
County of Carbon, State of Montana, intend to appropriate groundwater in accordance with Chapter 237, Montana Session Laws of 1961.
2. The beneficial use to which water is to be applied is Stock Water
(describe lands to be benefited, if for irrigation)
3. The rate of use in gallons per minute or miner's inches of groundwater claimed
4. The annual period (inclusive dates) of intended use Summer months
5. The probable or intended date of first beneficial use
6. The probable or intended date of commencement and completion of the well* or wells*
7. The location, type, size and depth of well or wells contemplated
8. The probable or estimated depth of the water table or artesian aquifer
9. Name, address and license number of the driller engaged

10. Give such other similar information as may be useful in carrying out the policy of this act.

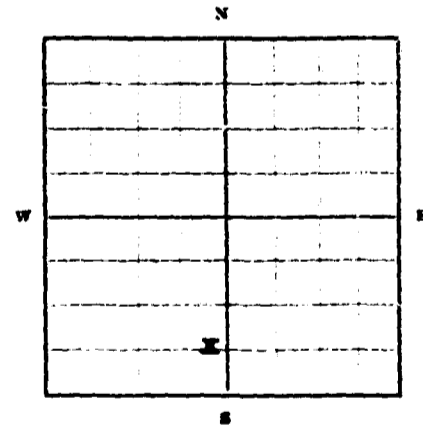

30.544 1/4 Sec. 33 T 5 R 24E
Locate well or other means of development as accurately as possible on the plat.

Signature of Appropriator [Signature]

Date Dec. 28, 1962

* As defined in the Code Sec. 1 (c) "Well" means any artificial opening or excavation in the ground, however made, by which groundwater can be obtained or through which it flows under natural pressures or is artificially withdrawn."

Three copies of this notice are to be filed with County Clerk and Recorder of the county in which the well is located.

Please answer all questions. If not applicable, so state, otherwise the form will be returned.

Original to the County Clerk and Recorder; duplicate to the State Engineer; Triplicate to the School of Mines and Quadruplicate for the Appropriator.

#50

155805

STATE OF MICHIGAN,
COUNTY OF CASS, SS.
Office of the County Clerk & Recorder

I hereby certify that the within
Appropriation was filed
for record in the County of Cass
of December 28 day
at 4:00 P. M.

Witness my hand and seal of
said County at _____
Frank Daniluk

By _____

GW1

File No. 51

T. 5 S. R. 24

DUPLICATE

County Carbon

STATE OF MONTANA
ADMINISTRATOR OF GROUNDWATER CODE
OFFICE OF STATE ENGINEER

Notice of Appropriation of Groundwater

(Under Chapter 237, Montana Session Laws, 1961)

- I, James and Lucille Schram of Edgar, Montana
(Name of Appropriator) (Address) (Town)
County of Carbon, State of Montana, intend to appropriate groundwater in accordance with Chapter 237, Montana Session Laws of 1961.
- The beneficial use to which water is to be applied is Stock Water
(describe lands to be benefited, if for irrigation)
- The rate of use in gallons per minute or miner's inches of groundwater claimed
- The annual period (inclusive dates) of intended use Summer months
- The probable or intended date of first beneficial use
- The probable or intended date of commencement and completion of the well* or wells*
- The location, type, size and depth of well or wells contemplated
- The probable or estimated depth of the water table or artesian aquifer
- Name, address and license number of the driller engaged

10. Give such other similar information as may be useful in carrying out the policy of this act.

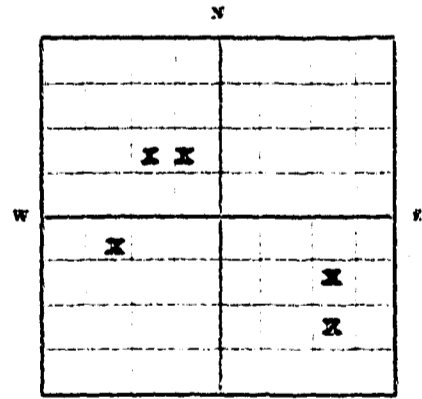

1/4 Sec. 35 T. 5 R. 24

Locate well or other means of development as accurately as possible on the plat.

Signature of Appropriator [Signature]

Date _____

* As defined in the Code Sec. 1 (c) "Well" means any artificial opening or excavation in the ground, however made, by which groundwater can be obtained or through which it flows under natural pressures or is artificially withdrawn."

Three copies of this notice are to be filed with County Clerk and Recorder of the county in which the well is located.

Please answer all questions. If not applicable, so state, otherwise the form will be returned.

Original to the County Clerk and Recorder; duplicate to the State Engineer; Triplicate to the School of Mines and Quadruplicate for the Appropriator.

51

155806

STATE OF _____
COUNTY OF _____ SS.

Office of the County Clerk & Recorder

I hereby certify that the within
Appropriation was
for record in my office this 28 day
of December A. D. 1962
at 4:05 o'clock P. M.

Attest my hand and the seal of
said County
Frank Danilch
Clerk and Recorder

By _____ Deputy

Fees \$ _____

File No. _____

T 3 S R 23 E

DUPLICATE

County Carbon

STATE OF MONTANA
ADMINISTRATOR OF GROUNDWATER CODE
OFFICE OF STATE ENGINEER

Notice of Appropriation of Groundwater
(Under Chapter 237, Montana Session Laws, 1961)

1. I, Richard L. Shawles, of Box 13 Ballantine Mont.
(Name of Appropriator) (Address) (Town)

County of Yellowstone, State of Montana, intend to appropriate groundwater in accordance with Chapter 237, Montana Session Laws of 1961.

2. The beneficial use to which water is to be applied is Domestic & Stock

(describe lands to be benefited, if for irrigation)

3. The rate of use in gallons per minute or miner's inches of groundwater claimed _____

15 gal per minute

4. The annual period (inclusive dates) of intended use year round use

5. The probable or intended date of first beneficial use in use

6. The probable or intended date of commencement and completion of the well* or wells* _____

Completed before our purchase of land

7. The location, type, size and depth of well or wells contemplated SW 1/4 SE 1/4 Sec 14

T 3 S R 23 E drilled 85'

8. The probable or estimated depth of the water table or artesian aquifer 755'

9. Name, address and license number of the driller engaged not known

10. Give such other similar information as may be useful

in carrying out the policy of this act _____

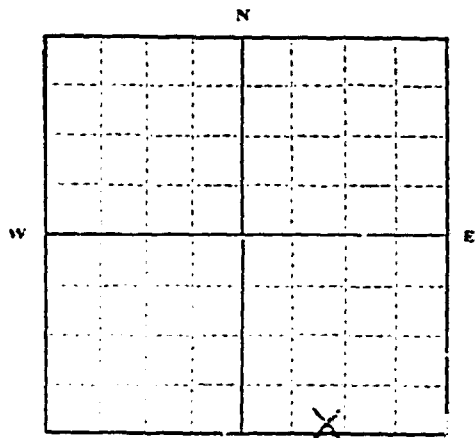

SW 1/4 Sec 14 T 3 S R 23 E
Locate well or other means of development as accurately as possible on the plat.

Signature of Appropriator Richard L. Shawles

Date June 15, 1973

* As defined in the Code Sec. 1 (c) "Well" means any artificial opening or excavation in the ground, however made, by which groundwater can be obtained or through which it flows under natural pressures or is artificially withdrawn "

Three copies of this notice are to be filed with County Clerk and Recorder of the county in which the well is located.

Please answer all questions. If not applicable, so state, otherwise the form will be returned.

Original to the County Clerk and Recorder; duplicate to the State Engineer; Triplicate to the Montana Bureau of Mines and Geology and Quadruplicate for the Appropriator.

File No.

T35 R23E

DUPLICATE

County Carbon

STATE OF MONTANA
ADMINISTRATOR OF GROUNDWATER CODE
OFFICE OF STATE ENGINEER

Notice of Appropriation of Groundwater

(Under Chapter 237, Montana Session Laws, 1961)

1. I, Richard L. Shawles of Box 73 Bullington Mont.
(Name of Appropriator) (Address) (Town)

County of Yellowstone, State of Montana intend to appropriate groundwater in accordance with Chapter 237, Montana Session Laws of 1961.

2. The beneficial use to which water is to be applied is Domestic & Stock

describe lands to be benefited, if for irrigation

3. The rate of use in gallons per minute or miner's inches of groundwater claimed.

15 gal per minute

4. The annual period (inclusive dates) of intended use year round use

5. The probable or intended date of first beneficial use in use

6. The probable or intended date of commencement and completion of the well or wells.

Completed before our purchase of land

7. The location, type, size and depth of well or wells contemplated SW 1/4 Sec 14

T35 R23E

8. The probable or estimated depth of the water table or artesian aquifer 45 ft

9. Name, address and license number of the driller engaged not known

10. Give such other similar information as may be useful

in carrying out the policy of this act.

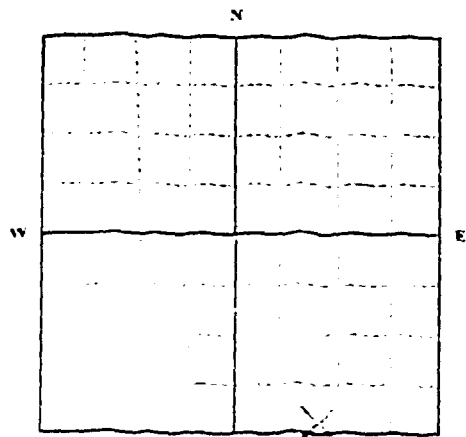

Locate well or other means of development as accurately as possible on the plat.

Signature of Appropriator Richard L. Shawles

Date 7-1-63

As defined in the Code Sec. 1 (c) "Well" means any artificial opening or excavation in the ground, however made, by which groundwater can be obtained or through which it flows under natural pressures or is artificially withdrawn.

Three copies of this notice are to be filed with County Clerk and Recorder of the county in which the well is located.

Please answer all questions. If not applicable, so state, otherwise the form will be returned.

Original to the County Clerk and Recorder; duplicate to the State Engineer; Triplicate to the Montana Bureau of Mines and Geology and Quadruplicate for the Appropriator.

#1420 188270

STATE OF MONTANA
COUNTY OF CARMAN

Office of the County Clerk & Recorder

I hereby certify that the within
Administration was filed
for record in my office this 27 day
of June A. D. 1973
at 2:00 o'clock P.M.

Witness my hand and the seal of
said County
Frank Brundick
County Clerk and Recorder

Fee \$ 2.00 Deputy

File No. 173

T. 9S. R. 27 E.

DUPLICATE

County Carbon

STATE OF MONTANA
ADMINISTRATOR OF GROUNDWATER CODE
OFFICE OF STATE ENGINEER

Notice of Appropriation of Groundwater

(Under Chapter 237, Montana Session Laws, 1961)

The United States of America
Bureau of Land Management

1. I, Billings District Office, of 320 4th Avenue North, Billings
(Name of Appropriator) (Address) (Town)

County of Carbon, State of Montana, intend to appropriate groundwater in accordance with Chapter 237, Montana Session Laws of 1961.

2. The beneficial use to which water is to be applied is for livestock and wildlife
within an allotment
(describe lands to be benefited, if for irrigation)

3. The rate of use in gallons per minute or miner's inches of groundwater claimed
estimated 30PM (minimum)

4. The annual period (inclusive dates) of intended use January 1 - December 31

5. The probable or intended date of first beneficial use August 1, 1963

6. The probable or intended date of commencement and completion of the well* or wells*
commencement - June 4, 1963; completion - July 15, 1963.

7. The location, type, size and depth of well or wells contemplated Public Lands administered
by the Bureau of Land Management in the NE 1/4, Sec. 10, Twp. 9 S., Rge. 27 E., PMM.

8. The probable or estimated depth of the water table or artesian aquifer 150 to 250 feet.

9. Name, address and license number of the driller engaged Mr. Ted L. Kaugan,
B & L Drilling Company, Fichtell, Montana License No. 27

10. Give such other similar information as may be useful in carrying out the policy of this act. Drilling operations will be by contract for five (5) water wells of which this is one (1). Contract name will be Carbon Water Wells. Commencement of work will be approximately by June 4, and completion of this contract within 45 days.

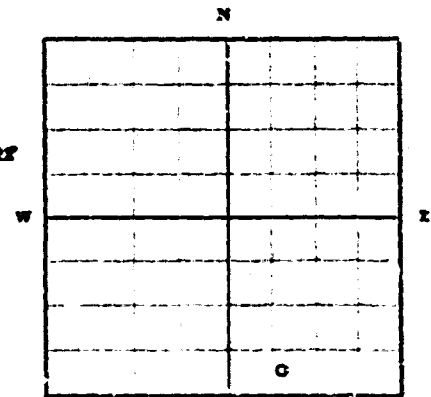

O PROPOSED WATER WELL SITE
NE 1/4 Sec. 10 T. 9 S. R. 27 E. PMM.

Locate well or other means of development as accurately as possible on the plat.

Signature of Appropriator [Signature]
District Manager

Date 6/4/63

* As defined in the Code Sec. 1 (c) "Well" means any artificial opening or excavation in the ground, however made, by which groundwater can be obtained or through which it flows under natural pressures or is artificially withdrawn."

Three copies of this notice are to be filed with County Clerk and Recorder of the county in which the well is located.

Please answer all questions. If not applicable, so state, otherwise the form will be returned.

Original to the County Clerk and Recorder; duplicate to the State Engineer; Triplicate to the School of Mines and Quadruplicate for the Appropriator.

#173
CA

157343

STATE OF MONTANA)
COUNTY OF CARBON) SS.

Office of the County Clerk & Recorder

I hereby certify that the within
notice was filed
for record in my office this 21ST day
of June A. D. 1963
at 1:45 o'clock P. M.

Attest my hand and the seal of
said County

FRANK DANICHEK, COUNTY CLERK
Clerk and Recorder

By Tony A. Zupans

Fees \$ 2.00 pd

DUPLICATE

County Carbon

STATE OF MONTANA
ADMINISTRATOR OF GROUNDWATER CODE
OFFICE OF STATE ENGINEER

Notice of Appropriation of Groundwater

(Under Chapter 237, Montana Session Laws, 1961)

The United States of America
Bureau of Land Management
Billings District Office

I, Billings District Office, of 3310 4th Avenue North, Billings
(Name of Appropriator) (Address) (Town)

County of Carbon, State of Montana, intend to appropriate groundwater in accordance with Chapter 237, Montana Session Laws of 1961.

2. The beneficial use to which water is to be applied is to provide water for livestock and wildlife within an allotment.
(describe lands to be benefited, if for irrigation)

3. The rate of use in gallons per minute or miner's inches of groundwater claimed estimated 3 GPM (minimum)

4. The annual period (inclusive dates) of intended use January 1 - December 31.

5. The probable or intended date of first beneficial use August 1, 1963.

6. The probable or intended date of commencement and completion of the well* or wells* commencement by June 4, 1963; completion by July 15, 1963.

7. The location, type, size and depth of well or wells contemplated Public Lands administered by the Bureau of Land Management within the SW 1/4, Sec. 29, Twp. 8 S., Rge. 23 E., PMM.

8. The probable or estimated depth of the water table or artesian aquifer 100 - 150 feet

9. Name, address and license number of the driller engaged Mr. Ted L. Haugan, B & H Drilling Company, Fichtell, Montana License No. 27

10. Give such other similar information as may be useful in carrying out the policy of this act. Drilling operations will be by contract for five (5) water wells of which this is one (1). Contract name will be Carbon Water Wells. Commencement of work will be approximately by June 4, and completion of this contract within 45 days.

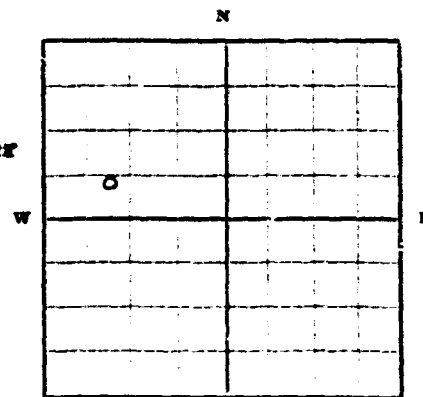

⁸³⁶¹⁵⁰
O PROPOSED WATER WELLSITE

SW 1/4 Sec. 29 T. 8 S. R. 23 E., PMM.

Locate well or other means of development as accurately as possible on the plat.

Signature of Appropriator Ted L. Haugan
District Manager

Date June 4, 1963

* As defined in the Code Sec. 1 (c) "Well" means any artificial opening or excavation in the ground, however made, by which groundwater can be obtained or through which it flows under natural pressures or is artificially withdrawn."

Three copies of this notice are to be filed with County Clerk and Recorder of the county in which the well is located.

Please answer all questions. If not applicable, so state, otherwise the form will be returned.

Original to the County Clerk and Recorder; duplicate to the State Engineer; Triplicate to the School of Mines and Quadruplicate for the Appropriator.

17 31 53 8

#176

157346

STATE OF MONTANA }
COUNTY OF CARBON } SS.

Office of the County Clerk & Recorder

I hereby certify that the within
Notice was filed
for record in my office this 21ST day
of June A. D. 1963
at 2:00 o'clock P.M.

Attest my hand and the seal of
said County
FRANK DANICHEK, COUNTY CLERK

Clerk and Recorder

By Jerry P. Zupka Deputy
Exam 3 26 pd.

File No. 172

T. & S. R. 23 E.

DUPLICATE

County Carbon

STATE OF MONTANA
ADMINISTRATOR OF GROUNDWATER CODE
OFFICE OF STATE ENGINEER

Notice of Appropriation of Groundwater

(Under Chapter 237, Montana Session Laws, 1961)

The United States of America
Bureau of Land Management
Billings District Office

1. I, Billings District Office, of 2310 4th Avenue North, Billings
(Name of Appropriator) (Address) (Town)

County of Carbon, State of Montana, intend to appropriate groundwater in accordance with Chapter 237, Montana Session Laws of 1961.

2. The beneficial use to which water is to be applied is to provide water for livestock and wildlife within an allotment.
(describe lands to be benefited, if for irrigation)

3. The rate of use in gallons per minute or miner's inches of groundwater claimed Estimated 3 GPM (minimum)

4. The annual period (inclusive dates) of intended use January 1 - December 31.

5. The probable or intended date of first beneficial use August 1, 1963

6. The probable or intended date of commencement and completion of the well^s or wells^s Commencement June 7, 1963, completion July 15, 1963

7. The location, type, size and depth of well or wells contemplated Public lands administered by the Bureau of Land Management within the NE 1/4 Sec. 13, Solid foot-cable & churn drilling, 6-inch diam. (ID) w/estimated depth of 100 feet. Top. 8 S., Rgn. 23 E., PMM.

8. The probable or estimated depth of the water table or artesian aquifer 75 - 100 feet.

9. Name, address and license number of the driller engaged Mr. Ted L. Haugan, B & H Drilling Company, Fishtail, Montana License No. 27

10. Give such other similar information as may be useful in carrying out the policy of this act. Drilling operations will be by contract for five (5) water wells of which this is one (1). Contract name will be Carbon Water Wells. Commencement of work will be approximately by June 4, and completion of this contract within 45 days.

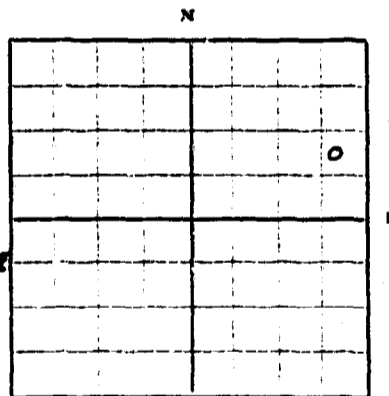

^{8, 23, 23, 23, 23}
O PROPOSED WATER WELL SITE
NE 1/4 Sec. 13 T. 8 S. R. 23 E. PMM.

Locate well or other means of development as accurately as possible on the plat.

Signature of Appropriator Wagner
District Manager

Date 6/10/63

* As defined in the Code Sec. 1 (c) "Well" means any artificial opening or excavation in the ground, however made, by which groundwater can be obtained or through which it flows under natural pressures or is artificially withdrawn."

Three copies of this notice are to be filed with County Clerk and Recorder of the county in which the well is located.

Please answer all questions. If not applicable, so state, otherwise the form will be returned.

Original to the County Clerk and Recorder; duplicate to the State Engineer; Triplicate to the School of Mines and Quadruplicate for the Appropriator.

#172

157342

STATE OF MONTANA
COUNTY OF CARBON) SS.

Office of the County Clerk & Recorder

I hereby certify that the within
Notice was filed
for record in my office this 21ST day
of June A. D. 19 63
at 1:40 o'clock P. M.

Attest my hand and the seal of
said County
FRANK DANICHEK COUNTY CLERK

Clerk and Recorder

By Jerry A. Zupan Deputy

Fee \$ 2.00 pd.

GW 1

File No. 177

T. 8 S. R. 24 E.

DUPLICATE

County Carbon

STATE OF MONTANA
ADMINISTRATOR OF GROUNDWATER CODE
OFFICE OF STATE ENGINEER

RECORDED
JAN 20 1963

Notice of Appropriation of Groundwater

(Under Chapter 237, Montana Session Laws, 1961)

The United States of America
Bureau of Land Management

1. I, Billings District Office of 3310 4th Avenue North, Billings
(Name of Appropriator) (Address) (Town)

County of Yellowstone State of Montana, intend to appropriate groundwater in accordance with Chapter 237, Montana Session Laws of 1961.

2. The beneficial use to which water is to be applied is to provide water for livestock and wildlife within an allotment.
(describe lands to be benefited, if for irrigation)

3. The rate of use in gallons per minute or miner's inches of groundwater claimed Estimated 3 GPM (minimum)

4. The annual period (inclusive dates) of intended use January 1 - December 31

5. The probable or intended date of first beneficial use August 1, 1963

6. The probable or intended date of commencement and completion of the well* or wells* Commencement by June 4, 1963, completion by July 15, 1963.

7. The location, type, size and depth of well or wells contemplated Public lands administered by the Bureau of Land Management within the SW 1/4, Section 12, Twp. 8 S., R. 24 E., T8N.

8. The probable or estimated depth of the water table or artesian aquifer 150 feet

9. Name, address and license number of the driller engaged Mr. Ted L. Hugen, B & H Drilling Company, Fishtail, Montana License No. 27

10. Give such other similar information as may be useful in carrying out the policy of this act. Drilling operations will be by contract for five(5) water wells of which this is one (1). Contract name will be Carbon Water Wells. Commencement of work will be approximately by June 4. and completion of this contract within 45 days.

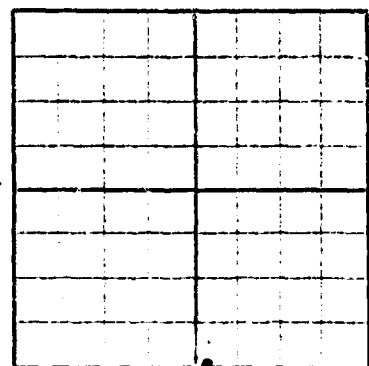

* Proposed Curve water well site
at 1/4 Sec. 12 T. 8 S. R. 24 E., T8N
Locate well or other means of development as accurately as possible on the plat.

Signature of Appropriator L. Eugene W. Linder
District Manager
Date June 4, 1963

* As defined in the Code Sec. 1 (c) "Well" means any artificial opening or excavation in the ground, however made, by which groundwater can be obtained or through which it flows under natural pressures or is artificially withdrawn."

Three copies of this notice are to be filed with County Clerk and Recorder of the county in which the well is located.

Please answer all questions. If not applicable, so state. otherwise the form will be returned.

Original to the County Clerk and Recorder; duplicate to the State Engineer; Triplicate to the School of Mines and Quadruplicate for the Appropriator.

3329 12720

#177

157347

STATE OF MONTANA }
COUNTY OF CARBON } SS.

Office of the County Clerk & Recorder

I hereby certify that the within

Notice was filed
for record in my office this 21ST day
of June A. D. 19 63
at 2:05 o'clock P. M.

Attest my hand and the seal of
said County

FRANK DANICHEK, COUNTY CLERK

Clerk and Recorder

By Joseph J. Zupian

Fees \$ 2.00 pd.

GW 1

File No. 174

T 9 S. R 27 E.

County Carbon

DUPLICATE
RECORDED
JAN 15 1968

CODE

valer
(1961)

The United
Bureau of
1. I, Billings
(Name of A
County of Car
propriate groundwa

NE 1/4 Sec 21

avenue North, Billings
(Town)

intend to ap
na Session Laws of 1961.

2. The beneficial use t
and wildlife vil
(describe lands

vide water for livestock

3. The rate of use in g
estimated 3

dwater claimed

4. The annual period

July 1 - December 31

5. The probable or intended date of first beneficial use

August 1, 1963

6. The probable or intended date of commencement and completion of the well* or wells*

commencement - June 4, 1963; completion - July 15, 1963.

7. The location, type, size and depth of well or wells contemplated

Public lands administered
by the Bureau of Land Management within the NE 1/4 Sec 21, T. 9 S., R. 27 E.,

8. The probable estimated depth of the water table or artesian aquifer

175 - 250 feet

9. Name, address and license number of the driller engaged

Mr. Ted L. Haugan

B & H Drilling Company, Fishtail, Montana

License No. 27.

10. Give such other similar information as may be use-
ful in carrying out the policy of this act. Drilling
operations will be by contract for five (5) water
wells of which this is one (1). Contract
work will be Carbon Water Wells. Commencement
of work will be approximately by June 4, and
completion of this contract within 45 days.

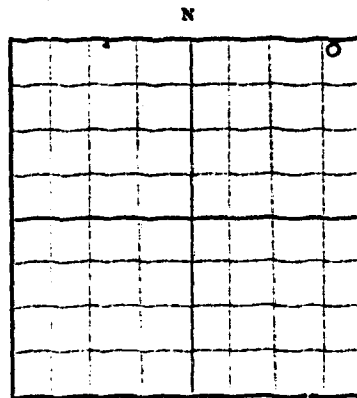

PROPOSED WATER WELL SITE

NE 1/4 Sec 21, T. 9 S. R. 27 E. P. 111.

Locate well or other means of
development as accurately as
possible on the plat.

Signature of Appropriator

Wayne A. Wilde
District Manager

Date

7/6/63

* As defined in the Code Sec. 1 (c) "Well" means any artificial opening or excavation in the ground, however made, by which groundwater can be obtained or through which it flows under natural pressures or is artificially withdrawn."

Three copies of this notice are to be filed with County Clerk and Recorder of the county in which the well is located.

Please answer all questions. If not applicable, so state, otherwise the form will be returned.

Original to the County Clerk and Recorder; duplicate to the State Engineer; Triplicate to the School of Mines and Quadruplicate for the Appropriator.

43827

ON DUPLICATE

County Carbon

STATE OF MONTANA
ADMINISTRATOR OF GROUNDWATER CODE
OFFICE OF STATE ENGINEER

Notice of Appropriation of Groundwater

(Under Chapter 237, Montana Session Laws, 1961)

The United States of America,
Bureau of Land Management

1. I, Billings District Office, of 3310 4th Avenue North, Billings
(Name of Appropriator) (Address) (Town)
County of Carbon State of Montana, intend to appropriate groundwater in accordance with Chapter 237, Montana Session Laws of 1961.

2. The beneficial use to which water is to be applied is to provide water for livestock and wildlife within an allotment.
(Describe lands to be benefited, if for irrigation)

3. The rate of use in gallons per minute or miner's inches of groundwater claimed estimated 3 GPM (minimum)

4. The annual period (inclusive dates) of intended use January 1 - December 31

5. The probable or intended date of first beneficial use August 1, 1963

6. The probable or intended date of commencement and completion of the well* or wells* commencement - June 4, 1963; completion - July 15, 1963.

7. The location, type, size and depth of well or wells contemplated Public lands administered by the Bureau of Land Management within the NE 1/4, Sec. 21, T. 9 S., R. 27 E., PM

8. The probable estimated depth of the water table or artesian aquifer 175 - 250 feet

9. Name, address and license number of the driller engaged Mr. L. Haugan, B & H Drilling Company, Fish Tail, Montana License No. 27.

10. Give such other similar information as may be useful in carrying out the policy of this act. Drilling operations will be by contract for five (5) water wells of which this is one (1). Contract name will be Carbon Water Wells. Commencement of work will be approximately by June 4, and completion of this contract within 45 days.

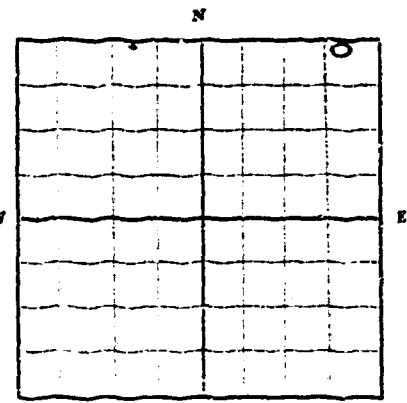

PROPOSED WATER WELL SITE
NE 1/4, Sec. 21, T. 9 S., R. 27 E., PM

Locate well or other means of development as accurately as possible on the plat.

Signature of Appropriator Wayne W. Wilde
District Manager
Date 7/6/63

* As defined in the Code Sec. 1 (c) "Well" means any artificial opening or excavation in the ground, however made, by which groundwater can be obtained or through which it flows under natural pressures or is artificially withdrawn."

Three copies of this notice are to be filed with County Clerk and Recorder of the county in which the well is located.

Please answer all questions. If not applicable, so state. Otherwise the form will be returned.

Original to the County Clerk and Recorder; duplicate to the State Engineer; Triplicate to the School of Mines and Quadruplicate for the Appropriator.

#174

157344

STATE OF MONTANA
COUNTY OF CARBON } SS.

Office of the County Clerk & Recorder

I hereby certify that the within
Notice was filed
for record in my office this 24th day
of June A. D. 19 63
at 5:50 o'clock P. M.

Attest my hand and the seal of
said County
FRANK DANICHEK, COUNTY CLERK

Clock and Recorder

by Jong J. Zupans
Fee \$ 2.00 pd.

GW1

File No. 1065

T. 9 S. R. 22 E.

DUPLICATE

County Carbon

STATE OF MONTANA
ADMINISTRATOR OF GROUNDWATER CODE
OFFICE OF STATE ENGINEER

Notice of Appropriation of Groundwater
(Under Chapter 237, Montana Session Laws, 1961)

1. I, United States of American, USDI
Bureau of Land Management of 3310 4th Avenue North, Billings, Montana
(Name of Appropriator) (Address) (Town)
County of Carbon State of Montana, intend to appropriate groundwater in accordance with Chapter 237, Montana Session Laws of 1961.

2. The beneficial use to which water is to be applied is livestock and possible wildlife use
(describe lands to be benefited, if for irrigation)

3. The rate of use in gallons per minute or miner's inches of groundwater claimed estimated yield 5 to 15 GPM

4. The annual period (inclusive dates) of intended use 5/1 - 12/1

5. The probable or intended date of first beneficial use 5/1/65

6. The probable or intended date of commencement and completion of the well* or wells* December 15, 1964

7. The location, type, size and depth of well or wells contemplated Williams Basin, (6 mi. southeast of Belfry) water well with 6" I.D. casing, 6" I.D., 300 ft.

8. The probable or estimated depth of the water table or artesian aquifer 300 ft.

9. Name, address and license number of the driller engaged to be known after award of contract

10. Give such other similar information as may be useful in carrying out the policy of this act. This well will be drilled on public lands administered by the Bureau of Land Management and will be used for livestock water (mainly) within this grazing allotment, elevation 4,390 ft.. Sandstone beds in the Tongue River member of the Fort Union Formation.

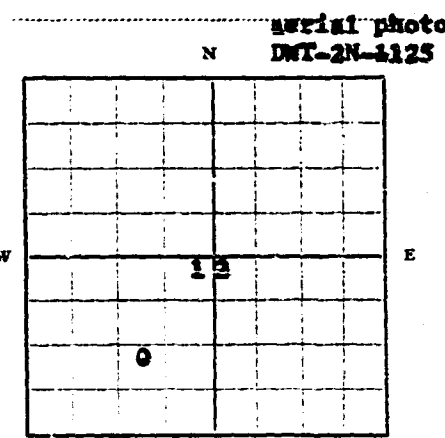

SE 1/4 Sec. 12 T. 9 S. R. 22 E.

Locate well or other means of development as accurately as possible on the plat.

BUREAU OF LAND MANAGEMENT, By:

Signature of Appropriator [Signature] District Manager

Date _____

* As defined in the Code Sec. 1 (c) "Well" means any artificial opening or excavation in the ground, however made, by which groundwater can be obtained or through which it flows under natural pressures or is artificially withdrawn."

Three copies of this notice are to be filed with County Clerk and Recorder of the county in which the well is located.

Please answer all questions. If not applicable, so state, otherwise the form will be returned.

Original to the County Clerk and Recorder; duplicate to the State Engineer; Triplicate to the School of Mines and Quadruplicate for the Appropriator.

43.810

#1065

161890

COUNTY OF CARRON, MS.

of the County Clerk & Recorder

I hereby certify that the within

Water filing was filed
for record in my office this 29 day
of Sept. A. D. 19 64
at 10:35 o'clock A. M.

Attest my hand and the seal of
said County

FRANK DANICHEK, COUNTY CLERK

Clerk and Recorder

Jerry A. Zupka Deputy

Fees \$ _____

GW1

File No. 1066

T. 9 S R. 22 E

DUPLICATE

County Carbon

STATE OF MONTANA
ADMINISTRATOR OF GROUNDWATER CODE
OFFICE OF STATE ENGINEER

Notice of Appropriation of Groundwater
(Under Chapter 237, Montana Session Laws, 1961)

JAN 30 1965

United States of America, U.S.D.I.

1. I, **Bureau of Land Management** of **3310 4th Avenue North, Billings, Montana**
(Name of Appropriator) (Address) (Town)
County of **Carbon**, State of **Montana**, intend to appropriate groundwater in accordance with Chapter 237, Montana Session Laws of 1961.

2. The beneficial use to which water is to be applied is **livestock and possible wildlife use.**

(describe lands to be benefited, if for irrigation)

3. The rate of use in gallons per minute or miner's inches of groundwater claimed **estimated yield 5-15 gpm**

4. The annual period (inclusive dates) of intended use **5/1 - 8/4**

5. The probable or intended date of first beneficial use **May 1, 1965**

6. The probable or intended date of commencement and completion of the well* or wells* **December 15, 1964**

7. The location, type, size and depth of well or wells contemplated **Mollenbeck draw 8 mi. south of Belfry and 1 mi. east of highway, later well with 4" casing, 6" I.D. casing, 150 ft.**

8. The probable or estimated depth of the water table or artesian aquifer **150 ft.**

9. Name, address and license number of the driller engaged **to be known after award of contract**

10. Give such other similar information as may be useful in carrying out the policy of this act. **This well will be drilled on public lands administered by the Bureau of Land Management and will be used for livestock water (mainly) within this grazing allotment. Elevation 4000 ft., Sandstone beds in the Tongue River Member of the Fort Union Formation.**

N serial photo
DWT-20-210

0 water well site

NE 1/4 Sec. 20 T. 9 S R. 22 E

Locate well or other means of development as accurately as possible on the plat.

Bureau of Land Management, By:
Signature of Appropriator **(Sgt.) Dante Solari**
District Manager

Date

* As defined in the Code Sec. 1 (c) "Well" means any artificial opening or excavation in the ground, however made, by which groundwater can be obtained or through which it flows under natural pressures or is artificially withdrawn."

Three copies of this notice are to be filed with County Clerk and Recorder of the county in which the well is located.

Please answer all questions. If not applicable, so state, otherwise the form will be returned.

Original to the County Clerk and Recorder; duplicate to the State Engineer; Triplicate to the School of Mines and Quadruplicate for the Appropriator.

43311

#1066

161891

STATE OF MONTANA
COUNTY OF CARBON) SS.
Office of the County Clerk & Recorder

I hereby certify that the within
Water filing was filed
for record in my office this 29 day
of Sept. A. D. 1964
at 10:40 o'clock A. M.

Attest my hand and the seal of
said County

FRANK DANICHEK, COUNTY CLERK

Clerk and Recorder

By Louise S. Zupka Deputy

Fees \$ _____