

#684

159376

AT 9:15 P. M. 1963

STATE OF MINNESOTA }
COUNTY OF CARBON } SS.

Office of the County Clerk & Recorder

I hereby certify that the within

Appropriation was filed
for record in my office this 31 day
of Dec A. D. 1963
at 9:15 o'clock A. M.

Attest my hand and the seal of
said County

FRANK DANICHEK, COUNTY CLERK

By Oliver E. Graves Clerk and Recorder Deputy

Fees \$ 2.00

GW 3
File No. 889

ONTARIO WATER RESOURCES BOARD

RECEIVED

JAN 26 1968

T 7 S R 20 E
County of Carbon

STATE OF MONTANA
ADMINISTRATOR OF GROUNDWATER CODE
OFFICE OF STATE ENGINEER

Notice of Completion of Groundwater Appropriation Without Well
(Under Chapter 237 Montana Session Laws, 1961)

Date of Appropriation of Groundwater _____

Owner

Ida Jaaski

Address

Rt 3 Red Lodge Mont

Contractor (if any) _____

Address of Contractor _____

Date Started _____

Date Completed _____

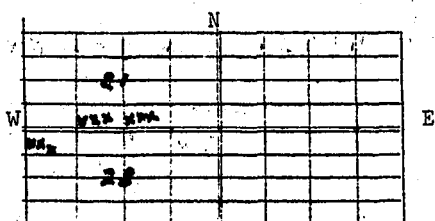

Describe means of obtaining groundwater without a well "as by sub-irrigation and other natural processes". Include depth to water when applicable

Household use, and
livestock

Quantity of water developed and used with explanation of method used to measure or estimate such amount. If use is intermittent estimate approximate lengths of periods of use

unknown
used constantly

Indicate point of appropriation and place of use, if possible.

Signature of Owner

Ida Jaaski By Ted Jaaski

Date

Dec 31 - 1965

STATE OF MONTANA)
County of Carbon) ss.

Having first been duly sworn, depose and say that he of lawful age and the appropriator and claimant of the order and water right mentioned in the foregoing notice of completion of groundwater appropriation without well and the person whose name subscribed thereto, as the appropriator and claimant, that he know the contents of said foregoing notice and that the matters and things therein stated are true.

Subscribed and sworn to before me, this _____ day of _____, 19____

Notary Public for the State of Montana
Residing at _____
My Commission expires _____ 19____

43,290

889

159597

STATE OF MONTANA }
COUNTY OF CARBON } SS.

Office of the County Clerk & Recorder.

I hereby certify that the within

Appropriation was filed
for record in my office this 31 day
of Dec A. D. 1963
at 7:40 o'clock P. M.

Attest my hand and the seal of

said County
FRANK DANICHEK, COUNTY CLERK

Alvin E. Grever Deputy
Clerk and Recorder

2 ac

GW 2

File No. 1172

DUPLICATE

MONTANA WATER RESOURCES BOARD
JAN 26 1968
LOG

Approved Stock Form—State Publishing Co., Helena, Montana—4225

T 7 R 20 21

County Carbon

STATE OF MONTANA
ADMINISTRATOR OF GROUNDWATER CODE
OFFICE OF STATE ENGINEER

Top of Ground

(Elev. above sea level)

0-11 Duff Haul

Notice of Completion of Groundwater
Appropriation by Means of Well

DEVELOPED AFTER JANUARY 1, 1962

(Under Chapter 237, Montana Session Laws, 1961)

11-26 Haul + Rock Owner J. L. Frank Address Bainbridge

26-37 Sand + Haul Driller B. H. Drilling Address Fish Tail, Mont

Date of Notice of appropriation of groundwater

Date well started 5/24/66 Date completed 5/26/66

Type of well Drilled Equipment used Churn Drill
(Dug, Driven, bored or drilled) (Churn drill, rotary or other)Water use: Domestic ☒ Municipal ☐ Stock ☒ Irrigation ☐
Industrial ☐ Drainage ☐ Other ☐

Indicate on the diagram the character and thickness of the different strata met with in drilling, such as soil, clay, shale, gravel, rock or sand, etc. Show depth at which water is encountered, thickness and character of water-bearing strata and height to which the water rises in the well.

Size of Drilled Hole	Size and Weight of Casing	From (Feet)	To (Feet)	PERFORATIONS		
				Kind Size	From (Feet)	To (Feet)
6 inch	6 5/8 17 #	14	37	Touch Cuts 1/8 X 6	31	36

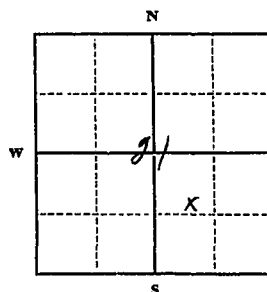

Static Water Level for non-flowing well 9 feet.

Shut-in Pressure for Flowing Well

Pumping Water Level 30 feet at 40 gal. per minute.

Discharge in gal. per min. of flowing well

How Tested Baileys

Length of Test 2 hrs

Remarks: (Gravel packing, cementing, packers, type of shutoff)

NW 1/4 SE 4 Sec. 21 T. 7 R. 20
Indicate location of well and place of use, if possible. Each small square represents 40 acres.

(Continue on reverse side)

USE—If used for irrigation, industrial, drainage or other. Explain, state number of acres and location or other data (i.e.: Lot, Block and Addition).

Show exact depth of bottom.

37 ft.

This form to be prepared by driller, and three copies to be filed by the owner with the County Clerk and Recorder in the county in which the well is located, tissue copy to be retained by driller.

Please answer all questions. If not applicable, so state, otherwise the form will be returned.

NO 27
Driller's License NumberRed L. Hargis
Driller's Signature

43,107

#1172

167315

STATE OF MONTANA
COUNTY OF CARBON

Office of the County Clerk & Recorder

I hereby certify that the within
Water filing was filed
for record in my office this 11 day
of July A. D. 1966
at 1:20 o'clock P. M.

Attest my hand and the seal of
said County

FRANK DANICHEK, COUNTY CLERK

By Long S. Zupar Deputy

Per S. Zupar

Hejona Independent Record
File No. 60

DUPLICATE

STATE OF MONTANA
ADMINISTRATOR OF GROUNDWATER CODE
OFFICE OF STATE ENGINEER

Declaration of Vested Groundwater Rights
(Under Chapter 237, Montana Session Laws, 1961)

T. 7 S. R. 20
County Carbon

RECEIVED
MAY 24 1963
STATE ENGINEER

John G. & Esther F. Frank of Box 367 Basin, Wyoming
(Name of Appropriator) (Address) (Town)
County of Carbon State of Montana
have appropriated groundwater according to the Montana laws in effect prior to January 1, 1962, as follows:

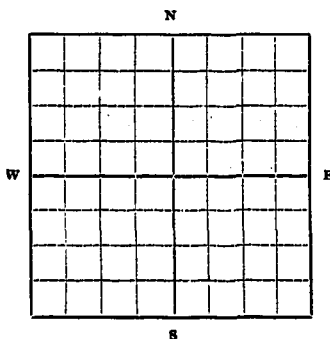

1/4 Sec. 21 T. 7 R. 20

Indicate point of appropriation
and place of use, if possible.
Each small square represents 10
acres.

2. The beneficial use on which the claim is based Stockwater and Household Use
3. Date or approximate date of earliest beneficial use; and how continuous the use has been Approximate Earliest Use 1928. Used for Stockwater since 1928
4. The amount of groundwater claimed (in miner's inches or gallons per minute) 10 Gallons per minute
5. If used for irrigation, give the acreage and description of the lands to which water has been applied and name of the owner thereof Not Used For Irrigation
6. The means of withdrawing such water from the ground and the location of each well or other means of withdrawal Electric Pump. Located Near Barn
7. The date of commencement and completion of the construction of the well, wells, or other works for withdrawal of groundwater Construction Dates Not Known
8. The depth of water table 28 Feet.
9. So far as it may be available, the type, size and depth of each well or the general specifications of any other works for the withdrawal of groundwater One Well with six inch casing. 30 ft. Deep. One well cased with rock and concrete 30 feet deep.
10. The estimated amount of groundwater withdrawn each year 200,000 Gallons
11. The log of formations encountered in the drilling of each well if available Not Available
12. Such other information of a similar nature as may be useful in carrying out the policy of this act, including reference to book and page of any county record. No Other Information Available

Signature of Owner

Date Feb. 25, 1963

Three copies to be filed by the owner with the County Clerk and Recorder of the county in which the well is located.

Please answer all questions. If not applicable, so state, otherwise the form will be returned.

Original to the County Clerk and Recorder; duplicate to the State Engineer; Triplicate to the Montana Bureau of Mines and Geology and Quadruplicate for the Appropriator.

4493

460

156464

STATE OF MONTANA, }
COUNTY OF CARBON } SS.

Office of the County Clerk & Recorder

I hereby certify that the within
Water Approp. was filed
for record in my office this 4TH day
of March A. D. 19 63
at 11:45 o'clock A. M.

Attest my hand and the seal of
said County

FRANK DANICHEK, COUNTY CLERK

Clerk and Recorder

By Sony J. Zupan Deputy

Fees \$ 2.00 pd.

OW 2 par

Approved Stock Form—State Publishing Co., Helena, Montana—41933

59068

File No.

DUPLICATE

RECEIVED

T. R. 22

County Carbon

MAY 26 1972

STATE OF MONTANA
ADMINISTRATOR OF GROUNDWATER CODE
OFFICE OF STATE ENGINEER

Notice of Completion of Groundwater
Appropriation by Means of Well

(Under Chapter 237, Montana Session Laws, 1961)

Top of Ground
(Elev. above sea level 5500)

Gravel Surface to Bottom

Water rises 29.6 ft.

Water encountered 9 ft.

Bottom 13 ft.

Owner Donald Earl Meyer Address Red Lodge, Montana

Driller Not Applicable Address

Date of Notice of Appropriation of Groundwater May 1, 1972

Date well started May 1, 72 Date Completed May 1, 72

Type of well Dug Equipment Used Back-hoe
(dug, driven, bored or (Churn, drill, rotary or
drilled) other)

Water Use: Domestic ☐ Municipal ☐ Other ☐ Irrigation ☐
Industrial ☐ Drainage ☐ Stock ☐

Indicate on the diagram the character and thickness of the different strata met with in drilling, such as soil, clay, shale, gravel, rock or sand, etc. Show depth at which water is encountered, thickness and character of water-bearing strata and height to which water rises in the well.

Size of Drilled Hole	Size and Weight of Casing	From (Feet)	To (Feet)	PERFORATIONS		
				Kind	From (Feet)	To (Feet)
36 "	36 " 350 lbs	surface	13 "	round 1 "	12 "	9 "

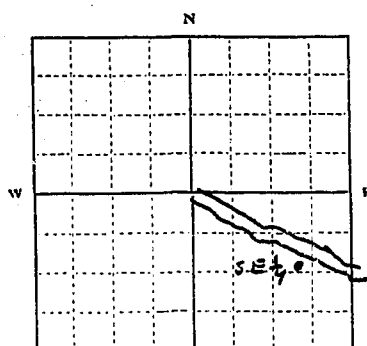

SW 1/4 Sec 22 S. T. 7 R. 2 E.
Indicate location of well and place of use, if possible. Each small square represents 10 acres.

Static Water Level for non-flowing Well 7 ft. feet.

Shut-in Pressure for Flowing Well Not Applicable

Pumping Water Level 11 1/2 feet at 29 gal. per minute.

Discharge in gal. per min. of flowing well 29 gal. per min.

How Tested Suction Pump Length of Test 4 Hrs.

Remarks: (Gravel packing, cementing, packers, type of shutoff, location of place of use of groundwater if not at well, and any other similar pertinent information, including number of

82.2 acres irrigated, if used for irrigation)

Shutoff on intake line, water to be used

in self service laundry.

Show exact depth of bottom.

Doc. No. #1347, 184703

Filed for record

this 25 day of May

A. D. 19 72, at 1:15

o'clock P. M.

Not Applicable
Driller's License Number

Not Applicable
Driller's Signature

This form to be prepared by driller, and three copies to be filed by the owner with the County Clerk and Recorder in the county in which the well is located.

Please answer all questions. If not applicable, so state, otherwise the form will be returned.

59462

Original to the County Clerk and Recorder; duplicate to the State Engineer; Triplicate to the Montana Bureau of Mines and Geology and Quadruplicate for the Appropriator.

#1347

184703

STATE OF MONTANA,
COUNTY OF CARBON } ss.

Office of the County Clerk & Recorder

I hereby certify that the within

Appropriation was filed
for record in my office this 25 day
of May A. D. 19 72
at 1:15 o'clock P. M.

Attest my hand and the seal of
said County Frank Davidlek
Clerk and Recorder

By _____ Deputy
Fees \$ 2.00

Address _____
Location 1.95 N. 24.00 E.
Doc. No. #1347 184703

Department of Natural Resources and Conservation
Water Resources Division
Engineering Bureau
Groundwater Section
Sam W. Mitchell Building
Helena, Montana 59601

As the Administrator of the Groundwater Code for the State of Montana, please take
note of the following special instructions, in order to properly protect your ground-
water right.

Special Instructions:

In reference to the attached form, the
Groundwater Code for the State of Montana specifically
states: "Until a notice of completion is filed with
the State, it is the right of the owner of the water
right to use of ground water in accordance with the
terms of the water right." It is the policy of the State of Montana to
protect the right of the owner of the water right to use of ground water
in accordance with the terms of the water right.

File No.

T. 7 S. R. 20 E.

DUPLICATE

County Carbon

STATE OF MONTANA
ADMINISTRATOR OF GROUNDWATER CODE
OFFICE OF STATE ENGINEER

APR 17 1972

Notice of Appropriation of Groundwater

(Under Chapter 237, Montana Session Laws, 1961)

1. I, DONALD EARL MEYER, of Box 818, Red Lodge,
(Name of Appropriator) (Address) (Town)
County of Carbon, State of Montana, intend to appropriate groundwater in accordance with Chapter 237, Montana Session Laws of 1961.
2. The beneficial use to which water is to be applied is to supply water for laundry.
(describe lands to be benefited, if for irrigation)
3. The rate of use in gallons per minute or miner's inches of groundwater claimed 29 gallons
per minute.
4. The annual period (inclusive dates) of intended use January 1, through December 31.
5. The probable or intended date of first beneficial use May 1, 1972.
6. The probable or intended date of commencement and completion of the well* or wells* May 1, 1972.
7. The location, type, size and depth of well or wells contemplated Located approximately 80 feet West of the East boundary line of the tract described on Schedule "A", attached hereto and made a part hereof, and approximately 145 feet North of the South boundary line of said tract. Excavated type. 36" casing, 16' deep.
8. The probable or estimated depth of the water table or artesian aquifer 6 feet.
9. Name, address and license number of the driller engaged not applicable.

10. Give such other similar information as may be useful

in carrying out the policy of this act.

Description of tract as set forth on

Schedule "A", attached hereto and made

a part hereof.

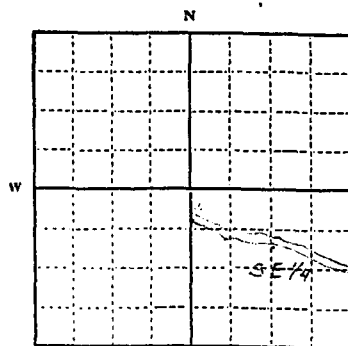

Doc. No. #1340, 184324
Filed for record
this 14th day of April
A. D. 19 72, at 1:25
o'clock P. M.

SW 1/4 Sec 22 T. 7 S. R. 20 E.
Locate well or other means of
development as accurately as
possible on the plat.

Signature of Appropriator Donald Earl Meyer

Date April 6, 1972

- * As defined in the Code Sec. 1 (c) "Well" means any artificial opening or excavation in the ground, however made, by which groundwater can be obtained or through which it flows under natural pressures or is artificially withdrawn."

Three copies of this notice are to be filed with County Clerk and Recorder of the county in which the well is located.

Please answer all questions. If not applicable, so state, otherwise the form will be returned.

Original to the County Clerk and Recorder; duplicate to the State Engineer; Triplicate to the Montana Bureau of Mines and Geology and Quadruplicate for the Appropriator.

50, 206

STATE OF MINNESOTA

COMMISSIONER OF REVENUE

DEPARTMENT OF REVENUE

STATE OF MINNESOTA

SCHEDULE

That portion of the Southwest Quarter of the Southeast Quarter of Section 22, Township 7 South, Range 20 East, M.P.M., more particularly described as follows: Beginning at a point six hundred Twenty-seven (627) feet East of the Southwest corner of the Southeast Quarter of said Section 22; thence East two hundred thirty (230) feet to the West right-of-way line of the State Highway; thence North nine degrees (9°) East along the West side of said Highway three hundred fifty-one (351) feet; thence West nine hundred ten (910) feet to the West line of the Southwest Quarter of the Southeast Quarter of said Section 22; thence South Forty-Seven (47) feet; thence East six hundred seventy-five (675) feet; thence South ten degrees (10°) West three hundred Four (304) feet to the place of beginning, containing two and 17/100 acres, more or less;

EXCEPTING Therefrom the following described tract:

That portion of the Southwest Quarter of the Southeast Quarter (SW $\frac{1}{4}$ SE $\frac{1}{4}$) of Section Twenty-two (22), Township Seven (7) South, Range Twenty (20) East, M.P.M., more particularly described as follows: Beginning at a point on the South line of said SW $\frac{1}{4}$ SE $\frac{1}{4}$, 627 feet East of the Southwest corner of said SW $\frac{1}{4}$ SE $\frac{1}{4}$, thence East along said South line of said SW $\frac{1}{4}$ SE $\frac{1}{4}$ a distance of 65 feet, thence North 10° East, a distance of 145 feet, thence West parallel with said South line of the SW $\frac{1}{4}$ SE $\frac{1}{4}$ a distance of 65 feet, thence South 10° West a distance of 145 feet to the point of beginning

ALSO EXCEPTING all easements of right-of-way for roads, ditches, pipes, and transmission lines. Together with reservation made in Deed, Harry Niese and Della Niese, his wife, to Edwin Dygert and Aune Dygert, husband and wife, dated February 5, 1940 recorded February 6, 1940, at 4:40 P.M., Book 56 Deeds, Page 310.

1340 184324

STATE OF MISSISSIPPI
COUNTY OF GADSDEN } SS.

Office of the County Clerk & Recorder

I hereby certify that the within
Appropriation was filed
for record in my office this 14 day
of April A. D. 19 72
at 1:25 o'clock P.M.

Attest my hand and the seal of
said County
Frank Stueck
Clerk and Recorder

by _____ Deputy

Fees \$ 2.00

File No. 381

Approved Stock State Publishing Co., Helena, Montana—42234

DUPLICATE

T. 7 R. 20
County Carbon 22

STATE OF MONTANA
ADMINISTRATOR OF GROUNDWATER CODE
OFFICE OF STATE ENGINEER
JAN 26 1968

Declaration of Vested Groundwater Rights

(Under Chapter 237, Montana Session Laws, 1961)

1. Castagne Bros. Inc. of Red Lodge
(Name of Appropriator) (Address) (Town)
County of Carbon State of Montana
have appropriated groundwater according to the Montana laws in effect prior to January 1, 1962, as follows:

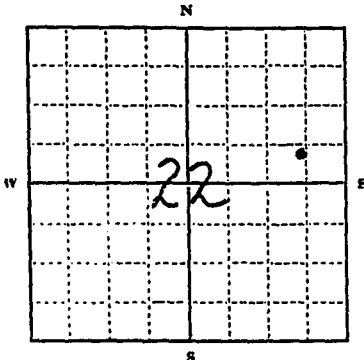

SE 1/4 NE Sec. 22 T. 7 R. 20

Indicate point of appropriation and place of use, if possible. Each small square represents 10 acres.

2. The beneficial use on which the claim is based Stock & domestic
3. Date or approximate date of earliest beneficial use; and how continuous the use has been 1910
4. The amount of groundwater claimed (in miner's inches or gallons per minute) 5 gals. per min.
5. If used for irrigation, give the acreage and description of the lands to which water has been applied and name of the owner thereof 2 ac.
6. The means of withdrawing such water from the ground and the location of each well or other means of withdrawal Pressure pump
7. The date of commencement and completion of the construction of the well, wells, or other works for withdrawal of groundwater 1910
8. The depth of water table 7 ft.
9. So far as it may be available, the type, size and depth of each well or the general specifications of any other works for the withdrawal of groundwater 10 ft., cement foundation to the well was dug.
10. The estimated amount of groundwater withdrawn each year 328,500 gals
11. The log of formations encountered in the drilling of each well if available Gravel & Rock
12. Such other information of a similar nature as may be useful in carrying out the policy of this act, including reference to book and page of any county record (None)

Signature of Owner James Castagne

Date 12/23/63

Three copies to be filed by the owner with the County Clerk and Recorder of the county in which the well is located.

Please answer all questions. If not applicable, so state, otherwise the form will be returned.

Original to the County Clerk and Recorder; Duplicate to the State Engineer; Triplicate to the Montana Bureau of Mines and Geology, and Quadruplicate for the Appropriator.

42,979

#381

159031

STATE OF MONTANA,
COUNTY OF CARBON } SS.
Office of the County Clerk & Recorder

I hereby certify that the within
Appropriation was filed
for record in my office this 23 day
of December A. D. 19 63
at 1:50 o'clock P. M.

Attest my hand and the seal of
said County

Frank Danielek
Clerk and Recorder

By _____ Deputy

Fees \$ 2.00

23 DEC 1963

GW 3

Approved Stock Form—State Publishing Co., Helena, Montana—42262

File No.

482

DUPLICATE

T

7

R

20

22

County

Carbon

STATE OF MONTANA
ADMINISTRATOR OF GROUNDWATER CODE
OFFICE OF STATE ENGINEER

Notice of Completion of Groundwater Appropriation
Without Well

(Under Chapter 237 Montana Session Laws, 1961)

JAN 26 1963

Date of Appropriation of Groundwater

1889

Owner

Castagna Bros Inc.

Address

Red Lodge

Contractor (if any)

NONE

Address of Contractor

NONE

Date Started

1889

Date Completed

1889

Describe means of obtaining groundwater without a well "as by sub-irrigation and other natural processes". Include depth to water when applicable.

Natural Springs

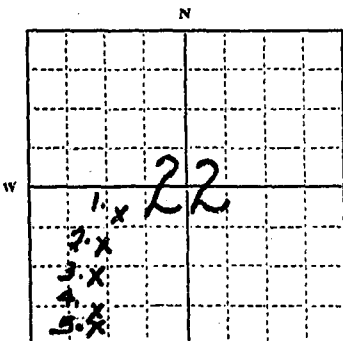

1/4 Sec. 22 T. 7 R. 20

Indicate point of appropriation and place of use, if possible.

Quantity of water developed and used with explanation of method used to measure or estimate such amount. If use is intermittent

estimate approximate lengths of periods of use

1 SW NE 50 inches 1889 when pump was first used.
2 SW NE " "
3 SW NE " "
4 SW NE " "
5 SW NE " "

Signature of Owner

Castagna Bros Inc. James Castagna

Date

12/27/62

This form to be prepared by contractor (if any), otherwise by the owner.

Three copies of this notice are to be filed with the County Clerk and Recorder of the county in which the works are located.

Please answer all questions. If not applicable, so state, otherwise the form will be returned.

Original to the County Clerk and Recorder; duplicate to the State Engineer; Triplicate to the Montana Bureau of Mines and Geology and Quadruplicate for the Appropriator.

42,977

159162

I hereby certify that the within
Water filing was filed
for record in my office this 27 day
of Dec. A. D. 1963
at 3:00 o'clock P. M.

Clerk and Recorder
By Jonny B. Zupara Deputy

Fees \$ 22.00

File No. 749T. 7 R. 20

DUPLICATE

County Carbon.

STATE OF MONTANA
ADMINISTRATOR OF GROUNDWATER CODE
OFFICE OF STATE ENGINEER

MONTANA WATER RESOURCES BOARD

RECEIVED

JAN 26 1968

Notice of Completion of Groundwater Appropriation
Without Well

(Under Chapter 237 Montana Session Laws, 1961)

Date of Appropriation of Groundwater July 1, 1960.Owner Walter Woody, Sr. Address Red LodgeContractor (if any) NoneAddress of Contractor NoneDate Started - - Date Completed - -

Describe means of obtaining groundwater without a well "as by sub-irrigation and other natural processes". Include depth to water when applicable. Water flows from springs in hillside. Appropriator built ditch below springs and water runs into ditch.

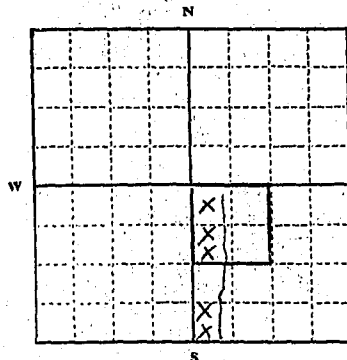
SE $\frac{1}{4}$ Sec 22 T. 7 R. 20

Indicate point of appropriation and place of use, if possible.

Springs (marked X) - Water flows east into ditch running North and South and is used in the NW $\frac{1}{4}$ of said Section 22, T. 7, R. 20.

Quantity of water developed and used with explanation of method used to measure or estimate such amount. If use is intermittent

estimate approximate lengths of periods of use Fifty inchesduring Spring of year, down to approximately 25inches in winter. Used all year around forirrigation and watering livestock.Signature of Owner Walter Woody, Sr.Date December 31, 1963.

This form to be prepared by contractor (if any), otherwise by the owner.

Three copies of this notice are to be filed with the County Clerk and Recorder of the county in which the works are located.

Please answer all questions. If not applicable, so state, otherwise the form will be returned.

Original to the County Clerk and Recorder; duplicate to the State Engineer; Triplicate to the Montana Bureau of Mines and Geology and Quadruplicate for the Appropriator.

43,921

749

159157

STATE OF MICHIGAN
COUNTY OF CARBON (SS.)

Office of the County Clerk & Recorder

I hereby certify that the within
Appropriation was filed
for record in my office this 31 day
of Dec A. D. 1963
at 2:35 o'clock P. M.

Attest my hand and the seal of
said County
FRANK DANICHEK, COUNTY CLERK

Clerk and Recorder
By Alice E. Graves Deputy

Fees \$ 2.00

GW 3
File No.

945

RECORDED

JAN 26 1963

T
County of

R

STATE OF MONTANA
ADMINISTRATOR OF GROUNDWATER CODE
OFFICE OF STATE ENGINEER

Notice of Completion of Groundwater Appropriation Without Well
(Under Chapter 237 Montana Session Laws, 1961)

Date of Appropriation of Groundwater

Owner: ROBT. W. + NANCY ROBINSON

Address RED LODGE, MONT

Contractor (if any)

Address of Contractor

Date Started

Date Completed

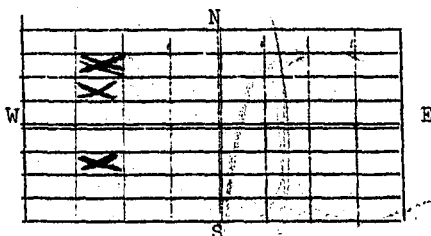

1/4 Sec. 22 T 7 R 20
Indicate point of appropriation and
place of use, if possible.

Describe means of obtaining groundwater without
a well "as by sub-irrigation and other natural
processes". Include depth to water when applicable

Sub irrigation & other
natural processes

Quantity of water developed and used with explana-
tion of method used to measure or estimate such
amount. If use is intermittent estimate approxi-
mate lengths of periods of use

50 inches - Continuous use.

Signature of Owner

Nancy Robinson
Robert W. Robinson

Date

Dec 31, 1963

STATE OF MONTANA)
County of Carbon) ss.

Having first been duly sworn, depose and say
that he of lawful age and the appropriator and claimant
of the order and water right mentioned in the foregoing notice of completion of groundwater
appropriation without well and the person whose name subscribed thereto, as
the appropriator and claimant, that he know the contents of said foregoing
notice and that the matters and things therein stated are true.

Subscribed and sworn to before me, this _____ day of _____, 19 _____

Notary Public for the State of Montana

Residing at _____

My Commission expires _____ 19 _____

43,593

159653

XX X

УВАЖАЮЩИЙ
ПРЕДСЕДАТЕЛЬ

22
22
L
22
22

459
471
472
473
474
475
476
477
478
479
480
481
482
483
484
485
486
487
488
489
490
491
492
493
494
495
496
497
498
499
500

〆
 一
 二
 三
 四
 五
 六
 七
 八
 九
 十
 十一
 十二
 十三
 十四
 十五
 十六
 十七
 十八
 十九
 二十
 二十一
 二十二
 二十三
 二十四
 二十五
 二十六
 二十七
 二十八
 二十九
 三十
 三十一
 三十二
 三十三
 三十四
 三十五
 三十六
 三十七
 三十八
 三十九
 四十
 四十一
 四十二
 四十三
 四十四
 四十五
 四十六
 四十七
 四十八
 四十九
 五十
 五十一
 五十二
 五十三
 五十四
 五十五
 五十六
 五十七
 五十八
 五十九
 六十
 六十一
 六十二
 六十三
 六十四
 六十五
 六十六
 六十七
 六十八
 六十九
 七十
 七十一
 七十二
 七十三
 七十四
 七十五
 七十六
 七十七
 七十八
 七十九
 八十
 八十一
 八十二
 八十三
 八十四
 八十五
 八十六
 八十七
 八十八
 八十九
 九十
 九十一
 九十二
 九十三
 九十四
 九十五
 九十六
 九十七
 九十八
 九十九
 一百

70-1-03

LODGE, WOMAN

GW 3
File No. 720

MONTANA WATER RESOURCE BOARD

RECEIVED

T 7 R 20
County of _____

JAN 26 1968 STATE OF MONTANA
ADMINISTRATOR OF GROUNDWATER CODE
OFFICE OF STATE ENGINEER

Notice of Completion of Groundwater Appropriation Without Well
(Under Chapter 237 Montana Session Laws, 1961)

Date of Appropriation of Groundwater 1900
Owner Kennan, L.E. & Mary E. Address Red Lodge, Mont
Contractor (if any) None
Address of Contractor None
Date Started 1900 Date Completed 1900

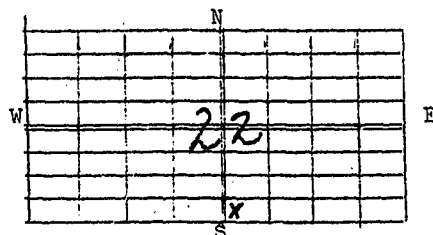

Describe means of obtaining groundwater without a well "as by sub-irrigation and other natural processes". Include depth to water when applicable

Natural Spring

SW 1/4 SE Sec. 22 T 7 R 20
Indicate point of appropriation and place of use, if possible.

Quantity of water developed and used with explanation of method used to measure or estimate such amount. If use is intermittent estimate approximate lengths of periods of use

60 inches per day. Per min
Used continuously for stock
only.

Signature of Owner L.E. Kennan

Date 12/31/63

STATE OF MONTANA)
County of Carbon) ss.

Having first been duly sworn, depose and say that he of lawful age and the appropriator and claimant of the order and water right mentioned in the foregoing notice of completion of groundwater appropriation without well and the person whose name subscribed thereto, as the appropriator and claimant, that he know the contents of said foregoing notice and that the matters and things therein stated are true.

Subscribed and sworn to before me, this _____ day of _____, 19____

Notary Public for the State of Montana
Residing at _____
My Commission expires _____ 19____

43.341

#720

159413

STATE OF MONTANA, }
COUNTY OF CARBON } SS.

Office of the County Clerk & Recorder

I hereby certify that the within
Appropriation was filed
for record in my office this 31 day
of Dec A. D. 19 63
at 12:12 o'clock P. M.

Attest my hand and the seal of
said County
FRANK DANICHEK, COUNTY CLERK

Clerk and Recorder
by Alvin E. Graves Deputy

Fees \$ 2.00

File No. 893

T 22 R 20
County Carbon 23

JAN 26 1968

STATE OF MONTANA
ADMINISTRATOR OF GROUNDWATER CODE
OFFICE OF STATE ENGINEER

Declaration of Vested Groundwater Rights
(Under Chapter 237, Montana Session Laws, 1961)

1. Ralph H. Young, of Roberts Montana County of Carbon
State of Montana have appropriated groundwater according to the Montana laws in
effect prior to January 1, 1962, as follows:

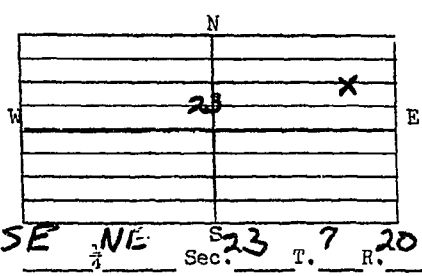

2. The beneficial use on which the claim is based
Household and business

3. Date or approximate date of earliest beneficial
use; and how continuous the use has been
1890

4. The amount of groundwater claimed (in miner's
inches or gallons per minute)
40 inches

5. If used for irrigation, give the acreage and description of the lands to which water
has been applied and name of the owner thereof
none

6. The means of withdrawing such water from the ground and the location of each well or
other means of withdrawal
Electric pump

7. The date of commencement and completion of the construction of the well, wells, or
other works for withdrawal of groundwater
1890

8. The depth of water table
4 ft.

9. So far as it may be available, the type, size and depth of each well or the general
specifications of any other works for the withdrawal of groundwater
Dug wells 16 ft deep

10. The estimated amount of groundwater withdrawn each year
70150.000 to 295000

11. The log of formations encountered in the drilling of each well if available
none

12. Such other information of a similar nature as may be useful in carrying out the policy
of this act, including reference to book and page of any county record
none

Date 12/31/68 Signature of Owner Ralph H. Young

STATE OF MONTANA,) County of Carbon ss.

Having first been duly sworn, depose and say that
he of lawful age and the appropriator and claimant of the
order and water right mentioned in the foregoing declaration of vested groundwater rights
and the person whose name subscribed thereto, as the appropriator
and claimant, that he know the contents of said foregoing notice and that the
matters and things therein stated are true.

Ralph H. Young

Subscribed and sworn to before me, this day of , 19

Notary Public for the State of Montana.
Residing at
My Commission expires

43,948

#895

159603

STATE OF MONTANA,
COUNTY OF CARBON } SS.
Office of the County Clerk & Recorder

I hereby certify that the within

Appropriation was filed
or record in my office this 31 day
of Dec A. D. 19 63
at 7:52 o'clock P. M.

Attest my hand and the seal of

and County

FRANK DANICHEK, COUNTY CLERK

County and Recorder

Alice E. Givens Deputy

2-2

File No. 954T. 7 R. 20 26

DUPLICATE

County CARBON

STATE OF MONTANA
ADMINISTRATOR OF GROUNDWATER CODE
OFFICE OF STATE ENGINEER

Notice of Completion of Groundwater Appropriation
Without Well

(Under Chapter 237 Montana Session Laws, 1961)

RECEIVED

JAN 26 1968

Date of Appropriation of Groundwater 1900 - all springsOwner 400 Ranch Inc. Address Red LodgeContractor (if any) NoneAddress of Contractor NoneDate Started 1900 Date Completed 1900

Describe means of obtaining groundwater without a well "as by sub-irrigation and other natural processes". Include depth to water when applicable.

free flowing - all springs.

Quantity of water developed and used with explanation of method used to measure or estimate such amount. If use is intermittent

estimate approximate lengths of periods of use.

#1 - 500 gal/min. continuous use - stock#2 - 800 gal/min. continuous use - domestic#3 - 500 gal/min. continuous use - stock#4 - 500 gal/min. continuous use - stockSignature of Owner 400 Ranch Inc.Date 1/2/64

This form to be prepared by contractor (if any), otherwise by the owner.

Three copies of this notice are to be filed with the County Clerk and Recorder of the county in which the works are located.

Please answer all questions. If not applicable, so state, otherwise the form will be returned.

Original to the County Clerk and Recorder; duplicate to the State Engineer; Triplicate to the Montana Bureau of Mines and Geology and Quadruplicate for the Appropriator.

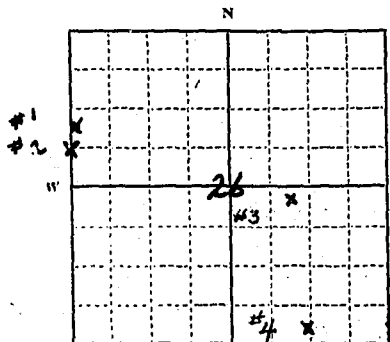

#1 - SW NW
#2 - SW NW
#3 - NW SE
#4 - SW SE

Indicate point of appropriation
and place of use, if possible.

#3 - NW SE

#4 - SW SE

43,121

4954

159662

STATE OF MONTANA }
COUNTY OF CARBON } SS.

Office of the County Clerk & Recorder

I hereby certify that the within
water filing was
for record in my office this 31 day
of Dec. A. D. 1963
at 9:50 o'clock P. M.

Attest my hand and the seal of
said County
FRANK DANICHER, COUNTY CLERK

Clerk and Recorder
by Alice E. Hansen Deputy

Fees \$ 2.00 Pd.

T 7 R 20
County Cuba

County. Cutbourn

MONTANA WATER RESOURCES BOARD

RECEIVED
ADMIN.

STATE OF MONTANA
ADMINISTRATOR OF GROUNDWATER CODE
OFFICE OF STATE ENGINEER

~~Declaration of Vested Groundwater Rights~~
~~(Under Chapter 237, Montana Session Laws, 1961)~~

1. Toivo J. Rintala [✓] Vienna M. Rintala of Red Lodge County of Carbon
State of Montana have appropriated groundwater according to the Montana laws in
effect prior to January 1, 1962, as follows:

NW $\frac{1}{4}$ SW ^S Sec. 27 T. 7 R. 20

2. The beneficial use on which the claim is based
7. House hold USE #2 + #3 Stock

3. Date or approximate date of earliest beneficial use; and how continuous the use has been ABOUT 1925 EVERY YEAR SINCE

4. The amount of groundwater claimed (in miner's inches or gallons per minute) 1,500 gals per day
2,500 gals 3,500 gals

5. If used for irrigation, give the acreage and description of the lands to which water has been applied and name of the owner thereof

NOT applicable

6. The means of withdrawing such water from the ground and the location of each well or other means of withdrawal 1. Pump located in basement
of house 2 & 3 electric pump

7. The date of commencement and completion of the construction of the well, wells, or other works for withdrawal of groundwater 1925

8. The depth of water table 1.6 FT. To 16 FT. 2.6 ft. 3.6 ft. 16 ft.

9. So far as it may be available, the type, size and depth of each well or the general specifications of any other works for the withdrawal of groundwater

2.64 ft in depth.
3 FT. diameter

10. The estimated amount of groundwater withdrawn each year 50,000 gallons

11. The log of formations encountered in the drilling of each well if available

Not available

12. Such other information of a similar nature as may be useful in carrying out the policy of this act, including reference to book and page of any county record

Date Dec. 31, 1963

Signature of Owner

STATE OF MONTANA,) County of Carbon) ss.

Having first been duly sworn, depose and say that
he of lawful age and the appropriator and claimant of the
order and water right mentioned in the foregoing declaration of vested groundwater rights
and the person whose name subscribed thereto, as the appropriator
and claimant, that he know the contents of said foregoing notice and that the
matters and things therein stated are true.

Subscribed and sworn to before me, this day of , 19

Notary Public for the State of Montana.
Residing at _____
My Commission expires _____

43,597

#890

159598

STATE OF MONTANA,
COUNTY OF CARBON } SS.

Office of the County Clerk & Recorder.

I hereby certify that the within.

Appropriation was filed
for record in my office this 31 day
of Dec A. D. 1963
at 7:42 o'clock P.M.

Attest my hand and the seal of
said County

FRANK DANICHEK, COUNTY CLERK

County and Recorder

Alvin E. Kruer Deputy

Page - 200

File No.

1232

T 7 S R 20 E

DUPLICATE

County Carbon

STATE OF MONTANA
ADMINISTRATOR OF GROUNDWATER CODE
OFFICE OF STATE ENGINEER

Top of Ground
(Elev. above sea level 5755)

Notice of Completion of Groundwater
Appropriation by Means of Well

(Under Chapter 237, Montana Session Laws, 1961)

HELEN T. HUDAK, husband and wife,

Owner MIKE P. HUDAK and / Address 302 S. McGillen Avenue,
Red Lodge, MontanaDriller MIKE P. HUDAK Address 302 S. McGillen Avenue,
Red Lodge, Montana

Date of Notice of Appropriation of Groundwater October 25, 1968.

Date well started 7-15-68 Date Completed 8-25-68

Type of well 4" tile Equipment Used Pick and shovel
(dug, driven, bored or (Churn, drill, rotary or
drilled) other)

Water Use: Domestic ☒ Municipal ☐ Other ☐ Irrigation ☒
Industrial ☐ Drainage ☐ Stock ☐ Garden ☒

Indicate on the diagram the character and thickness of the different strata met with in drilling, such as soil, clay, shale, gravel, rock or sand, etc. Show depth at which water is encountered, thickness and character of water-bearing strata and height to which water rises in the well.

Size of Drilled Hole	Size and Weight of Casing	From (Feet)	To (Feet)	PERFORATIONS		
				Kind Size	From (Feet)	To (Feet)
6"	4"	0	6	4"	2	6

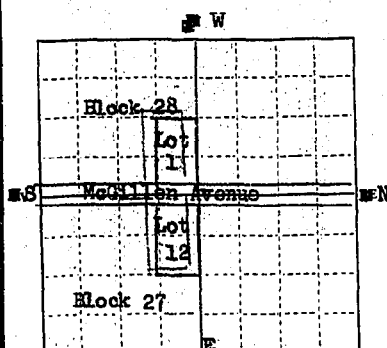

Second Addition, City of Red Lodge

SW 1/4 Sec 27 T7S R20E

Indicate location of well and place of use, if possible. Each small square represents 10 acres.

Show exact depth of bottom.

Static Water Level for non-flowing Well 6' feet.

Shut-in Pressure for Flowing Well 10 lbs. per square inch
not applicable

Pumping Water Level feet at gal. per minute.

Discharge in gal. per min. of flowing well 20

How Tested Filling cans Length of Test 2 months

Remarks: (Gravel packing, cementing, packers, type of shutoff, location of place of use of groundwater if not at well, and any other similar pertinent information, including number of

acres irrigated, if used for irrigation) 2/3 acre garden,

1/2 acre lawn and domestic

NONE

Driller's License Number

Mike P. Hudak
Driller's Signature

This form to be prepared by driller, and three copies to be filed by the owner with the County Clerk and Recorder in the county in which the well is located.

Please answer all questions. If not applicable, so state, otherwise the form will be returned.

Original to the County Clerk and Recorder; duplicate to the State Engineer; Triplicate to the Montana Bureau of Mines and Geology and Quadruplicate for the Appropriator.

44,955

#1232

173585

STATE OF MONTANA }
COUNTY OF CARSON }

Office of the County Clerk & Recorder

I hereby certify that the within
Appropriation was filed
for record in my office this 25 day

of Oct. A.D. 1968
at 4:15 o'clock P.M.

Attest my hand and the seal of
said County
Frank Pawelek
County Clerk and Recorder

by _____ Deputy

Fees \$ 2.00

GW 3
File No. 892

RECEIVED

T 7 R 20
County of Carbon

JAN 26 1968
STATE OF MONTANA
ADMINISTRATOR OF GROUNDWATER CODE
OFFICE OF STATE ENGINEER

Notice of Completion of Groundwater Appropriation Without Well
(Under Chapter 23, MONTANA GROUNDWATER LAWS, 1961)

Date of Appropriation of Groundwater 1910
Owner John J. Viennem Rintala Address R.2. Red Lodge, Mont.
Contractor (if any) None
Address of Contractor None
Date Started 1910 Date Completed 1910

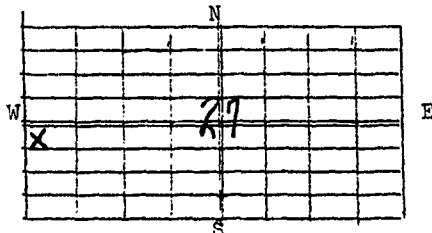

NW $\frac{1}{4}$ SW Sec. 27 T 7 R 20
Indicate point of appropriation and place of use, if possible.

Describe means of obtaining groundwater without a well "as by sub-irrigation and other natural processes". Include depth to water when applicable

Natural Spring

Quantity of water developed and used with explanation of method used to measure or estimate such amount. If use is intermittent estimate approximate lengths of periods of use 2000 gals per day.

Livestock Water
Continuously.

Signature of Owner John J. Rintala
Date Dec 31, 1963

STATE OF MONTANA)
County of Carbon) ss.

Having first been duly sworn, depose and say that he of lawful age and the appropriator and claimant of the order and water right mentioned in the foregoing notice of completion of groundwater appropriation without well and the person whose name subscribed thereto, as the appropriator and claimant, that he know the contents of said foregoing notice and that the matters and things therein stated are true.

Subscribed and sworn to before me, this _____ day of _____, 19____

Notary Public for the State of Montana
Residing at _____
My Commission expires _____ 19____

43,596

#892

159600

STATE OF MONTANA }
COUNTY OF CARBON } SS.
Office of the County Clerk & Recorder

I hereby certify that the within
appropriation was filed
for record in my office this 31 day
of Dec A. D. 1963
at 7:46 o'clock P. M.

Attest my hand and the seal of
said County

FRANK DANICHEK, COUNTY CLERK

Alice E. Graves
County Recorder

From 200

GW 3

File No. 544

DUPLICATE

Approved Stock Form—State Publishing Co., Helena, Montana—4262

T. 7 R. 20 27

County Carbon

STATE OF MONTANA
ADMINISTRATOR OF GROUNDWATER CODE
OFFICE OF STATE ENGINEER

Notice of Completion of Groundwater Appropriation
Without Well

(Under Chapter 237 Montana Session Laws, 1961)

JAN 26 1968

Date of Appropriation of Groundwater 1900
Owner Paul Duke Address Red Lodge
Contractor (if any) None
Address of Contractor None
Date Started 1900 Date Completed 1900

Describe means of obtaining groundwater without a well "as by sub-irrigation and other natural processes". Include depth to water when applicable.

Natural Springs

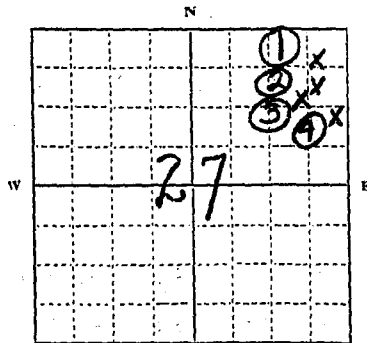

..... 1/4 Sec. T. R.
Indicate point of appropriation
and place of use, if possible.

Quantity of water developed and used with explanation of method used to measure or estimate such amount. If use is intermittent

estimate approximate lengths of periods of use

1. NENW Sec 27 7-20 600 per day, irrigation & stock
2. NENW " " 600 " " " " & stock
3. NENW " " 600 " " " " & stock
4. NENW " " 1000 " " " " domestic

Signature of Owner Paul E. Duke

Date 12/30/63

This form to be prepared by contractor (if any), otherwise by the owner.

Three copies of this notice are to be filed with the County Clerk and Recorder of the county in which the works are located.

Please answer all questions. If not applicable, so state, otherwise the form will be returned.

Original to the County Clerk and Recorder; duplicate to the State Engineer; Triplicate to the Montana Bureau of Mines and Geology and Quadruplicate for the Appropriator.

42643
43044

#544

STATE OF FLORIDA)
County of COLLIER) ss.:

Number 544.

By Alice E. Graves Clerk and Recorder Deputy
Fees \$ 2.00

[illegible]

STATE OF FLORIDA)
) ss.
County of COLLIER)

I am the Paul E. Duke who, on December 20, 1963, signed (as owner) that certain NOTICE OF COMPLETION OF GROUNDWATER APPROPRIATION WITHOUT WELL (hereinafter referred to as the NOTICE OF COMPLETION) which said NOTICE OF COMPLETION was filed in the office of the Clerk and Recorder of Carbon County, Montana, on December 20, 1963, at 12:07 P.M. as Document Number 159234, File Number 544,

1. Location of springs. The said NOTICE OF COMPLETION correctly described the location of the four springs as being in the Northeast Quarter of the Northwest Quarter (NE $\frac{1}{4}$ NW $\frac{1}{4}$) of Section 27, Township 7 South, Range 20 East, but on the plat which appears at left center of said NOTICE OF COMPLETION the springs were incorrectly shown on said plat as being in the Northeast Quarter. The correct location of said springs would be as shown on the attached plat (not to scale).

(a) The place of use of said water is on the property which was owned by the undersigned, located in the E½NW¼, and NW¼NE¼ of Section 27, Township 7 South, Range 20 East. This property is now more particularly described as follows:

PARCEL NO. 1:

Lots 1, 2, 3, 4, 5, 6, 7, 8, 9, 10, 11, and the North 115 feet of Lots 13, 14, and 15, and all of Lots 16, 17, and 18, in Block 83, and all of Block 96, of the ORIGINAL PLAT OF RED LODGE, Carbon County, Montana, according to the official plat thereof on file and of record in the office of the Clerk and Recorder of said County.

PARCEL NO. 2:

Tract 2 of Certificate of Survey No. 750, Carbon County, Montana, according to the official plat thereof on file and of record in the office of the Clerk and Recorder of said County, under Document No. 192754.

(b). The unit of measurement intended in the said NOTICE OF COMPLETION is the gallon, and, therefore, usage of Spring Number 1 is 600 gallons per day; Spring Number 2 is 600 gallons per day; Spring Number 3 is 600 gallons per day; and Spring Number 4 is 1,000 gallons per day.

3. Plat. The correct location of the springs, and the place of use are indicated on the following plat (not to scale):

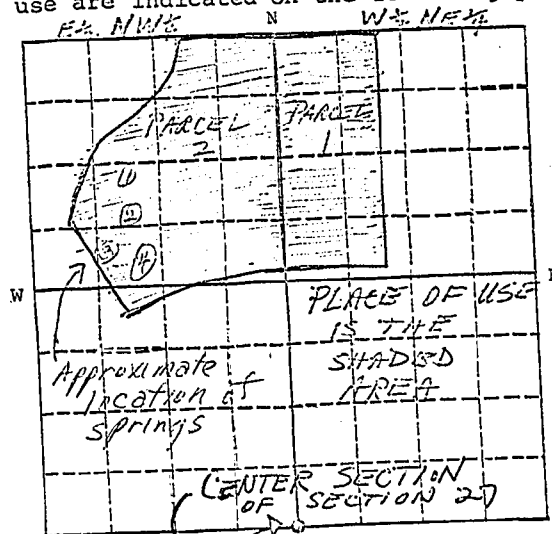

Paul E. Duke
Paul E. Duke

SUBSCRIBED AND SWORN TO before me this 27TH day of JAN., 1975.

(NOTARIAL SEAL)

Surveillance
Notary Public for the State of Florida
Residing at NAPLES - FLA -
My Commission expires My Commission Expires Dec. 31, 1976

Red Lodge, Montana, 18 February

19 75

M McNamer & Thompson

Billings, Montana

TO FRANK DANICHEK DR.

CLERK AND RECORDER, CARBON COUNTY

All Fees Are Payable in Advance, and if Not, Are Chargeable to the County Clerk

This is to acknowledge receipt of AFFIDAVIT
CORRECTING NOTICE OF COMPLETION OG GROUNDWATER
APPROPRIATION WITHOUT WELL, by PAUL A. DUKE.

RECEPTION NUMBER 194370

MISC FILE # 5303

Filed at : 9:10 AM, 18 February 1975

H. Ellis

Clerk & Recorder

\$1.00 Filing Fee received 2-18-75

H. Ellis

Co Clerk & Recorder

GW3

File No. 14T. 7S R. 20E

DUPLICATE

County Carbon

STATE OF MONTANA
ADMINISTRATOR OF GROUNDWATER CODE
OFFICE OF STATE ENGINEER

RECEIVED
MAY 24 1963

STATE ENGINEER

Notice of Completion of Groundwater Appropriation Without Well

(Under Chapter 237 Montana Session Laws, 1961)

Date of Appropriation of Groundwater December 15, 1961Owner Charles B Goldy Address Red Lodge, MontanaContractor (if any) Not applicableAddress of Contractor Not applicableDate Started July 25, 1961 Date Completed Dec. 15, 1961

Describe means of obtaining groundwater without a well "as by sub-irrigation and other natural processes". Include depth to

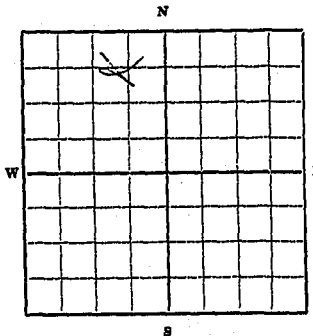

water when applicable. By sedimentation pond of approximately 1/2 acre in the depth of 2 feet westerly end to depth of 5 feet easterly and located in western half of tract of land in portion of NE 1/4 NW 1/4 Section 27, Township 7 South, Range 20 East, M.P.M. thence by 1 1/2 inch pipe buried to 3 foot depth for approximately 180 feet to dwelling and continued beyond by 1 1/2 inch surface pipe 150 feet to landscaped and cultivated area. The pond is supplied by several large springs in immediate area. Is of earth fill dam with overflow, 12 inch drain with headgate. Quantity of water developed and used with explanation of method used to measure or estimate such amount. If use is intermittent estimate approximate lengths of periods of use

NE 1/4 NW 1/4 Sec. 27 T. 7 S. R. 20 E.

Indicate point of appropriation and place of use, if possible.

2000 gallons per hour approximate maximum use for both irrigation and culinary and domestic use through pump system and gravity flow of 1 1/2 inch pipe with 12 foot drop. Amount of usage based on maximum capacity of pump system plus gravity flow of the 1 1/2 inch pipe. Irrigation usage intermittent to an estimated 4 hours usage per day during summer months. Daily culinary and domestic usage constant.

Signature of Owner Charles B GoldyDate January 31, 1962

This form to be prepared by contractor (if any), otherwise by the owner.

Three copies of this notice are to be filed with the County Clerk and Recorder of the county in which the works are located.

Please answer all questions. If not applicable, so state, otherwise the form will be returned.

Original to the County Clerk and Recorder; duplicate to the State Engineer; Triplicate to the School of Mines and Quadruplicate for the Appropriator.

#14

152792

STATE OF MONTANA }
COUNTY OF CARBON } SS.

Office of the County Clerk & Recorder

I hereby certify that the within

Water Approp. was filed
for record in my office this 1ST day
of Feb. A. D. 19 62
at 8:50 o'clock A. M.

Attest my hand and the seal of
said County

GEORGE W. FLASKERUD

Clerk and Recorder

By Tommy A. Zupaw Deputy

Fees & 2⁰⁰ pd.

File No. 471T. 7 S R. 20 E - 28

DUPLICATE

MONTANA WATER & LAND BOARD
JAN 26 1968STATE OF MONTANA
ADMINISTRATOR OF GROUNDWATER CODE
OFFICE OF STATE ENGINEER

County _____

Declaration of Vested Groundwater Rights

(Under Chapter 237, Montana Session Laws, 1961)

Jake Fox

1. Name of Appropriator _____ of _____ (Town)
County of _____ State of _____

have appropriated groundwater according to the Montana laws in effect prior to January 1, 1962, as follows:

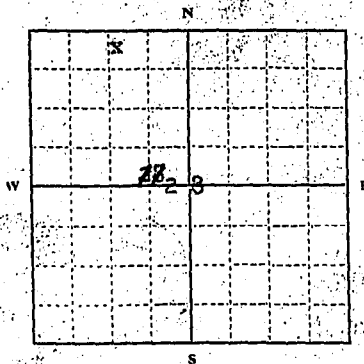
NE 1/4 Sec. 28 T. 7 R. 20
Indicate point of appropriation
and place of use, if possible. Each
small square represents 10 acres.

2. The beneficial use on which the claim is based _____

3. Date or approximate date of earliest beneficial use, and how continuous the use has been since 1926. Number one well has been in continuous use since Dec. 1961.

4. The amount of groundwater claimed (in miner's inches or gallons per minute) two well has 20 gal. per min.

5. If used for irrigation, give the acreage and description of the lands through which water has been applied, and name of the owner thereof _____

6. The means of withdrawing such water from the ground and the location of each well or other means of withdrawal _____

7. The date of commencement and completion of the construction of the well, wells, or other works for withdrawal of groundwater. Number one well has been in continuous use since 1926. Number two well was completed Dec. 15, 1961.

8. The depth of water table. 15 foot 3 inches in Number two well 14 feet in No. one well.

9. So far as it may be available, the type, size and depth of each well or the general specifications of any other works for the withdrawal of groundwater. Number one well is drilled with five inch casing, this well is 55 feet deep. Number two well is drilled with eight inch casing and is 25 feet deep.

10. The estimated amount of groundwater withdrawn each year. 500,000 gals from both wells.

11. The log of formations encountered in the drilling of each well if available. Number one well log formation not available. Number two well is 0-18--boulders, 18-32--brown clay, 32-41--boulders, 41-46--sand, 46-55--blue clay and shale.

12. Such other information of a similar nature as may be useful in carrying out the policy of this act, including reference to book and page of any county record _____

Signature of Owner. Jake FoxDate 12-27-63

Three copies to be filed by the owner with the County Clerk and Recorder of the county in which the well is located.

Please answer all questions. If not applicable, so state, otherwise the form will be returned.

Original to the County Clerk and Recorder; Duplicate to the State Engineer; Triplicate to the Montana Bureau of Mines and Geology, and Quadruplicate for the Appropriator.

43,127

File No. 471County 7 S R 20 E - 28

DUPLICATE

MONTANA WATER RESOURCES BOARD
RECEIVED
JAN 26 1968STATE OF MONTANA
ADMINISTRATOR OF GROUNDWATER CODE
OFFICE OF STATE ENGINEER

Declaration of Vested Groundwater Rights

(Under Chapter 237, Montana Session Laws, 1961)

Jake Fox

Port 2

Red Lodge

1. Name of Appropriator Madison

(Town)

County of MadisonState of Montana

have appropriated groundwater according to the Montana laws in effect prior to January 1, 1962, as follows:

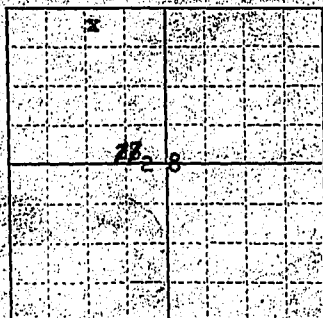
NE 1/4 Sec 28 T. 7 R. 20
Indicate point of appropriation
and place of use, if possible. Each
small square represents 10 acres.

2. The beneficial use on which the claim is based

3. Date or approximate date of earliest beneficial use, and how continuous use has been since 1926. Number one well has been in continuous use since Dec. 1961.

4. The amount of groundwater claimed (in miners inches or gallons per minute) Number one well has 10 gal. per min. two well has 20 gal. per min.

5. If used for irrigation, give the acreage and description of the lands through which water has been applied and name of the owner thereof

6. The means of withdrawing such water from the ground and the location of each well or other means of withdrawal

7. The date of commencement and completion of the construction of the well, wells, or other works for withdrawal of groundwater. Number one well has been in continuous use since 1926. Number two well was completed Dec. 15, 1961.

8. The depth of water table. 15 feet 3 inches in Number two well 14 feet in No. one well

9. So far as it may be available, the type, size and depth of each well or the general specifications of any other works for the withdrawal of groundwater. Number one well is drilled with five inch casing, this well is 55 feet deep. Number two well is drilled with eight inch casing and is 25 feet deep.

10. The estimated amount of groundwater withdrawn each year. 500,000 gals from both wells.

11. The log of formations encountered in the drilling of each well if available. Number one well log formation not available. Number two well is 0-13--boulders, 13-32--brown clay 32-41--boulders, 41-46--sand, 46-55--blue clay and shale

12. Such other information of a similar nature as may be useful in carrying out the policy of this act, including reference to book and page of any county record

Signature of Owner Jake FoxDate 12-27-63

Three copies to be filed by the owner with the County Clerk and Recorder of the county in which the well is located.

Please answer all questions. If not applicable, so state, otherwise the form will be returned.

Original to the County Clerk and Recorder; Duplicate to the State Engineer; Triplicate to the Montana Bureau of Mines and Geology, and Quadruplicate for the Appropriator.

43,127

1471

159151

STATE OF MONTANA, }
COUNTY OF CARBON } SS.

Office of the County Clerk & Recorder

I hereby certify that the within

Appropriation was filed
for record in my office this 27 day
of December A. D. 19 63
at 2:05 o'clock P. M.

Attest my hand and the seal of
said County

Frank Dawidke
Clerk and Recorder

By _____ Deputy

Fees \$ 2.00

GW 3
File No.

891

RECEIVED

JAN 26 1968

STATE OF MONTANA
ADMINISTRATOR OF GROUNDWATER CODE
OFFICE OF STATE ENGINEER

T

7

R

20

County of Carbon

Notice of Completion of Groundwater Appropriation Without Well
(Under Chapter 237 Montana Session Laws, 1961)

Date of Appropriation of Groundwater

1920

Owner

Toivo J. Vienna Rintala

Address

Rd 2, Red Lodge

Contractor (if any)

none

Address of Contractor

none

Date Started

1920

Date Completed

1920

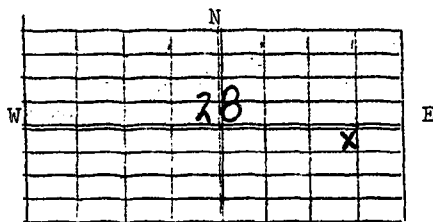

NE 1/4 Sec. 28 T 7 R 20

Indicate point of appropriation and place of use, if possible.

Describe means of obtaining groundwater without a well "as by sub-irrigation and other natural processes". Include depth to water when applicable.

Natural Spring

Quantity of water developed and used, and method used to measure it. If the use is intermittent, estimate approximate lengths of periods of use.

Livestock Water

Signature of Owner

Toivo J. Rintala

Date

Dec. 31, 1963

STATE OF MONTANA)
County of Carbon) ss.

Having first been duly sworn, depose and say that he of lawful age and the appropriator and claimant of the order and water right mentioned in the foregoing notice of completion of groundwater appropriation without well and the person whose name subscribed thereto, as the appropriator and claimant, that he know the contents of said foregoing notice and that all matters and things therein stated are true.

Subscribed and sworn to before me, this _____ day of _____, 19____

Notary Public _____ the State of Montana
Residing at _____
My Commission expires _____ 19____

43,595

#891

159599

STATE OF MONTANA
COUNTY OF CARBON } SS.

Office of the County Clerk & Recorder.

I hereby certify that the within

Appropriation was filed
for record in my office this 31 day
of Dec A. D. 1963
at 7:44 o'clock P. M.

Attest my hand and the seal of
said County

FRANK DANICHEK, COUNTY CLERK

Clerk and Recorder

By Alvin E. Kuever

Per \$ 2.00

GW 3

File No.

483

DUPLICATE

Approved Stock Form—State Publishing Co., Helena, Montana—42262

T

7

R

20

28

County

Carbon

STATE OF MONTANA
ADMINISTRATOR OF GROUNDWATER CODE
OFFICE OF STATE ENGINEER

Notice of Completion of Groundwater Appropriation
Without Well

(Under Chapter 237 Montana Session Laws, 1961)

RECEIVED
DEC 26 1963

Date of Appropriation of Groundwater

1889

Owner

Castagnier Bros. Inc.

Address

Red Lodge

Contractor (if any)

NONE

Address of Contractor

NONE

Date Started

1889

Date Completed

1889

Describe means of obtaining groundwater without a well "as by sub-irrigation and other natural processes". Include depth to water when applicable.

Natural.

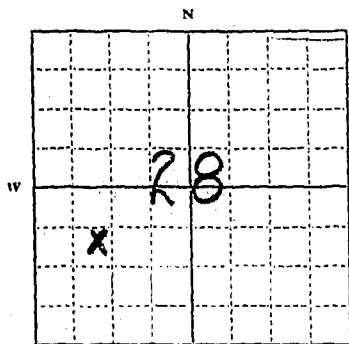

SUR. 14 SUR. Sec. 28 T. 7 R. 20

Indicate point of appropriation and place of use, if possible.

Quantity of water developed and used with explanation of method used to measure or estimate such amount. If use is intermittent

estimate approximate lengths of periods of use.

40 inches water per minute.

1889 when spring was first used.

Signature of Owner

Castagnier Bros. Inc. James Castagnier

Date

12/27/63

This form to be prepared by contractor (if any), otherwise by the owner.

Three copies of this notice are to be filed with the County Clerk and Recorder of the county in which the works are located.

Please answer all questions. If not applicable, so state, otherwise the form will be returned.

Original to the County Clerk and Recorder; duplicate to the State Engineer; Triplicate to the Montana Bureau of Mines and Geology and Quadruplicate for the Appropriator.

42,978

~~#483~~

159163

STATE OF MONTANA }
COUNTY OF CARBON } SS.

Office of the County Clerk & Recorder

I hereby certify that the within

Water filing was filed
for record in my office this 27 day
of Dec. A. D. 19 63
at 3:05 o'clock P. M.

Attest my hand and the seal of
said County

FRANK DANICHEK, COUNTY CLERK
Clerk and Recorder

By Tony J. Zupanc Deputy

Fees \$ 200 pd.

GN 3
File No.

819

MONTANA WATER RESOURCES BOARD

RECEIVED

T 7 S
County of

R 20 E
CARBON

29

JAN 26 1968

STATE OF MONTANA
ADMINISTRATOR OF GROUNDWATER CODE
OFFICE OF STATE ENGINEER

Notice of Completion of Groundwater Appropriation ¹⁷Without Well
(Under Chapter 237 Montana Session Laws, 1961)

Date of Appropriation of Groundwater 1896

Owner JOHN KRIVIZ

Address BED LODGE, MONTANA

Contractor (if any) None

Address of Contractor None

Date Started _____ Date Completed 1896

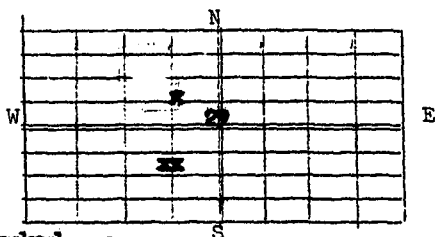

Sworn and
Signed by Sec. 29 T 7 R 20

Indicate point of appropriation and
place of use, if possible.

Describe means of obtaining groundwater without
a well "as by sub-irrigation and other natural
processes". Include depth to water when applicable

3 springs - normal flow - used year around

Quantity of water developed and used with explana-
tion of method used to measure or estimate such
amount. If use is intermittent estimate approxi-
mate lengths of periods of use

used continuous - used for stock

1000 in. per min.

Signature of Owner

Date 12/31/63

STATE OF MONTANA)
County of Carbon) ss.

Having first been duly sworn, depose and say
that he of lawful age and the appropriator and claimant
of the order and water right mentioned in the foregoing notice of completion of groundwater
appropriation without well and the person whose name subscribed thereto, as
the appropriator and claimant, that he know the contents of said foregoing
notice and that the matters and things therein stated are true.

Subscribed and sworn to before me, this 31st day of December, 19 63

Notary Public for the State of Montana
Residing at _____

My Commission expires _____ 19 _____

43,323

4819

159527

STATE OF MONTANA }
COUNTY OF CARBON } SS.
Office of the County Clerk & Recorder

I hereby certify that the within
Appropriation was filed
for record in my office this 31 day
of Dec A. D. 1963
at 5:20 o'clock P. M.

Attest my hand and the seal of
said County

FRANK DANICHEK, COUNTY CLERK

Allen E. Grimes Deputy
County Clerk and Recorder

\$ 2.00

GW 3
File No. 820

RECEIVED

JAN 26 1968

T 7 S R 20 E
County of CARBON

29

STATE OF MONTANA
ADMINISTRATOR OF GROUNDWATER CODE
OFFICE OF STATE ENGINEER

Notice of Completion of Groundwater Appropriation Without Well
(Under Chapter 237 Montana Session Laws, 1961)

Date of Appropriation of Groundwater 1896
Owner JOHN KRIVTZ Address RED LODGE, MONTANA
Contractor (if any) None
Address of Contractor None
Date Started _____ Date Completed 1896

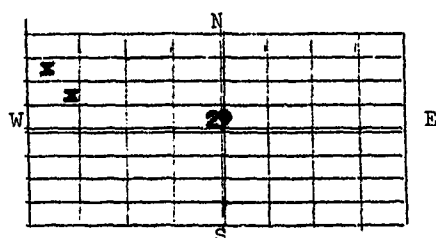

SW 1/4 Sec. 29 T 7 R 20
Indicate point of appropriation and place of use, if possible.

Describe means of obtaining groundwater without a well "as by sub-irrigation and other natural processes". Include depth to water when applicable
2 springs - normal flow - used year around

Quantity of water developed and used with explanation of method used to measure or estimate such amount. If use is intermittent estimate approximate lengths of periods of use used continuous,
used for stock and garden irrigation
1000 in. per min.

Signature of Owner

John Krivtz
Date 12/31/63

STATE OF MONTANA)
County of Carbon) ss.

Having first been duly sworn, depose and say that he of lawful age and _____ the appropriator and claimant of the order and water right mentioned in the foregoing notice of completion of groundwater appropriation without well and the person whose name _____ subscribed thereto, as the appropriator and claimant, that he know the contents of said foregoing notice and that the matters and things therein stated are true.

Subscribed and sworn to before me, this 31st day of Dec., 19 63

Notary Public for the State of Montana
Residing at _____
My Commission expires _____ 19 _____

43,324

#820

159528

STATE OF MONTANA
COUNTY OF CARBON } SS.

Office of the County Clerk & Recorder

I hereby certify that the within

Appropriation was filed
for record in my office this 31 day
of Dec A. D. 1963
at 5:22 o'clock P.M.

Attest my hand and the seal of
said County
FRANK DANICHEK, COUNTY CLERK

Alvin E. Davies Deputy
County Clerk and Recorder
\$ 2.00

File No. 679

T. 7S R. 20E

DUPLICATE

County

RECEIVED
JAN 26 1968STATE OF MONTANA
ADMINISTRATOR OF GROUNDWATER CODE
OFFICE OF STATE ENGINEER

Declaration of Mineral Groundwater Rights

(Under Chapter 22, Montana Code Annotated, 1955)

I, Joe Stringer, (Name of Appropriator) of RED LODGE (Town)
County of CARBON, State of MONTANA
have appropriated groundwater according to the provisions of the act approved January 2, 1955, as follows:

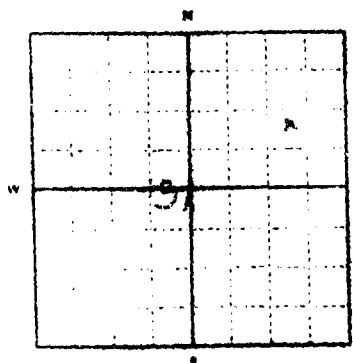

1/4 Sec. 7, E. 2.
Indicate point of appropriation
and place of use, if possible. Each
small square represents 16 acres.

2. The beneficial use or uses for the water is based Household and livestock
3. Date or approximate date of earliest beneficial use unknown
and in continuous use
4. The amount of groundwater claimed (in minutes, gallons or other units) 15 gal per minute
5. If used for irrigation, give the amount and location of the lands to which water is applied Household and livestock only
6. The means of withdrawal from the ground and the location of such withdrawal withdrawal by pump
7. The date of commencement and completion of the construction of the well, with, or other works for the withdrawal of groundwater date unknown
8. The depth of water table approximately 15 feet
9. So far as it may be available, the type, size and depth of each well or the general specifications of any other works for the withdrawal of groundwater dry well, depth about 20 feet, under pump
10. The estimated amount of groundwater withdrawn each year unknown
11. The log of formations encountered in the drilling of each well if available unknown
12. Such other information of a similar nature as may be useful in carrying out the policy of this act, including reference to book and page of any county record None

Signature of Owner

Date Dec. 31-1963

Three copies to be filed by the owner with the County Clerk and Recorder of the county in which the well is located

Please answer all questions. If not applicable, so state, otherwise the form will be returned.

Original to the County Clerk and Recorder, Duplicate to the State Engineer, Triplicate to the Montana Bureau of Mines and Geology, and Quadruplicate for the Appropriator

43705

7-20

Approved Stock Form—State Publishing Co., Helena, Montana—42234

File No. 679

T. 7 S R. 20 E

31

DUPLICATE

County

RECEIVED
JAN 26 1968STATE OF MONTANA
ADMINISTRATION OF GROUNDWATER CODE
OFFICE OF STATE ENGINEER

Declaration of Groundwater Rights

(Under Montana Groundwater Code, 1967)

1. Joe S. Thompson RED LODGE
(Name of Applicant) (County)
County of CARBON State of MONTANA
have appropriated groundwater according to the Montana Groundwater Code, Chapter 1, Part 1, as follows:

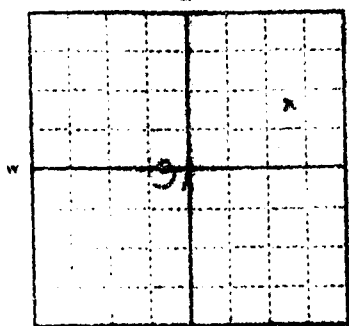

Indicate point of appropriation and place of use, if possible. Each small square represents 10 acres.

2. The land to which the water is used Household and livestock
3. Date or dates of drilling, location, bearing, and depth of well and in continuous use
4. The amount of groundwater claimed (in gallons per minute) 15 gpm per minute
5. If used for domestic purposes, the purpose of the well Household and livestock only
6. The purpose of the well, the location of the well, and the location of the point of appropriation withdrawal by pump

7. The date of commencement and completion of the construction of the well, cistern, or other works for withdrawal of groundwater date unknown
8. The depth of water table approximately 15 feet
9. So far as it may be available, the type, size and depth of each well or the general specifications of any other works for the withdrawal of groundwater dug well, depth about 20 feet, under pump
10. The estimated amount of groundwater withdrawn each year unknown
11. The log of formations encountered in the drilling of each well if available unknown
12. Such other information of a similar nature as may be needed in carrying out the policy of this act, including reference to book and page of any county records None

Signature of Owner

Date Dec. 31-1963

Three copies to be filed by the owner with the County Clerk and Recorder of the county in which the well is located

Please answer all questions. If not applicable, so state, otherwise the form will be returned.

Original to the County Clerk and Recorder; Duplicate to the State Engineer; Triplicate to the Montana Bureau of Mines and Geology; and Quadruplicate for the Appropriator.

43705

#679

159371

STATE OF MISSISSIPPI
COUNTY OF CARROLL) SS.
Office of the County Clerk & Recorder

I hereby certify that the within
Water filing was filed
for record in my office this 31 day
of Dec. A. D. 19 63
at 8:50 o'clock A. M.

Attest my hand and the seal of
said County
FRANK DANICHEK, COUNTY CLERK

Clark and Recorder
By Tony J. Zupka Deputy
Fees \$ 2.00 pd.

Form No. 18
8-60

RECEIVED
OCT 3 1961

STATE ENGINEER

T. 7S R. 20E

County Carbon

MONTANA BUREAU OF MINES AND GEOLOGY
Butte, Montana

Water Well Log

Owner U. S. Forest Service Address Red Lodge, Montana

Driller B & H Drilling Address Fishtail, Montana

Date Started 7-31-61 Date Completed 8-8-61

Location: Sec. 31 T. 7S R. 20E $\frac{1}{4}$ sec. SE

Type of well Drilled Equipment used Churn Drill
(Dug, driven, bored, or drilled) (Churn, drill, rotary, other)

Water use: Domestic ☒ Municipal ☐ Stock ☐ Irrigation ☐
Industrial ☐ Drainage ☐ Other _____

Casing: 0 ft. to 0 ft. Type Pulled Casing Size _____

Casing: _____ ft. to _____ ft. Type _____ Size _____

Casing: _____ ft. to _____ ft. Type _____ Size _____

Perforated or screened: Ft. _____ to ft. _____. Ft. _____ to ft. _____

Type of screen or perforations _____

Static water level, for non-flowing well: Dry Hole feet.

Shut-in pressure, for flowing well: _____ lb./sq. in. on: _____ (date)

Pumping water level Dry Hole feet at _____ gal. per min.

How tested: _____

Length of test _____

Remarks: (Gravel packing, cementing, packers, type of shut-off, depth of shut-off)

Cemented Hole from 21-18

Cemented Hole from 3-0

(over)

Log of Well

[illegible]

RECEIVED
JUN 2 1960

T. 7 S. R. 20 E. 32
County Carbon

STATE ENGINEER MONTANA BUREAU OF MINES AND GEOLOGY
Butte, Montana

WATER WELL LOG

Owner John Woods Address Red Lodge, Mont.

Driller B & H Drilling Address Fishtail, Mont.

Date Started 6/17/60 Date Completed 6/20/60

Location: Sec. 32 T. 7 S. R. 20 E. 1/4 sec. NW

Type of well Drilled Equipment used Churn Drill
(Dug, driven, bored, or drilled) (Churn drill, rotary, other)

Water use: Domestic ☒ Municipal ☐ Stock ☐ Irrigation ☐
Industrial ☐ Drainage ☐ Other:

Casing: 0 ft. to 21 ft. Type Black Size 6 in

Casing: 19 ft. to 85 ft. Type 20 gauge liner Size 5 in

Casing: ft. to ft. Type Size

Perforated or Screened: Ft. 34 to ft. 40 Ft. 68 to ft. 74

Type of screen or perforations

Static Water level, for non-flowing well: feet

Shut-in pressure, for flowing well: 4 lbs. lb./sq. in. on: 6/20/60 (date)

Pumping water level 75 feet at 3 gal. per min.

How tested: Bailer

Length of test One Hour

Remarks: (Gravel packing, cementing, packers, type of shut-off, depth of shut-off)

Water is just flowing over top of casing

(over)

Log of Well

[illegible]

RECEIVED

AUG 20 1960

STATE ENGINEER

MONTANA BUREAU OF MINES AND GEOLOGY
Butte, Montana

T. 7 S. R. 20 E.

County Carbon

32

WATER WELL LOG

Owner Archie Uap Address Red Lodge, Mont.

Driller B & H Drilling Address Fishtail, Mont.

Date Started 6/20/60 Date Completed 6/22/60

Location: Sec. 32 T. 7 S. R. 20 E. 1/4 sec. NW

Type of well Drilled Equipment used Churn Drill
(Dig, driven, bored, or drilled) (Churn drill, rotary, other)

Water use: Domestic ☒ Municipal ☐ Stock ☐ Irrigation ☐

Industrial ☐ Drainage ☐ Other:

Casing: 0 ft. to 23 ft. Type Black Size 6 in.

Casing: ft. to ft. Type Size

Casing: ft. to ft. Type Size

Perforated or screened: Ft. to ft. Ft. to ft.

Type of screen or perforations

Static Water level, for non-flowing well: 17 feet.

Shut-in pressure, for flowing well: lb./sq. in. on: (date)

Pumping water level 58 feet at 20 gal. per min.

How tested: Bailer

Length of test: One Hour

Remarks: (Gravel packing, cementing, packers, type of shut-off, depth of shut-off)

(over)

[illegible][illegible]

RECEIVED

T. 7 S. R. 20 E 32
County Carbon

STATE ENGINEER MONTANA BUREAU OF MINES AND GEOLOGY
Butte, Montana

WATER WELL LOG

Syboda Well

Owner Syboda Address Red Lodge, Mont.
Driller B & H Drilling Address Fishtail, Mont.
Date Started 5/21/60 Date Completed 5/24/60
Location: Sec. 32 T. 7 S. R. 20 E 1/4 sec. NW

Type of well Drilled Equipment used Churn Drill
(Dug, driven, bored, or drilled) (Churn drill, rotary, other)

Water use: Domestic ☒ Municipal ☐ Stock ☐ Irrigation ☐
Industrial ☐ Other: ☐

Casing: 0 ft. to 32 ft. Type Black Iron Size 6 in.

Casing: ft. to ft. Type Size

Casing: ft. to ft. Type Size

Perforated or Screened: Ft. to ft. Ft. to ft.

Type of screen or perforations

Static Water level, for non-flowing well: 5 feet.

Shut-in pressure, for flowing well: lb./sq. in. on: (date)

Pumping water level 63 feet at 10 gal. per min.

How tested: Bailer

Length of test One Hour

Remarks: (Gravel packing, cementing, packers, type of shut-off, depth of shut-off)

Set casing into Sandstone 3 or 4 feet.

Got a good seal.

(over)