

4900.

STATE OF MONTANA, } ss.
County of Cascade.

I hereby certify that the within in-
strument was filed in this office on

DEC 20 1965
Date

at 3:40 o'clock P.M.

J. L. BERNON

County Clerk and Recorder.

By [Signature]
Deputy.

File No. _____ T. _____ R. _____

DUPLICATE _____ County _____

Butterfield _____
Date _____
Duration _____
District _____
STATE OF MONTANA
ADMINISTRATOR OF GROUNDWATER CODE
OFFICE OF STATE ENGINEER

Notice of Completion of Groundwater Appropriation Without Well

(Under Chapter 237 Montana Session Laws, 1961)

Date of Appropriation of Groundwater DEC. 13, 1965

Owner William B. Ellis Address CASCADE, MONT.

Contractor (if any) _____

Address of Contractor _____

Date Started _____ Date Completed _____

Describe means of obtaining groundwater without a well "as by sub-irrigation and other natural processes". Include depth to water when applicable. SPRING

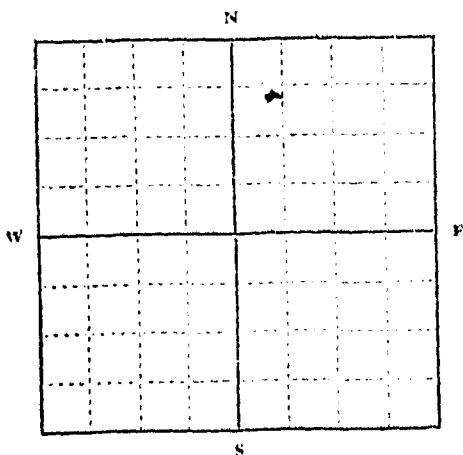

NE 1/4 Sec. 5 T. 17 R. 1W

Indicate point of appropriation and place of use, if possible.

Quantity of water developed and used with explanation of method used to measure or estimate such amount. If use is intermittent estimate approximate lengths of periods of use. 1890

Signature of Owner William B. Ellis

Date DEC. 13, 1965

This form to be prepared by contractor (if any), otherwise by the owner.

Three copies of this notice are to be filed with the County Clerk and Recorder of the county in which the works are located.

Please answer all questions. If not applicable, so state, otherwise the form will be returned.

Original to the County Clerk and Recorder; duplicate to the State Engineer; Triplicate to the Montana Bureau of Mines and Geology and Quadruplicate for the Appropriator.

40094

4912

STATE OF MONTANA, } ss.
County of Cascade.

I hereby certify that the within in-
strument was filed in this office on

DEC 20 1966

Date

at 3:52 o'clock P M

J. L. HENRY

County Clerk and Recorder

By *A.C. [Signature]*
Deputy

File No.

T. 17 R. 1

DUPLICATE

County

STATE OF MONTANA
ADMINISTRATOR OF GROUNDWATER CODE
OFFICE OF STATE ENGINEER

RECEIVED
JAN 3 1964

Declaration of Vested Groundwater Rights

(Under Chapter 237, Montana Session Laws, 1961)

STATE ENGINEER

1. W. J. Barrett, of Helena (Town)
(Name of Appropriator) (Address)

County of Blaine State of Montana
have appropriated groundwater according to the Montana laws in effect prior to January 1, 1962, as follows:

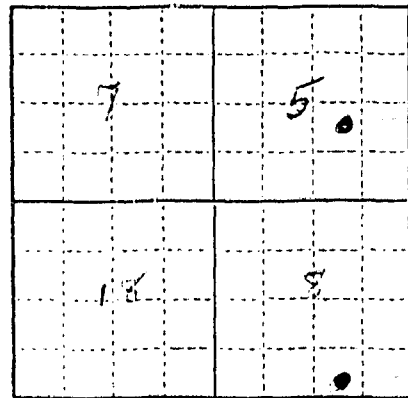

17N
1/4 Sec. 345 T. 17 N. R. 1 W.

Indicate point of appropriation and place of use, if possible. Each small square represents 10 acres.

2. The beneficial use on which the claim is based Domestic use

3. Date or approximate date of earliest beneficial use; and how continuous the use has been 1900

4. The amount of groundwater claimed (in miner's inches or gallons per minute) 100 gpm

5. If used for irrigation, give the acreage and description of the lands to which water has been applied and name of the owner thereof

6. The means of withdrawing such water from the ground and the location of each well or other means of withdrawal Hand-dug well

7. The date of commencement and completion of the construction of the well, wells, or other works for withdrawal of groundwater 1900

8. The depth of water table 100 ft

9. So far as it may be available, the type, size and depth of each well or the general specifications of any other works for the withdrawal of groundwater Hand-dug well

10. The estimated amount of groundwater withdrawn each year 100 gpm

11. The log of formations encountered in the drilling of each well if available

12. Such other information of a similar nature as may be useful in carrying out the policy of this act, including reference to book and page of any county record

Signature of Owner W. J. Barrett

Date 12/20-63

Three copies to be filed by the owner with the County Clerk and Recorder of the county in which the well is located.

Please answer all questions. If not applicable, so state, otherwise the form will be returned.

Original to the County Clerk and Recorder; Duplicate to the State Engineer; Triplicate to the Montana Bureau of Mines and Geology, and Quadruplicate for the Appropriator.

28249

4261

CLERK AND RECORDER
CASCADE COUNTY, MONTANA
I HEREBY CERTIFY THAT THE WITHIN
INSTRUMENT WAS FILED FOR RECORD
IN THIS OFFICE ON **DEC 31 1989**

AT 10:01 A.M.
AND DULY RECORDED AT DOCUMENT

NO. _____
J. L. LENNON
CLERK AND RECORDER

BY *A. C. [Signature]*
RECORDS

GW3

File No.....

T..... R.....

DUPLICATE

County.....

STATE OF MONTANA
ADMINISTRATOR OF GROUNDWATER CODE
OFFICE OF STATE ENGINEER

RECEIVED
JAN 9 1964

Notice of Completion of Groundwater Appropriation ~~SW~~ ~~Without Well~~ NEER

(Under Chapter 237 Montana Session Laws, 1961)

Date of Appropriation of Groundwater *Oct. 1963*

Owner *Belle Sullivan* Address *Lincoln*

Contractor (if any)

Address of Contractor

Date Started..... Date Completed.....

Describe means of obtaining groundwater without a well "as by sub-irrigation and other natural processes". Include depth to water when applicable.....

Spring surface

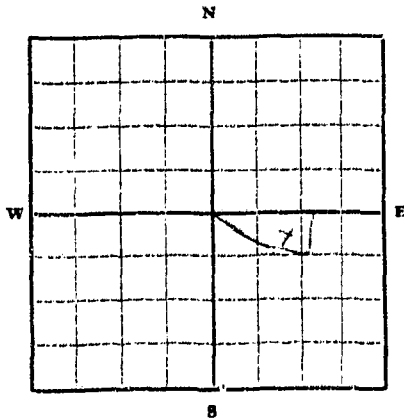

Quantity of water developed and used with explanation of method used to measure or estimate such amount. If use is intermit-

tent estimate approximate lengths of periods of use

S. 1/4 Sec. 14 T. 17 N. R. 1 W.
Indicate point of appropriation and place of use, if possible.

*90 gallons per minute
measured with a 50 gal. barrel
at the surface of dam*

Signature of Owner *Belle Sullivan*

Date *Dec. 31. 1963*

This form to be prepared by contractor (if any), otherwise by the owner.

Three copies of this notice are to be filed with the County Clerk and Recorder of the county in which the works are located.

Please answer all questions. If not applicable, so state, otherwise the form will be returned.

Original to the County Clerk and Recorder; duplicate to the State Engineer; Triplicate to the School of Mines and Quadruplicate for the Appropriator.

28384

4393

CLERK AND RECORDER
CASCADE COUNTY, MONTANA
I HEREBY CERTIFY THAT THE WITHIN
INSTRUMENT WAS FILED FOR RECORD
IN THIS OFFICE ON
DEC 31 1963
AT 12:19 P
AND DULY RECORDED AS DOCUMENT

NO. _____
J. L. LENNON
CLERK AND RECORDER
BY [Signature]
DEPUTY

5392

Address 325 2nd Ave. N., Great Falls
Location T. R. SEC.
Doc. No. 5392

ST 11-11-72

STATE OF MONTANA, } ss.
County of Cascade.

I hereby certify that the within instrument was filed in this office or

AUG 1 1972

at 2:30 o'clock P.M.

J. L. LENNON
County Clerk and Recorder

By *J. S. Wilson*
Deputy

WATER RESOURCES DIVISION
Engineering Bureau
Groundwater Section
Sam W. Mitchell Building
Helena, Montana 59601

As the Administrator of the Groundwater Code for the State of Montana, please take note of the following special instructions, in order to properly protect your groundwater right.

Special Instructions:

Please provide, as indicated in red on the attached form, the complete location of the well by township, range and section.

Thank you.

INCOMING		ACT
BY	INFO	
GJ		
RS		
LH		
HS		
HF		
RIS		
RY		

County _____

STATE OF MONTANA
ADMINISTRATOR OF GROUNDWATER CODE
MONTANA WATER RESOURCES BOARD

DRILLER'S LOG

Indicate the character, color, thickness of strata such as soil, clay, sand, gravel, shale, sandstone, etc. State depth at which water is found and height to which water rises in well.

NOTICE OF COMPLETION OF GROUNDWATER APPROPRIATION BY MEANS OF WELL
Developed after January 1, 1962

(Under Chapter 237 Montana Session Laws, 1961, as amended)

This form to be prepared by driller, and three copies to be filed by the owner with the County Clerk and Recorder in the county in which the well is located, last copy to be retained by driller.

Please answer all questions. If not applicable, so state, otherwise the form may be returned.

Owner _____

Address _____

Date well started _____

completed _____

For Administrator's Use
File # _____
_____ (Handwritten)
GW 1

Type of well _____ (Dig, driven, bored or drilled)

Equipment used _____ (Churn drill, rotary or other)

Water Use: Domestic Municipal Stock Irrigation
Industrial Drainage Other * Garden/Lawn

*Describe _____
USE: If used for irrigation, industrial, drainage or other. Explain, state number of acres and location or other data (i.e. Lot, Block and Addition). _____

ESTIMATED ANNUAL WITHDRAWAL

Size of Drilled Hole	Size and Weight of Casing	From (Feet)	To (Feet)	PERFORATIONS		
				Kind Size	From (Feet)	To (Feet)
4"	4"	0	1.0			

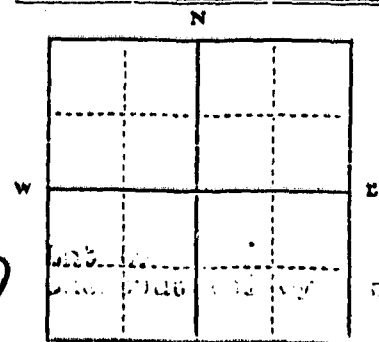

Static water level _____ ft.*
Pumping water level _____ ft.*
at _____ gallons per minute,
measured _____ minutes after pumping
began.

*Measured from ground level.
Well developed by _____*
for _____ hours.

Power _____ Pump _____ HP
Remarks: (Gravel packing, cementing,
packers, type of shaft)

S. 1/4 S. 27 N. Sec. 17
T. 17 N. R. 7 E
Blaine Cascade County, Montana

INDICATE LOCATION OF WELL AND PLACE OF USE, IF POSSIBLE. EACH SMALL SQUARE REPRESENTS 40 ACRES.

Driller's Signature _____

Driller's Address _____

LICENSE NO. _____

Top of Ground (Elev. above sea level) _____

From (Feet)	To (Feet)	

Show exact location of well

File No.

DUPLICATE

T 17 R 1 W
County: Cascade

STATE OF MONTANA
ADMINISTRATOR OF GROUNDWATER CODE
OFFICE OF STATE ENGINEER

Declaration of Vested Groundwater Rights

(Under Chapter 237, Montana Session Laws, 1961)

1. Nellie M. Leva, of Box 245 Augusta
(Name of Appropriator) (Address) (Town)
County of Lewis & Clark State of Montana

have appropriated groundwater according to the Montana laws in effect prior to January 1, 1962, as follows:

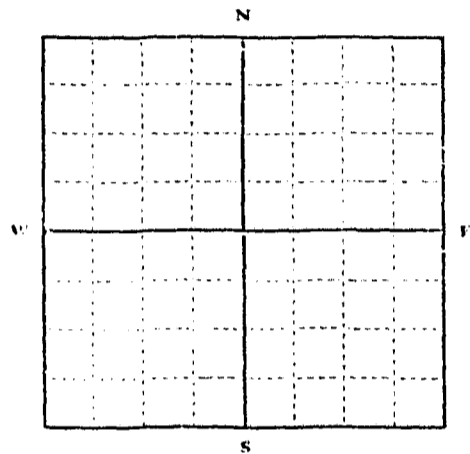

..... T. R.

Indicate point of appropriation and place of use, if possible. Each small square represents 10 acres.

2. The beneficial use on which the claim is based House hold use and stock water

3. Date or approximate date of earliest beneficial use; and how continuous the use has been 1920 Every day use since that time

4. The amount of groundwater claimed (in miner's inches or gallons per minute) A - 40, B - 50, C - 10, D - 15 gals. per min.

5. If used for irrigation, give the acreage and description of the lands to which water has been applied and name of the owner thereof used to water lawn & garden

6. The means of withdrawing such water from the ground and the location of each well or other means of withdrawal Electric driven pumps

7. The date of commencement and completion of the construction of the well, wells, or other works for withdrawal of groundwater Unknown

8. The depth of water table About 10 ft.

9. So far as it may be available, the type, size and depth of each well or the general specifications of any other works for the withdrawal of groundwater A and B are dug wells about 16 ft. deep with 30 inch casing. C and D are 1 1/2" sand points about 16 feet deep.

10. The estimated amount of groundwater withdrawn each year 20,000,000

11. The log of formations encountered in the drilling of each well if available not available

12. Such other information of a similar nature as may be useful in carrying out the policy of this act, including reference to book and page of any county record none

Signature of Owner Nellie M. Leva
Date December 26 - 1963

Three copies to be filed by the owner with the County Clerk and Recorder of the county in which the well is located.
Please answer all questions. If not applicable, so state, otherwise the form will be returned.

Original to the County Clerk and Recorder; Duplicate to the State Engineer; Triplicate to the Montana Bureau of Mines and Geology, and Quadruplicate for the Appropriator.

28321

RECORDED
JAN 9 1964

Township No. 7 Range No. ENGINEER

36	31	32	33	34	35
1	6	5	4	3	2
12	7	8	9	10	11
18	18	17	16	15	14
24	19	20	21	22	23
25	30	29	28	27	26
36	31	32	33	34	35
1	6	5	4	3	2

4331

STATE OF MISSISSIPPI
County of [unclear] ss.
I, [unclear], County Clerk, do hereby certify that the within in-
strument was filed in this office on
DEC 31 1863
Date
at 11 12 o'clock
J. L. LENNON
County Clerk and Recorder
By *J. L. Lennon*
Deputy

File No.....

T. 17 R. 1 W

DUPLICATE

County...CASADE

STATE OF MONTANA
ADMINISTRATOR OF GROUNDWATER CODE
OFFICE OF STATE ENGINEER

RECEIVED
STATE ENGINEER

Declaration of Vested Groundwater Rights

(Under Chapter 237, Montana Session Laws, 1961)

1. ARNOLD VENETZ of CASCADE
(Name of Appropriator) (Address) (Town)
County of CASCADE State of MONTANA
have appropriated groundwater according to the Montana laws in effect prior to January 1, 1962, as follows:

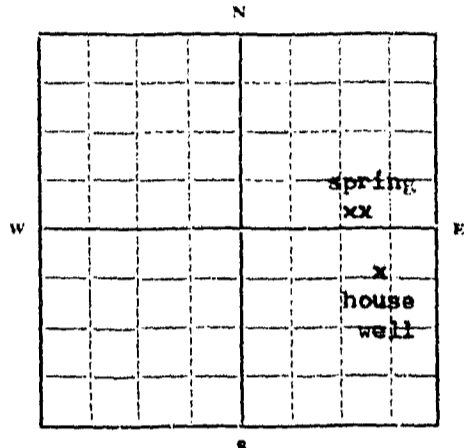

NE 1/4 Sec 19 T17 R1W Spring
SE 1/4 Sec 19 T. 17 R. 1W House Well

Indicate point of appropriation and place of use, if possible. Each small square represents 10 acres.

2. The beneficial use on which the claim is based. HOUSE WELL--HOUSE DOMESTICAL AND GARDEN SPRING LIVESTOCK AND GARDEN

3. Date or approximate date of earliest beneficial use; and how continuous the use has been. HOUSE-WELL APRIL 1, 1953 STEADY SPRING APRIL 1, 1956

4. The amount of groundwater claimed (in miner's inches or gallons per minute). HOUSE WELL 10 GALONS PER MINUTE SPRING 9 1/2 GALONS PER MINUTE

5. If used for irrigation, give the acreage and description of the lands to which water has been applied and name of the owner thereof. HOUSE WELL GARDEN SMALL SPRING 1 ACRE GARDEN ARNOLD VENETZ

6. The means of withdrawing such water from the ground and the location of each well or other means of withdrawal. HOUSE WELL PRESSURE ELECTRIC PUMP TO FEEDER LINES, SPRING GRAVITATIONAL FLOW FROM KATKEMEN

7. The date of commencement and completion of the construction of the well, wells, or other works for withdrawal of groundwater. HOUSE WELL MARCH 1 TO MARCH 10, 1953 spring natural flow as far back as history reaches

8. The depth of water table. HOUSE WELL 15 Ft.

9. So far as it may be available, the type, size and depth of each well or the general specifications of any other works for the withdrawal of groundwater. YES CURBED AND CAPPED

10. The estimated amount of groundwater withdrawn each year. HOUSE WELL GALLONS 50,000 or MORE SPRING 9 1/2 GAL. PER MI. STEADY FLOW

11. The log of formations encountered in the drilling of each well if available. HOUSE WELL HAND DUG AND CURBED

12. Such other information of a similar nature as may be useful in carrying out the policy of this act, including reference to book and page of any county record. None

Signature of Owner Arnold Venetz

Date MARCH 26, 1963

Three copies to be filed by the owner with the County Clerk and Recorder of the county in which the well is located.

Please answer all questions. If not applicable, so state, otherwise the form will be returned.

Original to the County Clerk and Recorder; duplicate to the State Engineer; Triplicate to the Montana Bureau of Mines and Geology, and Quadruplicate for the Appropriator.

3280

STATE OF MONTANA, } ss.
County of Cascade.

I hereby certify that the within in-
strument was filed in this office on
MAR 26 1963

Date
11:01 o'clock AM

J. E. LENNON
County Clerk and Recorder.

By B. Hein
Deputy.

File No.

T. 17 N., R. 1 W

DUPLICATE

County Cascade

STATE OF MONTANA
ADMINISTRATOR OF GROUNDWATER CODE
OFFICE OF STATE ENGINEER

RECEIVED
DEC 27 1963

Declaration of Vested Groundwater Rights

(Under Chapter 237, Montana Session Laws, 1961)

STATE ENGINEER

1. **ROBERT J. TINTINGER**, of **Cascade**
(Name of Appropriator) (Address) (Town)
County of **Cascade**, State of **Montana**,
have appropriated groundwater according to the Montana laws in effect prior to January 1, 1962, as follows:

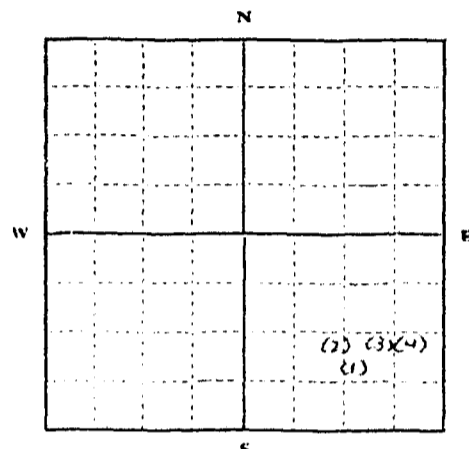

SE 1/4 Sec. 19, T. 17N R. 1W

Indicate point of appropriation and place of use, if possible. Each small square represents 10 acres.

2. The beneficial use on which the claim is based **(1) Household;**
(2) (3) (4) Watering Livestock.

3. Date or approximate date of earliest beneficial use; and how continuous the use has been **(1) 10-29-39; (2) 6-15-46;**
(3) 7-1-46; (4) 7-15-46.

4. The amount of groundwater claimed (in miner's inches or gallons per minute) **(1) 50 miners inches; (2) 20 miners inches;**
(3) 15 miners inches; (4) 15 miners inches.

5. If used for irrigation, give the acreage and description of the lands to which water has been applied and name of the owner thereof

6. The means of withdrawing such water from the ground and the location of each well or other means of withdrawal **(1) electric jet pump in the well; (2) (3) (4) electric jack pumps on top of the wells.**

7. The date of commencement and completion of the construction of the well, wells, or other works for withdrawal of groundwater **(1) 10-27-39 to 10-29-39; (2) 6-12-46 to 6-15-46;**
(3) 6-20-46 to 7-1-46; (4) 7-12-46 to 7-15-46.

8. The depth of water table **ten (10) feet to twelve (12) feet.**

9. So far as it may be available, the type, size and depth of each well or the general specifications of any other works for the withdrawal of groundwater: **(1) concrete casing ten feet deep.**
(2) (3) (4) shored timber casing with tank lining ten feet deep.

10. The estimated amount of groundwater withdrawn each year **1,000,000 gallons.**

11. The log of formations encountered in the drilling of each well if available **Sand**

12. Such other information of a similar nature as may be useful in carrying out the policy of this act, including reference to book and page of any county record.

Signature of Owner *Robert J. Tintinger*
Date **December 20, 1963.**

Three copies to be filed by the owner with the County Clerk and Recorder of the county in which the well is located.

Please answer all questions. If not applicable, so state, otherwise the form will be returned.

Original to the County Clerk and Recorder; Duplicate to the State Engineer; Triplicate to the Montana Bureau of Mines and Geology, and Quadruplicate for the Appropriator.

12958

3632

STATE OF MONTANA, } ss
County of Cascade.

I hereby certify that the within in-
strument was filed in this office on
DEC 20 1960

7:15 P.M.

County of Cascade

By [Signature]
Deputy.

STATE OF MONTANA
ADMINISTRATOR OF GROUNDWATER CODE
MONTANA WATER RESOURCES BOARD

**NOTICE OF COMPLETION OF GROUNDWATER
APPROPRIATION BY MEANS OF WELL**

Developed after January 1, 1962

(Under Chapter 237 Montana Session Laws, 1961, as amended)

This form to be prepared by driller, and three copies to be filed by the owner with the County Clerk and Recorder in the county in which the well is located, last copy to be retained by driller.

Please answer all questions. If not applicable, so state, otherwise the form may be returned.

Owner Malcolm G. MacGregor

Address Rt. 1 So., Box 1047

Great Falls, Montana

Date well started Apr. 27, 1972

completed May 2, 1972

For Administrator's Use
File 5369
May 24, 1972 11:40 a.m.
GW 1

Type of well Drilled
(Dug, driven, bored or drilled)

Equipment used Rotary
(Churn drill, rotary or other)

Water Use: Domestic Municipal Stock Irrigation

Industrial Drainage Other Garden/Lawn

*Describe

USE: If used for irrigation, industrial, drainage or other. Explain, state number of acres and location or other data (i.e. Lot, Block and Addition).

ESTIMATED ANNUAL WITHDRAWAL 700,000

Size of Drilled Hole	Size and Weight of Casing	From (Feet)	To (Feet)	PERFORATIONS		
				Kind Size	From (Feet)	To (Feet)
9"	6" PVC	Sfc	30'	Slotted	25'	30'

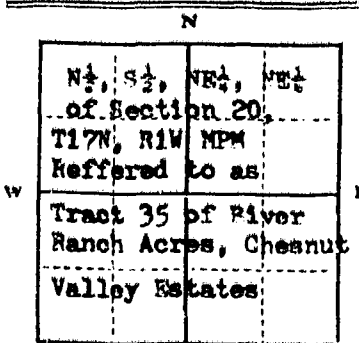

see above
N/2, S/2, NE 1/4, NE 1/4 Sec. 20
T. 17 N. R. 1 W. MPM
Referred to as:
Tract 35 of River Ranch Acres, Cheanut Valley Estates

Static water level 14 ft.*
Pumping water level 25 ft.*
at 15 gallons per minute,
measured 60 minutes after pumping began.
*Measured from ground level.
Well developed by Air Pump
for 4 hours.
Power Cat. G.D. Pump 140 HP
Remarks: (Gravel packing, cementing, packers, type of shutoff)

Casing Cemented

INDICATE LOCATION OF WELL AND PLACE OF USE, IF POSSIBLE. EACH SMALL SQUARE REPRESENTS 40 ACRES.

Driller's Signature [Signature]

Driller's Address 503 - 34th St., N.W.

Great Falls, Montana LICENSE NO. 214

DRILLER'S LOG

Indicate the character, color, thickness of strata such as soil, clay, sand, gravel, shale, sandstone, etc. Show depth at which water is found and height to which water rises in well.

Top of Ground 3570
(Elev. above sea level)

From (Feet)	To (Feet)	Soil
Sfc	2	Soil
2	10	Gravel
10	15	Sand
15	18	Course Gravel
18	30	Fine Gravel
30	35	Sand

35 Show exact depth of bottom

59,727

5367

STATE OF MONTANA, } ss.
County of Cascade.

I hereby certify that the within in-
strument was filed in this office on
MAY 24 1972

Date

at 11:40 o'clock A. M.

J. L. LENNON

County Clerk and Recorder

By J. S. Wilson
Deputy

File No.

T. 17 No. R. 1 West

DUPLICATE

County Cascade

STATE OF MONTANA
ADMINISTRATOR OF GROUNDWATER CODE
OFFICE OF STATE ENGINEER

RECORDED
JAN 2 1964

Declaration of Vested Groundwater Rights

(Under Chapter 237, Montana Session Laws, 1961)

1. Donald J. Wostala
Kathleen C. Wostala
(Name of Appropriator)

of Route #1 Cascade,
(Address) (Town)

County of Cascade

State of Montana

have appropriated groundwater according to the Montana laws in effect prior to January 1, 1962, as follows:

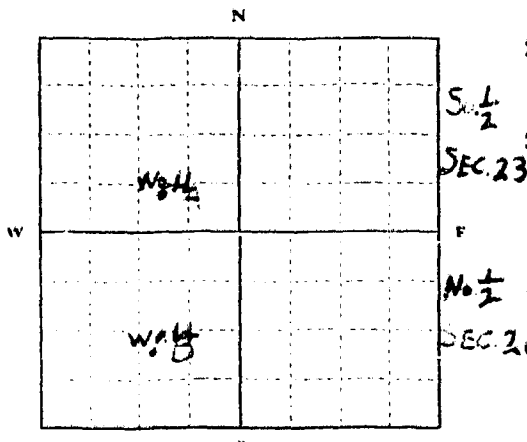

2. The beneficial use on which the claim is based Home use, irrigation, stock water and general farm use and proposed irrigation.
3. Date or approximate date of earliest beneficial use; and how continuous the use has been (A) June 20, 1884 - continuous use. (B) Nov. 10, 1961 - used when spring is low.

4. The amount of groundwater claimed (in miner's inches or gallons per minute) (A) 500 gallons per minute. (B) 400 gallons per minute.

5. If used for irrigation, give the acreage and description of the lands to which water has been applied and name of the owner thereof. (A) proposed irrigation - Donald J. Wostala SE 1/4 SW 1/4 and SE 1/4 NW 1/4 of Section 23. (B) E 1/2 NW 1/4 Total Acres - 130 A.

6. The means of withdrawing such water from the ground and the location of each well or other means of withdrawal. (A) Motor or engine driven pump SE 1/4 SW 1/4 Sec 23. (B) SE 1/4 NW 1/4 Sec. 26.

7. The date of commencement and completion of the construction of the well, wells, or other works for withdrawal of groundwater. (A) June 20, 1884 completed 1884. (B) Nov. 10, 1961 - incomplete.

8. The depth of water table (A) 25 feet (B) 6 to 12 ft.

9. So far as it may be available, the type, size and depth of each well or the general specifications of any other works for the withdrawal of groundwater. (A) Dug well 3ft. Diameter 50ft. deep with rock casing. (B) Drilled well - 1ft. Diameter - 20 feet deep.

10. The estimated amount of groundwater withdrawn each year (A) 5,500,000 gal. per year at present. (B) None - to be used in time of drought.

11. The log of formations encountered in the drilling of each well if available. (A) first 25ft. loam soil with rock to gravel bearing water. (B) first 5ft. heavy loam with rock to sand bearing water.

12. Such other information of a similar nature as may be useful in carrying out the policy of this act, including reference to book and page of any county record None recorded.

WASE SW 1/4 Sec. 23 T. 17 No. R. 1 West

WB: SE 1/4, NW 1/2 Sec. 26 T. 17 No. R. 1 West

Indicate point of appropriation and place of use, if possible. Each small square represents 10 acres.

Signature of Owner

Donald J. Wostala

Date

Dec. 31, 1963

Three copies to be filed by the owner with the County Clerk and Recorder of the county in which the well is located.

Please answer all questions. If not applicable, so state, otherwise the form will be returned.

Original to the County Clerk and Recorder; Duplicate to the State Engineer; Triplicate to the Montana Bureau of Mines and Geology, and Quadruplicate for the Appropriator.

4905

2112 P

A. C. Nichols.

File No.

T. 17 R. 1W

DUPLICATE

County Cascade

STATE OF MONTANA
ADMINISTRATOR OF GROUNDWATER CODE
OFFICE OF STATE ENGINEER

RECEIVED
JAN 4 1964
STATE ENGINEER

Notice of Completion of Groundwater Appropriation
Without Well

(Under Chapter 237 Montana Session Laws, 1961)

Date of Appropriation of Groundwater purchased 1952 before established when purchased

Owner F.C. Vanatta Jr. Address Cascade

Contractor (if any) _____

Address of Contractor _____

Date Started _____ Date Completed _____

Describe means of obtaining groundwater without a well "as by sub-irrigation and other natural processes". Include depth to water when applicable. each X on

diagram represents flowing spring ("X" in

Sec 25 means flowing spring piped to trough in Sec. 30 T.17 R.1E)

Quantity of water developed and used with explanation of method used to measure or estimate such amount. If use is intermittent

estimate approximate lengths of periods of use _____

1 to 5 gal. per min. each spring
5 gal. can't watch (stop)

Signature of Owner Franklin C. Vanatta Jr.

Date December 30, 1963

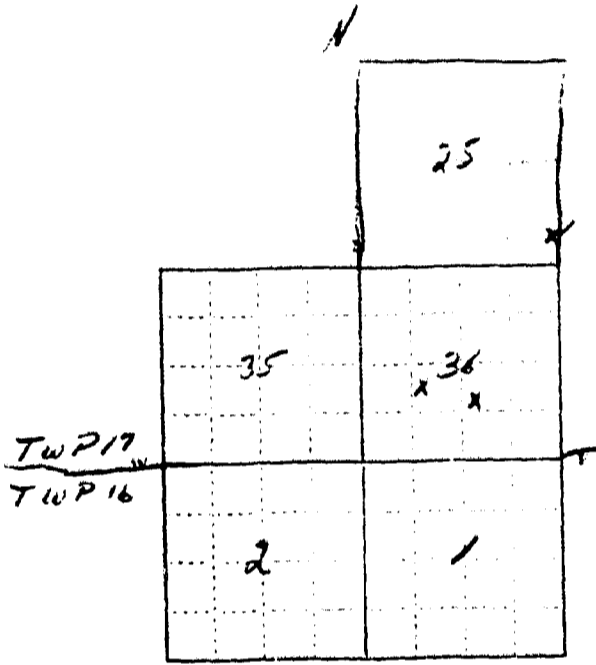

1/4 Sec 36 T. 17 R. 1W
25 17 1W
Indicate point of appropriation and place of use, if possible.

This form to be prepared by contractor (if any), otherwise by the owner.

Three copies of this notice are to be filed with the County Clerk and Recorder of the county in which the works are located.

Please answer all questions. If not applicable, so state, otherwise the form will be returned.

Original to the County Clerk and Recorder; duplicate to the State Engineer; Triplicate to the Montana Bureau of Mines and Geology and Quadruplicate for the Appropriator.

4464

STATE OF MONTANA, } ss.
County of Cascade.

I hereby certify that the within in-
strument was filed in this office on

DEC 31 1969

Date

at 1:31 o'clock P M.

K. L. LENNON

County Clerk and Recorder.

By *[Signature]*

T. 17 R. 1W
County Cascade

MONTANA BUREAU OF MINES AND GEOLOGY
Butte, Montana



WATER WELL LOG

STATE ENGINEER

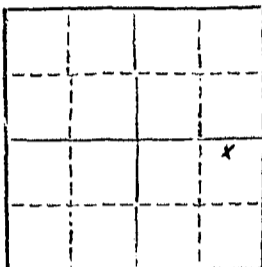

Owner Dorothy F Vanatta or Franklin C Vanatta Jr. Address Cascade Mont

Driller Harry Wiegand Address San River, Mont.

Date Started 1 Nov '52 Date Completed 18 March '53

Location: Sec. 26 T. 17 R. 1W 1/4 sec. NW

Type of well Dug (Dug, driven, bored, or drilled) Equipment used Jam (Churn drill, rotary, other)

Water use: Domestic Municipal Stock Irrigation
Industrial Drainage Other:

Casing: 0 ft. to 10 ft. Type Wood Plank Size 4' x 4'

Casing: ft. to ft. Type Size

Casing: ft. to ft. Type Size

Perforated or Screened: Ft. to ft. Ft. to ft.

Type of screen or perforations Holes in Plank

Static Water level, for non-flowing well: 7 feet.

Shut-in pressure, for flowing well: lb./sq. in. on: (date)

Pumping water level: 15' feet at 300 gal. per min.

How tested: P.M.P.

Length of test: 100 hrs

Remarks: (Gravel packing, cementing, packers, type of shut-off, depth of shut-off)

(over)

File No.

T. 17 R. 1W

DUPLICATE

County Cascade

STATE OF MONTANA
ADMINISTRATOR OF GROUNDWATER CODE
OFFICE OF STATE ENGINEER

RECEIVED
JAN 1 1964

Declaration of Vested Groundwater Rights

(Under Chapter 237, Montana Session Laws, 1961)

STATE ENGINEER

1. Franklin C. Vanatta Jr. of Cascade Mont
(Name of Appropriator) (Address) (Town)
County of Cascade State of Mont.
have appropriated groundwater according to the Montana laws in effect prior to January 1, 1962, as follows:

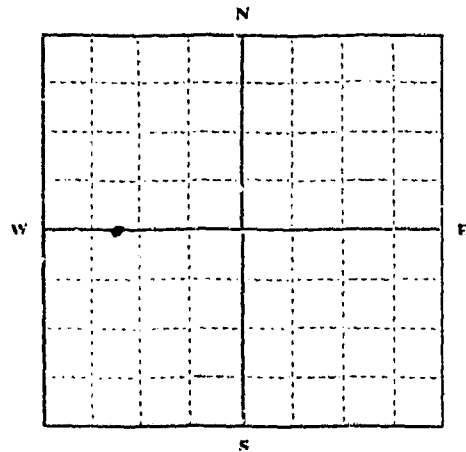

S.W. 1/4 Sec. 26 T. 17 R. 1W

Indicate point of appropriation and place of use, if possible. Each small square represents 10 acres.

2. The beneficial use on which the claim is based irrigation

3. Date or approximate date of earliest beneficial use; and how continuous the use has been 1960

4. The amount of groundwater claimed (in miner's inches or gallons per minute) 200 g.p.m.

5. If used for irrigation, give the acreage and description of the lands to which water has been applied and name of the owner thereof
15 Acres SW 1/4 Sec. 26
40 Acres NW 1/4 Sec. 26

6. The means of withdrawing such water from the ground and the location of each well or other means of withdrawal pump
S.W. 1/4 NW 1/4 Sec. 26

7. The date of commencement and completion of the construction of the well, wells, or other works for withdrawal of groundwater 1956

8. The depth of water table 10-20'

9. So far as it may be available, the type, size and depth of each well or the general specifications of any other works for the withdrawal of groundwater
dug 4'x4' wood curb 20' deep

10. The estimated amount of groundwater withdrawn each year 864,000,000 gal.

11. The log of formations encountered in the drilling of each well if available
black gumbo 10' to water bearing rock

12. Such other information of a similar nature as may be useful in carrying out the policy of this act, including reference to book and page of any county record

Signature of Owner

Franklin C. Vanatta Jr.

Date 30 Dec '63

Three copies to be filed by the owner with the County Clerk and Recorder of the county in which the well is located.

Please answer all questions. If not applicable, so state, otherwise the form will be returned.

Original to the County Clerk and Recorder; Duplicate to the State Engineer; Triplicate to the Montana Bureau of Mines and Geology, and Quadruplicate for the Appropriator.

28449

4462

STATE OF MONTANA, } ss.
County of Cascade.

I hereby certify that the within instrument was filed in this office on
DEC 31 1963

Date
at 1:29 o'clock P.M.

J. L. LENNON
County Clerk and Recorder.

By JL Deputy

34

File No.

T. 17 N. R. 1 WEST

DUPLICATE

County Cascade

STATE OF MONTANA
ADMINISTRATOR OF GROUNDWATER CODE
OFFICE OF STATE ENGINEER

RECEIVED
JAN 9 1964

Notice of Completion of Groundwater Appropriation
Without Well

(Under Chapter 237 Montana Session Laws, 1961)

Date of Appropriation of Groundwater DEC. 31, 1963
Owner Donald J. Waitala
Kathleen C. Waitala Address Cascade, Mont

Contractor (if any) None

Address of Contractor

Date Started Natural Spring Date Completed

Describe means of obtaining groundwater without a well "as by sub-irrigation and other natural processes". Include depth to water when applicable. Natural Flow of Spring, 3 feet to underground water. Source is applicable when spring is low.

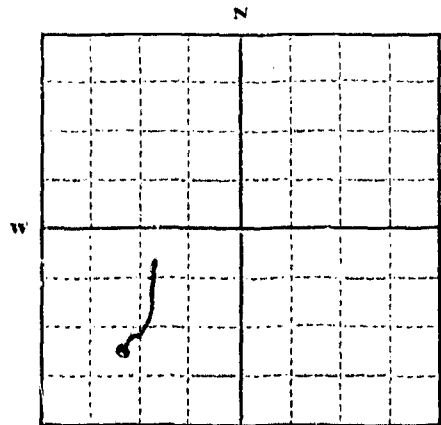

Quantity of water developed and used with explanation of method used to measure or estimate such amount. If use is intermittent

estimate approximate lengths of periods of use. The Spring flows 15 gallons per minute. Used only for stock water and some irrigation.

SW 1/4 NW 1/4 Sec. 26 T. 17 N. R. 1 West

Indicate point of appropriation and place of use, if possible.

Place of use:
E 1/2 NW 1/4 Sec. 26
T. 17 N. R. 1 West

Signature of Owner Donald J. Waitala
Kathleen C. Waitala
Date Dec. 31, 1963

This form to be prepared by contractor (if any), otherwise by the owner.

Three copies of this notice are to be filed with the County Clerk and Recorder of the county in which the works are located.

Please answer all questions. If not applicable, so state, otherwise the form will be returned.

Original to the County Clerk and Recorder; duplicate to the State Engineer; Triplicate to the Montana Bureau of Mines and Geology and Quadruplicate for the Appropriator.

4506

DEC 31 1962

RECEIVED
TIME 2:13 PM
DOCUMENT NO. _____

J. L. LENNON
CLERK AND RECORDER
CASCADE COUNTY, MONTANA

BY *[Signature]*
DEPUTY

GW 3

Approved Stock Form—State Publishing Co., Helena, Montana—42231

File No. _____

T. 17 R. 1W

DUPLICATE

County Cascade

STATE OF MONTANA
ADMINISTRATOR OF GROUNDWATER CODE
OFFICE OF STATE ENGINEER

RECEIVED
JAN 9 1964

Notice of Completion of Groundwater Appropriation
Without Well

(Under Chapter 237 Montana Session Laws, 1961)

STATE ENGINEER
Established
before

Date of purchase
1952 except

Date of Appropriation of Groundwater E 1/4 Sec 26 1963

Owner F. Vanatta Jr. Address Cascade Mont.

Contractor (if any) _____

Address of Contractor _____

Date Started _____ Date Completed _____

Describe means of obtaining groundwater without a well "as by sub-irrigation and other natural processes". Include depth to water when applicable.

Each "X" on diagram represents flowing spring. Circled areas are natural sub irrigated

Quantity of water developed and used with explanation of method used to measure or estimate such amount. If use is intermittent

estimate approximate length of periods of use Spring each flow 1 to 2 gal per min. In circled areas of sub irrigation 500,000,000 gals is estimated used by 4th of each year

Signature of Owner Frank L. Vanatta Jr.

Date Dec. 30, 1963

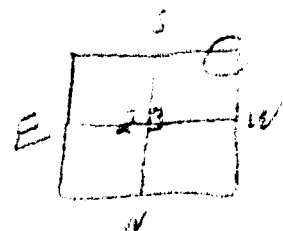

Note: (N & S reversed)
South

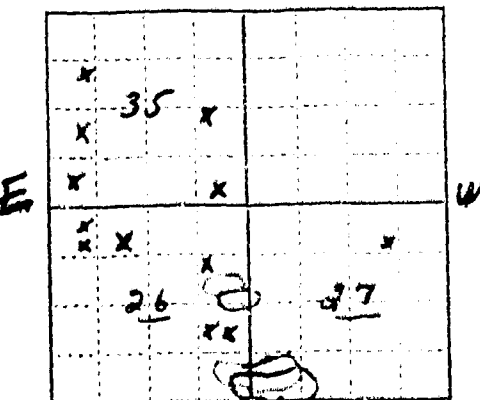

1/4 Sec. 26 T. 17 R. 1W
Indicate point of appropriation and place of use, if possible.

This form to be prepared by contractor (if any), otherwise by the owner.

Three copies of this notice are to be filed with the County Clerk and Recorder of the county in which the works are located.

Please answer all questions. If not applicable, so state, otherwise the form will be returned.

Original to the County Clerk and Recorder; duplicate to the State Engineer; Triplicate to the Montana Bureau of Mines and Geology; and Quadruplicate for the Appropriator.

28447

4460

STATE OF MONTANA, } ss.
County of Cascade.

I hereby certify that the within in-
strument was filed in this office on
DEC 31 1908

at 1:27 ^{Data} o'clock P M.

J. L. LENNON
County Clerk and Recorder.

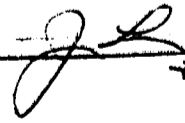
By  Deputy

STATE WATER CONSERVATION BOARD

DUPLICATE

DEC 21 1965

T. _____ R. _____

County Cascade

By _____
 State of _____
 County _____
 District _____
 District _____
 District _____

STATE OF MONTANA
 ADMINISTRATOR OF GROUNDWATER CODE
 OFFICE OF STATE ENGINEER

Notice of Completion of Groundwater Appropriation Without Well

(Under Chapter 237 Montana Session Laws, 1961)

Date of Appropriation of Groundwater DEC. 13, 1965
 Owner William B. Ellis Address CASCADE MONT.

Contractor (if any) _____

Address of Contractor _____

Date Started _____ Date Completed _____

Describe means of obtaining groundwater without a well "as by sub-irrigation and other natural processes". Include depth to water when applicable. S.P.R.I.N.G.S.

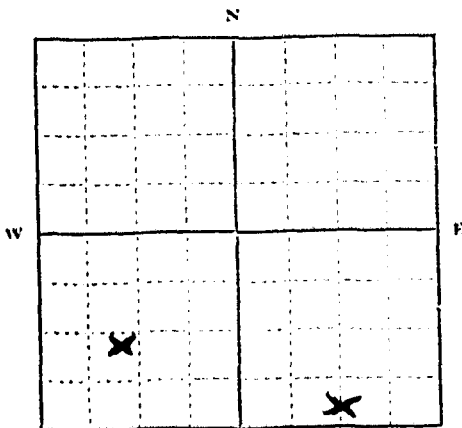

SW $\frac{1}{4}$ S
 SE $\frac{1}{4}$ Sec. 35. T.17. R.1W

Indicate point of appropriation and place of use, if possible.

Quantity of water developed and used with explanation of method used to measure or estimate such amount. If use is intermittent

estimate approximate lengths of periods of use. 189.0

Signature of Owner William B. Ellis

Date DEC. 13, 1965

This form to be prepared by contractor (if any), otherwise by the owner.

Three copies of this notice are to be filed with the County Clerk and Recorder of the county in which the works are located.

Please answer all questions. If not applicable, so state, otherwise the form will be returned.

Original to the County Clerk and Recorder; duplicate to the State Engineer; Triplicate to the Montana Bureau of Mines and Geology and Quadruplicate for the Appropriator.

40-93

4911

STATE OF MONTANA,) ss.
County of Cascade,)
I hereby certify that the within in-
strument is a true and correct copy of the office or

DEC 20 1965

3151 Clock P. M.

J. E. WILSON
County Clerk and Recorder

By J. E. Wilson
Deputy

County Cascade

STATE OF MONTANA
ADMINISTRATOR OF GROUNDWATER CODE
MONTANA WATER RESOURCES BOARD

DRILLER'S LOG 7

NOTICE OF COMPLETION OF GROUNDWATER
APPROPRIATION BY MEANS OF WELL

Developed after January 1, 1962

(Under Chapter 237 Montana Session Laws, 1961, as amended)

This form to be prepared by driller, and three copies to be filed by the owner with the County Clerk and Recorder in the county in which the well is located. Last copy to be retained by driller.

Please answer all questions. If not applicable, so state, otherwise the form may be returned.

Owner Geo. P. Wolfe
Address Cascade
Montana
Date well started Jan 14-66 GW 1
completed Jan 23
Type of well Drilled
(Dug, driven, bored or drilled)
Equipment used Churn drill
(Churn drill, rotary or other)
Water Use: Domestic Municipal Stock Irrigation
Industrial Drainage Other * Garden/Lawn

For Administrator's Use
File 5553
17579
181 ft

Indicate the character, color, thickness of strata such as soil, clay, sand, gravel, shale, sandstone, etc. Show depth at which water is found and height to which water rises in well.

Top of Ground		(Elev. above sea level)
From (Feet)	To (Feet)	
0	1	Soil
1	13	Loose sand
12	18	Silt
18	70	Sandy silt
70	76	Silt
76	117	Sandy silt
117	175	Silt
175	179	Loose sand
179	181	

*Describe
USE: If used for irrigation, industrial, drainage or other. Explain, state number of acres and location or other data (i.e. Lot, Block and Addition).

ESTIMATED ANNUAL WITHDRAWAL

Size of Drilled Hole	Size and Weight of Casing	From (Feet)	To (Feet)	PERFORATIONS		
				Kind	From (Feet)	To (Feet)
<u>5/8"</u>	<u>5/8" O.D. 17 ft.</u>	<u>0</u>	<u>181</u>	<u>Casing driven a few inches to gravel.</u>		

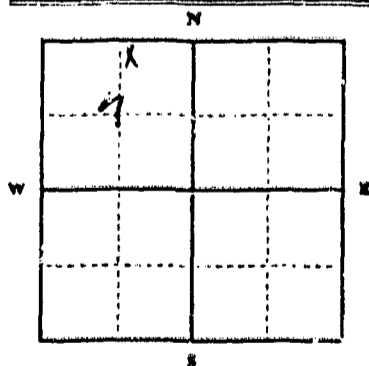

Static water level 25 ft. from top
Pumping water level 35 ft. from top
at 30 gallons per minute,
measured 60 minutes after pumping began.
*Measured from ground level.
Well developed by Baker
for 1 hours.
Power 1 Pump 1 HP
Remarks: (Gravel packing, cementing, packers, type of shutoff)

NE 1/4 NW 1/4 Sec. 7
T. 17 N. R. 1 E
S W

INDICATE LOCATION OF WELL AND PLACE OF USE, IF POSSIBLE. EACH SMALL SQUARE REPRESENTS 40 ACRES.

Driller's Signature P. D. Rafferty
Driller's Address 927-10 Ave S.W.

LICENSE NO. 28

181 ft. Show exact depth of bottom

5553

5553

STATE OF MONTANA, }
County of Cascade.

I hereby certify that the within in-
strument was filed in this office on

JUN 29 1973

at 22.3 ^{11:10} o'clock P M

J. L. LENNON
County Clerk and Recorder

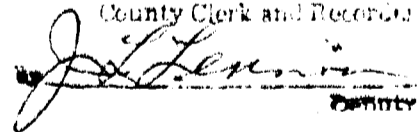
Clerk

County Cascade

STATE OF MONTANA
ADMINISTRATOR OF GROUNDWATER CODE
MONTANA WATER RESOURCES BOARD

NOTICE OF COMPLETION OF GROUNDWATER
APPROPRIATION BY MEANS OF WELL

Developed after January 1, 1962

(Under Chapter 237 Montana Session Laws, 1961, as amended)

This form to be prepared by driller, and three copies to be filed by the owner with the County Clerk and Recorder in the county in which the well is located, last copy to be retained by driller.

Please answer all questions. If not applicable, so state, otherwise the form may be returned.

Owner Geo. P. Wolfe
Address Cascade, Mont.
Date well started Dec 9-65
completed Jan 1-66

For Administrator's Use	
File	<u>5551</u>
GW 1	<u>179 H</u>

Type of well Drilled
(Dug, driven, bored or drilled)
Equipment used Churn drill
(Churn drill, rotary or other)
Water Use: Domestic Municipal Stock Irrigation
Industrial Drainage Other Garden/Lawn

*Describe
USE: If used for irrigation, industrial, drainage or other. Explain, state number of acres and location or other data (i.e. Lot, Block and Addition).

ESTIMATED ANNUAL WITHDRAWAL 1,000,000

Size of Drilled Hole	Size and Weight	From (Feet)	To (Feet)	PERFORATIONS		
				Kind	From (Feet)	To (Feet)
<u>17 1/2" x 17 1/2"</u>	<u>300 lb.</u>	<u>0</u>	<u>179</u>	<u>Casing driven open end into gravel</u>		

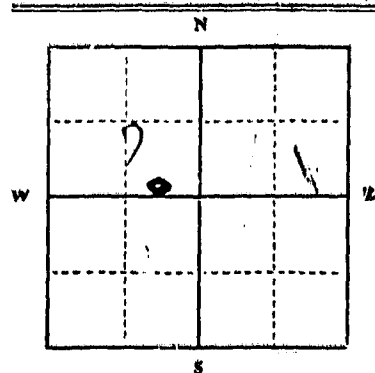

Static water level 25 ft. from top
Pumping water level 35 ft. from top
at 30 gallons per minute,
measured 60 minutes after pumping began.
*Measured from ground level.
Well developed by packing
for 1 hours.
Power Pump HP
Remarks: (Gravel packing, cementing, packers, type of shutoff)

S. 1/4 Sec. 7
T. 12 N. R. 1 E. W

INDICATE LOCATION OF WELL AND PLACE OF USE, IF POSSIBLE. EACH SMALL SQUARE REPRESENTS 40 ACRES.

Driller's Signature E. D. Rafferty
Driller's Address 927-10 1/2 avd. S. W.

LICENSE NO. 28

DRILLER'S LOG

Indicate the character, color, thickness of strata such as soil, clay, sand, gravel, shale, sandstone, etc. Show depth at which water is found and height to which water rises in well.

Top of Ground		(Elev. above sea level)
From (Feet)	To (Feet)	
<u>0</u>	<u>2</u>	<u>Loam</u>
<u>2</u>	<u>12</u>	<u>Sandy Silt</u>
<u>12</u>	<u>16</u>	<u>quick sand</u>
<u>16</u>	<u>42</u>	<u>Silt</u>
<u>42</u>	<u>131</u>	<u>Sandy Silt</u>
<u>131</u>	<u>171</u>	<u>Silt</u>
<u>171</u>	<u>177</u>	<u>Sand & fine gravel</u>
<u>177</u>	<u>179</u>	<u>Gravel</u>

179 ft. Show exact depth of bottom

5556

STATE OF MONTANA, }
County of Cascade.

I hereby certify that the within in-
strument was filed in this office on

JUN 29 1973

at 226 o'clock P M.

J. L. LENNON

County Clerk and Recorder.

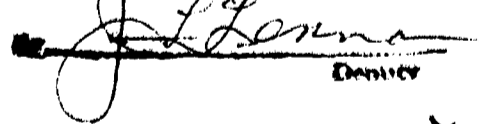
Deputy

File No.

T. 17 R. 18

DUPLICATE

County.

STATE OF MONTANA
ADMINISTRATOR OF GROUNDWATER CODE
OFFICE OF STATE ENGINEER

Declaration of Vested Groundwater Rights

(Under Chapter 237, Montana Session Laws, 1961)

1. George Wolfe and Edith Wolfe, of CASCADE
(Name of Appropriator) (Address) (Town)

County of _____ State of _____
have appropriated groundwater according to the Montana laws in effect prior to January 1, 1962, as follows:

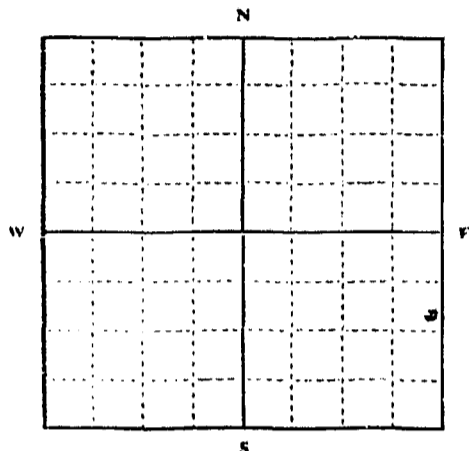

Sec. 1/4 Sec. 7 T. 17 N. R. 18

Indicate point of appropriation and place of use, if possible. Each small square represents 10 acres.

2. The beneficial use on which the claim is based Livestock

3. Date or approximate date of earliest beneficial use; and how continuous the use has been. Sept. 1963

4. The amount of groundwater claimed (in miner's inches or gallons per minute) 1.0

5. If used for irrigation, give the acreage and description of the lands to which water has been applied and name of the owner thereof 0

6. The means of withdrawing such water from the ground and the location of each well or other means of withdrawal Pump

7. The date of commencement and completion of the construction of the well, wells, or other works for withdrawal of groundwater. Sept, 1963

8. The depth of water table 7.15

9. So far as it may be available, the type, size and depth of each well or the general specifications of any other works for the withdrawal of groundwater 24 in. Steel Concreting

10. The estimated amount of groundwater withdrawn each year 2500000

11. The log of formations encountered in the drilling of each well if available Heavy sand 3.15
4.15 sand

12. Such other information of a similar nature as may be useful in carrying out the policy of this act, including reference to book and page of any county record.

Signature of Owner George Wolfe

Date Nov. 23, 1963

Three copies to be filed by the owner with the County Clerk and Recorder of the county in which the well is located.

Please answer all questions. If not applicable, so state, otherwise the form will be returned.

Original to the County Clerk and Recorder; Duplicate to the State Engineer; Triplicate to the Montana Bureau of Mines and Geology, and Quadruplicate for the Appropriator. 27864

3876

STATE OF MONTANA, }
County of Cascade. }

I hereby certify that the within in-
strument was filed in this office on

DEC 27 1962

Date

at 2:51 o'clock P. M.

J. L. LENNON

County Clerk and Recorder.

By

Ed Hartman

Deputy

RECEIVED

County Cascade 8

STATE OF MONTANA
ADMINISTRATOR OF GROUNDWATER CODE
MONTANA WATER RESOURCES BOARD

NOTICE OF COMPLETION OF GROUNDWATER
APPROPRIATION BY MEANS OF WELL
Developed after January 1, 1962

(Under Chapter 237 Montana Session Laws, 1961, as amended)

This form to be prepared by driller, and three copies to be filed by the owner with the County Clerk and Recorder in the county in which the well is located, last copy to be retained by driller. Please answer all questions. If not applicable, so state, otherwise the form may be returned.

Owner George P. Wolfe
Address Cascade, Montana
Date well started Nov. 29-65
completed Dec. 7-65

For Administrator's Use	
File	<u>100-15</u>
GW 1	<u>3000/100</u>

Type of well Drilled
Equipment used Churn Drill
Water Use: Domestic Municipal Stock Irrigation
Industrial Drainage Other * Garden/Lawn

*Describe
USE: If used for irrigation, industrial, drainage or other. Explain, state number of acres and location or other data (i.e. Lot, Block and Addition).

ESTIMATED ANNUAL WITHDRAWAL

Size of Drilled Hole	Size and Weight of Casing	From (Feet)	To (Feet)	PERFORATIONS		
				Kind Size	From (Feet)	To (Feet)
<u>5 in</u>	<u>5 in</u>	<u>0</u>	<u>17</u>			

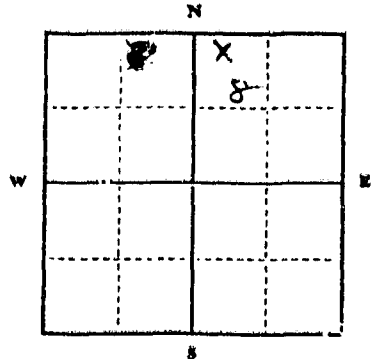

NW 1/4 NW 1/4 Sec. 8
T. 17 N. R. 1 E. S. 8 W.

INDICATE LOCATION OF WELL AND PLACE OF USE, IF POSSIBLE. EACH SMALL SQUARE REPRESENTS 40 ACRES.

Driller's Signature E. D. Rafferty
Driller's Address 927-10th Ave. S.W.

LICENSE NO. 28

DRILLER'S LOG

Indicate the character, color, thickness of strata such as soil, clay, sand, gravel, shale, sandstone, etc. Show depth at which water is found and height to which water rises in well.

Top of Ground (Elev. above sea level)		
From (Feet)	To (Feet)	
<u>0</u>	<u>170</u>	
<u>0</u>	<u>16</u>	<u>Sandy silt</u>
<u>16</u>	<u>18</u>	<u>Gravel</u>
<u>18</u>	<u>39</u>	<u>Silt</u>
<u>39</u>	<u>135</u>	<u>Quick sand</u>
<u>135</u>	<u>154</u>	<u>Sandy silt</u>
<u>154</u>	<u>156</u>	<u>Gravel</u>

156 ft. Show exact depth of bottom

55933

5552

010: To: [unclear]

W. [unclear]

STATE OF MONTANA,)
County of Cascade.

I hereby certify that the within-
mentioned is filed in this office

JUN 29 1973

222 [unclear]

RECORDED
INDEXED

J. L. [unclear]

197

County Cascade - 8

STATE OF MONTANA
ADMINISTRATOR OF GROUNDWATER CODE
MONTANA WATER RESOURCES BOARD
**NOTICE OF COMPLETION OF GROUNDWATER
APPROPRIATION BY MEANS OF WELL**
Developed after January 1, 1962

(Under Chapter 237 Montana Session Laws, 1961, as amended)

This form to be prepared by driller, and three copies to be filed by the owner with the County Clerk and Recorder in the county in which the well is located, last copy to be retained by driller.

Please answer all questions. If not applicable, so state, otherwise the form may be returned.

Owner Geo. P. Wolfe
Address Cascade, Mont.
Date well started March 9-57
completed March 15-57
Type of well Drilled
Equipment used Churn drill
Water Use: Domestic Municipal Stock Irrigation
Industrial Drainage Other * Garden/Lawn

For Administrator's Use
File _____
GW 1 _____

*Describe
USE: If used for irrigation, industrial, drainage or other. Explain, state number of acres and location or other data (i.e. Lot, Block and Addition).

ESTIMATED ANNUAL WITHDRAWAL 500,000 gals

Size of Drilling Bit	Size and Weight of Drill Pipe	From (Feet)	To (Feet)	PERFORATIONS
<u>6 1/2 inch</u>	<u>6 5/8 O.D. 20 lbs/ft.</u>	<u>0</u>	<u>105</u>	<u>Kind of Perforations: casing drilled remaining to gravel</u>

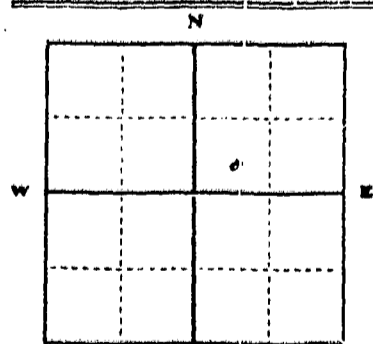

S.W. 1/4 SB 1/4 Sec. 8
T. 1 N. R. 5 E. W.

Static water level 60 ft
Pumping water level 55 ft
at 60 gallons per minute,
measured 60 minutes after pumping began.
*Measured from ground level.
Well developed by balling
for _____ hours.
Power _____ Pump _____ HP
Remarks: (Gravel packing, cementing, packers, type of shutoff)

INDICATE LOCATION OF WELL AND PLACE OF USE, IF POSSIBLE. EACH SMALL SQUARE REPRESENTS 40 ACRES.

Driller's Signature E. D. Rafferty
Driller's Address 927-10th Ave S.W.

LICENSE NO. 28

DRILLER'S LOG

Indicate the character, color, thickness of strata such as soil, clay, sand, gravel, shale, sandstone, etc. Show depth at which water is found and height to which water rises in well.

Top of Ground (Elev. above sea level)

From (Feet)	To (Feet)	Character
<u>0</u>	<u>20</u>	<u>soil</u>
<u>20</u>	<u>20</u>	<u>sandy silt</u>
<u>20</u>	<u>100</u>	<u>silt</u>
<u>100</u>	<u>105</u>	<u>fine gravel</u>

105 ft Show exact depth of bottom

5555

STATE OF MONTANA,)
County of Cascade.

I hereby certify that the within in-
strument was filed in this office on

JUN 29 1973

at 225 o'clock P.M.

J. L. LENNON

County Clerk and Recorder.

J. L. Lennon
Deputy

CAJ

File No.

T. 17 N. R. 1 E

DUPLICATE

County CASCADE

STATE OF MONTANA
ADMINISTRATOR OF GROUNDWATER CODE
OFFICE OF STATE ENGINEER

Declaration of Vested Groundwater Rights

(Under Chapter 237, Montana Session Laws, 1961)

1. REFUGO, H. CLIFF and wife of CASCADE
(Name of Appropriator) (Address) (Town)
County of CASCADE State of MONT.
have appropriated groundwater according to the Montana laws in effect prior to January 1, 1962, as follows:

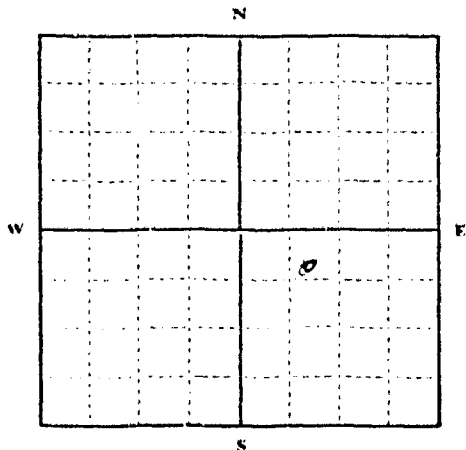

SE 1/4 Sec. 8 T17N R1E

Indicate point of appropriation and place of use, if possible. Each small square represents 10 acres.

2. The beneficial use on which the claim is based Residing
Out Stock

3. Date or approximate date of earliest beneficial use; and how continuous the use has been. 1955
Yearly

4. The amount of groundwater claimed (in miner's inches or gallons per minute) 12

5. If used for irrigation, give the acreage and description of the lands to which water has been applied and name of the owner thereof
Yard

6. The means of withdrawing such water from the ground and the location of each well or other means of withdrawal

7. The date of commencement and completion of the construction of the well, wells, or other works for withdrawal of groundwater. 1955

8. The depth of water table. 70 ft

9. So far as it may be available, the type, size and depth of each well or the general specifications of any other works for the withdrawal of groundwater.
Case casing 125 ft

10. The estimated amount of groundwater withdrawn each year. Unknown

11. The log of formations encountered in the drilling of each well if available. None

12. Such other information of a similar nature as may be useful in carrying out the policy of this act, including reference to book and page of any county record.

Signature of Owner George H. Cliff

Date Nov 23, 1963

Three copies to be filed by the owner with the County Clerk and Recorder of the county in which the well is located.

Please answer all questions. If not applicable, so state, otherwise the form will be returned.

Original to the County Clerk and Recorder; duplicate to the State Engineer; Triplicate to the Montana Bureau of Mines and Geology, and Quadruplicate for the Appropriator.

27865

3877

STATE OF MONTANA,)
County of Cascade)

I hereby certify that the within in-
strument was filed in the office of
DEC 27 1968

at _____
County of _____
By Ed Hartman
Deputy

File No.

T. J. M. R. I. E.

DUPLICATE

County CASCADIA

STATE OF MONTANA
ADMINISTRATOR OF GROUNDWATER CODE
OFFICE OF STATE ENGINEER

Declaration of Vested Groundwater Rights

(Under Chapter 237, Montana Session Laws, 1961)

1. ESCRGO Well Co. & the well of, of CASCADIA (Town)
(Name of Appropriator) (Address)
County of CASCADIA State of MONTANA
have appropriated groundwater according to the Montana laws in effect prior to January 1, 1962, as follows:

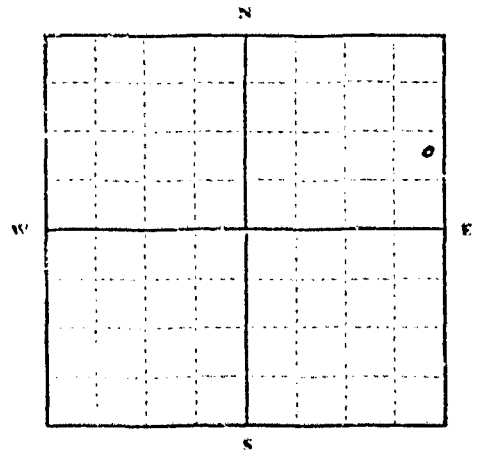

N 1/4 Sec. 8 T. 17 N. R. 12 E
Indicate point of appropriation and place of use, if possible. Each small square represents 10 acres.

- 2. The beneficial use on which the claim is based... stock water
- 3. Date or approximate date of earliest beneficial use; and how continuous the use has been... 1955
- 4. The amount of groundwater claimed (in miner's inches or gallons per minute)... 11
- 5. If used for irrigation, give the acreage and description of the lands to which water has been applied and name of the owner thereof... C
- 6. The means of withdrawing such water from the ground and the location of each well or other means of withdrawal... 2 wells
- 7. The date of commencement and completion of the construction of the well, wells, or other works for withdrawal of groundwater... 1955
- 8. The depth of water table... 17 ft
- 9. So far as it may be available, the type, size and depth of each well or the general specifications of any other works for the withdrawal of groundwater... 42 in casing 22 ft deep
- 10. The estimated amount of groundwater withdrawn each year... 11.0 million
- 11. The log of formations encountered in the drilling of each well if available... 6 ft sandstone, 16 ft sandstone
- 12. Such other information of a similar nature as may be useful in carrying out the policy of this act, including reference to book and page of any county record.

Signature of Owner... [Signature]
Date Dec 23, 1963

Three copies to be filed by the owner with the County Clerk and Recorder of the county in which the well is located.

Please answer all questions. If not applicable, so state, otherwise the form will be returned.

Original to the County Clerk and Recorder; duplicate to the State Engineer; Triplicate to the Montana Bureau of Mines and Geology, and Quadruplicate for the Appropriator.

3878

STATE OF MONTANA, } ss.
County of Cascade.

I hereby certify that the within in-
strument was filed in this office on
DEC 27 1904

Date
at 2:07 o'clock P.M.

J. L. LINTON
County Clerk and Recorder

By E. Hartman
Deputy

GWS

File No.....

T. 17 R. 17

DUPLICATE

County.....

STATE OF MONTANA
ADMINISTRATOR OF GROUNDWATER CODE
OFFICE OF STATE ENGINEER

JAN 5 1964
STATE OF MONTANA

Notice of Completion of Groundwater Appropriation Without Well

(Under Chapter 237 Montana Session Laws, 1961)

Date of Appropriation of Groundwater *Spring*

Owner *Col. G. R. Gage, M. Gage* Address *CASCADE*

Contractor (if any) *None*

Address of Contractor *None*

Date Started *Unknown* Date Completed *Unknown*

Describe means of obtaining groundwater without a well "as by sub-irrigation and other natural processes". Include depth to water when applicable. *Spring flow*

Casing cement 7 X 8 ft by 8 ft deep

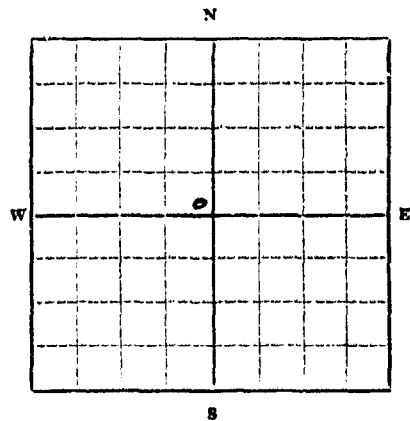

Section 7, T. 17 N. R. 17 E.
Indicate point of appropriation and place of use, if possible.

Quantity of water developed and used with explanation of method used to measure or estimate such amount. If use is intermittent estimate approximate lengths of periods of use

Runs year around

Signature of Owner *George Gage*

Date *Mar 23, 1963*

This form prepared by contractor (if any), otherwise by the owner.

Three copies of this notice are to be filed with the County Clerk and Recorder of the county in which the well is located.

Please answer all questions. If not applicable, so state, otherwise the form will be returned.

Original to the County Clerk and Recorder; duplicate to the State Engineer; Triplicate to the Montana Bureau of Mines and Geology and Quadruplicate for the Appropriator.

27867

3879

STATE OF MONTANA, }
County of Cascade. }

I hereby certify that the within in-
strument was filed in this office on
DEC 2 1907

Date

2:54 o'clock P M

M. L. LENNON
County Clerk and Recorder

By

E. Hartman

Deputy.

File No.

T. 17 R. 1E

DUPLICATE

County Cascade

STATE OF MONTANA
ADMINISTRATOR OF GROUNDWATER CODE
OFFICE OF STATE ENGINEER

RECEIVED
JAN 9 1964

Notice of Completion of Groundwater Appropriation Without Well

(Under Chapter 237 Montana Session Laws, 1961)

Date of Appropriation of Groundwater Established before purchase 1961
Owner FC Vanatta Jr. Address Cascade

Contractor (if any)

Address of Contractor

Date Started..... Date Completed.....

Describe means of obtaining groundwater without a well "as by sub-irrigation and other natural processes". Include depth to water when applicable. Each "x" represents flowing spring

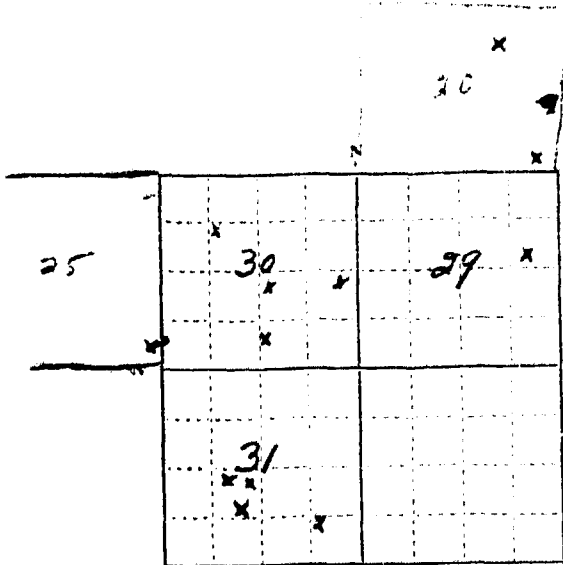

1/4 Sec. 30, 31 T. 17 R. 1E
Indicate point of appropriation and place of use, if possible.

Quantity of water developed and used with explanation of method used to measure or estimate such amount. If use is intermittent estimate approximate lengths of periods of use.....

1 to 5 gal. per minute each spring
5 gal. can + stop watch

Signature of Owner Franklin C. Vanatta Jr.
Date December 30, 1963

This form to be prepared by contractor (if any), otherwise by the owner.

Three copies of this notice are to be filed with the County Clerk and Recorder of the county in which the works are located.

Please answer all questions. If not applicable, so state, otherwise the form will be returned.

Original to the County Clerk and Recorder; duplicate to the State Engineer; Triplicate to the Montana Bureau of Mines and Geology and Quadruplicate for the Appropriator.

28452

4465

STATE OF MONTANA, }
County of Cascade. }

I hereby certify that the within instrument was filed in this office on

DEC 31 1969

Date

at 1:32 o'clock P.M.

J. L. LENNON

County Clerk and Recorder.

By JL Deputy

GW3

File No.

T 17 R 1E

DUPLICATE

County

STATE OF MONTANA
ADMINISTRATOR OF GROUNDWATER CODE
OFFICE OF STATE ENGINEER

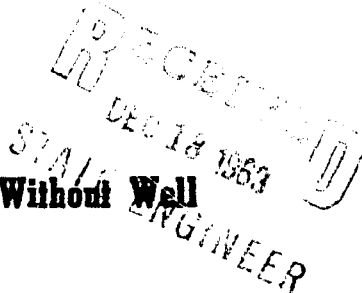

Notice of Completion of Groundwater Appropriation Without Well

(Under Chapter 237 Montana Session Laws, 1961)

Date of Appropriation of Groundwater 7/25/63

Owner Salo Ranch Co Address Cascade

Contractor (if any)

Address of Contractor

Date Started

Date Completed

Describe means of obtaining groundwater without a well "as by sub-irrigation and other natural processes". Include depth to water when applicable.

Underground Spring feeds reservoir

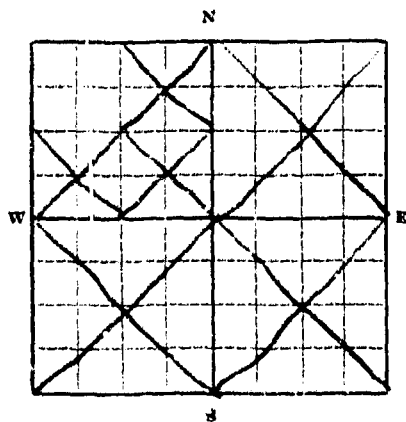

..... 1/4 Sec. 21 T. 17 R. 1E

Indicate point of appropriation and place of use, if possible.

Quantity of water developed and used with explanation of method used to measure or estimate such amount. If use is intermittent estimate approximate lengths of periods of use

Used to water livestock
12 months each year

Signature of Owner Salo Ranch Co
By Gary D. Salo

Date 7/25/63

This form to be prepared by contractor (if any), otherwise by the owner.

Three copies of this notice are to be filed with the County Clerk and Recorder of the county in which the works are located.

Please answer all questions. If not applicable, so state, otherwise the form will be returned.

Original to the County Clerk and Recorder; duplicate to the State Engineer; Triplicate to the Montana Bureau of Mines and Geology and Quadruplicate for the Appropriator.

9945

3562

STATE OF MONTANA,
County of Cascade.

I hereby certify that the within in-
strument was filed in this office on

DEC 17 1968

12-17-1968
Date

at 1:40 o'clock P.M.

A. L. HUTTON
County Clerk and Recorder.

By [Signature]
Deputy.

5534

STATE OF MONTANA }
County of Cascade }

I hereby certify that within the
jurisdiction of said County

JUN 28 1913

at 1.21

J. L. Lewis
County Clerk

By J. L. Lewis

CWS

File No.

DUPLICATE

T. 17 N. R. 1 E

County

4
26

STATE OF MONTANA
ADMINISTRATOR OF GROUNDWATER CODE
OFFICE OF STATE ENGINEER

Notice of Completion of Groundwater Appropriation Without Well

(Under Chapter 237 Montana Session Laws, 1961)

Date of Appropriation of Groundwater 7/25/63
Owner Solo Ranch Co Address CASCADE MOUNT
Contractor (if any) NONE
Address of Contractor NONE
Date Started..... Date Completed.....

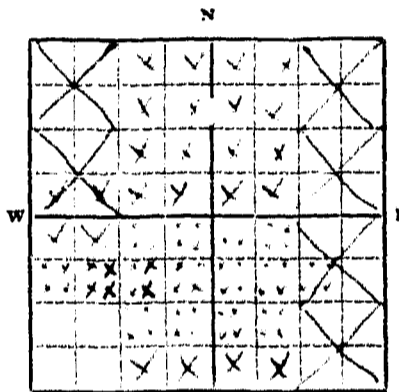

..... 1/4 Sec. 28 T. 17 R. 1E
Indicate point of appropriation and place of use, if possible.

Describe means of obtaining groundwater without a well "as by sub-irrigation and other natural processes". Include depth to water when applicable. SUB-IRRIGATION AND
Flowing Springs
Depth to water from 5-25 feet.

Quantity of water developed and used with explanation of method used to measure or estimate such amount. If use is intermittent estimate approximate lengths of periods of use
Quantity VARIES thru the
year Used to water all
types of livestock

Signature of Owner Solo Ranch Co
By Gary D. Solo
Date 7/25/63

This form to be prepared by contractor (if any), otherwise by the owner.
Three copies of this notice are to be filed with the County Clerk and Recorder of the county in which the works are located.
Please answer all questions. If not applicable, so state, otherwise the form will be returned.
Original to the County Clerk and Recorder; duplicate to the State Engineer; Triplicate to the Montana Bureau of Mines and Geology and Quadruplicate for the Appropriator.

9946

3975

STATE OF MONTANA, }
County of Cascade. }

I hereby certify that the within in-
strument was filed in this office on
DEC 17 1900

Date
at 1:43 o'clock P.M.

J. L. LENNON
County Clerk and Recorder.

By *A. O. [Signature]*
Deputy.

File No.

T. R.

DUPLICATE

County

STATE OF MONTANA
ADMINISTRATOR OF GROUNDWATER CODE
OFFICE OF STATE ENGINEER

RECEIVED
DEC 27 1963

Declaration of Vested Groundwater Rights STATE ENGINEER

(Under Chapter 237, Montana Session Laws, 1961)

1. BAR B. RANCH CO. of CASCADE
(Name of Appropriator) (Address) (Town)
County of CASCADE State of MONTANA
have appropriated groundwater according to the Montana laws in effect prior to January 1, 1962, as follows:

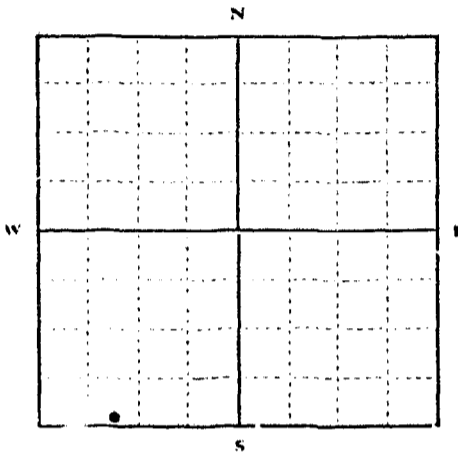

SW 1/4, Sec. 28, T17N, R1E,

Indicate point of appropriation and place of use, if possible. Each small square represents 10 acres.

2. The beneficial use on which the claim is based DOMESTIC - HOUSE, BUNK-HOUSE, LAWN, TREES, GARDEN.

3. Date or approximate date of earliest beneficial use; and how continuous the use has been OCT 9, 1961, CONTINUOUS SINCE.

4. The amount of groundwater claimed (in miner's inches or gallons per minute) 10.5 GAL PER MINUTE.

5. If used for irrigation, give the acreage and description of the lands to which water has been applied and name of the owner thereof NO IRRIGATION EXCEPT AS LISTED IN 2. ABOVE.

6. The means of withdrawing such water from the ground and the location of each well or other means of withdrawal DRILLED WELL, CASED 5" I. D., LOCATED AS ON MAP, ELECTRIC, CENTRIFUGAL PUMP, 200 FEET NORTH of SW COR. SEC. 28, T17N, R1E.

WELL LOCATED 976 FT. EAST

7. The date of commencement and completion of the construction of the well, wells, or other works for withdrawal of groundwater COMPLETE - OCT. 9, 1961.

8. The depth of water table 15 FEET.

9. So far as it may be available, the type, size and depth of each well or the general specifications of any other works for the withdrawal of groundwater DRILLED WELL CASED WITH 5 INCH. INSIDE DIAMETER IRON PIPE TO A DEPTH OF 45 FEET.

10. The estimated amount of groundwater withdrawn each year 260,000 gal.

11. The log of formations encountered in the drilling of each well if available 0' - 4' LOAM, 4' - 9' BOULDERS & GRAVEL, 9' - 15' SANDY DARK SHALE, WATER AT 15', 15' - 50' DARK SHALE.

12. Such other information of a similar nature as may be useful in carrying out the policy of this act, including reference to book and page of any county record

BAR B. RANCH CO.
Signature of Math S. Browning, Inc.
Date 12.19.63

Three copies to be filed by the owner with the County Clerk and Recorder of the county in which the well is located.

Please answer all questions. If not applicable, so state, otherwise the form will be returned.

Original to the County Clerk and Recorder; duplicate to the State Engineer; Triplicate to the Montana Bureau of Mines and Geology, and Quadruplicate for the Appropriator.

13783

3656

10

STATE OF MONTANA, } ss.
County of Cascade.

I hereby certify that the within instrument was filed in this office on
DEC 20 1963

at 4:33 o'clock P.M.

J. L. LENNON
County Clerk and Recorder.

By J. J. Johnson
Deputy