

Township Number 18 N.

Range Number 5 E.

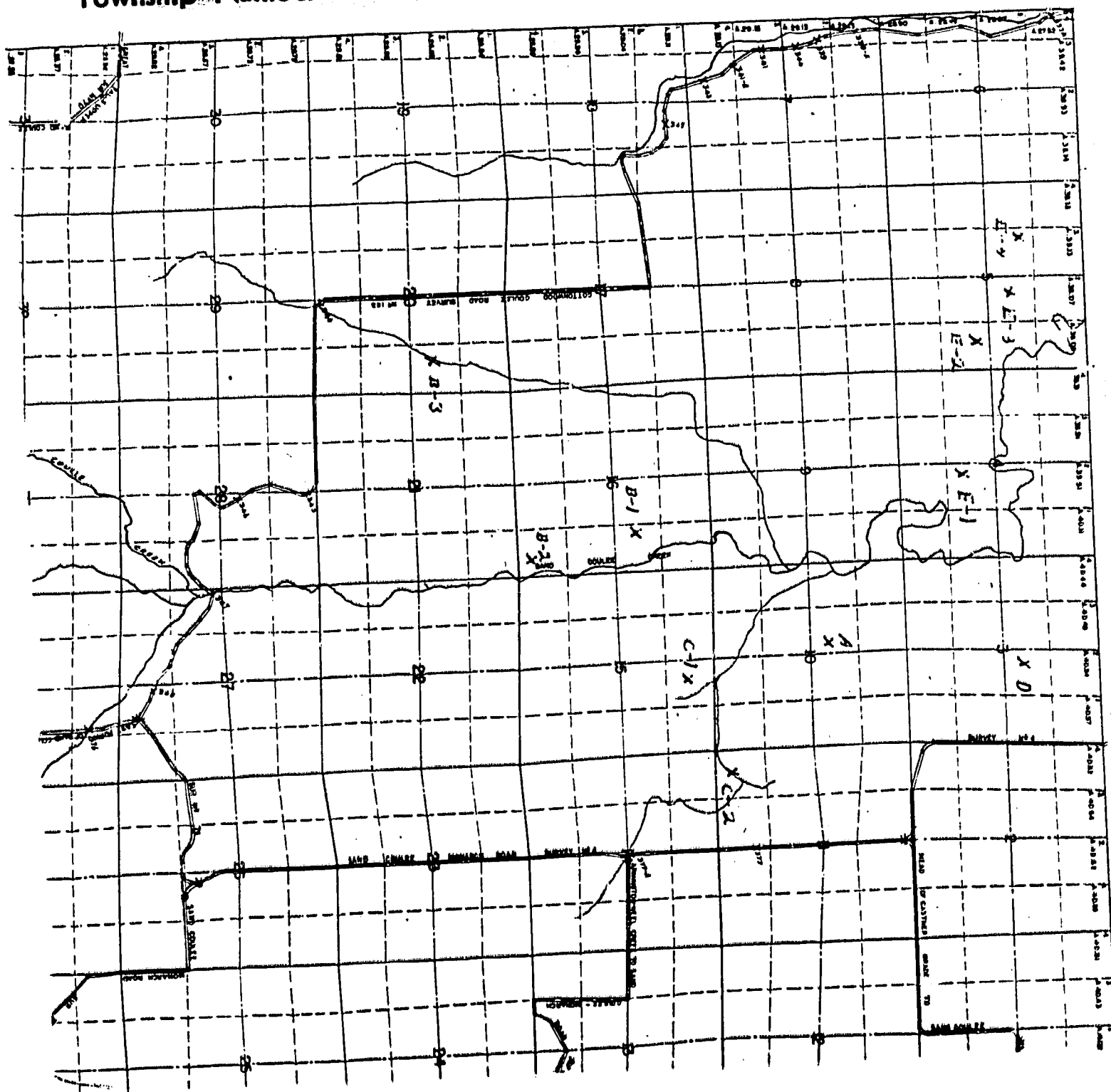

3646

STATE OF MONTANA, ss.
County of Cascade

I hereby certify that the within in-
strument was filed in this office on

DEC 20 1963

Date
at 3:26 o'clock P.M.

J. L. LENNON
County Clerk and Recorder.

By B. K. K. Deputy.

File No.

T. 18 N. R. 5 E.

DUPLICATE

County. Cascade

STATE OF MONTANA
ADMINISTRATOR OF GROUNDWATER CODE
OFFICE OF STATE ENGINEER

RECEIVED
JAN 9 1964

Notice of Completion of Groundwater Appropriation
Without Well

(Under Chapter 237 Montana Session Laws, 1961)

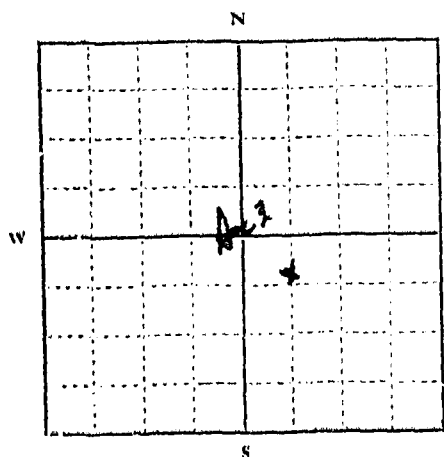

NW 1/4 SE Sec. 3 T. 18 N. R. 5 E.

Indicate point of appropriation
and place of use, if possible.

Date of Appropriation of Groundwater... Spring has been running
for over 50 years.

Owner... Ann R. Krebs
S. A. Krebs and/ Address... Belt, Montana

Contractor (if any) ... none

Address of Contractor ...

Date Started... Date Completed...

Describe means of obtaining groundwater without a well "as by
sub-irrigation and other natural processes". Include depth to
water when applicable. By sub-irrigation and other
natural processes.

Quantity of water developed and used with explanation of method
used to measure or estimate such amount. If use is intermittent

estimate approximate lengths of periods of use. Spring flows at
the rate of 5 gallons per minute; used throughout the year
for watering stock.

Signature of Owner... Ann R. Krebs

Date... December 27, 1963.

This form to be prepared by contractor (if any), otherwise by the owner.

Three copies of this notice are to be filed with the County Clerk and Recorder of the county in which the
works are located.

Please answer all questions. If not applicable, so state, otherwise the form will be returned.

Original to the County Clerk and Recorder; duplicate to the State Engineer; Triplicate to the Montana
Bureau of Mines and Geology and Quadruplicate for the Appropriator.

3924

STATE OF MONTANA, } ss.
County of Cascade.

I hereby certify that the within in-
strument was filed in this office on

DEC 30 1963

Date

at 9:11 o'clock A.M.

J. L. LENNON

County Clerk and Recorder.

By

H. C. Mahol

Deputy.

GV

File No.

T 18 N R 5 E

DUPLICATE

County Cascade

STATE OF MONTANA
ADMINISTRATOR OF GROUNDWATER CODE
OFFICE OF STATE ENGINEER

Declaration of Vested Groundwater Rights
(Under Chapter 237, Montana Session Laws, 1961)

RECEIVED
JAN 10 1962
STATE ENGINEER

1. Robert T. Klasner of Stockett
(Name of Appropriator) (Address) (Town)

County of Cascade State of Montana
have appropriated groundwater according to the Montana laws in effect prior to January 1, 1962, as follows:

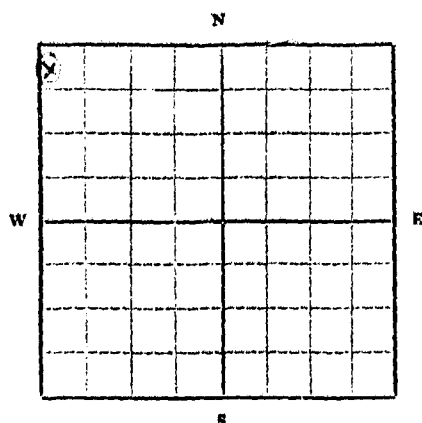

NW 1/4 NW 1/4 Sec. 6 T 18 N R 5 E

Indicate point of appropriation and place of use, if possible. Each small square represents 10 acres.

2. The beneficial use on which the claim is based Domestic use, Town of Stockett, Montana

3. Date or approximate date of earliest beneficial use; and how continuous the use has been November 1, 1955, continuous

4. The amount of groundwater claimed (in miner's inches or gallons per minute) 65 gallons per minute

5. If used for irrigation, give the acreage and description of the lands to which water has been applied and name of the owner thereof Incidental lawn irrigation for the town of Stockett, Montana. Owner - Robert T. Klasner

6. The means of withdrawing such water from the ground and the location of each well or other means of withdrawal Developed spring located in Lot 4, NW 1/4 NW 1/4, Section 6, T 18 N, R 5 E

7. The date of commencement and completion of the construction of the well, wells, or other works for withdrawal of groundwater Commenced August 2, 1955; Completion May 15, 1956

8. The depth of water table 0' to 6'

9. So far as it may be available, the type, size and depth of each well or the general specifications of any other works for the withdrawal of groundwater 6" Concrete Tank, 75' x 12' x 6', sunk in ground 6' and covered with 3' of earth.

10. The estimated amount of groundwater withdrawn each year 26,000,000 gallons per year.

11. The log of formations encountered in the drilling of each well if available 0 - 6' loose sandstone, gravel, and dirt; 6' solid massive sandstone, very fine to medium grained, hard to medium hard, light-gray and yellowish color.

12. Such other information of a similar nature as may be useful in carrying out the policy of this act, including reference to book and page of any county record. This is the primary source of domestic water for the town of Stockett, Montana.

Signature of Owner: Robert T. Klasner

Date January 2, 1962

Three copies to be filed by the owner with the County Clerk and Recorder of the county in which the well is located.

Please answer all questions. If not applicable, so state, otherwise the form will be returned.

Original to the County Clerk and Recorder; duplicate to the State Engineer; Triplicate to the School of Mines and Quadruplicate for the Appropriator.

1047

STATE OF MONTANA, } ss.
County of Cascade.

I hereby certify that the within in-
strument was filed in this office on

JAN 2 - 1962

Date

3:00 o'clock P.M.

J. L. LENNON

County Clerk and Recorder.

R. C. Nichols
Deputy.

File No.

T. 18 N. R. 5 E

DUPLICATE

County Cascade

STATE OF MONTANA
ADMINISTRATOR OF GROUNDWATER CODE
OFFICE OF STATE ENGINEER

RECEIVED
JAN 9 1964
STATE ENGINEER

Declaration of Vested Groundwater Rights

(Under Chapter 237, Montana Session Laws, 1961)

1. Robert T. Klasner, of Stockett,
(Name of Appropriator) (Address) (Town)
County of Cascade State of Montana
have appropriated groundwater according to the Montana laws in effect prior to January 1, 1962, as follows:

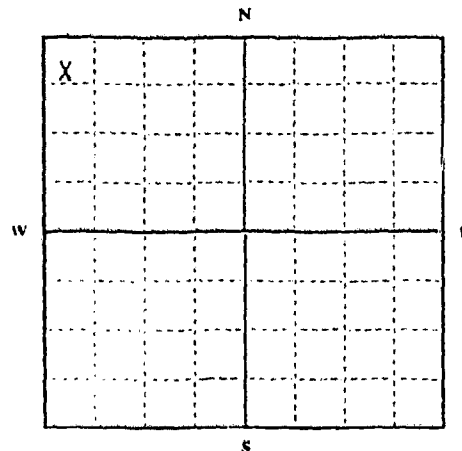

NW $\frac{1}{4}$ NW $\frac{1}{4}$ Sec. 6 T. 18 N. R. 5 E

Indicate point of appropriation and place of use, if possible. Each small square represents 10 acres.

2. The beneficial use on which the claim is based Domestic use, Town of Stockett, Montana
3. Date or approximate date of earliest beneficial use; and how continuous the use has been November 1, 1955, continuous
4. The amount of groundwater claimed (in miner's inches or gallons per minute) 55 gallons per minute
5. If used for irrigation, give the acreage and description of the lands to which water has been applied and name of the owner thereof Incidental lawn irrigation for the Town of Stockett, Montana. Owner - Robert T. Klasner
6. The means of withdrawing such water from the ground and the location of each well or other means of withdrawal Developed spring located in Lot 4, NW $\frac{1}{4}$ NW $\frac{1}{4}$, Section 6, T 18 N, R 5 E
7. The date of commencement and completion of the construction of the well, wells, or other works for withdrawal of groundwater No well, natural spring
8. The depth of water table 0' to 6'
9. So far as it may be available, the type, size and depth of each well or the general specifications of any other works for the withdrawal of groundwater Developed spring located in Lot 4, NW $\frac{1}{4}$ NW $\frac{1}{4}$, Section 6, T 18 N, R 5 E
10. The estimated amount of groundwater withdrawn each year 29,000,000 gallons per year.
11. The log of formations encountered in the drilling of each well if available
12. Such other information of a similar nature as may be useful in carrying out the policy of this act, including reference to book and page of any county record This is a second source of domestic water for the Town of Stockett, Montana.

Signature of Owner

Robert T. Klasner

Date December, 1963.

Three copies to be filed by the owner with the County Clerk and Recorder of the county in which the well is located.

Please answer all questions. If not applicable, so state, otherwise the form will be returned.

Original to the County Clerk and Recorder; Duplicate to the State Engineer; Triplicate to the Montana Bureau of Mines and Geology, and Quadruplicate for the Appropriator.

28554

4569

STATE OF MONTANA, } ss.
County of Cascade.

I hereby certify that the within in-
strument was filed in this office on
DEC 31 1962

at 407 o'clock M.

J. E. LANNON

County Clerk and Recorder.

By J. D. Dehner
Deputy

GW

File No.

DUPLICATE

T 18N. R 5-E

County.

STATE OF MONTANA
ADMINISTRATOR OF GROUNDWATER CODE
OFFICE OF STATE ENGINEER

Declaration of Vested Groundwater Rights
(Under Chapter 237, Montana Session Laws, 1961)

RECEIVED

STATE ENGINEER

1. Anna Leah Dolena of Stockett
(Name of Appropriator) (Address) (Town)
County of Cascade State of Montana
have appropriated groundwater according to the Montana laws in effect prior to January 1, 1962, as follows:

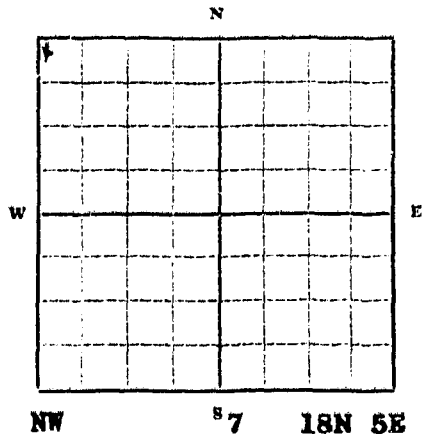

..... 1/4 Sec. T. R.

Indicate point of appropriation
and place of use, if possible.
Each small square represents 10
acres.

2. The beneficial use on which the claim is based household or domestic use, irrigating garden, approximately 10 acres of bottom land and watering stock.

3. Date or approximate date of earliest beneficial use; and how continuous the use has been on or about Dec. 1, 1961, and continuous every since and in the future.

4. The amount of groundwater claimed (in miner's inches or gallons per minute) 10 gallons per minute

5. If used for irrigation, give the acreage and description of the lands to which water has been applied and name of the owner 10 acres of bottom land situated as shown on the attached survey marked Exhibit A and by this reference made a part hereof as though fully set out herein. Anna Leah Dolena is the owner.

6. The means of withdrawing such water from the ground and the location of each well or other means of withdrawal electric pump

7. The date of commencement and completion of the construction of the well, wells, or other works for withdrawal of groundwater the well was started August 29, 1961 and completed on August 29, 1961
(See attached Exhibit B which by this reference is made a part hereof as though fully set out herein.)

8. The depth of water table 31-42 feet

9. So far as it may be available, the type, size and depth of each well or the general specifications of any other works for the withdrawal of groundwater ordinary drilled well with 7 inch casing. Depth is approximately 31-42 feet. (refer to Exhibit B)

10. The estimated amount of groundwater withdrawn each year 10,000 gallons

11. The log of formations encountered in the drilling of each well if available Refer to Exhibit B attached hereto and by this reference made a part hereof as though set fully out herein.

12. Such other information of a similar nature as may be useful in carrying out the policy of this act, including reference to book and page of any county record.

Signature of Owner

Date March 20, 1962

Three copies to be filed by the owner with the County Clerk and Recorder of the county in which the well is located.

Please answer all questions. If not applicable, so state, otherwise the form will be returned.

Original to the County Clerk and Recorder; duplicate to the State Engineer; Triplicate to the School of Mines and Quadruplicate for the Appropriator.

222

STONE NW COR
SEC 7
T18N R5E

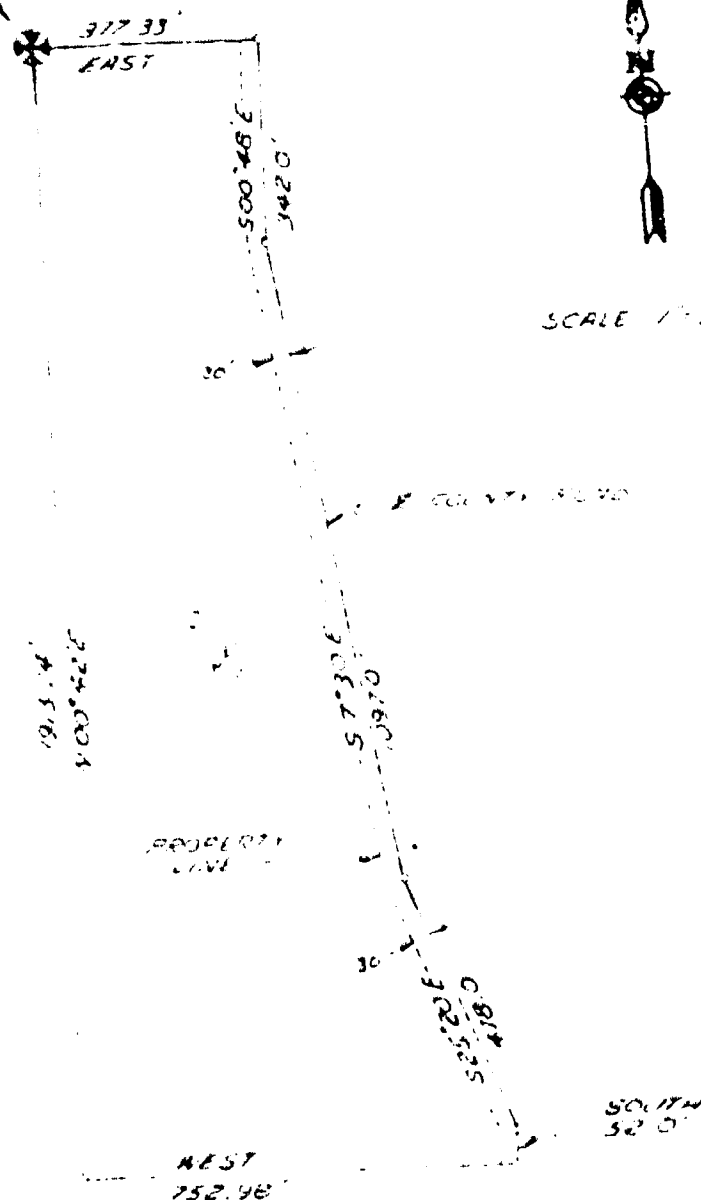

I, William J. Purvis, Professional Engineer and Land Surveyor, Montana License No. 466 ES do hereby certify that under my direction and supervision survey was made of a tract of land lying in the W $\frac{1}{2}$ NW $\frac{1}{4}$ Section 7 T18N, R5E, M.P.M., Cascade County, Montana, more particularly described as follows:

The point of beginning being a stone monument the NW corner of said Section 7, T18N, R5E, M.P.M. Cascade County, Montana; proceed thence East 377.33 feet to a point said point being the center line of a County Road; thence S 0° 48' E 342.0 feet along the center line of said County Road to a point; thence S 7° 30' E 1077.0 feet along the center line of said County Road to a point; thence S 25° 20' E 478.0 feet along the center line of said County Road to a point; thence South 52.0 feet along the center line of said County Road to a point; thence West 752.98 feet to a point; thence S 0° 42' E 1913.74 feet to a stone monument the point of beginning less a strip 30 feet wide along the West side of the center line of said County Road. Containing in all 17.34 acres more or less.

William J. Purvis
William J. Purvis
Montana License No. 466 ES
March 10, 1959

Exhibit B

Augusta, Montana, Aug 27, 1961

Anna Lark Helmer
Statist
Montana

IN ACCOUNT WITH

WHITAKER WELL DRILLING

P. O. Box 345 -- Phone LOgan 2-3291

AUGUSTA, MONTANA

41 1/2" drilling work

43" W.D. casing

Paid
Thank you

W. L. Helmer

LOG OF WELL

(LAND DESCRIPTION)

Tract NW Cor. Sec. 7

T 18 N R 5 E

0-1' topsoil

1'-5' hard sandstone

5'-28' silty clay

28'-35' soft sandstone w/ water

35'-41' coarse sand & gravel

Perforations from 38' to 41'

Slotted in casing by torch.

Boiled 30 min. 10 P.M.

Set pump 36' from ground level.

1- #3070
6

STATE OF MONTANA, } ss.
County of Cascade.

I hereby certify that the within instrument was filed in this office on

APR 4 - 1962
Date

at 11:15 o'clock A.M.

J. L. LENNON
County Clerk and Recorder.

By [Signature]
Deputy

File No.

T 17 R 11
County

STATE OF MONTANA
ADMINISTRATOR OF GROUNDWATER CODE
OFFICE OF STATE ENGINEER

RECEIVED
JAN 10 1964

DECLARATION OF VESTED GROUNDWATER RIGHTS
(Under Chapter 237, Montana Session Laws, 1961)

1. JOANN SHIRLEY of 2720 Broderick, San Francisco, California, but with property in Cascade County, Montana, has appropriated, and her predecessors in interest appropriated, groundwater according to Montana laws in effect prior to January 1, 1962, as follows: Lot 4 of Section 7, and that part of Lot 3 and the E $\frac{1}{4}$ SW $\frac{1}{4}$ of Section 7, lying west of the county road as now established and existing over and across said premises, all in Township 18 North, Range 5 East, M.M.
2. The beneficial use on which the claim is based - is use for watering livestock.
3. Date or approximate date of earliest beneficial use; and how continuous the use has been - since on and before the summer of 1911, and use has been continuous since.
4. The amount of groundwater claimed (in miner's inches or gallons per minute) - about 30 gallons per minute.
5. If used for irrigation, give the acreage and description of the lands to which water has been applied and name of the owner thereof - water has been used for watering livestock during the whole of said period of time since 1911 and prior thereto.
6. The means of withdrawing such water from the ground and the location of each well or other means of withdrawal - water arises from flowing springs arising at various places on said premises, and the flow thereof is used for watering livestock.
7. The date of commencement and completion of the construction of the well, wells or other works for withdrawal of groundwater - water flows from flowing springs, no wells or other works.
8. The depth of the water table - from 6 to 60 feet.
9. So far as it may be available, the type, size and depth of each well or the general specifications of any other works for the withdrawal of groundwater - water flows from flowing springs, no well involved.
10. The estimated amount of groundwater withdrawn each year - 93,000,000 gallons a year.
11. The log of formations encountered in the drilling of each well if available - no logs available, no well drilled.
12. Such other information of a similar nature as may be useful in carrying out the policy of this act, including reference to book and page of any county record - no other information presently available.

Joann Shirley
Date December 27 1963.

28104

RECEIVED
JAN 9 1964

STATE OF CALIFORNIA

: ss.

STATE ENGINEER

County of San Francisco

JOANN SHIRLEY, being duly sworn, deposes and says:

That she is of lawful age and successor of the appropriator and the claimant of the order and water right mentioned in the foregoing declaration of vested groundwater rights and the person whose name is subscribed thereto as the appropriator and claimant, and that she knows the contents of said foregoing notice and the matters and things therein stated are true.

Joann Shirley

SUBSCRIBED and SWORN to before me this 27th day of December, 1963.

Richard Stevens
Notary Public for the State of California,
Residing at San Francisco, California
My commission expires: Nov. 13, 1965

(Notarial Seal)

RICHARD STEVENS
NOTARY PUBLIC IN AND FOR THE CITY AND COUNTY
OF SAN FRANCISCO, STATE OF CALIFORNIA

RECEIVED
COUNTY CLERK
JAN 1 1967

(1967 Edition)

RECEIVED
COUNTY CLERK
JAN 1 1967

1967

and hereby certify that the within instrument was filed in this office on

STATE OF MONTANA, } ss.
County of Cascade.

DEC 30 1966

2:31 P.M. o'clock P.M.

J. L. LENNON
County Clerk and Recorder.

Deputy.

4117

File No.

T. 18N R. 5E

DUPLICATE

County Cascade

STATE OF MONTANA
ADMINISTRATOR OF GROUNDWATER CODE
OFFICE OF STATE ENGINEER

JAN 9 1964
STATE ENGINEER

**Notice of Completion of Groundwater Appropriation
Without Well**

(Under Chapter 237 Montana Session Laws, 1961)

Date of Appropriation of Groundwater October 1949
Owner Aili Almyra Takala Address Stockett, Montana

Contractor (if any)

Address of Contractor

Date Started..... Date Completed.....

Describe means of obtaining groundwater without a well "as by sub-irrigation and other natural processes". Include depth to water when applicable. Natural Spring

Quantity of water developed and used with explanation of method used to measure or estimate such amount. If use is intermittent

estimate approximate lengths of periods of use.....

Source of water originates on this location.

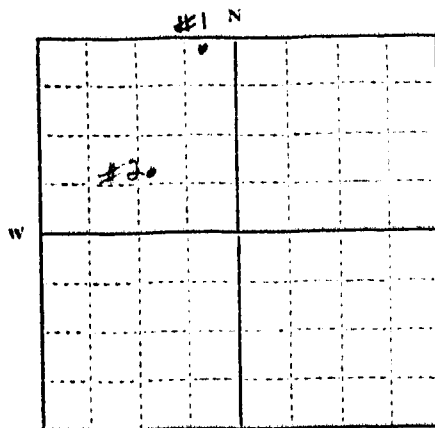

#1 NW 1/4 Sec. 7 T. 18N R. 5E

Indicate point of appropriation and place of use, if possible.

#2 NW 1/4 Sec. 7 T. 18N R. 5E

Signature of Owner Aili Almyra Takala

Date December 31, 1963

This form to be prepared by contractor (if any), otherwise by the owner.

Three copies of this notice are to be filed with the County Clerk and Recorder of the county in which the works are located.

Please answer all questions. If not applicable, so state, otherwise the form will be returned.

Original to the County Clerk and Recorder; duplicate to the State Engineer; Triplicate to the Montana Bureau of Mines and Geology and Quadruplicate for the Appropriator.

4314

CLERK AND RECORDER
CASCADE COUNTY MONTANA
I HEREBY CERTIFY THAT THE WITHIN
INSTRUMENT WAS FILED FOR RECORD
IN THIS OFFICE ON

DEC 31 1963

AT 10:55 4
AND DULY RECORDED AS DOCUMENT

NO.

J. L. LENNON
CLERK AND RECORDER

BY

[Signature]
DEPUTY

File No.....

T18N R.5E

DUPLICATE

County Cascade

STATE OF MONTANA
ADMINISTRATOR OF GROUNDWATER CODE
OFFICE OF STATE ENGINEER

RECEIVED
JAN 9 1964
STATE ENGINEER

**Notice of Completion of Groundwater Appropriation
Without Well**

(Under Chapter 237 Montana Session Laws, 1961)

Date of Appropriation of Groundwater October 1949

Matt William Takala

Owner Aili Almyra Takala Address Stockett, Montana

Contractor (if any)

Address of Contractor

Date Started..... Date Completed.....

Describe means of obtaining groundwater without a well "as by sub-irrigation and other natural processes". Include depth to water when applicable. Natural Spring

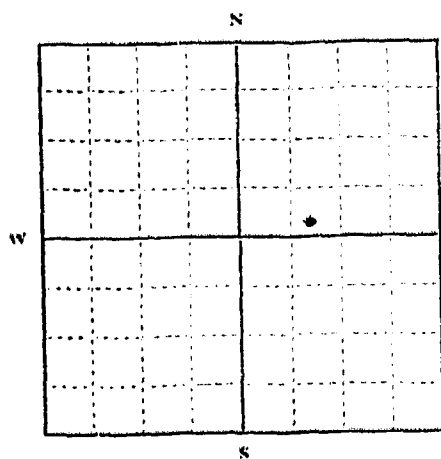

SE 1/4 SW 1/4 Sec. 8 T. 18N R. 5E

Indicate point of appropriation and place of use, if possible.

Quantity of water developed and used with explanation of method used to measure or estimate such amount. If use is intermittent

estimate approximate lengths of periods of use.....

Source of water originates on this location.

Signature of Owner Matt William Takala
Aili Almyra Takala

Date December 31, 1963

This form to be prepared by contractor (if any), otherwise by the owner.

Three copies of this notice are to be filed with the County Clerk and Recorder of the county in which the works are located.

Please answer all questions. If not applicable, so state, otherwise the form will be returned.

Original to the County Clerk and Recorder; duplicate to the State Engineer; Triplicate to the Montana Bureau of Mines and Geology and Quadruplicate for the Appropriator.

28302

4713

CLERK AND RECORDER
CASSIA COUNTY, MONTANA
I HEREBY CERTIFY THAT THE WITHIN
INSTRUMENT WAS FILED FOR RECORD
IN THIS OFFICE ON

DEC 31 1962

AT 10:47 A.M.
AND DULY RECORDED AS DOCUMENT

BY

J. L. LENNON
CLERK AND RECORDER

BY

[Signature]
DEPUTY

GW 3

File No.

DUPLICATE

T. 19 R. 5E

County CASCADE

STATE OF MONTANA
ADMINISTRATOR OF GROUNDWATER CODE
OFFICE OF STATE ENGINEER

RECEIVED
JAN 9 1964
STATE ENGINEER

Notice of Completion of Groundwater Appropriation Without Well

(Under Chapter 237 Montana Session Laws, 1961)

Date of Appropriation of Groundwater
OTTO E JOHNSON

Owner DON E JOHNSON Address SALT LAKE CITY

Contractor (if any)

Address of Contractor

Date Started Date Completed

Describe means of obtaining groundwater without a well "as by sub-irrigation and other natural processes". Include depth to water when applicable.

NATURAL SPRING FLOW

UNABLE TO DETERMINE DEPTH

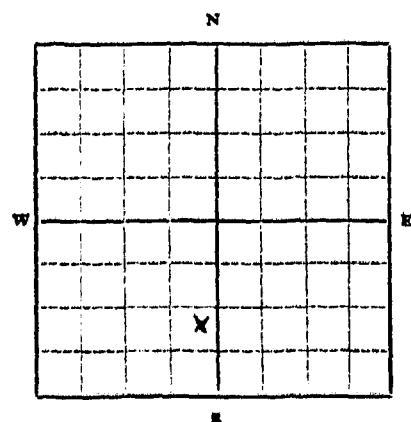

SW 1/4 Sec. 8 T. 19 R. 5E

Indicate point of appropriation and place of use, if possible.

Quantity of water developed and used with explanation of method used to measure or estimate such amount. If use is intermittent estimate approximate lengths of periods of use

NATURAL SPRING FLOW

UNABLE TO DETERMINE

Signature of Owner Otto E Johnson

Date DEC 26, 1963

This form to be prepared by contractor (if any), otherwise by the owner.

Three copies of this notice are to be filed with the County Clerk and Recorder of the county in which the works are located.

Please answer all questions. If not applicable, so state, otherwise the form will be returned.

Original to the County Clerk and Recorder; duplicate to the State Engineer; Triplicate to the Montana Bureau of Mines and Geology and Quadruplicate for the Appropriator.

28208

4220

STATE OF MONTANA, } ss.
County of Cascade.

I hereby certify that the within in-
strument was filed in this office on
DEC 31 1968

at 8:24 ^{Date} o'clock PM M.

J. L. LENNON

County Clerk and Recorder.

By

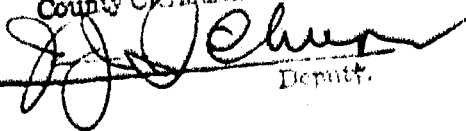

Deputy.

File No.

T. 18 N. R. 5 E.

DUPLICATE

County. Cascade

STATE OF MONTANA
ADMINISTRATOR OF GROUNDWATER CODE
OFFICE OF STATE ENGINEER

RECEIVED
JAN 9 1964

Declaration of Vested Groundwater Rights
(Under Chapter 237, Montana Session Laws, 1961)

1. Ben F. McCoy and Edith M. McCoy of Belt
(Name of Appropriator) (Address) (Town)
County of Cascade State of Montana
have appropriated groundwater according to the Montana laws in effect prior to January 1, 1962, as follows:

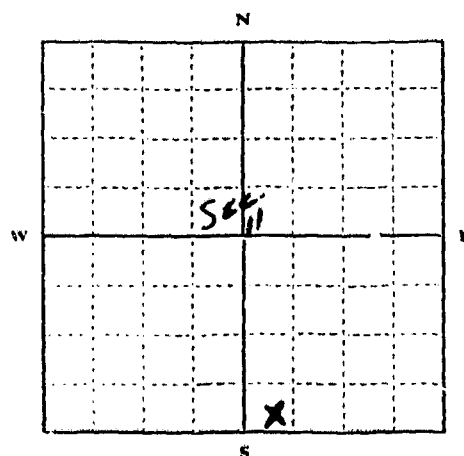

SW 1/4 Sec. 11 T18N R. 5 E.

Indicate point of appropriation
and place of use, if possible. Each
small square represents 10 acres.

2. The beneficial use on which the claim is based Household use, watering livestock, irrigation of lawn and yard.
3. Date or approximate date of earliest beneficial use; and l.w. continuous the use has been. 1907
4. The amount of groundwater claimed (in miner's inches or gallons per minute) 10 gallons per minute
5. If used for irrigation, give the acreage and description of the lands to which water has been applied and name of the owner thereof
Used for irrigation of garden and lawn in area adjacent to well on land owned by appropriators.
6. The means of withdrawing such water from the ground and the location of each well or other means of withdrawal
Withdrawn by windmill
7. The date of commencement and completion of the construction of the well, wells, or other works for withdrawal of groundwater 1907
8. The depth of water table Well is 90' deep, water is within 19' of surface of ground.
9. So far as it may be available, the type, size and depth of each well or the general specifications of any other works for the withdrawal of groundwater Well has 6" casing, is 90' deep and water is within 19' of the surface of the ground.
10. The estimated amount of groundwater withdrawn each year over 100,000 gallons per year.
11. The log of formations encountered in the drilling of each well if available. Not available.
12. Such other information of a similar nature as may be useful in carrying out the policy of this act, including reference to book and page of any county record None

Signature of Owner

Ben F. McCoy
Edith M. McCoy

Date December 27, 1963

Three copies to be filed by the owner with the County Clerk and Recorder of the county in which the well is located.

Please answer all questions. If not applicable, so state, otherwise the form will be returned.

Original to the County Clerk and Recorder; Duplicate to the State Engineer; Triplicate to the Montana Bureau of Mines and Geology, and Quadruplicate for the Appropriator

28025

c/o 40

STATE OF MONTANA, } ss.
County of Cascade.

I hereby certify that the within in-
strument was filed in this office on

_____ Date _____
at 12:13 o'clock P.M.

J. L. LENNON
County Clerk and Recorder.

By *[Signature]* Deputy.

File No.

T. 18 N. R. 5 E.

DUPLICATE

County. Cascade

STATE OF MONTANA
ADMINISTRATOR OF GROUNDWATER CODE
OFFICE OF STATE ENGINEER

RECEIVED
JAN 9 1964

Notice of Completion of Groundwater Appropriation
Without Well

(Under Chapter 237 Montana Session Laws, 1961)

Date of Appropriation of Groundwater Spring has been running for over 50 years.
Owner E. Sadie Pepos 1225 - 20th Ave. South, Butte, Montana.
Contractor (if any) none

Address of Contractor

Date Started..... Date Completed.....

Describe means of obtaining groundwater without a well "as by sub-irrigation and other natural processes". Include depth to water when applicable. By sub-irrigation and other natural

processes:

Quantity of water developed and used with explanation of method used to measure or estimate such amount. If use is intermittent

estimate approximate lengths of periods of use. 10 gallons per

minute, and the springs flow throughout the year.

Signature of Owner Sadie H. Pepos

Date December 30, 1963.

This form to be prepared by contractor (if any), otherwise by the owner.

Three copies of this notice are to be filed with the County Clerk and Recorder of the county in which the works are located.

Please answer all questions. If not applicable, so state, otherwise the form will be returned.

Original to the County Clerk and Recorder; duplicate to the State Engineer; Triplicate to the Montana Bureau of Mines and Geology and Quadruplicate for the Appropriator.

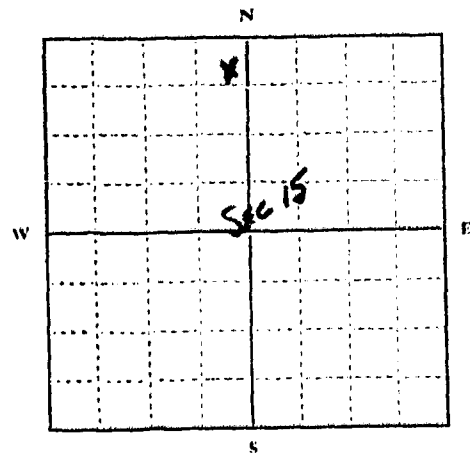

NE 1/4 Sec 15 T 18 N. R 5 E.
Indicate point of appropriation and place of use, if possible.

4153

STATE OF MONTANA, } ss.
County of Cascade.

I hereby certify that the within instrument was filed in this office on

DEC 30 1963

Date

at 250 o'clock P M.

J. L. LENNON

County Clerk and Recorder.

By

J. Lennon
Deputy.

File No.

T. 18 N. R. 5 E

DUPLICATE

County Cascade

STATE OF MONTANA
ADMINISTRATOR OF GROUNDWATER CODE
OFFICE OF STATE ENGINEER

RECEIVED
JAN 9 1964

Declaration of Vested Groundwater Rights

(Under Chapter 237, Montana Session Laws, 1961)

STATE ENGINEER

1. Patricia L. Cronin and Lilly Alsaker, of 3411 7th Avenue South, Great Falls.
(Name of Appropriator) (Address) (Town)

County of Cascade State of Montana
have appropriated groundwa according to the Montana laws in effect prior to January 1, 1962, as follows:

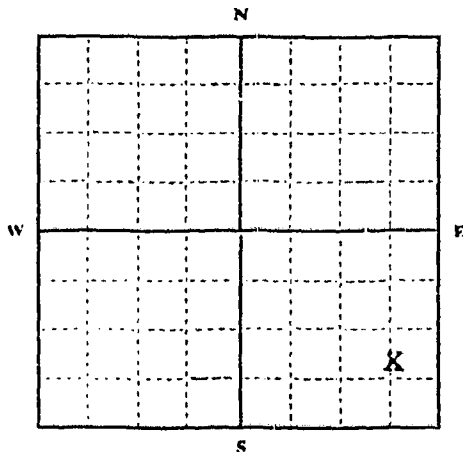

SE 1/4 Sec. 15 T. 18 N. R. 5 E

Indicate point of appropriation
and place of use, if possible. Each
small square represents 10 acres.

2. The beneficial use on which the claim is based.
household use and stock water
3. Date or approximate date of earliest beneficial use; and how continuous the use has been.
many years ago but date unknown to this claimant
4. The amount of groundwater claimed (in miner's inches or gallons per minute).
substantially all water flowing, no idea of amount
5. If used for irrigation, give the acreage and description of the lands to which water has been applied and name of the owner thereof.
immediately adjacent lands and garden plot
6. The means of withdrawing such water from the ground and the location of each well or other means of withdrawal.
pump and piping to house and stock tank
7. The date of commencement and completion of the construction of the well, wells, or other works for withdrawal of groundwater.
Not applicable
8. The depth of water table.
Not known; several feet below the ground level
9. So far as it may be available, the type, size and depth of each well or the general specifications of any other works for the withdrawal of groundwater.
Specifications of well unknown; 1 1/2 inch pipe currently used off pump
10. The estimated amount of groundwater withdrawn each year.
Probably several tens of thousands of gallons/
11. The log of formations encountered in the drilling of each well if available.
None available
12. Such other information of a similar nature as may be useful in carrying out the policy of this act, including reference to book and page of any county record.
Nothing further

Co-Signature of Owner Patricia L. Cronin
Patricia L. Cronin
Date December 30, 1963

Three copies to be filed by the owner with the County Clerk and Recorder of the county in which the well is located.

Please answer all questions. If not applicable, so state, otherwise the form will be returned.

Original to the County Clerk and Recorder; Duplicate to the State Engineer; Triplicate to the Montana Bureau of Mines and Geology, and Quadruplicate for the Appropriator.

28295

4306

STATE OF MONTANA, } ss.
County of Cascade.

I hereby certify that the within instrument was filed in this office on

DEC 31 19

Date

at 10:47 o'clock P M.

J. L. LENNON

County Clerk and Recorder.

By [Signature]
Deputy.

File No.

T 18 N R 5E

County

STATE OF MONTANA
ADMINISTRATOR OF GROUNDWATER CODE
OFFICE OF STATE ENGINEER

RECEIVED
JAN 9 1964

DECLARATION OF VESTED GROUNDWATER RIGHTS
(Under Chapter 237, Montana Session Laws, 1961)

1. JOANN SHIRLEY of 2720 Broderick, San Francisco, California, but with property in Cascade County, Montana, has appropriated, and her predecessors in interest appropriated, groundwater according to Montana laws in effect prior to January 1, 1962, as follows: Lot 4, Section 7, and that part of Lot 3 and the E $\frac{1}{2}$ SW $\frac{1}{4}$ of Section 7 lying west of the county road as now established and existing over and across said premises, all in Township 18 North, Range 5 East, M.M., and that part of Lot 1, Section 18, Township 18 North, Range 5 East, M.M., described by metes and bounds as follows: Beginning at the Northwest Corner of said Section 18, thence North 89°42' East 566.4 feet, thence South 41°18' West 127 feet, thence South 88°39' West 145 feet, thence South 03°38' West 478 feet, thence South 47°46' West 415 feet, more or less, to the West line of said Section 18, thence North along said West line to the point of beginning; all in Township 18 North, Range 4 East, M.M.
2. The beneficial use on which the claim is based - is use for household purposes and for garden, trees, yard and flowers.
3. Date or approximate date of earliest beneficial use; and how continuous the use has been - since on and before the summer of 1911, and use has been continuous since.
4. The amount of groundwater claimed (in miner's inches or gallons per minute) - about 50 gallons per minute.
5. If used for irrigation, give the acreage and description of the lands to which water has been applied and name of the owner thereof - water has been applied for irrigation of garden, lawn and flowers on land above described during the whole of said period of time since 1911 and prior thereto.
6. The means of withdrawing such water from the ground and the location of each well or other means of withdrawal - well is on land described and is a flowing well that is pumped at times from a concrete basin that was sunk 6 feet into a flowing well and water is pumped therefrom to the adjacent house and used for household purposes.
7. The date of commencement and completion of the construction of the well, wells, or other works for withdrawal of groundwater - flowing well was used on and prior to 1911 and concrete basin built by digging approximately 6 feet deep into the flowing well and installing a concrete basin and pumping water therefrom into the house, water also used for irrigation.
8. The depth of the water table - from 6 to 60 feet.
9. So far as it may be available, the type, size and depth of each well or the general specifications of any other works for the withdrawal of groundwater - water pumped from concrete basin in flowing well to use for household uses and purposes.
10. The estimated amount of groundwater withdrawn each year - total flow of groundwater each year is approximately 26,000,000 gallons.

28105

JAN 9 1964

11. The log of formations encountered in the drilling of each well if available - no logs available. no well drilled, spring dug out about 6 feet deep and lined with concrete basin over which there has been a cover placed, and water is pumped from basin to house, and water flows from basin and is used for garden, flowers and trees.

12. Such other information of a similar nature as may be useful in carrying out the policy of this act, including reference to book and page of any county record - do not have any additional information.

Joann Shirley
Date December 27 1963.

* * * * *

STATE OF CALIFORNIA :
County of San Francisco : ss.

JOANN SHIRLEY, being duly sworn, deposes and says:

That she is of lawful age and successor of the appropriator and the claimant of the order and water right mentioned in the foregoing declaration of vested groundwater rights and the person whose name is subscribed thereto as the appropriator and claimant, and that she knows the contents of said foregoing notice and the matters and things therein stated are true.

Joann Shirley

SUBSCRIBED and SWORN to before me this 27th day of December, 1963.

(Notarial Seal)

Richard Stevens
Notary Public for the State of California,
Residing at San Francisco, California
My commission expires: Nov. 13, 1965
RICHARD STEVENS
NOTARY PUBLIC IN AND FOR THE CITY AND COUNTY
OF SAN FRANCISCO, STATE OF CALIFORNIA

[illegible]

FROM THE
 "NEW YORK
 TIMES" 1908

1990

THE UNIVERSITY OF CHICAGO

STATE OF MONTANA ss.
County of Cascade.

I hereby certify that the within instrument was filed in this office on

DEC 30 1969

at 2:12 P.M. 2 o'clock M.

J. L. LENNON

County Clerk and Recorder.

By [Signature] Deputy.

File No.

T. 18 R. 5 E

DUPLICATE

County Cascade

STATE OF MONTANA
ADMINISTRATOR OF GROUNDWATER CODE
OFFICE OF STATE ENGINEER

Declaration of Vested Groundwater Rights

(Under Chapter 237, Montana Session Laws, 1961)

RECEIVED
NOV 18 1963

STATE ENGINEER

1. Joseph H. Karnowsky of Stockett
(Name of Appropriator) (Address) (Town)
County of Cascade State of Mont
have appropriated groundwater according to the Montana laws in effect prior to January 1, 1962, as follows:

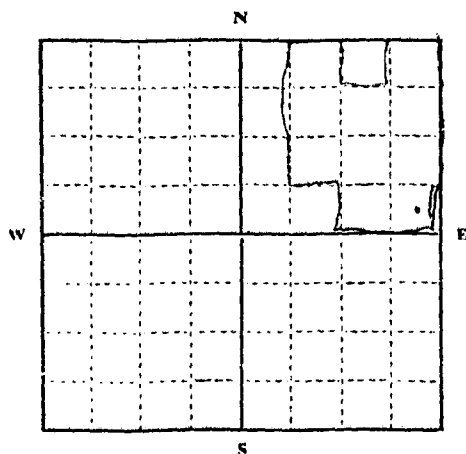

SE 1/4 NE Sec. 19 T. 18 R. 5E

Indicate point of appropriation
and place of use, if possible.
Each small square represents 10
acres.

2. The beneficial use on which the claim is based Stock
Water and House
3. Date or approximate date of earliest beneficial use; and how con-
tinuous the use has been 1914 Continuous
4. The amount of groundwater claimed (in miner's inches or gallons
per minute) 300 per Hour
5. If used for irrigation, give the acreage and description of the lands
to which water has been applied and name of the owner thereof
None
6. The means of withdrawing such water from the ground and the
location of each well or other means of withdrawal Pump
7. The date of commencement and completion of the construction of the well, wells, or other works for with-
drawal of groundwater 1914 Pump
8. The depth of water table 22
9. So far as it may be available, the type, size and depth of each well or the general specifications of any other
works for the withdrawal of groundwater Pump
10. The estimated amount of groundwater withdrawn each year don't know
11. The log of formations encountered in the drilling of each well if available Hand Dig sand stone
12. Such other information of a similar nature as may be useful in carrying out the policy of this act, including
reference to book and page of any county record.

Signature of Owner Joseph Karnowsky
Date Nov 4 - 1963

Three copies to be filed by the owner with the County Clerk and Recorder of the county in which the well is
located.

Please answer all questions. If not applicable, so state, otherwise the form will be returned.

Original to the County Clerk and Recorder; duplicate to the State Engineer; Triplicate to the Montana Bureau
of Mines and Geology, and Quadruplicate for the Appropriator.

7157

3416

STATE OF MONTANA, }
County of Cascade.

I hereby certify that the within in-
strument was filed in this office on
NOV 15 1963

Date

at 10:55 o'clock P.M.

J. L. LENNON

County Clerk and Recorder.

By *[Signature]*
Deputy.

File No.

DUPLICATE

T. R.

County

STATE OF MONTANA
ADMINISTRATOR OF GROUNDWATER CODE
OFFICE OF STATE ENGINEER

RECEIVED
DEC 27 1963

Notice of Completion of Groundwater Appropriation Without Well

(Under Chapter 237 Montana Session Laws, 1961)

Date of Appropriation of Groundwater Prior to 1910Owner Edna I. Dennis Address 1203 Washington
Wenatchee, WashingtonContractor (if any) NoneAddress of Contractor None

Date Started Date Completed

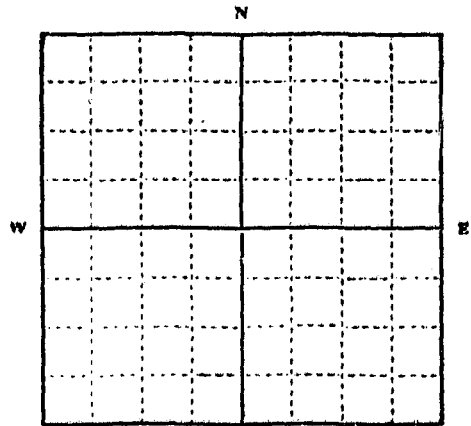
Describe means of obtaining groundwater without a well "as by
sub-irrigation and other natural processes". Include depth to
water when applicable. Natural springsSec. 14 Sec. 14 T. 16 R. 5EIndicate point of appropriation
and place of use, if possible.Quantity of water developed and used with explanation of method
used to measure or estimate such amount. If use is intermittent

estimate approximate lengths of periods of use

Quantity depends upon the year! less in
drought - more in wet years. Used year
around.

Signature of Owner Edna I. DennisDate December 27, 1963

This form to be prepared by contractor (if any), otherwise by the owner.

Three copies of this notice are to be filed with the County Clerk and Recorder of the county in which the
works are located.

Please answer all questions. If not applicable, so state, otherwise the form will be returned.

Original to the County Clerk and Recorder; duplicate to the State Engineer; Triplicate to the Montana
Bureau of Mines and Geology and Quadruplicate for the Appropriator.

3687

STATE OF MONTANA, }
County of Cascade, }

I hereby certify that the within in-
strument was filed in this office on

DEC 23 1963

at 108 o'clock P M.

J. L. PETERSON
County Clerk and Recorder.

By J. J. Schum
Deputy.

File No.

T. 18 N. R. 5 E.

DUPLICATE

County Cascade

STATE OF MONTANA
ADMINISTRATOR OF GROUNDWATER CODE
OFFICE OF STATE ENGINEER

RECEIVED
JAN 9 1964

Declaration of Vested Groundwater Rights

(Under Chapter 237, Montana Session Laws, 1961) STATE ENGINEER

1. Patricia L. Cronin and Lilly Alsaker, of 3411 7th Avenue South, Great Falls
(Name of Appropriator) (Address) (Town)

County of Cascade State of Montana
have appropriated groundwater according to the Montana laws in effect prior to January 1, 1962, as follows:

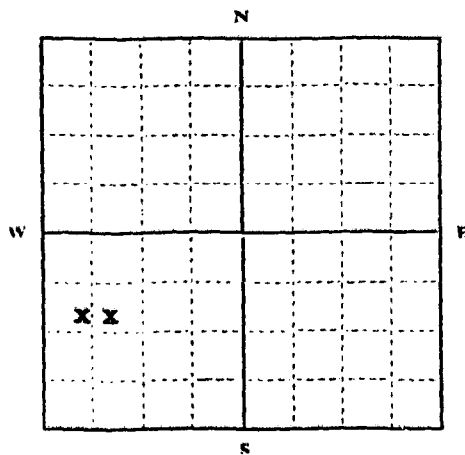

SW
NW 1/4 Sec. 21, T. 18 N. R. 5 E.

Indicate point of appropriation and place of use, if possible. Each small square represents 10 acres.

2. The beneficial use on which the claim is based.....
livestock water and sub-irrigation of adjacent land
3. Date or approximate date of earliest beneficial use; and how continuous the use has been.....
many years ago but date unknown to this claimant
4. The amount of groundwater claimed (in miner's inches or gallons per minute).....
substantially all water flowing, no idea of amount
5. If used for irrigation, give the acreage and description of the lands to which water has been applied and name of the owner thereof.....
as noted above
6. The means of withdrawing such water from the ground and the location of each well or other means of withdrawal.....
pipd with 1 1/2 inch pipe to stock water tankage area in immediate vicinity
7. The date of commencement and completion of the construction of the well, wells, or other works for withdrawal of groundwater..... Not applicable
8. The depth of water table..... Not applicable
9. So far as it may be available, the type, size and depth of each well or the general specifications of any other works for the withdrawal of groundwater..... Not applicable
10. The estimated amount of groundwater withdrawn each year..... unable to estimate, substantially all water flowing/
11. The log of formations encountered in the drilling of each well if available.....
Not applicable
12. Such other information of a similar nature as may be useful in carrying out the policy of this act, including reference to book and page of any county record..... Nothing further

Signature of Owner Patricia L. Cronin
Patricia L. Cronin

Date December 30, 1963

Three copies to be filed by the owner with the County Clerk and Recorder of the county in which the well is located.

Please answer all questions. If not applicable, so state, otherwise the form will be returned.

Original to the County Clerk and Recorder; Duplicate to the State Engineer; Triplicate to the Montana Bureau of Mines and Geology, and Quadruplicate for the Appropriator.

38294-

4305

STATE OF MONTANA
County of Carbon
I hereby certify that the foregoing
instrument was filed for record on
this 10th day of November 1916
at 10:44 A.M.
By *H. C. Schuch*

File No.

T. 18 N. R. 5 E

DUPLICATE

County Cascade

STATE OF MONTANA
ADMINISTRATOR OF GROUNDWATER CODE
OFFICE OF STATE ENGINEER

RECEIVED
JAN 2 1964
STATE ENGINEER

Declaration of Vested Groundwater Rights

(Under Chapter 237, Montana Session Laws, 1961)

1. Patricia L. Cronin and Lilly Alsaker, of 3411 7th Avenue South, Great Falls
(Name of Appropriator) (Address) (Town)

County of Cascade State of Montana
have appropriated groundwater according to the Montana laws in effect prior to January 1, 1962, as follows:

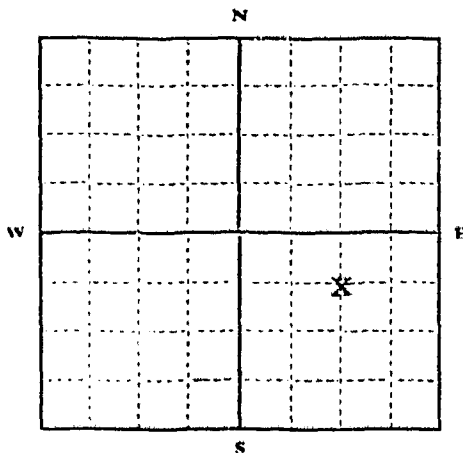

N 1/4 Sec. 21 T. 18 N. R. 5 E

Indicate point of appropriation
and place of use, if possible. Each
small square represents 10 acres.

2. The beneficial use on which the claim is based.....
livestock water and sub-irrigation of adjacent land
3. Date or approximate date of earliest beneficial use; and how continu-
ous the use has been.....
many years ago but date unknown to this claimant
4. The amount of groundwater claimed (in miner's inches or gallons
per minute).....
substantially all water flowing, no idea of amount
5. If used for irrigation, give the acreage and description of the lands
to which water has been applied and name of the owner thereof
as noted above
6. The means of withdrawing such water from the ground and the loca-
tion of each well or other means of withdrawal.....
ditch to small reservoir
7. The date of commencement and completion of the construction of the well, wells, or other works for with-
drawal of groundwater.....
Not applicable
8. The depth of water table.....
Not applicable
9. So far as it may be available, the type, size and depth of each well or the general specifications of any other
works for the withdrawal of groundwater.....
Not applicable
10. The estimated amount of groundwater withdrawn each year.....
unable to estimate,
substantially all water flowing
11. The log of formations encountered in the drilling of each well if available.....
Not applicable
12. Such other information of a similar nature as may be useful in carrying out the policy of this act, including
reference to book and page of any county record.....
Nothing further

Co-
Signature of Owner Patricia L. Cronin
Date December 30, 1963

Three copies to be filed by the owner with the County Clerk and Recorder of the county in which the well is located.

Please answer all questions. If not applicable, so state, otherwise the form will be returned.

Original to the County Clerk and Recorder; Duplicate to the State Engineer; Triplicate to the Montana Bureau of
Mines and Geology, and Quadruplicate for the Appropriator.

28293

4304

STATE OF MONTANA, } ss.
County of Cascade.

I hereby certify that the within in-
strument was filed in this office on
DEC 31 1945

Date
at 10:45 o'clock A.M.

J. L. LENNON
County Clerk and Recorder.

By [Signature]
Deputy.

GW.

Approved Stock Form—State Publishing Co., Helena, Montana—42234

File No.

T. 18 N. R. 5 E

DUPLICATE

County. Cascade

STATE OF MONTANA
ADMINISTRATOR OF GROUNDWATER CODE
OFFICE OF STATE ENGINEER

RECEIVED
JAN 3 1964

Declaration of Vested Groundwater Rights

(Under Chapter 237, Montana Session Laws, 1961)

STATE ENGINEER

1. Patricia L. Cronin and Lilly Alsaker . of 3411 7th Avenue South Great Falls
(Name of Appropriator) (Address) (Town)

County of Cascade State of Montana
have appropriated groundwater according to the Montana laws in effect prior to January 1, 1962, as follows:

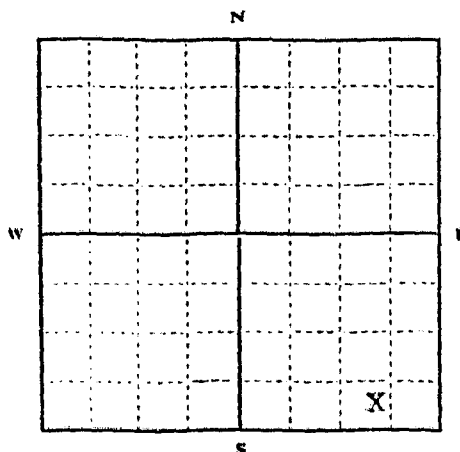

SE 1/4 Sec. 21. T. 18. N. 5. E

Indicate point of appropriation
and place of use, if possible. Each
small square represents 10 acres.

2. The beneficial use on which the claim is based
livestock water and sub-irrigation of adjacent land

3. Date or approximate date of earliest beneficial use; and how continu-
ous the use has been
many years ago but date unknown to this claimant

4. The amount of groundwater claimed (in miner's inches or gallons
per minute)
substantially all water flowing, no idea of amount

5. If used for irrigation, give the acreage and description of the lands
to which water has been applied and name of the owner thereof
as noted above

6. The means of withdrawing such water from the ground and the loca-
tion of each well or other means of withdrawal
ditch to small reservoir

7. The date of commencement and completion of the construction of the well, wells, or other works for with-
drawal of groundwater. Not applicable

8. The depth of water table. Not applicable

9. So far as it may be available, the type, size and depth of each well or the general specifications of any other
works for the withdrawal of groundwater. Not applicable

10. The estimated amount of groundwater withdrawn each year. Unable to estimate, substantially all
water flowing/

11. The log of formations encountered in the drilling of each well if available.
Not applicable

12. Such other information of a similar nature as may be useful in carrying out the policy of this act, including
reference to book and page of any county record. Nothing further

Signature of Co-Owner Patricia L. Cronin
Patricia L. Cronin
Date December 30, 1963

Three copies to be filed by the owner with the County Clerk and Recorder of the county in which the well is located.

Please answer all questions. If not applicable, so state, otherwise the form will be returned.

Original to the County Clerk and Recorder; Duplicate to the State Engineer; Triplicate to the Montana Bureau of
Mines and Geology, and Quadruplicate for the Appropriator.

28292

Nov. 16

06

4303

STATE OF MONTANA, } ss.
County of Cascade.

I hereby certify that the within instrument is a true and correct copy of the original as the same appears from the records of the County Clerk and Treasurer.

DEC 8 1902

10:44 A.M.
J. E. [illegible]
County Clerk and Treasurer.

By [Signature]
Deputy.

File No. _____

T. 18.0 R. 5E

DUPLICATE

County Cascade

STATE OF MONTANA
ADMINISTRATOR OF GROUNDWATER CODE
OFFICE OF STATE ENGINEER

Notice of Completion of Groundwater
Appropriation by Means of Well

(Under Chapter 237, Montana Session Laws, 1961)

Owner Andy LesinskyAddress Belt MontanaDriller A. J. WalshAddress Bellevue, Mont

Date of Notice of Appropriation of Groundwater _____

Date well started Apr 20-62Date Completed Apr 26-62Type of well drilled

(dug, driven, bored or drilled)

Equipment Used Capt. tools

(Churn, drill, rotary or other)

Water Use: Domestic ☐Municipal ☐Other ☐Irrigation ☐Industrial ☐Drainage ☐Stock ☒

Indicate on the diagram the character and thickness of the different strata met with in drilling, such as soil, clay, shale, gravel, rock or sand, etc. Show depth at which water is encountered, thickness and character of water-bearing strata and height to which water rises in the well.

Size of Drilled Hole	Size and Weight of Casing	From (Feet)	To (Feet)	PERFORATIONS		
				Kind Size	From (Feet)	To (Feet)
8 1/4	7.00 17 lb	0	65	1/2 in	30	65

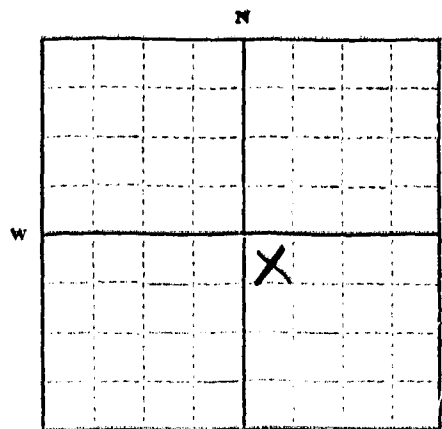

NW 1/4 Sec 24 T18 R5E
Indicate location of well and place of use, if possible. Each small square represents 10 acres.

Show exact depth of bottom.

Static Water Level for non-flowing Well 40 feet.

Shut-in Pressure for Flowing Well _____

Pumping Water Level _____ feet at 20 gal. per minute.

Discharge in gal. per min. of flowing well _____

How Tested Boiler Length of Test 2 hrs

Remarks: (Gravel packing, cementing, packers, type of shutoff, location of place of use of groundwater if not at well, and any other similar pertinent information, including number of acres irrigated, if used for irrigation). none

Driller's License Number 100Driller's Signature A. J. Walsh

This form to be prepared by driller, and three copies to be filed by the owner with the County Clerk and Recorder in the county in which the well is located.

Please answer all questions. If not applicable, so state, otherwise the form will be returned.

Original to the County Clerk and Recorder; duplicate to the State Engineer; Triplicate to the Montana Bureau of Mines and Geology and Quadruplicate for the Appropriator.

#3217

STATE OF MONTANA, }
County of Cascade.

I hereby certify that the within in-
strument was filed in this office on

DEC 19 1962

Date

at 12:25 o'clock P. M.

J. L. LENNON

County Clerk and Recorder.

By B. R. R.
Deputy.

File No.

T. 154 R 5 E

DUPLICATE

County Cascade

STATE OF MONTANA
ADMINISTRATOR OF GROUNDWATER CODE
OFFICE OF STATE ENGINEER

RECEIVED
JAN 9 1964

Notice of Completion of Groundwater Appropriation WITHOUT
Without Well

(Under Chapter 237 Montana Session Laws, 1961)

Date of Appropriation of Groundwater 1942
Owner Roy E Nelson Address Bellevue, Mont.

Contractor (if any)

Address of Contractor

Date Started 1945 Date Completed 1945

Describe means of obtaining groundwater without a well "as by
sub-irrigation and other natural processes". Include depth, to
water when applicable. Natural running
Spring

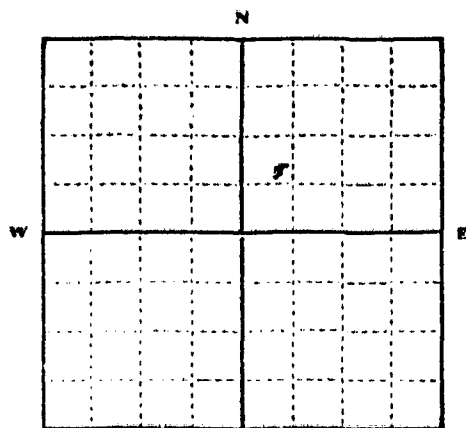

..... 1/4 Sec. 25 T. 154 R. 5 E
Indicate point of appropriation
and place of use, if possible.

Quantity of water developed and used with explanation of method
used to measure or estimate such amount. If use is intermittent

estimate approximate lengths of periods of use used year
round. Dam below spring.
Estimate spring would flow
600 gal. of water per hour.

Signature of Owner Roy E NelsonDate 12/30/63

This form to be prepared by contractor (if any), otherwise by the owner.

Three copies of this notice are to be filed with the County Clerk and Recorder of the county in which the works are located.

Please answer all questions. If not applicable, so state, otherwise the form will be returned.

Original to the County Clerk and Recorder; duplicate to the State Engineer; Triplicate to the Montana Bureau of Mines and Geology and Quadruplicate for the Appropriator.

25040

4055

STATE OF MONTANA, } ss.
County of Cascade. }

I hereby certify that the within instrument was filed in this office on

DEC 30 1968

at 107 o'clock M.

J. L. LENNON

County Clerk and Recorder.

By [Signature] Deputy.

File No.

T. 18 N. R. 5 E.

DUPLICATE

County Cascade

STATE OF MONTANA
ADMINISTRATOR OF GROUNDWATER CODE
OFFICE OF STATE ENGINEER

RECEIVED
JAN 2 1964

Notice of Completion of Groundwater Appropriation
Without Well

(Under Chapter 237 Montana Session Laws, 1961)

Spring has existed for over
Date of Appropriation of Groundwater 50 years.
Owner Ray L. Krebs and Mildred M. Krebs Address Salt, Montana
Contractor (if any) none
Address of Contractor
Date Started Date Completed

Describe means of obtaining groundwater without a well "as by
sub-irrigation and other natural processes". Include depth to
water when applicable. By sub-irrigation and other natural
processes.

Quantity of water developed and used with explanation of method
used to measure or estimate such amount. If use is intermittent
estimate approximate lengths of periods of use 10 gallons per
minute; spring flows throughout the year.

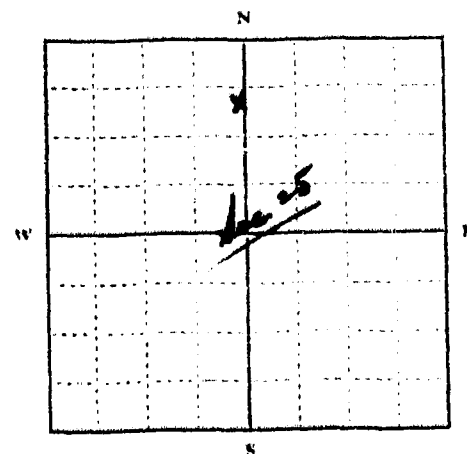

1/4 Sec. 25 T. 18 N. R. 5 E.
Indicate point of appropriation
and place of use, if possible.

Signature of Owner Ray L. Krebs Mildred M. Krebs
Date December 27, 1963.

This form to be prepared by contractor (if any), otherwise by the owner.

Three copies of this notice are to be filed with the County Clerk and Recorder of the county in which the
works are located.

Please answer all questions. If not applicable, so state, otherwise the form will be returned.

Original to the County Clerk and Recorder; duplicate to the State Engineer; Triplicate to the Montana
Bureau of Mines and Geology and Quadruplicate for the Appropriator.

4154

STATE OF MONTANA, } ss.
County of Cascade.

I hereby certify that the within in-
strument was filed in this office on

DEC 30 1963

Date

at 2 51 o'clock P M.

J. L. LENNON

County Clerk and Recorder.

By J. L. Lennon
Deputy.

File No.

T. 18 N. R. 5 E.

DUPLICATE

County Cascade

STATE OF MONTANA
ADMINISTRATOR OF GROUNDWATER CODE
OFFICE OF STATE ENGINEER

RECEIVED
JAN 4 1964

Declaration of Vested Groundwater Rights

(Under Chapter 237, Montana Session Laws, 1961)

1. Ray L. Krebs and Mildred M. Krebs, of Belt
(Name of Appropriator) (Address) (Town)

County of Cascade State of Montana
have appropriated groundwater according to the Montana laws in effect prior to January 1, 1962, as follows:

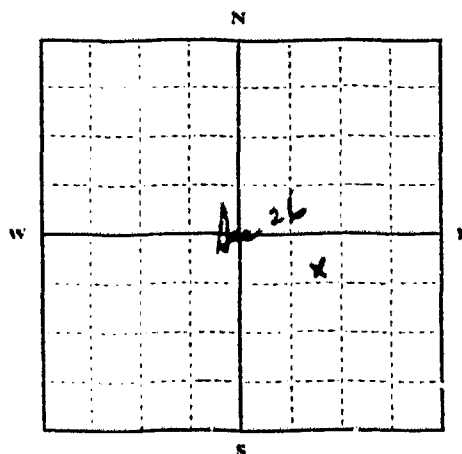

NE 1/4 Sec. 26, T. 18 N. R. 5 E.

Indicate point of appropriation and place of use, if possible. Each small square represents 10 acres.

2. The beneficial use on which the claim is based Household use, watering stock and irrigation of lawn and yard.
3. Date or approximate date of earliest beneficial use; and how continuous the use has been Earliest use 1926 and has been used continuously since.
4. The amount of groundwater claimed (in miner's inches or gallons per minute) 25 gallons per minute
5. If used for irrigation, give the acreage and description of the lands to which water has been applied and name of the owner thereof Used for irrigation of garden and lawn in land adjacent to well owned by appropriators.
6. The means of withdrawing such water from the ground and the location of each well or other means of withdrawal Well has in it 1 gas pump, a windmill pump and 2 electric pumps.
7. The date of commencement and completion of the construction of the well, wells, or other works for withdrawal of groundwater In 1926
8. The depth of water table Well is 18' deep and water is within 3 1/2' of surface of ground.
9. So far as it may be available, the type, size and depth of each well or the general specifications of any other works for the withdrawal of groundwater Well is 5' in diameter; 18' deep, and water is within 3 1/2' of surface of ground.
10. The estimated amount of groundwater withdrawn each year 200,000 gallons per year.
11. The log of formations encountered in the drilling of each well if available Not available
12. Such other information of a similar nature as may be useful in carrying out the policy of this act, including reference to book and page of any county record None.

Signature of Owner

Ray L. Krebs
Mildred M. Krebs

Date December 27, 1963.

Three copies to be filed by the owner with the County Clerk and Recorder of the county in which the well is located.

Please answer all questions. If not applicable, so state, otherwise the form will be returned.

Original to the County Clerk and Recorder; Duplicate to the State Engineer; Triplicate to the Montana Bureau of Mines and Geology, and Quaduplicate for the Appropriator.

28143

455
STATE OF MONTANA
County of Cascade

I hereby certify that the within instrument was filed by this office on
DEC 30 1963

at 2:52 p.m.

J. L. IERSON
County Clerk

By *J. L. Ierson*

GW3

File No.

DUPLICATE

T. 18 R. 55

County.

STATE OF MONTANA
ADMINISTRATOR OF GROUNDWATER CODE
OFFICE OF STATE ENGINEER

RECEIVED
NOV 22 1963

Notice of Completion of Groundwater Appropriation Without Well ENGINEER

(Under Chapter 237 Montana Session Laws, 1961)

Date of Appropriation of Groundwater 1948
John Tecinsky &
Owner Theresa Tecinsky Address Tokett, Mont.
Contractor (if any) None
Address of Contractor None
Date Started None Date Completed None

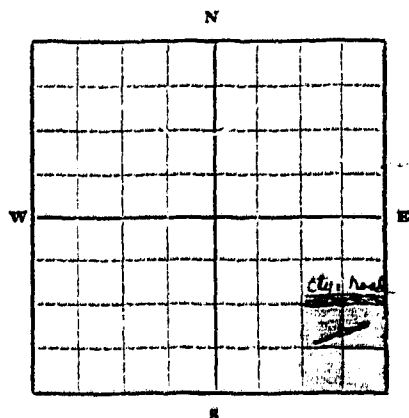

Sec. 27 T. 18 R. 55

Indicate point of appropriation
and place of use, if possible.

Describe means of obtaining groundwater without a well "as by
sub-irrigation and other natural processes". Include depth to
water when applicable. Springs & creek from runoff
and springs.

Quantity of water developed and used with explanation of meth-
od used to measure or estimate such amount. If use is intermit-

tent estimate approximate lengths of periods of use
approximately five gallons a minute estimated
by observing runoff. The use is continuous.

Signature of Owner

Theresa A. Tecinsky
John Tecinsky

Date Nov. 18, 1963

This form to be prepared by contractor (if any), otherwise by the owner.

Three copies of this notice are to be filed with the County Clerk and Recorder of the county in
which the works are located.

Please answer all questions. If not applicable, so state, otherwise the form will be returned.

Original to the County Clerk and Recorder; duplicate to the State Engineer; Triplicate to the
Montana Bureau of Mines and Geology and Quadruplicate for the Appropriator.

11/4/63

#3476

STATE OF MONTANA, } ss.
County of Cascade.

I hereby certify that the within in-
strument was filed in this office on
NOV 18 1963

at 3:43 ^{Date} o'clock P. M.

J. L. LENNON
County Clerk and Recorder.

By B. Jones
Deputy.

File No.

T. 18 N. R. 5 E

DUPLICATE

County Cascade

STATE OF MONTANA
ADMINISTRATOR OF GROUNDWATER CODE
OFFICE OF STATE ENGINEER

RECEIVED
JAN 9 1964
STATE ENGINEER

Declaration of Vested Groundwater Rights

(Under Chapter 237, Montana Session Laws, 1961)

1. Patricia L. Cronin and Lilly Alsaker of 3411 7th Avenue South Great Falls
(Name of Appropriator) (Address) (Town)

County of Cascade State of Montana
have appropriated groundwater according to the Montana laws in effect prior to January 1, 1962, as follows:

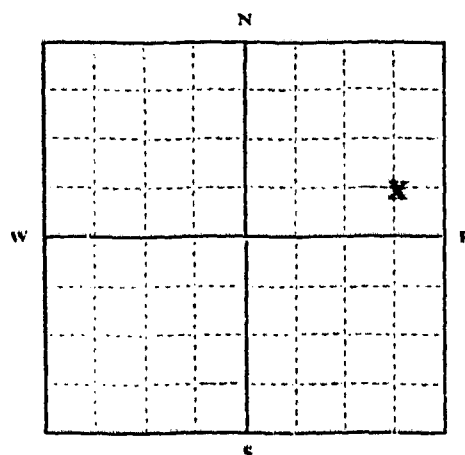

SE $\frac{1}{4}$ NE $\frac{1}{4}$ Sec. 28 T18NR. 5 E

Indicate point of appropriation and place of use, if possible. Each small square represents 10 acres.

2. The beneficial use on which the claim is based.....
livestock water and sub-irrigation of adjacent land

3. Date or approximate date of earliest beneficial use; and how continuous the use has been.....
many years ago but date unknown to this claimant

4. The amount of groundwater claimed (in miner's inches or gallons per minute).....
substantially all water flowing, no idea of amount

5. If used for irrigation, give the acreage and description of the lands to which water has been applied and name of the owner thereof.....
as noted above

6. The means of withdrawing such water from the ground and the location of each well or other means of withdrawal.....
surface spring into reservoir

7. The date of commencement and completion of the construction of the well, wells, or other works for withdrawal of groundwater..... Not applicable

8. The depth of water table..... Not applicable

9. So far as it may be available, the type, size and depth of each well or the general specifications of any other works for the withdrawal of groundwater..... Not applicable

10. The estimated amount of groundwater withdrawn each year..... Unable to estimate, substantially all
water flowing

11. The log of formations encountered in the drilling of each well if available.....
Not applicable

12. Such other information of a similar nature as may be useful in carrying out the policy of this act, including reference to book and page of any county record..... Nothing further

Signature of Owner Patricia L. Cronin
Date December 30, 1963

Three copies to be filed by the owner with the County Clerk and Recorder of the county in which the well is located.

Please answer all questions. If not applicable, so state, otherwise the form will be returned.

Original to the County Clerk and Recorder; Duplicate to the State Engineer; Triplicate to the Montana Bureau of Mines and Geology, and Quadruplicate for the Appropriator.

28291

4302

STATE OF MONTANA, } ss.
County of Cascade.

I hereby certify that the within
instrument was filed in the

Date

at 70143 9

J. L. LEE

County Clerk

By APC [Signature]
Deputy

File No.

T. 18 R. 3 East

DUPLICATE

County Cascade

STATE OF MONTANA
ADMINISTRATOR OF GROUNDWATER CODE
OFFICE OF STATE ENGINEER

DEC 6 1963

Notice of Completion of Groundwater Appropriation by Means of Well

(Under Chapter 237, Montana Session Laws, 1961)

Owner Knaup Brothers Address Stockert, MontanaDriller Patrick J. Byrne Address Great Falls, Mont.Date of Notice of Appropriation of Groundwater 10-21-63Date well started 10-22-63 Date Completed 10-23-63

Type of well drilled Equipment Used Churn Drill
(dug, driven, bored or (Churn, drill, rotary or
drilled) other)

Water Use: Domestic ☐ Municipal ☐ Other ☐ Irrigation ☐
Industrial ☐ Drainage ☐ Stock ☒

Indicate on the diagram the character and thickness of the different strata met with in drilling, such as soil, clay, shale, gravel, rock or sand, etc. Show depth at which water is encountered, thickness and character of water-bearing strata and height to which water rises in the well.

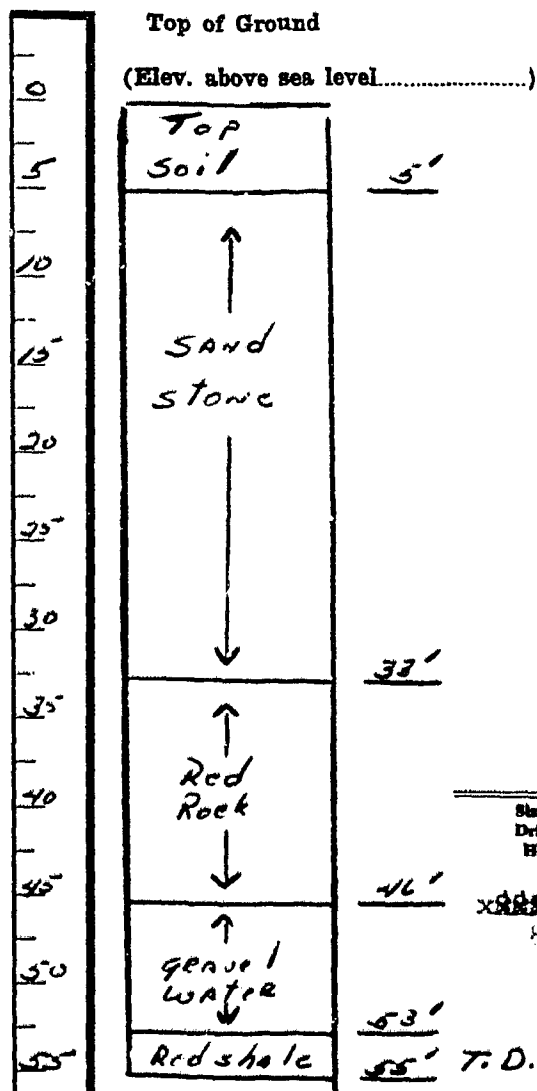

Size of Drilled Hole	Size and Weight of Casing	From (Feet)	To (Feet)	PERFORATIONS		
				Kind Size	From (Feet)	To (Feet)
8" O.D.	8" O.D. 6-5/8" I.D. 17' used seamless Suang J-55	0'	33'	-	-	-

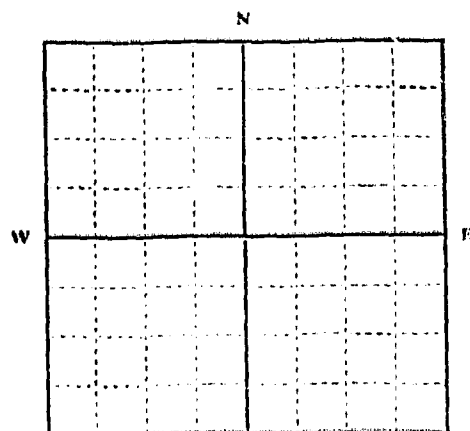

1/4 Sec. 29. T.18. R.5E.
Indicate location of well and
place of use, if possible. Each
small square represents 10 acres.

Show exact depth of bottom.

Static Water Level for non-flowing Well 45' below G.L. feet.

Shut-in Pressure for Flowing Well.....

Pumping Water Level 55' feet at 20 gal. per minute.

Discharge in gal. per min. of flowing well.....

How Tested bailer Length of Test 2 Hours

Remarks: (Gravel packing, cementing, packers, type of shutoff, loca-
tion of place of use of groundwater if not at well, and any
other similar pertinent information, including number of

acres irrigated, if used for irrigation) Hole was

drilled to a depth of 33 feet, at thispoint red rock was encountered and 7"

casing set at this depth. Well was then

continued with 6-5/8" bit to total depth.Driller's License Number 135

Patrick J. Byrne
Driller's Signature

This form to be prepared by driller, and three copies to be filed by the owner with the County Clerk and Recorder in the county in which the well is located.

Please answer all questions. If not applicable, so state, otherwise the form will be returned.

Original to the County Clerk and Recorder; duplicate to the State Engineer; Triplicate to the Montana Bureau of Mines and Geology and Quadruplicate for the Appropriator.

7904

#3438

STATE OF MONTANA, } ss.
County of Cascade.

I hereby certify that the within instrument was filed in this office on

NOV 27 1963
Date

at 11:35 o'clock A. M.

J. V. LENNON

County Clerk and Recorder.

By B. W. [Signature] Deputy.

File No.

T 18 R 5 E

DUPLICATE

County Cascade

STATE OF MONTANA
ADMINISTRATOR OF GROUNDWATER CODE
OFFICE OF STATE ENGINEER

Declaration of Vested Groundwater Rights

(Under Chapter 237, Montana Session Laws, 1961)

1. Mike & Mary Swartz, of 1318 Second Ave So Great Falls
(Name of Appropriator) (Address) (Town)

County of Cascade State of MONTANA
have appropriated groundwater according to the Montana laws in effect prior to January 1, 1962, as follows:

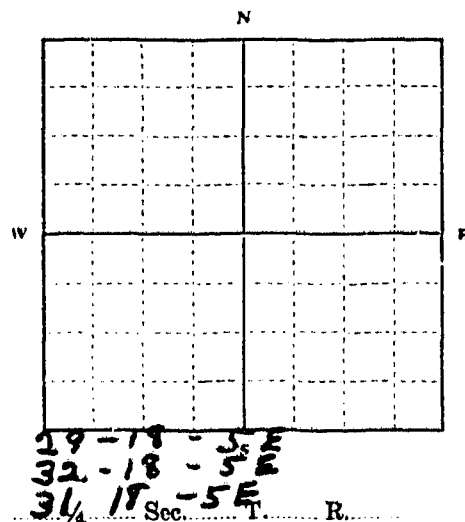

Indicate point of appropriation and place of use, if possible. Each small square represents 10 acres.

2. The beneficial use on which the claim is based For Farms and Live Stock

3. Date or approximate date of earliest beneficial use; and how continuous the use has been 80 years

4. The amount of groundwater claimed (in miner's inches or gallons per minute) 50 gallons

5. If used for irrigation, give the acreage and description of the lands to which water has been applied and name of the owner thereof NONE

6. The means of withdrawing such water from the ground and the location of each well or other means of withdrawal PUMPS AND ELECTRIC MOTORS

7. The date of commencement and completion of the construction of the well, wells, or other works for withdrawal of groundwater about 80 years

8. The depth of water table 50 Feet

9. So far as it may be available, the type, size and depth of each well or the general specifications of any other works for the withdrawal of groundwater

3 WELLS HAND dug
about 60 Feet

10. The estimated amount of groundwater withdrawn each year NOT applicable

11. The log of formations encountered in the drilling of each well if available NOT applicable

12. Such other information of a similar nature as may be useful in carrying out the policy of this act, including reference to book and page of any county record

Signature of Owner

Mike & Mary Swartz

Date

12-16-63

Three copies to be filed by the owner with the County Clerk and Recorder of the county in which the well is located.

Please answer all questions. If not applicable, so state, otherwise the form will be returned.

Original to the County Clerk and Recorder; Duplicate to the State Engineer; Triplicate to the Montana Bureau of Mines and Geology, and Quadruplicate for the Appropriator.

9956

3974

STATE OF MONTANA, } ss.
County of Cascade.

I hereby certify that the within instrument was filed in this office on

Date
at 1:52 o'clock P.M.

J. L. LENNON
County Clerk and Recorder.

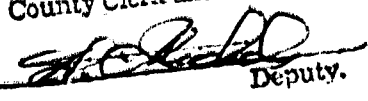
By  Deputy.

File No.

DUPLICATE

T. **18N** R. **5East**

County **Cascade**

STATE OF MONTANA
ADMINISTRATOR OF GROUNDWATER CODE
OFFICE OF STATE ENGINEER

RECEIVED
DEC 27 1963

STATE ENGINEER
**Notice of Completion of Groundwater Appropriation
Without Well**

(Under Chapter 237 Montana Session Laws, 1961)

Prior to Jan 1, 1930.

Date of Appropriation of Groundwater

Carl Gereke Owner..... Address **Stockett, Montana**

Contractor (if any) **None**

Address of Contractor

Date Started..... Date Completed.....

Describe means of obtaining groundwater without a well "as by sub-irrigation and other natural processes". Include depth to water when applicable. **Spring, flowing into**

stock reservoir, used to water livestock

Thruout year.

Quantity of water developed and used with explanation of method used to measure or estimate such amount. If use is intermittent

estimate approximate lengths of periods of use. **all year.**

Measured by bucket and watch, flowing

ten (10) gallons per minute.

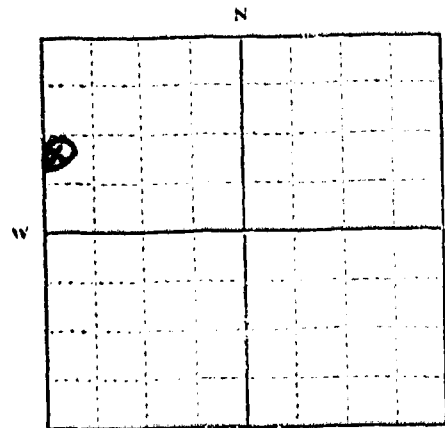

SW 1/4 NW 1/4 Sec. 30 T. 18N. R. 5E

Indicate point of appropriation and place of use, if possible.

Southwest Quarter of Northwest Quarter (SW 1/4 of NW 1/4) of Section Thirty (30) Twp 18North Range Five (5) East.

Signature of Owner **CARL GEREKE**

Date **December 26, 1963**

This form to be prepared by contractor (if any), otherwise by the owner.

Three copies of this notice are to be filed with the County Clerk and Recorder of the county in which the works are located.

Please answer all questions. If not applicable, so state, otherwise the form will be returned.

Original to the County Clerk and Recorder; duplicate to the State Engineer; Triplicate to the Montana Bureau of Mines and Geology and Quadruplicate for the Appropriator.

13060

3735

STATE OF MONTANA, } ss.
County of Cascade.

I hereby certify that the within in-
strument was filed in this office on
DEC 26 1983

at 9:00 o'clock A M.

J. L. LENNON
County Clerk and Recorder.

By B. Jones
Deputy.

32

File No.

T. 12 R. 34

DUPLICATE

County Cascade

STATE OF MONTANA
ADMINISTRATOR OF GROUNDWATER CODE
OFFICE OF STATE ENGINEER

Declaration of Vested Groundwater Rights

(Under Chapter 237, Montana Session Laws, 1961)

RECEIVED
NOV 22 1963
STATE ENGINEER

1. John Theresa A. Jesinsky, of Stockett
(Name of Appropriator) (Address) (Town)
County of Cascade State of Montana
have appropriated groundwater according to the Montana laws in effect prior to January 1, 1962, as follows:

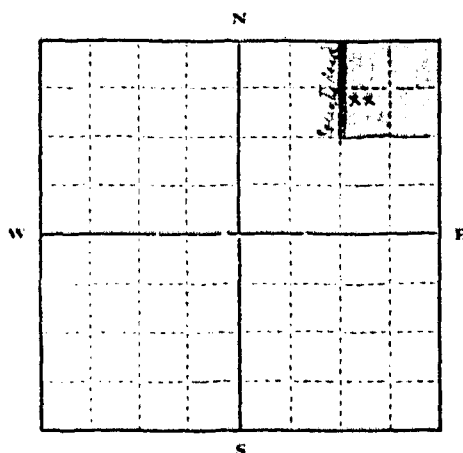

1/4 Sec. 32, T. 12, R. 34

Indicate point of appropriation
and place of use, if possible.
Each small square represents 10
acres.

2. The beneficial use on which the claim is based watering
stock, gardens and household use.
3. Date or approximate date of earliest beneficial use; and how con-
tinuous the use has been first well about 1910 and
in continuous use. second well drilled in
1939 and in continuous use.
4. The amount of groundwater claimed (in miner's inches or gallons
per minute) first well-25 gallons per minute
second well-20 gallons per minute
5. If used for irrigation, give the acreage and description of the lands
to which water has been applied and name of the owner thereof
irrigation only immediately surrounding
residence which is owned by the above
named appropriator.
6. The means of withdrawing such water from the ground and the
location of each well or other means of with- val.
first well by pump located at east end of
residence. second well by pump 50 ft. no. of rising
em.
7. The date of commencement and completion of the construction of the well, wells, or other works for with-
drawal of groundwater first well-1910 second well-1939
8. The depth of water table first well-30 ft. second well-50 feet
9. So far as it may be available, the type, size and depth of each well or the general specifications of any other
works for the withdrawal of groundwater first well-hand dug, 3 feet diameter, 35 feet
deep. second well-drill, 8 inch hole, 64 feet deep
10. The estimated amount of groundwater withdrawn each year continuous use
11. The log of formations encountered in the drilling of each well if available
both well identical--clay, shale, sand rock, water
12. Such other information of a similar nature as may be useful in carrying out the policy of this act, including
reference to book and page of any county record

Signature of Owner

Theresa A. Jesinsky
John Jesinsky
Date Nov 18, 1963

Three copies to be filed by the owner with the County Clerk and Recorder of the county in which the well is located.

Please answer all questions. If not applicable, so state, otherwise the form will be returned.

Original to the County Clerk and Recorder; duplicate to the State Engineer; Triplicate to the Montana Bureau of Mines and Geology, and Quadruplicate for the Appropriator.

21/11/63