

3756

STATE OF MONTANA, } ss.
County of Cascade.

I hereby certify that the within in-
strument was filed in this office on
DEC 26 1964

at _____ o'clock P M.
Date

J. L. LENNON

County Clerk and Recorder.

By E. J. Hartman
Deputy.

T 20 N R 3 E

County.....Cascadia.....

RECEIVED
JAN 9 1966

Rights ENGINEER

(Under Chapter 237, Montana Session Laws, 1961)

County of Cascade State of Montana
have appropriated groundwater according to the Montana laws in effect prior to January 1, 1962, as follows:

Lot 6	Block 2
Pearson	Addition
Cascade	County
Great Falls,	Montana

Indicate point of appropriation and place of use, if possible. Each small square represents 10 acres.

2. The beneficial use on which the claim is based. Domestic
3. Date or approximate date of earliest beneficial use; and how continuous the use has been. November 1, 1960 and continuous thereafter
4. The amount of groundwater claimed (in miner's inches or gallons per minute). 15 gallons per minute
5. If used for irrigation, give the acreage and description of the lands to which water has been applied and name of the owner thereof. not applicable
6. The means of withdrawing such water from the ground and the location of each well or other means of withdrawal. submersible pump
7. The date of the construction of the well, wells, or other works for withdrawal. in a period of approximately 7 days
date June 28, 1960
8. The size and depth of each well or the general specifications of any other water. cable tool - 6" O.D. - depth 258 ft.
9. The amount of water withdrawn each year. 250,000 gallons
10. The drilling of each well if available. see reverse side
11. Any other information as may be useful in carrying out the policy of this act, including county record. Certificate of dedication for Penn-on Addition
was filed December 30, 1959

Date Dec. 27, 1963

Three copies to be filed by the owner with the County Clerk and Recorder of the county in which the well is located.

Please answer all questions. If not applicable, so state, otherwise the form will be returned.

Original to the County Clerk and Recorder; duplicate to the State Engineer; Triplicate to the Montana Bureau of Mines and Geology, and Quadruplicate for the Appropriator.

28018

0 to 8 ft.	Shalerock with sandstone stringers
8 to 10 ft.	Sandstone
10 to 12 ft.	Clay
12 to 19 ft.	Sandstone
19 to 21 ft.	Shale & shalerock
21 to 26 ft.	Shalerock & sandstone stringers
26 to 31 ft.	Clay
31 to 36 ft.	Sandstone
36 to 42 ft.	Clay
42 to 53 ft.	Shalerock
53 to 61 ft.	Shalerock with sandstone stringers
61 to 92 ft.	Shalerock - Blue and red
92 to 96 ft.	Limestone - Hard
96 to 102 ft.	Redbed shalerock
102 to 106 ft.	Sandstone
106 to 108 ft.	Limestone
108 to 118 ft.	Sandstone - Gray - Hard
118 to 121 ft.	Shalerock
121 to 135 ft.	Sandstone - Fairly soft
135 to 138 ft.	Shalerock - Soft - Black
138 to 141 ft.	Clay
141 to 175 ft.	Shalerock
175 to 179 ft.	Sandstone - Water
179 to 199 ft.	Shalerock - Hard
199 to 212 ft.	Sandstone - Hard
212 to 251 ft.	Shalerock - Hard
251 to 258 ft.	Shalerock - Hard

Water - Not much
 Water - Not much

STATE OF MONTANA,
 County of Cascade.

I hereby certify that the within in-
 strument was filed in this office on
 DEC 30 1868

L. L. ENNON

County Clerk and Recorder.

Deputy.

41233

File No.

T. 22 R. 3 E

DUPLICATE

County Cascade

STATE OF MONTANA
ADMINISTRATOR OF GROUNDWATER CODE
OFFICE OF STATE ENGINEER

RECEIVED
JAN 8 1964

Declaration of Vested Groundwater Rights

(Under Chapter 237, Montana Session Laws, 1961)

1. Carl W. Trip, of East Helena Road 4 1/2 miles East Falls
(Name of Appropriator) (Address) (Town)

County of Cascade State of Montana
have appropriated groundwater according to the Montana laws in effect prior to January 1, 1962, as follows:

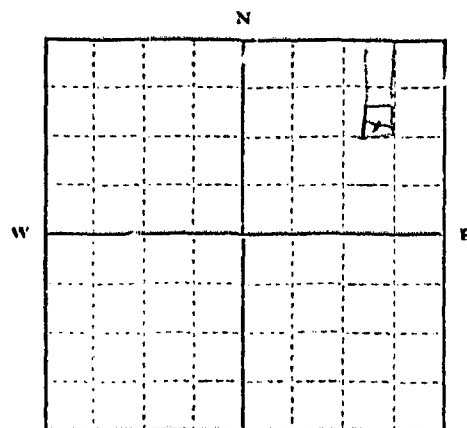

E 1/2 NW 1/4 NE NW

1/4 Sec. 23 T. 22 R. 3 E

Indicate point of appropriation
and place of use, if possible. Each
small square represents 10 acres.

2. The beneficial use on which the claim is based Domestic
household use & irrigation

3. Date or approximate date of earliest beneficial use; and how continu-
ous the use has been 1927
Steady continuous use

4. The amount of groundwater claimed (in miner's inches or gallons
per minute) I do not know any way of measuring
this amount of water used

5. If used for irrigation, give the acreage and description of the lands
to which water has been applied and name of the owner thereof
App. South 33 1/2 acres of described
land on East
Carl W. Trip

6. The means of withdrawing such water from the ground and the loca-
tion of each well or other means of withdrawal
Electrically operated pump

7. The date of commencement and completion of the construction of the well, wells, or other works for with-
drawal of groundwater East Well drilled and on use now
remained app. 5-1-1959

8. The depth of water table app. 120'

9. So far as it may be available, the type, size and depth of each well or the general specifications of any other
works for the withdrawal of groundwater
Well drilled 200' Cased with 5 1/2" casing
Electric pump attached

10. The estimated amount of groundwater withdrawn each year Min. of 150,000 gals. per yr.

11. The log of formations encountered in the drilling of each well if available app. 18' surface to
water bearing sand. 18' to 100' very fine water bearing sand.
Total depth surface to bedrock 200'

12. Such other information of a similar nature as may be useful in carrying out the policy of this act, including
reference to book and page of any county record
None known

Signature of Owner Carl W. Trip

Date 12-23-63

Three copies to be filed by the owner with the County Clerk and Recorder of the county in which the well is located.

Please answer all questions. If not applicable, so state, otherwise the form will be returned.

Original to the County Clerk and Recorder; Duplicate to the State Engineer; Triplicate to the Montana Bureau of
Mines and Geology, and Quadruplicate for the Appropriator.

27994

4009

STATE OF MONTANA, } ss.
County of Cascade.

I hereby certify that the within in-
strument was filed in this office on

DEC 30 1968

at 11:19 o'clock AM

J. L. LENNON

County Clerk and Recorder

By [Signature] Deputy

File No.

DUPLICATE

T. A. J. R. E.

County.

STATE OF MONTANA
ADMINISTRATOR OF GROUNDWATER CODE
OFFICE OF STATE ENGINEER

RECEIVED
DEC 27 1963

Declaration of Vested Groundwater Rights ENGINEER

(Under Chapter 237, Montana Session Laws, 1961)

1. Allen Workman, of Route #1 South Great Falls
(Name of Appropriator) (Address) (Town)
County of Gasconade State of Montana
have appropriated groundwater according to the Montana laws in effect prior to January 1, 1962, as follows:

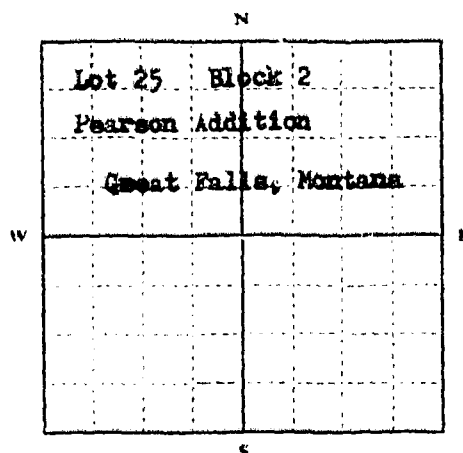

2. The beneficial use on which the claim is based Household & garden
3. Date or approximate date of earliest beneficial use; and how continuous the use has been July 1958
Has been in continuous use since this date.
4. The amount of groundwater claimed (in miner's inches or gallons per minute). 15 gallons
5. If used for irrigation, give the acreage and description of the lands to which water has been applied and name of the owner thereof
Lawn & garden only
6. The means of withdrawing such water from the ground and the location of each well or other means of withdrawal.
Electric Pump

1/4 Sec. T. R.

Indicate point of appropriation and place of use, if possible. Each small square represents 10 acres.

7. The date of commencement and completion of the construction of the well, wells, or other works for withdrawal of groundwater June 1958
8. The depth of water table 15 feet
9. So far as it may be available, the type, size and depth of each well or the general specifications of any other works for the withdrawal of groundwater 5 inch casing and about 40 feet deep.
10. The estimated amount of groundwater withdrawn each year 60,000 gallons per
11. The log of formations encountered in the drilling of each well if available Sand & Shale
12. Such other information of a similar nature as may be useful in carrying out the policy of this act, including reference to book and page of any county record Certificate of dedication for Pearson Addition was filed 12-30-57.

Signature of Owner

Allen Workman

Date December 23 1963

Three copies to be filed by the owner with the County Clerk and Recorder of the county in which the well is located.

Please answer all questions. If not applicable, so state, otherwise the form will be returned.

Original to the County Clerk and Recorder; Duplicate to the State Engineer; Triplicate to the Montana Bureau of Mines and Geology, and Quadruplicate for the Appropriator.

12486

3659

STATE OF MONTANA. } ss.
County of Cascade.

I hereby certify that the within in-
strument was filed in this office on
DEC 23 1963

at 8:11 o'clock PM

J. L. LERNER
County Clerk and Recorder.

By J. J. Johnson
Deputy.

County CascadeTwp. 20 NRge. 3ESections 24-36 and no sec. #

Sec.	Name of Appropriator	Type of Form	County File No.	Remarks
24	Belckner, Bernard S.	GW 4	4270	
24	"	"	4271	
24	Baer, Elmer, Roy P & Doretis	GW 2		
24	Bryant, J. E.	GW 1	3460	
24	"	GW 2	3461	
24	Dart, Vernon, Dan & Gayle M.	GW 4	3410	
24	Grover, Benjamin & Alene	"	3336	
24	Hallgren, Karl	GW 1	3340	
24	"	GW 2	3341	
24	"	GW 4	3897	
24	Kings, Charles J.	"	3496	
24	Malady, Bernard E.	"		
24	Meredith, Harold W. and Evelyn L.	"	4455	
24	Swingley, William C.	GW 2	4408	
24	Wadsworth, Leonard	"	4091	
25	Ayashite Dairy	GW 4	3691	
25	"	"	3692	
25	"	GW 2	3639	
25	Beale, Walter & Barbara	"	5527	
25	Bash, Vincent J.	"	4845	
25	Brugman, Dyal E. & Jean M.	"	4978	
25	Finneman, Fred	"	5203	
25	Happe, Frank Harold & Helen Christina	GW 4	3448	
25	Kleinhaus, William E.	GW 2	5502	
25	Karin, Darrell J.	GW 4	5274	
25	Leininger, Charles	GW 2	5129	
25	" Robert	"	5833	
25	Miteyee, Richard A.	GW 4	4350	
25	Michelotte, R. P. J.	GW 2	5084	
25	"	"	4735	
25	Newman, Jack	"	5291	
25	O'Day, Bartho E.	GW 4	4036	
25	Shell, Harry A.	"	3937	
25	"	GW 3	3938	
25	"	GW 4	3939	
25	Steffard, Walter M.	"	3757	
25	Thores, Matt & Thelma	"	3490	
25	-	Exhibit A	3714	
26	Thomas, T. H. & Marilyn	GW 2	5437	
27	Henderson, Vern E. and Grace M.	GW 2	5139	
27	Oac, Samuel & Mabel W.	"	5404	
28	Buchanan, John D.	"	5459	
28	"	"	5447	

County CascadeTwp. 20 NRge. 3 E

Sec.	Name of Appropriator	Type of Form	County File No.	Remarks
28	Ferguson, Clara F.	GW 3 5353	5353	
28	Keith, Harry C. & Margaret E.	GW 2	5339	
28	Pfleger, Wm. & Gene	"	5169	
28	Ramba, John W. & Marcelle W.	"	5346	
28	Schrader, Clarence	GW 3	3792	
28	"	"	3793	
28	"	GW 2	5371	
28	"	GW 1	5342	
28	Sevenson, Harry L.	GW 2	5272	
28	Talliver, Stan	"	5172	
28	Walfe, Otto R. & Adeline B.	"	5322	
29	Buchanan, John D.	"	5446	
29	"	"	5445	
29	Mion, Jac	"	5352	
29	Shaffarath, Henry C.	"	5237	
29	Williams, L.	"	5239	
31	Mont. Power Co.	GW 4	3091	
32	Connell, Henry E.	GW 3	5166	
32	Hartmann, Dudley B.	GW 2	5263	
32	Henry, Chuck	"	5285	
32	Olsen, Duane	"	5261	
32	Smith, Leslie H. & Carol S.	"	5305	
35	Lave, John E.	GW 4	3679	
35	Adgen, N.D. & Martin	GW 2	5382	
36	Biercragan, Lou	well log		
36	Cada, Emery	GW 2	5289	
36	Callahan, Mary	GW 4	3468	
36	Cattico, James L.	GW 2	4971	
36	Chamberlin, Gene	"	3500	
36	"	GW 1	3501	
36	" , Rex Jr.	GW 2	5200	
36	Chrisman, Sheldon & Alene	GW-4	4307	
36	Dannels, Ellen V. and Violet M.	"	3502	
36	Danover Park Youth etc.	"	4448	
36	"	GW 2	5095	
36	Earl, Joan L. & Bert H.	GW 4	3671	
36	Finlay, Wm. B. Jr. & Ida B.	"	3110	
36	Firman, Michael, Jr.	GW 2	5316	
36	Franklin, Robert B.	GW 4	3700	
36	"	"	3701	
36	Gaither, Robert P.	GW 2	3478	
36	Harrington, Helen M.	GW 4		
36	Hasbrouck, W. Earl and Gladys M.	"	3379	
36	"	"	3380	

File No. _____

T. _____ R. _____

DUPLICATE

County _____

STATE OF MONTANA
ADMINISTRATOR OF GROUNDWATER CODE
OFFICE OF STATE ENGINEER

RECORDED
1964

Declaration of Vested Groundwater Rights

(Under Chapter 237, Montana Session Laws, 1961)

1. Bernard S. Balochner of Butte Montana
(Name of Appropriator) (Address) (Town)
County of Butte State of Montana
have appropriated groundwater according to the Montana laws in effect prior to January 1, 1962, as follows:

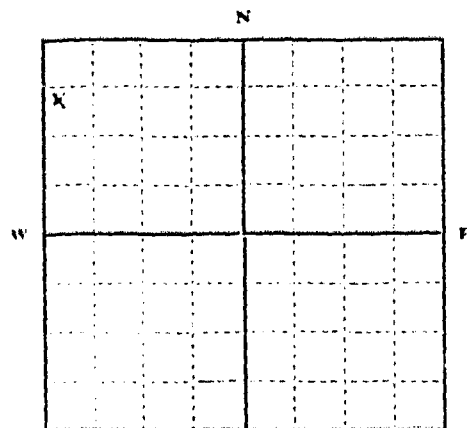

N 1/2 S 1/2 NW 1/4 Sec. 34 T. 20 R. 3 E

Indicate point of appropriation and place of use, if possible. Each small square represents 10 acres.

2. The beneficial use on which the claim is based domestic
irrigation
3. Date or approximate date of earliest beneficial use; and how continuous the use has been 6/25/1949
continuous
4. The amount of groundwater claimed (in miner's inches or gallons per minute) 50 gal
5. If used for irrigation, give the acreage and description of the lands to which water has been applied and name of the owner thereof
3 acres, lawn, flowers & garden
also surrounding area
Bernard S. Balochner
6. The means of withdrawing such water from the ground and the location of each well or other means of withdrawal
electric pump

7. The date of commencement and completion of the construction of the well, wells, or other works for withdrawal of groundwater completion of well 6/25/1949
8. The depth of water table 33 ft from surface
9. So far as it may be available, the type, size and depth of each well or the general specifications of any other works for the withdrawal of groundwater
stainless steel, 17.5 ft deep
10. The estimated amount of groundwater withdrawn each year 4200000 gallons
11. The log of formations encountered in the drilling of each well if available
none available
12. Such other information of a similar nature as may be useful in carrying out the policy of this act, including reference to book and page of any county record none

Signature of Owner

Bernard S. BalochnerDate Dec 31, 1963

Three copies to be filed by the owner with the County Clerk and Recorder of the county in which the well is located.

Please answer all questions. If not applicable, so state, otherwise the form will be returned.

Original to the County Clerk and Recorder; Duplicate to the State Engineer; Triplicate to the Montana Bureau of Mines and Geology, and Quadruplicate for the Appropriator.

28258

4270

STATE OF MONTANA, }
County of Cascade, }

I hereby certify that the within in-
strument was filed in this office on
DEC 31 1903

Date
10:10 o'clock P.M.

J. E. LERNER

County Clerk and Ex.

J. E. Lerner

File No.

T. ... R. ...

DUPLICATE

County

STATE OF MONTANA
ADMINISTRATOR OF GROUNDWATER CODE
OFFICE OF STATE ENGINEER

RECEIVED
JAN 9 1964

Declaration of Vested Groundwater Rights

(Under Chapter 237, Montana Session Laws, 1961)

1. Bernard S. Belachman, of Rt. 1 So. Great Falls
(Name of Appropriator) (Address) (Town)
County of Cascade State of Montana
have appropriated groundwater according to the Montana laws in effect prior to January 1, 1962, as follows:

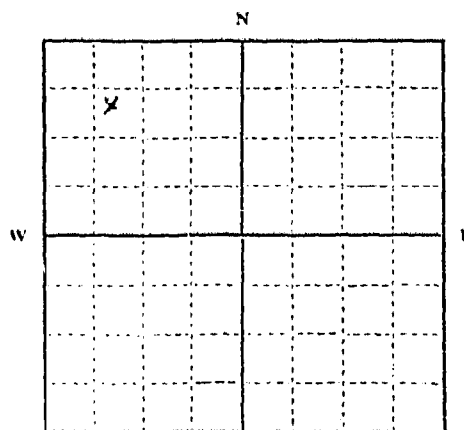

N 5 1/2 NW 1/4 NW
1/4 Sec. 24 T. 20 R. 3 E
Indicate point of appropriation
and place of use, if possible. Each
small square represents 10 acres.

2. The beneficial use on which the claim is based stock +
irrigation
3. Date or approximate date of earliest beneficial use; and how continu-
ous the use has been 6/22/49
Occasionally
4. The amount of groundwater claimed (in miner's inches or gallons
per minute) 30 gals. P.M.
5. If used for irrigation, give the acreage and description of the lands
to which water has been applied and name of the owner thereof
4 acres, stock water
6. The means of withdrawing such water from the ground and the loca-
tion of each well or other means of withdrawal Pump
7. The date of commencement and completion of the construction of the well, wells, or other works for with-
drawal of groundwater 6/25/49
8. The depth of water table 25 ft. from surface
9. So far as it may be available, the type, size and depth of each well or the general specifications of any other
works for the withdrawal of groundwater Shallow, 6' in. 19.5 ft. deep
10. The estimated amount of groundwater withdrawn each year 600,000 gal
11. The log of formations encountered in the drilling of each well if available
not available
12. Such other information of a similar nature as may be useful in carrying out the policy of this act, including
reference to book and page of any county record

Signature of Owner Bernard S. Belachman

Date Dec 30, 1963

Three copies to be filed by the owner with the County Clerk and Recorder of the county in which the well is located.

Please answer all questions. If not applicable, so state, otherwise the form will be returned.

Original to the County Clerk and Recorder; Duplicate to the State Engineer; Triplicate to the Montana Bureau of
Mines and Geology, and Quadruplicate for the Appropriator.

28259

4271

STATE OF MONTANA, }
County of Cascade.

I hereby certify that the within in-
strument was filed in this office on
DEC 9 1908

Date
10:11 o'clock

J. L. LENTON

County Clerk and Recorder

J. L. Lenton

File No.

T. 20N R. 3E

DUPLICATE

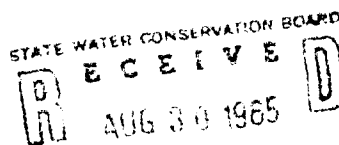
County Cascade

STATE OF MONTANA
ADMINISTRATOR OF GROUNDWATER CODE
OFFICE OF STATE ENGINEER

Top of Ground

(Elev. above sea level) 165

**Notice of Completion of Groundwater
Appropriation by Means of Well**

(Under Chapter 237, Montana Session Laws, 1961)

0
10
20
30
40
50
60
70
80
90
100
110
120
130
140
150
160
165

5-15
15-35
35-40
40-50
50-63
63-68
68-80
80-90
90-103
103-110

sandstone
Red rock
small ant. water
Red shale
gray sandstone
hard rock
hard shale
hard shale
gray + red shale
hard gray lime
sandstone
Gray shale

Owner Roy P. and/or Deloris F.Address Great Falls, Mont.Driller BoesflugAddress Great Falls, Mont.

Date of Notice of Appropriation of Groundwater

Date well started 7-5-1965 Date Completed 7-10-1965Type of well Drilled
(dug, driven, bored or drilled)Equipment Used Churn drill
(Churn, drill, rotary or other)

Water Use: Domestic ☒ Municipal ☐ Other ☐ Irrigation ☐
Industrial ☐ Drainage ☐ Stock ☐

Indicate on the diagram the character and thickness of the different strata met with in drilling, such as soil, clay, shale, gravel, rock or sand, etc. Show depth at which water is encountered, thickness and character of water-bearing strata and height to which water rises in the well.

Size of Drilled Hole	Size and Weight of Casing	From (Feet)	To (Feet)	PERFORATIONS		
				Kind Size	From (Feet)	To (Feet)
8"	17# 7"	0	40'	not perforated		

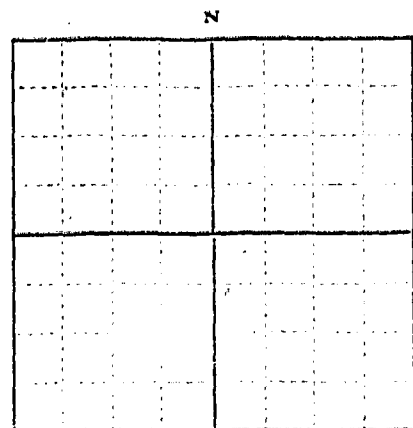

NE 1/4 Sec. 24 T. 20N R. 3E
Indicate location of well and place of use, if possible. Each small square represents 10 acres.

Show exact depth of bottom.

Static Water Level for non-flowing Well 85 feet.

Shut-in Pressure for Flowing Well

Pumping Water Level 160' feet at 8 gal. per minute.

Discharge in gal. per min. of flowing well

How Tested Bailer Length of Test 2 hours

Remarks: (Gravel packing, cementing, packers, type of shutoff, location of place of use of groundwater if not at well, and any other similar pertinent information, including number of acres irrigated, if used for irrigation)

135
Driller's License Number

[Signature]
Driller's Signature

This form to be prepared by driller, and three copies to be filed by the owner with the County Clerk and Recorder in the county in which the well is located.

Please answer all questions. If not applicable, so state, otherwise the form will be returned.

Original to the County Clerk and Recorder; duplicate to the State Engineer; Triplicate to the Montana Bureau of Mines and Geology and Quadruplicate for the Appropriator.

29478

STATE OF MONTANA, } ss.
County of Cascade.

I hereby certify that the within in-
strument was filed in this office on
AUG 23 1965

Date

at 10:30 o'clock A M.

J. L. LENNON

County Clerk and Recorder.

By

[Signature]
Deputy.

File No.

T. 20

R. 25

DUPLICATE

County

STATE OF MONTANA
ADMINISTRATOR OF GROUNDWATER CODE
OFFICE OF STATE ENGINEER

Notice of Appropriation of Groundwater

(Under Chapter 237, Montana Session Laws, 1961)

1. I, JAYE E BRYANT of RT 30 GREAT FALLS
(Name of Appropriator) (Address) (Town)
County of CASCADE, State of MONT, intend to appropriate groundwater in accordance with Chapter 237, Montana Session Laws of 1961.

2. The beneficial use to which water is to be applied is TRAILER COURT
LAWNS ONLY
(describe lands to be benefited, if for irrigation)

3. The rate of use in gallons per minute or miner's inches of groundwater claimed 4000 gal per day

4. The annual period (inclusive dates) of intended use year round

5. The probable or intended date of first beneficial use May 1, 1963

6. The probable or intended date of commencement and completion of the well* or wells* commencement April 20, 1963 completion July 25, 1963

7. The location, type, size and depth of well or wells contemplated sec 24 Township 20
deep well 5" 4" NW MK 6A range 3E SD 1-

8. The probable or estimated depth of the water table or artesian aquifer 165 ft.

9. Name, address and license number of the driller engaged Thomas B. Franklin
He 1 SO. Lic. #84

10. Give such other similar information as may be useful

in carrying out the policy of this act.

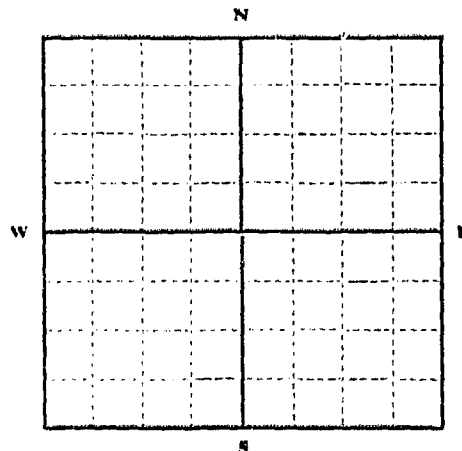

1/4 Sec. T. R.
Locate well or other means of development as accurately as possible on the plat.

Signature of Appropriator

Jaye E. Bryant
Date Dec 7, 1963

- * As defined in the Code Sec. 1 (c) "Well" means any artificial opening or excavation in the ground, however made, by which groundwater can be obtained or through which it flows under natural pressures or is artificially withdrawn."

Three copies of this notice are to be filed with County Clerk and Recorder of the county in which the well is located.

Please answer all questions. If not applicable, so state, otherwise the form will be returned.

Original to the County Clerk and Recorder; duplicate to the State Engineer; Triplicate to the Montana Bureau of Mines and Geology and Quadruplicate for the Appropriator.

8749

#3460

STATE OF MONTANA, } ss.
County of Cascade.

I hereby certify that the within in-
strument was filed in this office on
DEC 9 - 1983

at 9:34 ^{date} o'clock 9 M.

J. L. LENNON
County Clerk and Recorder.

By B. Hill
Deputy.

File No.

T. R.

DUPLICATE

County

STATE OF MONTANA
ADMINISTRATOR OF GROUNDWATER CODE
OFFICE OF STATE ENGINEER

DEC 13 1963

Top of Ground
(Elev. above sea level.....)

Notice of Completion of Groundwater
Appropriation by Means of Well

(Under Chapter 237, Montana Session Laws, 1961)

Owner *Jaye Bryant* Address *Great Falls, Mont.*Driller *Thomas B. Franklin* Address *Great Falls, Mont.*Date of Notice of Appropriation of Groundwater *April 22, 1963*Date well started *April 25, 1963* Date Completed *May 1, 1963*

Type of well *Drilled, Driven* Equipment Used *Cable Tools*
(dug, driven, bored or (Churn, drill, rotary or
drilled) other)

Trailer Court

Water Use: Domestic ☐ Municipal ☐ Other ☐ Irrigation ☐
Industrial ☐ Drainage ☐ Stock ☐

Indicate on the diagram the character and thickness of the different strata met with in drilling, such as soil, clay, shale, gravel, rock or sand, etc. Show depth at which water is encountered, thickness and character of water-bearing strata and height to which water rises in the well.

Size of Drilled Hole	Size and Weight of Casing	From (Feet)	To (Feet)	PERFORATIONS		
				Kind Size	From (Feet)	To (Feet)
<i>5 inch</i>	<i>5 inch OD Oil Well Casing 14 lbs per ft</i>	<i>Top</i>	<i>Bottom</i>			

From top to 160' Glacial Drift Silt
From 160' to 180' Sand

From 180' to 186' Water Bearing Sand, gravel

186'

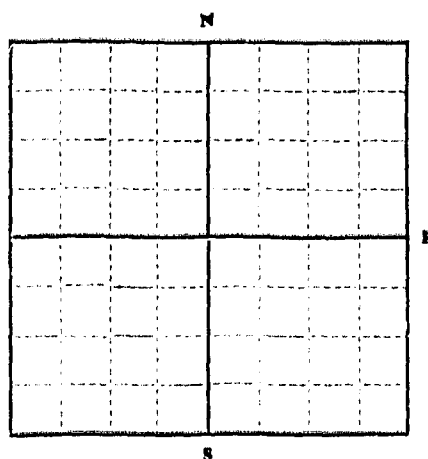

..... 1/4 Sec. T. R.
Indicate location of well and place of use, if possible. Each small square represents 10 acres.

Show exact depth of bottom.

Static Water Level for non-flowing Well *25* feet.

Shut-in Pressure for Flowing Well.....

Pumping Water Level *60* feet at *14* gal. per minute.

Discharge in gal. per min. of flowing well.....

How Tested *Jet pump* Length of Test *8 hrs.*

Remarks: (Gravel packing, cementing, packers, type of shutoff, location of place of use of groundwater if not at well, and any other similar pertinent information, including number of acres irrigated, if used for irrigation).....

84
Driller's License Number

Thomas B. Franklin
Driller's Signature

This form to be prepared by driller, and three copies to be filed by the owner with the County Clerk and Recorder in the county in which the well is located.

Please answer all questions. If not applicable, so state, otherwise the form will be returned.

Original to the County Clerk and Recorder; duplicate to the State Engineer; Triplicate to the Montana Bureau of Mines and Geology and Quadruplicate for the Appropriator.

1100

#2461

STATE OF MONTANA, } ss.
County of Cascade.

I hereby certify that the within in-
strument was filed in this office on

DEC 9 - 1968

at 9:35 o'clock 9 M.

J. L. LENNON

County Clerk and Recorder.

By B. H. H. H. Deputy.

File No.

T. R.

DUPLICATE

County.

STATE OF MONTANA
ADMINISTRATOR OF GROUNDWATER CODE
OFFICE OF STATE ENGINEER

RECEIVED
OCT 31 1963

Declaration of Vested Groundwater Rights

(Under Chapter 237, Montana Session Laws, 1961)

STATE ENGINEER

1. Merwin E. Carr + Gayle M. Carr of Route 1 South Great Falls
(Name of Appropriator) (Address) (Town)
County of Cascade State of Montana
have appropriated groundwater according to the Montana laws in effect prior to January 1, 1962, as follows:

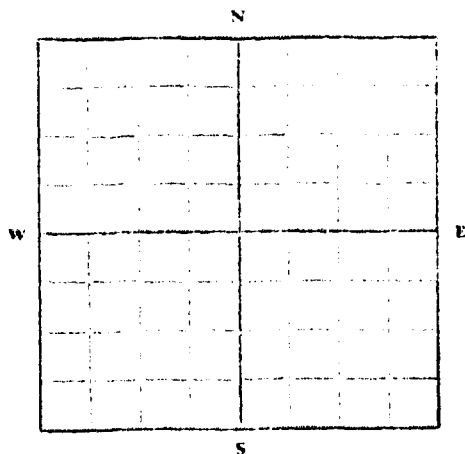

..... 1/4 Sec. T. R.
Indicate point of appropriation
and place of use, if possible.
Each small square represents 10
acres.

2. The beneficial use on which the claim is based Household
watering lawn & shrubs
3. Date or approximate date of earliest beneficial use; and how continuous the use has been Oct. 20, 1956
Constant use
4. The amount of groundwater claimed (in miner's inches or gallons per minute) 26 gal Per Min
5. If used for irrigation, give the acreage and description of the lands to which water has been applied and name of the owner thereof
3 1/4 acre lawn & shrubs
S.W. 1/4 NW 1/4 Section 24, T. 20 N., R. 3 E.
6. The means of withdrawing such water from the ground and the location of each well or other means of withdrawal
Jet Pump
7. The date of commencement and completion of the construction of the well, wells, or other works for withdrawal of groundwater
Sept. 20, 1956 to Oct. 28, 1956
8. The depth of water table 197 ft
9. So far as it may be available, the type, size and depth of each well or the general specifications of any other works for the withdrawal of groundwater
Drilled - Casing 5", 266 ft
10. The estimated amount of groundwater withdrawn each year 900,000 gal
11. The log of formations encountered in the drilling of each well if available
Sand & Gravel, Sand & Gravel, No Measurement Available
12. Such other information of a similar nature as may be useful in carrying out the policy of this act, including reference to book and page of any county record
- Signature of Owner Gayle M. Carr
Merwin E. Carr
Date Oct 25, 1963

Three copies to be filed by the owner with the County Clerk and Recorder of the county in which the well is located.

Please answer all questions. If not applicable, so state, otherwise the form will be returned.

Original to the County Clerk and Recorder; duplicate to the State Engineer; Triplicate to the Montana Bureau of Mines and Geology, and Quadruplicate for the Appropriator.

#3410

STATE OF MONTANA, } ss.
County of Cascade.

I hereby certify that the within in-
strument was filed in this office on

OCT 28 1963

Date

at 4:53 o'clock P.

J. L. LENNON

County Clerk and Recorder.

By [Signature]
Deputy.

File No. 3336T. 22N R. 3E

DUPLICATE

County Beaumont

STATE OF MONTANA
ADMINISTRATOR OF GROUNDWATER CODE
OFFICE OF STATE ENGINEER

Declaration of Vested Groundwater Rights

(Under Chapter 237, Montana Session Laws, 1961)

RECEIVED

STATE ENGINEER

1. Bryan F. Jones of St. Louis Falls
(Name of Appropriator) (Address) (Town)
County of Beaumont State of Montana
have appropriated groundwater according to the Montana laws in effect prior to January 1, 1962, as follows:

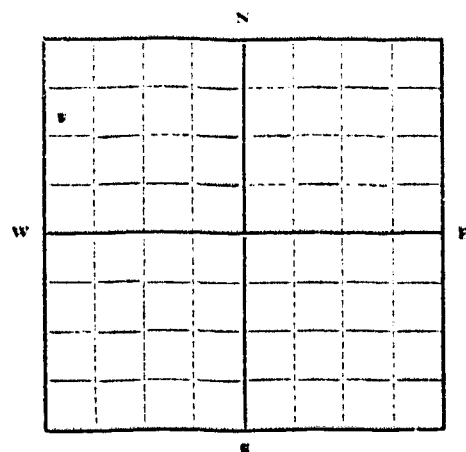

SW 1/4 Sec 24 T20N R.3E

Indicate point of appropriation
and place of use, if possible.
Each small square represents 10
acres.

2. The beneficial use on which the claim is based Household water supply
3. Date or approximate date of earliest beneficial use; and how continuous the use has been June 1957
constant use
4. The amount of groundwater claimed (in miner's inches or gallons per minute) 24 gal per min
5. If used for irrigation, give the acreage and description of the lands to which water has been applied and name of the owner thereof
3.00 acre house - 0.50 acre
SW 1/4 Sec 24 T20N R.3E
6. The means of withdrawing such water from the ground and the location of each well or other means of withdrawal
Art. Pump
7. The date of commencement and completion of the construction of the well, wells, or other works for withdrawal of groundwater April 29 1957 May 16 1957
8. The depth of water table 200 ft
9. So far as it may be available, the type, size and depth of each well or the general specifications of any other works for the withdrawal of groundwater Art. Well - 6" - 200 ft
10. The estimated amount of groundwater withdrawn each year 70000 gal
11. The log of formations encountered in the drilling of each well if available See log
Quick sand - sand gravel - no more formations
12. Such other information of a similar nature as may be useful in carrying out the policy of this act, including reference to book and page of any county record Book 2 Page 171

Signature of Owner Bryan F. JonesDate June 27 1963

Three copies to be filed by the owner with the County Clerk and Recorder of the county in which the well is located.

Please answer all questions. If not applicable, so state, otherwise the form will be returned.

Original to the County Clerk and Recorder; duplicate to the State Engineer; Triplicate to the Montana Bureau of Mines and Geology, and Quadruplicate for the Appropriator.

2376

SEAL OF MONTANA
County of Cascade

I hereby certify that the within in-
strument was filed in the office on

11. 25. 1933

at 3.30

W. S. I. R.

By 26000
Supervisor

File No. 3340T. 24 R. 3E

DUPLICATE

County

STATE OF MONTANA
ADMINISTRATOR OF GROUNDWATER CODE
OFFICE OF STATE ENGINEER

RECEIVED
AUG 5 1963

Notice of Appropriation of Groundwater

(Under Chapter 237, Montana Session Laws, 1961)

STATE ENGINEER

- I, Karl Hallgren of Rte. 1 So. Great Falls, Mont.
(Name of Appropriator) (Address) (Town)
County of Cascade State of Montana intend to appropriate groundwater in accordance with Chapter 237, Montana Session Laws of 1961.
- The beneficial use to which water is to be applied is Domestic
(describe lands to be benefited, if for irrigation)
- The rate of use in gallons per minute or miner's inches of groundwater claimed 10 gals. per minute
- The annual period (inclusive dates) of intended use Life Term, Indefinite
- The probable or intended date of first beneficial use Dec. 1, 1962
- The probable or intended date of commencement and completion of the well* or wells* Nov. 12, 1962
- The location, type, size and depth of well or wells contemplated North East corner of house 170 ft. 5 in. L.D.
- The probable or estimated depth of the water table or artesian aquifer 20 ft.
- Name, address and license number of the driller engaged Thomas B. Brinklin
Rte. 1 So. Great Falls, Mont.
- Give such other similar information as may be useful in carrying out the policy of this act.

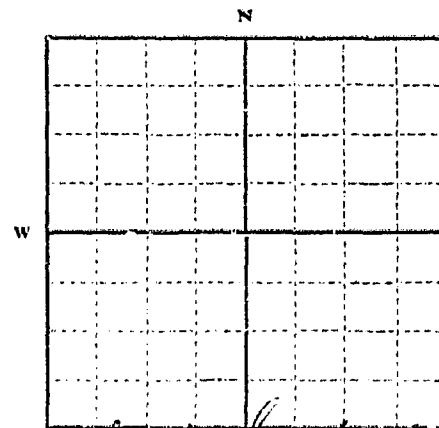

24 Sec. 24 T. 3E R. 3E
Locate well or other means of development as accurately as possible on the plat.

Signature of Appropriator

Karl H. Hallgren
Date Dec. 20 1962

* As defined in the Code Sec. 1 (a) "Well" means any artificial opening or excavation in the ground, however made, by which groundwater can be obtained or through which it flows under natural pressures or is artificially withdrawn."

Three copies of this notice are to be filed with County Clerk and Recorder of the county in which the well is located.

Please answer all questions. If not applicable, so state, otherwise the form will be returned.

Original to the County Clerk and Recorder; duplicate to the State Engineer; Triplicate to the Montana Bureau of Mines and Geology and Quadruplicate for the Appropriator.

#3340

STATE OF MONTANA, } ss.
County of Cascade.

I hereby certify that the within in-
strument was filed in this office on
AUG 1 - 1968

at 2:56 ^{Date} o'clock P. M.

J. L. LENNON
County Clerk and Recorder.

By Chris Deputy.

File No. 3341T. 22 N. R. 3 E

DUPLICATE

County LeewardSTATE OF MONTANA
ADMINISTRATOR OF GROUNDWATER CODE
OFFICE OF STATE ENGINEER

AUG 5 1963

Notice of Completion of Groundwater Appropriation by Means of Well

(Under Chapter 237, Montana Session Laws, 1961)

Owner Paul Hallgren Address Rte. 1. So. Great Falls, Mont.
Driller Thomas B. Franklin Address Rte. 1. So. Great Falls, Mont.Date of Notice of Appropriation of Groundwater Nov. 18, 1962Date well started Nov. 20 - 62 Date Completed Nov. 25, 1962Type of well Drilled, Driven Equipment Used Cable tools
(dug, driven, bored or drilled) (Churn, drill, rotary or other)Water Use: Domestic ☒ Municipal ☐ Other ☐ Irrigation ☐
Industrial ☐ Drainage ☐ Stock ☐

Indicate on the diagram the character and thickness of the different strata met with in drilling, such as soil, clay, shale, gravel, rock or sand, etc. Show depth at which water is encountered, thickness and character of water-bearing strata and height to which water rises in the well.

Size of Drilled Hole	Size and Weight of Casing	From (Feet)	To (Feet)	PERFORATIONS		
				Kind Size	From (Feet)	To (Feet)
5 inch	5 inch OD Oil well casing 14 lbs per ft.	Top	Bottom			

Static Water Level for non-flowing Well 22 feet.

Shut-in Pressure for Flowing Well.....

Pumping Water Level 65 feet at 12 gal. per minute.

Discharge in gal. per min. of flowing well.....

How Tested Bailer Length of Test 4 hrs

Remarks: (Gravel packing, cementing, packers, type of shutoff, location of place of use of groundwater if not at well, and any other similar pertinent information, including number of

acres irrigated, if used for irrigation) approx.5 ft. of gravel packing used.Top of Ground
(Elev. above sea level.....)

30 ft. sand

From 80 ft. to 165 glacial drift humbo

From 165 to 170 water bearing sand and shale

Water bearing sand, gravel

170

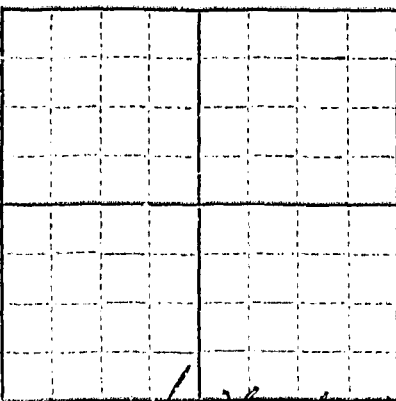

23.61 sec. 14.11 min. 14.11 sec. 14.11 min. 14.11 sec.

Indicate location of well and place of use, if possible. Each small square represents 10 acres.

Show exact depth of bottom.

84

Driller's License Number

Thomas B. Franklin

Driller's Signature

This form to be prepared by driller, and three copies to be filed by the owner with the County Clerk and Recorder in the county in which the well is located.

Please answer all questions. If not applicable, so state, otherwise the form will be returned.

Original to the County Clerk and Recorder; duplicate to the State Engineer; Triplicate to the Montana Bureau of Mines and Geology and Quadruplicate for the Appropriator.

5253

#3340

STATE OF MONTANA, }
County of Cascade.

I hereby certify that the within in-
strument was filed in this office on

AUG 1 - 1963
Date
at 2:56 o'clock AM.

J. L. LENNON
County Clerk and Recorder.

By B. J. J. J.
Deputy.

File No.

T. 2 S. R. 3 E.

DUPLICATE

County

STATE OF MONTANA
ADMINISTRATOR OF GROUNDWATER CODE
OFFICE OF STATE ENGINEER

Declaration of Vested Groundwater Rights

(Under Chapter 237, Montana Session Laws, 1961)

STATE ENGINEER

1. Karl H. Hallgren, of Bozeman South, Great Falls
(Name of Appropriator) (Address) (Town)
County of Cascade State of Montana
have appropriated groundwater according to the Montana laws in effect prior to January 1, 1962, as follows:

N

W E

Lot 3 s Block 3
Southvale Addition
1/4 Sec. T. R.

Indicate point of appropriation and place of use, if possible. Each small square represents 10 acres.

2. The beneficial use on which the claim is based Domestic
3. Date or approximate date of earliest beneficial use; and how continuous the use has been Dec. 1, 1962 continuously
4. The amount of groundwater claimed (in miner's inches or gallons per minute) 50 gallons per minute
5. If used for irrigation, give the acreage and description of the lands to which water has been applied and name of the owner thereof
Lot 3 Block 3 - Karl Hallgren
Lot 4 Block 3 - Hazel Hallgren
6. The means of withdrawing such water from the ground and the location of each well or other means of withdrawal
Jet Pump
7. The date of commencement and completion of the construction of the well, wells, or other works for withdrawal of groundwater
Nov. 26, 1962 finished Nov. 25, 1962
8. The depth of water table 2.2 feet
9. So far as it may be available, the type, size and depth of each well or the general specifications of any other works for the withdrawal of groundwater
Large casing 14 inch per foot 170 feet deep Old well casing
10. The estimated amount of groundwater withdrawn each year 250,000 gallons
11. The log of formations encountered in the drilling of each well if available
From top to 20 feet
Sand, from 20 to 11.5 feet Clay, from 11.5 to 12 feet
With bearing sand, gravel
12. Such other information of a similar nature as may be useful in carrying out the policy of this act, including reference to book and page of any county record
Well recorded at Cascade County
Cascade County

Signature of Owner Karl H. HallgrenDate Dec. 27, 1963

Three copies to be filed by the owner with the County Clerk and Recorder of the county in which the well is located.

Please answer all questions. If not applicable, so state, otherwise the form will be returned.

Original to the County Clerk and Recorder; Duplicate to the State Engineer; Triplicate to the Montana Bureau of Mines and Geology, and Quadruplicate for the Appropriator.

27885

3897

STATE OF MONTANA, } ss.
County of Cascade.

I hereby certify that the within in-
strument was filed in this office on

DEC 27 1903

at 3:10 ^{Date} o'clock PM.

J. L. LENNON

County Clerk and Recorder.

By

J. J. O'Connor
Deputy.

File No.

DUPLICATE

T. 30 R. 3 E

County

STATE OF MONTANA
ADMINISTRATOR OF GROUNDWATER CODE
OFFICE OF STATE ENGINEER

RECEIVED
DEC 17 1962

Declaration of Vested Groundwater Rights STATE ENGINEER
(Under Chapter 237, Montana Session Laws, 1961)

1. Charles J. King, of Southvale Addition Gt. Falls
(Name of Appropriator) (Address) (Town)
County of Cascade State of Montana
have appropriated groundwater according to the Montana laws in effect prior to January 1, 1962, as follows:

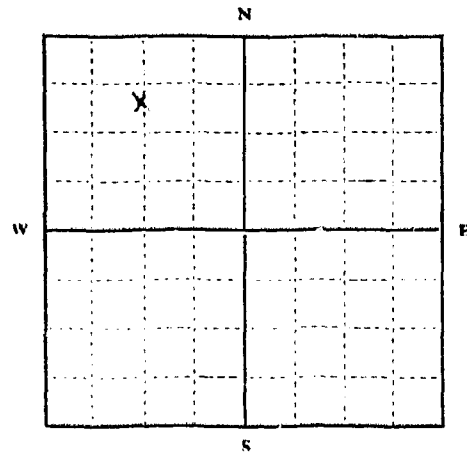

W $\frac{1}{2}$
NW $\frac{1}{4}$ Sec. 24, T. 30, R. 3, E

Indicate point of appropriation and place of use, if possible. Each small square represents 10 acres.

*Lot 18 - Block 1
Southvale Addition to Gt. Falls*

2. The beneficial use on which the claim is based Domestic, Lawn Shrubbery, Trees, etc.
3. Date or approximate date of earliest beneficial use; and how continuous the use has been. August 1961, In use daily
4. The amount of groundwater claimed (in miner's inches or gallons per minute). 30 gallons per minute
5. If used for irrigation, give the acreage and description of the lands to which water has been applied and name of the owner thereof. 120 x 120 feet, owner, self
6. The means of withdrawing such water from the ground and the location of each well or other means of withdrawal. One well with electric pump for withdrawal. Five inch casing I.D. Location, lot 18, Southvale Addition
7. The date of commencement and completion of the construction of the well, wells, or other works for withdrawal of groundwater. The well was started and completed in July 1961
8. The depth of water table. 175 feet
9. So far as it may be available, the type, size and depth of each well or the general specifications of any other works for the withdrawal of groundwater. None
10. The estimated amount of groundwater withdrawn each year. 50,000 to 80,000 gallons per year
11. The log of formations encountered in the drilling of each well if available. Unavailable
12. Such other information of a similar nature as may be useful in carrying out the policy of this act, including reference to book and page of any county record. No other information concerning this act is known by me.

Signature of Owner

Charles J. King
Date *Dec 13, 1962*

Three copies to be filed by the owner with the County Clerk and Recorder of the county in which the well is located.

Please answer all questions. If not applicable, so state, otherwise the form will be returned.

Original to the County Clerk and Recorder; Duplicate to the State Engineer; Triplicate to the Montana Bureau of Mines and Geology, and Quadruplicate for the Appropriator.

9573

#3496

STATE OF MONTANA, } ss.
County of Cascade.

I hereby certify that the within instrument was filed in this office on

DEC 13 1962

at 4:35 o'clock PM

J. L. LENNON

County Clerk and Recorder.

By [Signature]
Deputy.

GW

Approved Stock Form—State Publishing Co., Helena, Montana—49876

24

File No.

T 20 R 2

DUPLICATE

County

STATE OF MONTANA
ADMINISTRATOR OF GROUNDWATER CODE
OFFICE OF STATE ENGINEER

RECEIVED
AUG 26 1963

STATE ENGINEER
Declaration of Vested Groundwater Rights
(Under Chapter 237, Montana Session Laws, 1961)

1. Bernard E. Malady of Sumner Lane Tract #2 South
(Name of Appropriator) (Address) (Town)
County of Cascade State of Montana
have appropriated groundwater according to the Montana laws in effect prior to January 1, 1962, as follows:

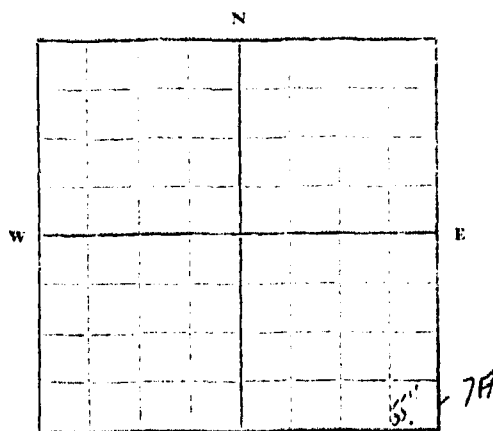

West 55' s lat 7A
Sumner Lane Tract
NW NW 1/4 Sec 34 T.20 R.3E

Indicate point of appropriation
and place of use, if possible.
Each small square represents 10
acres.

2. The beneficial use on which the claim is based Homehold & Domestic use Garden, & Lawn
3. Date or approximate date of earliest beneficial use; and how continuous the use has been June 9, 1959
4. The amount of groundwater claimed (in miner's inches or gallons per minute) 60 gal Minute
5. If used for irrigation, give the acreage and description of the lands to which water has been applied and name of the owner thereof
4 Acres Bernard E. Malady
6. The means of withdrawing such water from the ground and the location of each well or other means of withdrawal
Electric Pump

7. The date of commencement and completion of the construction of the well, wells, or other works for withdrawal of groundwater 1959
8. The depth of water table 89 ft
9. So far as it may be available, the type, size and depth of each well or the general specifications of any other works for the withdrawal of groundwater Satisfactory
10. The estimated amount of groundwater withdrawn each year 300,000 gal
11. The log of formations encountered in the drilling of each well if available
Not available
12. Such other information of a similar nature as may be useful in carrying out the policy of this act, including reference to book and page of any county record
Book 289
P. 255

Signature of Owner Bernard E. Malady
Phyllis E. Malady
Date Aug 19, 1963

Three copies to be filed by the owner with the County Clerk and Recorder of the county in which the well is located.

Please answer all questions. If not applicable, so state, otherwise the form will be returned.

Original to the County Clerk and Recorder; duplicate to the State Engineer; Triplicate to the Montana Bureau of Mines and Geology, and Quadruplicate for the Appropriator.

300 AC

STATE OF MONTANA, } ss.
County of Cascade.

I hereby certify that the within in-
strument was filed in this office on
AUG 22 1963

Date
at 10:18 o'clock ^a M.

J. L. LENNON
County Clerk and Recorder.

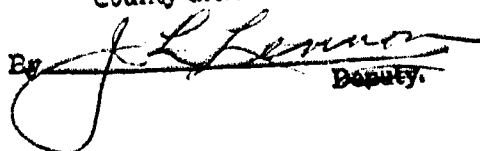
By  Deputy.

GW.

APPROVED STATE FORM - State Publishing Co., Helena, Montana 59604

File No. _____

T 22 R 35

DUPLICATE

County _____

STATE OF MONTANA
ADMINISTRATOR OF GROUNDWATER CODE
OFFICE OF STATE ENGINEER

Declaration of Vested Groundwater Rights

(Under Chapter 237, Montana Session Laws, 1961) STATE ENGINEER

HAROLD W. MEREDITH
1. EVELYN L. MEREDITH (Name of Appropriator) of ROUTE 1 SOUTH, GREAT FALLS. (Address) (Town)
County of CASCADE State of MONTANA
have appropriated groundwater according to the Montana laws in effect prior to January 1, 1962, as follows:

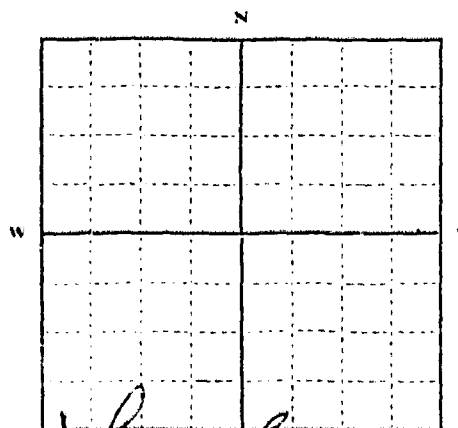

Indicate point of appropriation and place of use, if possible. Each square represents 10 acres.

2. The beneficial use on which the claim is based. WATER IS TO BE USED FOR DOMESTIC USE
3. Date or approximate date of earliest beneficial use; and how continuous the use has been JAN 20TH - 1962
WATER HAS BEEN USED ANNUALLY EVER SINCE JAN 20 - 1962
4. The amount of groundwater claimed (in miner's inches or gallons per minute) 30 GALS. PER MINUTE
5. If used for irrigation, give the acreage and description of the lands to which water has been applied and name of the owner thereof
SOME WATER USED FOR IRRIGATION SUCH AS SMALL LAWNS, TREES, SCHOOLS ETC.
6. The means of withdrawing such water from the ground and the location of each well or other means of withdrawal AT PRESENT A SMALL JET PUMP LOCATED BLACK 1 LOT 11 SOUTHVALE ADD.
7. The date of commencement and completion of the construction of the well, wells, or other works for withdrawal of groundwater DEC 20 - 1961 - COMMENCEMENT
JAN 15 - 1962
8. The depth of water table 175 FT.
9. So far as it may be available, the type, size and depth of each well or the general specifications of any other works for the withdrawal of groundwater TYPE & SIZE WELL IS DRILLED AND DRIVEN 5 INCH I.D. CASING 175 FT. EST. WATER TABLE
10. The estimated amount of groundwater withdrawn each year 30 GALS. PER MIN DAILY 365 DAYS PER YEAR FROM JAN 15 TO DEC 31 ANNUALLY
11. The log of formations encountered in the drilling of each well if available FROM TOP TO 182 FT. GLACIAL DRIFT, CLUMBO FROM 182 FT. TO 187 FT. WATER BEARING SAND AND GRAVEL

12. Such other information of a similar nature as may be useful in carrying out the policy of this act, including reference to book and page of any county record

N.A.

Signature of Owner

Harold W. Meredith
Evelyn L. Meredith
Date Dec 31st - 1963

Three copies to be filed by the owner with the County Clerk and Recorder of the county in which the well is located

Please answer all questions. If not applicable, so state, otherwise the form will be returned.

Original to the County Clerk and Recorder; Duplicate to the State Engineer; Triplicate to the Montana Bureau of Mines and Geology, and Quadruplicate for the Appropriator.

28442

H455

STATE OF MONTANA, } ss.
County of Cascade.

I hereby certify that the within in-
strument was filed in this office on

DEC 31 1922
Date
1:22 o'clock P.M.

J. L. LENNON

County Clerk and Recorder.

By [Signature]
Deputy.

File No.

DUPLICATE

T. 20 R. 3E

County CascadeSTATE OF MONTANA
ADMINISTRATOR OF GROUNDWATER CODE
OFFICE OF STATE ENGINEER**Notice of Completion of Groundwater
Appropriation by Means of Well**
(Under Chapter 237, Montana Session Laws, 1961)Owner William C. Surridge Address Alt. 1. So. West. FallsDriller Thomas B. Franklin Address Alt. 1. So. West. Falls, Mont.Date of Notice of Appropriation of Groundwater March 10-1963Date well started March 19-1963 Date Completed March 25-1963Type of well Drilled, driven Equipment Used Cable tools
(dug, driven, bored or (Churn, drill, rotary or
drilled) other)Water Use: Domestic ☒ Municipal ☐ Other ☐ Irrigation ☐
Industrial ☐ Drainage ☐ Stock ☐

Indicate on the diagram the character and thickness of the different strata met with in drilling, such as soil, clay, shale, gravel, rock or sand, etc. Show depth at which water is encountered, thickness and character of water-bearing strata and height to which water rises in the well.

Size of Drilled Hole	Size and Weight of Casing	From (Feet)	To (Feet)	PERFORATIONS		
				Kind Size	From (Feet)	To (Feet)
5 inch	5 inch I. D. Oil well casing 14 lbs per ft.	Top	Bottom			

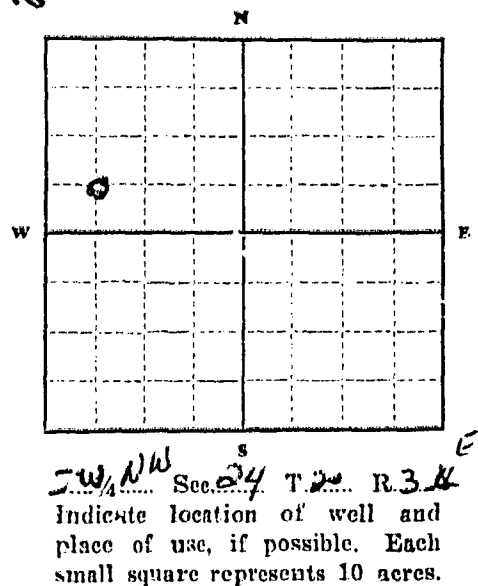
Top of Ground
(Elev. above sea level.....)Water Bearing Sand, Gravel
From 175 to 180 Water Bearing Sand, gravel.
180 ft.

Show exact depth of bottom.

Static Water Level for non-flowing Well 25 feet.

Shut-in Pressure for Flowing Well.....

Pumping Water Level 55 feet at 12 gal. per minute.

Discharge in gal. per min. of flowing well.....

How Tested Set pump Length of Test 4 hrs.

Remarks: (Gravel packing, cementing, packers, type of shutoff, location of place of use of groundwater if not at well, and any other similar pertinent information, including number of acres irrigated, if used for irrigation).....

84
Driller's License NumberThomas B. Franklin
Driller's Signature

This form to be prepared by driller, and three copies to be filed by the owner with the County Clerk and Recorder in the county in which the well is located.

Please answer all questions. If not applicable, so state, otherwise the form will be returned.

Original to the County Clerk and Recorder; duplicate to the State Engineer; Triplicate to the Montana Bureau of Mines and Geology and Quadruplicate for the Appropriator.

28396

4408

CLERK AND RECORDER
CASCADE COUNTY, MONTANA
I HEREBY CERTIFY THAT THE WITHIN
INSTRUMENT WAS FILED FOR RECORD
IN THIS OFFICE ON

DEC 31 1908

AT 12:32 P.M.
AND FULLY RECORDED AS DOCUMENT

NO. _____
J. L. LERSON
CLERK AND RECORDER

BY *[Signature]*
REPORT

File No.

T. 20 R. 3E

DUPLICATE

County Cascade

STATE OF MONTANA
ADMINISTRATOR OF GROUNDWATER CODE
OFFICE OF STATE ENGINEER

**Notice of Completion of Groundwater
Appropriation by Means of Well**

(Under Chapter 237, Montana Session Laws, 1961)

Owner Leonard Wadsworth Address South of Great FallsDriller Soennichsen Drilling Co. Address 2300-13th St. So.
Great Falls, MontanaDate of Notice of Appropriation of Groundwater noneDate well started June 2, 1962 Date Completed June 20, 1962

Type of well Drilled Equipment Used Rotary
(dug, driven, bored or (Churn, drill, rotary or
drilled) other)

Water Use Domestic ☒ Municipal ☐ Other ☐ Irrigation ☒
Industrial ☐ Drainage ☐ Stock ☐

Indicate on the diagram the character and thickness of the different strata met with in drilling, such as soil, clay, shale, gravel, rock or sand, etc. Show depth at which water is encountered, thickness and character of water-bearing strata and height to which water rises in the well.

Size of Drilled Hole	Size and Weight of Casing	From (Feet)	To (Feet)	PERFORATIONS		
				Kind Size	From (Feet)	To (Feet)
8"	6-5/8" OD.	0	60	none		
6"	4 1/2" O.D.	0	198	none		

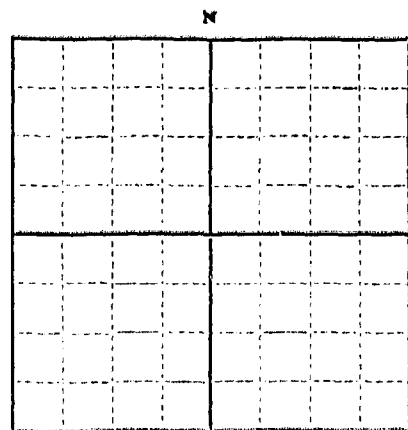

Indicate location of well and place of use, if possible. Each small square represents 10 acres.

Show exact depth of bottom.

Static Water Level for non-flowing Well 18 feet.Shut-in Pressure for Flowing Well not flowingPumping Water Level 30 feet at 60 gal. per minute.Discharge in gal. per min. of flowing well not flowingHow Tested Bailer Length of Test 6 hours

Remarks: (Gravel packing, cementing, packers, type of shutoff, location of place of use of groundwater if not at well, and any other similar pertinent information, including number of

acres irrigated, if used for irrigation)

6-5/8" Surface casing cemented from 0 to 60 ft.To be used for irrigating approximately 4 acresand furnishing water at present for 3 dwellings and possibly more laterDriller's License Number 51

Arnold Soennichsen
Driller's Signature

This form to be prepared by driller, and three copies to be filed by the owner with the County Clerk and Recorder in the county in which the well is located.

Please answer all questions. If not applicable, so state, otherwise the form will be returned.

Original to the County Clerk and Recorder; duplicate to the State Engineer; Triplicate to the Montana Bureau of Mines and Geology and Quadruplicate for the Appropriator.

28076

4091

CLERK AND RECORDER
CRIMINAL COURT, OKLAHOMA
I HEREBY CERTIFY THAT THE
INSTRUMENT WITHIN AND SO RECORDED
IN THIS OFFICE ON 1945

AT 1945 P
AND FULLY RECORDED
NO.

J. L. ...
CLERK
BY McMichael

File No.

T. 20N R. 3E

DUPLICATE

County **Cascade**

STATE OF MONTANA
ADMINISTRATOR OF GROUNDWATER CODE
OFFICE OF STATE ENGINEER

RECEIVED
JAN 23 1963

Declaration of Vested Groundwater Rights

(Under Chapter 237, Montana Session Laws, 1961)

STATE ENGINEER

1. **Ayrshire Dairy**, of **Box 2387** **Great Falls**
(Name of Appropriator) (Address) (Town)
County of **Cascade** State of **Montana**
have appropriated groundwater according to the Montana laws in effect prior to January 1, 1962, as follows:

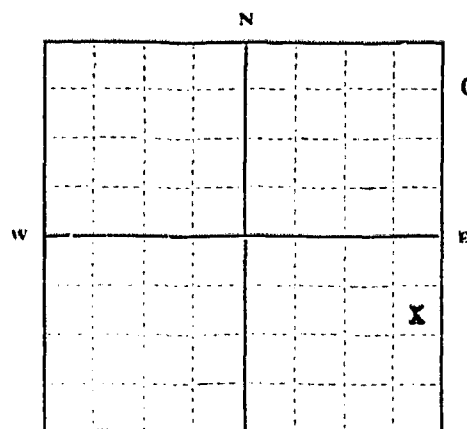

OK
25
NE 1/4 SE Sec. 25 T. 20N R. 3E

Indicate point of appropriation and place of use, if possible. Each small square represents 10 acres.

2. The beneficial use on which the claim is based **Domestic, Operation of dairy plant, Stock, Irrigation.**
3. Date or approximate date of earliest beneficial use; and how continuous the use has been **This well drilled in 1908 replacing well dug in 1885. Use has been continuous since 1885.**
4. The amount of groundwater claimed (in miner's inches or gallons per minute) **100 gallons per minute**
5. If used for irrigation, give the acreage and description of the lands to which water has been applied and name of the owner thereof **Used to irrigate gardens, lawns and trees in ten acre area around buildings at the Ayrshire Dairy.**
6. The means of withdrawing such water from the ground and the location of each well or other means of withdrawal **Electrically driven turbine pump.**
7. The date of commencement and completion of the construction of the well, wells, or other works for withdrawal of groundwater **Original well completed in 1885. Present well completed in 1908.**
8. The depth of water table **71 feet from surface.**
9. So far as it may be available, the type, size and depth of each well or the general specifications of any other works for the withdrawal of groundwater **6" well casing. Well 119 feet deep.**
10. The estimated amount of groundwater withdrawn each year **40 million gallons**
11. The log of formations encountered in the drilling of each well if available **No log available, sand, and clay were the formations encountered.**
12. Such other information of a similar nature as may be useful in carrying out the policy of this act, including reference to book and page of any county record

Ayrshire Dairy
Signature of Owner *Fergus G. Mitchell*
Fergus G. Mitchell, Pres.
Date **Dec. 23, 1963**

Three copies to be filed by the owner with the County Clerk and Recorder of the county in which the well is located.

Please answer all questions. If not applicable, so state, otherwise the form will be returned.

Original to the County Clerk and Recorder; Duplicate to the State Engineer; Triplicate to the Montana Bureau of Mines and Geology, and Quadruplicate to the Appropriator.

13018

STATE OF MONTANA, 3691
County of Cascade

I hereby certify that the within and foregoing is a true and correct copy of the original as the same appears in the records of the County of Cascade, Montana.

DEC 23 1963

1.12

1.

B. Bain

File No.

T 20N R 3E

DUPLICATE

County Cascade

STATE OF MONTANA
ADMINISTRATOR OF GROUNDWATER CODE
OFFICE OF STATE ENGINEER

RECEIVED
DEC 27 1963

Declaration of Vested Groundwater Rights

(Under Chapter 237, Montana Session Laws, 1961)

STATE ENGINEER

1. Ayrshire Dairy, of Box 2387, Great Falls, Montana
(Name of Appropriator) (Address) (Town)
County of Cascade State of Montana
have appropriated groundwater according to the Montana laws in effect prior to January 1, 1962, as follows:

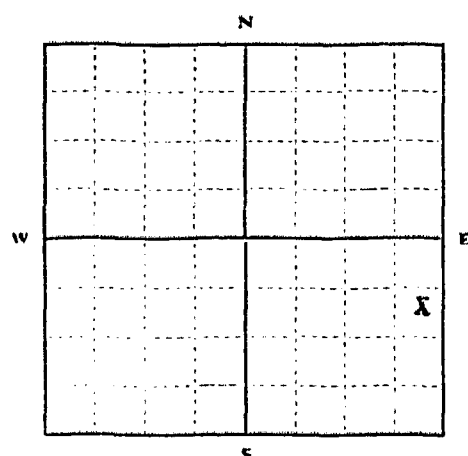

NE 1/4 SE Sec. 25 T.20NR. 3E

Indicate point of appropriation and place of use, if possible. Each small square represents 10 acres.

2. The beneficial use on which the claim is based Domestic, Operation of dairy plant, Stock, Irrigation.
3. Date or approximate date of earliest beneficial use; and how continuous the use has been Well drilled in 1928 and used continuously since that date.
4. The amount of groundwater claimed (in miner's inches or gallons per minute) 80 gallons per minute.
5. If used for irrigation, give the acreage and description of the lands to which water has been applied and name of the owner thereof Used to irrigate gardens, lawns and trees in ten acre area around buildings at Ayrshire Dairy.
6. The means of withdrawing such water from the ground and the location of each well or other means of withdrawal Electrically driven turbine pump.
7. The date of commencement and completion of the construction of the well, wells, or other works for withdrawal of groundwater Well completed in 1928.
8. The depth of water table 71 feet from surface.
9. So far as it may be available, the type, size and depth of each well or the general specifications of any other works for the withdrawal of groundwater Six inch well casing, Well 122 feet deep.
10. The estimated amount of groundwater withdrawn each year 20 million gallons.
11. The log of formations encountered in the drilling of each well if available No log available. Sand and clay were formations encountered.
12. Such other information of a similar nature as may be useful in carrying out the policy of this act, including reference to book and page of any county record

Ayrshire Dairy

Signature of Owner

Fergus G. Mitchell, Pres.

Date Dec. 23, 1963

Three copies to be filed by the owner with the County Clerk and Recorder of the county in which the well is located.

Please answer all questions. If not applicable, so state, otherwise the form will be returned.

Original to the County Clerk and Recorder; Duplicate to the State Engineer; Triplicate to the Montana Bureau of Mines and Geology, and Quadruplicate for the Appropriator.

13019

STATE OF MONTANA
County of Cascade

County Clerk of said County in-
strument was filed on

SEP 23 1924

1:13 P

A. E. HENRY
County Clerk

By *Henry*
Deputy

File No.

T. 20 N R. 3 E

DUPLICATE

RECEIVED
DEC 27 1963

County Cascade

STATE OF MONTANA
ADMINISTRATOR OF GROUNDWATER CODE
OFFICE OF STATE ENGINEER

Top of Ground **STATE ENGINEER**

(Elev. above sea level.....)

0 to 14 ft. Sand
14 to 28 ft. Clay (yellow)
28 to 138 ft. Shale (gray)
138 to 150 ft. Silt
150 to 168 ft. Clay
168 to 173 ft. Shale rock
173 to 193 ft. Sandstone
(water)

**Notice of Completion of Groundwater
Appropriation by Means of Well**

(Under Chapter 237, Montana Session Laws, 1961)

Owner Ayrshire Dairy
Fergus G. Mitchell Address Ayrshire Dairy, Great Falls

Driller Soennichsen Drilling Co. Address 2300-13 S S. Great Falls

Date of Notice of Appropriation of Groundwater NoneDate well started 8/25/62 Date Completed 9/7/62

Type of well Drilled Equipment Used rotary
(dug, driven, bored or (Churn, drill, rotary or
drilled) other)

Water Use: Domestic ☒ Municipal ☐ Other ☐ Irrigation ☒
Industrial ☐ Drainage ☐ Stock ☒

Indicate on the diagram the character and thickness of the different strata met with in drilling, such as soil, clay, shale, gravel, rock or sand, etc. Show depth at which water is encountered, thickness and character of water-bearing strata and height to which water rises in the well.

Size of Drilled Hole	Size and Weight of Casing	From (Feet)	To (Feet)	PERFORATIONS		
				Kind Size	From (Feet)	To (Feet)
8 inch X	170' 6" O.D.	0	170			
Cemented around casing from 0 to 170'						
5-5/8"		170	193'	none		

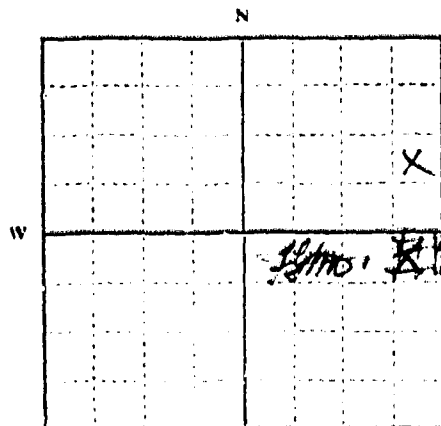

SE NE S
1/4 1/4 1/4 Sec. 25 T. 20 N R. 3 E

Indicate location of well and
place of use, if possible. Each
small square represents 10 acres.

Show exact depth of bottom.

Static Water Level for non-flowing Well 54 feet.Shut-in Pressure for Flowing Well not flowingPumping Water Level 79' feet at 30 gal. per minute.Discharge in gal. per min. of flowing well not flowingHow Tested pumped Length of Test several days

Remarks: (Gravel packing, cementing, packers, type of shutoff, loca-
tion of place of use of groundwater if not at well, and any
other similar pertinent information, including number of
acres irrigated, if used for irrigation) 2 acres

51
Driller's License Number

Arvid Soennichsen
Driller's Signature

This form to be prepared by driller, and three copies to be filed by the owner with the County Clerk and Recorder in the county in which the well is located.

Please answer all questions. If not applicable, so state, otherwise the form will be returned.

Original to the County Clerk and Recorder; duplicate to the State Engineer; Triplicate to the Montana Bureau of Mines and Geology and Quadruplicate for the Appropriator.

12966

2639

STATE OF MONTANA
County of Cascade.

I hereby certify that the within in-
strument was filed in this office on

DEC 23 1969

at 1:17 ^{PM} o'clock P M.

J. L. LENNON
County Clerk and Recorder.

By B. Sullivan
Deputy.

STATE OF MONTANA
ADMINISTRATOR OF GROUNDWATER CODE
MONTANA WATER RESOURCES BOARD

NOTICE OF COMPLETION OF GROUNDWATER
APPROPRIATION BY MEANS OF WELL

Developed after January 1, 1962

(Under Chapter 237 Montana Session Laws, 1961, as amended)

This form to be prepared by driller, and three copies to be filed by the owner with the County Clerk and Recorder in the county in which the well is located, last copy to be retained by driller.

Please answer all questions. If not applicable, so state, otherwise the form may be returned.

Owner Beals, Walter & Barbara

Address RR 2 So, Box 1003

Great Falls, Mont.

Date well started July 10 - 1968

completed July 14 - 1968

Type of well Drilled

Equipment used Churn Drill

Water Use: Domestic ☒ Municipal ☐ Stock ☐ Irrigation ☐

Industrial ☐ Drainage ☐ Other ☐* Garden/Lawn ☒

*Describe

USE: If used for irrigation, industrial, drainage or other. Explain, state number of acres and location or other data (i.e. Lot, Block and Addition).

ESTIMATED ANNUAL WITHDRAWAL 800,000 gals

Size of Drilled Hole	Size and Weight of Casing	From (Feet)	To (Feet)	PERFORATIONS
6 inch	6 5/8 O.D. 80 lbs per foot	0	79	Casing driven open end into gravel

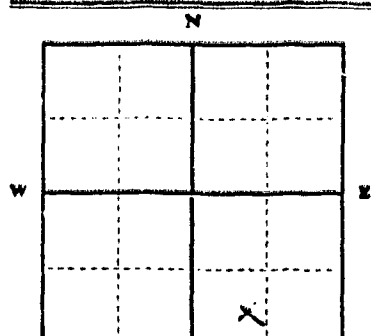

Lot 6 Irish Acres
SW 1/4 SE 1/4 Sec. 25
T. 20 N. R. 3 E. S. W.

INDICATE LOCATION OF WELL AND PLACE OF USE, IF POSSIBLE. EACH SMALL SQUARE REPRESENTS 40 ACRES.

Driller's Signature E. D. Rafferty

Driller's Address 927-10th ave. S.W.

LICENSE NO. 28

County 75

DRILLER'S LOG

Indicate the character, color, thickness of strata such as soil, clay, sand, gravel, shale, sandstone, etc. Show depth at which water is found and height to which water rises in well.

Top of Ground (Elev. above sea level)	
From (Feet)	To (Feet)
	700m
2	21
21	78
78	79
79	82
	25 Gals per min.

82 ft Show exact depth of bottom

5527

STATE OF MONTANA, }
County of Cascade. }

I hereby certify that the within in-
strument was filed in this office on
JUN 27 1973

at 3:10 o'clock P.M.

J. L. BENNON

County Clerk and Recorder.

By

J. S. Wilson
Deputy.

File No.

T 20 N R 3 E 25

DUPLICATE

County Conrad

STATE OF MONTANA
ADMINISTRATOR OF GROUNDWATER CODE
OFFICE OF STATE ENGINEER

RECEIVED
MAY 11 1964
STATE ENGINEER

Notice of Completion of Groundwater Appropriation by Means of Well

(Under Chapter 237, Montana Session Laws, 1961)

Top of Ground
(Elev. above sea level 3460)
0- to 2 ft - Loam
2- 32 - Loose Sand
32- 138 - Silt
138- 142 - Sand Fine grain
water filled up to
55 ft from top
142 FT.
BOTTOM

Owner Vincent J. Bosch Address RT-1 - So. Gt. FallsDriller C. D. Rafferty Address 927 - Tenth Ave. S. W.

Date of Notice of Appropriation of Groundwater

Date well started 4/27/1964 Date Completed 5/2/1964

Type of well Drilled Equipment Used Churn drill
(dug, driven, bored or (Churn, drill, rotary or
drilled) other)

Water Use: Domestic ☒ Municipal ☐ Other ☐ Irrigation ☒
Industrial ☐ Drainage ☐ Stock ☒

Indicate on the diagram the character and thickness of the different strata met with in drilling, such as soil, clay, shale, gravel, rock or sand, etc. Show depth at which water is encountered, thickness and character of water-bearing strata and height to which water rises in the well.

Size of Drilled Hole	Size and Weight of Casing	From (Feet)	To (Feet)	PERFORATIONS		
				Kind Size	From (Feet)	To (Feet)
5 inch	5 1/2 O.D. Black Iron	0	142	Casing driven open end into gravel		

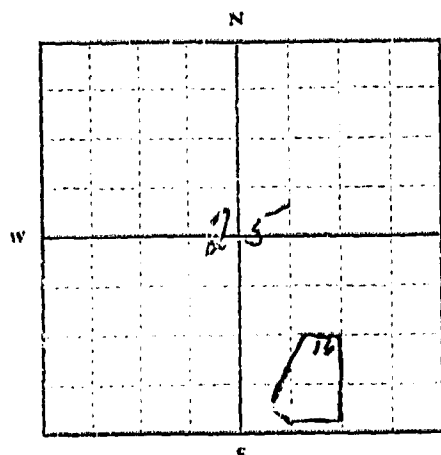

In SW 1/4 Sec. 25, T. 20, R. 3-E
Indicate location of well and place of use, if possible. Each small square represents 10 acres.

Show exact depth of bottom.

Static Water Level for non-flowing Well 55 feet from top feet.

Shut-in Pressure for Flowing Well

Pumping Water Level 55 ft. from top feet at 30 gal. per minute.

Discharge in gal. per min. of flowing well

How Tested Miller Length of Test 2 hours

Remarks: (Gravel packing, cementing, packers, type of shutoff, location of place of use of groundwater if not at well, and any other similar pertinent information, including number of acres irrigated, if used for irrigation) To irrigate

1 acre, some in garden, some in lawn and to
water 2 houses and several head of horses.

#28
Driller's License Number

C. D. Rafferty
Driller's Signature

This form to be prepared by driller, and three copies to be filed by the owner with the County Clerk and Recorder in the county in which the well is located.

Please answer all questions. If not applicable, so state, otherwise the form will be returned.

Original to the County Clerk and Recorder; duplicate to the State Engineer; Triplicate to the Montana Bureau of Mines and Geology and Quadruplicate for the Appropriator.

39115

4845
4845

STATE OF MONTANA, } ss.
County of Cascade.

I hereby certify that the within in-
strument was filed in this office on

APR 22 1965

Date

at 4:35 o'clock 8th M.

J. E. HEDGON

County Clerk and Recorder.

By

[Signature]

Deputy.

File No. STATE WATER CONSERVATION BOARDIrish AcresLot 2 Except the west 550'County Cascade

DUPLICATE

SEP 20 1966

STATE OF MONTANA
ADMINISTRATOR OF GROUNDWATER CODE
OFFICE OF STATE ENGINEERBile McDermott
Baker McIntyre
Top of Ground Morton
Darlinton Sullivan
(Elev. above sea level 32')**Notice of Completion of Groundwater
Appropriation by Means of Well**

(Under Chapter 237, Montana Session Laws, 1961)

Owner Lyal E. Brugman and/or Rt 1 South
Jean M. Brugman Address Gt. Falls, Mont.Driller Pat Byrne Address Gt. Falls, Mont.

Date of Notice of Appropriation of Groundwater

Date well started Aug. 9, 1966 Date Completed Aug. 11, 1966Type of well Drilled Equipment Used Churn drill
(dug, driven, bored or (Churn, drill, rotary or
drilled) other)Water Use: Domestic ☒ Municipal ☐ Other ☐ Irrigation ☐
Industrial ☐ Drainage ☐ Stock ☐

Indicate on the diagram the character and thickness of the different strata met with in drilling, such as soil, clay, shale, rock or sand, etc. Show depth at which water is encountered, thickness and character of water-bearing strata and height to which water rises in the well.

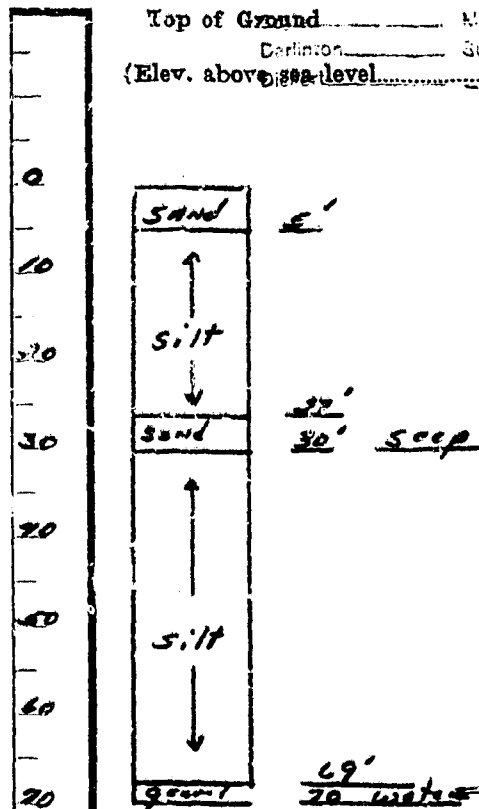

Size of Drilled Hole	Size and Weight of Casing	From (Feet)	To (Feet)	PERFORATIONS		
				Kind Size	From (Feet)	To (Feet)
6-5/8"	(6-5/8")	0'	70'	NOT PERFORATED		

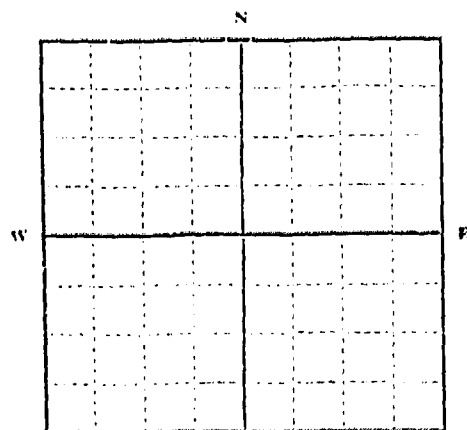

..... 1/4 Sec. T. R.
Indicate location of well and place of use, if possible. Each small square represents 10 acres.

Show exact depth of bottom.

Static Water Level for non-flowing Well 27' feet.

Shut-in Pressure for Flowing Well

Pumping Water Level 55' feet at 30 gal. per minute.

Discharge in gal. per min. of flowing well

How Tested Bailer Length of Test 1 hour

Remarks: (Gravel packing, cementing, packers, type of shutoff, location of place of use of groundwater if not at well, and any other similar pertinent information, including number of acres irrigated, if used for irrigation)

135
Driller's License Number

Pat Byrne
Driller's Signature

This form to be prepared by driller, and three copies to be filed by the owner with the County Clerk and Recorder in the county in which the well is located.

Please answer all questions. If not applicable, so state, otherwise the form will be returned.

Original to the County Clerk and Recorder; duplicate to the State Engineer; Triplicate to the Montana Bureau of Mines and Geology and Quadruplicate for the Appropriator.

4978

STATE OF MONTANA, } ss.
County of Cascade.

I hereby certify that the within in-
strument was filed in this office on

SEP 14 1966

Date

at 11:30 o'clock 9 M.

J. L. LENNON

County Clerk and Recorder.

By

[Signature]

Deputy.

File No.

T. R.

DUPLICATE

County Cascade

LOG

STATE OF MONTANA
ADMINISTRATOR OF GROUNDWATER CODE
OFFICE OF STATE ENGINEER

**Notice of Completion of Groundwater
Appropriation by Means of Well**
DEVELOPED AFTER JANUARY 1, 1962

(Under Chapter 237, Montana Session Laws, 1961)

Top of Ground

(Elev. above sea level 3310)

0 to 5ft. Snady Silt

5-10 Gravel

10-21 Red Shale

21-50 Sand Rock

Water filled up
to 30 ft. from topOwner Fred Finneman Address Rte. 1 So.Driller E. D. Rafferty Address 927-10th Ave. S.W.

Date of Notice of appropriation of groundwater

Date well started Dec. 12, 1969 Date completed Dec. 16, 1969Type of well drilled Equipment used churn drill
(Dug, driven, bored or drilled) (Churn drill, rotary or other)Water use: Domestic ☒ Municipal ☐ Stock ☐ Irrigation ☐
Industrial ☐ Drainage ☐ Other ☐

Indicate on the diagram the character and thickness of the different strata met with in drilling, such as soil, clay, shale, gravel, rock or sand, etc. Show depth at which water is encountered, thickness and character of water-bearing strata and height to which the water rises in the well.

Doc. No. 5203
Filed for record
this 2 day of January
A. D. 19 70, at 9:30
o'clock a M.

Size of Drilled Hole	Size and Weight of Casing	From (Feet)	To (Feet)	PERFORATIONS		
				Kind Size	From (Feet)	To (Feet)
5 inch	5 1/2" C D. Black iron	0	6	casing driven open end to sand rock		

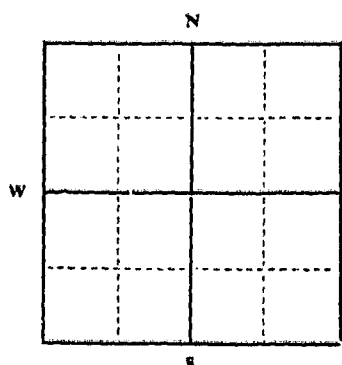
Static Water Level for non-flowing well
.....30.....feet.

Shut-in Pressure for Flowing Well.....

Pumping Water Level.....30.....feetat.....20.....gal. per minute.

Discharge in gal. per min. of flowing well

How Tested.....BailerLength of Test.....Two hoursRemarks: (Gravel packing, cementing, pack-
ers, type of shutoff).....

1/4 Sec. 25 T. 20N R. 3E
Indicate location of well and
place of use, if possible. Each
small square represents 40
acres.

Lot 8-SE 1/4 of the SW 1/4 of Section 25, T20N

R. 3 E MPM

(Continue on reverse side)

USE—If used for irrigation, industrial, drainage or other. Explain, state
number of acres and location or other data (i.e.: Lot, Block and Addi-
tion).

----- 50 ft.

Show exact depth of bottom.

This form to be prepared by driller, and three copies to be filed by the owner with the
County Clerk and Recorder in the county in which the well is located, tissue copy to be
retained by driller.

Please answer all questions. If not applicable, so state, otherwise the form will be
returned.

Driller's License Number

Driller's Signature

46019

5203

STATE OF MONTANA, } ss.
County of Cascade.

I hereby certify that the within in-
strument was filed in this office on

JAN 2 1970
Date

at 9:30 o'clock PM

J. L. LENNON

County Clerk and Recorder

By [Signature]
Deputy.

File No.

T. 20 R. 3E

DUPLICATE

County Cascade

STATE OF MONTANA
ADMINISTRATOR OF GROUNDWATER CODE
OFFICE OF STATE ENGINEER

RECEIVED
DEC 6 1963

Declaration of Vested Groundwater Rights

(Under Chapter 237, Montana Session Laws, 1961)

STATE ENGINEER

Helen Christina Hoppe
1. Frank Harold Hoppe of Porter South, Great Falls
(Name of Appropriator) (Address) (Town)
County of Cascade State of Montana
have appropriated groundwater according to the Montana laws in effect prior to January 1, 1962, as follows:

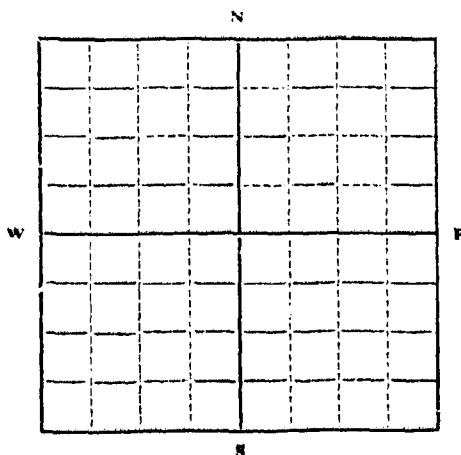

1/4 Sec. 25 T. 20 R. 3E

Indicate point of appropriation
and place of use, if possible.
Each small square represents 10
acres.

2. The beneficial use on which the claim is based.
Household and irrigation

3. Date or approximate date of earliest beneficial use; and how con-
tinuous the use has been.
August 15, 1953
Steady

4. The amount of groundwater claimed (in miner's inches or gallons
per minute). 6.9 gals. per minute

5. If used for irrigation, give the acreage and description of the lands
to which water has been applied and name of the owner thereof.
2 1/2 acres Garden, lawn, and field

6. The means of withdrawing such water from the ground and the
location of each well or other means of withdrawal.
Electrical pump

7. The date of commencement and completion of the construction of the well, wells, or other works for with-
drawal of groundwater. August 15, 1953

8. The depth of water table. 142'

9. So far as it may be available, the type, size and depth of each well or the general specifications of any other
works for the withdrawal of groundwater.
2" O.D. casing - 142'

10. The estimated amount of groundwater withdrawn each year. 120,000 gals. per year

11. The log of formations encountered in the drilling of each well if available. 5' to 12' surface soil and
shale 12' to 18' quick sand and surface water 18' to 128' blue shale and sand mixed
128' to 147' gravelly sand with water 147' to 165' green sand yellow 177' to 192'
lime rock gravel and water

12. Such other information of a similar nature as may be useful in carrying out the policy of this act, including
reference to book and page of any county record. None

Signature of Owner. Helen Christina Hoppe
Frank H. Hoppe

Date. Dec. 3, 1963

Three copies to be filed by the owner with the County Clerk and Recorder of the county in which the well is
located.

Please answer all questions. If not applicable, so state, otherwise the form will be returned.

Original to the County Clerk and Recorder; duplicate to the State Engineer; Triplicate to the Montana Bureau
of Mines and Geology, and Quadruplicate for the Appropriator.

7777

#2445

STATE OF MONTANA, } ss.
County of Cascade.

I hereby certify that the within instrument was filed in this office on

DEC 3 - 1963

at 11:10 o'clock A M.

J. L. LENNON
County Clerk and Recorder.

By [Signature]
Deputy.

County.....**Cascade**

STATE OF MONTANA
ADMINISTRATOR OF GROUNDWATER CODE
MONTANA WATER RESOURCES BOARD

NOTICE OF COMPLETION OF GROUNDWATER APPROPRIATION BY MEANS OF WELL

Developed after January 1, 1962

(Under Chapter 237 Montana Session Laws, 1961, as amended)

This form to be prepared by driller, and three copies to be filed by the owner with the County Clerk and Recorder in the county in which the well is located, last copy to be retained by driller.

Please answer all questions. If not applicable, so state, otherwise the form may be returned.

Owner -- William E. Klehano

Address ~~Irish Acres~~ Box 998C

Great Falls, MT 59401

Date well started ~~1.1-25-67~~

completed ...12-1-67

Type of well **Drilled**

(Dug, driven, bored or drilled)

Equipment used ~~Churn~~ Drill

(Turn drill, rotary or other)

Water Use: Domestic ☒ Municipal ☐ Stock ☐ Irrigation ☐

Industrial ☐ Drainage ☐ Other ☐* Garden/Lawn ☒

*Describe

USE: If used for irrigation, industrial, drainage or other. Explain, state number of acres and location or other data (i.e. Lot, Block

and Addition). 15,000 Gg/s

ESTIMATED ANNUAL WITHDRAWAL

Size of Drilled Hole	Size and Weight of Casing	From (Feet)	To (Feet)	PERFORATIONS		
				Rind Size	From (Feet)	To (Feet)
5-inch	5½ O.D. 17 lbs per ft.	0	121		Casing driven into gravel-open end.	

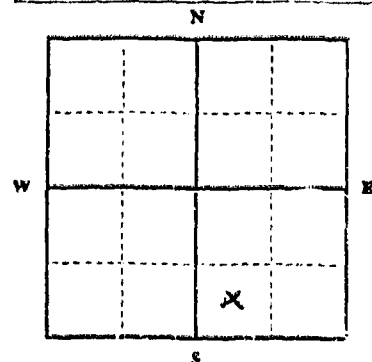

Static water level 35 ft from top
Pumping water level 40 ft from top
at twenty gallons per minute,
measured 60 minutes after pumping
began.

*Measured from ground level.

Well developed by ... ~~Bailine~~

for hours.

Power..... Pump..... HP

Remarks: (Gravel packing, cementing,
packers, type of shut-off)

packers, type of shutoff) - **Casing**.....

Driven open and into

gravel

INDICATE LOCATION OF WELL AND PLACE OF USE, IF POSSIBLE.
EACH SMALL SQUARE REPRESENTS 40 ACRES.

Driller's Signature

Driller's Address

.....Grent Wallm. ME 59401

LICENSE NO. 25

DRILLER'S LOG

Indicate the character, color, thickness of strata such as soil, clay, sand, gravel, shale, sandstone, etc. Show depth at which water is found and height to which water rises in well.

Top of Ground

(Elev. above sea level)

From (Feet)	To (Feet)	
0	10	Sand
10	70	Silt
70	88	Sandy Silt
88	119	Silt
119	124	Gravel

121— Show exact depth of bottom

53,635

5502

STATE OF MONTANA, } ss.
County of Cascade.

I hereby certify that the within instrument was filed in this office on

JUN 15 1973

at JUN 15 1973 11:25 A.M.

J. L. LEMMON

County Clerk and Recorder

By J. S. Welton
Deputy

STATE OF MONTANA
ADMINISTRATOR OF GROUNDWATER CODE
MONTANA WATER RESOURCES BOARD

NOTICE OF COMPLETION OF GROUNDWATER
APPROPRIATION BY MEANS OF WELL
Developed after January 1, 1962

(Under Chapter 237 Montana Session Laws, 1961, as amended)

This form to be prepared by driller, and three copies to be filed by the owner with the County Clerk and Recorder in the county in which the well is located, last copy to be retained by driller. Please answer all questions. If not applicable, so state, otherwise the form may be returned.

Owner Darrell J. Korin

Address Rt. 1 South

Great Falls, Mont.

Date well started March 18-71

completed March 24-71

For Administrator's Use

File 5224
Op. L. 8, 1971
10:50 AM

GW 1

Type of well Drilled

(Dug, driven, bored or drilled)

Equipment used Churn Drill

(Churn drill, rotary or other)

Water Use: Domestic ☒ Municipal ☐ Stock ☐ Irrigation ☐

Industrial ☐ Drainage ☐ Other ☐* Garden/Lawn ☐

*Describe

USE: If used for irrigation, industrial, drainage or other. Explain, state number of acres and location or other data (i.e. Lot, Block and Addition). Household, garden and lawn

ESTIMATED ANNUAL WITHDRAWAL 182,500 gal. a year

Size of Drilled Hole	Size and Weight of Casing	From (Feet)	To (Feet)	PERFORATIONS		
6 inch	6 5/8"	0	14	Kind Size	From (Feet)	To (Feet)
	20 lbs. Per ft.			Casing driven end to top of	open	shell

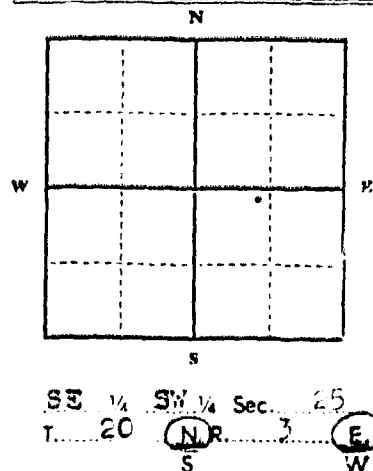

INDICATE LOCATION OF WELL AND PLACE OF USE, IF POSSIBLE. EACH SMALL SQUARE REPRESENTS 40 ACRES.

Driller's Signature E. D. Rafferty

Driller's Address 927-10 Ave. S.W.

Great Falls, Mont.

LICENSE NO. 28

County Cascade

DRILLER'S LOG

Indicate the character, color, thickness of strata such as soil, clay, sand, gravel, shale, sandstone, etc. Show depth at which water is found and height to which water rises in well.

Top of Ground (Elev. above sea level)		
From (Feet)	To (Feet)	
0	10	Gravel
10	18	Shale & Shells crevosa
18	21	Sand Rock
21	24	Varegated Shale
24	50	Sand Rock
		WATER 32-50

50 ft. Show exact depth of bottom

48237

52714

APR 8 1971

10:50 AM

[illegible]

County Clerk and Recorder

[Handwritten signature]