

File No. \_\_\_\_\_

T. 20 Range 3 East

DUPLICATE

County: Cascade

STATE OF MONTANA  
ADMINISTRATOR OF GROUNDWATER CODE  
OFFICE OF STATE ENGINEER

RECEIVED  
SEP 23 1963

Declaration of Vested Groundwater Rights

(Under Chapter 237, Montana Session Laws, 1961)

STATE ENGINEER

1. W. Earl & Gladys M. Hasbrouck of Box 1 Millegan Route, Great Falls, Montana  
(Name of Appropriator) (Address) (Town)  
County of Cascade State of Montana  
have appropriated groundwater according to the Montana laws in effect prior to January 1, 1962, as follows:

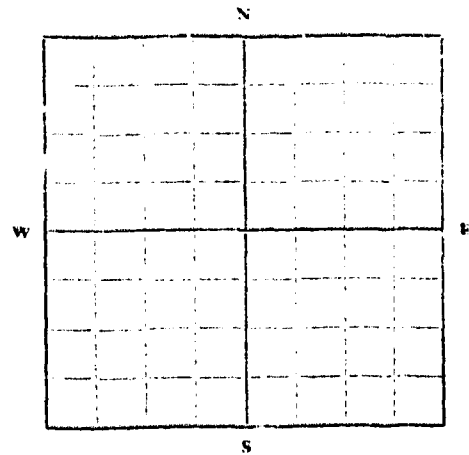

1/4 Sec. T. R.

Indicate point of appropriation and place of use, if possible. Each small square represents 10 acres.

2. The beneficial use on which the claim is based Well used for residence use, stock watering and irrigation.

3. Date or approximate date of earliest beneficial use; and how continuous the use has been June 1961  
Use has been continuous since that date.

4. The amount of groundwater claimed (in miner's inches or gallons per minute) 15 gallons per minute.

5. If used for irrigation, give the acreage and description of the lands to which water has been applied and name of the owner thereof  
Used on land in lot numbered five (5), Section Thirty Six (36), Township Twenty (20), North of Range Three (3) East, Approximately 1/4 acre.

6. The means of withdrawing such water from the ground and the location of each well or other means of withdrawal  
Submersible Electric pump, Located on approximate center of above described plot of ground.

7. The date of commencement and completion of the construction of the well, wells, or other works for withdrawal of groundwater Well drilled June 1961 Pump installed June 1961 Use has been continuous since that date.

8. The depth of water table Well drilled 168 feet, water fills casing to within 80 feet of top - 88 feet of water in casing.

9. So far as it may be available, the type, size and depth of each well or the general specifications of any other works for the withdrawal of groundwater  
One well 168 feet deep - flow checked at 11 gallons per minute when drilled. <sup>five</sup> 5/8 inch metal casing 168 feet in depth. Submersible pump with 1/2 inch discharge.

10. The estimated amount of groundwater withdrawn each year 500,000 Gallons.

11. The log of formations encountered in the drilling of each well if available 0 to 10 ft. Limestones, 10 to 32 feet Shalerock, 32 to 45 feet Sandstone Gray, 45 to 62 feet Shalerock, 62 to 79 feet Sandstone, black and white, 79 to 114 feet Shalerock, 114 to 168 feet Sandstone and shalerock stringers (water). Static water level 80 feet. Sailer test 10 Gal. per minute, Casing set 168 feet - 5 inch galvanized casing.

12. Such other information of a similar nature as may be useful in carrying out the policy of this act, including reference to book and page of any county record  
Recorded by Seennichsen Drilling Co. July 2, 1961.

W. Earl Hasbrouck - Gladys M. Hasbrouck  
W. Earl Hasbrouck Gladys M. Hasbrouck  
Signature of Owner  
Joint Tenants.  
Date Sept. 17, 1963.

Three copies to be filed by the owner with the County Clerk and Recorder of the county in which the well is located.

Please answer all questions. If not applicable, so state, otherwise the form will be returned.

Original to the County Clerk and Recorder; duplicate to the State Engineer; Triplicate to the Montana Bureau of Mines and Geology, and Quadruplicate for the Appropriator.

3379

STATE OF MONTANA, } ss.  
County of Cascade.

I hereby certify that the within instrument was filed in this office on  
SEP 19 1963

at 1:03 <sup>Day</sup> o'clock P M.

**J. L. LENNON**  
County Clerk and Recorder

By Ed. Hartman  
Deputy.

File No. ....

T. 20 Range 3 East.

DUPLICATE

County Cascade

STATE OF MONTANA  
ADMINISTRATOR OF GROUNDWATER CODE  
OFFICE OF STATE ENGINEER

RECEIVED  
SEP 23 1963

STATE ENGINEER

Declaration of Vested Groundwater Rights

(Under Chapter 237, Montana Session Laws, 1961)

I, W. Earl & Gladys M. Hasbrouck of Box 1 Millogan Route Great Falls, Montana  
(Name of Appropriator) (Address) (Town)

County of Cascade State of Montana  
have appropriated groundwater according to the Montana laws in effect prior to January 1, 1962, as follows:

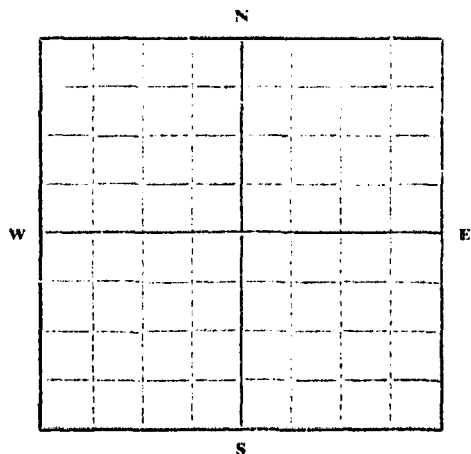

1/4 Sec. 36 T. 20 R. 3

Indicate point of appropriation and place of use, if possible. Each small square represents 10 acres.

- The beneficial use on which the claim is based... Well used for residential use, watering of stock and irrigation.
- Date or approximate date of earliest beneficial use; and how continuous the use has been... May 1926 date of drilling well. Use has been continuous since that date.
- The amount of groundwater claimed (in miner's inches or gallons per minute)... 30 gallons per minute.
- If used for irrigation, give the acreage and description of the lands to which water has been applied and name of the owner thereof... Used on land Lot 5, Section 36, Township 20, North of range 3 East of the Montana Principal Meridian, in Cascade County, Montana, lying and being South and West of the Montana State Highway and East of the Cascade County Highway.
- The means of withdrawing such water from the ground and the location of each well or other means of withdrawal... Electric Jet Pump located on South west portion of the above described property.
- The date of commencement and completion of the construction of the well, wells, or other works for withdrawal of groundwater... Drilled in May 1926 by Franklin Drilling Co. Pump installed at that time and use has been constant since that date.
- The depth of water table... Well drilled to 42 feet. Water in casing to within 20 feet of top.
- So far as it may be available, the type, size and depth of each well or the general specifications of any other works for the withdrawal of groundwater... One well 42 feet deep pumped at 30 gallons per minute for undetermined lengths of time with out depleting supply. Used for irrigation in summer 24 hours daily on 19.8 acres of ground. Also used for watering livestock up to 50 head plus residential use.
- The estimated amount of groundwater withdrawn each year... 750,000 Gallons.
- The log of formations encountered in the drilling of each well if available... Not available as no records kept at time this well was drilled.
- Such other information of a similar nature as may be useful in carrying out the policy of this act, including reference to book and page of any county record... No records available.

W. Earl Hasbrouck & Gladys M. Hasbrouck  
Signature W. Earl Hasbrouck Gladys M. Hasbrouck  
Joint tenants. Date Sept. 17, 1963

Three copies to be filed by the owner with the County Clerk and Recorder of the county in which the well is located.

Please answer all questions. If not applicable, so state, otherwise the form will be returned.

Original to the County Clerk and Recorder; duplicate to the State Engineer; Triplicate to the Montana Bureau of Mines and Geology, and Quadruplicate for the Appropriator.

6007

3380

STATE OF MONTANA, }  
County of Cascade. }

I hereby certify that the within in-  
strument was filed in this office on  
SEP 19 1958

Date  
at 12:04 o'clock P. M.

J. E. LENNON  
County Clerk and Recorder

By Ed Hartman  
Deputy



5295

STATE OF MONTANA, } ss.  
County of Cascade.

I hereby certify that the within instrument was filed in this office on  
JUL 1 1971

at 445 o'clock P M.

J. J. FORTSON  
County Clerk and Recorder

J. Lanna  
Deputy  
2.00

File No. ....

T. 20 R. 3 E

DUPLICATE

County Cascade

STATE OF MONTANA  
ADMINISTRATOR OF GROUNDWATER CODE  
OFFICE OF STATE ENGINEER

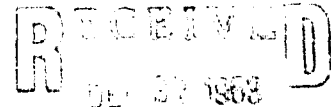

Declaration of Vested Groundwater Rights

(Under Chapter 237, Montana Session Laws, 1961)

STATE ENGINEER

1. ~~Mr. & Mrs.~~ William D. James of Route 1 South, Great Falls  
(Name of Appropriator) (Address) (Town)  
County of Cascade State of Montana  
have appropriated groundwater according to the Montana laws in effect prior to January 1, 1962, as follows:

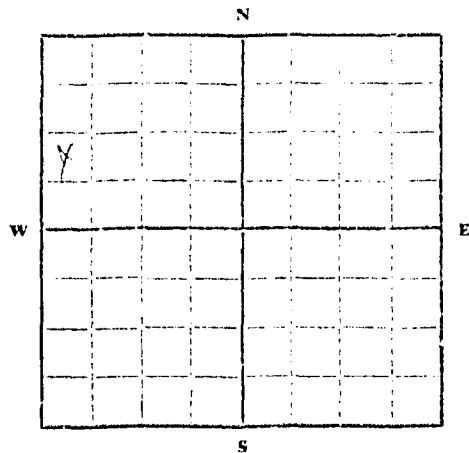

1/4NW Sec. 36 T. 20 R. 3E

Indicate point of appropriation and place of use, if possible. Each small square represents 10 acres.

2. The beneficial use on which the claim is based Household use and irrigation for lawns, flowers and garden.

3. Date or approximate date of earliest beneficial use; and how continuous the use has been September, 1958.  
Well has been used daily since then.

4. The amount of groundwater claimed (in miner's inches or gallons per minute) Sixty (60) gallons per minute.

5. If used for irrigation, give the acreage and description of the lands to which water has been applied and name of the owner thereof Eleven (11) acres of lawns, garden, grass.  
Owners, Mr. and Mrs. William D. James,  
Route 1 South, Great Falls, Montana.

6. The means of withdrawing such water from the ground and the location of each well or other means of withdrawal Deep well jet pump. Well is in southwest part of the 11 acres.

7. The date of commencement and completion of the construction of the well, wells, or other works for withdrawal of groundwater The well was started and completed in September, 1958.  
I do not remember exact dates but drilling required about one week.

8. The depth of water table Sixty feet from the surface.

9. So far as it may be available, the type, size and depth of each well or the general specifications of any other works for the withdrawal of groundwater The well has a six-inch casing and was drilled to a depth of 180 feet.

10. The estimated amount of groundwater withdrawn each year 263,000 gallons per year.

11. The log of formations encountered in the drilling of each well if available The well was dug through sand for most of the 180 feet. A few slight traces of gravel were hit but the well was at the 180 foot mark before sufficient gravel was reached to have a satisfactory well.

12. Such other information of a similar nature as may be useful in carrying out the policy of this act, including reference to book and page of any county record Tax book records are on Book 3, Page 10 in the Cascade County Treasurer's office.

Signature of Owner William D. James

Date Sept 27, 1962

Three copies to be filed by the owner with the County Clerk and Recorder of the county in which the well is located.

Please answer all questions. If not applicable, so state, otherwise the form will be returned.

Original to the County Clerk and Recorder; duplicate to the State Engineer; Triplicate to the Montana Bureau of Mines and Geology, and Quadruplicate for the Appropriator.

3678

STATE OF MONTANA, } ss.  
County of Cascade.

I hereby certify that the within in-  
strument was filed in this office on

DEC 29 1906

Date

at 12:05 o'clock P. M.

**J. L. LENNON**

County Clerk and Recorder.

By B. H. H. H. Deputy.



File No. ....

T. 200R 3E

DUPLICATE

County Cascade

STATE OF MONTANA  
ADMINISTRATOR OF GROUNDWATER CODE  
OFFICE OF STATE ENGINEER

RECEIVED  
JAN 1964

Declaration of Vested Groundwater Rights

(Under Chapter 237, Montana Session Laws, 1961)

1. Julia B. HARKIN, of RT. 1 S. Great Falls  
(Name of Appropriator) (Address) (Town)

County of Cascade State of Montana  
have appropriated groundwater according to the Montana laws in effect prior to January 1, 1962, as follows:

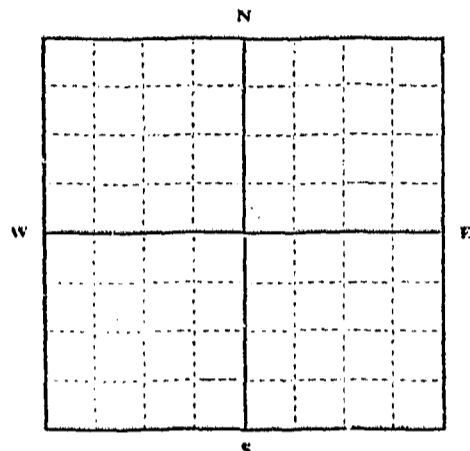

W. 43 Sec. 2 T. 1 R. Donovan Park  
Indicate point of appropriation and place of use, if possible. Each small square represents 10 acres.

2. The beneficial use on which the claim is based #1 irrigation  
#2 household use

3. Date or approximate date of earliest beneficial use; and how continuous the use has been 1941 #1 & #2  
continuously

4. The amount of groundwater claimed (in miner's inches or gallons per minute); #1 - 500 gal. per day  
#2 - 1000 gal. per day

5. If used for irrigation, give the acreage and description of the lands to which water has been applied and name of the owner thereof  
1 1/2 acres  
owner - Julia B. HARKIN

6. The means of withdrawing such water from the ground and the location of each well or other means of withdrawal  
Electric Pump #1  
Electric Pump #2

7. The date of commencement and completion of the construction of the well, wells, or other works for withdrawal of groundwater 1941 #1 & #2

8. The depth of water table #1 - 18 FT. #2 - 18 FT.

9. So far as it may be available, the type, size and depth of each well or the general specifications of any other works for the withdrawal of groundwater  
#1 DUG well - 22 FT. DEEP - 2 1/2 FT. DIAMETER  
#2 DUG well - 8 FT. - 8 FT. DIAMETER

10. The estimated amount of groundwater withdrawn each year #1 - 182,000 gal.  
#2 - 130,000 gal.

11. The log of formations encountered in the drilling of each well if available  
#1 Clay  
#2 Clay

12. Such other information of a similar nature as may be useful in carrying out the policy of this act, including reference to book and page of any county record None

Signature of Owner Julia B. Harkin  
Date Dec. 29, 1963

Three copies to be filed by the owner with the County Clerk and Recorder of the county in which the well is located.

Please answer all questions. If not applicable, so state, otherwise the form will be returned.

Original to the County Clerk and Recorder; Duplicate to the State Engineer; Triplicate to the Montana Bureau of Mines and Geology, and Quadruplicate for the Appropriator.

4349

STATE OF MINNESOTA  
County of Cass

I hereby certify that the within  
instrument was filed in my office on

DEC 31 1908

Book 1734

J. E. LEMMON  
County Clerk and Recorder.

BY J. Lemmon  
Deputy.

File No. ....

T-36 N R 3 E

DUPLICATE

County Cascade

STATE OF MONTANA  
ADMINISTRATOR OF GROUNDWATER CODE  
OFFICE OF STATE ENGINEER

RECEIVED  
JAN 9 1964

Declaration of Vested Groundwater Rights

(Under Chapter 237, Montana Session Laws, 1961)

STATE ENGINEER

1. ~~Edmund Lemieux~~ Edmund Lemieux, of Rt. 1 South Great Falls  
(Name of Appropriator) (Address) (Town)  
County of Cascade State of Montana  
have appropriated groundwater according to the Montana laws in effect prior to January 1, 1962, as follows:

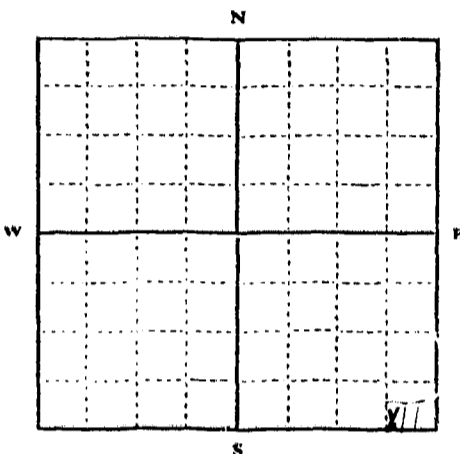

1/4 Sec. T36N R3E  
Indicate point of appropriation and place of use, if possible. Each small square represents 10 acres.

2. The beneficial use on which the claim is based house and garden

3. Date or approximate date of earliest beneficial use; and how continuous the use has been August 15, 1953 - used continuously since

4. The amount of groundwater claimed (in miner's inches or gallons per minute) This pump can pump 12 gallons per minute 8-12 hrs a day

5. If used for irrigation, give the acreage and description of the lands to which water has been applied and name of the owner thereof  
Edmund Lemieux  
3/4 36 N 3 E 4 NW 1/4 36 T36N R3E  
R3E - Cascade

6. The means of withdrawing such water from the ground and the location of each well or other means of withdrawal electric pump - jet pump

7. The date of commencement and completion of the construction of the well, wells, or other works for withdrawal of groundwater begun August 15, 1953 finished Aug 16, 1953

8. The depth of water table 50 ft from top

9. So far as it may be available, the type, size and depth of each well or the general specifications of any other works for the withdrawal of groundwater 4 inch pipe, size of drill pipe = 4 inches pumping water level 54 ft from top at 12 gal per minute static water level 50 ft from top 116' depth of well

10. The estimated amount of groundwater withdrawn each year 2 1/2 million gallons a year

11. The log of formations encountered in the drilling of each well if available nothing to 6 ft loose sand; 6 to 113' unconsolidated; 103-111' sandy silt + sand; 111-113' clay shale; 113-118' sand & silt with water in it, well produces 12 gal per minute

12. Such other information of a similar nature as may be useful in carrying out the policy of this act, including reference to book and page of any county record filed with plat # 28  
Edmund Lemieux  
11/20/63

Signature of Owner Edmund Lemieux  
Date Dec 3, 1963

Three copies to be filed by the owner with the County Clerk and Recorder of the county in which the well is located.

Please answer all questions. If not applicable, so state, otherwise the form will be returned.

Original to the County Clerk and Recorder; Duplicate to the State Engineer; Triplicate to the Montana Bureau of Mines and Geology, and Quadruplicate for the Appropriator.

28023

4038  
4031

STATE OF MONTANA, )  
County of Cascade )

I hereby certify that the within in-  
strument was filed in this office on

DEC 30 1958

12:11 P.M.

J. E. LEINON  
County Clerk and Recorder

By Bruce Deputy



4495-

RECORDED DEC 31 1963  
INDEX 154 GM  
DOCUMENT NO \_\_\_\_\_  
J. L. LENNON  
CLERK AND RECORDER  
CASCADE COUNTY, MONTANA  
BY JL

File No. ....

T. 20N R. 3E

DUPLICATE

County .....

STATE OF MONTANA  
 ADMINISTRATOR OF GROUNDWATER CODE  
 OFFICE OF STATE ENGINEER

**RECEIVED**  
 SEP 3 1963

**Declaration of Vested Groundwater Rights**  
 (Under Chapter 237, Montana Session Laws, 1961)

1. KENNETH J & RUTH H. NASH of Route 1, South Great Falls, Montana  
 (Name of Appropriator) (Address) (Town)  
 County of Cascade State of Montana  
 have appropriated groundwater according to the Montana laws in effect prior to January 1, 1962, as follows:

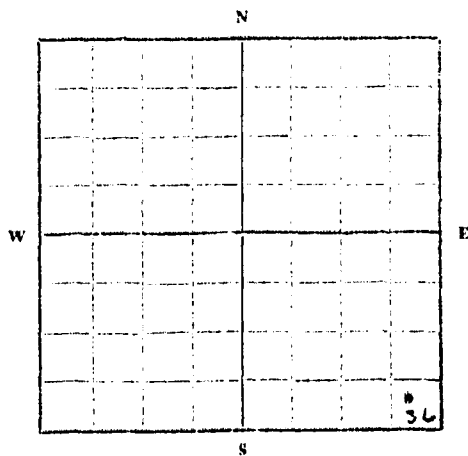

1/4 Sec. 36 T. 20N R. 3E

Indicate point of appropriation and place of use, if possible. Each small square represents 10 acres.

2. The beneficial use on which the claim is based. House use, water for livestock, irrigation.

3. Date or approximate date of earliest beneficial use, and how continuous the use has been. 1949-1963 continuous

4. The amount of groundwater claimed (in miner's inches or gallons per minute). Pump at house pumps 15 gal. per min. Pump on river (Missouri) pumps 50-60 gal. per min.

5. If used for irrigation, give the acreage and description of the lands to which water has been applied and name of the owner thereof. 2-3 acres pasture & 1-2 acres garden Kenneth J. & Ruth H. Nash

6. The means of withdrawing such water from the ground and the location of each well or other means of withdrawal. Well at house. Irrigation pump at river.

7. The date of commencement and completion of the construction of the well, wells, or other works for withdrawal of groundwater. 1949-50

8. The depth of water table. Well water reached at 12'.

9. So far as it may be available, the type, size and depth of each well or the general specifications of any other works for the withdrawal of groundwater. Shallow well, jet pump at house (21. P. 712-118) 21. P. ~~712-118~~ electric pump on river.

10. The estimated amount of groundwater withdrawn each year. 250,000 to 350,000 gal. (Well)

11. The log of formations encountered in the drilling of each well if available. Well - sand except for few inches of clay.

12. Such other information of a similar nature as may be useful in carrying out the policy of this act, including reference to book and page of any county record.

Signature of Owner. Kenneth J. Nash

Date. 8-26-63

Three copies to be filed by the owner with the County Clerk and Recorder of the county in which the well is located.

Please answer all questions. If not applicable, so state, otherwise the form will be returned.

Original to the County Clerk and Recorder; duplicate to the State Engineer; Triplicate to the Montana Bureau of Mines and Geology, and Quadruplicate for the Appropriator.

#2348

STATE OF MONTANA, } ss.  
County of Cascade.

I hereby certify that the within in-  
strument was filed in this office on  
AUG 26 1963

at 9:35<sup>date</sup> o'clock A M.

**J. L. LENNON**  
County Clerk and Recorder.

By [Signature]  
Deputy.



File No.....

T. 20 North 3

DUPLICATE

County.....

STATE OF MONTANA  
ADMINISTRATOR OF GROUNDWATER CODE  
OFFICE OF STATE ENGINEER

RECEIVED  
JAN 9 1964  
STATE ENGINEER

Declaration of Vested Groundwater Rights

(Under Chapter 237, Montana Session Laws, 1961)

1. Jerome L & Edna L. Podbielski of Rte. 1 South Great Falls  
(Name of Appropriator) (Address) (Town)  
County of Cascade State of Montana  
have appropriated groundwater according to the Montana laws in effect prior to January 1, 1962, as follows:

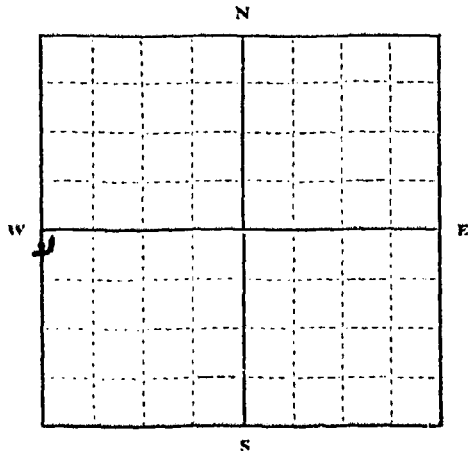

1/4 Sec. 36 T. 20 R. 3

Indicate point of appropriation and place of use, if possible. Each small square represents 10 acres.

- 2. The beneficial use on which the claim is based..... domestic and irrigation of lawn
- 3. Date or approximate date of earliest beneficial use; and how continuous the use has been..... 15 years of continuous use, since approximately 1958-1948
- 4. The amount of groundwater claimed (in miner's inches or gallons per minute)..... 60 gallons per minute
- 5. If used for irrigation, give the acreage and description of the lands to which water has been applied and name of the owner thereof 1 1/3 acres - sandy loam soil - owners names as listed above
- 6. The means of withdrawing such water from the ground and the location of each well or other means of withdrawal..... pit pump
- 7. The date of commencement and completion of the construction of the well, wells, or other works for withdrawal of groundwater..... 1948
- 8. The depth of water table..... 110 ft
- 9. So far as it may be available, the type, size and depth of each well or the general specifications of any other works for the withdrawal of groundwater..... deep - 8" - 150 ft. pit pump
- 10. The estimated amount of groundwater withdrawn each year..... 400,000 gallons
- 11. The log of formations encountered in the drilling of each well if available..... not available
- 12. Such other information of a similar nature as may be useful in carrying out the policy of this act, including reference to book and page of any county record.....

Signature of Owner..... Edna L. Podbielski  
Date..... 12/20/63

Three copies to be filed by the owner with the County Clerk and Recorder of the county in which the well is located.

Please answer all questions. If not applicable, so state, otherwise the form will be returned.

Original to the County Clerk and Recorder; duplicate to the State Engineer; Triplicate to the Montana Bureau of Mines and Geology, and Quadruplicate for the Appropriator.

28274

4286

STATE OF MONTANA, <sup>Sec.</sup>  
County of Cascade.

I hereby certify that the within in-  
strument was filed in this office on  
10.31.1908

at 10:18 <sup>PM</sup> o'clock PM

**E. L. LENNON**  
County Clerk and Recorder

By [Signature]  
Deputy



5535

STATE OF MONTANA, }  
County of Cascade. }

I hereby certify that the within instrument was filed in this office on  
JUN 28 1973

at 1:31 o'clock P.M.

J. L. LEMMA  
County Clerk and Recorder.

By J. L. Lemma  
Deputy.

T. \_\_\_\_\_ R. \_\_\_\_\_

County \_\_\_\_\_

MONTANA BUREAU OF MINES AND GEOLOGY  
Butte, Montana

WATER WELL LOG

Owner \_\_\_\_\_ Address \_\_\_\_\_

Driller \_\_\_\_\_ Address \_\_\_\_\_

Date Started \_\_\_\_\_ Date Completed \_\_\_\_\_

Location: Sec. 36 T. 44 N. R. 22 W. 1/4 sec. 34 of 35

Type of well \_\_\_\_\_ (Dug, driven, bored, or drilled) Equipment used \_\_\_\_\_ (Churn drill, rotary, other)

Water use: Domestic  Municipal  Stock  Irrigation   
Industrial  Drainage  Other: \_\_\_\_\_

Casing: \_\_\_\_\_ ft. to \_\_\_\_\_ ft. Type \_\_\_\_\_ Size \_\_\_\_\_

Casing: \_\_\_\_\_ ft. to \_\_\_\_\_ ft. Type \_\_\_\_\_ Size \_\_\_\_\_

Casing: \_\_\_\_\_ ft. to \_\_\_\_\_ ft. Type \_\_\_\_\_ Size \_\_\_\_\_

Perforated or Screened: Ft. \_\_\_\_\_ to ft. \_\_\_\_\_ Ft. \_\_\_\_\_ to ft. \_\_\_\_\_

Type of screen or perforations \_\_\_\_\_

Static Water level, for non-flowing well: \_\_\_\_\_ feet.

Shut-in pressure, for flowing well: \_\_\_\_\_ lb./sq. in. on: \_\_\_\_\_ (date)

Pumping water level: \_\_\_\_\_ feet at \_\_\_\_\_ gal. per min.

How tested: \_\_\_\_\_

Length of test: \_\_\_\_\_

Remarks: (Gravel packing, cementing, packers, type of shut-off, depth of shut-off)

\_\_\_\_\_  
\_\_\_\_\_  
\_\_\_\_\_  
\_\_\_\_\_  
\_\_\_\_\_

(over)

Log of Well

Depth, feet		Description of Material Drilled
From	To	
0	7	Surface
7	8	soil
8	15	loam
15	31	clay loam
31	35	hard rock
35	38	clay shale
38	44	hard rock with quartz
44	47	loam
47	72	hard rock
72	76	blue sandstone
76	140	blue sandstone
140	172	hard rock
172	212	clay shale
212	226	loam
226	230	clay shale
230	239	hard rock water
239	240	fine

STATE OF MONTANA  
ADMINISTRATOR OF GROUNDWATER CODE  
MONTANA WATER RESOURCES BOARD

NOTICE OF COMPLETION OF GROUNDWATER  
APPROPRIATION BY MEANS OF WELL

Developed after January 1, 1962

(Under Chapter 237 Montana Session Laws, 1961, as amended)

This form is to be prepared by driller, and three copies to be filed by the owner with the County Clerk and Recorder in the county in which the well is located, last copy to be retained by driller.

Please answer all questions. If not applicable, so state, otherwise the form may be returned.

Owner Trailer Remage

Address St. 1 Rd.

Great Falls, Montana

Date well started 3-17-71

completed 3-19-71

For Administrator's Use	
File	<u>5486</u>
	<u>April 25, 1973</u>
GW 1	<u>10:00 A.M.</u>

Type of well Drilled  
(Dug, driven, bored or drilled)

Equipment used Churn Drill  
(Churn drill, rotary or other)

Water Use: Domestic  Municipal  Stock  Irrigation

Industrial  Drainage  Other \* Garden/Lawn

\*Describe \_\_\_\_\_

USE: If used for irrigation, industrial, drainage or other. Explain, state number of acres and location or other data (i.e. Lot, Block and Addition). \_\_\_\_\_

ESTIMATED ANNUAL WITHDRAWAL

Size of Drilled Hole	Size and Weight of Casing	From (Feet)	To (Feet)	PERFORATIONS		
				Kind Size	From (Feet)	To (Feet)
<u>7"</u>	<u>7"00</u> <u>20'</u>	<u>0</u>	<u>98</u>			

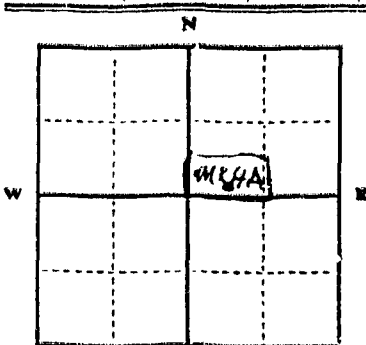

Lot 5  
1/4 Sec. 36  
T. 20N N.R. 38 E  
S W

Static water level 22 ft.\*  
Pumping water level 95 ft.\*  
at 50 gallons per minute,  
measured \_\_\_\_\_ minutes after pumping  
began.

\*Measured from ground level.  
Well developed by Bailer  
for 1 hours.

Power \_\_\_\_\_ Pump \_\_\_\_\_ HP

Remarks: (Gravel packing, cementing, packers, type of shutoff) \_\_\_\_\_

DRILLER'S LOG

Indicate the character, color, thickness of strata such as soil, clay, sand, gravel, shale, sandstone, etc. Show depth at which water is found and height to which water rises in well.

Top of Ground (Elev. above sea level)		
From (Feet)	To (Feet)	
<u>0</u>	<u>22</u>	<u>Top soil, sandy clay</u>
<u>22</u>	<u>97</u>	<u>Gray silt</u>
<u>97</u>	<u>98</u>	<u>Gravel-water</u>
<u>98</u>	<u>100</u>	<u>Br. Sandstone</u>

INDICATE LOCATION OF WELL AND PLACE OF USE, IF POSSIBLE. EACH SMALL SQUARE REPRESENTS 40 ACRES.

Driller's Signature [Signature]

Driller's Address \_\_\_\_\_

LICENSE NO. 135

100 Show exact depth of bottom

53025

5486

STATE OF MISSISSIPPI,  
County of Calhoun.

I hereby certify that the within in-  
strument was filed in this office on

**APR 25 1973**

at 10:00 o'clock AM

J. H. HENNING

County Clerk and Recorder.

By J. S. Wilson  
Deputy



File No. ....

T. 20 N R. 3 E

DUPLICATE

County Cascade

STATE OF MONTANA  
ADMINISTRATOR OF GROUNDWATER CODE  
OFFICE OF STATE ENGINEER

RECEIVED  
JAN 31 1964  
STATE ENGINEER

Declaration of Vested Groundwater Rights

(Under Chapter 237, Montana Session Laws, 1961)

1. Paul Wilhelm, of Route 1 South Great Falls  
(Name of Appropriator) (Address) (Town)  
County of Cascade State of Montana  
have appropriated groundwater according to the Montana laws in effect prior to January 1, 1962, as follows:

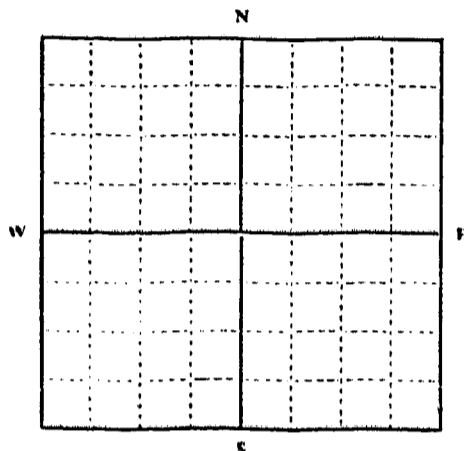

SW 1/4 Sec. 36 T. 20N R. 3E

Indicate point of appropriation and place of use, if possible. Each small square represents 10 acres.  
NW 1/4 of NE 1/4 of SW 1/4

2. The beneficial use on which the claim is based Human and animal consumption, & lawn surrounding house.

3. Date or approximate date of earliest beneficial use; and how continuous the use has been. July 1960

4. The amount of groundwater claimed (in miner's inches or gallons per minute) 750 gallons per hour

5. If used for irrigation, give the acreage and description of the lands to which water has been applied and name of the owner thereof

6. The means of withdrawing such water from the ground and the location of each well or other means of withdrawal  
Electric pump

7. The date of commencement and completion of the construction of the well, wells, or other works for withdrawal of groundwater July 1960 May 10, 1960

8. The depth of water table 118'

9. So far as it may be available, the type, size and depth of each well or the general specifications of any other works for the withdrawal of groundwater Drilled well; 4 1/2" O.D.; Depth 118 feet

10. The estimated amount of groundwater withdrawn each year 1,000,000 gal. per year

11. The log of formations encountered in the drilling of each well if available Not available

12. Such other information of a similar nature as may be useful in carrying out the policy of this act, including reference to book and page of any county record

Signature of Owner Paul Wilhelm

Date December 27, 1963

Three copies to be filed by the owner with the County Clerk and Recorder of the county in which the well is located.

Please answer all questions. If not applicable, so state, otherwise the form will be returned.

51 Original to the County Clerk and Recorder; Duplicate to the State Engineer; Triplicate to the Montana Bureau of  
5 Mines and Geology, and Quadruplicate for the Appropriator

28610

4625

STATE OF CALIFORNIA

County of Santa Clara

at 452 1/2

J. H. ...

By h Fayett Deputy.

File No. ....

Blk 4, T. 5, R. 19

DUPLICATE

County Cascade

STATE OF MONTANA  
ADMINISTRATOR OF GROUNDWATER CODE  
OFFICE OF STATE ENGINEER

RECEIVED  
OCT 24 1968

Declaration of Vested Groundwater Rights

(Under Chapter 237, Montana Session Laws, 1961)

STATE ENGINEER

1. Wm. B. Bandler, of 1038-25 Ave So. Ft Falls  
(Name of Appropriator) (Address) (Town)  
County of Cascade State of Montana  
have appropriated groundwater according to the Montana laws in effect prior to January 1, 1962, as follows:

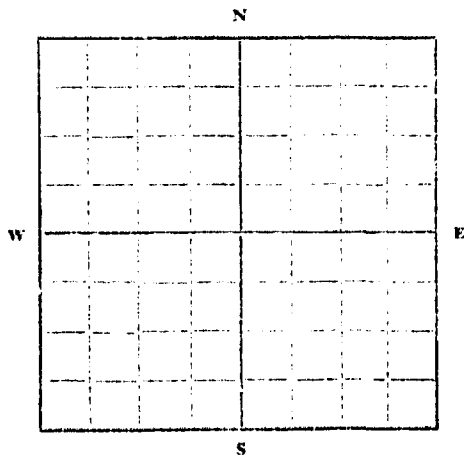

..... 1/4 ..... Sec. .... T. .... R. ....  
Indicate point of appropriation  
and place of use, if possible.  
Each small square represents 10  
acres.

2. The beneficial use on which the claim is based. Household  
and farm use

3. Date or approximate date of earliest beneficial use; and how con-  
tinuous the use has been. Sept 15, 1947

4. The amount of groundwater claimed (in miner's inches or gallons  
per minute). 3 gal per minute

5. If used for irrigation, give the acreage and description of the lands  
to which water has been applied and name of the owner thereof  
and grain

6. The means of withdrawing such water from the ground and the  
location of each well or other means of withdrawal.

7. The date of commencement and completion of the construction of the well, wells, or other works for with-  
drawal of groundwater. Sept 15, 1947

8. The depth of water table. 152 ft

9. So far as it may be available, the type, size and depth of each well or the general specifications of any other  
works for the withdrawal of groundwater. 1 1/2" dia. 10 ft deep

10. The estimated amount of groundwater withdrawn each year. 1.5 gpm

11. The log of formations encountered in the drilling of each well if available. 0 to 12 ft sand  
red shale, 10 to 40 ft sand, 40 to 50 ft clay shale (20 ft), 10 ft shale  
above 10 ft sand, 10 to 100 ft sand, 10 to 100 ft shale

12. Such other information of a similar nature as may be useful in carrying out the policy of this act, including  
reference to book and page of any county record.  
197-198-199-200-201-202-203-204-205-206-207-208-209-210-211-212-213-214-215-216-217-218-219-220-221-222-223-224-225-226-227-228-229-230-231-232-233-234-235-236-237-238-239-240-241-242-243-244-245-246-247-248-249-250

Signature of Owner Wm. B. Bandler  
Date .....

Three copies to be filed by the owner with the County Clerk and Recorder of the county in which the well is  
located.

Please answer all questions. If not applicable, so state, otherwise the form will be returned.

Original to the County Clerk and Recorder; duplicate to the State Engineer; Triplicate to the Montana Bureau  
of Mines and Geology, and Quadruplicate for the Appropriator.

# 3403

STATE OF MONTANA, } ss.  
County of Cascade. }

I hereby certify that the within in-  
strument was filed in this office on

  OCT 18 1963  

Date

at   4:00   o'clock   P.   M.

  J. L. JENNISON    
County Clerk and Recorder.

By   P. C. Nichols    
Deputy.

File No. ....

T. .... R. ....

DUPLICATE

RECEIVED  
NOV 22 1963

County Cascade

STATE OF MONTANA  
ADMINISTRATOR OF GROUNDWATER CODE  
OFFICE OF STATE ENGINEER

### Notice of Completion of Groundwater Appropriation by Means of Well

(Under Chapter 237, Montana Session Laws, 1961)

Owner Earl Bowcutt Address 212-16st. North Great Falls, Mont. 59113-704 Ave. 20.  
Driller Patrick J. Byrne Address Great Falls, Mont.

Date of Notice of Appropriation of Groundwater.....

Date well started 11-11-63 Date Completed 11-13-63

Type of well Drilled Equipment Used Churn drill  
(dug, driven, bored or drilled) (Churn, drill, rotary or other)

Water Use: Domestic  Municipal  Other  Irrigation   
Industrial  Drainage  Stock

Indicate on the diagram the character and thickness of the different strata met with in drilling, such as soil, clay, shale, gravel, rock or sand, etc. Show depth at which water is encountered, thickness and character of water-bearing strata and height to which water rises in the well.

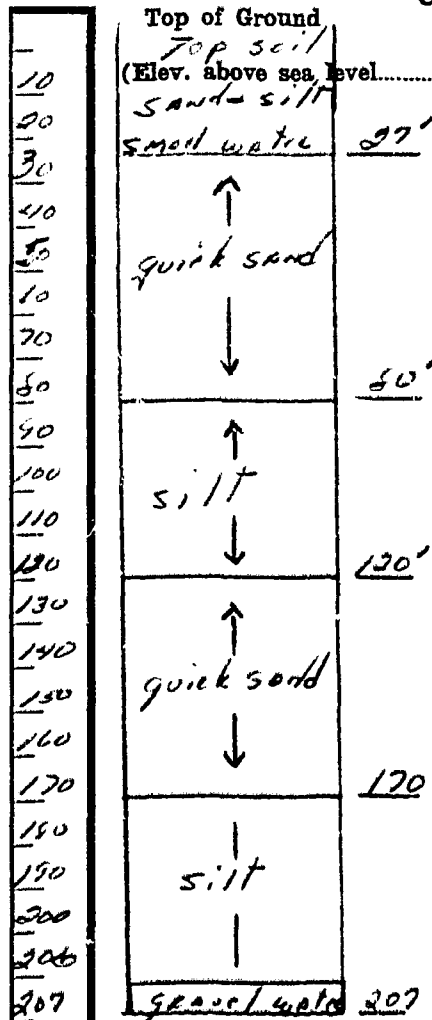

Size of Drilled Hole	Size and Weight of Casing	From (Feet)	To (Feet)	PERFORATIONS		
				Kind Size	From (Feet)	To (Feet)
7"	7" 17. seamless J-55 used	0'	206'	-	-	-

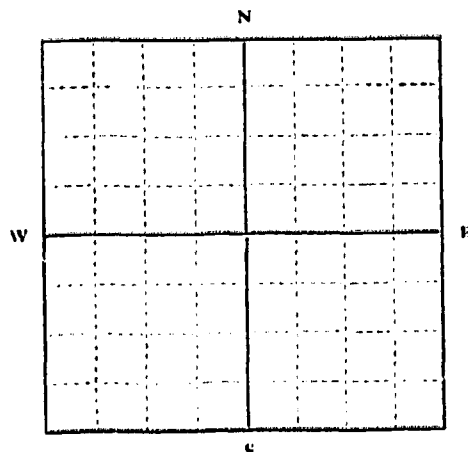

..... 1/4 Sec. .... T. .... R. ....  
Indicate location of well and place of use, if possible. Each small square represents 10 acres.

Show exact depth of bottom.

Static Water Level for non-flowing Well..... 211 feet.

Shut-in Pressure for Flowing Well.....

Pumping Water Level..... 100' feet at 20 gal. per minute.

Discharge in gal. per min. of flowing well.....

How Tested..... Bailer Length of Test..... 10 hrs.

Remarks: (Gravel packing, cementing, packers, type of shutoff, location of place of use of groundwater if not at well, and any other similar pertinent information, including number of acres irrigated, if used for irrigation).....

135  
Driller's License Number

Patrick J. Byrne  
Driller's Signature

This form to be prepared by driller, and three copies to be filed by the owner with the County Clerk and Recorder in the county in which the well is located.

Please answer all questions. If not applicable, so state, otherwise the form will be returned.

Original to the County Clerk and Recorder; duplicate to the State Engineer; Triplicate to the Montana Bureau of Mines and Geology and Quadruplicate for the Appropriator.

*[Handwritten mark]*

3431

STATE OF MONTANA, } ss.  
County of Cascade.

I hereby certify that the within in-  
strument was filed in this office on  
NOV 21 1963

Date

at 11:30 o'clock 9 M.

**J. L. LENNON**

County Clerk and Recorder.

By [Signature]  
Deputy.

GW

File No. ....

T. ... R. ....

DUPLICATE

County .....

STATE OF MONTANA  
ADMINISTRATOR OF GROUNDWATER CODE  
OFFICE OF STATE ENGINEER

**Declaration of Vested Groundwater Rights**  
(Under Chapter 237, Montana Session Laws, 1961)

1. Ralph E. Briggs of Support Bench Great Falls  
(Name of Appropriator) (Address) (Town)  
County of Cascade State of Montana  
have appropriated groundwater according to the Montana laws in effect prior to January 1, 1962, as follows:

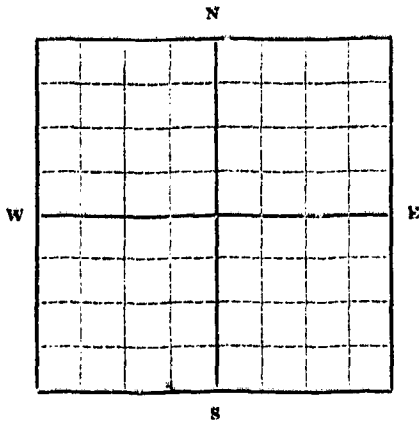

1/4 Sec. T. R.

Indicate point of appropriation and place of use, if possible. Each small square represents 10 acres.

2. The beneficial use on which the claim is based Domestic and human use

3. Date or approximate date of earliest beneficial use; and how continuous the use has been 1940 1948  
continuous

4. The amount of groundwater claimed (in miner's inches or gallons per minute) 2000 gallons per minute

5. If used for irrigation, give the acreage and description of the lands to which water has been applied and name of the owner thereof none

6. The means of withdrawing such water from the ground and the location of each well or other means of withdrawal jet pump on each well

7. The date of commencement and completion of the construction of the well, wells, or other works for withdrawal of groundwater 1940 1948

8. The depth of water table 70' 80'

9. So far as it may be available, the type, size and depth of each well or the general specifications of any other works for the withdrawal of groundwater

Hand dug 6" hole 80' depth  
6" hole 70' depth

10. The estimated amount of groundwater withdrawn each year 800,000 gal

11. The log of formations encountered in the drilling of each well if available

shale formations

12. Such other information of a similar nature as may be useful in carrying out the policy of this act, including reference to book and page of any county record

No Record

Signature of Owner

Date

Ralph E. Briggs  
10/2/62

Three copies to be filed by the owner with the County Clerk and Recorder of the county in which the well is located.

Please answer all questions. If not applicable, so state, otherwise the form will be returned.

Original to the County Clerk and Recorder; duplicate to the State Engineer; Triplicate to the School of Mines and Quadruplicate for the Appropriator.

#3184

STATE OF MONTANA, } ss.  
County of Cascade.

I hereby certify that the within in-  
strument was filed in this office on

OCT 22 1967

Date

at 9:30 o'clock a M.

**J. L. LENNON**

County Clerk and Recorder.

By B. R. R. Deputy.



File No. \_\_\_\_\_

T. S. R. \_\_\_\_\_

DUPLICATE

County Cascade

STATE OF MONTANA  
ADMINISTRATOR OF GROUNDWATER CODE  
OFFICE OF STATE ENGINEER

RECEIVED  
MAY 17 1965  
STATE ENGINEER

### Notice of Completion of Groundwater Appropriation by Means of Well

(Under Chapter 237, Montana Session Laws, 1961)

Owner Danell Gunkel Address Heat Falls, Mont.

Driller Thomas B. Franklin Address Heat Falls, Mont.

Date of Notice of Appropriation of Groundwater April 2, 1965

Date well started April 6, 1965 Date Completed April 13, 1965

Type of well Drilled, Driven Equipment Used Coll. Tools  
(dug, driven, bored or drilled) (Churn, drill, rotary or other)

Water Use: Domestic  Municipal  Other  Irrigation   
Industrial  Drainage  Stock

also Sandwich Making Business  
Indicate on the diagram the character and thickness of the different strata met with in drilling, such as soil, clay, shale, gravel, rock or sand, etc. Show depth at which water is encountered, thickness and character of water-bearing strata and height to which water rises in the well.

From top to 150 ft. Glacial Drift. Gravel  
From 150 ft to 158 ft. Water bearing sandy gravel

Top of Ground  
(Elev. above sea level.....)

Size of Drilled Hole	Size and Weight of Casing	From (Feet)	To (Feet)	PERFORATIONS		
				Kind Size	From (Feet)	To (Feet)
6 1/2	6 1/2 inch I.D. top Oil well casing 23 blw. per ft.		Bottom			

150 ft.

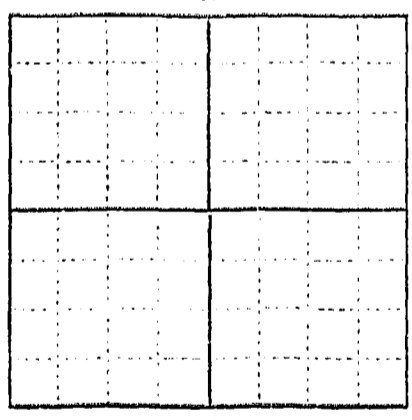

..... 1/4 Sec. .... T. .... R. ....  
Indicate location of well and place of use, if possible. Each small square represents 10 acres.

Show exact depth of bottom.

158 ft.

Static Water Level for non-flowing Well 22 feet.

Shut-in Pressure for Flowing Well.....

Pumping Water Level 50 feet at 30 gal. per minute.

Discharge in gal. per min. of flowing well.....

How Tested Bailer Length of Test 4 hrs

Remarks: (Gravel packing, cementing, packers, type of shutoff, location of place of use of groundwater if not at well, and any other similar pertinent information, including number of acres irrigated, if used for irrigation) approx

three ft. of gravel pack

84  
Driller's License Number

Thomas B. Franklin  
Driller's Signature

This form to be prepared by driller, and three copies to be filed by the owner with the County Clerk and Recorder in the county in which the well is located.

Please answer all questions. If not applicable, so state, otherwise the form will be returned.

Original to the County Clerk and Recorder; duplicate to the State Engineer; Triplicate to the Montana Bureau of Mines and Geology and Quadruplicate for the Appropriator.

39127

#4851

STATE OF MONTANA, } ss.  
County of Cascade.

I hereby certify that the within instrument was filed in this office on

MAY 12 1966

at 4:05 o'clock P. M.

**J. L. LENNON**  
County Clerk and Recorder.

by B. Kie Deputy.

File No. ....

T. 200 R. 30

DUPLICATE

County .....

STATE OF MONTANA  
ADMINISTRATOR OF GROUNDWATER CODE  
OFFICE OF STATE ENGINEER

Notice of Completion of Groundwater  
Appropriation by Means of Well

(Under Chapter 237, Montana Session Laws, 1961)

Owner *M. J. Flanagan* Address *Cte. 1, So. Great Falls, Mont.*

Driller *Thomas B. Franklin* Address *Cte. 1, So. Great Falls, Mont.*

Date of Notice of Appropriation of Groundwater *Sept. 5 - 1962*

Date well started *Sept. 7 - 1962* Date Completed *Sept. 12 - 1962*

Type of well *Drilled, Driven* Equipment Used *Cable tools*  
(dug, driven, bored or drilled) (Churn, drill, rotary or other)

Water Use: Domestic  Municipal  Other  Irrigation   
Industrial  Drainage  Stock

Indicate on the diagram the character and thickness of the different strata met with in drilling, such as soil, clay, shale, gravel, rock or sand, etc. Show depth at which water is encountered, thickness and character of water-bearing strata and height to which water rises in the well.

Glacial Drift gumbo from top to 150 ft. From 150 to 155 Water Bearing Sand, gravel. sand, gravel

Top of Ground  
(Elev. above sea level.....)

Size of Drilled Hole	Size and Weight of Casing	From (Feet)	To (Feet)	PERFORATIONS		
				Kind Size	From (Feet)	To (Feet)
<i>5 inch 2 D.</i>	<i>5 inch 2 1/2 O.D. Well. 14 lbs. per. ft.</i>	<i>Top</i>	<i>Bottom</i>			

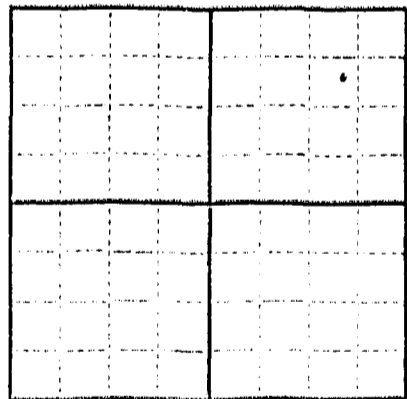

1/4 Sec. T. R.  
Indicate location of well and place of use, if possible. Each small square represents 10 acres.

155 Show exact depth of bottom.

Static Water Level for non-flowing Well *55* feet.

Shut-in Pressure for Flowing Well.....

Pumping Water Level *70* feet at *12* gal. per minute.

Discharge in gal. per min. of flowing well.....

How Tested *Bailer* Length of Test *4 hrs.*

Remarks: (Gravel packing, cementing, packers, type of shutoff, location of place of use of groundwater if not at well, and any other similar pertinent information, including number of

acres irrigated, if used for irrigation).....

*Some gravel packing used.  
approx. 3 ft.*

*84*

Driller's License Number

*Thomas B. Franklin*  
Driller's Signature

This form to be prepared by driller, and three copies to be filed by the owner with the County Clerk and Recorder in the county in which the well is located.

Please answer all questions. If not applicable, so state, otherwise the form will be returned.

Original to the County Clerk and Recorder; duplicate to the State Engineer; Triplicate to the Montana Bureau of Mines and Geology and Quadruplicate for the Appropriator.

#3185

STATE OF MONTANA  
County of Cascade

I hereby certify that the instrument was filed in this office.

SEP 2 1962

at 2:05 o'clock P.M.

J. L. LENTZ  
County Clerk and Registrar

By D. B. Burt  
Deputy

File No. ....

T. 20N R. 3 E

TRIPLICATE

County Cascade

STATE OF MONTANA  
ADMINISTRATOR OF GROUNDWATER CODE  
OFFICE OF STATE ENGINEER

RECEIVED

Notice of Appropriation of Groundwater

(Under Chapter 237, Montana Session Laws, 1961)

STATE ENGINEER

1. I, Bruce A. Nelson (Bruce Nelson #10 12th St Great Falls,  
(Name of Appropriator) Home Ins (Address) (Town)  
County of Cascade State of Montana, intend to appropriate groundwater in accordance with Chapter 237, Montana Session Laws of 1961.
2. The beneficial use to which water is to be applied is residential and irrigation  
usages  
(describe lands to be benefited, if for irrigation)
3. The rate of use in gallons per minute or miner's inches of groundwater claimed 20 gallons per minute
4. The annual period (inclusive dates) of intended use year around usage
5. The probable or intended date of first beneficial use September 1, 1962
6. The probable or intended date of commencement and completion of the well\* or wells\*  
Well dug July 30, 1962
7. The location, type, size and depth of well or wells contemplated  
5" id 145' depth located at NE corner of home of George Mader
8. The probable or estimated depth of the water table or artesian aquifer 150'
9. Name, address and license number of the driller engaged Thomas B. Franklin,  
Rt 1 South, Great Falls, Montana License #84
10. Give such other similar information as may be useful  
in carrying out the policy of this act

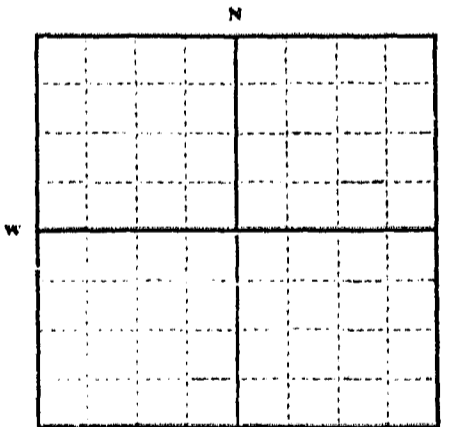

SE 1/4 NW 1/4 Sec. 20N T. R. 3E  
Locate well or other means of development as accurately as possible on the plat.

Signature of Appropriator \_\_\_\_\_

Date \_\_\_\_\_

\* As defined in the Code Sec. 1 (c) "Well" means any artificial opening or excavation in the ground, however made, by which groundwater can be obtained or through which it flows under natural pressures or is artificially withdrawn."

Three copies of this notice are to be filed with County Clerk and Recorder of the county in which the well is located.

Please answer all questions. If not applicable, so state, otherwise the form will be returned.

Original to the County Clerk and Recorder; duplicate to the State Engineer; Triplicate to the Montana Bureau of Mines and Geology and Quadruplicate for the Appropriator.

#3165

STATE OF MONTANA. } ss.  
County of Cascade.

I hereby certify that the within instrument was filed in this office on  
AUG 27 1962

at 8:15 o'clock a. M.

**J. L. DENNON**  
County Clerk and Recorder.

By B. Brin  
Deputy.

DUPLICATE

County .....

STATE OF MONTANA  
ADMINISTRATOR OF GROUNDWATER CODE  
OFFICE OF STATE ENGINEER

Notice of Completion of Groundwater  
Appropriation by Means of Well

(Under Chapter 237, Montana Session Laws, 1961)

Owner Orville A. Nelson Address 10-12 St. Great Falls, Mont.  
Driller Thomas B. Franklin Address Rt. 1, So. Great Falls, Mont.  
Date of Notice of Appropriation of Groundwater July 23 - 1962  
Date well started July 24, 1962 Date Completed July 30 - 1962  
Type of well Drilled, Driven Equipment Used Cable tools  
(dug, driven, bored or drilled) (Churn, drill, rotary or other)

Water Use: Domestic  Municipal  Other  Irrigation   
Industrial  Drainage  Stock

Indicate on the diagram the character and thickness of the different strata met with in drilling, such as soil, clay, shale, gravel, rock or sand, etc. Show depth at which water is encountered, thickness and character of water-bearing strata and height to which water rises in the well.

125 ft. Sand, with some gravel and water  
Glacial Drift  
145 Water-bearing sand, gravel at 145  
Drift

Top of Ground  
(Elev. above sea level.....)

Size of Drilled Hole	Size and Weight of Casing	From (Feet)	To (Feet)	PERFORATIONS		
				Kind Size	From (Feet)	To (Feet)
5 inch L.D.	5 inch L.D. Oil Well Casing 14 lbs. pipe	top	145			

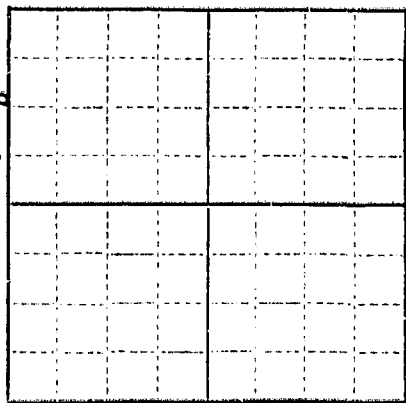

SE 1/4  
NW 1/4 Sec. 207 T. R. 3E  
Indicate location of well and place of use, if possible. Each small square represents 10 acres.

Show exact depth of bottom.

Static Water Level for non-flowing Well 10 feet.

Shut-in Pressure for Flowing Well.....

Pumping Water Level 35 feet at 13 gal. per minute.

Discharge in gal. per min. of flowing well.....

How Tested Boiler Length of Test 4 hrs

Remarks: (Gravel packing, cementing, packers, type of shutoff, location of place of use of groundwater if not at well, and any other similar pertinent information, including number of acres irrigated, if used for irrigation).....

84  
Driller's License Number

Thomas B. Franklin  
Driller's Signature

This form to be prepared by driller, and three copies to be filed by the owner with the County Clerk and Recorder in the county in which the well is located.

Please answer all questions. If not applicable, so state, otherwise the form will be returned.

Original to the County Clerk and Recorder; duplicate to the State Engineer; Triplicate to the Montana Bureau of Mines and Geology and Quadruplicate for the Appropriator.

# 3166

STATE OF MONTANA, } ss.  
County of Cascade.

I hereby certify that the within instrument was filed in this office on

AUG 27 1962

Date

at 8:16 o'clock a.

**J. L. LENNON**

County Clerk and Recorder

By B. B. Bui  
Deputy.



RECEIVED

T. 30N R. 2E  
County: Daniels

STATE ENGINEER MONTANA BUREAU OF MINES AND GEOLOGY  
Butte, Montana

WATER WELL LOG

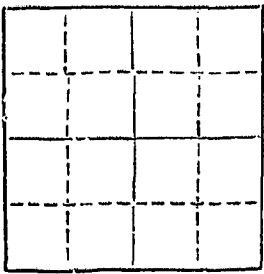

Owner: Barrett, Frank & Son Address: SW - 1st Falls  
Driller: Roscoe Peet Address: Box 741 - 1st  
Date Started: May 20 Date Completed: May 25 - 1959  
Location: Sec. T. R. 1/4 sec.

Type of well: Water Equipment used: Spudger Churn Drill  
(Dug, driven, bored, or drilled) (Churn drill, rotary, other)

Water use: Domestic  Municipal  Stock  Irrigation   
Industrial  Drainage  Other:

Casing: 72 1/2 ft. to Bottom ft. Type: 17 1/2" Size: 5" inside  
Casing: ft. to ft. Type: Size:  
Casing: ft. to ft. Type: Size:

Perforated or Screened: Ft. 20 to ft. Ft. to ft.

Type of screen or perforations: None

Static Water level, for non-flowing well: 30 feet.

Shut-in pressure, for flowing well: lb./sq. in. on: (date)

Pumping water level: feet at gal. per min.

How tested:

Length of test:

Remarks: (Gravel packing, cementing, packers, type of shut-off, depth of shut-off)

Casing down into & through red rock  
to shut off red water

(over)



GROUNDWATER INDEX

Page \_\_\_\_\_ of \_\_\_\_\_

County Cascade Twp. 20N Rge. 4E

Sec.	Name of Appropriator	Type of Form	County File No.	Remarks
4	Birch Can't. Co.	GW 2	3380	
4	Farm & Ranch Equip.	2	5418	
4	Rusicko, Gustave F. and Agnes E.	4	3181	
7	School Dist. #1	2	5294	
8	TIPPANY, Edward A.	4	4523	
9	Doran, M.P., Dr.	4	4364	
10	Alber, E.O.	4	3689	
13	Frazier, Ralph	2	5299	
15	Nelson, Dick	2	5363	
16	Butler, John M.	2	4780	
16	" " "	1	4779	
16	McIntyre, Robert B. & Judith K.	2	5463	
16	Modern Equip. Co.	2	5383	
16	Nilson, George B.	2	—	
16	" " "	2	5399	
17	Roman Catholic Bishop	2	5373	
18	Asiele, Michael M. & Edith	2	5175	
18	Bryant, Jaye	2	5218	
18	Carbett, Glen	4	4539	
18	Jones, Theo. C.	2	5347	
18	Lukes, Charles N.	4	4391	
18	McPherson, Gordon G.	4	4130	
18	" " G. G. and Clara E.	Well log	—	
18	" " " "	" "	—	
19	Rush, James C.	GW-2	4745	
20	Bau deau, James L. & Viala	2	5365	
20	Cannelley, Joseph & Mary	2	4868	
20	Cooper, Louise M.	4	4580	
20	" " "	4	4579	
20	Elmore, Max A.	4	4656	
20	Latray, Reatha (Mrs)	2	5052	
20	Hilts, Sam W.	4	4082	
20	Huston, Donald J. and Anne A.	2	5058	
20	Kemar, Shirley M. Hedrick	4	4575	
20	Quamen, Raymond W. & Rose Ellen	4	4634	
21	L. Johnson, Inc.	4	4359	
21	" " "	4	4358	
21	Preston, John H. & Nellie M.	4	4576	
25	Lyman Ranch Corp.	2	5079	
25	" " "	4	3593?	3993
25	Prinzing, Albert W. & Laura P.	4	—	

County CascadeTwp. 20NRge. 4E

Sec.	Name of Appropriator	Type of Form	County File No.	Remarks
26	Lyman Ranch	GW 2	5228	
26	" "	2	5229	
26	" "	4	3994	
27	Lyman, E. & Evelyn A.	4	4636	
28	Casteel, Helen L. Pierce & Pierce, Hamilton C.	4	4508	
28	Lyman, E. & Evelyn A.	4	4634	
30	Ayrshire Dairy	2	4813	
30	Gt. Falls Cemetery Assn.	2	5241	
31	Hueth, Joseph P.	2	5301	
31	Kenison, George E. and Sarah E.	4	4560	
31	" " " "	4	4561	
31	Klessig, Robert, Gary and Mary	4	3453	
31	Malberry, Clark L.	2	3488	
31	Miner, Boyd W.	4	3612	
31	Murray, Pegge M.	4	4356	
31	Nygard, Emil C. & Doris L.	2	3264	
31	Peterson, Rose A.	well log	—	
31	Plant, Charles L. & Donna M.	GW 2	5136	
31	Young, Robert W. & Ethel M.	2	5375	
31	Young, Robert	4	3379	
32	Babushkin, Nicholas C. & C. Cheryl L.	2	5519	
32	Chaan, George A. & Diane P.	2	5303	
32	Chappell, John	2	5131	
32	" "	1	5130	
32	" "	4	4658	
32	Larson, C. E.	2	5163	
32	" J. C. E.	2	5609	
32	Larson, C. E. or Bettie B.	2	5153	
32	Pursley, Clarence A. and Mary Ann	2	5179	
33	Bailey, Robert A.	3	3630	
33	Lyman, E. & Evelyn A.	4	4635	
34	Stanish, John M.	3	3488	
34	" " " "	4	3487	
34	Wirtala, Loretta Alice	4	3608	
?	Raty, Clark M.	4	4345	
—	Regan, Frank B.	4	3034	

File No. ....

DUPLICATE

T. R. ....

County Cascade

STATE OF MONTANA  
ADMINISTRATOR OF GROUNDWATER CODE  
OFFICE OF STATE ENGINEER

RECEIVED  
SEP 24 1963

### Notice of Completion of Groundwater Appropriation by Means of Well

STATE ENGINEER

(Under Chapter 237, Montana Session Laws, 1961)

Owner Burch Const Co Address Great Falls

Driller Pilly Colquhoun Address Hot Springs Mont

Date of Notice of Appropriation of Groundwater No Record

Date well started Feb 1963(?) Date Completed March 1963(?)

Type of well drilled Equipment Used rotary  
(dug, driven, bored or drilled) (Churn, drill, rotary or other)

Water Use: Domestic  Municipal  Stock  Irrigation   
Industrial  Drainage  Other

Indicate on the diagram the character and thickness of the different strata met with in drilling, such as soil, clay, shale, gravel, rock or sand, etc. Show depth at which water is encountered, thickness and character of water-bearing strata and height to which the water rises in the well.

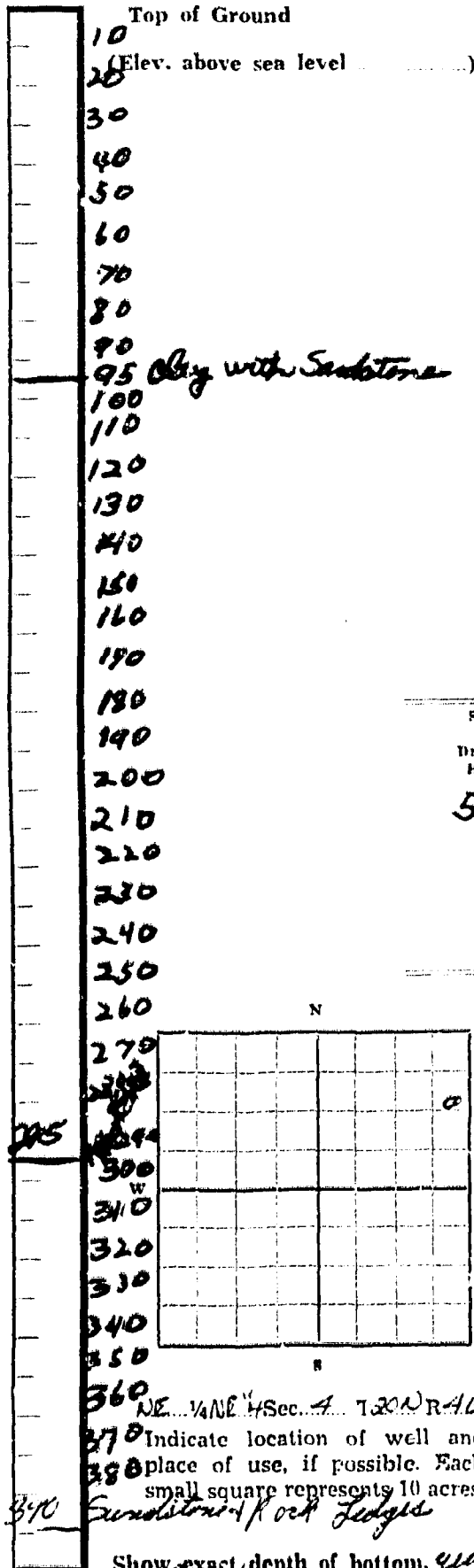

Size of Drilled Hole	Size and Weight of Casing	From (Feet)	To (Feet)	PERFORATIONS		
				Kind Size	From (Feet)	To (Feet)
5 5/8	4 1/2 I.D. slipper foot	30	400	torch cut 1/4"	240	400

Static Water Level for non-flowing Well.....feet.

Shut-in Pressure for Flowing Well None

Pumping Water Level.....feet at.....gal. per minute

Discharge in gal. per min. of flowing well None

How Tested..... Length of Test.....

Remarks: (Gravel packing, cementing, packers, type of shutoff, location of place of use of groundwater if not at well, and any other similar pertinent information, including number of acres irrigated, if used for irrigation)

Water used at well

Colquhoun 131  
Driller's License Number

Pilly Colquhoun  
Driller's Signature

This form to be prepared by driller, and three copies to be filed by the owner with the County Clerk and Recorder in the county in which the well is located.

Please answer all questions. If not applicable, so state, otherwise the form will be returned.

Original to the County Clerk and Recorder; duplicate to the State Engineer; Triplicate to the School of Mines and Quadruplicate for the Appropriator.

6067



County CASCADE

STATE OF MONTANA  
ADMINISTRATOR OF GROUNDWATER CODE  
MONTANA WATER RESOURCES BOARD

NOTICE OF COMPLETION OF GROUNDWATER  
APPROPRIATION BY MEANS OF WELL

Developed after January 1, 1962

(Under Chapter 237 Montana Session Laws, 1961, as amended)

This form to be prepared by driller, and three copies to be filed by the owner with the County Clerk and Recorder in the county in which the well is located, last copy to be retained by driller.

Please answer all questions. If not applicable, so state, otherwise the form may be returned.

Owner Fara & Ranch Equipment

Address River Road

Great Falls, Montana

Date well started May 11, 1972

completed July 27, 1972

For Administrator's Use	
File	<u>5418</u>
Date	<u>Oct. 11, 1972 11:40am</u>
GW	<u>1</u>

Type of well Drilled  
(Dug, driven, bored or drilled)

Equipment used Rotary  
(Churn drill, rotary or other)

Water Use: Domestic  Municipal  Stock  Irrigation

Industrial  Drainage  Other \* Garden/Lawn

\*Describe

USE: If used for irrigation, industrial, drainage or other. Explain, state number of acres and location or other data (i.e. Lot, Block and Addition).

ESTIMATED ANNUAL WITHDRAWAL

Size of Drilled Hole	Size and Weight of Casing	From (Feet)	To (Feet)	PERFORATIONS		
				Kind Size	From (Feet)	To (Feet)
9"	6" PVC	5fc	280	none		

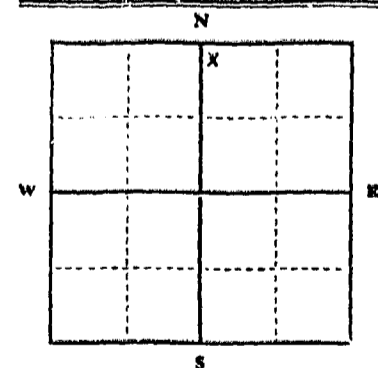

NW 1/4 NE 1/4 Sec. 4  
T. 20. N. R. 4. E

Static water level 145 ft.\*  
Pumping water level 250 ft.\*  
at 10 gallons per minute,  
measured 60 minutes after pumping began.

\*Measured from ground level.  
Well developed by Air Pump  
for 6 hours.  
Power Cat G.D. Pump 140 HP  
Remarks: (Gravel packing, cementing, packers, type of shutoff)

Puddled Clay, Rubber Packer

INDICATE LOCATION OF WELL AND PLACE OF USE, IF POSSIBLE. EACH SMALL SQUARE REPRESENTS 40 ACRES.

Driller's Signature George T. Taylor

Driller's Address 503 - 347 St. N.W.

Great Falls, Montana LICENSE NO. 214

DRILLER'S LOG

Indicate the character, color, thickness of strata such as soil, clay, sand, gravel, shale, sandstone, etc. Show depth at which water is found and height to which water rises in well.

Top of Ground (Elev. above sea level)		
From (Feet)	To (Feet)	
5fc	3	Soil
3	60	Clay
60	85	Red & Gray Shale
85	200	Gray Sandstone
200	230	Gray Shale
230	290	Lt Gray Sandstone
290	325	Gray Shale
325	365	Tan Sandstone
365	390	Blue Shale
390	400	Tan Shale
400	407	Gray Sandy Shale (water)

407 Show exact depth of bottom

51,621  
51,621

5418

STATE OF MONTANA, )  
County of Cascade.

I hereby certify that the within in-  
strument was filed in this office on

**OCT 11 1972**

Date

at 11:40 o'clock A M

**J. L. LENNON**

County Clerk and Recorder

By J. S. Wilson  
Deputy





RECEIVED

County CASCADE

STATE OF MONTANA  
ADMINISTRATOR OF GROUNDWATER CODE  
MONTANA WATER RESOURCES BOARD

OCT 12 1972

DRILLER'S LOG

Indicate the character, color, thickness of strata such as soil, clay, sand, gravel, shale, sandstone, etc. Show depth at which water is found and height to which water rises in well.

NOTICE OF COMPLETION OF GROUNDWATER  
APPROPRIATION BY MEANS OF WELL

Developed after January 1, 1962

(Under Chapter 237 Montana Session Laws, 1961, as amended)

This form to be prepared by driller, and three copies to be filed by the owner with the County Clerk and Recorder in the county in which the well is located, last copy to be retained by driller.

Please answer all questions. If not applicable, so state, otherwise the form may be returned.

Owner John A. Ranch Equipment

Address River Road

Great Falls, Montana

Date well started May 11, 1972

completed July 27, 1972

Type of well Drilled

Equipment used Rotary

Water Use: Domestic  Municipal  Stock  Irrigation

Industrial  Drainage  Other \* Garden/Lawn

\*Describe

USE: If used for irrigation, industrial, drainage or other. Explain, state number of acres and location or other data (i.e. Lot, Block and Addition).

ESTIMATED ANNUAL WITHDRAWAL

Size of Drilled Hole	Size and Weight of Casing	From (Feet)	To (Feet)	PERFORATIONS		
				Kind Size	From (Feet)	To (Feet)
9"	6" PTC Sbc	230		none		

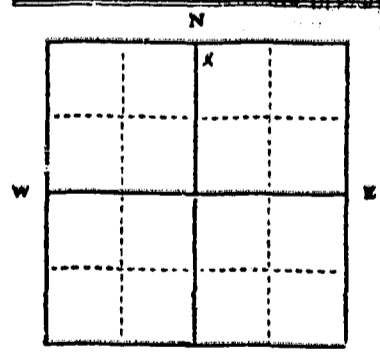

NW 1/4 Sec. 4  
T. 26 N. R. 41 E.  
S

INDICATE LOCATION OF WELL AND PLACE OF USE, IF POSSIBLE. EACH SMALL SQUARE REPRESENTS 40 ACRES.

Driller's Signature George T. Taylor

Driller's Address 502 - 3rd St. N.E.

Great Falls, Montana

LICENSE NO. 214

Top of Ground (Elev. above sea level)	
From (Feet)	To (Feet)
0	0
10	10
20	20
30	30
40	40
50	50
60	60
70	70
80	80
90	90
100	100
110	110
120	120
130	130
140	140
150	150
160	160
170	170
180	180
190	190
200	200
210	210
220	220
230	230
240	240
250	250
260	260
270	270
280	280
290	290
300	300
310	310
320	320
330	330
340	340
350	350
360	360
370	370
380	380
390	390
400	400
410	410
420	420
430	430
440	440
450	450
460	460
470	470
480	480
490	490
500	500
510	510
520	520
530	530
540	540
550	550
560	560
570	570
580	580
590	590
600	600
610	610
620	620
630	630
640	640
650	650
660	660
670	670
680	680
690	690
700	700
710	710
720	720
730	730
740	740
750	750
760	760
770	770
780	780
790	790
800	800
810	810
820	820
830	830
840	840
850	850
860	860
870	870
880	880
890	890
900	900
910	910
920	920
930	930
940	940
950	950
960	960
970	970
980	980
990	990
1000	1000

Static water level 115 ft.\*  
Pumping water level 150 ft.\*  
at 10 gallons per minute,  
measured 30 minutes after pumping  
began.  
\*Measured from ground level.  
Well developed by air lift  
for 6 hours.  
Power 3.0 HP Pump 1.5 HP  
Remarks: (Gravel packing, cementing,  
packers, type of shutoff)

Drilled clay. Rubber  
packer

407 Show exact depth of bottom

L.F.

57,021

STATE OF MONTANA  
ADMINISTRATOR OF GROUNDWATER CODE  
MONTANA WATER RESOURCES BOARD

NOTICE OF COMPLETION OF GROUNDWATER  
APPROPRIATION BY MEANS OF WELL

Developed after January 1, 1962

(Under Chapter 237 Montana Session Laws, 1961, as amended)

This form to be prepared by driller, and three copies to be filed by the owner with the County Clerk and Recorder in the county in which the well is located, last copy to be retained by driller.

Please answer all questions. If not applicable, so state, otherwise the form may be returned.

Owner Michael J. Firman & LANAM Firman  
 Address Rt. 1 Sec. Box 818  
Green Falls  
 Date well started July 30, 71  
 completed Aug 5, 71

For Administrator's Use	
File	<u>5316</u>
	<u>September 22, 1971</u>
	<u>2:30 PM</u>
GW 1	

Type of well drilled  
(Dug, driven, bored or drilled)  
 Equipment used Churn drill  
(Churn drill, rotary or other)  
 Water Use: Domestic  Municipal  Stock  Irrigation   
 Industrial  Drainage  Other \* Garden/Lawn

\*Describe \_\_\_\_\_  
 USE: If used for irrigation, industrial, drainage or other. Explain, state number of acres and location or other data (i.e. Lot, Block and Addition). \_\_\_\_\_

ESTIMATED ANNUAL WITHDRAWAL About 500,000 gall.

Size of Drilled Hole	Size and Weight of Casing	From (Feet)	To (Feet)	PERFORATIONS		
				Kind Size	From (Feet)	To (Feet)
<u>5 inch</u>	<u>5 7/8" O.D. 17 lb</u>	<u>0</u>	<u>187</u>	<u>Casing driven open end into gravel</u>		

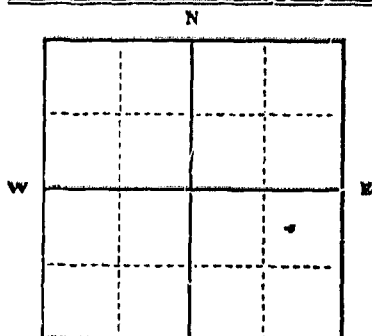

Virginia Bard Add  
Lot 7 1/4 NW 1/4 Sec. 36  
Blk 20 N.R. 35 E

Static water level 10 ft from top  
 Pumping water level 12 ft from top  
 at 50 gallons per minute,  
 measured 30 minutes after pumping  
 began.  
 \*Measured from ground level.  
 Well developed by washing  
 for 0.5 hours.  
 Power Electric Pump 1 1/2 HP  
 Remarks: (Gravel packing, cementing,  
 packers, type of shutoff) \_\_\_\_\_

INDICATE LOCATION OF WELL AND PLACE OF USE, IF POSSIBLE.  
 EACH SMALL SQUARE REPRESENTS 40 ACRES.

Driller's Signature E. D. Rafferty  
 Driller's Address 927-10<sup>th</sup> ave S.W. St. Falls

LICENSE NO. 28

County Cascade

DRILLER'S LOG 36

Indicate the character, color, thickness of strata such as soil, clay, sand, gravel, shale, sandstone, etc. Show depth at which water is found and height to which water rises in well.

Top of Ground		(Elev. above sea level)
From (Feet)	To (Feet)	
<u>0</u>	<u>18</u>	<u>coarse sand</u>
<u>18</u>	<u>32</u>	<u>water quick sand</u>
<u>32</u>	<u>170</u>	<u>sandy silt</u>
<u>170</u>	<u>186</u>	<u>silt</u>
<u>186</u>	<u>187</u>	<u>Gravel</u>

Show exact depth of bottom

49141

5316

STATE OF MONTANA, } ss.  
County of Cascade.

I hereby certify that the within in-  
strument was filed in this office on

22 1971

at 3:20 o'clock P.M.

J. M. LENTON  
County Clerk and Recorder.

By [Signature]  
Deputy

File No.

T. 20 N. R. 3

DUPLICATE

County Cascade

STATE OF MONTANA  
ADMINISTRATOR OF GROUNDWATER CODE  
OFFICE OF STATE ENGINEER

RECEIVED  
DEC 27 1963

Declaration of Vested Groundwater Rights ENGINEER  
(Under Chapter 237, Montana Session Laws, 1961)

1. Robert B. Franklin, of Route 1 So. Great Falls  
(Name of Appropriator) (Address) (Town)  
County of Cascade State of Montana  
have appropriated groundwater according to the Montana laws in effect prior to January 1, 1962, as follows:

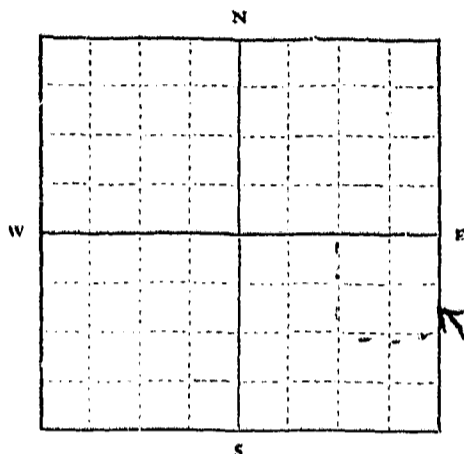

- 2. The beneficial use on which the claim is based... **domestic and irrigation - livestock**
- 3. Date or approximate date of earliest beneficial use; and how continuous the use has been... **May 1954 uninterrupted use to date**
- 4. The amount of groundwater claimed (in miner's inches or gallons per minute)... **25 G.P.M.**
- 5. If used for irrigation, give the acreage and description of the lands to which water has been applied and name of the owner thereof

1/4 Sec 36 T. 20 R. 3 Q. 4  
Indicate point of appropriation and place of use, if possible. Each small square represents 10 acres.  
A tract of land in the Northeast Quarter of the Southeast Quarter (NE 1/4) of section Thirty-six (36) Township Twenty (20) North, Range Three (3) East of the Montana Meridian, in Cascade County, Montana, more particularly bounded and described as follows: Means of withdrawing such water from the ground and the location of each well or other means of withdrawal... **paper deep well pump center of lot**

- 7. The date of commencement and completion of the construction of the well, wells, or other works for withdrawal of groundwater... **May 1 1954 May 7, 1954**
- 8. The depth of water table... **68 feet and 125 feet**
- 9. So far as it may be available, the type, size and depth of each well or the general specifications of any other works for the withdrawal of groundwater... **5' - 125 feet deep**
- 10. The estimated amount of groundwater withdrawn each year... **700,000**
- 11. The log of formations encountered in the drilling of each well if available... **(0-63ft) yellow and blue clay - water in broken sandstone at 68'-72ft) broken sandstone formation (72-123) yellow clay formation . (123-125) sand and gravel**
- 12. Such other information of a similar nature as may be useful in carrying out the policy of this act, including reference to book and page of any county record... **Deed recorded Book 227 Page 63 County Court House, 12 Nov, 1953**

Subscribed and sworn to before me this 23rd Day of Dec 1963  
G. H. Johnson

Signature of Owner Robert B. Franklin  
Date Dec 23, 1963

Three copies to be filed by the owner with the County Clerk and Recorder of the county in which the well is located.

Please answer all questions. If not applicable, so state, otherwise the form will be returned.

Original to the County Clerk and Recorder; Duplicate to the State Engineer; Triplicate to the Montana Bureau of Mines and Geology, and Quadruplicate for the Appropriator.

000000

Beginning at a point on the west line of the Northeast Quarter  
of the Southeast quarter (NE 1/4 SE 1/4) of Section Thirty-six (36)  
said point being on the south right-of-way line of the County  
road; thence East along the South right-of-way line of said  
county road 650' to the true point of beginning; thence East  
along the South right-of-way line of said County road one  
Hundred (100) feet; thence south one hundred and fifty  
(150) feet; thence south 86020' East one Hundred (100)  
feet; thence North one Hundred and fifty (150) feet  
to the place of beginning

*Robert B. Marklin*  
Dec. 23. 1963

2700

STATE OF MONTANA, } ss.  
County of Cascade.

I hereby certify that the within in-  
strument was filed in this office on

DEC 23 1963

at 1:27 <sup>PM</sup> o'clock

J. L. LENNON

County Clerk and Recorder.

By *J. J. [Signature]*  
Deputy.

File No.

T. 20 N. R. 3 E

DUPLICATE

RECEIVED  
DEC 27 1963

STATE OF MONTANA  
ADMINISTRATOR OF GROUNDWATER CODE  
OFFICE OF STATE ENGINEER

STATE ENGINEER

Declaration of Vested Groundwater Rights

(Under Chapter 237, Montana Session Laws, 1961)

1. Robert R. Franklin, of Box 130 Great Falls, Montana  
(Name of Appropriator) (Address) (Town)  
County of Cascade State of Montana  
have appropriated groundwater according to the Montana laws in effect prior to January 1, 1962, as follows:

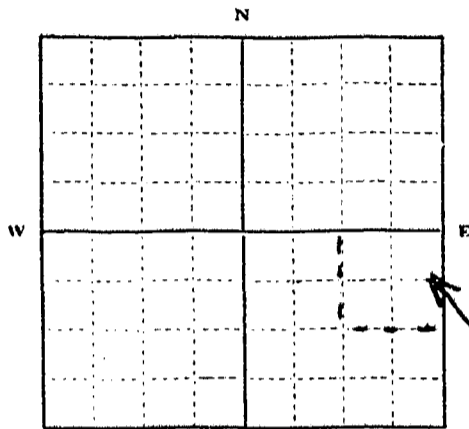

2. The beneficial use on which the claim is based Domestic and irrigation of ~~land~~ for 3 unit trailer O.G.

3. Date or approximate date of earliest beneficial use; and how continuous the use has been uninterrupted use to date June 1961

4. The amount of groundwater claimed (in miner's inches or gallons per minute) 25 gallons per minute

5. If used for irrigation, give the acreage and description of the lands to which water has been applied and name of the owner thereof

1/4 SE Sec. 36 T. 20 R. 3 A tract of land in the northeast quarter of the southeast quarter (NE 1/4) of section thirty-six (36), Township twenty (20) North, Range three (3) East of the Montana Meridian, in Cascade County, Montana more particularly bounded and described as follows to wit: see extra paper

Indicate point of appropriation and place of use, if possible. Each small square represents 10 acres.

6. The means of withdrawing such water from the ground and the location of each well or other means of withdrawal Deep well pump northeast corner of lot

7. The date of commencement and completion of the construction of the well, wells, or other works for withdrawal of groundwater June 5 June 13 - 1961

8. The depth of water table 90 feet

9. So far as it may be available, the type, size and depth of each well or the general specifications of any other works for the withdrawal of groundwater 5 5/8 inch casing

10. The estimated amount of groundwater withdrawn each year 800,000 gallons

11. The log of formations encountered in the drilling of each well if available 0'-14' sand 14'-87 blue gumbo and sand silt 87-90 sand and gravel

12. Such other information of a similar nature as may be useful in carrying out the policy of this act, including reference to book and page of any county record Recorded Cascade Co. Court House book 216 page 327 August 22, 1955

*Subscribed and Sworn to before me this 23rd Day of Dec 1963  
A. N. Johnson*

Signature of Owner *Robert B. Franklin*  
Date *Dec 23, 1963*

Three copies to be filed by the owner with the County Clerk and Recorder of the county in which the well is located.

Please answer all questions. If not applicable, so state, otherwise the form will be returned.

Original to the County Clerk and Recorder; Duplicate to the State Engineer; Triplicate to the Montana Bureau of Mines and Geology, and Quadruplicate for the Appropriator.

Beginning at a point on the west line of the Northeast Quarter of the Southeast Quarter (NE 1/4 S 1/4) of Section 36, Township 20 North, Range 3 East, said point being on the south right of way line of the county road, thence east along the said road right of way a distance of 525 feet, the true point of beginning of the tract herein described; thence continuing east along the South right-of-way line of said county road a distance of 125 feet; thence south 150 feet; thence south 86° 20' West 125 feet; then north 150 feet to the place of beginning

Robert H. Franklin  
Dec 23, 1963

8701

STATE OF MONTANA, ss  
County of Cascade,

I hereby certify that the within instrument was filed in this office on

DEC 23 1963

Date

at 1:27 o'clock P.M.

J. E. THORNTON

County Clerk and Recorder

By *J. E. Thornton*  
Deputy



File No. ....

T. 22 N. R. 3 E.

DUPLICATE

County CASCADE

STATE OF MONTANA  
ADMINISTRATOR OF GROUNDWATER CODE  
OFFICE OF STATE ENGINEER

DEC 18 1963

Notice of Completion of Groundwater  
Appropriation by Means of Well

(Under Chapter 237, Montana Session Laws, 1961)

Owner Robert P. Gaither Address .....

Driller Patrick S. Byrne Address 2112 7th Ave So.

Date of Notice of Appropriation of Groundwater .....

Date well started Aug 26, 63 Date Completed Aug 29, 1963

Type of well drilled Equipment Used Churn drill  
(dug, driven, bored or drilled) (Churn, drill, rotary or other)

Water Use: Domestic  Municipal  Other  Irrigation   
Industrial  Drainage  Stock

Indicate on the diagram the character and thickness of the different strata met with in drilling, such as soil, clay, shale, gravel, rock or sand, etc. Show depth at which water is encountered, thickness and character of water-bearing strata and height to which water rises in the well.

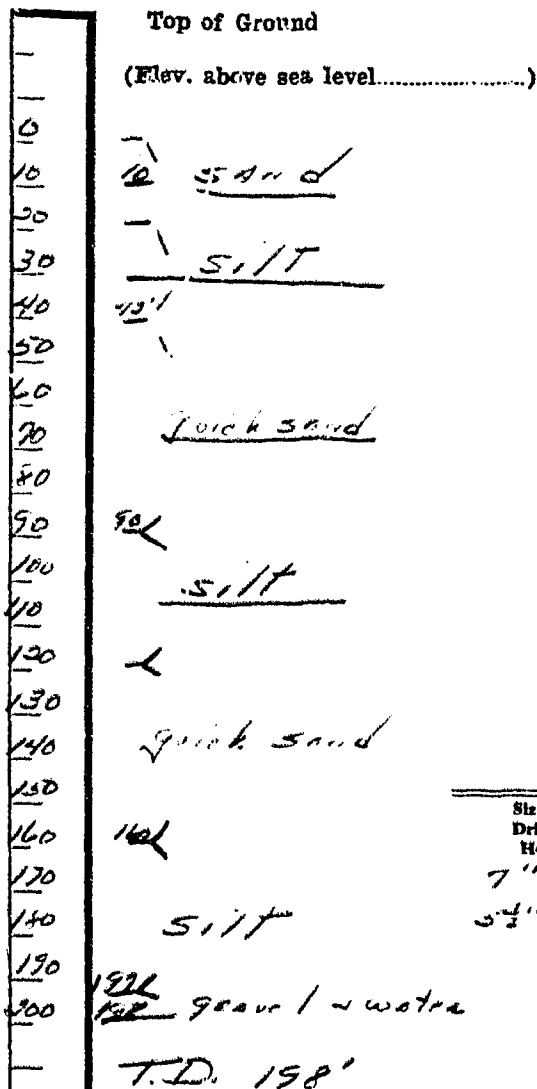

Size of Drilled Hole	Size and Weight of Casing	From (Feet)	To (Feet)	PERFORATIONS		
				Kind Size	From (Feet)	To (Feet)
7" OD.	7" 12#	0	92	-	-	-
5 1/2" OD.	5 1/2" 11#	0	198	-	-	-

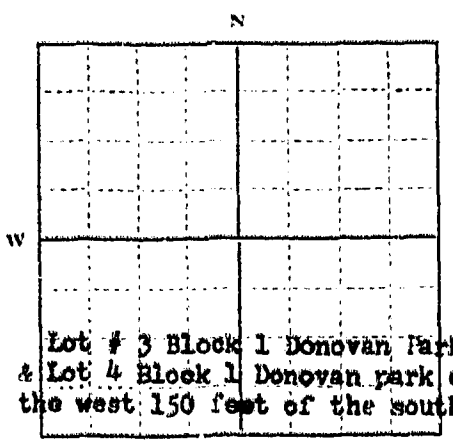

..... 1/4 Sec. .... T. .... R. ....  
Indicate location of well and place of use, if possible. Each small square represents 10 acres.

Show exact depth of bottom.

Static Water Level for non-flowing Well 47' feet.

Shut-in Pressure for Flowing Well .....

Pumping Water Level 85' feet at 26 gal. per minute.

Discharge in gal. per min. of flowing well .....

How Tested Bailer Length of Test 6 hrs.

Remarks: (Gravel packing, cementing, packers, type of shutoff, location of place of use of groundwater if not at well, and any other similar pertinent information, including number of acres irrigated, if used for irrigation) .....

135  
Driller's License Number  
Patrick S. Byrne  
Driller's Signature

This form to be prepared by driller, and three copies to be filed by the owner with the County Clerk and Recorder in the county in which the well is located.

Please answer all questions. If not applicable, so state, otherwise the form will be returned.

Original to the County Clerk and Recorder; duplicate to the State Engineer; Triplicate to the Montana Bureau of Mines and Geology and Quadruplicate for the Appropriator.

3478

STATE OF MONTANA, }  
County of Cascade.

I hereby certify that the within in-  
strument was filed in this office on

DEC 11 1963

Date

at 1:05 o'clock P.M.

J. E. LENTON

County Clerk and Recorder.

By *[Signature]*  
Deputy.

DUPLICATE

STATE OF MONTANA  
ADMINISTRATOR OF GROUNDWATER CODE  
OFFICE OF STATE ENGINEER

**Declaration of Vested Groundwater Rights**

(Under Chapter 237, Montana Session Laws, 1961)

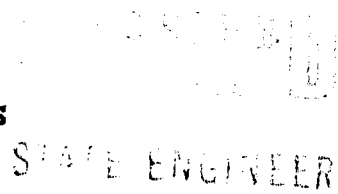

1. Helen M. Harrington of Route 1 South Great Falls,  
(Name of Appropriator) (Address) (Town)  
County of Cascade State of Montana  
have appropriated groundwater according to the Montana laws in effect prior to January 1, 1962, as follows:

East 150 feet of the South	
250 feet of lot Three (3)	
Block One (1) Donovan Park	
an addition to the City of	
Great Falls, Cascade County	
Montana and	
East 150 feet of west 174.4	
feet of the south 250 feet of	
lot Three (3), Block One (1)	
Donovan Park, an addition to	
the City of Great Falls, Cascade	
County, Mont.	

Donovan Park, Great Falls

1/4 Sec. T. R.

Indicate point of appropriation and place of use, if possible. Each small square represents 10 acres.

- The beneficial use on which the claim is based Domestic and irrigation
- Date or approximate date of earliest beneficial use; and how continuous the use has been Dec. 21, 1961 and continuous thereafter
- The amount of groundwater claimed (in miner's inches or gallons per minute) Thirty (30) gallons per minute.
- If used for irrigation, give the acreage and description of the lands to which water has been applied and name of the owner thereof One and one half acres level pasture and landscaped ground around residence. Owner of land Helen M. Harrington
- The means of withdrawing such water from the ground and the location of each well or other means of withdrawal withdrawn by three-quarter horsepower submersible pump. Well is located on South border of property.
- The date of commencement and completion of the construction of the well, wells, or other works for withdrawal of groundwater Deep well was commenced Nov. 27, 1961 and completed Dec. 21 1961. One other well (shallow) commenced Oct. 1960, Completed Oct. 1960
- The depth of water table Deep well water from 192 feet to within 40 feet of surface.
- So far as it may be available, the type, size and depth of each well or the general specifications of any other works for the withdrawal of groundwater Deep well is drilled, cased 6 inch diameter 192 feet deep. Shallow well is dug, cased with 6 foot culvert and 26 feet deep. Deep well is equipped with 3/4 horsepower submersible pump delivering 800 gals. per hr. Shallow well is equipped with 1/2 horsepower jet pump delivering 300 gals per hr.
- The estimated amount of groundwater withdrawn each year 800,000 gallons
- The log of formations encountered in the drilling of each well if available log on file with State Board of Health. Drilled by Mr. J. D. Rafferty, Great Falls, Mont. 0-15 feet sand 15-38 feet silt, 38-55 quick sand, 55-145 Sandy silt, 145-188 feet silt, 188-192 feet gravel.
- Such other information of a similar nature as may be useful in carrying out the policy of this act, including reference to book and page of any county record. Filed for record with Clerk and Recorder County of Cascade Book Page

Signature of Owner Helen M. Harrington

Date Jan 1 1962

Three copies to be filed by the owner with the County Clerk and Recorder of the county in which the well is located.

Please answer all questions. If not applicable, so state, otherwise the form will be returned.

Original to the County Clerk and Recorder; duplicate to the State Engineer; Triplicate to the School of Mines and Quadruplicate for the Appropriator.

STATE OF MONTANA, }  
County of Cascade.

I hereby certify that the within in-  
strument was filed in this office on

**JAN 2 - 1962**

Date

at 2:45 o'clock P.M.

**J. L. LEBNIG**

County Clerk and Recorder.

By B. B. B.  
Deputy.