

27

T. 16 R. 55

County Dawson

MONTANA BUREAU OF MINES AND GEOLOGY
Butte, Montana

RECEIVED
FEB 17 1961

WATER WELL LOG

STATE ENGINEER

well-

Owner Franklin Peterson Address Glendive, Montana
 Driller Robert W. Haggerty Address Box 73 Glendive, Mont.
 Date Started Aug. 18, 1960 Date Completed Aug. 22, 1960
 Jefferson School Addition
 Location: Sec. 27 T. 16 R. 55 1/4 sec. Lot 1 Block 2

Type of well Drilled Equipment used Churn drill
 (Dug, driven, bored, or drilled) (Churn drill, rotary, other)

Water use: Domestic Municipal Stock Irrigation
 Industrial Drainage Other: _____

Casing: 0 ft. to 97 ft. Type Steel Size 4"

Casing: _____ ft. to _____ ft. Type _____ Size _____

Casing: _____ ft. to _____ ft. Type _____ Size _____

Perforated or Screened: Ft. _____ to ft. _____ Ft. _____ to ft. _____

Type of screen or perforations _____

Static Water level, for non-flowing well: 93' feet.

Shut-in pressure, for flowing well: _____ lb./sq. in. on: _____ (date)

Pumping water level: 98' feet at 15 gal. per min.

How tested: Bailed 2 hrs. at 15 gal. per minute.

Length of test: 2 days pumped at 8 gal. per minute.

Remarks: (Gravel packing, cementing, packers, type of shut-off, depth of shut-off)

Water shut off at 60 ft.

Casing drove through water.

(over)

Form No. 18
8-60

27

T. 16 R. 55
County DAWSON

MONTANA BUREAU OF MINES AND GEOLOGY
Butte, Montana

WATER WELL LOG

Well

Owner Franklin Peterson Address Glendive, Montana
Driller Robert W. Haggerty Address Box 73 Glendive, Mont.
Date Started August 18, 1960 Date Completed Aug. 22, 1960
Jefferson School Add.
Location: Sec. 27 T. 16 R. 55 $\frac{1}{4}$ sec. Lot 1 Block 2

Type of well Drilled Equipment used Churn drill
(Dug, driven, bored, or drilled) (Churn, drill, rotary, other)

Water use: Domestic Municipal Stock Irrigation
Industrial Drainage Other _____

Casing: 0 ft. to 97 ft. Type Steel Size 4"

Casing: _____ ft. to _____ ft. Type _____ Size _____

Casing: _____ ft. to _____ ft. Type _____ Size _____

Perforated or Screened: Ft. _____ to ft. _____. Ft. _____ to ft. _____

Type of screen or perforations _____

Static Water level, for non-flowing well: 93' feet.

Shut-in pressure, for flowing well: _____ lb./sq. in. on: _____
(date)

Pumping water level 98' feet at 15 gal. per min.

How tested: Bailed 2 hours at 15 gal. per minute.

Length of test 2 days pumped at 8 gal. per minute.

Remarks: (Gravel packing, cementing, packers, type of shut-off, depth of shut-off)

Water shut off at 60 ft.

Casing drove through water.

(over)

File No.

T. 16 R. 55 E
N. Dawson

DUPLICATE

County Dawson

STATE OF MONTANA
ADMINISTRATOR OF GROUNDWATER CODE
OFFICE OF STATE ENGINEER

RECEIVED
DEC 18 1963

Declaration of Vested Groundwater Rights
(Under Chapter 237, Montana Session Laws, 1961)

1. Donald L Pulse, of West Glendive Mont
(Name of Appropriator) (Address) (Town)
County of Dawson State of Montana
have appropriated groundwater according to the Montana laws in effect prior to January 1, 1962, as follows:

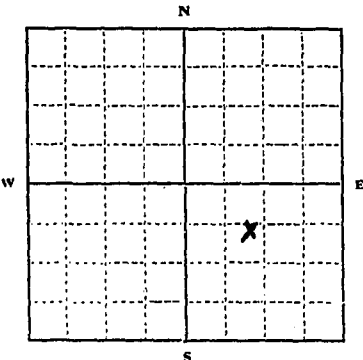

SE 1/4 Sec 27 T. 16 R. 55

Indicate point of appropriation and place of use, if possible. Each small square represents 10 acres.

- 2. The beneficial use on which the claim is based: House hold use Lawn and Garden watering
- 3. Date or approximate date of earliest beneficial use; and how continuous the use has been: 1956 USE has been continuous
- 4. The amount of groundwater claimed (in miner's inches or gallons per minute): 5 Gallons per Minute
- 5. If used for irrigation, give the acreage and description of the lands to which water has been applied and name of the owner thereof: None
- 6. The means of withdrawing such water from the ground and the location of each well or other means of withdrawal: Jet Pump

- 7. The date of commencement and completion of the construction of the well, wells, or other works for withdrawal of groundwater: 1956
- 8. The depth of water table: 45 Feet
- 9. So far as it may be available, the type, size and depth of each well or the general specifications of any other works for the withdrawal of groundwater: Drilled well 100 feet deep with 6" casing
- 10. The estimated amount of groundwater withdrawn each year: 300,000 gallons
- 11. The log of formations encountered in the drilling of each well if available: Unknown
- 12. Such other information of a similar nature as may be useful in carrying out the policy of this act, including reference to book and page of any county record: None

Signature of Owner: Don L Pulse
Date: 12-16-63

Three copies to be filed by the owner with the County Clerk and Recorder of the county in which the well is located.

Please answer all questions. If not applicable, so state, otherwise the form will be returned.

Original to the County Clerk and Recorder; Duplicate to the State Engineer; Triplicate to the Montana Bureau of Mines and Geology, and Quadruplicate for the Appropriator.

286296

STATE OF MONTANA
County of Dayson

Filed for record this 16th day of
December A. D. 1963, at
11:30 o'clock A.M.

Gordon W. Russell
County Clerk and Recorder.

By _____ Deputy.

GW 2

STATE WATER CONSERVATION BOARD

Approved Stock Form—State Publishing Co., Helena, Montana—42329

File No.

FEB 8 1967

T. 16N R. 55E 27

DUPLICATE

Blhe. _____ McDermott _____ County. Ransom
Butzerin. _____ McNulty _____ STATE OF MONTANA
Coyte. _____ Moran _____ ADMINISTRATOR OF GROUNDWATER CODE
Darlington. _____ Sullivan _____ OFFICE OF STATE ENGINEER
Dickert. _____

LOG

Top of Ground
0 gravel
12 (Elev. above sea level.....)
12
88 grey shale
88
100 water sand

Notice of Completion of Groundwater Appropriation by Means of Well DEVELOPED AFTER JANUARY 1, 1962

(Under Chapter 237, Montana Session Laws, 1961)

Owner. George R. M. Drea Address. Blondie Mt.

Driller. C. H. Starr Address. Box 1183-Blunda

Date of Notice of appropriation of groundwater.....

Date well started. Jan 26 Date completed. Feb 2

Type of well. Drilled Equipment used. Churn
(Dug, Driven, bored or drilled) (Churn drill, rotary or other)

Water use: Domestic Municipal Stock Irrigation
Industrial Drainage Other

Indicate on the diagram the character and thickness of the different strata met with in drilling, such as soil, clay, shale, gravel, rock or sand, etc. Show depth at which water is encountered, thickness and character of water-bearing strata and height to which the water rises in the well.

Size of Drilled Hole	Size and Weight of Casing	From (Feet)	To (Feet)	PERFORATIONS		
				Kind Size	From (Feet)	To (Feet)
3 7/8	4" 11# per ft.	0	88			

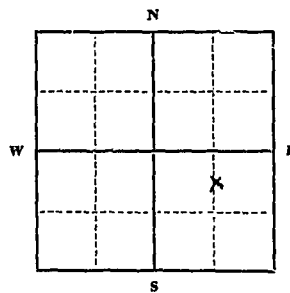

Static Water Level for non-flowing well 50 feet.

Shut-in Pressure for Flowing Well.....

Pumping Water Level 70 feet at 8 gal. gal per minute.

Discharge in gal. per min. of flowing well.....

How Tested. Bailer

Length of Test. 1 hr

Remarks: (Gravel packing, cementing, packers, type of shutoff).....

NE 1/4 SE Sec. 27 T. 16. R. 55
Indicate location of well and place of use, if possible. Each small square represents 40 acres.

(Continue on reverse side)

USE—If used for irrigation, industrial, drainage or other. Explain, state number of acres and location or other data (i.e.: Lot, Block and Addition).

Show exact depth of bottom.

This form to be prepared by driller, and three copies to be filed by the owner with the County Clerk and Recorder in the county in which the well is located, tissue copy to be retained by driller.

Please answer all questions, if not applicable, so state, otherwise the form will be returned.

168
Driller's License Number

C. H. Starr
Driller's Signature

41703

Owner's name and address
 Driller's name and address
 Name of Nation or State of which the well is located
 Date well completed

Type of well (Cotton gin, oil, water, etc.)
 (Check one box)
 Water use: Domestic Irrigation
 Industrial Stock Other

Indicate on the diagram the character and thickness of the different strata met with in drilling such as soft shale, gravel, rock or sand, etc. Show depth in feet of water in cased hole, thickness and character of water-bearing strata and depth to which the casing descends in the well.

DEPTH OF WELL	THICKNESS OF STRATA	CHARACTER OF STRATA	WATER-BEARING STRATA	DEPTH TO WATER
0 - 10	5	Soft shale		5
10 - 20	10	Gravel		10
20 - 30	10	Rock		20
30 - 40	10	Sand		30
40 - 50	10	Shale		40

State the character of the water-bearing strata
 Show the position of the casing in the well
 Indicate the depth of the casing in the well
 Indicate the depth of the water in the well
 Indicate the character of the water in the well
 Indicate the character of the water in the well
 Indicate the character of the water in the well
 Indicate the character of the water in the well

298318

STATE OF MONTANA
 County of Dawson
 Filed for record this 7th day of Feb
1909 A.D.
11:00 o'clock A.M.
Jordan O. Russell
 County Clerk & Recorder
Patricia J. Russell

File No.

T. 16 N R. 55 E

DUPLICATE

County Dawson

STATE OF MONTANA
ADMINISTRATOR OF GROUNDWATER CODE
OFFICE OF STATE ENGINEER

RECEIVED
JUN 26 1963

Declaration of Vested Groundwater Rights STATE ENGINEER

(Under Chapter 237, Montana Session Laws, 1961)

1. Walter H. & Margaret E. Reinart, of 1022 1/2 N. Warren St. Helena
(Name of Appropriator) (Address) (Town)

County of Lewis & Clark State of Montana
have appropriated groundwater according to the Montana laws in effect prior to January 1, 1962, as follows:

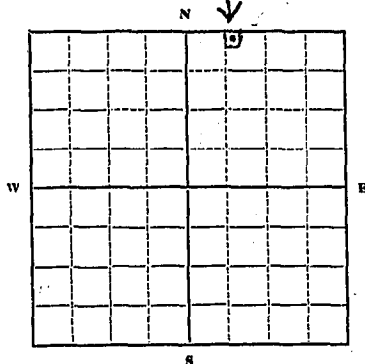

N.W. 1/4 NE 1/4 Sec. 27 T. 16 R. 55

Indicate point of appropriation and place of use, if possible. Each small square represents 10 acres.

2. The beneficial use on which the claim is based...
House hold use & irrigation

3. Date or approximate date of earliest beneficial use; and how continuous the use has been...
May 1954

4. The amount of groundwater claimed (in miner's inches or gallons per minute)...
20 gal/min

5. If used for irrigation, give the acreage and description of the lands to which water has been applied and name of the owner thereof...
2 acres NW 1/4 NE 1/4 Sec. 27 T. 16 R. 55
Owner is Walter H. & Margaret E. Reinart

6. The means of withdrawing such water from the ground and the location of each well or other means of withdrawal...
Pressure pump

7. The date of commencement and completion of the construction of the well, wells, or other works for withdrawal of groundwater...
May 1954

8. The depth of water table...
50 feet

9. So far as it may be available, the type, size and depth of each well or the general specifications of any other works for the withdrawal of groundwater...
Drilled well with 6 inch casing.
Drilled to depth of 140 feet

10. The estimated amount of groundwater withdrawn each year...
20000 gal

11. The log of formations encountered in the drilling of each well if available...
Not available

12. Such other information of a similar nature as may be useful in carrying out the policy of this act, including reference to book and page of any county record...
Not available

Signature of Owner Margaret E. Reinart
Walter H. Reinart

Date June 15, 1963

Three copies to be filed by the owner with the County Clerk and Recorder of the county in which the well is located.

Please answer all questions. If not applicable, so state, otherwise the form will be returned.

Original to the County Clerk and Recorder; duplicate to the State Engineer; Triplicate to the Montana Bureau of Mines and Geology, and Quadruplicate for the Appropriator.

Montana State Department of Health
Montana State Department of Health

284071

STATE OF MONTANA
County of Dawson

Filed for record this 25th day of
June A. D. 1963, at
9:00 o'clock A. M.

Landon W. Russell
County Clerk and Recorder.

By Alvin Quethy Deputy.

Fee pd. # 2.00

RECEIVED
DEC 2 1957

T. 16 R. 55 27
County. La Brea

STATE ENGINEER MONTANA BUREAU OF MINES AND GEOLOGY
Butte, Montana

WATER WELL LOG

Owner School District #1 Address Glendive, Montana
Driller Ira C. Bond Address Terry, Montana
Date Started May 29, 1957 Date Completed June 19, 1957
Location: Sec. 27 T. 16 R. 25 1/4 sec.

Type of well drilled Equipment used Cable and Rotary
(Dug, driven, bored, or drilled) (Churn drill, rotary, other)

Water use: Domestic Municipal Stock Irrigation
Industrial Drainage Other: Public School

Casing: top of ground 53' ft. Type Steel Size 10" casing
Casing: top of ground 200' ft. Type Steel PAC Size 8" casing

Casing: ft. to ft. Type Size

Perforated or Screened: Ft. 145' to ft. 200' Ft. to ft.

Type of screen or perforations one inch slots 3/16

Static Water level, for non-flowing well: 125 feet.

Shut-in pressure, for flowing well: lb./sq. in. on: (date)

Pumping water level: 155 feet feet at 75 gal. per min.

How tested: Cabbette Byron Jackson pump

Length of test: 2 weeks

Remarks: (Gravel packing, cementing, packers, type of shut-off, depth of shut-off)
Set 10 inch surface casing grouted with bentonite and clay, to
shut off surface water and gravel

(over)

File No. _____

T. 16N R. 55E

Original _____

County DAWSON

STATE OF MONTANA
ADMINISTRATOR OF GROUNDWATER CODE
OFFICE OF STATE ENGINEER

RECEIVED
FEB 13 1962

DECLARATION OF VESTED GROUNDWATER RIGHTS
(Under Chapter 237, Montana Sessions Laws 1961) STATE ENGINEER

1. Shell Oil Company of P. O. Box 2547 Billings
(Name of Appropriator) (Address) (Town)

County of Yellowstone State of Montana

have appropriated ground water according to the Montana laws in effect prior to January 1, 1962 as follows:

NE 1/4 Sec 27 T 16N R 55E

Indicate point of appropriation and place of use, if possible. Each small square represents 10 acres.

2. The beneficial use on which the claim is based: Industrial & Domestic

3. Date of approximate date of earliest beneficial use; and how continuous the use has been May 17, 1956

4. The amount of groundwater claimed (in miner's inches or gallons per minute) No gauge

5. If used for irrigation give the acreage and description of the lands to which water has been applied and name of owner thereof Not applicable

6. The means of withdrawing such water from the ground and the location of each well or other means of withdrawal Motor driven pump.

7. The date of commencement and completion of the construction of the well, wells or other works for withdrawal of ground water Started May 11, 1956 Comp. May 17, 1956

8. The depth of water table 30' ±

9. So far as it may be available, the type, size and depth of each well or the general specification of any other works for the withdrawal of groundwater TD 137 5-1/2" csg at 137 Perfs 97-117

10. The estimated amount of groundwater withdrawn each year * No Est. Made.

11. The log of formations encountered in the drilling of each well if available 0-33 gravel 33-37 wet gravel 37-62 Shale 62-117 Shale gumbo to bottom

12. Such other information of a similar nature as may be useful in carrying out the policy of this act indicating reference to book and page of any county record

Signature of Owner [Signature]
Shell Oil Company
Date February 2, 1962

Three copies to be filed by the owner with the County Clerk and Recorder of the county in which the well is located.

Please answer all questions. If not applicable, so state, otherwise the form will be returned.

Original to the County Clerk and Recorder; duplicate to the State Engineer; Triplicate to the School of Mines and Quadruplicate for the Appropriator.

STATE OF MONTANA

County of Yellowstone } SS

having first been duly sworn, depose and say A. Chadron he of lawful age and the appropriator and claimants of the order and water right mentioned ~~in the foregoing~~ clarification of vested groundwater rights and the person whose name subscribed thereto, as the appropriate and claimant is, that he know persons contents of said foregoing notice and that the matters and things ~~therein~~ stated as true.

Subscribed and sworn to before me, this 2nd day of February 19 62

Margaret W. Haag
Notary Public for the State of Montana

Residing at Billings, Montana

My Commission expires March 30 19 62

278344

STATE OF MONTANA
County of Dawson

Filed for record this 9th day of Feb. A. D. 19 62, at

9:00 o'clock A.M.

Lordan W. Russell
County Clerk and Recorder.

By Oliver Austin Deputy.

Fee pd. 2.00

RECEIVED
SEP 17 1959

T. 16 N R. 55 E
County Dawson

27

STATE ENGINEER MONTANA BUREAU OF MINES AND GEOLOGY
Butte, Montana

WATER WELL LOG

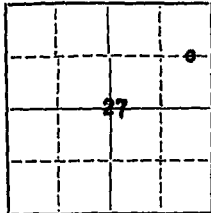

Owner SHELL OIL COMPANY Address P. O. Box 2517 Billings, Montana
Driller Ira Bond Address
Date Started May 14, 1956 Date Completed May 17, 1956
Location: Sec 27 T. 16 N R. 55 E 1/4 sec. Northeast

Type of well Drilled Equipment used Churn drill
(Dug, driven, bored, or drilled) (Churn drill, rotary, other)

Water use: Domestic Municipal Stock Irrigation
Industrial Drainage Other:

Casing: 0 ft. to 137 ft. Type Size 5-1/2"

Casing: ft. to ft. Type Size

Casing: ft. to ft. Type Size

Perforated or Screened: Ft. 97 to ft. 117 Ft. to ft.

Type of screen or perforations Torch perforated

Static Water level, for non-flowing well: feet.

Shut-in pressure, for flowing well: lb./sq. in. on: (date)

Pumping water level feet at gal. per min.

How tested:

Length of test:

Remarks: (Gravel packing, cementing, packers, type of shut-off, depth of shut-off)

Baker basket at 62'

(over)

GW 2

Erwin Hunter
Approved Stock Form—State Publishing Co., Helena, Montana—46805

27

File No. _____

RECEIVED

T. 16 R. 25

DUPLICATE

JUL 17 1972

County *Dawson*

LOG
MONTANA DEPARTMENT OF NATURAL RESOURCES AND CONSERVATION
STATE OF MONTANA
ADMINISTRATOR OF GROUNDWATER CODE
STATE WATER CONSERVATION BOARD

Notice of Completion of Groundwater Appropriation by Means of Well DEVELOPED AFTER JANUARY 1, 1962

(Under Chapter 237 Montana Session Laws, 1961, as amended)

Owner *Gene Sullivan* Address *Box 211 Glenview Mont*
Driller *C. F. Starr* Address *Box 1183-24*

Date of Notice of appropriation of groundwater.....

Date well started *9-29* Date completed *10-6-69*

Type of well *drilled* Equipment used *Cable Tool*
(Dug, driven, bored or drilled) (Churn drill, rotary or other)

Water use: Domestic Municipal Stock Irrigation
Industrial Drainage Other

Indicate on the diagram the character and thickness of the different strata met with in drilling, such as soil, clay, shale, gravel, rock or sand, etc. Show depth at which water is encountered, thickness and character of water-bearing strata and height to which the water rises in the well.

Top of Ground
(Elev. above sea level.....)

0 *dk clay*
8
8 *gravel*
31
31 *grey shale*
68
68 *water sand*
73 *3 1/2 gal. min.*
73 *shale*
137
137 *dk water*
152 *sand*

Size of Drilled Hole	Size and Weight of Casing	From (Feet)	To (Feet)	PERFORATIONS		
				Kind Size	From (Feet)	To (Feet)
<i>5 1/2"</i>	<i>4"</i>	<i>0</i>	<i>137'</i>			
<i>to 105'</i>	<i>11 #</i>					
<i>4" from</i>	<i>ft</i>					
<i>105' to</i>						
<i>152'</i>						

Doc. No. 316423
Filed for record
this 14th day of July
A. D. 19 72, at 2:50
o'clock P.M.

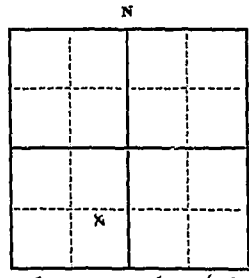

Static Water Level for non-flowing well
..... 69 feet.

Shut-in Pressure for Flowing Well.....

Pumping Water Level..... 125 feet
at..... 12 gal. per minute.

Discharge in gal. per min. of flowing well

How Tested..... Bailed

Length of Test..... 1 hr

Remarks: (Gravel packing, cementing, pack-
ing, type of shutoff).....
*hot 21 17 blocks left in hole
SE 1/4 SW 1/4 Sec. 27 T. 16 R. 25
N. E. 1/4*

Indicate location of well and place of use, if possible. Each small square represents 40 acres.

(Continue on reverse side)

USE—If used for irrigation, industrial, drainage or other. Explain, state number of acres and location or other data (i.e.: Lot, Block and Addition).

AMOUNT TO STATE

Show exact depth of bottom.....

This form to be prepared by driller, and three copies to be filed by the owner with the County Clerk and Recorder in the county in which the well is located, tissue copy to be retained by driller.
Driller's License Number 168
C. F. Starr
Driller's Signature.

Please answer all questions. If not applicable, so state, otherwise the form will be returned.

59925

State of Montana
 County of Dawson
 Filed for record this 17th day of July A.D. 1972 at 11 o'clock P.M.
 By Barbara J. Russell County Clerk & Recorder
 By Madeline Russell Deputy

316423
 1972

(Title to grant (check one))
 original duplicate certified corrected
 amended corrected

I hereby certify that the foregoing is a true and correct copy of the original as the same appears in the records of the County Clerk and Recorder of the County of Dawson, State of Montana.

316423

STATE OF MONTANA
County of Dawson
 Filed for record this 17th day of
July A.D. 1972 at
11 o'clock P.M.
Barbara J. Russell
 County Clerk & Recorder
 By Madeline Russell Deputy

Witness my hand and Official Seal,
 this _____ day of _____
 19____

 Clerk and Recorder
 By _____
 Deputy

GW.

Approved Stock Form—State Publishing Co., Helena, Montana—41338

File No. _____

DUPLICATE

16 R 55 27
County Dawson

STATE OF MONTANA
ADMINISTRATOR OF GROUNDWATER CODE
OFFICE OF STATE ENGINEER

Declaration of Vested Groundwater Rights

(Under Chapter 237, Montana Session Laws, 1961)

1. THOMAS G THOMPSON, of HIGHLAND PARK ROAD, GLENLIVE
(Name of Appropriator) (Address) (Town)
County of DAWSON State of MONTANA
have appropriated groundwater according to the Montana laws in effect prior to January 1, 1962, as follows:

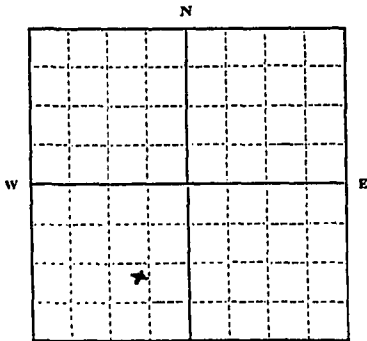

nw SE
1/4 Sec. 27 T. 16 R. 55

Indicate point of appropriation and place of use, if possible. Each small square represents 10 acres.

Lots 22 & 23 of Block 9
First Jefferson School Adn.

- The beneficial use on which the claim is based HOME AND LAWN USE AND GARDEN AND TREES
- Date or approximate date of earliest beneficial use; and how continuous the use has been AUGUST 31, 1960
CONTINUES SINCE AUGUST 31, 1960
- The amount of groundwater claimed (in miner's inches or gallons per minute) 40 GAL PER MINUTE
- If used for irrigation, give the acreage and description of the lands to which water has been applied and name of the owner thereof
- The means of withdrawing such water from the ground and the location of each well or other means of withdrawal WELL IN THE BASEMENT
- The date of commencement and completion of the construction of the well, wells, or other works for withdrawal of groundwater AUGUST 25, 1960 TO AUGUST 31, 1960
- The depth of water table 57 FEET
- So far as it may be available, the type, size and depth of each well or the general specifications of any other works for the withdrawal of groundwater WELL IS 70' DEEP
- The estimated amount of groundwater withdrawn each year 50,000 GAL
- The log of formations encountered in the drilling of each well if available 4-12' GUMBO
12-28' GRAVEL 28-57' CLAY 57-70' SAND
- Such other information of a similar nature as may be useful in carrying out the policy of this act, including reference to book and page of any county record none

Signature of Owner Thomas G. Thompson
Date Dec 10, 1963

Three copies to be filed by the owner with the County Clerk and Recorder of the county in which the well is located.

Please answer all questions. If not applicable, so state, otherwise the form will be returned.

Original to the County Clerk and Recorder; duplicate to the State Engineer; Triplicate to the Montana Bureau of Mines and Geology, and Quadruplicate for the Appropriator.

8840

286180

STATE OF MONTANA
County of Dawson

Filed for record this 10th day of
December A. D. 1963, at
9:30 o'clock A.M.

Darden H. Russell
County Clerk and Recorder.

By Gaye Scheithin Deputy.

Fee Pd \$ 2.00

File No. _____

MONTANA WATER RESOURCES BOARD

5 W 1/4 Sec 27 T. 16 N. R. 35 E S 55 E

DUPLICATE

RECEIVED

County Dawson

LOG

JUL 24 1968

STATE OF MONTANA
DEPARTMENT OF GROUNDWATER CODE
OFFICE OF STATE ENGINEER

Top of Ground _____

(Elev. above sea level) _____

0-15 Clumbo
15-39 Gravel
39-53 Clumbo

Notice of Completion of Groundwater Appropriation by Means of Well DEVELOPED AFTER JANUARY 1, 1962

(Under Chapter 23, Montana Session Laws, 1961)

Owner Lawrence Whitfield Glendive Address _____

Driller Joe Johnson Helena Address Jersey, Mont

Date of Notice of appropriation of groundwater _____

Date well started July 18, 68 Date completed July 22, 68

Type of well Drilled Equipment used Rotary Drill
(Dug, driven, bored or drilled) (Churn drill, rotary or other)

Water use: Domestic Municipal Stock Irrigation
Industrial Drainage Other

Indicate on the diagram the character and thickness of the different strata met with in drilling, such as soil, clay, shale, gravel, rock or sand, etc. Show depth at which water is encountered, thickness and character of water-bearing strata and height to which the water rises in the well.

Size of Drilled Hole	Size and Weight of Casing	From (Feet)	To (Feet)	PERFORATIONS		
				Kind and Size	From (Feet)	To (Feet)
7"	6" ID 19.0#/FT	0	42	Slots 3/8"	30	42
5 5/8"	4" ID 11#/FT	40	53	Slots 1/2 x 6"	40	53

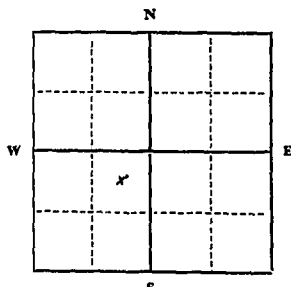

Static Water Level for non-flowing well 35 feet.

Shut-in Pressure for Flowing Well _____

Pumping Water Level 40 feet at 5 gal. per minute.

Discharge in gal. per min. of flowing well _____

How Tested Balley

Length of Test 1 hr

Remarks: (Gravel packing, cementing, packers, type of shutoff) _____

SW 1/4 Sec 27 T. 16 N. R. 35 E

Indicate location of well and place of use, if possible. Each small square represents 40 acres.

(Continue on reverse side)

USE—If used for irrigation, industrial, drainage or other. Explain, state number of acres and location or other data (i.e.: Lot, Block and Addition).

Lawrence Whitfield

Show exact depth of bottom.

This form to be prepared by driller, and three copies to be filed by the owner with the County Clerk and Recorder in the county in which the well is located, tissue copy to be retained by driller.

Please answer all questions. If not applicable, so state, otherwise the form will be returned.

154
Driller's License Number

Joe Johnson
Driller's Signature

44,338

PLAT
No. 1 of the Subdivision of
Section 36, Township 14 North,
Range 12 East, 10th Meridian,
Dawson County, Montana.

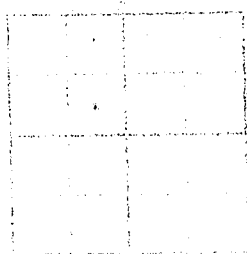

Subdivision of Section 36, Township 14 North,
Range 12 East, 10th Meridian,
Dawson County, Montana, into four
equal parts, to-wit: the Northeast
Quarter, the Northwest Quarter,
the Southeast Quarter and the
Southwest Quarter, and the
sale of the same to the highest
bidder, to-wit: the State of
Montana, for the purpose of
constructing a highway.

[Faint, illegible text, likely a description of the land or terms of sale.]

STATE OF MONTANA

County of Dawson

Filed for record this 22nd day of

July A. D. 19 68

at 3:10 o'clock P. M.

Harold A. Russell

County Clerk & Recorder

By _____ Deputy.

RECORDED

INDEXED

JUL 23 1968

27

File No. _____

T. 16 R. 55

DUPLICATE

County. Dawson

STATE OF MONTANA
ADMINISTRATOR OF GROUNDWATER CODE
OFFICE OF STATE ENGINEER

RECEIVED
JAN 14 1964

Declaration of Vested Groundwater Rights

(Under Chapter 237, Montana Session Laws, 1961)

STATE ENGINEER

I, Helen Botch, of B.E. Pt. Glendive
(Name of Appropriator) (Address) (Town)

County of Dawson State of Montana
have appropriated groundwater according to the Montana laws in effect prior to January 1, 1962, as follows:

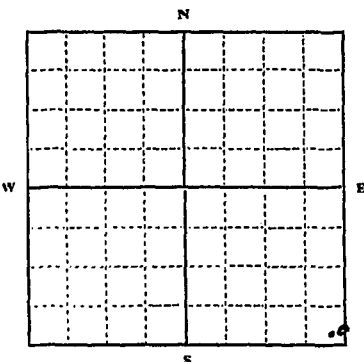

E. 1/2 Sec. 27, T. 16, R. 55
Indicate point of appropriation and place of use, if possible. Each small square represents 10 acres.

- The beneficial use on which the claim is based Household use and stock water
- Date or approximate date of earliest beneficial use; and how continuous the use has been well was drilled in approximately 1941 and has been used continuously since.
- The amount of groundwater claimed (in miner's inches or gallons per minute) 5 gallons per minute
- If used for irrigation, give the acreage and description of the lands to which water has been applied and name of the owner thereof
- The means of withdrawing such water from the ground and the location of each well or other means of withdrawal jet pump
- The date of commencement and completion of the construction of the well, wells, or other works for withdrawal of groundwater unknown
- The depth of water table approximately 50 Ft
- So far as it may be available, the type, size and depth of each well or the general specifications of any other works for the withdrawal of groundwater well has 6 in casing and is approximately 60 Ft deep
- The estimated amount of groundwater withdrawn each year 55,000 Gallons
- The log of formations encountered in the drilling of each well if available None
- Such other information of a similar nature as may be useful in carrying out the policy of this act, including reference to book and page of any county record None

Signature of Owner Helen Botch
Date 12/30/63

Three copies to be filed by the owner with the County Clerk and Recorder of the county in which the well is located.
Please answer all questions. If not applicable, so state, otherwise the form will be returned.

Original to the County Clerk and Recorder; Duplicate to the State Engineer; Triplicate to the Montana Bureau of Mines and Geology, and Quadruplicate for the Appropriator.

32020

1. The purpose of this document is to provide a record of the proceedings of the Board of Commissioners of the County of Dawson, Montana, for the year 1963.

2. The Board of Commissioners met on the 31st day of December, 1963, at 4:30 o'clock P. M.

3. The Board of Commissioners met on the 31st day of December, 1963, at 4:30 o'clock P. M.

4. The Board of Commissioners met on the 31st day of December, 1963, at 4:30 o'clock P. M.

5. The Board of Commissioners met on the 31st day of December, 1963, at 4:30 o'clock P. M.

6. The Board of Commissioners met on the 31st day of December, 1963, at 4:30 o'clock P. M.

7. The Board of Commissioners met on the 31st day of December, 1963, at 4:30 o'clock P. M.

8. The Board of Commissioners met on the 31st day of December, 1963, at 4:30 o'clock P. M.

9. The Board of Commissioners met on the 31st day of December, 1963, at 4:30 o'clock P. M.

10. The Board of Commissioners met on the 31st day of December, 1963, at 4:30 o'clock P. M.

286915

STATE OF MONTANA
County of Dawson

Filed for record this 31st day of
December A. D. 19 63, at
4:30 o'clock P. M.

Gordon W. Russell
County Clerk and Recorder.

By _____ Deputy.

GW 2

Approved Stock Form—State Publishing Co., Helena, Montana—40472

File No. _____

T 16-N-R-55-E

DUPLICATE

JAN 16 1964

County Dawson

STATE OF MONTANA
ADMINISTRATOR OF GROUNDWATER CODE
OFFICE OF STATE ENGINEER

Notice of Completion of Groundwater Appropriation by Means of Well

(Under Chapter 237, Montana Session Laws, 1961)

Owner Willard Kent Address Blendike

Driller Edison Water Well Drilling Blendike

Date of Notice of Appropriation of Groundwater _____

Date well started 2-14-62 Date Completed 2-15-62

Type of well drilled Equipment Used Rotary
(dug, driven, bored or drilled) (Churn, drill, rotary or other)

Water Use: Domestic Municipal Other Irrigation
Industrial Drainage Stock

Indicate on the diagram the character and thickness of the different strata met with in drilling, such as soil, clay, shale, gravel, rock or sand, etc. Show depth at which water is encountered, thickness and character of water-bearing strata and height to which water rises in the well.

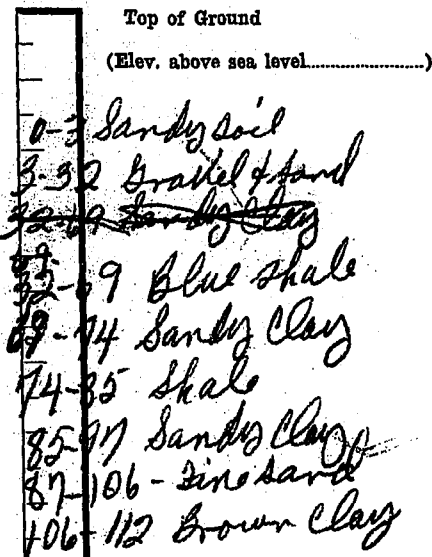

Size of Drilled Hole	Size and Weight of Casing	From (Feet)	To (Feet)	PERFORATIONS		
				Kind Size	From (Feet)	To (Feet)
6"	4 1/2 X 11 #	0	110	touch slots	96	110

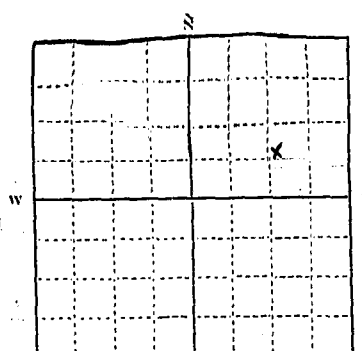

1/4 M.L. Sec 27 T16-N R63-E
Indicate location of well and place of use, if possible. Each small square represents 10 acres.

Show exact depth of bottom.

Static Water Level for non-flowing Well 64 feet.

Shut-in Pressure for Flowing Well _____

Pumping Water Level 70 feet at 20 gal. per minute.

Discharge in gal. per min. of flowing well _____

How Tested Drilled Length of Test 2.7 hrs

Remarks: (Gravel packing, cementing, packers, type of shutoff, location of place of use of groundwater if not at well, and any other similar pertinent information, including number of acres irrigated; if used for irrigation) _____

Willard Kent
Driller's License Number 61
Edison
Driller's Signature

This form to be prepared by driller, and three copies to be filed by the owner with the County Clerk and Recorder in the county in which the well is located.

Please answer all questions. If not applicable, so state, otherwise the form will be returned.

Original to the County Clerk and Recorder; duplicate to the State Engineer; Triplicate to the Montana Bureau of Mines and Geology and Quadruplicate for the Appropriator.

287180

STATE OF MONTANA
County of Dawson

Filed for record this 14th day of
January A. D. 1964, at
6:30 o'clock P.M.

Gordon H. Russell
County Clerk and Recorder.

By Jay Schmitt Deputy.

File No. _____

AUG 3 1966

T. 16 R. 55 27

DUPLICATE

Bill _____ McDermott
 Butcher _____ McNulty
 Coyle _____ Larson
 Dutton _____ Sullivan
 Dickert _____

County Dawson, O. M.

STATE OF MONTANA
 ADMINISTRATOR OF GROUNDWATER CODE
 OFFICE OF STATE ENGINEER

Top of Groundwater _____
 (Elev. above sea level _____)
 0 > dark clay
 7 >
 7 > sandy
 11 >
 11 > gravel
 31 >
 31 > grey sand
 46 > water
 46 > dark clay
 58 >
 58 > grey clay
 75 >
 75 > sandy clay
 94 > formation
 94 > water sand
 110 > water

**Notice of Completion of Groundwater
 Appropriation by Means of Well**

(Under Chapter 237, Montana Session Laws, 1961)

Owner Oscar Mastrolter Address Box 954, Glendive, Mont.

Driller C. H. Starr Address Box 1183, Glendive, Mont.

Date of Notice of Appropriation of Groundwater _____
Date well started June 1st 66 Date Completed June 4 - 66

Type of well Drilled Equipment Used Churn
(dug, driven, bored or drilled) (Churn, drill, rotary or other)

Water Use: Domestic Municipal Other Irrigation
Industrial Drainage Stock

Indicate on the diagram the character and thickness of the different strata met with in drilling, such as soil, clay, shale, gravel, rock or sand, etc. Show depth at which water is encountered, thickness and character of water-bearing strata and height to which water rises in the well.

Size of Drilled Hole	Size and Weight of Casing	From (Feet)	To (Feet)	PERFORATIONS		
				Kind Size	From (Feet)	To (Feet)
4"	4" 11# pipe	0	110			

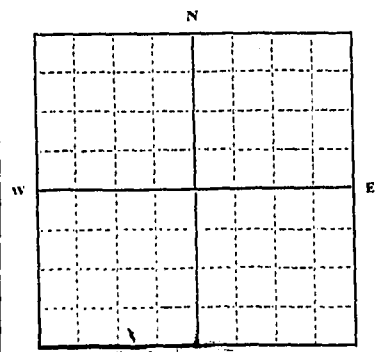

Sec. 30, T. 16, R. 55
 Indicate location of well and place of use, if possible. Each small square represents 10 acres.

Show exact depth of bottom.

Static Water Level for non-flowing Well 80 feet.

Shut-in Pressure for Flowing Well _____

Pumping Water Level 85 feet at 8 gal. per minute.

Discharge in gal. per min. of flowing well _____

How Tested Bailer Length of Test 1 ft.

Remarks: (Gravel packing, cementing, packers, type of shutoff, location of place of use of groundwater if not at well, and any other similar pertinent information, including number of acres irrigated, if used for irrigation) _____

Oscar Mastrolter

Driller's License Number _____

C. H. Starr
Driller's Signature

This form to be prepared by driller, and three copies to be filed by the owner with the County Clerk and Recorder in the county in which the well is located.

Please answer all questions. If not applicable, so state, otherwise the form will be returned.

Original to the County Clerk and Recorder; duplicate to the State Engineer; Triplicate to the Montana Bureau of Mines and Geology and Quadruplicate for the Appropriator.

41272

RECEIVED
COUNTY CLERK'S OFFICE
MONTANA
1966

[Faint, mostly illegible text, possibly a survey description or legal notice.]

296665

STATE OF MONTANA
County of Dawson
Filed for record this 2nd day of
August A. D. 1966 at
1:45 o'clock P. M.
Harold H. Russell
County Clerk & Recorder
By Patricia L. Peterson Deputy

Fee Pd \$2.00

[Vertical handwritten notes or signatures along the left margin.]

STATE OF MONTANA
ADMINISTRATOR OF GROUNDWATER CODE
MONTANA WATER RESOURCES BOARD

NOTICE OF COMPLETION OF GROUNDWATER
APPROPRIATION BY MEANS OF WELL

Developed after January 1, 1962

(Under Chapter 237 Montana Session Laws, 1961, as amended)

This form to be prepared by driller, and three copies to be filed by the owner with the County Clerk and Recorder in the county in which the well is located, last copy to be retained by driller.

Please answer all questions. If not applicable, so state, otherwise the form may be returned.

Owner Richard Michael Michael
 Address Bellevue, Mont. File 312783
June 21, 1971
4:45 PM
 Date well started May 25, 1971 6W 1
 completed June 11, 1971
 Type of well Drilled (Dig, driven, bored or drilled)
 Equipment used cab. to 7 ft (Churn drill, rotary or other)
 Water Use: Domestic Municipal Stock Irrigation
 Industrial Drainage Other * Garden/Lawn

*Describe _____
 USE: If used for irrigation, industrial, drainage or other. Explain, state number of acres and location or other data (i.e. Lot, Block and Addition). _____

ESTIMATED ANNUAL WITHDRAWAL 15 gal per min.

Size of Drilled Hole	Size and Weight of Casing	From (Feet)	To (Feet)	PERFORATIONS		
				Kind Size	From (Feet)	To (Feet)
<u>5 1/2"</u>	<u>14 lb</u>	<u>Top</u>	<u>68'</u>	<u>none</u>		
				<u>green sand.</u>		

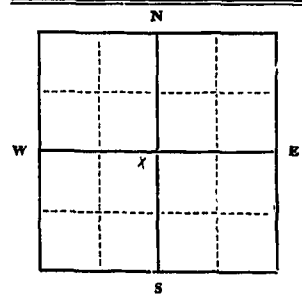

S.E. 1/4 S.W. 1/4 Sec. 27
 T. 16. N. R. 5. S. E.

INDICATE LOCATION OF WELL AND PLACE OF USE, IF POSSIBLE. EACH SMALL SQUARE REPRESENTS 40 ACRES.

Driller's Signature [Signature]
 Driller's Address Bellevue, Mont.
 LICENSE NO. 107

T. 16 N - R. 5 E
 County Blaine 27

MONTANA WATER RESOURCES BOARD
 RECEIVED
 JUN 23 1971

DRILLER'S LOG

Indicate the character, color, thickness of strata such as soil, clay, sand, gravel, shale, sandstone, etc. Show depth at which water is found and height to which water rises in well.

Top of Ground		(Elev. above sea level)
From (Feet)	To (Feet)	
0	13'	tan shale
13'	33'	dry sand & gravel
33'	62'	tan shale
62'	68'	Water & sand
68'	79'	water & sand
79'	81'	water to surface

81' Show exact depth of bottom

48644

312783
312783

STATE OF MONTANA
County of Dawson
Filed for record this 21st day of
June A. D. 19 71
11:45 o'clock P. M.
Dorothy W. Wagner
County Clerk & Recorder
By Dorothy W. Wagner Deputy

fu pd

RECEIVED
 AUG 7 1972
 County, Dawson 27

STATE OF MONTANA
 ADMINISTRATOR OF GROUNDWATER CODE
 MONTANA WATER RESOURCES BOARD

NOTICE OF COMPLETION OF GROUNDWATER
 APPROPRIATION BY MEANS OF WELL
 Developed after January 1, 1962

(Under Chapter 237 Montana Code Annotated, 1961, as amended)

This form to be prepared by driller, and three copies to be filed by the owner with the County Clerk and Recorder in the county in which the well is located, last copy to be retained by driller. Please answer all questions. If not applicable, so state, otherwise the form may be returned.

Owner Al Chick
 Address Highland Park
road Blendine

For Administrator's Use	
File	<u>316661</u>
Date	<u>August 4, 1972 3:30pm</u>
GW 1	

Date well started 6-9-72
 completed 6-13-72

Type of well drilled
 (Dug, driven, bored or drilled)
 Equipment used rotary
 (Churn drill, rotary or other)

Water Use: Domestic Municipal Stock Irrigation
 Industrial Drainage Other * Garden/Lawn

*Describe
 USE: If used for irrigation, industrial, drainage or other. Explain, state number of acres and location or other data (i.e. Lot, Block and Addition).

ESTIMATED ANNUAL WITHDRAWAL

Size of Drilled Hole	Size and Weight of Casing	From (Feet)	To (Feet)	PERFORATIONS		
				Kind Size	From (Feet)	To (Feet)
<u>7 7/8"</u>	<u>21# 65#</u>	<u>0</u>	<u>150</u>	<u>slotted</u>	<u>109</u>	<u>150</u>

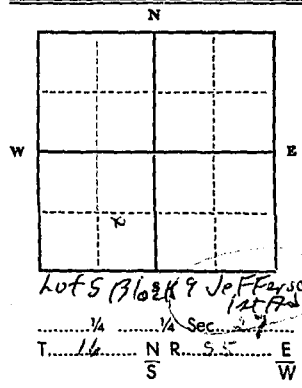

Static water level 55 ft.*
 Pumping water level 70 ft.*
 at 20 gallons per minute,
 measured 90 minutes after pumping
 began.

*Measured from ground level.
 Well developed by hauling
 for 3 hours.
 Power 6 Pump 1/2 HP
 Remarks: (Gravel packing, cementing,
 packers, type of shutoff)

gravel pack

INDICATE LOCATION OF WELL AND PLACE OF USE, IF POSSIBLE. EACH SMALL SQUARE REPRESENTS 40 ACRES.

Driller's Signature M. E. Waelich
 Driller's Address 916 So. Taylor Blendine
Montana LICENSE NO 223

DRILLER'S LOG
 Indicate the character, color, thickness of strata such as soil, clay, sand, gravel, shale, sandstone, etc. Show depth at which water is found and height to which water rises in well.

Feet	Feet	Strata
<u>0</u>	<u>15</u>	<u>Soil</u>
<u>15</u>	<u>31</u>	<u>Gravel</u>
<u>31</u>	<u>45</u>	<u>Clay blue</u>
<u>45</u>	<u>48</u>	<u>Shale brown</u>
<u>48</u>	<u>58</u>	<u>Clay blue</u>
<u>58</u>	<u>59</u>	<u>Gravel blue</u>
<u>110</u>	<u>121</u>	<u>Shale brown</u>
<u>121</u>	<u>145</u>	<u>Sand</u>
<u>145</u>	<u>150</u>	<u>C. Clay blue</u>

Top of Groundwater (Elev. above sea level) 150 Show exact depth of bottom

59,093

RECORDED INDEXED
FILED IN 1972

100 100 100 100 100
100 100 100 100 100

STATE OF MONTANA
COUNTY OF DAWSON
FILED FOR RECORD THIS 4th DAY OF AUGUST A. D. 1972 AT 3:30 O'CLOCK P. M.
By David W. Russell County Clerk & Recorder
By Natasha Jeter Deputy

100 100 100 100 100
100 100 100 100 100

316661
316661
STATE OF MONTANA
County of Dawson
Filed for record this 4th day of
August A. D. 1972 at
3:30 o'clock P. M.
David W. Russell
County Clerk & Recorder
By Natasha Jeter Deputy

GYM 4

File No.

DUPLICATE

T 161Y R 55E 28

County DAWSON

STATE OF MONTANA
ADMINISTRATOR OF GROUNDWATER CODE
OFFICE OF STATE ENGINEER

RECEIVED
OCT 15 1962

Declaration of Vested Groundwater Rights
(Under Chapter 237, Montana Session Laws, 1961) STATE ENGINEER

1. CLARENCE ALBRECHT, of DRYCREEK DRIVE, GLENDIVE
(Name of Appropriator) (Address) (Town)

County of DAWSON State of MONTANA
have appropriated groundwater according to the Montana laws in effect prior to January 1, 1962, as follows:

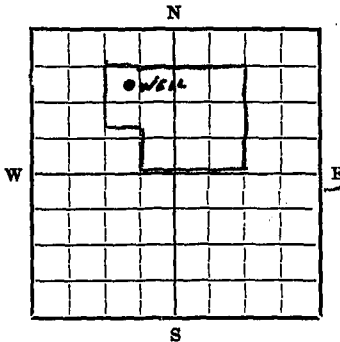

NW 1/4 Sec. 28 T. 16N. R. 55E

Indicate point of appropriation and place of use, if possible. Each small square represents 10 acres.

2. The beneficial use on which the claim is based DOMESTIC and LIVESTOCK USE.

3. Date or approximate date of earliest beneficial use; and how continuous the use has been 1948 DAILY USE

4. The amount of groundwater claimed (in miner's inches or gallons per minute) 8 gallon

5. If used for irrigation, give the acreage and description of the lands to which water has been applied and name of the owner thereof none

6. The means of withdrawing such water from the ground and the location of each well or other means of withdrawal PUMP AND ELECTRIC MOTOR

7. The date of commencement and completion of the construction of the well, wells, or other works for withdrawal of groundwater NOT KNOWN

8. The depth of water table 75 FT.

9. So far as it may be available, the type, size and depth of each well or the general specifications of any other works for the withdrawal of groundwater 4 IN STEEL CASING 75 FT DEEP

10. The estimated amount of groundwater withdrawn each year 60,000 GALLON

11. The log of formations encountered in the drilling of each well if available NOT AVAILABLE

12. Such other information of a similar nature as may be useful in carrying out the policy of this act, including reference to book and page of any county record A20-60

Signature of Owner Clarence Albrecht

Date Oct 11, 1962

Three copies to be filed by the owner with the County Clerk and Recorder of the county in which the well is located.

Please answer all questions, if not applicable, so state, otherwise the form will be returned.

Original to the County Clerk and Recorder; duplicate to the State Engineer; Triplicate to the School of Mines and Quadruplicate for the Appropriator.

STATE OF MONTANA
 County of Dawson
 Filed for record this 11th day of
 Oct. A. D. 1962, at
 2:00 o'clock P.M.

280867

STATE OF MONTANA
 County of Dawson
 Filed for record this 11th day of
 Oct. A. D. 1962, at
 2:00 o'clock P.M.
 Gordon W. Russell
 County Clerk and Recorder.
 By Alice Austby Deputy.

Fee pd. # 2.00

File No.

STATE WATER CONSERVATION BOARD

T. 16 R. 55

DUPLICATE

County Parson

DEC 19 1966

STATE OF MONTANA

ADMINISTRATOR OF GROUNDWATER CODE
OFFICE OF STATE ENGINEER

Notice of Completion of Groundwater Appropriation by Means of Well

(Under Chapter 237, Montana Session Laws, 1961)

Top of Ground (Elev. above sea level)	
0	> Gravel
2	
2	> Sandy Clay
15	
15	> Gravel
20	
20	> Coak & Sand
32	
32	> Clay
80	
80	> Clay & Sandy
90	
90	> Water Sand
111	

Owner Mike S. Boespflug Address Box 26 + 2 Glendive, Mont.

Driller C. H. Starr Address Glendive Mont

Date of Notice of Appropriation of Groundwater.....

Date well started 8-12-66 Date Completed 8-12-66

Type of well drilled Equipment Used Churn
(dug, driven, bored or drilled) (Churn, drill, rotary or other)

Water Use: Domestic Municipal Other Irrigation
Industrial Drainage Stock

Indicate on the diagram the character and thickness of the different strata met with in drilling, such as soil, clay, shale, gravel, rock or sand, etc. Show depth at which water is encountered, thickness and character of water-bearing strata and height to which water rises in the well.

Size of Drilled Hole	Size and Weight of Casing	From (Feet)	To (Feet)	PERFORATIONS		
				Kind Size	From (Feet)	To (Feet)
5"	4"	0	111			

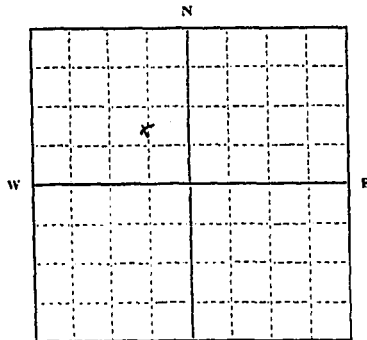

SE 1/4 NW Sec. 28 T. 16 R. 55
Indicate location of well and place of use, if possible. Each small square represents 10 acres.

Show exact depth of bottom.

Static Water Level for non-flowing Well 33 feet.

Shut-in Pressure for Flowing Well.....

Pumping Water Level 75 feet at 12 gal. per minute.

Discharge in gal. per min. of flowing well.....

How Tested Bailer Length of Test 1 ft

Remarks: (Gravel packing, cementing, packers, type of shutoff, location of place of use of groundwater if not at well, and any other similar pertinent information, including number of acres irrigated, if used for irrigation).....

Mike S. Boespflug

Driller's License Number

C. H. Starr
Driller's Signature

This form to be prepared by driller, and three copies to be filed by the owner with the County Clerk and Recorder in the county in which the well is located.

Please answer all questions. If not applicable, so state, otherwise the form will be returned.

Original to the County Clerk and Recorder; duplicate to the State Engineer; Triplicate to the Montana Bureau of Mines and Geology and Quadruplicate for the Appropriator.

41, 44 3

STATE OF MONTANA

County of Dawson

Filed for record this 15th day of

Dec A. D. 1966 at

10:00 o'clock a M.

Gordon B. Russell

County Clerk & Recorder

By Walter J. Brown Deputy

Fee Pd \$2.00

297830

GW2

File No.

DUPLICATE

T. 16N R. 55E

County Cassian

STATE OF MONTANA
ADMINISTRATOR OF GROUNDWATER CODE
OFFICE OF STATE ENGINEER
RECEIVED
OCT 5 1962
STATE ENGINEER

Notice of Completion of Groundwater Appropriation by Means of Well

(Under Chapter 237, Montana Session Laws, 1961)



Top of Ground
(Elev. above sea level.....)
0-40. all hole
40-50 gravel & sand
50-90 clay w/ trace coal
@ 68'
90-94. sandy clay
94-99 clay
99-108 sand
108-111 clay

Owner Pat Boyd Address Blundick, Mont.

Driller Adrian Water-Molding Blundick

Date of Notice of Appropriation of Groundwater

Date well started 9-28-62 Date Completed 9-29-62

Type of well Drilled Equipment Used Rotary
(dug, driven, bored or drilled) (Churn, drill, rotary or other)

Water Use: Domestic Municipal Stock Irrigation
Industrial Drainage Other

Indicate on the diagram the character and thickness of the different strata met with in drilling, such as soil, clay, shale, gravel, rock or sand, etc. Show depth at which water is encountered, thickness and character of water-bearing strata and height to which the water rises in the well.

Size of Drilled Hole	Size and Weight of Casing	From (Feet)	To (Feet)	PERFORATIONS		
				Kind Size	From (Feet)	To (Feet)
6"	4 1/2" 11	-1	109	trunk slate 3/8-1/8	92	107

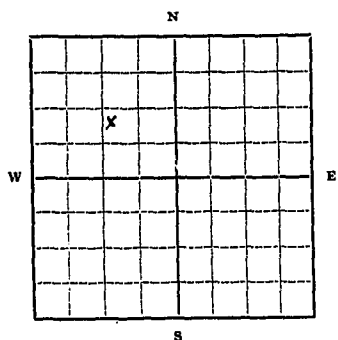

24 3/4 Sec. 16 T. 55 R.
Indicate location of well and place of use, if possible. Each small square represents 10 acres.

Static Water Level for non-flowing Well 84 feet.

Shut-in Pressure for Flowing Well

Pumping Water Level 92 feet at 10 gal. per minute.

Discharge in gal. per min. of flowing well

How Tested Bailed Length of Test 1 1/2 hrs.

Remarks: (Gravel packing, cementing, packers, type of shutoff, location of place of use of groundwater if not at well, and any other similar pertinent information, including number of acres irrigated, if used for irrigation)

Show exact depth of bottom.

61
Driller's License Number
Adrian Water-Molding
Driller's Signature

This form to be prepared by driller, and three copies to be filed by the owner with the County Clerk and Recorder in the county in which the well is located.

Please answer all questions. If not applicable, so state, otherwise the form will be returned.

Original to the County Clerk and Recorder; duplicate to the State Engineer; Triplicate to the School of Mines and Quadruplicate for the Appropriator.

Date of formation of corporation
 Date well started
 Equipment used
 (List items used in well)

Water (See Remarks)
 Steam Municipal Other
 Artesian Irrigation Other

It is hereby certified that the above is a true and correct copy of the original as filed in the office of the County Clerk and Recorder of Dawson County, Montana, on the 4th day of October, 1962, at 3:30 o'clock P.M.

Well No.	Section	Acres	Owner	Operator
1	1	1		
2	2	2		
3	3	3		
4	4	4		
5	5	5		
6	6	6		
7	7	7		
8	8	8		
9	9	9		
10	10	10		

Section 16, Township 14N, Range 10E, 100 acres
 Section 17, Township 14N, Range 10E, 100 acres
 Section 18, Township 14N, Range 10E, 100 acres
 Section 19, Township 14N, Range 10E, 100 acres
 Section 20, Township 14N, Range 10E, 100 acres

280802

STATE OF MONTANA
 County of Dawson

Filed for record this 4th day of
Oct A. D. 1962, at

3:30 o'clock P.M.

Gordon W. Russell
 County Clerk and Recorder.

By Alice Austin Deputy.

Fee pd. 2.00

28

File No.

STATE WATER CONSERVATION BOARD

T. 16 R. 55

DUPLICATE

NOV 9 1966

County DeWain

LOG

Bille _____ McDermott _____ STATE OF MONTANA
 Butzerin _____ McNulty _____ ADMINISTRATOR OF GROUNDWATER CODE
 Coyle _____ Merion _____ OFFICE OF STATE ENGINEER
 Darlinton _____ Sullivan _____
 Dickert _____

Top of Ground
 (Elev. above sea level _____)

**Notice of Completion of Groundwater
 Appropriation by Means of Well**
 DEVELOPED AFTER JANUARY 1, 1962

(Under Chapter 237, Montana Session Laws, 1961)

0-15 gray Cl.
 15-26 gravel
 26-38 blue Cl.
 38-44 quick sand
 44-50 blue Cl.
 50-57 hard coal
 57-64 blk. clay
 64-67 fine sand (small amount water)
 67-71 blake Cl.
 71-96 sandy clay
 96-110 med. fine dark sand
 110-112 sandy brown clay
 112-116 light blue Cl.

Owner Ed Carpenter Address Blondie
 Driller Alton Adkison Address "

Date of Notice of appropriation of groundwater _____
 Date well started 4-23-66 Date completed 4-25-66

Type of well augered Equipment used Rotary
 (Dug, Driven, bored or drilled) (Churn drill, rotary or other)

Water use: Domestic Municipal Stock Irrigation
 Industrial Drainage Other

Indicate on the diagram the character and thickness of the different strata met with in drilling, such as soil, clay, shale, gravel, rock or sand, etc. Show depth at which water is encountered, thickness and character of water-bearing strata and height to which the water rises in the well.

Size of Drilled Hole	Size and Weight of Casing	From (Feet)	To (Feet)	PERFORATIONS		
				Kind Size	From (Feet)	To (Feet)
8"	4x9 1/2"	0	116	rock slit	96	116

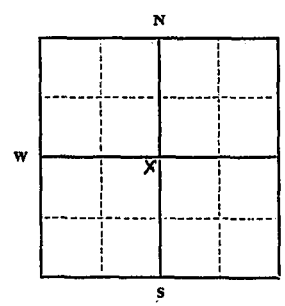

Static Water Level for non-flowing well _____ feet.
 Shut-in Pressure for Flowing Well _____
 ping Water Level 90 feet
 at 12 gal. per minute.
 Discharge in gal. per min. of flowing well _____

How Tested pumped
 Length of Test 4 hrs.

Remarks: (Gravel packing, cementing, packers, type of shutoff) _____

.....(Continue on reverse side)

USE—If used for irrigation, industrial, drainage or other. Explain, state number of acres and location or other data (i.e.: Lot, Block and Addition).
Mrs Ed Carpenter

Show exact depth of bottom.

This form to be prepared by driller, and three copies to be filed by the owner with the County Clerk and Recorder in the county in which the well is located, tissue copy to be retained by driller.

Please answer all questions. If not applicable, so state, otherwise the form will be returned.

61
 Driller's License Number

Alton Adkison
 Driller's Signature

41,591

Office of the
 Clerk of the Court
 State of Montana
 Date of filing of this instrument: _____
 Type of instrument: _____
 (Check one box)
 Original
 Copy
 Other

Case No.	Plaintiff	Defendant	Amount	Date
110				

This instrument is a true and correct copy of the original as the same appears in the files of the Clerk of the Court.

297429

STATE OF MONTANA
 County of Dawson
 Filed for record this 7th day of
November A. D. 1906 at
1:45 o'clock P. M.
Dorlan A. Russell
 County Clerk & Recorder
 By Patricia J. [Signature] Deputy

File No.

T. 16 R. 55

28

DUPLICATE

County Dawson

K.W.

STATE OF MONTANA
ADMINISTRATOR OF GROUNDWATER CODE
OFFICE OF STATE ENGINEER

RECEIVED
DEC 30 1963

Declaration of Vested Groundwater Rights
(Under Chapter 237, Montana Session Laws, 1961)

STATE ENGINEER

1. M. N. Gualif Farms, Inc., of Glendive
(Name of Appropriator) (Address) (Town)

County of Dawson State of Montana
have appropriated groundwater according to the Montana laws in effect prior to January 1, 1962, as follows:

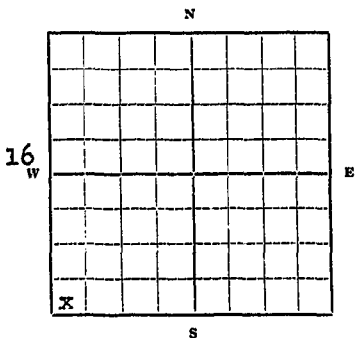

SW 1/4 Sec. 28 T. 16 R. 55

Indicate point of appropriation and place of use, if possible. Each small square represents 10 acres.

- 2. The beneficial use on which the claim is based
..... livestock
- 3. Date or approximate date of earliest beneficial use; and how continuous the use has been 1958
- 4. The amount of groundwater claimed (in miner's inches or gallons per minute) 100 miner's inches
- 5. If used for irrigation, give the acreage and description of the lands to which water has been applied and name of the owner thereof not so used at recent time
- 6. The means of withdrawing such water from the ground and the location of each well or other means of withdrawal natural flow

- 7. The date of construction and completion of the construction of the well, wells, or other works for withdrawal of groundwater 1958
- 8. The depth of water table 135 ft.
- 9. So far as it may be available, the type, size and depth of each well or the general specifications of any other works for the withdrawal of groundwater 150 ft. with 4" and 1 1/2" casing
- 10. The estimated amount of groundwater withdrawn each year not known
- 11. The log of formations encountered in the drilling of each well if available not available
- 12. Such other information of a similar nature as may be useful in carrying out the policy of this act, including reference to book and page of any county record

M. N. GUALIF FARMS, INC.
By Signature of Owner *M. N. Gualif*
Date 12/24/63 President

Three copies to be filed by the owner with the County Clerk and Recorder of the county in which the well is located.

Please answer all questions. If not applicable, so state, otherwise the form will be returned.

Original to the County Clerk and Recorder; duplicate to the State Engineer; Triplicate to the School of Mines and Quadruplicate for the Appropriator.

14235

288503

STATE OF MONTANA
County of Dawson

Filed for record this 26th day of December A. D. 1963, at
1:00 o'clock P.M.

Gordon W. Russell
County Clerk and Recorder.

By _____ Deputy.

W. P. 2

Form No. 18
8-60

28

T. 16 R. 55
County Dawson

MONTANA BUREAU OF MINES AND GEOLOGY
Butte, MONTANA

DEC 29 1961

10:30 A.M.

WATER WELL LOG

RECEIVED
JAN 4 1962
STATE ENGINEER

	+	

Owner Robert E Hostetler Address Glendive Montana
Driller Harold Gavin Address Lindsay Montana
Date Started Sept. 15 1961 Date Completed Sept. 25 1961
Location: Sec. 28 T. 16 R. 55 1/4 sec. N.W.

Type of well drilled Equipment used churn
(Dug, driven, bored, or drilled) (Churn, mill, rotar, other)

Water use: Domestic Municipal Stock Irrigation
Industrial Drainage Other _____

Casing: 0 ft. to 29 ft. Type steel Size 4 inch

Casing: _____ ft. to _____ ft. Type _____ Size _____

Casing: _____ ft. to _____ ft. Type _____ Size _____

Perforated or Screened: Ft. 79 to ft. 99, Ft. _____ to ft. _____

Type of screen or perforations slots cut in casing

Static Water level, for non-flowing well: 40 feet.

Shut-in pressure, for flowing well: _____ lb./sq. in. on: _____ (date)

Pumping water level 80 feet at 5 gal. per min.

How tested: slush test

Length of test 97 min

Remarks: (Gravel packing, cementing, packers, type of shut-off, depth of shut-off)

(over)

28

File No.

T 16 R 55

DUPLICATE

County Dawson

STATE OF MONTANA
ADMINISTRATOR OF GROUNDWATER CODE
OFFICE OF STATE ENGINEER

Declaration of Vested Groundwater Rights

(Under Chapter 237, Montana Session Laws, 1961)

JAN 14 1964

STATE ENGINEER

I, Bartley Schlicht, of Glendive,
(Name of Appropriator) (Address) (Town)
Dawson County of Montana State of
have appropriated groundwater according to the Montana laws in effect prior to January 1, 1962, as follows:

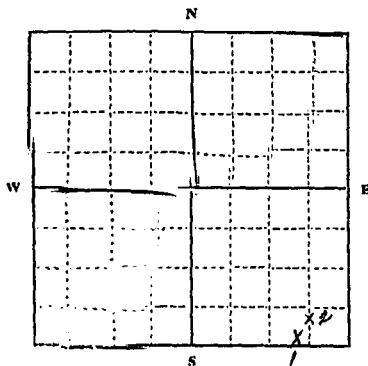

1/4 Sec 28 T 16 R 55

Indicate point of appropriation and place of use, if possible. Each small square represents 10 acres.

- The beneficial use on which the claim is based. #1, domestic; #2, domestic
- Date or approximate date of earliest beneficial use; and how continuous the use has been. #1, 1960 continuous; #2, 1950, continuous
- The amount of groundwater claimed (in miner's inches or gallons per minute). #1, 10 gallons per minute; #2, 10 gallons per minute
- If used for irrigation, give the acreage and description of the lands to which water has been applied and name of the owner thereof. None
- The means of withdrawing such water from the ground and the location of each well or other means of withdrawal. #1, electric motor, centrifugal; #2, electric motor, centrifugal
- The date of commencement and completion of the construction of the well, wells, or other works for withdrawal of groundwater. #1, 1960; #2, 1950
- The depth of water table. #1, 76'; #2, 76'
- So far as it may be available, the type, size and depth of each well or the general specifications of any other works for the withdrawal of groundwater. #1, drilled, 4" casing, 126' deep; #2, drilled, 4" casing, 116' deep
- The estimated amount of groundwater withdrawn each year. #1, 2,592,000 gallons; #2, 2,592,000 gal.
- The log of formations encountered in the drilling of each well if available. None
- Such other information of a similar nature as may be useful in carrying out the policy of this act, including reference to book and page of any record. None

Signature of Owner Bartley Schlicht
Date December 30, 1963

Three copies to be filed by the owner with the County Clerk and Recorder of the county in which the well is located.

Please answer all questions. If not applicable, so state, otherwise the form will be returned.

Original to the County Clerk and Recorder; Duplicate to the State Engineer; Triplicate to the Montana Bureau of Mines and Geology, and Quadruplicate for the Appropriator.

31908

286791

STATE OF MONTANA
County of Dawson

Filed for record this 30th day of
December A D. 1963, at
4:00 o'clock P.M.

Gordon W. Russell
County Clerk and Recorder.

By _____ Deputy.

File No. _____

16 N. R. G. 55 E

DUPLICATE

City of ~~Helena~~

STATE OF MONTANA
ADMINISTRATOR OF GROUNDWATER
OFFICE OF STATE ENGINEER

148
STATE ENGINEER

Declaration of Vested Groundwater Rights

(Under Chapter 237, Montana Session Laws, 1961)

1. Willis Lester Schmidt, of Dry Creek Dr. Gladwin
(Name of Appropriator) (Address) (Town)

County of Dawson State of Montana
have appropriated groundwater according to the Montana laws in effect prior to January 1, 1962, as follows:

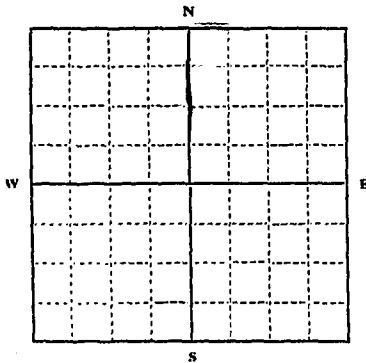

2 1/4 Sec. 22 T. 16 R. 55 E

Indicate point of appropriation and place of use, if possible. Each small square represents 10 acres.

2. The beneficial use on which the claim is based. drinking water
irrigation

3. Date or approximate date of earliest beneficial use; and how continuous the use has been. unknown

4. The amount of groundwater claimed (in miner's inches or gallons per minute). 300 g.p.m. minimum

5. If used for irrigation, give the acreage and description of the lands to which water has been applied and name of the owner thereof. 2 1/4 Sec. 22 T. 16 R. 55 E. land lying in the Southeast Quarter of the 2nd Section, Township 16 North, Range 55 East of the M.P.M. 1st Dawson Co., Mont.

6. The means of withdrawing such water from the ground and the location of each well or other means of withdrawal. by water pump

7. The date of commencement and completion of the construction of the well, wells, or other works for withdrawal of groundwater. unknown

8. The depth of water table. 6-8 feet

9. So far as it may be available, the type, size and depth of each well or the general specifications of any other works for the withdrawal of groundwater. none available

10. The estimated amount of groundwater withdrawn each year. for household use, irrigation depending on rainfall

11. The log of formations encountered in the drilling of each well if available. none available

12. Such other information of a similar nature as may be useful in carrying out the policy of this act, including reference to book and page of any county record. Book A 113 525

Signature of Owner Willis L. Schmidt
W. L. Schmidt

Date DEC 31 1963

Three copies to be filed by the owner with the County Clerk and Recorder of the county in which the well is located.

Please answer all questions. If not applicable, so state, otherwise the form will be returned.

Original to the County Clerk and Recorder; Duplicate to the State Engineer; Duplicate to the Montana Bureau of Mines and Geology, and Quadruplicate for the Appropriator.

287013

STATE OF MONTANA
County of Dawson

Filed for record this 31st day of
December A. D. 19 63, at
4:30 o'clock P. M.

Gordon W. Russell
County Clerk and Recorder.

By _____ Deputy.

File No.

MONTANA WATER RESOURCES BOARD

T. 16N R. 55E

DUPLICATE

RECEIVED

County Glendive

LOG

APR 11 1968

STATE OF MONTANA

ADMINISTRATOR OF GROUNDWATER CODE

OFFICE OF STATE ENGINEER

Top of Ground
(Elev. above sea level.....)

0 sand
3
3 sand & gravel
14
14 clay
18
18 gravel
31
31 sand & water
51
51 grey shale
65
65 dk shale
102
102 grey shale
161
161 dk water sand
183

Notice of Completion of Groundwater Appropriation by Means of Well
DEVELOPED AFTER JANUARY 1, 1962
(Under Chapter 237, Montana Session Laws, 1961)

Owner Andrew Pressman Address Box 1210

Driller C H Starr Address Glendive, Mont Box 1183

Date of Notice of appropriation of groundwater.....

Date well started March 25 Date completed Apr 3 - 68

Type of well drilled Equipment used Churn drill
(Dug, driven, bored or drilled) (Churn drill, rotary or other)

Water use: Domestic Municipal Stock Irrigation
Industrial Drainage Other

Indicate on the diagram the character and thickness of the different strata met with in drilling, such as soil, clay, shale, gravel, rock or sand, etc. Show depth at which water is encountered, thickness and character of water-bearing strata and height to which the water rises in the well.

Size of Drilled Hole	Size and Weight of Casing	From (Feet)	To (Feet)	PERFORATIONS		
				Kind Size	From (Feet)	To (Feet)
for 6"	4"	0	162'			
31"	11#					
4"	per ft					

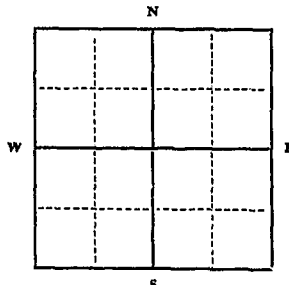

Static Water Level for non-flowing well 56 feet.

Static Pressure for Flowing Well.....

Pumping Water Level..... 93 feet at..... 10 gal. per minute.

Discharge in gal. per min. of flowing well

How Tested..... Bailer

Length of Test..... 1 hr

Remarks: (Gravel packing, cementing, packers, type of shutoff).....

E 7 NW 4 - R 28 N Sec. 28 T. 16 R. 55

Indicate location of well and place of use, if possible. Each small square represents 40 acres.

(Continue on reverse side)

USE—If used for irrigation, industrial, drainage or other. Explain, state number of acres and location or other data (i.e.: Lot, Block and Addition).

183 Show exact depth of bottom.

This form to be prepared by driller, and three copies to be filed by the owner with the County Clerk and Recorder in the county in which the well is located, tissue copy to be retained by driller.

Please answer all questions. If not applicable, so state, otherwise the form will be returned.

168 Driller's License Number

C H Starr Driller's Signature

44,048

STATE OF MONTANA

County of Dawson

Filed for record this 10th day of

April A. D. 19 68 at

9:45 o'clock a M.

Brandon K. Russell

County Clerk & Recorder

By Patricia Peterson Deputy

302493

File No.

T 16 R 55

DUPLICATE

County Dawson

STATE OF MONTANA
ADMINISTRATOR OF GROUNDWATER CODE
OFFICE OF STATE ENGINEER

RECEIVED
JAN 14 1964
STATE ENGINEER

Declaration of Vested Groundwater Rights

(Under Chapter 237, Montana Session Laws, 1961)

I, Eugene Vogele of P.O. Box 756 Glendive
(Name of Appropriator) (Address) (Town)
County of Dawson State of Montana
have appropriated groundwater according to the Montana laws in effect prior to January 1, 1962, as follows:

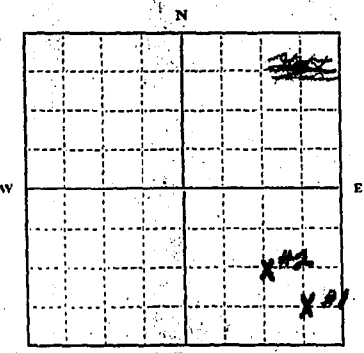

SE
1/4 SE Sec. 28 T. 16 R. 55
Indicate point of appropriation and place of use, if possible. Each small square represents 10 acres.

- The beneficial use on which the claim is based residential and water for livestock
- Date or approximate date of earliest beneficial use; and how continuous the use has been Well # 1 Oct. 1950 Well # 2 April 1951 continuous
- The amount of groundwater claimed (in miner's inches or gallons per minute) Well # 1 9 gal. per minute Well # 2 12 gal. per minute
- If used for irrigation, give the acreage and description of the lands to which water has been applied and name of the owner thereof to sprinkle lawn and garden
- Means of withdrawing such water from the ground and the location of each well or other means of withdrawal pumps
- The date of commencement and completion of the construction of the well, wells, or other works for withdrawal of groundwater Well # 1 Oct. 1950 Well # 2 April 1951
- The depth of water table Well # 1 60 feet Well # 2 30 feet
- So far as it may be available, the type, size and depth of each well or the general specifications of any other works for the withdrawal of groundwater Well # 1 4 inch casing 103 feet deep No. #2 6 inch casing 92 feet deep
- The estimated amount of groundwater withdrawn each year Well # 1 400,000 gallons Well # 2 750,000 gallons
- The log of formations encountered in the drilling of each well if available none
- Such other information of a similar nature as may be useful in carrying out the policy of this act, including reference to book and page of any county record none

Signature of Owner Eugene W. Vogele
Date 12-28-63

Three copies to be filed by the owner with the County Clerk and Recorder of the county in which the well is located.
Please answer all questions. If not applicable, so state, otherwise the form will be returned.

Original to the County Clerk and Recorder; Duplicate to the State Engineer, Triplicate to the Montana Bureau of Mines and Geology, and Quadruplicate for the Appropriator. 31933

Faint, illegible text at the top of the page, possibly a header or title area.

Faint, illegible text in the middle section of the page, possibly a body of text or a list.

286816

STATE OF MONTANA
County of Dawson

Filed for record this 30th day of
December A. D. 19 63, at
4:00 o'clock P. M.

Garbon W. Russell
County Clerk and Recorder.

By _____ Deputy.

GW2

File No.

DUPLICATE

T. 16 N. R. 55 E

County Dawson

STATE OF MONTANA
ADMINISTRATOR OF GROUNDWATER CODE
OFFICE OF STATE ENGINEER

Notice of Completion of Groundwater
Appropriation by Means of Well

RECEIVED
15 1962

(Under Chapter 237, Montana Session Laws 1962) STATE ENGINEER

Top of Ground
(Elev. above sea level.....)

0-8 Silty clay
8-34 loam sandy clay
34-40 gravel sand
40-55 blue sticky shale
55-57 gravel
57-72 clay
72-76 sand & sandy clay
76-84 clay
84-109 fine sandy sandstone
109-113 fine grey sand
113-120 - shale

Owner Dr. J. Zuff Address Klenlike
Driller Elton Johnson Address "

Date of Notice of Appropriation of Groundwater
Date well started 10-3-62 Date Completed 10-4-62

Type of well Drilled Equipment Used Rotary
(dug, driven, bored or drilled) (Churn, drill, rotary or other)

Water Use: Domestic Municipal Stock Irrigation
Industrial Drainage Other

Indicate on the diagram the character and thickness of the different strata met with in drilling, such as soil, clay, shale, gravel, rock or sand, etc. Show depth at which water is encountered, thickness and character of water-bearing strata and height to which the water rises in the well.

Size of Drilled Hole	Size and Weight of Casing	From (Feet)	To (Feet)	PERFORATIONS		
				Kind Size	From (Feet)	To (Feet)
6	4 1/2 X 11	-1	120	2 inch 2 1/2	70-80 100	96 120

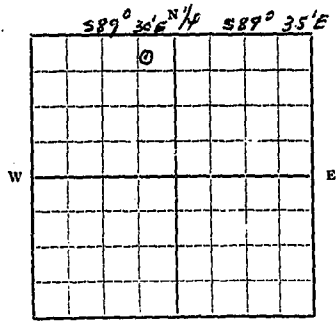

N.E. 1/4 NW 1/4 Sec 28 T. 16 N. R. 55 E
Indicate location of well and place of use, if possible. Each small square represents 10 acres.

Show exact depth of bottom.

Static Water Level for non-flowing Well 72 feet.

Shut-in Pressure for Flowing Well

Pumping Water Level 105 feet at 9 gal. per minute.

Discharge in gal. per min. of flowing well

How Tested Build Length of Test 2 hrs.

Remarks: (Gravel packing, cementing, packers, type of shutoff, location of place of use of groundwater if not at well, and any other similar pertinent information, including number of acres irrigated, if used for irrigation)

61
Driller's License Number
Elton Johnson
Driller's Signature

This form to be prepared by driller, and three copies to be filed by the owner with the County Clerk and Recorder in the county in which the well is located.

Please answer all questions. If not applicable, so state, otherwise the form will be returned.

Original to the County Clerk and Recorder; duplicate to the State Engineer; Triplicate to the School of Mines and Quadruplicate for the Appropriator.

State of Montana
 Department of Agriculture
 Division of Irrigation
 (Formerly State Engineer)

Water Right Certificate
 (Form No. 1)

Water Right No. _____
 Applicant _____
 Location _____

Water Right Description
 Municipal
 Domestic
 Industrial
 Agricultural
 Other _____

The undersigned, State Engineer of the State of Montana, do hereby certify that the above described water right is a valid and legal right under the laws of the State of Montana, and that the same is subject to the provisions of the Act to amend the Act to provide for the registration of water rights, approved March 1, 1909, and the Act to amend the Act to provide for the registration of water rights, approved March 1, 1909, and the Act to amend the Act to provide for the registration of water rights, approved March 1, 1909.

No.	Section	Range	County	State
1	36	10	Dawson	Montana
2	36	10	Dawson	Montana
3	36	10	Dawson	Montana
4	36	10	Dawson	Montana
5	36	10	Dawson	Montana
6	36	10	Dawson	Montana
7	36	10	Dawson	Montana
8	36	10	Dawson	Montana
9	36	10	Dawson	Montana
10	36	10	Dawson	Montana

Water Right Description

Water Right Holder

Water Right Beneficiary

Water Right Priority

Water Right Quantity

Water Right Location

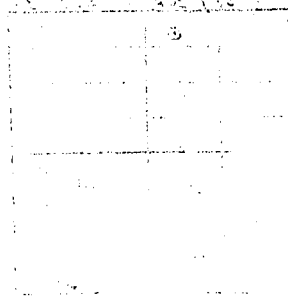

280858

STATE OF MONTANA
 County of Dawson

Filed for record this 10th day of
Oct, A. D. 1922, at
2 o'clock P. M.

Gordon W. Russell
 County Clerk and Recorder.

By Alice Audby Deputy.

200
 Fee pd. 2.00

30

File No.

T 16 R 55

DUPLICATE

County RAMSEY

STATE OF MONTANA
ADMINISTRATOR OF GROUNDWATER,
OFFICE OF STATE ENGINEER

JAN 14 1964

STATE ENGINEER

Notice of Completion of Groundwater Appropriation Without Well

(Under Chapter 237 Montana Session Laws, 1961)

Date of Appropriation of Groundwater MAY 1st, 1947
Owner H.F. Kinney Address P.O. Box 1186 Glendive
Contractor (if any)
Address of Contractor
Date Started JAN. 1, 1908 Date Completed Nov. 10, 1958

Describe means of obtaining groundwater without a well "as by sub-irrigation and other natural processes". Include depth to water when applicable.

*Rock Curbed Spring Ten feet deep.
Electric pump

*Day Care Stock use Irrigation use from NATURAL FLOW AS AVAILABLE

Quantity of water developed and used with explanation of method used to measure or estimate such amount. If use is intermittent

estimate approximate lengths of periods of use Agricultural
Domestic & Stock use

Amount used per day
App. 50 bbls. #2 stock use. #1
APPROX 2 gals. Per Minute each

Signature of Owner Horace F. Kinney
Date Dec 31, 1963

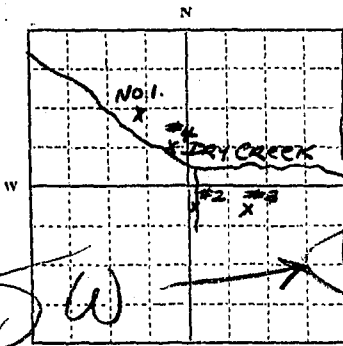

NW 1/4 Sec. 30 T. 16 R. 55
Indicate point of appropriation and place of use, if possible.

This form to be prepared by contractor (if any), otherwise by the owner.

Three copies of this notice are to be filed with the County Clerk and Recorder of the county in which the works are located.

Please answer all questions. If not applicable, so state, otherwise the form will be returned.

Original to the County Clerk and Recorder; duplicate to the State Engineer; Triplicate to the Montana Bureau of Mines and Geology and Quadruplicate for the Appropriator.

32078

12/31/63

W. OFFER...
... 12/26/63

MM

30 ... DOWN ... 2500K ...

...
...
...
...

...

...

286973

STATE OF MONTANA
County of Dawson

Filed for record this 31st day of
December A. D. 1963, at
4:30 o'clock P.M.

Gordon W. Russell
County Clerk and Recorder.

By _____ Deputy,

30

File No.

T. 16 R. 55

DUPLICATE

County Dawson

SEP

STATE OF MONTANA
ADMINISTRATOR OF GROUNDWATER CODE
OFFICE OF STATE ENGINEER

RECEIVED
MAR 19 1963

STATE ENGINEER

Notice of Completion of Groundwater Appropriation
Without Well

(Under Chapter 237 Montana Session Laws, 1961)

Date of Appropriation of Groundwater.....

Owner H.F. Kinney Address Glendive

Contractor (if any) M. Hood

Address of Contractor Glendive, Mont

Date Started Dec '62 Date Completed Jan 1, 1963

Describe means of obtaining groundwater without a well "as by sub-irrigation and other natural processes". Include depth of water when available. Seep Spring.

Perforated orangeburg to spring box to tank. - Overflow to a tank

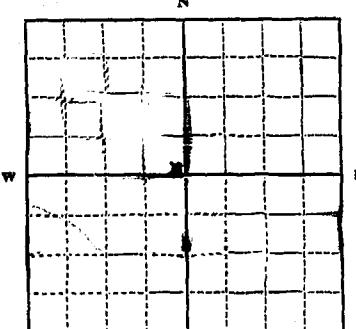

SE 1/4 NW Sec 30 T. 16 R. 55
Indicate point of appropriation and place of use, if possible.

Quantity of water developed and used with explanation of method used to measure or estimate such amount. If use is intermittent

estimate approximate lengths of periods of use.....
Continuous flow one gallon per minute

Signature of Owner Horace L. Kinney

Date Mar 18, 1963

This form to be prepared by contractor (if any), otherwise by the owner.
Three copies of this notice are to be filed with the County Clerk and Recorder of the county in which the works are located.
Please answer all questions. If not applicable, so state, otherwise the form will be returned.
Original to the County Clerk and Recorder; duplicate to the State Engineer; Triplicate to the Montana Bureau of Mines and Geology and Quadruplicate for the Appropriator.

282911

STATE OF MONTANA
County of Dawson

Filed for record this 18th day of
May A. D. 1963, at
11:30 o'clock A.M.

Harold W. Russell
County Clerk and Recorder,

By Alice Quilty Deputy.

Fee pd. 2⁰⁰

RECEIVED
JAN 27 1958

T. 16 R. 55 32
County Dawson

STATE ENGINEER MONTANA BUREAU OF MINES AND GEOLOGY
Butte, Montana

WATER WELL LOG

x		

Owner: John F. Baer Address: Glendive, Mont.
Driller: Harold Gavin Address: Lindsay, Mont.
Date Started: Date Completed: July 17, 1957
Location: Sec. 32 T. 16 R. 55 1/4 sec. N.W.

Type of well: (Dug, driven, bored, or drilled) Equipment used: (Churn drill, rotary, other)

Water use: Domestic Municipal Stock Irrigation
Industrial Drainage Other: _____

Casing: surface ft. to 70 ft. Type: Standard black Size: 4"

Casing: ft. to ft. Type: Size:

Casing: ft. to ft. Type: ~~SP~~

Perforated or Screened: Ft. 50 to ft. 70 Ft. to ft.

Type of screen or perforations: 3/16" x 3" slots, cut in case

Static Water level, for non-flowing well: 45' from surface feet.

Shut-in pressure, for flowing well: lb./sq. in. on: (date)

Pumping water level: 50' from surface feet at 8 gal. per min.

How tested: Slush bucket

Length of test: One hour

Remarks: (Gravel packing, cementing, packers, type of shut-off, depth of shut-off)

(over)