

County Dawson Twp. 17N Rge. 50E

Sec.	Name of Appropriator	Type of Form	County File No.	Remarks
9	Dion, H.M.	Hw3	286631	Sec. 9, 15, 16, 20, 21 + 28
11	Suckow, A.R.	Hw3	286697	Sec. 11, 14 + 16
12	Hildebrand Raymond	Hw4	286957	
13	Dion, H.N.	Hw3	286633	Sec. 13, 23, 24 + 26
14	Suckow, A.R.	Hw3	286697	See Sec. 11 Above
15	Dion, H.N.	Hw3	286631	See Sec. 9 Above
16	Dion, H.N.	Hw3	286631	See Sec. 9 Above
16	Suckow, A.R.	Hw3	286697	See Sec. 11 Above
20	Dion, H.N.	Hw3	286631	See Sec. 9 Above
21	Dion, H.N.	Hw3	286631	See Sec. 9 Above
22	Dion, H.N.	Hw4	286632	Sec. 22 + 27
23	Dion, H.N.	Hw3	286633	See Sec. 13 Above
24	Dion, H.N.	Hw3	286633	See Sec. 13 Above
26	Dion, H.N.	Hw3	286633	See Sec. 13 Above
26	Kalhsig, Martin	Hw2	314123	
27	Dion, H.N.	Hw4	286632	See Sec. 22 Above
28	Dion, H.N.	Hw3	286631	See Sec. 9 Above
28	Laxinet, D.C.	Hw4	286867	Sec. 28 + 34
29	Selman, Sam	Hw3	286694	Sec. 29, 30 + 31
30	Selman, Sam	Hw3	286694	See Sec. 29 Above
31	Selman, Sam	Hw3	286694	See Sec. 29 Above
31	Selman, Sam	Hw4	286695	
32	Wood, Bernice E.	Hw3	286701	
34	Laxinet, D.C.	Hw4	286867	See Sec. 28 Above
35	Bennett, Howard D.	Hw3	285612	

File No. ....

T. 17 R. 56

DUPLICATE

County Hawson

STATE OF MONTANA  
ADMINISTRATOR OF GROUNDWATER CODE  
OFFICE OF STATE ENGINEER

JAN 14 1964  
STATE ENGINEER

**Notice of Completion of Groundwater Appropriation  
Without Well**

(Under Chapter 237 Montana Session Laws, 1961)

Date of Appropriation of Groundwater 1954  
Owner A. R. Suckow Address Glendine P.O. Route  
Contractor (if any) \_\_\_\_\_  
Address of Contractor A. R. Suckow  
Date Started 1954 June Date Completed July, 1954

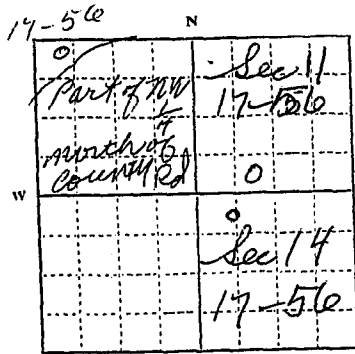

Describe means of obtaining groundwater without a well "as by sub-irrigation and other natural processes". Include depth to water when applicable. Sec 11. Bored and Piped 4 gals Per  
Sec 11 - Bored, piped out, 3 gals  
Sec 14 - Bored Piped 5 gals

Quantity of water developed and used with explanation of method used to measure or estimate such amount. If use is intermittent estimate approximate lengths of periods of use.  
Measured with gallon pail and stop watch

16-11-54  
1/4 Sec. T. 17 R. 56

Indicate point of appropriation and place of use, if possible.

Signature of Owner A. R. Suckow  
Date Dec 30 - 1963

This form to be prepared by contractor (if any), otherwise by the owner.  
Three copies of this notice are to be filed with the County Clerk and Recorder of the county in which the works are located.  
Please answer all questions. If not applicable, so state, otherwise the form will be returned.  
Original to the County Clerk and Recorder; duplicate to the State Engineer; Triplicate to the Montana Bureau of Mines and Geology and Quadruplicate for the Appropriator.

286697

STATE OF MONTANA  
County of Dawson

Filed for record this 30<sup>th</sup> day of  
December A. D. 1963, at  
3:00 o'clock P.M.

Gordon W. Russell  
County Clerk and Recorder.

By \_\_\_\_\_ Deputy.

*Free Pl. #200*

12

File No. ....

T. 17N R. 56E

DUPLICATE

STATE OF MONTANA  
ADMINISTRATOR OF GROUNDWATER CODE  
OFFICE OF STATE ENGINEER

County Dawson  
RECEIVED  
JAN 14 1964  
STATE ENGINEER

Declaration of Vested Groundwater Rights

(Under Chapter 237, Montana Session Laws, 1961)

1. **RAYMOND HILDEBRAND** of **Box 861** **Glendive, Montana**  
(Name of Appropriator) (Address) (Town)

County of **Dawson** State of **Montana**

have appropriated groundwater according to the Montana laws in effect prior to January 1, 1962, as follows:

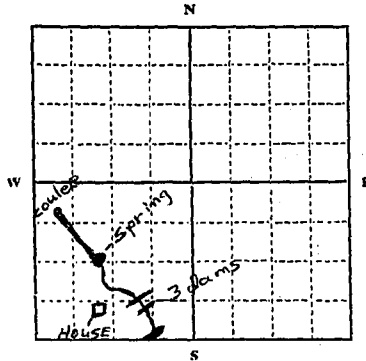

SW 1/4 Sec. 12, T. 17, R. 56

Indicate point of appropriation and place of use, if possible. Each small square represents 10 acres.

- The beneficial use on which the claim is based... **Livestock, agricultural, and domestic use**
- Date or approximate date of earliest beneficial use; and how continuous the use has been... **March 20, 1935 - continuous use since appropriation**
- The amount of groundwater claimed (in miner's inches or gallons per minute)... **1 cubic foot of water per second**
- If used for irrigation, give the acreage and description of the lands to which water has been applied and name of the owner thereof... **SW 1/4 of Section 12-17N-56E, which is grazing and irrigated land - Raymond Hildebrand, owner**
- The means of withdrawing such water from the ground and the location of each well or other means of withdrawal... **Water rises to surface from the spring and runs down a natural coulee where it is impounded by 3 earthen dams**
- The date of commencement and completion of the construction of the well, wells, or other works for withdrawal of groundwater... **March of 1935, excavation of spring and construction of pipe lines; 1936 to 1956, construction of 3 earthen dams and installation of electrically driven pumps and pipe lines, all at a cost of approximately \$2,500**
- The depth of water table... **Estimated 10' to 17'**
- So far as it may be available, the type, size and depth of each well or the general specifications of any other works for the withdrawal of groundwater... **The spring is approximately 15' below the surface. The water rises therein and some of it runs out by gravity for watering animals and household use. Surplus water is impounded by the three dams, from which, through electrically driven pumps and a pipe distribution system, it is applied to fruit trees, ornamental trees, native trees, garden, and lawn**
- The estimated amount of groundwater withdrawn each year... **Groundwater withdrawn during entire year, but principally from the 1st of March to the 1st of November of each year.**
- The log of formations encountered in the drilling of each well if available.....
- Such other information of a similar nature as may be useful in carrying out the policy of this act, including reference to book and page of any county record.....

Signature of Owner

*Raymond Hildebrand*

Date **December 31, 1963**

Three copies to be filed by the owner with the County Clerk and Recorder of the county in which the well is located.

Please answer all questions. If not applicable, so state, otherwise the form will be returned.

Original to the County Clerk and Recorder; Duplicate to the State Engineer; Triplicate to the Montana Bureau of Mines and Geology, and Quadruplicate for the Appropriator.

32062

1. The above described land is situated in the County of Dawson, State of Montana, and is more particularly described as follows: ...

2. The above described land is situated in the County of Dawson, State of Montana, and is more particularly described as follows: ...

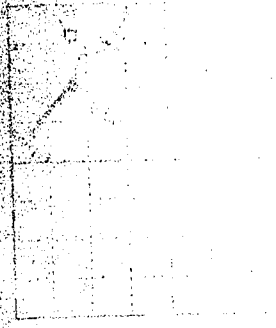

286957

STATE OF MONTANA  
County of Dawson

Filed for record this 31st day of  
December A. D. 1963, at  
4:30 o'clock P.M.  
Gordon W. Russell  
County Clerk and Recorder.

By \_\_\_\_\_ Deputy.

W 3

Approved Stock Form—State Publishing Co., Helena, Montana—19089

File No. \_\_\_\_\_

Sec 18, Sec 23, sec 26  
R sec 35, W sec 24

T 17 N R 56 E

DUPLICATE

County Dawson

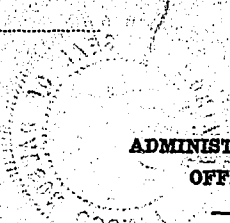

STATE OF MONTANA  
ADMINISTRATOR OF GROUNDWATER CODE  
OFFICE OF STATE ENGINEER

JAN 14 1964

13  
24  
23  
26

### Notice of Completion of Groundwater Appropriation Without Well

(Under Chapter 237 Montana Session Laws, 1961)

Date of Appropriation of Groundwater... December 26, 1963

Owner... H. N. Dion Address... Box 1027, Glendive, Montana

Contractor (if any) none

Address of Contractor \_\_\_\_\_

Date Started... 7-1-11 Date Completed... 7-1-11

Describe means of obtaining groundwater without a well "as by sub-irrigation and other natural processes". Include depth to water when applicable... natural springs and dams

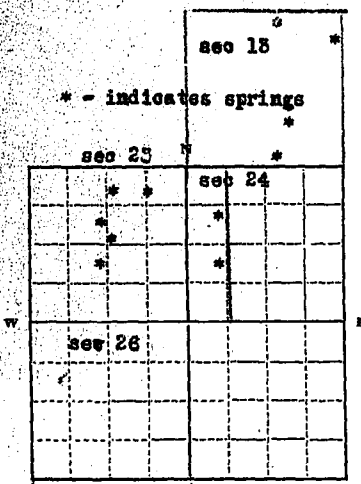

Quantity of water developed and used with explanation of method used to measure or estimate such amount. If use is intermittent

estimate approximate lengths of periods of use... no estimate of amount of water used is available; water is used for live stock which range adjacent lands, some of the time intermittently, according to weather and grass available

sec 35 \*  
dam Sec T 17 R 56 E  
Indicate point of appropriation and place of use, if possible.

all in twp 17N-R56E

Signature of Owner... *H. N. Dion*

Date... December 26, 1963

This form to be prepared by contractor (if any), otherwise by the owner.

Three copies of this notice are to be filed with the County Clerk and Recorder of the county in which the works are located.

Please answer all questions. If not applicable, so state, otherwise the form will be returned.

Original to the County Clerk and Recorder; duplicate to the State Engineer; Triplicate to the Montana Bureau of Mines and Geology and Quadruplicate for the Appropriator.

31756

286633

STATE OF MONTANA  
County of Dawson

Filed for record this 30<sup>th</sup> day of  
December A. D. 1965, at  
11:00 o'clock A.M.

Gordon W Russell  
County Clerk and Recorder.

By \_\_\_\_\_ Deputy.

Fee pd. \$ 2.00

File No.

DUPLICATE

Sec 9, all sec 15, all  
 sec 15, S<sup>2</sup> sec 20 and  
 sec 28, all sec 21

T. 17 N. R. 56 E.

County Dawson

135  
16  
21

STATE OF MONTANA  
 ADMINISTRATOR OF GROUNDWATER CODE  
 OFFICE OF STATE ENGINEER

RECEIVED  
 JAN 14 1964

**Notice of Completion of Groundwater Appropriation Without Well**

(Under Chapter 237 Montana Session Laws, 1961)

\* - indicates springs

Date of Appropriation of Groundwater... December 26, 1963

Owner... H. H. Dion Address... Box 1027, Glendive, Montana

Contractor (if any).....

Address of Contractor .....

Date Started... 7-1-1911 Date Completed... 7-1-1911

Describe means of obtaining groundwater without a well "as by sub-irrigation and other natural processes". Include depth to water when applicable. natural springs and dams

	Sec 9				
		* dam			
					*
	Sec 16		Sec 16		
	*	*	*	*	*
W					E
	Sec 21				
sec 20	*				
sec 20	*				
	Sec 28				

1/4 Sec. T. 17 N. R. 56 E  
 Indicate point of appropriation and place of use, if possible.

all in twp 17N-56E

Quantity of water developed and used with explanation of method used to measure or estimate such amount. If use is intermittent estimate approximate lengths of periods of use. no estimate of amount of water used is available; water is used for live-stock which range adjacent lands, some of the time intermittently, according to weather and grass available

Signature of Owner... *H. H. Dion*

Date... December 26, 1963

This form to be prepared by contractor (if any), otherwise by the owner.

Three copies of this notice are to be filed with the County Clerk and Recorder of the county in which the works are located.

Please answer all questions. If not applicable, so state, otherwise the form will be returned.

Original to the County Clerk and Recorder; duplicate to the State Engineer; Triplicate to the Montana Bureau of Mines and Geology and Quadruplicate for the Appropriator.

31254



286631

STATE OF MONTANA  
County of Dawson

Filed for record this 30<sup>th</sup> day of  
December A. D. 1963, at  
11:00 o'clock A.M.

Gordon W. Russell  
County Clerk and Recorder.

By \_\_\_\_\_ Deputy.

Fee pd. \$2<sup>00</sup>

GV

22

File No. \_\_\_\_\_

Sections 22 and 27 T. 17 N R. 56 E

DUPLICATE

County Dawson

STATE OF MONTANA  
ADMINISTRATOR OF GROUNDWATER CODE  
OFFICE OF STATE ENGINEER

Declaration of Vested Groundwater Rights

(Under Chapter 237, Montana Session Laws, 1961)

RECEIVED  
JAN 14 1964  
STATE ENGINEER

H. N. Dion, of Box 1027 Glendive, Montana  
(Name of Appropriator) (Address) (Town)  
County of Dawson State of Montana  
have appropriated groundwater according to the Montana laws in effect prior to January 1, 1962, as follows:

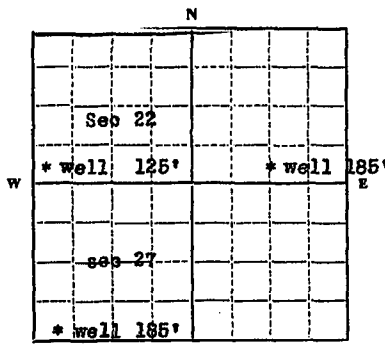

22 & Sec. 27 T. 17 N R. 56 E

Indicate point of appropriation and place of use, if possible. Each small square represents 10 acres.

2. The beneficial use on which the claim is based...  
Stock water

3. Date or approximate date of earliest beneficial use; and how continuous the use has been...  
July 1, 1911 live-stock in pasture

4. The amount of groundwater claimed (in miner's inches or gallons per minute)...  
no estimate

5. If used for irrigation, give the acreage and description of the lands to which water has been applied and name of the owner thereof...  
not used for irrigation

6. The means of withdrawing such water from the ground and the location of each well or other means of withdrawal...  
pumps

7. The date of commencement and completion of the construction of the well, wells, or other works for withdrawal of groundwater...  
July 1, 1911

8. The depth of water table...  
125 feet to 185 feet

9. So far as it may be available, the type, size and depth of each well or the general specifications of any other works for the withdrawal of groundwater...  
4" well pipe casing

10. The estimated amount of groundwater withdrawn each year...  
no estimate available

11. The log of formations encountered in the drilling of each well if available...  
none available

12. Such other information of a similar nature as may be useful in carrying out the policy of this act, including reference to book and page of any county record.

Signature of Owner: *H. N. Dion*

Date: December 26, 1963

Three copies to be filed by the owner with the County Clerk and Recorder of the county in which the well is located.

Please answer all questions. If not applicable, so state, otherwise the form will be returned.

Original to the County Clerk and Recorder; duplicate to the State Engineer; Triplicate to the Montana Bureau of Mines and Geology, and Quadruplicate for the Appropriator.

31755

Faint, illegible text at the top of the page, possibly a header or introductory paragraph.

Large block of faint, illegible text in the middle of the page, likely the main body of a document.

286632

STATE OF MONTANA  
County of Dawson

Filed for record this 30<sup>th</sup> day of  
December A. D. 1963, at  
11:00 o'clock A. M.

Harold Russell  
County Clerk and Recorder.

By \_\_\_\_\_ Deputy.

Fee pd. \$2.00

File No. ....

NOV 23 1971

T. 17-N R. 56-E

DUPLICATE

County DAWSON

LOG

STATE OF MONTANA  
ADMINISTRATOR OF GROUNDWATER CODE  
OFFICE OF STATE ENGINEER

Notice of Completion of Groundwater  
Appropriation by Means of Well  
DEVELOPED AFTER JANUARY 1, 1962

(Under Chapter 237, Montana Session Laws, 1961)

Owner Martin Kolberg Address Blandish

Driller Adrian Waterwell Drilling Address .....

Date of Notice of appropriation of groundwater .....

Date well started 10-28-65 Date completed 11-3-65

Type of well Drilled Equipment used Rotary  
(Dug, Driven, bored or drilled) (Churn drill, rotary or other)

Water use: Domestic  Municipal  Stock  Irrigation   
Industrial  Drainage  Other

- Top of Ground (Elev. above sea level.....)
- 0-3 Subsoil
- 0-15 Gravel
- 15-22 Hard coal
- 22-22 stubby clay
- 42-48 fine grey cl.
- 48-57 Hard coal
- 57-94 1/2 blue cl. w/ coal str.
- 94 1/2-95 Hard grey rock
- 95-104 grey sandy cl.
- 104-120 blk. cl. w/ coal str.
- 120-138 grey cl.
- 138-137 Hard sandstone
- 137-253 blue clay w/ scattered coal str.
- 253-254 Hard grey s. stone
- 254-307 sandy clay
- 307-321 firm to med. soft s. stone
- 321-346 Brown to grey clay
- 346-347 X-hard grey s. stone
- 347-350 fine sandy cl.
- 350-350 1/2 Rock shell
- 350 1/2-380 blue shale
- 380-389 blue sandy cl. w/ some sand
- 389-390 Hard coal
- 390-452 Brown-grey clay
- 452-459 fine grey cl. sandy
- 459-461 X-hard to med. hard
- 461-498 grey brown cl.
- 498-504 shale w/ med. hard sand stringers
- 504-530 grey cl.
- 530-632 Sandy clay w/ sand str. @ 605-620/4632
- 632-656 blk. sh.
- 656-659 Hard s. stone w/ soft str.
- 659-678 blk. sh.
- 678-679 Hard s. stone w/ soft str.
- 679-803 blk. sh.
- 803-811 fine grey firm s. stone
- 811-850 blk. sh.

Indicate on the diagram the character and thickness of the different strata met with in drilling, such as soil, clay, shale, gravel, rock or sand, etc. Show depth at which water is encountered, thickness and character of water-bearing strata and height to which the water rises in the well.

Size of Hole	Size and Weight of Casing	From (Feet)	To (Feet)	PERFORATIONS		
				Kind Size	From (Feet)	To (Feet)
6 1/4	4 1/2 X 9 1/2	0	94			
4 1/2	2 3/8 X 3 1/2	94	661	1/2" hole	600	618
					640	661

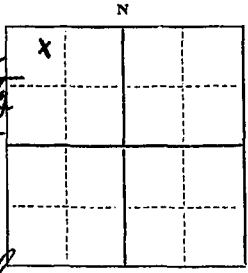

Static Water Level for non-flowing well ..... feet.

Shut-in Pressure for Flowing Well 24 feet

Pumping Water Level ..... feet at ..... gal. per minute.

Discharge in gal. per min. of flowing well 12-gal.

How Tested.....

Length of Test.....

Remarks: (Gravel packing, cementing, packers, type of shutoff).....

Indicate location of well and place of use, if possible. Each small square represents 40 acres.

580'  
collar sealed @ 94'

(Continue on reverse side)

USE—If used for irrigation, industrial, drainage or other. Explain, state number of acres and location or other data (i.e.: Lot, Block and Addition).

Doc. No. 314123

Filed for record this 23 day of Nov

A. D. 19 71, at 2:25 o'clock P.M.

This form to be prepared by driller, and three copies to be filed by the owner with the County Clerk and Recorder in the county in which the well is located, tissue copy to be retained by driller.

Please answer all questions. If not applicable, so state, otherwise the form will be returned.

Driller's License Number 61

Driller's Signature Adrian Waterwell

*[Faint, mostly illegible text and a grid table, possibly a survey or ledger. The grid has several empty cells.]*

APR 27 1991  
MAY 14 1991

11-10-91

11-10-91

314123  
314123

STATE OF MONTANA  
County of Dawson  
Filed for record this 22<sup>nd</sup> day of  
Nov 19 91 at  
2:25 o'clock P. M.  
Dorinda Russell  
County Clerk & Recorder  
By Patricia Burton Deputy

File No. ....

T. 17 R. 56  
County Dawson

DUPLICATE

STATE OF MONTANA  
ADMINISTRATOR OF GROUNDWATER CODE  
OFFICE OF STATE ENGINEER

RECEIVED  
JAN 14 1964

Declaration of Vested Groundwater Rights

(Under Chapter 237, Montana Session Laws, 1961)

STATE ENGINEER

1. Sam Selman, of B.P. 026, Blending Mont.  
(Name of Appropriator) (Address) (Town)  
County of Dawson State of Montana  
have appropriated groundwater according to the Montana laws in effect prior to January 1, 1962, as follows:

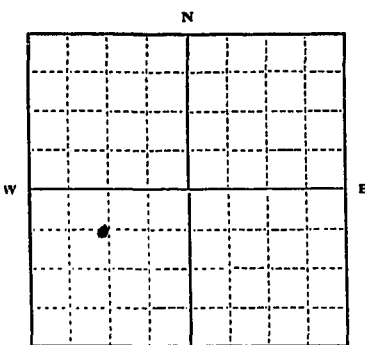

31-17-56<sup>s</sup>

1/4 Sec. 31 T. 17 R. 56

Indicate point of appropriation and place of use, if possible. Each small square represents 10 acres.

- 2. The beneficial use on which the claim is based. Stock water and irrigation
- 3. Date or approximate date of earliest beneficial use; and how continuous the use has been. 1945 periodic
- 4. The amount of groundwater claimed (in miner's inches or gallons per minute). 10 gal per
- 5. If used for irrigation, give the acreage and description of the lands to which water has been applied and name of the owner thereof
- 6. The means of withdrawing such water from the ground and the location of each well or other means of withdrawal. windmill

- 7. The date of commencement and completion of the construction of the well, wells, or other works for withdrawal of groundwater. 1945
- 8. The depth of water table. 365 ft 4 ft top
- 9. So far as it may be available, the type, size and depth of each well or the general specifications of any other works for the withdrawal of groundwater. 6" pipe 375 ft
- 10. The estimated amount of groundwater withdrawn each year. 800,000
- 11. The log of formations encountered in the drilling of each well if available. unknown
- 12. Such other information of a similar nature as may be useful in carrying out the policy of this act, including reference to book and page of any county record. none

Signature of Owner Sam Selman  
Date 12-30-63

Three copies to be filed by the owner with the County Clerk and Recorder of the county in which the well is located.

Please answer all questions. If not applicable, so state, otherwise the form will be returned.

Original to the County Clerk and Recorder; Duplicate to the State Engineer; Triplicate to the Montana Bureau of Mines and Geology, and Quadruplicate for the Appropriator.

286695

STATE OF MONTANA  
County of Dawson

Filed for record this 30<sup>th</sup> day of

December A. D. 1963, at

3:00 o'clock P. M.

Gordon T. Russell

County Clerk and Recorder.

By \_\_\_\_\_ Deputy.

JW 3

Approved Stock Form—State Publishing Co., Helena, Montana—42199

File No. ....

T. 17 R. 56

29

DUPLICATE

County Dawson

STATE OF MONTANA  
ADMINISTRATOR OF GROUNDWATER CODE  
OFFICE OF STATE ENGINEER

RECEIVED  
JAN 14 1964

STATE ENGINEER

### Notice of Completion of Groundwater Appropriation Without Well

(Under Chapter 237 Montana Session Laws, 1961)

Date of Appropriation of Groundwater..... 1940

Owner Sam Selman Address BP RTc

Contractor (if any) ..... Stanley Mont.

Address of Contractor .....

Date Started..... Date Completed.....

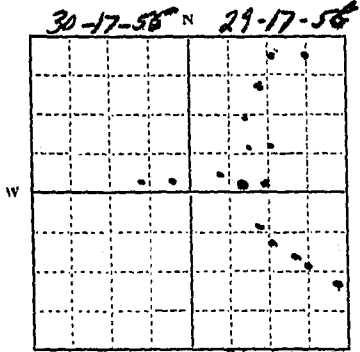

Describe means of obtaining groundwater without a well "as by sub-irrigation and other natural processes". Include depth to water when applicable Spring very during the year some never get below 12 gal per min. others will get a trickle most are quite strong.

Quantity of water developed and used with explanation of method used to measure or estimate such amount. If use is intermittent

estimate approximate lengths of periods of use Spring used to water 200 head of stock and run off in on grass. They will run from 15 gal per min to 2 gal per min.

29-30-31 30-17-56  
1/4 Sec. T. 17 R. 56  
Indicate point of appropriation and place of use, if possible.

Signature of Owner Sam Selman

Date 12-30-63

This form to be prepared by contractor (if any), otherwise by the owner.

Three copies of this notice are to be filed with the County Clerk and Recorder of the county in which the works are located.

Please answer all questions. If not applicable, so state, otherwise the form will be returned.

Original to the County Clerk and Recorder; duplicate to the State Engineer; Triplicate to the Montana Bureau of Mines and Geology and Quadruplicate for the Appropriator.



286694

STATE OF MONTANA  
County of Dawson

Filed for record this 30<sup>th</sup> day of  
December A. D. 1963, at  
3:00 o'clock P.M.

Gordon W. Russell  
County Clerk and Recorder.

By \_\_\_\_\_ Deputy.

Free Pd. \$2.00

32

File No.....

T 17 R 56

DUPLICATE

County DANSON

STATE OF MONTANA  
ADMINISTRATOR OF GROUNDWATER CODE  
OFFICE OF STATE ENGINEER

RECEIVED  
JAN 14 1964

STATE ENGINEER

Notice of Completion of Groundwater Appropriation  
Without Well

(Under Chapter 237 Montana Session Laws, 1961)

Date of Appropriation of Groundwater 12-30-63

Owner Cornelia E. Wood Address Box 199 Glendive

Contractor (if any) none

Address of Contractor none

Date Started none Date Completed none

Describe means of obtaining groundwater without a well "as by sub-irrigation and other natural processes". Include depth to water when applicable. Natural Springs from outcropping of water table

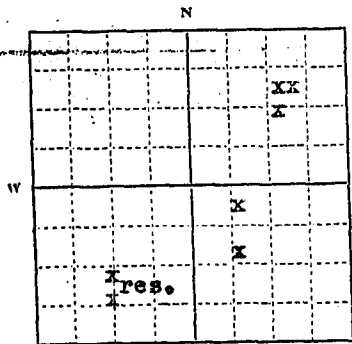

all 1/4 of Sec 32 17T 56

Indicate point of appropriation and place of use, if possible.

Quantity of water developed and used with explanation of method used to measure or estimate such amount. If use is intermittent estimate approximate lengths of periods of use. Natural flow unrestricted flow averages 5 gallons per minute from each spring. Use is continuous for residence and livestock.

Signature of Owner Cornelia E. Wood

Date 12/30/63

This form to be prepared by contractor (if any), otherwise by the owner.  
Three copies of this notice are to be filed with the County Clerk and Recorder of the county in which the works are located.  
Please answer all questions. If not applicable, so state, otherwise the form will be returned.  
Original to the County Clerk and Recorder; duplicate to the State Engineer; Triplicate to the Montana Bureau of Mines and Geology and Quadruplicate for the Appropriator.

THE STATE OF MONTANA  
COUNTY OF DAWSON  
RECORDS AND CLERK

286701

STATE OF MONTANA  
County of Dawson

Filed for record this 30<sup>th</sup> day of  
December A. D. 1963, at  
2:00 o'clock P.M.

Forbes W. Russell  
County Clerk and Recorder.

By \_\_\_\_\_ Deputy.

File No. ....

T. 17 R. 56

DUPLICATE

County Dawson

STATE OF MONTANA  
ADMINISTRATOR OF GROUNDWATER CODE  
OFFICE OF STATE ENGINEER

RECORDED  
JAN 14 1964  
STATE ENGINEER

Declaration of Vested Groundwater Rights

(Under Chapter 237, Montana Session Laws, 1961)

1. D.C. Larimer, of 309 E. Mann St. Glendive  
(Name of Appropriator) (Address) (Town)

County of Dawson State of MONT.  
have appropriated groundwater according to the Montana laws in effect prior to January 1, 1962, as follows:

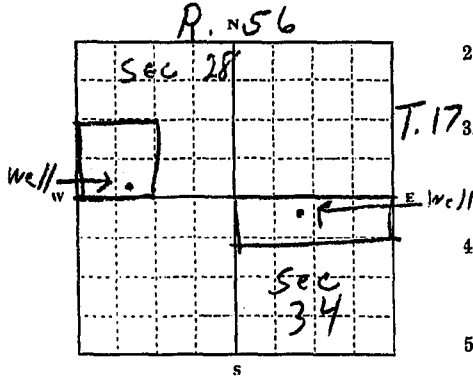

1/4 Sec. T. R.

Indicate point of appropriation and place of use, if possible. Each small square represents 10 acres.

2. The beneficial use on which the claim is based Household, Stock, garden irrigation

3. Date or approximate date of earliest beneficial use; and how continuous the use has been 1912, continuous since that time

4. The amount of groundwater claimed (in miner's inches or gallons per minute) 10 gals per minute total for the 2 wells (5 gals per min per well)

5. If used for irrigation, give the acreage and description of the lands to which water has been applied and name of the owner thereof 2 acres total (one acre garden near each well) D.C. Larimer, owner

6. The means of withdrawing such water from the ground and the location of each well or other means of withdrawal electric pump on each well

7. The date of commencement and completion of the construction of the well, wells, or other works for withdrawal of groundwater 1912

8. The depth of water table 120 FT.

9. So far as it may be available, the type, size and depth of each well or the general specifications of any other works for the withdrawal of groundwater electric pumps, six inch casing, 120 FT. deep

10. The estimated amount of groundwater withdrawn each year 1,000,000 gals. for two wells

11. The log of formations encountered in the drilling of each well if available not available

12. Such other information of a similar nature as may be useful in carrying out the policy of this act, including reference to book and page of any county record Time of homesteading used as start of water use

Signature of Owner D.C. Larimer

Date 12-31-63

Three copies to be filed by the owner with the County Clerk and Recorder of the county in which the well is located.

Please answer all questions. If not applicable, so state, otherwise the form will be returned.

Original to the County Clerk and Recorder; Duplicate to the State Engineer; Triplicate to the Montana Bureau of Mines and Geology, and Quadruplicate for the Appropriator. 31973

286867

STATE OF MONTANA  
County of Dawson

Filed for record this 31<sup>st</sup> day of  
December A. D. 1963, at  
3:30 o'clock P. M.

*Gordon W. Russell*

County Clerk and Recorder.

By \_\_\_\_\_ Deputy

JW 3

Approved Stock Form—State Publishing Co., Helena, Montana—39316

File No. ....

T. 17 R. 56

DUPLICATE

County Dawson

SW

STATE OF MONTANA  
ADMINISTRATOR OF GROUNDWATER CODE  
OFFICE OF STATE ENGINEER

RECEIVED  
NOV 6 1963  
STATE ENGINEER

### Notice of Completion of Groundwater Appropriation Without Well

(Under Chapter 237 Montana Session Laws, 1961)

Date of Appropriation of Groundwater June 14, 1962

Owner Howard D. Bennett Address Belle Prairie Route  
Glendive, Montana

Contractor (if any) .....

Address of Contractor .....

Date Started..... Date Completed.....

Describe means of obtaining groundwater without a well "as by sub-irrigation and other natural processes". Include depth to water when applicable. spring produces water by

natural processes

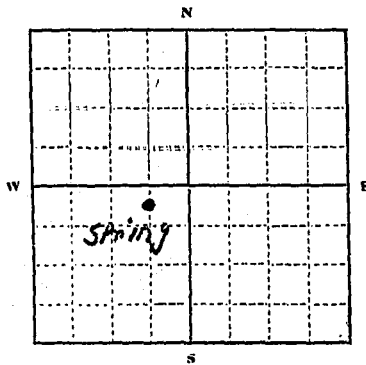

Quantity of water developed and used with explanation of method used to measure or estimate such amount. If use is intermittent

estimate approximate lengths of periods of use. spring water

used from spring till fall -- frozen over  
in winter

SW 1/4 Sec. 35 T. 17 R. 56  
Indicate point of appropriation and place of use, if possible.

Signature of Owner Howard D. Bennett

Date November 1, 1963

This form to be prepared by contractor (if any), otherwise by the owner.

Three copies of this notice are to be filed with the County Clerk and Recorder of the county in which the works are located.

Please answer all questions. If not applicable, so state, otherwise the form will be returned.

Original to the County Clerk and Recorder; duplicate to the State Engineer; Triplicate to the Montana Bureau of Mines and Geology and Quadruplicate for the Appropriator.

285672

STATE OF MONTANA  
County of Dawson

Filed for record this 5<sup>th</sup> day of  
Nov. A. D. 1963, at  
2:15 o'clock P. M.

Gordon W. Russell  
County Clerk and Recorder.

By Alice Austby Deputy.

Fee pd. \$ 2<sup>00</sup>





12

File No. ....

T. 17 R. 57

DUPLICATE

County Dawson

STATE OF MONTANA  
ADMINISTRATOR OF GROUNDWATER CODE  
OFFICE OF STATE ENGINEER

RECEIVED  
JAN 14 1964  
STATE ENGINEER

Declaration of Vested Groundwater Rights

(Under Chapter 237, Montana Session Laws, 1961)

1. Hildur G. Hutchinson, of Wilson, Mont.  
(Name of Appropriator) (Address) (Town)

County of Wilson State of Montana  
have appropriated groundwater according to the Montana laws in effect prior to January 1, 1962, as follows:

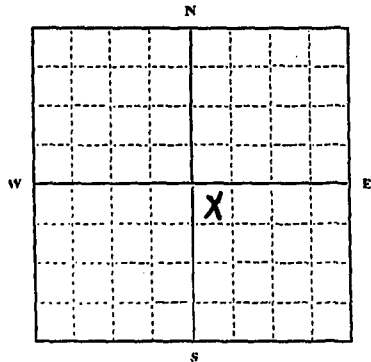

NW 1/4 SE Sec. 12 T. 17 R. 57

Indicate point of appropriation and place of use, if possible. Each small square represents 10 acres.

2. The beneficial use on which the claim is based stock

3. Date or approximate date of earliest beneficial use; and how continuous the use has been August 1, 1956

4. The amount of groundwater claimed (in miner's inches or gallons per minute) three gallons per minute

5. If used for irrigation, give the acreage and description of the lands to which water has been applied and name of the owner thereof not used for irrigation

6. The means of withdrawing such water from the ground and the location of each well or other means of withdrawal windmill

7. The date of commencement and completion of the construction of the well, wells, or other works for withdrawal of groundwater finished July 15, 1956 started - August 1, 1956

8. The depth of water table 180 feet

9. So far as it may be available, the type, size and depth of each well or the general specifications of any other works for the withdrawal of groundwater four inch casing 201 feet deep

10. The estimated amount of groundwater withdrawn each year unknown

11. The log of formations encountered in the drilling of each well if available not available

12. Such other information of a similar nature as may be useful in carrying out the policy of this act, including reference to book and page of any county record none

Signature of Owner Hildur G. Hutchinson  
Hildur G. Hutchinson  
Date Dec. 30, 1963

Three copies to be filed by the owner with the County Clerk and Recorder of the county in which the well is located.

Please answer all questions. If not applicable, so state, otherwise the form will be returned.

Original to the County Clerk and Recorder; Duplicate to the State Engineer; Triplicate to the Montana Bureau of Mines and Geology, and Quadruplicate for the Appropriator.

31875

286758

STATE OF MONTANA  
County of Dawson

Filed for record this 30th day of  
December A. D. 1963, at  
4:00 o'clock P.M.

Gordon W. Russell  
County Clerk and Recorder.

By \_\_\_\_\_ Deputy.

25

File No. ....

T. 17 R. 57

DUPLICATE

County Dawson

STATE OF MONTANA  
ADMINISTRATOR OF GROUNDWATER CODE  
OFFICE OF STATE ENGINEER

RECEIVED  
JAN 14 1964

STATE ENGINEER

Notice of Completion of Groundwater Appropriation  
Without Well

(Under Chapter 237 Montana Session Laws, 1961)

Date of Appropriation of Groundwater.....

Owner Willis L. & Olive A. Milliron Rte 6 Glendive, Monta

Contractor (if any) Ralph Kellock

Address of Contractor Glendive, Montana

Date Started 1945 Date Completed 1945

Describe means of obtaining groundwater without a well "as by sub-irrigation and other natural processes". Include depth to water when applicable. Dosed out by cat. 4'

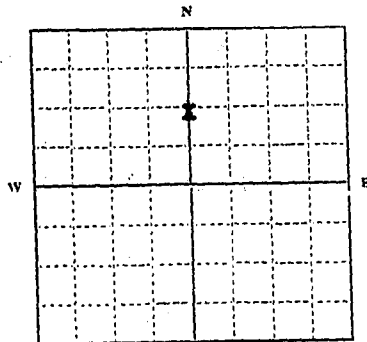

N/E 1/4 of Sec. 25 T. 17 R. 57

Indicate point of appropriation and place of use, if possible.

Quantity of water developed and used with explanation of method used to measure or estimate such amount. If use is intermittent

estimate approximate lengths of periods of use 2 Gal per min.

During summer months.

Signature of Owner Willis L. Milliron  
Olive A. Milliron

Willis L. & Olive A. Milliron

Date Dec 30 63

This form to be prepared by contractor (if any), otherwise by the owner.

Three copies of this notice are to be filed with the County Clerk and Recorder of the county in which the works are located.

Please answer all questions. If not applicable, so state, otherwise the form will be returned.

Original to the County Clerk and Recorder; duplicate to the State Engineer; Triplicate to the Montana Bureau of Mines and Geology and Quadruplicate for the Appropriator.

31895

286778

STATE OF MONTANA  
County of Dawson

Filed for record this 30th day of  
December A. D. 1963, at  
4:00 o'clock P. M.

Gordon W. Russell  
County Clerk and Recorder.

By \_\_\_\_\_ Deputy.



GW

Approved Stock Form—State Publishing Co., Helena, Montana—42234

30

File No. ....

T. 17 R. 58

DUPLICATE

County Dawson

STATE OF MONTANA  
ADMINISTRATOR OF GROUNDWATER CODE  
OFFICE OF STATE ENGINEER

RECEIVED  
JAN 14 1964  
STATE ENGINEER

Declaration of Vested Groundwater Rights

(Under Chapter 237, Montana Session Laws, 1961)

1. Willis L. & Olive A. Milliron of Rte. 6 Glendive  
(Name of Appropriator) (Address) (Town)

County of Dawson State of Montana  
have appropriated groundwater according to the Montana laws in effect prior to January 1, 1962, as follows:

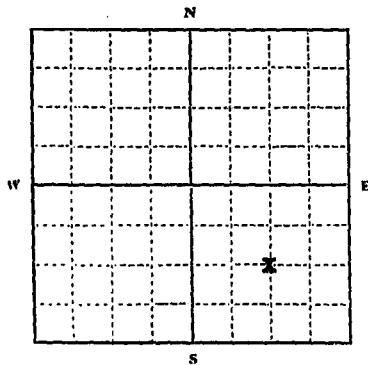

3/4 of Sec. 30 T. 17 R. 58

Indicate point of appropriation and place of use, if possible. Each small square represents 10 acres.

2. The beneficial use on which the claim is based.....  
Stock Water

3. Date or approximate date of earliest beneficial use; and how continuous the use has been.....  
1961 continuously

4. The amount of groundwater claimed (in miner's inches or gallons per minute).....  
8 Gal.

5. If used for irrigation, give the acreage and description of the lands to which water has been applied and name of the owner thereof.....  
None

6. The means of withdrawing such water from the ground and the location of each well or other means of withdrawal.....  
Windmill

7. The date of commencement and completion of the construction of the well, wells, or other works for withdrawal of groundwater.....  
Commenced and completed 1961

8. The depth of water table.....  
180'

9. So far as it may be available, the type, size and depth of each well or the general specifications of any other works for the withdrawal of groundwater.....  
Drilled 4" casing 270'

10. The estimated amount of groundwater withdrawn each year.....  
Unknown

11. The log of formations encountered in the drilling of each well if available.....  
Unknown

12. Such other information of a similar nature as may be useful in carrying out the policy of this act, including reference to book and page of any county record.....  
None

*Willis L. Milliron*

Signature of Owner Olive A. Milliron

Willis L. & Olive A. Milliron

Date 12-30-63

Three copies to be filed by the owner with the County Clerk and Recorder of the county in which the well is located.

Please answer all questions. If not applicable, so state, otherwise the form will be returned.

Original to the County Clerk and Recorder; Duplicate to the State Engineer; Triplicate to the Montana Bureau of Mines and Geology, and Quadruplicate for the Appropriator.

31894

286777

STATE OF MONTANA  
County of Dawson

Filed for record this 30th day of  
December A. D. 19 63, at  
4:00 o'clock P. M.

Gordon W. Russell  
County Clerk and Recorder.

By \_\_\_\_\_ Deputy.

31

File No. ....

T. 17 R. 58

DUPLICATE

County Deer

STATE OF MONTANA  
ADMINISTRATOR OF GROUNDWATER CODE  
OFFICE OF STATE ENGINEER

RECEIVED  
JAN 14 1964  
STATE ENGINEER

**Notice of Completion of Groundwater Appropriation  
Without Well**

(Under Chapter 237 Montana Session Laws, 1961)

Date of Appropriation of Groundwater.....

Owner Willis L. & Olive A. Milliron Address Eto. 6 Glendive, Montana

Contractor (if any) Self.....

Address of Contractor .....

Date Started 1957..... Date Completed 1957.....

Describe means of obtaining groundwater without a well "as by sub-irrigation and other natural processes". Include depth to water when applicable. Boxed Springs—5'

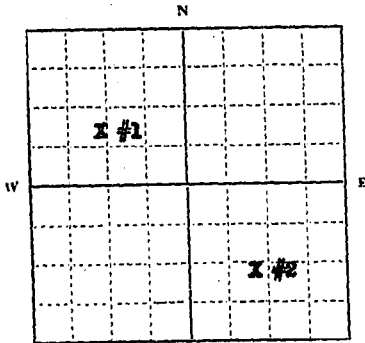

#1 N/W 1/4 of Sec 31 T. 17 R. 58  
S/E 1/4 of Sec 31 T. 17 R. 58

Indicate point of appropriation and place of use, if possible.

Quantity of water developed and used with explanation of method used to measure or estimate such amount. If use is intermittent

estimate approximate lengths of periods of use. #1 4 Gal.

#2 8 Gal.

Summer use

Willis L. Milliron

Signature of Owner Olive A. Milliron

Willis L. & Olive A. Milliron

Date Dec 30 63

This form to be prepared by contractor (if any), otherwise by the owner.

Three copies of this notice are to be filed with the County Clerk and Recorder of the county in which the works are located.

Please answer all questions. If not applicable, so state, otherwise the form will be returned.

Original to the County Clerk and Recorder; duplicate to the State Engineer; Triplicate to the Montana Bureau of Mines and Geology and Quadruplicate for the Appropriator.



Faded, illegible text, likely a legal document or court record. The text is mostly obscured by heavy shadows and noise.

and Book of new H. ...  
registered here on ...  
...  
...

A table with multiple rows and columns, containing illegible data. The table structure is faint and difficult to discern.

286779

STATE OF MONTANA  
County of Dawson

Filed for record this 30th day of  
December A. D. 1963, at  
4:00 o'clock P.M.

Gordon W. Russell  
County Clerk and Recorder.

By \_\_\_\_\_ Deputy.

GROUNDWATER INDEX

County Dawson Twp. 16 N Rge. 51

Sec.	Name of Appropriator	Type of Form	County File No.	Remarks
2	Lewis, Harold	Hw2	289012	
3	Dillon, V. F.	Hw4	281932	
4	Andersson, Sean O.	Hw4	286748	
6	Andersson, Olaf	Hw4	282898	
7	Andersson, Norman	Hw2	302024	
9	Basta, Dennis D.	Hw3	286913	
10	Basta, Dennis D.	Hw3	286913	See Sec. 9 Above
10	Basta, Dennis D.	Hw4	286914	
10	Hoese, Delbert	Hw3	286634	
14	Dillon, V. F.	Hw4	281932	See Sec. 3 Above
16	Basta, Dennis	Hw2	288984	
18	Basta, Dennis D.	Hw3	286913	See Sec. 9 Above
18	Bayan, Hazel Hedbergson	Hw2	286297	
18	Bayan, Hazel Hedbergson	Hw3	286209	
18	Bayan, Hazel Hedbergson	Hw3	286210	
19	Siles, Kenneth	Hw3	286484	
20	Sehman, Scoville	57 well log		
21	Lindeman, Alvina	Hw3	286767	
22	Sehman, S. S.	Hw3	286766	
22	Sehman, S. S.	57 well log		
22	Sehman, S. S.	57 well log		
22	Sehman, S. S.	57 well log		
22	Sehman, Scoville	57 well log		
22	Sehman, Scoville	57 well log		
25	Halsey, Elmer	Hw4	286516	
25	Halsey, Elmer	Hw2	283756	
26	Davis, James	Hw2	286247	
26	Davis, James E.	Hw4	286848	
27	Halsey, Elmer	Hw4	286516	
30	Siles, Kenneth	Hw4	288448	
31	Northern Pacific Ry. Co.	Hw4	286022	
32	Siles, Kenneth	Hw4	288448	
33	Burlington Northern Inc.	Hw2	313840	
36	Sehman, Best	Hw2	284800	

File No. ....

T. 16 R. 51

DUPLICATE

County Dawson

STATE OF MONTANA  
ADMINISTRATOR OF GROUNDWATER CODE  
OFFICE OF STATE ENGINEER

RECEIVED  
JUL 20 1964

Top of Ground  
(Elev. above sea level 2700)

### Notice of Completion of Groundwater Appropriation by Means of Well

(Under Chapter 237, Montana Session Laws, 1961)

Owner Harold Gavin Address Lindsay Montana

Driller Harold Gavin Address Lindsay Montana

Date of Notice of Appropriation of Groundwater.....

Date well started May 15-1964 Date Completed May 23-1964

Type of well drilled Equipment Used Churn  
(dug, driven, bored or drilled) (Churn, drill, rotary or other)

Water Use: Domestic  Municipal  Other  Irrigation   
Industrial  Drainage  Stock

Indicate on the diagram the character and thickness of the different strata met with in drilling, such as soil, clay, shale, gravel, rock or sand, etc. Show depth at which water is encountered, thickness and character of water-bearing strata and height to which water rises in the well.

29' clay  
sand  
68'  
clay  
140' sand & clay mix  
water  
172'

Size of Drilled Hole	Size and Weight of Casing	From (Feet)	To (Feet)	PERFORATIONS		
				Kind & Size	From (Feet)	To (Feet)
5 1/2"	4" I.D. orangeburg pipe	0	172	3 round 8 holes	148	172

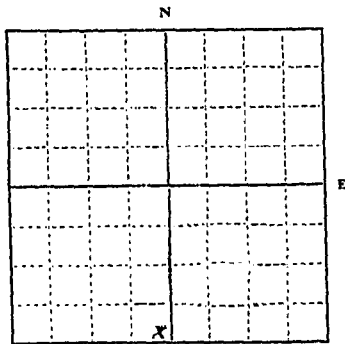

S. 1/4 W. Sec. 2 T. 16 R. 51  
Indicate location of well and place of use, if possible. Each small square represents 10 acres.

Show exact depth of bottom.

Static Water Level for non-flowing Well 110 feet.

Shut-in Pressure for Flowing Well.....

Pumping Water Level 140 feet at 5 gal. per minute.

Discharge in gal. per min. of flowing well.....

How Tested slush bucket Length of Test 2 hrs.

Remarks: (Gravel packing, cementing, packers, type of shut-off, location of place of use of groundwater if not at well, and any other similar pertinent information, including number of acres irrigated, if used for irrigation).....

85  
Driller's License Number

Harold Gavin  
Driller's Signature

This form to be prepared by driller, and three copies to be filed by the owner with the County Clerk and Recorder in the county in which the well is located.

Please answer all questions. If not applicable, so state, otherwise the form will be returned.

Original to the County Clerk and Recorder; duplicate to the State Engineer; Triplicate to the Montana Bureau of Mines and Geology and Quadruplicate for the Appropriator.

This is to certify that the within and foregoing is a true and correct copy of the original as the same appears in the records of the County Clerk and Recorder of the County of Dawson, State of Montana, this 12th day of July, 1964, at 2:45 o'clock P.M.

289012

STATE OF MONTANA  
County of Dawson

Filed for record this 12 day of

July A. D. 1964, at

2:45 o'clock P.M.

Gordon W. Russell  
County Clerk and Recorder.

By \_\_\_\_\_ Deputy.

See Pd. # 2.00

3/14

File No. ....

T. 16 R. 51

DUPLICATE

County DAWSON

STATE OF MONTANA  
ADMINISTRATOR OF GROUNDWATER CODE  
OFFICE OF STATE ENGINEER

RECEIVED  
JAN 14 1963

Declaration of Vested Groundwater Rights STATE ENGINEER  
(Under Chapter 237, Montana Session Laws, 1961)

I, V. F. Dillon, of Lindsay, Montana  
(Name of Appropriator) (Address) (Town)

County of Dawson State of Montana  
have appropriated groundwater according to the Montana laws in effect prior to January 1, 1962, as follows:

		Sec. 30		Sec. 32	
		T--17		T--17	
		R--51		R--51	
		Sec. 3		Sec. 14	
		T--16		T--16	
		R--51		R--51	

1/4 Sec. T. R.

Indicate point of appropriation and place of use, if possible. Each small square represents 10 acres.

- The beneficial use on which the claim is based 30-house, stock garden. 32-stockwater. 3-Stock water. 14- Stock water, Garden.
- Date or approximate date of earliest beneficial use; and how continuous the use has been 30-1910 used all year every year. 32-1943 used 8 months every year. 3-1947 used 3 months each year. 14-1940 used 4 months each year.
- The amount of groundwater claimed (in miner's inches or gallons per minute) 30-10 gallon per minute. 32-5 gallons per minute. 3-5 gallons per minute. 14-10 gallons per minute.
- If used for irrigation, give the acreage and description of the lands to which water has been applied and name of the owner thereof 30-1000 sq. ft. of garden and lawn. 14-1000 sq. ft. garden. V.F. Dillon
- The means of withdrawing such water from the ground and the location of each well or other means of withdrawal 30-force pump and jet pump in same well. 32-Cylinder pump. 3-Cylinder pump. 14-Cylinder pump.

- The date of commencement and completion of the construction of the well, wells, or other works for withdrawal of groundwater 30-1910, 32-1943, 3-1947, 14-1940.
- The depth of water table 30-90 ft., 32-40 ft., 3-50 ft., 14-10 ft.
- So far as it may be available, the type, size and depth of each well or the general specifications of any other works for the withdrawal of groundwater 30-Total depth 105ft. 24 inch bored. 32-105 ft. drilled six inch casing. 3-120 ft. drilled with six inch casing. 14-30 ft. drilled with six inch casing.
- 3-1000 gal. per day 3 month each year. 14-500 gal. per day for 5 mon.
- The estimated amount of groundwater withdrawn each year 30-2000 gallons per day summer 3000 winter. 32-2000 gal. per day six month each year.
- The log of formations encountered in the drilling of each well if available No information.
- Such other information of a similar nature as may be useful in carrying out the policy of this act, including reference to book and page of any county record.

Signature of Owner V. F. Dillon  
Date Jan 10 - 63

Three copies to be filed by the owner with the County Clerk and Recorder of the county in which the well is located.

Please answer all questions. If not applicable, so state, otherwise the form will be returned.

Original to the County Clerk and Recorder; duplicate to the State Engineer; Triplicate to the Montana Bureau of Mines and Geology, and Quadruplicate for the Appropriator.

Declaration of Voters Circumstances to be retained

(name) ... I have signed and sworn to the following...

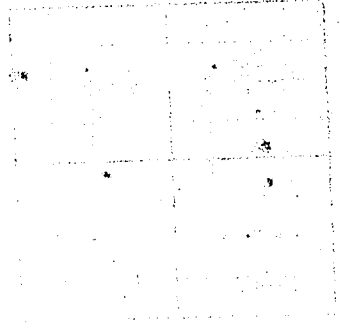

281932

STATE OF MONTANA  
County of Dawson

Filed for record this 10<sup>th</sup> day of Jan. A. D. 1963, at 2:30 o'clock P.M.

Larson W. Russell  
County Clerk and Recorder.

By Alice Austhy Deputy.

Fee pd. \$ 2.00

File No. ....

T. 16 R. 51 E

DUPLICATE

County Dawson

STATE OF MONTANA  
ADMINISTRATOR OF GROUNDWATER CODE  
OFFICE OF STATE ENGINEER

JAN 14 1964  
STATE ENGINEER

Declaration of Vested Groundwater Rights

(Under Chapter 237, Montana Session Laws, 1961)

I, Leon O Anderson, of Lindsey (Name of Appropriator) (Address) (Town)  
County of Dawson State of Montana  
have appropriated groundwater according to the Montana laws in effect prior to January 1, 1962, as follows:

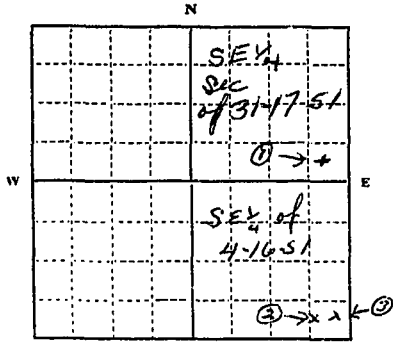

SE 1/4 Sec 31 - T. 17 - R. 51  
SE 1/4 Sec 4 T. 16 R. 51

Indicate point of appropriation and place of use, if possible. Each small square represents 10 acres.

- 2. The beneficial use on which the claim is based. No. 1 & 2 Stock water no 3 household use
- 3. Date or approximate date of earliest beneficial use; and how continuous the use has been. no. 1 drilled 1950, no. 2 drilled 1942, no 3 drilled 1945  
All wells in continuous use
- 4. The amount of groundwater claimed (in miner's inches or gallons per minute) no. 1 5 gals per min no. 2 8 gals per min  
no. 3 8 gals per min
- 5. If used for irrigation, give the acreage and description of the lands to which water has been applied and name of the owner thereof. no. 3 used for house, garden and lawn
- 6. The means of withdrawing such water from the ground and the location of each well or other means of withdrawal. no. 1 windmill  
no. 2 plunger pump no. 3 jet pump

7. The date of commencement and completion of the construction of the well, wells, or other works for withdrawal of groundwater. no. 1 well 1950, no. 2 well 1942, no. 3 well 1945

8. The depth of water table. no. 1 well 40 ft, no 2 well 20 ft, no 3 well 20 ft

9. So far as it may be available, the type, size and depth of each well or the general specifications of any other works for the withdrawal of groundwater. no. 1 well, drilled 4" I.D. 120 ft  
no. 2 well, bored 18" wood casing, 48 ft  
no. 3 well, drilled 4" I.D. 61 ft

10. The estimated amount of groundwater withdrawn each year. no. 1 well 150,000 gal, no. 2 well 200,000 gal  
no 3 well 200,000 gal

11. The log of formations encountered in the drilling of each well if available. unknown

12. Such other information of a similar nature as may be useful in carrying out the policy of this act, including reference to book and page of any county record. none

Signature of Owner Leon O Anderson  
Date DEC 30 1963

Three copies to be filed by the owner with the County Clerk and Recorder of the county in which the well is located.

Please answer all questions. If not applicable, so state, otherwise the form will be returned.

Original to the County Clerk and Recorder; Duplicate to the State Engineer; Triplicate to the Montana Bureau of Mines and Geology, and Quadruplicate for the Appropriator.

31865

Faint, illegible text, possibly bleed-through from the reverse side of the page.

286748

286748

STATE OF MONTANA  
County of Dawson

Filed for record this 30th day of  
December A. D. 1963, at  
4:00 o'clock P. M.

Gordon W. Powell  
County Clerk and Recorder.

By \_\_\_\_\_ Deputy.



File No. \_\_\_\_\_

6 - T. 16 R. 51

DUPLICATE

County Dawson

STATE OF MONTANA  
ADMINISTRATOR OF GROUNDWATER CODE  
OFFICE OF STATE ENGINEER

RECEIVED  
MAR 18 1963

Declaration of Vested Groundwater Rights STATE ENGINEER

(Under Chapter 237, Montana Session Laws, 1961)

1. Olof Anderson of Lindsay  
(Name of Appropriator) (Address) (Town)  
County of Dawson State of Montana  
have appropriated groundwater according to the Montana laws in effect prior to January 1, 1962, as follows:

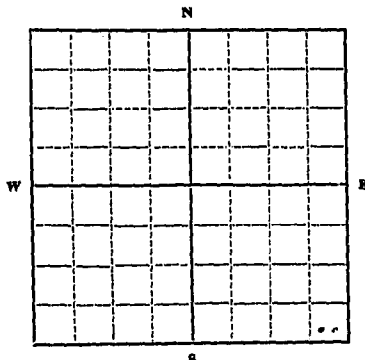

SE 1/4 Sec. 6 T. 16 R. 51

Indicate point of appropriation and place of use, if possible. Each small square represents 10 acres.

2. The beneficial use on which the claim is based. House & Stock

3. Date or approximate date of earliest beneficial use; and how continuous the use has been. 1949 Daily

4. The amount of groundwater claimed (in miner's inches or gallons per minute). 60

5. If used for irrigation, give the acreage and description of the lands to which water has been applied and name of the owner thereof. 2 acres garden & lawn SE 1/4 6-16-51

6. The means of withdrawing such water from the ground and the location of each well or other means of withdrawal. PUMPS SE 1/4 6-16-51

7. The date of commencement and completion of the construction of the well, wells, or other works for withdrawal of groundwater. SUMMER 1949 2 wells

8. The depth of water table. 30'

9. So far as it may be available, the type, size and depth of each well or the general specifications of any other works for the withdrawal of groundwater. PUMP well 4" casing 5.5' depth

10. The estimated amount of groundwater withdrawn each year. 60,000 + gallons

11. The log of formations encountered in the drilling of each well if available. silt, clay Blue sand

12. Such other information of a similar nature as may be useful in carrying out the policy of this act, including reference to book and page of any county record.

Signature of Owner Olof Anderson

Date 3-15-63

Three copies to be filed by the owner with the County Clerk and Recorder of the county in which the well is located.

Please answer all questions. If not applicable, so state, otherwise the form will be returned.

Original to the County Clerk and Recorder; duplicate to the State Engineer; Triplicate to the Montana Bureau of Mines and Geology, and Quadruplicate for the Appropriator.



File No. ....

T. 14 R. 51

MONTANA WATER RESOURCES BOARD

DUPLICATE

RECEIVED

County. Dawson

LOG FEB 29 1968

STATE OF MONTANA  
ADMINISTRATOR OF GROUNDWATER CODE  
OFFICE OF STATE ENGINEER

Top of Ground  
(Elev. above sea level.....)

### Notice of Completion of Groundwater Appropriation by Means of Well

DEVELOPED AFTER JANUARY 1, 1962  
(Under Chapter 237, Montana Session Laws, 1961)

Owner Norman Anderson Address Lindsay, Montana

Driller Daniel G. Haggerty Address Lindsay, Montana

Date of Notice of appropriation of groundwater.....

Date well started 9/19/56 Date completed 9/21/56

Type of well dilled Equipment used churn drill  
(Dug, Driven, bored or drilled) (Churn drill, rotary or other)

Domestic  Municipal  Stock  Irrigation   
 Industrial  Drainage  Other

Indicate on the diagram the character and thickness of the different strata met with in drilling, such as soil, clay, shale, gravel, rock or sand, etc. Show depth at which water is encountered, thickness and character of water-bearing strata and height to which the water rises in the well

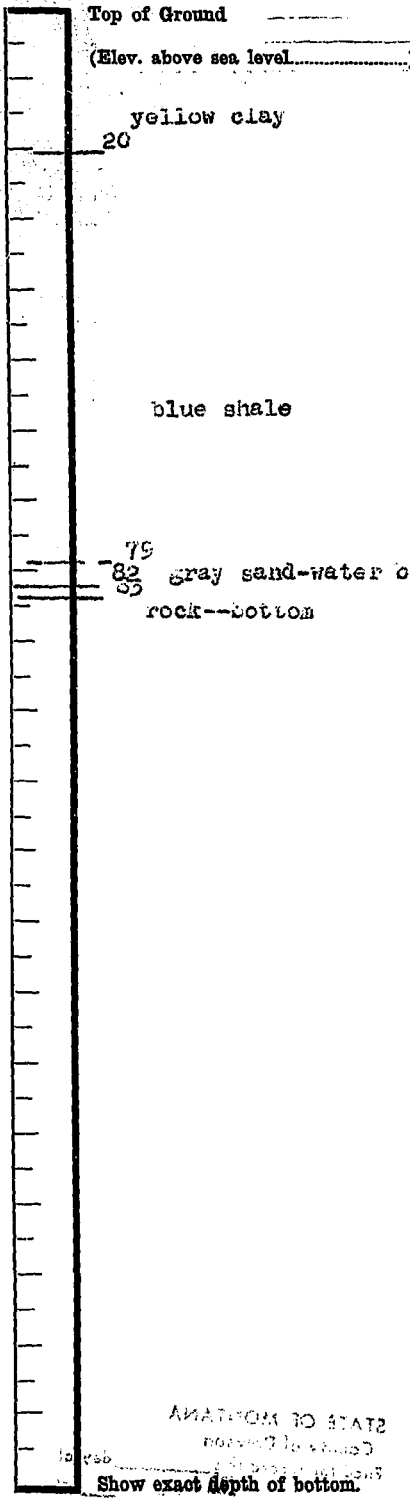

Size of Drilled Hole	Size and Weight of Casing	From (Feet)	To (Feet)	PERFORATIONS		
				Kind Size	From (Feet)	To (Feet)
5 1/2"	5" 1 1/2"	0	83	1/3" slots	73	83

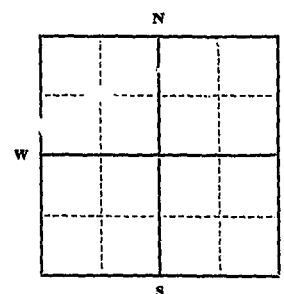

Static Water Level for non-flowing well ..... feet.  
 Shut-in Pressure for Flowing Well ..... feet.  
 Pumping Water Level ..... feet  
 Discharge in gal. per minute .....  
 Discharge in gal. per min. of flowing well .....  
 How Tested not applicable  
 Length of Test 1 1/2 hrs.

Remarks: (Gravel packing, cementing, packers, type of shutoff) none

..... (Continue on reverse side)

USE—If used for irrigation, industrial, drainage or other. Explain, state number of acres and location or other data (i.e.: Lot, Block and Addition).

.....

.....

This form to be prepared by driller, and three copies to be filed by the owner with the County Clerk and Recorder in the county in which the well is located, tissue copy to be retained by driller.

Please answer all questions. If not applicable, so state, otherwise the form will be returned.

13  
 Driller's License Number  
Daniel G. Haggerty  
 Driller's Signature

43,687

STATE OF MONTANA  
COUNTY OF DAWSON  
PLAT 100  
SECTION 34  
TOWNSHIP 10N  
RANGE 10E  
MONTANA  
This is to certify that the within and foregoing plat of the section of the Township of \_\_\_\_\_ Range of \_\_\_\_\_ County of \_\_\_\_\_ State of Montana, as shown on the within and foregoing plat, is a true and correct copy of the original plat on file in the office of the County Clerk and Recorder of the County of \_\_\_\_\_ State of Montana, this \_\_\_\_\_ day of \_\_\_\_\_ A. D. 19\_\_\_\_.

Section	Acres	Owner
34		

Witness my hand and the seal of the County Clerk and Recorder of the County of \_\_\_\_\_ State of Montana, this \_\_\_\_\_ day of \_\_\_\_\_ A. D. 19\_\_\_\_.

302024

STATE OF MONTANA  
County of Dawson  
Filed for record this 28<sup>th</sup> day of  
Feb A. D. 19 68 at  
8:00 o'clock P. M.  
Dorinda W. Russell  
County Clerk & Recorder  
By: [Signature] Deputy

GW 3

Approved Stock Form—State Publishing Co., Helena, Montana—42199

9

File No. ....

B<sup>2</sup> T. 16 R. 51

DUPLICATE

County DAWSON

STATE OF MONTANA  
ADMINISTRATOR OF GROUNDWATER CODE  
OFFICE OF STATE ENGINEER

RECEIVED  
JAN 14 1964

### Notice of Completion of Groundwater Appropriation Without Well

(Under Chapter 237 Montana Session Laws 1961)

Date of Appropriation of Groundwater 12-30-63

Appropriator (Name) LINDSAY, MONT.

Contractor (Name) .....

Date Completed .....

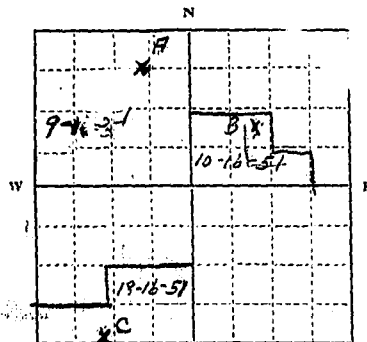

Indicate point of appropriation and place of use, if possible.  
9-10-18  
1/4 Sec. T. 16 R. 51

Description of appropriation of groundwater without a well "as by ... processes". Include depth to ...

Writes when applicable. ... IN BOTTOM OF CREEK BED (APPLIES TO A+B)  
SPRING IN SIDE OF CREEK BANK - (C)

Quantity of water developed and used with explanation of method used to measure or estimate such amount. If use is intermittent estimate approximate lengths of periods of use. A+B

RUN ABOUT 1/2 GAL PER MIN. FREE FLOW  
USED ALL YEAR  
SPRING "C" RUNS 2 GAL PER MIN. FREE FLOW  
USED 90 DAYS

Signature of Owner Dennis O. Banta

Date 12-31-63

This form to be prepared by contractor (if any), otherwise by the owner.

Three copies of this notice are to be filed with the County Clerk and Recorder of the county in which the works are located.

Please answer all questions. If not applicable, so state, otherwise the form will be returned.

Original to the County Clerk and Recorder; duplicate to the State Engineer; Triplicate to the Montana Bureau of Mines and Geology and Quadruplicate for the Appropriator.

32018

286913

STATE OF MONTANA  
County of Dawson

Filed for record this 31st day of  
December A. D. 1963, at  
4:31 o'clock P.M.

Gordon W. Russell  
County Clerk and Recorder.

By \_\_\_\_\_ Deputy.

2-10

File No. \_\_\_\_\_

T. 16 R. 51

DUPLICATE

County DAUSON

STATE OF MONTANA  
ADMINISTRATOR OF GROUNDWATER CODE  
OFFICE OF STATE ENGINEER

RECEIVED  
JAN 14 1964  
STATE ENGINEER

Declaration of Vested Groundwater Rights

(Under Chapter 237, Montana Session Laws, 1961)

1. DENNIS D. BASTA, of LINDSAY, MONTANA  
(Name of Appropriator) (Address) (Town)

County of DAUSON State of MONTANA  
have appropriated groundwater according to the Montana laws in effect prior to January 1, 1962, as follows:

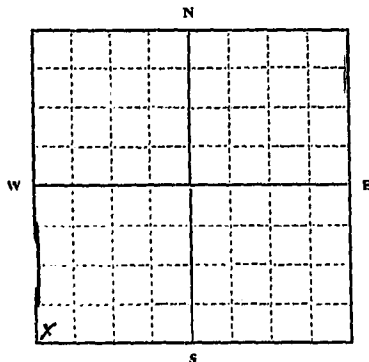

1/4 Sec. 10 T. 16 R. 51  
Indicate point of appropriation and place of use, if possible. Each small square represents 10 acres.

2. The beneficial use on which the claim is based  
HOUSEHOLD + STOCK WATER

3. Date or approximate date of earliest beneficial use; and how continuous the use has been  
WELL WAS DUG IN 1910 AND USED CONTINUOUSLY EVER SINCE

4. The amount of groundwater claimed (in miner's inches or gallons per minute)  
10 GALLONS PER MINUTE

5. If used for irrigation, give the acreage and description of the lands to which water has been applied and name of the owner thereof  
NONE

6. The means of withdrawing such water from the ground and the location of each well or other means of withdrawal  
A JET PUMP IS USED IN THE WELL

7. The date of commencement and completion of the construction of the well, wells, or other works for withdrawal of groundwater  
WELL WAS DUG IN 1910

8. The depth of water table  
40 FEET

9. So far as it may be available, the type, size and depth of each well or the general specifications of any other works for the withdrawal of groundwater  
HAND DUG, 4 FEET IN DIAMETER, 45 FEET DEEP

10. The estimated amount of groundwater withdrawn each year  
500,000 GALLONS

11. The log of formations encountered in the drilling of each well if available  
NOT AVAILABLE

12. Such other information of a similar nature as may be useful in carrying out the policy of this act, including reference to book and page of any county record  
NONE

Signature of Owner Dennis D. Basta

Date 12-31-63

Three copies to be filed by the owner with the County Clerk and Recorder of the county in which the well is located.

Please answer all questions. If not applicable, so state, otherwise the form will be returned.

Original to the County Clerk and Recorder; Duplicate to the State Engineer; Triplicate to the Montana Bureau of Mines and Geology, and Quadruplicate for the Appropriator.

32019

IN WITNESS WHEREOF, I have hereunto set my hand and the seal of said County at the City of Helena, Montana, this 31st day of December, 1963.

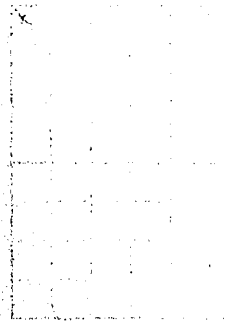

286914

STATE OF MONTANA  
County of Dawson

Filed for record this 31st day of  
December A. D. 1963, at  
4:30 o'clock P.M.

Gordon W. Russell  
County Clerk and Recorder.

By \_\_\_\_\_ Deputy.



10

File No. \_\_\_\_\_

T. 16 R. 51

DUPLICATE

County Nelson

STATE OF MONTANA  
ADMINISTRATOR OF GROUNDWATER CODE  
OFFICE OF STATE ENGINEER

RECORDED  
JAN 14 1964  
STATE ENGINEER

Notice of Completion of Groundwater Appropriation  
Without Well

(Under Chapter 237 Montana Session Laws, 1961)

Date of Appropriation of Groundwater 1910  
Owner Albert Mear Address 702 Broadway St. Helena  
Contractor (if any) \_\_\_\_\_  
Address of Contractor none  
Date Started \_\_\_\_\_ Date Completed \_\_\_\_\_

Describe means of obtaining groundwater without a well "as by sub-irrigation and other natural processes". Include depth to water when applicable.

Natural Spring

Quantity of water developed and used with explanation of method used to measure or estimate such amount. If use is intermittent estimate approximate lengths of periods of use.

open to year around  
Quantity unknown

Signature of Owner Albert Mear

Date Dec. 30, 1963

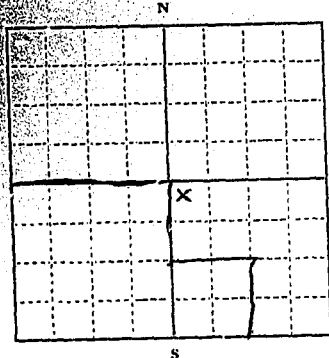

N.W. 1/4 Sec. 10 T. 16. R. 51

Indicate point of appropriation and place of use, if possible.

This form to be prepared by contractor (if any), otherwise by the owner.

Three copies of this notice are to be filed with the County Clerk and Recorder of the county in which the works are located.

Please answer all questions. If not applicable, so state, otherwise the form will be returned.

Original to the County Clerk and Recorder; duplicate to the State Engineer; Triplicate to the Montana Bureau of Mines and Geology and Quadruplicate for the Appropriator.

286634

STATE OF MONTANA  
County of Dawson

Filed for record this 30th day of  
December A. D. 1963, at  
11:00 clock A.M.

Gordon W. Russell  
County Clerk and Recorder.

By \_\_\_\_\_ Deputy.

Fee pd. \$2.00

GW 2

Approved Stock Form—State Publishing Co., Helena, Montana—40472

File No. ....

County Deer Lodge

DUPLICATE

STATE OF MONTANA  
ADMINISTRATOR OF GROUNDWATER CODE  
OFFICE OF STATE ENGINEER JUN 30 1964

Top of Ground  
(Elev. above sea level 2700)

### Notice of Completion of Groundwater Appropriation by Means of Well

(Under Chapter 237, Montana Session Laws, 1961)

Owner Dennis Basta Address Lindsay Montana

Driller Harold Garvin Address Lindsay Montana

Date of Notice of Appropriation of Groundwater.....

Date well started Feb. 18 - 1964 Date Completed Feb. 28 - 1964

Type of well drilled Equipment Used churn  
(dug, driven, bored or drilled) (Churn, drill, rotary or other)

Water Use: Domestic  Municipal  Other  Irrigation   
Industrial  Drainage  Stock

Indicate on the diagram the character and thickness of the different strata met with in drilling, such as soil, clay, shale, gravel, rock or sand, etc. Show depth at which water is encountered, thickness and character of water-bearing strata and height to which water rises in the well.

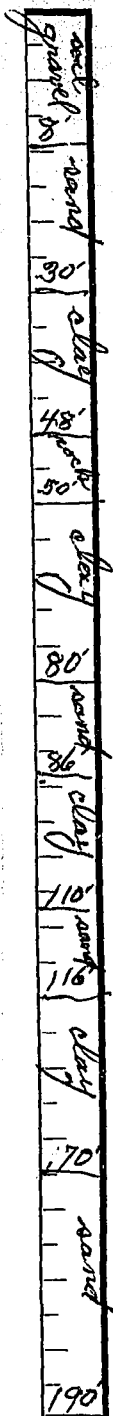

Size of Drilled Hole	Size and Weight of Casing	From (Feet)	To (Feet)	PERFORATIONS		
				Kind Size	From (Feet)	To (Feet)
5"	4" I. D. 11 lbs. per ft.	0	190	3/4" x 3" slots cut in casing	140	190

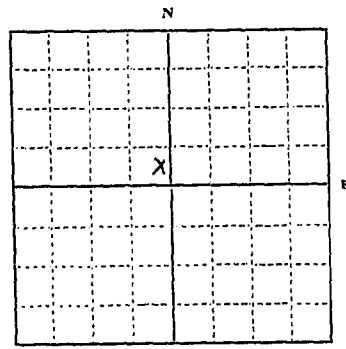

N. 16. T. 16. R. 51

Indicate location of well and place of use, if possible. Each small square represents 10 acres.

Show exact depth of bottom.

Static Water Level for non-flowing Well..... 100 feet.

Shut-in Pressure for Flowing Well.....

Pumping Water Level..... 1.50 feet at..... 5 gal. per minute.

Discharge in gal. per min. of flowing well.....

How Tested slush bucket Length of Test 2 hrs.

Remarks: (Gravel packing, cementing, packers, type of shutoff, location of place of use of groundwater if not at well, and any other similar pertinent information, including number of acres irrigated, if used for irrigation).....

Dennis Basta by Mrs. Dennis Basta

85  
Driller's License Number  
Harold Garvin  
Driller's Signature

This form to be prepared by driller, and three copies to be filed by the owner with the County Clerk and Recorder in the county in which the well is located.

Please answer all questions. If not applicable, so state, otherwise the form will be returned.

Original to the County Clerk and Recorder; duplicate to the State Engineer; Triplicate to the Montana Bureau of Mines and Geology and Quadruplicate for the Appropriator.

38230

STATE OF MONTANA  
COUNTY OF DAWSON  
RECORDS AND CLERK

...  
...  
...

288984

STATE OF MONTANA  
County of Dawson

Filed for record this 29<sup>th</sup> day of  
June A. D. 1964, at  
4:00 o'clock P. M.

Gordon M. Russell  
County Clerk and Recorder.

By Loye Scheitlin Deputy.

Fee Pd. \$2.00

File No.

T. 16 R. 51

DUPLICATE

County Dawson

STATE OF MONTANA  
ADMINISTRATOR OF GROUNDWATER CODE  
OFFICE OF STATE ENGINEER

RECEIVED  
DEC 18 1963  
STATE ENGINEER

### Notice of Completion of Groundwater Appropriation by Means of Well

(Under Chapter 237, Montana Session Laws, 1961)

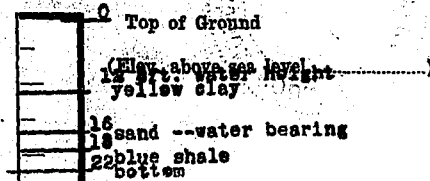

Owner Hazel Gerderson Bryan Address Lindsay, Montana

Driller Daniel G. Haggerty Address Lindsay, Montana

Date of Notice of Appropriation of Groundwater: Not applicable

Date well started Aug. 9, 1963 Date Completed Same

Type of well drilled Equipment Used cable tool rig  
(dug, driven, bored or drilled) (Churn, drill, rotary or other)

Water Use: Domestic  Municipal  Other  Irrigation   
Industrial  Drainage  Stock

Indicate on the diagram the character and thickness of the different strata met with in drilling, such as soil, clay, shale, gravel, rock or sand, etc. Show depth at which water is encountered, thickness and character of water-bearing strata and height to which water rises in the well.

Size of Drilled Hole	Size and Weight of Casing	From (Feet)	To (Feet)	PERFORATIONS		
				Kind Size	From (Feet)	To (Feet)
6"	5" 19#	0	22	1/8" slots	16	22

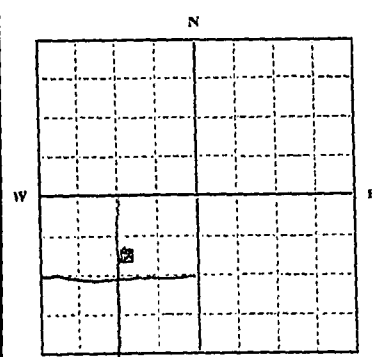

na. 1/4 SW Sec. 12 T. 16 R. 51  
Indicate location of well and place of use, if possible. Each small square represents 10 acres.

Show exact depth of bottom.

Static Water Level for non-flowing Well 10 feet.

Shut-in Pressure for Flowing Well not applicable

Pumping Water Level 12 feet at 5 gal. per minute.

Discharge in gal. per min. of flowing well not applicable

How Tested balled Length of Test 1 hr.

Remarks: (Gravel packing, cementing, packers, type of shutoff, location of place of use of groundwater if not at well, and any other similar pertinent information, including number of acres irrigated, if used for irrigation)

outside gravel packed

13  
Driller's License Number

Daniel G. Haggerty  
Driller's Signature

This form to be prepared by driller, and three copies to be filed by the owner with the County Clerk and Recorder in the county in which the well is located.

Please answer all questions. If not applicable, so state, otherwise the form will be returned.

Original to the County Clerk and Recorder; duplicate to the State Engineer; Triplicate to the Montana Bureau of Mines and Geology and Quadruplicate for the Appropriator.

286297

...of ...  
...to ...  
...and ...

...to ...  
...and ...  
...and ...

286297

STATE OF MONTANA  
County of Dawson

Filed for record this 16th day of December  
1965, at 6:00 o'clock P. M.  
Gordon W. Russell  
County Clerk and Recorder

By \_\_\_\_\_ Deputy.

Fee pd. #2

File No. ....

T. 16 R. 51

DUPLICATE

County Dawson

STATE OF MONTANA  
ADMINISTRATOR OF GROUNDWATER CODE  
OFFICE OF STATE ENGINEER

Declaration of ~~Water~~ Groundwater Rights

(Under Chapter 237, Montana Session Laws, 1961)

1. Hazel Godfreyson Bryan, of Lindsay  
(Name of Appropriator) (Address) (Town)  
County of Dawson State of Montana  
have appropriated groundwater according to the Montana laws in effect prior to January 1, 1962, as follows:

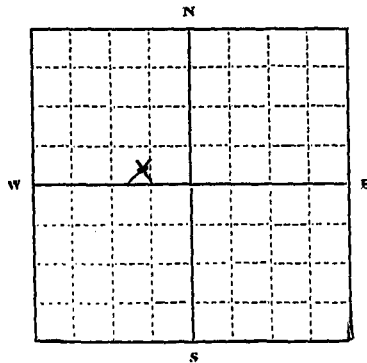

NW 1/4 Sec 18 T. 16 R. 51

Indicate point of appropriation and place of use, if possible. Each small square represents 10 acres.

- 2. The beneficial use on which the claim is based. Household use and for the live stock
- 3. Date or approximate date of earliest beneficial use; and how continuous the use has been. Since 1949 the use has been daily
- 4. The amount of groundwater claimed (in miner's inches or gallons per minute) 7 gallons per minute

5. If used for irrigation, give the acreage and description of the lands to which water has been applied and name of the owner thereof

None

6. The means of withdrawing such water from the ground and the location of each well or other means of withdrawal. by hand pump NW 1/4 Sec 18 - T. 16 R. 51

7. The date of commencement and completion of the construction of the well, wells, or other works for withdrawal of groundwater. The exact date is not known other than reference to #3

8. The depth of water table. Not known

9. So far as it may be available, the type, size and depth of each well or the general specifications of any other works for the withdrawal of groundwater. The well is machine drilled, 5 inch casing and the depth of the well is 60 feet

10. The estimated amount of groundwater withdrawn each year. 250,000 gal

11. The log of formations encountered in the drilling of each well if available. Not available

12. Such other information of a similar nature as may be useful in carrying out the policy of this act, including reference to book and page of county record.

Not available

Signature of Owner Hazel Godfreyson Bryan

Date 12/11/63

Three copies to be filed by the owner with the County Clerk and Recorder of the county in which the well is located.

Please answer all questions. If not applicable, so state, otherwise the form will be returned.

Original to the County Clerk and Recorder; Duplicate to the State Engineer; Triplicate to the Montana Bureau of Mines and Geology, and Quadruplicate for the Appropriator.

286209

STATE OF MONTANA  
County of Dawson

Filed for record this 11<sup>th</sup> day of  
December A. D. 1963, at  
3:00 o'clock P. M.

Gordon H. Russell  
County Clerk and Recorder.

By Zaye Schiller Deputy.

Fee pd. \$2<sup>00</sup>



W 3

18

File No. ....

T. 16 R. 51

DUPLICATE

County... Lawson

STATE OF MONTANA  
ADMINISTRATOR OF GROUNDWATER CODE  
OFFICE OF STATE ENGINEER

**Notice of Completion of Groundwater Appropriation  
Without Well**

(Under Chapter 237 Montana Session Laws, 1961)

Date of Appropriation of Groundwater... 1909

Owner Hazel Godfrson Bryan Address Lindsay

Contractor (if any) ... None

Address of Contractor ... None

Date Started... Not applicable Date Completed... (Same)

Describe means of obtaining groundwater without a well: "as by sub-irrigation and other natural processes". Include depth to water when applicable. Natural Flowing Spring

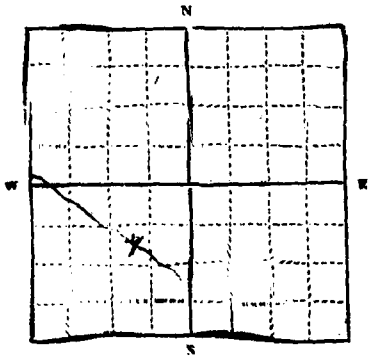

Indicate amount of appropriation and when of use if possible.

Quantity of water developed and used with explanation of method used to measure or estimate such amount. If use is intermittent estimate approximate lengths of periods of use.....

Quantity of water Not measurable  
is used about 9.2mc for  
livestock

Signature of Owner Hazel Godfrson Bryan

Date 12/11/63

This form to be prepared by contractor (if any), otherwise by the owner.

Three copies of this notice are to be filed with the County Clerk and Recorder of the county in which the works are located.

Please answer all questions. If not applicable, so state, otherwise the form will be returned.

Original to the County Clerk and Recorder; duplicate to the State Engineer; Triplicate to the Montana Bureau of Mines and Geology and Quadruplicate for the Appropriator.

File No.

County Beaverhead

DUPLICATE

STATE OF MONTANA  
ADMINISTRATOR OF GROUNDWATER CODE  
OFFICE OF STATE ENGINEER

Notice of Completion of Groundwater Appropriation  
Without Well

(Chapter 237, Montana Session Laws, 1961)

Date of Appropriation of Groundwater 1969  
Owner Hazel Godfrey Bryan Address Spokane  
Contractor (if any) None  
Address of Contractor None  
Date Started Not applicable Date Completed Same

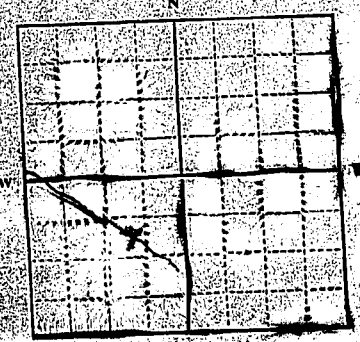

Sec. 18, T. 16, R. 51  
Indicate point of appropriation  
and place of use, if possible.

Describe means of obtaining groundwater without a well as by  
irrigation and other natural processes. Include depth to  
water when applicable. Natural flowing  
spring

Quantity of water developed and used with explanation of  
need to measure or estimate such amount. If use is intermittent,  
estimate approximate lengths of periods of use.

Quantity of water Not measurable  
used about 9 mos. for  
livestock

Signature of Owner Hazel Godfrey Bryan  
Date 12/11/69

This form to be prepared by contractor (if any), otherwise by the owner.  
Three copies of this notice are to be filed with the County Clerk and Recorder of the county in which the  
works are located.  
Please answer all questions. If not applicable, so state, otherwise the form will be returned.  
Original to the County Clerk and Recorder; duplicate to the State Engineer; Triplicate to the Montana  
Bureau of Mines and Geology and Quadruplicate for the Appropriator.

286210

STATE OF MONTANA  
County of Dawson

Filed for record this 11<sup>th</sup> day of  
December A. D. 1963, at  
10:30 AM.

Ernest H. Russell  
County Clerk and Recorder.

By Loye Scheitler Deputy.

Fee pd. 92

File No. ....

T. 16 R. 51

**DUPLICATE**

County **BRAZOS**

STATE OF MONTANA  
ADMINISTRATOR OF GROUNDWATER CODE  
OFFICE OF STATE ENGINEER

DEC 30 1963  
STATE ENGINEER

### Notice of Completion of Groundwater Appropriation Without Well

(Under Chapter 237 Montana Session Laws, 1961)

Date of Appropriation of Groundwater SPRING  
Owner KENNETH LILES Address LINDSAY  
Contractor (if any) BERT LEE  
Address of Contractor TERRY, MONT.  
Date Started JUNE 20, 1957 Date Completed JUNE 23, 1957

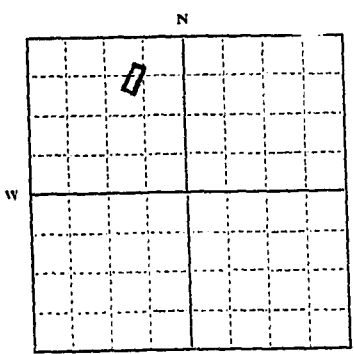

NW 1/4 Sec. 19 T. 16 R. 51  
Indicate point of appropriation and place of use, if possible.

Describe means of obtaining groundwater without a well "as by sub-irrigation and other natural processes". Include depth to water when applicable.

The ground is pretty well sub-irrigated already and I merely dug down six to eight feet and piped out to a tank, for stock.

Quantity of water developed and used with explanation of method used to measure or estimate such amount. If use is intermittent

estimate approximate lengths of periods of use. I use it

eight months of the year.

I have a three quarter inch pipe running into the tank and

the spring runs this pipe over half full 24 hrs. a day. I imagine it will flow 4 gallons a minute.

Signature of Owner Kenneth Liles

Date Dec. 23, 1963

This form to be prepared by contractor (if any), otherwise by the owner.

Three copies of this notice are to be filed with the County Clerk and Recorder of the county in which the works are located.

Please answer all questions. If not applicable, so state, otherwise the form will be returned.

Original to the County Clerk and Recorder; duplicate to the State Engineer; Triplicate to the Montana Bureau of Mines and Geology and Quadruplicate for the Appropriator.