

279741

STATE OF MONTANA
County of Dawson

Filed for record this 18th day of
June A. D. 1962, at
1:30 o'clock P. M.

Gordon W. Russell
County Clerk and Recorder.

By Alice Anthony Deputy.

See pd. 2nd

STATE WATER CONSERVATION BOARD

Approved Stock Form—State Publishing Co., Helena, Montana—42134

File No. DEC 1 1965

19 51-3
T 20 R 51-17, 18, 19

DUPLICATE McDermott
Butzerin McNulty
Coyle Morton
Darlington Sullivan
Dickert

County Dawson

STATE OF MONTANA

ADMINISTRATOR OF GROUNDWATER CODE

OFFICE OF STATE ENGINEER

Declaration of Vested Groundwater Rights

(Under Chapter 237, Montana Session Laws, 1961)

Irene Jeanne Brody, of Route One Circle, Montana
(Name of Appropriator) (Address) (Town)

County of Dawson State of Montana

have appropriated groundwater according to the Montana laws in effect prior to January 1, 1962, as follows:

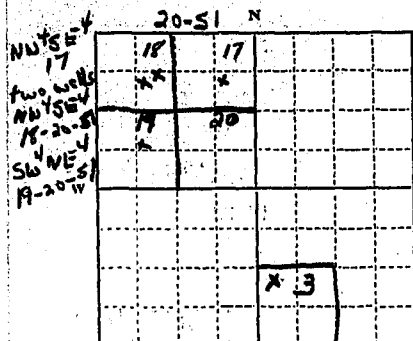

2. The beneficial use on which the claim is based one house water wall and rest stock walls

3. Date or approximate date of earliest beneficial use; and how continuous the use has been from 1954 intermittently through 1963

4. The amount of groundwater claimed (in miner's inches or gallons per minute) unknown to me

5. If used for irrigation, give the acreage and description of the lands to which water has been applied and name of the owner thereof none

6. The means of withdrawing such water from the ground and the location of each well or other means of withdrawal All are electrically pumped

7. The date of commencement and completion of the construction of the well, wells, or other works for withdrawal of groundwater unknown to me as this was in the past when record was not required of this

8. The depth of water table varied which I also do not know

9. So far as it may be available, the type, size and depth of each well or the general specifications of any other works for the withdrawal of groundwater unknown

10. The estimated amount of groundwater withdrawn each year unknown

11. The log of formations encountered in the drilling of each well if available

not available

12. Such other information of a similar nature as may be useful in carrying out the policy of this act, including reference to book and page of any county record

Signature of Owner

Irene Jeanne Brody

Date Nov 30, 1965

Three copies to be filed by the owner with the County Clerk and Recorder of the county in which the well is located.

Please answer all questions. If not applicable, so state, otherwise the form will be returned.

Original to the County Clerk and Recorder; Duplicate to the State Engineer; Triplicate to the Montana Bureau of Mines and Geology, and Quadruplicate for the Appropriator.

39924

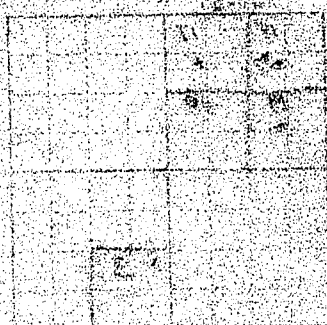

294352

STATE OF MONTANA
County of Dawson

Filed for record this 30th day of
Nov. A.D. 1965 at

1:00 o'clock P. M.
Gordon W. Russell
County Clerk & Recorder

By Alvin A. Smith Deputy

Fee pd. \$ 2.00

GW.2

Approved Stock Form—State Publishing Co., Helena, Montana—35496

File No.

T 19 R 51

County Dawson

DUPLICATE

STATE OF MONTANA
ADMINISTRATOR OF GROUNDWATER
OFFICE OF STATE ENGINEER

MAR 5 1963

Notice of Completion of Groundwater
Appropriation by Means of Well ENGINEER

(Under Chapter 237, Montana Session Laws, 1961)

Owner E. O. Lease Address Mink Rte. circle,
MontanaDriller Daniel G. Haggerty Address Lindsay, MontanaDate of Notice of Appropriation of Groundwater February 11, 1963Date well started Dec. 13, 1962 Date Completed February 11, '63Type of well Drilled Equipment Used Cable Tool
(dug, driven, bored or (Churn, drill, rotary or
drilled) other)Water Use: Domestic ☐ Municipal ☐ Other ☐ Irrigation ☐
Industrial ☐ Drainage ☐ Stock ☒

Indicate on the diagram the character and thickness of the different strata met with in drilling, such as soil, clay, shale, gravel, rock or sand, etc. Show depth at which water is encountered, thickness and character of water-bearing strata and height to which water rises in the well.

Size of Drilled Hole	Size and Weight of Casing	From (Feet)	To (Feet)	PERFORATIONS		
				Kind Size	From (Feet)	To (Feet)
7"	6" 20#	0'	182'			
5"	4"	137'	294'	2" slits 6" long)	264'	294'

Static Water Level for non-flowing Well 219' down feet.

Shut-in Pressure for Flowing Well

Pumping Water Level 244' feet at 6 gal. per minute.

Discharge in gal. per min. of flowing well

How Tested Bailer Length of Test 2 hours

Remarks: (Gravel packing, cementing, packers, type of shutoff, location of place of use of groundwater if not at well, and any other similar pertinent information, including number of acres irrigated, if used for irrigation)

#13

Driller's License Number

Daniel G. Haggerty
Driller's Signature
Daniel G. Haggerty

Original to the County Clerk and Recorder; duplicate to the State Engineer; Triplicate to the Montana Bureau of Mines and Geology and Quadruplicate for the Appropriator.

This form to be prepared by driller, and three copies to be filed by the owner with the County Clerk and Recorder in the county in which the well is located.

Please answer all questions. If not applicable, so state, otherwise the form will be returned.

Original to the County Clerk and Recorder; duplicate to the State Engineer; Triplicate to the Montana Bureau of Mines and Geology and Quadruplicate for the Appropriator.

3805

81 282716

STATE OF MONTANA
County of Dawson

Filed for record this 4th day of
Mar A. D. 1963, at
1:45 o'clock P. M.

Lester W. Russell
County Clerk and Recorder.

By Oliver Austby Deputy.

See pd. 2nd

GWS

File No.

DUPLICATE

STATE OF MONTANA
ADMINISTRATOR OF GROUNDWATER CODE
OFFICE OF STATE ENGINEER

T 19 N R 51 E

County

Dawson

RECEIVED

JUL 3 1982

STATE ENGINEER

Notice of Completion of Groundwater Appropriation Without Well

(Under Chapter 237 Montana Session Laws, 1961)

Date of Appropriation of Groundwater in use when purchased.

Owner E. O. Lease Address Wink Rte, Circle

Montana

Contractor (if any) None (Natural Springs)

Address of Contractor None

Date Started Natural Date Completed Spring

Describe means of obtaining groundwater without a well "as by sub-irrigation and other natural processes". Include depth to water when applicable By sub-irrigation and other natural processes (natural spring) Three springs identified as Spring A, Spring B, and Spring C.

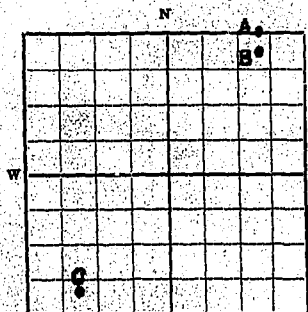

Quantity of water developed and used with explanation of method used to measure or estimate such amount. If use is intermittent estimate approximate lengths of periods of use Spring A:

55 gallons per minute. Spring B: 35 gallons per min, Spring C: 25 gallons per minute.

All water is needed.

Signature of Owner E. O. Lease
E. O. Lease, Circle, Montana

Date

This form to be prepared by contractor (if any), otherwise by the owner.

Three copies of this notice are to be filed with the County Clerk and Recorder of the county in which the works are located.

Please answer all questions. If not applicable, so state, otherwise the form will be returned.

Original to the County Clerk and Recorder; duplicate to the State Engineer; Triplicate to the School of Mines and Quadruplicate for the Appropriator.

279743

STATE OF MONTANA
County of Dawson

Filed for record this 19th day of

June A. D. 1962 at

1:30 o'clock P.M.

Landon W. Russell
County Clerk and Recorder.

By Alvin Gustafson Deputy.

Fee paid \$ 2.00

GWS

File No. B W 4

DUPLICATE

STATE OF MONTANA
ADMINISTRATOR OF GROUNDWATER CODE
OFFICE OF STATE ENGINEER

T. 19 R. 51

County Dawson

RECEIVED
JUL 3 1962

STATE ENGINEER

Notice of Completion of Groundwater Appropriation Without Well

(Under Chapter 237 Montana Session Laws, 1961)

Date of Appropriation of Groundwater in use when purchased.

Owner E. O. Lease Address Mink Rte., Circle,
Montana
Contractor (if any) None (Natural Springs)

Address of Contractor NoneDate Started Natural Date Completed Spring

Describe means of obtaining groundwater without a well "as by sub-irrigation and other natural processes". Include depth to water when applicable. By Sub-irrigation and other natural processes. (Natural spring) One spring identified as Spring A.

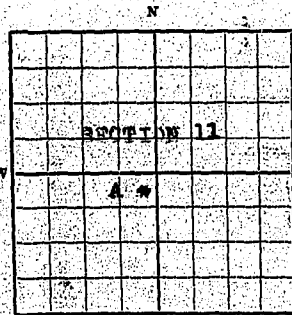

S 19
NE 1/4 Sec. 11 T. 19 R. 51

Indicate point of appropriation and place of use, if possible.

Quantity of water developed and used with a planation of method used to measure or estimate such amount. If use is intermittent estimate approximate lengths of periods of use Spring

A: 35 gallons per minute, All water is needed.

Signature of Owner E. O. Lease
E. O. LEASE, CIRCLE, MONTANA

Date _____

This form to be prepared by contractor (if any), otherwise by the owner.

Three copies of this notice are to be filed with the County Clerk and Recorder of the county in which the works are located.

Please answer all questions. If not applicable, so state, otherwise the form will be returned.

Original to the County Clerk and Recorder; duplicate to the State Engineer; Triplicate to the School of Mines and Quadruplicate for the Appropriator.

279,45

STATE OF MONTANA

County of Dawson

Filed for record this 18th day of June A. D. 1962 at 7:30 o'clock P.M.

Ernest W. Linsley
County Clerk and Recorder

By Chas. Austin Deputy

Ex. pt. 22

GV

Approved Stock Form—State Publishing Co., Helena, Montana—38496

File No.

T. 19 R. 51

DUPLICATE

County Dawson

STATE OF MONTANA
ADMINISTRATOR OF GROUNDWATER CODE
OFFICE OF STATE ENGINEER

RECEIVED
JAN 14 1964
STATE ENGINEER

Declaration of Vested Groundwater Rights

(Under Chapter 237, Montana Session Laws, 1961)

I, Lorretta Miller of Route 1 Lindsay
(Name of Appropriator) (Address) (Town)
County of Dawson State of Montana
have appropriated groundwater according to the Montana laws in effect prior to January 1, 1962, as follows:

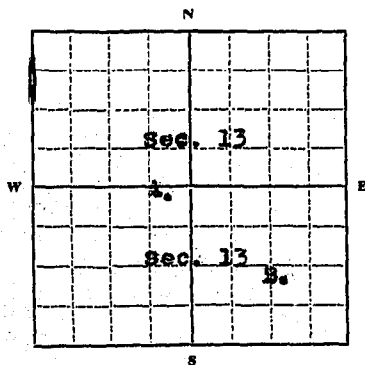

1/4 Sec. 13 T. 19 R. 51

Indicate point of appropriation
and place of use, if possible.
Each small square represents 10
acres.

2. The beneficial use on which the claim is based Well A. used
for livestock watering and operational use on
the ranch. Well B. used for livestock & household
3. Date or approximate date of earliest beneficial use; and how con-
tinuous the use has been Well A. used every day
April 1950. Well B. used every day Aug. 1956

4. The amount of groundwater claimed (in miner's inches or gallons
per minute) Well A. 10 gallons per minute.
Well B. 15 gallon per minute.

5. If used for irrigation, give the acreage and description of the lands
to which water has been applied and name of the owner thereof
No use of water for irrigation except for
garden on well B.

6. The means of withdrawing such water from the ground and the
location of each well or other means of withdrawal Well A. -
pump & cylinder from a six inch casing. Well B. -
pump & cylinder from a four inch casing. Located
as designated on map as well A. & well B.

7. The date of commencement and completion of the construction of the well, wells, or other works for with-
drawal of groundwater Well A. April 1, 1950 completed April 15, 1950.
Well B. July 30, 1956 completed Aug. 10, 1956.

8. The depth of water table Well A. 75 feet to table. Well B. 75 feet to table.

9. So far as it may be available, the type, size and depth of each well or the general specifications of any other
works for the withdrawal of groundwater Well A. 75' - 6" casing, pump and cylinder.
Well B. 75' - 4" casing, pump and cylinder

10. The estimated amount of groundwater withdrawn each year Well A. 150,000 gallons
Well B. 200,000 gallons

11. The log of formations encountered in the drilling of each well if available Not available for
either well.

12. Such other information of a similar nature as may be useful in carrying out the policy of this act, including
reference to book and page of any county record.

Signature of Owner Lorretta Miller

Date DEC 27 1963

Three copies to be filed by the owner with the County Clerk and Recorder of the county in which the well is
located.

Please answer all questions. If not applicable, so state, otherwise the form will be returned.

Original to the County Clerk and Recorder; duplicate to the State Engineer; Triplicate to the Montana Bureau
of Mines and Geology, and Quadruplicate for the Appropriator.

31707

THE STATE OF MONTANA
COUNTY OF DAWSON
I, the undersigned, Clerk and Recorder of the County of Dawson, do hereby certify that the within and foregoing is a true and correct copy of the original as the same appears from the records of said County.

IN WITNESS WHEREOF, I have hereunto set my hand and the seal of said County, at the City of Helena, Montana, this 27th day of December, A.D. 1963, at 3:00 o'clock P.M.

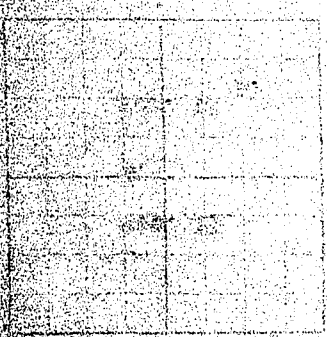

286566

STATE OF MONTANA
County of Dawson

DECISION OF ARBITRATION
Filed for record this 27 day of
December, A.D. 1963, at

3:00 o'clock P.M.
Gordon W. Russell
County Clerk and Recorder.

By _____ Deputy.

File No. _____

T. 19 R. 51

DUPLICATE

County Dawson

STATE OF MONTANA
ADMINISTRATOR OF GROUNDWATER CODE
OFFICE OF STATE ENGINEER

RECEIVED

APR 12 1963

Declaration of Vested Groundwater Rights

(Under Chapter 237, Montana Session Laws, 1961)

1. Frances E. Magalsky, of Lindsay
(Name of Appropriator) (Address) (Town)
County of Dawson State of Montana
have appropriated groundwater according to the Montana laws in effect prior to January 1, 1962, as follows:

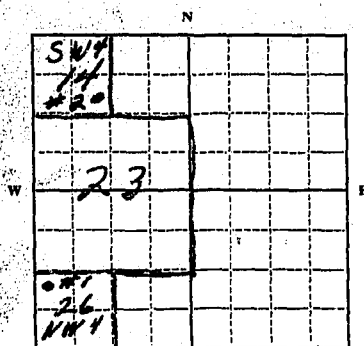

SW 1/4 Sec. 14 T. 19 R. 51 (#2)
NW 1/4 Sec. 26 T. 19 R. 51 (#1)

Indicate point of appropriation
and place of use, if possible.
Each small square represents 10
acres.

2. The beneficial use on which the claim is based. Stockwater and home use
3. Date or approximate date of earliest beneficial use, and how continuous the use has been. #1, Jan. 1945, continuous
#2, May 1955, continuous except in winter.
4. The amount of groundwater claimed (in miner's inches or gallons per minute). #1, 35 gals. per min.
#2, 20 gals. per min.
5. If used for irrigation, give the acreage and description of the lands to which water has been applied and name of the owner thereof.
no irrigation
6. The means of withdrawing such water from the ground and the location of each well or other means of withdrawal.
By pump and electric motor
7. The date of commencement and completion of the construction of the well, wells, or other works for withdrawal of groundwater. #1, unknown, #2, May 12-20, 1955
8. The depth of water table. #1, 40', #2, 238'
9. So far as it may be available, the type, size and depth of each well or the general specifications of any other works for the withdrawal of groundwater.
Well #1, dug well, 18" diameter, galvanized casing, 30'
#2, drilled, 4" steel casing, depth 236'
10. The estimated amount of groundwater withdrawn each year. #1, 90,000 gals., #2, 150,000 gals.
11. The log of formations encountered in the drilling of each well if available.
unavailable
12. Such other information of a similar nature as may be useful in carrying out the policy of this act, including reference to book and page of any county record.
none known

Signature of Owner Frances E. Magalsky
Date April 11, 1963

Three copies to be filed by the owner with the County Clerk and Recorder of the county in which the well is located.

Please answer all questions. If not applicable, so state, otherwise the form will be returned.

Original to the County Clerk and Recorder; duplicate to the State Engineer; Triplicate to the Montana Bureau of Mines and Geology, and Quadruplicate for the Appropriator.

4170

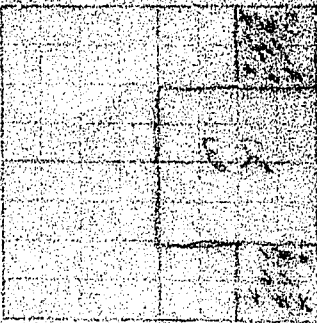

283284

STATE OF MONTANA
County of Dawson

Filed for record this 11th day of
April A. D. 1963, at
2:15 o'clock P. M.

Lester W. Russell
County Clerk and Recorder.

By Oliver Austin Deputy.

Fee pd. 2.00

GW

Approved Stock Form—State Publishing Co., Helena, Montana—38496

File No. _____

T. 19 N R 51 E

DUPLICATE

County Dawson

STATE OF MONTANA
ADMINISTRATOR OF GROUNDWATER CODE
OFFICE OF STATE ENGINEER

RECEIVED
JUL 3 1962

Declaration of Vested Groundwater Rights
(Under Chapter 237, Montana Session Laws, 1961)

1. E. O. Lease, of Mink Route, Circle
(Name of Appropriator) (Address) (Town)
County of Dawson State of Montana
have appropriated groundwater according to the Montana laws in effect prior to January 1, 1962, as follows:

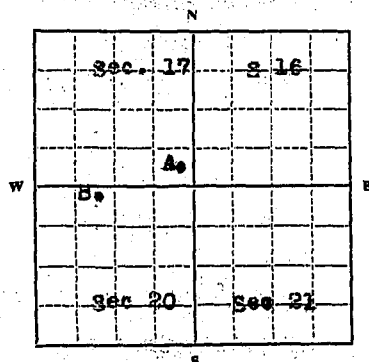

1/4 Sec. T. R.

Indicate point of appropriation
and place of use, if possible.
Each small square represents 10
acres.

- The beneficial use on which the claim is based water for livestock use and operational use on the ranch. (Well B; is used for domestic use also.)
- Date or approximate date of earliest beneficial use; and how continuous the use has been About June 1952, in used almost every day.
- The amount of groundwater claimed (in miner's inches or gallons per minute) Well A: 15 gallons per minute.
Well B: 15 gallons per minute
- If used for irrigation, give the acreage and description of the lands to which water has been applied and name of the owner thereof No use of water for irrigation except for garden on well B.
- The means of withdrawing such water from the ground and the location of each well or other means of withdrawal pump and cylinder from six inch casing OD. Located as designated on map as well A and well B.
- The date of commencement and completion of the construction of the well, wells, or other works for withdrawal of groundwater Well A: Commenced June 1, 1954--completed July 2, 1954.
Well B: Completed the spring of 1953.
- The depth of water table Well A: 140' to table. Well B: 136'.
- So far as it may be available, the type, size and depth of each well or the general specifications of any other works for the withdrawal of groundwater Well A: 160'--6 inch casing pump and cylinder.
Well B: 138'--6 inch casing--pump and cylinder.
- The estimated amount of groundwater withdrawn each year Well A: Well B:
- The log of formations encountered in the drilling of each well if available not available.
- Such other information of a similar nature as may be useful in carrying out the policy of this act, including reference to book and page of any county record.

Signature of Owner E. O. Lease

Date _____

Three copies to be filed by the owner with the County Clerk and Recorder of the county in which the well is located.

Please answer all questions. If not applicable, so state, otherwise the form will be returned.

Original to the County Clerk and Recorder; duplicate to the State Engineer; Triplicate to the Montana Bureau of Mines and Geology, and Quadruplicate for the Appropriator.

1772

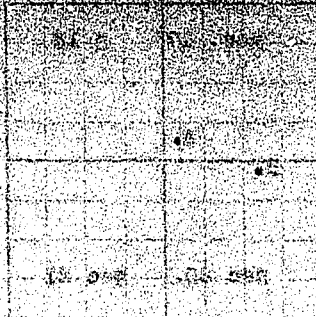

279742

STATE OF MONTANA

County of Dawson

Filed for record this 18th day of

June A. D. 1962, at
1:30 o'clock P. M.

Gordon W. Russell
County Clerk and Recorder.

By Chris Austin Deputy.

Fee paid \$2.00

File No. _____
DUPLICATE

Approved Stock Form—State Publishing Co., Helena, Montana—12262

T. 19 R. 51
County Dawson

STATE OF MONTANA
ADMINISTRATOR OF GROUNDWATER CODE
OFFICE OF STATE ENGINEER

RECEIVED
JAN 14 1964

Notice of Completion of Groundwater Appropriation
Without Well

(Under Chapter 237 Montana Session Laws, 1961)

Date of Appropriation of Groundwater _____

Owner George Mahlstedt Address Circle, Mont

Contractor (if any) None

Address of Contractor _____

Date Started _____ Date Completed _____

Describe means of obtaining groundwater without a well "as by sub-irrigation and other natural processes". Include depth to water when applicable.

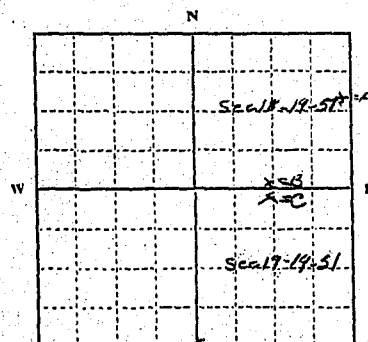

A. Basins

B. Basins

C. Perforated pipe 2 ft under ground + runs into tank

Quantity of water developed and used with explanation of method used to measure or estimate such amount. If use is intermittent

estimate approximate lengths of periods of use _____

A. 100 animal units estimate 6 mo

B. 50 " " estimate 6 mo

C. 50 " " estimate 6 mo

18-19
Indicate point of appropriation and place of use, if possible.

Signature of Owner George Mahlstedt

Date Dec. 30 1963

This form to be prepared by contractor (if any), otherwise by the owner.

Three copies of this notice are to be filed with the County Clerk and Recorder of the county in which the works are located.

Please answer all questions. If not applicable, so state, otherwise the form will be returned.

Original to the County Clerk and Recorder; duplicate to the State Engineer; Triplicate to the Montana Bureau of Mines and Geology and Quadruplicate for the Appropriator.

31886

286769

STATE OF MONTANA
County of Dawson

Filed for record this 30th day of

December A. D. 1963, at

4:00 o'clock P. M.

Gordon W. Russell
County Clerk and Recorder.

By _____ Deputy.

File No.

DUPLICATE

Approved State Form—State Publishing Co., Helena, Montana—1959

County

Dawson
RECEIVED
MAR 21 1963

**STATE OF MONTANA
ADMINISTRATOR OF GROUNDWATER CODE
OFFICE OF STATE ENGINEER**

STATE ENGINEER

**Notice of Completion of Groundwater Appropriation
Without Well**

(Under Chapter 237 Montana Session Laws, 1961)

Date of Appropriation of Groundwater.....

Owner *Edna G. Magalsky* address *Lindsay, Mont.*

Contractor (if any) *None*

Address of Contractor

Date Started..... Date Completed.....

Describe means of obtaining groundwater without a well "as by sub-irrigation and other natural processes" Include depth to water when applicable. *Natural springs.*

*Clean them out sometimes.
Sometimes have dug reservoir
below them to store water.*

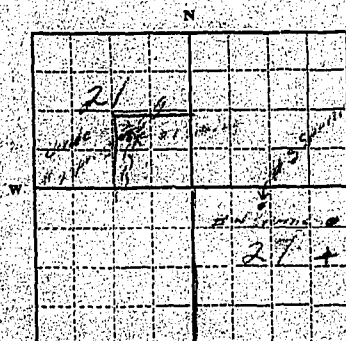

#1 SE 1/4 - 21 - 19 - 27

#3 NW 1/4 Sec. 27 T. 19 R. 27

Indicate point of appropriation
and place of use, if possible.

#4 NE 1/4 - 27 - 19 - 27

Quantity of water developed and used with explanation of method used to measure or estimate such amount. If use is intermittent

estimate approximate lengths of periods of use. *Used*

whenever pastures are grazed.

Estimated flow: #1, #2, 20-30

gals. per min. #3 30-40 gals. per

min. #4 50-75 gals. per min.

Signature of Owner *Edna G. Magalsky*

Date **MAR 20 1963**

This form to be prepared by contractor (if any), otherwise by the owner.

Three copies of this notice are to be filed with the County Clerk and Recorder of the county in which the works are located.

Please answer all questions. If not applicable, so state, otherwise the form will be returned.

Original to the County Clerk and Recorder; duplicate to the State Engineer; Triplicate to the Montana Bureau of Mines and Geology and Quadruplicate for the Appropriator.

282951

STATE OF MONTANA
County of Dawson

Filed for record this 22nd day of

March A.D. 1965

at 4:00 o'clock P.M.

Richard W. Lamm
County Clerk and Recorder

By Oliver D. Duthie

Dec. pd. 200

File No. _____

T. 19 R. 51

DUPLICATE

County Dawson

STATE OF MONTANA
ADMINISTRATOR OF GROUNDWATER CODE
OFFICE OF STATE ENGINEER

RECEIVED
 MAR 21 1963

Declaration of Vested Groundwater Rights

(Under Chapter 237, Montana Session Laws, 1961)

STATE ENGINEER

1. Edw. G. Magalsky, of Lindsay
 (Name of Appropriator) (Address) (Town)
 County of Dawson State of Montana
 have appropriated groundwater according to the Montana laws in effect prior to January 1, 1962, as follows:

		21		22	
			#2, #3		
W		28		27	E
		well #1			

#2+3, S $\frac{1}{2}$ - 22 - 19 - 51
 #1 SE $\frac{1}{4}$ Sec 28 T 19 R 51

Indicate point of appropriation
 and place of use, if possible.
 Each small square represents 10
 acres.

2. The beneficial use on which the claim is based
Homestead & stock water
3. Date or approximate date of earliest beneficial use; and how continuous the use has been. January 1948, has been in continuous use since. Well #2 has been in use during grazing season since March 1961.
4. The amount of groundwater claimed (in miner's inches or gallons per minute) Well #1, 50 gals. per min. #2, 40 gals. per min. #3, 20 gals. per min.
5. If used for irrigation, give the acreage and description of the lands to which water has been applied and name of the owner thereof
No irrigation
6. The means of withdrawing such water from the ground and the location of each well or other means of withdrawal
By pump and electric motor or gasoline engine.
7. The date of commencement and completion of the construction of the well, wells, or other works for withdrawal of groundwater. #1, June 28 - July 1, 1948; #2, March 25 - 30, 1961; #3 Unknown
8. The depth of water table. #1, 85' #2, 74' #3, 40'
9. So far as it may be available, the type, size and depth of each well or the general specifications of any other works for the withdrawal of groundwater.
#1, augured, 2" diameter hemlock casing. #2 drilled, 4" casing, (steel) #3 augured, 1 1/2" diameter, wooden casing.
10. The estimated amount of groundwater withdrawn each year. #1, 225,000 gals. #2, 120,000 gals. #3, unknown.
11. The log of formations encountered in the drilling of each well if available. #2, 0-25' yellow clay. 25-46 blue shale. 46-74 gray sand. Other wells unknown or unavailable.
12. Such other information of a similar nature as may be useful in carrying out the policy of this act, including reference to book and page of any county record. I know of none

Signature of Owner Edw. G. MagalskyDate MAR 20 1963

Three copies to be filed by the owner with the County Clerk and Recorder of the county in which the well is located.

Please answer all questions. If not applicable, so state, otherwise the form will be returned.

Original to the County Clerk and Recorder; duplicate to the State Engineer; Triplicate to the Montana Bureau of Mines and Geology, and Quadruplicate for the Appropriator.

3998

08	15
09	16
10	17
11	18
12	19
13	20
14	21
15	22
16	23
17	24
18	25
19	26
20	27
21	28
22	29
23	30
24	31
25	32
26	33
27	34
28	35
29	36
30	37
31	38
32	39
33	40
34	41
35	42
36	43
37	44
38	45
39	46
40	47
41	48
42	49
43	50
44	51
45	52
46	53
47	54
48	55
49	56
50	57
51	58
52	59
53	60
54	61
55	62
56	63
57	64
58	65
59	66
60	67
61	68
62	69
63	70
64	71
65	72
66	73
67	74
68	75
69	76
70	77
71	78
72	79
73	80
74	81
75	82
76	83
77	84
78	85
79	86
80	87
81	88
82	89
83	90
84	91
85	92
86	93
87	94
88	95
89	96
90	97
91	98
92	99
93	100
94	101
95	102
96	103
97	104
98	105
99	106
100	107
101	108
102	109
103	110
104	111
105	112
106	113
107	114
108	115
109	116
110	117
111	118
112	119
113	120
114	121
115	122
116	123
117	124
118	125
119	126
120	127
121	128
122	129
123	130
124	131
125	132
126	133
127	134
128	135
129	136
130	137
131	138
132	139
133	140
134	141
135	142
136	143
137	144
138	145
139	146
140	147
141	148
142	149
143	150
144	151
145	152
146	153
147	154
148	155
149	156
150	157
151	158
152	159
153	160
154	161
155	162
156	163
157	164
158	165
159	166
160	167
161	168
162	169
163	170
164	171
165	172
166	173
167	174
168	175
169	176
170	177
171	178
172	179
173	180
174	181
175	182
176	183
177	184
178	185
179	186
180	187
181	188
182	189
183	190
184	191
185	192
186	193
187	194
188	195
189	196
190	197
191	198
192	199
193	200
194	201
195	202
196	203
197	204
198	205
199	206
200	207
201	208

10-11-55 - 1/2, 1/4, 1/8, 1/16, 1/32, 1/64, 1/128, 1/256, 1/512, 1/1024, 1/2048, 1/4096, 1/8192, 1/16384, 1/32768, 1/65536, 1/131072, 1/262144, 1/524288, 1/1048576, 1/2097152, 1/4194304, 1/8388608, 1/16777216, 1/33554432, 1/67108864, 1/134217728, 1/268435456, 1/536870912, 1/1073741824, 1/2147483648, 1/4294967296, 1/8589934592, 1/17179869184, 1/34359738368, 1/68719476736, 1/137438953472, 1/274877906944, 1/549755813888, 1/1099511627776, 1/2199023255552, 1/4398046511104, 1/8796093022208, 1/17592186044416, 1/35184372088832, 1/70368744177664, 1/140737488355328, 1/281474976710656, 1/562949953421312, 1/1125899906842624, 1/2251799813685248, 1/4503599627370496, 1/9007199254740992, 1/18014398509481984, 1/36028797018963968, 1/72057594037927936, 1/144115188075855872, 1/288230376151711744, 1/576460752303423488, 1/1152921504606846976, 1/2305843009213693952, 1/4611686018427387904, 1/9223372036854775808, 1/18446744073709551616, 1/36893488147419103232, 1/73786976294838206464, 1/147573952589676412928, 1/295147905179352825856, 1/590295810358705651712, 1/1180591620717411303424, 1/2361183241434822606848, 1/4722366482869645213696, 1/9444732965739290427392, 1/18889465931478580854784, 1/37778931862957161709568, 1/75557863725914323419136, 1/151115727451828646838272, 1/302231454903657293676544, 1/604462909807314587353088, 1/1208925819614629174706176, 1/2417851639229258349412352, 1/4835703278458516698824704, 1/9671406556917033397649408, 1/19342813113834066795298816, 1/38685626227668133590597632, 1/77371252455336267181195264, 1/154742504910672534362390528, 1/309485009821345068724781056, 1/618970019642690137449562112, 1/1237940039285380274899124224, 1/2475880078570760549798248448, 1/4951760157141521099596496896, 1/9903520314283042199192993792, 1/19807040628566084398385987584, 1/39614081257132168796771975168, 1/79228162514264337593543950336, 1/158456325028528675187087900672, 1/316912650057057350374175801344, 1/633825300114114700748351602688, 1/1267650600228229401496703205376, 1/2535301200456458802993406410752, 1/5070602400912917605986812821504, 1/10141204801825835211973625643008, 1/20282409603651670423947251286016, 1/40564819207303340847894502572032, 1/81129638414606681695789005144064, 1/162259276829213363391578010288128, 1/324518553658426726783156020576256, 1/649037107316853453566312041152512, 1/1298074214633706907132624082305024, 1/2596148429267413814265248164610048, 1/5192296858534827628530496329220096, 1/10384593717069655257060992658440192, 1/20769187434139310514121985316880384, 1/41538374868278621028243970633760768, 1/83076749736557242056487941267521536, 1/166153499473114484112975882535043072, 1/332306998946228968225951765070086144, 1/664613997892457936451903530140172288, 1/1329227995784915872903807060280344576, 1/2658455991569831745807614120560689152, 1/5316911983139663491615228241121378304, 1/10633823966279326983230456482242756608, 1/21267647932558653966460912964485513216, 1/42535295865117307932921825928971026432, 1/85070591730234615865843651857942052864, 1/170141183460469231731687303715884105728, 1/340282366920938463463374607431768211456, 1/680564733841876926926749214863536422912, 1/1361129467683753853853498429727072845824, 1/2722258935367507707706996859454145691648, 1/5444517870735015415413993718908291383296, 1/10889035741470030830827987437816582766592, 1/21778071482940061661655974875633165533184, 1/43556142965880123323311949751266331066368, 1/87112285931760246646623899502532662132736, 1/174224571863520493293247799005065324265472, 1/348449143727040986586495598010130648530944, 1/696898287454081973172991196020261297061888, 1/1393796574908163946345982392040522594123776, 1/2787593149816327892691964784081045188247552, 1/5575186299632655785383929568162090376495104, 1/11150372599265311570767859136324180752990208, 1/22300745198530623141535718272648361505980416, 1/44601490397061246283071436545296723011960832, 1/89202980794122492566142873090593446023921664, 1/178405961588244985132285746181186892047843328, 1/356811923176489970264571492362373784095686656, 1/713623846352979940529142984724747568191373312, 1/1427247692705959881058285969449495136382746624,

STATE OF MONTANA
County of Dawson

County of Dawson

Filed for record this 20th day of Mar A D 1963 at

For record this Mar A. D. 1962, at

1:40 o'clock P.M.

1:40 o'clock P. M.
Gordon W. Russell
County Clerk and Recorder.

County Clerk and Recorder.

By Alice Austhery Deputy.

3 pd. ¹¹/₂ ac

File No.

DUPLICATE

T. 19 R. 51

County Dawson

STATE OF MONTANA
ADMINISTRATOR OF GROUNDWATER CODE
OFFICE OF STATE ENGINEER

RECEIVED

APR 12 1963

ASSISTANT
STATE ENGINEER

Notice of Completion of Groundwater Appropriation
Without Well

(Under Chapter 237 Montana Session Laws, 1961)

Date of Appropriation of Groundwater.....

Owner Frances E. Magaluk address Circle, MontanaContractor (if any) none

Address of Contractor

Date Started..... Date Completed.....

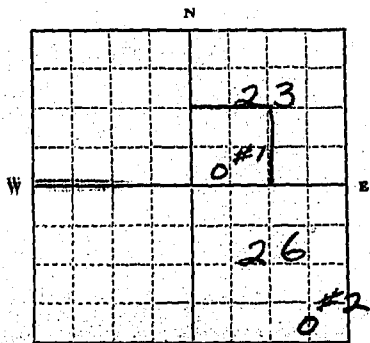
Describe means of obtaining groundwater without a well "as by sub-irrigation and other natural processes". Include depth to water when applicable. Natural springs.Sometimes have to dig them out, dig storage pits below them.

#1-SW 23-19-51
#2-SE 26-19-51

Indicate point of appropriation
and place of use, if possible.

Quantity of water developed and used with explanation of method used to measure or estimate such amount. If use is intermittent

estimate approximate lengths of periods of use. Both

springs used for stock water
during time pastures
are being grazed. Estimated
flow: #1, 30 gal. per min. #2, 50 gal. per min.

Signature of Owner Frances E. MagalukDate April 11, 1963

This form to be prepared by contractor (if any), otherwise by the owner.

Three copies of this notice are to be filed with the County Clerk and Recorder of the county in which the works are located.

Please answer all questions. If not applicable, so state, otherwise the form will be returned.

Original to the County Clerk and Recorder; duplicate to the State Engineer; Triplicate to the Montana
Bureau of Mines and Geology and Quadruplicate for the Appropriator.

283283

STATE OF MONTANA
County of Dawson

Filed for record this 11th day of
April A. D. 1962, at
9:15 o'clock P. M.

Gordon W. Russell
County Clerk and Recorder.

By Alvin D. Smith Deputy.

See pd # 204

File No.

T. 19 R. 51 and 52

DUPLICATE

County Dawson

STATE OF MONTANA
ADMINISTRATOR OF GROUNDWATER CODE
OFFICE OF STATE ENGINEER

Declaration of Vested Groundwater Rights

(Under Chapter 237, Montana Session Laws, 1961)

RECEIVED
JAN 14 1964
STATE ENGINEER

1. Bartley Schlicht, of Glandive
(Name of Appropriator) (Address) (Town)
County of Dawson State of Montana
have appropriated groundwater according to the Montana laws in effect prior to January 1, 1962, as follows:

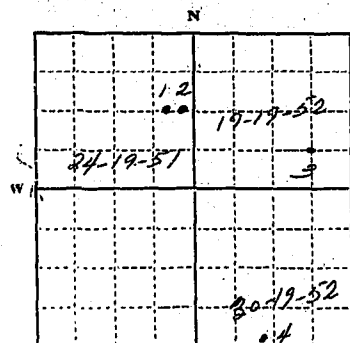

19 & 30, T. 19, R. 52

1/4 Sec. 24 T. 19 R. 51

Indicate point of appropriation
and place of use, if possible. Each
small square represents 10 acres.

2. The beneficial use on which the claim is based #1, livestock; #2, domestic; #3, livestock; #4, livestock
3. Date or approximate date of earliest beneficial use; and how continuous the use has been #1, 1959 continuous; #2, 1920 continuous; #3, 1960 continuous; #4, 1958 continuous
4. The amount of groundwater claimed (in miner's inches or gallons per minute) #1, 10 gal. per min.; #2, 10 gal. per min.; #3, 10 gal per min.; #4, 7 gal. per min.
5. If used for irrigation, give the acreage and description of the lands to which water has been applied and name of the owner thereof None
6. The means of withdrawing such water from the ground and the location of each well or other means of withdrawal #1, electric pump jack; #2, electric centrifugal; #3, gas motor pump jack; #4, gas motor, pump jack
7. The date of commencement and completion of the construction of the well, wells, or other works for withdrawal of groundwater #1, 1959; #2, 1920; #3, 1960, #4, 1958
8. The depth of water table #1, 70'; #2, 70'; #3, 30'; #4, 50'
9. So far as it may be available, the type, size and depth of each well or the general specifications of any other works for the withdrawal of groundwater #1, drilled, 4" casing, 109' deep; #2, Drilled, 4" casing, 100' deep; #3, drilled, 4" casing, 58' deep; #4, drilled, 4" casing, 85' deep
10. The estimated amount of groundwater withdrawn each year #1, 2,592,000 gal.; #2, 2,592,000 gal.; #3, 2,592,000 gal.; #4, 1,814,400 gal.
11. The log of formations encountered in the drilling of each well if available None
12. Such other information of a similar nature as may be useful in carrying out the policy of this act, including reference to book and page of any county record None

Signature of Owner

Bartley SchlichtDate December 30, 1963

Three copies to be filed by the owner with the County Clerk and Recorder of the county in which the well is located.

Please answer all questions. If not applicable, so state, otherwise the form will be returned.

Original to the County Clerk and Recorder; Duplicate to the State Engineer; Triplicate to the Montana Bureau of Mines and Geology, and Quadruplicate for the Appropriator.

31907

NOTE

1. The first section of the act is entitled "Short Title".
2. The second section of the act is entitled "Enactment".

3. The third section of the act is entitled "Definitions".
4. The fourth section of the act is entitled "Provisions".

5. The fifth section of the act is entitled "Penalties".

6. The sixth section of the act is entitled "Miscellaneous".
7. The seventh section of the act is entitled "Repeal".

8. The eighth section of the act is entitled "Effective Date".
9. The ninth section of the act is entitled "Severability".

10. The tenth section of the act is entitled "Construction".
11. The eleventh section of the act is entitled "Savings".

12. The twelfth section of the act is entitled "Amendments".
13. The thirteenth section of the act is entitled "Repeal".

14. The fourteenth section of the act is entitled "Severability".
15. The fifteenth section of the act is entitled "Effective Date".

16. The sixteenth section of the act is entitled "Miscellaneous".
17. The seventeenth section of the act is entitled "Repeal".

18. The eighteenth section of the act is entitled "Construction".
19. The nineteenth section of the act is entitled "Savings".
20. The twentieth section of the act is entitled "Amendments".

286790

STATE OF MONTANA
County of Dawson

Filed for record this 30th day of December, A. D. 1963, at 4:00 o'clock P.M.

Gordon Zell Russell
County Clerk and Recorder.

By _____ Deputy.

DECEMBER

1963

STATE OF MONTANA
ADMINISTRATOR OF GROUNDWATER CODE
MONTANA WATER RESOURCES BOARD

NOTICE OF COMPLETION OF GROUNDWATER
APPROPRIATION BY MEANS OF WELL

Developed after January 1, 1962

(Under Chapter 237 Montana Session Laws, 1961, as amended)

This form to be prepared by driller, and three copies to be filed by the owner with the County Clerk and Recorder in the county in which the well is located, last copy to be retained by driller.

Please answer all questions. If not applicable, so state, otherwise the form may be returned.

Owner George Storts

Address Lindsay Mont

Date well started 10-24-72

completed 10-26-72

Type of well Drilled

(Dug, driven, bored or drilled)

Equipment used Churn Drill

(Churn drill, rotary or other)

Water Use: Domestic ☐ Municipal ☐ Stock ☒ Irrigation ☐

Industrial ☐ Drainage ☐ Other ☐ Garden/Lawn ☐

*Describe

USE: If used for irrigation, industrial, drainage or other. Explain, state number of acres and location or other data (i.e. Lot, Block and Addition).

ESTIMATED ANNUAL WITHDRAWAL

Size of Drilled Hole	Size and Material of Casing	From (Feet)	To (Feet)	PERFORATIONS
7"	4" Plastic	0	116	Kind and Size of Slots
	5" Steel	+3	4	106 46 116 56

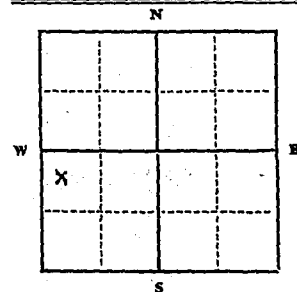

Static water level 50 ft.*
Pumping water level 112 ft.*
at 5 gallons per minute,
measured 10 minutes after pumping
began.

*Measured from ground level.

Well developed by Bailing

for 2 hours.

Power Electric Pump 1/2 HP

Remarks: (Gravel packing, cementing,

packers, type of shutoff)

Outside Gravel Packed

NW 1/4 Sec. 29

T. 19 N. R. 57 E.

INDICATE LOCATION OF WELL AND PLACE OF USE, IF POSSIBLE.
EACH SMALL SQUARE REPRESENTS 40 ACRES.

Driller's Signature David S. Haggerty

Driller's Address Lindsay Mont

LICENSE NO. 413

RECEIVED

County D. Dawson

NOV 13 1972

DRILLER'S LOG

Indicate the character, color, thickness of strata such as soil, clay, sand, gravel, shale, sandstone, etc. Show depth at which water is found and height to which water rises in well.

Top of Ground (Elev. above sea level)		
From (Feet)	To (Feet)	
0	52	Yellow Clay
52	54	Blue Clay
52	56	Blue Sand #20
56	106	Gray Clay
106	112	Gray Sand #20
112	116	Brown Clay

116 Show exact depth of bottom

57, 781

100

1000

10

1

15

File No.

T 19 N R 51 E

DUPLICATE

County.....**DAWSON**

STATE OF MONTANA
ADMINISTRATOR OF GROUNDWATER CODE
OFFICE OF STATE ENGINEER

RECEIVED
JAN 14 1964

Declaration of Vested Groundwater Rights

(Under Chapter 237, Montana Session Laws, 1961)

STATE ENGINEER

1. **GEORGE and LULU MAY STORIZ**, of **Lindsay, Montana**
(Name of Appropriator) (Address) (Town)

County of Beacon State of Montana
have appropriated groundwater according to the Montana laws in effect prior to January 1, 1962, as follows:

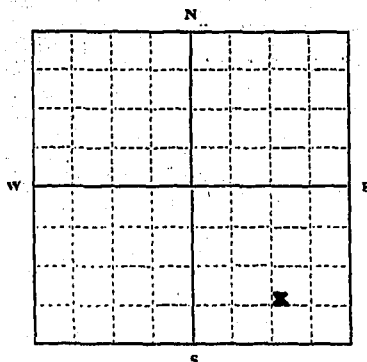

SE 1/4 Sec. 32 T. 19N. 51E

Indicate point of appropriation and place of use, if possible. Each small square represents 10 acres.

2. The beneficial use on which the claim is based stock water
3. Date or approximate date of earliest beneficial use; and how continuous the use has been 1951 - continuous
4. The amount of groundwater claimed (in miner's inches or gallons per minute) 5 gallons per minute
5. If used for irrigation, give the acreage and description of the lands to which water has been applied and name of the owner thereof
None
6. The means of withdrawing such water from the ground and the location of each well or other means of withdrawal electric pump

7. The date of commencement and completion of the construction of the well, wells, or other works for withdrawal of groundwater..... **September, 1951**
8. The depth of water table..... **90 feet**
9. So far as it may be available, the type, size and depth of each well or the general specifications of any other works for the withdrawal of groundwater..... **4" casing, 1 1/2" production pipe, 1 1/2 ft pump
158 feet deep**
10. The estimated amount of groundwater withdrawn each year..... **500 gallons a day**
11. The log of formation entered in the drilling of each well if available..... **None**
12. Such other information of a similar nature as may be useful in carrying out the policy of this act, including reference to book and page of any county record..... **None**

Signature of Owner _____

Date: December 18, 1963

Three copies to be filed by the owner with the County Clerk and Recorder of the county in which the well is located.

Please answer all questions. If not applicable, so state, otherwise the form will be returned.

Original to the County Clerk and Recorder; Duplicate to the State Engineer; Triplicate to the Montana Bureau of Mines and Geology, and Quadruplicate for the Appropriator.

319.4

286797

THE STATE OF MONTANA

County of Dawson

1911

December 30th

Filed for record this 30th day of December, A. D. 1911, at 4:20 o'clock P. M.

286797

STATE OF MONTANA
County of Dawson

Filed for record this 30th day of December, A. D. 1911, at 4:20 o'clock P. M.

Gordon W. Russell
County Clerk and Recorder.

By _____ Deputy.

File No. _____

T **19N** R **51E**

DUPLICATE

County **Dawson**

STATE OF MONTANA
ADMINISTRATOR OF GROUNDWATER CODE
OFFICE OF STATE ENGINEER

Declaration of Vested Groundwater Rights

(Under Chapter 237, Montana Session Laws, 1961)

JAN 14 1964

STATE ENGINEER

1. **ROBERT and CARLA J. STORTZ**, of **Lindsay**,
(Name of Appropriator) (Address) (Town)
County of **Dawson** State of **Montana**
have appropriated groundwater according to the Montana laws in effect prior to January 1, 1962, as follows:

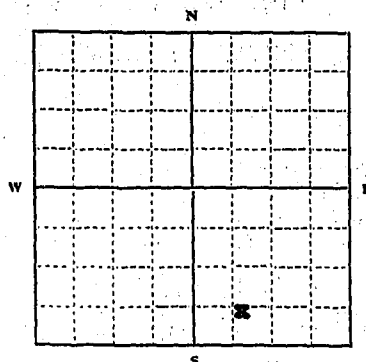

2. The beneficial use on which the claim is based **stock water**

3. Date or approximate date of earliest beneficial use; and how continuous the use has been **1941, continuous**

4. The amount of groundwater claimed (in miner's inches or gallons per minute) **4 gallons a minute**

5. If used for irrigation, give the acreage and description of the lands to which water has been applied and name of the owner thereof **None**

6. The means of withdrawing such water from the ground and the location of each well or other means of withdrawal **pump**

7. The date of commencement and completion of the construction of the well, wells, or other works for withdrawal of groundwater **1941**

8. The depth of water table **Unknown**

9. So far as it may be available, the type, size and depth of each well or the general specifications of any other works for the withdrawal of groundwater **4 inch casing, 1 1/2 inch production pipe, well is 120 feet deep**

10. The estimated amount of groundwater withdrawn each year **500 gallons a day, 6 months a year**

11. The log of formations encountered in the drilling of each well if available **None**

12. Such other information of a similar nature as may be useful in carrying out the policy of this act, including reference to book and page of any county record **None**

Signature of Owner

Robert Stortz
Carla J. Stortz

December 30, 1963

Three copies to be filed by the owner with the County Clerk and Recorder of the county in which the well is located.

Please answer all questions. If not applicable, so state, otherwise the form will be returned.

Original to the County Clerk and Recorder; Duplicate to the State Engineer; Triplicate to the Montana Bureau of Mines and Geology, and Quadruplicate for the Appropriator.

31927

[illegible]

286810 (1000)

By _____ Deputy _____

20

JW 3

File No.

DUPLICATE

Approved Stock Form—State Publishing Co., Helena, Montana, 1959

T 19N R 51E 33 34

County Blaine JAN 14 1964

STATE OF MONTANA
ADMINISTRATOR OF GROUNDWATER CODE
OFFICE OF STATE ENGINEER

STATE ENGINEER

Notice of Completion of Groundwater Appropriation Without Well

(Under Chapter 237 Montana Session Laws, 1961)

#1 - 1938
#2 - 1958
#3 - 1910
#4 - 1958

Date of Appropriation of Groundwater ROBERT STORTZ and
Owner CARLA J. STORTZ Address Lindsay, Montana
Contractor (if any) Davis & Engle, Nos. 2 & 4
L. P. Anderson, No. 3
Address of Contractor both of Glendive, Montana
all started and completed in year shown
Date Started _____ Date Completed _____
above except #3 in 1961
Describe means of obtaining groundwater without a well "as by
sub-irrigation and other natural processes". Include depth to
water when applicable. all are natural springs, dug out

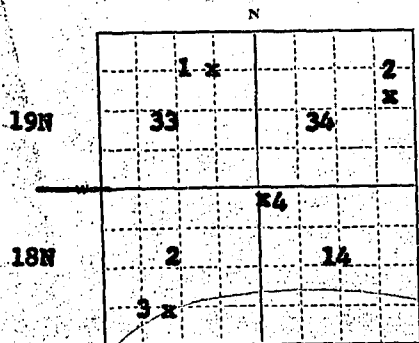

#1 NW 1/4 Sec. 2 T18N R 51E
#2 SW 1/4 Sec. 2 T18N R 51E
#3 NW 1/4 Sec. 2 T18N R 51E
#4 SW 1/4 Sec. 2 T18N R 51E
Indicate point of appropriation
and place of use, if possible.

Quantity of water developed and used with explanation of method
used to measure or estimate such amount. If use is intermittent

estimate approximate lengths of periods of use #1 - 250 gallons a
day from May 1 to December 1; #2 - 50 gallons a
day from May 1 to December 1; #3 - 250 gallons a
day the year around; #4 - 500 gallons a day from
August 1 to December 1

ROBERT STORTZ

Signature of Owner CARLA J. STORTZ

Date December 30, 1963

This form to be prepared by contractor (if any), otherwise by the owner.

Three copies of this notice are to be filed with the County Clerk and Recorder of the county in which the
works are located.

Please answer all questions. If not applicable, so state, otherwise the form will be returned.

Original to the County Clerk and Recorder; duplicate to the State Engineer; Triplicate to the Montana
Bureau of Mines and Geology and Quadruplicate for the Appropriator.

31928

286811

GW

Approved Stock Form—State Publishing Co., Helena, Montana—41921

File No. _____

T. 19N R. 51E

DUPLICATE

County Beaverhead

STATE OF MONTANA
ADMINISTRATOR OF GROUNDWATER CODE
OFFICE OF STATE ENGINEER

JAN 14 1964

Declaration of Vested Groundwater Rights

(Under Chapter 237, Montana Session Laws, 1961)

STATE ENGINEER

1. State of Montana, of Helena
(Name of Appropriator) (Address) (Town)
County of Lewis and Clark State of Montana
have appropriated groundwater according to the Montana laws in effect prior to January 1, 1962, as follows:

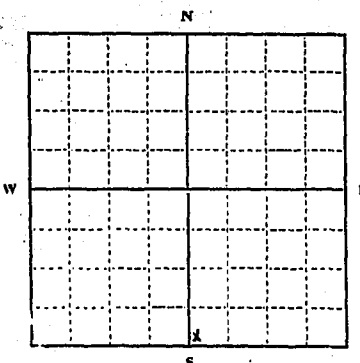

SW 1/4 Sec. 34 T. 19N R. 51E

Indicate point of appropriation and place of use, if possible. Each small square represents 10 acres.

2. The beneficial use on which the claim is based domestic and water for stock

3. Date or approximate date of earliest beneficial use; and how continuous the use has been 1920, continuous

4. The amount of groundwater claimed (in miner's inches or gallons per minute) 5 gallons per minute

5. If used for irrigation, give the acreage and description of the lands to which water has been applied and name of the owner thereof None

6. The means of withdrawing such water from the ground and the location of each well or other means of withdrawal pump, see plat

7. The date of commencement and completion of the construction of the well, wells, or other works for withdrawal of groundwater 1920

8. The depth of water table 115 feet

9. So far as it may be available, the type, size and depth of each well or the general specifications of any other works for the withdrawal of groundwater 5" casing, 1 1/2" production pipe, lift pump, 120 feet deep

10. The estimated amount of groundwater withdrawn each year 120,000 gallons

11. The log of formations encountered in the drilling of each well if available None

12. Such other information of a similar nature as may be useful in carrying out the policy of this act, including reference to book and page of any county record None

STATE OF MONTANA by James Robert Storts and George Korth
Signature of Owner James Robert Storts
George Korth
Date December 30, 1963

Three copies to be filed by the owner with the County Clerk and Recorder of the county in which the well is located.

Please answer all questions. If not applicable, so state, otherwise the form will be returned.

Original to the County Clerk and Recorder; Duplicate to the State Engineer; Triplicate to the Montana Bureau of Mines and Geology, and Quadruplicate for the Appropriator.

31925

By _____ Deputy.

File No.

T. 19N R. 51E

DUPLICATE

County Dawson

STATE OF MONTANA
ADMINISTRATOR OF GROUNDWATER CODE
OFFICE OF STATE ENGINEER

Declaration of Vested Groundwater Rights

(Under Chapter 237, Montana Session Laws, 1961)

JAN 14 1964

STATE ENGINEER

1. GEORGE and LINDA MAY STORTZ, of Lindsay, Montana
(Name of Appropriator) (Address) (Town)
County of Dawson State of Montana
have appropriated groundwater according to the Montana laws in effect prior to January 1, 1962, as follows:

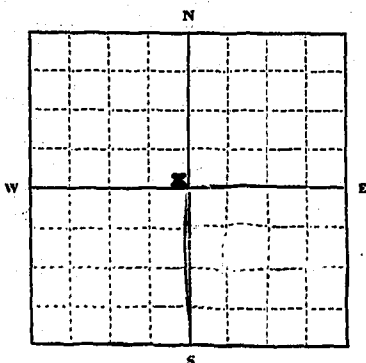

SE 1/4 NW 1/4 Sec 35 T19N R. 51E

Indicate point of appropriation and place of use, if possible. Each small square represents 10 acres.

2. The beneficial use on which the claim is based stock water
3. Date or approximate date of earliest beneficial use; and how continuous the use has been 1954 - continuous
4. The amount of groundwater claimed (in miner's inches or gallons per minute) 5 gallons per minute
5. If used for irrigation, give the acreage and description of the lands to which water has been applied and name of the owner thereof
None
6. The means of withdrawing such water from the ground and the location of well or other means of withdrawal
windmill pump
7. The date of commencement and completion of the construction of the well, wells, or other works for withdrawal of groundwater May, 1954
8. The depth of water table 40 feet
9. As far as it may be available, the type, size and depth of each well or the general specifications of any other works for the withdrawal of groundwater 5" casing, 2" production pipe, lift pump
68 feet total depth
10. The estimated amount of groundwater withdrawn each year 500 gallons a day
11. The log of formations encountered in the drilling of each well if available
None
12. Such other information of a similar nature as may be useful in carrying out the policy of this act, including reference to book and page of any county record
None

Signature of Owner George Stortz
Robert Stortz

Date December 18, 1963

Three copies to be filed by the owner with the County Clerk and Recorder of the county in which the well is located.

Please answer all questions. If not applicable, so state, otherwise the form will be returned.

Original to the County Clerk and Recorder; Duplicate to the State Engineer; Triplicate to the Montana Bureau of Mines and Geology, and Quadruplicate for the Appropriator.

31916

286799

IN WITNESS WHEREOF

I have hereunto set my hand and the seal of the County of Dawson, State of Montana, this 30th day of December, 1963.

1963

1963

WITNESSES

I, the undersigned, being duly sworn, depose and say that the foregoing is a true and correct copy of the original of the within and subscribed instrument, and that the same is a true and correct copy of the original of the within and subscribed instrument.

1963

I, the undersigned, being duly sworn, depose and say that the foregoing is a true and correct copy of the original of the within and subscribed instrument, and that the same is a true and correct copy of the original of the within and subscribed instrument.

286799

I, the undersigned, being duly sworn, depose and say that the foregoing is a true and correct copy of the original of the within and subscribed instrument, and that the same is a true and correct copy of the original of the within and subscribed instrument.

1963 - 00000000

I, the undersigned, being duly sworn, depose and say that the foregoing is a true and correct copy of the original of the within and subscribed instrument, and that the same is a true and correct copy of the original of the within and subscribed instrument.

286799

286799

STATE OF MONTANA
County of Dawson

Filed for record this 30th day of December, 1963, at 4:00 o'clock P.M.

Gordon W. Russell
County Clerk and Recorder.

By _____ Deputy

1963

File No.

DUPLICATE

19

County **Dawson**

STATE OF MONTANA
ADMINISTRATOR OF GROUNDWATER CODE
OFFICE OF STATE ENGINEER

RECEIVED
JUN 15 1962
STATE ENGINEER

Notice of Completion of Groundwater Appropriation Without Well

(Under Chapter 237 Montana Session Laws, 1961)

Dec 35-1945
B.

Date of Appropriation of Groundwater January 1920

Owner **F. R. Kreiman** Address **Lindsay, Montana**

Contractor (if any) Natural springs.

Address of Contractor None

Date Started natural Date Completed spring

Describe means of obtaining groundwater without a well "as by sub-irrigation and other natural processes" Include depth to water when applicable. ~~By sub-irrigation and other natural processed (natural aprings)~~

Sec 6-19-5

A.

Indicate point of appropriation
and place of use, if possible.

Quantity of water developed and used with explanation of method used to measure or estimate such amount. If use is intermit-

tent estimate approximate lengths of periods of use. **Spring A. 3 gal. per min. tiled and piped into tank.**
Spring B. 10 gal. per min. natural flow.

Flow measured by pipe and timing, all used for livestock water.

Signature of Owner J. P. Y. Krumm

Date July 3, 1962

This form to be prepared by contractor (if any), otherwise by the owner

Three copies of this notice are to be filed with the County Clerk and Recorder of the county in which the works are located.

Please answer all questions. If not applicable, so state, otherwise the form will be returned

Original to the County Clerk and Recorder; duplicate to the State Engineer; Triplicate to the School of Mines and Quadruplicate for the Appropriator.



GW3

File No. GW 4

DUPLICATE

T. 19 N. R. 51 E. S. 2

County Dawson

STATE OF MONTANA
ADMINISTRATOR OF GROUNDWATER CODE
OFFICE OF STATE ENGINEER

RECEIVED
JUL 5 1962

STATE ENGINEER

Notice of Completion of Groundwater Appropriation Without Well

(Under Chapter 237 Montana Session Laws, 1961)

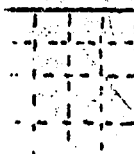

Sec 35-19-51
B.

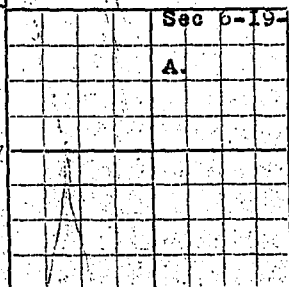

Indicate point of appropriation
and place of use, if possible.

Date of Appropriation of Groundwater January 1920

Owner F. R. Kreiman Address Lindsay, Montana

Contractor (if any) Natural springs

Address of Contractor None

Date Started natural Date Completed springs

Describe means of obtaining groundwater without a well "as by
sub-irrigation and other natural processes". Include depth to
water when applicable. By sub-irrigation and other
natural processed (natural springs)

Quantity of water developed and used with explanation of meth-
od used to measure or estimate such amount. If use is intermit-

tent estimate approximate lengths of periods of use Spring
A. 8 gal per min. tiled and piped into tank.
Spring B. 10 gal. per min. natural flow.

Flow measured by pipe and timing, all used
for livestock water.

Signature of Owner F. R. Kreiman

Date July 3, 1962

This form to be prepared by contractor (if any), otherwise by the owner.

Three copies of this notice are to be filed with the County Clerk and Recorder of the county in
which the works are located.

Please answer all questions. If not applicable, so state, otherwise the form will be returned.

Original to the County Clerk and Recorder; duplicate to the State Engineer; Triplicate to the
School of Mines and Quadruplicate for the Appropriator.



1783

279936

GWs

File No.

DUPLICATE

T. 19 R. 51

County Lawson

STATE OF MONTANA
ADMINISTRATOR OF GROUNDWATER CODE
OFFICE OF STATE ENGINEER

RECEIVED
JAN 14 1964

Notice of Completion of Groundwater Appropriation Without Well

(Under Chapter 237 Montana Session Laws, 1961)

Date of Appropriation of Groundwater May 1958

Owner J. J. Harvey

Address Lawson

Contractor (if any)

Address of Contractor

Date Started May 1958

Date Completed May 1958

Describe means of obtaining groundwater without a well "as by sub-irrigation and other natural processes". Include depth to water when applicable. dug out & Bored in

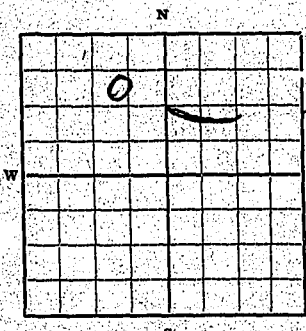

DRILL Spring & Built water Pond

Dam filled from spring & runoff

Quantity of water developed and used with explanation of method used to measure or estimate such amount: If use is intermittent estimate approximate lengths of periods of use.

1/4 Sec. 36 T. 19 R. 51

Indicate point of appropriation and place of use, if possible.

Measured with 5 gal Pail through 4 1/2

Pipe 5 gal Per min

Signature of Owner J. J. Harvey

Date Dec 37 1963

This form to be prepared by contractor (if any), otherwise by the owner.

Three copies of this notice are to be filed with the County Clerk and Recorder of the county in which the works are located.

Please answer all questions. If not applicable, so state, otherwise the form will be returned.

Original to the County Clerk and Recorder; duplicate to the State Engineer; Triplicate to the School of Mines and Quaduplicate for the Appropriator.

286676

STATE OF MONTANA
County of Dawson

Filed for record this 30th day of
December A. D. 1963 at
3:10 o'clock P.M.

Darwin H. Russell
County Clerk and Recorder

By Jaime Schertlin Deputy

See pl #28

GROUNDWATER INDEX

Page 1 of 1County Dawson Twp. 19 N Rge. 52 E

Sec.	Name of Appropriator	Type of Filing	County File No.	Remarks
17	Shags Hold, Kenneth	GW 2	286573	
5	Thielman, Jennie D.	GW 2	286573	
6	Keeiman, F. R.	GW 3	279935	See top of page 2
6	Thielman, F. R.	GW 3	279936	
8	Hill, Paul H.	GW 3	279937	
9	Thielman, Jennie D.	GW 4	286574	See 9 + 24
12	Coutts, Christina S.	GW 4	286641	
12	Ming, John J. + R. Marie	GW 4	286782	
14	Buck, John H.	GW 3	286556	
17	Hill, Paul H.	GW 4	279398	
19	Schlicht, Bartley	GW 4	286790	See top of page 29
19	Schlicht, Bartley	GW 3	286792	
18	Hill, Paul H.	GW 4	279392	
20	Harvey, James H.	GW 4	286679	
20	Keeiman, F. R.	GW 4	286571	
24	Thielman, Jennie D.	GW 4	286574	See Sec 9 Above
26	Spencer, Floyd W.	GW 4	286545	
27	Wooden, Melnette	GW 3	286048	
30	Schlicht, Bartley	GW 4	286790	See 19 Above
32	Berry, Joe + Lillian, M.	GW 3	286790	
32	Hagen, Justus	GW 4	286744	
32	Thielman, Albert	GW 4	286572	IN - 11 R 53 E
34	Hagen, O. V.	GW 4	286950	
7	Shags Hold, Kenneth	GW 2	286446	

RECEIVED

SEP 5 1973

11-52E 1

STATE PUBLISHING COMPANY

STATE OF MONTANA
ADMINISTRATOR OF GROUNDWATER RESOURCES
MONTANA WATER RESOURCES BOARD
MONTANA DEPARTMENT OF NATURAL RESOURCES AND CONSERVATION

NOTICE OF COMPLETION OF GROUNDWATER ABSORPTION BY MEANS OF WELL

Developed after January 1, 1962

(Under Chapter 237 Montana Session Laws, 1961, as amended)

This form to be prepared by driller, and three copies to be filed by the owner with the County Clerk and Recorder in the county in which the well is located, last copy to be retained by driller.

Please answer all questions. If not applicable, so state, otherwise the form may be returned.

Owner Kenneth Slagvold

Address Lindsay, Montana

Date well started 5/21/73

completed 5/31/73

Type of well drilled

Equipment used churn drill

Water Use: Domestic ☐ Municipal ☐ Stock ☒ Irrigation ☐

Industrial ☐ Drainage ☐ Other ☐* Garden/Lawn ☐

*Describe

USE: If used for irrigation, industrial, drainage or other. Explain, state number of acres and location or other data (i.e. Lot, Block

and Addition). not applicable

ESTIMATED ANNUAL WITHDRAWAL

Size of Drilled Hole	Size and Weight of Casing	From (Feet)	To (Feet)	PERFORATIONS		
				Kind Size	From (Feet)	To (Feet)
<u>5 1/2"</u>	<u>4" ID steel 10#</u>	<u>+1</u>	<u>186</u>	<u>1/8" slots</u>	<u>166</u>	<u>186</u>

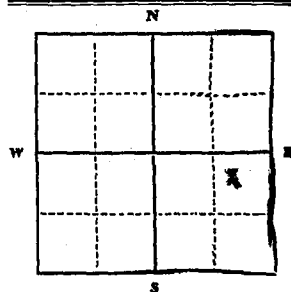

NE 1/4 SE 1/4 T. 19 N. R. 32 E. 1/4

Static water level 130 ft.
Pumping water level 180 ft.
at 44 gallons per minute
measured 200 minutes after pumping began.

*Measured from ground level.

Well developed by pumping balling for 4 hours.

Power 3/4 HP Pump 5 HP

Remarks: (Gravel packing, cementing, packers, type of shutoff)
outside gravel

INDICATE LOCATION OF WELL AND PLACE OF USE, IF POSSIBLE. EACH SMALL SQUARE REPRESENTS 40 ACRES.

Driller's Signature

Driller's Address Box 173

Lindsay, Montana

LICENSE NO. 13

Summary 100

Gravel, shale, sandstone, etc. show depth at which water is found and height to which water rises in well.

Top of Ground

(Elev. above sea level)

From (Feet)	To (Feet)	
0	40	yellow clay
40	42	blue clay
42	165	blue shale
165	167	gray sand
167	180	gray clay
180	186	gray sand (water bearing)
		blue clay bottom

186

Show exact depth of bottom

RECEIVED
 COUNTY CLERK
 COUNTY OF DAWSON
 MONTANA
 SEP 11 1912

FILED FOR RECORD
 THIS 11th DAY OF SEPTEMBER
 A.D. 1912
 AT 9 O'CLOCK A.M.
 BY Madeline H. Russell
 COUNTY CLERK & RECORDER

320446

STATE OF MONTANA
 County of Dawson
 Filed for record this 11th day of
Sept. A.D. 1912 at
9 o'clock A.M.
Madeline H. Russell
 County Clerk & Recorder
 By Madeline H. Russell Deputy

GW. 2

Approved Stock Form—Safe Publishing Co., Helena, Montana—19118

File No. _____

T. 19 R. 32

DUPLICATE

County DawsonSTATE OF MONTANA
ADMINISTRATOR OF GROUNDWATER CODE
OFFICE OF STATE ENGINEERNotice of Completion of Groundwater
Appropriation by Means of Well

(Under Chapter 237, Montana Session Laws, 1961)

Owner J. D. Thielman Address Elmfield, MontanaDriller James A. Wagner Address Lincoln, Montana

Date of Notice of Appropriation of Groundwater _____

Date well started August 22, 1963 Date Completed August 27, 1963Type of well drilled Equipment Used table tool drill
(dug, driven, bored or (Churn, drill, rotary or
drilled) other)Water Use: Domestic ☐ Municipal ☐ Other ☐ Irrigation ☐
Industrial ☐ Drainage ☐ Stock ☒

Indicate on the diagram the character and thickness of the different strata met with in drilling, such as soil, clay, shale, gravel, rock or sand, etc. Show depth at which water is encountered, thickness and character of water-bearing strata and height to which water rises in the well.

Size of Drilled Hole	Size and Weight of Casing	From (Feet)	To (Feet)	PERFORATIONS		
				Kind Size	From (Feet)	To (Feet)
6"	5 1/2" O.D.	0	126	1/8" slots	80	81
	14#				120	126

yellow clay

60- water level
61- gray sand
63- rock

blue shale

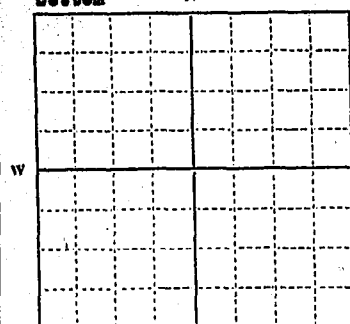
124
126 brown sand
bottomN. 5 1/4 Sec. 5 T. 19 R. 32
Indicate location of well and place of use, if possible. Each small square represents 10 acres.

Show exact depth of bottom.

Static Water Level for non-flowing Well 60 feet.Shut-in Pressure for Flowing Well not applicablePumping Water Level 114 feet at 2 gal. per minute.Discharge in gal. per min. of flowing well not applicableHow Tested bailed Length of Test 2 1/2 hours

Remarks: (Gravel packing, cementing, packers, type of shutoff, location of place of use of groundwater if not at well, and any other similar pertinent information, including number of acres irrigated, if used for irrigation) _____

J. D. Thielman

Driller's License Number _____

This form to be prepared by driller, and three copies to be filed by the owner with the County Clerk and Recorder in the county in which the well is located.

Please answer all questions. If not applicable, so state, otherwise the form will be returned.

Original to the County Clerk and Recorder; duplicate to the State Engineer; Triplicate to the Montana Bureau of Mines and Geology and Quadruplicate for the Appropriator.

31714

SENTE MUEL REAG FOR NON-PROFIT MCH 68 1981

[illegible]

...and
... ..
... ..
... ..
... ..

☐ ☐ ☐ ☐

(Date) _____ (Time) _____
 (Name) _____ (Address) _____
 (City) _____ (State) _____

Рассмотрим теперь функции $\varphi_1, \varphi_2, \varphi_3$ и φ_4 на отрезке $[0, 1]$. Полагая $x = 0$ и $x = 1$ в (1), получим

1966-67 Year: 1. Unpublished in 1966-67

Page 100 286572

74494022

286573

STATE OF MONTANA

County of Dawson

Filed for record this 37 day of December A.D. 1963 at 3:30 o'clock P.M.

CLERK OF DISTRICT COURT
COUNTY OF CLATSOP
CLATSOP COUNTY, OREGON
County Clerk and Recorder

By E. M. Warren Deputy

DATE: 11/11/77

7. 11. 2000

WAS: C

File No.

DUPLICATE

T 29 R 51 and ~~50~~

County.....Dawson

STATE OF MONTANA
ADMINISTRATOR OF GROUNDWATER CODE
OFFICE OF STATE ENGINEER

RECEIVED
JUN 6 1967

STATE ENGINEER

Notes: 1. Completion of Groundwater Appropriation Without Well

(Under Chapter 237 Montana Session Laws, 1961)

Date of Appropriation of Groundwater January 1920

Owner **F. R. Kreiman** Address **Lindsay, Mont.**

Contractor (if any) Jensen brothers

Address of Contractor Circle, Montana

Date Started 1956 Date Completed 1956

Sec. 1-19-51¹ Sec. 6-19-52 Describe means of obtaining groundwater without a well "as by sub-irrigation and other natural processes". Include depth to water when applicable. Pit A. and pit B. completed in 1956 to hold water run off. Pit C. and D. to be completed by Dec. 1 1962.

[illegible]

..... $\frac{1}{4}$ Sec..... T..... R.....

Indicate point of appropriation
and place of use, if possible.

Quantity of water developed and used with explanation of method used to measure or estimate such amount. If use is intermittent estimate approximate lengths of periods of use. All water used for livestock water during summer months

Signature of Owner.

Date July 3, 1962

This form to be prepared by contractor (if any), otherwise by the owner.

Three copies of this notice are to be filed with the County Clerk and Recorder of the county in which the works are located.

Please answer all questions. If not applicable, so state; otherwise the form will be returned.

Original to the County Clerk and Recorder; duplicate to the State Engineer; Triplicate to the School of Mines and Quadruplicate for the Appropriator.



File No

DUPLICATE

19

51 ENC

County

Dawson

STATE OF MONTANA
ADMINISTRATOR OF GROUNDWATER CODE
OFFICE OF STATE ENGINEER

RECEIVED
JUN 15 1962

STATE ENGINEER

Notice of Completion of Groundwater Appropriation Without Well

(Under Chapter 237 Montana Session Laws, 1961)

Date of Appropriation of Groundwater January 1920

Owner F. R. Kreiman Address Lindsay, Mont.

Contractor (if any) Jensen brothers

Address of Contractor Circle, Montana

Date Started 1956 Date Completed 1956

Sec. 1-19-51 Sec. 6-19-51

5 Describe means of obtaining groundwater without a well "as by sub-irrigation and other natural processes" Include depth to water when applicable. Pit A. and pit B. completed in 1956 to hold water run off. Pit C. and D. to be completed by Dec. 1 1962

pita.	C.	B.	
			D.

1/4 Sec T R
Indicate point of appropriation
and place of use, if possible.

Quantity of water developed and used with explanation of method used to measure or estimate such amount. If use is intermittent estimate approximate lengths of periods of use.

Signature of Owner.

Date **July 3, 1962**

This form to be prepared by contractor (if any), otherwise by the owner

Three copies of this notice are to be filed with the County Clerk and Recorder of the county in which the works are located.

Please answer all questions. If not applicable, so state, otherwise the form will be returned.

Original to the County Clerk and Recorder; duplicate to the State Engineer; Triplicate to the School of Mines and Quadruplicate for the Appropriator.



279935

GW:

File No. 62-19-51

DUPLICATE

T. 19 R. 51County Dawson

STATE OF MONTANA
ADMINISTRATOR OF GROUNDWATER CODE
OFFICE OF STATE ENGINEER

RECEIVED
JUL 5 1962
STATE ENGINEER

Notice of Completion of Groundwater Appropriation Without Well

(Under Chapter 237 Montana Session Laws, 1961)

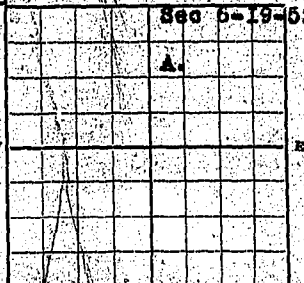
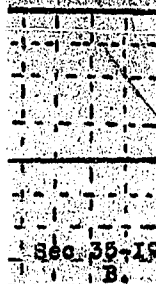

Indicate point of appropriation
and place of use, if possible.

Date of Appropriation of Groundwater January 1920

Owner F. R. Kreiman Address Lindsay, Montana

Contractor (if any) Natural springs

Address of Contractor None

Date Started natural Date Completed spring

Describe means of obtaining groundwater without a well "as by
sub-irrigation and other natural processes". Include depth to
water when applicable. By sub-irrigation and other
natural processes (natural springs)

Quantity of water developed and used with explanation of meth-
od used to measure or estimate such amount. Use is intermit-
tent estimate approximate lengths of periods of use. Spring
A. 5 gal. per min. tiled and piped into tank.
Spring B. 10 gal. per min. natural flow.

Flow measured by pipe and timing. all used
for livestock water.

Signature of Owner F. R. Kreiman

Date July 3, 1962

This form to be prepared by contractor (if any), otherwise by the owner.

Three copies of this notice are to be filed with the County Clerk and Recorder of the county in
which the works are located.

Please answer all questions. If not applicable, so state, otherwise the form will be returned.

Original to the County Clerk and Recorder; duplicate to the State Engineer; Triplicate to the
School of Mines and Quaduplicate for the Appropriator.

279936

STATE OF MONTANA
County of Dawson

Filed for record this 3rd day of
July A. D. 1962, at
11:45 o'clock A.M.

Landon W. Russell
County Clerk and Recorder.

By Alvin Austin Deputy.

See pd # 2

File No.

DUPLICATE

Approved Stock Form—State Publishing Co., Helena, Montana—38496

T. 19N R. 52E

County Dawson

STATE OF MONTANA
ADMINISTRATOR OF GROUNDWATER CODE
OFFICE OF STATE ENGINEER

RECEIVED
MAY 21 1962

Notice of Completion of Groundwater Appropriation
Without Well

(Under Chapter 237 Montana Session Laws, 1961)

Date of Appropriation of Groundwater 1918

Owner Paul G. Hill Address Lindsay, Montana

Contractor (if any) Self

Address of Contractor Same

Date Started 1918 Date Completed 1918

Describe means of obtaining groundwater without a well "as by sub-irrigation and other natural processes". Include depth to water when applicable. Natural springs.

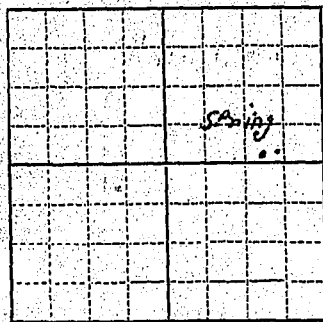

NE 1/4 Sec. 8 T. 19N. 52E

Indicate point of appropriation and place of use, if possible.

Quantity of water developed and used with explanation of method used to measure or estimate such amount. If use is intermittent estimate approximate lengths of periods of use.

Enough to water 50 head of livestock

Signature of Owner /s/ Paul G. Hill

Date May 18, 1962

This form to be prepared by contractor (if any), otherwise by the owner.

Three copies of this notice are to be filed with the County Clerk and Recorder of the county in which the works are located.

Please answer all questions. If not applicable, so state, otherwise the form will be returned.

Original to the County Clerk and Recorder; duplicate to the State Engineer; Triplicate to the Montana Bureau of Mines and Geology and Quadruplicate for the Appropriator.

279396

STATE OF MONTANA
County of Dawson

Filed for record this 18th day of
May A. D. 1962, at
11:45 o'clock A. M.

London W. Russell
County Clerk and Recorder.

By Alice Austin Deputy.

Fee pd. # 2.00

File No. _____

T 19

R 52

29/24

DUPLICATE

County _____

STATE OF MONTANA
ADMINISTRATOR OF GROUNDWATER CODE
OFFICE OF STATE ENGINEER

JAN 14 1964

Declaration of Vested Groundwater Rights

(Under Chapter 237, Montana Session Laws, 1961)

1. Jessie D. Thielman, of Bloomfield, Montana
(Name of Appropriator) (Address) (Town)
County of Dawson State of Montana
have appropriated groundwater according to the Montana laws in effect prior to January 1, 1962, as follows:

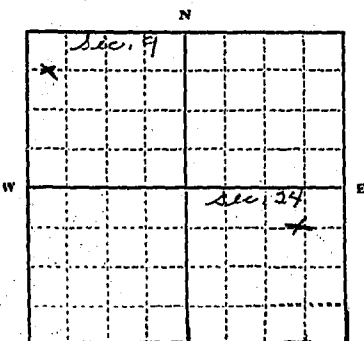

9 19 52

Indicate extent of appropriation
and place of use, if possible. Each
small square represents 10 acres.

2. The beneficial use on which the claim is based.
Sec. 9 - Stock well, Sec. 24 - Stock well
+ Household use.
3. Date or approximate date of earliest beneficial use; and how continuous the use has been.
Sec. 9 - 1912 - 1949
Sec. 24 - 1941 - 1963
4. The amount of groundwater claimed (in miner's inches or gallons per minute)
Sec. 9 - 8 gals per minute
Sec. 24 - 6 gals per minute
5. If used for irrigation, give the acreage and description of the lands to which water has been applied and name of the owner thereof.
None
6. The means of withdrawing such water from the ground and the location of each well or other means of withdrawal.
Sec. 9 - Windmill
Sec. 24 - Windmill + pump jack
7. The date of construction and completion of this construction of the well, wells, or other works for withdrawal of groundwater.
Sec. 9 - 1912-1912, Sec. 24 - 1941-1941
8. The depth of water table.
Sec. 9 - unknown Sec. 24 - 40 ft.
9. So far as it may be available, the type, size and depth of each well or the general specifications of any other works for the withdrawal of groundwater.
Sec. 9 - drilled, casing steel, 190 ft deep
Sec. 24 - drilled, casing steel, 80 ft deep
10. The estimated amount of groundwater withdrawn each year.
Sec. 9 - 547,500 gals, Sec. 24 - 547,500 gals
11. The log of formations encountered in the drilling of each well if available.
Unknown
12. Such other information of a similar nature as may be useful in carrying out the policy of this act, including reference to book and page of any county record.
Unknown

Signature of Owner

Jessie D. ThielmanDate December 27, 1963

Three copies to be filed by the owner with the County Clerk and Recorder of the county in which the well is located.

Please answer all questions. If not applicable, so state, otherwise the form will be returned.

Original to the County Clerk and Recorder; Duplicate to the State Engineer; Triplicate to the Montana Bureau of Mines and Geology, and Quadruplicate for the Appropriator.

31715

286574

STATE OF MONTANA

County of Dawson

Filed for record this 27 day of

December A. D. 1963 at

3:00 o'clock P. M.

London W. Russell

County Clerk and Recorder.

By *E. M. Warren* Deputy.

GW

Approved Stock Form—State Publishing Co., Helena, Montana—38496

File No. _____

T. 12 R. 52

DUPLICATE

County Dawson

STATE OF MONTANA
ADMINISTRATOR OF GROUNDWATER CODE
OFFICE OF STATE ENGINEER

JAN 14 1964

Declaration of Vested Groundwater Rights

(Under Chapter 237, Montana Session Laws, 1961)

STATE ENGINEER

1. Christina S. South, of _____, (Name of Appropriator) _____ (Address) _____ (Town)
County of Dawson State of Montana
have appropriated groundwater according to the Montana laws in effect prior to January 1, 1964, as follows:

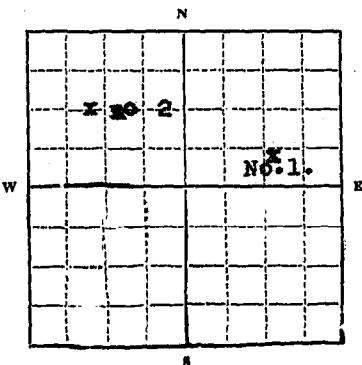

North Sec. 12 T. 12 R. 52

Indicate point of appropriation
and place of use, if possible.
Each small square represents 10
acres.

2. The beneficial use on which the claim is based _____

Domestic, Livestock, and Irrigation

3. Date or approximate date of earliest beneficial use; and how continuous the use has been _____

March 1910 has not been used since 1924March 1924 has not been used since 19274. The amount of groundwater claimed (in miner's inches or gallons per minute) (30) thirty gals. from all water wells drilled or dug at any future date.5. If used for irrigation, give the acreage and description of the lands to which water has been applied and name of the owner thereof
not used for irrigating at this time6. The means of withdrawing such water from the ground and the location of each well or other means of withdrawal
cylinder pumps, well No. 1. toward south side of the N.E. qua. No. 2 well near north side of N.W. qua.7. The date of commencement and completion of the construction of the well, wells, or other works for withdrawal of groundwater Not in use8. The depth of water table 30 to 40 feet9. So far as it may be available, the type, size and depth of each well or the general specifications of any other works for the withdrawal of groundwater
not available10. The estimated amount of groundwater withdrawn each year at present none.11. The log of formations encountered in the drilling of each well if available
not available12. Such other information of a similar nature as may be useful in carrying out the policy of this act, including reference to book and page of any county record none

Signature of owner

Date December 28, 1963

Three copies to be filed by the owner with the County Clerk and Recorder of the county in which the well is located.

Please answer all questions. If not applicable, so state, otherwise the form will be returned.

Original to the County Clerk and Recorder; duplicate to the State Engineer; Triplicate to the Montana Bureau of Mines and Geology, and Quadruplicate for the Appropriator.

31770

286647

STATE OF MONTANA
County of Dawson

Filed for record this 30th day of
December A. D. 19 63 at
11:00 o'clock A. M.

Gordon H. Russell
County Clerk and Recorder.

By Faye Schutte Deputy.

Fee pd \$3.00

File No. _____

T. 19 R. 52

DUPLICATE

County Dawson

STATE OF MONTANA
ADMINISTRATOR OF GROUNDWATER CODE
OFFICE OF STATE ENGINEER

RECEIVED
JAN 14 1964

Declaration of Vested Groundwater Rights

(Under Chapter 237, Montana Session Laws, 1961)

STATE ENGINEER

1. JOHN J. and P. MARIE MING, of _____BLOOMFIELD

(Name of Appropriator)

County of DAWSONState of MONTANA

have appropriated groundwater according to the Montana laws in effect prior to January 1, 1962, as follows:

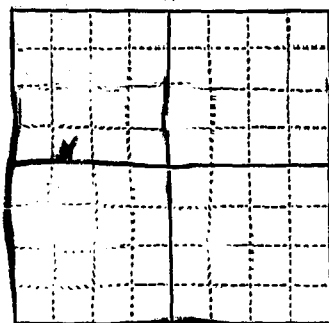

SW 1/4 12 19 52

Indicate point of appropriation and place of use, if possible. Each small square represents 10 acres.

2. The beneficial use on which the claim is based stock3. Date or approximate date of earliest beneficial use, and how continuous the use has been 19464. Amount of groundwater claimed (in miner's inches or gallons) 8 gpm5. If used for irrigation, give the acreage and description of the lands to which water has been applied and name of the owner thereof 300 ac6. The means of withdrawing such water from the ground and the location of each well or other means of withdrawal Pump, 10' casing and pump jack7. The date of commencement and completion of the construction of the well, wells, or other works for withdrawal of groundwater 19468. The depth of water table 80 ft9. So far as may be available, the type, size and depth of each well or the general specifications of any other works for the withdrawal of groundwater 6" casing 100ft deep10. The estimated amount of groundwater withdrawn each year 100,00011. The log of formations encountered in the drilling of each well if available Unknown12. Such other information of a similar nature as may be useful in carrying out the policy of this act, including reference to book and page of any county record UnknownSignature of Owner John J. MingDate 12-30-63

Three copies to be filed by the owner with the County Clerk and Recorder of the county in which the well is located.

Please answer all questions. If not applicable, so state, otherwise the form will be returned.

Original to the County Clerk and Recorder; Duplicate to the State Engineer; Triplicate to the Montana Bureau of Mines and Geology, and Quadruplicate for the Appropriator.

31899

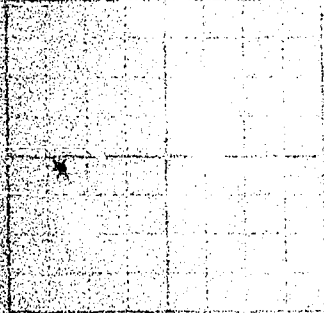

286782

STATE OF MONTANA
County of Dawson
Filed for record this 30th day of
December A. D. 1963, at
4:50 o'clock P.M.
Gordon W. Russell
County Clerk and Recorder.

By _____ Deputy.