

81398

FILED FOR RECORDS  
December 31, 1963  
at 37 minutes past 10 o'clock  
A.M. ANNA QUIGLEY  
Paul Mc Carthy  
Deputy Registrar  
Dubuque



81364

FILED FOR RECORD

at 03 minutes past 10 o'clock

A.M.  
James Dugley  
County Recorder

200

File No. ....

T. 4N R. 10W

DUPLICATE

County Deer Lodge

STATE OF MONTANA  
ADMINISTRATOR OF GROUNDWATER CODE  
OFFICE OF STATE ENGINEER

JAN 1 1962

### Declaration of Vested Groundwater Rights

(Under Chapter 237, Montana Session Laws, 1961)

1. Farrell Bates of Box 284 Anaconda  
(Name of Appropriator) (Address) (Town)  
County of Deer Lodge State of Montana  
have appropriated groundwater according to the Montana laws in effect prior to January 1, 1962, as follows:

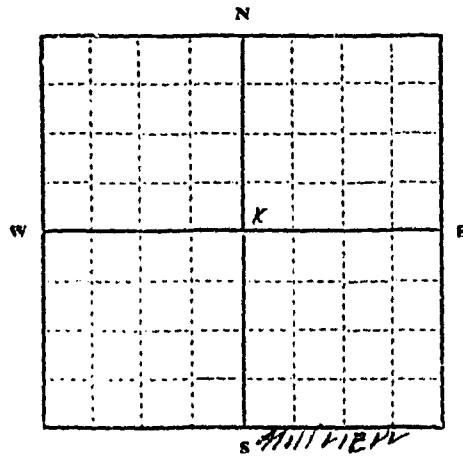

Sample 4/16  
Sec 8, T. 4N, R. 10W

Indicate point of appropriation and place of use, if possible. Each small square represents 10 acres.

2. The beneficial use on which the claim is based household use
3. Date or approximate date of earliest beneficial use; and how continuous the use has been continuous since approximately 1917
4. The amount of groundwater claimed (in miner's inches or gallons per minute) 600 Gallons per day
5. If used for irrigation, give the acreage and description of the lands to which water has been applied and name of the owner thereof not used for irrigation except flower beds
6. The means of withdrawing such water from the ground and the location of each well or other means of withdrawal pumped 25 ft. with electric pump
7. The date of commencement and completion of the construction of the well, wells, or other works for withdrawal of groundwater not known
8. The depth of water table not known
9. So far as it may be available, the type, size and depth of each well or the general specifications of any other works for the withdrawal of groundwater one dug well, approximately 27 ft. deep
10. The estimated amount of groundwater withdrawn each year 219,000 gallons
11. The log of formations encountered in the drilling of each well if available not known
12. Such other information of a similar nature as may be useful in carrying out the policy of this act, including reference to book and page of any county record not known. The well was on the property when purchased.

Signature of Owner Farrell BatesDate DEC 31 1962

Three copies to be filed by the owner with the County Clerk and Recorder of the county in which the well is located.

Please answer all questions. If not applicable, so state, otherwise the form will be returned.

Original to the County Clerk and Recorder; Duplicate to the State Engineer; Triplicate to the Montana Bureau of Mines and Geology, and Quadruplicate for the Appropriator.

28623

81356

FILED FOR RECORD

DEC 31 1963 19

at 55 minutes past 9 o'clock

A. M. ANNA QUIGLEY

County Recorder

*Mary Morrison*  
Deputy

File No. ....

T. 4 R. 10

DUPLICATE

County Deer Lodge

STATE OF MONTANA  
ADMINISTRATOR OF GROUNDWATER CODE  
OFFICE OF STATE ENGINEER

**Declaration of Vested Groundwater Rights**

(Under Chapter 237, Montana Session Laws, 1961)

1. Olaf A. Erikson Billquist of Bozeman Mont.  
(Name of Appropriator) (Address) (Town)  
County of DEER LODGE State of MONTANA  
have appropriated groundwater according to the Montana laws in effect prior to January 1, 1962, as follows:

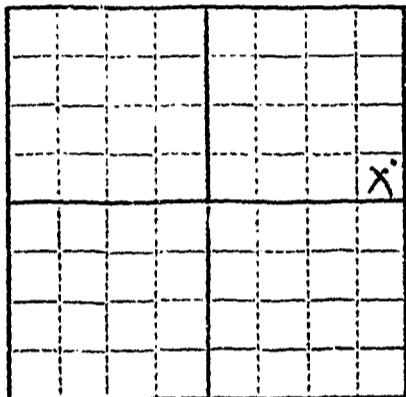

SE 1/4  
SE 1/4  
NE 1/4

Sec. 12 T. 4 R. 10

Indicate point of appropriation and place of use, if possible. Each small square represents 10 acres.

2. The beneficial use on which the claim is based. Household & Irrigation
3. Date or approximate date of earliest beneficial use; and how continuous the use has been. SEPT. 26 1956, Full Time
4. The amount of groundwater claimed (in miner's inches or gallons per minute). Yield 9 gpm.
5. If used for irrigation, give the acreage and description of the lands to which water has been applied and name of the owner thereof. ONE ACRE
6. The means of withdrawing such water from the ground and the location of each well or other means of withdrawal. Electric PUMP WELL LOCATED 35' S.W. CORNER OF HOUSE
7. The date of commencement and completion of the construction of the well, wells, or other works for withdrawal of groundwater. September 10, 1956 To September 15, 1956.
8. The depth of water table. Static Level 16 ft.
9. So far as it may be available, the type, size and depth of each well or the general specifications of any other works for the withdrawal of groundwater. 6" standard well casing, drilled well.
10. The estimated amount of groundwater withdrawn each year. 365,000 gals. or 1000 gals. per day
11. The log of formations encountered in the drilling of each well if available. Surface to 2 ft. top soil. 2 ft. to 6 ft. gravelly fill. 6 ft. to 25 ft. sand gravel and boulders. 25 ft. to 26 ft. Water bearing gravels.
12. Such other information of a similar nature as may be useful in carrying out the policy of this act, including reference to book and page of any county record. Drilling Log of Erikson Drilling Co. or FILES OF STATE WATER BOARD

Signature of Owner. Olaf A. Erikson Billquist

Date. Dec. 31-1963

Three copies to be filed by the owner with the County Clerk and Recorder of the county in which the well is located.

Please answer all questions. If not applicable, so state, otherwise the form will be returned.

Original to the County Clerk and Recorder; duplicate to the State Engineer; Triplicate to the Montana Bureau of Mines and Geology, and Quadruplicate for the Appropriator.

FILED FOR RECORD

January 17, 1964  
at 90 minutes past 4:00 o'clock  
P.M.

FILED OFFICE

County Recorder

Mark [Signature]  
Secretary

File No. \_\_\_\_\_

DUPLICATE

T. 1 R 10County Deer Lodge

STATE OF MONTANA  
ADMINISTRATOR OF GROUNDWATER CODE  
OFFICE OF STATE ENGINEER

JAN 9 1964

ENGINEER

### Declaration of Vested Groundwater Rights

(Under Chapter 237, Montana Session Laws, 1961)

1. Clifford James Cunningham Box 42 Onward  
(Name of Appropriator) (Address) (Town)  
County of Deer Lodge State of Montana  
have appropriated groundwater according to the Montana laws in effect prior to January 1, 1962, as follows:

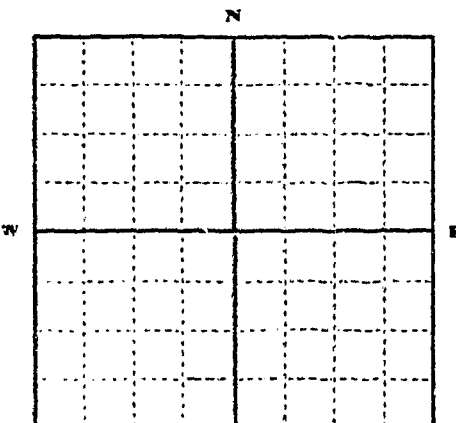

Lot 9

SW 1/4 ME8 Sec 28 T 4N R 10W

Indicate point of appropriation  
and place of use, if possible.  
Each small square represents 10  
acres.

2. The beneficial use on which the claim is based Home use
3. Date or approximate date of earliest beneficial use; and how continuous the use has been unknown
4. The amount of groundwater claimed (in miner's inches or gallons per minute) 3 1/2 gals per min
5. If used for irrigation, give the acreage and description of the lands to which water has been applied and name of the owner thereof Lawn & garden
6. The means of withdrawing such water from the ground and the location of each well or other means of withdrawal 1/2 horse power portable pump
7. The date of commencement and completion of the construction of the well, wells, or other works for withdrawal of groundwater unknown
8. The depth of water table 23 ft
9. So far as it may be available, the type, size and depth of each well or the general specifications of any other works for the withdrawal of groundwater 12 inch case in a 1 1/2 inch well 24 ft deep
10. The estimated amount of groundwater withdrawn each year 4,800,000 gals
11. The log of formations encountered in the drilling of each well if available unknown
12. Such other information of a similar nature as may be useful in carrying out the policy of this act, including reference to book and page of any county record unknown

Signature of Owner Clifford J CunninghamDate 12/31/63

Three copies to be filed by the owner with the County Clerk and Recorder of the county in which the well is located.

Please answer all questions. If not applicable, so state, otherwise the form will be returned.

Original to the County Clerk and Recorder; duplicate to the State Engineer; Triplicate to the Montana Bureau of Mines and Geology, and Quadruplicate for the Appropriator.

28750



81423

**FILED FOR RECORD**

December 31 1963  
at 02 minutes past 11 o'clock  
A.M.

ANNA QUIGLEY

Paul McCarthy  
Deputy



81485

FILED FOR RECORD

December 31 1963

at 04 minutes past 12 o'clock  
P.M.

Carol M. Carthy  
Deputy

File No. ....

T. 4N R. 10W.

DUPLICATE

County Deer Lodge

STATE OF MONTANA  
ADMINISTRATOR OF GROUNDWATER CODE  
OFFICE OF STATE ENGINEER

JAN 1 1962

Declaration of Vested Groundwater Rights

(Under Chapter 237, Montana Session Laws, 1961)

Howard Hamel of RFD Box 5-A (McBride) Quacoma  
(Name of Appropriator) (Address) (Town)

County of Deer Lodge State of Mont.  
have appropriated groundwater according to the Montana laws in effect prior to January 1, 1962, as follows:

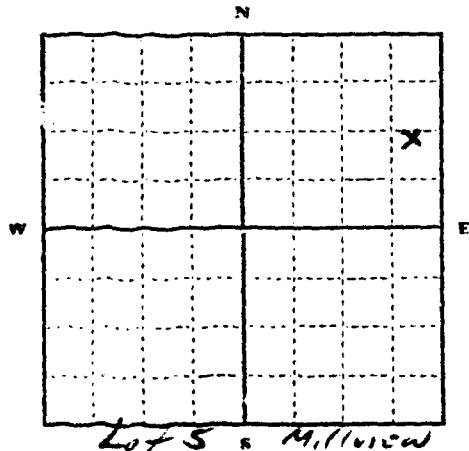

N. 5 1/4 Sec 18 T. 4 R. 10

Indicate point of appropriation and place of use, if possible. Each small square represents 10 acres.

2. The beneficial use on which the claim is based. Household (domestic)

3. Date or approximate date of earliest beneficial use; and how continuous the use has been. June 1950  
daily use

4. The amount of groundwater claimed (in miner's inches or gallons per minute) 8 gallons per minute

5. If used for irrigation, give the acreage and description of the lands to which water has been applied and name of the owner thereof

6. The means of withdrawing such water from the ground and the location of each well or other means of withdrawal. Hand-dug well by water pump from well. Well under the house

7. The date of commencement and completion of the construction of the well, wells, or other works for withdrawal of groundwater. Construction started in Aug. 1948, completed spring of 1950

8. The depth of water table. 0 ft.

9. So far as it may be available, the type, size and depth of each well or the general specifications of any other works for the withdrawal of groundwater. Type - drilled well  
Size - six inch casing  
depth - 91 ft.

10. The estimated amount of groundwater withdrawn each year. 300,000 gallons per yr.

11. The log of formations encountered in the drilling of each well if available. Rock & gravel layer

12. Such other information of a similar nature as may be useful in carrying out the policy of this act, including reference to book and page if any county record. no further information available

Signature of Owner Howard Hamel  
Date 1/31 1962

Three copies to be filed by the owner with the County Clerk and Recorder of the county in which the well is located.

Please answer all questions. If not applicable, so state, otherwise the form will be returned.

Original to the County Clerk and Recorder; Duplicate to the State Engineer; Triplicate to the Montana Bureau of Mines and Geology, and Quadruplicate for the Appropriator.

28786

81461

FILED FOR RECORD  
DEC 31 1963  
at 44 minutes past 11 o'clock  
A. M. ANNA QUINCY  
Mary M. [Signature]  
Clerk of the Court

File No. ....

T. 41 R. 10

DUPLICATE

County Deer Lodge

STATE OF MONTANA  
ADMINISTRATOR OF GROUNDWATER CODE  
OFFICE OF STATE ENGINEER

RECEIVED  
JAN 3 1962

Declaration of Vested Groundwater Rights ENGINEER  
(Under Chapter 237, Montana Session Laws, 1961)

1. Edwin Hamel of Mill Creek anconda  
(Name of Appropriator) (Address) (Town)  
Count, of Deer Lodge State of Montana  
have appropriated groundwater according to the Montana laws in effect prior to January 1, 1962, as follows:

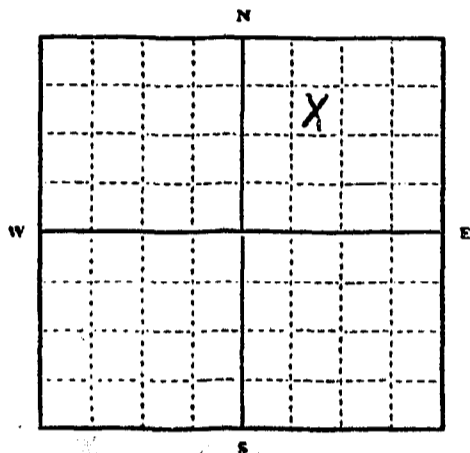

NW 1/4 NE 1/4 Sec. 18 T. 4. R. 10

Indicate point of appropriation and place of use, if possible. Each small square represents 10 acres.

2. The beneficial use on which the claim is based Domestic

3. Date or approximate date of earliest beneficial use; and how continuous the use has been Feb 15, 1953  
Daily

4. The amount of groundwater claimed (in miner's inches or gallons per minute) 1 per min

5. If used for irrigation, give the acreage and description of the lands to which water has been applied and name of the owner thereof  
none

6. The means of withdrawing such water from the ground and the location of each well or other means of withdrawal well driven pump

7. The date of commencement and completion of the construction of the well, wells, or other works for withdrawal of groundwater Feb. 5 1953 to March 20 1953

8. The depth of water table 18'

9. So far as it may be available, the type, size and depth of each well or the general specifications of any other works for the withdrawal of groundwater 6 in casing 19-5 lb. 76'

10. The estimated amount of groundwater withdrawn each year 3000 gal

11. The log of formations encountered in the drilling of each well if available  
gravel & boulders. then rest of way layer of clay mix. green to brown in color. large boulders all the way.

12. Such other information of a similar nature as may be useful in carrying out the policy of this act, including reference to book and page of any county record.

Signature of Owner Edwin Hamel

Date 12-31-63

Three copies to be filed by the owner with the County Clerk and Recorder of the county in which the well is located.

Please answer all questions. If not applicable, so state, otherwise the form will be returned.

Original to the County Clerk and Recorder; Duplicate to the State Engineer; Triplicate to the Montana Bureau of Mines and Geology, and Quadruplicate for the Appropriator.

81308

**FILED FOR RECORD**  
December 31 1963  
at 07 minutes past 7:00 o'clock  
P.M. ANNA QUIGLEY  
County Recorder  
Paul J. McCarthy  
Deputy

RECEIVED  
COUNTY CLERK  
COUNTY OF ALBANY  
JAN 1 1964

File No. ....

T. 4 N. R. 10 W.

DUPLICATE

County Deer Lodge

STATE OF MONTANA  
ADMINISTRATOR OF GROUNDWATER CODE  
OFFICE OF STATE ENGINEER

STATE ENGINEER

### Declaration of Vested Groundwater Rights

(Under Chapter 237, Montana Session Laws, 1961)

1. Albert J. & Florence M. Johnson, of R.F.D. Box 4 A, Anaconda  
(Name of Appropriator) (Address) (Town)  
County of Deer Lodge State of Montana  
have appropriated groundwater according to the Montana laws in effect prior to January 1, 1962, as follows:

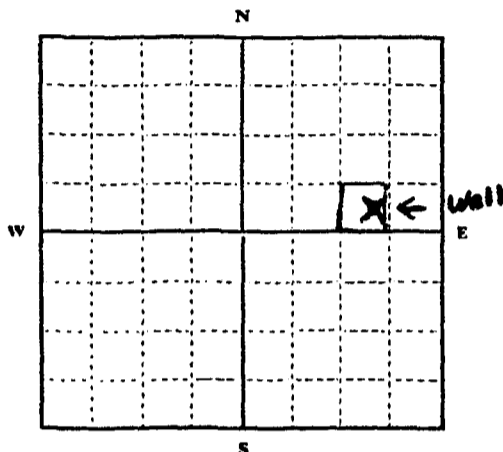

NE 1/4 Sec. 18, T. 4 N. R. 10 W.

Indicate point of appropriation and place of use, if possible. Each small square represents 10 acres.

2. The beneficial use on which the claim is based Household and irrigating lawns and gardens
3. Date or approximate date of earliest beneficial use; and how continuous the use has been 1952  
Continuous since then
4. The amount of groundwater claimed (in miner's inches or gallons per minute) 15 gallons per minute
5. If used for irrigation, give the acreage and description of the lands to which water has been applied and name of the owner thereof  
Approximately 2 acres  
Albert J. & Florence M. Johnson, owners  
Located on E 1/3 of SW 1/4 of SE 1/4 of NE 1/4 of Section 18, T 4 N, R 10 W.
6. The means of withdrawing such water from the ground and the location of each well or other means of withdrawal  
Electric pump. Well located on the  
E 1/3 of SW 1/4 of NE 1/4 of Section 18,  
T 4 N, R 10 W.
7. The date of commencement and completion of the construction of the well, wells, or other works for withdrawal of groundwater December 1962
8. The depth of water table Lowest point about 15 feet
9. So far as it may be available, the type, size and depth of each well or the general specifications of any other works for the withdrawal of groundwater  
This is a drilled well. 4 inch casing. Depth 38 feet
10. The estimated amount of groundwater withdrawn each year 1,500,000 gallons
11. The log of formations encountered in the drilling of each well if available
12. Such other information of a similar nature as may be useful in carrying out the policy of this act, including reference to book and page of any county record

Signature of Owner Florence M. Johnson  
Albert J. Johnson

Dated December 28, 1963

Three copies to be filed by the owner with the County Clerk and Recorder of the county in which the well is located.

Please answer all questions. If not applicable, so state, otherwise the form will be returned.

Original to the County Clerk and Recorder; duplicate to the State Engineer; Triplicate to the Montana Bureau of Mines and Geology, and Quadruplicate for the Appropriator.



81268

**FILED FOR RECORD**

December 3, 1963  
at 48 minutes past 1:00 o'clock  
P.M.

**ARINA QUIGLEY**

Lawrence J. Quigley  
Deputy

File No. ....

T. 4 N. R. 10 W.

DUPLICATE

County Deer Lodge

STATE OF MONTANA  
ADMINISTRATOR OF GROUNDWATER CODE  
OFFICE OF STATE ENGINEER

RECEIVED  
JAN 8 1964

Declaration of Vested Groundwater Rights

(Under Chapter 237, Montana Session Laws, 1961)

STATE ENGINEER

1. Albert J. & Florence M. Johnson, of R. F. D. Box 4A, Anaconda  
(Name of Appropriator) (Address) (Town)  
County of Deer Lodge State of Montana  
have appropriated groundwater according to the Montana laws in effect prior to January 1, 1962, as follows:

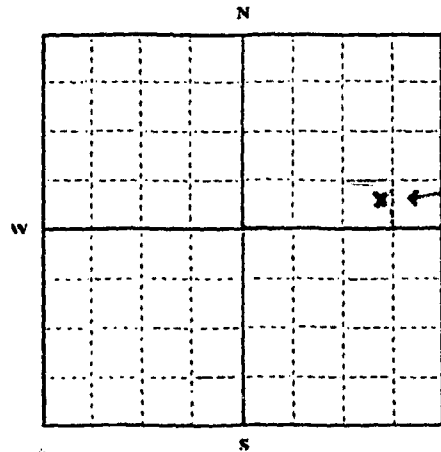

NE 1/4 Sec. 18, T. 4 N. R. 10 W.

Indicate point of appropriation and place of use, if possible. Each small square represents 10 acres.

2. The beneficial use on which the claim is based. Household and irrigating lawn and gardens
3. Date or approximate date of earliest beneficial use; and how continuous the use has been. 1940  
Continuous since then
4. The amount of groundwater claimed (in miner's inches or gallons per minute). 10 gallons per minute
5. If used for irrigation, give the acreage and description of the lands to which water has been applied and name of the owner thereof.  
Approximately 2 acres  
Albert J. & Florence M. Johnson, owners  
Located on E 1/2 of SW 1/4 of SE 1/4 of NE 1/4 of Section 18, T 4 N, R 10 W.
6. The means of withdrawing such water from the ground and the location of each well or other means of withdrawal.  
Electric Pump Well located on the  
E 1/2 of SW 1/4 of NE 1/4 of SW 1/4 of NE 1/4 of Sec  
18, T 4 N, R 10 W.
7. The date of commencement and completion of the construction of the well, wells, or other works for withdrawal of groundwater. Started May 1940  
Completed Sept 1940
8. The depth of water table. Lowest point about 15 feet
9. So far as it may be available, the type, size and depth of each well or the general specifications of any other works for the withdrawal of groundwater.  
This is a driven well, 1 1/2 inch pipe, 15 feet deep.
10. The estimated amount of groundwater withdrawn each year. 100,000 gallons
11. The log of formations encountered in the drilling of each well if available.  
Large rocks and gravel
12. Such other information of a similar nature as may be useful in carrying out the policy of this act, including reference to book and page of any county record.

Signature of Owner

*Florence M. Johnson*  
*Albert J. Johnson*

Date December 28, 1963

Three copies to be filed by the owner with the County Clerk and Recorder of the county in which the well is located.

Please answer all questions. If not applicable, so state, otherwise the form will be returned.

Original to the County Clerk and Recorder; duplicate to the State Engineer; Triplicate to the Montana Bureau of Mines and Geology, and Quadruplicate for the Appropriator.

17123

81270

FILED FOR RECORD

December 2, 1963

52 minutes past 1:00 o'clock

P.M.

ANNA QUIGLEY

Lawrence J. McCarthy  
County Register  
Notary

File No. ....

T. 4 N. R. 10 W.

DUPLICATE

County Deer Lodge

STATE OF MONTANA  
ADMINISTRATOR OF GROUNDWATER CODE  
OFFICE OF STATE ENGINEER

RECEIVED  
JAN 8 1964

STATE ENGINEER  
**Declaration of Vested Groundwater Rights**

(Under Chapter 237, Montana Session Laws, 1961)

1. Albert J. & Florence M. Johnson of R.F.D. Box 41 Anaconda  
(Name of Appropriator) (Address) (Town)

County of Deer Lodge State of Montana  
have appropriated groundwater according to the Montana laws in effect prior to January 1, 1962, as follows:

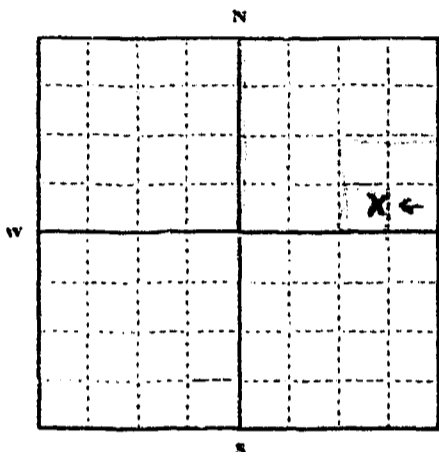

2. The beneficial use on which the claim is based Household and irrigating lawns and gardens

3. Date or approximate date of earliest beneficial use; and how continuous the use has been 1942

4. The amount of groundwater claimed (in miner's inches or gallons per minute) 10 gallons per minute

5. If used for irrigation, give the acreage and description of the lands to which water has been applied and name of the owner thereof  
Approximately one half acre  
Albert J. & Florence M. Johnson, owners.  
located on E 1/2 of SW 1/4 of SE 1/4 of NE 1/4 of Section 18, T 4 N, R 10 W.

6. The means of withdrawing such water from the ground and the location of each well or other means of withdrawal  
Electric pump well located on the E 1/2 of SW 1/4 of SE 1/4 of NE 1/4 of Section 18, T 4 N, R 10 W.

7. The date of commencement and completion of the construction of the well, wells, or other works for withdrawal of groundwater  
Started June 1942  
Completed July 1942

8. The depth of water table Lowest point about 15 feet

9. So far as it may be available, the type, size and depth of each well or the general specifications of any other works for the withdrawal of groundwater  
This is a driven well, 1 1/2 inch pipe, 20 feet deep.

10. The estimated amount of groundwater withdrawn each year 100,000 gallons

11. The log of formations encountered in the drilling of each well if available  
Large rocks and gravel

12. Such other information of a similar nature as may be useful in carrying out the policy of this act, including reference to book and page of any county record

*Florence M. Johnson*

Signature of Owner Albert J. Johnson

Date December 28, 1963

Three copies to be filed by the owner with the County Clerk and Recorder of the county in which the well is located.

Please answer all questions. If not applicable, so state, otherwise the form will be returned.

Original to the County Clerk and Recorder; duplicate to the State Engineer; Triplicate to the Montana Bureau of Mines and Geology, and Quadruplicate for the Appropriator.

81269

**FILED FOR RECORD**

December 30 1963

at 50 minutes past 1:00 o'clock

P.M.

**ANNA QUIGLEY**

*Carol McLaughlin*  
Notary

File No. ....

DUPLICATE

STATE OF MONTANA  
ADMINISTRATOR OF GROUNDWATER CODE  
OFFICE OF STATE ENGINEER

T. 4 R. 10  
County Deer Lodge  
JAN 9 1964

Declaration of Vested Groundwater Rights

(Under Chapter 237, Montana Session Laws, 1951)

1. VERI T. Johnson of MILLCREEK Arnacuda  
(Name of Appropriator) (Address) (Town)  
County of Deer Lodge State of Montana  
have appropriated groundwater according to the Montana laws in effect prior to January 1, 1962, as follows:

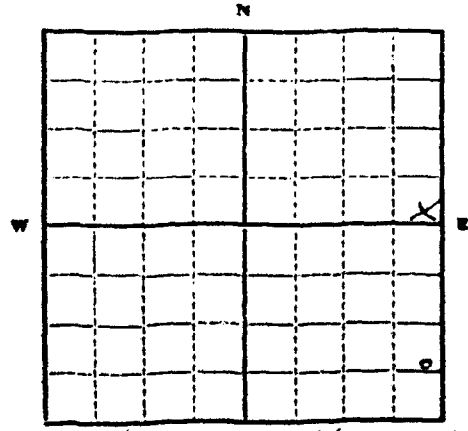

on lot 12 Millicreek

SE 1/4 Sec. 18 T. 4 R. 10

Indicate point of appropriation and place of use, if possible. Each small square represents 10 acres.

- 2. The beneficial use on which the claim is based House & yard
- 3. Date or approximate date of earliest beneficial use; and how continuous the use has been April 1951 - continuously since put in
- 4. The amount of groundwater claimed (in miner's inches or gallons per minute) 60 gals per min.
- 5. If used for irrigation, give the acreage and description of the lands to which water has been applied and name of the owner thereof not 300' by 300'
- 6. The means of withdrawing such water from the ground and the location of each well or other means of withdrawal 500 gal per hr. electric pump

- 7. The date of commencement and completion of the construction of the well, wells, or other works for withdrawal of groundwater April 1951
- 8. The depth of water table 14 Ft.
- 9. So far as it may be available, the type, size and depth of each well or the general specifications of any other works for the withdrawal of groundwater 20' hand dug concrete lined well
- 10. The estimated amount of groundwater withdrawn each year 230,000 gals
- 11. The log of formations encountered in the drilling of each well if available
- 12. Such other information of a similar nature as may be useful in carrying out the policy of this act, including reference to book and page of any county record

Signature of Owner Veri T. Johnson  
Date Dec 31 1963

Three copies to be filed by the owner with the County Clerk and Recorder of the county in which the well is located.

Please answer all questions. If not applicable, so state, otherwise the form will be returned.

Original to the County Clerk and Recorder; duplicate to the State Engineer; Triplicate to the Montana Bureau of Mines and Geology, and Quadruplicate for the Appropriator.

28829

816c4

FILED FOR RECORD

December 31 1963

23 minutes past 12 o'clock

P.M. ANNA QUIGLEY

By Carol Mc Larty  
County Recorder  
Deputy

18

File No. ....

T. 4 N. R. 10 W.

DUPLICATE

County Deer Lodge

STATE OF MONTANA  
ADMINISTRATOR OF GROUNDWATER CODE  
OFFICE OF STATE ENGINEER

RECEIVED  
JAN 8 1964  
STATE ENGINEER

Declaration of Vested Groundwater Rights

(Under Chapter 237, Montana Session Laws, 1961)

I Winnie A Johnson of Mill Creek Anaconda  
(Name of Appropriator) (Address) (Town)  
County of Deer Lodge State of Montana  
have appropriated groundwater according to the Montana laws in effect prior to January 1, 1962, as follows:

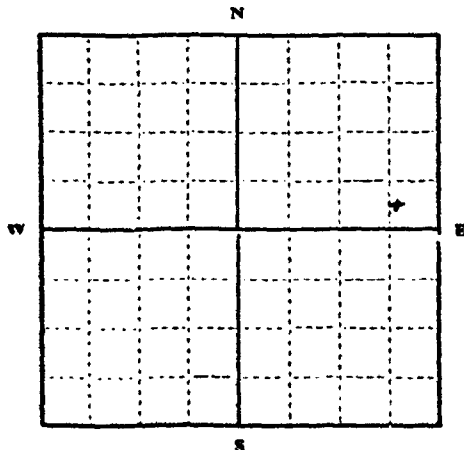

SE 1/4 NE 1/4 Sec. T. R.

Indicate point of appropriation and place of use, if possible. Each small square represents 10 acres.

2. The beneficial use on which the claim is based Household and Garden

3. Date or approximate date of earliest beneficial use; and how continuous the use has been July 1939

4. The amount of groundwater claimed (in miner's inches or gallons per minute) 480 Gallons per Hour

5. If used for irrigation, give the acreage and description of the lands to which water has been applied and name of the owner thereof  
2 Acres SE 1/4 NE 1/4 Sec. 18 T. 4 N. R. 10 W. M.P.M. Winnie A Johnson

6. The means of withdrawing such water from the ground and the location of each well or other means of withdrawal  
Electric Water Pump

7. The date of commencement and completion of the construction of the well, wells, or other works for withdrawal of groundwater May 1939 July 1939

8. The depth of water table 25' FT. About

9. So far as it may be available, the type, size and depth of each well or the general specifications of any other works for the withdrawal of groundwater not applicable Available

10. The estimated amount of groundwater withdrawn each year not available but about 182500 Gals.

11. The log of formations encountered in the drilling of each well if available not available

12. Such other information of a similar nature as may be useful in carrying out the policy of this act, including reference to book and page of any county record I cannot think of any other information I can give

Signature of Owner Winnie A Johnson  
Date Dec 26 1963

Three copies to be filed by the owner with the County Clerk and Recorder of the county in which the well is located.

Please answer all questions. If not applicable, so state, otherwise the form will be returned.

Original to the County Clerk and Recorder; duplicate to the State Engineer; Triplicate to the Montana Bureau of Mines and Geology, and Quadruplicate for the Appropriator.

17075





81220

**FILED FOR RECORD**

December 27 1963

at 15 minutes past 4 o'clock

P.M.

ANNA OUGLEY

County Recorder

Carol Mc Larty

Deputy

2000

FILED FOR RECORD

September 22 1912  
at 15 minutes past 3 o'clock

By HELEN L. LOVELL  
County Recorder  
By Mary Chase  
Deputy

200

W 3

File No. ....

DUPLICATE

Section No 7  
 Approved Stock Form—State Publishing Co., Helena, Montana—4262  
 T. D. R. 102  
 County Deer Lodge  
 JAN 9 1964  
 18

STATE OF MONTANA  
 STATE ENGINEER  
 ADMINISTRATOR OF GROUNDWATER CODE  
 OFFICE OF STATE ENGINEER

**Notice of Completion of Groundwater Appropriation  
 Without Well**

(Under Chapter 237 Montana Session Laws, 1961)

SW?

Date of Appropriation of Groundwater 1914

Owner Mill D. ... Address \_\_\_\_\_

Contractor (if any) \_\_\_\_\_

Address of Contractor \_\_\_\_\_

Date Started Not Known Date Completed Not Known

Describe means of obtaining groundwater without a well "as by sub-irrigation and other natural processes". Include depth to water when applicable \_\_\_\_\_

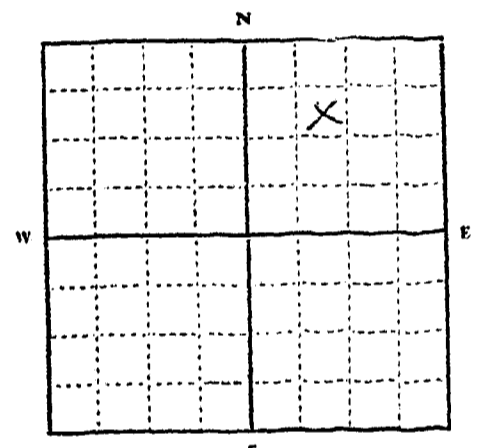

NW 1/4 Sec. 18 T. 4 R. 12 W  
 Indicate point of appropriation and place of use, if possible.

Quantity of water developed and used with explanation of method used to measure or estimate such amount. If use is intermittent

estimate approximate lengths of periods of use \_\_\_\_\_

Signature of Owner Peter Rafferty  
Ray ...  
 Date 2-31-63

This form to be prepared by contractor (if any), otherwise by the owner.  
 Three copies of this notice are to be filed with the County Clerk and Recorder of the county in which the works are located.  
 Please answer all questions. If not applicable, so state, otherwise the form will be returned.  
 Original to the County Clerk and Recorder; duplicate to the State Engineer; Triplicate to the Montana Bureau of Mines and Geology and Quadruplicate for the Appropriator.

28684

81351

FILED FOR RECORD  
December 31 1963  
at 56 minutes past 9 o'clock  
A.M. ANNA QUIGLEY  
Carol McCarthy  
Clerk of the Court  
Dorchester

File No. ....

T. 4th 10w

DUPLICATE

County Deer Lodge

STATE OF MONTANA  
ADMINISTRATOR OF GROUNDWATER CODE  
OFFICE OF STATE ENGINEER

RECEIVED  
JAN 9 1964

STATE ENGINEER  
**Notice of Completion of Groundwater Appropriation Without Well**

(Under Chapter 237 Montana Session Laws, 1961)

Date of Appropriation enigatin Co. May 22, 1950

Owner Milk & Wh. Co. address Opportunity

Contractor (if any) UNKNOWN

Address of Contractor .....

Date Started: ..... Date Completed: .....

Describe means of obtaining groundwater without a well "as by sub-irrigation and other natural processes". Include depth to water when applicable. Sub-irrigation by Ditch.

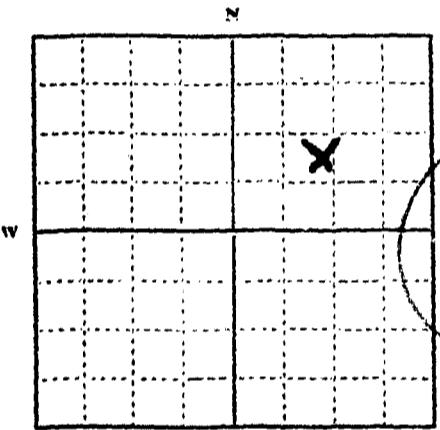

2nd 1/4 Sec. 10 T. 4 R. 10  
Indicate point of appropriation and place of use, if possible.

Quantity of water developed and used with explanation of method used to measure or estimate such amount. If use is intermittent estimate approximate lengths of periods of use. 3/4" water.

Thursday from 10 AM: Till 10 AM. Friday.

Signature of Owner Billie J. Cutler

Date Dec. 31 1963

This form to be prepared by contractor (if any), otherwise by the owner.  
Three copies of this notice are to be filed with the County Clerk and Recorder of the county in which the works are located.  
Please answer all questions. If not applicable, so state, otherwise the form will be returned.  
Original to the County Clerk and Recorder; duplicate to the State Engineer; Triplicate to the Montana Bureau of Mines and Geology and Quadruplicate for the Appropriator.

81497

FILED FOR RECORD  
December 31 1963  
at 16 minutes past 12 o'clock  
P.M.

JAMES DUGLEY  
By Paul McLarty  
Clerk

File No. ....

T. 4 R. 10

DUPLICATE

County .....

STATE OF MONTANA  
 ADMINISTRATOR OF GROUNDWATER CODE  
 OFFICE OF STATE ENGINEER

RECEIVED  
 JAN 3 1963

Declaration of Vested Groundwater Rights

(Under Chapter 237, Montana Session Laws, 1961)

STATE ENGINEER

1. Edgar C. Moll of R.F.D. Box 1-B Anaconda  
 (Name of Appropriator) (Address) (Town)  
 County of New Lodge State of Montana  
 have appropriated groundwater according to the Montana laws in effect prior to January 1, 1962, as follows:

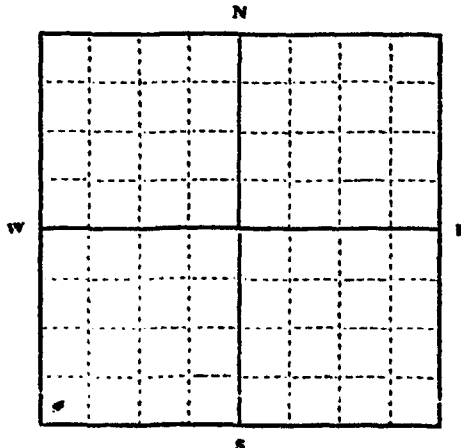

not Sec 4  
 for 1/4 Sec. 18 T. 4 R. 10  
 Indicate point of appropriation  
 and place of use, if possible. Each  
 small square represents 10 acres.

2. The beneficial use on which the claim is based.....

water for household use

3. Date or approximate date of earliest beneficial use; and how continu-  
 ous the use has been.....

well was drilled in 1950 and  
has been in use ever since

4. The amount of groundwater claimed (in miner's inches or gallons  
 per minute).....

Pump, Pumps about  
20 gal per min

5. If used for irrigation, give the acreage and description of the lands  
 to which water has been applied and name of the owner thereof

none

6. The means of withdrawing such water from the ground and the loca-  
 tion of each well or other means of withdrawal

One electric Pump

7. The date of commencement and completion of the construction of the well, wells, or other works for with-  
 drawal of groundwater.....

well was drilled as chart on 2 hand  
in 1950

8. The depth of water table.....

8'

9. So far as it may be available, the type, size and depth of each well or the general specifications of any other  
 works for the withdrawal of groundwater.....

well is a drilled well - bored with 4" casing  
and is 92'6" deep

10. The estimated amount of groundwater withdrawn each year.....

about 36500 gal

11. The log of formations encountered in the drilling of each well if available.....

not available

12. Such other information of a similar nature as may be useful in carrying out the policy of this act, including  
 reference to book and page of any county record.....

none that I know of

Signature of Owner Edgar C. Moll

Date 12-28-1963

Three copies to be filed by the owner with the County Clerk and Recorder of the county in which the well is located.

Please answer all questions. If not applicable, so state, otherwise the form will be returned.

Original to the County Clerk and Recorder; Duplicate to the State Engineer; Triplicate to the Montana Bureau of  
 Mines and Geology, and Quadruplicate for the Appropriator.

18886



81304

**FILED FOR RECORD**

December 31 1963

at 1 minutes past 9 o'clock

A.M.

**ANNA QUIGLEY**

Paul McCarthy  
County Recorder  
Dubuque

File No. \_\_\_\_\_

T. 4 R. 10

DUPLICATE

County \_\_\_\_\_

STATE OF MONTANA  
ADMINISTRATOR OF GROUNDWATER CODE  
OFFICE OF STATE ENGINEER

RECEIVED  
DEC 30 1963

Declaration of Vested Groundwater Rights

(Under Chapter 237, Montana Session Laws, 1961)

STATE ENGINEER

Raymond A. Patterson of R.F.D. Box 5 C Anaconda  
(Name of Appropriator) (Address) (Town)

County of Deer Lodge State of Montana

have appropriated groundwater according to the Montana laws in effect prior to January 1, 1962, as follows:

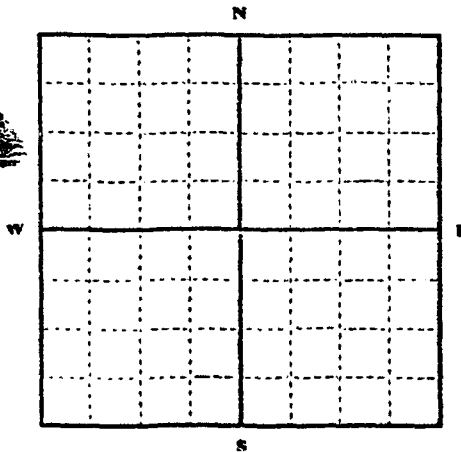

1/4 Sec. 18 T. 10 R. 10

Indicate point of appropriation and place of use, if possible. Each small square represents 10 acres.

2. The beneficial use on which the claim is based House hold

3. Date or approximate date of earliest beneficial use, and how continuous the use has been Approx 1952  
daily use

4. The amount of groundwater claimed (in miner's inches or gallons per minute) \_\_\_\_\_

5. If used for irrigation, give the acreage and description of the lands to which water has been applied and name of the owner thereof \_\_\_\_\_

6. The means of withdrawing such water from the ground and the location of each well or other means of withdrawal  
2 bore holes drilled  
well located by house

7. The date of commencement and completion of the construction of the well, wells, or other works for withdrawal of groundwater Completed in 1952

8. The depth of water table 30 ft.

9. So far as it may be available, the type, size and depth of each well or the general specifications of any other works for the withdrawal of groundwater hand dug well 30 ft

10. The estimated amount of groundwater withdrawn each year 20,000

11. The log of formations encountered in the drilling of each well if available gravel + Rock

12. Such other information of a similar nature as may be useful in carrying out the policy of this act, including reference to book and page of any county record \_\_\_\_\_

Signature of Owner Raymond A. Patterson

Date 12-27-63

Three copies to be filed by the owner with the County Clerk and Recorder of the county in which the well is located.

Please answer all questions. If not applicable, so state, otherwise the form will be returned.

Original to the County Clerk and Recorder; duplicate to the State Engineer; Triplicate to the Montana Bureau of Mines and Geology, and Quadruplicate for the Appropriator.

14268

81211

**FILED FOR RECORD**

December 27 1963  
at 42 minutes past 2 o'clock  
P. M.

ANNA QUIGLEY

County Recorder

Lawrence M. Kelly

County Clerk

GV

Approved Stock Form—State Publishing Co., Helena, Montana—2234

File No. \_\_\_\_\_

DUPLICATE

T. 4 R. 10  
County Frederick  
JAN 9 1964

STATE OF MONTANA  
ADMINISTRATOR OF GROUNDWATER CODES  
OFFICE OF STATE ENGINEER

Declaration of Vested Groundwater Rights

(Under Chapter 237, Montana Session Laws, 1961)

1. Harry H. Gueske, of RFD Box 2 Milk Creek Area  
(Name of Appropriator) (Address) (Town)  
County of Frederick State of Montana  
have appropriated groundwater according to the Montana laws in effect prior to January 1, 1962, as follows:

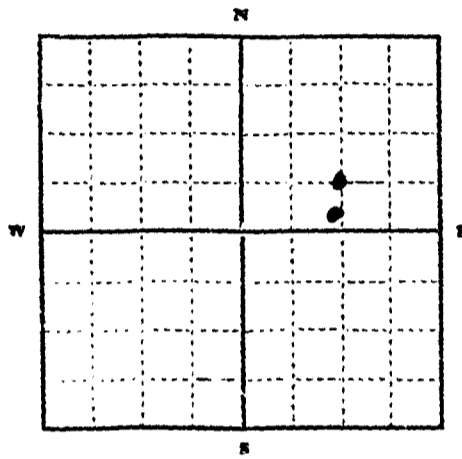

1/4 Sec. 18 T. 4 R. 10  
Indicate point of appropriation and place of use, if possible. Each small square represents 10 acres.

- 2. The beneficial use on which the claim is based irrigation
- 3. Date or approximate date of earliest beneficial use; and how continuous the use has been Sept 1954  
continuous
- 4. The amount of groundwater claimed (in miners' inches or gallons per minute) irrigation
- 5. If used for irrigation, give the acreage and description of the lands to which water has been applied and name of the owner thereof for same ground on same ground
- 6. The means of withdrawing such water from the Electricity pump location of each well or other means of withdrawal
- 7. The date of commencement and completion of Sept 1954 construction of the well, wells, or other works for withdrawal of groundwater
- 8. The depth of water table 10
- 9. So far as it may be available, the type, size and depth of each well with specifications of any other works for the withdrawal of groundwater one dug 40' square for 20' then 4' for 30'
- 10. The estimated amount of groundwater withdrawn each year 300,000 gal  
none
- 11. The log of formations encountered in the drilling of each well if available
- 12. Such other information of a similar nature as may be useful in carrying out the policy of this act, including reference to book and page of any county record

Signature of Owner Harry H. Gueske  
Date Dec. 31, 1963

Three copies to be filed by the owner with the County Clerk and Recorder of the county in which the well is located.  
Please answer all questions. If not applicable, so state, otherwise the form will be returned.  
Original to the County Clerk and Recorder; Duplicate to the State Engineer; Triplicate to the Montana Bureau of Mines and Geology, and Quadruplicate for the Appropriator.

28780

File No. ....

AUG 22 1965

T. 4 North R. 10 West

DUPLICATE

County Beaver Lodge

LOG

STATE OF MONTANA  
 ADMINISTRATOR OF GROUNDWATER CODE  
 OFFICE OF STATE ENGINEER

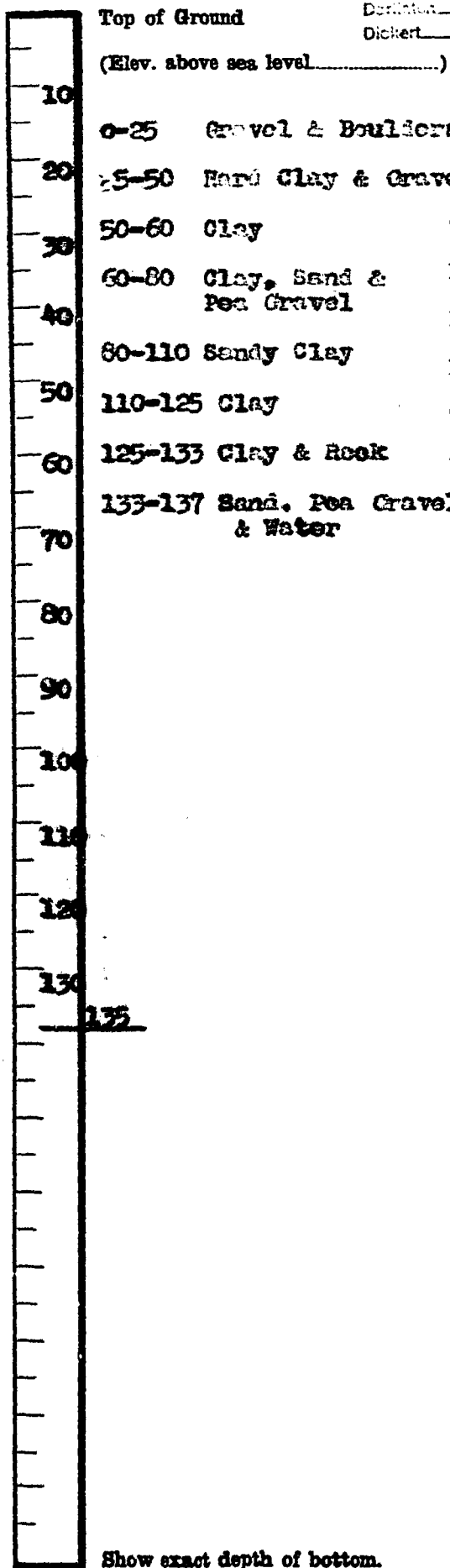

## Notice of Completion of Groundwater Appropriation by Means of Well

DEVELOPED AFTER JANUARY 1, 1962

(Under Chapter 237, Montana Session Laws, 1961)

Mount Haggin

Owner: Livestock, Inc. Address: Beaver Lodge, Mont.Driller: Keefe Drilling Address: Butte, Mont.

Date of Notice of appropriation of groundwater.....

Date well started: July 6, 1965 Date completed: July 9, 1965Type of well: drilled Equipment used: Chunk Drill  
 (Dug, Driven, bored or drilled) (Chunk drill, rotary or other)Water use: Domestic  Municipal  Stock  Irrigation   
 Industrial  Drainage  Other 

Indicate on the diagram the character and thickness of the different strata met with in drilling, such as soil, clay, shale, gravel, rock or sand, etc. Show depth at which water is encountered, thickness and character of water-bearing strata and height to which the water rises in the well.

Size of Drilled Hole	Size and Weight of Casing	From (Feet)	To (Feet)	PERFORATIONS		
				Kind Size	From (Feet)	To (Feet)
6"	6" I.D. 17 lb.	0'	136	Torch	128	133

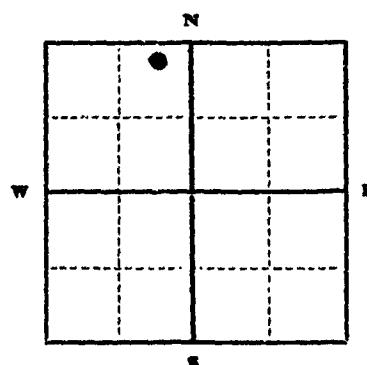

Static Water Level for non-flowing well

..... 15 feet.

Shut-in Pressure for Flowing Well.....

Pumping Water Level..... 60 feetat..... 15 gal. per minute.

Discharge in gal. per min. of flowing well

How Tested: BlowLength of Test: 2 hr.

Remarks: (Gravel packing, cementing, packers, type of shutoff).....

1/4 Sec. T. R. 10 W. R. 10  
 Indicate location of well and place of use, if possible. Each small square represents 40 acres.

(Continue on reverse side)

USE—If used for irrigation, industrial, drainage or other. Explain, state number of acres and location or other data (i.e.: Lot, Block and Addition).

Household and Livestock water.

This form to be prepared by driller, and three copies to be filed by the owner with the County Clerk and Recorder in the county in which the well is located, tissue copy to be retained by driller.

Please answer all questions. If not applicable, so state, otherwise the form will be returned.

Driller's License Number

Driller's Signature

410326

81455

**FILED FOR RECORD**

December 31 1963

at 34 minutes past 11 o'clock

A.M. ANNA QUIGLEY

By *Carol Mc Carthy*  
Deputy

At the time of the recording of this instrument, the County Recorder's Office was advised that the instrument was not properly recorded and that the County Recorder's Office was advised to file the instrument as a copy of the original instrument.

DATE	TIME	BY	REMARKS
1966	10:10	Anna Quigley	FILED FOR RECORD

**FILED FOR RECORD**

August 19 1966  
at 10 minutes past 2 o'clock  
P.M.  
Anna Quigley  
County Recorder  
By \_\_\_\_\_  
Deputy

272

File No. ....

T. U R. 10

DUPLICATE

County

STATE OF MONTANA  
ADMINISTRATOR OF GROUNDWATER CODE  
OFFICE OF STATE ENGINEER

R  
JAN 9 1964

STATE ENGINEER

Declaration of Vested Groundwater Rights

(Under Chapter 237, Montana Session Laws, 1961)

1. Phil H. Pick, Jr of RFD Aracoma  
(Name of Appropriator) (Address) (Town)

County of Deer Lodge State of Montana  
have appropriated groundwater according to the Montana law in effect prior to January 1, 1962, as follows:

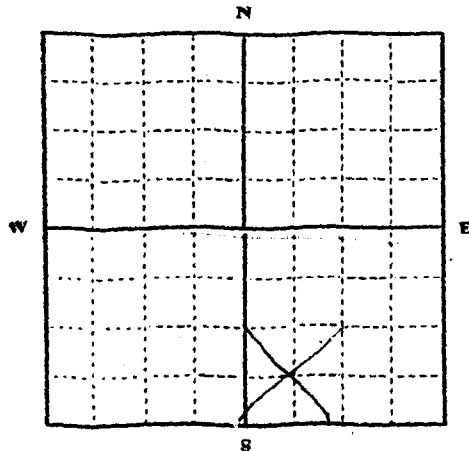

S.W. 1/4 SE 1/4 Sec 22 T. 4 N. R. 10 W

Indicate point of appropriation and place of use, if possible. Each small square represents 10 acres.

2. The beneficial use on which the claim is based Domestic

3. Date or approximate date of earliest beneficial use; and how continuous that use has been 1948

4. The amount of groundwater claimed (in miner's inches or gallons per minute) 30 gals per minute

5. If used for irrigation, give the acreage and description of the lands to which water has been applied and name of the owner thereof

6. The means of withdrawing such water from the ground and the location of each well or other means of withdrawal electric pump

7. The date of commencement and completion of the construction of the well, wells, or other works for withdrawal of groundwater 1948

8. The depth of water table 60 feet

9. So far as it may be available, the type, size and depth of each well or the general specifications of any other works for the withdrawal of groundwater 4 inch well 60' deep equipped with electric pump, 1/2" galvanized pipe, water pump, for the well

10. The estimated amount of groundwater withdrawn each year

11. The log of formations encountered in the drilling of each well if available

12. Such other information of a similar nature as may be useful in carrying out the policy of this act, including reference to book and page of any county record

Signature of Owner Phil H. Pick, Jr.  
Date 1/6/64

Three copies to be filed by the owner with the County Clerk and Recorder of the county in which the well is located.

Please answer all questions. If not applicable, so state, otherwise the form will be returned.

Original to the County Clerk and Recorder; Duplicate to the State Engineer; Triplicate to the Montana Bureau of Mines and Geology, and Quadruplicate for the Appropriator.

28855



81530

WILLIAM A. QUIGLEY

WILLIAM A. QUIGLEY

WILLIAM A. QUIGLEY

FILED FOR RECORD

Dec 31 1967

at 50 minutes past 12 o'clock

P.M. ANNA QUIGLEY

County Recorder

May, McQuinn

C

File No. ....

T. 4 R. 10

DUPLICATE

County Deer Lodge

STATE OF MONTANA  
ADMINISTRATOR OF GROUNDWATER CODE  
OFFICE OF STATE ENGINEER

RECEIVED  
DEC 30 1963

Declaration of Vested Groundwater Rights

(Under Chapter 237, Montana Session Laws, 1961)

STATE ENGINEER

1. William Mitschel, of Box 28, Annaconda  
(Name of Appropriator) (Address) (Town)

County of Deer Lodge State of Montana  
have appropriated groundwater according to the Montana laws in effect prior to January 1, 1962, as follows:

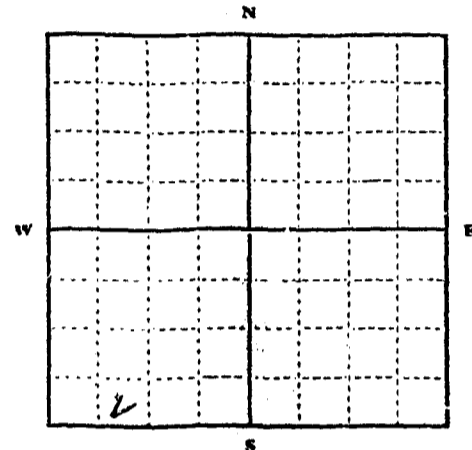

SW 1/4 Sec. 29 T. 4 R. 10 W.

Indicate point of appropriation and place of use, if possible. Each small square represents 10 acres.

2. The beneficial use on which the claim is based. water stock and general ranch use.

3. Date or approximate date of earliest beneficial use; and how continuous the use has been. 1882 ever since

4. The amount of groundwater claimed (in miner's inches or gallons per minute). 40 ga. per minute

5. If used for irrigation, give the acreage and description of the lands to which water has been applied and name of the owner thereof

6. The means of withdrawing such water from the ground and the location of each well or other means of withdrawal. Draw with pump. Located SW quarter of Section 29 Township 4 Range 10

7. The date of commencement and completion of the construction of the well, wells, or other works for withdrawal of groundwater. The well was dug (approximately) in 1882

8. The depth of water table. 42 in.

9. So far as it may be available, the type, size and depth of each well or the general specifications of any other works for the withdrawal of groundwater. type is just a rocked up well 8ft. deep and 28 in. across

10. The estimated amount of groundwater withdrawn each year. 36500 (Approximately)

11. The log of formations encountered in the drilling of each well if available.

12. Such other information of a similar nature as may be useful in carrying out the policy of this act, including reference to book and page of any county record. Recorded in Book U, page 501 of Deeds, Records of Deer Lodge County, Montana

Signature of Owner William Mitschel

Date.....

Three copies to be filed by the owner with the County Clerk and Recorder of the county in which the well is located.

Please answer all questions. If not applicable, so state, otherwise the form will be returned.

Original to the County Clerk and Recorder; duplicate to the State Engineer; Triplicate to the Montana Bureau of Mines and Geology, and Quadruplicate for the Appropriator.

4265

81208

**FILED FOR RECORD**

December 27 1963  
at 45 minutes past 1 o'clock  
P.M.

**ANITA QUIGLEY**

County Clerk  
Paul McTear  
Deputy

STATE OF MONTANA  
ADMINISTRATOR OF GROUNDWATER CODE  
MONTANA WATER RESOURCES BOARD

**NOTICE OF COMPLETION OF GROUNDWATER  
APPROPRIATION BY MEANS OF WELL**

Developed after January 1, 1962

(Under Chapter 237 Montana Session Laws, 1961, as amended)

This form to be prepared by driller, and three copies to be filed by the owner with the County Clerk and Recorder in the county in which the well is located, last copy to be retained by driller. Please answer all questions. If not applicable, so state, otherwise the form may be returned.

Owner H. E. Furgason  
 Address Crackerville  
Opportunity, Montana  
 Date well started 5/17/73  
 completed 5/17/73  
 Type of well Drilled  
 (Dug, driven, bored or drilled)  
 Equipment used Churn drill  
 (Churn drill, rotary or other)  
 Water Use: Domestic  Municipal  Stock  Irrigation   
 Industrial  Drainage  Other  Garden/Lawn

For Administrator's Use	
File	<u>7945</u>
	<u>6-29-73</u>
GW 1	<u>11.14 A.M.</u>

\*Describe  
 USE: If used for irrigation, industrial, drainage or other. Explain, state number of acres and location or other data (i.e. Lot, Block and Addition).

ESTIMATED ANNUAL WITHDRAWAL

Size of Drilled Hole	Size and Weight of Casing	From (Feet)	To (Feet)	PERFORATIONS		
				Kind Size	From (Feet)	To (Feet)
<u>6"</u>	<u>6 5/8" od</u> <u>x .250</u>	<u>+1'6"</u>	<u>23'</u>	<u>Cutting torch</u>	<u>16'</u>	<u>21'</u>

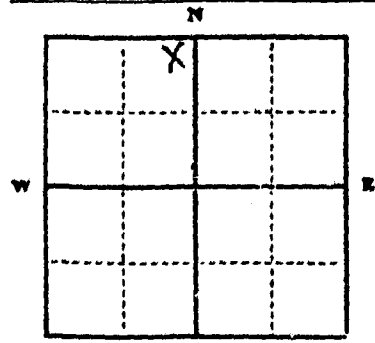

NE 1/4 NW 1/4 Sec. 26  
 T. 41 N. R. 12 E

INDICATE LOCATION OF WELL AND PLACE OF USE, IF POSSIBLE. EACH SMALL SQUARE REPRESENTS 40 ACRES.

Driller's Signature O'Keefe Contracting Company  
 Driller's Address 2804 Harvard Avenue  
Butte, Montana 59701 LICENSE NO. 8

County Haviland  
**DRILLER'S LOG 26**

Indicate the character, color, thickness of strata such as soil, clay, sand, gravel, shale, sandstone, etc. Show depth at which water is found and height to which water rises in well.

Top of Ground (Elev. above sea level)		
From (Feet)	To (Feet)	
<u>0'</u>	<u>2'</u>	<u>Top soil</u>
<u>2'</u>	<u>10'</u>	<u>Gravel, boulders, clay</u>
<u>10'</u>	<u>15'</u>	<u>Tight cemented gravel</u>
<u>15'</u>	<u>23'</u>	<u>Sand &amp; gravel, water</u>

23' Show exact depth of bottom

55129

99743

**FILED FOR RECORD**

June 29 1979  
at 14 minutes past 11 o'clock  
A M HELEN L. LOVELL

County Recorder  
By Mary McCarty  
200 12/22

93773  
Well # 2

County Deer Lodge 26

STATE OF MONTANA  
ADMINISTRATOR OF GROUNDWATER CODE  
MONTANA WATER RESOURCES BOARD

NOTICE OF COMPLETION OF GROUNDWATER  
APPROPRIATION BY MEANS OF WELL

Developed after January 1, 1962

(Under Chapter 237 Montana Session Laws, 1961, as amended)

This form to be prepared by driller, and three copies to be filed by the owner with the County Clerk and Recorder in the county in which the well is located, last copy to be retained by driller. Please answer all questions. If not applicable, so state, otherwise the form may be returned.

Owner <u>Mr. H. R. Ferguson,</u> <u>Mt. Haggis Livestock</u>	For Administrator's Use
Address <u>Box 640</u> <u>Anaconda, Montana</u>	File <u>93773</u> <u>August 3 1970</u> <u>2:10 P.M.</u>
Date well started <u>July 16, 1970</u>	
completed <u>same</u>	

Type of well Drilled  
(Dug, driven, bored or drilled)

Equipment used Churn Drill  
(Churn drill, rotary or other)

Water Use: Domestic  Municipal  Stock  Irrigation   
Industrial  Drainage  Other  Garden/Lawn

\*Describe  
USE: If used for irrigation, industrial, drainage or other. Explain, state number of acres and location or other data (i.e. Lot, Block and Addition).

ESTIMATED ANNUAL WITHDRAWAL

Size of Drilled Hole	Size and Weight of Casing	From (Feet)	To (Feet)	PERFORATIONS		
				Kind	From (Feet)	To (Feet)
<u>6 7/8"</u>	<u>6 5/8" cd</u> <u>18.024</u>	<u>0'</u>	<u>20'</u>	<u>cutting torch</u>	<u>13'</u>	<u>18'</u>

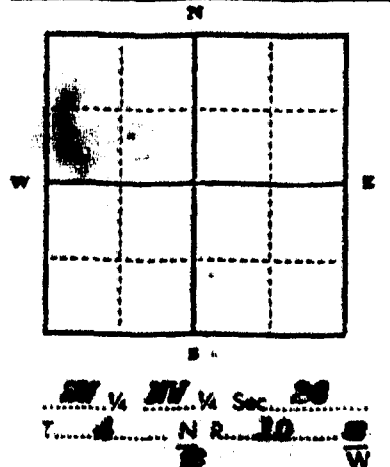

Static water level 4' ft.  
Pumping water level 10' ft.  
at 30 gallons per minute,  
measured 30 minutes after pumping  
began.  
\*Measured from ground level.  
Well developed by sand pump  
for 2 hours.  
Power 1 Pump 1 HP  
Remarks: (Gravel packing, cementing,  
packers, type of shutoff)

INDICATE LOCATION OF WELL AND PLACE OF USE, IF POSSIBLE.  
EACH SMALL SQUARE REPRESENTS 40 ACRES.

Driller's Signature O'Keefe Drilling Company  
Driller's Address 2804 Harvard Ave.  
Butte, Montana LICENSE NO. 0

DRILLER'S LOG  
Indicate the character, color, thickness of strata such as soil, clay, sand, gravel, shale, sandstone, etc. Show depth at which water is found and height to which water rises in well.

Top of Ground (Elev. above sea level)		
From (Feet)	To (Feet)	
<u>0'</u>	<u>3'</u>	<u>top soil</u>
<u>3'</u>	<u>20'</u>	<u>sand, gravel &amp; water</u>

29! Show exact depth of bottom

47315

Well developed by test pump  
 Measured from ground level  
 began  
 measured  
 minutes after pumping  
 at  
 gallons per minute  
 Pumping water level  
 ft.  
 Static water level  
 ft.

6 7/8"	6 5/8"	18.028	0	20	18.1	18
ft.	ft.	ft.	ft.	ft.	ft.	ft.

ESTIMATED ANNUAL WITHDRAWAL  
 750,000 Gals.  
 and Address)

93773

**FILED FOR RECORD**

*August 2* 19*70*  
 at *10* minutes past *2* o'clock  
*P.M.*

**HELEN L. LOVELL**

County Recorder

By *Mary Chen*  
 Deputy

*27*

93773

Well # 2

County Deer Lodge

GW 2 Revised 1969  
-10/69

STATE OF MONTANA  
ADMINISTRATOR OF GROUNDWATER CODE  
MONTANA WATER RESOURCES BOARD

NOTICE OF COMPLETION OF GROUNDWATER  
APPROPRIATION BY MEANS OF WELL

Developed after January 1, 1962

(Under Chapter 227 Montana Session Laws, 1961, as amended)

This form to be prepared by driller, and three copies to be filed by the owner with the County Clerk and Recorder in the county in which the well is located, last copy to be retained by driller. Please answer all questions. If not applicable, so state, otherwise the form may be returned.

Owner Mr. H. R. Ferguson  
Mt. Reggis Livestock  
Address Box 649  
Andover, Montana

For Administrator's Use  
File 93773  
August 9 1970  
2:40 P.M.

Date well started July 16, 1970 SW 1

completed same

Type of well Drilled

(Caug, driven, bored or drilled)

Equipment used Case 4011

(Case, drill, pump or other)

Water Use: Domestic  Municipal  Stock  Irrigation

Industrial  Drainage  Other  Garden/Lawn

\*Describe

USE: If used for irrigation, industrial, drainage or other. Explain, state number of acres and location or other data (i.e. lot, block and Addition).

ESTIMATED ANNUAL WITHDRAWAL 750,000 Gals.

Well ID	Type of Well	Diameter	Depth	PERFORATIONS		
				Top	Bottom	Depth
6 773	6 5/8" dia	0'	20'	working bench	15'	18'

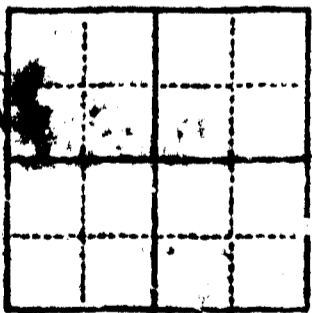

Static water level 4' ft.  
Pumping water level 20' ft.  
at 30 gallons per minute,  
measured        minutes after pumping  
began.  
\*Measured from ground level.  
Well developed by 2000 pump  
for 2 hours.  
Power        Pump 2 HP  
Remarks: (Gravel packing, cementing,  
packers, type of shutoff)

INDICATE LOCATION OF WELL AND PLACE OF USE, IF POSSIBLE  
EACH SMALL SQUARE REPRESENTS 40 ACRES

Driller's Signature O'Keefe Drilling Company

Driller's Address 2004 Harvard Ave.

License NO.       

Top of Ground (Mark above on log)

From (Feet)	To (Feet)	Description
0'	2'	top soil
2'	20'	sand, gravel & silt

20' Show sand depth of well

47315





Section 20

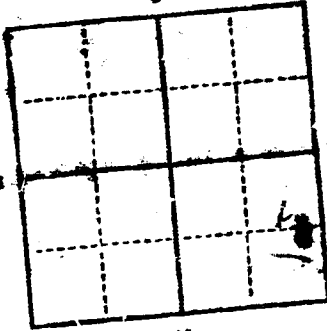

Static water level 19.4 ft.  
Pumping water level 30 ft.  
at 30 minutes after pumping  
began.  
measured from ground level  
Well developed by gravel packing  
for 1 1/2 hours.  
Pump (Gravel packing, cementing,  
Remarks: (Type of shaft))

Table with multiple rows and columns, mostly blank or illegible.

ESTIMATED ANNUAL WITHDRAWAL		and Addition)	
To	From	To	From
10	10	10	10
27	27	27	27
20	20	20	20
25	25	25	25

750,000 Gals.

93774

FILED FOR RECORD

August 3 1910

at 13 minutes past 2 o'clock

M HELEN L. LOVELL

County Recorder

By Mary Chan Deputy

20



93772  
 Well #1 on *Landmark Ranch*  
*Retched*

44 10 W - 26  
 County Deer Lodge

STATE OF MONTANA  
 ADMINISTRATOR OF GROUNDWATER CODE  
 MONTANA WATER RESOURCES BOARD

**NOTICE OF COMPLETION OF GROUNDWATER APPROPRIATION BY MEANS OF WELL**  
 Developed after January 1, 1962

(Under Chapter 237 Montana Session Laws, 1961, as amended)

This form to be prepared by driller, and three copies to be filed by the owner with the County Clerk and Recorder in the county in which the well is located, last copy to be retained by driller. Please answer all questions. If not applicable, so state, otherwise the form may be returned.

Owner Mr. H. E. Furgeson, Jr. For Administrator's Use  
 Address Mt. Haggis Livestock Box 640 Anaconda, Montana  
 Date well started July 15, 1970 GW 1  
 completed same

Type of well drilled  
 (Dug, driven, bored or drilled)

Equipment used churn drill  
 (Churn drill, rotary or other)

Water Use: Domestic  Municipal  Stock  irrigation   
 Industrial  Drainage  Other \* Garden/Lawn

\*Describe \_\_\_\_\_  
 USE: If used for irrigation, industrial, drainage or other. Explain, state number of acres and location or other data (i.e. Lot, Block and Addition).

ESTIMATED ANNUAL WITHDRAWAL

Size of Drilled Hole	Size and Weight of Casing	From (Feet)	To (Feet)	PERFORATIONS		
				Kind and Size	From (Feet)	To (Feet)
6 7/8"	6 5/8" od 15.025	0'	29'	cutting torch	22'	27'

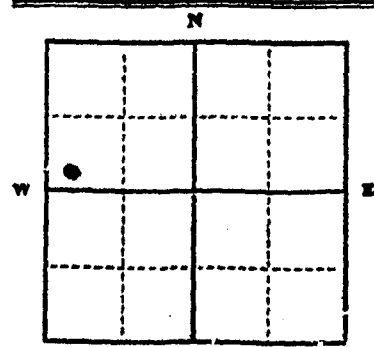

33 1/4 33 1/4 Sec. 33  
 T. 4 N. R. 10 W.

INDICATE LOCATION OF WELL AND PLACE OF USE, IF POSSIBLE. EACH SMALL SQUARE REPRESENTS 40 ACRES.

Driller's Signature O'Keefe Drilling Company

Driller's Address 2894 Harvard Ave.

Butterfield, Montana 59701 LICENSE NO. 8

DRILLER'S LOG

Indicate the character, color, thickness of strata such as soil, clay, sand, gravel, shale, sandstone, etc. Show depth at which water is found and height to which water rises in well.

Top of Ground (Elev. above sea level)	
From (Feet)	To (Feet)
0	5'
5'	29'

0 - 5' top soil  
 5' - 29' gravel & sand & water

29' Show exact depth of bottom

47316

measured	at				
minutes after pumping	gallons per minute				
Static water level	Pumping water level				
ft.	ft.				

Estimated Annual Withdrawal  
750,000 Gal.

	27	22	29	19.02	6/7/8
To	To	To	To	To	To
From	From	From	From	From	From

93772

**FILED FOR RECORD**

*August 3* 19*70*  
at *28* minutes past *2* o'clock  
*P.* M.

**HELEN L. LOVELL**

County Recorder

By *Mary Chan*  
Deputy

*27*

93772  
 Well #1 on ~~landed ranch~~  
 Retained

County Beaverhead

STATE OF MONTANA  
 ADMINISTRATOR OF GROUNDWATER CODE  
 MONTANA WATER RESOURCES BOARD

NOTICE OF COMPLETION OF GROUNDWATER  
 APPROPRIATION BY MEANS OF WELL

Developed after January 1, 1962

(Under Chapter 237 Montana Session Laws, 1961, as amended)

This form to be prepared by driller, and three copies to be filed by the owner with the County Clerk and Recorder in the county in which the well is located, last copy to be retained by driller. Please answer all questions. If not applicable, so state, otherwise the form may be returned.

Owner H. E. Ferguson For Administrator's Use

Address Box 640  
Bozeman, Montana

Date well started July 18, 1970 GW 1  
 completed same

93772  
 August 3, 1970  
 2:08 P.M.

Type of well drilled  
(Dig, drive, bored or drilled)

Equipment used case drill  
(Cable tool, rotary or other)

Water Use: Domestic  Municipal  Stock  Irrigation   
 Industrial  Drainage  Other  Garden/Lawn

\*Describe  
 USE: If used for irrigation, industrial, drainage or other. Explain, state number of acres and location or other data (i.e. Lot, Block and Addition).

ESTIMATED ANNUAL WITHDRAWAL 750,000 Gals.

Size of Hole	Size and Weight of Casing	From (Feet)	To (Feet)	PERFORATIONS		
				Kind	From (Feet)	To (Feet)
6 7/8"	5 5/8" od 18.025	0'	29'	cutting wash	22'	27'

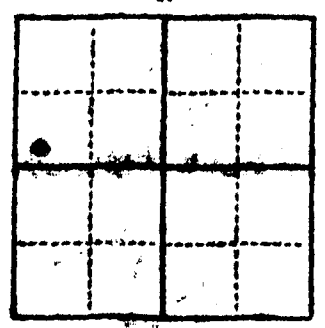

Static water level 21' ft.  
 Pumping water level 15' ft.  
 at 20 gallons per minute,  
 measured        minutes after pumping  
 began.  
 \*Measured from ground level.  
 Well developed by case pump  
 for 2 hours.  
 Power        Pump 2 HP  
 Remarks: (Gravel packing, cementing,  
 packers, type of shutoff)

INDICATE LOCATION OF WELL AND PLACE OF USE, IF POSSIBLE  
 EACH SMALL SQUARE REPRESENTS 10 ACRES

Driller's Signature O. E. ... Drilling Company

Driller's Address 2024 Main St

Driller's License No. 23781 LICENSE NO.       

DRILLER'S LOG  
 Indicate the character, color, thickness of strata such as soil, clay, sand, gravel, shale, sandstone, etc. Show depth at which water is found and height to which water rises in well.

Top of Ground (Show above sea level)

From (Feet)	To (Feet)	
0'	5'	top soil
5'	29'	gravel & sand
29'	27'	
27'	22'	
22'	15'	
15'	0'	

Show area north of well

4/7/70

95106

44-100W  
County Red Lodge  
26

STATE OF MONTANA  
ADMINISTRATOR OF GROUNDWATER CODE  
MONTANA WATER RESOURCES BOARD

NOTICE OF COMPLETION OF GROUNDWATER  
APPROPRIATION BY MEANS OF WELL

Developed after January 1, 1962

(Under Chapter 237 Montana Session Laws, 1961, as amended)

This form to be prepared by driller, and three copies to be filed by the owner with the County Clerk and Recorder in the county in which the well is located, last copy to be retained by driller. Please answer all questions. If not applicable, so state, otherwise the form may be returned.

DRILLER'S LOG  
Indicate the character, color, thickness of strata such as soil, clay, sand, gravel, shale, sandstone, etc. Show depth at which water is found and height to which water rises in well.

Owner Don Ray  
Address Cracker Hill, Montana  
Date well started March 10, 1970  
completed March 12, 1970

For Administrator's Use  
File 95106  
MARCH 25, 1971  
2:30 PM  
GW 1

Type of well drilled  
Equipment used chain drill  
Water Use: Domestic  Municipal  Stock  Irrigation   
Industrial  Drainage  Other \* Garden/Lawn

\*Describe \_\_\_\_\_  
USE: If used for irrigation, industrial, drainage or other. Explain, state number of acres and location or other data (i.e. Lot, Block and Addition).

ESTIMATED ANNUAL WITHDRAWAL

Size of Drilled Hole	Size and Weight of Casing	From (Feet)	To (Feet)	PERFORATIONS		
				Kind	From (Feet)	To (Feet)
6"	6" I.D. 17 lb.	0'	44'	setting screen	38'	43'

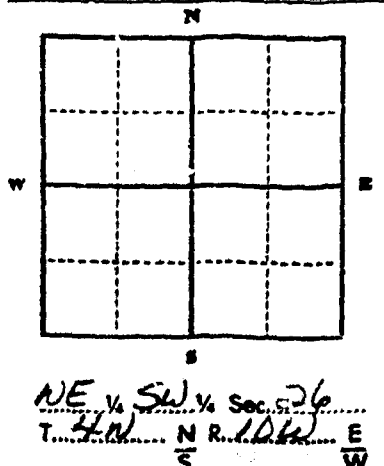

Static water level 1.2 ft.  
Pumping water level 3.5 ft.  
at 20 gallons per minute,  
measured            minutes after pumping  
began.  
\*Measured from ground level.  
Well developed by baller  
for 3 hours.  
Power            HP  
Remarks: (Gravel packing, cementing,  
packers, type of shutoff)

INDICATE LOCATION OF WELL AND PLACE OF USE, IF POSSIBLE.  
EACH SMALL SQUARE REPRESENTS 40 ACRES.

Driller's Signature [Signature]  
Driller's Address Cresco Drilling Co  
Dutton, Montana LICENSE NO. 8

Top of Ground		
From (Feet)	To (Feet)	
0	2	Top Soil
2	23	Gravel & Boulders
23	38	Sandy Clay
38	43	Sand, Gravel WATER

Show exact depth of bottom 43'

48247

Information is available. Please complete and return the corrected copy to the Montana Water Resources Board in Helena. Please furnish us with the legal description of the location of your well as to township, range, and section as indicated in red. Thank you.

Other.

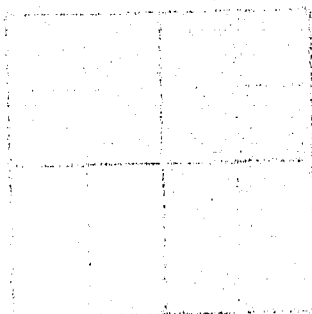

95106  
**FILED FOR RECORD**  
March 25 1971  
 at 30 minutes past 2 o'clock  
P M  
**HELEN L. LOVELL**  
 County Recorder  
 By Mary Chan  
 Deputy  
8.250



RECEIVED

MONTANA WATER RESOURCES BOARD  
Water Resources Division  
Mitchell Building  
Helena, Montana 59601

MONTANA WATER RESOURCES BOARD

Dir. \_\_\_\_\_ Fin. \_\_\_\_\_  
Asst. \_\_\_\_\_ Inf. \_\_\_\_\_  
Eng. \_\_\_\_\_ Grd. \_\_\_\_\_  
WRD \_\_\_\_\_ RBC \_\_\_\_\_  
ECO \_\_\_\_\_ WSW \_\_\_\_\_  
Lgt. \_\_\_\_\_ CON \_\_\_\_\_

MAY 1971

Recently a copy of a groundwater appropriation form:

- GW 1, Notice of Appropriation of Groundwater
- GW 2, Notice of Completion of Groundwater Appropriation by means of Well
- GW 3, Notice of Completion of Groundwater Appropriation without Well
- GW 4, Declaration of Vested Groundwater Rights (This form is obsolete and was limited by law to use only through 1965)

was forwarded to this office by the County Clerk and Recorder.

This form is identified by

Owner Mr. Don Hay Address Crackerville, Montana

Location T. \_\_\_\_\_ R. \_\_\_\_\_ Sec. \_\_\_\_\_ Document No. 95106

This is to inform you that your GW form has been received and is complete as filed.

This is a request for additional information if available. Please complete the enclosed copy by providing information where indicated, or as noted here and return the corrected copy to the Montana Water Resources Board in Helena.

Please furnish us with the legal description of the location of your well as to township, range, and section as indicated in red. Thank you.

Other.

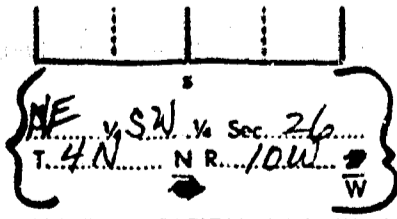

Power \_\_\_\_\_ Pump \_\_\_\_\_  
Remarks: (Gravel packing, cementing, packers, type of shut-off) \_\_\_\_\_  
\_\_\_\_\_

INDICATE LOCATION OF WELL AND PLACE OF USE, IF POSSIBLE. EACH SMALL SQUARE REPRESENTS 0 ACRES.

Driller's Signature \_\_\_\_\_

Driller's Address \_\_\_\_\_

Driller's License No. \_\_\_\_\_

Show exact depth in bottom.

10567

75106

County Beaumont

STATE OF MONTANA  
ADMINISTRATOR OF ~~GROUNDWATER~~ WATER  
MONTANA WATER RESOURCES BOARD

NOTICE OF COMPLETION OF GROUNDWATER  
APPROPRIATION BY MEANS OF WELL

Developed after January 1, 1962

(Under Chapter 237 Montana Session Laws, 1961, as amended)

This form to be prepared by driller, and three copies to be filed by the owner with the County Clerk and Recorder in the county in which the well is located, last copy to be retained by driller.

Please answer all questions. If not applicable, so state, otherwise the form may be returned.

Owner Montgomery

Address Oronoville, Montana

Date well started March 19, 1970

completed March 11, 1970

For Administrator's Use	
File	<u>95106</u>
	<u>MARCH 25, 1971</u>
	<u>2:30 PM</u>
GW 1	

Type of well drilled (Csg. driven, bored or drilled)

Equipment used chain drill (Chain drill, rotary or other)

Water Use: Domestic  Municipal  Stock  Irrigation

Industrial  Drainage  Other \* Garden/Lawn

\*Describe

USE: If used for irrigation, industrial, drainage or other. Explain, state number of acres and location or other data (i.e. Lot, Block and Addition).

ESTIMATED ANNUAL WITHDRAWAL

Size of Drilled Hole	Size and Weight of Casing	From (Feet)	To (Feet)	PERFORATIONS		
				Blind Size	From (Feet)	To (Feet)
5"	6" I.D. 17 lb.	0'	44'	cuttings torch	33'	43'

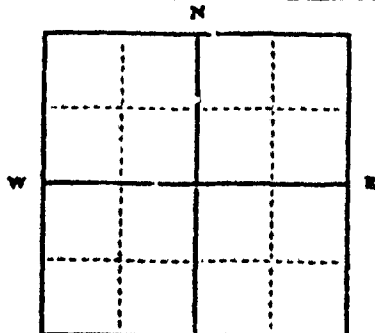

Static water level .....ft.\*  
Pumping water level .....ft.\*  
at .....gallons per minute,  
measured .....minutes after pumping  
began.

\*Measured from ground level.  
Well developed by .....  
for .....hours.  
Power..... Pump..... HP  
Remarks: (Gravel packing, cementing,  
packers, type of shutoff) .....

INDICATE LOCATION OF WELL AND PLACE OF USE, IF POSSIBLE.  
EACH SMALL SQUARE REPRESENTS 40 ACRES.

Driller's Signature [Signature]

Driller's Address Montgomery

Driller's License No. 4

DRILLER'S LOG

Indicate the character, color, thickness of strata such as soil, clay, sand, gravel, shale, sandstone, etc. Show depth at which water is found and height to which water rises in well.

Top of Ground (Elev. above sea level)		Remarks
From (Feet)	To (Feet)	
0		
1		
2		
3		
4		
5		
6		
7		
8		
9		
10		
11		
12		
13		
14		
15		
16		
17		
18		
19		
20		
21		
22		
23		
24		
25		
26		
27		
28		
29		
30		
31		
32		
33		
34		
35		
36		
37		
38		
39		
40		
41		
42		
43		
44		
45		
46		
47		
48		
49		
50		
51		
52		
53		
54		
55		
56		
57		
58		
59		
60		
61		
62		
63		
64		
65		
66		
67		
68		
69		
70		
71		
72		
73		
74		
75		
76		
77		
78		
79		
80		
81		
82		
83		
84		
85		
86		
87		
88		
89		
90		
91		
92		
93		
94		
95		
96		
97		
98		
99		
100		

Show exact depth of bottom

75106

File No. \_\_\_\_\_

DUPLICATE

STATE OF MONTANA  
ADMINISTRATOR OF GROUNDWATER CODE  
OFFICE OF STATE ENGINEER

T. UN R. 10County Deer Lodge

R

JAN 9 1964

STATE ENGINEER

### Declaration of Vested Groundwater Rights

(Under Chapter 237, Montana Session Laws, 1961)

1. Dan P. Ivankovich (Name of Appropriator), of 408 East Com'l, Anaconda (Address) (Town)

County of Deer Lodge State of Montana  
have appropriated groundwater according to the Montana laws in effect prior to January 1, 1962, as follows:

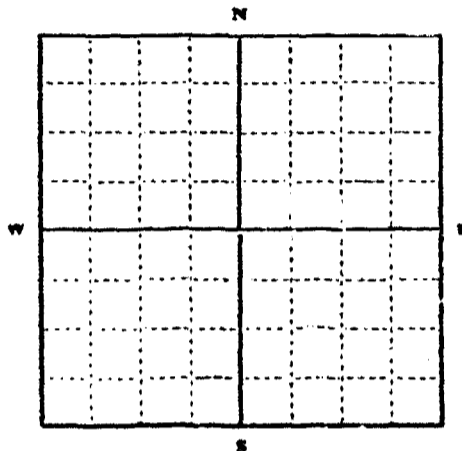

1/4 Sec. 26 T. 4 N. R. 10  
Indicate point of appropriation and place of use, if possible. Each small square represents 10 acres.

2. The beneficial use on which the claim is based drinking water, household use

3. Date or approximate date of earliest beneficial use; and how continuous the use has been September, 1957 to present date

4. The amount of groundwater claimed (in miner's inches or gallons per minute) approx 7 GPM

5. If used for irrigation, give the acreage and description of the lands to which water has been applied and name of the owner thereof  
not used for irrigation

6. The means of withdrawing such water from the ground location of each well or other means of withdrawal  
Electrical pump

7. The date of commencement and completion of the construction of the well, wells, or other works for withdrawal of groundwater September, 1957

8. The depth of water table 128 ft.

9. So far as it may be available, the type, size and depth of each well or the general specifications of any other works for the withdrawal of groundwater

10. The estimated amount of groundwater withdrawn each year ?

11. The log of formations encountered in the drilling of each well if available ? don't know

12. Such other information of a similar nature as may be useful in carrying out the policy of this act, including reference to book and page of any county record

Signature of Owner

Dan P. Ivankovich  
Date February 10, 1964

Three copies to be filed by the owner with the County Clerk and Recorder of the county in which the well is located.

Please answer all questions. If not applicable, so state, otherwise the form will be returned.

Original to the County Clerk and Recorder; Duplicates to the State Engineer; Triplicate to the Montana Bureau of Mines and Geology; and Quadruplicate for the Appropriator.

28836

81511

FILED FOR RECORD

Dec. 31 1963

at 30 minutes past 12 o'clock

P.M.

ANTA QUICKE

Clerk of Court

Mary McConner