

81225

FILED FOR RECORD

December 30, 1963
at 54 minutes past 9 o'clock
A.M. **ANNK QUIGLEY**

County Recorder
Carol McCarley
Deputy

File No.

T. S R 12

DUPLICATE

County Deer Lodge

STATE OF MONTANA
ADMINISTRATOR OF GROUNDWATER CODE
OFFICE OF STATE ENGINEER

RECEIVED
JAN 8 1964

Declaration of Vested Groundwater Rights

(Under Chapter 237, Montana Session Laws, 1961)

STATE ENGINEER

1. Joseph P. Kowalek, of Box 92 1/2 Cable Road Amesons
(Name of Appropriator) (Address) (Town)

County of Deer Lodge State of Montana
have appropriated groundwater according to the Montana laws in effect prior to January 1, 1962, as follows:

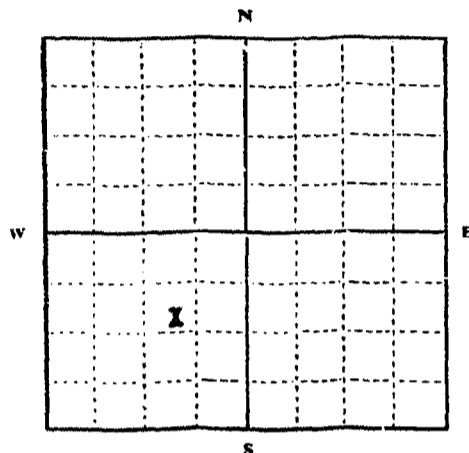

S W 1/4 Sec 26 T S R 12

Indicate point of appropriation and place of use, if possible. Each small square represents 10 acres.

2. The beneficial use on which the claim is based Domestic household use and irrigation.

3. Date or approximate date of earliest beneficial use; and how continuous the use has been June 1935. Daily.

4. The amount of groundwater claimed (in miner's inches or gallons per minute) 1000 gallons per hour.

5. If used for irrigation, give the acreage and description of the lands to which water has been applied and name of the owner thereof 2 acres for gardening and maintenance of grounds. Joseph P. Kowalek Lessee from Amesons Company.

6. The means of withdrawing such water from the ground and the location of each well or other means of withdrawal Two shallow wells one beneath house and one outside near east end of house. Pump.

7. The date of commencement and completion of the construction of the well, wells, or other works for withdrawal of groundwater June 1935.

8. The depth of water table 4 feet.

9. So far as it may be available, the type, size and depth of each well or the general specifications of any other works for the withdrawal of groundwater Concrete cistern type well. 8 feet deep, each installation.

10. The estimated amount of groundwater withdrawn each year.....

11. The log of formations encountered in the drilling of each well if available loose gravel.

12. Such other information of a similar nature as may be useful in carrying out the policy of this act, including reference to book and page of any county record.....

Signature of Owner

Joseph P. Kowalek
Date Dec. 30, 1963

Three copies to be filed by the owner with the County Clerk and Recorder of the county in which the well is located.

Please answer all questions. If not applicable, so state, otherwise the form will be returned.

Original to the County Clerk and Recorder; Duplicate to the State Engineer; Triplicate to the Montana Bureau of Mines and Geology, and Quadruplicate for the Appropriator.

17078

81223

FILED FOR RECORD

December 30 1963

at 50 minutes past 7 o'clock

P.M.

ANNA QUIGLEY

Clerk of the Court

Carol Mc Carthy
Deputy

File No.

T 5N R 12W

DUPLICATE

County Deer Lodge

STATE OF MONTANA
ADMINISTRATOR OF GROUNDWATER CODE
OFFICE OF STATE ENGINEER

1962
STATE ENGINEER

Declaration of Vested Groundwater Rights

(Under Chapter 237, Montana Session Laws, 1961)

1. Anaconda Co., of Anaconda, Montana
(Name of Appropriator) (Address) (Town)

County of Deer Lodge State of Montana
have appropriated groundwater according to the Montana laws in effect prior to January 1, 1962, as follows:

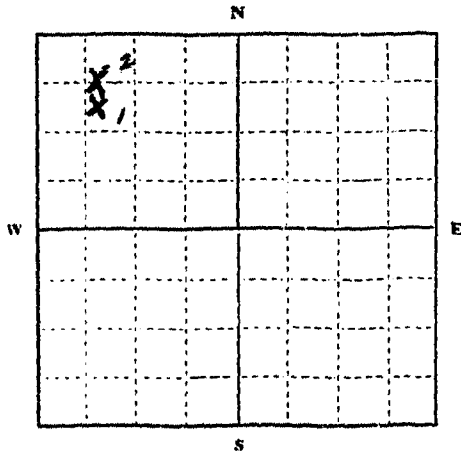

N.W. 1/4 Sec. 29 T. 5N R. 12W

Indicate point of appropriation and place of use, if possible. Each small square represents 10 acres.

2. The beneficial use on which the claim is based Household + irrigation use

3. Date or approximate date of earliest beneficial use; and how continuous the use has been Since 1925

4. The amount of groundwater claimed (in miner's inches or gallons per minute) 12 gallons per minute

5. If used for irrigation, give the acreage and description of the lands to which water has been applied and name of the owner thereof Land irrigation - approx - 1 Acre

6. The means of withdrawing such water from the ground and the location of each well or other means of withdrawal PUMP

7. The date of commencement and completion of the construction of the well, wells, or other works for withdrawal of groundwater 1st well Sept 1925
2nd well drilled 1959, July

8. The depth of water table 1st well 16ft.; 2nd well 50ft.

9. So far as it may be available, the type, size and depth of each well or the general specifications of any other works for the withdrawal of groundwater 1st well - Aug. well - 6ft dia. 30ft. deep
2nd well drilled 6" casing 180ft. deep

10. The estimated amount of groundwater withdrawn each year 500,000 gals.

11. The log of formations encountered in the drilling of each well if available Not available

12. Such other information of a similar nature as may be useful in carrying out the policy of this act, including reference to book and page of any county record Not applicable -

Signature of Owner Anaconda Co

Date 12-31-63

By James R. Boe, JFP5

Three copies to be filed by the owner with the County Clerk and Recorder of the county in which the well is located.

Please answer all questions. If not applicable, so state, otherwise the form will be returned.

Original to the County Clerk and Recorder; Duplicate to the State Engineer; Triplicate to the Montana Bureau of Mines and Geology, and Quadruplicate for the Appropriator.

28834

81509

FILED FOR RECORD

May 31 1967

at 38 minutes past 12 o'clock

P. M.

KING COUNTY

County Recorder

May Moore

Deputy

File No.

5N R - 2W

DUPLICATE

County DEER LODGE

STATE OF MONTANA
ADMINISTRATOR OF GROUNDWATER CODE
OFFICE OF STATE ENGINEER

JAN 7 1964

Declaration of Vested Groundwater Rights

(Under Chapter 237, Montana Session Laws, 1961)

1. JOHN V. APPLIGATE, of BOX 31 STAR RT. ANAERONDA
(Name of Appropriator) (Address) (Town)

County of DEER LODGE State of MONTANA
have appropriated groundwater according to the Montana laws in effect prior to January 1, 1962, as follows:

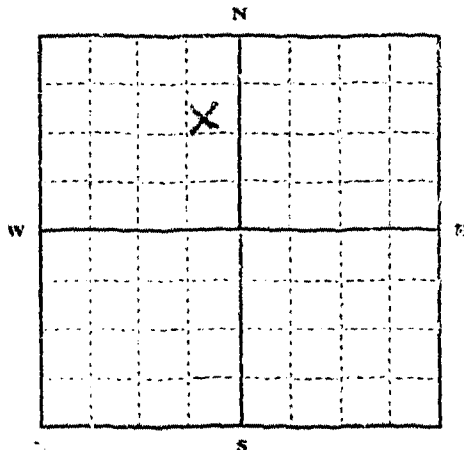

Sec. 29 T. 5. R. 12

Indicate point of appropriation and place of use, if possible. Each small square represents 10 acres.

2. The beneficial use on which the claim is based. DOMESTIC HOUSE HLD + IRRIGATION

3. Date or approximate date of earliest beneficial use; and how continuous the use has been. JULY 28, 60 - USED CONTINUOUS

4. The amount of groundwater claimed (in miner's inches or gallons per minute). TESTED 100 GPM NO DRAW DOWN

5. If used for irrigation, give the acreage and description of the lands to which water has been applied and name of the owner thereof. 1 TO 3 ACES - OWNER SAME AS ABOVE

6. The means of withdrawing such water from the ground and the location of each well or other means of withdrawal. START JUNE 7 SUBMERSIBLE PUMP

7. The date of commencement and completion of the construction of the well, wells, or other works for withdrawal of groundwater. START JULY 10 TO JULY 28, 1960

8. The depth of water table. 58' TESTED 20 GPM. 130' TESTED 100 GPM. 155' TOTAL DEPTH

9. So far as it may be available, the type, size and depth of each well or the general specifications of any other works for the withdrawal of groundwater. 7" STEEL CASING 155' deep. APPROXIMATE 1 1/2" DIA. 150' SUBMERSIBLE PUMP 1/2 HP. 120 GAL TANK

10. The estimated amount of groundwater withdrawn each year. 300,000 gal. yr.

11. The log of formations encountered in the drilling of each well if available. 1650' Boulder + GRAVEL 50' SANDY CLAY to 100' to 115' 125' lime broken 125' SANDY HARD 154' yellow clay

12. Such other information of a similar nature as may be useful in carrying out the policy of this act, including reference to book and page of any county record. page 229 line 29

Signature of Owner

John V. Appligate
Date Jan 7, 1964

Three copies to be filed by the owner with the County Clerk and Recorder of the county in which the well is located.

Please answer all questions. If not applicable, so state, otherwise the form will be returned.

Original to the County Clerk and Recorder; Duplicate to the State Engineer; Triplicate to the Montana Bureau of Mines and Geology, and Quadruplicate for the Appropriator.

2 1870

81591

FILED FOR RECORD

January 7 1964
at 23 minutes past 1 o'clock
P.M. ANNA QUIGLEY

County Recorder
By Paul McCarty
Deputy

File No.

T. 5 R. 12

DUPLICATE

County Beaverhead

STATE OF MONTANA
ADMINISTRATOR OF GROUNDWATER CODE
OFFICE OF STATE ENGINEER

JAN 20 1964

Notice of Completion of Groundwater Appropriation
Without Well

(Under Chapter 237 Montana Session Laws, 1961)

Date of Appropriation of Groundwater.....?

Owner HAROLD GARCIA Address WEST ANACORDA (YANKEE FLATS)

Contractor (if any)

Address of Contractor

Date Started.....? Date Completed.....?

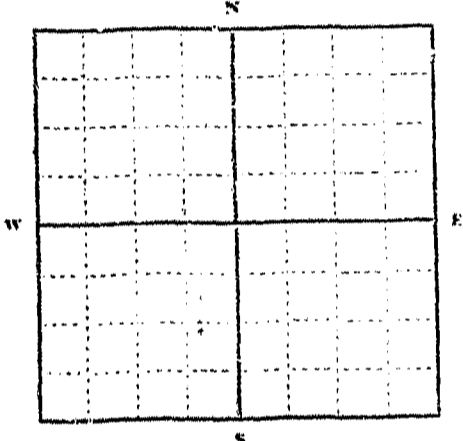

N.W. 1/4 Sec. 29 T. 5 R. 12
Indicate point of appropriation and place of use, if possible.

Describe means of obtaining groundwater without a well "as by sub-irrigation and other natural processes". Include depth to water when applicable. SUNKEN TANK ON WARM SPRING CREEK, + PUMPTO HOUSE

Quantity of water developed and used with explanation of method used to measure or estimate such amount. If use is intermittent

estimate approximate lengths of periods of use. 300 G.P. DAY FOR DOMESTIC USE, + SANITATION PURPOSE.

Signature of Owner Harold Garcia

Date Jan 17, 1964

This form to be prepared by contractor (if any), otherwise by the owner.
Three copies of this notice are to be filed with the County Clerk and Recorder of the county in which the works are located.
Please answer all questions. If not applicable, so state, otherwise the form will be returned.
Original to the County Clerk and Recorder; duplicate to the State Engineer; Triplicate to the Montana Bureau of Mines and Geology and Quadruplicate for the Appropriator.

81669

PAID TO ORDER
at Jan 17 1964
at 25 minutes past 4 o'clock
P.M. ATKIN CROCKETT
County Registrar
Mary M. Bennett

File No.

T. 5N R. 12W

DUPLICATE

County Deer Lodge

STATE OF MONTANA
ADMINISTRATOR OF GROUNDWATER CODE
OFFICE OF STATE ENGINEER

JAN 9 1964
STATE ENGINEER

**Notice of Completion of Groundwater Appropriation
Without Well**

(Under Chapter 237 Montana Session Laws, 1961)

Date of Appropriation of Groundwater JAN. 2, 1964
Owner A. Frank Allen Address Cable Road, Box 38A
Contractor (if any) NONE
Address of Contractor
Date Started Date Completed

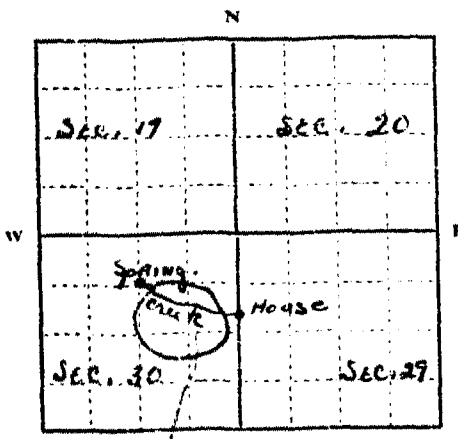

..... 1/4 Sec. 30 T. 5N R. 12W
Indicate point of appropriation
and place of use, if possible.

SW

Describe means of obtaining groundwater without a well "as by sub-irrigation and other natural processes". Include depth to water when applicable. SURFACE WATER FROM NATURAL SPRING.

Quantity of water developed and used with explanation of method used to measure or estimate such amount. If use is intermittent

estimate approximate lengths of periods of use don't know how to measure flow, but there is enough water for eight homes year around and some irrigating during the summer.

Signature of Owner A. Frank Allen

Date Jan. 2, 1964

This form to be prepared by contractor (if any), otherwise by the owner.

Three copies of this notice are to be filed with County Clerk and Recorder of the county in which the works are located.

Please answer all questions. If not applicable, so state, otherwise the form will be returned.

Original to the County Clerk and Recorder; duplicate to the State Engineer; Triplicate to the Montana Bureau of Mines and Geology and Quadruplicate for the Appropriator.

28783

91458

FILED FOR RECORD

December 31 1963

at 37 minutes past 11 o'clock

P.M. ANNA CINCERY

By C. A. Mc Carthy

Deputy

98723

County Deer Lodge

STATE OF MONTANA
ADMINISTRATOR OF GROUNDWATER CODE
MONTANA WATER RESOURCES BOARD

NOTICE OF COMPLETION OF GROUNDWATER
APPROPRIATION BY MEANS OF WELL
Developed after January 1, 1962

(Under Chapter 237 Montana Session Laws, 1961, as amended)

This form to be prepared by driller, and three copies to be filed by the owner with the County Clerk and Recorder in the county in which the well is located, last copy to be retained by driller.

Please answer all questions. If not applicable, so state, otherwise the form may be returned.

Owner COY INDUSTRIES
Address 1000 E. 10th St. Billings
Date well started January 15, 1973
completed February 1, 1973

For Administrator's Use
File <u>98723</u>
<u>January 15, 1973</u>
GW <u>1:40 P.M.</u>

Type of well Drilled
(Dug, driven, bored or drilled)
Equipment used Rotary Drill
(Chain drill, rotary or other)

Water Use: Domestic Municipal Stock Irrigation
Industrial Drainage Other * Garden/Lawn

*Describe _____
USE: If used for irrigation, industrial, drainage or other. Explain, state number of acres and location or other data (i.e. Lot, Block and Addition).

ESTIMATED ANNUAL WITHDRAWAL 100,000 gallons

Size of Drilled Hole	Size and Weight of Casing	From (Feet)	To (Feet)	PERFORATIONS		
				Kind Slot	From (Feet)	To (Feet)
4"	4" x 10' x 10' x 10' x 10'	10'	10'	Slot		

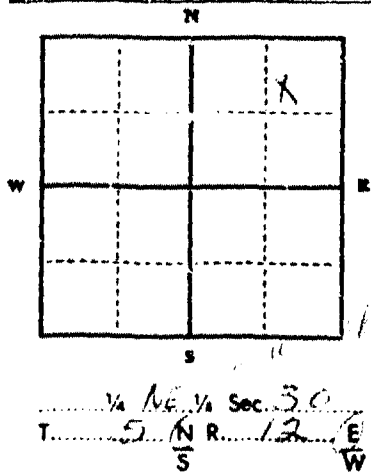

Static water level _____ ft.*
Pumping water level _____ ft.*
at _____ gallons per minute,
measured _____ minutes after pumping
began.
*Measured from ground level.
Well developed by _____
for _____ hours.
Power _____ Pump _____ HP
Remarks: (Gravel packing, cementing,
packers, type of shutoff)

INDICATE LOCATION OF WELL AND PLACE OF USE, IF POSSIBLE. EACH SMALL SQUARE REPRESENTS 40 ACRES.

Driller's Signature _____

Driller's Address _____

LICENSE NO. 9

DRILLER'S LOG

Indicate the character, color, thickness of strata such as soil, clay, sand, gravel, shale, sandstone, etc. Show depth at which water is found and height to which water rises in well.

Top of Ground (Elev. above sea level)	
From (Feet)	To (Feet)
	0 - 2' Sand, gravel, silt
	2 - 4' Gravel, sand, silt
	4 - 6' Gravel
	6 - 8' Gravel, sandstone
	8 - 10' Sandstone, shale, clay
	10 - 12' Sandstone
	12 - 14' Sandstone
	14 - 16' Sandstone, shale, clay
	16 - 18' Sandstone
	18 - 20' Sandstone, shale, clay
	20 - 22' Sandstone
	22 - 24' Sandstone, shale, clay
	24 - 26' Sandstone
	26 - 28' Sandstone, shale, clay
	28 - 30' Sandstone
	30 - 32' Sandstone, shale, clay
	32 - 34' Sandstone
	34 - 36' Sandstone, shale, clay
	36 - 38' Sandstone
	38 - 40' Sandstone, shale, clay
	40 - 42' Sandstone
	42 - 44' Sandstone, shale, clay
	44 - 46' Sandstone
	46 - 48' Sandstone, shale, clay
	48 - 50' Sandstone
	50 - 52' Sandstone, shale, clay
	52 - 54' Sandstone
	54 - 56' Sandstone, shale, clay
	56 - 58' Sandstone
	58 - 60' Sandstone, shale, clay
	60 - 62' Sandstone
	62 - 64' Sandstone, shale, clay
	64 - 66' Sandstone
	66 - 68' Sandstone, shale, clay
	68 - 70' Sandstone
	70 - 72' Sandstone, shale, clay
	72 - 74' Sandstone
	74 - 76' Sandstone, shale, clay
	76 - 78' Sandstone
	78 - 80' Sandstone, shale, clay
	80 - 82' Sandstone
	82 - 84' Sandstone, shale, clay
	84 - 86' Sandstone
	86 - 88' Sandstone, shale, clay
	88 - 90' Sandstone
	90 - 92' Sandstone, shale, clay
	92 - 94' Sandstone
	94 - 96' Sandstone, shale, clay
	96 - 98' Sandstone
	98 - 100' Sandstone, shale, clay

Show exact depth of bottom

52,520

98723

5N 12W
County Deer Lodge

STATE OF MONTANA
ADMINISTRATOR OF GROUNDWATER CODE
MONTANA WATER RESOURCES BOARD

NOTICE OF COMPLETION OF GROUNDWATER
APPROPRIATION BY MEANS OF WELL

Developed after January 1, 1962

(Under Chapter 237 Montana Session Laws, 1961, as amended)

This form to be prepared by driller, and three copies to be filed by the owner with the County Clerk and Recorder in the county in which the well is located, last copy to be retained by driller.

Please answer all questions. If not applicable, so state, otherwise the form may be returned.

Owner Log Lorange
Address Bozeman, Montana

For Administrator's Use	
File	<u>98723</u>
Date	<u>January 15, 1973</u>
Time	<u>GW 1 1:40 P.M.</u>

Date well started Apr 14, 1968
completed Apr 3, 1968

Type of well drill d
(Dig, driven, bored or drilled)
Equipment used Steam drill
(Churn drill, rotary or other)
Water Use: Domestic Municipal Stock Irrigation
Industrial Drainage Other * Garden/Lawn

*Describe _____
USE: If used for irrigation, industrial, drainage or other. Explain, state number of acres and location or other data (i.e. Lot, Block and Addition).

ESTIMATED ANNUAL WITHDRAWAL 1,500,000 gallons

Size of Drilled Hole	Size and Weight of Casing	From (Feet)	To (Feet)	PERFORATIONS		
				Kind	From (Feet)	To (Feet)
6"	6" I.D. 19 lb Black pipe steel	10'	230'	None		

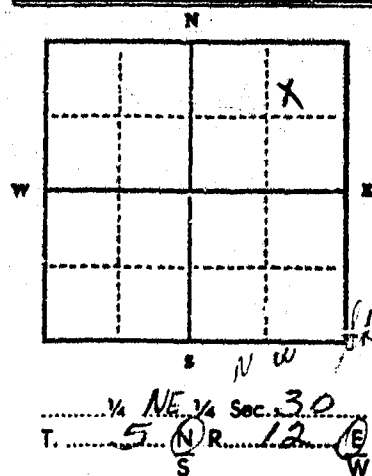

Static water level 220 ft.*
Pumping water level 230 ft.*
at 57 gallons per minute,
measured minutes after pumping
began.
*Measured from ground level.
Well developed by balling
for hours.
Power..... Pump..... HP
Remarks: (Gravel packing, cementing,
packers, type of shutoff) the well covered 1200 to get casing down

INDICATE LOCATION OF WELL AND PLACE OF USE, IF POSSIBLE. EACH SMALL SQUARE REPRESENTS 40 ACRES.

Driller's Signature _____
Driller's Address P. Box 5, Dillon, Montana 59725
LICENSE NO. 9

DRILLER'S LOG

Indicate the character, color, thickness of strata such as soil, clay, sand, gravel, shale, sandstone, etc. Show depth at which water is found and height to which water rises in well.

Top of Ground		(Elev. above sea level)
From (Feet)	To (Feet)	
0	15	Dark loam, gravel, sand & clay
15	67	Clay loam sand & gravel
67	80	clay
80	175	clay & broken rock
175	210	broken rock, yellow clay grey sand
210	251	broken rock
251		fractured broken rock

Show exact depth of bottom

52,250

98723

FILED FOR RECORD

January 15 1973
at 40 minutes past 1 o'clock

P. M

HELEN L. LOVELL

County Recorder

By

Laura McKeamy

Deputy

\$2.00

File No.

T. 5 R. 12 W

DUPLICATE

County Deer Lodge

STATE OF MONTANA
ADMINISTRATOR OF GROUNDWATER CODE
OFFICE OF STATE ENGINEER

1964
STATE ENGINEER

Declaration of Vested Groundwater Rights

(Under Chapter 237, Montana Session Laws, 1961)

1. Alfred B Anderson, of Box 1305 Agawanda
(Name of Appropriator) (Address) (Town)

County of Deer Lodge State of Montana
have appropriated groundwater according to the Montana laws in effect prior to January 1, 1962, as follows:

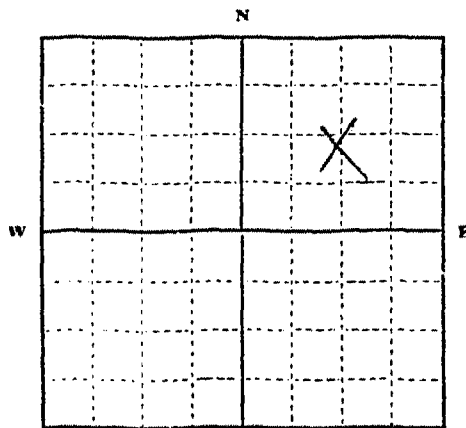

N.E. 1/4 Sec. 36 T. 5 R. 12 W

Indicate point of appropriation and place of use, if possible. Each small square represents 10 acres.

2. The beneficial use on which the claim is based Home & Irrigation

3. Date or approximate date of earliest beneficial use; and how continuous the use has been May, 1936

4. The amount of groundwater claimed (in miner's inches or gallons per minute) 150 Miner's in.

5. If used for irrigation, give the acreage and description of the lands to which water has been applied and name of the owner thereof 26 acres Pasture & Lawn

6. The means of withdrawing such water from the ground and the location of each well or other means of withdrawal Pump & spring

7. The date of commencement and completion of the construction of the well, wells, or other works for withdrawal of groundwater 1936

8. The depth of water table 20 ft.

9. So far as it may be available, the type, size and depth of each well or the general specifications of any other works for the withdrawal of groundwater 20 ft.

10. The estimated amount of groundwater withdrawn each year 150 Miner's in

11. The log of formations encountered in the drilling of each well if available Clay sand & granite gravel

12. Such other information of a similar nature as may be useful in carrying out the policy of this act, including reference to book and page of any county record none other available

Signature of Owner Alfred B Anderson
Date Dec. 31, 1963

Three copies to be filed by the owner with the County Clerk and Recorder of the county in which the well is located.

Please answer all questions. If not applicable, so state, otherwise the form will be returned.

Original to the County Clerk and Recorder; Duplicate to the State Engineer; Triplicate to the Montana Bureau of Mines and Geology, and Quadruplicate for the Appropriator. 28787

81462

FILED FOR RECORD

DEC 31 1963

at 41 minutes past 11 o'clock

P.M. ANNA COOLEY

Mary M. ...

File No.....

T. 5N R 12W

DUPLICATE

County Deer Lodge

STATE OF MONTANA
ADMINISTRATOR OF GROUNDWATER CODE
OFFICE OF STATE ENGINEER

RECEIVED
JAN 9 1964

STATE ENGINEER

Notice of Completion of Groundwater Appropriation Without Well

(Under Chapter 237 Montana Session Laws, 1961)

Date of Appropriation of Groundwater Natural Spring

Owner Beana Anceast Address Stumptown Antevia, Mont.

Contractor (if any)

Address of Contractor

Date Started..... Date Completed.....

Describe means of obtaining groundwater without a well "as by sub-irrigation and other natural processes". Include depth to water when applicable. Natural Spring flowing by Gravity to house

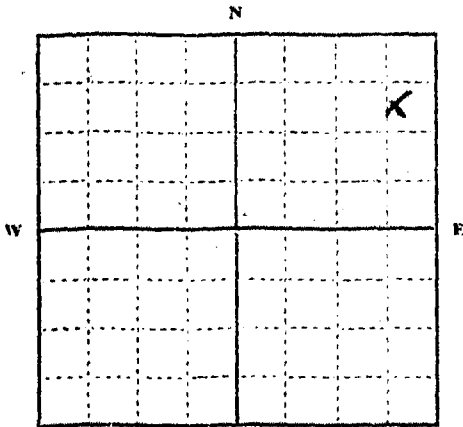

N 1/4 Sec 34 T 5 R 12

Indicate point of appropriation and place of use, if possible.

Quantity of water developed and used with explanation of method used to measure or estimate such amount. If use is intermittent estimate approximate lengths of periods of use. 250 gal.

per house

Signature of Owner Herbert C. Banks

Date 12-31-63

This form to be prepared by contractor (if any), otherwise by the owner.

Three copies of this notice are to be filed with the County Clerk and Recorder of the county in which the works are located.

Please answer all questions. If not applicable, so state, otherwise the form will be returned.

Original to the County Clerk and Recorder; duplicate to the State Engineer; Triplicate to the Montana Bureau of Mines and Geology and Quadruplicate for the Appropriator.

28804

81479

FILED FOR RECORD

December 31 1963
at 56 minutes past 11 o'clock
P.M. Anna Dugley
County Recorder

By _____
JOC
Deputy

File No.

DUPLICATE

T. SN R 12 W

County Beaumont

STATE OF MONTANA
ADMINISTRATOR OF GROUNDWATER CODE
OFFICE OF STATE ENGINEER

RECEIVED
FEB 7 1964

Notice of Completion of Groundwater Appropriation
Without Well

(Under Chapter 237 Montana Session Laws, 1961)

Date of Appropriation of Groundwater Jan 3, 1964

Owner George W. Anderson Address PO Box 1031

Contractor (if any) Same Jan 3, 1964

Address of Contractor Same

Date Started Oct 31, 1957 Date Completed Nov 15, 1957

Describe means of obtaining groundwater without a well "as by sub-irrigation and other natural processes". Include depth to water when applicable. Dug out natural spring?

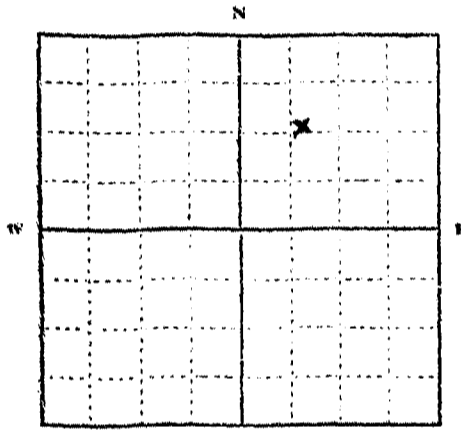

NE Sec. 36 T. 5N R. 12W
Indicate point of appropriation and place of use, if possible

Quantity of water developed and used with explanation of method used to measure or estimate such amount. If use is intermittent estimate approximate lengths of periods of use for reclamation

1000 gal per second (by spillway)

Signature of Owner George W. Anderson

Date Feb 3 1964

This form to be prepared by contractor (if any), otherwise by the owner.

Three copies of this notice are to be filed with the County Clerk and Recorder of the county in which the works are located.

Please answer all questions. If not applicable, so state, otherwise the form will be returned.

Original to the County Clerk and Recorder; duplicate to the State Engineer; Triplicate to the Montana Bureau of Mines and Geology and Quadruplicate for the Appropriator.

36

File No. _____

T. 5 N R 12 W

DUPLICATE

County Silver Lake

STATE OF MONTANA
ADMINISTRATOR OF GROUNDWATER CODE
OFFICE OF STATE ENGINEER

RECEIVED
FEB 7 1964

Notice of Completion of Groundwater Appropriation
Without Well

(Under Chapter 237 Montana Session Laws, 1961)

Date of Appropriation of Groundwater Jan. 3, 1964
Owner George W. Anderson Address P.O. Box 1031
Contractor (if any) Same Jan 3, 1964
Address of Contractor Same
Date Started Oct 21, 1957 Date Completed Nov 15, 1957

Describe means of obtaining groundwater without a well "as by sub-irrigation and other natural processes". Indicate depth to water when applicable. Drug out natural spring

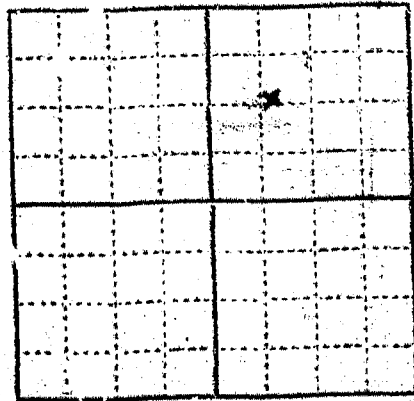

Indicate point of appropriation and place of use, if possible.
NE Sec 36 T. 5 N R 12 W

Quantity of water developed and used with explanation of method used to measure or estimate such amount. If use is intermittent estimate approximate lengths of periods of use. 1756

Signature of Owner George W. Anderson
Date Jan 3, 1964

This form to be prepared by contractor (if any), otherwise by the owner.

Three copies of this notice are to be filed with the County Clerk and Recorder of the county in which the works are located.

Please answer all questions. If not applicable, so state, otherwise, the form will be returned.

Original to the County Clerk and Recorder; duplicate to the State Engineer; Triplicate to the Montana Bureau of Mines and Geology and Quadruplicate for the Appropriator.

3646

81796

FILED FOR RECORD

February 6 1964
at 20 minutes past 10 o'clock
A.M.

ANNA QUIGLEY

Clerk of Court

Carol M. Conity

Notary

File No.

T. 5 N R 12 W

DUPLICATE

JAN 16 1964

County Deer

STATE ENGINEER
STATE OF MONTANA
ADMINISTRATOR OF GROUNDWATER CODE
OFFICE OF STATE ENGINEERS

Notice of Completion of Groundwater Appropriation by Means of Well

(Under Chapter 237, Montana Session Laws, 1961)

Owner George W. Anderson Address P.O. Box 1031

Driller Same Address Same

Date of Notice of Appropriation of Groundwater Jan 3, 1964

Date well started Sept 5, 1932 Date Completed Sept 30, 1932

Type of well Dug Equipment Used pick - shovel
(dug, driven, bored or drilled) (Churn, drill, rotary or other)

Water Use: Domestic Municipal Other Irrigation
Industrial Drainage Stock

Indicate on the diagram the character and thickness of the different strata met with in drilling, such as soil, clay, shale, gravel, rock or sand, etc. Show depth at which water is encountered, thickness and character of water-bearing strata and height to which water rises in the well.



Top of Ground
(Elev. above sea level 5,480)
Ground
Water
Level

Size of Drilled Hole	Size and Weight of Casing	From (Feet)	To (Feet)	PERFORATIONS		
				Kind Size	From (Feet)	To (Feet)
<u>No Casing - Dug by Hand and</u>						
<u>Rocked up</u>						

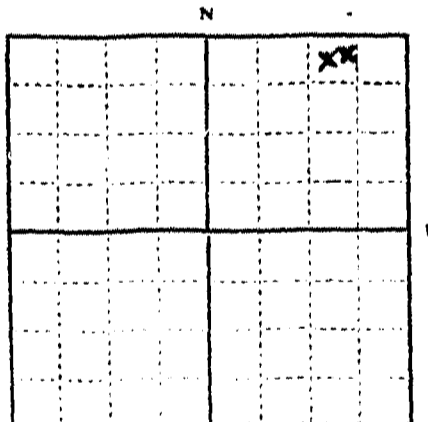

NE 1/4 Sec. 36 T. 5 N R 12 W
Indicate location of well and place of use, if possible. Each small square represents 10 acres.

Show exact depth of bottom.

Static Water Level for non-flowing Well 8 ft feet.

Shut-in Pressure for Flowing Well not applicable

Pumping Water Level not applicable feet at not applicable gal. per minute.

Discharge in gal. per min. of flowing well not applicable

How Tested not applicable Length of Test not applicable

Remarks: (Gravel packing, cementing, packers, type of shutoff, location of place of use of groundwater if not at well, and any other similar pertinent information, including number of acres irrigated, if used for irrigation) not used for irrigation

Driller's Signature George W. Anderson

This form to be prepared by driller, and three copies to be filed by the owner with the County Clerk and Recorder in the county in which the well is located.

Please answer all questions. If not applicable, so state, otherwise the form will be returned.

Original to the County Clerk and Recorder; duplicate to the State Engineer; Triplicate to the Montana Bureau of Mines and Geology and Quadruplicate for the Appropriator.

33225

FILED FOR RECORD

January 14, 1964
at 02 minutes past 11 o'clock

A.M. Anna Jungley
County Recorder

W 3

36

File No.

T. 5N R. 12W

DUPLICATE

County Oreida

STATE OF MONTANA
ADMINISTRATOR OF GROUNDWATER CODE
OFFICE OF STATE ENGINEER

JAN 3 1963
ENGINEER

Notice of Completion of Groundwater Appropriation
Without Well

(Under Chapter 237 Montana Session Laws, 1961)

Date of Appropriation of Groundwater Dec 31 1963

Owner Leonard Anderson address P.O. Box 912

Contractor (if any)

Address of Contractor

Date Started..... Date Completed.....

Describe means of obtaining groundwater without a well "as by sub-irrigation and other natural processes". Include depth to water when applicable.....

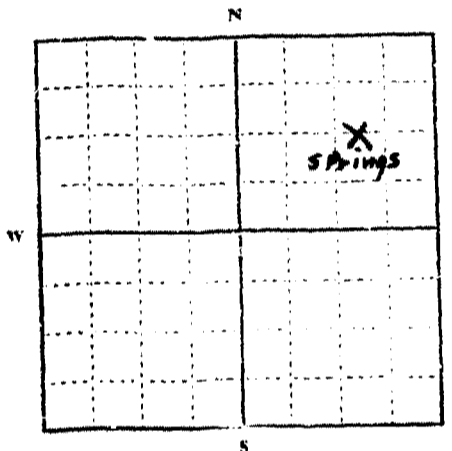

These certain springs located in NE 1/4 of section 36 Township 5N Range 12W. and to be used on same - for stock + irrigation.

Quantity of water developed and used with explanation of method used to measure or estimate such amount. If use is intermittent

estimate approximate lengths of periods of use..... all

year

5 cubic feet per second

Signature of Owner Leonard C Anderson

Date Dec 31 1963

NE 1/4 Sec. 36 T. 5N R. 12W
Indicate point of appropriation and place of use, if possible.

This form to be prepared by contractor (if any), otherwise by the owner.
Three copies of this notice are to be filed with the County Clerk and Recorder of the county in which the works are located.
Please answer all questions. If not applicable, so state, otherwise the form will be returned.
Original to the County Clerk and Recorder; duplicate to the State Engineer; Triplicate to the Montana Bureau of Mines and Geology and Quadruplicate for the Appropriator.

23769

51442

FILED FOR RECORD

December 31 1963

at 21 minutes past 10 o'clock

A.M. ANNA QUIGLEY

Paul Mc Carthy
County Recorder
District

12/31/63
10:21 AM
Anna Quigley
Paul Mc Carthy
County Recorder
District

File No.

T. 5 R. 12 W

DUPLICATE

County Deer Lodge

JAN 9 1964

STATE OF MONTANA
ADMINISTRATOR OF GROUNDWATER CODE
OFFICE OF STATE ENGINEER

ENGINEER

**Notice of Completion of Groundwater Appropriation
Without Well**

(Under Chapter 237 Montana Session Laws, 1961)

Date of Appropriation of Groundwater... Dec 31 1963

Owner Leonard Anderson Address P.O. Box 912
adm.

Contractor (if any)

Address of Contractor

Date Started..... Date Completed Filed 3-5-1919

Describe means of obtaining groundwater without a well "as by sub-irrigation and other natural processes". Include depth to water when applicable.....

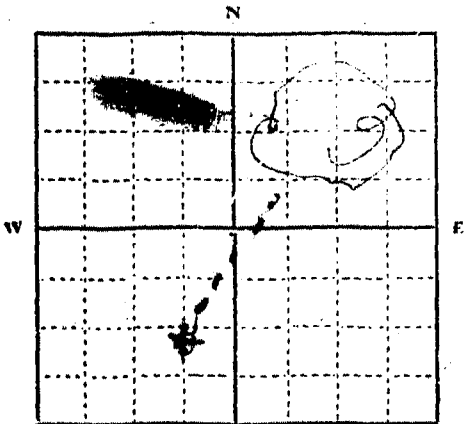

Springs situated in S.W. 1/4 of Sec 36 T-5 R-12W Montana Meridian. Known as Stumptown springs to be used for stock and Irrigation on N.E. 1/4

Quantity of water developed and used with explanation of method used to measure or estimate such amount. If use is intermittent

estimate approximate lengths of periods of use March till November

NE 1/4 Sec. 36 T. 5 R. 12W

Indicate point of appropriation and place of use, if possible.

2 cubic feet of water per second. Conveyed by ditch 1 ft wide on bottom 1 ft wide on top and 1 ft deep

Signature of Owner Leonard R. Anderson
adm.

Date Dec. 31 1963

This form to be prepared by contractor (if any), otherwise by the owner.

Three copies of this notice are to be filed with the County Clerk and Recorder of the county in which the works are located.

Please answer all questions. If not applicable, so state, otherwise the form will be returned.

Original to the County Clerk and Recorder; duplicate to the State Engineer; Triplicate to the Montana Bureau of Mines and Geology and Quadruplicate for the Appropriator.

2877

81445

FILED FOR RECORD

December 3, 1963

at 24 minutes past 11 o'clock

A.M.

ANNA QUIGLEY

Paul Mc Carthy

Deputy Register

[Faint, illegible vertical text on the right side of the page]

File No.

T. 5 N R 12 W

DUPLICATE

County Deer Lodge

STATE OF MONTANA
ADMINISTRATOR OF GROUNDWATER CODE
OFFICE OF STATE ENGINEER

RECEIVED
JAN 9 1964

Notice of Completion of Groundwater Appropriation
Without Well

(Under Chapter 237 Montana Session Laws, 1961)

Date of Appropriation of Groundwater Dec 31 1963

Owner Lemarch C. Anderson adm. Address P.O. Box 912

Contractor (if any)

Address of Contractor

Date Started

Date Completed Filed 3-6-1919

Describe means of obtaining groundwater without a well "as by sub-irrigation and other natural processes". Include depth to water when applicable.....

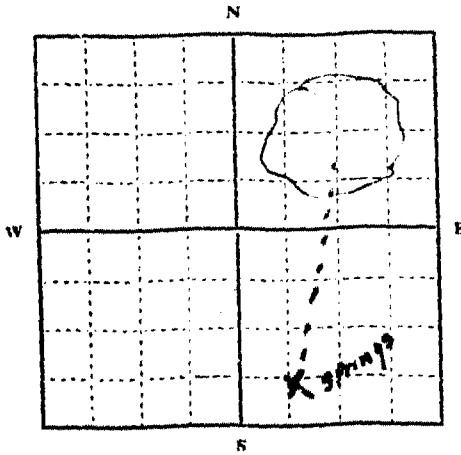

Three certain springs situated in the SE

1/4 of section 36 Township 5 N Range 12 W

Montana meridian - known as

Spring gulch. To be used on NE 1/4 for

stock and irrigation.
Quantity of water developed and used with explanation of method used to measure or estimate such amount. If use is intermittent

estimate approximate lengths of periods of use.....

March until November

NE 1/4 Sec 36 T5N R12W

Indicate point of appropriation and place of use, if possible.

4 cubic ft per second conveyed
by ditch 2 ft wide on bottom 2 ft wide on top + 2 ft deep

Signature of Owner Lemarch C. Anderson adm.

Date 12-31-63

This form to be prepared by contractor (if any), otherwise by the owner.

Three copies of this notice are to be filed with the County Clerk and Recorder of the county in which the works are located.

Please answer all questions. If not applicable, so state, otherwise the form will be returned.

Original to the County Clerk and Recorder; duplicate to the State Engineer; Triplicate to the Montana Bureau of Mines and Geology and Quadruplicate for the Appropriator.

28771

81444

FILED FOR RECORD

December 31 19 63

at 2:30 minutes past 11 o'clock

A.M.

ANNA QUIGLEY

Carroll McLarty
County Recorder
Dubuque

Handwritten vertical text, possibly a date or reference number.

Handwritten vertical text, possibly initials or a signature.

Handwritten notes on the right side of the page, including the name 'McLarty' and other illegible text.

File No.

T. 5 R. 12 W.

DUPLICATE

County Golden

STATE OF MONTANA
ADMINISTRATOR OF GROUNDWATER CODE
OFFICE OF STATE ENGINEER

JAN 5 1963

ENGINEER

Declaration of Vested Groundwater Rights

(Under Chapter 237, Montana Session Laws, 1961)

1. Leonard C Anderson, of P.O. Box 942 Ammonia
(Name of Appropriator) (Address) (Town)

County of _____ State of _____
have appropriated groundwater according to the Montana laws in effect prior to January 1, 1963, as follows:

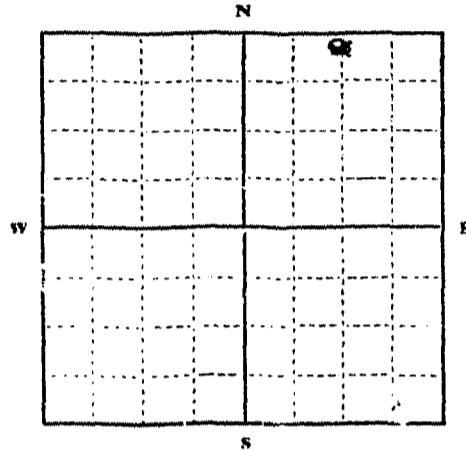

NE 1/4 Sec. 36 T. 5 R. 12 W

Indicate point of appropriation and place of use, if possible. Each small square represents 10 acres.

2. The beneficial use on which the claim is based Domestic

3. Date or approximate date of earliest beneficial use; and how continuous the use has been
Well dug in 1932 and was in continuous use since

4. The amount of groundwater claimed (in miner's inches or gallons per minute) 25 gal per minute

5. If used for irrigation, give the acreage and description of the lands to which water has been applied and name of the owner thereof
50' x 50' Lawn

6. The means of withdrawing such water from the ground and the location of each well or other means of withdrawal
Electric pump installed in summer of 1943

7. The date of commencement and completion of the construction of the well, wells, or other works for withdrawal of groundwater
2 1/2 feet of 12" pipe and screen was put in hand dug well and 8" cement top 4x4 opening was finished in 1943

8. The depth of water table 20 feet

9. So far as it may be available, the type, size and depth of each well or the general specifications of any other works for the withdrawal of groundwater
3 ft long 12" dia screen on bottom 18' long 12" dia pipe welded to screen and 8" cement 4x4 triple casing on top

10. The estimated amount of groundwater withdrawn each year

11. The log of formations encountered in the drilling of each well if available Gravel Rock and sand

12. Such other information of a similar nature as may be useful in carrying out the policy of this act, including reference to book and page of any county record

Signature of Owner Leonard C Anderson
Date Dec 31 - 1963

Three copies to be filed by the owner with the County Clerk and Recorder of the county in which the well is located.

Please answer all questions. If not applicable, so state, otherwise the form will be returned.

Original to the County Clerk and Recorder; Duplicate to the State Engineer; Triplicate to the Montana Bureau of Mines and Geology, and Quadruplicate for the Appropriator.

28763

81436

FILED FOR RECORD

December 31 1963

at 15 minutes past 11 o'clock

A.M.

ANNA QUIGLEY

Paul McKeon
County Registrar
Dubuque

File No.

T. 5 N. R. 12 W

DUPLICATE

County Beauregard

STATE OF MONTANA
ADMINISTRATOR OF GROUNDWATER CODE
OFFICE OF STATE ENGINEER

JAN 9 1964

STATE ENGINEER

Notice of Completion of Groundwater Appropriation Without Well

(Under Chapter 237 Montana Session Laws, 1961)

Date of Appropriation of Groundwater 10/30/57

Owner William J. Anderson Address Stump Town, West Valley

Contractor (if any) None

Address of Contractor None

Date Started Natural Date Completed -----

Describe means of obtaining groundwater without a well "as by sub-irrigation and other natural processes". Include depth to water when applicable. Surface Water or Springs coming out of Hill side Below Natural

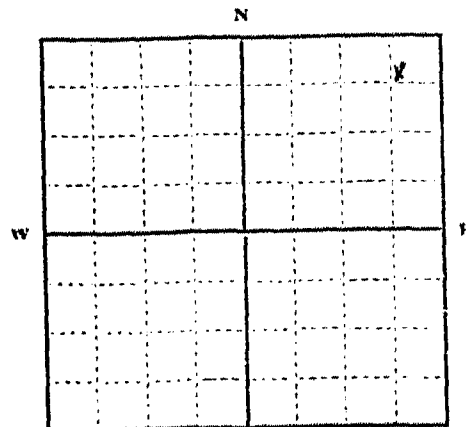

NE 1/4 NE Sec 36 T. 5. R. 12 W
x Indicate point of appropriation and place of use, if possible.

Quantity of water developed and used with explanation of method used to measure or estimate such amount. If use is intermittent

estimate approximate lengths of periods of use. Year Around Use

for stock watering etc. Pasture land. It raises a diurnal capacity to the season of the year, the spring being the highest or most water & winter being the lowest.

Signature of Owner William J. Anderson

Date Dec 31, 1963

This form to be prepared by contractor (if any), otherwise by the owner.

Three copies of this notice are to be filed with the County Clerk and Recorder of the county in which the works are located.

Please answer all questions. If not applicable, so state, otherwise the form will be returned.

Original to the County Clerk and Recorder; duplicate to the State Engineer; Triplicate to the Montana Bureau of Mines and Geology and Quadruplicate for the Appropriator.

81340

FILED FOR RECORD

December 31 1963
at 39 minutes past 900 o'clock
A.M. ASSIA QUIGLEY

Caro McPartly
County Registrar
Date

File No.

DUPLICATE

T. 5 R. 12W

County Deer Lodge

JAN 9 1964

STATE OF MONTANA
ADMINISTRATOR OF GROUNDWATER CODE
OFFICE OF STATE ENGINEER

ENGINEER

Notice of Completion of Groundwater Appropriation
Without Well

(Under Chapter 237 Montana Session Laws, 1961)

Date of Appropriation of Groundwater 10/30/57

Owner William J. Anderson Address Stump Town West Valley

Contractor (if any) None

Address of Contractor None

Date Started _____ Date Completed _____

Describe means of obtaining groundwater without a well "as by (by sub-irrigation and other natural processes". Include depth to [ditch] water when applicable. An undivided 1/6 interest in the following

Water Rights Two Cubic ft. per Second hereof Measurement of the waters of Stumptown Springs (For Further Description) Refer to Water Right hereof of Deer Lodge County Page 228 in Book 5 of Water Rights of Deer Lodge County at Clerk + Recorder's Office

Quantity of water developed and used with explanation of method used to measure or estimate such amount. If use is intermittent

estimate approximate lengths of periods of use. May through Sept for Pasture land & year around use for Stock watering

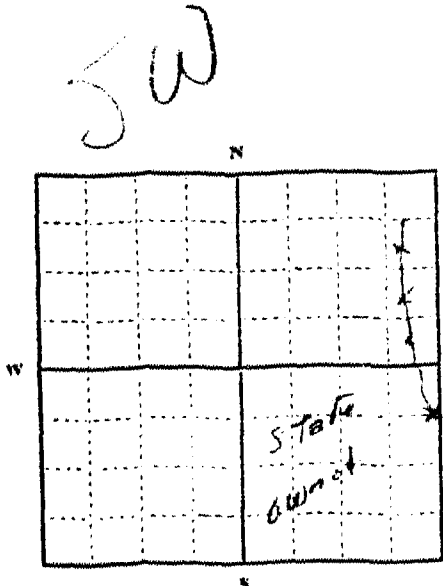

ME 1/4 N.E. Sec 36 T. 5 R. 12W

Indicate point of appropriation and place of use, if possible.

Signature of Owner William J. Anderson

Date Dec 31 1963

This form to be prepared by contractor (if any), otherwise by the owner.

Three copies of this notice are to be filed with the County Clerk and Recorder of the county in which the works are located.

Please answer all questions. If not applicable, so state, otherwise the form will be returned.

Original to the County Clerk and Recorder; duplicate to the State Engineer; Triplicate to the Montana Bureau of Mines and Geology and Quadruplicate for the Appropriator.

81350

FILED FOR RECORD

December 31 1963
at 47 minutes past 5:00 o'clock
A.M.

ANNA QUIGLEY

Carl McLaury
Clerk

T. 54 R. 12W
County

MONTANA BUREAU OF MINES AND GEOLOGY
Butte, Montana

WATER WELL LOG

RECEIVED
JUN 27 1958

STATE ENGINEER
Address Washington St. Box 461

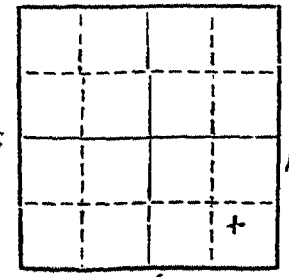

Owner William J. Anderson Address Washington St. Box 461

Driller E. J. Smith Address

Date Started June 27 1958 Date Completed June 27 1958

Location: Sec. NE 4 36 T. 5N R. 12W 1/4 sec.

Type of well drilled Equipment used Churn drill
(Dug, driven, bored, or drilled) (Churn drill, rotary, other)

Water use: Domestic Municipal Stock Irrigation
Industrial Drainage Other:

Casing: Surface ft. to 27' ft. Type Standard Size 8"

Casing: ft. to ft. Type Size

Casing: ft. to ft. Type Size

Perforated or Screened: Ft. to ft. Ft. to ft.

Type of screen or perforations

Static Water level, for non-flowing well: feet.

Shut-in pressure, for flowing well: lb./sq. in. on: (date)

Pumping water level feet at gal. per min.

How tested:

Length of test

Remarks: (Gravel packing, cementing, packers, type of shut-off, depth of shut-off)

.....
.....
.....
.....
.....

(over)

File No.

JUN 20 1966

87115

T 5 N 12 W

DUPLICATE

Bill _____ McDermott _____
Eugene _____ McNulty _____
LOG _____ Norton _____
Dawson _____ Sullivan _____
Dickert _____

County Deer Lodge

STATE OF MONTANA

ADMINISTRATOR OF GROUNDWATER CODE

OFFICE OF STATE ENGINEER

Top of Ground _____
(Elev. above sea level _____)

Notice of Completion of Groundwater Appropriation by Means of Well

DEVELOPED AFTER JANUARY 1, 1962

(Under Chapter 237, Montana Session Laws, 1961)

20 ft. Open hole

Owner Frank E. Kiaser Address 2515 Cable Road
(Betty E.) Anaconda, Mont.

Driller C. F. Noble Address Route 1, Millcreek
Anaconda, Mont.

Date of Notice of appropriation of groundwater _____

Date well started June 6, 1966 Date completed June 8, 1966

Type of well Drilled Equipment used Churn Drill
(Dug, Driven, bored or drilled) (Churn drill, rotary or other)

25 ft. Weathered granite Water use: Domestic Municipal Stock Irrigation
Water bearing Industrial Drainage Other

Indicate on the diagram the character and thickness of the different strata met with in drilling, such as soil, clay, shale, gravel, rock or sand, etc. Show depth at which water is encountered, thickness and character of water-bearing strata and height to which the water rises in the well.

Size of Drilled Hole	Size and Weight of Casing	From (Feet)	To (Feet)	PERFORATIONS		
				Kind Size	From (Feet)	To (Feet)
3"	3"			3/16 x 4"	22ft.	27 ft.
	34 lbs. per ft.					

40 ft. Granite bedrock

40 ft. Total depth

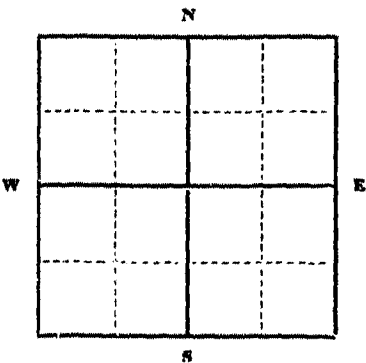

Static Water Level for non-flowing well _____
..... 15 feet.

Shut-in Pressure for Flowing Well _____

Pumping Water Level _____ feet
at _____ gal. per minute.

Discharge in gal. per min. of flowing well _____

How Tested Baller

Length of Test 3 hrs.

Remarks: (Gravel packing, cementing, packers, type of shutoff) _____

NE 1/4 Sec 36 T 5 N R 12 W
Indicate location of well and place of use, if possible. Each small square represents 40 acres.

(Continue on reverse side)

USE—If used for irrigation, industrial, drainage or other. Explain, state number of acres and location or other data (i.e.: Lot, Block and Addition).

Show exact depth of bottom.

This form to be prepared by driller, and three copies to be filed by the owner with the County Clerk and Recorder in the county in which the well is located, tissue copy to be retained by driller.

Please answer all questions. If not applicable, so state, otherwise the form will be returned.

Driller's License Number 62

Driller's Signature _____

41151

87115

FILED FOR RECORD

at 19 minutes past 2 o'clock
P M

June 17 1966
Anna Lingle
County Recorder

By _____

Deputy

25

File No.....

T. 5 N R. 12 W

DUPLICATE

County DEER LODGE

STATE OF MONTANA
ADMINISTRATOR OF GROUNDWATER CODE
OFFICE OF STATE ENGINEER

JAN 3 1963

Declaration of Vested Groundwater Rights

(Under Chapter 237, Montana Session Laws, 1961)

1. JACK RAVNDAL, of P.O. Box 465 ANACONDA
(Name of Appropriator) (Address) (Town)
County of DEER LODGE State of MONTANA
have appropriated groundwater according to the Montana laws in effect prior to January 1, 1962, as follows:

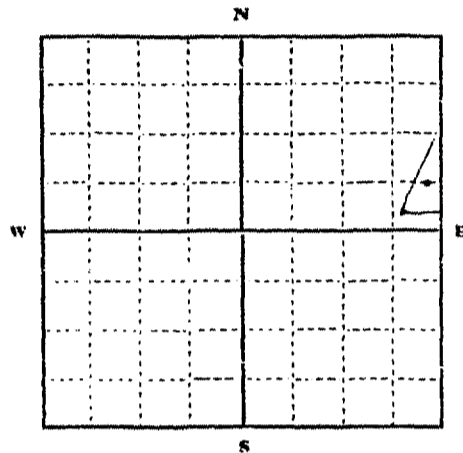

ENE 1/4 NE Sec. 36, T. 5 N R. 12 W

Indicate point of appropriation and place of use, if possible. Each small square represents 10 acres.

- 2. The beneficial use on which the claim is based.....
HOUSEHOLD, LAWN & GARDEN
- 3. Date or approximate date of earliest beneficial use; and how continuous the use has been.....
1948 TO PRESENT
CONTINUAL
- 4. The amount of groundwater claimed (in miner's inches or gallons per minute).....
15
FIFTEEN G.P.M.
- 5. If used for irrigation, give the acreage and description of the lands to which water has been applied and name of the owner thereof.....
LAWN + GARDEN 1/4 ACRE
JACK RAVNDAL
- 6. The means of withdrawing such water from the ground and the location of each well or other means of withdrawal.....
ELECTRIC PUMP

7. The date of commencement and completion of the construction of the well, wells, or other works for withdrawal of groundwater.....
1948

8. The depth of water table.....
25'

9. So far as it may be available, the type, size and depth of each well or the general specifications of any other works for the withdrawal of groundwater.....
DUG WELL 18" DIA. 25' DEEP

10. The estimated amount of groundwater withdrawn each year.....
100,000 GAL.

11. The log of formations encountered in the drilling of each well if available.....
NOT APPLICABLE
UNKNOWN

12. Such other information of a similar nature as may be useful in carrying out the policy of this act, including reference to book and page of any county record.....
Not Applicable

Signature of Owner Jack Ravndal
Date 1/3/64 DEC 31 1963

Three copies to be filed by the owner with the County Clerk and Recorder of the county in which the well is located.

Please answer all questions. If not applicable, so state, otherwise the form will be returned.

Original to the County Clerk and Recorder; Duplicate to the State Engineer; Triplicate to the Montana Bureau of Mines and Geology, and Quadruplicate for the Appropriator.

2877c

236

File No. _____

T 5 N R 12 W

DUPLICATE

County DEER Lodge

STATE OF MONTANA
ADMINISTRATOR OF GROUNDWATER CODE
OFFICE OF STATE ENGINEER

JAN 9 1964

Declaration of Vested Groundwater Rights

(Under Chapter 237, Montana Session Laws, 1961)

1. JACK RAVNDAL, of P.O. Box 465 ANACONDA
(Name of Appropriator) (Address) (Town)

County of DEER Lodge State of MONTANA
have appropriated groundwater according to the Montana laws in effect prior to January 1, 1962, as follows:

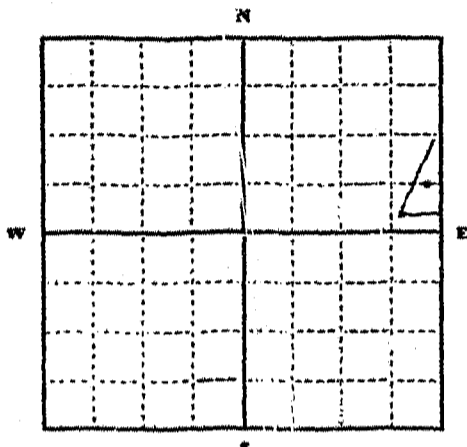

E 1/4, NE Sec. 36 T. 5 N R. 12 W

Indicate point of appropriation and place of use, if possible. Each small square represents 10 acres.

2. The beneficial use on which the claim is based
HOUSEHOLD, LAWN, & GARDEN

3. Date or approximate date of earliest beneficial use; and how continuous the use has been
1948 TO PRESENT
CONTINUOUS

4. The amount of groundwater claimed (in miner's inches or gallons per minute)
15
FIFTEEN G.P.M.

5. If used for irrigation, give the acreage and description of the lands to which water has been applied and name of the owner thereof
LAWN + GARDEN 1/4 ACRE
JACK RAVNDAL

6. The means of withdrawing such water from the ground and the location of each well or other means of withdrawal
ELECTRIC PUMP

7. The date of commencement and completion of the construction of the well, wells, or other works for withdrawal of groundwater
1948

8. The depth of water table
25'

9. So far as it may be available, the type, size and depth of each well or the general specifications of any other works for the withdrawal of groundwater
DUG WELL 18" DIA. 25' DEEP

10. The estimated amount of groundwater withdrawn each year
100,000 GAL.

11. The log of formations encountered in the drilling of each well if available
NOT APPLICABLE
UNKNOWN

12. Such other information of a similar nature as may be useful in carrying out the policy of this act, including reference to book and page of any county record
Not Applicable

Signature of Owner Jack Ravndal

Date 1/3/64 DEC 31 1963

Three copies to be filed by the owner with the County Clerk and Recorder of the county in which the well is located.

Please answer all questions. If not applicable, so state, otherwise the form will be returned.

Original to the County Clerk and Recorder; Duplicate to the State Engineer; Triplicate to the Montana Bureau of Mines and Geology, and Quadruplicate for the Appropriator.

2677

81443

FILED FOR RECORD

December 31 1963
at 22 minutes past 11 o'clock
A.M. ANNA QUIGLEY

Carol Mc Carthy
County Registrar
Deputy

36

File No.....

T. 5N R. 12W

DUPLICATE

County Deer Lodge

STATE OF MONTANA
ADMINISTRATOR OF GROUNDWATER CODE
OFFICE OF STATE ENGINEER

RECORDED
JAN 9 1964

STATE ENGINEER

**Notice of Completion of Groundwater Appropriation
Without Well**

(Under Chapter 237 Montana Session Laws, 1961)

Date of Appropriation of Groundwater 1940

Owner H. RUNDAL Address ANCONDA

Contractor (if any)

Address of Contractor

Date Started..... Date Completed.....

Describe means of obtaining groundwater without a well "as by sub-irrigation and other natural processes". Include depth to water when applicable. By

SUB IRRIGATION + OTHER NATURAL PROCESSES.

SPRINGS + SURFACE WATER

Quantity of water developed and used with explanation of method used to measure or estimate such amount. If use is intermittent

estimate approximate lengths of periods of use.....

SUMMER MONTHS -

USE LIMITED BY AMOUNT OF FLOW.

NO ESTIMATE OF AMOUNT USED.

Signature of Owner Harry Rundal

Date Jan. 3, 1964

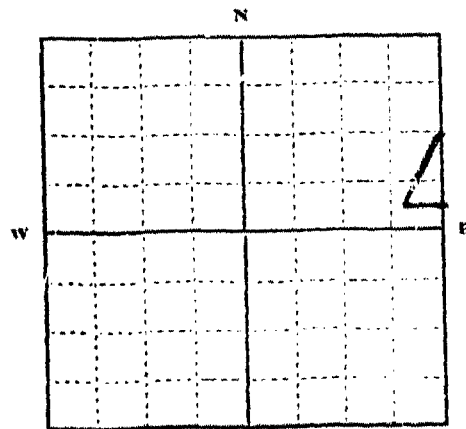

E 1/2 SE 1/4 Sec. 36 T. 5N R. 12W

Indicate point of appropriation and place of use, if possible.

This form to be prepared by contractor (if any), otherwise by the owner.

Three copies of this notice are to be filed with the County Clerk and Recorder of the county in which the works are located.

Please answer all questions. If not applicable, so state, otherwise the form will be returned.

Original to the County Clerk and Recorder; duplicate to the State Engineer; Triplicate to the Montana Bureau of Mines and Geology and Quadruplicate for the Appropriator.

28782

81457

DEC 31 1963

NO. 100-100000-100000
DEC 31 1963

100-100000-100000

FILED FOR RECORDS

DEC 31 1963 19

at 36 minutes past 11 o'clock
A.M.

ANNA QUIGLEY

County Recorder

Mary Morrison

200

210

County Deer Lodge Twp. 5N Rge. 11W

Sec.	Name of Appropriator	Type of Form	County File No.	Remarks
3	John Langer	57 Log	N/A	
3	Clavas Womack	LW4	81437	
12	Wm. P. Postlethwaite	LW3	81324	
15	Eliza Andreoli	LW4	81416	
15	Steve Frankovich	57 Log	N/A	
15	George W. Havens	LW3	81487	
15	George W. Havens	LW4	81347	Same as above
15	James Killey	LW2	97853	
15	John W. Manahan	LW2	96097	
19	Nubert R. Carlson	LW4	81616	
19	Russell + Rosalie Jones	LW4	81499	
19	Russell + Rosalie Jones	LW4	—	Same as above
19	Russell + Rosalie Jones	LW4	3163	" " "
19	James + Donna Kelly	LW2	94126	Copy attached
19	Floyd Mochen	LW3	88644	
20	Russell + Rosalie Jones	LW4	81498	Same as Dec. 19
23	Louis Beaudril	57 Log	N/A	
23	D. J. Bell	57 Log	N/A	
23	Samuel James Bell	57 Log	N/A	Same as above
23	Thomas J. Franklin	LW4	76979	
23	Charles Strimolo	LW4	81605	
23	Hugo Halle Sr.	57 Log	N/A	
23	Lyle L. Havens	LW2	95779	
23	Charles H. McDowell	LW4	81392	
23	Mr + Mrs Albert Martin	LW4	81454	
23	Lee J. Powers	LW4	81334	
23	Donald + Mary Langitach	LW2	95987	
23	Jack Reichel	LW3	—	
23	Joseph J. Siegenthaler	57 Log	N/A	
25	Hugo Halle Sr.	LW4	81375	Same as Dec. 23
25	Hugo Halle Sr.	57 Log	N/A	Same as above
25	Louis A. Tarnasch	LW4	81277	T 5N-R 12W?
26	Hugo Halle Sr.	57 Log	N/A	Same as Dec. 25
28	George H. Henderson	LW3	81452	
28	George H. Henderson	LW4	81451	THIS IS THE
28	O. W. Miller	LW4	81281	
29	Cliff Brooks	57 Log	N/A	
29	John A. Grant	LW4	81420	
29	John A. Grant	LW4	81419	Same as above
29	John A. Grant	LW2	92487	" " "
29	Dewey + Norma Hodgson	LW4	81306	
29	Pete Jananovich	LW4	81614	
29	Shirley V. Ferguson	LW4	81371	
29	Pete Jananovich	LW3	99764	Same as above
29	Michael + Jean Leschke	LW4	81473	
29	Larry Malone	LW2	88726	

County Deer LodgeTWD. 5 NRge. 1

Sec.	Name of Appropriator	Type of Form	County File No.	Remarks
29	Thomas Malloy	Hw 2	96472	
29	A. L. Manning	57 Log	NIA	
29	Milton T. Rubert	57 Log	NIA	
29	Milton T. Rubert	57 Log	NIA	Same as above
29	Herald L. Turner	57 Log	NIA	
30	Charles F. Allen	Hw 4	81414	
30	Charles A. Estey	Hw 4	81238	
30	Andrew T. Huntend	Hw 4	81718	
30	Arthur C. Becker	57 Log	NIA	
30	Leo & Kathie Brunning	Hw 4	80933	
30	Leon D. Collison	Hw 4	81592	
30	Glada Cronquist	57 Log	NIA	
30	Clifford J. Cunningham	Hw 4	81425	
30	Clifford J. Cunningham	Hw 4	81424	Same as above
30	Harold R. Cupp	Hw 4	81411	
30	Thomas Curran	Hw 2	98992	
30	Harold H. Dauterman	Hw 4	81950	
30	Elwin Duffely	Hw 2	98762	
30	John Fabrial	Hw 4	81656	
30	William Fairweather	Hw 4	81209	
30	Herman Faulstich	Hw 2	81154	
30	Dale Filchen	Hw 2	81254	
30	Le Roy Fitzgerald	Hw 3	82544	
30	Le Roy Fitzgerald	Hw 4	81278	Same as above
30	Nancy Flynn	Hw 2	81131	
30	James & Mildred Lullis	Hw 4	81216	
30	Allen Green	57 Log	NIA	
30	Allen Green	Hw 4	81226	Same as above
30	Lordon H. Marshall	Hw 4	81363	
30	Donald F. Hart	Hw 4	81400	
30	Peter Hart	Hw 2	80678	
30	Fred & Evelyn Hayes	Hw 4	81453	
30	Lynn Hochstetler	Hw 4	81476	
30	Robert Holmes	Hw 4	81483	
30	Leonard Hoshel	57 Log	NIA	
30	David L. Hunt	Hw 4	81362	
30	William Huestis	Hw 2	99045	
30	Joseph & Ethel Hunt	Hw 4	81413	
30	Gene Jurgensen	Hw 4		
30	Nancy K. Karner	Hw 4	81374	
30	Adam F. Klein	Hw 2	97265	copy attached
30	John P. Kopp	Hw 4	81507	
30	John P. Kossick	Hw 4	81824	
30	John P. Ledbetter	Hw 4	81418	
30	Alex Lapine	Hw 2	97614	
30	Alex Lapine	Hw 4	81615	

Sec.	Name of Appropriator	Type of Form	County File No.	Remarks
30	Joseph P. Mace	LW 4	81293	
30	Thomas + Genevieve MAALE	LW 4	81379	
30	John W. Malcom	LW 4	81840	
30	Alfred Matzola	LW 4	81515	
30	Edward G. Marrett	LW 4	81248	
30+31	Eugene P. Mayer	LW 4	81491	
30	E. A. McPherson	LW 2	—	
30	Digford C. Miller	LW 4	82963	
30	Theodore Miller	LW 4	81256	
30	David L. Miner	LW 4	81514	
30	Mt Hagen Baptist Church	LW 2	—	
30	John T. O'Donnell	LW 4	81249	
30	Robert Olson	LW 2	99167	
30	Tom Radonich	57 Log	N/A	
30	A. Reiss	LW 2	97456	
30	Allen + Elsie Richardson	LW 2	92700	
30	Parini Richard	LW 2	93659	Copy attached
30	Joseph Rona	LW 2	98027	
30	William O. Raulier	LW 4	81380	
30	Norman A. Rustad	LW 4	81266	
30	Lloyd H. Sanders	LW 4	81609	
30	Jane + Elizabeth Shanklin	LW 4	81263	
30	W. L. Stenbridge	LW 2	93550	
30	Wayland T. Stenbridge	LW 4	81251	
30	Anton Tavia	LW 4	81531	
30	Anna R. Taylor	LW 4	81401	
30	Elmer Thompson	LW 2	81412	
30	Norman F. Towner	LW 4	81338	
30	West Valley Community Club	57 Log	N/A	
30	Robert Walter	LW 2	97288	
30	Robert Wright	57 Log	N/A	
30	Phillip Zamudio	LW 4	81525	
30	Ben Zimmerman	LW 4	—	
31	Arthur R. Campbell	LW 4	81405	
31	Tony Mastelli	LW 2	97933	
31	Thomas Pegan	LW 4	81509	
32	Stanley Albert	LW 4	81402	
32	Margaret Anderson	LW 4	81587	
32	Alfred A. Benson	LW 4	81243	
32	Joseph Beames	LW 4	81385	
32	Ben R. Campbell	LW 4	81369	
32	Robert + Roberta Chandler	LW 2	—	
32	Bernard DuMontier	LW 4	81213	
32	Arvin + Ester Colcator	LW 4	81310	
32	Arvin + Esther Colcator	LW 4	81307	Same as above
32	Embassy Bar	LW 2	85643	

County Deer Lodge

Sec.	Name of Appropriator	Type of Form	County File No.	Remarks
32	George Forssman	Hw 3	81325	
32	Leonard C. Hagman	Hw 4	81475	
32	Arlo W. Hancock Jr.	Hw 4	81354	
32	J. Harding	Hw 2	-	
32	Jack J. Nittbrand	Hw 4	81367	
32	Orval & Lenore Hobbs	Hw 4	81686	
32	Robert Kester	Hw 2	79117	
32	Mansley Jacobson	Hw 2	79534	
32	Arson T. Edith Johnson	57 Log	NIA	
32	Michael Kapp	Hw 4	81271	
32	Don Larry	Hw 4	81508	
32	Mrs. George Mattson	Hw 4	81014	
32	Marion Montgomery	Hw 4	81399	
32	Albert H. Sletton	Hw 4	81528	
32	Mrs. Beatrice Smith	Hw 4	81272	
32	Leonard B. Smith	Hw 4	81288	
32	Geldon H. Smith	Hw 4	81361	
32	C. Wayne Clifford Smith	Hw 4	81960	
32	Vernon L. Staininger	Hw 4	81346	
32	Charles V. Tenness	Hw 4	81233	
32	Lloyd K. Waland	Hw 4	81432	
32	Eugene & Charlotte Ward	57 Log	NIA	
32	Charlotte P. Ward	Hw 4	81446	Same as above
32	Clarence Weid	Hw 4	81273	
33	The Anascondas Co.	Hw 4	80663	
33	The Anascondas Co.	Hw 4	80661	
33	The Anascondas Co.	Hw 4	80662	
33	B. A. & P. Remy Co.	Hw 3	81316	
33	Elnor Benzger	57 Log	NIA	
33	William E. Benzger	Hw 4	80701	
33	Emmett Cook	Hw 2	81342	
33	Boehr & Son	Hw 4	81585	
33	Benjamin S. Buchay	Hw 4	81002	
33	James C. Cadwell	Hw 4	81435	
33	Nancy E. Clauson	Hw 4	81339	
33	Lee Fritzpatrick	Hw 2	79736	
33	Mrs. Amy Harding	Hw 2	-	
33	Delmer E. Hughes	Hw 4	81480	
33	Charles H. Johnson	Hw 3	81287	
33	Charles H. Johnson	Hw 2	81291	Same as above
33	Charles H. Johnson	Hw 4	81289	" " "
33	Charles H. Johnson	Hw 4	81292	" " "
33	Charles H. Johnson	Hw 4	81290	" " "
33	Paul L. LaTray	Hw 4	81533	
33	Joseph & Paul Lesconty	Hw 4	81317	
35	Jim Mills	57 Log	NIA	

County

Sec.	Name of Appropriator	Type of Form	County File No.	Remarks
33	O.W. Miller	LW 4	81280	
33	O.W. Miller	LW 4	81282	Same as above
33	Clyde L. Pickett	LW 4	81333	
33	Alan W. Hether	LW 4	81388	
33	Maurice Walsh	LW 2	82097	
33	Mary E. Walsh	LW 3	80976	
33	Mary E. Walsh	LW 4	80730	
34	Annie Jessen	LW 4	81503	
34	Annie Jessen	LW 3	81502	Same as above
34	Peter J. Annigessen	LW 4	81501	
34	Narold Snow	LW 3	81331	
-	Element Alice Charles	LW 4	81311	
-	Asafelle Moning Arabick	LW 4	81279	
-	William Seacantz	LW 4	81263	
-	A.C. Logan	LW 4	81386	
30	RADERT, C. H.	well log	1958	
30	RADONICH, PETER	well log	1959	
30	CILIO, JAMES	well log	1959	
30	CILIO, JAMES	well log	1961	
30	Gress, William	well log	1957	
30	Hanson, Thor.	well log	1958	
30	KOVACICH, PAUL	well log	1958	
30	Krause, Andrew	well log	1961	
30	MacDonald, M.B.	well log	1958	
30	Ness, Robert	well log	1958	
30	Bygoneson, Ray	well log	1958	
30	Sharnock, Nick	well log	1958	
30	Davenport, Richard	well log	no #	
30	Davis, James I.	well log	1960	
30	Nicholson, Verle	well log	1957	
30	Domadue, Joseph M.	well log	1958	
30	Danich, Walter	well log	1958	
30	Fairweather, William	well log	1958	
30	Males, George	well log	957	
30	Masette, George	well log	1958	
30	Boehl, Charles H.	well log	1957	
30	Teachu, Charles A.	well log	1958	
30	Wetley, Edward	well log	1958	
30	Zucco, John	well log	1958	
33	McCallum, Wm.	well log	1957	
30	Crist, Robert C.	57 well log		
Ald	Villeneuve, William	57 well log		

RECEIVED

T. 5N R. 11W

County Deer Lodge

STATE ENGINEER

MONTANA BUREAU OF MINES AND GEOLOGY
Butte, Montana

WATER WELL LOG

Owner John Langer Address Lost Creek

Anaconda Mont.

Driller C.E. Frable Address PO Box 180

Anaconda Mont.

Date Started August 5, 1960 Date Completed Aug. 10, 1960

Location: Sec. 3 T. 5 R. 11 1/4 sec.

Type of well Drilled Equipment used Churn Drill
(Dug, driven, bored, or drilled) (Churn drill, rotary, other)

Water use: Domestic Municipal Stock Irrigation

Industrial Drainage Other: _____

Casing: 4 ft. to 35 ft. Type 24 lb. casing Size 6"

Casing: _____ ft. to _____ ft. Type _____ Size _____

Casing: _____ ft. to _____ ft. Type _____ Size _____

Perforated or Screened: Ft. _____ to ft. _____ Ft. _____ to ft. _____

Type of screen or perforations: _____

Static Water level, for non-flowing well: 19' feet.

Shut-in pressure, for flowing well: _____ lb./sq. in. on: _____ (date)

Pumping water level: 35 feet at 10 gal. per min.

How tested: Grinded

Length of test: One hour

Remarks: (Gravel packing, cementing, packers, type of shut-off, depth of shut-off)

(over)

RECEIVED

T. 5N R. 21W

County: Deer Lodge

STATE ENGINEER

MONTANA BUREAU OF MINES AND GEOLOGY
Butte, Montana

WATER WELL LOG

Owner: John Langer Address: Lost Creek
 Anaconda Mont.
 Driller: C. F. Zrable Address: PO Box 180
 Anaconda Mont.
 Date Started: August 5, 1960 Date Completed: Aug. 10, 1960
 Location: Sec. 3 T. 5 R. 11 1/4 sec.

Type of well: Drilled (Dug, driven, bored, or drilled) Equipment used: Churn Drill (Churn drill, rotary, other)

Water use: Domestic Municipal Stock Irrigation
 Industrial Drainage Other: _____

Casing: 6 ft. to 35 ft. Type: D4 1/2 casing Size: 3"
 Casing: _____ ft. to _____ ft. Type: _____ Size: _____
 Casing: _____ ft. to _____ ft. Type: _____ Size: _____

Perforated or Screened: Ft. _____ to ft. _____ Ft. _____ to ft. _____

Type of screen or perforations: _____

Static Water level, for non-flowing well: 10' feet.

Shut-in pressure, for flowing well: _____ lb./sq. in. on: _____ (date)

Pumping water level: 35 feet at 10 gal. per min.

How tested: Paired

Length of test: One hour

Remarks: (Gravel packing, cementing, packers, type of shut-off, depth of shut-off)

(over)

File No.

T. 5 P. 11

DUPLICATE

County Deer Lodge

STATE OF MONTANA
ADMINISTRATOR OF GROUNDWATER CODE
OFFICE OF STATE ENGINEER

JAN 9 1964

ENGINEER

Declaration of Vested Groundwater Rights

(Under Chapter 237, Montana Session Laws, 1961.)

1. Clevas Wornack, of 126 Howe Anaconda
(Name of Appropriator) (Address) (Town)
County of Deer Lodge State of Montana
have appropriated groundwater according to the Montana laws in effect prior to January 1, 1962, as follows:

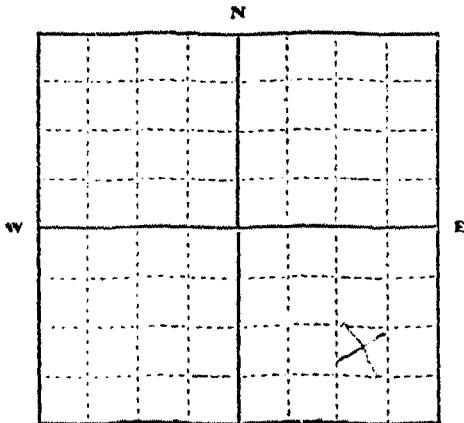

SEK/SE4 Sec. 3 T. 5 R. 11

Indicate point of appropriation and place of use, if possible. Each small square represents 10 acres.

2. The beneficial use on which the claim is based. home hold lawn & garden

3. Date or approximate date of earliest beneficial use; and how continuous the use has been. 1960

4. The amount of groundwater claimed (in miner's inches or gallons per minute) unknown

5. If used for irrigation, give the acreage and description of the lands to which water has been applied and name of the owner thereof. lawn & garden

6. The means of withdrawing such water from the ground and the location of each well or other means of withdrawal. electric pump from well

7. The date of commencement and completion of the construction of the well, wells, or other works for withdrawal of groundwater. 1959

8. The depth of water table. unknown

9. So far as it may be available, the type, size and depth of each well or the general specifications of any other works for the withdrawal of groundwater. has never pumped dry on 7 hours continued pumping

10. The estimated amount of groundwater withdrawn each year. unknown

11. The log of formations encountered in the drilling of each well if available. unknown

12. Such other information of a similar nature as may be useful in carrying out the policy of this act, including reference to book and page of any county record. unknown

Signature of Owner Clevas Wornack

Date DEC 31 1963

Three copies to be filed by the owner with the County Clerk and Recorder of the county in which the well is located.

Please answer all questions. If not applicable, so state, otherwise the form will be returned.

Original to the County Clerk and Recorder; Duplicate to the State Engineer; Triplicate to the Montana Bureau of Mines and Geology; and Quadruplicate for the Appropriator.

28764

81437

FILED FOR RECORD

December 31 1963

at 16 minutes past 11 o'clock

A.M.

ANNA QUIGLEY

Carol M. Carthy

Notary

File No.

T. 5 R. 11

DUPLICATE

County Deer Lodge

STATE OF MONTANA
ADMINISTRATOR OF GROUNDWATER CODE
OFFICE OF STATE ENGINEER

JAN 9 1969

Notice of Completion of Groundwater Appropriation Without Well

(Under Chapter 237 Montana Session Laws, 1961)

Date of Appropriation of Groundwater.....

Owner W. G. Postlethwaite, JR. Address RR #1 Box 157A, Anaconda, Mont.

Contractor (if any) None

Address of Contractor

Date Started 1953 Date Completed 1955

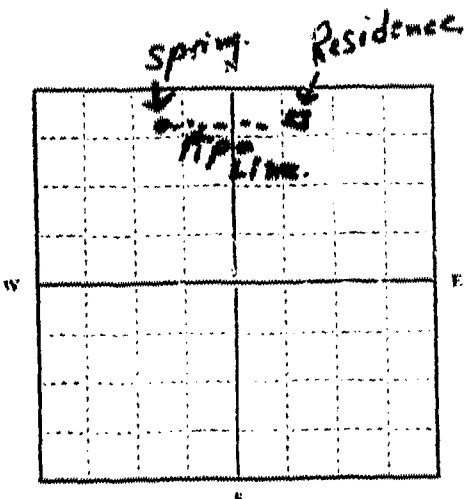

Describe means of obtaining groundwater without a well "as by sub-irrigation and other natural processes". Include depth to water when applicable. Natural Spring
(Cleared & Boxed in), piped to residence. (Approx. 5' depth)

Quantity of water developed and used with explanation of method used to measure or estimate such amount. If use is intermittent

estimate approximate lengths of periods of use Measured
by container & stop watch:
240 gal. per hour. Used for:
Residence - Lawn - Stock -
Garden - 5 plus on to field.

Signature of Owner W. G. Postlethwaite

Date Dec. 31. 1963

NW. 1/4 Sec. 17 T. 5 R. 11W
Indicate point of appropriation and place of use, if possible.

This form to be prepared by contractor (if any), otherwise by the owner.
Three copies of this notice are to be filed with the County Clerk and Recorder of the county in which the works are located.
Please answer all questions. If not applicable, so state, otherwise the form will be returned.
Original to the County Clerk and Recorder; duplicate to the State Engineer; Triplicate to the Montana Bureau of Mines and Geology and Quadruplicate for the Appropriator.

81324

Disc - 7/11/63

1300 - 1000 - 2/10/63
370 - 100 - 1/10/63
1/10/63

1/10/63
1/10/63

1/10/63

1/10/63

1/10/63
1/10/63

FILED FOR RECORD

Dec 31 1963

at 23 minutes past 9 o'clock
A.M. ANNA QUIGLEY

by Mary McKeown
Deputy

GW

File No.

T 5E R 11W NPM

DUPLICATE

County Deer Lodge, Montana

STATE OF MONTANA
ADMINISTRATOR OF GROUNDWATER CODE
OFFICE OF STATE ENGINEER

1963
D

Declaration of Vested Groundwater Rights
(Under Chapter 237, Montana Session Laws, 1961)

GINEED

1. ELIZA ANDREOLI, of 609 West Third Street Anaconda
(Name of Appropriator) (Address) (Town)

County of Deer Lodge State of Montana
have appropriated groundwater according to the Montana laws in effect prior to January 1, 1962, as follows:

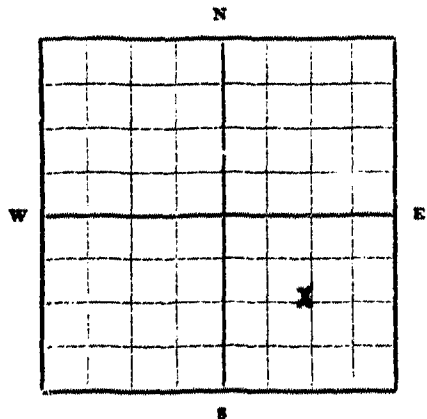

1/4 Sec. 18 T5E R. 11W NPM

Indicate point of appropriation and place of use, if possible. Each small square represents 10 acres.

2. The beneficial use on which the claim is based Household, Stock supply and irrigation

3. Date or approximate date of earliest beneficial use; and how continuous the use has been The well, being completed in 1966, has been in substantially constant use to date.

4. The amount of groundwater claimed (in miner's inches or gallons per minute) One Hundred (100) Inches

5. If used for irrigation, give the acreage and description of the lands to which water has been applied and name of the owner thereof

6. The means of withdrawing such water from the ground and the location of each well or other means of withdrawal A 525-gallon per hour pump (piston/jet) with one-inch suction pipe draws water from the dug well located near the residence at the above approximate location.

7. The date of commencement and completion of the construction of the well, wells, or other works for withdrawal of groundwater completed in the year 1966, other information not available.

8. The depth of water table Approximate 26 feet.

9. So far as it may be available, the type, size and depth of each well or the general specifications of any other works for the withdrawal of groundwater This is a hand-dug well of approximately 24 inch square dimensions and extends over 26 feet into the ground.

10. The estimated amount of groundwater withdrawn each year 25,000 gallons per year (guess)

11. The log of formations encountered in the drilling of each well if available not available.

12. Such other information of a similar nature as may be useful in carrying out the policy of this act, including reference to book and page of any county record none

Signature of Owner Eliza Andreoli
Date Dec 31 63

Three copies to be filed by the owner with the County Clerk and Recorder of the county in which the well is located.

Please answer all questions. If not applicable, so state, otherwise the form will be returned.

Original to the County Clerk and Recorder; duplicate to the State Engineer; Triplicate to the School of Mines and Quadruplicate for the Appropriator.

28743

81416

FILED FOR RECORD

December 31, 1963

at 55 minutes past 10 o'clock
P.M.

RECORD OFFICER

Carol M. Lantry

T. 5 R. 11
County San Diego

MONTANA BUREAU OF MINES AND GEOLOGY
Butte, Montana

WATER WELL LOG

Owner Steve Anderson Address Box 170 Unacorda Mt.
Driller C.F. Winkle Address Box 170 Unacorda Mt.
Date Started 4-30-57 Date Completed 5-1-57
Location: Sec. 15 T. 5 R. 11 1/4 sec.

Type of well Drilled Equipment used Churn drill
(Dug, driven, bored, or drilled) (Churn drill, rotary, other)

Water use: Domestic Municipal Stock Irrigation
Industrial Drainage Other: _____

Casing: 2 1/2 ft. to 25 ft. Galvanized pipe size 6"

Casing: _____ ft. to _____ ft. _____ size _____

Casing: _____ ft. to _____ ft. Type _____ Size _____

Perforated or Screened: Ft. _____ to ft. _____ Ft. _____ to ft. _____

Type of screen or perforations _____

Static Water level, for non-flowing well: _____ feet.

Shut-in pressure, for flowing well: _____ lb./sq. in. on: _____ (date)

Pumping water level: _____ feet at _____ gal. per min.

How tested: _____

Length of test: _____

Remarks: (Gravel packing, cementing, packers, type of shut-off, depth of shut-off)

(over)

15

T. 5 R. 11
County Deer Lodge

MONTANA BUREAU OF MINES AND GEOLOGY
Butte, Montana

WATER WELL LOG

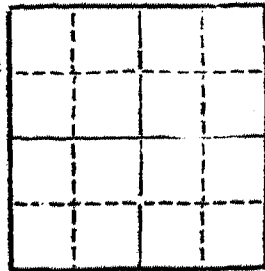

Owner Steve A. Renbourn Address Post Office, Penacosta, Mont.

Driller C. E. Worble Address Box 170, Penacosta, Mont.

Date Started June 30, 1957 Date Completed July 1, 1957

Location: Sec. 15 T. 5 R. 11 sec. 4

Type of well Drilled (Drill driven, bored, drilled) Equipment used Churn drill (Churn drill, rotary, other)

Water use: Domestic Municipal Stock Irrigation
Industrial Drainage Other: _____

Casing: Surface ft. to 35 ft. Type Cement & block size 6"

Casing: _____ ft. to _____ ft. Type _____ Size _____

Casing: _____ ft. to _____ ft. Type _____ Size _____

Perforated or Screened: Ft. _____ to ft. _____ Ft. _____ to ft. _____

Type of screen or perforations _____

Static Water level, for non-flowing well: _____ feet

Shut-in pressure, for flowing well: _____ lb./sq. in. on: _____ (date)

Pumping water level: _____ feet at _____ gal. per min.

How tested: _____

Length of test: _____

Remarks: (Gravel packing, cementing, packers, type of shut-off, depth of shut-off)

(over)