

17650

State of Montana, }
County of Fergus. } ss.

COPY

Filed DECEMBER 18 1893

at 1:40 o'clock P. M.

\$ 2 = 00

M. E. TELSON
County Clerk and Recorder

File No. 17042T. 14 R. 17

DUPLICATE

County Beaumont

STATE OF MONTANA
ADMINISTRATOR OF GROUNDWATER CODE
OFFICE OF STATE ENGINEER

Declaration of Vested Groundwater Rights

(Under Chapter 237, Montana Session Laws, 1961)

1. Adolf Kolar, of Beaumont, (Name of Appropriator) Mont (Address) Moore (Town)
County of Beaumont State of Mont
have appropriated groundwater according to the Montana laws in effect prior to January 1, 1962, as follows:

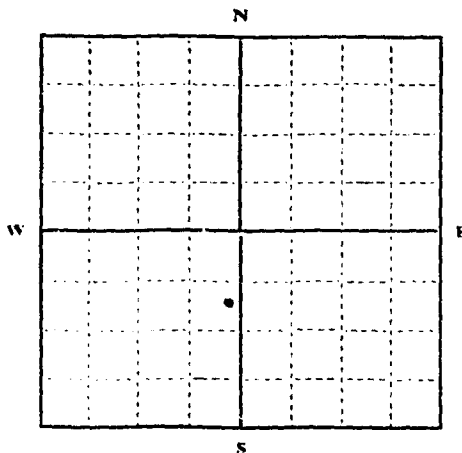

NW 1/4 Sec. 8 T. 14 R. 17

Indicate point of appropriation and place of use, if possible. Each small square represents 10 acres.

2. The beneficial use on which the claim is based stock and home use
3. Date or approximate date of 1965 beneficial use; and how continuous the use has been.
4. The amount of groundwater claimed (in mineral inches or gallons per minute) 1000
5. If used for irrigation, give the acreage and description of the lands to which water has been applied and name of the owner thereof owner
6. The means of withdrawing such water from the ground and the location of each well or other means of withdrawal pump
7. The date of commencement and completion of the construction of the well, wells, or other works for withdrawal of groundwater 1963
8. The depth of water table 12 feet
9. So far as it may be available, the type, size and depth of each well or the general specifications of any other works for the withdrawal of groundwater auger well
10. The estimated amount of groundwater withdrawn each year gals
11. The log of formations encountered in the drilling of each well if available Heavy clay
12. Such other information of a similar nature as may be useful in carrying out the policy of this act, including reference to book and page of any county record none

Signature of Owner

Adolf Kolar

Date

12-26-63

Three copies to be filed by the owner with the County Clerk and Recorder of the county in which the well is located.

Please answer all questions. If not applicable, so state, otherwise the form will be returned.

Original to the County Clerk and Recorder; Duplicate to the State Engineer; Triplicate to the Montana Bureau of Mines and Geology, and Quadruplicate for the Appropriator.

13263

17042

COPY

State of Montana, }
County of Park } ss.

Filed DEC 26 1963

at 10:35 o'clock A. M.

Wesley Rathbun
County Clerk and Recorder

& go pd.

File No. 17756

Type R

DUPLICATE

County

Descriptions:

STATE OF MONTANA

ADMINISTRATOR OF GROUNDWATER CODE

OFFICE OF STATE ENGINEER

A = SW 1/4 NW 1/4 Sec 8

B = NW 1/4 NE 1/4 Sec 8

Declaration of Vested Groundwater Rights

(Under Chapter 237, Montana Session Laws, 1961)

1. Roger M. Long, of Box 217, Lewistown, (Name of Appropriator) (Address) (Town)
 County of Fergus State of Montana
 have appropriated groundwater according to the Montana laws in effect prior to January 1, 1962, as follows:

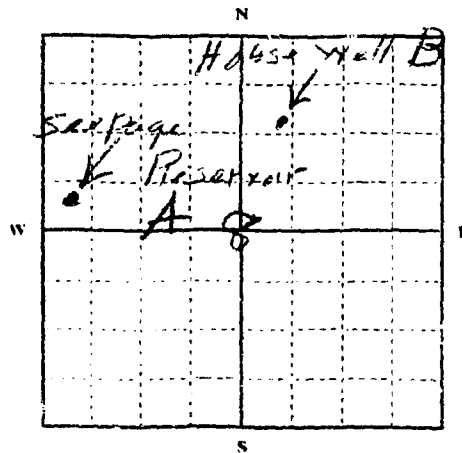

1/4 Sec 8 T14N R17E

Indicate point of appropriation and place of use, if possible. Each small square represents 10 acres.

2. The beneficial use on which the claim is based. House Water and Water for 500 Sheep from Well B. Water for 1000 Sheep from Reservoir A.
3. Date or approximate date of earliest beneficial use; and how continuous the use has been. Continuous since 1928 for Reservoir A. Continuous since 1904 for Well B.
4. The amount of groundwater claimed (in miner's inches or gallons per minute). 1 gal. per min. for Well B and 2 gal. per min. for Reservoir A continuous basis.
5. If used for irrigation, give the acreage and description of the lands to which water has been applied and name of the owner thereof. None.

6. The means of withdrawing such water from the ground and the location of each well or other means of withdrawal. Electric pump at Well B and clay sealed reservoir for A.

7. The date of commencement and completion of the construction of the well, wells, or other works for withdrawal of groundwater. Well B = 1904. Reservoir A = 1928.
8. The depth of water table. Variable, 20 ft to 30 ft = Well B. 4 ft = Reservoir A.
9. So far as it may be available, the type, size and depth of each well or the general specifications of any other works for the withdrawal of groundwater. dug well 30 ft deep Well B. Excavated Reservoir A = 4 ft deep.
10. The estimated amount of groundwater withdrawn each year. Well B = 525,000 gal. Reservoir A = 1,920,000 gal.
11. The log of formations encountered in the drilling of each well if available. Reservoir A was Clay Formation. Well B was Clay and Shale.
12. Such other information of a similar nature as may be useful in carrying out the policy of this act, including reference to book and page of any county record. No County Records found. Supporting at Electric Well B. Both A + B.

Signature of Owner

Date

31 Dec 1963

Three copies to be filed by the owner with the County Clerk and Recorder of the county in which the well is located.

Please answer all questions. If not applicable, so state, otherwise the form will be returned.

Original to the County Clerk and Recorder; Duplicate to the State Engineer; Triplicate to the Montana Bureau of Mines and Geology, and Quadruplicate for the Appropriator.

19199

17756

State of Montana,
County of Butte,

COPY

DEC 31 1963

at 3:40 o'clock P.M.

\$2.00

P.J.

MAY RATHBUN
County Clerk and Recorder

File No. 17684T. 14 R. 17E

DUPLICATE

County Fergus

STATE OF MONTANA
ADMINISTRATOR OF GROUNDWATER CODE
OFFICE OF STATE ENGINEER

Declaration of Vested Groundwater Rights

(Under Chapter 237, Montana Session Laws, 1961)

1. Julius TRESCH, of RR #2 Lewistown
(Name of Appropriator) (Address) (Town)
County of Fergus State of MONTANA
have appropriated groundwater according to the Montana laws in effect prior to January 1, 1962, as follows:

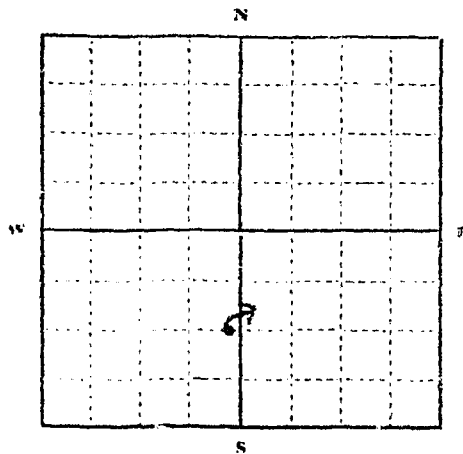

SW 1/4 Sec. 7 T. 14 R. 17

Indicate point of appropriation
and place of use, if possible. Each
small square represents 10 acres.

2. The beneficial use on which the claim is based water
for livestock
3. Date or approximate date of earliest beneficial use; and how continuous the use has been. 1908
4. The amount of groundwater claimed (in miner's inches or gallons per minute) 10 gal P.M.
5. If used for irrigation, give the acreage and description of the lands to which water has been applied and name of the owner thereof
12 irrigated
6. The means of withdrawing such water from the ground and the location of each well or other means of withdrawal
SPRING runs into tanks +
pond
7. The date of commencement and completion of the construction of the well, wells, or other works for withdrawal of groundwater
1913
8. The depth of water table 10-15 feet
9. So far as it may be available, the type, size and depth of each well or the general specifications of any other works for the withdrawal of groundwater
10' deep
10. The estimated amount of groundwater withdrawn each year 1000 gal
11. The log of formations encountered in the drilling of each well if available 10' deep
12. Such other information of a similar nature as may be useful in carrying out the policy of this act, including reference to book and page of any county record Rec. 46 Deeds 520 May 4, 1911
Rec. 51 Deeds 53 July 19, 1913

Signature of Owner

Julius Tersch
Date Dec 31 1963

Three copies to be filed by the owner with the County Clerk and Recorder of the county in which the well is located.

Please answer all questions. If not applicable, so state, otherwise the form will be returned.

Original to the County Clerk and Recorder; Duplicate to the State Engineer; Triplicate to the Montana Bureau of
Mines and Geology, and Quadruplicate for the Appropriator.

19144

17684

State of Montana, }
County of Fergus. } ss.

COPY

Filed _____ DEC 2 _____ 19__

at 2 1/2 _____ o'clock P.M.

Dec 2

MAY RATHBUN
County Clerk and Recorder

File No.

T. R.

DUPLICATE

County Lincoln

LOG

STATE OF MONTANA
ADMINISTRATOR OF GROUNDWATER CODE
STATE WATER CONSERVATION BOARD

**Notice of Completion of Groundwater
Appropriation by Means of Well**
DEVELOPED AFTER JANUARY 1, 1962

(Under Chapter 237 Montana Session Laws, 1961, as amended)

Owner Montana Electric Address Lexington, MontanaDriller George A. Singley Address Lexington, MontanaDate of Notice of appropriation of groundwater NoneDate well started June 4, 1973 Date completed June 6, 1973Type of well drilled Equipment used Rotary
(Dug, driven, bored or drilled) (Churn drill, rotary or other)Water use: Domestic ☐ Municipal ☐ Stock ☒ Irrigation ☐
Industrial ☐ Drainage ☐ Other ☐

Indicate on the diagram the character and thickness of the different strata met with in drilling, such as soil, clay, shale, gravel, rock or sand, etc. Show depth at which water is encountered, thickness and character of water-bearing strata and height to which the water rises in the well.

Size of Drilled Hole	Size and Weight of Casing	From (Feet)	To (Feet)	PERFORATIONS		
				Kind Size	From (Feet)	To (Feet)
7-1/8		0	131			
5-1/8		131	140			
	6-1/8 OD above 1" steel	140	147			

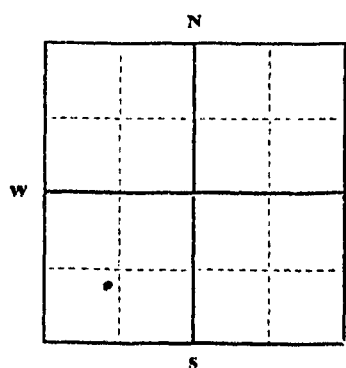

6.41 1/4 Sec. 11 T. 17. R. 17.
Indicate location of well and place of use, if possible. Each small square represents 40 acres.

Static Water Level for non-flowing well
107 feet.

Shut-in Pressure for Flowing Well None

Pumping Water Level 126 feet
at 20 gal. per minute.

Discharge in gal. per min. of flowing well
None

How Tested 40

Length of Test 2 days

Remarks: (Gravel packing, cementing, packers, type of shutoff) cell rod rod
rod rod

(Continue on reverse side)

USE—If used for irrigation, industrial, drainage or other. Explain, state number of acres and location or other data (i.e.: Lot, Block and Addition).

Show exact depth of bottom.

This form to be prepared by driller, and three copies to be filed by the owner with the County Clerk and Recorder in the county in which the well is located, tissue copy to be retained by driller.

Please answer all questions. If not applicable, so state, otherwise the form will be returned.

Driller's License Number 10

Driller's Signature George A. Singley

54008

51422

COPY

County of Fergus, Montana)
County of Fergus, Montana) ss. JUN 25 1973
Filed _____
at 10:00 o'clock A. M.
Wey R. Patton
County Clerk and Recorder
Fee Paid \$2.00

File No. _____

T. 14 R. 17

DUPLICATE

County Levi

LOG

STATE OF MONTANA
ADMINISTRATOR OF GROUNDWATER CODE
STATE WATER CONSERVATION BOARDNotice of Completion of Groundwater
Appropriation by Means of Well

DEVELOPED AFTER JANUARY 1, 1962

(Under Chapter 237 Montana Session Laws, 1961, as amended)

Top of Ground

(Elev. above sea level.....)

0 1 Topsoil
1 17 Clay, Sand, Gravel
17 130 Black Brittle Shale
130 195 White rock, lat. cat
Shale
195 279 Red Beds, red and
white, Purple, Grey
Varied
279 280 Extremely hard rock
280 346 Red, purple, grey,
white varietal shale
346 365 Top 2nd cat Creek
sand, water
365 375 Sandstone

Owner Floyd Maxwell Address Lewistown, MontanaDriller George O. Simpson Address Lewistown, MontanaDate of Notice of appropriation of groundwater NoneDate well started June 16, 1969 Date completed June 21, 1969Type of well Drilled Equipment used Rotary
(Dug, driven, bored or drilled) (Churn drill, rotary or other)Water use: Domestic ☐ Municipal ☐ Stock ☒ Irrigation ☐
Industrial ☐ Drainage ☐ Other ☐

Indicate on the diagram the character and thickness of the different strata met with in drilling, such as soil, clay, shale, gravel, rock or sand, etc. Show depth at which water is encountered, thickness and character of water-bearing strata and height to which the water rises in the well.

Size of Drilled Hole	Size and Weight of Casing	From (Feet)	To (Feet)	PERFORATIONS		
				Kid Size	From (Feet)	To (Feet)
7-7/8		0	21			
5-5/8		21	361			
3-7/8		361	375			
	4" ID 40D Galv.	above gr. 1'	361	1/2 x 4" slots	340	361

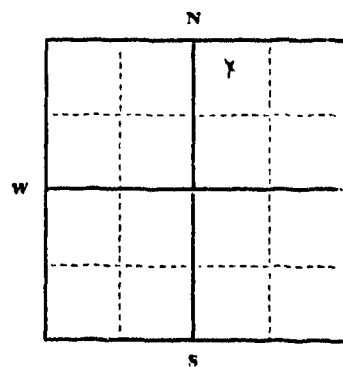

NW 1/4 NE Sec. 12 T. 14 R. 17
Indicate location of well and place of use, if possible. Each small square represents 40 acres.

Static Water Level for non-flowing well

None feet.Shut-in Pressure for Flowing Well approx. 10Pumping Water Level None feetat None gal. per minute.

Discharge in gal. per min. of flowing well

70How Tested Measured and BailingLength of Test 4 hrs.Remarks: (Gravel packing, cementing, packers, type of shutoff) Cemented.

(Continue on reverse side)

USE—If used for irrigation, industrial, drainage or other. Explain, state number of acres and location or other data (i.e.: Lot, Block and Addition).

Show exact depth of bottom.

This form to be prepared by driller, and three copies to be filed by the owner with the County Clerk and Recorder in the county in which the well is located, tissue copy to be retained by driller.

Please answer all questions. If not applicable, so state, otherwise the form will be returned.

19
Driller's License Number

Driller's Signature

48382

0000

State of Montana. } ss.
County of Lewis.

Filed APR 10 1971

at 5:00 P.M.

Wey Rethman
County Clerk and Recorder

File No.

17692

T 14 R 17

DUPLICATE

Fergus

STATE OF MONTANA
ADMINISTRATOR OF GROUNDWATER CODE
OFFICE OF STATE ENGINEER

**Notice of Completion of Groundwater
Appropriation by Means of Well**

(Under Chapter 237, Montana Session Laws, 1961)

	Top of Ground (Elev. above sea level)
0	
4	Surface soil
4	
10	Sandy clay
10	
30	Conglomerate
30	
130	Shale
130	
147	Sandy shale
147	
149	Sand good porosity, (Water)
149	
165	Shaley sand
165	
170	Sand good porosity (Water)
170	
175	Sandy shale
175	
178	White & Red Clays. T.

Owner Charles Bristol Address Lewistown, Route
Driller Wellman & Munson Drlg. address Grass Range, Mont.

Date of Notice of Appropriation of Groundwater (None)

Date well started Feb. 9- 1962 Date Completed March 14- 1962

Type of well Drilled Equipment Used Rotary
(dug, driven, bored or (Churn, drill, rotary or
drilled) other)

Water Use: Domestic ☒ Municipal ☐ Stock ☐ Irrigation ☐
Industrial ☐ Drainage ☐ Other ☐

Indicate on the diagram the character and thickness of the different strata met with in drilling, such as soil, clay, shale, gravel, rock or sand, etc. Show depth at which water is encountered, thickness and character of water-bearing strata and height to which the water rises in the well.

Size of Drilled Hole	Size and Weight of Casing	From (Feet)	To (Feet)	PERFORATIONS		
				Kind Size	From (Feet)	To (Feet)
9"	16 Lb. 7In.	0	40			
5 5/8	11 Lb. 4 1/2	0	178	Torch	147	170

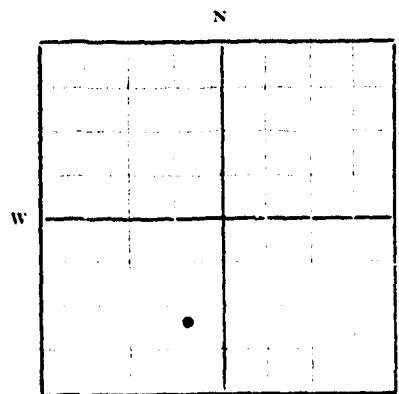

NE SE SW Sec. 15 T 14 R 17

Indicate location of well and place of use, if possible. Each small square represents 10 acres.

Show exact depth of bottom.

178, T. D.

Static Water Level for non-flowing Well 13 feet.

Shut-in Pressure for Flowing Well

Pumping Water Level 16 feet at 20 gal. per minute.

Discharge in gal. per min. of flowing well

How Tested Test Pump Length of Test Adequate

Remarks: (Gravel packing, cementing, packers, type of shutoff, location of place of use of groundwater if not at well, and any other similar pertinent information, including number of

acres irrigated, if used for irrigation)

Surface Cemented, Cone packer above perforations.

26

Driller's License Number

Driller's Signature

Wellman & Munson Drlg. Co. Inc. - R.C. Wellman

This form to be prepared by driller, and three copies to be filed by the owner with the County Clerk and Recorder in the county in which the well is located.

Please answer all questions. If not applicable, so state, otherwise the form will be returned.

Original to the County Clerk and Recorder; duplicate to the State Engineer; Triplicate to the School of Mines and Quadruplicate for the Appropriator.

1963

17602

State of Montana. }
County of Fergus. }

COPY

Filed DEC 3 1963 19

at 11:35 o'clock A.M.

J. C. Col.

MAY RATHBUN
County Clerk and Recorder

File No. 17599

T. 14 R. 17

DUPLICATE

County

Fergus

STATE OF MONTANA
ADMINISTRATOR OF GROUNDWATER CODE
OFFICE OF STATE ENGINEER

Declaration of Vested Groundwater Rights

(Under Chapter 237, Montana Session Laws, 1961)

1. Charles W Bristol, of Rt 2 Box 95 Lewistown
(Name of Appropriator) (Address) (Town)
County of Fergus State of Mont
have appropriated groundwater according to the Montana laws in effect prior to January 1, 1962, as follows:

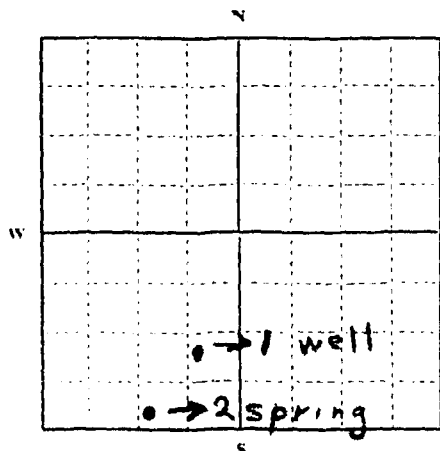

NE SE 1/4 SW Sec. 15 T. 14 R. 17

Indicate point of appropriation
and place of use, if possible. Each
small square represents 10 acres.

SW SE SW 15, 14, 17

2. The beneficial use on which the claim is based

① household

3. Date or approximate date of earliest beneficial use; and how continuous the use has been

① March 14, 1962
② 1911

4. The amount of groundwater claimed (in miner's inches or gallons per minute)

① 20 gal per min.
② natural flow

5. If used for irrigation, give the acreage and description of the lands to which water has been applied and name of the owner thereof

① 2 Irrigation of garden, shelterbelt
7 acres

6. The means of withdrawing such water from the ground and the location of each well or other means of withdrawal

① submersible pump
② natural flow

7. The date of commencement and completion of the construction of the well, wells, or other works for withdrawal of groundwater

① Feb 9, 1962 - March 14, 1962
② completed in 1911

8. The depth of water table

① 13 ft

② not applicable

9. So far as it may be available, the type, size and depth of each well or the general specifications of any other works for the withdrawal of groundwater

① drilled, 5 1/2", 17.5' deep

② not applicable

10. The estimated amount of groundwater withdrawn each year

① 200,000 gal

② steady flow

11. The log of formations encountered in the drilling of each well if available

① surface soil, sandy clay, conglomerate, shale, sandy shale, sand & water, sandy shale, white & red clay T. D.
② not applicable

12. Such other information of a similar nature as may be useful in carrying out the policy of this act, including reference to book and page of any county record

① not applicable

② not applicable

Signature of Owner

Charles W Bristol

Date Dec 30, 1963

Three copies to be filed by the owner with the County Clerk and Recorder of the county in which the well is located.

Please answer all questions. If not applicable, so state, otherwise the form will be returned.

Original to the County Clerk and Recorder; Duplicate to the State Engineer; Triplicate to the Montana Bureau of Mines and Geology, and Quadruplicate for the Appropriator

19060

17599
State of Montana, } ss. COPY
County of Fergus.
Filed _____ 19____
at 11:35 o'clock A.M.
#2-81 MAY RATHBUN
County Clerk and Recorder

17152

File No.

T. 14 R. 17

DUPLICATE

County Fergus

STATE OF MONTANA
ADMINISTRATOR OF GROUNDWATER CODE
OFFICE OF STATE ENGINEER

Declaration of Vested Groundwater Rights

(Under Chapter 237, Montana Session Laws, 1961)

School District # 8 of Pl 2 Lewistown
(Name of Appropriator) (Address) (Town)
County of Fergus State of Montana
have appropriated groundwater according to the Montana laws in effect prior to January 1, 1962, as follows:

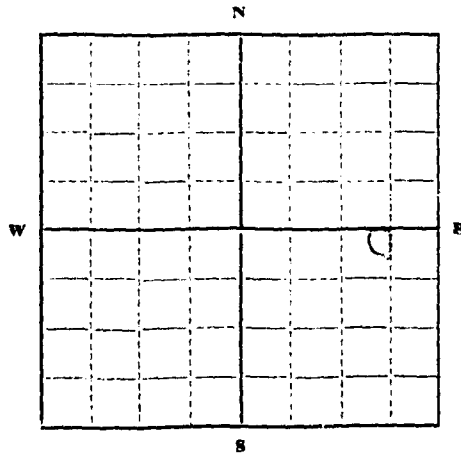

NE $\frac{1}{4}$ Sec. 15 T. 14 R. 17

Indicate point of appropriation
and place of use, if possible.
Each small square represents 10
acres.

2. The beneficial use on which the claim is based water for schoolhouse
3. Date or approximate date of earliest beneficial use; and how continuous the use has been 1954
continuous
4. The amount of groundwater claimed (in miner's inches or gallons per minute) 9 gal per min.
5. If used for irrigation, give the acreage and description of the lands to which water has been applied and name of the owner thereof
no.
6. The means of withdrawing such water from the ground and the location of each well or other means of withdrawal
pump
7. The date of commencement and completion of the construction of the well, wells, or other works for withdrawal of groundwater Nov 1 1953 - Jan 24 1954
8. The depth of water table 67 feet
9. So far as it may be available, the type, size and depth of each well or the general specifications of any other works for the withdrawal of groundwater 5" pipe 82' deep
10. The estimated amount of groundwater withdrawn each year 20,000
11. The log of formations encountered in the drilling of each well if available Topsoil, gravel, yellow clay, soft blue clay, bentonite, hard blue shale, chert rock, gravel, blue shale.
12. Such other information of a similar nature as may be useful in carrying out the policy of this act, including reference to book and page of any county record
Not applicable

SCHOOL DISTRICT #8

Robert Shammel, Chairman
Signature of Owner Mrs Ch. Bristol, clerk

Date 12-27-63

Three copies to be filed by the owner with the County Clerk and Recorder of the county in which the well is located.

Please answer all questions. If not applicable, so state, otherwise the form will be returned.

Original to the County Clerk and Recorder; duplicate to the State Engineer; Triplicate to the Montana Bureau of Mines and Geology, and Quadruplicate for the Appropriator.

17152 COPY

STATE OF ALABAMA
County of _____
FILED DEC 27 1967
at 2:45 o'clock P.M.
Way Rethman
County Clerk and Recorder
The Fee

File No. _____

T 14 R 17

DUPLICATE

County Fergus

STATE OF MONTANA
ADMINISTRATOR OF GROUNDWATER CODE
OFFICE OF STATE ENGINEER

Declaration of Vested Groundwater Rights

(Under Chapter 237, Montana Session Laws, 1961)

1. G. Robert Lodman and Laura A. Lodman of Route 2 Lewistown
(Name of Appropriator) (Address) (Town)
County of Fergus State of Montana
have appropriated groundwater according to the Montana laws in effect prior to January 1, 1962, as follows:

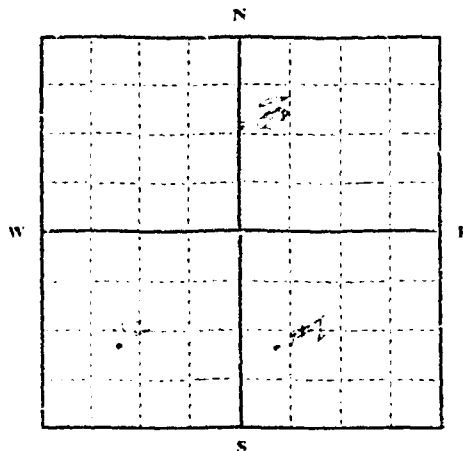

NW 1/4 &
SW 1/4 Sec. 16 T. 14 R. 17

Indicate point of appropriation
and place of use, if possible. Each
small square represents 10 acres.

2. The beneficial use on which the claim is based Stockwater and irrigation
3. Date or approximate date of earliest beneficial use; and how continuous the use has been #1 and #2 since 1962 and continuous since that year
4. The amount of groundwater claimed (in miner's inches or gallons per minute) #1 - 5 gallons per second and #2 - 5 gallons per second
5. If used for irrigation, give the acreage and description of the lands to which water has been applied and name of the owner thereof #1 - approximately 40 acres in NW 1/4 NE 1/4 of Sec. 16; #2 - approximately 30 acres in SW 1/4 SW 1/4 of Section 16.
6. The means of withdrawing such water from the ground and the location of each well or other means of withdrawal #1 is a spring and flows freely. #2 is a spring and has a pipe for dispersal.
7. The date of commencement and completion of the construction of the well, wells, or other works for withdrawal of groundwater unknown
8. The depth of water table surface
9. So far as it may be available, the type, size and depth of each well or the general specifications of any other works for the withdrawal of groundwater none
10. The estimated amount of groundwater withdrawn each year 157,680,000 on each well or spring.
11. The log of formations encountered in the drilling of each well if available none available
12. Such other information of a similar nature as may be useful in carrying out the policy of this act, including reference to book and page of any county record none known

Signature of Owner

Laura A. Lodman
G. Robert Lodman

Date September 22, 1969

Three copies to be filed by the owner with the County Clerk and Recorder of the county in which the well is located

Please answer all questions. If not applicable, so state, otherwise the form will be returned.

Original to the County Clerk and Recorder; Duplicate to the State Engineer; Triplicate to the Montana Bureau of Mines and Geology, and Quadruplicate for the Appropriator.

45736

37784

COF

State of Montana, } ss.
County of Fergus }

Filed COI 14 1969 19
at 4:55 o'clock P. M.
20pt Wey Arthur
County Clerk and Recorder

File No. 17564

I R

DUPLICATE

County

STATE OF MONTANA
ADMINISTRATOR OF GROUNDWATER CODE
OFFICE OF STATE ENGINEER

Declaration of Vested Groundwater Rights

(Under Chapter 237, Montana Session Laws, 1961)

1. Alfred M. Thichman of Theresa Moore
(Name of Appropriator) (Address) (Town)
County of Theresa State of Montana
have appropriated groundwater according to the Montana laws in effect prior to January 1, 1962, as follows:

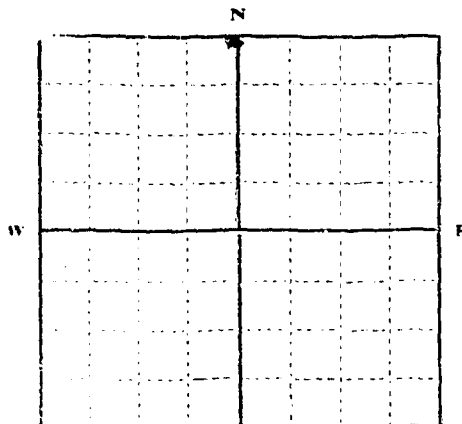

NE 1/4 Sec. 18 T. 14 R. 17

Indicate point of appropriation and place of use, if possible. Each small square represents 10 acres.

2. The beneficial use on which the claim is based Theresa

3. Date or approximate date of earliest beneficial use; and how continuous the use has been 1910 very land

4. The amount of groundwater claimed (in miner's inches or gallons per minute) 300 gals per min

5. If used for irrigation, give the acreage and description of the lands to which water has been applied and name of the owner thereof none

6. The means of withdrawing such water from the ground and the location of each well or other means of withdrawal open pit

7. The date of commencement and completion of the construction of the well, wells, or other works for withdrawal of groundwater. 36 ft

8. The depth of water table

9. So far as it may be available, the type, size and depth of each well or the general specifications of any other works for the withdrawal of groundwater

10. The estimated amount of groundwater withdrawn each year no data

11. The log of formations encountered in the drilling of each well if available none

12. Such other information of a similar nature as may be useful in carrying out the policy of this act, including reference to book and page of any county record

Signature of Owner

Date

Alfred M. Thichman
Dec. 31 / 1963

Three copies to be filed by the owner with the County Clerk and Recorder of the county in which the well is located.

Please answer all questions. If not applicable, so state, otherwise the form will be returned.

Original to the County Clerk and Recorder; Duplicate to the State Engineer; Triplicate to the Montana Bureau of Mines and Geology, and Quadruplicate for the Appropriator.

19030

17564

COPY

State of Montana, } ss.
County of Fergus }

Filed DEC 31 1963

at 10:15 o'clock A.M.

by J. D.

MAY RATHBUN
County Clerk and Recorder

File No. 17563

T R

DUPLICATE

County

STATE OF MONTANA
ADMINISTRATOR OF GROUNDWATER CODE
OFFICE OF STATE ENGINEER

Declaration of Vested Groundwater Rights

(Under Chapter 237, Montana Session Laws, 1961)

1. Alfred M. Thibault of Helena (Town)
(Name of Appropriator) (Address)

County of Hotone State of Montana
have appropriated groundwater according to the Montana laws in effect prior to January 1, 1962, as follows:

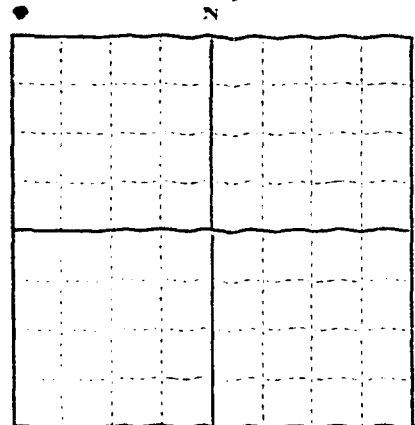

19^s 14^s 17^s
NW Sec. T. R.

Indicate point of appropriation
and place of use, if possible. Each
small square represents 10 acres.

2. The beneficial use on which the claim is based water

3. Date or approximate date of earliest beneficial use; and how continuous the use has been 1915

4. The amount of groundwater claimed (in miner's inches or gallons per minute) 150 gal. hr.

5. If used for irrigation, give the acreage and description of the lands to which water has been applied and name of the owner thereof none

6. The means of withdrawing such water from the ground and the location of each well or other means of withdrawal Pump
at time

7. The date of commencement and completion of the construction of the well, wells, or other works for withdrawal of groundwater 1915

8. The depth of water table 36 ft.

9. So far as it may be available, the type, size and depth of each well or the general specifications of any other works for the withdrawal of groundwater 36 ft. deep

10. The estimated amount of groundwater withdrawn each year none

11. The log of formations encountered in the drilling of each well if available none

12. Such other information of a similar nature as may be useful in carrying out the policy of this act, including reference to book and page of any county record none

Signature of Owner

Date

Alfred M. Thibault
Dec 31 1963

Three copies to be filed by the owner with the County Clerk and Recorder of the county in which the well is located.

Please answer all questions. If not applicable, so state, otherwise the form will be returned.

Original to the County Clerk and Recorder; Duplicate to the State Engineer; Triplicate to the Montana Bureau of Mines and Geology; and Quadruplicate for the Appropriator.

19029

17563

State of Montana, }
County of Fergus, } ss.

COPY

Filed..... 1903
at 10:15 o'clock A.M.
J. J. Q. MAY RATHBUN
County Clerk and Recorder

GW- 17601

File No.

DUPLICATE

14 R 17
County *Fergus*

STATE OF MONTANA
ADMINISTRATOR OF GROUNDWATER CODE
OFFICE OF STATE ENGINEER

Declaration of Vested Groundwater Rights

(Under Chapter 237, Montana Session Laws, 1961)

1. *Charles W Bristol* of *Rt 2 Box 95 Lewistown*
(Name of Appropriator) (Address) (To)
County of *Fergus* State of *Mont*
have appropriated groundwater according to the Montana laws in effect prior to January 1, 1962, as follows:

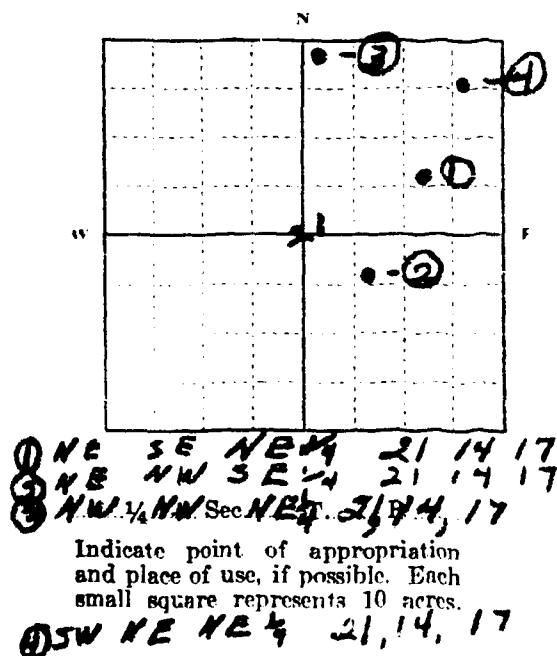

2. The beneficial use on which the claim is based *all four are stockwater*
3. Date or approximate date of earliest beneficial use; and how continuous the use has been *1948 - continuous*
1961 - continuous
4. The amount of groundwater claimed (in miner's inches or gallons per minute) *not known*
5. If used for irrigation, give the acreage and description of the lands to which water has been applied and name of the owner thereof *no*
6. The means of withdrawing such water from the ground and the location of each well or other means of withdrawal *natural flow*

7. The date of commencement and completion of the construction of the well, wells, or other works for withdrawal of groundwater *same as line 3*
8. The depth of water table *flowing*
9. So far as it may be available, the type, size and depth of each well or the general specifications of any other works for the withdrawal of groundwater
1 2 4" orangeburg pipe
3 4 4" orangeburg pipe + 1 1/2" plastic pipe
10. The estimated amount of groundwater withdrawn each year *steady flow*
11. The log of formations encountered in the drilling of each well if available *not applicable*
12. Such other information of a similar nature as may be useful in carrying out the policy of this act, including reference to book and page of any county record *not applicable*

Signature of Owner *Charles W Bristol*
Date *Dec. 31, 1963*

Three copies to be filed by the owner with the County Clerk and Recorder of the county in which the well is located

Please answer all questions. If not applicable, so state, otherwise the form will be returned.

Original to the County Clerk and Recorder; Duplicate to the State Engineer; Triplicate to the Montana Bureau of Mines and Geology; and Quadruplicate for the Appropriator

19002

17601

COPY

State of Montana, }
County of Fergus. } ss.

Filed..... DEC 3 1963
at 11:35 o'clock A.M.
#2012 MAY RATHBUN
County Clerk and Recorder

File No. 17600

DUPLICATE

T. 14 R. 17County Fergus

STATE OF MONTANA
ADMINISTRATOR OF GROUNDWATER CODE
OFFICE OF STATE ENGINEER

Declaration of Vested Groundwater Rights

(Under Chapter 237, Montana Session Laws, 1961)

1. Charles W Bristol of Rt 2 Box 95 Lewistown
(Name of Appropriator) (Address) (Town)
County of Fergus State of Montana
have appropriated groundwater according to the Montana laws in effect prior to January 1, 1962, as follows:

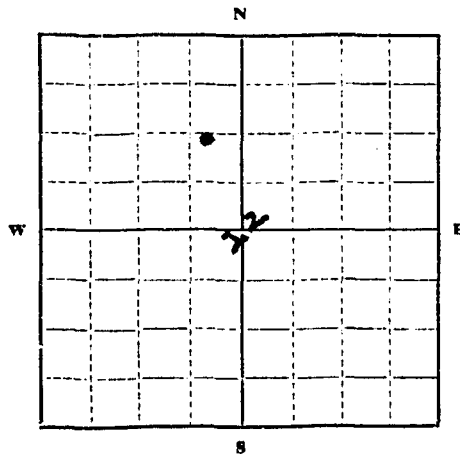

NE SE 1/4 NW 22 T. 14 R. 17

Indicate point of appropriation
and place of use, if possible.
Each small square represents 10
acres.

2. The beneficial use on which the claim is based. stock water
3. Date or approximate date of earliest beneficial use; and how continuous the use has been. natural flow
continuous use
4. The amount of groundwater claimed (in miner's inches or gallons per minute) not known
5. If used for irrigation, give the acreage and description of the lands to which water has been applied and name of the owner thereof no
6. The means of withdrawing such water from the ground and the location of each well or other means of withdrawal. natural flow
7. The date of commencement and completion of the construction of the well, wells, or other works for withdrawal of groundwater. none
8. The depth of water table. none
9. So far as it may be available, the type, size and depth of each well or the general specifications of any other works for the withdrawal of groundwater. not applicable
10. The estimated amount of groundwater withdrawn each year. steady flow
11. The log of formations encountered in the drilling of each well if available. not applicable
12. Such other information of a similar nature as may be useful in carrying out the policy of this act, including reference to book and page of any county record. not applicable

Signature of Owner

Charles W. Bristol
Date Dec 31, 1963

Three copies to be filed by the owner with the County Clerk and Recorder of the county in which the well is located.

Please answer all questions. If not applicable, so state, otherwise the form will be returned.

Original to the County Clerk and Recorder; duplicate to the State Engineer; Triplicate to the Montana Bureau of Mines and Geology, and Quadruplicate for the Appropriator.

19061

17600

State of Montana, } ss.
County of Fergus.

COPY

DEC 31 1963

Filed

at 11:35

o'clock A.M.

45⁰⁰ Qd.

MAY 21 1964

County Clerk and Recorder

File No.

T 14 R 17

DUPLICATE

County—Crown

STATE OF MONTANA
ADMINISTRATOR OF GROUNDWATER CODE
OFFICE OF STATE ENGINEER

Declaration of Vested Groundwater Rights

(Under Chapter 237, Montana Session Laws, 1961)

1. I, Joseph L. L. L., of Leavitt, Montana,
(Name of Appropriator) (Address) (Town)

County of Carbon State of Montana
have appropriated groundwater according to the Montana laws in effect prior to January 1, 1962, as follows:

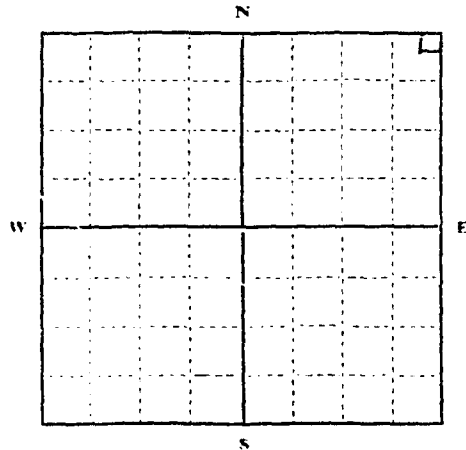

1/4 Sec. 22 T. 14 R. 17

Indicate point of appropriation
and place of use, if possible. Each
small square represents 10 acres.

2. The beneficial use on which the claim is based general irrigation
3. Date or approximate date of earliest beneficial use; and how continuous the use has been continuous since 1911
4. The amount of groundwater claimed (in miner's inches or gallons per minute) 200 million per hour
5. If used for irrigation, give the acreage and description of the lands to which water has been applied and name of the owner thereof about 2000 acres to the Carbon River, Carbon County, Montana
6. The means of withdrawing such water from the ground and the location of each well or other means of withdrawal see above as to location
7. The date of commencement and completion of the construction of the well, wells, or other works for withdrawal of groundwater see above as to location
8. The depth of water table with water between 20 and 100 feet below surface
9. So far as it may be available, the type, size and depth of each well or the general specifications of any other works for the withdrawal of groundwater see above as to location
10. The estimated amount of groundwater withdrawn each year 200 million
11. The log of formations encountered in the drilling of each well if available see above as to location
12. Such other information of a similar nature as may be useful in carrying out the policy of this act, including reference to book and page of any county record

Signature of Owner Joe R. L. L.

Date Dec 24, 1968

Three copies to be filed by the owner with the County Clerk and Recorder of the county in which the well is located.

Please answer all questions. If not applicable, so state, otherwise the form will be returned.

Original to the County Clerk and Recorder; Duplicate to the State Engineer; Triplicate to the Montana Bureau of Mines and Geology, and Quadruplicate for the Appropriator.

44, 28-3

COPY

State of Montana,) ss.
County of _____

Filed _____ 19____
at _____ o'clock _____
M. *Wm. Rathbone*
County Clerk and Recorder
#200 pt

File No. 12948T. 14 R. 17

DUPLICATE

County Fergus

STATE OF MONTANA
ADMINISTRATOR OF GROUNDWATER CODE
OFFICE OF STATE ENGINEER

Declaration of Vested Groundwater Rights

(Under Chapter 237, Montana Session Laws, 1961)

1. Lee R. Shammel of Heath
(Name of Appropriator) (Address) (Town)
County of Fergus State of Montana
have appropriated groundwater according to the Montana laws in effect prior to January 1, 1962, as follows:

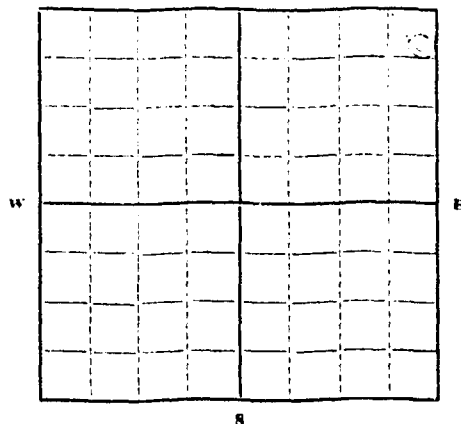

NE 1/4 Sec. 22 T. 14 R. 17

Indicate point of appropriation
and place of use, if possible.
Each small square represents 10
acres.

2. The beneficial use on which the claim is based Domestic and garden irrigation and lawn and stock water.
3. Date or approximate date of earliest beneficial use; and how continuous the use has been continuous since 1942.
4. The amount of groundwater claimed (in miner's inches or gallons per minute) 200 gallons per hour
5. If used for irrigation, give the acreage and description of the lands to which water has been applied and name of the owner thereof
about 2 acres in the NE ten acres of square of the plot.
Lee R Shammel
6. The means of withdrawing such water from the ground and the location of each well or other means of withdrawal
same as above as to location
pumped by electric pump
7. The date of commencement and completion of the construction of the well, wells, or other works for withdrawal of groundwater
summer of 1942
8. The depth of water table hit water between 50 ft. and 60 ft. and raises to within 15 ft. of surface.
9. So far as it may be available, the type, size and depth of each well or the general specifications of any other works for the withdrawal of groundwater 5 inch casing, 20 feet deep
Water is drawn by a 350 gallon per jet pump.
10. The estimated amount of groundwater withdrawn each year 300,000 gallons
11. The log of formations encountered in the drilling of each well if available 0' to 15' ft. clay, sand and gravel 15' to 20' black shale, 50 ft. to 60 ft. white rock, sand, gravel, hit water between 50 ft. and 60 ft.
12. Such other information of a similar nature as may be useful in carrying out the policy of this act, including reference to book and page of any county record

Signature of Owner Lee R ShammelDate Jan 7 - 1963

Three copies to be filed by the owner with the County Clerk and Recorder of the county in which the well is located.

Please answer all questions. If not applicable, so state, otherwise the form will be returned.

Original to the County Clerk and Recorder; duplicate to the State Engineer; Triplicate to the Montana Bureau of Mines and Geology, and Quadruplicate for the Appropriator.

12943 COPY

State of Montana, } ss.
County of Fergus, }

Filed JAN 15 1963

19

at 3:00 o'clock P.M.

Wey Arthur

County Clerk and Recorder

#200 pd

File No. **17071**

DUPLICATE

T. 14 R. 7County Fergus

STATE OF MONTANA
ADMINISTRATOR OF GROUNDWATER CODE
OFFICE OF STATE ENGINEER

Declaration of Vested Groundwater Rights

(Under Chapter 237, Montana Session Laws, 1961)

STATE ENGINEER

1. John D. Machler of Leavitt Town Montana
(Name of Appropriator) (Address) (Town)

County of Fergus State of Montana
have appropriated groundwater according to the Montana laws in effect prior to January 1, 1962, as follows:

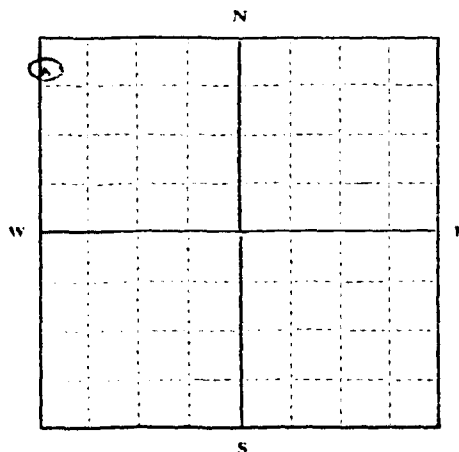

N 1/4, NW 1/4 Sec. 27 T. 14 R. 7

Indicate point of appropriation
and place of use, if possible.
Each small square represents 10
acres.

2. The beneficial use on which the claim is based household
and livestock
3. Date or approximate date of earliest beneficial use; and how continuous the use has been unknown
continuous
4. The amount of groundwater claimed (in miner's inches or gallons per minute) 52 gal per minute
5. If used for irrigation, give the acreage and description of the lands to which water has been applied and name of the owner thereof
120.28
6. The means of withdrawing such water from the ground and the location of each well or other means of withdrawal
gravity
7. The date of commencement and completion of the construction of the well, wells, or other works for withdrawal of groundwater
unknown
8. The depth of water table about
9. So far as it may be available, the type, size and depth of each well or the general specifications of any other works for the withdrawal of groundwater
1 1/2 inch pipe
10. The estimated amount of groundwater withdrawn each year about 9 gal
11. The log of formations encountered in the drilling of each well if available
see records
12. Such other information of a similar nature as may be useful in carrying out the policy of this act, including reference to book and page of any county record

Signature of Owner

John D. Machler
Date Dec 21, 1963

Three copies to be filed by the owner with the County Clerk and Recorder of the county in which the well is located.

Please answer all questions. If not applicable, so state, otherwise the form will be returned.

Original to the County Clerk and Recorder; duplicate to the State Engineer; Triplicate to the Montana Bureau of Mines and Geology, and Quadruplicate for the Appropriator.

13288

17071

COPY

State of Maryland } ss.
County of Prince Georges }
Filed DEC 26 1963 19
at 2:30 o'clock P.M.
Mary Rathbone
County Clerk and Recorder
200 pm

File No. 17666

T 4N R 17E

DUPLICATE

County Fergus

STATE OF MONTANA
ADMINISTRATOR OF GROUNDWATER CODE
OFFICE OF STATE ENGINEER

Declaration of Vested Groundwater Rights

(Under Chapter 237, Montana Session Laws, 1961)

1. Bertille H. Reese of MOORE MONT
(Name of Appropriator) (Address) (Town)

County of FERGUS State of MONTANA
have appropriated groundwater according to the Montana laws in effect prior to January 1, 1962, as follows:

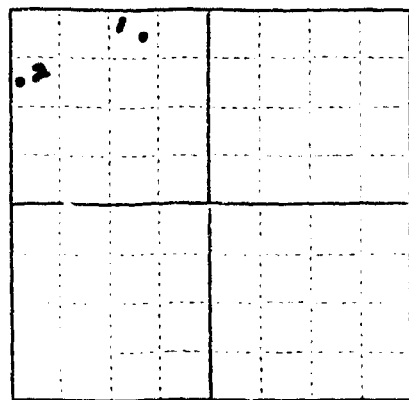

1. SE 1/4 Sec. 25 T. 4N R. 17E
2. SW 1/4 Sec. 25 T. 4N R. 17E

Indicate point of appropriation
and place of use, if possible. Each
small square represents 10 acres.

2. The beneficial use on which the claim is based...
1. STOCK WATER
2. STOCK WATER
3. Date or approximate date of earliest beneficial use; and how continuous the use has been...
1. APPROX 1885 - CONSTANT USE
2. APPROX 1885 - CONSTANT USE
4. The amount of groundwater claimed (in miner's inches or gallons per minute) 1. APPROX 5 GAL PER MINUTE
2. APPROX 3 GAL PER MINUTE
5. If used for irrigation, give the acreage and description of the lands to which water has been applied and name of the owner thereof
1. NOT USED FOR IRRIGATION
2. NOT USED FOR IRRIGATION
6. The means of withdrawing such water from the ground and the location of each well or other means of withdrawal
1. GRAVITY FLOW SPRING
2. GRAVITY FLOW SPRING
7. The date of commencement and completion of the construction of the well, wells, or other works for withdrawal of groundwater 1. SPRING - NOT APPLICABLE
2. SPRING - NOT APPLICABLE
8. The depth of water table 1. NOT KNOWN
2. NOT KNOWN
9. So far as it may be available, the type, size and depth of each well or the general specifications of any other works for the withdrawal of groundwater
1. NATURAL SPRING - GRAVITY FLOW
2. NATURAL SPRING - GRAVITY FLOW
10. The estimated amount of groundwater withdrawn each year 1. APPROX 125,000 GAL
2. APPROX 90,000 GAL
11. The log of formations encountered in the drilling of each well if available
1. NOT APPLICABLE
2. NOT APPLICABLE
12. Such other information of a similar nature as may be useful in carrying out the policy of this act, including reference to book and page of any county record
1. NONE
2. NONE

Signature of Owner Bertille H. ReeseDate DEC 31 1963

Three copies to be filed by the owner with the County Clerk and Recorder of the county in which the well is located

Please answer all questions. If not applicable, so state, otherwise the form will be returned.

Original to the County Clerk and Recorder; Duplicate to the State Engineer; Triplicate to the Montana Bureau of Mines and Geology, and Quadruplicate for the Appropriator.

File No. **17668**T **14N** R **17E**

DUPLICATE

County **FERGUS**

STATE OF MONTANA
ADMINISTRATOR OF GROUNDWATER CODE
OFFICE OF STATE ENGINEER

Declaration of Vested Groundwater Rights

(Under Chapter 237, Montana Session Laws, 1961)

1. **Bert H. A. Reese**, of **MOORE**
(Name of Appropriator) (Address) (Town)
County of **FERGUS** State of **MONTANA**
have appropriated groundwater according to the Montana laws in effect prior to January 1, 1962, as follows:

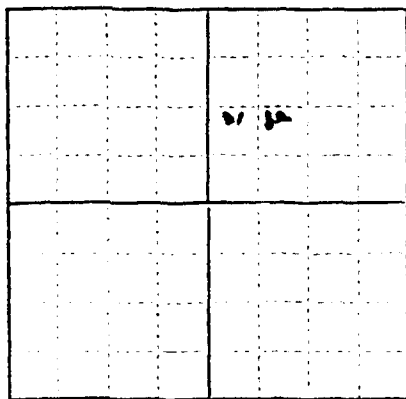

1. SW 1/4 Sec. 26 T. 14N R. 17E
2. SW 1/4 Sec. 26 T. 14N R. 17E

Indicate point of appropriation and place of use, if possible. Each small square represents 10 acres.

2. The beneficial use on which the claim is based.
1. **PROVIDES WATER FOR THE HOUSE**
2. **LIVESTOCK WATER**
3. Date or approximate date of earliest beneficial use; and how continuous the use has been
1. **SEPT. 20, 1949 - CONSTANT USE**
2. **APPROX. 1885 - CONSTANT USE**
4. The amount of groundwater claimed (in miner's inches or gallons per minute)
1. **10 GAL PER MINUTE**
2. **APPROX 3 GAL PER MINUTE**
5. If used for irrigation, give the acreage and description of the lands to which water has been applied and name of the owner thereof
1. **NOT USED FOR IRRIGATION**
2. **NOT USED FOR IRRIGATION**
6. The means of withdrawing such water from the ground and the location of each well or other means of withdrawal
1. **PUMP**
2. **GRAVITY FLOW SPRING**
7. The date of commencement and completion of the construction of the well, wells, or other works for withdrawal of groundwater
1. **COMMENCED - SEPT 13, 1949 - COMPLETED SEPT 20, 1949**
2. **SPRING - NOT APPLICABLE**
8. The depth of water table
1. **APPROX. 47'**
2. **NOT KNOWN**
9. So far as it may be available, the type, size and depth of each well or the general specifications of any other works for the withdrawal of groundwater
1. **DRILLED WELL - 6" CASING - 80' DEEP**
2. **NATURAL SPRING - GRAVITY FLOW**
10. The estimated amount of groundwater withdrawn each year
1. **APPROX. 182,500 GAL**
2. **APPROX 90,000 GAL**
11. The log of formations encountered in the drilling of each well if available
1. **NOT AVAILABLE**
2. **NOT APPLICABLE**
12. Such other information of a similar nature as may be useful in carrying out the policy of this act, including reference to book and page of any county record
1. **NONE**
2. **NONE**

Signature of Owner **Bert H. A. Reese**Date **DEC 31, 1963**

Three copies to be filed by the owner with the County Clerk and Recorder of the county in which the well is located

Please answer all questions. If not applicable, so state, otherwise the form will be returned.

Original to the County Clerk and Recorder; Duplicate to the State Engineer; Triuplicate to the Montana Bureau of Mines and Geology, and Quadruplicate for the Appropriator

17668

COPY

State of New York
County of [illegible]

Filed DEC 3 1908

at 1:50 o'clock P.M.
\$5.00 Ed. MAY RATHBUN
County Clerk and Recorder

[Faint, mostly illegible text, likely a legal document or record, possibly containing names and dates.]

File No. **17506**T. **14 N** R. **17 E**

DUPLICATE

County **Fergus**

STATE OF MONTANA
ADMINISTRATOR OF GROUNDWATER CODE
OFFICE OF STATE ENGINEER

Declaration of Vested Groundwater Rights

(Under Chapter 237, Montana Session Laws, 1961)

1. **Theodore Rowland** of **Leviestown**
(Name of Appropriator) (Address) (Town)
County of **Fergus** State of **Montana**
have appropriated groundwater according to the Montana laws in effect prior to January 1, 1962, as follows:

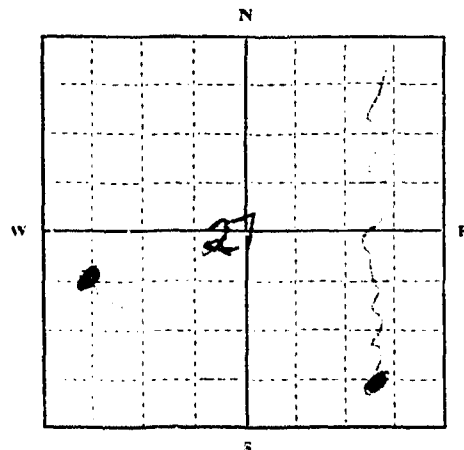

1/4 Sec. T. R.

Indicate point of appropriation and place of use, if possible. Each small square represents 10 acres.

2. The beneficial use on which the claim is based **Livestock and Irrigation**
3. Date or approximate date of earliest beneficial use; and how continuous the use has been **I purchased place in Aug 1962 which would be my first use**
4. The amount of groundwater claimed (in miner's inches or gallons per minute) **Est 3000 gal per min.**
5. If used for irrigation, give the acreage and description of the lands to which water has been applied and name of the owner thereof **30 acres E 1/2 Sec 27**
6. The means of withdrawing such water from the ground and the location of each well or other means of withdrawal **Natural flow**
7. The date of commencement and completion of the construction of the well, wells, or other works for withdrawal of groundwater **not applicable**
8. The depth of water table **Surface water**
9. So far as it may be available, the type, size and depth of each well or the general specifications of any other works for the withdrawal of groundwater **not applicable**
10. The estimated amount of groundwater withdrawn each year **not applicable**
11. The log of formations encountered in the drilling of each well if available **not applicable**
12. Such other information of a similar nature as may be useful in carrying out the policy of this act, including reference to book and page of any county record **not known**

Signature of Owner

Theodore RowlandDate **Dec 31, 1963**

Three copies to be filed by the owner with the County Clerk and Recorder of the county in which the well is located.

Please answer all questions. If not applicable, so state, otherwise the form will be returned.

Original to the County Clerk and Recorder; Duplicate to the State Engineer; Triplicate to the Montana Bureau of Mines and Geology, and Quadruplicate for the Appropriator.

18978

17506

COPY

State of Montana, }
County of Fergus }

Filed..... DEC 31 1963

at 9:35 o'clock A.M.

2 *Ed.* MAY RATHRIIN
County Clerk and Recorder

File No. 15520

DUPLICATE

STATE OF MONTANA
ADMINISTRATOR OF GROUNDWATER CODE
OFFICE OF STATE ENGINEER

T. 14 R. 17

County *Fergus*

RECEIVED
AUG 29 1963

Declaration of Vested Groundwater Rights

(Under Chapter 237, Montana Session Laws, 1961)

STATE ENGINEER

1. *Lula M. Clay* of *Missoula*
(Name of Appropriator) (Address) (Town)
County of *Fergus* State of *Montana*
have appropriated groundwater according to the Montana laws in effect prior to January 1, 1962, as follows:

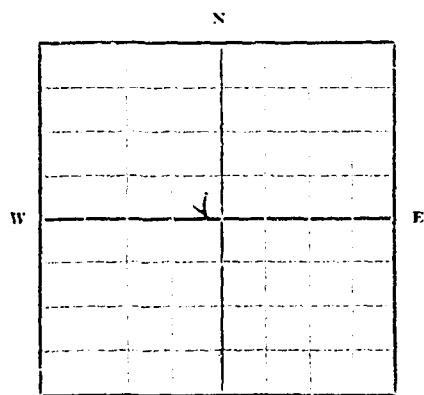

SE $\frac{1}{4}$ $\frac{1}{4}$ Sec. 33 T. 14 R. 17

Indicate point of appropriation and place of use, if possible. Each small square represents 10 acres.

2. The beneficial use on which the claim is based *water for cattle now but also used for household when first dug*
3. Date or approximate date of earliest beneficial use; and how continuous the use has been *have no idea perhaps forty*

4. The amount of groundwater claimed (in miner's inches or gallons per minute) *don't know*

5. If used for irrigation, give the acreage and description of the lands to which water has been applied and name of the owner thereof *Not used for irrigation*

6. The means of withdrawing such water from the ground and the location of each well or other means of withdrawal *electric pump when water is needed for cattle*

7. The date of commencement and completion of the construction of the well, wells, or other works for withdrawal of groundwater *don't know*

8. The depth of water table *don't know*

9. So far as it may be available, the type, size and depth of each well or the general specifications of any other works for the withdrawal of groundwater

It's a dug well about thirty feet deep. I think

10. The estimated amount of groundwater withdrawn each year *have no idea - but some*

11. The log of formations encountered in the drilling of each well if available

none available

12. Such other information of a similar nature as may be useful in carrying out the policy of this act, including reference to book and page of any county record

I know of none

Signature of Owner

Date

Lula M. Clay
Aug 28 1963

Three copies to be filed by the owner with the County Clerk and Recorder of the county in which the well is located.

Please answer all questions. If not applicable, so state, otherwise the form will be returned.

Original to the County Clerk and Recorder; duplicate to the State Engineer; Triplicate to the School of Mines and Quadruplicate for the Appropriator.

15316

COPY

State of Montana. } ss.
County of Fergus.

Mile _____ AUG 28 1963 19____
at _____ 9:45 _____ o'clock P. M.

Way Rathbun
County Clerk and Recorder

200 ps

Form No. 18
8-60

T. 14N. R. 17E
County Frederick

MONTANA BUREAU OF MINES AND GEOLOGY
Butte, Montana

WATER WELL LOG

Owner Lula M. Clay Address Moore
Driller McGraw-Hill Drilling Co. Address San Antonio, Texas
Date Started Aug. 24, 1950 Date Completed Aug 30, 1950
Location: Sec. 34 T. 14N. R. 17E $\frac{1}{4}$ sec. 1

Type of well Drilled Equipment used Rotary
(Lug, driven, bored, or drilled) (Churn, mill, rotary, other)

Water use: Domestic ☒ Municipal ☐ Stock ☒ Irrigation ☐
Industrial ☐ Drainage ☐ Other _____

Casing: 1' ft. to 144 1/2 ft. Type 14" Size 5-3/16"

Casing: _____ ft. to _____ ft. Type _____ Size _____

Casing: _____ ft. to _____ ft. Type _____ Size _____

Perforated or Screened: Ft. 103 1/2 to ft. 144 1/2. Ft. _____ to ft. _____

Type of screen or perforations Just perforations in pipe

Static Water level, for non-flowing well: 67' at time of completion feet.

Shut-in pressure, for flowing well: _____ lb./sq. in. on: _____ (date)

Pumping water level 67' to 76' feet at _____ gal. per min. hr.

How tested: ailed - level dropped from 67' to 76' in first

Length of test 24 hrs. half of test but remained static

Remarks: (Gravel packing, cementing, packers, type of shut-off, depth of shut-off)

Upper packer set 20' below surface. Sand above
packer to 13' depth. Cemented with one sack to 6'
below surface. Lower packer at 103 1/2'
(over)

Log of Well

[illegible]

copy

GW3

File No. 15308

DUPLICATE

T. 14 R. 17

County. Fergus

RECEIVED
AUG 29 1963STATE OF MONTANA
ADMINISTRATOR OF GROUNDWATER CODE
OFFICE OF STATE ENGINEER

STATE ENGINEER

Notice of Completion of Groundwater Appropriation Without Well

(Under Chapter 237 Montana Session Laws, 1961)

Date of Appropriation of Groundwater Sept. 1958

Owner: Lula M. Clay Address: Moore

Contractor (if any) No Contractor, just hired
a neighbor who hired men to dig trench
Address of Contractor for water pipe

Date Started Sept 1958 Date Completed Sept 1958

Describe means of obtaining groundwater without a well "as by
sub-irrigation and other natural processes". Include depth towater when applicable. This is a developed
spring piped to two cattle watering tanks.
The water "ozes" out between layers of
rock into an underground tank from
which the water goes down underground
to tanks.Quantity of water developed and used with explanation of meth-
od used to measure or estimate such amount. If use is intermit-tent estimate approximate lengths of periods of use Spring
is used for watering cattle
approximately from May to November
but flows all the time.

Signature of Owner Lula M. Clay

Date Aug 28, 1963

This form to be prepared by contractor (if any), otherwise by the owner.

Three copies of this notice are to be filed with the County Clerk and Recorder of the county in
which the works are located.

Please answer all questions. If not applicable, so state, otherwise the form will be returned.

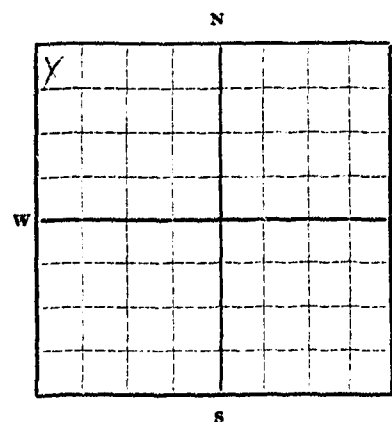
Original to the County Clerk and Recorder; duplicate to the State Engineer; Triplicate to the
School of Mines and Quadruplicate for the Appropriator.1/4 Sec. 34, T. 14, R. 17
Indicate point of appropriation
and place of use, if possible.

15308 COPY

State of Montana, }
County of Fergus. } ss.

Filed AUG 28 1963 19
at 9:45 o'clock P. M.
Wesley R. Keithum
County Clerk and Recorder

*2 pr

GV

File No.

17813

DUPLICATE

Approved: State Engineer, Helena, Montana 59201

T. L. R.

County

STATE OF MONTANA
ADMINISTRATOR OF GROUNDWATER CODE
OFFICE OF STATE ENGINEER

Declaration of Vested Groundwater Rights

(Under Chapter 237, Montana Session Laws, 1961)

6

JAN 3 1964

STATE ENGINEER

1. Walter Gordon of Bozeman Montana
(Name of Appropriator) (Address) (Town)
County of Bozeman State of Montana
have appropriated groundwater according to the Montana laws in effect prior to January 1, 1962, as follows:

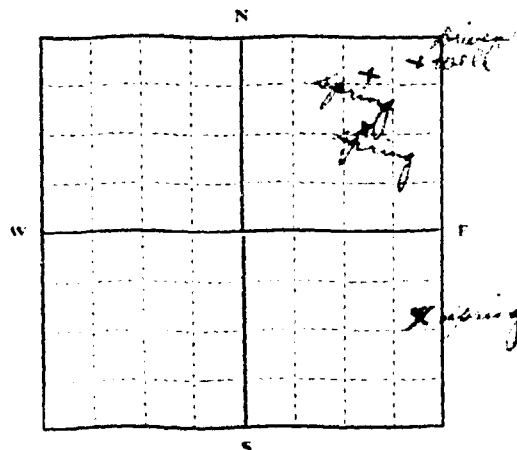

NE 1/4 NE Sec. 37 T. 13 R. 17

Indicate point of appropriation and place of use, if possible. Each small square represents 10 acres.

2. The beneficial use on which the claim is based household water
3. Date or approximate date of earliest beneficial use; and how continuous the use has been since 1947
4. The amount of groundwater claimed (in miner's inches or gallons per minute) using
5. If used for irrigation, give the acreage and description of the lands to which water has been applied and name of the owner thereof
6. The means of withdrawing such water from the ground and the location of each well or other means of withdrawal using
7. The date of commencement and completion of the construction of the well, wells, or other works for withdrawal of groundwater 1947
8. The depth of water table 5'
9. So far as it may be available, the type, size and depth of each well or the general specifications of any other works for the withdrawal of groundwater 1 1/2"
10. The estimated amount of groundwater withdrawn each year
11. The log of formations encountered in the drilling of each well if available
12. Such other information of a similar nature as may be useful in carrying out the policy of this act, including reference to book and page of any county record

Signature of Owner Walter Gordon

Date Jan 3, 1962

Three copies to be filed by the owner with the County Clerk and Recorder of the county in which the well is located

Please answer all questions. If not applicable, so state, otherwise the form will be returned.

Original to the County Clerk and Recorder; Duplicate to the State Engineer; Triplicate to the Montana Bureau of Mines and Geology, and Quadruplicate for the Appropriator.

19253

17813

State of Montana, } ss. COPY
County of Fergus.

Filed DEC 31 1963 19

at 4:40 o'clock P.M.

\$2.00
MAY RATHBUN
County Clerk and Recorder

GW

17819

Approved State Engineer's Office, Helena, Montana, 1962

File No.

T 14N R 17E

DUPLICATE

County FERGUS

STATE OF MONTANA
ADMINISTRATOR OF GROUNDWATER CODE
OFFICE OF STATE ENGINEER

Declaration of Vested Groundwater Rights

(Under Chapter 237, Montana Session Laws, 1961)

1. Marion Burke of Lewistown, Montana
(Name of Appropriator) (Address) (Town)
County of Fergus State of Montana
have appropriated groundwater according to the Montana laws in effect prior to January 1, 1962, as follows:

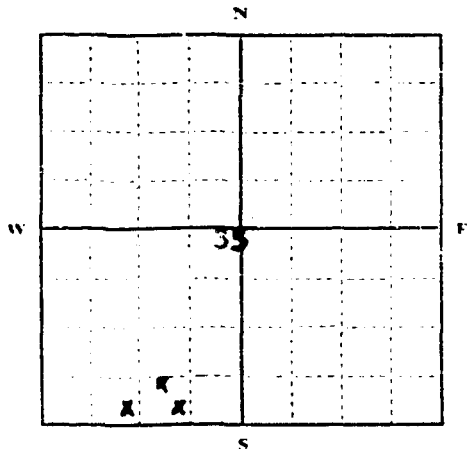

SE 36 7/4 Sec. 35 T. 14N R. 17E

Indicate point of appropriation and place of use, if possible. Each small square represents 10 acres.

2. The beneficial use on which the claim is based house use, stock water and garden irrigation
3. Date or approximate date of earliest beneficial use; and how continuous the use has been Since purchase of land in 1958 and constantly since
4. The amount of groundwater claimed (in miner's inches or gallons per minute) 200 gal. per minute
5. If used for irrigation, give the acreage and description of the lands to which water has been applied and name of the owner thereof garden irrigation only
6. The means of withdrawing such water from the ground and the location of each well or other means of withdrawal pumping and gravity flow out of springs
7. The date of commencement and completion of the construction of the well, wells, or other works for withdrawal of groundwater 1959 to Oct. 15, 1962
8. The depth of water table unknown
9. So far as it may be available, the type, size and depth of each well or the general specifications of any other works for the withdrawal of groundwater no wells
10. The estimated amount of groundwater withdrawn each year 900,000,000 gal. per year
11. The log of formations encountered in the drilling of each well if available. none
12. Such other information of a similar nature as may be useful in carrying out the policy of this act, including reference to book and page of any county record none available

Signature of Owner Marion Burke

Date Jan. 1, 1962

Three copies to be filed by the owner with the County Clerk and Recorder of the county in which the well is located

Please answer all questions. If not applicable, so state; otherwise the form will be returned.

Original to the County Clerk and Recorder; Duplicate to the State Engineer; Triplicate to the Montana Bureau of Mines and Geology, and Quadruplicate for the Appropriator

17259

17819

State of Montana, }
County of Fergus. } ss.

COPY

Filed... DEC 31 1963 ... 19

at... 4:55 ... o'clock P.M.

\$2.00
PD

MAY RATHEUN
County Clerk and Recorder

File No.

T 14 R 17

DUPLICATE

County Fergus

STATE OF MONTANA
ADMINISTRATOR OF GROUNDWATER CODE
OFFICE OF STATE ENGINEER

Declaration of Vested Groundwater Rights

(Under Chapter 237, Montana Session Laws, 1961)

1. Alex Gordon of Moore, Montana
(Name of Appropriator) (Address) (Town)
County of Fergus State of Montana
have appropriated groundwater according to the Montana laws in effect prior to January 1, 1962, as follows:

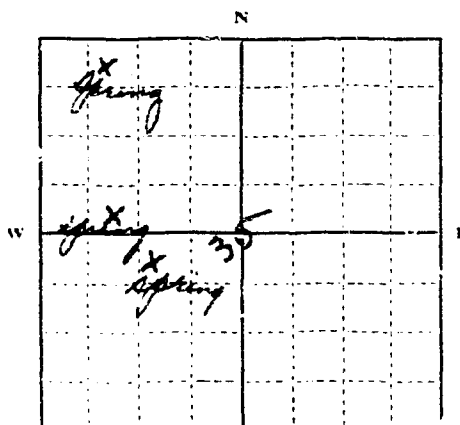

NW 1/4 SW Sec 35 T14 R17

Indicate point of appropriation and place of use, if possible. Each small square represents 10 acres.

2. The beneficial use on which the claim is based # stock water
3. Date or approximate date of earliest beneficial use; and how continuous the use has been
4. The amount of groundwater claimed (in miner's inches or gallons per minute)
5. If used for irrigation, give the acreage and description of the lands to which water has been applied and name of the owner thereof
6. The means of withdrawing such water from the ground and the location of each well or other means of withdrawal spring
7. The date of commencement and completion of the construction of the well, wells, or other works for withdrawal of groundwater
8. The depth of water table
9. So far as it may be available, the type, size and depth of each well or the general specifications of any other works for the withdrawal of groundwater
10. The estimated amount of groundwater withdrawn each year
11. The log of formations encountered in the drilling of each well if available
12. Such other information of a similar nature as may be useful in carrying out the policy of this act, including reference to book and page of any county record.
Land Classification map 16-113

Signature of Owner

Alex Gordon

Date

Dec 31, 1963

Three copies to be filed by the owner with the County Clerk and Recorder of the county in which the well is located.

Please answer all questions. If not applicable, so state, otherwise the form will be returned.

Original to the County Clerk and Recorder; Duplicate to the State Engineer; Triplicate to the Montana Bureau of Mines and Geology, and Quadruplicate for the Appropriator.

19254

17814

State of Montana,
County of Fergus.

ss. COPY

Filed DEC 31 1963 19

at 4:40 o'clock P.M.

#200

P.L.

MAY RATHBUN
County Clerk and Recorder

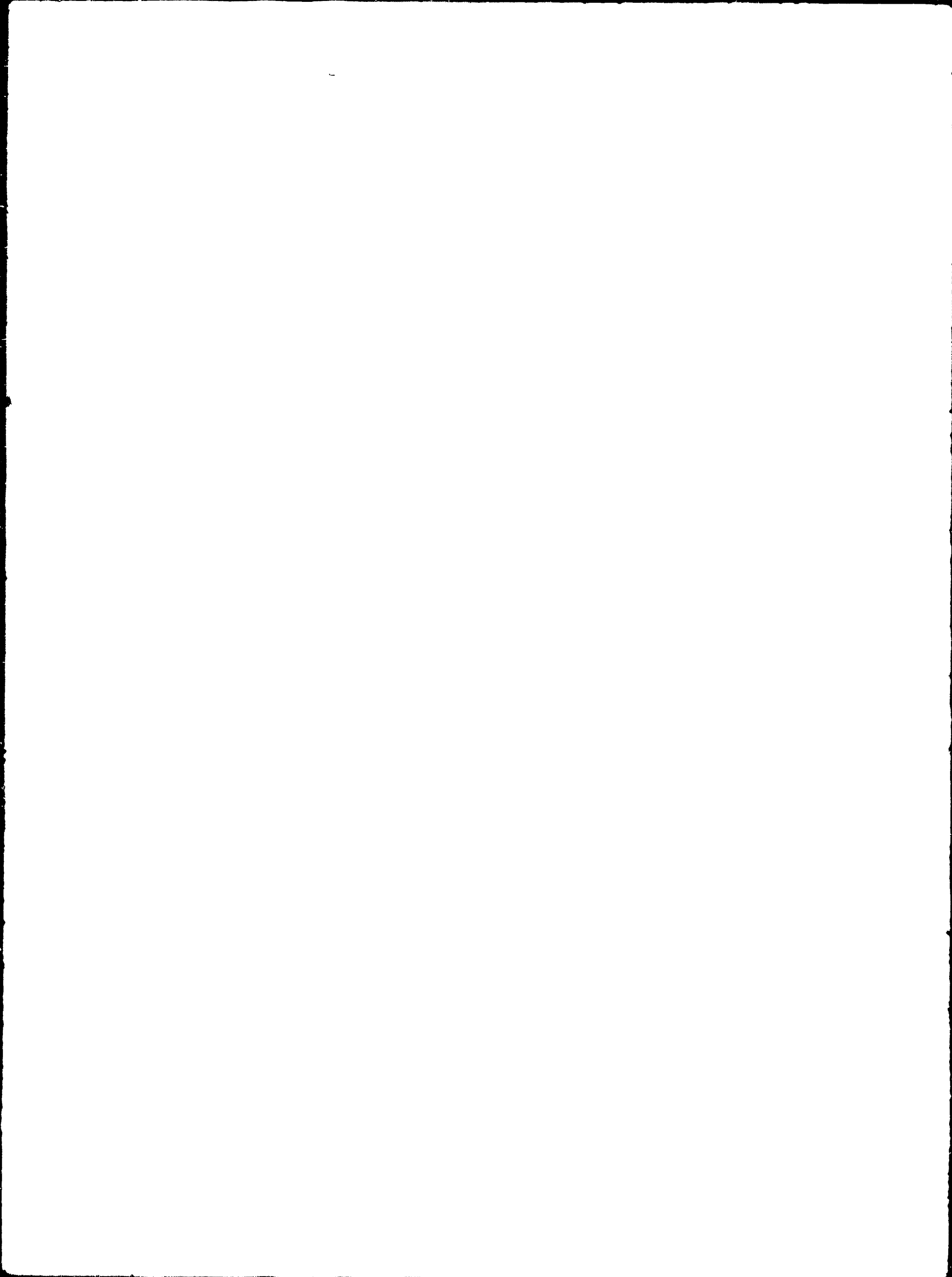

GW.

Approved Stock Form - State Publications - Helena, Montana 59601

File No. 17595

T R

DUPLICATE

County

STATE OF MONTANA
ADMINISTRATOR OF GROUNDWATER CODE
OFFICE OF STATE ENGINEER

JAN 3 1963

Declaration of Vested Groundwater Rights

(Under Chapter 237, Montana Session Laws, 1961)

1. George J. Long of Rt # 2 Lewistown
(Name of Appropriator) (Address) (Town)
County of Montana State of Montana
have appropriated groundwater according to the Montana laws in effect prior to January 1, 1962, as follows:

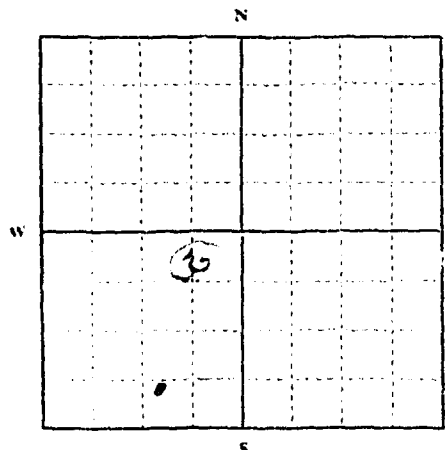

SE 1/4 Sec 35 T. 4 N. R. 17 E
Indicate point of appropriation and place of use, if possible. Each small square represents 10 acres.

2. The beneficial use on which the claim is based stock & irrigation
3. Date or approximate date of earliest beneficial use; and how continuous the use has been Sept. - 1947
4. The amount of groundwater claimed (in miner's inches or gallons per minute)
5. If used for irrigation, give the acreage and description of the lands to which water has been applied and name of the owner thereof
6. The means of withdrawing such water from the ground and the location of each well or other means of withdrawal

7. The date of commencement and completion of the construction of the well, wells, or other works for withdrawal of groundwater completed Sept. 1947
8. The depth of water table 140 ft deep
9. So far as it may be available, the type, size and depth of each well or the general specifications of any other works for the withdrawal of groundwater drilled well 140 ft deep 4" casing jet pump
10. The estimated amount of groundwater withdrawn each year 200,000 gal
11. The log of formations encountered in the drilling of each well if available
12. Such other information of a similar nature as may be useful in carrying out the policy of this act, including reference to book and page of any county record

Signature of Owner

Date Jan 31 - 1963

Three copies to be filed by the owner with the County Clerk and Recorder of the county in which the well is located

Please answer all questions. If not applicable, so state, otherwise the form will be returned.

Original to the County Clerk and Recorder; Duplicate to the State Engineer; Triplie to the Montana Bureau of Mines and Geology, and Quadruplicate for the Appropriator.

17595

17595

State of Montana, } ss.
County of Fergus }

COPY

DEC 3 1963

Filed _____ 19__

at 11:30 o'clock A.M.

H. J. G. G. G.

MAY RATHEUN
County Clerk and Recorder

File No. **17670**

DUPLICATE

T. R.

County

STATE OF MONTANA
ADMINISTRATOR OF GROUNDWATER CODE
OFFICE OF STATE ENGINEER

Declaration of Vested Groundwater Rights

(Under Chapter 237, Montana Session Laws, 1961)

1. Columbus Regli of Moore
(Name of Appropriator) (Address) (Town)
County of Fergus State of Montana
have appropriated groundwater according to the Montana laws in effect prior to January 1, 1962, as follows:

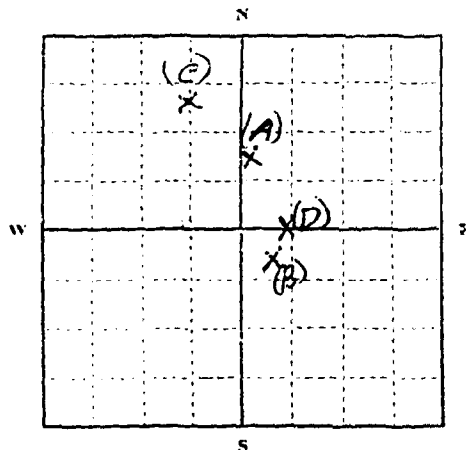

SW 1/4 NE Sec. 36 T.14 R.17

Indicate point of appropriation
and place of use, if possible. Each
small square represents 10 acres.

2. The beneficial use on which the claim is based Stock water
and house use
3. Date or approximate date of earliest beneficial use; and how continu-
ous the use has been 60 years
4. The amount of groundwater claimed (in miner's inches or gallons
per minute) (A) 25 gals. per min. (B) 20 gals. per min.
(C) 60 gals. per min. D - 45 per min.
5. If used for irrigation, give the acreage and description of the lands
to which water has been applied and name of the owner thereof
None
6. The means of withdrawing such water from the ground and the loca-
tion of each well or other means of withdrawal
Natural Flow
7. The date of commencement and completion of the construction of the well, wells, or other works for with-
drawal of groundwater -0-
8. The depth of water table Surface
9. So far as it may be available, the type, size and depth of each well or the general specifications of any other
works for the withdrawal of groundwater
10. The estimated amount of groundwater withdrawn each year Flows naturally
11. The log of formations encountered in the drilling of each well if available -0-
12. Such other information of a similar nature as may be useful in carrying out the policy of this act, including
reference to book and page of any county record -0-

Signature of Owner

Date

Three copies to be filed by the owner with the County Clerk and Recorder of the county in which the well is located

Please answer all questions. If not applicable, so state, otherwise the form will be returned

Original to the County Clerk and Recorder; Duplicate to the State Engineer; Triplicate to the Montana Bureau of
Mines and Geology; and Quadruplicate for the Appropriator.

17670

State of Montana, }
County of Fergus. } ss.

COPY

Filed _____ 19____
at 1:50 o'clock P. M.
B. J. & Ad. MAY PETHBUN
County Clerk and Recorder

File No. 17292

T 14 R 17

DUPLICATE

STATE ENGINEER
STATE OF MONTANA
ADMINISTRATOR OF GROUNDWATER CODE
OFFICE OF STATE ENGINEER

County
RECEIVED
JAN 2 1964

Declaration of Vested Groundwater Rights

(Under Chapter 237, Montana Session Laws, 1961)

1. Frank S. Smith, of R. 2 Lewis Town Mont
(Name of Appropriator) (Address) (Town)
County of Fergus State of Montana
have appropriated groundwater according to the Montana laws in effect prior to January 1, 1962, as follows:

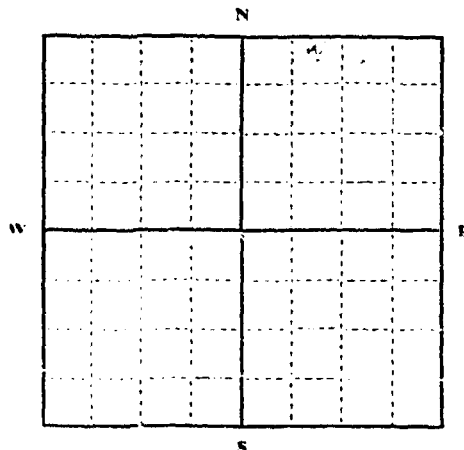

1/4 Sec. T. R.

Indicate point of appropriation
and place of use, if possible. Each
small square represents 10 acres.

2. The beneficial use on which the claim is based
Dwelling and livestock
3. Date or approximate date of earliest beneficial use; and how continuous the use has been
1875 Spring
1947 well
4. The amount of groundwater claimed (in miner's inches or gallons per minute)
5. If used for irrigation, give the acreage and description of the lands to which water has been applied and name of the owner thereof
6. The means of withdrawing such water from the ground and the location of each well or other means of withdrawal
Pump
and R. 2 Lewis
7. The date of commencement and completion of the construction of the well, wells, or other works for withdrawal of groundwater
8. The depth of water table
70
9. So far as it may be available, the type, size and depth of each well or the general specifications of any other works for the withdrawal of groundwater
20 ft deep
10. The estimated amount of groundwater withdrawn each year
11. The log of formations encountered in the drilling of each well if available
None
12. Such other information of a similar nature as may be useful in carrying out the policy of this act, including reference to book and page of any county record

Signature of Owner

Date 12/30/63

Three copies to be filed by the owner with the County Clerk and Recorder of the county in which the well is located.

Please answer all questions. If not applicable, so state, otherwise the form will be returned.

Original to the County Clerk and Recorder; Duplicate to the State Engineer; Triplicate to the Montana Bureau of
Mines and Geology, and Quadruplicate for the Appropriator.

17230

17292

State of Maryland } ss. COPY
County of Prince Georges }
Filed DEC 31 19
at 2:00 o'clock P. M.
Mary Rothman
County Clerk and Recorder
\$200 pt.