

File No.

GW 4

T. 28 N. 21 W. 34
County. FlatheadSTATE OF MONTANA
ADMINISTRATOR OF GROUNDWATER CODE
OFFICE OF STATE ENGINEER

Declaration of Vested Groundwater Rights JAN 6 1964

(Under Chapter 237, Montana Session Laws, 1961)

RECEIVED

STATE ENGINEER

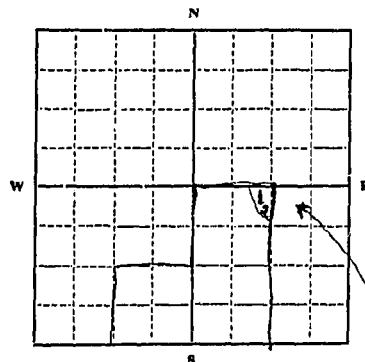
1. Doris Seney, of Rural Route 2 Kalispell
(Name of Appropriator) (Address) (Town)
County of Flathead State of MONTANA
have appropriated groundwater according to the Montana laws in effect prior to January 1, 1962, as follows:

NW 1/4 SE 1/4 Sec. 34 T. 22 R. 21

Indicate point of appropriation
and place of use, if possible.
Each small square represents 10
acres.

2. The beneficial use on which the claim is based #1 Household use #2 irrigation
3. Date or approximate date of earliest beneficial use; and how continuous the use has been #1 March 1949 to May 1959 #2 Household use - daily #3 irrigation - summer months
4. The amount of groundwater claimed (in miner's inches or gallons per minute) 25 gallons per minute
5. If used for irrigation, give the acreage and description of the lands to which water has been applied and name of the owner thereof 2 acres of lawn and garden Doris Seney
6. The means of withdrawing such water from the ground and the location of each well or other means of withdrawal Electric household pressure pump located by arrow #5
7. The date of commencement and completion of the construction of the well, wells, or other works for withdrawal of groundwater Total amount of time per well - 1 day Well #1 March 10, 1949 Well #2 May 15, 1959
8. The depth of water table 19 ft.
9. So far as it may be available, the type, size and depth of each well or the general specifications of any other works for the withdrawal of groundwater Both wells - 12 inch pipe used - depth 19 ft.
10. The estimated amount of groundwater withdrawn each year 5 acre feet
11. The log of formations encountered in the drilling of each well if available Clay & gravel sand
12. Such other information of a similar nature as may be useful in carrying out the policy of this act, including reference to book and page of any county record N.A.C.

Signature of Owner

Date Dec 30, 1963

Three copies to be filed by the owner with the County Clerk and Recorder of the county in which the well is located.

Please answer all questions. If not applicable, so state, otherwise the form will be returned.

Original to the County Clerk and Recorder; duplicate to the State Engineer; Triplicate to the Montana Bureau of Mines and Geology and Quadruplicate for the Appropriator.

22589

10,400

STATE OF MONTANA,
COUNTY OF PLATTE.

Filed on the 30 day of Dec

A.D. 1963 at 11:27 o'clock

2217
County Clerk and Recorder

By JCH Deputy

File No.

GW 4

T. ~~28~~ ^N R. ^W 21 35

County Flathead

STATE OF MONTANA
ADMINISTRATOR OF GROUNDWATER CODE
OFFICE OF STATE ENGINEER

Declaration of Vested Groundwater Rights

(Under Chapter 237, Montana Session Laws, 1961)

RECEIVED
DEC 30 1963

STATE ENGINEER

1. Joe C. Conner of Route 2 Kalispell
(Name of Appropriator) (Address) (Town)
County of Flathead State of Montana
have appropriated groundwater according to the Montana laws in effect prior to January 1, 1962, as follows:

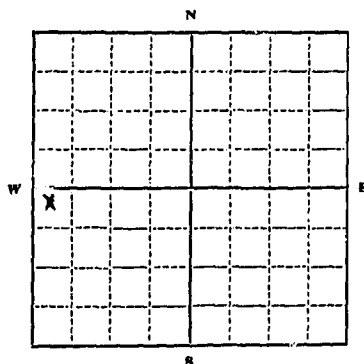

N. 1/4 SW. Sec. 35. T28. R. 21

Indicate point of appropriation
and place of use, if possible.
Each small square represents 10
acres.

2. The beneficial use on which the claim is based household,
hatch, and irrigation

3. Date or approximate date of earliest beneficial use; and how con-
tinuous the use has been 1944 Used Continuously.

4. The amount of groundwater claimed (in miner's inches or gallons
per minute) 500 gallon per minute

5. If used for irrigation, give the acreage and description of the lands
to which water has been applied and name of the owner thereof
2 acres of large yard and garden

6. The means of withdrawing such water from the ground and the
location of each well or other means of withdrawal
Electric pump

7. The date of commencement and completion of the construction of the well, wells, or other works for with-
drawal of groundwater 1944

8. The depth of water table 17 feet to 20 feet

9. So far as it may be available, the type, size and depth of each well or the general specifications of any other
works for the withdrawal of groundwater Drilled well 6 inch casing depth 120 feet

10. The estimated amount of groundwater withdrawn each year 500,000

11. The log of formations encountered in the drilling of each well if available extra heavy soil (gumbo)
top soil below sand and clay

12. Such other information of a similar nature as may be useful in carrying out the policy of this act, including
reference to book and page of any county record

Signature of Owner Joe C. Conner

Date Dec 26 1963

Three copies to be filed by the owner with the County Clerk and Recorder of the county in which the well is
located.

Please answer all questions. If not applicable, so state, otherwise the form will be returned.

Original to the County Clerk and Recorder; duplicate to the State Engineer; Triplicate to the Montana Bureau of
Mines and Geology and Quadruplicate for the Appropriator.

14601

10,221

SECTION 10, T1N1S, R1E1E, S3
COUNTY OF HARRIS, TEXAS

Filed on the 26 day of Dec
A.D. 1963 at 2:13 o'clock P. M.

L. E. M.
County Clerk and Recorder

By J. P.
Deputy

File No. _____

GW 4

T 28 N R 21 W 35

County Flathead

STATE OF MONTANA
ADMINISTRATOR OF GROUNDWATER CODE
OFFICE OF STATE ENGINEER

Declaration of Vested Groundwater Rights

(Under Chapter 237, Montana Session Laws, 1961)

1. Homer Frank Cooper of Rt 2, Kalispell
(Name of Appropriator) (Address) (Town)
County of Flathead State of Montana
have appropriated groundwater according to the Montana laws in effect prior to January 1, 1962, as follows:

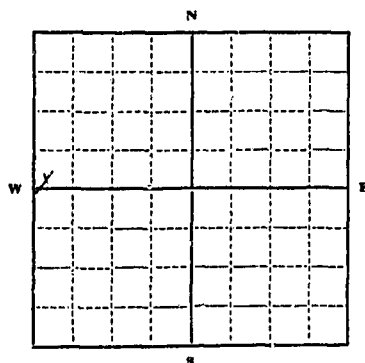

SH 1/4 NW 1/4 Sec. 35 T. 28 N. R. 21 W.

Indicate point of appropriation
and place of use, if possible.
Each small square represents 10
acres.

2. The beneficial use on which the claim is based. For Live-
Stock - garden - House hold use

3. Date or approximate date of earliest beneficial use; and how con-
tinuous the use has been. 1951 continuous
daily use since

4. The amount of groundwater claimed (in miner's inches or gallons
per minute). SEVEN GALLONS PER MIN
USE FOR EACH WELL OF 21 GALLONS

5. If used for irrigation, give the acreage and description of the lands
to which water has been applied and name of the owner thereof

Not applicable

6. The means of withdrawing such water from the ground and the
location of each well or other means of withdrawal. have three
wells located at building site
use electric pumps for withdrawal

7. The date of commencement and completion of the construction of the well, wells, or other works for with-
drawal of groundwater. April 1 1951 1st well June 1959 second well
and Nov 10 per 3rd well

8. The depth of water table. 17 Feet

9. So far as it may be available, the type, size and depth of each well or the general specifications of any other
works for the withdrawal of groundwater. use 2 in. pipe in all wells. ALL 3
wells are about 14 feet deep with about 7
feet of water in each. Used 6 inch casing in
each well. Pumps used have rated capacity of
430 Gal per hour.

10. The estimated amount of groundwater withdrawn each year. 365000 Gallons

11. The log of formations encountered in the drilling of each well if available. 14 Feet surface
soil four inches with balance of 10 ft
mostly sand

12. Such other information of a similar nature as may be useful in carrying out the policy of this act, including
reference to book and page of any county record. not applicable

Signature of Owner

Homer S. Cooper
Margaret A. Cooper
Date 30, 1963

Three copies to be filed by the owner with the County Clerk and Recorder of the county in which the well is
located.

Please answer all questions. If not applicable, so state, otherwise the form will be returned.

Original to the County Clerk and Recorder; duplicate to the State Engineer; Triplicate to the Montana Bureau of
Mines and Geology and Quadruplicate for the Appropriator.

22761

10583

RECEIVED
A.D. 1938
JAN 30 1938
BY *Ham*
Clerk and Research
BY *W.H.*
Deputy

2

GW File No. _____

728 21 35

STATE OF MONTANA
ADMINISTRATOR OF GROUNDWATER CODE
Office Of State Engineer

County _____

DUPLICATE

DECLARATION OF VESTED GROUNDWATER RIGHTS
(Under Chap. 237 Mont. Session Laws, 1961)

RECORDED
STATE ENGINEER

1. Arthur R. Crumell, of Route 2 Kodispeck
name of appropriator address town
County of Flathead State of Montana

have appropriated groundwater according to Montana laws in effect prior to Jan. 1, 1962 as follows:

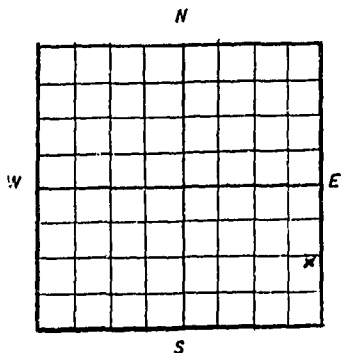

2. The beneficial use on which the claim is based domestic home use and stock water

3. Date or approximate date of earliest beneficial use; and how continuous the use has been Year - 1912
in continuous use since established

4. The amount of groundwater claimed (in miner's inches or gallons per minute) 15 Gpm per minute

5. If used for irrigation, give acreage and description of the lands to which water has been applied and name of the owner thereof Lawn and Garden 1/2 Acre

SE 1/4 SEC 35 T18N R 21W

indicate point of appropriation & place of use. Each square indicates 10 Acres.

6. The means of withdrawing such water from the ground and location of each well or other means of withdrawal Electric Pump

7. Date of commencement & completion of construction of well, wells, or other works for withdrawal of groundwater Year - 1912

8. Depth Of Water Table 14 Ft at hi-water - 26 Ft at Low Water

9. As it may be available, type, size, depth of each well or general specification of any other works for withdrawal of groundwater 24 Ft. depth - (12 Ft dug and Cemented 4 1/2 Ft by 4 1/2 Ft - 12 Ft Driven Sand Point)

10. Estimated amount of groundwater withdrawn each year 750,000 Gallons

11. The log of formations encountered in drilling each well (if available) Alternate Layers Clay and Sand Loam

12. Other information useful in carrying out policy of this act, including Book & Page of any county record _____

Signature Arthur R. Crumell
(owner)

Date March 12, 1962

3 copies to be filed by owner with clerk & recorder in county where well is located. Please answer all questions. If not applicable, so state.

Original to Co. Clerk & Recorder; Duplicate to State Engineer; Triplicate to School of Mines and Quadruplicate for the Appropriator.

1685

9250

STATE OF MONTANA
COUNTY OF FLAHEAD

Filed on the 12 day of *Mar*
A.D. 1962 at 11:20 o'clock A.M.

SEm

County Clerk and Recorder

By *M. J.*
Deputy

File No. _____

GW 4

T. 22 N 21 W 35
R. _____
County _____STATE OF MONTANA
ADMINISTRATOR OF GROUNDWATER CODE
OFFICE OF STATE ENGINEERRECEIVED
DEC 30 1963
STATE ENGINEER

Declaration of Vested Groundwater Rights

(Under Chapter 237, Montana Session Laws, 1961)

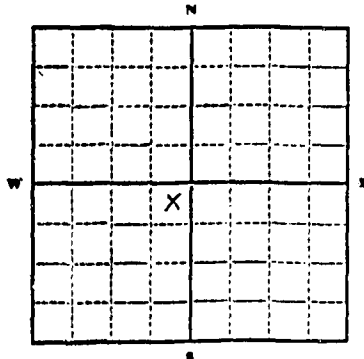
1. Elmer Maki
Mr. Elmer Maki of Route 2 Halispell
(Name of Appropriator) (Address) (Town)
County of Blaine State of Montana
have appropriated groundwater according to the Montana laws in effect prior to January 1, 1962, as follows:NE $\frac{1}{4}$ SW $\frac{1}{4}$ Sec. 35 T22N R21WIndicate point of appropriation
and place of use, if possible.
Each small square represents 10
acres.2. The beneficial use on which the claim is based. House
use, watering gardens and animals3. Date or approximate date of earliest beneficial use; and how con-
tinuous the use has been. approximately 1934
Used all the time4. The amount of groundwater claimed (in miner's inches or gallons
per minute) _____5. If used for irrigation, give the acreage and description of the lands
to which water has been applied and name of the owner thereofNothing except Gardens6. The means of withdrawing such water from the ground and the
location of each well or other means of withdrawalElectric Pump7. The date of commencement and completion of the construction of the well, wells, or other works for with-
drawal of groundwater. _____8. The depth of water table 22 ft.9. So far as it may be available, the type, size and depth of each well or the general specifications of any other
works for the withdrawal of groundwater. _____10. The estimated amount of groundwater withdrawn each year 100 gallons a day
36,000 gallons a year

11. The log of formations encountered in the drilling of each well if available. _____

12. Such other information of a similar nature as may be useful in carrying out the policy of this act, including
reference to book and page of any county record. _____Signature of Owner Mrs. Loly Haglen
Dated Dec 25, 1963Three copies to be filed by the owner with the County Clerk and Recorder of the county in which the well is
located.

Please answer all questions. If not applicable, so state, otherwise the form will be returned.

Original to the County Clerk and Recorder; duplicate to the State Engineer; Triplicate to the Montana Bureau
of Mines and Geology, and Quadruplicate for the Appropriator.

14602

10,222

26 day 1 piece
A. 11.53 at 2nd 11.53 P. M.
H.E.M.
J.P.
Deputy

File No. _____

GW 4

T. N R 21W 25

County _____

STATE OF MONTANA
ADMINISTRATOR OF GROUNDWATER CODE
OFFICE OF STATE ENGINEER

RECEIVED
DEC 30 1963

Declaration of Vested Groundwater Rights

(Under Chapter 237, Montana Session Laws, 1961)

STATE ENGINEER

1. Leimgrum, Melvin
Melvin Leimgrum of Route 2 Kalispell
(Name of Appropriator) (Address) (Town)
County of Flathead State of Montana
have appropriated groundwater according to the Montana laws in effect prior to January 1, 1962, as follows:

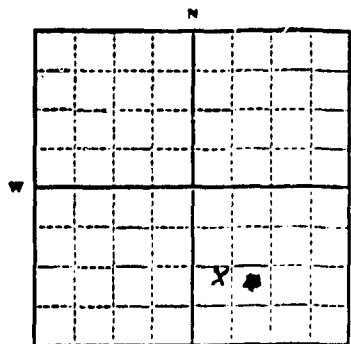

SW 1/4 Sec. 35 T28N R21W

Indicate point of appropriation
and place of use, if possible.
Each small square represents 10
acres.

2. The beneficial use on which the claim is based.
watering stock.
3. Date or approximate date of earliest beneficial use; and how continuous the use has been. 1962
use for watering stock in summertime.
4. The amount of groundwater claimed (in miner's inches or gallons per minute).
5. If used for irrigation, give the acreage and description of the lands to which water has been applied and name of the owner thereof.
all for stock
6. The means of withdrawing such water from the ground and the location of each well or other means of withdrawal.
Hand pump with gas motor
7. The date of commencement and completion of the construction of the well, wells, or other works for withdrawal of groundwater.
Drove and completed all in one day.
8. The depth of water table. 35 ft.
9. So far as it may be available, the type, size and depth of each well or the general specifications of any other works for the withdrawal of groundwater.
1 1/2 inch sand point.
10. The estimated amount of groundwater withdrawn each year. 75 gallons a day
11,550 gallons a year.
11. The log of formations encountered in the drilling of each well if available.
12. Such other information of a similar nature as may be useful in carrying out the policy of this act, including reference to book and page of any county record.

Signature of Owner Mrs. Lyle Leimgrum
Date Dec. 25, 1963

Three copies to be filed by the owner with the County Clerk and Recorder of the county in which the well is located.

Please answer all questions. If not applicable, so state, otherwise the form will be returned.

Original to the County Clerk and Recorder; duplicate to the State Engineer; Triplicate to the Montana Bureau of Mines and Geology; and Quadruplicate for the Appropriator.

14600

10,220

26 Dec
63 21
J.E.M.
J.P.

County.....

STATE OF MONTANA
ADMINISTRATOR OF GROUNDWATER CODE
OFFICE OF STATE ENGINEER

RECEIVED
DEC 30 1963

STATE ENGINEER

Declaration of Vested Groundwater Rights

(Under Chapter 237, Montana Session Laws, 1961)

Salmer Mauli

Leopoldo Bonelli

1 ~~Walter Lutz Hagen~~
(Name of Appropriator)

of..... Rt. 2
(Address

Kalispell
(Town)

County of Fatherland

State of Montana

have appropriated groundwater according to the Montana laws in effect prior to January 1, 1962, as follows:

A 4x4 grid representing a 2D lattice. The top edge is labeled 'N', the bottom edge 'S', the left edge 'W', and the right edge 'E'. The center of the grid is labeled 'X'.

NE $\frac{1}{4}$ SW

~~XXXXXX~~ Sec. 35 T. 25. R. 21.

Indicate point of appropriation
and place of use, if possible.
Each small square represents 10
acres.

2. The beneficial use on which the claim is based House
use, watering gardens and animals
3. Date or approximate date of earliest beneficial use, and how continuous the use has been approximately 1909
Paused all the time
4. The amount of groundwater claimed (in miner's inches or gallons per minute)
5. If used for irrigation, give the acreage and description of the lands to which water has been applied and name of the owner thereof
nothing except Gardens
6. The means of withdrawing such water from the ground and the location of each well or other means of withdrawal
Electric Pump
7. A description of the construction of the well, wells, or other works for withdrawing water
8. The size and depth of each well or the general specifications of any other water 2 inch sand points
9. The amount of water withdrawn each year 100 gallons a day
36,080 gallons a year
10. The cost of the drilling of each well if available
11. Any other facts as may be useful in carrying out the policy of this act, including a true and correct copy of the record

Signature of Owner. Mrs. Loren Hazen

Date Dec 15 1963

Three copies to be filed by the owner with the County Clerk and Recorder of the county in which the well is located.

Please answer all questions. If not applicable, so state, otherwise the form will be returned.

Original to the County Clerk and Recorder; duplicate to the State Engineer; Triplicate to the Montana Bureau of Mines and Geology, and Quadruplicate for the Appropriator.

14599

10, 219

STATE OF MONTANA
COUNTY OF DEWEE
Filed on the 26 day of Dec
A.D. 1963 at 2:10 o'clock P.M.
J. E. M.
County Clerk and Recorder
By J. P. Deputy

File No.

GW #

T 28 N 21 W - 35

County

STATE OF MONTANA
ADMINISTRATOR OF GROUNDWATER CODE
OFFICE OF STATE ENGINEER

Declaration of Vested Groundwater Rights

(Under Chapter 237, Montana Session Laws, 1961)

RECEIVED
JAN 6 1964
STATE ENGINEER

1. Amanda Muro of Route 2 A - Kalispell
(Name of Appropriator) (Address) (Town)
County of Gallatin State of Montana
have appropriated groundwater according to the Montana laws in effect prior to January 1, 1962, as follows:

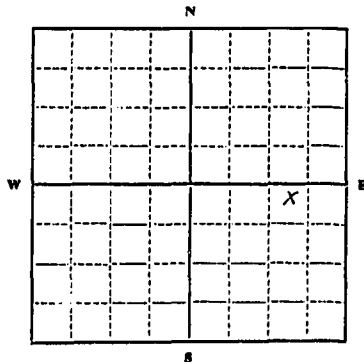

NW 1/4 Sec. 35 T. 28 N. R. 21 W.

Indicate point of appropriation and place of use, if possible. Each small square represents 10 acres.

2. The beneficial use on which the claim is based Household

3. Date or approximate date of earliest beneficial use; and how continuous the use has been 1912
used constantly

4. The amount of groundwater claimed (in miner's inches or gallons per minute) 60 gallons per minute

5. If used for irrigation, give the acreage and description of the lands to which water has been applied and name of the owner thereof

6. The means of withdrawing such water from the ground and the location of each well or other means of withdrawal sump
electric sump was installed around
1-9-38

7. The date of commencement and completion of the construction of the well, wells, or other works for withdrawal of groundwater 1919

8. The depth of water table 29 ft.

9. So far as it may be available, the type, size and depth of each well or the general specifications of any other works for the withdrawal of groundwater driven, sandpoint
1 1/2 in. pipe - 29 ft.

10. The estimated amount of groundwater withdrawn each year 80,000

11. The log of formations encountered in the drilling of each well if available

12. Such other information of a similar nature as may be useful in carrying out the policy of this act, including reference to book and page of any county record

Signature of Owner Amanda Muro

Date 12-30-63

Three copies to be filed by the owner with the County Clerk and Recorder of the county in which the well is located.

Please answer all questions. If not applicable, so state, otherwise the form will be returned.

Original to the County Clerk and Recorder; duplicate to the State Engineer; Triplicate to the Montana Bureau of Mines and Geology and Quadruplicate for the Appropriator.

10470

(S. B. OF RECORDS) 53
(COUNTY OF BURLINGAME)

Filed on the 30 day of Dec
A.D. 1863 at 1/2 o'clock P.M.

Edmund E. Melcham
County Clerk and Recorder

By Chith
Deputy

File No.

GW 2

T 28N R 21 W

35

County Flathead

STATE OF MONTANA
ADMINISTRATOR OF GROUNDWATER CODE
OFFICE OF STATE ENGINEER

MAY 1 1965

RECEIVED

Top of Ground

(Elev. above sea level.....)

0 to 30 ft. open hole
32 to 300 ft. silt
300 to 314 ft. water-bearing
gravel & sand.Notice of Completion of Groundwater
Appropriation by Means of Well

(Under Chapter 237, Montana Session Laws, 1961)

Owner Robert J. Sanders Address Holispell, Montana

Driller Olsen & Justin Address Columbia Falls, Montana

Date of Notice of Appropriation of Groundwater.....one filed

Date well started March 4, 1965 Date Completed March 12, 1965

Type of well Drilled Equipment Used Churn
(dug, driven, bored or (Churn, drill, rotary or
drilled) other)Water Use: Domestic ☒ Municipal ☐ Other ☐ Irrigation ☐
Industrial ☐ Drainage ☐ Stock ☐

Indicate on the diagram the character and thickness of the different strata met with in drilling, such as soil, clay, shale, gravel, rock or sand, etc. Show depth at which water is encountered, thickness and character of water-bearing strata and height to which water rises in the well.

Size of Drilled Hole	Size and Weight of Casing	From (Feet)	To (Feet)	PERFORATIONS		
				Kind Size	From (Feet)	To (Feet)
1"	7" O.D. 23 lbs. 10 ft.	0	314	- -	0-314	- -

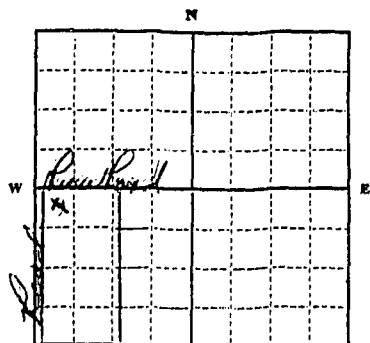
Section 24 T. 28N R. 21W
Indicate location of well and place of use, if possible. Each small square represents 10 acres.

Show exact depth of bottom.

Static Water Level for non-flowing Well ground level feet.

Shut-in Pressure for Flowing Well 20-25 lbs.

Pumping Water Level feet at gal. per minute.

Discharge in gal. per min. of flowing well non-flowing

How Tested Length of Test

Remarks: (Gravel packing, cementing, packers, type of shutoff, location of place of use of groundwater if not at well, and any other similar pertinent information, including number of acres irrigated, if used for irrigation)

No. 55

Driller's License Number

By George J. Justin
Driller's Signature

This form to be prepared by driller, and three copies to be filed by the owner with the County Clerk and Recorder in the county in which the well is located.

Please answer all questions. If not applicable, so state, otherwise the form will be returned.

Original to the County Clerk and Recorder; duplicate to the State Engineer; Triplicate to the Montana Bureau of Mines and Geology and Quadruplicate for the Appropriator.

39122

11 813

RECEIVED BY
COUNTY CLERK
Filed on the 10 day of May
A.D. 1915 at 10:30 o'clock A.M.
J.E.M.
County Clerk and Recorder

By  Deputy

P. No.

GW 4

T. ^N 28 ^W R. 21 ^W 36
CountySTATE OF MONTANA
ADMINISTRATOR OF GROUNDWATER CODE
OFFICE OF STATE ENGINEER

Declaration of Vested Groundwater Rights

(Under Chapter 237, Montana Session Laws, 1961)

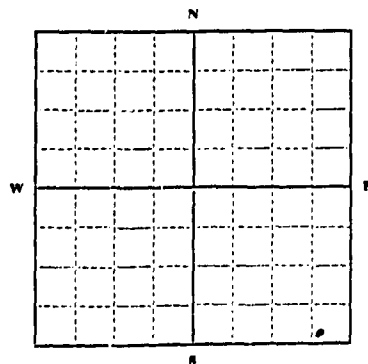
1. Mary Ribenaur Trustee of P.R.2 Kalispell
(Name of Appropriator) (Address) (Town)
County of Flathead State of Montana
have appropriated groundwater according to the Montana laws in effect prior to January 1, 1962, as follows:S.E. $\frac{1}{4}$ T. 4 N. Sec. 7 E. T. 28 R. 21 W.Indicate point of appropriation
and place of use, if possible.
Each small square represents 10
acres.

2. The beneficial use on which the claim is based.....

Household, garden & livestock3. Date or approximate date of earliest beneficial use; and how con-
tinuous the use has been.....1890continuous4. The amount of groundwater claimed (in miner's inches or gallons
per minute).....1.6 gallon per minute5. If used for irrigation, give the acreage and description of the lands
to which water has been applied and name of the owner thereofhome garden use for self6. The means of withdrawing such water from the ground and the
location of each well or other means of withdrawal.....Sandpoint and electric pump7. The date of commencement and completion of the construction of the well, wells, or other works for with-
drawal of groundwater.....8. The depth of water table..... 25 feet9. So far as it may be available, the type, size and depth of each well or the general specifications of any other
works for the withdrawal of groundwater.....10. The estimated amount of groundwater withdrawn each year..... 5.6 gallon per day11. The log of formations encountered in the drilling of each well if available..... not available12. Such other information of a similar nature as may be useful in carrying out the policy of this act, including
reference to book and page of any county record.....Signature of Owner..... James HandcockDate..... 12/28/45Three copies to be filed by the owner with the County Clerk and Recorder of the county in which the well is
located.

Please answer all questions. If not applicable, so state, otherwise the form will be returned.

Original to the County Clerk and Recorder; duplicate to the State Engineer; Triplicate to the Montana Bureau of
Mineral and Geology and Quadruplicate for the Appropriator.

40662

11,943

STATE OF MONTANA } SS
COUNTY OF FLATHEAD }
Filed on the 29 day of Dec
A. D. 1915 at 1:50 o'clock P. M.
B. E. M.
County Clerk and Recorder
By M. J. Deputy

File No.

T. 28N. R. 21W.

DUPLICATE

County. Flathead

STATE OF MONTANA
ADMINISTRATOR OF GROUNDWATER CODE
OFFICE OF STATE ENGINEER

RECEIVED
JAN 6 1964

Declaration of Vested Groundwater Rights ENGINEER

(Under Chapter 237, Montana Session Laws, 1961)

1. Alice G. Emmert and Mary K. Riedel, of Route 2 Kalispell
(Name of Appropriator) (Address) (Town)
County of Flathead State of Montana
have appropriated groundwater according to the Montana laws in effect prior to January 1, 1962, as follows:

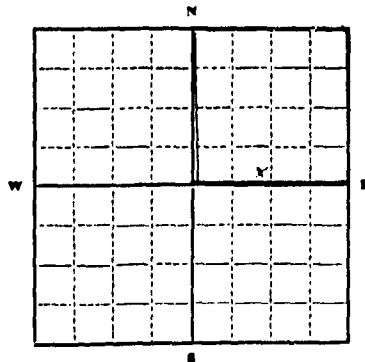

NE 1/4 Sec. 36 T28N R21W

Indicate point of appropriation
and place of use, if possible.
Each small square represents 10
acres.

2. The beneficial use on which the claim is based.....
household, stock and irrigation

3. Date or approximate date of earliest beneficial use; and how con-
tinuous the use has been.....
Continuously since about 1915

4. The amount of groundwater claimed (in miner's inches or gallons
per minute).....
50 miner's inches

5. If used for irrigation, give the acreage and description of the lands
to which water has been applied and name of the owner thereof
2-4 acres garden and lawn; Alice G. Emmert
and Mary K. Riedel

6. The means of withdrawing such water from the ground and the
location of each well or other means of withdrawal.....
Electrically powered pump; see plat for
location.

7. The date of commencement and completion of the construction of the well, wells, or other works for with-
drawal of groundwater About 1915

8. The depth of water table 15 feet from top of ground

9. So far as it may be available, the type, size and depth of each well or the general specifications of any other
works for the withdrawal of groundwater. 2 driven sand points about 25 feet deep.

10. The estimated amount of groundwater withdrawn each year. 365,000 gallon

11. The log of formations encountered in the drilling of each well if available. Unknown

12. Such other information of a similar nature as may be useful in carrying out the policy of this act, including
reference to book and page of any county record. None

Signature of Owner.

Alice G. Emmert
Mary K. Riedel
Date December 31, 1963

Three copies to be filed by the owner with the County Clerk and Recorder of the county in which the well is
located.

Please answer all questions. If not applicable, so state, otherwise the form will be returned.

Original to the County Clerk and Recorder; duplicate to the State Engineer; Triplicate to the Montana Bureau
of Mines and Geology, and Quadruplicate for the Appropriator.

23226

11056

63/38 Dec
Jim
K8 H.

File No.

Doc. No. 14123

GW 2

T. 4 R. 21

Filed for record

this 23 day of MarchCounty BeaumontA. D. 19 70, at 12:45
o'clock P. M.STATE OF MONTANA
ADMINISTRATOR OF GROUNDWATER CODE
OFFICE OF STATE ENGINEER

Top of Ground

(Elev. above sea level 1412.3)Notice of Completion of Groundwater
Appropriation by Means of Well

(Under Chapter 237, Montana Session Laws, 1961)

Owner John Patton Address 1111 1/2 St. N. Helena, MTDriller Henry Young Address 1111 1/2 St. N. Helena, MT

Date of Notice of Appropriation of Groundwater

Date well started 3/14/69 Date Completed 4/14/69Type of well drilled Equipment Used turn
(dug, driven, bored or (Churn, drill, rotary or
drilled) other)Water Use: Domestic ☐ Municipal ☐ Other ☐ Irrigation ☐
Industrial ☐ Drainage ☐ Stock ☐

Indicate on the diagram the character and thickness of the different strata met with in drilling, such as soil, clay, shale, gravel, rock or sand, etc. Show depth at which water is encountered, thickness and character of water-bearing strata and height to which water rises in the well.

Size of Drilled Hole	Size and Weight of Casing	From (Feet)	To (Feet)	PERFORATIONS		
				Kind Hole	From (Feet)	To (Feet)
1"	1" N.P.E.		53			

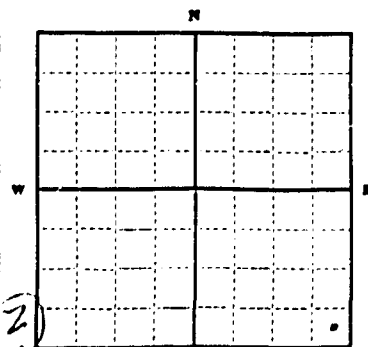

2) 1/4 Sec. T.28 R.21
Indicate location of well and place of use, if possible. Each small square represents 10 acres.

Show exact depth of bottom.

Static Water Level for non-flowing Well 31 feet.

Shut-in Pressure for Flowing Well

Pumping Water Level 45 feet at 50 gal. per minute.

Discharge in gal. per min. of flowing well

How Tested 2 Length of Test 1/2 hr.

Remarks: (Gravel packing, cementing, packers, type of shutoff, location of place of use of groundwater if not at well, and any other similar pertinent information, including number of acres irrigated, if used for irrigation)

Driller's License Number

Driller's Signature Henry Young

This form to be prepared by driller, and three copies to be filed by the owner with the County Clerk and Recorder, in the county in which the well is located.

Please answer all questions. If not applicable, so state, otherwise the form will be returned.

Original to the County Clerk and Recorder; duplicate to the State Engineer; Triplicate to the Montana Bureau of Mines and Geology and Quadruplicate for the Appropriator.

46309

14,123

23 mar
70 1215
Sam
P

File No.

GW 4

T. 28 N. R. 2 W.

County Flathead

DEC 17 1963

STATE OF MONTANA
ADMINISTRATOR OF GROUNDWATER CODE
OFFICE OF STATE ENGINEER

SINGLE ENGINEER

Declaration of Vested Groundwater Rights

(Under Chapter 237, Montana Session Laws, 1961)

1. Dick Snider, of 192 Bernard Road
(Name of Appropriator) (Address) (Town)
County of Flathead State of Montana Helena
have appropriated groundwater according to the Montana laws in effect prior to January 1, 1962, as follows:

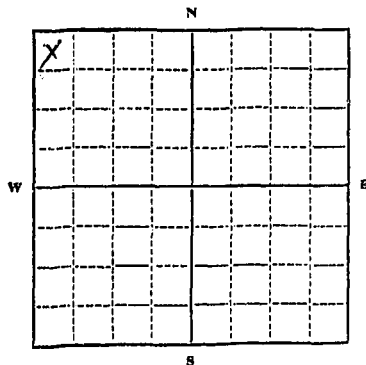

..... 1/4 Sec. T. R.

Indicate point of appropriation
and place of use, if possible.
Each small square represents 10
acres.

2. The beneficial use on which the claim is based. For home and sprinkling lawn and garden
3. Date or approximate date of earliest beneficial use; and how continuous the use has been. Well dug Sept 1958
4. The amount of groundwater claimed (in miner's inches or gallons per minute) Sufficient to fill up a home and a garden & lawn
5. If used for irrigation, give the acreage and description of the lands to which water has been applied and name of the owner thereof
Small garden about 30 x 50
Dick and Frances Snider
6. The means of withdrawing such water from the ground and the location of each well or other means of withdrawal
Well in front of house with pressure tank and pump
7. The date of commencement and completion of the construction of the well, wells, or other works for withdrawal of groundwater. Sept 1958
8. The depth of water table. 23 ft.
9. So far as it may be available, the type, size and depth of each well or the general specifications of any other works for the withdrawal of groundwater. None only one well
10. The estimated amount of groundwater withdrawn each year. Not known as we use garden hose which runs dry
11. The log of formations encountered in the drilling of each well if available.
The pump was driven thru open end with dynamite
12. Such other information of a similar nature as may be useful in carrying out the policy of this act, including reference to book and page of any county record.

Signature of Owner

Date

Dick Snider
12/10/63

Three copies to be filed by the owner with the County Clerk and Recorder of the county in which the well is located.

Please answer all questions. If not applicable, so state, otherwise the form will be returned.

Original to the County Clerk and Recorder; duplicate to the State Engineer; Triplicate to the Montana Bureau of Mines and Geology; and Quadruplicate for the Appropriator.

9619

9981

STATE OF MONTANA
COUNTY OF FLATHEAD

Filed on the 12 day of Dec
A.D. 1963 at 11:24 o'clock A.M.

SE 17

County Clerk and Recorder

By *[Signature]* Deputy

County Flathead

Twp. 2877

Rge. 20W

Sec.	Name of Appropriator	Type of Form	County File No.	Remarks
1	Baldwin, Gerald A. & Dorothy M.	GW4	10683	-
1	Foster, Edward H.	GW4	10612	-
1	Mr. Williams, R. B.	GW4	11074	-
1	Stahlberg, Boyana K.	GW2	13829	-
1	Williams, Linda L.	GW2	1107	-
2	Swanson, Harry F. & Virginia E.	GW4	10789	-
3	mt. view memorial Church, Inc.	GW4	10913	-
3	Odegard, Kenneth.	GW2	9890	-
3	Veigel, R. J.	GW4	10467	-
3	Von Wald, Dorothy M.	GW4	14009	-
4	Davis, John R. & Margaret A.	GW4	11102	T 28N-R 21W
4	De Haven, Gordon & Gerald E.	GW4	10791	T 28N-R 21W
4	McLaughlin, Edna A.	GW4	10146	-
4	Pederson, Clyde	GW2	14177	-
4	Reimer, A. W.	GW4	10260	-
5	Reeman, E. R.	GW4	9492	-
6	Fulbright, Wm W.	GW4	10160	-
6	Harbin, Elvira	GW4	9940	-
6	Sheldon, Clarence E.	GW4	10190	-
7	Jaquette, Eugene E.	GW4	10528	-
8	Busbard, George	GW4	11868	-
9	Horton, Mary Helen	GW4	10374	-
9	Horton, Olga L.	GW4	10089	-
9	Wagman, George J.	GW4	10478	-
10	Brennaman, Glanice David	GW4	10051	-
70	Craig, Rex W.	GW4	10091	-
10	Ankormasik	GW2	9925	-
10	Fish & Wildlife Service	GW4	10191	-
10	Fish & Wildlife Service	GW4	10192	-
10	Zimmerman, Allen	GW2	13333	-
10	Zimmerman, V. T.	GW2	9923	-
11	Broullier, Bert & Helen D.	GW4	10417	-
11	Fitzgerald, Katherine	GW2	11137	-
11	Hollinger, C. L.	GW3	11849	-
11	Tusmaat, Harold	GW4	10170	-
12	Darling, Marion	GW2	14720	-
12	Kauffman, Joe	GW2	12676	-
14	Bern, Lawrence H.	GW2	14509	-
14	Brewer, Maebel M.	GW4	11166	-
14	Buck, Milton	GW2	141361	-
14	Buck, Philip J. & Wilma E.	GW3	9979	-
14	Gyera, Harold	GW2	14560	-
14	Hula, Edmund J.	GW2	14539	-
14	Jessup, Harry W.	GW4	9306	-
14	Klein, P. H.	GW2	14449	-
14	Leffler, K. D.	GW2	14310	-

GROUNDWATER INDEX

County Waltham Twp. 2371 Rge. 20W

Sec.	Name of Appropriator	Type of Form	County File No.	Remarks
14	Russell, Oscar J. & Byrdie B.	GW4	10167	-
14	Russell, Oscar J. & Byrdie B.	GW4	10165	-
15	Bellmore, M. E.	GW2	14642	-
15	Broeder Bros. Lumber Co.	GW4	10894	-
15	Broeder, Gordon L.	GW4	10895	-
15	Hendon, Benjamin P. & Hazel	GW4	9577	-
15	Krob, Arnold M.	GW4	10349	-
15	Krob, Arnold M.	1959	No #	-
15	Higgins, M. Emma P.	GW2	13932	-
15	Reichle, J. H.	GW4	10948	-
15	Lang, William	GW4	10486	-
15	Mahugh, Leta H. & Mary A.	GW4	10154	-
15	Md. Agricultural Experiment St.	GW2	9930	-
16	Boolder, Fred O., Jr.	GW4	10823	-
16	Coaston, School	GW2	11561	-
16	Maat, Silas B.	GW4	11012	-
16	Roberts, Dr. M. C.	GW2	14005	-
16	Joerg, Nellis	GW4	9523	-
16	Gimmelman, Edward L.	GW4	10487	-
18	Altan, Fred M.	GW4	10208	-
18	Roll, E. F.	1957	No #	-
19	Cornwell, Maria & Harriet	GW4	10147	-
19	Spura, Richard E.	GW2	12629	-
19	Pasmore, James & Ruth N.	GW3	13823	-
19	Pasmore, Harold E. & Bernice J.	GW3	13822	-
19	Robinson, Edward E.	GW4	10622	-
19	Reith, Glenn L.	GW2	14055	-
20	DeLong, Daniel C. & Avis B.	GW2	14703	-
20	Pederson, Clyde A. & Jeanine	GW4	10171	-
20	Pederson, Clyde A. & Jeanine	1959	No #	-
20	Wiedensier, Elmer	GW2	14319	-
21	Wieferich, James J.	GW3	14816	-
22	Buck, Glen S.	GW3	11074	-
22	Marpetit, Dan & Helen	GW4	9959	-
22	Marpetit, Homer	1959	No #	-
23	Buck, Glen S.	GW3	11123	-
23	Buck, Glen S.	GW3	11122	-
23	Buck, Glen S.	GW3	11121	-
23	Buck, Glen S.	GW3	11120	-
23	Buck, Philip L. & Wilma C.	GW3	9980	-
23	Russell, Oscar J. & Byrdie B.	GW4	10166	-
25	Miller, Minnie	GW4	9926	-
25	Scruggs, Thomas B.	GW2	14466	-
26	Fisole, Ross	GW2	14230	-
26	Bauman, Gregory H.	GW4	10802	-
26	Buck, Russell L. & Shila C.	GW4	10190	-

County Ft. Verde

Twp. 28 72

Rqe. 206

Sec.	Name of Appropriator	Type of Form	County File No.	Remarks
26	Cieche, Russell + America	GW4	10591	-
26	Hugg, Josephine K.	GW4	10049	-
23	Wallace, W. L.	GW4	11073	-
30	Roboche, Elliott m.	GW2	14253	-
30	Roboche, Cathryn J. + Eugene S.	GW2	14683	-
32	O'Connell, Francis J.	GW4	9919	-
33	Grice, Gordon + Doris	GW2	13593	-
33	Potter, George	GW2	14510	-
34	Adams, John	GW4	9943	-
34	Olson, John O.	GW4	11072	-
34	Robbin, Walter C. + Mita M.	GW3	10230	-
34	Robbin, Walter C. + Mita M.	GW4	10230	-
35	Bruyer, M. A.	GW2	14237	-
35	Haynes, Jane	GW3	10077	-
35	La Brant, Duane L.	GW4	10731	-
35	Yenne, Thomas P.	GW4	10038	-
No#	Buck, Russell	GW2	11987	-
No#	Ambrase, Wm F.	GW4	10441	-
30	Nail, Gordon L.	GW2	9967	-

File No.

GW 4

28 N
T. 28 R. 20 W. 1
County Flathead

STATE OF MONTANA
ADMINISTRATOR OF GROUNDWATER CODE
OFFICE OF STATE ENGINEER

Declaration of Vested Groundwater Rights

(Under Chapter 237, Montana Session Laws, 1961)

RECEIVED
JAN 6 1964

STATE ENGINEER

Jessalda Dorothy M. Baldwin, of Route 4, Kalispell
(Name of Appropriator) (Address) (Town)
County of Flathead State of Montana
have appropriated groundwater according to the Montana laws in effect prior to January 1, 1962, as follows:

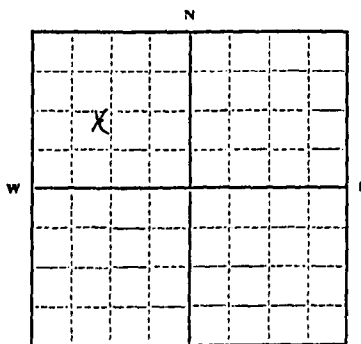

SW 1/4 NW Sec. 28 T. 28 R. 20

Indicate point of appropriation
and place of use, if possible.
Each small square represents 10
acres.

2. The beneficial use on which the claim is based. Household stock, lawn garden
3. Date or approximate date of earliest beneficial use; and how continuous the use has been. June 25, 1957, has been used continuously
4. The amount of groundwater claimed (in miner's inches or gallons per minute). 20 gallons per minute
5. If used for irrigation, give the acreage and description of the lands to which water has been applied and name of the owner thereof. has not been used to date for irrigation
6. The means of withdrawing such water from the ground and the location of each well or other means of withdrawal. Well located on said property
7. The date of commencement and completion of the construction of the well, wells, or other works for withdrawal of groundwater. June 20 to June 25, 1957 well was drilled
8. The depth of water table. Well is 137' water rise was to 65 ft bnd
9. So far as it may be available, the type, size and depth of each well or the general specifications of any other works for the withdrawal of groundwater. underground stream, well is 137 ft deep with 1 inch casing operated by a jet operated pump
10. The estimated amount of groundwater withdrawn each year. 200,000 gallons
11. The log of formations encountered in the drilling of each well if available. not available
12. Such other information of a similar nature as may be useful in carrying out the policy of this act, including reference to book and page of any county record. not known

Signature of Owner

Date Dec. 30, 1963

Three copies to be filed by the owner with the County Clerk and Recorder of the county in which the well is located.

Please answer all questions. If not applicable, so state, otherwise the form will be returned.

Original to the County Clerk and Recorder; duplicate to the State Engineer; Triplicate to the Montana Bureau of Mines and Geology and Quadruplicate for the Appropriator.

22810

1068-3

By L. L. 4 Deputy

File No.

OW 4

T. 28 N R. 20 W

County. FLATHEAD

STATE OF MONTANA
ADMINISTRATOR OF GROUNDWATER CODE
OFFICE OF STATE ENGINEER

Declaration of Vested Groundwater Rights

(Under Chapter 237, Montana Session Laws, 1961)

RECEIVED
JAN 6 1964

STATE ENGINEER

1. EDWARD H. FOSTER (LEONEM), of R.T. 4, YALISPELL
(Name of Appropriator) (Address) (Town)
County of FLATHEAD State of MONTANA
have appropriated groundwater according to the Montana laws in effect prior to January 1, 1962, as follows:

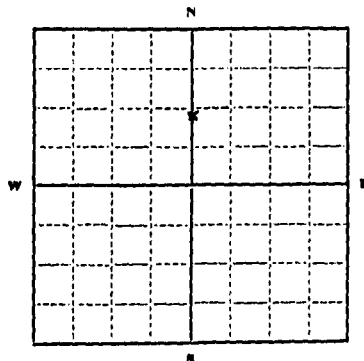

SE 1/4 NW Sec. 1 T. 28 N R. 20 W

Indicate point of appropriation
and place of use, if possible.
Each small square represents 10
acres.

2. The beneficial use on which the claim is based. HOUSEHOLD

3. Date or approximate date of earliest beneficial use; and how continuous the use has been. 1953 STEADY

4. The amount of groundwater claimed (in miner's inches or gallons per minute). 400 100 PER MIN.

5. If used for irrigation, give the acreage and description of the lands to which water has been applied and name of the owner thereof.
.90 ACRE

6. The means of withdrawing such water from the ground and the location of each well or other means of withdrawal.
ELC. PUMP

7. The date of commencement and completion of the construction of the well, wells, or other works for withdrawal of groundwater. 1953

8. The depth of water table. 60 FT.

9. So far as it may be available, the type, size and depth of each well or the general specifications of any other works for the withdrawal of groundwater. DRILLED WELL
6" CASING
60 FT.

10. The estimated amount of groundwater withdrawn each year. 200,000

11. The log of formations encountered in the drilling of each well if available.
ROCK

12. Such other information of a similar nature as may be useful in carrying out the policy of this act, including reference to book and page of any county record. NOT KNOWN

Signature of Owner. Edward Foster

Date. Dec 30, 1963

Three copies to be filed by the owner with the County Clerk and Recorder of the county in which the well is located.

Please answer all questions. If not applicable, so state, otherwise the form will be returned.

Original to the County Clerk and Recorder; duplicate to the State Engineer; Triplicate to the Montana Bureau of Mines and Geology and Quadruplicate for the Appropriator.

22790

10612

63³⁰ 725 Dec
H E m.
Jma

File No.

RECEIVED
MAY 19 1964

T. 27 N. R. 20 W. 1
County Flathead

STATE OF MONTANA
ADMINISTRATOR OF GROUNDWATER CODE
OFFICE OF STATE ENGINEER

RECEIVED
JAN 6 1964

Declaration of Vested Groundwater Rights

(Under Chapter 237, Montana Session Laws, 1961)

1. R. B. McWilliams of Route 4 Kalispell
(Name of Appropriator) (Address) (Town)
County of Flathead State of Montana
have appropriated groundwater according to the Montana laws in effect prior to January 1, 1962, as follows:

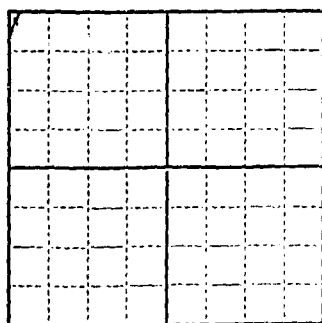

N.W. 1/4 Sec. 1, T. 27 N. R. 20 W.

Indicate point of appropriation and place of use, if possible. Each small square represents 10 acres.

2. The beneficial use on which the claim is based.....
Domestic, irrigation and watering stock

3. Date or approximate date of earliest beneficial use; and how continuous the use has been.....
1935 and continuous since said time.

4. The amount of groundwater claimed (in miner's inches or gallons per minute).....
6 gals. per minute

5. If used for irrigation, give the acreage and description of the lands to which water has been applied and name of the owner thereof.....
Irrigate only garden, flowers, etc.,

6. The means of withdrawing such water from the ground and the location of each well or other means of withdrawal.....
Pump located in the Northwest corner of said property.

7. The date of commencement and completion of the construction of the well, wells, or other works for withdrawal of groundwater.....
Commenced in 1935 and completed in 1935.

8. The depth of water table.....
Approximately 236 feet.

9. So far as it may be available, the type, size and depth of each well or the general specifications of any other works for the withdrawal of groundwater.....
8 1/2 inch casing, two inch pipe, drilled well, 236 feet deep.

10. The estimated amount of groundwater withdrawn each year.....
100000 gals.

11. The log of formations encountered in the drilling of each well if available.....
Not available.

12. Such other information of a similar nature as may be useful in carrying out the policy of this act, including reference to book and page of any county record.....
Not available.

Signature of Owner Pauline H. McWilliams
Date December 31, 1963

Three copies to be filed by the owner with the County Clerk and Recorder of the county in which the well is located.

Please answer all questions. If not applicable, so state, otherwise the form will be returned.

Original to the County Clerk and Recorder; duplicate to the State Engineer; Triplicate to the Montana Bureau of Mines and Geology and Quadruplicate for the Appropriator.

23243

11074

631 Dec
356
P
20 H

File No.

OW 2

T. ... R. ...
County FlatheadSTATE OF MONTANA
ADMINISTRATOR OF GROUNDWATER CODE
OFFICE OF STATE ENGINEER

Top of Ground

(Elev. above sea level.)

0 to 15 ft. (15 ft. stone,
boulders & gravel.)15 ft to 300 ft
from clay and gravel.

300 to 302 ft.

Waterbearing gravel
and sand.Notice of Completion of Groundwater
Appropriation by Means of Well

(Under Chapter 237, Montana Session Laws, 1961)

Owner Bryan K. Kiehlberg Address Kalispell, Mont.Driller Albert J. Gusten Address Cal. Falls, Mont.Date of Notice of Appropriation of Groundwater None filedDate well started April 23-68 Date Completed June 20-68Type of well Drilled Equipment Used Churn
(dug, driven, bored or
drilled) (Churn, drill, rotary or
other)Water Use: Domestic ☒ Municipal ☐ Other ☐ Irrigation ☐
Industrial ☐ Drainage ☐ Stock ☐Indicate on the diagram the character and thickness of the different
strata met with in drilling, such as soil, clay, shale, gravel, rock or sand, etc.
Show depth at which water is encountered, thickness and character of water-
bearing strata and height to which water rises in the well.

Size of Drilled Hole	Size and Weight of Casing	From (Feet)	To (Feet)	PERFORATIONS		
				Kind Size	From Feet	To Feet
6 3/8"	7" O.D. 23 lbs. per ft.	0	302	None		

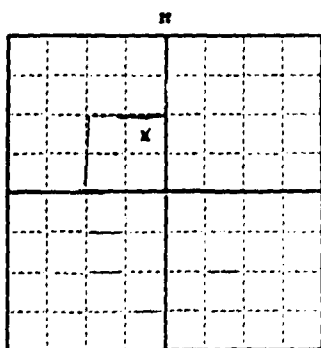

5th. 1/4 Sec. 1, T. 28. N. R. 20. W.

Indicate location of well and
place of use, if possible. Each
small square represents 10 acres.

Show exact depth of bottom.

Static Water Level for non-flowing Well 192 feet.Shut-in Pressure for Flowing Well 7.00 flowingPumping Water Level 25.2 feet at 10 g.p.m. per minute.Discharge in gal. per min. of flowing well 7.00 flowingHow Tested Barber Length of Test 7 hrsRemarks: (Gravel packing, cementing, packers, type of shutoff, loca-
tion of place of use of groundwater if not at well, and say
other similar pertinent information, including number of
acres irrigated, if used for irrigation).....

Driller's License Number

Driller's Signature
Albert J. GustenThis form to be prepared by driller, and three copies to be filed by the owner with the County Clerk and Recorder
in the county in which the well is located.

Please answer all questions. If not applicable, so state, otherwise the form will be returned.

Original to the County Clerk and Recorder; duplicate to the State Engineer; Triplicate to the Montana Bureau of
Mines and Geology and Quadruplicate for the Appropriator.

4/1, 6-31

13,829

STATE OF MONTANA }
COUNTY OF FLATHEAD } SS
Filed on the 15 day of July
A.D. 1908 at 3:30 Clock P M
County Clerk and Recorder
By M. J. Deputy

County FLATHEAD

STATE OF MONTANA
ADMINISTRATOR OF GROUNDWATER CODE
MONTANA WATER RESOURCES BOARD

NOTICE OF COMPLETION OF GROUNDWATER
APPROPRIATION BY MEANS OF WELL

Developed after January 1, 1962

(Under Chapter 237 Montana Session Laws, 1961, as amended)

This form to be prepared by driller, and three copies to be filed by the owner with the County Clerk and Recorder in the county in which the well is located, last copy to be retained by driller. Please answer all questions. If not applicable, so state, otherwise the form may be returned.

Owner Linda L. Williams

Address Route 4

Kalispell, Montana

Date well started 1/20/73

completed 1/24/73

Type of well Drilled

(Dug, driven, bored or drilled)

Equipment used Air Rotary

(Churn drill, rotary or other)

Water Use: Domestic ☒ Municipal ☐ Stock ☒ Irrigation ☐

Industrial ☐ Drainage ☐ Other ☐ Garden/Lawn ☒

*Describe

USE: If used for irrigation, industrial, drainage or other. Explain, state number of acres and location or other data (i.e. Lot, Block and Addition).

ESTIMATED ANNUAL WITHDRAWAL 27,300,000

Size of Drilled Hole	Size and Weight of Casing	From (Feet)	To (Feet)	PERFORATIONS		
				Kind Size	From (Feet)	To (Feet)
8"	6 5/8" OD 3/4" wall	+2	197'	Torch Cut 1/2"x4"	177'	197'

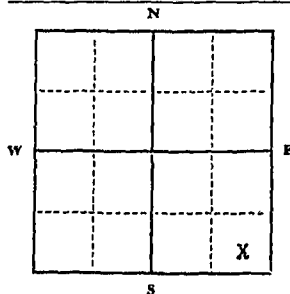

SE 1/4 SE 1/4 Sec. 1
T. 28 N. R. 20 W.

Static water level 1224' ft.*
Pumping water level 169' ft.*
at 50 gallons per minute,
measured 90 minutes after pumping
began.

*Measured from ground level.

Well developed by air surge

for 5 hours.

Power Diesel Pump 150 HP

Remarks: (Gravel packing, cementing, packers, type of shutoff)

Annulus between 6" casing and 8" hole grouted with 6 sacks of cement between 15 feet and 38 feet.

Note: Halls in this area (CONT.)

INDICATE LOCATION OF WELL AND PLACE OF USE, IF POSSIBLE. EACH SMALL SQUARE REPRESENTS 40 ACRES.

Driller's Signature Wm F. Calone

Driller's Address LIBERTY DRILLING & PUMP CO.

KALISPELL, MONTANA 59901 LICENSE NO. 52

DRILLER'S LOG

Indicate the character, color, thickness of strata such as soil, clay, sand, gravel, shale, sandstone, etc. Show depth at which water is found and height to which water rises in well.

Top of Ground Approx. (Elev. above sea level) 3250

From (Feet)	To (Feet)	
0	14	Clay & large boulders
14	15	Broken gray rock
15	16	Hard gray rock
16	18	Brown dirt & broken rock
18	25	Hard gray rock
25	27	Hard blue-gray rock
27	28	Broken blue & brown rock
28	65	Blue-gray rock
65	103	Blue-gray rock with some brown
103	144	Blue & brown rock-seep
144	162	Blue & brown rock-seep
162	179	Blue & brown rock-seep
179	204	Blue & brown rock-seep

204' Show exact depth of bottom

54460

can be depended upon to produce clear sand free water year after year, as long as they are not overpumped, i.e., they should be pumped at rates not in excess of 50 to 60 percent of the tested capacity of the aquifer.

STATE OF MONTANA }
COUNTY OF FLATHEAD }
Filed on the 27 day of June
A. D. 1923 at Rocky M
By mi Clerk and Recorder
By mi Deputy

File No.

GW 4

T. 28N R. 20W - 2

County Flathead

STATE OF MONTANA
ADMINISTRATOR OF GROUNDWATER CODE
OFFICE OF STATE ENGINEER

RECEIVED
JAN 6 1964

Declaration of Vested Groundwater Rights STATE ENGINEER

(Under Chapter 237, Montana Session Laws, 1961)

Harry F. + Virginia E. Swanson R#4 Halispell
(Name of Appropriator) (Address) (Town)
County of Flathead State of Montana
have appropriated groundwater according to the Montana laws in effect prior to January 1, 1962, as follows:

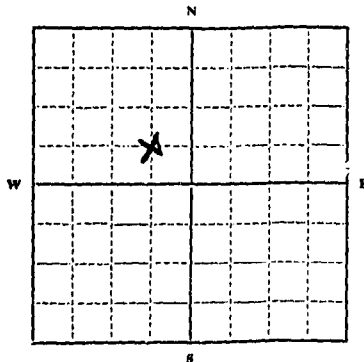

1/4 Sec. 2 T28 R20

Indicate point of appropriation
and place of use, if possible.
Each small square represents 10
acres.

W 1/2 Lt. 1,
W 1/2 SE 1/4 NE 1/4

2. The beneficial use on which the claim is based. Farm use

3. Date or approximate date of earliest beneficial use, and how continuous the use has been. Date not known

4. The amount of groundwater claimed (in miner's inches or gallons per minute). 350 pr. hr.

5. If used for irrigation, give the acreage and description of the lands to which water has been applied and name of the owner thereof. 5 acres garden + lawn
Harry Swanson

6. The means of withdrawing such water from the ground and the location of each well or other means of withdrawal. Electric pump

7. The date of commencement and completion of the construction of the well, wells, or other works for withdrawal of groundwater. Not known

8. The depth of water table. 60 ft.

9. So far as it may be available, the type, size and depth of each well or the general specifications of any other works for the withdrawal of groundwater. 90 ft deep

10. The estimated amount of groundwater withdrawn each year. 100,000 gallons

11. The log of formations encountered in the drilling of each well if available. not known

12. Such other information of a similar nature as may be useful in carrying out the policy of this act, including reference to book and page of any county record.

Signature of Owner Harry F. Swanson
Virginia E. Swanson
Date Dec 31, 1963

Three copies to be filed by the owner with the County Clerk and Recorder of the county in which the well is located.

Please answer all questions. If not applicable, so state, otherwise the form will be returned.

Original to the County Clerk and Recorder; duplicate to the State Engineer; Triplicate to the Montana Bureau of Mines and Geology and Quadruplicate for the Appropriator.

22960

10788

County Clerk and Recorder
Deputy

31 day of Dec
1863 at 10⁵⁵ o'clock A.M.
Geo W
County Clerk and Recorder
Deputy

Fl. No.

GW 4

T 28 N R 20 W 3

County Flathead

STATE OF MONTANA
ADMINISTRATOR OF GROUNDWATER CODE
OFFICE OF STATE ENGINEER

RECEIVED
JAN 6 1964

Declaration of Vested Groundwater Rights ENGINEER
(Under Chapter 237, Montana Session Laws, 1961)

1. Mountain View
Mennonite Church Incorporated, of Route # 4 Kalispell
(Name of Appropriator) (Address) (Town)
County of Flathead State of Montana
have appropriated groundwater according to the Montana laws in effect prior to January 1, 1962, as follows:

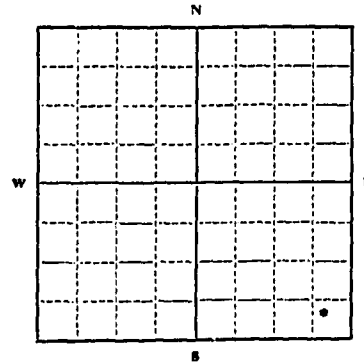

SW 1/4 3 Sec 28 T20 R

Indicate point of appropriation
and place of use, if possible.
Each small square represents 10
acres.

2. The beneficial use on which the claim is based.....
For church facilities and irrigation
3. Date or approximate date of earliest beneficial use; and how con-
tinuous the use has been..... June 5, 1961
Continuous use
4. The amount of groundwater claimed (in miner's inches or gallons
per minute)..... 150 gallons per minute
5. If used for irrigation, give the acreage and description of the lands
to which water has been applied and name of the owner thereof
To irrigate 4 acres at Mountain View
Mennonite Church Incorporated
6. The means of withdrawing such water from the ground and the
location of each well or other means of withdrawal.....
Electric pump

7. The date of commencement and completion of the construction of the well, wells, or other works for with-
drawal of groundwater.....
In April, 1961. Completed June 5, 1961
8. The depth of water table..... 65 feet
9. So far as it may be available, the type, size and depth of each well or the general specifications of any other
works for the withdrawal of groundwater..... Drilled 7 inch casing 210 feet deep
10. The estimated amount of groundwater withdrawn each year..... 1,200,00
11. The log of formations encountered in the drilling of each well if available.....
0' - 32' sand 32' - 76' river mud 76' - 196' silt 196' - 207' cemented
gravel 207' - 212' sand, gravel, water.
12. Such other information of a similar nature as may be useful in carrying out the policy of this act, including
reference to book and page of any county record..... none available

Trustee
Mountain View Mennonite Church Inc. Signature of Owner *Ray P. Ruck*
Date December 28, 1963

Three copies to be filed by the owner with the County Clerk and Recorder of the county in which the well is
located.

Please answer all questions. If not applicable, so state, otherwise the form will be returned.

Original to the County Clerk and Recorder; duplicate to the State Engineer; Triplicate to the Montana Bureau of
Mines and Geology and Quadruplicate for the Appropriator.

23083

10913

31/12 Dec
63 P
20 H
L & H

File No.

RECEIVED
OCT 21 1963

T 28 R 20

County *Glenn*

STATE ENGINEER
ADMINISTRATOR OF GROUNDWATER CODE
OFFICE OF STATE ENGINEER

RECEIVED
OCT 15 1963

Notice of Completion of Groundwater Appropriation by Means of Well

(Under Chapter 237, Montana Session Laws, 1961)

Owner *Kenneth O. Dege* Address *Box 4 Kalispell*

Driller *Harvey McCarty* Address *945 8th St.*

Date of Notice of Appropriation of Groundwater

Date well started *Sept 12/63* Date Completed *Sept 27/63*

Type of well *Drilled* Equipment Used *2 1/2" V. Bucyrus Erie*
(dug, driven, bored or (Churn, drill, rotary or other)

Water Use: Domestic ☐ Municipal ☐ Other ☐ Irrigation ☐
Industrial ☒ Drainage ☐ Stock ☒

Indicate on the diagram the character and thickness of the different strata met with in drilling, such as soil, clay, shale, gravel, rock or sand, etc. Show depth at which water is encountered, thickness and character of water-bearing strata and height to which water rises in the well.

Top of Ground
(Elev. above sea level *2980*)

Top soil 3 ft.

Sand to

20 ft. Cement gravel

65 ft to

145 ft Some water

182 ft water dirty 7" OD

198 ft to

Size of Drilled Hole	Size and Weight of Casing	From (Feet)	To (Feet)	PERFORATIONS		
				Kind Size	From (Feet)	To (Feet)
			<i>20 2 ft</i>			

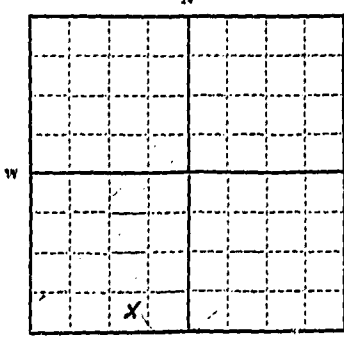

SW 1/4 Sec. 3 T. 28 R. 20

Indicate location of well and place of use, if possible. Each small square represents 10 acres.

20 2 ft water bearing gravel
Show exact depth of bottom

Static Water Level for non-flowing Well *35* feet.

Shut-in Pressure for Flowing Well

Pumping Water Level *120* feet at *20* gal. per minute.

Discharge in gal. per min. of flowing well

How Tested *failer* Length of Test *2 hrs*

Remarks: (Gravel packing, cementing, packers, type of shutoff, location of place of use of groundwater if not at well, and any other similar pertinent information, including number of acres irrigated, if used for irrigation)

18
Driller's License Number
Harvey McCarty
Driller's Signature

This form to be prepared by driller, and three copies to be filed by the owner with the County Clerk and Recorder in the county in which the well is located.

Please answer all questions. If not applicable, so state, otherwise the form will be returned.

Original to the County Clerk and Recorder; duplicate to the State Engineer; Triplicate to the Montana Bureau of Mines and Geology and Quadruplicate for the Appropriator.

9890

FILED OCT 11 1963
COUNTY CLERK
Filed on the 11 day of Oct
A.D. 1963 at 2:25 o'clock P.M.
JEM
County Clerk and Recorder
By JEM
Deputy

STATE OF MONTANA
ADMINISTRATOR OF GROUNDWATER CODE
OFFICE OF STATE ENGINEER

Declaration of Vested Groundwater Rights

(Under Chapter 237, Montana Session Laws, 1961)

RECEIVED
JAN 8 1964

STATE ENGINEER

1. R. J. VEIGEL of RTE. 4 NALISPELL
(Name of Appropriator) (Address) (Town)
County of FLAKEHEAD State of MONTANA
have appropriated groundwater according to the Montana laws in effect prior to January 1, 1962, as follows:

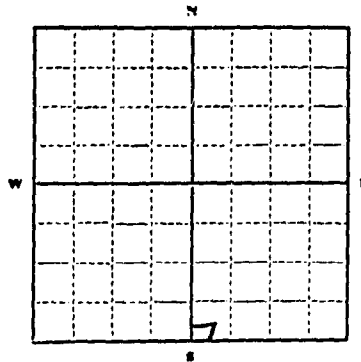

4252 1/4 Sec. 2 T28N R20E

Indicate point of appropriation and place of use, if possible. Each small square represents 10 acres.

2. The beneficial use on which the claim is based HOME, GARDEN AND LIVESTOCK
3. Date or approximate date of earliest beneficial use; and how continuous the use has been BOUGHT PLACE IN 1949 AND HAS BEEN OF CONTINUOUS USE SINCE. USE BEFORE THAT DATE IS UNKNOWN.
4. The amount of groundwater claimed (in miner's inches or gallons per minute) 16 GALLONS PER MINUTE.
5. If used for irrigation, give the acreage and description of the lands to which water has been applied and name of the owner thereof SHALL GARDEN
6. The means of withdrawing such water from the ground and the location of each well or other means of withdrawal ELECTRIC REWELING PRESSURE SYSTEM LOCATED 50 FEET NORTHEAST OF HOUSE
7. The date of commencement and completion of the construction of the well, wells, or other works for withdrawal of groundwater UNKNOWN
8. The depth of water table APPROXIMATELY 40 FEET
9. So far as it may be available, the type, size and depth of each well or the general specifications of any other works for the withdrawal of groundwater DRILLED WELL 110 FEET DEEP 4 INCH CASING WATER ABOUT 40 FEET FROM TOP, 1 1/2" SUCTION PIPE.
10. The estimated amount of groundwater withdrawn each year APPROXIMATELY 300,000 GALLONS
11. The log of formations encountered in the drilling of each well if available UNKNOWN
12. Such other information of a similar nature as may be useful in carrying out the policy of this act, including reference to book and page of any county record

Signature of Owner

R. J. Veigel
Date Dec 30, 1963

Three copies to be filed by the owner with the County Clerk and Recorder of the county in which the well is located.

Please answer all questions. If not applicable, so state, otherwise the form will be returned.

Original to the County Clerk and Recorder; duplicate to the State Engineer; Triplicate to the Montana Bureau of Mines and Geology and Quadruplicate for the Appropriator.

10467

30 Dec
63 193 P
Glen E. Meekins
Leitch

File No.
DUPLICATE

MONTANA WATER RESOURCES BOARD
RECEIVED

JUL 28 1969

T. 28 N. R. 20 W.
County Flathead

STATE OF MONTANA
ADMINISTRATOR OF GROUNDWATER CODE
OFFICE OF STATE ENGINEER

Declaration of Vested Groundwater Rights
(Under Chapter 237, Montana Session Laws, 1961)

1. Dorothy M. Von Wald, of Route 4, Kalispell
(Name of Appropriator) (Address) (Town)
County of Flathead State of Montana
have appropriated groundwater according to the Montana laws in effect prior to January 1, 1962, as follows:

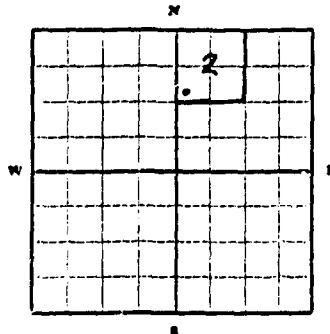

NE 1/4 Sec. 3 T. 28. R. 20.
Indicate point of appropriation
and place of use, if possible.
Each small square represents 10
acres.

2. The beneficial use on which the claim is based
domestic and irrigation purposes.
3. Date or approximate date of earliest beneficial use; and how continuous the use has been 1900. Use has been continuous since then.
4. The amount of groundwater claimed (in miner's inches or gallons per minute) 60 gallons per minute.
5. If used for irrigation, give the acreage and description of the lands to which water has been applied and name of the owner thereof. Lot 2 of Section 3, Township 28 North, Range 20 West, containing approximately 40.48 acres.
6. The means of withdrawing such water from the ground and the location of each well or other means of withdrawal pump The southwest corner of said Lot 2.
7. The date of commencement and completion of the construction of the well, wells, or other works for withdrawal of groundwater The well was commenced and completed in approximately 1900, and the well has been improved and added to and the system has been modernized at various times since then.
8. The depth of water table 130 feet.
9. So far as it may be available, the type, size and depth of each well or the general specifications of any other works for the withdrawal of groundwater One horsepower motor on a submersible pump 150 feet - depth of well.
10. The estimated amount of groundwater withdrawn each year 7,200,000 gallons.
11. The log of formations encountered in the drilling of each well if available not available.
12. Such other information of a similar nature as may be useful in carrying out the policy of this act, including reference to book and page of any county record no information available.

Signature of Owner

Dorothy M. Von Wald

Date June 18, 1969

Three copies to be filed by the owner with the County Clerk and Recorder of the county in which the well is located.

Please answer all questions. If not applicable, so state, otherwise the form will be returned.

Original to the County Clerk and Recorder; duplicate to the State Engineer; Triplicate to the School of Mines and Quadruplicate for the Appropriator.

45471

14009

STATE OF MONTANA
COUNTY OF FLATHEAD

SS

Filed on the 21 day of June
A.D. 19 69 at 12⁴⁵ o'clock P.M.

County Clerk and Recorder

By

Deputy

File No. _____

GW 4

T. 28 R. 20

County _____

STATE OF MONTANA
ADMINISTRATOR OF GROUNDWATER CODE
OFFICE OF STATE ENGINEER

RECEIVED
DEC 30 1963

Declaration of Vested Groundwater Rights

(Under Chapter 237, Montana Session Laws, 1961)

1. Edna A. M. Bloughlin, of Deer Calispell
(Name of Appropriator) (Address) (Town)
County of Gallatin State of Montana
have appropriated groundwater according to the Montana laws in effect prior to January 1, 1962, as follows:

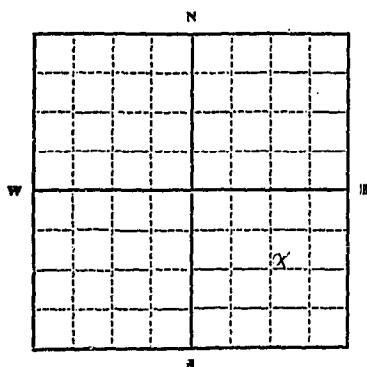

SE 1/4 Sec. 4 T-28 R-20

Indicate point of appropriation
and place of use, if possible.
Each small square represents 10
acres.

2. The beneficial use on which the claim is based farm use
3. Date or approximate date of earliest beneficial use; and how continuous the use has been steady since 1916
4. The amount of groundwater claimed (in miner's inches or gallons per minute) 1 second foot
5. If used for irrigation, give the acreage and description of the lands to which water has been applied and name of the owner thereof 1 acre
6. The means of withdrawing such water from the ground and the location of each well or other means of withdrawal deep well
7. The date of commencement and completion of the construction of the well, wells, or other works for withdrawal of groundwater 1916
8. The depth of water table 225 ft
9. So far as it may be available, the type, size and depth of each well or the general specifications of any other works for the withdrawal of groundwater 4" casing deep pump
10. The estimated amount of groundwater withdrawn each year 1 second foot
11. The log of formations encountered in the drilling of each well if available none
12. Such other information of a similar nature as may be useful in carrying out the policy of this act, including reference to book and page of any county record none

Signature of Owner Edna A. M. Bloughlin

Date 12-22-63

Three copies to be filed by the owner with the County Clerk and Recorder of the county in which the well is located.

Please answer all questions. If not applicable, so state, otherwise the form will be returned.

Original to the County Clerk and Recorder; duplicate to the State Engineer; Triplicate to the Montana Bureau of Mines and Geology and Quadruplicate for the Appropriator.

14530

10,146

STATE OF MONTANA)
COUNTY OF FLATHEAD) SS

Filed on the 23 day of Dec
A. D. 1963 at 12¹⁵ o'clock P. M.

J. E. M.

County Clerk and Recorder

By J. J. X.
Deputy

File No.

DUPLICATE

T. 78 R. 70

County. Flathead

STATE OF MONTANA
ADMINISTRATOR OF GROUNDWATER CODE
OFFICE OF STATE ENGINEERNotice of Completion of Groundwater
Appropriation by Means of Well

(Under Chapter 237, Montana Session Laws, 1961)

Owner Clyde Pederson address Rt 4 Kalispell

Driller Homer McCarty address 945-8th St Kalispell

Date of Notice of Appropriation of Groundwater

Date well started Apr. 14, 1969 Date Completed May 5/69

Type of well Drilled Equipment Used 21 W. B. System
(dug, driven, bored or (Churn, drill, rotary or other) Erie
drilled)Water Use: Domestic ☒ Municipal ☐ Stock ☐ Irrigation ☒
Industrial ☐ Drainage ☐ Other ☐

Indicate on the diagram the character and thickness of the different strata met with in drilling, such as soil, clay, shale, gravel, rock or sand, etc. Show depth at which water is encountered, thickness and character of water-bearing strata and height to which the water rises in the well.

Top of Ground

(Elev. above sea level 2980.)

3 ft. Top soil

Sand

Clay - Cream Color
85 ft.

Grey sand

155 ft.

Sand & grit

191 ft.

Hard pan

251 ft.

Course sand 7" OD

Gravel

Water

Size of Drilled Hole	Size and Weight of Casing	From (Feet)	To (Feet)	PERFORATIONS		
				Kind Size	From (Feet)	To (Feet)
	23 #		272			

Static Water Level for non-flowing Well 80 feet.

Shut-in Pressure for Flowing Well

Pumping Water Level 198 feet at 13 1/2 gal. per minute.

Discharge in gal. per min. of flowing well

How Tested 3 Bailer Length of Test 4 hrs

Remarks: (Gravel packing, cementing, packers, type of shutoff, location of place of use of groundwater if not at well, and any other similar pertinent information, including number of

Part lot 3 Blk 2 Pleasant View Homesites

Sec. 14 NE 1/4 Sec. 4 T2S. R2E

Indicate location of well and place of use, if possible. Each small square represents 10 acres.

273 ft
Show exact depth of bottom.Doc. No. 14177
Filed for record
this 14 day of July
A. D. 1970, at 3:28
o'clock P. M.18
Driller's License Number
Homer McCarty
Driller's Signature

This form to be prepared by driller, and three copies to be filed by the owner with the County Clerk and Recorder in the county in which the well is located.

Please answer all questions. If not applicable, so state, otherwise the form will be returned.

Original to the County Clerk and Recorder; duplicate to the State Engineer; Triplicate to the School of Mines and Quadruplicate for the Appropriator.

47269

14,177

STATE OF MONTANA) 53
COUNTY OF FLATHEAD)

Filed on the 14th day of July
A.D. 1970 at 3:28 o'clock P.M.

A. D. 1970 88-2000
Glenn E. Mathews
County Clerk and Recorder

By Donna C. Peterson Deputy.

File No. _____

GW 4

T. 28 N. 20 W. 4

STATE OF MONTANA
ADMINISTRATOR OF GROUNDWATER CODE
OFFICE OF STATE ENGINEER

County _____
RECEIVED
JAN 6 1964

Declaration of Vested Groundwater Rights STATE ENGINEER

(Under Chapter 237, Montana Session Laws, 1961)

1. A. Reimer of Rt 4 Kalispell
(Name of Appropriator) (Address) (Town)
County of Flathead State of Mont
have appropriated groundwater according to the Montana laws in effect prior to January 1, 1962, as follows:

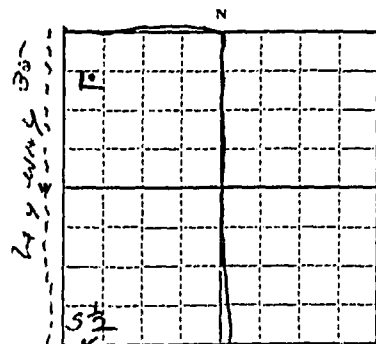

SW 1/4 NW 1/4 Lot 3 & 4
1/4 Sec. 4 T. 28 N. R. 20

Indicate point of appropriation
and place of use, if possible.
Each small square represents 10
acres.

2. The beneficial use on which the claim is based. Household
stock - garden & lawn irrigation

3. Date or approximate date of earliest beneficial use; and how con-
tinuous the use has been. 1927

Continuous - prior to 1900

4. The amount of groundwater claimed (in miner's inches or gallons
per minute) 15 gal

5. If used for irrigation, give the acreage and description of the lands
to which water has been applied and name of the owner thereof

6. The means of withdrawing such water from the ground and the
location of each well or other means of withdrawal.
Electric Centrifugal pump

7. The date of commencement and completion of the construction of the well, wells, or other works for with-
drawal of groundwater. April 1927 - May 1927

8. The depth of water table. 20 ft

9. So far as it may be available, the type, size and depth of each well or the general specifications of any other
works for the withdrawal of groundwater.

7" drilled - 80' depth

10. The estimated amount of groundwater withdrawn each year. 300-000 to 400,000 gal

11. The log of formations encountered in the drilling of each well if available.

Not available

12. Such other information of a similar nature as may be useful in carrying out the policy of this act, including
reference to book and page of any county record.

Signature of Owner. A. Reimer

Date. Dec 27 1963

Three copies to be filed by the owner with the County Clerk and Recorder of the county in which the well is
located.

Please answer all questions. If not applicable, so state, otherwise the form will be returned.

Original to the County Clerk and Recorder; duplicate to the State Engineer; Triplicate to the Montana Bureau of
Mines and Geology and Quadruplicate for the Appropriator.

10,260

STATE OF MISSISSIPPI
COUNTY OF PLAINHEAD

Filed on the 27 day of Dec.
A.D. 1963 at 1:35 o'clock P.M.

G. E. M.

County Clerk and Recorder

By

Jma

Deputy

GW File No. _____

STATE OF MONTANA
ADMINISTRATOR OF GROUNDWATER CODE
Office Of State Engineer

DUPLICATE

DECLARATION OF VESTED GROUNDWATER RIGHTS
(Under Chap. 237 Mont. Session Laws, 1961)

5 T 28 N 20 W
County Flathead
RECEIVED
STATE ENGINEER

1. E.R. BEEMAN, of Route 4 KALISPELL
name of appropriator address town
County of FLATHEAD State of MONTANA

have appropriated groundwater according to Montana laws in effect prior to Jan. 1, 1962 as follows:

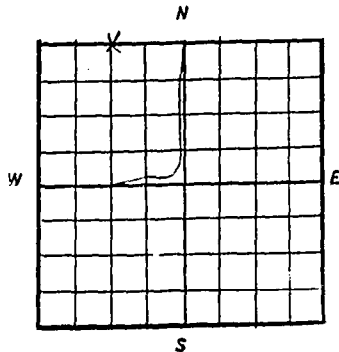

2. The beneficial use on which the claim is based GENERAL FARM USE

3. Date or approximate date of earliest beneficial use; and how continuous the use has been CONTINUOUS SINCE 1928

4. The amount of groundwater claimed (in miner's inches or gallons per minute) 20 gpm PER

5. If used for irrigation, give acreage and description of the lands to which water has been applied and name of the owner thereof 5 ACRES AROUND FARM HEADQUARTERS
ERU HILDA BEEMAN

S 1/4 NW 1/4 S 5 T 28 N 20 W
Indicate point of appropriation & place of use. Each square indicates 10 Acres.

6. The means of withdrawing such water from the ground and location of each well or other means of withdrawal ELECTRIC PUMP

7. Date of commencement & completion of construction of well, wells, or other works for withdrawal of groundwater 1910

8. Depth Of Water Table 175' WELL WATER LEVEL 20'

9. As it may be available, type, size, depth of each well or general specification of any other works for withdrawal of groundwater 4 IN CASING

10. Estimated amount of groundwater withdrawn each year 300,000 gal

11. The log of formations encountered in drilling each well (if available) NONE

12. Other information useful in carrying out policy of this act, including Book & Page of any county record _____

Signature E. R. Beeman
(owner)

Date _____

3 copies to be filed by owner with clerk & recorder in county where well is located. Please answer all questions. If not applicable, so state.

Original to Co. Clerk & Recorder; Duplicate to State Engineer; Triplicate to School of Mines and Quadruplicate for the Appropriator.

9492

63' 24" Jap
98m
m.s.

File No.

GW 4

T. 28 R. 20County Flathead

STATE OF MONTANA
ADMINISTRATOR OF GROUNDWATER CODE
OFFICE OF STATE ENGINEER

RECEIVED
DEC 30 1963

Declaration of Vested Groundwater Rights

(Under Chapter 237, Montana Session Laws, 1961)

STATE ENGINEER

1. William H. Fulbright of Box 4 Flathead
(Name of Appropriator) (Address) (Town)
County of Flathead State of Montana
have appropriated groundwater according to the Montana laws in effect prior to January 1, 1962, as follows:

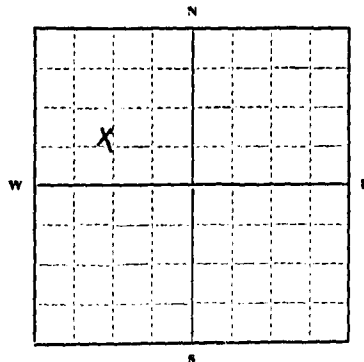
SE $\frac{1}{4}$ NW $\frac{1}{4}$ Sec. 6 T. 28 R. 20

Indicate point of appropriation
and place of use, if possible.
Each small square represents 10
acres.

2. The beneficial use on which the claim is based.....

Domestic and Farm use

3. Date or approximate date of earliest beneficial use; and how continuous the use has been.....

approximately 1962 and continuous since that time.

4. The amount of groundwater claimed (in miner's inches or gallons per minute).....

Twenty (20) gallons per minute

5. If used for irrigation, give the acreage and description of the lands to which water has been applied and name of the owner thereof.....

no irrigation

6. The means of withdrawing such water from the ground and the location of each well or other means of withdrawal.....

Pump SE $\frac{1}{4}$ NW $\frac{1}{4}$ Sec 6 T. 28 R. 20

7. The date of commencement and completion of the construction of the well, wells, or other works for withdrawal of groundwater.....

Before I acquired the real estate and the former owner is deceased, I have no way of knowing.

8. The depth of water table.....

190 ft.

9. So far as it may be available, the type, size and depth of each well or the general specifications of any other works for the withdrawal of groundwater.....

Drilled well 6 in. I.O. casing 212 ft. deep

10. The estimated amount of groundwater withdrawn each year.....

265,000 gallons

11. The log of formations encountered in the drilling of each well if available.....

not available

12. Such other information of a similar nature as may be useful in carrying out the policy of this act, including reference to book and page of any county record.....

No other information available to my knowledge.Signature of Owner Wm H. FulbrightDate Dec 23, 1963

Three copies to be filed by the owner with the County Clerk and Recorder of the county in which the well is located.

Please answer all questions. If not applicable, so state, otherwise the form will be returned.

Original to the County Clerk and Recorder; duplicate to the State Engineer; Triplicate to the Montana Bureau of Mines and Geology, and Quadruplicate for the Appropriator.

14543

10,160

23 Dec
63 216
2874
County Clerk and Recorder
M.T.
Deputy

File no.

GW 4

T. 22 N 20 W 6

County. Flathead

STATE OF MONTANA
ADMINISTRATOR OF GROUNDWATER CODE
OFFICE OF STATE ENGINEER

Declaration of Vested Groundwater Rights

(Under Chapter 237, Montana Session Laws, 1961)

RECEIVED
 NOV 29 1963

STATE ENGINEER

1. Flathead Electric Co. of Flathead (Name of Appropriator) (Address) (Town)

County of Flathead State of Montana
 have appropriated groundwater according to the Montana laws in effect prior to January 1, 1962, as follows:

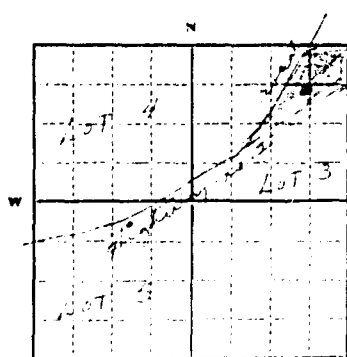

100' 100' 100' 100' 100' 100' 100' 100' 100' 100'

Indicate point of appropriation
 and place of use, if possible.
 Each small square represents 10
 acres.

2. The beneficial use on which the claim is based. Domestic water supply for irrigation and domestic use.

3. Date or approximate date of earliest beneficial use; and how continuous the use has been. Since 1950.

4. The amount of groundwater claimed (in miner's inches or gallons per minute). 100 miner's inches.

5. If used for irrigation, give the acreage and description of the lands to which water has been applied and name of the owner thereof. 100 acres, Flathead Electric Co., Flathead, Montana.

6. The means of withdrawing such water from the ground and the location of each well or other means of withdrawal. One well, 100' deep, located on the 100' square in the top-right corner of the grid.

7. The date of commencement and completion of the construction of the well, wells, or other works for withdrawal of groundwater. Commenced 1950, completed 1951.

8. The depth of water table. 100'.

9. So far as it may be available, the type, size and depth of each well or the general specifications of any other works for the withdrawal of groundwater. One well, 100' deep, 10" diameter.

10. The estimated amount of groundwater withdrawn each year. 100 miner's inches.

11. The log of formations encountered in the drilling of each well if available. None.

12. Such other information of a similar nature as may be useful in carrying out the policy of this act, including reference to book and page of any county record. None.

Signature of Owner [Signature]

Date Nov 29, 1963

Three copies to be filed by the owner with the County Clerk and Recorder of the county in which the well is located.

Please answer all questions. If not applicable, so state, otherwise the form will be returned.

Original to the County Clerk and Recorder; duplicate to the State Engineer; Triplicate to the Montana Bureau of Mines and Geology, and Quadruplicate for the Appropriator.