

File No. _____

GW 4

T 29 N R 21 W

County Flathead

STATE OF MONTANA
ADMINISTRATOR OF GROUNDWATER CODE
OFFICE OF STATE ENGINEER

RECEIVED

Declaration of Vested Groundwater Rights

(Under Chapter 237, Montana Session Laws, 1961)

STATE ENGINEER

I, James G. Edmiston of Route 1 Kalispell
(Name of Appropriator) (Address) (Town)
County of Flathead State of Montana
have appropriated groundwater according to the Montana laws in effect prior to January 1, 1962, as follows:

Sec. 16 & Sec. 15

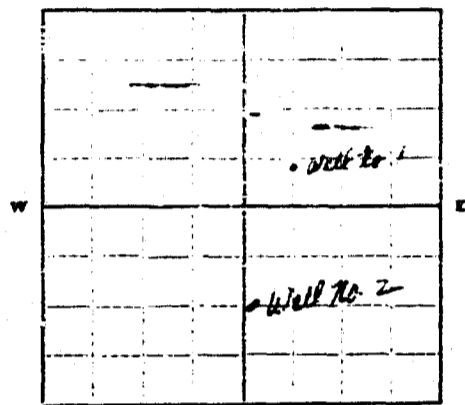

Sec. 21 & Sec. 22

1/4 Sec. T. 29 N. R. 21 W.

Indicate point of appropriation and place of use, if possible. Each small square represents 10 acres.

- The beneficial use on which the claim is based is irrigation.
- Date or approximate date of earliest beneficial use; and how continuous the use has been. Well No. 1 - 1961 - continuous use since.
Well No. 2 - 1956 - continuous use since.
- The amount of groundwater claimed (in miner's inches or gallons per minute). Well No. 1 - 1200
Well No. 2 - 600
- If used for irrigation, give the acreage and description of the lands to which water has been applied and name of the owner thereof. Well No. 1: S1/4 Sec. 15; N1/4 Sec. 22; T 29 N R 21 W.
Well No. 2: SW1/4 and NW1/4 Sec. 22; T. 29 N., R. 21 W.
- The means of withdrawing such water from the ground and the location of each well or other means of withdrawal.
Well No. 1: 50 HP Electric Motor
Well No. 2: 30 HP Electric Motor
- The date of commencement and completion of the construction of the well, wells, or other works for withdrawal of groundwater. Well No. 1: 1961
Well No. 2: 1956
- The depth of water table. Well No. 1: 10 feet Well No. 2: 12 feet.
- So far as it may be available, the type, size and depth of each well or the general specifications of any other works for the withdrawal of groundwater.
Well No. 1: Sump 75 feet in diameter
Well No. 2: Drilled well, 12 inches diameter, 30 feet deep
- The estimated amount of groundwater withdrawn each year. Well No. 1: 155,520,000
Well No. 2: 77,760,000
- The log of formations encountered in the drilling of each well if available.
Not available
- Such other information of a similar nature as may be useful in carrying out the policy of this act, including reference to book and page of any county record. None

Signature of Owner

Date September 14, 1962.

Three copies to be filed by the owner with the County Clerk and Recorder of the county in which the well is located.

Please answer all questions. If not applicable, so state, otherwise the form will be returned.

Original to the County Clerk and Recorder; duplicate to the State Engineer; Triplicate to the Montana Bureau of Mines and Geology; and Quadruplicate for the Appropriator.

6437

STATE OF MONTANA) SS
COUNTY OF FLATHEAD)

Filed on the 16 day of Oct
A.D. 1962 at 9:52 o'clock A.M

plm
County Clerk and Recorder

By [Signature] Deputy

STATE OF MONTANA
ADMINISTRATOR OF GROUNDWATER CODES
OFFICE OF STATE ENGINEER

RECEIVED
JAN 6 1964

Declaration of Vested Groundwater Rights ENGINEER

(Under Chapter 237, Montana Session Laws, 1951)

1. August H Grosswiler of Route 1 Kalispell
(Name of Appropriator) (Address) (Town)
County of Flathead State of Mont.
have appropriated groundwater according to the Montana laws in effect prior to January 1, 1962, as follows:

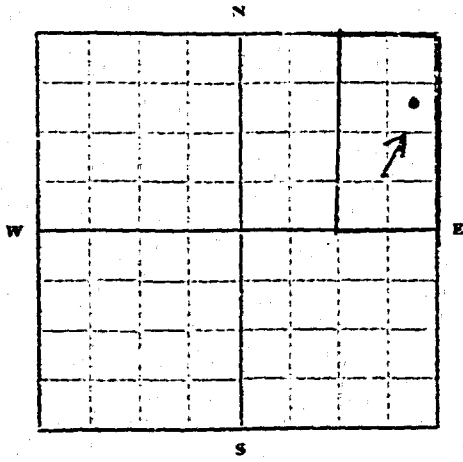

1/4 Sec. 22 T. 29 R. 21
Indicate point of appropriation and place of use, if possible. Each small square represents 10 acres.

- 2. The beneficial use on which the claim is based Irrigation
- 3. Date or approximate date of earliest beneficial use, and how continuous the use has been June 1956
4 months each year
- 4. The amount of groundwater claimed (in miner's inches or gallons per minute) 500 gal per minute
- 5. If used for irrigation, give the acreage and description of the lands to which water has been applied and name of the owner thereof
80 acres Hay and Pasture Land
August H Grosswiler
- 6. The means of withdrawing such water from the ground and the location of each well or other means of withdrawal
Electric Irrigation Pump
- 7. The date of commencement and completion of the construction of the well, wells, or other works for withdrawal of groundwater June 15, 1956
- 8. The depth of water table 4 ft
- 9. So far as it may be available, the type, size and depth of each well or the general specifications of any other works for the withdrawal of groundwater Dug out Hole 30 ft in Diameter
8 ft Deep
- 10. The estimated amount of groundwater withdrawn each year 500 gal per minute 4 months a year
- 11. The log of formations encountered in the drilling of each well if available 2 ft Dirt, 6 ft Gravel
- 12. Such other information of a similar nature as may be useful in carrying out the policy of this act, including reference to book and page of any county record None

Signature of Owner August H Grosswiler
Date Dec 26 1963

Three copies to be filed by the owner with the County Clerk and Recorder of the county in which the well is located.

Please answer all questions. If not applicable, so state, otherwise the form will be returned.

Original to the County Clerk and Recorder; duplicate to the State Engineer; Triplicate to the Montana Bureau of Mines and Geology, and Quadruplicate for the Appropriator.

10833

STATE OF MONTANA | SS
COUNTY OF FLAIREAD

Filed on the 31 day of *Dec*
A.D. 1963 at 11:45 o'clock *A.M.*

J. L. H.
By _____ Deputy

File No. _____

GW 4

T 29 N R 21 W 22

County _____

STATE OF MONTANA
ADMINISTRATOR OF GROUNDWATER CODE
OFFICE OF STATE ENGINEER

RECEIVED
JAN 6 1964

Declaration of Vested Groundwater Rights

(Under Chapter 237, Montana Session Laws, 1961)

STATE ENGINEER

William P. or Hazel I. Lambi of RRI Kalispell
(Name of Appropriator) (Address) (Town)

County of Flathead State of MONTANA
have appropriated groundwater according to the Montana laws in effect prior to January 1, 1962, as follows:

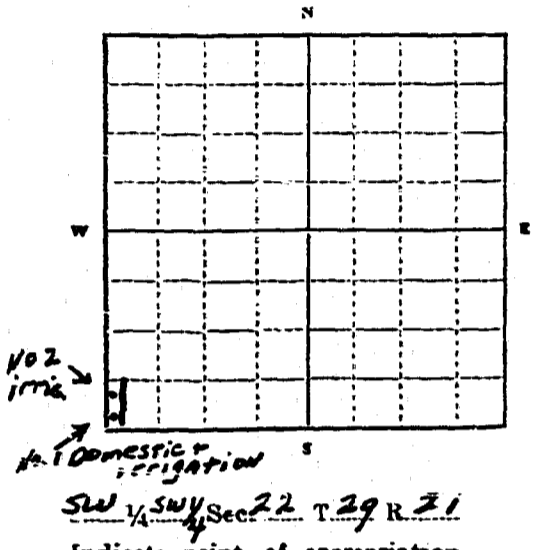

SW $\frac{1}{4}$ SW $\frac{1}{4}$ Sec 22 T. 29 R. 21

Indicate point of appropriation and place of use, if possible. Each small square represents 10 acres.

2. The beneficial use on which the claim is based domestic AND IRRIGATION

3. Date or approximate date of earliest beneficial use; and how continuous the use has been No 1 well 1918 CONTINUOUS
No 2 well 1930 CONTINUOUS

4. The amount of groundwater claimed (in miner's inches or gallons per minute): 300 GALLONS PER MINUTE

5. If used for irrigation, give the acreage and description of the lands to which water has been applied and name of the owner thereof
3 ACRES, 2 PASTURE, 1 ORCHARD & GARDEN
Hilham P Lamb Hazel I Lamb

6. The means of withdrawing such water from the ground and the location of each well or other means of withdrawal 2 electric pumps No 1 well at house in front part of acreage, No 2 well in pasture at rear half of acreage

7. The date of commencement and completion of the construction of the well, wells, or other works for withdrawal of groundwater No 1 well was started & completed in 1918 No 2 well was dug in 1930

8. The depth of water table 20 feet

9. So far as it may be available, the type, size and depth of each well or the general specifications of any other works for the withdrawal of groundwater No 1 well is a dug well 3 feet across and 20' deep; No 2 well is the same but being in lower terrain is 18 feet deep

10. The estimated amount of groundwater withdrawn each year 500,000 GALLON

11. The log of formations encountered in the drilling of each well if available Mostly Gravel

12. Such other information of a similar nature as may be useful in carrying out the policy of this act, including reference to book and page of any county record 1963 Tax Book page 837 Line 3
SW 1/4 SW 1/4 40 Rds. & 14 Rds

Signature of Owner Hilham P Lamb

Date Dec 30 1963

Three copies to be filed by the owner with the County Clerk and Recorder of the county in which the well is located.

Please answer all questions. If not applicable, so state, otherwise the form will be returned.

Original to the County Clerk and Recorder; duplicate to the State Engineer; Triplicate to the Montana Bureau of Mines and Geology and Quadruplicate for the Appropriator.

10667

COUNTY OF ...
COURT OF ...

Filed on the 31 day of Dec
A.D. 1913 at 8:16 o'clock A.M.

[Signature]
County Clerk and Recorder

By *[Signature]* Deputy

File No. _____

GW 4

T 29 N 21 W - 22
R
County Flathead

STATE OF MONTANA
ADMINISTRATOR OF GROUNDWATER CODE
OFFICE OF STATE ENGINEER

RECEIVED
JAN 6 1964

Declaration of Vested Groundwater Rights

(Under Chapter 237, Montana Session Laws, 1961)

STATE ENGINEER

MAURICE E. VANCE - BENTRICE E. VANCE
(Name of Appropriator) of Rt 1 - HALISPELL, MONT.
(Address) (Town)

County of FLATHEAD State of MONTANA

have appropriated groundwater according to the Montana laws in effect prior to January 1, 1962, as follows:

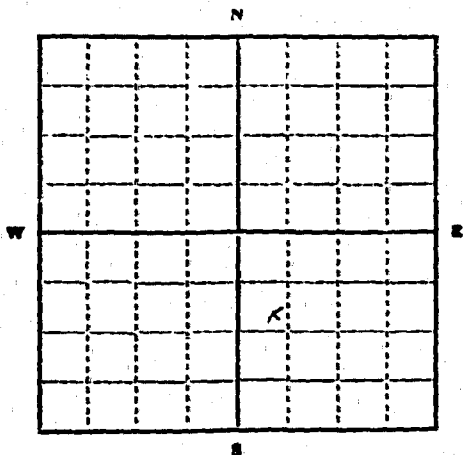

NW 1/4 SE 22 T 27 R 21

Indicate point of appropriation and place of use, if possible. Each small square represents 10 acres.

- The beneficial use on which the claim is based HOUSEHOLD, LIVESTOCK, & GARDEN IRRIGATION
- Date or approximate date of earliest beneficial use; and how continuous the use has been MAY-1955 EVERY DAY
- The amount of groundwater claimed (in miner's inches or gallons per minute) 10 GALLONS PER MINUTE
- If used for irrigation, give the acreage and description of the lands to which, water has been applied and name of the owner thereof NW 1/4 SE 4 - SEC 22 T 27 R 21
- The means of withdrawing such water from the ground and the location of each well or other means of withdrawal HOUSEHOLD WATER SYSTEM

- The date of commencement and completion of the construction of the well, wells, or other works for withdrawal of groundwater MAY 1955
- The depth of water table 12 ft.
- So far as it may be available, the type, size and depth of each well or the general specifications of any other works for the withdrawal of groundwater DRILLED, 7" CASING - 21 ft WELL DEPTH
- The estimated amount of groundwater withdrawn each year 12,500
- The log of formations encountered in the drilling of each well if available SAND & GRAVEL
- Such other information of a similar nature as may be useful in carrying out the policy of this act, including reference to book and page of any county record

Signature of Owner Maurice E. Vance
Date Dec 26 1963

Three copies to be filed by the owner with the County Clerk and Recorder of the county in which the well is located. Please answer all questions. If not applicable, so state, otherwise the form will be returned. Original to the County Clerk and Recorder; duplicate to the State Engineer; Triplicate to the Montana Bureau of Mines and Geology and Quadruplicate for the Appropriator.

22905

10734

STATE OF MONTANA
COUNTY OF PLATHEAR, SS

Filed on the 31 day of Dec
A. D. 1963 at 9:57 o'clock A. M.

S. C. W.
County Clerk and Recorder

By L. H. Deputy

14,425

STATE OF MONTANA } SS
COUNTY OF FLATHEAD }

Filed on the 15 day of May
A. D. 1921 at 2:45 o'clock P. M

Gene
County Clerk and Recorder

By by
Deputy

File No. 14345
 Filed for record
 this 9 day of November
 A. D. 19 71, at 3:05
 o'clock P. M. 11 1971

T. 29 R. 21 S. 23
 County Flax

STATE OF MONTANA
 ADMINISTRATOR OF GROUNDWATER CODE
 OFFICE OF STATE ENGINEER

Notice of Completion of Groundwater
 Appropriation by Means of Well

(Under Chapter 237, Montana Session Laws, 1961)

Owner Fred Eastman Address Somers, Mont.
 Driller Argyle Hendricks Address Kalispell, Mont.

Date of Notice of Appropriation of Groundwater _____
 Date well started Sept. 13, 1971 Date Completed Oct. 1, 1971

Type of well Drilled Equipment Used Drill
 (dug, driven, bored or drilled) (Churn, drill, rotary or other)

Water Use: Domestic Municipal Other Irrigation
 Industrial Drainage Stock

Indicate on the diagram the character and thickness of the different strata met with in drilling, such as soil, clay, sand, gravel, rock or sand, etc. Show depth at which water is encountered, thickness and character of water-bearing strata and height to which water rises in the well.

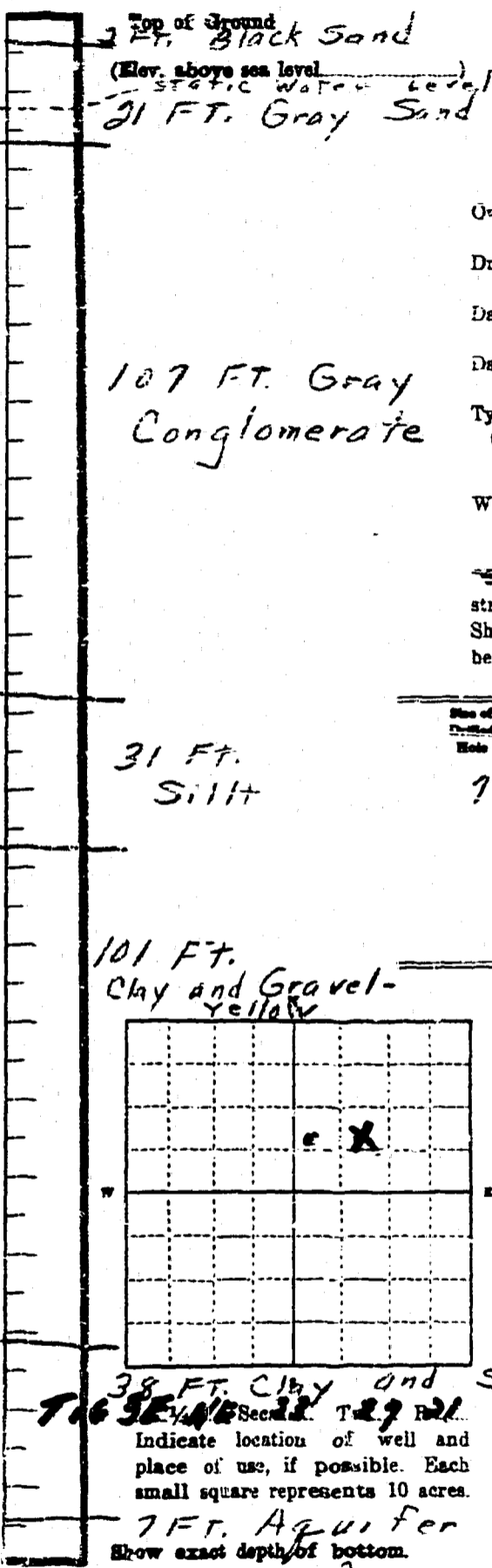

Size of Drilled Hole	Size and Weight of Casing	From (Feet)	To (Feet)	TEMPERATURE		
				Kind	From (Feet)	To (Feet)
7"	7" OD 20#	0	307	X	X	X

Static Water Level for non-flowing Well 20 feet.
 Shut-in Pressure for Flowing Well Not Applicable
 Pumping Water Level 100 feet at 20 gal. per minute.
 Discharge in gal. per min. of flowing well Not Applicable
 How Tested Boiler Length of Test 4 Hrs.

Remarks: (Gravel packing, cementing, packers, type of shutoff, location of place of use of groundwater if not at well, and any other similar pertinent information, including number of acres irrigated, if used for irrigation)

716 SE 1/4 Sec. 22 T. 29 N. R. 21 W.
 Indicate location of well and place of use, if possible. Each small square represents 10 acres.
7 FT. Aquifer
 Show exact depth of bottom.
307' - Bottom
 Level at which water was found:

153
 Driller's License Number
Argyle Hendricks
 Driller's Signature

This form to be prepared by driller, and three copies to be filed by the owner with the County Clerk and Recorder in the county in which the well is located.

Please answer all questions. If not applicable, so state, otherwise the form will be returned.

Original to the County Clerk and Recorder; duplicate to the State Engineer; Triplicate to the Montana Bureau of Mines and Geology and Quadruplicate for the Appropriator.

14,348

STATE OF MONTANA } SS
COUNTY OF FLEETHEAD }
Filed on the 9 day of Nov
A. D. 1971 at 3:45 o'clock P
Sen
County Clerk and Recorder
By [Signature] Deputy

14196

STATE OF MONTANA
COUNTY OF FLATHEAD SS

Filed on the 14th day of Aug
A.D. 1916 at 12:30 Clock P.M.

[Signature]
County Clerk and Recorder

By *[Signature]*
Deputy

14197

STATE OF MONTANA
COUNTY OF FLATHEAD, SS

Filed on the 4th day of *Aug*
A.D. 19*20* at 11:50 Clock *P. M.*

Wm
County Clerk and Recorder

By *Wm*
Deputy

File No. _____

GW 4

T. 29 N 21 W - 23

County _____

STATE OF MONTANA
ADMINISTRATOR OF GROUNDWATER CODE
OFFICE OF STATE ENGINEER

RECEIVED
JAN 6 1964

Declaration of Vested Groundwater Rights
(Under Chapter 237, Montana Session Laws, 1961)

1. Harold E. M. South of Rt. 1 Rainelle
(Name of Appropriator) (Address) (Town)
County of Blaine State of Montana
have appropriated groundwater according to the Montana laws in effect prior to January 1, 1962, as follows:

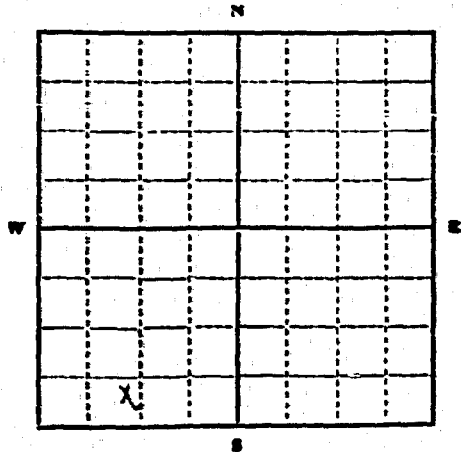

SW 1/4 Sec. 23 T. 29 R. 21

Indicate point of appropriation and place of use, if possible. Each small square represents 10 acres.

2. The beneficial use on which the claim is based domestic

3. Date or approximate date of earliest beneficial use; and how continuous the use has been 1949 continuous use

4. The amount of groundwater claimed (in miner's inches or gallons per minute) 450 gal per hr

5. If used for irrigation, give the acreage and description of the lands to which water has been applied and name of the owner thereof
12.202 for lawn irrigation on SW 1/4 Sec. 23 T. 29 R. 21

6. The means of withdrawing such water from the ground and the location of each well or other means of withdrawal
centrifugal pump 15 FT. from back of house at SW 1/4 Sec. 23 T. 29 R. 21

7. The date of commencement and completion of the construction of the well, wells, or other works for withdrawal of groundwater. 1947 unknown

8. The depth of water table. 9 ft

9. So far as it may be available, the type, size and depth of each well or the general specifications of any other works for the withdrawal of groundwater. concrete casing with 2 1/2 ft. depth 9 ft.

10. The estimated amount of groundwater withdrawn each year. 150,000 gal.

11. The log of formations encountered in the drilling of each well if available. unknown

12. Such other information of a similar nature as may be useful in carrying out the policy of this act, including reference to book and page of any county record. unknown

Signature of Owner Harold E. M. South

Date 12/30/63

Three copies to be filed by the owner with the County Clerk and Recorder of the county in which the well is located.

Please answer all questions. If not applicable, so state, otherwise the form will be returned.

Original to the County Clerk and Recorder; duplicate to the State Engineer; Triplicate to the Montana Bureau of Mines and Geology and Quadruplicate for the Appropriator.

22802

10674

STATE OF MONTANA) SS
COUNTY OF PLATEAU)

Filed on the 31 day of Dec
A. D. 1963 at 8⁵⁵ o'clock AM

J. C. M.
County Clerk and Recorder

By J. H.
Deputy

File No. _____

GW 4

T. 7 N 71 W R. 26

County _____

STATE OF MONTANA
ADMINISTRATOR OF GROUNDWATER CODE
OFFICE OF STATE ENGINEER

RECEIVED
JAN 8 1964

Declaration of Vested Groundwater Rights

(Under Chapter 237, Montana Session Laws, 1961)

STATE ENGINEER

I, _____ of _____
(Name of Appropriator) (Address) (Town)
County of _____ State of _____
have appropriated groundwater according to the Montana laws in effect prior to January 1, 1962, as follows:

APPA - Sec. 26 T. 71 R. 1
Indicate point of appropriation and place of use, if possible. Each small square represents 10 acres.

2. The beneficial use on which the claim is based _____

3. Date or approximate date of earliest beneficial use; and how continuous the use has been _____

4. The amount of groundwater claimed (in miner's inches or gallons per minute) _____

5. If used for irrigation, give the acreage and description of the lands to which water has been applied and name of the owner thereof _____

6. The means of withdrawing such water from the ground and the location of each well or other means of withdrawal _____

7. The date of commencement and completion of the construction of the well, wells, or other works for withdrawal of groundwater _____

8. The depth of water table _____

9. So far as it may be available, the type, size and depth of each well or the general specifications of any other works for the withdrawal of groundwater _____

10. The estimated amount of groundwater withdrawn each year _____

11. The log of formations encountered in the drilling of each well if available _____

12. Such other information of a similar nature as may be useful in carrying out the policy of this act, including reference to book and page of any county record _____

Signature of Owner Della McCallister

Date Dec 31, 1963

Three copies to be filed by the owner with the County Clerk and Recorder of the county in which the well is located.

Please answer all questions. If not applicable, so state, otherwise the form will be returned.

Original to the County Clerk and Recorder; duplicate to the State Engineer; Triplicate to the Montana Bureau of Mines and Geology and Quadruplicate for the Appropriator.

11030

STATE OF ILLINOIS
COUNTY OF [unclear] SS
Filed on 63/12 day of Dec
A.D. 1912 at 9 o'clock M
[Signature]
Clerk of Court and Recorder
By [Signature] Deputy

STATE OF MONTANA
ADMINISTRATOR OF GROUNDWATER CODE
MONTANA WATER RESOURCES BOARD

NOTICE OF COMPLETION OF GROUNDWATER
APPROPRIATION BY MEANS OF WELL

Developed after January 1, 1962

(Under Chapter 237 Montana Session Laws, 1961, as amended)

This form to be prepared by driller, and three copies to be filed by the owner with the County Clerk and Recorder in the county in which the well is located, last copy to be retained by driller.

Please answer all questions. If not applicable, so state, otherwise the form may be returned.

Owner LARRY D. BARGE

Address Rt. 1 Helena Flats

Kalispell, Mont

Date well started 3-15-73

completed 3-17-73

For Administrator's Use	
File	<u>15746</u>
Date	<u>June 27, 1973</u>
GW 1	<u>9-00 p.m.</u>

Type of well DRIVEN

(Dig, driven, bored or drilled)

Equipment used DRIVE 4" CASING

(Chain drill, rotary or other)

Water Use: Domestic Municipal Stock Irrigation

Industrial Drainage Other * Garden/Lawn

*Describe

USE: If used for irrigation, industrial, drainage or other. Explain, state number of acres and location or other data (i.e. Lot, Block and Addition).

ESTIMATED ANNUAL WITHDRAWAL 45,000 gal.

Size of Drilled Hole	Size and Weight of Casing	From (Feet)	To (Feet)	PERFORATIONS		
				Kind Size	From (Feet)	To (Feet)
<u>4"</u>	<u>1 1/4"</u>		<u>23'</u>			

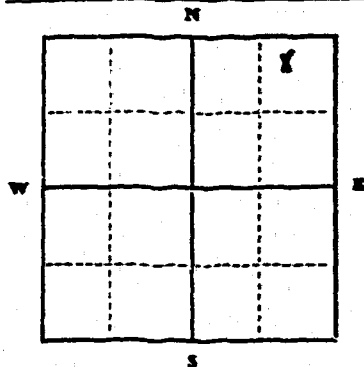

Static water level: 16 ft.*
Pumping water level 23 ft.*
at 600 gallons per minute,
measured 45 minutes after pumping began.

*Measured from ground level.
Well developed by Diaphragm Pump
for 48 hours.

Power 6AS Pump 8 HP
Remarks: (Gravel packing, cementing, packers, type of shutoff)

NE 1/4 NE 1/4 Sec. 27
T. 29 N. R. 21 E.
S. W.

INDICATE LOCATION OF WELL AND PLACE OF USE, IF POSSIBLE. EACH SMALL SQUARE REPRESENTS 40 ACRES.

Driller's Signature Jerry D Barge

Driller's Address ROUTE 1, HELENA FLATS

Kalispell, Mont.

LICENSE NO.

29N-21W Flathead 27
County

DRILLER'S LOG

Indicate the character, color, thickness of strata such as soil, clay, sand, gravel, shale, sandstone, etc. Show depth at which water is found and height to which water rises in well.

Top of Ground (Elev. above sea level)		
From (Feet)	To (Feet)	
<u>0</u>	<u>1</u>	<u>Top Soil</u>
<u>1</u>	<u>16</u>	<u>GRAVEL</u>
<u>16</u>	<u>-</u>	<u>WATER</u>
<u>23</u>	<u>-</u>	<u>SAND & GRAVEL</u>

23' Show exact depth of bottom

14746

STATE OF MONTANA)
COUNTY OF BEAUFORT, SS

Filed on the 27 day of June
A.D. 1923 at 3 o'clock PM

E M D
County Clerk and Recorder

By _____
Deputy

NOT RECORDED

RECORDED IN BEAUFORT COUNTY

BOOK 10 PAGE 10

9

3

County _____

STATE OF MONTANA
ADMINISTRATOR OF GROUNDWATER CODE
OFFICE OF STATE ENGINEER

RECEIVED
DEC 30 1963

Declaration of Vested Groundwater Rights
(Under Chapter 237, Montana Session Laws, 1961)

W.F. Cusick of Rt. 1 Kalispell
(Name of Appropriator) (Address) (Town)
County of Flathead State of Montana
have appropriated groundwater according to the Montana laws in effect prior to January 1, 1962, as follows:

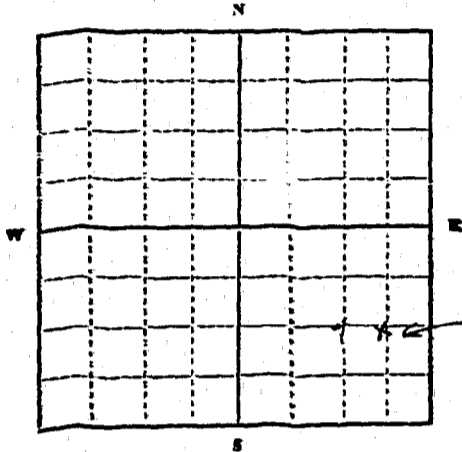

S. E 1/4 Sec. 27, T. 29, R. 21

Indicate point of appropriation and place of use, if possible. Each small square represents 10 acres.

2. The beneficial use on which the claim is based For Irrigation

3. Date or approximate date of earliest beneficial use; and how continuous the use has been May 15 to Sept. 15 since 1960

4. The amount of groundwater claimed (in miner's inches or gallons per minute) 200 gals.

5. If used for irrigation, give the acreage and description of the lands to which water has been applied and name of the owner thereof
100 aces S.E. 1/4 S. 27, T. 29, R. 21
W.F. Cusick

6. The means of withdrawing such water from the ground and the location of each well or other means of withdrawal 10 ft. P. 3 Phase Electric motor & 3' x 13" Centrifical pump.

7. The date of commencement and completion of the construction of the well, wells, or other works for withdrawal of groundwater. May 1st 1960 Well was dug and completed with 4 ft. curb.

8. The depth of water table 22 ft.

9. So far as it may be available, the type, size and depth of each well or the general specifications of any other works for the withdrawal of groundwater. Curb type 4 ft. diam 14 ft deep pump house located over curb

10. The estimated amount of groundwater withdrawn each year. 25,920,000 gals.

11. The log of formations encountered in the drilling of each well if available. The well was dug with a 2 1/2 in shell. It is located in a course approx. 12 ft. deep. There was a surface water 8 ft. clay 4 ft. heavy clay and coarse gravel.

12. Such other information of a similar nature as may be useful in carrying out the policy of this act, including reference to book and page of any county record. None

Signature of Owner W.F. Cusick

Date Dec 20, 1963

Three copies to be filed by the owner with the County Clerk and Recorder of the county in which the well is located.

Please answer all questions. If not applicable, so state, otherwise the form will be returned.

Original to the County Clerk and Recorder; duplicate to the State Engineer; Triplicate to the Montana Bureau of Mines and Geology and Quadruplicate for the Appropriator.

10, 101

STATE OF MONTANA : SS
COUNTY OF FLATHEAD

Filed on the 20 day of dec

A. D. 19 63 at 2:50 Clock P. M.

ben
County Clerk and Recorder

By

[Signature]
Deputy

File No. _____

GW 4

T 29^N R 21^W 29
County _____

STATE OF MONTANA
ADMINISTRATOR OF GROUNDWATER CODE
OFFICE OF STATE ENGINEER

Declaration of Vested Groundwater Rights

(Under Chapter 237, Montana Session Laws, 1961)

RECEIVED
JAN 8 1964
STATE ENGINEER

1. Jerome M Sand & Nadine M Sand, of East Reserve Drive, Kalispell
(Name of Appropriator) (Address) (Town)

County of Flathead State of Montana
have appropriated groundwater according to the Montana laws in effect prior to January 1, 1962, as follows:

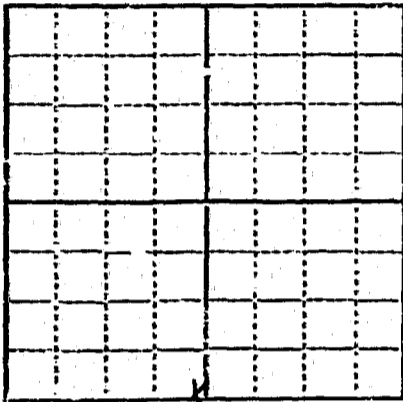

15 TR. IN SE $\frac{1}{4}$ SW $\frac{1}{4}$ T-58
SE $\frac{1}{4}$ SW $\frac{1}{4}$ Sec 27 T29 R21

Indicate point of appropriation and place of use, if possible. Each small square represents 10 acres.

2. The beneficial use on which the claim is based _____
Household, lawns and garden.

3. Date or approximate date of earliest beneficial use; and how continuous the use has been _____
1956, daily

4. The amount of groundwater claimed (in miner's inches or gallons per minute) _____
60 gallons per minute

5. If used for irrigation, give the acreage and description of the lands to which water has been applied and name of the owner thereof _____

6. The means of withdrawing such water from the ground and the location of each well or other means of withdrawal _____
Electric pump

7. The date of commencement and completion of the construction of the well, wells, or other works for withdrawal of groundwater _____
May 1956

8. The depth of water table _____
10 feet

9. So far as it may be available, the type, size and depth of each well or the general specifications of any other works for the withdrawal of groundwater _____
well; is 28 feet deep

10. The estimated amount of groundwater withdrawn each year _____
1,314,000 gallons

11. The log of formations encountered in the drilling of each well if available _____
sand and gravel

12. Such other information of a similar nature as may be useful in carrying out the policy of this act, including reference to book and page of any county record _____

Signature of Owner Jerome M Sand
Nadine M Sand
Date December 31, 1963

Three copies to be filed by the owner with the County Clerk and Recorder of the county in which the well is located.

Please answer all questions. If not applicable, so state, otherwise the form will be returned.

Original to the County Clerk and Recorder; duplicate to the State Engineer; Triplicate to the Montana Bureau of Mines and Geology and Quadruplicate for the Appropriator.

22776

10805

STATE OF MONTANA
COUNTY OF FLAHEAD

Filed on the 3rd day of Dec
A.D. 1963 at 11th o'clock A.M.

[Signature]
County Clerk and Recorder

By [Signature] Deputy

Fl. No. _____

GW. _____

T. 29 N. R. 21 W. - 21
County Flathead

STATE OF MONTANA
ADMINISTRATOR OF GROUNDWATER CODE
OFFICE OF STATE ENGINEER

RECEIVED
DEC 30 1963

Declaration of Vested Groundwater Rights

(Under Chapter 237, Montana Session Laws, 1961)

Howard V. Doran

STATE ENGINEER

1. Irene V. Doran of R-1 Kalispell
(Name of Appropriator) (Address) (Town)

County of Flathead State of Montana
have appropriated groundwater according to the Montana laws in effect prior to January 1, 1962, as follows:

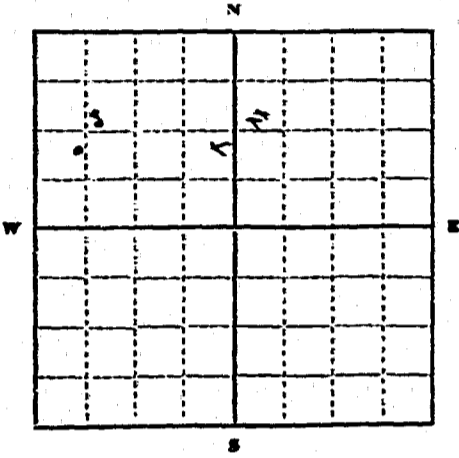

N.W. 1/4 NE 1/4 Sec. 27 T. 29 R. 21

Indicate point of appropriation and place of use, if possible. Each small square represents 10 acres.

SW 1/4 NE 1/4 27-29-21

2. The beneficial use on which the claim is based Irrigation
irrigating lawn & trees

3. Date or approximate date of earliest beneficial use; and how continuous the use has been April 1954
every day - present
3 times a week for lawn & trees

4. The amount of groundwater claimed (in miner's inches or gallons per minute) 3000 to 5000 in 24 hours drive
in winter 300 to 500

5. If used for irrigation, give the acreage and description of the lands to which water has been applied and name of the owner thereof
Lawn & Trees

6. The means of withdrawing such water from the ground and the location of each well or other means of withdrawal 3 pumps

7. The date of commencement and completion of the construction of the well, wells, or other works for withdrawal of groundwater April 1954

8. The depth of water table 9 ft

9. So far as it may be available, the type, size and depth of each well or the general specifications of any other works for the withdrawal of groundwater
1 - 2 1/2 ft - 7" O.D. casing
2 - 20 ft - 7" O.D. casing

10. The estimated amount of groundwater withdrawn each year 320,000 to 790,000

11. The log of formations encountered in the drilling of each well if available gravel

12. Such other information of a similar nature as may be useful in carrying out the policy of this act, including reference to book and page of any county record

Signature of Owner Howard V. Doran
Date Dec 16 - 1963

Three copies to be filed by the owner with the County Clerk and Recorder of the county in which the well is located.
Please answer all questions. If not applicable, so state, otherwise the form will be returned.

Original to the County Clerk and Recorder; duplicate to the State Engineer; Triplicate to the Montana Bureau of Mines and Geology and Quadruplicate for the Appropriator.

10,044

STATE OF MONTANA
COUNTY OF FLATHEAD

Filed on the 10th day of Dec
A. D. 1963 at 11 o'clock A.M.

G. L. M.
By [Signature] Deputy

File No. _____

GW 4

T. 29N R. 21W 27

County _____

STATE OF MONTANA
ADMINISTRATOR OF GROUNDWATER CODE
OFFICE OF STATE ENGINEER

RECEIVED
JAN 6 1964

Declaration of Vested Groundwater Rights

(Under Chapter 237, Montana Session Laws, 1961)

STATE ENGINEER

Therese M. Eickert of Route 1 Kalispell
(Name of Appropriator) (Address) (Town)

County of Flathead State of Montana
have appropriated groundwater according to the Montana laws in effect prior to January 1, 1962, as follows:

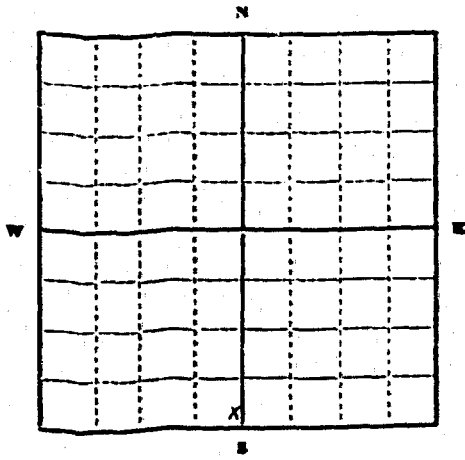

SE 1/4 SW 1/4 Sec 27 T 29 R 21

Indicate point of appropriation and place of use, if possible. Each small square represents 10 acres.

2. The beneficial use on which the claim is based Household
Lawn and garden

3. Date or approximate date of earliest beneficial use; and how continuous the use has been April 1959

4. The amount of groundwater claimed (in mixer's inches or gallons per minute) Unknown

5. If used for irrigation, give the acreage and description of the lands to which water has been applied and name of the owner thereof One acre

6. The means of withdrawing such water from the ground and the location of each well or other means of withdrawal Electric pump

7. The date of commencement and completion of the construction of the well, wells, or other works for withdrawal of groundwater April 1959

8. The depth of water table 15 feet

9. So far as it may be available, the type, size and depth of each well or the general specifications of any other works for the withdrawal of groundwater One 4" driven well

10. The estimated amount of groundwater withdrawn each year Unknown

11. The log of formations encountered in the drilling of each well if available Gravel

12. Such other information of a similar nature as may be useful in carrying out the policy of this act, including reference to book and page of any county record.

Signature of Owner Therese Eickert

Date Dec 31 - 1963

Three copies to be filed by the owner with the County Clerk and Recorder of the county in which the well is located.

Please answer all questions. If not applicable, so state, otherwise the form will be returned.

Original to the County Clerk and Recorder; duplicate to the State Engineer; Triplicate to the Montana Bureau of Mines and Geology and Quadruplicate for the Appropriator.

10776

STATE OF MISSISSIPPI
COUNTY OF ALBANY

Filed on the 31 day of Dec
A. D. 1963 at 10:11 o'clock A. M.

J. C. M.
County Clerk and Recorder

By *J. C. M.* Deputy

File No. _____

GW 4

T 29 N 2W 27

County _____

STATE OF MONTANA
ADMINISTRATOR OF GROUNDWATER CODE
OFFICE OF STATE ENGINEER

Declaration of Vested Groundwater Rights

(Under Chapter 237, Montana Session Laws, 1961)

RECEIVED
JAN 6 1964

STATE ENGINEER

Clarence F. Knutson & Elfrieda E. Knutson of Route #1 Kalispell
(Name of Appropriator) (Address) (Town)

County of Flathead State of Montana
have appropriated groundwater according to the Montana laws in effect prior to January 1, 1962, as follows:

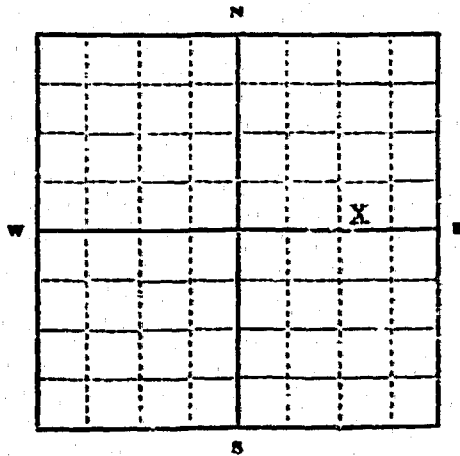

SE 1/4 Sec. 27 T29N R21W

Indicate point of appropriation and place of use, if possible. Each small square represents 10 acres.

2. The beneficial use on which the claim is based
domestic, livestock and garden.

3. Date or approximate date of earliest beneficial use; and how continuous the use has been
July 1905 and continuous since then.

4. The amount of groundwater claimed (in miner's inches or gallons per minute)
40 miner's inches.

5. If used for irrigation, give the acreage and description of the lands to which water has been applied and name of the owner thereof used to irrigate lawn and garden.

6. The means of withdrawing such water from the ground and the location of each well or other means of withdrawal
well and siphon type pump.

7. The date of commencement and completion of the construction of the well, wells, or other works for withdrawal of groundwater.
July 1905 and continued improvements since.

8. The depth of water table 15 feet.

9. So far as it may be available, the type, size and depth of each well or the general specifications of any other works for the withdrawal of groundwater.
3 feet square and 25 feet deep.

10. The estimated amount of groundwater withdrawn each year 150,000 gallons.

11. The log of formations encountered in the drilling of each well if available
sand and gravel.

12. Such other information of a similar nature as may be useful in carrying out the policy of this act, including reference to book and page of any county record.

Signature of Owner *Clarence F. Knutson*
Elfrieda E. Knutson

Date December 28, 1963

Three copies to be filed by the owner with the County Clerk and Recorder of the county in which the well is located.

Please answer all questions. If not applicable, so state, otherwise the form will be returned.

Original to the County Clerk and Recorder; duplicate to the State Engineer; Triplicate to the Montana Bureau of Mines and Geology and Quadruplicate for the Appropriator.

22552

10,372

STATE OF MONTANA
COUNTY OF FLAHEAD

Filed on the 30 day of Nov
A. D. 1923 at 8:20 o'clock P.M.

J. G. M.
County Clerk and Recorder

By J. G. M.
Deputy

File No. _____

RECEIVED ^{GW 2}

T 29 R 21 27

JUL 3 1973

County _____

MONTANA DEPARTMENT OF NATURAL RESOURCES AND CONSERVATION

STATE OF MONTANA ADMINISTRATOR OF GROUNDWATER CODE OFFICE OF STATE ENGINEER

Notice of Completion of Groundwater Appropriation by Means of Well

(Under Chapter 23, Montana Session Laws, 1961)

Owner Marilyn G. Goodsell Address Pt 1 - Helena Flats

Driller Lyle Goodsell Address Pt 1 - Helena Flats

Date of Notice of Appropriation of Groundwater _____

Date well started 5-1-69 Date Completed 5-3-69

Type of well Driven Equipment Used Other
(dug, driven, bored or drilled) (Churn, drill, rotary or other)

Water Use: Domestic Municipal Other Irrigation
Industrial Drainage Stock

Indicate on the diagram the character and thickness of the different strata met with in drilling, such as soil, clay, shale, gravel, rock or sand, etc. Show depth at which water is encountered, thickness and character of water-bearing strata and height to which water rises in the well.

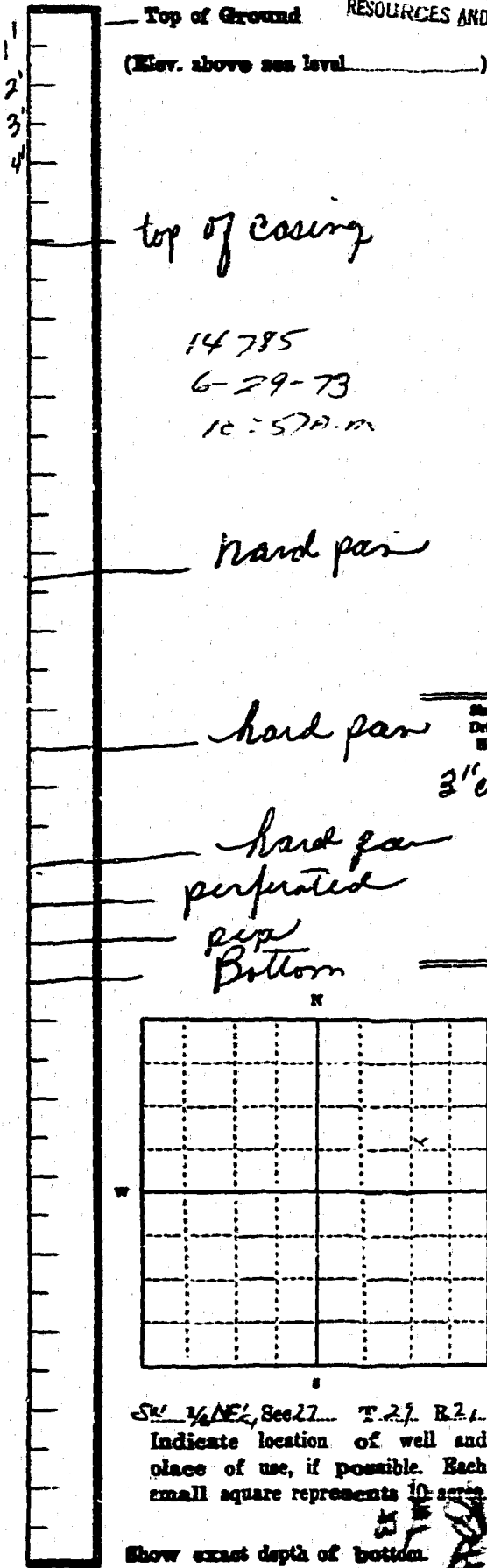

Size of Drilled Hole	Size and Weight of Casing	From (Feet)	To (Feet)	PERFORATIONS		
				Kind	From (Feet)	To (Feet)
3" casing	3 inch	6 ft	25			

Static Water Level for non-flowing Well 12 ft from top feet.

Shut-in Pressure for Flowing Well _____

Pumping Water Level 12 feet at 100 gal. per minute.

Discharge in gal. per min. of flowing well 600

How Tested five pumps Length of Test 48 hr

Remarks: (Gravel packing, cementing, packers, type of shutoff, location of place of use of groundwater if not at well, and any other similar pertinent information, including number of acres irrigated, if used for irrigation) garden & lawn

SW 1/4 NE 1/4, Sec 17, T. 27, R. 21

Indicate location of well and place of use, if possible. Each small square represents 10 acres.

Show exact depth of bottom.

Driller's License Number _____

Driller's Signature _____

This form to be prepared by driller, and three copies to be filed by the owner with the County Clerk and recorder in the county in which the well is located.

Please answer all questions. If not applicable, so state, otherwise the form will be returned.

Original to the County Clerk and Recorder; duplicate to the State Engineer; Triplicate to the Montana Bureau of Mines and Geology and Quadruplicate for the Appropriator.

55018

14,785

STATE OF MONTANA
COUNTY OF FLATHEAD

Filed on the 19 day of June
A. D. 1913 at 1:57 o'clock P. M.

[Signature]
County Clerk and Recorder
By [Signature] Deputy

File No. _____

County _____

DUPLICATE

STATE OF MONTANA
ADMINISTRATOR OF GROUNDWATER CODE
OFFICE OF STATE ENGINEER

RECEIVED
APR 11 1962

Declaration of Vested Groundwater Rights
(Under Chapter 237, Montana Session Laws, 1961)

STATE ENGINEER

1. Ernest D. Jenson and Gladys Jenson of Route 1 Kalispell, Montana
(Name of Appropriator) (Address) (Town)
County of Flathead State of Montana
have appropriated groundwater according to the Montana laws in effect prior to January 1, 1962, as follows:

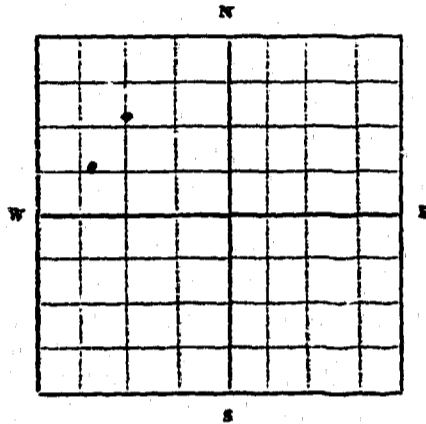

1/4 Sec 27 T29N R21W

Indicate point of appropriation and place of use, if possible. Each small square represents 10 acres.

- 2. The beneficial use on which the claim is based irrigation, domestic and other beneficial purposes.
- 3. Date or approximate date of earliest beneficial use; and how continuous the use has been Spring 1956, which use has been continuous to the present date.
- 4. The amount of groundwater claimed (in miner's inches or gallons per minute) 600 gallons per minute
- 5. If used for irrigation, give the acreage and description of the lands to which water has been applied and name of the owner thereof Northwest Quarter of Section 27, Township 29 North, Range 21 West, Flathead County, Montana - Ernest D. Jenson
- 6. The means of withdrawing such water from the ground and the location of each well or other means of withdrawal By pumps, one pump being located in the approx. center of the NW 1/4 of said NW 1/4, and one approx. 20 rods from the East line and 40 rods from the North line of the South half of said Northwest Quarter
- 7. The date of commencement and completion of the construction of the well, wells, or other works for withdrawal of groundwater Wells completed April 27, 1956

- 8. The depth of water table twelve feet
- 9. So far as it may be available, the type, size and depth of each well or the general specifications of any other works for the withdrawal of groundwater one well 16 x 16 feet, 6 feet deep and one well 14 x 14 feet and 6 feet deep.
- 10. The estimated amount of groundwater withdrawn each year six million gallons
- 11. The log of formations encountered in the drilling of each well if available None available
- 12. Such other information of a similar nature as may be useful in carrying out the policy of this act, including reference to book and page of any county record _____

Ernest D. Jenson
Signature of Owner Gladys Jenson
Date April 11, 1962

Three copies to be filed by the owner with the County Clerk and Recorder of the county in which the well is located.

Please answer all questions. If not applicable, so state. otherwise the form will be returned.

Original to the County Clerk and Recorder; duplicate to the State Engineer; Triplicate to the School of Mines and Quadruplicate for the Appropriator.

File No. _____

GW 4

T 29N R 21W 29
County _____

STATE OF MONTANA
ADMINISTRATOR OF GROUNDWATER CODE
OFFICE OF STATE ENGINEER

RECEIVED
JAN 6 1964

Declaration of Vested Groundwater Rights

(Under Chapter 237, Montana Session Laws, 1961) STATE ENGINEER

Harold Johnson of St. Helena
(Name of Appropriator) (Address) (Town)
County of Flathead State of Montana
have appropriated groundwater according to the Montana laws in effect prior to January 1, 1962, as follows:

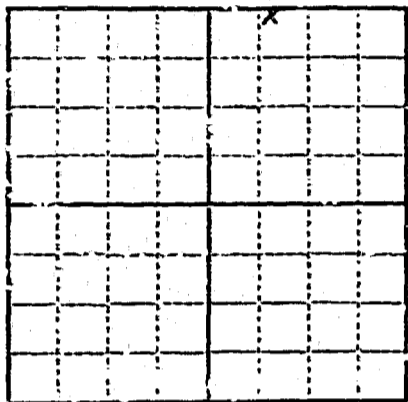

NE Sec 27 T29N R21W

Indicate point of appropriation and place of use, if possible. Each small square represents 10 acres.

2. The beneficial use on which the claim is based
household use

3. Date or approximate date of earliest beneficial use; and how continuous the use has been. August 1954
every day since then

4. The amount of groundwater claimed (in miner's inches or gallons per minute) 10 gals.

5. If used for irrigation, give the acreage and description of the lands to which water has been applied and name of the owner thereof

6. The means of withdrawing such water from the ground and the location of each well or other means of withdrawal
Electric water pump in basement of home

7. The date of commencement and completion of the construction of the well, wells, or other works for withdrawal of groundwater
started Aug 1954 completed Aug 1956

8. The depth of water table 8 ft.

9. So far as it may be available, the type, size and depth of each well or the general specifications of any other works for the withdrawal of groundwater
3" casing driven to 15 1/2 ft. below ground level

10. The estimated amount of groundwater withdrawn each year 300,000 gals

11. The log of formations encountered in the drilling of each well if available

12. Such other information of a similar nature as may be useful in carrying out the policy of this act, including reference to book and page of any county record

Signature of Owner Harold Johnson
Date Dec 30 1963

Three copies to be filed by the owner with the County Clerk and Recorder of _____ County in which the well is located.

Please answer all questions. If not applicable, so state, otherwise the form will be returned.

Original to the County Clerk and Recorder; duplicate to the State Engineer; Triuplicate to the Montana Bureau of Mines and Geology and Quadruplicate for the Appropriator.

22994

10823

COUNTY OF HONOLULU, SS

Filed on the 31 day of Dec
A.D. 1963 at 11:30 A.M.

2 E M
County Clerk and Recorder

By J. H. Deputy

File No. _____

GW 4

T 29 N R 21 W 27

County _____

STATE OF MONTANA
ADMINISTRATOR OF GROUNDWATER CODE
OFFICE OF STATE ENGINEER

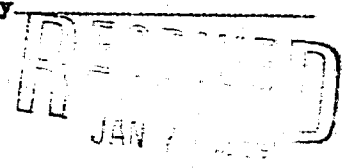

Declaration of Vested Groundwater Rights STATE ENGINEER
(Under Chapter 237, Montana Session Laws, 1961)

1. Carney M. Wilby of Helena, Montana
(Name of Appropriator) (Address) (Town)
County of Flathead State of Montana
have appropriated groundwater according to the Montana laws in effect prior to January 1, 1962, as follows:

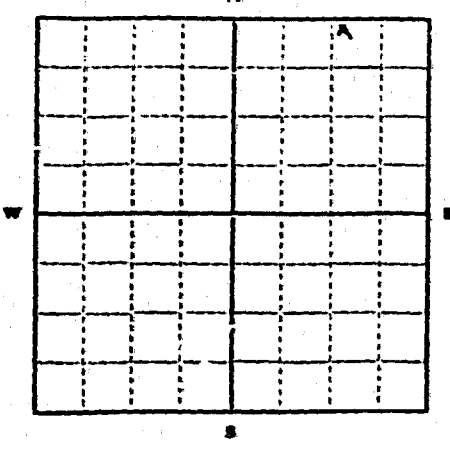

NE 1/4 Sec 27 T 29 R 21

Indicate point of appropriation and place of use, if possible. Each small square represents 10 acres.

- 2. The beneficial use on which the claim is based home use
- 3. Date or approximate date of earliest beneficial use; and how continuous the use has been July 1948 to present time
- 4. The amount of groundwater claimed (in miner's inches or gallons per minute) 100 gallons per minute
- 5. If used for irrigation, give the acreage and description of the lands to which water has been applied and name of the owner thereof Not used for irrigation but home use only and yard
- 6. The means of withdrawing such water from the ground and the location of each well or other means of withdrawal Electric pump located as described above
- 7. The date of commencement and completion of the construction of the well, wells, or other works for withdrawal of groundwater July 1948
- 8. The depth of water table about 20 ft
- 9. So far as it may be available, the type, size and depth of each well or the general specifications of any other works for the withdrawal of groundwater about 14 ft
- 10. The estimated amount of groundwater withdrawn each year 100,000 gal
- 11. The log of formations encountered in the drilling of each well if available granite
- 12. Such other information of a similar nature as may be useful in carrying out the policy of this act, including reference to book and page of any county record None

Signature of Owner Carney M. Wilby
Date Nov 31 - 1963

Three copies to be filed by the owner with the County Clerk and Recorder of the county in which the well is located.
Please answer all questions. If not applicable, so state, otherwise the form will be returned.
Original to the County Clerk and Recorder; duplicate to the State Engineer; Triplicate to the Montana Bureau of Mines and Geology and Quadruplicate for the Appropriator.

26720

11,132

COUNTY OF HENRICO, VA
(SUICIDE OF HENRICO)

Filed on the 3 day of January
A.D. 1964 at 2:30 o'clock P.M.

J.E.M.

County Clerk and Recorder

By

LX

Deputy

File No. _____

GW 4

T. 29^N R. 21^W 27
County Flathead

STATE OF MONTANA
ADMINISTRATOR OF GROUNDWATER CODE
OFFICE OF STATE ENGINEER

RECEIVED
JAN 6 1964

Declaration of Vested Groundwater Rights

(Under Chapter 237, Montana Session Laws, 1961)

STATE ENGINEER

1 George Street of Kalispell, Mont. R.T.L.
(Name of Appropriator) (Address) (Town)
County of Flathead State of Montana
have appropriated groundwater according to the Montana laws in effect prior to January 1, 1962, as follows:

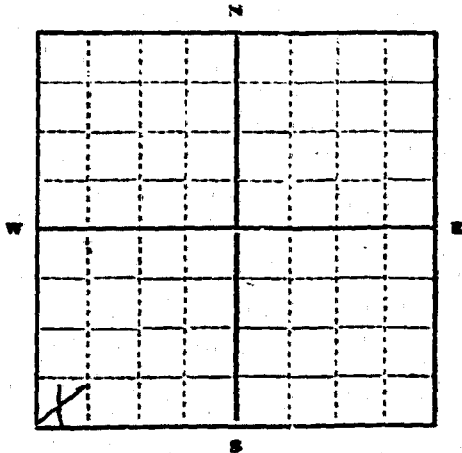

SW 1/4 Sec 27 T. 29 R. 21

Indicate point of appropriation and place of use, if possible. Each small square represents 10 acres.

2. The beneficial use on which the claim is based

general purpose use

3. Date or approximate date of earliest beneficial use; and how continuous the use has been

continuous use 1943

4. The amount of groundwater claimed (in miner's inches or gallons per minute)

when in use 5 gal. per minute

5. If used for irrigation, give the acreage and description of the lands to which water has been applied and name of the owner thereof

law 1/2 acre owner (George Street)

6. The means of withdrawing such water from the ground and the location of each well or other means of withdrawal

by pump; by house

7. The date of commencement and completion of the construction of the well, wells, or other works for withdrawal of groundwater

1943

8. The depth of water table

6 feet

9. So far as it may be available, the type, size and depth of each well or the general specifications of any other works for the withdrawal of groundwater.

depth of well 20 ft. 6 in casing

10. The estimated amount of groundwater withdrawn each year

75,000 gal.

11. The log of formations encountered in the drilling of each well if available.

sand & gravel

12. Such other information of a similar nature as may be useful in carrying out the policy of this act, including reference to book and page of any county record.

Signature of Owner

George Street
Date Dec 30 1963

Three copies to be filed by the owner with the County Clerk and Recorder of the county in which the well is located.

Please answer all questions. If not applicable, so state, otherwise the form will be returned.

Original to the County Clerk and Recorder; duplicate to the State Engineer; Triplicate to the Montana Bureau of Mines and Geology and Quadruplicate for the Appropriator.

22786

10608

STATE OF MISSISSIPPI
COUNTY OF HANCOCK

Filed on the 30th day of Dec
A.D. 1963 at 7th o'clock P. M.

Glenn E. Millhouse
County Clerk and Recorder

By *J. M. Prater*
Deputy

File No. _____

GW 4

T ^N 29 ^W R 21 28
County Flathead

STATE OF MONTANA
ADMINISTRATOR OF GROUNDWATER CODE
OFFICE OF STATE ENGINEER

RECEIVED
JAN 6 1964
STATE ENGINEER

Declaration of Vested Groundwater Rights

(Under Chapter 237, Montana Session Laws, 1961)

1. Vernon L. Birky of LaSalle rd. Kalispell
(Name of Appropriator) (Address) (Town)
County of Flathead State of Montana
have appropriated groundwater according to the Montana laws in effect prior to January 1, 1962, as follows:

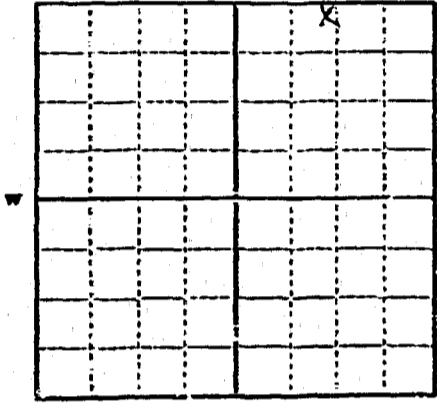

NW 1/4 NE 1/4 Sec 28 T 29 R 21

Indicate point of appropriation and place of use, if possible. Each small square represents 10 acres.

2. The beneficial use on which the claim is based
Domestic

3. Date or approximate date of earliest beneficial use; and how continuous the use has been
summer of 1947

4. The amount of groundwater claimed (in miner's inches or gallons per minute)
20 gal. per min

5. If used for irrigation, give the acreage and description of the lands to which water has been applied and name of the owner thereof
1 and 1/2 acre of garden and lawn

6. The means of withdrawing such water from the ground and the location of each well or other means of withdrawal
Pump

7. The date of commencement and completion of the construction of the well, well's, or other works for withdrawal of groundwater
unavailable

8. The depth of water table
unknown

9. So far as it may be available, the type, size and depth of each well or the general specifications of any other works for the withdrawal of groundwater
6 in casing - 21 ft well

10. The estimated amount of groundwater withdrawn each year
300,000 gals. per year

11. The log of formations encountered in the drilling of each well if available
sand & gravel

12. Such other information of a similar nature as may be useful in carrying out the policy of this act, including reference to book and page of any county record
None

Signature of Owner Vernon L. Birky
Date Dec 30, 1963

Three copies to be filed by the owner with the County Clerk and Recorder of the county in which the well is located.

Please answer all questions. If not applicable, so state, otherwise the form will be returned.

Original to the County Clerk and Recorder; duplicate to the State Engineer; Triplicate to the Montana Bureau of Mines and Geology and Quadruplicate for the Appropriator.

1074

STATE OF MONTANA 133
COUNTY OF HILLBORO

Filed on the 31 day of Dec
A. D. 1963 at 10:24 o'clock A.M.

R. M.
County Clerk and Recorder

By *[Signature]*
Deputy

RECEIVED
JUL 2 1958

STATE ENGINEER

MONTANA BUREAU OF MINES AND GEOLOGY
Butte, Montana

T 29 R 21 28
County Foothill

WATER WELL LOG

Owner Harold Blumer Address B.F. Knapell
Driller Self Address _____
Date Started July 1 - 1957 Date Completed July 3 - 1957
Location: Sec 28 T 29 R 21 1/4 sec Lot 5 Block 1 Sec 28 T 29 R 21

Type of well Driven Equipment used Weight on pipe
(Dug, driven, bored, or drilled) (Churn drill, rotary, other)

Water use: Domestic Municipal Stock Irrigation
Industrial Drainage Other: _____

Casing: 5 ft. to 1.8 ft. Type _____ Size _____
Casing: _____ ft. to _____ ft. Type _____ Size _____
Casing: _____ ft. to _____ ft. Type _____ Size _____

Perforated or Screened: Ft. _____ to ft. _____ Ft. 2 to ft. 3
Type of screen or perforations perforated pipe

Static Water level, for non-flowing well: _____ feet

Shut-in pressure, for flowing well: _____ lb./sq. in. on: _____ (date)

Pumping water level: 14 feet at _____ gal. per min.

How tested: never

Length of test: _____

Remarks: (Gravel packing, cementing, packers, type of shut-off, depth of shut-off)

(over)

File No. _____

GW 2

29 N 21 28
P. 1 W. 28
County Foothold

STATE OF MONTANA
ADMINISTRATOR OF GROUNDWATER
OFFICE OF STATE ENGINEER

Notice of Completion of Groundwater Appropriation by Means of Well

(Under Chapter 237, Montana Session Laws, 1961)

Carlisle A. Brunett and Florence M. Brunett

Owner Carlisle A. Brunett Address Box 1, Ellipoll, Montana

Driller Carlisle A. Brunett-Owner Address Box 1, Ellipoll, Montana

Date of Notice of Appropriation of Groundwater June 1, 1963

Date well started June 1, 1963 Date Completed June 5, 1963

Type of well Driven Equipment Used Drum
(dug, driven, bored or drilled) (Churn, drill, rotary or other)

Water Use: Domestic Municipal Other Irrigation
Industrial Drainage Stock

Indicate on the diagram the character and thickness of the different strata met with in drilling, such as soil, clay, shale, gravel, rock or sand, etc. Show depth at which water is encountered, thickness and character of water-bearing strata and height to which water rises in the well.

Size of Drilled Hole	Size and Weight of Casing	From (Feet)	To (Feet)	PERFORATIONS		
				Hole Size	From (Feet)	To (Feet)
<u>3 1/2 inches</u>	<u>3 1/2 inches</u>	<u>0-22 ft.</u>	<u>steel</u>	<u>3/8"</u>	<u>0-22'</u>	

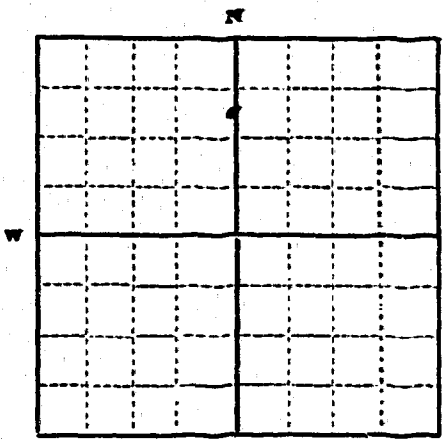

1/4 NE 1/4 Sec 4 T4 N R4 W
Indicate location of well and place of use, if possible. Each small square represents 10 acres.

Show exact depth of bottom.

Static Water Level for non-flowing Well 24 feet.

Shut-in Pressure for Flowing Well _____

Pumping Water Level 26 ft 600 gal. per minute.

Discharge in gal. per min. of flowing well _____

How Tested slug test Length of Test 1 1/2 hours

Remarks: (Gravel packing, cementing, packers, type of shutoff, location of place of use of groundwater if not at well, and any other similar pertinent information, including number of acres irrigated, if used for irrigation) acres Est.

Florence M. Brunett
Carlisle A. Brunett

None self-owner
Driller's License Number

Owners Carlisle A. Brunett Driller's Signature

This form to be prepared by driller, and three copies to be filed by the owner with the County Clerk and Recorder in the county in which the well is located.

Please answer all questions. If not applicable, so state, otherwise the form will be returned.

Original to the County Clerk and Recorder; duplicate to the State Engineer; Triplicate to the Montana Bureau of Mines and Geology and Quadruplicate for the Appropriator.

22579

10,400

STATE OF MONTANA SS
COUNTY OF FLATHEAD

Filed on the 30 day of Dec
A. D. 1923 at 10:36 Clock AM

[Signature]
County Clerk and Recorder

By *[Signature]* Deputy

File No. _____

GW 4

T. 29 N. R. 21 W. 28

County Foothill

STATE OF MONTANA
ADMINISTRATOR OF GROUNDWATER CODE
OFFICE OF STATE ENGINEER

RECEIVED
JAN 6 1964

Declaration of Vested Groundwater Rights

(Under Chapter 237, Montana Session Laws, 1961)

STATE ENGINEER

Camillet & Florence M. Brunett of Rt. 1, Kalispell
(Name of Appropriator) (Address) (Town)
County of Foothill State of Montana
have appropriated groundwater according to the Montana laws in effect prior to January 1, 1962, as follows:

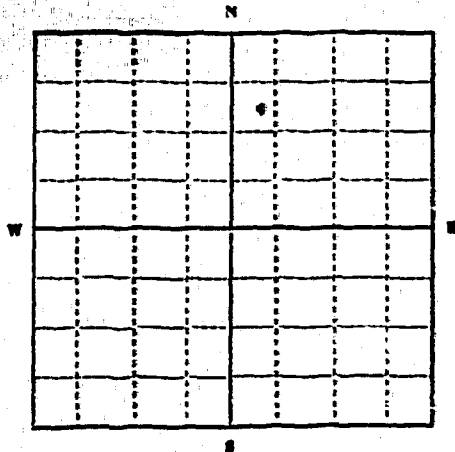

NE 1/4 Sec 28 T 29 R 21

Indicate point of appropriation and place of use, if possible. Each small square represents 10 acres.

- 2. The beneficial use on which the claim is based HOUSEHOLD USE
- 3. Date or approximate date of earliest beneficial use; and how continuous the use has been 1954 TO DATE
- 4. The amount of groundwater claimed (in miner's inches or gallons per minute) 10 gallons
- 5. If used for irrigation, give the acreage and description of the lands to which water has been applied and name of the owner thereof NOT USED FOR IRRIGATION
- 6. The means of withdrawing such water from the ground and the location of each well or other means of withdrawal ELECT PUMP (SUBMERGIBLE)

7. The date of commencement and completion of the construction of the well, wells, or other works for withdrawal of groundwater MAY 1954 TO JUNE 1954

8. The depth of water table 22 FT MORE OR LESS

9. So far as it may be available, the type, size and depth of each well or the general specifications of any other works for the withdrawal of groundwater AD DRIVEN CASING 3 1/2 IN AT DEPT OF 22 FT

10. The estimated amount of groundwater withdrawn each year 1,752,000 GALLONS

11. The log of formations encountered in the drilling of each well if available UNAVAILABLE BECAUSE OF DRIVEN PIPE

12. Such other information of a similar nature as may be useful in carrying out the policy of this act, including reference to book and page of any county record NO COUNTY RECORD

Camillet & Florence M. Brunett
Signature of Owner

Date DEC. 28, 1963

Three copies to be filed by the owner with the County Clerk and Recorder of the county in which the well is located.

Please answer all questions. If not applicable, so state, otherwise the form will be returned.

Original to the County Clerk and Recorder; duplicate to the State Engineer; Triplicate to the Montana Bureau of Mines and Geology and Quadruplicate for the Appropriator.

22833

10,319

STATE OF ALABAMA / SS
COUNTY OF FLAITHADK / SS
Filed on the 30 day of Dec
A.D. 1963 at 5:20 o'clock P.M.
J.H.M.
County Clerk and Recorder
By J.H. Deputy

File No. _____

T. 29 N., R. 21 W.

DUPLICATE

County Flathead

RECEIVED

STATE OF MONTANA
ADMINISTRATOR OF GROUNDWATER CODE
OFFICE OF STATE ENGINEER

Top of Ground
(Elev. above sea level 2960)
Sandy loam 11 1/2 Ft.
Sand & gravel 11 Ft.
Bottom of well 22 1/2 Ft.

STATE ENGINEER'S Notice of Completion of Groundwater Appropriation by Means of Well

(Under Chapter 237, Montana Session Laws, 1961)

Owner Charles W. Conrad Address 730 Fifth Ave. West

Helispell, Montana

Driller Gordon S. DeYoung Address Route #1, Helispell,

Montana

Date of Notice of Appropriation of Groundwater _____

Date well started May 31st, 1962 Date Completed June 1st, 1962

Type of well Drilled Equipment Used Churn
(dug, driven, bored or drilled) (Churn, drill, rotary or other)

Water Use: Domestic Municipal Stock Irrigation
Industrial Drainage Other

Indicate on the diagram the character and thickness of the different strata met with in drilling, such as soil, clay, shale, gravel, rock or sand, etc. Show depth at which water is encountered, thickness and character of water-bearing strata and height to which the water rises in the well.

Size of Drilled Hole	Size and Weight of Casing	From (Feet)	To (Feet)	PERFORATIONS		
				Kind Size	From (Feet)	To (Feet)
7" O. D.	7" O. D. 20#	Surface	22 1/2 Ft.	Cut with torch	20 1/2 Ft.	22 1/2 Ft.

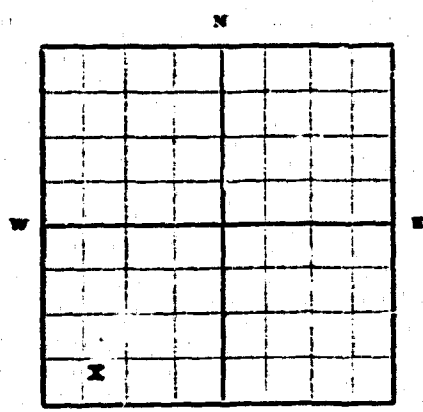

SE 1/4 SW 1/4 Sec. 28 T. 29 N. R. 21 W.

Indicate location of well and place of use, if possible. Each small square represents 10 acres.

Show exact depth of bottom.

Static Water Level for non-flowing Well 15 feet.

Shut-in Pressure for Flowing Well _____

Pumping Water Level 10 feet at 100 gal. per minute.

Discharge in gal. per min. of flowing well _____

How Tested Ballow Length of Test 2 Hours

Remarks: (Gravel packing, cementing, packers, type of shutoff, location of place of use of groundwater if not at well, and any other similar pertinent information, including number of acres irrigated, if used for irrigation) 5 acres

No. 101

Driller's License Number

Gordon S. DeYoung
Driller's Signature

This form to be prepared by driller, and three copies to be filed by the owner with the County Clerk and Recorder in the county in which the well is located.

Please answer all questions. If not applicable, so state, otherwise the form will be returned.

Original to the County Clerk and Recorder; duplicate to the State Engineer; triplicate to the School of Mines and Quadruplicate for the Appropriator.

9447

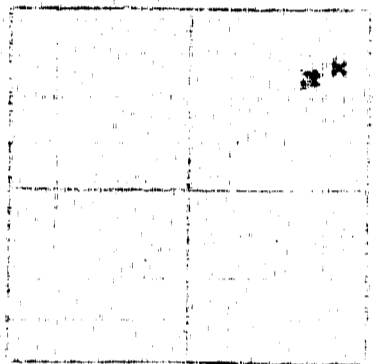

STATE OF MONTANA
COUNTY OF FLATHEAD

Filed on the 1 day of Dec
A. D. 1922 at 3⁰⁵ o'clock PM

H. C. M.
County Clerk and Recorder

By L. J. H. Deputy

and to certify that the same is a true and correct copy of the original as the same appears in the records of the County Clerk and Recorder of the County of Flathead, State of Montana.

File No. _____

GW 4

T. 2 N. 21 W. 38
County _____

STATE OF MONTANA
ADMINISTRATOR OF GROUNDWATER CODE
OFFICE OF STATE ENGINEER

RECEIVED
JAN 6 1964

Declaration of Vested Groundwater Rights

(Under Chapter 237, Montana Session Laws, 1961)

STATE ENGINEER

1. Margaret B. Dylina of Rte # 3 Kalispell
(Name of Appropriator) (Address) (Town)

County of Flathead State of Montana

have appropriated groundwater according to the Montana laws in effect prior to January 1, 1962, as follows:

2. The beneficial use on which the claim is based domestic
and irrigation

3. Date or approximate date of earliest beneficial use; and how con-
tinuous the use has been app. finished in 1953. In
continuse use.

4. The amount of groundwater claimed (in miner's inches or gallons
per minute) 2,000 gallons per hour

5. If used for irrigation, give the acreage and description of the lands
to which water has been applie and name of the owner thereof
Two acres. Domestic, orchard, garden, pasture.
Philip G. Dylina and Margaret B. Dylina

6. The means of withdrawing such water from the ground and the
location of each well or other means of withdrawal
electric pump

SW 25 1/4 Sec 28 T29 R21

Indicate point of appropriation
and place of use, if possible.
Each small square represents 10
acres.

7. The date of commencement and completion of the construction of the well, wells, or other works for with-
drawal of groundwater the well was drilled by Dave Bailey and Brothers in about 1953.

8. The depth of water table app. 16 feet.

9. So far as it may be available, the type, size and depth of each well or the general specifications of any other
works for the withdrawal of groundwater I have not the information

10. The estimated amount of groundwater withdrawn each year 500,000

11. The log of formations encountered in the drilling of each well if available refer to Bailey
Brothers

12. Such other information of a similar nature as may be useful in carrying out the policy of this act, including
reference to book and page of any county record no record

Signature of Owner Margaret B. Dylina
Date Dec. 31, 1963

Three copies to be filed by the owner with the County Clerk and Recorder of the county in which the well is
located.

Please answer all questions. If not applicable, so state, otherwise the form will be returned.

Original to the County Clerk and Recorder; duplicate to the State Engineer; Triplicate to the Montana Bureau of
Mines and Geology and Quadruplicate for the Appropriator.

10847

RECORDED 55
31 day of Dec
1963 11:54 Clock A.M.
D.C.M.
County Clerk and Recorder
D.L.H.
Deputy

File No. _____

GW 4

T 29 N R 21 W 28

County _____

STATE OF MONTANA
ADMINISTRATOR OF GROUNDWATER CODE
OFFICE OF STATE ENGINEER

Declaration of Vested Groundwater Rights

(Under Chapter 237, Montana Session Laws, 1961)

1. Philip G. Dylina of Box 243 Columbia Falls
(Name of Appropriator) (Address) (Town)
County of Flathead State of Montana
have appropriated groundwater according to the Montana laws in effect prior to January 1, 1962, as follows:

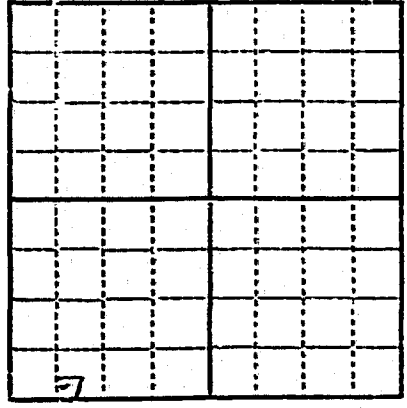

SW 1/4 SW 1/4 Sec. 28 T29N R21W

Indicate point of appropriation and place of use, if possible. Each small square represents 10 acres.

2. The beneficial use on which the claim is based Irrigation - Garden and pasture

3. Date or approximate date of earliest beneficial use; and how continuous the use has been Sept. 1957 - Daily and Seasonal

4. The amount of groundwater claimed (in minor's inches or gallons per minute) 800 GPM

5. If used for irrigation, give the acreage and description of the lands to which water has been applied and name of the owner thereof 2 Acres - SW 1/4 SW 1/4 28-29N-21W
Philip G. Dylina

6. The means of withdrawing such water from the ground and the location of each well or other means of withdrawal Elec. Pump Well in SW corner 28-29N-21W

7. The date of commencement and completion of the construction of the well, wells, or other works for withdrawal of groundwater Prior to Sept. 1957

8. The depth of water table 22 ft.

9. So far as it may be available, the type, size and depth of each well or the general specifications of any other works for the withdrawal of groundwater 6" Drilled - 29 Ft. Deep - Iron Cased

10. The estimated amount of groundwater withdrawn each year 500,000 Gal.

11. The log of formations encountered in the drilling of each well if available 13' Sand - 2 Ft. Clay - 4' Sand - 1' Clay - 9' Gravel

12. Such other information of a similar nature as may be useful in carrying out the policy of this act, including reference to book and page of any county record Well on Lot 11-1 of Scenic Tracts Purchased by me. Deed registered #1085 in Book 496 page 381.

Signature of Owner Philip G. Dylina
Date Dec. 28, 1962

Three copies to be filed by the owner with the County Clerk and Recorder of the county in which the well is located.

Please answer all questions. If not applicable, so state, otherwise the form will be returned.

Original to the County Clerk and Recorder; duplicate to the State Engineer; Triplicate to the Montana Bureau of Mines and Geology and Quadruplicate for the Appropriator.

22524

10,344

STATE OF MONTANA SS
COUNTY OF FLATHEAD

Filed on the 10 day of Dec
A.D. 1963 at 8:30 o'clock A.M.

[Signature]
County Clerk and Recorder

By *[Signature]*
Deputy

File No. _____

GW 4

T 21 R 21 u 28

County Flathead

STATE OF MONTANA
ADMINISTRATOR OF GROUNDWATER CODE
OFFICE OF STATE ENGINEER

JAN 22 1964

Declaration of Vested Groundwater Rights

(Under Chapter 237, Montana Session Laws, 1961)

I, Lawrence S. Evans, of Rte. # 1 LeSalle Rd. Malispell
(Name of Appropriator) (Address) (Town)
County of Flathead State of Montana

have appropriated groundwater according to the Montana laws in effect prior to January 1, 1962, as follows:

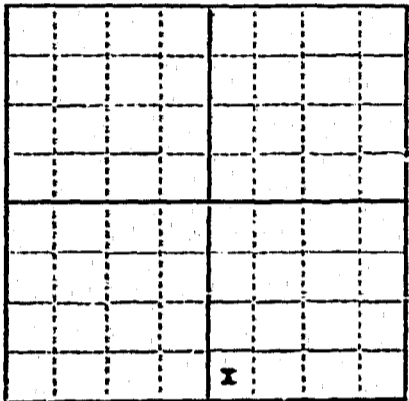

Tract
in SW 1/4 Sec 28 T29 R 21

Indicate point of appropriation
and place of use, if possible.
Each small square represents 10
acres.

2. The beneficial use on which the claim is based For home, lawn, and garden.
3. Date or approximate date of earliest beneficial use; and how continuous the use has been Approximately 1949
Date unknown Continuous use.
4. The amount of groundwater claimed (in miner's inches or gallons per minute) 10 gal. per min.
5. If used for irrigation, give the acreage and description of the lands to which water has been applied and name of the owner thereof Not used for irrigation
6. The means of withdrawing such water from the ground and the location of each well or other means of withdrawal
Pressure pump
7. The date of commencement and completion of the construction of the well, wells, or other works for withdrawal of groundwater Unknown
Well was here when I bought the place.
8. The depth of water table 20 ft.
9. So far as it may be available, the type, size and depth of each well or the general specifications of any other works for the withdrawal of groundwater Drilled 7in. 25 ft.
10. The estimated amount of groundwater withdrawn each year 80,000 gal.
11. The log of formations encountered in the drilling of each well if available
Not available.
12. Such other information of a similar nature as may be useful in carrying out the policy of this act, including reference to book and page of any county record
No other information available

Signature of Owner Lawrence S. Evans
Hope D. Evans

Date _____

Three copies to be filed by the owner with the County Clerk and Recorder of the county in which the well is located.

Please answer all questions. If not applicable, so state, otherwise the form will be returned.

Original to the County Clerk and Recorder; duplicate to the State Engineer; Triplicate to the Montana Bureau of Mines and Geology and Quadruplicate for the Appropriator.

11, 176

STATE OF MONTANA, SS
COUNTY OF FLATHEAD

Filed on the 21 day of Jan
A. D. 1961 at 10:30 o'clock P.M.

[Signature]
County Clerk and Recorder

By [Signature] Deputy

File No. _____

GW 1

T 29 N. R 21 W.

County Flathead

STATE OF MONTANA
ADMINISTRATOR OF GROUNDWATER CODE
OFFICE OF STATE ENGINEER

Notice of Completion of Groundwater
Appropriation by Means of Well

(Under Chapter 237, Montana Session Laws, 1961)

Owner Lyal V. & Helen M. Everett

Address Route #1 - 5th Scenic Dr.

Kalispell, Montana

Owner Everett

Address

Route #1

Driller Gordon S. DeYoung

Address

Kalispell, Montana

Date of Notice of Appropriation of Groundwater _____

Date well started Oct. 5, 1965 Date Completed Oct. 8, 1965

Type of well Driven

Equipment Used Churn

(dug, driven, bored or drilled)

(Churn, drill, rotary or other)

Water Use: Domestic Municipal Other Irrigation
Industrial Drainage Stock

Indicate on the diagram the character and thickness of the different strata met with in drilling, such as soil, clay, shale, gravel, rock or sand, etc. Show depth at which water is encountered, thickness and character of water-bearing strata and height to which water rises in the well.

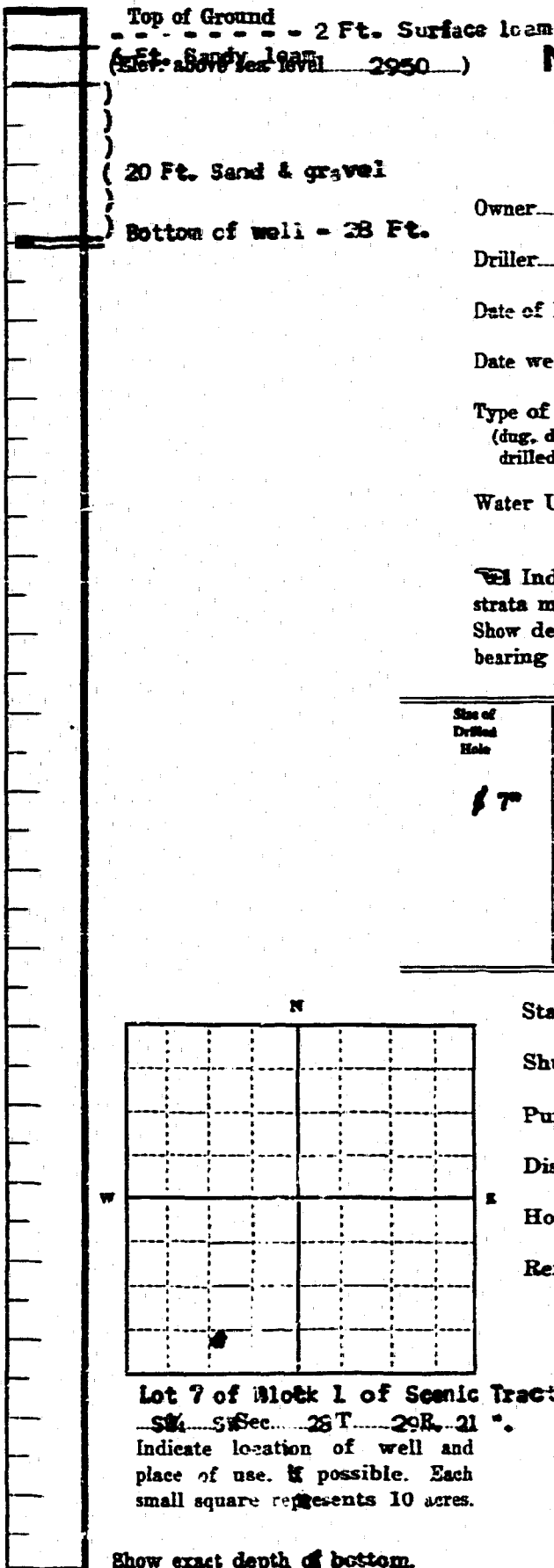

Size of Drilled Hole	Size and Weight of Casing	From (Feet)	To (Feet)	PERFORATIONS		
				Kind Size	From (Feet)	To (Feet)
7"	7" O. D. 17#	Surface	Bottom	2" long slits in casing	25 ft.	27 ft.

Static Water Level for non-flowing Well 17 feet.

Shut-in Pressure for Flowing Well _____

Pumping Water Level 20 feet at 35 gal. per minute.

Discharge in gal. per min. of flowing well _____

How Tested Ballor Length of Test 1 hr.

Remarks: (Gravel packing, cementing, packers, type of shutoff, location of place of use of groundwater if not at well, and any other similar pertinent information, including number of acres irrigated, if used for irrigation) 5 acres

#101
Driller's License Number
Gordon S. DeYoung
Driller's Signature

This form to be prepared by driller, and three copies to be filed by the owner with the County Clerk and Recorder in the county in which the well is located.

Please answer all questions. If not applicable, so state, otherwise the form will be returned.

Original to the County Clerk and Recorder; duplicate to the State Engineer; Triplicate to the Montana Bureau of Mines and Geology and Quadruplicate for the Appropriator.

46652

11,933

15 day Dec
65 325 of Chas R M
2000
County Clerk and Recorder
Dps

STATE WATER CONSERVATION BOARD

JAN 8 1965

Bills _____
Butterlin _____
Coville _____
Parfitt, Jr _____
Dicker _____
Eberhart _____
McNitt _____
Merrill _____
Sullivan _____

File No. _____

GW 4

T 29 R 21 28

County _____

STATE OF MONTANA
ADMINISTRATOR OF GROUNDWATER CODE
OFFICE OF STATE ENGINEER

RECEIVED
JAN 6 1964

Declaration of Vested Groundwater Rights

(Under Chapter 237, Montana Session Laws, 1961)

STATE ENGINEER

1. Harold H. Glendinning, Frances F. of West River Drive Kalispell, Mont.
(Name of Appropriator) (Address) (Town)

County of Flathead State of Montana
have appropriated groundwater according to the Montana laws in effect prior to January 1, 1962, as follows:

X					

2. The beneficial use on which the claim is based House hold
hairs, Watering of Animals.

3. Date or approximate date of earliest beneficial use; and how con-
tinuous the use has been Sept, 1959 Every day.

4. The amount of groundwater claimed (in miner's inches or gallons
per minute) 70 gal per minute

5. If used for irrigation, give the acreage and description of the lands
to which water has been applied and name of the owner thereof
1 Acre. house same

6. The means of withdrawing such water from the ground and the
location of each well or other means of withdrawal Centrifugal
Pump. 10' to the center of Acre

Sec. 22 T. 29R31

Indicate point of appropriation
and place of use, if possible.
Each small square represents 10
acres.

7. The date of commencement and completion of the construction of the well, wells, or other works for with-
drawal of groundwater Sept. 1959.

8. The depth of water table 9 feet

9. So far as it may be available, the type, size and depth of each well or the general specifications of any other
works for the withdrawal of groundwater 700 gal per hr 6" casing, 2 1/2 foot casing, 2 1/2 foot casing,
7 feet casing, Pump (Centrifugal)

10. The estimated amount of groundwater withdrawn each year 200, 750 household 45, 500 irrigation

11. The log of formations encountered in the drilling of each well if available. Mc Clary, Wild duffing
Kalispell, Montana, 6" casing, 2 1/2 foot casing, 9 foot water table
700 gal per hr, 19 sand, condition, 2 1/2 heavy gravel

12. Such other information of a similar nature as may be useful in carrying out the policy of this act, including
reference to book and page of any county record. Book 431, Page 244

Signature of Owner Harold H. Glendinning
Frances F. Glendinning
Date Dec 31 1963

Three copies to be filed by the owner with the County Clerk and Recorder of the county in which the well is
located.
Please answer all questions. If not applicable, so state, otherwise the form will be returned.

Original to the County Clerk and Recorder; duplicate to the State Engineer; Triplicate to the Montana Bureau of
Mines and Geology and Quadruplicate for the Appropriator.