

9709

STATE OF MONTANA } SS  
COUNTY OF FLATHEAD }

Filed on the 3 day of Jan  
A. D. 1963 at 12:45 o'clock P. M.

[Signature]  
County Clerk and Recorder

By [Signature] Deputy

File No

GW 2

T R

County Flathead

FEB 8 - 1970

STATE OF MONTANA  
ADMINISTRATOR OF GROUNDWATER CODE  
OFFICE OF STATE ENGINEER

Notice of Completion of Groundwater  
Appropriation by Means of Well  
(Under Chapter 237, Montana Session Laws, 1961)



Top of Ground  
Sand (Elev. above sea level 3000')  
Sand (seepage)  
Brown clay  
Brown clay & cobbles  
Gray clay & gravel  
seepage  
Cemented coarse sand & gravel (water)

Owner James Mateson Address Col. Falls  
Driller Weber Drilling Address Col. Falls  
Date of Notice of Appropriation of Groundwater  
Date well started 12-1-69 Date Completed 12-6-69  
Type of well drilled Equipment Used churn  
(dug, driven, bored or drilled) (Churn, drill, rotary or other)  
Water Use: Domestic  Municipal  Other  Irrigation   
Industrial  Drainage  Stock

Indicate on the diagram the character and thickness of the different strata met with in drilling, such as soil, clay, shale, gravel, rock or sand, etc. Show depth at which water is encountered, thickness and character of water-bearing strata and height to which water rises in the well.

Doc No. 14244  
Filed for record this 5 day of February A. D. 1970 at 2:22 o'clock P. M.

Size of Drilled Hole	Size and Weight of Casing	From (Feet)	To (Feet)	PERFORATIONS		
				Kind	From (Feet)	To (Feet)
	7" O.D.	0'	158'			NONE

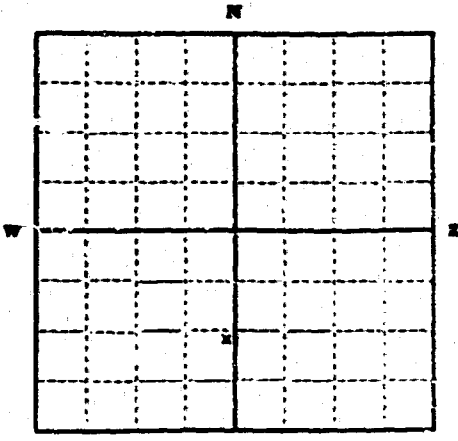

Indicate location of well and place of use, if possible. Each small square represents 10 acres.

Static Water Level for non-flowing Well 63 feet.  
Shut-in Pressure for Flowing Well NONE  
Pumping Water Level 80 feet at 30 gal per minute.  
Discharge in gal. per min. of flowing well NONE  
How Tested bailed Length of Test 1 hr.  
Remarks: (Gravel packing, cementing, packers, type of shutoff, location of place of use of groundwater if not at well, and any other similar pertinent information, including number of acres irrigated, if used for irrigation)

Open bottom

158'

Show exact depth of bottom.

181  
Driller's License Number  
James H. Weber  
Driller's Signature

This form to be prepared by driller, and three copies to be filed by the owner with the County Clerk and Recorder in the county in which the well is located.

Please answer all questions. If not applicable, so state, otherwise the form will be returned.

Original to the County Clerk and Recorder; duplicate to the State Engineer; Triplicate to the Montana Bureau of Mines and Geology and Quadruplicate for the Appropriator.

48114

10,244

STATE OF MONTANA  
COUNTY OF FLATHEAD, SS  
Filed on the 5<sup>th</sup> day of July  
A.D. 1971 at 2:30 Clock P.M.  
S.E.M.  
County Clerk and Recorder  
By M.J.  
Deputy

RECEIVED  
JUL 10 1971  
COUNTY CLERK  
FLATHEAD COUNTY  
MONTANA

10-244-1000-1000  
MESSAGE  
Date well started  
Type of work

*Montana Water Resources Board  
Helena, Mont*

GILSON E. MILLHOUSE  
COUNTY CLERK & RECORDER  
HELENA, MONTANA 59601

MESSAGE

*Please correct me if I am wrong on your copy of  
the attached to read #14,244*

Date of Notice of Appropriation of Groundwater \_\_\_\_\_  
 Date well started 12-1-69 Date Completed 12-6-69  
 Type of well drilled Equipment Used churn  
 (dug, driven, bored or (Churn, drill, rotary or drilled) other)  
 Water Use: Domestic  Municipal  Other  Irrigation   
 Industrial  Drainage  Stock   
 100 Brown clay & cobbles  
 122 Gray clay & gravel  
 150 seepage  
 156 Cemented coarse sand & gravel (water)  
 158

Indicate on the diagram the character and thickness of the different strata met with in drilling, such as soil, clay, shale, gravel, rock or sand, etc. Show depth at which water is encountered, thickness and character of water-bearing strata and height to which water rises in the well.

Size of Drill Hole	Size and Weight of Casing	From (Feet)	To (Feet)	PERFORATIONS		
				From (Feet)	To (Feet)	From (Feet)
7"	7" O.D.	0'	158'			NONE

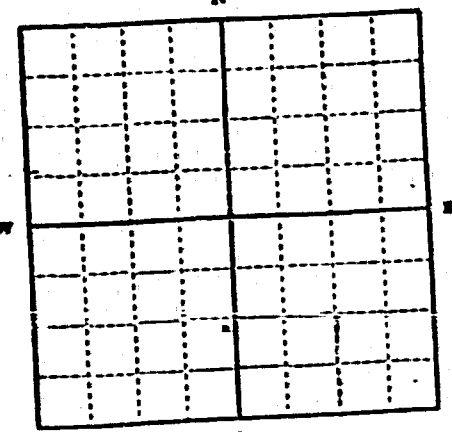

NE 1/4 Sec. 21 T.30 R.20  
 Indicate location of well and place of use, if possible. Each small square represents 10 acres.

158' Show exact depth of bottom.

Static Water Level for non-flowing Well 65 feet.  
 Shut-in Pressure for Flowing Well none  
 Pumping Water Level 80 feet at 30 gal. per minute.  
 Discharge in gal. per min. of flowing well none  
 How Tested bailed Length of Test 1 hr.

Remarks: (Gravel packing, cementing, packers, type of shutoff, location of place of use of groundwater if not at well, and any other similar pertinent information, including number of acres irrigated, if used for irrigation)

Open bottom

131  
 Driller's License Number  
*James H. Weber*  
 Driller's Signature

This form to be prepared by driller, and three copies to be filed by the owner with the County Clerk and Recorder in the county in which the well is located.  
 Please answer all questions. If not applicable, so state, otherwise the form will be returned.

Original to the County Clerk and Recorder; duplicate to the State Engineer; Triplicate to the Montana Bureau of Mines and Geology and Quadruplicate for the Appropriator.

GW 1

T 30 A R 200

County Flathead

STATE OF MONTANA  
ADMINISTRATION OF GROUNDWATER CODE  
OFFICE OF STATE ENGINEER

Notice of Completion of Groundwater  
Appropriation by Means of Well  
(Under Chapter 237, Montana Session Laws, 1961)

Top of Ground  
6' Sand (Elev. above sea level 3000')

30 Sand (seepage)

100 Brown clay

122 Brown clay & cobbles

150 Gray clay & gravel

156 seepage

158 Cemented coarse sand & gravel (water)

Owner James Mateson Address Col. Falls

Driller Weber Drilling Address Col. Falls

Date of Notice of Appropriation of Groundwater

Date well started 12-1-69 Date Completed 12-6-69

Type of well drilled Equipment Used CHURN  
(dug, driven, bored or drilled) (Churn, drill, rotary or other)

Water Use: Domestic  Municipal  Other  Irrigation   
Industrial  Drainage  Stock

Indicate on the diagram the character and thickness of the different strata met with in drilling, such as soil, clay, shale, gravel, rock or sand, etc. Show depth at which water is encountered, thickness and character of water-bearing strata and height to which water rises in the well.

Diameter of Hole	Diameter and Weight of Casing	From (Feet)	To (Feet)	PERFORATIONS		
				Kind	From (Feet)	To (Feet)
7"	7" O.D.	0'	158'	NONE		

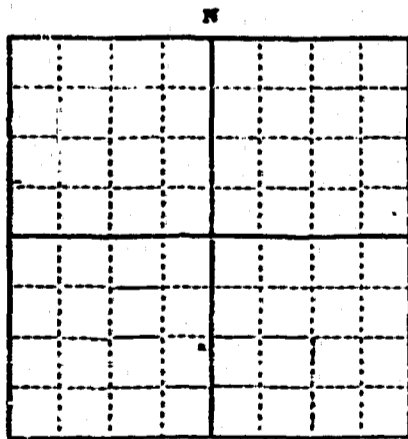

NE 1/4 Sec. 21 T. 30 R. 20  
Indicate location of well and place of use, if possible. Each small square represents 10 acres.

Show exact depth of bottom.

Static Water Level for non-flowing Well 65 feet.

Shut-in Pressure for Flowing Well none

Pumping Water Level 80 feet at 30 gal. per minute.

Discharge in gal. per min. of flowing well none

How Tested bailed Length of Test 1 hr.

Remarks: (Gravel packing, cementing, packers, type of shutoff, location of place of use of groundwater if not at well, and any other similar pertinent information, including number of acres irrigated, if used for irrigation)

Open bottom

181  
Driller's License Number

*James M. Weber*  
Driller's Signature

This form to be prepared by driller, and three copies to be filed by the owner with the County Clerk and Recorder in the county in which the well is located.

Please answer all questions. If not applicable, so state, otherwise the form will be returned.

Original to the County Clerk and Recorder; duplicate to the State Engineer; Triplicate to the Montana Bureau of Mines and Geology and Quadruplicate for the Appropriator.

Title No. \_\_\_\_\_

SW 4

T. 30 N. R. 30 W. 21

County Flathead

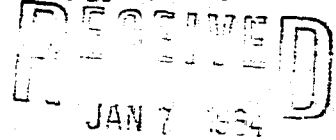

STATE OF MONTANA  
ADMINISTRATOR OF GROUNDWATER CODE  
OFFICE OF STATE ENGINEER

**Declaration of Vested Groundwater Rights**  
(Under Chapter 237, Montana Session Laws, 1961)

I, Joan A. Melning (Name of Appropriator) of Box 575 Columbia Falls (Address) (Town) County of Flathead State of Montana have appropriated groundwater according to the Montana laws in effect prior to January 1, 1962, as follows:

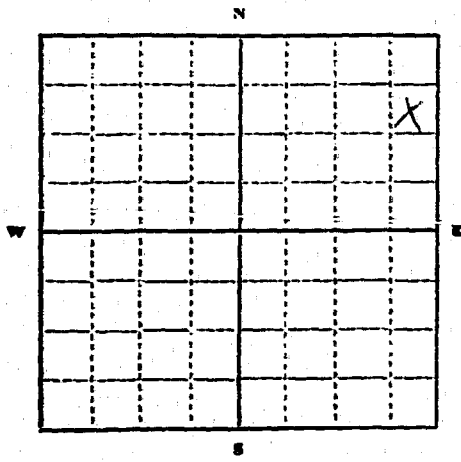

NE 1/4 NE Sec 21 T. 30 R. 20

Indicate point of appropriation and place of use, if possible. Each small square represents 10 acres.

2. The beneficial use on which the claim is based for home stock & irrigation

3. Date or approximate date of earliest beneficial use; and how continuous the use has been 1950 & constant use since then

4. The amount of groundwater claimed (in miner's inches or gallons per minute) 50 gal per min

5. If used for irrigation, give the acreage and description of the lands to which water has been applied and name of the owner thereof 5 acre NE 1/4 NE Sec 21

6. The means of withdrawing such water from the ground and the location of each well or other means of withdrawal forced pump

7. The date of commencement and completion of the construction of the well, wells, or other works for withdrawal of groundwater 1950

8. The depth of water table 20 ft

9. So far as it may be available, the type, size and depth of each well or the general specifications of any other works for the withdrawal of groundwater 3 ft cement casing - 20 ft deep

10. The estimated amount of groundwater withdrawn each year 365,000

11. The log of formations encountered in the drilling of each well if available sand & gravel

12. Such other information of a similar nature as may be useful in carrying out the policy of this act, including reference to book and page of any county record \_\_\_\_\_

Signature of Owner Joan A. Melning  
Date 12-31-63

Three copies to be filed by the owner with the County Clerk and Recorder of the county in which the well is located.

Please answer all questions. If not applicable, so state, otherwise the form will be returned.

Original to the County Clerk and Recorder; duplicate to the State Engineer; Triplicate to the Montana Bureau of Mines and Geology and Quadruplicate for the Appropriator.

26686

11098

STATE OF MONTANA SS  
COUNTY OF FLAHERTY

Filed on the 7 day of Jan  
A.D. 1964 at 8:32 o'clock P.M.

JEM  
County Clerk and Recorder

By JEM Deputy

File No. \_\_\_\_\_

Section \_\_\_\_\_

T. \_\_\_\_\_ R. \_\_\_\_\_ 21

County Flathead

STATE OF MONTANA  
ADMINISTRATOR OF GROUNDWATER CODE  
OFFICE OF STATE ENGINEER

Notice of Completion of Groundwater  
Appropriation by Means of Well

(Under Chapter 237, Montana Session Laws, 1961)

LAMAR G.  
CORA R.

Owner ~~Webber~~ ORNDORFF Address RTHA Col. Falls

Driller Webber Drilling Address Col. Falls

Date of Notice of Appropriation of Groundwater \_\_\_\_\_

Date well started 7-28-71 Date Completed 7-31-71

Type of well Drilled Equipment Used Churn  
(dug, driven, bored or drilled) (Churn, drill, rotary or other)

Water Use: Domestic  Municipal  Other  Irrigation   
Industrial  Drainage  Stock

Indicate on the diagram the character and thickness of the different strata met with in drilling, such as soil, clay, shale, gravel, rock or sand, etc. Show depth at which water is encountered, thickness and character of water-bearing strata and height to which water rises in the well.



Top of Ground  
TOP SURF 3,000  
(Elev. above sea level)

Brown  
sandy  
pebbles  
&  
clay  
MORE  
Firm

water  
formation

14734

June 26, 1973

1457 m

Size of Drilled Hole	Size and Weight of Casing	From (Feet)	To (Feet)	PERFORATIONS		
				Kind	From (Feet)	To (Feet)
6 7/8"	6 7/8" O.D. 1.780 Wt	0	150	None		

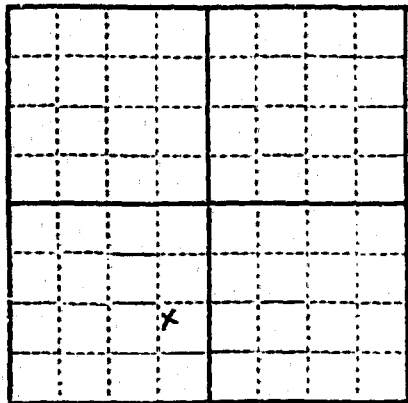

SE 1/4 SW 1/4 Sec 21 T. 30 R. 20

Indicate location of well and place of use, if possible. Each small square represents 10 acres.

Show exact depth of bottom.

Static Water Level for non-flowing Well 60 feet.

Shut-in Pressure for Flowing Well None

Pumping Water Level 85 feet at 30 gal. per minute.

Discharge in gal. per min. of flowing well None

How Tested Bailed Length of Test 2 hrs

Remarks: (Gravel packing, cementing, packers, type of shutoff, location of place of use of groundwater if not at well, and any other similar pertinent information, including number of acres irrigated, if used for irrigation) OPEN Bottom

181  
Driller's License Number  
James D. Weber  
Driller's Signature

This form to be prepared by driller, and three copies to be filed by the owner with the County Clerk and Recorder in the county in which the well is located.

Please answer all questions. If not applicable, so state, otherwise the form will be returned.

Original to the County Clerk and Recorder; duplicate to the State Engineer; Triplicate to the Montana Bureau of Mines and Geology and Quadruplicate for the Appropriator.

54169



14,734

STATE OF MONTANA | 22  
COUNTY OF FLATHEAD

Filed on the 25<sup>th</sup> day of June  
A. D. 1972 at 11<sup>15</sup> o'clock A. M.

MT

County Clerk and Recorder

By

L. L. W.

Deputy

File No. \_\_\_\_\_

GW 4

T. 36 R. 20 21

County DeWitt

STATE OF MONTANA  
ADMINISTRATOR OF GROUNDWATER CODE  
OFFICE OF STATE ENGINEER

RECEIVED  
JAN 6 1964

Declaration of Vested Groundwater Rights

(Under Chapter 237, Montana Session Laws, 1961)

STATE ENGINEER

John W. Perry of Rt 1A Columbia Falls  
(Name of Appropriator) (Address) (Town)

County of DeWitt State of Montana  
has appropriated groundwater according to the Montana laws in effect prior to January 1, 1963, as follows:

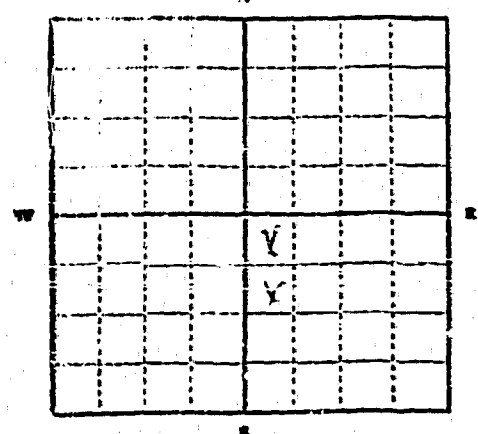

1/4 Sec 7 T 30 R 20

Indicate point of appropriation and place of use, if possible. Each small square represents 10 acres.

2. The beneficial use on which the claim is based stock water irrigation of lawn, garden, berries & some alfalfa  
3. Date or approximate date of earliest beneficial use; and how continuous the use has been October 1953

4. The amount of groundwater claimed (in miner's inches or gallons per minute) 6.35 gal per hr during winter months

5. If used for irrigation, give the acreage and description of the lands to which water has been applied and name of the owner thereof 1 acre of pasture thereof John W. Perry

6. The means of withdrawing such water from the ground and the location of each well or other means of withdrawal hand pump to engine

7. The date of commencement and completion of the construction of the well, wells, or other works for withdrawal of groundwater 1952

8. The depth of water table 6 ft. approximately

9. So far as it may be available, the type, size and depth of well or the general specifications of any other works for the withdrawal of groundwater 12 ft

10. The estimated amount of groundwater withdrawn each year 120,000 gal more or less

11. The log of formations encountered in the drilling of each well if available loam sand gravel

12. Such other information of a similar nature as may be useful in carrying out the policy of this act, including reference to book and page of any county record

Signature of Owner John W. Perry  
Date Jan 31 1963

Three copies to be filed by the owner with the County Clerk and Recorder of the county in which the well is located. Please answer all questions. If not applicable, so state, otherwise the form will be returned.

Original to the County Clerk and Recorder; duplicate to the State Engineer; Triplicate to the Montana Bureau of Mines and Geology and Quadruplicate for the Appropriator.

10800

STATE OF MONTANA  
COUNTY OF DEWEESE

Filed on the 31 day of Dec  
A.D. 1963 at 11<sup>05</sup> o'clock AM

*L. L. H.*  
County Clerk and Recorder

By *L. L. H.*  
Deputy

File No.

GW 2

T. 30 N. R. 20 W.

County Flathead

STATE OF MONTANA  
ADMINISTRATOR OF GROUNDWATER CODE  
OFFICE OF STATE ENGINEER

JUL 9 1964

### Notice of Completion of Groundwater Appropriation by Means of Well

(Under Chapter 237, Montana Session Laws, 1961)

Top of Ground  
4 Ft. surface loam  
(Elev. above sea level 3,050 Ft.)  
19 Ft. glacial conglomerate

7 Ft. gravel, sand  
and water  
Bottom of well - 32 Ft.

Owner E. D. Potter Address Box 419 Columbia Falls, Montana  
Driller Gordon S. DeYoung Address Route #1 Kalispell, Montana

Date of Notice of Appropriation of Groundwater.....

Date well started April 1, 1964 Date Completed April 3, 1964

Type of well Driven Equipment Used Churn  
(dug, driven, bored or drilled) (Churn, drill, rotary or other)

Water Use: Domestic  Municipal  Other  Irrigation   
Industrial  Drainage  Stock

Indicate on the diagram the character and thickness of the different strata met with in drilling, such as soil, clay, shale, gravel, rock or sand, etc. Show depth at which water is encountered, thickness and character of water-bearing strata and height to which water rises in the well.

Size of Drilled Hole	Size and Weight of Casing	From (Feet)	To (Feet)	PERFORATIONS		
				Kit Size	From (Feet)	To (Feet)
7"	7" 20#	Surface	Bottom	None		

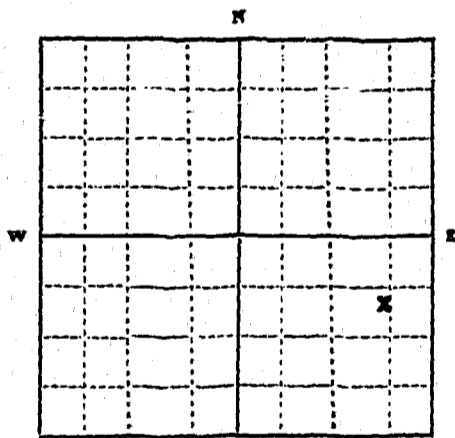
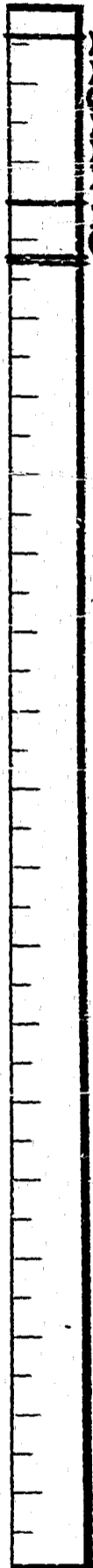

NE 1/4 Sec. 21 T. 30 N. R. 20 W.

Indicate location of well and place of use, if possible. Each small square represents 10 acres.

Show exact depth of bottom.

Static Water Level for non-flowing Well..... 22 feet.

Shut-in Pressure for Flowing Well.....

Pumping Water Level..... 22.5 feet at..... 20 gal. per minute.

Discharge in gal. per min. of flowing well.....

How Tested Basin Length of Test 2 Hours

Remarks: (Gravel packing, cementing, packers, type of shutoff, location of place of use of groundwater if not at well, and any other similar pertinent information, including number of acres irrigated, if used for irrigation).....

#101

Driller's License Number

Driller's Signature

*Gordon S. DeYoung*

This form to be prepared by driller, and three copies to be filed by the owner with the County Clerk and Recorder in the county in which the well is located.

Please answer all questions. If not applicable, so state, otherwise the form will be returned.

Original to the County Clerk and Recorder; duplicate to the State Engineer; Triplicate to the Montana Bureau of Mines and Geology and Quadruplicate for the Appropriator.

38270

11-106

STATE OF MONTANA ) SS  
COUNTY OF FLATHEAD )

Filed on the 6 day of May  
A. D. 1964 at 2:22 o'clock P.M.

[Signature]  
County Clerk and Recorder

By [Signature] Deputy

File No. \_\_\_\_\_

GW 4

T 30 N R 20 W 21

County \_\_\_\_\_

STATE OF MONTANA  
ADMINISTRATOR OF GROUNDWATER CODE  
OFFICE OF STATE ENGINEER

RECEIVED  
JAN 6 1964

Declaration of Vested Groundwater Rights

(Under Chapter 237, Montana Session Laws, 1961)

STATE ENGINEER

1 Fred A. Sorenson and Esther Sorenson, of Route 1-A, Columbia Falls  
(Name of Appropriator) (Address) (Town)

County of Flathead State of Montana

have appropriated groundwater according to the Montana laws in effect prior to January 1, 1962, as follows:

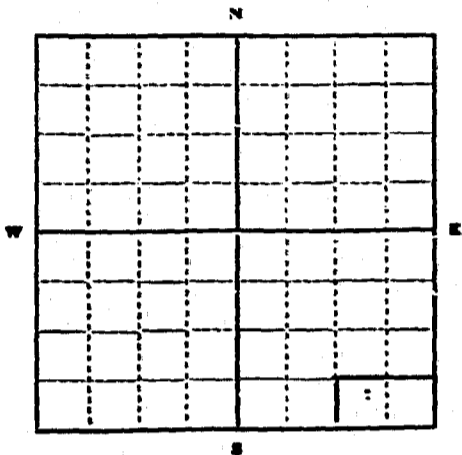

1/4 Sec. 21 T. 30 N. R. 20 W

Indicate point of appropriation and place of use, if possible. Each small square represents 10 acres.

2. The beneficial use on which the claim is based Domestic and irrigation
3. Date or approximate date of earliest beneficial use; and how continuous the use has been June, 1955 and daily since.
4. The amount of groundwater claimed (in miner's inches or gallons per minute) 228 gallons per minute during full use.
5. If used for irrigation, give the acreage and description of the lands to which water has been applied and name of the owner thereof Portions of the described land lying between wells & points east, southeast and south to a distance of 400 feet and consisting of gardens and orchards.
6. The means of withdrawing such water from the ground and the location of each well or other means of withdrawal 1-1/3 HP motor driven pump w/ 3/4" discharge and 1-1 HP motor driven pump w/ 1/2" discharge.
7. The date of commencement and completion of the construction of the well, wells, or other works for withdrawal of groundwater Present wells constructed about 1947. One is a sand point driven into the water bearing strata and the other was dug.
8. The depth of water table sight feet at pump sites.
9. So far as it may be available, the type, size and depth of each well or the general specifications of any other works for the withdrawal of groundwater Both wells take water from approximately fourteen feet below the surface.
10. The estimated amount of groundwater withdrawn each year ~~2,168,750~~ (2,168,750)
11. The log of formations encountered in the drilling of each well if available None available
12. Such other information of a similar nature as may be useful in carrying out the policy of this act, including reference to book and page of any county record Not applicable

Signature of Owner Fred A. Sorenson

Date December 28, 1963

Three copies to be filed by the owner with the County Clerk and Recorder of the county in which the well is located.

Please answer all questions. If not applicable, so state, otherwise the form will be returned.

Original to the County Clerk and Recorder; duplicate to the State Engineer; Triplicate to the Montana Bureau of Mines and Geology and Quadruplicate for the Appropriator.

22832

10706

STATE OF MISSISSIPPI  
COUNTY OF FLAYHEAD, SS

Filed on the 31<sup>st</sup> day of Dec  
A.D. 1963 at 9<sup>28</sup> o'clock A.M.

3874  
County Clerk and Recorder

By: L. L. H. Deputy

File No. \_\_\_\_\_

GW 4

T 20 N R 20 W

21

County Flathead

STATE OF MONTANA  
ADMINISTRATOR OF GROUNDWATER CODE  
OFFICE OF STATE ENGINEER

RECEIVED  
JAN 7 1964

Declaration of Vested Groundwater Rights

(Under Chapter 237, Montana Session Laws, 1961)

STATE ENGINEER

1. Elmer M. Strickland of Box 985 Columbia Falls  
(Name of Appropriator) (Address) (Town)

County of Flathead State of Montana  
have appropriated groundwater according to the Montana laws in effect prior to January 1, 1962, as follows:

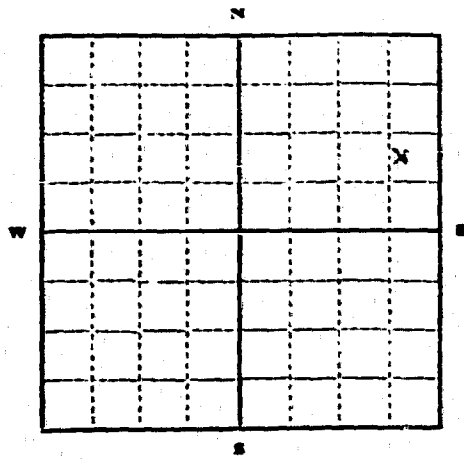

NE 1/4 Sec 21 T30 R20

Indicate point of appropriation and place of use, if possible. Each small square represents 10 acres.

2. The beneficial use on which the claim is based for house + irrigation

3. Date or approximate date of earliest beneficial use; and how continuous the use has been 1951 - constant since then

4. The amount of groundwater claimed (in miner's inches or gallons per minute) 50 gal per minute

5. If used for irrigation, give the acreage and description of the lands to which water has been applied and name of the owner thereof  
20 acres NE 1/4 Sec 21-30-20  
John E. + Elmer M. Strickland

6. The means of withdrawing such water from the ground and the location of each well or other means of withdrawal  
forced pump

7. The date of commencement and completion of the construction of the well, wells, or other works for withdrawal of groundwater 1950

8. The depth of water table 12 ft

9. So far as it may be available, the type, size and depth of each well or the general specifications of any other works for the withdrawal of groundwater  
cast iron 4" drilled well casing 25 ft deep

10. The estimated amount of groundwater withdrawn each year 365,000 gal

11. The log of formations encountered in the drilling of each well if available sand + gravel

12. Such other information of a similar nature as may be useful in carrying out the policy of this act, including reference to book and page of any county record

Signature of Owner Elmer M. Strickland

Date Dec 31, 1963

Three copies to be filed by the owner with the County Clerk and Recorder of the county in which the well is located.

Please answer all questions. If not applicable, so state, otherwise the form will be returned.

Original to the County Clerk and Recorder; duplicate to the State Engineer; Triplicate to the Montana Bureau of Mines and Geology and Quadruplicate for the Appropriator.

26689



11,100

THE COMMONWEALTH OF MASSACHUSETTS  
COUNTY OF HAMPDEN 53

Filed on the 2 day of Jan  
A. D. 1964 at 8<sup>th</sup> o'clock AM

*JEM*  
County Clerk and Recorder

By *JEM* Deputy

File No. \_\_\_\_\_

JAN 10 1967

County Flathead

DUPLICATE

STATE OF MONTANA  
ADMINISTRATOR OF GROUNDWATER CODE  
OFFICE OF STATE ENGINEER

Top of Ground  
(Elev. above sea level \_\_\_\_\_)

**Notice of Completion of Groundwater  
Appropriation by Means of Well**

(Under Chapter 237, Montana Session Laws, 1961)

0 to 9 ft open hole  
9 ft to 14 ft Gravel  
sand and some  
clay.  
14 to 45 ft Gray  
hard pan.  
45 to 79 ft Brown  
hard pan. Dry water.  
79 to 80 ft. Water bearing  
gravel & sand.

Owner Frank Bayler Address Col. Falls, Mont

Driller Alvin & Justin Address Col. Falls, Mont

Date of Notice of Appropriation of Groundwater none filed

Date well started Aug 19-66 Date Completed Aug 24-66

Type of well Drilled Equipment Used Churn  
(dug, driven, bored or drilled) (Churn, drill, rotary or other)

Water Use: Domestic  Municipal  Stock  Irrigation   
Industrial  Drainage  Other

Indicate on the diagram the character and thickness of the different strata met with in drilling, such as soil, clay, shale, gravel, rock or sand, etc. Show depth at which water is encountered, thickness and character of water-bearing strata and height to which the water rises in the well.

Size of Drilled Hole	Size and Weight of Casing	From (Feet)	To (Feet)	PERFORATIONS		
				Kind	From (Feet)	To (Feet)
6 3/8	7" O.D. 23 lbs per ft.	0	80	none		

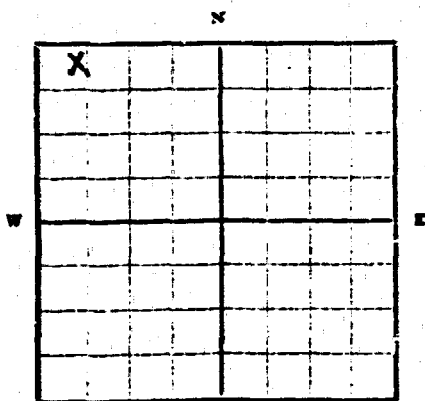

Mt. View Sec 21 T. 30 R. 20

Indicate location of well and place of use, if possible. Each small square represents 10 acres.

Show exact depth of bottom.

Static Water Level for non-flowing Well 26 feet.

Shut-in Pressure for Flowing Well non flowing

Pumping Water Level 55 feet at 15 gal. per minute.

Discharge in gal. per min. of flowing well non flowing

How Tested Pail Length of Test 2 hrs

Remarks: (Gravel packing, cementing, packers, type of shutoff, location of place of use of groundwater if not at well, and any other similar pertinent information, including number of acres irrigated, if used for irrigation)

no 55  
Driller's License Number  
Alvin & Justin  
Driller's Signature

This form to be prepared by driller, and three copies to be filed by the owner with the County Clerk and Recorder in the county in which the well is located.

Please answer all questions. If not applicable, so state, otherwise the form will be returned.

Original to the County Clerk and Recorder; duplicate to the State Engineer; Triplicate to the School of Mines and Quadruplicate for the Appropriator.

41632

12587

14 Sept  
66  
GEM  
SMT  
Clock and Recorder  
Secretary

Time taken at site	Approximate distance from base	Approximate altitude	Approximate temperature	Approximate wind direction and speed	Approximate humidity	Approximate cloud cover	Approximate visibility	Approximate sky condition	Approximate ground condition	Approximate soil condition	Approximate vegetation	Approximate animal life	Approximate human life
0.5	100	1000	10	SE 5	80	100	10	Partly cloudy	Grass	Moist	None	None	
1.0	200	2000	5	SE 10	70	200	5	Overcast	Grass	Dry	None	None	
1.5	300	3000	0	SE 15	60	300	0	Heavy rain	Grass	Wet	None	None	
2.0	400	4000	-5	SE 20	50	400	-5	Clear	Grass	Dry	None	None	
2.5	500	5000	-10	SE 25	40	500	-10	Clear	Grass	Dry	None	None	
3.0	600	6000	-15	SE 30	30	600	-15	Clear	Grass	Dry	None	None	
3.5	700	7000	-20	SE 35	20	700	-20	Clear	Grass	Dry	None	None	
4.0	800	8000	-25	SE 40	10	800	-25	Clear	Grass	Dry	None	None	
4.5	900	9000	-30	SE 45	0	900	-30	Clear	Grass	Dry	None	None	
5.0	1000	10000	-35	SE 50	0	1000	-35	Clear	Grass	Dry	None	None	

REPORT MADE BY: [Name]  
 DATE: [Date]  
 LOCATION: [Location]  
 TIME: [Time]  
 WEATHER: [Weather]  
 WIND: [Wind]  
 TEMPERATURE: [Temperature]  
 HUMIDITY: [Humidity]  
 CLOUDS: [Clouds]  
 VISIBILITY: [Visibility]  
 GROUND: [Ground]  
 SOIL: [Soil]  
 VEGETATION: [Vegetation]  
 ANIMAL LIFE: [Animal Life]  
 HUMAN LIFE: [Human Life]

RECEIVED  
OCT 29 1957

T 30 R 20  
County Flathead

STATE ENGINEER

MONTANA BUREAU OF MINES AND GEOLOGY  
Butte, Montana

WATER WELL LOG

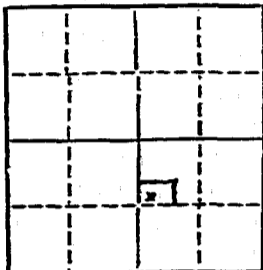

Owner Dan L. Wiltrout Address Columbia Falls

Driller Self Address Route 1. A.

Date Started Sept. 2 - 1957 Date Completed Sept. 15 - 1957

Location: Sec. 21 T. 0 R. 20 1/4 sec. SW 1/4 NW 1/4 SE 1/4 Sec. 21

Type of well Dug Equipment used shovel & pick set  
(Dug, driven, bored, or drilled) (Churn drill, rotary, other)

Water use: Domestic  Municipal  Stock  Irrigation   
Industrial  Drainage  Other: \_\_\_\_\_

Casing: 21 ft. to \_\_\_\_\_ ft. Type Concrete Size 3 ft

Casing: \_\_\_\_\_ ft. to \_\_\_\_\_ ft. Type \_\_\_\_\_ Size \_\_\_\_\_

Casing: \_\_\_\_\_ ft. to \_\_\_\_\_ ft. Type \_\_\_\_\_ Size \_\_\_\_\_

Perforated or Screened: Ft. 6 to ft. \_\_\_\_\_ Ft. \_\_\_\_\_ to ft. \_\_\_\_\_

Type of screen or perforations perforated concrete

Static Water level, for non-flowing well: 19 ft top of well to water level feet.

Shut-in pressure, for flowing well: \_\_\_\_\_ lb./sq. in. on: \_\_\_\_\_ (date)

Pumping water level \_\_\_\_\_ feet at \_\_\_\_\_ gal. per min.

How tested: \_\_\_\_\_

Length of test: \_\_\_\_\_

Remarks: (Gravel packing, cementing, packers, type of shut-off, depth of shut-off)

1 foot top soil remaining depth coarse gravel

STATE OF MONTANA  
ADMINISTRATOR OF GROUNDWATER CODE  
OFFICE OF STATE ENGINEER

RECEIVED  
DEC 30 1963

Declaration of Vested Groundwater Rights

(Under Chapter 237, Montana Session Laws, 1961)

STATE ENGINEER

1. Donald and Grace Barnum of West Glacier  
(Name of Appropriator) (Address) (Town)  
County of Flathead State of Montana  
have appropriated groundwater according to the Montana laws in effect prior to January 1, 1962, as follows:

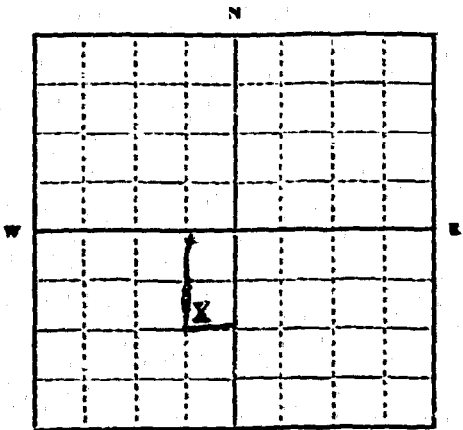

*E 1/2 of NW 1/4*  
*of SW 1/4 Sec 21 T30 N R20 W*

Indicate point of appropriation and place of use, if possible. Each small square represents 10 acres.

- 2. The beneficial use on which the claim is based Household use and irrigation
- 3. Date or approximate date of earliest beneficial use; and how continuous the use has been 1952 Approximately - used each summer since.
- 4. The amount of groundwater claimed (in miner's inches or gallons per minute) 100,000 gallons per day
- 5. If used for irrigation, give the acreage and description of the lands to which water has been applied and name of the owner thereof 1/2 acre garden - Horace Chabourne and Donald Barnum
- 6. The means of withdrawing such water from the ground and the location of each well or other means of withdrawal Electric driven pump. Well is in SE corner of property.

- 7. The date of commencement and completion of the construction of the well, wells, or other works for withdrawal of groundwater Summer of 1952
- 8. The depth of water table 20 feet below surface
- 9. So far as it may be available, the type, size and depth of each well or the general specifications of any other works for the withdrawal of groundwater One well. 1 1/2" sand point on end of 1 1/2" pipe.
- 10. The estimated amount of groundwater withdrawn each year 200,000 gallons
- 11. The log of formations encountered in the drilling of each well if available No log maintained as sand point was driven through sand and clay.
- 12. Such other information of a similar nature as may be useful in carrying out the policy of this act, including reference to book and page of any county record No record previously.

Signature of Owner Grace Barnum  
Date 12/19/63

Three copies to be filed by the owner with the County Clerk and Recorder of the county in which the well is located.  
Please answer all questions. If not applicable, so state, otherwise the form will be returned.

Original to the County Clerk and Recorder; duplicate to the State Engineer; Triplicate to the Montana Bureau of Mines and Geology and Quadruplicate for the Appropriator.

10,115

STATE OF MONTANA 33  
COUNTY OF FLATHEAD

Filed on the 23 day of Dec  
A. D. 1963 at 10:02 o'clock AM

26.77  
County Clerk and Recorder

37 M.T.  
Deputy

File No. \_\_\_\_\_

County Flathead

TRIPPLICATE

STATE OF MONTANA  
ADMINISTRATOR OF GROUNDWATER CODE  
OFFICE OF STATE ENGINEER

Notice of Completion of Groundwater  
Appropriation by Means of Well

(Under Chapter 237, Montana Session Laws, 1961)

Top of Ground  
(Elev. above sea level \_\_\_\_\_)

0 to 21 ft coarse gravel  
21 to 70 ft Sandy silt  
70 to 70.5 ft. silt  
70.5 to 316 ft. silt  
with trace of gravel.  
316 to 341 ft Gray  
hard pan.  
341 to 342 ft  
Waterbearing  
gravel and sand.

Owner June & Ann Belton Address Rt 2 Col. Falls

Driller Olson & J. Austin Address Col. Falls, Mont.

Date of Notice of Appropriation of Groundwater none filed

Date well started May 24-67 Date Completed June 2-67

Type of well Drilled Equipment Used Churn  
(dug, driven, bored or drilled) (Churn, drill, rotary or other)

Water Use: Domestic  Municipal  Stock  Irrigation   
Industrial  Drainage  Other

Indicate on the diagram the character and thickness of the different strata met with in drilling, such as soil, clay, shale, gravel, rock or sand, etc. Show depth at which water is encountered, thickness and character of water-bearing strata and height to which the water rises in the well.

Size of Drilled Hole	Size and Weight of Casing	From (Feet)	To (Feet)	PERFORATIONS		
				Kind Size	From (Feet)	To (Feet)
6 3/8	7" O.D. 23 lbs per ft	0	342		none	

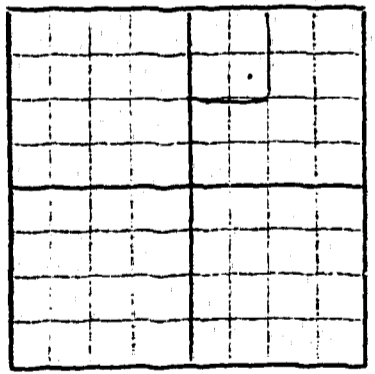

Part of N.E. 1/4 Sec. 22 T. 31 N. R. 20 W.  
Indicate location of well and place of use, if possible. Each small square represents 10 acres.

Show exact depth of bottom.

Static Water Level for non-flowing Well 60 feet.

Shut-in Pressure for Flowing Well non flowing

Pumping Water Level 160 feet at 2.0 gal. per minute.

Discharge in gal. per min. of flowing well non flowing

How Tested Bailer Length of Test 3 hrs

Remarks: (Gravel packing, cementing, packers, type of shutoff, location of place of use of groundwater if not at well, and any other similar pertinent information, including number of acres irrigated, if used for irrigation)

7055  
Driller's License Number  
Olson & J. Austin  
Driller's Signature

This form to be prepared by driller, and three copies to be filed by the owner with the County Clerk and Recorder in the county in which the well is located.

Please answer all questions. If not applicable, so state. otherwise the form will be returned.

Original to the County Clerk and Recorder; duplicate to the State Engineer; Triplicate to the School of Mines  
Quadruplicate for the Appropriator.

13127

STATE OF MONTANA } SS  
COUNTY OF FLATHEAD }  
Filed on the 7 day of Feb  
A. D. 1968 at 9:30 o'clock P M  
PCM  
County Clerk and Recorder

By [Signature] Deputy



RECEIVED

JUN 17 1977

MONT. DEPT. of NATURAL  
RESOURCES & CONSERVATION

RECORDED  
INDEXED  
JUN 17 1977

We the undersigned, filed a notice of completion of groundwater appropriation by means of a well, on Feb. 7, 1968, as P P #15127, records of Flathead County, Montana. Property was described as S E  $\frac{1}{4}$  N W  $\frac{1}{4}$  N E  $\frac{1}{4}$  S 22, T 30, R 20 W. It should be corrected to read, S W  $\frac{1}{4}$ , N W  $\frac{1}{4}$ , N E  $\frac{1}{4}$ , Section 22, Township 30 N, Range 20 West.

*William H. Belton*

*Jane A. Belton*

 *William H. Belton*  
Notary Public, State of Montana  
Residing at Columbia Falls, Mont.  
My commission expires 4-10-78

Q.2 # 13127.

STATE OF MONTANA }  
COUNTY OF FLATHEAD } SS

Filed on the 12<sup>th</sup> day of June  
A.D. 1967 at 7:30 o'clock P.M.

Arthur J. Smith  
County Clerk and Recorder

By Diana Adam  
Deputy

RECEIVED

30N-20W  
County Flathead 22

STATE OF MONTANA  
ADMINISTRATOR OF GROUNDWATER CODE  
MONTANA WATER RESOURCES BOARD

DRILLER'S LOG

NOTICE OF COMPLETION OF GROUNDWATER  
APPROPRIATION BY MEANS OF WELL

Indicate the character, color, thickness of strata such as soil, clay, sand, gravel, shale, sandstone, etc. Show depth at which water is found and height to which water rises in well.

Developed after January 1, 1962

(Under Chapter 237 Montana Session Laws, 1961, as amended)

This form to be prepared by driller, and three copies to be filed by the owner with the County Clerk and Recorder in the county in which the well is located, last copy to be retained by driller.

Please answer all questions. If not applicable, so state, otherwise the form may be returned.

Top of Ground (Elev. above sea level)

Owner Joseph W. Collins and Cheryl S. Collins

For Administrator's Use  
File 14640  
March 15/1973 3:45pm  
GW 1

Address RT. 7A

Columbia Falls, MT

Date well started approx 1915

completed approx 1915

Type of well Dug (Presently unused)

Equipment used

Water Use: Domestic  Municipal  Stock  Irrigation

Industrial  Drainage  Other  Garden/Lawn

\*Describe

USE: If used for irrigation, industrial, drainage or other. Explain, state number of acres and location or other data (i.e. Lot, Block

and Addition):

ESTIMATED ANNUAL WITHDRAWAL 125,000,000 Gal. (Proposed)

Size of Drilled Hole	Size and Weight of Casing	From (Feet)	To (Feet)	PERFORATIONS		
				Kind Size	From (Feet)	To (Feet)
Unknown						

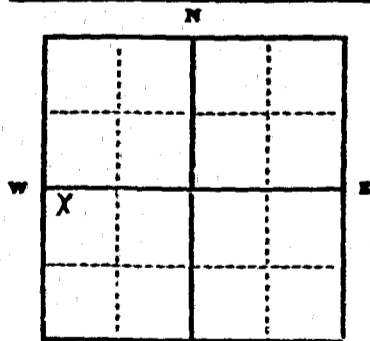

Static water level \_\_\_\_\_ ft.\*  
Pumping water level \_\_\_\_\_ ft.\*  
at \_\_\_\_\_ gallons per minute,  
measured \_\_\_\_\_ minutes after pumping  
began.

\*Measured from ground level.  
Well developed by \_\_\_\_\_  
for \_\_\_\_\_ hours.

Power \_\_\_\_\_ Pump \_\_\_\_\_ HP

Remarks: (Gravel packing, cementing,  
packers, type of shutoff)

NW 1/4 SW 1/4 Sec 22

T. 72 N. R. 22 E. S. 22 W.

INDICATE LOCATION OF WELL AND PLACE OF USE, IF POSSIBLE  
EACH SMALL SQUARE REPRESENTS 40 ACRES.

Driller's Signature

Driller's Address

LICENSE NO.

Show exact depth of bottom

52,681

Industrial  Drillage  Other  Garden

Water Use: Domestic  Municipal  Stock

Equipment used \_\_\_\_\_

Type of well Dug

completed Approx 1915

Date well started Approx 1915

Columbia Falls, Mt. Mansfield

Address RT. 1A

Owner Joseph W. Collins and Cheryl S. Collins

This form to be prepared by the owner with the County Engineer by which the well is located. If not approved, form may be returned.

(Under Chapter 227, Vermont Statutes)

NOTICE OF COMPLETION OF WELL

ADMINISTRATION OF THE STATE OF VERMONT

DEPARTMENT OF CONSERVATION

OFFICE OF THE COUNTY ENGINEER

11640

OFFICE OF THE COUNTY ENGINEER  
COUNTY OF PLATTSBURGH

Filed on the 15th day of May  
A.D. 1971 at 3:45 o'clock PM

M. J.  
County Clerk and Recorder

By \_\_\_\_\_  
Deputy

STATE OF MONTANA  
ADMINISTRATOR OF GROUNDWATER CODE  
MONTANA WATER RESOURCES BOARD

County Flathead

DRILLER'S LOG

Indicate the character, color, thickness of strata such as soil, clay, sand, gravel, shale, sandstone, etc. Show depth at which water is found and height to which water rises in well.

NOTICE OF COMPLETION OF GROUNDWATER APPROPRIATION BY MEANS OF WELL

Developed after January 1, 1962

(Under Chapter 237 Montana Session Laws, 1961, as amended)

This form to be prepared by driller, and three copies to be filed by the owner with the County Clerk and Recorder in the county in which the well is located, last copy to be retained by driller.

Please answer all questions. If not applicable, so state, otherwise the form may be returned.

Owner Joseph W. Collins and Cheryl S. Collins  
Address RT. 2A

For Administrator's Use

File 14,641

Columbia Falls, MT.

MARCH 15, 1973.

Date well started Approx 1915

GW 1 3:46 p.m.

completed Approx 1915

Type of well Dug

(Dug, driven, bored or drilled)

Equipment used \_\_\_\_\_

(Chain drill, rotary or other)

Water Use: Domestic  Municipal  Stock  Irrigation

Industrial  Drainage  Other \* Garden/Lawn

\*Describe \_\_\_\_\_

USE: If used for irrigation, industrial, drainage or other. Explain, state number of acres and location or other data (i.e. Lot, Block and Addition).

ESTIMATED ANNUAL WITHDRAWAL 160,000 Gal.

Size of Drilled Hole	Size and Weight of Casing	From (Feet)	To (Feet)	PERFORATIONS		
				Kind Size	From (Feet)	To (Feet)
34 x 34	23 feet Cement					

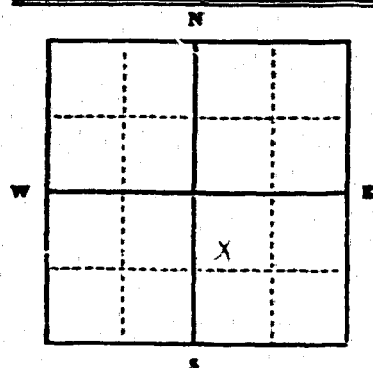

Static water level \_\_\_\_\_ ft.\*  
 Pumping water level \_\_\_\_\_ ft.\*  
 at \_\_\_\_\_ gallons per minute,  
 measured \_\_\_\_\_ minutes after pumping  
 began.  
 \*Measured from ground level.  
 Well developed by \_\_\_\_\_  
 for \_\_\_\_\_ hours.  
 Power \_\_\_\_\_ Pump \_\_\_\_\_ HP  
 Remarks: (Gravel packing, cementing,  
 packers, type of shutoff) \_\_\_\_\_

NW 1/4 SE 1/4 Sec 22  
T 30 N R 30 E  
S W

INDICATE LOCATION OF WELL AND PLACE OF USE, IF POSSIBLE. EACH SMALL SQUARE REPRESENTS 40 ACRES.

Driller's Signature \_\_\_\_\_

Driller's Address \_\_\_\_\_

LICENSE NO. \_\_\_\_\_

Show exact depth of bottom

57,682

15

14041

STATE OF MISSISSIPPI  
COUNTY OF CLAYTON, SS

Filed on the 5<sup>th</sup> day of May  
A. D. 19 20 at 3<sup>45</sup> o'clock P.M.

M. J.  
County Clerk and Recorder

By [Signature]  
Deputy

RECEIVED

300-226-22  
County FLATHEAD

JUL 3 1973

DRILLER'S LOG

STATE OF MONTANA  
ADMINISTRATOR OF GROUNDWATER CODE  
MONTANA WATER RESOURCES BOARD

MONTANA DEPARTMENT OF NATURAL RESOURCES AND CONSERVATION  
Indicate the character, color, thickness of strata such as soil, clay, sand, gravel, shale, sandstone, etc. Show depth at which water is found and height to which water rises in well.

NOTICE OF COMPLETION OF GROUNDWATER APPROPRIATION BY MEANS OF WELL

Developed after January 1, 1962

(Under Chapter 237 Montana Session Laws, 1961, as amended)

This form to be prepared by driller, and three copies to be filed by the owner with the County Clerk and Recorder in the county in which the well is located, last copy to be retained by driller.

Please answer all questions. If not applicable, so state, otherwise the form may be returned.

Owner STUART Foe  
MARGARET J. SREUSEN  
Address Rt 1-A  
Columbia Falls, MT  
Date well started May  
completed JUNE 1  
Type of well Dug  
(Dug, driven, bored or drilled)  
Equipment used BACK HOE  
(Chain drill, rotary or other)  
Water Use: Domestic  Municipal  Stock  Irrigation   
Industrial  Drainage  Other  Garden/Lawn

For Administrator's Use  
File 14879  
JUL 29, 1973  
GW 1 2:58 P.M.

Top of Ground (Elev. above sea level)		
From (Feet)	To (Feet)	
1	10'	gravel
6'	7'	Clay
7'	12'	gravel

\*Describe  
USE: If used for irrigation, industrial, drainage or other. Explain, state number of acres and location or other data (i.e. Lot, Block and Addition). 10A Sec 22 T30N R20W  
ESTIMATED ANNUAL WITHDRAWAL N.A.

Size of Drilled Hole	Size and Weight of Casing	From (Feet)	To (Feet)	PERFORATIONS		
				Kind Size	From (Feet)	To (Feet)
3'dia.	3'dia. concrete tile	ground level	10'	2"	6'	12'

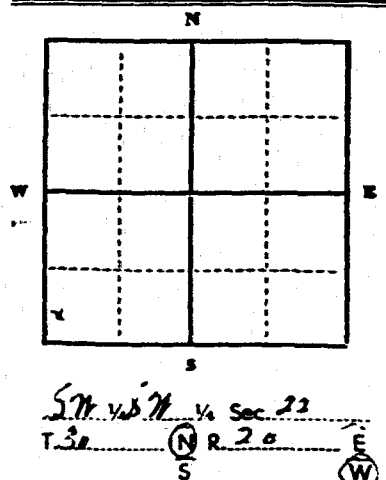

Static water level 9 ft.\*  
Pumping water level 10 ft.\*  
at 1800 gallons per minute,  
measured 60 minutes after pumping began.  
\*Measured from ground level.  
Well developed by SELF  
for N/A hours.  
Power etc Pump 1 HP  
Remarks: (Gravel packing, cementing, packers, type of shutoff)  
washed gravel packing

INDICATE LOCATION OF WELL AND PLACE OF USE, IF POSSIBLE. EACH SMALL SQUARE REPRESENTS 40 ACRES.

Driller's Signature Stuart Foe  
Driller's Address \_\_\_\_\_  
LICENSE NO. \_\_\_\_\_

12' Show exact depth of bottom  
55015

1489  
STATE OF MISSISSIPPI  
COUNTY OF HELLBEND, SS  
Filed on the 29 day of June  
A.D. 1913 at 2:30 o'clock P.M.  
Mrs.  
County Clerk and Recorder  
By \_\_\_\_\_

*[Faint, illegible text and markings, possibly a stamp or signature area]*



STATE OF MONTANA  
ADMINISTRATOR OF GROUNDWATER CODE  
MONTANA WATER RESOURCES BOARD

RECEIVED

DRILLER'S LOG

Indicate the character, color, thickness of strata such as soil, clay, sand, gravel, shale, sandstone, etc. Show depth at which water is found and height to which water rises in well.

NOTICE OF COMPLETION OF GROUNDWATER APPROPRIATION BY MEANS OF WELL

JUN 2 1971

Developed after January 1, 1962

(Under Chapter 237 Montana Session Laws, 1961, as amended)

This form to be prepared by driller, and three copies to be filed by the owner with the County Clerk and Recorder in the county in which the well is located, last copy to be retained by driller. Please answer all questions. If not applicable, so state, otherwise the form may be returned.

Owner Charles Foreman

Address Hungry Horse

Gen. E. Fire Station

Date well started 5-16-71

completed 5-17-71

Type of well Drilled

For Administrator's Use  
File 14284  
May 28, 1971  
2:45 PM  
GW I

Equipment used ORBIT (Aug. driven, bored or drilled)

(Cable drill, rotary or other)

Water Use: Domestic  Municipal  Stock  Irrigation   
Industrial  Drainage  Other \* Garden/Lawn

\*Describe

USE: If used for irrigation, industrial, drainage or other. Explain, state number of acres and location or other data (i.e. Lot, Block and Addition).

ESTIMATED ANNUAL WITHDRAWAL 100,000

Size of Drilled Hole	Size and Weight of Casing	From (Feet)	To (Feet)	PERFORATIONS		
				Kind and Size	From (Feet)	To (Feet)
<u>5/8 O.D.</u>	<u>6-1/8" O.D. .280</u>	<u>0</u>	<u>36</u>	<u>slot</u>	<u>32</u>	<u>28</u>
				<u>4" Prod end</u>		

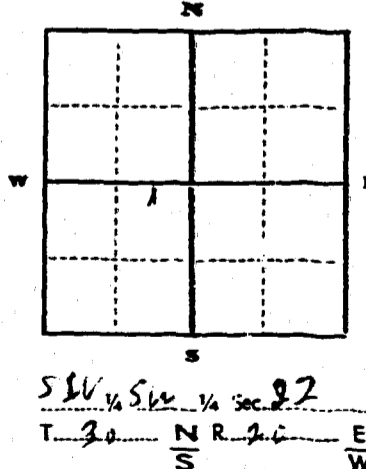

Static water level 18 ft.\*  
 Pumping water level 22 ft.\*  
 at 30 gallons per minute, measured 30 minutes after pumping began.  
 \*Measured from ground level.  
 Well developed by Baller  
 for 1 hours. 3/4 HP  
 Power Jet Pump 3/4 HP  
 Remarks: (Gravel packing, cementing, packers, type of shut-off)  
37'-6" total casing  
1'-6" plug in end of casing

Top of Ground (Elev. above sea level) 3,000

From (Feet)	To (Feet)	Character
<u>0</u>	<u>18</u>	<u>dry gravel</u>
<u>18</u>	<u>22</u>	<u>fine brown sand</u>
		<u>slity clay (sandy)</u>
<u>22</u>	<u>28</u>	<u>more water sandy</u>
<u>28</u>	<u>36</u>	<u>coarser sand &amp; some pebbles</u>

INDICATE LOCATION OF WELL AND PLACE OF USE, IF POSSIBLE. EACH SMALL SQUARE REPRESENTS 40 ACRES.

Driller's Signature Jerome J. Water  
Driller's Address P.O. Box 929, Col. Falls, Mont.

LICENSE NO. 181

36 Show exact depth of bottom

48557

14.281

STATE OF MONTANA  
COUNTY OF FLATHEAD SS

Filed on the 28 day of May  
A. D. 1971 at 2:45 Clock P. M.

DOM  
County Clerk and Recorder

By Jbt Deputy

Doc. No. 14103  
 Filed for record  
 \*nts: 30 day of Jan.  
 A. D. 1970, at 0:37  
 o'clock A. M.

T. 30 N R 20 E  
 County Flathead

STATE OF MONTANA  
 ADMINISTRATOR OF GROUNDWATER CODE  
 OFFICE OF STATE ENGINEER

Notice of Completion of Groundwater  
 Appropriation by Means of Well

(Under Chapter 237, Montana Session Laws, 1961)

Owner Edward Parpart Address Col. Falls

Driller Weber Drilling Address Col. Falls

Date of Notice of Appropriation of Groundwater \_\_\_\_\_

Date well started 6-2-69 Date Completed 6-5-69

Type of well drilled Equipment Used Churn  
 (dug, driven, bored or drilled) (Churn, drill, rotary or other)

Water Use: Domestic  Municipal  Other  Irrigation   
 Industrial  Drainage  Stock

Indicate on the diagram the character and thickness of the different strata met with in drilling, such as soil, clay, shale, gravel, rock or sand, etc. Show depth at which water is encountered, thickness and character of water-bearing strata and height to which water rises in the well.

0 Top of Ground  
 2' Top Soil (Elev. above sea level 3,000')  
 Gravel & Small  
 Boulders  
 20' Mucky clay  
 30' fine sand  
 fine sand  
 40' some small  
 gravel & fine sand  
 40' soft clay  
 Had to set  
 perforation to  
 clean the  
 clay out of  
 the sand  
 in order to  
 make the  
 sand point  
 work

Size of Drilled Hole	Size and Weight of Casing	From (Feet)	To (Feet)	PERFORATIONS		
				Kind and Size	From (Feet)	To (Feet)
7"	7" O.D. 20#/ft	0	41'	6" O.D.	41'	31'
				1-6"	Dead End	
				5"	perforations	
				seal	2' from Top	

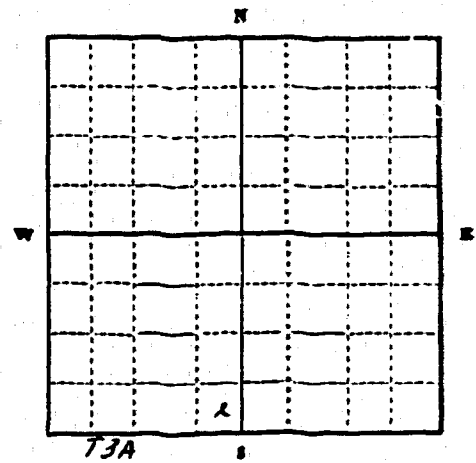

SE 1/4 Sec 22 T30 R20  
 Indicate location of well and place of use, if possible. Each small square represents 10 acres.

Show exact depth of bottom.

Static Water Level for non-flowing Well 24 feet.

Shut-in Pressure for Flowing Well \_\_\_\_\_

Pumping Water Level 38 feet at 4 gal. per minute.

Discharge in gal. per min. of flowing well \_\_\_\_\_

How Tested Bailed Length of Test 1 1/2 days  
pumped

Remarks: (Gravel packing, cementing, packers, type of shutoff, location of place of use of groundwater if not at well, and any other similar pertinent information, including number of acres irrigated, if used for irrigation) 3' sand point

60 gauge x 2" diameter - 4'-2"  
lead connect to a check valve 1/4"  
to Jet 1 1/4" drop pipe used.

181  
 Driller's License Number  
James H. Weber  
 Driller's Signature

This form to be prepared by driller, and three copies to be filed by the owner with the County Clerk and Recorder in the county in which the well is located.

Please answer all questions. If not applicable, so state, otherwise the form will be returned.

Original to the County Clerk and Recorder; duplicate to the State Engineer; TriPLICATE to the Montana Bureau of Mines and Geology and Quadruplicate for the Appropriator.

12/103

STATE OF MONTANA  
COUNTY OF FLATHEAD

Filed on the 30 day of  
A.D. 1970 at 9:11 AM

County Clerk and Recorder

By

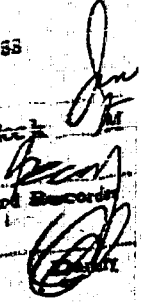
Handwritten signature and initials in black ink, appearing to be 'J. J. M.' and 'C. J. M.' written over the printed text.

304 20W  
County FLATHEAD

22

STATE OF MONTANA  
ADMINISTRATOR OF GROUNDWATER CODE  
MONTANA WATER RESOURCES BOARD

**NOTICE OF COMPLETION OF GROUNDWATER  
APPROPRIATION BY MEANS OF WELL**  
Developed after January 1, 1962

(Under Chapter 237 Montana Session Laws, 1961, as amended)

This form to be prepared by driller, and three copies to be filed by the owner with the County Clerk and Recorder in the county in which the well is located, last copy to be retained by driller.

Please answer all questions. If not applicable, so state, otherwise the form may be returned.

Owner FRANCIS V. AND  
PATRICIA A. ROOSE

Address GENERAL DELIVERY

COLUMBIA FALLS, MONTANA

Date well started 9/13/72

completed 9/19/71

For Administrator's Use	
File	<u>14,451</u>
	<u>Oct. 26, 1972 - 3:00 p.m.</u>
GW 1	

Type of well DRILLED  
(Dig, driven, bored or drilled)

Equipment used AIR ROTARY  
(Chain drill, rotary or other)

Water Use: Domestic  Municipal  Stock  Irrigation   
Industrial  Drainage  Other \* Garden/Lawn

\*Describe  
USE: If used for irrigation, industrial, drainage or other. Explain, state number of acres and location or other data (i.e. Lot, Block and Addition). APPROX. TEN ACRES

ESTIMATED ANNUAL WITHDRAWAL 66,225,600 GALLONS ?

Size of Drilled Hole	Size and Weight of Casing	From (Feet)	To (Feet)	PERFORATIONS		
				Min. Size	From (Feet)	To (Feet)
6"	6 5/8" OD x 1/2"	+2	257' 10"	N	O	N

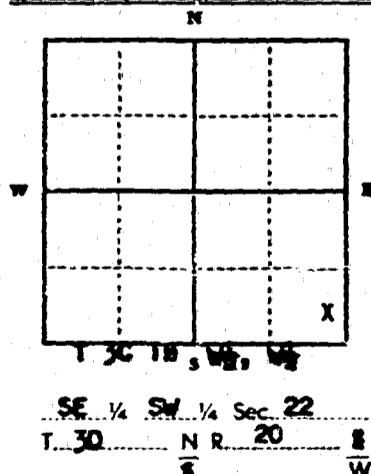

Static water level 43' 4" ft.\*  
Pumping water level 122 ft.\*  
at 125 gallons per minute,  
measured 120 minutes after pumping began.  
\*Measured from ground level.  
Well developed by AIR LIFT PUMP  
for Two hours.  
Power: DIESEL Pump 150 HP  
Remarks: (Gravel packing, cementing, packers, type of shutoff) ALL WATER ENTERING WELL THROUGH OPEN BOTTOM OF SIX INCH CASING. WELLS IN THIS AREA CAN BE DEPENDED UPON TO PRODUCE

INDICATE LOCATION OF WELL AND PLACE OF USE, IF POSSIBLE. EACH SMALL SQUARE REPRESENTS 40 ACRES.  
LIBERTY DRILLING COMPANY

Driller's Signature [Signature]

Driller's Address HWY 93 SOUTH  
KALISPELL, MONTANA LICENSE NO. 52

**DRILLER'S LOG**

Indicate the character, color, thickness of strata such as soil, clay, sand, gravel, shale, sandstone, etc. Show depth at which water is found and height to which water rises in well.

Top of Ground APPROX. (Elev. above sea level) 3089'

From (Feet)	To (Feet)	
0	2	TOPSOIL
2	26	GRAVEL AND COBBLESTONES MIXED WITH FINE TAN SAND
26	63	GRAY SILT WITH FINE SCATTERED GRAVELS MIXED IN
63	103	FINE GRAY SILTY SAND
103	183	GRAY SILT AND CLAY IN ALTERNATE LAYERS
183	220	GRAY SILT AND SAND IN THIN ALTERNATE LAYERS
220	236	SILTY SAND WITH COARSE GRAVEL MIXED IN. WATER SAND TOO FINE AND SILTY TO SUCCESSFULLY DEVELOP WELL
236	240	CLEAN COARSE SAND AND GRAVEL. WATER

240 FEET Show exact depth of bottom WATER RISES IN WELL 43' 4" FROM SURFACE.

51,706

CLEAR SAND FREE WATER YEAR AFTER YEAR AS LONG AS THEY ARE NOT OVERPUMPED, I.E.,  
THEY SHOULD BE PUMPED AT RATES NOT IN EXCESS OF 40 TO 50 PERCENT OF THE TESTED  
CAPACITY OF THE AQUIFER.

14, 451

STATE OF MONTANA ( 23  
COUNTY OF FLATHEAD)

Filed on the 2<sup>nd</sup> day of Oct  
A. D. 1972 at 3 o'clock P. M.

*[Signature]*  
County Clerk and Recorder

By \_\_\_\_\_ Deputy

304-200  
County Flathead

STATE OF MONTANA  
ADMINISTRATOR OF GROUNDWATER CODE  
MONTANA WATER RESOURCES BOARD

NOTICE OF COMPLETION OF GROUNDWATER  
APPROPRIATION BY MEANS OF WELL

Developed after January 1, 1962

(Under Chapter 237 Montana Session Laws, 1961, as amended)

This form to be prepared by driller, and three copies to be filed by the owner with the County Clerk and Recorder in the county in which the well is located, last copy to be retained by driller.

Please answer all questions. If not applicable, so state, otherwise the form may be returned.

Owner Bright Waco

Address E. E. Col. Heights

Col. Falls, Mont.

Date well started 5-19-72

completed 5-26-72

For Administrator's Use	
File #	<u>436</u>
Date	<u>June 6, 1972 2:25 p.m.</u>
Well No.	<u>GW 1</u>

Type of well Drilled  
(Dig, driven, bored or drilled)

Equipment used CHINA  
(China drill, rotary or other)

Water Use: Domestic  Municipal  Stock  Irrigation   
Industrial  Drainage  Other \* Garden/Lawn

\*Describe \_\_\_\_\_  
USE: If used for irrigation, industrial, drainage or other. Explain, state number of acres and location or other data (i.e. Lot, Block and Addition).

ESTIMATED ANNUAL WITHDRAWAL 100,000 gal.

Size of Drilled Hole	Size and Weight of Casing	From (Feet)	To (Feet)	PERFORATIONS		
				Kind Size	From (Feet)	To (Feet)
<u>6-5/8" O.D.</u>	<u>6-5/8" 250wall</u>	<u>0</u>	<u>134</u>			

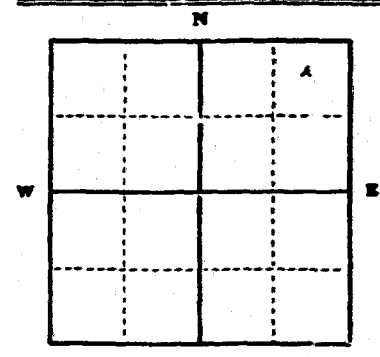

Static water level 26 ft.\*  
Pumping water level 40 ft.\*  
at 30 gallons per minute,  
measured 60 minutes after pumping  
began.  
\*Measured from ground level.  
Well developed by Bailer  
for 2 hours.  
Power 230 Pump 1 HP  
Remarks: (Gravel packing, cementing,  
packers, type of shutoff)  
Open Bottom

712 71 E 1/4 Sec 22  
T. 36 N. 26 E

total casing 134' 8"

INDICATE LOCATION OF WELL AND PLACE OF USE, IF POSSIBLE. EACH SMALL SQUARE REPRESENTS 40 ACRES.

Driller's Signature Jerome J. Weber

Driller's Address P.O. Box 929, Col. Falls, Mont.

LICENSE NO. 181

Top of Ground (Elev. above sea level) <u>3,000</u>		
From (Feet)	To (Feet)	
<u>0</u>	<u>2</u>	<u>Top Soil</u>
<u>2</u>	<u>22</u>	<u>Gravel</u>
<u>22</u>	<u>50</u>	<u>Fine yellow earthy clay</u>
		<u>seepage</u>
<u>50</u>	<u>104</u>	<u>gray sandy clay</u>
<u>104</u>	<u>120</u>	<u>Brown quick sand water</u>
<u>120</u>	<u>130</u>	<u>some small pebbles</u>
<u>130</u>	<u>134</u>	<u>fine orange material</u>
		<u>clay &amp; pebbles</u>

134 Show exact depth of bottom

59574

14,436

STATE OF MONTANA  
COUNTY OF FLEETHEAD

Filed on the 6 day of June  
A.D. 1922 at 2 o'clock PM

W. J. M.  
County Clerk and Recorder

By W. J. M. Deputy



Department of Natural Resources and Conservation  
 Water Resources Division  
 Engineering Bureau  
 Groundwater Section  
 Sam W. Mitchell Building  
 Helena, Montana 59601

Owner Burnell D. Hart 59912  
 Address Pl. 1A, Box 207 Columbia Falls  
 Location T. 30N. R. 20W Sec. 27  
 Doc. No. 14402

As the Administrator of the Groundwater Code for the State of Montana, please take note of the following special instructions, in order to properly protect your groundwater right.

Special Instructions:

Please provide, as indicated <sup>in red</sup> on the enclosed form, the dates the groundwater development was started and completed. Also indicate the claimed amount of water use in gallons per minute or miners' inches.  
 Thank you.

Sent on:  
 4/17/72

50,098

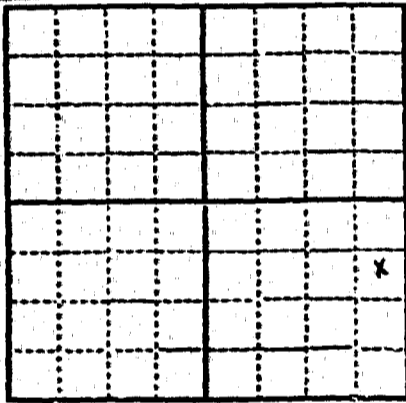

SE 1/4 Sec 27 T30 R20 N. W.

Indicate point of appropriation and place of use, if possible.

North half of the southeast quarter of section 27, Township 30 north, range 20 west, N.P.M.

sub-irrigation and other natural processes". Include depth to water when applicable. A pipe is run underground to top spring about 50 feet above point where spring first comes out of ground

quantity of water developed and used with explanation of method used to measure or estimate such amount. If use is intermittent

R.A.D.  
 estimate approximate lengths of periods of use year around use for house and yard only

Signature of Owner Burnell D. Hart

Date Apr 22, 1972

This form to be prepared by contractor (if any), otherwise by the owner.

Three copies of this notice are to be filed with the County Clerk and Recorder of the county in which the works are located.

Please answer all questions. If not applicable, so state, otherwise the form will be returned.

Original to the County Clerk and Recorder; duplicate to the State Engineer; Triplicate to the Montana Bureau of Mines and Geology and Quadruplicate for the Appropriator.

Doc. No. 14402  
 Filed for record  
 this 22 day of March  
 A. D. 19 72, at 2:50  
 o'clock P.M.

50,098

RECEIVED

MAR 24 1972

GW 3

File No. \_\_\_\_\_

MONTANA DEPARTMENT OF NATURAL RESOURCES AND CONSERVATION

County Flaxton

STATE OF MONTANA  
ADMINISTRATOR OF GROUNDWATER CODE  
OFFICE OF STATE ENGINEER

Notice of Completion of Groundwater Appropriation  
Without Well

(Under Chapter 237 Montana Session Laws, 1961)

*Notice of Purchaser's Interest*  
*Book 525*  
*Page 239*

*Rights by*

Date of Appropriation of Groundwater March 22, 1972

Owner Arnold D. Hart Address Rt. 1A, Box 307 Col. Falls

Contractor (if any) \_\_\_\_\_

Address of Contractor \_\_\_\_\_

Date Started \_\_\_\_\_ Date Completed \_\_\_\_\_

Describe means of obtaining groundwater without a well "as by sub-irrigation and other natural processes". Include depth to water when applicable. A pipe is run underground

to top spring about 50 feet above point where spring first comes out of ground.

Quantity of water developed and used with explanation of method used to measure or estimate such amount. If use is intermittent

R.D.  
estimate approximate lengths of periods of use year around

use for house and yard only.

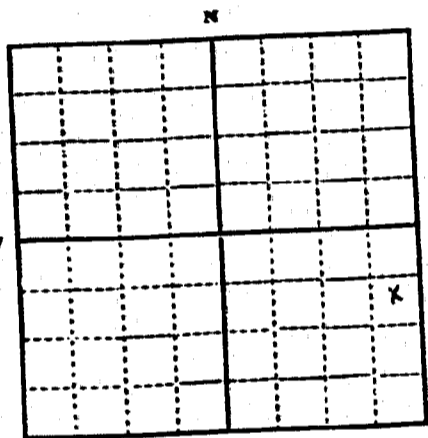

SE 1/4 Sec 27 T30 R20

Indicate point of appropriation and place of use, if possible.

*North half of the southeast quarter of section 27, Township 30 north, range 20 west, N.P.M.*

Signature of Owner Arnold D. Hart

Date Mar. 22, 1972

This form to be prepared by contractor (if any), otherwise by the owner.

Three copies of this notice are to be filed with the County Clerk and Recorder of the county in which the works are located.

Please answer all questions. If not applicable, so state, otherwise the form will be returned.

Original to the County Clerk and Recorder; duplicate to the State Engineer; Triplicate to the Montana Bureau of Mines and Geology and Quadruplicate for the Appropriator.

Doc. No. 14402  
Filed for record  
this 22 day of March  
A. D. 19 72, at 2:50  
o'clock P.M.

50,098

34402

STATE OF MONTANA }  
COUNTY OF FLEETHEAD } SS

Filed on the 21 day of March  
A. D. 1912 at 2:50 o'clock P

[Signature]  
County Clerk and Recorder

By [Signature] Deputy

525-237

NOTICE OF PUBLIC HEARING

STATE DEPARTMENT OF LAND MANAGEMENT

That the State of Montana and the State Board of Land Commissioners, of Montana, do hereby certify that the following is a true and correct copy of the proposed plan of subdivision of the land described in the foregoing, and that the same has been approved by the State Board of Land Commissioners, and that the same is hereby published for the purpose of giving notice to the public of the same.

The State Board of Land Commissioners of the State of Montana, do hereby certify that the following is a true and correct copy of the proposed plan of subdivision of the land described in the foregoing, and that the same has been approved by the State Board of Land Commissioners, and that the same is hereby published for the purpose of giving notice to the public of the same.

The State Board of Land Commissioners of the State of Montana, do hereby certify that the following is a true and correct copy of the proposed plan of subdivision of the land described in the foregoing, and that the same has been approved by the State Board of Land Commissioners, and that the same is hereby published for the purpose of giving notice to the public of the same.

The State Board of Land Commissioners of the State of Montana, do hereby certify that the following is a true and correct copy of the proposed plan of subdivision of the land described in the foregoing, and that the same has been approved by the State Board of Land Commissioners, and that the same is hereby published for the purpose of giving notice to the public of the same.

The State Board of Land Commissioners of the State of Montana, do hereby certify that the following is a true and correct copy of the proposed plan of subdivision of the land described in the foregoing, and that the same has been approved by the State Board of Land Commissioners, and that the same is hereby published for the purpose of giving notice to the public of the same.

525 237

NOTICE OF PURCHASERS' INTEREST

THOSE ALL MEN BY THESE PRESENTS:

That VICTOR BEYER and HILMA BEYER, husband and wife, of Highway 2 S.E., Columbia Falls, Montana, have agreed to sell, and BURTON D. HART and JUDE M. HART, husband and wife, as joint tenants with the right of survivorship, of 406 Second Avenue East, Columbia Falls, Montana, have agreed to purchase under a Contract for Deed the following-described real property situated in Blaine County, Montana, particularly described as follows:

The North Half of the North Half of the Southeast Quarter of Section 27, Township 30 North, Range 20 West, T.30N., R.20W., Blaine County, Montana, EXCEPTING AND RESERVING unto the First Parties, hereover, 51 per cent of all of the oil, gas and other minerals of any nature located on, in or under the above-described property, TOGETHER with all of the First Parties' right, title and interest in and to an easement for the use of the spring on the North Half of the Southeast Quarter of Section 27, Township 30 North, Range 21 West, T.30N., R.21W., Blaine County, Montana, and an easement for the location and maintenance of water lines over and across the property described in a Notice of Purchasers' Interest dated February 15, 1978 wherein Victor Beier and Hilma Beier, husband and wife, and Everett C. Cook and Irene C. Cook, husband and wife, were parties to which notice was given on January 24, 1978 in Book 113 at Page 234 of the records of Blaine County, Montana, and TOGETHER with the right of the First Parties to enter upon the property described in said Notice of Purchasers' Interest for the purpose of maintaining and repairing said water lines, all subject to the terms and conditions contained in the aforesaid Contract for Deed, in said Notice of Purchasers' Interest, and TOGETHER with an easement for ingress and egress to and from the property described in the Notice of Purchasers' Interest over and across the West 30 feet of the above-described property.

IN WITNESS WHEREOF, this Notice has been executed this 15th day of \_\_\_\_\_, 1971.

*Victor Beier*  
Victor Beier

\_\_\_\_\_  
Jude M. Hart

\_\_\_\_\_  
Burton D. Hart

T 30 N R 20 W 27

F. No.

County Flaxhead

TRIPPLICATE

STATE OF MONTANA  
ADMINISTRATOR OF GROUNDWATER  
OFFICE OF STATE ENGINEER

Notice of Completion of Groundwater  
Appropriation by Means of Well

(Under Chapter 237, Montana Session Laws, 1961)

Top of Ground  
(Elev. above sea level.....)

0 to 28 ft sandy silt  
with some gravel.

28 to 155 ft gray silt

155 to 191 ft gray  
silt with trace of  
gravel.

191 to 444 Gray  
silt.

444 to 445 ft  
waterbearing gravel  
and sand.

Total depth 445 ft.

Owner John Fadenburg Address Columbia Falls Mont

Driller Alvin & Justus Address Col. Falls Mont

Date of Notice of Appropriation of Groundwater none filed

Date well started May 17-63 Date Completed June 11 1963

Type of well Drilled Equipment Used Churn  
(dug, driven, bored or drilled) (Churn, drill, rotary or other)

Water Use: Domestic  Municipal  Stock  Irrigation   
Industrial  Drainage  Other

Indicate on the diagram the character and thickness of the different strata met with in drilling, such as soil, clay, shale, gravel, rock or sand, etc. Show depth at which water is encountered, thickness and character of water-bearing strata and height to which the water rises in the well.

Size of Drilled Hole	Size and Weight of Casing	From (Feet)	To (Feet)	PERFORATIONS		
				Kind Size	From (Feet)	To (Feet)
7"	7" O.D. 23 lbs per ft.	0	445	none		

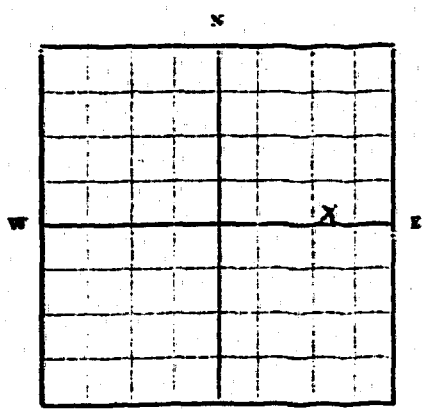

NW 1/4 Sec 27 T 30 R 20  
Indicate location of well and place of use, if possible. Each small square represents 10 acres.

Show exact depth of bottom.

Static Water Level for non-flowing Well 78 feet.

Shut-in Pressure for Flowing Well non-flowing

Pumping Water Level 82 feet at 20 gal. per minute.

Discharge in gal. per min. of flowing well non-flowing

How Tested Pump Length of Test 4 hrs.

Remarks: (Gravel packing, cementing, packers, type of shutoff, location of place of use of groundwater if not at well, and any other similar pertinent information, including number of acres irrigated, if used for irrigation)

(all measurements from existing ground surface)

no 55  
Driller's License Number  
Alvin & Justus  
By George J. Justus  
Driller's Signature

This form to be prepared by driller, and three copies to be filed by the owner with the County Clerk and Recorder in the county in which the well is located.

Please answer all questions. If not applicable, so state, otherwise the form will be returned.

Original to the County Clerk and Recorder; duplicate to the State Engineer; Triplicate to the School of Mines and Quadruplicate for the Appropriator.

10489

STATE OF MONTANA,  
COUNTY OF FLATHEAD, SS

Filed on the 30 day of Dec  
A.D. 1963 at 2:00 o'clock P.M.

*Glenn E. Melchior*  
County Clerk and Recorder

By *Keith*  
Deputy

T 30<sup>N</sup> R 20<sup>W</sup> - 21  
County Flathead

File No. \_\_\_\_\_

JUN 6 1966

DUPLICATE

Billie \_\_\_\_\_ McDermott \_\_\_\_\_  
Buttern \_\_\_\_\_ McNulty \_\_\_\_\_  
Coyle \_\_\_\_\_ Morton \_\_\_\_\_  
Darinton \_\_\_\_\_ Sullivan \_\_\_\_\_  
Dickert \_\_\_\_\_

STATE OF MONTANA  
ADMINISTRATOR OF GROUNDWATER CODE  
OFFICE OF STATE ENGINEER

Top of Ground \_\_\_\_\_  
(Elev. above sea level \_\_\_\_\_)

Notice of Completion of Groundwater  
Appropriation by Means of Well

(Under Chapter 237, Montana Session Laws, 1961)

0 to 20 ft Sandy silt.  
20 to 310 ft. light clay.  
310 to 315 ft. Dark  
mud with sand  
315 to 333 ft.  
Gravel, sandy silt.  
333 to 334 ft  
water bearing gravel  
and sand

Owner Howard E White Address Columbia Falls Mont

Driller Olsen & Justice Address \_\_\_\_\_

Date of Notice of Appropriation of Groundwater none filed

Date well started March 14-66 Date Completed March 30-66

Type of well Drilled Equipment Used Churn  
(dug, driven, bored or drilled) (Churn, drill, rotary or other)

Water Use: Domestic  Municipal  Stock  Irrigation   
Industrial  Drainage  Other

Indicate on the diagram the character and thickness of the different strata met with in drilling, such as soil, clay, shale, gravel, rock or sand, etc. Show depth at which water is encountered, thickness and character of water-bearing strata and height to which the water rises in the well.

Size of Drilled Hole	Size and Weight of Casing	From (Feet)	To (Feet)	PERFORATIONS		
				Kind Size	From (Feet)	To (Feet)
7" O.D.	7" O.D. 23 lbs per ft	0	334	none		

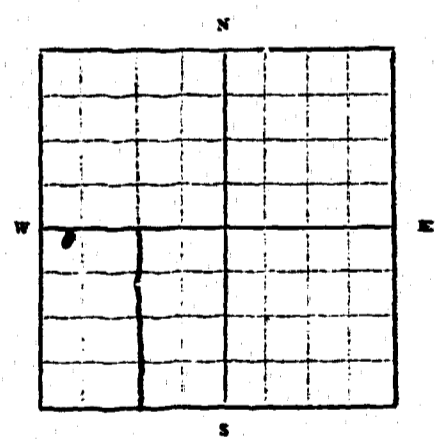

N 1/2 1/4 S. W. Sec. 27 T. 30 R. 20.  
Indicate location of well and place of use, if possible. Each small square represents 10 acres.

Show exact depth of bottom.

Static Water Level for non-flowing Well 50 feet.  
Shut-in Pressure for Flowing Well non-flowing  
Pumping Water Level 50 feet at 30 gal. per minute.  
Discharge in gal. per min. of flowing well non-flowing  
How Tested Leak Length of Test 2 hrs.

Remarks: (Gravel packing, cementing, packers, type of shutoff, location of place of use of groundwater if not at well, and any other similar pertinent information, including number of acres irrigated, if used for irrigation) 100

710 55 3  
Driller's License Number \_\_\_\_\_  
Olsen & Justice  
Driller's Signature

This form to be prepared by driller, and three copies to be filed by the owner with the County Clerk and Recorder in the county in which the well is located.

Please answer all questions. If not applicable, so state, otherwise the form will be returned.

Original to the County Clerk and Recorder; duplicate to the State Engineer; Triplicate to the School of Mines and Quadruplicate for the Appropriator.

41120



12, 217

STATE OF NEW YORK  
COUNTY OF FLATLAND, NY

Filed on the 20 day of May  
A.D. 19 1904 at 9 o'clock AM

*S. M.*

Clerk and Recorder

By \_\_\_\_\_ Deputy

*12, 217*

*12, 217*

*12, 217*

*12, 217*

*12, 217*

FILED

Deputy

T 30<sup>N</sup> R 20<sup>W</sup> S 28

File No. \_\_\_\_\_

JUN 6 1965

County Platteau

DUPLICATE

Billie \_\_\_\_\_ McDermott  
Butzer \_\_\_\_\_ McNulty  
Coye \_\_\_\_\_ Morton  
Dartinton \_\_\_\_\_ Sullivan

STATE OF MONTANA  
ADMINISTRATOR OF GROUNDWATER CODE  
OFFICE OF STATE ENGINEER

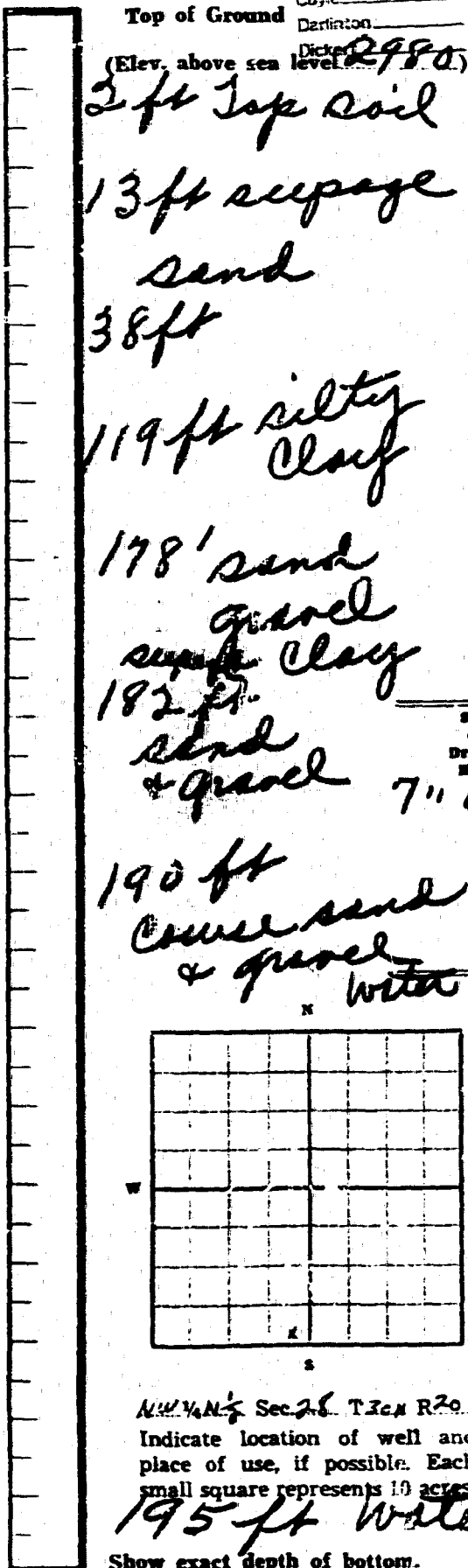

### Notice of Completion of Groundwater Appropriation by Means of Well

(Under Chapter 237, Montana Session Laws, 1961)

Owner Dallas H. Adkins Address Rt 2, Columbia Falls

Driller Homer McClarty Address 945-8th St

Date of Notice of Appropriation of Groundwater \_\_\_\_\_

Date well started Apr 26/65 Date Completed May 4/65

Type of well Drilled Equipment Used 2 1/2" Bystrom  
(dug, driven, bored or drilled) (Churn, drill, rotary or other)

Water Use: Domestic  Municipal  Stock  Irrigation   
Industrial  Drainage  Other

Indicate on the diagram the character and thickness of the different strata met with in drilling, such as soil, clay, shale, gravel, rock or sand, etc. Show depth at which water is encountered, thickness and character of water-bearing strata and height to which the water rises in the well

Size of Drilled Hole	Size and Weight of Casing	From (Feet)	To (Feet)	PERFORATIONS		
				Kind	From (Feet)	To (Feet)
7" OD	23"		195 ft			

Static Water Level for non-flowing Well 81 feet.

Shut-in Pressure for Flowing Well \_\_\_\_\_

Pumping Water Level 180 feet at 13 2/3 gal. per minute.

Discharge in gal. per min. of flowing well \_\_\_\_\_

How Tested Boiler Length of Test 3 hrs

Remarks: (Gravel packing, cementing, packers, type of shutoff, location of place of use of groundwater if not at well, and any other similar pertinent information, including number of acres irrigated, if used for irrigation)

N 1/4 Sec 26, T 30 N R 20 W M.P.M.

Indicate location of well and place of use, if possible. Each small square represents 10 acres.

195 ft water

Driller's License Number 18

Driller's Signature Homer McClarty

This form to be prepared by driller, and three copies to be filed by the owner with the County Clerk and Recorder in the county in which the well is located.

Please answer all questions. If not applicable, so state, otherwise the form will be returned.

Original to the County Clerk and Recorder; duplicate to the State Engineer; Triplicate to the School of Mines and Quadruplicate for the Appropriator.

12 213  
 ...  
 ...  
 ...  
 ...  
 ...  
 ...  
 ...  
 ...  
 ...

...  
 ...  
 ...  
 ...  
 ...

...  
 ...  
 ...

By \_\_\_\_\_ Deputy

...  
 ...

...

...

...

...

...

...

...

File No. \_\_\_\_\_

GW 4

T. 20W R. 23  
County Flathead

STATE OF MONTANA  
ADMINISTRATOR OF GROUNDWATER CODE  
OFFICE OF STATE ENGINEER

RECEIVED  
JAN 8 1964

Declaration of Vested Groundwater Rights  
(Under Chapter 237, Montana Session Laws, 1961)

1. Everett Baker (Name of Appropriator) of R1A Columbia Falls (Address) (Town)  
County of Flathead State of Montana  
have appropriated groundwater according to the Montana laws in effect prior to January 1, 1962, as follows:

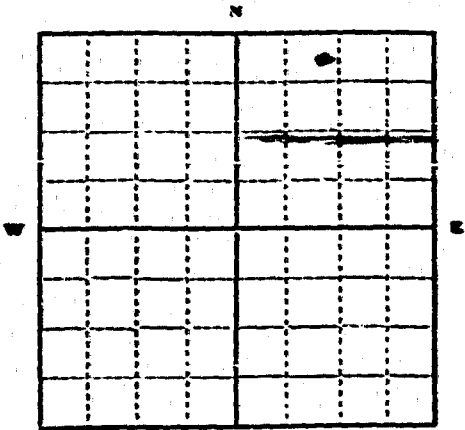

SE 1/4 1/4  
S 1/4 1/4 1/4  
1/4 Sec 28 T. 30R. 20

Indicate point of appropriation and place of use, if possible. Each small square represents 10 acres.

2. The beneficial use on which the claim is based household

3. Date or approximate date of earliest beneficial use; and how continuous the use has been 1-4-62  
continuous

4. The amount of groundwater claimed (in miner's inches or gallons per minute) 250 gal. hour

5. If used for irrigation, give the acreage and description of the lands to which water has been applied and name of the owner thereof

6. The means of withdrawing such water from the ground and the location of each well or other means of withdrawal deep well pumps

7. The date of commencement and completion of the construction of the well, wells, or other works for withdrawal of groundwater. July 19, 63

8. The depth of water table 60 ft.

9. So far as it may be available, the type, size and depth of each well or the general specifications of any other works for the withdrawal of groundwater. 165 ft deep -  
7" casing

10. The estimated amount of groundwater withdrawn each year 500,000

11. The log of formations encountered in the drilling of each well if available drilled  
no core was brought

12. Such other information of a similar nature as may be useful in carrying out the policy of this act, including reference to book and page of any county record.

Signature of Owner Everett Baker  
Everett Baker  
Date 12-31-63

Three copies to be filed by the owner with the County Clerk and Recorder of the county in which the well is located.

Please answer all questions. If not applicable, so state, otherwise the form will be returned.

Original to the County Clerk and Recorder; duplicate to the State Engineer; Triplicate to the Montana Bureau of Mines and Geology and Quadruplicate for the Appropriator.

10858

STATE OF MISSISSIPPI  
COUNTY OF HARRIS

Filed on the 31 day of Dec  
A. D. 1963 at 12 o'clock

J. C. M.  
County Clerk and Recorder

By J. L. H.  
Deputy

STATE OF MONTANA  
ADMINISTRATOR OF GROUNDWATER CODE NOV 29 1971  
MONTANA WATER RESOURCES BOARD

**NOTICE OF COMPLETION OF GROUNDWATER  
APPROPRIATION BY MEANS OF WELL**

Developed after January 1, 1962

(Under Chapter 237 Montana Session Laws, 1961, as amended)

This form to be prepared by driller, and three copies to be filed by the owner with the County Clerk and Recorder in the county in which the well is located, last copy to be retained by driller.

Please answer all questions. If not applicable, so state, otherwise the form may be returned.

Owner Larry Baker

Address Rt. 1st

Col. Falls, Mont.

Date well started 10-19-71

completed 11-3-71

For Administrator's Use	
File	<u>14355</u>
	<u>11-26-71</u>
	<u>11:15AM</u>
GW 1	

Type of well Drilled

(Dig, driven, bored or drilled)

Equipment used GEOR

(Cable drill, rotary or other)

Water Use: Domestic  Municipal  Stock  Irrigation

Industrial  Drainage  Other  Garden/Lawn

\*Describe

USE: If used for irrigation, industrial, drainage or other. Explain, state number of acres and location or other data (i.e. lot, block and Addition).

ESTIMATED ANNUAL WITHDRAWAL 300,000 Gal.

Size of Drilled Hole	Size and Weight of Casing	From (Feet)	To (Feet)	PERFORATIONS		
				Kind	From (Feet)	To (Feet)
<u>7 1/2</u>	<u>6 3/8 O.D. .280 wall</u>	<u>0</u>	<u>199</u>	<u>None</u>		

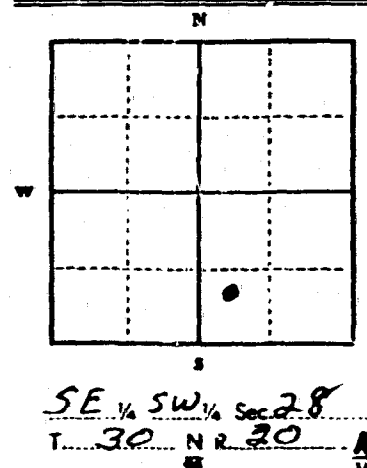

Static water level 85 ft.\*  
Pumping water level 155 ft.\*  
at 25 gallons per minute,  
measured 60 minutes after pumping  
began.  
\*Measured from ground level.  
Well developed by Bailer  
for 10 hours.  
Power Sub Pump 1 HP  
Remarks: (Gravel packing, cementing,  
packers, type of shutoff)  
Open Bottom

INDICATE LOCATION OF WELL AND PLACE OF USE, IF POSSIBLE. EACH SMALL SQUARE REPRESENTS 40 ACRES.

Driller's Signature James H. Weber

Driller's Address P.O. Box 929, Col. Falls, Mont.

LICENSE NO. 181

**DRILLER'S LOG**

Indicate the character, color, thickness of strata such as soil, clay, sand, gravel, shale, sandstone, etc. Show depth at which water is found and height to which water rises in well.

Top of Ground (Elev. above sea level) <u>3,000</u>		
From (Feet)	To (Feet)	
<u>0</u>	<u>2</u>	<u>Top Soil</u>
<u>2</u>	<u>30</u>	<u>Light Sand</u>
<u>30</u>	<u>30</u>	<u>" " Scrape</u>
<u>30</u>	<u>112</u>	<u>Gray sandy clay</u>
<u>112</u>	<u>158</u>	<u>" " pebbles</u>
<u>158</u>	<u>162</u>	<u>Light Gray clay</u>
		<u>and Silted Dry</u>
<u>162</u>	<u>163</u>	<u>Shot Water Off</u>
<u>163</u>	<u>180</u>	<u>Gray Clay</u>
<u>180</u>	<u>182</u>	<u>Boulder (blasted)</u>
<u>182</u>	<u>184</u>	<u>Gray Clay</u>
<u>184</u>		<u>Fragmented gravel brown</u>
		<u>5 G.M. with sand</u>
<u>190</u>		<u>1/2 G.M. " "</u>
<u>195</u>		<u>" " " "</u>
<u>199</u>		<u>" " " 255 feet</u>
<u>181</u>	<u>199</u>	<u>Extremely hard strata to break down</u>

159 Show exact depth of bottom

49278

14355

STATE OF MONTANA }  
COUNTY OF PLATHEAD } SS  
Filed on the 2 day of Nov  
A. D. 19 11 at 11 o'clock AM  
[Signature]  
County Clerk and Recorder  
By \_\_\_\_\_ Deputy

RECORDED  
INDEXED  
NOV 11 1911

12  
NOV 11 1911  
RECORDED  
INDEXED  
NOV 11 1911

STATE OF MONTANA  
ADMINISTRATOR OF GROUNDWATER CODE  
MONTANA WATER RESOURCES BOARD

NOTICE OF COMPLETION OF GROUNDWATER  
APPROPRIATION BY MEANS OF WELL

Developed after January 1, 1962

(Under Chapter 237 Montana Session Laws, 1961, as amended)

This form to be prepared by driller, and three copies to be filed by the owner with the County Clerk and Recorder in the county in which the well is located, last copy to be retained by driller.

Please answer all questions. If not applicable, so state, otherwise the form may be returned.

Owner Bess Bartlett

Address Rt. 1-A

Col. Falls, Mont.

Date well started 12-15-69

completed 12-30-69

For Administrator's Use	
File	<u>14, 264</u>
	<u>April 15, 1971</u>
	<u>1:16 p.m.</u>
GW 1	

Type of well Drilled

(Caug. driven, bored or drilled)

Equipment used Omura

(Class drill, rotary or other)

Water Use: Domestic  Municipal  Stock  Irrigation

Industrial  Drainage  Other  Garden/Lawn

\*Describe \_\_\_\_\_

USE: If used for irrigation, industrial, drainage or other. Explain, state number of acres and location or other data (i.e. Lot, Block and Addition).

ESTIMATED ANNUAL WITHDRAWAL 200,000 Gal.

Size of Drilled Hole	Size and Weight of Casing	From (Feet)	To (Feet)	PERFORATIONS		
				Kind	From (Feet)	To (Feet)
<u>7" O.D.</u>	<u>7" O.D. 20#/ft.</u>	<u>0</u>	<u>178</u>	<u>Open</u>	<u>Bottom</u>	

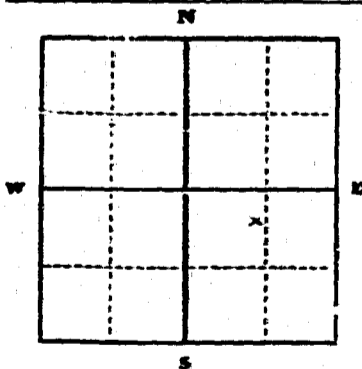

Static water level 40 ft.\*  
Pumping water level 140 ft.\*  
at 60 gallons per minute,  
measured 60 minutes after pumping  
began.  
\*Measured from ground level.  
Well developed by baller  
for 4 hours.  
Power 225 Pump 1 HP  
Remarks: (Gravel packing, cementing,  
packers, type of shutoff)

NW 1/4 SE 1/4 Sec 28  
T. 30 N. R. 20 E  
S W

INDICATE LOCATION OF WELL AND PLACE OF USE, IF POSSIBLE. EACH SMALL SQUARE REPRESENTS 40 ACRES.

Driller's Signature

Jerome J. Weber  
Col. Falls, Mont.

Driller's Address

121

LICENSE NO.

DRILLER'S LOG

Indicate the character, color, thickness of strata such as soil, clay, sand, gravel, shale, sandstone, etc. Show depth at which water is found and height to which water rises in well.

Top of Ground (Elev. above sea level) <u>3,000'</u>	
From (Feet)	To (Feet)
<u>0</u>	<u>14</u>
<u>14</u>	<u>16</u>
<u>16</u>	<u>100</u>
<u>100</u>	<u>140</u>
<u>140</u>	<u>160</u>
<u>160</u>	<u>174</u>
<u>174</u>	<u>177</u>
<u>178</u>	

178'

Show exact depth of bottom



14,264

STATE OF MONTANA  
COUNTY OF FLATHEAD  
Filed on the 15 day of April  
A.D. 1971 at 2 o'clock P.M.  
6673  
County Clerk and Recorder

By M. J. Deputy

STANDARDIZATION OF FEDERAL GOVERNMENT  
PROPERTY TO FEDERAL GOVERNMENT  
PROPERTY TO FEDERAL GOVERNMENT  
PROPERTY TO FEDERAL GOVERNMENT

Faint grid table with illegible text and numbers.

T. 30 N R. 20 W 23  
County Flathead

File No.

QUADRUPPLICATE

STATE OF MONTANA  
ADMINISTRATOR OF GROUNDWATER CODE  
OFFICE OF STATE ENGINEER

Notice of Completion of Groundwater  
Appropriation by Means of Well

(Under Chapter 237, Montana Session Laws, 1961)

Top of Ground  
(Elev. above sea level.....)

0 to 32 ft Sandy silt  
32 to 61 ft Silt  
61 to 167 ft Hard  
pan & cemented gravel  
167 to 168 ft  
Waterbearing  
gravel and sand.

Owner Byron Boes Address Columbia Falls Mont.

Driller George & Justin Address Col. Falls Mont.

Date of Notice of Appropriation of Groundwater none filed

Date well started Sept 21-70 Date Completed Sept 29-70

Type of well drilled Equipment Used Churn  
(dug, driven, bored or drilled) (Churn, drill, rotary or other)

Water Use: Domestic  Municipal  Stock  Irrigation   
Industrial  Drainage  Other

Indicate on the diagram the character and thickness of the different strata met with in drilling, such as soil, clay, shale, gravel, rock or sand, etc. Show depth at which water is encountered, thickness and character of water-bearing strata and height to which the water rises in the well.

14733  
June 28, 1973  
11:30 A.M.

Size of Drilled Hole	Size and Weight of Casing	From (Feet)	To (Feet)	PERFORATIONS		
				Kind	From (Feet)	To (Feet)
6 3/8"	7" O.D. 23 lb.	0	168	none		

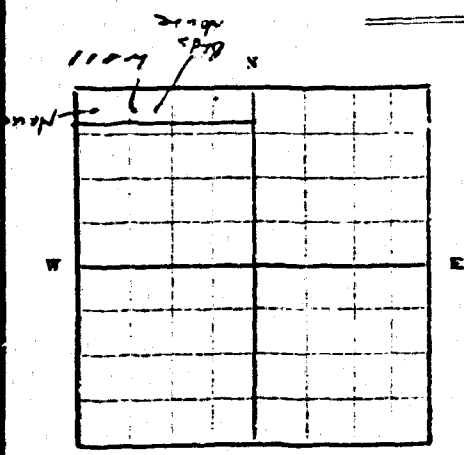

NW 1/4 Sec 28 T30N R20W  
Indicate location of well and place of use, if possible. Each small square represents 10 acres.

Show exact depth of bottom.

Static Water Level for non-flowing Well 90 feet

Shut-in Pressure for Flowing Well 700 ft. flowing

Pumping Water Level 130 feet at 20 gal. per minute.

Discharge in gal. per min. of flowing well 700 ft. flowing

How Tested Bailers Length of Test 2 hrs.

Remarks: (Gravel packing, cementing, packers, type of shutoff, location of place of use of groundwater if not at well, and any other similar pertinent information, including number of acres irrigated, if used for irrigation)

7155  
Driller's License Number  
By George & Justin  
Driller's Signature

This form to be prepared by driller, and three copies to be filed by the owner with the County Clerk and Recorder in the county in which the well is located.

Please answer all questions. If not applicable, so state, otherwise the form will be returned.

Original to the County Clerk and Recorder; duplicate to the State Engineer; Triplicate to the School of Mines and Quadruplicate for the Appropriator.

14733

STATE OF MONTANA }  
COUNTY OF FLATHEAD } SS

Filed on the 26 day of June  
A. D. 19 19 at 11 o'clock AM

MT  
County Clerk and Recorder

By [Signature]  
Deputy

STATE OF MONTANA  
ADMINISTRATOR OF GROUNDWATER CODE  
MONTANA WATER RESOURCES BOARD

NOTICE OF COMPLETION OF GROUNDWATER  
APPROPRIATION BY MEANS OF WELL

Developed after January 1, 1962

(Under Chapter 237 Montana Session Laws, 1961, as amended)

This form to be prepared by driller, and three copies to be filed by the owner with the County Clerk and Recorder in the county in which the well is located, last copy to be retained by driller.

Please answer all questions. If not applicable, so state, otherwise the form may be returned.

Owner Hester Spangness

Address St. 1st

Col. Falls, Mont.

Date well started 7-3-72

completed 7-13-72

For Administrator's Use	
File	<u>14,485</u>
	<u>Aug. 24, 1972 - 12:06 p.m.</u>
GN	

Type of well Drilled

(Caug, driven, bored or drilled)

Equipment used Charn

(Charn drill, rotary or other)

Water Use: Domestic  Municipal  Stock  Irrigation

Industrial  Drainage  Other  Garden/Lawn

\*Describe

USE: If used for irrigation, industrial, drainage or other. Explain, state number of acres and location or other data (i.e. Lot, Block and Addition).

ESTIMATED ANNUAL WITHDRAWAL 300,000 Gal.

Size of Drilled Hole	Size and Weight of Casing	From (Feet)	To (Feet)	PERFORATIONS		
				Kind Size	From (Feet)	To (Feet)
<u>65/8"</u>	<u>65/8" O.D. 0.250 wall</u>	<u>0</u>	<u>196</u>	<u>HOLES</u>		

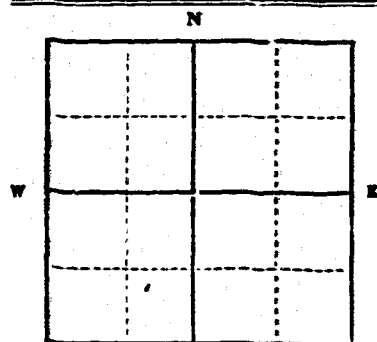

Static water level 79 ft.\*  
Pumping water level 170 ft.\*  
at 20 gallons per minute,  
measured 60 minutes after pumping  
began.

\*Measured from ground level.  
Well developed by tailor  
for 15 hours.

Power sub Pump 1 HP

Remarks: (Gravel packing, cementing, packers, type of shutoff)  
Open bottom

SE 1/4 Sec 28  
T. 30 N. R. 20 E.  
S. 27 W.

INDICATE LOCATION OF WELL AND PLACE OF USE, IF POSSIBLE. EACH SMALL SQUARE REPRESENTS 40 ACRES.

Driller's Signature [Signature]

Driller's Address P.O. Box 929, Col. Falls, Mont.

LICENSE NO. 181

DRILLER'S LOG

Indicate the character, color, thickness of strata such as soil, clay, sand, gravel, shale, sandstone, etc. Show depth at which water is found and height to which water rises in well.

Top of Ground		(Elev. above sea level) <u>3,000</u>
From (Feet)	To (Feet)	
<u>0</u>	<u>2</u>	<u>Top Soil</u>
<u>2</u>	<u>7</u>	<u>Brown Sand</u>
<u>7</u>	<u>25</u>	<u>Brown Sand Seepage</u>
<u>25</u>	<u>145</u>	<u>Gray Sandy Clay</u>
		<u>Some Cobble</u>
<u>145</u>	<u>180</u>	<u>Same as Above with some seepage</u>
<u>180</u>	<u>182</u>	<u>oulders in cemented clay</u>
<u>182</u>	<u>196</u>	<u>Cemented gravel with an extremely large amount of silt</u>
		<u>Last 6" of drilling showed a increase in clay - last gravel</u>

196 Show exact depth of bottom