

County Flathead 5

STATE OF MONTANA  
ADMINISTRATOR OF GROUNDWATER CODE  
MONTANA WATER RESOURCES BOARD  
**NOTICE OF COMPLETION OF GROUNDWATER  
APPROPRIATION BY MEANS OF WELL**

Developed after January 1, 1962

(Under Chapter 237 Montana Session Laws, 1961, as amended)

This form to be prepared by driller, and three copies to be filed by the owner with the County Clerk and Recorder in the county in which the well is located, last copy to be retained by driller. Please answer all questions. If not applicable, so state, otherwise the form may be returned.

Owner Klaus Heinrich

Address White Fish  
Montana

Date well started July 26, 1971  
completed Aug. 16, 1971

Type of well Drilled

Equipment used Drill

Water Use: Domestic  Municipal  Stock  Irrigation

Industrial  Drainage  Other  Garden/Lawn

\*Describe

USE: If used for irrigation, industrial, drainage or other. Explain, state number of acres and location or other data (i.e. Lot, Block and Addition).

ESTIMATED ANNUAL WITHDRAWAL 300,000 gal

Size of Drilled Hole	Size and Weight of Casing	From (Feet)	To (Feet)	PERFORATIONS		
				Kind Size	From (Feet)	To (Feet)
<u>7"</u>	<u>7" OD</u> <u>20#</u>	<u>0</u>	<u>232</u>	<u>X</u>	<u>X</u>	<u>X</u>

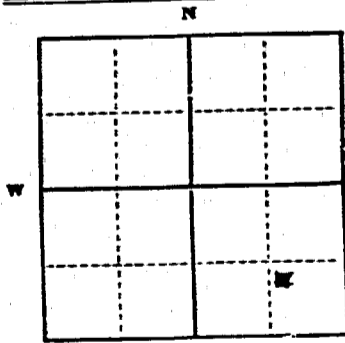

SE 1/4 SE 1/4 Sec. 5  
T. 30 N. R. 21 E.  
5 W

INDICATE LOCATION OF WELL AND PLACE OF USE, IF POSSIBLE. EACH SMALL SQUARE REPRESENTS 40 ACRES.

Driller's Signature Archie Hendrickson

Driller's Address Route 3, Kalispell

Montana 59901 LICENSE NO. 153

DRILLER'S LOG

Indicate the character, color, thickness of strata such as soil, clay, sand, gravel, shale, sandstone, etc. Show depth at which water is found and height to which water rises in well.

Top of Ground (Elev. above sea level) 3050

From (Feet)	To (Feet)	Description
<u>0</u>	<u>18</u>	<u>Yellow Clay</u>
<u>18</u>	<u>140</u>	<u>Clay and Silt</u>
<u>75</u>		<u>Static Water Level</u>
<u>140</u>	<u>152</u>	<u>Blue Clay</u>
<u>152</u>	<u>192</u>	<u>Blue Clay and Stone</u>
<u>192</u>	<u>228</u>	<u>Water found Blue Clay and Gravel</u>
<u>228</u>	<u>232</u>	<u>Gravel</u>

232' Show exact depth of bottom

14,726  
Same will as  
# 14725

STATE OF MONTANA (SS)  
COUNTY OF FLATHEAD

Filed on the 25 day of June  
A. D. 1913 at 11:57 o'clock A. M.

W. J. [Signature]  
Clerk and Recorder

By [Signature] Deputy

County Flathead

STATE OF MONTANA  
ADMINISTRATOR OF GROUNDWATER CODE  
OFFICE OF STATE ENGINEER

Notice of Completion of Groundwater  
Appropriation by Means of Well

(Under Chapter 237, Montana Session Laws, 1961)

Top of Ground  
(Elev. above sea level \_\_\_\_\_)  
0 to 190' Silt  
190 to 204' Silt  
with some gravel.  
204 to 210 ft  
Hard packed gravel  
and sand with  
seep water.  
210 to 211 ft  
Waterbearing  
gravel & sand.

Owner Anton Rambur Address Whitefish Mont.  
Driller Oliver & Justus Address Columbia Falls  
Date of Notice of Appropriation of Groundwater None filed  
Date well started Nov 14, 1964 Date Completed Nov 19, 1964  
Type of well Drilled Equipment Used Churn  
(dug, driven, bored or drilled) (Churn, drill, rotary or other)  
Water Use: Domestic  Municipal  Other  Irrigation   
Industrial  Drainage  Stock

Indicate on the diagram the character and thickness of the different strata met with in drilling, such as soil, clay, shale, gravel, rock or sand, etc. Show depth at which water is encountered, thickness and character of water-bearing strata and height to which water rises in the well.

Size of Drilled Hole	Size and Weight of Casing	From (Feet)	To (Feet)	PERFORATIONS		
				Kind Size	From (Feet)	To (Feet)
7"	7" O.D. 23 lbs per ft	0	211	None		

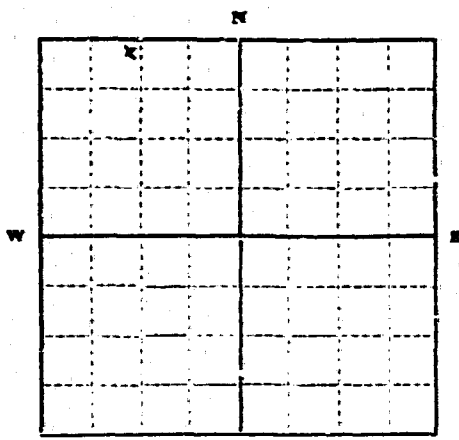

N (W) NW Sec. 5 T. 30 R. 21  
Indicate location of well and place of use, if possible. Each small square represents 10 acres.

Show exact depth of bottom.

Static Water Level for non-flowing Well 66 feet.  
Shut-in Pressure for Flowing Well non flowing  
Pumping Water Level 130 feet at 10 gal. per minute.  
Discharge in gal. per min. of flowing well non flowing  
How Tested Bailer Length of Test 3 hrs  
Remarks: (Gravel packing, cementing, packer, type of shutoff, location of place of use of groundwater if not at well, and any other similar pertinent information, including number of acres irrigated, if used for irrigation)

all measurements from existing ground surface.

no 55  
Driller's License Number  
Oliver & Justus  
Driller's Signature

This form to be prepared by driller, and three copies to be filed by the owner with the County Clerk and Recorder in the county in which the well is located.

Please answer all questions. If not applicable, so state, otherwise the form will be returned.

Original to the County Clerk and Recorder; duplicate to the State Engineer; Triplicate to the Montana Bureau of Mines and Geology and Quadruplicate for the Appropriator

39323

11,834

SALES TAX RECEIPT  
COUNTY OF ...  
Date of Sale 9<sup>th</sup> June  
65 No. 587  
M. J.

STATE OF MONTANA  
ADMINISTRATOR OF GROUNDWATER CODE  
OFFICE OF STATE ENGINEER

Declaration of Vested Groundwater Rights

(Under Chapter 237, Montana Session Laws, 1961)

RECEIVED  
JAN 6 1964  
STATE ENGINEER

1. CLARENCE BERYL CONGER of Box 221 WHITEFISH, MONTANA.  
(Name of Appropriator) (Address) (Town)  
County of FLATHEAD State of MONTANA.  
have appropriated groundwater according to the Montana laws in effect prior to January 1, 1962, as follows:

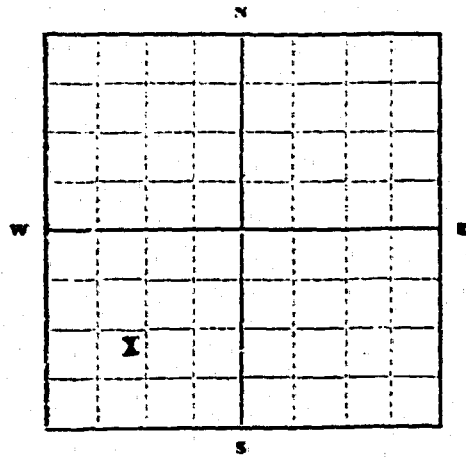

1/31/64 Sec. 7 T. 30 R. 21

Indicate point of appropriation and place of use, if possible. Each small square represents 10 acres.

2. The beneficial use on which the claim is based Domestic household and livestock

3. Date or approximate date of earliest beneficial use; and how continuous the use has been. September 1948, used for household livestock continuously since above date.

4. The amount of groundwater claimed (in miner's inches or gallons per minute) approximately 150,000 gallons per year.

5. If used for irrigation, give the acreage and description of the lands to which water has been applied and name of the owner thereof no irrigation system.

6. The means of withdrawing such water from the ground and the location of each well or other means of withdrawal Electric pump, capacity of 350 gal per hr.

7. The date of commencement and completion of the construction of the well, wells, or other works for withdrawal of groundwater 1953 July.

8. The depth of water table 5 feet

9. So far as it may be available, the type, size and depth of each well or the general specifications of any other works for the withdrawal of groundwater 1 hp electric centrifugal pump, depth of well 3 feet.

10. The estimated amount of groundwater withdrawn each year 150,000 gallons

11. The log of formations encountered in the drilling of each well if available concrete cased dug well.

12. Such other information of a similar nature as may be useful in carrying out the policy of this act, including reference to book and page of any county record none

Signature of Owner Clarence Beryl Conger  
Date December 27, 1963

Three copies to be filed by the owner with the County Clerk and Recorder of the county in which the well is located.

Please answer all questions. If not applicable, so state, otherwise the form will be returned.

Original to the County Clerk and Recorder; duplicate to the State Engineer; Triplicate to the Montana Bureau of Mines and Geology; and Quadruplicate for the Appropriator.

10, 305

110

STATE OF MONTANA  
COUNTY OF FLAHERTY SS

Filed on 27 day of Dec  
A.D. 1963 at 2:49 o'clock P.M

S.E.M.  
County Clerk and Recorder

By M.J.  
Deputy

STATE OF MONTANA  
ADMINISTRATOR OF GROUNDWATER CODE  
OFFICE OF STATE ENGINEER

Declaration of Vested Groundwater Rights

(Under Chapter 237, Montana Session Laws, 1961)

RECEIVED  
DEC 30 1963

STATE ENGINEER

1. *Vonda Hauke*  
*Mrs. Otto Hauke* of *Box 195* *Whitefish*  
(Name of Appropriator) (Address) (Town)  
County of *Flathead* State of *Montana*

have appropriated groundwater according to the Montana laws in effect prior to January 1, 1962, as follows:

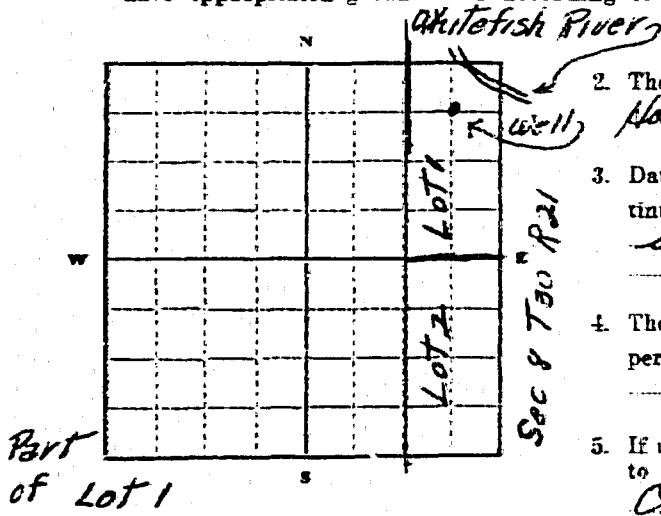

- 2. The beneficial use on which the claim is based *domestic use, house hold, garden and watering stock*
- 3. Date or approximate date of earliest beneficial use; and how continuous the use has been *Jan. 15, 1959 and used continuously since*
- 4. The amount of groundwater claimed (in miner's inches or gallons per minute) *at least 1000 gallons a day*
- 5. If used for irrigation, give the acreage and description of the lands to which water has been applied and name of the owner thereof *Only for garden and lawn irrigation*
- 6. The means of withdrawing such water from the ground and the location of each well or other means of withdrawal *Electric pump*

- 7. The date of commencement and completion of the construction of the well, wells, or other works for withdrawal of groundwater *Started Nov. 25, 1958 and finished Jan. 15, 1959*
- 8. The depth of water table *151' but tested contaminated 200' good water*
- 9. So far as it may be available, the type, size and depth of each well or the general specifications of any other works for the withdrawal of groundwater *drilled well 7" 259ft deep*
- 10. The estimated amount of groundwater withdrawn each year *365,000 gallons*
- 11. The log of formations encountered in the drilling of each well if available *Sand - Clay & gravel 151 ft. lot of water but contaminated to 200 ft. with some clay 200 ft. good gravel bearing formation*
- 12. Such other information of a similar nature as may be useful in carrying out the policy of this act, including reference to book and page of any county record.

Signature of Owner *Vonda Hauke*  
*Mrs. Otto Hauke*  
Date *12-16-63*

Three copies to be filed by the owner with the County Clerk and Recorder of the county in which the well is located.  
Please answer all questions. If not applicable, so state, otherwise the form will be returned.  
Original to the County Clerk and Recorder; duplicate to the State Engineer; Triplicate to the Montana Bureau of Mines and Geology; and Quadruplicate for the Appropriator.

10 odo

COUNTY OF PLAINFIELD, N.J.

Witnessed on the 18 day of Dec  
A.D. 1963 at 10:00 o'clock A.M.

JEM

County Clerk and Recorder

By



Deputy



STATE OF MONTANA  
ADMINISTRATOR OF GROUNDWATER CODE  
OFFICE OF STATE ENGINEER

Declaration of Vested Groundwater Rights

(Under Chapter 237, Montana Session Laws 1961)

RECEIVED  
DEC 10 1963

STATE ENGINEER

I GEORGE W. DUFFY of BOX 6 WHITEFLSH  
(Name of Appropriator) (Address) (Town)  
County of FLATHEAD State of MONTANA

have appropriated groundwater according to the Montana laws in effect prior to January 1, 1962, as follows:

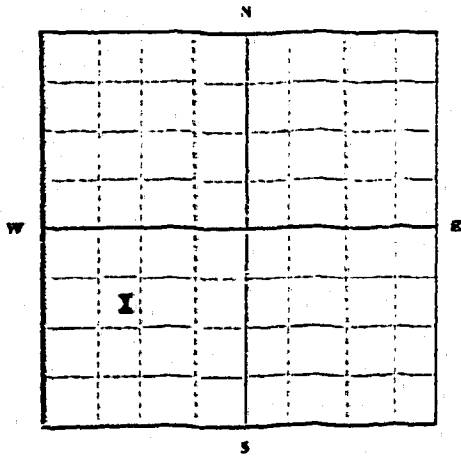

SE 1/4 Sec. 8 T. 30 R. 21

Indicate point of appropriation and place of use, if possible. Each small square represents 10 acres.

2. The beneficial use on which the claim is based General household and laundry use.
3. Date or approximate date of earliest beneficial use; and how continuous the use has been September 1945, continuous daily use since that date.
4. The amount of groundwater claimed (in miner's inches or gallons per minute) intermittent use at rate of 10 gallons per minute.
5. If used for irrigation, give the acreage and description of the lands to which water has been applied and name of the owner thereof Garden and orchard adjacent to dwelling consisting of about 1 acre.
6. The means of withdrawing such water from the ground and the location of each well or other means of withdrawal by use of subsurface pump.
7. The date of commencement and completion of the construction of the well, wells, or other works for withdrawal of groundwater September 1945.
8. The depth of water table 96 feet.
9. So far as it may be available, the type, size and depth of each well or the general specifications of any other works for the withdrawal of groundwater deep well, 253 feet, 6 inch steel casing to 175 feet reduced to 5 inch next 78 feet
10. The estimated amount of groundwater withdrawn each year 350,000 gallons
11. The log of formations encountered in the drilling of each well if available fine glacial silt of a light blue color with an occasional boulder. One rock eight feet in diameter at about 160 feet. Water bearing gravel up to 1/2 inch the last 3 feet. Very good water with little or no draw-down, Hardness of 17
12. Such other information of a similar nature as may be useful in carrying out the policy of this act, including reference to book and page of any county record.

Signature of Owner George W. Duffy  
Date Dec 5, 1963

Three copies to be filed by the owner with the County Clerk and Recorder of the county in which the well is located.

Please answer all questions. If not applicable, so state, otherwise the form will be returned.

Original to the County Clerk and Recorder; duplicate to the State Engineer; Triplicate to the Montana Bureau of Mines and Geology and Quadruplicate for the Appropriator.

9963

STATE OF MONTANA )  
COUNTY OF FLATHEAD ) SS

Filed on the 6 day of Dec  
A. D. 1913 at 12 o'clock PM

SEM  
County Clerk and Recorder

By M. J.  
Deputy

File No. \_\_\_\_\_

GW 4

T 30 N R 21 W

County Flathead

STATE OF MONTANA  
ADMINISTRATOR OF GROUNDWATER CODE  
OFFICE OF STATE ENGINEER

RECEIVED  
OCT 15 1963

Declaration of Vested Groundwater Rights STATE ENGINEER

(Under Chapter 237, Montana Session Laws, 1961)

1. C. W. Kallner of Box 835 Whitefish  
(Name of Appropriator) (Address) (Town)  
County of Flathead State of Montana  
have appropriated groundwater according to the Montana laws in effect prior to January 1, 1962, as follows:

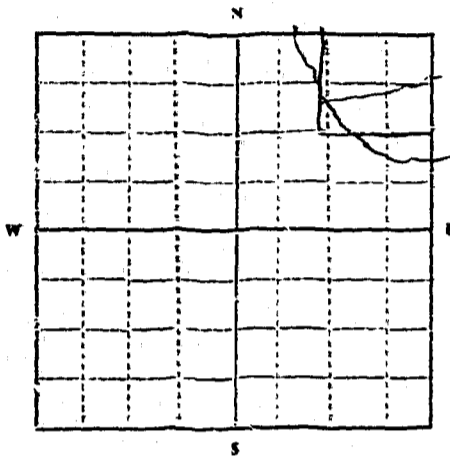

SW 1/4 NE 1/4 Sec 8 T30N R21W

Indicate point of appropriation and place of use, if possible. Each small square represents 10 acres.

2. The beneficial use on which the claim is based is  
household and stock watering

3. Date or approximate date of earliest beneficial use; and how continuous the use has been June, 1932; Use has been  
continuous

4. The amount of groundwater claimed (in miner's inches or gallons per minute) 200 gallons per minute

5. If used for irrigation, give the acreage and description of the lands to which water has been applied and name of the owner thereof  
Not so used

6. The means of withdrawing such water from the ground and the location of each well or other means of withdrawal  
Pump and pipe and well

7. The date of commencement and completion of the construction of the well, wells, or other works for withdrawal of groundwater June 1932

8. The depth of water table 15 feet

9. So far as it may be available, the type, size and depth of each well or the general specifications of any other works for the withdrawal of groundwater  
A dug well, 36 inches by 36 inches

10. The estimated amount of groundwater withdrawn each year 40,000 gallons

11. The log of formations encountered in the drilling of each well if available four inches of  
topsoil, the remainder is clay and sand, primarily clay

12. Such other information of a similar nature as may be useful in carrying out the policy of this act, including reference to book and page of any county record

Signature of Owner C. W. Kallner

Date October 5, 1963

Three copies to be filed by the owner with the County Clerk and Recorder of the county in which the well is located.

Please answer all questions. If not applicable, so state, otherwise the form will be returned.

Original to the County Clerk and Recorder; duplicate to the State Engineer; Triplicate to the Montana Bureau of Mines and Geology and Quadruplicate for the Appropriator.

9884

STATE OF MONTANA SS  
COUNTY OF FLATHEAD

Filed on the 9<sup>th</sup> day of Oct  
A. D. 1963 at 3<sup>00</sup> o'clock P. M.

687  
County Clerk and Recorder

By M. J.  
Deputy

File No. \_\_\_\_\_

GW 4

T 20N R 21W 8

County \_\_\_\_\_

STATE OF MONTANA  
ADMINISTRATOR OF GROUNDWATER CODE  
OFFICE OF STATE ENGINEER

RECEIVED  
JAN 6 1964

Declaration of Vested Groundwater Rights STATE ENGINEER

(Under Chapter 237, Montana Session Laws, 1961)

1. David W. Hedger M. Morris of P.O. Box 554 Whitefish  
(Name of Appropriator) (Address) (Town)  
County of Flathead State of Montana  
have appropriated groundwater according to the Montana laws in effect prior to January 1, 1962, as follows:

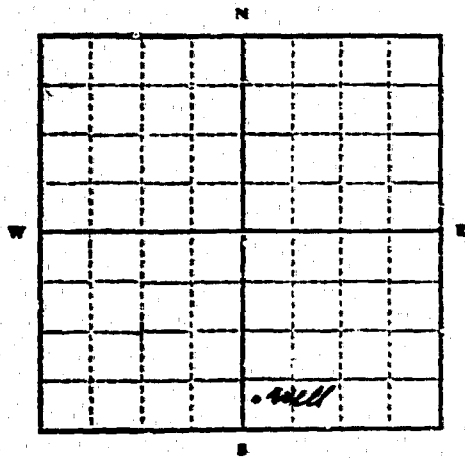

SW SE Sec 8 T0 R1

Indicate point of appropriation and place of use, if possible. Each small square represents 10 acres.

2. The beneficial use on which the claim is based House & Stock

3. Date or approximate date of earliest beneficial use and how continuous the use has been 1947 - present

4. The amount of groundwater claimed (in miner's inches or gallons per minute) 17 gal

5. If used for irrigation, give the acreage and description of the lands to which water has been applied and name of the owner thereof

6. The means of withdrawing such water from the ground and the location of each well or other means of withdrawal Electric Pump

7. The date of commencement and completion of the construction of the well, wells, or other works for withdrawal of groundwater 1947

8. The depth of water table 40 ft

9. So far as it may be available, the type, size and depth of each well or the general specifications of any other works for the withdrawal of groundwater Drilled 4' casing 2 1/2" pipe

10. The estimated amount of groundwater withdrawn each year 70,000 gal

11. The log of formations encountered in the drilling of each well if available

12. Such other information of a similar nature as may be useful in carrying out the policy of this act, including reference to book and page of any county record

Signature of Owner David W. Hedger M. Morris  
12-30-63

Date \_\_\_\_\_

Three copies to be filed by the owner with the County Clerk and Recorder of the county in which the well is located.

Please answer all questions. If not applicable, so state, otherwise the form will be returned.

Original to the County Clerk and Recorder; Duplicate to the State Engineer; Triplicate to the Montana Bureau of Mines and Geology; and Quadruplicate for the Appropriator.

23041

10868

COUNTY OF HARRIS, TEXAS  
On the 31 day of Dec  
A.D. 1963 at 12 o'clock P.M.  
J. C. M.  
County Clerk and Recorder  
By J. J. H. Deputy

File No. \_\_\_\_\_

GW 4

T. N. 31 W. 8

County \_\_\_\_\_

STATE OF MONTANA  
ADMINISTRATOR OF GROUNDWATER CODE  
OFFICE OF STATE ENGINEER

RECEIVED  
DEC 30 1963

Declaration of Vested Groundwater Rights

(Under Chapter 237, Montana Session Laws, 1961)

STATE ENGINEER

1. FLOYD A. PAYNE of PT. 1. B. COLUMBIA FALLS  
(Name of Appropriator) (Address) (Town)

County of FLATHEAD State of MONTANA

have appropriated groundwater according to the Montana laws in effect prior to January 1, 1962, as follows:

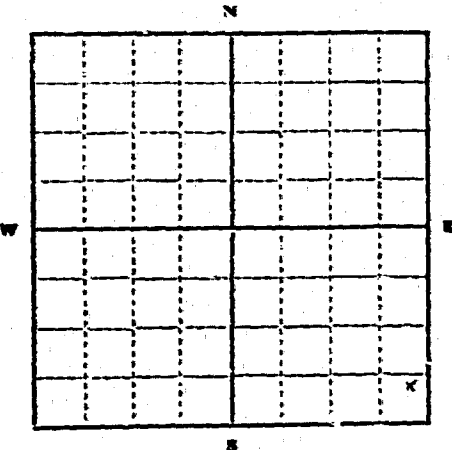

SE 1/4 Sec. 8 T26 R91

Indicate point of appropriation and place of use, if possible. Each small square represents 10 acres.

2. The beneficial use on which the claim is based HOUSEHOLD, STREET, GARDEN

3. Date or approximate date of earliest beneficial use; and how continuous the use has been NATURAL SPRING

4. The amount of groundwater claimed (in cubic inches or gallons per minute) 500

5. If used for irrigation, give the acreage and description of the lands to which water has been applied and name of the owner thereof GARDEN

6. The means of withdrawing such water from the ground and the location of each well or other means of withdrawal PRESSURE PUMP

7. The date of commencement and completion of the construction of the well, wells, or other works for withdrawal of groundwater.

8. The depth of water table. 15 FEET

9. So far as it may be available, the type, size and depth of each well or the general specifications of any other works for the withdrawal of groundwater. PRESSURE PUMP

10. The estimated amount of groundwater withdrawn each year. 300,000 GALLONS

11. The log of formations encountered in the drilling of each well if available. HEAVY CLAY

12. Such other information of a similar nature as may be useful in carrying out the policy of this act, including reference to book and page of any county record.

Signature of Owner Floyd A. Payne

Date 12-17-1963

Three copies to be filed by the owner with the County Clerk and Recorder of the county in which the well is located.

Please answer all questions. If not applicable, so state, otherwise the form will be returned.

Original to the County Clerk and Recorder; duplicate to the State Engineer; Triplicate to the Montana Bureau of Mines and Geology and Quadruplicate for the Appropriator.

10,056

STATE OF MONTANA - SS  
COUNTY OF FLAHEAD

Filed on the 18 day of Dec  
A.D. 19 63 at 5:02 o'clock P.M

JEM  
County Clerk and Recorder

By [Signature] Deputy



File No. \_\_\_\_\_

GW 4

T. 30 N R. 31 W  
County Flathead

STATE OF MONTANA  
ADMINISTRATOR OF GROUNDWATER CODE  
OFFICE OF STATE ENGINEER

RECEIVED  
DEC 17 1963  
STATE ENGINEER

Declaration of Vested Groundwater Rights

(Under Chapter 237, Montana Session Laws, 1961)

I, Alfred or Gelda Walter of Whitefish  
(Name of Appropriator) (Address) (Town)  
County of Flathead State of Montana  
have appropriated groundwater according to the Montana laws in effect prior to January 1, 1962, as follows:

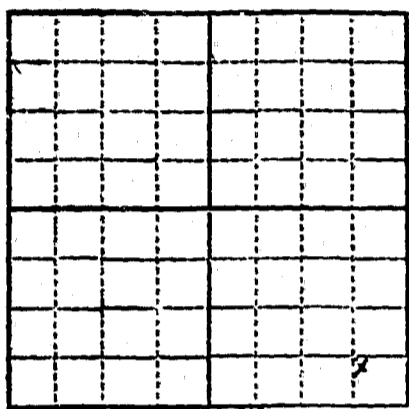

F2 NE 4 SW 4  
EA E2  
NW 1/4 Sec 6 T30 R21

Indicate point of appropriation and place of use, if possible. Each small square represents 10 acres.

- 2. The beneficial use on which the claim is based household use farm use, stock when we have it, none at present
- 3. Date or approximate date of earliest beneficial use; and how continuous the use has been 1935 and continuously to 1960 approximately one half of time since
- 4. The amount of groundwater claimed (in miner's inches or gallons per minute) 5 gal.
- 5. If used for irrigation, give the acreage and description of the lands to which water has been applied and name of the owner thereof no
- 6. The means of withdrawing such water from the ground and the location of each well or other means of withdrawal electric pump

- 7. The date of commencement and completion of the construction of the well, wells, or other works for withdrawal of groundwater 1935
- 8. The depth of water table 40 feet
- 9. So far as it may be available, the type, size and depth of each well or the general specifications of any other works for the withdrawal of groundwater dry well 40 ft deep
- 10. The estimated amount of groundwater withdrawn each year not known
- 11. The log of formations encountered in the drilling of each well if available not available
- 12. Such other information of a similar nature as may be useful in carrying out the policy of this act, including reference to book and page of any county record.

Signature of Owner Alfred Walter  
Gelda Walter  
Date Dec 12, 1963

Three copies to be filed by the owner with the County Clerk and Recorder of the county in which the well is located.

Please answer all questions. If not applicable, so state, otherwise the form will be returned.

Original to the County Clerk and Recorder; duplicate to the State Engineer; Triplicate to the Montana Bureau of Mines and Geology; and Quaduplicate for the Appropriator.

9622

4991

STATE OF MONTANA : SS  
COUNTY OF FLAIBAND

Filed on the 12 day of Dec  
A.D. 1943 at 1:00 o'clock P.M.

*REM*  
County Clerk and Recorder

By *[Signature]* Deputy

F. No. \_\_\_\_\_

County Flathead

TRIPPLICATE

STATE OF MONTANA  
ADMINISTRATOR OF GROUNDWATER CODE  
OFFICE OF STATE ENGINEER

**Notice of Completion of Groundwater  
Appropriation by Means of Well** ENGINEER

(Under Chapter 237, Montana Session Laws, 1961)

Top of Ground  
(Elev. above sea level 2950)

3 Feet Top Soil  
22 Feet Sandy Clay  
35 Feet Gravel and Boulders  
Cement Gravel  
110' some Water  
118' Water Bearing Gravel

180 Feet

Owner James C. Doyle Address Rte. 1, Whitefish, Mont.  
Driller Homer Mc Clarty Address 945-6th Ave. West Kalispell, Montana  
Date of Notice of Appropriation of Groundwater Nov. 3, 1963  
Date well started Nov. 13, 1963 Date Completed Nov. 22, 1963  
Type of well Drilled Equipment Used Dellner  
(dug, driven, bored or drilled) (Churn, drill, rotary or other)  
Water Use: Domestic  Municipal  Stock  Irrigation   
Industrial  Drainage  Other

Indicate on the diagram the character and thickness of the different strata met with in drilling, such as soil, clay, shale, gravel, rock or sand, etc. Show depth at which water is encountered, thickness and character of water-bearing strata and height to which the water rises in the well.

Size of Drilled Hole	Size and Weight of Casing	From (Feet)	To (Feet)	PERFORATIONS		
				Kind Size	From (Feet)	To (Feet)
7" $\text{OD}$	2 3/4"		118'			

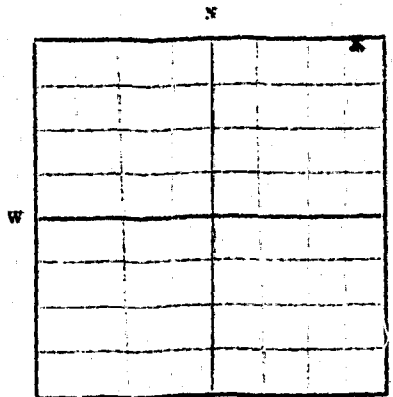

Indicate location of well and place of use, if possible. Each small square represents 10 acres.

Show exact depth of bottom.  
180 Feet

Static Water Level for non-flowing Well 93 feet.  
Shut-in Pressure for Flowing Well None  
Pumping Water Level 21 feet at 12 gal. per minute.  
Discharge in gal. per min. of flowing well \_\_\_\_\_  
How Tested Bailer Length of Test 1 1/2 Hrs.  
Remarks: (Gravel packing, cementing, packers, type of shutoff, location of place of use of groundwater if not at well, and any other similar pertinent information, including number of acres irrigated, if used for irrigation)  
3 Acres

18  
Driller's License Number  
Homer Mc Clarty  
Driller's Signature

This form to be prepared by driller, and three copies to be filed by the owner with the County Clerk and Recorder in the county in which the well is located.  
Please answer all questions. If not applicable, so state, otherwise the form will be returned.  
Original to the County Clerk and Recorder; duplicate to the State Engineer; Triplicate to the School of Mines and Quadruplicate for the Appropriator.

26702

11114

CLERK OF THE COURT  
COUNTY OF HAWAII, SS  
This on the 2 day of Jan  
A.D. 1967 at 1:00 o'clock P.M.  
L. B. W.  
Clerk and Recorder  
Deputy

111

File No. 2012

MONTANA WATER RESOURCES BOARD  
**RECEIVED** GW 2

T 70 R 21 9  
County Flathead

SEP 8 1967

STATE OF MONTANA  
ADMINISTRATOR OF GROUNDWATER CODE  
OFFICE OF STATE ENGINEER

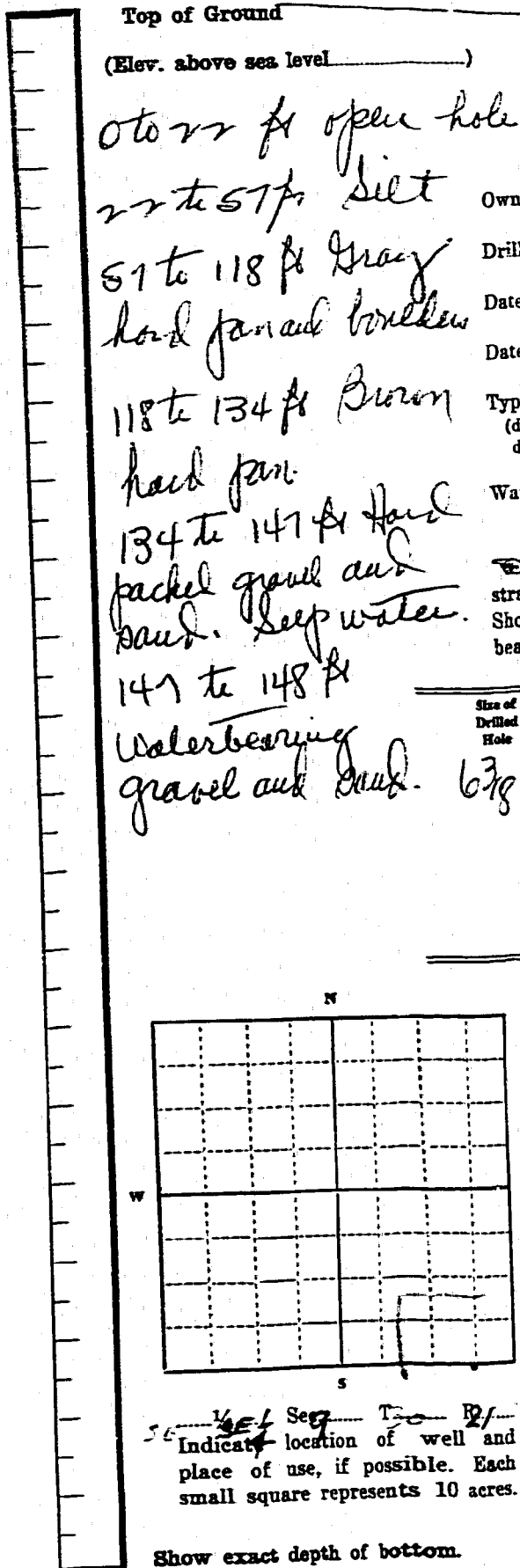

### Notice of Completion of Groundwater Appropriation by Means of Well

(Under Chapter 237, Montana Session Laws, 1961)

Owner Ray A. Neek Address Columbia Falls RD 1  
 Driller Allen & Justice Address Columbia Falls  
 Date of Notice of Appropriation of Groundwater none filed  
 Date well started July 18-67 Date Completed July 26-67  
 Type of well drilled Equipment Used Churn  
 (dug, driven, bored or drilled) (Churn, drill, rotary or other)

Water Use: Domestic  Municipal  Other  Irrigation   
 Industrial  Drainage  Stock

Indicate on the diagram the character and thickness of the different strata met with in drilling, such as soil, clay, shale, gravel, rock or sand, etc. Show depth at which water is encountered, thickness and character of water-bearing strata and height to which water rises in the well.

Size of Drilled Hole	Size and Weight of Casing	From (Feet)	To (Feet)	PERFORATIONS		
				Kind Size	From (Feet)	To (Feet)
6 3/8	7" OD 23-lbs per ft	6	148	none		

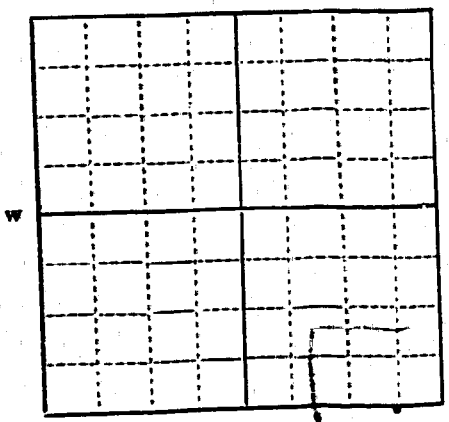

Indicate location of well and place of use, if possible. Each small square represents 10 acres.

Show exact depth of bottom.

Static Water Level for non-flowing Well 60 feet.  
 Shut-in Pressure for Flowing Well non-flowing  
 Pumping Water Level 134 feet at 8 gal. per minute.  
 Discharge in gal. per min. of flowing well non-flowing  
 How Tested Bailer Length of Test 3 hrs

Remarks: (Gravel packing, cementing, packers, type of shutoff, location of place of use of groundwater if not at well, and any other similar pertinent information, including number of acres irrigated, if used for irrigation)

All measurements from existing ground level.

70055  
 Driller's License Number  
Allen & Justice  
 Driller's Signature

This form to be prepared by driller, and three copies to be filed by the owner with the County Clerk and Recorder in the county in which the well is located.  
 Please answer all questions. If not applicable, so state, otherwise the form will be returned.  
 Original to the County Clerk and Recorder; duplicate to the State Engineer; Triplicate to the Montana Bureau of Mines and Geology and Quadruplicate for the Appropriator.

42,282

12971

17 Aug 67 3:13 PM  
Dem  
J

STATE OF MONTANA  
ADMINISTRATOR OF GROUNDWATER CODE  
OFFICE OF STATE ENGINEER

Declaration of Vested Groundwater Rights

(Under Chapter 237, Montana Session Laws, 1961)

Roy A. & Betty Jo Nock of Rt. 1-B Columbia Falls  
(Name of Appropriator) (Address) (Town)  
County of Flathead State of Montana

have appropriated groundwater according to the Montana laws in effect prior to January 1, 1962, as follows:

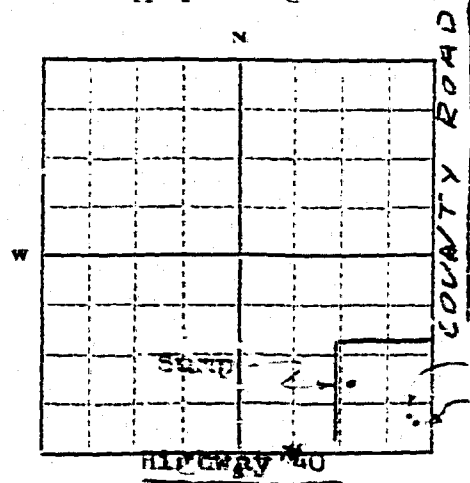

SE 1/4 Sec 9 T 30 R 21

Indicate point of appropriation and place of use, if possible. Each small square represents 10

Electric pump. Front well, 173 ft. north #40, 129 ft. west Co. road. Rear well, 232 ft. north #40, 129 ft. west Co. road. Sump, approx. 700 ft. north #40, approx. 1250 ft. west Co. road

7. The date of commencement and completion of the construction of the well, wells, or other works for withdrawal of groundwater. Front well, July 1959. Rear well and sump, date unknown

8. The depth of water table. Front well, 14'6". Rear well, 11'0". Sump, 4'0".

9. So far as it may be available, the type, size and depth of each well or the general specifications of any other works for the withdrawal of groundwater. Front well 30 inch casing by 22'0" deep. Rear well 30 inch casing by 22'0" deep. Sump Approx. 6 ft. square by 3 ft. deep.

10. The estimated amount of groundwater withdrawn each year. 30000

11. The log of formations encountered in the drilling of each well if available. UNKNOWN TO ME.

12. Such other information of a similar nature as may be useful in carrying out the policy of this act, including reference to book and page of any county record. UNKNOWN TO ME.

Signature of Owner Roy A. Nock  
Betty Jo Nock  
Date Dec. 22, 1955

Three copies to be filed by the owner with the County Clerk and Recorder of the county in which the well is located. Please answer all questions. If not applicable, so state, otherwise the form will be returned.

Original to the County Clerk and Recorder; duplicate to the State Engineer; Triplicate to the Montana Bureau of Mines and Geology and Quadruplicate for the Appropriator.

40661

11,937

21 Dec  
65 3<sup>rd</sup> P  
GEM  
J. I.



File No \_\_\_\_\_

T 30 N R 21 W 9

County FLATHEAD

DUPLICATE

STATE OF MONTANA  
ADMINISTRATOR OF GROUNDWATER CODE  
OFFICE OF STATE ENGINEER

Notice of Completion of Groundwater  
Appropriation by Means of Well

(Under Chapter 237, Montana Session Laws, 1961)

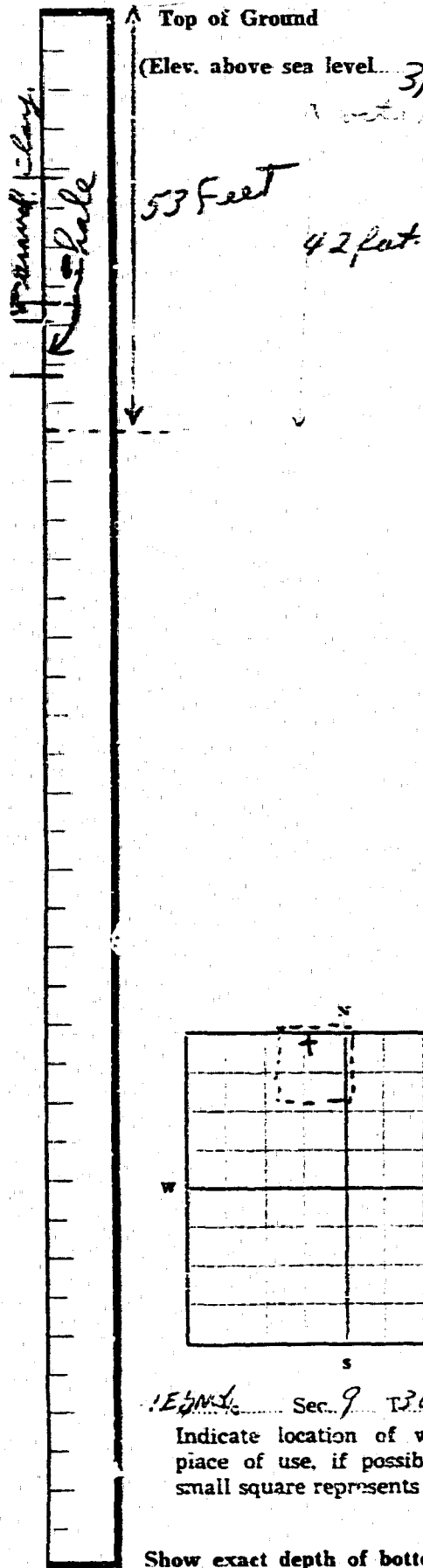

Owner R.E. Sherlock Address RT 1 Whitefish  
 Driller R.E. Sherlock Address RT 1 Whitefish  
 Date of Notice of Appropriation of Groundwater 12-27-63  
 Date well started June 4-1963 Date Completed July 10-1963  
 Type of well Driven Equipment Used Churn  
 (dug, driven, bored or (Churn, drill, rotary or  
 or cased) other)  
 Water Use: Domestic  Municipal  Stock  Irrigation   
 Industrial  Drainage  Other

Indicate on the diagram the character and thickness of the different strata met with in drilling, such as soil, clay, shale, gravel, rock or sand, etc. Show depth at which water is encountered, thickness and character of water-bearing strata and height to which the water rises in the well.

Size of Drilled Hole	Size and Weight of Casing	From (Feet)	To (Feet)	PERFORATIONS		
				Kind Size	From (Feet)	To (Feet)
6"	6" 19 lb.		53'	none	none	none

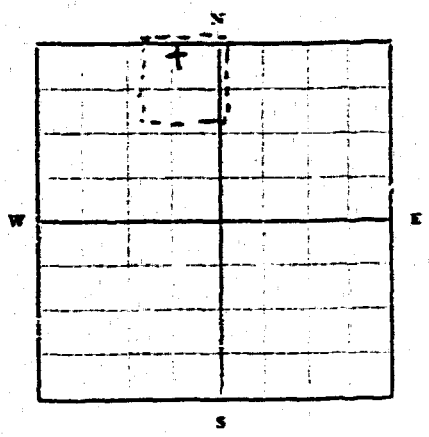

Sec. 9 T30N R21W  
Indicate location of well and place of use, if possible. Each small square represents 10 acres.

Static Water Level for non-flowing Well 40 Feet feet.  
 Shut-in Pressure for Flowing Well non flowing  
 Pumping Water Level 10 feet feet at 3 gal. per minute.  
 Discharge in gal. per min. of flowing well non flowing  
 How Tested wickler Length of Test 2 Days  
 Remarks: (Gravel packing, cementing, packers, type of shutoff, location of place of use of groundwater if not at well, and any other similar pertinent information, including number of acres irrigated, if used for irrigation)

Show exact depth of bottom.

not applicable  
 Driller's License Number  
R.E. Sherlock  
 Driller's Signature

This form to be prepared by driller, and three copies to be filed by the owner with the County Clerk and Recorder in the county in which the well is located.

Please answer all questions. If not applicable, so state. otherwise the form will be returned.

Original to the County Clerk and Recorder; duplicate to the State Engineer; Triplicate to the School of Mines and Quadruplicate for the Appropriator.

30954

1118

STATE OF OHIO  
COUNTY OF PLAIN

Filed on the 8 day of Jan  
A.D. 1914 at 1:15 o'clock P.M.

L. G. W.

County Clerk and Recorder

By

*[Signature]*

Deputy

F. No. \_\_\_\_\_

GW # \_\_\_\_\_

30 N 2 W 9

County Flathead

STATE OF MONTANA  
ADMINISTRATOR OF GROUNDWATER CODE  
OFFICE OF STATE ENGINEER

RECEIVED  
DEC 30 1963

Declaration of Vested Groundwater Rights

(Under Chapter 237, Montana Session Laws, 1961) STATE ENGINEER

I, John Kergul of Route 1-B Columbia Falls  
(Name of Appropriator) (Address) (Town)  
County of Flathead State of Montana  
have appropriated groundwater according to the Montana laws in effect prior to January 1, 1962, as follows:

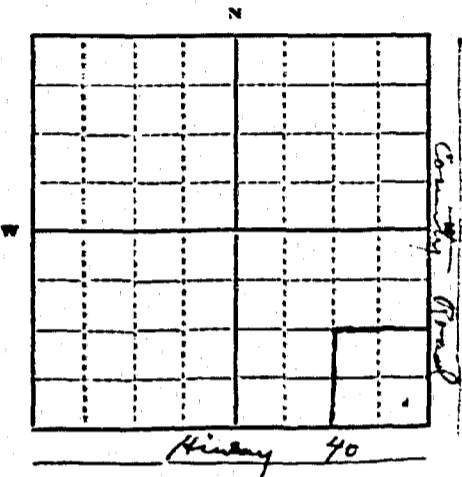

S.E. 1/4 Sec 9 T.30R.21

Indicate point of appropriation and place of use, if possible. Each small square represents 10 acres.

2. The beneficial use on which the claim is based For house stock water garden + lawn

3. Date or approximate date of earliest beneficial use; and how continuous the use has been Date of earliest beneficial use is unknown to me

4. The amount of groundwater claimed (in miner's inches or gallons per minute) 200 gal per hr

5. If used for irrigation, give the acreage and description of the lands to which water has been applied and name of the owner thereof

6. The means of withdrawing such water from the ground and the location of each well or other means of withdrawal Electric water pump Location is 312 ft North of Hwy 40 - 189 ft West of County Road

7. The date of commencement and completion of the construction of the well, wells, or other works for withdrawal of groundwater Date unknown to me

8. The depth of water table 23 ft

9. So far as it may be available, the type, size and depth of each well or the general specifications of any other works for the withdrawal of groundwater  
Hand dug well 36 in diameter 23 ft deep

10. The estimated amount of groundwater withdrawn each year 300 000 gal

11. The log of formations encountered in the drilling of each well if available

12. Such other information of a similar nature as may be useful in carrying out the policy of this act, including reference to book and page of any county record

Signature of Owner John Kergul  
Date Dec 23 1963

Three copies to be filed by the owner with the County Clerk and Recorder of the county in which the well is located. Please answer all questions. If not applicable, so state, otherwise the form will be returned.

Original to the County Clerk and Recorder; duplicate to the State Engineer; Triplicate to the Montana Bureau of Mines and Geology and Quadruplicate for the Appropriator.

10, 13 d

STATE OF MONTANA SS  
COUNTY OF FLATHEAD

Filed on the 23 day of dec  
A. D. 1963 at 12:17 o'clock P. M.

blm

County Clerk and Recorder

BY J. L. W.

Deputy

File No. \_\_\_\_\_

GW 2

T. 30N R 91W <sup>10</sup>

County Flathead

STATE OF MONTANA  
ADMINISTRATOR OF GROUNDWATER CODE  
OFFICE OF STATE ENGINEER

Notice of Completion of Groundwater  
Appropriation by Means of Well

(Under Chapter 237, Montana Session Laws, 1961)

Owner Merrill Anderson Address \_\_\_\_\_

Driller Weber Drilling Address Col. Falls

Date of Notice of Appropriation of Groundwater \_\_\_\_\_

Date well started 7-16-69 Date Completed 7-19-69

Type of well drilled Equipment Used Churn  
(dug, driven, bored or drilled) (Churn, drill, rotary or other)

Water Use: Domestic  Municipal  Other  Irrigation   
Industrial  Drainage  Stock

Indicate on the diagram the character and thickness of the different strata met with in drilling, such as soil, clay, shale, gravel, rock or sand, etc. Show depth at which water is encountered, thickness and character of water-bearing strata and height to which water rises in the well.

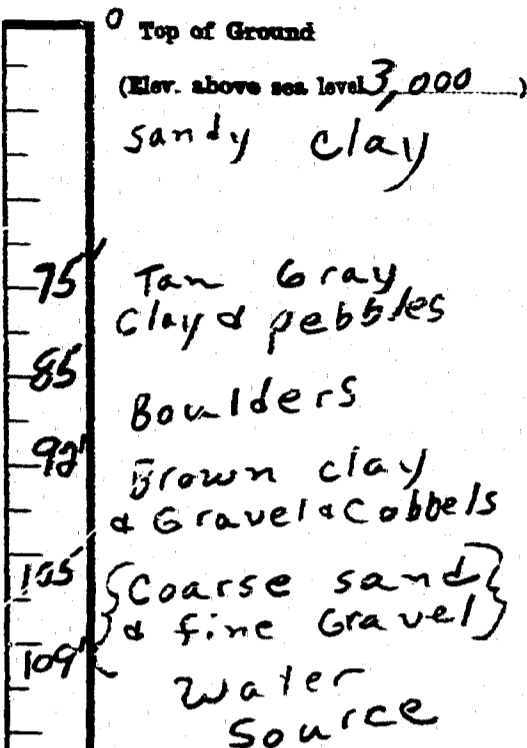

Size of Drilled Hole	Size and Weight of Casing	From (Feet)	To (Feet)	PERFORATIONS		
				Kind	From (Feet)	To (Feet)
7"	7" O.D. 20# 1/4"	0	109'	None		

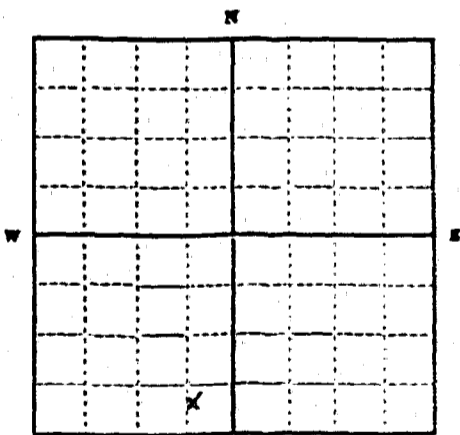

E. 2 E/2 S. 1/2 5+6  
1/4 Sec. 10 T. 30 R. 21

Indicate location of well and place of use, if possible. Each small square represents 10 acres.

Show exact depth of bottom.

Static Water Level for non-flowing Well 22 feet.

Shut-in Pressure for Flowing Well None

Pumping Water Level 40 feet at 24 gal. per minute.

Discharge in gal. per min. of flowing well None

How Tested Bailed Length of Test 1 hr.

Remarks: (Gravel packing, cementing, packers, type of shutoff, location of place of use of groundwater if not at well, and any other similar pertinent information, including number of acres irrigated, if used for irrigation)

Open Bottom

181

Driller's License Number

Jerome H. Weber  
Driller's Signature

This form to be prepared by driller, and three copies to be filed by the owner with the County Clerk and Recorder in the county in which the well is located.

Please answer all questions. If not applicable, so state, otherwise the form will be returned.

Original to the County Clerk and Recorder; duplicate to the State Engineer; Triplicate to the Montana Bureau of Mines and Geology and Quadruplicate for the Appropriator.

45526

14050

STATE OF MONTANA - )  
COUNTY OF FLATHEAD - SS

Filed on the 27<sup>th</sup> day of Aug  
A. D. 1969 at 10 o'clock A. M.

*[Signature]*  
County Clerk and Recorder

By *[Signature]*



14.544

STATE OF MONTANA }  
COUNTY OF FLATHEAD } SS  
Filed on the 4 day of Oct  
A. D. 1973 at 12:00 o'clock P.M.  
MA  
County Clerk and Recorder  
By CS Deputy

Groundwater Bureau Division  
Sam W. Mitchell Section  
Helena, Montana Building 59601  
-S- Division Resources and Conservation

As the Administrator of the Groundwater Code for  
note of the following special instructions, in order  
water right.

Special Instructions: Please  
note of the following special instructions, in order  
water right.

Owner  
Address Larry Blumer  
Location Rt. 1-B Colburn  
Doc. No. 14,544



Resources and Conservation  
 Division  
 Bureau  
 Groundwater Section  
 Sam W. Mitchell Building  
 Helena, Montana 59601

Owner Larry Blumer E-12  
 Address Rt. 1-B Columbia Falls  
 Location T. 30N R. 21W Sec. 10  
 Doc. No. 14,594

As the Administrator of the Groundwater Code for the State of Montana, please take note of the following special instructions, in order to properly protect your groundwater right.

Special Instructions: Please provide, as indicated in red on the attached form, the claimed water use.

Thank you.

? Water Use: Domestic  Municipal  Stock  Irrigation   
 Industrial  Drainage  Other \* Garden/Lawn

\*Describe \_\_\_\_\_  
 USE: If used for irrigation, industrial, drainage or other. Explain, state number of acres and location or other data (i.e. Lot, Block and Addition). \_\_\_\_\_

ESTIMATED ANNUAL WITHDRAWAL

Size of Drilled Hole	Size and Weight of Casing	From (Feet)	To (Feet)	PERFORATIONS		
				Kind Size	From (Feet)	To (Feet)
7" 25'	7" OD	0	333	X	X	X

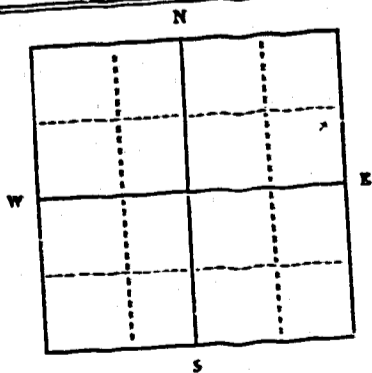

Static water level 29 ft.\*  
 Pumping water level 110 ft.\*  
 at 2 gallons per minute,  
 measured 2 minutes after pumping  
 began.  
 \*Measured from ground level.  
 Well developed by \_\_\_\_\_  
 for 4 hours.  
 Power \_\_\_\_\_ Pump \_\_\_\_\_ HP  
 Remarks: (Gravel packing, cementing,  
 packers, type of shutoff) \_\_\_\_\_

INDICATE LOCATION OF WELL AND PLACE OF USE, IF POSSIBLE.  
 EACH SMALL SQUARE REPRESENTS 40 ACRES.

Driller's Signature \_\_\_\_\_  
 Driller's Address \_\_\_\_\_  
 LICENSE NO. \_\_\_\_\_

110	194	2-1000	1 M...
			Gray

292 Show exact depth of bottom

STATE OF MONTANA  
 ADMINISTRATOR OF GROUNDWATER CODE  
 MONTANA WATER RESOURCES BOARD

NOTICE OF COMPLETION OF GROUNDWATER  
 APPROPRIATION BY MEANS OF WELL

Developed after January 1, 1962

(Under Chapter 237 Montana Session Laws, 1961, as amended)

This form to be prepared by driller, and three copies to be filed by the owner with the County Clerk and Recorder in the county in which the well is located, last copy to be retained by driller.

Please answer all questions. If not applicable, so state, otherwise the form may be returned.

Owner Larry Blumer

Address 1111 1st St

Date well started Sept 1, 1962 completed Sept 1, 1962

Type of well Drilled

Equipment used Drill

Water Use: Domestic  Municipal  Stock  Irrigation   
 Industrial  Drainage  Other \* Garden/Lawn

\*Describe \_\_\_\_\_

USE: If used for irrigation, industrial, drainage or other. Explain, state number of acres and location or other data (i.e. Lot, Block and Addition). \_\_\_\_\_

For Administrator's Use

File 14594

Date Jan 4, 1972

Time 12:04 p.m.

GW 1

ESTIMATED ANNUAL WITHDRAWAL

Size of Drilled Hole	Size and Weight of Casing	From (Feet)	To (Feet)	PERFORATIONS		
				Kind Size	From (Feet)	To (Feet)
7	700 26	0	333	X	X	X

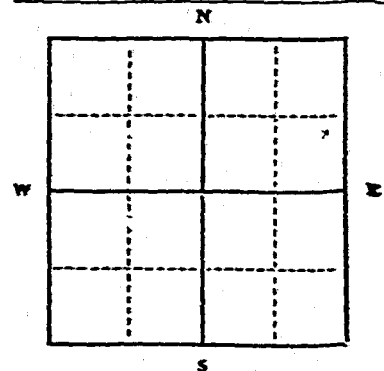

Static water level 91 ft.\*  
 Pumping water level 110 ft.\*  
 at \_\_\_\_\_ gallons per minute,  
 measured \_\_\_\_\_ minutes after pumping began.  
 \*Measured from ground level.  
 Well developed by \_\_\_\_\_  
 for \_\_\_\_\_ hours.  
 Power \_\_\_\_\_ Pump \_\_\_\_\_ HP  
 Remarks: (Gravel packing, cementing, packers, type of shutoff) \_\_\_\_\_

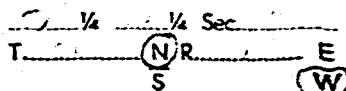

INDICATE LOCATION OF WELL AND PLACE OF USE, IF POSSIBLE. EACH SMALL SQUARE REPRESENTS 40 ACRES.

Driller's Signature \_\_\_\_\_

Driller's Address \_\_\_\_\_

LICENSE NO. \_\_\_\_\_

County \_\_\_\_\_

DRILLER'S LOG

Indicate the character, color, thickness of strata such as soil, clay, sand, gravel, shale, sandstone, etc. Show depth at which water is found and height to which water rises in well.

Top of Ground (Elev. above sea level)	
From (Feet)	To (Feet)
0	110
Soil - 12 ft.	
Clay - 12 ft.	
Sand - 12 ft.	
Gravel - 12 ft.	
Shale - 12 ft.	
Sandstone - 12 ft.	
Water level - 91 ft.	
Pumping level - 110 ft.	
Flow rate - 110 gpm	
Remarks - 110 ft.	
110 - 194	
Gravel - 12 ft.	
Sand - 12 ft.	
Shale - 12 ft.	
Water level - 91 ft.	
Pumping level - 110 ft.	
Flow rate - 110 gpm	
Remarks - 110 ft.	
110 - 194	
Gravel - 12 ft.	
Sand - 12 ft.	
Shale - 12 ft.	
Water level - 91 ft.	
Pumping level - 110 ft.	
Flow rate - 110 gpm	
Remarks - 110 ft.	
110 - 194	
Gravel - 12 ft.	
Sand - 12 ft.	
Shale - 12 ft.	
Water level - 91 ft.	
Pumping level - 110 ft.	
Flow rate - 110 gpm	
Remarks - 110 ft.	
110 - 194	
Gravel - 12 ft.	
Sand - 12 ft.	
Shale - 12 ft.	
Water level - 91 ft.	
Pumping level - 110 ft.	
Flow rate - 110 gpm	
Remarks - 110 ft.	
110 - 194	
Gravel - 12 ft.	
Sand - 12 ft.	
Shale - 12 ft.	
Water level - 91 ft.	
Pumping level - 110 ft.	
Flow rate - 110 gpm	
Remarks - 110 ft.	
110 - 194	
Gravel - 12 ft.	
Sand - 12 ft.	
Shale - 12 ft.	
Water level - 91 ft.	
Pumping level - 110 ft.	
Flow rate - 110 gpm	
Remarks - 110 ft.	
110 - 194	
Gravel - 12 ft.	
Sand - 12 ft.	
Shale - 12 ft.	
Water level - 91 ft.	
Pumping level - 110 ft.	
Flow rate - 110 gpm	
Remarks - 110 ft.	
110 - 194	
Gravel - 12 ft.	
Sand - 12 ft.	
Shale - 12 ft.	
Water level - 91 ft.	
Pumping level - 110 ft.	
Flow rate - 110 gpm	
Remarks - 110 ft.	
110 - 194	
Gravel - 12 ft.	
Sand - 12 ft.	
Shale - 12 ft.	
Water level - 91 ft.	
Pumping level - 110 ft.	
Flow rate - 110 gpm	
Remarks - 110 ft.	
110 - 194	
Gravel - 12 ft.	
Sand - 12 ft.	
Shale - 12 ft.	
Water level - 91 ft.	
Pumping level - 110 ft.	
Flow rate - 110 gpm	
Remarks - 110 ft.	
110 - 194	
Gravel - 12 ft.	
Sand - 12 ft.	
Shale - 12 ft.	
Water level - 91 ft.	
Pumping level - 110 ft.	
Flow rate - 110 gpm	
Remarks - 110 ft.	
110 - 194	
Gravel - 12 ft.	
Sand - 12 ft.	
Shale - 12 ft.	
Water level - 91 ft.	
Pumping level - 110 ft.	
Flow rate - 110 gpm	
Remarks - 110 ft.	
110 - 194	
Gravel - 12 ft.	
Sand - 12 ft.	
Shale - 12 ft.	
Water level - 91 ft.	
Pumping level - 110 ft.	
Flow rate - 110 gpm	
Remarks - 110 ft.	
110 - 194	
Gravel - 12 ft.	
Sand - 12 ft.	
Shale - 12 ft.	
Water level - 91 ft.	
Pumping level - 110 ft.	
Flow rate - 110 gpm	
Remarks - 110 ft.	
110 - 194	
Gravel - 12 ft.	
Sand - 12 ft.	
Shale - 12 ft.	
Water level - 91 ft.	
Pumping level - 110 ft.	
Flow rate - 110 gpm	
Remarks - 110 ft.	
110 - 194	
Gravel - 12 ft.	
Sand - 12 ft.	
Shale - 12 ft.	
Water level - 91 ft.	
Pumping level - 110 ft.	
Flow rate - 110 gpm	
Remarks - 110 ft.	
110 - 194	
Gravel - 12 ft.	
Sand - 12 ft.	
Shale - 12 ft.	
Water level - 91 ft.	
Pumping level - 110 ft.	
Flow rate - 110 gpm	
Remarks - 110 ft.	
110 - 194	
Gravel - 12 ft.	
Sand - 12 ft.	
Shale - 12 ft.	
Water level - 91 ft.	
Pumping level - 110 ft.	
Flow rate - 110 gpm	
Remarks - 110 ft.	
110 - 194	
Gravel - 12 ft.	
Sand - 12 ft.	
Shale - 12 ft.	
Water level - 91 ft.	
Pumping level - 110 ft.	
Flow rate - 110 gpm	
Remarks - 110 ft.	
110 - 194	
Gravel - 12 ft.	
Sand - 12 ft.	
Shale - 12 ft.	
Water level - 91 ft.	
Pumping level - 110 ft.	
Flow rate - 110 gpm	
Remarks - 110 ft.	
110 - 194	
Gravel - 12 ft.	
Sand - 12 ft.	
Shale - 12 ft.	
Water level - 91 ft.	
Pumping level - 110 ft.	
Flow rate - 110 gpm	
Remarks - 110 ft.	
110 - 194	
Gravel - 12 ft.	
Sand - 12 ft.	
Shale - 12 ft.	
Water level - 91 ft.	
Pumping level - 110 ft.	
Flow rate - 110 gpm	
Remarks - 110 ft.	
110 - 194	
Gravel - 12 ft.	
Sand - 12 ft.	
Shale - 12 ft.	
Water level - 91 ft.	
Pumping level - 110 ft.	
Flow rate - 110 gpm	
Remarks - 110 ft.	
110 - 194	
Gravel - 12 ft.	
Sand - 12 ft.	
Shale - 12 ft.	
Water level - 91 ft.	
Pumping level - 110 ft.	
Flow rate - 110 gpm	
Remarks - 110 ft.	
110 - 194	
Gravel - 12 ft.	
Sand - 12 ft.	
Shale - 12 ft.	
Water level - 91 ft.	
Pumping level - 110 ft.	
Flow rate - 110 gpm	
Remarks - 110 ft.	
110 - 194	
Gravel - 12 ft.	
Sand - 12 ft.	
Shale - 12 ft.	
Water level - 91 ft.	
Pumping level - 110 ft.	
Flow rate - 110 gpm	
Remarks - 110 ft.	
110 - 194	
Gravel - 12 ft.	
Sand - 12 ft.	
Shale - 12 ft.	
Water level - 91 ft.	
Pumping level - 110 ft.	
Flow rate - 110 gpm	
Remarks - 110 ft.	
110 - 194	
Gravel - 12 ft.	
Sand - 12 ft.	
Shale - 12 ft.	
Water level - 91 ft.	
Pumping level - 110 ft.	
Flow rate - 110 gpm	
Remarks - 110 ft.	
110 - 194	
Gravel - 12 ft.	
Sand - 12 ft.	
Shale - 12 ft.	
Water level - 91 ft.	
Pumping level - 110 ft.	
Flow rate - 110 gpm	
Remarks - 110 ft.	
110 - 194	
Gravel - 12 ft.	
Sand - 12 ft.	
Shale - 12 ft.	
Water level - 91 ft.	
Pumping level - 110 ft.	
Flow rate - 110 gpm	
Remarks - 110 ft.	
110 - 194	
Gravel - 12 ft.	
Sand - 12 ft.	
Shale - 12 ft.	
Water level - 91 ft.	
Pumping level - 110 ft.	
Flow rate - 110 gpm	
Remarks - 110 ft.	
110 - 194	
Gravel - 12 ft.	
Sand - 12 ft.	
Shale - 12 ft.	
Water level - 91 ft.	
Pumping level - 110 ft.	
Flow rate - 110 gpm	
Remarks - 110 ft.	
110 - 194	
Gravel - 12 ft.	
Sand - 12 ft.	
Shale - 12 ft.	
Water level - 91 ft.	
Pumping level - 110 ft.	
Flow rate - 110 gpm	
Remarks - 110 ft.	
110 - 194	
Gravel - 12 ft.	
Sand - 12 ft.	
Shale - 12 ft.	
Water level - 91 ft.	
Pumping level - 110 ft.	
Flow rate - 110 gpm	
Remarks - 110 ft.	
110 - 194	
Gravel - 12 ft.	
Sand - 12 ft.	
Shale - 12 ft.	
Water level - 91 ft.	
Pumping level - 110 ft.	
Flow rate - 110 gpm	
Remarks - 110 ft.	
110 - 194	
Gravel - 12 ft.	
Sand - 12 ft.	
Shale - 12 ft.	
Water level - 91 ft.	
Pumping level - 110 ft.	
Flow rate - 110 gpm	
Remarks - 110 ft.	
110 - 194	
Gravel - 12 ft.	
Sand - 12 ft.	
Shale - 12 ft.	
Water level - 91 ft.	
Pumping level - 110 ft.	
Flow rate - 110 gpm	
Remarks - 110 ft.	
110 - 194	
Gravel - 12 ft.	
Sand - 12 ft.	
Shale - 12 ft.	
Water level - 91 ft.	
Pumping level - 110 ft.	
Flow rate - 110 gpm	
Remarks - 110 ft.	
110 - 194	
Gravel - 12 ft.	
Sand - 12 ft.	
Shale - 12 ft.	
Water level - 91 ft.	
Pumping level - 110 ft.	
Flow rate - 110 gpm	
Remarks - 110 ft.	
110 - 194	
Gravel - 12 ft.	
Sand - 12 ft.	
Shale - 12 ft.	
Water level - 91 ft.	
Pumping level - 110 ft.	
Flow rate - 110 gpm	
Remarks - 110 ft.	
110 - 194	
Gravel - 12 ft.	
Sand - 12 ft.	
Shale - 12 ft.	
Water level - 91 ft.	
Pumping level - 110 ft.	
Flow rate - 110 gpm	
Remarks - 110 ft.	
110 - 194	
Gravel - 12 ft.	
Sand - 12 ft.	
Shale - 12 ft.	
Water level - 91 ft.	
Pumping level - 110 ft.	
Flow rate - 110 gpm	
Remarks - 110 ft.	
110 - 194	
Gravel - 12 ft.	
Sand - 12 ft.	
Shale - 12 ft.	
Water level - 91 ft.	
Pumping level - 110 ft.	
Flow rate - 110 gpm	
Remarks - 110 ft.	
110 - 194	
Gravel - 12 ft.	
Sand - 12 ft.	
Shale - 12 ft.	
Water level - 91 ft.	
Pumping level - 110 ft.	
Flow rate - 110 gpm	
Remarks - 110 ft.	
110 - 194	
Gravel - 12 ft.	
Sand - 12 ft.	
Shale - 12 ft.	
Water level - 91 ft.	
Pumping level - 110 ft.	
Flow rate - 110 gpm	
Remarks - 110 ft.	
110 - 194	
Gravel - 12 ft.	
Sand - 12 ft.	
Shale - 12 ft.	
Water level - 91 ft.	
Pumping level - 110 ft.	
Flow rate - 110 gpm	
Remarks - 110 ft.	
110 - 194	
Gravel - 12 ft.	
Sand - 12 ft.	
Shale - 12 ft.	
Water level - 91 ft.	
Pumping level - 110 ft.	
Flow rate - 110 gpm	
Remarks - 110 ft.	
110 - 194	
Gravel - 12 ft.	
Sand - 12 ft.	
Shale - 12 ft.	
Water level - 91 ft.	
Pumping level - 110 ft.	
Flow rate - 110 gpm	
Remarks - 110 ft.	
110 - 194	
Gravel - 12 ft.	
Sand - 12 ft.	
Shale - 12 ft.	
Water level - 91 ft.	
Pumping level - 110 ft.	
Flow rate - 110 gpm	
Remarks - 110 ft.	
110 - 194	
Gravel - 12 ft.	
Sand - 12 ft.	
Shale - 12 ft.	
Water level - 91 ft.	
Pumping level - 110 ft.	
Flow rate - 110 gpm	
Remarks - 110 ft.	
110 - 194	
Gravel - 12 ft.	
Sand - 12 ft.	
Shale - 12 ft.	
Water level - 91 ft.	
Pumping level - 110 ft.	
Flow rate - 110 gpm	
Remarks - 110 ft.	
110 - 194	
Gravel - 12 ft.	
Sand - 12 ft.	
Shale - 12 ft.	
Water level - 91 ft.	
Pumping level - 110 ft.	
Flow rate - 110 gpm	
Remarks - 110 ft.	
110 - 194	
Gravel - 12 ft.	
Sand - 12 ft.	
Shale - 12 ft.	
Water level - 91 ft.	
Pumping level - 110 ft.	
Flow rate - 110 gpm	
Remarks - 110 ft.	
110 - 194	
Gravel - 12 ft.	
Sand - 12 ft.	
Shale - 12 ft.	
Water level - 91 ft.	
Pumping level - 110 ft.	
Flow rate - 110 gpm	
Remarks - 110 ft.	
110 - 194	
Gravel - 12 ft.	
Sand - 12 ft.	
Shale - 12 ft.	
Water level - 91 ft.	
Pumping level - 110 ft.	
Flow rate - 110 gpm	
Remarks - 110 ft.</	

File No. \_\_\_\_\_

GW 2

T 30 R 21

County Flathead

STATE OF MONTANA  
ADMINISTRATOR OF GROUNDWATER CODE  
OFFICE OF STATE ENGINEER

Top of Ground  
(Elev. above sea level \_\_\_\_\_)

Notice of Completion of Groundwater  
Appropriation by Means of Well

(Under Chapter 237, Montana Session Laws, 1961)

0 to 28 ft Sandy Silt  
38 to 94 ft Silt  
94 to 115 ft Clay  
with gravel.  
115 to 130 ft  
Brown hard pan.  
130 to 131 ft  
Water-bearing  
gravel & sand.

Owner Ronald Buente Address Columbia Falls, Idaho

Driller Oliver L. Justice Address Columbia Falls, Idaho

Date of Notice of Appropriation of Groundwater None filed

Date well started July 18, 69 Date Completed Aug 1, 1969

Type of well Drilled Equipment Used Churn  
(dug, driven, bored or drilled) (Churn, drill, rotary or other)

Water Use: Domestic  Municipal  Other  Irrigation   
Industrial  Drainage  Stock

Indicate on the diagram the character and thickness of the different strata met with in drilling, such as soil, clay, shale, gravel, rock or sand, etc. Show depth at which water is encountered, thickness and character of water-bearing strata and height to which water rises in the well.

Size of Drilled Hole	Size and Weight of Casing	From (Feet)	To (Feet)	PERFORATIONS		
				Kind	From (Feet)	To (Feet)
6 3/8"	7" O.D. 23 lbs	0	131	None		

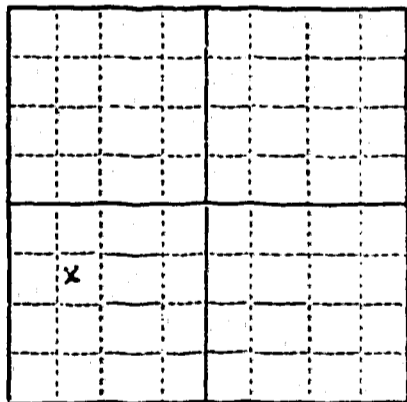

NW 1/4 Sec. 10 T. 30 R. 21  
Indicate location of well and place of use, if possible. Each small square represents 10 acres.

Show exact depth of bottom.

Static Water Level for non-flowing Well 40 feet

Shut-in Pressure for Flowing Well None - flowing

Pumping Water Level 80 feet at 70 gal per minute.

Discharge in gal. per min. of flowing well None - flowing

How Tested Bailer Length of Test 2 hrs

Remarks: (Gravel packing, cementing, packers, type of shutoff, location of place of use of groundwater if not at well, and any other similar pertinent information, including number of acres irrigated, if used for irrigation)

Oliver M. Hanson

70055

Driller's License Number  
George L. Justice  
Driller's Signature

This form to be prepared by driller, and three copies to be filed by the owner with the County Clerk and Recorder in the county in which the well is located.

Please answer all questions. If not applicable, so state, otherwise the form will be returned.

Original to the County Clerk and Recorder; duplicate to the State Engineer; Triplicate to the Montana Bureau of Mines and Geology and Quadruplicate for the Appropriator.

45597

12,052

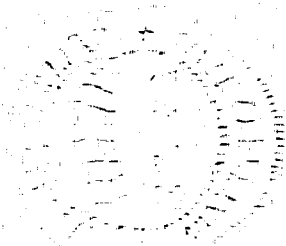

STATE OF MONTANA ) SS  
COUNTY OF FLATHEAD )

Filed on the 27<sup>th</sup> day of Aug  
A.D. 1949 at 2:25 o'clock P.M.

*[Signature]*  
County Clerk and Recorder

By *[Signature]* Deputy

MONTANA WATER RESOURCES BOARD  
RECEIVED

SEP 5 1949

File No. \_\_\_\_\_

GW 4

T 30<sup>N</sup> R 21<sup>W</sup> 10

County \_\_\_\_\_

STATE OF MONTANA  
ADMINISTRATOR OF GROUNDWATER CODE  
OFFICE OF STATE ENGINEER

RECEIVED  
JAN 1962

Declaration of Vested Groundwater Rights  
(Under Chapter 237, Montana Session Laws, 1961)

1. Carl Enwald of Columbia Falls  
(Name of Appropriator) (Address) (Town)  
County of Flathead State of Montana

have appropriated groundwater according to the Montana laws in effect prior to January 1, 1962, as follows:

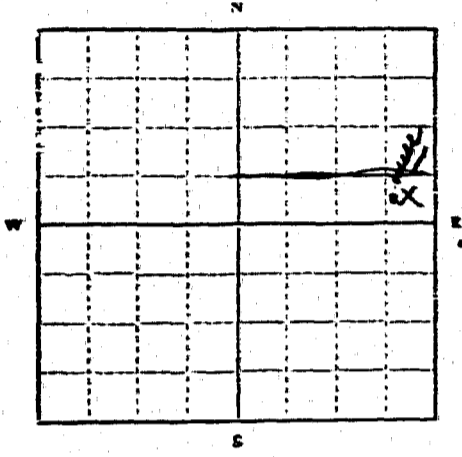

1/4 Sec. T R

Indicate point of appropriation and place of use, if possible. Each small square represents 10 acres.

2. The beneficial use on which the claim is based Sec 10 T 30 R 21

3. Date or approximate date of earliest beneficial use; and how continuous the use has been  
Has been used for only household use

4. The amount of groundwater claimed (in miner's inches or gallons per minute)  
Have no water meter

5. If used for irrigation, give the acreage and description of the lands which water has been applied and name of the owner thereof  
No Irrigation

6. The means of withdrawing such water from the ground and the location of each well or other means of withdrawal See

7. The date of commencement and completion of the construction of the well, wells, or other works for withdrawal of groundwater  
No record

8. The depth of water table In dry season it isn't more than a foot of water

9. So far as it may be available, the type, size and depth of each well or the general specifications of any other works for the withdrawal of groundwater  
Depth 18 feet (8 1/2) 70 minutes around

10. The estimated amount of groundwater withdrawn each year Dont know, used just for household

11. The log of formations encountered in the drilling of each well if available No drilling (We got a dry well only)

12. Such other information of a similar nature as may be useful in carrying out the policy of this act, including reference to book and page of any county record  
No record

Signature of Owner \_\_\_\_\_

Date Carl N Enwald  
Dec 30<sup>th</sup> 1939

Three copies to be filed by the owner with the County Clerk and Recorder of the county in which the well is located. Please answer all questions. If not applicable, so state, otherwise the form will be returned.

Original to the County Clerk and Recorder; duplicate to the State Engineer; Triplicate to the Montana Bureau of Mines and Geology and Quadruplicate for the Appropriator.

30955

11149

Jan  
2:10  
LGM  
JH

File No. \_\_\_\_\_

GW 4

T. 30 R. 21

County \_\_\_\_\_

STATE OF MONTANA  
ADMINISTRATOR OF GROUNDWATER CODE  
OFFICE OF STATE ENGINEER

RECEIVED  
JAN 6 1964

Declaration of Vested Groundwater Rights

(Under Chapter 237, Montana Session Laws, 1961)

Earl T. Frazier of R.I.B. Columbia Falls,  
(Name of Appropriator) (Address) (Town)

County of Flathead State of Montana  
have appropriated groundwater according to the Montana laws in effect prior to January 1, 1962, as follows:

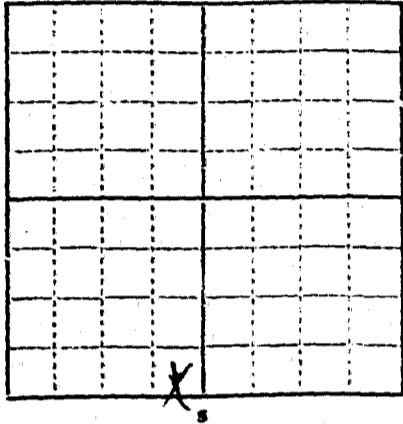

SE 1/4 SW 1/4 Sec. 10 T. 30 R. 21  
Indicate point of appropriation  
and place of use, if possible.  
Each small square represents 10  
acres.

2. The beneficial use on which the claim is based

Residential

3. Date or approximate date of earliest beneficial use; and how continuous the use has been

yearly Oct 1951

4. The amount of groundwater claimed (in miner's inches or gallons per minute)

500 gal. per min

5. If used for irrigation, give the acreage and description of the lands to which water has been applied and name of the owner thereof

1/4 acres. Garden, yard, flowers.

6. The means of withdrawing such water from the ground and the location of each well or other means of withdrawal

regular suction pump

7. The date of commencement and completion of the construction of the well, wells, or other works for withdrawal of groundwater

Oct. 1951

8. The depth of water table

60'

9. So far as it may be available, the type, size and depth of each well or the general specifications of any other works for the withdrawal of groundwater

Open Well. 156'

10. The estimated amount of groundwater withdrawn each year

300,000

11. The log of formations encountered in the drilling of each well if available

Day Sand, rock, gravel

12. Such other information of a similar nature as may be useful in carrying out the policy of this act, including reference to book and page of any county record

Signature of Owner

Earl T. Frazier

Date

12-31-63

Three copies to be filed by the owner with the County Clerk and Recorder of the county in which the well is located.

Please answer all questions. If not applicable, so state, otherwise the form will be returned.

Original to the County Clerk and Recorder; duplicate to the State Engineer; Triplicate to the Montana Bureau of Mines and Geology and Quadruplicate for the Appropriator.

23131

10960

31 Dec

63 20 M

L. L. H.

Deputy



File No. \_\_\_\_\_

GW 4

T. 20 R. 21

10

County \_\_\_\_\_

STATE OF MONTANA  
ADMINISTRATOR OF GROUNDWATER CODE  
OFFICE OF STATE ENGINEER

Declaration of Vested Groundwater Rights

(Under Chapter 237, Montana Session Laws, 1961)

RECEIVED  
JAN 8 1964

STATE ENGINEER

1. John W. FRERICH of Rt 1-B Columbia Falls  
(Name of Appropriator) (Address) (Town)

County of Flathead State of Montana  
have appropriated groundwater according to the Montana laws in effect prior to January 1, 1962, as follows:

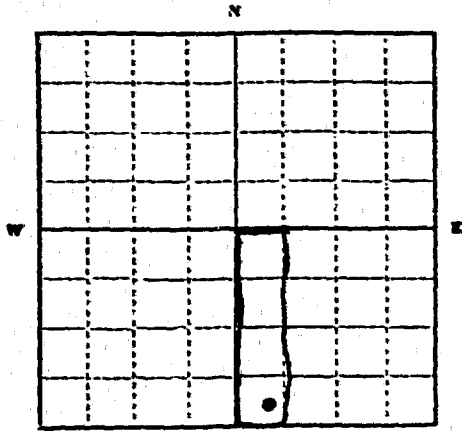

W 1/2 SE 1/4  
1/4 Sec 10 T. 20 R. 21

Indicate point of appropriation and place of use, if possible. Each small square represents 10 acres.

2. The beneficial use on which the claim is based Household and dairy stock

3. Date or approximate date of earliest beneficial use; and how continuous the use has been 1903  
continuous

4. The amount of groundwater claimed (in miner's inches or gallons per minute) 50 gal per min

5. If used for irrigation, give the acreage and description of the lands to which water has been applied and name of the owner thereof  
none

6. The means of withdrawing such water from the ground and the location of each well or other means of withdrawal  
Electric pump  
25' indicated above

7. The date of commencement and completion of the construction of the well, wells, or other works for withdrawal of groundwater 1954

8. The depth of water table 27 feet

9. So far as it may be available, the type, size and depth of each well or the general specifications of any other works for the withdrawal of groundwater dug well 3' diameter  
27' deep

10. The estimated amount of groundwater withdrawn each year 73,000

11. The log of formations encountered in the drilling of each well if available  
Blue Clay and sand

12. Such other information of a similar nature as may be useful in carrying out the policy of this act, including reference to book and page of any county record none to my  
knowledge

Signature of Owner John W. Frerich  
Date 12-28-63

Three copies to be filed by the owner with the County Clerk and Recorder of the county in which the well is located. Please answer all questions. If not applicable, so state, otherwise the form will be returned.

Original to the County Clerk and Recorder; duplicate to the State Engineer; Triplicate to the Montana Bureau of Mines and Geology and Quadruplicate for the Appropriator.

22573

10, 313

STATE OF MONTANA, SS  
COUNTY OF FAYETTE, SS

Filed on the 30 day of Dec

A. D. 1967 at 10:30 o'clock A M

per  
County Clerk and Recorder

By \_\_\_\_\_

[Signature]  
Clerk

File No.

GW 1

T

R

County Flathead

STATE OF MONTANA  
ADMINISTRATOR OF GROUNDWATER CODE  
OFFICE OF STATE ENGINEER

Notice of Completion of Groundwater  
Appropriation by Means of Well

(Under Chapter 237, Montana Session Laws, 1961)

Owner Robert L. Joy Address \_\_\_\_\_

Driller Weber Drilling Co. Address Col. Falls

Date of Notice of Appropriation of Groundwater \_\_\_\_\_

Date well started 9-10 Date Completed 9-16

Type of well drilled Equipment Used Churn  
(dug, driven, bored or drilled) (Churn, drill, rotary or other)

Water Use: Domestic  Municipal  Other  Irrigation   
Industrial  Drainage  Stock

Indicate on the diagram the character and thickness of the different strata met with in drilling, such as soil, clay, shale, gravel, rock or sand, etc. Show depth at which water is encountered, thickness and character of water-bearing strata and height to which water rises in the well.

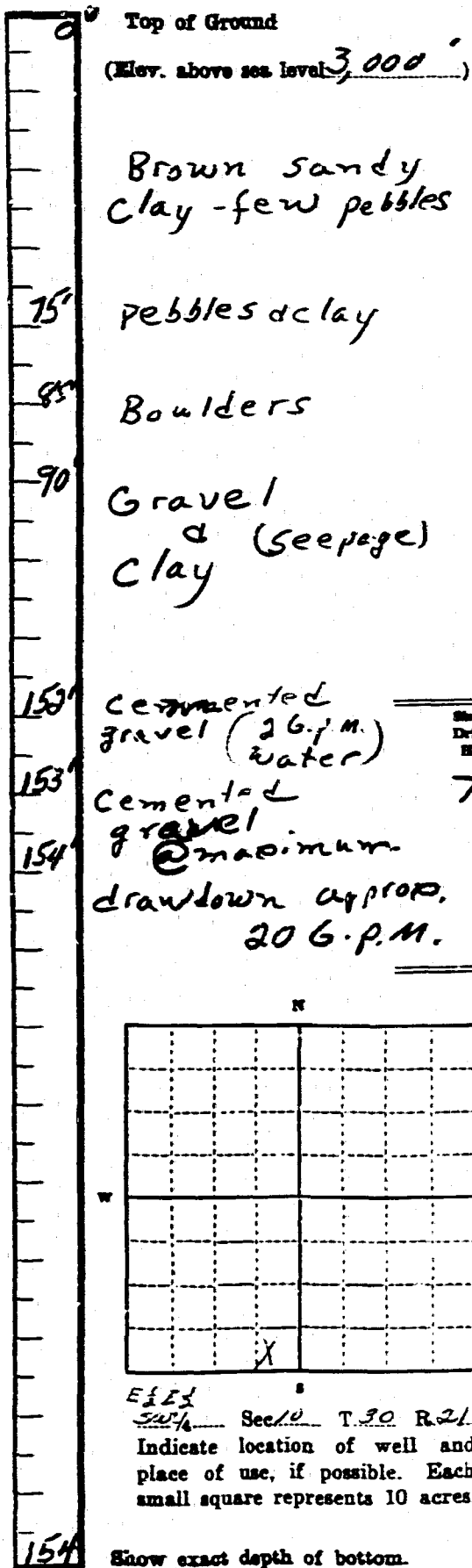

Size of Drilled Hole	Size and Weight of Casing	From (Feet)	To (Feet)	PERFORATIONS		
				Kind Size	From (Feet)	To (Feet)
7"	7" O.D. 20#/ft.	0	154	None		

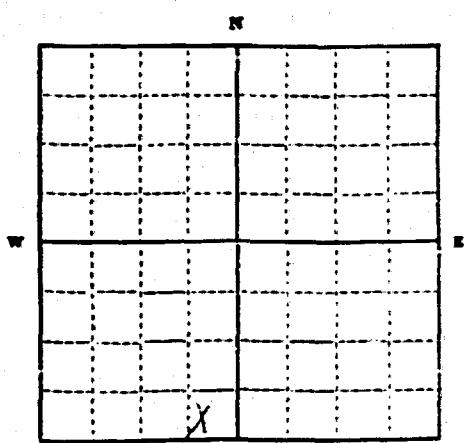

Section Sec 10 T. 30 R. 21  
Indicate location of well and place of use, if possible. Each small square represents 10 acres.

Static Water Level for non-flowing Well 25 feet.

Shut-in Pressure for Flowing Well \_\_\_\_\_

Pumping Water Level 94 feet at 12 gal. per minute.

Discharge in gal. per min. of flowing well \_\_\_\_\_

How Tested Bailed Length of Test 3 hrs

Remarks: (Gravel packing, cementing, packers, type of shutoff, location of place of use of groundwater if not at well, and any other similar pertinent information, including number of acres irrigated, if used for irrigation) \_\_\_\_\_

open Bottom

Show exact depth of bottom.

Driller's License Number 181  
Driller's Signature Guarino D. Weber

This form to be prepared by driller, and three copies to be filed by the owner with the County Clerk and Recorder in the county in which the well is located.

Please answer all questions. If not applicable, so state, otherwise the form will be returned.

Original to the County Clerk and Recorder; duplicate to the State Engineer; Triplicate to the Montana Bureau of Mines and Geology and Quadruplicate for the Appropriator.

14069

STATE OF MONTANA  
COUNTY OF FLATHEAD SS

Filed on the 10 day of Oct  
A. D. 1969 at 8:10 o'clock A. M.

*Kem*  
County Clerk and Recorder

By *[Signature]*  
Deputy

MONTANA WATER RESOURCES BOARD  
**RECEIVED**

GW 2 NEWS

T3C No. 21 West

No. \_\_\_\_\_

JUL 23 1969

County Flitwick

TRIPPLICATE

STATE OF MONTANA  
ADMINISTRATOR OF GROUNDWATER CODE  
OFFICE OF STATE ENGINEER

Top of Ground  
(Elev. above sea level.....)

**Notice of Completion of Groundwater  
Appropriation by Means of Well**

(Under Chapter 237, Montana Session Laws, 1961)

0 to 98 ft Silt  
98 to 125 ft  
gray hard pan  
125 to 129 ft  
Water bearing  
gravel & sand

Owner Frank Lee Address Columbia Falls Road  
Driller Oliver Justin Address Columbia Falls Road  
Date of Notice of Appropriation of Groundwater none filed  
Date well started June 4-69 Date Completed June 9-69  
Type of well Drilled Equipment Used Churn  
(dug, driven, bored or drilled) (Churn, drill, rotary or other)  
Water Use: Domestic  Municipal  Stock  Irrigation   
Industrial  Drainage  Other

Indicate on the diagram the character and thickness of the different strata met with in drilling, such as soil, clay, shale, gravel, rock or sand, etc. Show depth at which water is encountered, thickness and character of water-bearing strata and height to which the water rises in the well.

Size of Drilled Hole	Size and Weight of Casing	From (Feet)	To (Feet)	PERFORATIONS		
				Kind Size	From (Feet)	To (Feet)
6 3/8"	7" 00 23 lb	0	129	none		

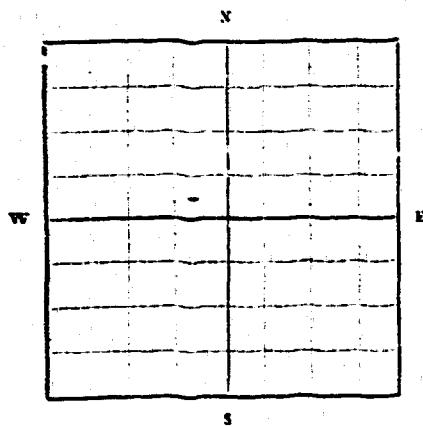

S.W. 1/4 Sec. 10 T.30N R.21W  
Indicate location of well and place of use, if possible. Each small square represents 10 acres.

Show exact depth of bottom.

Static Water Level for non-flowing Well 40 feet.  
Shut-in Pressure for Flowing Well non-flowing  
Pumping Water Level 75 feet at 15 gal. per minute.  
Discharge in gal. per min. of flowing well non-flowing  
How Tested Bailer Length of Test 3 hrs

Remarks: (Gravel packing, cementing, packers, type of shutoff, location of place of use of groundwater if not at well, and any other similar pertinent information, including number of acres irrigated, if used for irrigation)

no 55  
Driller's License Number  
Oliver Justin  
Driller's Signature

This form to be prepared by driller, and three copies to be filed by the owner with the County Clerk and Recorder in the county in which the well is located.

Please answer all questions. If not applicable, so state, otherwise the form will be returned.

Original to the County Clerk and Recorder; duplicate to the State Engineer; Triplicate to the School of Mines and Quadruplicate for the Appropriator.

45461

14,010

STATE OF MONTANA  
COUNTY OF FLATHEAD

Filed on the 23 day of June  
A.D. 1969 at 11:57 o'clock A.M.

26 m  
County Clerk and Recorder

by [Signature]  
Deputy

STATE OF MONTANA  
ADMINISTRATOR OF GROUNDWATER CODE  
OFFICE OF STATE ENGINEER

RECEIVED  
DEC 30 1963  
STATE ENGINEER

Declaration of Vested Groundwater Rights

(Under Chapter 237, Montana Session Laws, 1961)

1. Nearby H. Nelson (Name of Appropriator) of Columbia Falls (Address) (Town)  
County of Flathead State of Montana  
have appropriated groundwater according to the Montana laws in effect prior to January 1, 1962, as follows:

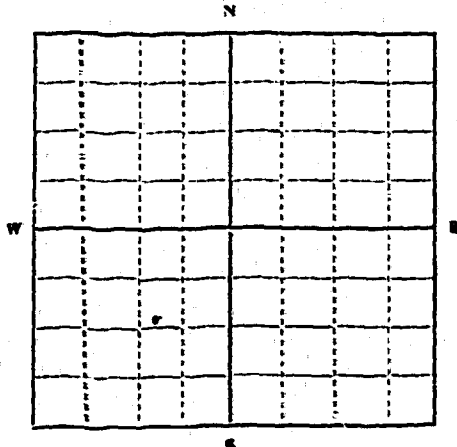

SW 1/4 Sec 10 T30 R21

Indicate point of appropriation and place of use, if possible. Each small square represents 10 acres.

- 2. The beneficial use on which the claim is based House  
CATTLE 40 ac Land
- 3. Date or approximate date of earliest beneficial use; and how continuous the use has been \_\_\_\_\_
- 4. The amount of groundwater claimed (in miner's inches or gallons per minute) 150
- 5. If used for irrigation, give the acreage and description of the lands to which water has been applied and name of the owner thereof \_\_\_\_\_
- 6. The means of withdrawing such water from the ground and the location of each well or other means of withdrawal \_\_\_\_\_
- 7. The date of commencement and completion of the construction of the well, wells, or other works for withdrawal of groundwater \_\_\_\_\_
- 8. The depth of water table (135 To Be Drilled) ONC 35 feet
- 9. So far as it may be available, the type, size and depth of each well or the general specifications of any other works for the withdrawal of groundwater \_\_\_\_\_
- 10. The estimated amount of groundwater withdrawn each year \_\_\_\_\_
- 11. The log of formations encountered in the drilling of each well if available \_\_\_\_\_
- 12. Such other information of a similar nature as may be useful in carrying out the policy of this act, including reference to book and page of any county record \_\_\_\_\_

Signature of Owner Nearby H. Nelson  
Date Dec 23-63

Three copies to be filed by the owner with the County Clerk and Recorder of the county in which the well is located.  
Please answer all questions. If not applicable, so state, otherwise the form will be returned.

Original to the County Clerk and Recorder; duplicate to the State Engineer; Triplicate to the Montana Bureau of Mines and Geology and Quadruplicate for the Appropriator.

10, 1963

STATE OF MONTANA, SS  
COUNTY OF FLATHEAD

Filed on the 23 day of Dec  
A.D. 1963 at 4:50 o'clock P.M.

*L E M*  
County Clerk and Recorder

By *J N* Deputy



County \_\_\_\_\_

STATE OF MONTANA  
ADMINISTRATOR OF GROUNDWATER CODE  
OFFICE OF STATE ENGINEER

RECEIVED  
DEC 30 1963

**Declaration of Vested Groundwater Rights**  
(Under Chapter 237, Montana Session Laws, 1961)

CHRIS RASHUSSEN of Rt. #1 B Columbia Falls  
(Name of Appropriator) (Address) (Town)  
County of Flathead State of Montana

have appropriated groundwater according to the Montana laws in effect prior to January 1, 1962, as follows:

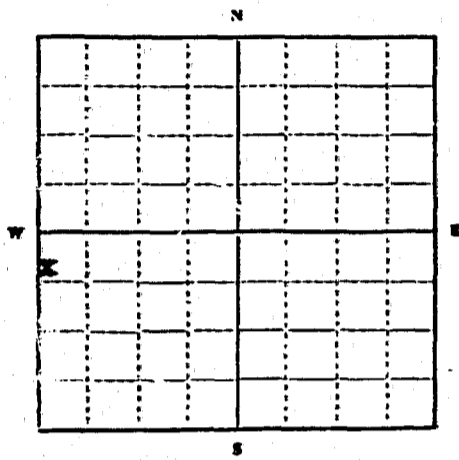

NW 1/4 SW 1/4 Sec 10 T. 30. R. 21

Indicate point of appropriation and place of use, if possible. Each small square represents 10 acres.

- 2. The beneficial use on which the claim is based Domestic use, garden, lawn and 15 head of livestock
- 3. Date or approximate date of earliest beneficial use; and how continuous the use has been 1938 and continuous ever since
- 4. The amount of groundwater claimed (in miner's inches or gallons per minute) \_\_\_\_\_
- 5. If used for irrigation, give the acreage and description of the lands to which water has been applied and name of the owner thereof used for personal garden and lawn
- 6. The means of withdrawing such water from the ground and the location of each well or other means of withdrawal Electric pump

7. The date of commencement and completion of the construction of the well, wells, or other works for withdrawal of groundwater 1938

8. The depth of water table 12 feet to top of water - well 19 feet deep

9. So far as it may be available, the type, size and depth of each well or the general specifications of any other works for the withdrawal of groundwater Cement curb 3 feet in diameter and 19 feet deep

10. The estimated amount of groundwater withdrawn each year 150,000 gallons

11. The log of formations encountered in the drilling of each well if available first 4 to 5 feet sandy loam, then about 3 inches of shale, and balance of very sandy loam

12. Such other information of a similar nature as may be useful in carrying out the policy of this act, including reference to book and page of any county record \_\_\_\_\_

Signature of Owner Chris Rashussen

Date December 18, 1963

Three copies to be filed by the owner with the County Clerk and Recorder of the county in which the well is located.

Please answer all questions. If not applicable, so state, otherwise the form will be returned.

Original to the County Clerk and Recorder; duplicate to the State Engineer; Triplicate to the Montana Bureau of Mines and Geology and Quadruplicate for the Appropriator.

10,058

STATE OF MONTANA SS  
COUNTY OF FLAREHEAD  
Filed on the 18 day of Dec  
A. D. 19 63 at 3:13 o'clock P. M.  
County Clerk and Recorder  
Deputy

304-21W  
County Blaine

STATE OF MONTANA  
ADMINISTRATOR OF GROUNDWATER CODE  
MONTANA WATER RESOURCES BOARD

NOTICE OF COMPLETION OF GROUNDWATER  
APPROPRIATION BY MEANS OF WELL

Developed after January 1, 1962

(Under Chapter 237 Montana Session Laws, 1961, as amended)

This form to be prepared by driller, and three copies to be filed by the owner with the County Clerk and Recorder in the county in which the well is located, last copy to be retained by driller.

Please answer all questions. If not applicable, so state, otherwise the form may be returned.

Owner Mr. & Mrs. David R. [unclear]  
Address Route 1-3  
Columbia Falls, Mt.  
Date well started July 5, 1971  
completed July 20, 1971

For Administrator's Use	
File	<u>4732</u>
	<u>July 26, 1971</u>
GW I	<u>10-51 A-III</u>

Type of well Drilled  
(Dug, driven, bored or drilled)

Equipment used Shure drill  
(Chain drill, rotary or other)

Water Use: Domestic  Municipal  Stock  Irrigation   
Industrial  Drainage  Other \* Garden/Lawn

\*Describe  
USE: If used for irrigation, industrial, drainage or other. Explain, state number of acres and location or other data (i.e. Lot, Block and Addition).

ESTIMATED ANNUAL WITHDRAWAL 1,000 gallons

Size of Drilled Hole	Size and Weight of Casing	From (Feet)	To (Feet)	PERFORATIONS		
				Kind	From (Feet)	To (Feet)
<u>6-5/8"</u> <u>O.C.</u>	<u>6-5/8"</u> <u>O.C.</u> <u>280 wall</u>	<u>0</u>	<u>20</u>	<u>1/2"</u>		

N W E S	1	2	3	4
	5	6	7	8
	9	10	11	12
	13	14	15	16

Static water level 30 ft.  
Pumping water level 30 ft.  
at 5 gallons per minute,  
measured 5 minutes after pumping  
began.  
\*Measured from ground level.  
Well developed by 3 hours.  
Power            Pump            HP  
Remarks: (Gravel packing, cementing,  
packers, type of shutoff)

1/4 Sec 10  
T 36 N R 1 E  
S W

INDICATE LOCATION OF WELL AND PLACE OF USE, IF POSSIBLE. EACH SMALL SQUARE REPRESENTS 40 ACRES.

Driller's Signature [Signature]  
Driller's Address 304-21W, Columbia Falls, Mt.

Phone 5912 LICENSE NO.           

DRILLER'S LOG

Indicate the character, color, thickness of strata such as soil, clay, sand, gravel, shale, sandstone, etc. Show depth at which water is found and height to which water rises in well.

Top of Ground (Elev. above sea level) 3000

From (Feet)	To (Feet)	
0	2	Top soil
2	25	Brown sandy clay
25	78	Gray sandy clay, see page
78	97	Gray clay, pebbles
97	99	Gravel & clay, water strata
99	105	Clay, water shut off

39 Show exact depth of bottom

54154

14732

STATE OF MONTANA } SS  
COUNTY OF FLATHEAD }

Filed on the 26 day of June  
A. D. 1922 at 10<sup>30</sup> o'clock AM

MT  
County Clerk and Recorder

By dp  
Deputy

MAY 17 1967

STATE OF MONTANA  
ADMINISTRATOR OF GROUNDWATER CODE  
OFFICE OF STATE ENGINEER

Top of Ground \_\_\_\_\_  
(Elev. above sea level \_\_\_\_\_)

Notice of Completion of Groundwater  
Appropriation by Means of Well

(Under Chapter 237, Montana Session Laws, 1961)

0 to 116 ft Silt  
116 to 148 ft Silt  
with some gravel.  
148 to 162 ft  
Brown hard pan.  
seeps water.  
162 to 175 ft  
Water bearing  
gravel & sand.

Owner Robert J. Sparks Address P.O. Box 692 Natl. Park West

Driller Olson & Justen Address Col. Falls, Mont.

Date of Notice of Appropriation of Groundwater none filed

Date started April 19-65 Date Completed April 22, 1965.

Type of well Drilled Equipment Used Churn  
(dug, driven, bored or drilled) (Churn, drill, rotary or other)

Water Use: Domestic  Municipal  Other  Irrigation   
Industrial  Drainage  Stock

Indicate on the diagram the character and thickness of the different strata met with in drilling, such as soil, clay, shale, gravel, rock or sand, etc. Show depth at which water is encountered, thickness and character of water-bearing strata and height to which water rises in the well.

Size of Drilled Hole	Size and Weight of Casing	From (Feet)	To (Feet)	PERFORATIONS		
				Kind Size	From (Feet)	To (Feet)
6 3/8	7" 00 23 lbs pup	0	175	none		

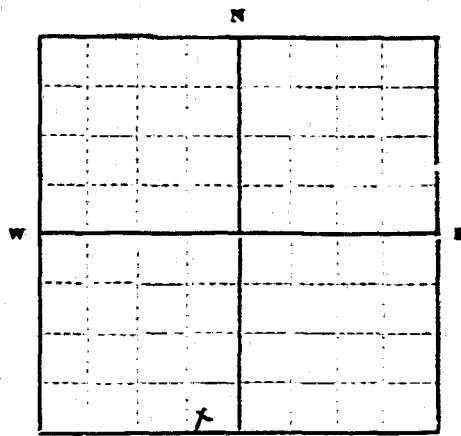

Section T34R21  
Indicate location of well and place of use, if possible. Each small square represents 10 acres.

Static Water Level for non-flowing Well 60 feet.

Shut-in Pressure for Flowing Well non-flowing

Pumping Water Level 96 feet at 20 gal. per minute.

Discharge in gal. per min. of flowing well non-flowing

How Tested Bailer Length of Test 2 hrs

Remarks: (Gravel packing, cementing, packers, type of shutoff, location of place of use of groundwater if not at well, and any other similar pertinent information, including number of acres irrigated, if used for irrigation)

Show exact depth of bottom.

Driller's License Number W 55  
Driller's Signature Olson & Justen

This form to be prepared by driller, and three copies to be filed by the owner with the County Clerk and Recorder in the county in which the well is located.

Please answer all questions. If not applicable, so state, otherwise the form will be returned.

Original to County Clerk and Recorder; duplicate to the State Engineer; triplicate to the Montana Bureau of Mines and Geology; and quadruplicate for the Appropriator.

12,894

67 <sup>1</sup>/<sub>9<sup>45</sup></sub> May  
96M  
County Clerk and Recorder  
M. J.

STATE OF MONTANA  
ADMINISTRATOR OF GROUNDWATER CODE  
MONTANA WATER RESOURCES BOARD

NOTICE OF COMPLETION OF GROUNDWATER  
APPROPRIATION BY MEANS OF WELL  
Developed after January 1, 1962

(Under Chapter 237 Montana Session Laws, 1961, as amended)

This form to be prepared by driller, and three copies to be filed by the owner with the County Clerk and Recorder in the county in which the well is located, last copy to be retained by driller.

Please answer all questions. If not applicable, so state, otherwise the form may be returned.

Owner Richard Sparks  
Address Route 40 West  
Columbia Falls Mont  
Date well started Aug 31-72  
completed Sept 5-72  
Type of well Drilled  
Equipment used Churn  
Water Use: Domestic  Municipal  Stock  Irrigation   
Industrial  Drainage  Other \* Garden/Lawn

For Administrator's Use  
File 14,523  
Oct 2, 1972 12:32 pm  
GW 1

\*Describe \_\_\_\_\_  
USE: If used for irrigation, industrial, drainage or other. Explain, state number of acres and location or other data (i.e. Lot, Block and Addition).

ESTIMATED ANNUAL WITHDRAWAL

Size of Drilled Hole	Size and Weight of Casing	From (Feet)	To (Feet)	PERFORATIONS		
				Kind Size	From (Feet)	To (Feet)
6 3/8 18	7" OP. 2 3/8"	0	161	none		

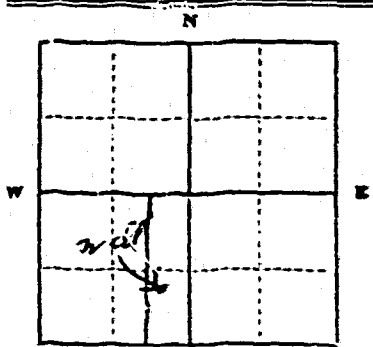

Static water level 45 ft.\*  
Pumping water level 60 ft.\*  
at 20 gallons per minute,  
measured \_\_\_\_\_ minutes after pumping began.  
\*Measured from ground level.  
Well developed by Gravel  
for 2 hours.  
Power \_\_\_\_\_ Pump \_\_\_\_\_ HP  
Remarks: (Gravel packing, cementing, packers, type of shutoff)

E 1/2 E 1/2 S 1/4 N 1/4  
1/4 Sec 10  
T. 30. N. R. 21. E  
S W

INDICATE LOCATION OF WELL AND PLACE OF USE, IF POSSIBLE. EACH SMALL SQUARE REPRESENTS 40 ACRES.

Driller's Signature Richard Sparks  
Driller's Address Columbia Falls Mont

LICENSE NO. 55

3211210  
County Fletcher 10

DRILLER'S LOG

Indicate the character, color, thickness of strata such as soil, clay, sand, gravel, shale, sandstone, etc. Show depth at which water is found and height to which water rises in well.

Top of Ground (Elev. above sea level)		
From (Feet)	To (Feet)	
0	34	Sand of silt
34	98	Silt
98	140	Silt with gravel
140	149	Hard pan.
149	160	Below clay with gravel
160	161	Seep water Water bearing gravel all over it

161 Show exact depth of bottom

51,533

14523

STATE OF MONTANA )  
COUNTY OF FLATHEAD ) SS

Filed on the 7 day of Oct  
A. D. 1977 at 12:00 Clock P. M.

DM  
County Clerk and Recorder  
By CP  
Deputy



File No \_\_\_\_\_

GW 2

T. 30 N. R. 21 W.

County Flathead

STATE OF MONTANA  
ADMINISTRATOR OF GROUNDWATER CODE  
OFFICE OF STATE ENGINEER

Notice of Completion of Groundwater  
Appropriation by Means of Well

(Under Chapter 237, Montana Session Laws, 1961)

Owner Artie E. Loars Address Route 40 East Columbia Falls Mont

Driller Olsen & Justice Address Columbia Falls Mont

Date of Notice of Appropriation of Groundwater none filed

Date well started Sept 23-69 Date Completed Sept 29-69

Type of well Drilled Equipment Used Churn  
(dug, driven, bored or drilled) (Churn, drill, rotary or other)

Water Use: Domestic  Municipal  Other  Irrigation   
Industrial  Drainage  Stock

Top of Ground  
(Elev. above sea level \_\_\_\_\_)  
0 to 88 ft Silt.  
88 to 143 ft  
clay and gravel  
143 to 187 ft  
brown hard pan  
187 to 191 ft  
water bearing gravel  
and sand.

Indicate on the diagram the character and thickness of the different strata met with in drilling, such as soil, clay, shale, gravel, rock or sand, etc. Show depth at which water is encountered, thickness and character of water-bearing strata and height to which water rises in the well.

Size of Drilled Hole	Size and Weight of Casing	From (Feet)	To (Feet)	PERFORATIONS		
				Kind	From (Feet)	To (Feet)
6 3/8	7" O.D. 23 lb.	0	191			

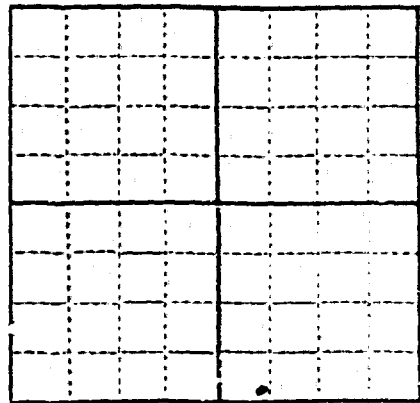

W 1/4 of N 1/4 of S  
SE 1/4 of Sec. 10. T30N R. 21W  
Indicate location of well and place of use, if possible. Each small square represents 10 acres.

Show exact depth of bottom.

Static Water Level for non-flowing Well 30 feet.

Shut-in Pressure for Flowing Well non-flowing

Pumping Water Level 90 feet at 15 gal per minute.

Discharge in gal per min. of flowing well non-flowing

How Tested Bailer Length of Test 2 hrs

Remarks: (Gravel packing, cementing, packers, type of shutoff, location of place of use of groundwater if not at well, and any other similar pertinent information, including number of acres irrigated, if used for irrigation)

NO 55

Driller's License Number

Olsen & Justice  
Driller's Signature

This form to be prepared by driller, and three copies to be filed by the owner with the County Clerk and Recorder in the county in which the well is located.

Please answer all questions. If not applicable, so state, otherwise the form will be returned.

Original to the County Clerk and Recorder; duplicate to the State Engineer; Triplicate to the Montana Bureau of Mines and Geology and Quadruplicate for the Appropriator.

45823

14068

STATE OF MONTANA | SS  
COUNTY OF FLATHEAD |  
Filed on the 6 day of Oct  
A.D. 1909 at 1:30 Clock A M  
JEM  
County Clerk and Recorder  
By [Signature] Deputy

Fr No \_\_\_\_\_

GW 4

T 30 N 24 W 10

County \_\_\_\_\_

STATE OF MONTANA  
ADMINISTRATOR OF GROUNDWATER CODE  
OFFICE OF STATE ENGINEER

RECEIVED  
DEC 30 1963

Declaration of Vested Groundwater Rights ENGINEER  
(Under Chapter 237, Montana Session Laws, 1961)

1. Francis W. West of Rte 113 Columbia Falls  
(Name of Appropriator) (Address) (Town)  
County of Flathead State of Montana  
have appropriated groundwater according to the Montana laws in effect prior to January 1, 1962, as follows:

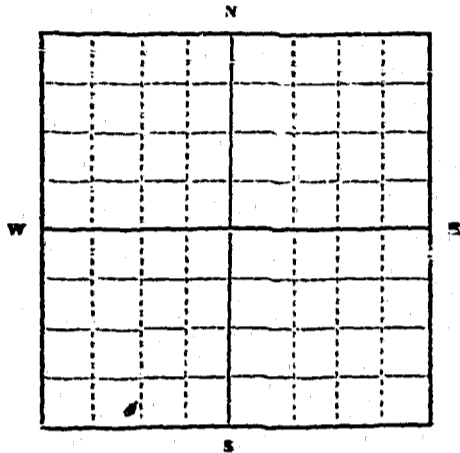

SW 1/4 SW Sec 10 T 30 R 21

Indicate point of appropriation and place of use, if possible. Each small square represents 10 acres.

- 2. The beneficial use on which the claim is based. Household garden lawn & stock
- 3. Date or approximate date of earliest beneficial use; and how continuous the use has been. 1949 and continuously
- 4. The amount of groundwater claimed (in miner's inches or gallons per minute). 5 gal per minute
- 5. If used for irrigation, give the acreage and description of the lands to which water has been applied and name of the owner thereof. 1/4 acre garden
- 6. The means of withdrawing such water from the ground and the location of each well or other means of withdrawal. shallow well pump

7. The date of commencement and completion of the construction of the well, wells, or other works for withdrawal of groundwater. May 1949 - July 1949

8. The depth of water table. 25 ft.

9. So far as it may be available, the type, size and depth of each well or the general specifications of any other works for the withdrawal of groundwater. dug well, 3ft round curbing and 30 ft deep

10. The estimated amount of groundwater withdrawn each year. 150,000 gal. per year

11. The log of formations encountered in the drilling of each well if available. non applicable

12. Such other information of a similar nature as may be useful in carrying out the policy of this act, including reference to book and page of any county record. non applicable

Signature of Owner Francis W. West  
Date Dec 17, 1963

Three copies to be filed by the owner with the County Clerk and Recorder of the county in which the well is located.

Please answer all questions. If not applicable, so state, otherwise the form will be returned.

Original to the County Clerk and Recorder; duplicate to the State Engineer; Triplicate to the Montana Bureau of Mines and Geology and Quadruplicate for the Appropriator.

10,067

ALL OF THE  
COUNTY OF EL PASO TEXAS  
ON the 19<sup>th</sup> day of Dec  
1963 at 8:30 AM  
J.P. W.,  
County Clerk and Recorder  
By J.P. W. Deputy