

10600

130 Dec
63 712
70200

22 #.

File No. _____

GW 2

T. 30N R. 21W 21

County Flathead

STATE OF MONTANA
ADMINISTRATOR OF GROUNDWATER CODE
OFFICE OF STATE ENGINEER

Notice of Completion of Groundwater
Appropriation by Means of Well

(Under Chapter 237, Montana Session Laws, 1961)

0 Top of Ground
2 (Elev. above sea level 2,800)
5' clay
20' Gravel - Boulders
4' clay
23' water zone
coarse sand
& fine sand
some clay

Owner Wayne H. Heford Address Rural Col. FallsDriller Weber Drilling Co. Address Col. Falls

Date of Notice of Completion of Groundwater _____

Date well started 10-14-69 Date Completed 10-15-69Type of well drilled Equipment Used Churn
(dug, driven, bored or drilled) (Churn, drill, rotary or other)Water Use: Domestic ☒ Municipal ☐ Other ☐ Irrigation ☐
Industrial ☐ Drainage ☐ Stock ☐

Indicate on the diagram the character and thickness of the different strata met with in drilling, such as soil, clay, shale, gravel, rock or sand, etc. Show depth at which water is encountered, thickness and character of water-bearing strata and height to which water rises in the well.

Size of Drilled Hole	Size and Weight of Casing	From (Feet)	To (Feet)	PERFORATIONS		
				Kind and Size	From (Feet)	To (Feet)
7"	7" O. C.	0	23	None		

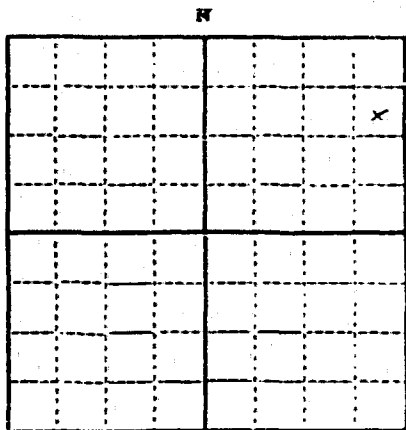

NE 1/4 Sec. 24 T. 22 R. 21E
Indicate location of well and place of use, if possible. Each small square represents 10 acres.

23'

Show exact depth of bottom.

Static Water Level for non-flowing Well 13 feet.

Shut-in Pressure for Flowing Well _____

Pumping Water Level 18 feet at 20 gal. per minute.

Discharge in gal. per min. of flowing well _____

How Tested Bailed Length of Test 2 hrs.

Remarks: (Gravel packing, cementing, packers, type of shutoff, location of place of use of groundwater if not at well, and any other similar pertinent information, including number of

acres irrigated, if used for irrigation) OpenBottom - drilled to 30':from 23' to 30' soft mucky clay & sand. - pulled casing back to 23' level

181

Driller's License Number

Driller's Signature Jerome H. Weber

This form to be prepared by driller, and three copies to be filed by the owner with the County Clerk and Recorder in the county in which the well is located.

Please answer all questions. If not applicable, so state, otherwise the form will be returned.

Original to the County Clerk and Recorder; duplicate to the State Engineer; Triplicate to the Montana Bureau of Mines and Geology and Quadruplicate for the Appropriator.

45,329

14075

STATE OF MONTANA
COUNTY OF FLATHEAD
Filed on the 3 day Nov
A.D. 1969 at 250 o'clock P M
sem
County Clerk and Recorder
By sem Deputy

File No. _____

GW 4

T 30 N R 21 W 24
County FlatheadSTATE OF MONTANA
ADMINISTRATOR OF GROUNDWATER CODE
OFFICE OF STATE ENGINEERRECEIVED
JUL 24 1962

Declaration of Vested Groundwater Rights

(Under Chapter 237, Montana Session Laws, 1961)

STATE ENGINEER

1. Paul L. Lynn & Irene M. Lynn of Columbia Falls Montana
 (Name of Appropriator) (Address) (Town)
 County of Flathead State of Montana
 have appropriated groundwater according to the Montana laws in effect prior to January 1, 1962, as follows:

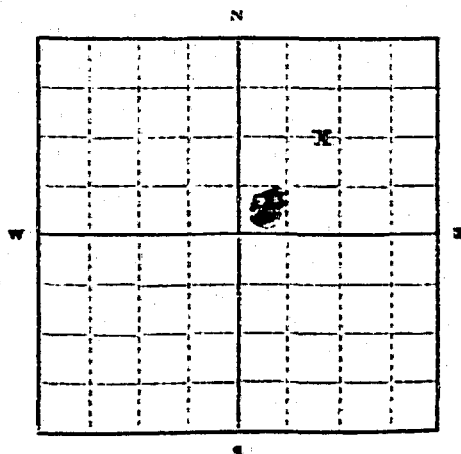

SW 1/4 NE Sec. 21 T.30 R.21

Indicate point of appropriation
 and place of use, if possible.
 Each small square represents 10
 acres.

X indicates location
 of well

2. The beneficial use on which the claim is based. DOMESTIC
3. Date or approximate date of earliest beneficial use; and how continuous the use has been. 1951
used continuously
4. The amount of groundwater claimed (in miner's inches or gallons per minute). 50 gallons
5. If used for irrigation, give the acreage and description of the lands to which water has been applied and name of the owner thereof.
domestic use & garden
6. The means of withdrawing such water from the ground and the location of each well or other means of withdrawal.
electric pump
7. The date of commencement and completion of the construction of the well, wells, or other works for withdrawal of groundwater. 1951
8. The depth of water table. 15 feet
9. So far as it may be available, the type, size and depth of each well or the general specifications of any other works for the withdrawal of groundwater. 2 ft. curbing, 17 feet deep
10. The estimated amount of groundwater withdrawn each year. 120,000 gallons per year
11. The log of formations encountered in the drilling of each well if available.
4 feet of top soil, balance gravel
12. Such other information of a similar nature as may be useful in carrying out the policy of this act, including reference to book and page of any county record.

Signature of Owner

Paul L. Lynn
 Date 7-8-62

Three copies to be filed by the owner with the County Clerk and Recorder of the county in which the well is located.

Please answer all questions. If not applicable, so state, otherwise the form will be returned.

Original to the County Clerk and Recorder; duplicate to the State Engineer; Triplicate to the Montana Bureau of Mines and Geology, and Quadruplicate for the Appropriator.

5147

97 97

STATE OF MONTANA
COUNTY OF FLATHEAD
Filed on the 10 day of July
A. D. 1967 at 1:40 o'clock P. M.
By [Signature] County Clerk and Recorder
Deputy

File No. _____

SW 4

T 36 N R 21 W 24

County Flathead

STATE OF MONTANA
ADMINISTRATOR OF GROUNDWATER CODE
OFFICE OF STATE ENGINEER

RECEIVED
JUL 24 1963

Declaration of Vested Groundwater Rights

(Under Chapter 237, Montana Session Laws, 1961)

STATE ENGINEER

Paul L. Lynn & Irene M. Lynn

of Columbia Falls

(Name of Appropriator)

(Address)

(Town)

County of Flathead

State of Montana

have appropriated groundwater according to the Montana laws in effect prior to January 1, 1952, as follows:

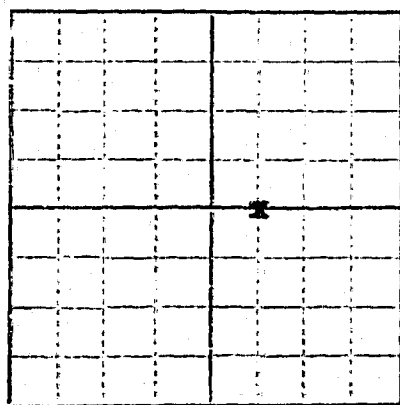

SW 1/4 Sec. 24 T. 30 R. 21

Indicate point of appropriation and place of use, if possible. Each small square represents 10 acres.

X indicates location of well

2. The beneficial use on which the claim is based stock water

3. Date or approximate date of earliest beneficial use; and how continuous the use has been 1956
used continually

4. The amount of groundwater claimed (in miner's inches or gallons per minute) 10 gallons

5. If used for irrigation, give the acreage and description of the lands to which water has been applied and name of the owner thereof

6. The means of withdrawing such water from the ground and the location of each well or other means of withdrawal electric pump

7. The date of commencement and completion of the construction of the well, wells, or other works for withdrawal of groundwater 1956

8. The depth of water table 13 ft.

9. So far as it may be available, the type, size and depth of each well or the general specifications of any other works for the withdrawal of groundwater 3 feet. 15ft. deep

10. The estimated amount of groundwater withdrawn each year 22,000 gallons

11. The log of formations encountered in the drilling of each well if available 3 feet top soil
5 feet clay, balance quick sand

12. Such other information of a similar nature as may be useful in carrying out the policy of this act, including reference to book and page of any county record.

Signature of Owner

Paul L. Lynn

Date 7/8/63

Three copies to be filed by the owner with the County Clerk and Recorder of the county in which the well is located.

Please answer all questions. If not applicable, so state, otherwise the form will be returned.

Original to the County Clerk and Recorder; duplicate to the State Engineer; Triplicate to the Montana Bureau of Mines and Geology; and Quadruplicate for the Appropriator.

9798

STATE OF MONTANA
COUNTY OF FLATHEAD
Filed on the 10 day of July
A. D. 1962 at Helena, Montana
JEM
County Clerk and Recorder
by [Signature]
Deputy

File No. _____

GW 4

T 30 N 21 W 24
County FlatheadSTATE OF MONTANA
ADMINISTRATOR OF GROUNDWATER CODE
OFFICE OF STATE ENGINEER**RECEIVED**
JUL 24 1963**Declaration of Vested Groundwater Rights**

(Under Chapter 237, Montana Session Laws, 1961)

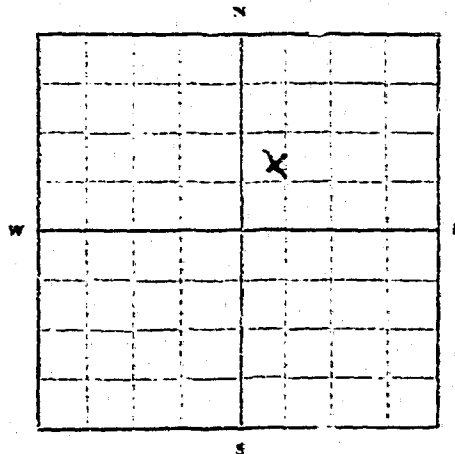
STATE ENGINEERI, Paul L. Lynn & Irene M. Lynn of Columbia Falls
(Name of Appropriator) (Address) (Town)
County of Flathead State of Montana
have appropriated groundwater according to the Montana laws in effect prior to January 1, 1962, as follows:SW 1/4 Sec 24, Twp 30, Range 21Indicate point of appropriation
and place of use, if possible.
Each small square represents 10
acres.**X indicates location
of well**2. The beneficial use on which the claim is based
Irrigating farm land3. Date or approximate date of earliest beneficial use; and how con-
tinuous the use has been 19404. The amount of groundwater claimed (in miner's inches or gallons
per minute) 240 gallons5. If used for irrigation, give the acreage and description of the lands
to which water has been applied and name of the owner thereof
Paul L. Lynn
SW 1/4 Sec 24, Twp 30, Range 216. The means of withdrawing such water from the ground and the
location of each well or other means of withdrawal
7 1/2 horse electric pump7. The date of commencement and completion of the construction of the well, wells, or other works for with-
drawal of groundwater 19408. The depth of water table 13 feet9. So far as it may be available, the type, size and depth of each well or the general specifications of any other
works for the withdrawal of groundwater 8 feet square, 21 feet deep10. The estimated amount of groundwater withdrawn each year 12,000,00011. The log of formations encountered in the drilling of each well if available
3 feet top soil, balance gravel12. Such other information of a similar nature as may be useful in carrying out the policy of this act, including
reference to book and page of any county record

Signature of Owner

Paul L. Lynn
Date 7-5-68Three copies to be filed by the owner with the County Clerk and Recorder of the county in which the well is
located.

Please answer all questions. If not applicable, so state, otherwise the form will be returned.

Original to the County Clerk and Recorder; duplicate to the State Engineer; Triplicate to the Montana Bureau
of Mines and Geology, and Quadruplicate for the Appropriator.

9799

STATE OF MONTANA
COUNTY OF FLATHEAD
Filed on the 10 day of June
A. D. 1963 at 11:52 a.m.
JEM
County Clerk and Recorder
Denny

53.294

14 499

STATE OF MONTANA }
COUNTY OF FLATHEAD } SS

Filed on the 29 day of May
A. D. 1919 at 1 1/2 o'clock P. M

M. R.
County Clerk and Recorder

By [Signature]
Deputy

RECEIVED

STATE OF MONTANA
ADMINISTRATOR OF GROUNDWATER CODE
OFFICE OF STATE ENGINEER

Declaration of Vested Groundwater Rights

(Under Chapter 237, Montana Session Laws, 1961)

1. Robert W. McCallum of Rt 1-B Columbia Falls
(Name of Appropriator) (Address) (Town)
County of Fallhead State of Montana
have appropriated groundwater according to the Montana laws in effect prior to January 1, 1962, as follows:

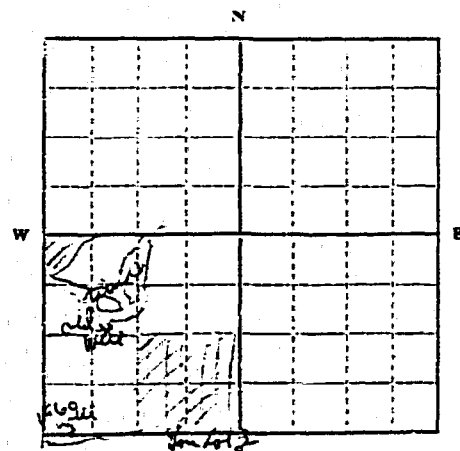

1/4 Sec. ²⁴25 T. 30N R. 21W

Indicate point of appropriation and place of use, if possible. Each small square represents 10 acres.

2. The beneficial use on which the claim is based domestic
and irrigation
3. Date or approximate date of earliest beneficial use; and how continuous the use has been on well approximately 1910
according to information received. Other 1960

4. The amount of groundwater claimed (in miner's inches or gallons per minute) domestic well pump 1.0 gal per min
irrigation pump 4.0 gal per min. Other
intermittent use on both
5. If used for irrigation, give the acreage and description of the lands to which water has been applied and name of the owner thereof
Water has not been used for irrigation since
but owner plans to do so beginning
1963

6. The means of withdrawing such water from the ground and the location of each well or other means of withdrawal well
by gas or electric powered pumps

7. The date of commencement and completion of the construction of the well, wells, or other works for withdrawal of groundwater.

8. The depth of water table approximately 20-25 ft

9. So far as it may be available, the type, size and depth of each well or the general specifications of any other works for the withdrawal of groundwater One well 6' deep casing, hand dug. Other
partially dug & not down with sand point. Outside pipe casing.

10. The estimated amount of groundwater withdrawn each year 182, sec gal (approx)

11. The log of formations encountered in the drilling of each well if available not available

12. Such other information of a similar nature as may be useful in carrying out the policy of this act, including reference to book and page of any county record.

Signature of Owner Robert W. McCallum
Date 5-17-63

Three copies to be filed by the owner with the County Clerk and Recorder of the county in which the well is located.

Please answer all questions. If not applicable, so state, otherwise the form will be returned.

Original to the County Clerk and Recorder; duplicate to the State Engineer; Triplicate to the Montana Bureau of Mines and Geology, and Quadruplicate for the Appropriator.

9753

STATE OF MONTANA SS
COUNTY OF FATHLEAD

Filed on the 17 day of May
A. D. 1963 at 12:30 o'clock P. M.

J. E. M.

County Clerk and Recorder

By

J. J. N.

Deputy

File No. _____

T. 30N. R. 21W

County Flathead

STATE OF MONTANA
ADMINISTRATOR OF GROUNDWATER CODE
OFFICE OF STATE ENGINEER

**Notice of Completion of Groundwater Appropriation
Without Well**

(Under Chapter 237 Montana Session Laws, 1961)

Date of Appropriation of Groundwater 1911
Owner Joseph J. Motichka Route 1 B. Columbia
Richard Motichka Address Falls, Montana

Contractor (if any) not applicable

Address of Contractor " "

Date Started 1911 Date Completed 1911

Describe means of obtaining groundwater without a well "as by
sub-irrigation and other natural processes". Include depth to
water when applicable. originally reached by excavation;
electric pump and pipe; surface spring as water
now reaches the surface.

Quantity of water developed and used with explanation of method
used to measure or estimate such amount. If use is intermittent

estimate approximate lengths of periods of use.

20,000 gallons monthly May, June, July, August;
15,000 gallons monthly January, February, March
April, September October November Dec.

Estimate on domestic use and
irrigation.

Signature of Owner Richard Motichka
Joseph Motichka

Date December 30, 1963

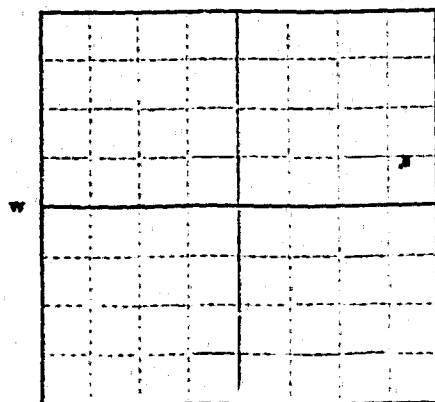

SE 1/4 NE 1/4 34 T. 30N. R. 21W

Indicate point of appropriation
and place of use, if possible.

This form to be prepared by contractor if any, otherwise by the owner.

Three copies of this notice are to be filed with the County Clerk and Recorder of the county in which the
works are located.

Please answer all questions. If not applicable, so state, otherwise the form will be returned.

Original to the County Clerk and Recorder, duplicate to the State Engineer, Triplicate to the Montana
Bureau of Mines and Geology and Quadruplicate for the Appropriator.

22773

10595 ✓

130 Dec
63 402
Pm
28th

File No. _____

3W 4

T. 30N R. 21W
County Flathead

24

STATE OF MONTANA
ADMINISTRATOR OF GROUNDWATER CODE
OFFICE OF STATE ENGINEER

Declaration of Vested Groundwater Rights

(Under Chapter 237, Montana Session Laws, 1961)

I, Joseph J. Motichka and Richard Motichka, of Route 1 B, Columbia Falls,
(Name of Appropriator) (Address) (Town)
County of Flathead State of Montana,
have appropriated groundwater according to the Montana laws in effect prior to January 1, 1962, as follows:

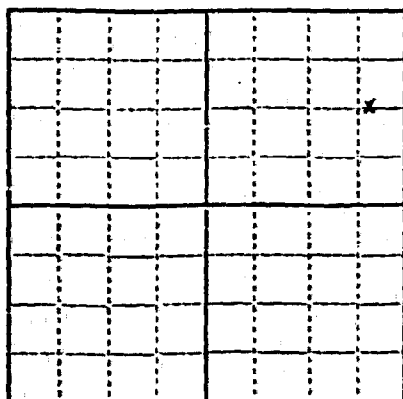

NE 1/4 Sec 24 T 30N R 21W

Indicate point of appropriation and place of use, if possible. Each small square represents 10 acres.

2. The beneficial use on which the claim is based Irrigation
3. Date or approximate date of earliest beneficial use; and how continuous the use has been July, 1963; continuous use since then.
4. The amount of groundwater claimed (in miner's inches or gallons per minute) 1 1/2 cubic feet per second
5. If used for irrigation, give the acreage and description of the lands to which water has been applied and name of the owner thereof The North half of the Northeast Quarter and the Southeast Quarter of the Northeast Quarter of Section 24, Township 30 North, Range 21 West.
6. The means of withdrawing such water from the ground and the location of each well or other means of withdrawal dug well with pump and pipe, in the Northeast Quarter of the Northeast Quarter of Section 24, Township 30N, Range 21 W.
7. The date of commencement and completion of the construction of the well, wells, or other works for withdrawal of groundwater. February, 1963; completion to be September 1, 1964.
8. The depth of water table five feet.
9. So far as it may be available, the type, size and depth of each well or the general specifications of any other works for the withdrawal of groundwater. Dug well, 8 feet square, 12 feet deep, curbed in with ties.
10. The estimated amount of groundwater withdrawn each year 1,000.000 cubic feet .
11. The log of formations encountered in the drilling of each well if available. primarily gravel
12. Such other information of a similar nature as may be useful in carrying out the policy of this act, including reference to book and page of any county record.

signature of owner

Signature of Owner

Date December 30, 1963

Three copies to be filed by the owner with the County Clerk and Recorder of the county in which the well is located.

Please answer all questions. If not applicable, so state, otherwise the form will be returned.

Original to the County Clerk and Recorder; duplicate to the State Engineer; Triplicate to the Montana Bureau of Mines and Geology and Quadruplicate for the Appropriator.

22775

10 597

FILED IN CASE NO. 33
A.D. 1903 1409 Dec
J. H. M.
County Clerk and Recorder
J. H. M.
Deputy

T. 30N R. 21W 25
County Festival

MONTANA BUREAU OF MINES AND GEOLOGY
Butte, Montana

RECEIVED

WATER WELL LOG

STATE ENGINEER

Owner Charles Jellison Estate Address Rte. #1 Kalispell
Driller Owner, dug Address _____
Date Started 1950 Date Completed 1954
Location: Sec. 25 T. 30 R. 21 $\frac{1}{4}$ sec. SE $\frac{1}{4}$

Type of well Aug. (Dug, driven, bored, or drilled) Equipment Used Auger (Churn drill, rotary, other)

Water use: Domestic ☐ Municipal ☐ Stock ☐ Irrigation ☒
Industrial ☐ Drainage ☐ Other: _____

Casing: _____ ft. to _____ ft. Type Concrete Size 4x8
Casing: _____ ft. to _____ ft. Type _____ Size _____
Casing: _____ ft. to _____ ft. Type _____ Size _____

Perforated or Screened: Ft. 1 to ft. 1 Ft. _____ to ft. _____

Type of screen or perforations 6 in. holes in concrete

Static Water level, for non-flowing well: river level feet.

Shut-in pressure, for flowing well: _____ lb./sq. in. on: _____ (date)

Pumping water level river level feet at _____ gal. per min.

How tested: open sight

Length of test 5 years

Remarks: (Gravel packing, cementing, packers, type of shut-off, depth of shut-off)

9014

STATE OF MONTANA
COUNTY OF FLAHERD
Filed on the 26 day of Sept
A.D. 1961 at 8:00 o'clock A.M.
J.E.M.
County Clerk and Recorder
By M.J. Deputy

File No. _____

GW 4

T 30 N R 21 W

County _____

STATE OF MONTANA
ADMINISTRATOR OF GROUNDWATER CODE
OFFICE OF STATE ENGINEER

RECEIVED
JAN 6 1964

Declaration of Vested Groundwater Rights

(Under Chapter 237, Montana Session Laws, 1961)

STATE ENGINEER

1. Fred C. & Aurelia E. Wittlake of Route #1, Kalispell
(Name of Appropriator) (Address) (Town)
County of Flathead State of Montana
have appropriated groundwater according to the Montana laws in effect prior to January 1, 1962, as follows:

N									
X									
S									

NW 1/4 Sec 25 T30 R21

Indicate point of appropriation
and place of use, if possible.
Each small square represents 10
acres.

2. The beneficial use on which the claim is based domestic use and family garden.
3. Date or approximate date of earliest beneficial use; and how continuous the use has been this well hasn't been in use since before 1950 to the best of our knowledge, but we bought the place in 1961 and plan to fix the house and grounds for use.
4. The amount of groundwater claimed (in miner's inches or gallons per minute) five (5) gallons per minute.
5. If used for irrigation, give the acreage and description of the lands to which water has been applied and name of the owner thereof approximately two (2) acres; NW 1/4 NW 1/4, 25 30 21; Fred C. & Aurelia E. Wittlake.
6. The means of withdrawing such water from the ground and the location of each well or other means of withdrawal at the present time there is a hand pump; 50' SE of the house.

7. The date of commencement and completion of the construction of the well, wells, or other works for withdrawal of groundwater unavailable

8. The depth of water table 15 to 20 feet

9. So far as it may be available, the type, size and depth of each well or the general specifications of any other works for the withdrawal of groundwater not known

10. The estimated amount of groundwater withdrawn each year 1,000,000 gallons

11. The log of formations encountered in the drilling of each well if available unavailable

12. Such other information of a similar nature as may be useful in carrying out the policy of this act, including reference to book and page of any county record none known

Signature of Owner Aurelia E. Wittlake

Date Dec. 30, 1963

Three copies to be filed by the owner with the County Clerk and Recorder of the county in which the well is located.

Please answer all questions. If not applicable, so state, otherwise the form will be returned.

Original to the County Clerk and Recorder; duplicate to the State Engineer; Triplicate to the Montana Bureau of Mines and Geology and Quadruplicate for the Appropriator.

22942

10772

FILED ON 31 day of Dec
A. D. 1963 at 10:30 o'clock a.m.
L. L. M.
County Clerk and Recorder
By L. L. M.
Deputy

File No. _____

GW 4

T. 20N R. 21 W. 26
County _____

STATE OF MONTANA
ADMINISTRATOR OF GROUNDWATER CODE
OFFICE OF STATE ENGINEER

Declaration of Vested Groundwater Rights

(Under Chapter 237, Montana Session Laws, 1961)

RECEIVED
JAN 6 1964

STATE ENGINEER

1. Mark W. Hodgson of R 1-B Columbia Falls
(Name of Appropriator) (Address) (Town)
County of Fleethad State of Montana
have appropriated groundwater according to the Montana laws in effect prior to January 1, 1962, as follows:

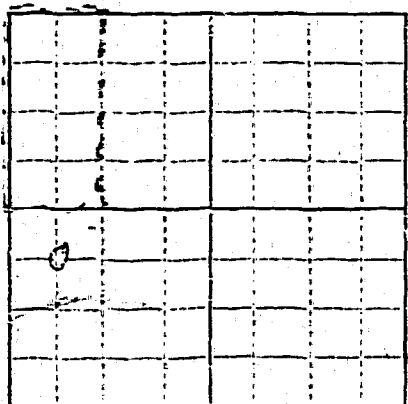

W 21 N 1/4 Sec 34 T 30 R 21

Indicate point of appropriation
and place of use, if possible.
Each small square represents 10
acres.

2. The beneficial use on which the claim is based
Irrigation
3. Date or approximate date of earliest beneficial use; and how continuous the use has been about 1953
Seasonal use since then
4. The amount of groundwater claimed (in miner's inches or gallons per minute) 400 gal. per min.
5. If used for irrigation, give the acreage and description of the lands to which water has been applied and name of the owner thereof
800. N.W. 1/4 of Sec. 39-30-21
and SW 1/4 of Sub 7 of Sec. 26-30-21
Mark Hodgson
6. The means of withdrawing such water from the ground and the location of each well or other means of withdrawal
Irrigation pump - approximately
center of N.W. 1/4 of N.W. 1/4 of Sec. 39-30-21
7. The date of commencement and completion of the construction of the well, wells, or other works for withdrawal of groundwater 1953
8. The depth of water table 14 ft.
9. So far as it may be available, the type, size and depth of each well or the general specifications of any other works for the withdrawal of groundwater hole scooped with dows
10. The estimated amount of groundwater withdrawn each year 6 min. in. per a.
11. The log of formations encountered in the drilling of each well if available
12. Such other information of a similar nature as may be useful in carrying out the policy of this act, including reference to book and page of any county record

Signature of Owner

Date

Mark W. Hodgson
Dec 30 1963

Three copies to be filed by the owner with the County Clerk and Recorder of the county in which the well is located.

Please answer all questions. If not applicable, so state, otherwise the form will be returned.

Original to the Count. Clerk and Recorder; duplicate to the State Engineer; Triplicate to the Montana Bureau of Mines and Geology and Quadruplicate for the Appropriator.

22671

10492

STATE OF MICHIGAN SS
COUNTY OF FLAMING

Filed on the 30 day of Dec
A. D. 1963 at 2:30 Clock P. M.

Glenn E. Meekins
County Clerk and Recorder

By Keith
Deputy

File No. _____

GW 4

T. 30 N. 21 W. 26
County Flathead

STATE OF MONTANA
ADMINISTRATOR OF GROUNDWATER CODE
OFFICE OF STATE ENGINEER

RECEIVED
JAN 8 1964

Declaration of Vested Groundwater Rights

(Under Chapter 237, Montana Session Laws, 1961)

STATE ENGINEER

1. Alfred M. Hoge of Route 18 Columbia Falls
(Name of Appropriator) (Address) (Town)
County of Flathead State of Montana
have appropriated groundwater according to the Montana laws in effect prior to January 1, 1962, as follows:

11 1/4 Sec. 26 T. 30 R. 21

Indicate point of appropriation
and place of use, if possible.
Each small square represents 10
acres.

2. The beneficial use on which the claim is based Stock and household
3. Date or approximate date of earliest beneficial use; and how continuous the use has been 1926
4. The amount of groundwater claimed (in miner's inches or gallons per minute) 20
5. If used for irrigation, give the acreage and description of the lands to which water has been applied and name of the owner thereof none
6. The means of withdrawing such water from the ground and the location of each well or other means of withdrawal Electric Pump
7. The date of commencement and completion of the construction of the well, wells, or other works for withdrawal of groundwater 1926
8. The depth of water table 15 ft
9. So far as it may be available, the type, size and depth of each well or the general specifications of any other works for the withdrawal of groundwater 20 ft
10. The estimated amount of groundwater withdrawn each year 100,000 gal
11. The log of formations encountered in the drilling of each well if available Gravel
12. Such other information of a similar nature as may be useful in carrying out the policy of this act, including reference to book and page of any county record

Signature of Owner Alfred M. Hoge

Date Dec. 30, 1963

Three copies to be filed by the owner with the County Clerk and Recorder of the county in which the well is located.

Please answer all questions. If not applicable, so state, otherwise the form will be returned.

Original to the County Clerk and Recorder; duplicate to the State Engineer; Triplicate to the Montana Bureau of Mines and Geology; and Quadruplicate for the Appropriator.

22601

10,422

STATE OF MONTANA
COUNTY OF FLATHEAD SS

Filed on the 30 day of Dec
A.D. 1963 at 12:57 o'clock P.M.

g l m

County Clerk and Recorder

By

DDH

Deputy

STATE WATER CONSERVATION BOARD

File No. _____

OCT 14 1965 GW 2

T 20 R 21

Sils _____ McDonnell _____
Butter _____ McNulty _____
Coyne _____ Morton _____
Dartinton _____ Sullivan _____
Dickert _____

County F. Littell

STATE OF MONTANA
ADMINISTRATOR OF GROUNDWATER CODE
OFFICE OF STATE ENGINEER

Top of Ground
(Elev. above sea level 2480)

Notice of Completion of Groundwater
Appropriation by Means of Well

(Under Chapter 237, Montana Session Laws, 1961)

Owner Henry A. Papp Address Rt 13 Columbia Falls
Driller Homer M. McCarty Address 745 - Rt. 1, G. H.

Date of Notice of Appropriation of Groundwater _____

Date well started Aug 23/65 Date Completed Aug 25/65

Type of well Drilled Equipment Used 2 1/2" Buggins
(dug, driven, bored or (Churn, drill, rotary or
drilled) other)

Water Use: Domestic ☒ Municipal ☐ Other ☐ Irrigation ☐
Industrial ☐ Drainage ☐ Stock ☐

Indicate on the diagram the character and thickness of the different strata met with in drilling, such as soil, clay, shale, gravel, rock or sand, etc. Show depth at which water is encountered, thickness and character of water-bearing strata and height to which water rises in the well.

Top soil
2 ft
Sand
10 ft
Gravel
coarsers
20 ft
Clay
silt
118 ft
sand
&
gravel
water

Size of Drilled Hole	Size and Weight of Casing	From (Feet)	To (Feet)	PERFORATIONS		
				Kind Size	From (Feet)	To (Feet)
7" O.D.	2 3/4"		124 ft			

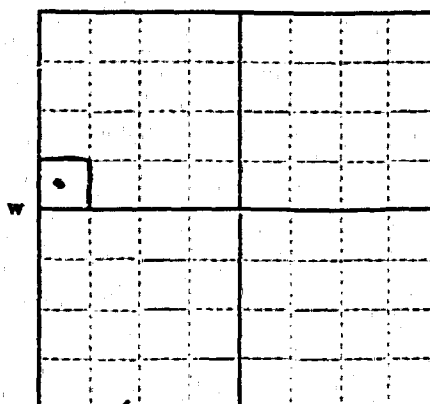

S.W. 1/4 of S.W. 1/4 of N.W. 1/4
1/4 Sec. 26 T. 30 R. 21
Indicate location of well and place of use, if possible. Each small square represents 10 acres.

Show exact depth of bottom.

Static Water Level for non-flowing Well 30 feet.

Shut-in Pressure for Flowing Well _____

Pumping Water Level 100 feet at 1 1/2 gal. per minute.

Discharge in gal. per min. of flowing well _____

How Tested Boiler Length of Test 3 hrs

Remarks: (Gravel packing, cementing, packers, type of shutoff, location of place of use of groundwater if not at well, and any other similar pertinent information, including number of acres irrigated, if used for irrigation)

Driller's License Number 18
Driller's Signature Homer M. McCarty

This form to be prepared by driller, and three copies to be filed by the owner with the County Clerk and Recorder in the county in which the well is located.

Please answer all questions. If not applicable, so state, otherwise the form will be returned.

Original to the County Clerk and Recorder; duplicate to the State Engineer; Triplicate to the Montana Bureau of Mines and Geology and Quadruplicate for the Appropriator.

11,897

STATE OF MINNESOTA
COUNTY OF FLEMMING, SS
Filed on the 21 day of Sept
A.D. 1965 at 12 o'clock P.M.
G.M.
County Clerk and Recorder
By: J.H.
Deputy

File No. _____

GW 4

T. 30 N 21 W 26
County FLATHEAD

STATE OF MONTANA
ADMINISTRATOR OF GROUNDWATER CODE
OFFICE OF STATE ENGINEER

RECEIVED
JAN 6 1964
STATE ENGINEER

Declaration of Vested Groundwater Rights

(Under Chapter 237, Montana Session Laws, 1961)

1. Alice H. Warner
Urval S. Warner of RT. 1-B Col. Falls
(Name of Appropriator) (Address) (Town)
County of FLATHEAD State of MONTANA
have appropriated groundwater according to the Montana laws in effect prior to January 1, 1962, as follows:

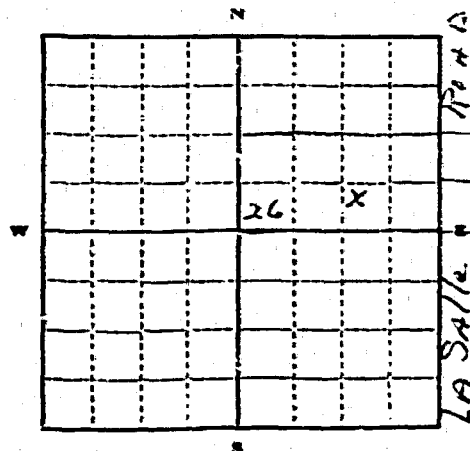

S.E. 1/4 Sec. 26 T. 30 N. 21 W.

Indicate point of appropriation
and place of use, if possible.
Each small square represents 10
acres.

2. The beneficial use on which the claim is based.
TO WATER STOCK

3. Date or approximate date of earliest beneficial use; and how continuous the use has been.
1900

POSSIBLY BEFORE AND USED EVER SINCE

4. The amount of groundwater claimed (in miner's inches or gallons per minute).
12 GALLONS

5. If used for irrigation, give the acreage and description of the lands to which water has been applied and name of the owner thereof.

NOT USED FOR IRRIGATION

6. The means of withdrawing such water from the ground and the location of each well or other means of withdrawal.

PUMP WITH ELECTRIC MOTOR ON IT

7. The date of commencement and completion of the construction of the well, wells, or other works for withdrawal of groundwater.
DON'T KNOW

8. The depth of water table.
18 FEET

9. So far as it may be available, the type, size and depth of each well or the general specifications of any other works for the withdrawal of groundwater.

8" TILE CASING - 18' DEEP - 2' WATER

10. The estimated amount of groundwater withdrawn each year.
36,500 GAL.

11. The log of formations encountered in the drilling of each well if available.

NOT AVAILABLE

12. Such other information of a similar nature as may be useful in carrying out the policy of this act, including reference to book and page of any county record.

HAVE NO OTHER INFORMATION

Signature of Owner: Alice H. Warner

Date: DEC. 29, 1963

Three copies to be filed by the owner with the County Clerk and Recorder of the county in which the well is located.

Please answer all questions. If not applicable, so state, otherwise the form will be returned.

Original to the County Clerk and Recorder; duplicate to the State Engineer; Triplicate to the Montana Bureau of Mines and Geology and Quadruplicate for the Appropriator.

10, 281

STATE OF MONTANA SS
COUNTY OF FLATHEAD
Filed on the 27 day of Dec
A.D. 1963 at 1:4 o'clock P.M.
J.E.M.
County Clerk and Recorder
By J.P. Deputy

File No. _____

GW 4

T 32 N 21 W 26
County FLATHEAD

STATE OF MONTANA
ADMINISTRATOR OF GROUNDWATER CODE
OFFICE OF STATE ENGINEER

RECEIVED
JAN 6 1964
STATE ENGINEER

Declaration of Vested Groundwater Rights

(Under Chapter 227, Montana Session Laws, 1961)

1. Alice H. Warner
URVAL S. WARNER of Rt. 1-13 Col. Falls
(Name of Appropriator) (Address) (Town)
County of FLATHEAD State of MONTANA
have appropriated groundwater according to the Montana laws in effect prior to January 1, 1962, as follows:

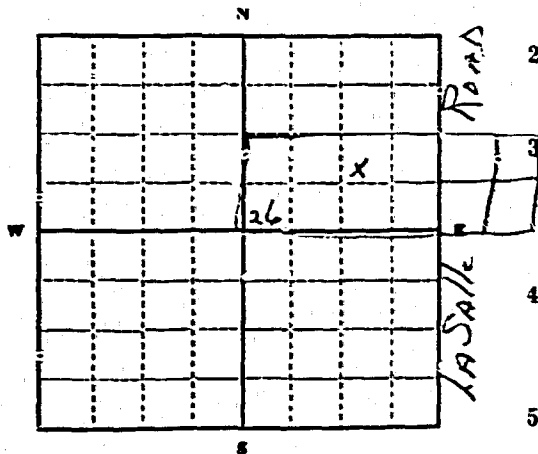

2. The beneficial use on which the claim is based
HOUSE HOLD USE

3. Date or approximate date of earliest beneficial use; and how continuous the use has been
1934 - EVER SINCE

4. The amount of groundwater claimed (in miner's inches or gallons per minute)
12 GAL PER MINUTE

5. If used for irrigation, give the acreage and description of the lands to which water has been applied and name of the owner thereof
NOT USED FOR IRRIGATION

6. The means of withdrawing such water from the ground and the location of each well or other means of withdrawal
PUMP WITH ELEC. MOTOR

7. The date of commencement and completion of the construction of the well, wells, or other works for withdrawal of groundwater
1934

8. The depth of water table
18 feet

9. So far as it may be available, the type, size and depth of each well or the general specifications of any other works for the withdrawal of groundwater
8" TILE CAGING 18' DEEP 7 FT WATER

10. The estimated amount of groundwater withdrawn each year
36,500 GAL.

11. The log of formations encountered in the drilling of each well if available
UNAVAILABLE

12. Such other information of a similar nature as may be useful in carrying out the policy of this act, including reference to book and page of any county record
None

Signature of Owner Alice H. Warner

Date Dec 27, 1963

Three copies to be filed by the owner with the County Clerk and Recorder of the county in which the well is located.

Please answer all questions. If not applicable, so state, otherwise the form will be returned.

Original to the County Clerk and Recorder; duplicate to the State Engineer; Triplicate to the Montana Bureau of Mines and Geology and Quadruplicate for the Appropriator.

10,280

STATE OF MONTANA SS
COUNTY OF FLATHEAD
Filed on the 27 day of Dec
A.D. 1963 at 1:40 o'clock P.M.
J.E.M.
County Clerk and Recorder
By J.P. Deputy

G.

Approved Stock Form—State Publishing Co., Helena, Montana

File No. _____

T. 20N R. 21W

DUPLICATE

County BEAVER

STATE OF MONTANA
ADMINISTRATOR OF GROUNDWATER CODE
OFFICE OF STATE ENGINEER

JAN 6 1964

ENGINEER

Declaration of Vested Groundwater Rights

(Under Chapter 237, Montana Session Laws, 1961)

1. Hugh G. Kidder, of 115 Crestline Drive, Missoula
(Name of Appropriator) (Address) (Town)
County of Missoula State of Montana
have appropriated groundwater according to the Montana laws in effect prior to January 1, 1962, as follows:

Not possible

1/4 Sec. T. R.
Indicate point of appropriation
and place of use, if possible. Each
small square represents 10 acres.

- The beneficial use on which the claim is based Domestic water and irrigation
- Date or approximate date of earliest beneficial use; and how continuous the use has been Approximately 1890 and continuous since that date on one well; and 1936 to date on second well.
- The amount of groundwater claimed (in miner's inches or gallons per minute) 100 Gallons per minute for each well
- If used for irrigation, give the acreage and description of the lands to which water has been applied and name of the owner thereof 60 acres; NE 1/4 by NW 1/4 and E. 1/2 of NW 1/4 NW 1/4 T. - 3 - D; 6H Land in NW 1/4 NW 1/4 T. - 3 - C 27 30 21; Hugh G. Kidder (Appropriator)
- The means of withdrawing such water from the ground and the location of each well or other means of withdrawal Pumps at each well site.
- The date of commencement and completion of the construction of the well, wells, or other works for withdrawal of groundwater First well approximately 1890, Second well completed in year 1936.
- The depth of water table Twenty-five feet
- So far as it may be available, the type, size and depth of each well or the general specifications of any other works for the withdrawal of groundwater. First well cement curbing three feet in diameter; Second well wood curbing twelve feet in diameter. Both wells are approximately 25 feet deep.
- The estimated amount of groundwater withdrawn each year unknown
- The log of formations encountered in the drilling of each well if available. Well dug through sandy loam all 25 feet.
- Such other information of a similar nature as may be useful in carrying out the policy of this act, including reference to book and page of any county record None

Signature of Owner

Hugh G. KidderDate December 30, 1963

Three copies to be filed by the owner with the County Clerk and Recorder of the county in which the well is located.

Please answer all questions. If not applicable, so state, otherwise the form will be returned.

Original to the County Clerk and Recorder; Duplicate to the State Engineer; Triplicate to the Montana Bureau of Mines and Geology, and Quadruplicate for the Appropriator.

23186

11016

631 Dec
~~7358~~
Ken

kr 27

RECEIVED

T 30N R 21W

28

F. No.

APR 20 1973

County Santerville

TRIPPLICATE

MONTANA DEPARTMENT OF NATURAL
RESOURCES AND CONSERVATIONSTATE OF MONTANA
ADMINISTRATOR OF GROUNDWATER CODE
OFFICE OF STATE ENGINEER

Top of Ground

(Elev. above sea level)

0 to 8 ft Gray hard pan
8 ft to 300 ft Brown
hard pan
300 to 310 ft
Hard packed
gravel and
sand.

Notice of Completion of Groundwater Appropriation by Means of Well

(Under Chapter 237, Montana Session Laws, 1961)

BENARD JOHNSON

Owner Benard Johnson Address Box 12 Columbia FallsDriller Alvin J. Foster Address Columbia FallsDate of Notice of Appropriation of Groundwater None filedDate well started Sept 13 68 Date Completed Oct 9 68Type of well Drilled Equipment Used Churn
(dug, driven, bored or (Churn, drill, rotary or
drilled) other)Water Use: Domestic ☒ Municipal ☐ Stock ☐ Irrigation ☐
Industrial ☐ Drainage ☐ Other ☐

Indicate on the diagram the character and thickness of the different strata met with in drilling, such as soil, clay, shale, gravel, rock or sand, etc. Show depth at which water is encountered, thickness and character of water-bearing strata and height to which the water rises in the well.

Size of Drilled Hole	Size and Weight of Casing	From (Feet)	To (Feet)	PERFORATIONS		
				Kind Size	From (Feet)	To (Feet)
6 1/2"	7" C.P. 2 1/2"	0	310	none		

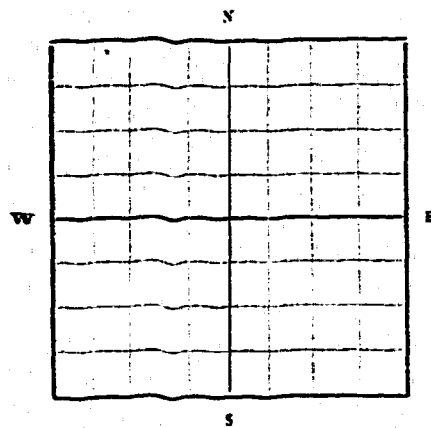

T. 30N. Sec. 15. T. 30N. R. 21W.

Indicate location of well and place of use, if possible. Each small square represents 10 acres.

Static Water Level for non-flowing Well 17.0 feet.Shut-in Pressure for Flowing Well None flowingPumping Water Level 2.65 feet at 0 gal. per minute.Discharge in gal. per min. of flowing well None flowingHow Tested 3 hrs Length of Test 3 hrs

Remarks: (Gravel packing, cementing, packers, type of shutoff, location of place of use of groundwater if not at well, and any other similar pertinent information, including number of acres irrigated, if used for irrigation)

Show exact depth of bottom.

Doc. No. 14,663

Filed for record

this 18th day of AprilA.D. 1973 at 2:20Clerk R.M.

Driller's License Number

Driller's Signature

This form to be prepared by driller, and three copies to be filed by the owner with the County Clerk and Recorder in the county in which the well is located.

Please answer all questions. If not applicable, so state, otherwise the form will be returned.

Original to the County Clerk and Recorder; duplicate to the State Engineer; Triplicate to the School of Mines and Quadruplicate for the Appropriator.

52,958

14663

STATE OF MONTANA }
COUNTY OF PLATEAU } SS
Filed on the 17 day of April
A. D. 1911 at 2 o'clock P.M.
MT
County Clerk and Recorder
By df Deputy

File No. _____

GW 4

County _____

STATE OF MONTANA
ADMINISTRATOR OF GROUNDWATER CODE
OFFICE OF STATE ENGINEER

RECEIVED
JAN 8 1964
STATE ENGINEER

Declaration of Vested Groundwater Rights

(Under Chapter 237, Montana Session Laws, 1961)

I, Edward Johnson, of Kahpelt,
(Name of Appropriator) (Address) (Town)
County of Blaine State of Mont
have appropriated groundwater according to the Montana Laws in effect prior to January 1, 1962, as follows:

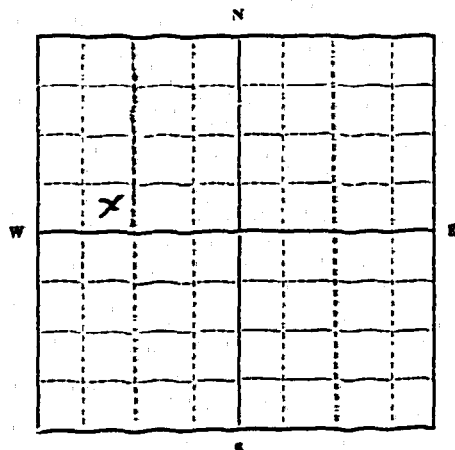

SW 1/4 Sec 28 T38 R 21

Indicate point of appropriation
and place of use, if possible.
Each small square represents 10
acres.

2. The beneficial use on which the claim is based Water for #5
headstock, irrigation of 2 acres, in household

3. Date or approximate date of earliest beneficial use; and how con-
tinuous the use has been from July 1957 to
Dec 31-63

4. The amount of groundwater obtained (in miner's inches or gallons
per minute) 3.5 gallons per minute

5. If used for irrigation, give the acreage and description of the lands
to which water has been applied and name of the owner thereof
SW 1/4 NW 1/4 Sec 28 T38
R 21

6. The means of withdrawing such water from the ground and the
location of each well or other means of withdrawal 3 horse
submersible pump

7. The date of commencement and completion of the construction of the well, wells, or other works for with-
drawal of groundwater July 1957

8. The depth of water table 125 ft

9. So far as it may be available, the type, size and depth of each well or the general specifications of any other
works for the withdrawal of groundwater dug well 8 inch casing
125 ft deep

10. The estimated amount of groundwater withdrawn each year 210,500 gallon

11. The log of formations encountered in the drilling of each well if available Clay
sand and Rock

12. Such other information of a similar nature as may be useful in carrying out the policy of this act, including
reference to book and page of any county record

Signature of Owner Edward Johnson

Date Dec 31-63

Three copies to be filed by the owner with the County Clerk and Recorder of the county in which the well is
located

Please answer all questions. If not applicable, so state, otherwise the form will be returned.

Original to the County Clerk and Recorder; duplicate to the State Engineer; Triplicate to the Montana Bureau of
Mines and Geology and Quadruplicate for the Appropriator.

23210

11040

31 day of Dec
763 322 Clock M

W. H. H.
J. H. H.

File No. _____

GW 4

T. 30~ R. 21~

County Flathead

STATE OF MONTANA
ADMINISTRATOR OF GROUNDWATER CODE
OFFICE OF STATE ENGINEER

Doc. No. 14178

Filed for record

this 20 day of JulyA. D. 19 70, at 2:30o'clock P.M.

Declaration of Vested Groundwater Rights

(Under Chapter 237, Montana Session Laws, 1961)

1. Vincent C. Lidstrom of Route 1A Kalispell
(Name of Appropriator) (Address) (Town)
County of Flathead State of Montana
have appropriated groundwater according to the Montana laws in effect prior to January 1, 1962, as follows:

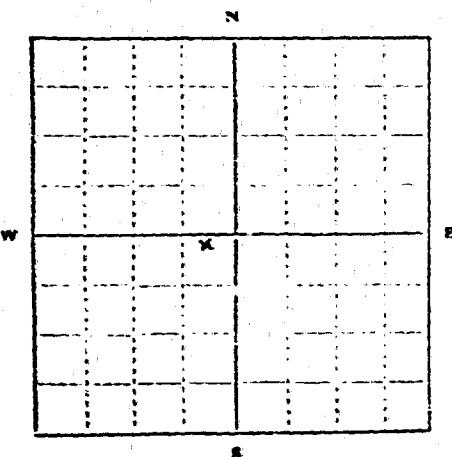

NE 1/4 Sec. 28 T. 30N R. 21W

Indicate point of appropriation
and place of use, if possible.
Each small square represents 10
acres.

2. The beneficial use on which the claim is based.
Livestock, house & garden
3. Date or approximate date of earliest beneficial use; and how continuous the use has been 1900, continuous since then.
4. The amount of groundwater claimed (in miner's inches or gallons per minute) _____
5. If used for irrigation, give the acreage and description of the lands to which water has been applied and name of the owner thereof _____
6. The means of withdrawing such water from the ground and the location of each well or other means of withdrawal.
electric pump located in NE 1/4, SW 1/4, sec. 28, T. 30N R. 21W

7. The date of commencement and completion of the construction of the well, wells, or other works for withdrawal of groundwater 1900

8. The depth of water table. 9 feet 5 inches

9. So far as it may be available, the type, size and depth of each well or the general specifications of any other works for the withdrawal of groundwater 24 feet deep, 38 inch curbing, hand dug.

10. The estimated amount of groundwater withdrawn each year 400,000 gallons

11. The log of formations encountered in the drilling of each well if available _____

12. Such other information of a similar nature as may be useful in carrying out the policy of this act including reference to book and page of any county record _____

Mary J. Quinn
NOTARY PUBLIC for the State of Montana
Resident of Kalispell, Montana
My commission expires 8/22/72

Signature of Owner

Vincent C. LidstromDate 7-20-70

Three copies to be filed by the owner with the County Clerk and Recorder of the county in which the well is located.

Please answer all questions. If not applicable, so state, otherwise the form will be returned.

Original to the County Clerk and Recorder; duplicate to the State Engineer; Triplicate to the Montana Bureau of Mines and Geology and Quadruplicate for the Appropriator.

47284

14178

STATE OF MONTANA
COUNTY OF FLATHEAD

Filed on the 20 day of July
A.D. 1970 at 2 o'clock P.M.
GEM

County Clerk and Recorder

BY

M.J.

CLERK

STATE OF MONTANA
ADMINISTRATOR OF GROUNDWATER CODE
OFFICE OF STATE ENGINEER

RECEIVED
DEC 30 1953

Declaration of Vested Groundwater Rights

(Under Chapter 237, Montana Session Laws, 1961)

STATE ENGINEER

Robert and Nancy Elizabeth Patterson of Route 1 Columbia Falls
(Name of Appropriator) (Address) (Town)
County of Flathead State of Montana
have appropriated groundwater according to the Montana laws in effect prior to January 1, 1962, as follows:

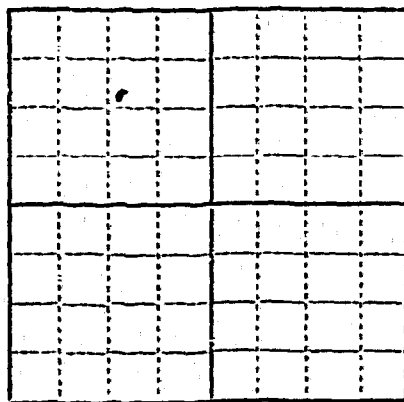

W 1/4 NE 1/4, E 1/4 NW 1/4
1/4 Sec 28 T30 R21

Indicate point of appropriation
and place of use, if possible.
Each small square represents 10
acres.

2. The beneficial use on which the claim is based
Household, stock and irrigation
3. Date or approximate date of earliest beneficial use; and how continuous the use has been About July 1952, used continuously since then.
4. The amount of groundwater claimed (in miner's inches or gallons per minute) 10 gal. per minute
5. If used for irrigation, give the acreage and description of the lands to which water has been applied and name of the owner thereof
Small garden spot located in the NE 1/4 NW 1/4 of Sec. 28, 30-21 owned by Robert and Nancy Elizabeth Patterson.
6. The means of withdrawing such water from the ground and the location of each well or other means of withdrawal
Immerseable electric pump
7. The date of commencement and completion of the construction of the well, wells, or other works for withdrawal of groundwater Commenced May 1952 and finished in July 1952.
8. The depth of water table 115 feet
9. So far as it may be available, the type, size and depth of each well or the general specifications of any other works for the withdrawal of groundwater Well is 255 feet deep and with 7 inch casing reduced to a 5 1/2 inch.
10. The estimated amount of groundwater withdrawn each year 50,000 gals.
11. The log of formations encountered in the drilling of each well if available
0-22 Sandy loam and 22-45 sand and water, 45-90 soft grey clay, 90-130 cement gravel.
12. Such other information of a similar nature as may be useful in carrying out the policy of this act, including reference to book and page of any county record.

Signature of Owner

Robert Patterson
Nancy Elizabeth Patterson

Date December 23d, 1963.

Three copies to be filed by the owner with the County Clerk and Recorder of the county in which the well is located.

Please answer all questions. If not applicable, so state, otherwise the form will be returned.

Original to the County Clerk and Recorder; duplicate to the State Engineer; Triplicate to the Montana Bureau of Mines and Geology and Quadruplicate for the Appropriator.

10,130

COUNTY OF HAMILTON, SS
COUNTY OF FLAMINGO

Filed on the 23 day of Dec
A.D. 1963 at 11 o'clock A.M.

26m

County Clerk and Recorder

By *LOT*

Deputy

File No. _____

GW 4

T. 31 N. R. 21 West

County Flathead

STATE OF MONTANA
ADMINISTRATOR OF GROUNDWATER CODE
OFFICE OF STATE ENGINEER

Declaration of Vested Groundwater Rights

(Under Chapter 237, Montana Session Laws, 1961)

RECEIVED
JAN 6 1964

STATE ENGINEER

I, Robert E. Patterson, of Route 1, Whitefish
(Name of Appropriator) (Address) (Town)
County of Flathead State of Montana
have appropriated groundwater according to the Montana laws in effect prior to January 1, 1962, as follows:

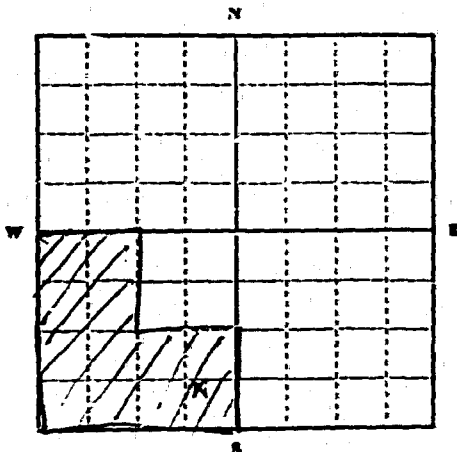

SE 1/4 SW Sec 28 T31 R21 W

Indicate point of appropriation
and place of use, if possible.
Each small square represents 10
acres.

2. The beneficial use on which the claim is based Domestic and
irrigation
3. Date or approximate date of earliest beneficial use; and how con-
tinuous the use has been Approximately July 1, 1943,
continually since said date.
4. The amount of groundwater claimed (in miner's inches or gallons
per minute) Five gallons per minute
5. If used for irrigation, give the acreage and description of the lands
to which water has been applied and name of the owner thereof
Lawn and garden, approximately 10,000 sq. ft. owned
by Robert E. Patterson
6. The means of withdrawing such water from the ground and the
location of each well or other means of withdrawal
Electric pump and 1-inch pipe pumped from well with
6-inch casing 60 ft. deep, located in pump house
approximately 20 ft. from main dwelling.
7. The date of commencement and completion of the construction of the well, wells, or other works for with-
drawal of groundwater July 1, 1948
8. The depth of water table Estimated 40 ft. at well sight
9. So far as it may be available, the type, size and depth of each well or the general specifications of any other
works for the withdrawal of groundwater Drilled well with 6-inch casing, 60 ft. deep.
10. The estimated amount of groundwater withdrawn each year 500,000 gallons
11. The log of formations encountered in the drilling of each well if available unknown and not available
12. Such other information of a similar nature as may be useful in carrying out the policy of this act, including
reference to book and page of any county record unknown

Signature of Owner Robert E. PattersonDate December 23, 1963

Three copies to be filed by the owner with the County Clerk and Recorder of the county in which the well is
located.

Please answer all questions. If not applicable, so state, otherwise the form will be returned.

Original to the County Clerk and Recorder; duplicate to the State Engineer; Triplicate to the Montana Bureau of
Mines and Geology and Quadruplicate for the Appropriator.

32545

63

December

23rd

Whitefish, Montana

66

July 31

10,365

STATE OF MONTANA - 33
COUNTY OF FLAINDO.

Filed on the 30 day of Dec
A.D. 1963 at 8:10 o'clock P.M.

287
By JST
County Clerk and Recorder

Deputy

File No. _____

RECEIVED

County Flathead

DUPLICATE

SEP 8 1967

STATE OF MONTANA
ADMINISTRATOR OF GROUNDWATER CODE
OFFICE OF STATE ENGINEER

Top of Ground _____

(Elev. above sea level 2980)Notice of Completion of Groundwater
Appropriation by Means of Well

(Under Chapter 237, Montana Session Laws, 1961)

1ft Top soil
Sand

8' Silt, sand + gravel

51' Clay, grit + gravel

157' Clay, grit + silt

169' Clay + silt

182' boulders + clay

199' silt, sand

226' + water 7" dia

sand, gravel

& little silt

Owner Harry H Redinger Address Old Whitefish RoadDriller Homer McClutty Address 945-8th A.W.Date of Notice of Appropriation of Groundwater _____
Date well started Jan 3, 1967 Date Completed Jan 19/67Type of well Drilled Equipment Used 22W Buoyne
(dug, driven, bored or (Churn, drill, rotary or other)Water Use: Domestic ☒ Municipal ☐ Stock ☒ Irrigation ☐
Industrial ☐ Drainage ☐ Other ☐

Indicate on the diagram the character and thickness of the different strata met with in drilling, such as soil, clay, shale, gravel, rock or sand, etc. Show depth at which water is encountered, thickness and character of water-bearing strata and height to which the water rises in the well.

Size of Drilled Hole	Size and Weight of Casing	From (Feet)	To (Feet)	PERFORATIONS		
				Kind Size	From (Feet)	To (Feet)
			232			

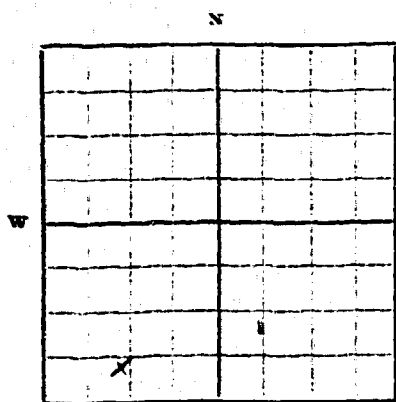

SW 1/4 Sec 28 T 30N R 21W M.P.M

Indicate location of well and place of use, if possible. Each small square represents 10 acres.

232 ft.

Show exact depth of bottom.

Static Water Level for non-flowing Well 142 feet.

Shut-in Pressure for Flowing Well _____

Pumping Water Level 12 feet at 13 gal. per minute.

Discharge in gal. per min. of flowing well _____

How Tested Bailer Length of Test 4 hrs

Remarks: (Gravel packing, cementing, packers, type of shutoff, location of place of use of groundwater if not at well, and any other similar pertinent information, including number of acres irrigated, if used for irrigation) _____

Driller's License Number 18Driller's Signature Homer McClutty

This form to be prepared by driller, and three copies to be filed by the owner with the County Clerk and Recorder in the county in which the well is located.

Please answer all questions. If not applicable, so state, otherwise the form will be returned.

Original to the County Clerk and Recorder; duplicate to the State Engineer; Triplicate to the School of Mines and Quadruplicate for the Appropriator.

42,277

12,961

卷之四

Figure 6

10

53

100-100000

100

26
 67 11 30
 day of July
 30 Clock M
 867
 County Clerk and Recorder
 M. J.

2677
Crazy Clerk and Recorder
M. J.

32

1990

2000

1

1990

1

1874

10

1990

File No. _____

GW 4

T. 30 N R. 21 W - 29

County FLATHEAD

STATE OF MONTANA
ADMINISTRATOR OF GROUNDWATER CODE
OFFICE OF STATE ENGINEER

RECEIVED

Declaration of Vested Groundwater Rights

(Under Chapter 237, Montana Session Laws, 1961)

I, BURTRAM W SNOW of ROUTI WHITEFISH
(Name of Appropriator) (Address) (Town)
County of FLATHEAD State of MONTANA
have appropriated groundwater according to the Montana laws in effect prior to January 1, 1962, as follows:

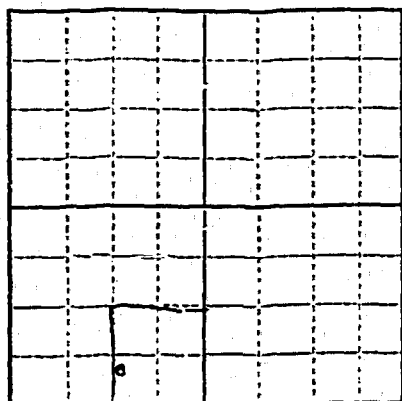

SW 1/4 Sec 29 T. 30 R. 21

Indicate point of appropriation and place of use, if possible. Each small square represents 10 acres.

2. The beneficial use on which the claim is based HOUSEHOLD STOCK IRRIGATION
3. Date or approximate date of earliest beneficial use; and how continuous the use has been JULY 1955
CONTINUOUS TO DATE
4. The amount of groundwater claimed (in miner's inches or gallons per minute) TEN GALLONS PER MINUTE
5. If used for irrigation, give the acreage and description of the lands to which water has been applied and name of the owner thereof
1/2 ACRE GARDEN + FRUIT TREES
B. W. SNOW
6. The means of withdrawing such water from the ground and the location of each well or other means of withdrawal
ELECTRIC PUMP
ONE WELL AT HOUSE
7. The date of commencement and completion of the construction of the well, wells, or other works for withdrawal of groundwater JULY 15, 1955 - JULY 10, 1958
8. The depth of water table 9 FEET IN THE CASE / 106
9. So far as it may be available, the type, size and depth of each well or the general specifications of any other works for the withdrawal of groundwater
DRILLED WELL 6 INCH CASEING
ONE HUNDRED FIFTY NINE FEET DEEP
10. The estimated amount of groundwater withdrawn each year 15000 GALLONS
11. The log of formations encountered in the drilling of each well if available 15 FEET OF ROCK
CLAY SAND + GRAVEL 17 FEET OF CLAY 3 INCHES OF FINE GRAVEL
128 FEET OF SOLID CLAY ONE FOOT OF LOOSE ROCKS.
12. Such other information of a similar nature as may be useful in carrying out the policy of this act, including reference to book and page of any county record THIS WELL IS DRILLED IN TIMBER
LAND AND THE WATER CONTAINS A CLAY SEDIMENT THAT SEPARATES
FROM THE WATER WHEN HEATED.

Signature of Owner Burtram W Snow
Date Jan. 16, 1963

Three copies to be filed by the owner with the County Clerk and Recorder of the county in which the well is located.

Please answer all questions. If not applicable, so state, otherwise the form will be returned.

Original to the County Clerk and Recorder; duplicate to the State Engineer; Triplicate to the Montana Bureau of Mines and Geology; and Quadruplicate for the Appropriator.

9507

STATE OF MONTANA
COUNTY OF HAVANA, MS
Filed on the 21 day of Jan
A.D. 1913 at 9 o'clock A.M.
J.E.M.
County Clerk and Recorder
By J.J.H. Deputy

File No.

RECEIVED

GW 2

T 30N R 21W

29

OCT 24 1972

County

Flathead

MONTANA DEPARTMENT OF NATURAL RESOURCES

STATE OF MONTANA
ADMINISTRATOR OF GROUNDWATER CODE
OFFICE OF STATE ENGINEER

Top of Ground

(Elev. above sea level)

14 FT. Gray Clay and Sand

Notice of Completion of Groundwater
Appropriation by Means of Well

(Under Chapter 237, Montana Session Laws, 1961)

Owner Duane Johnson Address White Fish, Mont.Driller Argyle Hendrickson Address Kalispell, Mont.

Date of Notice of Appropriation of Groundwater

Date well started Aug. 17, 1971 Date Completed Sept. 3, 1971Type of well Drilled
(Cug, driven, bored or drilled)Equipment Used Drill
(Churn, drill, rotary or other)

Static Water Level 40 FT.

110' Glacial Mud

Water Use: Domestic ☒ Municipal ☐ Other ☐ Irrigation ☐
Industrial ☐ Drainage ☐ Stock ☐

Indicate on the diagram the character and thickness of the different strata met with in drilling, such as soil, clay, shale, gravel, rock or sand, etc. Show depth at which water is encountered, thickness and character of water-bearing strata and height to which water rises in the well.

Size of Drilled Hole	Size and Weight of Casing	From (Feet)	To (Feet)	PERFORATIONS		
				Kind Size	From (Feet)	To (Feet)
7"	7" OD 20#	0	184	X	X	X

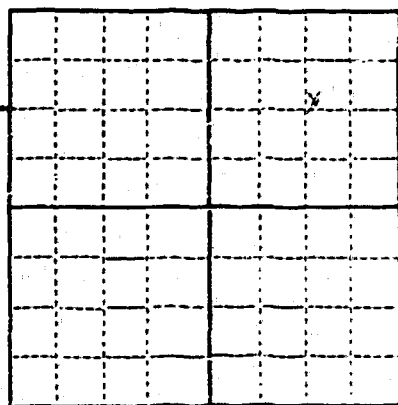
38 FT. Stone and Yellow W. Clay
SURVEY Sec. 29 T3R R2E
R. 2

Indicate location of well and place of use, if possible. Each small square represents 10 acres.

Water Found 177 FT.

Show exact depth of bottom.

184 Feet

Static Water Level for non-flowing Well 40 feet.Shut-in Pressure for Flowing Well Not ApplicablePumping Water Level 70 feet at 2.5 gal. per minute.Discharge in gal. per min. of flowing well Not ApplicableHow Tested Baler Length of Test 4 Hours

Remarks: (Gravel packing, cementing, packers, type of shutoff, location of place of use of groundwater if not at well, and any other similar pertinent information, including number of acres irrigated, if used for irrigation)

Doc. No. 14,533

Filed for record

on 12th day of OctoberA.D. 19 72, at 11:15O.C. A.M.Driller's License Number 153Driller's Signature Argyle Hendrickson

This form to be prepared by driller, and three copies to be filed by the owner with the County Clerk and Recorder in the county in which the well is located.

Please answer all questions. If not applicable, so state, otherwise the form will be returned.

Original to the County Clerk and Recorder; duplicate to the State Engineer; Triplicate to the Montana Bureau of Mines and Geology and Quadruplicate for the Appropriator.

51,644

14,533

STANDARD FORM NO. 64
OFFICE OF THE SECRETARY OF DEFENSE

FILED IN 12, City of Cal
AD 127A 11.15.00 Class A M

MT
County Clerk and Recorder
By WJ Deputy

14,717

STATE OF MONTANA }
COUNTY OF FLATHEAD } SS

Filed on the 21 day of June
A.D. 1973 at 148 o'clock M

MT
County Clerk and Recorder
By Llew
Deputy

53,038

14.670

STATE OF MONTANA)
COUNTY OF FLATHEAD) SS

Filed on the 20 day of April
A. D. 1973 at 3:05 o'clock P M

mi
County Clerk and Recorder

By [Signature] Deputy

RECEIVED

30 N - 21 W

20

County Fla.thead

STATE OF MONTANA
ADMINISTRATOR OF GROUNDWATER CODE
MONTANA WATER RESOURCES BOARD

NOTICE OF COMPLETION OF GROUNDWATER APPROPRIATION BY MEANS OF WELL

Developed after January 1, 1962

(Under Chapter 237 Montana Session Laws, 1961, as amended)

This form to be prepared by driller, and three copies to be filed by the owner with the County Clerk and Recorder in the county in which the well is located, last copy to be retained by driller.

Please answer all questions. If not applicable, so state, otherwise the form may be returned.

Happy Valley, Ariz.

Owner Sewer Dist. #

Address: A.O. Box 550

Industrial, etc. 594.37

Date well started Sept 20 - 65

completed *NA 30-65*

Type of well:

Equipment used

Water Use: Domestic ☐ Municipal ☒ Stock ☐ Irrigation ☐

Industrial ☐ Drainage ☐ Other ☐* Garden/Lawn ☐

Describe

USE: If used for irrigation, industrial, drainage or other. Explain, state number of acres and location or other data (i.e. Lot, Block and Addition).

ESTIMATED ANNUAL WITHDRAWAL

Size of Drilled Hole	Size and Weight of Carling	From (Feet)	To (Feet)	PERFORATIONS		
				Hole Size	From (Feet)	To (Feet)
6 3/8"	7" 00 2346	0	354		none	

Figure 1 shows a 2x2 grid of squares. The top-right square contains an 'X' and is labeled 'X' below it. The bottom-left square is labeled 'W' to its left.

Static water level 324 ft.
Pumping water level 334 ft.
at SCgallons per minute,
measuredminutes after pumping
began.

*Measured from ground level.
Well developed by Barburg
for 2 hours.

Power _____ Pump _____ HP
Remarks. (Gravel packing, cementing,
packers, type of shutoff) _____

NE^s
NE 1/4 ~~2~~ 1/4 Sec 30
T. 35 N. R. 31 E.
X

INDICATE LOCATION OF WELL AND PLACE OF USE, IF POSSIBLE.
EACH SMALL SQUARE REPRESENTS 40 ACRES.

Driller's Signature _____

Driller's Address

LICENSE NO. 55

DRILLER'S LOG

Indicate the character, color, thickness of strata such as soil, clay, sand, gravel, shale, sandstone, etc. Show depth at which water is found and height to which water rises in well.

Ten of Ground

(Elev. above sea level)

From (Foot)	To (Foot)	
0	1105	Gray hard pan
165	352	Brown hard pan
352	354	Waterbearing gravel acc. to N.W. 11.

354 Show exact depth of bottom

well no 2

STATE OF MONTANA.

County of Flathead

Floyd S. Carrett

having first been duly sworn, depose

and water board represents the appropriator

say that he

of lawful age and as chairman of the

and claimant of the order and water right mentioned in the foregoing notice of

completion of ground-water appropriation by means of well and the person whose name

Happy Valley Water & Sewer Dist subscribed thereto, as the appropriator and claimant.

that he know the contents of said foregoing notice and that the matters and things therein stated are true.

Floyd S. Carrett

Subscribed and sworn to before me, this 23 day of August

19 73

Fannie C. Grover *Fannie C. Grover*
Notary Public for the State of Montana.

Residing at Whitefish MT 59937

My Commission expires 7 Oct. 19 74

File No. _____

GW 4

T 2930 R 21

County Flathead

STATE OF MONTANA
ADMINISTRATOR OF GROUNDWATER CODE
OFFICE OF STATE ENGINEER

RECEIVED
JAN 6 1964

Declaration of Vested Groundwater Rights ENGINEER
(Under Chapter 237, Montana Session Laws, 1961)

1. John T and Shirley S Bowdish of Rt 1# Kalispell
(Name of Appropriator) (Address) (Town)
County of Flathead State of Montana
have appropriated groundwater according to the Montana laws in effect prior to January 1, 1962, as follows:

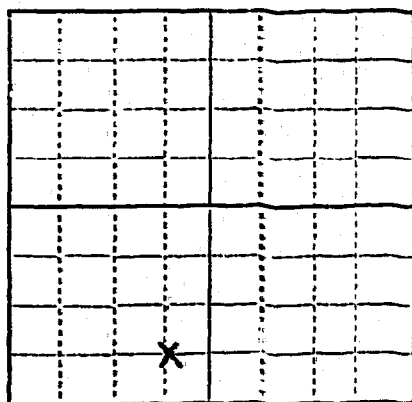

SE 1/4 Sec. 32 T 30 R 21

Indicate point of appropriation
and place of use, if possible.
Each small square represents 10
acres.

2. The beneficial use on which the claim is based
Livestock water
3. Date or approximate date of earliest beneficial use; and how continuous the use has been
July 1953 and used every summer since
4. The amount of groundwater claimed (in miner's inches or gallons per minute) one gallon per minute
5. If used for irrigation, give the acreage and description of the lands to which water has been applied and name of the owner thereof
Not so used
6. The means of withdrawing such water from the ground and the location of each well or other means of withdrawal
Piston pump

7. The date of commencement and completion of the construction of the well, wells, or other works for withdrawal of groundwater. This well was dug in July 1953

8. The depth of water table. Eight feet to water

9. So far as it may be available, the type, size and depth of each well or the general specifications of any other works for the withdrawal of groundwater.
This well is 12 feet deep and has 7 ft square wood curbing

10. The estimated amount of groundwater withdrawn each year. 50,000 gallons

11. The log of formations encountered in the drilling of each well if available.
Top eight feet was rocky clay and water bearing strata is pea gravel layers between clay soil.

12. Such other information of a similar nature as may be useful in carrying out the policy of this act, including reference to book and page of any county record.

Signature of Owner

John T. Bowdish
Date 2-9-64 ec 1963

Three copies to be filed by the owner with the County Clerk and Recorder of the county in which the well is located.

Please answer all questions. If not applicable, so state, otherwise the form will be returned.

Original to the County Clerk and Recorder; duplicate to the State Engineer; Triplicate to the Montana Bureau of Mines and Geology and Quadrate for the Appropriator.

23151

10986

631 Dec
232
Pen
County Clerk and Treasurer
By 88 # -
Deputy

T 20 N 21 W 33
County Flat

STATE OF MONTANA
ADMINISTRATOR OF GROUNDWATER CODE
OFFICE OF STATE ENGINEER

Declaration of Vested Groundwater Rights

(Under Chapter 237, Montana Session Laws, 1961)

STATE ENGINEER

1. Robert J. Sutton of Kalispell,
(Name of Appropriator) (Address) (Town)
County of Flathead State of Montana
have appropriated groundwater according to the Montana laws in effect prior to January 1, 1962, as follows:

[illegible]

NE 1/4 Sec. 33 T30N R. 21W

Indicate point of appropriation and place of use, if possible. Each small square represents 10 acres.

2. The beneficial use on which the claim is based **household, garden, livestock**
3. Date or approximate date of earliest beneficial use; and how continuous the use has been **1889**
continual ever since
4. The amount of groundwater claimed (in miner's inches or gallons per minute) **40 gallons per minute**
5. If used for irrigation, give the acreage and description of the lands to which water has been applied and name of the owner thereof
garden
6. The means of withdrawing such water from the ground and the location of each well or other means of withdrawal
SE corner NE 1/4 Sec. 33, T 30N R. 21W
dredging, ditching and pipeline
7. A description of the construction of the well, wells, or other works for withdrawing water from the ground
g comes to surface
8. The size and depth of each well or the general specifications of any other water-lifting device
4' deep. 150 feet long
9. The amount of water withdrawn each year **40 gallons per minute**
10. The cost of the drilling of each well if available
necessary
11. Any other facts that may be useful in carrying out the policy of this act, including a description of the water record

Signature of Owner

Date **July 6, 1962**

Three copies to be filed by the owner with the County Clerk and Recorder of the county in which the well is located.

Please answer all questions. If not applicable, so state, otherwise the form will be returned.

Original to the County Clerk and Recorder; duplicate to the State Engineer; Triplicate to the Montana Bureau of Mines and Geology, and Quadruplicate for the Appropriator.

9374

STATE OF MONTANA) SS
COUNTY OF FLATHEAD)

Filed on the 13 day of July
A. D. 1964 at 9:31 o'clock A. M.

DEM
County Clerk and Recorder

By JP Deputy