

3326

State of Montana } ss.  
County of Gallatin  
Filed June 29 1973  
at 7:10 o'clock A.M.  
Paul L. Stuckey  
County Clerk & Recorder  
By Alta Hargan  
Deputy  
Fee \$ 2<sup>00</sup> 00

Form No. 18  
8-60

<sup>136</sup>  
<sup>13S</sup> <sup>5E</sup>  
Twp. Yellowstone R. Lot 6 Block 4

County Gallatin

MONTANA BUREAU OF MINES AND GEOLOGY  
Butte, Montana

RECEIVED  
JAN 17 1961

WATER WELL LOG

STATE ENGINEER

Owner John Whitman Address West Yellowstone, Mont

Driller Carl E. Hollensteiner Address Dillon, Montana

Date Started Aug. 17, 1960 Date Completed Aug. 20, 1960

Location: Sec. 34 T. 13S R. 5E  $\frac{1}{4}$  sec.

Type of well Drilled Equipment used Churn Drill  
(Dug, driven, bored, or drilled) (Churn, drill, rotary, other)

Water use: Domestic ☒ Municipal ☐ Stock ☐ Irrigation ☐  
Industrial ☐ Drainage ☐ Other

Casing: 41 ft. to 103 ft. Type Galv. Water well Size 6" O.D. 10 $\frac{1}{2}$  lb.

Casing:  ft. to  ft. Type  Size

Casing:  ft. to  ft. Type  Size

Perforated or Screened: Ft.  to ft. . Ft.  to ft.

Type of screen or perforations None

Static Water level, for non-flowing well:  117 feet.

Shut-in pressure, for flowing well:  lb./sq. in. on:  (date)

Pumping water level 80 feet at 20 gal. per min.

How tested: Bailer

Length of test 30 min.

Remarks: (Gravel packing, cementing, packers, type of shut-off, depth of shut-off)

(over)

## Log of Well

[illegible]

Gold in Country	} ss.
Side of Mountain	

Gold in Country	} ss.
Side of Mountain	

Filed.

at...

४३

EARL WILTON  
COUNTY CLERK &

EARL WILTON  
COUNTY CLERK &

By John J. Morris  
Deputy

By John J. Morris  
Deputy

Fee \$	2.00 Pd.
--------	----------

Fee \$	2.00 Pd.
--------	----------

GW 2

Approved Stock Form—State Publishing Co., Helena, Montana—35495

File No. ....

DUPLICATE

Top of Ground

(Elev. above sea level. 6666.66)

0 - 115 ft.  
fine obsidian sand  
115 - 118 - feet  
gravel

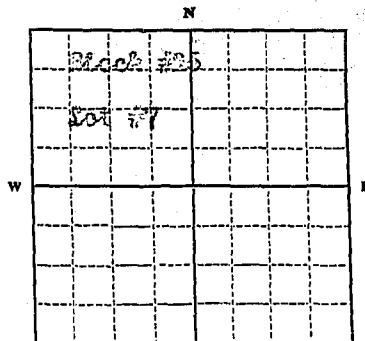

1/4 Sec 34 T12S R3E  
Indicate location of well and  
place of use, if possible. Each  
small square represents 10 acres.

Show exact depth of bottom.

118 ft.

STATE OF MONTANA  
ADMINISTRATOR OF GROUNDWATER CODE  
OFFICE OF STATE ENGINEER

# Notice of Completion of Groundwater Appropriation by Means of Well

(Under Chapter 237, Montana Session Laws, 1961)

Owner: Harold H. Young Address: West Yellowstone

Driller: Van Dusen Drilling Address: Bozeman, Montana

Date of Notice of Appropriation of Groundwater: .....

Date well started: Nov. 11, 1962 Date Completed: Nov. 16, 1962

Type of well: drilled Equipment Used: drill  
(dug, driven, bored or (Churn, drill, rotary or  
drilled) other)

Water Use: Domestic ☒ Municipal ☐ Other ☐ Irrigation ☐  
Industrial ☐ Drainage ☐ Stock ☐

Indicate on the diagram the character and thickness of the different strata met with in drilling, such as soil, clay, shale, gravel, rock or sand, etc. Show depth at which water is encountered, thickness and character of water-bearing strata and height to which water rises in the well.

Size of Drilled Hole	Size and Weight of Casing	From (Feet)	To (Feet)	PERFORATIONS		
				Kind Size	From (Feet)	To (Feet)
6 5/8" O.D.	6 5/8" O.D. 17# P.E.	ground level	118'	None		

Static Water Level for non-flowing Well: 35' feet.

Shut-in Pressure for Flowing Well: None

Pumping Water Level: 49' feet at 25 gal. per minute.

Discharge in gal. per min. of flowing well: -

How Tested: 30 min Length of Test: 1 Hour

Remarks: (Gravel packing, cementing, packers, type of shutoff, location of place of use of groundwater if not at well, and any other similar pertinent information, including number of acres irrigated, if used for irrigation) none

#1  
Driller's License Number

Van Dusen Drilling Co.  
Driller's Signature: .....

This form to be prepared by driller, and three copies to be filed by the owner with the County Clerk and Recorder in the county in which the well is located.

Please answer all questions. If not applicable, so state, otherwise the form will be returned.

Original to the County Clerk and Recorder; duplicate to the State Engineer; Triplicate to the Montana Bureau of Mines and Geology and Quadruplicate for the Appropriator.

1703

State of Montana }  
County of Gallatin }

Filed July 20, 1962

at 1:30 o'clock P.M.

Wallace

COUNTY CLERK & RECORDER

By Paul Whitman

DEPUTY

Fee \$ 2.00

County Nellatin Twp. N.L.D Rge.       

Sec.	Name of Appropriator	Type of Form	County File No.	Remarks
<del>0</del>	<del>Abelin Alfred and</del>	<del>57 Well Log</del>	<del>—</del>	<del>✓</del>
0	Abelin Frances			
<del>0</del>	<del>Abelin Alfred and</del>	<del>57 Well Log</del>	<del>—</del>	
0	Abelin Frances			
<del>0</del>	<del>Abelin Frances &amp;</del>	<del>57 Well Log</del>	<del>—</del>	
0	Abelin Alfred			
<del>0</del>	<del>Adams Cecil C.</del>	<del>57 Well Log</del>	<del>400</del>	
<del>0</del>	<del>Anderson Jim</del>	<del>HW 2</del>	<del>3271</del>	
0	Anderson Nancy C.			
<del>0</del>	<del>Anderson Wendell</del>	<del>57 Well Log</del>	<del>—</del>	
0	Armstrong F.H.	HW 2	411687	
<del>0</del>	<del>Ballock Camilla</del>	<del>HW 2</del>	<del>3134</del>	
<del>0</del>	<del>Buckley George D.</del>	<del>57 Well Log</del>	<del>—</del>	
<del>0</del>	<del>Burnell Lester W.</del>	<del>57 Well Log</del>	<del>—</del>	
—	Cain Harold K.	HW 2	3361	✓
<del>0</del>	<del>Carter Arnold B.</del>	<del>HW 4</del>	<del>1030</del>	
<del>0</del>	<del>Chesnut Chester B.</del>	<del>HW 2</del>	<del>1933</del>	
0	Christ Pete	57 Well Log	106	
0	Clark John S.	HW 2	1926	
<del>0</del>	<del>Colonial Motel and</del>	<del>HW 2</del>	<del>3284</del>	
0	Jones Selder M.			
<del>0</del>	<del>Community Protestant Church</del>	<del>HW 2</del>	<del>2141</del>	
<del>0</del>	<del>Conner Marjorie</del>	<del>HW 2</del>	<del>2317</del>	
<del>0</del>	<del>Crosby Donald A.</del>	<del>57 Well Log</del>	<del>—</del>	
—	Cosall Wayne	HW 2	3382	✓
0	Elliston C.	HW 2	3088	
0	First Baptist Church	HW 2	2311	
0	Fullen Abram	HW 2	3305	
0	Fullen Abram	HW 2	3370	
0	Fullen Carrie Mae	HW 2	3308	
0	Fullen Dora			
<del>0</del>	<del>Gaston M. H. &amp;</del>	<del>HW 2</del>	<del>3216</del>	
0	Gaston Lillian V.			
0	Gengel Ray	HW 2	3228	
0	Gilmore Carl	HW 2	3099	
<del>0</del>	<del>Hempfer Bud</del>	<del>HW 2</del>	<del>3722</del>	
—	Grist Charles C. &	HW 4	1018	✓
0	Grist Daisy L.			
<del>0</del>	<del>Gussett Pearl E. &amp;</del>	<del>57 Well Log</del>	<del>403</del>	
0	Durham W. E.			
0	Hadley Motel	57 Well Log	—	
—	Hanner Carl W. M. D.	57 Well Log	—	✓
0	Hardin Ellen T.	HW 4	1310	
<del>0</del>	<del>Hardie</del>	<del>HW 2</del>	<del>1004</del>	
0	Hargis Rex	57 Well Log	155	

Sec.	Name of Appropriator	Type of Form	County File No.	Remarks
6	Harris Daryl L.	H W 4	555	
6	Harrison Robert K.	H W 2	3327	
6	Harner William	H W 4	1249	
2	Hiller Florence L.	H W 2	2210	
0	Higginbottom Pearl			
6	Indiana University	H W 2	2235	
6	Jelly D.V. "Kip"	H W 2	3103	
6	Jensen Harold	57 Mellog	157	
6	Jensen Leonard	H W 2	2216	
6	Jones Robert C. and	H W 4	1806	
0	Jones Thomas P.			
-	King Monte +	H W 4	667	✓
0	King Lillian N.			
0	Kerrison C.W.	57 Mellog	—	
-	Laws Robert L.	H W 2	680	✓
6	Laws Margaret I.			
6	Leisner Dorothy M.	H W 4	1220	
6	Louderlager Elizabeth	H W 2	3230	
0	Louderlager Paul			
6	Loughane William D.	H W 2	2192	
0	Loughane Anne Belle			
0	Lover Gary	H W 2	3321	
6	Malone Martha	H W 2	2214	
6	City of Muskegon	57 Mellog	—	
6	Martin Fern S.	H W 2	3344	
-	Martin Hugo Isaac	H W 2	1187	✓
-	McCall Robert C.	H W 4	1741	✓
0	McLean Howard	H W 2	2039	
6	Meister Arnold	H W 2	2251	
6	Melburn Fred	H W 2	552	
-	Mohr Jack	57 Mellog	—	✓
0	Mohr Howard L.	57 Mellog	36721	
6	Old Faithful Lodge	57 Mellog	—	
-	Oriet William	57 Mellog	197	✓
6	Paraly L.C.	57 Mellog	—	
6	Petersen Frank E.	H W 4	1452	
0	Petersen Elsie L.			
6	Petersen Ken	H W 2	3158	
6	Petersen Richard A.	H W 2	3217	
0	Petersen Mae R.			
6	Potts William F.	H W 4	1319	
0	Potts Lena			
6	Prett Jess	57 Mellog	—	
0	Ralph's Food Storage	57 Mellog	—	



County WallerTwp. N. 20

Range

Sec.	Name of Appropriator	Type of Form	County File No.	Remarks
-	Ramler Matt	57 Mill Log	—	
-	Randall Arthur E.	57 Mill Log	17040	
-	Randall Darnell	57 Mill Log	17042	
-	Richardson Charles P.	H R 2	3251	
	Richardson Anne M.			
-	Riley John	57 Mill Log	—	
-	Rodick Charles H. &	H R 4	539	
	Rodick Vera D.			
-	Rosney Florence Rose	H R 4	1846	
-	Rothermel Joe	H R 2	3335	
-	Shackman Mary E.	H R 4	463	
-	Shewen Keith	H R 2	—	
-	Spartan Lodge (Lew Ford)	57 Mill Log	152	
-	Spaulding Charles	57 Mill Log	—	✓
-	Quires Rose B.	57 Mill Log	288	✓
-	Stallard Grocery	57 Mill Log	—	
-	Taylor Emma W.	H R 2	3342	✓
-	Tompson Elia M.	H R 2	547	
-	Torres Conrad	57 Mill Log	—	
-	Three Forks City of	57 Mill Log	—	
-	Three Forks City of	57 Mill Log	—	
-	Turley Royal	57 Mill Log	—	
-	Walker Harry S. Jr.	57 Mill Log	—	✓
-	Wary Melvin L.	H R 2	3310	
-	West Yellowstone KOA	H R 2	3248	
-	W. Whitman Clyde &	H R 2	3325	
	Whitman Lusia			
-	Whitman Francis	H R 2	3326	
	Whitman John			
-	Whitman John	57 Mill Log	—	
-	William R. H.	57 Mill Log	—	
-	Young Harold M.	H R 2	—	
19	Wilke Richard &	H R 2	3319	
	Wilke Edna			
19	Lamer Charles A. &	H R 2	3320	
	Lamer Billie P.			
17	Lulloff William E. Sr.	H R 3	3260	
	Lulloff Gladys D.			



## GROUNDWATER INDEX

Page of

County

# Gallatin

Twp.

NLD

**Rge.**

[illegible]

RECEIVED

MAY 27 1958

STATE ENGINEER

MONTANA BUREAU OF MINES AND GEOLOGY  
Butte, Montana

WATER WELL LOG

Owner Fred and Frances Abelin Address Bozeman, Montana  
798 South Church Street

Driller Mr. Clausin Address Bozeman, Montana

Date Started 1939 June Date Completed 1939 June

Location: Sec. 7 T. 17 R. 36 1/4 sec. E

Type of well Drill (Dug, driven, bored, or drilled) Equipment used Church Drill (Hand drill, rotary, other)

Water use: Domestic ☒ Municipal ☐ Stock ☐ Irrigation ☒  
Industrial ☐ Drainage ☐ Other: \_\_\_\_\_

Casing: Metal ft. to 65 ft. Type well Size 5

Casing: \_\_\_\_\_ ft. to \_\_\_\_\_ ft. Type \_\_\_\_\_ Size \_\_\_\_\_

Casing: \_\_\_\_\_ ft. to \_\_\_\_\_ ft. Type \_\_\_\_\_ Size \_\_\_\_\_

Perforated or Screened: Ft. \_\_\_\_\_ to ft. \_\_\_\_\_ Ft. \_\_\_\_\_ to ft. \_\_\_\_\_

Type of screen or perforations \_\_\_\_\_

Static Water level, for non-flowing well: 19 feet.

Shut-in pressure, for flowing well: \_\_\_\_\_ lb./sq. in. on: \_\_\_\_\_ (date)

Pumping water level 19 feet at 180 gal. per min.

How tested: well driller had equipment to test

Length of test \_\_\_\_\_

Remarks: (Gravel packing, cementing, packers, type of shut-off, depth of shut-off)

Metal cap cemented in

(over)

ॐ

By *James A. Miller*  
DEPUTY

RECEIVED

County Gallatin

JUL 5 1973

DRILLER'S LOG

STATE OF MONTANA  
ADMINISTRATOR OF GROUNDWATER CODE  
MONTANA WATER RESOURCES BOARD

MONTANA DEPARTMENT OF NATURAL  
RESOURCES AND CONSERVATION

NOTICE OF COMPLETION OF GROUNDWATER  
APPROPRIATION BY MEANS OF WELL

Developed after January 1, 1962

(Under Chapter 237 Montana Session Laws, 1961, as amended)

This form to be prepared by driller, and three copies to be filed by the owner with the County Clerk and Recorder in the county in which the well is located, last copy to be retained by driller. Please answer all questions. If not applicable, so state, otherwise the form may be returned.

Owner Harold E. Cain

Address Rt. 4 Box 148

Bozeman, Mont.

Date well started Feb. 21 1973

completed March 5 1973

For Administrator's Use.

File 3361

6-29-73

GW 1 3:29 p.m.

Type of well drilled

(Dug, driven, bored or drilled)

Equipment used cable tool

(Churn drill, rotary or other)

Water Use: Domestic ☒ Municipal ☐ Stock ☐ Irrigation ☐

Industrial ☐ Drainage ☐ Other ☐\* Garden/Lawn ☐

\*Describe

USE: If used for irrigation, industrial, drainage or other. Explain, state number of acres and location or other data (i.e. Lot, Block and Addition).

ESTIMATED ANNUAL WITHDRAWAL

Size of Drilled Hole	Size and Weight of Casing	From (Feet)	To (Feet)	PERFORATIONS		
				Kind Size	From (Feet)	To (Feet)
7"	6 5/8 OD 19 lb	2 above	58 ft	none		

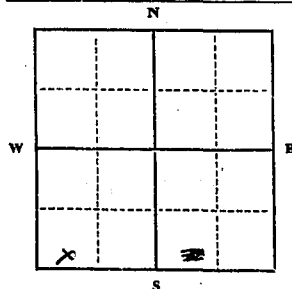

Static water level 3 ft.\*  
Pumping water level 44 ft.\*  
at 20 gallons per minute,  
measured 30 minutes after pumping  
began.

\*Measured from ground level.

Well developed by bailer and pump  
for 3 hours.

Power 115 volt 1/2 HP

Remarks: (Gravel packing, cementing, packers, type of shut-off)

1/4 Sec.

T. N R. E  
S. S W. W

INDICATE LOCATION OF WELL AND PLACE OF USE, IF POSSIBLE. EACH SMALL SQUARE REPRESENTS 40 ACRES.

Driller's Signature

Harold B. Hulbert

Driller's Address

Route one Bozeman, Montana

Hulbert Drilling

LICENSE NO. 47

Top of Ground

(Elev. above sea level)

From (Feet)	To (Feet)	
0	3	soil
3	9	gravel
9	15	gravel and sand
15	20	rock and clay
20	26	gravel and clay
26	30	clay and gravel
30	32	sand clay & some water
32	40	clay sand & little water
40	45	clay and gravel
45	48	gravel and clay
48	55	gravel and some water
55	58	gravel and water
58	60	water

49 ft Show exact depth of bottom

55511

3361

State of Montana }  
County of Gallatin } ss.  
Filed June 29, 1973  
at 3:29 o'clock P.M.  
Carl L. Stucky  
County Clerk & Recorder  
By Alta Hargan  
Deputy  
Fee \$ 2<sup>00</sup> ad.

56075



3382

State of Montana ss.  
County of Gallatin

Filed July 12, 1973  
at 7:35 o'clock A. M.

Carl A. Stucky  
County Clerk & Recorder  
By Allen M. Whitman  
Deputy

Fee \$ 2.00

GV

Approved Stock Form—State Publishing Co., Helena, Montana—42234

File No. \_\_\_\_\_

T. \_\_\_\_\_ R. \_\_\_\_\_  
County Gallatin

DUPLICATE

STATE OF MONTANA  
ADMINISTRATOR OF GROUNDWATER CODE  
OFFICE OF STATE ENGINEER

RECEIVED  
DEC 27 1963

Declaration of Vested Groundwater Rights  
(Under Chapter 237, Montana Session Laws, 1961)

I, Charles C. & Daisy L. Guio, of 414 4th Ave. E. Three Forks,  
(Name of Appropriator) (Address) (Town)

County of Gallatin State of Montana  
have appropriated groundwater according to the Montana laws in effect prior to January 1, 1962, as follows:

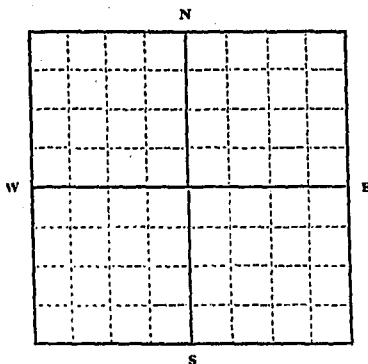

1/4 Sec. T. R. \_\_\_\_\_

Indicate point of appropriation and place of use, if possible. Each small square represents 10 acres.

2. The beneficial use on which the claim is based.....  
Garden Irrigation

3. Date or approximate date of earliest beneficial use; and how continuous the use has been April 1st. to Sept. 1st.

4. The amount of groundwater claimed (in miner's inches or gallons per minute)..... 240 gallons

5. If used for irrigation, give the acreage and description of the lands to which water has been applied and name of the owner thereof  
Lot 5, block 32, approximately 1/3 of the lot.  
Charles C. & Daisy L. Guio.

6. The means of withdrawing such water from the ground and the location of each well or other means of withdrawal  
Electric Centrifugal pump.

7. The date of commencement and completion of the construction of the well, wells, or other works for withdrawal of groundwater..... Hand dug. During April of 1939.

8. The depth of water table..... 4 to 5 feet.

9. So far as it may be available, the type, size and depth of each well or the general specifications of any other works for the withdrawal of groundwater..... Hand dug, with galvanized liner, gravel fill, and electric centrifugal pump/ and approximately 10 feet deep

10. The estimated amount of groundwater withdrawn each year..... about 12,000 gallons.

11. The log of formations encountered in the drilling of each well if available 4 & 1/2 feet of clay. the rest gravel.

12. Such other information of a similar nature as may be useful in carrying out the policy of this act, including reference to book and page of any county record..... Deed for lot recorded at Courthouse in Bozeman, Gallatin County, Montana.

Signature of Owner Charles C. Guio

Date Dec 23-1963

Three copies to be filed by the owner with the County Clerk and Recorder of the county in which the well is located.

Please answer all questions. If not applicable, so state, otherwise the form will be returned.

Original to the County Clerk and Recorder; Duplicate to the State Engineer; Triplicate to the Montana Bureau of Mines and Geology, and Quadruplicate for the Appropriator.

13307

#1018

State of Montana ss.  
County of Gallatin

Filed **December 26**, 1963  
at **8:32** o'clock **A**. M.

**EARL WALTON**

COUNTY CLERK & RECORDER

By *Paul G. Maffett*

DEPUTY

Fee \$ **2.00** pd

RECEIVED  
SEP 30 1957

STATE ENGINEER

MONTANA BUREAU OF MINES AND GEOLOGY  
Butte, Montana

T. \_\_\_\_\_ R. \_\_\_\_\_  
County Granite

WATER WELL LOG

Owner Carl H. Hammer M.D. Address \_\_\_\_\_

Driller Van Dyke Drilling Co. Address Bozeman

Date Started May 14/55 Date Completed May 18/55

Location: Sec. \_\_\_\_\_ T. \_\_\_\_\_ R. \_\_\_\_\_ ¼ sec. \_\_\_\_\_

Type of well Drilled Equipment used Cable tool  
(Dug, driven, bored, or drilled) (Churn drill, rotary, other)

Water use: Domestic ☒ Municipal ☐ Stock ☐ Irrigation ☒

Industrial ☐ Drainage ☐ Other: \_\_\_\_\_

Casing: 0 ft. to 53 ft. Type P.E. Steel Size 6 5/8" A.P.

Casing: \_\_\_\_\_ ft. to \_\_\_\_\_ ft. Type \_\_\_\_\_ Size \_\_\_\_\_

Casing: \_\_\_\_\_ ft. to \_\_\_\_\_ ft. Type \_\_\_\_\_ Size \_\_\_\_\_

Perforated or Screened: Ft. \_\_\_\_\_ to ft. \_\_\_\_\_ Ft. \_\_\_\_\_ to ft. \_\_\_\_\_

Type of screen or perforations \_\_\_\_\_

Static Water level, for non-flowing well: 12 ft from Surface feet.

Shut-in pressure, for flowing well: \_\_\_\_\_ lb./sq. in. on: \_\_\_\_\_ (date)

Pumping water level 33 feet at 42 G.P.M. gal. per min.

How tested: Bailer

Length of test 2 hr.

Remarks: (Gravel packing, cementing, packers, type of shut-off, depth of shut-off)

(over)

## Log of Well

[illegible]

File No. \_\_\_\_\_

DUPLICATE

Location  
Domestic - OK

STATE OF MONTANA  
ADMINISTRATOR OF GROUNDWATER CODE  
OFFICE OF STATE ENGINEER

T. \_\_\_\_\_ R. \_\_\_\_\_  
County Gallatin  
**RECEIVED**  
JUL 17 1963  
STATE ENGINEER

# Declaration of Vested Groundwater Rights

(Under Chapter 237, Montana Session Laws, 1961)

1. Walter L. King, of Bozeman, Montana  
(Name of Appropriator) (Address) (Town)  
County of Gallatin State of Montana  
have appropriated groundwater according to the Montana laws in effect prior to January 1, 1962, as follows:

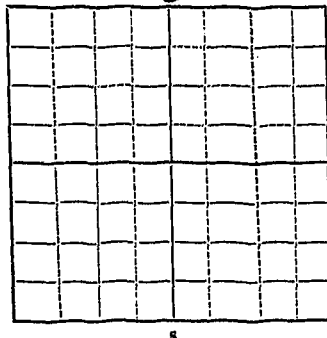

\_\_\_\_\_ 1/4 \_\_\_\_\_ Sec. \_\_\_\_\_ T. \_\_\_\_\_ R. \_\_\_\_\_

Indicate point of appropriation  
and place of use, if possible.  
Each small square represents 10  
acres.

2. The beneficial use on which the claim is based  
Domestic & Irrigation

3. Date or approximate date of earliest beneficial use; and how continuous the use has been June 1960

4. The amount of groundwater claimed (in miner's inches or gallons per minute) 30 gallons

5. If used for irrigation, give the acreage and description of the lands to which water has been applied and name of the owner thereof  
Longview Farm & Garden

6. The means of withdrawing such water from the ground and the location of each well or other means of withdrawal  
Pump 1, Home garden

7. The date of commencement and completion of the construction of the well, wells, or other works for withdrawal of groundwater June 1960

8. The depth of water table 36 feet

9. So far as it may be available, the type, size and depth of each well or the general specifications of any other works for the withdrawal of groundwater  
2" pipe 2' deep  
1" x 1/2" pipe 1' deep

10. The estimated amount of groundwater withdrawn each year 500,000

11. The log of formations encountered in the drilling of each well if available  
3' top soil  
23' fine sand & gravel

12. Such other information of a similar nature as may be useful in carrying out the policy of this act, including reference to book and page of any county record.

Signature of Owner \_\_\_\_\_

Date 7/8/1963

Three copies to be filed by the owner with the County Clerk and Recorder of the county in which the well is located.

Please answer all questions. If not applicable, so state, otherwise the form will be returned.

Original to the County Clerk and Recorder; duplicate to the State Engineer; Triplicate to the Montana Bureau of Mines and Geology, and Quadruplicate for the Appropriator.

5047



# 667

State of Montana }  
County of Gallatin } ss.

Filed July 16, 1963

at 12:40 o'clock P. M.

Carl Walton  
COUNTY CLERK & RECORDER

By Ida J. Morrow  
2.00 Pd. DEPUTY

Fee \$ \_\_\_\_\_

File No. ....

DUPLICATE

T.....R.....

County.....

STATE OF MONTANA  
ADMINISTRATOR OF GROUNDWATER CODE  
OFFICE OF STATE ENGINEER  
AUG 6 1963

Top of Ground

(Elev. above sea level.....)

D-1' Soil  
1-3 Soil & Rock  
3-15 gravel Rock  
15-20 gravel & clay  
20-27 Clay Rock  
27-30 Clay & gravel  
30' bottom of well  
29-30 water course

## Notice of Completion of STATE ENGINEER Appropriation by Means of Well

(Under Chapter 237, Montana Session Laws, 1961)

Owner Robert S. and Address .....Driller Harold B. Hilluf Address Route 1, Bozeman, Mont

Date of Notice of Appropriation of Groundwater.....

Date well started May 27, 1963 Date Completed May 29, 1963

Type of well Drilled Equipment Used Churn  
(dug, driven, bored or (Churn, drill, rotary or  
drilled) other)

Water Use: Domestic ☒ Municipal ☐ Other ☐ Irrigation ☐  
Industrial ☐ Drainage ☐ Stock ☐

Indicate on the diagram the character and thickness of the different strata met with in drilling, such as soil, clay, shale, gravel, rock or sand, etc. Show depth at which water is encountered, thickness and character of water-bearing strata and height to which water rises in the well.

Size of Drilled Hole	Size and Weight of Casing	From (Feet)	To (Feet)	PERFORATIONS		
				Kind Size	From (Feet)	To (Feet)
7	6 5/8 OD 14 1/4	0	29	none		

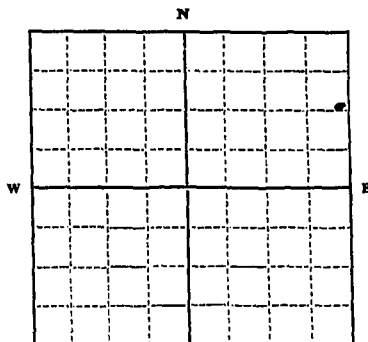

1/4 Sec. T. R.  
Indicate location of well and place of use, if possible. Each small square represents 10 acres.

Show exact depth of bottom.

Static Water Level for non-flowing Well.....12.....feet.

Shut-in Pressure for Flowing Well.....

Pumping Water Level.....14.....feet at.....28.....gal. per minute.

Discharge in gal. per min. of flowing well.....

How Tested Bailer Length of Test 2 hrs

Remarks: (Gravel packing, cementing, packers, type of shutoff, location of place of use of groundwater if not at well, and any other similar pertinent information, including number of

acres irrigated, if used for irrigation).....

none

Driller's License Number 47Driller's Signature Harold B. Hilluf

This form to be prepared by driller, and three copies to be filed by the owner with the County Clerk and Recorder in the county in which the well is located.

Please answer all questions. If not applicable, so state, otherwise the form will be returned.

Original to the County Clerk and Recorder; duplicate to the State Engineer; Triplicate to the Montana Bureau of Mines and Geology and Quadruplicate for the Appropriator.

5270



File No. ....

DUPLICATE

T. .... R. ....

County .....

STATE OF MONTANA  
ADMINISTRATOR OF GROUNDWATER CODE  
OFFICE OF STATE ENGINEER

JAN 16 1964

Notice of Completion of Groundwater  
Appropriation by Means of Well

(Under Chapter 237, Montana Session Laws, 1961)

Owner Hugo Ivan Martin Address Route 1, BozemanDriller M. E. Jones Address Bozeman

Date of Notice of Appropriation of Groundwater .....

Date well started July 24, '62 Date Completed July 26, '62Type of well Drilled Equipment Used Churn drill  
(dug, driven, bored or drilled) (Churn, drill, rotary or other)Water Use: Domestic ☒ Municipal ☐ Other ☐ Irrigation ☐  
Industrial ☐ Drainage ☐ Stock ☐

Indicate on the diagram the character and thickness of the different strata met with in drilling, such as soil, clay, shale, gravel, rock or sand, etc. Show depth at which water is encountered, thickness and character of water-bearing strata and height to which water rises in the well.

Size of Drilled Hole	Size and Weight of Casing	From (Feet)	To (Feet)	PERFORATIONS		
				Kind Size	From (Feet)	To (Feet)
	6 5/8" by 15#	Top of ground	32'	None		

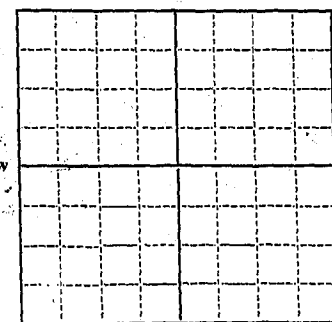

1/4 Sec. T. R.  
Indicate location of well and place of use, if possible. Each small square represents 10 acres.

Show exact depth of bottom.

Static Water Level for non-flowing Well 6 feet.

Shut-in Pressure for Flowing Well .....

Pumping Water Level 32 feet at 40 gal. per minute.

Discharge in gal. per min. of flowing well .....

How Tested Pump Length of Test 2 hrs.

Remarks: (Gravel packing, cementing, packers, type of shutoff, location of place of use of groundwater if not at well, and any other similar pertinent information, including number of acres irrigated, if used for irrigation)

*Hugo I. Martin*  
*M. E. Jones*

Driller's License Number 17Driller's Signature *Milton E. Jones*

This form to be prepared by driller, and three copies to be filed by the owner with the County Clerk and Recorder in the county in which the well is located.

Please answer all questions. If not applicable, so state, otherwise the form will be returned.

Original to the County Clerk and Recorder; duplicate to the State Engineer; Triplicate to the Montana Bureau of Mines and Geology and Quadruplicate for the Appropriator.

33327



File No. \_\_\_\_\_

DUPLICATE

T. \_\_\_\_\_ R. \_\_\_\_\_

County Gallatin

STATE OF MONTANA  
ADMINISTRATOR OF GROUNDWATER CODE  
OFFICE OF STATE ENGINEER

**RECEIVED**  
JAN 16 1964  
STATE ENGINEER

**Declaration of Vested Groundwater Rights**

(Under Chapter 237, Montana Session Laws, 1961)

1. Robert C. McCall, of 502 South Sixth Bozeman  
(Name of Appropriator) (Address) (Town)

County of Gallatin State of Montana  
have appropriated groundwater according to the Montana laws in effect prior to January 1, 1962, as follows:

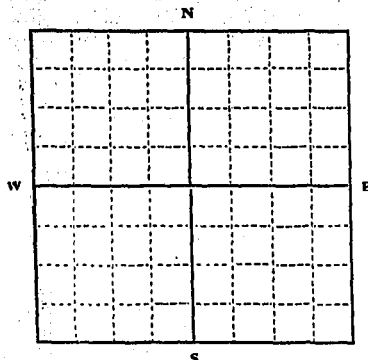

Lot 6 Bl 10

1/4 Sec. TWY. R.

Indicate point of appropriation  
and place of use, if possible. Each  
small square represents 10 acres.

2. The beneficial use on which the claim is based Houses
3. Date or approximate date of earliest beneficial use; and how continuous the use has been continuous since 1947
4. The amount of groundwater claimed (in miner's inches or gallons per minute) 50 gal per minute
5. If used for irrigation, give the acreage and description of the lands to which water has been applied and name of the owner thereof  
lawn only
6. The means of withdrawing such water from the ground and the location of each well or other means of withdrawal  
by electric pump
7. The date of commencement and completion of the construction of the well, wells, or other works for withdrawal of groundwater.  
June 1947
8. The depth of water table 9
9. So far as it may be available, the type, size and depth of each well or the general specifications of any other works for the withdrawal of groundwater.  
120 ft
10. The estimated amount of groundwater withdrawn each year 1.5 million gal
11. The log of formations encountered in the drilling of each well if available.  
5 ft clay and dirt water rises to 40 ft sand to 60 ft yellow clay
12. Such other information of a similar nature as may be useful in carrying out the policy of this act, including reference to book and page of any county record.

Signature of Owner Robert C. McCallDate 11/29/63

Three copies to be filed by the owner with the County Clerk and Recorder of the county in which the well is located.

Please answer all questions. If not applicable, so state, otherwise the form will be returned.

Original to the County Clerk and Recorder; Duplicate to the State Engineer; Triplicate to the Montana Bureau of Mines and Geology, and Quadruplicate for the Appropriator.

36055



RECORDED  
FILED

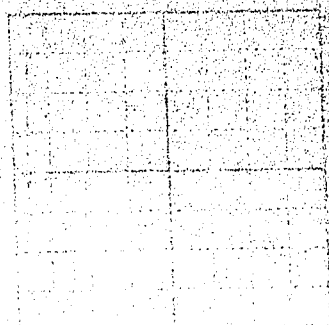

NOTARY PUBLIC  
STATE OF MONTANA  
My Comm. Expires

1741

State of Montana }  
County of Gallatin } ss.  
Filed Dec - 31 1963  
at 3:48 o'clock P. M.  
Carl Walton  
COUNTY CLERK & RECORDER  
By [Signature]  
Fee \$ 2.00 DEPUTY

RECEIVED  
JUN 4 1958

STATE ENGINEER

MONTANA BUREAU OF MINES AND GEOLOGY  
Butte, Montana

T. \_\_\_\_\_ R. \_\_\_\_\_  
County Gallatin

WATER WELL LOG

Owner Jack Nash Address \_\_\_\_\_

Driller Hans Stephens Drilling Co Address Bozeman

Date Started Sept 12/57 Date Completed Sept 16/57

Location: Sec. \_\_\_\_\_ T. \_\_\_\_\_ R. \_\_\_\_\_ 1/4 sec. \_\_\_\_\_

Type of well Drilled Equipment used Cable tool  
(Dug, driven, bored, or drilled) (Churn drill, rotary, other)

Water use: Domestic ☐ Municipal ☐ Stock ☐ Irrigation ☐  
Industrial ☐ Drainage ☐ Other: \_\_\_\_\_

Casing: surface ft. to 50' 7" ft. Type P.F. Steel Size 6 5/8" 17# per Ft.

Casing: \_\_\_\_\_ ft. to \_\_\_\_\_ ft. Type \_\_\_\_\_ Size \_\_\_\_\_

Casing: \_\_\_\_\_ ft. to \_\_\_\_\_ ft. Type \_\_\_\_\_ Size \_\_\_\_\_

Perforated or Screened: Ft. \_\_\_\_\_ to ft. \_\_\_\_\_ Ft. \_\_\_\_\_ to ft. \_\_\_\_\_

Type of screen or perforations \_\_\_\_\_

Static Water level, for non-flowing well: 12' feet

Shut-in pressure, for flowing well: \_\_\_\_\_ lb./sq. in. on: \_\_\_\_\_ (date)

Pumping water level 5 ft drawdown feet at 40 gal. per min

How tested: Bailer

Length of test 1 hr

Remarks: (Gravel packing, cementing, packers, type of shut-off, depth of shut-off)

(over)

## Log of Well

[illegible]

T. \_\_\_\_\_ R. \_\_\_\_\_  
County Gallatin

MONTANA BUREAU OF MINES AND GEOLOGY  
Butte, Montana

RECEIVED  
FEB 21 1961

WATER WELL LOG

STATE ENGINEER

Owner William Oriet Address Bozeman  
Driller M E Jones Address Bozeman  
Date Started February 20, 1961 Date Completed Feb. 21, 1961  
Location: Sec. \_\_\_\_\_ T. \_\_\_\_\_ R. \_\_\_\_\_ 1/4 sec. \_\_\_\_\_

Type of well Drilled Equipment used Churn Drill  
(Dug, driven, bored, or drilled) (Churn drill, rotary, other)

Water use: Domestic ☒ Municipal ☐ Stock ☐ Irrigation ☒  
Industrial ☐ Drainage ☐ Other: \_\_\_\_\_

Casing: Surface ft. to 40 ft. Type Black Steel Size 6 5/8" OD 15#

Casing: \_\_\_\_\_ ft. to \_\_\_\_\_ ft. Type \_\_\_\_\_ Size \_\_\_\_\_

Casing: \_\_\_\_\_ ft. to \_\_\_\_\_ ft. Type \_\_\_\_\_ Size \_\_\_\_\_

Perforated or Screened: Ft. Nine to ft. \_\_\_\_\_ Ft. \_\_\_\_\_ to ft. \_\_\_\_\_

Type of screen or perforations: \_\_\_\_\_

Static Water level, for non-flowing well: 19 feet.

Shut-in pressure, for flowing well: \_\_\_\_\_ lb./sq. in. on: \_\_\_\_\_ (date)

Pumping water level 40 feet at 25 gal. per min.

How tested: Pump

Length of test 24 hours

Remarks: (Gravel packing, cementing, packers, type of shut-off, depth of shut-off)

\_\_\_\_\_  
\_\_\_\_\_  
\_\_\_\_\_  
\_\_\_\_\_

(over)

# Log of Well

Depth, feet		Description of Material Drilled
From	To	
Surface	5'	Topsoil & Clay
5'	23'	Gravel
23'	27'	Tight Sand
27'	28'	Fine Gravel & Sand
28'	32'	Tight Sand
32'	34'	Fine Gravel & Sand
34'	40'	Clay
40'		Fine Gravel

# 199  
 Gallatin County, } ss.  
 State of Montana.  
 Filed November 20, 1961  
 at 9:10 o'clock A.M.  
 EARL WALTON  
 COUNTY CLERK & RECORDER  
 By *Earl Walton*  
 Fee \$ 2.00 pd

T. \_\_\_\_\_ R. \_\_\_\_\_  
County Flathead

MONTANA BUREAU OF MINES AND GEOLOGY  
Butte, Montana

RECEIVED  
JAN 21 1961

WATER WELL LOG

STATE ENGINEER

Owner Charles Spaulding Address Manhattan  
Driller M.E. Jones Address 1

Date Started Dec. 27, 1960 Date Completed Dec. 28, 1960

Location: Sec. \_\_\_\_\_ T. \_\_\_\_\_ R. \_\_\_\_\_ 1/4 sec. S<sup>2</sup>W<sup>2</sup>NW<sup>4</sup>SW<sup>4</sup>

Type of well Drilled Equipment used Churn Drill  
(Dug, driven, bored, or drilled) (Churn drill, rotary, other)

Water use: Domestic ☒ Municipal ☐ Stock ☒ Irrigation ☒  
Industrial ☐ Drainage ☐ Other: \_\_\_\_\_

Casing: Surface ft. to 43 1/2 ft. Type Black Steel Size 6 5/8" x 15 #

Casing: \_\_\_\_\_ ft. to \_\_\_\_\_ ft. Type \_\_\_\_\_ Size \_\_\_\_\_

Casing: \_\_\_\_\_ ft. to \_\_\_\_\_ ft. Type \_\_\_\_\_ Size \_\_\_\_\_

Perforated or Screened: Ft. \_\_\_\_\_ to ft. \_\_\_\_\_ Ft. \_\_\_\_\_ to ft. \_\_\_\_\_

Type of screen or perforations \_\_\_\_\_

Static Water level, for non-flowing well: 22 feet.

Shut-in pressure, for flowing well: \_\_\_\_\_ lb./sq. in. on: \_\_\_\_\_ (date)

Pumping water level 50 feet at 20 gal. per min.

How tested: Pump

Length of test: 2 HOURS

Remarks: (Gravel packing, cementing, packers, type of shut-off, depth of shut-off)

(over)



# Log of Well

Depth, feet		Description of Material Drilled
From	To	
Surface	5'	Topsoil
5	27	Gravel
27	38	Clay
38	39½	Gravel
39	43½	Clay
43½	44½	Gravel
44½	50	Clay
50	51	Gravel

Filed \_\_\_\_\_  
 at \_\_\_\_\_  
 January 23, 1961  
 4:20 o'clock P.M.  
 By John T. McNamee  
 DEPUTY  
 Fee \$ 2.00 pd.

Gallatin County,  
 State of Montana, } ss.

Form No. 18  
8-60

T. 2 R. 1  
County Goldman

MONTANA BUREAU OF MINES AND GEOLOGY  
Butte, Montana

RECEIVED  
JAN 2 1962

STATE ENGINEER

Water Well Log

X		

Owner Rose B. Squires Address Bygonia 5792  
Driller Clarence Hansen Address 11  
Date Started unknown Date Completed   
Location: Sec.  T.  R.   $\frac{1}{4}$  sec.

Type of well Dug Equipment used   
(Dug, driven, or drilled) (Churn, drill, rotary, other)

Water use: Domestic ☐ Municipal ☐ Stock ☐ Irrigation ☐  
Industrial ☐ Drainage ☐ Other household

Casing: 15 ft. to  ft. Type Pipe Size 1 1/2"

Casing:  ft. to  ft. Type  Size

Casing:  ft. to  ft. Type  Size

Perforated or screened: Ft.  to ft. . Ft.  to ft.

Type of screen or perforations

Static water level, for non-flowing well:  feet.

Shut-in pressure, for flowing well:  lb./sq. in. on:  (date)

Pumping water level  feet at  gal. per min.

How tested:

Length of test

Remarks: (Gravel packing, cementing, packers, type of shut-off, depth of shut-off)

(over)

County Ballwin

JUL 5 1975

STATE OF MONTANA  
ADMINISTRATOR OF GROUNDWATER CODE  
MONTANA WATER RESOURCES BOARD

# NOTICE OF COMPLETION OF GROUNDWATER APPROPRIATION BY MEANS OF WELL

Developed after January 1, 1962

(Under Chapter 237 Montana Session Laws, 1961, as amended)

This form to be prepared by driller, and three copies to be filed by the owner with the County Clerk and Recorder in the county in which the well is located, last copy to be retained by driller.

Please answer all questions. If not applicable, so state, otherwise the form may be returned.

Owner ARMOUR W. TAYLOR

For Administrator's Use

Address ROUTE 4 Box 237

File 3342

BOZEMAN, MT

6-29-73

Date well started ..... 1968

GW 1 1:05 p.m.

completed 1968

Type of well ..... Dug .....

(Dug, driven, bored or drilled)

Equipment used Buckhorn

(Churn drill, rotary or other)

Water Use: Domestic ☐ Municipal ☐ Stock ☐ Irrigation ☒

Industrial ☐ Drainage ☐ Other ☐\* Garden/Lawn ☐

\*Describe 10' deep 30" casing

**USE:** If used for irrigation, industrial, drainage or other. Explain, state number of acres and location or other data (i.e. Lot, Block

and Addition). 1.18 Acres York & Horden & 2.6 acres Pasture

ESTIMATED ANNUAL WITHDRAWAL 270,000 gallons

Size of Drilled Hole	Size and Weight of Casing	From (Feet)	To (Feet)	PERFORATIONS		
				Kind Size	From (Feet)	To (Feet)
30	30 10 1/2 lbs	0	10			

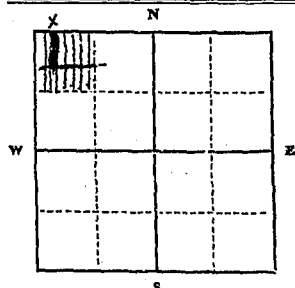

Static water level ..... 5 ..... ft.\*  
Pumping water level ..... 7 ..... ft.\*  
at ..... 300 ..... gallons per minute,  
measured ..... 10 ..... minutes after pumping  
began.

\*Measured from ground level.

Well developed by ...  
for .....hours.

Power: Electric Pump: 1 HP  
Remarks: (Gravel packing, cementing,  
packers, type of shutoff) \_\_\_\_\_

.....<sup>1</sup>/<sub>4</sub>.....<sup>1</sup>/<sub>4</sub> Sec.....  
T..... N R..... E  
                    S                    W

INDICATE LOCATION OF WELL AND PLACE OF USE, IF POSSIBLE.  
EACH SMALL SQUARE REPRESENTS 40 ACRES.

Driller's Signature .....

Driller's Address .....

LICENSE NO. ....

## DRILLER'S LOG

Indicate the character, color, thickness of strata such as soil, clay, sand, gravel, shale, sandstone, etc. Show depth at which water is found and height to which water rises in well.

Top of Ground

(Elev. above sea level)

[illegible]

Show exact depth of bottom

55579

~~3337~~  
3342

State of Montana  
County of Gallatin ss.

Filed June 29, 1973  
at 105 o'clock P.M.  
Coch. L. Stucky

County Clerk & Recorder

By Alta M. Whitman  
Deputy

Fee \$ 2.00

RECEIVED  
AUG 25 1958

T. \_\_\_\_\_ R. \_\_\_\_\_  
County Gallatin

STATE ENGINEER MONTANA BUREAU OF MINES AND GEOLOGY  
Butte, Montana

WATER WELL LOG

Owner HARRY S. WALKER, Jr. Address Star Route  
Driller Harriet Van Dyken Address 317 N. WILLOW ST. BUTTE MONT  
Date Started Oct 11, 1956 Date Completed Oct 21, 1956  
Location: Sec. \_\_\_\_\_ T. \_\_\_\_\_ R. \_\_\_\_\_ 1/4 sec. E 2 N 14

Type of well drilled Equipment used Churn drill  
(Dug, driven, bored, or drilled) (Churn drill, rotary, other)

Water use: Domestic ☒ Municipal ☐ Stock ☐ Irrigation ☐  
Industrial ☐ Drainage ☐ Other: \_\_\_\_\_

Casing: 0 ft. to 35 ft. Type 12 1/4 U.S. Std Size 6 in

Casing: \_\_\_\_\_ ft. to \_\_\_\_\_ ft. Type \_\_\_\_\_ Size \_\_\_\_\_

Casing: \_\_\_\_\_ ft. to \_\_\_\_\_ ft. Type \_\_\_\_\_ Size \_\_\_\_\_

Perforated or Screened: Ft. \_\_\_\_\_ to ft. \_\_\_\_\_ Ft. \_\_\_\_\_ to ft. \_\_\_\_\_

Type of screen or perforations NONE

Static Water level, for non-flowing well: 28 ft of standing water feet.

Shut-in pressure, for flowing well: \_\_\_\_\_ lb./sq. in. on: \_\_\_\_\_ (date)

Pumping water level 20 feet at 2730 gal. per min. 60

How tested: Baker (or) Sand Pump

Length of test Two Hours

Remarks: (Gravel packing, cementing, packers, type of shut-off, depth of shut-off)

NONE

(over)

### Log of Well

[illegible]