

State of Montana / ss.  
County of Gallatin /

Filed December 3, 1963

2:50 o'clock P. M.

**EARL WALTON**

COUNTY CLERK & RECORDER

Ida T. Morrow

DEPUTY

File # 2.00 Pd.

RECEIVED  
JUL 11 1958

36  
T. 2N R 2E  
County Gallatin

STATE ENGINEER MONTANA BUREAU OF MINES AND GEOLOGY  
Butte, Montana

WATER WELL LOG

Owner Lester W. Burrell Address Logan, Montana  
Driller Van Dyken Drilling Co. Address Bozeman, Montana  
Date Started Dec. 1950 Date Completed Dec. 28, 1950  
Location: Sec. Logan Townsite Lot #1 Blk #4 R. 1  $\frac{1}{4}$  sec.

Type of well Drilled Equipment used Churn drill  
(Dug, driven, bored, or drilled) (Churn drill, rotary, other)

Water use: Domestic ☒ Municipal ☐ Stock ☐ Irrigation ☐  
Industrial ☐ Drainage ☐ Other:

Casing from 7 ft. to 19 ft. Type Iron Size 6 inch  
Casing:  ft. to  ft. Type  Size   
Casing:  ft. to  ft. Type  Size

Perforated or Screened: Ft.  to ft.  Ft.  to ft.

Type of screen or perforations:

Static Water level, for non-flowing well:  feet.

Shut-in pressure, for flowing well:  lb./sq. in. on:  (date)

Pumping water level: 7.5 feet at 15 gal. per min.

How tested: By well bailer

Length of test: until water level could not be lowered further

Remarks: (Gravel packing, cementing, packers, type of shut-off, depth of shut-off)

(over)

## Log of Well

Sallaber County,  
 State of Montana,  
 ss.  
 I, Edith \_\_\_\_\_, Clerk of said County, do hereby certify that the within and foregoing is a true and correct copy of the original as the same appears from the records of said County.  
 Edith \_\_\_\_\_, Clerk.  
 J. W. \_\_\_\_\_, Deputy Clerk.  
 DEPUTY

RECEIVED

T 2N R 2E 36  
County Gallatin

STATE ENGINEER MONTANA BUREAU OF MINES AND GEOLOGY  
Butte, Montana

WATER WELL LOG

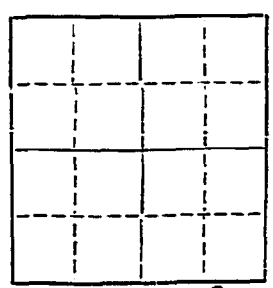

Owner Joe Zupka Address Logan Mont.

Driller \_\_\_\_\_ Address \_\_\_\_\_

Date Started \_\_\_\_\_ Date Completed 1923

Location: Sec. NW 36 T. 2N R. 2E 1/4 sec. SW NW 1  
Lot 18 BRR 2 Original State Logan

Type of well Drilled Equipment used Churn Drill  
(Dug, driven, bored, or drilled) (Churn drill, rotary, other)

Water use: Domestic ☒ Municipal ☐ Stock ☐ Irrigation ☐  
Industrial ☐ Drainage ☐ Other: \_\_\_\_\_

Casing: 5 1/2 ft. to 40 ft. Type \_\_\_\_\_ Size \_\_\_\_\_

Casing: \_\_\_\_\_ ft. to \_\_\_\_\_ ft. Type \_\_\_\_\_ Size \_\_\_\_\_

Casing: \_\_\_\_\_ ft. to \_\_\_\_\_ ft. Type \_\_\_\_\_ Size \_\_\_\_\_

Perforated or Screened: Ft. \_\_\_\_\_ to ft. \_\_\_\_\_ Ft. \_\_\_\_\_ to ft. \_\_\_\_\_

Type of screen or perforations: \_\_\_\_\_

Static Water level, for non-flowing well: \_\_\_\_\_ feet.

Shut-in pressure, for flowing well: \_\_\_\_\_ lb./sq. in. on: \_\_\_\_\_ (date)

Pumping water level 7 FT. 8 IN. feet at 520 gal. per min.

How tested: 3/4 HORSE PUMP

Length of test 6 HR.

Remarks: (Gravel packing, cementing, packers, type of shut-off, depth of shut-off)

Original depth 65 feet.

## Log of Well

[illegible]

Callahan County,  
State of Montana } ss.  
I, the undersigned,  
Judge of the District Court of  
Callahan County, Montana, do hereby  
certify that the within and foregoing  
is a true and correct copy of the  
original as the same appears from  
the records of said Court.

Witness my hand and the seal of said  
Court at Helena, Montana, this  
17th day of August, 1969.

Earl Walton  
District Clerk

By *John T. Morrison*  
Attorney

1.00 Pd.

Free \$

51,496

# 3134

State of Montana  
County of Gallatin ss.  
Filed Sept. 12, 1977  
at 11:30 o'clock AM.  
Carl L. Stucky  
County Clerk & Recorder  
By Harold A. Bridges  
Deputy  
Fee \$ 2.00

File No. ....

DUPLICATE

T 2 N R 2 E  
County Gallatin

STATE OF MONTANA  
ADMINISTRATOR OF GROUNDWATER CODE  
OFFICE OF STATE ENGINEER

**Declaration of Vested Groundwater Rights**

(Under Chapter 237, Montana Session Laws, 1961)

1. MARY E. SHOOKMAN, of 527 No. Bozeman, Bozeman, Montana  
(Name of Appropriator) (Address) (Town)  
County of Gallatin State of Montana  
have appropriated groundwater according to the Montana laws in effect prior to January 1, 1962, as follows:

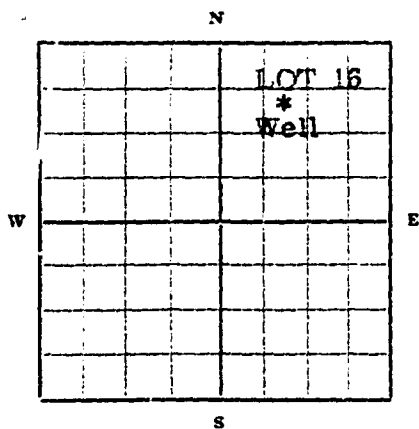

1/4 Sec 36 T2N R2E

Indicate point of appropriation  
and place of use, if possible.  
Each small square represents 10  
acres.

2. The beneficial use on which the claim is based Domestic
3. Date or approximate date of earliest beneficial use; and how continuous the use has been June 15, 1920 - use has been continuous
4. The amount of groundwater claimed (in miner's inches or gallons per minute) 25 gal. per minute
5. If used for irrigation, give the acreage and description of the lands to which water has been applied and name of the owner thereof Garden - Lot 16, Block Four, Northern Pacific Addition to Logan, Montana
6. The means of withdrawing such water from the ground and the location of each well or other means of withdrawal Electric pump
7. The date of commencement and completion of the construction of the well, wells, or other works for withdrawal of groundwater Completed approximately June 15, 1920
8. The depth of water table 65 feet
9. So far as it may be available, the type, size and depth of each well or the general specifications of any other works for the withdrawal of groundwater 65 feet deep - 5 inch casing
10. The estimated amount of groundwater withdrawn each year 20,000 gallons
11. The log of formations encountered in the drilling of each well if available
12. Such other information of a similar nature as may be useful in carrying out the policy of this act, including reference to book and page of any county record.

Signature of Owner

*Mary E. Shookman*

Date January 8, 1962

Three copies to be filed by the owner with the County Clerk and Recorder of the county in which the well is located.

Please answer all questions. If not applicable, so state, otherwise the form will be returned.

Original to the County Clerk and Recorder; duplicate to the State Engineer; Triplicate to the School of Mines and Quadruplicate for the Appropriator.

1332



443

January 9

8:15 A.

EARL WALTON

*Ida J. Morrow*

2.00

## GROUNDWATER INDEX

Page 1 of 3

County Gallatin Twp. 2 N Rge. 3 E

[illegible]

File No. \_\_\_\_\_

DUPLICATE

T. 2N R. 3ECounty Gallatin

STATE OF MONTANA  
ADMINISTRATOR OF GROUNDWATER CODE  
OFFICE OF STATE ENGINEER

JAN 16 1964

# Declaration of Vested Groundwater Rights

(Under Chapter 237, Montana Session Laws, 1961)

1. Ralph E. Green, of 1311 South Grand Bozeman  
(Name of Appropriator) (Address) (Town)

County of Gallatin State of Montana  
have appropriated groundwater according to the Montana laws in effect prior to January 1, 1962, as follows:

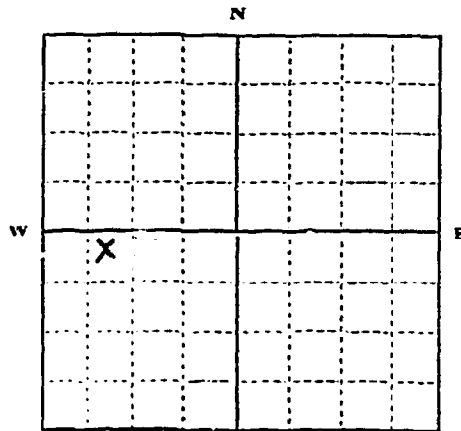

Well in NE  $\frac{1}{4}$ , NW  $\frac{1}{4}$   
SW  $\frac{1}{4}$  Sec 5 T2N R3E

Indicate point of appropriation  
and place of use, if possible. Each  
small square represents 10 acres.

2. The beneficial use on which the claim is based  
Live stock and domestic

3. Date or approximate date of earliest beneficial use; and how continu-  
ous the use has been 1912 Intermittent

4. The amount of groundwater claimed (in miner's inches or gallons  
per minute) Three gallons per minute every  
other hour

5. If used for irrigation, give the acreage and description of the lands  
to which water has been applied and name of the owner thereof  
None

6. The means of withdrawing such water from the ground and the loca-  
tion of each well or other means of withdrawal  
Not in use now

7. The date of commencement and completion of the construction of the well, wells, or other works for with-  
drawal of groundwater 1912

8. The depth of water table 15 feet

9. So far as it may be available, the type, size and depth of each well or the general specifications of any other  
works for the withdrawal of groundwater Dug well walled with rock, 30 feet deep

10. The estimated amount of groundwater withdrawn each year Not known

11. The log of formations encountered in the drilling of each well if available  
Alluvial material and shale

12. Such other information of a similar nature as may be useful in carrying out the policy of this act, including  
reference to book and page of any county record

Signature of Owner \_\_\_\_\_

Date \_\_\_\_\_

Three copies to be filed by the owner with the County Clerk and Recorder of the county in which the well is located.

Please answer all questions. If not applicable, so state, otherwise the form will be returned.

Original to the County Clerk and Recorder; Duplicate to the State Engineer; Triplicate to the Montana Bureau of  
Mines and Geology, and Quadruplicate for the Appropriator.

33415

1276

State of Montana } ss.  
County of Gallatin }  
Filed 12-30 1963  
at 11-22 o'clock A. M.  
Carl H. Hatten  
COUNTY CLERK & RECORDER  
By BS DEPUTY  
Fee \$ 200

File No. \_\_\_\_\_

T. 2N R. 3E

DUPLICATE

MONTANA WATER RESOURCES BOARD  
**RECEIVED**County Gallatin

LOG

JUL 23 1969

STATE OF MONTANA

ADMINISTRATOR OF GROUNDWATER CODE  
OFFICE OF STATE ENGINEER

Top of Ground

(Elev. above sea level \_\_\_\_\_)

0 - 14 ft.

Very Silty

14 - 19 feet

loamy clay and sand

19 - 21 feet

Dry, Hard, Silty Clay  
bound Sand & Gravels

20 Feet

Static Water Level

21 - 24 feet

Solid Rock

24 - 30 Feet

Lenses of Solid and  
Fractured Rock**Notice of Completion of Groundwater  
Appropriation by Means of Well**

DEVELOPED AFTER JANUARY 1, 1962

(Under Chapter 237, Montana Session Laws, 1961)

Katherine G Steele

Owner Katherine G Steele Address Manhattan, MontanaDriller Potts Drilling & Dev. Address Rt. 1, Bozeman, Mont.

Date of Notice of appropriation of groundwater \_\_\_\_\_

Date well started 3/17/69 Date completed 3/20/69Type of well drilled Equipment used cable tool  
(Dug, Driven, bored or drilled) (Churn drill, rotary or other)Water use: Domestic ☒ Municipal ☐ Stock ☒ Irrigation ☐  
Industrial ☐ Drainage ☐ Other ☐

Indicate on the diagram the character and thickness of the different strata met with in drilling, such as soil, clay, silt, gravel, rock or sand, etc. Show depth at which water is encountered, thickness and character of water-bearing strata and height to which the water rises in the well.

Size of Drilled Hole	Size and Weight of Casing	From (Feet)	To (Feet)	PERFORATIONS		
				Kind Size	From (Feet)	To (Feet)
6"	6" I.D. 17# 250 lb	1	24			

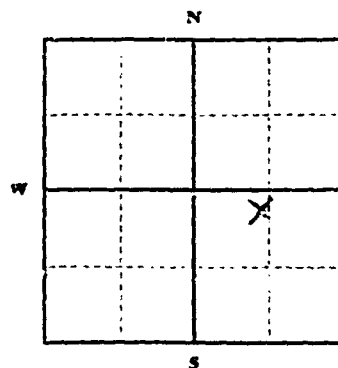

Static Water Level for non-flowing well \_\_\_\_\_ feet.

Shut-in Pressure for Flowing Well \_\_\_\_\_

Pumping Water Level 25 feetat 40 gal. per minute.

Discharge in gal. per min. of flowing well \_\_\_\_\_

How Tested BoilerLength of Test 2 hours

Remarks: (Gravel packing, cementing, packers, type of shutoff) \_\_\_\_\_

Indicate location of well and place of use, if possible. Each small square represents 40 acres.

(Continue on reverse side)

USE—If used for irrigation, industrial, drainage or other. Explain, state number of acres and location or other data (i.e.: Lot, Block and Addition).

Show exact depth of bottom.

This form to be prepared by driller, and three copies to be filed by the owner with the County Clerk and Recorder in the county in which the well is located, tissue copy to be retained by driller.

Please answer all questions. If not applicable, so state, otherwise the form will be returned.

150

Driller's License Number

Driller's Signature

45451

2237

State of Montana } ss.  
County of Gallatin  
Filed July 21, 1969  
at 1:48 o'clock P.M.  
Carl L. Stucky  
County Clerk & Recorder  
By Alta M. Hargrave  
Deputy  
Fee \$2.00

File No. \_\_\_\_\_

T 2N R 3E

DUPLICATE

County Callahan

STATE OF MONTANA  
ADMINISTRATOR OF GROUNDWATER CODE  
OFFICE OF STATE ENGINEER

JAN 16 1964

## Declaration of Vested Groundwater Rights

(Under Chapter 237, Montana Session Laws, 1961)

1. Ralph E. Green, of 1511 South Grand Bozeman  
(Name of Appropriator) (Address) (Town)  
County of Callahan State of Montana  
have appropriated groundwater according to the Montana laws in effect prior to January 1, 1962, as follows:

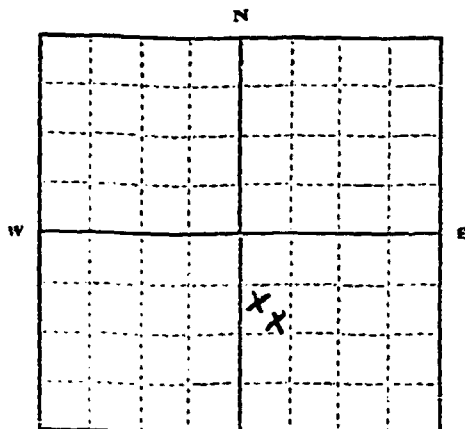

*Two wells in SW 1/4, NW 1/4  
SE 1/4 Sec. 6 T. 2N R. 3E*

Indicate point of appropriation and place of use, if possible. Each small square represents 10 acres.

2. The beneficial use on which the claim is based  
Live stock and domestic
3. Date or approximate date of earliest beneficial use; and how continuous the use has been. North well before 1908  
South well before 1914
4. The amount of groundwater claimed (in miner's inches or gallons per minute)  
4 gallons per minute
5. If used for irrigation, give the acreage and description of the lands to which water has been applied and name of the owner thereof  
Yard and trees
6. The means of withdrawing such water from the ground and the location of each well or other means of withdrawal  
Gas engine power  
Standard 3 1/2 inch cylindrical pump
7. The date of commencement and completion of the construction of the well, wells, or other works for withdrawal of groundwater.  
North well before 1908  
South well before 1914
8. The depth of water table. 10 feet in both wells
9. So far as it may be available, the type, size and depth of each well or the general specifications of any other works for the withdrawal of groundwater. South well dug and walled with rock 8 feet I 20 f  
North well dug and walled with rock and with steel cylinder, 4 feet I 20 ft.
10. The estimated amount of groundwater withdrawn each year. Not known
11. The log of formations encountered in the drilling of each well if available. Gravel, soil, and shale
12. Such other information of a similar nature as may be useful in carrying out the policy of this act, including reference to book and page of any county record.

Signature of Owner \_\_\_\_\_

Date \_\_\_\_\_

Three copies to be filed by the owner with the County Clerk and Recorder of the county in which the well is located.

Please answer all questions. If not applicable, so state, otherwise the form will be returned.

Original to the County Clerk and Recorder; Duplicate to the State Engineer; Triplicate to the Montana Bureau of Mines and Geology, and Quadruplicate for the Appropriator.

33416

1277

State of Montana ss.  
County of Gallatin

Filed 12-30, 1963

at 11-23 o'clock 9 A.M.

Carl Wilson  
COUNTY CLERK & RECORDER

By [Signature]  
DEPUTY

Fee \$ 2.00



File No. \_\_\_\_\_

DUPLICATE

T. 2N R. 3E

County Gallatin

STATE OF MONTANA  
ADMINISTRATOR OF GROUNDWATER CODE  
OFFICE OF STATE ENGINEER

JAN 16 1964

## Declaration of Vested Groundwater Rights

(Under Chapter 237, Montana Session Laws, 1961)

1. Ralph E. Green, of 1311 South Grand Bozeman  
(Name of Appropriator) (Address) (Town)  
County of Gallatin State of Montana  
have appropriated groundwater according to the Montana laws in effect prior to January 1, 1962, as follows:

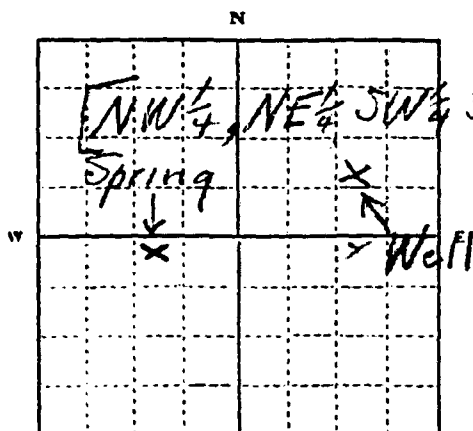

Well in NW 1/4, SE 1/4, NE 1/4  
Sec. 9 T. 2 R. 3E

Indicate point of appropriation  
and place of use, if possible. Each  
small square represents 10 acres.

2. The beneficial use on which the claim is based Livestock and domestic
3. Date or approximate date of earliest beneficial use; and how continuous the use has been Spring before 1900  
with continuous use  
Well completed March 20 1963
4. The amount of groundwater claimed (in miner's inches or gallons per minute) Spring - 6 gallons per minute  
Well - 4 gallons per minute
5. If used for irrigation, give the acreage and description of the lands to which water has been applied and name of the owner thereof  
None
6. The means of withdrawing such water from the ground and the location of each well or other means of withdrawal  
Spring runs by gravity into tank  
Well is pumped with gas engine driving regular 3 1/2 inch cylindrical pump
7. The date of commencement and completion of the construction of the well, wells, or other works for withdrawal of groundwater  
Spring was improved with pipes and central storage tank in 1941  
Well was completed March 20, 1963
8. The depth of water table  
Spring comes to surface from hill  
Static water in well is 25 feet
9. So far as it may be available, the type, size and depth of each well or the general specifications of any other works for the withdrawal of groundwater  
Spring water is collected by porous or perforated pipes leading to a central tank. From here water goes to stock watering tank  
Well is cased with five inch light weight perforated casing and is 33 feet deep
10. The estimated amount of groundwater withdrawn each year Spring runs continuously at 6 gallons per minute  
Well furnishes four gallons per minute
11. The log of formations encountered in the drilling of each well if available  
Spring comes out of hill of boulders, gravel, clay and shale  
Well is drilled through alluvial gravel and into clay.
12. Such other information of a similar nature as may be useful in carrying out the policy of this act, including reference to book and page of any county record

Signature of Owner \_\_\_\_\_

Date \_\_\_\_\_

Three copies to be filed by the owner with the County Clerk and Recorder of the county in which the well is located.

Please answer all questions. If not applicable, so state, otherwise the form will be returned.

Original to the County Clerk and Recorder; Duplicate to the State Engineer; Triplicate to the Montana Bureau of Mines and Geology, and Quadruplicate for the Appropriator.

33414

1275

State of Montana ) ss.  
County of Gallatin )  
Filed 12-30, 1968  
at 11,21 O'clock 9, AM.  
Earl Walton  
COUNTY CLERK & RECORDER  
By [Signature] DEPUTY  
Fee \$ 7.00

File No. \_\_\_\_\_

T. 2N R. 3E

DUPLICATE

County Gallatin

STATE OF MONTANA  
ADMINISTRATOR OF GROUNDWATER CODE  
OFFICE OF STATE ENGINEER

RECEIVED  
JUL 30 1963

## Declaration of Vested Groundwater Rights

(Under Chapter 237, Montana Session Laws, 1961)

STATE ENGINEER

1. Northern Pacific Railway Company of N.P. Building, St. Paul  
(Name of Appropriator) (Address) (Town)  
County of Ramsey State of Minnesota  
have appropriated groundwater according to the Montana laws in effect prior to January 1, 1962, as follows:

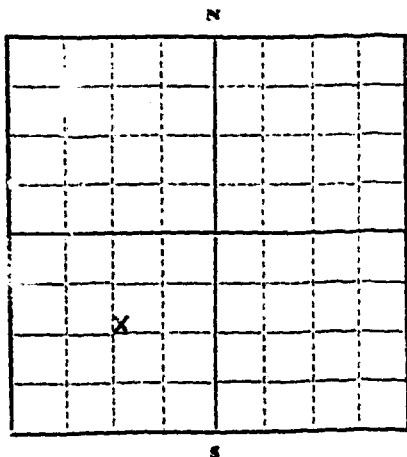
SW 1/4 Sec. 23 T2N R. 3E

Indicate point of appropriation  
and place of use, if possible.  
Each small square represents 10  
acres.

2. The beneficial use on which the claim is based.  
On Stock Water
3. Date or approximate date of earliest beneficial use; and how continuous the use has been. 1954 - continuous
4. The amount of groundwater claimed (in miner's inches or gallons per minute). fifty gallons / minute
5. If used for irrigation, give the acreage and description of the lands to which water has been applied and name of the owner thereof
6. The means of withdrawing such water from the ground and the location of each well or other means of withdrawal.  
Gas Pump
7. The date of commencement and completion of the construction of the well, wells, or other works for withdrawal of groundwater. Summer of 1954
8. The depth of water table. 134'
9. So far as it may be available, the type, size and depth of each well or the general specifications of any other works for the withdrawal of groundwater. none other
10. The estimated amount of groundwater withdrawn each year. 200,000 gallons
11. The log of formations encountered in the drilling of each well if available. not available
12. Such other information of a similar nature as may be useful in carrying out the policy of this act, including reference to book and page of any county record. not recorded

Signature of Owner

Date

July 28, 1963

Three copies to be filed by the owner with the County Clerk and Recorder of the county in which the well is located.

Please answer all questions. If not applicable, so state, otherwise the form will be returned.

Original to the County Clerk and Recorder; duplicate to the State Engineer; Triplicate to the Montana Bureau of Mines and Geology, and Quadruplicate for the Appropriator.

Aug 22 1893

674

State of Montana } ss.  
County of Gallatin }  
Filed July 29 1963  
at 11:25 o'clock P. M.  
Carl Wallen  
By A. J. Stone COUNTY CLERK & RECORDER  
Fee \$ 2.75 pd DEPUTY

GV

Approved Stock Form—State Publishing Co., Helena, Montana—19089

File No. \_\_\_\_\_

T. 2 N R 3 E  
County Gallatin

DUPLICATE

STATE OF MONTANA  
ADMINISTRATOR OF GROUNDWATER CODE  
OFFICE OF STATE ENGINEERRECEIVED  
NOV 14 1963

## Declaration of Vested Groundwater Rights

(Under Chapter 237, Montana Session Laws, 1961)

STATE ENGINEER

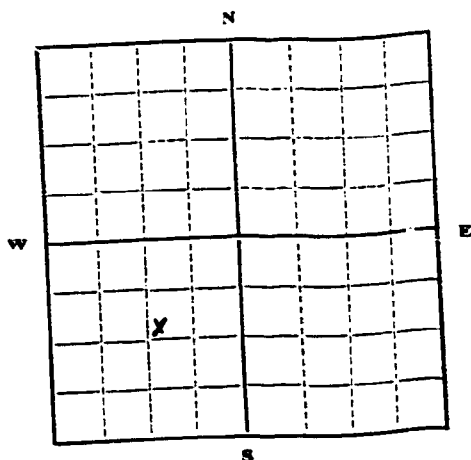
1. Northern Pacific Ry. Co., of St. Paul (Town)  
(Name of Appropriator) (Address)  
County of Ramsey State of Minnesota  
have appropriated groundwater according to the Montana laws in effect prior to January 1, 1962, as follows:

NE 1/4 Sec. 23 T. 2 N. R. 3 E

Indicate point of appropriation  
and place of use, if possible.  
Each small square represents 10  
acres.

2. The beneficial use on which the claim is based Stockwater
3. Date or approximate date of earliest beneficial use; and how continuous the use has been 1954 — Continuous  
(All year)
4. The amount of groundwater claimed (in miner's inches or gallons per minute) 10 gallons per minute
5. If used for irrigation, give the acreage and description of the lands to which water has been applied and name of the owner thereof
6. The means of withdrawing such water from the ground and the location of each well or other means of withdrawal Pump
7. The date of commencement and completion of the construction of the well, wells, or other works for withdrawal of groundwater 1954
8. The depth of water table 130 feet
9. So far as it may be available, the type, size and depth of each well or the general specifications of any other works for the withdrawal of groundwater 6 inch diameter, 134 feet deep
10. The estimated amount of groundwater withdrawn each year 182,500 gals.
11. The log of formations encountered in the drilling of each well if available
12. Such other information of a similar nature as may be useful in carrying out the policy of this act, including reference to book and page of any county record

Signature of Owner

N. P. Railway Co.  
By: Robert B. Wright  
Date 11/13/63

Three copies to be filed by the owner with the County Clerk and Recorder of the county in which the well is located.

Please answer all questions. If not applicable, so state, otherwise the form will be returned.

Original to the County Clerk and Recorder; duplicate to the State Engineer; Triplicate to the Montana Bureau of Mines and Geology, and Quadruplicate for the Appropriator.

File No. \_\_\_\_\_

DUPLICATE

LIVINGSTON WELL  
T. 2N R 3E  
County Gallatin

STATE OF MONTANA  
ADMINISTRATOR OF GROUNDWATER CODE  
OFFICE OF STATE ENGINEER

JAN 16 1964

# Declaration of Vested Groundwater Rights

(Under Chapter 237, Montana Session Laws, 1961)

1. Jesse R. Green, of 1016 South Fifth, Bozeman, Montana  
(Name of Appropriator) (Address) (Town)  
County of Gallatin State of Montana  
have appropriated groundwater according to the Montana laws in effect prior to January 1, 1962, as follows:

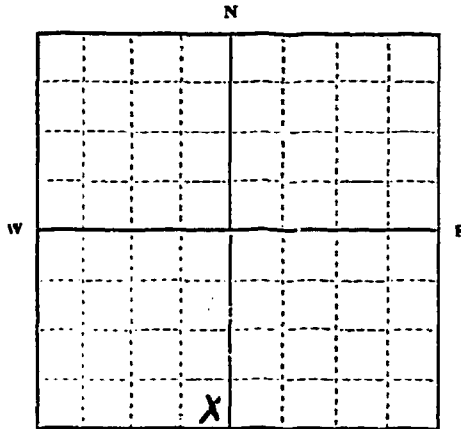

Well in SE  $\frac{1}{4}$ , NE  $\frac{1}{4}$ ,  
SW  $\frac{1}{4}$  Sec. 27 T. 2N R. 3E

Indicate point of appropriation  
and place of use, if possible. Each  
small square represents 10 acres.

2. The beneficial use on which the claim is based  
Live stock and domestic
3. Date or approximate date of earliest beneficial use; and how continuous the use has been 1911
4. The amount of groundwater claimed (in miner's inches or gallons per minute) 4 gallons per minute
5. If used for irrigation, give the acreage and description of the lands to which water has been applied and name of the owner thereof  
Lawn and garden adjacent
6. The means of withdrawing such water from the ground and the location of each well or other means of withdrawal  
Regular 3 1/2 inch cylindrical pump with electric power
7. The date of commencement and completion of the construction of the well, wells, or other works for withdrawal of groundwater 1911
8. The depth of water table 6 to 8 feet
9. So far as it may be available, the type, size and depth of each well or the general specifications of any other works for the withdrawal of groundwater  
Drilled with 6 inch casing. Depth 20 feet
10. The estimated amount of groundwater withdrawn each year Not known
11. The log of formations encountered in the drilling of each well if available  
River gravel
12. Such other information of a similar nature as may be useful in carrying out the policy of this act, including reference to book and page of any county record

Signature of Owner \_\_\_\_\_

Date \_\_\_\_\_

Jesse R. Green  
December 20 1963

Three copies to be filed by the owner with the County Clerk and Recorder of the county in which the well is located.

Please answer all questions. If not applicable, so state, otherwise the form will be returned.

Original to the County Clerk and Recorder; Duplicate to the State Engineer; Triplicate to the Montana Bureau of Mines and Geology, and Quadruplicate for the Appropriator.

33252

762

State of Montana } ss.  
County of Gallatin }  
Filed Nov 11, 1963  
At 4:25 o'clock P. M.  
Carl Walker  
COUNTY CLERK & RECORDER  
By [Signature]  
DEPUTY  
Fee \$ 2.50

#1108

State of Montana }  
County of Gallatin } ss.  
Filed December 27, 1963  
at 3:31 o'clock P.M.  
EARL WALTON  
COUNTY CLERK & RECORDER  
By *Idina Fadden*  
Fee \$ 2.00 DEPUTY



File No. \_\_\_\_\_

DUPLICATE

T. 5 N. R. 3 E

County BALLANTIN

STATE OF MONTANA  
ADMINISTRATOR OF GROUNDWATER CODE  
OFFICE OF STATE ENGINEER

RECEIVED  
DEC 27 1963

**Declaration of Vested Groundwater Rights**  
(Under Chapter 237, Montana Session Laws, 1961)

1. RUSSELL J. GLISAN, of R.R. 1, MANHATTAN  
(Name of Appropriator) (Address) (Town)  
FRANCES G. GLISAN  
County of BALLANTIN State of MONTANA  
have appropriated groundwater according to the Montana laws in effect prior to January 1, 1962, as follows:

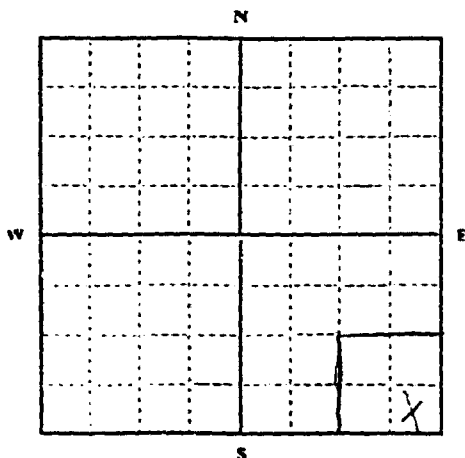

SE 1/4 Sec. 32, T. 2 N. R. 3 E.

Indicate point of appropriation and place of use, if possible. Each small square represents 10 acres.

2. The beneficial use on which the claim is based Domestic yard irrigation, stock water

3. Date or approximate date of earliest beneficial use; and how continuous the use has been no known date but previous to 1911

4. The amount of groundwater claimed (in miner's inches or gallons per minute) 50 Gal per minute

5. If used for irrigation, give the acreage and description of the lands to which water has been applied and name of the owner thereof not used for irrigation

6. The means of withdrawing such water from the ground and the location of each well or other means of withdrawal See Pump

7. The date of commencement and completion of the construction of the well, wells, or other works for withdrawal of groundwater no record

8. The depth of water table about 19 feet

9. So far as it may be available, the type, size and depth of each well or the general specifications of any other works for the withdrawal of groundwater 8" casing 39 feet deep

10. The estimated amount of groundwater withdrawn each year 1,113,250 Gallons

11. The log of formations encountered in the drilling of each well if available no record

12. Such other information of a similar nature as may be useful in carrying out the policy of this act, including reference to book and page of any county record no record

Signature of Owner R. J. Glisan

Date Dec 26, 1963

Three copies to be filed by the owner with the County Clerk and Recorder of the county in which the well is located.

Please answer all questions. If not applicable, so state, otherwise the form will be returned.

Original to the County Clerk and Recorder; Duplicate to the State Engineer; Triplicate to the Montana Bureau of Mines and Geology, and Quadruplicate for the Appropriator.

13337

#1052

State of Montana }  
County of Gallatin } ss.

Filed December 26, 1963

at 3:50 o'clock P M.

EARL WALTON

COUNTY CLERK & RECORDER

By

Leah A. Maple

DEPUTY

Fee \$ 2.00 pd

File No. \_\_\_\_\_

T. 2 N R. 3 E

DUPLICATE

County Gallatin

STATE OF MONTANA  
ADMINISTRATOR OF GROUNDWATER CODE  
OFFICE OF STATE ENGINEER

# Declaration of Vested Groundwater Rights

(Under Chapter 237, Montana Session Laws, 1961)

1. WYTANA LIVESTOCK COMPANY, of 1670 Denver Club Bldg., Denver  
(Name of Appropriator) (Address) (Town)  
County of Denver State of Colorado  
have appropriated groundwater according to the Montana laws in effect prior to January 1, 1962, as follows:

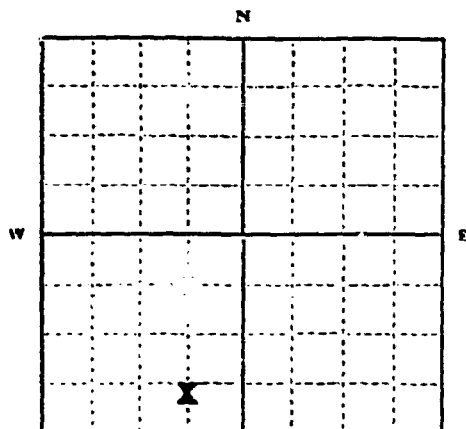

SE 1/4, Southwest side of  
barn

1/4 Sec. 32 T. 2N R. 3E

Indicate point of appropriation  
and place of use, if possible. Each  
small square represents 10 acres.

2. The beneficial use on which the claim is based  
Domestic and livestock water
3. Date or approximate date of earliest beneficial use; and how continuous the use has been Actual earliest date unknown but used continuously for above purpose since 1955
4. The amount of groundwater claimed (in miner's inches or gallons per minute) 15 gallons per minute
5. If used for irrigation, give the acreage and description of the lands to which water has been applied and name of the owner thereof  
Not used for irrigation
6. The means of withdrawing such water from the ground and the location of each well or other means of withdrawal  
Pump (see map for location)
7. The date of commencement and completion of the construction of the well, wells, or other works for withdrawal of groundwater Prior to 1955
8. The depth of water table Not known. Approximately \_\_\_\_\_ feet.
9. So far as it may be available, the type, size and depth of each well or the general specifications of any other works for the withdrawal of groundwater 6" casing, approximately 165' deep
10. The estimated amount of groundwater withdrawn each year 200,000 gallons
11. The log of formations encountered in the drilling of each well if available Not available
12. Such other information of a similar nature as may be useful in carrying out the policy of this act, including reference to book and page of any county record Not known

WYTANA LIVESTOCK COMPANY

Signature of Owner/Partner: James E. TaylorDate December 26, 1963

Three copies to be filed by the owner with the County Clerk and Recorder of the county in which the well is located.

Please answer all questions. If not applicable, so state, otherwise the form will be returned.

Original to the County Clerk and Recorder; Duplicate to the State Engineer; Triplicate to the Montana Bureau of Mines and Geology, and Quadruplicate for the Appropriator.

#1157

State of Montana } ss.  
County of Gallatin }  
December 30  
Filed 8:19 1963  
at o'clock A.  
KARL WALTON  
COUNTY CLERK & RECORDER  
By *Phelma Fiddes*  
2.00 DEPUTY  
Fee \$

File No. \_\_\_\_\_

T. 2 N R. 3 E

DUPLICATE

County Gallatin

STATE OF MONTANA  
ADMINISTRATOR OF GROUNDWATER CODE  
OFFICE OF STATE ENGINEER

## Declaration of Vested Groundwater Rights

(Under Chapter 237, Montana Session Laws, 1961)

JAN 16 1964  
STATE ENGINEER

1. WYTANA LIVESTOCK COMPANY, of 1670 Denver Club Bldg., Denver  
(Name of Appropriator) (Address) (Town)  
County of Denver State of Colorado  
have appropriated groundwater according to the Montana laws in effect prior to January 1, 1962, as follows:

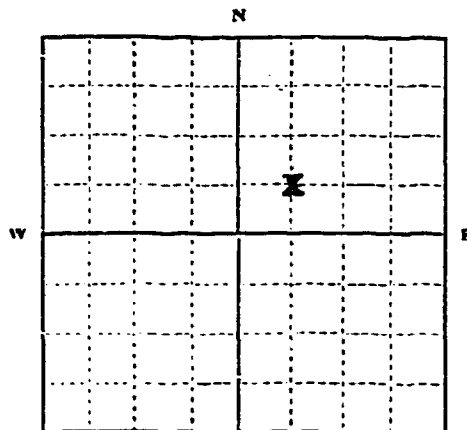

SW 1/4, Northwest side of house Not used for irrigation

1/4 Sec. 32 T. 2N R. 3E

Indicate point of appropriation and place of use, if possible. Each small square represents 10 acres.

2. The beneficial use on which the claim is based Domestic and livestock water
3. Date or approximate date of earliest beneficial use; and how continuous the use has been Actual earliest date unknown but used continuously for above purpose since 1955
4. The amount of groundwater claimed (in miner's inches or gallons per minute) 15 gallons per minute
5. If used for irrigation, give the acreage and description of the lands to which water has been applied and name of the owner thereof Not used for irrigation
6. The means of withdrawing such water from the ground and the location of each well or other means of withdrawal Pump (see map for location)
7. The date of commencement and completion of the construction of the well, wells, or other works for withdrawal of groundwater Prior to 1955
8. The depth of water table Not known. Approximately \_\_\_\_\_ feet
9. So far as it may be available, the type, size, and depth of each well or the general specifications of any other works for the withdrawal of groundwater 4" casing, approximately 70 feet deep
10. The estimated amount of groundwater withdrawn each year 200,000 gallons
11. The log of formations encountered in the drilling of each well if available Not available
12. Such other information of a similar nature as may be useful in carrying out the policy of this act, including reference to book and page of any county record Not known

**WYTANA LIVESTOCK COMPANY**

Signature of ~~owner~~ Partner: Mrs. C. Taylor

Date December 26, 1963

Three copies to be filed by the owner with the County Clerk and Recorder of the county in which the well is located.

Please answer all questions. If not applicable, so state, otherwise the form will be returned.

Original to the County Clerk and Recorder; Duplicate to the State Engineer; Triplicate to the Montana Bureau of Mines and Geology, and Quadruplicate for the Appropriator.

33298

#1158

State of Montana )  
County of Gallatin ) ss.  
Filed **December 30**, 1963  
at **8:20** o'clock **M.**  
**EARL WALTON**  
By *Theresa P. Bates*  
Fee \$ **2.00** DEPUTY

File No. \_\_\_\_\_

T 27 R 3E  
County Gallatin

DUPLICATE

STATE OF MONTANA  
ADMINISTRATOR OF GROUNDWATER CODE  
OFFICE OF STATE ENGINEER

## Declaration of Vested Groundwater Rights

(Under Chapter 237, Montana Session Laws, 1961)

I, Ralph W. Clark, of Box 164 Monkattan  
(Name of Appropriator) (Address) (Town)  
County of Gallatin State of Montana  
have appropriated groundwater according to the Montana laws in effect prior to January 1, 1962, as follows:

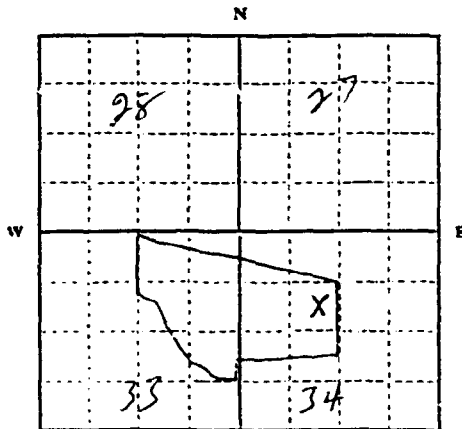

Sec. 27, 28, 33, 34  
1/4 Sec. 34 T. 27 N. R. 3 E.

Indicate point of appropriation and place of use, if possible. Each small square represents 10 acres.

2. The beneficial use on which the claim is based Human + Stock Water
3. Date or approximate date of earliest beneficial use; and how continuous the use has been 1924 Continuous
4. The amount of groundwater claimed (in miner's inches or gallons per minute) 25 gallons / minute
5. If used for irrigation, give the acreage and description of the lands to which water has been applied and name of the owner thereof 1/2 acre about farm buildings
6. The means of withdrawing such water from the ground and the location of each well or other means of withdrawal Person  
1 in. Electric pump
7. The date of commencement and completion of the construction of the well, wells, or other works for withdrawal of groundwater 1927, Well started in 1941 to run  
location + Electric system installed
8. The depth of water table 4 1/2 - 5 ft.
9. So far as it may be available, the type, size and depth of each well or the general specifications of any other works for the withdrawal of groundwater.  
Drum Well 4" casing
10. The estimated amount of groundwater withdrawn each year 125,000 gal.
11. The log of formations encountered in the drilling of each well if available not available
12. Such other information of a similar nature as may be useful in carrying out the policy of this act, including reference to book and page of any county record none

Signature of Owner

Date Oct 12, 1945

Three copies to be filed by the owner with the County Clerk and Recorder of the county in which the well is located.

Please answer all questions. If not applicable, so state, otherwise the form will be returned.

Original to the County Clerk and Recorder; Duplicate to the State Engineer; Triplicate to the Montana Bureau of Mines and Geology, and Quadruplicate for the Appropriator.

34723





File No. \_\_\_\_\_

DUPLICATE

MONTANA WATER RESOURCES BOARD  
**RECEIVED**

T. 20 R. 3E

County GALLATIN

LOG

STATE OF MONTANA

ADMINISTRATOR OF GROUNDWATER CODE  
OFFICE OF STATE ENGINEER

Top of Ground

(Elev. above sea level \_\_\_\_\_)

**Notice of Completion of Groundwater  
Appropriation by Means of Well**

DEVELOPED AFTER JANUARY 1, 1962

(Under Chapter 237, Montana Session Laws, 1961)

0'-1' Soils.

1'-15' Sand and gravels. dry.

15'-28' Sandy clays. dry.

28'-33' Sand and gravels.  
dry.

33'-44' Gritty clays. dry.

44'-76' Gravels. Little  
water.76'-83' Claybound gravels.  
Wet

83'-88' Claystone. dry

88'-90' Coarse sands,  
Heaves. Water.90'-98' Claystone and loose  
sand lenses, water.98'-100' Clean sand and  
gravels. Water.100'-115' Claystone and coarse  
sands. Water.Owner 4 SQUARE CATTLE CO. Address BOZEMAN, MONT.Driller VAN DYKEN DRILLING CO. Address BOZEMAN MONT.Date of Notice of appropriation of groundwater noneDate well started Aug 12/68 Date completed Aug 15/68Type of well DRILLED Equipment used ROTARY / CABLE TOOL  
(Dug, Driven, bored or drilled) (Churn drill, rotary or other)Water use: Domestic ☐ Municipal ☐ Stock ☒ Irrigation ☐  
Industrial ☐ Drainage ☐ Other ☐

Indicate on the diagram the character and thickness of the different strata met with in drilling, such as soil, clay, shale, gravel, rock or sand, etc. Show depth at which water is encountered, thickness and character of water-bearing strata and height to which the water rises in the well.

Size of Drilled Hole	Size and Weight of Casing	From (Feet)	To (Feet)	PERFORATIONS		
				Kind Size	From (Feet)	To (Feet)
7 7/8"	6 5/8" O.D. 17# per ft.	0'	115'	1 1/8" X 1/4" Slots.	65'	115'

T.D. 115'

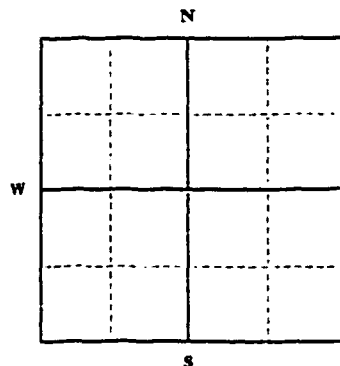

1/4  
T. 20 R. 3E Sec. 34  
Indicate location of well and place of use, if possible. Each small square represents 40 acres.

Static Water Level for non-flowing well 31' feet.Shut-in Pressure for Flowing Well nonePumping Water Level 50' feet  
at 35 gal. per minute.Discharge in gal. per min. of flowing well noneHow Tested Air Lift.Length of Test 3 Hrs.Remarks: (Gravel packing, cementing, packers, type of shutoff) Packer on casing set at 50'. Bentonite seal from 50' to surface.

(Continue on reverse side)

USE—If used for irrigation, industrial, drainage or other. Explain, state number of acres and location or other data (i.e.: Lot, Block and Addition).

Show exact depth of bottom.

LICENSE NO. 1

Driller's License Number

Bert Van Dyken  
Driller's Signature  
**BERT VAN DYKEN**

45,054

This form to be prepared by driller, and three copies to be filed by the owner with the County Clerk and Recorder in the county in which the well is located, tissue copy to be retained by driller.

Please answer all questions. If not applicable, so state, otherwise the form will be returned.

2226

State of Montana }  
County of Gallatin } ss.

Filed March 11, 1969  
at 9:00 o'clock A.M.

Carl L. Stucky  
County Clerk & Recorder

By Betty Rose Griggs  
Deputy

Fee \$ 2.00 pd.

File No. \_\_\_\_\_

T 2N R 3E

DUPLICATE

County \_\_\_\_\_

STATE OF MONTANA  
ADMINISTRATOR OF GROUNDWATER CODE  
OFFICE OF STATE ENGINEER

Notice of Completion of Groundwater  
Appropriation by Means of Well

(Under Chapter 237, Montana Session Laws, 1961)

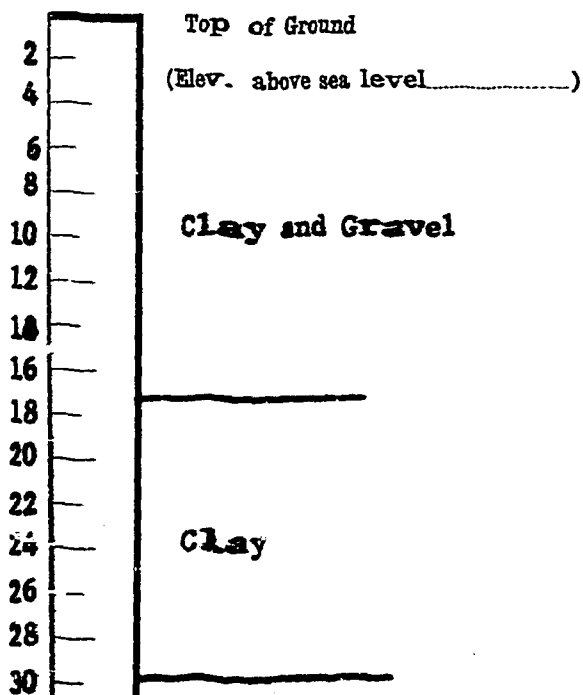
Owner Four Square Livestock Address ManhattanDriller M. Jones Address 633 E. LanneDate of Notice of Appropriation of Groundwater December 30, 1963Date well started October 18, '63 Date Completed Oct. 19, 1963Type of well Drilled Equipment Used Churn Drill  
(dug, driven, bored or drilled) (Churn, drill, rotary or other)Water Use: Domestic ☒ Municipal ☐ Other ☐ Irrigation ☒  
Industrial ☐ Drainage ☐ Stock ☒

Indicate on the diagram the character and thickness of the different strata met with in drilling, such as soil, clay, shale, gravel, rock or sand, etc. Show depth at which water is encountered, thickness and character of water-bearing strata and height to which water rises in the well.

Size of Drilled Hole	Size and Weight of Casing	From (Feet)	To (Feet)	PERFORATIONS		
				Kind Size	From (Feet)	To (Feet)
6 5/8" x 15'	6 5/8" x 15'	1' above	30'			

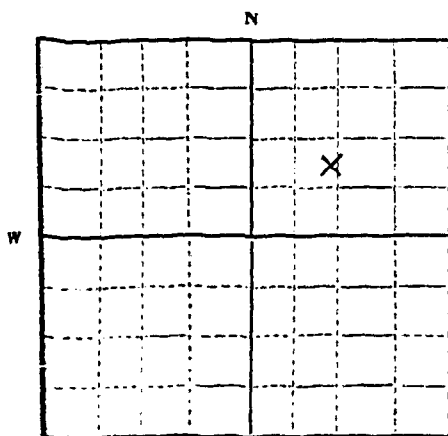

E1SE Sec 34 T2N R3E  
Indicate location of well and place of use, if possible. Each small square represents 10 acres.

Show exact depth of bottom.

Static Water Level for non-flowing Well 6 feet.

Shut-in Pressure for Flowing Well \_\_\_\_\_

Pumping Water Level 30 feet at 24 gal. per minute.

Discharge in gal. per min. of flowing well \_\_\_\_\_

How Tested Pump Length of Test 1 hour

Remarks: (Gravel packing, cementing, packers, type of shutoff, location of place of use of groundwater if not at well, and any other similar pertinent information, including number of acres irrigated, if used for irrigation)

17  
Driller's License Number

Milton E. Jones  
Driller's Signature

This form to be prepared by driller, and three copies to be filed by the owner with the County Clerk and Recorder in the county in which the well is located.

Please answer all questions. If not applicable, so state, otherwise the form will be returned.

Original to the County Clerk and Recorder; duplicate to the State Engineer; Triplicate to the Montana Bureau of Mines and Geology and Quadruplicate for the Appropriator.

35832

1518

Dec 31  
11:00 a  
L. A. Mapell  
200

File No.

T. 24 R. 33

DUPLICATE

County

STATE OF MONTANA  
ADMINISTRATOR OF GROUNDWATER CODE  
OFFICE OF STATE ENGINEER

JAN 16 1964

# Declaration of Vested Groundwater Rights

(Under Chapter 237, Montana Session Laws, 1961)

1. Four SQUARE LIVESTOCK, of MANHATTAN  
(Name of Appropriator) (Address) (Town)  
County of GALLATIN State of MONTANA  
have appropriated groundwater according to the Montana laws in effect prior to January 1, 1962, as follows:

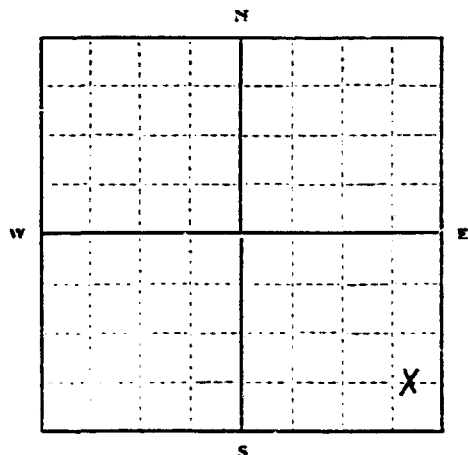

E1/2SE1/4 Sec. 34 T2N R3E

Indicate point of appropriation  
and place of use, if possible. Each  
small square represents 10 acres.

2. The beneficial use on which the claim is based  
Household and Stock
3. Date or approximate date of earliest beneficial use; and how continuous the use has been approximately 1948
4. The amount of groundwater claimed (in miner's inches or gallons per minute) 50 gallons/minute
5. If used for irrigation, give the acreage and description of the lands to which water has been applied and name of the owner thereof
6. The means of withdrawing such water from the ground and the location of each well or other means of withdrawal  
Electric Pump
7. The date of commencement and completion of the construction of the well, wells, or other works for withdrawal of groundwater  
approximately 1948
8. The depth of water table 30' of water in well
9. So far as it may be available, the type, size and depth of each well or the general specifications of any other works for the withdrawal of groundwater  
6" - Casing  
65' deep  
55' of casing
10. The estimated amount of groundwater withdrawn each year.
11. The log of formations encountered in the drilling of each well if available unknown
12. Such other information of a similar nature as may be useful in carrying out the policy of this act, including reference to book and page of any county record.

Signature of Owner

Date

Three copies to be filed by the owner with the County Clerk and Recorder of the county in which the well is located.

Please answer all questions. If not applicable, so state, otherwise the form will be returned.

Original to the County Clerk and Recorder; Duplicate to the State Engineer; Triplicate to the Montana Bureau of Mines and Geology; and Quadruplicate for the Appropriator.

35833

1519

State of Maryland  
County of Cecil  
Filed Dec 31  
11:01  
Paul Walter  
A. A. Maxwell  
Lee

File No. \_\_\_\_\_

DUPLICATE

T. 2N R. 3E  
County GallatinSTATE OF MONTANA  
ADMINISTRATOR OF GROUNDWATER CODE  
OFFICE OF STATE ENGINEERJAN 16 1964  
STATE ENGINEERNotice of Completion of Groundwater Appropriation  
Without Well

(Under Chapter 237 Montana Session Laws, 1961)

Date of Appropriation of Groundwater 1907Owner H.E. KREIS Address Box 171  
Manhattan Mont

Contractor (if any) \_\_\_\_\_

Address of Contractor \_\_\_\_\_

Date Started \_\_\_\_\_ Date Completed \_\_\_\_\_

Describe means of obtaining groundwater without a well "as by sub-irrigation and other natural processes". Include depth to water when applicable.

Electric pumps to Sprinkler system.

Quantity of water developed and used with explanation of method used to measure or estimate such amount. If use is intermittent

estimate approximate lengths of periods of use 5 Months.500 inches.Signature of Owner H.E. KreisDate 12-31-63.

This form to be prepared by contractor (if any), otherwise by the owner.

Three copies of this notice are to be filed with the County Clerk and Recorder of the county in which the works are located.

Please answer all questions. If not applicable, so state, otherwise the form will be returned.

Original to the County Clerk and Recorder; duplicate to the State Engineer; Triplicate to the Montana Bureau of Mines and Geology and Quadruplicate for the Appropriator.

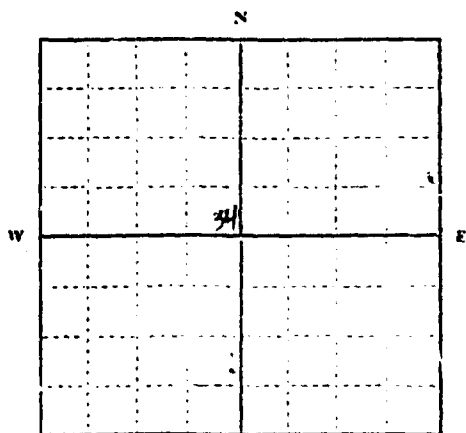
SE  $\frac{1}{4}$  NE Sec. 34 T. 2N R. 3E  
Indicate point of appropriation  
and place of use, if possible.

1510

County of Galatia  
Dec 31  
at 10.52 o'clock A.M.  
Earl Walton  
By [Signature]  
Fee \$ 7.00



File No. \_\_\_\_\_

T. 2N R. 3E  
County Gallatin

DUPLICATE

STATE OF MONTANA  
ADMINISTRATOR OF GROUNDWATER CODE  
OFFICE OF STATE ENGINEER

JAN 16 1964

Notice of Completion of Groundwater Appropriation  
Without Well

(Under Chapter 237 Montana Session Laws, 1961)

Date of Appropriation of Groundwater April 1959  
Owner Joseph & Shirley Kauter Address Manhattan, Mont.Contractor (if any) NONEAddress of Contractor NONEDate Started Apr 1 - 1959 Date Completed Apr 2 - 1959

Describe means of obtaining groundwater without a well "as by sub-irrigation and other natural processes". Include depth to water when applicable.

Centrifugal Pump  
5 Ft to water  
Hole 20 Ft x 30 Ft x 8 Ft deep

Quantity of water developed and used with explanation of method used to measure or estimate such amount. If use is intermittent

estimate approximate lengths of periods of use.

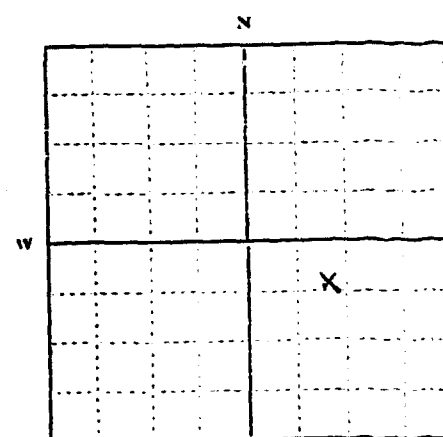
Sprinkler Irrigation 200 G.P.M.  
Use From April to Sept.Signature of Owner Joseph & Shirley KauterDate Dec 30, 1963

Indicate point of appropriation  
and place of use, if possible.

71 1/2 SE Sec. 35 T. 2N R. 3E

This form to be prepared by contractor (if any), otherwise by the owner.

Three copies of this notice are to be filed with the County Clerk and Recorder of the county in which the works are located.

Please answer all questions. If not applicable, so state, otherwise the form will be returned.

Original to the County Clerk and Recorder; duplicate to the State Engineer; Triplicate to the Montana Bureau of Mines and Geology and Quadruplicate for the Appropriator.

35904

1590

State of Montana } ss.  
County of Gallatin }

Filed Dec 31, 1963

W. L. 13 of check M.

State of Montana  
COUNTY CLERK'S RECEIPT

BY [Signature] DEPUTY

Page 37

File No. \_\_\_\_\_

T. 24 R. 3 E

DUPLICATE

County Gallatin

STATE OF MONTANA  
ADMINISTRATOR OF GROUNDWATER CODE  
OFFICE OF STATE ENGINEER

APR 15 1964

## Declaration of Vested Groundwater Rights

(Under Chapter 237, Montana Session Laws, 1961)

1. Joseph & Shirley Koerber of P.O. Box 63 Manhattan  
(Name of Appropriator) (Address) (Town)

County of Gallatin State of Montana  
have appropriated groundwater according to the Montana laws in effect prior to January 1, 1962, as follows:

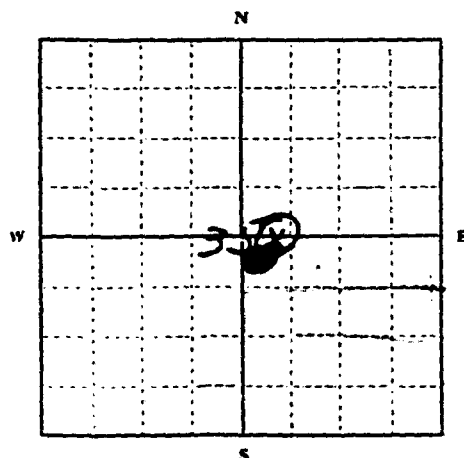

NW 1/4 Sec. 3 T. 24 R. 3 E

Indicate point of appropriation and place of use, if possible. Each small square represents 10 acres.

2. The beneficial use on which the claim is based DOMESTIC  
IRRIGATION - Stock water
3. Date or approximate date of earliest beneficial use; and how continuous the use has been  
CONTINUOUS SINCE APR. 15 1939
4. The amount of groundwater claimed (in miner's inches or gallons per minute) 2.4 GAL PER MIN
5. If used for irrigation, give the acreage and description of the lands to which water has been applied and name of the owner thereof  
1/4 A. ~~STRAWBERRY PATCH & LAWN~~ Gardens,  
Joseph & Shirley Koerber
6. The means of withdrawing such water from the ground and the location of each well or other means of withdrawal  
CENTRIFUGAL PUMP
7. The date of commencement and completion of the construction of the well, wells, or other works for withdrawal of groundwater  
3-1-1 started 3-1-2 finished - 1939
8. The depth of water table average 3.5 Feet
9. So far as it may be available, the type, size and depth of each well or the general specifications of any other works for the withdrawal of groundwater  
2" dia 4" deep  
33 ft deep
10. The estimated amount of groundwater withdrawn each year 2.4 gal per min
11. The log of formations encountered in the drilling of each well if available  
2.5 ft sand
12. Such other information of a similar nature as may be useful in carrying out the policy of this act, including reference to book and page of any county record  
None

Signature of Owner

Shirley KoerberDate Apr 30 1963

Three copies to be filed by the owner with the County Clerk and Recorder of the county in which the well is located.

Please answer all questions. If not applicable, so state, otherwise the form will be returned.

Original to the County Clerk and Recorder; Duplicate to the State Engineer; Triplicate to the Montana Bureau of Mines and Geology, and Quadruplicate for the Appropriator.

35903

1589

State of Montana ss.  
County of Gallatin  
Filed Dec 31, 1963  
at 12:12 o'clock P.M.  
James B. Smith  
COUNTY CLERK & RECORDER  
By [Signature] DEPUTY  
Fee \$ 700

35

T. 2 N R. 3 E  
County Callahan

MONTANA BUREAU OF MINES AND GEOLOGY  
Butte, Montana

RECEIVED

WATER WELL LOG

Owner Allen S. Sells Address Manhattan, Mont  
Driller M. E. Jones Address Bozeman  
Date Started March 4, 1940 Date Completed Mar 8, 1940  
Location: Sec. 35 T. 2 N R. 3 E  $\frac{1}{4}$  sec. S. 17. 1

Type of well Drilled Equipment used Churn Drill  
(Dug, driven, bored, or drilled) (Churn drill, rotary, other)

Water use: Domestic ☒ Municipal ☐ Stock ☒ Irrigation ☒  
Industrial ☐ Drainage ☐ Other: \_\_\_\_\_

Casing: Surface ft. to 69 ft. Type Black Pipe Size 6 5/8" OD x 18 1/2"

Casing: \_\_\_\_\_ ft. to \_\_\_\_\_ ft. Type \_\_\_\_\_ Size \_\_\_\_\_

Casing: \_\_\_\_\_ ft. to \_\_\_\_\_ ft. Type \_\_\_\_\_ Size \_\_\_\_\_

Perforated or Screened: Ft. None to ft. \_\_\_\_\_ Ft. \_\_\_\_\_ to ft. \_\_\_\_\_

Type of screen or perforations None

Static Water level, for non-flowing well: 192 feet.

Shut-in pressure, for flowing well: \_\_\_\_\_ lb./sq. in. on: \_\_\_\_\_ (date)

Pumping water level 69 feet at 15 gal. per min.

How tested: Ball-and-plate

Length of test: 1 Hour

Remarks: (Gravel packing, cementing, packers, type of shut-off, depth of shut-off)

(over)

## Log of Well

[illegible]

## GROUNDWATER INDEX

Page 1 of 4

County Gallatin Twp. 2 N Rge. 4 E

Sec.	Name of Appropriator	Type of Form	County File No.	Remarks
6	Lunt Joe - K	DN 4	1128	-
6	Lunt Jack K.	DN 3	1129	-
6	Schmidt James	DN 2	1902	-
7	Lunt Jack K.	DN 3	1120	-
12	Dyk Peter S. and Dyk Catherine D.	DN 4	907	-
13	Dyk Peter S. and Dyk Catherine D.	DN 4	903	-
15	Brownell Robert E. & Brownell Wallace Neil	DN 4	1453	-
20	Heeper R. W.	DN 4	669	-
22	Brownell Wesley R. & Brownell Nora M.	DN 4	1447	-
23	Morgan Horace and Morgan Richard	DN 4	1719	-
23	Morgan Horace & Morgan Richard	DN 3	1718	-
24	Dyk Peter S. and Dyk Catherine D.	DN 4	905	-
24	Heeper R. W.	DN 4	670	-
25	Heiser John C.	DN 4	985	-
26	Brownell Wesley R. & Brownell Nora M.	DN 4	1448	-
26	Nisbet Jane and Nisbet Hazel	DN 2	936	-
26	Snyder Thos. & Lela	DN 4	1380	-
27	Brownell Nora M.	DN 2	2329	-
28	Heeper R. W.	DN 4	668	-
29	McClosie Orie B.	57 Mill Log	—	-
32	Gunneth Pearl E.	57 Mill Log	406	-
33	Orie Jesse R.	DN 4	1107	-
34	Holdman Elvira L.	DN 4	496	-
34	McClosie Orie B.	57 Mill Log	—	-
35	Brownell Nora M.	DN 2	3050	-
35	Creser James Earl	DN 4	1421	-
35	Irvine Norman J. & Irvine Blanche M.	DN 4	1489	-

File No. \_\_\_\_\_

T2N. R4E.

DUPLICATE

County Gallatin

STATE OF MONTANA  
ADMINISTRATOR OF GROUNDWATER CODE  
OFFICE OF STATE ENGINEER

**Declaration of Vested Groundwater Rights**

(Under Chapter 237, Montana Session Laws, 1961)

RECEIVED  
DEC 30 1963

STATE ENGINEER

1. Jack K. Lunt of Belgrade  
(Name of Appropriator) (Address) (Town)  
County of Gallatin State of Montana  
have appropriated groundwater according to the Montana laws in effect prior to January 1, 1962, as follows:

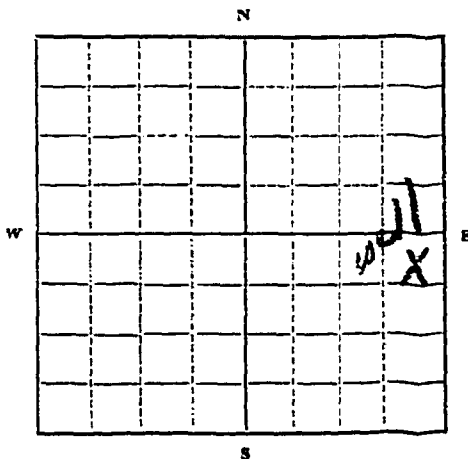

SE 1/4 Sec. T2N R4E

Indicate point of appropriation  
and place of use, if possible.  
Each small square represents 10  
acres.

2. The beneficial use on which the claim is based livestock
3. Date or approximate date of earliest beneficial use; and how continuous the use has been unknown earliest use
4. The amount of groundwater claimed (in miner's inches or gallons per minute) 5 gal. per minute
5. If used for irrigation, give the acreage and description of the lands to which water has been applied and name of the owner thereof
6. The means of withdrawing such water from the ground and the location of each well or other means of withdrawal Pumpjack
7. The date of commencement and completion of the construction of the well, wells, or other works for withdrawal of groundwater unknown
8. The depth of water table 20 ft.
9. So far as it may be available, the type, size and depth of each well or the general specifications of any other works for the withdrawal of groundwater two inch pipe to depth unknown
10. The estimated amount of groundwater withdrawn each year 200,000 gals.
11. The log of formations encountered in the drilling of each well if available not available as far as I can tell
12. Such other information of a similar nature as may be useful in carrying out the policy of this act, including reference to book and page of any county record I just bought the place

Signature of Owner

Date Dec. 27, 1963

Three copies to be filed by the owner with the County Clerk and Recorder of the county in which the well is located.

Please answer all questions. If not applicable, so state, otherwise the form will be returned.

Original to the County Clerk and Recorder; duplicate to the State Engineer; Triplicate to the Montana Bureau of Mines and Geology, and Quadruplicate for the Appropriator.

14668



1128

State of Montana }  
County of Gallatin } 57  
Filed Dec 27, 1963  
at 3.55 o'clock P. M.  
Carl Wallen  
COUNTY CLERK & RECORDER  
By [Signature]  
DEPUTY  
Fee \$ 254.21

File No. \_\_\_\_\_

T. 2N. R. 4E

DUPLICATE

County Gallatin

STATE OF MONTANA  
ADMINISTRATOR OF GROUNDWATER CODE  
OFFICE OF STATE ENGINEER

RECEIVED  
DEC 30 1963

## Notice of Completion of Groundwater Appropriation Without Well

(Under Chapter 237 Montana Session Laws, 1961)

Date of Appropriation of Groundwater \_\_\_\_\_

Owner Jack K. Hunt Address Belgrade

Contractor (if any) \_\_\_\_\_

Address of Contractor \_\_\_\_\_

Date Started \_\_\_\_\_ Date Completed \_\_\_\_\_

Describe means of obtaining groundwater without a well "as by sub-irrigation and other natural processes". Include depth to water when applicable. Water runs in a Creek

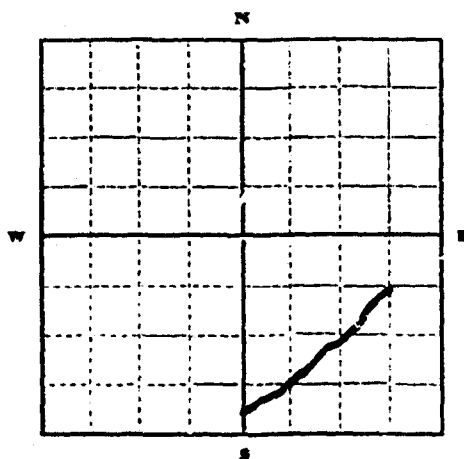

SE 1/4 Sec. 4 T. 2N. R. 4E  
Indicate point of appropriation  
and place of use, if possible.

Quantity of water developed and used with explanation of method used to measure or estimate such amount. If use is intermittent

estimate approximate lengths of periods of use. Amount  
used; guess 5000 dail; Time  
used 8 to 9 months of the year.

Signature of Owner \_\_\_\_\_

Date Dec. 27, 1963

This form to be prepared by contractor (if any), otherwise by the owner.

Three copies of this notice are to be filed with the County Clerk and Recorder of the county in which the works are located.

Please answer all questions. If not applicable, so state, otherwise the form will be returned.

Original to the County Clerk and Recorder; duplicate to the State Engineer; Triplicate to the Montana Bureau of Mines and Geology and Quadruplicate for the Appropriator.

1129

State of Montana } ss.  
County of Gallatin }

Filed Dec 27, 1963

at 356 o'clock M.  
Car. Hallen

COUNTY CLERK & RECORDER

By [Signature] DEPUTY

Fee \$ 2.50

Mr. Jack K. Lunt, Belgrade, Montana

February 26, 1964

December 27, 1963

1129

from a creek.

File No. \_\_\_\_\_

T. 2N R. 4E 6

DUPLICATE

County Gallatin

STATE OF MONTANA  
ADMINISTRATOR OF GROUNDWATER CODE  
OFFICE OF STATE ENGINEER

**Notice of Completion of Groundwater  
Appropriation by Means of Well**

(Under Chapter 237, Montana Session Laws, 1961)

Top of Ground

(Elev. above sea level \_\_\_\_\_)

0-2 Soil  
2-25 Clay gravel & water  
25-30 " "  
30-33 Clay & gravel  
33-35 " " little water  
" " Rock & sand  
35-49 Clay & Rock  
49-53 Sand & gravel  
" " water case  
50 ft bottom of well

Owner Schmidt Farms Address Revaton R. D. 2Driller Harold Hulbert Address Route 1 Argonne

Date of Notice of Appropriation of Groundwater \_\_\_\_\_

Date well started Oct 24, 1964 Date Completed Oct 27, 1964

Type of well Drilled Equipment Used Churn  
(dug, driven, bored or (Churn, drill, rotary or  
drilled) other)

Water Use: Domestic ☒ Municipal ☐ Other ☐ Irrigation ☐  
Industrial ☐ Drainage ☐ Stock ☐

Indicate on the diagram the character and thickness of the different strata met with in drilling, such as soil, clay, shale, gravel, rock or sand, etc. Show depth at which water is encountered, thickness and character of water-bearing strata and height to which water rises in the well.

Size of Drilled Hole	Size and Weight of Casing	From (Feet)	To (Feet)	PERFORATIONS		
				Kind Size	From (Feet)	To (Feet)
7"	6 5/8" OP 19 lb	2	49'	none		

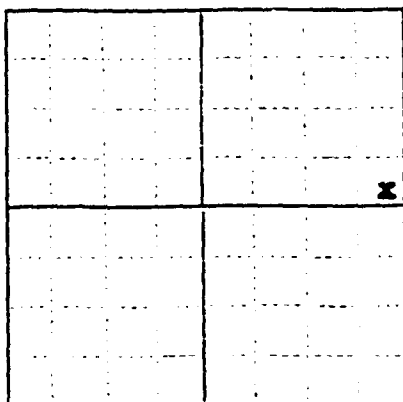

SE 1/4 Sec 6 T2N R4E

Indicate location of well and place of use, if possible. Each small square represents 10 acres.

Show exact depth of bottom.

Static Water Level for non-flowing Well 8 feet.

Shut-in Pressure for Flowing Well \_\_\_\_\_

Pumping Water Level 23 feet at 21 gal. per minute.

Discharge in gal. per min. of flowing well \_\_\_\_\_

How Tested Packer Length of Test 2 hrs

Remarks: (Gravel packing, cementing, packers, type of shutoff, location of place of use of groundwater if not at well, and any other similar pertinent information, including number of acres irrigated, if used for irrigation) \_\_\_\_\_

none

Driller's License Number 47Driller's Signature Harold B. Hulbert

This form to be prepared by driller, and three copies to be filed by the owner with the County Clerk and Recorder in the county in which the well is located.

Please answer all questions. If not applicable, so state, otherwise the form will be returned.

Original to the County Clerk and Recorder; duplicate to the State Engineer; Triplicate to the Montana Bureau of Mines and Geology and Quadruplicate for the Appropriator.

5910

#1902

State of Montana }  
County of Gallatin } ss.

Filed April 30, 1965

at 10:30 o'clock A. M.

CARL L. STUCKY

COUNTY CLERK & RECORDER

By Judith A. Macfarlane

DEPUTY

Fee \$ 2.00 pd.

File No. \_\_\_\_\_

T. 2 N. R. 4 E

DUPLICATE

County Gallatin

STATE OF MONTANA  
ADMINISTRATOR OF GROUNDWATER CODE  
OFFICE OF STATE ENGINEER

RECEIVED  
DEC 30 1963

Notice of Completion of Groundwater Appropriation  
Without Well

(Under Chapter 237 Montana Session Laws, 1961)

Date of Appropriation of Groundwater \_\_\_\_\_

Owner Jack K. Lunt Address Belgrade

Contractor (if any) \_\_\_\_\_

Address of Contractor \_\_\_\_\_

Date Started \_\_\_\_\_ Date Completed \_\_\_\_\_

Describe means of obtaining groundwater without a well "as by sub-irrigation and other natural processes". Include depth to water when applicable. Pipeline put in 1960

+ Spring dugout obtaining more water. Creek natural flow

Quantity of water developed and used with explanation of method used to measure or estimate such amount. If use is intermittent

estimate approximate lengths of periods of use. Spring,

guess 500 gal. daily for 9 to 9 months. Creek. The ground in Soil Bank now but when not use will be 3000 gal. daily.

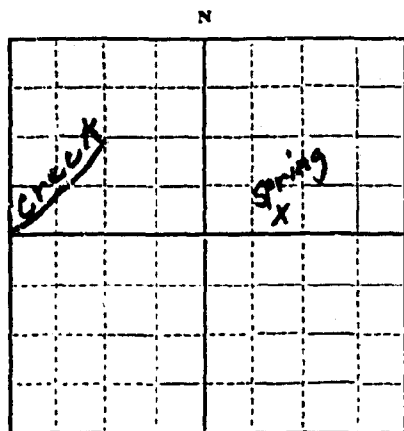
Signature of Owner Jack K. LuntDate Dec. 27, 1963

N 1/4 NE Sec. 7 T. 2 N. R. 4 E.

Indicate point of appropriation and place of use, if possible.

This form to be prepared by contractor (if any), otherwise by the owner.

Three copies of this notice are to be filed with the County Clerk and Recorder of the county in which the works are located.

Please answer all questions. If not applicable, so state, otherwise the form will be returned.

Original to the County Clerk and Recorder; duplicate to the State Engineer; Triplicate to the Montana Bureau of Mines and Geology and Quadruplicate for the Appropriator.

1130

State of Montana }  
County of Gallatin } ss.  
Filed Dec 27, 1963  
at 3:57 o'clock P M.  
Carl Wallis  
COUNTY CLERK & RECORDER  
By [Signature]  
Fee \$ 2.57 1/2 DEPUTY



G

Approved Stock Form—State Publishing Co., Helena, Montana—19089

File No. \_\_\_\_\_

DUPLICATE

T 2N R 4ECounty Gallatin

STATE OF MONTANA  
ADMINISTRATOR OF GROUNDWATER CODE  
OFFICE OF STATE ENGINEER

RECEIVED  
DEC 19 1963

Declaration of Vested Groundwater Rights  
(Under Chapter 237, Montana Session Laws, 1961)

I, Peter S. and Catherine D. Dyk, of 422 West Olive, Bozeman, Montana  
(Name of Appropriator) (Address) (Town)  
County of Gallatin State of Montana  
have appropriated groundwater according to the Montana laws in effect prior to January 1, 1962, as follows:

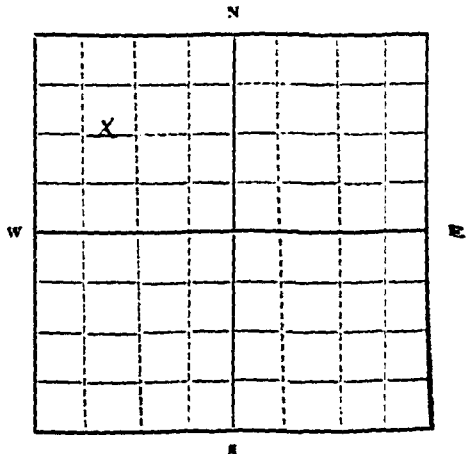

NW  $\frac{1}{4}$  NW  $\frac{1}{4}$  Sec. 12 T. 2N R. 4E

Indicate point of appropriation  
and place of use, if possible.  
Each small square represents 10  
acres.

2. The beneficial use on which the claim is based well water domestic
3. Date or approximate date of earliest beneficial use; and how continuous the use has been 1890 to 1955, continuous;  
 $\frac{1}{2}$  time since 1955
4. The amount of groundwater claimed (in miner's inches or gallons per minute) 40,000 gallons
5. If used for irrigation, give the acreage and description of the lands to which water has been applied and name of the owner thereof
6. The means of withdrawing such water from the ground and the location of each well or other means of withdrawal pump, mechanical
7. The date of commencement and completion of the construction of the well, wells, or other works for withdrawal of groundwater 1890
8. The depth of water table 100 feet
9. So far as it may be available, the type, size and depth of each well or the general specifications of any other works for the withdrawal of groundwater 4 inch casing, around 100 feet
10. The estimated amount of groundwater withdrawn each year 40,000 gallons
11. The log of formations encountered in the drilling of each well if available none
12. Such other information of a similar nature as may be useful in carrying out the policy of this act, including reference to book and page of any county record none

Signature of Owner

Peter S. Dyk  
Date Dec. 16, 1963

Three copies to be filed by the owner with the County Clerk and Recorder of the county in which the well is located.

Please answer all questions. If not applicable, so state, otherwise the form will be returned.

Original to the County Clerk and Recorder; duplicate to the State Engineer; Triplicate to the Montana Bureau of Mines and Geology, and Quadruplicate for the Appropriator.

107-87

907

State of Montana } ss.  
County of Gallatin }  
Filed Dec 18 1963  
at 2:20 o'clock PM  
Carl Wallen  
COUNTY CLERK & RECORDER  
By [Signature] DEPUTY  
Fee \$ 2.00

File No. \_\_\_\_\_

T 2N R 4E

DUPLICATE

County Gallatin

STATE OF MONTANA  
ADMINISTRATOR OF GROUNDWATER CODE  
OFFICE OF STATE ENGINEER

**Declaration of Vested Groundwater Rights** DEC 19 1963

(Under Chapter 237, Montana Session Laws, 1961)

STATE ENGINEER

1. Peter S. and Catherine D. Dyk, of 422 West Olive, Bozeman, Montana  
(Name of Appropriator) (Address) (Town)  
County of Gallatin State of Montana  
have appropriated groundwater according to the Montana laws in effect prior to January 1, 1962, as follows:

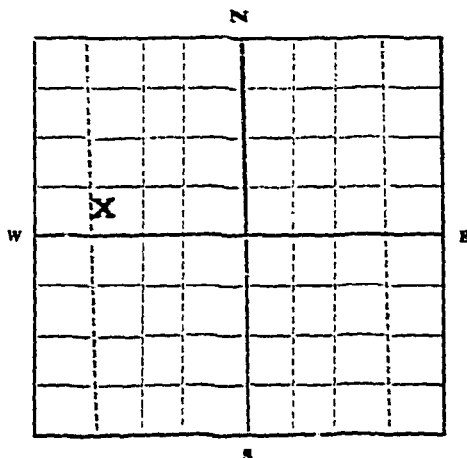
SW  $\frac{1}{4}$  NW  $\frac{1}{4}$  Sec. 13 T. 2N R. 4E

Indicate point of appropriation  
and place of use, if possible.  
Each small square represents 10  
acres.

2. The beneficial use on which the claim is based  
well - domestic purposes
3. Date or approximate date of earliest beneficial use; and how continuous the use has been 1890 continuous until 1958,  
1/2 time since then
4. The amount of groundwater claimed (in miner's inches or gallons per minute) 35,000 gallons/year
5. If used for irrigation, give the acreage and description of the lands to which water has been applied and name of the owner thereof  
none
6. The means of withdrawing such water from the ground and the location of each well or other means of withdrawal pump,  
mechanical; 4 inch casing
7. The date of commencement and completion of the construction of the well, wells, or other works for withdrawal of groundwater 1890
8. The depth of water table 80 feet
9. So far as it may be available, the type, size and depth of each well or the general specifications of any other works for the withdrawal of groundwater 4 inch casing
10. The estimated amount of groundwater withdrawn each year 35,000
11. The log of formations encountered in the drilling of each well if available none available
12. Such other information of a similar nature as may be useful in carrying out the policy of this act, including reference to book and page of any county record

Signature of Owner

Date

Peter S. Dyk  
Dec 16, 1963

Three copies to be filed by the owner with the County Clerk and Recorder of the county in which the well is located.

Please answer all questions. If not applicable, so state, otherwise the form will be returned.

Original to the County Clerk and Recorder; duplicate to the State Engineer; Triplicate to the Montana Bureau of Mines and Geology, and Quadruplicate for the Appropriator.

903

State of Montana ) ss.  
County of Gallatin )  
Filed Dec 18, 1963  
at 2:00 o'clock P.M.  
Paul H. Hulse  
COUNTY CLERK & RECORDER  
By [Signature]  
DEPUTY  
Fee \$ 2.00