

RECEIVED

County DeWitt 10

STATE OF MONTANA  
ADMINISTRATOR OF GROUNDWATER CODE  
MONTANA WATER RESOURCES BOARD

JAN 10 1972

DRILLER'S LOG

NOTICE OF COMPLETION OF GROUNDWATER  
APPROPRIATION BY MEANS OF WELL

Developed after January 1, 1962

MONTANA DEPARTMENT OF NATURAL  
RESOURCES AND CONSERVATION

Indicate the character, color, thickness of strata such as soil, clay, sand, gravel, shale, sandstone, etc. Show depth at which water is found and height to which water rises in well.

(Under Chapter 237 Montana Session Laws, 1961, as amended)

This form to be prepared by driller, and three copies to be filed by the owner with the County Clerk and Recorder in the county in which the well is located, last copy to be retained by driller. Please answer all questions. If not applicable, so state, otherwise the form may be returned.

Owner Betty I. McKel G. Wesley White & Charles M. Neig  
Address RT 1 FOREST PARK BOZEMAN, MONT.  
Date well started Aug. 23, 1971  
completed Oct. 29, 1971

For Administrator's Use	
File # <u>3033</u>	Date <u>Jan 9, 1972</u>
<u>10:15 A.M.</u>	
GW 1	

Type of well Drilled  
(Dug, driven, bored or drilled)  
Equipment used Churn Drill  
(Churn drill, rotary or other)  
Water Use: Domestic  Municipal  Stock  Irrigation   
Industrial  Drainage  Other  Garden/Lawn

\*Describe Trailer court  
USE: If used for irrigation, industrial, drainage or other. Explain, state number of acres and location or other data (i.e. Lot, Block and Addition).

ESTIMATED ANNUAL WITHDRAWAL

Size of Drilled Hole	Size and Weight of Casing	From (Feet)	To (Feet)	PERFORATIONS SCREEN		
				Kind Size	From (Feet)	To (Feet)
8 in.	8 5/8" O.D. 24#	13 above ground	112'	4" Stainless Steel Screen 1070 slot	112	142
				3" Galv. Pipe	105'	112'
					142'	145'

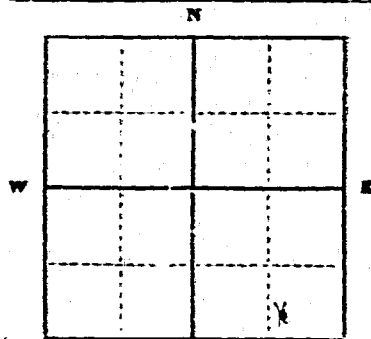

Static water level 6 1/2 ft.  
Pumping water level 105 ft.  
measured 7 1/2 hours after pumping began.  
\*Measured from ground level.  
Well developed by Pump for 7 1/2 hours.  
Power            Pump            HP  
Remarks: (Gravel packing, cementing, packers, type of shutoff) Gravel packed from 105' to 145' with 1/2" to 3/8" sand. Gravel from 6 ft. to 105 ft.

INDICATE LOCATION OF WELL AND PLACE OF USE, IF POSSIBLE. EACH SMALL SQUARE REPRESENTS 40 ACRES.

Driller's Signature Donald Jones  
Driller's Address 2107 Bridger Dr. Bozeman, Montana  
LICENSE NO. 17

Top of Ground (Elev. above sea level)		
From (Feet)	To (Feet)	
0	1 1/2	Top Soil + Sandy Clay
1 1/2	11	Gravel
11	6 1/2	Static water level
11	35	Clay
35	46	Sand
46	51	Sand & Clay
51	52	Sand + Fine Gravel
52	56	Sand + Clay
56	71	Sand
71	114	Gravel bound in Clay
114	115	Sand
115	128	Clay
128	132	Sand
132	133	Clay
138	142	Sand
142	145	Clay

145 ft. Show exact depth of bottom

#3033

State of Montana  
County of Gallatin

Filed Jan. 7, 1972

at 10:15 o'clock A.M.

Carl L. Stucky

County Clerk & Recorder

By Frederick A. Lindgren

Deputy

Fee 7.00

*[Faint, illegible text and markings, possibly bleed-through from the reverse side of the page.]*

STATE OF MONTANA  
ADMINISTRATOR OF GROUNDWATER CODE  
MONTANA WATER RESOURCES BOARD

DRILLER'S LOG

**NOTICE OF COMPLETION OF GROUNDWATER  
APPROPRIATION BY MEANS OF WELL**

SEP 15 1972

Developed after January 1, 1962

Indicate the character, color, thickness of strata such as soil, clay, sand, gravel, shale, sandstone, etc. Show depth at which water is found and height to which water rises in well.

(Under Chapter 237 Montana Session Laws, 1961, as amended)

This form to be prepared by driller, and three copies to be filed by the owner with the County Clerk and Recorder in the county in which the well is located, last copy to be retained by driller.

Please answer all questions. If not applicable, so state, otherwise the form may be returned.

Owner Mary E. Farmer  
Mrs. John A. L. Farmer

Address Route 1 - Box 198  
Bozeman, Montana

Date well started Dec. 2, 1961  
completed Dec. 5, 1961

For Administrator's Use  
File 3124  
Sept. 8, 1972 - 1:00 p.m.  
GW 1

Type of well Drilled  
(Dug, driven, bored or drilled)

Equipment used Churn Drill  
(Churn drill, rotary or other)

Water Use: Domestic  Municipal  Stock  Irrigation   
Industrial  Drainage  Other \* Garden/Lawn

\*Describe \_\_\_\_\_  
USE: if used for irrigation, industrial, drainage or other. Explain, state number of acres and location or other data (i.e. Lot, Block and Addition).

ESTIMATED ANNUAL WITHDRAWAL \_\_\_\_\_

Size of Drilled Hole	Size and Weight of Casing	From (Feet)	To (Feet)	PERFORATIONS		
				Kind Size	From (Feet)	To (Feet)
6"	6 5/8 O.D. 15#	top of ground	46			

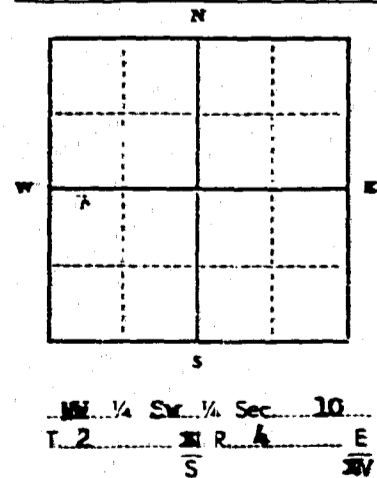

Static water level 12 ft.\*  
Pumping water level 48 ft.\*  
at 16 gallons per minute,  
measured 60 minutes after pumping began.  
\*Measured from ground level.  
Well developed by DAVID  
for 1 hours.  
Power \_\_\_\_\_ Pump \_\_\_\_\_ HP  
Remarks: (Gravel packing, cementing, packers, type of shutoff)

INDICATE LOCATION OF WELL AND PLACE OF USE, IF POSSIBLE. EACH SMALL SQUARE REPRESENTS 40 ACRES

Driller's Signature Milton E. Jones  
Driller's Address 2103 Bridger Drive  
Bozeman, Montana LICENSE NO. 17

Top of Ground (Elev. above sea level)		
From (Feet)	To (Feet)	
<u>0</u>	<u>22</u>	<u>Coarse Gravel</u>
<u>22</u>	<u>48</u>	<u>Clay</u>
<u>48</u>		<u>Fine Gravel</u>

3124

State of Montana }  
County of Gallatin } ss.

Filed September 8, 1972

at 10 o'clock P.M.

Carl de Stucky

County Clerk & Recorder

By Peta M. Whitman

Deputy

Fee \$ 2.00



Form No. 18  
8-60

10

T. 25 R. 4E  
County Callahan

MONTANA BUREAU OF MINES AND GEOLOGY  
Butte, Montana

RECEIVED  
APR 27 1961

Water Well Log

STATE ENGINEER

SE. Cor.	Sec. 0

Owner F. Lyle Theobald Address Bozeman, Montana  
 Driller Jones (A) Address Bozeman, Montana  
 Date Started April 22, 1959 Date Completed April 27, 1959  
 Location: Sec. 10 T. 25 R. 4E  $\frac{1}{4}$  sec. 33

Type of well Drilled Equipment used Churn Drill  
(Dug, driven, bored, or drilled) (Churn, drill, rotary, other)

Water use: Domestic  Municipal  Stock  Irrigation   
 Industrial  Drainage  Other Any use owner may devise

Casing: 27 ft. to \_\_\_\_\_ ft. Type Steel Size 6" dia

Casing: \_\_\_\_\_ ft. to \_\_\_\_\_ ft. Type \_\_\_\_\_ Size \_\_\_\_\_

Casing: \_\_\_\_\_ ft. to \_\_\_\_\_ ft. Type \_\_\_\_\_ Size \_\_\_\_\_

Perforated or screened: Ft. \_\_\_\_\_ to ft. \_\_\_\_\_ . Ft. \_\_\_\_\_ to ft. \_\_\_\_\_

Type of screen or perforations \_\_\_\_\_

Static water level, for non-flowing well: Write to 3110 feet.

Shut-in pressure, for flowing well: \_\_\_\_\_ lb./sq. in. on: \_\_\_\_\_ (date)

Pumping water level \_\_\_\_\_ feet at 30 better than gal. per min.

How tested: Driller tested for adequate flow

Length of test \_\_\_\_\_

Remarks: (Gravel packing, cementing, packers, type of shut-off, depth of shut-off)

The water from this well to be used as other case fit or may wish to use it or may use any or all available water entering this casing at any time now or in the future

(over)



GW3

File No. \_\_\_\_\_

DUPLICATE

10  
F23 R 43  
County Beaumont

STATE OF MONTANA  
ADMINISTRATOR OF GROUNDWATER CODE  
OFFICE OF STATE ENGINEER

**RECEIVED**  
DEC 12 1963

STATE ENGINEER

**Notice of Completion of Groundwater Appropriation Without Well**

(Under Chapter 237 Montana Session Laws, 1961)

Date of Appropriation of Groundwater July 20, 1962

Owner Faye & K. Lyle Theobald Address Bosman, Montana

Contractor (if any) none

Address of Contractor \_\_\_\_\_

Date Started July 20, 1962 Date Completed July 22, 1962

Describe means of obtaining groundwater without a well "as by sub-irrigation and other natural processes". Include depth to water when applicable. refer to reverse side as this form is not applicable to this case.

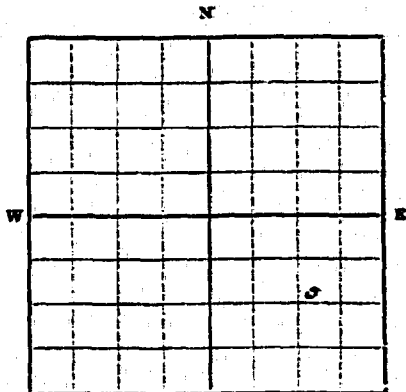

**NE 1/4 Sec. 10 T2S R4E**  
1/4 Sec. T R

Indicate point of appropriation and place of use, if possible.

Quantity of water developed and used with explanation of method used to measure or estimate such amount. If use is intermittent estimate approximate lengths of periods of use \_\_\_\_\_

Signature of Owner K. Lyle Theobald

Date December 10, 1963

This form to be prepared by contractor (if any), otherwise by the owner.

Three copies of this notice are to be filed with the County Clerk and Recorder of the county in which the works are located.

Please answer all questions. If not applicable, so state, otherwise the form will be returned.

Original to the County Clerk and Recorder; duplicate to the State Engineer; Triplicate to the School of Mines and Quadruplicate for the Appropriator.



During periods of irrigation of ground above and to the west of my residence, there is excess sub water. Installed around the footing of my residence is a 4" drain tile and this is extended some 200' to a sump which I dug July 20, 1962. This hole is cribbed up and is about 3 ft. square and about 8 ft. deep. This hole collects water from the tile as well as some other seepage. The tile runs from partially full to full at times. I can pump this water back up for irrigation. It will supply a 1" discharge pressure pump at some periods. The flow is quite varied as irrigation comes from above. At times the 4" tile did not carry enough and some water seeped into the basement. There is seepage from about June 1st to October 1st each year.

State of Montana }  
County of Gallatin } ss.  
Filed \_\_\_\_\_ 1963  
at \_\_\_\_\_ o'clock \_\_\_\_\_ M.  
By \_\_\_\_\_  
COUNTY CLERK & RECORDER  
DEPUTY  
Fee \$ \_\_\_\_\_

248

RECEIVED

25-4E  
County Gallatin

STATE OF MONTANA  
ADMINISTRATOR OF GROUNDWATER CODE  
MONTANA WATER RESOURCES BOARD

NOTICE OF COMPLETION OF GROUNDWATER  
APPROPRIATION BY MEANS OF WELL

Developed after January 1, 1962

(Under Chapter 237 Montana Session Laws, 1961, as amended)

This form to be prepared by driller, and three copies to be filed by the owner with the County Clerk and Recorder in the county in which the well is located, last copy to be retained by driller.

Please answer all questions. If not applicable, so state, otherwise the form may be returned.

Owner Gene Hermanson

Address Gallatin Gateway,  
Montana

Date well started July 22, 1971  
completed July 23, 1971

For Administrator's Use	
File	<u>3016</u>
	<u>10-29-71</u>
	<u>1:45 P.M.</u>
GW I	

Type of well drilled  
(Dug, driven, bored or drilled)

Equipment used cable tool  
(Churn drill, rotary or other)

Water Use: Domestic  Municipal  Stock  Irrigation   
Industrial  Drainage  Other \* Garden/Lawn

\*Describe \_\_\_\_\_  
USE: If used for irrigation, industrial, drainage or other. Explain, state number of acres and location or other data (i.e. Lot, Block and Addition).

ESTIMATED ANNUAL WITHDRAWAL

Size of Drilled Hole	Size and Weight of Casing	From (Feet)	To (Feet)	PERFORATIONS		
				Kind Size	From (Feet)	To (Feet)
6"	6" I.D. 250 wall	4'	41 ft.			

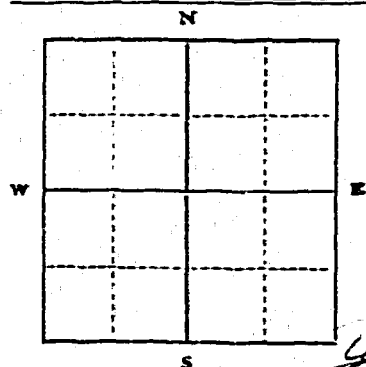

Static water level 3 ft.\*  
Pumping water level 8 ft.\*  
at 45 gallons per minute,  
measured \_\_\_\_\_ minutes after pumping began.

\*Measured from ground level.  
Well developed by bailer  
for 2 hours.

Power \_\_\_\_\_ Pump \_\_\_\_\_ HP  
Remarks: (Gravel packing, cementing, packers, type of shutoff)

In N. 1/2 Lot 7, Blk 13, Gallatin Gateway, Mont.

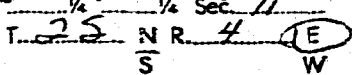

INDICATE LOCATION OF WELL AND PLACE OF USE, IF POSSIBLE. EACH SMALL SQUARE REPRESENTS 40 ACRES.

Driller's Signature Hubert A. Potts

Driller's Address Potts Drilling and Development

Route 11, Bozeman, Montana

LICENSE NO. 150

Top of Ground (Elev. above sea level)

From (Feet)	To (Feet)	
1	7	Coarse Gravel
7	20	Slimy Clay
20	41	Sand and Gravel
3	ft.	Static Water Level

4' ft. Show exact depth of bottom

49288

# 3016

State of Montana  
County of Gallatin  
Filed Oct. 29, 1971  
at 1:45 o'clock P.M.  
Carl L. Stucky  
County Clerk & Recorder  
By Lucille A. Bridges  
Deputy  
Fee \$ 2.00

MONTANA WATER RESOURCES BOARD  
**RECEIVED**

County Gallatin

STATE OF MONTANA  
ADMINISTRATOR OF GROUNDWATER CODE  
MONTANA WATER RESOURCES BOARD  
**NOTICE OF COMPLETION OF GROUNDWATER  
APPROPRIATION BY MEANS OF WELL**

Developed after January 1, 1962

(Under Chapter 237 Montana Session Laws, 1961, as amended)

This form to be prepared by driller, and three copies to be filed by the owner with the County Clerk and Recorder in the county in which the well is located, last copy to be retained by driller. Please answer all questions. If not applicable, so state, otherwise the form may be returned.

Owner H.E. [unclear]  
Address [unclear]  
Date well started 10-29-71  
completed 11-1-71

For Administrator's Use	
File	<u>2-16</u>
	<u>10-29-71</u>
	<u>11-45 P.M.</u>
GW I	

Type of well drilled  
(Dug, driven, bored or drilled)  
Equipment used churn drill  
(Churn drill, rotary or other)  
Water Use: Domestic  Municipal  Stock  Irrigation   
Industrial  Drainage  Other \* Garden/Lawn

\*Describe home and garden  
USE: If used for irrigation, industrial, drainage or other. Explain, state number of acres and location or other data (i.e. Lot, Block and Addition). My lot here is 50 ft. by 150 ft.

ESTIMATED ANNUAL WITHDRAWAL 10,000

Size of Drilled Hole	Size and Weight of Casing	From (Feet)	To (Feet)	PERFORATIONS		
				Kind	From (Feet)	To (Feet)
<u>6"</u>	<u>4" x 4" x 12'</u>	<u>0'</u>	<u>41 ft.</u>			

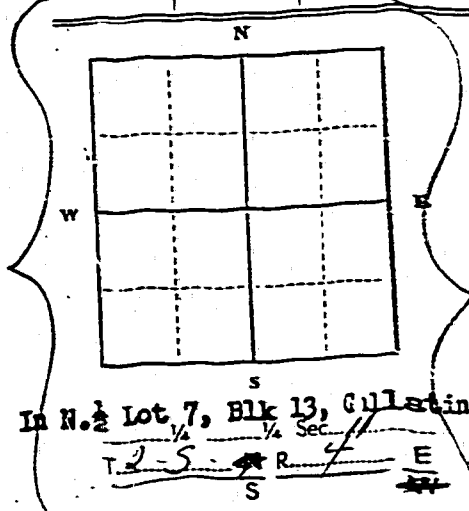

Static water level 3 ft.\*  
Pumping water level 3 ft.\*  
at 4 1/2 gallons per minute,  
measured        minutes after pumping  
began.  
\*Measured from ground level.  
Well developed by driller  
for 2 hours.  
Power        Pump        HP  
Remarks: (Gravel packing, cementing,  
packers, type of shutoff)       

INDICATE LOCATION OF WELL AND PLACE OF USE, IF POSSIBLE.  
EACH SMALL SQUARE REPRESENTS 40 ACRES.

Driller's Signature [Signature]  
Driller's Address Route 11, Helena, Mont.  
LICENSE NO. 150

DRILLER'S LOG  
Indicate the character, color, thickness of strata such as soil, clay, sand, gravel, shale, sandstone, etc. Show depth at which water is found and height to which water rises in well.

Top of Ground (Elev. above sea level)		
From (Feet)	To (Feet)	
<u>1</u>	<u>7</u>	<u>Coarse gravel</u>
<u>7</u>	<u>20</u>	<u>fine clay</u>
<u>20</u>	<u>5</u>	<u>fine sand and gravel</u>
<u>3</u>	<u>7</u>	<u>stable water level</u>

41 ft. Show exact depth of bottom

Form No. 18  
8-60

T. 2 S R. 4 E

County Big Horn

MONTANA BUREAU OF MINES AND GEOLOGY  
Butte, Montana

Water Well Log

Owner J. P. Hetherington - C. W. Francis Address Bozeman

Driller Van Pulsen Co Address Bozeman

Date Started Aug 15 - 53 Date Completed Aug 29 - 53

Location: Sec. 11 T. 2 S R. 4 E.  $\frac{1}{2}$  sec.

Type of well \_\_\_\_\_ Equipment used Cable tool  
(Dug, driven, or drilled) (Churn, drill, rotary, other)

Water use: Domestic  Municipal  Stock  Irrigation   
Industrial  Drainage  Other \_\_\_\_\_

Casing: 0 ft. to 90 ft. Type perforated Size 10 in - 19 lb.

Casing: \_\_\_\_\_ ft. to \_\_\_\_\_ ft. Type \_\_\_\_\_ Size P.E.

Casing: \_\_\_\_\_ ft. to \_\_\_\_\_ ft. Type \_\_\_\_\_ Size \_\_\_\_\_

Perforated or screened: Ft. 13 to ft. 65. Ft. \_\_\_\_\_ to ft. \_\_\_\_\_

Type of screen or perforations 21 slots 3/8 x 8 in

Static water level, for non-flowing well: 17 feet.

Shut-in pressure, for flowing well: None lb./sq. in. on: \_\_\_\_\_ (date)

Pumping water level 27 feet at 60 gal. per min.

How tested: test pump

Length of test 4 in.

Remarks: (Gravel packing, cementing, packers, type of shut-off, depth of shut-off)

None

(over)



Form No. 18  
8-60

11

T. 2 S R. 4 E  
County Gallatin

MONTEANA BUREAU OF MINES AND GEOLOGY  
Butte, Montana

RECEIVED

Sec 11

	X	

Water well log

STATE ENGINEER

Owner Joseph & Ann Pacovsky Address Rt. 102, ems  
 Driller 1925 Address \_\_\_\_\_  
 Date Started \_\_\_\_\_ Date Completed \_\_\_\_\_  
 Location: Sec. 11 T. 2 S R. 4 E  $\frac{1}{4}$  sec.

Type of well Driven (Dug, driven, or drilled) Equipment used \_\_\_\_\_ (Churn, drill, rotary, other)

Water use: Domestic  Municipal  Stock  Irrigation   
 Industrial  Drainage  Other \_\_\_\_\_

Casing: 31 ft. to \_\_\_\_\_ ft. Type cast Size 5 in.

Casing: \_\_\_\_\_ ft. to \_\_\_\_\_ ft. Type \_\_\_\_\_ Size \_\_\_\_\_

Casing: \_\_\_\_\_ ft. to \_\_\_\_\_ ft. Type \_\_\_\_\_ Size \_\_\_\_\_

Perforated or screened: Ft. \_\_\_\_\_ to ft. \_\_\_\_\_ Ft. \_\_\_\_\_ to ft. \_\_\_\_\_

Type of screen or perforations \_\_\_\_\_

Static water level, for non-flowing well: 15 feet.

Shut-in pressure, for flowing well: \_\_\_\_\_ lb./sq. in. on: \_\_\_\_\_ (date)

Pumping water level \_\_\_\_\_ feet at \_\_\_\_\_ gal. per min.

How tested: \_\_\_\_\_

Length of test \_\_\_\_\_

Remarks: (Gravel packing, cementing, packers, type of shut-off, depth of shut-off)

\_\_\_\_\_  
\_\_\_\_\_  
\_\_\_\_\_

(over)

#379

Gallatin County, }  
State of Montana. } ss.  
Filed Dec 29, 1961  
at 2:40 o'clock P. M.  
Carl H. Hutton  
COUNTY CLERK & RECORDER  
By A. H. Hutton DEPUTY  
Fee \$ 2.00



File No. \_\_\_\_\_

T 28 R 4E 11

DUPLICATE

County Yellowstone

LOG

STATE OF MONTANA  
ADMINISTRATOR OF GROUNDWATER CODE  
OFFICE OF STATE ENGINEER

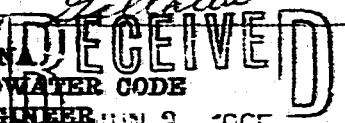

### Notice of Completion of Groundwater Appropriation by Means of Well DEVELOPED AFTER JANUARY 1, 1962

(Under Chapter 237, Montana Session Laws, 1961)

Owner Allen David Pruett, et al Address Route #1 Bozeman

Driller Potts Drilling Address Route #1 Bozeman

Date of Notice of appropriation of groundwater \_\_\_\_\_

Date well started May 19-65 Date completed May 20-65

Type of well Drilled Equipment used Cable Tools  
(Dug, Driven, bored or drilled) (Churn drill, rotary or other)

Water use: Domestic  Municipal  Stock  Irrigation   
Industrial  Drainage  Other

Indicate on the diagram the character and thickness of the different strata met with in drilling, such as soil, clay, shale, gravel, rock or sand, etc. Show depth at which water is encountered, thickness and character of water-bearing strata and height to which the water rises in the well.

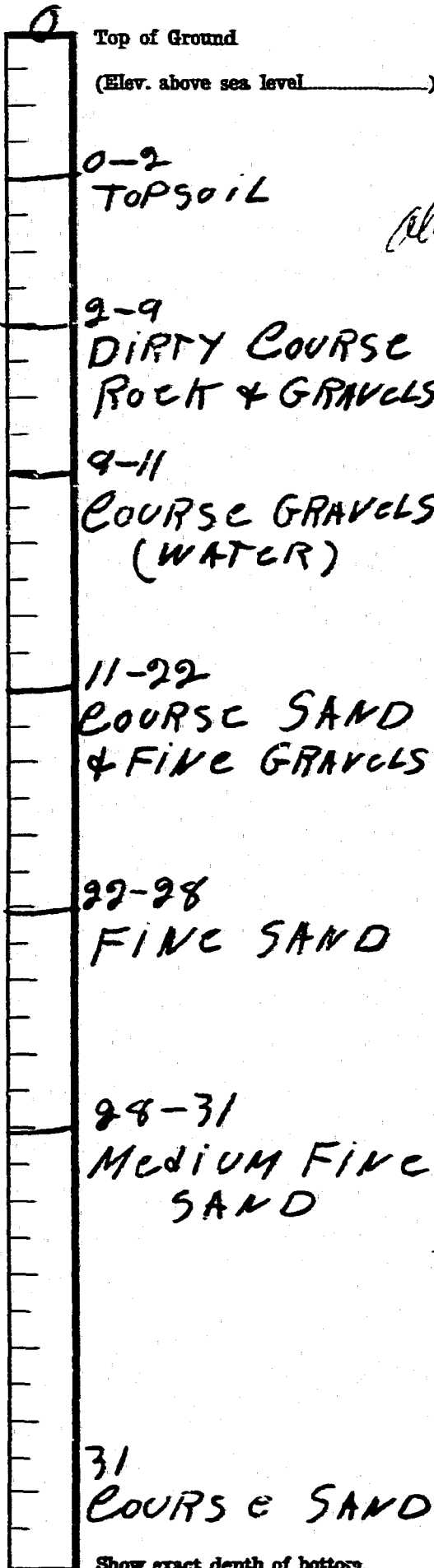

Size of Drilled Hole	Size and Weight of Casing	From (Feet)	To (Feet)	PERFORATIONS		
				Kind Size	From (Feet)	To (Feet)
6"	6" ID 18.97	0	31			

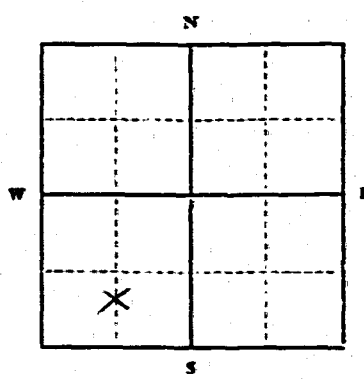

Static Water Level for non-flowing well \_\_\_\_\_ feet.

Shut-in Pressure for Flowing Well \_\_\_\_\_

Pumping Water Level 10 feet at 40 gal. per minute.

Discharge in gal. per min. of flowing well \_\_\_\_\_

How Tested Bailer

Length of Test 2 1/2 hrs

Remarks: (Gravel packing, cementing, packers, type of shutoff) \_\_\_\_\_

SW 1/4 Sec 11 T28 R4E  
Indicate location of well and place of use, if possible. Each small square represents 40 acres.

(Continue on reverse side)

USE—If used for irrigation, industrial, drainage or other. Explain, state number of acres and location or other data (i.e.: Lot, Block and Addition).

Show exact depth of bottom. 31 Feet.

This form to be prepared by driller, and three copies to be filed by the owner with the County Clerk and Recorder in the county in which the well is located, tissue copy to be retained by driller.

Please answer all questions. If not applicable, so state, otherwise the form will be returned.

150  
Driller's License Number

Hubert A. Potts  
Driller's Signature

39175

1911

11-25-65  
BOONCE SAND  
E LINDS CHAIRS

11-25-65  
BOONCE SAND

State of Montana )  
County of Gallatin ) ss  
Filed July 1965  
at 1:40 o'clock P M.  
Carl L. Stucky  
COUNTY CLERK & RECORDER  
By [Signature]  
DEPUTY  
Fee \$ 20.00

11-25-65  
BOONCE SAND  
E LINDS CHAIRS

3195

State of Montana } ss.  
County of Gallatin }

Filed Feb 22, 1973

at 1:00 o'clock P.M.  
Carl L. Stucky

County Clerk & Recorder

By Alta M. Whitman

Deputy

Fee \$ 2.00

STATE OF MONTANA  
ADMINISTRATOR OF GROUNDWATER CODE  
MONTANA WATER RESOURCES BOARD  
**NOTICE OF COMPLETION OF GROUNDWATER  
APPROPRIATION BY MEANS OF WELL**  
Developed after January 1, 1962

(Under Chapter 237 Montana Session Laws, 1961, as amended)

This form to be prepared by driller, and three copies to be filed by the owner with the County Clerk and Recorder in the county in which the well is located, last copy to be retained by driller.

Please answer all questions. If not applicable, so state, otherwise the form may be returned.

Owner Dave Pruitt & Patricia Pruitt

Address Route #1, Bozeman, Montana 59715

Date well started Oct. 5, 1971

completed Oct. 6, 1971

For Administrator's Use	
File	<u>3195</u>
Date	<u>February 12, 1972</u>
Time	<u>1:00 p.m.</u>

Type of well drilled  
(Dug, driven, bored or drilled)

Equipment used cable tool  
(Churn drill, rotary or other)

Water Use: Domestic  Municipal  Stock  Irrigation   
Industrial  Drainage  Other \* Garden/Lawn

\*Describe \_\_\_\_\_  
USE: If used for irrigation, industrial, drainage or other. Explain, state number of acres and location or other data (i.e. Lot, Block and Addition).

ESTIMATED ANNUAL WITHDRAWAL

Size of Drilled Hole	Size and Weight of Casing	From (Feet)	To (Feet)	PERFORATIONS		
				Kind Size	From (Feet)	To (Feet)
6"	6" 17# 250 Wall	-5ft.	26 ft.			

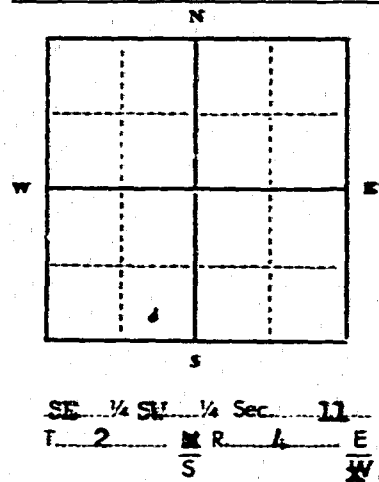

Static water level 9 ft.\*  
Pumping water level 14 ft.\*  
at 40 gallons per minute,  
measured \_\_\_\_\_ minutes after pumping  
began.  
\*Measured from ground level.  
Well developed by pump & bailer  
for 2 hours.  
Power \_\_\_\_\_ Pump \_\_\_\_\_ HP  
Remarks: (Gravel packing, cementing,  
packers, type of shutoff)

INDICATE LOCATION OF WELL AND PLACE OF USE, IF POSSIBLE. EACH SMALL SQUARE REPRESENTS 40 ACRES.

Driller's Signature Herbert A Potts  
Driller's Address Potts Drilling and Developing  
Route #1, Bozeman, Montana LICENSE NO. 250

**DRILLER'S LOG**  
Indicate the character, color, thickness of strata such as soil, clay, sand, gravel, shale, sandstone, etc. Show depth at which water is found and height to which water rises in well.

From (Feet)	To (Feet)	Top of Ground (Elev. above sea level)
1		<u>Topsoil</u>
1	9	<u>Course, dirty overburden</u>
9	ft.	<u>Static Water Level</u>
9	28	<u>Very Sand Gravel</u>
28	31	<u>Sand and Gravel</u>

31 Show exact depth of bottom

File No. \_\_\_\_\_

T 2 R 4E

DUPLICATE

County Gallatin

STATE OF MONTANA  
ADMINISTRATOR OF GROUNDWATER CODE  
OFFICE OF STATE ENGINEER

RECEIVED  
APR 25 1963

Declaration of Vested Groundwater Rights STATE ENGINEER

(Under Chapter 237, Montana Session Laws, 1961)

I, Essie Lillian Pruitt of Route 1, Bozeman, Montana  
(Name of Appropriator) (Address) (Town)

County of Gallatin State of Montana

have appropriated groundwater according to the Montana laws in effect prior to January 1, 1962, as follows:

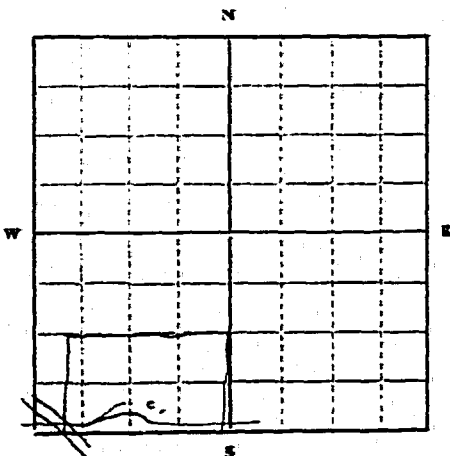

2. The beneficial use on which the claim is based domestic use from one well, and stockwater from another well.

3. Date or approximate date of earliest beneficial use; and how continuous the use has been The well for domestic use established the year 1876; the stockwater well constructed 1944; continuous use to date.

4. The amount of groundwater claimed (in miner's inches or gallons per minute) Domestic use well--30 gallons per min. stockwater well--20 gallons per minute

5. If used for irrigation, give the acreage and description of the lands to which water has been applied and name of the owner thereof Not applicable

In SW 1/4 Sec. 11 T 2 R 4E

Indicate point of appropriation and place of use, if possible. Each small square represents 10 acres.

6. The means of withdrawing such water from the ground and the location of each well or other means of withdrawal Domestic well use by electric pump (formerly hand pump) 5' east and 7' north of SE corner of front porch of residence as it now exists; stockwater well 30' north of south edge of property and 20 feet south of barn.

7. The date of commencement and completion of the construction of the well, wells, or other works for withdrawal of groundwater Domestic use well has been in existence prior to the issuance of patent in 1877; the stockwater well was constructed, completed and used in the year 1944.

8. The depth of water table 6 to 14 feet

9. So far as it may be available, the type, size and depth of each well or the general specifications of any other works for the withdrawal of groundwater Domestic use well, formerly dug, now a 4 inch casing 25 feet deep with piping connections to house and use on lawn and garden; stockwater well 6 inch stick casing 30 feet deep with hand pump.

10. The estimated amount of groundwater withdrawn each year Domestic well-800 gal. per day Stockwater well-500 gal. per day

11. The log of formations encountered in the drilling of each well if available None

12. Such other information of a similar nature as may be useful in carrying out the policy of this act, including reference to book and page of any county record See book 25 of Deeds p. 406 See book 35 of Deeds p. 629 See book 15 of Deeds p. 275

Signature of Owner Essie Lillian Pruitt

Date Apr 17 - 1963

Three copies to be filed by the owner with the County Clerk and Recorder of the county in which the well is located.

Please answer all questions. If not applicable, so state, otherwise the form will be returned.

Original to the County Clerk and Recorder; duplicate to the State Engineer; Triplicate to the Montana Bureau of Mines and Geology, and Quadruplicate for the Appropriator.

# 627

State of Montana ss.  
County of Gallatin

Filed April 24, 1963

at 8:07 o'clock A.M.

**EARL WALTON**

COUNTY CLERK & RECORDER

By Ida J. Morrow  
DEPUTY

Fee \$ 2.00

File No. \_\_\_\_\_

T 25 R 4E

DUPLICATE

County Gallatin

STATE OF MONTANA  
ADMINISTRATOR OF GROUNDWATER CODE  
OFFICE OF STATE ENGINEER

RECEIVED

Declaration of Vested Groundwater Rights

(Under Chapter 237, Montana Session Laws, 1961)

STATE ENGINEER

1 Henry M Shank of Bozeman  
(Name of Appropriator) (Address) (Town)  
County of Gallatin State of Montana  
have appropriated groundwater according to the Montana laws in effect prior to January 1, 1962, as follows:

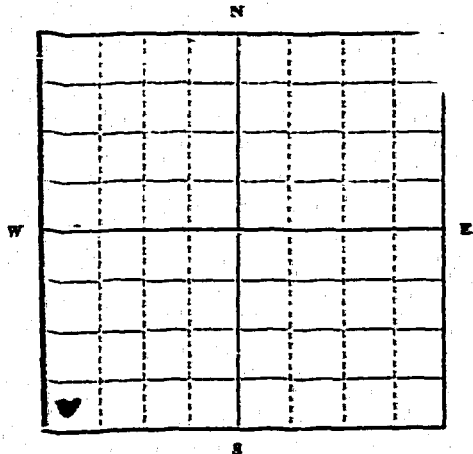

SW 1/4 Sec. 11 T25 R4E

Indicate point of appropriation and place of use, if possible. Each small square represents 10 acres.

2. The beneficial use on which the claim is based \_\_\_\_\_

Domestic

3. Date or approximate date of earliest beneficial use; and how continuous the use has been \_\_\_\_\_

Continuous since 1954

4. The amount of groundwater claimed (in miner's inches or gallons per minute) \_\_\_\_\_

28 gallon per minute

5. If used for irrigation, give the acreage and description of the lands to which water has been applied and name of the owner thereof \_\_\_\_\_

6. The means of withdrawing such water from the ground and the location of each well or other means of withdrawal \_\_\_\_\_

1/4 H.P. Electric Motor on a 3/4 inch pump and suction pipe

7. The date of commencement and completion of the construction of the well, wells, or other works for withdrawal of groundwater \_\_\_\_\_

June 6 - 1956

8. The depth of water table \_\_\_\_\_

5 feet

9. So far as it may be available, the type, size and depth of each well or the general specifications of any other works for the withdrawal of groundwater \_\_\_\_\_

bench cased drilled well 315 feet deep

10. The estimated amount of groundwater withdrawn each year \_\_\_\_\_

43,800 gallon

11. The log of formations encountered in the drilling of each well if available \_\_\_\_\_

12. Such other information of a similar nature as may be useful in carrying out the policy of this act, including reference to book and page of any county record \_\_\_\_\_

Signature of Owner Henry M Shank

Date Dec 14 1962

Three copies to be filed by the owner with the County Clerk and Recorder of the county in which the well is located.

Please answer all questions. If not applicable, so state, otherwise the form will be returned.

Original to the County Clerk and Recorder; duplicate to the State Engineer; Triplicate to the Montana Bureau of Mines and Geology, and Quadruplicate for the Appropriator.

Wesley  
Wesley

Wesley  
Wesley

Wesley

Wesley

Wesley

Wesley

Wesley

Wesley

Wesley

Wesley

State of Montana  
County of Blaine  
1962  
232  
Wesley

By \_\_\_\_\_  
DEPUTY  
Fee \$ 20.00



File No. \_\_\_\_\_

T. 2S R. 4E

DUPLICATE

County Gallatin

STATE OF MONTANA  
ADMINISTRATOR OF GROUNDWATER CODE  
OFFICE OF STATE ENGINEER

STATE ENGINEER  
Notice of Completion of Groundwater  
Appropriation by Means of Well

(Under Chapter 237, Montana Session Laws, 1961)

Owner Henry M. Skank Address Route 1; Bosman

Driller Harold Hulbert Address R.I. Bozeman

Date of Notice of Appropriation of Groundwater \_\_\_\_\_

Date well started July 31, 1962 Date Completed Aug 1, 1962

Type of well Drilled Equipment Used Churn  
(dug, driven, bored or drilled) (Churn, drill, rotary or other)

Water Use: Domestic  Municipal  Other  Irrigation   
Industrial  Drainage  Stock

Indicate on the diagram the character and thickness of the different strata met with in drilling, such as soil, clay, shale, gravel, rock or sand, etc. Show depth at which water is encountered, thickness and character of water-bearing strata and height to which water rises in the well.

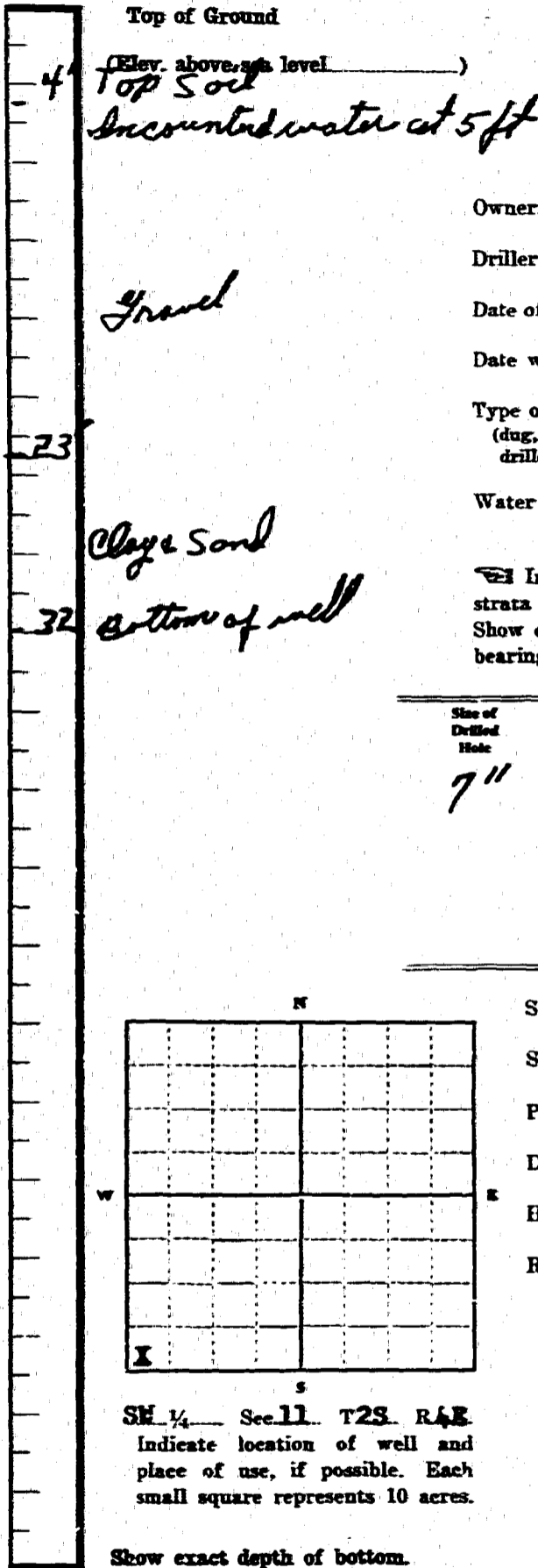

Size of Drilled Hole	Size and Weight of Casing	From (Feet)	To (Feet)	PERFORATIONS		
				Kind Size	From (Feet)	To (Feet)
7"	6 5/8 OD 14 Lbs	0	20	None		

Static Water Level for non-flowing Well 5 feet.

Shut-in Pressure for Flowing Well \_\_\_\_\_

Pumping Water Level 1.0 feet at 3.5 gal. per minute.

Discharge in gal. per min. of flowing well \_\_\_\_\_

How Tested Boiler Length of Test 1 hr

Remarks: (Gravel packing, cementing, packers, type of shutoff, location of place of use of groundwater if not at well, and any other similar pertinent information, including number of acres irrigated, if used for irrigation) \_\_\_\_\_

NOTE

47  
Driller's License Number  
Harold B. Hulbert  
Driller's Signature

This form to be prepared by driller, and three copies to be filed by the owner with the County Clerk and Recorder in the county in which the well is located.

Please answer all questions. If not applicable, so state, otherwise the form will be returned.

Original to the County Clerk and Recorder; duplicate to the State Engineer; Triplicate to the Montana Bureau of Mines and Geology and Quadruplicate for the Appropriator.

#519

State of Montana }  
County of Gallatin } ss.  
Filed August 3 1962  
at 11:30 o'clock A M.  
EARL WALTON  
COUNTY CLERK & RECORDER  
By Paul A. Russell  
DEPUTY  
Fee \$ 2.00 pd

File No. \_\_\_\_\_

T. 2 S R 4 E.

DUPLICATE

County Gallatin

*GW 4*

STATE OF MONTANA  
ADMINISTRATOR OF GROUNDWATER CODE  
OFFICE OF STATE ENGINEER

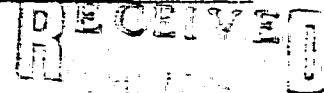

STATE ENGINEER

Notice of Completion of Groundwater Appropriation  
Without Well

(Under Chapter 237 Montana Session Laws, 1961)

Date of Appropriation of Groundwater Before 1918

Owner Henry M. Skank Address Bozeman, Mont.

Contractor (if any) \_\_\_\_\_

Address of Contractor \_\_\_\_\_

Date Started \_\_\_\_\_ Date Completed Before 1918

Describe means of obtaining groundwater without a well "as by sub-irrigation and other natural processes". Include depth to water when applicable. Open Spring-2 H. P. Electric pump on 2 in pump line and 3 inch suction pipe

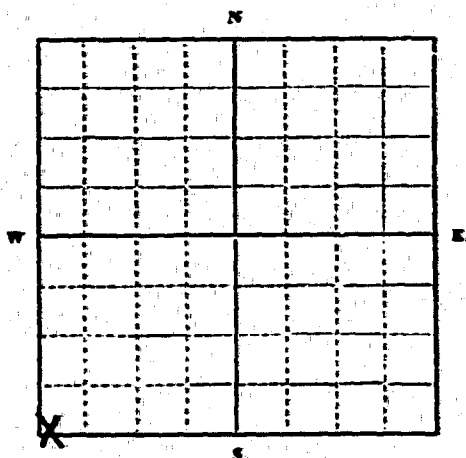

Quantity of water developed and used with explanation of method used to measure or estimate such amount. If use is intermittent estimate approximate lengths of periods of use \_\_\_\_\_

SW 1/4 Sec 11 T 2SR 4E  
Indicate point of appropriation and place of use, if possible.

100 gallon per minute used continuously during summer months  
at the home of Henry M. Skank in the SW 1/4 Sec

Sec 11 T 2 S R 5 E. Use about 200000 Gallon per year.  
Signature of Owner Henry M. Skank

Date December 14, 1962

This form to be prepared by contractor (if any), otherwise by the owner.

Three copies of this notice are to be filed with the County Clerk and Recorder of the county in which the works are located.

Please answer all questions. If not applicable, so state, otherwise the form will be returned.

Original to the County Clerk and Recorder; duplicate to the State Engineer; Triplicate to the Montana Bureau of Mines and Geology and Quadruplicate for the Appropriator.

# 569

# 568

State of Montana ( ss.  
County of Gallatin )

Filed Dec 16 1962

at 7:33 o'clock P.M.

Carl Watson  
COUNTY CLERK & RECORDS

By \_\_\_\_\_

Fee \$ \_\_\_\_\_

File No. \_\_\_\_\_

T 25 R 4E

DUPLICATE

County Hallatin

STATE OF MONTANA  
ADMINISTRATOR OF GROUNDWATER CODE  
OFFICE OF STATE ENGINEER

JAN 16 1964

Declaration of Vested Groundwater Rights

(Under Chapter 237, Montana Session Laws, 1961)

1. John Sternhagen Bella of Bozeman  
(Name of Appropriator) (Address) (Town)  
County of Hallatin State of Mont  
have appropriated groundwater according to the Montana laws in effect prior to January 1, 1962, as follows:

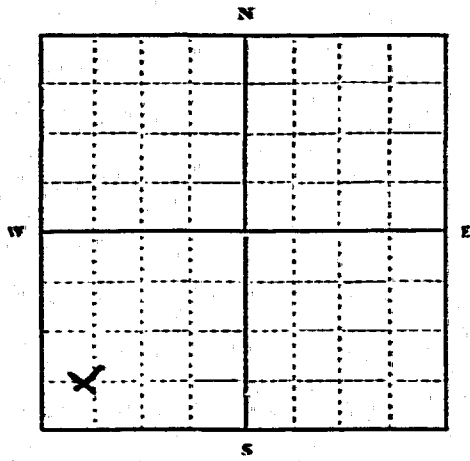

SW 1/4 Sec. 11 T25 R4E

Indicate point of appropriation and place of use, if possible. Each small square represents 10 acres.

2. The beneficial use on which the claim is based

house and farm use

3. Date or approximate date of earliest beneficial use; and how continuous the use has been

Two years

4. The amount of groundwater claimed (in miner's inches or gallons per minute)

100 gallons

5. If used for irrigation, give the acreage and description of the lands to which water has been applied and name of the owner thereof

None

6. The means of withdrawing such water from the ground and the location of each well or other means of withdrawal

Electric Pump

7. The date of commencement and completion of the construction of the well, wells, or other works for withdrawal of groundwater

Not known

8. The depth of water table

15 ft

9. So far as it may be available, the type, size and depth of each well or the general specifications of any other works for the withdrawal of groundwater

6" casing 45' deep

10. The estimated amount of groundwater withdrawn each year

300 000 gal

11. The log of formations encountered in the drilling of each well if available

Not known

12. Such other information of a similar nature as may be useful in carrying out the policy of this act, including reference to book and page of any county record

None

Signature of Owner John Sternhagen

Date 12-30-63

Three copies to be filed by the owner with the County Clerk and Recorder of the county in which the well is located.

Please answer all questions. If not applicable, so state, otherwise the form will be returned.

Original to the County Clerk and Recorder; Duplicate to the State Engineer; Triplicate to the Montana Bureau of Mines and Geology; and Quadruplicate for the Appropriator.

# 1213

State of Montana }  
County of Gallatin } ss.

Filed December 30, 1963  
at 9:32 o'clock A.M.

Carl Walton  
COUNTY CLERK & RECORDER

Helma Fiddler  
DEPUTY

Fee \$ 2.00

File No. \_\_\_\_\_

T. 25 R. 4E

DUPLICATE

County Gallatin

STATE OF MONTANA  
ADMINISTRATOR OF GROUNDWATER CODE  
OFFICE OF STATE ENGINEER

JAN 15 1964

Declaration of Vested Groundwater Rights

(Under Chapter 237, Montana Session Laws, 1961)

L. Mason Thompson of RT 1 Logan  
(Name of Appropriator) (Address) (Town)  
County of Gallatin State of Montana  
have appropriated groundwater according to the Montana laws in effect prior to January 1, 1962, as follows:

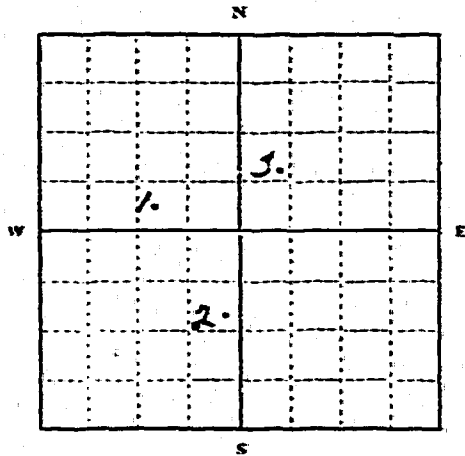

1/4 Sec. 11 T. 25 R. 4E  
Indicate point of appropriation and place of use, if possible. Each small square represents 10 acres.

- The beneficial use on which the claim is based House Livestock Garden Lawn
- Date or approximate date of earliest beneficial use; and how continuous the use has been 1. 30 yrs. 2. 14 yrs. 3. 3 yrs.
- The amount of groundwater claimed (in miner's inches or gallons per minute) 1. approx 20 gal/min
- If used for irrigation, give the acreage and description of the lands to which water has been applied and name of the owner thereof Just front garden about to house
- The means of withdrawing such water from the ground and the location of each well or other means of withdrawal 1. 2 electric automatic water pumps, 3. hand pump for livestock
- The date of commencement and completion of the construction of the well, wells, or other works for withdrawal of groundwater not exactly known
- The depth of water table approx. 8 ft.
- So far as it may be available, the type, size and depth of each well or the general specifications of any other works for the withdrawal of groundwater 1. 2 drilled 6" case 34 ft. 2. " " " 34 ft. 3. " " " 34 ft.
- The estimated amount of groundwater withdrawn each year unknown
- The log of formations encountered in the drilling of each well if available not avail.
- Such other information of a similar nature as may be useful in carrying out the policy of this act, including reference to book and page of any county record not known

Signature of Owner L. Mason Thompson  
Date 12-30-63

Three copies to be filed by the owner with the County Clerk and Recorder of the county in which the well is located.

Please answer all questions. If not applicable, so state, otherwise the form will be returned.

Original to the County Clerk and Recorder; Duplicate to the State Engineer; Triplicate to the Montana Bureau of Mines and Geology, and Quadruplicate for the Appropriator.

36006

#1692

State of Montana }  
County of Gallatin } ss.

Filed Dec. 31, 1963  
at 2:59 o'clock P.M.

EARL WALTON

COUNTY CLERK & RECORDER

By *A. H. Maxwell*  
DEPUTY

Fee \$ 2.00



67

File No. \_\_\_\_\_

DUPLICATE

RECEIVED  
JUN 11 1964

Approved Stock Form - State Publishing Co., Helena, Montana - 0734

T-2-S-R-4-E

County Gallatin

STATE ENGINEER  
STATE OF MONTANA

ADMINISTRATOR OF GROUNDWATER CODE  
OFFICE OF STATE ENGINEER

JAN 16 1964

### Declaration of Vested Groundwater Rights

(Under Chapter 237, Montana Session Laws, 1961)

1. Clara Esther Ward of Star Pk. Bozeman  
(Name of Appropriator) (Address) (Town)

County of Gallatin State of Mont  
have appropriated groundwater according to the Montana laws in effect prior to January 1, 1962, as follows:

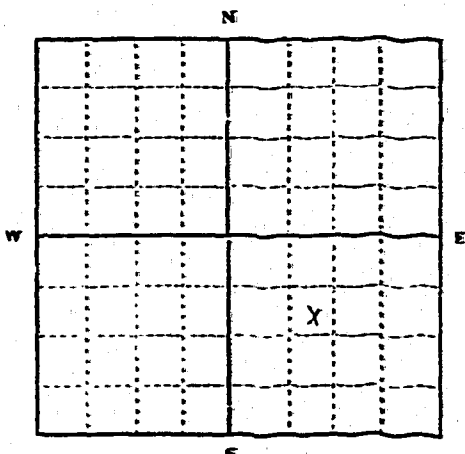

SE 1/4 Sec. 11 T.23 R.4E

Indicate point of appropriation and place of use, if possible. Each small square represents 10 acres.

2. The beneficial use on which the claim is based House hold use & irrigation

3. Date or approximate date of earliest beneficial use; and how continuous the use has been Still have been used continuously since May 9 1960

4. The amount of groundwater claimed (in miner's inches or gallons per minute) All of the water the well is capable of producing

5. If used for irrigation, give the acreage and description of the lands to which water has been applied and name of the owner thereof 4 acres S.E. 1/4 SE 1/4 T.23 R.4E.

6. The means of withdrawing such water from the ground and the location of each well or other means of withdrawal Water is pumped Location: SE 1/4 SE 1/4 T.23 R.4E

7. The date of commencement and completion of the construction of the well, wells, or other works for withdrawal of groundwater Completed - May - 1960

8. The depth of water table 10 ft.

9. So far as it may be available, the type, size and depth of each well or the general specifications of any other works for the withdrawal of groundwater well is 42 ft deep - drilled with Smith casing

10. The estimated amount of groundwater withdrawn each year No work

11. The log of formations encountered in the drilling of each well if available Not available

12. Such other information of a similar nature as may be useful in carrying out the policy of this act, including reference to book and page of any county record

Signature of Owner: Clara Esther Ward  
Date: Jan 30 - 1963

Three copies to be filed by the owner with the County Clerk and Recorder of the county in which the well is located.

Please answer all questions. If not applicable, so state, otherwise the form will be returned.

Original to the County Clerk and Recorder; Duplicate to the State Engineer; Triplicate to the Montana Bureau of Mines and Geology, and Quadruplicate for the Appropriator.

33496

1357

State of Montana / ss.  
County of Gallatin \

Filed 12-30, 1963

at 2:31 o'clock PM.

Carl Walton

COUNTY CLERK & RECORDER

By Helma Fiedler

DEPUTY

Fee \$ 70

RECEIVED

County Gallatin

STATE OF MONTANA  
ADMINISTRATOR OF GROUNDWATER CODE  
MONTANA WATER RESOURCES BOARD  
**NOTICE OF COMPLETION OF GROUNDWATER  
APPROPRIATION BY MEANS OF WELL**  
Developed after January 1, 1962

DRILLER'S LOG

Indicate the character, color, thickness of strata such as soil, clay, sand, gravel, shale, sandstone, etc. Show depth at which water is found and height to which water rises in well.

(Under Chapter 237 Montana Session Laws, 1961, as amended)

This form to be prepared by driller, and three copies to be filed by the owner with the County Clerk and Recorder in the county in which the well is located, last copy to be retained by driller.

Please answer all questions. If not applicable, so state, otherwise the form may be returned.

Owner Curtis L. Larson & Frances Mae Larson  
Address 415 Alda Lane Bozeman, Montana  
Date well started Dec. 23, 1958 completed Dec. 30, 1958  
Type of well Drilled  
Equipment used Churn Drill  
Water Use: Domestic  Municipal  Stock  Irrigation   
Industrial  Drainage  Other  Garden/Lawn

For Administrator's Use  
File 3356  
6-29-73  
GW 1 2:52 p.m.

\*Describe \_\_\_\_\_  
USE: If used for irrigation, industrial, drainage or other. Explain, state number of acres and location or other data (i.e. lot, Block and Addition). \_\_\_\_\_

ESTIMATED ANNUAL WITHDRAWAL

Size of Drilled Hole	Size and Weight of Casing	From (Feet)	To (Feet)	PERFORATIONS		
				Kind Size	From (Feet)	To (Feet)
6"	6" ID	Surface	52'	---	---	---

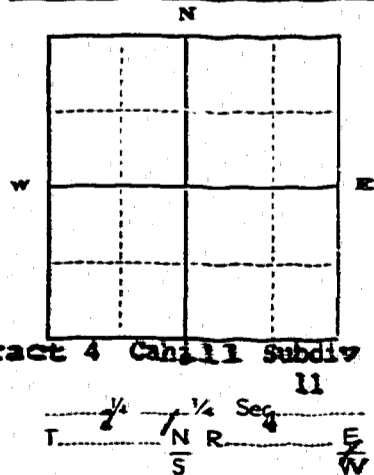

Static water level 104 ft.\*  
Pumping water level 53 ft.\*  
at 16 gallons per minute,  
measured 60 minutes after pumping began.  
\*Measured from ground level.  
Well developed by 2 1/2  
for 1 hours.  
Power \_\_\_\_\_ Pump \_\_\_\_\_ HP  
Remarks: (Gravel packing, cementing, packers, type of shutoff) \_\_\_\_\_

INDICATE LOCATION OF WELL AND PLACE OF USE, IF POSSIBLE. EACH SMALL SQUARE REPRESENTS 40 ACRES.

Driller's Signature Walter C. Jones

Driller's Address 2103 Bridger Drive

Bozeman, Montana

LICENSE NO. 17

Top of Ground (Elev. above sea level)		
From (Feet)	To (Feet)	
0	2	Top Soil
2	20	Coarse Gravel
20	31	Clay
31	32	Fine Gravel & Sand
32	41	Clay
41	42	Fine Gravel & Sand
42	49	Clay
49	50	Sand
50	52	Clay
52	53	Fine Gravel & Sand

53' Show exact depth of bottom

3356

State of Montana  
County of Gallatin } ss.  
Filed June 27 1973  
at 2:52 o'clock P.M.  
Carl J. Stucky  
County Clerk & Recorder  
By Alta Hargan  
Deputy  
Fee \$ 2.00

File No. \_\_\_\_\_

T 25 R 4E

DUPLICATE

County Hell Creek

STATE OF MONTANA  
ADMINISTRATOR OF GROUNDWATER CODE  
OFFICE OF STATE ENGINEER

Notice of Completion of Groundwater  
Appropriation by Means of Well

(Under Chapter 237, Montana Session Laws, 1962)

JAN 27 1963

Top of Ground  
(Elev. above sea level \_\_\_\_\_)

0-1 Soil Rock  
1-15 Rock  
15-22 Clay Rock  
22-26 Gravel  
26 water  
26-28 gravel

Owner Car. Noon Address Rt. 1

Driller Harold Hulbert Address A. I. Byrum

Date of Notice of Appropriation of Groundwater \_\_\_\_\_

Date well started Sept 17, 1963 Date Completed Sept 20, 1963

Type of well Drilled Equipment Used Churn  
(dug, driven, bored or drilled) (Churn, drill, rotary or other)

Water Use: Domestic  Municipal  Other  Irrigation   
Industrial  Drainage  Stock

Indicate on the diagram the character and thickness of the different strata met with in drilling, such as soil, clay, shale, gravel, rock or sand, etc. Show depth at which water is encountered, thickness and character of water-bearing strata and height to which water rises in the well.

Size of Drilled Hole	Size and Weight of Casing	From (Feet)	To (Feet)	PERFORATIONS		
				Kind Size	From (Feet)	To (Feet)
7"	4 5/8" D 12.59	0	36	Gravel		

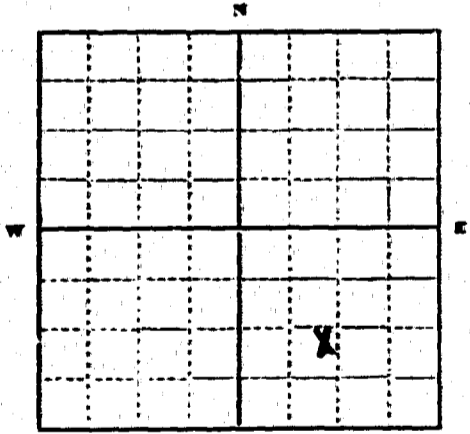

SW 1/4 SE Sec 12 T25 R4E  
Indicate location of well and place of use, if possible. Each small square represents 10 acres.

Static Water Level for non-flowing Well 14 feet.

Shut-in Pressure for Flowing Well \_\_\_\_\_

Pumping Water Level 23 feet at 4.2 gal. per minute.

Discharge in gal. per min. of flowing well \_\_\_\_\_

How Tested  Pump  Length of Test  6 hrs

Remarks: (Gravel packing, cementing, packers, type of shutoff, location of place of use of groundwater if not at well, and any other similar pertinent information, including number of acres irrigated, if used for irrigation)

None

Show exact depth of bottom.

Driller's License Number \_\_\_\_\_

Harold B. Hulbert  
Driller's Signature

This form to be prepared by driller, and three copies to be filed by the owner with the County Clerk and Recorder in the county in which the well is located.

Please answer all questions. If not applicable, so state, otherwise the form will be returned.

Original to the County Clerk and Recorder; duplicate to the State Engineer; Triplicate to the Montana Bureau of Mines and Geology and Quadruplicate for the Appropriator.

1628

Gallatin County, )  
State of Montana, ) ss.  
Filed January 22 19 64  
at 11:00 o'clock A. M.

KARL WALTON  
COUNTY CLERK & RECORDER  
By Luella A. Mayfield  
DEPUTY

Fee \$ 2.00 pd

Form No. 12  
8-00

28 # 4E <sup>12</sup>  
County \_\_\_\_\_

STATE BUREAU OF MINES AND GEOLOGY  
Butte, Montana

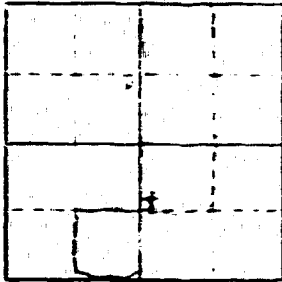

water well log REGISTERED ENGINEER

Owner Joseph & Anna Pacoosky Address \_\_\_\_\_

Driller \_\_\_\_\_ Address \_\_\_\_\_

Date started 1931? Date completed \_\_\_\_\_

Location Sec. 12 T. 2 N. R. 7 E. Sec. \_\_\_\_\_

Type of well Power Equipment used \_\_\_\_\_  
(Dom. driven, or other) (cable, drill, rotary, other)

Water use: Domestic  Municipal  Stock  Irrigation   
Industrial  Drainage  Other \_\_\_\_\_

Casing: 31 \_\_\_\_\_ Type Iron size 5"

Casing: \_\_\_\_\_ ft. to \_\_\_\_\_ ft. Type \_\_\_\_\_ size \_\_\_\_\_

Casing: \_\_\_\_\_ ft. to \_\_\_\_\_ ft. Type \_\_\_\_\_ size \_\_\_\_\_

Perforated or screened: \_\_\_\_\_ ft. to \_\_\_\_\_ ft. \_\_\_\_\_ ft. to \_\_\_\_\_ ft.

Type of screen or perforations \_\_\_\_\_

Static water level, for non-flowing well: 15 feet.

Shut-in pressure, for flowing well: \_\_\_\_\_ lb. sq. in. on: \_\_\_\_\_

Pumping water level \_\_\_\_\_ feet at \_\_\_\_\_ gal. per min.

How tested: \_\_\_\_\_

Length of test \_\_\_\_\_

Remarks: (Gravel packing, cementing, packers, type of shut-off, depth of shut-off)

\_\_\_\_\_  
\_\_\_\_\_  
\_\_\_\_\_

(over)

#380

Gallatin County, } ss.  
State of Montana. }  
Filed Dec 29 1961  
at 2:41 o'clock P.M.  
Earl Walton  
COUNTY CLERK & RECORDER  
By A. Maxwell DEPUTY  
Fee \$ 7.00





3315

State of Montana } 56.  
County of Gallatin }  
Filed June 28, 1973  
at 2:55 o'clock P.M.  
Carl L. Stuck  
County Clerk & Recorder  
By Alta Huggan  
Deputy  
P. 2<sup>nd</sup> Ed.

RECEIVED

25-4E-12  
County

STATE OF MONTANA  
ADMINISTRATOR OF GROUNDWATER CODE  
MONTANA WATER RESOURCES BOARD

NOTICE OF COMPLETION OF GROUNDWATER  
APPROPRIATION BY MEANS OF WELL

Developed after January 1, 1962

(Under Chapter 237 Montana Session Laws, 1961, as amended)

This form to be prepared by driller, and three copies to be filed by the owner with the County Clerk and Recorder in the county in which the well is located, last copy to be retained by driller. Please answer all questions. If not applicable, so state, otherwise the form may be returned.

Owner Janille  
Address Rt 4 Bynum  
Date well started \_\_\_\_\_  
completed \_\_\_\_\_

For Administrator's Use  
File 3363  
GW I 535 PM

Type of well drilled  
(Dug, driven, bored or drilled)  
Equipment used casings tool  
(Chain drill, rotary or other)  
Water Use: Domestic  Municipal  Stock  Irrigation   
Industrial  Drainage  Other \* Garden/Lawn

\*Describe \_\_\_\_\_  
USE: If used for irrigation, industrial, drainage or other. Explain, state number of acres and location or other data (i.e. Lot, Block and Addition).

ESTIMATED ANNUAL WITHDRAWAL

Size of Drilled Hole	Size and Weight of Casing	From (Feet)	To (Feet)	PERFORATIONS		
				Kind Size	From (Feet)	To (Feet)
6"	50 cell 17"	1.	1.2			

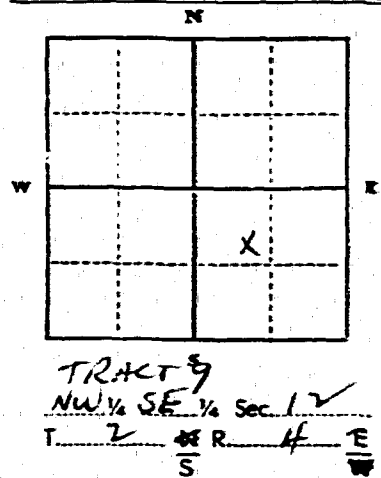

Static water level \_\_\_\_\_ ft.\*  
Pumping water level \_\_\_\_\_ ft.\*  
at \_\_\_\_\_ gallons per minute,  
measured \_\_\_\_\_ minutes after pumping  
began.  
\*Measured from ground level.  
Well developed by \_\_\_\_\_  
for \_\_\_\_\_ hours.  
Power \_\_\_\_\_ Pump \_\_\_\_\_ HP  
Remarks: (Gravel packing, cementing,  
packers, type of shutoff)

INDICATE LOCATION OF WELL AND PLACE OF USE, IF POSSIBLE. EACH SMALL SQUARE REPRESENTS 40 ACRES.

Driller's Signature [Signature]  
Driller's Address \_\_\_\_\_

LICENSE NO. 152

DRILLER'S LOG

Indicate the character, color, thickness of strata such as soil, clay, sand, gravel, shale, sandstone, etc. Show depth at which water is found and height to which water rises in well.

Top of Ground (Elev. above sea level)		
From (Feet)	To (Feet)	
7	6	coarse, dirty gravel
6	10	fine gravel
12	15	fine clay
16	42	fine sand and silt

Show exact depth of bottom

3363

State of Montana } ss.  
County of Gallatin }  
Filed June 29, 1973  
at 3:32 o'clock P.M.  
Carl de Stucky  
County Clerk & Recorder  
By Olta Hangan  
Deputy  
Fee \$ 3.00

File No. \_\_\_\_\_

DUPLICATE

JAN 16 1964

T 25 R 4E

County CALLAHAN

STATE OF MONTANA  
ADMINISTRATOR OF GROUNDWATER CODE  
OFFICE OF STATE ENGINEER

Notice of Completion of Groundwater  
Appropriation by Means of Well

(Under Chapter 237, Montana Session Laws, 1961)

Owner Ralph W. Porter Address 708 So 12 Bozeman

Driller DONALD C. JONES Address 633 E. HAMME BOZEMAN

Date of Notice of Appropriation of Groundwater Aug 8, 1962

Date well started Aug 2, 1962 Date Completed Aug 8, 1962

Type of well Drilled Equipment Used Churn Drill  
(dug, driven, bored or drilled) (Churn, drill, rotary or other)

Water Use: Domestic  Municipal  Other  Irrigation   
Industrial  Drainage  Stock

Indicate on the diagram the character and thickness of the different strata met with in drilling, such as soil, clay, shale, gravel, rock or sand, etc. Show depth at which water is encountered, thickness and character of water-bearing strata and height to which water rises in the well.

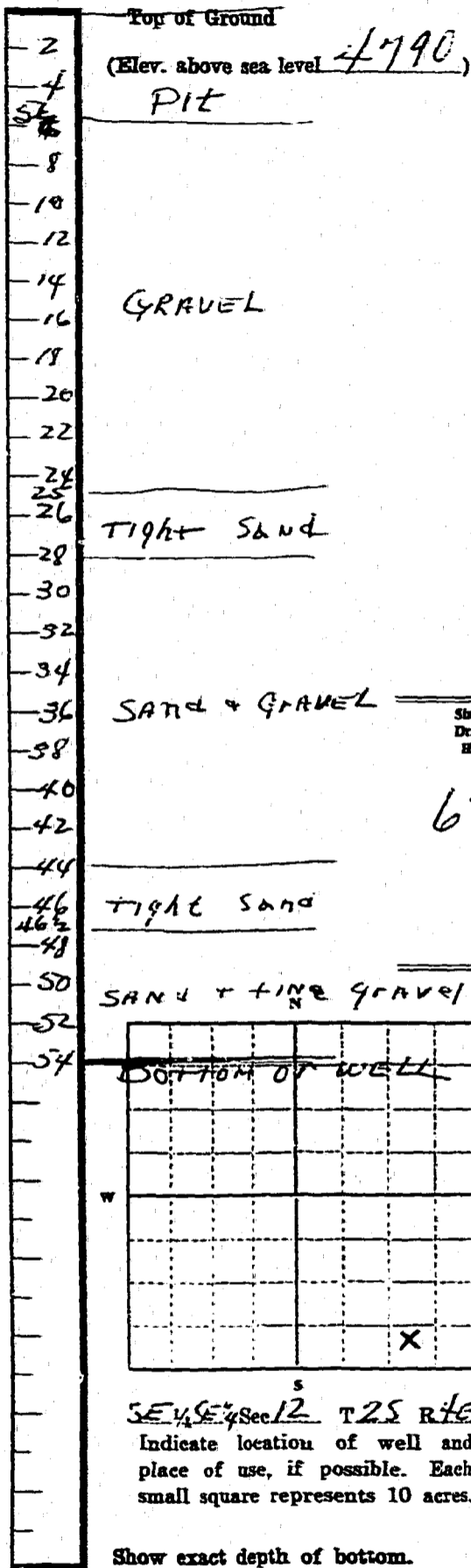

Size of Drilled Hole	Size and Weight of Casing	From (Feet)	To (Feet)	PERFORATIONS		
				Kind Size	From (Feet)	To (Feet)
<u>6 5/8"</u>	<u>6 7/8" OD</u>	<u>3 1/2'</u>	<u>54'</u>	<u>NONE</u>		
	<u>1 1/2"</u>	<u>BELOW SURFACE</u>				

Static Water Level for non-flowing Well 12 1/2 feet.

Shut-in Pressure for Flowing Well NONE

Pumping Water Level 54 feet at 30 gal. per minute.

Discharge in gal. per min. of flowing well NONE

How Tested PUMP Length of Test 1 hr 15 MIN

Remarks: (Gravel packing, cementing, packers, type of shutoff, location of place of use of groundwater if not at well, and any other similar pertinent information, including number of acres irrigated, if used for irrigation) IRRIGATION

INCLUDES APPROXIMATELY 2 ACRES OF YARD + GARDEN.

17  
Driller's License Number

Milton E. Jones  
Driller's Signature

This form to be prepared by driller, and three copies to be filed by the owner with the County Clerk and Recorder in the county in which the well is located.

Please answer all questions. If not applicable, so state, otherwise the form will be returned.

Original to the County Clerk and Recorder; duplicate to the State Engineer; Triplicate to the Montana Bureau of Mines and Geology and Quadruplicate for the Appropriator.

1247

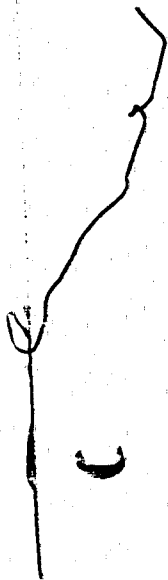

State of Montana )  
County of Gallatin ) ss.

Filed 12-30 1963

at 12:43 o'clock P.M.

Carl Walton

COUNTY CLERK & RECORDER

Theresa Alder

DEPUTY

Fee \$2.00

File No. \_\_\_\_\_

T. 2 R. 4E

DUPLICATE

County Gallatin

STATE OF MONTANA  
ADMINISTRATOR OF GROUNDWATER CODE  
OFFICE OF STATE ENGINEER

RECEIVED  
APR 1 1963

Declaration of Vested Groundwater Rights

(Under Chapter 237, Montana Session Laws, 1961)

STATE ENGINEER

I, Alice M. Sweeney, of Route 1 Bozeman  
(Name of Appropriator) (Address) (Town)

County of Gallatin State of Montana

have appropriated groundwater according to the Montana laws in effect prior to January 1, 1962, as follows:

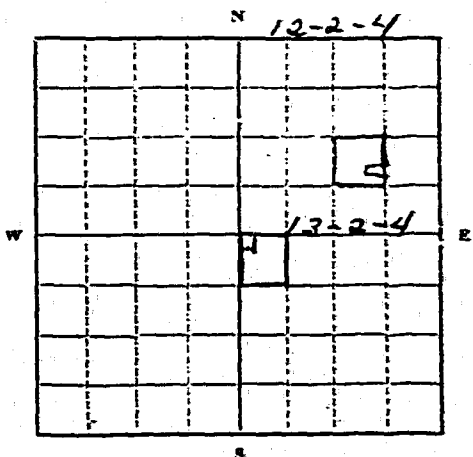

1/4 Sec. T. 2 R. 4E

Indicate point of appropriation and place of use, if possible. Each small square represents 10 acres.

2. The beneficial use on which the claim is based Household and irrigation

3. Date or approximate date of earliest beneficial use; and how continuous the use has been April 1872 and continuously since that date.

4. The amount of groundwater claimed (in miner's inches or gallons per minute) Approximately 50" in each well.

5. If used for irrigation, give the acreage and description of the lands to which water has been applied and name of the owner thereof 7 acres and the owner is Alice Menard Sweeney

6. The means of withdrawing such water from the ground and the location of each well or other means of withdrawal originally hand pump, now electric pump on both wells. SE 1/4 NW 1/4 SE 1/4 Sec. 12 T. 2 R. 4. NE 1/4 NE 1/4 Sec. 13 T. 2 R. 4.

7. The date of commencement and completion of the construction of the well, wells, or other works for withdrawal of groundwater April 1872

8. The depth of water table Approximately 30"

9. So far as it may be available, the type, size and depth of each well or the general specifications of any other works for the withdrawal of groundwater. There are two wells, both electric pumps, both approximately 50' and 3 1/2' diameter. The well on the NE 1/4 NE 1/4 NE 1/4 Sec. 13-2-4 was built approx. Oct. 20, 1911.

10. The estimated amount of groundwater withdrawn each year. The estimated amount of water withdrawn has never been recorded.

11. The log of formations encountered in the drilling of each well if available not available.

12. Such other information of a similar nature as may be useful in carrying out the policy of this act, including reference to book and page of any county record. There is no other information available within the knowledge of the undersigned.

Signature of Owner Alice M. Sweeney

Date May 1, 1962

Three copies to be filed by the owner with the County Clerk and Recorder of the county in which the well is located.

Please answer all questions. If not applicable, so state, otherwise the form will be returned.

Original to the County Clerk and Recorder; duplicate to the State Engineer; Triplicate to the Montana Bureau of Mines and Geology, and Quadruplicate for the Appropriator.



#609

45515

State of Montana ss.  
County of Granite

Mar 29 1953

10:30 o'clock P.M.

*Paul LeBlond*  
COUNTY CLERK & RECORDER

*2007* DEPUTY



File No. \_\_\_\_\_

DUPLICATE

RECEIVED  
MAY 7 1963

T 2 S R 4 E

County Gallatin

STATE ENGINEER  
ADMINISTRATOR OF GROUNDWATER CODE  
OFFICE OF STATE ENGINEER

Declaration of Vested Groundwater Rights ENGINEER  
(Under Chapter 237, Montana Session Laws, 1961)

I Alice M. Sweeney of Route 1, Bosman  
(Name of Appropriator) (Address) (Town)  
County of Gallatin State of Montana  
have appropriated groundwater according to the Montana laws in effect prior to January 1, 1962, as follows:

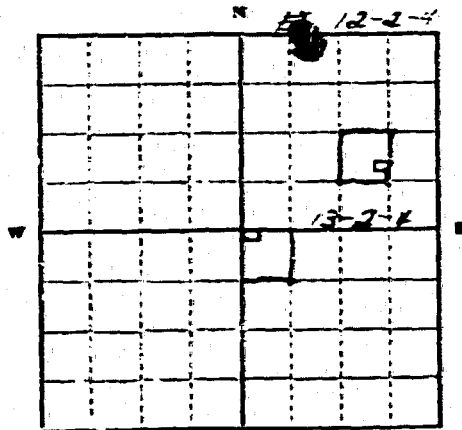

NW 13 of 13  
NW/SE 12 T2S R 4E

Indicate point of appropriation and place of use, if possible. Each small square represents 10 acres.

2. The beneficial use on which the claim is based Household and irrigation.

3. Date or approximate date of earliest beneficial use; and how continuous the use has been April 1872 and continuously since that date.

4. The amount of groundwater claimed (in miner's inches or gallons per minute) Approximately 50 " in each well.

5. If used for irrigation, give the acreage and description of the lands to which water has been applied and name of the owner thereof 7 acres and the owner is Alice Manard Sweeney

6. The means of withdrawing such water from the ground and the location of each well or other means of withdrawal. originally hand pump, now electric pump on both wells. SE 1/4 NW 1/4 SE 1/4 Sec. 12 T 2 R 4. NE 1/4 NE 1/4 NE 1/4 Sec. 13 T 2 R 4.

7. The date of commencement and completion of the construction of the well, wells, or other works for withdrawal of groundwater. April 1872

8. The depth of water table. Approximately 30"

9. So far as it may be available, the type, size and depth of each well or the general specifications of any other works for the withdrawal of groundwater. There are two wells, both electric pumps, both approximately 50' and 3 1/2' diameter. The well on the NE 1/4 NE 1/4 NE 1/4 Sec. 13-2-4 was built approx. Oct. 20, 1911.

10. The estimated amount of groundwater withdrawn each year. The estimated amount of water withdrawn has never been recorded.

11. The log of formations encountered in the drilling of each well if available. not available.

12. Such other information of a similar nature as may be useful in carrying out the policy of this act, including reference to book and page of any county record. There is no other information available within the knowledge of the undersigned.

Signature of Owner Alice M. Sweeney

Date May 1, 1962

Three copies to be filed by the owner with the County Clerk and Recorder of the county in which the well is located.

Please answer all questions. If not applicable, so state, otherwise the form will be returned.

Original to the County Clerk and Recorder; duplicate to the State Engineer; Triplicate to the Montana Bureau of Mines and Geology, and Quaduplicate for the Appropriator.

# 556-A

State of Montana ss.  
County of Gallatin

Filed Nov 19 1962  
at 8<sup>30</sup> East Wallon A.M.

COUNTY CLERK & RECORDER

By Ida J. Morrow

Fee \$ 2.00 Pd.

13

File No. \_\_\_\_\_

T 25 R 4 E

DUPLICATE

County \_\_\_\_\_

STATE OF MONTANA  
ADMINISTRATOR OF GROUNDWATER CODE  
OFFICE OF STATE ENGINEER

JAN 16 1964

Declaration of Vested Groundwater Rights

(Under Chapter 237, Montana Session Laws, 1961)

1 Myron W. Beatty, of Route 1, Bogman  
(Name of Appropriator) (Address) (Town)

County of Gallatin State of Montana  
have appropriated groundwater according to the Montana laws in effect prior to January 1, 1962, as follows:

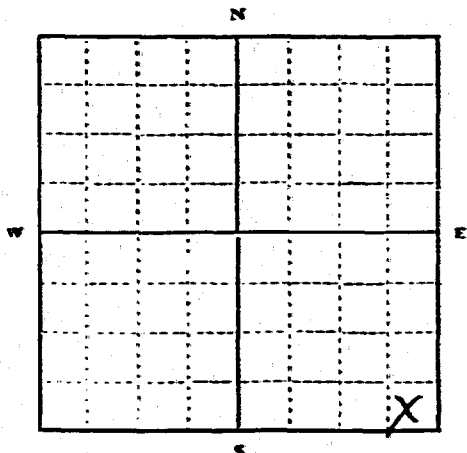

SE 1/4 Sec. 13 T25 R4E

Indicate point of appropriation and place of use, if possible. Each small square represents 10 acres.

2. The beneficial use on which the claim is based House, livestock garden, lawns etc

3. Date or approximate date of earliest beneficial use; and how continuous the use has been 1912 or earlier in continuous use

4. The amount of groundwater claimed (in miner's inches or gallons per minute) 350 - 1000 gal Per day

5. If used for irrigation, give the acreage and description of the lands to which water has been applied and name of the owner thereof 1 1/2 acres adjacent to wells

6. The means of withdrawing such water from the ground and the location of each well or other means of withdrawal drawn by electric powered pumps at wells

7. The date of commencement and completion of the construction of the well, wells, or other works for withdrawal of groundwater. 1 well approximately 1912 - other 1957

8. The depth of water table variable - approximately 20 ft

9. So far as it may be available, the type, size and depth of each well or the general specifications of any other works for the withdrawal of groundwater.

10. The estimated amount of groundwater withdrawn each year. 350 - 1000 gal Per day

11. The log of formations encountered in the drilling of each well if available.

12. Such other information of a similar nature as may be useful in carrying out the policy of this act, including reference to book and page of any county record.

Signature of Owner Myron W. Beatty  
Date Dec 28 1963

Three copies to be filed by the owner with the County Clerk and Recorder of the county in which the well is located.

Please answer all questions. If not applicable, so state, otherwise the form will be returned.

Original to the County Clerk and Recorder; Duplicate to the State Engineer; Triplicate to the Montana Bureau of Mines and Geology, and Quaduplicate for the Appropriator.

#1211

County of Gallatin  
Filed **December 30**, 1963  
at **9:30** o'clock **A**.M.  
**EARL WALTON**  
By *Thomas J. Feltner*  
Fee \$ **2.00** DEPUTY

File No. WATER CONSERVATION BOARD

T 22 R 4E

13  
24

DUPLICATE

JAN 12 1966

County Gallatin

Billie \_\_\_\_\_ McDemott  
Eustace \_\_\_\_\_ McNulty  
Coyne \_\_\_\_\_  
Donahoe \_\_\_\_\_  
Dicker \_\_\_\_\_  
**STATE OF MONTANA**  
**ADMINISTRATOR OF GROUNDWATER CODE**  
**OFFICE OF STATE ENGINEER**

### Notice of Completion of Groundwater Appropriation Without Well

(Under Chapter 237 Montana Session Laws, 1961)

Date of Appropriation of Groundwater July 1, 1959

Owner Louis A. Bruno Address Route 1, Bozeman, Montana

Contractor (if any) Not applicable

Address of Contractor Not applicable

Date Started before July 1, 1959 Date Completed July 1, 1959

Describe means of obtaining groundwater without a well "as by sub-irrigation and other natural processes". Include depth to water when applicable. drainage ditch cut from swamp leading to pasture on the Southwest Quarter of the Southwest Quarter, Section 13, the Northwest Quarter of the Northwest Quarter, Section 24, and tracts numbered 563 through 584 of the Rainbow Subdivision, all in Township 2 South, Range 4 East, M. P. M., Gallatin County, Montana.

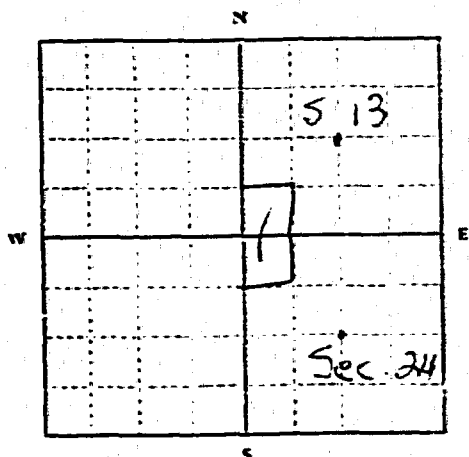

Quantity of water developed and used with explanation of method used to measure or estimate such amount. If use is intermittent

estimate approximate lengths of periods of use \_\_\_\_\_

50 miner's inches. Used for irrigation of pasture. Use is from spring through August of each year.

Signature of Owner Louis A. Bruno

Date December 30, 1965



Indicate point of appropriation and place of use, if possible.

**SW $\frac{1}{4}$  of the SW $\frac{1}{4}$ , Sec. 13**  
**NW $\frac{1}{4}$  of the NW $\frac{1}{4}$ , Sec. 24**  
**Tracts numbered 563-584,**  
**Township 2 South, Range**  
**4 East, M. P. M.**

This form to be prepared by contractor (if any), otherwise by the owner.

Three copies of this notice are to be filed with the County Clerk and Recorder of the county in which the works are located.

Please answer all questions. If not applicable, so state, otherwise the form will be returned.

Original to the County Clerk and Recorder; duplicate to the State Engineer; Triplicate to the Montana Bureau of Mines and Geology and Quadruplicate for the Appropriator.

40736

#1971

State of Montana } ss.  
County of Gallatin }  
Filed **January 10**, 1963  
at **8:10** o'clock **A.M.**  
**CARL L. STUCKY**  
County Clerk & Recorder  
By *Paul G. Maples*  
Deputy  
Fee \$ **2.00**

RECORDED  
INDEXED  
JAN 10 1963  
GALLATIN COUNTY CLERK'S OFFICE  
MONTANA

T. 25 R. 4E <sup>13</sup>  
County \_\_\_\_\_

MONTANA BUREAU OF MINES AND GEOLOGY  
Butte, Montana

RECEIVED

WATER WELL LOG

STATE ENGINEER

Owner Clarence W. Curdy Address \_\_\_\_\_  
Driller M. E. ... Address 3-2...  
Date Started Aug 15 1951 Date Completed Aug 7 1951  
Location: Sec. 15 T. 25 R. 4E  $\frac{1}{4}$  sec. E  $\frac{1}{2}$  E  $\frac{1}{2}$

Type of well D Equipment used Churn Drill  
(Dug, driven, bored, or drilled) (Churn drill, rotary, other)

Water use: Domestic  Municipal  Stock  Irrigation   
Industrial  Drainage  Other: \_\_\_\_\_

Casing: 5 1/2 ft. to 7 ft. Type ... Size 7 00  
Casing: \_\_\_\_\_ ft. to \_\_\_\_\_ ft. Type \_\_\_\_\_ Size \_\_\_\_\_  
Casing: \_\_\_\_\_ ft. to \_\_\_\_\_ ft. Type \_\_\_\_\_ Size \_\_\_\_\_

Perforated or Screened: Ft. \_\_\_\_\_ to ft. \_\_\_\_\_ Ft. \_\_\_\_\_ to ft. \_\_\_\_\_

Type of screen or perforations ...

Static Water level, for non-flowing well: 27 feet.

Shut-in pressure, for flowing well: \_\_\_\_\_ lb./sq. in. on: \_\_\_\_\_ (date)

Pumping water level 55 feet at 20 gal. per min.

How tested: ...

Length of test 1 H...

Remarks: (Gravel packing, cementing, packers, type of shut-off, depth of shut-off)  
\_\_\_\_\_  
\_\_\_\_\_  
\_\_\_\_\_  
\_\_\_\_\_

T. 25 R. 4E 13  
County Carbon

MONTANA BUREAU OF MINES AND GEOLOGY  
Butte, Montana

RECEIVED  
MAR 23 1961

WATER WELL LOG

STATE ENGINEER  
D07-1127

Owner Clarence W. Curdy Address Bozeman  
Driller M.E. Jones Address Bozeman  
Date Started August 5, 1957 Date Completed Aug. 7, 1959  
Location: Sec 13 T. 25 R. 4E  $\frac{1}{4}$  sec. E  $\frac{1}{2}$  E  $\frac{1}{2}$

Type of well Drilled (Dug, driven, bored, or drilled) Equipment used Cherry Drill (Churn drill, rotary, other)

Water use: Domestic  Municipal  Stock  Irrigation   
Industrial  Drainage  Other: \_\_\_\_\_

Casing: Surface ft. to 57 1/2 ft. Type Black Steel Size 7" OD 1.33  
Casing: \_\_\_\_\_ ft. to \_\_\_\_\_ ft. Type \_\_\_\_\_ Size \_\_\_\_\_  
Casing: \_\_\_\_\_ ft. to \_\_\_\_\_ ft. Type \_\_\_\_\_ Size \_\_\_\_\_

Perforated or Screened: Ft. \_\_\_\_\_ to ft. \_\_\_\_\_ Ft. \_\_\_\_\_ to ft. \_\_\_\_\_

Type of screen or perforations None

Static Water level, for non-flowing well: 37 feet.

Shut-in pressure, for flowing well: \_\_\_\_\_ lb./sq. in. on: \_\_\_\_\_ (date)

Pumping water level 5 feet at 20 gal. per min.

How tested: Well

Length of test: 1 Hour

Remarks: (Gravel packing, cementing, packers, type of shut-off, depth of shut-off)  
\_\_\_\_\_  
\_\_\_\_\_  
\_\_\_\_\_  
\_\_\_\_\_

(over)



**Log of Well**

Depth, feet		Description of Material Drilled
From	To	
51	0	Top
	1	fine sand
2	32	fine sand
32		fine sand
32		fine sand
37	44	clay
44	51	fine sand
51	53	clay
53		fine sand

(Stillman County, SS.  
 State of Montana.  
 Filed May 27 1904  
 at 3 30 o'clock P.M.  
 by Geo. L. Walker  
 COUNTY CLERK & EXOFFICIO  
 By Geo. J. McNameis DEPUTY  
 Fee \$



File No. \_\_\_\_\_

T 25 R 4E

DUPLICATE

County Dallatin

STATE OF MONTANA  
ADMINISTRATOR OF GROUNDWATER CODE  
OFFICE OF STATE ENGINEER

JAN 16 1964

Declaration of Vested Groundwater Rights

(Under Chapter 237, Montana Session Laws, 1961)

1. Herman John and Ferna Ogbitso of RRI Bozeman  
(Name of Appropriator) (Address) (Town)

County of Dallatin State of Montana  
have appropriated groundwater according to the Montana laws in effect prior to January 1, 1962, as follows:

1/4 Sec 13 T 25 R 4E

Indicate point of appropriation and place of use, if possible. Each small square represents 10 acres.

Lot 481 - Rainbow  
sub division - Bozeman  
hot Springs.

2. The beneficial use on which the claim is based house use  
and irrigation

3. Date or approximate date of earliest beneficial use; and how continuous the use has been Oct 1959  
continuously

4. The amount of groundwater claimed (in miner's inches or gallons per minute) 29 gallons per minute.

5. If used for irrigation, give the acreage and description of the lands to which water has been applied and name of the owner thereof  
1 acre - grass and garden  
Herman John and Ferna Ogbitso

6. The means of withdrawing such water from the ground and the location of each well or other means of withdrawal pressure system  
sub division - Bozeman  
hot Springs

7. The date of commencement and completion of the construction of the well, wells, or other works for withdrawal of groundwater Oct 1959

8. The depth of water table 8 feet

9. So far as it may be available, the type, size and depth of each well or the general specifications of any other works for the withdrawal of groundwater 6 inch casing - 27 ft deep.

10. The estimated amount of groundwater withdrawn each year 400,000 gallons.

11. The log of formations encountered in the drilling of each well if available not available

12. Such other information of a similar nature as may be useful in carrying out the policy of this act, including reference to book and page of any county record none

Signature of Owner Ferna Ogbitso  
Herman John Ogbitso  
Date Dec 30, 1963

Three copies to be filed by the owner with the County Clerk and Recorder of the county in which the well is located.  
Please answer all questions. If not applicable, so state, otherwise the form will be returned.

Original to the County Clerk and Recorder; Duplicate to the State Engineer; Triplicate to the Montana Bureau of Mines and Geology, and Quadruplicate for the Appropriator.

35876

1562

1563

State of Montana )  
County of Gallatin ) SS.

Executed this 31 day of Dec, 1963

at 11.44 o'clock A.M.

Earl Walters

COUNTY CLERK & RECORDER

EW

yc