

File No.

T. 28 R. 7E

DUPLICATE

sw

County... Beaumont

RECEIVED
DEC 5 1963

STATE OF MONTANA
ADMINISTRATOR OF GROUNDWATER CODE
OFFICE OF STATE ENGINEER

STATE ENGINEER

Notice of Completion of Groundwater Appropriation
Without Well

(Under Chapter 237 Montana Session Laws, 1961)

Date of Appropriation of Groundwater... 5/31/62

Owner... Cleo S. Butler & Ellis N. Butler Address... Route #2 Bozeman, Mont.

Contractor (if any) ... Not Applicable

Address of Contractor ... Not Applicable

Date Started... Not Applicable Date Completed... Not Applicable

Describe means of obtaining groundwater without a well "as by sub-irrigation and other natural processes". Include depth to water when applicable.

Springs and creeks sw

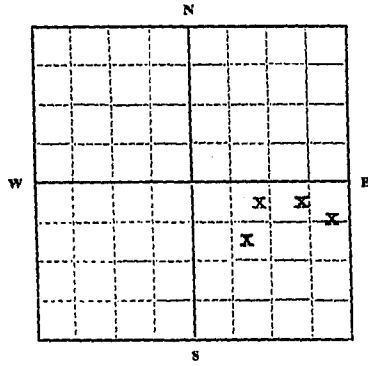

N 1/4 SE Sec. 18 T2 S R. 7 E

Indicate point of appropriation and place of use, if possible.

Quantity of water developed and used with explanation of method used to measure or estimate such amount. If use is intermittent

estimate approximate lengths of periods of use... 6 Months

per Year

Signature of Owners... Cleo S. Butler & Ellis N. Butler

Date... 10/9/63

This form to be prepared by contractor (if any), otherwise by the owner.

Three copies of this notice are to be filed with the County Clerk and Recorder of the county in which the works are located.

Please answer all questions. If not applicable, so state, otherwise the form will be returned.

Original to the County Clerk and Recorder; duplicate to the State Engineer; Triplicate to the Montana Bureau of Mines and Geology and Quadruplicate for the Appropriator.

#802

State of Montana }
County of Gallatin } ss.

Filed **December 4**, 1963

at **2:22** o'clock **P** M.

EARL WALTON

COUNTY CLERK & REGISTER

By *Luella A. Maxwell*

DEPUTY

Fee \$ **2.00** pd

257E18
RECEIVED 18
County Golden

STATE OF MONTANA
ADMINISTRATOR OF GROUNDWATER CODE
MONTANA WATER RESOURCES BOARD
MONTANA DEPARTMENT OF NATURAL
RESOURCES AND CONSERVATION

JUL 5 1973

NOTICE OF COMPLETION OF GROUNDWATER APPROPRIATION WITHOUT WELL
Developed After January 1, 1962

(Under Chapter 237, Montana Session Laws, 1961, as amended)

This form to be prepared by contractor (if any), otherwise by the owner.
Three copies of this notice are to be filed with the County Clerk and Recorder of the county in which the works are located.
Please answer all questions. If not applicable, so state, otherwise the form may be returned.

For Administrator's Use
File 3358
6-29-73
GW 1 302 p.m.

Owner ^{McClue} RICHARD L. & DENISE B. McCLUE
WESTBERG TRACTS, RTE 1, Bozeman
Address ~~26~~ ~~Westberg~~ ~~Tracts~~ Lot 6

Contractor (if any) _____
Address of Contractor _____
Date Started _____ Date Completed _____

1. Describe means of obtaining groundwater (as by sub-irrigation, developed spring, drains, etc.) _____

Developed Spring

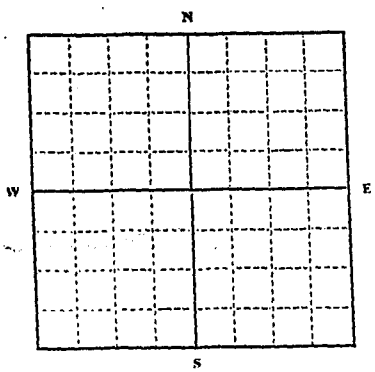

NW 1/4 SW 1/4 ^{NE 1/4} SEC. 18
T. 2 S. R. 7 E.

INDICATE POINT OF APPROPRIATION AND PLACE OF USE, IF POSSIBLE.
Elevation of spring, if known or estimated _____

2. Means of withdrawing water (gravity, pump, canal, etc.) _____

gravity

3. Depth of water table _____

4. Use of the water Personal Domestic +
use on 10 acres on lot 6 Westberg

5. Amount of groundwater claimed (in miner's inches or gallons per minute) 10 MINER'S INCHES

6. If used for irrigation, give number of acres and description of land 10 ACRES
LOT 6 WESTBERG TRACTS

7. Estimate amount of water used each year _____

8. Months of year spring flows 12 MONTHS

Signature of Owner Denise B. McClue
Date 6/29/73

55489

3358

State of Montana
County of Gallatin

Filed June 29 19 73
at 3:02 o'clock P.M.

Paul P. Smith
County Clerk & Recorder

By Chela M. Whitman
Deputy

Fee \$ 2.00 pd

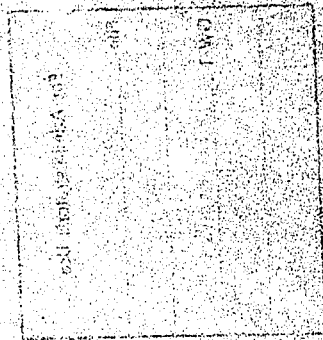

[Faint, mostly illegible text and markings, possibly bleed-through or a very light stamp. Some words like 'RECORDED' and 'INDEXED' are faintly visible.]

RECEIVED

JUL 5 1973

25-7E
County Gallatin 18

STATE OF MONTANA
ADMINISTRATOR OF NATURAL RESOURCES AND CONSERVATION
MONTANA DEPARTMENT OF NATURAL RESOURCES AND CONSERVATION
ADMINISTRATOR OF GROUNDWATER CODE
MONTANA WATER RESOURCES BOARD

NOTICE OF COMPLETION OF GROUNDWATER APPROPRIATION WITHOUT WELL

Developed After January 1, 1962

(Under Chapter 237, Montana Session Laws, 1961, as amended)

This form to be prepared by contractor (if any), otherwise by the owner.

Three copies of this notice are to be filed with the County Clerk and Recorder of the county in which the works are located.

Please answer all questions. If not applicable, so state, otherwise the form may be returned.

For Administrator's Use	
File	<u>3369</u>
	<u>6-29-73</u>
GW 1	<u>4:16 p.m.</u>

Owner Larry + Marla Schroeder

Address 102 Kowitz TRB, KT, Bozeman

Contractor (if any) _____

Address of Contractor _____

Date Started _____ Date Completed _____

1. Describe means of obtaining groundwater (as by sub-irrigation, developed spring, drains, etc.) _____

Developed Spring

2. Means of withdrawing water (gravity, pump, canal, etc.) _____

Pump + gravity

3. Depth of water table _____

Surface

4. Use of the water _____

Domestic + Sprinkle Irrigation

5. Amount of groundwater claimed (in miner's inches or gallons per minute) _____

50 inches

6. If used for irrigation, give number of acres and description of land _____

4 acres

7. Estimate amount of water used each year _____

182,500

8. Months of year spring flows _____

12

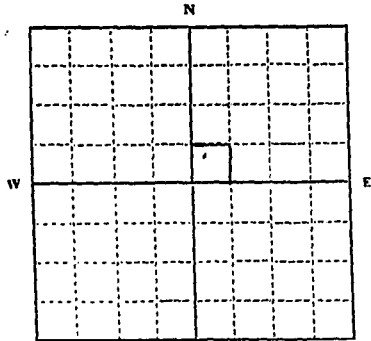

TR. 10 of Westberg Tracts

SW 4 SW 1/4 NE 1/4 Sec. 18

T. 2 S R. 7 E

INDICATE POINT OF APPROPRIATION AND PLACE OF USE, IF POSSIBLE.

Elevation of spring, if known or estimated 4900' estimated

Signature of Owner _____

Date _____

55522

3369

State of Montana }
County of Gallatin } ss.
Filed June 29 1973
at 4:16 o'clock P.M.
Paul L. Stuby
County Clerk & Recorder
By Alta Naugon
Deputy
Fee \$ 2.00

RECEIVED

25-7E

18

GW 3 Revised 1969
191-1500-10/69

JUL 5 1973

County GALLATIN

MONTANA DEPARTMENT OF STATE OF MONTANA
RESOURCES ADMINISTRATION OF GROUNDWATER CODE
MONTANA WATER RESOURCES BOARD

NOTICE OF COMPLETION OF GROUNDWATER APPROPRIATION WITHOUT WELL

Developed After January 1, 1962

(Under Chapter 237, Montana Session Laws, 1961, as amended)

This form to be prepared by contractor (if any), otherwise by the owner.

Three copies of this notice are to be filed with the County Clerk and Recorder of the county in which the works are located.

Please answer all questions. If not applicable, so state, otherwise the form may be returned.

For Administrator's Use

File 3355

2:50 p.m.

GW 1 June, 1973

Owner LARRY N & DARLENE KAY WILLARD
Address 113 WESTFARG, TRACTS, RFE 1, BIGHAM, M.T.

Contractor (if any) _____

Address of Contractor _____

Date Started _____ Date Completed _____

1. Describe means of obtaining groundwater (as by sub-irrigation, developed spring, drains, etc.) _____

DEVELOPED SPRING

2. Means of withdrawing water (gravity, pump, canal, etc.) _____

GRAVITY

3. Depth of water table _____

4. Use of the water DOMESTIC USE ON

10 ACRES ON LOT 13, WESTFARG TRACTS

5. Amount of groundwater claimed (in miner's inches or gallons per minute) _____

10 MINER'S INCHES

6. If used for irrigation, give number of acres and description of land _____

10 ACRES

LOT 13, WESTFARG TRACTS

7. Estimate amount of water used each year _____

8. Months of year spring flows _____

12 MONTHS

Signature of Owner Darlene Kay Willard

Date June 29, 1973

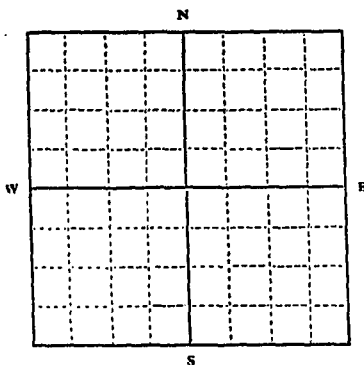

3 1/4 Sec. 10, 11, 12, 13

T. 7N R. 7E

INDICATE POINT OF APPROPRIATION AND PLACE OF USE, IF POSSIBLE.

Elevation of spring, if known or estimated _____

55581

3355

State of Montana } ss.
County of Gallatin }

Filed June 1973
at 2:50 o'clock P.M.

County Clerk & Recorder
By Alex M. Whitman
Deputy
Fee \$ 2.00

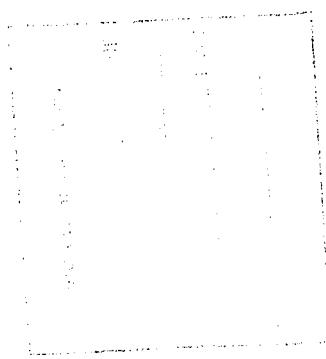

Notary Public for the State of Montana

File No.

T. 25 R 7E

DUPLICATE

County Gallatin

STATE OF MONTANA
ADMINISTRATOR OF GROUNDWATER CODE
OFFICE OF STATE ENGINEER

RECEIVED
JUL 30 1963
STATE ENGINEER

Declaration of Vested Groundwater Rights

(Under Chapter 237, Montana Session Laws, 1961)

1. Chestnut School Dist #43, of Route #2 Bozeman
(Name of Appropriator) (Address) (Town)
County of Gallatin State of Montana
have appropriated groundwater according to the Montana laws in effect prior to January 1, 1962, as follows:

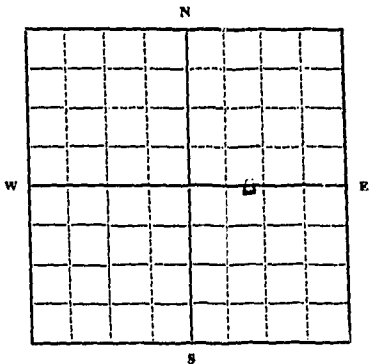

SE 1/4 Sec. 20 T. 25 R. 7E

Indicate point of appropriation and place of use, if possible. Each small square represents 10 acres.

2. The beneficial use on which the claim is based. Domestic

3. Date or approximate date of earliest beneficial use; and how continuous the use has been. 1950
9 Mo. School Term

4. The amount of groundwater claimed (in miner's inches or gallons per minute).....

5. If used for irrigation, give the acreage and description of the lands to which water has been applied and name of the owner thereof.....

6. The means of withdrawing such water from the ground and the location of each well or other means of withdrawal. Electric Pumping System

7. The date of commencement and completion of the construction of the well, wells, or other works for withdrawal of groundwater. 1950

8. The depth of water table.....

9. So far as it may be available, the type, size and depth of each well or the general specifications of any other works for the withdrawal of groundwater. 6" Drilled 9.5' Deep

10. The estimated amount of groundwater withdrawn each year.....

11. The log of formations encountered in the drilling of each well if available.....

12. Such other information of a similar nature as may be useful in carrying out the policy of this act, including reference to book and page of any county record.....

Signature of Owner. Chestnut School
by James Kurks - Chairman
Date. May 31 1963

Three copies to be filed by the owner with the County Clerk and Recorder of the county in which the well is located.

Please answer all questions. If not applicable, so state, otherwise the form will be returned.

Original to the County Clerk and Recorder; duplicate to the State Engineer; Triplicate to the Montana Bureau of Mines and Geology, and Quadruplicate for the Appropriator.

#673

State of Montana } ss.
County of Gallatin }

Filed July 26, 1963
at 11:15 o'clock A.

EARI WALTON
COUNTY CLERK & RECORDER

By Ida J. Morrow
DEPUTY

Fee \$

Form No. 18
8-60

20

T. 25 R. 7E

County Ballantine

RECEIVED

MONTANA BUREAU OF MINES AND GEOLOGY
Butte, Montana

STATE ENGINEER

WATER WELL LOG

Owner Wesley S. Plavin Address Rt #2 Bozeman,

Driller M. E. Jones Address Bozeman

Date Started Oct. 12, 1961 Date Completed Oct 27, 1961

Location: Sec. 20 T. 25 R. 7E $\frac{1}{4}$ sec. NW 4/SE 4/

Type of well Drilled Equipment used Churn Drill
(Dug, driven, bored, or drilled) (Churn, drill, rotary, other)

Water use: Domestic Municipal Stock Irrigation
Industrial Drainage Other _____

Casing: Surface ft. to 60' ft. Type Black Size 6 5/8" O.D. 15#

Casing: _____ ft. to _____ ft. Type _____ Size _____

Casing: _____ ft. to _____ ft. Type _____ Size _____

Perforated or Screened: Ft. 60' to ft. 200' Ft. 0 to ft. _____

Type of screen or perforations 5" x 20 to 60 Gal. Limer

Static Water level, for non-flowing well: 35 feet.

Shut-in pressure, for flowing well: _____ lb./sq. in. on: _____ (date)

Pumping water level 200 feet at 4 gal. per min.

How tested: Pump

Length of test 4 hours.

Remarks: (Gravel packing, cementing, packers, type of shut-off, depth of shut-off)

(over)

File No.....

T. 2 S..... R. 7 E.....

DUPLICATE

County.....Gallatin.....

STATE OF MONTANA
ADMINISTRATOR OF GROUNDWATER CODE
OFFICE OF STATE ENGINEER

RECEIVED
DEC 6 1963

STATE ENGINEER

Notice of Completion of Groundwater Appropriation
Without Well

(Under Chapter 237 Montana Session Laws, 1961)

Date of Appropriation of Groundwater.....1949.....
Owner.....~~Gertrude Baker~~..... Address.....~~Santa Monica, Calif.~~.....
Contractor (if any).....~~(none)~~.....System built by.....~~Ralph K. Williams,~~
Address of Contractor.....~~former owner. Date obtained from him.~~

Date Started.....1949..... Date Completed.....~~probably 1949~~.....

Describe means of obtaining groundwater without a well "as by sub-irrigation and other natural processes". Include depth to water when applicable.....~~Water runs from spring in side of hill to concrete box 51x71x39 inches in size, from which it is piped approx. 700 ft. to house for house and yard use. Pipe is 1 1/2", reduced to 3/4" at house. Depth of water in box is about 18".~~

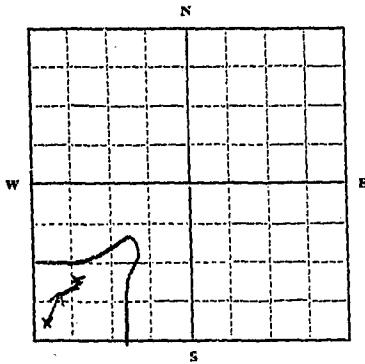

SW 1/4..... Sec. 21..... T. 25..... R. 7 E.....
Indicate point of appropriation and place of use, if possible.

Quantity of water developed and used with explanation of method used to measure or estimate such amount. If use is intermittent estimate approximate lengths of periods of use.....~~Quantity varies with season and dryness of year; ranges from around 2 to 4 gals. per min. (System is inefficient; at least as much water runs out of spring into Linker creek several yards west.) Present use is from May through October.~~

Signature of Owner.....*Gertrude Baker*.....
Date.....*November 15, 1963*.....

This form to be prepared by contractor (if any), otherwise by the owner.

Three copies of this notice are to be filed with the County Clerk and Recorder of the county in which the works are located.

Please answer all questions. If not applicable, so state, otherwise the form will be returned.

Original to the County Clerk and Recorder; duplicate to the State Engineer; Triplicate to the Montana Bureau of Mines and Geology and Quadruplicate for the Appropriator.

804

State of Montana } ss.
County of Gallatin }

Filed Dec. 5, 1963
12:45 o'clock P.M.

at Bozeman

By Paul Wallum
COUNTY CLERK & RECORDER

By John F. Morrow
DEPUTY

Fee \$ 2.00

25-7E 2H

County REGAIVED

STATE OF MONTANA
ADMINISTRATOR OF GROUNDWATER CODE
MONTANA WATER RESOURCES BOARD

JUL 5 1973

MONTANA DEPARTMENT OF NATURAL
RESOURCES AND CONSERVATION

NOTICE OF COMPLETION OF GROUNDWATER APPROPRIATION WITHOUT WELL

Developed After January 1, 1962

(Under Chapter 237, Montana Session Laws, 1961, as amended)

This form to be prepared by contractor (if any), otherwise by the owner.

Three copies of this notice are to be filed with the County Clerk and Recorder of the county in which the works are located.

Please answer all questions. If not applicable, so state, otherwise the form may be returned.

For Administrator's Use	
File	<u>3300</u>
	<u>6-29-73</u>
GW 1	<u>1:15 p.m.</u>

Owner Howard and Mildred Carter
 Address Huffman Route, Livingston, Mont
 Contractor (if any) None
 Address of Contractor _____
 Date Started _____ Date Completed _____

1. Describe means of obtaining groundwater (as by sub-irrigation, developed spring, drains, etc.) NATURAL FLOW

2. Means of withdrawing water (gravity, pump, canal, etc.) NATURAL FLOW

3. Depth of water table UNKNOWN

4. Use of the water STOCK WATER

5. Amount of groundwater claimed (in miner's inches or gallons per minute) Ten inches

6. If used for irrigation, give number of acres and description of land NOT used for irrigation

7. Estimate amount of water used each year UNKNOWN

8. Months of year spring flows twelve

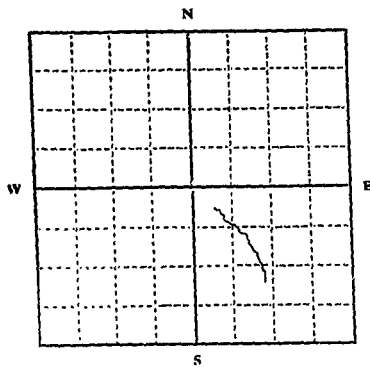

N.W. 1/4 S.E. 1/4 Sec. 24

T. 2 N. R. 7 E. W

INDICATE POINT OF APPROPRIATION AND PLACE OF USE, IF POSSIBLE.

Elevation of spring, if known or estimated 6,000 FT.

Signature of Owner Howard M. Carter

Date June 25, 1973

3300

State of Montana ss.
County of Ballwin

Filed June 27, 1973
at 1:15 o'clock P.M.

Carl P. Suckey
County Clerk & Recorder

By Alta Hargan
Deputy

Fee \$ 2⁰⁰ Ad.

31

File No.

T. 2S R. 7E

DUPLICATE

Hoell Spring

County Gallatin

STATE OF MONTANA
ADMINISTRATOR OF GROUNDWATER CODE
OFFICE OF STATE ENGINEER

RECEIVED
DEC 10 1963

STATE ENGINEER

Notice of Completion of Groundwater Appropriation Without Well

(Under Chapter 237 Montana Session Laws, 1961)

Date of Appropriation of Groundwater..... 1958

UNITED STATES OF AMERICA

Owner (Forest Service) Address Bozeman, Montana

Contractor (if any) N/A

Address of Contractor N/A

Date Started..... 1952 Date Completed..... 1958

Describe means of obtaining groundwater without a well "as by sub-irrigation and other natural processes". Include depth to water when applicable.....

Spring

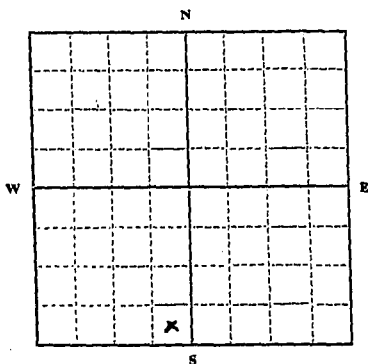

Quantity of water developed and used with explanation of method used to measure or estimate such amount. If use is intermittent

estimate approximate lengths of periods of use.....

HOELL SPRING - 6 G. P. M. - measured flow, AND TIMED.

Use period: Grazing season, approximately 4 months.

SE1/4SW1/4 1/4 Sec. 31 T. 2S R. 7E

Indicate point of appropriation and place of use, if possible.

HOELL SPRING

UNITED STATES OF AMERICA
Signature of Owner..... By [Signature]

Date..... December 4, 1963

This form to be prepared by contractor (if any), otherwise by the owner.

Three copies of this notice are to be filed with the County Clerk and Recorder of the county in which the works are located.

Please answer all questions. If not applicable, so state, otherwise the form will be returned.

Original to the County Clerk and Recorder; duplicate to the State Engineer; Triplicate to the Montana Bureau of Mines and Geology and Quadruplicate for the Appropriator.

8322

#831

State of Montana }
County of Gallatin } ss.

Filed December 9, 1963

at 12:02 o'clock P.M.

EARL WALTON

COUNTY CLERK & RECORDER

By Lucille A. Wapell

DEPUTY

Fee \$ 2.00

File No. _____

10257E

T. 28 R. 7E

DUPLICATE

County Park

STATE OF MONTANA
ADMINISTRATOR OF GROUNDWATER CODE
OFFICE OF STATE ENGINEER

RECEIVED
NOV 20 1963

Declaration of Vested Groundwater Rights

STATE ENGINEER

(Under Chapter 237, Montana Session Laws, 1961)

I, Northern Pacific Railway Co., of N.P. Depot West End
(Name of Appropriator) (Address) (Town)
County of Park State of Montana
have appropriated groundwater according to the Montana laws in effect prior to January 1, 1962, as follows:

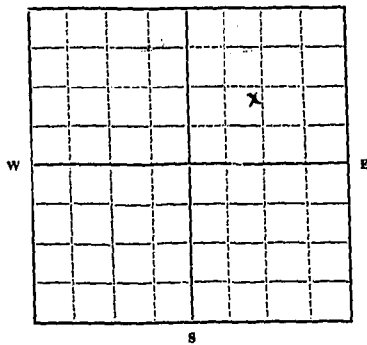

SW 1/4 NE Sec 14 T 28 R 7E

Indicate point of appropriation and place of use, if possible. Each small square represents 10 acres.

2. The beneficial use on which the claim is based.....
Domestic purposes

3. Date or approximate date of earliest beneficial use; and how continuous the use has been.....
June 4, 1946 to present

4. The amount of groundwater claimed (in miner's inches or gallons per minute).....
15 gallons per minute

5. If used for irrigation, give the acreage and description of the lands to which water has been applied and name of the owner thereof.....
None

6. The means of withdrawing such water from the ground and the location of each well or other means of withdrawal.....
Hand pump

7. The date of commencement and completion of the construction of the well, wells, or other works for withdrawal of groundwater.....
Started April 11, 1946 Completed June 4, 1946

8. The depth of water table..... 27 feet

9. So far as it may be available, the type, size and depth of each well or the general specifications of any other works for the withdrawal of groundwater.....
6 inch drilled well, 64 feet deep

10. The estimated amount of groundwater withdrawn each year..... 200,000 gallons

11. The log of formations encountered in the drilling of each well if available..... see attached log 66

12. Such other information of a similar nature as may be useful in carrying out the policy of this act, including reference to book and page of any county record.....
None

Signature of Owner..... *[Signature]*

Date..... NOV 8 '63

Three copies to be filed by the owner with the County Clerk and Recorder of the county in which the well is located.

Please answer all questions. If not applicable, so state, otherwise the form will be returned.

Original to the County Clerk and Recorder; duplicate to the State Engineer; Triplicate to the Montana Bureau of Mines and Geology, and Quadruplicate for the Appropriator.

7336

ICE, A.F.E. 114-46.

MONT. 66.
Oct. 16-53.
N.P.Ry. Rocky Mtn. Div.

97033

Filed this 19th day of
November A. D. 1963
at 2:30 o'clock P. M.

Margaret Monson
County Clerk and Recorder.
By Lamma Bowers
Fees \$2.00

Water Analysis, Nov. 25-53.

Calcium bicarbonate	5.2 G.P.G.	Expressed as CaCO ₃
Magnesium " sulfate	1.5 "	
Sodium carbonate bicarbonate	0.4 "	
" sulfate	0.0 "	
" chloride	1.6 "	
Silica	0.9 "	
Iron	0.72 "	
pH	0.0 P.P.M.	
Total dissolved solids	9.6 G.P.G. (actual)	
Turbidity	5	

Note: See file 1565-1, for drilling and test data,
Office of Engineer of Water Service, St. Paul.

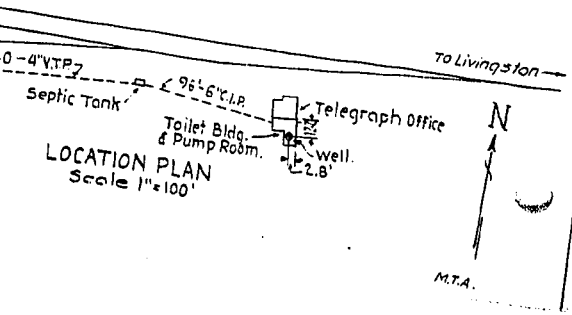

MONT. 66.

Oct. 16-53.

N.P.Ry. Rocky Mtn. Div.

WEST END, MONT. WELL AT TELEGRAPH OFFICE, A.F.E. 114-46.

6" Well, 63.7' deep.

Drilled by E.A. Bodin, N.P.Ry.

Work begun Apr. 11-46, completed June 4-46.

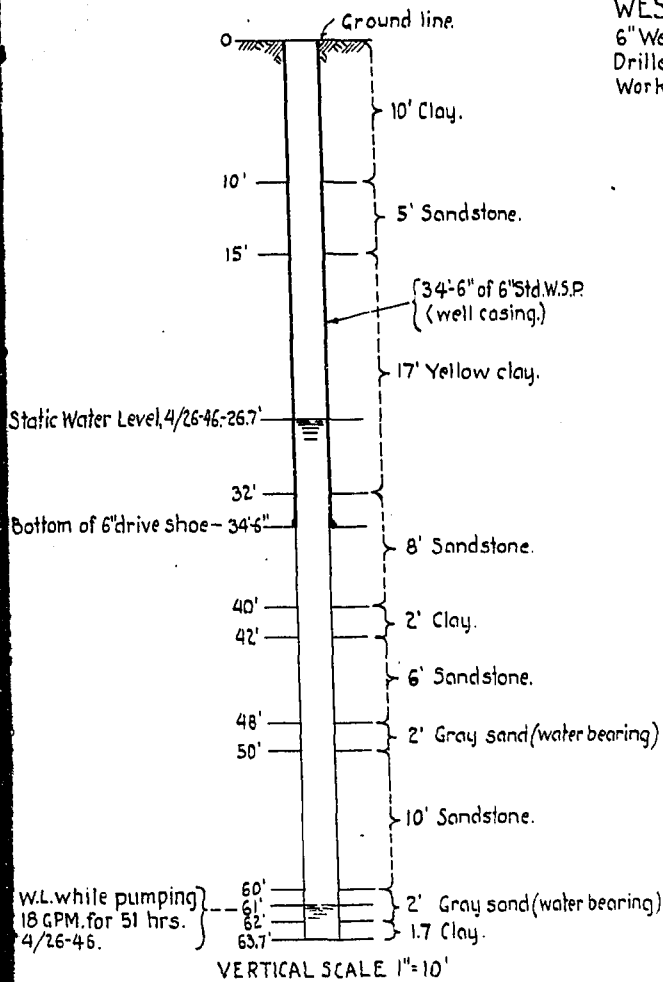

Water Analysis, Nov. 25-53.

Calcium bicarbonate	5.2 G.P.G.	Expressed as CaCO ₃
Magnesium "	1.5 "	
" sulfate	0.4 "	
Sodium carbonate	0.0 "	
" bicarbonate	0.0 "	
" sulfate	1.6 "	
" chloride	0.9 "	
Silica	0.72 "	
Iron	0.0 P.P.M.	
pH		
Total dissolved solids	9.6 G.P.G. (actual)	
Turbidity	5	

Note: See file 1565-1, for drilling and test data, Office of Engineer of Water Service, St. Paul.

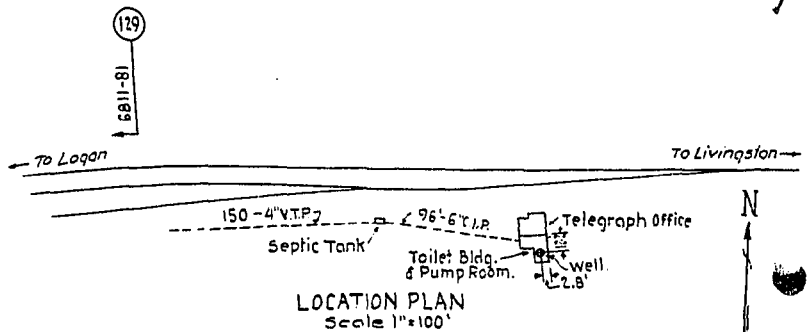

M.T.A.

GW

File No.

DUPLICATE

T. 28 R. 7E

County Park

STATE OF MONTANA
ADMINISTRATOR OF GROUNDWATER CODE
OFFICE OF STATE ENGINEER

22572
RECEIVED
NOV 20 1963

Declaration of Vested Groundwater Rights
(Under Chapter 237, Montana Session Laws, 1961) STATE ENGINEER

1. Northern Pacific Railway Co. of N.P. Section House West End
(Name of Appropriator) (Address) (Town)
County of Park State of Montana
have appropriated groundwater according to the Montana laws in effect prior to January 1, 1962, as follows:

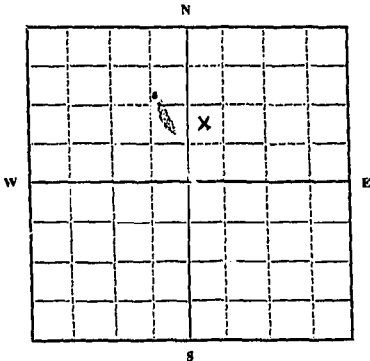

SW 1/4 NE Sec. 14 T. 28 R. 7E

Indicate point of appropriation and place of use, if possible. Each small square represents 10 acres.

2. The beneficial use on which the claim is based.....
Domestic purposes

3. Date or approximate date of earliest beneficial use; and how continuous the use has been.....
Nov. 6, 1946 to present

4. The amount of groundwater claimed (in miner's inches or gallons per minute).....
10 gallons per minute

5. If used for irrigation, give the acreage and description of the lands to which water has been applied and name of the owner thereof.....
None

6. The means of withdrawing such water from the ground and the location of each well or other means of withdrawal.....
Hand pump

7. The date of commencement and completion of the construction of the well, wells, or other works for withdrawal of groundwater.....
Started Oct. 4, 1946 Completed Nov. 6, 1946

8. The depth of water table.....
10 feet

9. So far as it may be available, the type, size and depth of each well or the general specifications of any other works for the withdrawal of groundwater.....
6 inch drilled well, 65 feet deep

10. The estimated amount of groundwater withdrawn each year.....
100,000 gallons

11. The log of formations encountered in the drilling of each well if available.....
see attached log 66-A

12. Such other information of a similar nature as may be useful in carrying out the policy of this act, including references to book and page of any county record.....
None

Signature of Owner..... *D. King*

Date..... NOV 8 '63

Three copies to be filed by the owner with the County Clerk and Recorder of the county in which the well is located.

Please answer all questions. If not applicable, so state, otherwise the form will be returned.

Original to the County Clerk and Recorder; duplicate to the State Engineer; Triplicate to the Montana Bureau of Mines and Geology, and Quadruplicate for the Appropriator.

46. MONT. 66-A
 Oct. 16-53
 N.P.Ry. Rocky Mtn. Div.

Calcium carbonate	analysis Nov. 25-53	3.4 G.P.G.	Expressed as CaCO ₃
Magnesium sulfate	"	0.6 "	
Sodium carbonate	"	0.0 "	
" bicarbonate	"	0.0 "	
" sulfate	"	1.3 "	
" chloride	"	0.5 "	
Silica	"	0.69 "	
Iron	"	0.0 P.P.M.	
pH			
Total dissolved solids		6.4 G.P.G. (actual)	
Turbidity		5	

Note: See file 1565-2 for drilling and test data,
 Office of Engineer of Water Service, St. Paul.

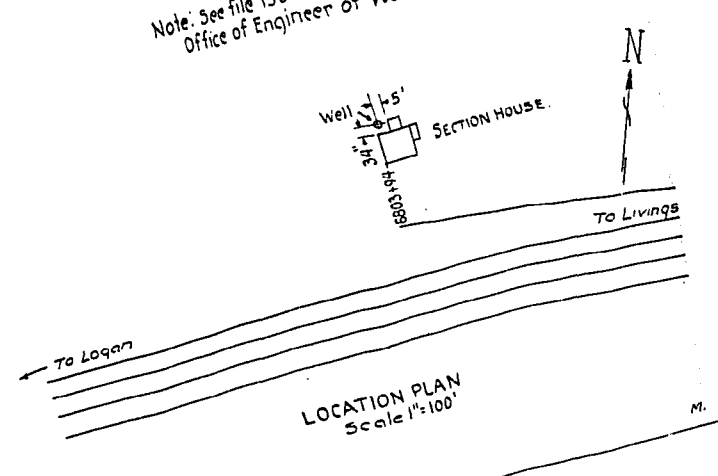

Doc #97035

Filed this 19th day of
November A. D. 1963
 at 2:35 o'clock P. M.
Margaret Monahan
 County Clerk and Recorder.
 By Emma Bowers
 Deputy.
 Fee \$2.00

MONT. 66-A

Oct. 16-53.

N.P.Ry. Rocky Mtn. Div.

WEST END, MONT. SECTION HOUSE WELL, A.F.E. 485-46.

6" Well, 64.7' deep.

Drilled by E.A. Bodin, N.P.Ry.

Work begun Oct. 4, 46, completed Nov. 6, 46.

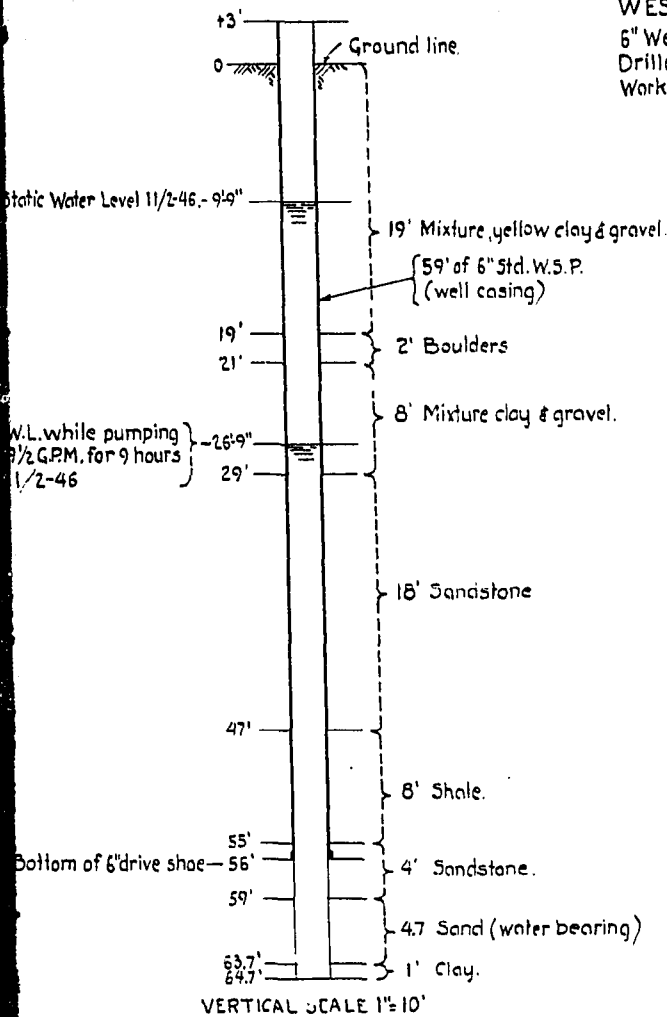

Water Analysis Nov. 25-53

Calcium bicarbonate	3.4 G.P.G.	} Expressed as CaCO ₃
Magnesium "	0.6 "	
" sulfate	0.6 "	
Sodium carbonate	0.0 "	
" bicarbonate	0.0 "	
" sulfate	1.3 "	
" chloride	0.5 "	
Silica	0.69 "	
Iron	0.0 P.P.M.	

pH

Total dissolved solids 6.4 G.P.G. (actual)
Turbidity 5

Note: See file 1565-2 for drilling and test data,
Office of Engineer of Water Service, St. Paul.

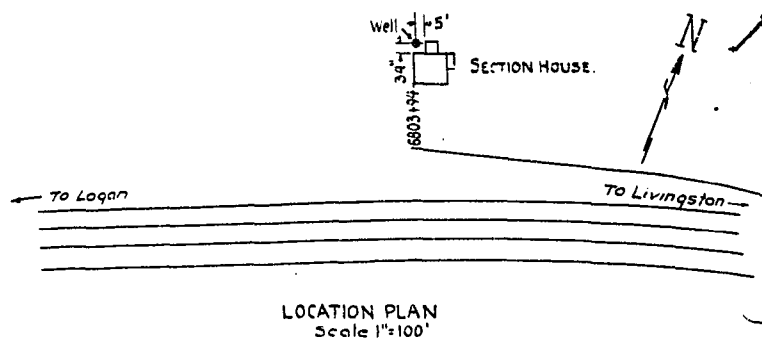

M.T.A.