

Abstract

17N-33E
County Garfield

STATE OF MONTANA
ADMINISTRATOR OF GROUNDWATER CODE
MONTANA WATER RESOURCES BOARD

AUG 7 1970

NOTICE OF COMPLETION OF GROUNDWATER APPROPRIATION BY MEANS OF WELL

Developed after January 1, 1962

(Under Chapter 237 Montana Session Laws, 1961, as amended)

This form to be prepared by driller, and three copies to be filed by the owner with the County Clerk and Recorder in the county in which the well is located, last copy to be retained by driller.

Please answer all questions. If not applicable, so state, otherwise the form may be returned.

Owner Lawrence Hellyer
Address SAND SPRINGS MOUNT
Date well started 8-4-70
completed 8-5-70

For Administrator's Use	
File	<u>135450</u> <u>August 6, 1970</u> <u>2:15 P.M.</u>
GW 1	

Type of well drilled
(Dug, driven, bored or drilled)

Equipment used ROTARY
(Churn drill, rotary or other)

Water Use: Domestic ☐ Municipal ☐ Stock ☒ Irrigation ☐

Industrial ☐ Drainage ☐ Other ☐* Garden/Lawn ☐

*Describe

USE: If used for irrigation, industrial, drainage or other. Explain, state number of acres and location or other data (i.e. Lot, Block and Addition).

ESTIMATED ANNUAL WITHDRAWAL 1500,000 (E)

Size of Drilled Hole	Size and Weight of Casing	From (Feet)	To (Feet)	PERFORATIONS		
				Kind Size	From (Feet)	To (Feet)
12 in	6 in 20 lb	1	78	slotted 4	28	78

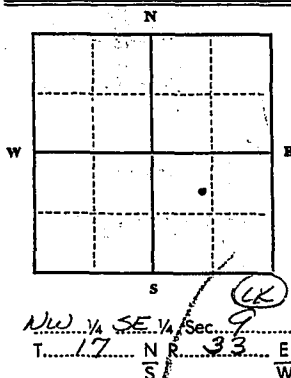

Static water level 12 ft.*
Pumping water level 10 ft.*
at 10 gallons per minute,
measured 5 minutes after pumping
began.

*Measured from ground level.
Well developed by pump fact
for 12 hours.

Power..... Pump..... HP

Remarks: (Gravel packing, cementing,
packers, type of shutoff)

INDICATE LOCATION OF WELL AND PLACE OF USE, IF POSSIBLE.
EACH SMALL SQUARE REPRESENTS 40 ACRES.

Driller's Signature Kenneth Chan

Driller's Address Box 21

Jordan Mont. LICENSE NO. 29

Indicate the character, color, thickness of strata such as soil, clay, sand, gravel, shale, sandstone, etc. Show depth at which water is found and height to which water rises in well.

Top of Ground (Elev. above sea level)

[illegible]

Show exact depth of bottom

417327

mlu		

STATE OF MONTANA
County of Garfield

RECEIVED 70 2:15 o'clock

Kelpha E. Cinnaltrong
230

2000 10/10/00

[illegible]

between just an all-digital one. It just adds capable to go into, otherwise it's not going to be the main focus, and we want to be talking to the public about the possibilities of the General. And that's especially in the world of the main to be a very good thing, and it's not about to be a good thing.

DATE	DESCRIPTION	AMOUNT	CHECK NO.	BANK	REMARKS
1/1/19
1/2/19
1/3/19
1/4/19
1/5/19
1/6/19
1/7/19
1/8/19
1/9/19
1/10/19
1/11/19
1/12/19
1/13/19
1/14/19
1/15/19
1/16/19
1/17/19
1/18/19
1/19/19
1/20/19
1/21/19
1/22/19
1/23/19
1/24/19
1/25/19
1/26/19
1/27/19
1/28/19
1/29/19
1/30/19
1/31/19
2/1/19
2/2/19
2/3/19
2/4/19
2/5/19
2/6/19
2/7/19
2/8/19
2/9/19
2/10/19
2/11/19
2/12/19
2/13/19
2/14/19
2/15/19
2/16/19
2/17/19
2/18/19
2/19/19
2/20/19
2/21/19
2/22/19
2/23/19
2/24/19
2/25/19
2/26/19
2/27/19
2/28/19
2/29/19
2/30/19
3/1/19
3/2/19
3/3/19
3/4/19
3/5/19
3/6/19
3/7/19
3/8/19
3/9/19
3/10/19
3/11/19
3/12/19
3/13/19
3/14/19
3/15/19
3/16/19
3/17/19
3/18/19
3/19/19
3/20/19

MODERN EDUCATION BOARD
RECEIVED
JAN 12 1971

<u> </u>	GW 1, Notice of Appropriation of Groundwater
<u> X </u>	GW 2, Notice of Completion of Groundwater Appropriation by means of Well
<u> </u>	GW 3, Notice of Completion of Groundwater Appropriation without Well
<u> </u>	GW 4, Declaration of Vested Groundwater Rights (This form is obsolete and was limited by law to use only through 1965)

Location E 1/2 Sec 9. 17-33 Document No. 135450

Other.

Remarks: (Gravel packing, cementing,
packers) type of shutoff)

S
T. 17 N. R. 33 E. S. W.
INDICATE LOCATION OF WELL AND PLACE OF USE, IF POSSIBLE.
EACH SMALL SQUARE REPRESENTS 40 ACRES.

Driller's Signature *Jennett Dean*

Driller's Address *Box 213*

Jordan Mont. LICENSE NO. *29*

78 Show exact depth of bottom

47327

STATE OF MONTANA
ADMINISTRATOR OF GROUNDWATER CODE
MONTANA WATER RESOURCES BOARD

NOTICE OF COMPLETION OF GROUNDWATER
APPROPRIATION BY MEANS OF WELL

Developed after January 1, 1962

(Under Chapter 237 Montana Session Laws, 1961, as amended)

This form to be prepared by driller, and three copies to be filed by the owner with the County Clerk and Recorder in the county in which the well is located, last copy to be retained by driller. Please answer all questions. If not applicable, so state, otherwise the form may be returned.

Owner LAWRENCE HELLER

Address SAND SPRINGS MOUNTAIN

For Administrator's Use
File 135450
August 6 1970
2:15 P.M.

Date well started 8-4-70

GW 1

completed 8-5-70

Type of well drilled

(Dug, driven, bored or drilled)

Equipment used ROTARY

(Churn drill, rotary or other)

Water Use: Domestic ☐ Municipal ☐ Stock ☒ Irrigation ☐

Industrial ☐ Drainage ☐ Other ☐ Garden/Lawn ☐

*Describe

USE: If used for irrigation, industrial, drainage or other. Explain, state number of acres and location or other data (i.e. Lot, Block

and Addition):

ESTIMATED ANNUAL WITHDRAWAL 1500 000

Size of Drilled Hole	Size and Weight of Casing	From (Feet)	To (Feet)	PERFORATIONS		
<u>12 in</u>	<u>6 in</u>	<u>1</u>	<u>78</u>	Kind Size	From (Feet)	To (Feet)
	<u>30 lb.</u>			<u>slotted</u>	<u>28</u>	<u>78</u>
				<u>4x4</u>		

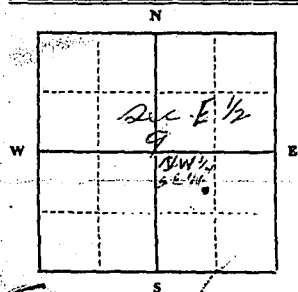

Static water level 12 ft.*
Pumping water level 70 ft.*
at 10 gallons per minute,
measured 5 minutes after pumping
began.

*Measured from ground level.
Well developed by ramming for 12 hours.
Power Electric Pump 1/2 HP.
Remarks: (Gravel packing, cementing, packers, type of shutoff)

{ 1/4 Sec. 9-17-33
T 17 N 33 E
S W

INDICATE LOCATION OF WELL AND PLACE OF USE, IF POSSIBLE.
EACH SMALL SQUARE REPRESENTS 40 ACRES.

Driller's Signature Jimmie Dean

Driller's Address Box 213

Jordan Mont. LICENSE NO. 29

County GARFIELD

DRILLER'S LOG

Indicate the character, color, thickness of strata such as soil, clay, sand, gravel, shale, sandstone, etc. Show depth at which water is found and height to which water rises in well.

Top of Ground (Elev. above sea level)		
From (Feet)	To (Feet)	
<u>1</u>	<u>13</u>	<u>shale</u>
<u>15</u>	<u>43</u>	<u>shale</u>
<u>45</u>	<u>47</u>	<u>rock</u>
<u>47</u>	<u>53</u>	<u>shale</u>
<u>53</u>	<u>78</u>	<u>sand</u>

Show exact depth of bottom

47327

File No. _____

DUPLICATE

Approved Stock Form—State Publishing Co., Helena, Montana—4723

T. _____

County _____

STATE OF MONTANA
ADMINISTRATOR OF GROUNDWATER CODE
OFFICE OF STATE ENGINEER

RECEIVED
JAN 8 1964

Declaration of Vested Groundwater Rights ENGINEER
(Under Chapter 237, Montana Session Laws, 1961)

1. _____, of _____
(Name of Appropriator) (Address) (Town)

County of _____ State of _____
have appropriated groundwater according to the Montana laws in effect prior to January 1, 1962, as follows:

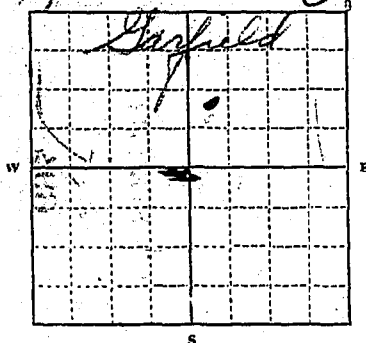

N.E. 1/4 Sec. 11 T. 33
Indicate point of appropriation
and place of use, if possible. Each
small square represents 10 acres.

2. The beneficial use on which the claim is based _____

3. Date or approximate date of earliest beneficial use; and how continuous the use has been _____

4. The amount of groundwater claimed (in inches or gallons per minute) _____

5. If used for irrigation, give the acreage and description of the lands to which water has been applied and name of the owner thereof _____

6. The means of withdrawing such water from the ground and the location of each well or other means of withdrawal _____

7. The date of commencement and completion of the construction of the well, wells, or other works for withdrawal of groundwater _____

8. The depth of water table _____

9. So far as it may be available, the type, size and depth of each well or the general specifications of any other works for the withdrawal of groundwater _____

10. The estimated amount of groundwater withdrawn each year _____

11. The log of formations encountered in the drilling of each well if available _____

12. Such other information of a similar nature as may be useful in carrying out the policy of this act, including reference to book and page of any county record _____

Signature of Owner _____

Date _____

Three copies to be filed by the owner with the County Clerk and Recorder of the county in which the well is located.

Please answer all questions. If not applicable, so state, otherwise the form will be returned.

Original to the County Clerk and Recorder; Duplicate to the State Engineer; Triplicate to the Montana Bureau of Mines and Geology, and Quadruplicate for the Appropriator.

23625

0

RECEIVED

RECEIVED
COUNTY CLERK
GAILFILD COUNTY
MONTANA
JAN 31 1963

RECEIVED
COUNTY CLERK
GAILFILD COUNTY
MONTANA
JAN 31 1963

STATE OF MONTANA
County of Garfield

Filed in the office of the County Clerk and
Recorder of Garfield County, State of Montana,
this 31 day of Jan.

A. D. 1963 at 1:30 o'clock

Charles E. Thompson
County Clerk and Recorder

By Marion R. Daniel
Deputy

Fee Paid \$2.00

INDEXED
FILED

769
125428

File No. _____

DUPLICATE

MONTANA WATER RESOURCES BOARD
LOG RECEIVED

JAN 28 1962

T 17N R 33E

County SanfordSTATE OF MONTANA
ADMINISTRATOR OF GROUNDWATER CODE
OFFICE OF STATE ENGINEER

Top of Ground

(Elev. above sea level _____)

Notice of Completion of Groundwater

Appropriation by Means of Well

DEVELOPED AFTER JANUARY 1, 1962

(Under Chapter 237, Montana Session Laws, 1961)

Owner Frank WittAddress Sanford, Mont.Driller Marle + Kenneth DrameAddress Sanford, Mont.

Date of Notice of appropriation of groundwater _____

Date well started _____

Date completed June 2, 67Type of well drilledEquipment used rotary

(Dug, driven, bored or drilled)

(Churn drill, rotary or other)

Water use:

Domestic ☐ Municipal ☐Industrial ☐ Drainage ☐Stock ☒ Irrigation ☐Other ☐

Indicate on the diagram the character and thickness of the different strata met with in drilling, such as soil, clay, shale, gravel, rock or sand, etc. Show depth at which water is encountered, thickness and character of water-bearing strata and height to which the water rises in the well.

Size of Drilled Hole	Size and Weight of Casing	From (Feet)	To (Feet)	PERFORATIONS		
				Kind Size	From (Feet)	To (Feet)
6" 9 1/2"	4"	1	209	SLOT 1/4 x 1/4	145	208

17-17-33

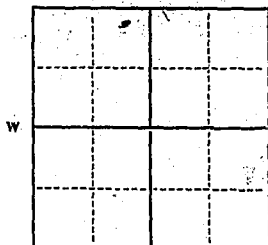

Static Water Level for non-flowing well

130 feet

Shut-in Pressure for Flowing Well _____

Pumping Water Level 168 feetat 3 1/2 gal. per minute.

Discharge in gal. per min. of flowing well _____

How Tested pump

Length of Test _____

Remarks: (Gravel packing, cementing, packers type of shutoff) _____

1/4 Sec. T. R. _____
Indicate location of well and place of use, if possible. Each small square represents 40 acres.

(Continue on reverse side)

USE—If used for irrigation, industrial, drainage or other. Explain, state number of acres and location or other data (i.e.: Lot, Block and Addition).

Show exact depth of bottom.

This form to be prepared by driller, and three copies to be filed by the owner with the County Clerk and Recorder in the county in which the well is located, tissue copy to be retained by driller.

Please answer all questions. If not applicable, so state, otherwise the form will be returned.

Driller's License Number

29
Kenneth Drame
Driller's Signature.

44,932

GW

Approved Stock Form—State Publishing Co., Helena, Montana—42234

File No.

T. 17 R. 33

DUPLICATE

County

Garfield

STATE OF MONTANA
ADMINISTRATOR OF GROUNDWATER CODE
OFFICE OF STATE ENGINEER

RECEIVED
JAN 6 1964

Declaration of Vested Groundwater Rights ENGINEER

(Under Chapter 237, Montana Session Laws, 1961)

I, Bill Broughton, of Burnett
(Name of Appropriator) (Address) (Town)
County of Garfield State of Montana
have appropriated groundwater according to the Montana laws in effect prior to January 1, 1962, as follows:

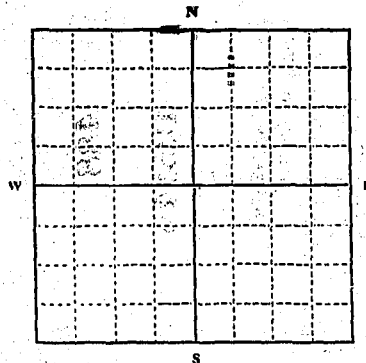

Sec. 21 T. 17 R. 33

Indicate point of appropriation and place of use, if possible. Each small square represents 10 acres.

2. The beneficial use on which the claim is based Stockwater

3. Date or approximate date of earliest beneficial use; and how continuous the use has been 1961

4. The amount of groundwater claimed (in miner's inches or gallons per minute) 9 gpm

5. If used for irrigation, give the acreage and description of the lands to which water has been applied and name of the owner thereof

None

6. The means of withdrawing such water from the ground and the location of each well or other means of withdrawal

Gas engine + Pump Jack

7. The date of commencement and completion of the construction of the well, wells, or other works for withdrawal of groundwater 1961

8. The depth of water table 35'

9. So far as it may be available, the type, size and depth of each well or the general specifications of any other works for the withdrawal of groundwater 130' deep 4" pipe

10. The estimated amount of groundwater withdrawn each year 900,000

11. The log of formations encountered in the drilling of each well if available 1-15 top soil
15-19 gravel 19-44 shale 44-48 coal 48-98 shale
98-104 sand Rock 104-107 Rock 107-126 sand Rock 126-130 shale

12. Such other information of a similar nature as may be useful in carrying out the policy of this act, including reference to book and page of any county record None

Signature of Owner

Wm H Broughton

Date 12-30-63

Three copies to be filed by the owner with the County Clerk and Recorder of the county in which the well is located.

Please answer all questions. If not applicable, so state, otherwise the form will be returned.

Original to the County Clerk and Recorder; Duplicate to the State Engineer; Triplicate to the Montana Bureau of Mines and Geology, and Quadruplicate for the Appropriator.

23402

488

125145

STATE OF MONTANA }
County of Garfield

Filed in the office of the County Clerk and
Recorder of Garfield County, State of Montana,
this 30 day of Dec.

A. D. 1903 at 11:45 o'clock P. M.

Charles E. Langford
County Clerk and Recorder

By Marion R. James
Deputy

Fee Paid \$...

INDEXED mj
FILED ef

RECEIVED

CIVIL DIVISION

23

T. 17N R. 33E

County Garfield

MONTANA BUREAU OF MINES AND GEOLOGY
Butte, Montana

RECEIVED
NOV 20 1961

WATER WELL LOG

STATE ENGINEER

Owner Bill Meckel Address Sand Springs, Montana

Driller McConnell Bros Address Roundup, Montana

Date Started November 10, 1961 Date Completed November 14, 1961

Location: Sec. 23 T. 17N R. 33E sec. 33E

Type of well drilled Equipment used Rotary
(Dug, driven, bored, or drilled) (Churn drill, rotary, other)

Water use: Domestic ☐ Municipal ☐ Stock ☒ Irrigation ☐
Industrial ☐ Drainage ☐ Other:

Casing: 0 ft. to 200 ft. Type iron EX100 Size 6 inch

Casing: ft. to ft. Type Size

Casing: ft. to ft. Type Size

Perforated or Screened: Ft. 120 to ft. 140 and 175 to ft. 185

Type of screen or perforations slots

Static Water level, for non-flowing well: 100 feet from top feet

Shut-in pressure, for flowing well: lb./sq. in. on: (date)

Pumping water level: feet at 9 gal. per min.

How tested: bailer

Length of test: 1 hour

Remarks: (Gravel packing, cementing, packers, type of shut-off, depth of shut-off)



(over)

Log of Well

[illegible]

File No.

DUPLICATE

County

STATE OF MONTANA
ADMINISTRATOR OF GROUNDWATER
OFFICE OF STATE ENGINEER

DEC 10 1963

Notice of Completion of Groundwater Appropriation by Means of Well

(Under Chapter 237, Montana Session Laws, 1961)

Owner Frank W. Karhiako Address Great Falls, MontanaDriller Carl Ferrel Address Miss. City, Mont.

Date of Notice of Appropriation of Groundwater

Date well started Sept. 26-63 Date Completed Sept 30-1963

Type of well (dug, driven, bored or drilled) _____ Equipment Used (Churn, drill, rotary or other) _____

Water Use: Domestic ☒ Municipal ☐ Other ☐ Irrigation ☐
Industrial ☐ Drainage ☐ Stock ☒

Indicate on the diagram the character and thickness of the different strata met with in drilling, such as soil, clay, shale, gravel, rock or sand, etc. Show depth at which water is encountered, thickness and character of water-bearing strata and height to which water rises in the well.

Size of Drilled Hole	Size and Weight of Casing	From (Feet)	To (Feet)	PERFORATIONS		
				Kind Size	From (Feet)	To (Feet)
5 5/8	4 1/4 lb	0	490	slots	250	280
					450	to 480

Static Water Level for non-flowing Well 285 feet.

Shut-in Pressure for Flowing Well _____

Pumping Water Level 230 feet at 3 1/2 gal. per minute.

Discharge in gal. per min. of flowing well _____

How Tested Bailer Length of Test 2 hrs.

Remarks: (Gravel packing, cementing, packers, type of shutoff, location of place of use of groundwater if not at well, and any other similar pertinent information, including number of acres irrigated, if used for irrigation) _____

Top of Ground about
(Elev. above sea level 3,000)

0 to top soil
17 shale
45
97 rock
to
120 shale
121 rock
121
225 shale
to
228 rock
to
265 shale
265
to sandstone
285 2 gals. per min.
to
390 shale
390
to
391 rock
to
430 shale
to
432 rock
to
468 shale
to
480 sand
to
490 shale

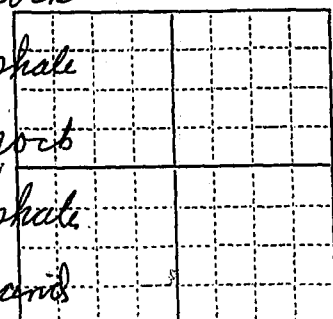

SE 1/4 NE 1/4 S 26 T. 17 R. 32 E

Indicate location of well and place of use, if possible. Each small square represents 10 acres.

Show exact depth of bottom.

Frank W. Karhiako
Owner and appropriator.

Driller's License Number

35
Carl Ferrel
Driller's Signature

This form to be prepared by driller, and three copies to be filed by the owner with the County Clerk and Recorder in the county in which the well is located.

Please answer all questions. If not applicable, so state, otherwise the form will be returned.

Original to the County Clerk and Recorder; duplicate to the State Engineer; Triplicate to the Montana Bureau of Mines and Geology and Quadruplicate for the Appropriator.

8416.

123

124594

STATE OF MONTANA
County of Garfield

Filed in the office of the County Clerk and
Recorder of Garfield County, State of Montana,
this 6th day of December

A. D. 1923 at 3:40 o'clock P. M.

Charles S. Langburn
County Clerk and Recorder

By [Signature] Deputy

Fee Paid \$ 1.00

Index

Case	Filed	Index	Page	Volume
123				
124				
125				
126				
127				
128				
129				
130				
131				
132				
133				
134				
135				
136				
137				
138				
139				
140				
141				
142				
143				
144				
145				
146				
147				
148				
149				
150				

(See above and last page of book)

Abolition of Means of Access
Office of the County Clerk and Recorder
ADMINISTRATIVE OF RECORDS
RECORDS OF THE COUNTY

OFFICE OF THE COUNTY CLERK AND RECORDER
ADMINISTRATIVE OF RECORDS
RECORDS OF THE COUNTY

RECORDS OF THE COUNTY

Designated in East for part of the county and
Bromide Water Road
Spring Branch for the county
Spring Branch for the county

File No. _____

T. 17 N., R. 33 E.

DUPLICATE

County Garfield

STATE OF MONTANA
ADMINISTRATOR OF GROUNDWATER CODE
OFFICE OF STATE ENGINEER

RECEIVED
JAN 8 1964

STATE ENGINEER
**Notice of Completion of Groundwater Appropriation
Without Well**

(Under Chapter 237 Montana Session Laws, 1961)

Date of Appropriation of Groundwater Approximately 1910
(by Chris Nelson, former owner).

Owner Clement A. Larson Address Sand Springs, Montana,
(now Hamilton, Montana).

Contractor (if any) none

Address of Contractor none

Date Started — — — — — Date Completed — — — — —

Describe means of obtaining groundwater without a well "as by
sub-irrigation and other natural processes". Include depth to
water when applicable. This spring is located on Lodge Pole
Creek and has a natural flow. It has been flowing
since 1910.

Quantity of water developed and used with explanation of method
used to measure or estimate such amount. If use is intermittent

estimate approximate lengths of periods of use

Spring water flows down Lodge Pole Creek at the rate
of approximately 3 gallons per minute.

Signature of Owner

Hamilton, Montana

Date December 30, 1963

This form to be prepared by contractor (if any), otherwise by the owner.

Three copies of this notice are to be filed with the County Clerk and Recorder of the county in which the
works are located.

Please answer all questions. If not applicable, so state, otherwise the form will be returned.

Original to the County Clerk and Recorder; duplicate to the State Engineer; Triplicate to the Montana
Bureau of Mines and Geology and Quadruplicate for the Appropriator.

23322

408

125065

STATE OF MONTANA
County of Garfield

Filed in the office of the County Clerk and
Recorder of Garfield County, State of Montana,
this 30 day of Dec.

A. D. 1963 at 10:24 o'clock A. M.

Charles E. Augustine
County Clerk and Recorder
By Marion R. [Signature]
Deputy

Fee Paid \$2.00

no
copy

Office of County of Garfield
JANUARY 11, 1964
CIVIL ENGINEER

OFFICE OF STATE ENGINEER
TOWNSHIPS OF GARFIELD COUNTY
STATE OF MONTANA

RECEIVED

RECEIVED

RECEIVED

RECEIVED

RECEIVED

File No. _____

T. 17 N. R. 33 E

DUPLICATE

County Garfield

STATE OF MONTANA
ADMINISTRATOR OF GROUNDWATER CODE
OFFICE OF STATE ENGINEER

RECEIVED
JAN 6 1964

Declaration of Vested Groundwater Rights

(Under Chapter 237, Montana Session Laws, 1961)

STATE ENGINEER

1. CLEMENT A. JARSON of Sand Springs
(Name of Appropriator) (Address) (Town)
County of Garfield State of Montana (now of Hamilton, Montana)
have appropriated groundwater according to the Montana laws in effect prior to January 1, 1962, as follows:

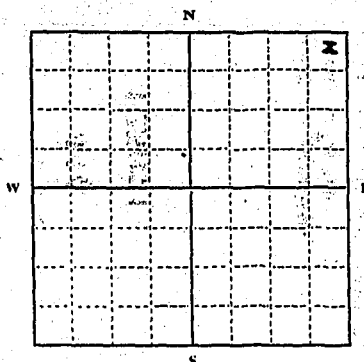

NE 1/4 NE 1/4 Sec. 31 T. 17 N. R. 33 E

Indicate point of appropriation and place of use, if possible. Each small square represents 10 acres.

2. The beneficial use on which the claim is based
Stockwater purposes
3. Date or approximate date of earliest beneficial use; and how continuous the use has been October, 1960 and continuously since that date
4. The amount of groundwater claimed (in miner's inches or gallons per minute) 1 gallon per minute
5. If used for irrigation, give the acreage and description of the lands to which water has been applied and name of the owner thereof
Used for livestock watering only
6. The means of withdrawing such water from the ground and the location of each well or other means of withdrawal
by windmill and electric motor

7. The date of commencement and completion of the construction of the well, wells, or other works for withdrawal of groundwater October, 1960
8. The depth of water table 80 feet
9. So far as it may be available, the type, size and depth of each well or the general specifications of any other works for the withdrawal of groundwater drilled water well, 4-inch casing, 1 1/2-inch pipe, and approximately 128 feet deep.
10. The estimated amount of groundwater withdrawn each year 75,000 gallons per year.
11. The log of formations encountered in the drilling of each well if available
Not available.
12. Such other information of a similar nature as may be useful in carrying out the policy of this act, including reference to book and page of any county record
Not available.

Signature of Owner Clement A. Jarson

Date December 30, 1963

Three copies to be filed by the owner with the County Clerk and Recorder of the county in which the well is located.

Please answer all questions. If not applicable, so state, otherwise the form will be returned.

Original to the County Clerk and Recorder; Duplicate to the State Engineer; Triplicate to the Montana Bureau of Mines and Geology, and Quadruplicate for the Appropriator.

23328

414

125071

STATE OF MONTANA }
County of Garfield

Filed in the office of the County Clerk and
Recorder of Garfield County, State of Montana,
this 30 day of Dec.

A. D. 1913 at 10:30 o'clock A M.

Charles E. Rogers
County Clerk and Recorder
By Marian G. James
Deputy

Fee Paid \$2.00

INDEXED 2
FILED 2

RECEIVED
COUNTY CLERK
GARFIELD COUNTY
MONTANA
DEC 31 1913

File No.

T 17 N R 33 E

DUPLICATE

County Garfield

STATE OF MONTANA
ADMINISTRATOR OF GROUNDWATER CODE
OFFICE OF STATE ENGINEER

RECEIVED
JAN 6 1964

Notice of Completion of Groundwater Appropriation Without Well

(Under Chapter 237 Montana Session Laws, 1961)

Date of Appropriation of Groundwater... Approximately 1910
(by Chris Nelson, former owner).

Owner Clement A. Larson Address Sand Springs, Montana
(now Hamilton, Montana).

Contractor (if any) none

Address of Contractor none

Date Started --- Date Completed ---

Describe means of obtaining groundwater without a well "as by sub-irrigation and other natural processes". Include depth to water when applicable. This spring is located on Lodge Pole Creek and has a natural flow. It has been flowing since 1910.

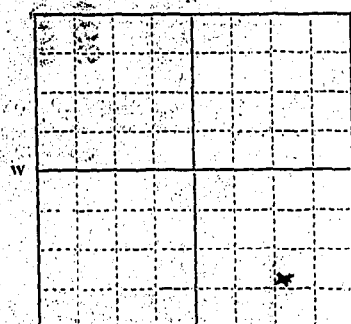

SE 1/4 Sec. 33 T. 17 N. R. 33 E

Indicate point of appropriation and place of use, if possible.

Quantity of water developed and used with explanation of method used to measure or estimate such amount. If use is intermittent

estimate approximate lengths of periods of use.

Spring water flows down Lodge Pole Creek at the rate of 4 gallons per minute continuously.

Signature of Owner

Clement A. Larson
Hamilton, Montana.

Date December 30, 1963

This form to be prepared by contractor (if any), otherwise by the owner.

Three copies of this notice are to be filed with the County Clerk and Recorder of the county in which the works are located.

Please answer all questions. If not applicable, "no" state; otherwise the form will be returned.

Original to the County Clerk and Recorder; duplicate to the State Engineer; Triplicate to the Montana Bureau of Mines and Geology and Quadruplicate for the Appropriator.

23323

409
125066

THIS OFFICE OF REC'D RECEIVED
INDICATES DATE OF SUBMISSION
BY THE JURY OR BY THE COURT

STATE OF MONTANA }
County of Garfield }

Filed in the office of the County Clerk and
Recorder of Garfield County, State of Montana,
this 30 day of Dec.

A.D. 1935 at 12:35 o'clock P.M.
Charles E. Dargatzis

County Clerk and Recorder
By Marion A. Dargatzis
Deputy

Fee Paid \$ 2.00

RECEIVED
FILED

County of Garfield
State of Montana
RECEIVED

File No. _____

T. 17 N. R. 23E

DUPLICATE

County Garfield

STATE OF MONTANA
ADMINISTRATOR OF GROUNDWATER CODE
OFFICE OF STATE ENGINEER

RECEIVED
JAN 6 1964
STATE ENGINEER

Declaration of Vested Groundwater Rights

(Under Chapter 237, Montana Session Laws, 1961)

I, Clement A. Larson, of Sand Springs, Montana,
(Name of Appropriator) (Address) (Town)
County of Garfield State of Montana (now of Hamilton, Montana),
have appropriated groundwater according to the Montana laws in effect prior to January 1, 1962, as follows:

2. The beneficial use on which the claim is based
stockwater purposes

3. Date or approximate date of earliest beneficial use; and how continuous the use has been about 1955; and continuously
since that date have pumped it several times.

4. The amount of groundwater claimed (in miner's inches or gallons per minute) 2 gallons per minute

5. If used for irrigation, give the acreage and description of the lands to which water has been applied and name of the owner thereof
used for stockwater purposes only.

6. The means of withdrawing such water from the ground and the location of each well or other means of withdrawal windmill and electric motor.

7. The date of commencement and completion of the construction of the well, wells, or other works for withdrawal of groundwater August 1955

8. The depth of water table approximately 50 feet.

9. So far as it may be available, the type, size and depth of each well or the general specifications of any other works for the withdrawal of groundwater
drilled water well, 4 inch casing, 1 1/2 inch pipe; depth of 125 feet.

10. The estimated amount of groundwater withdrawn each year approximately 75000 gallons per year.

11. The log of formations encountered in the drilling of each well if available.
Not available.

12. Such other information of a similar nature as may be useful in carrying out the policy of this act, including reference to book and page of any county record.
Not available.

Signature of Owner Clement A. LarsonDate December 30, 1963

Three copies to be filed by the owner with the County Clerk and Recorder of the county in which the well is located.

Please answer all questions. If not applicable, so state, otherwise the form will be returned.

Original to the County Clerk and Recorder; Duplicate to the State Engineer; Triplicate to the Montana Bureau of Mines and Geology, and Quadruplicate for the Appropriator.

23326

~~CONFIDENTIAL~~ *ms*
~~EXCLUDED FROM AUTOMATIC DOWNGRADING AND DECLASSIFICATION~~

100

File No.

T. 17N R. 33E

DUPLICATE

County Garfield

STATE OF MONTANA
ADMINISTRATOR OF GROUNDWATER CODE
OFFICE OF STATE ENGINEER

RECEIVED
OCT 21 1963

Declaration of Vested Groundwater Rights
(Under Chapter 237, Montana Session Laws, 1961)

1. Gladys L. Kreider, of Sand Springs,
(Name of Appropriator) (Address) (Town)
County of Garfield State of Montana
have appropriated groundwater according to the Montana laws in effect prior to January 1, 1962, as follows:

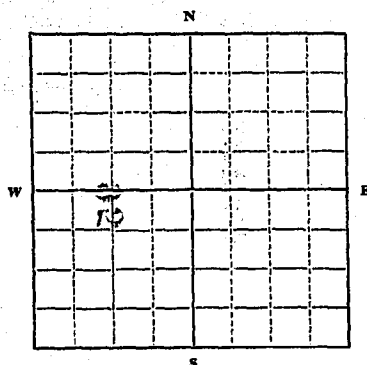

NW 1/4 Sec. 34 T. 17N R. 33 East

Indicate point of appropriation
and place of use, if possible.
Each small square represents 10
acres.

2. The beneficial use on which the claim is based.
Stock water;

3. Date or approximate date of earliest beneficial use; and how continuous the use has been. July 20, 1961;

4. The amount of groundwater claimed (in miner's inches or gallons per minute). Eight (8) gallons per minute

5. If used for irrigation, give the acreage and description of the lands to which water has been applied and name of the owner thereof

6. The means of withdrawing such water from the ground and the location of each well or other means of withdrawal.
Pumped by electricity;

7. The date of commencement and completion of the construction of the well, wells, or other works for withdrawal of groundwater. Commenced July 14, 1961, completed July 20, 1961;

8. The depth of water table. Well depth 200 feet, water rises to within 60 feet of top;

9. So far as it may be available, the type, size and depth of each well or the general specifications of any other works for the withdrawal of groundwater. Well depth 200 feet;
6 inch, 20 gauge to 200 feet; factory slots 1/8 inch 180 to 195 feet.

10. The estimated amount of groundwater withdrawn each year. 270,000 gallons

11. The log of formations encountered in the drilling of each well if available. Drilled by McConnell Bros.
Roundup, Montana.
5 inches; 110 feet shale; 150 feet sand; 180 feet shale; 195 feet
sand and water; 200 feet shale.

12. Such other information of a similar nature as may be useful in carrying out the policy of this act, including reference to book and page of any county record.

Signature of Owner Gladys L. Kreider

Date 10-9-63

Three copies to be filed by the owner with the County Clerk and Recorder of the county in which the well is located.

Please answer all questions. If not applicable, so state, otherwise the form will be returned.

Original to the County Clerk and Recorder; duplicate to the State Engineer; Triplicate to the Montana Bureau of Mines and Geology, and Quadruplicate for the Appropriator.

6524

95

124027

STATE OF MONTANA }
County of Garfield

Filed in the office of the County Clerk and
Recorder of Garfield County, State of Montana,
this 16th day of October

A. D. 1963 at 3:25 o'clock P.M.

Charles E. Tangburn
County Clerk and Recorder

By _____ Deputy

Fee Paid \$ 2.00

CD
CD

Great Falls, Montana

Declaration of Assessor of Garfield County, State of Montana

Office of Assessor of Garfield County, State of Montana

Garfield County

Assessor

GROUNDWATER INDEX

Page 1 of 1

County

Garfield

Twp.

174

Rge.

34 C.

Sec.	Name of Appropriator	Type of Form	County File No.	Remarks
1	Bliss Kenneth	492	139514	T. 16N - R 34E
1	Wheatcraft James A. & M. L. M.	494	125330	
2	Wheatcraft James A. & M. L. M.	494	125332	
4	Bliss Kenneth	492	123823	
8	Bliss Kenneth	493	139515	
8	Bliss Kenneth	494	125074	
10	Wheatcraft James A.	494	125328	
15	Bliss Kenneth	494	123567	
15	Bliss Kenneth	492	139513	
20	Bliss Kenneth	492	139513	See Sec. 15 above
20	Bliss Kenneth	492	123824	
21	Bliss Kenneth	493	139516	
21	State of Montana, Dept. of Land	492	139531	
21	State of Montana, Dept. of Land	493	139531	
27	Bliss Kenneth	492	139513	See Sec. 15 above
28	Bliss Kenneth	493	139517	
30	Wheatcraft James A. & M. L. M.	494	125173	
32	Bliss Kenneth	492	139514	T. 18N - R 34E
32	Wheatcraft James A. & M. L. M.	579 in log		
34	Bliss Kenneth	492	139514	

File No. _____

DUPLICATE

T. 17 N. R. 34 E

County Garfield

STATE OF MONTANA
ADMINISTRATOR OF GROUNDWATER CODE
OFFICE OF STATE ENGINEER

RECEIVED
JAN 8 1964

Declaration of Vested Groundwater Rights STATE ENGINEER

(Under Chapter 237, Montana Session Laws, 1961)

on Elin M. W. Heatcraft
1 James A. W. Heatcraft, of Sand Springs
(Name of Appropriator) (Address) (Town)
County of Garfield State of Mont
have appropriated groundwater according to the Montana laws in effect prior to January 1, 1962, as follows:

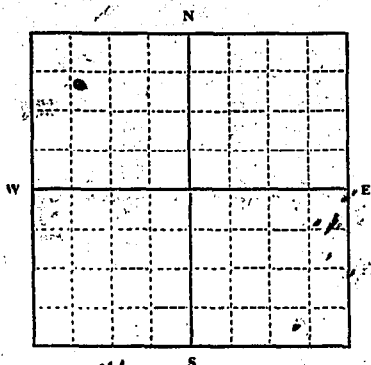

NW 1/4 Sec. 1 T. 17 R. 34

Indicate point of appropriation and place of use, if possible. Each small square represents 10 acres.

2. The beneficial use on which the claim is based.

Stock Water

3. Date or approximate date of earliest beneficial use; and how continuous the use has been.

1920 - Continuous

Exact date not known.

4. The amount of groundwater claimed (in miner's inches or gallons per minute).

4 gal. per minute

5. If used for irrigation, give the acreage and description of the lands to which water has been applied and name of the owner thereof.

None

6. The means of withdrawing such water from the ground and the location of each well or other means of withdrawal.

pump with gas motor

7. The date of commencement and completion of the construction of the well, wells, or other works for withdrawal of groundwater.

1920

8. The depth of water table.

not known

9. So far as it may be available, the type, size and depth of each well or the general specifications of any other works for the withdrawal of groundwater.

100 feet 4 inch casing - approx depth

10. The estimated amount of groundwater withdrawn each year.

amount varies from year to year.

11. The log of formations encountered in the drilling of each well if available.

not available

12. Such other information of a similar nature as may be useful in carrying out the policy of this act, including reference to book and page of any county record.

none available

Signature of Owner

James A. W. Heatcraft
Date Dec. 30 - 1963

Three copies to be filed by the owner with the County Clerk and Recorder of the county in which the well is located.

Please answer all questions. If not applicable, so state, otherwise the form will be returned.

Original to the County Clerk and Recorder; Duplicate to the State Engineer; Triplicate to the Montana Bureau of Mines and Geology, and Quadruplicate for the Appropriator.

23587

1. The fee on subsequent recordings is not to be paid in any case.
In the absence of record in the recorder's office, the fee shall be paid in full.

100 feet
1 inch square
1 inch square

100 feet
1 inch square
1 inch square

100 feet

100 feet

100 feet

671

125830

STATE OF MONTANA
County of Cascade

Filed in _____ of the County Clerk and
Recorder of Cascade Co., State of Montana,
this _____ day of _____, 19____.

A. D. 19____ at _____ o'clock
_____ County Clerk and Recorder

By _____ Deputy

Fee Paid \$ _____

2nd
Clerk

100 feet
1 inch square
1 inch square

100 feet

100 feet

100 feet

100 feet

100 feet

100 feet

ON

Approved Stock Form—State Publishing Co., Helena, Montana—42234

File No. _____

T. 17 N. 34 E. 2

DUPLICATE

County _____

STATE OF MONTANA
ADMINISTRATOR OF GROUNDWATER CODE
OFFICE OF STATE ENGINEER

RECEIVED
JAN 8 1964

Declaration of Vested Groundwater Rights

(Under Chapter 237, Montana Session Laws, 1961)

on *Elie M. Schofield*

1. *James A. Whatecroft* of *Sand Springs*
(Name of Appropriator) (Address) (Town)

County of *Jefferson* State of *Montana*
have appropriated groundwater according to the Montana laws in effect prior to January 1, 1962, as follows:

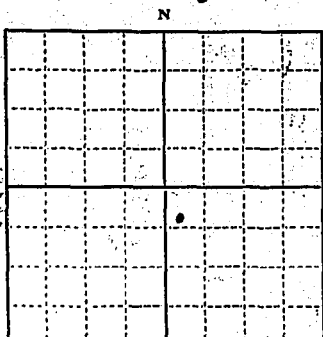

NE 1/4 Sec. 2 T. 17 R. 34

Indicate point of appropriation and place of use, if possible. Each small square represents 10 acres.

2. The beneficial use on which the claim is based *Stock water*

3. Date or approximate date of earliest beneficial use; and how continuous the use has been *1960 continuous*

4. The amount of groundwater claimed (in miner's inches or gallons per minute) *6 gal per minute*

5. If used for irrigation, give the acreage and description of the lands to which water has been applied and name of the owner thereof *None*

6. The means of withdrawing such water from the ground and the location of each well or other means of withdrawal *pump & pump jack & gas motor*

7. The date of commencement and completion of the construction of the well, wells, or other works for withdrawal of groundwater *to part date not known*

8. The depth of water table *not known*

9. So far as it may be available, the type, size and depth of each well or the general specifications of any other works for the withdrawal of groundwater *4" casing to bottom - approx 50 feet*

10. The estimated amount of groundwater withdrawn each year *not known*

11. The log of formations encountered in the drilling of each well if available *not available*

12. Such other information of a similar nature as may be useful in carrying out the policy of this act, including reference to book and page of any county record *None*

Signature of Owner *James A. Whatecroft*
Date *Dec. 30 - 1963*

Three copies to be filed by the owner with the County Clerk and Recorder of the county in which the well is located.

Please answer all questions. If not applicable, so state, otherwise the form will be returned.

Original to the County Clerk and Recorder; Duplicate to the State Engineer; Triplicate to the Montana Bureau of Mines and Geology, and Quadruplicate for the Appropriator.

23589

100
100

100

ALABAMA TO STATE

AND COMMISSIONER TO REVENUE

SECTION OF REVENUE

Handwritten notes:
To be paid to the
State of Alabama
for the year 1902
by the
County of
Garfield
Montana

673

125332

STATE OF MONTANA }
County of Garfield }

Filed in the _____ of the County Clerk and
Recorder of Garfield _____ State of Montana,
this _____ 31 _____

A. D. 1902 of 1052 _____

Charles S. Daugherty
County Clerk and Recorder

By Marian B. Dennis Deputy

Fee Paid \$ 2.00

INDEXED

FILED

Handwritten: FILED

Vertical text: This document is a record of the proceedings of the County Clerk and Recorder of Garfield, Montana, for the year 1902.

Vertical text: This document is a record of the proceedings of the County Clerk and Recorder of Garfield, Montana, for the year 1902.

Handwritten: Charles S. Daugherty

Vertical text: This document is a record of the proceedings of the County Clerk and Recorder of Garfield, Montana, for the year 1902.

Vertical text: This document is a record of the proceedings of the County Clerk and Recorder of Garfield, Montana, for the year 1902.

Vertical text: This document is a record of the proceedings of the County Clerk and Recorder of Garfield, Montana, for the year 1902.

Vertical text: This document is a record of the proceedings of the County Clerk and Recorder of Garfield, Montana, for the year 1902.

Handwritten: Charles S. Daugherty

File No.

DUPLICATE

T. 17

R. 34

County

GARFIELD

STATE OF MONTANA

ADMINISTRATOR OF GROUNDWATER

OFFICE OF STATE ENGINEER

AUG 23 1963

Notice of Completion of Groundwater Appropriation by Means of Well

(Under Chapter 237, Montana Session Laws, 1961)

Owner Kenneth BlissAddress SAND SPRINGS MOUNT.Driller Marla DraneAddress Jordan, Mont.Date of Notice of Appropriation of Groundwater 7-25-63Date well started 7-28-63 Date Completed 8-4-63Type of well drilled
(dug, driven, bored or drilled)Equipment Used rotary
(Churn, drill, rotary or other)

Water Use: Domestic ☐ Municipal ☐ Other ☐ Irrigation ☐
Industrial ☐ Drainage ☐ Stock ☒

Indicate on the diagram the character and thickness of the different strata met with in drilling, such as soil, clay, shale, gravel, rock or sand, etc. Show depth at which water is encountered, thickness and character of water-bearing strata and height to which water rises in the well.

Size of Drilled Hole	Size and Weight of Casing	From (Feet)	To (Feet)	PERFORATIONS		
				Kind Size	From (Feet)	To (Feet)
6 in.	4 in. 7 lb.	7	130	3/4" slotted	90	130

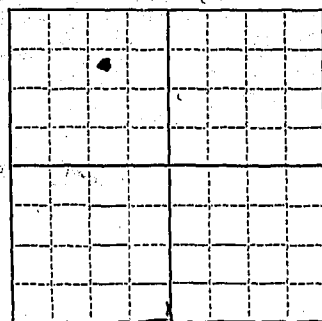

SE 1/4 Sec. 4 T. 17 R. 34

Indicate location of well and place of use, if possible. Each small square represents 10 acres.

Show exact depth of bottom.

Static Water Level for non-flowing Well 60 feet.Shut-in Pressure for Flowing Well nonePumping Water Level 126 feet at 5 gal. per minute.Discharge in gal. per min. of flowing well noneHow Tested pump Length of Test 36 hrs

Remarks: (Gravel packing, cementing, packers, type of shutoff, location of place of use of groundwater if not at well, and any other similar pertinent information, including number of acres irrigated, if used for irrigation)

29
Driller's License Number

Marla Drane
Driller's Signature

This form to be prepared by driller, and three copies to be filed by the owner with the County Clerk and Recorder in the county in which the well is located.

Please answer all questions. If not applicable, so state, otherwise the form will be returned.

Original to the County Clerk and Recorder; duplicate to the State Engineer; Triplicate to the Montana Bureau of Mines and Geology and Quadruplicate for the Appropriator.

RECEIVED

3 GW-3 Revised 1969
191-150-10/69

JUL 5 1973

County

Sanfield

STATE OF MONTANA
MONTANA DEPARTMENT OF AGRICULTURE
ADMINISTRATOR OF GROUNDWATER CODE
RESOURCES AND MONTANA WATER RESOURCES BOARD

NOTICE OF COMPLETION OF GROUNDWATER APPROPRIATION WITHOUT WELL

Developed After January 1, 1962

Under Chapter 237, Montana Session Laws, 1961, as amended

This notice is to be prepared by contractor (if any), otherwise by the owner.

Three copies of this notice are to be filed with the County Clerk and Recorder of the county in which the works are located.

Please answer all questions. If not applicable, so state, otherwise the form may be returned.

For Administrator's Use

File 139515

June 28, 1973

GW 1 3:00 p.m.

Owner Kenneth Bliss

Address Sand Springs, MMT

Contractor (if any) (none)

Address of Contractor _____

Date Started unk Date Completed unk

1. Describe means of obtaining groundwater (as by sub-irrigation, developed spring, drains, etc.) developed springs

2. Means of withdrawing water (gravity, pump, canal, etc.) gravity

3. Depth of water table unk

4. Use of the water stock, etc.

5. Amount of groundwater claimed (in miner's inches or gallons per minute) 200 gals. per min.

6. If used for irrigation, give number of acres and description of land (not so used)

7. Estimate amount of water used each year

5,000,000 gals.

8. Months of year spring flows year round

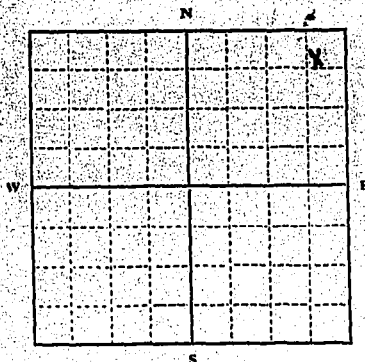

NE 1/4 NO 1/4 Sec. 8

T. 17 N. R. 34 E.

INDICATE POINT OF APPROPRIATION
AND PLACE OF USE, IF POSSIBLE.
Elevation of spring, if known or esti-

mated _____

Signature of Owner

Kenneth Bliss

Date

June 28, 1973

55681

File No. _____

T. 17 N. R. 34 E. 8

DUPLICATE

County _____

STATE OF MONTANA
ADMINISTRATOR OF GROUNDWATER CODE
OFFICE OF STATE ENGINEER

RECEIVED
JAN 6 1964

Declaration of Vested Groundwater Rights

(Under Chapter 237, Montana Session Laws, 1961)

STATE ENGINEER

1. Kenneth Bliss, of Sand Springs
(Name of Appropriator) (Address) (Town)
County of Garfield State of Mont
have appropriated groundwater according to the Montana laws in effect prior to January 1, 1962, as follows:

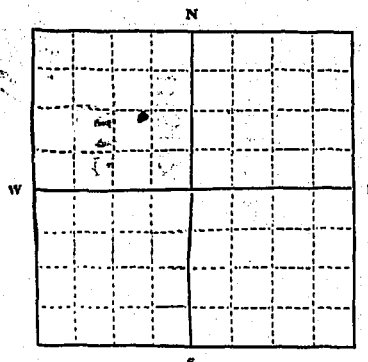

Sec. 8 T. 17 R. 34

Indicate point of appropriation and place of use, if possible. Each small square represents 10 acres.

2. The beneficial use on which the claim is based Stock water & Irrigation

3. Date or approx. date of earliest beneficial use; and how continuous the use has been Year around for stock water since July, Aug. for Irrigation

4. The amount of groundwater claimed (in miner's inches or gallons per minute) 800 gal per min.

5. If used for irrigation, give the acreage and description of the lands to which water has been applied and name of the owner thereof

N 1/2 Sec. 4. & N 1/2 Sec. 3 T. 17, R. 34

6. The means of withdrawing such water from the ground and the location of each well or other means of withdrawal

Pump for irrigation when installed

7. The date of commencement and completion of the construction of the well, wells, or other works for withdrawal of groundwater Spring 1964

8. The depth of water table from top of ground & down, depth not known

9. So far as it may be available, the type, size and depth of each well or the general specifications of any other works for the withdrawal of groundwater

not applicable

10. The estimated amount of groundwater withdrawn each year not known

11. The log of formations encountered in the drilling of each well if available Not known

12. Such other information of a similar nature as may be useful in carrying out the policy of this act, including reference to book and page of any county record

no record of

Signature of Owner

Kenneth Bliss

Dated Dec. 30-1963

Three copies to be filed by the owner with the County Clerk and Recorder of the county in which the well is located.

Please answer all questions. If not applicable, so state, otherwise the form will be returned.

Original to the County Clerk and Recorder; Duplicate to the State Engineer; Triplicate to the Montana Bureau of Mines and Geology, and Quadruplicate for the Appropriator.

23331

DAIRYMAN
EPO 30

REGISTRATION OF AGRICULTURAL
MACHINERY
CHIEF ENGINEER

RECEIVED

417
125074

STATE OF MONTANA
County of Garfield

Filed in the office of the County Clerk and
Recorder of Garfield County, State of Montana,
this 30 day of Dec

A. D. 1923 at 10:33 o'clock PM

Charles E. Davis
County Clerk and Recorder
By Marion B. Davis
Deputy

Fee Paid \$ 2.00

INDEXED
FILED

File No. _____

T. 17 N. R. 34 E.

DUPLICATE

County. Sanfield

STATE OF MONTANA
ADMINISTRATOR OF GROUNDWATER CODE
OFFICE OF STATE ENGINEER

RECEIVED
JAN 6 1964

Declaration of Vested Groundwater Rights ENGINEER

(Under Chapter 237, Montana Session Laws, 1961)

1. James A. Wheatcroft of Sanfield (Name of Appropriator) (Address) (Town)
County of Sanfield State of Montana
have appropriated groundwater according to the Montana laws in effect prior to January 1, 1962, as follows:

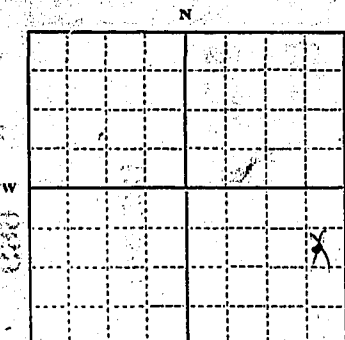

SW 1/4 NE 1/4 Sec. 10 T. 17 N. R. 34 E.

Indicate point of appropriation and place of use, if possible. Each small square represents 10 acres.

2. The beneficial use on which the claim is based.
Household & stock water
3. Date or approximate date of earliest beneficial use; and how continuous the use has been.
1920 - continuous use until 1953 - has not been used since
4. The amount of groundwater claimed (in miner's inches or gallons per minute) 5 gal. per minute
5. If used for irrigation, give the acreage and description of the lands to which water has been applied and name of the owner thereof
None
6. The means of withdrawing such water from the ground and the location of each well or other means of withdrawal.
no pump - windmill & gas engine
7. The date of commencement and completion of the construction of the well, wells, or other works for withdrawal of groundwater. 1920 A.D.
8. The depth of water table. Not known
9. So far as it may be available, the type, size and depth of each well or the general specifications of any other works for the withdrawal of groundwater.
approx 3 foot casing approx 40 feet hand dug
10. The estimated amount of groundwater withdrawn each year. not known
11. The log of formations encountered in the drilling of each well if available.
not available
12. Such other information of a similar nature as may be useful in carrying out the policy of this act, including reference to book and page of any county record.
they were used continuously until 1953 then land purchased by me & I have had other water rights before by for watering livestock

Signature of Owner. James A. Wheatcroft
Date. Dec. 30 - 1963

Three copies to be filed by the owner with the County Clerk and Recorder of the county in which the well is located.

Please answer all questions. If not applicable, so state, otherwise the form will be returned.

Original to the County Clerk and Recorder; Duplicate to the State Engineer; Triplicate to the Montana Bureau of Mines and Geology, and Quadruplicate for the Appropriator.

ALL INFORMATION CONTAINED
HEREIN IS UNCLASSIFIED
DATE 06-10-2008 BY 60322
UCBAW/STP

Figure 1. The effect of the concentration of the *Agrobacterium* suspension on the transformation efficiency of *Agrobacterium* strains. The *Agrobacterium* strains were incubated in the presence of 100 mg/ml of gentamicin and 100 mg/ml of rifampicin. The concentration of the *Agrobacterium* suspension was 10⁶ cells/ml. The transformation efficiency was determined by the number of transformants per 10⁶ cells. The data are the mean \pm SD of three independent experiments.

Year	1900	1901	1902	1903	1904	1905	1906	1907	1908	1909	1910	1911	1912	1913	1914	1915	1916	1917	1918	1919	1920	1921	1922	1923	1924	1925	1926	1927	1928	1929	1930	1931	1932	1933	1934	1935	1936	1937	1938	1939	1940	1941	1942	1943	1944	1945	1946	1947	1948	1949	1950	1951	1952	1953	1954	1955	1956	1957	1958	1959	1960	1961	1962	1963	1964	1965	1966	1967	1968	1969	1970	1971	1972	1973	1974	1975	1976	1977	1978	1979	1980	1981	1982	1983	1984	1985	1986	1987	1988	1989	1990	1991	1992	1993	1994	1995	1996	1997	1998	1999	2000	2001	2002	2003	2004	2005	2006	2007	2008	2009	2010	2011	2012	2013	2014	2015	2016	2017	2018	2019	2020	2021	2022	2023	2024	2025	2026	2027	2028	2029	2030	2031	2032	2033	2034	2035	2036	2037	2038	2039	2040	2041	2042	2043	2044	2045	2046	2047	2048	2049	2050	2051	2052	2053	2054	2055	2056	2057	2058	2059	2060	2061	2062	2063	2064	2065	2066	2067	2068	2069	2070	2071	2072	2073	2074	2075	2076	2077	2078	2079	2080	2081	2082	2083	2084	2085	2086	2087	2088	2089	2090	2091	2092	2093	2094	2095	2096	2097	2098	2099
1900	1901	1902	1903	1904	1905	1906	1907	1908	1909	1910	1911	1912	1913	1914	1915	1916	1917	1918	1919	1920	1921	1922	1923	1924	1925	1926	1927	1928	1929	1930	1931	1932	1933	1934	1935	1936	1937	1938	1939	1940	1941	1942	1943	1944	1945	1946	1947	1948	1949	1950	1951	1952	1953	1954	1955	1956	1957	1958	1959	1960	1961	1962	1963	1964	1965	1966	1967	1968	1969	1970	1971	1972	1973	1974	1975	1976	1977	1978	1979	1980	1981	1982	1983	1984	1985	1986	1987	1988	1989	1990	1991	1992	1993	1994	1995	1996	1997	1998	1999	2000	2001	2002	2003	2004	2005	2006	2007	2008	2009	2010	2011	2012	2013	2014	2015	2016	2017	2018	2019	2020	2021	2022	2023	2024	2025	2026	2027	2028	2029	2030	2031	2032	2033	2034	2035	2036	2037	2038	2039	2040	2041	2042	2043	2044	2045	2046	2047	2048	2049	2050	2051	2052	2053	2054	2055	2056	2057	2058	2059	2060	2061	2062	2063	2064	2065	2066	2067	2068	2069	2070	2071	2072	2073	2074	2075	2076	2077	2078	2079	2080	2081	2082	2083	2084	2085	2086	2087	2088	2089	2090	2091	2092	2093	2094	2095	2096	2097	2098	2099	

125328

Filed in the office of the County Clerk and
Recorder of Garfield County, State of Montana
this 31 day of May 1909.

A. D. 19... 63... B⁹... ack... a

Chas. E. Langdon

County Clerk
By Marian R. Jones Order
Deputy

Fee Paid \$ 2.00

RECEIVED *in*
FBI *Case*

100

1. The quality of service given
 2. The quality of service given
 3. The quality of service given
 4. The quality of service given
 5. The quality of service given
 6. The quality of service given
 7. The quality of service given
 8. The quality of service given
 9. The quality of service given
 10. The quality of service given

File No.

DUPLICATE

T. 170 R. 33E

County Garfield

STATE OF MONTANA
ADMINISTRATOR OF GROUNDWATER CODE
OFFICE OF STATE ENGINEER

RECEIVED
JUN 18 1963

Declaration of Vested Groundwater Rights STATE ENGINEER

(Under Chapter 237, Montana Session Laws, 1961)

1. Kenneth Bliss of Sand Springs, Montana
(Name of Appropriator) (Address) (Town)
County of Garfield State of Montana
have appropriated groundwater according to the Montana laws in effect prior to January 1, 1962, as follows:

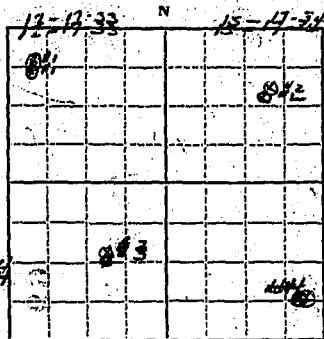

2. The beneficial use on which the claim is based. stock water and irrigation of shelter belt

3. Date or approximate date of earliest beneficial use; and how continuous the use has been. #1 May thru Aug. #2 April thru remainder of year #3 April thru remainder of year

4. The amount of groundwater claimed (in miner's inches or gallons per minute) 10 gal per min. for all wells

5. If used for irrigation, give the acreage and description of the lands to which water has been applied and name of the owner thereof #4 shelter belt trees

6. The means of withdrawing such water from the ground and the location of each well or other means of withdrawal #1 elect. #2 wind mill #3 wind mill #4 elect. motor

7. The date of commencement and completion of the construction of the well, wells, or other works for withdrawal of groundwater. 1948-#1 1960 #2-1959 #3

8. The depth of water table. #1 60' #2 28' #3 200' #4 10'

9. So far as it may be available, the type, size and depth of each well or the general specifications of any other works for the withdrawal of groundwater. #1 4" casing 40' deep #2 4" casing 35' deep #3 4" casing 25' deep #4 70' rock casing 25' deep

10. The estimated amount of groundwater withdrawn each year. 864,000

11. The log of formations encountered in the drilling of each well if available. not available

12. Such other information of a similar nature as may be useful in carrying out the policy of this act, including reference to book and page of any county record.

Signature of Owner Kenneth Bliss

Date June 13-1963

Three copies to be filed by the owner with the County Clerk and Recorder of the county in which the well is located.

Please answer all questions. If not applicable, so state, otherwise the form will be returned.

Original to the County Clerk and Recorder; duplicate to the State Engineer; Triplicate to the Montana Bureau of Mines and Geology, and Quadruplicate for the Appropriator.

11652

OFFICE OF ASSET PROTECTION
DEPARTMENT OF REVENUE
STATE OF MARYLAND
JAN 10 10 10AM '07

1967-1968

Yonah 3:15

1950

12-10-1964

1997, 1998, 1999, 2000, 2001, 2002, 2003, 2004, 2005, 2006, 2007, 2008, 2009, 2010, 2011, 2012, 2013, 2014, 2015, 2016, 2017, 2018, 2019, 2020, 2021, 2022, 2023, 2024, 2025, 2026, 2027, 2028, 2029, 2030, 2031, 2032, 2033, 2034, 2035, 2036, 2037, 2038, 2039, 2040, 2041, 2042, 2043, 2044, 2045, 2046, 2047, 2048, 2049, 2050, 2051, 2052, 2053, 2054, 2055, 2056, 2057, 2058, 2059, 2060, 2061, 2062, 2063, 2064, 2065, 2066, 2067, 2068, 2069, 2070, 2071, 2072, 2073, 2074, 2075, 2076, 2077, 2078, 2079, 2080, 2081, 2082, 2083, 2084, 2085, 2086, 2087, 2088, 2089, 2090, 2091, 2092, 2093, 2094, 2095, 2096, 2097, 2098, 2099, 2100, 2101, 2102, 2103, 2104, 2105, 2106, 2107, 2108, 2109, 2110, 2111, 2112, 2113, 2114, 2115, 2116, 2117, 2118, 2119, 2120, 2121, 2122, 2123, 2124, 2125, 2126, 2127, 2128, 2129, 2130, 2131, 2132, 2133, 2134, 2135, 2136, 2137, 2138, 2139, 2140, 2141, 2142, 2143, 2144, 2145, 2146, 2147, 2148, 2149, 2150, 2151, 2152, 2153, 2154, 2155, 2156, 2157, 2158, 2159, 2160, 2161, 2162, 2163, 2164, 2165, 2166, 2167, 2168, 2169, 2170, 2171, 2172, 2173, 2174, 2175, 2176, 2177, 2178, 2179, 2180, 2181, 2182, 2183, 2184, 2185, 2186, 2187, 2188, 2189, 2190, 2191, 2192, 2193, 2194, 2195, 2196, 2197, 2198, 2199, 2200, 2201, 2202, 2203, 2204, 2205, 2206, 2207, 2208, 2209, 2210, 2211, 2212, 2213, 2214, 2215, 2216, 2217, 2218, 2219, 2220, 2221, 2222, 2223, 2224, 2225, 2226, 2227, 2228, 2229, 2230, 2231, 2232, 2233, 2234, 2235, 2236, 2237, 2238, 2239, 2240, 2241, 2242, 2243, 2244, 2245, 2246, 2247, 2248, 2249, 2250, 2251, 2252, 2253, 2254, 2255, 2256, 2257, 2258, 2259, 2260, 2261, 2262, 2263, 2264, 2265, 2266, 2267, 2268, 2269, 2270, 2271, 2272, 2273, 2274, 2275, 2276, 2277, 2278, 2279, 2280, 2281, 2282, 2283, 2284, 2285, 2286, 2287, 2288, 2289, 2290, 2291, 2292, 2293, 2294, 2295, 2296, 2297, 2298, 2299, 2300, 2301, 2302, 2303, 2304, 2305, 2306, 2307, 2308, 2309, 2310, 2311, 2312, 2313, 2314, 2315, 2316, 2317, 2318, 2319, 2320, 2321, 2322, 2323, 2324, 2325, 2326, 2327, 2328, 2329, 2330, 2331, 2332, 2333, 2334, 2335, 2336, 2337, 2338, 2339, 2340, 2341, 2342, 2343, 2344, 2345, 2346, 2347, 2348, 2349, 2350, 2351, 2352, 2353, 2354, 2355, 2356, 2357, 2358, 2359, 2360, 2361, 2362, 2363, 2364, 2365, 2366, 2367, 2368, 2369, 2370, 2371, 2372, 2373, 2374, 2375, 2376, 2377, 2378, 2379, 2380, 2381, 2382, 2383, 2384, 2385, 2386, 2387, 2388, 2389, 2390, 2391, 2392, 2393, 2394, 2395, 2396, 2397, 2398, 2399, 2400, 2401, 2402, 2403, 2404, 2405, 2406, 2407, 2408, 2409, 2410, 2411, 2412, 2413, 2414, 2415, 2416, 2417, 2418, 2419, 2420, 2421, 2422, 2423, 2424, 2425, 2426, 2427, 2428, 2429, 2430, 2431, 2432, 2433, 2434, 2435, 2436, 2437, 2438, 2439, 2440, 2441, 2442, 2443, 2444, 2445, 2446, 2447, 2448, 2449, 2450, 2451, 2452, 2453, 2454, 2455, 2456, 2457, 2458, 2459, 2460, 2461, 2462, 2463, 2464, 2465, 2466, 2467, 2468, 2469, 2470, 2471, 2472, 2473, 2474, 2475, 2476, 2477, 2478, 2479, 2480, 2481, 2482, 2483, 2484, 2485, 2486, 2487, 2488, 2489, 2490, 2491, 2492, 2493, 2494, 2495, 2496, 2497, 2498, 2499, 2500, 2501, 2502, 2503, 2504, 2505, 2506, 2507, 2508, 2509, 2510, 2511, 2512, 2513, 2514, 2515, 2516, 2517, 2518, 2519, 2520, 2521, 2522, 2523, 2524, 2525, 2526, 2527, 2528, 2529, 2530, 2531, 2532, 2533, 2534, 2535, 2536, 2537, 2538, 2539, 2540, 2541, 2542, 2543, 2544, 2545, 2546, 2547, 2548, 2549, 2550, 2551, 2552, 2553, 2554, 2555, 2556, 2557, 2558, 2559, 2560, 2561, 2562, 2563, 2564, 2565, 2566, 2567, 2568, 2569, 2570, 2571, 2572, 2573, 2574, 2575, 2576, 2577, 2578, 2579, 2580, 2581, 2582, 2583, 2584, 2585, 2586, 2587, 2588, 2589, 2590, 2591, 2592, 2593, 2594, 2595, 2596, 2597, 2598, 2599, 2600, 2601, 2602, 2603, 2604, 2605, 2606, 2607, 2608, 2609, 2610, 2611, 2612, 2613, 2614, 2615, 2616, 2617, 2618, 2619, 2620, 2621, 2622, 2623, 2624, 2625, 2626, 2627, 2628, 2629, 2630, 2631, 2632, 2633, 2634, 2635, 2636, 2637, 2638, 2639, 2640, 2641, 2642, 2643, 2644, 2645, 2646, 2647, 2648, 2649, 2650, 2651, 2652, 2653, 2654, 2655, 2656, 2657, 2658, 2659, 2660, 2661, 2662, 2663, 2664, 2665, 2666, 2667, 2668, 2669, 2670, 2671, 2672, 2673, 2674, 2675, 2676, 2677, 2678, 26

STATE OF MONTANA
County of Garfield

Filed in the office of the County Clerk and Recorder of Garfield County, State of Montana, this 13 day of June

A, D. 19 63 at 4:30 o'clock 0 M

By Charles E. Anderson
County Clerk and Recorder
Marion R. James

Post Paid 2.00

INDEX *mf*
FILE *mf*

69

12356?
123567

STATE OF MONTANA
ADMINISTRATOR OF GROUNDWATER CODE
MONTANA WATER RESOURCES BOARD

RECEIVED

JUL 15 1973

17N-34E 15
County Gallatin

NOTICE OF COMPLETION OF GROUNDWATER
APPROPRIATION BY MEANS OF WELL
Developed after January 1, 1962

DRILLER'S LOG
Indicate the character, color, thickness of strata such as soil, clay, sand, gravel, shale, sandstone, etc. Show depth at which water is found and height to which water rises in well.

(Under Chapter 237 Montana Session Laws, 1961, as amended)

This form to be prepared by driller, and three copies to be filed by the owner with the County Clerk and Recorder in the county in which the well is located, last copy to be retained by driller. Please answer all questions. If not applicable, so state, otherwise the form may be returned.

Owner Kenneth Bliss

Address Sand Springs

mt

Date well started unk.

completed unk.

Type of well sec. 20 - dug; sec. 15 - drilled

Equipment used #20 - shovel; #15 - drill

Water Use: Domestic ☒ Municipal ☐ Stock ☒ Irrigation ☒

Industrial ☐ Drainage ☐ Other ☐ Garden/Lawn ☒

*Describe 44000

USE: If used for irrigation, industrial, drainage or other. Explain, state number of acres and location or other data (i.e. lot, block and Addition). land in and about NE 1/4 SW 1/4 sec. 20, T17N-R34E and SW 1/4 NE 1/4 sec. 15, T17N-R34E

ESTIMATED ANNUAL WITHDRAWAL 5,000,000 gals.

Size of Drilled Hole	Size and Weight of Casing	From (Feet)	To (Feet)	PERFORATIONS
#20 10'	(none)	0	15	Kind Size From (Feet) To (Feet)
#15 4"	4"	0	35	unknown

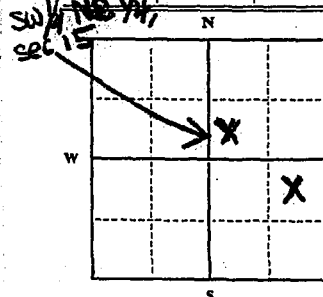

Static water level #20-2 #15-20 ft.*
Pumping water level #20-2 ft.*
at #20 #15 unknown gpm, measured 30 minutes after pumping began.

*Measured from ground level.
Well developed by pump
for 6 hours.

Power Sec 20 Pump HP

Remarks: (Gravel packing, cementing, packers, type of shutoff)

1/4 Sec. 34
T. 17 N. R. 34 E.

INDICATE LOCATION OF WELL AND PLACE OF USE, IF POSSIBLE. EACH SMALL SQUARE REPRESENTS 40 ACRES.

Driller's Signature Carl Jarrel (now deceased)

Driller's Address

LICENSE NO.

#20 15'
#15 35'

Show exact depth of bottom

55683

901

139513

STATE OF MONTANA
County of Garfield

Filed in the office of the County Clerk and
Recorder of Garfield County, State of Montana,
this 28th day of June.

A. D. 19 1913 at 2:50 o'clock P. M.
Charles E. Partridge
County Clerk and Recorder

By Jo. H. Strickland
Deputy

Fee Paid \$2.00

INDEXED Yes
FILED Yes

RECEIVED BY THE COUNTY CLERK AND RECORDER OF GARFIELD COUNTY, MONTANA, THIS 28th DAY OF JUNE, A.D. 1913, AT 2:50 O'CLOCK P.M. FOR THE RECORDING OF A DEED, TO WIT: THE DEED OF TRUST, BEARING DATE OF JUNE 13, 1913, IN BOOK 13, PAGE 13, OF THE RECORDS OF GARFIELD COUNTY, MONTANA.

1	2	3	4	5	6	7	8	9	10	11	12	13	14	15	16	17	18	19	20	21	22	23	24	25	26	27	28	29	30	31	32	33	34	35	36	37	38	39	40	41	42	43	44	45	46	47	48	49	50	51	52	53	54	55	56	57	58	59	60	61	62	63	64	65	66	67	68	69	70	71	72	73	74	75	76	77	78	79	80	81	82	83	84	85	86	87	88	89	90	91	92	93	94	95	96	97	98	99	100
---	---	---	---	---	---	---	---	---	----	----	----	----	----	----	----	----	----	----	----	----	----	----	----	----	----	----	----	----	----	----	----	----	----	----	----	----	----	----	----	----	----	----	----	----	----	----	----	----	----	----	----	----	----	----	----	----	----	----	----	----	----	----	----	----	----	----	----	----	----	----	----	----	----	----	----	----	----	----	----	----	----	----	----	----	----	----	----	----	----	----	----	----	----	----	----	----	----	----	-----

File No.

T. 17

R.

DUPLICATE

County Garfield

STATE OF MONTANA
ADMINISTRATOR OF GROUNDWATER CODE
OFFICE OF STATE ENGINEER

JUN 23 1963

Notice of Completion of Groundwater
Appropriation by Means of Well

(Under Chapter 237, Montana Session Laws, 1961)

Owner Kenneth Bliss Address Sand Springs, MontanaDriller Merle Drane Address Jordan, MontanaDate of Notice of Appropriation of Groundwater 7-30-63Date well started 8-6-63 Date Completed 8-16-63Type of well Drilled Equipment Used Rotary
(dug, driven, bored or (Churn, drill, rotary or
drilled) other)Water Use: Domestic ☐ Municipal ☐ Other ☐ Irrigation ☐
Industrial ☐ Drainage ☐ Stock ☐

Indicate on the diagram the character and thickness of the different strata met with in drilling, such as soil, clay, shale, gravel, rock or sand, etc. Show depth at which water is encountered, and character of water-bearing strata and height to which water rises.

Size of Packer Hole	Size and Weight of Casing	From (Feet)	To (Feet)	Kind Size	From (Feet)	To (Feet)
6 in.	4 in. 91b.	1	300	1 1/2 in.	237	300

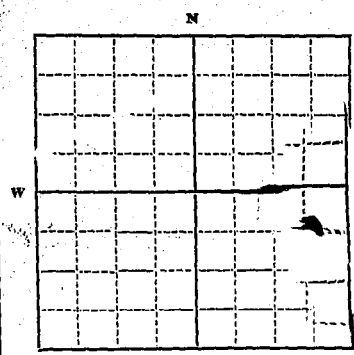

ns. 1/4 Sec. 20. T. 17. R. 20

Indicate location of well and place of use, if possible. Each small square represents 10 acres.

Show exact depth of bottom.

Static Water Level for non-flowing Well 710 feet.Shut-in Pressure for Flowing Well nonePumping Water Level 189 feet at 10 gal. per minute.Discharge in gal. per min. of flowing well noneHow Tested None Length of Test 36 hr.

Remarks: (Gravel packing, cementing, packers, type of shut-off, location of place of use of groundwater if not at well, and any other similar pertinent information, including number of acres irrigated, if used for irrigation)

29
Driller's License Number

Driller's Signature

This form to be prepared by driller, and three copies to be filed by the owner with the County Clerk and Recorder in the county in which the well is located.

Please answer all questions. If not applicable, so state, otherwise the form will be returned.

Original to the County Clerk and Recorder; duplicate to the State Engineer; Triplicate to the Montana Bureau of Mines and Geology and Quadruplicate for the Appropriator.

5516

CHARLES
Clerk and Re
10

Will you please change your record
next Sec 20 T. 17 R. 34 instee
on Aug. 22, 1963. the description
Means of Well. Made by Kenneth B.
Notice of Completion of Ground

81
123824

**STATE OF MONTANA
County of Garfield**

Filed in the office of the County Clerk and
Recorder of Garfield County, State of Montana,
this 22 day of Aug.

A. D. 19 63 at 8:25 o'clock A. M.

Charles A. Thompson
County Clerk and Recorder

Fee \$24.00 2.00



Now known as
situated in the NW 1/4 of Section 10
T. 17 N. R. 34 E. of the
Section 10, T. 17 N. R. 34 E.
of the

RECORDED
INDEXED
AUG 22 1963

Dear Sir:
On the Notice of Completion of Groundwater Appropriation
by Means of Well. Made by Kenneth Bliss filed
on Aug. 22, 1963. the discreption should be
Sec 20 T. 17 R. 34 instead of Range 20.
Will you please change your records. Thank you.

CHARLES E. PANGBURN
Clerk and Recorder, Garfield County
JORDAN, MONTANA
59337

RECEIVED
DEC 13 1963

STATE ENGINEER

RECEIVED

17N-34E

3 GW-3 Revised 1969
191-1500-10/69

5 1973

County

Sno. Field

MONTANA DEPARTMENT OF NATURAL RESOURCES
ADMINISTRATOR OF GROUNDWATER CODE
MONTANA WATER RESOURCES BOARD

NOTICE OF COMPLETION OF GROUNDWATER APPROPRIATION WITHOUT WELL

Developed After January 1, 1962

(Under Chapter 237, Montana Session Laws, 1961, as amended)

This form to be prepared by contractor (if any), otherwise by the owner.

Three copies of this notice are to be filed with the County Clerk and Recorder of the county in which the works are located.

Please answer all questions. If not applicable, so state, otherwise the form may be returned.

For Administrator's Use

File 139516, 904

4-28-73

GW 1 3:05 P.M.

Owner Kenneth Bliss

Address Sand Springs, MT

Contractor (if any) NONE

Address of Contractor _____

Date Started unk. Date Completed unk.

1. Describe means of obtaining groundwater (as by sub-irrigation, developed spring, drains, etc.) developed spring

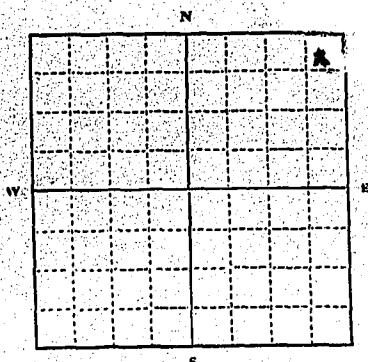

NE 1/4 NE 1/4 Sec 21

T. 17 N. R. 34 E.

INDICATE POINT OF APPROPRIATION AND PLACE OF USE, IF POSSIBLE.
Elevation of spring, if known or estimated _____

2. Means of withdrawing water (gravity, pump, canal, etc.) gravity

3. Depth of water table UNKNOWN

4. Use of the water livestock, etc.

5. Amount of groundwater claimed (in miner's inches or gallons per minute) 200 gals. per min.

6. If used for irrigation, give number of acres and description of land (not so used)

7. Estimate amount of water used each year 5,000,000 gals.

8. Months of year spring flows year round

Signature of Owner

Kenneth Bliss
Date June 28, 1973

55880

#904
139516
139516

STATE OF MONTANA
County of Garfield

Filed in the office of the County Clerk and
Recorder of Garfield County, State of Montana
this 21st day of April
A.D. 1913 at 3:00 o'clock P.M.
Charles E. Packard
County Clerk and Recorder

Sp. Am. Minister
Per. Seal E. 100

POLICE OF

LEWIS MONTGOMERY MICHIGAN 1911

RECORDED

INDEXED

FILED

APR 21 1913

CLERK

RECORDED

INDEXED

FILED

APR 21 1913

CLERK

RECORDED

INDEXED

FILED

APR 21 1913

CLERK

RECORDED

INDEXED

FILED

APR 21 1913

CLERK

Developed after January 1, 1962

This form to be prepared by driller, and three copies to be filed by the owner with the County Clerk and Recorder in the county in which the well is located, last copy to be retained by driller. Please answer all questions. If not applicable, so state, otherwise, the form may be returned.

Owner

Address Helena, Montana

For Administrator's Use

File 912: 139531

6-29-73

Date well started Sept 23, 1966

GW 1 8:20 A.M.

completed Sept-23-1966

Type of well Drill

(Dug, driven, bored or drilled)

Equipment used

~~NOTARY~~

(Churn drill, rotary or other)

Water Use: Domestic ☐ Municipal ☐ Stock ☒ Irrigation ☐

Industrial ☐ Drainage ☐ Other ☐* Garden/Lawn ☐

***Describe**

USE: If used for irrigation, industrial, drainage or other. Explain, state number of acres and location or other data (i.e. Lot, Block and Addition).

ESTIMATED ANNUAL WITHDRAWAL 5,256,000 185

Static water level 8 ft.
Pumping water level 15 ft.
at 10 gallons per minute
measured minutes after pumping
began.

UNKNOWN

*Measured from ground level.

Well developed by ..

forhours.

Power..... Pump..... HF.....

Remarks: (Gravel packing, cementing)

packers, type of shutoff)

SE $\frac{1}{4}$ NW $\frac{1}{4}$ Sec. 21
T. 17 N R. 34 S

INDICATE LOCATION OF WELL AND PLACE OF USE, IF POSSIBLE.
EACH SMALL SQUARE REPRESENTS 40 ACRES.

Driller's Signature

CARL TERRA (NW deceased)

Driller's Address

LICENSE NO.

Indicate the character, thickness of strata such as sand, gravel, shale, sandstone. Show depth at which water is and height to which water will.

Top of Ground

DELEV. ABOVE

[illegible]

211' Show exact depth of bottom

55474

#912
139531

STATE OF MONTANA
County of Garfield.

Filed in the office of the County Clerk and
Recorder of Garfield County, State of Montana
this 29th day of June

A. D. 19 13 at 8:15 o'clock P. M.

Charles E. Englund
County Clerk and Recorder

By Sp. Const. Stanton
Deputy

See Book 1 Page 100

INDEXED

FILED

Jas
Jas

FILED IN THE OFFICE OF THE COUNTY CLERK AND RECORDER OF GARFIELD COUNTY, MONTANA

NOTE: If copies for recording are required, they should be filed in the proper place in the office of the County Clerk and Recorder.

Approved: ☐ Original ☐ Copy ☐ Carbon ☐ Duplicate ☐

After fees paid: ☐ Original ☐ Copy ☒ Duplicate ☐

Embarked: ☐ Original ☐ Copy ☒ Duplicate ☐

Filed in well: ☐ Original ☐ Copy ☒ Duplicate ☐

264 331444

264 331444

264 331444

264 331444

264 331444

264 331444

264 331444

264 331444

264 331444

264 331444

264 331444

264 331444

264 331444

264 331444

912
13953

STATE OF MONTANA
County of Garfield

Filed in the office of the County Clerk and Recorder of Garfield County, State of Montana, on the 29th day of June

A. D. 1913 at 8:20 o'clock A. M.

Charles E. Thompson

County Clerk and Recorder

By J. W. L. L. L.

Not Public

INDEXED

FILED

264 331444

264 331444

264 331444

264 331444

264 331444

264 331444

264 331444

264 331444

264 331444

264 331444

264 331444

264 331444

264 331444

264 331444

264 331444

264 331444

264 331444

264 331444

264 331444

17N-34E

1973

County

Garfield

3. GW 3 Revised 1969
191-1500-10/69

1967

COURT

MONTANA DEPARTMENT OF STATE OF MONTANA
RESOURCES AND ADMINISTRATION
ADMINISTRATOR OF GROUNDWATER CODE
MONTANA WATER RESOURCES BOARD

NOTICE OF COMPLETION OF GROUNDWATER APPROPRIATION WITHOUT WELL

Developed After January 1, 1962

(Under Chapter 237, Montana Session Laws, 1961, as amended)

This form to be prepared by contractor (if any), otherwise by the owner.

Three copies of this notice are to be filed with the County Clerk and Recorder of the county in which the works are located.

Please answer all questions. If not applicable, so state, otherwise the form may be returned.

For Administrator's Use

File 139512, 509

6-29-73

GW 1 3:10pm

NW ¼ SW ¼ Sec. 28

T. 17 N R. 34 E

INDICATE POINT OF APPROPRIATION
AND PLACE OF USE, IF POSSIBLE.
Elevation of spring, if known or esti-

mated

Owner Kenneth Bliss
Address Sand Springs, MIT
Contractor (if any) (None)
Address of Contractor _____
Date Started unk Date Completed unk
1. Describe means of obtaining groundwater (as by sub-irrigation,
developed spring, drains, etc.) developed spring

2. Means of withdrawing water (gravity, pump, canal, etc.) _____

gravity

3. Depth of water table unk.

4. Use of the water stock, etc.

5. Amount of groundwater claimed (in miner's inches or gallons per minute) 200 gals. per min.

6. If used for irrigation, give number of acres and description of land (not so used)

7. Estimate amount of water used each year 5,000,000 gals.

8. Months of year spring flows _____
YEAR ROUND

Signature of Owner

Kenneth Bliss

Date _____

June 28, 1973

55679

#905

139677

STATE OF MONTANA
County of Garfield

Filed in the office of the County Clerk and
Recorder of Garfield County, State of Montana,
this 28th day of February

A.D. 1973 at 3:00 o'clock P.M.

Charles E. McQuinn
County Clerk and Recorder

By *[Signature]*

Doc. Ref. # 250

[Signature]
[Signature]

NEW MONTANA LABORERS' UNION

File No. _____

T. 17 N. R. 34 E.

DUPLICATE

County Garfield

STATE OF MONTANA
ADMINISTRATOR OF GROUNDWATER CODE
OFFICE OF STATE ENGINEER

Declaration of Vested Groundwater Rights

(Under Chapter 237, Montana Session Laws, 1961)

RECEIVED
JAN 6 1964

STATE ENGINEER

1. Emma R. Fitzgerald, of _____, (Name of Appropriator) _____ (Address) _____ (Town)
 County of Garfield State of Montana
 have appropriated groundwater according to the Montana laws in effect prior to January 1, 1962, as follows:

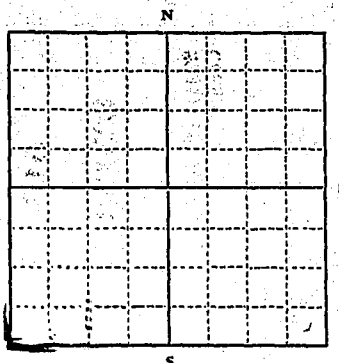

SE 1/4 Sec. 30 T. 17 R. 34

Indicate point of appropriation and place of use, if possible. Each small square represents 10 acres.

2. The beneficial use on which the claim is based Stockwater

3. Date or approximate date of earliest beneficial use; and how continuous the use has been 1924

4. The amount of groundwater claimed (in miner's inches or gallons per minute) 10 gal.

5. If used for irrigation, give the acreage and description of the lands to which water has been applied and name of the owner thereof

6. The means of withdrawing such water from the ground and the location of each well or other means of withdrawal none

7. The date of commencement and completion of the construction of the well, wells, or other works for withdrawal of groundwater 1924

8. The depth of water table 80

9. So far as it may be available, the type, size and depth of each well or the general specifications of any other works for the withdrawal of groundwater 150' Deep 6" casing
2" Pipe

10. The estimated amount of groundwater withdrawn each year 120,000

11. The log of formations encountered in the drilling of each well if available Not available

12. Such other information of a similar nature as may be useful in carrying out the policy of this act, including reference to book and page of any county record none

Signature of Owner Emma R. Fitzgerald

Date Dec 31, 1963

Three copies to be filed by the owner with the County Clerk and Recorder of the county in which the well is located.

Please answer all questions. If not applicable, so state, otherwise the form will be returned.

Original to the County Clerk and Recorder; Duplicate to the State Engineer; Triplicate to the Montana Bureau of Mines and Geology, and Quaduplicate for the Appropriator.

23430

516

125173

STATE OF MONTANA }
County of C. Field

Filed in the Office of the County Clerk and
Recorder of C. Field County, State of Montana,
this 31 day of Dec.

A. D. 1962 at 8:13 o'clock A. M.

Charles E. Vaughan
County Clerk and Recorder
By Marion A. Jensen
Deputy

Fee Paid \$ 2.00

ml
ml

Form No. 18
8-60

T. 17N R. 34E
County Garfield

MONTANA BUREAU OF MINES AND GEOLOGY
Butte, Montana

RECEIVED
22 1961

Water Well Log

STATE ENGINEER

Owner Esma Fitzgerald Address Jordan, Montana
Driller Carl Jerrel Address Miles City, Montana
Date Started Sept 10/1961 Date Completed 9/22/61
Location: Sec. 32 T. 17 R. 34 $\frac{1}{4}$ sec. NE 1/4

Type of well Drilled Equipment used Rotary
(Dug, driven, or drilled) (Churn, drill, rotary, other)

Use: Domestic ☐ Municipal ☐ Stock ☒ Irrigation ☐
Industrial ☐ Drainage ☐ Other ☐

Casing: 0 ft. to 257 ft. Type iron Size 4 inch

Casing: _____ ft. to _____ ft. Type _____ Size _____

Casing: _____ ft. to _____ ft. Type _____ Size _____

Perforated or screened: Ft. 213 to ft. 257 . Ft. _____ to ft. _____

Type of screen or perforations slots

Static water level, for non-flowing well: _____ feet.

Shut-in pressure, for flowing well: _____ lb./sq. in. on _____
(date)

Pumping water level _____ feet at 9 gal. per min.

How tested: bailer

Length of test 2 hours

Remarks: (Gravel packing, cementing, packers, type of shut-off, depth of shut-off)
Bails to 240 feet at nine gallons per minute

(over)

Log of Well

[illegible]

RECEIVED

17N-34E
County Sheridan 34

JUL 5 1973

DRILLER'S LOG

STATE OF MONTANA
ADMINISTRATOR OF GROUNDWATER CODE
MONTANA WATER RESOURCES BOARD

MONTANA DEPARTMENT OF NATURAL RESOURCES AND CONSERVATION
Indicate the character, color, thickness of strata such as soil, clay, sand, gravel, shale, sandstone, etc. Show depth at which water is found and height to which water rises in well.

NOTICE OF COMPLETION OF GROUNDWATER APPROPRIATION BY MEANS OF WELL

Developed after January 1, 1962

(Under Chapter 237 Montana Session Laws, 1961, as amended)

This form to be prepared by driller, and three copies to be filed by the owner with the County Clerk and Recorder in the county in which the well is located, last copy to be retained by driller. Please answer all questions. If not applicable, so state, otherwise the form may be returned.

Owner Kenneth Bliss
Address Sand Springs, MT

For Administrator's Use	
File	<u>902-19754</u>
GW I	

Date well started unk.
completed unk.

Type of well 90% sec 34 - dug; all other drilled
(Dug, driven, bored or drilled)

Equipment used shovel on dug well - drill on others
(Chain drill, rotary or other)

Water Use: Domestic ☒ Municipal ☐ Stock ☒ Irrigation ☐

Industrial ☐ Drainage ☐ Other ☐ Garden/Lawn ☒

*Describe

USE: If used for irrigation, industrial, drainage or other, explain state number of acres and location or other data (i.e., lot, block and Addition).

ESTIMATED ANNUAL WITHDRAWAL 2,000,000 gals.

Size of Drilled Hole	Age and Weight of Casing	From (Feet)	To (Feet)	PERFORATIONS		
4 1/2"	4 1/2"	UNKNOWN		Kind Size	From (Feet)	To (Feet)
					UNKNOWN	

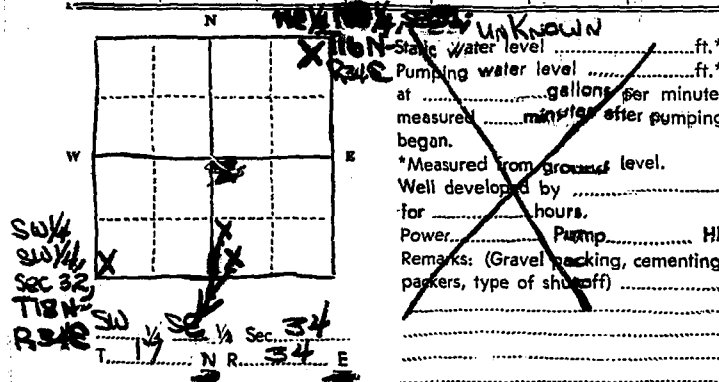

INDICATE LOCATION OF WELL AND PLACE OF USE, IF POSSIBLE. EACH SMALL SQUARE REPRESENTS 40 ACRES.

Driller's Signature Carl J. [unclear]
Driller's Address driller of other wells unknown

LICENSE NO.

Show exact depth of bottom

[illegible]