

Page 1 of 1

County Hill Twp. 3077 Rge. 11E

[illegible]

GW. 11
FIL. NO. _____

TWP 30N RGE 11E
COUNTY _____

2

STATE OF MONTANA
ADMINISTRATOR OF GROUNDWATER CODE
OFFICE OF STATE ENGINEER

RECEIVED
JAN 12 1963

DECLARATION OF VESTED GROUNDWATER RIGHTS
(Under Chapter 237, Montana Session Laws, 1961)

1. Larry D. Solberg, of Butte STATE ENGINEER
(Name of Appropriator) (Address) (Town)
County of Hill, State of MONTANA
Have appropriated groundwater according to the Montana laws in effect prior to Jan. 1, 1962 as follows:

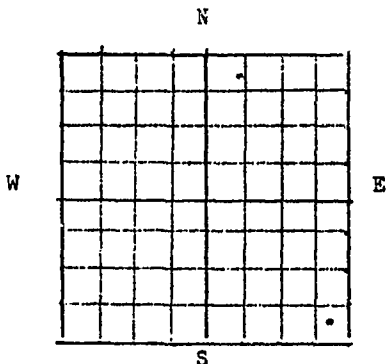

2. The beneficial use on which the claim is based
Stock + Household

3. Date or approximate date of earliest beneficial use; and how continuous the use has been
1916

4. The amount of groundwater claimed (in miner's inches or gallons per minute)
15 GAL PER MIN

5. If used for irrigation, give the acreage and description of the lands to which water has been applied and name of the owner thereof

SE 1/4 Sec 2 T 30R 11

Indicate point of appropriation and place of use, if possible. Each small square represents 10 acres.

6. The means of withdrawing such water from the ground and the location of each well or other means of withdrawal
Wind Mill

7. The date of commencement and completion of the construction of the well, wells, or other works for withdrawal of groundwater
1916

8. The depth of water table
75 ft

9. So far as it may be available, the type, size and depth of each well or the general specifications of any other works for the withdrawal of groundwater
Drilled - 6" - CASED - 95 ft

10. The estimated amount of groundwater withdrawn each year
60,000 GAL

11. The log of formations encountered in the drilling of each well if available

12. Such other information of a similar nature as may be useful in carrying out the policy of this act, including reference to book and page of any county record

Signature of Owner Larry D. Solberg
Date 12-31-63

Three copies to be filed by the owner with the County Clerk & Recorder of the County in which the well is located.

PLEASE ANSWER ALL QUESTIONS. IF NOT APPLICABLE, SO STATE, OTHERWISE THE FORM WILL BE RETURNED.

Original to the County Clerk & Recorder; duplicate to the State Engineer; Triplicate to the School of Mines and Quadruplicate for the Appropriator.

397120

LARRY R. SOLBERG

TO

THE PUBLIC

DECLARATION OF VESTED
GROUNDWATER RIGHTS

STATE OF MONTANA) ss.
COUNTY OF HILL)
Filed at 11 o'clock *a*m.

ON DEC 8 1963
16 Blain
COUNTY CLERK
DEPUTY

FEE: \$2.00 pd.

File No. _____

DUPLICATE

T. 30 R. 11

County Hill

STATE OF MONTANA
ADMINISTRATOR OF GROUNDWATER CODE
OFFICE OF STATE ENGINEER

DEC 27 1963

STATE ENGINEER

Notice of Completion of Groundwater Appropriation
Without Well

(Under Chapter 237 Montana Session Laws, 1961)

Date of Appropriation of Groundwater Dec 20 1963

Owner Odedum Salberg Address Box 5, Eden, Mont

Contractor (if any) Unknown

Address of Contractor Unknown

Date Started Unknown Date Completed About 1920

Describe means of obtaining groundwater without a well "as by sub-irrigation and other natural processes". Include depth to water when applicable. Natural Snow & Rain runoff.

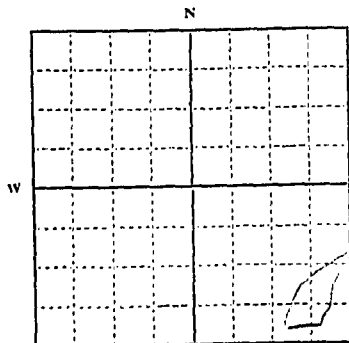

S.E. 1/4 Sec. 10, T. 30 R. 11

Indicate point of appropriation and place of use, if possible.

Quantity of water developed and used with explanation of method used to measure or estimate such amount. If use is intermittent

estimate approximate lengths of periods of use.

Told water to a depth of 8 feet
Used to water stock

Signature of Owner Odedum Salberg

Date Dec 20 1963

This form to be prepared by contractor (if any), otherwise by the owner.

Three copies of this notice are to be filed with the County Clerk and Recorder of the county in which the works are located.

Please answer all questions. If not applicable, so state, otherwise the form will be returned.

Original to the County Clerk and Recorder; duplicate to the State Engineer; Triplicate to the Montana Bureau of Mines and Geology and Quadruplicate for the Appropriator.

396688

ORDEAN SOLBERG

TO

THE PUBLIC

NOTICE OF COMPLETION OF
GROUNDWATER APPROPRIATION
WITHOUT WELL.

STATE OF MONTANA) ss.
COUNTY OF HILL)
Filed at 11 o'clock A.M.

ON DEC 20 1963

R. E. Blom

COUNTY CLERK

DEPUTY

Fee: \$2.00 pd.

Mr. Ordean R. Solberg, Box Elder, Montana
February 26, 1964

from natural surface runoff.

396688

December 20, 1963

396688

ORDEAN SOLBERG

TO

THE PUBLIC

NOTICE OF COMPLETION OF
GROUNDWATER APPROPRIATION
WITHOUT WELL

STATE OF MONTANA, ss.
COUNTY OF HILL
Filed at 11:00 a.m.

ON DEC 20 1963

R. E. BLOM
COUNTY CLERK

NOTARY

Fee: \$2.00 pd.

Mr. Ordean R. Solberg, Box Elder, Montana

February 26, 1964

December 20, 1963

396688

from natural surface runoff.

STATE OF MONTANA
ADMINISTRATOR OF GROUNDWATER CODE
OFFICE OF STATE ENGINEER

DECLARATION OF VESTED GROUNDWATER RIGHTS
(Under Chapter 237, Montana Session Laws, 1961) STATE ENGINEER

1. F. D. Solberg, of Edgemoor (Town)
(Name of Appropriator) (Address)
County of Richmond, State of Montana
Have appropriated groundwater according to the Montana laws in effect prior to Jan. 1, 1962 as follows:

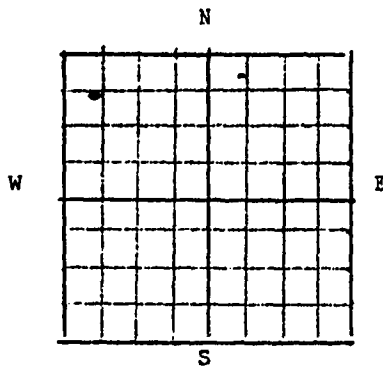

NW 1/4 NW Sec 10 T 30 R 11

Indicate point of appropriation and place of use, if possible. Each small square represents 10 acres.

2. The beneficial use on which the claim is based
Household & stock
3. Date or approximate date of earliest beneficial use; and how continuous the use has been
1920
4. The amount of groundwater claimed (in miner's inches or gallons per minute)
12 gal. per min.
5. If used for irrigation, give the acreage and description of the lands to which water has been applied and name of the owner thereof

6. The means of withdrawing such water from the ground and the location of each well or other means of withdrawal

7. The date of commencement and completion of the construction of the well, wells, or other works for withdrawal of groundwater
1920
8. The depth of water table

9. So far as it may be available, the type, size and depth of each well or the general specifications of any other works for the withdrawal of groundwater
drilled well 80 ft
10. The estimated amount of groundwater withdrawn each year
100 gpm
11. The log of formations encountered in the drilling of each well if available

12. Such other information of a similar nature as may be useful in carrying out the policy of this act, including reference to book and page of any county record

Signature of Owner F. D. Solberg
Date 12-31-63

Three copies to be filed by the owner with the County Clerk & Recorder of the County in which the well is located.

PLEASE ANSWER ALL QUESTIONS. IF NOT APPLICABLE, SO STATE, OTHERWISE THE FORM WILL BE RETURNED.

Original to the County Clerk & Recorder; duplicate to the State Engineer; Triplicate to the School of Mines and Quadruplicate for the Appropriator.

397119

LARRY D. SOLBERG

TO

THE PUBLIC

DECLARATION OF VESTED
GROUNDWATER RIGHTS

STATE OF MONTANA, ss.
COUNTY OF HILL
Filed at 11 o'clock am.

ON DEC 31 1963

18 COUNTY CLERK
DEPUTY

FEE: \$2.00 pd.

File No.

T. 30 N. R. 11

DUPLICATE

County Hill

STATE OF MONTANA
ADMINISTRATOR OF GROUNDWATER CODE
OFFICE OF STATE ENGINEER

RECEIVED
DEC 27 1963

Declaration of Vested Groundwater Right
(Under Chapter 237, Montana Session Laws, 1961)

1. Loy M. Salberg, of Hill,
(Name of Appropriator) (Address) (Town)
County of Hill State of Montana
have appropriated groundwater according to the Montana laws in effect prior to January 1, 1962, as follows:

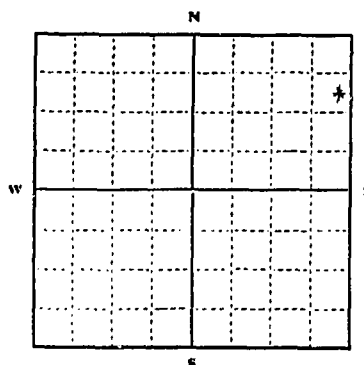

NE 1/4 Sec 15 T. 30 R. 11

Indicate point of appropriation and place of use, if possible. Each small square represents 10 acres.

2. The beneficial use on which the claim is based Personal & Stock

3. Date or approximate date of earliest beneficial use; and how continuous the use has been June 23, 1958 - every day

4. The amount of groundwater claimed (in miner's inches or gallons per minute) 8 gal per min

5. If used for irrigation, give the acreage and description of the lands to which water has been applied and name of the owner thereof

None

6. The means of withdrawing such water from the ground and the location of each well or other means of withdrawal Deep Turbine Pump
1/2 other wells

7. The date of commencement and completion of the construction of the well, wells, or other works for withdrawal of groundwater finished June 21, 1958

8. The depth of water table 36 ft

9. So far as it may be available, the type, size and depth of each well or the general specifications of any other works for the withdrawal of groundwater 11 1/2' hole 6 1/2' of 6" c.p. casing
4 1/2' 3/4" x 1/2" hole 2 1/2' of 2" c.p. casing

10. The estimated amount of groundwater withdrawn each year 150,000 gal. per year

11. The log of formations encountered in the drilling of each well if available 1 1/2' yellow clay, 10' yellow clay, 30' gray sand, 43' sand, yellow, 65' sandy clay, 75' hard shell, 85' sandstone, white, 96' sandstone gray, 95' sandstone gray, water 100' sandstone, gray, medium, 117' sandstone gray medium well sandstone

12. Such other information of a similar nature as may be useful in carrying out the policy of this act, including reference to book and page of any county record

Signature of Owner Loy M. Salberg

Date Dec 20, 1963

Three copies to be filed by the owner with the County Clerk and Recorder of the county in which the well is located.

Please answer all questions. If not applicable, so state, otherwise the form will be returned.

Original to the County Clerk and Recorder; Duplicate to the State Engineer; Triplicate to the Montana Bureau of Mines and Geology, and Quadruplicate for the Appropriator.

396690

ROY M. SOLER JR

TO

THE PUBLIC

DECLARATION OF VESTED GROUND
WATER RIGHTS

STATE OF MONTANA)
COUNTY OF HILL)
Filed at 11 o'clock A.M.

ON Dec 20 1963

R. E. Blom

COUNTY CLERK

SEAL

Fee: \$2.00 pd.

GW-4
FILE NO. _____

TWP 30 N RGE 11E
COUNTY HILL

22

STATE OF MONTANA
ADMINISTRATOR OF GROUNDWATER CODE
OFFICE OF STATE ENGINEER

DECLARATION OF VESTED GROUNDWATER RIGHTS
(Under Chapter 237, Montana Session Laws, 1961)

1. Elmer Walls, or Box Elder
(Name of Appropriator) (Address) (Town)
County of Hill, State of Montana
Have appropriated groundwater according to the Montana laws in effect prior to Jan. 1, 1962 as follows:

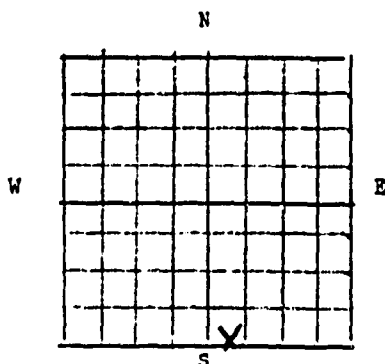

Indicate point of appropriation and place of use, if possible. Each small square represents 10 acres.

2. The beneficial use on which the claim is based Household & Stock
3. Date or approximate date of earliest beneficial use; and how continuous the use has been Nov. 1913 Continuous
4. The amount of groundwater claimed (in miner's inches or gallons per minute) 6 G.P.M.
5. If used for irrigation, give the acreage and description of the lands to which water has been applied and name of the owner thereof none
6. The means of withdrawing such water from the ground and the location of each well or other means of withdrawal Windmill
7. The date of commencement and completion of the construction of the well, wells, or other works for withdrawal of groundwater Nov. 1913
8. The depth of water table 40 ft.
9. So far as it may be available, the type, size and depth of each well or the general specifications of any other works for the withdrawal of groundwater 45 ft. 5 ft. diameter Concrete Casing
10. The estimated amount of groundwater withdrawn each year 150,000 gal.
11. The log of formations encountered in the drilling of each well if available not available
12. Such other information of a similar nature as may be useful in carrying out the policy of this act, including reference to book and page of any county record

Signature of Owner Elmer Walls

Date 12-30-63

Three copies to be filed by the owner with the County Clerk & Recorder of the County in which the well is located.

PLEASE ANSWER ALL QUESTIONS. IF NOT APPLICABLE, SO STATE, OTHERWISE THE FORM WILL BE RETURNED.

Original to the County Clerk & Recorder; duplicate to the State Engineer; Triplicate to the School of Mines and Quadruplicate for the Appropriator.

36041

396970

1000

1000

1000

1000

1000

RECEIVED

11N-30E
County: Hill 22

STATE OF MONTANA
ADMINISTRATOR OF GROUNDWATER CODE
MONTANA WATER RESOURCES BOARD

MAR 13 1973

DRILLER'S LOG

NOTICE OF COMPLETION OF GROUNDWATER
APPROPRIATION BY MEANS OF WELL

Developed after January 1, 1962

(Under Chapter 237 Montana Session Laws, 1961, as amended)

This form to be prepared by driller, and three copies to be filed by the owner with the County Clerk and Recorder in the county in which the well is located, last copy to be retained by driller.

Please answer all questions. If not applicable, so state, otherwise the form may be returned.

Owner: Edward Zabel

Address: 1111 1st St. N. Helena, MT

Date well started: Mar 11

completed: Mar 10, 1973

For Administrator's Use

File: 427528

MARCH 13, 1973

GW 1: 2:10 P.M.

Type of well: Driller
(Dug, driven, bored or drilled)

Equipment used: Churn drill
(Churn drill, rotary or other)

Water Use: Domestic ☐ Municipal ☐ Stock ☒ Irrigation ☐

Industrial ☐ Drainage ☐ Other ☐ Garden/Lawn ☐

*Describe: _____

USE: If used for irrigation, industrial, drainage or other. Explain, state number of acres and location or other data (i.e. Lot, Block and Addition). _____

ESTIMATED ANNUAL WITHDRAWAL: _____

Size of Drilled Hole	Size and Weight of Casing	From (Feet)	To (Feet)	PERFORATIONS		
				Kind Size	From (Feet)	To (Feet)
7	7 1/2"	0	80	7 1/2"	65	70

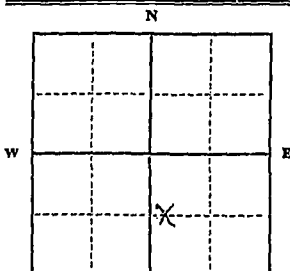

Static water level: 52 ft.*
Pumping water level: 2 ft.*
at _____ gallons per minute,
measured _____ minutes after pumping began.

*Measured from ground level.
Well developed by _____
for _____ hours.

Power: _____ Pump: _____ HP

Remarks: (Gravel packing, cementing, packers, type of shutoff) _____

SE 1/4 Sec. 22
T. 30 N. R. 11 E.
S. 11 W.

INDICATE LOCATION OF WELL AND PLACE OF USE, IF POSSIBLE. EACH SMALL SQUARE REPRESENTS 40 ACRES.

Driller's Signature: Edward Zabel

Driller's Address: Helena, Montana

LICENSE NO. 56

80 Show exact depth of bottom

52,632

RECEIVED

11N-30E

County Hill

DRILLER'S LOG

STATE OF MONTANA
ADMINISTRATOR OF GROUNDWATER CODE
MONTANA WATER RESOURCES BOARD

MAR 17 1973

NOTICE OF COMPLETION OF GROUNDWATER
APPROPRIATION BY MEANS OF WELL

Developed after January 1, 1962

(Under Chapter 237 Montana Session Laws, 1961, as amended)

This form to be prepared by driller, and three copies to be filed by the owner with the County Clerk and Recorder in the county in which the well is located, last copy to be retained by driller.

Please answer all questions. If not applicable, so state, otherwise the form may be returned.

Owner Edward Zabel
Address Edwards Montana 59711
Date well started Nov. 11
completed Feb. 10 1973

For Administrator's Use
File 427528
MPROH 13 1973
GW 1 2:10 P.M.

Type of well Drilled
(Dug, driven, bored or drilled)

Equipment used Churn Drill
(Churn drill, rotary or other)

Water Use: Domestic ☐ Municipal ☐ Stock ☒ Irrigation ☐

Industrial ☐ Drainage ☐ Other ☐* Garden/Lawn ☐

*Describe

USE: If used for irrigation, industrial, drainage or other. Explain, state number of acres and location, or other data (i.e. Lot, Block and Addition).

ESTIMATED ANNUAL WITHDRAWAL

Size of Drilled Hole	Size and Weight of Casing	From (Feet)	To (Feet)	PERFORATIONS		
				Kind Size	From (Feet)	To (Feet)
7	7 1/2	0	80	7 1/2	65	70

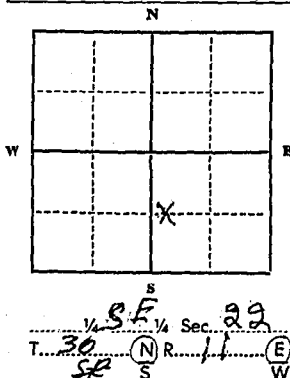

Static water level 40 ft.*
Pumping water level 39 ft.*
at gallons per minute,
measured minutes after pumping began.

*Measured from ground level.

Well developed by

for hours.

Power Pump HP

Remarks: (Gravel packing, cementing, packers, type of shutoff)

INDICATE LOCATION OF WELL AND PLACE OF USE, IF POSSIBLE. EACH SMALL SQUARE REPRESENTS 40 ACRES.

Driller's Signature Edward Zabel

Driller's Address Edwards Montana

LICENSE NO. 56

Top of Ground		(Elev. above sea level)
From (Feet)	To (Feet)	
0	15	Clay
15	20	Sand and Gravel
20	22	Gravel
22	26	Clay
26	28	Clay
28	32	Gravel
32	35	Gravel
35	38	Gravel
38	40	Gravel
40	42	Gravel
42	45	Gravel
45	48	Gravel
48	50	Gravel
50	52	Gravel
52	55	Gravel
55	58	Gravel
58	60	Gravel
60	62	Gravel
62	65	Gravel
65	68	Gravel
68	70	Gravel
70	72	Gravel
72	75	Gravel
75	78	Gravel
78	80	Gravel
80	82	Gravel
82	85	Gravel
85	88	Gravel
88	90	Gravel
90	92	Gravel
92	95	Gravel
95	98	Gravel
98	100	Gravel

80 Show exact depth of bottom

52,632

427328

MAINARD WALLS

TO

THE PUBLIC

WATER WELL

STATE OF MONTANA } SS
COUNTY OF HILL
Filed at 2:10 o'clock P M

ON MAR 13 1973

R. E. Blom

BY Wanda E. May COUNTY CLERK
DEPUTY.

Fee:\$2.00 pd.

INDEXED

RECEIVED

County Will
DRILLER'S LOG

STATE OF MONTANA
ADMINISTRATOR OF GROUNDWATER CODE
MONTANA WATER RESOURCES BOARD

MAR 1 1973

NOTICE OF COMPLETION OF GROUNDWATER
APPROPRIATION BY MEANS OF WELL

Developed after January 1, 1962

Indicate the character, color, thickness of strata such as soil, clay, sand, gravel, shale, sandstone, etc. Show depth at which water is found and height to which water rises in well.

(Under Chapter 237 Montana Session Laws, 1961, as amended)

This form to be prepared by driller, and three copies to be filed by the owner with the County Clerk and Recorder in the county in which the well is located, last copy to be retained by driller.

Please answer all questions. If not applicable, so state, otherwise the form may be returned.

Owner Edward J. Abel
Address 427.231
Date well started Nov 11 completed Feb 10
Type of well Drill
Equipment used Churn
Water Use: Domestic ☐ Municipal ☐ Stock ☒ Irrigation ☐
Industrial ☐ Drainage ☐ Other ☐ * Garden/Lawn ☐
*Describe USE: If used for irrigation, industrial, drainage or other. Explain, state number of acres and location or other data (i.e. Lot, Block and Addition).
ESTIMATED ANNUAL WITHDRAWAL

For Administrator's Use
File 427.231
February 28, 1973
GW 1 2:30 p.m.

Top of Ground		(Elev. above sea level)
From (Feet)	To (Feet)	
0	15	Clay
15	20	Sand and water
20	22	Stone
22	25	Clay
25	35	Clay
35	40	Sand Stone
40	45	Stone
45	50	Clay
50	55	Sand Stone
55	65	Sand Clay Water
65	70	Clay
70	75	Good Gravel
75	80	Some Water
80	85	Stone
85	90	Sand Stone

Size of Drilled Hole	Size and Weight of Casing	From (Feet)	To (Feet)	PERFORATIONS		
				Kind Size	From (Feet)	To (Feet)
7	7-25	0	75	1/8 inch	65	70

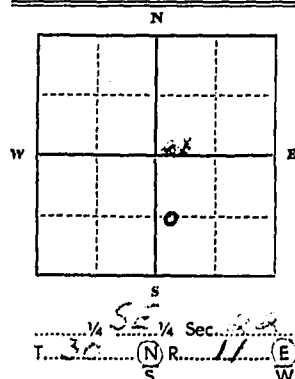

Static water level 40 ft.*
Pumping water level 5 ft.*
at 5 gallons per minute,
measured 5 minutes after pumping began.
*Measured from ground level.
Well developed by 5 hours.
Power 5 Pump 5 HP
Remarks: (Gravel packing, cementing, packers, type of shutoff)

INDICATE LOCATION OF WELL AND PLACE OF USE, IF POSSIBLE. EACH SMALL SQUARE REPRESENTS 40 ACRES.

Driller's Signature Edward J. Abel

Driller's Address Clifford Montana

LICENSE NO. 56

Show exact depth of bottom

75

52,516

RECEIVED

County Hill
DRILLER'S LOG 22

STATE OF MONTANA
ADMINISTRATOR OF GROUNDWATER CODE
MONTANA WATER RESOURCES BOARD

MAR 1 1973

NOTICE OF COMPLETION OF GROUNDWATER
APPROPRIATION BY MEANS OF WELL

Developed after January 1, 1962

Indicate the character, color, thickness of strata such as soil, clay, sand, gravel, shale, sandstone, etc. Show depth at which water is found and height to which water rises in well.

(Under Chapter 237 Montana Session Laws, 1961, as amended)

This form to be prepared by driller, and three copies to be filed by the owner with the County Clerk and Recorder in the county in which the well is located, last copy to be retained by driller. Please answer all questions. If not applicable, so state, otherwise the form may be returned.

Owner Edwards, E. L.
Address 1414 1st St. N. Helena, MT 59601
Date well started Nov 11 completed Feb 10
Type of well Drill
Equipment used Churn Drill
Water Use: Domestic ☐ Municipal ☐ Stock ☒ Irrigation ☐
Industrial ☐ Drainage ☐ Other ☐ Garden/Lawn ☐
*Describe _____
USE: If used for irrigation, industrial, drainage or other. Explain, state number of acres and location or other data (i.e. Lot, Block and Addition). _____

For Administrator's Use
File 427231
February 28, 1973
GW 1 2:30 p.m.

Top of Ground (Elev. above sea level)		
From (Feet)	To (Feet)	
0	15	Clay
15	20	Sand and water
20	22	Stone
22	26	Clay
26	35	Clay
35	40	Sand Stone
40	45	Stone
45	50	Clay
50	55	Sand Stone
55	65	Sand Clay water
65	68	Clay
68	70	Good Gravel
70	75	Stone Water
75	80	Sand Stone

ESTIMATED ANNUAL WITHDRAWAL						
Size of Drilled Hole	Size and Weight of Casing	From (Feet)	To (Feet)	PERFORATIONS		
				Kind Size	From (Feet)	To (Feet)
7	7-25	0	75	1/8 inch	65	70

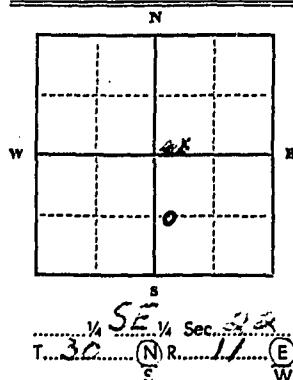

Static water level 40 ft.*
Pumping water level _____ ft.*
at 5 gallons per minute,
measured _____ minutes after pumping began.
*Measured from ground level.
Well developed by _____
for _____ hours.
Power _____ Pump _____ HP
Remarks: (Gravel packing, cementing, packers, type of shutoff) _____

INDICATE LOCATION OF WELL AND PLACE OF USE, IF POSSIBLE. EACH SMALL SQUARE REPRESENTS 40 ACRES.

Driller's Signature Edward Zabel
Driller's Address Gilford Montana
LICENSE NO. 56

Show exact depth of bottom

427231

MAINARD L. WALLS

TO

THE PUBLIC

WATER WELL

STATE OF MONTANA
COUNTY OF HILL
Filed at 2:30 o'clock P M

ON FEB 28 1973

E. E. Blom COUNTY CLERK
BY Paul E. May DEPUTY

Fee:\$2.00 pd.

INDEXED

GW 3

Approved Stock Form—State Publishing Co., Helena, Montana—42199

File No.

T 30 R 11E

DUPLICATE

County HILL

STATE OF MONTANA
ADMINISTRATOR OF GROUNDWATER CODE
OFFICE OF STATE ENGINEER

RECEIVED
DEC 27 1963

Notice of Completion of Groundwater Appropriation Without Well

(Under Chapter 237 Montana Session Laws, 1961)

Date of Appropriation of Groundwater

Owner K. A. GROPP Address BOX ELDER

Contractor (if any) PAULSIN CONST.

Address of Contractor CHINOOK MONT.

Date Started 1961 Date Completed 1962

Describe means of obtaining groundwater without a well "as by sub-irrigation and other natural processes". Include depth to water when applicable.

RUN OFF & SEEPAGE
10 FT.

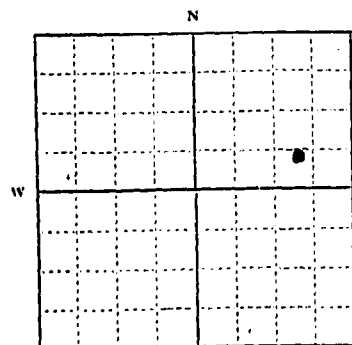

NE 1/4 Sec 36 T30 R11

Indicate point of appropriation and place of use, if possible.

Quantity of water developed and used with explanation of method used to measure or estimate such amount. If use is intermittent

estimate approximate lengths of periods of use

Signature of Owner Kenneth Gropp

Date Dec 20 1963

This form to be prepared by contractor (if any), otherwise by the owner.

Three copies of this notice are to be filed with the County Clerk and Recorder of the county in which the works are located.

Please answer all questions. If not applicable, so state, otherwise the form will be returned.

Original to the County Clerk and Recorder; duplicate to the State Engineer; Triplicate to the Montana Bureau of Mines and Geology and Quadruplicate for the Appropriator.

396691

K. A. GROSS

TO

THE PUBLIC

NOTICE OF CANCELLATION OF GRANTED
POWER AND ABANDONMENT OF RIGHT TO SUE

STATE OF MONTANA)
COUNTY OF HILL) ss.
Filed at 11 o'clock A.M.

ON DEC 20 1963

R. E. Blom

COUNTY CLERK

DEPUTY

Fees: \$2.00 pd.

GROUNDWATER INDEX

Page 1 of 1

County Hill Twp. 3077 Rge. 12E

[illegible]

GWJ
FILE NO. _____

TWP 30^N RGE 12^E
COUNTY DEERBOLT

STATE OF MONTANA
ADMINISTRATOR OF GROUNDWATER CODE
OFFICE OF STATE ENGINEER

DECLARATION OF VESTED GROUNDWATER RIGHTS

(Under Chapter 237, Montana Session Laws, 1961)

1. THADDEUS A. SABIRIC, or 705 S 4th HAMILTON
EVELYN B. THOMAS (Name of Appropriator) (Address) (Town)
County of HILL State of MONTANA
Have appropriated groundwater according to the Montana laws in effect prior to Jan. 1, 1962 as follows:

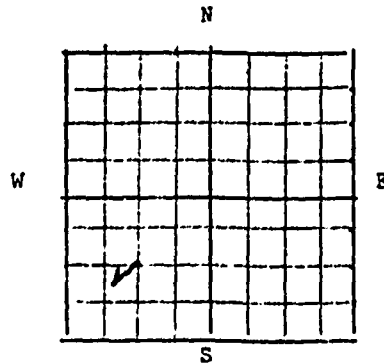

SW 1/4 Sec 7 T 30 R 12

Indicate point of appropriation and place of use, if possible. Each small square represents 10 acres.

2. The beneficial use on which the claim is based HOUSEHOLD

3. Date or approximate date of earliest beneficial use; and how continuous the use has been 1976

4. The amount of groundwater claimed (in miner's inches or gallons per minute) 15 GAL PER MIN.

5. If used for irrigation, give the acreage and description of the lands to which water has been applied and name of the owner thereof _____

6. The means of withdrawing such water from the ground and the location of each well or other means of withdrawal PUMP

7. The date of commencement and completion of the construction of the well, wells, or other works for withdrawal of groundwater 1976

8. The depth of water table 20 FT.

9. So far as it may be available, the type, size and depth of each well or the general specifications of any other works for the withdrawal of groundwater 35 FT. WOOD CASING

10. The estimated amount of groundwater withdrawn each year 36,500 GAL

11. The log of formations encountered in the drilling of each well if available NOT AVAILABLE

12. Such other information of a similar nature as may be useful in carrying out the policy of this act, including reference to book and page of any county record NONE

Signature of Owner Evelyn B. Thomas
Thaddeus A. Sabiric

Date DEC. 26. 1963

Three copies to be filed by the owner with the County Clerk & Recorder of the County in which the well is located.

PLEASE ANSWER ALL QUESTIONS. IF NOT APPLICABLE, SO STATE, OTHERWISE THE FORM WILL BE RETURNED.

Original to the County Clerk & Recorder; duplicate to the State Engineer; Triplicate to the School of Mines and Quadruplicate for the Appropriator.

706822

THE STATE OF MONTANA

COUNTY OF HILL

FILED AT 10 O'CLOCK P.M.

1963

STATE OF MONTANA
COUNTY OF HILL
Filed at 10 O'clock P.M.

ON 26.1963

COUNTY CLERK

DEPUTY

2012.000.

File No.

DUPLICATE

RECEIVED
MAY 29 1964

T. 30^N R. 12^E 14^W
County HILL

STATE OF MONTANA
ADMINISTRATOR OF GROUNDWATER CODE
OFFICE OF STATE ENGINEER

Top of Ground STATE ENGINEER

Notice of Completion of Groundwater Appropriation by Means of Well

(Under Chapter 237, Montana Session Laws, 1961)

0-10
0-10
53
56
76
77
102
109
133
138
159
161
165
167
187
196
199
199
201
224
225
236
246
254

(Elev. above sea level.....)
TOPT SUR 3014
SANDY BROWNISH YELLOW CLAYS
(DISPERSED WITH GRAVEL & BOULDERS)
BROWN SHALE (ENTERING
JUDITH RIVER FORMATION)
SANDY BROWN & GREY SHALES
HARD BROWN SANDSTONE
SHALEY BROWN SANDSTONE
SHALEY GREY SANDSTONE -
WATER - APPROX 1 GPM
SANDY GREY SHALE - STREAMERS OF
BROWN SHALE
BLUE-GREY SHALE
PREDOMINATELY DARK BROWN SHALE
GREY SHALE (EMBEDDED IVORY SHELL)
SANDY LT. GREY SHALE
HARD SHELL
RED, GREY & BROWN SHALES
BLUE GREY SHALE
DARK GREY SHALE
MEDIUM GREY SHALE
BROWN SHALE
SHALEY GREY SANDSTONE -
WATER - 2 GPM
HARD SANDSTONE SHELL
SANDY GREY SHALE
DARK GREY SHALE
GREYISH BLACK SHALE (CLAWETT FORMATION)

Owned H. H. BITZ LAND CO. Address BOX ELDER MONTANA
Drilled H. H. DRILLING SERVICE Address HAYRE, MONTANA
Date of Notice of Appropriation of Groundwater.....
Date well started 4/28/64 Date Completed MAY 9, 1964
Type of well DRILLED Equipment Used CABLE TOOL RIG
(dug, driven, bored or drilled) (Churn, drill, rotary or other)
Water Use: Domestic ☐ Municipal ☐ Other ☐ Irrigation ☐
Industrial ☐ Drainage ☐ Stock ☒
Indicate on the diagram the character and thickness of the different strata met with in drilling, such as soil, clay, shale, gravel, rock or sand, etc. Show depth at which water is encountered, thickness and character of water-bearing strata and height to which water rises in the well.

Size of Drilled Hole	Line and Weight of Casing	From (Feet)	To (Feet)	PERFORATIONS		
				Kind Size	From (Feet)	To (Feet)
8"	6" I.D. 13" PER FT	0	254	3/8" x 4"	102	124
				SLOTTED	201	224

Static Water Level for non-flowing Well 101 feet.
Shut-in Pressure for Flowing Well NOT APPLICABLE
Pumping Water Level 245 feet at 3 gal. per minute.
Discharge in gal. per min. of flowing well NOT APPLICABLE
How Tested RULER Length of Test 3 HOURS
Remarks: (Gravel packing, cementing, packers, type of shutoff, location of place of use of groundwater if not at well, and any other similar pertinent information, including number of acres irrigated, if used for irrigation) WASHED PEA SIZE TO 1/2" DIAMETER WELL - ROUNDED GRAVEL PLACED AROUND CASING TO ELIMINATE CAVING UP FORMATION

NE 1/4, NE 1/4, Sec. 14, T. 30 N, R. 12 W
Indicate location of well and place of use, if possible. Each small square represents 10 acres.
Show exact depth of bottom.

Driller's License Number

Driller's Signature

This form to be prepared by driller, and three copies to be filed by the owner with the County Clerk and Recorder in the county in which the well is located.

Please answer all questions. If not applicable, so state, otherwise the form will be returned.

Original to the County Clerk and Recorder; duplicate to the State Engineer; Triplicate to the Montana Bureau of Mines and Geology and Quadruplicate for the Appropriator.

37136

Doc. No. 398955

H. H. BITZ LAND CO.
BOX ELDER, MONTANA

TO

THE PUBLIC

COMPLETION OF GROUNDWATER
APPROPRIATION BY MEANS OF WELL

STATE OF MONTANA, ss.
COUNTY OF HILL)
Filed at 12:00 o'clock noon.

ON MAY 28 1964

COUNTY CLERK

By _____
DEPUTY

Fee: \$ 2.00 pd.

RECEIVED

NOV 18 1959

STATE ENGINEER

MONTANA BUREAU OF MINES AND GEOLOGY
Butte, Montana

T. 30N R. 12E
County HILL

19

WATER WELL LOG

Owner OTTO WALL
HELEN RENNER Address BOX ELDER

Driller COLFEA TAYLOR Address HAVRE

Date Started OCT 6-59 Date Completed OCT 13-59

Location: Sec. 5E T. 30 R. 12 1/4 sec. 19

Type of well DRILLED Equipment used CHURN DRILL
(Dr., driven, bored, or drilled) (Churn drill, rotary, other)

Water use: Domestic ☐ Municipal ☐ Stock ☒ Irrigation ☐

Industrial ☐ Drainage ☐ Other:

Casing: 0 ft. to 113 ft. Type SPANG Size 6 CD

Casing: 113 ft. to 117 ft. Type SPANG Size 4 1/2

Casing: ft. to ft. Type Size

Perforated or Screened: Ft. 112 to ft. 117 Ft. to ft.

Type of screen or perforations 1/4" x 2" 4 per 2'

Static Water level, for non-flowing well: 42 feet.

Shut-in pressure, for flowing well: lb./sq. in. on: (date)

Pumping water level: 10.5 feet at 8 gal. per min.

How tested: BALER

Length of test: 2 HRS

Remarks: (Gravel packing, cementing, packers, type of shut-off, depth of shut-off)

[Signature]

(over)

Log of Well

[illegible]

File No. _____

T. 30 N. R. 12 E

DUPLICATE

County Hill

STATE OF MONTANA
ADMINISTRATOR OF GROUNDWATER CODE
OFFICE OF STATE ENGINEER

RECEIVED
NOV 18 1963

Declaration of Vested Groundwater Rights

(Under Chapter 237, Montana Session Laws, 1961)

STATE ENGINEER

1. ALBERT BITZ, of BOX 156 BOX ELDER
(Name of Appropriator) (Address) (Town)
County of HILL State of MONTANA
have appropriated groundwater according to the Montana laws in effect prior to January 1, 1962, as follows:

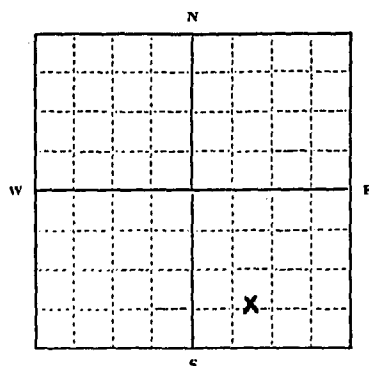

S. 1/4 E. Sec. 23 T. 30 R. 12

Indicate point of appropriation
and place of use, if possible.
Each small square represents 10
acres.

2. The beneficial use on which the claim is based STOCK
+ HOUSE

3. Date or approximate date of earliest beneficial use; and how con-
tinuous the use has been 1942
CONTINUOUS SINCE 1942

4. The amount of groundwater claimed (in miner's inches or gallons
per minute) 20 gal per minute

5. If used for irrigation, give the acreage and description of the lands
to which water has been applied and name of the owner thereof

6. The means of withdrawing such water from the ground and the
location of each well or other means of withdrawal PUMP

7. The date of commencement and completion of the construction of the well, wells, or other works for with-
drawal of groundwater well was here when the right was
land in 1942

8. The depth of water table 50 ft.

9. So far as it may be available, the type, size and depth of each well or the general specifications of any other
works for the withdrawal of groundwater 6 in hole 110 ft deep

10. The estimated amount of groundwater withdrawn each year 1,300,000 gal

11. The log of formations encountered in the drilling of each well if available Don't know

12. Such other information of a similar nature as may be useful in carrying out the policy of this act, including
reference to book and page of any county record

Signature of Owner Albert BitzDate Jan 15, 1963

Three copies to be filed by the owner with the County Clerk and Recorder of the county in which the well is
located.

Please answer all questions. If not applicable, so state, otherwise the form will be returned.

Original to the County Clerk and Recorder; duplicate to the State Engineer; Triplicate to the Montana Bureau
of Mines and Geology, and Quadruplicate for the Appropriator.

7138

396061

ALBERT BITZ

TO

THE PUBLIC

DECLARATION OF VESTED GROUND
WATER RIGHTS

STATE OF MONTANA) ss.
COUNTY OF HILL)
Filed at 1:30 o'clock P.m.

ON NOV 15 1963

COUNTY CLERK

DEPUTY

Fee: \$2.00 pdl

File No.

T. 30 R. 12E

DUPLICATE

County HILL

STATE OF MONTANA
ADMINISTRATOR OF GROUNDWATER CODE
OFFICE OF STATE ENGINEER

Declaration of Vested Groundwater Rights
(Under Chapter 237, Montana Session Laws, 1961)

RECEIVED
AUG 12 1963
STATE ENGINEER

1. Fred C. Schmidt, of Box Elder, Montana
(Name of Appropriator) (Address) (Town)
County of Hill State of Montana
have appropriated groundwater according to the Montana laws in effect prior to January 1, 1962, as follows:

NE 36 T. 30 R. 12
Indicate point of appropriation
and place of use, if possible.
Each small square represents 10
acres.

2. The beneficial use on which the claim is based.....
Domestic & Stock

3. Date or approximate date of earliest beneficial use; and how con-
tinuous the use has been.....
Continuous use since June 2, 1945

4. The amount of groundwater claimed (in miner's inches or gallons
per minute).....
100 gallons per minute

5. If used for irrigation, give the acreage and description of the lands
to which water has been applied and name of the owner thereof
none

6. The means of withdrawing such water from the ground and the
location of each well or other means of withdrawal.....
2 horse Fairbanks & Morse submersible

7. The date of commencement and completion of the construction of the well, wells, or other works for with-
drawal of groundwater.....
June 2d. 1945

8. The depth of water table.....
10 feet flows at times

9. So far as it may be available, the type, size and depth of each well or the general specifications of any other
works for the withdrawal of groundwater.....
Well drilled to depth of 728 feet 6" O.D. cased

10. The estimated amount of groundwater withdrawn each year.....
2,592,000 gallons

11. The log of formations encountered in the drilling of each well if available.....
Mostly slaggett shale small vein of coal at 694 feet

12. Such other information of a similar nature as may be useful in carrying out the policy of this act, including
reference to book and page of any county record.....
none

Signature of Owner.....Fred C. Schmidt

Date.....8/6/63

Three copies to be filed by the owner with the County Clerk and Recorder of the county in which the well is
located.

Please answer all questions. If not applicable, so state, otherwise the form will be returned.

Original to the County Clerk and Recorder; duplicate to the State Engineer; Triplicate to the Montana Bureau
of Mines and Geology, and Quadruplicate for the Appropriator.

394740

FRED C. SCHMIDT

TO

THE PUBLIC

DECLARATION OF VESTED GROUND
WATER RIGHTS

STATE OF MONTANA,)
COUNTY OF HILL) ss.
Filed at 4:45 o'clock P.M.

ON AUG 7 1963

R. E. Blom
COUNTY CLERK

By _____ DEPUTY

Fee: \$2.00 pd.

County HillTwp. 30NRge. 13E

Sec.	Name of Appropriator	Type of Form	County File No.	Remarks
2	Kiemele, Al Fred L.	GW 4	395980	-
15	Niederegger, Anton	2	398722	-
26	Briggs, Webster	3	397121	-
26	Feachner, Al Fred	4	396470	-
26	GN R.R.	4	391623	-
27	Belcaert, Gerald J. (Chief)	2	426922	-
27	Bitz, Herbert G.	2	412822	-
27	Keller, Harvey H.	4	396976	-
29	Niederegger, Anton	4	396686	-
29	Schmidt, Fred C.	4	394736	-
29	" " "	4	394737	-
29	" " "	4	394738	-
29	" " "	4	394739	-
30	Bitz, Albert	4	396062	-
32	Niederegger, Anton	2	395126	-
34	Pogrebe, Luaille	2	397771	-
35	Bex Elder School Dist. 13	2	413760	-
35	Briggs, George Webster	4	397122	-
35	Dauer, Vincent P.	4	388810	-
35	Davis, Sam F.	4	397144	-
35	Freier, Adolph	4	396149	-
35	" " "	4	396150	-
35	Freier, Ed	Well log	385084	-
35	Genger, B. W.	GW 4	397087	-
35	Gaudin, Howard G. & Luaille L.	2	389718	-
35	Gaudin, Lucile	2	399568	-
35	Green, Bradan B.	2	428533	-
35	Hanberg, Lloyd G.	4	387825	-
35	Hobbs, A. W.	4	387944	-
35	" Perry	4	396290	-
35	" Perry & Alice W.	2	401798	-
35	Johnson, Leonard	4	387896	-
35	Kallenberger, Helen (Mrs.)	2	412869	-
35	Keene, Lauren (Mrs.)	4	397139	-
35	" " "	4	397140	-
35	Niederegger, Anton	4	396687	-
35	Prather, J. E.	Well log	367383	-
35	School Dist. 13	GW 4	991054	-
35	Sarberg, Frank & Katherine	2	426946	-
35	Smith, Rob Ray	4	393835	-
35	Swain, Walter & Shirley L.	2	413140	-
35	Salberg, Odean	4	396689	-
35	Vasen, Clifford & Gladys	2	427651	-
35	Walls, Irene H.	2	391039	-
35	Wilson, Art B.	Well log	382951	-
35	Wilson, Arthur B.	GW 4	395249	-
35	YOUSB, Thomas	GW 4	396918	-

Gv.

Approved Stock Form—State Publishing Co., Helena, Montana—41338

File No.

T. 30 N. R. 13 E.

DUPLICATE

County Hill

STATE OF MONTANA
ADMINISTRATOR OF GROUNDWATER CODE
OFFICE OF STATE ENGINEER

RECEIVED
NOV 12 1963

Declaration of Vested Groundwater Rights
(Under Chapter 237, Montana Session Laws, 1961)

1. Walter Krenke of 801 6th St. Havre
(Name of Appropriator) (Address) (Town)
County of Hill State of Montana
have appropriated groundwater according to the Montana laws in effect prior to January 1, 1962, as follows:

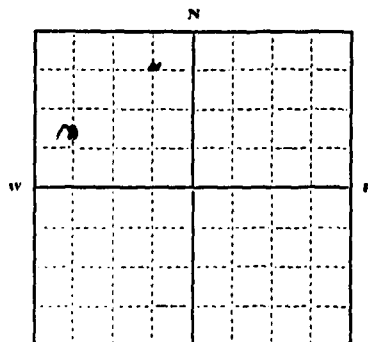

NW 1/4 Sec. 2 T. 31 N. R. 13 E.

Indicate point of appropriation and place of use, if possible. Each small square represents 10 acres.

2. The beneficial use on which the claim is based Stock water

3. Date or approximate date of earliest beneficial use; and how continuous the use has been 1949

4. The amount of groundwater claimed (in miner's inches or gallons per minute) 15 gal minute

5. If used for irrigation, give the acreage and description of the lands to which water has been applied and name of the owner thereof

6. The means of withdrawing such water from the ground and the location of each well or other means of withdrawal pump jack motor

7. The date of commencement and completion of the construction of the well, wells, or other works for withdrawal of groundwater June 1949

8. The depth of water table 240'

9. So far as it may be available, the type, size and depth of each well or the general specifications of any other works for the withdrawal of groundwater 2 1/2" pipe pump jack & motor

10. The estimated amount of groundwater withdrawn each year 282,000 gal

11. The log of formations encountered in the drilling of each well if available

12. Such other information of a similar nature as may be useful in carrying out the policy of this act, including reference to book and page of any county record

Signature of Owner Walter Krenke

Date Nov 8, 1963

Three copies to be filed by the owner with the County Clerk and Recorder of the county in which the well is located.

Please answer all questions. If not applicable, so state, otherwise the form will be returned.

Original to the County Clerk and Recorder; duplicate to the State Engineer; Triplicate to the Montana Bureau of Mines and Geology, and Quadruplicate for the Appropriator.

69.28.

395980

ALFRED L. KIEMELE

TO

THE PUBLIC

DECLARATION OF VESTED
GROUNDWATER RIGHTS

STATE OF MONTANA
COUNTY OF HILL
Filed at 11:45 clock P.M.

1963

R. E. Blom
COUNTY CLERK

RECEIVED

Fee: \$2.00 pd.

File No. _____

T. 30 R. 13 E

DUPLICATE

County HILL

STATE OF MONTANA
ADMINISTRATOR OF GROUNDWATER CODE
OFFICE OF STATE ENGINEER MAY 8 1964

Notice of Completion of Groundwater Appropriation by Means of Well

(Under Chapter 237, Montana Session Laws, 1961)

Owner ANTON MEDEREGGER Address Box ELDER, MONTANADrill AIR-LINE DRILLING SERVICE Address HAYRE, MONTANA

Date of Notice of Appropriation of Groundwater _____

Date well started APRIL 4, 1964 Date Completed APRIL 9, 1964Type of well DRILLED Equipment Used CABLE TOOL RIG
(dug, driven, bored or (Churn, drill, rotary or
drilled) other)Water Use: Domestic ☐ Municipal ☐ Other ☐ Irrigation ☐
Industrial ☐ Drainage ☐ Stock ☒

Indicate on the diagram the character and thickness of the different strata met with in drilling, such as soil, clay, shale, gravel, rock or sand, etc. Show depth at which water is encountered, thickness and character of water-bearing strata and height to which water rises in the well.

Size of Drilled Hole	Size and Weight of Casing	From (Feet)	To (Feet)	PERFORATIONS		
				Kind Size	From (Feet)	To (Feet)
7"	6" I.D. 13" wgt	0	35	NO PERFORATIONS CASING BOTTOMED IN COARSE SAND & SMALL GRAVEL		

(WELL CAPABLE OF
HIGH YIELD IF SCREENED,
& DEVELOPED)

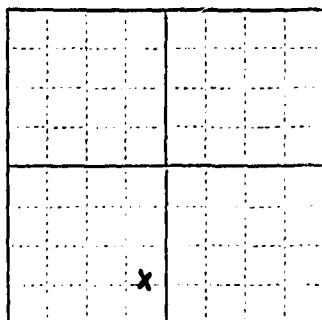

SE 1/4 SW 1/4 Sec. 15 T30. R13
Indicate location of well and place of use, if possible. Each small square represents 10 acres.

Show exact depth of bottom.

Static Water Level for non-flowing Well 5.9 feet.Shut-in Pressure for Flowing Well NOT APPLICABLEPumping Water Level 12 feet at 15 gal. per minute.Discharge in gal. per min. of flowing well 3 1/2 GPM.How Tested PUMP & METER Length of Test 3 HOURS

Remarks: (Gravel packing, cementing, packers, type of shutoff, location of place of use of ground-water if not at well, and any other similar pertinent information, including number of

acres irrigated, if used for irrigation) DUE TO THE FACT

THAT THE WATER TABLE WAS FAIRLY DEEP & RECOVERY
WAS GOOD, THE WELL WAS TAPPED AT THE 9 FT
LEVEL & PIPED INTO TANK IN CREEK, FURNISHING AT
RATE OF 3 1/2 GPM.

Driller's License Number 76

Robert J. Smith
Driller's Signature

This form to be prepared by driller, and three copies to be filed by the owner with the County Clerk and Recorder in the county in which the well is located.

Please answer all questions. If not applicable, so state, otherwise the form will be returned.

Original to the County Clerk and Recorder; duplicate to the State Engineer; Triplicate to the Montana Bureau of Mines and Geology and Quadruplicate for the Appropriator.

35665

Doc. No. 398722

ANTON NIEDEREGGER

TO

THE PUBLIC

NOTICE OF COMPLETION OF
GROUNDWATER APPRO. BY MEANS
OF WELL

STATE OF MONTANA)ss.
COUNTY OF HILL)
Filed at 2:10 o'clock P.m.

ON MAY 6 1964

RUSS E. BLOM

COUNTY CLERK

By _____
DEPUTY

Fees: \$ 2.00 ad.

GW 3

Approved Stock Form—State Publishing Co., Helena, Montana—42199

File No.

DUPLICATE

T 26 R 30-3

County Hill

STATE OF MONTANA
ADMINISTRATOR OF GROUNDWATER CODE
OFFICE OF STATE ENGINEER

RECEIVED
JAN 13 1964

Notice of Completion of Groundwater Appropriation
Without Well

(Under Chapter 237 Montana Session Laws, 1961)

Date of Appropriation of Groundwater 12-17-63

Owner Theodor Biggs Address Box 448 Mont.

Contractor (if any)

Address of Contractor

Date Started 12-9-60 Date Completed

Describe means of obtaining groundwater without a well "as by sub-irrigation and other natural processes". Include depth to water when applicable.

Dam is fed by 2 springs

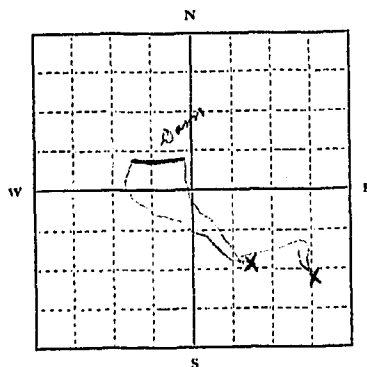

N 6 1/4 Sec. 26 T. 30 R. 13

Indicate point of appropriation and place of use, if possible.

Quantity of water developed and used with explanation of method used to measure or estimate such amount. If use is intermittent

estimate approximate lengths of periods of use.

3 months use to irrigate

29 acres

The springs flow about 600 to 1000 gal per hour depends upon the time of year.

Signature of Owner Theodor Biggs

Date 12-17-63

This form to be prepared by contractor (if any), otherwise by the owner.

Three copies of this notice are to be filed with the County Clerk and Recorder of the county in which the works are located.

Please answer all questions. If not applicable, so state, otherwise the form will be returned.

Original to the County Clerk and Recorder; duplicate to the State Engineer; Triplicate to the Montana Bureau of Mines and Geology and Quadruplicate for the Appropriator.

31179

397121

WEBSTER BRIGGS

TO

THE PUBLIC

COMPLETION OF GROUNDWATER
WITHOUT WELL

STATE OF MONTANA } ss.
COUNTY OF HILL }
Filed at 11 o'clock a.m.

ON FEB 24 1963
J. B. Blain
COUNTY CLERK

BY _____ DEPUTY

FEE: \$2.00 pd.

File No. _____

T 30 N R 13 E 26

DUPLICATE

County HILL

STATE OF MONTANA
ADMINISTRATOR OF GROUNDWATER CODE
OFFICE OF STATE ENGINEER

RECEIVED
DEC 12 1963
ENGINEER

Declaration of Vested Groundwater Rights
(Under Chapter 237, Montana Session Laws, 1961)

1. MR. ALFRED FEACHNER, of BOX ELDER
(Name of Appropriator) (Address) (Town)
County of HILL State of MONTANA
have appropriated groundwater according to the Montana laws in effect prior to January 1, 1962, as follows:

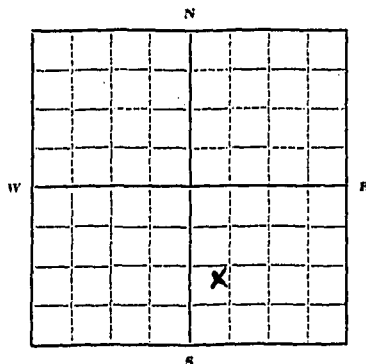

W 1/4 SE 1/4 22. Sec. 26. T30. R. 13

Indicate point of appropriation
and place of use, if possible.
Each small square represents 10
acres.

2. The beneficial use on which the claim is based.....
DOMESTIC

3. Date or approximate date of earliest beneficial use; and how continuous the use has been.....
(1) 1921, (2) 1937, (3) 1940. CONTINUOUS

4. The amount of groundwater claimed (in miner's inches or gallons per minute).....
20 gallons per minute

5. If used for irrigation, give the acreage and description of the lands to which water has been applied and name of the owner thereof.....
NONE

6. The means of withdrawing such water from the ground and the location of each well or other means of withdrawal.....
(1) manual, (2) manual (3) ELECTRIC PUMPS.

7. The date of commencement and completion of the construction of the well, wells, or other works for withdrawal of groundwater. (1) STARTED JUNE 2, 1921 FINISHED JULY 17, 1921.
(2) STARTED MARCH 28, 1937 FINISHED APRIL 10, 1937 (3) STARTED FEB. 23, 1940 FINISHED FEB. 26, 1940.

8. The depth of water table..... APPROX 40 FT.

9. So far as it may be available, the type, size and depth of each well or the general specifications of any other works for the withdrawal of groundwater..... (1) 4 FT. SQ. CEMENT WALLS 45 FT DEPTH.
(2) 4 FT SQ. CEMENT WALLS 45 FT. DEPTH. (3) DRILLED, 6 INCH CASING 48 ft. DEPTH

10. The estimated amount of groundwater withdrawn each year..... 1,000,000 GALLONS

11. The log of formations encountered in the drilling of each well if available.....
CLAY, SAND, GRAVEL. WATER ENCOUNTERED IN GRAVEL

12. Such other information of a similar nature as may be useful in carrying out the policy of this act, including reference to book and page of any county record.....
NONE

Signature of Owner Alfred J. Feachner

Date Dec 7 1963

Three copies to be filed by the owner with the County Clerk and Recorder of the county in which the well is located.

Please answer all questions. If not applicable, so state, otherwise the form will be returned.

Original to the County Clerk and Recorder; duplicate to the State Engineer; Triplicate to the Montana Bureau of Mines and Geology, and Quadruplicate for the Appropriator.

8680

396470

MR. ALFRED PEACHNER

TO

THE PUBLIC

DECLARATION OF VESTED GROUND
WATER RIGHTS

STATE OF MONTANA,) ss.
COUNTY OF HILL)
Filed at 1 o'clock p.m.

ON DEC 10 1963
R. E. Blom

COUNTY CLERK

DEPUTY

Fee: \$2.00 pc.

File No.

DUPLICATE

T. 30 R. 13
County **DECEIVED**
JUN 17 1962
STATE ENGINEER

STATE OF MONTANA
ADMINISTRATOR OF GROUNDWATER CODE
OFFICE OF STATE ENGINEER

Declaration of Vested Groundwater Rights

(Under Chapter 237, Montana Session Laws, 1961)

1. Great Northern Railway Company, of 175 E. 4th St., St. Paul, Minnesota
(Name of Appropriator) (Address) (Town)
County of Hill State of Montana
have appropriated groundwater according to the Montana laws in effect prior to January 1, 1962, as follows:

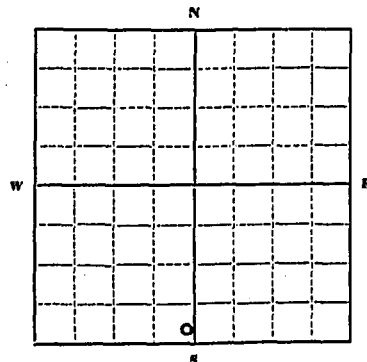

Sec. 1/4 SW 1/4 Sec. 26 T. 30N R. 13E

Indicate point of appropriation
and place of use, if possible.
Each small square represents 10
acres.

Well at Box Elder

(for location of Well at Havre, see reverse side)

2. The beneficial use on which the claim is based. Railroad
Purposes
3. Date or approximate date of earliest beneficial use; and how continuous the use has been. 1930
4. The amount of groundwater claimed (in miner's inches or gallons per minute). N/A
5. If used for irrigation, give the acreage and description of the lands to which water has been applied and name of the owner thereof. N/A
6. The means of withdrawing such water from the ground and the location of each well or other means of withdrawal. Well at Box Elder and Well at Havre
7. The date of commencement and completion of the construction of the well, wells, or other works for withdrawal of groundwater. N/A
8. The depth of water table. N/A
9. So far as it may be available, the type, size and depth of each well or the general specifications of any other works for the withdrawal of groundwater. 4" dia. dug well, 33' deep
10. The estimated amount of groundwater withdrawn each year. 100,000 gallons
11. The log of formations encountered in the drilling of each well if available. N/A
12. Such other information of a similar nature as may be useful in carrying out the policy of this act, including reference to book and page of any county record. N/A

GREAT NORTHERN RAILWAY COMPANY

Signature of Owner By: H. H. Holmgren
Superintendent of the Butte Division
Date: 11-2-62

Three copies to be filed by the owner with the County Clerk and Recorder of the county in which the well is located.

Please answer all questions. If not applicable, so state, otherwise the form will be returned.

Original to the County Clerk and Recorder; duplicate to the State Engineer; Triplicate to the Montana Bureau of Mines and Geology, and Quadruplicate for the Appropriator.

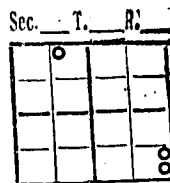

Location of Well at
Havre

- Well No. 1
SE $\frac{1}{4}$ SE $\frac{1}{4}$ Sec. 5, T 32N., R16E
3. Nov. 5, 1929
 4. 395 GPM
 7. 9-30-29 - 11-5-29
 8. Static level, 12'
 9. 16" gravel wall well,
120' deep, cased 103'
 10. 10,000,000 gallons
 1. See attached log sheet

- Well No. 2
SE $\frac{1}{4}$ SE $\frac{1}{4}$ Sec. 5, T32N, R-16E
3. May 15, 1940
 4. 220 G.P.M.
 7. Jan. 16, 1940 - May 15, 1940
 8. Static level, 20'
 9. 12" gravel wall well, 80'
deep, cased 61'
 10. 10,000,000 gallons
 11. See attached log sheet

- Well No. 9
NW $\frac{1}{4}$ NW $\frac{1}{4}$ Sec. 9, T32N, R16E
3. Feb. 8, 1956
 4. 140 G.P.M.
 7. Jan. 3, 1956-Feb. 8, 1956
 8. Static level, 27'
 9. 12" drilled well, 96'
deep.
 10. 3,000,000 gallons
 11. See attached log sheet

391623

GREAT NO. TERN RAILWAY COMPANY

to

THE PUBLIC

DECLARATION OF VESTED GROUND
WATER RIGHTS

STATE OF MONTANA, ss.
COUNTY OF HILL)
Filed at 8 o'clock A.M.

ON DEC 12 1962

G. C. Yeet COUNTY CLERK

W. C. Yeet DEPUTY

Fee \$2.00 pd.

AFE 40201

HAVRE, MONT.

No. 1

Log of 26" x 16" x 103' gravel packed well put down by Fairbanks-Morse Water Supply Co. under contract # 9291 - dated July 9th 1929. ~ Work began Sept. 30th & completed Nov. 5th 1929. ~ Water level was at 12' & lowered to 50'-8" when pumping 395 g.p.m.

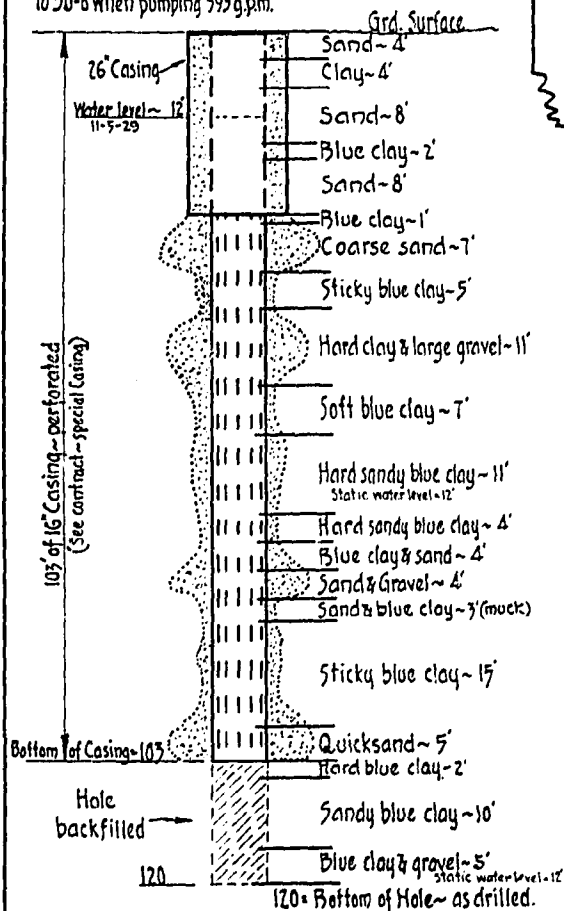

Office of Engr. Water Service

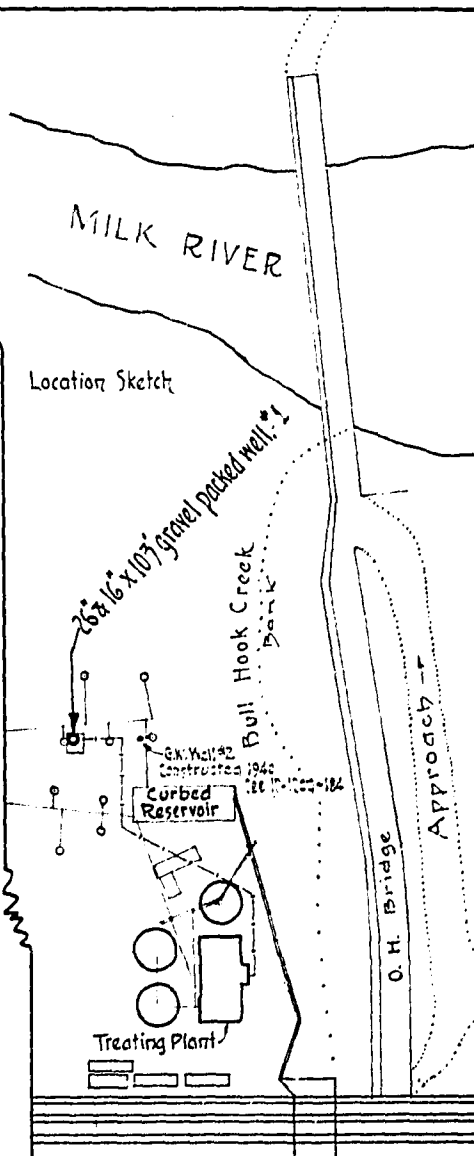

ID-1200-112

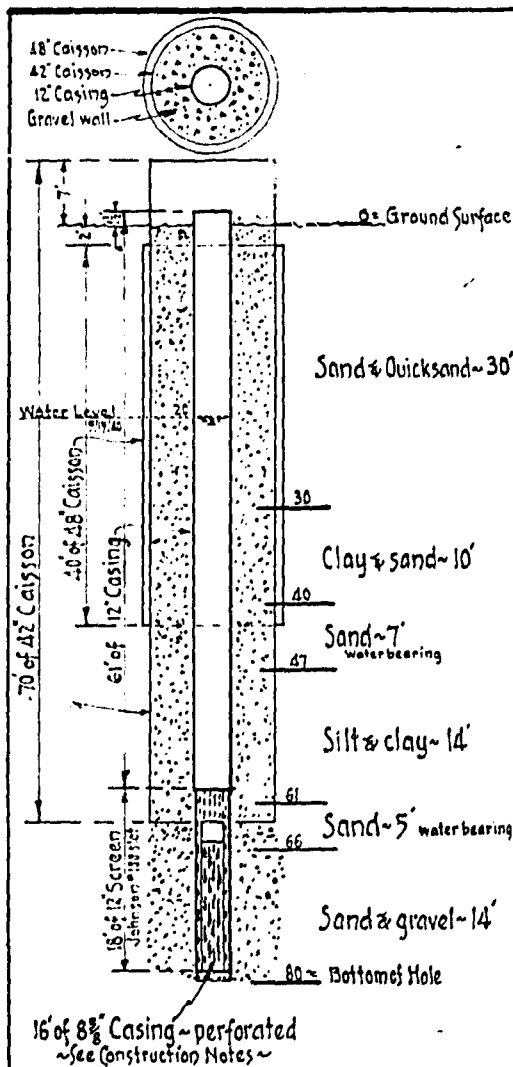

~ HAVRE, Montana ~
~ Afe 57897 ~

Log of Gravel Wall Well #2 put down by Ry. Co. force and machine. ~ C.M. Wick, driller
Work started Jan. 16th and finished May 15th 1940.
Pumping test: ~ Water level was at 20' below Surface and lowered to 46' when delivering 220 G.P.M.

Construction Notes: ~

Excavation started with 48" Caisson and tapered to 42" with 36" to depth of 80'. ~ Concentrically, 12" Casing with 12" Screen - 18' g. was placed with bottom of Screen at 79' below Surface. ~ Gravel was placed between 12" string and caisson - the 36" pulled and recovered; the 42" & 48" left in place.

A cloudburst (in June '40) flooded the flat where Wells are located - causing settlement around new well (also G.W. Well #1). It was learned when lowering permanent pumping unit that Screen had collapsed and to increase the supply was necessary to move in drill machine and wedge out Screen so could insert 8" casing as reinforcement and to prevent further damage.

~ Location Sketch ~

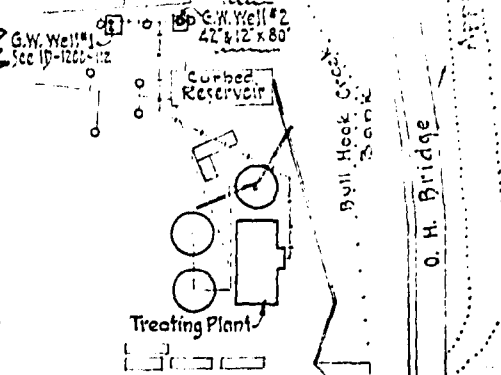

RECEIVED

30N-13E
County H. 11 27

STATE OF MONTANA
ADMINISTRATOR OF GROUNDWATER CODE
MONTANA WATER RESOURCES BOARD

JAN 16 1973

DRILLER'S LOG

Indicate the character, color, thickness of strata such as soil, clay, sand, gravel, shale, sandstone, etc. Show depth at which water is found and height to which water rises in well.

NOTICE OF COMPLETION OF GROUNDWATER APPROPRIATION BY MEANS OF WELL

Developed after January 1, 1962

(Under Chapter 237 Montana Session Laws, 1961, as amended)

This form to be prepared by driller, and three copies to be filed by the owner with the County Clerk and Recorder in the county in which the well is located, last copy to be retained by driller.

Please answer all questions. If not applicable, so state, otherwise the form may be returned.

Owner Cliff Belmont
Address Rocky Bay Pk
Box Elder Mont
Date well started Nov. 15-72
completed Nov 15-72

For Administrator's Use	
File	<u>426922</u>
Date	<u>Jan. 17, 1973</u>
GW	<u>4:00 P.M.</u>

Type of well drilled
(Dug, driven, bored or drilled)
Equipment used Rotary
(Churn drill, rotary or other)
Water Use: Domestic ☒ Municipal ☐ Stock ☐ Irrigation ☐
Industrial ☐ Drainage ☐ Other ☐ Garden/Lawn ☐

*Describe
USE: If used for irrigation, industrial, drainage or other. Explain, state number of acres and location or other data (i.e. Lot, Block and Addition).

ESTIMATED ANNUAL WITHDRAWAL 500,000

Size of Drilled Hole	Size and Weight of Casing	From (Feet)	To (Feet)	PERFORATIONS		
				Kind Size	From (Feet)	To (Feet)
<u>7 3/8</u>	<u>280</u> <u>19.91</u>	<u>TOP</u>	<u>29</u>	<u>1/8 inch</u>	<u>24</u>	<u>29</u>

31 ft casing

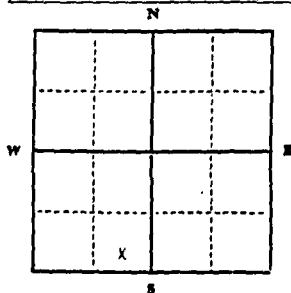

Static water level 11 ft.*
Pumping water level 22 ft.*
at 15 gallons per minute,
measured 60 minutes after pumping began.
*Measured from ground level.
Well developed by an jet
for 2 hours.
Power 1/2 HP
Remarks: (Gravel packing, cementing, packers, type of shutoff)

SE 1/4 SW 1/4 Sec. 27
T. 30 N. R. 13 E.
S W

INDICATE LOCATION OF WELL AND PLACE OF USE, IF POSSIBLE. EACH SMALL SQUARE REPRESENTS 40 ACRES.

Driller's Signature Richard D. Hinkel

Driller's Address

LICENSE NO. 196

Top of Ground (Elev. above sea level)	
From (Feet)	To (Feet)
<u>0</u>	<u>2</u> <u>top</u>
<u>2</u>	<u>11</u> <u>clay</u>
<u>11</u>	<u>29</u> <u>sand water</u>

29 Show exact depth of bottom

52237

426922

GERALD J. "CHIEF" BELCOURT

TO

THE PUBLIC

WATER WELL

STATE OF MONTANA } SS
COUNTY OF HILL }
Filed at 4:00 o'clock P.M

ON JAN 17 1973

R. E. Blom
COUNTY CLERK
BY Dante E. May
DEPUTY

Fee:\$2.00 pd.

INDEXED

File No. _____

T 30X R 13E 27

DUPLICATE

RECEIVED

County HILL

LOG

JAN 30 1967

STATE OF MONTANA
ADMINISTRATOR OF GROUNDWATER CODE
OFFICE OF STATE ENGINEER

Top of Ground

(Elev. above sea level. _____)

Notice of Completion of Groundwater
Appropriation by Means of Well

DEVELOPED AFTER JANUARY 1, 1962

(Under Chapter 237, Montana Session Laws, 1961)

0 to 3' TOP + SUBSOIL

9' SANDY BROWN CLAY

18' BROWNISH-YELLOW CLAY

20' SATURATED SANDY CLAY

21' BROWN SAND - TRACE
OF GRAVEL - WATER -
APPROX 3 GPM

25' SOFT BROWN CLAY

29' SANDY BROWN CLAY

31' BROWN CLAY

33' BROWN SAND - SHOW
OF GRAVEL - WATER -
APPROX 5 GPM

34' COARSE SAND - GRAVEL -
WATER - APPROX 18
GPM BY BALER TEST

BALING FROM
BOTTOM

Owner: HERBERT G. BITZ Address: Box ELDER, MONTANADriller: Hi-Line Drilling Service Address: HAIRE, MONTANA

Date of Notice of appropriation of groundwater. _____

Date well started: MAY 27, 1967 Date completed: MAY 27, 1967Type of well: DRIILLED Equipment used: CANE TOOL RIG
(Dug, driven, bored or drilled) (Churn drill, rotary or other)Water use: Domestic ☐ Municipal ☐ Stock ☒ Irrigation ☐
Industrial ☐ Drainage ☐ Other ☐

Indicate on the diagram the character and thickness of the different strata met with in drilling, such as soil, clay, shale, gravel, rock or sand, etc. Show depth at which water is encountered, thickness and character of water-bearing strata and height to which the water rises in the well.

Size of Drilled Hole	Size and Weight of Casing	From (Feet)	To (Feet)	PERFORATIONS		
				Kind Size	From (Feet)	To (Feet)
6 7/8"	6 5/8" O.D.	8 INCHES ABOVE GROUND LEVEL	34'	(NO PERFORATIONS)		
	13" PER FOOT GALVANIZED T+C			WATER COMING IN		
				THRU BOTTOM OF DRIVE COLLAR AT 34' LEVEL		

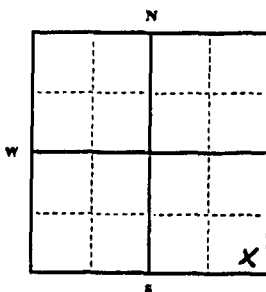

SE 1/4 Sec. 27, T. 30 R. 13
Indicate location of well and place of use, if possible. Each small square represents 40 acres.

Static Water Level for non-flowing well _____ feet.

Shut-in Pressure for Flowing Well NOT APPLICABLEPumping Water Level 24' feet
at 15' gal. per minute.Discharge in gal. per min. of flowing well NOT APPLICABLEHow Tested: BALER & PUMPLength of Test: 5 HOURSRemarks: (Gravel packing, cementing, pack-
ers, type of shutoff) CEMENTEDFROM 15 FT LEVEL BACK TO 5 FT LEVEL

(Continue on reverse side)

USE—If used for irrigation, industrial, drainage or other. Explain, state number of acres and location or other data (i.e.: Lot, Block and Addition).

34' Show exact depth of bottom.

This form to be prepared by driller, and three copies to be filed by the owner with the County Clerk and Recorder in the county in which the well is located, tissue copy to be retained by driller.

Please answer all questions. If not applicable, so state, otherwise the form will be returned.

Driller's License Number 46Driller's Signature Robert Brown

44,961

412822

HERBERT G. BITZ

TO

THE PUBLIC

NOTICE OF GROUNDWATER
APPROPRIATION

STATE OF MONTANA,)
COUNTY OF HILL) ss
Filed at 10:15 o'clock A.M.

JAN 28 1969

R. E. BLOM

COUNTY CLERK

DEPUTY

fee: \$2.00 paid

File No.

DUPLICATE

STATE OF MONTANA
ADMINISTRATOR OF GROUNDWATER CODE
OFFICE OF STATE ENGINEER

T. 30 N. 13 E. 27
HILL
COUNTY
RECEIVED
JAN 18 1964

Declaration of Vested Groundwater Rights STATE ENGINEER

(Under Chapter 237, Montana Session Laws, 1961)

1. HARVEY H. KELLER, of Box Elder
(Name of Appropriator) (Address) (Town)
County of HILL State of MONTANA
have appropriated groundwater according to the Montana laws in effect prior to January 1, 1962, as follows:

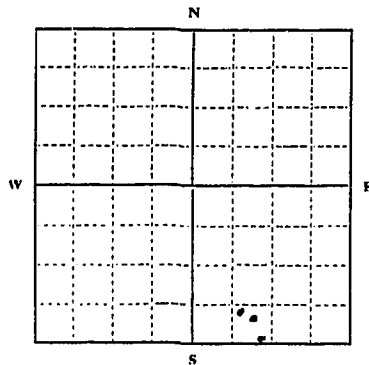

SE 1/4 Sec. 27 T. 30 N. 13 E.

Indicate point of appropriation and place of use, if possible. Each small square represents 10 acres.

2. The beneficial use on which the claim is based STOCK WATER
3. Date or approximate date of earliest beneficial use; and how continuous the use has been 1935
DAILY Use
4. The amount of groundwater claimed (in miner's inches or gallons per minute) 45 GALLONS / MINUTE
5. If used for irrigation, give the acreage and description of the lands to which water has been applied and name of the owner thereof
None
6. The means of withdrawing such water from the ground and the location of each well or other means of withdrawal Shallow well pumps in three wells on above property
7. The date of commencement and completion of the construction of the well, wells, or other works for withdrawal of groundwater 1935
8. The depth of water table 12 feet
9. So far as it may be available, the type, size and depth of each well or the general specifications of any other works for the withdrawal of groundwater 16 feet maximum
10. The estimated amount of groundwater withdrawn each year 400,000 gallons/year
11. The log of formations encountered in the drilling of each well if available Clay and Sand
12. Such other information of a similar nature as may be useful in carrying out the policy of this act, including reference to book and page of any county record None

Signature of Owner Harvey H. KellerDate 12-26-63

Three copies to be filed by the owner with the County Clerk and Recorder of the county in which the well is located.

Please answer all questions. If not applicable, so state, otherwise the form will be returned.

Original to the County Clerk and Recorder; Duplicate to the State Engineer; Triplicate to the Montana Bureau of Mines and Geology, and Quadruplicate for the Appropriator.

31047

396976

HARVEY H. KELLER

TO

THE PUBLIC

DECLARATION OF VESTED
GROUNDWATER RIGHTS

STATE OF MONTANA } ss.
COUNTY OF HILL }
Filed at 1:02 o'clock p.m.

ON 11/23/1962
J. S. Pham
COUNTY CLERK

BY _____ DEPUTY

FEE: \$2.00 pd.

WEBER, BOSCH & KUHR

ATTORNEYS AND COUNSELLORS

FRED J. WEBER
BURTON O. BOSCH
JOHN B. KUHR
BRADLEY E. DUGDALE

CITIZENS BANK BUILDING
HAVRE, MONTANA

March 13, 1967

AREA 406
26 5-6706

STATE WATER CONSERVATION BOARD

MAR 14 1967

Billings _____ McDermott _____
Butte _____ McIntosh _____
Casper _____ Morton _____
Dartmouth _____ Sullivan _____
Dickert _____

State Engineer
Helena
Montana

Dear Sir:

Re: Anton Niederegger

I enclose a duplicate copy of a Declaration of Vested
Groundwater Rights filed by Anton Niederegger.

Very truly yours,

WEBER, BOSCH & KUHR

By *Bradley E. Dugdale*
Bradley E. Dugdale

BED/amb
Enclosure

12. Such other information of a similar nature as may be useful in carrying out the policy of this act, including reference to book and page of any county record ~~A previous declaration was made on December 20, 1963 which was filed as Document No. 396686. This Declaration is being made to set forth the correct property description, said previous declaration showing the well being located in Section 19.~~

Signature of Owner *Anton Niederegger*
Date *March 9, 1967*

Three copies to be filed by the owner with the County Clerk and Recorder of the county in which the well is located.

Please answer all questions. If not applicable, so state, otherwise the form will be returned.

Original to the County Clerk and Recorder; Duplicate to the State Engineer; Triplicate to the Montana Bureau of Mines and Geology, and Quadruplicate for the Appropriator.

T. 30 NR 13E 29

County.....

MAR 34 1967

ter Rights	McDermott
(1961)	McNelly
Dickert	Morton
Dickert	Quinn

Dickert

Box Elder
(Town)

H111

F

- X

Indicate point of appropriation and place of use, if possible. Each small square represents 10 acres.

- 20, 1963 which was filed as Document No. 330000. This Declaration was made to set forth the correct property description, said previous declaration showing the well being located in Section 19.

Date March 9, 1967

Please answer all questions. If not applicable, so state, otherwise the form will be returned.

Original to the County Clerk and Recorder; Duplicate to the State Engineer; Triplicate to the Montana Bureau of Mines and Geology, and Quadruplicate for the Appropriator.

T. 30 N. R. 13 E.

DUPLICATE

County Hill

STATE OF MONTANA
ADMINISTRATOR OF GROUNDWATER CODE
OFFICE OF STATE ENGINEER

RECEIVED
DEC 27 1963

Declaration of Vested Groundwater Rights

(Under Chapter 237, Montana Session Laws, 1961)

STATE ENGINEER

1. Anton Niederreger, of Box Elder
(Name of Appropriator) (Address) (Town)
County of Hill State of Montana
have appropriated groundwater according to the Montana laws in effect prior to January 1, 1962, as follows:

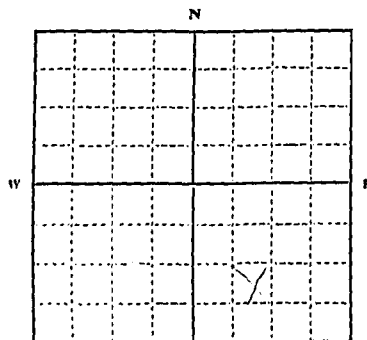

SB 1/4 Sec 19 T30 R13

Indicate point of appropriation
and place of use, if possible.
Each small square represents 10
acres.

2. The beneficial use on which the claim is based.....
stock

3. Date or approximate date of earliest beneficial use; and how con-
tinuous the use has been..... fall 1940

4. The amount of groundwater claimed (in miner's inches or gallons
per minute)..... 15 gpm

5. If used for irrigation, give the acreage and description of the lands
to which water has been applied and name of the owner thereof
none

6. The means of withdrawing such water from the ground and the
location of each well or other means of withdrawal.....
electric pump

7. The date of commencement and completion of the construction of the well, wells, or other works for with-
drawal of groundwater..... fall 1940

8. The depth of water table..... 140 ft.

9. So far as it may be available, the type, size and depth of each well or the general specifications of any other
works for the withdrawal of groundwater..... drilled, 6" OD, 142 ft.

10. The estimated amount of groundwater withdrawn each year..... 11,169,000 gals.

11. The log of formations encountered in the drilling of each well if available..... not available

12. Such other information of a similar nature as may be useful in carrying out the policy of this act, including
reference to book and page of any county record..... none

Signature of Owner

Anton NiederregerDate Dec 20 - 1963

Three copies to be filed by the owner with the County Clerk and Recorder of the county in which the well is
located.

Please answer all questions. If not applicable, so state, otherwise the form will be returned.

Original to the County Clerk and Recorder; duplicate to the State Engineer; Triplicate to the Montana Bureau
of Mines and Geology, and Quadruplicate for the Appropriator.

13387

376686

ANTON HINNENBERG, R

TO

THE PUBLIC

RECAPITULATION OF VESTED GROUND
WATER RIGHTS

STATE OF MONTANA,
COUNTY OF HILL) ss.
Witness my hand and seal this 11th day of October, A.D. 1963.

WITNESSED AND SUBSCRIBED at Helena, Montana, this 11th day of October, 1963.

R. E. Blom

COUNTY CLERK

SEAL

Fee: \$2.00 pd.

396686

ANTON HIRSH RECO. R

THE PUBLIC

SEPARATION OF VOTER RECORD
AND RIGHTS

STATE OF MONTANA
COUNTY OF HILL
Filed at 11 o'clock A.M.

APR 20 1963

R. E. Blom
COUNTY CLERK

RECEIVED

Fee: \$2.00 pd.

File No.

T. 30 R. 13E

DUPLICATE

County Hill

STATE OF MONTANA
ADMINISTRATOR OF GROUNDWATER CODE
OFFICE OF STATE ENGINEER

Declaration of Vested Groundwater Rights

(Under Chapter 237, Montana Session Laws, 1961)

RECEIVED
AUG 12 1963
STATE ENGINEER

1. Fred C. Schmidt, of Box Elder, Montana
(Name of Appropriator) (Address) (Town)
County of Hill State of Montana
have appropriated groundwater according to the Montana laws in effect prior to January 1, 1962, as follows:

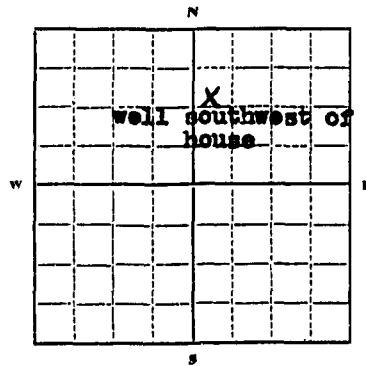

1/4 Sec. 29 T. 30 R. 13

Indicate point of appropriation
and place of use, if possible.
Each small square represents 10
acres.

2. The beneficial use on which the claim is based.....
Domestic & Stock
3. Date or approximate date of earliest beneficial use; and how continuous the use has been.....
Continuous since 1930
4. The amount of groundwater claimed (in miner's inches or gallons per minute).....
500 gallons per minute
5. If used for irrigation, give the acreage and description of the lands to which water has been applied and name of the owner thereof.....
none
6. The means of withdrawing such water from the ground and the location of each well or other means of withdrawal.....
Barnes 2" centrifugal
7. The date of commencement and completion of the construction of the well, wells, or other works for withdrawal of groundwater.....
1930
8. The depth of water table.....
6 feet
9. So far as it may be available, the type, size and depth of each well or the general specifications of any other works for the withdrawal of groundwater.....
Dug well to depth of 11 feet across 4 feet square
10. The estimated amount of groundwater withdrawn each year.....
360,000,000
11. The log of formations encountered in the drilling of each well if available.....
Coarse gravel entire depth no log available
12. Such other information of a similar nature as may be useful in carrying out the policy of this act, including reference to book and page of any county record.....
none
supply of water unlimited

Signature of Owner.....Fred C. SchmidtDate.....8/6/63

Three copies to be filed by the owner with the County Clerk and Recorder of the county in which the well is located.

Please answer all questions. If not applicable, so state, otherwise the form will be returned.

Original to the County Clerk and Recorder; duplicate to the State Engineer; Triplicate to the Montana Bureau of Mines and Geology, and Quadruplicate for the Appropriator.

5345

394726

FRED C. SCHMIDT

TO

THE PUBLIC

DECLARATION OF VESTED GROUND
WATER RIGHTS

STATE OF MONTANA, ss.
COUNTY OF HILL)
Filed at 4:45 o'clock P.M.

ON AUG 7 1963
R. E. Blom

COUNTY CLERK

by _____ DEPUTY

Fee: \$2.00 pd.

File No. _____

T. 30 R. 13E

DUPLICATE

County Hill

STATE OF MONTANA
ADMINISTRATOR OF GROUNDWATER CODE
OFFICE OF STATE ENGINEER

RECEIVED
AUG 12 1963

Declaration of Vested Groundwater Rights

(Under Chapter 237, Montana Session Laws, 1961)

STATE ENGINEER

1. Fred C. Schmidt, of Box Elder, Montana
(Name of Appropriator) (Address) (Town)
County of Hill State of Montana
have appropriated groundwater according to the Montana laws in effect prior to January 1, 1962, as follows:

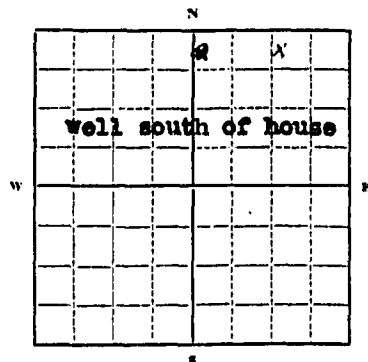

$\frac{1}{4}$ Sec. 29 T. 30 R. 13

Indicate point of appropriation
and place of use, if possible.
Each small square represents 10
acres.

2. The beneficial use on which the claim is based...
Domestic & Stock
3. Date or approximate date of earliest beneficial use; and how continuous the use has been...
Continuous since the fall 1955
4. The amount of groundwater claimed (in miner's inches or gallons per minute)...
30 gallons per minute
5. If used for irrigation, give the acreage and description of the lands to which water has been applied and name of the owner thereof...
none
6. The means of withdrawing such water from the ground and the location of each well or other means of withdrawal...
2 horse Fairbanks & Morse submersible
7. The date of commencement and completion of the construction of the well, wells, or other works for withdrawal of groundwater...
Fall of 1955 1955
8. The depth of water table...
50 feet
9. So far as it may be available, the type, size and depth of each well or the general specifications of any other works for the withdrawal of groundwater...
93 feet deep drilled 6" O. D. cased
10. The estimated amount of groundwater withdrawn each year...
12,960,000 gals
11. The log of formations encountered in the drilling of each well if available...
Claggett shale total depth no log available
12. Such other information of a similar nature as may be useful in carrying out the policy of this act, including reference to book and page of any county record...
none

Signature of Owner

Fred C. SchmidtDate 8/6/63

Three copies to be filed by the owner with the County Clerk and Recorder of the county in which the well is located.

Please answer all questions. If not applicable, so state, otherwise the form will be returned.

Original to the County Clerk and Recorder; duplicate to the State Engineer; Triplicate to the Montana Bureau of Mines and Geology, and Quadruplicate for the Appropriator.

5346

394737

FRED S. SCHMIDT

TO

THE PUBLIC

DECLARATION OF VESTED GROUND
WATER RIGHTS

STATE OF MONTANA) ss.
COUNTY OF BILL)
Filed at 4:45 o'clock P.M.

ON AUG 7 1963

R. E. Blom

COUNTY CLERK

By _____ DEPUTY

Fee:\$2.00 pd.

File No. _____

T 30 R 13E

DUPLICATE

County Hill

STATE OF MONTANA
ADMINISTRATOR OF GROUNDWATER CODE
OFFICE OF STATE ENGINEER

RECEIVED
AUG 12 1963
STATE ENGINEER

Declaration of Vested Groundwater Rights

(Under Chapter 237, Montana Session Laws, 1961)

1. Fred C. Schmidt of Box Elder, Montana
(Name of Appropriator) (Address) (Town)
County of Hill State of Montana
have appropriated groundwater according to the Montana laws in effect prior to January 1, 1962, as follows:

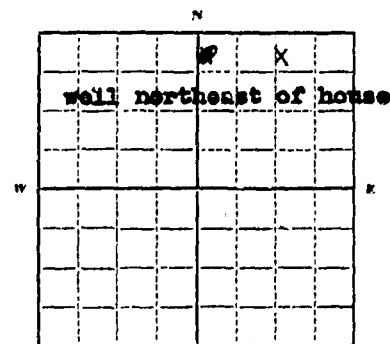

SW $\frac{1}{4}$ Sec. 29 T. 30 R. 13

Indicate point of appropriation
and place of use, if possible.
Each small square represents 10
acres.

2. The beneficial use on which the claim is based Domestic & Stock
3. Date or approximate date of earliest beneficial use; and how continuous the use has been Continuous since 1930
First dug and later drilled to a deeper depth
4. The amount of groundwater claimed (in miner's inches or gallons per minute) 500 gallons per minute
5. If used for irrigation, give the acreage and description of the lands to which water has been applied and name of the owner thereof Two acres in the SW $\frac{1}{4}$ sec 29 T30 R13E
to Fred C. Schmidt
6. The means of withdrawing such water from the ground and the location of each well or other means of withdrawal 3/4 horse Fairbanks & Morse submersible
7. The date of commencement and completion of the construction of the well, wells, or other works for withdrawal of groundwater Spring of 1930
8. The depth of water table 40 feet
9. So far as it may be available, the type, size and depth of each well or the general specifications of any other works for the withdrawal of groundwater 240 feet deep drilled 6" o.d. cased
10. The estimated amount of groundwater withdrawn each year 360,000,000 gals
11. The log of formations encountered in the drilling of each well if available Olsgott shale total depth. no log available
12. Such other information of a similar nature as may be useful in carrying out the policy of this act, including reference to book and page of any county record none
supply of water unlimited

Signature of Owner

Fred C. Schmidt
Date 8/6/63

Three copies to be filed by the owner with the County Clerk and Recorder of the county in which the well is located.

Please answer all questions. If not applicable, so state, otherwise the form will be returned.

Original to the County Clerk and Recorder; duplicate to the State Engineer; Triplicate to the Montana Bureau of Mines and Geology, and Quadruplicate for the Appropriator.