

394738

FRED C. SCHMIDT

TO

THE PUBLIC

DECLARATION OF VESTED GROUND  
WATER RIGHTS

STATE OF MONTANA, ) ss.  
COUNTY OF HILL )  
Filed at 4:45 o'clock P.M.

ON AUG 7 1963

R. E. Blom

COUNTY CLERK

Fee: \$2.00 pd.

29

File No. ....

T. 30 R. 13E

DUPLICATE

County Hill

STATE OF MONTANA  
 ADMINISTRATOR OF GROUNDWATER CODE  
 OFFICE OF STATE ENGINEER

RECEIVED  
 AUG 12 1963

Declaration of Vested Groundwater Rights  
 (Under Chapter 237, Montana Session Laws, 1961) STATE ENGINEER

I, Fred C. Schmidt, of Box Elder, Montana  
 (Name of Appropriator) (Address) (Town)  
 County of Hill State of Montana  
 have appropriated groundwater according to the Montana laws in effect prior to January 1, 1962, as follows:

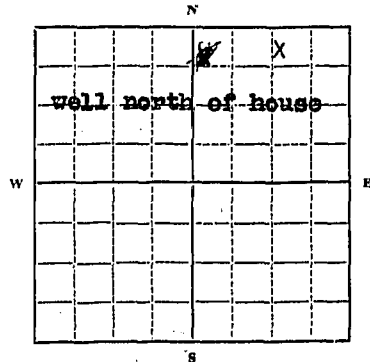

29 1/4 Sec. 29 1/4 T. 30 R. 13

Indicate point of appropriation and place of use, if possible. Each small square represents 10 acres.

2. The beneficial use on which the claim is based.....  
Domestic & Stock

3. Date or approximate date of earliest beneficial use; and how continuous the use has been.....  
continuous since July 1954 1954

4. The amount of groundwater claimed (in miner's inches or gallons per minute).....  
one gallon per minute

5. If used for irrigation, give the acreage and description of the lands to which water has been applied and name of the owner thereof.....  
none

6. The means of withdrawing such water from the ground and the location of each well or other means of withdrawal.....  
3 horse Fairbanks & Morse submersible

7. The date of commencement and completion of the construction of the well, wells, or other works for withdrawal of groundwater.....  
July 1954

8. The depth of water table.....  
20 feet

9. So far as it may be available, the type, size and depth of each well or the general specifications of any other works for the withdrawal of groundwater.....  
Drillers report # 199 Lloyd Hamberg of Box Elder Montana  
Filed with Montana State Board of Health

10. The estimated amount of groundwater withdrawn each year.....  
518,400 gals.

11. The log of formations encountered in the drilling of each well if available.....  
Filed by the driller Lloyd Hamberg of Box Elder Montana  
with Montana State Board of Health Driller's # 199

12. Such other information of a similar nature as may be useful in carrying out the policy of this act, including reference to book and page of any county record.....  
see above none other

Signature of Owner Fred C. Schmidt  
 Date 8/6/63

Three copies to be filed by the owner with the County Clerk and Recorder of the county in which the well is located.

Please answer all questions. If not applicable, so state, otherwise the form will be returned.

Original to the County Clerk and Recorder; duplicate to the State Engineer; Triplicate to the Montana Bureau of Mines and Geology, and Quadruplicate for the Appropriator.

5348

394739

FRED C. SCHMIDT

TO

THE PUBLIC

DECLARATION OF VESTED GROUND  
WATER RIGHTS

STATE OF MONTANA ) ss.  
COUNTY OF HILL )  
*Filed at 4:45 o'clock P. m.*

ON AUG 7 1963

R. E. Blom

COUNTY CLERK

By \_\_\_\_\_ DEPUTY

Fee: \$2.00 pd.

File No.....

T. 30<sup>N</sup> R. 13<sup>E</sup>

DUPLICATE

County HILL

STATE OF MONTANA  
ADMINISTRATOR OF GROUNDWATER CODE  
OFFICE OF STATE ENGINEER

RECEIVED  
NOV 18 1963

Declaration of Vested Groundwater Rights STATE ENGINEER  
(Under Chapter 237, Montana Session Laws, 1961)

1. ALBERT BITZ of Box 156 Box ELDER  
(Name of Appropriator) (Address) (Town)  
County of HILL State of MONTANA  
have appropriated groundwater according to the Montana laws in effect prior to January 1, 1962, as follows:

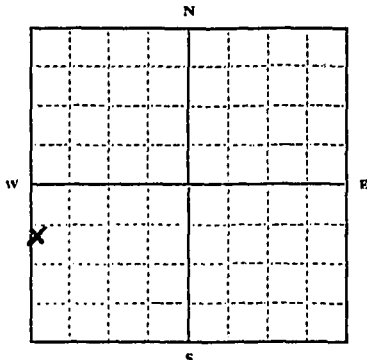

S. 1/4 Sec. 30, T. 30, R. 13.

Indicate point of appropriation and place of use, if possible. Each small square represents 10 acres.

2. The beneficial use on which the claim is based. STOCK

3. Date or approximate date of earliest beneficial use; and how continuous the use has been. 1956  
used during summer

4. The amount of groundwater claimed (in miner's inches or gallons per minute) 10 gal per minute

5. If used for irrigation, give the acreage and description of the lands to which water has been applied and name of the owner thereof

6. The means of withdrawing such water from the ground and the location of each well or other means of withdrawal. PUMP

7. The date of commencement and completion of the construction of the well, wells, or other works for withdrawal of groundwater. 17 July 1956 completed by the first

8. The depth of water table. 141 8 ft.

9. So far as it may be available, the type, size and depth of each well or the general specifications of any other works for the withdrawal of groundwater. 6 in diameter 14 ft deep

10. The estimated amount of groundwater withdrawn each year. 450,000

11. The log of formations encountered in the drilling of each well if available

12. Such other information of a similar nature as may be useful in carrying out the policy of this act, including reference to book and page of any county record

Signature of Owner Albert Bitz

Date July 15, 63

Three copies to be filed by the owner with the County Clerk and Recorder of the county in which the well is located.

Please answer all questions. If not applicable, so state, otherwise the form will be returned.

Original to the County Clerk and Recorder; duplicate to the State Engineer; Triplicate to the Montana Bureau of Mines and Geology, and Quadruplicate for the Appropriator.

396062

ALBERT BITZ

TO

THE PUBLIC

DECLARATION OF VESTED GROUND  
WATER RIGHTS

STATE OF MONTANA )  
COUNTY OF HILL )  
*Filed at 1:30 o'clock P.M.*

ON NOV 15 1963

R. E. Blom  
COUNTY CLERK

BY \_\_\_\_\_ DEPUTY

Fee: \$2.00 pd.

32

File No. ....

T. 30 R. 13

DUPLICATE

County Hill

STATE OF MONTANA RECEIVED  
ADMINISTRATOR OF GROUNDWATER CODE  
OFFICE OF STATE ENGINEER SEP 9 1963

Top of Ground  
(Elev. above sea level 2650)

0  
3 Top + Subsoil  
14 SANDY BROWN CLAY  
23 SAND-SILT-TRACE  
OF GRAVEL + WATER  
34 SOFT BLUE-GREY  
CLAY  
41 GREY CLAY  
43 HARD SANDSTONE  
LEDGE  
50 BROWNISH-GREY  
CLAY  
51 GREY SANDY SILT  
52 GRAVEL-WATER  
APPROX - 5 1/2 GPM

52

### Notice of Completion of Groundwater Appropriation by Means of Well

(Under Chapter 237, Montana Session Laws, 1961)

Owner ANTON NEDEREGGER Address BOX ELDER MONT.

Driller HELINE DRILLING SERVICE Address HAYRE, MONTANA

Date of Notice of Appropriation of Groundwater .....

Date well started AUG. 26, 1963 Date Completed AUG. 29, 1963

Type of well DRILLED Equipment Used CABLE TOOL RIG  
(dug, driven, bored or drilled) (Churn, drill, rotary or other)

Water Use: Domestic  Municipal  Other  Irrigation   
Industrial  Drainage  Stock

Indicate on the diagram the character and thickness of the different strata met with in drilling, such as soil, clay, shale, gravel, rock or sand, etc. Show depth at which water is encountered, thickness and character of water-bearing strata and height to which water rises in the well.

Size of Drilled Hole	Size and Weight of Casing	From (Feet)	To (Feet)	PERFORATIONS		
				Kind Size	From (Feet)	To (Feet)
7"	6" I.O. 13" PER FT.	0	52	NO PERFORATIONS CASING BEDDED INTO GRAVEL + WATER COMING THRU BOTTOM OF CASING		

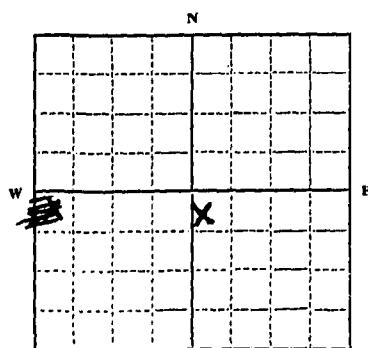

NW 1/4 Sec. 30 T. 30 R. 13  
Indicate location of well and place of use, if possible. Each small square represents 10 acres.

Show exact depth of bottom.

Static Water Level for non-flowing Well 10 feet.

Shut-in Pressure for Flowing Well NOT APPLICABLE

Pumping Water Level 46 feet at 4 gal. per minute.

Discharge in gal. per min. of flowing well NOT APPLICABLE

How Tested BALER Length of Test 3 HOURS

Remarks: (Gravel packing, cementing, packers, type of shutoff, location of place of use of groundwater if not at well, and any other similar pertinent information, including number of acres irrigated, if used for irrigation) SURFACE

CEMENTED TO PREVENT CONTAMINATION

46  
Driller's License Number

Hubert Graver  
Driller's Signature

This form to be prepared by driller, and three copies to be filed by the owner with the County Clerk and Recorder in the county in which the well is located.

Please answer all questions. If not applicable, so state, otherwise the form will be returned.

Original to the County Clerk and Recorder; duplicate to the State Engineer; Triplicate to the Montana Bureau of Mines and Geology and Quadruplicate for the Appropriator.

5782

395126

ANTON NIEDERECGER

TO

THE PUBLIC

NOTICE OF COMPLETION OF GROUND  
WATER APPROPRIATION BY MEANS  
OF WELL

STATE OF MONTANA,  
COUNTY OF HILL )  
*Filed at 2:15 o'clock A.M.*

ON SEP 6 1963

R. E. Blom

COUNTY CLERK

DEPUTY

Fee: \$2.00 pd.

34

File No. ....

T 30 N R 13

DUPLICATE

County HILL

STATE OF MONTANA  
ADMINISTRATOR OF GROUNDWATER CODE  
OFFICE OF STATE ENGINEER

FEB 17 1964

**Notice of Completion of Groundwater Appropriation by Means of Well**

(Under Chapter 237, Montana Session Laws, 1961)

Top of Ground  
(Elev. above sea level.....)

0  
3  
16  
21  
26  
31  
36  
36 1/2

TOP + SUBSOIL  
SANDY BROWN CLAY  
QUICKSAND - WATER  
APPROX 4 GPM (CASED OFF)  
BROWN CLAY  
SOFT GREY CLAY +  
PEBBLES  
FINE SAND + GRAVEL  
SMALL GRAVEL -  
WATER - 15 GPM

Owner LUCILLE POGREDA Address BOX ELDER, MONT.

Driller ALLIANCE DRILLING SERVICE Address HARRE, MONTANA  
381 N STATE ST.

Date of Notice of Appropriation of Groundwater.....

Date well started OCT 22, 1963 Date Completed OCT 26, 1963

Type of well DRILLED Equipment Used CABLE TOOL RIG  
(dug, driven, bored or drilled) (Churn, drill, rotary or other)

Water Use: Domestic  Municipal  Other  Irrigation   
Industrial  Drainage  Stock  GARDEN

Indicate on the diagram the character and thickness of the different strata met with in drilling, such as soil, clay, shale, gravel, rock or sand, etc. Show depth at which water is encountered, thickness and character of water-bearing strata and height to which water rises in the well.

FORMATION BELOW  
36 1/2 FEET - GREY  
CLAY

Size of Drilled Hole	Size and Weight of Casing	From (Feet)	To (Feet)	PERFORATIONS		
				Kind Slip	From (Feet)	To (Feet)
7	6" I.D. 13# PER FOOT	0	31 1/2	NO PERFORATIONS WATER FEEDING THRU BOTTOM OF CASING		

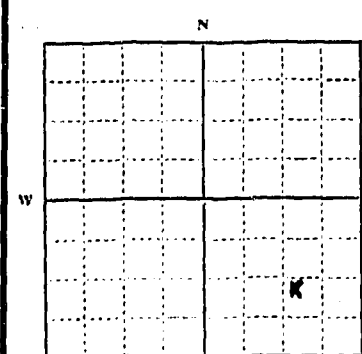

S 1/2 Sec. 34 T 30 R 13  
Indicate location of well and place of use, if possible. Each small square represents 10 acres.

36 1/2 Show exact depth of bottom.

**WATER ANALYSIS**  
HARDNESS 18 GR. PER GALLON  
IRON 0.1 PPM  
PH + 9.5

Static Water Level for non-flowing Well 16 feet.

Shut-in Pressure for Flowing Well NOT APPLICABLE

Pumping Water Level 19 feet at 4 1/2 gal. per minute.

Discharge in gal. per min. of flowing well NOT APPLICABLE

How Tested SAVER & PUMP Length of Test 6 HOURS

Remarks: (Gravel packing, cementing, packers, type of shutoff, location of place of use of groundwater if not at well, and any other similar pertinent information, including number of acres irrigated, if used for irrigation) WELL GRAVEL

PACKED BACK TO 31 FT WITH FEA GRAVEL

CASING SET AT 31 1/2 FT + GRAVEL PLACED AROUND

OUTSIDE OF CASING BACK TO 28 FT CEMENTED

FROM 28' BACK TO 24' TO SHUT OFF UPPER WATER

Driller's License Number 46

Driller's Signature Herbert Dreier

This form to be prepared by driller, and three copies to be filed by the owner with the County Clerk and Recorder in the county in which the well is located.

Please answer all questions. If not applicable, so state, otherwise the form will be returned.

Original to the County Clerk and Recorder; duplicate to the State Engineer; Triplicate to the Montana Bureau of Mines and Geology and Quadruplicate for the Appropriator.

34925



397771

LUCILLE POGGERA

TO

THE PUBLIC

NOTICE OF COMPLETION OF GROUNDWATER  
APPROPRIATION BY MEANS OF WELL

STATE OF MONTANA )  
COUNTY OF HILL )  
*Filed at 3:38'clock P.M.*

ON FEB 14 1964

R. B. COUNTY CLERK

DEPUTY

Fee \$2.00 pd.

File No. \_\_\_\_\_

T. 30N R 13E 35

DUPLICATE

County HILL

LOG

STATE OF MONTANA  
ADMINISTRATOR OF GROUNDWATER CODE  
STATE WATER CONSERVATION BOARD

Notice of Completion of Groundwater  
Appropriation by Means of Well  
DEVELOPED AFTER JANUARY 1, 1963

(Under Chapter 237 Montana Session Laws, 1961, as amended)

Owner BOX ELDER SCHOOL DIST #73 Address BOX ELDER, MONTANA

Driller H-LINE DRILLING SERVICE Address HAIRE, MONTANA

Date of Notice of appropriation of groundwater \_\_\_\_\_

Date well started MAY 18, 1968 Date completed MAY 20, 1968

Type of well DRILLED Equipment used CABLE TOOL RIG  
(Dug, driven, bored or drilled) (Churn drill, rotary or other)

Water use: Domestic  Municipal  Stock  Irrigation   
Industrial  Drainage  Other

Indicate on the diagram the character and thickness of the different strata met with in drilling, such as soil, clay, shale, gravel, rock or sand, etc. Show depth at which water is encountered, thickness and character of water-bearing strata and height to which the water rises in the well.

Top of Ground (Elev. above sea level _____)	
0 To 2	SOIL
6	GRAVELLY BROWN CLAY
7	DRY SAND + GRAVEL
12	YELLOWISH-BROWN CLAY
17	SANDY BROWN CLAY
19	BROWN SAND - WATER - APPROX 3 GPM CASED OFF
26	SOFT BROWN CLAY
33	GREY CLAY
36	GREY SAND + SILT - WATER - APPROX 6 GPM
40	SILTY CLAY
44 1/2	SANDY GREY CLAY
45 1/2	GRAVEL + CONSIDERABLE AMOUNT OF SAND - WATER - APPROX 12 GPM
46	GREY SAND
48	GREY SAND + CONSIDERABLE SILT - WATER - NOT CLEARING
48 1/2	SAND + COARSE GRAVEL - WATER - EXCEEDING 20 GPM
49	GRAVEL - (PEA SIZE TO 1" DIAMETER) WATER - EXCEEDING 30 GPM BY BALER TEST
49	Show exact depth of bottom.

Size of Drilled Hole	Size and Weight of Casing	From (Feet)	To (Feet)	PERFORATIONS		
				Kind Size	From (Feet)	To (Feet)
10"		0	17	NO PERFORATIONS.		
6 7/8"	6 7/8" O.D. 1 3/8" PER FT CALVANIZED	1 FOOT ABOVE GROUND LEVEL	49	WATER COMING IN THRU BOTTOM OF DRIVE SHOE AT 49 FT LEVEL		

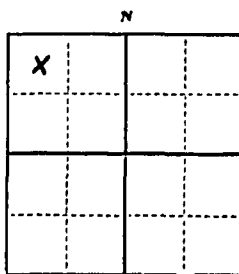

Static Water Level for non-flowing well \_\_\_\_\_ feet.

Shut-in Pressure for Flowing Well NOT APPL

Pumping Water Level \_\_\_\_\_ feet  
at \_\_\_\_\_ gal. per minute.

Discharge in gal. per min. of flowing well NOT APPLICABLE

How Tested PUMP

Length of Test 6 HOURS

Remarks: (Gravel packing, cementing, packers, type of shutoff) HOLE REAMED TO 10" DIAMETER TO 17 FT. WELL CASED TO 49 FT LEVEL & COMPLETED. ANNULAR SPACE AROUND CASING FILLED WITH BENTONITE & GAILUNG MUD FROM 17 FT LEVEL BACK TO 9 FT LEVEL (Continue on reverse side)

USE—If used for irrigation, industrial, drainage or other. Explain, state number of acres and location or other data (i.e.: Lot, Block and Addition).

This form to be prepared by driller, and three copies to be filed by the owner with the County Clerk and Recorder in the county in which the well is located, tissue copy to be retained by driller.

Please answer all questions. If not applicable, so state, otherwise the form will be returned.

46  
Driller's License Number  
Herbert Dreier  
Driller's Signature.

45,287

413760

BOX ELDER SCHOOL DISTRICT # 13

to

THE PUBLIC

NOTICE OF COMPLETION OF  
GROUNDWATER APPROPRIATION

STATE OF MONTANA )  
COUNTY OF HILL ) ss.  
Filed at 1:45 o'clock P. M.

MAY 27 1969  
R. E. BLOM

COUNTY CLERK

DEPUTY  
fee: \$2.00 paid

File No.

T30N 13E

T. 6 R. 2

DUPLICATE

Bas Elnor - J.T.  
County Hill 35

STATE OF MONTANA  
ADMINISTRATOR OF GROUNDWATER CODE  
OFFICE OF STATE ENGINEER

Declaration of Vested Groundwater Rights

(Under Chapter 237, Montana Session Laws, 1961)

STATE ENGINEER

1. George Webster Briggs of Bas Elnor Bas Elnor  
(Name of Appropriator) (Address) (Town)

County of \_\_\_\_\_ State of \_\_\_\_\_  
have appropriated groundwater according to the Montana laws in effect prior to January 1, 1962, as follows:

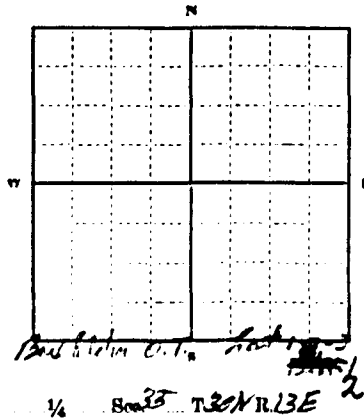

Indicate point of appropriation and place of use, if possible. Each small square represents 10 acres.

- 2. The beneficial use which the claim is based \_\_\_\_\_
- 3. Date or approximate date of earliest beneficial use; and how continuous the use has been \_\_\_\_\_
- 4. The amount of groundwater pumped (in feet inches or gallons per minute) \_\_\_\_\_
- 5. If used for irrigation, give the acreage and description of the lands to which water has been applied and name of the owner thereof \_\_\_\_\_
- 6. The means of withdrawing such water from the ground and the location of each well (with depth) \_\_\_\_\_

7. The date of commencement and completion of the construction of the well, wells, or other works for withdrawal of groundwater \_\_\_\_\_

8. The depth of water table 49 ft.

9. So far as it may be available, the type, size and depth of each well or the general specifications of any other works for the withdrawal of groundwater  
6" casing 49' deep

10. The estimated amount of groundwater withdrawn each year 211 200 gal per year

11. The log of formations encountered in the drilling of each well is available  
4' Top soil  
26 Sand, clay 31 fine sand 33 heavy sandy clay 38 gravelly clay  
40 sandy clay 41 sand & gravel 46 gravel 46 gravel  
49 12'10' completed Well Water level 18' from surface

12. Such other information of a similar nature as may be useful in carrying out the policy of this act, including reference to book and page of any county record. Well described 20' per 122' case to  
inspect with operation

Signature of Owner George Webster Briggs  
Date 12-17-63

Three copies to be filed by the owner with the County Clerk and Recorder of the county in which the well is located.

Please answer all questions. If not applicable, so state, otherwise the form will be returned.

Original to the County Clerk and Recorder; Duplicate to the State Engineer; Triplicate to the Montana Bureau of Mines and Geology, and Quadruplicate for the Appropriator.

31180

397122

GEORGE WEBSTER BRIGGS

TO  
THE PUBLIC

DECLARATION OF VESTED  
GROUNDWATER RIGHTS

STATE OF MONTANA, )  
COUNTY OF HILL ) ss.  
Filed at 11 o'clock AM.

ON DEC 31 1963  
*[Signature]*  
COUNTY CLERK

BY \_\_\_\_\_  
DEPUTY

FEE: \$2.00 pd.

GW 4  
FILE NO. \_\_\_\_\_  
DUPLICATE

STATE OF MONTANA  
ADMINISTRATOR OF GROUNDWATER CODE  
OFFICE OF STATE ENGINEER

30N 13E 33  
TWP \_\_\_\_\_  
COUNTY \_\_\_\_\_  
RECEIVED  
MAY 24 1962

STATE ENGINEER

DECLARATION OF VESTED GROUNDWATER RIGHTS  
(Under Chapter 237, Montana Session Laws, 1961)

1. Vincent P. Dauer, of Box Elder, Montana  
(Name of Appropriator) (Address) (Town)  
County of Hill, State of Montana  
Have appropriated groundwater according to the Montana laws in effect prior to Jan. 1, 1962 as follows:

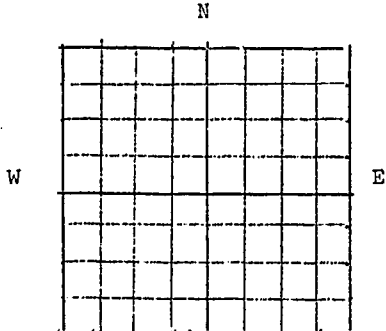

Lot 7 Block #4 Neilson's Addition  
Box Elder townsite  
Sec 35 T30N R13E

Indicate point of appropriation and place of use, if possible. Each small square represents 10 acres.

2. The beneficial use on which the claim is based domestic, drinking, washing, watering lawn
3. Date or approximate date of earliest beneficial use; and how continuous the use has been June 1957
4. The amount of groundwater claimed (in miner's inches or gallons per minute) 10 gal. per min.
5. If used for irrigation, give the acreage and description of the lands to which water has been applied and name of the owner thereof 1 30 x 150 ft. town lot
6. The means of withdrawing such water from the ground and the location of each well or other means of withdrawal electric suction pump
7. The date of commencement and completion of the construction of the well, wells, or other works for withdrawal of groundwater April 26, 1957
8. The depth of water table 13 foot
9. So far as it may be available, the type, size and depth of each well or the general specifications of any other works for the withdrawal of groundwater 45 feet
10. The estimated amount of groundwater withdrawn each year 100,000 gal
11. The log of formations encountered in the drilling of each well if available Sandy clay - yellow gravelly clay - yellow sandy clay - some gravel, sandy clay - yellow gravel - water well completed
12. Such other information of a similar nature as may be useful in carrying out the policy of this act, including reference to book and page of any county record none

Signature of Owner Vincent P. Dauer

Date May 15, 1962

Three copies to be filed by the owner with the County Clerk & Recorder of the County in which the well is located.

PLEASE ANSWER ALL QUESTIONS. IF NOT APPLICABLE, SO STATE, OTHERWISE THE FORM WILL BE RETURNED.

Original to the County Clerk & Recorder; duplicate to the State Engineer; Triplicate to the School of Mines and Quadruplicate for the Appropriator.

Document # 388810

VINCINT P. DAUER

TO

THE PUBLIC

DECLARATION OF GROUND WATER RIGHTS

STATE OF MONTANA, ) ss.  
COUNTY OF HILL )  
Filed at 11.30'clock A.M. A

ON MAY 22 1962

COUNTY CLERK

By \_\_\_\_\_ DEPUTY

Fee. \$2.00 pd

File No. \_\_\_\_\_

T. 30 N R. 38X 13

DUPLICATE

STATE OF MONTANA  
ADMINISTRATOR OF GROUNDWATER CODE  
OFFICE OF STATE ENGINEER

County \_\_\_\_\_  
**RECEIVED**  
JAN 18 1964

**Declaration of Vested Groundwater Rights** STATE ENGINEER

(Under Chapter 237, Montana Session Laws, 1961)

1. Sam F. Davis, of Box Elder  
(Name of Appropriator) (Address) (Town)  
County of Hill State of Montana  
have appropriated groundwater according to the Montana laws in effect prior to January 1, 1962, as follows:

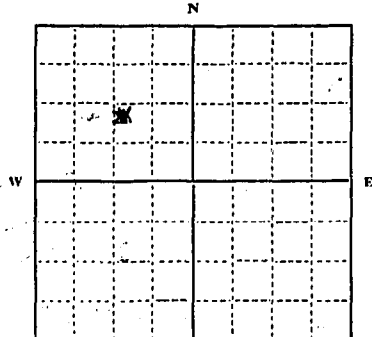

Lot 3, Blk. 2 s Box Elder  
Townsite  
SE 1/4 NW 1 Sec 25 T. 30 R. 13

Indicate point of appropriation  
and place of use, if possible.  
Each small square represents 10  
acres.

2. The beneficial use on which the claim is based Household  
lawn, & irrigation on trees on four lots

3. Date or approximate date of earliest beneficial use; and how con-  
tinuous the use has been 1945 continuous

4. The amount of groundwater claimed (in miner's inches or gallons  
per minute) 10 g.p.m.

5. If used for irrigation, give the acreage and description of the lands  
to which water has been applied and name of the owner thereof

6. The means of withdrawing such water from the ground and the  
location of each well or other means of withdrawal 2 elec. pumps

7. The date of commencement and completion of the construction of the well, wells, or other works for with-  
drawal of groundwater 1945

8. The depth of water table 24 ft.

9. So far as it may be available, the type, size and depth of each well or the general specifications of any other  
works for the withdrawal of groundwater 48 ft. deep 6" steel casing

10. The estimated amount of groundwater withdrawn each year 150,000 gal.

11. The log of formations encountered in the drilling of each well if available not available

12. Such other information of a similar nature as may be useful in carrying out the policy of this act, including  
reference to book and page of any county record.

Signature of Owner Sam F. Davis

Date 12-31-63

Three copies to be filed by the owner with the County Clerk and Recorder of the county in which the well is  
located.

Please answer all questions. If not applicable, so state, otherwise the form will be returned.

Original to the County Clerk and Recorder; duplicate to the State Engineer; Triplicate to the Montana Bureau  
of Mines and Geology, and Quadruplicate for the Appropriator.

31202



397144

SAM F. DAVIS

TO

THE PUBLIC

DECLARATION OF VESTED  
GROUNDWATER RIGHTS

STATE OF MONTANA, )  
COUNTY OF HILL ) ss.  
Filed at 11 o'clock A.M.

ON 6/13/1963  
[Signature]  
COUNTY CLERK

BY \_\_\_\_\_  
SEAL

FEES: \$2.00 pd.

File No. ....

T. 30 N R 13 E

DUPLICATE

County Hill

STATE OF MONTANA  
 ADMINISTRATOR OF GROUNDWATER CODE  
 OFFICE OF STATE ENGINEER

RECEIVED  
 NOV 21 1963  
 STATE ENGINEER

Declaration of Vested Groundwater Rights

(Under Chapter 237, Montana Session Laws, 1961)

I, Moloh Freier, of Box Elder,  
 (Name of Appropriator) (Address) (Town)

County of Hill State of Montana  
 have appropriated groundwater according to the Montana laws in effect prior to January 1, 1962, as follows:

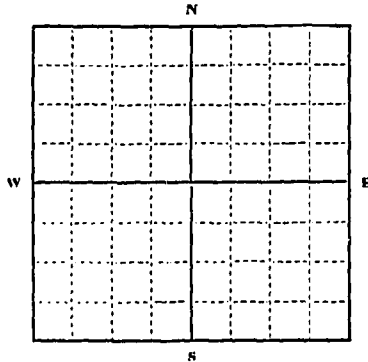

$\frac{1}{4}$  Sec 35 T. 30 R. 13

Indicate point of appropriation and place of use, if possible. Each small square represents 10 acres.

**Lot 30 (less North 30 ft)  
 original townsite of Box Elder.**

2. The beneficial use on which the claim is based.....  
domestic

3. Date or approximate date of earliest beneficial use; and how continuous the use has been July, 1954  
Constant use

4. The amount of groundwater claimed (in miner's inches or gallons per minute)..... 9 (nine) gpm

5. If used for irrigation, give the acreage and description of the lands to which water has been applied and name of the owner thereof  
none

6. The means of withdrawing such water from the ground and the location of each well or other means of withdrawal.....  
electric pump

7. The date of commencement and completion of the construction of the well, wells, or other works for withdrawal of groundwater..... started July, 1954, ended July, 1954

8. The depth of water table..... 45 ft.

9. So far as it may be available, the type, size and depth of each well or the general specifications of any other works for the withdrawal of groundwater..... 40 ft. depth, 6 in. diameter, drilled

10. The estimated amount of groundwater withdrawn each year..... 4,730,400 gals.

11. The log of formations encountered in the drilling of each well if available..... gravel, quicksand, hardshell, clay

12. Such other information of a similar nature as may be useful in carrying out the policy of this act, including reference to book and page of any county record..... none

Signature of Owner Moloh Freier

Date 11-20-63

Three copies to be filed by the owner with the County Clerk and Recorder of the county in which the well is located.

Please answer all questions. If not applicable, so state, otherwise the form will be returned.

Original to the County Clerk and Recorder; duplicate to the State Engineer; Triplicate to the Montana Bureau of Mines and Geology, and Quadruplicate for the Appropriator.

1373

396149

ADOLPH FREIER

TO

THE PUBLIC

DECLARATION OR VESTED GROUND  
WATER RIGHTS

STATE OF MONTANA, )  
COUNTY OF HILL ) ss.  
Filed at 8 o'clock A M.

ON NOV 20 1963

R. E. Blom

COUNTY CLERK

BY \_\_\_\_\_  
DEPUTY

Fee: \$2.00 pd.

35

File No. \_\_\_\_\_

T. 30 N. R. 13 E

DUPLICATE

County **RECEIVED**  
NOV 21 1963

STATE OF MONTANA  
ADMINISTRATOR OF GROUNDWATER CODE  
OFFICE OF STATE ENGINEER

STATE ENGINEER

**Declaration of Vested Groundwater Rights**

(Under Chapter 237, Montana Session Laws, 1961)

1. Adolph Freier, of Box Elder  
(Name of Appropriator) (Address) (Town)

County of Hill State of Montana  
have appropriated groundwater according to the Montana laws in effect prior to January 1, 1962, as follows:

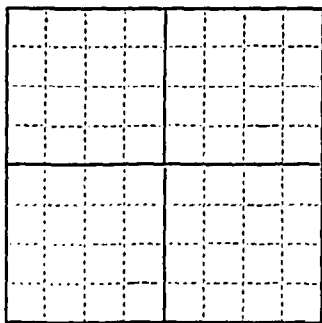

1/4 Sec. 35 T. 30. R. 13

Indicate point of appropriation and place of use, if possible. Each small square represents 10 acres.

**North 30 feet of Lot 30 of original Box Elder townsite.**

2. The beneficial use on which the claim is based.....  
domestic

3. Date or approximate date of earliest beneficial use; and how continuous the use has been.....  
Summer, 1948  
generally continuous

4. The amount of groundwater claimed (in miner's inches or gallons per minute).....  
10 (ten) gpm

5. If used for irrigation, give the acreage and description of the lands to which water has been applied and name of the owner thereof.....  
none

6. The means of withdrawing such water from the ground and the location of each well or other means of withdrawal.....  
electric pump

7. The date of commencement and completion of the construction of the well, wells, or other works for withdrawal of groundwater.....  
started summer of 1948, completed summer, 1948

8. The depth of water table.....  
45 ft.

9. So far as it may be available, the type, size and depth of each well or the general specifications of any other works for the withdrawal of groundwater.....  
50 ft. depth, 6 inch diameter, drilled

10. The estimated amount of groundwater withdrawn each year.....  
3,256,000 gals.

11. The log of formations encountered in the drilling of each well if available.....  
blue clay, brown clay, quicksand, gravel

12. Such other information of a similar nature as may be useful in carrying out the policy of this act, including reference to book and page of any county record.....  
none

Signature of Owner Adolph Freier

Date 11-20-63

Three copies to be filed by the owner with the County Clerk and Recorder of the county in which the well is located.

Please answer all questions. If not applicable, so state, otherwise the form will be returned.

Original to the County Clerk and Recorder; duplicate to the State Engineer; Triplicate to the Montana Bureau of Mines and Geology, and Quadruplicate for the Appropriator.

7374

396150

ADOLPH FREIER

TO

THE PUBLIC

DECLARATION OF VESTED GROUND  
WATER RIGHTS

STATE OF MONTANA )  
COUNTY OF HILL )  
Filed at 8 o'clock A.M.

ON NOV 20 1963

R. E. Blom

COUNTY CLERK

by \_\_\_\_\_

DEPUTY

Fee: \$2.00 pd.

35

Form No. 18  
8-60

T. 20 N R. 13 E

County Hill

MONTANA BUREAU OF MINES AND GEOLOGY  
Butte, Montana

RECEIVED  
1961

STATE ENGINEER

WATER WELL LOG

Owner FD FREIER Address HAURE, MONT.

Driller LLOYD HANBERG Address FAKELER, MONT.

Date Started JUNE 19, 1961 Date Completed JUNE 21, 1961

Location: Sec. 35 T. 30 N R. 13 E 1/4 sec.  
Lot 9 BIK 3 taken out to Paul Olsen townsite

Type of well drilled Equipment used screw & socket  
(auger, driven, solow, or drilled) (churn, drill, rotary, other)

Water use: Domestic  Municipal  Stock  Irrigation   
Industrial  Drainage  Other Post office building  
for telephone

Casing: \_\_\_\_\_ ft. to \_\_\_\_\_ ft. Type \_\_\_\_\_ Size \_\_\_\_\_

Casing: 0 ft. to 55 ft. Type \_\_\_\_\_ Size \_\_\_\_\_

Casing: \_\_\_\_\_ ft. to \_\_\_\_\_ ft. Type Steel Size 6" OD

Perforated or Screened: Ft. \_\_\_\_\_ to ft. \_\_\_\_\_ . Ft. \_\_\_\_\_ to ft. \_\_\_\_\_

Type of screen or perforations \_\_\_\_\_

Static Water level, for non-flowing well: 18 feet.

Shut-in pressure, for flowing well: \_\_\_\_\_ lb./sq. in. on: \_\_\_\_\_  
(Date)

Pumping water level \_\_\_\_\_ feet at 20 gal. per min. \_\_\_\_\_

How tested: meter

Length of test \_\_\_\_\_

Remarks: (Gravel packing, cementing, packers, type of shut-off, depth of shut-off)

\_\_\_\_\_  
\_\_\_\_\_  
\_\_\_\_\_

(over)

Calvin Trevis



Document No. 385094

EDWIN FREIER  
TO  
THE PUBLIC

WATER WELL LOG

STATE OF MONTANA  
COUNTY OF HILL  
Filed at 11:15 o'clock A.M.

ON SEP 6 1961

G. S. Yeom  
COUNTY CLERK

By \_\_\_\_\_ DEPUTY

Fee \$1.00 Pd.

35-43	sandy clay, some pebbles
43-48	sand & gravel, water
48-55	gravel
well completed static water level	
15 ft from surface	
well equipped with pitless adapter	
and submersible pump.	



File No. ....

T. 30N R. 13E 35

DUPLICATE

County HILL  
**RECEIVED**  
JAN 13 1964

STATE OF MONTANA  
ADMINISTRATOR OF GROUNDWATER CODE  
OFFICE OF STATE ENGINEER

**Declaration of Vested Groundwater Rights** STATE ENGINEER  
(Under Chapter 237, Montana Session Laws, 1961)

1. BW Genger, of Box Elder  
(Name of Appropriator) (Address) (Town)  
County of HILL State of Montana  
have appropriated groundwater according to the Montana laws in effect prior to January 1, 1962, as follows:

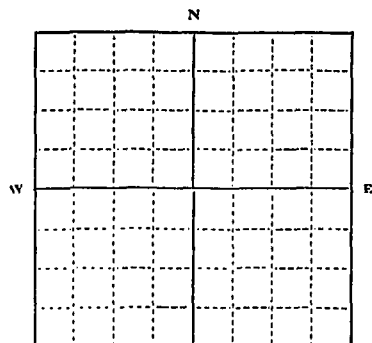

Lots 2-4-6-8  
1/4 Sec. 35 T30 R.13

Indicate point of appropriation and place of use, if possible. Each small square represents 10 acres.

Nielsens Add.  
Block #2

- 2. The beneficial use, on which the claim is based... Household and irrigation
- 3. Date or approximate date of earliest beneficial use; and how continuous the use has been... Apr. 1937 + 25 years to date
- 4. The amount of groundwater claimed (in miner's inches or gallons per minute)... 150 gals per minute
- 5. If used for irrigation, give the acreage and description of the lands to which water has been applied and name of the owner thereof... Lawn and garden
- 6. The means of withdrawing such water from the ground and the location of each well or other means of withdrawal... Pump

- 7. The date of commencement and completion of the construction of the well, wells, or other works for withdrawal of groundwater... about 25 years ago
- 8. The depth of water table... about 30 ft.
- 9. So far as it may be available, the type, size and depth of each well or the general specifications of any other works for the withdrawal of groundwater... Hand drilled 6 inch case 45 ft. deep
- 10. The estimated amount of groundwater withdrawn each year... 1,000,000 gals.
- 11. The log of formations encountered in the drilling of each well if available... \_\_\_\_\_
- 12. Such other information of a similar nature as may be useful in carrying out the policy of this act, including reference to book and page of any county record... \_\_\_\_\_

Signature of Owner BW Genger  
Date 12/30/63

Three copies to be filed by the owner with the County Clerk and Recorder of the county in which the well is located.

Please answer all questions. If not applicable, so state, otherwise the form will be returned.

Original to the County Clerk and Recorder; duplicate to the State Engineer; Triplicate to the Montana Bureau of Mines and Geology, and Quadruplicate for the Appropriator.

397037

B. W. GINGER

TO

THE PUBLIC

DECLARATION OF VESTED  
GROUNDWATER RIGHTS

STATE OF MONTANA, ss.  
COUNTY OF HILL )  
Filed at \_\_\_\_\_ o'clock *p.m.*

ON ~~DEC 30~~ 1963

*L. E. Blom*  
COUNTY CLERK

*By* \_\_\_\_\_ DEPUTY

FEE: \$2.00 pd.

GW2

File No. ....

DUPLICATE

T. 30N R. 13E

Sec. 35  
Lot 12-Block 3  
County Hill

STATE OF MONTANA  
ADMINISTRATOR OF GROUNDWATER CODE  
OFFICE OF STATE ENGINEER

Notice of Completion of Groundwater  
Appropriation by Means of Well

(Under Chapter 237, Montana Session Laws, 1961)

RECEIVED  
STATE ENGINEER

Top of Ground  
(Elev. above sea level. 2740)

0 top soil  
2 yellow clay  
5 clay and gravel mix  
30 sandy yellow clay  
32 runny sand  
38 sandy clay, yellow  
46 sand and gravel, some water  
57 gravel, water  
well completed

Owner Howard C. & Lucille I. Goodian Address Box Elder, Montana

Driller Lloyd G. Hanberg Address Box Elder, Montana

Date of Notice of Appropriation of Groundwater June 28, 1962

Date well started June 28, 1962 Date Completed July 2, 1962

Type of well drilled Equipment Used spudder  
(dug, driven, bored or drilled) (Churn, drill, rotary or other)

Water Use: Domestic  Municipal  Stock  Irrigation   
Industrial  Drainage  Other

Indicate on the diagram the character and thickness of the different strata met with in drilling, such as soil, clay, shale, gravel, rock or sand, etc. Show depth at which water is encountered, thickness and character of water-bearing strata and height to which the water rises in the well.

Size of Drilled Hole	Size and Weight of Casing	From (Feet)	To (Feet)	PERFORATIONS		
				Kind Size	From (Feet)	To (Feet)
6 3/4"	6" O.D. 10.50	0	57	none	none	none

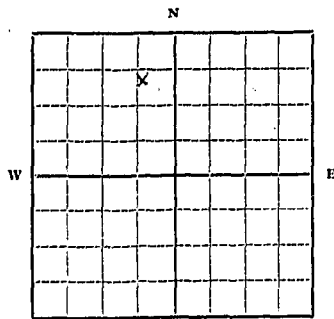

Lot 12-Blk 3  
Sec. 35 T. 30N R. 13E

Indicate location of well and place of use, if possible. Each small square represents 10 acres.

Show exact depth of bottom.

Static Water Level for non-flowing Well 20 feet.

Shut-in Pressure for Flowing Well none

Pumping Water Level 37 feet at 12 gal. per minute.

Discharge in gal. per min. of flowing well none

How Tested bailer Length of Test 2 hrs.

Remarks: (Gravel packing, cementing, packers, type of shutoff, location of place of use of groundwater if not at well, and any other similar pertinent information, including number of acres irrigated, if used for irrigation) none

State License #

Driller's License Number

Lloyd G. Hanberg  
Driller's Signature

This form to be prepared by driller, and three copies to be filed by the owner with the County Clerk and Recorder in the county in which the well is located.

Please answer all questions. If not applicable, so state, otherwise the form will be returned.

Original to the County Clerk and Recorder; duplicate to the State Engineer; Triplicate to the School of Mines and Quadruplicate for the Appropriator.

389718

HOWARD G. GOODIAN and  
LUCILLE I. GOODIAN  
TO

THE PUBLIC

Declaration of Groundwater  
Rights

STATE OF MONTANA, ss.  
COUNTY OF HILL )  
Filed at 3:00 o'clock m.

ON JUL 26 1962  
G. C. Yeon

COUNTY CLERK

By \_\_\_\_\_ DEPUTY

Fee: 2.00 Pd.

File No. ....

T. 30N R. 13E 35

DUPLICATE

County HILL

STATE OF MONTANA  
ADMINISTRATOR OF GROUNDWATER CODE  
OFFICE OF STATE ENGINEER

RECEIVED  
JUL 17 1964  
STATE ENGINEER

25  
TO  
27  
21  
44  
45  
45

Top of Ground  
(Elev. above sea level.....)

**Notice of Completion of Groundwater Appropriation by Means of Well**

(Under Chapter 237, Montana Session Laws, 1961)

WELL WAS ORIGINALLY  
DUG TO DEPTH OF  
25 FT - 4 FT CURBING  
DIAMETER IN 1914

Owner MICHAEL GOODIAN Address BOX ELDER, MONT

Driller AIR-LINE DRILLING SERVICE Address HAURE, MONT

Date of Notice of Appropriation of Groundwater.....

Date well started 6/25/64 Date Completed 6/27/64

Type of well DRILLED Equipment Used CABLE TOOL RIG  
(dug, driven, bored or drilled) (Churn, drill, rotary or other)

Water Use: Domestic  Municipal  Other  Irrigation   
Industrial  Drainage  Stock

BROWN CLAY (SANDY)  
RUNNY SAND

CLAY & GRAVEL COMPOSITE

GRAVEL & SAND

WATER 13 BPM  
BY GALER TEST

Indicate on the diagram the character and thickness of the different strata met with in drilling, such as soil, clay, shale, gravel, rock or sand, etc. Show depth at which water is encountered, thickness and character of water-bearing strata and height to which water rises in the well.

Size of Drilled Hole	Size and Weight of Casing	From (Feet)	To (Feet)	PERFORATIONS		
				Kind Size	From (Feet)	To (Feet)
7"	6 5/8 O.D. GALVANIZED 13" PER FT	6 FT BELOW GROUND LEVEL	45	NO PERFORATIONS WATER FEEDING THRU BOTTOM OF CASING		

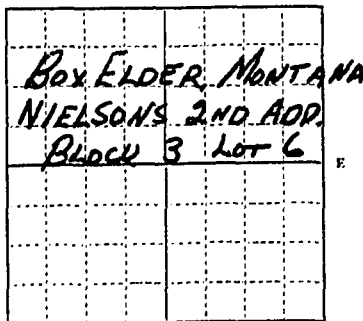

1/4 Sec. 35 T. 30N R. 13E  
Indicate location of well and place of use, if possible. Each small square represents 10 acres.

Show exact depth of bottom.

Static Water Level for non-flowing Well 22 feet.

Shut-in Pressure for Flowing Well NOT APPLICABLE

Pumping Water Level 40 feet at 11 gal. per minute.

Discharge in gal. per min. of flowing well NOT APPLICABLE

How Tested GALER & PUMP Length of Test 3 HOURS

Remarks: (Gravel packing, cementing, packers, type of shutoff, location of place of use of groundwater if not at well, and any other similar pertinent information, including number of acres irrigated, if used for irrigation) WELL CEMENTED AT 24 TO 25 FT LEVEL & DIRT FILLED BACK TO 7 FT BELOW GROUND LEVEL TO PREVENT SURFACE CONTAMINATION

46  
Driller's License Number

Herbert Green  
Driller's Signature

This form to be prepared by driller, and three copies to be filed by the owner with the County Clerk and Recorder in the county in which the well is located.

Please answer all questions. If not applicable, so state, otherwise the form will be returned.

Original to the County Clerk and Recorder; duplicate to the State Engineer; Triplicate to the Montana Bureau of Mines and Geology and Quadruplicate for the Appropriator.

399568

LUCILE GOODIAN  
TO  
THE PUBLIC

NOTICE OF COMPLETION OF GROUNDWATER  
APPROPRIATION BY MEANS OF WELL - #2

STATE OF MONTANA, ss.  
COUNTY OF HILL )  
Filed at 8:00 o'clock A.M.

ON JUL 15 1964

R. E. BLUM  
COUNTY CLERK

BY \_\_\_\_\_  
DEPUTY

\$2.00 fee - pd.

RECEIVED

304-13E  
County.....35  
HILL  
DRILLER'S LOG

STATE OF MONTANA  
ADMINISTRATOR OF GROUNDWATER CODE  
MONTANA WATER RESOURCES BOARD  
NOTICE OF COMPLETION OF GROUNDWATER  
APPROPRIATION BY MEANS OF WELL  
Developed after January 1, 1962

Indicate the character, color, thickness of strata such as soil, clay, sand, gravel, shale, sandstone, etc. Show depth at which water is found and height to which water rises in well.

(Under Chapter 237 Montana Session Laws, 1961, as amended)

This form to be prepared by driller, and three copies to be filed by the owner with the County Clerk and Recorder in the county in which the well is located, last copy to be retained by driller. Please answer all questions. If not applicable, so state, otherwise the form may be returned.

Owner FRANK D. GREEN  
Address 1011 1/2 ST. N.E., BUTTE, MONT.  
Date well started 6/2/1972  
completed 6/10/1972

For Administrator's Use	
File	<u>428523</u>
GW 1	<u>3.4 ft. per</u>

Type of well drilled  
(Dug, driven, bored or drilled)  
Equipment used cable tools  
(Churn drill, rotary or other)  
Water Use: Domestic  Municipal  Stock  Irrigation   
Industrial  Drainage  Other \* Garden/Lawn

\*Describe .....  
USE: If used for irrigation, industrial, drainage or other. Explain, state number of acres and location or other data (i.e. Lot, Block and Addition).  
770.000

ESTIMATED ANNUAL WITHDRAWAL

Size of Drilled Hole	Size and Weight of Casing	From (Feet)	To (Feet)	PERFORATIONS		
				Kind	From (Feet)	To (Feet)
<u>5 1/4</u>	<u>10.50 5</u>	<u>15</u>	<u>40</u>			

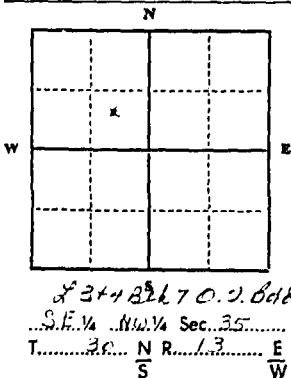

Static water level 1.1 ft.\*  
Pumping water level 1.0 ft.\*  
at 10 gallons per minute,  
measured 10 minutes after pumping began.  
\*Measured from ground level.  
Well developed by .....  
for ..... hours.  
Power..... Pump..... HP  
Remarks: (Gravel packing, cementing, packers, type of shutoff) .....

INDICATE LOCATION OF WELL AND PLACE OF USE, IF POSSIBLE. EACH SMALL SQUARE REPRESENTS 40 ACRES.

Driller's Signature [Signature]  
Driller's Address [Address]  
LICENSE NO. 15

Top of Ground (Elev. above sea level)		
From (Feet)	To (Feet)	
<u>0</u>	<u>1</u>	<u>top soil</u>
<u>1</u>	<u>10</u>	<u>brown clay</u>
<u>10</u>	<u>14</u>	<u>gravel and sandstone</u>
<u>14</u>	<u>16</u>	<u>sand gravel and water</u>
<u>16</u>	<u>18</u>	<u>gravel and water</u>

48 Show exact depth of bottom

RECEIVED

30N-13E  
County 35  
MILL  
DRILLER'S LOG

STATE OF MONTANA  
ADMINISTRATOR OF GROUNDWATER CODE  
MONTANA WATER RESOURCES BOARD  
NOTICE OF COMPLETION OF GROUNDWATER  
APPROPRIATION BY MEANS OF WELL

MONTANA DEPARTMENT OF NATURAL RESOURCES AND CONSERVATION  
Indicate the character, color, thickness of strata such as soil, clay, sand, gravel, shale, sandstone, etc. Show depth at which water is found and height to which water rises in well.

Developed after January 1, 1962

(Under Chapter 237 Montana Session Laws, 1961, as amended)

This form to be prepared by driller, and three copies to be filed by the owner with the County Clerk and Recorder in the county in which the well is located, last copy to be retained by driller.

Please answer all questions. If not applicable, so state, otherwise the form may be returned.

Owner WALTER B GREEN  
Address BOX 1208, MONTANA  
Date well started 6/9/1972  
completed 6/10/1972  
Type of well drilled  
Equipment used cable tools  
Water Use: Domestic  Municipal  Stock  Irrigation   
Industrial  Drainage  Other \* Garden/Lawn

For Administrator's Use	
File	<u>428533</u>
Date	<u>July 12, 1972</u>
GW 1	<u>3:45 p.m.</u>

\*Describe .....  
USE: If used for irrigation, industrial, drainage or other. Explain, state number of acres and location or other data (i.e. Lot, Block and Addition).  
700.000

ESTIMATED ANNUAL WITHDRAWAL

Size of Drilled Hole	Size and Weight of Casing	From (Feet)	To (Feet)	PERFORATIONS		
				Kind	From (Feet)	To (Feet)
<u>5 3/4</u>	<u>2.50 5'</u>	<u>13'</u>	<u>18'</u>			

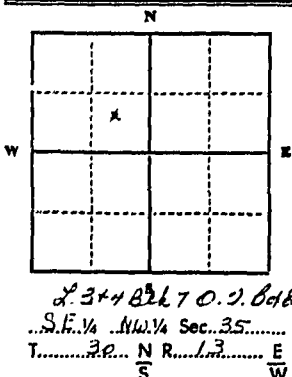

Static water level 15' ft.\*  
Pumping water level 26' ft.\*  
at 10 gallons per minute,  
measured ..... minutes after pumping began.  
\*Measured from ground level.  
Well developed by .....  
for ..... hours.  
Power..... Pump..... HP  
Remarks: (Gravel packing, cementing, packers, type of shutoff) .....

Top of Ground		(Elev. above sea level)
From (Feet)	To (Feet)	
<u>0</u>	<u>1</u>	<u>top soil</u>
<u>1</u>	<u>10</u>	<u>brown clay</u>
<u>10</u>	<u>14</u>	<u>gravel and boulders</u>
<u>14</u>	<u>16</u>	<u>sand gravel and water</u>
<u>16</u>	<u>18</u>	<u>gravel and water</u>

INDICATE LOCATION OF WELL AND PLACE OF USE, IF POSSIBLE. EACH SMALL SQUARE REPRESENTS 40 ACRES.

Driller's Signature [Signature]  
Driller's Address 162 [Address]  
License No 15

48 Show exact depth of bottom



428533

GRADON B. GREEN

TO.

THE PUBLIC

STATE OF MONTANA } SS  
COUNTY OF HILL }  
Filed at 3:45 o'clock P.M

ON JUL 13 1973

R. E. Blom

BY Ward E. Ray COUNTY CLERK  
DEPUTY

Fee:\$2.00 Pd.

INDEXED

GV

35

File No. ....

T 30N R 13E

DUPLICATE

County Hill

STATE OF MONTANA  
ADMINISTRATOR OF GROUNDWATER CODE  
OFFICE OF STATE ENGINEER

Declaration of Vested Groundwater Rights  
(Under Chapter 237, Montana Session Laws, 1961)

STATE ENGINEER

1. Lloyd G. Hanberg of Box Rider  
(Name of Appropriator) (Address) (Town)

County of Hill State of Montana  
have appropriated groundwater according to the Montana laws in effect prior to January 1, 1962, as follows:

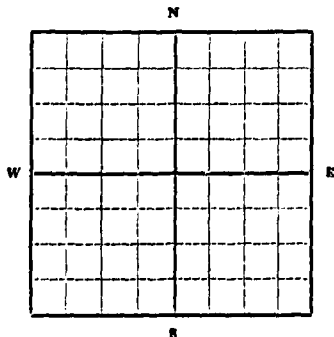

Nielson's Addition to Box Rider  
NW 1/4, Sec 35, T30N, R13E  
Lots 7 & 9  
Indicate point of appropriation  
and place of use, if possible.  
Each small square represents 10  
acres.

2. The beneficial use on which the claim is based  
domestic

3. Date or approximate date of earliest beneficial use; and how continuous the use has been  
constant domestic use since 1948

4. The amount of groundwater claimed (in miner's inches or gallons per minute)  
30 gpm

5. If used for irrigation, give the acreage and description of the lands to which water has been applied and name of the owner thereof  
none

6. The means of withdrawing such water from the ground and the location of each well or other means of withdrawal  
Jet water pump

7. The date of commencement and completion of the construction of the well, wells, or other works for withdrawal of groundwater  
commencement of well Oct. 15, 1948, completed Oct. 18, 1948

8. The depth of water table  
18 ft. from surface

9. So far as it may be available, the type, size and depth of each well or the general specifications of any other works for the withdrawal of groundwater  
5 1/2" diameter, drilled, 55 ft. deep

10. The estimated amount of groundwater withdrawn each year  
5,000,000 gals.

11. The log of formations encountered in the drilling of each well if available  
not available

12. Such other information of a similar nature as may be useful in carrying out the policy of this act, including reference to book and page of any county record  
none

Signature of Owner Lloyd G. Hanberg

Date

Three copies to be filed by the owner with the County Clerk and Recorder of the county in which the well is located.

Please answer all questions. If not applicable, so state, otherwise the form will be returned.

Original to the County Clerk and Recorder; duplicate to the State Engineer; Triplicate to the School of Mines and Quadruplicate for the Appropriator.

1690

DOCUMENT NO. 387825

LLOYD O. HANBERG  
TO  
THE PUBLIC

DECLARATION OF VESTED  
GROUNDWATER RIGHTS

STATE OF MONTANA )  
COUNTY OF HILL )  
Filed at 1:15 o'clock P. m.

27 MAR 13 1962

G. C. YEON  
COUNTY CLERK

By \_\_\_\_\_ DEPUTY  
FEE \$2.00- paid

GWJ  
FILE NO. \_\_\_\_\_  
DUPLICATE

TWP 30 RGE 13  
COUNTY Hill

STATE OF MONTANA  
ADMINISTRATOR OF GROUNDWATER CODE  
OFFICE OF STATE ENGINEER

STATE ENGINEER

DECLARATION OF VESTED GROUNDWATER RIGHTS  
(Under Chapter 237, Montana Session Laws, 1961)

1. A. W. Hobbs, of Box #168  
(Name of Appropriator) (Address) (Town)  
County of Hill, State of Montana  
Have appropriated groundwater according to the Montana laws in effect prior to Jan.  
1, 1962 as follows:

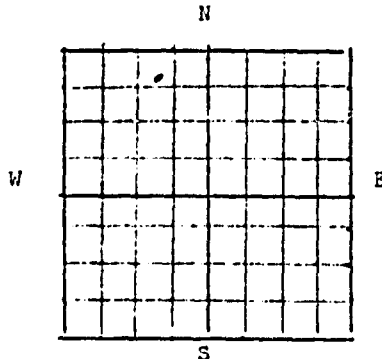

Bank  
N 2 NW 1 Sec 35 T 30 R 13

Indicate point of appropriation and place of use, if possible. Each small square represents 10 acres.

2. The beneficial use on which the claim is based domestic
3. Date or approximate date of earliest beneficial use; and how continuous the use has been summer, 1885
4. The amount of groundwater claimed (in miner's inches or gallons per minute) 30 gpm
5. If used for irrigation, give the acreage and description of the lands to which water has been applied and name of the owner thereof none
6. The means of withdrawing such water from the ground and the location of each well or other means of withdrawal pump (electric)
7. The date of commencement and completion of the construction of the well, wells, or other works for withdrawal of groundwater sp box, summer 1885
8. The depth of water table 30 ft.
9. So far as it may be available, the type, size and depth of each well or the general specifications of any other works for the withdrawal of groundwater dug well, 30 ft. deep, 4 ft. diameter
10. The estimated amount of groundwater withdrawn each year 8,000,000 gals.
11. The log of formations encountered in the drilling of each well if available not available
12. Such other information of a similar nature as may be useful in carrying out the policy of this act, including reference to book and page of any county record not available

Signature of Owner A W Hobbs

Date 3-21-62

Three copies to be filed by the owner with the County Clerk & Recorder of the County in which the well is located.

PLEASE ANSWER ALL QUESTIONS. IF NOT APPLICABLE, SO STATE, OTHERWISE THE FORM WILL BE RETURNED.

Original to the County Clerk & Recorder; duplicate to the State Engineer; Triplicate to the School of Mines and Quadruplicate for the Appropriator.

DOCUMENT NO. 387944

A.W. HOBBS

TO  
THE PUBLIC

DECLARATION OF VESTED  
GROUNDWATER RIGHTS

STATE OF MONTANA, ) ss.  
COUNTY OF HILL )  
*Filed at 2:00'clock P.M.*

ON MAR 21 1962

G.C. YEON  
COUNTY CLERK

By \_\_\_\_\_ DEPUTY

FEE \$2.00- paid

GW-4  
FILE NO. \_\_\_\_\_  
DUPLICATE

TWP 30 N RGE 13N E  
COUNTY HILL

STATE OF MONTANA  
ADMINISTRATOR OF GROUNDWATER CODE  
OFFICE OF STATE ENGINEER

RECEIVED  
DEC 4 1963

DECLARATION OF VESTED GROUNDWATER RIGHTS  
(Under Chapter 237, Montana Session Laws, 1961)

STATE ENGINEER

1. PERCY HOBBS, of BOX ELDER  
(Name of Appropriator) (Address) (Town)  
County of HILL, State of MONTANA  
Have appropriated groundwater according to the Montana laws in effect prior to Jan. 1, 1962 as follows:

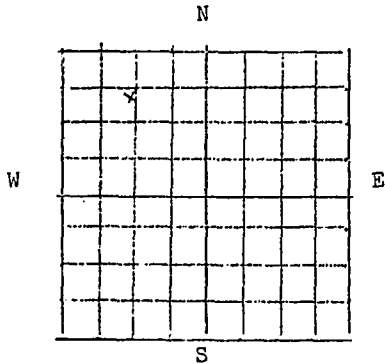

1/4 Sec 35 T30 R13N

Indicate point of appropriation and place of use, if possible. Each small square represents 10 acres.

2. The beneficial use on which the claim is based  
DOMESTIC
3. Date or approximate date of earliest beneficial use; and how continuous the use has been  
OCT. 23, 1946 CONTINUOUS
4. The amount of groundwater claimed (in miner's inches or gallons per minute) (A) 2 gal p.m.  
(B) 15 GALLONS PER MINUTE
5. If used for irrigation, give the acreage and description of the lands to which water has been applied and name of the owner thereof  
NONE
6. The means of withdrawing such water from the ground and the location of each well or other means of withdrawal ELECTRIC PUMPS
7. The date of commencement and completion of the construction of the well, wells, or other works for withdrawal of groundwater. STARTED OCT. 10, 1946  
FINISHED OCT. 23, 1946
8. The depth of water table approx 10 ft.
9. So far as it may be available, the type, size and depth of each well or the general specifications of any other works for the withdrawal of groundwater  
A-- HAND DUG 6 inch Galv. casing. (B) DRILLED, 5 inch, 42 ft.
10. The estimated amount of groundwater withdrawn each year 3,000,000
11. The log of formations encountered in the drilling of each well if available (A)  
DIRT, SAND, LIGHT GRAVEL, WATER IN GRAVEL (B) CLAY, SAND,  
AND GRAVEL, WATER FOUND IN GRAVEL
12. Such other information of a similar nature as may be useful in carrying out the policy of this act, including reference to book and page of any county record  
NONE

Signature of Owner Percy Hobbs

Date Nov 30 1963

Three copies to be filed by the owner with the County Clerk & Recorder of the County in which the well is located.

PLEASE ANSWER ALL QUESTIONS. IF NOT APPLICABLE, SO STATE, OTHERWISE THE FORM WILL BE RETURNED.

Original to the County Clerk & Recorder; duplicate to the State Engineer; Triplicate to the School of Mines and Quadruplicate for the Appropriator.

396290

PERCY HOBBS

TO

THE PUBLIC

DECLARATION OF VESTED GROUND  
WATER RIGHTS

STATE OF MONTANA, ) ss.  
COUNTY OF HILL )

*Filed at 12:30 o'clock P.M.*

ON 2 1963

R. E. Blom

COUNTY CLERK

DEPUTY

Fee: \$2.00 pd.

File No. ....

T. 30 N R. 13 E 35

DUPLICATE

County Hill

LOG

STATE OF MONTANA  
ADMINISTRATOR OF GROUNDWATER CODE  
OFFICE OF STATE ENGINEER

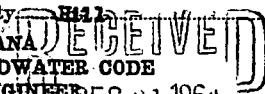

Notice of Completion of Groundwater  
Appropriation by Means of Well

DEVELOPED AFTER JANUARY 1, 1962

(Under Chapter 237, Montana Session Laws, 1961)

Top of Ground  
(Elev. above sea level.....)

0 to  
3 Top & subsoil  
9 Sandy brown clay & sand layers  
18 Soft sandy brown clay  
21 Brown sand-water—Approx 3 GPM  
32 Gray clay  
35 Brown silt & sand—trace of coal & show of water  
35 1/2 Pea gravel—Water—Approx. 5 GPM  
39 1/2 Silt & fine sand—very little gravel  
40 Coarse sand & pea gravel  
41 Gravel—Water—Exceeding 30 GPM by baler test.

Owner Percy E. & Alice W. Hobbs Address Box Elder, Montana

Driller H4-Line Drilling Service Address Harre, Montana

Date of Notice of appropriation of groundwater.....

Date well started Sept. 28, 1964 Date completed Sept. 29, 1964

Type of well Drilled Equipment used Cable tool rig  
(Dug, Driven, bored or drilled) (Churn drill, rotary or other)

Water use: Domestic  Municipal  Stock  Irrigation   
Industrial  Drainage  Other

Indicate on the diagram the character and thickness of the different strata met with in drilling, such as soil, clay, shale, gravel, rock or sand, etc. Show depth at which water is encountered, thickness and character of water-bearing strata and height to which the water rises in the well.

Size of Drilled Hole	Size and Weight of Casing	From (Feet)	To (Feet)	PERFORATIONS		
				Kind Size	From (Feet)	To (Feet)
6 5/8"	6 1/8" ID 13 1/2 per' Galvanized	0	41	No perforations. Casing bottomed in coarse gravel. Water coming thru bottom of drive shoe.		

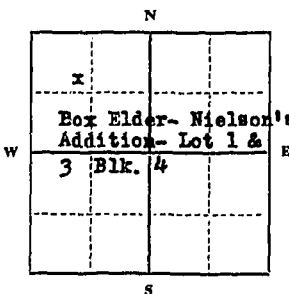

Static Water Level for non-flowing well ..... 18 feet.

Shut-in Pressure for Flowing Well Not appl.

Pumping Water Level..... 26 feet  
at..... 10 gal. per minute.

Discharge in gal. per min. of flowing well  
Not applicable

How Tested..... Baler & pump

Length of Test..... 6 hours

Remarks: (Gravel packing, cementing, packers, type of shutoff)..... Cement grout placed around casing to prevent contamination.

Indicate location of well and place of use, if possible. Each small square represents 40 acres.

(Continue on reverse side)

USE—If used for irrigation, industrial, drainage or other. Explain, state number of acres and location or other data (i.e.: Lot, Block and Addition).

41 Show exact depth of bottom.

This form to be prepared by driller, and three copies to be filed by the owner with the County Clerk and Recorder in the county in which the well is located, tissue copy to be retained by driller.

Please answer all questions. If not applicable, so state, otherwise the form will be returned.

46 Driller's License Number

Driller's Signature

38785



Doc. N o. 401778

PERCY P. & ALICE W. HOBBS  
(husband & wife)

TO

THE PUBLIC

NOTICE OF COMPLETION OF  
GROUNDWATER APPRO. BY MEANS  
OF WELL

STATE OF MONTANA )  
COUNTY OF HILL ) ss.  
Filed at 1:00 o'clock P.m.

ON ~~DEC 18~~ 1964

I. E. Blain  
COUNTY CLERK

By \_\_\_\_\_  
DEPUTY

*for \$2.00 pd*

GW 4  
FILE NO. \_\_\_\_\_  
DUPLICATE

TWP 30 N. RGE 13 E.  
COUNTY Hill

35

STATE OF MONTANA  
ADMINISTRATOR OF GROUNDWATER CODE  
OFFICE OF STATE ENGINEER

RECEIVED

DECLARATION OF VESTED GROUNDWATER RIGHTS  
(Under Chapter 237, Montana Session Laws, 1961) STATE ENGINEER

1. Leonard Johnson, of Box 51der (Address) (Town)  
(Name of Appropriator)  
County of Hill, State of Montana  
Have appropriated groundwater according to the Montana laws in effect prior to Jan. 1, 1962 as follows:

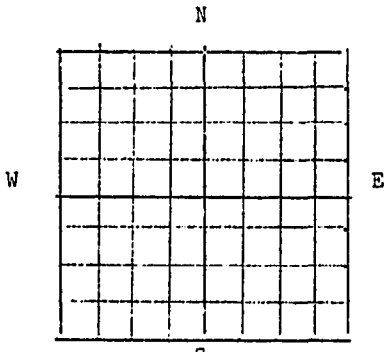

- 2. The beneficial use on which the claim is based domestic
- 3. Date or approximate date of earliest beneficial use; and how continuous the use has been  
Bar & Cafe, since summer of 1946  
House, since summer of 1949
- 4. The amount of groundwater claimed (in miner's inches or gallons per minute) 20 gpm each well
- 5. If used for irrigation, give the acreage and description of the lands to which water has been applied and name of the owner thereof none

House: Lot 2 Bar & Cafe: Lots 3 & 5  
1/4 Sec 35 T 30N R 13E  
Nielson addition to Box 51der Townsite

Indicate point of appropriation and place of use, if possible. Each small square represents 10 acres.

- 6. The means of withdrawing such water from the ground and the location of each well or other means of withdrawal pumps
- 7. The date of commencement and completion of the construction of the well, wells, or other works for withdrawal of groundwater approximate dates:  
Bar & Cafe--June, 1946, House--August, 1949
- 8. The depth of water table 55 ft.
- 9. So far as it may be available, the type, size and depth of each well or the general specifications of any other works for the withdrawal of groundwater both wells drilled, 6" diameter
- 10. The estimated amount of groundwater withdrawn each year 8,000,000 gals
- 11. The log of formations encountered in the drilling of each well if available not available
- 12. Such other information of a similar nature as may be useful in carrying out the policy of this act, including reference to book and page of any county record none

Signature of Owner L.H. Johnson  
Date 3-19-62

Three copies to be filed by the owner with the County Clerk & Recorder of the County in which the well is located.

PLEASE ANSWER ALL QUESTIONS. IF NOT APPLICABLE, SO STATE, OTHERWISE THE FORM WILL BE RETURNED.

Original to the County Clerk & Recorder; duplicate to the State Engineer; Triplicate to the School of Mines and Quadruplicate for the Appropriator.

DOCUMENT NO. 387896

LEONARD JOHNSON  
TO  
THE PUBLIC

DECLARATION OF VESTED  
GROUNDWATER RIGHTS

STATE OF MONTANA, )  
COUNTY OF HILL ) ss.  
*Filed at 3:45 o'clock P.m.*

ON MAR 19 1962

G.C. YEON  
COUNTY CLERK

By \_\_\_\_\_  
DEPUTY.

Fee \$2.00- paid

File No. \_\_\_\_\_

T. 30N R. 13E 35

DUPLICATE

County HILL

LOG

STATE OF MONTANA  
ADMINISTRATOR OF GROUNDWATER CODE  
OFFICE OF STATE ENGINEER

FEB 5 1967

**Notice of Completion of Groundwater  
Appropriation by Means of Well**  
DEVELOPED AFTER JANUARY 1, 1962

(Under Chapter 237, Montana Session Laws, 1961)

Top of Ground  
(Elev. above sea level \_\_\_\_\_)

0 TO 3 TOP + SUBSOIL

9 SANDY BROWN CLAY

18 BROWN CLAY - PEBBLES

19 BROWN SAND - WATER -  
APPROX 2 BPM

26 BROWN CLAY

30 GREY CLAY

32 SOFT GREY CLAY

34 GREY SILT + SAND -  
WATER - APPROX. 6 GPM

34 1/2 COARSE SAND + LARGE  
GRAVEL - WATER  
INCREASING TO 9 1/2 BPM

35 GRAVEL (PEA SIZE) AND  
SOME SAND  
WATER - APPROX  
13 BPM BY  
BAILER TEST  
BAILING FROM  
BOTTOM

35 Show exact depth of bottom.

Owner MRS. HELEN KALLENBERGER address BOX ELDER, MONTANA

Driller AT-LINE DRILLING SERVICE Address HAVRE, MONTANA

Date of Notice of appropriation of groundwater \_\_\_\_\_

Date well started MAY 24, 1967 Date completed MAY 25, 1967

Type of well DRILLED Equipment used CABLE TOOL RIG  
(Dug, driven, bored or drilled) (Churn drill, rotary or other)

Water use: Domestic  Municipal  Stock  Irrigation   
Industrial  Drainage  Other

Indicate on the diagram the character and thickness of the different strata met with in drilling, such as soil, clay, shale, gravel, rock or sand, etc. Show depth at which water is encountered, thickness and character of water-bearing strata and height to which the water rises in the well.

Size of Drilled Hole	Size and Weight of Casing	From (Feet)	To (Feet)	PERFORATIONS		
				Kind	From (Feet)	To (Feet)
6 5/8"	6 7/8" O.D. 13" PER FT. GALVANIZED TTC	1 FOOT ABOVE GROUND LEVEL	35	NO PERFORATIONS. WATER COMING IN THRU BOTTOM OF DRIVE COLLAR AT 35 FT LEVEL		

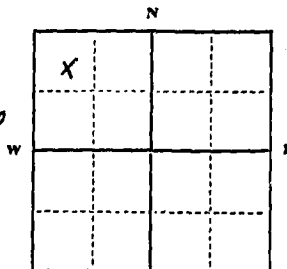

Static Water Level for non-flowing well 17 feet.

Shut-in Pressure for Flowing Well Not App.

Pumping Water Level 31 feet  
at 11 gal. per minute.

Discharge in gal. per min. of flowing well Not Applicable

How Tested TEST PUMP

Length of Test 8 HOURS

Remarks: (Gravel packing, cementing, packers, type of shutoff) CEMENTED  
FROM 16 FT BACK TO  
7 FT LEVEL TO SEAL  
OFF SURFACE CONTAMINATION

USE—If used for irrigation, industrial, drainage or other. Explain, state number of acres and location or other data (i.e.: Lot, Block and Addition).

This form to be prepared by driller, and three copies to be filed by the owner with the County Clerk and Recorder in the county in which the well is located, tissue copy to be retained by driller.

Please answer all questions. If not applicable, so state, otherwise the form will be returned.

46  
Driller's License Number

Robert J. [Signature]  
Driller's Signature.

44,974

412869

MRS. HELEN KALLENBERGER

TO

THE PUBLIC

NOTICE OF COMPLETION OF  
GROUNDWATER APPROPRIATION

STATE OF MONTANA, ) ss.  
COUNTY OF HILL )  
Filed at 11:25 o'clock A.M.

FEB 4 1969

R. E. BLOM

COUNTY CLERK

DEPUTY

fee: \$2.00 paid

GW

Approved Stock Form—State Publishing Co., Helena, Montana—41338

File No. ....

T 30 N R 13

DUPLICATE

County Hill

STATE OF MONTANA  
ADMINISTRATOR OF GROUNDWATER CODE  
OFFICE OF STATE ENGINEER

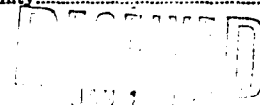

Declaration of Vested Groundwater Rights

(Under Chapter 237, Montana Session Laws, 1961)

I, Mrs. Lauren Keene, of Box Elder  
(Name of Appropriator) (Address) (Town)  
County of Hill State of Montana  
have appropriated groundwater according to the Montana laws in effect prior to January 1, 1962, as follows:

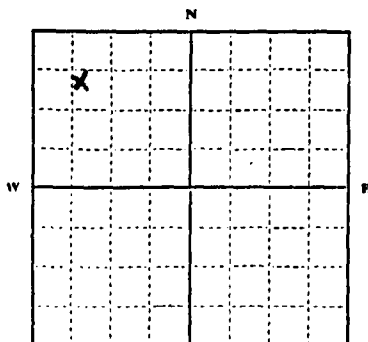

*Lot 19, Blk 5 Malonia 1st  
Addr to Box Elder*

Sec. 35 T30 R13  
Indicate point of appropriation  
and place of use, if possible.  
Each small square represents 10  
acres.

- The beneficial use on which the claim is based... domestic
- Date or approximate date of earliest beneficial use; and how continuous the use has been... summer 1951
- The amount of groundwater claimed (in miner's inches or gallons per minute)... 7 gpm
- If used for irrigation, give the acreage and description of the lands to which water has been applied and name of the owner thereof... none
- The means of withdrawing such water from the ground and the location of each well or other means of withdrawal... electric pump
- The date of commencement and completion of the construction of the well, wells, or other works for withdrawal of groundwater... summer 1951
- The depth of water table... 17 ft. from surface
- So far as it may be available, the type, size and depth of each well or the general specifications of any other works for the withdrawal of groundwater... drilled, 6" diameter, 47 ft. depth
- The estimated amount of groundwater withdrawn each year... 3,685,200
- The log of formations encountered in the drilling of each well if available... clay, quicksand, gravel
- Such other information of a similar nature as may be useful in carrying out the policy of this act, including reference to book and page of any county record... none

Signature of Owner Mrs. Lauren Keene  
Date Dec 31 - 63

Three copies to be filed by the owner with the County Clerk and Recorder of the county in which the well is located.  
Please answer all questions. If not applicable, so state, otherwise the form will be returned.

Original to the County Clerk and Recorder; duplicate to the State Engineer; Triplicate to the Montana Bureau of Mines and Geology, and Quadruplicate for the Appropriator.

397139

MRS. LAUREN KEENE

TO

THE PUBLIC

DECLARATION OF VESTED  
GROUNDWATER RIGHTS

STATE OF MONTANA )  
COUNTY OF HILL )  
Filed at \_\_\_\_\_ o'clock \_\_\_\_\_ m.

1963  
*I. E. Blain*  
COUNTY CLERK

922117

FEES: \$2.00 pd.

File No. \_\_\_\_\_

T. 30 N. R. 13 E

DUPLICATE

County Hill

STATE OF MONTANA  
ADMINISTRATOR OF GROUNDWATER CODE  
OFFICE OF STATE ENGINEER

Declaration of Vested Groundwater Rights

(Under Chapter 237, Montana Session Laws, 1961)

1. Mrs. Lauren Keene of Box Elder  
(Name of Appropriator) (Address) (Town)  
County of Hill State of Montana  
have appropriated groundwater according to the Montana law in effect prior to January 1, 1962, as follows:

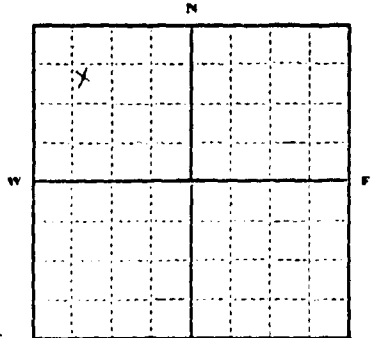

*Lot 19, Blk 5, Hillside 1st  
Addn to Box Elder*

Mont. Sec. 35 T. 30 R. 13

Indicate point of appropriation and place of use, if possible. Each small square represents 10 acres.

- 2. The beneficial use on which the claim is based.....  
domestic
- 3. Date or approximate date of earliest beneficial use; and how continuous the use has been.....  
Fall 1936
- 4. The amount of groundwater claimed (in miner's inches or gallons per minute).....  
7 GPM
- 5. If used for irrigation, give the acreage and description of the lands to which water has been applied and name of the owner thereof.....  
none
- 6. The means of withdrawing such water from the ground and the location of each well or other means of withdrawal.....  
electric pump
- 7. The date of commencement and completion of the construction of the well, wells, or other works for withdrawal of groundwater.....  
Fall 1936
- 8. The depth of water table.....  
17 ft. from surface
- 9. So far as it may be available, the type, size and depth of each well or the general specifications of any other works for the withdrawal of groundwater.....  
hand drilled, 3 1/2" diameter, 33 ft. depth
- 10. The estimated amount of groundwater withdrawn each year.....  
3,685,200 gals.
- 11. The log of formations encountered in the drilling of each well if available.....  
quicksand, clay, gravel
- 12. Such other information of a similar nature as may be useful in carrying out the policy of this act, including reference to book and page of any county record.....  
None

Signature of Owner Mrs. Lauren Keene  
Date Aug 31 - 63

Three copies to be filed by the owner with the County Clerk and Recorder of the county in which the well is located.

Please answer all questions. If not applicable, so state, otherwise the form will be returned.

Original to the County Clerk and Recorder; duplicate to the State Engineer; Triplicate to the Montana Bureau of Mines and Geology, and Quadruplicate for the Appropriator.

31198



397140

MRS. LAUREN KEENE

TO

THE PUBLIC

DECLARATION OF VESTED  
GROUNDWATER RIGHTS  
STATE OF MONTANA, ss.  
COUNTY OF HILL )  
Filed at 11 o'clock A.M.

ON DEC 31 1963

*[Signature]*  
COUNTY CLERK  
DEPUTY

FEE: \$2.00 pd.

GW

File No. ....

T. 30 R. 13

DUPLICATE

County Hill

STATE OF MONTANA  
ADMINISTRATOR OF GROUNDWATER CODE  
OFFICE OF STATE ENGINEER

RECEIVED  
DEC 27 1963

Declaration of Vested Groundwater Rights STATE ENGINEER

(Under Chapter 237, Montana Session Laws, 1961)

1. Anton Niederegger, of Box Elder, (Name of Appropriator) (Address) (Town)  
County of Hill State of Montana  
have appropriated groundwater according to the Montana laws in effect prior to January 1, 1962, as follows:

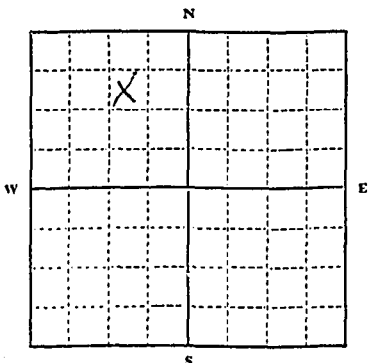

Town of Box Elder  
NW 1/4 Sec. 35 T. 30 R. 13

Indicate point of appropriation and place of use, if possible. Each small square represents 10 acres.

2. The beneficial use on which the claim is based..... domestic

3. Date or approximate date of earliest beneficial use; and how continuous the use has been..... 1935 and 1940

4. The amount of groundwater claimed (in miner's inches or gallons per minute)..... 7 gpm each

5. If used for irrigation, give the acreage and description of the lands to which water has been applied and name of the owner thereof..... none

6. The means of withdrawing such water from the ground and the location of each well or other means of withdrawal..... electric pump

7. The date of commencement and completion of the construction of the well, wells, or other works for withdrawal of groundwater..... 1935 and 1940

8. The depth of water table..... 45 ft.

9. So far as it may be available, the type, size and depth of each well or the general specifications of any other works for the withdrawal of groundwater..... drilled, 6" OD, 45 ft.

10. The estimated amount of groundwater withdrawn each year..... 5,500,000 each well

11. The log of formations encountered in the drilling of each well if available..... not available

12. Such other information of a similar nature as may be useful in carrying out the policy of this act, including reference to book and page of any county record..... none

Signature of Owner Anton Niederegger

Date Dec 20 1963

Three copies to be filed by the owner with the County Clerk and Recorder of the county in which the well is located.

Please answer all questions. If not applicable, so state, otherwise the form will be returned.

Original to the County Clerk and Recorder; duplicate to the State Engineer; Triplicate to the Montana Bureau of Mines and Geology, and Quadruplicate for the Appropriator.

396687

ANTON MINDENBERGER

TO

THE PUBLIC

DECLARATION OF VESTED GROUND  
WATER RIGHTS

STATE OF MONTANA ) ss.  
COUNTY OF HILL )

Filed at 11 o'clock Am.

ON DEC 20 1963

R. E. Blom

COUNTY CLERK

BY

REPUTY

Fee: \$2.00 pd.

T. 30 N R. 13 E  
County Hill

RECEIVED  
SEP 19 1958  
STATE ENGINEER

MONTANA BUREAU OF MINES AND GEOLOGY  
Butte, Montana

WATER WELL LOG

Owner J. E. Prather Address Box Elder, Mont.  
Driller Lloyd O. Hanberg Address Box Elder, Mont.  
Date Started Aug. 27, 1958 Date Completed Aug. 30, 1958  
Location: Sec. 35 T. 30 R. 13 1/4 sec.

Type of well drilled Equipment used spudder  
(Dug, driven, bored, or drilled) (Churn drill, rotary, other)

Water use: Domestic  Municipal  Stock  Irrigation   
Industrial  Drainage  Other:

Casing: 0 ft. to 51 ft. Type casing Size 4" O.D.

Casing: ft. to ft. Type Size

Casing: ft. to ft. Type Size

Perforated or Screened: Ft. none to ft. none Ft. none to ft. none

Type of screen or perforations none

Static Water level, for non-flowing well: 17' from surface feet.

Shut-in pressure, for flowing well: lb./sq. in. on: (date)

Pumping water level: feet at gal. per min.

How tested: bailer

Length of test: approx. 6 hrs.

Remarks: (Gravel packing, cementing, packers, type of shut-off, depth of shut-off)

.....  
.....  
.....  
.....  
.....





GW-4  
FILE NO. \_\_\_\_\_

TWP 30 RGE 13 E  
COUNTY Hill

35

DUPLICATE

STATE OF MONTANA  
ADMINISTRATOR OF GROUNDWATER CODE  
OFFICE OF STATE ENGINEER

RECEIVED

DECLARATION OF VESTED GROUNDWATER RIGHTS  
(Under Chapter 237, Montana Session Laws, 1961)

STATE ENGINEER

1. School District #13, of Box Elder  
(Name of Appropriator) (Address) (Town)  
County of Hill, State of Montana  
Have appropriated groundwater according to the Montana laws in effect prior to Jan. 1, 1962 as follows:

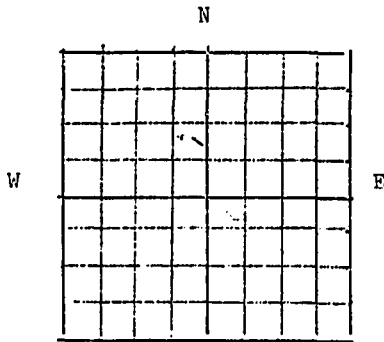

SE 1/4 of 1/4 NW Sec 35 T 30 R 13 E

Indicate point of appropriation and place of use, if possible. Each small square represents 10 acres.

2. The beneficial use on which the claim is based  
Water for school and four teacherages.
3. Date or approximate date of earliest beneficial use; and how continuous the use has been  
Well #1 33 years  
Well #2 10 years
4. The amount of groundwater claimed (in miner's inches or gallons per minute)  
= 100 gallons per minute per well.
5. If used for irrigation, give the acreage and description of the lands to which water has been applied and name of the owner thereof  
Irrigation of lawns one acre
6. The means of withdrawing such water from the ground and the location of each well or other means of withdrawal  
Wells are pumped  
Well #1 Block 4 Old townsite  
Well #2 Block 3 Old townsite
7. The date of commencement and completion of the construction of the well, wells, or other works for withdrawal of groundwater  
Well #1 1929  
Well #2 1952
8. The depth of water table 18
9. So far as it may be available, the type, size and depth of each well or the general specifications of any other works for the withdrawal of groundwater  
Wells are fifty-six feet deep and have 40 feet of water; six inch steel casing.
10. The estimated amount of groundwater withdrawn each year 120,000,000 gallons per year.
11. The log of formations encountered in the drilling of each well if available  
Clay, sand, and gravel.
12. Such other information of a similar nature as may be useful in carrying out the policy of this act, including reference to book and page of any county record  
Original well in school basement; moved outside building in 1956.  
Auxiliary well dug 1950.

Signature of Owner School District #13  
G. H. Hanson  
Date 11-6-62

Three copies to be filed by the owner with the County Clerk & Recorder of the County in which the well is located.

PLEASE ANSWER ALL QUESTIONS. IF NOT APPLICABLE, SO STATE, OTHERWISE THE FORM WILL BE RETURNED.

Original to the County Clerk & Recorder; duplicate to the State Engineer; Triplicate to the School of Mines and Quadruplicate for the Appropriator.

391054

SCHOOL DISTRICT #13

to

THE PUBLIC

DECLARATION OF VESTED  
GROUNDWATER RIGHTS

STATE OF MONTANA )  
COUNTY OF HILL )

Filed at \_\_\_\_\_ o'clock \_\_\_\_\_ m.

ON \_\_\_\_\_ 1962

G. C. Yeon

COUNTY CLERK

By \_\_\_\_\_ DEPUTY

Fee: None



STATE OF MONTANA  
ADMINISTRATOR OF GROUNDWATER CODE  
MONTANA WATER RESOURCES BOARD  
**NOTICE OF COMPLETION OF GROUNDWATER  
APPROPRIATION BY MEANS OF WELL**

Developed after January 1, 1962

(Under Chapter 237 Montana Session Laws, 1961, as amended)

This form to be prepared by driller, and three copies to be filed by the owner with the County Clerk and Recorder in the county in which the well is located, last copy to be retained by driller.

Please answer all questions. If not applicable, so state, otherwise the form may be returned.

Owner FRANK & KATHARINE SEABERG

Address Box ELDER,

MONTANA 59581

Date well started APRIL 28, 1972

completed APRIL 29, 1972

For Administrator's Use	
File	<u>436946</u>
Date	<u>January 19, 1973</u>
GW 1	<u>1:30 p.m.</u>

Type of well DRILLED (Dug, driven, bored or drilled)

Equipment used CABLE TOOL RIG (Churn drill, rotary or other)

Water Use: Domestic  Municipal  Stock  Irrigation

Industrial  Drainage  Other \* Garden/Lawn

\*Describe

USE: If used for irrigation, industrial, drainage or other. Explain, state number of acres and location or other data (i.e. Lot, Block and Addition).

ESTIMATED ANNUAL WITHDRAWAL EXCEEDING 500,000 GALLONS

Size of Drilled Hole	Size and Weight of Casing	From (Feet)	To (Feet)	PERFORATIONS		
				Kind	From (Feet)	To (Feet)
<u>12"</u>		<u>5</u>	<u>20</u>			
<u>6 5/8"</u>	<u>6 5/8" O.D. (188 W&amp;W) 13' PER FOOT GALVANIZED STEEL</u>	<u>4 FEET BELOW GROUND LEVEL</u>	<u>48 1/2</u>	<u>(NO PERFORATIONS)</u>		
				<u>WATER COMING IN THRU BOTTOM OF DRIVE COLLAR AT 48 1/2 FOOT LEVEL</u>		

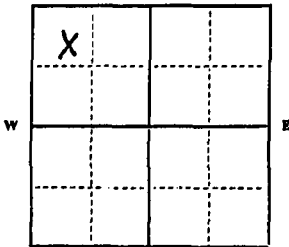

N 1/4 N 1/4 Sec 35  
T. 30 S. R. 13 W.

INDICATE LOCATION OF WELL AND PLACE OF USE, IF POSSIBLE. EACH SMALL SQUARE REPRESENTS 40 ACRES.

Driller's Signature Robert Arwin Hill HILL DRILLING SERVICE

Driller's Address 1173 6th St. No. PHONE 265-4200

HAURE, MONTANA 59501 LICENSE NO. 46

DRILLER'S LOG

Indicate the character, color, thickness of strata such as soil, clay, sand, gravel, shale, sandstone, etc. Show depth at which water is found and height to which water rises in well.

Top of Ground (Elev. above sea level)	
From (Feet)	To (Feet)
<u>0</u>	<u>5</u>
	<u>WELL PIT</u>
<u>6</u>	<u>SANDY CLAY</u>
<u>8</u>	<u>BROWN SAND</u>
<u>30</u>	<u>SANDY BROWN CLAY</u>
<u>32</u>	<u>BROWN SAND - TRACE OF GRAVEL - WATER - APPROX 3 GPM</u>
<u>36</u>	<u>GREY CLAY</u>
<u>30</u>	<u>SANDY GREY CLAY</u>
<u>35</u>	<u>GREY CLAY</u>
<u>36</u>	<u>SAND - VERY LITTLE GRAVEL - WATER</u>
<u>40 1/2</u>	<u>BROWN SAND - TRACE OF GRAVEL - WATER - APPROX 5 GPM - SAND HEAVING UP IN CASING (CASED OFF)</u>
<u>41 1/2</u>	<u>SAND &amp; GRAVEL - WATER - APPROX 7 GPM (CASED OFF)</u>
<u>46</u>	<u>BROWN SILTY &amp; SANDY CLAY</u>
<u>48</u>	<u>SAND &amp; GRAVEL - WATER - APPROX 12 GPM</u>
<u>48 1/2</u>	<u>GRAVEL - WATER EXCEEDING 20 GPM</u>

48 1/2 Show exact depth of bottom

426946

FRANK SEABERG & KATHERINE  
SEABERG

TO

THE PUBLIC

WATER WELL

STATE OF MONTANA }  
COUNTY OF HILL } SS  
Filed at 1:30 o'clock P M

ON JAN 19 1973

R. E. Blom

BY *Katherine E. Blom* COUNTY CLERK  
DEPUTY

Fee: \$2.00 pd.

INDEXED

GW 4  
FILE NO. \_\_\_\_\_  
DUPLICATE

TWP 30 RGE 13E  
COUNTY HILL

STATE OF MONTANA  
ADMINISTRATOR OF GROUNDWATER CODE  
OFFICE OF STATE ENGINEER

DECLARATION OF VESTED GROUNDWATER RIGHTS STATE ENGINEER  
(Under Chapter 237, Montana Session Laws, 1961)

1. Rob Roy Smith, of Box 212,  
(Name of Appropriator) (Address) (Town)  
County of Hill, State of Montana  
Have appropriated groundwater according to the Montana laws in effect prior to Jan. 1, 1962 as follows:

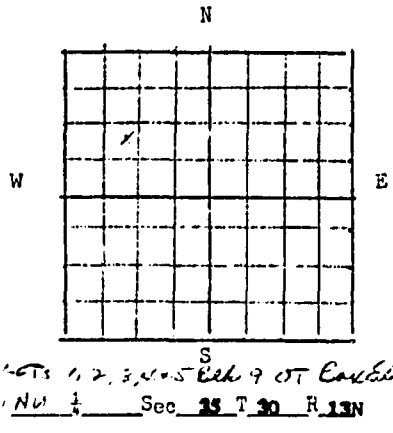

- The beneficial use on which the claim is based domestic
- Date or approximate date of earliest beneficial use; and how continuous the use has been April 30, 1957 continuous use
- The amount of groundwater claimed (in miner's inches or gallons per minute) 15 gallons per minute
- If used for irrigation, give the acreage and description of the lands to which water has been applied and name of the owner thereof none
- The means of withdrawing such water from the ground and the location of each well or other means of withdrawal electric pump
- The date of commencement and completion of the construction of the well, wells, or other works for withdrawal of groundwater started April 27, 1957  
finished April 30, 1957
- The depth of water table approx. 20 ft.
- So far as it may be available, the type, size and depth of each well or the general specifications of any other works for the withdrawal of groundwater drilled, 6" diameter, 48 ft. depth
- The estimated amount of groundwater withdrawn each year 3,000,000
- The log of formations encountered in the drilling of each well if available clay, sand, gravel. Water encountered in gravel
- Such other information of a similar nature as may be useful in carrying out the policy of this act, including reference to book and page of any county record none

Indicate point of appropriation and place of use, if possible. Each small square represents 10 acres.

Signature of Owner Rob Roy Smith  
Date May 20 1962

Three copies to be filed by the owner with the County Clerk & Recorder of the County in which the well is located.

PLEASE ANSWER ALL QUESTIONS. IF NOT APPLICABLE, SO STATE, OTHERWISE THE FORM WILL BE RETURNED.

Original to the County Clerk & Recorder; duplicate to the State Engineer; Triplicate to the School of Mines and Quadruplicate for the Appropriator.

393835

ROB ROY SMITH

TO

THE PUBLIC

DECLARATION OF VESTED GROUNDWATER  
RIGHTS

STATE OF MONTANA )  
COUNTY OF HILL ) ss.  
Filed at 2 o'clock P.M.

ON MAY 21 1963

R. E. BLOD  
COUNTY CLERK

BY \_\_\_\_\_  
DEPUTY

FEE: \$2.00 pd.