

File No. ....

T. 30N R. 13E 35

DUPLICATE

MONTANA WATER RESOURCES BOARD  
**RECEIVED**

County HILL

LOG

MAR 18 1969

STATE OF MONTANA  
ADMINISTRATOR OF GROUNDWATER CODE  
OFFICE OF STATE ENGINEER

Top of Ground  
(Elev. above sea level.....)

### Notice of Completion of Groundwater Appropriation by Means of Well

DEVELOPED AFTER JANUARY 1, 1962

(Under Chapter 237, Montana Session Laws, 1961)

- 0 TO
- 3 TOP + SUBSOIL
- 12 SANDY BROWN CLAY
- 13 DRY SAND + GRAVEL
- 19 GRAVELLY BROWN CLAY
- 24 YELLOWISH-BROWN CLAY
- 29 SANDY BROWN CLAY
- 33 SILT + SAND - WATER - (CASED OFF)
- 35 SAND + SOME GRAVEL WATER - APPROX 4 GPM (CASED OFF)
- 41 BROWN CLAY
- 44 BROWN SILT + SAND
- 45 SAND + COARSE GRAVEL CONSIDERABLE SAND - WATER - APPROX 5 GPM
- 46 COARSE SAND + MEDIUM GRAVEL WATER YIELD INCREASED TO APPROX 10 GPM
- 47 PEA GRAVEL - SOME SAND WATER YIELD APPROX 20 GPM BY BALER TEST
- 47 Show exact depth of bottom.

Owner WALTER J. + SHIRLEY A. SWANA Address BOX ELDER, MONTANA

Driller HI-LINE DRILLING SERVICE Address HAURE, MONTANA

Date of Notice of appropriation of groundwater.....

Date well started MAY 25, 1967 Date completed MAY 27, 1967

Type of well DRILLED Equipment used CABLE TOOL RIG  
(Dug, driven, bored or drilled) (Churn drill, rotary or other)

Water use: Domestic  Municipal  Stock  Irrigation   
Industrial  Drainage  Other

Indicate on the diagram the character and thickness of the different strata met with in drilling, such as soil, clay, shale, gravel, rock or sand, etc. Show depth at which water is encountered, thickness and character of water-bearing strata and height to which the water rises in the well.

Size of Drilled Hole	Size and Weight of Casing	From (Feet)	To (Feet)	PERFORATIONS		
				Kind Size	From (Feet)	To (Feet)
6 5/8"	6 7/8" O.D. 13" PER FOOT T + C GALVANIZED	1' 2" ABOVE GROUND LEVEL	47	NO PERFORATIONS. WATER COMING IN TARDY BOTTOM OF DRIVE COLLAR AT 47 FT LEVEL		

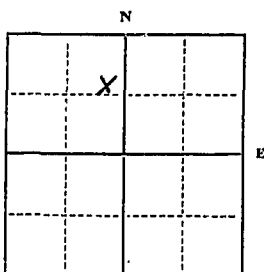

Static Water Level for non-flowing well ..... 18 feet.

Shut-in Pressure for Flowing Well NOT APPL.

Pumping Water Level..... 28 feet

at..... 12 gal. per minute.

Discharge in gal. per min. of flowing well NOT APPLICABLE

How Tested BALER + TEST PUMP

Length of Test..... 8 HOURS

Remarks: (Gravel packing, cementing, packers, type of shutoff) CEMENTED

FROM 14 FT LEVEL BACK TO 8 FT TO SEAL OFF SURFACE CONTAMINATION

NIELSON'S 2ND ADDITION  
LOT 5 BLOCK 3  
NE 1/4 Sec. 35 T. 30. R. 13  
Indicate location of well and place of use, if possible. Each small square represents 40 acres.

46

Driller's License Number

Robert Davis  
Driller's Signature.

45,066

This form to be prepared by driller, and three copies to be filed by the owner with the County Clerk and Recorder in the county in which the well is located, tissue copy to be retained by driller.

Please answer all questions. If not applicable, so state, otherwise the form will be returned.

USE—If used for irrigation, industrial, drainage or other. Explain, state number of acres and location or other data (i.e.: Lot, Block and Addition).

(Continue on reverse side)

413140

WALTER J. AND SHIRLEY L. SWAN  
(husband and wife)

to

the public

NOTICE OF COMPLETION OF  
GROUNDWATER APPROPRIATION

STATE OF MONTANA, ss.  
COUNTY OF HILL )  
Filed at 3:00 o'clock P.m.

MAR 17 1969

R. E. BLOM

COUNTY CLERK

DEPUTY

fee: \$2.00 paid

GV

Approved Stock Form—State Publishing Co., Helena, Montana—41921

730N R 13E  
Lot 2 Block 8 35

File No. ....

DUPLICATE

County Hill

STATE OF MONTANA  
ADMINISTRATOR OF GROUNDWATER CODE  
OFFICE OF STATE ENGINEER

RECEIVED  
DEC 27 1963

Declaration of Vested Groundwater Rights ENGINEER

(Under Chapter 237, Montana Session Laws, 1961)

1. Ordean Salberg, of Box Elder, (Name of Appropriator) (Address) (Town)  
County of Hill State of Mont  
have appropriated groundwater according to the Montana laws in effect prior to January 1, 1962, as follows:

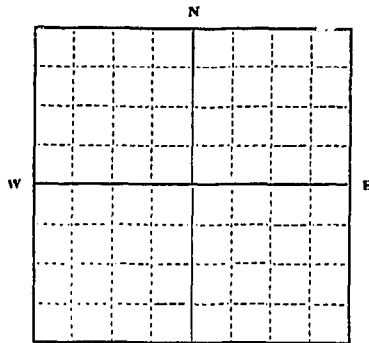

Lot 2 Block 8 Box Elder  
1/4 Sec 35 30N R 13E

Indicate point of appropriation and place of use, if possible. Each small square represents 10 acres.

2. The beneficial use on which the claim is based. Domestic & Garden

3. Date or approximate date of earliest beneficial use; and how continuous the use has been. 1927 - been used continuously

4. The amount of groundwater claimed (in miner's inches or gallons per minute). 1.5 gal per minute

5. If used for irrigation, give the acreage and description of the lands to which water has been applied and name of the owner thereof

6. The means of withdrawing such water from the ground and the location of each well or other means of withdrawal. Electric Pump

7. The date of commencement and completion of the construction of the well, wells, or other works for withdrawal of groundwater. Started June 12 - 1927 Completed July 8, 1927

8. The depth of water table. 20 feet

9. So far as it may be available, the type, size, and depth of each well or the general specifications of any other works for the withdrawal of groundwater. 48 feet deep with 6 inch casing to 26' bottom

10. The estimated amount of groundwater withdrawn each year. 1,774,000

11. The log of formations encountered in the drilling of each well if available. Unknown

12. Such other information of a similar nature as may be useful in carrying out the policy of this act, including reference to book and page of any county record. Unknown

Signature of Owner Ordean B. Salberg  
Date Dec 20, 1963

Three copies to be filed by the owner with the County Clerk and Recorder of the county in which the well is located.

Please answer all questions. If not applicable, so state, otherwise the form will be returned.

Original to the County Clerk and Recorder; Duplicate to the State Engineer; Triplicate to the Montana Bureau of Mines and Geology, and Quadruplicate for the Appropriator.

396689

ORNEAN SOLBERG

TO

THE PUBLIC

DECLARATION OF VESTED GROUND

WATER RIGHTS

STATE OF MONTANA )  
COUNTY OF HILL )  
Filed at 11 o'clock Am

ON DEC 20 1963

R. E. Blom

COUNTY CLERK

REPUTY

Fee: \$2.00 pd.

STATE OF MONTANA  
ADMINISTRATOR OF GROUNDWATER CODE  
MONTANA WATER RESOURCES BOARD

NOTICE OF COMPLETION OF GROUNDWATER  
APPROPRIATION BY MEANS OF WELL

Developed after January 1, 1962

(Under Chapter 237 Montana Session Laws, 1961, as amended)

This form to be prepared by driller, and three copies to be filed by the owner with the County Clerk and Recorder in the county in which the well is located, last copy to be retained by driller. Please answer all questions. If not applicable, so state, otherwise the form may be returned.

Owner CLIFFORD & GLADYS VOSEN  
Address Box ELDER, MONTANA 59501  
Date well started APRIL 15, 1972  
completed APRIL 18, 1972

For Administrator's Use  
File 427651  
April 18, 1973  
GW 1 2:15 p.m.

Type of well DRILLED  
(Dug, driven, bored or drilled)

Equipment used CABLE TOOL RIG  
(Churn drill, rotary or other)

Water Use: Domestic  Municipal  Stock  Irrigation   
Industrial  Drainage  Other \* Garden/Lawn

\*Describe  
USE: If used for irrigation, industrial, drainage or other. Explain, state number of acres and location or other data (i.e. Lot, Block and Addition).

ESTIMATED ANNUAL WITHDRAWAL EXCEEDING 300,000 GALLONS

Size of Drilled Hole	Size and Weight of Casing	From (Feet)	To (Feet)	PERFORATIONS		
				Kind	From (Feet)	To (Feet)
10"		0	20			
6 5/8"	6 5/8" O.D. / FOOT (.188 WALL) 13" PER FOOT GALVANIZED STEEL	0	49 1/2	(NO PERFORATIONS)		
					WATER COMING IN THRU BOTTOM OF DRIVE COLLAR AT 49 1/2 FOOT LEVEL	

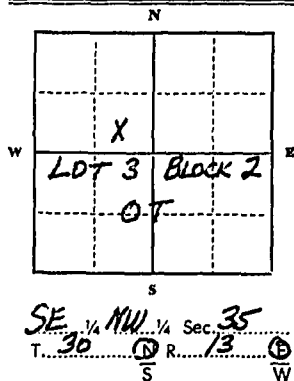

Static water level 16 ft.\*  
Pumping water level 24 1/2 ft.\*  
at 17 1/2 gallons per minute, measured 180 minutes after pumping began.  
\*Measured from ground level.  
Well developed by BALER & PUMP for 7 hours.  
Power ELECTRIC Pump 3/4 HP  
Remarks: (Gravel packing, cementing, packers, type of shutoff) SOLE  
HEAVEN TO 10" DIAMETER BEFORE CASING INSTALLED.  
UPON COMPLETION OF WELL ANNULAR SPACE AROUND OUTSIDE OF CASING FILLED WITH BENTONITE + DRILLING MUD

INDICATE LOCATION OF WELL AND PLACE OF USE, IF POSSIBLE. EACH SMALL SQUARE REPRESENTS 40 ACRES.

Driller's Signature Robert Train HI-LINE DRILLING SERVICE  
Driller's Address 1173 6th St. No. HAURE, MONTANA 59501 PHONE 265-4210  
HAURE, MONTANA 59501 LICENSE NO. 46

30N-13E  
County HILL  
DRILLER'S LOG 35

Indicate the character, color, thickness of strata such as soil, clay, sand, gravel, shale, sandstone, etc. Show depth at which water is found and height to which water rises in well.

Top of Ground (Elev. above sea level)	
From (Feet)	To (Feet)
0	2
10	12
12	14
14	20
20	22
22	21
21	35
35	36
36	38
38	39
39	40
40	42
42	45
45	46
46	48
48	49 1/2

Soil  
SANDY BROWN CLAY  
BROWN SAND  
SAND + GRAVEL - (DRY)  
BROWN CLAY  
SAND + CLAY MIX - SOME WATER - (CAVING)  
BROWN CLAY  
SANDY BROWN CLAY  
SAND + TRACE OF GRAVEL - SOME WATER  
SANDY BROWN CLAY  
BROWN SILT  
SAND + GRAVEL - WATER - APPROX. 7 GPM  
SAND + GRAVEL - WATER INCREASED TO 10 GPM BUT HAD LOW BALING LEVEL AND SLOW RECOVERY - (CASED OFF)  
BROWN SILTY CLAY  
BROWN SAND - TRACE OF WATER  
GRAVELLY BROWN CLAY  
BROWN SAND + GRAVEL - WATER - EXCEEDING 20 GPM BY BALER TEST  
HARDNESS - 20 GRAINS  
IRON - 1 PPM  
PH - 7.5  
SULFATE - NONE

49 1/2 Show exact depth of bottom

427651

CLIFFORD VOSEN & GLADYS VOSEN

TO

THE PUBLIC

WATER WELL

*APR 18 1973  
DEPT. OF REVENUE  
MONTANA  
BOZEMAN*

STATE OF MONTANA } SS  
COUNTY OF HILL }  
Filed at 2:15 o'clock P M

ON APR 18 1973  
R. E. Blom

BY *R. E. Blom* COUNTY CLERK  
DEPUTY

Fee: \$2.00 pd.

INDEXED

*Handwritten notes and signatures at the bottom of the page, including names like 'Blom' and 'Deputy'.*

File No. ....

T. 30N R. 13E

DUPLICATE

County Hill

STATE OF MONTANA  
ADMINISTRATOR OF GROUNDWATER CODE  
OFFICE OF STATE ENGINEER

Notice of Completion of Groundwater  
Appropriation by Means of Well

(Under Chapter 237, Montana Session Laws, 1961)

RECEIVED  
NOV 2 1962  
STATE ENGINEER



Top of Ground  
(Elev. above sea level... 2740.....)  
0 top soil  
1 yellow clay  
6 sandy clay  
12 sandy yellow clay  
23 very sandy clay  
33 quick sand  
36 sandy clay, some gravel  
45 gravel and sand  
49 gravel, water well completed

Owner Irene H. Walls Address Box Elder, Montana

Driller Lloyd G. Hanberg Address Box Elder, Montana

Date of Notice of Appropriation of Groundwater.....

Date well started April 2, 1962 Date Completed April 3, 1962

Type of well drilled Equipment Used spudder  
(dug, driven, bored or (Churn, drill, rotary or drilled) other)

Water Use: Domestic  Municipal  Other  Irrigation   
Industrial  Drainage  Stock

Indicate on the diagram the character and thickness of the different strata met with in drilling, such as soil, clay, shale, gravel, rock or sand, etc. Show depth at which water is encountered, thickness and character of water-bearing strata and height to which water rises in the well.

Size of Drilled Hole	Size and Weight of Casing	From (Feet)	To (Feet)	PERFORATIONS		
				Kind Size	From (Feet)	To (Feet)
6"	6" O.D. 10.50	0	49	none	none	none

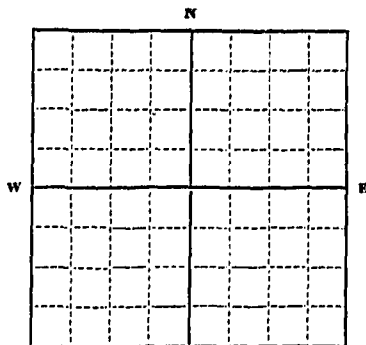

Lot 4, Blk. 6, Box Elder Townsite  
1/4 Sec 35 T30N R. 13E  
Indicate location of well and place of use, if possible. Each small square represents 10 acres.

Show exact depth of bottom.

Static Water Level for non-flowing Well 20' front surface .....feet.

Shut-in Pressure for Flowing Well.....none.....

Pumping Water Level..... 29.....feet at..... 20.....gal. per minute.

Discharge in gal. per min. of flowing well.....none.....

How Tested.....bailer.....Length of Test approx. 4 hrs......

Remarks: (Gravel packing, cementing, packers, type of shutoff, location of place of use of groundwater if not at well, and any other similar pertinent information, including number of acres irrigated, if used for irrigation).....none.....

State License No. 6  
Driller's License Number

Lloyd G. Hanberg  
Driller's Signature

This form to be prepared by driller, and three copies to be filed by the owner with the County Clerk and Recorder in the county in which the well is located.

Please answer all questions. If not applicable, so state, otherwise the form will be returned.

Original to the County Clerk and Recorder; duplicate to the State Engineer; Triplicate to the Montana Bureau of Mines and Geology and Quadruplicate for the Appropriator.

391039

IRFNE H. WALLS

to

THE PUBLIC

NOTICE OF COMPLETION O GROUND  
WATER APPROPRIATION BY MEANS OF WELL

STATE OF MONTANA )  
COUNTY OF HILL ) ss.  
*Filed at 12:30 o'clock P.M.*

ON July 7 1962  
G. G. Yeon

COUNTY CLERK

By \_\_\_\_\_  
DEPUTY

Fee: \$2.00 pd.



T. 30N R. 13E 35  
 County Richmond

MONTANA BUREAU OF MINES AND GEOLOGY STATE ENGINEER  
 Butte, Montana

WATER WELL LOG

Owner Carl B. Williams Address Rox Eldon  
199  
 Driller Joseph Handberg Address Rox Eldon  
 Date Started 3-7-61 Date Completed 3-22-61  
 Location: Sec. 95 T. 30 R. 13 1/4 sec. 24.20 of 4.20

Type of well drain Equipment used drain  
(Dug, driven, bored, or drilled) (Churn drill, rotary, other)

Water use: Domestic  Municipal  Stock  Irrigation   
 Industrial  Drainage  Other: .....

Casing: 51 ft. to all ft. Type cast iron Size 6" O.D.  
 Casing: ..... ft. to ..... ft. Type ..... Size .....  
 Casing: ..... ft. to ..... ft. Type ..... Size .....

Perforated or Screened: Ft. .... to ft. .... Ft. .... to ft. ....

Type of screen or perforations drain

Static Water level, for non-flowing well: 48 feet.

Shut-in pressure, for flowing well: ..... lb./sq. in. on: ..... (date)

Pumping water level: 48 feet at 20 gal. per min.

How tested: bailed

Length of test: 17 min.

Remarks: (Gravel packing, cementing, packers, type of shut-off, depth of shut-off)  
Start with 30 gal. pressure tank  
Output 11.10 gpm  
Rox Eldon Mont.

(over)

Log of Well

Depth	Description
0 - 15	surface
15 - 40	gravel
40 - 48	yellow clay
48 - 55	yellow sand
55 - 60	yellow clay
60 - 65	yellow sand
65 - 71	yellow clay



35

File No. \_\_\_\_\_

T. 20 R. 13

DUPLICATE

County HILL

STATE OF MONTANA  
ADMINISTRATOR OF GROUNDWATER CODE  
OFFICE OF STATE ENGINEER

RECEIVED  
SEP 19 1963

Declaration of Vested Groundwater Rights

(Under Chapter 237, Montana Session Laws, 1961)

STATE ENGINEER

1. Arthur B. Wilson of Box Elder  
(Name of Appropriator) (Address) (Town)

County of HILL State of MONT  
have appropriated groundwater according to the Montana laws in effect prior to January 1, 1962, as follows:

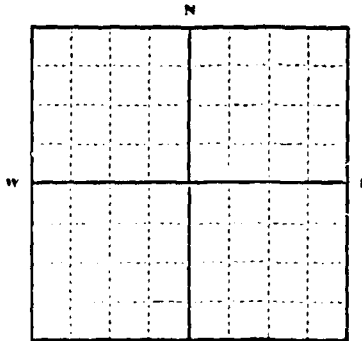

SW  
§ 4444 Sec. 35, T. 20 R. 13

Indicate point of appropriation and place of use, if possible. Each small square represents 10 acres.

2. The beneficial use on which the claim is based Domestic

3. Date or approximate date of earliest/beneficial use; and how continuous the use has been March 22, 1961

Continental use

4. The amount of groundwater claimed (in miner's inches or gallons per minute) 14 g.p.m.

5. If used for irrigation, give the acreage and description of the lands to which water has been applied and name of the owner thereof

none

6. The means of withdrawing such water from the ground and the location of each well or other means of withdrawal

Pump

7. The date of commencement and completion of the construction of the well, wells, or other works for withdrawal of groundwater March 21, 1961, March 22, 1961

8. The depth of water table 50'

9. So far as it may be available, the type, size and depth of each well or the general specifications of any other works for the withdrawal of groundwater

50'

10. The estimated amount of groundwater withdrawn each year 7,096,320

11. The log of formations encountered in the drilling of each well, if available 0-15' sand & gravel - 15-26' gravelly clay, yellow, 16-20' sandy clay yellow, 20-26' gravelly clay, yellow, 26-32' sandy clay, 32-39' 46' quick sand, 46-47' sandy clay, 48-50' sand, gravel & water

12. Such other information of a similar nature as may be useful in carrying out the policy of this act, including reference to book and page of any county record none

Arthur B. Wilson  
Signature of Owner Thomas C. Cooper  
Date Sept. 6 1963

Three copies to be filed by the owner with the County Clerk and Recorder of the county in which the well is located.

Please answer all questions. If not applicable, so state, otherwise the form will be returned.

Original to the County Clerk and Recorder; duplicate to the State Engineer; Triplicate to the Montana Bureau of Mines and Geology, and Quadruplicate for the Appropriator.

395249

ARTHUR B. WILSON

TO

THE PUBLIC

DECLARATION OF VESTED GROUND  
WATER RIGHTS

STATE OF MONTANA, ) ss.  
COUNTY OF BILL )  
Filed at 3:30 o'clock P.m.

ON SEP 17 1963

R. E. Blom  
DEPUTY CLERK

BY \_\_\_\_\_ DEPUTY

Fee: \$2.00 filing



396918

THOMAS MOUSE

TO

THE PUBLIC

DECLARATION OF VESTED  
GROUNDWATER RIGHTS

STATE OF MONTANA ) ss.  
COUNTY OF HILL )  
Filed at 8 o'clock a.m.

ON DEC 30 1963  
T. E. Blain  
COUNTY CLERK

BY \_\_\_\_\_ DEPUTY

SEE: \$2.00 pd.





GV.

20

File No.

DUPLICATE

SPRING

T. 30 N. R. 14 E  
County FORT BEND

STATE OF MONTANA  
ADMINISTRATOR OF GROUNDWATER CODE  
OFFICE OF STATE ENGINEER

JAN 13 1963  
STATE ENGINEER

Declaration of Vested Groundwater Rights

(Under Chapter 237, Montana Session Laws, 1961)

1. B.W. Geringer, of Baxfield,  
(Name of Appropriator) (Address) (Town)  
County of Hill State of Montana  
have appropriated groundwater according to the Montana laws in effect prior to January 1, 1962, as follows:

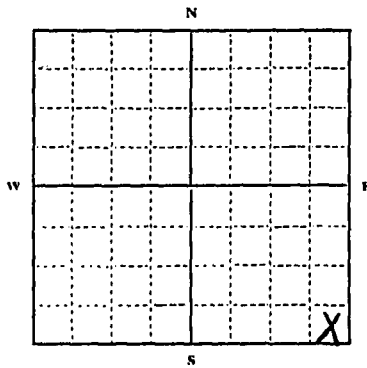

SE 1/4 Sec 20 T30 R. 14

Indicate point of appropriation and place of use, if possible. Each small square represents 10 acres.

2. The beneficial use on which the claim is based.....  
Stock water

3. Date or approximate date of earliest beneficial use; and how continuous the use has been.....  
continuous

4. The amount of groundwater claimed (in miner's inches or gallons per minute).....  
200 Miner's inches

5. If used for irrigation, give the acreage and description of the lands to which water has been applied and name of the owner thereof.....

6. The means of withdrawing such water from the ground and the location of each well or other means of withdrawal.....  
Flowing

7. The date of commencement and completion of the construction of the well, wells, or other works for withdrawal of groundwater.....

8. The depth of water table.....  
Spring

9. So far as it may be available, the type, size and depth of each well or the general specifications of any other works for the withdrawal of groundwater.....

10. The estimated amount of groundwater withdrawn each year.....

11. The log of formations encountered in the drilling of each well if available.....

12. Such other information of a similar nature as may be useful in carrying out the policy of this act, including reference to book and page of any county record.....

Signature of Owner B.W. Geringer  
Date 12/30/63

Three copies to be filed by the owner with the County Clerk and Recorder of the county in which the well is located.

Please answer all questions. If not applicable, so state, otherwise the form will be returned.

Original to the County Clerk and Recorder; duplicate to the State Engineer; Triplicate to the Montana Bureau of Mines and Geology, and Quadruplicate for the Appropriator.

31109

397038

B. W. CENGER

TO

THE PUBLIC

DECLARATION OF VESTED  
GROUNDWATER RIGHTS

STATE OF MONTANA, )  
COUNTY OF HILL )  
*Filed at 1 o'clock p.m.*

ON DEC 30 1963

\_\_\_\_\_  
COUNTY CLERK

By \_\_\_\_\_  
DEPUTY

FEE: \$2.00 pd.



File No. \_\_\_\_\_

T. 30 R 15

DUPLICATE

County Hill

STATE OF MONTANA  
ADMINISTRATOR OF GROUNDWATER CODE  
OFFICE OF STATE ENGINEER

RECEIVED

Notice of Completion of Groundwater Appropriation  
Without Well

STATE ENGINEER

(Under Chapter 237 Montana Session Laws, 1961)

Date of Appropriation of Groundwater 1918  
Owner R. A. Hegle Address Hambo Pt. House Mont

Contractor (if any) \_\_\_\_\_

Address of Contractor \_\_\_\_\_

Date Started \_\_\_\_\_ Date Completed \_\_\_\_\_

Describe means of obtaining groundwater without a well "as by sub-irrigation and other natural processes". Include depth to water when applicable.

6" Spring

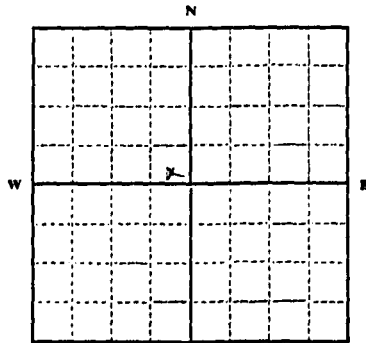

Quantity of water developed and used with explanation of method used to measure or estimate such amount. If use is intermittent

estimate approximate lengths of periods of use \_\_\_\_\_

runs freely  
never dries

SEN W.  $\frac{1}{4}$  Sec. 2, T. 30, R. 15  
Indicate point of appropriation and place of use, if possible.

Signature of Owner R. A. Hegle

Date Jan 2, 1963

This form to be prepared by contractor (if any), otherwise by the owner.

Three copies of this notice are to be filed with the County Clerk and Recorder of the county in which the works are located.

Please answer all questions. If not applicable, so state, otherwise the form will be returned.

Original to the County Clerk and Recorder; duplicate to the State Engineer; Triplicate to the Montana Bureau of Mines and Geology and Quadruplicate for the Appropriator.

391874

R. A. HEGLE

TO

THE PUBLIC

NOTICE OF COMPLETION OF  
GROUNDWATER APPROPRIATION  
WITHOUT WELL

STATE OF MONTANA )  
COUNTY OF HILL )  
Filed at 9 o'clock A.M.

JAN 2 1963

G. C. Yeon  
COUNTY CLERK

DEPUTY

Fee: \$2.00 pd.

GWS

File No. \_\_\_\_\_

DUPLICATE

T. 30 R. 15

County Hill

STATE OF MONTANA  
ADMINISTRATOR OF GROUNDWATER CODE  
OFFICE OF STATE ENGINEER

RECEIVED  
MAR 7 1963

STATE ENGINEER

Notice of Completion of Groundwater Appropriation Without Well

(Under Chapter 237 Montana Session Laws, 1961)

Date of Appropriation of Groundwater 1958

Owner W. E. Hillbrand Address B. G. 1068 Havre

Contractor (if any) \_\_\_\_\_

Address of Contractor \_\_\_\_\_

Date Started 1958 Date Completed 1958

Describe means of obtaining groundwater without a well "as by sub-irrigation and other natural processes". Include depth to water when applicable. 20 foot dam for

stock water

Dam 20 feet high 10 feet long and back water about 450 feet about 112500 cubic feet of water. Spring has been excavated.

Quantity of water developed and used with explanation of method used to measure or estimate such amount. If use is intermit-

tent estimate approximate lengths of periods of use \_\_\_\_\_

Summer range cattle

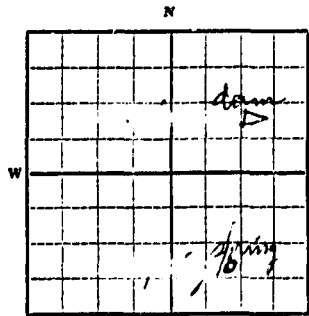

Section 8, Sec. 3, T. 30, R. 15.  
Indicate point of appropriation and place of use, if possible.

Signature of Owner W. E. Hillbrand

Date Feb. 1963

This form to be prepared by contractor (if any), otherwise by the owner.

Three copies of this notice are to be filed with the County Clerk and Recorder of the county in which the works are located.

Please answer all questions. If not applicable, so state, otherwise the form will be returned.

Original to the County Clerk and Recorder; duplicate to the State Engineer; Triplicate to the School of Mines and Quadruplicate for the Appropriator.

392674

W. E. Hillbrant

to

The Public

NOTICE OF COMPLETION OF  
GROUNDWATER APPROPRIATION  
WITHOUT WELL

STATE OF MONTANA, } ss.  
COUNTY OF HILL }

Filed at 10 o'clock A.M.

ON MAR 5 1963

R. E. Blom  
COUNTY CLERK

BY \_\_\_\_\_ DEPUTY

Fee: \$2.00 pd.

File No. \_\_\_\_\_

T. 30N R. 15E

DUPLICATE

County Hill

STATE OF MONTANA  
ADMINISTRATOR OF GROUNDWATER CODE  
OFFICE OF STATE ENGINEER

RECORDED  
DEC 19 1963

STATE ENGINEER  
**Notice of Completion of Groundwater Appropriation  
Without Well**

(Under Chapter 237 Montana Session Laws, 1961)

Date of Appropriation of Groundwater Dec 16 1963

Owner Stuart Heron Address Box 1209 Havre

Contractor (if any) \_\_\_\_\_

Address of Contractor \_\_\_\_\_

Date Started \_\_\_\_\_ Date Completed \_\_\_\_\_

Describe means of obtaining groundwater without a well "as by sub-irrigation and other natural processes". Include depth to water when applicable.

Springs, seeps + reservoirs  
water rights for irrigation use  
filed and used

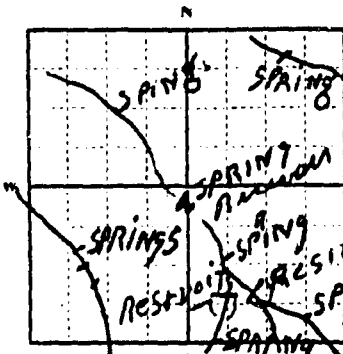

Quantity of water developed and used with explanation of method used to measure or estimate such amount. If use is intermittent

estimate approximate lengths of periods of use

Water is used by livestock year through  
Water from reservoirs is used for irrigation

1/4 Sec. 4 T. 30N R. 15E  
Indicate point of appropriation and place of use, if possible.

Signature of Owner Stuart Heron

Date Dec 16 1963

This form to be prepared by contractor (if any), otherwise by the owner.

Three copies of this notice are to be filed with the County Clerk and Recorder of the county in which the works are located.

Please answer all questions. If not applicable, so state, otherwise the form will be returned.

Original to the County Clerk and Recorder; duplicate to the State Engineer; Triplicate to the Montana Bureau of Mines and Geology and Quadruplicate for the Appropriator.



396617

STUART HERRON & FLORENCE HERRON

TO

THE PUBLIC

NOTICE OF COMPLETION OF GROUND  
WATER APPROPRIATION WITHOUT WELL

STATE OF MONTANA )  
COUNTY OF HILL )  
Filed at \_\_\_\_\_ o'clock \_\_\_\_\_ m.

ON DEC 17 1963

R. E. Blom

COUNTY CLERK

DEPUTY

Fee: \$2.00 pd.

GW 3

Approved Stock Form—State Publishing Co., Helena, Montana—42199

8

File No. ....

T. 30N R 15E

DUPLICATE

County Hill

STATE OF MONTANA  
ADMINISTRATOR OF GROUNDWATER CODE  
OFFICE OF STATE ENGINEER

RECEIVED  
DEC 19 1963

STATE ENGINEER

### Notice of Completion of Groundwater Appropriation Without Well

(Under Chapter 237 Montana Session Laws, 1961)

Date of Appropriation of Groundwater Natural Springs Dec 16 1963  
Owner Shuart Herron Address Box 1209

Contractor (if any) .....

Address of Contractor .....

Date Started..... Date Completed.....

Describe means of obtaining groundwater without a well "as by sub-irrigation and other natural processes". Include depth to water when applicable. Natural Springs

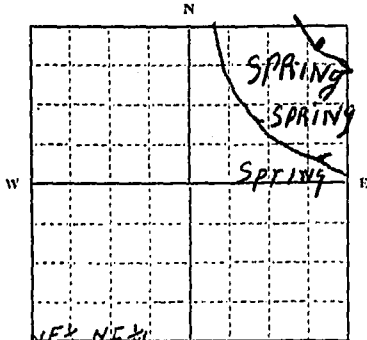

NE 1/4 NE 1/4  
SE 1/4 NE 1/4 8 30 15  
1/4 Sec. T. R.

Indicate point of appropriation and place of use, if possible.

Quantity of water developed and used with explanation of method used to measure or estimate such amount. If use is intermittent

estimate approximate lengths of periods of use. Natural flow springs, small amount used by livestock at different times of year

Signature of Owner Shuart Herron

Date Dec 16 1963

This form to be prepared by contractor ("any), otherwise by the owner.

Three copies of this notice are to be filed with the County Clerk and Recorder of the county in which the works are located.

Please answer all questions. If not applicable, so state, otherwise the form will be returned.

Original to the County Clerk and Recorder; duplicate to the State Engineer; Triplicate to the Montana Bureau of Mines and Geology and Quadruplicate for the Appropriator.

10311

396615

STUART FERRIN

TO

THE PUBLIC

NOTICE OF COMPLETION OF GROUNDS  
WATER APPROPRIATION MIT OUT WELL

STATE OF MONTANA ) ss.  
COUNTY OF HILL )  
Filed at \_\_\_\_\_ o'clock \_\_\_\_\_ m.

ON DEC 17 1963

COUNTY CLERK

DEPUTY

OW 3

Approved Stock Form—State Publishing Co., Helena, Montana—42199

File No.....

T. 30 N. R. 15 E

DUPLICATE

County *Hill*

STATE OF MONTANA  
ADMINISTRATOR OF GROUNDWATER CODE  
OFFICE OF STATE ENGINEER

RECEIVED  
JAN 13 1964

STATE ENGINEER

### Notice of Completion of Groundwater Appropriation Without Well

(Under Chapter 237 Montana Session Laws, 1961)

Date of Appropriation of Groundwater *Sept 1946*

Owner *Hubert Helmer Helmer* Address *Box 1209*

Contractor (if any) .....

Address of Contractor .....

Date Started..... Date Completed.....

Describe means of obtaining groundwater without a well "as by sub-irrigation and other natural processes". Include depth to water when applicable. *Natural spring keeps*

*water course alive for 1/2 mile*

*0.5 mile*

Quantity of water developed and used with explanation of method used to measure or estimate such amount. If use is intermittent

estimate approximate lengths of periods of use. *used for*

*livestock when range is used*

*spring flows 5 to 10 gal a min.*

Signature of Owner *Hubert Helmer*

Date *Dec 16 1963*

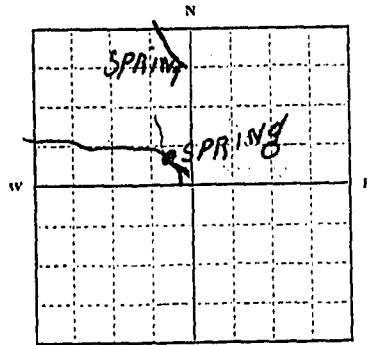

*W 1/4* Sec. *8* T. *30* R. *15*

Indicate point of appropriation and place of use, if possible.

This form to be prepared by contractor (if any), otherwise by the owner.

Three copies of this notice are to be filed with the County Clerk and Recorder of the county in which the works are located.

Please answer all questions. If not applicable, so state, otherwise the form will be returned.

Original to the County Clerk and Recorder; duplicate to the State Engineer; Triplicate to the Montana Bureau of Mines and Geology and Quadruplicate for the Appropriator.

397033

HERBERT & ANITA JOLIE

TO

THE PUBLIC

COMPLETION OF GROUNDWATER  
WELL

STATE OF MONTANA, ss.  
COUNTY OF HILL )

Filed at 1 o'clock pm.

ON DEC 20 1963

T. G. Blain  
COUNTY CLERK

By \_\_\_\_\_ DEPUTY

FEES: \$2.00 pd.

1963  
BY 180

1963  
1/1/64

1963  
1/1/64

1963

MONTANA WATER RESOURCES BOARD  
RECEIVED

Approved Stock Form—State Publishing Co., Helena, Montana—42199

File No. ....

OCT 9 1970

T. 30N R. 15E

DUPLICATE

County Hill

STATE OF MONTANA  
ADMINISTRATOR OF GROUNDWATER CODE  
OFFICE OF STATE ENGINEER

Notice of Completion of Groundwater Appropriation  
Without Well

(Under Chapter 237 Montana Session Laws, 1961)

Doc. No. 419206  
Filed for record  
this 8 day of October  
A. D. 19 70, at 9:45  
o'clock A. M.

Date of Appropriation of Groundwater.....

Owner Hubert or Agatha Golie Address Box 1209

Contractor (if any) Frank Papillo

Address of Contractor Haute, Montana

Date Started June Date Completed Sept. 30

Describe means of obtaining groundwater without a well "as by sub-irrigation and other natural processes". Include depth to water when applicable. Spring & runoff water stored in reservoir 20' deep 35 feet by soil conservation measurement.

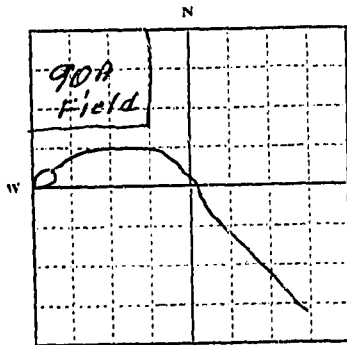

NW 1/4 Sec. 8 T. 30 R. 15  
Indicate point of appropriation and place of use, if possible.

Quantity of water developed and used with explanation of method used to measure or estimate such amount. If use is intermittent estimate approximate lengths of periods of use. Built

for fish production and sprinkler irrigation on 90A field. No. of reservoir site

Signature of Owner Hubert Golie

Date 10-8-70

This form to be prepared by contractor (if any), otherwise by the owner.

Three copies of this notice are to be filed with the County Clerk and Recorder of the county in which the works are located.

Please answer all questions. If not applicable, so state, otherwise the form will be returned.

Original to the County Clerk and Recorder; duplicate to the State Engineer; Triplicate to the Montana Bureau of Mines and Geology and Quadruplicate for the Appropriator.

47610

419206

HERBERT OR AGATHA GOLIE

TO

THE PUBLIC

NOTICE OF COMPLETION OF GROUNDWATER  
APPROPRIATION WITHOUT WELL

STATE OF MONTANA )  
COUNTY OF HILL ) ss.  
*Filed at 9:45 o'clock a.m.*

OCT 8 1970

R. E. BLOM  
COUNTY CLERK  
By *Robert Drey*

fee: \$2.00 paid

GW 3

Approved Stock Form—State Publishing Co., Helena, Montana—2199

10

File No. ....

T. 30 N. R. 15 E

DUPLICATE

County Hill

STATE OF MONTANA  
ADMINISTRATOR OF GROUNDWATER CODE  
OFFICE OF STATE ENGINEER

RECEIVED  
DEC 19 1963

STATE ENGINEER

Notice of Completion of Groundwater Appropriation  
Without Well

(Under Chapter 237 Montana Session Laws, 1961)

Date of Appropriation of Groundwater... Nov 19 41

Owner Glenn Stuart Herron Address Box 1209 House

Contractor (if any) .....

Address of Contractor .....

Date Started..... Date Completed.....

Describe means of obtaining groundwater without a well "as by sub-irrigation and other natural processes". Include depth to water when applicable. Pam built in 43

Spring developed in 61

Quantity of water developed and used with explanation of method used to measure or estimate such amount. If use is intermittent

estimate approximate lengths of periods of use. used when range is used spring in tank about 1/2 gal. minimum other springs not developed

Signature of Owner Stuart Herron

Date Dec 16 1963

This form to be prepared by contractor (if any), otherwise by the owner.

Three copies of this notice are to be filed with the County Clerk and Recorder of the county in which the works are located.

Please answer all questions. If not applicable, so state, otherwise the form will be returned.

Original to the County Clerk and Recorder; duplicate to the State Engineer; Triplicate to the Montana Bureau of Mines and Geology and Quadruplicate for the Appropriator.

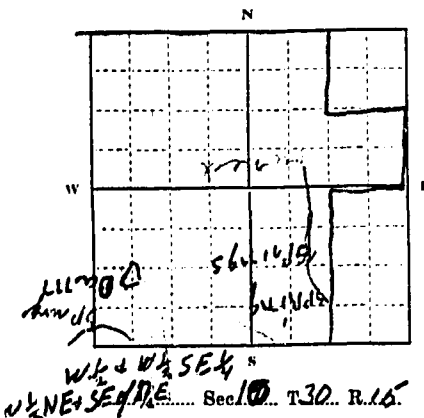

W 1/2 & W 1/2 SE 1/4  
N 1/2 NE 1/4 SE 1/4  
Sec 10 T30 R15

Indicate point of appropriation and place of use, if possible.

16310



396611

FLORENCE & STUART HERSON

TO

THE PUBLIC

NOTICE OF CONVEYANCE OF GRANT  
UNDER APPROPRIATION WITHOUT WELL

STATE OF MONTANA, )  
COUNTY OF HILL ) ss.  
Filed at 4 o'clock P. m.

ON DEC 17 1963  
R. E. Blom

COUNTY CLERK

DEPUTY

Fee \$2.00 pd.

File No. STATE WATER CONSERVATION BOARD

T. 30N R. 15E S. 32

OCT 28 1965

DUPLICATE

County Miss

Top of Ground \_\_\_\_\_  
 (Elev. above sea level) \_\_\_\_\_  
 -1 top soil  
 12 black clay  
 24 gravel and hard pan  
 58 felsic rock (Falic)  
 66 igneous rock (mafic) water

By: \_\_\_\_\_  
 B. \_\_\_\_\_  
 C. \_\_\_\_\_  
 D. \_\_\_\_\_  
 E. \_\_\_\_\_

STATE OF MONTANA  
 ADMINISTRATOR OF GROUNDWATER CODE  
 OFFICE OF STATE ENGINEER

**Notice of Completion of Groundwater Appropriation by Means of Well**

(Under Chapter 237, Montana Session Laws, 1961)

Owner Ralph George Address Havre Montana

Driller Simpson Drilling Co. Address Malta, Montana  
1609 Maple Drive, Havre, Montana

Date of Notice of appropriation of ground water \_\_\_\_\_

Date well started 6/22/1965 Date Completed 6/29/1965

Type of well Drilled Equipment used Chase Tools  
(dug, driven, bored or Churn, drill, rotary or drilled) other)

Water use: Domestic  Municipal  Stock  Irrigation   
 Industrial  Drainage  Other

Indicate on the diagram the character and thickness of the different strata met with in drilling, such as soil, clay, shale, gravel, rock or sand, etc. Show depth at which water is encountered, thickness and character of water-bearing strata and height to which the water rises in the well.

Size of Drilled Hole	Size and Weight of Casing	From (Feet)	To (Feet)	PERFORATIONS		
				Kind Size	From (Feet)	To (Feet)
6"	5" 15 lbs	1' A.G.	66	3/16	58'	66'

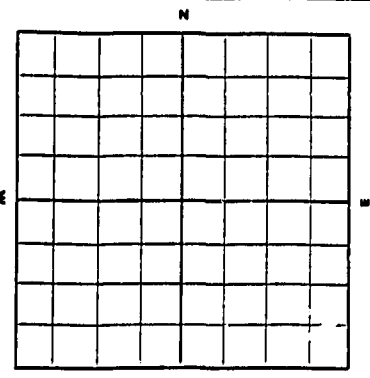

1/4 Sec. 22, T. 30 N. R. 15 E.  
 Indicate location of well and place of use, if possible. Each small square represents 10 acres.

Show exact depth of bottom.

Static Water Level for non-flowing well \_\_\_\_\_ feet.

Shut-in Pressure for Flowing Well \_\_\_\_\_

Pumping Water Level 55 feet  
at 5 gal. per minute.

Discharge in gal. per min. of flowing well \_\_\_\_\_

How Tested Pelle

Length of Test 2 hours

Remarks: (Gravel packing, cementing, packers, type of shutoff, location of place of use of groundwater if not at well, and any other similar pertinent information, including number of acres irrigated, if used for irrigation) \_\_\_\_\_

15 Driller's License Number

*[Signature]*  
Driller's Signature

This form to be prepared by driller, and three copies to be filed by the owner with the County Clerk and Recorder in the county in which the well is located.

Please answer all questions. If not applicable, so state, otherwise the form will be returned.

Original to the County Clerk and Recorder; duplicate to the State Engineer; Triplicate to the School of Mines and Quadruplicate for Appropriator.

File No.

STATE WATER CONSERVATION BOARD

T 301 R 15E 30 32

001 28 1965

DUPLICATE

County Miss

Top of Ground \_\_\_\_\_  
 (Elev. above sea level) \_\_\_\_\_  
 \_\_\_\_\_  
 \_\_\_\_\_  
 \_\_\_\_\_

STATE OF MONTANA  
 ADMINISTRATOR OF GROUNDWATER CODE  
 OFFICE OF STATE ENGINEER

### Notice of Completion of Groundwater Appropriation by Means of Well

(Under Chapter 237, Montana Session Laws, 1961)

Owner Ralph George Address Harre Montana

Driller Simpson Drilling Co. Address Malta, Montana  
1609 Maple Drive, Harre, Montana

Date of Notice of appropriation of ground water \_\_\_\_\_

Date well started 6/28/1965 Date Completed 6/29/1965

Type of well Drilled Equipment used Chas Tools  
(dug, driven, bored or Churn, drill, rotary or drilled) other)

Water use: Domestic  Municipal  Stock  Irrigation   
 Industrial  Drainage  Other

Indicate on the diagram the character and thickness of the different strata met with in drilling, such as soil, clay, shale, gravel, rock or sand, etc. Show depth at which water is encountered, thickness and character of water-bearing strata and height to which the water rises in the well.



Size of Drilled Hole	Size and Weight of Casing	From (Feet)	To (Feet)	PERFORATIONS		
				Kind Size	From (Feet)	To (Feet)
6"	5 1/2" 15 Lbs	1' A.G.	66	3/16	58'	66'

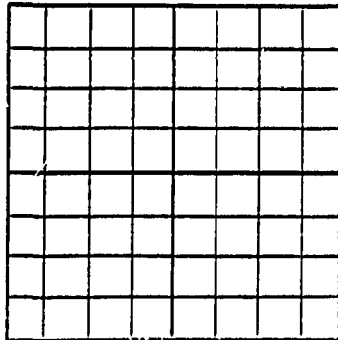

1/4 Sec. 12, T. 24 R. 15  
 Indicate location of well and place of use, if possible. Each small square represents 10 acres.

Static Water Level for non-flowing well 40 feet.

Shut-in Pressure for Flowing Well \_\_\_\_\_

Pumping Water Level 55 feet at 5 gal. per minute.

Discharge in gal. per min. of flowing well \_\_\_\_\_

How Tested Ball

Length of Test 2 Hours

Remarks: (Gravel packing, cementing, packers, type of shutoff, location of place of use of groundwater if not at well, and any other similar pertinent information, including number of acres irrigated, if used for irrigation) \_\_\_\_\_

25 Driller's License Number

D. Simpson  
Driller's Signature

66 Show exact depth of bottom.

This form to be prepared by driller, and three copies to be filed by the owner with the County Clerk and Recorder in the county in which the well is located.

Please answer all questions. If not applicable, so state, otherwise the form will be returned.

Original to the County Clerk and Recorder; duplicate to the State Engineer; Triplicate to the School of Mines and Quadruplicate for Appropriator.

Doc. No. 404480

RALPH GEORGE

TO

THE PUBLIC

COMPLETION OF GROUNDWATER  
APPROPRIATION BY MEANS OF WELL

STATE OF MONTANA )  
COUNTY OF HILL )  
Filed at 1:45 o'clock P.M.

GN OCT 27 1965

R. E. BLOM

COUNTY CLERK

By \_\_\_\_\_

(11/11)

Fees: \$ 2.00 pd.



GW 3

Approved Stock Form—State Publishing Co., Helena, Montana—42199

File No. ....

T. 30 N R. 16 E

DUPLICATE

County Hill

STATE OF MONTANA  
ADMINISTRATOR OF GROUNDWATER CODE  
OFFICE OF STATE ENGINEER

RECEIVED  
JAN 19 1964

Notice of Completion of Groundwater Appropriation  
Without Well

STATE ENGINEER

(Under Chapter 237 Montana Session Laws, 1961)

Date of Appropriation of Groundwater Indefinitely

Owner Margaret E. Clayborn Address Flussie, Mont. Shamba.

Contractor (if any) .....

Address of Contractor .....

Date Started..... Date Completed.....

Describe means of obtaining groundwater without a well "as by sub-irrigation and other natural processes". Include depth to water when applicable.....

Natural Flow

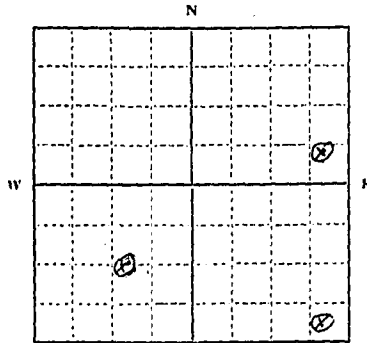

Quantity of water developed and used with explanation of method used to measure or estimate such amount. If use is intermittent

estimate approximate lengths of periods of use.....

Year Around

- (1) SE 4 NE 4 7 30 16
  - (2) SE 4 SE 4 Sec. 7 T. 30 R. 16
  - (3) SE 4 SW 4 7 30 16
- Indicate point of appropriation and place of use, if possible.

Signature of Owner Margaret E. Clayborn

Date Dec. 30, 1963

This form to be prepared by contractor (if any), otherwise by the owner.

Three copies of this notice are to be filed with the County Clerk and Recorder of the county in which the works are located.

Please answer all questions. If not applicable, so state, otherwise the form will be returned.

Original to the County Clerk and Recorder; duplicate to the State Engineer; Triplicate to the Montana Bureau of Mines and Geology and Quadruplicate for the Appropriator.

397066

MARGARET E. CLAYBORN

TO

THE PUBLIC

COMPLETION OF GROUNDWATER  
WITHOUT WELL

STATE OF MONTANA,  
COUNTY OF HILL  
*Filed at 3 o'clock p.m.*

ON DEC 30 1963

*[Signature]*  
COUNTY CLERK

SEENTY

FEE: \$2.00 pd.

File No. \_\_\_\_\_

T. 30 N. R. 16 E

DUPLICATE

County \_\_\_\_\_

STATE OF MONTANA  
ADMINISTRATOR OF GROUNDWATER CODE  
OFFICE OF STATE ENGINEER

RECEIVED  
JAN 13 1964

Declaration of Vested Groundwater Rights ENGINEER  
(Under Chapter 237, Montana Session Laws, 1961)

1. Margaret L. Clayborn, of Shamboltz House  
(Name of Appropriator) (Address) (Town)  
County of Hill State of Montana  
have appropriated groundwater according to the Montana laws in effect prior to January 1, 1962, as follows:

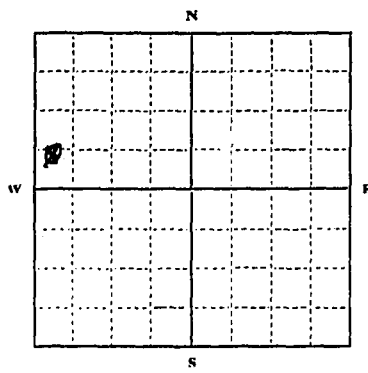

S.W. 1/4 Sec. 8, T. 30 N. R. 16 E  
Indicate point of appropriation and place of use, if possible. Each small square represents 10 acres.

2. The beneficial use on which the claim is based. Stock at buildings and home use.
3. Date or approximate date of earliest beneficial use; and how continuous the use has been. Indefinitely
4. The amount of groundwater claimed (in miner's inches or gallons per minute). Five gallon per minute.
5. If used for irrigation, give the acreage and description of the lands to which water has been applied and name of the owner thereof. None.
6. The means of withdrawing such water from the ground and the location of each well or other means of withdrawal. Shallow well with force pump.
7. The date of commencement and completion of the construction of the well, wells, or other works for withdrawal of groundwater. Perpetual in 1950
8. The depth of water table. Six to eight ft.
9. So far as it may be available, the type, size and depth of each well or the general specifications of any other works for the withdrawal of groundwater. Shallow well pumps. pumps.
10. The estimated amount of groundwater withdrawn each year. 7500 approximately
11. The log of formations encountered in the drilling of each well if available. Black loam & gravel.
12. Such other information of a similar nature as may be useful in carrying out the policy of this act, including reference to book and page of any county record. None.

Signature of Owner Margaret L. Clayborn  
Date Dec. 30-1963

Three copies to be filed by the owner with the County Clerk and Recorder of the county in which the well is located.  
Please answer all questions. If not applicable, so state, otherwise the form will be returned.

Original to the County Clerk and Recorder; Duplicate to the State Engineer; Triplicate to the Montana Bureau of Mines and Geology, and Quadruplicate for the Appropriator.



397065

MARGARET E. CLAYBORN

TO

THE PUBLIC

DECLARATION OF VESTED  
GROUNDWATER RIGHTS

STATE OF MONTANA, ) ss.  
COUNTY OF HILL )  
*Witness at 3 o'clock p.m.*

ON *Dec 8* 1963

*[Signature]*  
COUNTY CLERK

*[Signature]*  
DEPUTY

FEE: \$2.00 pd.

GW 3

Approved Stock Form—State Publishing Co., Helena, Montana—42199

File No. ....

T. 30 N R. 16 E

DUPLICATE

County Still

STATE OF MONTANA  
ADMINISTRATOR OF GROUNDWATER CODE  
OFFICE OF STATE ENGINEER

RECEIVED  
JAN 18 1964

### Notice of Completion of Groundwater Appropriation Without Well

(Under Chapter 237 Montana Session Laws, 1961)

Date of Appropriation of Groundwater Indefinitely

Owner Margaret E. Chapman Address Thurs, Montana

Contractor (if any) .....

Address of Contractor .....

Date Started..... Date Completed.....

Describe means of obtaining groundwater without a well "as by sub-irrigation and other natural processes". Include depth to water when applicable. Natural flow

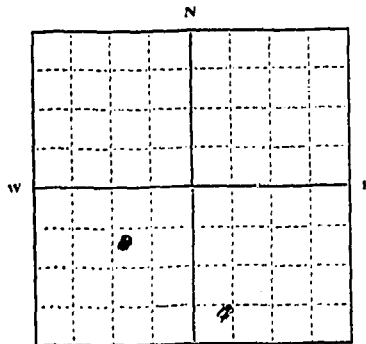

SW 4 NE 2 34 30 16  
NE 1/4 Sec. 17 T. 30. R. 16.

Indicate point of appropriation and place of use, if possible.

Quantity of water developed and used with explanation of method used to measure or estimate such amount. If use is intermittent

estimate approximate lengths of periods of use.....

Year round

Signature of Owner Margaret E. Chapman

Date Dec. 30-1963

This form to be prepared by contractor (if any), otherwise by the owner.

Three copies of this notice are to be filed with the County Clerk and Recorder of the county in which the works are located.

Please answer all questions. If not applicable, so state, otherwise the form will be returned.

Original to the County Clerk and Recorder; duplicate to the State Engineer; Triplicate to the Montana Bureau of Mines and Geology and Quadruplicate for the Appropriator.

397064

MARGARET CLAYBORN

TO

THE PUBLIC

COMPLETION OF GROUNDWATER  
WITHOUT WELL

STATE OF MONTANA  
COUNTY OF HILL  
Filed at *2* o'clock *p.m.*

ON *DEC 3* 1963

*[Signature]*  
COUNTY CLERK  
DEPUTY

FEE: \$2.00 pd.

RECEIVED

30N-16E  
County MTL 29

SEP 12 1972

STATE OF MONTANA  
ADMINISTRATOR OF GROUNDWATER CODE  
MONTANA WATER RESOURCES BOARD  
NOTICE OF COMPLETION OF GROUNDWATER  
APPROPRIATION BY MEANS OF WELL

Developed after January 1, 1962

DRILLER'S LOG

Indicate the character, color, thickness of strata such as soil, clay, sand, gravel, shale, sandstone, etc. Show depth at which water is found and height to which water rises in well.

(Under Chapter 237 Montana Session Laws, 1961, as amended)

This form to be prepared by driller, and three copies to be filed by the owner with the County Clerk and Recorder in the county in which the well is located, last copy to be retained by driller. Please answer all questions. If not applicable, so state, otherwise the form may be returned.

Owner GORDON H. KENNEL

Address 726 6TH AVE

HAYRE, MONTANA

Date well started MAY 8, 1972

completed MAY 12, 1972

Type of well DRILLED

Equipment used CABLE TOOL RIG

Water Use: Domestic  Municipal  Stock  Irrigation

Industrial  Drainage  Other  Garden/Lawn

\*Describe

USE: if used for irrigation, industrial, drainage or other. Explain, state number of acres and location or other data (i.e. Lot, Block and Addition). 12 ACRES

ESTIMATED ANNUAL WITHDRAWAL EXCEEDING 2,500,000 GALLONS

Size of Drilled Hole	Size and Weight of Casing	From (Feet)	To (Feet)	PERFORATIONS		
				Kind Size	From (Feet)	To (Feet)
<u>8 1/2"</u>		<u>0</u>	<u>148</u>			
<u>6 5/8"</u>	<u>6 5/8" O.D. (.188 WALL)</u>	<u>1 FOOT ABOVE GROUND LEVEL</u>	<u>151' 3"</u>	<u>(NO PERFORATIONS)</u>		
	<u>1 3/8" PER FOOT BLACK STEEL</u>			<u>WATER COMING IN THRU BOTTOM OF DRIVE SHOE AT 151' 3" LEVEL</u>		

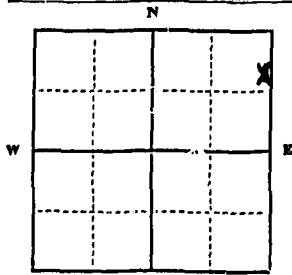

NE 1/4 NE 1/4 Sec. 29  
T. 30 N. R. 16 W.

INDICATE LOCATION OF WELL AND PLACE OF USE, IF POSSIBLE. EACH SMALL SQUARE REPRESENTS 40 ACRES.

Driller's Signature Robert Quinn HI-LINE DRILLING SERVICE

Driller's Address 1173 6TH S. 16. PHONE 265-4210

HAYRE, MONTANA 59501 LICENSE NO. 46

Top of Ground (Elev. above sea level)	
From (Feet)	To (Feet)
<u>0 TO 3</u>	<u>SOIL</u>
<u>7</u>	<u>SANDY YELLOWISH-BROWN CLAY</u>
<u>20</u>	<u>YELLOWISH-BROWN CLAY</u>
<u>42</u>	<u>BROWN CLAY - SMALL BOULDERS</u>
<u>50</u>	<u>GREY CLAY</u>
<u>74</u>	<u>SANDY GREY CLAY</u>
<u>75</u>	<u>BOULDER</u>
<u>104</u>	<u>SANDY GREY CLAY</u>
<u>124</u>	<u>SANDY GRAVELLY GREY CLAY</u>
<u>143</u>	<u>GREY CLAY</u>
<u>148 1/2</u>	<u>GREY CLAY - BOULDERS</u>
<u>151' 3"</u>	<u>VOLCANIC SAND &amp; GRAVEL - WATER - EXCEEDING 20 GPM</u>
	<u>YIELD ON 30 MINUTE BALER TEST: 17 1/2 GALLONS PER MINUTE AT 112 FOOT LEVEL</u>

151' 3" Show exact depth of bottom

51,347

425677

GORDON H. KENNEL

TO

THE PUBLIC

WATER WELL

STATE OF MONTANA )  
COUNTY OF HILL ) ss.  
Filed at 11:15'clock A.m

SEP 11 1972

R. E. Blom

COUNTY CLERK

By

*Barth E. Day*  
DEPUTY

INDEXED

Fee:\$2.00 pd.



G.W. FIL. NO. \_\_\_\_\_

TWP 30N RGE 17 E  
COUNTY DEERBOLT

STATE OF MONTANA  
ADMINISTRATOR OF GROUNDWATER CODE  
OFFICE OF STATE ENGINEER

DECLARATION OF VESTED GROUNDWATER RIGHTS  
(Under Chapter 237, Montana Session Laws, 1961) STATE ENGINEER

1. Harold Blain, of Box 122 Reine  
(Name of Appropriator) (Address) (Town)  
County of HILL, State of Montana  
Have appropriated groundwater according to the Montana laws in effect prior to Jan. 1, 1962 as follows:

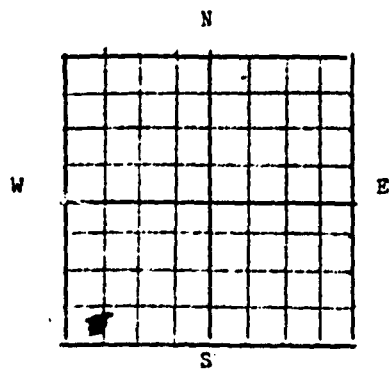

E 1/2 W 1/2 Sec. 4 T 30R 17

Indicate point of appropriation and place of use, if possible. Each small square represents 10 acres.

2. The beneficial use on which the claim is based house & irrigation
3. Date or approximate date of earliest beneficial use; and how continuous the use has been 1918 continuous
4. The amount of groundwater claimed (in miner's inches or gallons per minute) 10 cfm
5. If used for irrigation, give the acreage and description of the lands to which water has been applied and name of the owner thereof \_\_\_\_\_
6. The means of withdrawing such water from the ground and the location of each well or other means of withdrawal Electric Power Pump
7. The date of commencement and completion of the construction of the wells, walls, or other works for withdrawal of groundwater finished July 1963
8. The depth of water table 100'
9. So far as it may be available, the type, size and depth of each well or the general specifications of any other works for the withdrawal of groundwater 3 casing 120' deep
10. The estimated amount of groundwater withdrawn each year 169511 gal
11. The log of formations encountered in the drilling of each well if available \_\_\_\_\_
12. Such other information of a similar nature as may be useful in carrying out the policy of this act, including reference to book and page of any county record \_\_\_\_\_

Signature of Owner Harold Blain  
Date Dec 31 - 1963

Three copies to be filed by the owner with the County Clerk & Recorder of the County in which the well is located.

PLEASE ANSWER ALL QUESTIONS. IF NOT APPLICABLE, SO STATE, OTHERWISE THE FORM WILL BE RETURNED.

Original to the County Clerk & Recorder; duplicate to the State Engineer; Triplicate to the School of Mines and Quadruplicate for the Appropriator.

397168

HOWARD PERPET

TO

THE PUBLIC

DECLARATION OF VESTED  
GROUNDWATER RIGHTS

STATE OF MONTANA, ss.  
COUNTY OF HILL

Filed at 11 o'clock *50*

ON 31 1963

*16 Blain*  
COUNTY CLERK

RECEIVED

FEE: \$2.00 pd.



File No. ....

RECEIVED  
NOV 28 1962

T. 30 R. 17

DUPLICATE

County HILL

STATE OF MONTANA  
STATE ENGINEER ADMINISTRATOR OF GROUNDWATER CODE  
OFFICE OF STATE ENGINEER

Notice of Completion of Groundwater  
Appropriation by Means of Well

(Under Chapter 237, Montana Session Laws, 1961)

Owner TED & HARRY S. LAMON Address HAURE

Driller ERNEST O. LEE Address 1200 3rd St

Date of Notice of Appropriation of Groundwater NOV 1

Date well started NOV 10 Date Completed NOV 17

Type of well DRILLED Equipment Used C. H. V. R. N.  
(dug, driven, bored or drilled) (Churn, drill, rotary or other)

Water Use: Domestic  Municipal  Other  Irrigation   
Industrial  Drainage  Stock

Indicate on the diagram the character and thickness of the different strata met with in drilling, such as soil, clay, shale, gravel, rock or sand, etc. Show depth at which water is encountered, thickness and character of water-bearing strata and height to which water rises in the well.

10  
6  
31  
31  
39  
76  
76  
97  
97  
145  
115  
121

Top of Ground  
(Elev. above sea level.....)  
Top soil  
Blue clay  
Quartzite  
Blue clay  
yellow clay  
sand & clay  
sand & sh

Size of Drilled Hole	Size and Weight of Casing	From (Feet)	To (Feet)	PERFORATIONS		
				Kind Size	From (Feet)	To (Feet)
7"	7 26.6	0	121			
40	4 1/2 10.79	81	121			

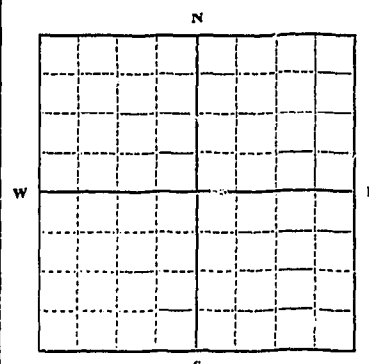

5W 1/4 Sec. 6 T. 2E. R. 17  
Indicate location of well and place of use, if possible. Each small square represents 10 acres.

Show exact depth of bottom.

Static Water Level for non-flowing Well 6.5 feet.  
Shut-in Pressure for Flowing Well .....  
Pumping Water Level 10.5 feet at 6 gal. per minute.  
Discharge in gal. per min. of flowing well .....  
How Tested PALER Length of Test 2 hr

Remarks: (Gravel packing, cementing, packers, type of shutoff, location of place of use of groundwater if not at well, and any other similar pertinent information, including number of acres irrigated, if used for irrigation) .....

#21  
Driller's License Number  
Ernest O. Lee  
Driller's Signature

This form to be prepared by driller, and three copies to be filed by the owner with the County Clerk and Recorder in the county in which the well is located.

Please answer all questions. If not applicable, so state, otherwise the form will be returned.

Original to the County Clerk and Recorder; duplicate to the State Engineer; Triplicate to the Montana Bureau of Mines and Geology and Quadruplicate for the Appropriator.

391327

TED & HARRY SOLOMON

TO

THE PUBLIC

NOTICE OF COMPLETION OF GROUND  
WATER APPROPRIATION BY MANS OF  
WELL

STATE OF MONTANA )  
COUNTY OF HILL ) ss.  
Filed at 2 o'clock P.m

ON NOV 27 1962  
G. C. Yeon

COUNTY CLERK

By \_\_\_\_\_  
DEPUTY

Fee: \$2.00 pd.

GW  
FILE NO. \_\_\_\_\_

TWP 30<sup>N</sup> RGE 17<sup>E</sup> 27  
COUNTY \_\_\_\_\_

STATE OF MONTANA  
ADMINISTRATOR OF GROUNDWATER CODE  
OFFICE OF STATE ENGINEER

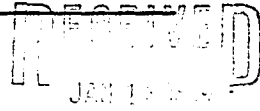

DECLARATION OF VESTED GROUNDWATER RIGHTS  
(Under Chapter 237, Montana Session Laws, 1961) STATE ENGINEER

1. The Brown Company, of Chinook  
(Name of Appropriator) (Address) (Town)  
County of Blaine, State of \_\_\_\_\_

Have appropriated groundwater according to the Montana laws in effect prior to Jan. 1, 1962 as follows:

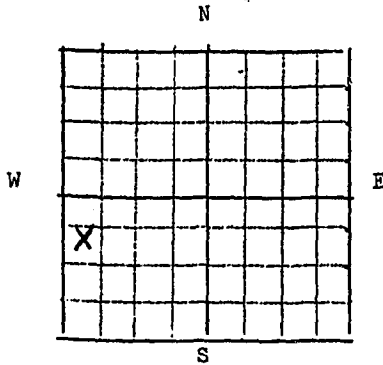

NW 1/4 SW Sec 27 T 30 R 17

Indicate point of appropriation and place of use, if possible. Each small square represents 10 acres.

2. The beneficial use on which the claim is based  
stock water

3. Date or approximate date of earliest beneficial use; and how continuous the use has been \_\_\_\_\_

4. The amount of groundwater claimed (in miner's inches or gallons per minute)  
12 gal

5. If used for irrigation, give the acreage and description of the lands to which water has been applied and name of the owner thereof \_\_\_\_\_

6. The means of withdrawing such water from the ground and the location of each well or other means of withdrawal  
flowing spring

7. The date of commencement and completion of the construction of the well, wells, or other works for withdrawal of groundwater  
Not available

8. The depth of water table \_\_\_\_\_

9. So far as it may be available, the type, size and depth of each well or the general specifications of any other works for the withdrawal of groundwater \_\_\_\_\_

10. The estimated amount of groundwater withdrawn each year  
250,000 gal

11. The log of formations encountered in the drilling of each well if available \_\_\_\_\_

12. Such other information of a similar nature as may be useful in carrying out the policy of this act, including reference to book and page of any county record \_\_\_\_\_

Signature of Owner The Brown Company  
By [Signature]  
Date 12-31-63

Three copies to be filed by the owner with the County Clerk & Recorder of the County in which the well is located.

PLEASE ANSWER ALL QUESTIONS. IF NOT APPLICABLE, SO STATE, OTHERWISE THE FORM WILL BE RETURNED.

Original to the County Clerk & Recorder; duplicate to the State Engineer; Triplicate to the School of Mines and Quadruplicate for the Appropriator.

3971.09

THE BROWN COMPANY

TO

THE PUBLIC

DECLARATION OF VESTED  
GROUNDWATER RIGHTS

STATE OF MONTANA, ) ss.  
COUNTY OF HILL )  
Filed at 11 o'clock a.m.

ON DEC 31 1963  
[Signature]  
COUNTY CLERK

[Signature] DEPUTY

EE: \$2.00 pd.



File No. ....

T. 29 N. R. 8 E. 6

DUPLICATE

RECEIVED  
DEC 27 1963  
HILL

STATE OF MONTANA  
ADMINISTRATOR OF GROUNDWATER CODE  
OFFICE OF STATE ENGINEER

STATE ENGINEER

Declaration of Vested Groundwater Rights

(Under Chapter 237, Montana Session Laws, 1961)

1. Roald Haaland, of Inverness  
(Name of Appropriator) (Address) (Town)

County of Hill State of Montana  
have appropriated groundwater according to the Montana laws in effect prior to January 1, 1962, as follows:

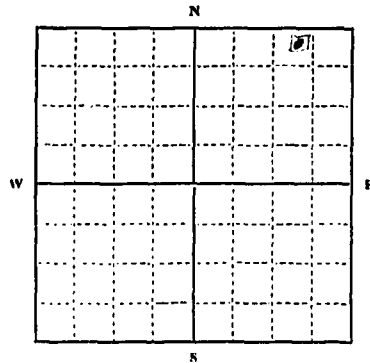

NE 1/4 Sec. 6, T. 29, R. 8

Indicate point of appropriation and place of use, if possible. Each small square represents 10 acres.

2. The beneficial use on which the claim is based Home home & livestock

3. Date or approximate date of earliest beneficial use; and how continuous the use has been October 1951 continuous

4. The amount of groundwater claimed (in miner's inches or gallons per minute) 3 gallons per minute

5. If used for irrigation, give the acreage and description of the lands to which water has been applied and name of the owner thereof

6. The means of withdrawing such water from the ground and the location of each well or other means of withdrawal Submersible Pump

7. The date of commencement and completion of the construction of the well, wells, or other works for withdrawal of groundwater October 1951

8. The depth of water table 4.0 ft

9. So far as it may be available, the type, size and depth of each well or the general specifications of any other works for the withdrawal of groundwater Drug well side track 239 ft deep

10. The estimated amount of groundwater withdrawn each year 190,000 gal

11. The log of formations encountered in the drilling of each well if available Not available

12. Such other information of a similar nature as may be useful in carrying out the policy of this act, including reference to book and page of any county record

Signature of Owner Roald Haaland

Date .....

Three copies to be filed by the owner with the County Clerk and Recorder of the county in which the well is located.

Please answer all questions. If not applicable, so state, otherwise the form will be returned.

Original to the County Clerk and Recorder; Duplicate to the State Engineer; Triplicate to the Montana Bureau of Mines and Geology, and Quadruplicate for the Appropriator.

396697

ROALD HAALAND

TO

THE PUBLIC

DECLARATION OF VESTED OR FUND  
WATER RIGHTS

STATE OF MONTANA )  
COUNTY OF HILL )  
Filed at 4 o'clock P.M.

BY R. E. Blom  
COUNTY CLERK

DEPUTY

Fee: \$2.00 pd.

GW

Approved Stock Form—State Publishing Co., Helena, Montana—41921

File No. \_\_\_\_\_

T. 29N R. 8E

DUPLICATE

County Hill

STATE OF MONTANA  
ADMINISTRATOR OF GROUNDWATER CODE  
OFFICE OF STATE ENGINEER

RECEIVED  
DEC 20 1963  
STATE ENGINEER

Declaration of Vested Groundwater Rights

(Under Chapter 237, Montana Session Laws, 1961)

I, L. B. Horn, of Ammon,  
(Name of Appropriator) (Address) (Town)  
County of Hill State of Montana  
have appropriated groundwater according to the Montana laws in effect prior to January 1, 1962, as follows:

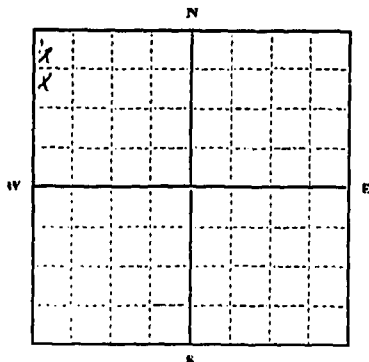

1/4 Sec. 1 T. 29. R. 8

Indicate point of appropriation and place of use, if possible. Each small square represents 10 acres.

- The beneficial use on which the claim is based Domestic and livestock water garden and shelter belt
- Date or approximate date of earliest beneficial use; and how continuous the use has been July 1947 - Present
- The amount of groundwater claimed (in miner's inches or gallons per minute) 8 gallons
- If used for irrigation, give the acreage and description of the lands to which water has been applied and name of the owner thereof  
11.14 - 6-29-8
- The means of withdrawing such water from the ground and the location of each well or other means of withdrawal Hand pump
- The date of commencement and completion of the construction of the well, wells, or other works for withdrawal of groundwater First part of June 1947 - finished last of July
- The depth of water table 200 ft.
- So far as it may be available, the type, size and depth of each well or the general specifications of any other works for the withdrawal of groundwater 6 inch casing - 2 inch pipe - depth 236 ft.
- The estimated amount of groundwater withdrawn each year 700,000 gal.
- The log of formations encountered in the drilling of each well if available Not available
- Such other information of a similar nature as may be useful in carrying out the policy of this act, including reference to book and page of any county record 1111

Signature of Owner L. B. Horn  
Date \_\_\_\_\_

Three copies to be filed by the owner with the County Clerk and Recorder of the county in which the well is located.

Please answer all questions. If not applicable, so state, otherwise the form will be returned.

Original to the County Clerk and Recorder; Duplicate to the State Engineer; Triplicate to the Montana Bureau of Mines and Geology, and Quadruplicate for the Appropriator.



396664

L. B. WAB

TO

THE PUBLIC

DECLARATION OF VESTED GROUND  
WATER RIGHTS

STATE OF MONTANA )  
COUNTY OF HILL )  
Filed at 1 o'clock Pm.

ON DEC 19 1963

R. E. Blom

COUNTY CLERK

BY \_\_\_\_\_ DEPUTY

Fee: \$2.00 pd.

GW2

File No.....

T.29N R. 8 E.

DUPLICATE

County Hill

STATE OF MONTANA  
ADMINISTRATOR OF GROUNDWATER CODE  
OFFICE OF STATE ENGINEER

Notice of Completion of Groundwater  
Appropriation by Means of Well

(Under Chapter 237, Montana Session Laws, 1961)

- 0 3 - Surface Soil (Elev. above sea level.....)
- 3 35 - Clay
- 35 50 - Blue Clay (Seep of Water)
- 50 70 - Blue Sandy Clay
- 70 75 - Gravel & Clay - Sandy Seep of Water
- 75 90 - Blue Clay
- 90 100 - Gravel, Water, Sand & Quick Sand
- 100 120 - Blue ~~sandy~~ clay
- 120 125 - Blue Sandy Clay
- 125 145 - Quick Sand - Gravel & Water
- 145 225 - Blue Clay, Gravel, Quick Sand, Seep of Water
- 225 285 - Quick Sand, Gravel & Clay
- 285 295 - Clay & Gravel
- 295 305 - Gravel & Coarse Sand & Water
- 305 - Bottom - Pumping Level 208 Ft.

Owner Frederick L. O'Neil Address Rudyard, Montana

Driller Orville Jacobson Address Chester, Montana

Date of Notice of Appropriation of Groundwater .....

Date well started Sept. 5, 1962 Date Completed 9/25/62

Type of well Stock Equipment Used Cable Tools  
(dug, driven, bored or drilled) Drilled (Churn, drill, rotary or other)

Water Use: Domestic  Municipal  Stock  Irrigation   
Industrial  Drainage  Other

Indicate on the diagram the character and thickness of the different strata met with in drilling, such as soil, clay, shale, gravel, rock or sand, etc. Show depth at which water is encountered, thickness and character of water-bearing strata and height to which the water rises in the well.

Size of Drilled Hole	Size and Weight of Casing	From (Feet)	To (Feet)	PERFORATIONS		
				Kind Size	From (Feet)	To (Feet)
7 in.	used	0				
5 1/2 in.	new & used	18 in above ground	297	Slot	187	297

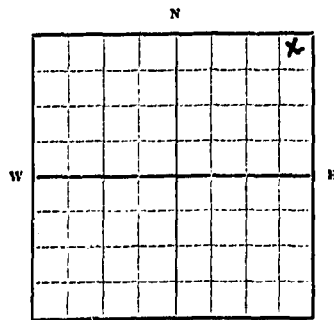

NE 1/4 Sec. 12. T29N R. 8E.  
Indicate location of well and place of use, if possible. Each small square represents 10 acres.

Show exact depth of bottom.

Static Water Level for non-flowing Well.....feet.

Shut-in Pressure for Flowing Well .....

Pumping Water Level.....208.....feet at.....6.....gal. per minute.

Discharge in gal. per min. of flowing well .....

How Tested.....Bailer..... Length of Test.....8 Hrs

Remarks: (Gravel packing, cementing, packers, type of shutoff, location of place of use of groundwater if not at well, and any other similar pertinent information, including number of acres irrigated, if used for irrigation) .....

62  
Driller's License Number

Orville Jacobson  
Driller's Signature

This form to be prepared by driller, and three copies to be filed by the owner with the County Clerk and Recorder in the county in which the well is located.

Please answer all questions. If not applicable, so state, otherwise the form will be returned.

Original to the County Clerk and Recorder; duplicate to the State Engineer; Triplicate to the School of Mines and Quadruplicate for the Appropriator.

390851

FREDERICK L. O'NEIL

TO

THE PUBLIC

NOTICE OF COMPLETION OF  
GROUNDWATER APPROPRIATION  
BY MEANS OF WELL

STATE OF MONTANA )  
COUNTY OF HILL )

*Filed at 1:25 o'clock P.m.*

ON OCT 23 1962

G. C. Yeon

COUNTY CLERK

By \_\_\_\_\_

DEPUTY

Fee: \$2.00 pd.

GWS

File No. ....

DUPLICATE

T. 29 N E 8  
County: **BEAUFORT**

STATE OF MONTANA  
ADMINISTRATOR OF GROUNDWATER CODE  
OFFICE OF STATE ENGINEER

**RECEIVED**  
JAN 1 1963  
STATE ENGINEER

**Notice of Completion of Groundwater Appropriation Without Well**

(Under Chapter 237 Montana Session Laws, 1961)

*Surface  
irrigation*

Date of Appropriation of Groundwater MAY, 1947

Owner SILMENS, (DOROTHY) Address RUDYARD, MONTANA

Contractor (if any) none

Address of Contractor .....

Date Started MAY, 1947 Date Completed June 1951

Describe means of obtaining groundwater without a well "as by sub-irrigation and other natural processes". Include depth to water when applicable. We use a six (6) inch Hyshon Push Pump and depth to water is approximately 12 feet.

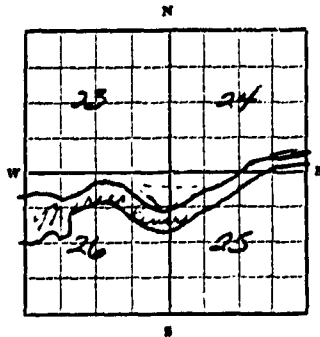

Quantity of water developed and used with explanation of method used to measure or estimate such amount. If use is intermittent estimate approximate lengths of periods of use

The pump pumps 3000 gallons a minute and we irrigate for four (4) days each time we irrigate for ten hours each day. We generally irrigate four (4) times during each summer. The rainfall we get determine the times we have to irrigate.

Signature of Owner Pete Silmens  
Dorothy Silmens  
Date Dec. 30, 1963

..... 1/4 Sec. .... T. .... R. ....  
Indicate point of appropriation and place of use, if possible.  
Sec. 26 Lot 1, T. 29. R. 8  
Sec. 25 Lot 5, T. 29. R. 8

This form to be prepared by contractor (if any), otherwise by the owner.

Three copies of this notice are to be filed with the County Clerk and Recorder of the county in which the works are located.

Please answer all questions. If not applicable, so state, otherwise the form will be returned.

Original to the County Clerk and Recorder; duplicate to the State Engineer; Triplicate to the School of Mines and Quadruplicate for the Appropriator.

31076