

423833

ARTHUR J. REYNOLDS

TO

THE PUBLIC

WATER WELL

STATE OF MONTANA, ss.  
COUNTY OF HILL )  
Filed at 1:00 o'clock P.M.

ON FEB 28 1972

R. E. Blom COUNTY CLERK

*Barth E. Dry*  
DEPUTY

Fee: \$2.00 pd.

INDEXED

GWS

File No. ....

DUPLICATE

T. 31 N R. 14 E

23

County HILL

STATE OF MONTANA  
ADMINISTRATOR OF GROUNDWATER CODE  
OFFICE OF STATE ENGINEER

RECEIVED  
DEC 27 1963

STATE ENGINEER

**Notice of Completion of Groundwater Appropriation Without Well**

(Under Chapter 237 Montana Session Laws, 1961)

Date of Appropriation of Groundwater .....

Owner WILLIAM E. BRANN Address SHAMBO RTZ HAZARD ALBERTA

Contractor (if any) NONE

Address of Contractor .....

Date Started..... Date Completed.....

Describe means of obtaining groundwater without a well "as by sub-irrigation and other natural processes". Include depth to

water when applicable. A Spring Feeds into a natural reservoir

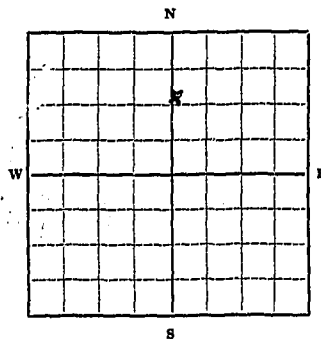

NW 1/4 Sec 23 T. 31 N. R. 14 E

Indicate point of appropriation and place of use, if possible.

Quantity of water developed and used with explanation of method used to measure or estimate such amount. If use is intermit-

tent estimate approximate lengths of periods of use .....

IT FILLS A RESERVOIR ABOUT 60 FT LONG X 15 FT WIDE & 3 FT DEEP

Signature of Owner William E. Brann

Date Dec. 17-63

This form to be prepared by contractor (if any), otherwise by the owner.

Three copies of this notice are to be filed with the County Clerk and Recorder of the county in which the works are located.

Please answer all questions. If not applicable, so state, otherwise the form will be returned.

Original to the County Clerk and Recorder; duplicate to the State Engineer; Triplicate to the School of Mines and Quadruplicate for the Appropriator.

295817

WILLIAM E. BROWN

TO

THE PUBLIC

COMPLETION OF GROUNDWATER  
WITHOUT A WELL

STATE OF MONTANA, ss.  
COUNTY OF HILL )  
*Filed at 2:00 o'clock pm.*

ON DEC 26 1963  
W. E. Brown  
COUNTY CLERK  
DEPUTY

FEES \$2.00 pd.

396817

WILLIAM E. BROWN

TO

THE PUBLIC

COMPLETION OF GROUNDWATER  
WITHOUT A WELL

STATE OF MONTANA )  
COUNTY OF HILL )  
*Filed at 2:00'clock pm.*

ON DEC 26 1963  
W. E. Plain  
COUNTY CLERK

DEPUTY

FEE: \$2.00 pd.

GW3

File No. ....

DUPLICATE

T. 31 N R 14 E

County.....

RECEIVED  
DEC 13 1963

STATE OF MONTANA  
ADMINISTRATOR OF GROUNDWATER CODE  
OFFICE OF STATE ENGINEER

STATE ENGINEER

Notice of Completion of Groundwater Appropriation Without Well

(Under Chapter 237 Montana Session Laws, 1961)

Date of Appropriation of Groundwater .....  
Owner Richard W. Brown address Shadoboltz Mont

Contractor (if any) None

Address of Contractor .....

Date Started..... Date Completed.....

Describe means of obtaining groundwater without a well "as by sub-irrigation and other natural processes". Include depth to water when applicable. A Spring Feeds INTO a natural reservoir that is about 150 FT long & 50 FT wide

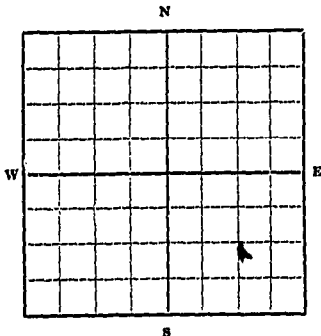

Quantity of water developed and used with explanation of method used to measure or estimate such amount. If use is intermittent estimate approximate lengths of periods of use .....

SE 1/4 Sec 23 T31 R14  
IT keeps a reservoir 150 FT X 50 FT X 5 FT deep full

Indicate point of appropriation and place of use, if possible.

Signature of Owner Richard W. Brown

Date Dec 10 1963

This form to be prepared by contractor (if any), otherwise by the owner.

Three copies of this notice are to be filed with the County Clerk and Recorder of the county in which the works are located.

Please answer all questions. If not applicable, so state, otherwise the form will be returned.

Original to the County Clerk and Recorder; duplicate to the State Engineer; Triplicate to the School of Mines and Quadruplicate for the Appropriator.

396513

RICHARD W. BROWN

TO

THE PUBLIC

NOTICE OF COMPLETION OF GROUND  
WATER APPROPRIATION WITHOUT WELL

STATE OF MONTANA, ) ss.  
COUNTY OF HILL )  
Filed at 11 o'clock A.M.

ON DEC 12 1963

R. E. Blom

COUNTY CLERK

BY \_\_\_\_\_ DEPUTY

Fee: \$2.00 pd.

File No. ....

T. 31 N 14 E

DUPLICATE

County Hill

STATE OF MONTANA  
ADMINISTRATOR OF GROUNDWATER CODE  
OFFICE OF STATE ENGINEER

RECEIVED  
DEC 23 1963

Declaration of Vested Groundwater Rights  
(Under Chapter 237, Montana Session Laws, 1961)

STATE ENGINEER

1. Ray Latta of Shamba Route House  
(Name of Appropriator) (Address) (Town)  
County of Hill State of Montana  
have appropriated groundwater according to the Montana laws in effect prior to January 1, 1962, as follows:

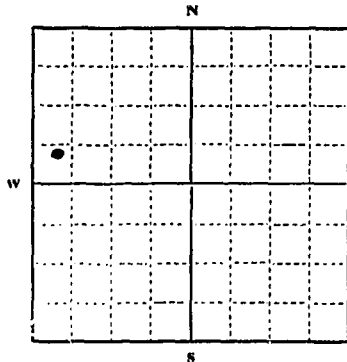

pt. 14 Sec 23 T. 31 R. 14  
Indicate point of appropriation and place of use, if possible. Each small square represents 10 acres.

2. The beneficial use on which the claim is based  
House hold use

3. Date or approximate date of earliest beneficial use; and how continuous the use has been  
Sept 1943  
Continually

4. The amount of groundwater claimed (in miner's inches or gallons per minute)  
1 gal per minute

5. If used for irrigation, give the acreage and description of the lands to which water has been applied and name of the owner thereof  
Not applicable

6. The means of withdrawing such water from the ground and the location of each well or other means of withdrawal  
Electric pump

7. The date of commencement and completion of the construction of the well, wells, or other works for withdrawal of groundwater  
Sept 1943

8. The depth of water table  
20 feet

9. So far as it may be available, the type, size and depth of each well or the general specifications of any other works for the withdrawal of groundwater  
Dug well - Brick wall 6' Diameter  
1 1/2" withdrawal pipe

10. The estimated amount of groundwater withdrawn each year  
50,000 gal

11. The log of formations encountered in the drilling of each well if available  
Not available

12. Such other information of a similar nature as may be useful in carrying out the policy of this act, including reference to book and page of any county record  
None

Signature of Owner Ray Latta  
Date Dec 20 - 63

Three copies to be filed by the owner with the County Clerk and Recorder of the county in which the well is located.

Please answer all questions. If not applicable, so state, otherwise the form will be returned.

Original to the County Clerk and Recorder; Duplicate to the State Engineer; Triplicate to the Montana Bureau of Mines and Geology, and Quadruplicate for the Appropriator.

396678

ROY LOTTEH

TO

THE PUBLIC

DECLARATION OF VESTED GROUND  
WATER RIGHTS

STATE OF MONTANA, ss.  
COUNTY OF HILL )  
Filed at \_\_\_\_\_ o'clock A.M.

ON DEC 20 1963

R. E. BISHOP  
CLERK

BY \_\_\_\_\_ DEPUTY

Fee: \$2.00 pd.



File No. \_\_\_\_\_

T31N R14E

DUPLICATE

County HILL

Top of Ground  
(Elev. above sea level \_\_\_\_\_)

STATE OF MONTANA  
ADMINISTRATOR OF GROUNDWATER CODE  
OFFICE OF STATE ENGINEER

### Notice of Completion of Groundwater Appropriation by Means of Well

(Under Chapter 237, Montana Session Laws, 1961)

28 brown clay  
32 blue sand water  
71 brown clay  
75 blue sand  
77 sand and gravel

Owner WILLIAM TOW Address SILVER ROUTE

Driller T.P. NO. DRILLING CO. Address MALTA, MONTANA

Date of Notice of appropriation of ground water \_\_\_\_\_

Date well started OCT. 12 1968 Date Completed OCT. 15 1968

Type of well DRILLED Equipment used CALLS TOOLS  
(dug, driven, bored or Churn, drill, rotary or drilled) other)

Water use: Domestic  Municipal  Stock  Irrigation   
Industrial  Drainage  Other

Indicate on the diagram the character and thickness of the different strata met with in drilling, such as soil, clay, shale, gravel, rock or sand, etc. Show depth at which water is encountered, thickness and character of water-bearing strata and height to which the water rises in the well.

Size of Drilled Hole	Size and Weight of Casing	From (Feet)	To (Feet)	PERFORATIONS		
				Kind Size	From (Feet)	To (Feet)
9"	3 1/2" I.D.	1'	A. G.	77'		

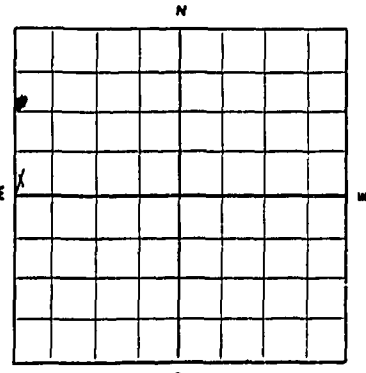

S. 1/4 NW 1/4 Sec. 23 T. 31 N. R. 14 E  
Indicate location of well and place of use, if possible. Each small square represents 10 acres.

Static Water Level for non-flowing well 21 feet.

Shut-in Pressure for Flowing Well \_\_\_\_\_

Pumping Water Level 40 feet  
at 10 gal. per minute.

Discharge in gal. per min. of flowing well \_\_\_\_\_

How Tested BAILER

Length of Test 2 HOURS

Remarks: (Gravel packing, cementing, packers, type of shutoff, location of place of use of groundwater if not at well, and any other similar pertinent information, including number of acres irrigated, if used for irrigation) \_\_\_\_\_

15  
Driller's License Number

*[Signature]*  
Driller's Signature

77 Show exact depth of bottom.

This form to be prepared by driller, and three copies to be filed by the owner with the County Clerk and Recorder in the county in which the well is located.

Please answer all questions. If not applicable, so state, otherwise the form will be returned.

Original to the County Clerk and Recorder; duplicate to the State Engineer; Triplicate to the School of Mines and Quadruplicate for Appropriator.

44,991

~~412889~~

412889

RAYMOND TOW

TO

THE PUBLIC

NOTICE OF COMPLETION OF  
GROUNDWATER APPROPRIATION

STATE OF MONTANA, ) ss.  
COUNTY OF HILL )  
Filed at 2:20 o'clock P.m.

FEB 10 1969

R. E. BLOM

COUNTY CLERK

DEPUTY

fee: \$2.00 paid

GW 4  
FILE NO. \_\_\_\_\_  
DUPLICATE

TWP 31 RGE 14  
COUNTY Hell

STATE OF MONTANA  
ADMINISTRATOR OF GROUNDWATER CODE  
OFFICE OF STATE ENGINEER

RECEIVED

DECLARATION OF VESTED GROUNDWATER RIGHTS  
(Under Chapter 237, Montana Session Laws, 1961)

STATE ENGINEER

1. Carl Becker, of Shambert House  
(Name of Appropriator) (Address) (Town)  
County of Hell, State of Montana  
Have appropriated groundwater according to the Montana laws in effect prior to Jan. 1, 1962 as follows:

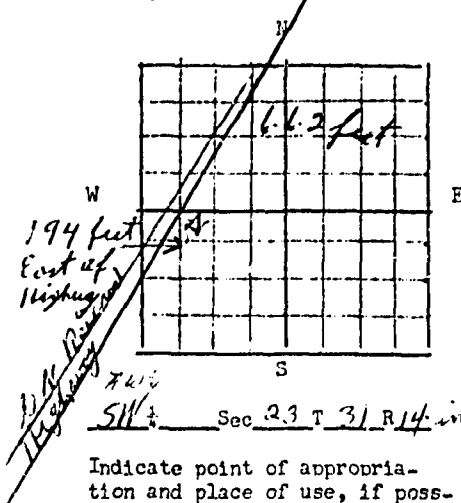

- The beneficial use on which the claim is based has not been used irrigation in part garden
- Date or approximate date of earliest beneficial use; and how continuous the use has been begin irrigation Aug 27 1953 and has been continued since then in summer
- The amount of groundwater claimed (in miner's inches or gallons per minute) 13 gallons per minute
- If used for irrigation, give the acreage and description of the lands to which water has been applied and name of the owner thereof Carl Becker 6.62 acre yard surrounding well garden
- The means of withdrawing such water from the ground and the location of each well or other means of withdrawal Electric pump
- The date of commencement and completion of the construction of the well, wells, or other works for withdrawal of groundwater started drilling about the 20th of Aug 1953 completed Aug 26 1953
- The depth of water table 155 ft
- So far as it may be available, the type, size and depth of each well or the general specifications of any other works for the withdrawal of groundwater Drilled well 6" dia, 10' deep
- The estimated amount of groundwater withdrawn each year 500,000 Gall per year
- The log of formations encountered in the drilling of each well if available 2' fill of thickness 14' sandy fill, 14' to 28' thickness 14' yellow fill, 28' to 100' thickness blue gray clay, 10' to 18' thickness 7' red sand, 18' to 10' thickness 2' sandy gravel, 10' to 2'
- Such other information of a similar nature as may be useful in carrying out the policy of this act, including reference to book and page of any county record \_\_\_\_\_

Signature of Owner Carl Becker  
Date \_\_\_\_\_

Three copies to be filed by the owner with the County Clerk & Recorder of the County in which the well is located.

PLEASE ANSWER ALL QUESTIONS. IF NOT APPLICABLE, SO STATE, OTHERWISE THE FORM WILL BE RETURNED.

Original to the County Clerk & Recorder; duplicate to the State Engineer; Triplicate to the School of Mines and Quadruplicate for the Appropriator.

201176

CARL L. P.

NO

THE PUBLIC

DECLARATION OF VACATED GROUND  
WATER RIGHTS

STATE OF MONTANA  
COUNTY OF HILL  
Filed at 11:15 o'clock A.M.

ON NOV 4 1962  
G. C. Yeon

CLERK

DEPUTY

Fee: \$2.00 pd.

GV

24

File No. ....

T. 31 N. R. 14 E

DUPLICATE

County Hill

STATE OF MONTANA  
ADMINISTRATOR OF GROUNDWATER CODE  
OFFICE OF STATE ENGINEER

RECEIVED  
DEC 12 1963

Declaration of Vested Groundwater Rights STATE ENGINEER  
(Under Chapter 237, Montana Session Laws, 1961)

I, Roy A. Berger, of Box 629 Havre, (Name of Appropriator) (Address) (Town) County of Hill State of Montana have appropriated groundwater according to the Montana laws in effect prior to January 1, 1962, as follows:

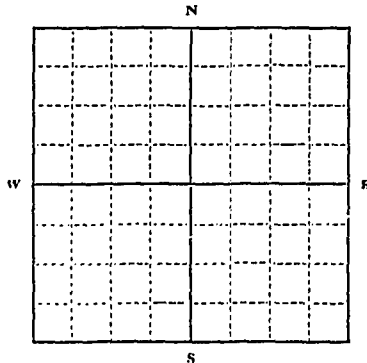

SW 1/4 Sec. 24 T31 R. 14

Indicate point of appropriation and place of use, if possible. Each small square represents 10 acres.

2. The beneficial use on which the claim is based. Domestic

3. Date or approximate date of earliest beneficial use; and how continuous the use has been. Homestead days. About 1930.

4. The amount of groundwater claimed (in miner's inches or gallons per minute). Two hundred gallons (200) per minute.

5. If used for irrigation, give the acreage and description of the lands to which water has been applied and name of the owner thereof. None.

6. The means of withdrawing such water from the ground and the location of each well or other means of withdrawal. Water pump, located on SW 1/4 of Sec. 24, Twp. 31 N. R. 14 E.M.M.

7. The date of commencement and completion of the construction of the well, wells, or other works for withdrawal of groundwater. No record.

8. The depth of water table. Twenty-nine (29) feet.

9. So far as it may be available, the type, size and depth of each well or the general specifications of any other works for the withdrawal of groundwater. Type--drilled; Size--6" hole; Depth--90 feet.

10. The estimated amount of groundwater withdrawn each year. Has not been in use for many years.

11. The log of formations encountered in the drilling of each well if available. No record.

12. Such other information of a similar nature as may be useful in carrying out the policy of this act, including reference to book and page of any county record. No record.

Signature of Owner Roy A. Berger

Date Dec. 10, 1963.

Three copies to be filed by the owner with the County Clerk and Recorder of the county in which the well is located.

Please answer all questions. If not applicable, so state, otherwise the form will be returned.

Original to the County Clerk and Recorder; duplicate to the State Engineer; Triplicate to the Montana Bureau of Mines and Geology, and Quadruplicate for the Appropriator.

8674

396168

ROY A. BERGER

TO

THE PUBLIC

DECLARATION OF VESTED GROUND  
WATER RIGHTS

STATE OF MONTANA, ss.  
COUNTY OF HILL

*Filed at 1 o'clock P.M.*

ON DEC 10 1963

R. E. Blom

COUNTY CLERK

DEPUTY

Fee: \$2.00 pd.

File No. ....

T. ~~31~~<sup>N</sup> 14 R

DUPLICATE

County HILL

STATE OF MONTANA  
ADMINISTRATOR OF GROUNDWATER CODE  
OFFICE OF STATE ENGINEER

RECEIVED  
DEC 27 1963

Declaration of Vested Groundwater Rights

(Under Chapter 237, Montana Session Laws, 1961)

STATE ENGINEER

1. William E. Brown, of Shambortte, Havre  
(Name of Appropriator) (Address) (Town)

County of HILL State of Montana

have appropriated groundwater according to the Montana laws in effect prior to January 1, 1962, as follows:

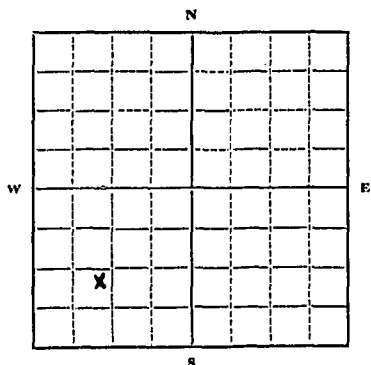

SW 1/4 NW 1/4 Sec 24 T31 R14

Indicate point of appropriation and place of use, if possible. Each small square represents 10 acres.

2. The beneficial use on which the claim is based.....  
Stock Water

3. Date or approximate date of earliest beneficial use; and how continuous the use has been 1917  
IT WAS USED FROM 1917 TO 1936  
BUT HAS NOT BEEN USED SINCE

4. The amount of groundwater claimed (in miner's inches or gallons per minute) 4 gals. per min.

5. If used for irrigation, give the acreage and description of the lands to which water has been applied and name of the owner thereof  
None

6. The means of withdrawing such water from the ground and the location of each well or other means of withdrawal.  
hand pump

7. The date of commencement and completion of the construction of the well, wells, or other works for withdrawal of groundwater.....  
NOT KNOWN

8. The depth of water table.....  
55 FT.

9. So far as it may be available, the type, size and depth of each well or the general specifications of any other works for the withdrawal of groundwater.....  
IT WAS DUG BY HAND  
IT IS ABOUT 3 FT SQUARE & 57 FT DEEP

10. The estimated amount of groundwater withdrawn each year.....

11. The log of formations encountered in the drilling of each well if available.....  
None

12. Such other information of a similar nature as may be useful in carrying out the policy of this act, including reference to book and page of any county record.....

Signature of Owner.....  
William E. Brown

Date.....  
Nov. 17-63

Three copies to be filed by the owner with the County Clerk and Recorder of the county in which the well is located.

Please answer all questions. If not applicable, so state, otherwise the form will be returned.

Original to the County Clerk and Recorder; duplicate to the State Engineer; Triplicate to the Montana Bureau of Mines and Geology, and Quadruplicate for the Appropriator.

396815

WILLIAM E. BROWN

TO

TAX PUBLIC

DECLARATION OF VESTED  
GROUNDWATER RIGHTS

STATE OF MONTANA, ss.  
COUNTY OF HILL

Filed at 2:00 o'clock p.m.

ON DEC 26 1963

*E. Blum*  
COUNTY CLERK

DEPUTY

Fee: \$2.00 pd.



File No. ....

T. 31 R. 14E

DUPLICATE

County HILL

STATE OF MONTANA  
ADMINISTRATOR OF GROUNDWATER CODE  
OFFICE OF STATE ENGINEER

RECEIVED  
AUG 22 1963  
STATE ENGINEER

Notice of Completion of Groundwater Appropriation by Means of Well

(Under Chapter 237, Montana Session Laws, 1961)

Owner RICHARD W. BROWN Address SNAMBO RT. HAIRE, MONTANA

Driller HI-LINE DRILLING SERVICE HAIRE, MONT

Date of Notice of Appropriation of Groundwater.....

Date well started AUG. 6, 1963 Date Completed AUG. 13, 1963

Type of well DRILLED Equipment Used CABLE TOOL  
(dug, driven, bored or drilled) (Churn, drill, rotary or other)

Water Use: Domestic  Municipal  Other  Irrigation   
Industrial  Drainage  Stock

Indicate on the diagram the character and thickness of the different strata met with in drilling, such as soil, clay, shale, gravel, rock or sand, etc. Show depth at which water is encountered, thickness and character of water-bearing strata and height to which water rises in the well.

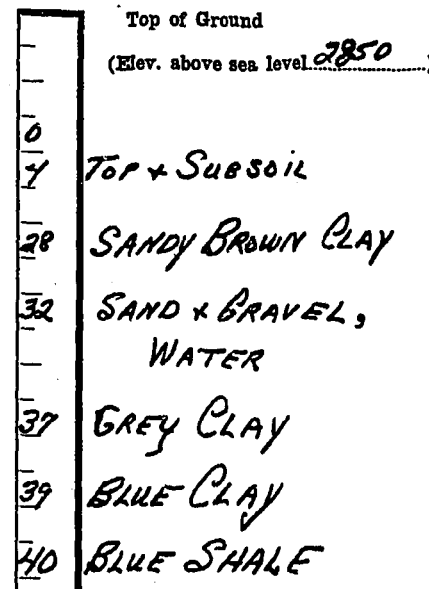

12 1/4 I.D. CASING  
INSTALLED DUE TO  
SMALL YIELD, FOR  
GREATER STORAGE

Size of Drilled Hole	Size and Weight of Casing	From (Feet)	To (Feet)	PERFORATIONS		
				Kind Size	From (Feet)	To (Feet)
15"	12 1/4" I.D. 40# PER FOOT	0	40	3/16" 5" SLIGHTED	24	35

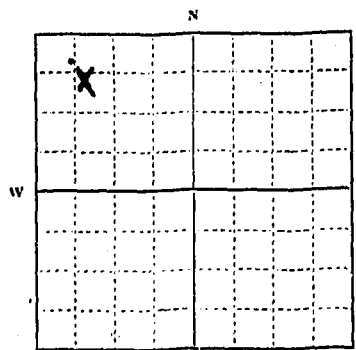

NW 1/4 Sec. 25 T. 31 N. R. 14E

Indicate location of well and place of use, if possible. Each small square represents 10 acres.

70 Show exact depth of bottom.

Static Water Level for non-flowing Well 24 feet.

Shut-in Pressure for Flowing Well NOT APPLICABLE

Pumping Water Level 39 feet at 3 gal. per minute.

Discharge in gal. per min. of flowing well NOT APPLICABLE

How Tested BAUER + PUMP Length of Test 4 HOURS

Remarks: (Gravel packing, cementing, packers, type of shutoff, location of place of use of groundwater if not at well, and any other similar pertinent information, including number of acres irrigated, if used for irrigation) CONSIDERABLE

SAND PROBLEM SAND REPLACED WITH 2 YARDS OF 1/2" WELL-ROUNDED GRAVEL WELL ABOVE STATIC LEVEL - SURFACE CEMENTED TO PREVENT CONTAMINATION 46

Driller's License Number

Robert Zrien  
Driller's Signature

This form to be prepared by driller, and three copies to be filed by the owner with the County Clerk and Recorder in the county in which the well is located.

Please answer all questions. If not applicable, so state, otherwise the form will be returned.

Original to the County Clerk and Recorder; duplicate to the State Engineer; Triplicate to the Montana Bureau of Mines and Geology and Quadruplicate for the Appropriator.

394863

RICHARD W. BROWN

TO

THE PUBLIC

GROUNDWATER RIGHTS # 2

STATE OF MONTANA ) ss.  
COUNTY OF HILL )  
Filed at 2:45 o'clock P. M.

BY AUG 15 1963

R. E. Blom COUNTY CLERK

BY DEPUTY

FEE: \$2.00 pd.

*Handwritten notes:*  
...  
...  
...  
...  
...

*Handwritten notes:*  
...  
...

*Handwritten notes:*  
...

File No. ....

DUPLICATE

T 31 N 14 E 28  
County Hill

STATE OF MONTANA  
ADMINISTRATOR OF GROUNDWATER CODE  
OFFICE OF STATE ENGINEER

RECEIVED  
STATE ENGINEER

Declaration of Vested Groundwater Rights  
(Under Chapter 237, Montana Session Laws, 1961)

1. Hubert H. Siegel (Name of Appropriator) of Hambo Pt., Havre (Address) (Town)  
County of Hill State of Montana  
have appropriated groundwater according to the Montana laws in effect prior to January 1, 1962, as follows:

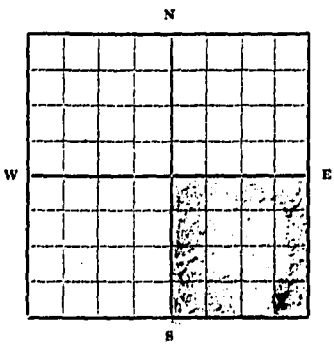

SE 1/4 Sec 28 T 31 R 14  
Indicate point of appropriation and place of use, if possible. Each small square represents 10 acres.

- The beneficial use on which the claim is based Home use
- Date or approximate date of earliest beneficial use; and how continuous the use has been Oct 15 - 1956  
in continuous use since
- The amount of groundwater claimed (in miner's inches or gallons per minute) 48 inch 4x4 sq. in.
- If used for irrigation, give the acreage and description of the lands to which water has been applied and name of the owner thereof not applicable
- The means of withdrawing such water from the ground and the location of each well or other means of withdrawal pressure pump system
- The date of commencement and completion of the construction of the well, wells, or other works for withdrawal of groundwater Oct 15 - 1956
- The depth of water table 33 feet
- So far as it may be available, the type, size and depth of each well or the general specifications of any other works for the withdrawal of groundwater 4x4 hand dug well  
37 feet deep
- The estimated amount of groundwater withdrawn each year not applicable
- The log of formations encountered in the drilling of each well if available not applicable
- Such other information of a similar nature as may be useful in carrying out the policy of this act, including reference to book and page of any county record hardy logan + clay formation evident well in dug

Signature of Owner Hubert H. Siegel  
Date Jan 2 - 1962

Three copies to be filed by the owner with the County Clerk and Recorder of the county in which the well is located.  
Please answer all questions. If not applicable, so state, otherwise the form will be returned.

Original to the County Clerk and Recorder; duplicate to the State Engineer; Triplicate to the School of Mines and Quadruplicate for the Appropriator.

1066

DOCUMENT NO. 386856

HUBERT H. SIEGEL  
TO  
THE PUBLIC

DECLARATION OF VESTED  
GROUNDWATER RIGHTS

STATE OF MONTANA,  
COUNTY OF HILL )  
*Filed at 1:20 o'clock P. m.*

ON JAN 4 1962

G. C. YEON  
COUNTY CLERK

By \_\_\_\_\_ DEPUTY

FEE \$2.00 paid

GW 4  
FILE NO. \_\_\_\_\_

TWP 21 N RGE 10 E  
COUNTY 4.7

STATE OF MONTANA  
ADMINISTRATOR OF GROUNDWATER CODE  
OFFICE OF STATE ENGINEER

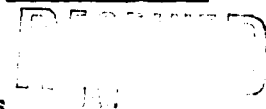

DECLARATION OF VESTED GROUNDWATER RIGHTS  
(Under Chapter 237, Montana Session Laws, 1961)

1. Edward J Cook, of 1021 2nd Ave Harpe  
(Name of Appropriator) (Address) (Town)  
County of Hill, State of Mont.

Have appropriated groundwater according to the Montana laws in effect prior to Jan. 1, 1962 as follows:

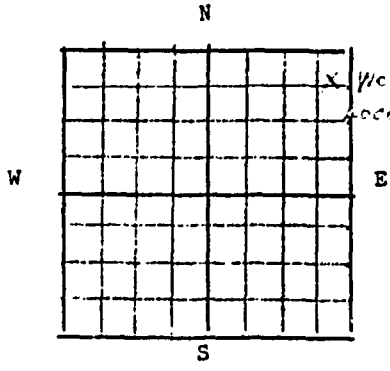

2. The beneficial use on which the claim is based  
Domestic (House & Stock) Irrigate garden

3. Date or approximate date of earliest beneficial use; and how continuous the use has been  
April Intermittent use  
to Oct.

4. The amount of groundwater claimed (in miner's inches or gallons per minute) 10 gals

5. If used for irrigation, give the acreage and description of the lands to which water has been applied and name of the owner thereof  
Garden Plot One-fourth (1/4) A.

Indicate point of appropriation and place of use, if possible. Each small square represents 10 acres.

6. The means of withdrawing such water from the ground and the location of each well or other means of withdrawal Hand pump & Engine  
22000'

7. The date of commencement and completion of the construction of the well, wells, or other works for withdrawal of groundwater Approx. 1915

8. The depth of water table 20 ft.

9. So far as it may be available, the type, size and depth of each well or the general specifications of any other works for the withdrawal of groundwater 23 ft. depth  
curbing 36" (Aug well)

10. The estimated amount of groundwater withdrawn each year 50,000 gals

11. The log of formations encountered in the drilling of each well if available  
clay - gravel (3ft)

12. Such other information of a similar nature as may be useful in carrying out the policy of this act, including reference to book and page of any county record  
None

Signature of Owner Edward J. Cook

Date Dec 26, 1963

Three copies to be filed by the owner with the County Clerk & Recorder of the County in which the well is located.

PLEASE ANSWER ALL QUESTIONS. IF NOT APPLICABLE, SO STATE, OTHERWISE THE FORM WILL BE RETURNED.

Original to the County Clerk & Recorder; duplicate to the State Engineer; Triplicate to the School of Mines and Quadruplicate for the Appropriator.

396820

CLARENCE H. ROY

TO

THE PUBLIC

DECLARATION OF VESTED GROUND  
WATER RIGHTS

STATE OF MONTANA )  
COUNTY OF HILL ) ss.  
Filed at 4:20'clock p.m.

1963  
16  
Blain  
COUNTY CLERK

DEPUTY

Fee: 2.00 pd.

GROUNDWATER INDEX

County Hill Twp. 31 N Rge. 15 E

Sec.	Name of Appropriator	Type of Form	County File No.	Remarks
4	Max Newcastle	GW1	307300	
9	Max Newcastle	GW1	385147	
14	M. T. Carver	GW3	39428	
17	Max Newcastle	GW1	380166	
20	Jack Kimblich	GW2	425702	
21	L. A. Heigle	GW2	201236	
25	L. A. Heigle	GW4	301223	
20	Jack Halverson	GW4	392282	
20	J. Hanson & W. Heigle	GW3	386613	
31	Kenneth Hanson	GW2	392216	
32	Wesley Kimblich	GW4	202136	
34	Frank Cook	GW4	360097	
24	W. E. Stillman	GW4	392673	
34	Frank Cook	GW4	397173	
1015	M. T. Carver	GW3	304971	

T. 31 N R. 15 E H  
 County: Yellowstone

MONTANA BUREAU OF MINES AND GEOLOGY  
 Butte, Montana

WATER WELL LOG STATE ENGINEER

Owner: MAX NEWORTH Address: HAYES, MONTANA  
 Driller: SIMPSON DRILLING CO Address: MARIETTA, MONTANA  
 Date Started: APRIL 13, 1961 Date Completed: APRIL 30, 1961  
 Location: Sec. 4 T. 31 R. 15 1/4 sec. 22

Type of well: drilled (Dug, driven, bored, or drilled) Equipment used: rotary (Churn drill, rotary, other)

Water use: Domestic  Municipal  Stock  Irrigation   
 Industrial  Drainage  Other: \_\_\_\_\_

Casing: 0 ft. to 510 ft. Type: S & S Size: 6 1/2 inch

Casing: \_\_\_\_\_ ft. to \_\_\_\_\_ ft. Type: \_\_\_\_\_ Size: \_\_\_\_\_

Casing: \_\_\_\_\_ ft. to \_\_\_\_\_ ft. Type: \_\_\_\_\_ Size: \_\_\_\_\_  
 Perforated or Screened: Ft. 70 - 75 300 - 308 380 - 385  
 280 - 290 to ft. 325 - 337 Ft. 420 - 435 to ft.

Type of screen or perforations: drilled 1/2 inch holes

Static Water level, for non-flowing well: 195 feet.

Shut-in pressure, for flowing well: \_\_\_\_\_ lb./sq. in. on: \_\_\_\_\_ (date)

Pumping water level: 360 feet at 7 gal. per min.

How tested: bailer

Length of test: 5 hours

Remarks: (Gravel packing, cementing, packers, type of shut-off, depth of shut-off)  
packers were used above the top of each perforations  
these were placed at 70 280 300 325 380 420 feet

*Max Neworth*

(over)





DOCUMENT NO. 383994

MAX NEUWERTH

WATER WELL LOG

STATE OF MONTANA, ss.  
COUNTY OF HILL )  
Filed at 11:00 o'clock A.M.

ON JUN 7 1961

G.C. YEON

COUNTY CLERK

By

DEPUTY

226	rock layer
280	light blue shale some dark streaks
290	dark sandstone
300	light blue shale
308	sandstone
312	light blue shale
325	dark sandstone
335	light green & tan shale and sandstone layers
335	sandstone
337	sandstone & shale layers
355	tan shale
374	rock in yr
376	tan shale
380	dark sandstone
385	rock in yer
388	tan shale
420	sandstone
435	green shale
450	rock layer
457	dark grey shale
459	sandstone - best circulation
476	rock layer
478	black shale
480	black shale
490	black shale
510	black shale

GW-4  
FILE NO. DUPLICATE

*Started in 7/62*

TWP 31N RGE 15E  
COUNTY HULL

STATE OF MONTANA  
ADMINISTRATOR OF GROUNDWATER CODE  
OFFICE OF STATE ENGINEER

RECEIVED  
APR 20 1962

DECLARATION OF VESTED GROUNDWATER RIGHTS  
(Under Chapter 237, Montana Session Laws, 1961)

STATE ENGINEER

1. May F. Neuwirth, of Stamba Pt. Naville  
(Name of Appropriator) (Address) (Town)  
County of Hull, State of Mont  
Have appropriated groundwater according to the Montana laws in effect prior to Jan. 1, 1962 as follows:

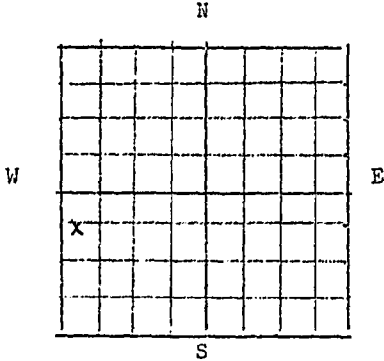

SW 1/4 Sec 9 T31 R15

Indicate point of appropriation and place of use, if possible. Each small square represents 10 acres.

2. The beneficial use on which the claim is based  
Water Cattle & Ranch House

3. Date or approximate date of earliest beneficial use; and how continuous the use has been  
1/27/62 Every Day

4. The amount of groundwater claimed (in miner's inches or gallons per minute) 3 gal per min

5. If used for irrigation, give the acreage and description of the lands to which water has been applied and name of the owner thereof

6. The means of withdrawing such water from the ground and the location of each well or other means of withdrawal  
Submersible Pumps

7. The date of commencement and completion of the construction of the well, wells, or other works for withdrawal of groundwater  
Completed 1/27/62 Started 1/12/62

8. The depth of water table 17.6 ft.

9. So far as it may be available, the type, size and depth of each well or the general specifications of any other works for the withdrawal of groundwater  
2-102 ft. 8 in Casing 101-200 ft. casing

10. The estimated amount of groundwater withdrawn each year 100,000 gal

11. The log of formations encountered in the drilling of each well if available  
Attached

12. Such other information of a similar nature as may be useful in carrying out the policy of this act, including reference to book and page of any county record

Signature of Owner May F. Neuwirth  
Date March 9, 1962

Three copies to be filed by the owner with the County Clerk & Recorder of the County in which the well is located.

PLEASE ANSWER ALL QUESTIONS. IF NOT APPLICABLE, SO STATE, OTHERWISE THE FORM WILL BE RETURNED.

Original to the County Clerk & Recorder; duplicate to the State Engineer; Triplicate to the School of Mines and Quadruplicate for the Appropriator.

DOCUMENT NO. 368397

MAX F. NEUWERTH

TO

THE PUBLIC

DECLARATION OF VESTED  
GROUNDWATER RIGHTS

STATE OF MONTANA, )  
COUNTY OF HILL ) ss.  
*Filed at 3:30 o'clock P. m.*

ON APR 23 1962

G.C. YEON

COUNTY CLERK

By \_\_\_\_\_

DEPUTY

Fee \$2.00- paid

File No. \_\_\_\_\_

T. 31 N R 15 E 14

DUPLICATE

*SW 1/4*

County Hell  
**RECEIVED**  
AUG 26 1963

STATE OF MONTANA  
ADMINISTRATOR OF GROUNDWATER CODE  
OFFICE OF STATE ENGINEER

STATE ENGINEER

### Notice of Completion of Groundwater Appropriation Without Well

(Under Chapter 237 Montana Session Laws, 1961)

Date of Appropriation of Groundwater 1919  
Owner M. P. Crowe Address Shamba, P. Thore

Contractor (if any) \_\_\_\_\_

Address of Contractor \_\_\_\_\_

Date Started June 1 Date Completed June

Describe means of obtaining groundwater without a well "as by sub-irrigation and other natural processes". Include depth to water when applicable. spring for house + farm use garden irrigation

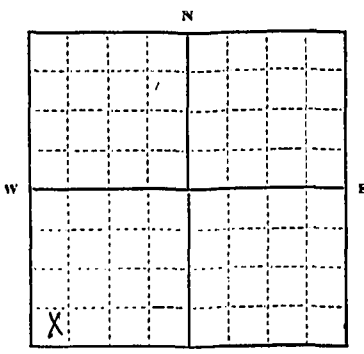

*SW 1/4* Sec. 14 T. 31 R. 15  
Indicate point of appropriation and place of use, if possible.

Quantity of water developed and used with explanation of method used to measure or estimate such amount. If use is intermittent

estimate approximate lengths of periods of use. approximately 10 gal min

Signature of Owner M. P. Crowe

Date 8/19/63

This form to be prepared by contractor (if any), otherwise by the owner.  
Three copies of this notice are to be filed with the County Clerk and Recorder of the county in which the works are located.  
Please answer all questions. If not applicable, so state, otherwise the form will be returned.  
Original to the County Clerk and Recorder; duplicate to the State Engineer; Triplicate to the Montana Bureau of Mines and Geology and Quadruplicate for the Appropriator.

394968

M. R. CROWE

TO

THE PUBLIC

NOTICE OF COMPLETION OF  
GROUNDWATER APPRO. # 3

STATE OF MONTANA, )  
COUNTY OF HILL ) ss.  
*Filed at 3 o'clock P.m.*

ON AUG 22 1963

R. E. Blom COUNTY CLERK

By \_\_\_\_\_ DEPUTY

FEE: \$2.00 pd.

T. 31 N R. 15 E 17  
County HILL

MONTANA BUREAU OF MINES AND GEOLOGY  
Butte, Montana

RECEIVED  
OCT 19 1960

WATER WELL LOG

STATE ENGINEER

Owner Max Neuwerth Address Havre, Montana  
Driller Simpson Drilling Co. Address Malta, Montana  
Date Started October 3, 1960 Date Completed October 12, 1960  
Location: Sec. 17 T. 31 R. 15 1/4 sec. NE

Type of well Drilled (Dug, driven, bored, or drilled) Equipment used Churn (Churn drill, rotary, other)

Water use: Domestic  Municipal  Stock  Irrigation   
Industrial  Drainage  Other:

Casing: 0 ft. to 385 ft. Type Steel Size 6 5/8

Casing: ft. to ft. Type Size

Casing: ft. to ft. Type Size

Perforated or Screened: Ft. 305 to ft. 338 Ft. to ft.

Type of screen or perforations Slots with cutting torch

Static Water level, for non-flowing well: 140 feet.

Shut-in pressure, for flowing well: lb./sq. in. on: (date)

Pumping water level 200 feet at 2 1/2-3 gal. per min.

How tested: Bailer

Length of test 1/2 hour

Remarks: (Gravel packing, cementing, packers, type of shut-off, depth of shut-off)

Max Neuwerth





DOCUMENT NO. 380166

MAX NEUWERTH  
TO  
THE PUBLIC

WATER WELL LOG

STATE OF MONTANA  
COUNTY OF HILL  
Filed at 2:25 o'clock P.M.

OCT 15 1911  
G. C. YEON  
COUNTY CLERK  
DEPUTY

106	109	Hard shale
109	130	Grey shale
130	155	Grey sand and shale
155	215	Grey sandy shale
215	216	Hard shale
216	257	Grey sandy shale
257	260	Hard grey sandstone
260	265	Sandstone (natural gas) burns at top of pipe
265	305	Grey shaley sandstone
305	338	Grey sandstone (water 3 ft. up.)
338	348	Grey green shale

STATE OF MONTANA  
ADMINISTRATOR OF GROUNDWATER CODE  
MONTANA WATER RESOURCES BOARD  
**NOTICE OF COMPLETION OF GROUNDWATER  
APPROPRIATION BY MEANS OF WELL**

Developed after January 1, 1962

(Under Chapter 237 Montana Session Laws, 1961, as amended)

This form to be prepared by driller, and three copies to be filed by the owner with the County Clerk and Recorder in the county in which the well is located, last copy to be retained by driller. Please answer all questions. If not applicable, so state, otherwise the form may be returned.

Owner JACK DAHLIN  
Address SHAMBO PT  
HAURE, MONTANA  
Date well started JULY 6, 1972  
completed JULY 17, 1972  
Type of well DRILLED  
Equipment used CABLE TOOL RIG  
Water Use: Domestic  Municipal  Stock  Irrigation   
Industrial  Drainage  Other \* Garden/Lawn

For Administrator's Use  
File 425702  
APR 13, 1972 - 10:35 AM  
GW 1

\*Describe \_\_\_\_\_  
USE: If used for irrigation, industrial, drainage or other. Explain, state number of acres and location or other data (i.e. Lot, Block and Addition).

ESTIMATED ANNUAL WITHDRAWAL EXCEEDING 600,000 GALLONS

Size of Drilled Hole	Size and Weight of Casing	From (Feet)	To (Feet)	PERFORATIONS		
				Kind Size	From (Feet)	To (Feet)
<u>7 1/2"</u>	<u>5 3/8" OD PVC 100'</u>	<u>1 FOOT ABOVE GROUND LEVEL</u>	<u>72</u>	<u>7 1/4" DRILLED</u>	<u>68</u>	<u>109</u>
	<u>5 3/8" OD PVC 200'</u>	<u>72</u>	<u>112</u>			

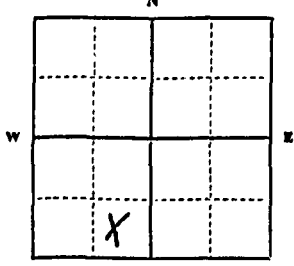

Static water level ..... 72 ft.\*  
Pumping water level ..... 110 ft.\*  
at 7 1/4 gallons per minute,  
measured 180 minutes after pumping began.  
\*Measured from ground level.  
Well developed by ELECTRIC PUMP  
for 6 hours.  
Power ELECTRIC Pump 1/3 HP  
Remarks: (Gravel packing, cementing, packers, type of shutoff) WELL REARED TO 7 1/2" DIAMETER TO 112 FEET LEVEL. AFTER CASING WAS INSTALLED ANNUAL SPACE AROUND OUTSIDE OF CASING FILLED WITH 1/2" GRAVEL FROM BOTTOM OF HOLE UP TO APPROX. 45 FT. CRUSHED GRAVEL ABOVE GRAVEL TO 40 FT. CEMENT GRANT FROM 40 TO 55 FT.

INDICATE LOCATION OF WELL AND PLACE OF USE, IF POSSIBLE. EACH SMALL SQUARE REPRESENTS 40 ACRES.  
Driller's Signature Hubert J. J. Miller Miller Drilling Service  
Driller's Address 1173 6TH ST. No Phone 265-4210  
HAURE, MONTANA 57501 LICENSE NO. 46

DRILLER'S LOG

Indicate the character, color, thickness of strata such as soil, clay, sand, gravel, shale, sandstone, etc. Show depth at which water is found and height to which water rises in well.

Top of Ground		(Elev. above sea level)
From (Feet)	To (Feet)	
<u>0</u>	<u>8</u>	<u>GRAVELLY SOIL</u>
	<u>8</u>	<u>GRAVELLY BROWN CLAY</u>
	<u>12</u>	<u>SANDY BROWN CLAY</u>
	<u>24</u>	<u>BROWN CLAY</u>
	<u>37</u>	<u>GREY CLAY</u>
	<u>65</u>	<u>GREY CLAY + VOLCANIC GRAVEL MIX</u>
	<u>72</u>	<u>VOLCANIC MATERIAL - WHITE CLAYEY</u>
	<u>87</u>	<u>VOLCANIC ROCK - RED-FRACTURED</u>
	<u>97</u>	<u>GREY VOLCANIC ROCK - HARD</u>
	<u>99</u>	<u>GREY VOLCANIC ROCK - WATER - 7 GPM</u>
	<u>105</u>	<u>GREY VOLCANIC ROCK</u>
	<u>106</u>	<u>GREY VOLCANIC ROCK - WATER - 2 GPM</u>
	<u>108</u>	<u>VOLCANIC ROCK - HARD</u>
	<u>109</u>	<u>VOLCANIC ROCK - WATER - 14 GPM</u>
	<u>112</u>	<u>VOLCANIC ROCK</u>

112 Show exact depth of bottom

425702

JACK DAHLIN

TO

THE PUBLIC

WATER WELL

STATE OF MONTANA, )  
COUNTY OF HILL ) ss.  
Filed at 10:25'clock A.m

BY SEP 13 1972

R. E. Blom COUNTY CLERK  
By Carole E. Day DEPUTY

Fee:\$2.00 pd.

INDEXED

GW:

File No. \_\_\_\_\_

DUPLICATE

T. 31 N R. 15 E 21

County Hill

RECEIVED

STATE OF MONTANA  
ADMINISTRATOR OF GROUNDWATER CODE  
OFFICE OF STATE ENGINEER

STATE ENGINEER

**Notice of Completion of Groundwater Appropriation Without Well**

(Under Chapter 237 Montana Session Laws, 1961)

Date of Appropriation of Groundwater 1918

Owner L.A. Heyle Address Flambeau, Mont.

Contractor (if any) \_\_\_\_\_

Address of Contractor \_\_\_\_\_

Date Started \_\_\_\_\_ Date Completed \_\_\_\_\_

Describe means of obtaining groundwater without a well "as by sub-irrigation and other natural processes". Include depth to water when applicable.

Spring  
8' deep

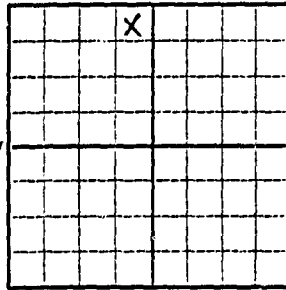

Quantity of water developed and used with explanation of method used to measure or estimate such amount. If use is intermittent estimate approximate lengths of periods of use

run freely  
never dry

NE 1/4 Sec. 21 T. 31 R. 15

Indicate point of appropriation and place of use, if possible.

Signature of Owner R.A. Heyle

Date Jan. 2, 1963

This form to be prepared by contractor (if any), otherwise by the owner.

Three copies of this notice are to be filed with the County Clerk and Recorder of the county in which the works are located.

Please answer all questions. If not applicable, so state, otherwise the form will be returned.

Original to the County Clerk and Recorder; duplicate to the State Engineer; Triplicate to the School of Mines and Quadruplicate for the Appropriator.

391876

R. A. HEGLE

TO

THE PUBLIC

NOTICE OF COMPLETION OF  
GROUNDWATER APPROPRIATION  
WITHOUT WELL

STATE OF MONTANA, ss.  
COUNTY OF HILL )  
Filed at 9 o'clock A. m.

ON JAN 2 1963

G. C. Yeon

COUNTY CLERK

BY \_\_\_\_\_ DEPUTY

Fee: \$2.00 pd.

GW-4  
FILE NO. \_\_\_\_\_  
DUPLICATE

TWP 31 RGE 15  
COUNTY Hill

STATE OF MONTANA  
ADMINISTRATOR OF GROUNDWATER CODE  
OFFICE OF STATE ENGINEER

RECEIVED

DECLARATION OF VESTED GROUNDWATER RIGHTS  
(Under Chapter 237, Montana Session Laws, 1961) STATE ENGINEER

1. R. A. Hegle, of Shanko St. House,  
(Name of Appropriator) (Address) (Town)  
County of Hill, State of Mont  
Have appropriated groundwater according to the Montana laws in effect prior to Jan. 1, 1962 as follows:

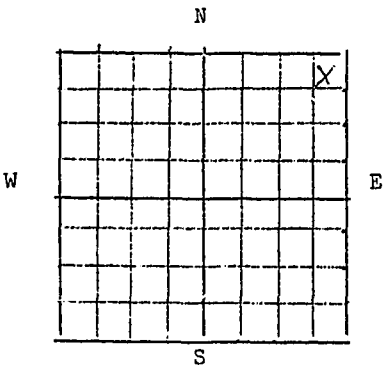

NE 1/4 Sec 25 T. 31 R. 15

Indicate point of appropriation and place of use, if possible. Each small square represents 10 acres.

- The beneficial use on which the claim is based livestock water
- Date or approximate date of earliest beneficial use, and how continuous the use has been 1918 to present time
- The amount of groundwater claimed (in miner's inches or gallons per minute) Personal. (but never dry)
- If used for irrigation, give the acreage and description of the lands to which water has been applied and name of the owner thereof X
- The means of withdrawing such water from the ground and the location of each well or other means of withdrawal by pump
- The date of commencement and completion of the construction of the well, wells, or other works for withdrawal of groundwater 1915
- The depth of water table 8 ft
- So far as it may be available, the type, size and depth of each well or the general specifications of any other works for the withdrawal of groundwater 14 ft deep
- The estimated amount of groundwater withdrawn each year Not known
- The log of formations encountered in the drilling of each well if available 4' clay - 6" sand - rest through coal
- Such other information of a similar nature as may be useful in carrying out the policy of this act, including reference to book and page of any county record

Signature of Owner R. A. Hegle  
Date Jan. 2 1963

Three copies to be filed by the owner with the County Clerk & Recorder of the County in which the well is located.

PLEASE ANSWER ALL QUESTIONS. IF NOT APPLICABLE, SO STATE, OTHERWISE THE FORM WILL BE RETURNED.

Original to the County Clerk & Recorder; duplicate to the State Engineer; Triplicate to the School of Mines and Quadruplicate for the Appropriator.

391873

R. A. HEGLE

TO

THE PUBLIC

DECLARATION OF VESTED GROUND  
WATER RIGHTS

STATE OF MONTANA, ss.  
COUNTY OF BILLINGS, ss.  
Filed at 9 o'clock A.M.

BY  
JAN 9 1961  
G. C. Yeon  
COUNTY CLERK

Fee: \$2.00 pd.

GW. FILE NO. \_\_\_\_\_

TWP 31N RGE 15E 20  
COUNTY \_\_\_\_\_

STATE OF MONTANA  
ADMINISTRATOR OF GROUNDWATER CODE  
OFFICE OF STATE ENGINEER

RECEIVED  
JAN 1 1963

DECLARATION OF VESTED GROUNDWATER RIGHTS  
(Under Chapter 237, Montana Session Laws, 1961)

1. Jack Dahlia, of Hill Montana  
(Name of Appropriator) (Address) (Town)  
County of Hill, State of Montana  
Have appropriated groundwater according to the Montana laws in effect prior to Jan. 1, 1962 as follows:

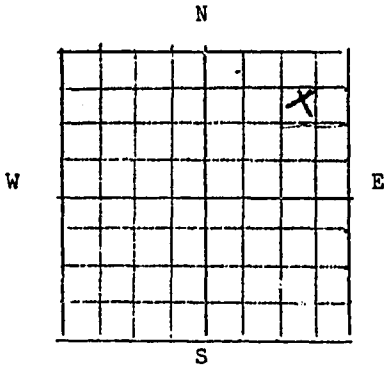

NE 1/4 NE Sec 30 T 31 R 15

Indicate point of appropriation and place of use, if possible. Each small square represents 10 acres.

- The beneficial use on which the claim is based Household + Stock
- Date or approximate date of earliest beneficial use; and how continuous the use has been Household since 1924 to 33 + Stock from 1933 to date
- The amount of groundwater claimed (in miner's inches or gallons per minute) 400 gal Per hour
- If used for irrigation, give the acreage and description of the lands to which water has been applied and name of the owner thereof No.
- The means of withdrawing such water from the ground and the location of each well or other means of withdrawal Natural spring surface water.

- The date of commencement and completion of the construction of the well, wells, or other works for withdrawal of groundwater \_\_\_\_\_
- The depth of water table ground level
- So far as it may be available, the type, size and depth of each well or the general specifications of any other works for the withdrawal of groundwater \_\_\_\_\_
- The estimated amount of groundwater withdrawn each year \_\_\_\_\_
- The log of formations encountered in the drilling of each well if available \_\_\_\_\_
- Such other information of a similar nature as may be useful in carrying out the policy of this act, including reference to book and page of any county record \_\_\_\_\_

Signature of Owner Jack Dahlia  
Date Dec - 31 - 62

Three copies to be filed by the owner with the County Clerk & Recorder of the County in which the well is located.

PLEASE ANSWER ALL QUESTIONS. IF NOT APPLICABLE, SO STATE, OTHERWISE THE FORM WILL BE RETURNED.

Original to the County Clerk & Recorder; duplicate to the State Engineer; Triplicate to the School of Mines and Quadruplicate for the Appropriator.



397082

JACK DAHLIN

TO

THE PUBLIC

DECLARATION OF VESTED  
GROUNDWATER RIGHTS

STATE OF MONTANA, ss.  
COUNTY OF HILL )  
Filed at 11 o'clock *am*.

ON DEC 31 1963

*18 Blain*  
COUNTY CLERK

DEPUTY

FEE: \$2.00 pd.

30

File No.....

T. 31N R. 15E

DUPLICATE

County.....

STATE OF MONTANA  
ADMINISTRATOR OF GROUNDWATER CODE  
OFFICE OF STATE ENGINEER

RECEIVED  
DEC 19 1963

Notice of Completion of Groundwater Appropriation  
Without Well

STATE ENGINEER

(Under Chapter 237 Montana Session Laws, 1961)

Date of Appropriation of Groundwater May 1961

Owner Stewart H. Herron, H. Helen Address Box 1209

Contractor (if any) .....

Address of Contractor .....

Date Started..... Date Completed.....

Describe means of obtaining groundwater without a well "as by sub-irrigation and other natural processes". Include depth to water when applicable. Reservoirs used for

basins to be used to irrigate field with  
Spring piped to trough for livestock  
water 4 ft 7 8 ft metal coil 4 ft  
of water

Quantity of water developed and used with explanation of method used to measure or estimate such amount. If use is intermittent

estimate approximate lengths of periods of use.....

Spring flows about one gal a  
minute

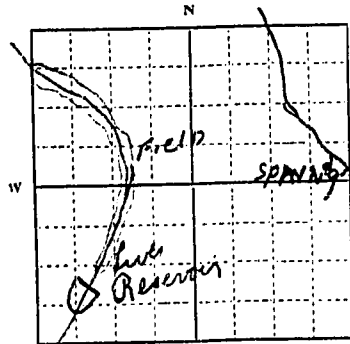

SW 4 SW 4  
SE 4 NE 7 1/4 Sec 30 T31 R15

Indicate point of appropriation and place of use, if possible.

Signature of Owner Stewart H. Herron & Helen Helen  
by S. Herron  
Date Dec 16 1963

This form to be prepared by contractor (if any), otherwise by the owner.

Three copies of this notice are to be filed with the County Clerk and Recorder of the county in which the works are located.

Please answer all questions. If not applicable, so state, otherwise the form will be returned.

Original to the County Clerk and Recorder; duplicate to the State Engineer; Triplicate to the Montana Bureau of Mines and Geology and Quadruplicate for the Appropriator.

10314

396618

STUART HERRON & HUBERT COLIE

TO

THE PUBLIC

NOTICE OF COMPLETION OF GROUND  
WATER APPROPRIATION WITHOUT WELL

STATE OF MONTANA, ) ss.  
COUNTY OF HILL )  
Filed at 4 o'clock P. m.

ON DEC 17 1963

R. E. Blom

COUNTY CLERK

BY \_\_\_\_\_ DEPUTY

Fee: \$2.00 pd.

31

File No. ....

T. 31<sup>N</sup> R. 15<sup>W</sup>

DUPLICATE

County Hill

RECEIVED  
DEC 19 1963

STATE OF MONTANA  
ADMINISTRATOR OF GROUNDWATER CODE  
OFFICE OF STATE ENGINEER

STATE ENGINEER

Notice of Completion of Groundwater Appropriation  
Without Well

(Under Chapter 237 Montana Session Laws, 1961)

Date of Appropriation of Groundwater. Aug 1946

Owner. Stuart Herron Address. Box 1209

Contractor (if any) .....

Address of Contractor .....

Date Started..... Date Completed.....

Describe means of obtaining groundwater without a well "as by sub-irrigation and other natural processes". Include description of water when applicable.

spring & small well start. Artesian well 60 ft deep; synograph drilled in about 1957 not used flowed about 50 gal minute through 2 in pipe

Quantity of water developed and used with explanation of method used to measure or estimate such amount. If use is intermittent

estimate approximate lengths of periods of use. various periods for livestock when range is used. Intend to use artesian well for irrigation

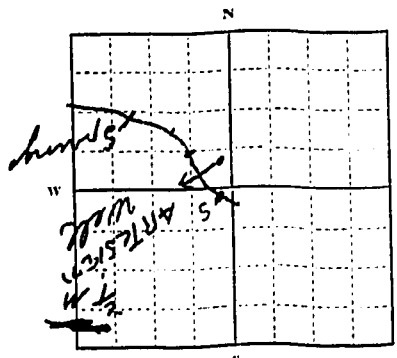

N 1/4 Sec 31 T. 31 R. 15

Indicate point of appropriation and place of use, if possible.

Signature of Owner. Stuart Herron

Date. Dec 16 1963

This form to be prepared by contractor (if any), otherwise by the owner.

Three copies of this notice are to be filed with the County Clerk and Recorder of the county in which the works are located.

Please answer all questions. If not applicable, so state, otherwise the form will be returned.

Original to the County Clerk and Recorder; duplicate to the State Engineer; Triplicate to the Montana Bureau of Mines and Geology and Quadruplicate for the Appropriator.

10312

396616

STUART WARDEN

TO

THE PEOPLE

NOTICE OF COMPLETION OF GROUND  
WATER APPROPRIATION WITHOUT WELL

STATE OF MONTANA, )  
COUNTY OF HILL )  
Filed at 4 o'clock P.M.

ON DEC 17 1963

R. E. Blom

COUNTY CLERK

DEPUTY

Fee: \$2.00 pd.

GW. FILE NO. \_\_\_\_\_

TWP. 31 N RGE 15 E  
COUNTY HULL 32

STATE OF MONTANA  
ADMINISTRATOR OF GROUNDWATER CODE  
OFFICE OF STATE ENGINEER

DECLARATION OF VESTED GROUNDWATER RIGHTS  
(Under Chapter 237, Montana Session Laws, 1961)

1. Mavis Dablin, of PO Box 901 Harlow  
(Name of Appropriator) (Address) (Town)  
County of Hull, State of Montana  
Have appropriated groundwater according to the Montana laws in effect prior to Jan. 1, 1962 as follows:

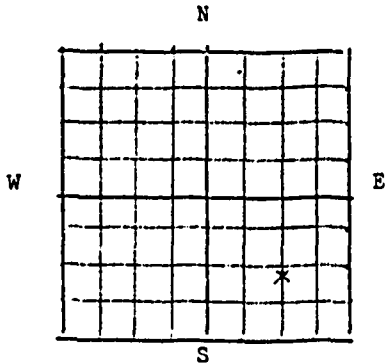

S.E. 1/4 Sec. 32 T. 31 R. 15

Indicate point of appropriation and place of use, if possible. Each small square represents 10 acres.

2. The beneficial use on which the claim is based stock water
3. Date or approximate date of earliest beneficial use; and how continuous the use has been Sept 1928 and used continuously to date
4. The amount of groundwater claimed (in miner's inches or gallons per minute) 5 gallons per minute
5. If used for irrigation, give the acreage and description of the lands to which water has been applied and name of the owner thereof None
6. The means of withdrawing such water from the ground and the location of each well or other means of withdrawal running spring
7. The date of commencement and completion of the construction of the well, wells, or other works for withdrawal of groundwater N/A
8. The depth of water table N/A
9. So far as it may be available, the type, size and depth of each well or the general specifications of any other works for the withdrawal of groundwater N/A
10. The estimated amount of groundwater withdrawn each year Spring run continuously
11. The log of formations encountered in the drilling of each well if available N/A
12. Such other information of a similar nature as may be useful in carrying out the policy of this act, including reference to book and page of any county record This is a free flowing spring

Signature of Owner Mavis Dablin  
Date \_\_\_\_\_

Three copies to be filed by the owner with the County Clerk & Recorder of the County in which the well is located.

PLEASE ANSWER ALL QUESTIONS. IF NOT APPLICABLE, SO STATE, OTHERWISE THE FORM WILL BE RETURNED.

Original to the County Clerk & Recorder; duplicate to the State Engineer; Triplicate to the School of Mines and Quadruplicate for the Appropriator.

397136

MARIE DAHLIN

TO

THE PUBLIC

DECLARATION OF VALID  
GROUNDWATER RIGHTS

STATE OF MONTANA )  
COUNTY OF HILL ) ss.  
Filed at 11 o'clock am

BY 12/3/63 1963

COUNTY CLERK

DEPUTY

FEE: \$2.00 pd.

RECEIVED  
1958

T. 31 N R. 16E  
County Hill

3H

STATE ENGINEER MONTANA BUREAU OF MINES AND GEOLOGY  
Butte, Montana

WATER WELL LOG

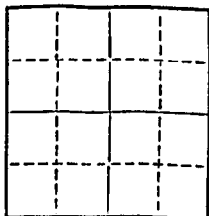

Owner Frank Fox Address 445 West Ave  
Driller Lloyd Sargent Address 274 95 East Ellis Street  
Date Started Feb 21 1958 Date Completed Oct 12 1958  
Location: Sec. 27 T. 31 R. 16E 1/4 sec. SW

South West

Type of well Drilled Equipment used spudder  
(Dug, driven, bored, or drilled) (Churn drill, rotary, other)

Water use: Domestic  Municipal  Stock  Irrigation   
Industrial  Drainage  Other: .....

Casing: 1 ft. to 247 ft. Type Size  
Casing: ft. to ft. Type Size  
Casing: ft. to ft. Type Size

Perforated or Screened: Ft. 120 to ft. 247 Ft. 247 to ft. 247

Type of screen or perforations slots

Static Water level, for non-flowing well: feet.

Shut-in pressure, for flowing well: lb./sq. in. on: (date)

Pumping water level: feet at gal. per min.

How tested: Back

Length of test: approx. 8 hrs.

Remarks: (Gravel packing, cementing, packers, type of shut-off, depth of shut-off)

Frank Fox

(over)



Log of Well

Depth, feet		Description of Material Drilled
From	To	
	0	top soil
0	1	sandy clay, yellow
1	16	clay, fat, yellow
16	26	sandy yellow clay
26	48	fat yellow clay
48	52	coal
52	53	blue shale, Judith
53	56	grey shale
56	60	light brown shale
60	65	light grey shale, sandy
65	138	hard shell
138	140	light grey sandy shale
140	168	hard shell
168	170	grey shale, sandy
170	204	grey shale, very sandy, some water
204	220	grey shale, sandy
220	225	brown shale
225	237	light green shale
237	279	sandy grey shale
279	287	brown shale
287	292	yellow shale
292	296	grey shale
296	300	blue shale
300	302	grey shale
302	340	brown shale
340	349	grey very sandy, trace water
349	352	blue shale, sandy
352	360	sandstone, trace water
360	370	sandstone, bentonite mix
370	380	sandstone, grey
380	390	grey shale, sandy
390	397	grey shale

DOC. NO. 369097

FRANK EARL  
TO  
THE PUBLIC

WATER WELL LOG

STATE OF MONTANA, )  
COUNTY OF HILL )  
Filed at 3:30 o'clock P.M.

ON DEC 3 1958

G.C. YEON  
COUNTY CLERK

By \_\_\_\_\_ DEPUTY

26	48	fat yellow clay
48	52	coal
52	53	blue shale, Judith
53	56	gray shale
56	60	light brown shale
60	65	light gray shale, sandy
65	138	hard shell
138	140	light gray sandy shale
140	168	hard shell
168	170	gray shale, sandy
170		gray shale, very sandy, some water

GW 4  
FILE NO. \_\_\_\_\_  
DUPLICATE

STATE OF MONTANA  
ADMINISTRATOR OF GROUNDWATER CODE  
OFFICE OF STATE ENGINEER

TWP 31 RGE 15  
COUNTY Hill  
**RECEIVED**  
MAR 6 1963

DECLARATION OF VESTED GROUNDWATER RIGHTS STATE ENGINEER  
(Under Chapter 237, Montana Session Laws, 1961)

1. M. E. Hillbrant, of Box 1068 Haure  
(Name of Appropriator) (Address) (Town)  
County of Hill, State of Montana  
Have appropriated groundwater according to the Montana laws in effect prior to Jan. 1, 1962 as follows:

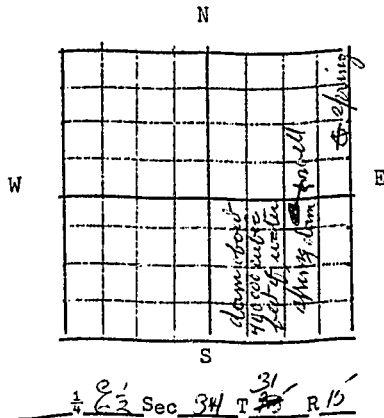

Indicate point of appropriation and place of use, if possible. Each small square represents 10 acres.

2. The beneficial use on which the claim is based Dwelling and livestock
3. Date or approximate date of earliest beneficial use; and how continuous the use has been 1925 continuous
4. The amount of groundwater claimed (in miner's inches or gallons per minute) About 40 gallons per minute
5. If used for irrigation, give the acreage and description of the lands to which water has been applied and name of the owner thereof none
6. The means of withdrawing such water from the ground and the location of each well or other means of withdrawal Pump on well
7. The date of commencement and completion of the construction of the well, wells, or other works for withdrawal of groundwater well completed 1925 pumps have been cleaned by dragline on sediment fills them up.
8. The depth of water table About 15 feet varies some
9. So far as it may be available, the type, size and depth of each well or the general specifications of any other works for the withdrawal of groundwater Dug well 15 feet deep
10. The estimated amount of groundwater withdrawn each year \_\_\_\_\_
11. The log of formations encountered in the drilling of each well if available none
12. Such other information of a similar nature as may be useful in carrying out the policy of this act, including reference to book and page of any county record none

Signature of Owner M. E. Hillbrant  
Date Feb 1963

Three copies to be filed by the owner with the County Clerk & Recorder of the County in which the well is located.

PLEASE ANSWER ALL QUESTIONS. IF NOT APPLICABLE, SO STATE, OTHERWISE THE FORM WILL BE RETURNED.

Original to the County Clerk & Recorder; duplicate to the State Engineer; Triplicate to the School of Mines and Quadruplicate for the Appropriator.

392673

W. E. HILLBRANT

TO

THE PUBLIC

DECLARATION OF VESTED GROUND  
WATER RIGHTS

STATE OF MONTANA ) ss.  
COUNTY OF HILL )  
Filed at 10 o'clock A.M.

27 MAR 5 1963

R. E. Blom  
COUNTY CLERK

BY \_\_\_\_\_ DEPUTY

Fee: \$2.00 pd.

GW-4  
FILE NO. \_\_\_\_\_

TWP 31 N RGE 15 E  
COUNTY Hill County

STATE OF MONTANA  
ADMINISTRATOR OF GROUNDWATER CODE  
OFFICE OF STATE ENGINEER

RECEIVED  
JAN 1962

DECLARATION OF VESTED GROUNDWATER RIGHTS  
(Under Chapter 237, Montana Session Laws, 1961)

1. Frank Fox Coal, of 1145 Grant Ave Glenn  
(Name of Appropriator) (Address) (Town)  
County of Hill, State of Montana  
Have appropriated groundwater according to the Montana laws in effect prior to Jan. 1, 1962 as follows:

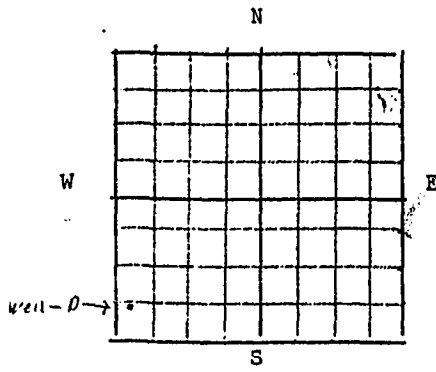

SW 1/4 Sec 34 T31 R15

Indicate point of appropriation and place of use, if possible. Each small square represents 10 acres.

- The beneficial use on which the claim is based farm & house use
- Date or approximate date of earliest beneficial use; and how continuous the use has been 1958 - continuous
- The amount of groundwater claimed (in miner's inches or gallons per minute) 2 gal per minute
- If used for irrigation, give the acreage and description of the lands to which water has been applied and name of the owner thereof \_\_\_\_\_
- The means of withdrawing such water from the ground and the location of each well or other means of withdrawal submersible pump
- The date of commencement and completion of the construction of the well, wells, or other works for withdrawal of groundwater fall of 1958
- The depth of water table 398 feet
- So far as it may be available, the type, size and depth of each well or the general specifications of any other works for the withdrawal of groundwater deep well - 6 inch casing - 398 feet
- The estimated amount of groundwater withdrawn each year 129,400 gal.
- The log of formations encountered in the drilling of each well if available not available - should have been filed by driller - pump & casing, cleaned &
- Such other information of a similar nature as may be useful in carrying out the policy of this act, including reference to book and page of any county record unknown

Signature of Owner Frank Fox Coal

Date 12-30-1962

Three copies to be filed by the owner with the County Clerk & Recorder of the County in which the well is located.

PLEASE ANSWER ALL QUESTIONS. IF NOT APPLICABLE, SO STATE, OTHERWISE THE FORM WILL BE RETURNED.

Original to the County Clerk & Recorder; duplicate to the State Engineer; Triplicate to the School of Mines and Quadruplicate for the Appropriator.

397173

STAMP BOX LABEL

TO

THE PUBLIC

DEPARTMENT OF REVENUE  
GROUNDWATER RIGHTS

STATE OF MONTANA, )  
COUNTY OF HILL )  
Called at 11 o'clock a.m.

BY 19 30 1963  
[Signature]  
COUNTY CLERK

BY \_\_\_\_\_  
DEPUTY

SEE: 2.00 pd.

File No. \_\_\_\_\_

T. 31N R 15E

10/15

DUPLICATE

County Hill

*SW*

STATE OF MONTANA  
ADMINISTRATOR OF GROUNDWATER CODE  
OFFICE OF STATE ENGINEER

RECEIVED  
AUG 26 1963

### Notice of Completion of Groundwater Appropriation Without Well

(Under Chapter 237 Montana Session Laws, 1961)

Date of Appropriation of Groundwater: Sept 20-1958  
Owner: M. R. & L. R. Crow Address: Shamba Pt. House

Contractor (if any) \_\_\_\_\_

Address of Contractor \_\_\_\_\_

Date Started: Aug 27 Date Completed: Sept 22

Describe means of obtaining groundwater without a well "as by sub-irrigation and other natural processes". Include depth to water when applicable. Team for stock reservoir

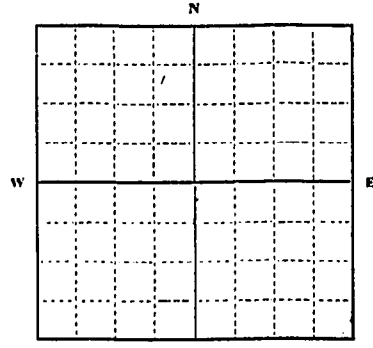

.....<sup>s</sup>/<sub>4</sub>..... Sec. 15-15 31N R 15E

Indicate point of appropriation and place of use, if possible.

Quantity of water developed and used with explanation of method used to measure or estimate such amount. If use is intermittent estimate approximate lengths of periods of use.....

Continuous since construction

Signature of Owner: M. R. & L. R. Crow  
Date: 8/22/63

This form to be prepared by contractor (if any), otherwise by the owner.  
Three copies of this notice are to be filed with the County Clerk and Recorder of the county in which the works are located.  
Please answer all questions. If not applicable, so state, otherwise the form will be returned.  
Original to the County Clerk and Recorder; duplicate to the State Engineer; Triplicate to the Montana Bureau of Mines and Geology and Quadruplicate for the Appropriator.

394971

M. R. & L. R. CROWE

TO

THE PUBLIC

NOTICE OF COMPLETION OF  
GROUNDWATER APPROPRIATION

# 3

STATE OF MONTANA, ) ss.  
COUNTY OF HILL )  
Filed at 3 o'clock P.m.

ON AUG 22 1963

R. E. Blom  
COUNTY CLERK

by \_\_\_\_\_ DEPUTY

FEE: \$2.00 pd.





GW3

File No. ....

DUPLICATE

T. 31<sup>N</sup> R. 16<sup>E</sup>

County Hill

STATE OF MONTANA  
ADMINISTRATOR OF GROUNDWATER CODE  
OFFICE OF STATE ENGINEER

RECEIVED  
DEC 27 1963

STATE ENGINEER  
**Notice of Completion of Groundwater Appropriation Without Well**

(Under Chapter 237 Montana Session Laws, 1961)

Date of Appropriation of Groundwater 27 Dec. 1963

Owner C.I. Hendricks Address Box 227 Havre

Contractor (if any) None

Address of Contractor None

Date Started Unknown Date Completed unknown

Describe means of obtaining groundwater without a well "as by sub-irrigation and other natural processes". Include depth to water when applicable. Spring - at surface

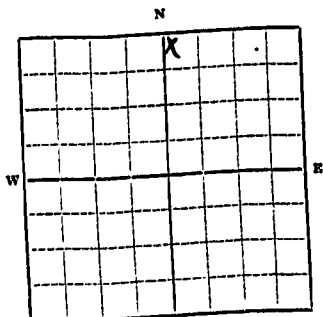

N 1/2 of NE 1/4  
NE 1/4 of Sec. 5 T. 21 R. 16  
Indicate point of appropriation and place of use, if possible.

Quantity of water developed and used with explanation of method used to measure or estimate such amount. If use is intermittent estimate approximate lengths of periods of use

Approximately 150,000 gallons per year - intermittent use - household & block watering.

Signature of Owner C.I. Hendricks

Date 27 Dec 1963

This form to be prepared by contractor (if any), otherwise by the owner.

Three copies of this notice are to be filed with the County Clerk and Recorder of the county in which the works are located.

Please answer all questions. If not applicable, so state, otherwise the form will be returned.

Original to the County Clerk and Recorder; duplicate to the State Engineer; Triplicate to the Montana Bureau of Mines and Geology and Quadruplicate for the Appropriator.

396743

G. I. BARRINGS

TO

THE PUBLIC

NOTICE OF CANCELLATION OF APPROPRIATION  
OF CERTAIN REAL ESTATE WELLS

STATE OF MONTANA, ss.  
COUNTY OF HILL )  
Filed at 1 o'clock p.m.

ON DEC 23 1963

R. E. Blom  
COUNTY CLERK

By \_\_\_\_\_ DEPUTY

Fee: \$2.00 pd.

STATE OF MONTANA  
ADMINISTRATOR OF GROUNDWATER CODE  
MONTANA WATER RESOURCES BOARD

NOTICE OF COMPLETION OF GROUNDWATER  
APPROPRIATION BY MEANS OF WELL  
Developed after January 1, 1962

(Under Chapter 237 Montana Session Laws, 1961, as amended)

This form to be prepared by driller, and three copies to be filed by the owner with the County Clerk and Recorder in the county in which the well is located, last copy to be retained by driller. Please answer all questions. If not applicable, so state, otherwise the form may be returned.

Owner RAYMOND PATRICK  
 Address HAVRE, MONTANA  
 Date well started 11/1/71  
 completed 11/5/71  
 Type of well DRILLED  
 Equipment used CABLE TOOL RIG  
 Water Use: Domestic  Municipal  Stock  Irrigation   
 Industrial  Drainage  Other  Garden/Lawn

For Administrator's Use  
 File 423834  
28.28.1972 3:15 p.m.  
 GW 1

\*Describe  
 USE: If used for irrigation, industrial, drainage or other. Explain, state number of acres and location or other data (i.e. Lot, Block and Addition).

ESTIMATED ANNUAL WITHDRAWAL 1,500,000 GALLONS

Size of Drilled Hole	Size and Weight of Casing	From (Feet)	To (Feet)	PERFORATIONS		
				Kind	From (Feet)	To (Feet)
12"	6 5/8" O.D. PVC 160#	0	98	3/16" DRILLED	38 (MODERATE)	85
	6 5/8" O.D. PVC 200#	59	98		85 (HEAVY)	94

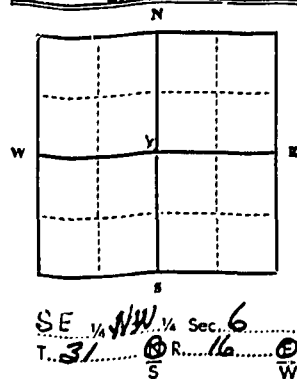

Static water level 38 1/2 ft.\*  
 Pumping water level 9.5 ft.\*  
 at 8 1/2 gallons per minute,  
 measured 240 minutes after pumping began.  
 \*Measured from ground level.  
 Well developed by BAKER'S PUMP  
 for 8 hours.  
 Power ELECTRIC Pump 1/2 HP  
 Remarks: (Gravel packing, cementing, packers, type of shutoff) HALE REAMED TO 12" DIAMETER TO 42 FOOT LEVEL. REFORATED 6 5/8" O.D. PVC CASING INSTALLED AND GRAVEL PACKED AROUND OUTSIDE OF CASING FROM 98 FOOT LEVEL BACK TO 25 FOOT LEVEL. CEMENT PLACED DIRECTLY ABOVE GRAVEL PACK TO SEAL OFF SURFACE CONTAMINATION. CLAY SOIL FILLED IN ABOVE CEMENT TO SURFACE

INDICATE LOCATION OF WELL AND PLACE OF USE, IF POSSIBLE. EACH SMALL SQUARE REPRESENTS 40 ACRES.

Driller's Signature Robert Quinn HI-LINE DRILLING SERVICE  
 Driller's Address 1173 6TH ST. NO. PHONE 265-4210  
HAVRE, MONTANA 59501 LICENSE NO. 46

31N 16E  
 County HILL

DRILLER'S LOG

Indicate the character, color, thickness of strata such as soil, clay, sand, gravel, shale, sandstone, etc. Show depth at which water is found and height to which water rises in well.

Top of Ground (Elev. above sea level)		
From (Feet)	To (Feet)	
0	7	FILL DIRT
18		SANDY & GRAVELLY BROWN CLAY
28		BROWN CLAY - SMALL BOULDERS
52		GREY CLAY
53		BOULDER
68		SANDY GREY CLAY
73		SANDY & GRAVELLY GREY CLAY
84		BOULDER
91		GREY CLAY - SANDY
92		SAND & GRAVEL - WATER
94		GRAVELLY GREY CLAY
98		SANDY GREY SHALE

98 Show exact depth of bottom

49,945