

STATE OF MONTANA
ADMINISTRATOR OF GROUNDWATER CODE
MONTANA WATER RESOURCES BOARD

RECEIVED

DRILLER'S LOG

JUN 4 1971

Indicate the character, color, thickness of strata such as soil, clay, sand, gravel, shale, sandstone, etc. Show depth at which water is found and height to which water rises in well.

NOTICE OF COMPLETION OF GROUNDWATER APPROPRIATION BY MEANS OF WELL

Developed after January 1, 1962

(Under Chapter 237 Montana Session Laws, 1961, as amended)

This form to be prepared by driller, and three copies to be filed by the owner with the County Clerk and Recorder in the county in which the well is located, last copy to be retained by driller. Please answer all questions. If not applicable, so state, otherwise the form may be returned.

Owner Ivan G. & Dolores A. Dibbles
Address Star Route 36
Havre, Montana
Date well started 4/22/71
completed 4/28/71

| | |
|-------------------------|--|
| For Administrator's Use | |
| File # <u>421276</u> | |
| <u>June 3, 1971</u> | |
| <u>2:30 PM</u> | |
| GW 1 | |

Type of well Drilled
(Dug, driven, bored or drilled)
Equipment used Cable Tool Rig
(Churn drill, rotary or other)
Water Use: Domestic Municipal Stock Irrigation
Industrial Drainage Other Garden/Lawn

*Describe _____
USE: If used for irrigation, industrial, drainage or other. Explain, state number of acres and location or other data (i.e. Lot, Block and Addition).

ESTIMATED ANNUAL WITHDRAWAL 1,000,000 GALLONS

| Size of Drilled Hole | Size and Weight of Casing | From (Feet) | To (Feet) | PERFORATIONS | | |
|----------------------|---------------------------|-------------|-----------|--------------|-------------|-----------|
| | | | | Kind Size | From (Feet) | To (Feet) |
| 12" | | 0 | 20 | | | |
| 6 5/8" | 6 5/8" OD (.188 wall) | 15 in | 117 | | | |
| | 6 5/8" OD (.250 wall) | 117 | 133 | | | |

No perforations. Water coming in thru bottom of drive shoes at 133 foot level.

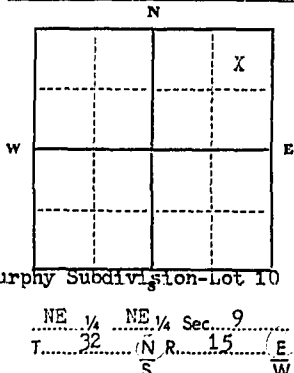

Static water level 31 ft.*
Pumping water level 32 ft.*
at 16 gallons per minute, measured 300 minutes after pumping began.
*Measured from ground level.
Well developed by Baler & pump for 8 hours.
Power Electric Pump 3/4 HP
Remarks: (Gravel packing, cementing, packers, type of shutoff) Hole roamed to 12" diameter to 20 ft. level. Upon completion of well, this annular space filled with cement grout & bentonite. Remainder filled with clay silt.
INDICATE LOCATION OF WELL AND PLACE OF USE, IF POSSIBLE. EACH SMALL SQUARE REPRESENTS 40 ACRES.

Driller's Signature Hi-Line Drilling Service Herbert Dreier
Driller's Address 1173 6th Street North
Havre, Montana LICENSE NO. 46

| Top of Ground (El. above sea level) | | |
|-------------------------------------|-----------|---|
| From (Feet) | To (Feet) | |
| 0 | 3 | Fill dirt |
| | 5 | Soil |
| | 14 | Sandy brown clay |
| | 22 | Gravelly brown clay |
| | 24 | Brown sand & gravel-dry |
| | 29 | Boulders & clay |
| | 34 | Brown sand-some gravel |
| | 38 | Boulders & clay |
| | 46 | Gravelly grey clay |
| | 50 | Sandy grey clay |
| | 62 | Grey clay |
| | 71 | Sandy grey clay |
| | 74 | Runny grey sand |
| | 92 | Sandy grey clay |
| | 95 | Silty grey clay |
| | 98 | Grey silt & sand |
| | 105 | Sandy grey clay |
| | 115 | Gravelly grey clay |
| | 122 | Brown sand-float coal-water-approx. 6 GPM |
| | 124 | Brown sand-some gravel-water-approx. 10GPM baling from bottom. (not clearing well) |
| | 129 | Brown silt & sand (very dirty) |
| | 132 | Sand & gravel-water-exceeding 15 GPM |
| | 133 | Sand & gravel (Pee size to 1" diameter)-water-exceeding 20 GPM with little draw down. |

133 Show exact depth of bottom

48568

421276

IVAN G. DIBBLEE & DELORES A.
DIBBLEE (husband and wife)

to

THE PUBLIC

NOTICE OF COMPLETION OF
GROUNDWATER APPROPRIATION

STATE OF MONTANA)
COUNTY OF HILL) ss.
Filed at 2:30 o'clock P m

JUN 3 1971

R. E. BLOM

COUNTY CLERK

DEPUTY

fee: \$2.00 paid

GW 4
FILE NO. _____

TWP 32N RGE 15E
COUNTY Hill

DUPLICATE

STATE OF MONTANA
ADMINISTRATOR OF GROUNDWATER CODE
OFFICE OF STATE ENGINEER

RECEIVED
OCT 18 1962

DECLARATION OF VESTED GROUNDWATER RIGHTS
(Under Chapter 237, Montana Session Laws, 1961) STATE ENGINEER

1. Donald Chute, of General Delivery Hayre,
(Name of Appropriator) (Address) (Town)
County of Hill, State of Montana
Have appropriated groundwater according to the Montana laws in effect prior to Jan.
1, 1962 as follows:

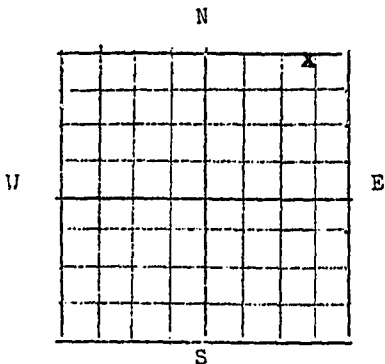

N 1/4 Sec 9 T 32N R 15E

Indicate point of appropriation and place of use, if possible. Each small square represents 10 acres.

2. The beneficial use on which the claim is based domestic
 3. Date or approximate date of earliest beneficial use; and how continuous the use has been continuous since May 29, 1957
 4. The amount of groundwater claimed (in miner's inches or gallons per minute) 12 gals. per minute
 5. If used for irrigation, give the acreage and description of the lands to which water has been applied and name of the owner thereof none
 6. The means of withdrawing such water from the ground and the location of each well or other means of withdrawal electric pump
7. The date of commencement and completion of the construction of the well, wells, or other works for withdrawal of groundwater Drilling begun: May 17, 1957
well finished: May 29, 1957
 8. The depth of water table 115 ft.
 9. So far as it may be available, the type, size and depth of each well or the general specifications of any other works for the withdrawal of groundwater drilled well, 6" OD diameter, 115 ft. depth
 10. The estimated amount of groundwater withdrawn each year 3,000,000
 11. The log of formations encountered in the drilling of each well if available clay, quicksand, gravel
 12. Such other information of a similar nature as may be useful in carrying out the policy of this act, including reference to book and page of any county record none

Signature of Owner Donald Chute

Date October 17, 1962

Three copies to be filed by the owner with the County Clerk & Recorder of the County in which the well is located.

PLEASE ANSWER ALL QUESTIONS. IF NOT APPLICABLE, SO STATE, OTHERWISE THE FORM WILL BE RETURNED.

Original to the County Clerk & Recorder; duplicate to the State Engineer; Triplicate to the School of Mines and Quadruplicate for the Appropriator.

390773

DONALD CHUTE

to

THE PUBLIC

DECLARATION OF VESTED
GROUNDWATER RIGHTS

STATE OF MONTANA)
COUNTY OF HILL) ss.
Filed at 10:40 o'clock A m.

ON OCT 17 1962

G. C. Yeon

COUNTY CLERK

By _____

DEPUTY

Fee:\$2.00 pd.

RECEIVED

Approved Stock Form—State Publishing Co., Helena, Montana—18557

GW 2

File No.

FEB 22 1972

T. 32 N. R. 15 E. 9

DUPLICATE

MONTANA DEPARTMENT OF NATURAL RESOURCES AND CONSERVATION

County HILL

LOG

STATE OF MONTANA ADMINISTRATOR OF GROUNDWATER CODE STATE WATER CONSERVATION BOARD

Notice of Completion of Groundwater Appropriation by Means of Well DEVELOPED AFTER JANUARY 1, 1962

(Under Chapter 237 Montana Session Laws, 1961, as amended)

Owner LLOYD & CATHERINE PARK Address STAR RT. 36 HAVER, MONTANA

Driller HILL LINE DRILLING SERVICE Address 1173 6TH ST. N. HAVER, MONTANA

Date of Notice of appropriation of groundwater.....

Date well started 6/20/64 Date completed 6/25/64

Type of well DRILLED Equipment used BALE TOOL RIG (Dug, driven, bored or drilled) (Churn drill, rotary or other)

Water use: Domestic Municipal Stock Irrigation Industrial Drainage Other LAWN & GARDEN

Indicate on the diagram the character and thickness of the different strata met with in drilling, such as soil, clay, shale, gravel, rock or sand, etc. Show depth at which water is encountered, thickness and character of water-bearing strata and height to which the water rises in the well.

- Top of Ground (Elev. above sea level.....)
0-10 SOIL
16 GRAVELLY BROWN CLAY
37 YELLOWISH-BROWN CLAY
49 SANDY BROWN CLAY
60 BROWNISH-GREY CLAY - GRAVELLY
63 BROWN SAND + GRAVEL - SOME WATER (CASED OFF)
70 GREY CLAY
79 SANDY GREY CLAY
84 GREY CLAY
86 RUNNY GREY SAND - BITS OF COAL (CASED OFF)
97 SANDY GREY CLAY
100 SILTY GREY CLAY
107 GREY SILT + SAND - SMALL AMOUNT OF WATER (CASED OFF)
119 SANDY GREY CLAY
120 GREY SAND + GRAVEL - WATER - EXCEEDING 15 GPM BY BALER TEST
180 Show exact depth of bottom.

Table with columns: Size of Drilled Hole, Size and Weight of Casing, From (Feet), To (Feet), PERFORATIONS (Kind Size, From (Feet), To (Feet)).

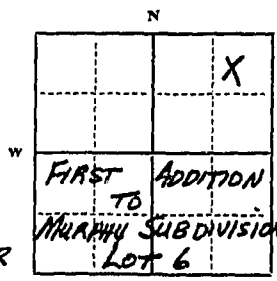

Static Water Level for non-flowing well 52 feet. Shut-in Pressure for Flowing Well Not App. Pumping Water Level 55 feet at 10 gal. per minute. Discharge in gal. per min. of flowing well Not Applicable. How Tested Baler + Pump. Length of Test 8 Hours.

Remarks: (Gravel packing, cementing, packers, type of shutoff)..... NE 1/4 Sec. 9 T. 32 N. R. 15 E. Indicate location of well and place of use, if possible. Each small square represents 40 acres.

USE—If used for irrigation, industrial, drainage or other. Explain, state number of acres and location or other data (i.e.: Lot, Block and Addition). Doc. No. 423759

Filed for record this 18th day of February A.D. 1972 at 4:20 o'clock P.M.

Driller's License Number 46 Driller's Signature Herbert Zeeien

This form to be prepared by driller, and three copies to be filed by the owner with the County Clerk and Recorder in the county in which the well is located, tissue copy to be retained by driller. Please answer all questions. If not applicable, so state, otherwise the form will be returned.

49,903

423759

LLOYD CLARK & KATHERINE
CLARK

TO

THE PUBLIC

STATE OF MONTANA,
COUNTY OF HILL) ss.
February 4: 20 o'clock A.M.

FEB 18 1972

R. E. Blom

COUNTY CLERK

David E. May
DEPUTY

Fee: \$2.00 pd.

(INDEXED)

GW-4
FILE NO. _____
DUPLICATE

32 15
368,9 TWP 32 RGE 15
COUNTY _____

STATE OF MONTANA
ADMINISTRATOR OF GROUNDWATER CODE
OFFICE OF STATE ENGINEER

RECEIVED

DECLARATION OF VESTED GROUNDWATER RIGHTS
(Under Chapter 237, Montana Session Laws, 1961)

STATE ENGINEER

1. CHARLES J. COLLIER, of HAVRE, (Town)
(Name of Appropriator) (Address)
County of HILL, State of MONTANA
Have appropriated groundwater according to the Montana laws in effect prior to Jan. 1, 1962 as follows:

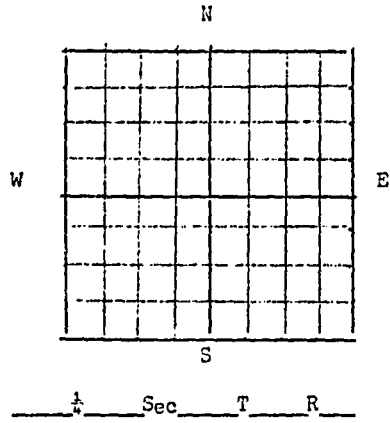

Indicate point of appropriation and place of use, if possible. Each small square represents 10 acres.

2. The beneficial use on which the claim is based
~~HOUSEHOLD & IRRIGATION FOR LANDSCAPING~~
3. Date or approximate date of earliest beneficial use; and how continuous the use has been
JUNE 2 1960

4. The amount of groundwater claimed (in miner's inches or gallons per minute)
25 GAL. PER MINUTE

5. If used for irrigation, give the acreage and description of the lands to which water has been applied and name of the owner thereof
2 acre MURKINS SUBDIVISION LOT 11
Owner: CHARLES J. COLLIER

6. The means of withdrawing such water from the ground and the location of each well or other means of withdrawal
1st TYPE 7000 / CAPACITY
150 GALS. PER HOUR
7 WELLS LOCATED (SEE PLAN) - SEE PLAN FOR W. N.

7. The date of commencement and completion of the construction of the well, wells, or other works for withdrawal of groundwater
STARTED JUNE 24 COMPLETED JUNE 1 1960

8. The depth of water table 30 feet
9. So far as it may be available, the type, size and depth of each well or the general specifications of any other works for the withdrawal of groundwater
TOTAL D&PW 139 feet, 6 inch type CB 10.50 casing

10. The estimated amount of groundwater withdrawn each year 100,000 GALS.
11. The log of formations encountered in the drilling of each well if available

8' sandy clay, 12' gravelly clay, 29' sandy clay, 36' sandy clay, 38' gravelly clay, 58' very sandy clay, 72' gray clay, 108' brown clay, 120' gravel & water

12. Such other information of a similar nature as may be useful in carrying out the policy of this act, including reference to book and page of any county record

Signature of Owner Charles J. Collier
Date 12-16-1967

Three copies to be filed by the owner with the County Clerk & Recorder of the County in which the well is located.

PLEASE ANSWER ALL QUESTIONS. IF NOT APPLICABLE, SO STATE, OTHERWISE THE FORM WILL BE RETURNED.

Original to the County Clerk & Recorder; duplicate to the State Engineer; Triplicate to the School of Mines and Quadruplicate for the Appropriator.

391551

STANLEY J. COLIER

TO

THE PUBLIC

ALL THIS

DECLARATION OF VESTED GROUND
WATER RIGHTS

1962

STATE OF MONTANA
COUNTY OF HILL
Filed at 2:12 o'clock P.M.

G. C. Yeon
COUNTY CLERK

Fee: \$2.00 pd.

APR 1 1962

52 APR 1 1962

IF THE ORIGINAL IS NOT
RECORDED IN THE
OFFICE OF THE COUNTY CLERK
IT IS VOID

RECORDED IN THE
OFFICE OF THE COUNTY CLERK
HILL COUNTY MONTANA
APR 1 1962

30 44

File No. _____

T 32N R 15E 9

DUPLICATE

County Lill

LOG

STATE OF MONTANA
ADMINISTRATOR OF GROUNDWATER CODE
STATE WATER CONSERVATION BOARD

Notice of Completion of Groundwater
Appropriation by Means of Well

DEVELOPED AFTER JANUARY 1, 1962

(Under Chapter 237 Montana Session Laws, 1961, as amended)



Top of Ground
(Elev. above sea level _____)

21-22' --- rock
22-55' --- brown clay
55-70' --- gray shale & clay
70-95' --- quick sand
95-96' --- coal
96-116' --- blue shale
& clay
116-139' --- brown shale
& clay
139-145' --- gravel streak
145' --- bottom

Owner JAMES W COLE Address HAURE, MONT.

Driller S. LEE Address HAURE, MONT.

Date of Notice of appropriation of groundwater March 17, 1971

Date well started Mar. 12 Date completed Mar. 19

Type of well drilled Equipment used churn
(Dug, driven, bored or drilled) (Churn drill, rotary or other)

Water use: Domestic Municipal Stock Irrigation
Industrial Drainage Other

Indicate on the diagram the character and thickness of the different strata met with in drilling, such as soil, clay, shale, rock or sand, etc. Show depth at which water is encountered, thickness and character of water-bearing strata and height to which the water rises in the well.

| Size of Drilled Hole | Size and Weight of Casing | From (Feet) | To (Feet) | PERFORATIONS | | |
|----------------------|---------------------------|-------------|-----------|--------------|-------------|-----------|
| | | | | Kind Size | From (Feet) | To (Feet) |
| 8" | 7" - 22lb. | 0 | 116 | 1/2" X 6 | 135 | 145 |
| 6" | 4 1/2" - 11lb. | 100 | 145 | | | |

Filed for record
Doc. No. _____
at _____ day of _____
1971

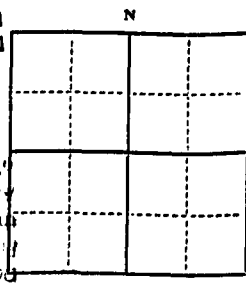

Static Water Level for non-flowing well 95 feet.

Shut-in Pressure for Flowing Well _____

Pumping Water Level 130 feet
at 30 gal. per minute.

Discharge in gal. per min. of flowing well _____

How Tested Baler

Length of Test 2 hrs.

Remarks: (Gravel packing, cementing, pack-
ery, type of shut-off) quick sand churn off

with 7" casing.

(Continue on reverse side)

USE—If used for irrigation, industrial, drainage or other. Explain, state number of acres and location or other data (i.e.: Lot, Block and Addition).
1 acre

Doc. No. 420646
Filed for record
this 39th day of March
A.D. 19 71
o'clock 2 P.M.

Show exact depth of bottom.

This form to be prepared by driller, and three copies to be filed by the owner with the County Clerk and Recorder in the county in which the well is located, tissue copy to be retained by driller.

Please answer all questions. If not applicable, so state, otherwise the form will be returned.

Mont #21
Driller's License Number

[Signature]
Driller's Signature.

48305

420646

JAMES W. COLE

TO

THE PUBLIC

NOTICE OF COMPLETION OF
GROUNDWATER APPROPRIATION

STATE OF MONTANA,
COUNTY OF HILL
MAR 29 2:20 PM 1971

MAR 29 1971
R. E. BLOM
COUNTY CLERK

DEPUTY

fee: \$2.00 paid

File No.

DUPLICATE

LOG

STATE OF MONTANA
ADMINISTRATOR OF GROUNDWATER CODE
STATE WATER CONSERVATION BOARD

5 1971

Notice of Completion of Groundwater Appropriation by Means of Well

DEVELOPED AFTER JANUARY 1, 1962

(Under Chapter 237 Montana Session Laws, 1961, as amended)

Top of Ground
(Elev. above sea level 1971)

- 21-22' — rock
- 22-55' — brown clay
- 55-70' — gray shale & clay
- 70-95' — quick sand
- 95-96' — coal
- 96-116' — blue shale & clay
- 116-139' — brown shale & clay
- 139-145' — gravel streak
- 145' — bottom

Owner: JAMES W. COLE Address: HANDE, MONT.

Driller: SLAY LEE Address: HANDE, MONT.

Date of Notice of appropriation of groundwater: March 17, 1971

Date well started: Mar. 12 Date completed: Mar. 19

Type of well: drilled Equipment used: churn
(Dug, driven, bored or drilled) (Churn drill, rotary or other)

Water use: Domestic Municipal Stock Irrigation
Industrial Drainage Other

Indicate on the diagram the character and thickness of the different strata met with in drilling, such as soil, clay, shale, gravel, rock or sand, etc. Show depth at which water is encountered, thickness and character of water-bearing strata and height to which the water rises in the well.

| Size of Drilled Hole | Size and Weight of Casing | From (Feet) | To (Feet) | PERFORATIONS | | |
|----------------------|---------------------------|-------------|-----------|--------------|-------------|-----------|
| | | | | Kind Size | From (Feet) | To (Feet) |
| 8" | 7"-22lb. | 0 | 116 | 1/2" X 6 | 135 | 145 |
| 6" | 4 1/2" - 11lb. | 100 | 145 | | | |

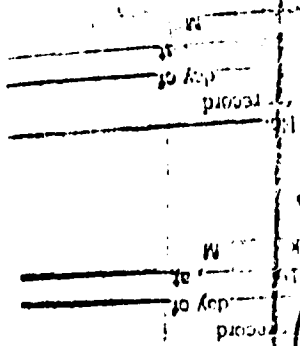

Static Water Level for non-flowing well: 95 feet.

Shut-in Pressure for Flowing Well: _____

Pumping Water Level: 130 feet at 30 gal. per minute.

Discharge in gal. per min. of flowing well: _____

How Tested: Baler

Length of Test: 2 hrs.

Remarks: (Gravel packing, cementing, pack-
ern type of shutoff)

quick sand shut off

with 7" casing.

Indicate location of well and place of use, if possible. Each small square represents 40 acres.

Lot 10, Block 15, T. 22 N. R. 15 E. Sec. 9, Twp. 22 N. R. 15 E.

15 E. M. P. M. (Continue on reverse side)

USE—If used for irrigation, industrial, drainage or other. Explain, state number of acres and location or other data (i.e.: Lot, Block and Addition).

1 acre

Exp. No. 420646
Filed for record this 29th day of March A.D. 19 71

Show exact depth of bottom.

This form to be prepared by driller, and three copies to be filed by the owner with the County Clerk and Recorder in the county in which the well is located, tissue copy to be retained by driller.

Please answer all questions. If not applicable, so state, otherwise the form will be returned.

Mont H 21
Driller's License Number
James W. Cole
Driller's Signature.

NAME of 9215

FILE NO. _____
DUPLICATE

TWP 17 RGE _____
COUNTY MISS

STATE OF MONTANA
ADMINISTRATOR OF GROUNDWATER CODE
OFFICE OF STATE ENGINEER

RECEIVED
DEC 10 1963

DECLARATION OF VESTED GROUNDWATER RIGHTS
(Under Chapter 237, Montana Session Laws, 1961)

STATE ENGINEER

1. Mr. H. & Alice G. Beck, & Heirs, of Box 1386, Havre, Montana.
 (Name of Appropriator) (Address) (Town)
 County of MISS, State of Montana
 have appropriated groundwater according to the Montana laws in effect prior to Jan. 1, 1962 as follows:

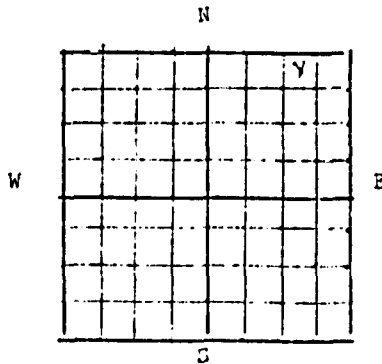

NE 1/4 Sec 7 T.12 R.17

Indicate point of appropriation and place of use, if possible. Each small square represents 10 acres.

2. The beneficial use on which the claim is based Household & irrigation of landscaping
3. Date or approximate date of earliest beneficial use; and how continuous the use has been July 6th, 1956
4. The amount of groundwater claimed (in miner's inches or gallons per minute) 25 gal. per min.
5. If used for irrigation, give the acreage and description of the lands to which water has been applied and name of the owner thereof 1 acre - lot 8 - Mary's sub. Mr. H. & Alice G. Beck - owners
6. The means of withdrawing such water from the ground and the location of each well or other means of withdrawal Jet Pump
7. The date of commencement and completion of the construction of the well, wells, or other works for withdrawal of groundwater June 24, 1956 - completed July 6, 1956
8. The depth of water table 40 feet
9. So far as it may be available, the type, size and depth of each well or the general specifications of any other works for the withdrawal of groundwater 0ft. to 120ft. - type DD10.50 - 6 inch
10. The estimated amount of groundwater withdrawn each year 500,000 gal.
11. The log of formations encountered in the drilling of each well if available see bottom of sheet
12. Such other information of a similar nature as may be useful in carrying out the purposes of this act, including reference to book and page of any county record _____

Signature of Owner Alice G. Beck
Date Dec 10 1963

Three copies to be filed by the owner with the County Clerk & Recorder of the County in which the well is located.

PLEASE ANSWER ALL QUESTIONS. IF NOT APPLICABLE, SO STATE, OTHERWISE THE FORM WILL BE RETURNED.

Original to the County Clerk & Recorder; duplicate to the State Engineer; Triplicate to the School of Mines and Quadruplicate for the Appropriator.

Log- 0-3ft, top soil, 3-17ft- sandy clay, 17-29ft-gravelly clay, 29-36ft-sandy clay, 36-44ft, gravelly clay, 44ft-58ft, very sandy clay, 58-67ft, sandy clay, some boulders, 67-72ft, grey clay, some boulders, 72- 108ft, sandy grey clay, 108-113ft, brown clay, 113-134ft, sandy clay, some water, 139ft,-gravel-water.

396402

WM. H. & ALICE C. BEEM

TO

THE PUBLIC

DECLARATION OF VESTED GROUND
WATER RIGHTS

STATE OF MONTANA
COUNTY OF HILL
Filed at 10:30 o'clock A.M.

ON 1230 1963

R. E. Blom

COUNTY CLERK

DEPUTY

Fee: \$2.00 pd.

Vertical text on the right side of the page, including "RECORDED" and "INDEXED" stamps, and other illegible markings.

File No.

MONTANA WATER RESOURCES BOARD

T. 32N R. 15E 9

DUPLICATE

RECEIVED

County HILL

LOG

JUL 24 1969

STATE OF MONTANA
ADMINISTRATOR OF GROUNDWATER CODE
OFFICE OF STATE ENGINEER

Top of Ground
(Elev. above sea level.....)

Notice of Completion of Groundwater
Appropriation by Means of Well
DEVELOPED AFTER JANUARY 1, 1962

(Under Chapter 237, Montana Session Laws, 1961)

Owner HAROLD BOSTIC Address HAYRE, MONTANA

Driller HI-LINE DRILLING SERVICE Address HAYRE, MONTANA

Date of Notice of appropriation of groundwater.....

Date well started JUNE 17, 1967 Date completed JUNE 23, 1967

Type of well DRILLED Equipment used CABLE TOOL RIG
(Dug, driven, bored or drilled) (Churn drill, rotary or other)

Water use: Domestic Municipal Stock Irrigation
Industrial Drainage Other

Indicate on the diagram the character and thickness of the different strata met with in drilling, such as soil, clay, shale, gravel, rock or sand, etc. Show depth at which water is encountered, thickness and character of water-bearing strata and height to which the water rises in the well.

- 0-10 Top + SUBSOIL
- 3-8 YELLOWISH-BROWN CLAY
- 8-14 SANDY BROWN CLAY
- 14-39 YELLOWISH BROWN CLAY
- 39-46.2 BROWN SAND (CAVING BED) (CASED OFF)
- 46.2-51 BROWN CLAY
- 51-55 SOFT BROWN CLAY
- 55-57 BROWN SAND (CASED OFF)
- 57-59 SOFT BROWNISH-GREY CLAY
- 59-72 GREY CLAY
- 72-87 GRAVELLY GREY CLAY
- 87-93 GREY SILT + SAND TRACE OF WATER - (CASED OFF)
- 93-101 GRAVELLY GREY CLAY
- 101-114 SANDY GREY CLAY
- 114-122 GREY CLAY - FRAGMENTS OF SHALE + COAL
- 122-134 GREY SILT + SAND - SOME GRAVEL - WATER - APPROX 2 GPM
- 134-141 GRAVELLY GREY CLAY
- 141-143 SANDY GREY CLAY
- 143-144 SAND + GRAVEL - WATER
- 144-145 GRAVEL - WATER EXCEEDING 25 GPM AT 65 FT. FROM GROUND LEVEL
- 145 Show exact depth of bottom.

| Size of Drilled Hole | Size and Weight of Casing | From (Feet) | To (Feet) | PERFORATIONS | | |
|----------------------|---------------------------|-----------------------------|-----------|---|-------------|-----------|
| | | | | Kind Size | From (Feet) | To (Feet) |
| 6 5/8" | 6 7/8" O.D. | 9 INCHES ABOVE GROUND LEVEL | 145 | NO PERFORATIONS WATER COMING IN THROUGH BOTTOM OF DRIVE SHADE AT 145 FT LEVEL | | |

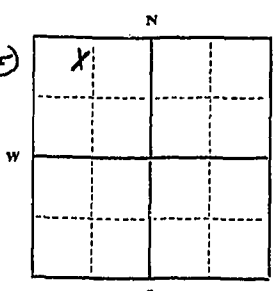

Static Water Level for non-flowing well 58 feet.

Shut-in Pressure for Flowing Well NOT APPL.

Pumping Water Level 62 feet at 14 gal. per minute.

Discharge in gal. per min. of flowing well NOT APPLICABLE

How Tested BALER + PUMP

Length of Test 6 HOURS

Remarks: (Gravel packing, cementing, packers, type of shutoff) CEMENTED FROM APPROX 95 FT LEVEL BACK TO 20 FT LEVEL DRILLING MUD FILLED IN BACK TO 8 FT LEVEL

Sec. 9 T. 32 R. 15
Indicate location of well and place of use, if possible. Each small square represents 40 acres.

USE—If used for irrigation, industrial, drainage or other. Explain, state number of acres and location or other data (i.e.: Lot, Block and Addition).

This form to be prepared by driller, and three copies to be filed by the owner with the County Clerk and Recorder in the county in which the well is located, tissue copy to be retained by driller.

Please answer all questions. If not applicable, so state, otherwise the form will be returned.

46
Driller's License Number
Herbert Graier
Driller's Signature

45477

414381

HAROLD BOSTIC

TO

THE PUBLIC

NOTICE OF COMPLETION OF
GROUNDWATER APPROPRIATION

STATE OF MONTANA,) ss.
COUNTY OF HILL)

Filed at 10:20 o'clock A m

ON JUL 22 1969

R. E. BLOM

COUNTY CLERK

By _____

DEPUTY

fee: \$2.00 paid

File No.

T. 32^N R. 15^E

DUPLICATE

County Hill

STATE OF MONTANA
ADMINISTRATOR OF GROUNDWATER CODE
OFFICE OF STATE ENGINEER

RECEIVED
DEC 10 1963

Declaration of Vested Groundwater Rights

(Under Chapter 237, Montana Session Laws, 1961)

STATE ENGINEER

1. John M. Grant, of Box 185 Haure
(Name of Appropriator) (Address) (Town)
County of Hill State of Montana
have appropriated groundwater according to the Montana laws in effect prior to January 1, 1962, as follows:

| | | | |
|--|---|--|--|
| | | | |
| | X | | |
| | | | |
| | | | |
| | | | |
| | | | |
| | | | |
| | | | |

Lot 6 - Schms 1st addition

N. 1/4, W. 1/4 Sec. 9, T. 32, R. 15

Indicate point of appropriation and place of use, if possible. Each small square represents 10 acres.

2. The beneficial use on which the claim is based Irrigation
domestic & stock

3. Date or approximate date of earliest beneficial use; and how continuous the use has been. March 3 - 1961

4. The amount of groundwater claimed (in miner's inches or gallons per minute) 60 gallons per minute

5. If used for irrigation, give the acreage and description of the lands to which water has been applied, and name of the owner thereof
2 acres John M. Grant

6. The means of withdrawing such water from the ground, and the location of each well or other means of withdrawal. Electric
power

7. The date of commencement and completion of the construction of the well, wells, or other works for withdrawal of groundwater. March 1 - 1961 to March 3 - 1961

8. The depth of water table. 40 ft.

9. So far as it may be available, the type, size and depth of each well or the general specifications of any other works for the withdrawal of groundwater. 6 inch heavy duty casing
143 ft deep

10. The estimated amount of groundwater withdrawn each year. 682500 gal.

11. The log of formations encountered in the drilling of each well if available. not available

12. Such other information of a similar nature as may be useful in carrying out the policy of this act, including reference to book and page of any county record. none

Signature of Owner John M. Grant
Date 12-9-63

Three copies to be filed by the owner with the County Clerk and Recorder of the county in which the well is located.

Please answer all questions. If not applicable, so state, otherwise the form will be returned.

Original to the County Clerk and Recorder; Duplicate to the State Engineer; Triplicate to the Montana Bureau of Mines and Geology, and Quadruplicate for the Appropriator.

396429

JOHN M. CRANT

TO

THE PUBLIC

DECLARATION OF VESTED GROUND
WATER RIGHTS

STATE OF MONTANA,) ss.
COUNTY OF HILL)
Filed at 10:30'clock A.M.

ON DEC 9 1963

R. E. Blom

COUNTY CLERK

DEPUTY

Fee: \$2.00 pd.

File No.

T. 32N R. 15E 9

DUPLICATE

County Hill

STATE OF MONTANA
ADMINISTRATOR OF GROUNDWATER CODE
OFFICE OF STATE ENGINEER

Top of Ground

RECEIVED

(Elev. above sea level FEB 1969)

Notice of Completion of Groundwater
Appropriation by Means of Well
DEVELOPED AFTER JANUARY 1, 1962

(Under Chapter 237, Montana Session Laws, 1961)

- 0 to 3 Soil
- 12 Sandy brown clay
- 28 Gravelly brown clay
- 37 yellowish-brown clay
- 49 Sandy brown clay (caving-cased off)
- 54 Brown clay
- 57 Brown sand (cased off)
- 61 Soft brown clay
- 76 Grey clay
- 89 Gravelly grey clay
- 92 Silty grey clay
- 94 Grey sand (cased off)
- 108 Gravelly grey clay
- 119 Sandy grey clay
- 122 Greysand & silt trace of water (cased off)
- 134 Gravelly grey clay
- 138 Soft grey clay
- 150 Sandy grey clay
- 151 Sand & gravel-water exceeding 35 Gpm
- 151 Show exact depth of bottom.

Owner Fred Harshaw Address Haure, Montana
Driller Hi-Line Drilling Service Address Haure, Montana

Date of Notice of appropriation of groundwater

Date well started 7-8-66 Date completed 7-12-66

Type of well Drilled Equipment used Cable tool r.i.g.
(Dug, driven, bored or drilled) (Churn drill, rotary or other)

Water use: Domestic Municipal Stock Irrigation
Industrial Drainage Other

Indicate on the diagram the character and thickness of the different strata met with in drilling, such as soil, clay, shale, gravel, rock or sand, etc. Show depth at which water is encountered, thickness and character of water-bearing strata and height to which the water rises in the well.

| Size of Drilled Hole | Size and Weight of Casing | From (Feet) | To (Feet) | PERFORATIONS | | |
|----------------------|---------------------------|---------------------------------|------------|--|-------------|-----------|
| | | | | Kind Size | From (Feet) | To (Feet) |
| <u>6 5/8"</u> | <u>6 5/8" O.D.</u> | <u>5 ft. below Ground level</u> | <u>151</u> | <u>(No Perforations) water coming in thru bottom of drive shoe at 151 ft level</u> | | |

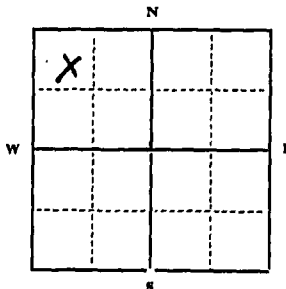

Static Water Level for non-flowing well 51 feet.

Shut-in Pressure for Flowing Well Not App.

Pumping Water Level 65 feet
at 1.5 gal. per minute.

Discharge in gal. per min. of flowing well Not App.

How Tested Case & submersible pump
Length of Test 2 hours

Remarks: (Gravel packing, cementing, packers, type of shutoff) Bentonite & drilling mud placed around casing back to bottom of P.T. Cement floor poured around casing

(Continue on reverse side)

USE—If used for irrigation, industrial, drainage or other. Explain, state number of acres and location or other data (i.e.: Lot, Block and Addition).

This form to be prepared by driller, and three copies to be filed by the owner with the County Clerk and Recorder in the county in which the well is located, tissue copy to be retained by driller.

Please answer all questions. If not applicable, so state, otherwise the form will be returned.

46
Driller's License Number

Herbert Seiser
Driller's Signature.

44, 975

412868

FRED HARSHAW

TO

THE PUBLIC

NOTICE OF COMPLETION OF
GROUNDWATER APPROPRIATION

STATE OF MONTANA,) ss.
COUNTY OF HILL)
Filed at 11:20 o'clock A.M.

FEB 4 1969

R. E. BLOM
COUNTY CLERK

DEPUTY

fee: \$2.00 paid

File No. 2102

T. 32 N R. 15 E 9

DUPLICATE

County HILL

8
33
63
80
105
124
125

Top of Ground
(Elev. above sea level)
brown clay
brown clay and boulders
gray sand
boulders and gravel
blue clay
blue clay and boulders
gravel and water

MONTANA WATER RESOURCES BOARD ADMINISTRATOR OF GROUNDWATER CODE
OFFICE OF STATE ENGINEER

RECEIVED

JUL 31 1968
Notice of Completion of Groundwater Appropriation by Means of Well

(Under Chapter 237, Montana Session Laws, 1961)

Owner EVETTE SMISHER Address HAVER, MONTANA

Driller LIPSON DRILLING CO. Address MILTA, MONTANA

Date of Notice of appropriation of ground water _____

Date well started MAY 5 1968 Date Completed DECEMBER 1968

Type of well _____ Equipment used CABLE TOOLS
(dug, driven, bored or drilled) Churn, drill, rotary or other

Water use: Domestic Municipal Stock Irrigation
Industrial Drainage Other

Indicate on the diagram the character and thickness of the different strata met with in drilling, such as soil, clay, shale, gravel, rock or sand, etc. Show depth at which water is encountered, thickness and character of water-bearing strata and height to which the water rises in the well.

| Size of Drilled Hole | Size and Weight of Casing | From (Feet) | To (Feet) | PERFORATIONS | | |
|----------------------|---------------------------|-------------|-----------|--------------|-------------|-----------|
| | | | | Kind Size | From (Feet) | To (Feet) |
| 7" | 5/8" 17 LBS | 1' A.G. | 124 | | | |

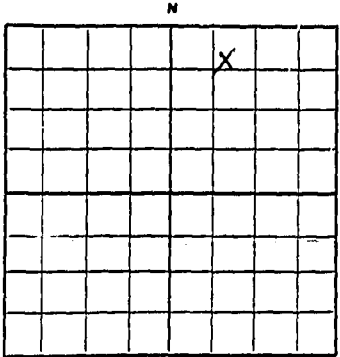

Static Water Level for non-flowing well 15 feet.
Shut-in Pressure for Flowing Well _____
Pumping Water Level 55 feet
at 15 gal. per minute.
Discharge in gal. per min. of flowing well _____

How Tested _____
Length of Test 2 HOURS
Remarks: (Gravel packing, cementing, packers, type of shutoff, location of place of use of groundwater if not at well, and any other similar pertinent information, including number of acres irrigated, if used for irrigation) _____

NW 1/4 NE Sec 9 T32 R15
Indicate location of well and place of use, if possible. Each small square represents 10 acres.

1.5 Show exact depth of bottom.

15
Driller's License Number
Richard Jacobson
Driller's Signature

This form to be prepared by driller, and three copies to be filed by the owner with the County Clerk and Recorder in the county in which the well is located.

Please answer all questions. If not applicable, so state, otherwise the form will be returned.

Original to the County Clerk and Recorder; duplicate to the State Engineer; Triplicate to the School of Mines and Quadruplicate for Appropriator.

44,460

File No. GW2

T. 32 N R. 76 E

DUPLICATE

County HILL

8
38
63
80
105
124
125

Top of Ground
(Elev. above sea level)
brown clay
brown clay and boulders
gray sand
boulders and gravel
blue clay
blue clay and boulders
gravel and water

STATE OF MONTANA
MONTANA WATER RESOURCES BOARD ADMINISTRATOR OF GROUNDWATER CODE
OFFICE OF STATE ENGINEER

RECEIVED

JUL 31 1968

Notice of Completion of Groundwater Appropriation by Means of Well

(Under Chapter 237, Montana Session Laws, 1961)

Owner EVERETT SMISHER Address HAVRE, MONTANA

Driller LIPSON DRILLING CO. Address MALTA, MONTANA

Date of Notice of appropriation of ground water _____

Date well started MAY 5 1968 Date Completed MAY 29 1968

Type of well drilled Equipment used CABLE TOOLS
(dug, driven, bored or Churn, drill, rotary or drilled) other)

Water use: Domestic Municipal Stock Irrigation
Industrial Drainage Other

Indicate on the diagram the character and thickness of the different strata met with in drilling, such as soil, clay, shale, gravel, rock or sand, etc. Show depth at which water is encountered, thickness and character of water-bearing strata and height to which the water rises in the well.

| Size of Drilled Hole | Size and Weight of Casing | From (Feet) | To (Feet) | PERFORATIONS | | |
|----------------------|---------------------------|-------------|-----------|--------------|-------------|-----------|
| | | | | Kind Size | From (Feet) | To (Feet) |
| 7" | 5/5/8 17 LBS | 1'A.G. | 124 | | | |

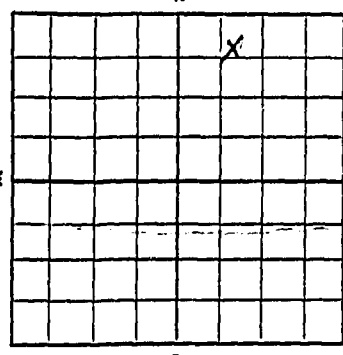

Static Water Level for non-flowing well 45 feet.

Shut-in Pressure for Flowing Well _____

Pumping Water Level 55 feet at 15 gal. per minute.

Discharge in gal. per min. of flowing well _____

How Tested direct

Length of Test 2 HOURS

Remarks: (Gravel packing, cementing, packers, type of shutoff, location of place of use of groundwater if not at well, and any other similar pertinent information, including number of acres irrigated, if used for irrigation) _____

NW 1/4 NE Sec. 9 T32 R15
Indicate location of well and place of use, if possible. Each small square represents 10 acres.

125 Show exact depth of bottom.

15
Driller's License Number

Parking Jackson
Driller's Signature

This form to be prepared by driller, and three copies to be filed by the owner with the County Clerk and Recorder in the county in which the well is located.

Please answer all questions. If not applicable, so state, otherwise the form will be returned.

Original to the County Clerk and Recorder; duplicate to the State Engineer; Triplicate to the School of Mines and Quadruplicate for Appropriator.

44,460

411598

EVERETT SWISHER

TO

THE PUBLIC

NOTICE OF
GROUND WATER APPROPRIATION

STATE OF MONTANA)
COUNTY OF HILL)
Filed at 2:30 o'clock P. M.

ON JUL 29 1968

R. E. BLON

COUNTY CLERK

By _____

DEPUTY

fee: \$2.00 paid

RECEIVED

T 32N R 15E
County Hill

STATE ENGINEER MONTANA BUREAU OF MINES AND GEOLOGY
Butte, Montana

WATER WELL LOG

| | | | |
|--|--|--|--|
| | | | |
| | | | |
| | | | |
| | | | |

Owner: C. Claude C. Salyer Address: Box 305
 Driller: Lloyd G. Hanberg Address: Box Elder, Mont.
 Date Started: May 7, 1960 Date Completed: May 21, 1960
 Location: Sec. 29 T32N R15E 1/4 sec. Lot 10

Type of well: Drilled (Dug, driven, bored, or drilled) Equipment used: Churn Driller (Churn drill, rotary, other)

Water use: Domestic Municipal Stock Irrigation
 Industrial Drainage Other: _____

Casing: 0 ft. to 10.2 ft. Type: gal. H. D. Size: 6"

Casing: _____ ft. to _____ ft. Type: _____ Size: _____

Casing: _____ ft. to _____ ft. Type: _____ Size: _____

Perforated or Screened: Ft. _____ to ft. _____ Ft. _____ to ft. _____

Type of screen or perforations: None

Static Water level, for non-flowing well: _____ feet.

Shut-in pressure, for flowing well: _____ lb./sq. in. on: _____ (date)

Pumping water level: 64 feet at 25 gal. per min.

How tested: baller

Length of test: _____

Remarks: (Gravel packing, cementing, packers, type of shut-off, depth of shut-off)

Lloyd G. Hanberg
(over)

DOCUMENT NO. 378946

CLAUDE C. SALYER
TO
THE PUBLIC

WATER WELL LOG

STATE OF MONTANA,
COUNTY OF HILL)
Filed at 9:50 o'clock A.M.

ON AUG 17 1960

G. C. YEON

COUNTY CLERK

BY _____ DEPUTY

FEE \$1.00- paid

| | | |
|---------|---------|---|
| 112 ft. | 142 ft. | gravelly clay |
| 142 ft. | 143 ft. | clay, gravel, saome water |
| 143 ft. | 162ft. | fine sand |
| 162 ft. | 168 ft. | drift coal sand |
| 168 ft. | 174 ft. | fine sand some gravel |
| 174 ft. | 178 ft. | coarse sand and gravel, |
| | | water |
| | | well completed water table 65 ft. from surface. |
| | | 15 ft. drawdown. |

DUPLICATE

RECEIVED

County Hill

Top of Ground

(Elev. above sea level)

- 17 brown clay
- 18 boulders
- 60 brown claysandy
- 75 sand and black clay
- 85 sticky gray clay
- 128 gray sand
- 138 hard pan
- 146 sand and water
- 146 gravel and water

STATE OF MONTANA
 ADMINISTRATOR OF GROUNDWATER CODE
 OFFICE OF STATE ENGINEER

Notice of Completion of Groundwater Appropriation by Means of Well

(Under Chapter 237, Montana Session Laws, 1961)

Owner ALVIE WEBB Address MALTA, MONTANA

Driller SIMPSON DRING CO. Address MALTA, MONTANA

Date of Notice of appropriation of ground water _____

Date well started AUGUST 1 1967 Date Completed AUGUST 4 1967

Type of well DRILLED Equipment used CABLE TOOLS
(dug, driven, bored or drilled) Churn, drill, rotary or other)

Water use: Domestic Municipal Stock Irrigation
 Industrial Drainage Other

Indicate on the diagram the character and thickness of the different strata met with in drilling, such as soil, clay, shale, gravel, rock or sand, etc. Show depth at which water is encountered, thickness and character of water-bearing strata and height to which the water rises in the well.

| Size of Drilled Hole | Size and Weight of Casing | From (Feet) | To (Feet) | PERFORATIONS | | |
|----------------------|---------------------------|-------------|-----------|--------------|-------------|-----------|
| | | | | Kind Size | From (Feet) | To (Feet) |
| 5 1/2" | 12 LBS | 1' AG | 146' | | | |

Doc. No. 427163
 Filed for record this 16th day of Feb A. D. 1973 at 9:50 o'clock A.M.

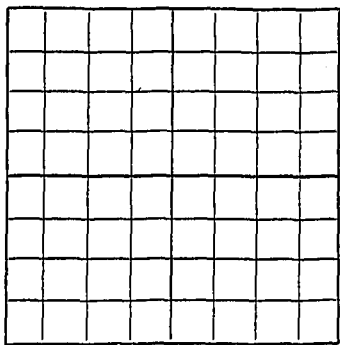

Static Water Level for non-flowing well 61 feet.

Shut-in Pressure for Flowing Well _____

Pumping Water Level 66 feet at 11 gal. per minute.

Discharge in gal. per min. of flowing well _____

How Tested ump Length of Test 10 hours

Remarks: (Gravel packing, cementing, packers, type of shutoff, location of place of use of groundwater if not at well, and any other similar pertinent information, including number of acres irrigated, if used for irrigation) _____

E 5 L s 3
 1/4 Sec 9 32N R 15E
 Indicate location of well and place of use, if possible. Each small square represents 10 acres.

Murphy's Sub. Division

Show exact depth of bottom.

15

Driller's License Number

[Signature]
Driller's Signature

This form to be prepared by driller, and three copies to be filed by the owner with the County Clerk and Recorder in the county in which the well is located.

Please answer all questions. If not applicable, so state, otherwise the form will be returned.

Original to the County Clerk and Recorder; duplicate to the State Engineer; Triplicate to the School of Mines and Quadruplicate for Appropriator.

GW 4
FILE NO.

DUPLICATE

STATE OF MONTANA
ADMINISTRATOR OF GROUNDWATER CODE
OFFICE OF STATE ENGINEER

TWP 32 N. RGE 15 E.
COUNTY Hill

RECEIVED
JAN 18 1963

DECLARATION OF VESTED GROUNDWATER RIGHTS
(Under Chapter 237, Montana Session Laws, 1961) STATE ENGINEER

1. Hayre Lodge No. 1201, BPOE, of 328 Second St., Hayre
(Name of Appropriator) (Address) (Town)
County of Hill, State of Montana
Have appropriated groundwater according to the Montana laws in effect prior to Jan. 1, 1962 as follows:

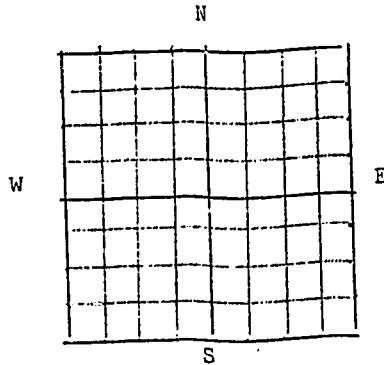

SW 1/4 NW Sec 10 T 32N R 15E

Indicate point of appropriation and place of use, if possible. Each small square represents 10 acres.

2. The beneficial use on which the claim is based
Domestic and irrigation.
3. Date or approximate date of earliest beneficial use; and how continuous the use has been
June, 1949, and continuously since.

4. The amount of groundwater claimed (in miner's inches or gallons per minute)
250 gallons per minute

5. If used for irrigation, give the acreage and description of the lands to which water has been applied and name of the owner thereof Part of Lots 9 & 10, Sec. 3, Twp. 32 N., Rge. 15 E.M.P.M.; Part of Lot 4, Part of NE 1/4 NW 1/4, North 70 yards of SE 1/4 NW 1/4 and W 1/2 NW 1/4 of Sec. 10, Twp. 32 N., Rge. 15 E.M.P.M. Appropriator

6. The means of withdrawing such water from the ground and the location of each well or other means of withdrawal turbine pump; well located in SW 1/4 NW 1/4 of Section 10, Township 32 North, Range 15 East M.P.M.

7. The date of commencement and completion of the construction of the well, wells, or other works for withdrawal of groundwater commenced and completed June, 1949.

8. The depth of water table Static head 2 ft. above ground level

9. So far as it may be available, the type, size and depth of each well or the general specifications of any other works for the withdrawal of groundwater 99' well with 84' 6" of 2 1/2" 8" std. pipe and screen set at 81' to 96'.

10. The estimated amount of groundwater withdrawn each year 22,500,000 gallons

11. The log of formations encountered in the drilling of each well if available 0'-24' sur-face and silt; 24'-28' yellow till, 28'-30' clay, sand & gravel, 30'-50' blue-grey clay, 50'-51' fine sand and gravel, 51'-55' fine sand and gravel, 55'-59' fine sand

12. Such other information of a similar nature as may be useful in carrying out the policy of this act, including reference to book and page of any county record
None

Signature of Owner By Fred M. G. Crowder
Chairman of the Board of Trustees
Date December 26, 1963

Three copies to be filed by the owner with the County Clerk & Recorder of the County in which the well is located.

PLEASE ANSWER ALL QUESTIONS. IF NOT APPLICABLE, SO STATE, OTHERWISE THE FORM WILL BE RETURNED.

Original to the County Clerk & Recorder; duplicate to the State Engineer; Triplicate to the School of Mines and Quadruplicate for the Appropriator.

397208

HAVRE LODGE # 1201, BPOE

TO

THE PUBLIC

DECLARATION OF VESTED
GROUNDWATER RIGHTS

STATE OF MONTANA)
COUNTY OF HILL)
Filed at 11 o'clock a.m.

ON 12-31 1963
[Signature]
COUNTY CLERK
DEPUTY

FEES: \$2.00 pd.

GW-4
FILE NO. _____
DUPLICATE

TWP 32 N. RGE 15 E.
COUNTY HILL

STATE OF MONTANA
ADMINISTRATOR OF GROUNDWATER CODE
OFFICE OF STATE ENGINEER

RECEIVED
JAN 1963

DECLARATION OF VESTED GROUNDWATER RIGHTS
(Under Chapter 237, Montana Session Laws, 1961)

STATE ENGINEER

1. Havre Lodge No. 1201, BPOE, of 328 Second St. Havre
(Name of Appropriator) (Address) (Town)
County of Hill, State of Montana
Have appropriated groundwater according to the Montana laws in effect prior to Jan. 1, 1962 as follows:

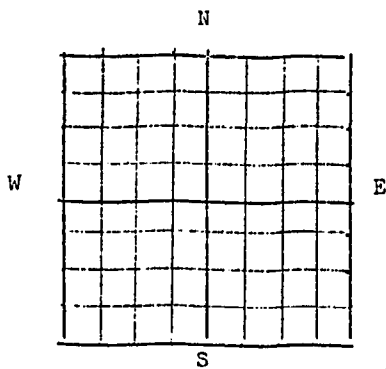

NW 1/4 NW 1/4 Sec 10 T 32N R 15E

Indicate point of appropriation and place of use, if possible. Each small square represents 10 acres.

- 2. The beneficial use on which the claim is based
Domestic and irrigation
- 3. Date or approximate date of earliest beneficial use; and how continuous the use has been
October, 1949, and continuously since
- 4. The amount of groundwater claimed (in miner's inches or gallons per minute)
300 gallons per minute

5. If used for irrigation, give the acreage and description of the lands to which water has been applied and name of the owner thereof
Part of Lots 9 & 10, Sec. 3, Twp. 32 N., Rge. 15 E.M.P.M.; Part of Lot 4, Part of NW 1/4, North 70 yards of SE 1/4 and W 1/2 of Sec. 10, Twp. 32 N., Rge. 15 E.M.P.M.

- 6. The means of withdrawing such water from the ground and the location of each well or other means of withdrawal
turbine pump; well located in NW 1/4 of Section 10, Township 32 North, Range 15 East M.P.M.

- 7. The date of commencement and completion of the construction of the well, wells, or other works for withdrawal of groundwater
commenced and completed October, 1949.
Static head
- 8. The depth of water table
head 10' 4" below ground level
- 9. So far as it may be available, the type, size and depth of each well or the general specifications of any other works for the withdrawal of groundwater
136' well with 119' 7" of 24" std. 8" pipe and screen set at 117' to 130'
- 10. The estimated amount of groundwater withdrawn each year
27,000,000 gallons
- 11. The log of formations encountered in the drilling of each well if available
0' - 10' surface clay or gumbo, 10' - 21' soft brown silt clay, 21' - 106' soft blue grey silt clay, 106' - 131' sand and gravel, 131' - 136' grey shale.
- 12. Such other information of a similar nature as may be useful in carrying out the policy of this act, including reference to book and page of any county record
None

Havre Lodge No. 1201, BPOE
Signature of Owner By David M. Gersmeyer
Chairman of the Board of Trustees
Date December 26, 1963

Three copies to be filed by the owner with the County Clerk & Recorder of the County in which the well is located.

PLEASE ANSWER ALL QUESTIONS. IF NOT APPLICABLE, SO STATE, OTHERWISE THE FORM WILL BE RETURNED.

Original to the County Clerk & Recorder; duplicate to the State Engineer; Triplicate to the School of Mines and Quadruplicate for the Appropriator.

397209

HAVRE LODGE # 1201 BPOE

TO

THE PUBLIC

DECLARATION OF VESTED
GROUNDWATER RIGHTS

STATE OF MONTANA)
COUNTY OF HILL)
Filed at 11 o'clock a.m.

1963

CLERK

DEPUTY

FEE: \$2.00 pd.

GW 4
FILE NO. _____
DUPLICATE

TWP 32N RGE 15E
COUNTY Hill

STATE OF MONTANA
ADMINISTRATOR OF GROUNDWATER CODE
OFFICE OF STATE ENGINEER

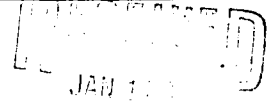

DECLARATION OF VESTED GROUNDWATER RIGHTS
(Under Chapter 237, Montana Session Laws, 1961) STATE ENGINEER

1. Havre Lodge No. 1201, BPOE, of 328 Second St. Havre
(Name of Appropriator) (Address) (Town)
County of Hill, State of Montana
Have appropriated groundwater according to the Montana laws in effect prior to Jan. 1, 1962 as follows:

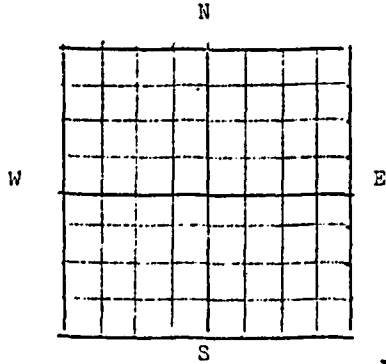

NE 1/4 NW 1/4 Sec 10 T 32N R 15E

Indicate point of appropriation and place of use, if possible. Each small square represents 10 acres.

2. The beneficial use on which the claim is based
Domestic and Irrigation.

3. Date or approximate date of earliest beneficial use; and how continuous the use has been
May, 1934, and continuously since.

4. The amount of groundwater claimed (in miner's inches or gallons per minute)
125 gallons per minute.

5. If used for irrigation, give the acreage and description of the lands to which water has been applied and name of the owner thereof
Part of Lots 9 & 10, Sec. 3, Twp. 32 N., Rge. 15 E.M.P.M.; Part of Lot 4, Part of NE 1/4, North 70 yards of SE 1/4 and W 1/2 of Sec. 10, Twp. 32 N., Rge. 15 E.M.P.M. Appropriator

6. The means of withdrawing such water from the ground and the location of each well or other means of withdrawal
Artesian well located in NE 1/4 of Section 10, Township 32 North, Range 15 East M.P.M.

7. The date of commencement and completion of the construction of the well, wells, or other works for withdrawal of groundwater
commenced and completed May, 1934.

8. The depth of water table
Static head 11 feet above ground level.

9. So far as it may be available, the type, size and depth of each well or the general specifications of any other works for the withdrawal of groundwater
78" well with 6" 6" of 10.50" merchant 6" O.D. casing

10. The estimated amount of groundwater withdrawn each year
11,250,000 gallons.

11. The log of formations encountered in the drilling of each well if available
0'-35' valley fill, soft clay, sand, 35'-76' soft blue clay, 76'-78' pea size gravel and fine sand

12. Such other information of a similar nature as may be useful in carrying out the policy of this act, including reference to book and page of any county record
None

Havre Lodge No. 1201, BPOE
Signature of Owner By [Signature]
Chairman of the Board of Trustees
Date December 26, 1963

Three copies to be filed by the owner with the County Clerk & Recorder of the County in which the well is located.

PLEASE ANSWER ALL QUESTIONS. IF NOT APPLICABLE, SO STATE, OTHERWISE THE FORM WILL BE RETURNED.

Original to the County Clerk & Recorder; duplicate to the State Engineer; Triplicate to the School of Mines and Quadruplicate for the Appropriator.

397210

HAVRE LODGE # 1201 BPOE

TO

THE PUBLIC

DECLARATION OF VESTED
GROUNDWATER RIGHTS

STATE OF MONTANA
COUNTY OF HILL
Filed at 11 o'clock am

ON DEC 31 1963

CLERK

DEPUTY

Fee: \$2.00 pd.

10

File No. _____

T 32 N R 15 E

DUPLICATE

County Hill

STATE OF MONTANA
ADMINISTRATOR OF GROUNDWATER CODE
OFFICE OF STATE ENGINEER

RECEIVED
JAN 1 1962

Declaration of Vested Groundwater Rights

(Under Chapter 237, Montana Session Laws, 1961)

STATE ENGINEER

1. Havre City County Airport Board, of Box 231 Havre
(Name of Appropriator) (Address) (Town)
County of Hill State of Montana
have appropriated groundwater according to the Montana laws in effect prior to January 1, 1962, as follows:

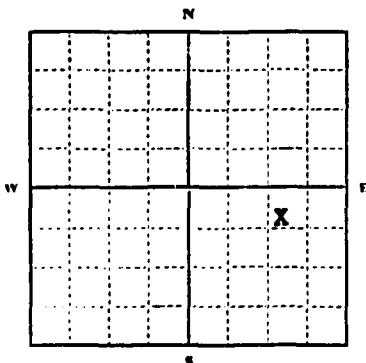

1/4 Sec. 10. T.32N R. 15E

Indicate point of appropriation and place of use, if possible. Each small square represents 10 acres.

2. The beneficial use on which the claim is based Domestic and Commercial

3. Date or approximate date of earliest beneficial use; and how continuous the use has been September 8, 1941 continuous

4. The amount of groundwater claimed (in miner's inches or gallons per minute) 30 gallons/minute

5. If used for irrigation, give the acreage and description of the lands to which water has been applied and name of the owner thereof None

6. The means of withdrawing such water from the ground and the location of each well or other means of withdrawal Jet Pump

7. The date of commencement and completion of the construction of the well, wells, or other works for withdrawal of groundwater September 8, 1941

8. The depth of water table 20 feet

9. So far as it may be available, the type, size and depth of each well or the general specifications of any other works for the withdrawal of groundwater 6"- 150 deep

10. The estimated amount of groundwater withdrawn each year 250,000 gallons

11. The log of formations encountered in the drilling of each well if available

State Board of Health

12. Such other information of a similar nature as may be useful in carrying out the policy of this act, including reference to book and page of any county record

Signature of Owner M. J. ... Secretary

Date 12-23-63

Three copies to be filed by the owner with the County Clerk and Recorder of the county in which the well is located.

Please answer all questions. If not applicable, so state, otherwise the form will be returned.

Original to the County Clerk and Recorder; Duplicate to the State Engineer; Triplicate to the Montana Bureau of Mines and Geology, and Quadruplicate for the Appropriator.

31122

397051

HAVRE CITY COUNTY AIRPORT BD.

TO

THE PUBLIC

DECLARATION OF VESTED
GROUNDWATER RIGHTS

Filed Dec 30 - 1963

4³⁰ pm

J. E. Brown

FEE: \$2.00 pd.

File No.

T. 32 N. R. 15 East N.P.M

DUPLICATE

County Hill

STATE OF MONTANA
ADMINISTRATOR OF GROUNDWATER
OFFICE OF STATE ENGINEER

RECEIVED
APR 1 1963

Notice of Completion of Groundwater Appropriation by Meas. STATE ENGINEER

(Under Chapter 237, Montana Session Laws, 1961)

Owner Thomas Crocker Address Havra, Montana

Driller Ernest O. Lee Address 1200 3rd St., Havra, Montana

Date of Notice of Appropriation of Groundwater.....

Date well started May 24, 1962 Date Completed May 26, 1962

Type of well Drilled Equipment Used Churn
(dug, driven, bored or drilled) (Churn, drill, rotary or other)

Water Use: Domestic Municipal Other Irrigation
Industrial Drainage Stock

Indicate on the diagram the character and thickness of the different strata met with in drilling, such as soil, clay, shale, gravel, rock or sand, etc. Show depth at which water is encountered, thickness and character of water-bearing strata and height to which water rises in the well.

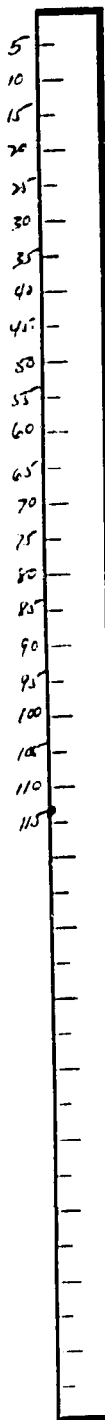

Top of Ground
(Elev. above sea level 2533)

| Size of Drilled Hole | Size and Weight of Casing | From (Feet) | To (Feet) | PERFORATIONS | | |
|----------------------|---------------------------|-------------|-----------|--------------|-------------|-----------|
| | | | | Kind Size | From (Feet) | To (Feet) |
| 6 5/8 | 6 5/8 21 lbs. | 0 | 114 | | | |

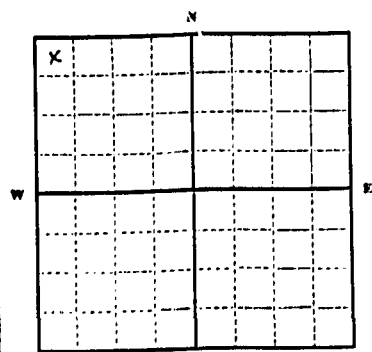

NW 1/4 NW 1/4 Sec. 10 T. 32. R. 15

Indicate location of well and place of use, if possible. Each small square represents 10 acres.

Show exact depth of bottom.

Static Water Level for non-flowing Well 45 feet.

Shut-in Pressure for Flowing Well N/A

Pumping Water Level 70 feet at 20 gal. per minute.

Discharge in gal. per min. of flowing well N/A

How Tested Baler Length of Test 2 hours

Remarks: (Gravel packing, cementing, packers, type of shutoff, location of place of use of groundwater if not at well, and any other similar pertinent information, including number of acres irrigated, if used for irrigation)

None

Thomas Crocker

Mr. J. H. 21
Driller's License Number

Ernest O. Lee
Driller's Signature

This form to be prepared by driller, and three copies to be filed by the owner with the County Clerk and Recorder in the county in which the well is located.

Please answer all questions. If not applicable, so state, otherwise the form will be returned.

Original to the County Clerk and Recorder; duplicate to the State Engineer; Triplicate to the Montana Bureau of Mines and Geology and Quadruplicate for the Appropriator.

392985

THOMAS CROCKER

TO

THE PUBLIC

NOTICE OF COMPLETION OF
GROUNDWATER APPROPRIATION BY
MEANS OF WELL

STATE OF MONTANA,) ss.
COUNTY OF HILL)
Filed at 3:45 o'clock P. m.

ON MAR 28 1963

R. E. Blom

COUNTY CLERK

By _____

DEPUTY

Fee: \$2.00 pd.

RECEIVED
MAR 28 1963
COUNTY CLERK

GW 2

Approved Stock Form—State Publishing Co., Helena, Montana—59116

File No.

DUPLICATE

RECEIVED
JUN 17 1964

T. 32^N R. 15^W 10

County Hill

STATE OF MONTANA
ADMINISTRATOR OF GROUNDWATER CODE
STATE ENGINEER

JAN 13 1964

Notice of Completion of Groundwater Appropriation by Means of Well

(Under Chapter 237, Montana Session Laws, 1961)

Top of Ground
(Elev. above sea level.....)

0 tp soil
1 blue clay
34 brown clay
40 sand gravel & water

Owner Pearl Getzel Address Hayre, Montana

Driller Simpson Drilling Co. Address Malta, Montana

Date of Notice of Appropriation of Groundwater.....

Date well started 3-28-63 Date Completed 4-1-63

Type of well DRILLED Equipment Used Cable Tools
(dug, driven, bored or drilled) (Churn, drill, rotary or other)

Water Use: Domestic Municipal Other Irrigation
Industrial Drainage Stock

Indicate on the diagram the character and thickness of the different strata met with in drilling, such as soil, clay, shale, gravel, rock or sand, etc. Show depth at which water is encountered, thickness and character of water-bearing strata and height to which water rises in the well.

| Size of Drilled Hole | Size and Weight of Casing | From (Feet) | To (Feet) | PERFORATIONS | | |
|----------------------|---------------------------|-------------|-----------|--------------|-------------|-----------|
| | | | | Kind Size | From (Feet) | To (Feet) |
| 7" h | 6" o.d. | 0 | 40 | 3/16 | 34' | 40' |

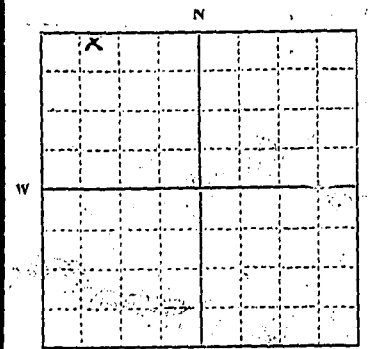

710 N. 1/4 Sec. 12 T. 32 R. 15 E

Indicate location of well and place of use, if possible. Each small square represents 10 acres.

Show exact depth of bottom.

Static Water Level for non-flowing Well 9.1 feet.

Shut-in Pressure for Flowing Well.....

Pumping Water Level 1.4 feet at 1.4 gal. per minute.

Discharge in gal. per min. of flowing well.....

How Tested Pump Length of Test 1 hour

Remarks: (Gravel packing, cementing, packers, type of shutoff, location of place of use of groundwater if not at well, and any other similar pertinent information, including number of acres irrigated, if used for irrigation)

15
Driller's License Number

Cushing Jacobson
Driller's Signature

This form to be prepared by driller, and three copies to be filed by the owner with the County Clerk and Recorder in the county in which the well is located.

Please answer all questions. If not applicable, so state, otherwise the form will be returned.

Original to the County Clerk and Recorder; duplicate to the State Engineer; Triplicate to the Montana Bureau of Mines and Geology and Quadruplicate for the Appropriator.

31091

397020

PEARL GEYZEL

TO

THE PUBLIC

NOTICE OF COMPLETION OF
GROUNDWATER WITH WELL

STATE OF MONTANA, ss.
COUNTY OF HILL

Filed at 1 o'clock p.m.

ON DEC 30 1963

H. E. Blain
COUNTY CLERK

By _____ DEPUTY

FEE: \$2.00 pd.

File No.

T. 32 N. R. 15 E. 10

DUPLICATE

County Hill

STATE OF MONTANA
ADMINISTRATOR OF GROUNDWATER CODE
OFFICE OF STATE ENGINEER

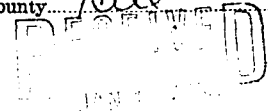

Declaration of Vested Groundwater Rights STATE ENGINEER
(Under Chapter 237, Montana Session Laws, 1961)

1. Scott Lucke, of Box 230 West of Havre
(Name of Appropriator) (Address) (Town)
County of Hill State of Montana
have appropriated groundwater according to the Montana laws in effect prior to January 1, 1962, as follows:

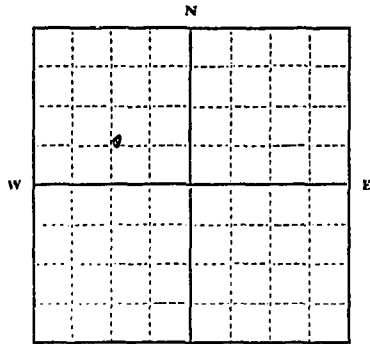

SE 1/4 of NW 1/4 in SW corner
1/4 Sec. 10, T. 32 R. 15 E

Indicate point of appropriation and place of use, if possible. Each small square represents 10 acres.

- 2. The beneficial use on which the claim is based. Hemp
Stock, Irrigation
- 3. Date or approximate date of earliest beneficial use; and how continuous the use has been. Continuous use since 1936
- 4. The amount of groundwater claimed (in miner's inches or gallons per minute). 35 gal. per mine
- 5. If used for irrigation, give the acreage and description of the lands to which water has been applied and name of the owner thereof. About 300 Acres of grass lawn & hay and garden
Owner Scott Lucke
- 6. The means of withdrawing such water from the ground and the location of each well or other means of withdrawal. pump & flow

- 7. The date of commencement and completion of the construction of the well, wells, or other works for withdrawal of groundwater. July 15, 1933 started finished July 20, 1933
- 8. The depth of water table. bottom 98' water 92' from bottom, water all the way
sometimes flowing well
- 9. So far as it may be available, the type, size and depth of each well or the general specifications of any other works for the withdrawal of groundwater. 5 1/2" Drilled 10.5 # 9
surface to bottom
- 10. The estimated amount of groundwater withdrawn each year. 1,400,000 gal. per year
- 11. The log of formations encountered in the drilling of each well if available. 35' yellow brown clay
a little water in base, 76' soft blue clay, 76' fine sand in part of
sand with thin layers of blue clay, 98' sand + fine gravel water
- 12. Such other information of a similar nature as may be useful in carrying out the policy of this act, including reference to book and page of any county record. Register book 1113

Signature of Owner. Scott Lucke
Date. Dec 16, 1963

Three copies to be filed by the owner with the County Clerk and Recorder of the county in which the well is located.

Please answer all questions. If not applicable, so state, otherwise the form will be returned.

Original to the County Clerk and Recorder; Duplicate to the State Engineer; Triplicate to the Montana Bureau of Mines and Geology, and Quadruplicate for the Appropriator.

396870

SCOTT LUCKE

TO

THE PUBLIC

DECLARATION OF VESTED
GROUNDWATER RIGHTS
STATE OF MONTANA
COUNTY OF HILL
Wetland at 11 o'clock (175)

7/27 1963
18 Blum
COUNTY CLERK
DEPUTY

FEE: \$2.00 pd.

STATE OF MONTANA



OIL AND GAS CONSERVATION COMMISSION

325 FULLER AVENUE
BOX 217
HELENA, MONTANA 59601

July 23, 1970

ADMINISTRATORS
NORMAN J. BEAUDRY, EXEC. SECT.
P. O. BOX 217
HELENA, MONTANA 59601
DONALD A. GARRITY, ATTORNEY
422 NORTH PARK AVENUE
HELENA, MONTANA 59601
JUDSON D. SWEET,
PETROLEUM ENGINEER
19 POLY DRIVE
BILLINGS, MONTANA 59101
HERBERT D. HADLEY, GEOLOGIST
19 POLY DRIVE
BILLINGS, MONTANA 59101

Sec. Lucke

COMMISSIONERS
WINSTON L. COX, CHAIRMAN
528 SECURITIES BLDG.
BILLINGS, MONTANA 59101
ALLEN ZIMMERMAN, VICE CHAIRMAN
P. O. BOX 377
POPLAR, MONTANA 59255
E. G. BALSAM
2300 PEARL
MILES CITY, MONTANA 59301
L. V. HARRIS
MORSKY BLOCK BLDG.
HELENA, MONTANA 59601
C. J. IVERSON
WHITLASH, MONTANA 59648

RECEIVED
JUL 24 1970

Water Conservation Board
Water Resources Engineer
Sam W. Mitchell Building
Helena, Montana 59601

MONTANA WATER RESOURCES BOARD
Dir. _____ Pin. _____
Adm. _____ Inf. _____
Eng. _____ Brd. _____
WRD _____ RSC. _____
ECO _____ WSW _____
Lgt. _____ CON _____

Dear Sir:

Enclosed you will find a copy of a Release Agreement for the utilization of a fresh water well.

Operator: Montana Power Company
Lease: Lucke
Well No. 6-10 Sec. 10 Twp. 32N Rge. 15E.
Hill County

Yours very truly,

N. J. Beaudry
Norman J. Beaudry
Executive Secretary

NJB/ml
Encl.
cc: Mr. W. Vond
Bureau of Mines and Geology
Butte, Montana 59701

APPROVED BY:

Oil and Gas Conservation Commission

Judson D. Sweet

Petroleum Engineer, Geologist, or Executive Secretary

Dated: *July 15*, 1970



46717

OIL AND GAS CONSERVATION COMMISSION
OF THE STATE OF MONTANA

RECEIVED
JUL 15 1970

RELEASE AGREEMENT

KNOW ALL MEN BY THESE PRESENTS, that I, Scott Lucke
_____ of the County of Hill _____ in

the State of Montana, am the owner of the hereinafter described land upon which
a well for oil or gas was drilled, to-wit:

Operator The Montana Power Company

Lease Name Lucke

Well No. 6-10 Sec. 10, Twp. 32N, Rge. 15E

The well is located 2810 feet ^{XX}_N of the South
line and _____ feet ^E_{XX} of the West line.

That, in accordance with Regulation 233.6, Order No. 1-1, November 30,
1953, I do hereby notify the Oil and Gas Conservation Commission of the State
of Montana of my desire to utilize said well as a fresh water well; and, that
if such utilization is approved, I do hereby release and discharge the operator
hereinabove named from any further work or responsibility in relation to the
plugging of said well.

Water Use: Domestic XX Municipal _____ Stock XX Other _____
Industrial _____ Drainage _____ Irrigation _____

Producing Depth 200' and shallower Producing Formation Judith River & Glacial
Gravel

Yield of well Unknown, to be perforated Annual Withdrawal Unknown

WITNESS my hand and seal this 9th day of July, 1970.

Scott W Lucke (L.S)
Landowner
Address _____
Havre, Montana

B-7230

IN THE PRESENCE OF:

Kneelon E. Teague Address 574 5th Ave. So., Shelby, Montana
Leslie Ranok Address Cut Bank, Montana

APPROVED BY:

Oil and Gas Conservation Commission
Judson D. Smith
Petroleum Engineer, Geologist, or Executive Secretary

Dated: July 15, 1970



46717

427164

GEORGE MAJERUS

TO

THE PUBLIC

WATER WELL

STATE OF MONTANA }
COUNTY OF HILL } SS
Filed at 11:25 o'clock A M

ON FEB 16 1973

R. E. Blom

BY David E. Gray COUNTY CLERK
DEPUTY

Fee:\$2.00 pd.

INDEXED

File No. _____

T 32N R 15E

DUPLICATE

County Hill

STATE OF MONTANA
ADMINISTRATOR OF GROUNDWATER CODE
OFFICE OF STATE ENGINEER

Declaration of Vested Groundwater Rights

(Under Chapter 237, Montana Session Laws, 1961)

RECEIVED
JUL 9 - 1963

STATE ENGINEER

1. Dr. R.C. Yallas D.D.S. of Hill (Name of Appropriator) (Town)

County of Hill State of Montana have appropriated groundwater according to the Montana laws in effect prior to January 1, 1962, as follows:

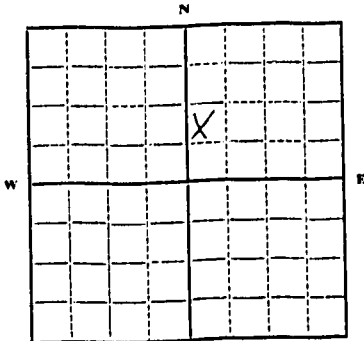

SW 1/4 NE 1/4 Sec. 10. T32N R15E M.M.

Indicate point of appropriation and place of use, if possible. Each small square represents 10 acres.

(SW 1/4 NE 1/4) 2.33 acres

2. The beneficial use on which the claim is based. Domestic, or home use.

3. Date or approximate date of earliest beneficial use; and how continuous the use has been. Dec. 5, 1955 at completion of home

4. The amount of groundwater claimed (in miner's inches or gallons per minute). 30 gals per min.

5. If used for irrigation, give the acreage and description of the lands to which water has been applied and name of the owner thereof. None used - other than lawn 2.33 acres long but lawn is 50 x 100 feet only.

6. The means of withdrawing such water from the ground and the location of each well or other means of withdrawal. Deep pump, electric

7. The date of commencement and completion of the construction of the well, wells, or other works for withdrawal of groundwater. July 27, 1951 begun completed Jan. 30, 1951

8. The depth of water table. 126 feet from 2700 sea level

9. So far as it may be available, the type, size and depth of each well or the general specifications of any other works for the withdrawal of groundwater. 6 in. pipe. screw - 14 thread 9.50 L.B.S.

10. The estimated amount of groundwater withdrawn each year. ? Family 2 adults, 3 children

11. The log of formations encountered in the drilling of each well if available. 0-2 Ft coarse gravel 2-24 sandy clay, 24-52 clay from 52-74 sandy clay grey 74-86 gravelly clay grey 86-102 gravelly clay grey + some water 102-124 sand & gravel clay 124-138 gravel - water, 128 to 135 gravelly clay grey

12. Such other information of a similar nature as may be useful in carrying out the policy of this act, including reference to book and page of any county record. Book of mortgages 107, at page 495. Abstract entry 26

Signature of Owner Dr. R.C. Yallas D.D.S.

Date 7/2/63

Three copies to be filed by the owner with the County Clerk and Recorder of the county in which the well is located.

Please answer all questions. If not applicable, so state, otherwise the form will be returned.

Original to the County Clerk and Recorder; duplicate to the State Engineer; Triplicate to the Montana Bureau of Mines and Geology, and Quadruplicate for the Appropriator.

394392

DR. R.C. GALLUS D.D.S.

TO

THE PUBLIC

DECLARATION OF VESTED GROUNDWATER
RIGHTS

STATE OF MONTANA)
COUNTY OF HILL)
Filed at 4:00 clock P.M.

ON JUL 2 1963

R. E. Blom COUNTY CLERK

By _____ DEPUTY

FEE: \$2.00 pd.

File No. _____

T. 32 N R 15 E 12

~~UNDEVELOPABLE~~ DUPLICATE

MONTANA WATER RESOURCES BOARD

County Hills

LOG

RECEIVED

STATE OF MONTANA

ADMINISTRATOR OF GROUNDWATER CODE

OFFICE OF STATE ENGINEER

Top of Ground

OCT 18 1968

Notice of Completion of Groundwater Appropriation by Means of Well

DEVELOPED AFTER JANUARY 1, 1962

(Under Chapter 237, Montana Session Laws, 1961)

- 10 Top of Ground (Elev. above sea level _____)
- 11 TOP SOIL
- 11 SANDY BROWN CLAY
- 18 BROWNISH YELLOW CLAY
- 23 GRAVELLY CLAY
- 38 SANDY BROWNISH YELLOW CLAY
- 42 GRAVELLY BROWN CLAY
- 68 SANDY BROWNISH YELLOW CLAY
- 69 DRY GRAVEL
- 76 BROWNISH YELLOW CLAY
- 90 GRAVELLY BROWN CLAY
- 75 BROWN SAND - TRACE OF GRAVEL - WATER, APPROX 36PM
- 97 VERY COARSE GRAVEL, UP TO 3" IN DIAMETER, EXTREMELY SANDY
- 101 SAND & GRAVEL
- 111 BROWN SAND & SILT - TRACE OF GRAVEL
- 116 SAND & GRAVEL - WATER APPROX 8 BPM (SHUT OFF) WATER VERY HARD, 140 LB/IN
- 128 BRACKISH GREY CLAY
- 135 SAND GREY CLAY
- 160 GREY CLAY
- 166 GREY SAND & SILT - TRACE OF COAL
- 177 GREY CLAY
- 185 SAND GREY CLAY
- 185 VOLCANIC ASH - WATER EXCEEDING 10 BPM

Owner James Ramsey Address Box 925 HAVE MONT

Driller Hilary Ramsey Address Have, Montana

Date of Notice of appropriation of groundwater _____

Date well started 11/1/68 Date completed 2/1/69

Type of well drilled Equipment used Case 400 Air
(Dug, Driven, bored or drilled) (Churn drill, rotary or other)

Water use: Domestic Municipal Stock Irrigation
Industrial Drainage Other

Indicate on the diagram the character and thickness of the different strata met with in drilling, such as soil, clay, shale, gravel, rock or sand, etc. Show depth at which water is encountered, thickness and character of water-bearing strata and height to which the water rises in the well.

| Size of Drilled Hole | Size and Weight of Casing | From (Feet) | To (Feet) | PERFORATIONS | | |
|----------------------|---------------------------|-------------|-----------|-----------------------|-------------|-----------|
| | | | | Kind Size | From (Feet) | To (Feet) |
| 6 3/8 | 6 1/2 I.D. | 0 | 171 | No PERFORATIONS | | |
| | 12" PER FOOT | | | WATER FLOWING THROUGH | | |
| | 6" I.D. | 171 | 185 1/2 | BOTTOM OF DRIVE | | |
| | 18" PER FT | | | SEALS AT 185 1/2 FT | | |

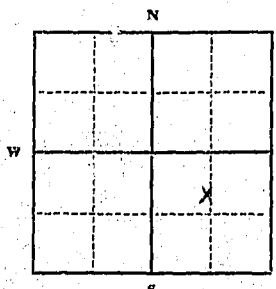

Static Water Level for non-flowing well 133 feet.

Shut-in Pressure for Flowing Well Not Applicable

Pumping Water Level 165 feet at 7 gal. per minute.

Discharge in gal. per min. of flowing well Not Applicable

How Tested Flow & Pump

Length of Test 24 Hours

Remarks: (Gravel packing, cementing, packers, type of shutoff) Due to insufficient thickness of water bearing strata casing was pulled back, used button bottom gravel packer to draw water

INDICATE LOCATION OF WELL AND PLACE OF USE, IF POSSIBLE. EACH SMALL SQUARE REPRESENTS 40 ACRES.

USE - If used for irrigation, industrial, drainage or other. Explain, state number of acres and location or other data (i.e.: Lot, Block and Addition).

TOTAL CASINGS INSTALLED, INCLUDING DRIVE SHAFT & 1 1/2" ROUSE GRIND HEAD, 186' 8"

Show exact depth of bottom.

This form to be prepared by driller, and three copies to be filed by the owner with the County Clerk and Recorder in the county in which the well is located, tissue copy to be retained by driller.

Please answer all questions. If not applicable, so state, otherwise the form will be returned.

Driller's License Number 46

Driller's Signature Hilary Ramsey

44,696

412096

JAMES BURMLEY

TO

THE PUBLIC

NOTICE OF GROUND WATER
APPROPRIATION

STATE OF MONTANA)
COUNTY OF HILL) ss.
Filed at 1:00 o'clock P.m

BY OCT 11 1968
R. E. BLCM
COUNTY CLERK

By _____
DEPUTY

fee: \$2.00 paid

CW-4
FILE NO. _____

32 N 15 E 12
Hill
TWP
COUNTY
JAN 1 9 1962

STATE OF MONTANA
ADMINISTRATOR OF GROUNDWATER CODE
OFFICE OF STATE ENGINEER

DECLARATION OF VESTED GROUNDWATER RIGHTS STATE ENGINEER
Under Chapter 21, Montana Session Laws 1962
Julius Van Orsdel Box 1443 HAVRE

1. (Name of Appropriator) Hill, of (Address) MONT. (Town)
County of _____, State of _____
Have appropriated groundwater according to the Montana laws in effect prior to Jan. 1, 1962 as follows:

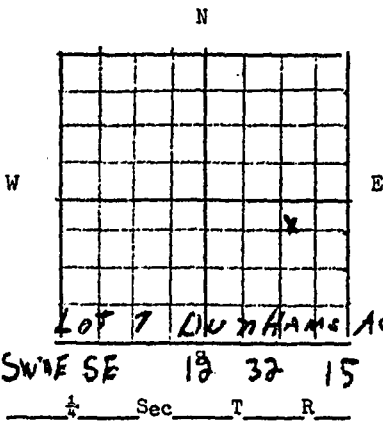

2. Household use on yard
The beneficial use on which the claim is based _____

3. Date or approximate date of earliest beneficial use; and how continuous the use has been
1952

4. The amount of groundwater claimed 5 gal
inches or gallons per minute) _____

If used for irrigation, give the acreage and description of the lands to which water has been applied and name of the owner thereof
5.94 acres

Indicate point of appropriation and place of use, if possible. Each small square represents 10 acres.

6. The means of withdrawing such water from the ground and the location of each well or other means of withdrawal
Electric Pump

7. The date of commencement and completion of the construction of the well, wells, or other works for withdrawal of groundwater
1952

8. The depth of water table _____

9. So far as it may be available, the type, size and depth of each well or the general specifications of any other works for the withdrawal of groundwater
50 ft

10. The estimated amount of groundwater withdrawn each year
200 000

11. The log of formations encountered in the drilling of each well if available _____

12. Such other information of a similar nature as may be useful in carrying out the policy of this act, including reference to book and page of any county record _____

Signature of Owner Julius Van Orsdel

Date 12-31-62

Three copies to be filed by the owner with the County Clerk & Recorder of the County in which the well is located.

PLEASE ANSWER ALL QUESTIONS. IF NOT APPLICABLE, SO STATE, OTHERWISE THE FORM WILL BE RETURNED.

Original to the County Clerk & Recorder; duplicate to the State Engineer; Triplicate to the School of Mines and Quadruplicate for the Appropriator.

397182

JULIUS VAN DESSEL

TO

THE PUBLIC

DECLARATION OF VESTED
GROUNDWATER RIGHTS

STATE OF MONTANA, ss.
COUNTY OF HILL
Filed at 11 o'clock a.m.

ON DEC 21 1963
[Signature]
COUNTY CLERK

DEPUTY

SEE: \$2.00 pd.

GW-4
FILE NO. _____

TWP 32 N RGE 15 E. 1111
COUNTY Hill

STATE OF MONTANA
ADMINISTRATOR OF GROUNDWATER CODE
OFFICE OF STATE ENGINEER

RECEIVED
JAN 13 1964

DECLARATION OF VESTED GROUNDWATER RIGHTS
(Under Chapter 237, Montana Session Laws, 1958)

STATE ENGINEER

1. Donald Keith Beatty, of Ray Del Havre
 (Name of Appropriator) (Address) (Town)
 County of Hill, State of Montana
 Have appropriated groundwater according to the Montana laws in effect prior to Jan. 1, 1962 as follows:

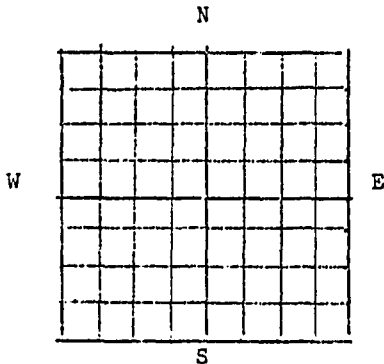

NW 1/4 Sec 12 T 32 N R 15 E

Indicate point of appropriation and place of use, if possible. Each small square represents 10 acres.

2. The beneficial use on which the claim is based For Domestic use.
3. Date or approximate date of earliest beneficial use; and how continuous the use has been Feb 1957
4. The amount of groundwater claimed (in miner's inches or gallons per minute) 20 gallons per minute.
5. If used for irrigation, give the acreage and description of the lands to which water has been applied and name of the owner thereof _____
6. The means of withdrawing such water from the ground and the location of each well or other means of withdrawal with a Electric water pump
7. The date of commencement and completion of the construction of the well, wells, or other works for withdrawal of groundwater Sept of 1956
8. The depth of water table 60 Feet of Water in Casing
9. So far as it may be available, the type, size and depth of each well or the general specifications of any other works for the withdrawal of groundwater 204 Feet deep 6" casing
10. The estimated amount of groundwater withdrawn each year 150,000
11. The log of formations encountered in the drilling of each well if available _____
12. Such other information of a similar nature as may be useful in carrying out the policy of this act, including reference to book and page of any county record _____

Signature of Owner Donald K Beatty

Date Dec 28-1963

Three copies to be filed by the owner with the County Clerk & Recorder of the County in which the well is located.

PLEASE ANSWER ALL QUESTIONS. IF NOT APPLICABLE, SO STATE, OTHERWISE THE FORM WILL BE RETURNED.

Original to the County Clerk & Recorder; duplicate to the State Engineer; Triplicate to the School of Mines and Quadruplicate for the Appropriator.

395907

DONALD KEITH DEATY

TO

THE PUBLIC

DECLARATION OF VESTED
GROUNDWATER RIGHTS

STATE OF MONTANA }
COUNTY OF HILL } ss.
Filed at 9 o'clock a.m.

ON DEC 30 1963

E. Blain
COUNTY CLERK

BY _____
DEPUTY

11/27/63

STE: \$2.00 pd.

GW

Approved Stock Form—State Publishing Co., Helena, Montana—41921

File No.

T. 32 N R. 15 E 12

DUPLICATE

County Hill

STATE OF MONTANA
ADMINISTRATOR OF GROUNDWATER CODE
OFFICE OF STATE ENGINEER

RECEIVED
JAN 13 1954

Declaration of Vested Groundwater Rights

(Under Chapter 237, Montana Session Laws, 1961)

STATE ENGINEER

1. OPAL F. STICKA, of Box 652 S.W. HAYRE
(Name of Appropriator) (Address) (Town)

County of Hill State of MONTANA
have appropriated groundwater according to the Montana laws in effect prior to January 1, 1962, as follows:

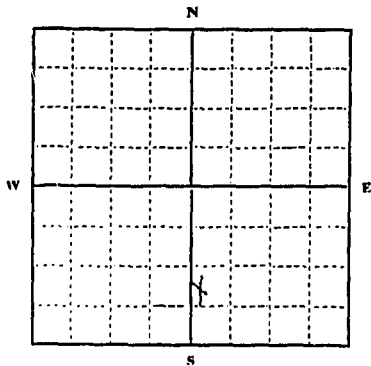

SW 1/4 Sec. 12 T. 32 R. 15

Indicate point of appropriation and place of use, if possible. Each small square represents 10 acres.

2. The beneficial use on which the claim is based...
~~Domestic use for house~~
Hall well

3. Date or approximate date of earliest beneficial use; and how continuous the use has been... 1957 used continuously

4. The amount of groundwater claimed (in miner's inches or gallons per minute)... 3.5 gal. per min

5. If used for irrigation, give the acreage and description of the lands to which water has been applied and name of the owner thereof
~~One acre~~

6. The means of withdrawing such water from the ground and the location of each well or other means of withdrawal... Pump
(Submersible Pump)

7. The date of commencement and completion of the construction of the well, wells, or other works for withdrawal of groundwater... 1957

8. The depth of water table... Not Available

9. So far as it may be available, the type, size and depth of each well or the general specifications of any other works for the withdrawal of groundwater... 2.20 ft deep - 6 inch pipe

10. The estimated amount of groundwater withdrawn each year... 25000

11. The log of formations encountered in the drilling of each well if available... Not Available

12. Such other information of a similar nature as may be useful in carrying out the policy of this act, including reference to book and page of any county record... Not Available

Signature of Owner Opal F. Sticka
Date Dec 26 1953

Three copies to be filed by the owner with the County Clerk and Recorder of the county in which the well is located.

Please answer all questions. If not applicable, so state, otherwise the form will be returned.

Original to the County Clerk and Recorder; Duplicate to the State Engineer; Triplicate to the Montana Bureau of Mines and Geology, and Quadruplicate for the Appropriator.

395910

OPAL M. STICKA

TO

THE PUBLIC

DECLARATION OF VESTED
GROUNDWATER RIGHTS

STATE OF MONTANA)
COUNTY OF HILL)
Filed at 8 o'clock AM

ON DECEMBER 30 1963
W. E. Blain
COUNTY CLERK

DEPUTY

FEE: \$2.00 pd.

File No. MONTANA WATER RESOURCES BOARD
DUPLICATE RECEIVED

T. 32 N. R. 15E 12
County Hill

LOG DEC 28 1970

STATE OF MONTANA
ADMINISTRATOR OF GROUNDWATER CODE
STATE WATER CONSERVATION BOARD

Notice of Completion of Groundwater
Appropriation by Means of Well
DEVELOPED AFTER JANUARY 1, 1962

(Under Chapter 237 Montana Session Laws, 1961, as amended)

- 0 to Top of Ground (Elev. above sea level _____)
- 3 Soil
- 12 Gravelly brown clay
- 18 Brown clay
- 20 Brown sand
- 34 Sandy brown clay
- 46 Gravelly brown clay
- 47 Brown sand (dry)
- 48 Brown sand & gravel (dry)
- 56 Brown clay-small boulders
- 66 Gravelly brown clay
- 71 Brown sand & clay mix
- 80 Sandy brown clay
- 84 Brownish-grey clay
- 90 Gravelly grey clay
- 92 Brown sand & clay mix
- 99 Brown sand-some gravel
- 106 Brown sand & clay mix
- 114 Gravelly grey clay
- 115 Boulder
- 125 Gravelly grey clay
- 126 Boulder
- 139 Gravelly grey clay
- 146 Grey clay
- 150 Sandy grey clay
- 162 Gravelly grey clay
- 166 Sandy & silty grey clay
- 178 1/2 Grey clay
- 179 Grey sand-coarse-some fine sand - water
- 179 1/2 Grey sand-medium to coarse-water
- 180 Grey sand & gravel-pea size to 1" diameter Water-exceeding 20 GPM. by baler test

Owner Maurice Klabunde Address Star Rte. 36-Havre, Mont.
 Driller H1-Line Drilling Service Address Havre, Montana
 Date of Notice of appropriation of groundwater _____
 Date well started May 11, 1970 Date completed May 15, 1970
 Type of well Drilled Equipment used Cable Tool
 (Dug, driven, bored or drilled) (Churn drill, rotary or other)
 Water use: Domestic Municipal Stock Irrigation
 Industrial Drainage Other

Indicate on the diagram the character and thickness of the different strata met with in drilling, such as soil, clay, shale, gravel, rock or sand, etc. Show depth at which water is encountered, thickness and character of water-bearing strata and height to which the water rises in the well.

| Size of Drilled Hole | Size and Weight of Casing | From (Feet) | To (Feet) | PERFORATIONS | | |
|----------------------|--------------------------------------|-------------|-----------|--------------|-------------|--|
| | | | | Kind Size | From (Feet) | To (Feet) |
| 12" | | 0 | 15 | | | |
| 6 5/8" | 6 5/8" O.D. .188 wall 13#/ft. | 169 | 169 | | | No perforations. Water coming in thru drive shoe at 180 ft. level. |
| 6 5/8" | 6 5/8" O.D. .280 wall 11-10# per ft. | 169 | 180 | | | |

Static Water Level for non-flowing well 131feet.
 Shut-in Pressure for Flowing Well Not appl.
 Pumping Water Level 132feet
 at 16gal. per minute.
 Discharge in gal. per min. of flowing well Not applicable.
 How Tested Submersible pump.
 Length of Test 10 hours
 Remarks: (Gravel packing, cementing, packers, type of shutoff) Hole reamed to 12" diameter to 15 foot level. Upon completion of well, cement grout was placed around outside of casing from 15 ft. level back to surface.

S. 1/4 Sec. 12, T. 32N R. 15E
Indicate location of well and place of use, if possible. Each small square represents 40 acres.

Doc. No. 419809 (Continue on reverse side)
 Filed for record this 22 day of December A. D. 19 70, at 1:45 o'clock P. M.
 USE—If used for irrigation, industrial, drainage or other. Explain, state number of acres and location or other data (i.e.: Lot, Block and Addition).

This form to be prepared by driller, and three copies to be filed by the owner with the County Clerk and Recorder in the county in which the well is located, tissue copy to be retained by driller.
 Please answer all questions. If not applicable, so state, otherwise the form will be returned.

46
 Driller's License Number
Herbert Greier
 Driller's Signature

47943

419809

MAURICE KLABUNDE

TO

THE PUBLIC

NOTICE OF COMPLETION OF
GROUNDWATER APPROPRIATION

STATE OF MONTANA
COUNTY OF HILL
1:45 o'clock P.M.

DEC 22 1970

R. E. BLOM

fee: \$2.00 paid

411218

WALDO K. AND HILDE D.
SOLONAR

TO

THE PUBLIC

GROUND WATER APPROPRIATION

STATE OF MONTANA,)
COUNTY OF HILL)

Filed at 8:00 o'clock A.M.

MAY 20 1968

R. E. BLUM

COUNTY CLERK

By _____ DEPUTY

fee: \$2.00 paid