

File No.

T. 32 N. R. 16 E. 4

DUPLICATE

Haure townsite

County Hill

STATE OF MONTANA
ADMINISTRATOR OF GROUNDWATER CODE
OFFICE OF STATE ENGINEER

RECEIVED
SEP 28 1964
STATE ENGINEER

Notice of Completion of Groundwater Appropriation by Means of Well

(Under Chapter 237, Montana Session Laws, 1961)

Top of Ground
(Elev. above sea level.....)

0 to 5 SOIL
15 SANDY BROWN CLAY
19 RUNNY SAND - TRACE OF WATER
33 SILTY BROWN CLAY
36 GREY SAND - TRACE OF GRAVEL + WATER
41 BLUE-GREY CLAY (SOFT)
44 GREY SAND - GRAVEL - WATER (APPROX 12 GPM) (1.0 PPM IRON - SHUT OFF)
49 GREY CLAY
57 SILTY GREY CLAY
59 SAND + COARSE GRAVEL
63 SILTY GREY CLAY
64 1/2 COARSE GRAVEL.
67 CONSIDERABLE SILTY SAND. (UNABLE TO CLEAR)
76 GREY SAND, SILT + COAL PARTICLES
76 GREY CLAY
79 YELLOWISH-BROWN SHALE
88 BROWN SANDSTONE, WATER - APPROX 11 GPM

1/4 Sec 4 32N R16E
Indicate location of well and place of use, if possible. Each small square represents 10 acres.
YELLOWISH-GREY SHALE BELOW 88'

88 Show exact depth of bottom.

HARDNESS 7 GR. PER GALLON
IRON 0.3 PPM
P.H. 8

Owner DAVID H. TURNER Address 849 5TH ST N HAURE, MONT
Driller H. L. LIME DRILLING SERVICE Address HAURE, MONTANA

Date of Notice of Appropriation of Groundwater.....
Date well started SEPT 12, 1964 Date Completed SEPT 19, 1964

Type of well DRILLED Equipment Used CABLE TOOL RIG
(dug, driven, bored or drilled) (Churn, drill, rotary or other)

Water Use: Domestic Municipal Other Irrigation
Industrial Drainage Stock

Indicate on the diagram the character and thickness of the different strata met with in drilling, such as soil, clay, shale, gravel, rock or sand, etc. Show depth at which water is encountered, thickness and character of water-bearing strata and height to which water rises in the well.

Size of Drilled Hole	Size and Weight of Casing	From (Feet)	To (Feet)	PERFORATIONS		
				Kind Size	From (Feet)	To (Feet)
6 5/8"	6 1/8" I.D. 13# PER FOOT	0	79	NO PERFORATIONS CASING SET DIRECTLY ABOVE SANDSTONE AT 79 FT. SANDSTONE FROM 79'-88' LEFT OPEN (NOT CASING)		

Static Water Level for non-flowing Well 11 feet.

Shut-in Pressure for Flowing Well NOT APPLICABLE

Pumping Water Level 77 feet at 10 gal. per minute.

Discharge in gal. per min. of flowing well NOT APPLICABLE

How Tested BAUER + PUMP Length of Test 12 HOURS

Remarks: (Gravel packing, cementing, packers, type of shutoff, location of place of use of groundwater if not at well, and any other similar pertinent information, including number of acres irrigated, if used for irrigation) WATER AT 44 FT LEVEL CASING OFF DUE TO IRON + HARDNESS + 6 1/2 FT VEIN SHUT OFF DUE TO CONSIDERABLE SILTING CONDITION

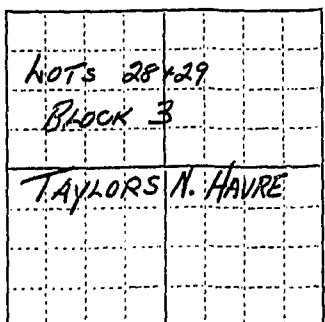

Driller's License Number 46

Driller's Signature Robert Greiner

This form to be prepared by driller, and three copies to be filed by the owner with the County Clerk and Recorder in the county in which the well is located.

Please answer all questions. If not applicable, so state, otherwise the form will be returned.

Original to the County Clerk and Recorder; duplicate to the State Engineer; Triplicate to the Montana Bureau of Mines and Geology and Quadruplicate for the Appropriator.

Doc. No. 400400

DAVID H. TURNER

TO

THE PUBLIC

NOTICE OF COMPLETION OF
GROUNDWATER APPROPRIATION BY
MEANS OF WELL

STATE OF MONTANA,)
COUNTY OF HILL) ss.
Filed at 10:30'clock a.m.

ON SEP 25 1964

I. E. Flain
COUNTY CLERK

By _____
DEPUTY

See #2 00 pd

GW
FILE NO. _____

TWP 32^N RGE 16^E 4
COUNTY _____
RECEIVED
JAN 15 1964

STATE OF MONTANA
ADMINISTRATOR OF GROUNDWATER CODE
OFFICE OF STATE ENGINEER

DECLARATION OF VESTED GROUNDWATER RIGHTS
(Under Chapter 237, Montana Session Laws, 1961) STATE ENGINEER

1. Lawrence L. Whaley, of 179 FARLEY AVE
(Name of Appropriator) (Address) (Town)
County of HILL, State of MONTANA
Have appropriated groundwater according to the Montana laws in effect prior to Jan. 1, 1962 as follows:

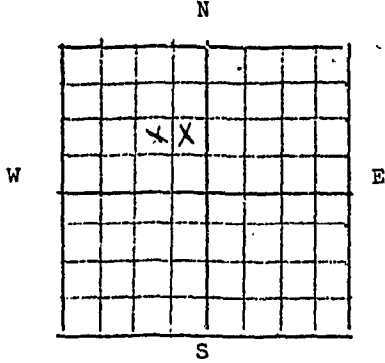

NW 1/4 Sec 4 T 32 R 16

Indicate point of appropriation and place of use, if possible. Each small square represents 10 acres.

2. The beneficial use on which the claim is based House Lawn Garden
3. Date or approximate date of earliest beneficial use; and how continuous the use has been 1960
4. The amount of groundwater claimed (in miner's inches or gallons per minute) _____
5. If used for irrigation, give the acreage and description of the lands to which water has been applied and name of the owner thereof House Water
6. The means of withdrawing such water from the ground and the location of each well or other means of withdrawal _____
7. The date of commencement and completion of the construction of the well, wells, or other works for withdrawal of groundwater _____
8. The depth of water table 12 to 20
9. So far as it may be available, the type, size and depth of each well or the general specifications of any other works for the withdrawal of groundwater _____
10. The estimated amount of groundwater withdrawn each year 360,000
11. The log of formations encountered in the drilling of each well if available no log
12. Such other information of a similar nature as may be useful in carrying out the policy of this act, including reference to book and page of any county record _____

Signature of Owner Lawrence L. Whaley
Date Dec 31 - 1963

Three copies to be filed by the owner with the County Clerk & Recorder of the County in which the well is located.

PLEASE ANSWER ALL QUESTIONS. IF NOT APPLICABLE, SO STATE, OTHERWISE THE FORM WILL BE RETURNED.

Original to the County Clerk & Recorder; duplicate to the State Engineer; Triplicate to the School of Mines and Quadruplicate for the Appropriator.

397108
LAURENCE L. WHALEY

TO

THE PUBLIC

DECLARATION OF VESTED
GROUNDWATER RIGHTS

STATE OF MONTANA) ss.
COUNTY OF HILL)
Filed at 11 o'clock a.m.

ON DEC 31 1963

[Signature]
COUNTY CLERK

DEPUTY

FEES: \$2.00 pd.

GW-4
FILE NO. _____

TWP 32 N RGE N. of 16 E.M.M.
COUNTY Hill

STATE OF MONTANA
ADMINISTRATOR OF GROUNDWATER CODE
OFFICE OF STATE ENGINEER

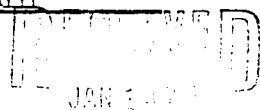

DECLARATION OF VESTED GROUNDWATER RIGHTS
(Under Chapter 237, Montana Session Laws, 1961) STATE ENGINEER

1. Charles Wynia & Violet Mae Wynia, of 174 Farley Ave., Havre
(Name of Appropriator) (Address) (Town)
County of Hill, State of Montana
have appropriated groundwater according to the Montana laws in effect prior to Jan. 1, 1962 as follows:

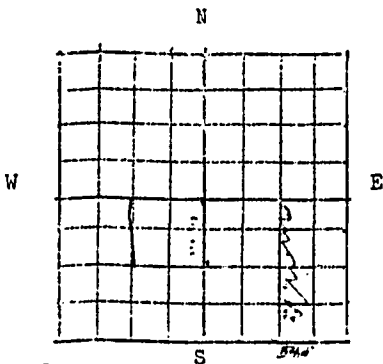

~~NE 1/4~~ NE 1/4 SW Sec 4 T 32N R 16 E M.M.

Indicate point of appropriation and place of use, if possible. Each small square represents 10 acres.

2. The beneficial use on which the claim is based House hold and irrigation (5) five wells
3. Date or approximate date of earliest beneficial use; and how continuous the use has been 30 yrs. plus continuous
though some wells haven't been used for 10 yrs the others are in use.
4. The amount of groundwater claimed (in miner's inches or gallons per minute) 5,000 G.P.H. 100 G.P.M.
5. If used for irrigation, give the acreage and description of the lands to which water has been applied and name of the owner thereof 0.26
6. The means of withdrawing such water from the ground and the location of each well or other means of withdrawal water line pump
7. The date of commencement and completion of the construction of the well, wells, or other works for withdrawal of groundwater well five completed Aug 13, 1954
the others were prior. (new well started in '63 but not in will be '66).
8. The depth of water table 46ft.
9. So far as it may be available, the type, size and depth of each well or the general specifications of any other works for the withdrawal of groundwater (1,2,3,4) not known 5' 2" 16'
10. The estimated amount of groundwater withdrawn each year _____
11. The log of formations encountered in the drilling of each well if available _____
12. Such other information of a similar nature as may be useful in carrying out the policy of this act, including reference to book and page of any county record _____

Signature of Owner Charles Wynia
Date 12-31-63

Three copies to be filed by the owner with the County Clerk & Recorder of the County in which the well is located.

PLEASE ANSWER ALL QUESTIONS. IF NOT APPLICABLE, SO STATE, OTHERWISE THE FORM WILL BE RETURNED.

Original to the County Clerk & Recorder; duplicate to the State Engineer; Triplicate to the School of Mines and Quadruplicate for the Appropriator.

GW 4
FILE NO. _____

TWP 32 ^N RGE N. of 16 E.M.M.
COUNTY Hill

STATE OF MONTANA
ADMINISTRATOR OF GROUNDWATER CODE
OFFICE OF STATE ENGINEER

RECEIVED
JAN 13 1964

DECLARATION OF VESTED GROUNDWATER RIGHTS
(Under Chapter 237, Montana Session Laws, 1961) STATE ENGINEER

1. Charles Wynia & Violet Mae Wynia, of 174 Farley Ave., Havre
(Name of Appropriator) (Address) (Town)
County of Hill, State of Montana
Have appropriated groundwater according to the Montana laws in effect prior to Jan. 1, 1962 as follows:

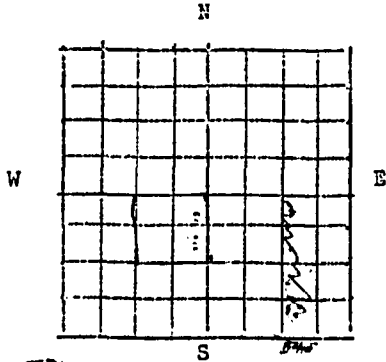

~~NE~~ SW Sec 4 T. 32 N. R. 16 E. M.M.

Indicate point of appropriation and place of use, if possible. Each small square represents 10 acres.

2. The beneficial use on which the claim is based
House hold and irrigation (5) five wells
3. Date or approximate date of earliest beneficial use; and how continuous the use has been
30 yrs. plus continuous
though some wells haven't been used for 10 yrs the others are in use.
4. The amount of groundwater claimed (in miner's inches or gallons per minute)
5,000 G.P.H. 100 G.P.M.
5. If used for irrigation, give the acreage and description of the lands to which water has been applied and name of the owner thereof
0.86
6. The means of withdrawing such water from the ground and the location of each well or other means of withdrawal
motor drive pumps
7. The date of commencement and completion of the construction of the well, wells, or other works for withdrawal of groundwater well five completed Aug 13, 1954
the others were prior. (new well started Aug 63 but not in well #6).
8. The depth of water table 56ft.
9. So far as it may be available, the type, size and depth of each well or the general specifications of any other works for the withdrawal of groundwater.
(1,2,3,4.) not known 5 2" 86'
10. The estimated amount of groundwater withdrawn each year _____
11. The log of formations encountered in the drilling of each well if available _____
12. Such other information of a similar nature as may be useful in carrying out the policy of this act, including reference to book and page of any county record _____

Signature of Owner Charles Wynia

Date 12-31-63

Three copies to be filed by the owner with the County Clerk & Recorder of the County in which the well is located.

PLEASE ANSWER ALL QUESTIONS. IF NOT APPLICABLE, SO STATE, OTHERWISE THE FORM WILL BE RETURNED.

Original to the County Clerk & Recorder; duplicate to the State Engineer; Triplicate to the School of Mines and Quadruplicate for the Appropriator.

31269

397218

CHARLES & VIOLET WYNIA

TO

THE PUBLIC

DECLARATION OF VESTED
GROUND WATER RIGHTS

STATE OF MONTANA)
COUNTY OF HILL)
Filed at 11:00'clock a.m.

BY _____
FEB 31 1963

COUNTY CLERK

REGIST

FEE: \$2.00 pd.

STATE OF MONTANA
ADMINISTRATOR OF GROUNDWATER CODE
OFFICE OF STATE ENGINEER

DECLARATION OF VESTED GROUNDWATER RIGHTS
(Under Chapter 237, Montana Session Laws, 1961)

1. R. R. Brantner, of Hamilton North House
(Name of Appropriator) (Address) (Town)
County of _____ State of _____
Have appropriated groundwater according to the Montana laws in effect prior to Jan. 1, 1962 as follows:

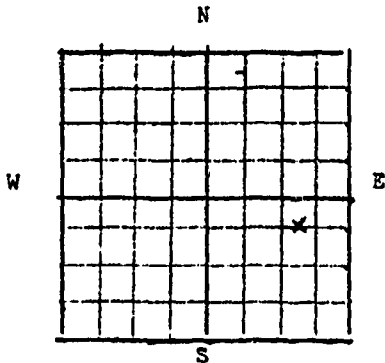

Indicate point of appropriation and place of use, if possible. Each small square represents 10 acres.
No. NE 5 E 1 Sec 5 T 32 R 16

Indicate point of appropriation and place of use, if possible. Each small square represents 10 acres.

- 2. The beneficial use on which the claim is based Household & garden
- 3. Date or approximate date of earliest beneficial use; and how continuous the use has been 1957 Continuous
- 4. The amount of groundwater claimed (in miner's inches or gallons per minute) 30 gal p.m.
- 5. If used for irrigation, give the acreage and description of the lands to which water has been applied and name of the owner thereof _____
- 6. The means of withdrawing such water from the ground and the location of each well or other means of withdrawal 6 in pump

- 7. The date of commencement and completion of the construction of the well, wells, or other works for withdrawal of groundwater 1957
- 8. The depth of water table 50 ft.
- 9. So far as it may be available, the type, size and depth of each well or the general specifications of any other works for the withdrawal of groundwater 52 ft. Sand point 1 1/2" pipe
- 10. The estimated amount of groundwater withdrawn each year 100,000 gal
- 11. The log of formations encountered in the drilling of each well if available _____
- 12. Such other information of a similar nature as may be useful in carrying out the policy of this act, including reference to book and page of any county record _____

Signature of Owner R. R. Brantner
Date 12-31-63

Three copies to be filed by the owner with the County Clerk & Recorder of the County in which the well is located.

PLEASE ANSWER ALL QUESTIONS. IF NOT APPLICABLE, SO STATE, OTHERWISE THE FORM WILL BE RETURNED.

Original to the County Clerk & Recorder; duplicate to the State Engineer; Triplicate to the School of Mines and Quadruplicate for the Appropriator.

397114

RENE BAUCHERE

TO

THE PUBLIC

DECLARATION OF VESTED
GROUNDWATER RIGHTS

STATE OF MONTANA)
COUNTY OF HILL)
Filed at 11 o'clock *am*

BY *[Signature]* DEPT 30 1963

[Signature]
COUNTY CLERK

DEPUTY

EE: \$2.00 pd.

RECEIVED

County HILL

MAR 2 1972

DRILLER'S LOG

STATE OF MONTANA
ADMINISTRATOR OF GROUNDWATER CODE
MONTANA WATER RESOURCES BOARD
MONTANA DEPARTMENT OF NATURAL RESOURCES AND CONSERVATION
NOTICE OF COMPLETION OF GROUNDWATER APPROPRIATION BY MEANS OF WELL
Developed after January 1, 1962

Indicate the character, color, thickness of strata such as soil, clay, sand, gravel, shale, sandstone, etc. Show depth at which water is found and height to which water rises in well.

(Under Chapter 237 Montana Session Laws, 1961, as amended)

This form to be prepared by driller, and three copies to be filed by the owner with the County Clerk and Recorder in the county in which the well is located, last copy to be retained by driller. Please answer all questions. If not applicable, so state, otherwise the form may be returned.

Owner ARTHUR DE LONG

Address 647 5th Ave. No.

HAURE, MONTANA

Date well started 10/14/71

completed 10/18/71

Type of well DRILLED

Equipment used CABLE TOOL RIG

Water Use: Domestic Municipal Stock Irrigation

Industrial Drainage Other Garden/Lawn

*Describe

USE: If used for irrigation, industrial, drainage or other. Explain, state number of acres and location or other data (i.e. Lot, Block and Addition).

ESTIMATED ANNUAL WITHDRAWAL 600,000 Gallons

Size of Trilled Hole	Size and Weight of Casing	From (Feet)	To (Feet)	PERFORATIONS		
				Kind	From (Feet)	To (Feet)
8 5/8"	8 5/8" O.D. 24" PER FT.	7 FEET BELOW GROUND LEVEL	71			
8 1/4"	5 1/2" O.D. PVC 160"	65	105	3/16" DRILLED	76	103

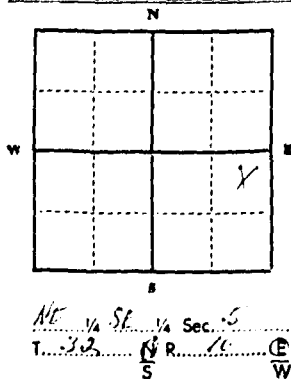

Static water level 21 ft.*
Pumping water level 101 ft.*
at 2 1/4 gallons per minute,
measured 80 minutes after pumping began.

*Measured from ground level.
Well developed by PAKER + PUMP
for 3 hours.
Power ELECTRIC Pump 1/3 HP

Remarks: (Gravel packing, cementing, packers, type of shutoff) HOLE DRILLED TO 8 1/4" DIAMETER FROM 71-105 FT LEVEL. PERFORATED 5 1/2" PVC CASING INSTALLED + GRAVEL PACKED FROM 105 BACK TO 71 FT LEVEL. PUT COARSE SAND FILLER ABOVE GRAVEL TO 72 1/2 FT TO HOLD EACH CENTRE GROUT WHICH WAS PLACED ABOVE FILLER BETWEEN 71 1/2 AND 72 1/2 FT. BACK TO TOP OF 5 1/2" CASING AT 65 FT LEVEL.

INDICATE LOCATION OF WELL AND PLACE OF USE, IF POSSIBLE. EACH SMALL SQUARE REPRESENTS 40 ACRES.

Driller's Signature Hubert Frazer - HI-LINE DRILLING SERVICE

Driller's Address 1173 6th St. No

HAURE, MONTANA

LICENSE NO. 416

Top of Ground (Elev. above sea level)	
From (Feet)	To (Feet)
0 TO 8	EXISTING WELL PIT
14	GRAVEL + CLAY MIX
18	GRAVELLY GREY CLAY
21	BROWN SAND - SOME LARGE GRAVEL - FINEST POW. WATER - (CASED OFF)
33	SANDY BROWN CLAY
37	BROWN SAND - TRACE OF GRAVEL - WATER - NOT CEMENTING - (CASED OFF)
61	SANDY BROWN CLAY
62	BROWN SAND - SOME WATER
70	SANDY + GRAVELLY BROWN CLAY
74	STALEY BROWN SANDSTONE
76	FINE-GRAINED SANDSTONE
85	STALEY GRY SANDSTONE - WATER - APPROX 1/2 GPM
85 1/2	HARD LONESTONE SHELL
89	SANDY GRAY SHALE - WATER - APPROX 1/2 GPM
91	BLUE-GRAY SHALE
95	SANDY BLUE-GRAY SHALE - FINE
98	BLUE-GRAY SHALE
100	SANDY LT. BROWN SHALE
103	GRAY SHALE
105	SANDY GRAY SHALE - WATER - APPROX 3/4 GPM

NOTE: HOLE DRILLED TO 107 FT LEVEL IN QUEST OF MORE WATER BUT TO NO AVAIL. PICKED UP SMALL YIELD OF 1/2 GPM IN FINE SANDSTONE AT 131-141 FT LEVEL BUT DID NOT WARRANT BASING HOLE TO THIS DEPTH. PLUGGED HOLE WITH GRAVEL BACK TO 106 FT LEVEL. INSTALLED PERFORATED 5 1/2" PVC CASING, GRAVEL PACKED + CEMENTED + COMPLETED WELL.

105 Show exact depth of bottom

49,951

423862

ARTHUR DE LONG

TO

THE PUBLIC

WATER WELL

STATE OF MONTANA, ss
COUNTY OF HILL
Attest: 10:15'clock A.M.

MAR 1 1972

R. E. Blom

COUNTY CLERK

David E. May
DEPUTY

Fee: \$2.00 pd.

INDEXED

File No. _____

T. 32¹ R. 16^E

DUPLICATE

County _____

STATE OF MONTANA
ADMINISTRATOR OF GROUNDWATER CODE
OFFICE OF STATE ENGINEER

RECEIVED
SEP 13 1963

Declaration of Vested Groundwater Rights
(Under Chapter 237, Montana Session Laws, 1961)

STATE ENGINEER

I, Mrs Anna Dainger of 234 N.S. Harre
(Name of Appropriator) (Address) (Town)

County of Blaine State of Montana
have appropriated groundwater according to the Montana laws in effect prior to January 1, 1962, as follows:

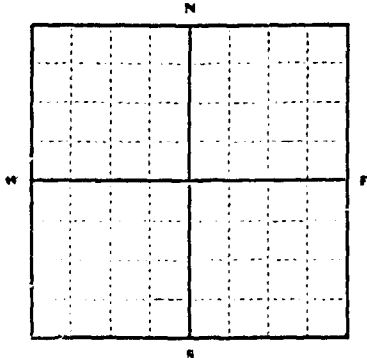

NE 1/4 SE Sec. 5, T. 20, R. 16.

Indicate point of appropriation and place of use, if possible. Each small square represents 10 acres.

2. The beneficial use on which the claim is based. Household

3. Date or approximate date of earliest beneficial use; and how continuous the use has been. May Daily

4. The amount of groundwater claimed (in miner's inches or gallons per minute). 15 gal per minute

5. If used for irrigation, give the acreage and description of the lands to which water has been applied and name of the owner thereof

6. The means of withdrawing such water from the ground and the location of each well or other means of withdrawal. pump

7. The date of commencement and completion of the construction of the well, wells, or other works for withdrawal of groundwater. May 12 1963 May 15 1963

8. The depth of water table. 3.0 ft

9. So far as it may be available, the type, size and depth of each well or the general specifications of any other works for the withdrawal of groundwater. 21 ft

10. The estimated amount of groundwater withdrawn each year.

11. The log of formations encountered in the drilling of each well if available.
0-4 ft gravel & sand, 4-15' brown clay, 15-47' fresh water, 47-57' water gravel

12. Such other information of a similar nature as may be useful in carrying out the policy of this act, including reference to book and page of any county record.

Signature of Owner. Mrs Anna Dainger

Date. Sept 11 1963

Three copies to be filed by the owner with the County Clerk and Recorder of the county in which the well is located.

Please answer all questions. If not applicable, so state, otherwise the form will be returned.

Original to the County Clerk and Recorder; duplicate to the State Engineer; Triplicate to the Montana Bureau of Mines and Geology, and Quadruplicate for the Appropriator.

5266

395189

MRS. ANNA DRAEGER

TO

THE PUBLIC

DECLARATION OF VESTED GROUND
WATER RIGHTS

STATE OF MONTANA,) ss.
COUNTY OF HILL)
Filed at 2:30 o'clock P.M.

ON SEP 11 1963

R. E. Blom

COUNTY CLERK

By _____

DEPUTY

Fee: \$2.00 pd.

STATE OF MONTANA
ADMINISTRATOR OF GROUNDWATER CODE
MONTANA WATER RESOURCES BOARD

NOTICE OF COMPLETION OF GROUNDWATER
APPROPRIATION BY MEANS OF WELL

Developed after January 1, 1962

(Under Chapter 237 Montana Session Laws, 1961, as amended)

This form to be prepared by driller, and three copies to be filed by the owner with the County Clerk and Recorder in the county in which the well is located, last copy to be retained by driller.

Please answer all questions. If not applicable, so state, otherwise the form may be returned.

Owner CHARLES & GAYNELLEA DURWARD
Address 505 5TH ST. NO. HAURE, MONTANA
Date well started 12/16/70 completed 12/28/70
Type of well DRILLED
Equipment used CABLE TOOL RIG
Water Use: Domestic Municipal Stock Irrigation
Industrial Drainage Other * Garden/Lawn

For Administrator's Use
File 425968
Date Oct. 6, 1972 2:45 p.m.
GW 1

*Describe

USE: If used for irrigation, industrial, drainage or other. Explain, state number of acres and location or other data (i.e. Lot, Block and Addition).

ESTIMATED ANNUAL WITHDRAWAL 1,500,000 GALLONS

Size of Drilled Hole	Size and Weight of Casing	From (Feet)	To (Feet)	PERFORATIONS
10"	0	15		
6 5/8"	1 1/2" O.D. GALVANIZED 13" PER FT.	1 FOOT ABOVE GROUND LEVEL	47	JONSON STAINLESS STEEL 20 SLOT TELESCOPE TYPE 304 1/2" WELL SCREEN CONSISTING OF LEAD PIPES, 2 1/2' OF SCREEN SECTION AND 4" OF 5/8" CASING WELDED TO BOTTOM OF SCREEN WITH BOTTOM WELDED SHIRT COVER ALL LENGTH OF UNIT. 4 FT. INSTALLED FROM 46 1/2' TO 50 1/2' FROM GROUND LEVEL OR

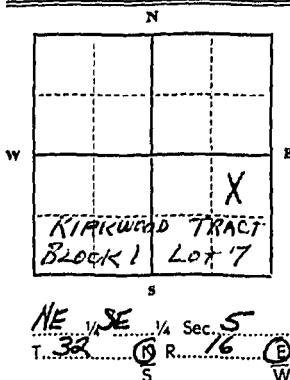

47 1/2' TO 51 1/2' FROM TOP OF CASING
Static water level 13 ft.*
Pumping water level 35 ft.*
at 10 gallons per minute,
measured 180 minutes after pumping
began.
*Measured from ground level.
Well developed by BALER, SURGE BLOCK
for 10 hours. * AIR COMPRESSOR
Power ELECTRIC Pump 1/2 HP
Remarks: (Gravel packing, cementing,
packers, type of shutoff) ADDF
HEAVED TO 10" DIAMETER TOPS
FT LEVEL. UPON COMPLETION OF
WELL AN UNLARG. SPACE AROUND
6 5/8" CASING FILLED WITH DRILLING MUD

INDICATE LOCATION OF WELL AND PLACE OF USE, IF POSSIBLE. EACH SMALL SQUARE REPRESENTS 40 ACRES.

Driller's Signature Hubert Quinn - HI-LINE DRILLING SERVICE
Driller's Address 1173 6TH ST. NO. HAURE, MONTANA LICENSE NO. 46

RECEIVED
OCT 10 1972

271-106
County HILL

DRILLER'S LOG

Indicate the character, color, thickness of strata such as soil, clay, sand, gravel, shale, sandstone, etc. Show (water) which water is found and (depth) to which water rises in well.

Top of Ground (Elev. above sea level)	
From (Feet)	To (Feet)
0 to 3	SOIL
15	SANDY BROWN CLAY
18	BROWN SAND & SILT - VERY LITTLE CLAY
21	SANDY GREY CLAY - SOFT
23	MUDDY GREY SAND - WATER
28	SILTY GREY CLAY
29	GREY SILT & SAND - SOME GRAVEL - WATER
34	SANDY GREY CLAY
36	GREY SAND - GRAVEL - WATER
39	GREY SILT
40	GREY SAND - SOME GRAVEL - WATER - APPROX. 6 GPM HARDNESS - 42 GR. / PPM - 3 PPM SULFATE - MODERATE
45 1/2	SOFT SANDY GREY CLAY
49	GREY SAND - FINE TO COARSE - SOME GRAVEL - WATER - APPROX 7 GPM
50 1/2	SANDY GREY CLAY
SCREEN INSTALLED FROM 47 1/2 TO 51 1/2 FEET FROM TOP OF CASING, WHICH IS 1 FOOT ABOVE GROUND LEVEL. WELL DEVELOPED BY BALER, SURGE BLOCK & AIR COMPRESSOR. CONSIDERABLE AMOUNT OF FINE SAND & SILT TAKEN OUT. FIRMATION ALSO HAD QUITE A BIT OF CLAY PARTICLES, MAKING CLEARING OF WATER A PROBLEM. BALER WELL FOR YIELD OF 18-20 GPM	

50 1/2 Show exact depth of bottom

51,559

425968

CHARLES DURWARD & GAYNELLE
A. DURWARD

TO

THE PUBLIC

WATER WELL

STATE OF MONTANA,) ss.
COUNTY OF HILL)

Filed at 2:45 o'clock P.M.

OCT 6 1972

R. E. Blom

COUNTY CLERK

By Carole E. Day
DEPUTY

Fee: \$2.00 pd.

CIDEXED

[Faint, illegible handwritten notes and stamps on the right side of the page, including a vertical stamp that appears to say "RECORDED" and "INDEXED".]

File No. _____

RECEIVED

T. 3011 R. 16 E 3

DUPLICATE

DEC 23 1971

County HILL

Top of Ground _____

(Elev. above sea level _____)

STATE OF MONTANA
ADMINISTRATOR OF GROUNDWATER CODE
OFFICE OF STATE ENGINEER

Notice of Completion of Groundwater Appropriation by Means of Well

(Under Chapter 237, Montana Session Laws, 1961)

Owner JAMES ENGLAND Address NORTH HAVRE

Driller SIMPSON DRILLING CO Address HAVRE, MONTANA

Date of Notice of appropriation of ground water _____

THIS 20 day of December Date well started 12/1/1971 Date Completed 12/3/1971
A. D. 1971, at 2:50
o'clock P M.

Type of well DRILLED Equipment used CABLE TOOLS
(dug, driven, bored or Churn, drill, rotary or drilled) other)

Water use: Domestic Municipal Stock Irrigation
Industrial Drainage Other

Indicate on the diagram the character and thickness of the different strata met with in drilling, such as soil, clay, shale, gravel, rock or sand, etc. Show depth at which water is encountered, thickness and character of water-bearing strata and height to which the water rises in the well.

10
28
32
53
78

brown clay
brown sandstone
rock
sandy blue shale
sandstone and water

Size of Drilled Hole	Size and Weight of Casing	From (Feet)	To (Feet)	PERFORATIONS		
				Kind Size	From (Feet)	To (Feet)
5 3/4	5 1/2 15LBS	12" A.G.	78'	2" holes	53	78

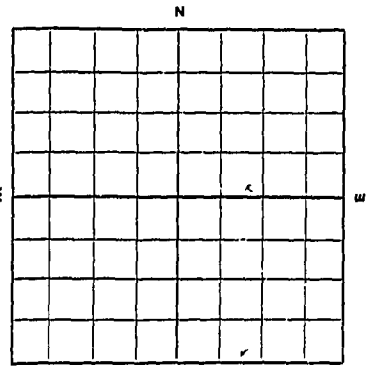

Sec. 5 T. 22 R. 16
Indicate location of well and place of use, if possible. Each small square represents 10 acres.

Static Water Level for non-flowing well _____
28 feet.
Shut-in Pressure for Flowing Well _____
Pumping Water Level _____ feet
at 10 gal. per minute.
Discharge in gal. per min. of flowing well _____

How Tested BATLER
Length of Test 1/2 hour
Remarks: (Gravel packing, cementing, packers, type of shutoff, location of place of use of groundwater if not at well, and any other similar pertinent information, including number of acres irrigated, if used for irrigation) _____

Show exact depth of bottom.

15
Driller's License Number
[Signature]
Driller's Signature

This form to be prepared by driller, and three copies to be filed by the owner with the County Clerk and Recorder in the county in which the well is located.

Please answer all questions. If not applicable, so state, otherwise the form will be returned.

Original to the County Clerk and Recorder; duplicate to the State Engineer; Triplicate to the School of Mines and Quadruplicate for Appropriator.

49631

423251

JAMES ENGLAND

TO

THE PUBLIC

BY
OF
IN

OF MONTANA
COUNTY OF HILL
2:50 P
DEC 20 1971
COUNTY CLERK
DEPUTY

Fee:\$2.00 pd

INDEXED

File No.

T. 32 N R 16 E

DUPLICATE

County Hill

STATE OF MONTANA
ADMINISTRATOR OF GROUNDWATER CODE
OFFICE OF STATE ENGINEER

RECEIVED
OCT 30 1963

Declaration of Vested Groundwater Rights STATE ENGINEER

(Under Chapter 237, Montana Session Laws, 1961)

Charles Arthur & Donald George Gameon, of 308 1/2 Hill, North Side, Havre
(Name of Appropriator) (Address) (Town)

County of Hill State of Montana
have appropriated groundwater according to the Montana laws in effect prior to January 1, 1962, as follows:

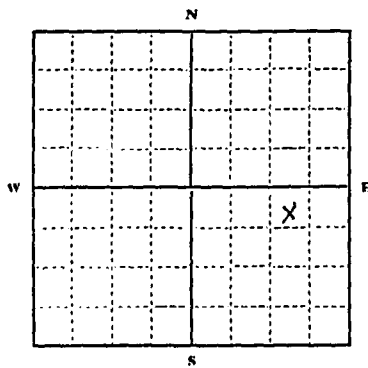

NE 1/4 SR 1 Sec 5 T 32 R 16

Indicate point of appropriation and place of use, if possible. Each small square represents 10 acres.

- 2. The beneficial use on which the claim is based... domestic
- 3. Date or approximate date of earliest beneficial use; and how continuous the use has been... Sept. 20, 1958 constant
- 4. The amount of groundwater claimed (in miner's inches or gallons per minute)... 7 gpm
- 5. If used for irrigation, give the acreage and description of the lands to which water has been applied and name of the owner thereof... none
- 6. The means of withdrawing such water from the ground and the location of each well or other means of withdrawal... electric

7. The date of commencement and completion of the construction of the well, wells, or other works for withdrawal of groundwater... started Sept. 16, 1958 finished Sept. 20, 1958

8. The depth of water table... 54 ft.

9. So far as it may be available, the type, size and depth of each well or the general specifications of any other works for the withdrawal of groundwater... drilled, 6" diameter, 99 ft. depth

10. The estimated amount of groundwater withdrawn each year... 3,679,200

11. The log of formations encountered in the drilling of each well if available... clay, sandstone, shale, gravel

12. Such other information of a similar nature as may be useful in carrying out the policy of this act, including reference to book and page of any county record... none

Signature of Owner... C.A. Gameon
Date... 10-29-63

Three copies to be filed by the owner with the County Clerk and Recorder of the county in which the well is located.

Please answer all questions. If not applicable, so state, otherwise the form will be returned.

Original to the County Clerk and Recorder; duplicate to the State Engineer; Triplicate to the Montana Bureau of Mines and Geology, and Quadruplicate for the Appropriator.

395855

CHARL S ARTHUR & DONALD GEORGE
GAMEON ~~YERGEN~~

to

THE PUBLIC

DECLARATION OF VES' ED GROUND
WATER RIGHTS

STATE OF MONTANA,)
COUNTY OF HILL)
Filed at 10 o'clock A.m.

ON OCT 29 1963

R. E. Blom

DEPUTY CLERK

DEPUTY

Fee: \$2.00 pd.

30 N R 13 E

STATE OF MONTANA
 ADMINISTRATOR OF GROUNDWATER CODE
 OFFICE OF STATE ENGINEER

STATE ENGINEER

Declaration of Vested Groundwater Rights

(Under Chapter 237, Montana Session Laws, 1961)

1. Great Northern Railway Company, of 175 E. 4th St., St. Paul, Minnesota
 (Name of Appropriator) (Address) (Town)

County of Hill State of Montana

have appropriated groundwater according to the Montana laws in effect prior to January 1, 1962, as follows:

Se 1/4 SW 1/4 Sec. 26 T. 30N R. 13E

Indicate point of appropriation and place of use, if possible. Each small square represents 10 acres.

Well at Box Elder

(for location of Well at Havre, see reverse side)

- The beneficial use on which the claim is based. Railroad
 Purposes.....
- Date or approximate date of earliest beneficial use; and how continuous the use has been. 1930
- The amount of groundwater claimed (in miner's inches or gallons per minute). N/A
- If used for irrigation, give the acreage and description of the lands to which water has been applied and name of the owner thereof. N/A
- The means of withdrawing such water from the ground and the location of each well or other means of withdrawal. Well at Box Elder and Well at Havre

- The date of commencement and completion of the construction of the well, wells, or other works for withdrawal of groundwater. N/A
- The depth of water table. N/A
- So far as it may be available, the type, size and depth of each well or the general specifications of any other works for the withdrawal of groundwater. Hand dug well, 33' deep
- The estimated amount of groundwater withdrawn each year. 100,000 gallons
- The log of formations encountered in the drilling of each well if available. N/A
- Such other information of a similar nature as may be useful in carrying out the policy of this act, including reference to book and page of any county record. N/A

GREAT NORTHERN RAILWAY COMPANY
 Signature of Owner By: H. N. Halmgren
 Superintendent of the Butte Division
 Date: 11-2-62

Three copies to be filed by the owner with the County Clerk and Recorder of the county in which the well is located.

Please answer all questions. If not applicable, so state, otherwise the form will be returned.

Original to the County Clerk and Recorder; duplicate to the State Engineer; Triplicate to the Montana Bureau of Mines and Geology, and Quadruplicate for the Appropriator.

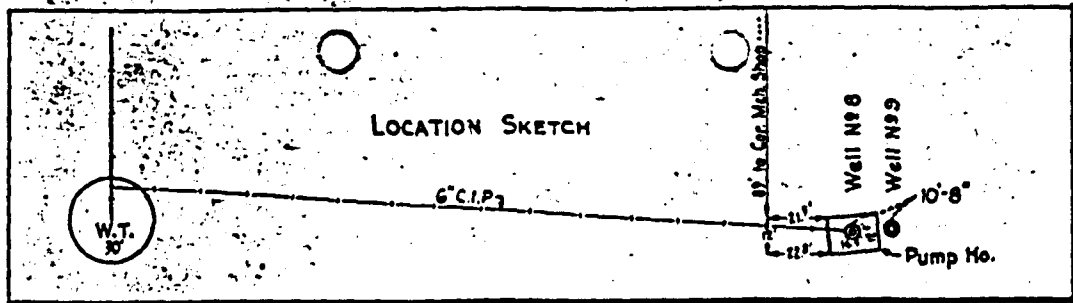

HAVRE, MONT.

WELL No. 9

Water stood at 27' from surface and pumped down to 36' when pumping at rate of 140 G.P.M.

Drilling began Jan. 3 and finished Feb. 8, 1956

Ground Surface
Cinders & Gravel - 7'
Yellow Clay - 23'
Water Level - 1-27-56
Sandy Clay - 21'
Blue Clay - 27'
Hard Pan - 8'
Hard Clay - 2'
Gravel - 8'
96' Bottom of Well
10'-8"-12" Johnson Everdur
Screen (7' exposed)

90'-12" W.C. Casing (make up int.)
17' Drive shoe

Well put down by Ry. Co force & machine, C.M. Wick driller. Afe 86163

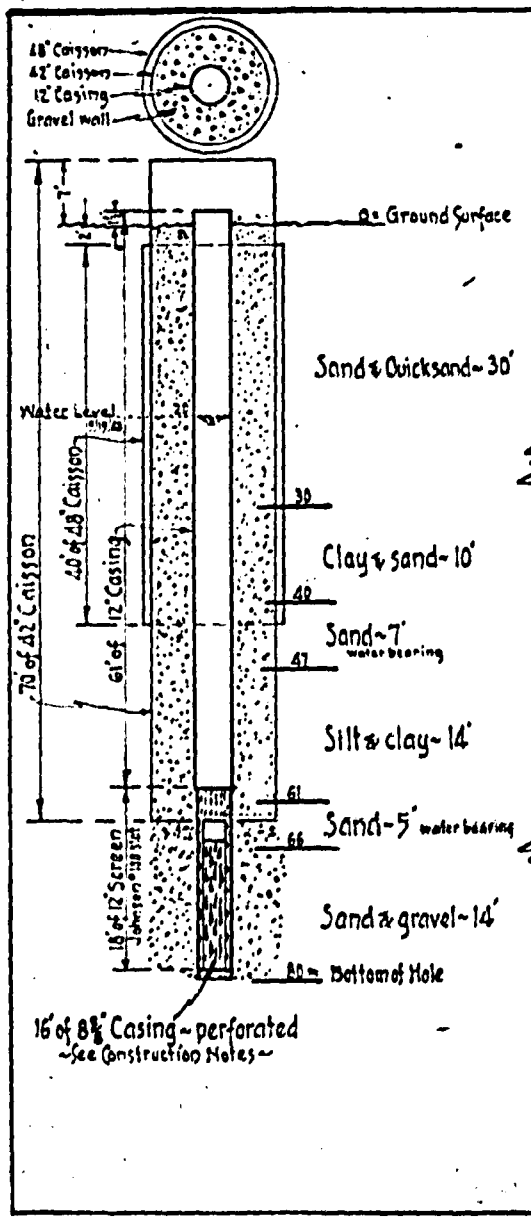

~ HAVRE, Montana ~
~ Afe 57897 ~

Log of Gravel Wall Well #2 put down by Ry. Co. force and machine. ~ C.M. Wick, driller
Work started Jan. 16th and finished May 15th 1940.
Pumping test: ~ Water level was at 20' below Surface and lowered to 46' when delivering 220 G.P.M.

Construction Notes:-

Excavation started with 48" Caisson and tapered to 42" with 36" to depth of 80'. ~ Concentricly, 12" Casing with 12" Screen-18'g. was placed with bottom of Screen at 79' below Surface. Gravel was placed between 12" string and caisson- the 36" pulled and recovered; the 42" & 48" left in place.

A cloudburst (in June '40) flooded the flat where Wells are located - causing settlement around new well (also 6" Well #1). It was learned when lowering permanent pumping unit that Screen had collapsed and to increase the supply was necessary to move in drill machine and swedge out Screen so could insert 8 1/2" Casing as reinforcement and to prevent further damage.

~ Location Sketch ~

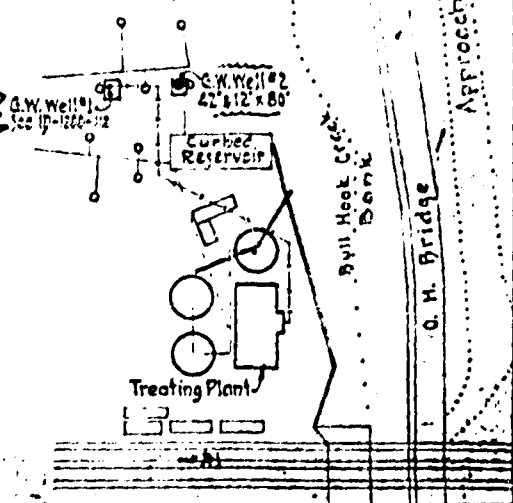

Engr. Water Service

17-1200-184

324-16E
HILL
County 5

STATE OF MONTANA
ADMINISTRATOR OF GROUNDWATER CODE
MONTANA WATER RESOURCES BOARD

NOTICE OF COMPLETION OF GROUNDWATER
APPROPRIATION BY MEANS OF WELL

Developed after January 1, 1962

(Under Chapter 237 Montana Session Laws, 1961, as amended)

This form to be prepared by driller, and three copies to be filed by the owner with the County Clerk and Recorder in the county in which the well is located, last copy to be retained by driller.

Please answer all questions. If not applicable, so state, otherwise the form may be returned.

Owner HERMON + BETTY HEAD

Address 533 5TH AVE. NO
HAURE, MONTANA

Date well started FEBRUARY 26, 1973
completed FEBRUARY 29, 1973

Type of well DRILLED
(Dug, driven, bored or drilled)

Equipment used CABLE TOOL RIG
(Churn drill, rotary or other)

Water Use: Domestic Municipal Stock Irrigation
Industrial Drainage Other * Garden/Lawn

For Administrator's Use

File 427336

MARCH 14, 1973

GW 1 9:00 A.M.

*Describe _____

USE: If used for irrigation, industrial, drainage or other. Explain, state number of acres and location or other data (i.e. Lot, Block and Addition). _____

ESTIMATED ANNUAL WITHDRAWAL EXCEEDING 500,000 GALLONS

Size of Drilled Hole	Size and Weight of Casing	From (Feet)	To (Feet)	PERFORATIONS		
				Kind Size	From (Feet)	To (Feet)
8"	5 1/2" O.D. PVC PLASTIC 160#	3 1/2 FT. BELDOW GROUND LEVEL	65 1/2	5 1/32" DRILLED	40 1/2	60 1/2

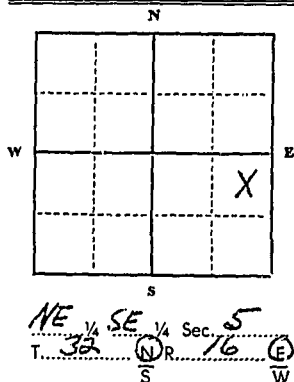

Static water level 13 ft.*
Pumping water level 10 ft.*
at 60 gallons per minute,
measured 60 minutes after pumping
began.
*Measured from ground level.
Well developed by SAUER + PUMP
for 6 hours.
Power ELECTRIC Pump 1/2 HP
Remarks: (Gravel packing, cementing),
packers, type of shutoff) HOLE BEAMED TO 8" DIAMETER, CASING
INSTALLED TO 65 1/2 FT. LEVEL AND GRAVEL PLACED AROUND
OUTSIDE OF 5 1/2" PVC CASING FROM 65 1/2 FT. BACK TO 36
FOOT LEVEL. CRUSHED GRAVEL PLACED ABOVE GRAVEL PACK TO
3 1/2 FOOT LEVEL. CEMENT GROUT PLACED ABOVE CRUSHED GRAVEL
BACK TO APPROX. 65 FOOT LEVEL TO
CEMENT OFF HIGH IRON WATER AT
65-37 1/2 FT. DRILLING AND
FILLED IN ABOVE CEMENT TO
BOTTOM OF WELL PIT

INDICATE LOCATION OF WELL AND PLACE OF USE, IF POSSIBLE.
EACH SMALL SQUARE REPRESENTS 40 ACRES.

Driller's Signature Robert Groves HI-LINE DRILLING SERVICE

Driller's Address 1173 6TH ST. NO. HAURE, MONTANA 59501 PHONE 265-4210

LICENSE NO. 46

DRILLER'S LOG

Indicate the character, color, thickness of strata such as soil, clay, sand, gravel, shale, sandstone, etc. Show depth at which water is found and height to which water rises in well.

Top of Ground (Elev. above sea level)	
From (Feet)	To (Feet)
0 TO 7	EXISTING WELL PIT
7 1/2	BROWN SILT + SAND - VERY LITTLE CLAY
23	BROWN SAND - SATURATED
25	SANDY BROWN CLAY
27 1/2	BROWN SAND - LARGE GRAVEL - WATER - HIGH IRON CONTENT - (CASED OFF)
29	SANDY BROWN CLAY
31	GREY CLAY
37 1/2	BLUE-GREY SHALE
38	HARD BROWN SANDSTONE - RIB
41	SANDY LT. BROWN SHALE - TRACE OF WATER
45	BROWN SANDSTONE - WATER - APPROX 3 1/2 GPM. MOST OF WATER COMING IN AT 44 FOOT LEVEL.
51	BROWN SANDSTONE - WATER INCREASED TO APPROX. 9 GPM
61	BLUE-GREY SHALE
65	SANDY LT. BROWN SHALE
65 1/2	HARD SANDSTONE

NOTE: WATER YIELD INCREASED TO 10 GPM AFTER BEARING HOLE TO 8" DIAMETER

65 1/2 Show exact depth of bottom

427336

HERMON & BETTY HEAD

TO

THE PUBLIC

WATER WELL

STATE OF MONTANA } SS
COUNTY OF HILL }
Filed at 9:00 o'clock A.M

ON MAR 14 1973

R. E. Blom

COUNTY CLERK
BY *David E. Roy*
DEPUTY

Fee:\$2.00 pd.

INDEXED

File No.

T 327 R 16E 3

DUPLICATE

County Hill

LOG

STATE OF MONTANA
ADMINISTRATOR OF GROUNDWATER CODE
OFFICE OF STATE ENGINEER

Notice of Completion of Groundwater
Appropriation by Means of Well
DEVELOPED AFTER JANUARY 1, 1962

(Under Chapter 237, Montana Session Laws, 1961)

Owner James Head Address 663 5th Ave. No. Havre, Montana
Driller H. L. Line Drilling Service Address Havre, Montana

Date of Notice of appropriation of groundwater.....

Date well started 8-24-65 Date completed 9-7-65

Type of well Drilled Equipment used Cable tool rig
(Dug, driven, bored or drilled) (Churn drill, rotary or other)

Water use: Domestic Municipal Stock Irrigation
Industrial Drainage Other

Indicate on the diagram the character and thickness of the different strata met with in drilling, such as soil, clay, shale, gravel, rock or sand, etc. Show depth at which water is encountered, thickness and character of water-bearing strata and height to which the water rises in the well.

- 0 to Top of Ground (Elev. above sea level.....)
- 11 Gravelly brown clay
- 17 Sandy brown clay
- 25 Brown clay
- 29 Grey clay
- 35 Brownish-yellow shale
- 37 Sandstone - water - 2 1/2 Gpm
- 42 Shaley sandstone
- 49 Sandstone - water - 1 1/2 Gpm
- 54 Blue shale
- 56 Grey shale
- 59 Blue-grey shale
- 59 1/2 Hard shell
- 70 Blue-grey shale
- 82 1/2 Sandstone - water - approx. 7 Gpm
- 87 1/2 Hard sandstone
- 91 Shaley sandstone
- 97 Grey shale
- 107 Blue-grey shale
- 110 Dark grey shale
- 115 1/2 Grey shale
- 117 1/2 Sandstone - water - 3 Gpm
- 126 Light grey shale
- 136 Blue-grey shale
- 139 Sandy grey shale
- 140 Sandy Lt. brown shale
- 159 Blue-grey shale
- 160 Hard sandstone shell
- 170 Grey sandstone water - approx. 8 Gpm
- 181 Blue-grey shale
- 185 Sandy blue-grey shale
- 185 Show exact depth of bottom.

Size of Drilled Hole	Size and Weight of Casing	From (Feet)	To (Feet)	PERFORATIONS		
				Kind Size	From (Feet)	To (Feet)
9"	6 5/8" O.D. 13 #/foot	2 feet above ground level	185	48" x 4" Slotted	18	36
					42	49
					70	83
					87	91
					115	118
					136	139
					160	170

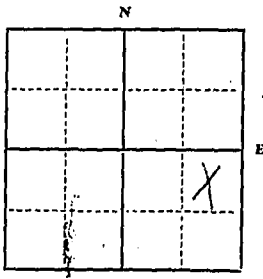

Static Water Level for non-flowing well 18 feet.

Shut-in Pressure for Flowing Well Not Appl.

Pumping Water Level 17.5 feet at 2.2 gal. per minute.

Discharge in gal. per min. of flowing well Not Applicable

How Tested Bailers & pump

Length of Test 8 hours

Remarks: (Gravel packing, cementing, packers, type of shutoff) Hole reamed to 7" diameter to 185 feet.

Casing installed & gravel placed around casing from 185 foot level back to 17 foot level. Cemented above 17 ft level.

(Continue on reverse side)

USE—If used for irrigation, industrial, drainage or other. Explain, state number of acres and location or other data (i.e.: Lot, Block and Addition).

46
Driller's License Number

Robert Jackson
Driller's Signature

45,030

This form to be prepared by driller, and three copies to be filed by the owner with the County Clerk and Recorder in the county in which the well is located, tissue copy to be retained by driller.

Please answer all questions. If not applicable, so state, otherwise the form will be returned.

412993

JAMES HEAD

TO

THE PUBLIC

NOTICE OF COMPLETION OF
GROUNDWATER APPROPRIATION

STATE OF MONTANA,)
COUNTY OF HILL)ss.

Filed at 10:45 o'clock A.M.

FEB 26 1969

R. E. BLOM

COUNTY CLERK

BY

DEPUTY

fee: \$2.00 paid

File No. _____

T. 32N R. 16E 3

DUPLICATE

County Hill

LOG

STATE OF MONTANA
ADMINISTRATOR OF GROUNDWATER CODE
OFFICE OF STATE ENGINEER

Notice of Completion of Groundwater
Appropriation by Means of Well
DEVELOPED AFTER JANUARY 1, 1962

(Under Chapter 237, Montana Session Laws, 1961)

0	Top of Ground
(Elev. above sea level.....)	
-3	Gravel & clay fill
19	Sandy brown clays
28	Soft grey clay
32	Sand-grace of gravel & water
-36	Yellowish-grey shale
39	Grey sandstone-trace water
43	Blue-grey shale
49	Sandy blue-grey shale
53	Light grey shale
59	Shaley sandstone (dry)
61	Blue shale
62	Brown shale
64	Grey shale
73	Grey sandstone-Water- Approx. 14 GPM by baler test, baling from 73'.
73	Show exact depth of bottom.

Owner James Head Address Havra, Montana

Driller Hi-Line Drilling Service Address Havra, Montana

Date of Notice of appropriation of groundwater.....

Date well started Sept. 24, 1964 Date completed Sept. 26, 1964

Type of well Drilled Equipment used Cable tool rig
(Dug, Driven, bored or drilled) (Churn drill, rotary or other)

Water use: Domestic Municipal Stock Irrigation
Industrial Drainage Other

Indicate on the diagram the character and thickness of the different strata met with in drilling, such as soil, clay, shale, gravel, rock or sand, etc. Show depth at which water is encountered, thickness and character of water-bearing strata and height to which the water rises in the well.

Size of Drilled Hole	Size and Weight of Casing	From (Feet)	To (Feet)	PERFORATIONS		
				Kind Size	From (Feet)	To (Feet)
6 5/8"	6 1/8" ID 13# per "	0	64	No perforations Casing driven to top of sandstone at 64' level. Sandstone left uncased.		

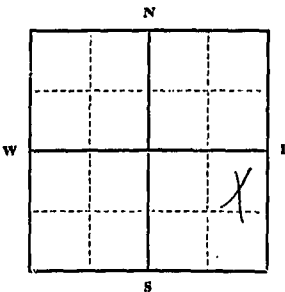

Static Water Level for non-flowing well20.....feet.

Shut-in Pressure for Flowing Well Not appl.
Pumping Water Level.....63.....feet

at.....10.....gal. per minute.
Discharge in gal. per min. of flowing well
Not applicable.

How Tested.....Baler & pump.....
Length of Test.....4 hours.....

NE 1/4 Sec. 5 T. 32 N. R. 16 E.
Indicate location of well and place of use, if possible. Each small square represents 40 acres.

Remarks: (Gravel packing, cementing, packers, type of shutoff) Cement grout placed around casing to prevent surface contamination.

(Continue on reverse side)

USE—If used for irrigation, industrial, drainage or other. Explain, state number of acres and location or other data (i.e.: Lot, Block and Addition).

This form to be prepared by driller, and three copies to be filed by the owner with the County Clerk and Recorder in the county in which the well is located, tissue copy to be retained by driller.

Please answer all questions. If not applicable, so state, otherwise the form will be returned.

46
Driller's License Number

Herbert Greier
Driller's Signature

45,029

412994

JAMES HEAD

TO

THE PUBLIC

NOTICE OF COMPLETION OF
GROUND WATER APPROPRIATION

STATE OF MONTANA,) ss.
COUNTY OF HILL)
Filed at 10:45 o'clock A.M.

FEB 26 1969
R. E. BLOM

COUNTY CLERK

BY _____
DEPUTY

fee: \$2.00 paid

File No. _____

T 32N R 16 E 5

DUPLICATE

County HILL

LOG RECEIVED

STATE OF MONTANA
ADMINISTRATOR OF GROUNDWATER CODE
STATE WATER CONSERVATION BOARD

APR 16 1969

- 0 to Top of Ground (Elev. above sea level _____)
- 5 FILL GRAVEL
- 8 BROWN SAND + GRAVEL MIX
- 14 SOFT SANDY BROWN CLAY
- 17 SOFT GREY CLAY
- 20 RUNNY SAND-WATER
- 21 SAND + GRAVEL-WATER-VERY HARD - APPROX 10 GPM (CASED OFF WITH 8 3/4" O.D SURFACE CASING)
- 23 GREY CLAY
- 28 BROWN SANDSTONE-WATER-APPROX 2 GPM - OVER 50 GRAMS HARDNESS - (CASED OFF)
- 33 BLUE-GREY SHALE
- 48 BROWN SANDSTONE-WATER-2 1/2 GPM
- 51 BLUE SHALE
- 52 SANDY GREY SHALE
- 53 SANDY GREY SHALE - STREAKS OF BROWN SHALE
- 61 SHALEY BROWN SANDSTONE-WATER - 1 GPM
- 62 HARD BROWN SANDSTONE
- 64 SANDY YELLOWISH-BROWN SHALE
- 66 HARD SHELL
- 73 SHALEY BROWN SANDSTONE-WATER - 1 GPM
- 75 GREY SHALE
- 79 BLUE-GREY SHALE
- 80 FIRM BLUE SHALE
- 82 SANDY BROWN SHALE
- 85 SANDY GREY SHALE
- 87 SHALEY GREY SANDSTONE
- 89 FIRM SANDY BROWN SHALE
- 95 GREY SANDSTONE - WATER - 2 1/2 GPM
- 96 SANDY GREY SHALE
- 96 Show exact depth of bottom.

Notice of Completion of Groundwater Appropriation by Means of Well DEVELOPED AFTER JANUARY 1, 1962

(Under Chapter 237 Montana Session Laws, 1961, as amended)

Owner: EVERETT HOMAD Address: 1701 S. CARNAHAN SPARKS, WASHINGTON

Driller: HI-LINE DRILLING SERVICE Address: HAURE, MONTANA

Date of Notice of appropriation of groundwater: _____

Date well started: AUGUST 5, 1968 Date completed: AUGUST 13, 1968

Type of well: DRILLED Equipment used: CABLE TOOL RIG
(Dug, driven, bored or drilled) (Churn drill, rotary or other)

Water use: Domestic Municipal Stock Irrigation
Industrial Drainage Other

Indicate on the diagram the character and thickness of the different strata met with in drilling, such as soil, clay, shale, gravel, rock or sand, etc. Show depth at which water is encountered, thickness and character of water-bearing strata and height to which the water rises in the well.

Size of Drilled Hole	Size and Weight of Casing	From (Feet)	To (Feet)	PERFORATIONS		
				Kind Size	From (Feet)	To (Feet)
8 3/4"		0	96			
	6 7/8" O.D. 13 # PER FT	1 1/2 FEET ABOVE GROUND LEVEL	8			
	5 3/8" O.D. (.190 WALL) PLASTIC	6	96	DRILLED 3/8"	33	95

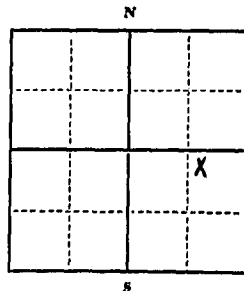

Static Water Level for non-flowing well _____ feet.

Shut-in Pressure for Flowing Well NOT APPL.

Pumping Water Level _____ feet at _____ gal. per minute.

Discharge in gal. per min. of flowing well NOT APPLICABLE

How Tested: PUMP

Length of Test: 8 HOURS

Remarks: (Gravel packing, cementing, packers, type of shutoff) HOLE PACKED TO 8 1/2" DIAMETER TO 96 FT LEVEL.

PERFORATED 5 3/8" PLASTIC CASING INSTALLED TO 96 FT. GRAVEL PLACED

AROUND CASING BACK TO 32 FT LEVEL. CEMENTED FROM 32 FT. BACK TO 16 FT TO ISOLATE HARD WATER VEINS. CASING OVERLAP AT 6-8 FT LEVEL CEMENTED

(Continue on reverse side)

USE—If used for irrigation, industrial, drainage or other. Explain, state number of acres and location or other data (i.e.: Lot, Block and Addition).

This form to be prepared by driller, and three copies to be filed by the owner with the County Clerk and Recorder in the county in which the well is located, tissue copy to be retained by driller.

Please answer all questions. If not applicable, so state, otherwise the form will be returned.

46
Driller's License Number

Robert Breier
Driller's Signature

45, 146

413339

KATHRYN HOMAD



THE PUBLIC

NOTICE OF COMPLETION OF
GROUNDWATER APPROPRIATION

STATE OF MONTANA,) ss.
COUNTY OF HILL)

Flow of 8,100 cfs. at

APR 13 1969

R. E. BLOM
COUNTY CLERK

DEPUTY

fee: \$2.00 paid

File No. _____

DUPLICATE

32N R 16E
County Hill

STATE OF MONTANA
ADMINISTRATOR OF GROUNDWATER CODE
OFFICE OF STATE ENGINEER

RECEIVED
NOV 20 1963

Declaration of Vested Groundwater Rights

(Under Chapter 237, Montana Session Laws, 1961)

STATE ENGINEER

1. Tina H. Jones of 289 Hill St Hill
(Name of Appropriator) (Address) (Town)
County of Hill State of Montana
have appropriated groundwater according to the Montana laws in effect prior to January 1, 1962, as follows:

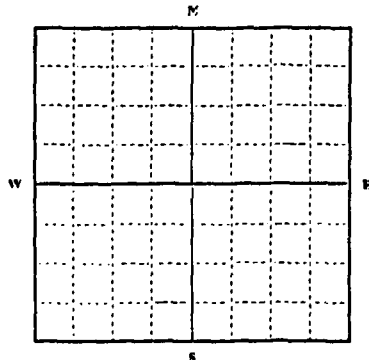

$\frac{1}{4}$ Sec 5 T. 32 R. 16
Indicate point of appropriation and place of use, if possible. Each small square represents 10 acres.
45' x 104' in NESE

2. The beneficial use on which the claim is based Household use

3. Date or approximate date of earliest beneficial use; and how continuous the use has been drope down a sand point april 1946. had a 4 inch casing put down in the same hole Oct 1-1961

4. The amount of groundwater claimed (in miner's inches or gallons per minute) 10 gal. a minute

5. If used for irrigation, give the acreage and description of the lands to which water has been applied and name of the owner thereof none

6. The means of withdrawing such water from the ground and the location of each well or other means of withdrawal Electric pump.

7. The date of commencement and completion of the construction of the well, wells, or other works for withdrawal of groundwater used the water since apr 1946 - drilled same hole

8. The depth of water table 69-70 ft. Oct 1-1961

9. So far as it may be available, the type, size and depth of each well or the general specifications of any other works for the withdrawal of groundwater none

10. The estimated amount of groundwater withdrawn each year 2,000 gal.

11. The log of formations encountered in the drilling of each well if available © - 6' pit
6-6' sand

12. Such other information of a similar nature as may be useful in carrying out the policy of this act, including reference to book and page of any county record State 12 ft

Signature of Owner Tina H. Jones
Date Nov 15 - 1963

Three copies to be filed by the owner with the County Clerk and Recorder of the county in which the well is located.

Please answer all questions. If not applicable, so state, otherwise the form will be returned.

Original to the County Clerk and Recorder; duplicate to the State Engineer; Triplicate to the Montana Bureau of Mines and Geology, and Quadruplicate for the Appropriator.

1333

396103

TINA H. JONES

TO

THE PUBLIC

DECLARATION OF VESTED GROUND
WATER RIGHTS

STATE OF MONTANA,) ss.
COUNTY OF HILL)
Filed at 1 o'clock P.M.

ON NOV 18 1963

R. E. Blom
COUNTY CLERK

DEPUTY

RECEIVED

STATE ENGINEER

MONTANA BUREAU OF MINES AND GEOLOGY
Butte, Montana

T. 22 N. R. 1 E
County Hill

WATER WELL LOG

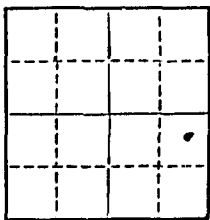

Owner: Address:
Driller: Address:
Date Started: Date Completed:
Location: Sec. 3 T. 22 N. R. 1 E 1/4 sec. 24

Type of well: drilled (Dug, driven, bored, or drilled) Equipment used: (Cable drill, rotary, other)

Water use: Domestic Municipal Stock Irrigation
Industrial Drainage Other:

Casing: 0 ft. to 33 ft. Type: 1 1/2" Size: 30/3
Casing: ft. to ft. Type: Size:
Casing: ft. to ft. Type: Size:

Perforated by screened/ Ft. 32 to ft. 30 Ft. to ft.

Type of screen or perforations: 1/8" holes

Static Water level, for non-flowing well: 10.11 feet.

Shut-in pressure, for flowing well: lb./sq. in. on: (date)

Pumping water level: feet at gal. per min.

How tested:

Length of test:

Remarks: (Gravel packing, cementing, packers, type of shut-off, depth of shut-off)

Handwritten signature and notes:
10/10/58
Hill

(over)

RECEIVED

DEC 5 1958

STATE ENGINEER

MONTANA BUREAU OF MINES AND GEOLOGY
Butte, Montana

T. 32 N R. 13 E

County Hill

5

WATER WELL LOG

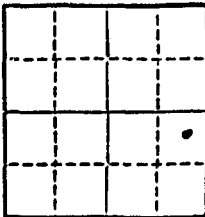

Owner Bob T. Le Croix Address 201 Hill St, Havre

Driller H. C. Simpson Address Butte

Date Started 12 Sept. Date Completed 23 Sept. 58

Location: Sec. 5 T. 32 R. 13 1/4 sec. 11 of 11

Type of well drilled Equipment used
(Dig, driven, bored, or drilled) (Cable drill, rotary, other)

Water use: Domestic Municipal Stock Irrigation
Industrial Drainage Other: _____

Casing: 0 ft. to 32 ft. Type steel Size 5 5/8 inches

Casing: _____ ft. to _____ ft. Type _____ Size _____

Casing: _____ ft. to _____ ft. Type _____ Size _____

Perforated ~~or screened~~ Ft. 32 to ft. 33 Ft. _____ to ft. _____

Type of screen/perforations 2/16 in. holes drilled in pipe

Static Water level, for non-flowing well: 10 ft. _____ feet.

Shut-in pressure, for flowing well: _____ lb./sq. in. on: _____ (date)

Pumping water level: 13 feet at 7 gal. per min.

How tested: _____

Length of test: 2 hrs.

Remarks: (Gravel packing, cementing, packers, type of shut-off, depth of shut-off)

Bob T. Le Croix

(over)

5

File No.

T. 32 R. 16

DUPLICATE

County Hill

STATE OF MONTANA
ADMINISTRATOR OF GROUNDWATER CODE
OFFICE OF STATE ENGINEER

RECEIVED
SEP 9 1963

Declaration of Vested Groundwater Rights

(Under Chapter 237, Montana Session Laws, 1961)

STATE ENGINEER

1. Mrs. Allene E. Larson, of Laure
(Name of Appropriator) (Address) (Town)

County of Hill State of Montana
have appropriated groundwater according to the Montana laws in effect prior to January 1, 1962, as follows:

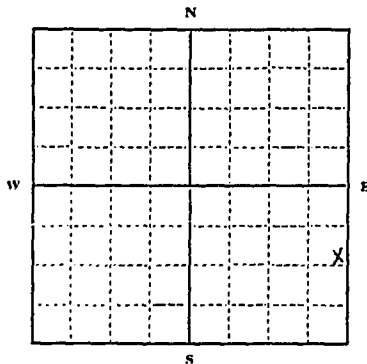

NE 1/4 SE 1/4 Sec. 5 T. 32 R. 16

Indicate point of appropriation and place of use, if possible. Each small square represents 10 acres.

2. The beneficial use on which the claim is based. House hold and lawn.

3. Date or approximate date of earliest beneficial use; and how continuous the use has been. 7:19 PM every day since.

4. The amount of groundwater claimed (in miner's inches or gallons per minute). 3 gal per min.

5. If used for irrigation, give the acreage and description of the lands to which water has been applied and name of the owner thereof.

6. The means of withdrawing such water from the ground and the location of each well or other means of withdrawal. Electric pump.

7. The date of commencement and completion of the construction of the well, wells, or other works for withdrawal of groundwater. Well about 4 days. It is a downer sand point.

8. The depth of water table. 10 ft.

9. So far as it may be available, the type, size and depth of each well or the general specifications of any other works for the withdrawal of groundwater. at 75 ft deep.

10. The estimated amount of groundwater withdrawn each year.

11. The log of formations encountered in the drilling of each well if available. none

12. Such other information of a similar nature as may be useful in carrying out the policy of this act, including reference to book and page of any county record.

Signature of Owner Mrs. Allene E. Larson

Date Sept 6 1963

Three copies to be filed by the owner with the County Clerk and Recorder of the county in which the well is located.

Please answer all questions. If not applicable, so state, otherwise the form will be returned.

Original to the County Clerk and Recorder; duplicate to the State Engineer; Triplicate to the Montana Bureau of Mines and Geology, and Quadruplicate for the Appropriator.

5783.

395132

MRS. ELENA E. LARSON

TO

THE PUBLIC

DECLARATION OF VESTED
GROUNDWATER RIGHTS

STATE OF MONTANA,) ss.
COUNTY OF HILL)
Filed at 10:10 clock A.M.

ON SEP 6 1963

R. E. Blom

COUNTY CLERK

BY _____ DEPUTY

Fee: \$2.00 pd

RECORDED
INDEXED
SEP 10 1963
HILL COUNTY CLERK

RECEIVED

32K-16E
County HILL 5

STATE OF MONTANA
ADMINISTRATOR OF GROUNDWATER CODE
MONTANA WATER RESOURCES BOARD
MONTANA DEPARTMENT OF NATURAL RESOURCES AND CONSERVATION
NOTICE OF COMPLETION OF GROUNDWATER APPROPRIATION BY MEANS OF WELL
Developed after January 1, 1962

11 MAR 9 1977

DRILLER'S LOG

Indicate the character, color, thickness of strata such as soil, clay, sand, gravel, shale, sandstone, etc. Show depth at which water is found and height to which water rises in well.

(Under Chapter 237 Montana Session Laws, 1961, as amended)

This form to be prepared by driller, and three copies to be filed by the owner with the County Clerk and Recorder in the county in which the well is located, last copy to be retained by driller. Please answer all questions. If not applicable, so state, otherwise the form may be returned.

Owner MRS. THEO. LARSON
Address 418 7TH AVE. No.
HAURE, MONTANA
Date well started 9/29/71
completed 10/4/71
Type of well DRILLED
Equipment used CABLE TOOL RIG
Water Use: Domestic Municipal Stock Irrigation
Industrial Drainage Other Garden/Lawn

For Administrator's Use
File 423903 Mon. 7/19/72
2:45 p.m.
GW 1

*Describe
USE: If used for irrigation, industrial, drainage or other. Explain, state number of acres and location or other data (i.e. Lot, Block and Addition).

ESTIMATED ANNUAL WITHDRAWAL 6,000,000 GALLONS

Size of Drilled Hole	Size and Weight of Casing	From (Feet)	To (Feet)	PERFORATIONS		
				Kind	From (Feet)	To (Feet)
12"	6 5/8" O.D. GALVANIZED ABOVE GROUND (188 WALL) 13" PER FT	0	15	JOHNSON STAINLESS STEEL 304 TELESCOPE TYPE 6" 25-SLOT SCREEN CONSISTING OF 3/4" LEAD PACKER, 2 1/4" OF SCREEN SECTION & 1 1/2" OF 5/16" CASING (OVERALL LENGTH OF 3' 9 1/2") INSTALLED FROM 79 FT TO 82' 9" FROM GROUND LEVEL OR 80 FT TO 83' 9" BELOW THE 80' CASING.		

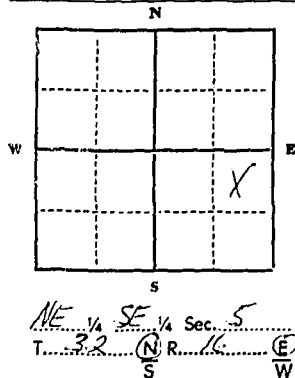

Static water level 14 ft.*
Pumping water level 17 ft.*
at 10 gallons per minute, measured 10 minutes after pumping began.
*Measured from ground level.
Well developed by BAUER, AIR M. PUMP for 10 hours.
Power ELECTRIC Pump 1/3 HP
Remarks: (Gravel packing, cementing, packers, type of shutoff) ANNULAR SPACE AROUND CASING FILLED WITH DRILLING MUD FROM 15 FT LEVEL BACK TO 6 FT LEVEL

INDICATE LOCATION OF WELL AND PLACE OF USE, IF POSSIBLE. EACH SMALL SQUARE REPRESENTS 40 ACRES.

Driller's Signature Robert J. ... HI-LINE DRILLING SERVICE

Driller's Address 1173 6TH ST. No.

HAURE, MONTANA LICENSE NO. 46

Top of Ground (Elev. above sea level)		
From (Feet)	To (Feet)	
0	2	SOIL
16		SANDY SILTY BROWN CLAY
17		BROWN SAND - COAL FRAGMENTS
24		SANDY BROWN CLAY
26		BROWN SAND - TRACE OF GRAVEL - WATER (CASED OFF)
29		GREY CLAY - TACKY
32		GREY SAND + SILT - WATER - (CASED OFF)
34		GRAVELLY GREY CLAY
35		GREY SAND + GRAVEL - WATER - (CASED OFF)
42		SANDY GREY CLAY - SOFT
43 1/2		SAND + GRAVEL - WATER - (CASED OFF)
46		GREY SAND + SILT
51		GRAVELLY GREY CLAY
53		SAND + SOME GRAVEL
54		SANDY GREY CLAY
62 1/2		SANDY SILTY GRAY CLAY
64 1/2		GREY SAND - SOME GRAVEL - WATER NOT CLEARING WELLS - SAND HEAVING UP IN CASING
77		PREDOMINATELY SANDY SILTY CLAY - SOFT - CASING SETTLED BY ITSELF FROM 64 TO 77 FT WHILE DRILLING ONE SAND + GRAVEL FROM CASING
82		GREY SAND - FINES TO TRACE - VERY LITTLE GRAVEL - HEAVING UP IN CASING DUE TO CLAY PARTICLES + SMALL BITS OF SHALE IN FORMATION RESTRICTING FREE FLOW OF WATER TERN SAND, SCREEN INSTALLED + FORMATION STABILIZED WATER INCREASED + CLEARING
82' 9"		82' 9" SANDY GREY CLAY

82' 9" Show exact depth of bottom

59006

423903

Mrs. THEO LARSON

TO
THE PUBLIC

WATER WELL

STATE OF MONTANA,) ss.
COUNTY OF HILL) P
Filed at 2:45 o'clock. 11

MAR 7 1972

R. E. Blom

COUNTY CLERK

Neville E. Dwyer
DEPUTY

Fee: \$2.00 pd.

C. J. H. C. M. I.

GW-4
FILE NO. _____

NWSE 5-32-16

TWP 32 N RGE 16 E
COUNTY Hill

STATE OF MONTANA
ADMINISTRATOR OF GROUNDWATER CODE
OFFICE OF STATE ENGINEER

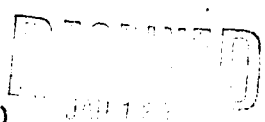

DECLARATION OF VESTED GROUNDWATER RIGHTS
(Under Chapter 237, Montana Session Laws, 1961)

1. Mamie McGee Lucas, of 3157 Sidest. Home
(Name of Appropriator) (Address) (Town)
County of Deer, State of Montana
Have appropriated groundwater according to the Montana laws in effect prior to Jan. 1, 1962 as follows:

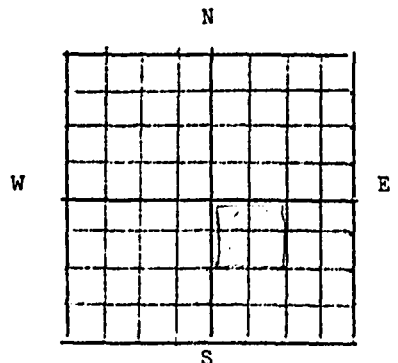

NW 1/4 SE Sec 5 T.32 R.16

Indicate point of appropriation and place of use, if possible. Each small square represents 10 acres.

- 2. The beneficial use on which the claim is based SOIL WATER IRRIGATION
- 3. Date or approximate date of earliest beneficial use; and how continuous the use has been 1917 TO THE PRESENT TIME
- 4. The amount of groundwater claimed (in miner's inches or gallons per minute) 300 gpm
- 5. If used for irrigation, give the acreage and description of the lands to which water has been applied and name of the owner thereof TEN ACRES NWSE 45-32-16 Mamie McGee Lucas
- 6. The means of withdrawing such water from the ground and the location of each well or other means of withdrawal ELECTRIC PUMP IN WELL
- 7. The date of commencement and completion of the construction of the well, wells, or other works for withdrawal of groundwater IN JUNE 15 1917
- 8. The depth of water table 5 to 8 feet
- 9. So far as it may be available, the type, size and depth of each well or the general specifications of any other works for the withdrawal of groundwater based on one hundred feet deep - 5 1/2 casing
- 10. The estimated amount of groundwater withdrawn each year VARIES
- 11. The log of formations encountered in the drilling of each well if available Not available
- 12. Such other information of a similar nature as may be useful in carrying out the policy of this act, including reference to book and page of any county record _____

Signature of Owner Mamie McGee Lucas
Date December 30, 1962

Three copies to be filed by the owner with the County Clerk & Recorder of the County in which the well is located.

PLEASE ANSWER ALL QUESTIONS. IF NOT APPLICABLE, SO STATE, OTHERWISE THE FORM WILL BE RETURNED.

Original to the County Clerk & Recorder; duplicate to the State Engineer; Triplicate to the School of Mines and Quadruplicate for the Appropriator.

397135

MANIE MCOTE LUCAS

TO

THE PUBLIC

DECLARATION OF VESTED
GROUNDWATER RIGHTS

STATE OF MONTANA) ss.
COUNTY OF HILL)
Filed at 11 o'clock *am*

ON 31 1963
I. E. Blom
COUNTY CLERK

DEPUTY

FEES: \$2.00 pd.

GW
FILE NO. _____

TWP 32 RGE 16 E
COUNTY Hill
RECORDED
JAN 1 1962

STATE OF MONTANA
ADMINISTRATOR OF GROUNDWATER CODE
OFFICE OF STATE ENGINEER

DECLARATION OF VESTED GROUNDWATER RIGHTS
(Under Chapter 237, Montana Session Laws, 1961)

STATE ENGINEER

1. L. D. W. FADDEN, of 742 Bowler St Helena
(Name of Appropriator) (Address) (Town)
County of Hill, State of Mont
Have appropriated groundwater according to the Montana laws in effect prior to Jan. 1, 1962 as follows:

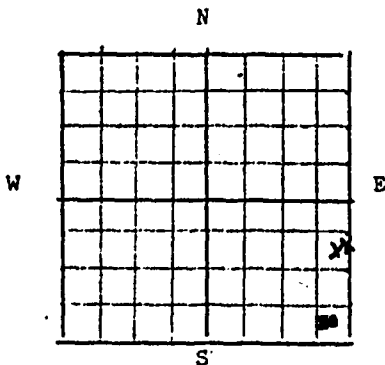

1544259A Sec 5 T 32R 16

Indicate point of appropriation and place of use, if possible. Each small square represents 10 acres.

2. The beneficial use on which the claim is based
Domestic Use

3. Date or approximate date of earliest beneficial use; and how continuous the use has been 1940

4. The amount of groundwater claimed (in miner's inches or gallons per minute) 5 cfm

5. If used for irrigation, give the acreage and description of the lands to which water has been applied and name of the owner thereof

6. The means of withdrawing such water from the ground and the location of each well, or other means of withdrawal 1 1/2 in. Well Pump

7. The date of commencement and completion of the construction of the well, wells, or other works for withdrawal of groundwater 1960

8. The depth of water table 50

9. So far as it may be available, the type, size and depth of each well or the general specifications of any other works for the withdrawal of groundwater see #1

10. The estimated amount of groundwater withdrawn each year 5,000 gal

11. The log of formations encountered in the drilling of each well if available
not available

12. Such other information of a similar nature as may be useful in carrying out the policy of this act, including reference to book and page of any county record

Signature of Owner L. D. W. Fadden

Date 1/1/62

Three copies to be filed by the owner with the County Clerk & Recorder of the County in which the well is located.

PLEASE ANSWER ALL QUESTIONS. IF NOT APPLICABLE, SO STATE, OTHERWISE THE FORM WILL BE RETURNED.

Original to the County Clerk & Recorder; duplicate to the State Engineer; Triplicate to the School of Mines and Quadruplicate for the Appropriator.

397217

L. D. MC PADDEN

TO

THE PUBLIC

DECLARATION OF VESTED
GROUNDWATER RIGHTS

STATE OF MONTANA) ss.
COUNTY OF HILL)
Filed at 11 o'clock am

ON ~~3~~ 1 1963

LG COUNTY CLERK

DEPUTY

FEE: \$2.00 pd.

File No. _____

T. 22 N. 16 E.

DUPLICATE

County Will

STATE OF MONTANA
ADMINISTRATOR OF GROUNDWATER CODE
OFFICE OF STATE ENGINEER

RECEIVED
DEC 12 1963

Declaration of Vested Groundwater Rights

(Under Chapter 237, Montana Session Laws, 1961)

STATE ENGINEER

1. Charles A. Johnson, of 220 Northside Lane
(Name of Appropriator) (Address) (Town)

County of Will State of Montana
have appropriated groundwater according to the Montana laws in effect prior to January 1, 1962, as follows:

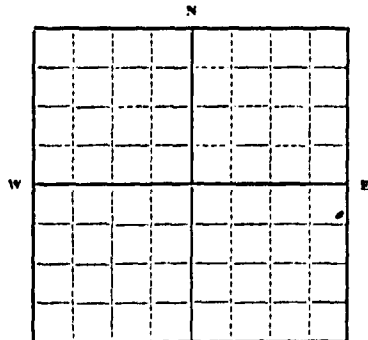

N. 1/4 Sec. 5 T. 30 R. 16

Indicate point of appropriation and place of use, if possible. Each small square represents 10 acres.

2. The beneficial use on which the claim is based. Home

3. Date or approximate date of earliest beneficial use; and how continuous the use has been. Since 1961

4. The amount of groundwater claimed (in miner's inches or gallons per minute) 1.5 miner's inches

5. If used for irrigation, give the acreage and description of the lands to which water has been applied and name of the owner thereof

6. The means of withdrawing such water from the ground and the location of each well or other means of withdrawal 20' diameter hole in back yard

7. The date of commencement and completion of the construction of the well, wells, or other works for withdrawal of groundwater. July 1961

8. The depth of water table. Static was 19 feet from surface

9. So far as it may be available, the type, size and depth of each well or the general specifications of any other works for the withdrawal of groundwater. 6" well with 10' casing

10. The estimated amount of groundwater withdrawn each year. 2.5 gpm

11. The log of formations encountered in the drilling of each well if available. Static water

12. Such other information of a similar nature as may be useful in carrying out the policy of this act, including reference to book and page of any county record.

Signature of Owner _____

Date 12-11-1963

Three copies to be filed by the owner with the County Clerk and Recorder of the county in which the well is located.

Please answer all questions. If not applicable, so state, otherwise the form will be returned.

Original to the County Clerk and Recorder; duplicate to the State Engineer; Triplicate to the Montana Bureau of Mines and Geology, and Quadruplicate for the Appropriator.

CHARLES W. MOORE

TO

THE PUBLIC

DECLARATION OF VESTED
GROUNDWATER RIGHTS

STATE OF MONTANA }
COUNTY OF HILL }
Filed at 11 o'clock Am

MAY 14 1963

R. E. Blom

COUNTY CLERK

SEAL

Fee \$2.00 pd.

File No.

MONTANA

T. 32N R. 16E

DUPLICATE

County Hill

LOG

STATE OF MONTANA
ADMINISTRATOR OF GROUNDWATER CODE
STATE WATER CONSERVATION BOARD

Notice of Completion of Groundwater
Appropriation by Means of Well

DEVELOPED AFTER JANUARY 1, 1962

(Under Chapter 237 Montana Session Laws, 1961, as amended)

0	Top of Ground
to	(Elev. above sea level.....)
4	Sandy soil
14	Sandy brown clay
17	Tacky grey clay
20	Grey silt & sand-some water
27	Grey silt & sand-decayed vegetation
28	Sand & gravel-water
32	Gravelly grey clay
36	Sandy grey clay
38	Grey silt & sand
44	Grey clay
46	Grey sand & silt-water
49	Grey sand & clay mix
54	Grey clay
55	Grey sand(Fine to Medium) Water - Approx. 8 GPM.
56	Grey sand & gravel-Water exceeding 15 GPM at 30 feet from ground level by bailer test.

Owner Mrs. Esther Naber Address 542 5th St. No.-Hayra

Driller Hi-Line Drilling Service Address Hayra, Montana

Date of Notice of appropriation of groundwater.....

Date well started 11/20/69 Date completed 11/22/69

Type of well Drilled Equipment used Cable Tool Rig
(Dug, driven, bored or drilled) (Churn drill, rotary or other)

Water use: Domestic Municipal Stock Irrigation
Industrial Drainage Other

Indicate on the diagram the character and thickness of the different strata met with in drilling, such as soil, clay, shale, gravel, rock or sand, etc. Show depth at which water is encountered, thickness and character of water-bearing strata and height to which the water rises in the well.

Size of Drilled Hole	Size and Weight of Casing	From (Feet)	To (Feet)	PERFORATIONS		
				Kind Size	From (Feet)	To (Feet)
6 5/8"	6 5/8" O.D. 1 ft. 188 wall 13# per ft.	above ground level	56	No perforations. Water coming thru bottom of drive collar at 56 ft. level.		

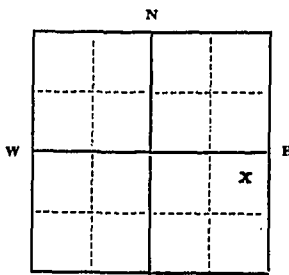

O.C.L. Stramcha Tract Lot 3

NE 1/4 Sec. 5 T. 32N R. 16E

Indicate location of well and place of use, if possible. Each small square represents 40 acres.

Static Water Level for non-flowing well 12 feet.

Shut-in Pressure for Flowing Well Not appl.

Pumping Water Level 23 feet at 13 gal. per minute.

Discharge in gal. per min. of flowing well Not applicable

How Tested Test Pump

Length of Test 8 hours

Remarks: (Gravel packing, cementing, packers, type of shutoff)

(Continue on reverse side)

USE—If used for irrigation, industrial, drainage or other. Explain, state number of acres and location or other data (i.e.: Lot, Block and Addition).

56 Show exact depth of bottom.

This form to be prepared by driller, and three copies to be filed by the owner with the County Clerk and Recorder in the county in which the well is located, tissue copy to be retained by driller.

Please answer all questions. If not applicable, so state, otherwise the form will be returned.

46 Driller's License Number

Herbert Davis Driller's Signature

46594

418307

MRS. ESTHER NABER

TO

THE PUBLIC

COMPLETION OF GROUNDWATER
APPROPRIATION

STATE OF MONTANA,)
COUNTY OF HILL) ss.
Filed at 4:00 o'clock P.M.

ON JUN 18 1970

R. E. BLOM

COUNTY CLERK

By Ruth E. Day

DEPUTY

fee: \$2.00 paid

RECEIVED

32H-16E
County HILL 5

STATE OF MONTANA
ADMINISTRATOR OF GROUNDWATER CODE
MONTANA WATER RESOURCES BOARD

NOTICE OF COMPLETION OF GROUNDWATER
APPROPRIATION BY MEANS OF WELL
Developed after January 1, 1962

DRILLER'S LOG

Indicate the character, color, thickness of strata such as soil, clay, sand, gravel, shale, sandstone, etc. Show depth at which water is found and height to which water rises in well.

(Under Chapter 237 Montana Session Laws, 1961, as amended)

This form to be prepared by driller, and three copies to be filed by the owner with the County Clerk and Recorder in the county in which the well is located, last copy to be retained by driller. Please answer all questions. If not applicable, so state, otherwise the form may be returned.

Owner CHARLES A. NELSON
Address 337 5TH ST. No
HAURE, MONTANA
Date well started 11/14/69
completed 11/20/69
Type of well DRILLED
Equipment used CABLE TOOL RIG

For Administrator's Use
File 428324
JUNE 25, 1972
GW 1 12:15

Water Use: Domestic Municipal Stock Irrigation
Industrial Drainage Other * Garden/Lawn

*Describe MACHINE & WELDING SHOP
USE: If used for irrigation, industrial, drainage or other. Explain, state number of acres and location or other data (i.e. Lot, Block and Addition).

ESTIMATED ANNUAL WITHDRAWAL EXCEEDING 300,000 GALLONS

Size of Drilled Hole	Size and Weight of Casing	From (Feet)	To (Feet)	PERFORATIONS		
				Kind Size	From (Feet)	To (Feet)
9"	6 7/8" O.D. (188 WALL) BLACK STEEL	4 FEET BELOW GROUND LEVEL	17			
	6 1/4" O.D. (190 WALL) PLASTIC	16 1/2	82	3/16" DRILLED	37	79

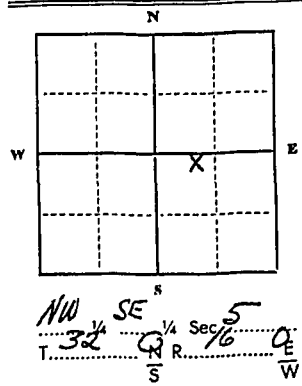

Static water level 39 ft.*
Pumping water level 78 ft.*
at 120 gallons per minute, measured 120 minutes after pumping began.
*Measured from ground level.
Well developed by SAUER & PUMP for 6 hours.
Power ELECTRIC Pump 1/2 HP
Remarks: (Gravel packing, cementing, packers, type of shutoff) WELL GRAVEL-PACKED FROM BOTTOM BACK TO 20 FT LEVEL. CEMENT GROUT PLACED ABOVE GRAVEL TO APPROX. 78 FOOT LEVEL TO SEAL OFF SURFACE CONTAMINATION

Top of Ground (Elev. above sea level)	
From (Feet)	To (Feet)
0	2
21	22 1/2
35	37
39	40
44	49
52	56
73	78
81	82

GRAVELLY SOIL
GRAVELLY BROWN CLAY
BOULDER
GRAVELLY GREY CLAY
BOULDER
GREY SHALE
HARD BROWN SANDSTONE
SHALEY BROWN SANDSTONE - TRACE OF WATER
LT BROWN SHALE - FIRM
SANDY GREY SHALE
SHALEY GREY SANDSTONE - WATER - APPROX 1 GPM
BLUE-GREY SHALE
GREY SANDSTONE - WATER - APPROX 3 GPM
SANDY BLUE-GREY SHALE
BLUE-GREY SHALE

INDICATE LOCATION OF WELL AND PLACE OF USE, IF POSSIBLE. EACH SMALL SQUARE REPRESENTS 40 ACRES.
Driller's Signature Robert Brown HI-LINE DRILLING SERVICE
Driller's Address 1173 6TH ST No PHONE 265-4210
HAURE, MONTANA 59501 LICENSE NO. 46

82 Show exact depth of bottom

53,850

428324

CHARLES A. NELSON

TO

THE PUBLIC

WATER WELL

STATE OF MONTANA | SS
COUNTY OF HILL
Filed at 12:15 o'clock P. M

ON JUN 25 1973

R. E. Blom

BY Walter E. Day COUNTY CLERK
DEPUTY

Fee: \$2.00 pd.

INDEXED

T. 32 N R 16 E
County Hill

ERNEST O. LEE, DRILLING
1200 3RD STREET HAVRE

WATER WELL LOG

Owner Hannah Nelson Address 296 North Side, Havre

Driller Herbert Freier Address 281 N. State St., Havre

Date Started October 25, 1961 Date Completed October 26, 1961

Location: Sec. 5 T. 32 R. 16 1/4 sec. lot 1 Blockwood Tract.

Type of well Drilled Equipment used Churn Drill
(Dug, driven, bored, or drilled) (Churn drill, rotary, other)

Water use: Domestic Municipal Stock Irrigation
Industrial Drainage Other: _____

Casing: 0 ft. to 52 ft. Type Spang-seamless Size 7"

Casing: 49 ft. to 72 ft. Type Spang-seamless Size 5 1/2"

Casing: _____ ft. to _____ ft. Type _____ Size _____

Perforated or Screened: Ft. 50 to ft. 70 Ft. _____ to ft. _____

Type of screen or perforations 1/4" X 5" Perforations

Static Water level, for non-flowing well: 20 feet.

Shut-in pressure, for flowing well: _____ lb. sq. in. on: _____ (date)

Pumping water level 60 feet at 16 gal. per min.

How tested: Baler

Length of test 1 1/2 hours

Remarks: (Gravel packing, cementing, packers, type of shut-off, depth of shut-off)

Hannah Nelson
Drilled by Ernest Lee

(over)

File No.

T. 37 R. 16

DUPLICATE

County Hill

STATE OF MONTANA
ADMINISTRATOR OF GROUNDWATER CODE
OFFICE OF STATE ENGINEER

RECEIVED
AUG 8 1963

STATE ENGINEER

Notice of Completion of Groundwater Appropriation Without Well

(Under Chapter 237 Montana Session Laws, 1961)

Date of Appropriation of Groundwater.....

Owner John Heumiller Address 228 W. Side

Contractor (if any) Sandpoint

Address of Contractor

Date Started..... Date Completed.....

Describe means of obtaining groundwater without a well "as by sub-irrigation and other natural processes". Include depth to water when applicable.....

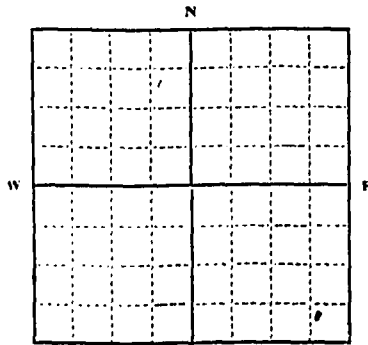

NE 1/4 Sec. 5 T. 37 R. 16

Indicate point of appropriation and place of use, if possible.

Quantity of water developed and used with explanation of method used to measure or estimate such amount. If use is intermittent estimate approximate lengths of periods of use.....

Irrigation and household

Signature of Owner John Heumiller

Date 8-2-63

This form to be prepared by contractor (if any), otherwise by the owner.

Three copies of this notice are to be filed with the County Clerk and Recorder of the county in which the works are located.

Please answer all questions. If not applicable, so state, otherwise the form will be returned.

Original to the County Clerk and Recorder; duplicate to the State Engineer; Triplicate to the Montana Bureau of Mines and Geology and Quadruplicate for the Appropriator.

394731

JOHN NEUMILLER

TO

THE PUBLIC

NOTICE OF COMPLETION OF GROUND
WATER APPROPRIATION WITHOUT WELL

STATE OF MONTANA,)
COUNTY OF HILL)
Filed at 2:30 o'clock P.M.

AUG 7 1963

R. E. Blom
COUNTY CLERK
DEPUTY

Fees: \$2.00 pd.

File No.

T. 32^N R. 8-16^E

DUPLICATE

County. Hill

STATE OF MONTANA
 ADMINISTRATOR OF GROUNDWATER CODE
 OFFICE OF STATE ENGINEER

Declaration of Vested Groundwater Rights

(Under Chapter 237, Montana Session Laws, 1961)

1. I, Frank Pell, of 337 North Side East of House,
 (Name of Appropriator) (Address) (Town)
 County of Hill State of Montana
 have appropriated groundwater according to the Montana laws in effect prior to January 1, 1962, as follows:

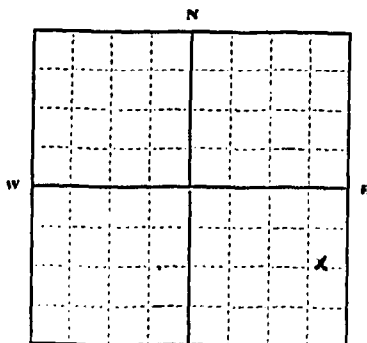

1/4 Sec 4 + 5

N. 1/4 Sec. 5 T. 32 N. R. 16 E.

Indicate point of appropriation and place of use, if possible. Each small square represents 10 acres.

2. The beneficial use on which the claim is based Domestic

3. Date or approximate date of earliest beneficial use; and how continuous the use has been 5/28/61

4. The amount of groundwater claimed (in miner's inches or gallons per minute) 10 GPM at 30 Feet

5. If used for irrigation, give the acreage and description of the lands to which water has been applied and name of the owner thereof

Not applicable

6. The means of withdrawing such water from the ground and the location of each well or other means of withdrawal pump

337 North Side East of House

7. The date of commencement and completion of the construction of the well, wells, or other works for withdrawal of groundwater 5/27/61 - 5/28/61

8. The depth of water table 54 ft

9. So far as it may be available, the type, size and depth of each well or the general specifications of any other works for the withdrawal of groundwater

Size of Drilled Hole 5"
Size of and Height of Casing 4" 11 Bls
From (Feet) 0
To (Feet) 54

10. The estimated amount of groundwater withdrawn each year

11. The log of formations encountered in the drilling of each well if available

1- top soil
51- brown clay & sand
52- sand
54- gravel

12. Such other information of a similar nature as may be useful in carrying out the policy of this act, including reference to book and page of any county record

Signature of Owner Frank Pell

Date 12-10-63

Three copies to be filed by the owner with the County Clerk and Recorder of the county in which the well is located.

Please answer all questions. If not applicable, so state, otherwise the form will be returned.

Original to the County Clerk and Recorder; Duplicate to the State Engineer; Triplicate to the Montana Bureau of Mines and Geology, and Quadruplicate for the Appropriator.

396529

FRANK PAPILO

TO

THE PUBLIC

DECLARATION OF VESTED ROUND
WATER RIGHTS

STATE OF MONTANA, ss.
COUNTY OF HILL)
Filed at 3 o'clock P. m.

ON 12 1963

R. E. Blom
COUNTY CLERK

BY _____
DEPUTY

Fee: \$2.00 pd.

File No. _____

T. 32 N 16 E

DUPLICATE

County Hill

STATE OF MONTANA
ADMINISTRATOR OF GROUNDWATER CODE
OFFICE OF STATE ENGINEER

Declaration of Vested Groundwater Rights

(Under Chapter 237, Montana Session Laws, 1961)

1. Fred A. Spittle, of Hill (Name of Appropriator) (Address) (Town)

County of Hill State of Montana
have appropriated groundwater according to the Montana laws in effect prior to January 1, 1962, as follows:

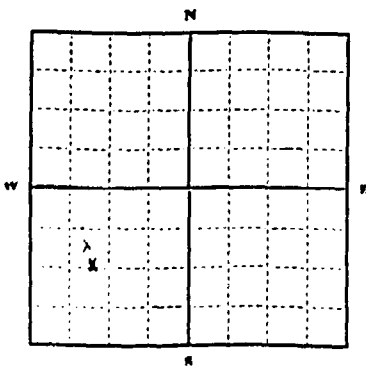

Indicate point of appropriation and place of use, if possible. Each small square represents 10 acres.

2. The beneficial use on which the claim is based Home use

3. Date or approximate date of earliest beneficial use; and how continuous the use has been 11-1-1947 to 4-1-1962

4. The amount of groundwater claimed (in miner's inches or gallons per minute) 704

5. If used for irrigation, give the acreage and description of the lands to which water has been applied and name of the owner thereof

6. The means of withdrawing such water from the ground and the location of each well or other means of withdrawal 12'

7. The date of commencement and completion of the construction of the well, wells, or other works for withdrawal of groundwater 1949 to 1956

8. The depth of water table 20' to 25'

9. So far as it may be available, the type, size and depth of each well or the general specifications of any other works for the withdrawal of groundwater

10. The estimated amount of groundwater withdrawn each year

11. The log of formations encountered in the drilling of each well if available

12. Such other information of a similar nature as may be useful in carrying out the policy of this act, including reference to book and page of any county record

Signature of Owner _____

Date _____

Three copies to be filed by the owner with the County Clerk and Recorder of the county in which the well is located.

Please answer all questions. If not applicable, so state, otherwise the form will be returned.

Original to the County Clerk and Recorder; Duplicate to the State Engineer; Triplicate to the Montana Bureau of Mines and Geology, and Quadruplicate for the Appropriator.