

396475

DEAN McFADDEN

TO

THE PUBLIC

NOTICE OF COMPLETION OF GROUND
WATER APPROPRIATION WITHOUT WELL

STATE OF MONTANA, ss.
COUNTY OF HILL)
Filed at 4:30 o'clock P.m.

ON DEC 10 1963

R. E. Blom
COUNTY CLERK

DEPUTY

Fee: \$2.00 pd.

GW3

File No.

DUPLICATE

SW

T. 34 R. 8

County Hill

RECEIVED
DEC 12 1963

STATE OF MONTANA
ADMINISTRATOR OF GROUNDWATER CODE
OFFICE OF STATE ENGINEER

STATE ENGINEER

Notice of Completion of Groundwater Appropriation Without Well

(Under Chapter 237 Montana Session Laws, 1961)

Date of Appropriation of Groundwater 1957

Owner Dean McFadden Address Inverness, Montana

Contractor (if any) Herschel Fox

Address of Contractor Havre, Montana

Date Started 8/1/57 Date Completed 8/20/57

Describe means of obtaining groundwater without a well "as by sub-irrigation and other natural processes". Include depth to

water when applicable. Irrigation reservoir;

average depth 13 ft.

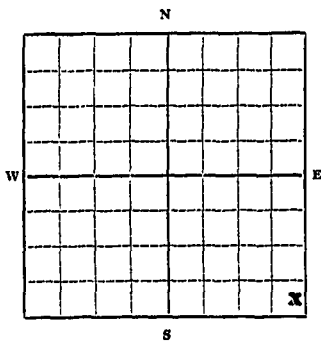

SE 1/4 SE Sec. 9 T34 R. 8

Indicate point of appropriation and place of use, if possible.

Quantity of water developed and used with explanation of method used to measure or estimate such amount. If use is intermit-

tent estimate approximate lengths of periods of use

3 acre feet; estimated by Soil Conservation

Service. Used approximately four months

per annum.

Signature of Owner Dean McFadden

Date 12/9/63

This form to be prepared by contractor (if any), otherwise by the owner.

Three copies of this notice are to be filed with the County Clerk and Recorder of the county in which the works are located.

Please answer all questions. If not applicable, so state, otherwise the form will be returned.

Original to the County Clerk and Recorder; duplicate to the State Engineer; Triplicate to the Montana Bureau of Mines and Geology and Quadruplicate for the Appropriator.

868.3

396474

DEAN McFADDEN

TO

THE PUBLIC

NOTICE OF COMPLETION OF GROUND
WATER APPROPRIATION WITHOUT WELL

STATE OF MONTANA)
COUNTY OF HILL)
Filed at 4:30 o'clock P.M.

ON DEC 10 1963

R. E. Blom
COUNTY CLERK

By _____
DEPUTY

Fee:\$2.00 pd.

Dean McFadden, Inverness, Montana
19. 1964

12-10-63

Dean McFadden, Inverness, Montana

May 19, 1964

12-10-63

396475 & 396474

from a reservoir

File No. _____

T. 34 N R. 8 E

DUPLICATE

County Hill

STATE OF MONTANA
ADMINISTRATOR OF GROUNDWATER CODE
OFFICE OF STATE ENGINEER

RECEIVED
DEC 12 1963

Declaration of Vested Groundwater Rights

(Under Chapter 237, Montana Session Laws, 1961)

STATE ENGINEER

1. Dean McFadden, of Inverness
(Name of Appropriator) (Address) (Town)
County of Hill State of Montana
have appropriated groundwater according to the Montana laws in effect prior to January 1, 1962, as follows:

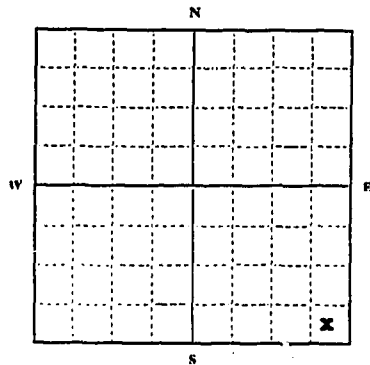

SE 1/4 SE. Sec. 9, T. 34, R. 8

Indicate point of appropriation and place of use, if possible. Each small square represents 10 acres.

2. The beneficial use on which the claim is based.....
household and stock water

3. Date or approximate date of earliest beneficial use; and how continuous the use has been.....
in continuous use since 1915

4. The amount of groundwater claimed (in miner's inches or gallons per minute).....
50 g.p.m.

5. If used for irrigation, give the acreage and description of the lands to which water has been applied and name of the owner thereof.....
none

6. The means of withdrawing such water from the ground and the location of each well or other means of withdrawal.....
Water is withdrawn by pump affixed to well

7. The date of commencement and completion of the construction of the well, wells, or other works for withdrawal of groundwater.....
1915

8. The depth of water table.....
75 ft.

9. So far as it may be available, the type, size and depth of each well or the general specifications of any other works for the withdrawal of groundwater.....
Well is 135 ft. deep, cased with 6" casing, and water is withdrawn through 1 1/2" pipe.

10. The estimated amount of groundwater withdrawn each year.....
125,000 gal.

11. The log of formations encountered in the drilling of each well if available.....
none available

12. Such other information of a similar nature as may be useful in carrying out the policy of this act, including reference to book and page of any county record.....
none

Signature of Owner Dean McFadden

Date 12/9/63

Three copies to be filed by the owner with the County Clerk and Recorder of the county in which the well is located.

Please answer all questions. If not applicable, so state, otherwise the form will be returned.

Original to the County Clerk and Recorder; Duplicate to the State Engineer; Triplicate to the Montana Bureau of Mines and Geology, and Quadruplicate for the Appropriator.

396473

DEAN McFADDEN

TO

THE PUBLIC

DECLARATION OF VESTED GROUND
WATER RIGHTS

STATE OF MONTANA) ss.
COUNTY OF HILL)
Filed at 4:30 o'clock P.m.

ON 10 10 1963

R. EL BLOOM DEPUTY CLERK

BY _____ DEPUTY

Fee: \$2.00 pd.

GW-4
FILE NO. _____

TWP 34 N 8 E
COUNTY _____

STATE OF MONTANA
ADMINISTRATOR OF GROUNDWATER CODE
OFFICE OF STATE ENGINEER

DECLARATION OF VESTED GROUNDWATER RIGHTS

(Under Chapter 237, Montana Session Laws, 1961)

1. Ray S. Rudolph, of Joplin (Name of Appropriator), of Montana (Address) (Town)
County of _____, State of _____
Have appropriated groundwater according to the Montana laws in effect prior to Jan. 1, 1962 as follows:

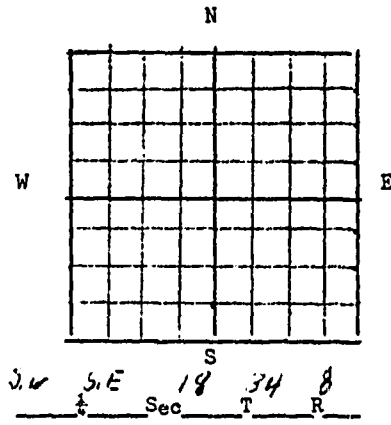

Indicate point of appropriation and place of use, if possible. Each small square represents 10 acres.

- 2. ~~The beneficial use on which the claim is based~~ _____
- 3. Date or approximate date of earliest beneficial use; ~~and if~~ continuous the use has been _____
- 4. The amount of groundwater claimed (in miner's inches or ~~gallons~~ per minute) _____
- 5. If used for irrigation, give the acreage and description of the lands to which water has been applied ~~and name of the owner thereof~~ _____
- 6. The means of withdrawing such water from the ground and the location of each well or other means of ~~withdrawing~~ _____
- 7. The date of commencement and completion of the ~~construction~~ 20' of the well, wells, or other works for withdrawal of groundwater _____
- 8. The depth of water table _____
- 9. So far as it may be available, the type, size and depth of each well or the general specifications of ~~any~~ other works for the withdrawal of groundwater _____
- 10. The estimated amount of groundwater withdrawn each year 1025 m _____
- 11. The log of formations encountered ~~in~~ the drilling of each well if available _____
- 12. Such other information of a similar nature as may be useful in carrying out the policy of this act, including reference to book and page of any county record _____

Signature of Owner Ray S. Rudolph By Donald Rudolph
Date _____

Three copies to be filed by the owner with the County Clerk & Recorder of the County in which the well is located.

PLEASE ANSWER ALL QUESTIONS. IF NOT APPLICABLE, SO STATE, OTHERWISE THE FORM WILL BE RETURNED.

Original to the County Clerk & Recorder; duplicate to the State Engineer; Triplicate to the School of Mines and Quadruplicate for the Appropriator.

397018

RAY S. WHEELER

TO

THE PUBLIC

DECLARATION OF VESSEL
GROUNDEWATER RIGHTS

STATE OF MONTANA)
COUNTY OF HILL)
Filed on 1 o'clock p.m.

DEC 30 1963
18 E. C. ...
SECRETARY

FEES: 2.00 pd.

GW-4
FILE NO. _____
DUPLICATE

TWP 34 N RGE 8 E
COUNTY HILL

STATE OF MONTANA
ADMINISTRATOR OF GROUNDWATER CODE
OFFICE OF STATE ENGINEER

RECEIVED
MAR 14 1962

DECLARATION OF VESTED GROUNDWATER RIGHTS
(Under Chapter 237, Montana Session Laws, 1961) STATE ENGINEER

1. Roy E. Gutcher & Son, of Joplin (Town)
(Name of Appropriator) (Address) (Town)
County of Hill, State of Montana
Have appropriated groundwater according to the Montana laws in effect prior to Jan. 1, 1962 as follows:

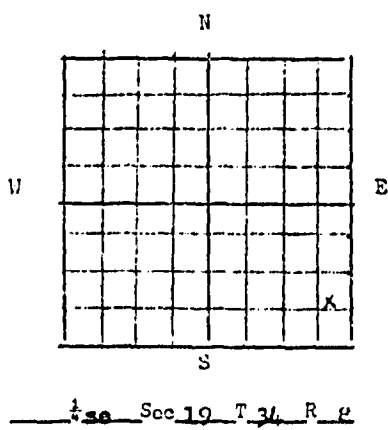

Indicate point of appropriation and place of use, if possible. Each small square represents 10 acres.

2. The beneficial use on which the claim is based
House use

3. Date or approximate date of earliest beneficial use; and how continuous the use has been
1954, continuously

4. The amount of groundwater claimed (in miner's inches or gallons per minute)
5 gal./min.

5. If used for irrigation, give the acreage and description of the lands to which water has been applied and name of the owner thereof
None

6. The means of withdrawing such water from the ground and the location of each well or other means of withdrawal
Electric pump

7. The date of commencement and completion of the construction of the well, wells, or other works for withdrawal of groundwater
1954

8. The depth of water table 10'

9. So far as it may be available, the type, size and depth of each well or the general specifications of any other works for the withdrawal of groundwater
Dug, 42" culvert curb, 12' deep

10. The estimated amount of groundwater withdrawn each year 25,000 g.p.d.

11. The log of formations encountered in the drilling of each well if available
Not available

12. Such other information of a similar nature as may be useful in carrying out the policy of this act, including reference to book and page of any county record
None

Signature of Owner _____

Date _____

Three copies to be filed by the owner with the County Clerk & Recorder of the County in which the well is located.

PLEASE ANSWER ALL QUESTIONS. IF NOT APPLICABLE, SO STATE, OTHERWISE THE FORM WILL BE RETURNED.

Original to the County Clerk & Recorder; duplicate to the State Engineer; Triplicate to the School of Mines and Quadruplicate for the Appropriator.

392825

ROY F. GUTCHER & SON

TO

THE PUBLIC

DECLARATION OF VESTED
GROUNDWATER RIGHTS

STATE OF MONTANA,
COUNTY OF HILL
Filed at 11:55 A.M.

ON 11/17/1963

R. E. Elton
COUNTY CLERK

WELPITY

Fee: \$2.00 pd.

GW 4
FILE NO. _____

TWP 34 N RGE 8 E
COUNTY HILL

DUPLICATE

STATE OF MONTANA
ADMINISTRATOR OF GROUNDWATER CODE
OFFICE OF STATE ENGINEER

RECEIVED

DECLARATION OF VESTED GROUNDWATER RIGHTS
(Under Chapter 237, Montana Session Laws, 1961)

STATE ENGINEER

1. Ray F. Gutcher & Son, of Joplin
(Name of Appropriator) (Address) (Town)
County of Hill, State of Montana
Have appropriated groundwater according to the Montana laws in effect prior to Jan. 1, 1962 as follows:

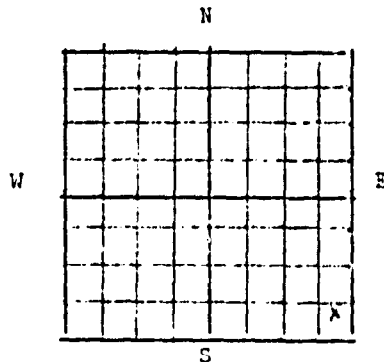

See Sec 19 T. 34 R. 8

Indicate point of appropriation and place of use, if possible. Each small square represents 10 acres.

2. The beneficial use on which the claim is based
House use and stock water
3. Date or approximate date of earliest beneficial use; and how continuous the use has been
1916, continuously
4. The amount of groundwater claimed (in miner's inches or gallons per minute)
5 g/m
5. If used for irrigation, give the acreage and description of the lands to which water has been applied and name of the owner thereof
None
6. The means of withdrawing such water from the ground and the location of each well or other means of withdrawal
Electric pump and free flow
7. The date of commencement and completion of the construction of the well, wells, or other works for withdrawal of groundwater
1916, Improved 1940
8. The depth of water table
9 ft.
9. So far as it may be available, the type, size and depth of each well or the general specifications of any other works for the withdrawal of groundwater
Drilled, 5" case, 80-90 ft. deep
10. The estimated amount of groundwater withdrawn each year
50,000 gal.
11. The log of formations encountered in the drilling of each well if available
Not available
12. Such other information of a similar nature as may be useful in carrying out the policy of this act, including reference to book and page of any county record
None

Signature of Owner _____

Date _____

Three copies to be filed by the owner with the County Clerk & Recorder of the County in which the well is located.

PLEASE ANSWER ALL QUESTIONS. IF NOT APPLICABLE, SO STATE, OTHERWISE THE FORM WILL BE RETURNED.

Original to the County Clerk & Recorder; duplicate to the State Engineer; Triplicate to the School of Mines and Quadruplicate for the Appropriator.

392826

ROY F. GUTCHER & SON

TO

THE PUBLIC

DECLARATION OF VESTED
GROUNDWATER RIGHTS

RECORDED
IN BOOK 11:55 PAGE 101.

MAR 1953

R. E. Blom
COUNTY CLERK

Fee: \$2.00 pd.

GW-4
FILE NO. _____
DUPLICATE

TWP 34 N RGE 8 E
COUNTY Hill

not applicable

STATE OF MONTANA
ADMINISTRATOR OF GROUNDWATER CODE
OFFICE OF STATE ENGINEER

RECEIVED
MAR 15 1963
STATE ENGINEER

DECLARATION OF VESTED GROUNDWATER RIGHTS
(Under Chapter 237, Montana Session Laws, 1961)

1. Roy F. Gutcher & Son, of Joplin
(Name of Appropriator) (Address) (Town)
County of Hill, State of Montana
have appropriated groundwater according to the Montana laws in effect prior to Jan.
1, 1962 as follows:

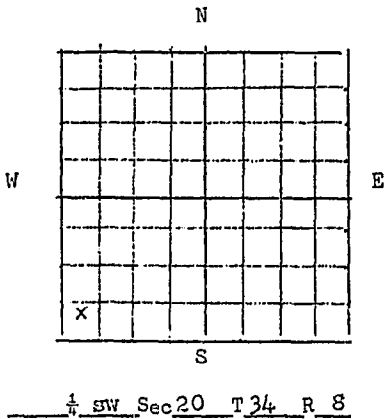

- 2. The beneficial use on which the claim is based
House use and stock water
- 3. Date or approximate date of earliest beneficial use; and how continuous the use has been
1916, continuously
- 4. The amount of groundwater claimed (in miner's inches or gallons per minute)
5 g/m
- 5. If used for irrigation, give the acreage and description of the lands to which water has been applied and name of the owner thereof
None
- 6. The means of withdrawing such water from the ground and the location of each well or other means of withdrawal
Pump (electric) & free flow
- 7. The date of commencement and completion of the construction of the well, wells, or other works for withdrawal of groundwater
1916, Improved 1953
- 8. The depth of water table
9 ft.
- 9. So far as it may be available, the type, size and depth of each well or the general specifications of any other works for the withdrawal of groundwater
Drilled, 5" case, 80-90 ft. deep
- 10. The estimated amount of groundwater withdrawn each year
50,000 gal.
- 11. The log of formations encountered in the drilling of each well if available
Not available
- 12. Such other information of a similar nature as may be useful in carrying out the policy of this act, including reference to book and page of any county record
None

Indicate point of appropriation and place of use, if possible. Each small square represents 10 acres.

Signature of Owner _____
Date _____

Three copies to be filed by the owner with the County Clerk & Recorder of the County in which the well is located.

PLEASE ANSWER ALL QUESTIONS. IF NOT APPLICABLE, SO STATE, OTHERWISE THE FORM WILL BE RETURNED.

Original to the County Clerk & Recorder; duplicate to the State Engineer; Triplicate to the School of Mines and Quadruplicate for the Appropriator.

392624

ROY F. GUTCHER & SON

TO

THE PUBLIC

DECLARATION OF VESTED
GROUNDWATER RIGHTS
STATE OF MONTANA }
COUNTY OF HILL } ss

Filed at 11:55'clock A.M.

ON MAR 14 1963

R. E. Blom

COUNTY CLERK

By _____
DEPUTY

Fee: \$2.00 pd.

GW
FIL. NO. _____

TWP 34^N RGE 8^E 23
COUNTY _____

STATE OF MONTANA
ADMINISTRATOR OF GROUNDWATER CODE
OFFICE OF STATE ENGINEER

RECEIVED
JAN 1 1963

DECLARATION OF VESTED GROUNDWATER RIGHTS
(Under Chapter 237, Montana Session Laws, 1961)

STATE ENGINEER

1. John E. Francis, of Billings, Mont. (Town)
County of Yellowstone, State of Montana
Have appropriated groundwater according to the Montana laws in effect prior to Jan. 1, 1962 as follows:

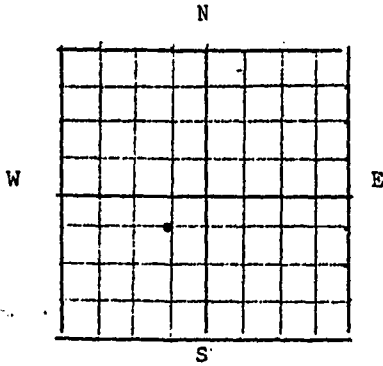

SW¹ Sec 23 T 34 R 8

Indicate point of appropriation and place of use, if possible. Each small square represents 10 acres.

2. The beneficial use on which the claim is based
irrigation + spraying.
3. Date or approximate date of earliest beneficial use; and how continuous the use has been
1961 - continuous since
4. The amount of groundwater claimed (in miner's inches or gallons per minute)
10 gallons per minute
5. If used for irrigation, give the acreage and description of the lands to which water has been applied and name of the owner thereof
yard usage
6. The means of withdrawing such water from the ground and the location of each well or other means of withdrawal
8" pump
7. The date of commencement and completion of the construction of the well, wells, or other works for withdrawal of groundwater
1961
8. The depth of water table
8 ft
9. So far as it may be available, the type, size and depth of each well or the general specifications of any other works for the withdrawal of groundwater
open well / 15' wide by 15' depth
10. The estimated amount of groundwater withdrawn each year
2,000,000
11. The log of formations encountered in the drilling of each well if available
none available
12. Such other information of a similar nature as may be useful in carrying out the policy of this act, including reference to book and page of any county record
none

Signature of Owner John E. Francis
Date Dec. 31 / 1963

Three copies to be filed by the owner with the County Clerk & Recorder of the County in which the well is located.

PLEASE ANSWER ALL QUESTIONS. IF NOT APPLICABLE, SO STATE, OTHERWISE THE FORM WILL BE RETURNED.

Original to the County Clerk & Recorder; duplicate to the State Engineer; Triplicate to the School of Mines and Quadruplicate for the Appropriator.

397145

ARVILLE FREEMAN

TO

THE PUBLIC

DECLARATION OF VESTED
GROUNDWATER RIGHTS

STATE OF MONTANA)
COUNTY OF HILL) ss.
Filed at... 11 o'clock a.m.

ON DECEMBER 1, 1963

L. E. Blain
COUNTY CLERK

RECEIVED

FEE: \$2.00 pd.

GW

File No.

T. 34N R 8E

DUPLICATE

County Hill

STATE OF MONTANA
ADMINISTRATOR OF GROUNDWATER CODE
OFFICE OF STATE ENGINEER

RECEIVED

Declaration of Vested Groundwater Rights

(Under Chapter 237, Montana Session Laws, 1961)

STATE ENGINEER

1. Alvin Barbie (Name of Appropriator), of Laverness (Address) (Town)

County of Hill State of Montana
have appropriated groundwater according to the Montana laws in effect prior to January 1, 1962, as follows:

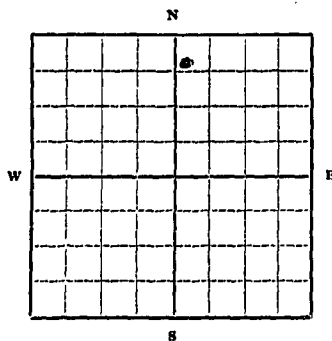

N 6 1/4 Sec. 27 T. 34 R. 8

Indicate point of appropriation and place of use, if possible. Each small square represents 10 acres.

2. The beneficial use on which the claim is based drinking

3. Date or approximate date of earliest beneficial use; and how continuous the use has been 1924

4. The amount of groundwater claimed (in miner's inches or gallons per minute) 5 gallons per minute

5. If used for irrigation, give the acreage and description of the lands to which water has been applied and name of the owner thereof

6. The means of withdrawing such water from the ground and the location of each well or other means of withdrawal motor pump 1/4 mi

7. The date of commencement and completion of the construction of the well, wells, or other works for withdrawal of groundwater

8. The depth of water table 20 ft to 10 ft depending on season

9. So far as it may be available, the type, size and depth of each well or the general specifications of any other works for the withdrawal of groundwater 4 ft in diameter 25 ft in depth

10. The estimated amount of groundwater withdrawn each year 25,000 gallons

11. The log of formations encountered in the drilling of each well if available None

12. Such other information of a similar nature as may be useful in carrying out the policy of this act, including reference to book and page of any county record.

Signature of Owner Alvin Barbie

Date 3-8-62

Three copies to be filed by the owner with the County Clerk and Recorder of the county in which the well is located.

Please answer all questions. If not applicable, so state, otherwise the form will be returned.

Original to the County Clerk and Recorder; duplicate to the State Engineer; Triplicate to the School of Mines and Quadruplicate for the Appropriator.

DOCUMENT NO. 387760

ALVIN BARBIE
TO
THE PUBLIC

DECLARATION
OF VESTED
GROUNDWATER RIGHTS

STATE OF MONTANA) ss.
COUNTY OF HILL)
Filed at 11:10'clock A.m.

ON MAR 8 1962
G.C. YEON

COUNTY CLERK
BY _____ DEPUTY

FEE \$2.00- paid

Gv.

File No.

DUPLICATE

T. 24 R. 8

County Hill

RECEIVED

STATE OF MONTANA
ADMINISTRATOR OF GROUNDWATER CODE
OFFICE OF STATE ENGINEER

Declaration of Vested Groundwater Rights
(Under Chapter 237, Montana Session Laws, 1961)

STATE ENGINEER

1. Alvin Barbie of Inverness Montana
(Name of Appropriator) (Address) (Town)
County of Hill State of Montana

have appropriated groundwater according to the Montana laws in effect prior to January 1, 1962, as follows:

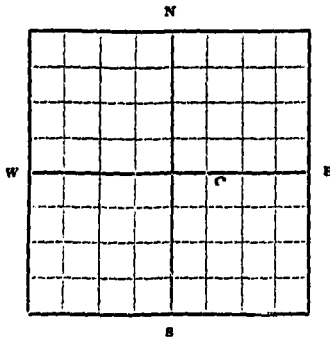

S.E. 1/4 of Sec. 27, T24, R. 8

Indicate point of appropriation and place of use, if possible. Each small square represents 10 acres.

2. The beneficial use on which the claim is based Home use

3. Date or approximate date of earliest beneficial use; and how continuous the use has been 1954

4. The amount of groundwater claimed (in miner's inches or gallons per minute) 20 gallons per minute

5. If used for irrigation, give the acreage and description of the lands to which water has been applied and name of the owner thereof Mo. Good

6. The means of withdrawing such water from the ground and the location of each well or other means of withdrawal jet pump

7. The date of commencement and completion of the construction of the well, wells, or other works for withdrawal of groundwater 11-13-1954

8. The depth of water table 70 feet

9. So far as it may be available, the type, size and depth of each well or, the general specifications of any other works for the withdrawal of groundwater 6 ins. casing, 125 ft. in depth

10. The estimated amount of groundwater withdrawn each year 100,000 gal

11. The log of formations encountered in the drilling of each well if available None

12. Such other information of a similar nature as may be useful in carrying out the policy of this act, including reference to book and page of any county record.

Signature of Owner Alvin Barbie

Date 3-8-62

Three copies to be filed by the owner with the County Clerk and Recorder of the county in which the well is located.

Please answer all questions. If not applicable, so state, otherwise the form will be returned.

Original to the County Clerk and Recorder; duplicate to the State Engineer; Triplicate to the School of Mines and Quaduplicate for the Appropriator.

DOCUMENT NO. 387759

ALVIN BARBIE
TO
THE PUBLIC

DECLARATION OF
VESTED GROUNDWATER
RIGHTS

STATE OF MONTANA)
COUNTY OF HILL)
Filed at 11:10 AM

ON MAR 8 1962

G.C. YEON

COUNTY CLERK

By _____ DEPUTY

FEE \$2.00- paid

28

File No. _____

N 1/2 T. 28 R. 8 N. 1/4

DUPLICATE

County Hill

STATE OF MONTANA
ADMINISTRATOR OF GROUNDWATER CODE
OFFICE OF STATE ENGINEER

RECEIVED

Declaration of Vested Groundwater Rights

NOV 5 1963

(Under Chapter 237, Montana Session Laws, 1961)

STATE ENGINEER

1. Bernhard Storvik of Inverness
(Name of Appropriator) (Address) (Town)

County of Hill State of Montana
have appropriated groundwater according to the Montana laws in effect prior to January 1, 1962, as follows:

		X		

2. The beneficial use on which the claim is based. was used for stock reservoir, are now used household and for watering trees and other plants

3. Date or approximate date of earliest beneficial use; and how continuous the use has been. Reservoir made in 1937. Flowingwell drilled in 1944. Flowingwell reservoir combination

4. The amount of groundwater claimed (in miner's inches or gallons per minute). Reservoir-flow running about 1 Gal

5. If used for irrigation, give the acreage and description of the lands to which water has been applied and name of the owner thereof. Same. I haul it to my home place on Sec. 33-34-8

6. The means of withdrawing such water from the ground and the location of each well or other means of withdrawal. Flowing well

N 1/4 Sec. 28 T. 34 R. 8

Indicate point of appropriation and place of use, if possible. Each small square represents 10 acres.

7. The date of commencement and completion of the construction of the well, wells, or other works for withdrawal of groundwater. October 1944

8. The depth of water table. 104 ft.

9. So far as it may be available, the type, size and depth of each well or the general specifications of any other works for the withdrawal of groundwater. Drilled 6 in. casing, flowing

10. The estimated amount of groundwater withdrawn each year. 40,000 gal

11. The log of formations encountered in the drilling of each well if available. Clay, fine sand where water was found

12. Such other information of a similar nature as may be useful in carrying out the policy of this act, including reference to book and page of any county record.

Signature of Owner Bernhard Storvik

Date 7-1-1963

Three copies to be filed by the owner with the County Clerk and Recorder of the county in which the well is located.

Please answer all questions. If not applicable, so state, otherwise the form will be returned.

Original to the County Clerk and Recorder; duplicate to the State Engineer; Triplicate to the Montana Bureau of Mines and Geology, and Quadruplicate for the Appropriator.

6796

395911

BERNHARD STORVIK

TO

THE PUBLIC

DECLARATION OF VESTED GROUND
WATER RIGHTS
STATE OF MONTANA,
COUNTY OF HILL) ss.
Filed at 10 o'clock A.M.

ON 11/14/1963

R. E. Blom
COUNTY CLERK

BY _____
DEPUTY

Fee: \$2.00 pd.

GW-4
FILE NO. _____

TWP 4^N RGE 8^E 21
COUNTY _____

STATE OF MONTANA
ADMINISTRATOR OF GROUNDWATER CODE
OFFICE OF STATE ENGINEER

DECLARATION OF VESTED GROUNDWATER RIGHTS

(Under Chapter 237, Montana Session Laws, 1961)

1. Mrs Amelia Johnson of Joplin
(Name of Appropriator) (Address)
County of Hill State of Montana (Town)
Have appropriated groundwater according to the Montana laws in effect prior to Jan. 1, 1962 as follows:

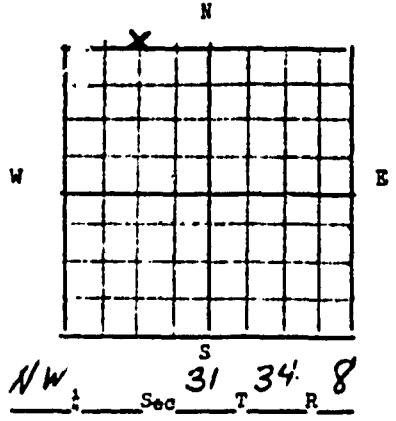

Indicate point of appropriation and place of use, if possible. Each small square represents 10 acres.

- 2. The beneficial stock water based _____
- 3. Date or approximate date of earliest beneficial use; and how continuous the use has been 1916
- 4. The amount of groundwater claimed (in miner's inches or gallons per foot) 5 gal per min
- 5. If used for irrigation, give the acreage and description of the lands to which water has been applied and name of the owner thereof _____
- 6. The means of withdrawing such water from the ground and the location of each well or other means of withdrawal Pumpjack
- 7. The date of commencement and completion of the construction of the well, wells, or other works for the withdrawal of groundwater Drilled 1916
- 8. The depth of water table 180 ft
- 9. So far as it may be available, the type, size and depth of each well or the general specifications of any other works for the withdrawal of groundwater Drilled well, 6 in - 200 ft
- 10. The estimated amount of groundwater withdrawn each year 20 + 50 ft
- 11. The log of formations encountered in the drilling of each well if available _____
- 12. Such other information of a similar nature as may be useful in carrying out the policy of this act, including reference to book and page of any county record _____

Signature of Owner Mrs Amelia Johnson
Date Dec 30, 1963

Three copies to be filed by the owner with the County Clerk & Recorder of the County in which the well is located.

PLEASE ANSWER ALL QUESTIONS. IF NOT APPLICABLE, SO STATE, OTHERWISE THE FORM WILL BE RETURNED.

Original to the County Clerk & Recorder; duplicate to the State Engineer; Triplicate to the School of Mines and Quadruplicate for the Appropriator.

396971

11th 8th
J. G. Blum

1 700 200

GW 4
FILE NO. _____

TWP 34^N RGE 8^E 31
COUNTY _____
RECEIVED
JAN 13 1964

STATE OF MONTANA
ADMINISTRATOR OF GROUNDWATER CODE
OFFICE OF STATE ENGINEER

DECLARATION OF VESTED GROUNDWATER RIGHTS

Under Chapter 237, Montana Session Laws, 1961

1. Arnold E. Johnson
Berger A. Johnson, Jr., of Joplin
(Name of Appropriator) (Address) (Town)
County of Hill, State of Montana
Have appropriated groundwater according to the Montana laws in effect prior to Jan. 1, 1962 as follows:

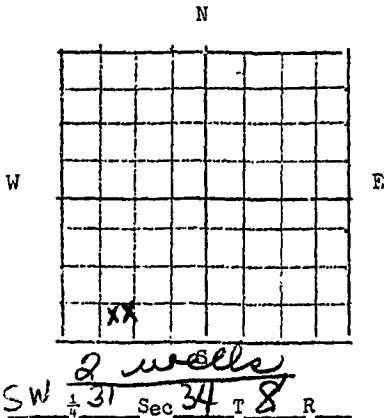

- 2. The beneficial use on which the claim is based Stock & Domestic
- 3. Date or approximate date of earliest beneficial use; and how continuous the use has been
1913 - Each Day
1946 " "
- 4. The amount of groundwater claimed (in miner's inches or gallons per minute)
1 or 2 gal
- 5. If used for irrigation, give the acreage and description of the lands to which water has been applied and name of the owner thereof _____
- 6. The means of withdrawing such water from the ground and the location of each well or other means of withdrawal Electric pump
Joplin

Indicate point of appropriation and place of use, if possible. Each small square represents 10 acres.

- 7. The date of commencement and completion of the construction of the well, wells, or other works for withdrawal of groundwater 1913 & 1946
- 8. The depth of water table 300 ft & 165 ft
- 9. So far as it may be available, the type, size and depth of each well or the general specifications of any other works for the withdrawal of groundwater
Drilled 6 in - 335 ft
- 10. The estimated amount of groundwater withdrawn each year 20,000 each well
- 11. The log of formations encountered in the drilling of each well if available _____

12. Such other information of a similar nature as may be useful in carrying out the policy of this act, including reference to book and page of any county record _____

Signature of Owner Arnold E. Johnson
Berger Johnson, Jr.
Date Dec 30, 1963

Three copies to be filed by the owner with the County Clerk & Recorder of the County in which the well is located.

PLEASE ANSWER ALL QUESTIONS. IF NOT APPLICABLE, SO STATE, OTHERWISE THE FORM WILL BE RETURNED.

Original to the County Clerk & Recorder; duplicate to the State Engineer; Triplicate to the School of Mines and Quadruplicate for the Appropriator.

396965

ARNOLD E. JOHNSON &
BERGER A. JOHNSON

TO

THE PUBLIC

DECLARATION OF VESTED
GROUNDWATER RIGHTS

STATE OF MONTANA, ss.
COUNTY OF HILL)
Filed at 1:00 o'clock p.m.

ON

DEC 30 1963

W. E. Blain
COUNTY CLERK

SECURITY

FEE: \$2.00 pd.

GW

32

File No.

T 24 N 8 E R

DUPLICATE

County

STATE OF MONTANA
ADMINISTRATOR OF GROUNDWATER CODE
OFFICE OF STATE ENGINEER

RECEIVED
JAN 7 1964

Declaration of Vested Groundwater Rights
(Under Chapter 237, Montana Session Laws, 1961)

STATE ENGINEER

1. Howard E. Hall of Ingersess,
(Name of Appropriator) (Address) (Town)
County of Hill State of Montana
have appropriated groundwater according to the Montana laws in effect prior to January 1, 1962, as follows:

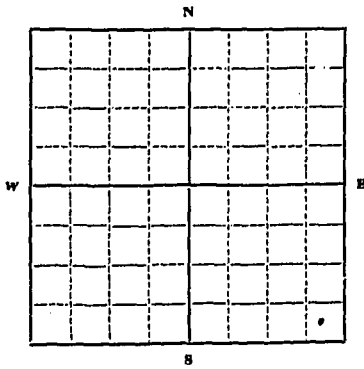

SE 1/4 Sec 32 T34 R8N

Indicate point of appropriation and place of use, if possible. Each small square represents 10 acres.

- 2. The beneficial use on which the claim is based. Wheat & Stock Ranch
- 3. Date or approximate date of earliest beneficial use; and how continuous the use has been. 1943 continuous
- 4. The amount of groundwater claimed (in miner's inches or gallons per minute). 7 gpm
- 5. If used for irrigation, give the acreage and description of the lands to which water has been applied and name of the owner thereof. None
- 6. The means of withdrawing such water from the ground and the location of each well or other means of withdrawal. Electric Submersible pump
- 7. The date of commencement and completion of the construction of the well, wells, or other works for withdrawal of groundwater. 1942
- 8. The depth of water table. 120 ft
- 9. So far as it may be available, the type, size and depth of each well or the general specifications of any other works for the withdrawal of groundwater. Drilled well, casing, Depth of well 142'
- 10. The estimated amount of groundwater withdrawn each year. 60,000 gal
- 11. The log of formations encountered in the drilling of each well if available. Not available. This well is drilled into sand rock
- 12. Such other information of a similar nature as may be useful in carrying out the policy of this act, including reference to book and page of any county record.

Signature of Owner: Howard E. Hall
Date: Dec 19, 1963

Three copies to be filed by the owner with the County Clerk and Recorder of the county in which the well is located.

Please answer all questions. If not applicable, so state, otherwise the form will be returned.

Original to the County Clerk and Recorder; duplicate to the State Engineer; Triplicate to the Montana Bureau of Mines and Geology, and Quadruplicate for the Appropriator.

26553

396830

HOWARD E. HALL

TO

THE PUBLIC

DECLARATION OF VESTED GROUND
WATER RIGHTS

STATE OF MONTANA
COUNTY OF HILL
Filed at 8 o'clock a.m.

BY 16. Blain 27 1963
COUNTY CLERK

DEPUTY

Fee: \$2.00 pd.

GW 4
FILE NO. _____
DUPLICATE

STATE OF MONTANA
ADMINISTRATOR OF GROUNDWATER CODE
OFFICE OF STATE ENGINEER

TWP. 34N RGE. 8E
COUNTY HILL
RECEIVED
MAR 21 1962

DECLARATION OF VESTED GROUNDWATER RIGHTS
(Under Chapter 237, Montana Session Laws, 1961)

STATE ENGINEER

1. Oscar Goldberg, of Townsend
(Name of Appropriator) (Address) (Town)
County of Hill, State of Montana
Have appropriated groundwater according to the Montana laws in effect prior to Jan. 1, 1962 as follows:

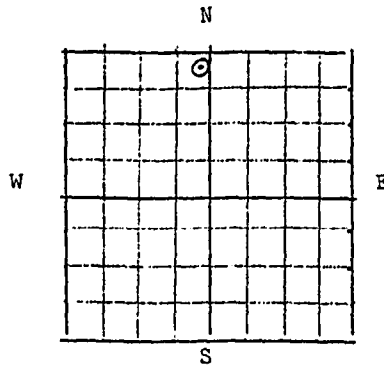

1/2 Sec 32 T 34 R 8

Indicate point of appropriation and place of use, if possible. Each small square represents 10 acres.

2. The beneficial use on which the claim is based Farm water supply
3. Date or approximate date of earliest beneficial use; and how continuous the use has been 1912
4. The amount of groundwater claimed (in miner's inches or gallons per minute) Continuous pumping with 2 in. diameter possible
5. If used for irrigation, give the acreage and description of the lands to which water has been applied and name of the owner thereof garden lawn + household
6. The means of withdrawing such water from the ground and the location of each well or other means of withdrawal See map manual engine tubular pump setup
7. The date of commencement and completion of the construction of the well, wells, or other works for withdrawal of groundwater 1912
8. The depth of water table 90 ft
9. So far as it may be available, the type, size and depth of each well or the general specifications of any other works for the withdrawal of groundwater 5 in casing to 110 ft depth
10. The estimated amount of groundwater withdrawn each year ?
11. The log of formations encountered in the drilling of each well if available ?
12. Such other information of a similar nature as may be useful in carrying out the policy of this act, including reference to book and page of any county record _____

Signature of Owner Oscar Goldberg

Date Mar 23 1962

Three copies to be filed by the owner with the County Clerk & Recorder of the County in which the well is located.

PLEASE ANSWER ALL QUESTIONS. IF NOT APPLICABLE, SO STATE, OTHERWISE THE FORM WILL BE RETURNED.

Original to the County Clerk & Recorder; duplicate to the State Engineer; Triplicate to the School of Mines and Quadruplicate for the Appropriator.

DOCUMENT NO. 387986

OSCAR GOLDBERG
TO
THE PUBLIC

DECLARATION OF VESTED
GROUNDWATER RIGHTS

STATE OF MONTANA,) ss.
COUNTY OF HILL)
Filed at 1:25 o'clock P.M.

ON MAR 23 1962

G.C. YEON
COUNTY CLERK

By _____ DEPUTY

FEE \$2.00- paid

33

File No. _____

T 34 N R 8 E

DUPLICATE

County Hill

STATE OF MONTANA
ADMINISTRATOR OF GROUNDWATER CODE
OFFICE OF STATE ENGINEER

RECEIVED
NOV 5 1963

Declaration of Vested Groundwater Rights

(Under Chapter 237, Montana Session Laws, 1961)

STATE ENGINEER

1. Bernhard Storvik, of Inverness
(Name of Appropriator) (Address) (Town)

County of Hill State of Montana
have appropriated groundwater according to the Montana laws in effect prior to January 1, 1962, as follows:

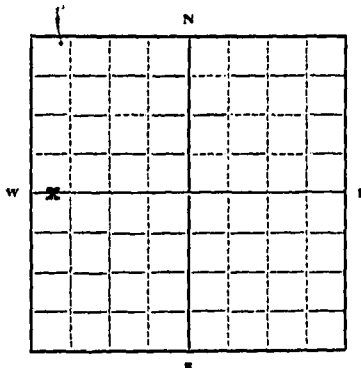

S.E. 1/4 Sec. 33 T34. R8

Indicate point of appropriation and place of use, if possible. Each small square represents 10 acres.

2. The beneficial use on which the claim is based. Household

3. Date or approximate date of earliest beneficial use; and how continuous the use has been. Nov. 1956. Continuous since

4. The amount of groundwater claimed (in miner's inches or gallons per minute). 10 Gal.

5. If used for irrigation, give the acreage and description of the lands to which water has been applied and name of the owner thereof

6. The means of withdrawing such water from the ground and the location of each well or other means of withdrawal. Pump

7. The date of commencement and completion of the construction of the well, wells, or other works for withdrawal of groundwater. Nov. 1956

8. The depth of water table. 110 ft.

9. So far as it may be available, the type, size and depth of each well or the general specifications of any other works for the withdrawal of groundwater. Drilled 6 in. casing, 120 ft. deep. Electric Pump

10. The estimated amount of groundwater withdrawn each year. 70,000 gal.

11. The log of formations encountered in the drilling of each well if available. Clay, Sandstone where water was found

12. Such other information of a similar nature as may be useful in carrying out the policy of this act, including reference to book and page of any county record.

Signature of Owner. Bernhard Storvik
Date. 7-1-1963

Three copies to be filed by the owner with the County Clerk and Recorder of the county in which the well is located.

Please answer all questions. If not applicable, so state, otherwise the form will be returned.

Original to the County Clerk and Recorder; duplicate to the State Engineer; Triplicate to the Montana Bureau of Mines and Geology, and Quadruplicate for the Appropriator.

697

395912

BERNHARD STORVIK

TO

THE PUBLIC

DECLARATION OF VESTED GROUND
WATER RIGHTS

STATE OF MONTANA,) ss.
COUNTY OF HILL)
Filed at 10 o'clock A.M.

ON NOV 4 1963

R. E. Blom
COUNTY CLERK

BY _____ DEPUTY

Fees \$2.00 pd.

File No.

T. 34 N 9 E

DUPLICATE

County Hill

STATE OF MONTANA
ADMINISTRATOR OF GROUNDWATER CODE
OFFICE OF STATE ENGINEER

RECEIVED
DEC 27 1963

Declaration of Vested Groundwater Rights STATE ENGINEER

(Under Chapter 237, Montana Session Laws, 1961)

1. H. E. Rosenberg, of Rudyard,
(Name of Appropriator) (Address) (Town)
County of Hill State of Mont.
have appropriated groundwater according to the Montana laws in effect prior to January 1, 1962, as follows:

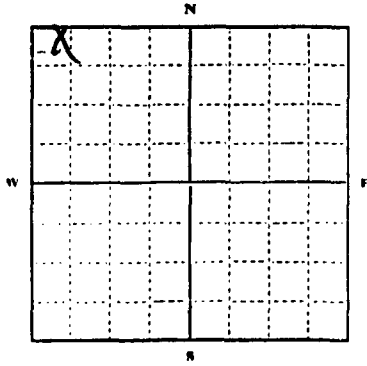

NW 1/4 Sec. 3 T34 R. 9

Indicate point of appropriation and place of use, if possible. Each small square represents 10 acres.

- 2. The beneficial use on which the claim is based Household use and stock garden irrig.
- 3. Date or approximate date of earliest beneficial use; and how continuous the use has been 1918
- 4. The amount of groundwater claimed (in miner's inches or gallons per minute) 10 gal per min
- 5. If used for irrigation, give the acreage and description of the lands to which water has been applied and name of the owner thereof approx 20 acres - 2.9'
- 6. The means of withdrawing such water from the ground and the location of each well or other means of withdrawal submersible pump
- 7. The date of commencement and completion of the construction of the well, wells, or other works for withdrawal of groundwater 1918
- 8. The depth of water table 98 feet
- 9. So far as it may be available, the type, size and depth of each well or the general specifications of any other works for the withdrawal of groundwater 140 feet drilled well - 8 in casing
- 10. The estimated amount of groundwater withdrawn each year 500.000
- 11. The log of formations encountered in the drilling of each well if available gravel
- 12. Such other information of a similar nature as may be useful in carrying out the policy of this act, including reference to book and page of any county record

Signature of Owner H. E. Rosenberg
H. E. Rosenberg
Date Dec 27, 1963

Three copies to be filed by the owner with the County Clerk and Recorder of the county in which the well is located.

Please answer all questions. If not applicable, so state, otherwise the form will be returned.

Original to the County Clerk and Recorder; Duplicate to the State Engineer; Triplicate to the Montana Bureau of Mines and Geology, and Quadruplicate for the Appropriator.

396754

KATHA B. BACCHING

TO

THE PUBLIC

DECLARATION OF VESTED
CONJUGATE RIGHTS

STATE OF MONTANA,
COUNTY OF BILLINGS
Filed on 11/10/63

NOV 10 1963

R. E. Blom

FILED 11/10/63

GW-4
FILE NO. _____

TWP 34 N R9E 5
COUNTY HILL

STATE OF MONTANA
ADMINISTRATOR OF GROUNDWATER CODE
OFFICE OF STATE ENGINEER

DECLARATION OF VESTED GROUNDWATER RIGHTS
(Under Chapter 237, Montana Session Laws, 1961)

1. Lester Van Wechel, of Box 133 Rudyard
 (Name of Appropriator) (Address) (Town)
 County of Hill, State of Montana
 Have appropriated groundwater according to the Montana laws in effect prior to Jan. 1, 1962 as follows:

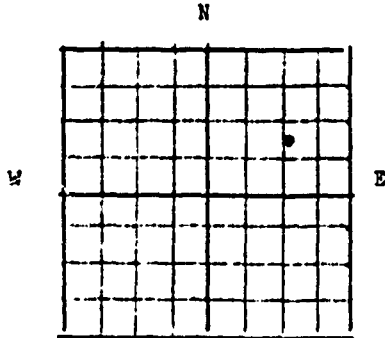

N.E. 1/4 Sec 5 T34 R9E

Indicate point of appropriation and place of use, if possible. Each small square represents 10 acres.

2. The beneficial use on which the claim is based Stock water
3. Date or approximate date of earliest beneficial use; and how continuous the use has been 1915 to 1947
4. The amount of groundwater claimed (in miner's inches or gallons per minute) 20 gal per min.
5. If used for irrigation, give the acreage and description of the lands to which water has been applied and name of the owner thereof no irrigation
6. The means of withdrawing such water from the ground and the location of each well or other means of withdrawal deep well pump
7. The date of commencement and completion of the construction of the well, wells, or other works for withdrawal of groundwater 1915
8. The depth of water table 100 ft
9. So far as it may be available, the type, size and depth of each well or the general specifications of any other works for the withdrawal of groundwater 4 in hole 1-3 ft
10. The estimated amount of groundwater withdrawn each year undetermined
11. The log of formations encountered in the drilling of each well if available unknown
12. Such other information of a similar nature as may be useful in carrying out the policy of this act, including reference to book and page of any county record _____

Signature of Owner Lester Van Wechel
Date Dec 30, 1963

Three copies to be filed by the owner with the County Clerk & Recorder of the County in which the well is located.

PLEASE ANSWER ALL QUESTIONS. IF NOT APPLICABLE, SO STATE, OTHERWISE THE FORM WILL BE RETURNED.

Original to the County Clerk & Recorder; duplicate to the State Engineer; Triplicate to the School of Mines and Quadruplicate for the Appropriator.

396957

LESTER VAN WAGEN

TO

THE PUBLIC

DECLARATION OF VESTED
CROUCHMATER RIGHTS

STATE OF MONTANA)
COUNTY OF HILL)
Filed at _____ o'clock p.m.

ON 3 1963

L. E. Blum
COUNTY CLERK

DEPUTY

FEE: \$2.00 pd.

GW 4
FILE NO. _____

34 N 9 E 6
TWP ~~9~~ RGE 9 E
COUNTY _____
JAN 19 1963

STATE OF MONTANA
ADMINISTRATOR OF GROUNDWATER CODE
OFFICE OF STATE ENGINEER

DECLARATION OF VESTED GROUNDWATER RIGHTS STATE ENGINEER

(Under Chapter 237, Montana Session Laws, 1961)

1. Lester Van Wechel of Box 133 Rudyard
(Name of Appropriator) (Address) (Town)
County of MT, State of Mont.
Have appropriated groundwater according to the Montana laws in effect prior to Jan. 1, 1962 as follows:

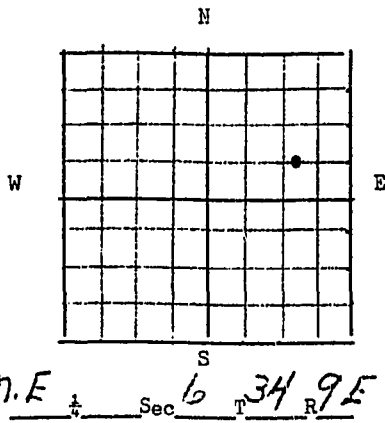

2. The beneficial use on which the claim is based
Stock water

3. Date or approximate date of earliest beneficial use; and how continuous the use has been
1915 to 1947

4. The amount of groundwater claimed (in miner's inches or gallons per minute)
20 gal per acre

5. If used for irrigation, give the acreage and description of the lands to which water has been applied and name of the owner thereof
no irrigation

6. The means of withdrawing such water from the ground and the location of each well or other means of withdrawal
deep well pump

Indicate point of appropriation and place of use, if possible. Each small square represents 10 acres.

7. The date of commencement and completion of the construction of the well, wells, or other works for withdrawal of groundwater
1915

8. The depth of water table
80 ft

9. So far as it may be available, the type, size and depth of each well or the general specifications of any other works for the withdrawal of groundwater
4 in. 180 ft deep

10. The estimated amount of groundwater withdrawn each year
unknown

11. The log of formations encountered in the drilling of each well if available
unknown

12. Such other information of a similar nature as may be useful in carrying out the policy of this act, including reference to book and page of any county record

Signature of Owner Lester Van Wechel
Date Dec. 30 1963

Three copies to be filed by the owner with the County Clerk & Recorder of the County in which the well is located.

PLEASE ANSWER ALL QUESTIONS. IF NOT APPLICABLE, SO STATE, OTHERWISE THE FORM WILL BE RETURNED.

Original to the County Clerk & Recorder; duplicate to the State Engineer; Triplicate to the School of Mines and Quadruplicate for the Appropriator.

31027

396956

LESTER VAN WEGHEL

TO

THE PUBLIC

DECLARATION OF VESTED
GROUNDWATER RIGHTS

STATE OF MONTANA, ss.
COUNTY OF HILL
Filed at 1:00 o'clock Pm.

ON 12 3 1963
L. E. Blain
COUNTY CLERK

DEPUTY

FEE: 2.00 pd.

21

File No.

T. 34 N. R. 9 E

DUPLICATE

County Hill

STATE OF MONTANA
ADMINISTRATOR OF GROUNDWATER CODE
OFFICE OF STATE ENGINEER

RECEIVED
DEC 19 1963

Declaration of Vested Groundwater Rights

(Under Chapter 237, Montana Session Laws, 1961)

STATE ENGINEER

1. Russell Anderson, of Ruyard
(Name of Appropriator) (Address) (Town)

County of Hill State of Montana
have appropriated groundwater according to the Montana laws in effect prior to January 1, 1962, as follows:

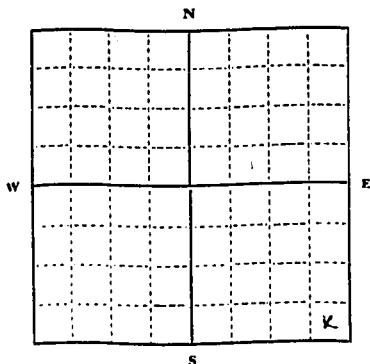

SE 1/4 - Sec. 21, T. 34, R. 9

Indicate point of appropriation and place of use, if possible. Each small square represents 10 acres.

2. The beneficial use on which the claim is based Stock Irrigation

3. Date or approximate date of earliest beneficial use; and how continuous the use has been 1916 well 1950 Dam

4. The amount of groundwater claimed (in miner's inches or gallons per minute) 2 well 50 Dam

5. If used for irrigation, give the acreage and description of the lands to which water has been applied and name of the owner thereof LAWN TREES Garden etc

6. The means of withdrawing such water from the ground and the location of each well or other means of withdrawal Pumps

7. The date of commencement and completion of the construction of the well, wells, or other works for withdrawal of groundwater well 1916 Dam Oct 1950

8. The depth of water table well 10' Dam Surface

9. So far as it may be available, the type, size and depth of each well or the general specifications of any other works for the withdrawal of groundwater well Dam 6' 18'

10. The estimated amount of groundwater withdrawn each year well 10,000 Dam 200,000 gal

11. The log of formations encountered in the drilling of each well if available Dam well

12. Such other information of a similar nature as may be useful in carrying out the policy of this act, including reference to book and page of any county record.

Signature of Owner Russell Anderson

Date Dec 18 1963

Three copies to be filed by the owner with the County Clerk and Recorder of the county in which the well is located.

Please answer all questions. If not applicable, so state, otherwise the form will be returned.

Original to the County Clerk and Recorder; Duplicate to the State Engineer; Triplicate to the Montana Bureau of Mines and Geology, and Quadruplicate for the Appropriator.

10312

396612

RINSELL AND POOR

TO

THE PUBLIC

DECLARATION OF VESTED GROUND
WATER RIGHTS

STATE OF MONTANA)
COUNTY OF HILL) ss.
Filed at 3 o'clock PM.

ON DEC 18 1963

R. E. Blom

COUNTY CLERK

DEPUTY

Fee: \$2.00 pd.

GW

File No.

DUPLICATE

T. N R. 22
County

STATE OF MONTANA
ADMINISTRATOR OF GROUNDWATER CODE
OFFICE OF STATE ENGINEER

RECEIVED
JAN 13 1964

Declaration of Vested Groundwater Rights
(Under Chapter 237, Montana Session Laws, 1961)

STATE ENGINEER

1. Donald Storb of Rudyard
(Name of Appropriator) (Address) (Town)
County of Hill State of Montana
have appropriated groundwater according to the Montana laws in effect prior to January 1, 1962, as follows:

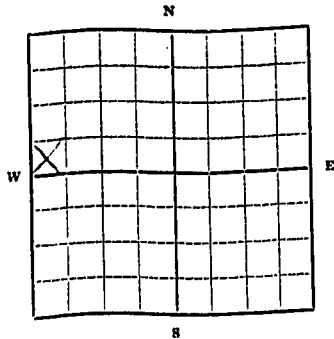

SW 1/4 NW 1/4 Sec. 22, T. 24, R. 9

Indicate point of appropriation and place of use, if possible. Each small square represents 10 acres.

2. The beneficial use on which the claim is based Domestic & stock use

3. Date or approximate date of earliest beneficial use; and how continuous the use has been May 6, 1961
Continuous since date

4. The amount of groundwater claimed (in miner's inches or gallons per minute) 15 gal per min

5. If used for irrigation, give the acreage and description of the lands to which water has been applied and name of the owner thereof None

6. The means of withdrawing such water from the ground and the location of each well or other means of withdrawal Not app.

7. The date of commencement and completion of the construction of the well, wells, or other works for withdrawal of groundwater Started May 3, 1961 Completed May 4, 1961

8. The depth of water table 10.5 ft

9. So far as it may be available, the type, size and depth of each well or the general specifications of any other works for the withdrawal of groundwater 113 ft of Spang - seamless 5 1/2 in diam steel casing

10. The estimated amount of groundwater withdrawn each year Approx 180,000 gal

11. The log of formations encountered in the drilling of each well if available 0-100 ft. Glacial drift 109-113 ft. Brown sandstone 103-108 ft. Brown shale, Shony shell 1/2 gal water prominent 108-110 ft. Dark brown shale 110-113 ft. Red, water 1/2 gal prominent, 113-114 ft. Gray shale

12. Such other information of a similar nature as may be useful in carrying out the policy of this act, including reference to book and page of any county record Not app.

Signature of Owner Donald Storb

Date Feb 10, 1962

Three copies to be filed by the owner with the County Clerk and Recorder of the county in which the well is located.

Please answer all questions. If not applicable, so state, otherwise the form will be returned.

Original to the County Clerk and Recorder; duplicate to the State Engineer; Triplicate to the School of Mines and Quadruplicate for the Appropriator.

30987

396906

DONALD BRACK

TO

THE PUBLIC

DECLARATION OF VESTED
COUNSMAN RIGHTS

STATE OF MONTANA, ss.
COUNTY OF HILL)
Filed at _____ o'clock a.m.

ON _____ 1968
[Signature]
COUNTY CLERK

BY _____ DEPUTY

FFP: \$2.00 pd.

25

GW

File No. _____

DUPLICATE

T. 34^N R. 9^E
County _____

RECEIVED
JAN 18 1964

STATE OF MONTANA
ADMINISTRATOR OF GROUNDWATER CODE
OFFICE OF STATE ENGINEER

Declaration of Vested Groundwater Rights
(Under Chapter 237, Montana Session Laws, 1961)

1. Mrs. Ruth M. Greeno, of Rudyard, (Name of Appropriator) (Address) (Town)
County of Hill, State of Montana

have appropriated groundwater according to the Montana laws in effect prior to January 1, 1962, as follows:

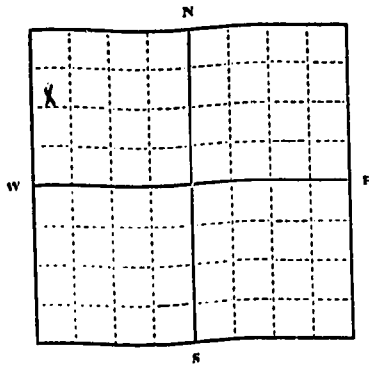

N. 1/4 Sec. 25 T. 94 R. 9

Indicate point of appropriation and place of use, if possible. Each small square represents 10 acres.

- 2. The beneficial use on which the claim is based. Household and stock
- 3. Date or approximate date of earliest beneficial use; and how continuous the use has been. Continuous since 1925
- 4. The amount of groundwater claimed (in miner's inches or gallons per minute). 12
- 5. If used for irrigation, give the acreage and description of the lands to which water has been applied and names of the owner thereof. None
- 6. The means of withdrawing such water from the ground and the location of each well or other means of withdrawal. PUMP & PIPE

- 7. The date of commencement and completion of the construction of the well, wells, or other works for withdrawal of groundwater. 1925
- 8. The depth of water table. 100 feet
- 9. So far as it may be available, the type, size and depth of each well or the general specifications of any other works for the withdrawal of groundwater. 6 inch casing well 100 ft deep
- 10. The estimated amount of groundwater withdrawn each year. 25,000 gals. Not known
- 11. The log of formations encountered in the drilling of each well if available.
- 12. Such other information of a similar nature as may be useful in carrying out the policy of this act, including reference to book and page of any county record.

Signature of Owner. Mrs. Ruth M. Greeno
Date. Dec. 31, 1963

Three copies to be filed by the owner with the County Clerk and Recorder of the county in which the well is located.

Please answer all questions. If not applicable, so state, otherwise the form will be returned.

Original to the County Clerk and Recorder; Duplicate to the State Engineer; Triplicate to the Montana Bureau of Mines and Geology, and Quadruplicate for the Appropriator. 31146

397088
MRS. RUTH M. GREENO

TO

THE PUBLIC

DECLARATION OF VESTED
GROUNDWATER RIGHTS

STATE OF MONTANA,) ss.
COUNTY OF HILL)
Filed at 11 o'clock A.M.

ON FEB 1 1963

COUNTY CLERK

DEPUTY

EE: \$2.00 pd.

28

File No.

T. 34N R. 9E

County Hill

DUPLICATE

STATE OF MONTANA
ADMINISTRATOR OF GROUNDWATER CODE
OFFICE OF STATE ENGINEER

RECEIVED
DEC 19 1963

Declaration of Vested Groundwater Rights STATE ENGINEER
(Under Chapter 237, Montana Session Laws, 1961)

1. Russell Anderson, of Rudyard
(Name of Appropriator) (Address) (Town)
County of Hill State of Montana
have appropriated groundwater according to the Montana laws in effect prior to January 1, 1962, as follows:

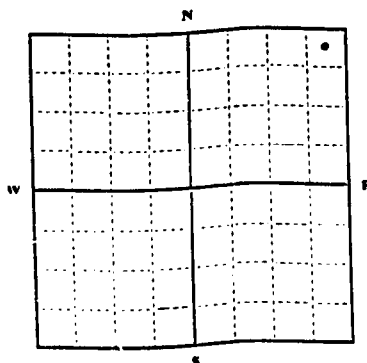

NE 1/4 - Sec 24 T 33 R 9
Indicate point of appropriation and place of use, if possible. Each small square represents 10 acres.

- 2. The beneficial use on which the claim is based: House hold stock irrigation
- 3. Date or approximate date of earliest beneficial use; and how continuous the use has been: 1948 - Steady
- 4. The amount of groundwater claimed (in miner's inches or gallons per minute): 6 gpm
- 5. If used for irrigation, give the acreage and description of the lands to which water has been applied and name of the owner thereof: Lawn garden trees etc.
- 6. The means of withdrawing such water from the ground and the location of each well or other means of withdrawal: Pump

- 7. The date of commencement and completion of the construction of the well, wells, or other works for withdrawal of groundwater: June 1948 July 1948
- 8. The depth of water table: 135'
- 9. So far as it may be available, the type, size and depth of each well or the general specifications of any other works for the withdrawal of groundwater: casing, drilled, 6" 135'
- 10. The estimated amount of groundwater withdrawn each year: 40,000
- 11. The log of formations encountered in the drilling of each well if available: N.T. Available
- 12. Such other information of a similar nature as may be useful in carrying out the policy of this act, including reference to book and page of any county record.

Signature of Owner: Russell Anderson
Date: Dec 18th 1963

Three copies to be filed by the owner with the County Clerk and Recorder of the county in which the well is located.
Please answer all questions. If not applicable, so state, otherwise the form will be returned.

Original to the County Clerk and Recorder; Duplicate to the State Engineer; Triplicate to the Montana Bureau of Mines and Geology, and Quadruplicate for the Appropriator.

16319

396613

ESTATE OF JOHN

THE PUBLIC

DEPARTMENT OF VESTED GROUND
WATER RIGHTS

STATE OF MONTANA
COUNTY OF HILL
Filed at 3 o'clock P.M.

ON 10 16 1963
R. E. Blom

COUNTY CLERK

RECEIVED

Fees: \$2.00 pd.

GW
FILE NO. _____

TWP 34^N RGE 10E - 4
COUNTY _____

STATE OF MONTANA
ADMINISTRATOR OF GROUNDWATER CODE
OFFICE OF STATE ENGINEER

RECEIVED
JAN 13 1962

DECLARATION OF VESTED GROUNDWATER RIGHTS
(Under Chapter 237, Montana Session Laws, 1961)

1. Glenron H. Halson, of Wildford STATE ENGINEER
(Name of Appropriator) (Address) (Town)
County of Hill, State of Montana
Have appropriated groundwater according to the Montana laws in effect prior to Jan. 1, 1962 as follows:

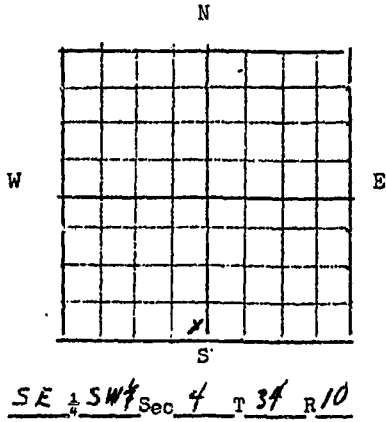

Indicate point of appropriation and place of use, if possible. Each small square represents 10 acres.

2. The beneficial use on which the claim is based domestic
3. Date or approximate date of earliest beneficial use; and how continuous the use has been 1910
4. The amount of groundwater claimed (in miner's inches or gallons per minute) 5 gpm
5. If used for irrigation, give the acreage and description of the lands to which water has been applied and name of the owner thereof _____
6. The means of withdrawing such water from the ground and the location of each well or other means of withdrawal pumps
7. The date of commencement and completion of the construction of the well, wells, or other works for withdrawal of groundwater _____
8. The depth of water table 100 ft
9. So far as it may be available, the type, size and depth of each well or the general specifications of any other works for the withdrawal of groundwater drilled 6 in casing 125 ft deep
10. The estimated amount of groundwater withdrawn each year 30,000 gallons
11. The log of formations encountered in the drilling of each well if available _____
12. Such other information of a similar nature as may be useful in carrying out the policy of this act, including reference to book and page of any county record _____

Signature of Owner Glenron H. Halson
Date Dec 31, 1962

Three copies to be filed by the owner with the County Clerk & Recorder of the County in which the well is located.

PLEASE ANSWER ALL QUESTIONS. IF NOT APPLICABLE, SO STATE, OTHERWISE THE FORM WILL BE RETURNED.

Original to the County Clerk & Recorder; duplicate to the State Engineer; Triplicate to the School of Mines and Quadruplicate for the Appropriator.

397164

GLENNON H. WATSON

TO

THE PUBLIC

DECLARATION OF VESTED
GROUNDWATER RIGHTS

STATE OF MONTANA, ss.
COUNTY OF HILL)
Filed at... 11 o'clock a.m.

ON DEC 31 1963
I. G. Blain
COUNTY CLERK

DEPUTY

FEE: \$2.00 pd.

GW-4
FILE NO. _____
DUPLICATE

TWP 34 N RGE 10 E
COUNTY Hill

STATE OF MONTANA
ADMINISTRATOR OF GROUNDWATER CODE
OFFICE OF STATE ENGINEER

RECEIVED
SEP 3 1963

DECLARATION OF VESTED GROUNDWATER RIGHTS
(Under Chapter 237, Montana Session Laws, 1961)

1. Allen J. Chinadle, of Hingham (Town)
(Name of Appropriator) (Address)
County of Hill, State of Montana
Have appropriated groundwater according to the Montana laws in effect prior to Jan. 1, 1962 as follows:

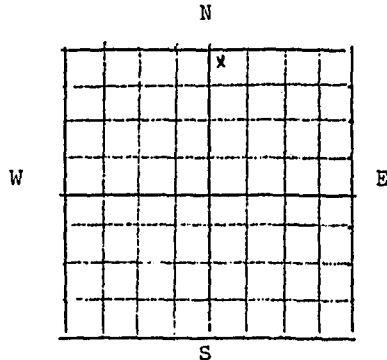

NW ^{1/4} Sec 8 T 34 R 10

Indicate point of appropriation and place of use, if possible. Each small square represents 10 acres.

2. The beneficial use on which the claim is based
House & Stock
3. Date or approximate date of earliest beneficial use; and how continuous the use has been 1916
Continual Use
4. The amount of groundwater claimed (in miner's inches or gallons per minute) 5 gal per min.
5. If used for irrigation, give the acreage and description of the lands to which water has been applied and name of the owner thereof _____
6. The means of withdrawing such water from the ground and the location of each well or other means of withdrawal Jet Pump
7. The date of commencement and completion of the construction of the well, wells, or other works for withdrawal of groundwater 1916
8. The depth of water table 14 Foot
9. So far as it may be available, the type, size and depth of each well or the general specifications of any other works for the withdrawal of groundwater
6' diameter, Hand dug, 12' depth
10. The estimated amount of groundwater withdrawn each year 219,000 gal
11. The log of formations encountered in the drilling of each well if available
Sand
12. Such other information of a similar nature as may be useful in carrying out the policy of this act, including reference to book and page of any county record _____

Signature of Owner Allen Chinadle

Date August 30 1963

Three copies to be filed by the owner with the County Clerk & Recorder of the County in which the well is located.

PLEASE ANSWER ALL QUESTIONS. IF NOT APPLICABLE, SO STATE, OTHERWISE THE FORM WILL BE RETURNED.

Original to the County Clerk & Recorder; duplicate to the State Engineer; Triplicate to the School of Mines and Quadruplicate for the Appropriator.

395061

ALLEN J. CHINADLE

TO

THE PUBLIC

DECLARATION OF VESTED
GROUNDWATER RIGHT

STATE OF MONTANA,
COUNTY OF HILL)
Filed at 11:30 o'clock A.M.

ON AUG 30 1963

R. E. Blom

DEPUTY CLERK

By _____ DEPUTY

FEE: \$2.00 pd.

GWS

File No.

DUPLICATE

T 34^N R 10^E 8
County Hill

STATE OF MONTANA
ADMINISTRATOR OF GROUNDWATER CODE
OFFICE OF STATE ENGINEER

RECEIVED
SEP 3 1963

STATE ENGINEER

Notice of Completion of Groundwater Appropriation Without Well

(Under Chapter 237 Montana Session Laws, 1961)

Date of Appropriation of Groundwater July 1961
Owner Allen J. Chinade Address Higginsham
Contractor (if any) Ralph George Construction
Address of Contractor HAIRE, Mont
Date Started July 1961 Date Completed July 1961

Describe means of obtaining groundwater without a well "as by sub-irrigation and other natural processes". Include depth to water when applicable. 14' to water

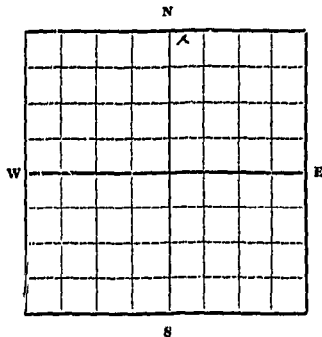

NW 1/4 of Sec. 8, T.34. N. 10. E.

Indicate point of appropriation and place of use, if possible.

Quantity of water developed and used with explanation of method used to measure or estimate such amount. If use is intermittent estimate approximate lengths of periods of use

Used Summer Months
1000 gal per day by
pumping into tank

Signature of Owner Allen Chinade

Date August 30 1963

This form to be prepared by contractor (if any), otherwise by the owner.

Three copies of this notice are to be filed with the County Clerk and Recorder of the county in which the works are located.

Please answer all questions. If not applicable, so state, otherwise the form will be returned.

Original to the County Clerk and Recorder; duplicate to the State Engineer; Triplicate to the School of Mines and Quadruplicate for the Appropriator.

395060

ALLEN J. CHINADLE

TO

THE PUBLIC

NOTICE OF COMPLETION OF
GROUNDWATER APPROPRIATION
WITHOUT WELL

STATE OF MONTANA, ss.
COUNTY OF HILL)
Filed at 11:30 o'clock A.M.

ON AUG 30 1963

R. E. Blom

CLERK

By _____ DEPUTY

FEE: \$2.00 pd.

GW2

File No.

DUPLICATE

T 34 N R 10 E 2H

County **DEUEL**

STATE OF MONTANA
ADMINISTRATOR OF GROUNDWATER CODE
OFFICE OF STATE ENGINEER

Notice of Completion of Groundwater Appropriation by Means of Well

(Under Chapter 237, Montana Session Laws, 1961)

Owner **A. F. Burkhartsmeyer** Address **Gildford, Montana**

Driller **Lloyd G. Hanberg** Address **Box Elder, Montana**

Date of Notice of Appropriation of Groundwater **June 11, 1962**

Date well started **June 11, 1962** Date Completed **June 15, 1962**

Type of well **drilled** Equipment Used **spudger**
(dug, driven, bored or drilled) (Churn, drill, rotary or other)

Water Use: Domestic Municipal Stock Irrigation
Industrial Drainage Other

Indicate on the diagram the character and thickness of the different strata met with in drilling, such as soil, clay, shale, gravel, rock or sand, etc. Show depth at which water is encountered, thickness and character of water-bearing strata and height to which the water rises in the well.

Top of Ground
(Elev. above sea level...2950.....)

0 top soil
1 silty clay
6 sandy clay, yellow
16 boulders
18 quick sand
26 sandy yellow clay
32 yellow clay with show of grey
36 grey clay, sandy
46 grey sandstone, Judith river
58 grey shale, sandy
66 grey shale
70 grey sandy shale

well completed

Size of Drilled Hole	Size and Weight of Casing	From (Feet)	To (Feet)	PERFORATIONS		
				Kind Size	From (Feet)	To (Feet)
6 3/4"	6" O.D. 10.40	0	38	none	none	none
	4 1/2" O.D. 8.75	34	70	slot	40	58

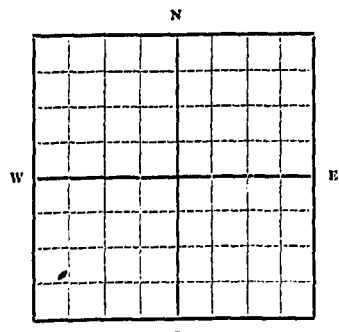

Indicate location of well and place of use, if possible. Each small square represents 10 acres.

Show exact depth of bottom.

Static Water Level for non-flowing Well..... **20** feet.

Shut-in Pressure for Flowing Well

Pumping Water Level.....feet at **8** gal. per minute.

Discharge in gal. per min. of flowing well

How Tested **bailer** Length of Test **4 hrs.**

Remarks: (Gravel packing, cementing, packers, type of shutoff, location of place of use of groundwater if not at well, and any other similar pertinent information, including number of acres irrigated, if used for irrigation)

State License # **6**
Driller's License Number

Lloyd G. Hanberg
Driller's Signature

This form to be prepared by driller, and three copies to be filed by the owner with the County Clerk and Recorder in the county in which the well is located.

Please answer all questions. If not applicable, so state, otherwise the form will be returned.

Original to the County Clerk and Recorder; duplicate to the State Engineer; Triplicate to the School of Mines and Quadruplicate for the Appropriator.

964

#1

£ 389384

A F BURKHARTSMEY R

TO

THE PUBLIC

NOTICE OF COMPLETION OF ~~GROUND~~ WATER
RIGHTS BY MEANS OF A WELL.

STATE OF MONTANA,) ss.
COUNTY OF HILL)

Filed at 3.00'clock P.M.

ON JUN 8 1962

COUNTY CLERK

By _____ DEPUTY

FEE \$2.00 pd

File No. _____

T. 34th R. 10^E

DUPLICATE

County _____

STATE OF MONTANA
ADMINISTRATOR OF GROUNDWATER CODE
OFFICE OF STATE ENGINEER

RECEIVED
JAN 18 1969

Declaration of Vested Groundwater Rights

(Under Chapter 237, Montana Session Laws, 1961)

STATE ENGINEER

1. Walter Greene of Rudyard
(Name of Appropriator) (Address)
County of Hill State of Montana
have appropriated groundwater according to the Montana laws in effect prior to January 1, 1962, as follows:

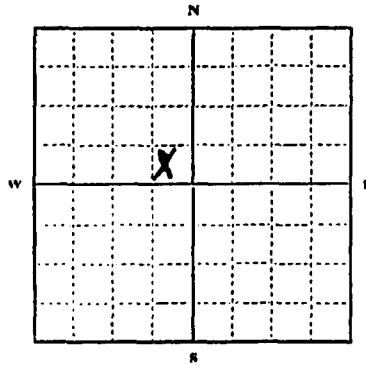

NW 1/4 Sec. 30 T. 34 R. 10

Indicate point of appropriation and place of use, if possible. Each small square represents 10 acres.

2. The beneficial use on which the claim is based... Farm - Home + Stock

3. Date or approximate date of earliest beneficial use; and how continuous the use has been... Continuous since about 1913

4. The amount of groundwater claimed (in miner's inches or gallons per minute)... 1.2

5. If used for irrigation, give the acreage and description of the lands to which water has been applied and name of the owner thereof... None

6. The means of withdrawing such water from the ground and the location of each well or other means of withdrawal... Pumps + Pipes

7. The date of commencement and completion of the construction of the well, wells, or other works for withdrawal of groundwater... 1913

8. The depth of water table... 90 feet

9. So far as it may be available, the type, size and depth of each well or the general specifications of any other works for the withdrawal of groundwater... 6 in casing 90 feet deep

10. The estimated amount of groundwater withdrawn each year... 25,000 gals.

11. The log of formations encountered in the drilling of each well if available... Not known.

12. Such other information of a similar nature as may be useful in carrying out the policy of this act, including reference to book and page of any county record.

Signature of Owner... Walter Greene

Date... Dec. 31, 1968.

Three copies to be filed by the owner with the County Clerk and Recorder of the county in which the well is located.

Please answer all questions. If not applicable, so state, otherwise the form will be returned.

Original to the County Clerk and Recorder; Duplicate to the State Engineer; Triplicate to the Montana Bureau of Mines and Geology, and Quadruplicate for the Appropriator.

397089

WALTER GREENO

TO

THE PUBLIC

DECLARATION OF VESIED
GROUNDWATER RIGHTS

STATE OF MONTANA,) ss.
COUNTY OF HILL)
Filed at 11 o'clock a.m.

ON DEC 21 1963

COUNTY CLERK

DEPUTY

PER: \$2.00 pd.