

File No.

T. 16 N R 19 W

DUPLICATE

County Lake

STATE OF MONTANA
ADMINISTRATOR OF GROUNDWATER CODE
OFFICE OF STATE ENGINEER

RECEIVED
AUG 21 1963

STATE ENGINEER

Notice of Completion of Groundwater Appropriation Without Well

(Under Chapter 237 Montana Session Laws, 1961)

Date of Appropriation of Groundwater.....

Owner T.O. Million Address Arlee Mont

Contractor (if any) not known

Address of Contractor

Date Started not known Date Completed not known

Describe means of obtaining groundwater without a well "as by sub-irrigation and other natural processes". Include depth to water when applicable. Springs developed, 4 feet to water.

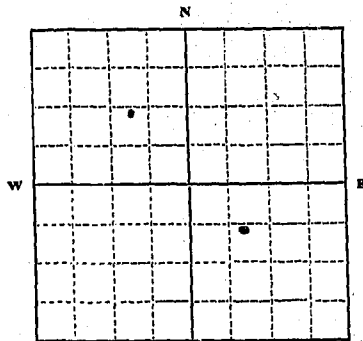

SE 1/4 NW Sec 5 T 16 N R 19 W

Indicate point of appropriation and place of use, if possible.

NW 1/4 SE sec 5 T 16 N R 19 W

Quantity of water developed and used with explanation of method used to measure or estimate such amount. If use is intermittent

estimate approximate lengths of periods of use Year Around usage, each spring running approximately 25 gallons per minute.

T.O. Million

Signature of Owner T.O. Million

Date 13 August 1963

This form to be prepared by contractor (if any), otherwise by the owner.

Three copies of this notice are to be filed with the County Clerk and Recorder of the county in which the works are located.

Please answer all questions. If not applicable, so state, otherwise the form will be returned.

Original to the County Clerk and Recorder; duplicate to the State Engineer; Triplicate to the Montana Bureau of Mines and Geology and Quadruplicate for the Appropriator.

R-203

160825

Water Report

D. O. Millian
to
The Public

STATE OF MONTANA
County of Lake

Filed on the 19 day of August
A. D. 1963 at 11:07 o'clock A. M.

HAZEL KINNICK

County Clerk and Recorder

By M. Kraus Deput

\$200

T. 16N R. 19W 6/

County Lake

MONTANA BUREAU OF MINES AND GEOLOGY
Butte, Montana

RECEIVED
APR 25 1961

WATER WELL LOG

STATE ENGINEER

Owner E H Badgley Address Missoula Montana

Driller John Farrell Address Arlee Montana

Date Started April 5-1961 Date Completed April 14-1961

Location: Sec. 6 T. 16 R. 19 1/4 sec. Lots 3 & 4

Type of well..... X (Dug, driven, bored, or drilled) Equipment used..... X (Churn drill, rotary, other)

Water use: Domestic Municipal Stock Irrigation

Industrial Drainage Other:.....

Casing: 6 ft. to 102 ft. Type 24 LB steel Size 6'

Casing:..... ft. to..... ft. Type..... Size.....

Casing:..... ft. to..... ft. Type..... Size.....

Perforated or Screened: Ft..... to ft..... Ft..... to ft.....

Type of screen or perforations.....

Static Water level, for non-flowing well:..... 14 feet.

Shut-in pressure, for flowing well:..... lb./sq. in. on: April 14-1961
(date)

Pumping water level..... 90 feet at..... 18 gal. per min.

How tested: Bailey

Length of test..... 1 Hr

Remarks: (Gravel packing, cementing, packers, type of shut-off, depth of shut-off)
.....
.....
.....
.....

(over)

File No.

T. 16 R. 19

DUPLICATE

MONTANA WATER RESOURCES BOARD

County Lake

RECEIVED

JAN 24 1968

STATE OF MONTANA
ADMINISTRATOR OF GROUNDWATER CODE
OFFICE OF STATE ENGINEER



Top of Ground
(Elev. above sea level)

Notice of Completion of Groundwater Appropriation by Means of Well

(Under Chapter 237, Montana Session Laws, 1961)

Top Soil

Owner Gary Chambers Address Arlee Montana

Gravel Sand Clay

Driller John Farrell Address Arlee Montana

Gravel & Water

Date of Notice of Appropriation of Groundwater

Date well started June 12 1967 Date Completed June 23 1967

Type of well Drilled Equipment Used Clayton Drill
(dug, driven, bored or drilled) (Churn, drill, rotary or other)

Water Use: Domestic Municipal Other Irrigation
Industrial Drainage Stock

Indicate on the diagram the character and thickness of the different strata met with in drilling, such as soil, clay, shale, gravel, rock or sand, etc. Show depth at which water is encountered, thickness and character of water-bearing strata and height to which water rises in the well.

Size of Drilled Hole	Size and Weight of Casing	From (Feet)	To (Feet)	PERFORATIONS		
				Kind Size	From (Feet)	To (Feet)
6"	(6" 17#)	0	105'			

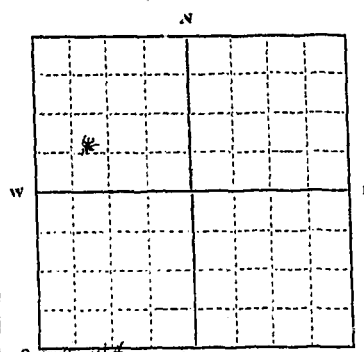

N 2 1/2 SW 1/4 Sec. 6 T. 16 R. 19

Indicate location of well and place of use, if possible. Each small square represents 10 acres.

Show exact depth of bottom.

Static Water Level for non-flowing Well 92 feet.

Shut-in Pressure for Flowing Well

Pumping Water Level 100 feet at 12 gal. per minute.

Discharge in gal. per min. of flowing well

How Tested Pump Length of Test 1 Hour

Remarks: (Gravel packing, cementing, packers, type of shutoff, location of place of use of groundwater if not at well, and any other similar pertinent information, including number of acres irrigated, if used for irrigation)

14
Driller's License Number

John Farrell
Driller's Signature

This form to be prepared by driller, and three copies to be filed by the owner with the County Clerk and Recorder in the county in which the well is located.

Please answer all questions. If not applicable, so state, otherwise the form will be returned.

Original to the County Clerk and Recorder; duplicate to the State Engineer; Triplicate to the Montana Bureau of Mines and Geology and Quadruplicate for the Appropriator.

42, 7-79.

File No. _____

T. 16 N. R. 19 W

DUPLICATE

County Lake

STATE OF MONTANA
ADMINISTRATOR OF GROUNDWATER CODE
OFFICE OF STATE ENGINEER

RECEIVED
AUG 21 1963

Declaration of Vested Groundwater Rights STATE ENGINEER
(Under Chapter 237, Montana Session Laws, 1961)

1. T. O. Million, of Arke
(Name of Appropriator) (Address) (Town)
County of Lake State of Mont
have appropriated groundwater according to the Montana laws in effect prior to January 1, 1962, as follows:

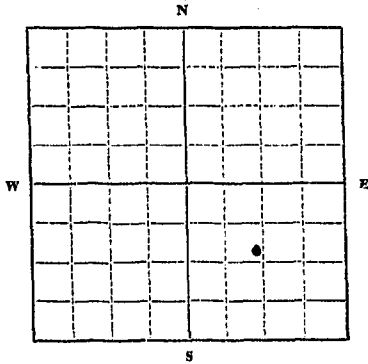

NW 1/4 SE Sec. 6 T. 16 N. R. 19 W

Indicate point of appropriation and place of use, if possible. Each small square represents 10 acres.

- 2. The beneficial use on which the claim is based Domestic & stock water
- 3. Date or approximate date of earliest beneficial use; and how continuous the use has been Complete in 1925, has been in continuous usage since then
- 4. The amount of groundwater claimed (in miner's inches or gallons per minute) forty gallons per minute
- 5. If used for irrigation, give the acreage and description of the lands to which water has been applied and name of the owner thereof For irrigating garden & yard space, T. O. Million. Also main water supply for house.
- 6. The means of withdrawing such water from the ground and the location of each well or other means of withdrawal Pumping

7. The date of commencement and completion of the construction of the well, wells, or other works for withdrawal of groundwater 1925, exact date unknown

8. The depth of water table 135 Feet

9. So far as it may be available, the type, size and depth of each well or the general specifications of any other works for the withdrawal of groundwater Water well, six inch, 144 feet total depth.

10. The estimated amount of groundwater withdrawn each year 800,000 gallons per year

11. The log of formations encountered in the drilling of each well if available Not Known

12. Such other information of a similar nature as may be useful in carrying out the policy of this act, including reference to book and page of any county record Not Known

Signature of Owner T. O. Million
Date 13 August 1963

Three copies to be filed by the owner with the County Clerk and Recorder of the county in which the well is located.

Please answer all questions. If not applicable, so state, otherwise the form will be returned.

Original to the County Clerk and Recorder; duplicate to the State Engineer; Triplicate to the Montana Bureau of Mines and Geology, and Quadruplicate for the Appropriator.

R-202

160824

Water Report
D. O. Milhoir
to
The Public

STATE OF MONTANA }
County of Lake, }

Filed on the 19 day of August
A. D. 1963 at 11:05 o'clock A.M.

HAZEL KINNICE
County Clerk and Recorder

By M. Kraus
Deputy

200

File No.

RECEIVED

T. 16N R. 19W

TRIPPLICATE

MAY 25 1970

County Lake

LOG

STATE OF MONTANA
ADMINISTRATOR OF GROUNDWATER CODE
OFFICE OF STATE ENGINEER

Notice of Completion of Groundwater
Appropriation by Means of Well
DEVELOPED AFTER JANUARY 1, 1962

(Under Chapter 237, Montana Session Laws, 1961)

John R. and

Owner: ~~Lawrence~~ Koelbel Address: Missoula, Montana

Driller: Liberty Drilling Co. Address: Missoula, Montana

Date of Notice of appropriation of groundwater: None filed.

Date well started: 5/2/69 Date completed: 5/21/69

Type of well: Drilled Equipment used: Cable tools
(Dug, Driven, bored or drilled) (Churn drill, rotary or other)

Water use: Domestic Municipal Stock Irrigation
Industrial Drainage Other

Indicate on the diagram the character and thickness of the different strata met with in drilling, such as soil, clay, shale, gravel, rock or sand, etc. Show depth at which water is encountered, thickness and character of water-bearing strata and height to which the water rises in the well.

- Top of Ground (Elev. above sea level: 3146.72)
- Formations Log:
 - 0 - 14 Sand and gravel mixed with cobbles.
 - 14 - 22 Cobblestones and gravel mixed in clay.
 - 22 - 27 Fine sand and gravel.
 - 27 - 43 Gravel and cobblestones mixed in sandy clay.
 - 43 - 86 Sand and gravel mixed in clay.
 - 86 - 98 Gravel and cobblestones mixed in clay.
 - 98 - 127 Sandy clay, some gravel mixed in.
 - 127 - 149 Fine sand and gravel mixed in clay. Seeps of water.
 - 149 - 152 Silty sand, some gravel mixed in.
 - 152 - 179 Gravel and cobblestones mixed in sandy clay.
 - 179 - 182 Clean coarse gravel. Water.

Size of Drilled Hole	Size and Weight of Casing	From (Feet)	To (Feet)	PERFORATIONS		
				Kind Size	From (Feet)	To (Feet)
6"	6 5/8" x 1/2"	+1.9"	182	N	O	N

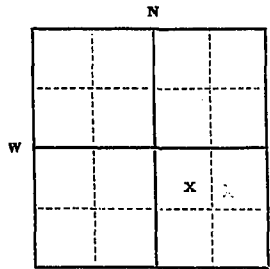

Static Water Level for non-flowing well 125 feet.

Shut-in Pressure for Flowing Well ~~None~~
Pumping Water Level 160 feet
at 35 gal. per minute.

Discharge in gal. per min. of flowing well
~~Non-flowing~~

How Tested: Air Lift Pump
Length of Test: 4

Remarks: (Gravel packing, cementing, packers, type of shutoff) All water entering well is coming through the open bottom of six inch casing. Wells in this area

Water rises in well 125 feet from surface.

NE 1/4 Sec. 7 T. 16N. 19W
Indicate location of well and place of use, if possible. Each small square represents 40 acres.

Doc. No. 1209
Filed for record this 29 day of May A. D. 1970, at 2:12 o'clock P. M.

can be depended upon to produce clear sand free water year after year as long (Continue on reverse side)

USE If used for irrigation, industrial, drainage or other. Explain, state number of acres and location or other data (i.e.: Lot, Block and Addition).

Approximately 80 acres.

Show exact depth of bottom.
Bottom of well 182 ft.

This form to be prepared by driller, and three copies to be filed by the owner with the County Clerk and Recorder in the county in which the well is located, tissue copy to be retained by driller.

Please answer all questions. If not applicable, so state, otherwise the form will be returned.

52
Driller's License Number

William F. Osborne
Driller's Signature

as they are not overpumped, i.e., they should be pumped at rates not in excess of 50 percent of the tested capacity of the aquifer.

R- 1207

WELL REPORT

John R. Koelbel

To

The Public

STATE OF MONTANA | ss
County of Lake

Filed on the 22 day of May
A. D. 19 70 at 2:12 o'clock P. M.

ETHEL M. HARDING

County Clerk and Recorder

by *(Signature)*
Deputy

File No.

T. 16^W R. 19^S

DUPLICATE

County

STATE OF MONTANA
ADMINISTRATOR OF GROUNDWATER CODE
OFFICE OF STATE ENGINEER

RECEIVED
JAN 10 1964

Declaration of Vested Groundwater Rights

(Under Chapter 237, Montana Session Laws, 1961)

STATE ENGINEER

1. Alfred G. Walkor, of Arlee
(Name of Appropriator) (Address) (Town)
County of Lake State of Montana
have appropriated groundwater according to the Montana laws in effect prior to January 1, 1962, as follows:

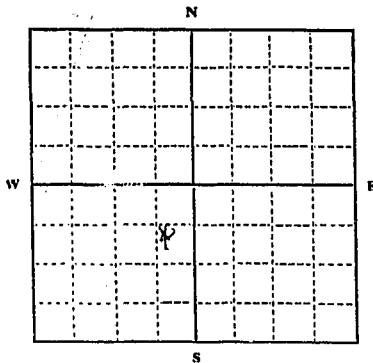

1/4 Sec. 7 T. 16 R. 19

Indicate point of appropriation and place of use, if possible. Each small square represents 10 acres.

- 2. The beneficial use on which the claim is based. Domestic use, stock water, and irrigation for yard and garden
- 3. Date or approximate date of earliest beneficial use; and how continuous the use has been. March 1953
Continuous use
- 4. The amount of groundwater claimed (in miner's inches or gallons per minute) 50 gallon per minute
- 5. If used for irrigation, give the acreage and description of the lands to which water has been applied and name of the owner thereof. Garden and yard around the house
- 6. The means of withdrawing such water from the ground and the location of each well or other means of withdrawal. Electric submersible pump

- 7. The date of commencement and completion of the construction of the well, wells, or other works for withdrawal of groundwater. Drilled in March of 1953, completed in Feb of 1953.
- 8. The depth of water table. 104 feet
- 9. So far as it may be available, the type, size and depth of each well or the general specifications of any other works for the withdrawal of groundwater. 110 foot deep with 5 inch casing.
- 10. The estimated amount of groundwater withdrawn each year. 100,500 gallon
- 11. The log of formations encountered in the drilling of each well if available. Sand, gravel, and chert rock.
- 12. Such other information of a similar nature as may be useful in carrying out the policy of this act, including reference to book and page of any county record. Location of well.

Signature of Owner Alfred G. Walkor
Date Dec 30, 1963

Three copies to be filed by the owner with the County Clerk and Recorder of the county in which the well is located.

Please answer all questions. If not applicable, so state, otherwise the form will be returned.

Original to the County Clerk and Recorder; Duplicate to the State Engineer; Triplicate to the Montana Bureau of Mines and Geology, and Quadruplicate for the Appropriator.

28966

File No. _____

DUPLICATE

County _____

**STATE OF MONTANA
ADMINISTRATOR OF GROUNDWATER CODE
OFFICE OF STATE ENGINEER**

RECEIVED
JAN 10 1964

Declaration of Vested Groundwater Rights

(Under Chapter 237, Montana Session Laws, 1961)

I, Alfred G. Walker, of _____
(Name of Appropriator) (Address) (Town)
County of _____ State of _____
have appropriated groundwater according to the Montana laws in effect prior to January 1, 1962, as follows:

Sec. 7 T. 16 R. 19

Indicate point of appropriation and place of use, if possible. Each small square represents 10 acres.

- The beneficial use on which the claim is based. Domestic use, stock water, and irrigation for yard and garden
- Date or approximate date of earliest beneficial use; and how continuous the use has been. March 1953
Continuous use
- The amount of groundwater claimed (in miner's inches or gallons per minute). 50 gallon per minute
- If used for irrigation, give the acreage and description of the lands to which water has been applied and name of the owner thereof. Garden and yard around the house
- The means of withdrawing such water from the ground and the location of each well or other means of withdrawal. Electric submersible pump

- The date of commencement and completion of the construction of the well, wells or other works for withdrawal of groundwater. Drilled in March of 1953, completed in March of 1953.
- The depth of water table. 104 feet
- So far as it may be available, the type, size, and depth of each well or the general specifications of any other works for the withdrawal of groundwater. 115 foot deep with 5 inch casing
- The estimated amount of groundwater withdrawn each year. 182,500 gallon
- The log of formations encountered in the drilling of each well if available. Sand, gravel, and shale rock.
- Such other information of a similar nature as may be useful in carrying out the policy of this act, including reference to book and page of any county record. Location of city.

Signature of Owner Alfred G. Walker
Date Dec 30, 1963

Three copies to be filed by the owner with the County Clerk and Recorder of the county in which the well is located.

Please answer all questions. If not applicable, so state, otherwise the form will be returned.

Original to the County Clerk and Recorder; Duplicate to the State Engineer; Triplicate to the Montana Bureau of Mines and Geology, and Quadruplicate for the Appropriator.

28966

R889

63275

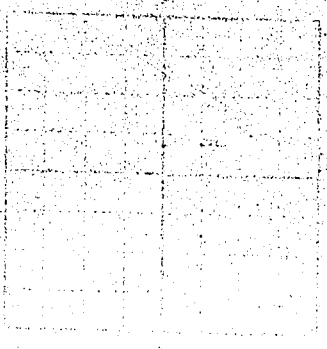

STATE OF MONTANA
County of Lake, ³²

Filed on the 6 day of Jan
A. D. 1964 at 8:44 o'clock A. M.

HAZEL KINNICK

County Clerk and Recorder

By C. Cowman
Deputy

File No.

RECEIVED

T. 16N R. 19W

DUPLICATE

NOV 20 1969

County Lake

LOG

STATE OF MONTANA
ADMINISTRATOR OF GROUNDWATER CODE
OFFICE OF STATE ENGINEER

Notice of Completion of Groundwater Appropriation by Means of Well

DEVELOPED AFTER JANUARY 1, 1962

(Under Chapter 237, Montana Session Laws, 1961)

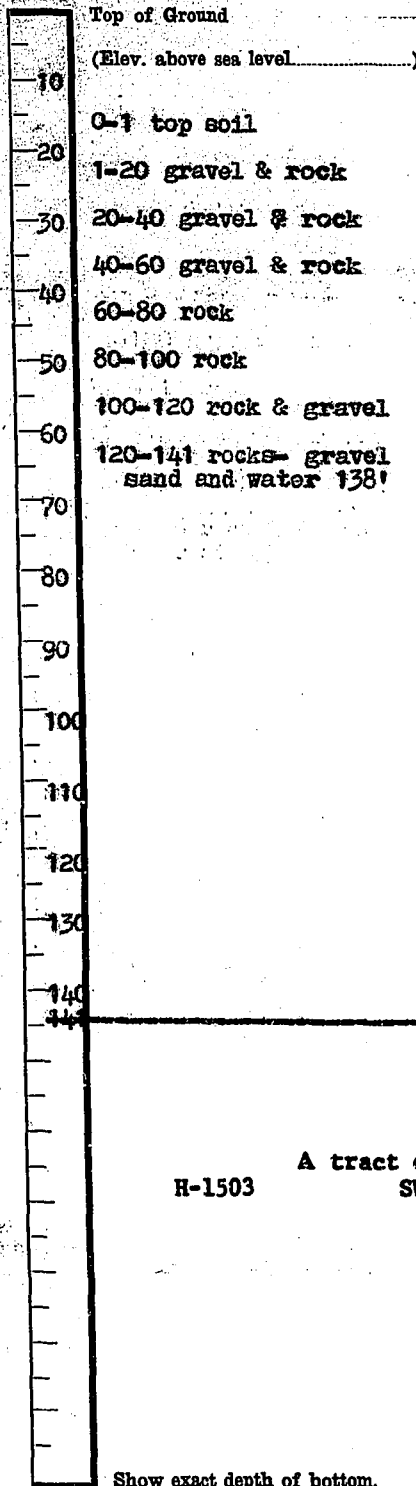

Owner Roger W. Busby Address Arlee
 Driller O. Keefe Drilling Co. Address Butte, Montana
 Date of Notice of appropriation of groundwater Sept. 18, 1969
 Date well started Sept. 7, 1969 Date completed Sept. 6, 1969
 Type of well drilled Equipment used churn drill
 (Dug, Driven, bored or drilled) (Churn drill, rotary or other)
 Water use: Domestic Municipal Stock Irrigation
 Industrial Drainage Other

Indicate on the diagram the character and thickness of the different strata met with in drilling, such as soil, clay, shale, gravel, rock or sand, etc. Show depth at which water is encountered, thickness and character of water-bearing strata and height to which the water rises in the well.

Size of Drilled Hole	Size and Weight of Casing	From (Feet)	To (Feet)	PERFORATIONS		
				Kind Size	From (Feet)	To (Feet)
6"	6" I.D. 17 lb.	0'	141'	cutting torch	135'	140'

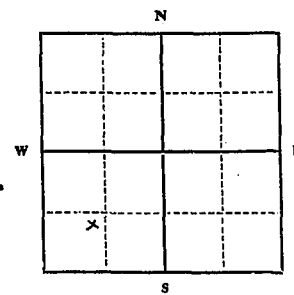

Static Water Level for non-flowing well 125' feet.
 Shut-in Pressure for Flowing Well.....feet
 Pumping Water Level.....feet
 at 12 gal. per minute.
 Discharge in gal. per min. of flowing well

How Tested bailer
 Length of Test 3 hours
 Remarks: (Gravel packing, cementing, packers, type of shutoff).....

H-1503 A tract of land located in SW 1/4 Sec. 9 T. 16 R. 19W
 Indicate location of well and place of use, if possible. Each small square represents 40 acres.

.....(Continue on reverse side)
 USE—If used for irrigation, industrial, drainage or other. Explain, state number of acres and location or other data (i.e.: Lot, Block and Addition).

Show exact depth of bottom.

This form to be prepared by driller, and three copies to be filed by the owner with the County Clerk and Recorder in the county in which the well is located, tissue copy to be retained by driller.

Please answer all questions. If not applicable, so state, otherwise the form will be returned.

Driller's License Number
 Driller's Signature
 45886

R-1177
191128
ROGER W. HUBBY

TO
THE PUBLIC
WELL REPORT

STATE OF MONTANA
County of Lake
Filed on the _____ day of _____
A. D. 19 11 of Nov M
By [Signature] Deputy Recorder
69
COUNTY OF LAKE

2.00

Flow information for "Point 1" shows
flow of water from the well
flow of water from the well
flow of water from the well
flow of water from the well
flow of water from the well
flow of water from the well
flow of water from the well
flow of water from the well
flow of water from the well
flow of water from the well

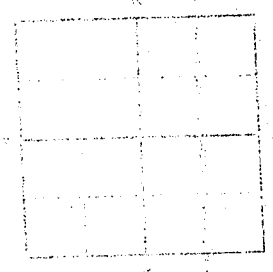

Flow	Flow	Flow	Flow	Flow	Flow
(ft/min)	(ft/min)	(ft/min)	(ft/min)	(ft/min)	(ft/min)

Flow information for "Point 2" shows
flow of water from the well
flow of water from the well
flow of water from the well
flow of water from the well
flow of water from the well
flow of water from the well
flow of water from the well
flow of water from the well
flow of water from the well
flow of water from the well

191128
COUNTY OF LAKE

File No. _____

T. 16 N. R. 19 W. 9

DUPLICATE

County Lake

STATE OF MONTANA
ADMINISTRATOR OF GROUNDWATER CODE
OFFICE OF STATE ENGINEER

RECEIVED
JAN 6 1964

Declaration of Vested Groundwater Rights

(Under Chapter 237, Montana Session Laws, 1961)

STATE ENGINEER

1. Dale R. Colvin, of Arlee
(Name of Appropriator) (Address)

County of Lake State of Montana
have appropriated groundwater according to the Montana laws in effect prior to January 1, 1962, as follows:

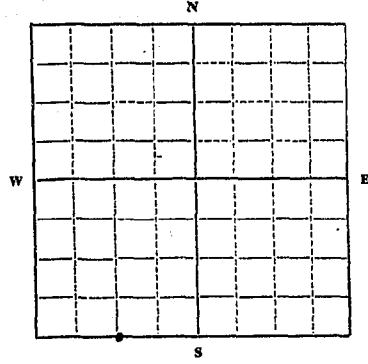

SE 1/4 SW Sec 9 T. 16 N. R. 19 W.
Indicate point of appropriation and place of use, if possible. Each small square represents 10 acres.

2. The beneficial use on which the claim is based Domestic & Stock water & Irrigation

3. Date or approximate date of earliest beneficial use; and how continuous the use has been Un Known

4. The amount of groundwater claimed (in miner's inches or gallons per minute) 30 gallons per minute

5. If used for irrigation, give the acreage and description of the lands to which water has been applied and name of the owner thereof
Used on section nine Dale R. Colvin

6. The means of withdrawing such water from the ground and the location of each well or other means of withdrawal
Electric pump

7. The date of commencement and completion of the construction of the well, wells, or other works for withdrawal of groundwater Un Known

8. The depth of water table Un Known

9. So far as it may be available, the type, size and depth of each well or the general specifications of any other works for the withdrawal of groundwater
Water well, six inch, 110 feet

10. The estimated amount of groundwater withdrawn each year 500,000 gallons per year

11. The log of formations encountered in the drilling of each well if available
Un Known

12. Such other information of a similar nature as may be useful in carrying out the policy of this act, including reference to book and page of any county record
Un Known

Signature of Owner Dale R. Colvin

Date 13 August 1963

Three copies to be filed by the owner with the County Clerk and Recorder of the county in which the well is located.

Please answer all questions. If not applicable, so state, otherwise the form will be returned.

Original to the County Clerk and Recorder; duplicate to the State Engineer; Triplicate to the Montana Bureau of Mines and Geology, and Quadruplicate for the Appropriator.

24366

R-866
163214

Dale R. Colvin

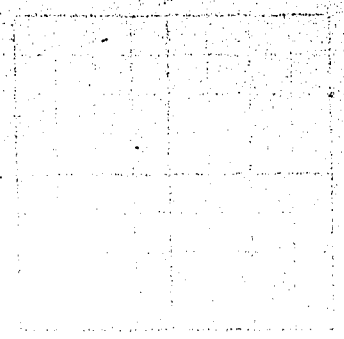

STATE OF MONTANA
County of Lake,
Filed on the 31 day of Dec
A. D. 1963 at 5:39 o'clock P. M.
HAZEL KENNEDY
County Clerk and Recorder
By M. Kraus
200 Deposits

RECORDED
INDEXED
DEC 31 1963
COUNTY CLERK
HAZEL KENNEDY

Electronically Recorded



MONTANA WATER RESOURCES BOARD
RECEIVED

16N-19W
County Lake

OCT 19 1970

STATE OF MONTANA
ADMINISTRATOR OF GROUNDWATER CODE
MONTANA WATER RESOURCES BOARD

DRILLER'S LOG

Indicate the character, color, thickness of strata such as soil, clay, sand, gravel, shale, sandstone, etc. Show depth at which water is found and height to which water rises in well.

NOTICE OF COMPLETION OF GROUNDWATER APPROPRIATION BY MEANS OF WELL

Developed after January 1, 1962

(Under Chapter 237, Montana Session Laws, 1961, as amended)

This form to be prepared by driller, and three copies to be filed by the owner with the County Clerk and Recorder in the county in which the well is located, last copy to be retained by driller.

Please answer all questions. If not applicable, so state, otherwise the form may be returned.

Approx. **3360**

Top of Ground (Elev. above sea level)

Owner John Finley

Address Arlee, Montana

Date well started 12/3/69

completed 12/4/69

For Administrator's Use

File 195651
October 15, 1970
J.S.P.R.M.

GW 1

Type of well Drilled

(Dug, driven, bored or drilled)

Equipment used Air Rotary

(Churn drill, rotary or other)

Water Use: Domestic Municipal Stock Irrigation

Industrial Drainage Other Garden/Lawn

*Describe

USE: If used for irrigation, industrial, drainage or other. Explain, state number of acres and location or other data (i.e. Lot, Block and Addition). Approximately 100 acres.

ESTIMATED ANNUAL WITHDRAWAL Unknown

Size of Drilled Hole	Size and Weight of Casing	From (Feet)	To (Feet)	PERFORATIONS		
				Kind Size	From (Feet)	To (Feet)
6"	6 5/8" OD x 1/4"	+2	36	N	O	N

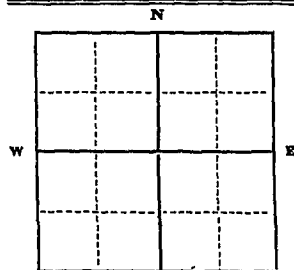

Static water level 50 ft.*
Pumping water level 63 ft.*
at 20 gallons per minute,
measured 1 1/2 hours after pumping began.

*Measured from ground level.
Well developed by Air Lift for 1 1/2 hours. Pump Power 230 V Pump 1/2 HP

Remarks: (Gravel packing, cementing, packers, type of shutoff) All water entering well through cracks and seams in the rock. Wells in this area

SW 1/4 NE 1/4, SE 1/4 NW 1/4, & part of NE 1/4 SW 1/4 Sec. 9
T. 16 N. R. 19 E.

Line north of Locks River.
INDICATE LOCATION OF WELL AND PLACE OF USE, IF POSSIBLE. EACH SMALL SQUARE REPRESENTS 40 ACRES.

Driller's Signature William J. Calhoun
Driller's Address 2500 Reserve Street

Missoula, Montana LICENSE NO. 52

98 ft. Show exact depth of bottom water rises in well 50 feet to surface.

47647

R-1367

204985

WELL REPORT
TONY HOYT
TO
THE PUBLIC

STATE OF MONTANA) ss
County of Lake

Filed on the 7th day of Aug
A. D. 19 72 at 11:10 o'clock A.M.
ETHEL M. HARDING

County Clerk and Recorder
By Laurie Barrows
Deputy

Special Instructions:

Please provide the information as indicated in red on the attached form.

Thank you.

Completed and endorsed

Thank of
for that

1972

Montana Department of Natural Resources and Conservation
 Resources Division
 Engineering Bureau
 Groundwater Section
 Sam W. Mitchell Building
 Helena, Montana 59601

Owner Tony Hoyt
 Address Box 51 - Arlee MT 59821
 Location T. 16N R. 19W Sec. 9
 Doc. No. R-1367, 204985

As the Administrator of the Groundwater Code for the State of Montana, please take note of the following special instructions, in order to properly protect your groundwater right.

Special Instructions:

Please provide the information as indicated in red on the attached ^{form}.

Thank you.

Completed out enclosed

*Thank of
Tony Hoyt*

RECEIVED

OCT 13 1972

MONTANA DEPARTMENT OF NATURAL RESOURCES AND CONSERVATION

(Churn drill, rotary or other)

Water Use: Domestic Municipal Stock Irrigation
 Industrial Drainage Other Garden/Lawn

*Describe _____

USE: If used for irrigation, industrial, drainage or other. Explain, state number of acres and location or other data (i.e. Lot, Block and Addition). _____

ESTIMATED ANNUAL WITHDRAWAL _____

Size of Drilled Hole	Size and Weight of Casing	From (Feet)	To (Feet)	PERFORATIONS		
				Kind Size	From (Feet)	To (Feet)
6"	6 5/8" od x .250	2 1/2'	47'	none		

Static water level 17 ft.*
 Pumping water level 9.2 ft.*
 at 25 gallons per minute,
 measured 2.1 minutes after pumping
 began. *Bailing*
 *Measured from ground level.
 Well developed by Bailing
 for 2 hours.
 Power _____ Pump _____ HP
 Remarks: (Gravel packing, cementing,
 packers, type of shutoff) _____
Shutoff by
D. J. J. J. J.

Tr Lot 2 Jack & Kenneth

16 1/4 Sec. 9
 T. 16 N. R. 19 E. 9

INDICATE LOCATION OF WELL AND PLACE OF USE, IF POSSIBLE. EACH SMALL SQUARE REPRESENTS 40 ACRES.

Driller's Signature O'Leary Contracting Company
W. F. O'Leary
 Driller's Address 2004 Harvard Ave.

Butte, Montana LICENSE NO. 8 47' Show exact depth of bottom

F.

51,098

RECEIVED

FEB 24 1972

16N-19W 9
County Lake

STATE OF MONTANA MONTANA DEPARTMENT OF NATURAL RESOURCES AND CONSERVATION
ADMINISTRATOR OF GROUNDWATER CODES AND REGULATIONS
MONTANA WATER RESOURCES BOARD

DRILLER'S LOG

Indicate the character, color, thickness of strata such as soil, clay, sand, gravel, shale, sandstone, etc. Show depth at which water is found and height to which water rises in well.

NOTICE OF COMPLETION OF GROUNDWATER APPROPRIATION BY MEANS OF WELL

Developed after January 1, 1962

(Under Chapter 237 Montana Session Laws, 1961, as amended)

This form to be prepared by driller, and three copies to be filed by the owner with the County Clerk and Recorder in the county in which the well is located, last copy to be retained by driller. Please answer all questions. If not applicable, so state, otherwise the form may be returned.

Owner RUSSELL LANE
Address Box 156
Missoula, Mt.
Date well started NOV. 8, 1971
completed DEC. 2, 1971

For Administrator's Use	
File	<u>P. 13.23, 20.23.26</u>
Date	<u>20.23.1972 8:10 a.m.</u>
GW	<u>1</u>

Type of well DRILLED
(Dug, driven, bored or drilled)

Equipment used CHURN
(Churn drill, rotary or other)

Water Use: Domestic Municipal Stock Irrigation
Industrial Drainage Other * Garden/Lawn

*Describe Home use
USE: If used for irrigation, industrial, drainage or other. Explain, state number of acres and location or other data (i.e. Lot, Block and Addition). Tract # 12 Jocko Ranchette

ESTIMATED ANNUAL WITHDRAWAL home use for 2 people

Size of Drilled Hole	Size and Weight of Casing	From (Feet)	To (Feet)	PERFORATIONS		
				Kind	From (Feet)	To (Feet)
<u>6" I.D. 6-5/8" OD</u>	<u>ground level</u>	<u>135 ft.</u>	<u>135 ft.</u>	<u>none</u>	<u>none</u>	<u>none</u>
<u>1/4" side-wall</u>	<u>17 lbs.</u>					

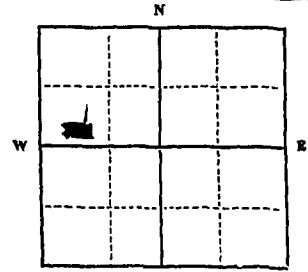

Static water level 118 ft.*
Pumping water level 130 ft.*
at 30 gallons per minute,
measured 60 minutes after pumping began.
*Measured from ground level.
Well developed by ball test and sub test pump
for 4 hours.
Power 230 Pump 3/4 HP
Remarks: (Gravel packing, cementing, packers, type of shutoff)

Tract 12, 9
Jocko Ranchettes 12
T. 16 N. 19 E. 9

INDICATE LOCATION OF WELL AND PLACE OF USE, IF POSSIBLE. EACH SMALL SQUARE REPRESENTS 40 ACRES.

Driller's Signature Herman T. Williams
Driller's Address 1558 So. 5th, W. MISSOULA, MONTANA

Top of Ground		(Elev. above sea level)
From (Feet)	To (Feet)	
<u>41</u>	<u>48</u>	<u>Tan clay, gravel & scattered boulder stones</u>
<u>48</u>	<u>49</u>	<u>bedrock</u>
<u>49</u>	<u>69</u>	<u>Tan clay and gravel</u>
<u>69</u>	<u>73</u>	<u>Tan clay, gravel and boulder</u>
<u>73</u>	<u>89</u>	<u>Tan clay and gravel</u>
<u>89</u>	<u>90</u>	<u>Boulders</u>
<u>90</u>	<u>121</u>	<u>Tan clay, sand and gravel</u>
<u>121</u>	<u>122</u>	<u>Sand, gravel and a seep of water</u>
<u>122</u>	<u>126</u>	<u>Tan clay and gravel</u>
<u>126</u>	<u>135</u>	<u>Sand, gravel and water</u>

LICENSE NO. 151

135 ft. Show exact depth of bottom

49, 915
44, 915

202396

R- 1323

RUSSELL LANE

TO

THE PUBLIC

WELL REPORT

Address: POX 120
Missoula, MT.

Date well completed: [unclear]

Informational form with checkboxes:
- Changes
- Open
- Inspection
- [unclear]

MISSOULA, MONTANA
FEB 23 1972

STATE OF MONTANA } ss
County of Lake

Filed on the 23 day of Feb.

A. D. 1972 at 8:10 o'clock 9 M

By: ETHEL M. HARDING
County Clerk and Recorder
[Signature]
Deputy

1871	1872	1873	1874	1875
1876	1877	1878	1879	1880
1881	1882	1883	1884	1885
1886	1887	1888	1889	1890
1891	1892	1893	1894	1895

Missoula, Montana 59660
August 1, 1972

TO THE
THE
WELL

Missoula, Montana

STATE OF MONTANA
DEPARTMENT OF LAND AND MINES
LAND RIGHTS DIVISION

August 1, 1972

Mrs. Ethel M. Harding
Clerk & Recorder, Lake County
P. O. Box 491
Polson, Montana 59860

Dear Mrs. Harding:

This is in response to your July 21, 1972 letter requesting suggestions on how to correct a typographical error on Well Report, R-1323. The owner is a Mr. Russell Lane who has drilled a well in Tract 12, Jocko Ranchettes in Lake County. The original filing indicated the well to be located in Section 19, Township 16 N, Range 19 W. This particular well filing was returned to Mr. Lane because, according to the location, the well was located in Missoula County. Therefore, the well should have been recorded and filed in Missoula County and not Lake County. Evidently Mr. Lane noticed that the section number on his filing was incorrect and proceeded to your office to change the section number to 9 instead of 19.

We would suggest, that since it was only a typographical error that the 19 be changed to a 9 without any additional paper work. We have made the correction change on our form and indicated the error to be typographical.

Thank you for bringing the error to our attention. If we can be of further assistance, please feel free to call on us at any time.

Sincerely,

Ronald J. Guse
Groundwater Rights Coordinator
WATER RESOURCES DIVISION

RJG/lk

Enclosure (1)



Tract 12, s
Jocko Ranchettes 19
T. 16 N. R. 19 E
16 S 19 W

Power: _____ Pump: _____ HP
Remarks: (Gravel packing, cementing, packers, type of shutoff) _____

Section 9 not 19
typographical error!

INDICATE LOCATION OF WELL AND PLACE OF USE, IF POSSIBLE. EACH SMALL SQUARE REPRESENTS 40 ACRES.

Driller's Signature _____

Driller's Address _____

LICENSE NO. _____

~~135 ft.~~ Show exact depth of bottom

49.915

SPEED LETTER

Water Resources Division
Sam W. Mitchell Bldg.
Helena, Mt. 59601

FROM

ETHEL M. HARDING
CLERK AND RECORDER
LAKE COUNTY COURTHOUSE

P.O. Box 491 — Polson, Montana — 59860

SUBJECT Russell Lane R-1323

No. 9 & 10 FOLD

MESSAGE

DATE 7-21-72 19

Mr. Lane brought in the notice from you that there is an error on the Well Report, R-1323. Tract 12, Jocko Ranchettes is in Lake County and the report should read Sec. 9, T16N R 19W.

How do you suggest this be corrected, as it is a typographical error.

jb Enc.

SIGNED

Ethel M. Harding

REPLY

DATE

19

See attached letter RECEIVED
JUL 25 1972

MONTANA DEPARTMENT OF NATURAL
RESOURCES AND CONSERVATION

SIGNED

Ronald J. Guse

Gray-Man "SNAP-A-WAY" FORM 44-902P 3 PARTS
WILSON JONES COMPANY • © 1961 • PRINTED IN U.S.A.

RETAIN WHITE COPY, RETURN PINK COPY

871

USE: (If used for irrigation, industrial, drainage or other. Explain state number of acres and location or other data (i.e. Lot, Block and Addition). *Tract # 12 Jocko Ranchettes*

ESTIMATED ANNUAL WITHDRAWAL *None used for 2 years*

Size of Drilled Hole	Size and Weight of Casing	From (Feet)	To (Feet)	PERFORATIONS		
				Kind Size	From (Feet)	To (Feet)
6" I.D. 5-5/8" OD	ground level	135 ft.				
1/4" side-wall				none	none	none

Location in Missoula County

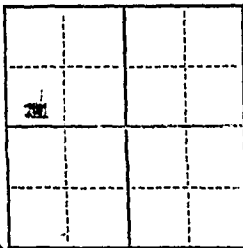

Tract 12, Jocko Ranchettes 19
T. 16 N. R. 19 W.

Static water level 130 ft.*
Pumping water level 130 ft.*
at 30 gallons per minute,
measured 60 minutes after pumping
began.

*Measured from ground level.
Well developed by drill test and 5 ft test pump
for 4 hours.
Power 30 Pump 1/4 HP
Remarks: (Gravel packing, cementing,
packers, type of shutoff)

Section 9, not 19
typographical error

INDICATE LOCATION OF WELL AND PLACE OF USE, IF POSSIBLE.
EACH SMALL SQUARE REPRESENTS 40 ACRES.

Driller's Signature *Ronald J. Guse*

Driller's Address *1573 So. 5th W. Helena, MT 59601*

LICENSE NO. 151

135 ft. Show exact depth of bottom

49.915

Department of Natural Resources and Conservation
 Water Resources Division
 Engineering Bureau
 Groundwater Section
 Sam W. Mitchell Building
 Helena, Montana 59601

Owner Mr. Russell Lane
 Address Box 156, Missoula, MT 59801
 Location T. 16N R. 19W Sec. 19
 Doc. No. R-1323, 202396

As the Administrator of the Groundwater Code for the State of Montana, please take note of the following special instructions, in order to properly protect your groundwater right.

Special Instructions:

According to the location indicated (Section 19, T 16N, R 19W) on the attached form, the well is located in Missoula County and not Lake County.

The well should be recorded and filed in the county in which the well construction is located. Please check the location to see that it is correct.

Thank you.

RECEIVED

JUL 25 1972

MONTANA DEPARTMENT OF NATURAL RESOURCES AND CONSERVATION

Equipment used _____ (Churn drill, rotary or other)

Water Use: Domestic Municipal Stock Irrigation
 Industrial Drainage Other * Garden/Lawn

*Describe Shower use

USE: If used for irrigation, industrial, drainage or other. Explain, state number of acres and location or other data (i.e. Lot, Block and Addition). Tract # 12 Jocko Ranchette

ESTIMATED ANNUAL WITHDRAWAL Low use for 2 years

Size of Drilled Hole	Size and Weight of Casing	From (Feet)	To (Feet)	PERFORATIONS		
				Kind Size	From (Feet)	To (Feet)
6" I.D. 6-5/8" OD	ground level	135 ft.	none	none	none	
1/4" side-wall						

Location in Missoula County

Static water level 112 ft.*
 Pumping water level 130 ft.*
 at 30 gallons per minute, measured 30 minutes after pumping began.
 *Measured from ground level.
 Well developed by well test and s-p test pump for 4 hours.
 Power 3/4 HP Pump 1/4 HP
 Remarks: (Gravel packing, cementing, packers, type of shutoff) _____

Tract 12, S
 Jocko Ranchette 19
 T. 16 N. R. 19 W. Section 9 not 19
typographical error!

INDICATE LOCATION OF WELL AND PLACE OF USE, IF POSSIBLE. EACH SMALL SQUARE REPRESENTS 40 ACRES.

Driller's Signature Norman L. Williams

Driller's Address 1322 So. 5th St. Missoula, MT 59801

LICENSE NO. 151 135 ft. Show exact depth of bottom

49. 9/15

STATE OF MONTANA
 ADMINISTRATOR OF GROUNDWATER CODE
 MONTANA WATER RESOURCES BOARD

MONTANA DEPARTMENT OF NATURAL
 RESOURCES AND CONSERVATION

DRILLER'S LOG

Indicate the character, color, thickness of strata such as soil, clay, sand, gravel, shale, sandstone, etc. Show depth at which water is found and height to which water rises in well.

NOTICE OF COMPLETION OF GROUNDWATER
 APPROPRIATION BY MEANS OF WELL

Developed after January 1, 1962

(Under Chapter 237 Montana Session Laws, 1961, as amended)

This form to be prepared by driller, and three copies to be filed by the owner with the County Clerk and Recorder in the county in which the well is located, last copy to be retained by driller.

Please answer all questions. If not applicable, so state, otherwise the form may be returned.

Owner W. H. HILL, LAND
 Address Box 156
Missoula, Mt.
 Date well started NOV. 3, 1971
 completed D.D. 3, 1971

Filed in Lake Co
 For Administrator's Use
 File # 13.23, 22396
Feb. 23, 1972 8:10 a.m.
 GW 1

Type of well DRILLED
 (Dug, driven, bored or drilled)

Equipment used CHURN
 (Churn drill, rotary or other)

Water Use: Domestic Municipal Stock Irrigation
 Industrial Drainage Other * Garden/Lawn

*Describe Line use

USE: If used for irrigation, industrial, drainage or other. Explain, state number of acres and location or other data (i.e. Lot, Block and Addition). Tract # 12 Jocko Ranchette

ESTIMATED ANNUAL WITHDRAWAL Line use for 2 years

Size of Drilled Hole	Size and Weight of Casing	From (Feet)	To (Feet)	PERFORATIONS		
				Kind Size	From (Feet)	To (Feet)
6" I.D. 6-5/8" O.D.	ground level	135 ft.	none	none	none	
1/4" side-well						

Top of Ground		(Elev. above sea level)
From (Feet)	To (Feet)	
01	49'	tan clay, gravel & boulders
48'	40'	boulder
49'	69'	tan clay and gravel
80'	73'	tan clay, gravel and boulder
73'	89'	tan clay and gravel
89'	60'	boulders
60'	121'	tan clay, sand and gravel
121'	122'	sand, gravel and a touch of water
122'	128'	tan clay and gravel
128'	135'	sand, gravel and water

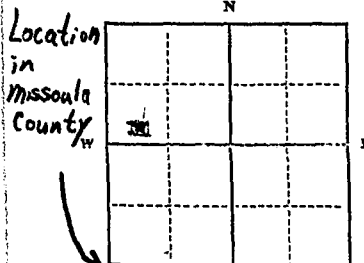

Static water level 110 ft.*
 Pumping water level 150 ft.*
 at 40 gallons per minute, measured 60 minutes after pumping began.

*Measured from ground level.
 Well developed by well test and sub test pump for 4 hours.

Power 300 Pump 1/2 HP
 Remarks: (Gravel packing, cementing, packers, type of shutoff)

Tract 12, Section 19
 T. 16 N. R. 19 E. S. 19 W.

INDICATE LOCATION OF WELL AND PLACE OF USE, IF POSSIBLE. EACH SMALL SQUARE REPRESENTS 40 ACRES.

Driller's Signature Herbert Williams

Driller's Address 1552 Gr. 5th W. Missoula, Montana

LICENSE NO. 151

135 ft. Show exact depth of bottom

49.915

16N-19W 9
County Lake

STATE OF MONTANA
ADMINISTRATOR OF GROUNDWATER CODE
MONTANA WATER RESOURCES BOARD
RECEIVED
SEP 8 1971

NOTICE OF COMPLETION OF GROUNDWATER APPROPRIATION BY MEANS OF WELL

Developed after January 1, 1962

(Under Chapter 237 Montana Session Laws, 1961, as amended)

This form to be prepared by driller, and three copies to be filed by the owner with the County Clerk and Recorder in the county in which the well is located, last copy to be retained by driller.

Please answer all questions. If not applicable, so state, otherwise the form may be returned.

Owner Howard McGinnis

For Administrator's Use
File R-1287 200006
September 1, 1971
8:45 AM

Address Box 266

Arlee, Montana

Date well started August 27, 1969

completed August 29, 1969

Type of well Drilled

(Dug, driven, bored or drilled)

Equipment used Churn Drill

(Churn drill, rotary or other)

Water Use: Domestic Municipal Stock Irrigation

Industrial Drainage Other * Garden/Lawn

*Describe

USE: If used for irrigation, industrial, drainage or other. Explain, state number of acres and location or other data (i.e. lot, Block and Addition).

ESTIMATED ANNUAL WITHDRAWAL

Size of Drilled Hole	Size and Weight of Casing	From (Feet)	To (Feet)	PERFORATIONS		
				Kind Size	From (Feet)	To (Feet)
6"	6 5/8" od x .250	0'	136'	cutting torch	130'	135'
		142'	141'			

May, 1970
deepened 8'

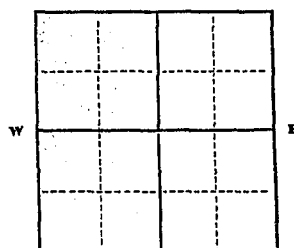

Static water level 115' ft.*
Pumping water level 115' ft.*
at 15 gallons per minute,
measured minutes after pumping
began.

*Measured from ground level.

Well developed by bailing and test pumping

for 4 hours.

Power Pump 2 HP

Remarks: (Gravel packing, cementing, packers, type of shutoff)

Lot #7 Jocko Raychoff

1/4 SW 9 Sec.
T. 16N 19W R. 19W
S E
W

INDICATE LOCATION OF WELL AND PLACE OF USE, IF POSSIBLE. EACH SMALL SQUARE REPRESENTS 40 ACRES.

Driller's Signature O'Keefe Contracting Company

Driller's Address 2804 Harvard Ave,

Butte, Montana

LICENSE NO.

Top of Ground (Elev. above sea level)

From (Feet)	To (Feet)
<u>0</u>	<u>142</u>

DRILLER'S LOG
Indicate the character, color, thickness of strata such as soil, clay, sand, gravel, shale, sandstone, etc. Show depth at which water is found and height to which water rises in well.

Show exact depth of bottom
142'

49027

R-1287

#2002006

HOWARD MCGINNIS
TO
THE PUBLIC

STATE OF MONTANA) ss
COUNTY OF LAKE)

Filed on the 7th day
of Sept. A.D. 1971
at 8:45 o'clock A.M.

ETHEL M. HARDING
County Clerk & Record
er

James Bentley
deputy

Original
 Duplicate
 Copy
 Other

RECEIVED
 SEP 10 1971
 COUNTY CLERK
 LAKE COUNTY, MONTANA

HOWARD MCGINNIS
 TO THE PUBLIC

STATE OF MONTANA
 COUNTY OF LAKE

Filed on the 7th day
 of Sept. A.D. 1971
 at 8:45 o'clock A.M.

ETHEL M. HARDING
 County Clerk & Record
 er

James Bentley
 deputy

STATE OF MONTANA
ADMINISTRATOR OF GROUNDWATER CODE
MONTANA WATER RESOURCES BOARD

NOTICE OF COMPLETION OF GROUNDWATER
APPROPRIATION BY MEANS OF WELL

Developed after January 1, 1962

(Under Chapter 237 Montana Session Laws, 1961, as amended)

This form to be prepared by driller, and three copies to be filed by the owner with the County Clerk and Recorder in the county in which the well is located, last copy to be retained by driller.

Please answer all questions. If not applicable, so state, otherwise the form may be returned.

Owner Vassey, Kenneth
Address Arles, Montana
Date well started May 8, 1970
completed _____
Type of well drilled
(Dug, driven, bored or drilled)
Equipment used churn drills
(Churn drill, rotary or other)
Water Use: Domestic Municipal Stock Irrigation
Industrial Drainage Other Garden/Lawn
*Describe _____
USE: If used for irrigation, industrial, drainage or other. Explain, state number of acres and location or other data (i.e. Lot, Block and Addition). _____
ESTIMATED ANNUAL WITHDRAWAL 35,200 gal

For Administrator's Use
File 194710
August 5, 1970
D. S. P. H.
GW 1

Size of Drilled Hole	Size and Weight of Casing	From (Feet)	To (Feet)	PERFORATIONS		
				Kind and Size	From (Feet)	To (Feet)
6"	3/8" OD 17.02	0'	140'	cutting torch	none	

Static water level 125 ft.*
Pumping water level 126 ft.*
at _____ gallons per minute,
measured _____ minutes after pumping began.
*Measured from ground level.
Well developed by test bail
for _____ hours.
Power _____ Pump _____ HP
Remarks: (Gravel packing, cementing, packers, type of shutoff) _____

SW 1/4-22-1/4 Sec. 9
T. 16 N. 19 E.
INDICATE LOCATION OF WELL AND PLACE OF USE, IF POSSIBLE.
EACH SMALL SQUARE REPRESENTS 40 ACRES.
Driller's Signature G. Keefe Drilling Company
Driller's Address 2804 Harvard Ave.
Butte, Montana LICENSE NO. _____

16N-19W
County LeBoeuf 9

DRILLER'S LOG

Indicate the character, color, thickness of strata such as soil, clay, sand, gravel, shale, sandstone, etc. Show depth at which water is found and height to which water rises in well.

Top of Ground (Elev. above sea level)

From (Feet)	To (Feet)	
0	1'	top soil
1	20'	heavy gravel & rock
20	40'	gravel & rock
40	60'	gravel & rock
60	80'	gravel
80	100'	rocky & gravel
100	120'	rocky
120	140'	gravel rocky water

140' Show exact depth of bottom

47322

R- 1219

194740

Well Report

Kenneth Vessey

To
The Public

Owner
Address
AZLEW, Montana

Date well started
MAY 8, 1970

Type of well
drilled

Equipment used
Water Use: Domestic Municipal Stock Irrigation
Industrial Drainage Other Garden/Lawn

*Describe
USE: If used for irrigation, industrial, drainage or other. Explain,
state number of acres and location or other data (i.e. Lot, Block
and Addition).

File
194740
Drilled 5/1970
40' & 60' dia.

STATE OF MONTANA } ss
County of Lake
Filed on the 5 day of Aug
A. D. 1970 at 4:06 o'clock P.M.
ETHEL M. HARDING
County Clerk and Recorder
By Darlene Prigen
Deputy

ANNUAL WITHDRAWAL
OPERATIONS
35200 gal/ann

40'	60' gravel & rock
60'	60' gravel
80'	rock & gravel
100'	rock
120'	gravel rock water

County Lake

GROUNDWATER CODE
RESOURCES BOARD

PROTECTION OF GROUNDWATER
BY MEANS OF WELL

Developed after January 1, 1962

Chapter 237 Montana Session Laws, 1961, as amended

This form to be prepared by driller, and three copies to be filed with the owner with the County Clerk and Recorder in the county in which the well is located, last copy to be retained by driller. Please answer all questions. If not applicable, so state, otherwise the form may be returned.

Owner Yessy, Kenneth

Address Arlee, Montana

Date well started May 8, 1970

completed May 19, 1970

Type of well drilled

Equipment used churn drill

Water Use: Domestic Municipal Stock Irrigation

Industrial Drainage Other * Garden/Lawn

*Describe

USE: If used for irrigation, industrial, drainage or other. Explain, state number of acres and location or other data (i.e. Lot, Block and Addition).

ESTIMATED ANNUAL WITHDRAWAL 3,500 gallons

Size of Drilled Hole	Size and Weight of Casing	From (Feet)	To (Feet)	PERFORATIONS		
				Kind	From (Feet)	To (Feet)
6"	6 5/8" od 17.028	0'	140'	cutting torch	none	

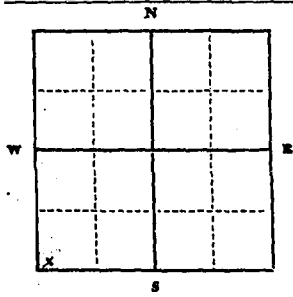

Static water level 126 ft.*
Pumping water level 126 ft.*
at 10 gallons per minute,
measured minutes after pumping
began.

*Measured from ground level.
Well developed by test bailer

for hours.
Power..... Pump..... HP

Remarks: (Gravel packing, cementing,
packers, type of shutoff)

SW 1/4 Sec. 9
T. 16 R. 19 E
S W

INDICATE LOCATION OF WELL AND PLACE OF USE, IF POSSIBLE.
EACH SMALL SQUARE REPRESENTS 40 ACRES.

Driller's Signature O'Keefe Drilling Company

Driller's Address 2804 Harvard Ave.

Butte, Montana

LICENSE NO. 8

DRILLER'S LOG

Indicate the character, color, thickness of strata such as soil, clay, sand, gravel, shale, sandstone, etc. Show depth at which water is found and height to which water rises in well.

Top of Ground		(Elev. above sea level)
From (Feet)	To (Feet)	
0	1'	top soil
1	25'	heavy gravel & rock
20	40'	gravel & rock
40	60'	Gravel & rock
60	80'	gravel
80	100'	rocks & gravel
100	120'	rocks
120	140'	gravel rocks water

140' Show exact depth of bottom

47322

RECEIVED

16N-19W
County _____

16



STATE OF MONTANA
ADMINISTRATOR OF GROUNDWATER CODE
MONTANA WATER RESOURCES BOARD
MONTANA DEPARTMENT OF NATURAL RESOURCES AND CONSERVATION

FEB 18 1972

DRILLER'S LOG

Indicate the character, color, thickness of strata such as soil, clay, sand, gravel, shale, sandstone, etc. Show depth at which water is found and height to which water rises in well.

NOTICE OF COMPLETION OF GROUNDWATER APPROPRIATION BY MEANS OF WELL
Developed after January 1, 1962

(Under Chapter 237 Montana Session Laws, 1961, as amended)

This form to be prepared by driller, and three copies to be filed by the owner with the County Clerk and Recorder in the county in which the well is located, last copy to be retained by driller. Please answer all questions. If not applicable, so state, otherwise the form may be returned.

Top of Ground (Elev. above sea level)

From (Feet)	To (Feet)	
0	1	top soil
1	65	Large Gravel
65	70	Brown Clay
70	110	Gravel
110	126	Gravel & Water

Owner Earl Atchley

For Administrator's Use

File R-1321-202353

Feb 17, 1972 U-35a

GW 1

Address Arlee Jacks Road

Date well started Jan 5, 1972

completed Nov 8, 1972

Type of well (Dug, driven, bored or drilled) R.G.B.

Equipment used (Churn drill, rotary or other) R.G.B.

Water Use: Domestic Municipal Stock Irrigation

Industrial Drainage Other * Garden/Lawn

*Describe

USE: If used for irrigation, industrial, drainage or other. Explain, state number of acres and location or other data (i.e. Lot, Block and Addition).

ESTIMATED ANNUAL WITHDRAWAL

Size of Drilled Hole	Size and Weight of Casing	From (Feet)	To (Feet)	PERFORATIONS		
				Kind Size	From (Feet)	To (Feet)
6	6. 17 1/2	0	126			

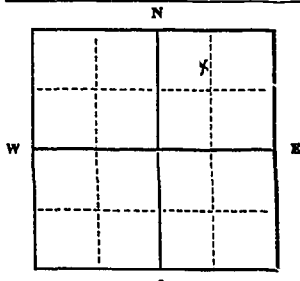

Static water level 119 ft.*
Pumping water level 123 ft.*
at 1.5 gallons per minute,
measured 60 minutes after pumping began.

*Measured from ground level.
Well developed by Drill
for 2 hours.

Power 1/2 HP. Pump 1/2 HP
Remarks: (Gravel packing, cementing, packers, type of shutoff)

E 2 NW 1/4 NE 1/4 Sec. 16
T. 16 N. R. 19 E

INDICATE LOCATION OF WELL AND PLACE OF USE, IF POSSIBLE. EACH SMALL SQUARE REPRESENTS 40 ACRES.

Driller's Signature John Farrell

Driller's Address Arlee Mont

LICENSE NO. 14

126 Show exact depth of bottom

49,889

R-1321

202353

WELL REPORT

EARL ATCHLEY

TO

THE PUBLIC

STATE OF MONTANA
County of Lake

Filed on the 17 day of Feb.

A.D. 19 73 at 11:35 o'clock A.M.

ETHEL M. HARDING

County Clerk and Recorder

By Laura Barron
200 Deputy

THIS REPORT IS SUBJECT TO THE PROVISIONS OF SECTION 10-10-101, M.C.A. WHICH PROVIDES THAT ANY PERSON WHOSE REPORT IS SUBJECT TO THE PROVISIONS OF SECTION 10-10-101, M.C.A. SHALL BE DEEMED TO HAVE AGREED TO THE PROVISIONS OF SECTION 10-10-101, M.C.A. AND TO WAIVE ANY RIGHTS HE OR SHE MAY HAVE UNDER ANY OTHER LAW OR CONTRACT TO THE EXTENT SUCH RIGHTS OR CONTRACTS ARE INCONSISTENT WITH THE PROVISIONS OF SECTION 10-10-101, M.C.A.

REGISTERED PROFESSIONAL ENGINEER
STATE OF MONTANA
No. 1000
E. J. MURPHY
BOZEMAN, MONTANA

5

5

RECEIVED

16N-19W
County Lake 516

DEC 8 1972

DRILLER'S LOG

STATE OF MONTANA
ADMINISTRATOR OF GROUNDWATER CODE
MONTANA WATER RESOURCES BOARD

MONTANA DEPARTMENT OF
NATURAL RESOURCES AND CONSERVATION

Indicate the character, color, thickness of strata such as soil, clay, sand, gravel, shale, sandstone, etc. Show depth at which water is found and height to which water rises in well.

NOTICE OF COMPLETION OF GROUNDWATER APPROPRIATION BY MEANS OF WELL

Developed after January 1, 1962

(Under Chapter 237 Montana Session Laws, 1961, as amended)

This form to be prepared by driller, and three copies to be filed by the owner with the County Clerk and Recorder in the county in which the well is located, last copy to be retained by driller. Please answer all questions. If not applicable, so state, otherwise the form may be returned.

Owner WALTER Bud ROUGHAS

Address 404 C Avenue
24 Day Mont

Date well started 27 Nov. 1972
completed RJD + Dec. 1972

For Administrator's Use	
File	<u>R-1402, 206957</u>
Date	<u>Dec. 7/1972 3:45 pm</u>
GW	<u>1</u>

Type of well Drilled
(Dug, driven, bored or drilled)
Equipment used Churn drill
(Churn drill, rotary or other)

Water Use: Domestic Municipal Stock Irrigation
Industrial Drainage Other * Garden/Lawn

*Describe _____
USE: If used for irrigation, industrial, drainage or other. Explain, state number of acres and location or other data (i.e. Lot, Block and Addition). N/A

ESTIMATED ANNUAL WITHDRAWAL 26,000 GALS

Size of Drilled Hole	Size and Weight of Casing	From (Feet)	To (Feet)	PERFORATIONS		
				Kind Size	From (Feet)	To (Feet)
<u>6"</u>	<u>6" 120 lb.</u>	<u>1'</u>	<u>70'</u>			

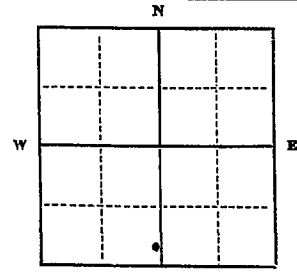

Static water level 15.6 ft.*
Pumping water level 62 ft.*
at 10 gallons per minute,
measured 11 minutes after pumping began.
*Measured from ground level.
Well developed by Gravel
for 4 hours.
Power..... Pump..... HP
Remarks: (Gravel packing, cementing, packers, type of shutoff) _____

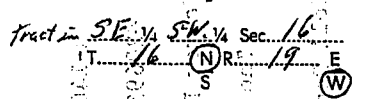

INDICATE LOCATION OF WELL AND PLACE OF USE, IF POSSIBLE. EACH SMALL SQUARE REPRESENTS 40 ACRES.

Driller's Signature George Oberbe

Driller's Address Mont
Mont LICENSE NO. 104

Top of Ground (Elev. above sea level)

From (Feet)	To (Feet)	Description
<u>0</u>	<u>2</u>	<u>Topsoil</u>
<u>2</u>	<u>37</u>	<u>Gravel & Clay with some sandstone</u>
<u>37</u>	<u>69</u>	<u>Thin clay + thin sandstone</u>
<u>69</u>	<u>11</u>	<u>Water</u>

70' Show exact depth of bottom

51,974

RECEIVED

16-N-1900
County

STATE OF MONTANA
ADMINISTRATOR OF GROUNDWATER CODE
MONTANA WATER RESOURCES BOARD

DEC 8 1972

DRILLER'S LOG

NOTICE OF COMPLETION OF GROUNDWATER
APPROPRIATION BY MEANS OF WELL
Developed after January 1, 1962

Indicate the character, color, thickness of strata such as silt, clay, sand, gravel, shale, sandstone, etc. Show depth at which water is found and height to which water rises in well.

(Under Chapter 237, Montana Session Laws, 1961, as amended)

This form to be prepared by driller, and three copies to be filed by the owner with the County Clerk and Recorder in the county in which the well is located; last copy to be retained by driller. Please answer all questions. If not applicable, so state; otherwise the form may be returned.

Owner Walter Burroughs
Walter Burroughs

Address 404 C. Avenue
Malay, Mont

For Administrator's Use
File R-1402-206951
Dec 7/1972 3:45pm
Date well started 27 Nov, 1972 GW.1
completed R.D. 4 Dec, 1972

Date well started 27 Nov, 1972

completed R.D. 4 Dec, 1972

Type of well Drilled
(Dig, driven, bored or drilled)

Equipment used Churn Drill
(Churn drill, rotary or other)

Water Use: Domestic Municipal Stock Irrigation

Industrial Drainage Other * Garden/Lawn

*Describe
USE: If used for irrigation, industrial, drainage or other. Explain, state number of acres and location or other data (i.e. Lot, Block and Addition). N/A

ESTIMATED ANNUAL WITHDRAWAL 36 000 GALS.

Size of Drilled Hole	Size and Weight of Casing	From (Feet)	To (Feet)	PERFORATIONS		
				Kind Size	From (Feet)	To (Feet)
6"	6" 110 lb.	1' above ground	70'	none		

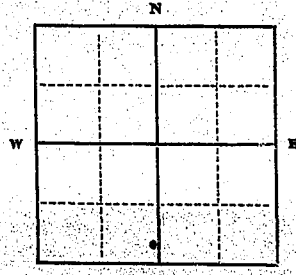

Static water level 15.0 ft.*
Pumping water level 6.0 ft.*
at 10 gallons per minute,
measured 10 minutes after pumping
began.
*Measured from ground level.
Well developed by hammer
for 4 hours.
Power _____ Pump _____ HP
Remarks: (Gravel packing, cementing,
packers, type of shutoff)

Tract in S.E. 1/4 Sec. 16



INDICATE LOCATION OF WELL AND PLACE OF USE, IF POSSIBLE. EACH SMALL SQUARE REPRESENTS 40 ACRES.

Driller's Signature George Oberbe

Driller's Address Box 47

Malay, Mont

LICENSE NO. 204

Top of Ground		(Elev above sea level)
From (Feet)	To (Feet)	
0	1	
1	2	
2	3	
3	4	
4	5	
5	6	
6	7	
7	8	
8	9	
9	10	
10	11	
11	12	
12	13	
13	14	
14	15	
15	16	
16	17	
17	18	
18	19	
19	20	
20	21	
21	22	
22	23	
23	24	
24	25	
25	26	
26	27	
27	28	
28	29	
29	30	
30	31	
31	32	
32	33	
33	34	
34	35	
35	36	
36	37	
37	38	
38	39	
39	40	
40	41	
41	42	
42	43	
43	44	
44	45	
45	46	
46	47	
47	48	
48	49	
49	50	
50	51	
51	52	
52	53	
53	54	
54	55	
55	56	
56	57	
57	58	
58	59	
59	60	
60	61	
61	62	
62	63	
63	64	
64	65	
65	66	
66	67	
67	68	
68	69	
69	70	
70	71	
71	72	
72	73	
73	74	
74	75	
75	76	
76	77	
77	78	
78	79	
79	80	
80	81	
81	82	
82	83	
83	84	
84	85	
85	86	
86	87	
87	88	
88	89	
89	90	
90	91	
91	92	
92	93	
93	94	
94	95	
95	96	
96	97	
97	98	
98	99	
99	100	

71' Show exact depth of bottom

51,974

R-1402

#206957

Walter Burroughs
to
The Public

Well Report

STATE OF MONTANA } ss
County of Lake }
Filed on the 7 day of Dec
A. D. 1972 at 3:45 o'clock P. M.
ETHEL M. HANBING
County Clerk and Recorder
By Jewel Dent
Deputy

RECEIVED
JUN 13 1972

16N-19W
County TARLE

STATE OF MONTANA
ADMINISTRATOR OF GROUNDWATER CODE
MONTANA WATER RESOURCES BOARD
**NOTICE OF COMPLETION OF GROUNDWATER
APPROPRIATION BY MEANS OF WELL**
Developed after January 1, 1962

DRILLER'S LOG

Indicate the character, color, thickness of strata such as soil, clay, sand, gravel, shale, sandstone, etc. Show depth at which water is found and height to which water rises in well.

(Under Chapter 237, Montana Session Laws, 1961, as amended)
This form to be prepared by driller, and three copies to be filed by the owner with the County Clerk and Recorder in the county in which the well is located, last copy to be retained by driller. Please answer all questions. If not applicable, so state, otherwise the form may be returned.

Owner Robert Carlsberg

Address 1505 Delee

Missoula, Mont.

Date well started 26 Apr. 72

completed 2 May

Type of well Drilled

Equipment used Churn drill

Water Use: Domestic Municipal Stock Irrigation

Industrial Drainage Other Garden/Lawn

*Describe _____

USE: If used for irrigation, industrial, drainage or other. Explain, state number of acres and location or other data (i.e. Lot, Block and Addition). _____

ESTIMATED ANNUAL WITHDRAWAL 150,000

Size of Drilled Hole	Size and Weight of Casing	From (Feet)	To (Feet)	PERFORATIONS		
				Kind Size	From (Feet)	To (Feet)
6"	6 5/8 17 #	1'8" up	112'	saw cut	110	122
				5" Plastic		

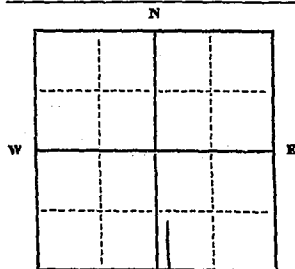

Static water level 261 ft.*
Pumping water level 85 ft.*
at 10 gallons per minute,
measured 120 minutes after pumping
began.

*Measured from ground level.
Well develop. by Roller
for 4 hours.

Power _____ Pump _____ HP
Remarks: (Gravel packing, cementing,
packers, type of shutoff) _____

T. 16 1/4 Sec. 16
N 19
S 19 E 19

INDICATE LOCATION OF WELL AND PLACE OF USE, IF POSSIBLE. EACH SMALL SQUARE REPRESENTS 40 ACRES.

Driller's Signature George A. Roche

Driller's Address Box 17

Revelle, Mont. LICENSE NO. 204

Top of Ground (Elev. above sea level)		
From (Feet)	To (Feet)	Description
0	3	Clay, sand
3	15	Expansive gravel
15	30	tan clay & gravel
30	35	tan clay & gravel
35	47	tan clay & gravel
47	68	tan clay & gravel
68	91	tan clay, gravel, sand
91	111	tan clay, gravel
111	122	clay streaks of gravel, water

122' Show exact depth of bottom

50,589

#204056
1556

STATE OF MONTANA
County of Lake

Filed on the 12th day of June
A. D. 1977 at 3:55 P.M.
E. H. HARDING

County Clerk and Recorder
By *Jewell B. Burt*

OFFICE OF COMMISSION BY WILLIAM O. WEST
MONTANA RECORDS SOCIETY
ADMINISTRATOR OF GEORGE WASHINGTON
HALL OF MONTANA

Original Certified Copy
Dated and signed June 11, 1977
Attest: *Jewell B. Burt*
County Clerk and Recorder

Order of Court
Case No. 1556
Date of trial
Trial date
Verdict
Judge
Clerk
Deputy Clerk
Court Reporter
Court Officer
Court Reporter
Court Officer
Court Reporter
Court Officer

Case No.	Date	Time	Place	Judge	Clerk	Reporter	Officer
1556	June 12, 1977	3:55 P.M.

STATE OF MONTANA
County of Lake

Filed on the 12th day of June
A. D. 1977 at 3:55 P.M.
E. H. HARDING

County Clerk and Recorder
By *Jewell B. Burt*

Case No.	Date	Time	Place	Judge	Clerk	Reporter	Officer
1556	June 12, 1977	3:55 P.M.

16N-19W
Beake
Ravalli
County

STATE OF MONTANA
ADMINISTRATOR OF GROUNDWATER CODE
MONTANA WATER RESOURCES BOARD

DRILLER'S LOG

NOTICE OF COMPLETION OF GROUNDWATER
APPROPRIATION BY MEANS OF WELL

RECEIVED
OCT 26 1971

indicate the character, color, thickness of strata such as soil, clay, sand, gravel, shale, sandstone, etc. Show depth at which water is found and height to which water rises in well.

Developed after January 1, 1962

(Under Chapter 237 Montana Session Laws, 1961, as amended)

This form to be prepared by driller, and three copies to be filed by the owner with the County Clerk and Recorder in the county in which the well is located, last copy to be retained by driller.

Please answer all questions. If not applicable, so state, otherwise the form may be returned.

Owner Lloyd Jackson
Address Arlee, Montana

For Administrator's Use	
File	<u>200718</u>
	<u>October 22, 1971</u>
	<u>12:20 P.M.</u>
GW 1	

Date well started 12/30/70
completed

Type of well drilled
(Dug, driven, bored or drilled)

Equipment used churn drill
(Churn drill, rotary or other)

Water Use: Domestic Municipal Stock Irrigation
Industrial Drainage Other * Garden/Lawn

*Describe
USE: If used for irrigation, industrial, drainage or other. Explain, state number of acres and location or other data (i.e. Lot, Block and Addition).

ESTIMATED ANNUAL WITHDRAWAL

Size of Drilled Hole	Size and Weight of Casing	From (Feet)	To (Feet)	PERFORATIONS		
				Kind Size	From (Feet)	To (Feet)
6"	6 5/8" od x .280 Sch 40	18" a.c.	147'	none		

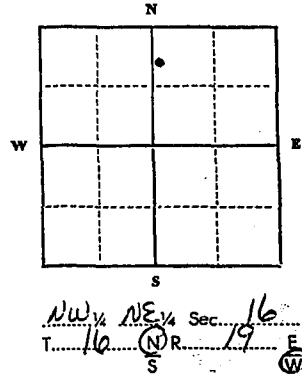

Static water level 132 ft.*
Pumping water level 132 ft.*
at 14 gallons per minute,
measured minutes after pumping began.

*Measured from ground level.
Well developed by test pump
for 2 hours.
Power electric Pump 1 HP
Remarks: (Gravel packing, cementing, packers, type of shutoff)

Top of Ground		(Elev. above sea level)
From (Feet)	To (Feet)	
0'	2'	Black dirt
2'	70'	Red Gravel
70'	105'	Tan gravel & sand-- tight
105'	123'	Red Cemented gravel
123'	128'	Tan sand-tight seepage
128'	142'	Tan gravel (muddy)
142'	147'	red sand & gravel water

INDICATE LOCATION OF WELL AND PLACE OF USE, IF POSSIBLE. EACH SMALL SQUARE REPRESENTS 40 ACRES.

Driller's Signature O'Keefe Drilling Company
Driller's Address 2804 Harvard Butte, Montana 59701

LICENSE NO. 8

147' Show exact depth of bottom

49329

R-1297
200718

LLOYD JACKSON
TO
THE PUBLIC
WELL REPORT

STATE OF MONTANA }
County of Lake } ss
Filed on the 22 day of Oct
A. D. 1917 at 12:20 o'clock P.M.
ETHEL M. HARDING
County Clerk and Recorder
By: Jewell Beatty
Deputy

APPROVED AND FORWARDED:
Clerk of Court
Notary Public
Notary at Large

GW

File No.

T. 16^W R. 19^W S. 16

DUPLICATE

County

STATE OF MONTANA
ADMINISTRATOR OF GROUNDWATER CODE
OFFICE OF STATE ENGINEER

RECEIVED
JAN 6 1964

Declaration of Vested Groundwater Rights STATE ENGINEER
(Under Chapter 237, Montana Session Laws, 1961)

1. Dallas H. Jensen, of Arlee
(Name of Appropriator) (Address) (Town)

County of Lake State of Mont.
have appropriated groundwater according to the Montana laws in effect prior to January 1, 1962, as follows:

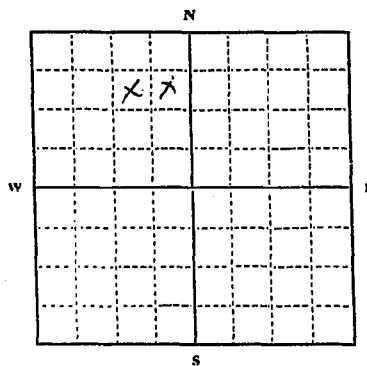

NE 1/4 NW Sec. 16 T. 16. R. 19
Indicate point of appropriation and place of use, if possible. Each small square represents 10 acres.

- 2. The beneficial use on which the claim is based. Necessaries, Livestock
- 3. Date or approximate date of earliest beneficial use; and how continuous the use has been. 1936
- 4. The amount of groundwater claimed (in miner's inches or gallons per minute). 5 gal per min.
- 5. If used for irrigation, give the acreage and description of the lands to which water has been applied and name of the owner thereof. [Redacted]
- 6. The means of withdrawing such water from the ground and the location of each well or other means of withdrawal. Electric Pump

- 7. The date of commencement and completion of the construction of the well, wells, or other works for withdrawal of groundwater. NOT KNOWN
- 8. The depth of water table. 65 ft.
- 9. So far as it may be available, the type, size and depth of each well or the general specifications of any other works for the withdrawal of groundwater.
- 10. The estimated amount of groundwater withdrawn each year. 360,000 gals.
- 11. The log of formations encountered in the drilling of each well if available. NOT KNOWN
- 12. Such other information of a similar nature as may be useful in carrying out the policy of this act, including reference to book and page of any county record. Book 2, page 35 Line 2

Signature of Owner. Dallas H. Jensen
Date. Dec 31, 1962

Three copies to be filed by the owner with the County Clerk and Recorder of the county in which the well is located.
Please answer all questions. If not applicable, so state, otherwise the form will be returned.
Original to the County Clerk and Recorder; Duplicate to the State Engineer; Triplicate to the Montana Bureau of Mines and Geology, and Quadruplicate for the Appropriator.

243

R-842

163190

Dallas H. Jerral

STATE OF MONTANA

County of Lake, ^{sa}

Filed on the 31 day of Dec

A. D. 1963 at 5:15 o'clock P. M.

~~CLARENCE~~ KINNIC

County Clerk and Recorder

M. Kraus

200

Deputy

File No. _____

T. 16N R. 19W

DUPLICATE

County Lake

LOG

STATE OF MONTANA
ADMINISTRATOR OF GROUNDWATER CODE
STATE WATER CONSERVATION BOARD

MONTANA WATER RESOURCES BOARD
RECEIVED
JUL 23 1969

**Notice of Completion of Groundwater
Appropriation by Means of Well**
DEVELOPED AFTER JANUARY 1, 1962

(Under Chapter 237 Montana Session Laws, 1961, as amended)

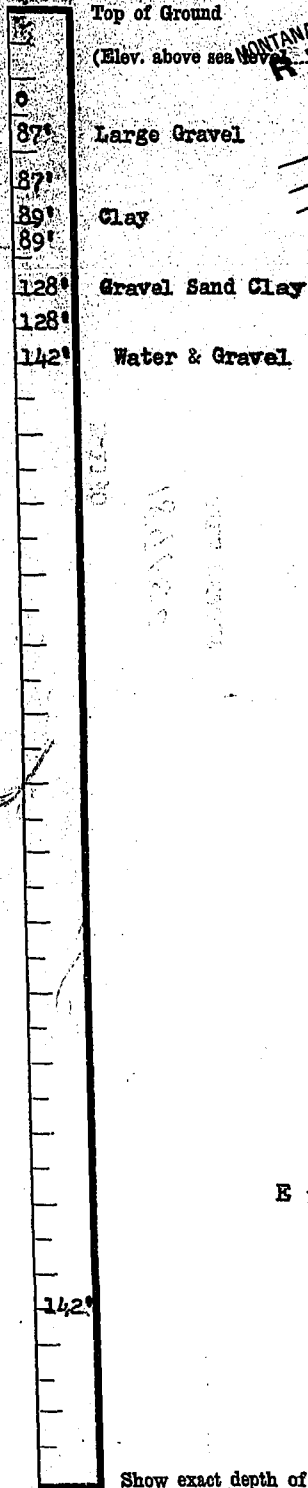

Owner Sarah Moran Two Teeth Address Arles Mont.

Driller John Farrell Address Arles Mont.

Date of Notice of appropriation of groundwater _____

Date well started May 9 1969 Date completed May 21 1969

Type of well Drilled Equipment used Churn Drill
(Dug, driven, bored or drilled) (Churn drill, rotary or other)

Water use: Domestic Municipal Stock Irrigation
Industrial Drainage Other

Indicate on the diagram the character and thickness of the different strata met with in drilling, such as soil, clay, shale, gravel, rock or sand, etc. Show depth at which water is encountered, thickness and character of water-bearing strata and height to which the water rises in the well.

Size of Drilled Hole	Size and Weight of Casing	From (Feet)	To (Feet)	PERFORATIONS		
				Kind Size	From (Feet)	To (Feet)
6"	6" 1D 17 1b	0	142			

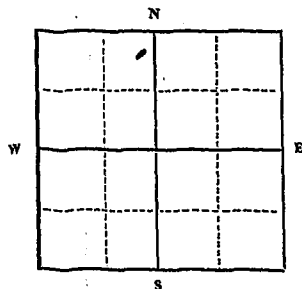

Static Water Level for non-flowing well _____ 122 feet.

Shut-in Pressure for Flowing Well _____

Pumping Water Level _____ 140 feet
at _____ 25 gal. per minute.

Discharge in gal. per min. of flowing well _____

How Tested _____ Bailer

Length of Test _____ 2 Hrs

Remarks: (Gravel packing, cementing, packers, type of shutoff) _____

E $\frac{1}{2}$ NE $\frac{1}{4}$ NE $\frac{1}{4}$ NW $\frac{1}{4}$ Sec. 16 T. 16N R. 19W
Indicate location of well and place of use, if possible. Each small square represents 40 acres.

(Continue on reverse side)

USE—If used for irrigation, industrial, drainage or other. Explain, state number of acres and location or other data (i.e.: Lot, Block and Addition).

Show exact depth of bottom.

This form to be prepared by driller, and three copies to be filed by the owner with the County Clerk and Recorder in the county in which the well is located, tissue copy to be retained by driller.

Please answer all questions. If not applicable, so state, otherwise the form will be returned.

Driller's License Number

Driller's Signature

14
John Farrell
15452

DISTRICT

R-1150

189650

WELL REPORT

RECEIVED
DIVISION OF CONSERVATION
ADMINISTRATION OF GEORGETOWN
STATE OF MONTANA
JUL 21 1909

SARAH MORAN
TWO TEETH
TO
THE PUBLIC

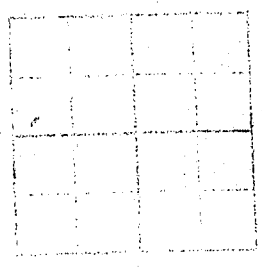

STATE OF MONTANA
County of Lake
Filed on the 21 day of July
A. D. 1909 at 11:30 clock A. M.
ETHEL M. HARDING
County Clerk and Recorder
By *J. J. Dent* Deputy

GW 2

APR 6 1966

T. 16 N R. 19 W 17

File No.

DUPLICATE

Billie _____ McDermott _____
Butzerin _____ McNulty _____
Coyle _____ Morton _____
Darlington _____
Dickert _____
STATE OF MONTANA
ADMINISTRATOR OF GROUNDWATER CODE
OFFICE OF STATE ENGINEER

Top of Ground
(Elev. above sea level.....)

0
85'
85'
90'

Clay Gravel Boulders

Gravel & Water

Notice of Completion of Groundwater Appropriation by Means of Well

(Under Chapter 237, Montana Session Laws, 1961)

Owner Clyde P. Howard Address Arlee Mont

Driller John Farrell Address Arlee Mont

Date of Notice of Appropriation of Groundwater.....

Date well started Feb 21 1966 Date Completed March 4 1966

Type of well Drilled Equipment Used Churn Drill
(dug, driven, bored or drilled) (Churn, drill, rotary or other)

Water Use: Domestic Municipal Other Irrigation
Industrial Drainage Stock

Indicate on the diagram the character and thickness of the different strata met with in drilling, such as soil, clay, shale, gravel, rock or sand, etc. Show depth at which water is encountered, thickness and character of water-bearing strata and height to which water rises in the well.

Size of Drilled Hole	Size and Weight of Casing	From (Feet)	To (Feet)	PERFORATIONS		
				Kind Size	From (Feet)	To (Feet)
5"	5" 1D 14.69 # 0.250 wall	0	90'			

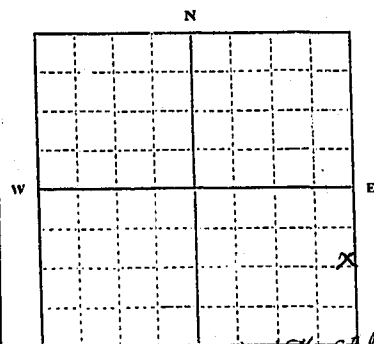

1/4 Sec. 17 T. 16 N R. 19 W
Indicate location of well and place of use, if possible. Each small square represents 10 acres.

Show exact depth of bottom.

Static Water Level for non-flowing Well..... 32 feet.

Shut-in Pressure for Flowing Well.....

Pumping Water Level..... 85 feet at..... 8 gal. per minute.

Discharge in gal. per min. of flowing well.....

How Tested..... Pump Length of Test..... 2 Hrs

Remarks: (Gravel packing, cementing, packers, type of shutoff, location of place of use of groundwater if not at well, and any other similar pertinent information, including number of acres irrigated, if used for irrigation).....

14
Driller's License Number

John Farrell
Driller's Signature

This form to be prepared by driller, and three copies to be filed by the owner with the County Clerk and Recorder in the county in which the well is located.

Please answer all questions. If not applicable, so state, otherwise the form will be returned.

Original to the County Clerk and Recorder; duplicate to the State Engineer; Triplicate to the Montana Bureau of Mines and Geology and Quadruplicate for the Appropriator.

40943

R1033

14902

Well Report
Clyde P. Howard
to
The Public

STATE OF MONTANA DEPARTMENT OF REVENUE

STATE OF MONTANA
County of Lake } ss

Filed on the 4 day of Apr

A. D. 1916 at 2:00 o'clock P M

HAZEL KINNICK

County Clerk and Recorder
By Eunice Cowan
Deputy

File No. _____

T. 16^N R. 19^W

DUPLICATE

County Lake

STATE OF MONTANA
ADMINISTRATOR OF GROUNDWATER CODE
OFFICE OF STATE ENGINEER

RECEIVED
JAN 2 1964
STATE ENGINEER

Declaration of Vested Groundwater Rights
(Under Chapter 237, Montana Session Laws, 1961)

Arjen M. Rasmussen, of Box 337 Olney
(Name of Appropriator) (Address) (Town)

County of Lake State of Mont
have appropriated groundwater according to the Montana laws in effect prior to January 1, 1962, as follows:

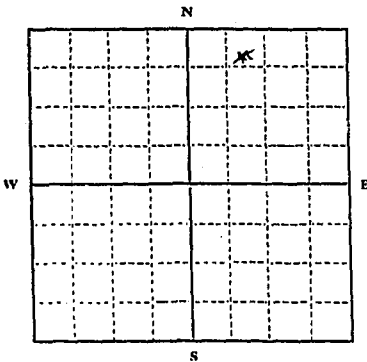

N 1/2 NE 1/4 Sec. 17 T. 16 R. 19

Indicate point of appropriation and place of use, if possible. Each small square represents 10 acres.

- 2. The beneficial use on which the claim is based Household
laundry & garden
- 3. Date or approximate date of earliest beneficial use; and how continuous the use has been about 1916
used all the time
- 4. The amount of groundwater claimed (in miner's inches or gallons per minute) 80 gallons a minute
- 5. If used for irrigation, give the acreage and description of the lands to which water has been applied and name of the owner thereof
Garden
- 6. The means of withdrawing such water from the ground and the location of each well or other means of withdrawal
Electric pump

- 7. The date of commencement and completion of the construction of the well, wells, or other works for withdrawal of groundwater year 1916
- 8. The depth of water table 141 ft deep when government takes all the water out of area level drops 3 ft
- 9. So far as it may be available, the type, size and depth of each well or the general specifications of any other works for the withdrawal of groundwater
Aug well tile lined - 141 ft deep
- 10. The estimated amount of groundwater withdrawn each year don't know guess 600 gal a day
- 11. The log of formations encountered in the drilling of each well if available
don't know of any
- 12. Such other information of a similar nature as may be useful in carrying out the policy of this act, including reference to book and page of any county record
don't know of any

Arjen M Rasmussen
Signature of Owner Arjen M Rasmussen
Date Dec 30 1963

Three copies to be filed by the owner with the County Clerk and Recorder of the county in which the well is located.

Please answer all questions. If not applicable, so state, otherwise the form will be returned.

Original to the County Clerk and Recorder; Duplicate to the State Engineer; Triplicate to the Montana Bureau of Mines and Geology, and Quadruplicate for the Appropriator.

Q 569 162891

Water Report
Anker M. & June M.
Kasmussen
to
The Public

STATE OF MONTANA

County of Lake

Filed on the 30th day of Dec
A. D. 1963 at 10:45^{AM} clock A.M

HAZEL KINNICK
County Clerk and Recorder

By C. Cowman
Deputy

\$200

OW 2

Approved Stock Form—State Publishing Co., Helena, Montana—46803

File No. _____

RECEIVED

T. 16 N. R. 19 W.

DUPLICATE

FEB 8 1973

County Lake

LOG

STATE OF MONTANA
ADMINISTRATOR OF GROUNDWATER CODE
STATE WATER CONSERVATION BOARD

Top of Ground
(Elev. above sea level _____)

0
67' Large Gravel
67' Heaving sand & Water
80' Water & Pea Gravel
83'

Notice of Completion of Groundwater Appropriation by Means of Well

DEVELOPED AFTER JANUARY 1, 1962

(Under Chapter 237 Montana Session Laws, 1961, as amended)

Owner Ed Blascovich Address Arlee Mont

Driller John Farrell Address Arlee Mont

Date of Notice of appropriation of groundwater _____

Date well started July 16 1968 Date completed July 19 1968

Type of well Drilled Equipment used Churn Drill
(Dug, driven, bored or drilled) (Churn drill, rotary or other)

Water use: Domestic Municipal Stock Irrigation
Industrial Drainage Other

Indicate on the diagram the character and thickness of the different strata met with in drilling, such as soil, clay, shale, gravel, rock or sand, etc. Show depth at which water is encountered, thickness and character of water-bearing strata and height to which the water rises in the well.

Size of Drilled Hole	Size and Weight of Casing	From (Feet)	To (Feet)	PERFORATIONS		
				Kind Size	From (Feet)	To (Feet)
6"	67 18.97#	0	83'			

Loc. No. R-1413-207904
Filed for record
this 7th day of Feb.
A. D. 1973, at 2:55
o'clock P.M.

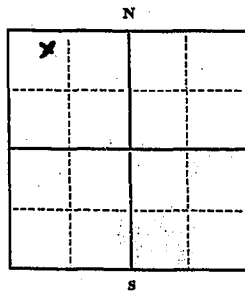

Static Water Level for non-flowing well _____ feet.

Shut-in Pressure for Flowing Well _____

Pumping Water Level _____ feet
at _____ gal. per minute.

Discharge in gal. per min. of flowing well _____

How Tested Bailer

Length of Test 1 Hour

Remarks: (Gravel packing, cementing, packers, type of shutoff) _____

Tr. in W 1/4 NW 1/4 N. 1/4 Sec 18 T. 16 R. 19
Indicate location of well and place of use, if possible. Each small square represents 40 acres.

(Continue on reverse side)

USE—If used for irrigation, industrial, drainage or other. Explain, state number of acres and location or other data (i.e.: Lot, Block and Addition).

Show exact depth of bottom.

This form to be prepared by driller, and three copies to be filed by the owner with the County Clerk and Recorder in the county in which the well is located, tissue copy to be retained by driller.

Please answer all questions. If not applicable, so state, otherwise the form will be returned.

14
Driller's License Number

John Farrell
Driller's Signature.

52363

R-1413

207904

all Report

Edward L. Blaskovich

The Public

STATE OF MONTANA } ss
County of Lake

Filed on this 7 day of February
A. D. 1913 at 2:55 o'clock P. M.

ETHEL M. HARDING
County Clerk and Recorder
by Wilhelmina Laupha
Deputy

200

STATE OF MONTANA
COUNTY OF LAKE

RECEIVED
FEB 10 1913

FILED

CLERK

DEPUTY

RECORDED

INDEXED

...

RECEIVED

STATE OF MONTANA
ADMINISTRATOR OF GROUNDWATER CODE
MONTANA WATER RESOURCES BOARD

DEC 3 1970

DRILLER'S LOG

Indicate the character, color, thickness of strata such as soil, clay, sand, gravel, shale, sandstone, etc. Show depth at which water is found and height to which water rises in well.

NOTICE OF COMPLETION OF GROUNDWATER APPROPRIATION BY MEANS OF WELL
Developed after January 1, 1962

(Under Chapter 237 Montana Session Laws, 1961, as amended)

This form to be prepared by driller, and three copies to be filed by the owner with the County Clerk and Recorder in the county in which the well is located, last copy to be retained by driller. Please answer all questions. If not applicable, so state, otherwise the form may be returned.

Owner James W Gates

Address Arlene Mont

Date well started Aug 3 1970

completed Aug 7 1970

For Administrator's Use
File <u>196279</u>
<u>December 3, 1970</u>
<u>P. 35 A.M.</u>
GW 1

Type of well 2
(Dug, driven, bored or drilled)

Equipment used X X
(Churn drill, rotary or other)

Water Use: Domestic Municipal Stock Irrigation
Industrial Drainage Other * Garden/Lawn

*Describe
USE: If used for irrigation, industrial, drainage or other. Explain, state number of acres and location or other data (i.e. Lot, Block and Addition).

ESTIMATED ANNUAL WITHDRAWAL 20,000 gal

Size of Drilled Hole	Size and Weight of Casing	From (Feet)	To (Feet)	PERFORATIONS		
				Kind Size	From (Feet)	To (Feet)
6"	6" 17 #	0	115			

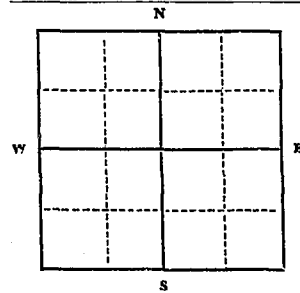

Static water level 88 ft.*
Pumping water level 108 ft.*
at 24 gallons per minute,
measured 2 minutes after pumping
began. Bailer
*Measured from ground level.
Well developed by Bailer
for 2 hours.
Power Bailer Pump Bailer HP
Remarks: (Gravel packing, cementing,
packers, type of shutoff)

NE 1/4 NE 1/4 Sec 18
T. 16N N R. 19W E

INDICATE LOCATION OF WELL AND PLACE OF USE, IF POSSIBLE. EACH SMALL SQUARE REPRESENTS 40 ACRES.

Driller's Signature John Farrell

Driller's Address Arlene Mont

LICENSE NO. 14

Top of Ground		(Elev. above sea level)
From (Feet)	To (Feet)	
0	95	Coble Rock Sand Gravel
95	112	Fine sand water
112	115	Pea Gravel & Water

115

Show exact depth of bottom

47843

1	2	3	4	5	6	7	8	9	10	11	12	13	14	15	16	17	18	19	20	21	22	23	24	25	26	27	28	29	30	31	32	33	34	35	36	37	38	39	40	41	42	43	44	45	46	47	48	49	50	51	52	53	54	55	56	57	58	59	60	61	62	63	64	65	66	67	68	69	70	71	72	73	74	75	76	77	78	79	80	81	82	83	84	85	86	87	88	89	90	91	92	93	94	95	96	97	98	99	100
---	---	---	---	---	---	---	---	---	----	----	----	----	----	----	----	----	----	----	----	----	----	----	----	----	----	----	----	----	----	----	----	----	----	----	----	----	----	----	----	----	----	----	----	----	----	----	----	----	----	----	----	----	----	----	----	----	----	----	----	----	----	----	----	----	----	----	----	----	----	----	----	----	----	----	----	----	----	----	----	----	----	----	----	----	----	----	----	----	----	----	----	----	----	----	----	----	----	----	-----

R-1240

196279

JAMES W. GATES

DEPT. OF REVENUE

THE PUBLIC

County 1962

RECEIVED
 DEPT. OF REVENUE
 STATE OF MONTANA
 HEAVENLY BODIES

STATE OF MONTANA
 COUNTY OF LAKE
 DEPT. OF REVENUE
 HEAVENLY BODIES

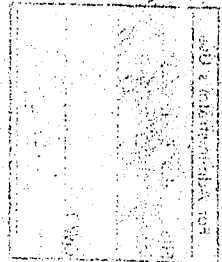

STATE OF MONTANA
 County of Lake
 Filed on the _____ day of _____
 A. D. 19__ at _____
 THEE M. HARDING
 County Clerk and Recorder
 By Jewell Burt
 Deputy

2.00

GW 2

File No.

DUPLICATE

RECEIVED
DEC 21 1964

STATE ENGINEER

Approved Stock Form—State Publishing Co., Helena, Montana—4193

Location

T. 16 N. R. 19 W. Sec. 4

T. 16 N. R. 19 W.

County

STATE OF MONTANA

ADMINISTRATOR OF GROUNDWATER CODE

OFFICE OF STATE ENGINEER

RECEIVED
DEC 14 1964

Notice of Completion of Groundwater Appropriation by Means of Well

(Under Chapter 237, Montana Session-Laws, 1961)

Owner KARL DODGE Address ARLEE MONT

Driller PHILIP R. LEWIS Address Box 95, STEADMAN

Date of Notice of Appropriation of Groundwater

Date well started AUG 8, 64 Date Completed SEPT 27, 64

Type of well DRILLED Equipment Used CHURN
(dug, driven, bored or drilled) (Churn, drill, rotary or other)

Water Use: Domestic Municipal Other Irrigation
Industrial Drainage Stock

Indicate on the diagram the character and thickness of the different strata met with in drilling, such as soil, clay, shale, gravel, rock or sand, etc. Show depth at which water is encountered, thickness and character of water-bearing strata and height to which water rises in the well.

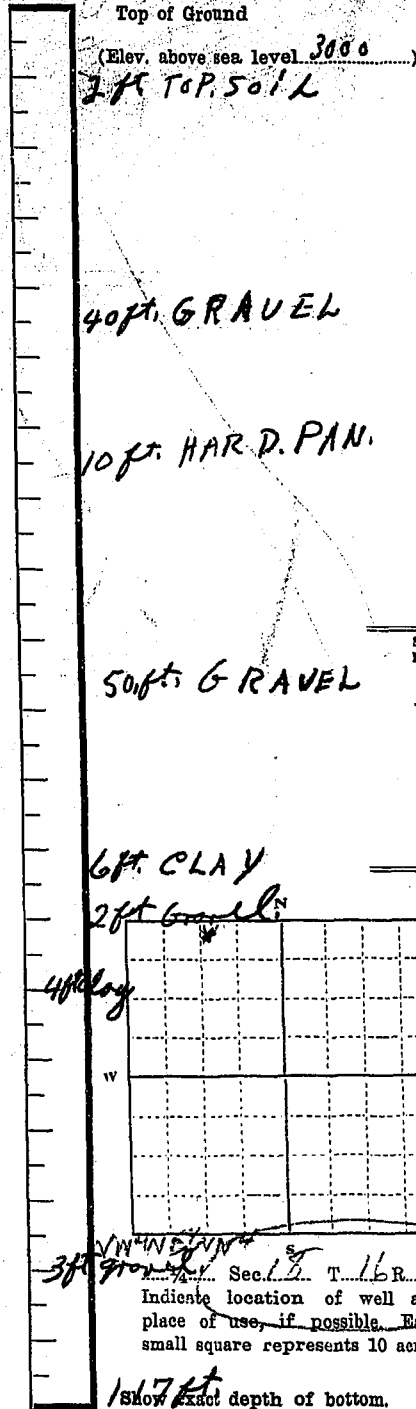

Size of Drilled Hole	Size and Weight of Casing	From (Feet)	To (Feet)	PERFORATIONS		
				Kind Size	From (Feet)	To (Feet)
<u>5 IN</u>	<u>5 IN, 18 lb</u>	<u>TOP</u>	<u>117 ft</u>	<u>NONE</u>	<u>NONE</u>	<u>NONE</u>

Static Water Level for non-flowing Well 70 ft. feet.

Shut-in Pressure for Flowing Well _____

Pumping Water Level 8.5 feet at 1.0 gal. per minute.

Discharge in gal. per min. _____

How Tested BALE Length of Test 8 HRS.

Remarks: (Gravel packing, cementing, packers, type of shutoff, location of place of use of groundwater if not at well, and any other similar pertinent information, including number of acres irrigated, if used for irrigation) 1 A.C.R.E. YARD + FRUIT TREES.

Driller's License Number 136

Driller's Signature Philip R. Lewis

Location ?

This form to be prepared by driller, and three copies to be filed by the owner with the County Clerk and Recorder in the county in which the well is located.

Please answer all questions. If not applicable, so state, otherwise the form will be returned.

Original to the County Clerk and Recorder; duplicate to the State Engineer; Triplicate to the Montana Bureau of Mines and Geology and Quadruplicate for the Appropriator.

R-972
168240
Well Report
Karl Lodge
To
The Public

STATE OF MONTANA
County of Lake
Filed on the 7th day of Dec
A. D. 1964 at 4:00 o'clock P. M.
HAZEL KINNICK
County Clerk and Recorder
By G. Cowman
2000 Deputy

RECEIVED

Handwritten notes and signatures in the right margin, including names like "Karl Lodge" and "The Public".

File No.

T. 16 N R. 19 W

DUPLICATE

County Tabe

STATE OF MONTANA
ADMINISTRATOR OF GROUNDWATER CODE
OFFICE OF STATE ENGINEER

RECEIVED
MAY 15 1963

Declaration of Vested Groundwater Rights

(Under Chapter 237, Montana Session Laws, 1961)

STATE ENGINEER

1. Glen Johnston, of R.F.D. Orlee
(Name of Appropriator) (Address) (Town)

County of Tabe State of Montana

have appropriated groundwater according to the Montana laws in effect prior to January 1, 1962, as follows:

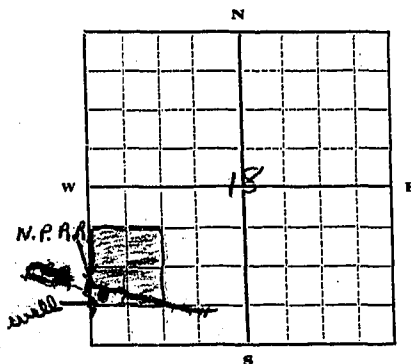

N.W. 1/4 Sec. 18 T. 16 R. 19

Indicate point of appropriation and place of use, if possible. Each small square represents 10 acres.

2. The beneficial use on which the claim is based human consumption, stock water, utilities, irrigation

3. Date or approximate date of earliest beneficial use; and how continuous the use has been the well was dug around 1910 and has been in steady use ever since

4. The amount of groundwater claimed (in miner's inches or gallons per minute) 60 gallons per minute

5. If used for irrigation, give the acreage and description of the lands to which water has been applied and name of the owner thereof Two (2) acres are irrigated by the well, they include - lawn, pasture, garden and fruit orchard. The owner is Glen Johnston.

6. The means of withdrawing such water from the ground and the location of each well or other means of withdrawal a pressure pump is used all year as well as a hand pump and a small irrigation pump is used as well in the summer.

7. The date of commencement and completion of the construction of the well, wells, or other works for withdrawal of groundwater Exact dates are unknown however according to available records it was begun and completed in 1910.

8. The depth of water table between 20 and 25 feet

9. So far as it may be available, the type, size and depth of each well or the general specifications of any other works for the withdrawal of groundwater there is just the one well and it is hand dug.

10. The estimated amount of groundwater withdrawn each year 219,000 gallons

11. The log of formations encountered in the drilling of each well if available There is no log of formations available.

12. Such other information of a similar nature as may be useful in carrying out the policy of this act, including reference to book and page of any county record no other records known to be available.

Signature of Owner Glen Johnston

Date February 4, 1963

Three copies to be filed by the owner with the County Clerk and Recorder of the county in which the well is located.

Please answer all questions. If not applicable, so state, otherwise the form will be returned.

Original to the County Clerk and Recorder; duplicate to the State Engineer; Triplicate to the Montana Bureau of Mines and Geology, and Quadruplicate for the Appropriator.

R-162

159665

State Report

Glen Johnston

To
The Public

STATE OF MONTANA }
 County of Lake. }
 Filed on the 13 day of May
 A. D. 1963 at 1:20 o'clock P. M
 HAZEL KINNICK
 County Clerk and Recorder
 By L. Knauer
 Deputy

200