

R-6/6-

162944  
Water Report

Ernest E. Udall  
To  
The Public

STATE OF MONTANA  
County of Lake,

Filed on the 30 day of Dec.  
A. D. 1963 at 12:44 o'clock P. M.

HAZEL KINNICK  
County Clerk and Recorder

By C. Cowman  
Deputy

File No. ....

T. 19<sup>N</sup> R. 30<sup>W</sup>

DUPLICATE

County Lake

STATE OF MONTANA  
ADMINISTRATOR OF GROUNDWATER CODE  
OFFICE OF STATE ENGINEER

RECEIVED  
JAN 2 1964  
STATE ENGINEER

Notice of Completion of Groundwater Appropriation  
Without Well

(Under Chapter 237 Montana Session Laws, 1961)

Date of Appropriation of Groundwater.....

Owner Ernest E. Uell Address St Ignace

Contractor (if any) None

Address of Contractor None

Date Started..... Date Completed.....

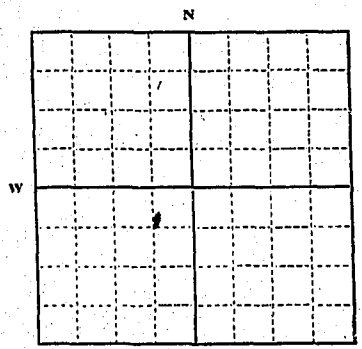

Describe means of obtaining groundwater without a well "as by sub-irrigation and other natural processes". Include depth to water when applicable. Natural Springs

A grouping of (3) three spring flowing into a one natural creek flowing 1,000 gal per minute.

Quantity of water developed and used with explanation of method used to measure or estimate such amount. If use is intermittent

estimate approximate lengths of periods of use. year  
around for stock and irrigation use. Measured with pump metering gal per minutes.

NE 1/4 NE Sec 33 T. 19 R. 30  
Indicate point of appropriation and place of use, if possible.

Signature of Owner Ernest E. Uell

Date Dec. 18 1963

This form to be prepared by contractor (if any), otherwise by the owner.

Three copies of this notice are to be filed with the County Clerk and Recorder of the county in which the works are located.

Please answer all questions. If not applicable, so state, otherwise the form will be returned.

Original to the County Clerk and Recorder; duplicate to the State Engineer; Triplicate to the Montana Bureau of Mines and Geology and Quadruplicate for the Appropriator.

R-615

162943

Water Report

Ernest E. Udall

To

The Public

STATE OF MONTANA  
 County of Lake,  
 Filed on the 30 day of Dec.  
 A. D. 1963 at 12:30 clock P. M.  
 HAZEL KINNICK  
 County Clerk and Recorder  
 By E. Cowman  
 Deputy

File No.....

T. 19 R. 20

DUPLICATE

County Lake

STATE OF MONTANA  
ADMINISTRATOR OF GROUNDWATER CODE  
OFFICE OF STATE ENGINEER

RECEIVED  
JAN 6 1964  
STATE ENGINEER

Notice of Completion of Groundwater Appropriation  
Without Well

(Under Chapter 237 Montana Session Laws, 1961)

Date of Appropriation of Groundwater 1944

Owner Archie R. Anderson Address St. Ignatius, Montana.

Contractor (if any) None.

Address of Contractor .....

Date Started Aug. 7, 1944 Date Completed Aug. 20, 1944

Describe means of obtaining groundwater without a well "as by sub-irrigation and other natural processes". Include depth to water when applicable. Natural Spring, no. 1 for

domestic use, appropriated in Sec. 34 used in  
Sec. 27. Spring no. 2 used for irrigation in open  
ditch June, July & Aug. for stock water year  
around.

Quantity of water developed and used with explanation of method used to measure or estimate such amount. If use is intermittent

estimate approximate lengths of periods of use.....

Dammed up the out let and measured it through  
a pipe. Spring no. 1, 3 gal. per min. Spring no. 2,  
7 gal. per min.

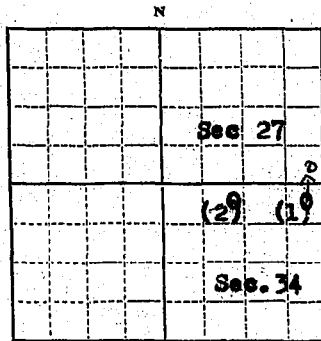

W 1/4 NE 1/4 Sec. 34 T. 19 R. 20  
Indicate point of appropriation  
and place of use, if possible.  
SE 1/4 SE 1/4 Sec. 27.  
T. 19, R. 20.

Signature of Owner Archie R. Anderson

Date Dec. 30, 1963.

This form to be prepared by contractor (if any), otherwise by the owner.

Three copies of this notice are to be filed with the County Clerk and Recorder of the county in which the works are located.

Please answer all questions. If not applicable, so state, otherwise the form will be returned.

Original to the County Clerk and Recorder; duplicate to the State Engineer; Triplicate to the Montana Bureau of Mines and Geology and Quadruplicate for the Appropriator.

R 136

163079

Archie R. Anderson

to

The Public

STATE OF MONTANA

County of Lake

Filed on the 31 day of Dec

A. D. 1963 at 12:12 o'clock P. M.

HAZEL KINNICK

Court Clerk and Recorder

By E. Cowan

Deputy

JW 3

Approved Stock Form—State Publishing Co., Helena, Montana—39318

File No. \_\_\_\_\_

T. 19 R. 20 S. 34

DUPLICATE

County \_\_\_\_\_

STATE OF MONTANA  
ADMINISTRATOR OF GROUNDWATER CODE  
OFFICE OF STATE ENGINEER

RECEIVED  
JAN 6 1964  
STATE ENGINEER

Notice of Completion of Groundwater Appropriation Without Well

(Under Chapter 237 Montana Session Laws, 1961)

Date of Appropriation of Groundwater... 1941

Owner... Art Drake  
Frank Drake Address... St. Ignatius

Contractor (if any) None

Address of Contractor \_\_\_\_\_

Date Started 1941 Date Completed 1941

Describe means of obtaining groundwater without a well "as by sub-irrigation and other natural processes". Include depth to water when applicable. Springs rising on this property were drained and channeled to be used for irrigation

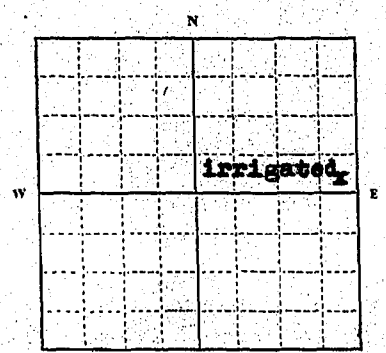

SE 1/4 NE Sec. 34 T. 19 R. 20

Indicate point of appropriation and place of use, if possible.

Quantity of water developed and used with explanation of method used to measure or estimate such amount. If use is intermittent

estimate approximate lengths of periods of use 13 1/2 - 1 1/2  
acre feet flow measured on standard weir

Signature of Owner Art Drake Frank Drake

Date Dec. 19, 1963

This form to be prepared by contractor (if any), otherwise by the owner.

Three copies of this notice are to be filed with the County Clerk and Recorder of the county in which the works are located.

Please answer all questions. If not applicable, so state, otherwise the form will be returned.

Original to the County Clerk and Recorder; duplicate to the State Engineer; Triplicate to the Montana Bureau of Mines and Geology and Quadruplicate for the Appropriator.

24372

K-8725

163220

Att + Frank Drake

STATE OF MONTANA

County of Lake

Filed on the 31 day of Dec

A. D. 1965 at 5:45 o'clock P. M.

FRANK KINNICE

County Clerk and Recorder

By M. Kraus

Deputy

200



34

File No. ....

T. 19 N R 20 W

DUPLICATE

County Lake

STATE OF MONTANA  
ADMINISTRATOR OF GROUNDWATER CODE  
OFFICE OF STATE ENGINEER

RECEIVED  
DEC 30 1963

Declaration of Vested Groundwater Rights STATE ENGINEER  
(Under Chapter 237, Montana Session Laws, 1961)

1. Charles and Christina KREIS, of St. Ignatius  
(Name of Appropriator) (Address) (Town)  
County of Lake State of Montana  
have appropriated groundwater according to the Montana laws in effect prior to January 1, 1962, as follows:

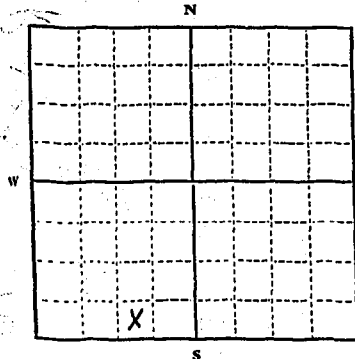

SE 1/4 Sec. 34 T. 19 R. 20

Indicate point of appropriation and place of use, if possible. Each small square represents 10 acres.

- 2. The beneficial use on which the claim is based domestic and yard irrigation
- 3. Date or approximate date of earliest beneficial use; and how continuous the use has been October, 1947; use continuous, since that date
- 4. The amount of groundwater claimed (in miner's inches or gallons per minute) 12 gallons per minute
- 5. If used for irrigation, give the acreage and description of the lands to which water has been applied and name of the owner thereof yard and garden irrigation only
- 6. The means of withdrawing such water from the ground and the location of each well or other means of withdrawal deep well jet pump located at well head

7. The date of commencement and completion of the construction of the well, wells, or other works for withdrawal of groundwater October, 1947

8. The depth of water table about 12 feet

9. So far as it may be available, the type, size and depth of each well or the general specifications of any other works for the withdrawal of groundwater drilled well with 5 inch steel casing

10. The estimated amount of groundwater withdrawn each year 125,000 gallons

11. The log of formations encountered in the drilling of each well if available not available; driller: Earl King, St. Ignatius, Montana (now deceased)

12. Such other information of a similar nature as may be useful in carrying out the policy of this act, including reference to book and page of any county record not applicable

Signature of Owner Charles Kreis  
Christina Kreis

Date December 27, 1963

Three copies to be filed by the owner with the County Clerk and Recorder of the county in which the well is located.

Please answer all questions. If not applicable, so state, otherwise the form will be returned.

Original to the County Clerk and Recorder; Duplicate to the State Engineer; Triplicate to the Montana Bureau of Mines and Geology, and Quadruplicate for the Appropriator.

16566



R-523 102856

Water Report  
Charles & Christina  
Kris  
to  
The Public

STATE OF MONTANA  
County of Lake  
Filed on the 27 day of Dec  
1965 at 10 o'clock A.M.  
By *Shirley Ann*  
County Clerk and Recorder

Deputy

\$2.00

RECORDED

INDEXED

RECORDED

RECEIVED

19N-20W  
County Blaine

AUG 8 1972

DRILLER'S LOG

STATE OF MONTANA  
ADMINISTRATOR OF GROUNDWATER CODE  
MONTANA WATER RESOURCES BOARD  
NOTICE OF COMPLETION OF GROUNDWATER  
APPROPRIATION BY MEANS OF WELL  
Developed after January 1, 1962

INDICATE THE CHARACTER, COLOR, THICKNESS OF STRATA SUCH AS SOIL, CLAY, SAND, GRAVEL, SHALE, SANDSTONE, ETC. SHOW DEPTH AT WHICH WATER IS FOUND AND HEIGHT TO WHICH WATER RISES IN WELL.

(Under Chapter 237 Montana Session Laws, 1961, as amended)

This form to be prepared by driller, and three copies to be filed by the owner with the County Clerk and Recorder in the county in which the well is located, last copy to be retained by driller. Please answer all questions. If not applicable, so state, otherwise the form may be returned.

Owner W. Peterson & Doris A. Peterson  
Address Box 205  
Blaine, Mont.  
Date well started 28 June / 72  
completed 29 June

For Administrator's Use  
File R-136.8; 204.987  
August 2, 1972 12:06 p.m.  
GW 1

Type of well Drill  
(Dug, driven, bored or drilled)  
Equipment used Churn Drill  
(Churn drill, rotary or other)  
Water Use: Domestic  Municipal  Stock  Irrigation   
Industrial  Drainage  Other \* Garden/Lawn

\*Describe \_\_\_\_\_  
USE: If used for irrigation, industrial, drainage or other. Explain, state number of acres and location or other data (i.e. Lot, Block and Addition). \_\_\_\_\_

ESTIMATED ANNUAL WITHDRAWAL 10,000

Size of Drilled Hole	Size and Weight of Casing	From (Feet)	To (Feet)	PERFORATIONS		
				Kind Size	From (Feet)	To (Feet)
<u>4"</u>	<u>5/8" O.D. 17#</u>	<u>1 1/2</u>	<u>37 1/2</u>	<u>XXXX</u>	<u>XXXX</u>	<u>XXXX</u>

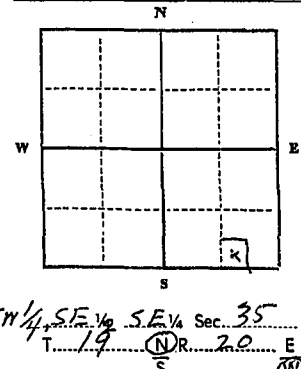

Static water level 2 ft.\*  
Pumping water level 22 1/2 ft.\*  
at 12 gallons per minute,  
measured 120 minutes after pumping began.  
\*Measured from ground level.  
Well developed by 21 hours.  
Power 230 Pump 1 HP  
Remarks: (Gravel packing, cementing, packers, type of shutoff) \_\_\_\_\_

Top of Ground (Elev. above sea level)		
From (Feet)	To (Feet)	
<u>0</u>	<u>1</u>	<u>Top of Ground</u>
<u>1</u>	<u>2</u>	<u>Top of Ground</u>
<u>2</u>	<u>3</u>	<u>Top of Ground</u>
<u>3</u>	<u>4</u>	<u>Top of Ground</u>
<u>4</u>	<u>5</u>	<u>Top of Ground</u>
<u>5</u>	<u>6</u>	<u>Top of Ground</u>
<u>6</u>	<u>7</u>	<u>Top of Ground</u>
<u>7</u>	<u>8</u>	<u>Top of Ground</u>
<u>8</u>	<u>9</u>	<u>Top of Ground</u>
<u>9</u>	<u>10</u>	<u>Top of Ground</u>
<u>10</u>	<u>11</u>	<u>Top of Ground</u>
<u>11</u>	<u>12</u>	<u>Top of Ground</u>
<u>12</u>	<u>13</u>	<u>Top of Ground</u>
<u>13</u>	<u>14</u>	<u>Top of Ground</u>
<u>14</u>	<u>15</u>	<u>Top of Ground</u>
<u>15</u>	<u>16</u>	<u>Top of Ground</u>
<u>16</u>	<u>17</u>	<u>Top of Ground</u>
<u>17</u>	<u>18</u>	<u>Top of Ground</u>
<u>18</u>	<u>19</u>	<u>Top of Ground</u>
<u>19</u>	<u>20</u>	<u>Top of Ground</u>
<u>20</u>	<u>21</u>	<u>Top of Ground</u>
<u>21</u>	<u>22</u>	<u>Top of Ground</u>
<u>22</u>	<u>23</u>	<u>Top of Ground</u>
<u>23</u>	<u>24</u>	<u>Top of Ground</u>
<u>24</u>	<u>25</u>	<u>Top of Ground</u>
<u>25</u>	<u>26</u>	<u>Top of Ground</u>
<u>26</u>	<u>27</u>	<u>Top of Ground</u>
<u>27</u>	<u>28</u>	<u>Top of Ground</u>
<u>28</u>	<u>29</u>	<u>Top of Ground</u>
<u>29</u>	<u>30</u>	<u>Top of Ground</u>
<u>30</u>	<u>31</u>	<u>Top of Ground</u>
<u>31</u>	<u>32</u>	<u>Top of Ground</u>
<u>32</u>	<u>33</u>	<u>Top of Ground</u>
<u>33</u>	<u>34</u>	<u>Top of Ground</u>
<u>34</u>	<u>35</u>	<u>Top of Ground</u>
<u>35</u>	<u>36</u>	<u>Top of Ground</u>
<u>36</u>	<u>37</u>	<u>Top of Ground</u>
<u>37</u>	<u>38</u>	<u>Top of Ground</u>
<u>38</u>	<u>39</u>	<u>Top of Ground</u>
<u>39</u>	<u>40</u>	<u>Top of Ground</u>
<u>40</u>	<u>41</u>	<u>Top of Ground</u>
<u>41</u>	<u>42</u>	<u>Top of Ground</u>
<u>42</u>	<u>43</u>	<u>Top of Ground</u>
<u>43</u>	<u>44</u>	<u>Top of Ground</u>
<u>44</u>	<u>45</u>	<u>Top of Ground</u>
<u>45</u>	<u>46</u>	<u>Top of Ground</u>
<u>46</u>	<u>47</u>	<u>Top of Ground</u>
<u>47</u>	<u>48</u>	<u>Top of Ground</u>
<u>48</u>	<u>49</u>	<u>Top of Ground</u>
<u>49</u>	<u>50</u>	<u>Top of Ground</u>
<u>50</u>	<u>51</u>	<u>Top of Ground</u>
<u>51</u>	<u>52</u>	<u>Top of Ground</u>
<u>52</u>	<u>53</u>	<u>Top of Ground</u>
<u>53</u>	<u>54</u>	<u>Top of Ground</u>
<u>54</u>	<u>55</u>	<u>Top of Ground</u>
<u>55</u>	<u>56</u>	<u>Top of Ground</u>
<u>56</u>	<u>57</u>	<u>Top of Ground</u>
<u>57</u>	<u>58</u>	<u>Top of Ground</u>
<u>58</u>	<u>59</u>	<u>Top of Ground</u>
<u>59</u>	<u>60</u>	<u>Top of Ground</u>
<u>60</u>	<u>61</u>	<u>Top of Ground</u>
<u>61</u>	<u>62</u>	<u>Top of Ground</u>
<u>62</u>	<u>63</u>	<u>Top of Ground</u>
<u>63</u>	<u>64</u>	<u>Top of Ground</u>
<u>64</u>	<u>65</u>	<u>Top of Ground</u>
<u>65</u>	<u>66</u>	<u>Top of Ground</u>
<u>66</u>	<u>67</u>	<u>Top of Ground</u>
<u>67</u>	<u>68</u>	<u>Top of Ground</u>
<u>68</u>	<u>69</u>	<u>Top of Ground</u>
<u>69</u>	<u>70</u>	<u>Top of Ground</u>
<u>70</u>	<u>71</u>	<u>Top of Ground</u>
<u>71</u>	<u>72</u>	<u>Top of Ground</u>
<u>72</u>	<u>73</u>	<u>Top of Ground</u>
<u>73</u>	<u>74</u>	<u>Top of Ground</u>
<u>74</u>	<u>75</u>	<u>Top of Ground</u>
<u>75</u>	<u>76</u>	<u>Top of Ground</u>
<u>76</u>	<u>77</u>	<u>Top of Ground</u>
<u>77</u>	<u>78</u>	<u>Top of Ground</u>
<u>78</u>	<u>79</u>	<u>Top of Ground</u>
<u>79</u>	<u>80</u>	<u>Top of Ground</u>
<u>80</u>	<u>81</u>	<u>Top of Ground</u>
<u>81</u>	<u>82</u>	<u>Top of Ground</u>
<u>82</u>	<u>83</u>	<u>Top of Ground</u>
<u>83</u>	<u>84</u>	<u>Top of Ground</u>
<u>84</u>	<u>85</u>	<u>Top of Ground</u>
<u>85</u>	<u>86</u>	<u>Top of Ground</u>
<u>86</u>	<u>87</u>	<u>Top of Ground</u>
<u>87</u>	<u>88</u>	<u>Top of Ground</u>
<u>88</u>	<u>89</u>	<u>Top of Ground</u>
<u>89</u>	<u>90</u>	<u>Top of Ground</u>
<u>90</u>	<u>91</u>	<u>Top of Ground</u>
<u>91</u>	<u>92</u>	<u>Top of Ground</u>
<u>92</u>	<u>93</u>	<u>Top of Ground</u>
<u>93</u>	<u>94</u>	<u>Top of Ground</u>
<u>94</u>	<u>95</u>	<u>Top of Ground</u>
<u>95</u>	<u>96</u>	<u>Top of Ground</u>
<u>96</u>	<u>97</u>	<u>Top of Ground</u>
<u>97</u>	<u>98</u>	<u>Top of Ground</u>
<u>98</u>	<u>99</u>	<u>Top of Ground</u>
<u>99</u>	<u>100</u>	<u>Top of Ground</u>

INDICATE LOCATION OF WELL AND PLACE OF USE, IF POSSIBLE. EACH SMALL SQUARE REPRESENTS 40 ACRES.

Driller's Signature George O. Beebe  
Driller's Address Box 47  
Blaine, Mont. LICENSE NO. 204

37 1/2 Show exact depth of bottom

51,099

R-1368

204987

WELL REPORT  
VIC F. PETERSON  
AND DORIS A. PETERSON  
TO  
THE PUBLIC

Checked for accuracy  
Date: 10/10/51  
Checked for accuracy  
Date: 10/10/51  
Checked for accuracy  
Date: 10/10/51

ASBFB2 100

STATE OF MONTANA ) ss.  
County of Lake

Filed on the 7 day of Aug.

A. D. 1951 at 12:06 o'clock p.m.

ETHEL M. HARDING

County Clerk and Recorder

by Laura ... Deputy

200

NOTICE OF COMPLETION OF RECONSTRUCTION  
MONTANA WATER REFINANCING BOARD  
MEMBER OF THE FEDERAL RESERVE SYSTEM

Vertical text on the left side of the page, possibly a list or index.

Vertical text on the left side of the page, possibly a list or index.

Vertical text on the left side of the page, possibly a list or index.

File No. \_\_\_\_\_

DUPLICATE

T. 19<sup>N</sup> R. 20<sup>W</sup>

County Lake

RECEIVED  
DEC 13 1963  
STATE ENGINEER

STATE OF MONTANA  
ADMINISTRATOR OF GROUNDWATER CODE  
OFFICE OF STATE ENGINEER

Declaration of Vested Groundwater Rights

(Under Chapter 237, Montana Session Laws, 1961)

1. Jesse L. & Alma E. Sipe of St. Ignace  
(Name of Appropriator) (Address) (Town)

County of Lake State of Montana  
have appropriated groundwater according to the Montana laws in effect prior to January 1, 1962, as follows:

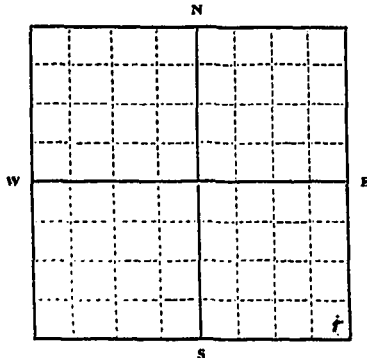

E 1/2 SE 1/4 Sec. 35 T. 19 R. 20

Indicate point of appropriation and place of use, if possible. Each small square represents 10 acres.

- 2. The beneficial use on which the claim is based Household, Stock and Poultry.
- 3. Date or approximate date of earliest beneficial use; and how continuous the use has been 1945, Continuous
- 4. The amount of groundwater claimed (in miner's inches or gallons per minute) two gallon per minute
- 5. If used for irrigation, give the acreage and description of the lands to which water has been applied and name of the owner thereof not used
- 6. The means of withdrawing such water from the ground and the location of each well or other means of withdrawal well with pump

- 7. The date of commencement and completion of the construction of the well, wells, or other works for withdrawal of groundwater July 1945
- 8. The depth of water table 80 feet
- 9. So far as it may be available, the type, size and depth of each well or the general specifications of any other works for the withdrawal of groundwater. drilled well 80 feet deep.
- 10. The estimated amount of groundwater withdrawn each year. 3,000 gallon
- 11. The log of formations encountered in the drilling of each well if available. not available
- 12. Such other information of a similar nature as may be useful in carrying out the policy of this act, including reference to book and page of any county record.

Jesse L. Sipe  
Signature of Owner Alma E. Sipe  
Date 12-10-63

Three copies to be filed by the owner with the County Clerk and Recorder of the county in which the well is located.  
Please answer all questions. If not applicable, so state, otherwise the form will be returned.

Original to the County Clerk and Recorder; Duplicate to the State Engineer; Triplicate to the Montana Bureau of Mines and Geology, and Quadruplicate for the Appropriator.

R 334

162439

Jose L & Alma E  
Lipe  
to  
The Public

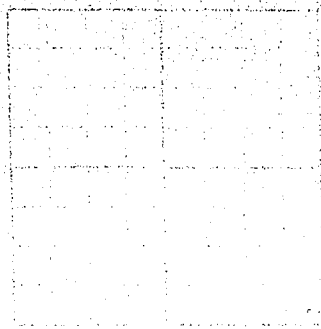

STATE OF MONTANA }  
County of Lake, }  
Filed on the 10 day of Dec  
A. D. 1963 at 10:00 o'clock P.M.  
HAZEL KINNAUK  
County Clerk and Recorder  
By E. Cowman  
Deputy

RECORDED  
INDEXED  
DEC 11 1963  
COUNTY CLERK

36

File No. ....

T 19 R 20

DUPLICATE

County Lake

STATE OF MONTANA  
ADMINISTRATOR OF GROUNDWATER CODE  
OFFICE OF STATE ENGINEER

RECEIVED  
JAN 8 1964  
STATE ENGINEER

Declaration of Vested Groundwater Rights

(Under Chapter 237, Montana Session Laws, 1961)

1. Zetta Rollins Baker, of Sh. Junction Wash.  
(Name of Appropriator) (Address) (Town)  
County of Lake State of Montana  
have appropriated groundwater according to the Montana laws in effect prior to January 1, 1962, as follows:

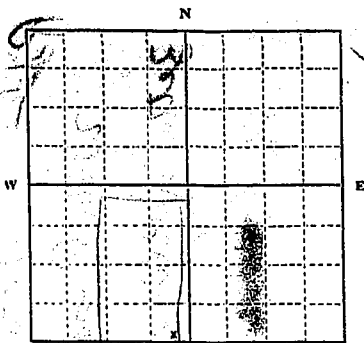

670 S.W. 1/4 Sec 36 T. 19 R. 20

Indicate point of appropriation and place of use, if possible. Each small square represents 10 acres.

- 2. The beneficial use on which the claim is based Domestic
- 3. Date or approximate date of earliest beneficial use; and how continuous the use has been 1949 - used continuously
- 4. The amount of groundwater claimed (in miner's inches or gallons per minute) 25 gal per min
- 5. If used for irrigation, give the acreage and description of the lands to which water has been applied and name of the owner thereof
- 6. The means of withdrawing such water from the ground and the location of each well or other means of withdrawal hand pump

7. The date of commencement and completion of the construction of the well, wells, or other works for withdrawal of groundwater 1949

8. The depth of water table.....

9. So far as it may be available, the type, size and depth of each well or the general specifications of any other works for the withdrawal of groundwater hand dug - 20 ft deep

10. The estimated amount of groundwater withdrawn each year 20,000 gal

11. The log of formations encountered in the drilling of each well if available.....

12. Such other information of a similar nature as may be useful in carrying out the policy of this act, including reference to book and page of any county record.....

Signature of Owner Zetta Rollins Baker

Date Dec. 27, 1963

Three copies to be filed by the owner with the County Clerk and Recorder of the county in which the well is located.

Please answer all questions. If not applicable, so state, otherwise the form will be returned.

Original to the County Clerk and Recorder; Duplicate to the State Engineer; Triplicate to the Montana Bureau of Mines and Geology, and Quadruplicate for the Appropriator.

17472

File No.

19  
County Lake

DUPLICATE

STATE OF MONTANA  
ADMINISTRATOR OF GROUNDWATER CODE  
OFFICE OF STATE ENGINEER

RECEIVED  
JAN 2 1964  
STATE ENGINEER

Declaration of Vested Groundwater Rights

(Under Chapter 237 Montana Session Laws 1961)

I, Zetta Rollins Baker of St. Ignace (Name of Appropriator) (Address) (Town)  
County of Lake State of Montana  
have appropriated groundwater according to the Montana laws in effect prior to January 1, 1962, as follows:

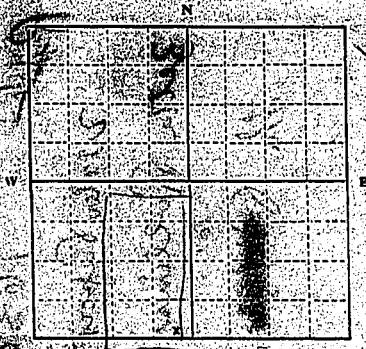

Sec. 26 T. 19 R. 20

Indicate point of appropriation and place of use, if possible. Each small square represents 10 acres.

2. The beneficial use on which the claim is based: domestic

3. Date or approximate date of earliest beneficial use, and how continuous the use has been: 1949, used continuously

4. The amount of groundwater claimed (in miner's inches or gallons per minute): 25 gal per min

5. If used for irrigation, give the acreage and description of the lands to which water has been applied and name of the owner thereof.

6. The means of withdrawing such water from the ground and the location of each well or other means of withdrawal: hand pump

7. The date of commencement and completion of the construction of the well, wells, or other works for withdrawal of groundwater: 1949

8. The depth of water table.

9. So far as it may be available, the type, size and depth of each well or the general specifications of any other works for the withdrawal of groundwater: hand dug - 20 ft deep

10. The estimated amount of groundwater withdrawn each year: 24,000 gal

11. The log of formations encountered in the drilling of each well if available.

12. Such other information of a similar nature as may be useful in carrying out the policy of this act, including reference to book and page of any county record.

Signature of Owner: Zetta Rollins Baker  
Date: Dec. 27, 1963

Three copies to be filed by the owner with the County Clerk and Recorder of the county in which the well is located.

Please answer all questions. If not applicable, so state, otherwise the form will be returned.

Original to the County Clerk and Recorder; Duplicate to the State Engineer; Triplicate to the Montana Bureau of Mines and Geology, and Quadruplicate for the Appropriator.

17472



R-665 163002  
Water Report  
Zetta Rollins Baker  
To  
The Public

STATE OF MONTANA  
County of Lake.  
Filed on the 21 day of Dec  
A. D. 1965 at 4:05 o'clock P. M.  
J. M. Smith  
County Clerk and Recorder

By \_\_\_\_\_  
Deputy

File No. ....

T. 19<sup>N</sup> R. 20<sup>W</sup>

DUPLICATE

County Lake

STATE OF MONTANA  
ADMINISTRATOR OF GROUNDWATER CODE  
OFFICE OF STATE ENGINEER

JAN 2 1964  
STATE ENGINEER

Notice of Completion of Groundwater Appropriation  
Without Well

(Under Chapter 237 Montana Session Laws, 1961)

Date of Appropriation of Groundwater March 1940

Owner Zetta Pellin Baker Address St Ignace

Contractor (if any) .....

Address of Contractor .....

Date Started ..... Date Completed May 1940

Describe means of obtaining groundwater without a well "as by sub-irrigation and other natural processes". Include depth to water when applicable. Sub irrigation

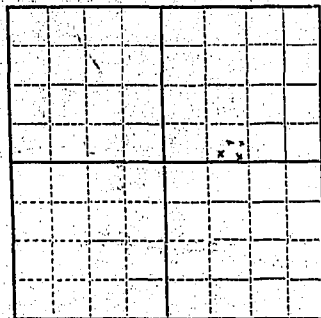

SE 1/4 of E 1/4 of S 24 N 19 T. 19 R. 20  
Indicate point of appropriation and place of use, if possible.

Quantity of water developed and used with explanation of method used to measure or estimate such amount. If use is intermittent estimate approximate lengths of periods of use.

Water runs steady flow used to water stock.

Signature of Owner Zetta Pellin Baker

Date December 27, 1963

This form to be prepared by contractor (if any), otherwise by the owner.

Three copies of this notice are to be filed with the County Clerk and Recorder of the county in which the works are located.

Please answer all questions. If not applicable, so state, otherwise the form will be returned.

Original to the County Clerk and Recorder; duplicate to the State Engineer; Triplicate to the Montana Bureau of Mines and Geology and Quadruplicate for the Appropriator.

R-1606 163003  
Water Report  
Zetta Rollins Baker  
to  
The Public

STATE OF MONTANA  
County of Lake, ss  
Filed on the 24 day of Dec  
A. D. 1963 at 10 o'clock P.M.  
Skinner  
County Clerk and Recorder  
By \_\_\_\_\_  
Deputy

File No. \_\_\_\_\_  
DUPLICATE

RECEIVED  
MAY 20 1964

Approved Stock Form - State Publishing Co., Helena, Montana - 4121  
T. 19<sup>N</sup> R. 20<sup>W</sup> 36  
County Lake

STATE OF MONTANA  
ADMINISTRATOR OF GROUNDWATER CODE  
OFFICE OF STATE ENGINEER

RECEIVED  
JAN 6 1964

Declaration of Vested Groundwater Rights

(Under Chapter 237, Montana Session Laws, 1961) STATE ENGINEER

1. Allen & Helma Downing, of St. Ignace  
(Name of Appropriator) (Address) (Town)  
County of Lake State of Montana  
have appropriated groundwater according to the Montana laws in effect prior to January 1, 1962, as follows:

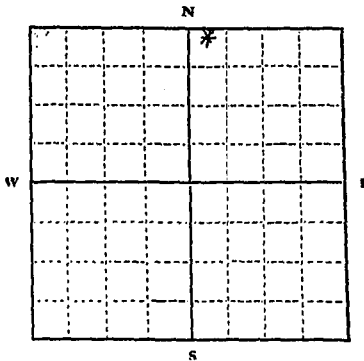

NE 1/4 Sec. 36, T. 19, R. 20

Indicate point of appropriation and place of use, if possible. Each small square represents 10 acres.

2. The beneficial use on which the claim is based Culturing & Stock water

3. Date or approximate date of earliest beneficial use; and how continuous the use has been 1951

4. The amount of groundwater claimed (in miner's inches or gallons per minute) 5 gpm for minutes

5. If used for irrigation, give the acreage and description of the lands to which water has been applied and name of the owner thereof  
Less 1/2 acre

6. The means of withdrawing such water from the ground and the location of each well or other means of withdrawal  
Ed Pressure Pump

7. The date of commencement and completion of the construction of the well, wells, or other works for withdrawal of groundwater 3-2-1951

8. The depth of water table 27 ft

9. So far as it may be available, the type, size and depth of each well or the general specifications of any other works for the withdrawal of groundwater  
100' drilled, 57 ft casing

10. The estimated amount of groundwater withdrawn each year 734,400 gals

11. The log of formations encountered in the drilling of each well if available Clay Rock Sand

12. Such other information of a similar nature as may be useful in carrying out the policy of this act, including reference to book and page of any county record Book 1 Page 97

Signature of Owner Allen Downing

Date Mar. 30, 1963

Three copies to be filed by the owner with the County Clerk and Recorder of the county in which the well is located.

Please answer all questions. If not applicable, so state, otherwise the form will be returned.

Original to the County Clerk and Recorder; Duplicate to the State Engineer; Triplicate to the Montana Bureau of Mines and Geology, and Quadruplicate for the Appropriator.

27287

File No. \_\_\_\_\_  
DUPLICATE

RECEIVED  
MAY 20 1964

County John

STATE ENGINEER  
ADMINISTRATOR OF GROUNDWATER CODE  
OFFICE OF STATE ENGINEER

RECEIVED  
JAN 6 1964

### Declaration of Vested Groundwater Rights

(Under Chapter 237, Montana Session Laws, 1961)

STATE ENGINEER

Allen Downing of St Ignace  
(Name of Appropriator) (Address) (Town)  
County of John State of Montana  
have appropriated groundwater according to the Montana laws in effect prior to January 1, 1962, as follows:

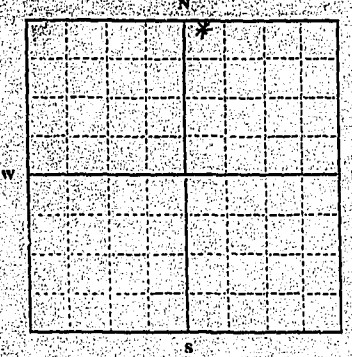

NE 1/4 Sec 36 T19 R20  
Indicate point of appropriation and place of use, if possible. Each small square represents 10 acres.

- The beneficial use on which the claim is based Cultivating & Stock raising
- Date or approximate date of earliest beneficial use, and how continuous the use has been 1957
- The amount of groundwater claimed (in miner's inches or gallons per minute) 5 gpm per minute
- If used for irrigation, give the acreage and description of the lands to which water has been applied and name of the owner thereof 1/2 acre
- The means of withdrawing such water from the ground and the location of each well or other means of withdrawal Well
- The date of commencement and completion of the construction of the well, wells, or other works for withdrawal of groundwater 3-2-1957
- The depth of water table 27 ft
- So far as it may be available, the type, size and depth of each well or the general specifications of any other works for the withdrawal of groundwater 1/2 inch drilled well 57 ft
- The estimated amount of groundwater withdrawn each year 734,400 gallons
- The log of formations encountered in the drilling of each well if available Clay beds sand
- Such other information of a similar nature as may be useful, in carrying out the policy of this act, including reference to book and page of any county record Book 1 Page 97 Sub 11

Signature of Owner Allen Downing  
Date Nov 30, 1963

Three copies to be filed by the owner with the County Clerk and Recorder of the county in which the well is located.  
Please answer all questions. If not applicable, so state, otherwise the form will be returned.  
Original to the County Clerk and Recorder; Duplicate to the State Engineer; Triplicate to the Montana Bureau of Mines and Geology, and Quadruplicate for the Appropriator.

29287

R-786

163122

STATE OF MONTANA  
County of Lake  
Filed on the 31 day of *Dec*  
A. D. 1963 at 3:24 o'clock *P.M.*  
*R. K. Kinnick*  
County Clerk and Recorder  
By \_\_\_\_\_ Deputy

GW

Approved Stock Form—State Publishing Co., Helena, Montana 59138

36

File No. ....

T. 19<sup>20</sup> R. 20

DUPLICATE

County Lake

STATE OF MONTANA  
ADMINISTRATOR OF GROUNDWATER CODE  
OFFICE OF STATE ENGINEER

RECEIVED  
JAN 2 1964  
STATE ENGINEER

Declaration of Vested Groundwater Rights

(Under Chapter 237, Montana Session Laws, 1961)

1. Robert W. & Margaret B. Delp of St. Ignatius  
(Name of Appropriator) (Address) (Town)  
County of Lake State of Montana  
have appropriated groundwater according to the Montana laws in effect prior to January 1, 1962, as follows:

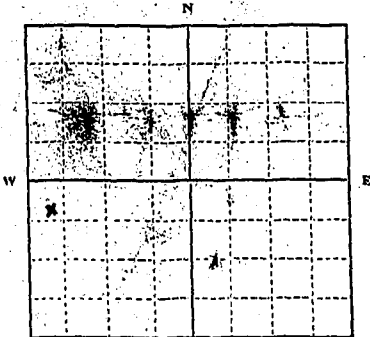

NW 1/4, NE 1/4, SW 1/4  
1/4 Sec. 36 T19 R20

Indicate point of appropriation and place of use, if possible. Each small square represents 10 acres.

2. The beneficial use on which the claim is based  
Household and Domestic use.

3. Date or approximate date of earliest beneficial use; and how continuous the use has been: Dec. 1953 Continuous

4. The amount of groundwater claimed (in miner's inches or gallons per minute) 5 gallon per minute

5. If used for irrigation, give the acreage and description of the lands to which water has been applied and name of the owner thereof  
Not Used

6. The means of withdrawing such water from the ground and the location of each well or other means of withdrawal  
Drilled Well with pump

7. The date of commencement and completion of the construction of the well, wells, or other works for withdrawal of groundwater Dec. 1953

8. The depth of water table 49 feet

9. So far as it may be available, the type, size and depth of each well or the general specifications of any other works for the withdrawal of groundwater Drilled Well, 49 feet in depth.

10. The estimated amount of groundwater withdrawn each year 20,000 gallons

11. The log of formations encountered in the drilling of each well if available Not available

12. Such other information of a similar nature as may be useful in carrying out the policy of this act, including reference to book and page of any county record Unknown

Margaret B. Delp  
Signature of Owner Robert W. Delp  
Date .....

Three copies to be filed by the owner with the County Clerk and Recorder of the county in which the well is located.

Please answer all questions. If not applicable, so state, otherwise the form will be returned.

Original to the County Clerk and Recorder; duplicate to the State Engineer; Triplicate to the Montana Bureau of Mines and Geology, and Quadruplicate for the Appropriator.

17377



R-570

162892

State Report

Robert H. + Margaret B.

Deerp

To

The Public

STATE OF MONTANA

County of Lake,

Filed on the 30 day of Dec  
A. D. 1963 at 10:40'clock A. M.

HAZEL KINNICK

County Clerk and Recorder

By G. Cowan

Deputy

1/2/63

File No. \_\_\_\_\_

T. 19N R. 20W 36

DUPLICATE

MONTANA WATER RESOURCES BOARD

County Lake

RESTRICTION

APR 4 1968

STATE OF MONTANA  
ADMINISTRATOR OF GROUNDWATER CODE  
OFFICE OF STATE ENGINEER

LOG

Top of Ground  
(Elev. above sea level.....)

### Notice of Completion of Groundwater Appropriation by Means of Well DEVELOPED AFTER JANUARY 1, 1962

(Under Chapter 237, Montana Session Laws, 1961)

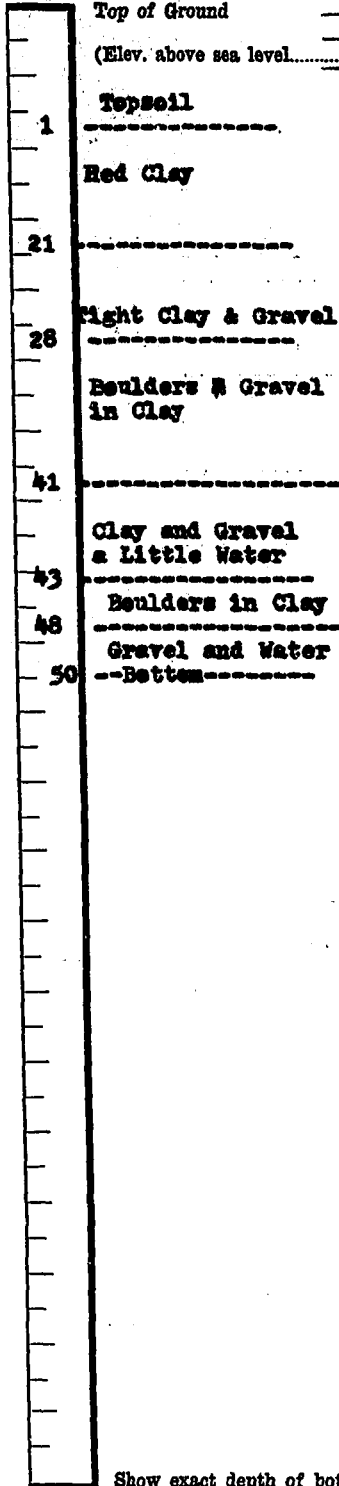

Owner Fred Krien Address St. Ignace

Driller Becke Drilling Address Polson

Date of Notice of appropriation of groundwater N/A

Date well started Mar. 24, 68 Date completed Mar. 27, 68

Type of well Drilled Equipment used Surge Drill  
(Dug, driven, bored or drilled) (Churn drill, rotary or other)

Water use: Domestic  Municipal  Stock  Irrigation   
Industrial  Drainage  Other

Indicate on the diagram the character and thickness of the different strata met with in drilling, such as soil, clay, shale, gravel, rock or sand, etc. Show depth at which water is encountered, thickness and character of water-bearing strata and height to which the water rises in the well.

Size of Drilled Hole	Size and Weight of Casing	From (Feet)	To (Feet)	PERFORATIONS		
				Kind Size	From (Feet)	To (Feet)
6"	6 5/8	1'	50'	None		
	15 #	above G-L				

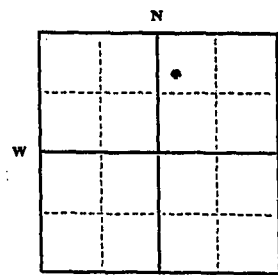

Static Water Level for non-flowing well 38 feet.

Shut-in Pressure for Flowing Well N/A

Pumping Water Level 38 feet  
at 30 gal. per minute.

Discharge in gal. per min. of flowing well N/A

How Tested Bailer

Length of Test two hours

Remarks: (Gravel packing, cementing, packers, type of shutoff).....

Indicate location of well and place of use, if possible. Each small square represents 40 acres.  
36 19N. 20W  
T. 19N R. 20W

163

Driller's License Number

Donald Becke  
Driller's Signature.

44,027

This form to be prepared by driller, and three copies to be filed by the owner with the County Clerk and Recorder in the county in which the well is located, tissue copy to be retained by driller.

Please answer all questions. If not applicable, so state, otherwise the form will be returned.

USE—If used for irrigation, industrial, drainage or other. Explain, state number of acres and location or other data (i.e.: Lot, Block and Addition).

Domestic

Show exact depth of bottom.

R-1104

CM 5

110

NOTICE

COUNTY OF LAKE  
 DEPARTMENT OF LANDS  
 DEPARTMENT OF REVENUE  
 DEPARTMENT OF CORRECTIONS  
 DEPARTMENT OF AGRICULTURE  
 DEPARTMENT OF MINES  
 DEPARTMENT OF PUBLIC SAFETY  
 DEPARTMENT OF TRANSPORTATION  
 DEPARTMENT OF HEALTH  
 DEPARTMENT OF SOCIAL SERVICES  
 DEPARTMENT OF EDUCATION  
 DEPARTMENT OF ENVIRONMENTAL QUALITY  
 DEPARTMENT OF ENERGY  
 DEPARTMENT OF ECONOMIC DEVELOPMENT  
 DEPARTMENT OF LABOR  
 DEPARTMENT OF NATURAL RESOURCES  
 DEPARTMENT OF PROFESSIONAL REGULATION  
 DEPARTMENT OF SENIORS AND ASSISTIVE SERVICES  
 DEPARTMENT OF STATE  
 DEPARTMENT OF TECHNOLOGY  
 DEPARTMENT OF TRANSITATION  
 DEPARTMENT OF WATER RESOURCES  
 DEPARTMENT OF WORKERS' COMPENSATION

STATE OF MONTANA ) ss  
 County of Lake )  
 Filed on the 12 day of April  
 A. D. 1968 at 12:08 o'clock P.M.  
 ETHEL M. HARDING  
 County Clerk and Recorder  
 by Mae Johnson  
 Deputy

200

1	2	3	4
5	6	7	8
9	10	11	12
13	14	15	16
17	18	19	20
21	22	23	24
25	26	27	28
29	30	31	

Approved: \_\_\_\_\_  
 State of Montana  
 Clerk of the Board of Commissioners  
 \_\_\_\_\_  
 State of Montana

RECEIVED

19N-20W  
County LAKE  
36/

STATE OF MONTANA  
ADMINISTRATOR OF GROUNDWATER CODE  
MONTANA WATER RESOURCES BOARD  
MAY 12 1972  
MONTANA DEPARTMENT OF NATURAL AND CONSERVATION

NOTICE OF COMPLETION OF GROUNDWATER APPROPRIATION BY MEANS OF WELL  
Developed after January 1, 1962  
(Under Chapter 237 Montana Session Laws, 1961, as amended)

DRILLER'S LOG  
Indicate the character, color, thickness of strata such as soil, clay, sand, gravel, shale, sandstone, etc. Show depth at which water is found and height to which water rises in well.

This form to be prepared by driller, and three copies to be filed by the owner with the County Clerk and Recorder in the county in which the well is located, last copy to be retained by driller. Please answer all questions. If not applicable, so state, otherwise the form may be returned.

Owner Steve Messner  
Address St. Ignace, Mont.  
Date well started 20 Apr.  
completed 20 Apr. 1972

For Administrator's Use  
File R-1345; 203498  
May 11, 1972 8:15 a.m.  
GW 1

Type of well Drilled  
(Dug, driven, bored or drilled)  
Equipment used Churn Drill  
(Churn drill, rotary or other)  
Water Use: Domestic  Municipal  Stock  Irrigation   
Industrial  Drainage  Other \* Garden/Lawn

\*Describe \_\_\_\_\_  
USE: if used for irrigation, industrial, drainage or other. Explain, state number of acres and location or other data (i.e. Lot, Block and Addition). \_\_\_\_\_

ESTIMATED ANNUAL WITHDRAWAL 250,000

Size of Drilled Hole	Size and Weight of Casing	From (Feet)	To (Feet)	PERFORATIONS		
				Kind Size	From (Feet)	To (Feet)
6"	5/8 17#	15' up	40			

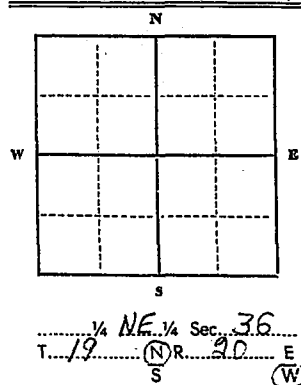

Static water level 37 ft.\*  
Pumping water level 32 ft.\*  
at 20 gallons per minute,  
measured 60 minutes after pumping  
began.  
\*Measured from ground level.  
Well developed by Baller  
for 4 hours.  
Power \_\_\_\_\_ Pump \_\_\_\_\_ HP  
Remarks: (Gravel packing, cementing,  
packers, type of shutoff) \_\_\_\_\_  
R.J.L.

INDICATE LOCATION OF WELL AND PLACE OF USE, IF POSSIBLE. EACH SMALL SQUARE REPRESENTS 40 ACRES.

Driller's Signature George A. Beebe  
Driller's Address Box 47  
Ballin, Mont. LICENSE NO. 204

Top of Ground (Elev. above sea level)		
From (Feet)	To (Feet)	
0	1	soil
1	11	tan clay
11	25	light tan clay heavy gravel
25	37	medium tan clay & gravel
37	40	yellow clay & gravel
40	41	soft gravel, yellow clay
41	42	yellow clay & gravel
42	49	clean gravel, water

Show exact depth of bottom  
50360

1	...
2	...
3	...
4	...
5	...
6	...
7	...
8	...
9	...
10	...
11	...
12	...
13	...
14	...
15	...
16	...
17	...
18	...
19	...
20	...
21	...
22	...
23	...
24	...
25	...
26	...
27	...
28	...
29	...
30	...

R-1345

#203498

LLOYD F. MESSNER

TO

THE PUBLIC

WELL REPORT

DEPT. OF AGRICULTURE

GENERAL

STATE OF MONTANA  
 DEPARTMENT OF AGRICULTURE  
 DIVISION OF WATER RESOURCES  
 Helena, Montana

WELL REPORT  
 No. 203498  
 State of Montana  
 County of Lake

FILED ON THE 17th day of May  
 A. D. 1915 at 9:15 o'clock A. M.  
 ETHEL M. HARDING  
 County Clerk and Recorder  
 DEPUTY  
 LLOYD F. MESSNER  
 DEPT. OF AGRICULTURE

RECEIVED

JUN 13 1972

STATE OF MONTANA  
ADMINISTRATOR OF GROUNDWATER CODE  
MONTANA WATER RESOURCES BOARD

MAY 12 1972

MONTANA DRILLER'S LOG  
INDICATE THE CHARACTER, COLOR, THICKNESS OF STRATA SUCH AS SOIL, CLAY, SAND, GRAVEL, SHALE, SANDSTONE, ETC. SHOW DEPTH AT WHICH WATER IS FOUND AND HEIGHT TO WHICH WATER RISES IN WELL.

NOTICE OF COMPLETION OF GROUNDWATER APPROPRIATION BY MEANS OF WELL

Developed after January 1, 1962

(Under Chapter 237 Montana Session Laws, 1961, as amended)

This form to be prepared by driller, and three copies to be filed by the owner with the County Clerk and Recorder in the county in which the well is located, last copy to be retained by driller.

Please answer all questions. If not applicable, so state, otherwise the form may be returned.

Owner Edward Magnuson

Address St. Ignace, Mont.

Date well started 30 Nov.  
completed 30 June 1972

For Administrator's Use  
File R-1345; 203498  
May 11, 1972 8:15 a.m.  
GW 1

Type of well Drilled  
(Dug, driven, bored or drilled)

Equipment used Chum drill  
(Chum drill, rotary or other)

Water Use: Domestic  Municipal  Stock  Irrigation   
Industrial  Drainage  Other \* Garden/Lawn

\*Describe  
USE: If used for irrigation, industrial, drainage or other. Explain, state number of acres and location or other data (i.e. Lot, Block and Addition).

ESTIMATED ANNUAL WITHDRAWAL 250,000

Size of Drilled Hole	Size and Weight of Casing	From (Feet)	To (Feet)	PERFORATIONS		
				Kind Size	From (Feet)	To (Feet)
6"	6 5/8 17 1/2	16 1/2	49			

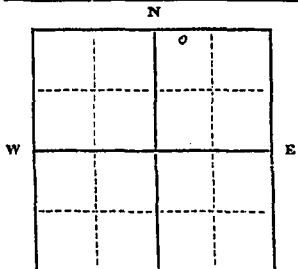

Static water level 39 ft.\*  
Pumping water level 32 ft.\*  
at 33 gallons per minute,  
measured 60 minutes after pumping began.

\*Measured from ground level.  
Well developed by driller  
for 4 hours.  
Power..... Pump..... HP  
Remarks: (Gravel packing, cementing, packers, type of shutoff)

? {  
1/4 N.E. 1/4 Sec. 36  
T. 19 N. R. 20 E.  
S. W.

INDICATE LOCATION OF WELL AND PLACE OF USE, IF POSSIBLE. EACH SMALL SQUARE REPRESENTS 40 ACRES.

Driller's Signature George A. Beebe

Driller's Address Box 17

Box 111, Mont. LICENSE NO. 216

Top of Ground (Elev. above sea level)		
From (Feet)	To (Feet)	
0	1	top soil
1	1 1/2	top clay
1 1/2	2 1/2	white clay with gravel
2 1/2	3 1/2	gravel
3 1/2	4 1/2	reddish brown clay & gravel
4 1/2	5 1/2	reddish brown clay
5 1/2	6 1/2	yellow clay & gravel
6 1/2	7 1/2	reddish brown clay
7 1/2	8 1/2	reddish brown clay
8 1/2	9 1/2	reddish brown clay
9 1/2	10 1/2	reddish brown clay
10 1/2	11 1/2	reddish brown clay
11 1/2	12 1/2	reddish brown clay
12 1/2	13 1/2	reddish brown clay
13 1/2	14 1/2	reddish brown clay
14 1/2	15 1/2	reddish brown clay
15 1/2	16 1/2	reddish brown clay
16 1/2	17 1/2	reddish brown clay
17 1/2	18 1/2	reddish brown clay
18 1/2	19 1/2	reddish brown clay
19 1/2	20 1/2	reddish brown clay
20 1/2	21 1/2	reddish brown clay
21 1/2	22 1/2	reddish brown clay
22 1/2	23 1/2	reddish brown clay
23 1/2	24 1/2	reddish brown clay
24 1/2	25 1/2	reddish brown clay
25 1/2	26 1/2	reddish brown clay
26 1/2	27 1/2	reddish brown clay
27 1/2	28 1/2	reddish brown clay
28 1/2	29 1/2	reddish brown clay
29 1/2	30 1/2	reddish brown clay
30 1/2	31 1/2	reddish brown clay
31 1/2	32 1/2	reddish brown clay
32 1/2	33 1/2	reddish brown clay
33 1/2	34 1/2	reddish brown clay
34 1/2	35 1/2	reddish brown clay
35 1/2	36 1/2	reddish brown clay
36 1/2	37 1/2	reddish brown clay
37 1/2	38 1/2	reddish brown clay
38 1/2	39 1/2	reddish brown clay
39 1/2	40 1/2	reddish brown clay
40 1/2	41 1/2	reddish brown clay
41 1/2	42 1/2	reddish brown clay
42 1/2	43 1/2	reddish brown clay
43 1/2	44 1/2	reddish brown clay
44 1/2	45 1/2	reddish brown clay
45 1/2	46 1/2	reddish brown clay
46 1/2	47 1/2	reddish brown clay
47 1/2	48 1/2	reddish brown clay
48 1/2	49 1/2	reddish brown clay
49 1/2	50 1/2	reddish brown clay
50 1/2	51 1/2	reddish brown clay
51 1/2	52 1/2	reddish brown clay
52 1/2	53 1/2	reddish brown clay
53 1/2	54 1/2	reddish brown clay
54 1/2	55 1/2	reddish brown clay
55 1/2	56 1/2	reddish brown clay
56 1/2	57 1/2	reddish brown clay
57 1/2	58 1/2	reddish brown clay
58 1/2	59 1/2	reddish brown clay
59 1/2	60 1/2	reddish brown clay
60 1/2	61 1/2	reddish brown clay
61 1/2	62 1/2	reddish brown clay
62 1/2	63 1/2	reddish brown clay
63 1/2	64 1/2	reddish brown clay
64 1/2	65 1/2	reddish brown clay
65 1/2	66 1/2	reddish brown clay
66 1/2	67 1/2	reddish brown clay
67 1/2	68 1/2	reddish brown clay
68 1/2	69 1/2	reddish brown clay
69 1/2	70 1/2	reddish brown clay
70 1/2	71 1/2	reddish brown clay
71 1/2	72 1/2	reddish brown clay
72 1/2	73 1/2	reddish brown clay
73 1/2	74 1/2	reddish brown clay
74 1/2	75 1/2	reddish brown clay
75 1/2	76 1/2	reddish brown clay
76 1/2	77 1/2	reddish brown clay
77 1/2	78 1/2	reddish brown clay
78 1/2	79 1/2	reddish brown clay
79 1/2	80 1/2	reddish brown clay
80 1/2	81 1/2	reddish brown clay
81 1/2	82 1/2	reddish brown clay
82 1/2	83 1/2	reddish brown clay
83 1/2	84 1/2	reddish brown clay
84 1/2	85 1/2	reddish brown clay
85 1/2	86 1/2	reddish brown clay
86 1/2	87 1/2	reddish brown clay
87 1/2	88 1/2	reddish brown clay
88 1/2	89 1/2	reddish brown clay
89 1/2	90 1/2	reddish brown clay
90 1/2	91 1/2	reddish brown clay
91 1/2	92 1/2	reddish brown clay
92 1/2	93 1/2	reddish brown clay
93 1/2	94 1/2	reddish brown clay
94 1/2	95 1/2	reddish brown clay
95 1/2	96 1/2	reddish brown clay
96 1/2	97 1/2	reddish brown clay
97 1/2	98 1/2	reddish brown clay
98 1/2	99 1/2	reddish brown clay
99 1/2	100 1/2	reddish brown clay

Show exact depth of bottom

59360

File No. ....

T. 19 R. 20

DUPLICATE

County .....

STATE OF MONTANA  
ADMINISTRATOR OF GROUNDWATER CODE  
OFFICE OF STATE ENGINEER

RECORDED  
JAN 3 1963

### Notice of Completion of Groundwater Appropriation Without Well

(Under Chapter 237 Montana Session Laws, 1961)

Date of Appropriation of Groundwater..... 1912 ,  
Owner Mary Butler Temple Address..... Pendleton , Oreg.  
Contractor (if any) ..... None  
Address of Contractor ..... None  
Date Started..... 1912 Date Completed..... 1912

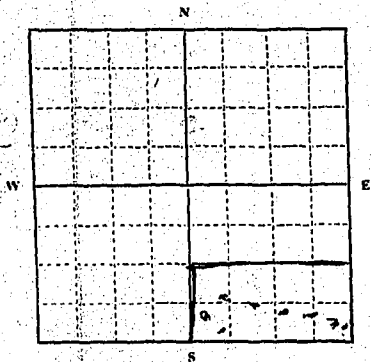

S 1/2 SE 1/4 36 Sec 36 T 20 R  
Indicate point of appropriation and place of use, if possible.

Describe means of obtaining groundwater without a well "as by sub-irrigation and other natural processes". Include depth to water when applicable..... Flowing Springs used for stock and irrigation

Quantity of water developed and used with explanation of method used to measure or estimate such amount. If use is intermittent estimate approximate lengths of periods of use.....  
Three acre foot . Flowing from said Springs year round.

Signature of Owner..... Mary Butler Temple  
Date..... Dec 10, 1963

This form to be prepared by contractor (if any), otherwise by the owner.  
Three copies of this notice are to be filed with the County Clerk and Recorder of the county in which the works are located.  
Please answer all questions. If not applicable, so state, otherwise the form will be returned.  
Original to the County Clerk and Recorder; duplicate to the State Engineer; Triplicate to the Montana Bureau of Mines and Geology and Quadruplicate for the Appropriator.

19625



R-683

163020

Water Report  
Melvin Udall  
&  
The Public

STATE OF MONTANA  
County of Lake

Filed on the 30 day of Dec  
A. D. 1963 at 4:57 o'clock P. M.

HAZEL KINNICK

County Clerk and Recorder

By H. Knauis Deputy

200

## GROUNDWATER INDEX

Page      of     County Lake Twp. 19N Rge. 19W

Sec.	Name of Appropriator	Type of Form	County File No.	Remarks
3	Cheff, Vern E. + Adell	GW3	160299	
7	Cable, Keith E. + Bonnie L.	GW3	210486	
7	Hunlock, Harold	GW4	160303	
7	Stobie, Irving + Alberta	GW4	167020	
8	Walker, U. W.	GW4	162927	
16	Hill, Wayne B. or B. W.	GW3	162487	
16	McVey, Clarence L.	GW3	161590	
16	Reum, Clinton	GW3	208581	
17	Hill, Loren or Wanda	GW4	162400	
18	Delaney, Walter P. + Lois	GW4	163133	
18	Murphy, Glen E. or Patricia A.	GW3	210322	
19	Trudell Bros. - Trudell Clifford M.	GW3	165588	
19	Trudell, Clifford	GW2	199775	
19	Trudell, Clifford M.	GW4	162709	
19	Walker, U. W.	GW4	162925	
19	Walker, Ural	GW3	171003	
20	Dalke, Raymond R.	GW4	162741	
20	Low, Ann Marie	GW3	162385	
20	Low, Mrs. Leth	GW2	158823	
20	Schock, Walt	GW2	189813	
20	Schock, Walter M. + Louise	GW4	162769	
23	Hughes Bros.	GW4	214901	
28	Bristol, William W. + Elsie M.	GW4	163073	
29	Delaney, Howard	GW3	163310	
29	Delaney, William + Anna	GW4	162917	
29	Hogge, Robert	GW4	163186	
31	Lemery, Charles J.	GW3	208797	
31	Malle, Theris	GW2	201243	
31	Romsey, Joseph C. + Marie V.	GW3	162285	
31	Udall, Ruth	GW3	163021	
32	Delaney, Howard	GW4	163309	

File No. ....

T. 19 N. R. 19 W.

DUPLICATE

County

RECEIVED  
JUL 8 - 1963

STATE OF MONTANA  
ADMINISTRATOR OF GROUNDWATER CODE  
OFFICE OF STATE ENGINEER

STATE ENGINEER

Notice of Completion of Groundwater Appropriation  
Without Well

(Under Chapter 237, Montana Session Laws, 1961)

Date of Appropriation of Groundwater June 29, 1963

Owner Vern E & Adele Choff Address Charles, Mont RFD

Contractor (if any) .....

Address of Contractor .....

Date Started..... Date Completed.....

Describe means of obtaining groundwater without a well "as by sub-irrigation and other natural processes". Include depth to water when applicable. Four springs coming to surface of ground

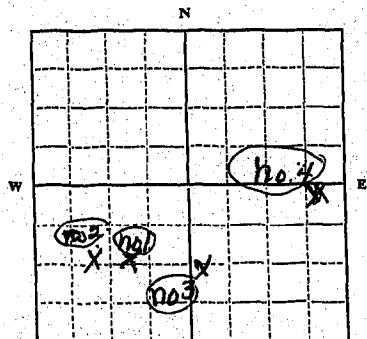

Lot 3+4 1/2 NW 1/4 Sec. 3 T. 19 R. 19  
Indicate point of appropriation and place of use, if possible.

Quantity of water developed and used with explanation of method used to measure or estimate such amount. If use is intermittent estimate approximate lengths of periods of use.

Spring No. 1 runs a 4 in pipe. We use it year around. No. 2 runs a 3 in pipe the year around. Spring No. 3 runs 5 in pipe of water. Spring No. 4 runs a 6 in pipe, use for irrigation.

Signature of Owner Vern E Choff

Date June 29, 1963

This form to be prepared by contractor (if any), otherwise by the owner.

Three copies of this notice are to be filed with the County Clerk and Recorder of the county in which the works are located.

Please answer all questions. If not applicable, so state, otherwise the form will be returned.

Original to the County Clerk and Recorder; duplicate to the State Engineer; Triplicate to the Montana Bureau of Mines and Geology and Quadruplicate for the Appropriator.

R-180 160299

Water Report  
Vern E. Adell Cheff  
to  
The Public

STATE OF MONTANA  
County of Lake,  
Filed on the 5 day of July  
A. D. 1963 at 9:02 o'clock A.M.  
~~HAZEL KINNICK~~  
County Clerk and Recorder  
By E. Cowman  
200 Deputy

RECEIVED

JUN 28 1973

Approved Stock Form—State Publishing Co., Helena, Montana—42345

GW 3

File No.

T 19N R 19W

QUADRUPPLICATE MONTANA DEPARTMENT OF NATURAL RESOURCES AND CONSERVATION

County Lake

STATE OF MONTANA  
ADMINISTRATOR OF GROUNDWATER CODE  
OFFICE OF STATE ENGINEER

Notice of Completion of Groundwater Appropriation  
Without Well

Developed After January 1, 1962

(Under Chapter 237 Montana Session Laws, 1961)

Date of Appropriation of Groundwater Jan. 1967

Owner Keith E. Cable Bonnie L. Cable Address St. Ignatius

Contractor (if any) None

Address of Contractor

Date Started Haven't started Date Completed

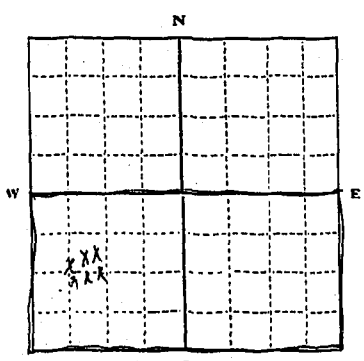

S 1/2 SW 1/4 Sec 7 T 19N R 19W

Indicate point of appropriation and place of use, if possible.

XX = approximate location of Springs

1491; 210486  
June 27, 1973  
3:40 p.m.

1) Describe means of obtaining groundwater (as by sub-irrigation, developed spring, drains, etc.) Dig out Springs for better flow.

2) Means of withdrawing water (gravity, pump, canal, etc.) May pump in the future

3) Depth of water table 26 feet

4) Use of the water Stock water and irrigation

5) Amount of groundwater claimed (in miner's inches, or gallons per minute) 750 gallons per minute

6) If used for irrigation, give number of acres and description of land We own 160 acres adjacent to Springs. S 1/2 SW 1/4, NE 1/4 SW 1/4, NW 1/4 S E 1/4 of section 7 T 19N R 19W G.M.P.

7) Estimate amount of water used each year Haven't used except for stock water

Signature of Owner Keith E. Cable, Bonnie L. Cable

Date June 26, 1973

This form to be prepared by contractor (if any), otherwise by the owner.  
Three copies of this notice are to be filed with the County Clerk and Recorder of the county in which the works are located.  
Please answer all questions. If not applicable, so state, otherwise the form will be returned.

R-1491

210486

GROUNDWATER APPROPRIATION

KEITH E. & BONNIE L. CABLE

TO  
THE PUBLIC

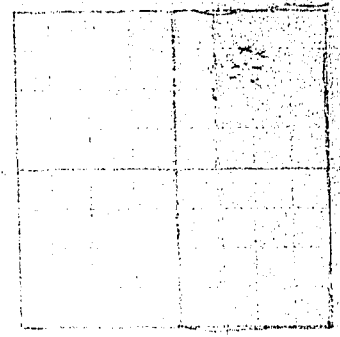

STATE OF MONTANA ss  
County of Lake  
Filed on the 27 day of June  
A. D. 1973 at 3:40 o'clock P. M.  
ETHEL M. HARDING  
County Clerk and Recorder  
By: [Signature] Deputy

*[Faint, illegible handwritten notes and signatures, possibly including a date like 11/17/73 and a name like Ethel M. Harding.]*

GW.

File No. ....

DUPLICATE

*Location*

RECEIVED  
JUL 15 1963

State Publishing Co., Helena, Montana 40876

T. 19 N. R. 19 W

County Lake

STATE ENGINEER

ADMINISTRATOR OF GROUNDWATER CODE  
OFFICE OF STATE ENGINEER

RECEIVED  
JUL 8 - 1963

### Declaration of Vested Groundwater Rights STATE ENGINEER

(Under Chapter 237, Montana Session Laws, 1961)

1. Harold Gunlock of St. Ignatius, Montana  
(Name of Appropriator) (Address) (Town)  
County of Lake State of Montana  
have appropriated groundwater according to the Montana laws in effect prior to January 1, 1962, as follows:

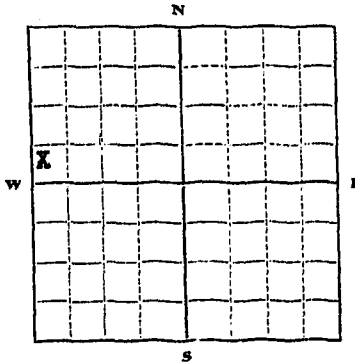

*W<sup>2</sup> NW 1/4 Sec 7 T. 19 N. R. 19 W*

Indicate point of appropriation and place of use, if possible. Each small square represents 10 acres.

2. The beneficial use on which the claim is based. Stock and house water
3. Date or approximate date of earliest beneficial use; and how continuous the use has been. May 1954  
Continuous
4. The amount of groundwater claimed (in miner's inches or gallons per minute). 200,000 gallons
5. If used for irrigation, give the acreage and description of the lands to which water has been applied and name of the owner thereof
6. The means of withdrawing such water from the ground and the location of each well or other means of withdrawal. Pump in drilled well
7. The date of commencement and completion of the construction of the well, wells, or other works for withdrawal of groundwater. 1950
8. The depth of water table. 115'
9. So far as it may be available, the type, size and depth of each well or the general specifications of any other works for the withdrawal of groundwater. Drilled well with 6" casing 115' feet deep
10. The estimated amount of groundwater withdrawn each year. 200,000 gallons
11. The log of formations encountered in the drilling of each well if available. not available
12. Such other information of a similar nature as may be useful in carrying out the policy of this act, including reference to book and page of any county record.

Signature of Owner Harold Gunlock

Date 7-5-63

Three copies to be filed by the owner with the County Clerk and Recorder of the county in which the well is located.

Please answer all questions. If not applicable, so state, otherwise the form will be returned.

Original to the County Clerk and Recorder; duplicate to the State Engineer; Triplicate to the Montana Bureau of Mines and Geology, and Quadruplicate for the Appropriator.



R181

160303

Water Report  
Harold Gunkel  
to  
The Public

STATE OF MONTANA

County of Lake,

Filed on the 5 day of July  
A. D. 1963 at 11:00 o'clock A. M.

HAZEL KINNICK

County Clerk and Recorder

By 200 G. Cowman  
Deputy

File No. \_\_\_\_\_

T 19 N R 19 W 7

DUPLICATE

County Lake

STATE OF MONTANA  
ADMINISTRATOR OF GROUNDWATER CODE  
OFFICE OF STATE ENGINEER

RECEIVED  
SEP 25 1964

Declaration of Vested Groundwater Rights

STATE ENGINEER

(Under Chapter 237, Montana Session Laws, 1961)

1. Irving Stobie and Alberta Stobie, of St. Ignatius  
(Name of Appropriator) (Address) (Town)

County of Lake State of Montana

have appropriated groundwater according to the Montana laws in effect prior to January 1, 1962, as follows:

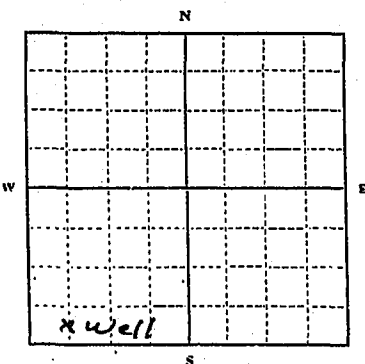

$S\frac{1}{2}$ SW  $\frac{1}{4}$ SW  $\frac{1}{4}$  Sec. 7 T. 19 R. 19

Indicate point of appropriation and place of use, if possible. Each small square represents 10 acres.

2. The beneficial use on which the claim is based domestic and stockwater

3. Date or approximate date of earliest beneficial use; and how continuous the use has been April 1949

4. The amount of groundwater claimed (in miner's inches or gallons per minute) 20 gallons per minute

5. If used for irrigation, give the acreage and description of the lands to which water has been applied and name of the owner thereof domestic garden and lawn

6. The means of withdrawing such water from the ground and the location of each well or other means of withdrawal cased well and electric pump

7. The date of commencement and completion of the construction of the well, wells, or other works for withdrawal of groundwater 1940

8. The depth of water table 60 feet

9. So far as it may be available, the type, size and depth of each well or the general specifications of any other works for the withdrawal of groundwater 6 inch metal casing - 180 feet deep

10. The estimated amount of groundwater withdrawn each year 500 gallons per day

11. The log of formations encountered in the drilling of each well if available

12. Such other information of a similar nature as may be useful in carrying out the policy of this act, including reference to book and page of any county record

Alberta Stobie

Signature of Owner Irving Stobie

Date December 28, 1963

Three copies to be filed by the owner with the County Clerk and Recorder of the county in which the well is located.

Please answer all questions. If not applicable, so state, otherwise the form will be returned.

Original to the County Clerk and Recorder; Duplicate to the State Engineer; Triplicate to the Montana Bureau of Mines and Geology, and Quadruplicate for the Appropriator.

38487

R953

167020

Well Report

Jwing & Alberta  
Stobie

To

The Public

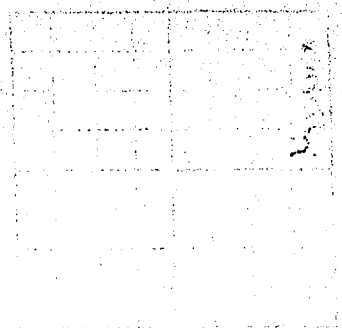

STATE OF MONTANA

County of Lake,

Filed on the 23 day of Sept  
A. D. 1964 at 11:18 o'clock P. M.

HAZEL KINNICK

County Clerk and Recorder

By E. Cowman  
Deputy

File No. ....

T. 19 N. R. 19 S. 8

DUPLICATE

County .....

STATE OF MONTANA  
ADMINISTRATOR OF GROUNDWATER CODE  
OFFICE OF STATE ENGINEER

RECEIVED  
JAN 2 1964  
STATE ENGINEER

Declaration of Vested Groundwater Rights

(Under Chapter 237, Montana Session Laws, 1961)

1. W W Walker, of Box 245 St. Ignace  
(Name of Appropriator) (Address) (Town)  
County of Fake State of Montana  
have appropriated groundwater according to the Montana laws in effect prior to January 1, 1962, as follows:

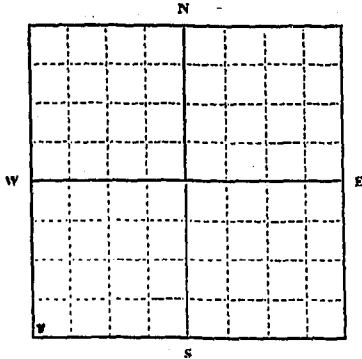

SW 1/4 Sec. 9, T. 19, R. 19

Indicate point of appropriation and place of use, if possible. Each small square represents 10 acres.

2. The beneficial use on which the claim is based Livestock

3. Date or approximate date of earliest beneficial use; and how continuous the use has been. Information unavailable

4. The amount of groundwater claimed (in miner's inches or gallons per minute) .....

5. If used for irrigation, give the acreage and description of the lands to which water has been applied and name of the owner thereof. Not used for irrigation

6. The means of withdrawing such water from the ground and the location of each well or other means of withdrawal. Hand Pump

7. The date of commencement and completion of the construction of the well, wells, or other works for withdrawal of groundwater. Information unavailable

8. The depth of water table. six feet

9. So far as it may be available, the type, size and depth of each well or the general specifications of any other works for the withdrawal of groundwater. Wood casing 3'x3' 12 ft deep

10. The estimated amount of groundwater withdrawn each year. 5000 gal

11. The log of formations encountered in the drilling of each well if available. Not Available

12. Such other information of a similar nature as may be useful in carrying out the policy of this act, including reference to book and page of any county record.

Signature of Owner W W Walker

Date .....

Three copies to be filed by the owner with the County Clerk and Recorder of the county in which the well is located.

Please answer all questions. If not applicable, so state, otherwise the form will be returned.

Original to the County Clerk and Recorder; Duplicate to the State Engineer; Triplicate to the Montana Bureau of Mines and Geology, and Quadruplicate for the Appropriator.

R-600 167977

Water Report

U. W. Walker

to  
The Public

STATE OF MONTANA  
County of Lake,  
Filed on the 30 day of Dec  
A. D. 1903 at 3 o'clock P. M.  
*[Signature]*  
County Clerk and Recorder

By *[Signature]* Deputy

RECORDED  
INDEXED  
MONTANA  
COUNTY CLERK AND RECORDER  
LAKESIDE, MONTANA

File No. ....

T. 19 N. R. 19 W.

DUPLICATE

County LAKE

STATE OF MONTANA  
ADMINISTRATOR OF GROUNDWATER CODE  
OFFICE OF STATE ENGINEER

RECEIVED  
DEC 19 1963

Notice of Completion of Groundwater Appropriation  
Without Well

(Under Chapter 237 Montana Session Laws, 1961)

Date of Appropriation of Groundwater: Nov 1 1963  
Owner: Wayne B Hill Address: [Signature] or 80 W. Hill  
Contractor (if any):  
Address of Contractor: [Signature]  
Date Started: Date Completed: 4-25-71

Describe means of obtaining groundwater without a well "as by sub-irrigation and other natural processes". Include depth to water when applicable. Spring

There are (2) two separate springs  
no 1 is on other than my property but is claim  
of flow of water - no 2 is on my property

Quantity of water developed and used with explanation of method used to measure or estimate such amount. If use is intermittent

estimate approximate lengths of periods of use Year around  
Water 125 Cattle  
House use & lawn & garden

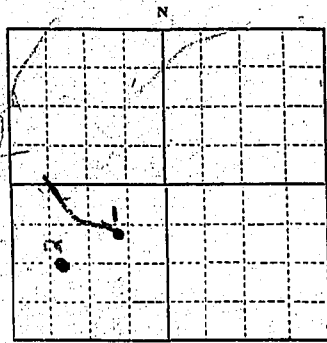

W 1/2 SW 1/4 Sec. 16 T. 19 R. 19  
Indicate point of appropriation and place of use, if possible.

Signature of Owner: Wayne B Hill  
Date: Dec 12 1963

This form to be prepared by contractor (if any), otherwise by the owner.

Three copies of this notice are to be filed with the County Clerk and Recorder of the county in which the works are located.

Please answer all questions. If not applicable, so state, otherwise the form will be returned.

Original to the County Clerk and Recorder; duplicate to the State Engineer; Triplicate to the Montana Bureau of Mines and Geology and Quadruplicate for the Appropriator.

R 357

162487

Water Report  
Wayne B. Hill  
to  
The Public

STATE OF MONTANA  
County of Lake  
Filed on the 12 day of May  
A. D. 1963 at 10:40 o'clock P. M.  
HAZEL KINNICK  
County Clerk and Recorder  
By G. Cowman  
Deputy

File No.....

T. 19 R. 19

DUPLICATE

County Lake

*SW*

STATE OF MONTANA  
ADMINISTRATOR OF GROUNDWATER CODE  
OFFICE OF STATE ENGINEER

RECEIVED  
OCT 21 1959

STATE ENGINEER

Notice of Completion of Groundwater Appropriation  
Without Well

(Under Chapter 237 Montana Session Laws, 1961)

Date of Appropriation of Groundwater Sept. 15, 1943

Owner Clarence L. McVey Address St Ignatius, Montana

Contractor (if any) .....

Address of Contractor .....

Date Started 9-10-43 Date Completed Oct. 1, 1959

Describe means of obtaining groundwater without a well "as by sub-irrigation and other natural processes". Include depth to water when applicable. Series of large springs over an area of approximately 8 acres. Rock and concrete reservoirs with inch and half to 3/4 inch galvanized pipes to residences and gardens. One to 4 ft. excavations at pipe intakes. Source of water apparently from "June Creek" a subterranean stream in Mission Range. Immediately below reservoirs constructed water runs in surface channels and is diverted for irrigation purposes on approximately 8 acres of pasture. Water flows from East to West.

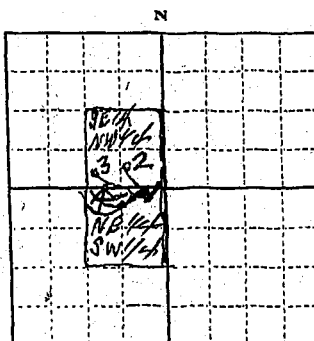

SE NW S  
NE 1/4 SW Sec. 16. T. 19 R. 19

Indicate point of appropriation and place of use, if possible.

- 1. Point of appropriation
- 2. 450 ft. pipe to garden and buildings.
- 3. 1200 feet pipe to residence and garden.
- 4. Approx. 8 acres irrigation.

Quantity of water developed and used with explanation of method used to measure or estimate such amount. If use is intermittent,

estimate approximate lengths of periods of use. Water through two pipelines used continuously for domestic purposes. Irrigation water used intermittently for irrigation during growing season and stock water during winter months, continuously. Estimated aggregate flow 12 inches continuous flow and amount arrived at by numerous comparisons with like amount of water furnished me for irrigation by United States Indian Reclamation Service on other section of ranch.

Signature of Owner..... Clarence L. McVey  
Clarence L. McVey  
Date.....

This form to be prepared by contractor (if any), otherwise by the owner.

Three copies of this notice are to be filed with the County Clerk and Recorder of the county in which the works are located.

Please answer all questions. If not applicable, so state, otherwise the form will be returned.

Original to the County Clerk and Recorder; duplicate to the State Engineer; Triplicate to the Montana Bureau of Mines and Geology and Quadruplicate for the Appropriator.



R264

161590

Water Report  
Clarence Mc Vey  
to  
The Public

STATE OF MONTANA

County of Lake

Filed on the 18 day of Oct

A. D. 1963 at 2:10 o'clock P.M.

HAZEL KINNICK

County Clerk and Recorder

By G. Cowman

200

Deputy

File No. ....

T. 19N R. 19W

QUADRUPPLICATE

County Spike

RECEIVED

STATE OF MONTANA  
ADMINISTRATOR OF GROUNDWATER CODE  
OFFICE OF STATE ENGINEER

MAR 22 1973

MONTANA DEPARTMENT OF NATURAL RESOURCES AND CONSERVATION

Notice of Completion of Groundwater Appropriation  
Without Well

Developed After January 1, 1962

(Under Chapter 237 Montana Session Laws, 1961)

Date of Appropriation of Groundwater... May 1, 1970

Owner... Clinton Reum Address... St. Ignatius, Mt.

Contractor (if any)... none-- self

Address of Contractor... self

Date Started Sept. 1969 Date Completed... 5/1/70

*NW 1/4 NW 16 T 19 R 19*

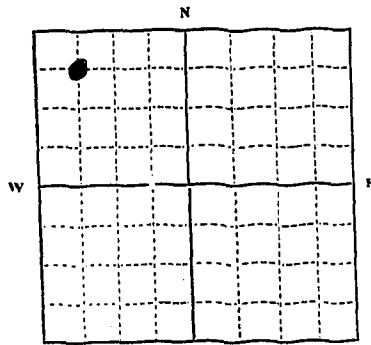

1/4 Sec. 16 T. 19 R. 19

Indicate point of appropriation and place of use, if possible.

1) Describe means of obtaining groundwater (as by sub-irrigation, developed spring, drains, etc.)... developed series of springs and percolating waters

2) Means of withdrawing water (gravity, pump, canal, etc.)... gravity- pipe

3) Depth of water table... about 3 1/2 ft.

4) Use of the water... stock water and irrigation

5) Amount of groundwater claimed (in miners inches, or gallons per minute)... twenty miners inches

6) If used for irrigation, give number of acres and description of land... NE 1/4 Sec. 17, T. 19 N. R. 19 W. MN

7) Estimate amount of water used each year...

runs continually, but reduces to about ten miners inches in winter months

Signature of Owner... Clinton Reum

Date... March 16, 1973

Doc. No. 208581; R-1429  
Filed for record  
this 21st day of MARCH  
A. D. 1973 at 2:05  
o'clock PM.

This form to be prepared by contractor (if any), otherwise by the owner.

Three copies of this notice are to be filed with the County Clerk and Recorder of the county in which the works are located.

Please answer all questions. If not applicable, so state, otherwise the form will be returned.

NW 1/4 NW 1/4 316-19-R19

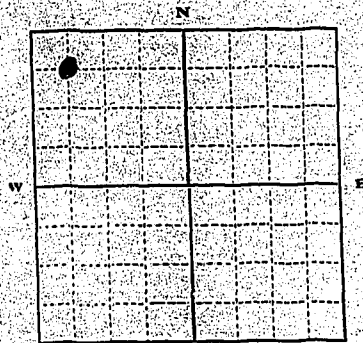

1/4 Sec. 16 T. 19 R. 19

Indicate point of appropriation and place of use, if possible.

Doc. No. 208581 R-1429  
 Filed for record  
 this 21st day of MARCH  
 A. D. 1972 at 2:05  
 o'clock PM

Date of Appropriation of Groundwater May 1970  
 Owner Clinton Rees Address 1715 1/2 St. SW  
 Contractor (if any) none self  
 Address of Contractor self  
 Date Started Sept. 1969 Date Completed 5/1/70

1) Describe means of obtaining groundwater (as by sub-irrigation, developed spring, drains, etc.) developed series of springs and percolating waters

2) Means of withdrawing water (gravity pump, canal, etc.) gravity-pipe

3) Depth of water table about 34 ft.

4) Use of the water stock water and irrigation

5) Amount of groundwater claimed (in miner's inches, or gallons per minute) twenty miners inches

6) If used for irrigation, give number of acres and description of land NE 1/4 Sec. 17, T. 19 N. R. 19 W. NW

7) Estimate amount of water used each year runs continually, but reduces to about ten miners inches in winter months

Signature of Owner Clinton Rees

Date March 10, 1972

This form to be prepared by contractor (if any), otherwise by the owner.  
 Three copies of this notice are to be filed with the County Clerk and Recorder of the county in which the works are located.  
 Please answer all questions. If not applicable, so state, otherwise the form will be returned.

#208531

R- 1429

Clinton Reum

to

The Public

Groundwater Appropriation

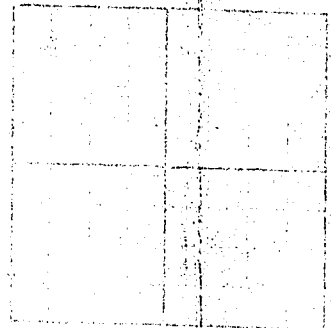

STATE OF MONTANA  
County of Lake

Filed on the 21 day of March

A. D. 1973 at 2:05 o'clock P. M.

ETHEL M. HARDING

County Clerk and Recorder

*Jewell Beck*  
Deputy

Vertical text on the left side, possibly a stamp or recording information, including the words "RECORDING" and "MARCH 21 1973".

Vertical text in the center, possibly a title or reference number, including the words "MONTANA" and "WATER".

Vertical text on the right side, possibly a date or time stamp, including the words "MARCH 21 1973".

File No. \_\_\_\_\_

T. 19<sup>N</sup> R. 19<sup>W</sup>

DUPLICATE

County: Lake

STATE OF MONTANA  
ADMINISTRATOR OF WATER CODE  
OFFICE OF STATE ENGINEER

RECEIVED  
DEC 13 1963  
STATE ENGINEER

Declaration of Vested Groundwater Rights

(Under Chapter 237, Montana Session Laws, 1961)

Loren and Wanda Hill of Rt. 1 Box 103 St Ignace  
(Name of Appropriator) (Address) (Town)

County of Lake State of Montana

have appropriated groundwater according to the Montana laws in effect prior to January 1, 1962, as follows:

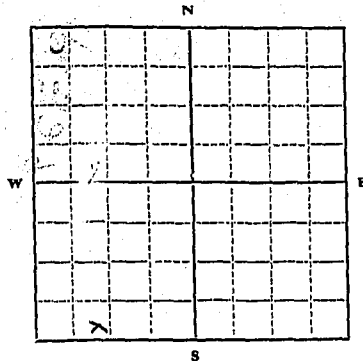

W 1/2 Sec 17 T. 19 R. 19

Indicate point of appropriation and place of use, if possible. Each small square represents 10 acres.

2. The beneficial use on which the claim is based. For house, livestock, garden and yard

3. Date or approximate date of earliest beneficial use; and how continuous the use has been. 1949 used continuously

4. The amount of groundwater claimed (in miner's inches or gallons per minute). 3.2 per minute

5. If used for irrigation, give the acreage and description of the lands to which water has been applied and name of the owner thereof. Used to water lawn, garden about 1 acre by Loren & Wanda Hill

6. The means of withdrawing such water from the ground and the location of each well or other means of withdrawal. Electric pump

7. The date of commencement and completion of the construction of the well, wells, or other works for withdrawal of groundwater. during the year of 1949

8. The depth of water table. 49 feet (about)

9. So far as it may be available, the type, size and depth of each well or the general specifications of any other works for the withdrawal of groundwater. 6 inch well drilled about 65 feet deep

10. The estimated amount of groundwater withdrawn each year. 450,000

11. The log of formations encountered in the drilling of each well if available. Not Available

12. Such other information of a similar nature as may be useful in carrying out the policy of this act, including reference to book and page of any county record. Not Available

Signature of Owner: Wanda J. Hill  
Loren E. Hill

Date: Dec. 6 1963

Three copies to be filed by the owner with the County Clerk and Recorder of the county in which the well is located.

Please answer all questions. If not applicable, so state, otherwise the form will be returned.

Original to the County Clerk and Recorder; duplicate to the State Engineer; Triplicate to the Montana Bureau of Mines and Geology, and Quadruplicate for the Appropriator.

162400

P-329

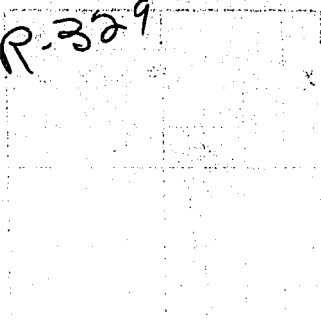

STATE OF MONTANA

County of Lake,

Filed on the 6 day of Dec

A. D. 1963 11:34 No'clock P.M.

*[Signature]*  
County Clerk and Recorder

By *[Signature]* Deputy

DIVISION ENGINE

*[Faint stamp or text]*

File No. \_\_\_\_\_

T 19 R 19

DUPLICATE

County LAKE

STATE OF MONTANA  
ADMINISTRATOR OF GROUNDWATER CODE  
OFFICE OF STATE ENGINEER

RECEIVED

Declaration of Vested Groundwater Rights JAN 6 1964

(Under Chapter 237, Montana Session Laws, 1961)

STATE ENGINEER

WALTER P. DELANEY & LOIS DELANEY of ST. IGNATIUS  
(Name of Appropriator) (Address) (Town)

County of LAKE State of MONTANA  
have appropriated groundwater according to the Montana laws in effect prior to January 1, 1962, as follows:

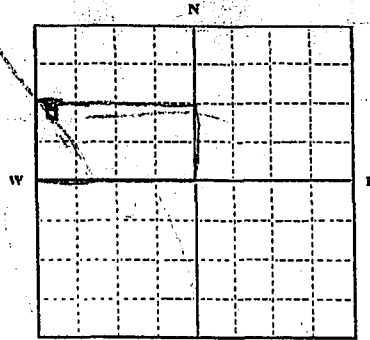

S 2 NW 1 4 Sec 18 T 19 R 19

Indicate point of appropriation and place of use, if possible. Each small square represents 10 acres.

2. The beneficial use on which the claim is based. Home FARM STOCK WATER

3. Date or approximate date of earliest beneficial use; and how continuous the use has been. 1936 - CONSTANT

4. The amount of groundwater claimed (in miner's inches or gallons per minute). 10 gal per minute

5. If used for irrigation, give the acreage and description of the lands to which water has been applied and name of the owner thereof. 1/2 Acre - Garden Walter P. Delaney Lois Delaney

6. The means of withdrawing such water from the ground and the location of each well or other means of withdrawal. Pressure Pump

7. The date of commencement and completion of the construction of the well, wells, or other works for withdrawal of groundwater. 1936

8. The depth of water table. 10 ft.

9. So far as it may be available, the type, size and depth of each well or the general specifications of any other works for the withdrawal of groundwater. Depth - 36 ft. 6 inch casing

10. The estimated amount of groundwater withdrawn each year. 450,000

11. The log of formations encountered in the drilling of each well if available. Sandy to Silt.

12. Such other information of a similar nature as may be useful in carrying out the policy of this act, including reference to book and page of any county record. N.R. Records

Signature of Owner. Walter P. Delaney

Date. 12-26-63

Three copies to be filed by the owner with the County Clerk and Recorder of the county in which the well is located.

Please answer all questions. If not applicable, so state, otherwise the form will be returned.

Original to the County Clerk and Recorder; Duplicate to the State Engineer; Triplicate to the Montana Bureau of Mines and Geology, and Quadruplicate for the Appropriator.

R-787

163133

STATE OF MONTANA

County of Lake

Filed on the 31 day of Dec

A. D. 1903 at 2 o'clock P.M.

Skinner  
County Clerk and Recorder

By

Detels

11/11/03



RECEIVED

Approved Stock Form—State Publishing Co., Helena, Montana—42345

JUN 2 1973

T 19 R 39

File No. QUADRUPPLICATE GREEN AND YELLOW

MONTANA DEPARTMENT OF NATURAL RESOURCES AND CONSERVATION

County Lake

STATE OF MONTANA ADMINISTRATOR OF GROUNDWATER CODE OFFICE OF STATE ENGINEER

Notice of Completion of Groundwater Appropriation Without Well

Developed After January 1, 1962

(Under Chapter 237 Montana Session Laws, 1961)

Date of Appropriation of Groundwater 5-30-1973

Owner Gentry / Contract Address 21st Box 126, St Ignatius, Mt.

Contractor (if any) None

Address of Contractor

Date Started Date Completed

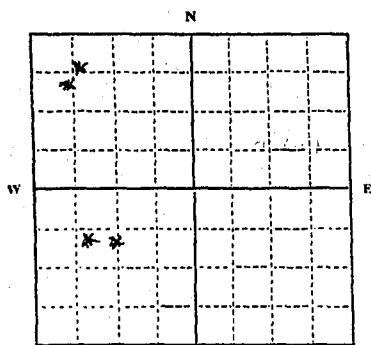

Indicate point of appropriation and place of use, if possible.

1) Describe means of obtaining groundwater (as by sub-irrigation, developed spring, drains, etc.)

surfacing springs as located below ground

2) Means of withdrawing water (gravity, pump, canal, etc.)

self-flowing

3) Depth of water table

surface water

4) Use of the water

ground drainage and stock water

5) Amount of groundwater claimed (in miner's inches, or gallons per minute)

second foot per minute

6) If used for irrigation, give number of acres and description of land

7) Estimate amount of water used each year

second foot

Signature of Owner Glenn Murphy

Date

Doc. No. R1475:210322 Filed for record this 21st day of June A. D. 1973 at 8:15 o'clock AM.

This form to be prepared by contractor (if any), otherwise by the owner. Three copies of this notice are to be filed with the County Clerk and Recorder of the county in which the works are located. Please answer all questions. If not applicable, so state, otherwise the form will be returned.

Date of Appropriation of Groundwater 8-21-1973

Owner Donna / or Patricia Address Box 1, Box 100,

Contractor (if any) None St Ignace, MT.

Address of Contractor \_\_\_\_\_

Date Started \_\_\_\_\_ Date Completed \_\_\_\_\_

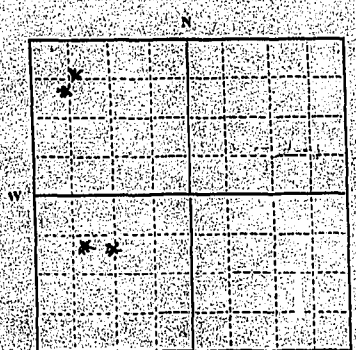

2 1/4 1/4 1/4 1/4  
1/4 1/4 1/4 1/4 1/4 1/4 1/4 1/4  
Indicate point of appropriation and place of use, if possible.

1) Describe means of obtaining groundwater (as by sub-irrigation, developed spring, drains, etc.) \_\_\_\_\_

Surfacing springs as located below ground

2) Means of withdrawing water (gravity, pump, canal, etc.) \_\_\_\_\_

self flowing

3) Depth of water table surface water

4) Use of the water ground drainage and stock water

5) Amount of groundwater claimed (in miner's inches, or gallons per minute) 1 second foot per spring

6) If used for irrigation, give number of acres and description of land \_\_\_\_\_

7) Estimate amount of water used each year \_\_\_\_\_

2 second foot

Signature of Owner Allen C. Murphy

Date \_\_\_\_\_

This form to be prepared by contractor (if any), otherwise by the owner.

Three copies of this notice are to be filed with the County Clerk and Recorder of the county in which the works are located.

Please answer all questions. If not applicable, so state, otherwise the form will be returned.

# 210322

R-1475

GLEN E. or PATRICIA A.  
MURPHY

~~XXXXXX~~

TO

THE PUBLIC

GROUNDWATER APPROPRIATION

STATE OF MONTANA  
 County of Lake  
 Filed on the 21 day of June  
 A. D. 1973 at 8:15 o'clock A.  
 BY Ethel M. Harding  
 County Clerk and Registrar

RECORDED

APPROPRIATION TO NOVEMBER 1973

APPROPRIATION TO NOVEMBER 1973

APPROPRIATION TO NOVEMBER 1973

NEW QUANTITY

APPROPRIATION TO NOVEMBER 1973

APPROPRIATION TO NOVEMBER 1973

APPROPRIATION TO NOVEMBER 1973

APPROPRIATION TO NOVEMBER 1973

APPROPRIATION TO NOVEMBER 1973

APPROPRIATION TO NOVEMBER 1973

APPROPRIATION TO NOVEMBER 1973

APPROPRIATION TO NOVEMBER 1973

APPROPRIATION TO NOVEMBER 1973

APPROPRIATION TO NOVEMBER 1973

APPROPRIATION TO NOVEMBER 1973

APPROPRIATION TO NOVEMBER 1973

APPROPRIATION TO NOVEMBER 1973

APPROPRIATION TO NOVEMBER 1973

File No. ....

T. 19 N. R. 19 W.

DUPLICATE

County LANE

STATE OF MONTANA  
ADMINISTRATOR OF GROUNDWATER CODE  
OFFICE OF STATE ENGINEER

RECEIVED  
MAY 22 1964

Notice of Completion of Groundwater Appropriation  
Without Well

(Under Chapter 237 Montana Session Laws, 1961)

POINT OF DIVERSION  
POINTS  
OF ORIGINAL WATER  
CONTROL  
DITCH

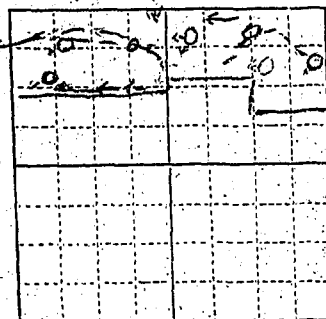

N 2 1/2 Sec. 19 T. 19 R. 19

Indicate point of appropriation and place of use, if possible.

Date of Appropriation of Groundwater.....  
Owner TRUDELL BROTHERS Address ST. IGNATIUS  
CLIFFORD M. TRUDELL  
Contractor (if any) LANE COUNTY SOIL CONSERVATION DISTRICT  
Address of Contractor POHSON MONT.  
Date Started 4/1/60 Date Completed 8/1/60

Describe means of obtaining groundwater without a well "as by sub-irrigation and other natural processes". Include depth to water when applicable. 3.0 FT. DEPTH TO WATER

MEANS OF OBTAINING GROUNDWATER  
BY SUB-IRRIGATION AND SPRINGS

Quantity of water developed and used with explanation of method used to measure or estimate such amount. If use is intermittent

estimate approximate lengths of periods of use.....  
QUANTITY 2 C.F.S.  
MEASURE BY LANE COUNTY SOIL CONSERVATION DISTRICT  
USE IS CONTINUOUS

Signature of Owner Trudell Brothers  
Clifford M. Trudell  
Date 5/1/64

This form to be prepared by contractor (if any), otherwise by the owner.

Three copies of this notice are to be filed with the County Clerk and Recorder of the county in which the works are located.

Please answer all questions. If not applicable, so state, otherwise the form will be returned.

Original to the County Clerk and Recorder; duplicate to the State Engineer; Triplicate to the Montana Bureau of Mines and Geology and Quadruplicate for the Appropriator.

GW-1

Approved State Form - State Printing Co., Helena, Montana - 216

File No. \_\_\_\_\_

Title \_\_\_\_\_

DUPLICATE

County \_\_\_\_\_

STATE OF MONTANA  
ADMINISTRATOR OF GROUNDWATER CODE  
OFFICE OF STATE ENGINEER

RECEIVED  
MAY 22 1964

### Notice of Completion of Groundwater Appropriation Without Well

(Under Chapter 237, Montana Session Laws, 1961)

Date of Appropriation of Groundwater \_\_\_\_\_

Owner T. W. DUFFELL BROTHERS Address ST. LOUIS, MISSOURI

Contractor (if any) LANE COUNTY SOIL CONSERVATION DISTRICT

Address of Contractor POKESON MOUNTAIN

Date Started 4/16/60 Date Completed 5/11/64

Describe means of obtaining groundwater without a well, such as by sub-irrigation and other natural processes. Indicate depth to water when applicable. 3.0 FT. DEPT. OF WATER

MEANS OF OBTAINING GROUNDWATER  
by SUB IRRIGATION AND  
SPRINGS

Quantity of water developed and used with explanation of method used to measure or estimate such amount. If use is intermittent

estimate approximate lengths of periods of use \_\_\_\_\_

QUANTITY 2 C.F.S.  
MEASURE BY LANE COUNTY SOIL CONSERVATION DISTRICT  
USE IS CONTINUOUS

Signature of Owner T. W. Duffell Brothers

Date 5/11/64

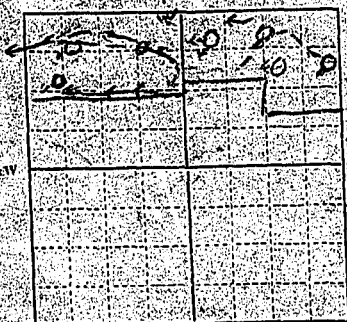

Indicate point of appropriation and place of use, if possible.  
N. 7.20' S  
T. 19 R. 9 S  
Sec. 19 T. 19 R. 9

This form to be prepared by contractor (if any), otherwise by the owner.

Three copies of this notice are to be filed with the County Clerk and Recorder of the county in which the works are located.

Please answer all questions. If not applicable, so state, otherwise the form will be returned.

Original to the County Clerk and Recorder; Duplicate to the State Engineer; Triplicate to the Montana Bureau of Mines and Geology and Quadruplicate for the Appropriator.



R-941

165588

Water Report

Clifford M. Trudell

to

The Public

STATE OF MONTANA

County of Lake

Filed on the 19 day of May

A. D. 1964 at 2:10 o'clock P.M.

HAZE KENNICK

County Clerk and Recorder

By H. Kraus Deputy

\$2.00



19N-19W 19  
County Lake

STATE OF MONTANA  
ADMINISTRATOR OF GROUNDWATER CODE  
MONTANA WATER RESOURCES BOARD

MONTANA WATER RESOURCES BOARD  
DRILLER'S LOG  
RECEIVED

NOTICE OF COMPLETION OF GROUNDWATER  
APPROPRIATION BY MEANS OF WELL  
Developed after January 1, 1962

Indicate the character, color, thick-  
ness of strata such as soil, clay, sand,  
gravel, shale, sandstone, etc. Show  
depth at which water is found and  
height to which water rises in well.

(Under Chapter 237 Montana Session Laws, 1961, as amended)  
This form to be prepared by driller, and three copies to be filed  
by the owner with the County Clerk and Recorder in the county in  
which the well is located, last copy to be retained by driller.  
Please answer all questions. If not applicable, so state, otherwise the  
form may be returned.

Owner Clifford Trudell  
Address St. Ignace  
Montana  
Date well started June 2, 1971  
completed June 3, 1971

For Administrator's Use  
File R-1281 199175  
August 20, 1971  
3:30 PM  
GW 1

Type of well Drilled  
(Dug, driven, bored or drilled)  
Equipment used Churn Drill  
(Churn drill, rotary or other)  
Water Use: Domestic  Municipal  Stock  Irrigation   
Industrial  Drainage  Other \* Garden/Lawn

\*Describe  
USE: If used for irrigation, industrial, drainage or other. Explain,  
state number of acres and location or other data (i.e. Lot, Block  
and Addition).

ESTIMATED ANNUAL WITHDRAWAL

Size of Drilled Hole	Size and Weight of Casing	From (Feet)	To (Feet)	PERFORATIONS		
				Kind Size	From (Feet)	To (Feet)
6" I.O.	6" I.O. 17 lb per ft. g.l.	1' 6"	74' 2"			
				none		

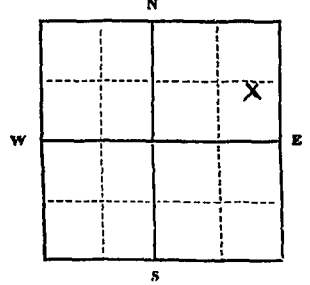

Static water level ..... 29 ..... ft.\*  
Pumping water level ..... 37 ..... ft.\*  
at ..... 25 ..... gallons per minute,  
measured ..... 1 ..... minutes after pumping  
began.  
\*Measured from ground level.  
Well developed by test pump  
for ..... 1 ..... hours.  
Power Elec Pump ..... 1 ..... HP  
Remarks: (Gravel packing, cementing,  
packers, type of shutoff)

SE 1/4 NE 1/4 Sec. 19  
T. 19 N. R. 19 E

INDICATE LOCATION OF WELL AND PLACE OF USE, IF POSSIBLE.  
EACH SMALL SQUARE REPRESENTS 40 ACRES.

Driller's Signature J. Lenn Camp  
Camp Well Drilling & Pump Supply  
Driller's Address 1522 S. 14th W., Missoula, Montana 59804

Top of Ground (Elev. above sea level)		
From (Feet)	To (Feet)	
0	1	Black Topsoil
1	4	Tan Clay
4	5	Boulders & Tan Clay
5	20	Tan Clay
20	25	Tan Clay and Gravel
25	52	Yellow Clay and Gravel
52	53	Yellow Clay & Gravel Water - 3' ann
53	59	Yellow Clay
59	60	Yellow Clay, Gravel & Water
60	72	Yellow Clay
72	74' 2"	Yellow Clay Gravel & Water

LICENSE NO. 7

74' 2" Show exact depth of bottom

48928

R- 128

199775

WELL REPORT  
CLIFFORED TRUDELL  
TO  
THE PUBLIC

STATE OF MONTANA  
County of Lane

Filed on the 20 day of Aug.

A. D. 1911 at 3:30 o'clock P. M.

ETHEL M. HARDING  
County Clerk and Recorder

By James Barrows  
Deputy