

File No.

T 23N R 20W

DUPLICATE

County Lake County

LOG

STATE OF MONTANA ADMINISTRATOR OF GROUNDWATER CODE OFFICE OF STATE ENGINEER

Top of Ground Approx. (Elev. above sea level 2942')

Notice of Completion of Groundwater Appropriation by Means of Well DEVELOPED AFTER JANUARY 1, 1962

(Under Chapter 237, Montana Session Laws, 1961)

Owner George Cecil Metcalf & Bernice Ethel Metcalf Address Polson, Montana

Driller Liberty Drilling Co. Address Missoula, Montana

Date of Notice of appropriation of groundwater None filed

Date well started 2/5/68 Date completed 2/12/68

Type of well Drilled Equipment used Cable tools & Air Rotary

Water use: Domestic [x] Municipal [] Stock [] Irrigation [x] Industrial [] Drainage [] Other []

Indicate on the diagram the character and thickness of the different strata met with in drilling, such as soil, clay, shale, gravel, rock or sand, etc. Show depth at which water is encountered, thickness and character of water-bearing strata and height to which the water rises in the well.

Formations Log:

- 0 - 1 Black dirt.
1 - 36 Tan silty clay.
36 - 49 Gravel mixed in tan silty clay.
49 - 51 Coarse gravel imbedded in tan clay.
51 - 67 Sand & gravel imbedded in tan silty clay.
67 - 92 Gravel imbedded in tan & brown clay.
92 - 98 Broken green rock.
98 - 108 Green & yellow rock. Seeps of water.
108 - 133 Grayish green rock. Some water.
133 - 144 Purple rock.
144 - 148 Gray green rock.
148 - 172 Purple rock.
172 - 173 Purple & gray rock. Some water.
173 - 176 Gray rock.
176 - 181 Gray green rock.
181 - 183 Gray - purple rock. Some water.
183 - 184 Purple rock. Some water.
184 - 201 Gray & purple rock. Some water.
201 - 203 Gray, green & white rock. Some water.
203 - 210 Gray & purple rock. Total 60 gallons per minute.

Table with columns: Size of Drilled Hole, Size and Weight of Casing, From (Feet), To (Feet), PERFORATIONS (Kind Size, From (Feet), To (Feet)).

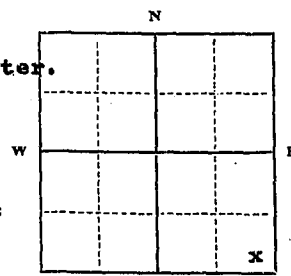

Static Water Level for non-flowing well two feet. Shut-in Pressure for Flowing Well Non-f. Pumping Water Level 176 feet at 60 gal. per minute. Discharge in gal. per min. of flowing well Non-flowing. How Tested Air Lift Pump. Length of Test Two hours.

Water rises in the well two feet from surface.

Remarks: (Gravel packing, cementing, packers, type of shutoff). All water entering well through cracks and seams in rock below 133 ft. Wells in this area can be depended upon to produce clear sand free water year after year as long as they are not overpumped, i.e., they should be pumped at rates not more than 50 to 75 percent of the tested capacity of aquifer. USE - If used for irrigation, industrial, drainage or other. Explain, state number of acres and location or other data (i.e.: Lot, Block and Addition).

Lot 3 Cecil And Bernice Villa

Show exact depth of bottom. Bottom of hole 210'

This form to be prepared by driller, and three copies to be filed by the owner with the County Clerk and Recorder in the county in which the well is located, tissue copy to be retained by driller. Please answer all questions. If not applicable, so state, otherwise the form will be returned.

52 Driller's License Number. Driller's Signature: William F. Osborne

43,962

R-1102

183590

George Cecil & Bernice
Metcalf
to
The Public

STATE OF MONTANA } ss
County of Lake
Filed on the 8 day of Mar
A. D. 1968 at 10:00 o'clock AM
ETHEL M. HARDING
County Clerk and Recorder
By Mae Johnson
Deputy

5
2:00

183590
George Cecil & Bernice Metcalf
to
The Public

183590

183590
George Cecil & Bernice Metcalf
to
The Public

STATE WATER CONSERVATION BOARD

File No.

JUL 11 1967

T. 23N R. 20W

TRIPLICATE

County Lake
Billie _____ McDermott _____
Butcher _____ STATE OF MONTANA
Coye _____ McNulty _____
Darlington _____ Domic _____ ADMINISTRATOR OF GROUNDWATER CODE
Sullivan _____ OFFICE OF STATE ENGINEER

LOG

Top of Ground _____
Approx. (Elev. above sea level) 3220'

Formation Log:

- 0 - 1 Black dirt.
- 1 - 27 Tan clay with a few scattered gravels imbedded.
- 27 - 132 Green argillite. Fractures 127' to 129' 2 GPM
- 132 - 179 Green & tan argillite in alternate layers. Fractures 163' to 169' (70 GPM)

Notice of Completion of Groundwater Appropriation by Means of Well
DEVELOPED AFTER JANUARY 1, 1962

(Under Chapter 237, Montana Session Laws, 1961)

Owner Frank W. & Grace B. Prochnow Address Polson, Montana

Driller Liberty Drilling Co. Address Missoula, Montana

Date of Notice of appropriation of groundwater None filed

Date well started 6/14/67 Date completed 6/21/67

Equipment used Cable Tools & Air Rotary
(Dug, driven, bored or drilled) (Churn drill, rotary or other)

Water use: Domestic Municipal Stock Irrigation
Industrial Drainage Other

Indicate on the diagram the character and thickness of the different strata met with in drilling, such as soil, clay, shale, gravel, rock or sand, etc. Show depth at which water is encountered, thickness and character of water-bearing strata and height to which the water rises in the well.

Size of Drilled Hole	Size and Weight of Casing	From (Feet)	To (Feet)	PERFORATIONS		
				Kind Size	From (Feet)	To (Feet)
6"	6 5/8" OD x 1/4"	+1	35	NONE		

Water rises in the well 4 feet from surface.

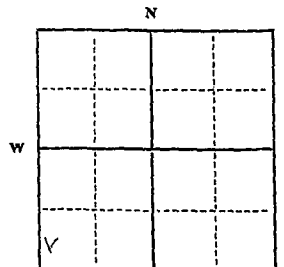

Static Water Level for non-flowing well 4 feet.

Shut-in Pressure for Flowing Well None.

Pumping Water Level 30 feet at 20 gal. per minute.

Discharge in gal. per min. of flowing well Non-flowing

How Tested Submersible Pump

Length of Test Six hours

Mountain View Villa West 739' of Lot 1, Block 2
1/4 Sec. 21, T.23N R. 20W
Indicate location of well and place of use, if possible. Each small square represents 40 acres.
Remarks: (Gravel packing, cementing, packers, type of shutoff) All water is entering the well from cracks and seams in the rock below 127 feet.

52

Driller's License Number

William S. O'Connell
Driller's Signature.

(Continue on reverse side)

USE—If used for irrigation, industrial, drainage or other. Explain, state number of acres and location or other data (i.e.: Lot, Block and Addition).

Approx. 2.67 Acres

Show exact depth of bottom.
Bottom of hole 179'

This form to be prepared by driller, and three copies to be filed by the owner with the County Clerk and Recorder in the county in which the well is located, tissue copy to be retained by driller.

Please answer all questions. If not applicable, so state, otherwise the form will be returned.

42, 129

R-1077

180399

Will Report
Thank to Grace B.
Prochnow
to
The Public

STATE OF MONTANA } ss
County of Lake }
Filed on the 7 day of July
A. D. 1967 at 9:30 o'clock A.M

ETHEL M. HARDING
County Clerk and Recorder
By Erin M. Cowman
Deputy

File No.

DUPLICATE

Approved Stock Form—State Publishing Co., Helena, Montana—19676

23N - 20W
Lot 31, Block 2
Mountain View Villa

County Lake

STATE OF MONTANA
ADMINISTRATOR OF GROUNDWATER CODE
OFFICE OF STATE ENGINEER

RECEIVED
JUL 2 - 1963

Declaration of Vested Groundwater Rights

(Under Chapter 237, Montana Session Laws, 1961)

STATE ENGINEER

Willett F. & Mildred A. WEBER of Shoreline Route Polson, Montana
(Name of Appropriator) (Address) (Town)

County of Lake State of Montana

have appropriated groundwater according to the Montana laws in effect prior to January 1, 1962, as follows:

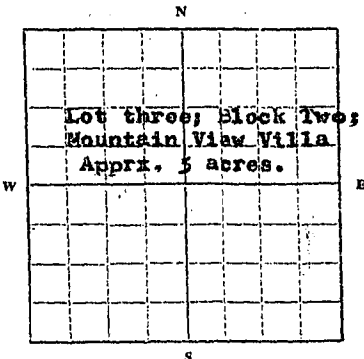

$\frac{1}{4}$ Sec. 21 T23 R20

Indicate point of appropriation and place of use, if possible. Each small square represents 10 acres.

2. The beneficial use on which the claim is based Domestic and Truck Garden and Family Orchard irrigation

3. Date or approximate date of earliest beneficial use; and how continuous the use has been 20 May 1959 and continuous since that date

4. The amount of groundwater claimed (in miner's inches or gallons per minute) Sixteen (16) gallons per minute

5. If used for irrigation, give the acreage and description of the lands to which water has been applied and name of the owner thereof Various portions of above noted five acres, all owned by appropriator

6. The means of withdrawing such water from the ground and the location of each well or other means of withdrawal Electric operated pump located at well on property

7. The date of commencement and completion of the construction of the well, wells, or other works for withdrawal of groundwater Drilling begun, 18 May 1959, completed and well operated 20 May 1959.

8. The depth of water table Twentythree (23) feet

9. So far as it may be available, the type, size and depth of each well or the general specifications of any other works for the withdrawal of groundwater Fortysix (46) feet deep with 5 inch I.D. well pipe (19 pounds per foot standard seamless) extending into well from ground level to depth of 44 feet.

10. The estimated amount of groundwater withdrawn each year 1,250,000 gallons

11. The log of formations encountered in the drilling of each well if available 0 to 1 ft. top soil; 1 to 44 ft. clay; 44 to 46+ ft. broken rock.

12. Such other information of a similar nature as may be useful in carrying out the policy of this act, including reference to book and page of any county record Drillers registration #215; driller, Glenn Camp 705 Alder St., Missoula, Montana. Well driller's report filed with Montana State Board of Health, Division of Environmental Sanitation, Helena, Montana, dated 26 May, 1959.

Signature of Owner Willett F. Weber

Dated: 28 June 1963

Mildred A. Weber

Three copies to be filed by the owner with the County Clerk and Recorder of the county in which the well is located.

Please answer all questions. If not applicable, so state, otherwise the form will be returned.

Original to the County Clerk and Recorder; duplicate to the State Engineer; Triplicate to the Montana Bureau of Mines and Geology, and Quadruplicate for the Appropriator.

R-175 160239

Willet G. & Mildred A.
Weber
to

STATE OF MONTANA
County of Lake,

Filed on the 28 day of June
A. D. 1963 at 2:30 o'clock PM

~~HAZEL KINNICK~~
County Clerk and Recorder

By M. Kraus
Deputy

\$2.00

File No.

DUPLICATE

T. 23^N R. 20^W 27
County Spokane

STATE OF MONTANA
ADMINISTRATOR OF GROUNDWATER CODE
OFFICE OF STATE ENGINEER

RECEIVED
DEC 30 1963

Declaration of Vested Groundwater Rights

(Under Chapter 237, Montana Session Laws, 1961)

STATE ENGINEER

1 CHARLES J. FRANKIE C. GRIFFIN of RT. 1 TARGET RANGE MISSOULA
(Name of Appropriator) (Address) (Town)

County of MISSOULA State of MONTANA

have appropriated groundwater according to the Montana laws in effect prior to January 1, 1962, as follows:

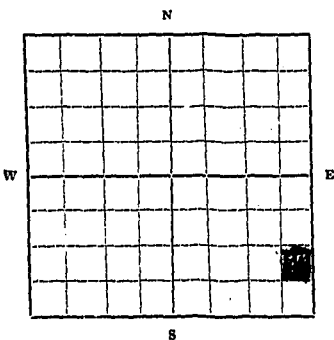

1/4 Sec. 27 T. 23 R. 20

Indicate point of appropriation and place of use, if possible. Each small square represents 10 acres.

2. The beneficial use on which the claim is based IRRIGATION
For 10 ACRES

3. Date or approximate date of earliest beneficial use; and how continuous the use has been CONTINUOUS SINCE
JULY 1952

4. The amount of groundwater claimed (in miner's inches or gallons per minute) 500 G.P.M.

5. If used for irrigation, give the acreage and description of the lands to which water has been applied and name of the owner thereof 10 ACRES
GRIFFIN, CHARLES J. & FRANKIE C.

6. The means of withdrawing such water from the ground and the location of each well or other means of withdrawal BY
7.5 HP ELECTRIC PUMP &

7. The date of commencement and completion of the construction of the well, wells, or other works for withdrawal of groundwater JULY 1952

8. The depth of water table UNKNOWN

9. So far as it may be available, the type, size and depth of each well, or the general specifications of any other works for the withdrawal of groundwater 42 FT 12" WELL CASING TOP
3 FT BELOW TOP GROUND

10. The estimated amount of groundwater withdrawn each year 20 000 000

11. The log of formations encountered in the drilling of each well if available SAND & GRAVEL

12. Such other information of a similar nature as may be useful in carrying out the policy of this act, including reference to book and page of any county record.

Frankie C. Griffin
Signature of Owner Charles J. Griffin

Date Dec 16, 1963

Three copies to be filed by the owner with the County Clerk and Recorder of the county in which the well is located.

Please answer all questions. If not applicable, so state, otherwise the form will be returned.

Original to the County Clerk and Recorder; duplicate to the State Engineer; Triplicste to the Montana Bureau of Mines and Geology and Quadruplicate for the Appropriator.

542 214 844

I received and filed this instrument for
 record on the 20 day of Dec 1963
 at 9:30 o'clock A.M. in Minerals files
 of Missoula County, State of Montana
 Witness my hand
 By Max S. Bevin County Recorder
Max S. Bevin Deputy
 Fee \$ 1.00 Paid

RECORDED

INDEXED

MISSOULA COUNTY RECORDS

RECEIVED

MISSOULA COUNTY RECORDS

RECEIVED

10 10 63

11 11 63

11 11 63

MISSOULA

MISSOULA COUNTY RECORDS

Form No. 18
8-60

27

T. 23N R. 34E

County LEWIS & CLARK

MONTANA BUREAU OF MINES AND GEOLOGY
Butte, Montana

RECEIVED
JAN 2 1961

Water Well Log

STATE ENGINEER

Owner H. B. MONTAN Address Box 1705, Helena

Driller Smith & Williams Co Address Helena, MT

Date Started July 1960 Date Completed August 1960

Location: Sec. 7 T. 23N R. 34E 1/4 sec. 27 Lot 5

Type of well DRILLED Equipment used PENNIX
(Dug, driven, or drilled) (Churn, drill, rotary, other)

Water use: Domestic Municipal Stock Irrigation
Industrial Drainage Other _____

Casing: TOP ft. to 20 ft. Type H-T Size 6"

Casing: _____ ft. to _____ ft. Type _____ Size _____

Casing: _____ ft. to _____ ft. Type _____ Size _____

Perforated or screened: Ft. _____ to ft. _____. Ft. _____ to ft. _____

Type of screen or perforations WIRE

Static water level, for non-flowing well: 9 FT BELOW TOP feet.
103" FROM BOTTOM

Shut-in pressure, for flowing well: _____ lb./sq. in. on: _____
(date)

Pumping water level 76 feet at 6 gal. per min.

How tested: ELECTRIC DRIVEN TEST - PERMANENT INSTALLATION

Length of test 1 1/2 HOURS

Remarks: (Gravel packing, cementing, packers, type of shut-off, depth of shut-off)

(over)

STATE OF MONTANA
ADMINISTRATOR OF GROUNDWATER CODE
MONTANA WATER RESOURCES BOARD

**NOTICE OF COMPLETION OF GROUNDWATER
APPROPRIATION BY MEANS OF WELL**

Developed after January 1, 1962

(Under Chapter 237 Montana Session Laws, 1961, as amended)

This form to be prepared by driller, and three copies to be filed by the owner with the County Clerk and Recorder in the county in which the well is located, last copy to be retained by driller.

Please answer all questions. If not applicable, so state, otherwise the form may be returned.

Owner E. J. Anderson

Address Palau, Montana

Date well started 5/10/72

completed 5/19/72

Type of well Drilled
(Dug, driven, bored or drilled)

Equipment used Churn Drill
(Churn drill, rotary or other)

Water Use: Domestic Municipal Stock Irrigation
Industrial Drainage Other * Garden/Lawn

*Describe

USE: If used for irrigation, industrial, drainage or other. Explain, state number of acres and location or other data (i.e. Lot, Block and Addition).

ESTIMATED ANNUAL WITHDRAWAL 200,000

Size of Drilled Hole	Size and Weight of Casing	From (Feet)	To (Feet)	PERFORATIONS		
				Kind Size	From (Feet)	To (Feet)
6"	6 5/8" 17lb.	19'	9'	barrel out	64'	76'
	1 1/2" 5/8" 25 lb.	7	76			

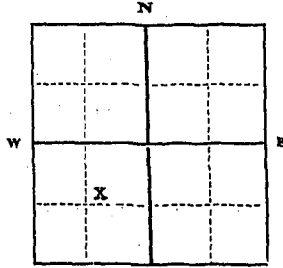

Anderson's Lot 7 Blk 2
Sec. 22
T. 51 N. R. 20 W. E. S. W.

INDICATE LOCATION OF WELL AND PLACE OF USE; IF POSSIBLE. EACH SMALL SQUARE REPRESENTS 40 ACRES.

Driller's Signature George Beebe

Driller's Address Box 17

Palau, Mont. LICENSE NO. 24

RECEIVED 23N-20W 28
County Lake

DRILLER'S LOG

Indicate the character, color, thickness of strata such as soil, clay, sand, gravel, shale, sandstone, etc. Show depth at which water is found and height to which water rises in well.

Top of Ground (Elev. above sea level)		Description
From (Feet)	To (Feet)	
0	9	Top soil addition
9	32	Gravelly sandstone
32	76	Gravelly sandstone

76 ft. Show exact depth of bottom

1484
 210461
 ell Report
 C. J. Andersen
 To
 The public

STATE OF MONTANA } ss
 County of Lake
 Filed on the 27 day of June
 A. D. 1973 at 10:00 o'clock A.M.
 ETHEL M. HARDING
 County Clerk and Recorder
 By Wilhelmina Daughlin
 Deputy
 20

GW 2

RECEIVED

Approved Stock Form—State Publishing Co., Helena, Montana—42329

File No. _____

FEB 24 1972

T. 23N R. 20W

DUPLICATE

LOG

MONTANA DEPARTMENT OF NATURAL RESOURCES AND CONSERVATION

STATE OF MONTANA ADMINISTRATOR OF GROUNDWATER CODE OFFICE OF STATE ENGINEER

County Lake

Top of Ground (Elev. above sea level.....)

Notice of Completion of Groundwater Appropriation by Means of Well DEVELOPED AFTER JANUARY 1, 1962

(Under Chapter 237, Montana Session Laws, 1961)

0-8 Clay
8-160 Blue-green, purple, and Dk. blue rock
160-180 Fractured red rock with stringers of clay.

Owner Wallace Weivoda Address Polson, MT 59860

Driller Joe Johnson Drilling Address Terry, MT

Date of Notice of appropriation of groundwater.....

Date well started 12/16/69 Date completed 12/23/69

Type of well Drilled Equipment used Rotary (Churn drill, rotary or other)

Water use: Domestic [X] Municipal [] Stock [] Irrigation [] Industrial [] Drainage [] Other []

Indicate on the diagram the character and thickness of the different strata met with in drilling, such as soil, clay, shale, gravel, rock or sand, etc. Show depth at which water is encountered, thickness and character of water-bearing strata and height to which the water rises in the well.

Table with columns: Size of Drilled Hole, Size and Weight of Casing, From (Feet), To (Feet), PERFORATIONS (Kind Size, From (Feet), To (Feet)).

Doc. No. R-1324, 202403 Filed for record this 23rd day of February A. D. 1972, at 10:45 o'clock A.M.

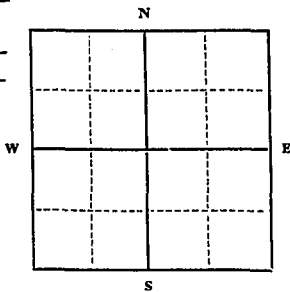

Static Water Level for non-flowing well feet. Shut-in Pressure for Flowing Well Pumping Water Level 106 feet at 10 gal. per minute. Discharge in gal. per min. of flowing well 3 How Tested pump tested Length of Test 18 hrs. Remarks: (Gravel packing, cementing, packers, type of shutoff) Cemented casing in.

NW 1/4 NE Sec. 26 T. 23N R. 20W Indicate location of well and place of use, if possible. Each small square represents 40 acres.

(Continue on reverse side) USE—If used for irrigation, industrial, drainage or other. Explain, state number of acres and location or other data (i.e.: Lot, Block and Addition).

180 Ft. Show exact depth of bottom.

This form to be prepared by driller, and three copies to be filed by the owner with the County Clerk and Recorder in the county in which the well is located, tissue copy to be retained by driller.

Please answer all questions. If not applicable, so state, otherwise the form will be returned.

15k Driller's License Number Driller's Signature Joe Leon Johnson

202403

SR-1324

WALLACE WEIVODA

TO

THE PUBLIC

WELL REPORT

STATE OF MONTANA }
County of Lake }
Filed on the 23 day of Feb
A. D. 1972 at 10:45 o'clock A. M.

ETHEL M. HARDING
County Clerk and Recorder
By Jewell Bentz
Deputy

Doc No. 1324
Filed for Public
V.D. 1324
C.S. 1324

How satisfied are you with the service of the County Clerk and Recorder?
Date

STATE OF MONTANA
ADMINISTRATOR OF GROUNDWATER CODE
MONTANA WATER RESOURCES BOARD
**NOTICE OF COMPLETION OF GROUNDWATER
APPROPRIATION BY MEANS OF WELL**
Developed after January 1, 1962

23N-20W
County Lake

RECEIVED
DEC 5 1972

DRILLER'S LOG

Indicate the character, color, thickness of strata such as soil, clay, sand, gravel, shale, sandstone, etc. Show depth at which water is found and height to which water rises in well.

(Under Chapter 237 Montana Session Laws, 1961, as amended)

This form to be prepared by driller, and three copies to be filed by the owner with the County Clerk and Recorder in the county in which the well is located, last copy to be retained by driller. Please answer all questions. If not applicable, so state, otherwise the form may be returned.

Owner Harold F. and Dorcas Alexander

Address Polson, Montana

Date well started 6/25/71

completed 6/30/71

Type of well Drilled

Equipment used Air Rotary

Water Use: Domestic Municipal Stock Irrigation

Industrial Drainage Other * Garden/Lawn

*Describe

USE: If used for irrigation, industrial, drainage or other. Explain, state number of acres and location or other data (i.e. Lot, Block and Addition). One Acre South 150 ft., Lot 3

ESTIMATED ANNUAL WITHDRAWAL 8,935,200 gallons

Size of Drilled Hole	Size and Weight of Casing	From (Feet)	To (Feet)	PERFORATIONS		
				Kind Size	From (Feet)	To (Feet)
8"	8 5/8"	0	78			
6"	6 1/2"	+2	160		110	115
	6 5/8"			Knife	125	130
					145	150

Annulus around eight inch casing filled with puddled clay to prevent seepage of surface and other undesirable water down around casing

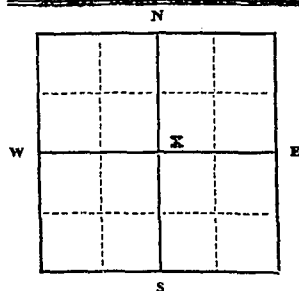

SW 1/4 NE 1/4 Sec. 29
T. 23 N. R. 20 E. S. 2

INDICATE LOCATION OF WELL AND PLACE OF USE, IF POSSIBLE. EACH SMALL SQUARE REPRESENTS 40 ACRES.

LIBERTY DRILLING & PUMP COMPANY

Driller's Signature William F. Williams

Driller's Address 2500 Reserve Street

Missoula, Montana

LICENSE NO. 52

Top of Ground Approx. (Elev. above sea level) 3025'

From (Feet)	To (Feet)	Description
0	1	Topsoil
1	50	Tan clay
50	52	Boulders
52	71	Tan silty clay. Seeps
71	110	Light green & tan rock
110	148	Green rock. Some water Total of 4 gallons per minute
148	158	Green broken rock. Some water. Total of ten gallons per minute
158	162	Green rock
162	163	Green rock, broken
163	165	Green rock
165	166	Green rock, broken. Some water. Total of 12 gallons per minute
166	168	Green rock. Water. Total of 20 gallons per minute

168 ft. Show exact depth of bottom
Water rises in well to 13 feet
from surface.

5,950

R-1400

206881

Well Report

Harold F. & Doreen Alexander

to

The Public

STATE OF MONTANA
COUNTY OF LAKE

Filed on the 14 day of December

A. D. 1972 at 10:00 o'clock AM

By: Ethel M. Harbin, Recorder
County Clerk and Deputy

Note: Wells in this area can be depended upon to produce clear sand free water year after year as long as they are not overpumped, i.e., they should be pumped at rates not in excess of 50 to 60 percent of the tested capacity of the aquifer

Well No.	Owner	Depth	Capacity	Remarks
1	Harold F. & Doreen Alexander	120	100	Clear sand free water
2	Harold F. & Doreen Alexander	130	110	Clear sand free water
3	Harold F. & Doreen Alexander	140	120	Clear sand free water
4	Harold F. & Doreen Alexander	150	130	Clear sand free water
5	Harold F. & Doreen Alexander	160	140	Clear sand free water
6	Harold F. & Doreen Alexander	170	150	Clear sand free water
7	Harold F. & Doreen Alexander	180	160	Clear sand free water
8	Harold F. & Doreen Alexander	190	170	Clear sand free water
9	Harold F. & Doreen Alexander	200	180	Clear sand free water
10	Harold F. & Doreen Alexander	210	190	Clear sand free water
11	Harold F. & Doreen Alexander	220	200	Clear sand free water
12	Harold F. & Doreen Alexander	230	210	Clear sand free water
13	Harold F. & Doreen Alexander	240	220	Clear sand free water
14	Harold F. & Doreen Alexander	250	230	Clear sand free water
15	Harold F. & Doreen Alexander	260	240	Clear sand free water
16	Harold F. & Doreen Alexander	270	250	Clear sand free water
17	Harold F. & Doreen Alexander	280	260	Clear sand free water
18	Harold F. & Doreen Alexander	290	270	Clear sand free water
19	Harold F. & Doreen Alexander	300	280	Clear sand free water
20	Harold F. & Doreen Alexander	310	290	Clear sand free water
21	Harold F. & Doreen Alexander	320	300	Clear sand free water
22	Harold F. & Doreen Alexander	330	310	Clear sand free water
23	Harold F. & Doreen Alexander	340	320	Clear sand free water
24	Harold F. & Doreen Alexander	350	330	Clear sand free water
25	Harold F. & Doreen Alexander	360	340	Clear sand free water
26	Harold F. & Doreen Alexander	370	350	Clear sand free water
27	Harold F. & Doreen Alexander	380	360	Clear sand free water
28	Harold F. & Doreen Alexander	390	370	Clear sand free water
29	Harold F. & Doreen Alexander	400	380	Clear sand free water
30	Harold F. & Doreen Alexander	410	390	Clear sand free water
31	Harold F. & Doreen Alexander	420	400	Clear sand free water
32	Harold F. & Doreen Alexander	430	410	Clear sand free water
33	Harold F. & Doreen Alexander	440	420	Clear sand free water
34	Harold F. & Doreen Alexander	450	430	Clear sand free water
35	Harold F. & Doreen Alexander	460	440	Clear sand free water
36	Harold F. & Doreen Alexander	470	450	Clear sand free water
37	Harold F. & Doreen Alexander	480	460	Clear sand free water
38	Harold F. & Doreen Alexander	490	470	Clear sand free water
39	Harold F. & Doreen Alexander	500	480	Clear sand free water
40	Harold F. & Doreen Alexander	510	490	Clear sand free water
41	Harold F. & Doreen Alexander	520	500	Clear sand free water
42	Harold F. & Doreen Alexander	530	510	Clear sand free water
43	Harold F. & Doreen Alexander	540	520	Clear sand free water
44	Harold F. & Doreen Alexander	550	530	Clear sand free water
45	Harold F. & Doreen Alexander	560	540	Clear sand free water
46	Harold F. & Doreen Alexander	570	550	Clear sand free water
47	Harold F. & Doreen Alexander	580	560	Clear sand free water
48	Harold F. & Doreen Alexander	590	570	Clear sand free water
49	Harold F. & Doreen Alexander	600	580	Clear sand free water
50	Harold F. & Doreen Alexander	610	590	Clear sand free water
51	Harold F. & Doreen Alexander	620	600	Clear sand free water
52	Harold F. & Doreen Alexander	630	610	Clear sand free water
53	Harold F. & Doreen Alexander	640	620	Clear sand free water
54	Harold F. & Doreen Alexander	650	630	Clear sand free water
55	Harold F. & Doreen Alexander	660	640	Clear sand free water
56	Harold F. & Doreen Alexander	670	650	Clear sand free water
57	Harold F. & Doreen Alexander	680	660	Clear sand free water
58	Harold F. & Doreen Alexander	690	670	Clear sand free water
59	Harold F. & Doreen Alexander	700	680	Clear sand free water
60	Harold F. & Doreen Alexander	710	690	Clear sand free water
61	Harold F. & Doreen Alexander	720	700	Clear sand free water
62	Harold F. & Doreen Alexander	730	710	Clear sand free water
63	Harold F. & Doreen Alexander	740	720	Clear sand free water
64	Harold F. & Doreen Alexander	750	730	Clear sand free water
65	Harold F. & Doreen Alexander	760	740	Clear sand free water
66	Harold F. & Doreen Alexander	770	750	Clear sand free water
67	Harold F. & Doreen Alexander	780	760	Clear sand free water
68	Harold F. & Doreen Alexander	790	770	Clear sand free water
69	Harold F. & Doreen Alexander	800	780	Clear sand free water
70	Harold F. & Doreen Alexander	810	790	Clear sand free water
71	Harold F. & Doreen Alexander	820	800	Clear sand free water
72	Harold F. & Doreen Alexander	830	810	Clear sand free water
73	Harold F. & Doreen Alexander	840	820	Clear sand free water
74	Harold F. & Doreen Alexander	850	830	Clear sand free water
75	Harold F. & Doreen Alexander	860	840	Clear sand free water
76	Harold F. & Doreen Alexander	870	850	Clear sand free water
77	Harold F. & Doreen Alexander	880	860	Clear sand free water
78	Harold F. & Doreen Alexander	890	870	Clear sand free water
79	Harold F. & Doreen Alexander	900	880	Clear sand free water
80	Harold F. & Doreen Alexander	910	890	Clear sand free water
81	Harold F. & Doreen Alexander	920	900	Clear sand free water
82	Harold F. & Doreen Alexander	930	910	Clear sand free water
83	Harold F. & Doreen Alexander	940	920	Clear sand free water
84	Harold F. & Doreen Alexander	950	930	Clear sand free water
85	Harold F. & Doreen Alexander	960	940	Clear sand free water
86	Harold F. & Doreen Alexander	970	950	Clear sand free water
87	Harold F. & Doreen Alexander	980	960	Clear sand free water
88	Harold F. & Doreen Alexander	990	970	Clear sand free water
89	Harold F. & Doreen Alexander	1000	980	Clear sand free water
90	Harold F. & Doreen Alexander	1010	990	Clear sand free water
91	Harold F. & Doreen Alexander	1020	1000	Clear sand free water
92	Harold F. & Doreen Alexander	1030	1010	Clear sand free water
93	Harold F. & Doreen Alexander	1040	1020	Clear sand free water
94	Harold F. & Doreen Alexander	1050	1030	Clear sand free water
95	Harold F. & Doreen Alexander	1060	1040	Clear sand free water
96	Harold F. & Doreen Alexander	1070	1050	Clear sand free water
97	Harold F. & Doreen Alexander	1080	1060	Clear sand free water
98	Harold F. & Doreen Alexander	1090	1070	Clear sand free water
99	Harold F. & Doreen Alexander	1100	1080	Clear sand free water
100	Harold F. & Doreen Alexander	1110	1090	Clear sand free water

File No.

T. 23N R. 20W

DUPLICATE

County LAKE

LOG

STATE OF MONTANA
ADMINISTRATOR OF GROUNDWATER CODE
STATE WATER CONSERVATION BOARD

Notice of Completion of Groundwater
Appropriation by Means of Well

DEVELOPED AFTER JANUARY 1, 1962

(Under Chapter 237 Montana Session Laws, 1961, as amended)

Top of Ground

(Elev. above sea level.....)

0 - 6
2 - 22 Clay
22 - 60 Gravel with layers
of clay
60 - 95 Clay with layers
of quicksand
95 - 100 Fractured rock
and gravel

Owner..... James Anderson Address..... Polson, Mt.

Driller..... Joe Johnson Drig. Address..... Polson, Mt.

Date of Notice of appropriation of groundwater.....

Date well started..... 1/3/70 Date completed..... 1/8/70

Type of well Drilled Equipment used Rotary & Cable
(Dug, driven, bored or drilled) (Churn drill, rotary, etc.)

Water use: Domestic Municipal Stock Irrigation
Industrial Drainage Other

Indicate on the diagram the character and thickness of the different strata met with in drilling, such as soil, clay, shale, gravel, rock or sand, etc. Show depth at which water is encountered, thickness and character of water-bearing strata and height to which the water rises in the well.

Size of Drilled Hole	Size and Weight of Casing	From (Feet)	To (Feet)	PERFORATIONS			
				Kind Size	From (Feet)	To (Feet)	
6"	6" ID 18.97#/ft.	+1	97'	N	O	N	E

Doc. No. 195104
Filed for record
this 2 day of September
A. D. 19 70, at 4:45
o'clock P. M.

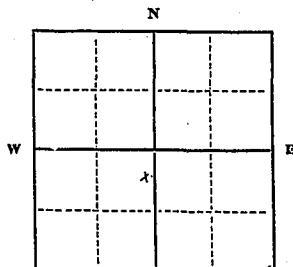

Static Water Level for non-flowing well 16 feet.

Shut-in Pressure for Flowing Well.....

Pumping Water Level..... 50 feet
at..... 20 gal. per minute.

Discharge in gal. per min. of flowing well

How Tested..... Bailer Tested

Length of Test..... 1 hr.

Remarks: (Gravel packing, cementing, packers, type of shutoff).....

Ferguson Heights Sub-Div.
Lot 1 - Blk 1 E 1/4 Sec. 29 T. 23N R. 20W
Indicate location of well and place of use, if possible. Each small square represents 40 acres.

(Continue on reverse side)

USE—If used for irrigation, industrial, drainage or other. Explain, state number of acres and location or other data (i.e.: Lot, Block and Addition).

Show exact depth of bottom.

This form to be prepared by driller, and three copies to be filed by the owner with the County Clerk and Recorder in the county in which the well is located, tissue copy to be retained by driller.

Please answer all questions. If not applicable, so state, otherwise the form will be returned.

154
Driller's License Number

Joe Johnson
Driller's Signature

R-1227 #195104

WELL REPORT

JAMES ANDERSON

TO

THE PUBLIC

Ferguson Heights

STATE OF MONTANA
County of Lake

Filed on the 2 day of
Sept. A.D. 1970 at
4:45 o'clock PM

Ethel M. Harding
County Clerk &
Recorder

Jewell Bentz
Deputy

2.00

File No. _____

DUPLICATE

23N R 20W 29

County Lake

STATE OF MONTANA
ADMINISTRATOR OF GROUNDWATER CODE
OFFICE OF STATE ENGINEERS

RECEIVED
OCT 28 1964

Notice of Completion of Groundwater Appropriation by Means of Well

(Under Chapter 237, Montana Session Laws, 1961)

Top of Ground
(Elev. above sea level 2916)

7' of top soil

39' of clay

58' of Hard Rock

21' of soft Rock

Owner Edwin A. Hamon Address Polson

Driller Fred Morrison Address Polson Mont.

Date of Notice of Appropriation of Groundwater _____

Date well started Sept. 7 Date Completed Sept. 24, 1964

Type of well Drilled Equipment Used Churn
(dug, driven, bored or drilled) (Churn, drill, rotary or other)

Water encountered at 49' & 119' in Rock

Water Use: Domestic Municipal Other Irrigation
Industrial Drainage Stock

Water rises in well 102'

Indicate on the diagram the character and thickness of the different strata met with in drilling, such as soil, clay, shale, gravel, rock or sand, etc. Show depth at which water is encountered, thickness and character of water-bearing strata and height to which water rises in the well.

Size of Drilled Hole	Size and Weight of Casing	From (Feet)	To (Feet)	PERFORATIONS		
				Kind Size	From (Feet)	To (Feet)
6"	6" 19 Pounds Foot	care from ground level	40' below ground level			

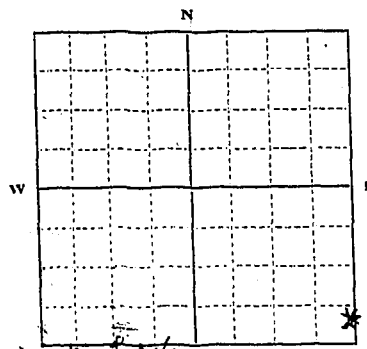

Section Lot 4
1/4 Sec 19 T23 R20
Indicate location of well and place of use, if possible. Each small square represents 10 acres.

719'

Show exact depth of bottom.

Static Water Level for non-flowing Well 17' from ground level feet.

Shut-in Pressure for Flowing Well _____

Pumping Water Level 110' feet at 2 gal. per minute.

Discharge in gal. per min. of flowing well _____

How Tested Bailer Length of Test 2 hours

Remarks: (Gravel packing, cementing, packers, type of shutoff, location of place of use of groundwater if not at well, and any other similar pertinent information, including number of acres irrigated, if used for irrigation) _____

108
Driller's License Number

Fred Morrison
Driller's Signature

This form to be prepared by driller, and three copies to be filed by the owner with the County Clerk and Recorder in the county in which the well is located.

Please answer all questions. If not applicable, so state, otherwise the form will be returned.

Original to the County Clerk and Recorder; duplicate to the State Engineer; Triplicate to the Montana Bureau of Mines and Geology and Quadruplicate for the Appropriator.

R-963 167467
Water Report
Edwin A. Hanson
to
The Public

STATE OF MONTANA
County of Lake,
Filed on the 27 day of Oct
A. D. 1964 at 11:35 o'clock A. M.
HAZEL KINNICK
County Clerk and Recorder
By Maie Johnson
Deputy

C

1964 OCT 29 10 56 AM
CLERK OF DISTRICT COURT
LAKESIDE, MONTANA

File No.

T. 23 R. 20

DUPLICATE

County... LAKE

STATE OF MONTANA
ADMINISTRATOR OF GROUNDWATER CODE
OFFICE OF STATE ENGINEER

RECEIVED
OCT 1 1963
STATE ENGINEER



Top of Ground
(Elev. above sea level.....)

Notice of Completion of Groundwater Appropriation by Means of Well

(Under Chapter 237, Montana Session Laws, 1961)

0-2 BLACK DIET

2-28 TAN CLAY

28-45 BROKEN GREEN
ROCK. SEEPS
OF WATER IN
CRACKS AND
SEAMS - SWL
29 1/2' -

Owner... ARTHUR H. EUGEN Address... BOZEMAN, MONTANA

Driller... LIBERTY DRILLING CO. Address... MISSOULA, MONTANA

Date of Notice of Appropriation of Groundwater.....

Date well started... APRIL 2, 1962 Date Completed... APRIL 12, 1962

Type of well... DRILLED (dug, driven, bored or drilled) Equipment Used... CASE tools (Churn, drill, rotary or other)

Water Use: Domestic Municipal Other Irrigation
Industrial Drainage Stock

Indicate on the diagram the character and thickness of the different strata met with in drilling, such as soil, clay, shale, gravel, rock or sand, etc. Show depth at which water is encountered, thickness and character of water-bearing strata and height to which water rises in the well.

BOTTOM OF WELL 45'

Size of Drilled Hole	Size and Weight of Casing	From (Feet)	To (Feet)	PERFORATIONS		
				Kid Size	From (Feet)	To (Feet)
6"	6 5/8" OD X 17#	+1	32'5"	NONE		

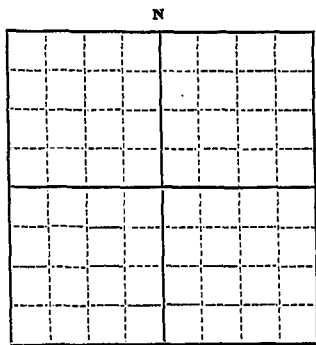

Lot 7 of Lot 4
NW 1/4 Sec. 29 T. 23 R. 20
Indicate location of well and place of use, if possible. Each small square represents 10 acres.

Show exact depth of bottom.

Static Water Level for non-flowing Well... 29 1/2 feet.

Shut-in Pressure for Flowing Well... NON-FLOWING

Pumping Water Level... 39 feet at 3 gal. per minute.

Discharge in gal. per min. of flowing well... NON-FLOWING

How Tested... BAYLOR Length of Test... 7 HOURS

Remarks: (Gravel packing, cementing, packers, type of shutoff, location of place of use of groundwater if not at well, and any other similar pertinent information, including number of

acres irrigated, if used for irrigation)... ALL WATER ENTERING WELL THROUGH CRACKS AND SEAMS IN THE ROCK FROM 30 TO 45 FEET.

Arthur H. Eugen

Driller's License Number 52

William F. Osborne
Driller's Signature

This form to be prepared by driller, and three copies to be filed by the owner with the County Clerk and Recorder in the county in which the well is located.

Please answer all questions. If not applicable, so state, otherwise the form will be returned.

Original to the County Clerk and Recorder; duplicate to the State Engineer; Triplicate to the Montana Bureau of Mines and Geology and Quadruplicate for the Appropriator.

R-241 161259

STATE OF MONTANA
County of Lake,

Filed on the 24 day of Sept

A. D. 1963 at 9:00 o'clock P. M.

Shirley Ann
County Clerk and Recorder

By _____ Deputy

2

RECEIVED

234-20W
County Lake 29

FEB 18 1972

STATE OF MONTANA
ADMINISTRATOR OF GROUNDWATER CODE
MONTANA WATER RESOURCES BOARD
NOTICE OF COMPLETION OF GROUNDWATER
APPROPRIATION BY MEANS OF WELL

Developed after January 1, 1962

(Under Chapter 237 Montana Session Laws, 1961, as amended)

This form to be prepared by driller, and three copies to be filed by the owner with the County Clerk and Recorder in the county in which the well is located; last copy to be retained by driller.

Please answer all questions. If not applicable, so state, otherwise the form may be returned.

Frank E. Hodge and
Elma V. Hodge

Owner
Address Box 10
Polson, Montana 59860
Date well started 8/17/71
completed 8/18/71

For Administrator's Use
File R-1322, 202363
Feb. 17, 1972 3:00 p.m.
GW 1

Type of well Drilled (Dug, driven, bored or drilled)
Equipment used Air Rotary (Churn drill, rotary or other)
Water Use: Domestic Municipal Stock Irrigation
Industrial Drainage Other * Garden/Lawn

*Describe Drain into pond

USE: If used for irrigation, industrial, drainage or other. Explain, state number of acres and location or other data (i.e. Lot, Block and Addition). 8 Acres

ESTIMATED ANNUAL WITHDRAWAL 15,768,000

Size of Drilled Hole	Size and Weight of Casing	From (Feet)	To (Feet)	PERFORATIONS		
				Kind Size	From (Feet)	To (Feet)
8"	8 5/8" OD by 1/2"	+2'	36'9"	NONE		

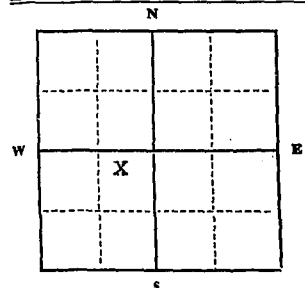

NE 1/4 SW 1/4 Sec. 29
T. 23 N. R. 20 W. EX

INDICATE LOCATION OF WELL AND PLACE OF USE, IF POSSIBLE. EACH SMALL SQUARE REPRESENTS 40 ACRES.

LIBERTY DRILLING COMPANY
Driller's Signature William J. Osborne
Driller's Address 2500 Reserve Street

Missoula, Montana 59801 LICENSE NO. 52

DRILLER'S LOG
Indicate the character, color, thickness of strata such as soil, clay, sand, gravel, shale, sandstone, etc. Show depth at which water is found and height to which water rises in well.

Top of Ground		Approx. (Elev. above sea level)
From (Feet)	To (Feet)	
0	1	Topsoll
1	30	Tan clay
30	36	Tan clay and gravel
36	93	Green rock
93	99	Fractured tan and green rock in thin alternate layers. Red clay in cracks and seams
99	108	Green rock
108	110	Fractured green rock. Water 7gpm
110	112	Green rock
112	114	Fractured green rock. Water 15gpm
114	121	Green rock
121	122	Fractured green rock. Water. 20gpm
122	128	Green rock
128	133	Fractured green rock. Water 30 gpm
133	135	Green rock

135' Show exact depth of bottom water rises in well 39' from surface.
49,890

(Faint, mostly illegible text from the top half of the document, possibly including a title and introductory paragraphs.)

(Con't) in the rock below 110 feet.

Note: Wells in this area can be depended upon to produce clear sand free water year after year as long as they are not overpumped, i.e., they should be pumped at rates not in excess of 50 to 60 percent of the tested capacity of the aquifer.

R-1322

202363

WELL REPORT

FRANK E. & EIMA HODGE

TO

THE PUBLIC

STATE OF MONTANA } ss
County of Lake

Filed on the 17 day of July

A. D. 19 1923 at 3:00 o'clock P.M.

ETHEL M. HARDING
County Clerk and Recorder

By [Signature]
Deputy

200

RECEIVED

DRILLER'S LOG

NOTICE OF COMPLETION OF GROUNDWATER APPROPRIATION BY MEANS OF WELL

Developed after January 1, 1962

(Under Chapter 237 Montana Session Laws, 1961, as amended)

This form to be prepared by driller, and three copies to be filed by the owner with the County Clerk and Recorder in the county in which the well is located, last copy to be retained by driller.

Please answer all questions. If not applicable, so state, otherwise the form may be returned.

Owner Larry Hoffman

Address West Shore

Folsom, Mont.

Date well started 26 Sept. (20)

completed 27 Sept.

Type of well Drilled

(Dug, driven, bored or drilled)

Equipment used Churn Drill

(Churn drill, rotary or other)

Water Use: Domestic Municipal Stock Irrigation

Industrial Drainage Other * Garden/Lawn

*Describe

USE: If used for irrigation, industrial, drainage or other. Explain, state number of acres and location or other data (i.e. Lot, Block and Addition).

ESTIMATED ANNUAL WITHDRAWAL 5,000

Size of Drilled Hole	Size and Weight of Casing	From (Feet)	To (Feet)	PERFORATIONS		
				Kind Size	From (Feet)	To (Feet)
6"	6 5/8 o.d. 17#	2' above ground	42'	5" plastic saw cut liner	40'	70'

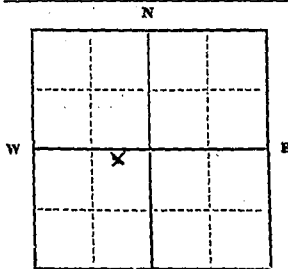

Ferguson Hcs L 10-131

E 1/4 SW 1/4 Sec 29

T23 R.20

Static water level 16 ft.*
Pumping water level 55 ft.*
at 10 gallons per minute,
measured 120 minutes after pumping began.
*Measured from ground level.
Well developed by hammer
for 4 hours.
Power 200 Pump 1/3 HP
Remarks: (Gravel packing, cementing, packers, type of shutoff)

INDICATE LOCATION OF WELL AND PLACE OF USE, IF POSSIBLE. EACH SMALL SQUARE REPRESENTS 40 ACRES.

Driller's Signature George O. Beebe

Driller's Address Box 17

Favall, Mont.

LICENSE NO. 204

Top of Ground (Elev. above sea level)

From (Feet)	To (Feet)	
0	2	topsoil
2	29	tan clay
29	41	soft tan rock
41	56	hard brown rock
56	67	hard gray rock
67	70	very hard green rock

70 ft. Show exact depth of bottom

R- 1298

200719

Well Report
Larry Hoffman
to
The Public

STATE OF MONTANA }
County of Lake } ss

Filed on the 22 day of Oct. 22

A. D. 19 71 at 1:30 o'clock P.M

ETHEL M. HARBING

County Clerk and Recorder

By Wilhelmina Luepke

Deputy

200

RECEIVED
SEP 28 1972

231-200
County Lake 29

STATE OF MONTANA
ADMINISTRATOR OF GROUNDWATER CODE
MONTANA WATER RESOURCES BOARD
NOTICE OF COMPLETION OF GROUNDWATER
APPROPRIATION BY MEANS OF WELL

MONTANA DEPARTMENT OF NATURAL
RESOURCES AND CONSERVATION

DRILLER'S LOG

Indicate the character, color, thick-
ness of strata such as soil, clay, sand,
gravel, shale, sandstone, etc. Show
depth at which water is found and
height to which water rises in well.

Developed after January 1, 1962

(Under Chapter 237 Montana Session Laws, 1961, as amended)

This form to be prepared by driller, and three copies to be filed
by the owner with the County Clerk and Recorder in the county in
which the well is located, last copy to be retained by driller.
Please answer all questions. If not applicable, so state, otherwise the
form may be returned.

Owner Odean J. and
Helen M. Pulsing

Address Box 176

Columbia Falls, Montana

Date well started 8/28/72

completed 8/30/72

For Administrator's Use	
File <u>R-1387 205836</u>	
<u>Sept. 27, 1972 - 8:15 a.m.</u>	
GW <u>1</u>	

Type of well Drilled
(Dug, driven, bored or drilled)

Equipment used Air Rotary
(Churn drill, rotary or other)

Water Use: Domestic Municipal Stock Irrigation
Industrial Drainage Other Garden/Lawn

*Describe

USE: If used for irrigation, industrial, drainage or other. Explain,
state number of acres and location or other data (i.e. Lot, Block
and Addition). Part of Lot 4, TR6

ESTIMATED ANNUAL WITHDRAWAL 31,536,000 gallons

Size of Drilled Hole	Size and Weight of Casing	From (Feet)	To (Feet)	PERFORATIONS		
				Kind Size	From (Feet)	To (Feet)
10"	8 5/8"	0	41'8"			
8"	OD x 3/4"	+2	41'8"	Torch Cut	135	155
	6 5/8"	15	155			

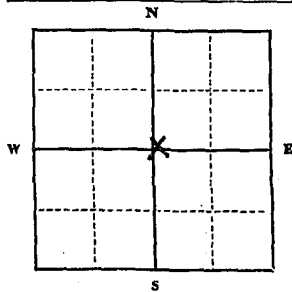

SW 1/4 NE 1/4 Sec. 29
T. 23 N. R. 20 E
S. W.

Static water level 12 ft.*
Pumping water level 79 ft.*
at ±60 gallons per minute,
measured 180 minutes after pumping
began.

*Measured from ground level.
Well developed by Air Lift Pump
for Three hours.
Power Diesel Pump 150 HP
Remarks: (Gravel packing, cementing,
packers, type of shutoff) All water
entering well is coming
through perforations in
six inch casing. Wells
in this area can be de-
Cont'd

INDICATE LOCATION OF WELL AND PLACE OF USE, IF POSSIBLE.
EACH SMALL SQUARE REPRESENTS 40 ACRES.

Driller's Signature Liberty Drilling Company

Driller's Address Highway 93 South

Kalispell, Montana LICENSE NO. 52

Top of Ground Approx (Elev. above sea level) 2925'

From (Feet)	To (Feet)	
0	1	Topsoil
1	34	Tan clay
34	55	Tan rock
55	107	Green rock
107	110	Tan, brown and green rock in thin alternate layers
110	146	Green rock. Five gallons per minute
146	155	Fractured green rock. Total 60 gallons per minute.

155 Show exact depth of bottom
Water rises in well 12 feet
from surface. 51,487

DRINKING WATER REGULATIONS
CHAPTER 10
SECTION 10-101

SECTION 10-101-101
SECTION 10-101-102

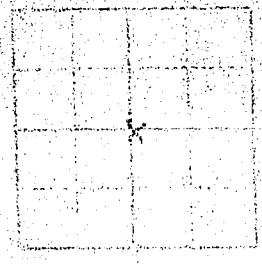

TO THE EXTENT THAT THE WATER RESOURCES DEPARTMENT HAS THE AUTHORITY TO ENFORCE THE PROVISIONS OF THIS CHAPTER, IT IS HEREBY ORDERED THAT THE WATER RESOURCES DEPARTMENT SHALL ENFORCE THE PROVISIONS OF THIS CHAPTER TO THE EXTENT THAT IT HAS THE AUTHORITY TO DO SO.

Table with multiple columns and rows, likely for recording data or observations. The text is mostly illegible due to the quality of the scan.

SECTION 10-101-103
SECTION 10-101-104
SECTION 10-101-105

pending upon to produce clear sand free water year after year as long as they are not overpumped, i.e., they should be pumped at rates not in excess of 40 to 50 percent of the tested capacity of the aquifer.

Faint, mostly illegible text, possibly bleed-through from the reverse side of the page.

STATE OF MONTANA
DEPARTMENT OF WATER RESOURCES
A.C. 72
FILED A. HARDING
Deputy Clerk and Recorder
2-50

H-1387
205836
WELL REPORT
ODEAN J. & HELEN M. HUISING
TO THE PUBLIC

GW 2

Approved Stock Form—State Publishing Co., Helena, Montana—485.

File No.

MONTANA WATER RESOURCES BOARD
RECEIVED

T. 23 N R. 20 W

DUPLICATE

LOG

OCT 2 1968

County Lake

STATE OF MONTANA
ADMINISTRATOR OF GROUNDWATER CODE
STATE WATER CONSERVATION BOARD

Notice of Completion of Groundwater Appropriation by Means of Well

DEVELOPED AFTER JANUARY 1, 1962

(Under Chapter 237 Montana Session Laws, 1961, as amended)

Owner Gordon & Jean Kvande Address Box 1657 Polson, Mt.

Driller Gordon Kvande Address Box 1657 Polson, Mt.

Date of Notice of appropriation of groundwater.....

Date well started 6/1/68 Date completed 7/15/68

Type of well Drilled Equipment used Cable Drill
(Dug, driven, bored or drilled) (Churn drill, rotary or other)

Water use: Domestic Municipal Stock Irrigation
Industrial Drainage Other

Indicate on the diagram the character and thickness of the different strata met with in drilling, such as soil, clay, shale, gravel, rock or sand, etc. Show depth at which water is encountered, thickness and character of water-bearing strata and height to which the water rises in the well.

2
4
6
8
10
12
14
16
18
20
22
24
26
28
30
32
34
36
38
40
42
44
46
48
50
52
54
56
58
60
62
64
66
68
70
72
74
76
78
80
82
84

Top of Ground
(Elev. above sea level 2932)

-- Water rises to this level

Rock
Some water

Gravel

Show exact depth of bottom.

Size of Drilled Hole	Size and Weight of Casing	From (Feet)	To (Feet)	PERFORATIONS		
				Kind Size	From (Feet)	To (Feet)
6"	6" .219 Black Pipe	Ground Level	38.5	None	- - -	- - -

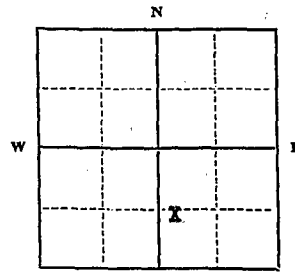

Static Water Level for non-flowing well 30 feet.

Shut-in Pressure for Flowing Well.....

Pumping Water Level..... 78.5 feet

at 6 (six) gal. per minute.

Discharge in gal. per min. of flowing well

How Tested..... Pumped

Length of Test..... 6 hours

So. $\frac{1}{2}$ of Tract 10 Part

of Lot 10 $\frac{1}{4}$ Sec. 29 T. 23 R. 20

Indicate location of well and place of use, if possible. Each small square represents 40 acres.

Remarks: (Gravel packing, cementing, packers, type of shutoff) All water

coming into the well is from cracks and seams in the rock

from 40 feet to 80 feet and

from gravel in the bottom of the well.

(Continue on reverse side)

USE—If used for irrigation, industrial, drainage or other. Explain, state number of acres and location or other data (i.e.: Lot, Block and Addition).

Driller's License Number

Gordon Kvande
Driller's Signature

45695

This form to be prepared by driller, and three copies to be filed by the owner with the County Clerk and Recorder in the county in which the well is located, tissue copy to be retained by driller.

Please answer all questions. If not applicable, so state, otherwise the form will be returned.

R- 1168

190562

GORDON & JEAN KVANDE

TO

THE PUBLIC

STATE OF MONTANA }
County of Lake } ss

Filed on the 30 day of Sept
A. D. 19 69 at 4:50 o'clock P M

ETHEL M. HARDING
County Clerk and Recorder
By J. J. Dentz
Deputy

2.00

STATE OF MONTANA
ADMINISTRATOR OF GROUNDWATER CODE
MONTANA WATER RESOURCES BOARD
**NOTICE OF COMPLETION OF GROUNDWATER
APPROPRIATION BY MEANS OF WELL**
Developed after January 1, 1962

(Under Chapter 237 Montana Session Laws, 1961, as amended)

This form to be prepared by driller, and three copies to be filed by the owner with the County Clerk and Recorder in the county in which the well is located, last copy to be retained by driller. Please answer all questions. If not applicable, so state, otherwise the form may be returned.

Owner Alvin M. Kay
Address Polson, Montana
Date well started 7/10/70
completed 7/22/70

For Administrator's Use	
File	<u>194828</u>
	<u>August 12, 1970</u>
	<u>2:45 P.M.</u>
GW 1	

Type of well Drilled
(Dug, driven, bored or drilled)
Equipment used Cable Tool
(Churn drill, rotary or other)
Water Use: Domestic Municipal Stock Irrigation
Industrial Drainage Other * Garden/Lawn

*Describe
USE: If used for irrigation, industrial, drainage or other. Explain, state number of acres and location or other data (i.e. Lot, Block and Addition).

ESTIMATED ANNUAL WITHDRAWAL

Size of Drilled Hole	Size and Weight of Casing	From (Feet)	To (Feet)	PERFORATIONS		
				Kind Size	From (Feet)	To (Feet)
6"	6" ID	41	224			
	19#					
	5" ID	220	285		220	285

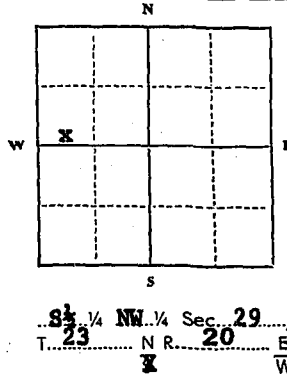

Static water level 30 ft.*
Pumping water level 200 ft.*
at 10 gallons per minute,
measured 240 minutes after pumping began.
*Measured from ground level.
Well developed by Bailing
for 4 hours.
Power..... Pump..... HP
Remarks: (Gravel packing, cementing, packers, type of shutoff)

INDICATE LOCATION OF WELL AND PLACE OF USE, IF POSSIBLE. EACH SMALL SQUARE REPRESENTS 40 ACRES.

Driller's Signature
Driller's Address Joe Johnson Drig. Terry, Mont.

LICENSE NO. 154

23N-20W 79
County LAKE

DRILLER'S LOG

Indicate the character, color, thickness of strata such as soil, clay, sand, gravel, shale, sandstone, etc. Show depth at which water is found and height to which water rises in well.

Top of Ground (Elev. above sea level) _____

From (Feet)	To (Feet)	
0	66	Tan Clay
66	78	Tan Clay & Chunks of Rock
78	81	Tan Clay - Fine Gravel 2 gpm silty water
81	96	Broken Tan Rock
		Hard & Soft Streaks
96	118	Hard Gray Clay & Gravel
118	156	Reddish Brown Clay and Gravel
156	178	Greenish Tan Clay and Gravel
178	221	Fractured Rock
221	256	Soft Tan & Green Fractured Rock
256	285	Tan Clay & Chunks of Rock

285' Show exact depth of bottom

47353

R- 1222

194828

Well Report

Alvin McKay

TO

The Public

STATE OF MONTANA } ss
County of Lake

Filed on the 12 day of August

A. D. 1970 at 3:45 o'clock P. M.

ETHEL M. HARDING

County Clerk and Recorder

By William Joseph
Deputy

File No.

T. 23N R. 20W

DUPLICATE

STATE OF MONTANA WATER RESOURCES BOARD

County Lake

LOG

NOV 18 1968

STATE OF MONTANA ADMINISTRATOR OF GROUNDWATER CODE OFFICE OF STATE ENGINEER

Top of Ground Approx. (Alley above sea level 2932')

Notice of Completion of Groundwater Appropriation by Means of Well DEVELOPED AFTER JANUARY 1, 1962

(Under Chapter 237, Montana Session Laws, 1961)

Formations Log:

- 0 - 68 Tan silty clay.
68 - 96 Tan silty clay. Some gravel mixed in.
96 - 101 Tan silty clay mixed with gravel. Seeps of water.
101 - 110 Broken green rock. Seeps of water.
110 - 126 Green and yellow rock in alternate layers. Seeps of water.
126 - 138 Hard gray rock.
138 - 141 Brown rock.
141 - 159 Hard gray rock.
159 - 199 Green and tan rock in alternate layer.
199 - 226 Hard gray-green rock.
226 - 227 Tan rock.
227 - 229 Hard gray-green rock.
229 - 230 Tan rock.
230 - 232 Gray-green rock.

Owner: Harry P. & Barbara W. Medland, Address: Polson, Montana
Driller: Liberty Drilling Co., Address: Missoula, Montana
Date of Notice of appropriation of groundwater: None filed
Date well started: 1/8/68 Date completed: 1/31/68
Type of well: Drilled Equipment used: Air Rotary
Water use: Domestic [checked] Municipal [] Stock [] Irrigation []

Indicate on the diagram the character and thickness of the different strata met with in drilling, such as soil, clay, shale, gravel, rock or sand, etc. Show depth at which water is encountered, thickness and character of water-bearing strata and height to which the water rises in the well.

Table with columns: Size of Drilled Hole, Size and Weight of Casing, From (Feet), To (Feet), PERFORATIONS (Kind Size, From (Feet), To (Feet)).

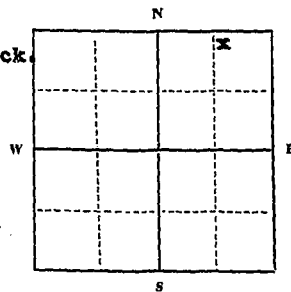

Static Water Level for non-flowing well: Free flow feet.
Shut-in Pressure for Flowing Well: 4#
Pumping Water Level: 135 feet at 40 gal. per minute.
Discharge in gal. per min. of flowing well: 4
How Tested: pump test
Length of Test: Four hour

Water rises in the well free flow 4 gpm

Lot 1 1/4 Sec. 29 T. 23N R. 20W
Indicate location of well and place of use, if possible. Each small square represents 40 acres.
Remarks: (Gravel packing, cementing, packers, type of shutoff) Most of the water flow is coming from fractures in the rock between 226 feet and 238 feet.

(Continue on reverse side)
USE--If used for irrigation, industrial, drainage or other. Explain, state number of acres and location or other data (i.e.: Lot, Block and Addition).

Approx. 0.73+ Acres

Show exact depth of bottom.

Bottom of hole 232'

This form to be prepared by driller, and three copies to be filed by the owner with the County Clerk and Recorder in the county in which the well is located, tissue copy to be retained by driller.

Please answer all questions. If not applicable, so state, otherwise the form will be returned.

52
Driller's License Number
William S. DeBorne
Driller's Signature.

44,767

R1131

786744

Well Report

Barbara N. Medland
Harry P. Medland

to
The Public

STATE OF MONTANA } ss
County of Lake
Filed on the 14 day of Nov
A. D. 1968 at 4:15 o'clock P M
ETHEL M. HARDING

County Clerk and Recorder
By Samuel Cowman
Deputy

Bix 66 3

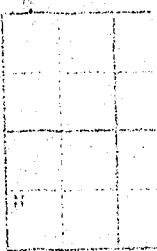

Optional form for the Department of
Internal Revenue Service
Form 706 (Rev. 6-6-64)

23N-20W
County Lake 29

STATE OF MONTANA
ADMINISTRATOR OF GROUNDWATER CODE
MONTANA WATER RESOURCES BOARD
**NOTICE OF COMPLETION OF GROUNDWATER
APPROPRIATION BY MEANS OF WELL**
Developed after January 1, 1962

RECEIVED
SEP 13 1971

DRILLER'S LOG
Indicate the character, color, thickness of strata such as soil, clay, sand, gravel, shale, sandstone, etc. Show depth at which water is found and height to which water rises in well.

(Under Chapter 237 Montana Session Laws, 1961, as amended)

This form to be prepared by driller, and three copies to be filed by the owner with the County Clerk and Recorder in the county in which the well is located, last copy to be retained by driller. Please answer all questions, so state, otherwise the form may be returned.

Owner Thalton Helen Myers

Address Box 711
Falcon Mont

Date well started 10/1/69
completed 10/3/69

Type of well DRILLED

Equipment used ROTARY

Water Use: Domestic Municipal Stock Irrigation
Industrial Drainage Other * Garden/Lawn

*Describe _____
USE: If used for irrigation, industrial, drainage or other. Explain, state number of acres and location or other data (i.e. Lot, Block and Addition). _____

ESTIMATED ANNUAL WITHDRAWAL _____

Size of Drilled Hole	Size and Weight of Casing	From (Feet)	To (Feet)	PERFORATIONS		
				Kind Size	From (Feet)	To (Feet)
7-7/8"	6" 10 18.97# FT.	0	40	NONE		
6"	4 1/2 OD 11 # FT.	30	107	SLOTS 1/8 x 6	86	107

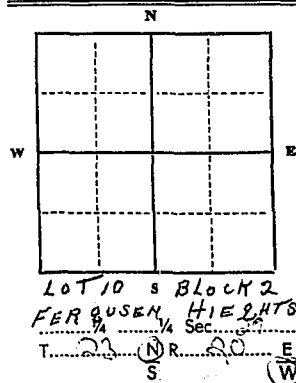

Static water level 50 ft.*
Pumping water level 6.62 ft.*
at 14 gallons per minute,
measured _____ minutes after pumping began.
*Measured from ground level.
Well developed by _____
for _____ hours.
Power _____ Pump _____ HP
Remarks: (Gravel packing, cementing, packers, type of shutoff) _____

INDICATE LOCATION OF WELL AND PLACE OF USE, IF POSSIBLE. EACH SMALL SQUARE REPRESENTS 40 ACRES.

Driller's Signature JOE JOHNSON
Driller's Address FERRY MONT.

LICENSE NO. 154

Top of Ground (Elev. above sea level)

From (Feet)	To (Feet)	Description
0	16	YELLOW SAND WITH BLUE ROULDERS
16	40	RED CRUMBLY ROCK
40	90	BLUE-GREEK SOLID ROCK
90	107	YELLOW FRACTURED ROCK

Show exact depth of bottom

49054

[Faint, illegible text, possibly bleed-through from the reverse side of the page]

R- 1289
#200073

WALTER & HELEN MYERS
TO
THE PUBLIC
WELL REPORT

STATE OF MONTANA } ss
County of Lake
Filed on this 10 day of Sept
A. D. 19 71 at 11:05 clock A.M.
EISEL M. HARDING
County Clerk and Recorder
By *[Signature]* Deputy



MONTANA WATER RESOURCES BOARD
RECEIVED

23N-20W 29
 County Lake

STATE OF MONTANA
 ADMINISTRATOR OF GROUNDWATER CODE NOV 23 1971
 MONTANA WATER RESOURCES BOARD

NOTICE OF COMPLETION OF GROUNDWATER APPROPRIATION BY MEANS OF WELL

Developed after January 1, 1962

(Under Chapter 237 Montana Session Laws, 1961, as amended)

This form to be prepared by driller, and three copies to be filed by the owner with the County Clerk and Recorder in the county in which the well is located, last copy to be retained by driller. Please answer all questions. If not applicable, so state, otherwise the form may be returned.

Owner Tony Nohejl
 Address West Shore
Polson, Montana 59860
 Date well started 6/30/71
 completed 6/30/71

For Administrator's Use	
File <u>21-157-71306</u>	<u>Nov. 19, 1971</u>
GW <u>1</u>	<u>4:30 P.M.</u>

Type of well Drilled
 (Dug, driven, bored or drilled)

Equipment used Air Rotary
 (Churn drill, rotary or other)

Water Use: Domestic Municipal Stock Irrigation
 Industrial Drainage Other * Garden/Lawn

*Describe _____
 USE: If used for irrigation, industrial, drainage or other. Explain, state number of acres and location or other data (i.e. Lot, Block and Addition).

ESTIMATED ANNUAL WITHDRAWAL 15,768,000

Size of Drilled Hole	Size and Weight of Casing	From (Feet)	To (Feet)	PERFORATIONS		
				Kind Size	From (Feet)	To (Feet)
8"	8 5/8" OD x 1/4"	+1'6"	77'4"	NONE		

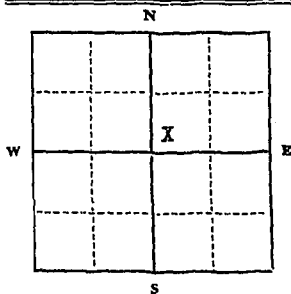

SW 1/4 NE 1/4 Sec 29
 T. 23 N R. 20

Static water level 22 ft.*
 Pumping water level 67 ft.*
 at 30 gallons per minute,
 measured 20 minutes after pumping began.
 *Measured from ground level.
 Well developed by Air Lift Pump
 for 2 hours.
 Power Diesel Pump 150 HP
 Remarks: (Gravel packing, cementing, packers, type of shutoff) Annulus around eight inch casing is filled with puddled clay to prevent seepage of surface and other

INDICATE LOCATION OF WELL AND PLACE OF USE, IF POSSIBLE. EACH SMALL SQUARE REPRESENTS 40 ACRES.

LIBERTY DRILLING COMPANY

Driller's Signature William J. Adams

Driller's Address 2500 Reserve

Missoula, Montana 59801 LICENSE NO. 52

DRILLER'S LOG

Indicate the character, color, thickness of strata such as soil, clay, sand, gravel, shale, sandstone, etc. Show depth at which water is found and height to which water rises in well.

Top of Ground Approx (Elev. above sea level) 3025'

From (Feet)	To (Feet)	
0	1	Topsoil
1	53 1/2	Tan clay
53 1/2	77	Tan clay with gravel mixed in
77	80	Clean gravel

80' Show exact depth of bottom
 Water rises in well 22' from surface.

STATE OF MONTANA
ADMINISTRATOR OF GROUNDWATER CODE
MONTANA WATER RESOURCES BOARD

JUN 25 1971

DRILLER'S LOG

Indicate the character, color, thickness of strata such as soil, clay, sand, gravel, shale, sandstone, etc. Show depth at which water is found and height to which water rises in well.

NOTICE OF COMPLETION OF GROUNDWATER APPROPRIATION BY MEANS OF WELL

Developed after January 1, 1962

(Under Chapter 237 Montana Session Laws, 1961, as amended)

This form to be prepared by driller, and three copies to be filed by the owner with the County Clerk and Recorder in the county in which the well is located, last copy to be retained by driller.

Please answer all questions. If not applicable, so state, otherwise the form may be returned.

Owner Homer G. & Jean A. Reed
Address Box 1263
Folsom, Montana
Date well started 5/24/71 completed 5/25/71
Type of well Drilled
Equipment used Air Rotary
Water Use: Domestic Municipal Stock Irrigation
Industrial Drainage Other * Garden/Lawn

For Administrator's Use
File P-1269 198999
June 24, 1971
2:14 PM
GW 1

Type of well Drilled (Dug, driven, bored or drilled)
Equipment used Air Rotary (Churn drill, rotary or other)
Water Use: Domestic Municipal Stock Irrigation
Industrial Drainage Other * Garden/Lawn

*Describe
USE: If used for irrigation, industrial, drainage or other. Explain, state number of acres and location or other data (i.e. Lot, Block

and Addition). Lot 9, Block 2, Ferguson Heights Dedicated Subdivision.

ESTIMATED ANNUAL WITHDRAWAL 7,000,000 gallons

Size of Drilled Hole	Size and Weight of Casing	From (Feet)	To (Feet)	PERFORATIONS		
				Kind Size	From (Feet)	To (Feet)
8"		0	158'			
6"	6 5/8" OD x 1/2"	1'9"	159'9"	Torch cut	118'	158'

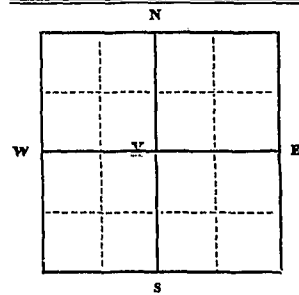

SEC. 1/4 COR. 1/4 Sec. 29
T. 23 N. R. 20 E.

Static water level 52 ft.*
Pumping water level 105 ft.
at 20 gallons per minute,
measured 120 minutes after pumping began.

*Measured from ground level.
Well developed by Air Lift
for 2 hours. Pump

Power Diesel Pump 150 HP
Remarks: (Gravel packing, cementing, packers, type of shutoff) Annular between six inch casing and eight inch hole is grouted with six sacks of cement.

INDICATE LOCATION OF WELL AND PLACE OF USE, IF POSSIBLE. EACH SMALL SQUARE REPRESENTS 40 ACRES.

LIBERTY DRILLING COMPANY
Driller's Signature William J. Colvine

Driller's Address 2500 Reserve Street

Missoula, Montana LICENSE NO. 52

Top of Ground (Elev. above sea level) 2970'

From (Feet)	To (Feet)	
0	1	Topsoil
1	16 1/2	Tan clay, gravel & cobbles
16 1/2	57	Green rock
57	83	Green fractured rock with stringers of tan
83	89	Green rock
89	104	Tan, brown and gray rock, broken with red clay in cracks & seams
104	107	Gray rock
107	115	Tan & green broken rock
115	126	Green rock
126	138	Green broken rock
138	138	Green rock

138 ft. Show exact depth of bottom water rises in well 52 ft. from surface.

48665

All water entering well through perforations in six inch casing.

Note: Wells in this area can be depended upon to produce clear sand free water year after year as long as they are not overpumped, i.e., they should be pumped at rates not in excess of 50 to 60 percent of the tested capacity of the aquifer.

R-1269

198999
WELL REPORT

HOMER G. & JEAN A. REED
TO

THE PUBLIC

STATE OF MONTANA }
County of Lake } ss

Filed on the 24 day of June
A. D. 19 11 at 2:15 o'clock PM

ETHEL M. HARDING
County Clerk and Recorder
By *Ethel M. Harding*
Deputy

NOV 29 1971

23N-20W
County Lake 30

STATE OF MONTANA
ADMINISTRATOR OF GROUNDWATER CODE
MONTANA WATER RESOURCES BOARD

NOTICE OF COMPLETION OF GROUNDWATER
APPROPRIATION BY MEANS OF WELL

Developed after January 1, 1962

(Under Chapter 237 Montana Session Laws, 1961, as amended)

This form to be prepared by driller, and three copies to be filed by the owner with the County Clerk and Recorder in the county in which the well is located, last copy to be retained by driller.

Please answer all questions. If not applicable, so state, otherwise the form may be returned.

Owner Wayne E. Rabin
Address Foleon, Montana
Date well started 1 Oct. / 71
completed 19 NOV. / 71

For Administrator's Use
File <u>201223</u>
<u>11-26-71</u>
<u>11:20 A.M.</u>
GW <u>1</u>

Type of well Drilled
(Dug, drives, bored or drilled)

Equipment used Churn drill
(Churn drill, rotary or other)

Water Use: Domestic Municipal Stock Irrigation
Industrial Drainage Other * Garden/Lawn

*Describe _____
USE: If used for irrigation, industrial, drainage or other. Explain, state number of acres and location or other data (i.e. Lot, Block and Addition).

ESTIMATED ANNUAL WITHDRAWAL 4,200,000

Size of Drilled Hole	Size and Weight of Casing	From (Feet)	To (Feet)	PERFORATIONS		
				Kind Size	From (Feet)	To (Feet)
6"	65/8 od 1 1/2 #	18"	132"	XXXX	XXXX	XXXX

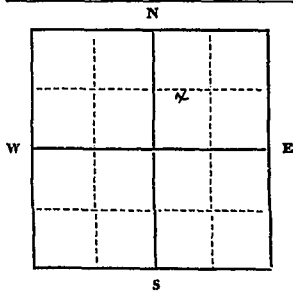

Static water level 1.0m ft.*
Pumping water level 20 ft.*
at 20 gallons per minute,
measured 120 minutes after pumping began.

*Measured from ground level.
Well developed by Railer
for 4 hours.
Power XXXX Pump XXXX HP
Remarks: (Gravel packing, cementing, packers, type of shutoff)

S.W. 1/4 N.E. 1/4 Sec. 30
T. 23 N. R. 20

1" free flow discharge
at ground level

INDICATE LOCATION OF WELL AND PLACE OF USE, IF POSSIBLE. EACH SMALL SQUARE REPRESENTS 40 ACRES.

Driller's Signature George O. Beebe

Driller's Address Box 17

Ravalli, Mont. LICENSE NO. 204

DRILLER'S LOG

Indicate the character, color, thickness of strata such as soil, clay, sand, gravel, shale, sandstone, etc. Show depth at which water is found and height to which water rises in well.

Top of Ground (Elev. above sea level)		
From (Feet)	To (Feet)	
0	4	tan clay
4	17	tan clay, streaks of gravel
17	19	clay & cobblestones
19	26	tan clay gravel mixed
26	30	sandy sand
30	36	sandy gray clay gravel
36	38	gray clay, white stones, pebbles
38	49	gray sandy clay
49	109	gray clay/fine gravel mixed
109	128	gray clay, streaks of gravel - seep of water
128	131	gray clay & gravel
131	132	clean gravel / water
132	??	gray clay

Show exact depth of bottom 132

R

1307

2013-23
WELL REPORT
WAYNE EVJEN

TO
THE PUBLIC

STATE OF MONTANA } ss
County of Lake

Filed on the 26 day of May

A D 1911 11:20 o'clock AM
ETHEL M. HARDING
County Clerk and Recorder

By [Signature]
200 Deputy

Third, where the law is applied, the...
leave to the courts to follow...
to the public.

ADDITION TO THE...
FOR THE STATE OF MONTANA...
BEFORE THE COMMISSIONER OF...
1911

23N-200W
39

RECEIVED

County: TARRANT

STATE OF MONTANA
ADMINISTRATOR OF GROUNDWATER CODE
MONTANA WATER RESOURCES BOARD

DEC 23 1971

DRILLER'S LOG

NOTICE OF COMPLETION OF GROUNDWATER APPROPRIATION BY MEANS OF WELL

MONTANA DEPARTMENT OF NATURAL RESOURCES AND CONSERVATION

Indicate the character, color, thickness of strata such as soil, clay, sand, gravel, shale, sandstone, etc. Show depth at which water is found and height to which water rises in well.

Developed after January 1, 1962

(Under Chapter 237 Montana Session Laws, 1961, as amended)

This form to be prepared by driller, and three copies to be filed by the owner with the County Clerk and Recorder in the county in which the well is located, last copy to be retained by driller. Please answer all questions. If not applicable, so state, otherwise the form may be returned.

Owner Geo. Johnson

Address Falsen, Mont.

Date well started 1 Dec. /71
completed 14 DEC.

R-1312
For Administrator's Use
File 201632
December 22, 1971
10:00 AM
GW 1

Type of well Drilled
(Dug, driven, bored or drilled)

Equipment used Starn drill
(Churn drill, rotary or other)

Water Use: Domestic Municipal Stock Irrigation
Industrial Drainage Other * Garden/Lawn

*Describe _____
USE: If used for irrigation, industrial, drainage or other. Explain, state number of acres and location or other data (i.e. Lot, Block and Addition).

ESTIMATED ANNUAL WITHDRAWAL 10,000,000

Size of Drilled Hole	Size and Weight of Casing	From (Feet)	To (Feet)	PERFORATIONS		
				Kind Size	From (Feet)	To (Feet)
6"	6 5/8 17'	2' up	124'	XXXXX	XXXXX	XXXXX

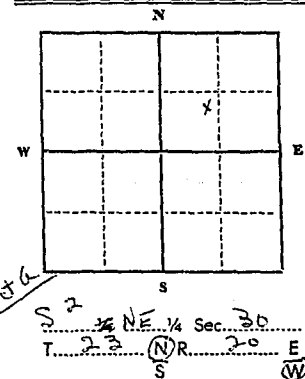

Static water level FLOW ft.*
Pumping water level FLOW ft.*
at 25 gallons per minute,
measured 16 minutes after pumping
began.
*Measured from ground level.
Well developed by Pailey
for 2 hours.
Power xxxx Pump xxx HP
Remarks: (Gravel packing, cementing,
packers, type of shutoff)

Top of Ground (Elev. above sea level)		
From (Feet)	To (Feet)	
0	5	Clay, topped
5	9	Boulders, cobblestones
9	11	tan clay
11	12	tan clay, & gravel
12	16	Boulders, cobblestones, tan clay
16	78	tan clay, coarse gravel
78	121	tan clay, fine gravel
121	123	sandy tan clay
123	124	gray gravel, coarse sand

INDICATE LOCATION OF WELL AND PLACE OF USE, IF POSSIBLE. EACH SMALL SQUARE REPRESENTS 40 ACRES.

Driller's Signature George P. Beebe
Driller's Address Box 47

Revelia, Mont. LICENSE NO. 204

124 Show exact depth of bottom

49630

R- 1312

2016
WELL REPORT

GENE JOHNSON

TO

THE PUBLIC

STATE OF MONTANA } ss
County of Lake

Filed on the 27 day of Dec.

A. D. 19 11 at 10:00 clock A.M.

ETHEL M. HARDING

Count, Clerk and Recorder

By David D. Brown
200 Deputy

Special Instructions:
Please submit all documents to the appropriate
county clerk for recording. If recording by other
party, the well is being recorded by other
party, the owner, operator, or other party, the
county clerk must be notified and the recording
fee must be paid.

--- The Groundwater
(For Informational Purposes Only) ---
No groundwaters shall be wasted
Code specifically states, "No groundwaters shall require all
without beneficial use. The administrator shall require all
wells producing waters which contaminate other waters
to be plugged or capped. He shall also require all
flowing wells to be so capped or equipped with valves
that the flow of water can be stopped when the
(over)

RECEIVED

Department of Natural Resources and Conservation
Resources Division
Engineering Bureau
Groundwater Section
Sam W. Mitchell Building
Helena, Montana 59601

Sent on
1/10/72

Owner Frene Johnson
Address Polson, Montana 59860
Location T. 23N, R. 20W Sec. 30
Doc. No. 201632, P-1312

As the Administrator of the Groundwater Code for the State of Montana, please take note of the following special instructions, in order to properly protect your groundwater right.

Special Instructions:

(For Informational Purposes Only) --- The Groundwater Code specifically states, "No groundwaters shall be wasted without beneficial use. The administrator shall require all wells producing waters which contaminate other waters to be plugged or capped. He shall also require all flowing wells to be so capped or equipped with valves that the flow of water can be stopped when the (OVER)

STATE OF CALIFORNIA
 COUNTY OF ...
 Filed on ...
 A.D. 19...

WATER RIGHTS ...
 ...
 ...

water is not being put to beneficial use. Likewise, both flowing and non-flowing wells shall be so constructed and maintained as to prevent the waste, contamination or pollution of groundwaters through leaky casings, pipes, fittings, valves, or pumps either above or below the land surface --- " except in certain necessary cases. (Section 89-2926 of the Groundwater Code.)

If your well is capped or valved and constructed properly to prevent waste and contamination, please disregard this notice.

STATE OF MONTANA
ADMINISTRATOR OF GROUNDWATER CODE
MONTANA WATER RESOURCES BOARD

MONTANA WATER RESOURCES BOARD
RECEIVED

23N-20W
County LAKE

DRILLER'S LOG

Indicate the character, color, thickness of strata such as soil, clay, sand, gravel, shale, sandstone, etc. Show depth at which water is found and height to which water rises in well.

NOV 19 1971

NOTICE OF COMPLETION OF GROUNDWATER APPROPRIATION BY MEANS OF WELL
Developed after January 1, 1962

(Under Chapter 237 Montana Session Laws, 1961, as amended)

This form to be prepared by driller, and three copies to be filed by the owner with the County Clerk and Recorder in the county in which the well is located, last copy to be retained by driller. Please answer all questions. If not applicable, so state, otherwise the form may be returned.

Owner Bernice Morrison

Address 333 1/2 Main
Polson, Mont.

Date well started 29 Sept.
completed 30 Sept.

For Administrator's Use	
File	<u>201085</u>
	<u>November 17, 1971</u>
	<u>2:15 P.M.</u>
GW 1	

Type of well Drilled

(Dug, driven, bored or drilled)

Equipment used Churn Drill

(Churn drill, rotary or other)

Water Use: Domestic Municipal Stock Irrigation
Industrial Drainage Other * Garden/Lawn

*Describe

USE: If used for irrigation, industrial, drainage or other. Explain, state number of acres and location or other data (i.e. Lot, Block and Addition).

ESTIMATED ANNUAL WITHDRAWAL 5,000

Size of Drilled Hole	Size and Weight of Casing	From (Feet)	To (Feet)	PERFORATIONS		
				Kind Size	From (Feet)	To (Feet)
<u>6"</u>	<u>65/8 od 17#</u>	<u>2' up</u>	<u>41</u>	<u>XXXX</u>	<u>XXXX</u>	<u>XXXX</u>

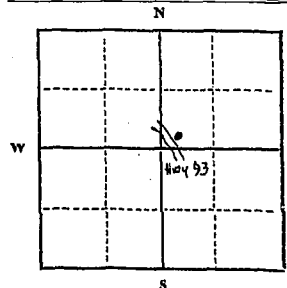

SW 1/4 NE 1/4 Sec. 30
T. 23 N. R. 20 W.

Static water level 1 ft.*
Pumping water level 35 ft.*
at 12 gallons per minute,
measured 60 minutes after pumping began.

*Measured from ground level.
Well developed by balls
for 4 hours.
Power None Pump None HP
Remarks: (Gravel packing, cementing, packers, type of shutoff)

Top of Ground (Elev. above sea level)		
From (Feet)	To (Feet)	
<u>0</u>	<u>1</u>	<u>top soil</u>
<u>1</u>	<u>28</u>	<u>tan clay w/ broken rock</u>
<u>28</u>	<u>33</u>	<u>tan clay & gravel</u>
<u>33</u>	<u>34</u>	<u>fine broken rock & gravel</u>
<u>34</u>	<u>39</u>	<u>tan clay thin streaks of gravel - some of water</u>
<u>39</u>	<u>41</u>	<u>clean gravel/ water</u>

INDICATE LOCATION OF WELL AND PLACE OF USE, IF POSSIBLE. EACH SMALL SQUARE REPRESENTS 40 ACRES.

Driller's Signature George O. Beebe

Driller's Address Box 147

Polson, Mont. LICENSE NO. 204

Show exact depth of bottom

R 1304
201085

**BERNICE BERNARD
MORSEMAN**

**TO
THE PUBLIC
WELL REPORT**

STATE OF MONTANA }
County of Lake } ss
Filed on the 17 day of Nov
A. D. 19 71 at 3:15 o'clock M
EHEL M. HARDING
County Clerk and Recorder
by Samuel Dentz
Deputy

201085
NOV 17 3 30 PM '71

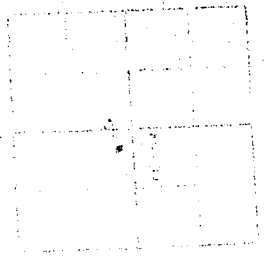

APPROVED AND FORWARDED:
RECORDED
INDEXED

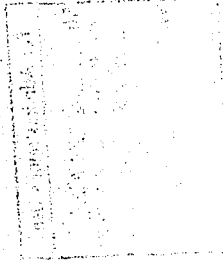

APPROVED AND FORWARDED:
RECORDED
INDEXED

208494

R- FF 1428

OBERT TU

TO

THE PUBLIC

WELL REPORT

STATE OF MONTANA }
County of Lake

Filed on the 16 day of March
A. D. 1973 at 4:25 o'clock P.M.

ETHEL M. HARDING

County Clerk and Recorder

By [Signature] Deputy

File No.

T. 23 N. R. 20 W.

30

DUPLICATE

County Lake

STATE OF MONTANA
ADMINISTRATOR OF GROUNDWATER CODE
OFFICE OF STATE ENGINEER

RECEIVED
JAN 6 1964

Declaration of Vested Groundwater Rights

(Under Chapter 237, Montana Session Laws, 1961)

STATE ENGINEER

1. WILLIAM G. WELCH and JEAN K. WELCH, of P. O. Box 1407 Polson
(Name of Appropriator) (Address) (Town)

County of Lake State of Montana
have appropriated groundwater according to the Montana laws in effect prior to January 1, 1962, as follows:

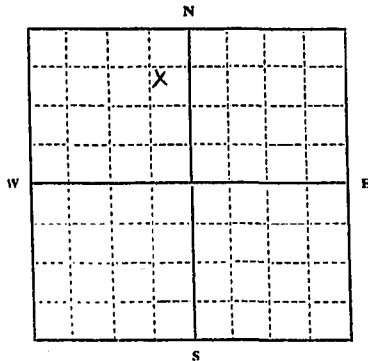

NE 1/4 NW 1/4 Sec 30 T 23 R 20

Indicate point of appropriation and place of use, if possible. Each small square represents 10 acres.

2. The beneficial use on which the claim is based stock water and sub irrigation

3. Date or approximate date of earliest beneficial use; and how continuous the use has been well, 1920; sub irrigation natural process; use continuous since 1920

4. The amount of groundwater claimed (in miner's inches or gallons per minute) well, 6 gallons per minute; sub irrigation, amount unknown.

5. If used for irrigation, give the acreage and description of the lands to which water has been applied and name of the owner thereof about 10 acres in NE 1/4 NW 1/4 sub irrigated

6. The means of withdrawing such water from the ground and the location of each well or other means of withdrawal well, bucket dip

7. The date of commencement and completion of the construction of the well, wells, or other works for withdrawal of groundwater 1920

8. The depth of water table about 1 foot

9. So far as it may be available, the type, size and depth of each well or the general specifications of any other works for the withdrawal of groundwater dug well 5 x 5 x 5 feet deep, rock lined

10. The estimated amount of groundwater withdrawn each year 15,000 gallons per year

11. The log of formations encountered in the drilling of each well if available not available

12. Such other information of a similar nature as may be useful in carrying out the policy of this act, including reference to book and page of any county record not applicable

Signature of Owner William G. Welch
Jean K. Welch
Date 12-31-63

Three copies to be filed by the owner with the County Clerk and Recorder of the county in which the well is located.

Please answer all questions. If not applicable, so state, otherwise the form will be returned.

Original to the County Clerk and Recorder; Duplicate to the State Engineer; Triplicate to the Montana Bureau of Mines and Geology, and Quadruplicate for the Appropriator.

R 764

163110

Water Report
Wm. H. + Jean K. Welch
to
The Public

STATE OF MONTANA
County of Lake.
Filed on the 31 day Dec
A. D. 1963 at 2:29 p.m. P
HAZEL KINNICK
County Clerk and Recorder
6 Cowman
Deeds

STATE OF MONTANA
ADMINISTRATOR OF GROUNDWATER CODE
MONTANA WATER RESOURCES BOARD

NOTICE OF COMPLETION OF GROUNDWATER
APPROPRIATION BY MEANS OF WELL

Developed after January 1, 1962

(Under Chapter 237 Montana Session Laws, 1961, as amended)

This form to be prepared by driller, and three copies to be filed by the owner with the County Clerk and Recorder in the county in which the well is located, last copy to be retained by driller.

Please answer all questions. If not applicable, so state, otherwise the form may be returned.

Owner JOHN A. CARPENTER
Carl Seifert

Address Polson, Montana

Date well started January 31, 1962
completed May 24, 1962

Type of well Drilled
(Dug, driven, bored or drilled)

Equipment used Churn
(Churn drill, rotary or other)

Water Use: Domestic Municipal Stock Irrigation
Industrial Drainage Other * Garden/Lawn

*Describe _____

USE: If used for irrigation, industrial, drainage or other. Explain, state number of acres and location or other data (i.e. Lot, Block and Addition). _____

ESTIMATED ANNUAL WITHDRAWAL

Size of Drilled Hole	Size and Weight of Casing	From (Feet)	To (Feet)	PERFORATIONS		
				Kind Size	From (Feet)	To (Feet)
6"	6" 17#	185	555	4" 1/2	185	555

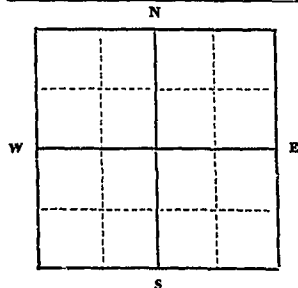

SW 1/4 NW 1/4 Sec. 30
T. 23 N. R. 20 E

INDICATE LOCATION OF WELL AND PLACE OF USE, IF POSSIBLE. EACH SMALL SQUARE REPRESENTS 40 ACRES.

Driller's Signature Emmitt O'Keefe
Driller's Address Polson, Montana

LICENSE NO. 700

4660-976LS
SEC 30 T 23 N R 20 W
County Lake 30

DRILLER'S LOG

Indicate the character, color, thickness of strata such as soil, clay, sand, gravel, shale, sandstone, etc. Show depth at which water is found and height to which water rises in well.

Top of Ground (Elev. above sea level)		
From (Feet)	To (Feet)	
0	84	Tan clay
84	96	Sand, stones, silt
96	164	Gravel, silt
164	191	Clay, gravel
191	239	Clay, gravel
239	240	Gravel, water 5 gal
240	481	Clay, gravel
481	504	Cemented gravel
504	520	Gravel, gray clay
520	530	Soft rock
530	595	Gray clay
595	640	Gray rock
640	690	Yellow rock
690	700	Hard, brown rock

Static water level 126 ft.*
Pumping water level 170 ft.*
at _____ gallons per minute,
measured 30 minutes after pumping
began.

*Measured from ground level.
Well developed by _____
for _____ hours.

Power _____ Pump _____ HP
Remarks (Gravel packing, cementing,
packers, type of shutoff) _____

700 Show exact depth of bottom

STATE OF MONTANA
ADMINISTRATOR OF GROUNDWATER CODE
MONTANA WATER RESOURCES BOARD

NOTICE OF COMPLETION OF GROUNDWATER
APPROPRIATION BY MEANS OF WELL

Developed after January 1, 1962

(Under Chapter 237 Montana Session Laws, 1961, as amended)

This form to be prepared by driller, and three copies to be filed by the owner with the County Clerk and Recorder in the county in which the well is located; last copy to be retained by driller. Please answer all questions. If not applicable, so state, otherwise the form may be returned.

Owner JOHN A. CARPENTER
Carl Seifert

Address Polson, Montana File _____

Date well started January 31, 1973

completed May 24, 1973

For Administrator's Use

Type of well Drilled
(Dug, driven, bored or drilled)

Equipment used Churn
(Churn drill, rotary or other)

Water Use: Domestic Municipal Stock Irrigation
Industrial Drainage Other * Garden/Lawn

*Describe _____
USE: If used for irrigation, industrial, drainage or other. Explain, state number of acres and location or other data (i.e. Lot, Block and Addition). _____

ESTIMATED ANNUAL WITHDRAWAL _____

Size of Drilled Hole	Size and Weight of Casing	From (Feet)	To (Feet)	PERFORATIONS		
				Kind Size	From (Feet)	To (Feet)
6"	6" 17#	189	553	1" plastic	466	655

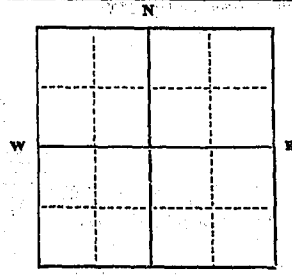

Static water level 126 ft.*
Pumping water level 6 ft.*
at 12 gallons per minute,
measured 30 minutes after pumping
began.
*Measured from ground level.
Well developed by all
for _____ hours.
Power _____ Pump _____ HP
Remarks: (Gravel packing, cementing,
packers, type of shutoff) _____

SW 1/4 NW 1/4 Sec. 30
T. 23 N. R. 20 E.

INDICATE LOCATION OF WELL AND PLACE OF USE, IF POSSIBLE. EACH SMALL SQUARE REPRESENTS 40 ACRES.

Driller's Signature Samuel O'Keefe
Driller's Address Polson, Montana

4660-97645
SEC 30 T23N R20W
County: Lake

DRILLER'S LOG

Indicate the character, color, thickness of strata such as soil, clay, sand, gravel, shale, sandstone, etc. Show depth at which water is found and height to which water rises in well.

Top of Ground (Elev. above sea level)		
From (Feet)	To (Feet)	
0	84	Tan clay
84	96	Sand, stone, silt
96	164	Gravel, silt
164	191	Clay, gravel
191	239	Clay, gravel
239	240	Gravel, water 3 gal
240	481	Clay, gravel
481	504	Cemented gravel
504	520	Gravel, gray clay
520	530	Soft rock
530	595	Gray clay
595	640	Gray rock
640	690	Yellow rock
690	700	Hard, brown rock

STATE OF MONTANA,

County of

Lake

} ss.

Carl Seifert

having first been duly sworn, depose S and

say S that he is of lawful age and is the appropriator

and claimant of the order and water right mentioned in the foregoing notice of

completion of groundwater appropriation by means of well and the person whose name

is subscribed thereto, as the appropriator and claimant,

that he know S the contents of said foregoing notice and that the matters and things

therein stated are true.

Carl Seifert

Subscribed and sworn to before me, this 20th day of March, 1974

Ethel M. Harding
Notary Public for the State of Montana.

Residing at Salmon, Montana

My Commission expires Sept. 10, 1974

GW.

Approved Stock Form—State Publishing Co., Helena, Montana—42234

31

File No.

T. 23^N R. 20^W

DUPLICATE

County Lake

STATE OF MONTANA
ADMINISTRATOR OF GROUNDWATER CODE
OFFICE OF STATE ENGINEER

RECEIVED
JAN 6 1964

Declaration of Vested Groundwater Rights
(Under Chapter 237, Montana Session Laws, 1961) STATE ENGINEER

1. Ralph R. Tower of Polson
(Name of Appropriator) (Address) (Town)
County of Lake State of Montana
have appropriated groundwater according to the Montana laws in effect prior to January 1, 1962, as follows:

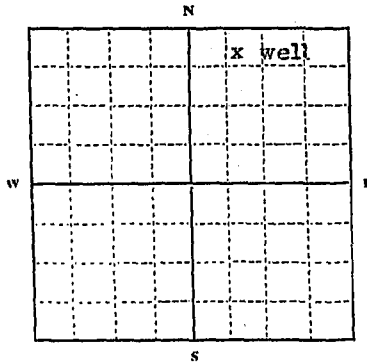

NW 1/4 NE 1/4 Sec. 31 T. 23 R. 20

Indicate point of appropriation and place of use, if possible. Each small square represents 10 acres.

2. The beneficial use on which the claim is based stockwater and domestic
3. Date or approximate date of earliest beneficial use; and how continuous the use has been 1955
4. The amount of groundwater claimed (in miner's inches or gallons per minute) 10 gallons per minute
5. If used for irrigation, give the acreage and description of the lands to which water has been applied and name of the owner thereof
6. The means of withdrawing such water from the ground and the location of each well or other means of withdrawal electric pump

7. The date of commencement and completion of the construction of the well, wells, or other works for withdrawal of groundwater 1955
8. The depth of water table fifty feet
9. So far as it may be available, the type, size and depth of each well or the general specifications of any other works for the withdrawal of groundwater 100 feet in depth
10. The estimated amount of groundwater withdrawn each year 2,000 gallons per day
11. The log of formations encountered in the drilling of each well if available
12. Such other information of a similar nature as may be useful in carrying out the policy of this act, including reference to book and page of any county record

Signature of Owner Ralph R. Tower
Date December 31, 1963

Three copies to be filed by the owner with the County Clerk and Recorder of the county in which the well is located.

Please answer all questions. If not applicable, so state, otherwise the form will be returned.

Original to the County Clerk and Recorder; Duplicate to the State Engineer; Triplicate to the Montana Bureau of Mines and Geology, and Quadruplicate for the Appropriator.

24197

R-696

163037

Ralph R. Jones

STATE OF MONTANA

County of Lake

Filed on the 31 day of Dec

A. D. 1963 at 9:29 o'clock A.M.

HAZEL KINNICE

County Clerk and Recorder

By M Kraus

FA 200

Deputy

File No.

T. 23^N R. 20^W

DUPLICATE

County Lake

STATE OF MONTANA
ADMINISTRATOR OF GROUNDWATER CODE
OFFICE OF STATE ENGINEER

RECEIVED
DEC 26 1963

Declaration of Vested Groundwater Rights

(Under Chapter 237, Montana Session Laws, 1961)

STATE ENGINEER

1. Cyril and Vera Eid, of Shore Line Route Polson
(Name of Appropriator) (Address) (Town)
County of Lake State of Montana
have appropriated groundwater according to the Montana laws in effect prior to January 1, 1962, as follows:

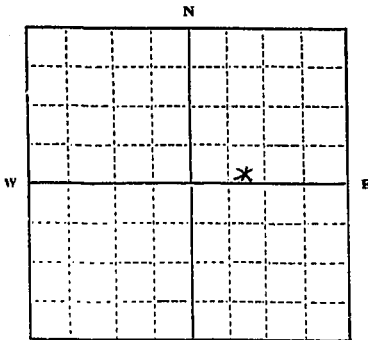

Tr. 30 inches

SE 1/4 NW 1/4 32 T 230R 20W

Indicate point of appropriation and place of use, if possible. Each small square represents 10 acres.

- 2. The beneficial use on which the claim is based Household
- 3. Date or approximate date of earliest beneficial use; and how continuous the use has been 11 years constantly
- 4. The amount of groundwater claimed (in miner's inches or gallons per minute)
- 5. If used for irrigation, give the acreage and description of the lands to which water has been applied and name of the owner thereof None
- 6. The means of withdrawing such water from the ground and the location of each well or other means of withdrawal electric pump
- 7. The date of commencement and completion of the construction of the well, wells, or other works for withdrawal of groundwater.....
- 8. The depth of water table.....
- 9. So far as it may be available, the type, size and depth of each well or the general specifications of any other works for the withdrawal of groundwater 6 inch casing 55 ft. deep
- 10. The estimated amount of groundwater withdrawn each year 19 thousand gallon
- 11. The log of formations encountered in the drilling of each well if available.....
- 12. Such other information of a similar nature as may be useful in carrying out the policy of this act, including reference to book and page of any county record.....

Signature of Owner Cyril Eid
Vera B. Eid
Date Dec 20 1963

Three copies to be filed by the owner with the County Clerk and Recorder of the county in which the well is located.

Please answer all questions. If not applicable, so state, otherwise the form will be returned.

Original to the County Clerk and Recorder; Duplicate to the State Engineer; Triplicate to the Montana Bureau of Mines and Geology, and Quadruplicate for the Appropriator.

R 418

162656

Water Report

Cyril J Bid

Verab Bid

to

The Public

STATE OF MONTANA

County of Lake,

Filed on the 20 day of Dec

A. D. 1963 at 2:25 o'clock P. M.

HAZEL KINNICK

County Clerk and Recorder

By G. Lewman

200

Deputy

RECEIVED

23N-20W
County, Leira 32

APR 11 1973

DRILLER'S LOG

STATE OF MONTANA
ADMINISTRATOR OF GROUNDWATER CODE
MONTANA WATER RESOURCES BOARD
**NOTICE OF COMPLETION OF GROUNDWATER
APPROPRIATION BY MEANS OF WELL**

Developed after January 1, 1962

(Under Chapter 237 Montana Session Laws, 1961, as amended)

This form to be prepared by driller, and three copies to be filed by the owner with the County Clerk and Recorder in the county in which the well is located, last copy to be retained by driller. Please answer all questions. If not applicable, so state, otherwise the form may be returned.

Indicate the character, color, thickness of strata such as soil, clay, sand, gravel, shale, sandstone, etc. Show depth at which water is found and height to which water rises in well.

Top of Ground (Elev. above sea level)

From (Feet)	To (Feet)	Character
0	90	Clay & Rock
90	105	Rock

Owner Donald Groves
Address West Shore
Polson, Montana
Date well started Oct. 9, 72
completed Oct. 9, 72
Type of well Drilled
Equipment used Rotary
Water Use: Domestic Municipal Stock Irrigation
Industrial Drainage Other Garden/Lawn

For Administrator's Use
File 208911, R.1436
April 16, 1973
GW 12:25 p.m.

ESTIMATED ANNUAL WITHDRAWAL

Size of Drilled Hole	Size and Weight of Casing	From (Feet)	To (Feet)	PERFORATIONS		
				Kind Size	From (Feet)	To (Feet)
6"	6" ID 17#	0	90	None		

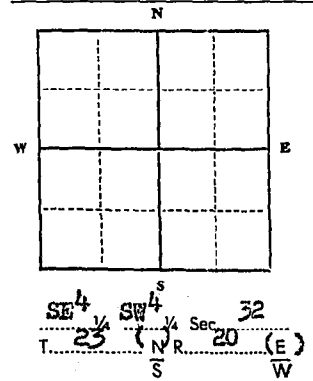

Static water level 65 ft.*
Pumping water level 80 ft.*
at 20 gallons per minute,
measured 30 minutes after pumping
began.
*Measured from ground level.
Well developed by Air
for 2 hours.
Power..... Pump..... HP
Remarks: (Gravel packing, cementing,
packers, type of shut-off)

INDICATE LOCATION OF WELL AND PLACE OF USE, IF POSSIBLE. EACH SMALL SQUARE REPRESENTS 40 ACRES.

Driller's Signature G. M. O'Keefe
Driller's Address Polson, Montana
LICENSE NO. 8

Show exact depth of bottom