

R234

161157

Water Report
C. R. Rathbone
to
The Public

STATE OF MONTANA

County of Lake,

Filed on the 13 day of Sept

A. D. 1963 at 2:50 o'clock P. M.

HAZEL KINNICK

County Clerk and Recorder

M. Kraus

Deputy

80
\$ 200

RECEIVED

25N-19W

29

GW 3 Revised 1969
2037-1500-1/71 JUN 28 1973

County Lake

STATE OF MONTANA
MONTANA DEPARTMENT OF NATURAL RESOURCES AND CONSERVATION
ADMINISTRATOR OF GROUNDWATER CODE
MONTANA WATER RESOURCES BOARD

NOTICE OF COMPLETION OF GROUNDWATER APPROPRIATION WITHOUT WELL

Developed After January 1, 1962

(Under Chapter 237, Montana Session Laws, 1961, as amended)

This form to be prepared by contractor (if any), otherwise by the owner.

Three copies of this notice are to be filed with the County Clerk and Recorder of the county in which the works are located.

Please answer all questions. If not applicable, so state, otherwise the form may be returned.

For Administrator's Use	
File	<u>1493</u>
	<u>?</u>
GW 1	<u>?</u>

Owner R & H Best Farms, Inc., Richard J. Best

Address East Lakeshore Bigfork, Montana

Contractor (if any) NONE

Address of Contractor NONE

Date Started 1946 Date Completed 1946

1. Describe means of obtaining groundwater (as by sub-irrigation, developed spring, drains, etc.) spring

Lot 3 - North 330' of
South 660' in Sec. 20
Twn. 25 R 19 N

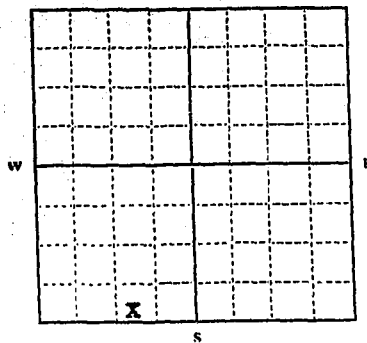

S. 1/4 W. 1/4 Sec. 20

T. 25 N R. 19 E

INDICATE POINT OF APPROPRIATION AND PLACE OF USE, IF POSSIBLE.

Elevation of spring, if known or estimated S.E. quarter and N.W. quarter

2. Means of withdrawing water (gravity, pump, canal, etc.) NONE

3. Depth of water table unknown

4. Use of the water drinking, fire prevention, water for use by cherry pickers (showers & drinking) irrigation of lawn and garden.

5. Amount of groundwater claimed (in miner's inches or gallons per minute) 10" or 100 gal/min.

6. If used for irrigation, give number of acres and description of land 3 acres of land (grass, garden and timber).

7. Estimate amount of water used each year 50,000 gal.

8. Months of year spring flows all year

Signature of Owner Richard J. Best

Date

54639

File No. _____

T. 25^N R. 19^W

DUPLICATE

County _____

STATE OF MONTANA
ADMINISTRATOR OF GROUNDWATER CODE
OFFICE OF STATE ENGINEER

RECEIVED
JAN 6 1964

Declaration of Vested Groundwater Rights

(Under Chapter 237, Montana Session Laws, 1961)

STATE ENGINEER

HELIA STEPHENS

1. SAMUEL L. STEPHENS, of FAST SHORE, BIG FORK
(Name of Appropriator) (Address) (Town)

County of LAKE State of MONTANA
have appropriated groundwater according to the Montana laws in effect prior to January 1, 1962, as follows:

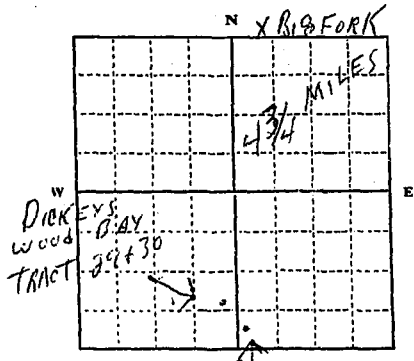

SW 1/4 NW 1/4 Sec. 20 T. 25^N R. 19

Indicate point of appropriation and place of use, if possible. Each small square represents 10 acres.

- The beneficial use on which the claim is based. House Hold And XARD IRRIGATION USE
- Date or approximate date of earliest beneficial use; and how continuous the use has been. 1943 (BOTH PLACES)
- The amount of groundwater claimed (in miner's inches or gallons per minute). 10 BARRELS PER MINUTE (BOTH PLACES)
- If used for irrigation, give the acreage and description of the lands to which water has been applied and name of the owner thereof. XARD ONLY (BOTH PLACES)
- The means of withdrawing such water from the ground and the location of each well or other means of withdrawal. JET TYPE PUMP BOTH PLACES

- The date of commencement and completion of the construction of the well, wells, or other works for withdrawal of groundwater. 1943 BOTH PLACES
- The depth of water table. 1.7 FEET FROM PUMP (WATER LEVEL) BOTH PLACES
- So far as it may be available, the type, size and depth of each well or the general specifications of any other works for the withdrawal of groundwater. DICK EYS WOOD BAY TRACTS 29430 40' OF 6" CASING DRILLED WELL PLACE EAST OF MONTANA 35 51' OF 8" CASING DRILLED WELL
- The estimated amount of groundwater withdrawn each year. 100,000 PER YEAR (EACH PLACE)
- The log of formations encountered in the drilling of each well if available. NAME

12. Such other information of a similar nature as may be useful in carrying out the policy of this act, including reference to book and page of any county record. DICK EYS WOOD BAY TRACTS 29430 1963 BOOK 3 PAGE 31 LINE 3 WELL EAST OF MONTANA 35 1962 12 2 4 11 2 11

Signature of Owner. Samuel L. Stephens Helia Stephens
Date. 1-31-63

Three copies to be filed by the owner with the County Clerk and Recorder of the county in which the well is located.
Please answer all questions. If not applicable, so state, otherwise the form will be returned.

Original to the County Clerk and Recorder; Duplicate to the State Engineer; Triplicate to the Montana Bureau of Mines and Geology, and Quadruplicate for the Appropriator.

24351

851

163199

Ramuel L. Adelia Stephens

STATE OF MONTANA

County of Lake,

Filed on the 31 day of Dec

A. D. 1963 at 5:24 o'clock P. M.

County Clerk and Recorder

By M. Kraus

Deputy

200

20

File No.

T. 25th R. 19th

DUPLICATE

County

STATE OF MONTANA
ADMINISTRATOR OF GROUNDWATER CODE
OFFICE OF STATE ENGINEER

R JAN 2 1964 D
STATE ENGINEER

Declaration of Vested Groundwater Rights

(Under Chapter 237, Montana Session Laws, 1961)

I, J. W. Symonds, of Bigfork,
(Name of Appropriator) (Address) (Town)
County of Lake State of Montana
have appropriated groundwater according to the Montana laws in effect prior to January 1, 1962, as follows:

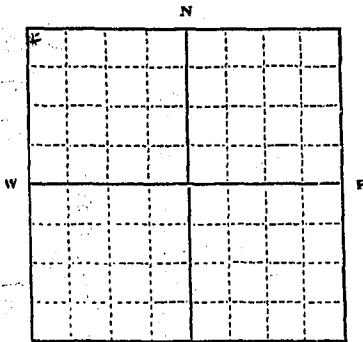

TR. 2E in Lot 3, NO. 330' 20-25-19

1/4 Sec. T. R.

Indicate point of appropriation and place of use, if possible. Each small square represents 10 acres.

2. The beneficial use on which the claim is based Domestic

3. Date or approximate date of earliest beneficial use; and how continuous the use has been 1952 - two months in summer only

4. The amount of groundwater claimed (in miner's inches or gallons per minute) Maximum of 10 gallons per minute

5. If used for irrigation, give the acreage and description of the lands to which water has been applied and name of the owner thereof None

6. The means of withdrawing such water from the ground and the location of each well or other means of withdrawal 1/2 H.P. deep well pump

7. The date of commencement and completion of the construction of the well, wells, or other works for withdrawal of groundwater 1952

8. The depth of water table 56 feet

9. So far as it may be available, the type, size and depth of each well or the general specifications of any other works for the withdrawal of groundwater One well 8" size, 80' deep

10. The estimated amount of groundwater withdrawn each year 30,000 gallons

11. The log of formations encountered in the drilling of each well if available Not available

12. Such other information of a similar nature as may be useful in carrying out the policy of this act, including reference to book and page of any county record

Signature of Owner J. W. Symonds

Date December 24, 1963

Three copies to be filed by the owner with the County Clerk and Recorder of the county in which the well is located.

Please answer all questions. If not applicable, so state, otherwise the form will be returned.

Original to the County Clerk and Recorder; Duplicate to the State Engineer; Triplicate to the Montana Bureau of Mines and Geology, and Quadruplicate for the Appropriator.

17478

R-671 163008
Water Report
J. W. Symonds
To
The Public

STATE OF MONTANA
County of Lake,
Filed on the 31 day of Dec
A. D. 1908 at 5:20 o'clock P. M.
J. W. Symonds
County Clerk and Recorder

Ry _____ Debts

GWS

File No.

T. 25^N R. 19

DUPLICATE

County Lake

STATE OF MONTANA
ADMINISTRATOR OF GROUNDWATER CODE
OFFICE OF STATE ENGINEER

RECEIVED
DEC 26 1963

STATE ENGINEER

Notice of Completion of Groundwater Appropriation Without Well

(Under Chapter 237 Montana Session Laws, 1961)

Date of Appropriation of Groundwater June, 1961

Owner Lillian K. Symonds Address East Shore, Bigfork, Montana

Contractor (if any) None

Address of Contractor

Date Started June, 1961 Date Completed June, 1961

Describe means of obtaining groundwater without a well "as by sub-irrigation and other natural processes". Include depth to water when applicable. electric pump takes water from Flathead Lake after water is captured in 36' metal road tile or culvert.

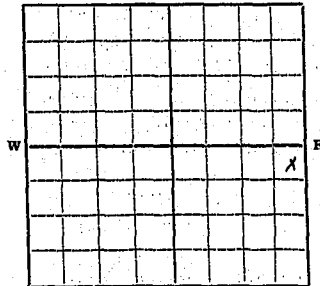

S. 330' of North 660' of
ME4 NE4 1/4 Sec. 20 T. 25. R. 19.

Indicate point of appropriation and place of use, if possible.

Quantity of water developed and used with explanation of method used to measure or estimate such amount. If use is intermittent estimate approximate lengths of periods of use

4000 gallons per minute used approximately 20 days each year.

Signature of Owner Lillian K. Symonds

Date December 17, 1963

This form to be prepared by contractor (if any), otherwise by the owner.

Three copies of this notice are to be filed with the County Clerk and Recorder of the county in which the works are located.

Please answer all questions. If not applicable, so state, otherwise the form will be returned.

Original to the County Clerk and Recorder; duplicate to the State Engineer; Triplicate to the School of Mines and Quadruplicate for the Appropriator.

12203

R 423

162666

Lillian K. Symonds
to
The Public

Lillian K. Symonds, East Shore, Bigfork, Montana
February 26, 1964

STATE OF MONTANA
County of Lake
Filed on the 20 day of Dec
A. D. 1963 at 4:04 o'clock P. M.
HAZEL KENNICK
County Clerk and Recorder
By E. Cowman
200 Deputy

December 20, 1963

Lillian K. Symonds, East Shore, Bigfork, Montana

February 26, 1964

December 20, 1963

162666

from Flathead Lake.

20

File No.

T. 25^N R. 19^W

DUPLICATE

County Lake

STATE OF MONTANA
ADMINISTRATOR OF GROUNDWATER CODE
OFFICE OF STATE ENGINEER

RECEIVED
DEC 26 1963

Declaration of Vested Groundwater Rights

(Under Chapter 237, Montana Session Laws, 1961)

STATE ENGINEER

I, Lillian K. Symond, of East Lake Shore Bigfork
(Name of Appropriator) (Address) (Town)

County of Lake State of Montana

have appropriated groundwater according to the Montana laws in effect prior to January 1, 1962, as follows:

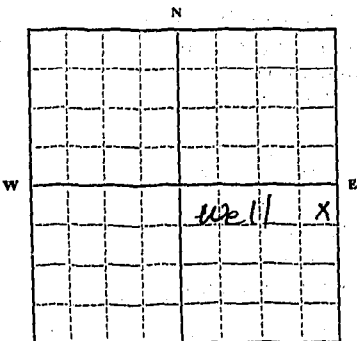

So. 330' of N. 660' of Lot 3
NE 1/4 SE 1/4 Sec. 20 T. 25 R. 19

Indicate point of appropriation and place of use, if possible. Each small square represents 10 acres.

- The beneficial use on which the claim is based. domestic
- Date or approximate date of earliest beneficial use; and how continuous the use has been. October, 1946
Continuous use
- The amount of groundwater claimed (in miner's inches or gallons per minute). 650 gallons per minute
- If used for irrigation, give the acreage and description of the lands to which water has been applied and name of the owner thereof. modest lawn and garden
- The means of withdrawing such water from the ground and the location of each well or other means of withdrawal. electric pump in cased well, see plat

7. The date of commencement and completion of the construction of the well, wells, or other works for withdrawal of groundwater. October, 1946

8. The depth of water table. 55'

9. So far as it may be available, the type, size and depth of each well or the general specifications of any other works for the withdrawal of groundwater. well 58 feet in depth and metal cased

10. The estimated amount of groundwater withdrawn each year. 1,200,000 gallons

11. The log of formations encountered in the drilling of each well if available. not available

12. Such other information of a similar nature as may be useful in carrying out the policy of this act, including reference to book and page of any county record.

Signature of Owner Lillian K. Symonds
Date December 17, 1963

Three copies to be filed by the owner with the County Clerk and Recorder of the county in which the well is located.

Please answer all questions. If not applicable, so state, otherwise the form will be returned.

Original to the County Clerk and Recorder; duplicate to the State Engineer; Triplicate to the Montana Bureau of Mines and Geology, and Quadruplicate for the Appropriator.

12201

R 421

162664

Lillian K. Symonds

to

The Public

STATE OF MONTANA

County of Lake,

Filed on the 20 day of Dec

A. D. 1963 at 4:00 o'clock P M

HAZEL KINNAIR

County Clerk and Recorder

By S. Cowman

200

Deputy

21

File No.

T. 25^N R. 19^W

DUPLICATE

County LAKE

STATE OF MONTANA
ADMINISTRATOR OF GROUNDWATER CODE
OFFICE OF STATE ENGINEER

DEC 30 1963

Declaration of Vested Groundwater Rights

(Under Chapter 237, Montana Session Laws, 1961)

STATE ENGINEER

1. Nellie A. Clark
(Name of Appropriator)

of East Lake Shore Bigfork
(Address) (Town)

County of LAKE

State of MONTANA

have appropriated groundwater according to the Montana laws in effect prior to January 1, 1962, as follows:

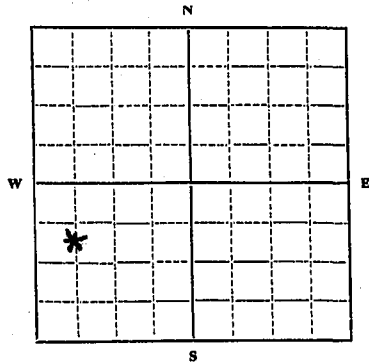

SW 1/4 SW 1/4 Sec 21 T 25 R 19

Indicate point of appropriation and place of use, if possible. Each small square represents 10 acres.

2. The beneficial use on which the claim is based Household IRRIGATION & STOCKS

3. Date or approximate date of earliest beneficial use; and how continuous the use has been JUNE 1923

4. The amount of groundwater claimed (in miner's inches or gallons per minute) 1000 GAL PER MINUTE

5. If used for irrigation, give the acreage and description of the lands to which water has been applied and name of the owner thereof 10 ACRES OF ORCHARD LAND NELLIE A. CLARK

6. The means of withdrawing such water from the ground and the location of each well or other means of withdrawal 400 GAL PUMP

7. The date of commencement and completion of the construction of the well, wells, or other works for withdrawal of groundwater 1923

8. The depth of water table 6 ft.

9. So far as it may be available, the type, size and depth of each well or the general specifications of any other works for the withdrawal of groundwater 6 ft. ACROST. 12 ft. DEEP

10. The estimated amount of groundwater withdrawn each year AT LEAST 1/2 MILLION GAL

11. The log of formations encountered in the drilling of each well if available NOT AVAILABLE

12. Such other information of a similar nature as may be useful in carrying out the policy of this act, including reference to book and page of any county record NONE

Signature of Owner Nellie A. Clark

Date 12-27-63

Three copies to be filed by the owner with the County Clerk and Recorder of the county in which the well is located.

Please answer all questions. If not applicable, so state, otherwise the form will be returned.

Original to the County Clerk and Recorder; duplicate to the State Engineer; Triplicate to the Montana Bureau of Mines and Geology, and Quadruplicate for the Appropriator.

R-545

162860

State Report
Nellie Q. Clark
to
The Public

STATE OF MONTANA

County of Lake.

Filed on the 27 day of Dec
A.D. 1963 at 3:34 o'clock P.M.

[Signature]
County Clerk and Recorder

By

Deputy

200

WERTMAN

[Faint, mostly illegible text, possibly bleed-through from the reverse side of the document]

21

File No. _____

T. 25 R. 19

DUPLICATE

County Kato

STATE OF MONTANA
ADMINISTRATOR OF GROUNDWATER CODE
OFFICE OF STATE ENGINEER

RECEIVED
MAY 14 1962

Declaration of Vested Groundwater Rights STATE ENGINEER
(Under Chapter 237, Montana Session Laws, 1961)

1. John H. & Insa O. Gaines of East Kato Shore, Bigfork
(Name of Appropriator) (Address) (Town)

County of Kato State of Montana

have appropriated groundwater according to the Montana laws in effect prior to January 1, 1962, as follows:

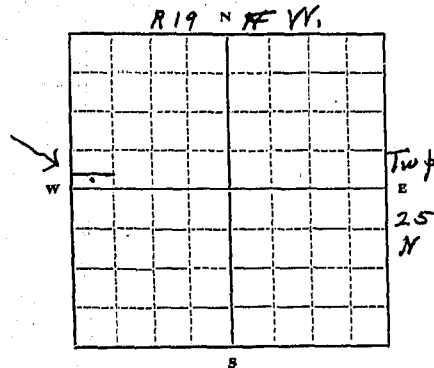

S.W. 1/4 Sec. 21 T. 25 R. 19

Indicate point of appropriation and place of use, if possible. Each small square represents 10 acres.

2. The beneficial use on which the claim is based Household, lawn & garden

3. Date or approximate date of earliest beneficial use; and how continuous the use has been Oct. 20, 1961, drilled. Has been used daily since

4. The amount of groundwater claimed (in miner's inches or gallons per minute) 7 (seven) gallons per min.

5. If used for irrigation, give the acreage and description of the lands to which water has been applied and name of the owner thereof

6. The means of withdrawing such water from the ground and the location of each well or other means of withdrawal jet pump located in basement of home about 15 ft. from well.

7. The date of commencement and completion of the construction of the well, wells, or other works for withdrawal of groundwater started drilling Oct. 17, 1961, completed Oct. 20, 1961, pump & machinery installed Nov. 8 - 1961.

8. The depth of water table static water level 43 ft from bott. of casing.

9. So far as it may be available, the type, size and depth of each well or the general specifications of any other works for the withdrawal of groundwater. Depth of well 73 ft. Drilled with churn drill, using 7" O.D. casing, 23 lbs. per foot from 0 to 73 feet. No screen used, no perforations. Pumping level 43 ft from bottom of casing at 420 G.P.H.

10. The estimated amount of groundwater withdrawn each year 800 barrels.

11. The log of formations encountered in the drilling of each well if available. 0 to 51 ft. shale rock and clay. Trace of gravel. 51 to 73 ft. Shattered bedrock with gouge.

12. Such other information of a similar nature as may be useful in carrying out the policy of this act, including reference to book and page of any county record. Drilled by Olson & Justin, Columbia Falls, Mont. Pumping machinery & pipe purchased from and installed by Flathead Electric Service, Polson, Mont.

Signature of Owner John Harry Gaines

Date May 10, 1962

Three copies to be filed by the owner with the County Clerk and Recorder of the county in which the well is located.

Please answer all questions. If not applicable, so state, otherwise the form will be returned.

Original to the County Clerk and Recorder; duplicate to the State Engineer; Triplicate to the Montana Bureau of Mines and Geology, and Quadruplicate for the Appropriator.

R-86 154969

Water Well Log

John Harry Gines
to

The Public

STATE OF MONTANA

County of Lake

Filed on the 10 day of May

A. D. 1967 at 1:35 o'clock A.M.

HAZEL KINNICK

County Clerk and Recorder

By M. Kraus

Deputy

200

GW 2

Approved Stock Form—State Publishing Co., Helena, Montana—390.

File No. _____

T. 25 R. 19

DUPLICATE

County Lake

STATE OF MONTANA RECEIVED
 ADMINISTRATOR OF GROUNDWATER CODE
 OFFICE OF STATE ENGINEER OCT 4 1963

Notice of Completion of Groundwater Appropriation by Means of Well

(Under Chapter 237, Montana Session Laws, 1961)

Owner S.A. or Esther Hinkerman Address Bigfork Mont

Driller Oleson & Justin Address Columbia Falls Mont

Date of Notice of Appropriation of Groundwater 6-20-1963

Date well started Nov 13 1961 Date Completed Nov 16 1961

Type of well Drilled Equipment Used Phuon Drill
 (dug, driven, bored or drilled) (Churn, drill, rotary or other)

Water Use: Domestic Municipal Other Irrigation
 Industrial Drainage Stock

Indicate on the diagram the character and thickness of the different strata met with in drilling; such as soil, clay, shale, gravel, rock or sand, etc. Show depth at which water is encountered, thickness and character of water-bearing strata and height to which water rises in the well.

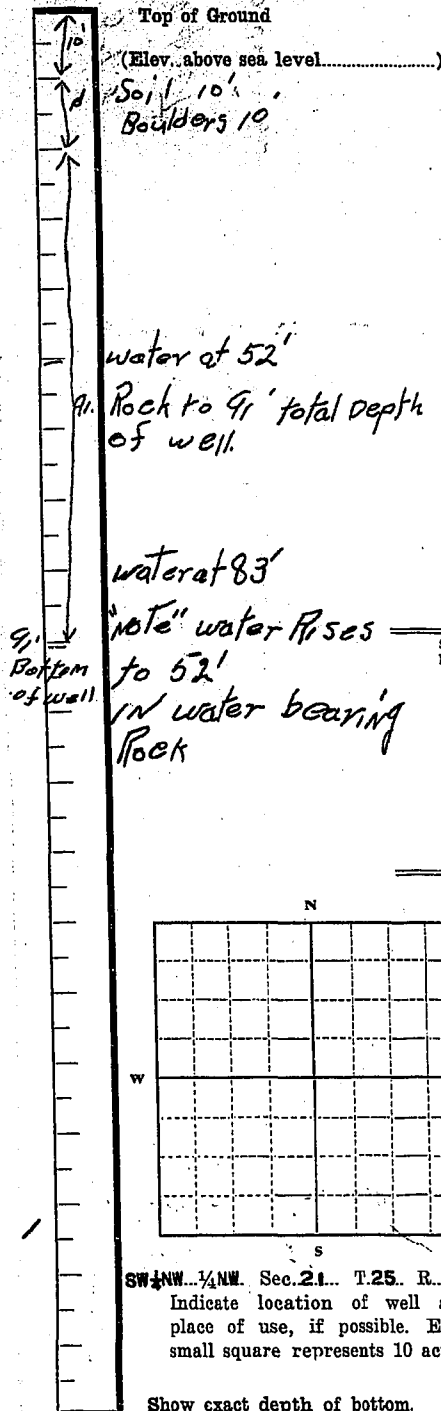

Size of Drilled Hole	Size and Weight of Casing	From (Feet)	To (Feet)	PERFORATIONS		
				Kind Size	From (Feet)	To (Feet)
7"	7"	Surface of ground	74'	NONE	NONE	NONE

Static Water Level for non-flowing Well 52' feet.

Shut-in Pressure for Flowing Well Not applicable

Pumping Water Level 52' feet at 6 gal. per minute.

Discharge in gal. per min. of flowing well Not applicable

How Tested Boiler pump Length of Test 12 hrs

Remarks: (Gravel packing, cementing, packers, type of shutoff, location of place of use of groundwater if not at well, and any other similar pertinent information, including number of

acres irrigated, if used for irrigation)

No ground water used other than well used to irrigate lawn and garden approximately 1 acre.

Oleson & Justin Driller's License Number 55

Oleson & Justin Driller's Signature

This form to be prepared by driller, and three copies to be filed by the owner with the County Clerk and Recorder in the county in which the well is located.

Please answer all questions. If not applicable, so state, otherwise the form will be returned.

Original to the County Clerk and Recorder; duplicate to the State Engineer; Triplicate to the Montana Bureau of Mines and Geology and Quadruplicate for the Appropriator.

6201

B253
161372
Water Report
L. A. Thorne

10/21/83
10/21/83
10/21/83

STATE OF MONTANA
County of Lake
Filed on the 2 day of Oct
A. D. 1983 at 2:00 o'clock P.M.
HAZEL KINNICK
County Clerk and Recorder
By L. A. Thorne
Deputy

RECORDED
INDEXED
OCT 21 1983
COUNTY CLERK
HAZEL KINNICK

10/21/83
10/21/83
10/21/83

GV

Approved Stock Form—State Publishing Co., Helena, Montana—41338

321

File No.....

T. 25. W. R. 19

DUPLICATE

County Lake

STATE OF MONTANA
ADMINISTRATOR OF GROUNDWATER CODE
OFFICE OF STATE ENGINEER

RECEIVED

DEC 26 1963

Declaration of Vested Groundwater Rights

(Under Chapter 237, Montana Session Laws, 1961)

STATE ENGINEER

I, Florence Lambert, of Bigfork
(Name of Appropriator) (Address) (Town)
County of Lake State of Montana
have appropriated groundwater according to the Montana laws in effect prior to January 1, 1962, as follows:

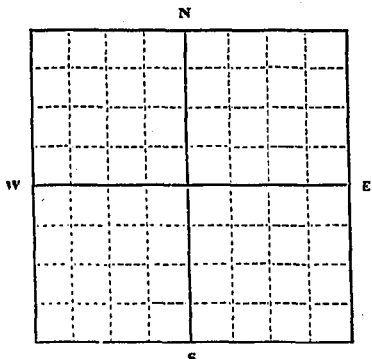

1/4 Sec. 21 T. 25 R. 19

Indicate point of appropriation and place of use, if possible. Each small square represents 10 acres.

2. The beneficial use on which the claim is based...
Household use, irrigating garden and lawn

3. Date or approximate date of earliest beneficial use; and how continuous the use has been...
1947 and continuous to the present

4. The amount of groundwater claimed (in miner's inches or gallons per minute)...
5 gallons per minute

5. If used for irrigation, give the acreage and description of the lands to which water has been applied and name of the owner thereof...
Approximately 1 acre for garden and lawn
Owner—Florence Lambert

6. The means of withdrawing such water from the ground and the location of each well or other means of withdrawal...
By means of centrifugal electric pump;
NW 1/4 of NW 1/4 of NW 1/4 S21, T25, R19

7. The date of commencement and completion of the construction of the well, wells, or other works for withdrawal of groundwater...
May 12 to 15, 1947

8. The depth of water table...
5 ft.

9. So far as it may be available, the type, size and depth of each well or the general specifications of any other works for the withdrawal of groundwater...
Dug; 5 ft. sq.; 14 ft. deep

10. The estimated amount of groundwater withdrawn each year...
54,750 gal. a year

11. The log of formations encountered in the drilling of each well if available...
5 ft. of loam; 4 ft. of boulders; 5 ft. of rock

12. Such other information of a similar nature as may be useful in carrying out the policy of this act, including reference to book and page of any county record...
not applicable

Signature of Owner Florence Lambert

Date November 19, 1963

Three copies to be filed by the owner with the County Clerk and Recorder of the county in which the well is located.

Please answer all questions. If not applicable, so state, otherwise the form will be returned.

Original to the County Clerk and Recorder; duplicate to the State Engineer; Triplicate to the Montana Bureau of Mines and Geology, and Quadruplicate for the Appropriator.

62171

R. 306

162267

Water Report
Florence Lambert

to

The Public

STATE OF MONTANA

County of Lake,

Filed on the 2 day of December

A. D. 1963 at 11:20 o'clock A. M.

HAZEL KINNICK

County Clerk and Recorder

By

Mae Johnson

Deputy

File No.

T. 25 N. R. 19 W.

DUPLICATE

County *Beauregard*

STATE OF MONTANA
ADMINISTRATOR OF GROUNDWATER CODE
OFFICE OF STATE ENGINEER

RECEIVED
DEC 30 1968

STATE ENGINEER

Notice of Completion of Groundwater Appropriation
Without Well

(Under Chapter 237 Montana Session Laws, 1961)

Date of Appropriation of Groundwater: *12-18-1968*

Owner: *J. J. Schaefer* Address: *Beauregard*

Contractor (if any) *none*

Address of Contractor *none*

Date Started..... Date Completed.....

Describe means of obtaining groundwater without a well "as by sub-irrigation and other natural processes". Include depth to water when applicable. *10 to 20 ft*

springs developed into flowing wells

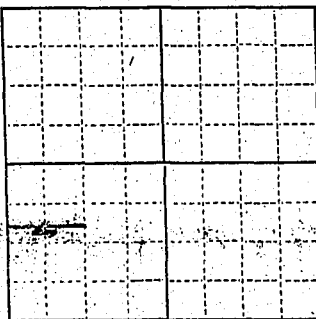

S 3/4 Sec 21 T 25 N R 19 W

Indicate point of appropriation and place of use, if possible.

Quantity of water developed and used with explanation of method used to measure or estimate such amount. If use is intermittent

estimate approximate lengths of periods of use.....

used year around

Rosa Schaefer

J. J. Schaefer

Signature of Owner: *J. J. Schaefer*

Date: *12-18-68*

This form to be prepared by contractor (if any), otherwise by the owner.

Three copies of this notice are to be filed with the County Clerk and Recorder of the county in which the works are located.

Please answer all questions. If not applicable, so state, otherwise the form will be returned.

Original to the County Clerk and Recorder; duplicate to the State Engineer; Triplicate to the Montana Bureau of Mines and Geology and Quadruplicate for the Appropriator.

R-490

162778

Water Report

J. L. & Rosa Picheyer

to

The Public

STATE OF MONTANA

County of Lake

Filed on the 24th day of Dec

A. D. 1907 2:32 clock P. M.

WAGEL KINNICK

County Clerk and Recorder

By M. P. Knous

629

Deputy

File No. MONTANA WATER RESOURCES BOARD
 DUPLICATE **RECEIVED**

T. 25 R. 19
 County Lake

MAR 13 1968 STATE OF MONTANA
 ADMINISTRATOR OF GROUNDWATER CODE
 OFFICE OF STATE ENGINEER

**Notice of Completion of Groundwater Appropriation
 Without Well**

Developed After January 1, 1962

(Under Chapter 237 Montana Session Laws, 1961)

Date of Appropriation of Groundwater October 16, 1967

Tiensvold

Owner Leonard and Jean Address Bigfork, Montana

Contractor (if any) none

Address of Contractor

Date Started Date Completed

1) Describe means of obtaining groundwater (as by sub-irrigation,
 developed spring, drains, etc.) Spring and seepage
 water

2) Means of withdrawing water (gravity, pump, canal, etc.) gravity

3) Depth of water table not applicable

4) Use of the water domestic and irrigation

5) Amount of groundwater claimed (in miner's inches, or gallons
 per minute) 10 miners inches

6) If used for irrigation, give number of acres and description of
 land the south 363 feet of the SW 1/4 SW 1/4, Sec.
 21, Twp. 25 N. Range 19 W.

7) Estimate amount of water used each year 2 acre feet

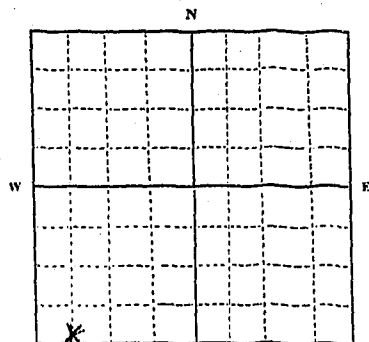

So. 363' of ⁵
 SW 1/4 SW Sec. 21 T. 25 N. R. 19.
 E. of Hwy
 indicate point of appropriation
 and place of use, if possible.

Signature of Owner Leonard Tiensvold
Jean Tiensvold
 Date Oct 17, 1967

This form to be prepared by contractor (if any), otherwise by the owner.

Three copies of this notice are to be filed with the County Clerk and Recorder of the county in which the works are located.

Please answer all questions. If not applicable, so state, otherwise the form will be returned.

R1103
183626
Water Report
Leonard & Jean
Jensenold
To
The Public

STATE OF MONTANA } ss
County of Lake
Filed on the 11 day of Mar
A. D. 1928 at 3:40 o'clock P
ETHEL M. HARDING
County Clerk and Recorder
By Samuel Cowman
Deputy

File No.

GW 4

T. 25^N R. 19^W A
County LAKE

STATE OF MONTANA
ADMINISTRATOR OF GROUNDWATER CODE
OFFICE OF STATE ENGINEER

RECEIVED
DEC 27 1963

Declaration of Vested Groundwater Rights
(Under Chapter 237, Montana Session Laws, 1961) STATE ENGINEER

1. George & Evelyn H. Blongren of Box 761, Columbia Falls, Montana
(Name of Appropriator) (Address) or Bigfork, Mont (Town)
County of Lake State of Montana
have appropriated groundwater according to the Montana laws in effect prior to January 1, 1962, as follows:

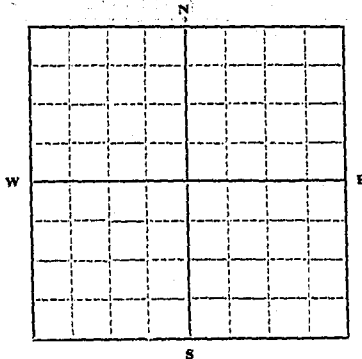

Tr. 2A in Lot 1, in W $\frac{1}{2}$ NW $\frac{1}{4}$ Sec. 20 T.25. R. 19

Indicate point of appropriation and place of use, if possible. Each small square represents 10 acres.

2. The beneficial use on which the claim is based
house & irrigation use on lawn & garden

3. Date or approximate date of earliest beneficial use; and how continuous the use has been
July 1949 - every year

4. The amount of groundwater claimed (in miner's inches or gallons per minute)
1000 gallons per hour

5. If used for irrigation, give the acreage and description of the lands to which water has been applied and name of the owner thereof

6. The means of withdrawing such water from the ground and the location of each well or other means of withdrawal
deep well pump - 80 feet north of south boundary - within 400 feet of lakeshore

7. The date of commencement and completion of the construction of the well, wells, or other works for withdrawal of groundwater
July 1949 - drilled in two days

8. The dept' water table
about 40 feet

9. So far as it may be available, the type, size and depth of each well or the general specifications of any other works for the withdrawal of groundwater
6 inch casing, 72 feet deep

10. The estimated amount of groundwater withdrawn each year
75,000 gallons

11. The log of formations encountered in the drilling of each well if available
gravel

12. Such other information of a similar nature as may be useful in carrying out the policy of this act, including reference to book and page of any county record
drilled by Olson & Justin - Columbia Falls, Montana - License #55

Signature of Owner George Blongren
E. G. H. Blongren
Date 12/8/63

Three copies to be filed by the owner with the County Clerk and Recorder of the county in which the well is located.

Please answer all questions. If not applicable, so state, otherwise the form will be returned.

Original to the County Clerk and Recorder; duplicate to the State Engineer; Triplicate to the Montana Bureau of Mines and Geology and Quadruplicate for the Appropriator.

13475

D-461

162742

Water Report

George + Evelyn Blomgren
to

The Public

STATE OF MONTANA

County of Lake,

Filed on the 26 day of Dec

A. D. 1963 at 9:22 o'clock A. M.

HAZEL KINNICK

County Clerk and Recorder

By

S. Cowman

Deputy

200

GW

Approved Stock Form—State Publishing Co., Helena, Montana—41338

File No.

T. 25 R. 19

DUPLICATE

County Lake

STATE OF MONTANA
 ADMINISTRATOR OF GROUNDWATER CODE
 OFFICE OF STATE ENGINEER

RECEIVED
 OCT 4 1963

Declaration of Vested Groundwater Rights

(Under Chapter 237, Montana Session Laws, 1961)

STATE ENGINEER

1. Emmett A. S. Mahal Richy Mechler, of East Lake Shore, Bigfork
 (Name of Appropriator) (Address) (Town)
 County of Lake State of Montana
 have appropriated groundwater according to the Montana laws in effect prior to January 1, 1962, as follows:

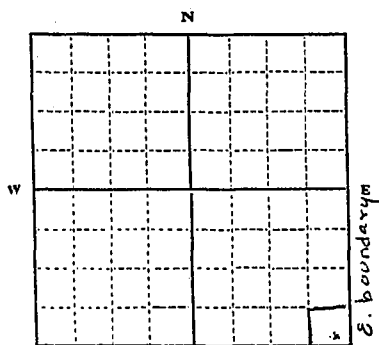

assume sq. as being 5 acres
 each small square represents 10 acres
 1/4 Sec. 29 T. R.

Indicate point of appropriation
 and place of use, if possible.
 Each small square represents 10
 acres.

Tr. 3FA of Lot 4 29-25-19
 about 5 acres

2. The beneficial use on which the claim is based.....
Water supply for Household use
3. Date or approximate date of earliest beneficial use; and how con-
 tinuous the use has been.....
December 1954, Continuous use
4. The amount of groundwater claimed (in miner's inches or gallons
 per minute).....
at time of installation about one gal. per minute
5. If used for irrigation, give the acreage and description of the lands
 to which water has been applied and name of the owner thereof.....
not used for irrigation
6. The means of withdrawing such water from the ground and the
 location of each well or other means of withdrawal.....
water is drawn from ground by Jet pump
7. The date of commencement and completion of the construction of the well, wells, or other works for with-
 drawal of groundwater.....
Began December, 1954. Completed December, 1954
8. The depth of water table..... Depth of water in pipe 111 ft.
9. So far as it may be available, the type, size and depth of each well or the general specifications of any other
 works for the withdrawal of groundwater..... Depth of well 150 ft.
From top of well to top of water 37 ft. Total depth of water
in pipe 111 ft. Total storage 166 gal. Rate of flow one gal. per minute
10. The estimated amount of groundwater withdrawn each year..... The usual amount used in a
home of moderate size family
11. The log of formations encountered in the drilling of each well if available.....
not available
12. Such other information of a similar nature as may be useful in carrying out the policy of this act, including
 reference to book and page of any county record.....

Signature of Owner

Emmett A. Mahal Richy Mechler

Date 9.23.63

Three copies to be filed by the owner with the County Clerk and Recorder of the county in which the well is located.

Please answer all questions. If not applicable, so state, otherwise the form will be returned.

Original to the County Clerk and Recorder; duplicate to the State Engineer; Triplicate to the Montana Bureau of Mines and Geology, and Quadruplicate for the Appropriator.

6199

R251 161346

Water Right
Emmett & Mabel
Becky Meekler

to
The Public

STATE OF MONTANA

County of Lake,

Filed on the 1 day of Oct

A. D. 1963 at 11:00 o'clock A.M

HAZEL KINNICK

County Clerk and Recorder

By E. Lawmen

200

Deputy

RECORDED BY: [illegible]

FILED IN: [illegible]

INDEXED IN: [illegible]

File No.

RECEIVED

T. 25N R. 19W

DUPLICATE

OCT 2 1970

County Lake

LOG

STATE OF MONTANA
ADMINISTRATOR OF GROUNDWATER CODE
STATE WATER CONSERVATION BOARD

Top of Ground

(Elev. above sea level 3000 Approx.)

**Notice of Completion of Groundwater
Appropriation by Means of Well**
DEVELOPED AFTER JANUARY 1, 1962

Formations Log:

- 0 - 24 Dirty gravel & cobbles.
- 24 - 64 Sand and gravel imbedded in tan silt.
- 64 - 69 Gravel and cobbles imbedded in tan clay.
- 69 - 120 Gravel and boulders imbedded in yellow clay.
- 120 - 127 Gravel imbedded in tan clay.
- 127 - 146 Blue and yellow rock.
- 146 - 168 Blue and yellow rock. Seeps of water.
- 168 - 170 Gray rock. Water.

(Under Chapter 237 Montana Session Laws, 1961, as amended)

Owner Thomas W. and Margaret L. Cahill Address Bigfork, Montana

Driller Liberty Drilling Co Address Missoula, Montana

Date of Notice of appropriation of groundwater None filed

Date well started 9/5/70 Date completed 9/11/70

Type of well Drilled Equipment used Cable Tools
(Dug, driven, bored or drilled) (Churn drill, rotary or other)

Water use: Domestic Municipal Stock Irrigation
Industrial Drainage Other

Indicate on the diagram the character and thickness of the different strata met with in drilling, such as soil, clay, shale, gravel, rock or sand, etc. Show depth at which water is encountered, thickness and character of water-bearing strata and height to which the water rises in the well.

Size of Drilled Hole	Size and Weight of Casing	From (Feet)	To (Feet)	PERFORATIONS		
				Kind Size	From (Feet)	To (Feet)
6"	6 5/8" OD x 1/4"	+1'6"	129'3"	N	O	N

Water rises in the well 125 feet to surface.

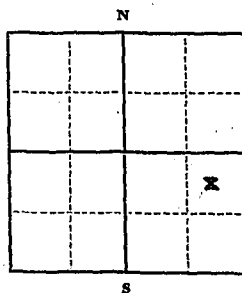

Static Water Level for non-flowing well 125 feet.

Shut-in Pressure for Flowing Well None
Pumping Water Level 160 feet
at 20 gal. per minute.

Discharge in gal. per min. of flowing well None
Non-flowing

How Tested Bailer

Length of Test Four hours

Remarks: (Gravel packing, cementing, packers, type of shutoff) All water entering well from cracks and seams in the rock below 168'.

NE 1/4 Sec 32 T. 25N R. 19W
Indicate location of well and place of use, if possible. Each small square represents 40 acres.

Wells in this area can be depended upon to produce clear sand free water year after year as long as they are not overpumped, i.e., they should be pumped at rate not in excess of 50 percent of the tested capacity of the aquifer. (Continue on reverse side)

USE—If used for irrigation, industrial, drainage or other. Explain, state number of acres and location or other data (i.e.: Lot, Block and Addition).

Lot 11 Rosselle Sub-Division

Show exact depth of bottom.

Bottom of well 170'

This form to be prepared by driller, and three copies to be filed by the owner with the County Clerk and Recorder in the county in which the well is located, tissue copy to be retained by driller.

Please answer all questions. If not applicable, so state, otherwise the form will be returned.

52
Driller's License Number

William F. Dahme
Driller's Signature

47579

32

File No. _____

T. 25N. R. 19W.

DUPLICATE

County Lake

STATE OF MONTANA
ADMINISTRATOR OF GROUNDWATER CODE
OFFICE OF STATE ENGINEER

RECEIVED
JAN 17 1964
STATE ENGINEER

Declaration of Vested Groundwater Rights

(Under Chapter 237, Montana Session Laws, 1961)

1. Charles P. & Ruby M. Keim of East Lakeshore Bigfork
(Name of Appropriator) (Address) (Town)

County of Lake State of Montana
have appropriated groundwater according to the Montana laws in effect prior to January 1, 1962, as follows:

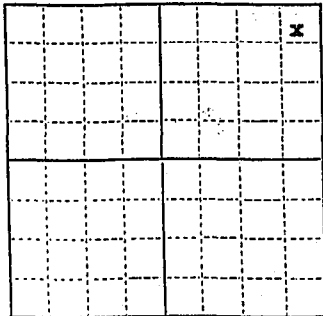

Lot 1, 25N.
1/4 Sec. 32, T. 25N. R. 19W

Indicate point of appropriation and place of use, if possible. Each small square represents 10 acres.

- The beneficial use on which the claim is based Household use and yard irrigation
- Date or approximate date of earliest beneficial use; and how continuous the use has been February 1955 and daily since that time.
- The amount of groundwater claimed (in miner's inches or gallons per minute) 3 to 4 GPM.
- If used for irrigation, give the acreage and description of the lands to which water has been applied and name of the owner thereof Irrigation of small grassed yard area and flower beds. Normal yard area.
- The means of withdrawing such water from the ground and the location of each well or other means of withdrawal 2 hp. deep well pump. located in building. Well located in yard area.
- The date of commencement and completion of the construction of the well, wells, or other works for withdrawal of groundwater Commenced in November 1954 and completed in January 1955
- The depth of water table Approx. 213 60'
- So far as it may be available, the type, size and depth of each well or the general specifications of any other works for the withdrawal of groundwater 183 foot depth, 5 inch casing. drilled well
- The estimated amount of groundwater withdrawn each year Approx. 50M gallons per year
- The log of formations encountered in the drilling of each well if available Cannot recall exact depths of formations, but there was heavy stratas of vari-colored clay, hard pan, solid rock requiring much blasting. Drilling at 120' level stymied with 7" casing. Had to go down thru with 5" casing.
- Such other information of a similar nature as may be useful in carrying out the policy of this act, including reference to book and page of any county record Ownership of property recorded on Page 132 of Book 24-

Signature of Owner s/ Ruby M. Keim
Date January 7, 1964

Three copies to be filed by the owner with the County Clerk and Recorder of the county in which the well is located.
Please answer all questions. If not applicable, so state, otherwise the form will be returned.
Original to the County Clerk and Recorder; Duplicate to the State Engineer; Triplicate to the Montana Bureau of Mines and Geology, and Quadruplicate for the Appropriator.

37169

R916

76374

RECORDED
INDEXED
JAN 14 1944

STATE OF MONTANA
County of Lake,
Filed on the 14 day of Jan
A. D. 1944 at 2:00 o'clock P. M.
HAZEL KINNICK
County Clerk and Recorder
By 6 Cowman
Deputy

GW 2

File No. _____

T. 25 R. 19 W.

DUPLICATE

County LakeSTATE OF MONTANA
ADMINISTRATOR OF GROUNDWATER CODE
OFFICE OF STATE ENGINEERRECEIVED
SEP 14 1962Notice of Completion of Groundwater
Appropriation by Means of Well ENGINEER

(Under Chapter 237, Montana Session Laws, 1961) (Bigfork, Mont.)

Owner Robert T. Maddox Home 903 N. McKinney
Address Odessa, TexasDriller Olsen & Justin Address Columbia FallsDate of Notice of Appropriation of Groundwater none filedDate well started July 19-62 Date Completed July 26-62Type of well Drilled Equipment Used Churn
(dug, driven, bored or drilled) (Churn, drill, rotary or other)Water Use: Domestic Municipal Stock Irrigation
Industrial Drainage Other

Indicate on the diagram the character and thickness of the different strata met with in drilling, such as soil, clay, shale, gravel, rock or sand, etc. Show depth at which water is encountered, thickness and character of water-bearing strata and height to which the water rises in the well.

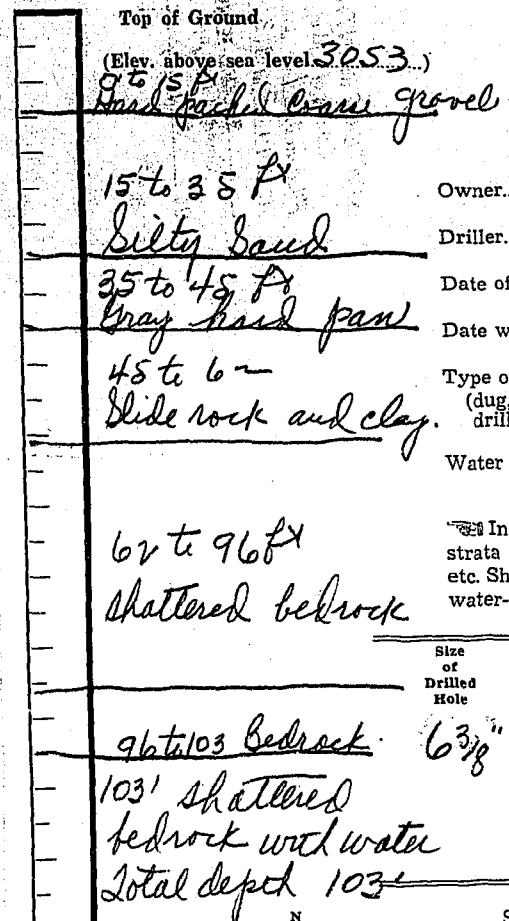

Size of Drilled Hole	Size and Weight of Casing	From (Feet)	To (Feet)	PERFORATIONS		
				Kind Size	From (Feet)	To (Feet)
<u>6 3/8"</u>	<u>7" OD</u>	<u>0</u>	<u>96' 6"</u>	<u>none</u>		

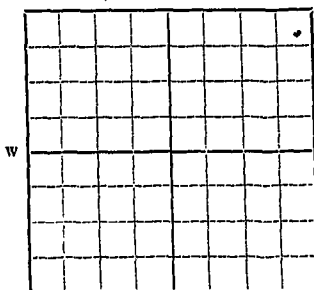

Lot 9 Cor. Lot 4
S.E. 1/4 Sec. 32 T. 25 R. 19 W
Indicate location of well and place of use, if possible. Each small square represents 10 acres.

Show exact depth of bottom.

103'Static Water Level for non-flowing Well 79 feet.Shut-in Pressure for Flowing Well non-flowingPumping Water Level 85 feet at 1.0 gal. per minute.Discharge in gal. per min. of flowing well non-flowingHow Tested Bailer Length of Test 2 hrs

Remarks: (Gravel packing, cementing, packers, type of shutoff, location of place of use of groundwater if not at well, and any other similar pertinent information, including number of

acres irrigated, if used for irrigation) _____

1/2 acreNo. 55
Driller's License NumberOlsen & Justin
By George J. Justin
Driller's Signature

This form to be prepared by driller, and three copies to be filed by the owner with the County Clerk and Recorder in the county in which the well is located.

Please answer all questions. If not applicable, so state, otherwise the form will be returned.

Original to the County Clerk and Recorder; duplicate to the State Engineer; Triplicate to the School of Mines and Quadruplicate for the Appropriator.

2100

State of Montana, Lake and Mountain Counties
 156565
 State of Montana
 County of Lake
 Filed on the 12 day of Sept
 A. D. 1967 at 3:30 o'clock P. M.
 HAZEL KINNICK
 County Clerk and Recorder
 By M. Krauss
 Deputy
 202

STATE OF MONTANA
 County of Lake,
 Filed on the 12 day of Sept
 A. D. 1967 at 3:30 o'clock P. M.
 HAZEL KINNICK
 County Clerk and Recorder
 By M. Krauss
 Deputy

STATE OF MONTANA
 County of Lake,
 Filed on the 12 day of Sept
 A. D. 1967 at 3:30 o'clock P. M.
 HAZEL KINNICK
 County Clerk and Recorder
 By M. Krauss
 Deputy

156565
 State Hall Report
 Robert L. Maddox
 to
 The Public

File No.

MONTANA WATER RESOURCES BOARD

GW 2

T. 25N R. 19W

RECEIVED

FEB 10 1970

County

STATE OF MONTANA
ADMINISTRATOR OF GROUNDWATER CODE
OFFICE OF STATE ENGINEER

Top of Ground

(Elev. above sea level)

Notice of Completion of Groundwater Appropriation by Means of Well

(Under Chapter 237, Montana Session Laws, 1961)
GLEN W. ROSS Bigfork, Mont.

Owner Homer McClarty Address 945 8th A. W.

Driller _____ Address _____

Date of Notice of Appropriation of Groundwater 10-9-69 Dec 15, 1969

Date well started Drilled Date Completed _____

Type of well _____ Equipment Used _____
(dug, driven, bored or (Churn, drill, rotary or drilled) other)

Water Use: Domestic Municipal Other Irrigation
Industrial Drainage Stock

Indicate on the diagram the character and thickness of the different strata met with in drilling, such as soil, clay, shale, gravel, rock or sand, etc. Show depth at which water is encountered, thickness and character of water-bearing strata and height to which water rises in the well.

Size of Drilled Hole	Size and Weight of Casing	From (Feet)	To (Feet)	PERFORATIONS		
				Kind Size	From (Feet)	To (Feet)
7 1/2 OD 5	23#		49' 8"			

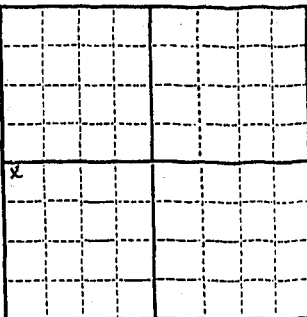

1/4 Sec. 33 T. 25 R. 19
Indicate location of well and place of use, if possible. Each small square represents 10 acres.

Static Water Level for non-flowing Well _____ feet.

Shut-in Pressure for Flowing Well _____

Pumping Water Level _____ feet at _____ gal. per minute.

Discharge in gal. per min. of flowing well _____

How Tested _____ Length of Test _____

Remarks: (Gravel packing, cementing, packers, type of shutoff, location of place of use of groundwater if not at well, and any other similar pertinent information, including number of acres irrigated, if used for irrigation) _____

Show exact depth of bottom

Doc. No. 192314
Filed for record
this 7 day of February
A. D. 19 70, at 10:20
o'clock 2 A.M.

Driller's License Number _____
Driller's Signature Homer McClarty

This form to be prepared by driller, and three copies to be filed by the owner with the County Clerk and Recorder in the county in which the well is located.

Please answer all questions. If not applicable, so state, otherwise the form will be returned.

Original to the County Clerk and Recorder; duplicate to the State Engineer; Triplicate to the Montana Bureau of Mines and Geology and Quadruplicate for the Appropriator.

46149

33

Dr

it.

1969

igation

different
sand, etc.
of water-

To
(Foot)

feet.

per minute.

utoff, loca-
ell, and any
number of

[Signature]
Recorder

Bureau of

6149

R-1191

#192314

GLEN W. ROSS

TO

THE PUBLIC

STATE OF MONTANA }
County of Lake } ss
Filed on the 9 day of Feb.
A. D. 1970 at 10:26 o'clock A.M.
ETHEL M. HARDING
County Clerk and Recorder
By *[Signature]* Deputy

MONTANA WATER RESOURCES BOARD
RECEIVED

FEB 10 1970

County Libe

STATE OF MONTANA
 ADMINISTRATOR OF GROUNDWATER CODE
 OFFICE OF STATE ENGINEER

**Notice of Completion of Groundwater
 Appropriation by Means of Well**

(Under Chapter 237, Montana Session Laws, 1961)

Top of Ground
 (Elev. above sea level 2980)

1' 13ft boulders
 cobbles & gravel
 38ft gray
 hard pan
 91' Boulders
 cobbles, clay

Glacier
 till
 with
 water

Owner Glenn H. Ross Address Bigfork, Mont

Driller James McLarty Address 945 5th St. N.

Date of Notice of Appropriation of Groundwater.....

Date well started Oct 9, 1969 Date Completed Dec. 16/69

Type of well Drilled Equipment Used 2 1/2" Bucyrus Erie
 (dug, driven, bored or drilled) (Churn, drill, rotary or other)

Water Use: Domestic Municipal Other Irrigation
 Industrial Drainage Stock

Indicate on the diagram the character and thickness of the different strata met with in drilling, such as soil, clay, shale, gravel, rock or sand, etc. Show depth at which water is encountered, thickness and character of water-bearing strata and height to which water rises in the well.

Size of Drilled Hole	Size and Weight of Casing	From (Foot)	To (Foot)	PERFORATIONS		
				Kind	From (Foot)	To (Foot)
7" OD	23"		42'			
5" OD	14 1/2"		33'			

Static Water Level for non-flowing Well..... 80 feet.

Shut-in Pressure for Flowing Well.....

Pumping Water Level..... 340 feet at..... 60 gal. per minute.

Discharge in gal. per min. of flowing well.....

How Tested..... Bailer Length of Test..... 10 hrs

Remarks: (Gravel packing, cementing, packers, type of shutoff, location of place of use of groundwater if not at well, and any other similar pertinent information, including number of acres irrigated, if used for irrigation).....

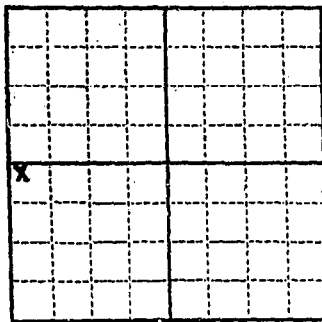

NW 1/4 Sec. 33 T. 25 R. 19

Indicate location of well and place of use, if possible. Each small square represents 10 acres.

340 ft
 Show exact depth of bottom.

Driller's License Number 18

Driller's Signature James McLarty

This form to be prepared by driller, and three copies to be filed by the owner with the County Clerk and Recorder in the county in which the well is located.

Please answer all questions. If not applicable, so state, otherwise the form will be returned.

Original to the County Clerk and Recorder; duplicate to the State Engineer; Triplicate to the Montana Bureau of Mines and Geology and Quadruplicate for the Appropriator.

MONTANA WATER RESOURCES BOARD
RECEIVED
FEB 10 1970

STATE OF MONTANA

County of Lake } ss.

Glenn W. Ross having first been duly sworn, deposes and says that he is of lawful age and the appropriator and claimant of the order and water right mentioned in the foregoing notice of completion of groundwater appropriation by means of well and the person whose name subscribed thereto, as the appropriator and claimant, that he knows the contents of said foregoing notice and that the matters and things therein stated are true.

Glenn W. Ross

Subscribed and sworn to before me, this 9 day of Feb., 1970

Dorothy K. Thompson
Notary Public for the State of Montana.
Residing at Falsum, Montana
My Commission expires 6-1, 1972

R-1191
192314

GLEN W. ROSS
TO
THE PUBLIC

STATE OF MONTANA }
County of Lake }
Filed on the 9 day of Feb.
A. D. 19 70 at 10:26 clock A.M.
ETHEL M. HARDING
County Clerk and Recorder
By Quell Beasly
Deputy

File No.

DUPLICATE

T. 25 N. R. 19 W
County Lake SEC. 8 OR 9

STATE OF MONTANA
ADMINISTRATOR OF GROUNDWATER CODE
OFFICE OF STATE ENGINEER

RECEIVED
JAN 6 1964
STATE ENGINEER

Declaration of Vested Groundwater Rights

(Under Chapter 237, Montana Session Laws, 1961)

1. Walter N. Streeter
Mildred M. Streeter of East Shore Bigfork
(Name of Appropriator) (Address) (Town)

County of Lake State of Montana
have appropriated groundwater according to the Montana laws in effect prior to January 1, 1962, as follows:

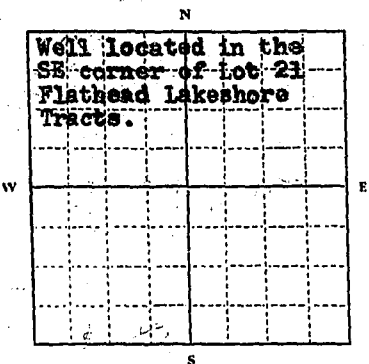

1/4 Sec. T. R.

Indicate point of appropriation and place of use, if possible. Each small square represents 10 acres.

- The beneficial use on which the claim is based. Domestic and Irrigation
- Date or approximate date of earliest beneficial use; and how continuous the use has been. Well completed September 30 1952 Has been used continuously since.
- The amount of groundwater claimed (in miner's inches or gallons per minute). 40 gallons per minute
- If used for irrigation, give the acreage and description of the lands to which water has been applied and name of the owner thereof. Approximately one acre of orchard land owned by Walter N. Streeter and Mildred M. Streeter
- The means of withdrawing such water from the ground and the location of each well or other means of withdrawal. electric pump
- The date of commencement and completion of the construction of the well, wells, or other works for withdrawal of groundwater. Drilling commenced September 27, 1952, completed September 30, 1952
- The depth of water table. Well is 46 feet deep and it is a flowing well
- So far as it may be available, the type, size and depth of each well or the general specifications of any other works for the withdrawal of groundwater. Flowing well, 46 feet deep, cased with six inch steel welded casing
- The estimated amount of groundwater withdrawn each year. Domestic use for two dwellings and irrigation water for one acre of orchard
- The log of formations encountered in the drilling of each well if available. Clay and broken rock 0 to 44 feet, broken rock and sand 44 feet to 46 feet.
- Such other information of a similar nature as may be useful in carrying out the policy of this act, including reference to book and page of any county record.

Signature of Owner Walter N. Streeter
Mildred M. Streeter

Date 12/31-63

Three copies to be filed by the owner with the County Clerk and Recorder of the county in which the well is located.

Please answer all questions. If not applicable, so state, otherwise the form will be returned.

Original to the County Clerk and Recorder; Duplicate to the State Engineer; Triplicate to the Montana Bureau of Mines and Geology, and Quadruplicate for the Appropriator.

R. 716 163058
Water Report
Walter N. Streeter
to
The Public

STATE OF MONTANA
County of Lake, ^{sr}
Filed on the 1 day of Dec
A. D. 1903 at 10:30 clock A. M.
W. N. Streeter
County Clerk and Recorder
By _____
Deputy

GROUNDWATER INDEX

Page 1 of 1

County Lake Twp. 25 N. Rge. 18 W.

Sec.	Name of Appropriator	Type of Form	County File No.	Remarks
3	Fisher, John	GW 1	157508	? Filed in No-GW 24
3	Fisher, John & Ella Mae	GW 1	18137	? " " "
3	Ill, Bernard A.	GW 3	181224	-
3	Wade, Erling & Carrie	GW 3	163970	-
4	Danem, Edith	GW 3	163189	-
4	Fisher, John	GW 1	157508	See Above, Sec. #3
5	Danem, Edith	GW 3	163189	See Above, Sec. #4
11	Williamson, Olen E.	GW 2	166947	? Filed in No-GW 24
11	U.S. Forest Service	GW 1	167465	? " " " "
13	Westphal, Frank	GW 1	152948	-
14	Baker, Anna E.	GW 4	163183	-
14	Brayko, William	GW 2	210473	-
14	Christianson, Leo	GW 2	166801	-
14	Cloninger, Dan	GW 2	210513	OR 210515
14	Gallagher, Frances & Fast, Ervin	GW 2	210487	-
14	Kahn, George M., Jr.	GW 4	178312	-
14	Maki, Wayne (Deer Lick Road)	GW 2	208912	-
14	Stahl, Roy W. & Margaret	GW 4	163075	-
14	Taylor, A. L. & Irene A.	GW 4	162772	-
14	Wells, Virgil M. & Alice M.	GW 2	156894	-
22	Toole, J. C.	GW 3	162886	-
23	Martin, Norman E.	GW 2	164930	-
23	Toole, J. C.	GW 2	162886	See Above, Sec. # 22
23	Tye, Rose Ellen	GW 2	205525	-
23	U.S. Forest Service	GW 4	161245	-
23	Wilhelm, Rodney W.	GW 2	158082	-
24	Jolin, Wesley I.	GW 3	169420	-
26	State Highway Dept.	GW 2	202596	-
26	State of Montana	1957 Well Log	153066	-
26	Toole, J. C.	GW 3	162886	See Above, Sec. # 22
27	Toole, J. C.	GW 3	162886	See Above, Sec. # 22
36	Redd, G. B. & Leta	GW 3	162734	-

File No. **RECEIVED**

T. **25 N** R. **18 W**

DUPLICATE SEP 15 1967

County **Lake**

STATE OF MONTANA
ADMINISTRATOR OF GROUNDWATER CODE
OFFICE OF STATE ENGINEER

**Notice of Completion of Groundwater Appropriation
Without Well**

Developed After January 1, 1962

(Under Chapter 237 Montana Session Laws, 1961)

Date of Appropriation of Groundwater **Sept. 7, 1967**

Owner **Bernard A. Ill** Address **Swan Lake, Mont.**

Contractor (if any) **---**

Address of Contractor **---**

Date Started **---** Date Completed **---**

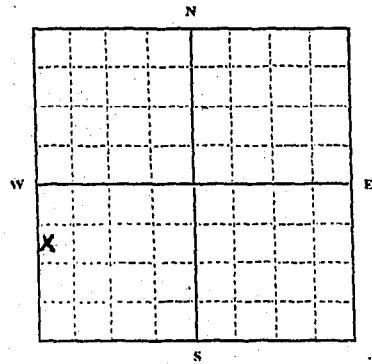

SW 1/4 Sec. **2** T. **25 N** R. **18 W**

Indicate point of appropriation and place of use, if possible.

1) Describe means of obtaining groundwater (as by sub-irrigation, developed spring, drains, etc.) **Developed Stream**

2) Means of withdrawing water (gravity, pump, canal, etc.) **Gravity Feed**

3) Depth of water table **---**

4) Use of the water **House and yard**

5) Amount of groundwater claimed (in miner's inches, or gallons per minute) **50 gallons per minute**

6) If used for irrigation, give number of acres and description of land **---**

7) Estimate amount of water used each year **200 ac. ft.**

Signature of Owner **Bernard A. Ill**

Date **Sept. 10, 1967**

This form to be prepared by contractor (if any), otherwise by the owner.

Three copies of this notice are to be filed with the County Clerk and Recorder of the county in which the works are located.

Please answer all questions. If not applicable, so state, otherwise the form will be returned.

42,316

R1684

181224
Notice

Bernard A III
to
The Public

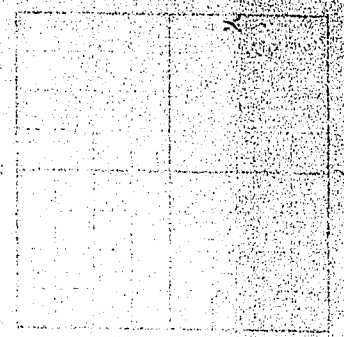

STATE OF MONTANA } ss
County of Lake
Filed on the 13 day of Sept
A. D. 1967 at 3:25 o'clock PM

ETHEL M. HARDING
County Clerk and Recorder
Gene Cowman
Deputy

W 3

Approved Stock Form—State Publishing Co., Helena, Montana—38496

File No.

T. 25^N R. 18^W

DUPLICATE

County Lake

STATE OF MONTANA
ADMINISTRATOR OF GROUNDWATER CODE
OFFICE OF STATE ENGINEER

RECEIVED
FEB 10 1964

STATE ENGINEER
Notice of Completion of Groundwater Appropriation
Without Well

(Under Chapter 237 Montana Session Laws, 1961)

Date of Appropriation of Groundwater March 1961
Owner Edley & Carrie Wade address Bigfork Montana
Contractor (if any)

Address of Contractor

Date Started March 1961 Date Completed May 1961

Describe means of obtaining groundwater without a well "as by sub-irrigation and other natural processes". Include depth to water when applicable. fed by stream into 250 gallon reservoir

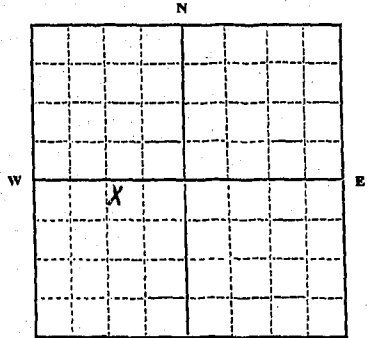

SW 1/4 Sec 3 T. 25N R. 18W
Indicate point of appropriation and place of use, if possible.

Quantity of water developed and used with explanation of method used to measure or estimate such amount. If use is intermittent estimate approximate lengths of periods of use. this water is used by two families consisting of seven persons estimating each person use at app 25 gallons per day and upon 8 months use a year
Signature of Owner Edley & Carrie Wade
Date 10-5-63

This form to be prepared by contractor (if any), otherwise by the owner.
Three copies of this notice are to be filed with the County Clerk and Recorder of the county in which the works are located.
Please answer all questions. If not applicable, so state, otherwise the form will be returned.
Original to the County Clerk and Recorder; duplicate to the State Engineer; Triplicate to the Montana Bureau of Mines and Geology and Quadruplicate for the Appropriator.

34853

P. 931

163970

Erving Glara Wade
TO
The Public

STATE OF MONTANA

County of Lake

Filed on the 27 day of Jan:
A. D. 1964 at 2:38 o'clock P. M.

HAZEL KINNICK

County Clerk and Recorder

By Mae Johnson Deputy

GW 3

File No.

DUPLICATE

T 25^N R 18^W 4^{1/2}

County

STATE OF MONTANA
ADMINISTRATOR OF GROUNDWATER CODE
OFFICE OF STATE ENGINEER

RECEIVED
JAN 6 1964

Notice of Completion of Groundwater Appropriation Without Well

(Under Chapter 237 Montana Session Laws, 1961)

Date of Appropriation of Groundwater April 1938
Owner Edith Danum Address Big Fork Mont
Contractor (if any) John S. Fauver
Address of Contractor (Deceased)
Date Started April 1938 Date Completed May - 1938

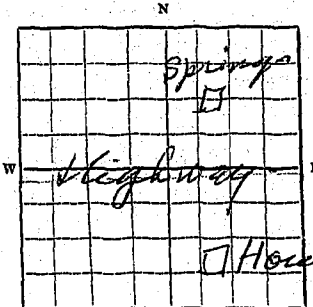

Describe means of obtaining groundwater without a well "as by sub-irrigation and other natural processes". Include depth to water when applicable. Spring fed Gravity System -

H25760^S
.....⁴..... Sec 405 T25 R18

Indicate point of appropriation and place of use, if possible.

Quantity of water developed and used with explanation of method used to measure or estimate such amount. If use is intermittent estimate approximate lengths of periods of use 3690 to 4600 Gal per day, for 7 to 8 months. Water used to supply household needs of 6 property owners on Lake Shore
Signature of Owner Edith Danum
Date Dec 31-63

This form to be prepared by contractor (if any), otherwise by the owner.
Three copies of this notice are to be filed with the County Clerk and Recorder of the county in which the works are located.
Please answer all questions. If not applicable, so state, otherwise the form will be returned.
Original to the County Clerk and Recorder; duplicate to the State Engineer; Triplicate to the Montana Bureau of Mines and Geology and Quadruplicate for the Appropriator.

27341

R-841

163189

Edith Bonens

STATE OF MONTANA }
County of Lake, } sa
Filed on the 31 day of Dec
A. D. 1963 at 5:14 o'clock P. M.
HAZEL KINCK
County Clerk and Recorder
By M. Anus
209 Deputy

ore

341

152945
surface water appropriation
Filed in 1961

NOTICE OF APPROPRIATION OF WATER RIGHT

STATE OF MONTANA, }
County of Flathead, } ss.

KNOW ALL MEN BY THESE PRESENTS, That the undersigned did on the 27th day of December 1961, appropriate and claim, and do^{es} by these presents appropriate, locate and claim 1 cubic foot

cubic feet per second of time, legal measurement, of the waters of Bond Creek near Swan Lake in the County of Flathead, State of Montana, and did, on the above named date, mark the point of intended diversion by posting thereat a copy of this notice in a conspicuous place.

The said water is claimed for irrigation and other useful and beneficial purposes, and the place of intended use is A tract of land lying in section 13, Township 29 North, Range 16 West, T. P. M., more particularly described as follows:

Beginning at the Southeast corner of N E S 1098, marked corner No. 5; the -nce North 810 feet; thence South 89° 11' West a distance of 810 feet; thence South a distance of 810 feet; thence North 89° 11' East a distance of 810 feet to the point of beginning, containing 15.002 acres, more or less.

Said water to be diverted and conveyed to said place by means of a dam and ditch pipe said ditch to be feet wide on bottom feet wide on top, and feet deep

That the stream from which said diversion is to be made is more particularly described as follows, to-wit: Known as Bond Creek, source of which is a lake in the Swan Range of the Rocky Mountains and emptying into Spring Creek, which in turn empties into Swan Lake, all in Lake County, Montana.

and measured from said point of diversion as an initial point, the following well-known natural objects and permanent monuments are adjacent to the following: North 180 feet to section line Southeast corner of N E S 1009, marked corner 75. is distant in a direction; is distant in a direction.

And the undersigned hereby claim^s a right of way over all unappropriated lands of the United States through which said ditch pipe shall pass, together with the right to repair and enlarge said ditch pipe whenever and wherever the same may be necessary to convey the water hereby appropriated.

Frank F. Westphal
Idella M. Westphal

Appropriator^s and Claimant^s

STATE OF MONTANA, }
County of Flathead, } ss.
Lake

Frank F. Westphal and Idella M. Westphal, being first duly sworn, says: That ~~now~~ they are the appropriator^s and claimant^s named in the foregoing Notice of Appropriation; that they have read said Notice of Appropriation, and knows the contents thereof, and that all the matters and statements contained therein are true.

Subscribed and sworn to before me this 27th day of Dec. 1961

RECORDED IN BOOK 200 FILE, 200 BY HAZEL KINNICK Notary Public in and for Flathead County, State of Montana. E. C. Cardman DEP. NOTARY PUBLIC for the State of Montana Residing at Polson, Montana My Commission Expires

File No.

T. 25 N. R. 18 W

DUPLICATE

County LAKE

STATE OF MONTANA
ADMINISTRATOR OF GROUNDWATER CODE
OFFICE OF STATE ENGINEER

RECEIVED
FEB 19 1964

Declaration of Vested Groundwater Rights

(Under Chapter 237, Montana Session Laws, 1961)

STATE ENGINEER

1. ANNA E. BAKER, of SWAN LAKE, (Name of Appropriator) (Address) (Town)
County of LAKE State of MONTANA
have appropriated groundwater according to the Montana laws in effect prior to January 1, 1962, as follows:

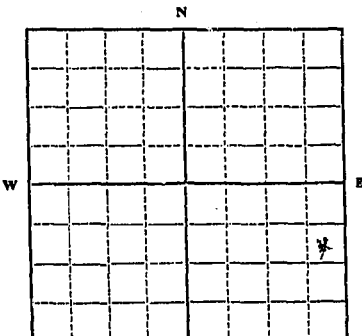

PART OF E 1/2 S SE 1/4

1/4 Sec. 14 T25N R. 18 W

Indicate point of appropriation and place of use, if possible. Each small square represents 10 acres.

2. The beneficial use on which the claim is based. DOMESTIC DRINKING, WASHING, BATHROOM, SPRINKLING.

3. Date or approximate date of earliest beneficial use; and how continuous the use has been. OCTOBER 1955 DAILY USE

4. The amount of groundwater claimed (in miner's inches or gallons per minute) 10-15 GALLONS PER MINUTE CONTINUOUS

5. If used for irrigation, give the acreage and description of the lands to which water has been applied and name of the owner thereof. LAWN SPINKLING, NO IRRIGATION

6. The means of withdrawing such water from the ground and the location of each well or other means of withdrawal. ELECTRIC PUMP, LOT 8 PETERSONS SWAN LAKE TRACTS, SWAN LAKE, MONTANA.

7. The date of commencement and completion of the construction of the well, wells, or other works for withdrawal of groundwater. DEFINITE DATE NOT AVAILABLE, SOME TIME IN 1954.

8. The depth of water table. APPROXIMATELY 20 FEET

9. So far as it may be available, the type, size and depth of each well or the general specifications of any other works for the withdrawal of groundwater. DRILLED WELL, SIX INCH IRON CASING ABOUT 26 FEET DEEP

10. The estimated amount of groundwater withdrawn each year. 73000 GALLONS.

11. The log of formations encountered in the drilling of each well if available. NOT AVAILABLE

12. Such other information of a similar nature as may be useful in carrying out the policy of this act, including reference to book and page of any county record. WELL LOCATED ON LOT NO. 8 OF PETERSON'S SWAN LAKE TRACTS SWAN LAKE, LAKE COUNTY, MONTANA, DESCRIBED IN ABSTRACT AS PART OF LOT 3 OF SECTION 14 TOWNSHIP 25 NORTH RANGE 18 WEST, MPM, BOOK 45 OF DEEDS PAGE 157.

Signature of Owner Mrs. Anna E. Baker

Date Dec. 24, 1963

Three copies to be filed by the owner with the County Clerk and Recorder of the county in which the well is located.

Please answer all questions. If not applicable, so state, otherwise the form will be returned.

Original to the County Clerk and Recorder; duplicate to the State Engineer; Triplicate to the Montana Bureau of Mines and Geology, and Quadruplicate for the Appropriator.

34982

R 837

163193

STATE OF MONTANA }
COUNTY OF LAKE }
Filed on the 31 day of DEC
AD 1963 at 5:08 o'clock PM
HAZEL KINNICK
County Clerk + Recorder
By E. COWMAN
Deputy

COPY

STATE ENGINEER

By: Donald D. Sullivan
Deputy State Engineer

DDS/b
Enc.

February 3, 1964

Mrs. A. L. Baker
1037 West Steel St.
Butte, Montana

Dear Mrs. Baker:

In regard to your letter of December 31, 1963 requesting we send back to you a vested right form which was sent to us on December 23. We regret that such a form cannot be located. It may, however, be in the mountainous pile of mail we have received after January 10, which we are unable to search through at this time.

In the meantime, however, please copy from the original all pertinent information plus the recording data on the enclosed form and return it to our office for filing.

We regret the delay but we have been flooded with forms and correspondence the past two months and we are unable to process our mail any sooner. Thank you for any inconvenience this may cause you.

Sincerely,

EVERETT V. DARLINTON
STATE ENGINEER

By: Donald D. Sullivan
Deputy State Engineer

DDS/b
Enc.

Enc.

Office of
Helena Mead

RECEIVED
JAN 2 1964

Dear Sir,

STATE ENGINEER

On December 23rd I mailed to
your office a copy of Declaration of
Vested Groundwater Rights

I am now informed that the copy
should have been mailed with the
original to the Lake County Recorder.

Will you please return the copy to
me so I may mail it to Lake County
with the original

Thank you.

Yours truly

Mrs. A. L. Baker
1037 West Steel St
Butte Mont

Anna E. Baker

State Engineer
Helena Mont
Attn: Donald A. Sullivan

RECEIVED
FEB 19 1964

Dear Sir:

On December 14th 1963 I mailed to your office an unrecorded copy of a Declaration of Vested Groundwater Rights.

In your letter of February 3rd you stated you were unable to locate my letter of transmittal and requested that I prepare a copy of the declaration including the recording data which is on the reverse side of the form.

Enclosed is the completed form as requested. Please destroy the form which I mailed to you in December as it does not contain the recording data.

Thank you.

Yours truly
Mrs. A. P. Baker ^{dsj} _{AKS}
(Anna E. Baker)
1037 West Steel St

File No.

GW 4

25N R 18W

County LAKE

STATE OF MONTANA
ADMINISTRATOR OF GROUNDWATER CODE
OFFICE OF STATE ENGINEER

RECEIVED
DEC 27 1969

Declaration of Vested Groundwater Rights

(Under Chapter 237, Montana Session Laws, 1961)

STATE ENGINEER

1. ANNA E. BAKER, of SWAN LAKE
(Name of Appropriator) (Address) (Town)
County of LAKE State of MONTANA
have appropriated groundwater according to the Montana laws in effect prior to January 1, 1962, as follows:

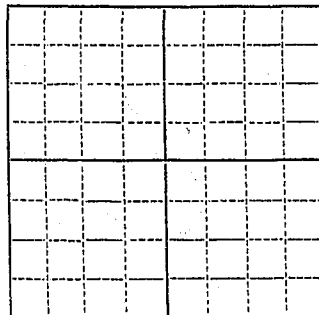

PART OF E 1/2 SE 1/4

1/4 Sec. 14 25N 18W

Indicate point of appropriation and place of use, if possible. Each small square represents 10 acres.

2. The beneficial use on which the claim is based DOMESTIC, DRINKING WASHING, BATHROOM, SPRINKLING

3. Date or approximate date of earliest beneficial use; and how continuous the use has been. OCTOBER 1955 DAILY USE

4. The amount of groundwater claimed (in miner's inches or gallons per minute) 10-15 GALLONS PER MINUTE CONTINUOUS

5. If used for irrigation, give the acreage and description of the lands to which water has been applied and name of the owner thereof. LAWN SPRINKLING. NO IRRIGATION.

6. The means of withdrawing such water from the ground and the location of each well or other means of withdrawal. ELECTRIC PUMP. LOT 8 PETERSON SWAN LAKE TRACTS, SWAN LAKE, MONTANA.

7. The date of commencement and completion of the construction of the well, wells, or other works for withdrawal of groundwater. DEFINITE DATE NOT AVAILABLE, SOMETIME IN 1954.

8. The depth of water table. APPROXIMATELY 20 FEET

9. So far as it may be available, the type, size and depth of each well or the general specifications of any other works for the withdrawal of groundwater. DRILLED WELL, SIX INCH IRON CASING ABOUT 26 FEET DEEP

10. The estimated amount of groundwater withdrawn each year. 73000 GALLONS

11. The log of formations encountered in the drilling of each well if available. NOT AVAILABLE

12. Such other information of a similar nature as may be useful in carrying out the policy of this act, including reference to book and page of any county record. WELL LOCATED ON LOT NO. 8 OF PETERSON'S SWAN LAKE TRACTS, SWAN LAKE, LAKE COUNTY, MONTANA, DESCRIBED IN ABSTRACT AS PART OF LOT 3 OF SECTION 14, TOWNSHIP 25 NORTH RANGE 18 WEST, 14PM, BOOK 45 OF DEEDS PAGE 157.

Signature of Owner.....

Date.....

Three copies to be filed by the owner with the County Clerk and Recorder of the county in which the well is located.

Please answer all questions. If not applicable, so state, otherwise the form will be returned.

Original to the County Clerk and Recorder; duplicate to the State Engineer; Triplicate to the Montana Bureau of Mines and Geology and Quadruplicate for the Appropriator.

Helena, Mont., Dec 15, 1963

Office of State Engineer
Helena Mont

Dear Sir:

Enclosed is copy of Declaration of Vested Groundwater Rights, original of which is being filed with the Lake County Clerk & Recorder at Polson.

It was not possible to indicate by an X in the 10 acre square section the exact location of the well. It is a lake side lot on the east shore of Swan Lake with a 65 ft lake frontage, about 170 ft deep, and about 100 ft wide on the highway side.

The amount of total withdrawal is based on all year living which it will be eventually. Temporarily it is used as a summer home.

Equipment includes a modern bath room, automatic washer & dryer etc.

Yours truly

Mrs Anna E. Baker
1037 West Steel St

va)

2, as follows:

TIC, DRINKING

and how con-

es or gallons
WHITE

of the lands
owner thereof
DN.

ound and the
ELECTRIC
TRACTS.

rks for with-
St.

s of any other
SING ABOUT

LE

act, including
PERSON'S
ED
S. NORTH

ch the well is

ontana Bureau

Note - This is a domestic well
and evidently Mrs. Baker
has sent the forms to the
offices as shown on the bottom
of the form - So we don't have
the filing date at this time.

Doc

3000 GALLONS

NOT AVAILABLE

WELL LOCATED ON LOT NO. 2 OF TRACT
SOUTH LAKE TOWNSHIP, TOWN OF
IN SECTION 12, TOWNSHIP 12 N, RANGE 12 E, COUNTY OF
STATE OF OHIO, DEED NO. 12345

STATE OF MONTANA
ADMINISTRATOR OF GROUNDWATER CODE
MONTANA WATER RESOURCES BOARD

MONTANA DEPARTMENT OF NATURAL RESOURCES AND CONSERVATION

RECEIVED 25-NR-69
JUN 28 1973
Swan Lake
County

14

DRILLER'S LOG

Indicate the character, color, thickness of strata such as soil, clay, sand, gravel, shale, sandstone, etc. Show depth at which water is found and height to which water rises in well.

NOTICE OF COMPLETION OF GROUNDWATER APPROPRIATION BY MEANS OF WELL

Developed after January 1, 1962

(Under Chapter 237, Montana Session Laws, 1961, as amended)

This form to be prepared by driller, and three copies to be filed by the owner with the County Clerk and Recorder in the county in which the well is located, last copy to be retained by driller. Please answer all questions. If not applicable, so state, otherwise the form may be returned.

Owner B. B. BRAYKO
Address Swan Lake
Date well started 5-20-73
completed 5-20-73

For Administrator's Use
File 1488, 210473
June 27, 1973
GW 12:15 P.M.

Type of well Drilled
Equipment used _____
Water Use: Domestic Municipal Stock Irrigation
Industrial Drainage Other Garden/Lawn

*Describe 119500
USE: If used for irrigation, industrial, drainage or other. Explain, state number of acres and location or other data (i.e. Lot, Block and Addition).

ESTIMATED ANNUAL WITHDRAWAL

Size of Drilled Hole	Size and Weight of Casing	From (Feet)	To (Feet)	PERFORATIONS		
				Kind Size	From (Feet)	To (Feet)
<u>5 3/4</u>	<u>250 wall</u>	<u>0</u>		<u>none</u>		
	<u>18.8</u>					
	<u>26 FT.</u>					
	<u>6500</u>					

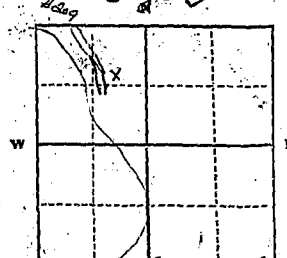

Static water level _____ ft.*
Pumping water level 18 ft.*
at _____ gallons per minute,
measured _____ minutes after pumping began.
*Measured from ground level.
Well developed by _____
for _____ hours.
Power _____ Pump 1.25 HP
Remarks: (Gravel packing, cementing, packers, type of shutoff) _____

Portion of Blv. lot 1
T. 23 N. 14 E.
S. 18 W.

INDICATE LOCATION OF WELL AND PLACE OF USE, IF POSSIBLE. EACH SMALL SQUARE REPRESENTS 40 ACRES.
Driller's Signature Robert Hudson
Driller's Address Swan Lake Mont

Top of Ground (Elev. above sea level)		
From (Feet)	To (Feet)	
<u>0.5</u>	<u>1.5</u>	<u>top soil</u>
		<u>sand & gravel</u>
<u>5.14</u>	<u>6.14</u>	<u>clay and rock</u>
<u>14.16</u>	<u>15.16</u>	<u>clay & gravel</u>
		<u>surface water</u>
<u>16.31</u>	<u>17.31</u>	<u>clay & gravel</u>
<u>31.37</u>	<u>32.37</u>	<u>ground water</u>

LICENSE NO. 103 Show exact depth of bottom

54035

File No.

T. 25 N. R. 18 W. 15

DUPLICATE

County Beauregard

STATE OF MONTANA
ADMINISTRATOR OF GROUNDWATER CODE
OFFICE OF STATE ENGINEER

RECEIVED
SEP 3 1964

Notice of Completion of Groundwater Appropriation by Means of Well ENGINEER

(Under Chapter 237, Montana Session Laws, 1961)

Owner Leo Christensen Address Sun Lake Mont
Driller Robert Hudson Address Sun Lake Mont

Date of Notice of Appropriation of Groundwater.....

Date well started 8-1-18-64 Date Completed 8-20-64

Type of well Drilled Equipment Used Churn
(dug, driven, bored or drilled) (Churn, drill, rotary or other)

Water Use: Domestic Municipal Other Irrigation
Industrial Drainage Stock

Indicate on the diagram the character and thickness of the different strata met with in drilling, such as soil, clay, shale, gravel, rock or sand, etc. Show depth at which water is encountered, thickness and character of water-bearing strata and height to which water rises in the well.

Fill 4' Top of Ground
Silt and sand 16' (Elev. above sea level 3000)
18' Surface water
Clay and gravel
To 31' Water
to 36' ft.

Size of Drilled Ho'e	Size and Weight of Casing	From (Feet)	To (Feet)	PERFORATIONS		
				Kind Size	From (Feet)	To (Feet)
6"	15 LB 6500	0	35.6'	none		

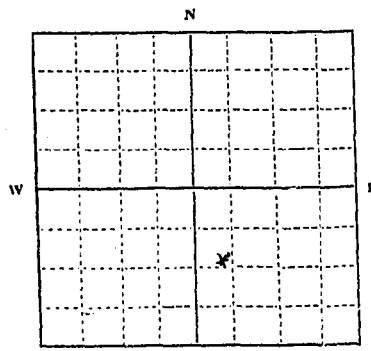

SW 1/4 Sec. 14 T. 25 N. R. 18 W

Indicate location of well and place of use, if possible. Each small square represents 10 acres.

36' Show exact depth of bottom.

Static Water Level for non-flowing Well 43" feet.

Shut-in Pressure for Flowing Well.....

Pumping Water Level 47" feet at 37 gal. per minute.

Discharge in gal. per min. of flowing well.....

How Tested Pump Length of Test 6 hours

Remarks: (Gravel packing, cementing, packers, type of shutoff, location of place of use of groundwater if not at well, and any other similar pertinent information, including number of

acres irrigated, if used for irrigation).....

103
Driller's License Number
Robert Hudson
Driller's Signature

This form to be prepared by driller, and three copies to be filed by the owner with the County Clerk and Recorder in the county in which the well is located.
Please answer all questions. If not applicable, so state, otherwise the form will be returned.
Original to the County Clerk and Recorder; duplicate to the State Engineer; Triplicate to the Montana Bureau of Mines and Geology and Quadruplicate for the Appropriator.

38429

ED
 64
 NEER
 moit
 moit
 LY
 rigation
 e different
 r sand, etc.
 r of water-
 NS
 To
 (Feet)
 feet.
 per minute.
 shutoff, loca-
 well, and any
 ; number of
 d Recorder
 Bureau of
 38429

R 951

166801

Leo Christerson

STATE OF MONTANA
 County of Lake
 Filed on the 1 day of Sept
 A. D. 1964 at 3:30 o'clock P. M.
 HAZEL KINNICK
 County Clerk and Recorder
 By Deputy

[Faint, mostly illegible text and markings, possibly bleed-through or a second page of a document. Includes some vertical lines and scattered characters.]