

STATE OF MONTANA
ADMINISTRATOR OF GROUNDWATER CODE
MONTANA WATER RESOURCES BOARD

NOTICE OF COMPLETION OF GROUNDWATER
APPROPRIATION BY MEANS OF WELL

Developed after January 1, 1962

(Under Chapter 237 Montana Session Laws, 1961, as amended)

This form to be prepared by driller, and three copies to be filed by the owner with the County Clerk and Recorder in the county in which the well is located, last copy to be retained by driller.

Please answer all questions. If not applicable, so state, otherwise the form may be returned.

Owner FRED LAMPING
Address NE S 1/4 Sec 17 T. 1 S. R. 2 E
Date well started MAR. 27 completed MAR. 27-72
For Administrator's Use
File 219250
Date Aug 19, 1972 Time 9:35 am
GW 1

Type of well CABLE TOOLS DRILLED
(Dug, driven, bored or drilled)

Equipment used CABLE TOOLS
(Churn drill, rotary or other)

Water Use: Domestic Municipal Stock Irrigation
Industrial Drainage Other * Garden/Lawn

*Describe

USE: If used for irrigation, industrial, drainage or other. Explain, state number of acres and location or other data (i.e. Lot, Block and Addition).

ESTIMATED ANNUAL WITHDRAWAL 7

Size of Drilled Hole	Size and Weight of Casing	From (Feet)	To (Feet)	PERFORATIONS		
				Kind Size	From (Feet)	To (Feet)
<u>6 5/8</u>	<u>6 5/8</u> <u>16 LB</u>	<u>0</u>	<u>53</u>			

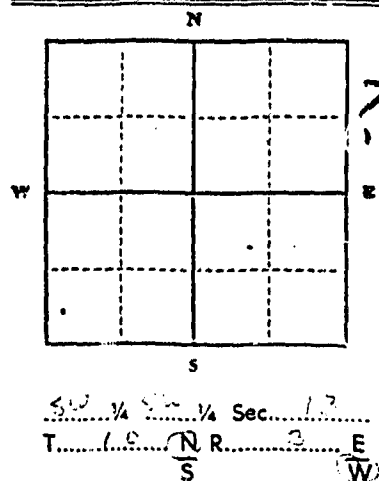

Static water level 35 ft.*
Pumping water level _____ ft.*
at _____ gallons per minute
measured _____ minutes after pumping began.
*Measured from ground level.
Well developed by BAILER
for 2 hours.
Power _____ Pump _____ HP
Remarks: (Gravel packing, cementing, packers, type of shutoff)

INDICATE LOCATION OF WELL AND PLACE OF USE, IF POSSIBLE. EACH SMALL SQUARE REPRESENTS 40 ACRES.

Driller's Signature A. J. Welch
Driller's Address 5820 N. MONT.
HELENA LICENSE NO. 100

County _____

DRILLER'S LOG

Indicate the character, color, thickness of strata such as soil, clay, sand, gravel, shale, sandstone, etc. Show depth at which water is found and height to which water rises in well.

Top of Ground (Elev. above sea level)	
From (Feet)	To (Feet)
<u>0</u>	<u>35</u>
	<u>ROCK, SAND & GRAVEL</u>
<u>35</u>	<u>53</u>
	<u>SAND & GRAVEL</u>
<u>53</u>	<u>53</u>
	<u>WATER</u>

53 Show exact depth of bottom

File No.

T. 10 N R 3 W

DUPLICATE

County Lewis & Clark

STATE OF MONTANA
ADMINISTRATOR OF GROUNDWATER CODE
OFFICE OF STATE ENGINEER

JAN 9 1962

Declaration of Vested Groundwater Rights

(Under Chapter 237, Montana Session Laws, 1961)

1. Charles WALTER WARREN, of Woodlawn B.F.D., Helena
(Name of Appropriator) (Address) (Town)
County of Lewis & Clark State of MONTANA
have appropriated groundwater according to the Montana laws in effect prior to January 1, 1962, as follows:

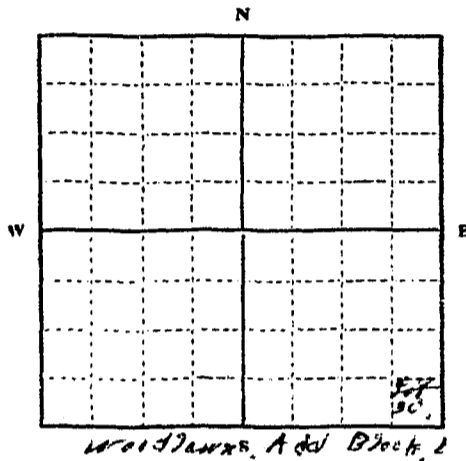

1/4 Sec. 12 T. 10. R. 3 W.

Indicate point of appropriation and place of use, if possible. Each small square represents 10 acres.

2. The beneficial use on which the claim is based... Household & YARD

3. Date or approximate date of earliest beneficial use; and how continuous the use has been... 1946 Continuous

4. The amount of groundwater claimed (in miner's inches or gallons per minute)... 6 Gallons Per Min

5. If used for irrigation, give the acreage and description of the lands to which water has been applied and name of the owner thereof

6. The means of withdrawing such water from the ground and the location of each well or other means of withdrawal... Elec. Pump

7. The date of commencement and completion of the construction of the well, wells, or other works for withdrawal of groundwater... 1946

8. The depth of water table... 63

9. So far as it may be available, the type, size and depth of each well or the general specifications of any other works for the withdrawal of groundwater... 6" casing 63 ft

10. The estimated amount of groundwater withdrawn each year... 36,000

11. The log of formations encountered in the drilling of each well if available... 26'

12. Such other information of a similar nature as may be useful in carrying out the policy of this act, including reference to book and page of any county record

Signature of Owner... [Signature]

Date... 12/30/63

Three copies to be filed by the owner with the County Clerk and Recorder of the county in which the well is located.

Please answer all questions. If not applicable, so state, otherwise the form will be returned.

Original to the County Clerk and Recorder; Duplicate to the State Engineer; Triplicate to the Montana Bureau of Mines and Geology, and Quadruplicate for the Appropriator.

2897

151987

151987
Recorded

STATE OF MONTANA } 36.
COUNTY OF LEWIS & CLARK

I hereby certify that the within in-
strument was filed in my office on
this 7 day of June
A.D. 1904 at 22 min. past
1 o'clock P.M.

Records of Lewis & Clark
County, State of Montana

[Handwritten Signature]

County Recorder

By *M. Lass*
Deputy

[Handwritten initials]

RECEIVED

11th SW
County Levi & Park

STATE OF MONTANA
ADMINISTRATOR OF GROUNDWATER CODE
MONTANA WATER RESOURCES BOARD

SEP 5 1977

DRILLER'S LOG

Indicate the character, color, thickness of strata such as soil, clay, sand, gravel, shale, sandstone, etc. Show depth at which water is found and height to which water rises in well.

NOTICE OF COMPLETION OF GROUNDWATER APPROPRIATION BY MEANS OF WELL

Developed after January 1, 1962

(Under Chapter 237 Montana Session Laws, 1961, as amended)

This form to be prepared by driller, and three copies to be filed by the owner with the County Clerk and Recorder in the county in which the well is located, last copy to be retained by driller. Please answer all questions. If not applicable, so state, otherwise the form may be returned.

Owner: C.B. (Joe) Whitson
Address: E. Helena
Box # 507
Date well started: April 6-71
completed: April 10-71

For Administrator's Use
File <u>228302</u>
<u>Aug. 30, 1972 - 1:25 p.m.</u>
GW 1

Type of well: Drilled
(Dug, driven, bored or drilled)

Equipment used: Churn
(Churn drill, rotary or other)

Water Use: Domestic Municipal Stock Irrigation
Industrial Drainage Other * Garden/Lawn

*Describe
USE: If used for irrigation, industrial, drainage or other. Explain, state number of acres and location or other data (i.e. Lot, Block and Addition).

ESTIMATED ANNUAL WITHDRAWAL 200,000

Size of Drilled Hole	Size and Weight of Casing	From (Feet)	To (Feet)	PERFORATIONS		
				Kind Size	From (Feet)	To (Feet)
8"	8" 25 lb	0	90	5/16 x 1/2	60	62

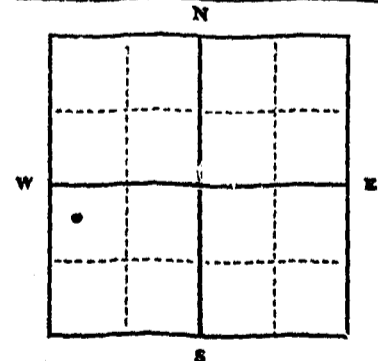

S E 1/4 SW 1/4 Sec. 13
T. 1.0 N. R. 3. E. W.

Static water level 16 ft.*
Pumping water level 80 ft.*
at 80 gallons per minute,
measured 60 minutes after pumping began.
*Measured from ground level.
Well developed by Bailer
for 2 hours.
Power..... Pump..... HP
Remarks: (Gravel packing, cementing, packers, type of shutoff)

INDICATE LOCATION OF WELL AND PLACE OF USE, IF POSSIBLE. EACH SMALL SQUARE REPRESENTS 40 ACRES.

Driller's Signature: Wesley Lindsey
Driller's Address: Clancy Montana

LICENSE NO. 38

Top of Ground (Elev. above sea level)		
From (Feet)	To (Feet)	
0	6	Topsoil + gravel
6	18	gravel (course)
18	38	Hard pan
38	46	Clay
46	60	Sand + Clay
60	65	gravel
65	85	Sand + silt
85	92	gravel

90 Show exact depth of bottom

51,292

228302

Indexed
Recorded
Guaranteed

[Handwritten initials]

STATE OF MONTANA }
COUNTY OF LEWIS & CLARK } SS

I hereby certify that the within in-
strument was filed in my office on
this 30 day of May
A.D. 1922 at 2.5 pm, past
1 o'clock PM and record-
ed on page of Book
of Records of Lewis and
Clark County, State of Montana.

[Handwritten signature]
County Recorder

[Handwritten signature]

200

104-36
County Lewis & Clark

STATE OF MONTANA
ADMINISTRATOR OF GROUNDWATER CODE
MONTANA WATER RESOURCES BOARD

APR 24 1971

DRILLER'S LOG

Indicate the character, color, thickness of strata such as soil, clay, sand, gravel, shale, sandstone, etc. Show depth at which water is found and height to which water rises in well.

NOTICE OF COMPLETION OF GROUNDWATER APPROPRIATION BY MEANS OF WELL

Developed after January 1, 1962

(Under Chapter 237 Montana Session Laws, 1961, as amended)

This form to be prepared by driller, and three copies to be filed by the owner with the County Clerk and Recorder in the county in which the well is located, last copy to be retained by driller. Please answer all questions. If not applicable, so state, otherwise the form may be returned.

Owner Steve Zivicic
Address East Helena
Montana

For Administrator's Use	
File	<u>216407</u>
	<u>April 5, 1971</u>
	<u>8:40 AM</u>
GW 1	

Date well started Mar 8-71
completed Mar 10-71

Type of well Drilled
(Dug, driven, bored or drilled)
Equipment used Churn
(Churn drill, rotary or other)

Water Use: Domestic Municipal Stock Irrigation
Industrial Drainage Other * Garden/Lawn

*Describe _____
USE: If used for irrigation, industrial, drainage or other. Explain, state number of acres and location or other data (i.e. Lot, Block and Addition).

ESTIMATED ANNUAL WITHDRAWAL 80,000

Size of Drilled Hole	Size and Weight of Casing	From (Feet)	To (Feet)	PERFORATIONS		
				Kind Size	From (Feet)	To (Feet)
<u>6</u>	<u>17 LB</u>	<u>0</u>	<u>56</u>	<u>none</u>		

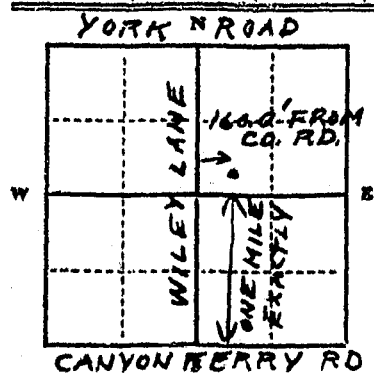

Static water level 21 ft.*
Pumping water level 4.8 ft.*
at 2.5 gallons per minute,
measured 60 minutes after pumping began.
*Measured from ground level.
Well developed by Ruler
for 2 hours.
Power elec Pump 1/2 HP
Remarks: (Gravel packing, cementing, packers, type of shutoff)

N.W. 1/4 1.3 Sec. 1
T. 12 N. R. 3 E. W

INDICATE LOCATION OF WELL AND PLACE OF USE, IF POSSIBLE. EACH SMALL SQUARE REPRESENTS 40 ACRES.

Driller's Signature Wesley Lindsay
Driller's Address Clancy Montana

LICENSE NO. 38

Top of Ground		(Elev. above sea level)
From (Feet)	To (Feet)	
<u>0</u>	<u>5</u>	<u>topsoil & gravel</u>
<u>5</u>	<u>19</u>	<u>gravel</u>
<u>19</u>	<u>32</u>	<u>clay & gravel</u>
<u>32</u>	<u>48</u>	<u>clay & hardpan</u>
<u>48</u>	<u>55</u>	<u>sand & clay</u>
<u>55</u>	<u>57</u>	<u>gravel</u>

5-6 Show exact depth of bottom

48377

216407

Indexed
Recorded
Compared

STATE OF MONTANA
COUNTY OF LEWIS & CLARK

I hereby certify that the within instrument was filed in my office on this 10 day of April A.D. 1911 at 10 min. past 8 o'clock A.M.

Records of Lewis & Clark
County, State of Montana.
John L. ...
County Recorder
Harold ...
Deputy
Bill

Handwritten notes and signatures in the right margin.

Handwritten notes and signatures at the bottom of the page.

69500

File No. _____
DUPLICATE

STATE WATER CONSERVATION BOARD

R E C E I V E D
AUG 10 1965

T. 16^N R. 3^W 14
County Lewis & Clark

LOG

STATE OF MONTANA
ADMINISTRATOR OF GROUNDWATER CODE
OFFICE OF STATE ENGINEER

**Notice of Completion of Groundwater
Appropriation by Means of Well**
DEVELOPED AFTER JANUARY 1, 1962

(Under Chapter 237, Montana Session Laws, 1961)

Layne Well No. 1

Owner City of East Helena Address East Helena, Mont.

Driller Layne-Minnesota Co. Address Minneapolis, Minn.

Date of Notice of appropriation of groundwater _____

Date well started Feb. 13, 1965 Date completed Mar. 22, 1965

Type of well Drilled Equipment used Caisson
(Dug, Driven, bored or drilled) (Churn drill, rotary or other)

Water use: Domestic Municipal Stock Irrigation
Industrial Drainage Other

Indicate on the diagram the character and thickness of the different strata met with in drilling, such as soil, clay, shale, gravel, rock or sand, etc. Show depth at which water is encountered, thickness and character of water-bearing strata and height to which the water rises in the well.

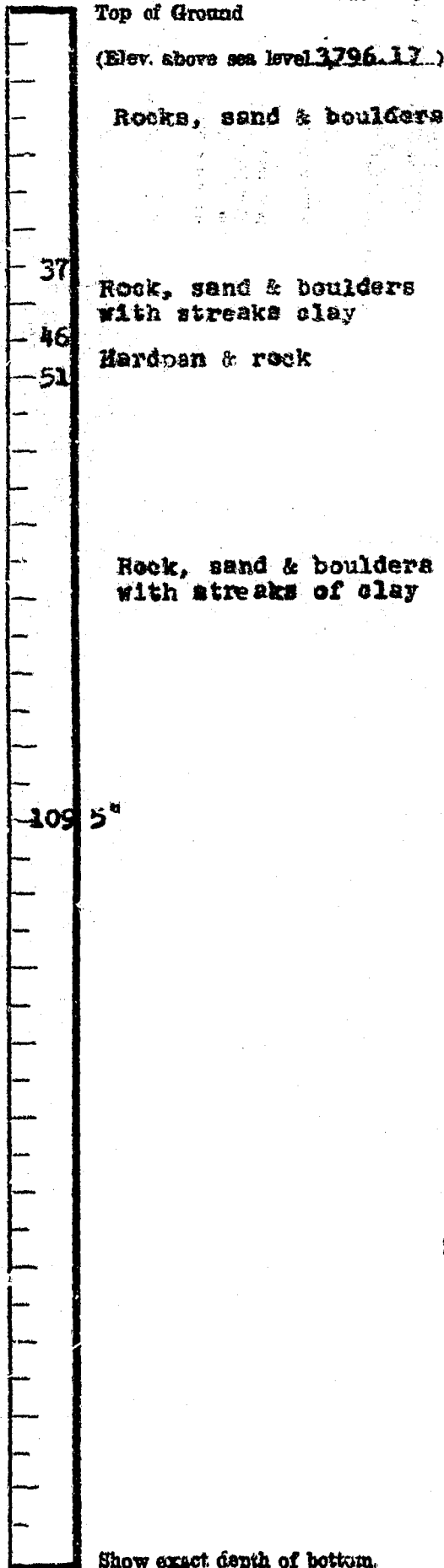

Size of Drilled Hole	Size and Weight of Casing	From (Feet)	To (Feet)	PERFORATIONS		
				Kind Size	From (Feet)	To (Feet)
Mix. 38" dia	48" OD (cemented in)	0	30			
	16" 3/8" wall	0	90			
	16" OD stainless steel shutter casing			#2	60	110

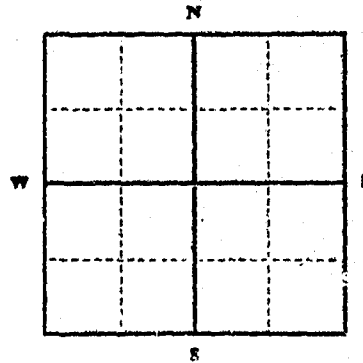

Static Water Level for non-flowing well 34.4 feet.
Shut-in Pressure for Flowing Well _____
Pumping Water Level 54.1 feet
at 600 gal. per minute.
Discharge in gal. per min. of flowing well _____

How Tested Turbine Pump
Length of Test 12 hrs

Remarks: (Gravel packing, cementing, packers, type of shutoff) _____
Outer casing cemented in.
Double gravel well wall with
28" dia. gravel casing

SE 1/4 SE Sec. 14, T. 10 R. 3W
Indicate location of well and place of use, if possible. Each small square represents 40 acres.

(Continue on reverse side)

USE—If used for irrigation, industrial, drainage or other. Explain, state number of acres and location or other data (i.e.: Lot, Block and Addition).

This form to be prepared by driller, and three copies to be filed by the owner with the County Clerk and Recorder in the county in which the well is located, tissue copy to be retained by driller.

Please answer all questions. If not applicable, so state, otherwise the form will be returned.

Driller's License Number 76
Layne-Minnesota Co.
Driller's Signature D. C. Vry

39414

#170401

INDEXED
RECORDED
COMPARED

STATE OF MONTANA
COUNTY OF LEWIS & CLARK

I hereby certify that the within instrument was filed in my office on this 6th day of August A.D. 1965 at 7:35 m. past 7 o'clock A. M.

Records of Lewis & Clark
County, State of Montana

STATE OF MONTANA
RECORDS & COURTS
DIVISION

[Signature]
County Recorder
By *[Signature]*
Deputy

No Fee

U

STATE OF MONTANA
ADMINISTRATOR OF GROUNDWATER CODE
MONTANA WATER RESOURCES BOARD

County Lewis & Clark

RECEIVED

DRILLER'S LOG

NOTICE OF COMPLETION OF GROUNDWATER
APPROPRIATION BY MEANS OF WELL

Developed after January 1, 1962

MONTANA DEPARTMENT OF NATURAL
RESOURCES AND CONSERVATION

Indicate the character, color, thickness of strata such as soil, clay, sand, gravel, shale, sandstone, etc. Show depth at which water is found and height to which water rises in well.

(Under Chapter 237 Montana Session Laws, 1961, as amended)

This form to be prepared by driller, and three copies to be filed by the owner with the County Clerk and Recorder in the county in which the well is located, last copy to be retained by driller.

Please answer all questions. If not applicable, so state, otherwise the form may be returned.

Owner Don Didrikson

Address 929 N. Jackson

Helena, Montana 59601

Date well started 6/20/73

completed 5/20/73

Type of well Drilled

Equipment used Churn drill

Water Use: Domestic Municipal Stock Irrigation

Industrial Drainage Other Garden/Lawn

*Describe

USE: If used for irrigation, industrial, drainage or other. Explain, state number of acres and location or other data (i.e. Lot, Block and Addition).

ESTIMATED ANNUAL WITHDRAWAL

Size of Drilled Hole	Size and Weight of Casing	From (Feet)	To (Feet)	PERFORATIONS		
				Kind Size	From (Feet)	To (Feet)
6"	6 5/8" od x .250	0'	54'	cutting torch	49'	54'

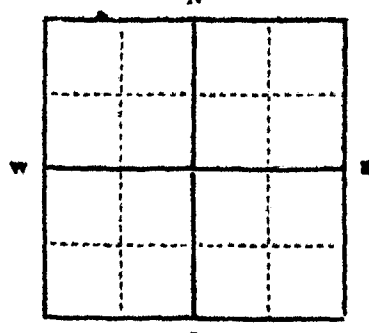

Static water level 48 ft.
Pumping water level: 23 ft.
at 10 gallons per minute,
measured 3 minutes after pumping
began.

*Measured from ground level.
Well developed by bailing one hour
for 1 hours.

Power..... Pump..... HP
Remarks: (Gravel packing, cementing,
packers, type of shutoff)

N.W. 1/4 NW 1/4 Sec. 14
T. 10 N. R. 3 E. S. 3

INDICATE LOCATION OF WELL AND PLACE OF USE, IF POSSIBLE. EACH SMALL SQUARE REPRESENTS 40 ACRES.

Driller's Signature Bailey & O'Keefe Drilling Company

Driller's Address Box #136 East Helena,

Montana 59635 LICENSE NO. 248

Top of Ground (Elev. above sea level)		
From (Feet)	To (Feet)	
0'	3'	Top soil
3'	25'	Gravel, sand, water
25'	33'	Sand, clay, water
33'	38'	Heavy sand, water
38'	45'	Coarse sand, clay
45'	50'	Clay, some water
50'	54'	Water, sand

54' Show exact depth of bottom

55834

226677

Indexed
Recorded
Guaranteed **B**

STATE OF MONTANA
COUNTY OF LEWIS & CLARK } S:

I hereby certify that the within in
strument was filed in my office on
this 3 day of July
A.D. 1923 at 407 min. past
1 o'clock P.M.

Records of Lewis & Clark
County, State of Montana

John J. Daniels
County Recorder
by *Carl E. Johnson*
Deputy

2.00

RECEIVED

JUL 19 1973

MONTANA DEPARTMENT OF NATURAL
RESOURCES AND CONSERVATION

O'KEEFE DRILLING CO.
2804 Harvard
BUTTE, MONTANA 59701

INDUSTRIAL DOMESTIC MINING EXPLORATION
DRILLING



Mr. Don Didrikson
929 North Jackson
Helena, Montana 59601

*Envelope Postage date
per 30.*

236511

STATE OF MONTANA
COUNTY OF LEWIS & CLARK

I hereby certify that the within in-
strument was filed in my office on
this 29 day of June
A.D. 1973 at 11 min. past
11 o'clock A.M.

Records of Lewis & Clark
County, State of Montana.

Robert D. Smith
County Recorder
by *Carol Anderson*
Deputy

2.00

SEARCHED
SERIALIZED
INDEXED *KE*

RECORDED
INDEXED
JUN 29 1973
11:11 AM

236510

Indexed
Recorded
4/10

STATE OF MONTANA
COUNTY OF LEWIS & CLARK } S:

hereby certify that the within in
strument was filed in my office on
this 29 day of June
A.D. 1993 at 10 min. past
11 o'clock A.M.

Records of Lewis & Clark
County, State of Montana

John D. ...
County Recorder
Charles ...
Deputy
2.00

[Faint handwritten notes and stamps, including "RECORDED" and "INDEXED" with checkmarks]

226394

STATE OF MONTANA
COUNTY OF LEWIS & CLARK } ss

I hereby certify that the within in-
strument was filed in the office on
this 29 day of June
A.D. 19 23 at 11 min. past
9 o'clock A.M.

Records of Lewis & Clark
County, State of Montana

John Donald
County Recorder

Carl Peterson
Deputy

R. D.

INDEXED
SERIALIZED
FILED

JUN 29 1923

RECORDED

JUN 29 1923

JUN 29 1923

JUN 29 1923

DEPT. OF

RECORDS

RECORDED
INDEXED
FILED
JUN 29 1923

000,000.5

104 20
County Lewis + Clark

STATE OF MONTANA
ADMINISTRATOR OF GROUNDWATER CODE
MONTANA WATER RESOURCES BOARD

14

NOTICE OF COMPLETION OF GROUNDWATER APPROPRIATION WITHOUT WELL

Developed After January 1, 1962

(Under Chapter 237, Montana Session Laws, 1961, as amended)

This form to be prepared by contractor (if any), otherwise by the owner.

Three copies of this notice are to be filed with the County Clerk and Recorder of the county in which the works are located.

Please answer all questions. If not applicable, so state, otherwise the form may be returned.

For Administrator's Use	
File	<u>236379</u>
	<u>June 29, 1973</u>
GW 1	<u>9:04 a.m.</u>

Owner Ray F + Jean M. Kimble

Address 5495 No. Mont. A. Helena, Mt.

Contractor (if any) unknown

Address of Contractor _____

Date Started unknown Date Completed unknown

1. Describe means of obtaining groundwater (as by sub-irrigation, developed spring, drains, etc.) Developed Spring

2. Means of withdrawing water (gravity, pump, canal, etc.) Gravity + Pump

3. Depth of water table 6 to 8'

4. Use of the water Irrigation

5. Amount of groundwater claimed (in miner's inches or gallons per minute) 5

6. If used for irrigation, give number of acres and description of land 10 acres

7. Estimate amount of water used each year 30 acre feet

8. Months of year spring flows 12 months

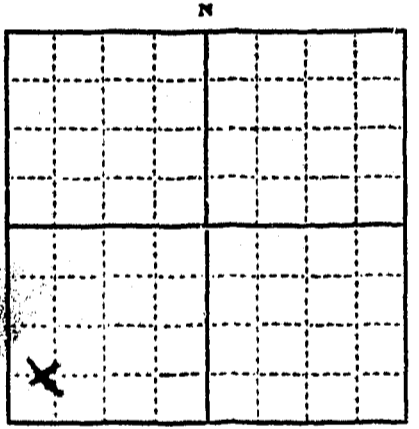

SW 1/4 SW 1/4 Sec 14

T 10 N R 3 W

INDICATE POINT OF APPROPRIATION AND PLACE OF USE, IF POSSIBLE.

Elevation of spring, if known or estimated 3865

Signature of Owner Jean M. Kimble
Ray F. Kimble

Date 6-29-73

5474

236379

Index
Recorded
INDEXED *ke*

STATE OF MONTANA
COUNTY OF LEWIS & CLARK } S:

I hereby certify that the within in
strument was filed in my office on
the 29 day of June
A.D. 1973 at 04 min past
9 o'clock A.M.

Records of Lewis & Clark
County, State of Montana

John Donald
County Recorder

Carl Peterson
Deputy

R.O.

File No.

MAY 16 1966

T. 10N. R. 3W.

DUPLICATE

LOG

Bill _____ McDermott _____ County L. & S.
 Butler _____ McNulty _____ STATE OF MONTANA
 Coyle _____ Morton _____ ADMINISTRATOR OF GROUNDWATER CODE
 Carlsson _____ Sullivan _____ OFFICE OF STATE ENGINEER
 Dickert _____

Top of Ground

(Elev. above sea level 4,000 ft.)

Notice of Completion of Groundwater Appropriation by Means of Well

DEVELOPED AFTER JANUARY 1, 1962

(Under Chapter 237, Montana Session Laws, 1961)

0 to 25 ft. sand and gravel
Owner Gene A. Picotte Address Helena, Montana

Driller Walter Riddock Address Helena, Montana

25 to 37 clay and gravel
Date of Notice of appropriation of groundwater April 4, 1966

Date well started March 28, 66 Date completed April 2, 66

37 to 46 gravel water
course gravel 44 to 46

Type of well Drilled Equipment used Churn Drill
(Dug, Driven, bored or drilled) (Churn drill, rotary or other)

Water use: Domestic Municipal Stock Irrigation
Industrial Drainage Other

Indicate on the diagram the character and thickness of the different strata met with in drilling, such as soil, clay, shale, gravel, rock or sand, etc. Show depth at which water is encountered, thickness and character of water-bearing strata and height to which the water rises in the well.

Total depth 46 ft.

Size of Drilled Hole	Size and Weight of Casing	From (Feet)	To (Feet)	PERFORATIONS		
				Kind Size	From (Feet)	To (Feet)
6"	2" 10# - 6"	0	46'		None	

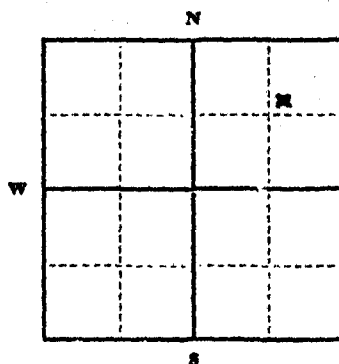

Static Water Level for non-flowing well 37 feet.

Shut-in Pressure for Flowing Well.....

Pumping Water Level..... 36 feet
at..... 16 gal. per minute.

Discharge in gal. per min. of flowing well

How Tested..... Bailer

Length of Test..... 2 Hr.

Remarks: (Gravel packing, cementing, packers, type of shutoff).....

NE 1/4 Sec. 14 T. 10N. R. 3W.
Indicate location of well and place of use, if possible. Each small square represents 40 acres

(Continue on reverse side)

USE—If used for irrigation, industrial, drainage or other. Explain, state number of acres and location or other data (i.e.: Lot, Block and Addition).

Show exact depth of bottom.

This form to be prepared by driller, and three copies to be filed by the owner with the County Clerk and Recorder in the county in which the well is located, tissue copy to be retained by driller.

Please answer all questions. If not applicable, so state, otherwise the form will be returned.

Montana No. 49

Driller's License Number

Walter Riddock
Driller's Signature

41051

177783

Indexed
Recorded
Compared

STATE OF MONTANA } 96
COUNTY OF LEWIS & CLARK }

I hereby certify that the within in-
strument, was filed in my office on
this 19 day of May
A.D. 1906 at 25 m. and
11 o'clock A.M.

Recorder of Lewis & Clark
County, State of Montana.

Arthur J. ...
County Recorder

C. ...
Deputy

S. ad

File No. _____

T 10N R S E

DUPLICATE

County Lewis and Clark

STATE OF MONTANA
ADMINISTRATOR OF GROUNDWATER CODE
OFFICE OF STATE ENGINEER

RECEIVED

Declaration of Vested Groundwater Rights

(Under Chapter 237, Montana Session Laws, 1961)

STATE ENGINEER

1. John E. Rogan, of York St. Helena,
(Name of Appropriator) (Address) (Town)

County of Lewis & Clark State of Montana

have appropriated groundwater according to the Montana laws in effect prior to January 1, 1962, as follows:

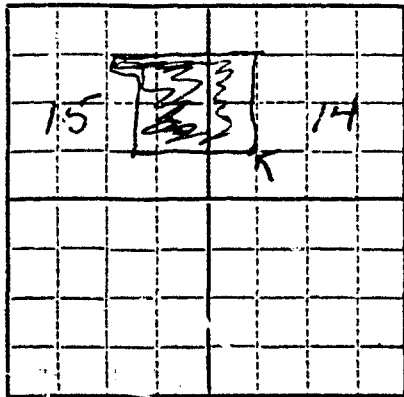

NW, SW 1/4 Sec. 14 T 10N R SE

Indicate point of appropriation and place of use, if possible. Each small square represents 10 acres.

2. The beneficial use on which the claim is based...
Irrigation and Live Stock.

3. Date or approximate date of earliest beneficial use; and how continuous the use has been...
June 15, 1948.

Used annually ever since.

4. The amount of groundwater claimed (in miner's inches or gallons per minute)...
1,150 gallons per minute.

5. If used for irrigation, give the acreage and description of the lands to which water has been applied and name of the owner thereof...
156 acres farm land on Rogan Ranch.

6. The means of withdrawing such water from the ground and the location of each well or other means of withdrawal...
Electric pump.

7. The date of commencement and completion of the construction of the well, wells, or other works for withdrawal of groundwater...
Started digging March 28, 1948 and finished about April 15, 1948.

8. The depth of water table...
Well is 50' deep and averages 30' of water when not pumping. Pumps down to about 6'.

9. So far as it may be available, the type, size and depth of each well or the general specifications of any other works for the withdrawal of groundwater...
6 feet steel casing, 50 feet deep.

10. The estimated amount of groundwater withdrawn each year...
1,615,680,000 gal.

11. The log of formations encountered in the drilling of each well if available...
Sand and gravel.

12. Such other information of a similar nature as may be useful in carrying out the policy of this act, including reference to book and page of any county record...
Refer to Soil Conservation records.

Signature of Owner... John E. Rogan
Date... 1-9-63

Three copies to be filed by the owner with the County Clerk and Recorder of the county in which the well is located.

Please answer all questions. If not applicable, so state, otherwise the form will be returned.

Original to the County Clerk and Recorder; duplicate to the State Engineer; Triplicate to the Montana Bureau of Mines and Geology, and Quadruplicate for the Appropriator.

139309

RECORDED
INDEXED

STATE OF MONTANA
COUNTY OF LEWIS & CLARK

I hereby certify that the within in-
strument was filed in my office on
this 4th day of Jan
A.D. 1963 at 50 min. past
8 o'clock A.M.

Records of Lewis & Clark
County, State of Montana.

John David
County Recorder

By James E. Russell
Deputy

2:00

RECEIVED
OCT 19 1957

T. 10 N. R. 3 West 14
County Lewis & Clark

STATE ENGINEER MONTANA BUREAU OF MINES AND GEOLOGY
Butte, Montana

WATER WELL LOG

Owner *J. Paul J. W. Conrad Regan* Address *Helena Mont, P.O. 1*
 Driller *Progress Drilling Co* Address *Helena Mont*
 Date Started *Feb 20 1949* Date Completed *March 25 1949*
 Location: Sec. *14* T. *10 N.* R. *3 W 1/4* sec. *SE Corner of 4 NW 1/4 SW 1/4*

Type of well *Dug* Equipment used *Clam*
(Dug, driven, bored, or drilled) (Churn drill, rotary, other)

Water use: Domestic Municipal Stock Irrigation
 Industrial Drainage Other: _____

Casing: *52* ft. to *52* ft. Type *Steel* Size *5 ft. diameter*
 Casing: _____ ft. to _____ ft. Type _____ Size _____
 Casing: _____ ft. to _____ ft. Type _____ Size _____

Perforated or Screened: Ft. *37* to ft. *52* Ft. _____ to ft. _____

Type of screen or perforations *2 inch holes at several intervals*

Static Water level, for non-flowing well: *38* feet.

Shut-in pressure, for flowing well: _____ lb./sq. in. on: _____ (date)

Pumping water level: *38* feet at *1000* gal. per min.

How tested: *Pump*

Length of test: *Six weeks*

Remarks: (Gravel packing, cementing, packers, type of shut-off, depth of shut-off)
The reason for the well being 5 ft. in diameter is that the gravel failed to pack, so had to underream to the clay had fan separating the surface water from the second strata water.

(over)

HARRY STAHLER
 BOX 260
 EAST HELENA

County Lewis & Clark

DRILLER'S LOG

Indicate the character, color, thickness of strata such as soil, clay, sand, gravel, shale, sandstone, etc. Show depth at which water is found and height to which water rises in well.

NOTICE OF COMPLETION OF GROUNDWATER APPROPRIATION BY MEANS OF WELL

Developed after January 1, 1962

(Under Chapter 237 Montana Session Laws, 1961, as amended)

This form to be prepared by driller, and three copies to be filed by the owner with the County Clerk and Recorder in the county in which the well is located, last copy to be retained by driller.

Please answer all questions. If not applicable, so state, otherwise the form may be returned.

Owner Harry Stahl

Address Canyon Ferry Rte.

Helena, Montana

Date well started June 16, 1970

completed June 18, 1970

Type of well drilled

Equipment used churn

Water Use: Domestic Municipal Stock Irrigation

Industrial Drainage Other * Garden/Lawn

*Describe

USE: If used for irrigation, industrial, drainage or other. Explain, state number of acres and location or other data (i.e. Lot, Block and Addition).

ESTIMATED ANNUAL WITHDRAWAL

Size of Drilled Hole	Size and Weight of Casing	From (Feet)	To (Feet)	PERFORATIONS		
				Kind Size	From (Feet)	To (Feet)
6"	17 lb.	0	57	none	none	none

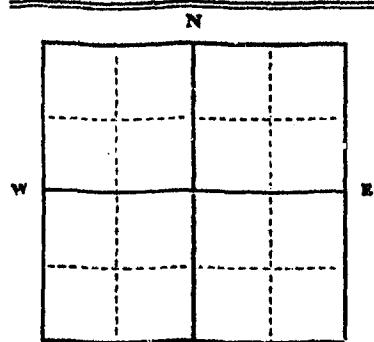

Static water level 14 ft.*
 Pumping water level 50 ft.*
 at 20 gallons per minute,
 measured 60 minutes after pumping
 began.
 *Measured from ground level.
 Well developed by pump
 for 2 hours.
 Power ELCO Pump 1/2 HP
 Remarks: (Gravel packing, cementing,
 packers, type of shutoff)

S 2 1/2 E 1/4 NE 1/4 Sec 14
T. 12 N. R. 3 West

INDICATE LOCATION OF WELL AND PLACE OF USE, IF POSSIBLE. EACH SMALL SQUARE REPRESENTS 40 ACRES.

Driller's Signature Wesley Lindsey

Driller's Address Clancy Montana

LICENSE NO. 38

Top of Ground (Elev. above sea level)		
From (Feet)	To (Feet)	
0	6	pit
6	18	gravel (coarse)
18	29	hardpan
29	38	clay & gravel
38	51	hardpan
51	58	clay
58	60	gravel & clay
60	63	gravel & sand

57 Show exact depth of bottom

47752

213569

Indexed
Recorded
Compared *JH*

STATE OF MONTANA }
COUNTY OF LEWIS & CLARK } SS.

I hereby certify that the within In-
strument was filed in my office on
this 2 day of Nov
A.D. 1970 at 10 min. past
1 o'clock PM.

Records of Lewis & Clark
County, State of Montana

John Daniel
County Recorder

By *Carol Jackson*
Deputy

200

10N-30D
County LEWIS & CLARK

STATE OF MONTANA
ADMINISTRATOR OF GROUNDWATER CODE
MONTANA WATER RESOURCES BOARD

DRILLER'S LOG

NOTICE OF COMPLETION OF GROUNDWATER
APPROPRIATION BY MEANS OF WELL

Developed after January 1, 1962

14
Indicate the character, color, thickness of strata such as soil, clay, sand, gravel, shale, sandstone, etc. Show depth at which water is found and height to which water rises in well.

(Under Chapter 237 Montana Session Laws, 1961, as amended)

This form to be prepared by driller, and three copies to be filed by the owner with the County Clerk and Recorder in the county in which the well is located, last copy to be retained by driller.

Please answer all questions. If not applicable, so state, otherwise the form may be returned.

Owner PAUL L. STAV
Address 229 WALLACE
HELENA, MONTANA
Date well started APR. 26, 1971
completed APR. 29, 1971

For Administrator's Use
File 217545
May 25, 1971
10:25 AM
GW 1

Type of well DRILLED
(Dug, driven, bored or drilled)

Equipment used CHURN
(Churn drill, rotary or other)

Water Use: Domestic Municipal Stock Irrigation
Industrial Drainage Other * Garden/Lawn

*Describe

USE: If used for irrigation, industrial, drainage or other. Explain, state number of acres and location or other data (i.e. Lot, Block and Addition). IRRIGATING 10 ACRES

ESTIMATED ANNUAL WITHDRAWAL 200,000

Size of Drilled Hole	Size and Weight of Casing	From (Feet)	To (Feet)	PERFORATIONS		
				Kind Size	From (Feet)	To (Feet)
6"	1716	0	77	5/16" x 1 1/2"	52	54

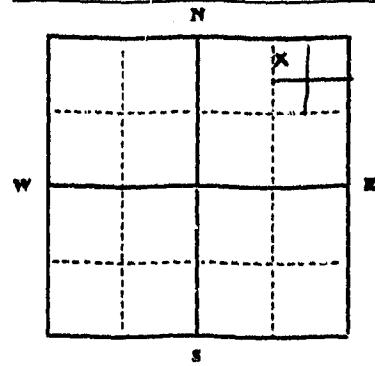

Static water level 16 ft.*
Pumping water level 20 ft.*
at 60 gallons per minute,
measured 120 minutes after pumping
began.
*Measured from ground level.
Well developed by BALLER
for 2 hours.
Power..... Pump..... HP
Remarks: (Gravel packing, cementing,
packers, type of shutoff)

N.E. 1/4 NE 1/4 Sec. 14
T. 10 N. R. 3 E
S (W)

INDICATE LOCATION OF WELL AND PLACE OF USE, IF POSSIBLE.
EACH SMALL SQUARE REPRESENTS 40 ACRES.

Driller's Signature Wesley Lindsay
Driller's Address Clancy Montana

LICENSE NO. 38

Top of Ground (Elev. above sea level)

From (Feet)	To (Feet)	
0	5	TOPSOIL & GRAVEL
5	28	GRAVEL (LARGE)
28	48	HARD PAN
48	52	SAND
52	55	GRAVEL
52	72	SAND & SILT
72	76	GRAVEL

76 Show exact depth of bottom

48547

217545

Indexed
Recorded
Compared *A*

STATE OF MONTANA
COUNTY OF LEWIS & CLARK

I hereby certify that the within in-
strument was filed in my office on
this 25 day of May
A.D. 19 91 at 2 1/2 min. past
10 o'clock AM.

Records of Lewis & Clark
County, State of Montana

John D. Smith
County Recorder

Carol Anderson
Deputy

A. D.

15/20
21/26

File No.

T. 107 R. 3 N
County Lewis & Clark

DUPLICATE

STATE OF MONTANA
ADMINISTRATOR OF GROUNDWATER CODE
OFFICE OF STATE ENGINEER

RECEIVED
JUL 11 1963

Declaration of Vested Groundwater Rights
(Under Chapter 237, Montana Session Laws, 1961) STATE ENGINEER

1. I, James Bompert, of C. F. Rte Helena
(Name of Appropriator) (Address) (Town)

County of Lewis & Clark State of Montana
have appropriated groundwater according to the Montana laws in effect prior to January 1, 1962, as follows: Sec 15 SE 1/4 SW 1/4 SW 1/4 SE 1/4

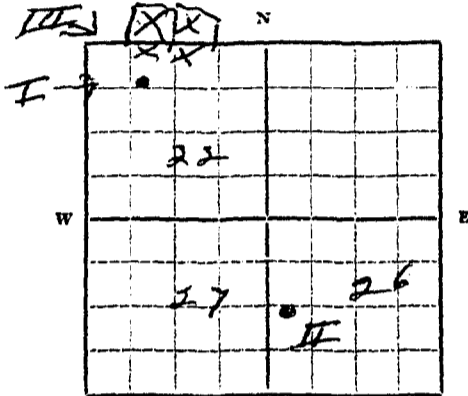

INE 1/4 Sec 26 T. 107 R. 3 N

II 1/4 Sec 26 T. 107 R. 3 N

Indicate point of appropriation and place of use, if possible. Each small square represents 10 acres.

- The beneficial use on which the claim is based Livestock
Horsehold and Irrigation
- Date or approximate date of earliest beneficial use; and how continuous the use has been I 1909 Continuous
II Spring run since 1909
used for beneficial purposes
- The amount of groundwater claimed (in miner's inches or gallons per minute) I 10 gals per minute
II 10 gals per min
III 5 ac ft area for 60 acres
- If used for irrigation, give the acreage and description of the lands to which water has been applied and name of the owner thereof Sub Irrigation water table
4 ft 7 in under 2 ft deep sec 15
Sec 15 SW 1/4 T. 107 R. 3 N Sec 26 NE 1/4 T. 107 N
James Bompert, part town 7 N 1/4 & 7 E 1/4
- The means of withdrawing such water from the ground and the location of each well or other means of withdrawal Jet
 pumps & sump pump
Capillary attraction
- The date of commencement and completion of the construction of the well, wells, or other works for withdrawal of groundwater I 9 months Sept 1909 to June July
1909
II Capillary attraction
III C
- The depth of water table I 18 ft.
II 3 1/2 ft.
III 20 ft.
- So far as it may be available, the type, size and depth of each well or the general specifications of any other works for the withdrawal of groundwater I Well 3 1/2 ft deep
diameter 5 ft 8 ft water
II 3 1/2 x 4 x 15 ft deep
capillary 3 1/2 ft water to overflow
III through soil by capillary attraction
to hand set pump also
- The estimated amount of groundwater withdrawn each year I 2,190,000 gal
II 4,580,000 gal
III 4 ac ft area
- The log of formations encountered in the drilling of each well if available I Clay
II Shale
III Clay sump 4 ft 7 in to water
table on sec line between sec 15 and 26
T. 107 R. 3 N
- Such other information of a similar nature as may be useful in carrying out the policy of this act, including reference to book and page of any county record.

Signature of Owner James Bompert
Date May 10 1963

Three copies to be filed by the owner with the County Clerk and Recorder of the county in which the well is located.

Please answer all questions. If not applicable, so state, otherwise the form will be returned.

Original to the County Clerk and Recorder; duplicate to the State Engineer; Triplicate to the School of Mines and Quadruplicate for the Appropriator.

145504

INDEXED
RECORDED
COMPARED

STATE OF MONTANA }
COUNTY OF LEWIS & CLARK } 55

I hereby certify that the within in-
strument was filed in my office on
this 27th day of June
A.D. 1943 at 10 min. PM
of clock 10 M.

Records of Lewis & Clark
County of Montana.

John J. Jovich

County Recorder
Louise C. Russell

2:00

RECORDED
INDEXED

File No.

T. 10 N R. 3 W

DUPLICATE

County Lewis and Clark

STATE OF MONTANA
ADMINISTRATOR OF GROUNDWATER CODE
OFFICE OF STATE ENGINEER

RECEIVED
JAN 2 1964
STATE ENGINEER

Declaration of Vested Groundwater Rights

(Under Chapter 237, Montana Session Laws, 1961)

1. B. H. Lichtwardt, of Helena Route 1 Montana
(Name of Appropriator) (Address) (Town)
County of Lewis and Clark State of Montana
have appropriated groundwater according to the Montana laws in effect prior to January 1, 1962, as follows:

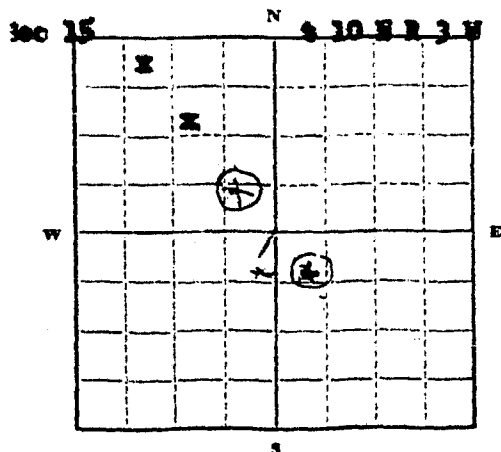

1/4 Sec 15 T 10 N R 3 W

Indicate point of appropriation and place of use, if possible. Each small square represents 10 acres.

2. The beneficial use on which the claim is based irrigation

3. Date or approximate date of earliest beneficial use; and how continuous the use has been. August 1945
Other wells 1865 to 1930

4. The amount of groundwater claimed (in miner's inches or gallons per minute) 125 miners inches
Approximately 100 sec 15

5. If used for irrigation, give the acreage and description of the lands to which water has been applied and name of the owner thereof Approximately 100 acres
Sec. 15 T 10 N R 3 W

6. The means of withdrawing such water from the ground and the location of each well or other means of withdrawal 6 in. pump water pump

7. The date of commencement and completion of the construction of the well, wells, or other works for withdrawal of groundwater March 1945 June 1945

8. The depth of water table 70 ft wide 70 ft deep

9. So far as it may be available, the type, size and depth of each well or the general specifications of any other works for the withdrawal of groundwater.

10. The estimated amount of groundwater withdrawn each year 125 inches for several days

11. The log of formations encountered in the drilling of each well if available log with a dragline

12. Such other information of a similar nature as may be useful in carrying out the policy of this act, including reference to book and page of any county record.

Signature of Owner B. H. Lichtwardt

Date 12-15-63

Three copies to be filed by the owner with the County Clerk and Recorder of the county in which the well is located.

Please answer all questions. If not applicable, so state, otherwise the form will be returned.

Original to the County Clerk and Recorder; duplicate to the State Engineer; Triplicate to the Montana Bureau of Mines and Geology, and Quadruplicate for the Appropriator.

17502

Indexed
Recorded
Completed

151483

STATE OF MONTANA
COUNTY OF LEWIS & CLARK

I hereby certify that the within in-
strument was filed in my office on
this 30 day of Dec.
A.D. 1963 at 4 min. past
7 o'clock P.M.

Records of Lewis & Clark
County, State of Montana

Delores Kovach
County Recorder

By *Norma Kelley*
Deputy

\$2.00

File No.

T. 10 N R. 3 W

DUPLICATE

County Lewis and Clark

STATE OF MONTANA
ADMINISTRATOR OF GROUNDWATER CODE
OFFICE OF STATE ENGINEER

RECEIVED
JAN 2 1964

Declaration of Vested Groundwater Rights

(Under Chapter 237, Montana Session Laws, 1961)

STATE ENGINEER

1. B. E. Lichtwardt of Route 1 Helena
(Name of Appropriator) (Address) (Town)
County of Lewis and Clark State of Montana

have appropriated groundwater according to the Montana laws in effect prior to January 1, 1962, as follows:

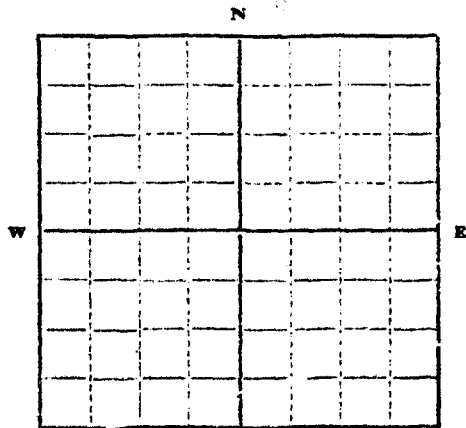

15 & 16

..... 1/4 Sec. T. R.

Indicate point of appropriation and place of use, if possible. Each small square represents 10 acres.

2. The beneficial use on which the claim is based underground
and irrigation

3. Date or approximate date of earliest beneficial use; and how continuous the use has been since 1864 continuous

4. The amount of groundwater claimed (in miner's inches or gallons per minute) undetermined

5. If used for irrigation, give the acreage and description of the lands to which water has been applied and name of the owner thereof
Approximately 200 acres
In sec 15 & 16 T 10 N R 3 W

6. The means of withdrawing such water from the ground and the location of each well or other means of withdrawal.

7. The date of commencement and completion of the construction of the well, wells, or other works for withdrawal of groundwater.

8. The depth of water table.

9. So far as it may be available, the type, size and depth of each well or the general specifications of any other works for the withdrawal of groundwater.

10. The estimated amount of groundwater withdrawn each year.

11. The log of formations encountered in the drilling of each well if available.

12. Such other information of a similar nature as may be useful in carrying out the policy of this act, including reference to book and page of any county record.

Signature of Owner B. E. Lichtwardt

Date 12/10/63

Three copies to be filed by the owner with the County Clerk and Recorder of the county in which the well is located.

Please answer all questions. If not applicable, so state, otherwise the form will be returned.

Original to the County Clerk and Recorder; duplicate to the State Engineer; Triplicate to the Montana Bureau of Mines and Geology, and Quadruplicate for the Appropriator.

1750

Received
December 30 1963

151482

STATE OF MONTANA
COUNTY OF LEWIS & CLARK | SS

I hereby certify that the within in-
strument was filed in my office on
this 30 day of Dec.
A.D. 19 63 at 2:00 min. past
4 o'clock P.M.

Recorder of Lewis & Clark
County, State of Montana.

John J. Daniel
County Recorder
Thomas Kelley
Deputy

2.00

RECEIVED

1011-36
County Lewis & Clark

STATE OF MONTANA
ADMINISTRATOR OF GROUNDWATER CODE
MONTANA WATER RESOURCES BOARD

NOTICE OF COMPLETION OF GROUNDWATER
APPROPRIATION BY MEANS OF WELL

Developed after January 1, 1962

(Under Chapter 237 Montana Session Laws, 1961, as amended)

This form to be prepared by driller, and three copies to be filed by the owner with the County Clerk and Recorder in the county in which the well is located, last copy to be retained by driller.

Please answer all questions. If not applicable, so state, otherwise the form may be returned.

Owner Mrs. Edna Lichtwardt

Address 2205 York Rd.

Helena, Montana 59601

Date well started Dec. 30, 1972

completed Jan. 30, 1973

For Administrator's Use
File <u>234679</u>
<u>MAY 11, 1973</u>
GW1 <u>10:05 A.M.</u>

Type of well Drilled
(Dug, driven, bored or drilled)

Equipment used Churn Drill
(Churn drill, rotary or other)

Water Use: Domestic Municipal Stock Irrigation

Industrial Drainage Other * Garden/Lawn

*Describe _____

USE: If used for irrigation, industrial, drainage or other. Explain, state number of acres and location or other data (i.e. Lot, Block and Addition).

ESTIMATED ANNUAL WITHDRAWAL

Size of Drilled Hole	Size and Weight of Casing	From (Feet)	To (Feet)	PERFORATIONS		
				Kind Size	From (Feet)	To (Feet)
6 In.	17 lb.	0	110	Torch	107	105

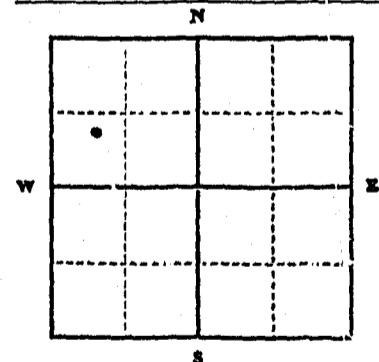

N.W. 1/4 S.W. 1/4 Sec. 15
T. 10 R. 2 E. W

INDICATE LOCATION OF WELL AND PLACE OF USE, IF POSSIBLE. EACH SMALL SQUARE REPRESENTS 40 ACRES.

Driller's Signature John Johnston

Driller's Address 338 Griffin Rd. Helena, Montana

LICENSE NO. 155

DRILLER'S LOG

Indicate the character, color, thickness of strata such as soil, clay, sand, gravel, shale, sandstone, etc. Show depth at which water is found and height to which water rises in well.

Top of Ground (Elev. above sea level)		
From (Feet)	To (Feet)	
0	5	Top soil
5	18	Gravel
18	25	Sand
25	28	Clay
28	41	Sand
41	45	Hard Pan
45	65	Sand
65	78	Brown Clay
78	80	Sand
80	91	Gray Clay
91	98	Sand
98	100	Hard Pan
100	105	Coarse gravel under
105	110	Clay
110		Water

110 Show exact depth of bottom

File No.

T. 10 N R. 3 W
County Lewis And Clark

DUPLICATE

STATE OF MONTANA
ADMINISTRATOR OF GROUNDWATER CODE
OFFICE OF STATE ENGINEER

JAN 6 1964

Declaration of Vested Groundwater Rights

(Under Chapter 237, Montana Session Laws, 1961)

1. Wilford R Glasscock of P.O. Box 138
(Name of Appropriator) (Address) (Town)
County of Lewis And Clark State of Montana
have appropriated groundwater according to the Montana laws in effect prior to January 1, 1962, as follows:

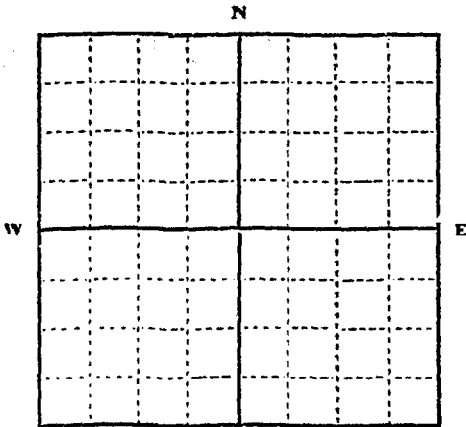

1.3 Acres
NW 1/4 Sec 15 T. 10 N R. 3 W

Indicate point of appropriation and place of use, if possible. Each small square represents 10 acres.

2. The beneficial use on which the claim is based DOMESTIC

3. Date or approximate date of earliest beneficial use; and how continuous the use has been MARCH 1961
CONTINUOUSLY SINCE

4. The amount of groundwater claimed, (in miner's inches or gallons per minute) 5 gal. per hr.

5. If used for irrigation, give the acreage and description of the lands to which water has been applied and name of the owner thereof
ONE ACRE LAWN AND GARDEN
1 SELF,

6. The means of withdrawing such water from the ground and the location of each well or other means of withdrawal
PUMP WITH ELECTRIC MOTOR WELL

7. The date of commencement and completion of the construction of the well, wells, or other works for withdrawal of groundwater UNKNOWN

8. The depth of water table 32 inches

9. So far as it may be available, the type, size and depth of each well or the general specifications of any other works for the withdrawal of groundwater 6 inches diameter by 42 ft deep.

10. The estimated amount of groundwater withdrawn each year UNKNOWN

11. The log of formations encountered in the drilling of each well, if available UNKNOWN

12. Such other information of a similar nature as may be useful in carrying out the policy of this act, including reference to book and page of any county record NONE

Signature of Owner Wilford R Glasscock

Date Dec 31, 1963

Three copies to be filed by the owner with the County Clerk and Recorder of the county in which the well is located.

Please answer all questions. If not applicable, so state, otherwise the form will be returned.

Original to the County Clerk and Recorder; Duplicate to the State Engineer; Triplicate to the Montana Bureau of Mines and Geology, and Quadruplicate for the Appropriator.

27059

151899

STATE OF MONTANA
COUNTY OF LEWIS & CLARK

I hereby certify that the within in-
strument was filed in my office on
this 6 day of Jan
A.D. 1964 at 30 min. past
3 o'clock P.M.

Records of Lewis & Clark
County, State of Montana.

Debra Davis
County Recorder

By *M. Lass*
Deputy

200

151899
RECORDED
JAN 14 1964

JAN 14 1964

JAN 14 1964

STATE OF MONTANA
ADMINISTRATOR OF GROUNDWATER CODE
MONTANA WATER RESOURCES BOARD

NOTICE OF COMPLETION OF GROUNDWATER
APPROPRIATION BY MEANS OF WELL

Developed after January 1, 1962

(Under Chapter 237 Montana Session Laws, 1961, as amended)

This form to be prepared by driller, and three copies to be filed by the owner with the County Clerk and Recorder in the county in which the well is located, last copy to be retained by driller.

Please answer all questions. If not applicable, so state, otherwise the form may be returned.

Owner Lvelyn Cooper
Address Box 415
Thompson Falls Mont
Date well started MAY - 1962
completed MAY - 1962
Type of well Drilled
Equipment used Churn
Water Use: Domestic Municipal Stock Irrigation
Industrial Drainage Other * Garden/Lawn

For Administrator's Use
File 236543
6-29-73
GW 1 11.53 A. 170

*Describe
USE: If used for irrigation, industrial, drainage or other. Explain, state number of acres and location or other data (i.e. Lot, Block and Addition).

ESTIMATED ANNUAL WITHDRAWAL 80,000

Size of Drilled Hole	Size and Weight of Casing	From (Feet)	To (Feet)	PERFORATIONS		
				Kind Size	From (Feet)	To (Feet)
6"	1716	0	41	NONE		

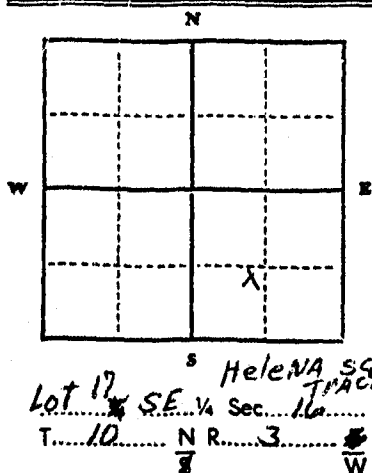

Static water level 8ft.*
Pumping water level 25ft.*
at 25gallons per minute,
measured 60 minutes after pumping began.
*Measured from ground level.
Well developed by Boiler
for 2hours.
Power 3hp Pump 1/2 HP
Remarks: (Gravel packing, cementing, packers, type of shutoff)

INDICATE LOCATION OF WELL AND PLACE OF USE, IF POSSIBLE. EACH SMALL SQUARE REPRESENTS 40 ACRES.

Driller's Signature Wesley Lindsay
Driller's Address Clancy Montana
LICENSE NO. 38

RECEIVED

104130
County Lewis & Clark

DRILLER'S LOG

Indicate the character, color, thickness of strata such as soil, clay, sand, gravel, shale, sandstone, etc. Show depth at which water is found and height to which water rises in well.

Top of Ground (Elev. above sea level)

From (Feet)	To (Feet)	
0	3	Top soil
3	18	gravel
18	28	Clay & gravel
28	33	CLAY
33	39	SAND
39	41	GRAVEL

41 Show exact depth of bottom

236543

Indexed	<i>Y</i>
Recorded	<i>Y</i>
Compared	

STATE OF MONTANA
COUNTY OF LEWIS & CLARK } SS

I hereby certify that the within instrument was filed in my office on this 29 day of June A.D. 19 73 at 53 min. past 11 o'clock A.M

Records of Lewis & Clark
County, State of Montana.

County Recorder
Carol Richardson
Deputy
L.O.D.

File No.

T. 10 R. 3

DUPLICATE

County L & C

STATE OF MONTANA
ADMINISTRATOR OF GROUNDWATER CODE
OFFICE OF STATE ENGINEER

JAN 6 1964

Declaration of Vested Groundwater Rights

(Under Chapter 237, Montana Session Laws, 1961)

STATE ENGINEER

ROBERTS & EVAL. CRAWFORD, of YORKBIE HELENA
(Name of Appropriator) (Address) (Town)

County of LEWIS & CLARK State of MONT.
have appropriated groundwater according to the Montana laws in effect prior to January 1, 1962, as follows:

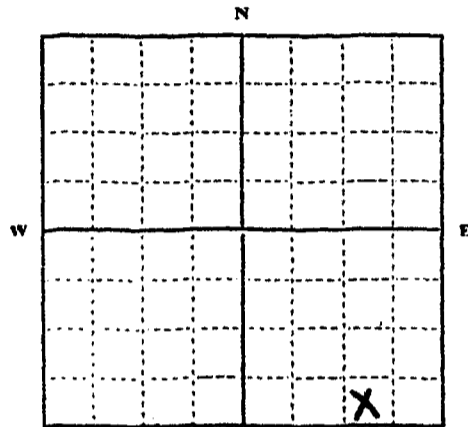

8E 1/4 S 1/2 SE 1/4
T. 10 R. 3 Sec. 16

Indicate point of appropriation and place of use, if possible. Each small square represents 10 acres.

Block 24 Helena School Tracts

2. The beneficial use on which the claim is based
HOUSEHOLD + Garden + Lawn

3. Date or approximate date of earliest beneficial use; and how continuous the use has been
1956 - CONTINUOUS

4. The amount of groundwater claimed (in miner's inches or gallons per minute)
15 gal per min.

5. If used for irrigation, give the acreage and description of the lands to which water has been applied and name of the owner thereof

6. The means of withdrawing such water from the ground and the location of each well or other means of withdrawal
ELECTRIC PUMP

7. The date of commencement and completion of the construction of the well, wells, or other works for withdrawal of groundwater

8. The depth of water table
14 FT.

9. So far as it may be available, the type, size and depth of each well or the general specifications of any other works for the withdrawal of groundwater
6 in. CASING - 50 FT. DEEP

10. The estimated amount of groundwater withdrawn each year
N.A.

11. The log of formations encountered in the drilling of each well if available
sand gravel & clay formation

12. Such other information of a similar nature as may be useful in carrying out the policy of this act, including reference to book and page of any county record
not available

Signature of Owner Robert S Crawford

Date December 31, 1963

Three copies to be filed by the owner with the County Clerk and Recorder of the county in which the well is located.

Please answer all questions. If not applicable, so state, otherwise the form will be returned.

Original to the County Clerk and Recorder; Duplicate to the State Engineer; Triplicate to the Montana Bureau of Mines and Geology, and Quadruplicate for the Appropriator.

24516

151754

RECORDED
INDEXED
CL

STATE OF MONTANA
COUNTY OF LEWIS & CLARK } SS.

I hereby certify that the within instrument was filed in my office on this 7 day of Jan A.D. 1966 at 06 min. past 10 o'clock A.

Records of Lewis & Clark
County, State of Montana.
John J. Smith
County Recorder
By Therese
Deputy

22nd pd

STATE OF MONTANA
ADMINISTRATOR OF GROUNDWATER CODE
MONTANA WATER RESOURCES BOARD

NOTICE OF COMPLETION OF GROUNDWATER
APPROPRIATION BY MEANS OF WELL
Developed after January 1, 1962

(Under Chapter 237 Montana Session Laws, 1961, as amended)

This form to be prepared by driller, and three copies to be filed by the owner with the County Clerk and Recorder in the county in which the well is located, last copy to be retained by driller. Please answer all questions. If not applicable, so state, otherwise the form may be returned.

Owner Bill Fredericks
Address Custer Ave East
Helena, Montana
Date well started April 21, 1972
completed April 23, 1972

For Administrator's Use	
File	<u>227363</u>
	<u>July 27, 1972 10:00 a.m.</u>
GW 1	

Type of well Driven
(Dig, driven, bored or drilled)
Equipment used Churn
(Churn drill, rotary or other)
Water Use: Domestic Municipal Stock Irrigation
Industrial Drainage Other * Garden/Lawn

*Describe
USE: If used for irrigation, industrial, drainage or other. Explain, state number of acres and location or other data (i.e. Lot, Block and Addition).

ESTIMATED ANNUAL WITHDRAWAL

Size of Drilled Hole	Size and Weight of Casing	From (Feet)	To (Feet)	PERFORATIONS		
				Kind Size	From (Feet)	To (Feet)
6"	6" 15 lb.	1 ft.	71.8'			

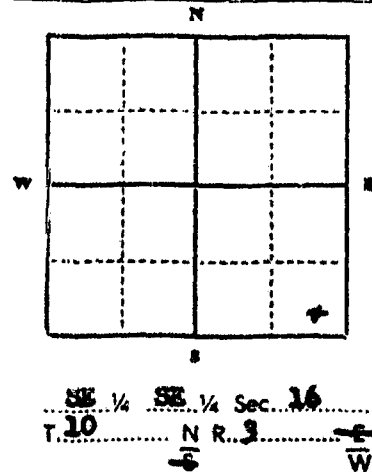

Static water level 40.0 ft.*
Pumping water level 48.0 ft.*
at 25 gallons per minute,
measured 10 minutes after pumping
began.
*Measured from ground level.
Well developed by Bailing
for 6 hours.
Power..... Pump..... HP
Remarks: (Gravel packing, cementing,
peckers, type of shutoff)
Gravel pack from 71.0'
to 75.0'

INDICATE LOCATION OF WELL AND PLACE OF USE, IF POSSIBLE. EACH SMALL SQUARE REPRESENTS 40 ACRES.

Driller's Signature Donald C. McMillan
Driller's Address 220 C Custer Ave. West
Helena, Montana 59601 LICENSE NO. 225

County Lewis & Clark

DRILLER'S LOG

Indicate the character, color, thickness of strata such as soil, clay, sand, gravel, shale, sandstone, etc. Show depth at which water is found and height to which water rises in well.

Top of Ground		(Elev. above sea level)
From (Feet)	To (Feet)	
0.0'	1.0'	Brown silt
1.0'	25.8'	Tan gravelly silty clay
25.8'	46.5'	Brown gravelly clay
46.5'	47.2'	Brown fine sand with 4 to 5 GPH
47.2'	51.0'	Brown gravelly clayey fine sand
51.0'	58.0'	It. Tan gravelly clay
58.0'	59.0'	Tan gravelly sand with 5 GPH
59.0'	70.5'	Tan silty sandy clay
70.5'	71.8'	Brown silty gravelly sand with 25 GPH
71.8'	75.0'	Gravel pack
75.0'		Bottom of well

75.0' Show exact depth of bottom

51,039

227363

Indexed
Recorded
Compared

STATE OF MONTANA }
COUNTY OF LEWIS & CLARK } 56

I hereby certify that the within in-
strument was filed in my office on
this 27 day of July
A.D. 1922 at 10 min past
10 o'clock P.M. and record-
ed on page _____ of Book _____
of _____ Records of Lewis and
Clark County, State of Montana.

[Signature]
County Recorder

by *[Signature]*
Deputy

200

RECEIVED
OCT 19 1957

T 10 N R 3 W 16
County Lewis & Clark

STATE ENGINEER MONTANA BUREAU OF MINES AND GEOLOGY
Butte, Montana

WATER WELL LOG

X		

Owner James L. Lemon Address York St. Helena

Driller Walter Riddock Address Helena Montana

Date Started 4-23-51 Date Completed 5-1-51

Location: Sec. 16 T10N R. 3W 1/4 sec SE 1/4 OF SW 1/4

Type of well Drilled (Dug, driven, bored, or drilled) Equipment used Churn Drill (Churn drill, rotary, other)

Water use: Domestic Municipal Stock Irrigation
Industrial Drainage Other: _____

Casing: 60 ft. to 60 ft. Type Well Casing Size 6 in

Casing: _____ ft. to _____ ft. Type _____ Size _____

Casing: _____ ft. to _____ ft. Type _____ Size _____

Perforated or Screened: Ft. None to ft. _____ Ft. _____ to ft. _____

Type of screen or perforations Foot valve with strainer

Static Water level, for non-flowing well: 30 ft. _____ feet

Shut-in pressure, for flowing well: _____ lb./sq. in. on: _____ (date)

Pumping water level: 45 feet at 25 gal. per min.

How tested: Bailor

Length of test: 3 Hours

Remarks: (Gravel packing, cementing, packers, type of shut-off, depth of shut-off)

This water is produced from the bottom of the well from a course
of gravel.

(over)

Log of Well

Depth, feet		Description of Material Drilled
From	To	
0	55	Clay mixed with gravel
55	60	Water gravel loose

Indexed
Recorded
Coburn

85518

State of Montana
County of Lewis & Clark

I hereby certify that the within
instrument was filed in my office on
this 3rd day of Sept. A.D.
1937, at 12 minutes of 1 o'clock
P.M.

Notary Public
for the State of
Lewis and Clark County, State of
Montana

Florence E. Fisher, Fomer
County Recorder

By: [Signature]
[Signature] Deputy

File No.

T. 10 N. R. 3 W

DUPLICATE

County Lewis and Clark

STATE OF MONTANA
ADMINISTRATOR OF GROUNDWATER CODE
OFFICE OF STATE ENGINEER

RECEIVED
JAN 2 1964

Declaration of Vested Groundwater Rights
(Under Chapter 237, Montana Session Laws, 1961)

1. R. H. Lehmann, of Route 1 Helena
(Name of Appropriator) (Address) (Town)

County of Lewis and Clark State of Montana
have appropriated groundwater according to the Montana laws in effect prior to January 1, 1962, as follows:

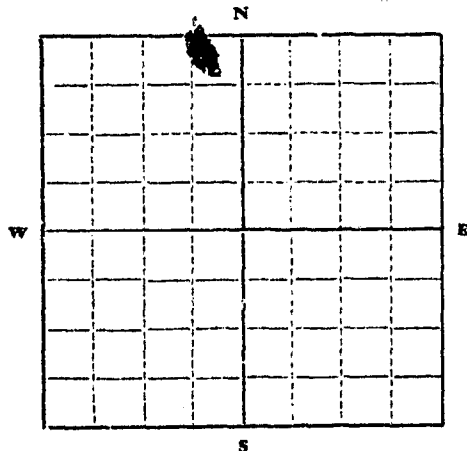

SW 1/4 NW 1/4 Sec. 16, T. 10, R. 3

Indicate point of appropriation and place of use, if possible. Each small square represents 10 acres.

2. The beneficial use on which the claim is based Livestock and irrigation

3. Date or approximate date of earliest beneficial use; and how continuous the use has been April 1944 and following years
Other well at least 40 years

4. The amount of groundwater claimed (in miner's inches or gallons per minute) 150 miner's inches

5. If used for irrigation, give the acreage and description of the lands to which water has been applied and name of the owner thereof
S. W. 1/4 of N. W. 1/4 of Sec 16 approximately 80 acres.

6. The means of withdrawing such water from the ground and the location of each well or other means of withdrawal
Power Turbin pump and other smaller pumps

7. The date of commencement and completion of the construction of the well, wells, or other works for withdrawal of groundwater March 1944 completed in April 1944

8. The depth of water table Approximately 30 feet

9. So far as it may be available, the type, size and depth of each well or the general specifications of any other works for the withdrawal of groundwater
12 inch casing 80 feet depth
8 inch turbin pump

10. The estimated amount of groundwater withdrawn each year 2 second feet - 30 to 40 days per year

11. The log of formations encountered in the drilling of each well if available
Clay and Gravel

12. Such other information of a similar nature as may be useful in carrying out the policy of this act, including reference to book and page of any county record

Signature of Owner B. H. Lehmann
Date 12-10-63

Three copies to be filed by the owner with the County Clerk and Recorder of the county in which the well is located.

Please answer all questions. If not applicable, so state, otherwise the form will be returned.

Original to the County Clerk and Recorder; duplicate to the State Engineer; Triplicate to the Montana Bureau of Mines and Geology, and Quadruplicate for the Appropriator.

17500

Indexed
Recorded
Compared

2

151481

STATE OF MONTANA
COUNTY OF LEWIS & CLARK } SS

I hereby certify that the within in-
strument was filed in my office on
this 30 day of Dec.
A.D. 1963 at 4 o'clock P. past
7 o'clock P. M.

Recorder of Lewis & Clark
County, State of Montana

Allen Louie

County Recorder

By *Norma Kelley*
Deputy

2.00

RECORDED
INDEXED
DEC 30 1963
LEWIS & CLARK COUNTY

236403

INDEXED
RECORDED
ALBERTA
K

STATE OF MONTANA }
COUNTY OF LEWIS & CLARK } S.

I hereby certify that the within in-
strument was filed in my office on
this 29 day of June
A.D. 1973 at 9 min. past
9 o'clock A.M.

Records of Lewis & Clark
County, State of Montana.

Jehan Davial
County Recorder.

Carol Erickson
Deputy

7.00

[Faint, illegible text and markings, possibly bleed-through from the reverse side of the page.]

RECEIVED

County 16

STATE OF MONTANA
ADMINISTRATOR OF GROUNDWATER CODE
MONTANA WATER RESOURCES BOARD

NOTICE OF COMPLETION OF GROUNDWATER
APPROPRIATION BY MEANS OF WELL

Developed after January 1, 1962

DRILLER'S LOG

Indicate the character, color, thickness of strata such as soil, clay, sand, gravel, shale, sandstone, etc. Show depth at which water is found and height to which water rises in well.

(Under Chapter 237 Montana Session Laws, 1961, as amended)

This form to be prepared by driller, and three copies to be filed by the owner with the County Clerk and Recorder in the county in which the well is located, last copy to be retained by driller.

Please answer all questions. If not applicable, so state, otherwise the form may be returned.

Owner Mr. J. Mack
Address 3175 Meagher Rd. Helena Mont.
Date well started May 13-71 completed May 14-71
Type of well Drilled
Equipment used Churn

For Administrator's Use	
File <u>236365</u>	Date <u>June 29, 1973</u>
GW <u>1</u>	Time <u>3:00 p.m.</u>

Water Use: Domestic Municipal Stock Irrigation
Industrial Drainage Other * Garden/Lawn

*Describe
USE: If used for irrigation, industrial, drainage or other. Explain, state number of acres and location or other data (i.e. Lot, Block and Addition).

ESTIMATED ANNUAL WITHDRAWAL 100,000

Size of Drilled Hole	Size and Weight of Casing	From (Feet)	To (Feet)	PERFORATIONS		
				Kind Size	From (Feet)	To (Feet)
<u>6"</u>	<u>17lb</u>	<u>0</u>	<u>38</u>	<u>None</u>		

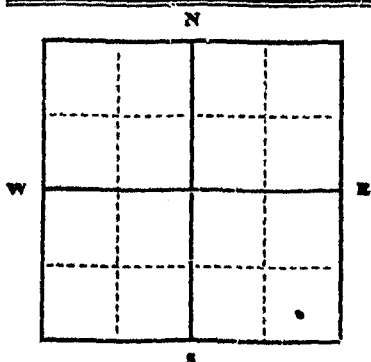

Static water level 9 ft.*
Pumping water level 20 ft.*
at 20 gallons per minute,
measured 60 minutes after pumping began.
*Measured from ground level,
Well developed by Bailers
for 2 hours.
Power..... Pump..... HP
Remarks: (Gravel packing, cementing, packers, type of shutoff)

SE 1/4 SE 1/4 Sec. 16
T. 10 N. R. 3 E

INDICATE LOCATION OF WELL AND PLACE OF USE, IF POSSIBLE. EACH SMALL SQUARE REPRESENTS 40 ACRES.

Driller's Signature Clancy Lindsay
Driller's Address Clancy Montana

LICENSE NO. 38

Top of Ground (Elev. above sea level)		
From (Feet)	To (Feet)	
<u>0</u>	<u>6</u>	<u>Clay & gravel</u>
<u>6</u>	<u>18</u>	<u>Hard pan</u>
<u>18</u>	<u>23</u>	<u>Clay</u>
<u>23</u>	<u>27</u>	<u>Sand</u>
<u>27</u>	<u>28</u>	<u>gravel</u>

28 Show exact depth of bottom

236265

STATE OF MONTANA }
COUNTY OF LEWIS & CLARK } SS

I hereby certify that the within instrument was filed in my office on this 28 day of June A.D. 19 73 at 9 min. past 9 o'clock P.M.

Records of Lewis & Clark
County, State of Montana

Delroy L. Smith
County Recorder
by *Earl Erickson*
Deputy

7.00

236390

SEARCHED
INDEXED
SERIALIZED
FILED

STATE OF MONTANA
COUNTY OF LEWIS & CLARK

I hereby certify that the within in-
strument was filed in my office on
this 19 day of June
A.D. 1917 at 10 min. past
9 o'clock A.M.

Records of Lewis & Clark
County, State of Montana

John Smith
County Recorder
Carroll
Deputy

2.00

T. 10 N R. 3 W 14
County Leitch

MONTANA BUREAU OF MINES AND GEOLOGY
Butte, Montana

RECEIVED

WATER WELL LOG

STATE ENGINEER

Owner Arthur M. Muffick Address 17 South Dakota
Helena Montana

Driller Walter Ridlock Address Helena Montana

Date Started 8-23-59 Date Completed 8-27-59

Location: Sec. 16 T. 10 N R. 3 W 1/4 sec. SE 1/4 SE 1/4 SE 1/4

Type of well Drilled Equipment used Churn Drill
(Dug, driven, bored, or drilled) (Churn drill, rotary, other)

Water use: Domestic Municipal Stock Irrigation

Industrial Drainage Other: _____

Casing: 0 ft. to 60 ft. Type BLACK IRON Size 6"

Casing: _____ ft. to _____ ft. Type _____ Size _____

Casing: _____ ft. to _____ ft. Type _____ Size _____

Perforated or Screened: Ft. _____ to ft. _____ Ft. _____ to ft. _____

Type of screen or perforations: _____

Static Water level, for non-flowing well: _____ feet.

Shut-in pressure, for flowing well: _____ lb./sq. in. on: _____ (date)

Pumping water level _____ feet at _____ gal. per min. 20

How tested: Boiler

Length of test: _____

Remarks: (Gravel packing, cementing, packers, type of shut-off, depth of shut-off)

(over)

Log of Well

Depth, feet		Description of Material Drilled
From	To	
0	20	Clay + Gravel
20	26	Hard Pan Clay
26	47	Clay + Gravel, Small flow of Water
47	55	Clay + Sand
55	60	Water Gravel + Sand Course

113046

STATE OF MONTANA
COUNTY OF LEWIS & CLARK

I hereby certify that the within in-
strument was filed in my office on
this 26 day of Dec
A.D. 1960 at
9 o'clock P.M.
milit. past

Records of Lewis & Clark
County, State of Montana

By *[Signature]*
County Recorder
Deputy

G'

Approved Stock Form—State Publishing Co., Helena, Montana—38687

File No. _____

T. 10 R. 3W

DUPLICATE

County _____

STATE OF MONTANA
ADMINISTRATOR OF GROUNDWATER CODE
OFFICE OF STATE ENGINEER

RECEIVED
JUN 11 1962

Declaration of Vested Groundwater Rights STATE ENGINEER
(Under Chapter 237, Montana Session Laws, 1961)

1. ROBERT D. PAINTER of R.T.L. HELENA
(Name of Appropriator) (Address) (Town)
County of LEWIS & CLARK State of MONTANA
have appropriated groundwater according to the Montana laws in effect prior to January 1, 1962, as follows:

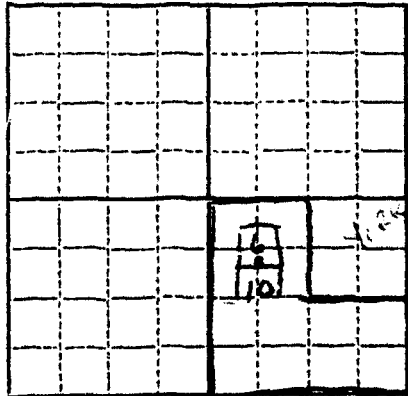

HELENA SCHOOL TRACT
NW 1/4 of SE 1/4 of Sec. 16 T. 10 R. 3 W
S. E. 1/4 Sec. 16 T. 10 R. 3 W

Indicate point of appropriation and place of use, if possible. Each small square represents 10 acres.

- 2. The beneficial use on which the claim is based HOUSEHOLD, GARDEN, LANDSCAPE, PASTURE
- 3. Date or approximate date of earliest beneficial use; and how continuous the use has been 1963 proposed
- 4. The amount of groundwater claimed (in miner's inches or gallons per minute) 30 gals/minute
- 5. If used for irrigation, give the acreage and description of the lands to which water has been applied and name of the owner thereof Lot 6, Lot 10 Helena School Tract (consisting of NW 1/4 of SE 1/4 and S 1/2 of SE 1/4 of Sec. 16 - 10 N 3 W)
- 6. The means of withdrawing such water from the ground and the location of each well or other means of withdrawal Indefinite Wells on Lot 6, 10

- 7. The date of commencement and completion of the construction of the well, wells, or other works for withdrawal of groundwater Proposed in 1963
- 8. The depth of water table Est 40-50' Drilled to 74' 11-20-62
- 9. So far as it may be available, the type, size and depth of each well or the general specifications of any other works for the withdrawal of groundwater 80'
- 10. The estimated amount of groundwater withdrawn each year 1,500,000 gallons
- 11. The log of formations encountered in the drilling of each well if available _____
- 12. Such other information of a similar nature as may be useful in carrying out the policy of this act, including reference to book and page of any county record _____

Signature of Owner Robert D. Painter
Date 6-6-62

Three copies to be filed by the owner with the County Clerk and Recorder of the county in which the well is located.

Please answer all questions. If not applicable, so state, otherwise the form will be returned.

Original to the County Clerk and Recorder; duplicate to the State Engineer; Triplicate to the Montana Bureau of Mines and Geology, and Quadruplicate for the Appropriator.

Indexed *d*
Recorded
Comptroller

#133376

STATE OF MONTANA
COUNTY OF LEWIS & CLARK } SS

I hereby certify that the within instrument was filed in my office on this 14th day of June A.D. 19 1917 at 15 min. past 8 o'clock A.M.

Records of Lewis & Clark
County, State of Montana.

John Danick
County Recorder

Wm. H. Kelley
Deputy

2.00