

File No. \_\_\_\_\_

T. 10 R. 3

DUPLICATE

STATE WATER CONSERVATION BOARD

County Lea

LOG

OCT 17 1966

STATE OF MONTANA

ADMINISTRATOR OF GROUNDWATER CODE

OFFICE OF STATE ENGINEER

Top of Ground

(Elev. above sea level)

 Bill \_\_\_\_\_  
 Eutzerin \_\_\_\_\_  
 Coyle \_\_\_\_\_  
 Dickinson \_\_\_\_\_  
 Dickert \_\_\_\_\_

# Notice of Completion of Groundwater Appropriation by Means of Well

DEVELOPED AFTER JANUARY 1, 1962

(Under Chapter 237, Montana Session Laws, 1961)

 0-16' fairly loose  
 coarse gravel

 16-23' very tight  
 clay bound  
 gravel

 23-31' fine silty  
 sand

 31-40' very tight  
 clay bound  
 gravel

40-47' clay

 47-56' loose silty  
 fine sand

56-59' clay

 59-61' tight clean  
 gravel
Owner John S. Romsko Address 301 W. GAIL E. HELENADriller Pricer Lindsay Address C. Andy

Date of Notice of appropriation of groundwater \_\_\_\_\_

Date well started April 7, 66 Date completed April 7 - 1966Type of well drilled Equipment used Churn drill  
(Dug, driven, bored or drilled) (Churn drill, rotary or other)Water use: Domestic ☒ Municipal ☐ Stock ☐ Irrigation ☐  
Industrial ☐ Drainage ☐ Other ☐

Indicate on the diagram the character and thickness of the different strata met with in drilling, such as soil, clay, shale, gravel, rock or sand, etc. Show depth at which water is encountered, thickness and character of water-bearing strata and height to which the water rises in the well.

Size of Drilled Hole	Size and Weight of Casing	From (Feet)	To (Feet)	PERFORATIONS		
				Kind Size	From (Feet)	To (Feet)
6"	6 7/8" O.D. 15 lb	0	61	-	-	-

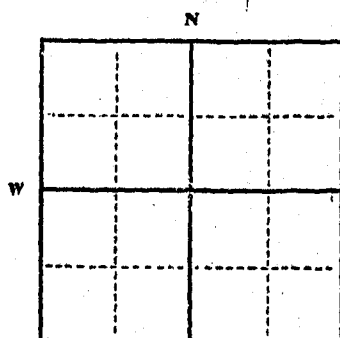
Static Water Level for non-flowing well 22 feet.

Shut-in Pressure for Flowing Well \_\_\_\_\_

Pumping Water Level 30 feet  
at 2.5 gal. per minute.

Discharge in gal. per min. of flowing well \_\_\_\_\_

How Tested bailerLength of Test 2 hrs

Remarks: (Gravel packing, cementing, packers, type of shutoff) \_\_\_\_\_

 Lot 1 Blk 4 - Garisch  
 1962 Addn.  
 East Helena

Indicate location of well and place of use, if possible. Each small square represents 40 acres.

(Continue on reverse side)

USE—If used for irrigation, industrial, drainage or other. Explain, state number of acres and location or other data (i.e.: Lot, Block and Addition).

Show exact depth of bottom.

This form to be prepared by driller, and three copies to be filed by the owner with the County Clerk and Recorder in the county in which the well is located, tissue copy to be retained by driller.

Please answer all questions. If not applicable, so state, otherwise the form will be returned.

Driller's License Number 38Driller's Signature Pricer Lindsay

181919

STATE OF MONTANA  
COUNTY OF LEWIS & CLARK

I hereby certify that the within  
statement was filed in my office on  
the 10 day of Oct.  
A.D. 1966 at 35 min. past  
9 o'clock A.M.

Records of Lewis & Clark  
County, State of Montana

*John A. Smith*  
County Recorder  
by *P. Swanson*  
Deputy

\$2.00

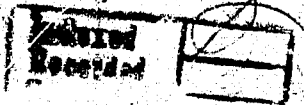

RECORDED  
INDEXED  
FILED  
OCT 10 1966  
LEWIS & CLARK COUNTY  
MONTANA

G

Approved Stock Form—State Publishing Co., Helena, Montana—41921

File No.

DUPLICATE

STATE OF MONTANA  
ADMINISTRATOR OF GROUNDWATER CODE  
OFFICE OF STATE ENGINEER

County Lewis & ClarkRECEIVED  
JAN 8 1964

## Declaration of Vested Groundwater Rights

(Under Chapter 237, Montana Session Laws, 1961)

1. William Wiebeck, of Corner Gail & Morton East Helena  
(Name of Appropriator) (Address) (Town)  
County of Lewis & Clark State of Montana  
have appropriated groundwater according to the Montana laws in effect prior to January 1, 1962, as follows:

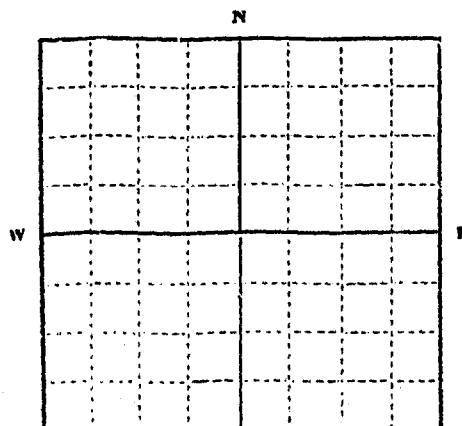

Gorsich 1963 Amended plat  
Lot 1 1/4 Block 1 T. R.

Indicate point of appropriation  
and place of use, if possible. Each  
small square represents 10 acres.

2. The beneficial use on which the claim is based Domestic Household Use.
3. Date or approximate date of earliest beneficial use; and how continuous the use has been JANUARY 1 1964
4. The amount of groundwater claimed (in miner's inches or gallons per minute) 80 gallons per minute
5. If used for irrigation, give the acreage and description of the lands to which water has been applied and name of the owner thereof  
Not used
6. The means of withdrawing such water from the ground and the location of each well or other means of withdrawal  
Electric pump
7. The date of commencement and completion of the construction of the well, wells, or other works for withdrawal of groundwater. Started 12-29-1954 and completed 1-5-55
8. The depth of water table. 12 feet
9. So far as it may be available, the type, size and depth of each well or the general specifications of any other works for the withdrawal of groundwater. From 0 to 33 feet 7" O. D. 24 lb new casing from 32 to 43 feet place 6" I. D. casing perforated with torch. Depth 100 feet.
10. The estimated amount of groundwater withdrawn each year.
11. The log of formations encountered in the drilling of each well if available 0-2' soil & sand, 2-12' v. very tight gravel & clay, 12-33 feet v. very tight clay bound gravel, 33-35' water bearing sand & gravel, 35-40' alternate stratas of hardpan & silty clay, 40-43' alternate stratas washed sand & gravel hardpan, 43-58' hardpan with some shallow stratas of coarse sand and fine gravel, 58-100' brown sandy clay.
12. Such other information of a similar nature as may be useful in carrying out the policy of this act, including reference to book and page of any county record.  
None

Signature of Owner William WiebeckDate 12-30-63

Three copies to be filed by the owner with the County Clerk and Recorder of the county in which the well is located.

Please answer all questions. If not applicable, so state, otherwise the form will be returned.

Original to the County Clerk and Recorder; Duplicate to the State Engineer; Triplicate to the Montana Bureau of Mines and Geology, and Quadruplicate for the Appropriator.

2704

151835

STATE OF MONTANA  
COUNTY OF LEWIS & CLARK

I hereby certify that the within instrument was filed in my office on this 6 day of Jan A.D. 1964 at 11 min. past 11 o'clock A.M.

Records of Lewis & Clark  
County State of Montana.

John Daniel  
County Recorder

By M. Rose  
Deputy

new pd

Indexed  
Recorded  
Compared

File No. \_\_\_\_\_

NOV 21 1966

T. \_\_\_\_\_ R. 9 out  
10N-3W  
County \_\_\_\_\_

DUPLICATE

LOG

Bill \_\_\_\_\_ McDermott \_\_\_\_\_  
 Butler \_\_\_\_\_  
 Coyle \_\_\_\_\_  
 Darlington \_\_\_\_\_ Sullivan \_\_\_\_\_  
 Dickert \_\_\_\_\_

STATE OF MONTANA  
 ADMINISTRATOR OF GROUNDWATER CODE  
 OFFICE OF STATE ENGINEER

Top of Ground

(Elev. above sea level \_\_\_\_\_)

0-4 ft.--ditch

4ft. to 22ft.  
clay and gravel22 ft to 31 ft  
hardpan31 ft to 43 ft  
clay and seams of sand

Static level

43 ft to 62 ft  
clay62 ft to 63 ft  
coarse sand,  
some gravel

Show exact depth of bottom.

## Notice of Completion of Groundwater Appropriation by Means of Well

DEVELOPED AFTER JANUARY 1, 1962

(Under Chapter 237, Montana Session Laws, 1961)

Owner F.M. Dailey Address Seaver Park,Driller Wesley Lindsay Address Clancy, Mont.

Date of Notice of appropriation of groundwater \_\_\_\_\_

Date well started Sept. 14, 1966 Date completed Sept. 15, 1966Type of well Drilled Equipment used Churn  
(Dug, driven, bored or drilled) (Churn drill, rotary or other)Water use: Domestic ☒ Municipal ☐ Stock ☐ Irrigation ☒  
Industrial ☐ Drainage ☐ Other ☐

Indicate on the diagram the character and thickness of the different strata met with in drilling, such as soil, clay, shale, gravel, rock or sand, etc. Show depth at which water is encountered, thickness and character of water-bearing strata and height to which the water rises in the well.

Size of Drilled Hole	Size and Weight of Casing	From (Feet)	To (Feet)	PERFORATIONS		
				Kind Size	From (Feet)	To (Feet)
6"	17LB	0	63		none	

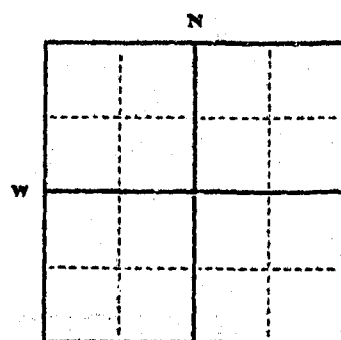

Static Water Level for non-flowing well \_\_\_\_\_ feet.

Shut-in Pressure for Flowing Well \_\_\_\_\_

Pumping Water Level \_\_\_\_\_ feet  
at \_\_\_\_\_ gal. per minute.

Discharge in gal. per min. of flowing well \_\_\_\_\_

How Tested pumpLength of Test 2 hoursRemarks: (Gravel packing, cementing, pack-  
ers, type of shutoff) \_\_\_\_\_

Seaver Park

Willis' of N. of lot 4 range 9

Indicate location of well and  
place of use, if possible. Each  
small square represents 40  
acres.

(Continue on reverse side)

USE—If used for irrigation, industrial, drainage or other. Explain, state  
number of acres and location or other data (i.e.: Lot, Block and Addi-  
tion).

Irrigate yard and garden

This form to be prepared by driller, and three copies to be filed by the owner with the  
County Clerk and Recorder in the county in which the well is located, tissue copy to be  
retained by driller.Please answer all questions. If not applicable, so state, otherwise the form will be  
returned.

Driller's License Number

Driller's Signature

41,618

182601

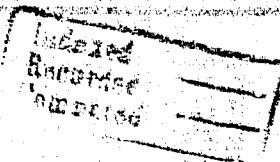

STATE OF MONTANA  
COUNTY OF LEWIS & CLARK

I hereby certify that the within in-  
strument was filed in my office on  
this 16 day of Nov.  
A.D. 19 66 at 10 o'clock, PM.

Records of Lewis & Clark  
County, State of Montana

John Donich  
County Recorder

By P. Devanion  
Deputy

200

RECORDED TO PROTECT THE  
INTERESTS OF THE  
COUNTY OF LEWIS & CLARK  
STATE OF MONTANA

STATE OF MONTANA  
ADMINISTRATOR OF GROUNDWATER CODE  
MONTANA WATER RESOURCES BOARD

NOTICE OF COMPLETION OF GROUNDWATER  
APPROPRIATION BY MEANS OF WELL

Developed after January 1, 1962

(Under Chapter 237 Montana Session Laws, 1961, as amended)

This form to be prepared by driller, and three copies to be filed by the owner with the County Clerk and Recorder in the county in which the well is located, last copy to be retained by driller. Please answer all questions. If not applicable, so state, otherwise the form may be returned.

Owner M. & M. D. D. S.  
Address 3433 Beech  
Helena, Montana  
Date well started 4-31-69  
completed 4-33-69

For Administrator's Use

File 230723

Dec 5/1972 10:15 am

GW 1

Type of well Drilled  
(Dig, driven, bored or drilled)

Equipment used Churn Drill  
(Churn drill, rotary or other)

Water Use: Domestic ☒ Municipal ☐ Stock ☐ Irrigation ☐

Industrial ☐ Drainage ☐ Other ☐ Garden/Lawn ☐

\*Describe

USE: If used for irrigation, industrial, drainage or other. Explain, state number of acres and location or other data (i.e. lot, block and Addition).

ESTIMATED ANNUAL WITHDRAWAL

Size of Drilled Hole	Size and Weight of Casing	From (Feet)	To (Feet)	PERFORATIONS
6"	6 5/8" O.D. - 0	83'		Kind Size From (Feet) To (Feet)
	new 15 lb.			

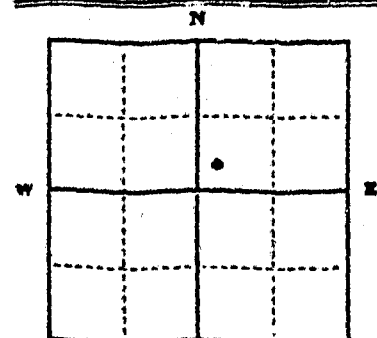

NE 1/4 Sec 34  
T. 10 N. R. 3 E. S. 34

INDICATE LOCATION OF WELL AND PLACE OF USE, IF POSSIBLE. EACH SMALL SQUARE REPRESENTS 40 ACRES.

Driller's Signature

Driller's Address

LICENSE NO. 171

Price Drilling - Box 104 - Carey, Montana 59634

County Lewis & Clark

DRILLER'S LOG

Indicate the character, color, thickness of strata such as soil, clay, sand, gravel, shale, sandstone, etc. Show depth at which water is found and height to which water rises in well.

From (Feet)	To (Feet)	
0	3	Soil - Sand - some gravel
3	5	clay - some sand
5	18	light gravel
18	37	sandy silt
37	43	very sandy clay
43	74	dark shale
74	83	Coarse sand
83	83	fine fine gravel
83	83	Coarse sand
83	83	water
83	83	water, very sandy

83' Show exact depth of bottom

5,987

STATE OF MONTANA  
COUNTY OF LEWIS & CLARK

I hereby certify that the within in-  
 strument was filed in my office on  
 the 5 day of May 1912  
 at 7:25 min. past  
10 o'clock AM and record.  
 It is on page        of book  
       records of Lewis and  
 Clark County, State of Montana.

County Recorder  
P. Thomas  
Deputy

201

INDEXED  
RECORDED

U

*[Faint, illegible handwriting throughout the page]*



File No.

STATE WATER CONSERVATION BOARD

RECEIVED  
AUG 30 1965

T. 10N R. 2W

DUPLICATE

County L. &amp; C.

LOG  
EXEMPTED TO

STATE OF MONTANA  
ADMINISTRATOR OF GROUNDWATER CODE  
OFFICE OF STATE ENGINEER

Top of Ground

(Elev. above sea level)

Notice of Completion of Groundwater  
Appropriation by Means of Well  
DEVELOPED AFTER JANUARY 1, 1962

(Under Chapter 237, Montana Session Laws, 1961)

0 to 102 clay mixed with  
boulders and gravel

Owner Jack Gentry Address Helena, Mont.

Driller Walter Kiddock Address Helena, Montana

Date of Notice of appropriation of groundwater 7-29-65

102 to 116 sand stone  
open hole.

Date well started 8-21-65 Date completed 8-29-65

making 6 gallons of  
water per min.

Type of well Drilled (Dug, Driven, Bored or drilled) Equipment used 8" 8-111 (Churn drill, rotary or other)

Water use: Domestic ☒ Municipal ☐ Stock ☐ Irrigation ☐  
Industrial ☐ Drainage ☐ Other ☐

Indicate on the diagram the character and thickness of the different strata met with in drilling, such as soil, clay, shale, gravel, rock or sand, etc. Show depth at which water is encountered, thickness and character of water-bearing strata and height to which the water rises in the well.

total depth 116 ft.

Size of Drilled Hole	Size and Weight of Casing	From (Feet)	To (Feet)	PERFORATIONS		
				Kind	From (Feet)	To (Feet)
8"	15#	0	102			
open hole 102 to 116						

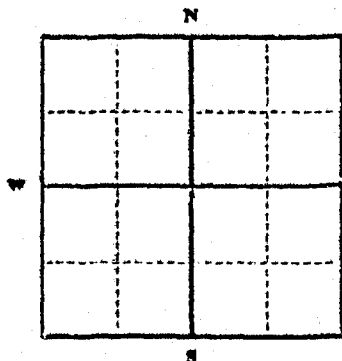

Lots 7, 8, 21 and 22, Block  
B. Seaver Park, Helena, Mont.  
Indicate location of well and  
place of use, if possible. Each  
small square represents 40  
acres.

Static Water Level for non-flowing well

Shut-in Pressure for Flowing Well

Pumping Water Level 28 ft. feet  
at 6 gal. per minute.

Discharge in gal. per min. of flowing well

How Tested

Length of Test 2 hr.

Remarks: (Gravel packing, cementing, pack-  
ers, type of shutoff)

(Continue on reverse side)

USE—If used for irrigation, industrial, drainage or other. Explain, state  
number of acres and location or other data (i.e.: Lot, Block and Addi-  
tion).

Show exact depth of bottom.

This form to be prepared by driller, and three copies to be filed by the owner with the  
County Clerk and Recorder in the county in which the well is located, tissue copy to be  
retained by driller.

Please answer all questions. If not applicable, so state, otherwise the form will be  
returned.

Driller's License Number

Driller's Signature  
39481

Indexed  
Recorded  
Comptrol

170932  
STATE OF MONTANA  
COUNTY OF LEWIS & CLARK

I hereby certify that the within in-  
strument was filed in my office on  
the 27 day of Aug  
A.D. 1965 at 30 min past  
10 o'clock A.M.

Records of Lewis & Clark  
County, State of Montana

*John Daniel*  
County Recorder  
By *Norma Kelley*  
Deputy

2.00

File No. \_\_\_\_\_

T. 16 R. 3

DUPLICATE

County Lewis & Clark

## LOG

STATE OF MONTANA  
ADMINISTRATOR OF GROUNDWATER CODE  
STATE WATER CONSERVATION BOARDNotice of Completion of Groundwater  
Appropriation by Means of Well  
DEVELOPED AFTER JANUARY 1, 1962

(Under Chapter 237 Montana Session Laws, 1961, as amended)

Top of Ground

(Elev. above sea level \_\_\_\_\_)

0-2 Soil, sand, and  
some gravel.

2-5 Clay, some sand.

5-18 Tight gravel.

18-27 Sandy silt.

27-42 Gray sandy clay.

42-78 Alternate shallow  
strata of gray  
and brown colored  
bentonite-like  
material.78-82 Coarse sand,  
silt, some clay.82-83 Firm fine gravel  
and coarse sand.

60' Some water.

78-81 Water, very sandy.

Owner Hokanson Address East Helena, Mont.Driller Robert Price Address Glancy, Mont.

Date of Notice of appropriation of groundwater \_\_\_\_\_

Date well started 4/21/69 Date completed 4/23/69Type of well Drilled Equipment used Lucas drill  
(Dug, driven, bored or drilled) (Cable drill, rotary or other)Water use: Domestic ☒ Municipal ☐ Stock ☐ Irrigation ☐  
Industrial ☐ Drainage ☐ Other ☐

Indicate on the diagram the character and thickness of the different strata met with in drilling, such as soil, clay, shale, gravel, rock or sand, etc. Show depth at which water is encountered, thickness and character of water-bearing strata and height to which the water rises in the well.

Type of Drilled Hole	Size and Weight of Casing	From (Feet)	To (Feet)	PERFORATIONS		
				Kind Size	From (Feet)	To (Feet)
6"	6 5/8" O.D.-0		83'			
	How 15 lb.					

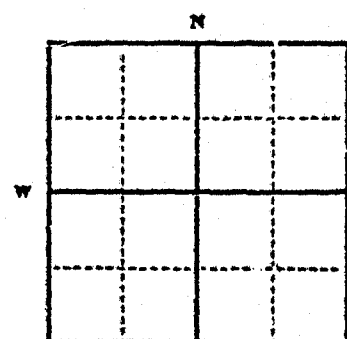

Lat 16. 2 Sec 26 T. 16 R. 3  
Indicate location of well and place of use, if possible. Each small square represents 40 acres.

Static Water Level for non-flowing well 50 feet.

Shut-in Pressure for Flowing Well \_\_\_\_\_

Pumping Water Level 55 feet  
at 20 gal. per minute.

Discharge in gal. per min. of flowing well \_\_\_\_\_

How Tested RollerLength of Test 1 1/2 hoursRemarks: (Gravel packing, cementing, pack-  
ers, type of shutoff) \_\_\_\_\_

(Continue on reverse side)

USE—If used for irrigation, industrial, drainage or other. Explain, state number of acres and location or other data (i.e.: Lat, Block and Addition).

Show exact depth of bottom.

This form to be prepared by driller, and three copies to be filed by the owner with the County Clerk and Recorder in the county in which the well is located, tissue copy to be retained by driller.

Please answer all questions. If not applicable, so state, otherwise the form will be returned.

171  
Driller's License Number

Robert Price  
Driller's Signature.

Indexed  
Recorded  
Unrecorded

*JH*

206971

STATE OF MONTANA  
COUNTY OF LEWIS & CLARK

I hereby certify that the within in-  
strument was filed in my office on  
this 20 day of Nov  
A.D. 1929 at 30 min. past  
1 o'clock P.M.

Records of Lewis & Clark  
County, State of Montana

*John Daniel*  
County Recorder

*W. B. White*  
Deputy

*R. D.*

GW

Approved Stock Form—State Publishing Co., Helena, Montana—42234

File No.

T. 10 N. R. 3 W.

DUPLICATE

County. Bozeman

STATE OF MONTANA  
ADMINISTRATOR OF GROUNDWATER CODE  
OFFICE OF STATE ENGINEER

RECEIVED

JAN 13 1964

## Declaration of Vested Groundwater Rights

(Under Chapter 237, Montana Session Laws, 1961)

STATE ENGINEER

1. Melvin V. or Edna M. Johnson of Canyon Ferry Route, Helena  
(Name of Appropriator) (Address) (Town)

County of Lewis and Clark State of Montana

have appropriated groundwater according to the Montana laws in effect prior to January 1, 1962, as follows:

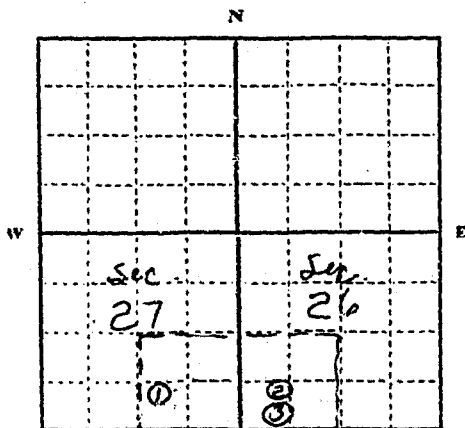

SE 1/4 Sec. 27 T. 10 N. R. 3 W.  
SW 1/4 Sec. 26 T. 10 N. R. 3 W.

Indicate point of appropriation  
and place of use, if possible. Each  
small square represents 10 acres.

wells are numbered ① ② ③

- The beneficial use on which the claim is based domestic livestock, garden, and farm irrigation
- Date or approximate date of earliest beneficial use; and how continuous the use has been. ① Prior to 1900 (not presently in use)  
② About 1930 (currently in use)  
③ About 1900 (in current use)
- The amount of groundwater claimed (in miner's inches or gallons per minute) All available up to 225 GPM. In past 10 years have pumped up to 150 GPM (for seasonal use)
- If used for irrigation, give the acreage and description of the lands to which water has been applied and name of the owner thereof. About 5 acres on SW 1/4 Sec. 26 T. 10 N. R. 3 W. About 3 acres now under irrigation on SE 1/4 Sec. 27 T. 10 N. R. 3 W. by G.H. Railroad for irrigation station or about the above ground now owned by the signor of this application.
- The means of withdrawing such water from the ground and the location of each well or other means of withdrawal. pumping

- The date of commencement and completion of the construction of the well, wells, or other works for withdrawal of groundwater. Exact years not known to the present owner. See above statement 3-5.
- The depth of water table. ① 30 ft ② 10 ft ③ varies from 2-10 ft.
- So far as it may be available, the type, size and depth of each well or the general specifications of any other works for the withdrawal of groundwater. ① 6" steel well casing 43 ft deep ② 4" steel well casing 44 ft deep beneath a 5' x 7' x 6' concrete pump below ground level ③ One 10 ft diameter and one 4 ft diameter hand excavated rock lined well about 12 ft deep drawing from same source.
- The estimated amount of groundwater withdrawn each year. about 6 million gallons per year
- The log of formations encountered in the drilling of each well if available. ① Shale bed rock of gravel lined below gravel lined not known ② Blank 10 ft clay then 5 ft gravel then shale bed rock ③ About 12 ft unconsolidated shale rock and gravel then shale bed rock
- Such other information of a similar nature as may be useful in carrying out the policy of this act, including reference to book and page of any county record. Hydrographs show 20 years record of water rights to be pumped from the above sources.

Signature of Owner Edna M. Johnson

Date 12-31-63

Three copies to be filed by the owner with the County Clerk and Recorder of the county in which the well is located.

Please answer all questions. If not applicable, so state, otherwise the form will be returned.

Original to the County Clerk and Recorder; Duplicate to the State Engineer; Triplicate to the Montana Bureau of Mines and Geology, and Quadruplicate for the Appropriator.

31364

152304

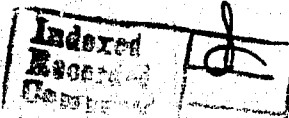

STATE OF MONTANA } ss.  
COUNTY OF LEWIS & CLARK

I hereby certify that the within in-  
strument was filed in my office on  
this 18 day of Jan  
A.D. 1964 at 38 mi. past  
11 o'clock A.M.

Records of Lewis & Clark  
County, State of Montana.

*[Signature]*  
County Recorder  
By M. Lave  
Deputy

*[Signature]*  
202/ed.

File No. ....

T. 10N R. 3W

DUPLICATE

County Lincoln

STATE OF MONTANA  
ADMINISTRATOR OF GROUNDWATER CODE  
OFFICE OF STATE ENGINEER

RECEIVED  
JAN 6 1964

Declaration of Vested Groundwater Rights  
(Under Chapter 237, Montana Session Laws, 1961)

1. Fred A. Langfing of Box 454 East Helena  
(Name of Appropriator) (Address) (Town)  
County of Lincoln State of Montana  
have appropriated groundwater according to the Montana laws in effect prior to January 1, 1962, as follows:

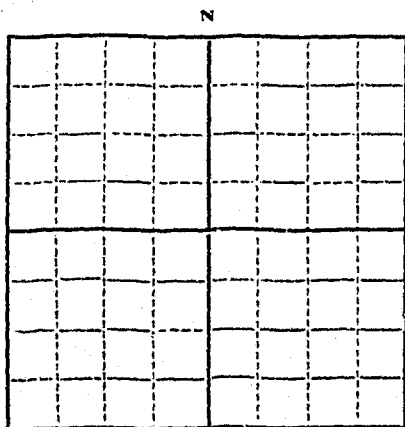

$\frac{1}{4}$  Sec. 26 T. 10 R. 3

Indicate point of appropriation and place of use, if possible. Each small square represents 10 acres.

2. The beneficial use on which the claim is based House garden

yard irrigation short water

3. Date or approximate date of earliest beneficial use; and how continuous the use has been 1954

continuous

4. The amount of groundwater claimed (in miner's inches or gallons per minute) 20 gal per minute

5. If used for irrigation, give the acreage and description of the lands to which water has been applied and name of the owner thereof

1 1/2 acre garden, yard

6. The means of withdrawing such water from the ground and the location of each well or other means of withdrawal

jet pump

7. The date of commencement and completion of the construction of the well, wells, or other works for withdrawal of groundwater 1954

8. The depth of water table 38 feet

9. So far as it may be available, the type, size and depth of each well or the general specifications of any other works for the withdrawal of groundwater

6" casing Drilled Well  
approximate 73 feet

10. The estimated amount of groundwater withdrawn each year 40000 gal

11. The log of formations encountered in the drilling of each well if available

Top soil  
gravel & boulders Hard pan gravel & clay  
thin gravel

12. Such other information of a similar nature as may be useful in carrying out the policy of this act, including reference to book and page of any county record

There is Lind'say  
wellers  
Loc # 38

Signature of Owner

Fred A. Langfing

Date 1954

Three copies to be filed by the owner with the County Clerk and Recorder of the county in which the well is located.

Please answer all questions. If not applicable, so state, otherwise the form will be returned.

Original to the County Clerk and Recorder; duplicate to the State Engineer; Triplicate to the Montana Bureau of Mines and Geology, and Quadruplicate for the Appropriator.

24383

151514

Recorded  
Compared

STATE OF MONTANA } ss.  
COUNTY OF LEWIS & CLARK

I hereby certify that the within in-  
strument was filed in my office on  
this 30 day of Dec.  
A.D. 19 63 at 4 min. past  
4 o'clock P.M.

Records of Lewis & Clark  
County, State of Montana.

County Recorder  
By Norma Kelley  
Deputy

\$2.00



File No. ....

DUPLICATE

T. 16 N R. 3 W

County San JuanSTATE OF MONTANA  
ADMINISTRATOR OF GROUNDWATER  
OFFICE OF STATE ENGINEERRECEIVED  
JAN 6 1964Notice of Completion of Groundwater  
Appropriation by Means of Well ENGINEER

(Under Chapter 237, Montana Session Laws, 1961)

Owner Mr. Langley Address East HelenaDriller Prior & Lindsey Address Clancy, Mont

Date of Notice of Appropriation of Groundwater .....

Date well started March 8, 1963 Date Completed March 13, 1963Type of well Drilled Equipment Used Churn  
(dug, driven, bored or (Churn, drill, rotary or  
drilled) other)Water Use: Domestic ☐ Municipal ☐ Stock ☒ Irrigation ☐  
Industrial ☐ Drainage ☐ Other ☐

Indicate on the diagram the character and thickness of the different strata met with in drilling, such as soil, clay, shale, gravel, rock or sand, etc. Show depth at which water is encountered, thickness and character of water-bearing strata and height to which the water rises in the well.

Top of Ground  
(Elev. above sea level.....)0 34 ft - pit & well1 32 ft to 40 ft  
clay & silt2 40 ft to 57 ft  
running sand  
coarse3 57 ft to 70 ft - clay  
& silt4 73 ft to 75 ft  
hard clay & some  
gravel & sand

Size of Drilled Hole	Size and Weight of Casing	From (Feet)	To (Feet)	PERFORATIONS		
				Kind Size	From (Feet)	To (Feet)
<u>6 1/4 i.d.</u>	<u>15/16</u>	<u>0</u>	<u>74 1/2</u>			

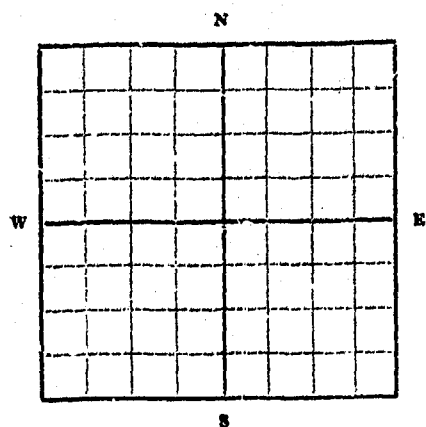
..... 1/4 ..... Sec. 26 T. 16 N R. 3 W  
Indicate location of well and place of use, if possible. Each small square represents 10 acres.

Show exact depth of bottom.

Static Water Level for non-flowing Well 34 feet.

Shut-in Pressure for Flowing Well .....

Pumping Water Level 54 feet at 15 gal. per minute.

Discharge in gal. per min. of flowing well .....

How Tested Boiler Length of Test 2 hrs.Remarks: (Gravel packing, cementing, packers, type of shutoff, location of place of use of groundwater if not at well, and any other similar pertinent information, including number of acres irrigated, if used for irrigation) 1 1/238  
Driller's License NumberWesley Lindsey  
Driller's Signature

This form to be prepared by driller, and three copies to be filed by the owner with the County Clerk and Recorder in the county in which the well is located.

Please answer all questions. If not applicable, so state, otherwise the form will be returned.

Original to the County Clerk and Recorder; duplicate to the State Engineer; Triplicate to the School of Mines and Quadruplicate for the Appropriator.

24384



STATE OF MONTANA  
ADMINISTRATOR OF GROUNDWATER CODE  
MONTANA WATER RESOURCES BOARD

NOTICE OF COMPLETION OF GROUNDWATER  
APPROPRIATION BY MEANS OF WELL

Developed after January 1, 1962

(Under Chapter 237 Montana Session Laws, 1961, as amended)

This form to be prepared by driller, and three copies to be filed by the owner with the County Clerk and Recorder in the county in which the well is located, last copy to be retained by driller.

Please answer all questions. If not applicable, so state, otherwise the form may be returned.

Owner Jason Speer Jr.  
Address Sequoia Park Fork Route Helena Montana  
Date well started Oct 1970 completed Oct 1970  
Type of well Drilled  
Equipment used Churn  
Water Use: Domestic ☒ Municipal ☐ Stock ☐ Irrigation ☐  
Industrial ☐ Drainage ☐ Other ☐\* Garden/Lawn ☒  
\*Describe \_\_\_\_\_  
USE: If used for irrigation, industrial, drainage or other. Explain, state number of acres and location or other data (i.e. Lot, Block and Addition). \_\_\_\_\_

ESTIMATED ANNUAL WITHDRAWAL 80,000

Size of Drilled Hole	Size and Weight of Casing	From (Feet)	To (Feet)	PERFORATIONS		
				Kind Size	From (Feet)	To (Feet)
6"	1716	0	119			

Static water level 70 ft.\*  
Pumping water level 20 ft.\*  
at 20 gallons per minute, measured 60 minutes after pumping began.  
\*Measured from ground level.  
Well developed by Ballen  
for 2 hours.  
Power 5 HP  
Remarks: (Gravel packing, cementing, packer, type of shutoff) \_\_\_\_\_  
Sequoia Park Lot 194 20 800 8  
NE 1/4 SW 1/4 Sec 26  
T. 10 N. R. 3 E. S. 3 W.

INDICATE LOCATION OF WELL AND PLACE OF USE, IF POSSIBLE. EACH SMALL SQUARE REPRESENTS 40 ACRES.

Driller's Signature Wesley Lindsay  
Driller's Address Helena Montana  
Montana LICENSE NO. 38

County Lewis & Clark

DRILLER'S LOG

Indicate the character, color, thickness of strata such as soil, clay, sand, gravel, shale, sandstone, etc. Show depth at which water is found and height to which water rises in well.

Top of Ground (Elev. above sea level)		
From (Feet)	To (Feet)	
0	8	top soil & clay
8	38	clay & small gravel
38	70	sandy clay
70	93	hardpan
93	120	disrupted line rock.

120 Show exact depth of bottom

48006

INDEXED  
SERIALIZED  
FILED

I hereby certify that the within instrument was filed in my office this 15 day of Jan A.D. 19 71 at 350 8 o'clock A.M.

RECTOR OF LIVER &  
COSTA, STATE OF MONTANA

*John D. ...*  
*John D. ...*  
*John D. ...*

1. The first step is to identify the problem or question that needs to be addressed. This involves understanding the context and the specific requirements of the task.

[illegible]

File No. \_\_\_\_\_

DUPLICATE

County La C

STATE OF MONTANA  
ADMINISTRATOR OF GROUNDWATER CODE  
OFFICE OF STATE ENGINEER

# Notice of Completion of Groundwater Appropriation by Means of Well

(Under Chapter 237, Montana Session Laws, 1961)

Owner Jason & Lijer Address East HelenaDriller Rue & Lindsey Address Clancy Mont

Date of Notice of Appropriation of Groundwater \_\_\_\_\_

Date well started April 15-63 Date Completed April 20-63

Type of well Drilled Equipment Used Churn drill  
(dug, driven, bored or drilled) (Churn, drill, rotary or other)

Water Use: Domestic ☒ Municipal ☐ Other ☐ Irrigation ☐  
Industrial ☐ Drainage ☐ Stock ☐

Indicate on the diagram the character and thickness of the different strata met with in drilling, such as soil, clay, shale, gravel, rock or sand, etc. Show depth at which water is encountered, thickness and character of water-bearing strata and height to which water rises in the well.

Top of Ground  
(Elev. above sea level)  
0 - 8 ft soil

8 ft to 25 ft clay  
+ some gravel

25 ft to 40 ft  
Hard pan + clay

40 ft to 62 ft  
Decomposed lime stone

62 to 80 ft  
clay

80 to 90 ft  
Decomposed lime  
and sand

Size of Drilled Hole	Size and Weight of Casing	From (Feet)	To (Feet)	PERFORATIONS		
				Kind Size	From (Feet)	To (Feet)
<u>6 1/4</u>	<u>17 lb</u>	<u>0</u>	<u>85</u>			

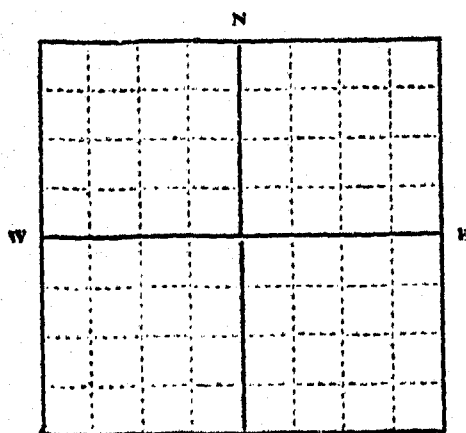

Lot 14 Block B. same park  
..... 1/4 Sec. .... T. .... R. ....  
Indicate location of well and place of use, if possible. Each small square represents 10 acres.

Show exact depth of bottom.

Static Water Level for non-flowing Well 70 feet.

Shut-in Pressure for Flowing Well \_\_\_\_\_

Pumping Water Level 80 feet at 12 gal. per minute.

Discharge in gal. per min. of flowing well \_\_\_\_\_

How Tested Boiler Length of Test 3 hrs

Remarks: (Gravel packing, cementing, packers, type of shutoff, location of place of use of groundwater if not at well, and any other similar pertinent information, including number of acres irrigated, if used for irrigation) \_\_\_\_\_

Driller's License Number 38Driller's Signature W. Lindsey

This form to be prepared by driller, and three copies to be filed by the owner with the County Clerk and Recorder in the county in which the well is located.

Please answer all questions. If not applicable, so state, otherwise the form will be returned.

Original to the County Clerk and Recorder; duplicate to the State Engineer; Triplicate to the Montana Bureau of Mines and Geology and Quadruplicate for the Appropriator.

4641.

144526

Indexed  
Recorded  
Compared

STATE OF MONTANA  
COUNTY OF LEWIS & CLARK

I hereby certify that the within instrument was filed in my office on this 3 day of June A.D. 1963 at 10 min. PM o'clock P. M.

Records of Lewis & Clark County, State of Montana.

County Register  
C. Lepore

200

Approved by me  
to be recorded in the  
County of Lewis & Clark  
State of Montana

Notary Public  
My Comm. Expires  
I am a Notary Public in and for the State of Montana  
My Comm. No. 12 expires on 12 day of August 1964

Notary Public  
My Comm. Expires  
I am a Notary Public in and for the State of Montana  
My Comm. No. 12 expires on 12 day of August 1964

T. 10N R. 3W 26  
County Lincoln & Clark

MONTANA BUREAU OF MINES AND GEOLOGY  
Butte, Montana

RECEIVED  
JAN 1 1913

WATER WELL LOG

STATE ENGINEER

	X		

Owner LOHN P. MARPON Address Seaver Park Helena Mont

Driller \_\_\_\_\_ Address \_\_\_\_\_

Date Started Approx 1912 Date Completed Approx 1912

Location: Sec. 26 T. 10N R. 3W  $\frac{1}{4}$  sec. NE  $\frac{1}{4}$  SW  $\frac{1}{4}$   
Lot 1 Block A Seaver Park addition Helena

Type of well Dug Equipment used \_\_\_\_\_  
(Dug, driven, bored, or drilled) (Churn drill, rotary, other)

Water use: Domestic ☐ Municipal ☐ Stock ☐ Irrigation ☐  
Industrial ☐ Drainage ☐ Other: \_\_\_\_\_

Casing: \_\_\_\_\_ ft. to 110 ft. Type Steel Size 4"

Casing: \_\_\_\_\_ ft. to \_\_\_\_\_ ft. Type \_\_\_\_\_ Size \_\_\_\_\_

Casing: \_\_\_\_\_ ft. to \_\_\_\_\_ ft. Type \_\_\_\_\_ Size \_\_\_\_\_

Perforated or Screened: Ft. \_\_\_\_\_ to ft. \_\_\_\_\_ Ft. \_\_\_\_\_ to ft. \_\_\_\_\_

Type of screen or perforations \_\_\_\_\_

Static Water level, for non-flowing well: \_\_\_\_\_ feet.

Shut-in pressure, for flowing well: \_\_\_\_\_ lb./sq. in. on: \_\_\_\_\_ (date)

Pumping water level \_\_\_\_\_ feet at \_\_\_\_\_ gal. per min.

How tested: \_\_\_\_\_

Length of test \_\_\_\_\_

Remarks: (Gravel packing, cementing, packers, type of shut-off, depth of shut-off)

\_\_\_\_\_  
\_\_\_\_\_  
\_\_\_\_\_  
\_\_\_\_\_  
\_\_\_\_\_

(over)

### Log of Well

Depth, feet		Description of Material Drilled
From	To	
0	20'	Clay
20	36'	Loam
35'	110'	Decomposed rock

This description of material obtained from description of section of a well which was drilled 100 ft from my well

STATE OF LOUISIANA  
COUNTY OF LEWIS & CLARK

I hereby certify that the within statement was filed in my office on the 19th day of July, A.D. 1900.

Record of Lewis & Clark  
County Recorder  
J. L. Davis

1100



File No. ....

T. 10N R. 3W

DUPLICATE

County LEWIS &amp; CLARK

STATE OF MONTANA  
ADMINISTRATOR OF GROUNDWATER CODE  
OFFICE OF STATE ENGINEER

RECEIVED

## Declaration of Vested Groundwater Rights

(Under Chapter 237, Montana Session Laws, 1961)

STATE ENGINEER

1. John P. Marren of Seaver Park Helena  
(Name of Appropriator) (Address) (Town)  
County of Lewis & Clark State of Montana  
have appropriated groundwater according to the Montana laws in effect prior to January 1, 1962, as follows:

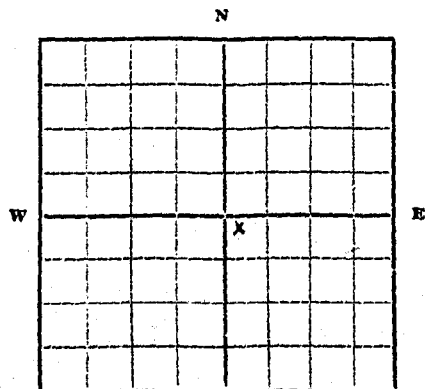

Lot 1, Block A, Seaver Park  
Addition to Helena

NE  $\frac{1}{4}$  Sec 26 T10N R. 3W

Indicate point of appropriation  
and place of use, if possible.  
Each small square represents 10  
acres.

2. The beneficial use on which the claim is based Household use lawn and garden
3. Date or approximate date of earliest beneficial use; and how continuous the use has been 1912 or earlier. Continuous use since well drilled.
4. The amount of groundwater claimed (in miner's inches or gallons per minute) All that is necessary for household and garden irrigation.
5. If used for irrigation, give the acreage and description of the lands to which water has been applied and name of the owner thereof one half acre in lawn and garden
6. The means of withdrawing such water from the ground and the location of each well or other means of withdrawal Jet well pump
7. The date of commencement and completion of the construction of the well, wells, or other works for withdrawal of groundwater 1912 or earlier
8. The depth of water table 45 feet (estimated)
9. So far as it may be available, the type, size and depth of each well or the general specifications of any other works for the withdrawal of groundwater 110 feet deep, 4 inch steel casing, drilled well
10. The estimated amount of groundwater withdrawn each year Amount not known. In summer, some days will use 4000 gallons per day (estimated)
11. The log of formations encountered in the drilling of each well if available 1-20 feet clay  
20-30 feet sand and gravel  
30-110 feet decayed rock
12. Such other information of a similar nature as may be useful in carrying out the policy of this act, including reference to book and page of any county record None

Signature of Owner

John P. Marren  
Date Feb. 26, 1962

Three copies to be filed by the owner with the County Clerk and Recorder of the county in which the well is located.

Please answer all questions. If not applicable, so state, otherwise the form will be returned.

Original to the County Clerk and Recorder; duplicate to the State Engineer; Triplicate to the School of Mines and Quadruplicate for the Appropriator.

Indexed  
139854  
CORRECTION  
COMPLETION

STATE OF MONTANA } SS.  
COUNTY OF LEWIS & CLARK }

I hereby certify that the within instrument was filed in my office on this 1st day of March A.D. 1962 at 5 min. past 10 o'clock a.m.

Records of Lewis & Clark  
County, State of Montana.

*John Donich*  
County Recorder  
*James C. Russell*  
Deputy

\$2.00

FILED  
MAR 1 1962  
CLERK OF DISTRICT COURT  
LEWIS & CLARK COUNTY  
MONTANA

...the following is a true and correct copy of the original as the same appears in the records of the County of Lewis & Clark, State of Montana, this 1st day of March, 1962.

...the following is a true and correct copy of the original as the same appears in the records of the County of Lewis & Clark, State of Montana, this 1st day of March, 1962.

...the following is a true and correct copy of the original as the same appears in the records of the County of Lewis & Clark, State of Montana, this 1st day of March, 1962.

File No. \_\_\_\_\_

T. \_\_\_\_\_

R. \_\_\_\_\_

County \_\_\_\_\_

~~QUADRUPPLICATE~~*Duplicate*

STATE OF MONTANA  
ADMINISTRATOR OF GROUNDWATER CODE  
OFFICE OF STATE ENGINEER

JAN 16 1964

Declaration of Vested Groundwater Rights **STATE ENGINEER**

(Under Chapter 237, Montana Session Laws, 1961)

1. ~~ROY J. BERGMAN & ROBERT E. BERGMAN~~, of P.O. ~~Box 115~~, ~~Helena~~ (Town)  
(Name of Appropriator) (Address)

County of ~~LEWIS & CLARK~~ State of ~~MONTANA~~  
have appropriated groundwater according to the Montana laws in effect prior to January 1, 1962, as follows:

~~Owner's Tract = lots 9 & 10, & 10' of E 217.0' & W 1/2 of 13, 14 & 15, & 1/2 of 17 & 18~~

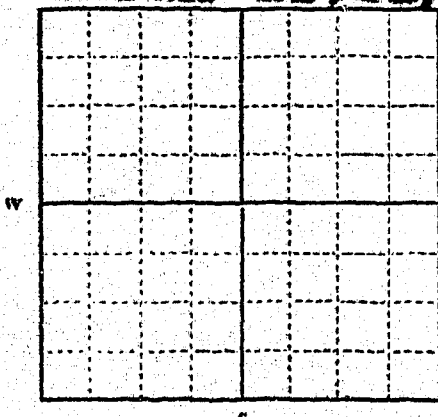

~~1/4~~ Sec. ~~26~~ T. ~~10~~ R. ~~3~~

Indicate point of appropriation and place of use, if possible. Each small square represents 10 acres.

2. The beneficial use on which the claim is based ~~Domestic~~

~~Irrigation and Pasture~~

3. Date or approximate date of earliest beneficial use; and how continuous the use has been

~~April 1961~~  
~~Continuous~~

4. The amount of groundwater claimed (in miner's inches or gallons per minute)

~~27 gallons per minute~~

5. If used for irrigation, give the acreage and description of the lands to which water has been applied and name of the owner thereof

~~Approx 7 acres, Margen and Landscaping~~

6. The means of withdrawing such water from the ground and the location of each well or other means of withdrawal

~~Deep well jet pump~~

7. The date of commencement and completion of the construction of the well, wells, or other works for withdrawal of groundwater

~~Exact date unknown~~

8. The depth of water table

~~50 feet~~

9. So far as it may be available, the type, size and depth of each well or the general specifications of any other works for the withdrawal of groundwater

~~Drilled well - five (5) inch casing - 57 feet deep~~

10. The estimated amount of groundwater withdrawn each year

~~5,000,000 gallons~~

11. The log of formations encountered in the drilling of each well if available

~~Not available~~

12. Such other information of a similar nature as may be useful in carrying out the policy of this act, including reference to book and page of any county record

~~not applicable~~

Signature of Owner

*J. Lawrence M. Kahan*

Date ~~12-31-63~~

Three copies to be filed by the owner with the County Clerk and Recorder of the county in which the well is located.

Please answer all questions. If not applicable, so state, otherwise the form will be returned.

Original to the County Clerk and Recorder; Duplicate to the State Engineer; Triplicate to the Montana Bureau of Mines and Geology, and Quadruplicate for the Appropriator.

36241

152-439

STATE OF MONTANA }  
COUNTY OF LEWIS & CLARK } SS

I hereby certify that the within en-  
rollment was filed in my office on  
this day of August  
A.D. 1964 at Helena, Mont.  
J. B. Goodrich  
Records of Lewis & Clark  
County of Montana

John Goodrich  
County Clerk

John Goodrich  
County Clerk

John Goodrich  
County Clerk

John Goodrich  
County Clerk

John Goodrich  
County Clerk

John Goodrich  
County Clerk

John Goodrich  
County Clerk

John Goodrich  
County Clerk

John Goodrich  
County Clerk

John Goodrich  
County Clerk

John Goodrich  
County Clerk

John Goodrich  
County Clerk

John Goodrich  
County Clerk

John Goodrich  
County Clerk

John Goodrich  
County Clerk

File No. \_\_\_\_\_

DUPLICATE

STATE ENGINEER

STATE OF MONTANA

ADMINISTRATOR OF GROUNDWATER CODE

OFFICE OF STATE ENGINEER

T. 10 N R. 3 W

County Lewis & Clark**Declaration of Vested Groundwater Rights**

(Under Chapter 237, Montana Session Laws, 1961)

1. Robert L. & Margaret Ann Millegan of Seaver Park Helena  
 (Name of Appropriator) (Address) (Town)

County of Lewis & Clark State of Montana  
 have appropriated groundwater according to the Montana laws in effect prior to January 1, 1962, as follows:

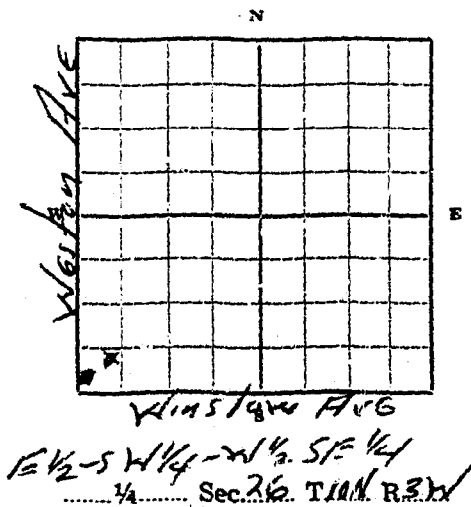

Indicate point of appropriation and place of use, if possible. Each small square represents 10 acres.

2. The beneficial use on which the claim is based Household, Irrigation and Poultry Farm
3. Date or approximate date of earliest beneficial use; and how continuous the use has been Well No. 1 April 1917  
Well No. 2 February 1942  
These wells have been in constant use since above dates.
4. The amount of groundwater claimed (in miner's inches or gallons per minute) Well No. 1 500 gallons per minute  
Well No. 2 500 gallons per minute
5. If used for irrigation, give the acreage and description of the lands to which water has been applied and name of the owner thereof Gardens, Lawns and Trees - 2 acres  
Robert L. & Margaret Ann Millegan - Owner
6. The means of withdrawing such water from the ground and the location of each well or other means of withdrawal Drilled wells with Electric Pumps  
For location see map above
7. The date of commencement and completion of the construction of the well, wells, or other works for withdrawal of groundwater Well No. 1 April 1917  
Well No. 2 February 1942
8. The depth of water table Well No. 1 136 feet - Well No. 2 241 feet
9. So far as it may be available, the type, size and depth of each well or the general specifications of any other works for the withdrawal of groundwater Well No. 1 - 4 inch steel casing, 93 feet deep, drilled  
Well No. 2 - 6 inch steel casing, 100 feet deep, drilled
10. The estimated amount of groundwater withdrawn each year Well No. 1 - 600,000 gallons  
Well No. 2 - 500,000 gallons
11. The log of formations encountered in the drilling of each well if available Not available
12. Such other information of a similar nature as may be useful in carrying out the policy of this act, including reference to book and page of any county record.

Signature of Owner

Date

May 28, 1962

Three copies to be filed by the owner with the County Clerk and Recorder of the county in which the well is located.

Please answer all questions. If not applicable, so state, otherwise the form will be returned.

Original to the County Clerk and Recorder; duplicate to the State Engineer; Triplicate to the School of Mines and Quadruplicate for the Appropriator.



Indexed 732891  
Recorded

UPPER  
STATE OF MONTANA } ss.  
COUNTY OF LEWIS & CLARK

I hereby certify that the within in-  
strument was filed in my office on  
this 28th day of May  
A.D. 1927 at 35 min. past  
10 o'clock A. M.

Records of Lewis & Clark  
County, State of Montana.

Allen Donich  
County Recorder  
Leonard E. Pinner  
Deputy

2200

File No. \_\_\_\_\_

T 10N R 3W

DUPLICATE

County Lewis & Clark

STATE OF MONTANA  
ADMINISTRATOR OF GROUNDWATER CODE  
OFFICE OF STATE ENGINEER

RECEIVED  
FEB 17 1962

Declaration of Vested Groundwater Rights STATE ENGINEER

(Under Chapter 237, Montana Session Laws, 1961)

1. The Montana Power Company of 40 East Broadway Butte  
(Name of Appropriator) (Address) (Town)  
County of Lewis & Clark State of Montana  
have appropriated groundwater according to the Montana laws in effect prior to January 1, 1962, as follows:

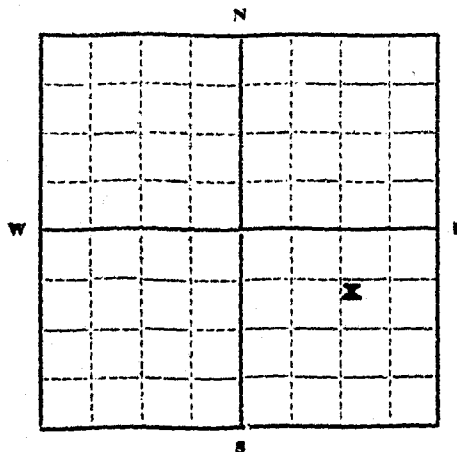

NE 1/4 Sec. 25 T.10N R.3W

Indicate point of appropriation and place of use, if possible. Each small square represents 10 acres.

2. The beneficial use on which the claim is based... Domestic consumption
3. Date or approximate date of earliest beneficial use; and how continuous the use has been... Continuous from 1910
4. The amount of groundwater claimed (in miner's inches or gallons per minute)... 60 gallons per hour - 24 hours per day.
5. If used for irrigation, give the acreage and description of the lands to which water has been applied and name of the owner thereof... Not used
6. The means of withdrawing such water from the ground and the location of each well or other means of withdrawal... By pump in driven well
7. The date of commencement and completion of the construction of the well, wells, or other works for withdrawal of groundwater... Present well drilled in 1936 - old well abandoned
8. The depth of water table... 85 feet
9. So far as it may be available, the type, size and depth of each well or the general specifications of any other works for the withdrawal of groundwater... Depth of well - 105 feet, 3 inch casing  
is H.P. deep well pump
10. The estimated amount of groundwater withdrawn each year... 73,000 Gallons
11. The log of formations encountered in the drilling of each well if available... Not available
12. Such other information of a similar nature as may be useful in carrying out the policy of this act, including reference to book and page of any county record... None

(CORPORATE SEAL)

ATTEST:

L. J. J. J.  
Its Secretary

THE MONTANA POWER COMPANY

Signature of Owner

By [Signature]  
Vice President  
Date February 1, 1962

Three copies to be filed by the owner with the County Clerk and Recorder of the county in which the well is located.

Please answer all questions. If not applicable, so state, otherwise the form will be returned.

Original to the County Clerk and Recorder; duplicate to the State Engineer; Triplicate to the Montana Bureau of Mines and Geology, and Quadruplicate for the Appropriator.

130898

RECORDED  
INDEXED  
COMPTON

STATE OF MONTANA  
COUNTY OF LEWIS & CLARK } 25.

I hereby certify that the within in-  
strument was filed in my office on  
this 2nd day of Apr  
A.D. 1962 at 5 min. past  
9 o'clock a.M.

Records of Lewis & Clark  
County, State of Montana.

John Donich  
County Recorder

C. L. Smith  
Deputy

2:00



T 10-N R 3W 26

County LEWIS & CLARKE

MONTANA BUREAU OF MINES AND GEOLOGY  
Butte, Montana

RECEIVED  
JAN 1960

WATER WELL LOG

STATE ENGINEER

Box 657 EAST Helena

X		

Owner Arthur Myrtle Petan Address SEASER PARK

Driller Price & Lindsay Address CLANCY MONT

Date Started SEPT 14 - 1959 Date Completed SEPT 15 1959

Location: Sec. 26 T. 10 N. R. 3 W. 1/4 sec. NE 1/4 of SW 1/4

Type of well Drilled Equipment used Drill  
(Dug, driven, bored, or drilled) (Churn drill, rotary, other)

Water use: Domestic ☒ Municipal ☐ Stock ☐ Irrigation ☐  
Industrial ☐ Drainage ☐ Other:

Casing: 6 ft. to 79 ft. Type Iron Size 6 inch

Casing: ft. to ft. Type Size

Casing: ft. to ft. Type Size

Perforated or Screened: Ft. to ft. Ft. to ft.

Type of screen or perforations

Static Water level, for non-flowing well: 30 feet.

Shut-in pressure, for flowing well: lb./sq. in. on: (date)

Pumping water level: 35 feet at gal. per min. 10 to 15

How tested: Bailing & pumping

Length of test: 4 to 5 hrs

Remarks: (Gravel packing, cementing, packers, type of shut-off, depth of shut-off)

LOCATED ON LOT 6 IN BLOCK H IN SEASER PARK ADDITION

(over)

## Log of Well

[illegible]

File No. \_\_\_\_\_

DUPLICATE

T. 10 N. R. 34 E.

County \_\_\_\_\_

STATE OF MONTANA  
ADMINISTRATOR OF GROUNDWATER CODE  
OFFICE OF STATE ENGINEER

RECEIVED

## Declaration of Vested Groundwater Rights

(Under Chapter 237, Montana Session Laws, 1961) STATE ENGINEER

(Page)

Clyde H. & Dorothy M. Pugh of Seaver Park Helena  
(Name of Appropriator) (Address) (Town)

County of Lewis & Clark State of Montana  
have appropriated groundwater according to the Montana laws in effect prior to January 1, 1962, as follows:

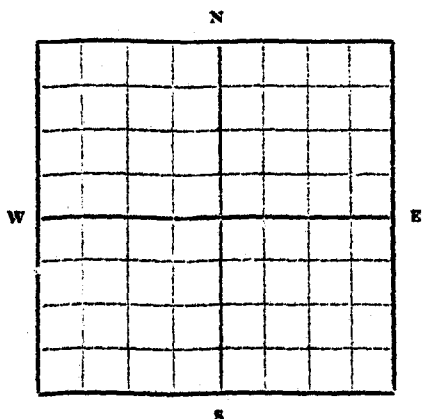

..... 1/4 ..... Sec. .... T. .... R. ....

Indicate point of appropriation  
and place of use, if possible.  
Each small square represents 10  
acres.

2. The beneficial use on which the claim is based irrigation of gardens, lawn & household use
3. Date or approximate date of earliest beneficial use; and how continuous the use has been June 1957 and used continuously
4. The amount of groundwater claimed (in miner's inches or gallons per minute) 15000 gallons an hour
5. If used for irrigation, give the acreage and description of the lands to which water has been applied and name of the owner, thereof About 12 Acres lots 8-9-10-11-Block 12 lots 1-2-3 and lots 1-2-3-4-5-6-7-8-9-10-11-12 in Block 5. lots 1 & 2 on about 5 acres. All of the above in Seaver Park Addition
6. The means of withdrawing such water from the ground and the location of each well or other means of withdrawal well on lot 1 of 22 acres near
7. The date of commencement and completion of the construction of the well, wells, or other works for withdrawal of groundwater June 1957 finished same month & year
8. The depth of water table 22 feet
9. So far as it may be available, the type, size and depth of each well or the general specifications of any other works for the withdrawal of groundwater 8 inch casing down 22 feet, water pumped out from this well during summer months at 1000 gallons an hour.
10. The estimated amount of groundwater withdrawn each year 250000 gallons
11. The log of formations encountered in the drilling of each well if available unknown
12. Such other information of a similar nature as may be useful in carrying out the policy of this act, including reference to book and page of any county record none

Signature of Owner Clyde H. PughDate 2-12-62

Three copies to be filed by the owner with the County Clerk and Recorder of the county in which the well is located.

Please answer all questions. If not applicable, so state, otherwise the form will be returned.

Original to the County Clerk and Recorder; duplicate to the State Engineer; Triplicate to the School of Mines and Quadruplicate for the Appropriator.

1469

127293

Indexed  
Recorded  
Compared

✓

STATE OF MONTANA } ss.  
COUNTY OF LEWIS & CLARK

I hereby certify that the within in-  
strument was filed in my office on  
this 14th day of July  
A.D. 1963 at 3 min. past

7 o'clock a. M.  
Records of Lewis & Clark  
County, State of Montana.

William L. Davis

County Recorder

by Louise C. Rinehart

Deputy

2.00

RECEIVED  
APR 14 1958

T. 10-N R. 3-W

County Lewis & Clark

STATE ENGINEER MONTANA BUREAU OF MINES AND GEOLOGY  
Butte, Montana

WATER WELL LOG

	X	

Owner Richard and Mary Stern Address Box 1011 - Helena, Montana

Driller Sidney Ray Address Unknown

Date Started October 1933 Date Completed November 1933

Location: Sec. 24 T. 10-N R. 3-W 1/4 sec. N-W 1/4 in S.West 1/4

Type of well Drilled (Dug, driven, bored, or drilled) Equipment used Churn Drill (Churn drill, rotary, other)

Water use: Domestic ☒ Municipal ☐ Stock ☐ Irrigation ☒

Industrial ☐ Drainage ☐ Other:

Casing: 90 ft. to 90 ft. Type Steel Size 8 4 inch

Casing: ft. to ft. Type Size

Casing: ft. to ft. Type Size

Perforated or Screened: Ft. to ft. Ft. to ft.

Type of screen or perforations

Static Water level, for non-flowing well: (35 feet) Fifty-five feet.

Shut-in pressure, for flowing well: lb./sq. in. on: (date)

Pumping water level: feet at Five (5) gal. per min.

How tested:

Length of test:

Remarks: (Gravel packing, cementing, packers, type of shut-off, depth of shut-off)

Located in lot 18 - Block A - Sever Park

Well is 90 feet deep from ground to elevation

Well is 80 feet deep from bottom to pit

(over)

Indexed  
Recorded  
Compared

86506

State of Montana } ss.  
County of Lewis & Clark }

I hereby certify that the within  
instrument was filed in my office on  
this 8th day of Nov A.D.  
1950 at 20 min past 9 o'clock  
A.M.

Records of Lewis & Clark  
County, State of Montana  
Florence Thiel Fauver

County Recorder,  
By Florence Thiel Fauver  
Deputy

\$ 50

File No. ....

DUPLICATE

T. 10 N. R. 3 W.

County. LEWIS & CLARK

STATE OF MONTANA  
ADMINISTRATOR OF GROUNDWATER CODE  
OFFICE OF STATE ENGINEER

RECEIVED

Declaration of Vested Groundwater Rights STATE ENGINEER  
(Under Chapter 237, Montana Session Laws, 1961)

1. Richard A. Stern of Seaver Park Box 1011 Helena  
(Name of Appropriator) (Address) (Town)  
County of Lewis & Clark State of Montana  
have appropriated groundwater according to the Montana laws in effect prior to January 1, 1962, as follows:

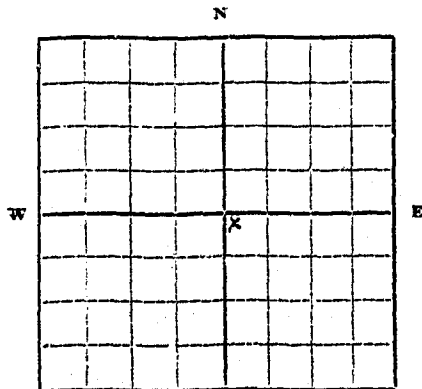

Let 18, Block A, Seaver Park  
Addition to Helena

NE 1/4 SW 1/4 Sec. 26 T10N. R. 3W

Indicate point of appropriation  
and place of use, if possible.  
Each small square represents 10  
acres.

2. The beneficial use on which the claim is based Household use, garden and lawn
3. Date or approximate date of earliest beneficial use; and how continuous the use has been Dug well 1919 which was filled in 1935. Drilled well in 1935. Continuous use since 1919
4. The amount of groundwater claimed (in miner's inches or gallons per minute) Amount needed for household and yard irrigation
5. If used for irrigation, give the acreage and description of the lands to which water has been applied and name of the owner thereof One-fourth acre in lawn and garden
6. The means of withdrawing such water from the ground and the location of each well or other means of withdrawal Jet well pump
7. The date of commencement and completion of the construction of the well, wells, or other works for withdrawal of groundwater First well started in 1919 and finished in 1920. This well was filled in 1935 and new well drilled in 1935
8. The depth of water table 50 feet (estimated)
9. So far as it may be available, the type, size and depth of each well or the general specifications of any other works for the withdrawal of groundwater 90 feet deep, 4 inch steel casing, drilled well
10. The estimated amount of groundwater withdrawn each year Amount not known
11. The log of formations encountered in the drilling of each well if available 1. - 20 feet clay  
20. - 30 feet sand and gravel  
30. - 90 feet decayed rock
12. Such other information of a similar nature as may be useful in carrying out the policy of this act, including reference to book and page of any county record None

Signature of Owner Richard A. Stern

Date February 26 - 1962

Three copies to be filed by the owner with the County Clerk and Recorder of the county in which the well is located.

Please answer all questions. If not applicable, so state, otherwise the form will be returned.

Original to the County Clerk and Recorder; duplicate to the State Engineer; Triplicate to the School of Mines and Quadruplicate for the Appropriator.

1604

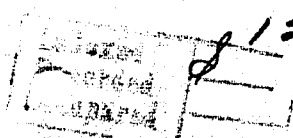

129855

STATE OF MONTANA  
COUNTY OF LEWIS & CLARK } ss.

I hereby certify that the within in-  
strument was filed in my office on  
this 1st day of March  
A.D. 1967 at 10 min. past  
10 o'clock a.m.

Records of Lewis & Clark  
County, State of Montana

John A. Reich  
County Recorder  
James E. Rumsse  
Deputy

200



File No. ....

T 10N R 3W

DUPLICATE

County Lewis & Clark

STATE OF MONTANA  
ADMINISTRATOR OF GROUNDWATER CODE  
OFFICE OF STATE ENGINEER

**Declaration of Vested Groundwater Rights**  
(Under Chapter 237, Montana Session Laws, 1961)

RECEIVED  
JAN 8 1964  
STATE ENGINEER

1. Howard Eugene Stratton, of York Nelson Route, Helena  
(Name of Appropriator) (Address) (Town)  
County of Lewis & Clark State of Montana  
have appropriated groundwater according to the Montana laws in effect prior to January 1, 1962, as follows:

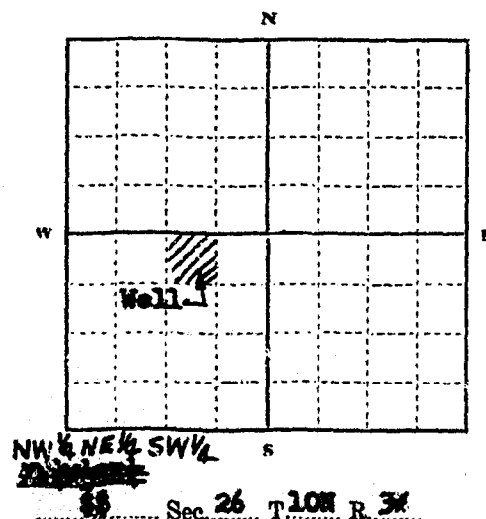

2. The beneficial use on which the claim is based Domestic, Irrigation and Livestock use.
3. Date or approximate date of earliest beneficial use; and how continuous the use has been. Beneficial use began in September of 1955 and has been continuous since that date.
4. The amount of groundwater claimed (in miner's inches or gallons per minute) 15 gallons per minute
5. If used for irrigation, give the acreage and description of the lands to which water has been applied and name of the owner thereof. Approximate acreage under irrigation is three acres which is composed of shelterbelt, garden and pasture owned by Howard E. Stratton.
6. The means of withdrawing such water from the ground and the location of each well or other means of withdrawal. Water is withdrawn by a one H.P. electric Jet Pump located as shown on the sketch to the left.
7. The date of commencement and completion of the construction of the well, wells, or other works for withdrawal of groundwater. July 1955 - Commencement of construction of the well. Well was completed in September of 1955.
8. The depth of water table. forty-five feet.
9. So far as it may be available, the type, size and depth of each well or the general specifications of any other works for the withdrawal of groundwater. 2 1/2" Type - Drilled well by means of a churn well. Size - 6" steel casing. Drilled depth - 80 feet deep.
10. The estimated amount of groundwater withdrawn each year. 2,000,000 gallons
11. The log of formations encountered in the drilling of each well if available. Overburden - Fine Silt - Sand & Gravel - Hardpan - Clay - Sand & Gravel - Water bearing strata composed of sand and Gravel.
12. Such other information of a similar nature as may be useful in carrying out the policy of this act, including reference to book and page of any county record. Additional information to be found within the well-drilling records of Mr. Walter Bidcock, 606 N. Warren Helena, Montana

Signature of Owner Howard E. StrattonDate December 26-1963

Three copies to be filed by the owner with the County Clerk and Recorder of the county in which the well is located.

Please answer all questions. If not applicable, so state, otherwise the form will be returned.

Original to the County Clerk and Recorder; Duplicate to the State Engineer; Triplicate to the Montana Bureau of Mines and Geology, and Quadruplicate for the Appropriator.

17485

Indexed  
Recorded  
Compared

151455

STATE OF MONTANA  
COUNTY OF LEWIS & CLARK } SS

I hereby certify that the within in-  
strument was read in my office on  
this 30 day of Dec  
A.D. 1963 at 3 min. past  
o'clock P.M.

Records of Lewis & Clark  
County, State of Montana

John W. Kinn  
County Recorder

By Norman Kelley  
Deputy

2.00

10N-36W  
County LEWIS AND CLARK

STATE OF MONTANA  
ADMINISTRATOR OF GROUNDWATER CODE  
MONTANA WATER RESOURCES BOARD

# NOTICE OF COMPLETION OF GROUNDWATER APPROPRIATION BY MEANS OF WELL

**Developed after January 1, 1962**

(Under Chapter 237 Montana Session Laws, 1961, as amended)

This form to be prepared by driller, and three copies to be filed by the owner with the County Clerk and Recorder in the county in which the well is located, last copy to be retained by driller.

Please answer all questions. If not applicable, so state, otherwise the form may be returned.

Owner J W TIPTON

Address SEVER PORT

2743 Winslow

Date well started 4/17/72

completed 4/19/72

Type of well Drilled

(Dug, driven, bored or drilled)

Equipment used CHURN DRILL

(Churn drill, rotary or other)

Water Use: Domestic ☒ Municipal ☐ Stock ☐ Irrigation ☐

Industrial ☐ Drainage ☐ Other ☐\* Garden/Lawn: ☒

**\* Describe**

**USE:** If used for irrigation, industrial, drainage or other. Explain, state number of acres and location or other data (i.e. Lot, Block and Addition).

## ESTIMATED ANNUAL WITHDRAWAL

Size of Drilled Hole	Size and Weight of Lining	From (Feet)	To (Feet)	PERFORATIONS		
				Kind Size	From (Feet)	To (Feet)
6"	1716	0	12.8'		LINEAR	
					118	125

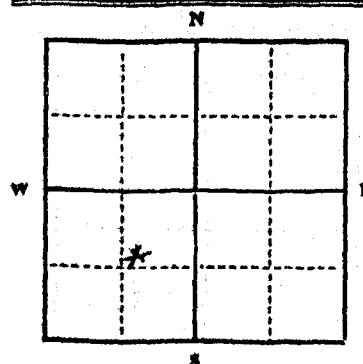

Static water level 64 ft.\*  
Pumping water level 100 ft.\*  
at 3.0 gallons per minute,  
measured 4.0 minutes after pumping  
began.

\*Measured from ground level.

Well developed by B.A.L.L.R.

for 2 hours.

Power 1.25 Pump..... HP

Remarks: (Gravel packing, cementing,  
packers, type of shutoff) .....

N.E. 1/4 S.W. 1/4 Sec. 26.

T....12....DR....3

INDICATE LOCATION OF WELL AND PLACE OF USE, IF POSSIBLE.  
EACH SMALL SQUARE REPRESENTS 40 ACRES.

Driller's Signature Wesley Lindsay

Driller's Address Clancy Monahan

LICENSE NO. 38

### DRILLER'S LOG

Indicate the character, color, thickness of strata such as soil, clay, sand, gravel, shale, sandstone, etc. Show depth at which water is found and height to which water rises in well.

Top of Ground (Elev. above sea level)

[illegible]

128 Show exact depth of bottom

50,333

225210

Index  
Recorded  
Compared



STATE OF MONTANA  
COUNTY OF LEWIS & CLARK } SS

I hereby certify that the within in-  
strument was filed in my office on  
this 3 day of July  
A.D. 1922 at 20 min. past  
9 o'clock A.M. and record-  
ed on page      of Book  
of      Records of Deeds and  
and County State of Montana.

*John J. Thomas*

County Recorder

*J. P. Thomas*

Deputy

200

Department of Natural Resources and Conservation  
Water Resources Division  
Engineering Bureau  
Groundwater Section  
Sam W. Mitchell Building  
Helena, Montana 59601

Owner Mr. J. W. Tipton  
Address Sever Pk, 2743 Winslow, Helena  
Location T. 10N R. Sec. 26  
Doc. No. 225210

As the Administrator of the Groundwater Code for the State of Montana, please take note of the following special instructions, in order to properly protect your groundwater right.

Special Instructions:

Please provide, as indicated on the attached form, the Range number in order to complete the location of the well.

Thank you.

RECEIVED

JUN 29 1972

MONTANA DEPARTMENT OF NATURAL  
RESOURCES AND CONSERVATION

Water Use: Domestic ☒ Municipal ☐ Stock ☐ Irrigation ☐  
Industrial ☐ Drainage ☐ Other ☐\* Garden/Lawn ☒

\*Describe .....

USE: If used for irrigation, industrial, drainage or other. Explain, state number of acres and location or other data (i.e. Lot, Block and Addition). .....

ESTIMATED ANNUAL WITHDRAWAL .....

Size of Drilled Hole	Size and Weight of Casing	From (Feet)	To (Feet)	PERFORATIONS		
				Kind Size	From (Feet)	To (Feet)
6"	1716	0	125	LINEAR	114	125

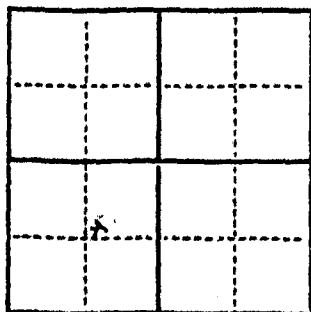

Static water level ..... 64 ..... ft.\*  
Pumping water level ..... 100 ..... ft.\*  
at ..... 3.2 ..... gallons per minute,  
measured ..... 2.0 ..... minutes after pumping  
began.  
\*Measured from ground level.  
Well developed by ..... 12.1 .....  
for ..... 2 ..... hours.  
Power ..... 1.5 ..... HP  
Remarks: (Gravel packing, cementing,  
packers, type of shutoff) .....

INDICATE LOCATION OF WELL AND PLACE OF USE, IF POSSIBLE.  
EACH SMALL SQUARE REPRESENTS 40 ACRES.

Driller's Signature W. Early

Driller's Address Clancy Montana

LICENSE NO. 35

125 Show exact depth of bottom

50,333

GW 2

LINDSAY DRILLING

Approved Stock Form—State Publishing Co., Helena, Montana—50551

File No.

PH 933-5511

CLANCY, MONT. 59634

T. 10 N R 3 W

DUPLICATE

MONTANA WATER RESOURCES BOARD

County Lewis &amp; Clark

LOG RECEIVED

STATE OF MONTANA  
ADMINISTRATOR OF GROUNDWATER CODE  
STATE WATER CONSERVATION BOARD

Top of Ground

MAY 26 1969

(Elev. above sea level)

0 - 8 ft

topsoil &amp; gravel

8 - 28 ft

clay &amp; gravel

28 - 84 ft

clay

84 ft to 100 ft

Hardpan

100 to 111 ft

Decomposed Lime Rock

**Notice of Completion of Groundwater  
Appropriation by Means of Well**  
DEVELOPED AFTER JANUARY 1, 1962

(Under Chapter 237 Montana Session Laws, 1961, as amended)

Owner Glen E Tusler Address Seaver Park, Helena  
MontanaDriller Wes Lindsay Address Clancy, Montana

Date of Notice of appropriation of groundwater

Date well started June 1962 Date completed June 1962Type of well shelled Equipment used churn  
(Dug, driven, bored or drilled) (Churn drill, rotary or other)Water use: Domestic ☒ Municipal ☐ Stock ☐ Irrigation ☐  
Industrial ☐ Drainage ☐ Other ☐

Indicate on the diagram the character and thickness of the different strata met with in drilling, such as soil, clay, shale, gravel, rock or sand, etc. Show depth at which water is encountered, thickness and character of water-bearing strata and height to which the water rises in the well.

Size of Drilled Hole	Size and Weight of Casing	From (Feet)	To (Feet)	PERFORATIONS		
				Kind Size	From (Feet)	To (Feet)
6 "	17lb	0	111		None	

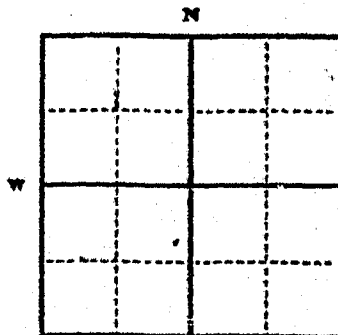
Lot 17, Block B  
Seaver ParkNE 1/4 Sec 26 T. 10 N R. 3 W  
Indicate location of well and place of use, if possible. Each small square represents 40 acres.Static Water Level for non-flowing well  
70 feet.

Shut-in Pressure for Flowing Well

Purping Water Level 80 feet

at 18 gal. per minute.

Discharge in gal. per min. of flowing well

How Tested Boiler

Length of Test

Remarks: (Gravel packing, cementing, packers, type of shutoff)

(Continue on reverse side)

USE—If used for irrigation, industrial, drainage or other. Explain, state number of acres and location or other data (i.e.: Lot, Block and Addition).

Irrigate yard &amp; garden

Show exact depth of bottom.

This form to be prepared by driller, and three copies to be filed by the owner with the County Clerk and Recorder in the county in which the well is located, tissue copy to be retained by driller.

Please answer all questions. If not applicable, so state, otherwise the form will be returned.

Driller's License Number

Wesley Lindsay  
Driller's Signature.

45,265

Indexed  
Recorded 27  
203585

STATE OF MONTANA  
COUNTY OF LEWIS & CLARK

I hereby certify that the within in  
strument was filed in my office on  
the 19 day of May  
A.D. 1929 at 11 o'clock A.M.

Records of Lewis & Clark  
County, State of Montana

John J. Smith  
County Recorder  
Carl J. Smith  
Deputy  
2.00

CIVIL, MONT. 26634  
BH 933-221  
LINDSAY DRILLING

File No. \_\_\_\_\_

DUPLICATE

T. 10<sup>N</sup> R. 2<sup>W</sup>County Lea

STATE OF MONTANA  
ADMINISTRATOR OF GROUNDWATER CODE  
OFFICE OF STATE ENGINEER

JAN 9 1964

RECEIVED

## Declaration of Vested Groundwater Rights

(Under Chapter 237, Montana Session Laws, 1961)

1. \_\_\_\_\_, of \_\_\_\_\_  
(Name of Appropriator) (Address) (Town)  
County of \_\_\_\_\_ State of \_\_\_\_\_  
have appropriated groundwater according to the Montana laws in effect prior to January 1, 1962, as follows:

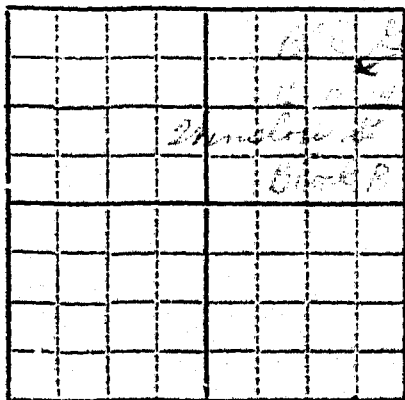

Lots 12 to 14 Bld H Levee  
Sec 26 T. 10 N. R. 2

Indicate point of appropriation  
and place of use, if possible.  
Each small square represents 10  
acres.

2. The beneficial use on which the claim is based \_\_\_\_\_
3. Date or approximate date of earliest beneficial use; and how continuous the use has been \_\_\_\_\_
4. The amount of groundwater claimed (in miner's inches or gallons per minute) \_\_\_\_\_
5. If used for irrigation, give the acreage and description of the lands to which water has been applied and name of the owner thereof \_\_\_\_\_
6. The means of withdrawing such water from the ground and the location of each well or other means of withdrawal \_\_\_\_\_
7. The date of commencement and completion of the construction of the well, wells, or other works for withdrawal of groundwater \_\_\_\_\_
8. The depth of water table \_\_\_\_\_
9. So far as it may be available, the type, size and depth of each well or the general specifications of any other works for the withdrawal of groundwater \_\_\_\_\_
10. The estimated amount of groundwater withdrawn each year \_\_\_\_\_
11. The log of formations encountered in the drilling of each well if available \_\_\_\_\_
12. Such other information of a similar nature as may be useful in carrying out the policy of this act, including reference to book and page of any county record \_\_\_\_\_

Signature of Owner \_\_\_\_\_

Date \_\_\_\_\_

Three copies to be filed by the owner with the County Clerk and Recorder of the county in which the well is located.

Please answer all questions. If not applicable, so state, otherwise the form will be returned.

Original to the County Clerk and Recorder; duplicate to the State Engineer; Triplicate to the Montana Bureau of Mines and Geology, and Quadruplicate for the Appropriator.

28895



151927  
STATE OF MONTANA } 96.  
COUNTY OF LEWIS & CLARK }

I hereby certify that the within in-  
strument was filed in my office on  
this 7 day of Jan  
A.D. 1964 at 36 min. past  
8 o'clock A.M.

Records of Lewis & Clark  
County, State of Montana.

John L. Lovich  
County Recorder

By Norma R. Kelly  
Deputy

52 <sup>10</sup> pd

INDEXED  
RECORDED  
COMPARED

B

File No. ....

T. 10 R. 3

DUPLICATE

County. LEWIS AND CLARK

STATE OF MONTANA  
ADMINISTRATOR OF GROUNDWATER CODE  
OFFICE OF STATE ENGINEER

RECEIVED

Declaration of Vested Groundwater Rights STATE ENGINEER

(Under Chapter 237, Montana Session Laws, 1961)

1. EVA C. BROOKS of 1530 JACKSON ST HELENA  
(Name of Appropriator) (Address) (Town)  
County of LEWIS AND CLARK State of MONTANA  
have appropriated groundwater according to the Montana laws in effect prior to January 1, 1962, as follows:

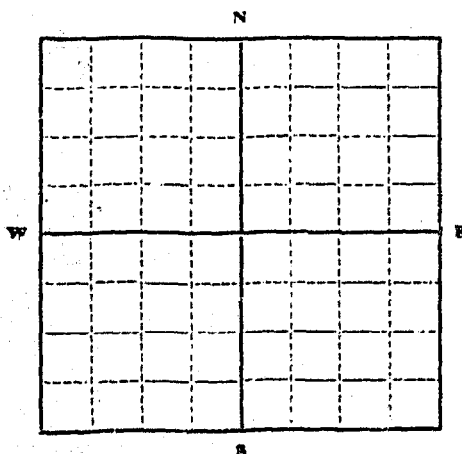

SW 1/4 Sec. 28 T10N R3W

Indicate point of appropriation  
and place of use, if possible.  
Each small square represents 10  
acres. **IN BLOCK 150F CITY  
PARK ADDITION EAST OF  
HELENA**

2. The beneficial use on which the claim is based. A WELL  
FOR DOMESTIC USE
3. Date or approximate date of earliest beneficial use; and how con-  
tinuous the use has been. WELL WAS MADE IN 1900  
OR 1901; use has been INTERMITTENTLY
4. The amount of groundwater claimed (in miner's inches or gallons  
per minute). UNABLE TO ESTIMATE
5. If used for irrigation, give the acreage and description of the lands  
to which water has been applied and name of the owner thereof  
NOT FOR IRRIGATION
6. The means of withdrawing such water from the ground and the  
location of each well or other means of withdrawal. WATER WAS THROUGH WELL WITH PIPES AND  
PUMP

7. The date of commencement and completion of the construction of the well, wells, or other works for with-  
drawal of groundwater. THE WELL WAS MADE IN THE YEARS 1900 OR 1901 BY MY  
FATHER MILO BROOKS
8. The depth of water table. UNABLE TO ESTIMATE
9. So far as it may be available, the type, size and depth of each well or the general specifications of any other  
works for the withdrawal of groundwater. THE WELL WAS 1/2" AND DRILLED A ABOUT  
100 FEET AND PIPES AND PUMP WERE PUT IN
10. The estimated amount of groundwater withdrawn each year. UNABLE TO ESTIMATE
11. The log of formations encountered in the drilling of each well if available. CLAY SAND AND GRAVEL
12. Such other information of a similar nature as may be useful in carrying out the policy of this act, including  
reference to book and page of any county record.

Signature of Owner

Eva C Brooks

Date

3-5-62

Three copies to be filed by the owner with the County Clerk and Recorder of the county in which the well is  
located.

Please answer all questions. If not applicable, so state, otherwise the form will be returned.

Original to the County Clerk and Recorder; duplicate to the State Engineer; Triplicate to the Montana Bureau  
of Mines and Geology, and Quadruplicate for the Appropriator.

1625

INDEXED  
RECORDED  
CORRECTION

1729950  
STATE OF MONTANA }  
COUNTY OF LEWIS & CLARK } SS.

I hereby certify that the within in-  
strument was filed in my office on  
this 5th day of March  
A.D. 1922 at 50 min. past  
8 o'clock A.M.

Records of Lewis & Clark  
County State of Montana

John J. Smith  
County Recorder  
Loraine C. Rame  
Deputy

\$2.00

STATE OF MONTANA  
ADMINISTRATOR OF GROUNDWATER CODE  
MONTANA WATER RESOURCES BOARD

NOTICE OF COMPLETION OF GROUNDWATER  
APPROPRIATION BY MEANS OF WELL

Developed after January 1, 1962

(Under Chapter 237 Montana Session Laws, 1961, as amended)

This form to be prepared by driller, and three copies to be filed by the owner with the County Clerk and Recorder in the county in which the well is located, last copy to be retained by driller.

Please answer all questions. If not applicable, so state, otherwise the form may be returned.

Owner Department of Highways

Address Helena, Montana 59601

Date well started July 1, 1970

completed July 15, 1970

Type of well Bored

(Dug, driven, bored or drilled)

Equipment used Rotary

(Chain drill, rotary or other)

Water Use: Domestic ☒ Municipal ☐ Stock ☐ Irrigation ☒

Industrial ☐ Drainage ☐ Other ☐\* Garden/Lawn ☐

\*Describe

USE: If used for irrigation, industrial, drainage or other. Explain, state number of acres and location or other data (i.e. Lot, Block and Addition).

ESTIMATED ANNUAL WITHDRAWAL

Size of Drilled Hole	Size and Weight of Casing	From (Feet)	To (Feet)	PERFORATIONS		
				Kind Size	From (Feet)	To (Feet)
8 5/8"	8" I.D. +1.5'	251.0'	262.0'	1/8"		
				slot	163.0'	173.0'
				1/8" slot	247.0'	257.0'
				80 slot	259.0'	267.0'
	8" Red brass screen					

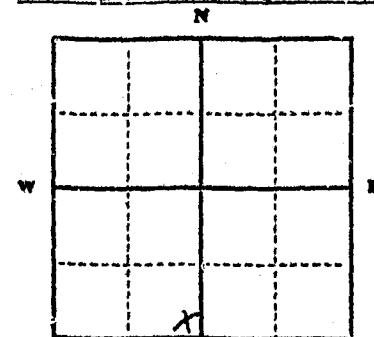

T. 10 N. R. 3 E. S. 28  
S. 28 W. 28

INDICATE LOCATION OF WELL AND PLACE OF USE, IF POSSIBLE. EACH SMALL SQUARE REPRESENTS 40 ACRES.

Driller's Signature Robert R. Healy

Driller's Address Department of Highways, Core Drill Section

Helena, Montana

LICENSE NO. 208

RECEIVED

County Lea & Clark

DRILLER'S LOG

Indicate the character, color, thickness of strata such as soil, clay, sand, gravel, shale, sandstone, etc. Show depth at which water is found and height to which water rises in well.

Top of Ground (Elev. above sea level)		
From (Feet)	To (Feet)	
0.0'	28.5'	Dense brown gravelly silt with streaks of ash.
28.5'	169.0'	Dense brown silt with decomposed granite and bentonite.
169.0'	262.0'	Very dense brown decomposed granite with pyrite, streaks of bentonite and ash.
	173.0'	Water contact.
262.0'	267.0'	Very dense gray sandstone gravel with water.

267.0 ft. Show exact depth of bottom

55556

236192

Indexed  
Recorded  
Clerk

STATE OF MONTANA  
COUNTY OF LEWIS & CLARK

hereby certify that the within in-  
strument was filed in my office on  
this 27 day of June  
A.D. 1979 at 10 min. past  
10 o'clock AM.

Records of Lewis & Clark  
County, State of Montana.

John J. Connel  
County Recorder

Carl J. Erickson  
Deputy

refer

RECORDED  
INDEXED  
JUN 27 1979

RECORDED  
INDEXED  
JUN 27 1979

RECORDED  
INDEXED  
JUN 27 1979

RECORDED  
INDEXED  
JUN 27 1979

RECORDED  
INDEXED  
JUN 27 1979

RECORDED  
INDEXED  
JUN 27 1979

RECORDED  
INDEXED  
JUN 27 1979

RECORDED  
INDEXED  
JUN 27 1979

RECORDED  
INDEXED  
JUN 27 1979

RECEIVED

County Lewis & Clark

STATE OF MONTANA  
ADMINISTRATOR OF GROUNDWATER CODE  
MONTANA WATER RESOURCES BOARD

JUL 3 1972

DRILLER'S LOG

Indicate the character, color, thickness of strata such as soil, clay, sand, gravel, shale, sandstone, etc. Show depth at which water is found and height to which water rises in well.

NOTICE OF COMPLETION OF GROUNDWATER  
APPROPRIATION BY MEANS OF WELL

Developed after January 1, 1962

(Under Chapter 237 Montana Session Laws, 1961, as amended)

This form to be prepared by driller, and three copies to be filed by the owner with the County Clerk and Recorder in the county in which the well is located, last copy to be retained by driller. Please answer all questions. If not applicable, so state, otherwise the form may be returned.

Owner Adrienne Oil Co

Address 775 Carter Dr

Helena

Date well started MAY 15

completed MAY 17-72

Type of well DRILLED

Equipment used CABLE TOOLS

Water Use: Domestic ☐ Municipal ☐ Stock ☐ Irrigation ☐

Industrial ☐ Drainage ☐ Other ☐\* Garden/Lawn ☐

\*Describe

USE: If used for irrigation, industrial, drainage or other. Explain, state number of acres and location or other data (i.e. Lot, Block and Addition).

ESTIMATED ANNUAL WITHDRAWAL

Size of Drilled Hole	Size and Weight of Casing	From (Feet)	To (Feet)	PERFORATIONS		
				Kind Size	From (Feet)	To (Feet)
<u>6 5/8</u>	<u>6 5/8</u> <u>16</u>	<u>0</u>	<u>92</u>			

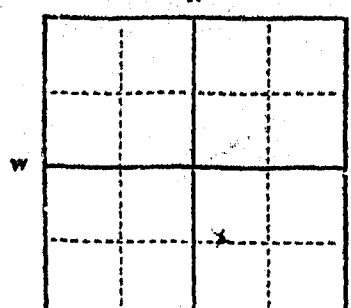

N.W. 1/4 Sec. 28  
T. 10 N. R. 3 W.

INDICATE LOCATION OF WELL AND PLACE OF USE, IF POSSIBLE. EACH SMALL SQUARE REPRESENTS 40 ACRES.

Driller's Signature A. M. Welch

Driller's Address 5820 N. MONT

HELENA

LICENSE NO. 100

Top of Ground (Elev. above sea level)	
From (Feet)	To (Feet)
<u>0</u>	<u>92</u>
	<u>BETNITE &amp; GRAY</u>
	<u>SHALE</u>
<u>92</u>	<u>100</u>
	<u>WATER SAND</u>

Static water level 50 ft.\*  
Pumping water level 50 ft.\*  
at 50 gallons per minute,  
measured 50 minutes after pumping  
began.  
\*Measured from ground level.  
Well developed by BAILEY  
for 2 hours.  
Power 50 Pump 50 HP  
Remarks: (Gravel packing, cementing,  
packers, type of shutoff)

100 Show exact depth of bottom

50, 282

226568

STATE OF MONTANA  
COUNTY OF LEWIS & CLARK } SS

I hereby certify that the within in-  
strument was filed in my office on  
this 28 day of June  
A.D. 1972 at 12:30 min. past  
1 o'clock P.M. and records  
ed on page        of Book         
in        Records of Lewis and  
Clark County, State of Montana

*John Daniel*  
County Clerk

*W. Thomas*  
Deputy

200

Indexed  
Recorded  
Filed



CABLE 10012  
DELETED  
MAY 13 1972

C.C.

226568  
JUN 28 1972  
LEWIS & CLARK COUNTY

Department of Natural Resources and Conservation  
Water Resources Division  
Engineering Bureau  
Groundwater Section  
Sam W. Mitchell Building  
Helena, Montana 59601

Owner Didrickson Oil Co.  
Address 775 Carter Dr. - Helena  
Location T. 10N R. 3W Sec. 28  
Doc. No. 226568

As the Administrator of the Groundwater Code for the State of Montana, please take note of the following special instructions, in order to properly protect your groundwater right.

Special Instructions:

Please provide, as indicated in red on the attached form, the water use, pumping water level, and gallons per minute claimed.

Thank you.

Water Use: Domestic ☐ Municipal ☐ Stock ☐ Irrigation ☐  
Industrial ☒ Drainage ☐ Other ☐\* Garden/Lawn ☐

\*Describe

USE: If used for irrigation, industrial, drainage or other. Explain, state number of acres and location or other data (i.e. Lot, Block and Addition).

ESTIMATED ANNUAL WITHDRAWAL

Size of Drilled Hole	Size and Weight of Casing	From (Feet)	To (Feet)	PERFORATIONS		
				Kind Size	From (Feet)	To (Feet)
6 5/8	1 5/8 1 1/4	0	92	RECEIVED SEP 29 1972 MONTANA DEPARTMENT OF NATURAL RESOURCES AND CONSERVATION		

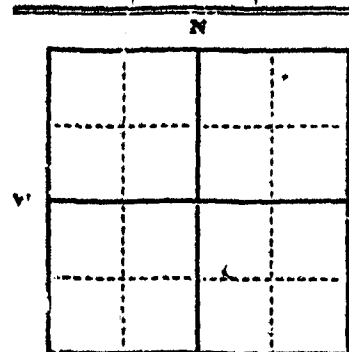

Approx. 1/4 Sec. 28  
T. 10N R. 3W

Static water level 50 ft.\*  
Pumping water level 90 ft.\*  
at 15 minutes after pumping began.  
\*Measured from ground level.  
Well developed by BAILEY for 2 hours.  
Power..... Pump..... HP  
Remarks: (Gravel packing, cementing, packers, type of shutoff) .....

INDICATE LOCATION OF WELL AND PLACE OF USE, IF POSSIBLE. EACH SMALL SQUARE REPRESENTS 40 ACRES.

Driller's Signature A. G. Welch

Driller's Address 5820 N. MONT.

HELENA LICENSE NO. 100

100 Show exact depth of bottom

50,782



County ~~deeds~~ T. Larn

STATE OF MONTANA  
ADMINISTRATOR OF GROUNDWATER CODE  
MONTANA WATER RESOURCES BOARD

JUL 3 1972

**DRILLER'S LOG**

Indicate the character, color, thickness of strata such as soil, clay, sand, gravel, shale, sandstone, etc. Show depth at which water is found and height to which water rises in well.

# NOTICE OF COMPLETION OF GROUNDWATER APPROPRIATION BY MEANS OF WELL

**Developed after January 1, 1962**

(Under Chapter 237 Montana Session Laws, 1961, as amended)

This form to be prepared by driller, and three copies to be filed by the owner with the County Clerk and Recorder in the county in which the well is located, last copy to be retained by driller.

Please answer all questions. If not applicable, so state, otherwise the form may be returned.

Owner Richmond Oil Co.

Address 775 Carter Rd

*Helena*

Date well started Aug 15

completed MAY 17-72

Type of well ..... DRILLED

(Dug, driven, bored or drilled)

Equipment used CABLE TOOLS

(Churn drill, rotary or other)

**Water Use:** Domestic ☐ Municipal ☐ Stock ☐ Irrigation ☐

Industrial ☒ Drainage ☐ Other ☐\* Garden/Lawn ☐

**\*Describe**

**USE:** If used for irrigation, industrial, drainage or other. Explain, state number of acres and location or other data (i.e. Lot, Block and Addition).

### ESTIMATED ANNUAL WITHDRAWAL

Size of Drilled Hole	Size and Weight of Casing	From (Feet)	To (Feet)	PERFORATIONS		
				Kind Size	From (Feet)	To (Feet)
6 5/8	6 5/8	0	92	RECEIVED	SEP 29 1912	
	1 1/2			MONTANA DEPARTMENT OF NATURAL RESOURCES		

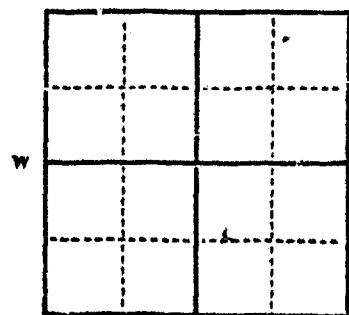

1/4 1/4 Sec. 3  
T. 10 N. R. 3 W.

Static water level ..... 50 ..... ft.\*  
 ? Pumping water level ..... 70 ..... ft.\*  
 ? at 15 ..... gallons per minute.  
 ? measured ..... minutes after pumping  
 began.

\*Measured from group level.

Well developed by PALEO  
for 2 hours.

Power..... Pump..... HP

Remarks: (Gravel packing, cementing,  
packers, type of shutoff) .....

INDICATE LOCATION OF WELL AND PLACE OF USE, IF POSSIBLE.  
EACH SMALL SQUARE REPRESENTS 40 ACRES.

Driller's Signature C. E. Welch

Driller's Address 5830 N. MONT

HELENA

LICENSE NO. 150

Top of Ground

(Elev. above sea level)

[illegible]

Show exact depth of bottom

50,282

File No. \_\_\_\_\_

T. 10 N. R. 3 W.

DUPLICATE

County Lewis & Clark

STATE OF MONTANA  
ADMINISTRATOR OF GROUNDWATER CODE  
OFFICE OF STATE ENGINEER

## Declaration of Vested Groundwater Rights

(Under Chapter 237, Montana Session Laws, 1961)

JAN 6 1964  
STATE ENGINEER

1. J. Wellington Fawver, of Highway 12, East of Helena, Helena  
(Name of Appropriator) (Address) (Town)  
County of Lewis and Clark State of Montana  
have appropriated groundwater according to the Montana laws in effect prior to January 1, 1962, as follows:

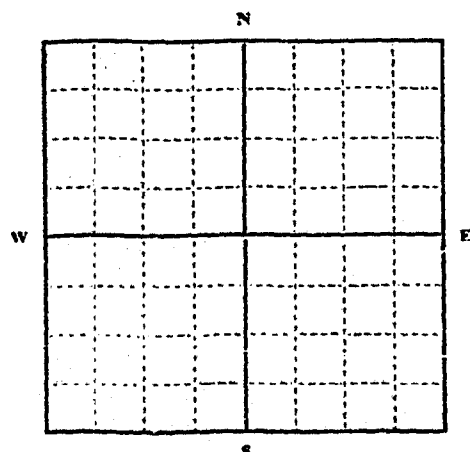

Lot 1 Block 29 City Park Addn.

$\frac{1}{4}$  Sec. 28 T.10 R. 3 W

Indicate point of appropriation and place of use, if possible. Each small square represents 10 acres.

2. The beneficial use on which the claim is based domestic, and livestock, and public use.
3. Date or approximate date of earliest beneficial use; and how continuous the use has been March 22, 1957, and used daily since that date to present, continued use.
4. The amount of groundwater claimed (in miner's inches or gallons per minute) 15 gallons per minute
5. If used for irrigation, give the acreage and description of the lands to which water has been applied and name of the owner thereof  
not applicable.
6. The means of withdrawing such water from the ground and the location of each well or other means of withdrawal electric pump, well located on Lot 1 Block 29 of City Park Addn, to City of Helena
7. The date of commencement and completion of the construction of the well, wells, or other works for withdrawal of groundwater Drilling began: Mar. 15, 1957, well finished Mar. 22, 1957
8. The depth of water table Start making first water at 100'; static water level 24' from ground elevation, pump set at 100' from bottom of pit.
9. So far as it may be available, the type, size and depth of each well or the general specifications of any other works for the withdrawal of groundwater Well is 110' deep from ground elev. Well is 105' deep from bottom of pit. Size of pipe 6" I. D. Kind and weight of material used: 13 lb. new
10. The estimated amount of groundwater withdrawn each year 152,500 gallons
11. The log of formations encountered in the drilling of each well if available 0-11' some top soil & broken sharp gravel clay bands; 11'-56' gray-colored decomposed limestone; 56'-79' alternated shallow strata of firm & soft, gray limestone clay; 79'-100' brown firm limestone clay; 100'-105' firm white decomposed limestone; 105'-110' very firm white decomposed limestone fairly free of clay.
12. Such other information of a similar nature as may be useful in carrying out the policy of this act, including reference to book and page of any county record.

Signature of Owner J. Wellington Fawver

Date December 31, 1963

Three copies to be filed by the owner with the County Clerk and Recorder of the county in which the well is located.

Please answer all questions. If not applicable, so state, otherwise the form will be returned.

Original to the County Clerk and Recorder; Duplicate to the State Engineer; Triplicate to the Montana Bureau of Mines and Geology, and Quadruplicate for the Appropriator.

24506

151741

STATE OF MONTANA  
COUNTY OF LEWIS & CLARK

I hereby certify that the within in-  
strument was filed in my office on  
the 3rd day of Jan  
A.D. 1964 at 2:00 min. past  
9 o'clock A.M.

Records of Lewis & Clark  
County, State of Montana.

William J. Smith  
County Recorder  
By Lanorris C. Russell  
Deputy

sd pd

Indexed  
Recorded  
Compared

CL

28  
Township 10 N. Range 3 West

County Lewis and Clark

MONTANA BUREAU OF MINES AND GEOLOGY  
Butte, Montana

WATER WELL LOG

RECEIVED  
MAR 22 1957

STATE ENGINEER

Owner J. A. Wellington Fauver Address Hwy 10, East of Helena  
C.F. Rte., Helena, Montana

Driller Price & Lindsay Address Clancy, Montana

Date Started March 15, 1957 Date Completed March 22, 1957

Location: Sec. 28 T. 10 N. R. 3 W. 1/4 sec. SE 1/4 SW 1/4  
Lot 1, Block 29, City Park Addition

Type of well drilled Equipment used churn drill  
(Dug, driven, bored, or drilled) (Churn drill, rotary, other)

Water use: Domestic ☒ Municipal ☐ Stock ☒ Irrigation ☐

Industrial ☐ Drainage ☐ Other: Public uses

Casing: 0 ft. to 105 ft. Type 13 lb. N.W. Size 6 1/2 I. D.

Casing: ft. to ft. Type Size

Casing: ft. to ft. Type Size

5" I. D. liner  
Perforated or Screened: Ft. 105 to ft. 110 Ft. to ft.

Type of screen or perforations 5" I. D. liner

Static Water level, for non-flowing well: 84 feet  
(from ground elevation)

Shut-in pressure, for flowing well: lb./sq. in. on: (date)

Pumping water level 100 from bottom of pit 12 to 15 feet at gal. per min.

How tested: Bailer

Length of test

Remarks: (Gravel packing, cementing, packers, type of shut-off, depth of shut-off)

Well is 110 ft. deep from ground elevation.

Well is 105 ft. deep from bottom of pit.

(over)