

File No.

DUPLICATE

T. 10^N R. 4^W

County. L & C.

28
29
32

STATE OF MONTANA
ADMINISTRATOR OF GROUNDWATER CODE
OFFICE OF STATE ENGINEER

RECEIVED
JAN 2 1964

Notice of Completion of Groundwater Appropriation
Without Well

STATE ENGINEER

(Under Chapter 237 Montana Session Laws, 1961)

Date of Appropriation of Groundwater. Approx. 1870

Owner. C. W. & Beryl D. Smallwood Address. Rimini Rd.
Helena, Mont.

Contractor (if any) - None

Address of Contractor

Date Started Date Completed

Describe means of obtaining groundwater without a well "as by sub-irrigation and other natural processes". Include depth to water when applicable. Sub-irrigation

Along Meadows - 50 Acres

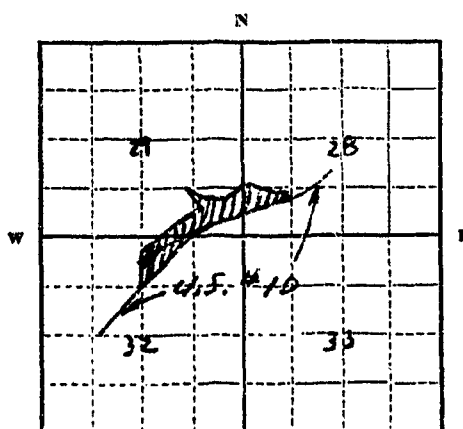

28-29-32
1/4 Sec. T10^N R. 4^W

Indicate point of appropriation and place of use, if possible.

Placer #1037 Lot 50
All of said Placer
North of Hi-way #10
and west

Quantity of water developed and used with explanation of method used to measure or estimate such amount. If use is intermittent

estimate approximate lengths of periods of use.

Enough to grow wild hay
and alfalfa

Signature of Owner. C. W. Smallwood

Date. December 23, 1963

This form to be prepared by contractor (if any), otherwise by the owner.

Three copies of this notice are to be filed with the County Clerk and Recorder of the county in which the works are located.

Please answer all questions. If not applicable, so state, otherwise the form will be returned.

Original to the County Clerk and Recorder; duplicate to the State Engineer; Triplicate to the Montana Bureau of Mines and Geology and Quadruplicate for the Appropriator.

File No. _____

T. 10 R. 4

DUPLICATE

County Lewis & Clark

STATE OF MONTANA
ADMINISTRATOR OF GROUNDWATER CODE
OFFICE OF STATE ENGINEER

RECEIVED
OCT 29 1963

Declaration of Vested Groundwater Rights

(Under Chapter 237, Montana Session Laws, 1961)

STATE ENGINEER

1. Norman W. or Margaret L. Alm, of Rimini Rt., Helena
(Name of Appropriator) (Address) (Town)
County of Lewis & Clark State of Montana
have appropriated groundwater according to the Montana laws in effect prior to January 1, 1962, as follows:

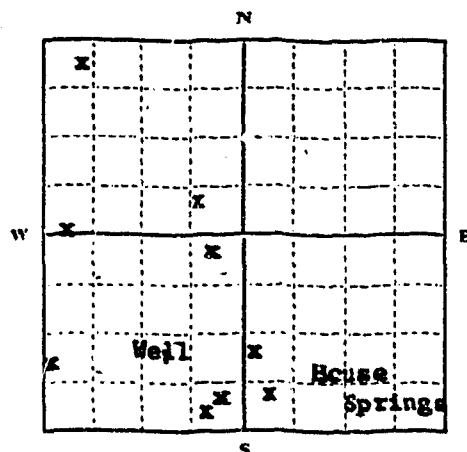
1/4 Sec. 33 T. 10 R. 4

Indicate point of appropriation
and place of use, if possible.
Each small square represents 10
acres.

2. The beneficial use on which the claim is based. Stockwater & Domestic
3. Date or approximate date of earliest beneficial use; and how continuous the use has been. 1934 Well & Developed Springs
4. The amount of groundwater claimed (in miner's inches or gallons per minute). Springs - 3 gal/min. to 10 gal/min
Well - 20 g/min.
5. If used for irrigation, give the acreage and description of the lands to which water has been applied and name of the owner thereof. Garden Irrigation
6. The means of withdrawing such water from the ground and the location of each well or other means of withdrawal. Springs Gravity - Well by pump
7. The date of commencement and completion of the construction of the well, wells, or other works for withdrawal of groundwater. 1934
8. The depth of water table. 20 feet
9. So far as it may be available, the type, size and depth of each well or the general specifications of any other works for the withdrawal of groundwater. Cribbed well - 35 feet deep
10. The estimated amount of groundwater withdrawn each year. Water for 100 head cattle plus domestic
11. The log of formations encountered in the drilling of each well if available. None
12. Such other information of a similar nature as may be useful in carrying out the policy of this act, including reference to book and page of any county record. None

Signature of Owner Norman C. AlmDate Oct 22/63

Three copies to be filed by the owner with the County Clerk and Recorder of the county in which the well is located.

Please answer all questions. If not applicable, so state, otherwise the form will be returned.

Original to the County Clerk and Recorder; duplicate to the State Engineer; Triplicate to the Montana Bureau of Mines and Geology, and Quadruplicate for the Appropriator.

6687

Indexed
Recorded
Retained

77K

149248

STATE OF MONTANA
COUNTY OF LEWIS & CLARK } SS

I hereby certify that the within in-
strument was filed in my office on
this 27 day of Oct
A.D. 1923 at 45 min. past
8 o'clock A. M.

Records of Lewis & Clark
County, State of Montana.

John L. Linnick
County Recorder
By Norma Kelley
Deputy
2.00

File No. _____

T 10 R 4 W

DUPLICATE

County Lewis & Clark

STATE OF MONTANA
ADMINISTRATOR OF GROUNDWATER CODE
OFFICE OF STATE ENGINEER

RECEIVED
OCT 29 1963

Declaration of Vested Groundwater Rights
(Under Chapter 237, Montana Session Laws, 1961)

1. Norman E. & Margaret I. Alm of Rimini Rt. Helena
(Name of Appropriator) (Address) (Town)
County of Lewis & Clark State of Montana
have appropriated groundwater according to the Montana laws in effect prior to January 1, 1962, as follows:

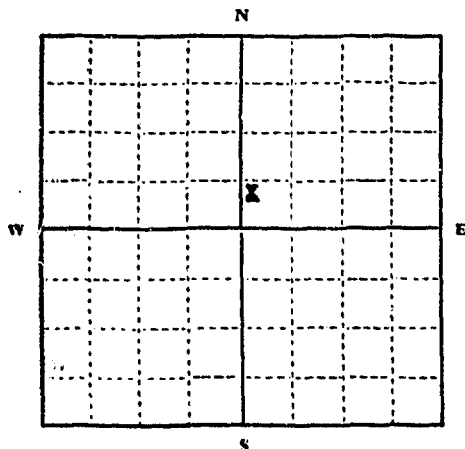

$\frac{1}{4}$ Sec. 34 T 10 R 4

Indicate point of appropriation
and place of use, if possible.
Each small square represents 10
acres.

2. The beneficial use on which the claim is based. Developed Spring - Stockwater
3. Date or approximate date of earliest beneficial use; and how continuous the use has been. Development now - use Spring in 1964
4. The amount of groundwater claimed (in miner's inches or gallons per minute). 3 Gal/min.
5. If used for irrigation, give the acreage and description of the lands to which water has been applied and name of the owner thereof. None
6. The means of withdrawing such water from the ground and the location of each well or other means of withdrawal. Gravity
7. The date of commencement and completion of the construction of the well, wells, or other works for withdrawal of groundwater. Started Construction 6-53, complete by 5-64
8. The depth of water table. Surface
9. So far as it may be available, the type, size and depth of each well or the general specifications of any other works for the withdrawal of groundwater. 12 feet deep
10. The estimated amount of groundwater withdrawn each year. 50 head cattle
11. The log of formations encountered in the drilling of each well if available. None
12. Such other information of a similar nature as may be useful in carrying out the policy of this act, including reference to book and page of any county record. None

Signature of Owner Norman E. Alm

Date Oct 22/63

Three copies to be filed by the owner with the County Clerk and Recorder of the county in which the well is located.

Please answer all questions. If not applicable, so state, otherwise the form will be returned.

Original to the County Clerk and Recorder; duplicate to the State Engineer; Triplicate to the Montana Bureau of Mines and Geology, and Quadruplicate for the Appropriator.

6688

Indexed
Recorded
149249

149249
STATE OF MONTANA
COUNTY OF LEWIS & CLARK } SS

I hereby certify that the within in-
strument was filed in my office on
this 22 day of Oct.
A.D. 1923 at 8:40 min. past
8 o'clock A.M.

Records of Lewis & Clark
County, State of Montana.

John A. Smith
County Recorder

By Norma Valley
Deputy

2.00

File No.

T. 10 N. R. 4

DUPLICATE

County Lewis & Clark

STATE OF MONTANA
ADMINISTRATOR OF GROUNDWATER CODE
OFFICE OF STATE ENGINEER

Declaration of Vested Groundwater Rights

(Under Chapter 237, Montana Session Laws, 1961)

RECEIVED
OCT 29 1963

STATE ENGINEER

1. Norman E. or Margaret I. Alm of Helena, St. Helena
(Name of Appropriator) (Address) (Town)
County of Lewis & Clark State of Montana
have appropriated groundwater according to the Montana laws in effect prior to January 1, 1962, as follows:

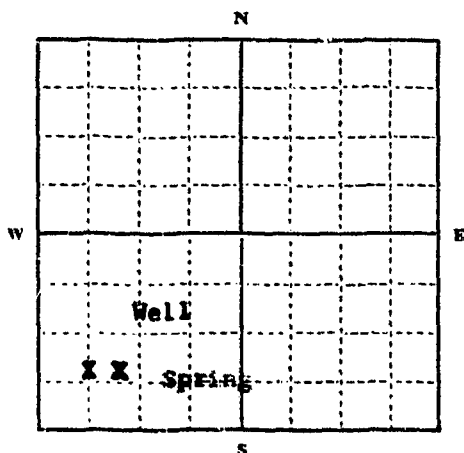
1/4 Sec. 35 T. 10. R. 4.

Indicate point of appropriation
and place of use, if possible.
Each small square represents 10
acres.

2. The beneficial use on which the claim is based
Stockwater & Domestic
3. Date or approximate date of earliest beneficial use; and how continuous the use has been
Well - 1934 Spring - 1934
4. The amount of groundwater claimed (in miner's inches or gallons per minute)
16 G.P.M. Each
5. If used for irrigation, give the acreage and description of the lands to which water has been applied and name of the owner thereof
None
6. The means of withdrawing such water from the ground and the location of each well or other means of withdrawal
Well - Pump - Spring Gravity
7. The date of commencement and completion of the construction of the well, wells, or other works for withdrawal of groundwater
1934
8. The depth of water table
Well - 150 feet
9. So far as it may be available, the type, size and depth of each well or the general specifications of any other works for the withdrawal of groundwater
200 Feet
10. The estimated amount of groundwater withdrawn each year
Water for 45 Head
11. The log of formations encountered in the drilling of each well if available
None
12. Such other information of a similar nature as may be useful in carrying out the policy of this act, including reference to book and page of any county record
None

Signature of Owner Norman E. AlmDate Oct 22/63

Three copies to be filed by the owner with the County Clerk and Recorder of the county in which the well is located.

Please answer all questions. If not applicable, so state, otherwise the form will be returned.

Original to the County Clerk and Recorder; duplicate to the State Engineer; Triplicate to the Montana Bureau of Mines and Geology, and Quadruplicate for the Appropriator.

6685

Indexed
Recorded
Compared

DK

149246

STATE OF MISSISSIPPI
COUNTY OF LEE & CLARK SS

I hereby certify that the within in-
strument is a true and correct copy of
the original as shown to me on
this 27th day of Oct. 1963
A.C. 1963 at 3:35 min. past
8 o'clock A.M.

Records of Lee & Clark
County, State of Mississippi.

John Daniel
County Recorder
Norma Kelley
Deputy
\$2.00

File No. _____

DUPLICATE

T. 10 N R. 4 W
County. L & C.

STATE OF MONTANA
ADMINISTRATOR OF GROUNDWATER CODE
OFFICE OF STATE ENGINEER

Declaration of Vested Groundwater Rights
(Under Chapter 237, Montana Session Laws, 1961)

RECEIVED
STATE ENGINEER

1. CITY OF HELENA WATER DEPARTMENT, of CIVIC CENTER, HELENA
(Name of Appropriator) (Address) (Town)

County of LEWIS & CLARK State of MONTANA
have appropriated groundwater according to the Montana laws in effect prior to January 1, 1962, as follows:

Dureka Well - W. Main St.

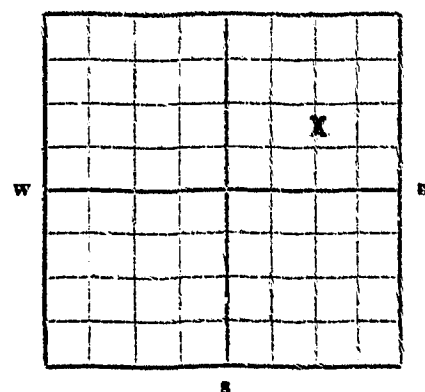

NE 1/4 Sec 36 T10N R4W

Indicate point of appropriation and place of use, if possible. Each small square represents 10 acres.

2. The beneficial use on which the claim is based
Municipal Supply
3. Date or approximate date of earliest beneficial use; and how continuous the use has been
1933
4. The amount of groundwater claimed (in miner's inches or gallons per minute)
500 G.P.M.
5. If used for irrigation, give the acreage and description of the lands to which water has been applied and name of the owner thereof
6. The means of withdrawing such water from the ground and the location of each well or other means of withdrawal
50 H.P. Byron Jackson Turbine

7. The date of commencement and completion of the construction of the well, wells, or other works for withdrawal of groundwater
1933

8. The depth of water table
40'

9. So far as it may be available, the type, size and depth of each well or the general specifications of any other works for the withdrawal of groundwater
Dug Well 42'

10. The estimated amount of groundwater withdrawn each year
25,000,000

11. The log of formations encountered in the drilling of each well if available

12. Such other information of a similar nature as may be useful in carrying out the policy of this act, including reference to book and page of any county record

Signature of Owner George Wallen
Date 7-6-62

Three copies to be filed by the owner with the County Clerk and Recorder of the county in which the well is located.

Please answer all questions. If not applicable, so state, otherwise the form will be returned.

Original to the County Clerk and Recorder; duplicate to the State Engineer; Triplicate to the School of Mines and Quadruplicate for the Appropriator.

1621

130024
Indexed
Recorded
INDEXED

STATE OF MONTANA
COUNTY OF LEWIS & CLARK } SS.

I hereby certify that the within in-
strument was filed in my office on
this 6th day of March
A.D. 1902 at 2:00 pm, past
7 o'clock PM and record-
ed on of 2
of Records of Lewis and
Clark County, State of Montana.

John Tonick
County Recorder
By Louise C. Russell
Deputy

\$ 2.00

52.674

232971

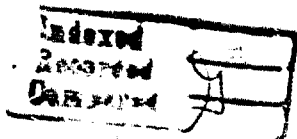

STATE OF MONTANA
COUNTY OF LEWIS & CLARK } 52

hereby certify that the within in-
strument was filed in my office on
this 8 day of Mar.
A.D. 1973 at 25 min. past
10 o'clock A.M.

Records of Lewis & Clark
County, State of Montana

Richard K. ...
P. Zachary
Deputy

200

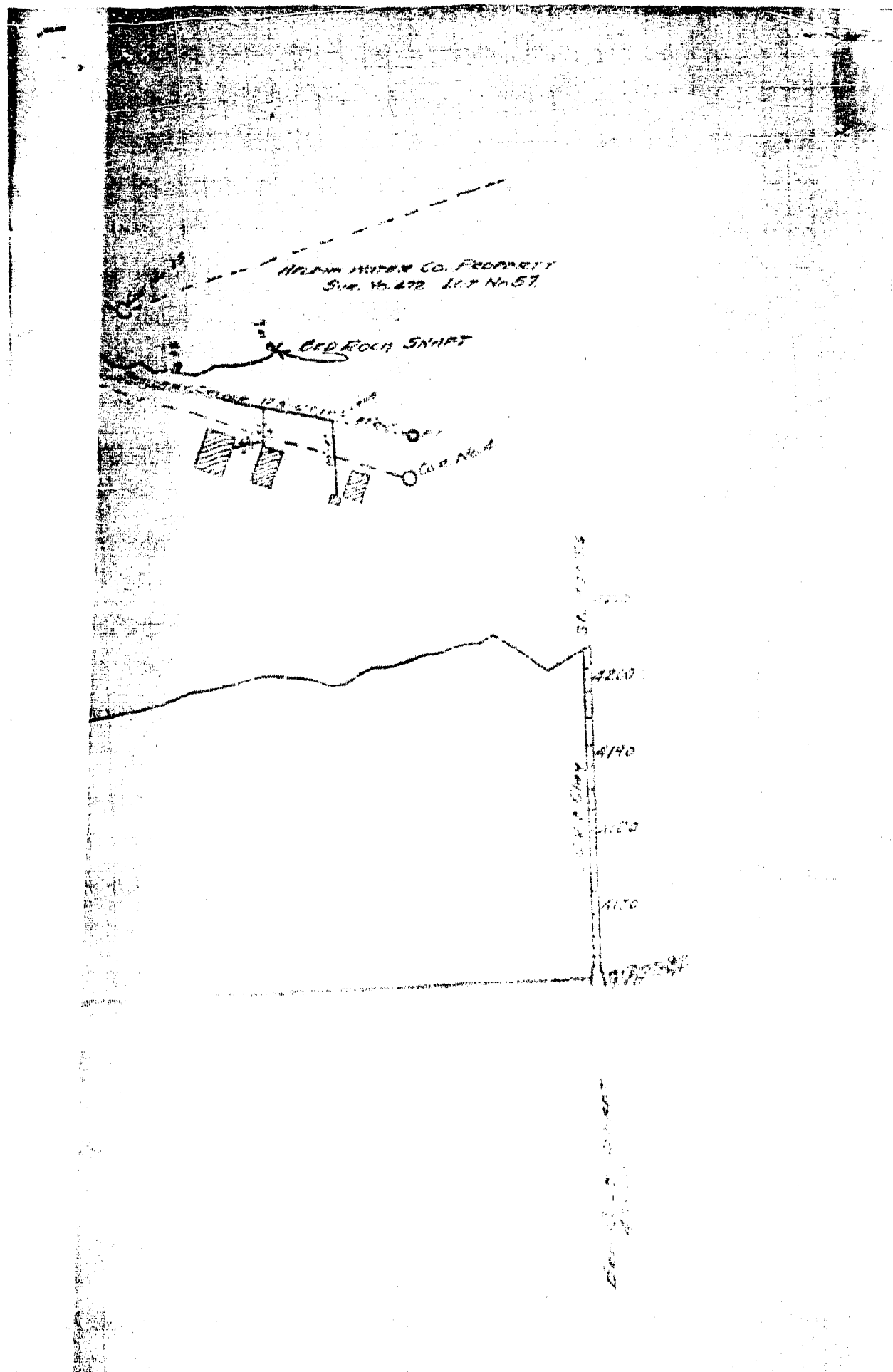

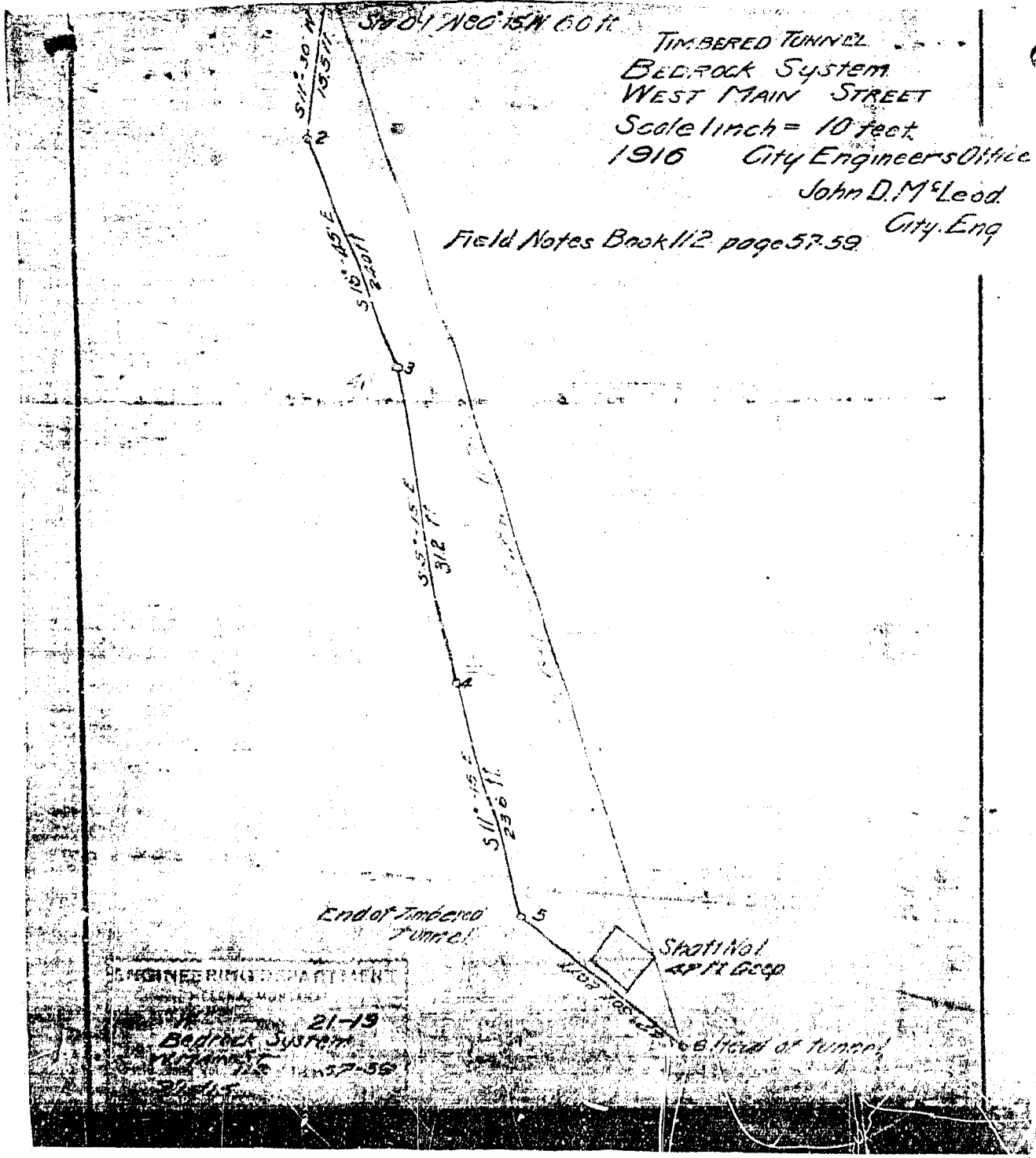

TIMBERED TUNNEL
BEDROCK SYSTEM
WEST MAIN STREET
Scale 1 inch = 10 feet
1916 City Engineers Office
John D. McLeod
City Eng

Field Notes Book 112 page 57-59

End of Timbered Tunnel

Station 101
47 ft deep

ENGINEERING DEPARTMENT
CITY OF CHICAGO
21-19
BEDROCK SYSTEM
1916

Head of Tunnel

File No. _____

DUPLICATE

RECEIVED
MAY 20 1964

STATE OF MONTANA
ADMINISTRATOR OF GROUNDWATER CODE
OFFICE OF STATE ENGINEER

T 10 N R 34 W 36
County L & C.

RECEIVED
JAN 7 1964

STATE ENGINEER

Declaration of Vested Groundwater Rights

(Under Chapter 237, Montana Session Laws, 1961)

1. HOWARD & DOROTHY PETERSEN, of RTE A. HELENA
(Name of Appropriator) (Address) (Town)
County of L & C State of MONT.
have appropriated groundwater according to the Montana laws in effect prior to January 1, 1962, as follows:

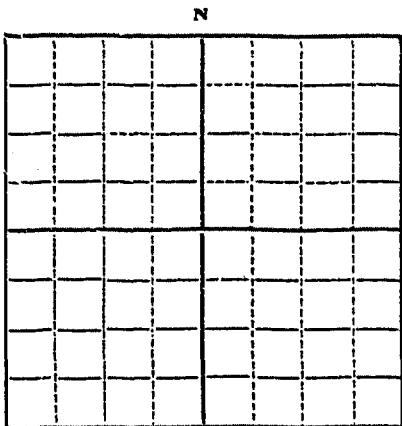

85'14
E 1/2 Sec. 36 T. 10 N. R. 4

Indicate point of appropriation
and place of use, if possible.
Each small square represents 10
acres.

2. The beneficial use on which the claim is based HOUSE HOLD & LAWN
3. Date or approximate date of earliest beneficial use; and how continuous the use has been UNKNOWN
4. The amount of groundwater claimed (in miner's inches or gallons per minute) 5 GAL PR MIN.
5. If used for irrigation, give the acreage and description of the lands to which water has been applied and name of the owner thereof
6. The means of withdrawing such water from the ground and the location of each well or other means of withdrawal DEEP WELL JET PUMP.
7. The date of commencement and completion of the construction of the well, wells, or other works for withdrawal of groundwater JUNE 1961
8. The depth of water table 47 FT
9. So far as it may be available, the type, size and depth of each well or the general specifications of any other works for the withdrawal of groundwater 6" CASER WELL
10. The estimated amount of groundwater withdrawn each year UNKNOWN
11. The log of formations encountered in the drilling of each well if available UNKNOWN
12. Such other information of a similar nature as may be useful in carrying out the policy of this act, including reference to book and page of any county record UNKNOWN

Signature of Owner Howard Petersen

Date Dec 31 - 63

Three copies to be filed by the owner with the County Clerk and Recorder of the county in which the well is located.

Please answer all questions. If not applicable, so state, otherwise the form will be returned.

Original to the County Clerk and Recorder; duplicate to the State Engineer; Triplicate to the Montana Bureau of Mines and Geology, and Quadruplicate for the Appropriator.

26611

151780

Indexed
Recorded
Compared

OL

STATE OF MONTANA } ss,
COUNTY OF LEWIS & CLARK

I hereby certify that the within in-
strument was filed in my office on
this 3 day of Jan
A.D. 1964 at 30 min. past
11 o'clock A.M.

Records of Lewis & Clark
County State of Montana.

Shelton K. Smith
County Recorder

By Myrtle Lane
Deputy

sz to pd

151780
JAN 3 1964
FILED

File No.

DUPLICATE

STATE OF MONTANA
ADMINISTRATOR OF GROUNDWATER CODE
OFFICE OF STATE ENGINEER

County Lewis & Clark
RECEIVED
OCT 17 1963

STATE ENGINEER
Declaration of Vested Groundwater Rights

(Under Chapter 237, Montana Session Laws, 1961)

1. Earl G. Elliott, of Route A Helena
(Name of Appropriator) (Address) (Town)
County of Lewis & Clark State of Montana
have appropriated groundwater according to the Montana laws in effect prior to January 1, 1962, as follows:

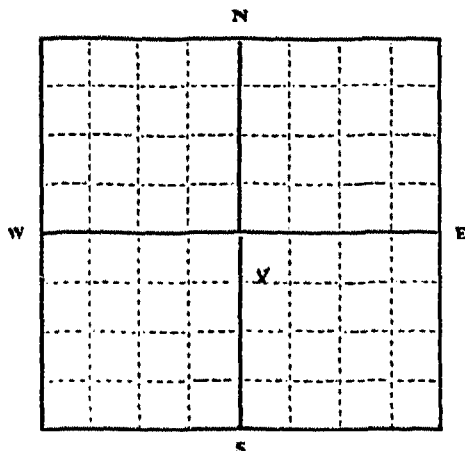

..... 1/4 Sec. T. R.

Indicate point of appropriation
and place of use, if possible.
Each small square represents 10
acres.

2. The beneficial use on which the claim is based household and yard + garden
3. Date or approximate date of earliest beneficial use; and how continuous the use has been 1884 continuous
4. The amount of groundwater claimed (in miner's inches or gallons per minute) 6.0 gallons per minute
5. If used for irrigation, give the acreage and description of the lands to which water has been applied and name of the owner thereof
6. The means of withdrawing such water from the ground and the location of each well or other means of withdrawal electric pump and hand pump
7. The date of commencement and completion of the construction of the well, wells, or other works for withdrawal of groundwater hand dug well in 1894 and deepened in 1941
8. The depth of water table 22'
9. So far as it may be available, the type, size and depth of each well or the general specifications of any other works for the withdrawal of groundwater 4.2' and cased with 3.0" concrete pipe
10. The estimated amount of groundwater withdrawn each year
11. The log of formations encountered in the drilling of each well if available clay, gravel sandstone and gravel
12. Such other information of a similar nature as may be useful in carrying out the policy of this act, including reference to book and page of any county record

Signature of Owner Earl G. ElliottDate October 14, 1963

Three copies to be filed by the owner with the County Clerk and Recorder of the county in which the well is located.

Please answer all questions. If not applicable, so state, otherwise the form will be returned.

Original to the County Clerk and Recorder; duplicate to the State Engineer; Triplicate to the Montana Bureau of Mines and Geology, and Quadruplicate for the Appropriator.

6436.

148969

STATE OF MONTANA
COUNTY OF LEWIS & CLARK

I hereby certify that the within in-
strument was filed in my office on
this 17th day of Oct

A.D. 1963 at 35 min. past
8 o'clock P.M.

Records of Lewis & Clark
County State of Montana.

John L. Louch
County Recorder

By Loraine C. Russell
Deputy

\$2.00

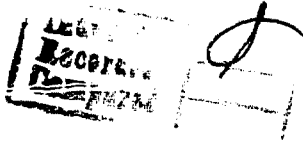

STATE OF MONTANA
ADMINISTRATOR OF GROUNDWATER CODE
MONTANA WATER RESOURCES BOARD

NOTICE OF COMPLETION OF GROUNDWATER
APPROPRIATION BY MEANS OF WELL

Developed after January 1, 1962

(Under Chapter 237 Montana Session Laws, 1961, as amended)

This form to be prepared by driller, and three copies to be filed by the owner with the County Clerk and Recorder in the county in which the well is located, last copy to be retained by driller.

Please answer all questions. If not applicable, so state, otherwise the form may be returned.

Owner Emma Fargnoli
Address 725 Helena Ave
City
Date well started Mar. 16, 1971 GW 1
completed Mar. 19, 1971

For Administrator's Use	
File	<u>217839</u>
	<u>June 7, 1971</u>
	<u>10:35 AM</u>

Type of well drilled
(Dug, driven, bored or drilled)
Equipment used churn drill
(Churn drill, rotary or other)
Water Use: Domestic ☒ Municipal ☐ Stock ☐ Irrigation ☐
Industrial ☐ Drainage ☐ Other ☐* Garden/Lawn ☐

*Describe
USE: If used for irrigation, industrial, drainage or other. Explain, state number of acres and location or other data (i.e. Lot, Block and Addition);

ESTIMATED ANNUAL WITHDRAWAL

Size of Drilled Hole	Size and Weight of Casing	From (Feet)	To (Feet)	PERFORATIONS
6"	65/8" O.D. 17 lb.	0	54	
6"	520 O.D. 15 lb.	54'6"	64'	5" liner perforated with torch

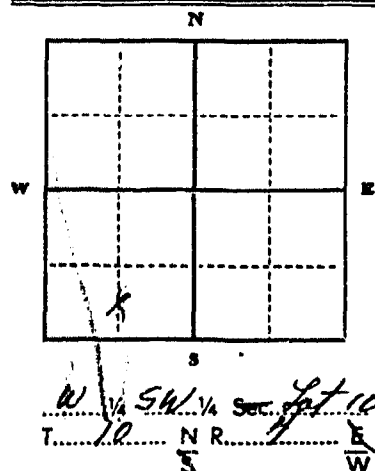

Static water level 34 ft.*
Pumping water level 58 ft.*
at 5 gallons per minute,
measured 5 minutes after pumping began.
*Measured from ground level.
Well developed by bailer
for 3 hours.
Power 3 HP
Remarks: (Gravel packing, cementing, packers, type of shutoff)

INDICATE LOCATION OF WELL AND PLACE OF USE, IF POSSIBLE. EACH SMALL SQUARE REPRESENTS 40 ACRES.

Driller's Signature Robert Puce
Driller's Address Clancy, Mont

LICENSE NO. 174

10N-4W
County Leisure Clark

DRILLER'S LOG

Indicate the character, color, thickness of strata such as soil, clay, sand, gravel, shale, sandstone, etc. Show depth at which water is found and height to which water rises in well.

Top of Ground (Elev. above sea level)		
From (Feet)	To (Feet)	
0	29	loose gravel with some soil
10	29	very tight coarse clay bound gravel
29	58	tight gravel with gray lime stone like clay
58	64	blocky fractured limestone, very tight at 64'
	52	start making water
55	56	water approx. 2-3 g.p.m.
59	61	water approx. 2-3 g.p.m.

64 Show exact depth of bottom

48601

217839

Indexed	<i>[Handwritten Mark]</i>
Recorded	
Compared	

STATE OF MONTANA
COUNTY OF LEWIS & CLARK

I hereby certify that the within in-
strument was filed in my office on
this 7 day of June
A.D. 19 71 at 2:50 min. past
10 o'clock A.M.

Records of Lewis & Clark
County, State of Montana

[Signature]
County Recorder
by *[Signature]*
Deputy
2:00

17114

Indexed
Recorded
Compared

STATE OF MONTANA
COUNTY OF LEWIS & CLARK SS

I hereby certify that the within in-
strument was filed in my office on
this 1st day of Sept

A.D. 19 25 min. past
2 o'clock P.M.

County of Lewis & Clark
State of Montana

County Recorder

By James C. Russell
Deputy

10:00

3

ONION

File No. _____

DUPLICATE

T 10 N R 3 W

County Lewis & Clark

STATE OF MONTANA
ADMINISTRATOR OF GROUNDWATER CODE
OFFICE OF STATE ENGINEER

RECEIVED

APR 12 1963

Declaration of Vested Groundwater Rights

(Under Chapter 237, Montana Session Laws, 1961)

ASSISTANT
STATE ENGINEER

1. Eugene B. Donaldson of Route 1 Helena
(Name of Appropriator) (Address) (Town)
County of Lewis & Clark State of Montana
have appropriated groundwater according to the Montana laws in effect prior to January 1, 1962, as follows:

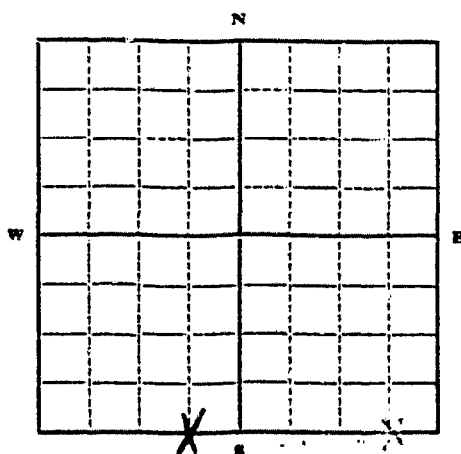

SW 1/4 Sec. 2 T 10 R 3

Indicate point of appropriation
and place of use, if possible.
Each small square represents 10
acres.

2. The beneficial use on which the claim is based Domestic use
3. Date or approximate date of earliest beneficial use; and how continuous the use has been 1938
4. The amount of groundwater claimed (in miner's inches or gallons per minute) 100 gals./min.
5. If used for irrigation, give the acreage and description of the lands to which water has been applied and name of the owner thereof not applicable
6. The means of withdrawing such water from the ground and the location of each well or other means of withdrawal pump
7. The date of commencement and completion of the construction of the well, wells, or other works for withdrawal of groundwater 1938
8. The depth of water table 6 - 14 feet
9. So far as it may be available, the type, size and depth of each well or the general specifications of any other works for the withdrawal of groundwater Dug 21 feet, drilled to 45 feet
10. The estimated amount of groundwater withdrawn each year 365,000 gals./year
11. The log of formations encountered in the drilling of each well if available not available
12. Such other information of a similar nature as may be useful in carrying out the policy of this act, including reference to book and page of any county record Recorded by M.G. Donaldson

Signature of Owner

Eugene B. Donaldson
Date April 11 1963

Three copies to be filed by the owner with the County Clerk and Recorder of the county in which the well is located.

Please answer all questions. If not applicable, so state, otherwise the form will be returned.

Original to the County Clerk and Recorder; duplicate to the State Engineer; Triplicate to the Montana Bureau of Mines and Geology, and Quadruplicate for the Appropriator.

4160

Indexed
Recorded
Filed

142427

STATE OF MONTANA
COUNTY OF LEWIS & CLARK } SS.

I hereby certify that the within in-
strument was filed in my office on
this 11th day of Apr
A.D. 19 63 at 50 min. past
8 o'clock A.M. and record

of County of Lewis and Clark
State of Montana.

John L. Lounsbury
County Recorder
By Loraine L. Lounsbury
Deputy

2:00

G

File No. _____

DUPLICATE

T. 10^N R. 3^WCounty LEC.**RECEIVED**

APR 17 1963

STATE OF MONTANA
ADMINISTRATOR OF GROUNDWATER CODE
OFFICE OF STATE ENGINEER

Declaration of Vested Groundwater Rights
(Under Chapter 237, Montana Session Laws, 1961)

1. Eugene C. Donaldson of Route 1 Helena
(Name of Appropriator) (Address) (Town)
County of Lewis & Clark State of Montana
have appropriated groundwater according to the Montana laws in effect prior to January 1, 1962, as follows:

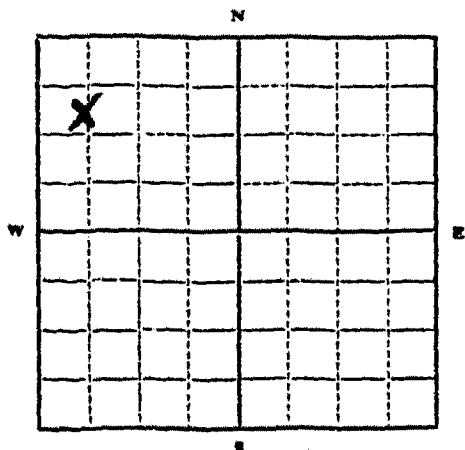

NW 1/4 Sec. 2 T. 10R. 3

Indicate point of appropriation
and place of use, if possible.
Each small square represents 10
acres.

2. The beneficial use on which the claim is based Livestock
USE

3. Date or approximate date of earliest beneficial use; and how con-
tinuous the use has been 1935

4. The amount of groundwater claimed (in miner's inches or gallons
per minute) 50 gals. / min.

5. If used for irrigation, give the acreage and description of the lands
to which water has been applied and name of the owner thereof
not applicable

6. The means of withdrawing such water from the ground and the
location of each well or other means of withdrawal Hand

7. The date of commencement and completion of the construction of the well, wells, or other works for with-
drawal of groundwater 1935

8. The depth of water table 4 - 10 feet

9. So far as it may be available, the type, size and depth of each well or the general specifications of any other
works for the withdrawal of groundwater Drilled to 30 feet

10. The estimated amount of groundwater withdrawn each year 20,000 gals. / year

11. The log of formations encountered in the drilling of each well if available not available

12. Such other information of a similar nature as may be useful in carrying out the policy of this act, including
reference to book and page of any county record Recorded by M.C. Donaldson

Signature of Owner Eugene C. Donaldson

Date April 1, 1963

Three copies to be filed by the owner with the County Clerk and Recorder of the county in which the well is
located.

Please answer all questions. If not applicable, so state, otherwise the form will be returned.

Original to the County Clerk and Recorder; duplicate to the State Engineer; Triplicate to the Montana Bureau
of Mines and Geology, and Quadruplicate for the Appropriator.

416.2

142 429

STATE OF MONTANA } ss.
COUNTY OF LEWIS & CLARK

I hereby certify that the within instrument was filed in my office on this 11th day of Apr A.D. 1913 at 10 min. past 9 o'clock AM.

Records of Lewis & Clark
County, State of Montana.

John L. Linnick
County Recorder

By Louise C. Russell
Deputy

2:00

Indexed
Recorded
Compared

1

File No. _____

DUPLICATE

RECEIVED

APR 16 1973

T. 10 N. R. 3 W.

County Lewis & Clark

LOG

STATE OF MONTANA

MONTANA DEPARTMENT OF NATURAL RESOURCES AND CONSERVATION
ADMINISTRATOR OF GROUNDWATER CODE
STATE WATER CONSERVATION BOARD

Top of Ground

(Elev. above sea level _____)

0 - 7 FT

Top soil

7 FT. - 22 FT.

SAND & GRAVEL

22' - 31'

CLAY

31' - 48'

SAND & SILT

48' - 50'

GRAVEL

Doc. No. 233807

Filed for record

this 9th day of AprilA. D. 19 73 at 1:30o'clock P.M.**Notice of Completion of Groundwater
Appropriation by Means of Well**

DEVELOPED AFTER JANUARY 1, 1962

(Under Chapter 237 Montana Session Laws, 1961, as amended)

Owner FLOYD FINNØG Address HELENA, MONT.Driller Wesley Lindsay Address CLANCY, MONT.

Date of Notice of appropriation of groundwater _____

Date well started Nov. 10 - 1969 Date completed Nov. 12 - 1969Type of well Drilled Equipment used CHURN
(Dug, driven, bored or drilled) (Churn drill, rotary or other)Water use: Domestic ☒ Municipal ☐ Stock ☐ Irrigation ☐
Industrial ☐ Drainage ☐ Other ☐

Indicate on the diagram the character and thickness of the different strata met with in drilling, such as soil, clay, shale, gravel, rock or sand, etc. Show depth at which water is encountered, thickness and character of water-bearing strata and height to which the water rises in the well.

Size of Drilled Hole	Size and Weight of Casing	From (Feet)	To (Feet)	PERFORATIONS		
				Kind Size	From (Feet)	To (Feet)
6"	17-16	0	50			

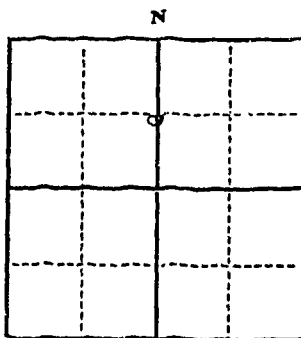

SE NW

SW NE Sec. 3 T. 10 R. 3
Indicate location of well and
place of use, if possible. Each
small square represents 40
acres.Static Water Level for non-flowing well
_____ feet.

Shut-in Pressure for Flowing Well _____

Pumping Water Level _____ feet
at _____ gal. per minute.

Discharge in gal. per min. of flowing well _____

How Tested PUMPLength of Test 6 HRSRemarks: (Gravel packing, cementing, pack-
ers, type of shutoff) _____

(Continue on reverse side)

USE—If used for irrigation, industrial, drainage or other. Explain, state
number of acres and location or other data (i.e.: Lot, Block and Addi-
tion).

Show exact depth of bottom.

This form to be prepared by driller, and three copies to be filed by the owner with the
County Clerk and Recorder in the county in which the well is located, tissue copy to be
retained by driller.Please answer all questions. If not applicable, so state, otherwise the form will be
returned.

Driller's License Number

Wesley Lindsay
Driller's Signature.

52,891

233807

Indexed
Recorded
Compared

STATE OF MONTANA
COUNTY OF LEWIS & CLARK

I hereby certify that the within in-
strument was filed in my office on
this 9 day of Apr
A.D. 1923 at 30 min. past
1 o'clock P.M.

Records of Lewis & Clark
County, State of Montana.

Allen L. Smith
County Recorder
P. J. Smith
Deputy

200

11-10-23
J. W. Smith
J. W. Smith
J. W. Smith

11-10-23
J. W. Smith
J. W. Smith
J. W. Smith

11-10-23
J. W. Smith
J. W. Smith
J. W. Smith

File No. _____

T. 10 N. R. 3 W.

DUPLICATE

County Lewis and Clark

STATE OF MONTANA
ADMINISTRATOR OF GROUNDWATER CODE
OFFICE OF STATE ENGINEER

Declaration of Vested Groundwater Rights

(Under Chapter 237, Montana Session Laws, 1961)

RECEIVED
JAN 6 1964

STATE ENGINEER

1. THOMAS H. HERRIN, of ROUTE A Helena,
(Name of Appropriator) (Address) (Town)

County of Lewis and Clark State of Montana
have appropriated groundwater according to the Montana laws in effect prior to January 1, 1962, as follows:

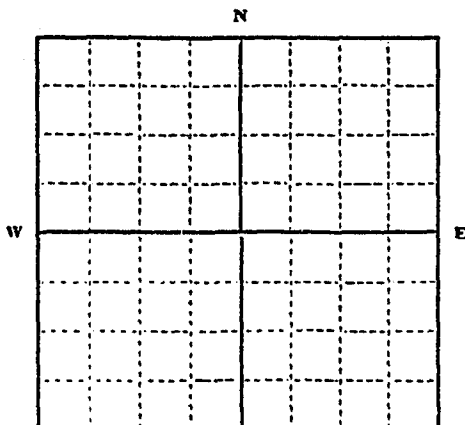

N $\frac{1}{4}$ Section 10
S $\frac{1}{4}$ SE $\frac{1}{4}$, and SE $\frac{1}{4}$ SW $\frac{1}{4}$ Section 3,
T $\frac{1}{4}$ Sec. T10N R.3W.

Indicate point of appropriation
and place of use, if possible. Each
small square represents 10 acres.

2. The beneficial use on which the claim is based Sub-Irrigated Pasture and Hay Meadow

3. Date or approximate date of earliest beneficial use; and how continuous the use has been Since 1865

4. The amount of groundwater claimed (in miner's inches or gallons per minute) 300 miners inches

5. If used for irrigation, give the acreage and description of the lands to which water has been applied and name of the owner thereof
300 Acres of sub-irrigated land

6. The means of withdrawing such water from the ground and the location of each well or other means of withdrawal nature

7. The date of commencement and completion of the construction of the well, wells, or other works for withdrawal of groundwater 1865

8. The depth of water table 6" - 18"

9. So far as it may be available, the type, size and depth of each well or the general specifications of any other works for the withdrawal of groundwater all underground water

10. The estimated amount of groundwater withdrawn each year

11. The log of formations encountered in the drilling of each well if available none available

12. Such other information of a similar nature as may be useful in carrying out the policy of this act, including reference to book and page of any county record good sub-irrigated, pastures and hay meadow.

Signature of Owner

Date Dec 23, 1963

Three copies to be filed by the owner with the County Clerk and Recorder of the county in which the well is located.

Please answer all questions. If not applicable, so state, otherwise the form will be returned.

Original to the County Clerk and Recorder; Duplicate to the State Engineer; Triplicate to the Montana Bureau of Mines and Geology, and Quadruplicate for the Appropriator.

24425

INGR.
RECORDS
OFFICE

8

151597

STATE OF MONTANA
COUNTY OF LEWIS & CLARK

I hereby certify that the within in-
strument was filed in my office on
this 31 day of Dec.
A.D. 1923 at 12 min. past
12 o'clock P.M.

Records of Lewis & Clark
County, State of Montana.
Edna Lovick

County Recorder
By *Norma Kelley*
Deputy

\$2.00

File No. _____

DUPLICATE

T. 10N R. 3W
County LEC

STATE OF MONTANA
ADMINISTRATOR OF GROUNDWATER CODE
OFFICE OF STATE ENGINEER

RECEIVED

Declaration of Vested Groundwater Rights
(Under Chapter 237, Montana Session Laws, 1961)

STATE ENGINEER

1. Walter B. & V. Laurene Holland, of Route A, Helena
(Name of Appropriator) (Address) (Town)
County of Lewis & Clark State of Montana
have appropriated groundwater according to the Montana laws in effect prior to January 1, 1962, as follows:

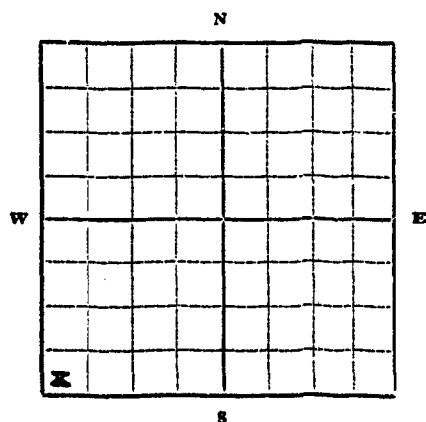

SW 1/4 Sec. 3 T.10N R.3E

Indicate point of appropriation and place of use, if possible. Each small square represents 10 acres.

2. The beneficial use on which the claim is based Continuous Domestic and Irrigation
3. Date or approximate date of earliest beneficial use; and how continuous the use has been 1/10/54
continuous
4. The amount of groundwater claimed (in miner's inches or gallons per minute) 40 gallons per minute
5. If used for irrigation, give the acreage and description of the lands to which water has been applied and name of the owner thereof 3 acres owner same as above
6. The means of withdrawing such water from the ground and the location of each well or other means of withdrawal Pump underneath house
7. The date of commencement and completion of the construction of the well, wells, or other works for withdrawal of groundwater 1/10/54 to 1/18/54
8. The depth of water table 20 ft.
9. So far as it may be available, the type, size and depth of each well or the general specifications of any other works for the withdrawal of groundwater Drilled well 75 ft.
10. The estimated amount of groundwater withdrawn each year 21,024,000
11. The log of formations encountered in the drilling of each well if available Gravel, Hardpan, Gravel and Sand
12. Such other information of a similar nature as may be useful in carrying out the policy of this act, including reference to book and page of any county record.

Signature of Owner W. Laurene Holland

Date April 9, 1962

Three copies to be filed by the owner with the County Clerk and Recorder of the county in which the well is located.

Please answer all questions. If not applicable, so state, otherwise the form will be returned.

Original to the County Clerk and Recorder; duplicate to the State Engineer; Triplicate to the School of Mines and Quadruplicate for the Appropriator.

Indexed
Recorded
Filed

131341

STATE OF MONTANA
COUNTY OF LEWIS & CLARK } ss.

I hereby certify that the within in-
strument was filed in my office on
this 13th day of Apr
A.D. 1962 at 35 min. past
8 o'clock A.M.

Records of Lewis & Clark
County State of Montana

John L. Lovich
County Recorder

Lorance C. Russell
Deputy

2:00

File No.

T. 10^N R. 3^W

DUPLICATE

County. LEC

STATE OF MONTANA
ADMINISTRATOR OF GROUNDWATER CODE
OFFICE OF STATE ENGINEER

RECEIVED
DEC 17 1963

Declaration of Vested Groundwater Rights

(Under Chapter 237, Montana Session Laws, 1961)

STATE ENGINEER

1. Walter B. Holland, of Rte. A, Helena, Montana
(Name of Appropriator) (Address) (Town)
County of Lewis & Clark State of Montana
have appropriated groundwater according to the Montana laws in effect prior to January 1, 1962, as follows:

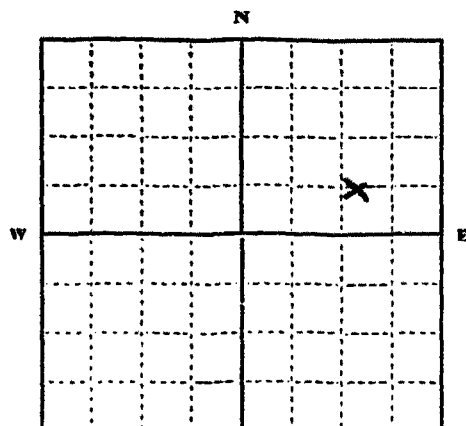

SW 1/4
of
Sub 1/4 Sec. 3 T. 10 R. 3 W.

Indicate point of appropriation and place of use, if possible. Each small square represents 10 acres.

2. The beneficial use on which the claim is based.
Household, Livestock & Irrigation

3. Date or approximate date of earliest beneficial use; and how continuous the use has been.
1948 Thru 1963

4. The amount of groundwater claimed (in miner's inches or gallons per minute).
Approx. 400 gallon per minute.

5. If used for irrigation, give the acreage and description of the lands to which water has been applied and name of the owner thereof.
About eight acres.

6. The means of withdrawing such water from the ground and the location of each well or other means of withdrawal.
Pump

7. The date of commencement and completion of the construction of the well, wells, or other works for withdrawal of groundwater.
1948. Completed in 1948.

8. The depth of water table. 20 Ft.

9. So far as it may be available, the type, size and depth of each well or the general specifications of any other works for the withdrawal of groundwater. 75 Ft.

10. The estimated amount of groundwater withdrawn each year. As needed.

11. The log of formations encountered in the drilling of each well if available.
Not Available

12. Such other information of a similar nature as may be useful in carrying out the policy of this act, including reference to book and page of any county record.

Signature of Owner W B Holland

Date 12-9-63

Three copies to be filed by the owner with the County Clerk and Recorder of the county in which the well is located.

Please answer all questions. If not applicable, so state, otherwise the form will be returned.

Original to the County Clerk and Recorder; Duplicate to the State Engineer; Triplicate to the Montana Bureau of Mines and Geology, and Quadruplicate for the Appropriator.

9687

150797

STATE OF MONTANA }
COUNTY OF LEWIS & CLARK } SS

I hereby certify that the within in-
strument was filed in my office on
this 12 day of Dec
A.D. 1963 at 10 min. past
9 o'clock A.M.

Records of Lewis & Clark
County, State of Montana.

John Dovich
County Recorder

By Norma Kelley
Deputy

2.00

File No. _____

STATE WATER CONSERVATION BOARD

T. 10 R. 3

DUPLICATE

APR 24 1967

County Lewis & Clark

LOG

Biller _____

Biller _____

Covis _____

Dicker _____

No. _____

No. _____

No. _____

STATE OF MONTANA

ADMINISTRATOR OF GROUNDWATER CODE

OFFICE OF STATE ENGINEER

Top of Ground

(Elev. above sea level _____)

Notice of Completion of Groundwater Appropriation by Means of Well

DEVELOPED AFTER JANUARY 1, 1962

(Under Chapter 237, Montana Session Laws, 1961)

Owner Walter B. Holland Address Route 1, Box 54Driller Wesly Lindsay Address Clancy, Montana

Date of Notice of appropriation of groundwater _____

Date well started Aug - 1966 Date completed Aug - 1966Type of well Drilled Equipment used Churn
(Dug, driven, bored or drilled) (Churn drill, rotary or other)Water use: Domestic ☒ Municipal ☐ Stock ☒ Irrigation ☒
Industrial ☐ Drainage ☐ Other ☐

Indicate on the diagram the character and thickness of the different strata met with in drilling, such as soil, clay, shale, gravel, rock or sand, etc. Show depth at which water is encountered, thickness and character of water-bearing strata and height to which the water rises in the well.

Size of Drilled Hole	Size and Weight of Casing	From (Feet)	To (Feet)	PERFORATIONS		
				Kind Size	From (Feet)	To (Feet)
6"	1 3/4"	0	16		none	

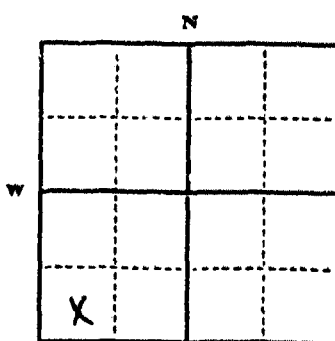
Static Water Level for non-flowing well 5 feet.

Shut-in Pressure for Flowing Well _____

Pumping Water Level 10 feet
at 20 gal. per minute.

Discharge in gal. per min. of flowing well _____

How Tested Boiler

Length of Test _____

Remarks: (Gravel packing, cementing, packers, type of shutoff) _____

Indicate location of well and place of use, if possible. Each small square represents 40 acres.

(Continue on reverse side)

USE—If used for irrigation, industrial, drainage or other. Explain, state number of acres and location or other data (i.e.: Lot, Block and Addition).

Irrigated yard & garden

Show exact depth of bottom.

This form to be prepared by driller, and three copies to be filed by the owner with the County Clerk and Recorder in the county in which the well is located, tissue copy to be retained by driller.

Please answer all questions. If not applicable, so state, otherwise the form will be returned.

Driller's License Number 38Driller's Signature Wesly Lindsay

41,894

185927

STATE OF MONTANA
COUNTY OF LEWIS & CLARK

Indexed
Recorded
Compared

I hereby certify that the within in-
strument was filed in my office, on
this 19 day of April
A.D. 1967 at Butte Mon. past
10 o'clock.

Recorder of Lewis & Clark

By C. Spades
Deputy

200

File No. _____

T. 10 N. R. 3 West

DUPLICATE

County Lewis & Clark

STATE OF MONTANA
ADMINISTRATOR OF GROUNDWATER CODE
OFFICE OF STATE ENGINEER

Declaration of Vested Groundwater Rights JAN 6 1964

(Under Chapter 237, Montana Session Laws, 1961)

STATE ENGINEER

1. Ralph LaRue, of Montana, Helena
(Name of Appropriator) (Address) (Town)

County of Lewis & Clark State of Montana
have appropriated groundwater according to the Montana laws in effect prior to January 1, 1962, as follows:

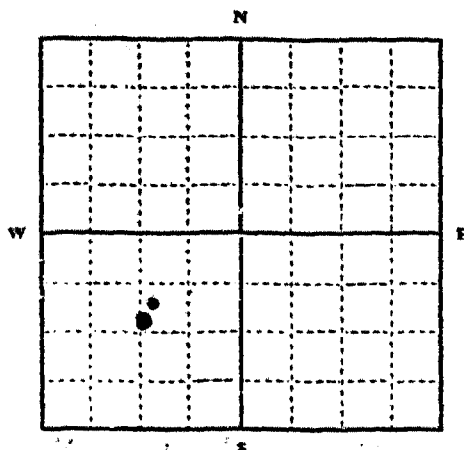

SW 1/4 Sec. 3 T. 10 N. R. 3 West

Indicate point of appropriation
and place of use, if possible. Each
small square represents 10 acres.

2. The beneficial use on which the claim is based
Watering Stock - Carving - Domestic

3. Date or approximate date of earliest beneficial use; and how continuous the use has been
May 11, 1962 - continuous

4. The amount of groundwater claimed (in miner's inches or gallons per minute)
20 gal per minute

5. If used for irrigation, give the acreage and description of the lands to which water has been applied and name of the owner thereof
SW 1/4, Sec. 3, Twp 10 North, Range 3 West.
5 acres used for gardening
owner - Ralph LaRue

6. The means of withdrawing such water from the ground and the location of each well or other means of withdrawal
Pump

7. The date of commencement and completion of the construction of the well, wells, or other works for withdrawal of groundwater
May 11, 1962 and completed May 14, 1962

8. The depth of water table
8 feet

9. So far as it may be available, the type, size and depth of each well or the general specifications of any other works for the withdrawal of groundwater
6 1/2 in.
50 ft. deep

10. The estimated amount of groundwater withdrawn each year
Not available

11. The log of formations encountered in the drilling of each well if available
Topsoil & Clay - 15 ft. clay & gravel - 15 to 31 ft. gravel - 31 ft. to 36 ft. gravel
& sand - 36 ft. to 50 ft. clay.

12. Such other information of a similar nature as may be useful in carrying out the policy of this act, including reference to book and page of any county record
Not available

Signature of Owner Ralph J. LaRue
Date 12-30-63

Three copies to be filed by the owner with the County Clerk and Recorder of the county in which the well is located.

Please answer all questions. If not applicable, so state, otherwise the form will be returned.

Original to the County Clerk and Recorder; Duplicate to the State Engineer; Triuplicate to the Montana Bureau of Mines and Geology, and Quadruplicate for the Appropriator.

24518

151756

STATE OF MONTANA
COUNTY OF LEWIS & CLARK

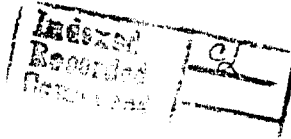

I hereby certify that the within in-
strument was filed in my office on
this 3 day of Jan
A.D. 1964 at 080 min. past
10 o'clock A.M.

Records of Lewis & Clark
County, State of Montana.

John D. Smith
County Recorder

By Myrtle Lee
Deputy

\$2.00
pd

RECEIVED

County Lewis & Clark

JAN 24 1973

DRILLER'S LOG

STATE OF MONTANA
ADMINISTRATOR OF GROUNDWATER CODE
MONTANA WATER RESOURCES BOARD

NOTICE OF COMPLETION OF GROUNDWATER
APPROPRIATION BY MEANS OF WELL

Developed after January 1, 1962

(Under Chapter 237 Montana Session Laws, 1961, as amended)

This form to be prepared by driller, and three copies to be filed by the owner with the County Clerk and Recorder in the county in which the well is located, last copy to be retained by driller.

Please answer all questions. If not applicable, so state, otherwise the form may be returned.

Owner C. A. Nettleton

Address 4030 Flowera Drive

Helena, Montana 59601

Date well started August 26, 1972

completed August 29, 1972

For Administrator's Use

File 231910

Jan 23, 1973

GW 1 10:30 A.M.

Type of well drilled

(Dug, driven, bored or drilled)

Equipment used churn drill

(Churn drill, rotary or other)

Water Use: Domestic ☒ Municipal ☐ Stock ☐ Irrigation ☐

Industrial ☐ Drainage ☐ Other ☐ Garden/Lawn ☐

*Describe

USE: If used for irrigation, industrial, drainage or other. Explain, state number of acres and location or other data (i.e. Lot, Block and Addition).

ESTIMATED ANNUAL WITHDRAWAL

Size of Drilled Hole	Size and Weight of Casing	From (Feet)	To (Feet)	PERFORATIONS		
				Kind Size	From (Feet)	To (Feet)
6"	Iron pipe 1.5'	60.3'		1/16x6"	55.3'	60.3'

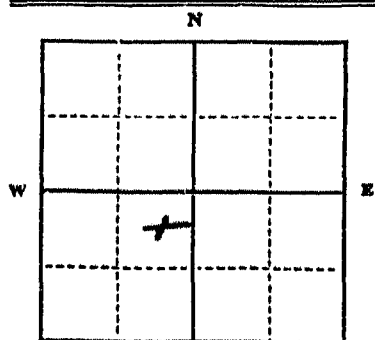

Static water levelft.*
Pumping water levelft.*
at 33 gpm gallons per minute,
measuredminutes after pumping began.

*Measured from ground level.
Well developed by bailing
for 4 hours.

Power..... Pump..... HP

Remarks: (Gravel packing, cementing, packers, type of shutoff)

NE 1/4 SW 1/4 Sec. 3

T. 10 N R. 3

INDICATE LOCATION OF WELL AND PLACE OF USE, IF POSSIBLE. EACH SMALL SQUARE REPRESENTS 40 ACRES.

Driller's Signature Ronald C. Mahan

Driller's Address 220 C Custer Ave. West

Helena, Montana 59601 LICENSE NO. 225

Indicate the character, color, thickness of strata such as soil, clay, sand, gravel, shale, sandstone, etc. Show depth at which water is found and height to which water rises in well.

Top of Ground

(Elev. above sea level)

From (Feet)	To (Feet)	
0.0'	3.0'	Black sand silt (top soil)
3.0'	5.0'	Brown sandy silt
5.0'	12.0'	Brown sandy gravel
12.0'	26.0'	tan sandy silt
26.0'	32.0'	Brown coarse to fine sand (sands pumped)
32.0'	39.0'	Tan gravelly sandy clay
39.0'	46.0'	Tan clayey sand
46.0'	54.0'	Brown fine sand
54.0'	60.3'	Fine sand. Lost 20' of hole. Coarse sand with pebble gravel
60.3'		Bottom of hole

60.3' Show exact depth of bottom

52,325

231910

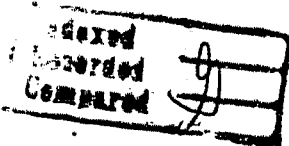

STATE OF MONTANA
COUNTY OF LEWIS & CLARK

I hereby certify that the within in-
strument was filed in my office on
this 23 day of Jan
A.D. 19 23 at 3 min. past
10 o'clock A.M.

Records of Lewis & Clark
County, State of Montana

John L. Smith
County Recorder
by A. Thomas
Deputy

200

File No. _____

DUPLICATE

STATE OF MONTANA
ADMINISTRATOR OF GROUNDWATER CODE
OFFICE OF STATE ENGINEER

Declaration of Vested Groundwater Rights
(Under Chapter 237, Montana Session Laws, 1961)

T 107 R 3 W 3
County LEWIS & CLARK
RECEIVED
DEC 26 1963
STATE ENGINEER

1. Elmer E. Nettleton of Route A Helena, Montana
(Name of Appropriator) (Address) (Town)
County of Lewis and Clark State of Montana
have appropriated groundwater according to the Montana laws in effect prior to January 1, 1962, as follows:

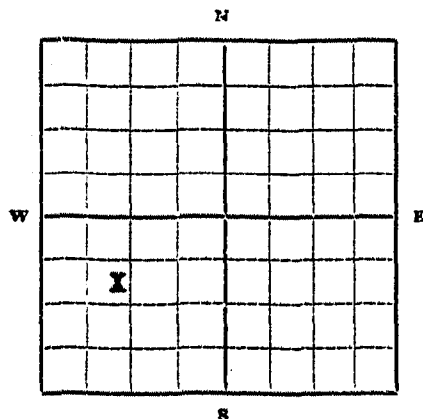

Commencing at the SE corner of thereof 1 acre of yard and pasture - owner
NW 1/4 SW 1/4 Sec. 3 T10N R. 3W. same

Indicate point of appropriation and place of use, if possible. Each small square represents 10 acres.

2. The beneficial use on which the claim is based household, livestock and irrigation
3. Date or approximate date of earliest beneficial use; and how continuous the use has been since 1948
4. The amount of groundwater claimed (in miner's inches or gallons per minute) 200 gal per min.
5. If used for irrigation, give the acreage and description of the lands to which water has been applied and name of the owner same
6. The means of withdrawing such water from the ground and the location of each well or other means of withdrawal pump
7. The date of commencement and completion of the construction of the well, wells, or other works for withdrawal of groundwater 1948
8. The depth of water table 15 ft.
9. So far as it may be available, the type, size and depth of each well or the general specifications of any other works for the withdrawal of groundwater 8 in. casing 60-65 ft. deep
10. The estimated amount of groundwater withdrawn each year as needed
11. The log of formations encountered in the drilling of each well if available Well was drilled when we bought the place. Unavailable.
12. Such other information of a similar nature as may be useful in carrying out the policy of this act, including reference to book and page of any county record not available

Signature of Owner Elmer E. Nettleton

Date 12-18-63

Three copies to be filed by the owner with the County Clerk and Recorder of the county in which the well is located.

Please answer all questions. If not applicable, so state, otherwise the form will be returned.

Original to the County Clerk and Recorder; duplicate to the State Engineer; Triplicate to the School of Mines and Quadruplicate for the Appropriator.

12266

151061

Index
Record
Cor

STATE OF MONTANA
COUNTY OF LEWIS & CLARK

I hereby certify that the within in-
strument was filed in the office on
this 18 day of Dec
A.D. 19 63 at 45 min. past
12 o'clock P.M.

By John H. Lewis
County Clerk (Montana)

By Myrtle Luss
Deputy

RECORDED

File No. _____

DUPLICATE

Approved Stock Form—State Publishing Co., Helena, Montana—40876

T. 10N R. 3W

County

Lewis & Clark

STATE OF MONTANA
ADMINISTRATOR OF GROUNDWATER CODE
OFFICE OF STATE ENGINEER

RECEIVED
DEC 6 1963

STATE ENGINEER

Declaration of Vested Groundwater Rights

(Under Chapter 237, Montana Session Laws, 1961)

1. Arnold Trinsvold of Route 6 FF Helena
(Name of Appropriator) (Address) (Town)
County of Lewis & Clark State of Montana
have appropriated groundwater according to the Montana laws in effect prior to January 1, 1962, as follows:

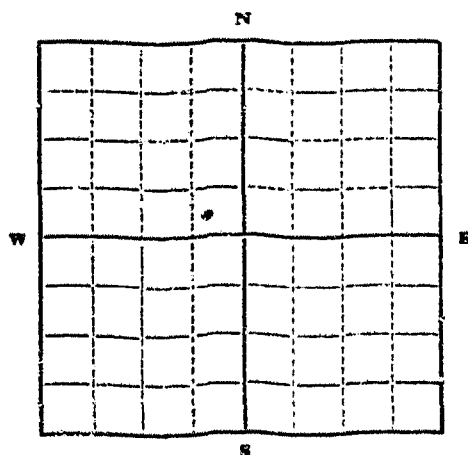

SE 1/4 NW 1/4 Sec. 3 T. 10 N. R. 3 W. 1/2

Indicate point of appropriation
and place of use, if possible.
Each small square represents 10
acres.

2. The beneficial use on which the claim is based Since sold
line stock & garden
3. Date or approximate date of earliest beneficial use; and how con-
tinuous the use has been 1949 Continuous
4. The amount of groundwater claimed (in miner's inches or gallons
per minute) 100 g.p.m.
5. If used for irrigation, give the acreage and description of the lands
to which water has been applied and name of the owner thereof
Home Garden & yard
6. The means of withdrawing such water from the ground and the
location of each well or other means of withdrawal
10 ft Pump & 1 centrifugal pump
7. The date of commencement and completion of the construction of the well, wells, or other works for with-
drawal of groundwater 1949
8. The depth of water table varies from 5 to 10 feet
9. So far as it may be available, the type, size and depth of each well or the general specifications of any other
works for the withdrawal of groundwater
6" well 30 feet deep
10. The estimated amount of groundwater withdrawn each year 120,000 g.p.
11. The log of formations encountered in the drilling of each well if available none
12. Such other information of a similar nature as may be useful in carrying out the policy of this act, including
reference to book and page of any county record none

Signature of Owner

Arnold Trinsvold

Date Dec 2, 1963

Three copies to be filed by the owner with the County Clerk and Recorder of the county in which the well is located.

Please answer all questions. If not applicable, so state, otherwise the form will be returned.

Original to the County Clerk and Recorder; duplicate to the State Engineer; Triplicate to the Montana Bureau of Mines and Geology, and Quadruplicate for the Appropriator.

7926

150492

STATE OF MONTANA } ss.
COUNTY OF LEWIS & CLARK }

I hereby certify that the within in-
strument was filed in my office on
this 4th day of Dec
A.D. 1963 at 30 min. past
8 o'clock a.m.

Records of Lewis & Clark
County, State of Montana

John L. Smith
County Recorder

By Lorraine A. Russell
Deputy

2:00

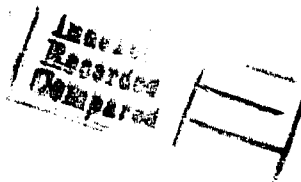

File No.

T. 10 R. 3

DUPLICATE

County Lewis & Clark

LOG

APR 7 1966

STATE OF MONTANA
ADMINISTRATOR OF GROUNDWATER CODE
STATE WATER CONSERVATION BOARD

**Notice of Completion of Groundwater
Appropriation by Means of Well**
DEVELOPED AFTER JANUARY 1, 1962

(Under Chapter 237 Montana Session Laws, 1961, as amended)

Owner Soosvratia Address 76 Beaverhead DriveDriller Lindsay Address Helena, Montana
Clancy, Montana

Date of Notice of appropriation of groundwater

Date well started May 18, 1965 Date completed May 21, 1965Type of well Drilled Equipment used Churn
(Dug, driven, bored or drilled) (Churn drill, rotary or other)Water use: Domestic ☒ Municipal ☐ Stock ☐ Irrigation ☒
Industrial ☐ Drainage ☐ Other ☐

Indicate on the diagram the character and thickness of the different strata met with in drilling, such as soil, clay, shale, gravel, rock or sand, etc. Show depth at which water is encountered, thickness and character of water-bearing strata and height to which the water rises in the well.

Size of Drilled Hole	Size and Weight of Casing	From (Feet)	To (Feet)	PERFORATIONS		
				Kind Size	From (Feet)	To (Feet)
6"	17lb	0	53		None	

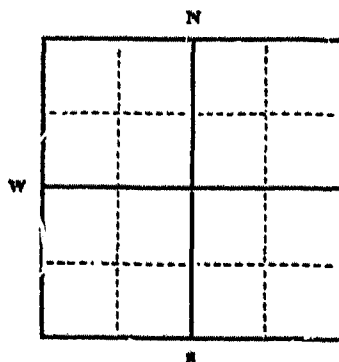
Part of 2 1/2 Sec. 11 T. 10 R. 3

Indicate location of well and place of use, if possible. Each small square represents 40 acres.

Static Water Level for non-flowing well 22 feet.

Shut-in Pressure for Flowing Well

Pumping Water Level 25 feet
at 20 gal. per min.

Discharge in gal. per min. of flowing well

How Tested BoilerLength of Test 3 hrs.

Remarks: (Gravel packing, cementing, packers, type of shutoff)

(Continue on reverse side)

USE—If used for irrigation, industrial, drainage or other. Explain, state number of acres and location or other data (i.e.: Lot, Block and Addition).

Irrigate yard and garden.

Show exact depth of bottom.

This form to be prepared by driller, and three copies to be filed by the owner with the County Clerk and Recorder in the county in which the well is located, tissue copy to be retained by driller.

Please answer all questions. If not applicable, so state, otherwise the form will be returned.

Driller's License Number

Driller's Signature.

Wesley Lindsay45,110

202789

Indexed	<i>W</i>
Recorded	
Filed	

STATE OF MONTANA
COUNTY OF LEWIS & CLARK

I hereby certify that the within instrument was filed in my office on this 31 day of March A.D. 1929 at 35 min. past 8 o'clock A.M.

Records of Lewis & Clark
County, State of Montana

John A. Smith
County Recorder
by *C. Snyder*
Deputy

2.00

RECEIVED
STATE OF MONTANA
COUNTY OF LEWIS & CLARK
RECORDS OF LEWIS & CLARK
COUNTY, MONTANA
MARCH 31 1929
FILED

RECEIVED
STATE OF MONTANA
COUNTY OF LEWIS & CLARK
RECORDS OF LEWIS & CLARK
COUNTY, MONTANA
MARCH 31 1929
FILED

File No. _____

DUPLICATE

T. 10 N. B. 3 W.

County. L & C

STATE OF MONTANA
ADMINISTRATOR OF GROUNDWATER CODE
OFFICE OF STATE ENGINEER

RECORDED
JAN 8 1964

Declaration of Vested Groundwater Rights
(Under Chapter 237, Montana Session Laws, 1961)

1. Stephen F. & Ramona G. Weber, of Helena, Route A, Helena
(Name of Appropriator) (Address) (Town)
County of Lewis & Clark State of Montana
have appropriated groundwater according to the Montana laws in effect prior to January 1, 1962, as follows:

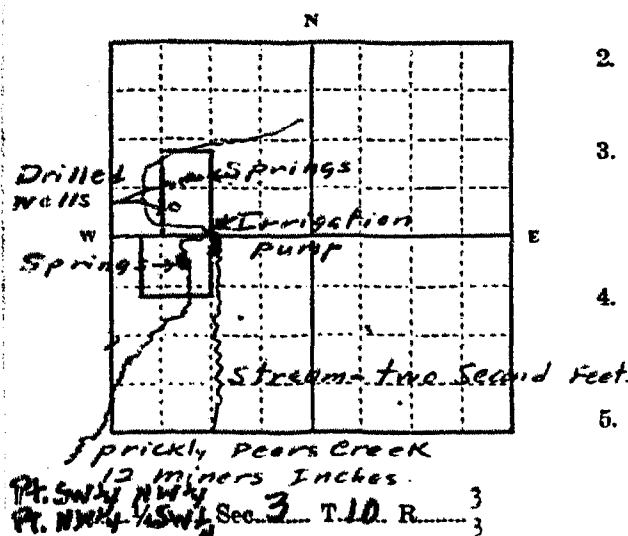

Indicate point of appropriation
and place of use, if possible.
Each small square represents 10
acres.

2. The beneficial use on which the claim is based Household,
irrigation & stockwater uses.
3. Date or approximate date of earliest beneficial use; and how con-
tinuous the use has been Wells continuously since 1948
Irrigation from streams according to water-right grants
Springs continuously since 1948.
4. The amount of groundwater claimed (in miner's inches or gallons
per minute) Ten miners inches for springs & wells
Two second feet for stream indicated. Twelve miners
inches for Prickly Pears Creek
5. If used for irrigation, give the acreage and description of the lands
to which water has been applied and name of the owner thereof
Twenty nine acres belonging to Stephen F. & Ramona G.
Weber. Description is as indicated on plat.
6. The means of withdrawing such water from the ground and the
location of each well or other means of withdrawal Water is
withdrawn from springs & streams by means of an irrigation
pump. From house well by means of jet pump. From barn well by
means of a hand pump.
7. The date of commencement and completion of the construction of the well, wells, or other works for with-
drawal of groundwater Wells were drilled, cased and completed on or about 1948
8. The depth of water table Varies from five to zero feet according to contour of the land.
9. So far as it may be available, the type, size and depth of each well or the general specifications of any other
works for the withdrawal of groundwater Household well is six inches in dia., 55 feet deep, with
jet-type pump. Barn well is six inches in dia., six feet deep, with hand operated pump.
Irrigation pump is five horsepower, electric, with four inch aluminum pipe distribution
system.
10. The estimated amount of groundwater withdrawn each year 20,000 cubic feet from wells,
80 acre feet from springs and streams
11. The log of formations encountered in the drilling of each well if available.
not available
12. Such other information of a similar nature as may be useful in carrying out the policy of this act, including
reference to book and page of any county record.

Signature of Owner Stephen F. WeberDate Dec. 27, 1963

Three copies to be filed by the owner with the County Clerk and Recorder of the county in which the well is located.

Please answer all questions. If not applicable, so state, otherwise the form will be returned.

Original to the County Clerk and Recorder; duplicate to the State Engineer; Triplicate to the Montana Bureau of Mines and Geology, and Quadruplicate for the Appropriator.

17527

151512

Indexed
Recorded
Compared

07

STATE OF MONTANA
COUNTY OF LEWIS & CLARK } SS

I hereby certify that the within in-
strument was filed in my office on
this 30 day of Dec.
A.D. 1946 at 4 min. past

4 o'clock
Records of Lewis & Clark
County, State of Montana

County Recorder

By Norma Kelley
Deputy

2.00

STATE OF MONTANA

ADMINISTRATOR OF GROUNDWATER CODE
MONTANA WATER RESOURCES BOARD

NOTICE OF COMPLETION OF GROUNDWATER
APPROPRIATION BY MEANS OF WELL

Developed after January 1, 1962

(Under Chapter 237 Montana Session Laws, 1961, as amended)

This form to be prepared by driller, and three copies to be filed by the owner with the County Clerk and Recorder in the county in which the well is located, last copy to be retained by driller.

Please answer all questions. If not applicable, so state, otherwise the form may be returned.

Owner Jack Williams

Address 1227 Houses

For Administrator's Use

File 228410

May 5, 1972 - 8:40 a.m.

Date well started MAY 29

GW 1

completed MAY 31 - 72

Type of well DRILLED

(Dig, driven, bored or drilled)

Equipment used CABLE TOOLS

(Cable drill, rotary or other)

Water Use: Domestic ☒ Municipal ☐ Stock ☒ Irrigation ☒

Industrial ☐ Drainage ☐ Other ☐ Garden/Lawn ☒

*Describe

USE: If used for irrigation, industrial, drainage or other. Explain, state number of acres and location or other data (i.e. Lot, Block and Addition).

ESTIMATED ANNUAL WITHDRAWAL

Size of Drilled Hole	Size and Weight of Casing	From (Feet)	To (Feet)	PERFORATIONS		
				Kind Size	From (Feet)	To (Feet)
<u>6 5/8</u>	<u>6 5/8</u> <u>17LB</u>	<u>0</u>	<u>72</u>			

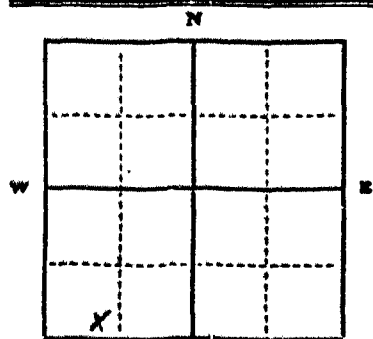

Static water level 20 ft.*
Pumping water level 30 ft.*
at 30 gallons per minute,
measured 1 minutes after pumping
began.
*Measured from ground level.
Well developed by BAILER
for 2 hours.
Power Electric Pump 3/4 HP
Remarks: (Gravel packing, cementing,
packers, type of shutoff)

SE 1/4 SW 1/4
SW 1/4 SE 1/4
T. 10 N. R. 3 E. S. 3 W.

INDICATE LOCATION OF WELL AND PLACE OF USE, IF POSSIBLE. EACH SMALL SQUARE REPRESENTS 40 ACRES.

Driller's Signature R. M. Welch

Driller's Address 5820 N. MONT.

HELENA

LICENSE NO. 100

10M-36
County LEWIS & CLARK

DRILLER'S LOG

Indicate the character, color, thickness of strata such as soil, clay, sand, gravel, shale, sandstone, etc. Show depth at which water is found and height to which water rises in well.

Top of Ground		(Elev. above sea level)
From (Feet)	To (Feet)	
<u>0</u>	<u>35</u>	<u>CLAY & SAND</u>
<u>35</u>	<u>72</u>	<u>WATER</u>
		<u>LOT OF SAND</u>
		<u>72 WATER</u>

72 Show exact depth of bottom

51,392

STATE OF MONTANA
COUNTY OF LEWIS & CLARK } 52

I hereby certify that the within instrument was filed in my office on this 3 day of Sept A.D. 1922 at 40 min. past 8 o'clock A.M. and recorded on page _____ of Book _____ of _____ Records of Lewis and Clark County, State of Indiana.

10

Deputy

3.00

**Indexed
Racquet**

[illegible]

10 21 01 2 4 1 2 3 4 5 6 7 8 9 10 11 12 13 14 15 16 17 18 19 20 21 22 23 24 25 26 27 28 29 30 31 32 33 34 35 36 37 38 39 40 41 42 43 44 45 46 47 48 49 50 51 52 53 54 55 56 57 58 59 60 61 62 63 64 65 66 67 68 69 70 71 72 73 74 75 76 77 78 79 80 81 82 83 84 85 86 87 88 89 90 91 92 93 94 95 96 97 98 99 100 101 102 103 104 105 106 107 108 109 110 111 112 113 114 115 116 117 118 119 120 121 122 123 124 125 126 127 128 129 130 131 132 133 134 135 136 137 138 139 140 141 142 143 144 145 146 147 148 149 150 151 152 153 154 155 156 157 158 159 160 161 162 163 164 165 166 167 168 169 170 171 172 173 174 175 176 177 178 179 180 181 182 183 184 185 186 187 188 189 190 191 192 193 194 195 196 197 198 199 200 201 202 203 204 205 206 207 208 209 210 211 212 213 214 215 216 217 218 219 220 221 222 223 224 225 226 227 228 229 230 231 232 233 234 235 236 237 238 239 240 241 242 243 244 245 246 247 248 249 250 251 252 253 254 255 256 257 258 259 260 261 262 263 264 265 266 267 268 269 270 271 272 273 274 275 276 277 278 279 280 281 282 283 284 285 286 287 288 289 290 291 292 293 294 295 296 297 298 299 300 301 302 303 304 305 306 307 308 309 310 311 312 313 314 315 316 317 318 319 320 321 322 323 324 325 326 327 328 329 330 331 332 333 334 335 336 337 338 339 340 341 342 343 344 345 346 347 348 349 350 351 352 353 354 355 356 357 358 359 360 361 362 363 364 365 366 367 368 369 370 371 372 373 374 375 376 377 378 379 380 381 382 383 384 385 386 387 388 389 390 391 392 393 394 395 396 397 398 399 400 401 402 403 404 405 406 407 408 409 410 411 412 413 414 415 416 417 418 419 420 421 422 423 424 425 426 427 428 429 430 431 432 433 434 435 436 437 438 439 440 441 442 443 444 445 446 447 448 449 450 451 452 453 454 455 456 457 458 459 460 461 462 463 464 465 466 467 468 469 470 471 472 473 474 475 476 477 478 479 480 481 482 483 484 485 486 487 488 489 490 491 492 493 494 495 496 497 498 499 500 501 502 503 504 505 506 507 508 509 510 511 512 513 514 515 516 517 518 519 520 521 522 523 524 525 526 527 528 529 530 531 532 533 534 535 536 537 538 539 540 541 542 543 544 545 546 547 548 549 550 551 552 553 554 555 556 557 558 559 560 561 562 563 564 565 566 567 568 569 570 571 572 573 574 575 576 577 578 579 580 581 582 583 584 585 586 587 588 589 590 591 592 593 594 595 596 597 598 599 600 601 602 603 604 605 606 607 608 609 610 611 612 613 614 615 616 617 618 619 620 621 622 623 624 625 626 627 628 629 630 631 632 633 634 635 636 637 638 639 640 641 642 643 644 645 646 647 648 649 650 651 652 653 654 655 656 657 658 659 660 661 662 663 664 665 666 667 668 669 670 671 672 673 674 675 676 677 678 679 680 681 682 683 684 685 686 687 688 689 690 691 692 693 694 695 696 697 698 699 700 701 702 703 704 705 706 707 708 709 710 711 712 713 714 715 716 717 718 719 720 721 722 723 724 725 726 727 728 729 730 731 732 733 734 735 736 737 738 739 740 741 742 743 744 745 746 747 748 749 750 751 752 753 754 755 756 757 758 759 760 761 762 763 764 765 766 767 768 769 770 771 772 773 774 775 776 777 778 779 780 781 782 783 784 785 786 787 788 789 790 791 792 793 794 795 796 797 798 799 800 801 802 803 804 805 806 807 808 809 810 811 812 813 814 815 816 817 818 819 820 821 822 823 824 825 826 827 828 829 830 831 832 833 834 835 836 837 838 839 840 841 842 843 844 845 846 847 848 849 850 851 852 853 854 855 856 857 858 859 860 861 862 863 864 865 866 867 868 869 870 871 872 873 874 875 876 877 878 879 880 881 882 883 884 885 886 887 888 889 890 891 892 893 894 895 896 897 898 899 900 901 902 903 904 905 906 907 908 909 910 911 912 913 914 915 916 917 918 919 920 921 922 923 924 925 926 927 928 929 930 931 932 933 934 935 936 937 938 939 940 941 942 943 944 945 946 947 948 949 950 951 952 953 954 955 956 957 958 959 960 961 962 963 964 965 966 967 968 969 970 971 972 973 974 975 976 977 978 979 980 981 982 983 984 985 986 987 988 989 990 991 992 993 994 995 996 997 998 999 1000 1001 1002 1003 1004 1005 1006 1007 1008 1009 1010 1011 1012 1013 1014 1015 1016 1017 1018 1019 1020 1021 1022 1023 1024 1025 1026 1027 1028 1029 1030 1031 1032 1033 1034 1035 1036 1037 103

10

T. 10 R. 3 S. 5
County Levi & Clark

MONTANA BUREAU OF MINES AND GEOLOGY
Butte, Montana

RECEIVED
JUN 4 1947

WATER WELL LOG

STATE ENGINEER

Owner Mrs. L. M. DeBorde Address Helena, Mont

Driller Walt - Riddick Address Helena

Date Started 1947 Date Completed 1947

Location: Sec. T. R. 1/4 sec.

Type of well drilled Equipment used
(Dug, driven, bored, or drilled) (Churn drill, rotary, other)

Water use: Domestic ☒ Municipal ☐ Stock ☐ Irrigation ☐

Industrial ☐ Drainage ☐ Other:

Casing: 60 ft. to ft. Type Steel Size 6"

Casing: ft. to ft. Type Size

Casing: ft. to ft. Type Size

Perforated or Screened: Ft. to ft. Ft. to ft.

Type of screen or perforations

Static Water level, for non-flowing well: 20 feet.

Shut-in pressure, for flowing well: lb./sq. in. on: (date)

Pumping water level 35 feet at 17 gal. per min.

How tested:

Length of test

Remarks: (Gravel packing, cementing, packers, type of shut-off, depth of shut-off)

Tract B in NW 1/4 NW 1/4 Sec. 5, Twp 10, Rge 3

(over)

127497

STATE OF MONTANA
COUNTY OF LEWIS & CLARK

I hereby certify that the within in-
strument was filed in my office on
this 7th day of Nov
A.D. 1961 at 25 min. past
10 o'clock AM.

Records of Lewis & Clark
County, State of Montana

Stelen L. Smith
County Recorder

By James O. Russell
Deputy

\$ 1.00

Log of Well

Description of Material Drilled

Depth, feet

To

From

File No.

T. 10 R. 3 W

DUPLICATE

County L & C

STATE OF MONTANA
ADMINISTRATOR OF GROUNDWATER CODE
OFFICE OF STATE ENGINEER

RECEIVED
DEC 26 1963

Declaration of Vested Groundwater Rights

(Under Chapter 237, Montana Session Laws, 1961)

STATE ENGINEER

1. Robert A. Ellis, of Route A Helena
(Name of Appropriator) (Address) (Town)

County of Lewis & Clark State of Montana
have appropriated groundwater according to the Montana laws in effect prior to January 1, 1962, as follows:

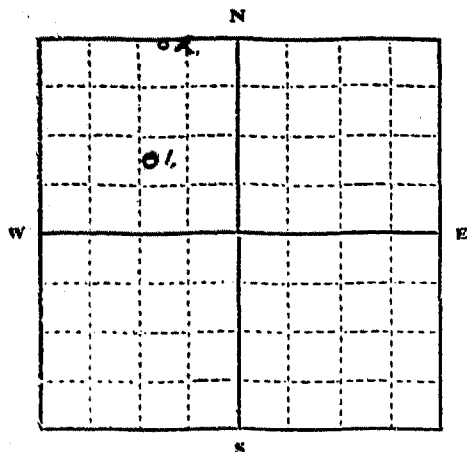

1/4 Sec. 5 T. 10 R. 3 W
Indicate point of appropriation
and place of use, if possible. Each
small square represents 10 acres.

2. The beneficial use on which the claim is based agriculture
(1) Irrigation (2) House well

3. Date or approximate date of earliest beneficial use; and how continu-
ous the use has been (1) 1922 (2) 1945

4. The amount of groundwater claimed (in miner's inches or gallons
per minute) 1200 inches

5. If used for irrigation, give the acreage and description of the lands
to which water has been applied and name of the owner thereof

6. The means of withdrawing such water from the ground and the loca-
tion of each well or other means of withdrawal Pump at
well head 1.2

7. The date of commencement and completion of the construction of the well, wells, or other works for with-
drawal of groundwater 1922

8. The depth of water table 12 ft

9. So far as it may be available, the type, size and depth of each well or the general specifications of any other
works for the withdrawal of groundwater 22 ft deep dug well cement
encased with 2.8 inch steel casing of unknown depth

10. The estimated amount of groundwater withdrawn each year unknown

11. The log of formations encountered in the drilling of each well if available unknown

12. Such other information of a similar nature as may be useful in carrying out the policy of this act, including
reference to book and page of any county record

Signature of Owner

Robert A. Ellis

Date Dec 17, 1963

Three copies to be filed by the owner with the County Clerk and Recorder of the county in which the well is located.

Please answer all questions. If not applicable, so state, otherwise the form will be returned.

Original to the County Clerk and Recorder; Duplicate to the State Engineer; Triplicate to the Montana Bureau of
Mines and Geology, and Quadruplicate for the Appropriator.

12257

151025

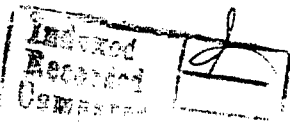

STATE OF MONTANA
COUNTY OF LEWIS & CLARK

I hereby certify that the within instrument was filed in my office on this 18 day of Dec A.D. 19 63 at 4:30 min. past 9 o'clock A.M.

Record of Lewis & Clark
County, State of Montana.

Selen Donich
County Recorder
Myrtle Liss
Deputy
209

RECORDED

INDEXED

File No.

MONTANA WATER RESOURCES BOARD
RECEIVEDT. 10 R. 3

DUPLICATE

County L. & C.

LOG

STATE OF MONTANA
ADMINISTRATOR OF GROUNDWATER CODE
STATE WATER CONSERVATION BOARD

Top of Ground

(Elev. above sea level)

**Notice of Completion of Groundwater
Appropriation by Means of Well**
DEVELOPED AFTER JANUARY 1, 1962

(Under Chapter 237 Montana Session Laws, 1961, as amended)

Open hole to 5'

Sand & gravel

Owner John W. Fredrick Address Helena, MontanaDriller Walter Riddick Address Helena, Montana

5' to 26' coarse gravel & sand

making water at 26'

Date of Notice of appropriation of groundwater January 1, 196026' to 39 ft clay and
gravel 39 to 42 sand
and gravel.Date well started Dec. 12, 1958 Date completed Dec. 19, 195842 to 44 coarse gravel
making 20 gal per min.Type of well Drilled Equipment used Churn Drill
(Dug, driven, bored or drilled) (Churn drill, rotary or other)Water use: Domestic ☒ Municipal ☐ Stock ☐ Irrigation ☐
Industrial ☐ Drainage ☐ Other ☐

Indicate on the diagram the character and thickness of the different strata met with in drilling, such as soil, clay, shale, gravel, rock or sand, etc. Show depth at which water is encountered, thickness and character of water-bearing strata and height to which the water rises in the well.

Size of Drilled Hole	Size and Weight of Casing	From (Feet)	To (Feet)	PERFORATIONS		
				Kind Size	From (Feet)	To (Feet)
6"	6" 17#	0	44'	None		

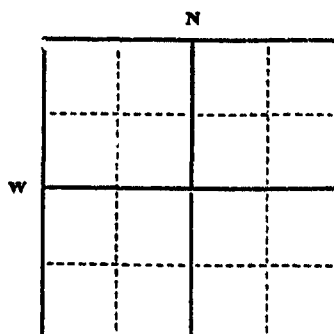
Static Water Level for non-flowing well
..... 18 feet.

Shut-in Pressure for Flowing Well.....

Pumping Water Level..... 25 feetat 20 gal. per minute.

Discharge in gal. per min. of flowing well

How Tested BailerLength of Test 2.1 hr.Remarks: (Gravel packing, cementing, pack-
ers, type of shutoff).....

Tract 5-B Puma Tract
1/4 Sec 5 T. 10 R. 3
 Indicate location of well and
 place of use, if possible. Each
 small square represents 40
 acres.

(Continue on reverse side)

USE—If used for irrigation, industrial, drainage or other. Explain, state
number of acres and location or other data (i.e.: Lot, Block and Addi-
tion).Show exact depth of bottom. 44'This form to be prepared by driller, and three copies to be filed by the owner with the
County Clerk and Recorder in the county in which the well is located, tissue copy to be
retained by driller.Please answer all questions. If not applicable, so state, otherwise the form will be
returned.Mont. No. 49
Driller's License NumberDriller's Signature
Walter Riddick
44,928

201771

Indexed
Recorded
Compared *L*

STATE OF MONTANA }
COUNTY OF LEWIS & CLARK } Ss

I hereby certify that the within in-
strument was filed in my office on
this 14 day of Jan
A.D. 1969 at 6 min. past
9 o'clock A.M.

Records of Lewis & Clark
County, State of Montana.
John Donich

County Recorder
by *C. Lyndes*
Deputy

200

File No. _____

DUPLICATE

T 10N R 3W
County L. & C

STATE OF MONTANA
ADMINISTRATOR OF GROUNDWATER CODE
OFFICE OF STATE ENGINEER

Declaration of Vested Groundwater Rights 15 1963

(Under Chapter 237, Montana Session Laws, 1961)

RECEIVED
STATE ENGINEER

1. Helena Gun Club of Helena
(Name of Appropriator) (Address) (Town)
County of Lewis and Clark State of Montana
have appropriated groundwater according to the Montana laws in effect prior to January 1, 1962, as follows:

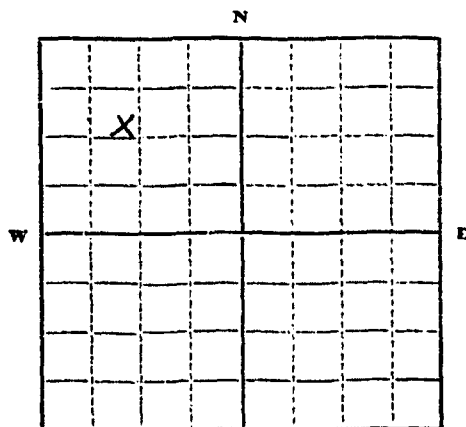

Indicate point of appropriation
and place of use, if possible.
Each small square represents 10
acres.

2. The beneficial use on which the claim is based is irrigation and domestic use.
3. Date or approximate date of earliest beneficial use; and how continuous the use has been: Began in the year 1950 and has been continuous ever since.
4. The amount of groundwater claimed (in miner's inches or gallons per minute) is 25 miner's inches.
5. If used for irrigation, give the acreage and description of the lands to which water has been applied and name of the owner thereof: The land is the South Half of the Northwest Quarter, Section 5, Township Ten (10) North, Range Three (3) West.
6. The means of withdrawing such water from the ground and the location of each well or other means of withdrawal is an electric pump.
7. The date of commencement and completion of the construction of the well, wells, or other works for withdrawal of groundwater was 1950.
8. The depth of water table is 55 feet.
9. So far as it may be available, the type, size and depth of each well or the general specifications of any other works for the withdrawal of groundwater is a 7-inch casing with a high pressure electric pump, which does not ever pump the well dry.
10. The estimated amount of groundwater withdrawn each year is variable.
11. The log of formations encountered in the drilling of each well if available is none available.
12. Such other information of a similar nature as may be useful in carrying out the policy of this act, including reference to book and page of any county record: none available.

John Delano
Sec

Helena Gun Club, a corporation

Signature of Owner By: *J. A. Eaton*Date: *7/10/63*

Three copies to be filed by the owner with the County Clerk and Recorder of the county in which the well is located.

Please answer all questions. If not applicable, so state, otherwise the form will be returned.

Original to the County Clerk and Recorder; duplicate to the State Engineer; Triplicate to the Montana Bureau of Mines and Geology, and Quadruplicate for the Appropriator.

5061

RECORDED
COMPARED

145913

STATE OF MONTANA
COUNTY OF LEWIS & CLARK

I hereby certify that the within in-
strument was filed in my office on
this 12th day of July
A.D. 1963 at 2:51 pm just
before 2 o'clock P.M.

Records of Lewis & Clark
County, State of Montana

John L. Donich
County Recorder
By Lawrence C. Russell
Deputy

2:00

RECORDED
INDEXED
JUL 15 1963

RECEIVED

SEP 04 1990

10 N 4 W No SECTION

049 T10N R4W-100

County Deer & Clark

STATE PUBLISHED BY GW 1 Revised 1969

MONT. DEPT. OF NATURAL
RESOURCES & CONSERVATION
ADMINISTRATOR OF GROUNDWATER CODE
MONTANA WATER RESOURCES BOARD

JUN 14 1971

NOTICE OF COMPLETION OF GROUNDWATER
APPROPRIATION BY MEANS OF WELL

Developed after January 1, 1962

(Under Chapter 237 Montana Session Laws, 1961, as amended)

This form to be prepared by driller, and three copies to be filed by the owner with the County Clerk and Recorder in the county in which the well is located, last copy to be retained by driller. Please answer all questions. If not applicable, so state, otherwise the form may be returned.

Owner Emma Hargrave

Address 785 Helena Ave

Butte

Date well started Mar. 16, 1971

completed Mar. 19, 1971

For Administrator's Use

File

GW 1

Type of well drilled

(Dig, driven, bored or drilled)

Equipment used churn drill

(Churn drill, rotary or other)

Water Use: Domestic ☒ Municipal ☐ Stock ☐ Irrigation ☐

Industrial ☐ Drainage ☐ Other ☐ Garden/Lawn ☐

*Describe

USE: If used for irrigation, industrial, drainage or other. Explain, state number of acres and location or other data (i.e. Lot, Block and Addition).

ESTIMATED ANNUAL WITHDRAWAL

Size of Drilled Well	Size and Weight of Casing	From (Feet)	To (Feet)	PERFORATIONS
6"	65/8" O.D. 17 lb.	0	54	
6"	53/20" O.D. 15 lb.	54'6"	64'	5" liner per forated with torch

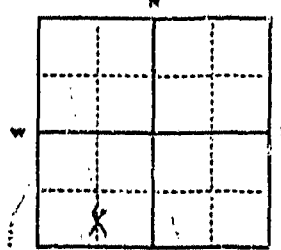

Static water level 31 ft.
Pumping water level 38 ft.
at 5 gallons per minute,
measured 5 minutes after pumping
began.
*Measured from ground level.
Well developed by baller
for 3 hours.
Power 3 Pump HP
Remarks: (Gravel packing, cementing,
packers, type of shut-off)

INDICATE LOCATION OF WELL AND PLACE OF USE, IF POSSIBLE.
EACH SMALL SQUARE REPRESENTS 40 ACRES.

Driller's Signature Robert Price

Driller's Address Clancy Mont

LICENSE NO. 121

DRILLER'S

039925

Indicate the charac
ness of strata such as sand, gravel,
gravel, shale, sandstone, etc. Show
depth at which water is found and
height to which water rises in well.

Top of Ground

(Elev. above sea level) 3980

From (Feet)	To (Feet)	
0	29	loose gravel with sand soil
10	29	very tight coarse clay bound gravel
29	33	tight gravel with gray lime stone like clay
33	64	blocky fractured limestone, very tight at 64'
52		start making water
55	56	water approx. 2-3 G.P.M.
59	61	water approx. 2-3 G.P.M.

113' - 115' MT
400' HEL II

64 Show exact depth of bottom

217839

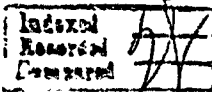

STATE OF MONTANA
COUNTY OF LEWIS & CLARK

I hereby certify that the within in-
strument was filed in my office on
the 17 day of June
A.D. 19 17 at 10 min. past
10 o'clock A.M.

Records of Lewis & Clark
County, State of Montana

John J. Smith
County Recorder
John J. Smith
Deputy
L. C.