

File No.

T. 27 R. 28

DUPLICATE

County LINCOLN

STATE OF MONTANA
ADMINISTRATOR OF GROUNDWATER CODE
OFFICE OF STATE ENGINEER

JAN 27 1964

Declaration of Vested Groundwater Rights

(Under Chapter 237, Montana Session Laws, 1961)

1. LORNE W OR LUCILLE W. BOYARD, of 401 MINERAL AVE LIBBY
(Name of Appropriator) (Address) (Town)

County of LINCOLN State of MONTANA
have appropriated groundwater according to the Montana laws in effect prior to January 1, 1962, as follows:

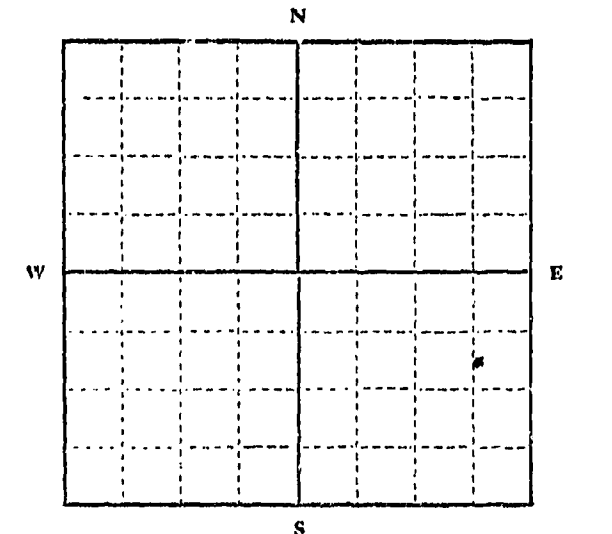

SE 1/4 Sec 24 T. 27 R. 28

Indicate point of appropriation and place of use, if possible. Each small square represents 10 acres.

2. The beneficial use on which the claim is based.....
DOMESTIC USE

3. Date or approximate date of earliest beneficial use; and how continuous the use has been.....
1955 - SIX MONTHS
EACH YEAR

4. The amount of groundwater claimed (in miner's inches or gallons per minute).....
LOT-3 - 30 GALLONS PER MINUTE
LOT-4 - 10 GALLONS PER MINUTE

5. If used for irrigation, give the acreage and description of the lands to which water has been applied and name of the owner thereof.....
NOT APPLICABLE

6. The means of withdrawing such water from the ground and the location of each well or other means of withdrawal.....
WELL - WITH PRESSURE TANK AND PUMP

7. The date of commencement and completion of the construction of the well, wells, or other works for withdrawal of groundwater.....
1955 SAME

8. The depth of water table.....
31 FT

9. So far as it may be available, the type, size and depth of each well or the general specifications of any other works for the withdrawal of groundwater.....
LOT 4 OF LOT 6 HAGGYS LAND - 2 IN CASING 31 FT DEEP
LOT 3 OF LOT 6 HAGGYS LAND - 6 IN CASING 26 FT DEEP

10. The estimated amount of groundwater withdrawn each year.....
DOMESTIC USE FOR TWO CABINS

11. The log of formations encountered in the drilling of each well if available.....
2 IN CASING ROCK - CLAY - SAND
6 IN CASING - SAND

12. Such other information of a similar nature as may be useful in carrying out the policy of this act, including reference to book and page of any county record.....
PLAT 269 BOOK 106 - PAGE 401

Signature of Owner Lorne W. Boyard - Lucille Boyard
Date Dec 12 - 1963

Three copies to be filed by the owner with the County Clerk and Recorder of the county in which the well is located.

Please answer all questions. If not applicable, so state, otherwise the form will be returned.

Original to the County Clerk and Recorder; duplicate to the State Engineer; Triplicate to the Montana Bureau of Mines and Geology, and Quadruplicate for the Appropriator.

204

[Faint stamp]

STATE OF MONTANA
COUNTY OF LINCOLN

Filed this 19th day of

December A. D. 1915

at 3:05 P. M.

By W. J. Mansfield County Clerk

W. H. Watson Deputy

18

GW3

File No.....

T. 27N R. 27W

~~ORIGINAL~~ Duplicate

County Lincoln

STATE OF MONTANA
ADMINISTRATOR OF GROUNDWATER CODE
OFFICE OF STATE ENGINEER

RECEIVED
DEC 19 1963

STATE ENGINEER

Notice of Completion of Groundwater Appropriation Without Well

(Under Chapter 237 Montana Session Laws, 1961)

Date of Appropriation of Groundwater Oct. 1, 1963
Northern Pacific Railway N. P. Building
Owner Company Address St. Paul, Minnesota

Contractor (if any)

Address of Contractor

Date Started..... Date Completed Oct. 1, 1963

Describe means of obtaining groundwater without a well "as by sub-irrigation and other natural processes". Include depth to water when applicable. Gravity flow through a 3/4 inch pipeline from a fifty gallon barrel used as a catchment basin.

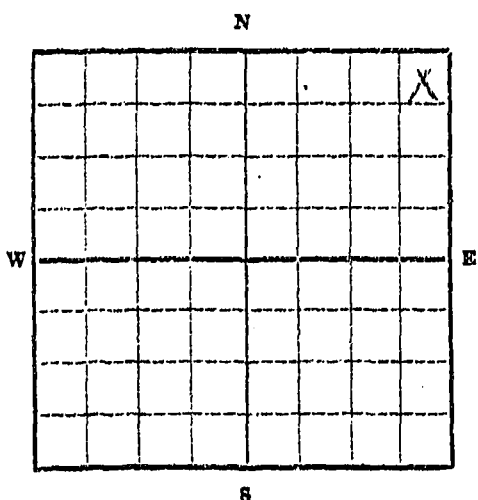

NE 1/4 Sec. 16 T. 27N R. 27W
Indicate point of appropriation and place of use, if possible.

Quantity of water developed and used with explanation of method used to measure or estimate such amount. If use is intermittent estimate approximate lengths of periods of use 3 minutes inches used continuously year round. Quantity estimate based on the amount that will flow through pipe and on measurements on overflow channel.

Signature of Owner Northern Pacific Railway Company
By Donald D. W. [Signature]
Date Dec. 12, 1963

This form to be prepared by contractor (if any), otherwise by the owner.

Three copies of this notice are to be filed with the County Clerk and Recorder of the county in which the works are located.

Please answer all questions. If not applicable, so state, otherwise the form will be returned.

Original to the County Clerk and Recorder; duplicate to the State Engineer; Triplicate to the School of Mines and Quadruplicate for the Appropriator.

10381

179

STATE OF MONTANA
COUNTY OF LINCOLN

Filed this 12th day of
December A. D. 1963
at 4:25 P. M.
M. M. Mansfield
County Clerk
By Mac Wilson,
Deputy

File No. _____

1227 N. 11th St. H

DUPLICATE

STATE OF MONTANA
ADMINISTRATOR OF GROUNDWATER CONTROL
OFFICE OF STATE ENGINEERS

Notice of Completion of Groundwater
Appropriation by Means of Well

(Under Chapter 237, Montana Fluvial Law, 1961)

Owner Al Witthof Address Libby Mont.

Driller C/L Plumbing Address Libby Mont.

Date of Notice of Appropriation of Groundwater _____

Date well started Jan 1st Area Contained 3.6

Type of well Drilled Depth 111
(log, strata, found in casing) (feet, rods, variety of feet)

Water Use: Domestic Irrigation
Industrial Stock

ES indicate on the diagram the character and thickness of each strata met with in drilling, such as silt, clay, shale, gravel, etc. and the depth at which water is encountered. Indicate the nature of the water and height to which water rises in the well.

Top of Ground
(Elev. above sea level.....)

Sand & gravel

Clay 17

Silt 31

fine sand & water 40

Size of Inch Diameter	Flow and Capacity GPM	Flow Rate	to Foot	HYDROLOGICAL		
				Area Sq. Ft.	Flow GPM	% Flow
<u>5 7/8</u>	<u>5 7/8</u>	<u>0</u>	<u>40</u>	<u>16</u>	<u>34</u>	<u>40</u>

Static Water Level for non-pumping Well 20 ft.

Static Pressure for Pumping Well _____

Flowing Water Level 35 ft.

Flowing Pressure for Pumping Well _____

Flowing Rate 10 GPM

Flowing Pressure for Pumping Well _____

Flowing Rate 10 GPM

Flowing Pressure for Pumping Well _____

EXPLANATION OF WELL LOG
INDICATING CHARACTER OF STRATA
ENCOUNTERED IN DRILLING AND
DEPTH AT WHICH WATER IS
ENCOUNTERED.

[Handwritten signatures]

This notice is a statement of the completion of a well for the purpose of appropriating groundwater...
The well is located in the _____
The well is owned by _____
The well is drilled by _____
The well is completed on _____

File No.

T27N R. 27W

DUPLICATE

County Lincoln

STATE OF MONTANA
ADMINISTRATOR OF GROUNDWATER CODE
OFFICE OF STATE ENGINEER

MAR 5 1964

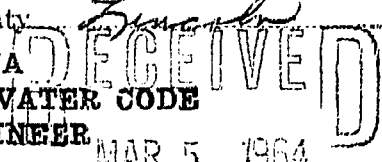

Notice of Completion of Groundwater Appropriation by Means of Well

(Under Chapter 237, Montana Session Laws, 1961)

Owner Al. Uithof Address Libby Mont.

Driller C. H. Plumbing Address Libby Mont.

Date of Notice of Appropriation of Groundwater

Date well started 8-1-62 Date Completed 8-6-62

Type of well Drilled Equipment Used Churn
(dug, driven, bored or drilled) (Churn, drill, rotary or other)

Water Use: Domestic Municipal Other Irrigation
Industrial Drainage Stock

Indicate on the diagram the character and thickness of the different strata met with in drilling, such as soil, clay, shale, gravel, rock or sand, etc. Show depth at which water is encountered, thickness and character of water-bearing strata and height to which water rises in the well.

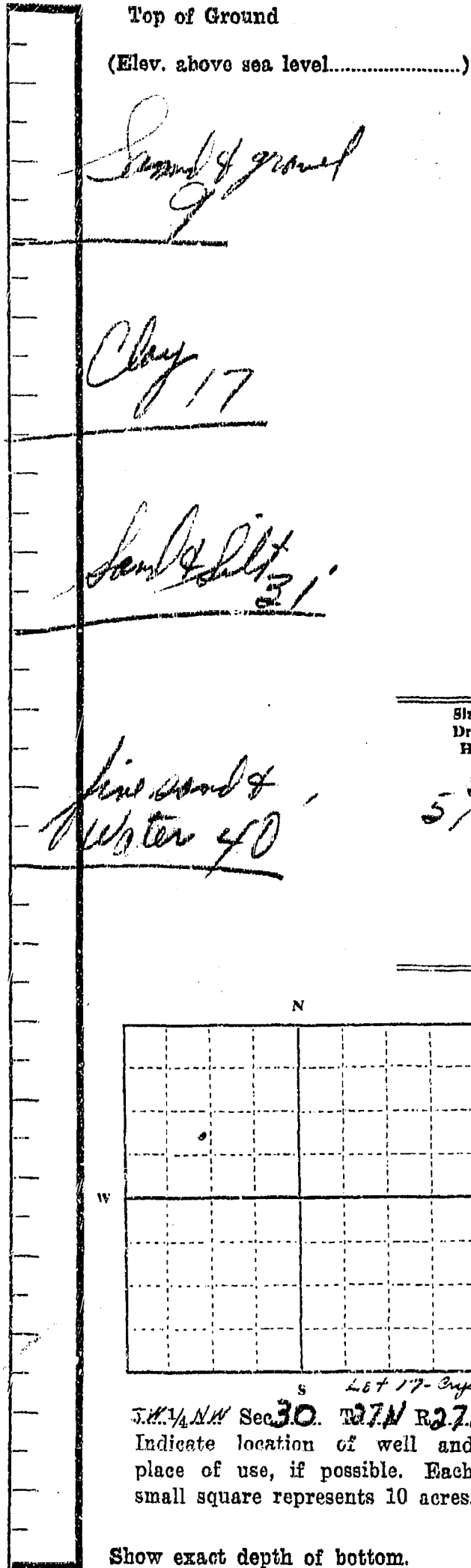

Size of Drilled Hole	Size and Weight of Casing	From (Feet)	To (Feet)	PERFORATIONS		
				Kind Size	From (Feet)	To (Feet)
<u>5 5/8</u>	<u>5 5/8</u> <u>18#</u>	<u>0</u>	<u>40</u>	<u>1/2" Round</u>	<u>34</u>	<u>40</u>

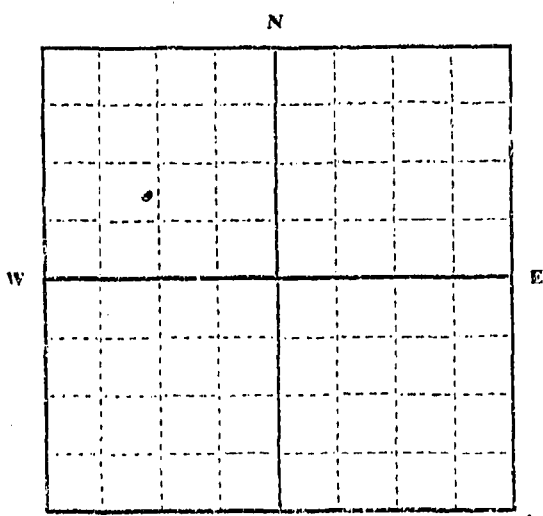

Section 30 T27N R27W
Indicate location of well and place of use, if possible. Each small square represents 10 acres.

Static Water Level for non-flowing Well 20 feet.
Shut-in Pressure for Flowing Well

Pumping Water Level 35 feet at 6 gal. per minute.
Discharge in gal. per min. of flowing well

How Tested Pump Length of Test 12 hrs.
Remarks: (Gravel packing, cementing, packers, type of shutoff, location of place of use of groundwater if not at well, and any other similar pertinent information, including number of acres irrigated, if used for irrigation)

Driller's License Number 141
Driller's Signature Clifford Bunker

This form to be prepared by driller, and three copies to be filed by the owner with the County Clerk and Recorder in the county in which the well is located.

Please answer all questions. If not applicable, so state, otherwise the form will be returned.

Original to the County Clerk and Recorder; duplicate to the State Engineer; Triplicate to the Montana Bureau of Mines and Geology and Quadruplicate for the Appropriator.

344

IN

STATE OF MONTANA
COUNTY OF LINCOLN

Filed this 31st day of

December A. D. 1927

at 9:40 a.m.
M. M. Mansfield
County Clerk

By Verden Light
Deputy

File No. MONTANA WATER RESOURCES BOARD

T. 27 N. R. 27 W

DUPLICATE

RECEIVED

County Lincoln

LOG NOV 24 1971

STATE OF MONTANA ADMINISTRATOR OF GROUNDWATER CODE OFFICE OF STATE ENGINEER

Notice of Completion of Groundwater Appropriation by Means of Well DEVELOPED AFTER JANUARY 1, 1962

(Under Chapter 237, Montana Session Laws, 1961)

Owner Fred H. Maurer and Viola M. Maurer Star Route 1 Libby, Montana

Driller Owners Address Above

Date of Notice of appropriation of groundwater June 16, 1970

Date well started June 14, 1970 Date completed June 16, 1970

Type of well Driven Equipment used Driver (Dug, Driven, bored or drilled) (Churn drill, rotary or other)

Water use: Domestic [X] Municipal [] Stock [] Irrigation [] Industrial [] Drainage [] Other []

Indicate on the diagram the character and thickness of the different strata met with in drilling, such as soil, clay, shale, gravel, rock or sand, etc. Show depth at which water is encountered, thickness and character of water-bearing strata and height to which the water rises in the well.

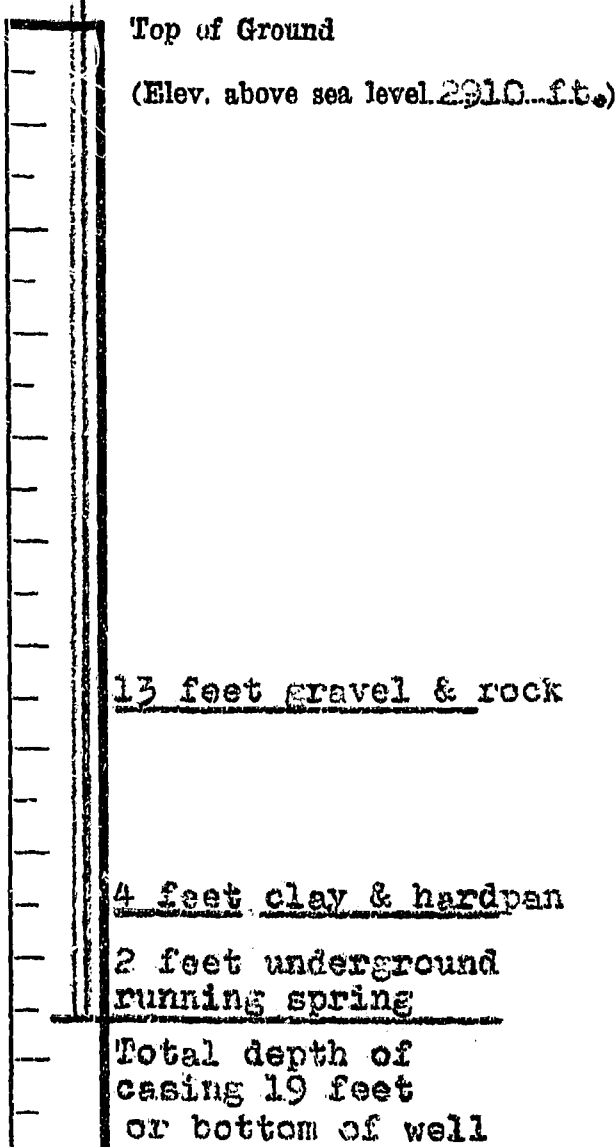
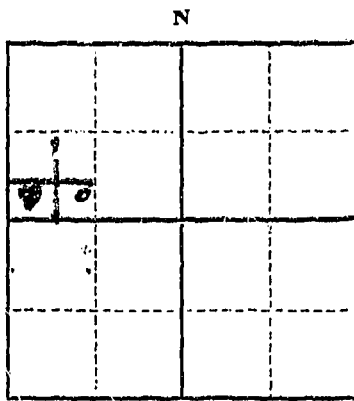

Table with columns: Size of Drilled Hole, Size and Weight of Casing, From (Feet), To (Feet), PERFORATIONS (Kind Size, From (Feet), To (Feet)). Data: 2 inch, 2 inch, 0 feet, 19 ft., 1/2 inch, 15 ft, 19 ft.

Doc. No. 814 Filed for record this 22 day of Nov. A.D. 1971 at 11:00 o'clock A.M.



SE 1/4, SW 1/4, SW 1/4 of Sec. 30, T. 27 N. R. 27 W. Indicate location of well and place of use, if possible. Each small square represents 40 acres.

Static Water Level for non-flowing well 12 feet. Shut-in Pressure for Flowing Well. Pumping Water Level 12 to 19 feet at 76 gal. per minute. Discharge in gal. per min. of flowing well. How Tested Pressure pump. Length of Test 12 hours.

Remarks: (Gravel packing, cementing, packers, type of shutoff) Pressure gauge with shut off at 47 pounds. Lot 19 of Crystal Lake Shore Lots in the SE 1/4, SW 1/4, NW 1/4 of Sec. 30, TWP. 27 North of Range 27 West, E.P.M. (Continue on reverse side)

USE—If used for irrigation, industrial, drainage or other. Explain, state number of acres and location or other data (i.e.: Lot, Block and Addition).

Show exact depth of bottom.

This form to be prepared by driller, and three copies to be filed by the owner with the County Clerk and Recorder in the county in which the well is located, tissue copy to be retained by driller.

Please answer all questions. If not applicable, so state, otherwise the form will be returned. Owner's

Signatures of Fred H. Maurer and Viola M. Maurer. Driller's Signatures

49462

814 INDEXED

STATE OF MONTANA
COUNTY OF LINCOLN

Filed this 2nd day of November 1911

at 11:00 o'clock A.M.
Charles L. Houghton
County Clerk.

By _____ Deputy

THE REGISTER OF DEEDS
COUNTY OF LINCOLN

RECORDED
INDEXED
BY _____

File No. **RECEIVED**

T. 26 R. 30

DUPLICATE

AUG 27 1971

County LINCOLN

STATE OF MONTANA
ADMINISTRATOR OF GROUNDWATER CODE
OFFICE OF STATE ENGINEER

**Notice of Completion of Groundwater Appropriation
Without Well**

Doc. No. 793 (Under Chapter 237 Montana Session Laws, 1961)

Filed for record
this 25 day of August

A. D. 19 71, at 11:45
o'clock A M.

Date of Appropriation of Groundwater 25 AUG 71

Owner R.J. Chapman Address W. Fisher Road

Contractor (if any)

Address of Contractor

Date Started..... Date Completed.....

Describe means of obtaining groundwater without a well "as by sub-irrigation and other natural processes". Include depth to water when applicable.....

Natural Flowing Spring

Quantity of water developed and used with explanation of method used to measure or estimate such amount. If use is intermittent

estimate approximate lengths of periods of use.....

In Process of Development

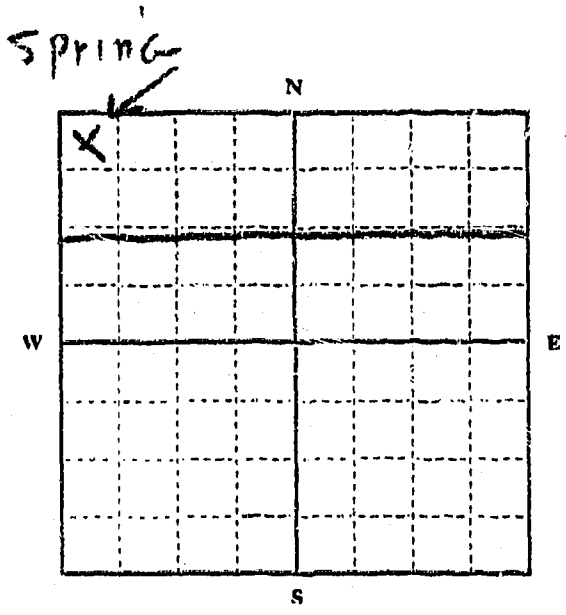

1/4 Sec. 9 T. 26 R. 30

Indicate point of appropriation and place of use, if possible.

North Half of the
North Half

Signature of Owner Robert J. Chapman

Date 25 AUG 71

This form to be prepared by contractor (if any), otherwise by the owner.

Three copies of this notice are to be filed with the County Clerk and Recorder of the county in which the works are located.

Please answer all questions. If not applicable, so state, otherwise the form will be returned.

Original to the County Clerk and Recorder; duplicate to the State Engineer; Triplicate to the Montana Bureau of Mines and Geology and Quadruplicate for the Appropriator.

48954

#793

MONTANA WATER RESOURCES BOARD
R E C E I V E D
AUG 27 1971

STATE OF MONTANA
COUNTY OF LINCOLN
Filed this 25th day of
August A.D. 1971
at 11:45 A.M.
Leopold L. Dargatzis
County Clerk
By Betty Standaeker Deputy

T. 26 N R. 29 W

County Lincoln

RECEIVED
MAR 10 1958

MONTANA BUREAU OF MINES AND GEOLOGY
Butte, Montana

STATE ENGINEER

WATER WELL LOG

Owner U. S. Forest Service Address Libby, Mont.

Driller Art Ottenbacher Address Kalispell, Mont.

Date Started June 1953 Date Completed June 1953

Location: Sec. 2 T. 26 N R. 29 W 1/4 sec. NE

Type of well drilled Equipment used churn
(Dug, driven, bored, or drilled) (Churn drill, rotary, other)

Water use: Domestic Municipal Stock Irrigation
Industrial Drainage Other: _____

Casing: 1 ft. to 107 ft. Type Std. steel pipe Size 6" I.D.

Casing: _____ ft. to _____ ft. Type _____ Size _____

Casing: _____ ft. to _____ ft. Type _____ Size _____

Perforated or Screened: Ft. _____ to ft. _____ Ft. _____ to ft. _____

Type of screen or perforations none

Static Water level, for non-flowing well: (60 ft. from surface) 47 feet.

Shut-in pressure, for flowing well: _____ lb./sq. in. on: _____ (date)

Pumping water level 44 feet at 847 gal. per min. 60

How tested: bailing

Length of test: one hour

Remarks: (Gravel packing, cementing, packers, type of shut-off, depth of shut-off)

(over)

File No. B-51-Page 595-596 T 26N R 27W

ORIGINAL Lincoln Co. Montana County Lincoln

STATE OF MONTANA
ADMINISTRATOR OF GROUNDWATER CODE
OFFICE OF STATE ENGINEER

DECLARATION OF VESTED GROUNDWATER RIGHTS
(Under Chapter 237, Montana Session Laws, 1961)

1. United States of America Raven Ranger Station
(Name of Appropriator) Libby, Montana (Address) (Town)

County of Lincoln State of Montana
have appropriated groundwater according to the Montana laws in effect prior to January 1, 1962, as follows:

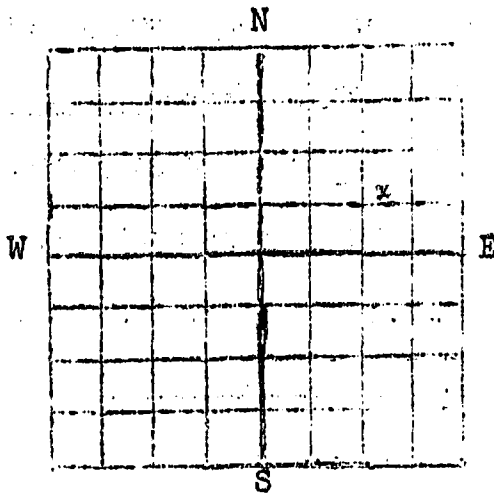

Sec. 2 T26 R27
Indicate point of appropriation and place of use, if possible. Each small square represents 10 acres.

- 2. The beneficial use on which the claim is based Domestic and Irrigation - residents at the Raven Ranger Station
- 3. Date or approximate date of earliest beneficial use; and how continuous the use has been The use has been continuous since 1933.
- 4. The amount of groundwater claimed (in miner's inches or gallons per minute) 50 gal. per min. max. 3/4 gal. per min. average use 3/4 gal. per min. average use.
- 5. If used for irrigation, give the acreage and description of the lands to which water has been applied and name of the owner thereof Not used for irrigation
- 6. The means of withdrawing such water from the ground and the location of each well or other means of withdrawal Well which is located in ~~Sec~~ Section 2, T26N, R27W

- 7. The date of commencement and completion of the construction of the well, wells, or other works for withdrawal of groundwater. Well was drilled in 1932. Used continuously since.
- 8. The depth of water table Unknown
- 9. So far as it may be available, the type, size and depth of each well or the general specifications of any other works for the withdrawal of groundwater Well drilled is 110 feet deep with 6" casing 60' of water. Pump on well is 3 HP Heric Ejector pump.
- 10. The estimated amount of groundwater withdrawn each year 400,000 gallons.
- 11. The log of formations encountered in the drilling of each well if available Not available. Last 16 feet of well is water bearing sand gravel.
- 12. Such other information of a similar nature as may be useful in carrying out the policy of this act, including reference to book and page of any county record Recorded Lincoln County, Libby, Montana Book 51 Page 595, 596

J. Henderson Act. Forest Supervisor
Signature of Owner Kootenai National Forest
Libby, Montana
Date 3-5-62

1701

Three copies to be filed by the owner with the County Clerk and Recorder of the county in which the well is located.

Please answer all questions. If not applicable, so state, otherwise the form will be returned.

Original to the County Clerk and Recorder; duplicate to the State Engineer; Triplicate to the School of Mines and Quadruplicate for the Appropriator.

STATE OF MONTANA

County of Lincoln ss.

J.E. Sanderson representing the United States

having first been duly sworn, depose

and say that he is of lawful age and represents the

appropriator and claimant of the order and water right mentioned

in the foregoing declaration of vested groundwater rights and the person

whose name is subscribed thereto, as the appropriator and claimant

that he know the contents of said foregoing notice and

that the matters and things therein stated are true.

J. Sanderson

At Forest Supervisor

Kootenai National Forest

Libby, Montana

Subscribed and sworn to before me, this 6 day of March, 19 62

Notary Public for the State of Montana

Residing at Libby, Montana

My Commission expires July 6, 19 62

925

STATE OF MONTANA
COUNTY OF LINCOLN

Filed this 13th day of Feb. A. D. 1973
at 1:45 P.M.
Billings, Montana
County Clerk
By Wanda L. Hylton
Deputy

File No.

T. 26 R. 29

DUPLICATE

County Lincoln

LOG

RECEIVED
APR 21 1969
STATE WATER CONSERVATION BOARD

STATE OF MONTANA
ADMINISTRATOR OF GROUNDWATER CODE
STATE WATER CONSERVATION BOARD



Top of Ground
(Elev. above sea level 3000)

Notice of Completion of Groundwater Appropriation by Means of Well

DEVELOPED AFTER JANUARY 1, 1962

(Under Chapter 227 Montana Session Laws, 1961, as amended)

- 0' - 1' Topsoil.
- 1' - 6' Clay.
- 6' - 24' Sand and Water.
- 24' - 98' Silty Clay.
- 98' - 112' Sandy Silt.
- 112' - 136' Silty Clay.
- 136' - 137' Gravel, Water, and Silt.
- 137' - 139' Silt.
- 139' - 143' Sand and Gravel, with Water.

Owner George F. & Helen D. House Address Box 127, Bigfork, Mont. 59911

Driller William D. Lake Address Libby, Montana

Date of Notice of appropriation of groundwater.....

Date well started April 21, 1969 Date completed April 24, 1969

Type of well Drilled Equipment used Churn
(Dug, driven, bored or drilled) (Churn drill, rotary or other)

Water use: Domestic Municipal Stock Irrigation
Industrial Drainage Other

Indicate on the diagram the character and thickness of the different strata met with in drilling, such as soil, clay, shale, gravel, rock or sand, etc. Show depth at which water is encountered, thickness and character of water-bearing strata and height to which the water rises in the well.

Size of Drilled Hole	Size and Weight of Casing	From (Feet)	To (Feet)	PERFORATIONS		
				Kind Size	From (Feet)	To (Feet)
6" I.D.	6 5/8" O.D. 17.00 lbs. per foot	0	143		none	

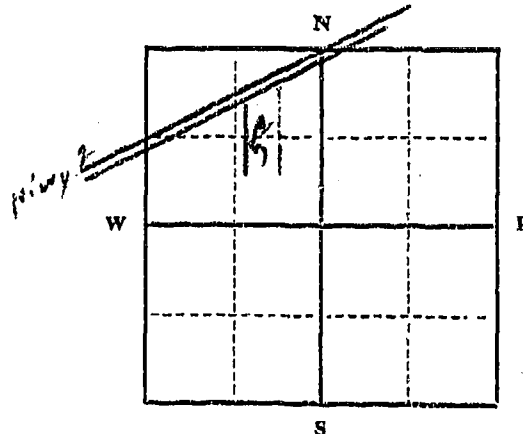

Lot 5

N. 1/4 Sec. 10 T. 26 R. 29
Indicate location of well and place of use, if possible. Each small square represents 40 acres.

Static Water Level for non-flowing well 1' feet.

Shut-in Pressure for Flowing Well.....

Pumping Water Level 3' 6" feet at 15 gal. per minute.

Discharge in gal. per min. of flowing well.....

How Tested Pump

Length of Test 4 hours

Remarks: (Gravel packing, cementing, packers, type of shutoff).....

(Continue on reverse side)

USE—If used for irrigation, industrial, drainage or other. Explain, state number of acres and location or other data (i.e.: Lot, Block and Addition).

Show exact depth of bottom.

This form to be prepared by driller, and three copies to be filed by the owner with the County Clerk and Recorder in the county in which the well is located, tissue copy to be retained by driller.

Please answer all questions. If not applicable, so state, otherwise the form will be returned.

152
Driller's License Number

William D. Lake
Driller's Signature.

45,244

INDEXED

687

STATE OF MONTANA
COUNTY OF LINCOLN

Filed this 16th day of

A. D. 1969

at 11:45 A.M.

Edward L. Douglas
County Clerk.

By Max Watson Deputy

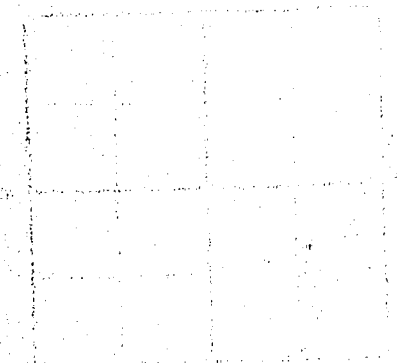

[Faint, mostly illegible text, possibly a list or ledger entries]

RECEIVED

JUN 20 1972

GW 3

File No.

MONTANA DEPARTMENT OF NATURAL
RESOURCES AND CONSERVATION

T. R.
County Lincoln

STATE OF MONTANA
ADMINISTRATOR OF GROUNDWATER CODE
OFFICE OF STATE ENGINEER

Notice of Completion of Groundwater Appropriation
Without Well

(Under Chapter 237 Montana Session Laws, 1961)

Date of Appropriation of Groundwater July 20-71

Owner Malrose Co. Address Star Rt. #1 Libby

Contractor (if any) Self

Address of Contractor Star Rt. #1 Libby, Mont.

Date Started July 20-71

Date Completed July 25-71

Describe means of obtaining groundwater without a well "as by
sub-irrigation and other natural processes". Include depth to
water when applicable. 5 feet. a cedar

cistern set in a natural
spring.

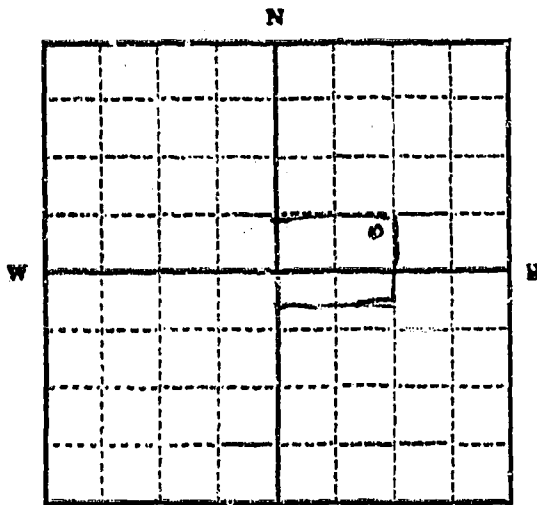

NE 1/4
S.E. 1/4 SW 1/4 Sec. 18 T26N R29W

Indicate point of appropriation
and place of use, if possible.

Quantity of water developed and used with explanation of method
used to measure or estimate such amount. If use is intermittent

estimate approximate lengths of periods of use 1 1/2 inch

plastic pipe carries a
constant flow and is
used year around for
domestic purposes

Signature of Owner Malrose Co.

Date June 16 - 1972

This form to be prepared by contractor (if any), otherwise by the owner.

Three copies of this notice are to be filed with the County Clerk and Recorder of the county in which the works are located.

Please answer all questions. If not applicable, so state, otherwise the form will be returned.

Original to the County Clerk and Recorder; duplicate to the State Engineer; Triplicate to the Montana Bureau of Mines and Geology and Quadruplicate for the Appropriator.

Doc. No. #878
Filed for record
this 16th day of June
A. D. 19 72, at 10:00
o'clock A M.

50,640

878

STATE OF MONTANA
COUNTY OF LINCOLN

Filed this 16th day of June A. D. 1922

at 10:00 AM Helena County Clerk

By Betty Thacker Deputy

sub-irrigation and other natural processes". Include depth to water when applicable 5 feet. as per
location set in a natural
spring
This spring runs 1 gal every 3 min into
a 300 gal reserve tank for domestic use.

Quantity of water developed and used with explanation of method used to measure or estimate such amount. If use is intermittent estimate approximate lengths of periods of use.

SEE PAGE 2

Department of Natural Resources and Conservation
 Water Resources Division
 Engineering Bureau
 Groundwater Section
 Sam W. Mitchell Building
 Helena, Montana 59601

Owner Dalores Oens
 Address Star Route #1 - Libby 59923
 Location T. 26N R. 29W Sec. 18
 Doc. No. _____

As the Administrator of the Groundwater Code for the State of Montana, please take note of the following special instructions, in order to properly protect your groundwater right.

Special Instructions:

Please provide, as indicated in red on the attached form, the amount of spring water claimed for beneficial use in gallons per minute or miner's inches.

Thank you.

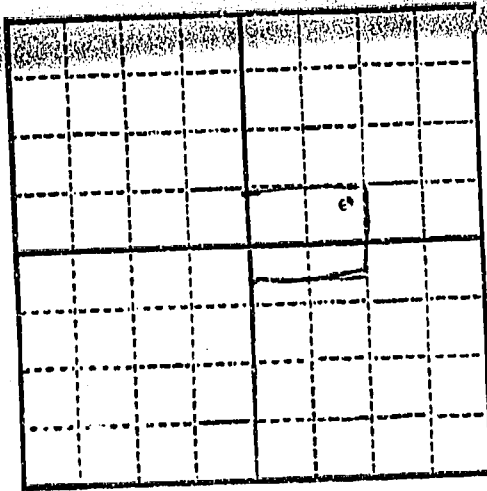

SE 1/4 Sec. 18 T. 26N R. 29W
 Indicate point of appropriation and place of use, if possible.

Means of obtaining groundwater without a well, as by subsirrigation and other natural processes. Include depth to water when applicable. 5 feet. a cedar

system set in a natural spring.
This spring runs 1 gal every 3 min into a 300 gal reserve tank for domestic use.

Quantity of water developed and used with explanation of method used to measure or estimate such amount. If use is intermittent

estimate approximate lengths of periods of use. 1 1/2 inch
plastic pipe carries a
constant flow and is
used year around for
domestic purposes

Signature of Owner Dalores Oens
 Date June 16, 1972

This form to be prepared by contractor (if any), otherwise by the owner.

Three copies of this notice are to be filed with the County Clerk and Recorder of the county in which the works are located.

Please answer all questions. If not applicable, so state, otherwise the form will be returned.

Original to the County Clerk and Recorder; duplicate to the State Engineer; Triplicate to the Montana Bureau of Mines and Geology and Quadruplicate for the Appropriator.

Doc. No. #878
 Filed for record
 this 16th day of June
 A. D. 19 72, at 10:00
 o'clock A. M.

50,640

JUN 20 1972

MONTANA DEPARTMENT OF NATURAL RESOURCES AND CONSERVATION T. R. County Lincoln

STATE OF MONTANA ADMINISTRATOR OF GROUNDWATER CODE OFFICE OF STATE ENGINEER

Notice of Completion of Groundwater Appropriation Without Well

(Under Chapter 237 Montana Session Laws, 1961)

Date of Appropriation of Groundwater July 20-71
Owner Alford C. ... Address St. Rt. #1 Libby
Contractor (any) Self
Address of Contractor St. Rt. #1 Libby, Mont.
Date Started July 20-71 Date Completed July 25-71

Describe means of obtaining groundwater without a well "as by sub-irrigation and other natural processes". Include depth to water when applicable. 5 feet in a center system set in a natural spring
This spring runs 1 gal every 3 min into a 300 gal reserve tank for domestic use.

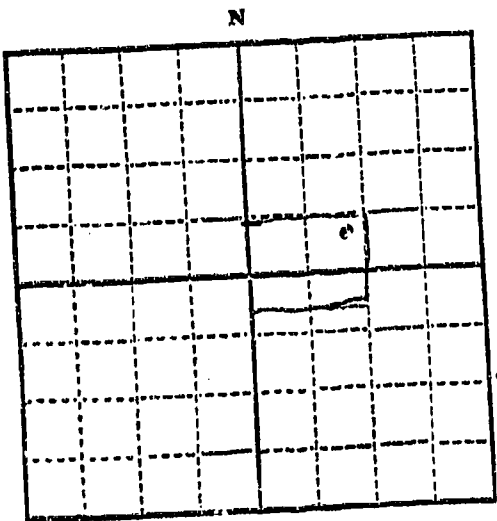

SE 1/4 SW 1/4 Sec. 18 T26N R29W
Indicate point of appropriation and place of use, if possible.

Quantity of water developed and used with explanation of method used to measure or estimate such amount. If use is intermittent estimate approximate lengths of periods of use. 1/2 inch plastic pipe carries a constant flow and is used year around for domestic purposes

Signature of Owner Alford C. ...
Date June 16, 1972

This form to be prepared by contractor (if any), otherwise by the owner.
Three copies of this notice are to be filed with the County Clerk and Recorder of the county in which the works are located.
Please answer all questions. If not applicable, so state, otherwise the form will be returned.
Original to the County Clerk and Recorder; duplicate to the State Engineer; Triplicate to the Montana Bureau of Mines and Geology and Quadruplicate for the Appropriator.

Doc. No. #878
Filed for record this 16th day of June A. D. 19 72 at 10:00 o'clock A.M.

50,640

STATE OF MONTANA
ADMINISTRATOR OF GROUNDWATER CODE
MONTANA WATER RESOURCES BOARD

NOTICE OF COMPLETION OF GROUNDWATER
APPROPRIATION BY MEANS OF WELL

Developed after January 1, 1962

(Under Chapter 237 Montana Session Laws, 1961, as amended)

This form to be prepared by driller, and three copies to be filed by the owner with the County Clerk and Recorder in the county in which the well is located; last copy to be retained by driller. Please answer all questions. If not applicable, so state, otherwise the form may be returned.

Owner State of Montana

Fish & Game Department
Address Loan State Recreation Area, 45 Miles W. of Kellsell Middle Thompson Lake area

Date well started June 21, 1971
completed June 30, 1971

Type of well Drilled
(Dug, driven, bored or drilled)

Equipment used Churn Drill
(Churn drill, rotary or other)

Water Use: Domestic Municipal Stock Irrigation
Industrial Drainage Other * Garden/Lawn

*Describe Recreation Area

USE: If used for irrigation, industrial, drainage or other. Explain, state number of acres and location or other data (i.e. Lot, Block and Addition).

ESTIMATED ANNUAL WITHDRAWAL 200,000 Gallons per year

For Administrator's Use

File 788
August 6, 1971
10:20 AM

GW 1

Size of Drilled Hole	Size and Weight of Casing	From (Feet)	To (Feet)	PERFORATIONS		
				Kind Size	From (Feet)	To (Feet)
6" I.D. 6 5/8" O.D.	19.00 lbs. per ft.	0	130	None		

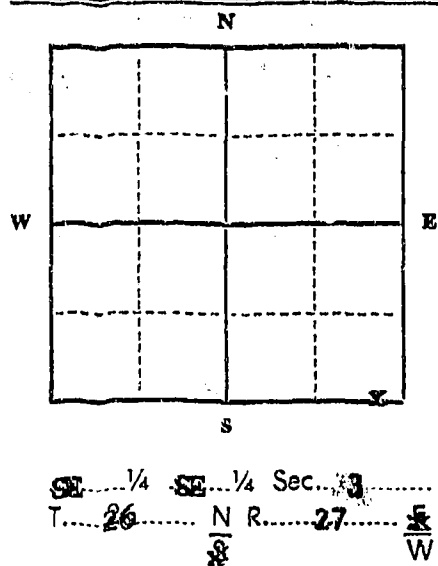

Static water level 311.91 ft.*
Pumping water level 181.21 ft.*
at 50 gallons per minute,
measured 210 minutes after pumping began.
*Measured from ground level.
Well developed by Pump
for 4 hours.
Power 3 HP
Remarks: (Gravel packing, cementing, packers, type of shutoff)
Grout from ground level to 12 feet deep.

INDICATE LOCATION OF WELL AND PLACE OF USE, IF POSSIBLE. EACH SMALL SQUARE REPRESENTS 40 ACRES.

Driller's Signature Wm D Lake

Driller's Address P. O. Box 967, Libby, Montana 59923

LICENSE NO. 152

County Lincoln

DRILLER'S LOG

Indicate the character, color, thickness of strata such as soil, clay, sand, gravel, silt, sandstone, etc. Show depth at which water is found and height to which water rises in well.

Top of Ground (Elev. above sea level)

From (Feet)	To (Feet)	Description
0	1	Topsoil
1	35	Yellow Clay
35	115	Sandy Clay, going more to sand
115	125	Sand
125	130	Sand and Gravel with Water

130 Show exact depth of bottom

48860

788

STATE OF MONTANA
COUNTY OF LINCOLN

Filed this 6th day of
August A. D. 1971
at 10:30 P.M.
Charles J. Thompson
County Clerk.
By Mae Watson Deputy

File No. g.m.4

GW 4

T. 36 N R. 27 W 5

County Lincoln

RECEIVED
APR 29 1963

STATE OF MONTANA
ADMINISTRATOR OF GROUNDWATER CODE
OFFICE OF STATE ENGINEER

Declaration of Vested Groundwater Rights

STATE ENGINEER

(Under Chapter 237, Montana Session Laws, 1961)

Howard F. Metcalf of Star Route Libby
(Name of Appropriator) (Address) (Town)

County of Lincoln State of Montana
have appropriated groundwater according to the Montana laws in effect prior to January 1, 1962, as follows:

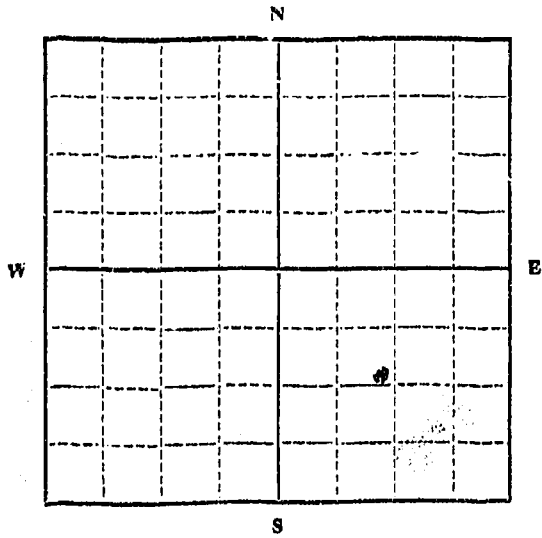

NW 1/4 S. 25 Sec. 5 T. 26. R. 27.

Indicate point of appropriation and place of use, if possible. Each small square represents 10 acres.

2. The beneficial use on which the claim is based.....

House water

3. Date or approximate date of earliest beneficial use; and how continuous the use has been.....

1940
sucky dry

4. The amount of groundwater claimed (in miner's inches or gallons per minute).....

2 gal per min

5. If used for irrigation, give the acreage and description of the lands to which water has been applied and name of the owner thereof.....

6. The means of withdrawing such water from the ground and the location of each well or other means of withdrawal.....

pipe gravity flow

7. The date of commencement and completion of the construction of the well, wells, or other works for withdrawal of groundwater.....

1940

8. The depth of water table.....

2 ft

9. So far as it may be available, the type, size and depth of each well or the general specifications of any other works for the withdrawal of groundwater.....

3 ft x 8 ft dug

10. The estimated amount of groundwater withdrawn each year.....

4000 gal

11. The log of formations encountered in the drilling of each well if available.....

clay

12. Such other information of a similar nature as may be useful in carrying out the policy of this act, including reference to book and page of any county record.....

Signature of Owner Howard Metcalf

Date April 29, 1963

Three copies to be filed by the owner with the County Clerk and Recorder of the county in which the well is located.

Please answer all questions. If not applicable, so state, otherwise the form will be returned.

Original to the County Clerk and Recorder; duplicate to the State Engineer; Triplicate to the Montana Bureau of Mines and Geology, and Quadruplicate for the Appropriator.

76

STATE OF MONTANA
COUNTY OF LINCOLN

Filed this 25th day of

April A. D. 1963

at 10:35 A. M.

By M. M. H. [Signature] County Clerk

By [Signature] Deputy